



LAND CORNER RECORDATION CERTIFICATE  
Filing Requirement of Act 74, Mich. P.A. 1970

For corners in

_____ Cheboygan _____ (County)	Located in:	Corner Code #
1. Public Land Survey	T33N_R03W	_H-2, I-2_
	T _____ R _____	_____
	T _____ R _____	_____
	T _____ R _____	_____
2. Property Controlling in Section	S _____ T _____ R _____	_____
	S _____ T _____ R _____	_____
3. Miscellaneous Property in Sec.	S _____ T _____ R _____	_____
	S _____ T _____ R _____	_____

RECEIVED FOR RECORD REGISTER  
MARY ELLEN THYBANK, CLERK/MICHIGAN  
CHEBOYGAN COUNTY  
10/13/2004 10:34:53 AM

\$14.00 RECEIPT # 6280 STATION 2  
LAND CORNER RECORDATION

Register of Deeds Stamp & File Number

4. Lot No. \_\_\_\_\_, Recorded Plat \_\_\_\_\_  
5. Private Claims \_\_\_\_\_

I, John P May, in a field survey on October 10, 2004 do hereby state that under requirements of P.A. 74, Michigan P.A. of 1970, the corner points mention in lines 1 and 2 above were in conformance with regulations and rules therefore as required in the current manual of survey instructions of the United States Department of the Interior, Bureau of Land Management or by a decree of a Court of Law and/or that the corner points mentioned in lines 3, 4 and 5 above were in conformance with the rules of the Michigan Board of Land Surveyors or by a Decree of a Court of Law; established, re-established, monumented, recovered, found as expressed below:

**NOTE: Not more than 2 corners, all in the same town and range, may be recorded on this certificate**

1	A	B	C	D	E	F	G	H	I	J	K	L	M
2		6		5		4		•	•	2		1	
3													
4		7		8		9		10		11		12	
5													
6		18		17		16		15		14		13	
7													
8		19		20		21		22		23		24	
9													
10		30		29		28		27		26		25	
11													
12		31		32		33		34		35		36	
13													

A. Description of original monument and accessories and/or subsequent restoration:

H-2: LCRC, L2, P281, Ennes, 1993  
Found 1/2" rod, 4 witnesses

I-2: LCRC, L2, P281, Ennes, 1993  
Found 1/2" iron rod, 4 Wits

B. Description of corner evidence found and/or method applied in restoring or reestablishing corner:

H-2: Found 1/2" iron in monument box and 3 Ennes witnesses. This corner was located and witness as part of the monument preservation of MDOT Job No:16555-77469.

I-2: Found 1/2" iron in monument box and two Ennes witnesses. This monument was located and witnessed prior to construction as part of monument preservation of MDOT Job No: 16555-77469. Reset corner and monument box after construction.

C. Description of monument for corner and accessories established to perpetuate locating the position of the corner:

H-2: 1/2" iron in monument box  
N68E 86.09' Set Nail in Fence Post  
S28E 51.35' Fnd Nail in 14" Pine  
S40W 43.45' Fnd. Nail in Utility Pole  
N50W 55.24' Fnd. Nail in Utility Pole

I-2: Set 1/2" capped iron in a monument box  
N33E 98.15' To set nail in 18" Maple  
S38E 81.85' Fnd Nail in Fence Post  
S62W 96.07' Set Nail in Utility Pole  
N32W 118.55' Set Nail in 10" Apple

Signed by \_\_\_\_\_  
Surveyor's Michigan License No. 43061

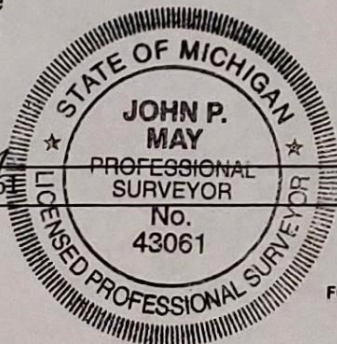

Date 10/10/04

LIBER 004 PAGE 30