

MICHIGAN
DEPARTMENT OF CONSERVATION
FORESTRY DIVISION

LAND CORNER RECORD

T. 34 N.R. 4 W

Emmet COUNTY

DESCRIPTION OF CORNER Section corner common to Sections 32 and 33, on south boundary of township.

CORNER MONUMENT 1" pipe with 4" Aluminum cap

DATE MONUMENT PLACED AND WITNESSED August 17, 1961

WITNESSES TO CORNER.....

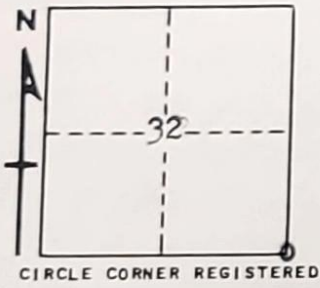

10" Spruce	-	N47E	-	97.4 feet
5" Apple Tree	-	North	-	72.1 feet

AND _____

DESCRIPTION IN DETAIL AS TO HOW CORNER WAS LOCATED AND IDENTIFIED OR RESTORED.

This corner was restored at record measurement east of closing corner. Found 1 1/2" pipe for closing corner as established by Marcus Schaaf, RLS, who apparently restored the corner as established in 1909 survey by county surveyor. County records indicate corner to Sections 32-33 was established 77 links east of closing corner and was marked by a B. Granite rock which is in place. However, this does not concur with the US record which prescribes a 30 link offset between corners. Could find no reason to depart from government record in restoring this corner. USBTs all gone.

Corner to Sections 4 and 5, T33N, R4W is 30 links west.

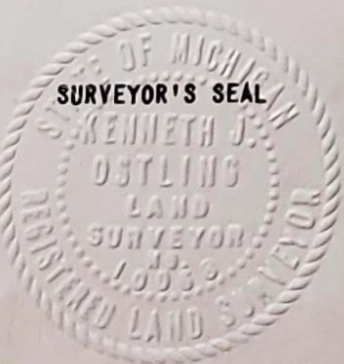

SIGNED Kenneth J. Ostling DATE 8/18/61
REGISTERED LAND SURVEYOR