

NORTHEAST PART EWING SOUTH PART TURIN NORTH PART WELLS T.43N.-R.24W.

SEE PAGE 17

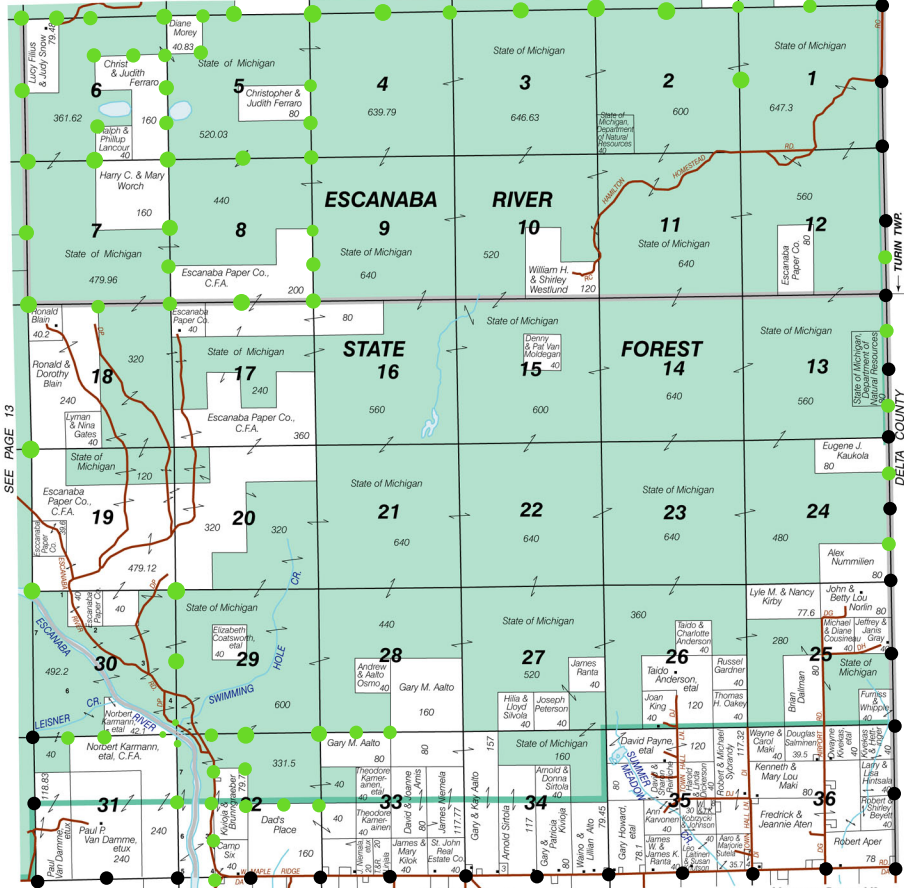

SEE PAGE 13

SEE PAGE 10

© 2001 Rockford Map Publs., Inc.
WELLS TWP. ← EHING TWP.

Marquette County, MI

- MQT/DELTA REMON
- MI DNR