



DEPARTMENT OF NATURAL RESOURCES
STATE OF MICHIGAN

TIMBER SALE PROSPECTUS

Notice is hereby given that bids will be received by the Unit Manager,
CADILLAC MANAGEMENT UNIT, MANTON OFFICE, for certain timber on the following described
lands:

6 RD MIX / T24N, R11W, SEC. 11, SWSW.
T24N, R11W, SEC. 14, NWMW.
WEXFORD COUNTY (Appr. \$5,866.00)

REDSTONE PINE / T21N, R05W, SEC. 30, NW.
MISSAUKEE COUNTY (Appr. \$113,042.50)

DEERPAW MIX / T21N, R05W, SEC. 30, W1/2.
MISSAUKEE COUNTY (Appr. \$69,230.00)

////////////////////

SALE DATE AND TIME: 03:00 p.m. on February 02, 2009.

MANTON

BID INSTRUCTIONS (Ver. 06/23/2008):

1. Bid Location, Date, and Time: Bids must be received by the Unit Manager, Cadillac Management Unit, Manton Field Office, 521 N Michigan, Manton, MI 49663, no later than 3:00 p.m. on February 2, 2009. For further information concerning this sale, contact the Unit Manager at 231-824-3591.

2. Bidder's Qualifications: Purchaser shall obtain workers compensation insurance to cover claims under Michigan's Worker's Disability Compensation Act of 1969 or similar employee benefit act of any other state applicable to an employee. If all or part of a timber sale was prepared by a private contractor, that contractor and that contractor's company are not permitted to bid on the timber sale contract. Bids will not be accepted from individuals or companies appearing on the DNR/FMFM No-Bid List. This list contains the names of purchasers who previously failed to execute a contract within 21-days or who have a history of poor performance.

3. Preparation of Sealed Bids: Bids shall be manually signed in ink; bid prices must be entered for each species and product in the Bid Price column for all material subject to bidding; and all fill-in blanks must be completed. If erasures or other changes appear on the forms, each erasure or change must be initialed by the person signing the bid.

4. Submission of Sealed Bids: Bid forms may be obtained from the Unit Manager. All bids must be submitted on the bid form and in an envelope clearly identified as described in this section. NOTE: Only one bid form per bid envelope. Sealed bids must be submitted to the Unit office designated in the prospectus and must be submitted at or prior to the time established in the prospectus. The envelope should show on the outside (a) that it is a "Bid for Timber," and (b) the sale name or number, and (c) the date and time of bid opening as shown in the prospectus. Bids received after the time specified in the sale prospectus are late bids and will be rejected.

5. Public Opening of Sealed Bids: If conditions permit, the sealed bids will be publicly opened and posted at the time and place set in the prospectus.

6. Award of Contract: Award of the contract will be made to the Bidder whose bid, conforming to the prospectus, is most advantageous to the State of Michigan on the basis of total value at rates bid for the estimated quantities. The State reserves the right to reject any bid or waive any minor irregularity in bids received. A written award mailed (or otherwise furnished) to the successful Bidder shall be deemed to result in a binding contract without further action by either party.

7. Down Payment: The Bidder to whom award is made must make a down payment within 21 days of the sale award. The amount of the down payment will be calculated as shown in the Bond and Payment Schedule of this prospectus. Only cash may be used to meet this requirement.

8. Performance Security: As guarantee of faithful performance, a cash bond, certificate of deposit, surety bond or irrevocable letter of credit (LOC) is required within 21 days of the sale award. The amount of the performance security is shown in the Bond and Payment Schedule of this prospectus. If an LOC or surety is used, the coverage must extend for at least 6 months beyond the contract expiration.

9. Timber Sale Contract: Additional conditions and requirements common to all timber sales are listed on the timber sale contract (R4031) and are available on line at www.michigan.gov/dnr. Contact the Unit Manager for additional information or a sample contract. Within 21 days of the date of the award letter, the bidder must sign the contract and provide the required down payment, performance security, and verification of worker's disability compensation. The down payment and performance security shall be in accordance with the provisions of the timber sale contract, in the sums stated in this prospectus. If these actions are not taken, then the Bidder, the Bidder's corporation, and the corporation's principals may not be permitted to bid on State timber sales for a period of 1 year. In addition, the Bidder certifies that if awarded this contract, the Bidder will complete the timber sale contract in accordance with its terms and any modifications thereof including requirements to purchase, cut, and remove the included timber by the termination date.

10. Disclaimer of Estimates and Bidder's Warranty of Inspection: Before submitting this bid, the Bidder is advised and cautioned to inspect the sale area, review the requirements of the sale contract, and take other steps as may be reasonably necessary to ascertain the location, estimated volumes, construction estimates, and operating costs of the proposed sale. Failure to do so will not relieve the Bidder from responsibility for completing the contract.

The Bidder warrants that this bid is submitted solely on the basis of the Bidder's examination and inspection of the quality and quantity of the timber offered for sale and the Bidder's opinion of the value thereof and the costs of recovery. No reliance should be placed on the State of Michigan's estimates of timber quality, quantity or costs of recovery. Bidder further acknowledges that the State of Michigan: (i) expressly disclaims any warranty of fitness of timber for any purpose; (ii) offers this timber as is without any warranty of quality (merchantability) or quantity and (iii) expressly disclaims any warranty as to the quantity or quality of timber sold.

11. Certification and Chain-of-Custody: Unless otherwise indicated in the contract under section 7 - Other Conditions of the Sale Specific Conditions & Requirements, the area encompassed by this timber sale is certified to the standards of the Forest Stewardship Council (FSC) - Certificate #SCS-FM/COC-090N and the Sustainable Forestry Initiative (SFI) - Certificate # NSF-SFIS-5Y031-S1. Forest products from this sale may be delivered to the mill as "FSC and / or SFI certified" as long as the contractor hauling the forest products is chain-of-custody (COC) certified or covered under a COC certificate from the destination mill. The purchaser is responsible for maintaining COC after leaving the sale area.

REBECCA A. HUMPHRIES
Director

6 RD MIX (010-07-01)

A timber sale contract for this LUMP SUM SEALED timber sale will be awarded the responsible bidder offering the highest sealed bid price. Bids must be at or above the following appraised price for each species:

<u>SPECIES</u>	<u>ESTIMATED VOLUME*</u>	<u>APPRAISED PRICE</u>
SAWLOGS		
MIX ASPEN	7.10 MBF	\$ 60.00/MBF
PULPWOOD		
WHITE PINE	327.00 CORDS	\$ 5.10/CORD
MIX ASPEN	211.00 CORDS	\$ 13.25/CORD

In addition, the successful bidder agrees to purchase the following species at the indicated appraised price:

<u>SPECIES</u>	<u>ESTIMATED VOLUME*</u>	<u>APPRAISED PRICE</u>
SAWLOGS		
WHITE PINE	6.70 MBF	\$ 55.00/MBF
MIX HARDWD	3.80 MBF	\$ 87.00/MBF
PULPWOOD		
MIX HARDWD	31.00 CORDS	\$ 8.95/CORD

*The volumes are statistically estimated within plus (+) or minus (-) 13.77 percent. These estimated volumes are final and not subject to adjustment. Prospective bidders are urged to examine this timber and to make their own estimates of quantity and quality.

BOND AND PAYMENT SCHEDULE:

1. A bond in the amount of \$300.00 to insure faithful performance of the conditions of the contract, will be deposited by the successful bidder within 21 days of the sale award.
2. Cutting in any sale or unit without the required advance payment would be considered a trespass.
3. Total payment may be paid in advance or according to the following schedule:
 - (a) Ten percent (10%) of the sale value must be paid within 21 days of the sale award.
 - (b) The 10% down payment will be credited towards the first unit cut.
 - (c) Payment for each of the following units must be made before cutting begins in that unit:

<u>PAYMENT UNIT NUMBER</u>	<u>PERCENT OF TOTAL SALE VALUE</u>
1	50%
2	50%

4. If no cutting takes place, the 10% down payment will not be refunded.
5. Operations on the contract issued will terminate on March 31, 2011.



Michigan Department of Natural Resources – Forest, Mineral & Fire Management
TIMBER SALE MAP

This information is provided by authority of Part 525 of Act 451, PA 1994, as amended.

SALE NUMBER	YEAR
63-010-07-01	2007
DATE	PAGE OF
01/26/2007	1 1

FOREST MANAGEMENT UNIT Cadillac FMU		COUNTY Wexford	MAPPED BY Jim Malloy	DATE 01/26/2007	PAGE OF 1 1
TOWNSHIP 24 N	RANGE 11 W	SECTION(S) AND SUBDIVISION(S) SWSW Sect. 11, NW Sect. 14		0 0.25 0.5 Miles	

Cover Type				Density	
A = Aspen	H = Hemlock	P = Lowland Poplar	V = Bog or Marsh	0 = Non Stocked	5 = Pole Timber Medium
B = Paper Birch	J = Jack Pine	Q = Mixed Swamp Cnfr	W = White Pine	1 = Seedling Sapling Poor	6 = Pole Timber Well
C = Cedar	L = Lowland Brush	R = Red Pine	X = Non Stocked	2 = Seedling Sapling Medium	7 = Saw Timber Poor
E = Swamp Hdwoods	M = Mpl, Bch, Brch	S = Black Spruce	Z = Water	3 = Seedling Sapling Well	8 = Saw Timber Medium
F = Spruce Fir	N = Marsh	T = Tamarack		4 = Pole Timber Poor	9 = Saw Timber Well
G = Grass	O = Oak	U = Upland Brush			

6 Rd. Mix
 Compt 131 YOE 2007
 Wexford Co.
 45 Ac.



21 1/2 Rd.

23 Rd.

6 Rd.

- Forest Rd
- County Rd
- blue sale line
- red sale line
- private line

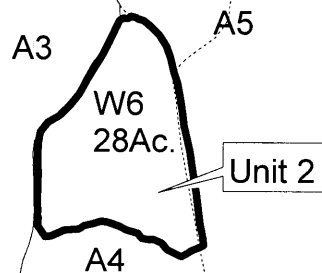
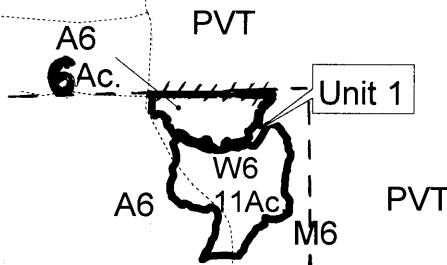

15

Anderson Creek

14

Sale Specific Conditions & Requirements

Sale Name: 6 Rd Mix Sale Number: 63-010-07-01

1 - Sale Area

1.2 - Boundaries

1.2.1 - Painted boundaries (6/05)

The sale boundary and Payment Unit boundaries are marked and identified by blue and red paint. Exterior sale boundary lines against private property are marked with blue paint. Exterior sale boundary lines against state are marked with red paint.

2 - Timber Specifications

2.1 - Included Timber

2.1.1 - Clearcut unit(s) with unmerchantable trees (2/04)

Within Payment Unit(s) 1 (Aspen Unit Only), cut all trees that are two (2) inches or more in diameter measured at a point of four and one-half (4-1/2) feet above ground level regardless of merchantability

2.1.8 - Designated plantation row unit(s) (11/04)

Within Payment Unit(s) 1 and 2, all trees which meet minimum piece specifications in 2.2 Utilization, within designated plantation rows are designated for cutting. Plantation rows designated for cutting are as follows: Unit 2, begin with the third row in from the outside of the plantation, then continue every third row. Because of the variability of row direction, it shall be the responsibility of the producer to maintain the third row sequence. Unit 1 (White Pine Unit Only), begin with the third and fourth row in from the outside of the plantation, then continue leaving two row and cutting two rows. Because of the variability of row direction, it shall be the responsibility of the producer to maintain the row sequence. In addition in units 1 and 2 cut all aspen, red maple and trace jack pine.

2.2 - Utilization

2.2.3 - Stump heights (5/04)

Stump heights within the Sale Area shall not exceed 12 inches for trees greater than 10 inches DBH and 4 inches for trees smaller than 10 inches DBH.

4 - Transportation

4.1 - Construction

4.1.7 - Road closure (8/04)

All new roads built into the sale must be blocked to vehicle traffic upon completion of the sale. Overgrown roads that are reopened shall be considered new roads. In general, this will require constructing a four (4') foot high berm constructed of stumps and logs covered with earth. Stumps and brush must be placed along the remainder of the trail. These roads must be rendered impassable to cars and trucks. All stumps from road building and landing construction must be reserved to block any newly constructed roads upon completion of the sale. These stumps must be scattered along the road system to prohibit vehicular movement. Temporary berms may be required if no sale activity occurs for 30 or more consecutive days. Contact the sale administrator for specific details of design and placement.

4.2 - Maintenance

4.2.4 - Grading (2/04)

Roads must be graded after the sale is completed. The grading equipment to be used must be approved by the Unit Manager or their representative.

4.2.5 - Two wheel drive condition (2/04)

All existing trail roads on and adjacent to the sale area must be passable by two-wheel drive traffic for the duration of the sale.

5 - Operations

5.1 - Notification

5.1.1 - Pre-sale conference (6/04)

A pre-sale conference on site between the Purchaser and sale administrator is required prior to beginning any operations to determine landing and road locations. The Unit Manager or their representative must be contacted at least 10 days in advance to schedule the conference.

5.1.4 - Post-sale conference (2/04)

A post-sale conference on site between the Purchaser and sale administrator is required 5 days prior to the completion of active logging operations to determine clean-up and repair of landings, road edges, and the fulfillment of other contract specifications.

5.2 - Conduct of Operations

5.2.1 - Slash

5.2.1.1 - Slash within sale area (2/04)

No trees are to be felled outside the sale area and all slash is to be kept at least 10 feet back from the blue paint line.

5.2.1.7 - Slash must be scattered (2/04)

Unless otherwise directed, slash and logging debris shall be uniformly scattered over the sale area and not left in piles or windrows. Slash shall not be allowed to accumulate at the landings. All slash work shall be done concurrently with harvesting.

5.2.1.8 - Slash height (2/04)

No slash or tree tops may exceed 24 inches in height.

5.2.12 - Bark slippage restriction (3/07)

Within Payment Unit(s) 1 and 2, unless changed by written agreement, cutting, skidding, and hauling are not permitted during the period of April 15 to July 15. This restriction is because of bark slippage.

5.2.32 - Decking/landing restoration (2/04)

All decking and landing areas must have the surface area restored to a condition equal to or better than before. This is to insure the proper regeneration of the stand.

5.2.38 - No decking against live trees (2/04)

Cut products may not be decked against unmarked or designated leave trees.

6 - Safety and Fire Prevention

6.2 - Signing

6.2.1 - Road posting (5/05)

The purchaser is responsible for posting and maintaining caution signs on 6 Rd. prior to beginning operations. The road must be posted at appropriate distances from the sale area to warn of logging activity and truck traffic. Signs must be removed when harvest operations are suspended or completed.

REDSTONE PINE (023-08-01)

A timber sale contract for this LUMP SUM SEALED timber sale will be awarded the responsible bidder offering the highest sealed bid price. Bids must be at or above the following appraised price for each species:

<u>SPECIES</u>	<u>ESTIMATED VOLUME*</u>	<u>APPRAISED PRICE</u>
SAWLOGS		
RED PINE	595.20 MBF	\$ 130.00/MBF
PULPWOOD		
RED PINE	636.00 CORDS	\$ 45.00/CORD

In addition, the successful bidder agrees to purchase the following species at the indicated appraised price:

<u>SPECIES</u>	<u>ESTIMATED VOLUME*</u>	<u>APPRAISED PRICE</u>
SAWLOGS		
RED MAPLE	12.70 MBF	\$ 95.00/MBF
MIX ASPEN	27.50 MBF	\$ 60.00/MBF
PULPWOOD		
MIX ASPEN	163.00 CORDS	\$ 18.00/CORD
MIX HARDWD	157.00 CORDS	\$ 8.00/CORD

*The volumes are statistically estimated within plus (+) or minus (-) 9.69 percent. These estimated volumes are final and not subject to adjustment. Prospective bidders are urged to examine this timber and to make their own estimates of quantity and quality.

BOND AND PAYMENT SCHEDULE:

1. A bond in the amount of \$6,000.00 to insure faithful performance of the conditions of the contract, will be deposited by the successful bidder within 21 days of the sale award.
2. Cutting in any sale or unit without the required advance payment would be considered a trespass.
3. Total payment may be paid in advance or according to the following schedule:
 - (a) Ten percent (10%) of the sale value must be paid within 21 days of the sale award.
 - (b) The 10% down payment will be credited towards the first unit cut.
 - (c) Payment for each of the following units must be made before cutting begins in that unit:

<u>PAYMENT UNIT NUMBER</u>	<u>PERCENT OF TOTAL SALE VALUE</u>
1	05%
2	40%
3	55%

4. If no cutting takes place, the 10% down payment will not be refunded.
5. Operations on the contract issued will terminate on March 31, 2011.

Michigan Department of Natural Resources-Forest Management Division
TIMBER SALE MAP

This information provided under authority of Part 525, Act 451 of 1994, as amended.

Sale No. 63-023-08-01	Year 08	Sale Type 01
--------------------------	-------------------	------------------------

State Forest and Forest Management Unit: Cadillac		Mapped By/ Cruised By: Andy Church		Comp. 104 YOE 2008 Stands 1,4,6	
Township 21N	Range 05W	Section(s) 30	Subdivision NW Sec. 30		
					Scale: 1:15840

Cover Type				Density		
A=Aspen	H=Hemlock	P=Lowland Poplar	V=Bog or Marsh	1=Non Stocked	7=Saw Timber Poor	
B=Paper Birch	J=Jack Pine	Q=Mixed Swamp Cnfr	W=White Pine	2=Seedling Sapling Poor	8=Saw Timber Medium	
C=Cedar	L=Lowland Brush	R=Red Pine	X=Non Stocked	3=Seedling Sapling Well	9=Saw Timber Well	
E=Swamp Hdwoods	M=Mpl, Bch, Brch	S=Black Spruce	Z=Water	4=Pole Timber Poor		
F=Spruce Fir	N=Marsh	T=Tamarack		5=Pole Timber Medium		
G=Grass	O=Oak	U=Upland Brush		6=Pole Timber Well		

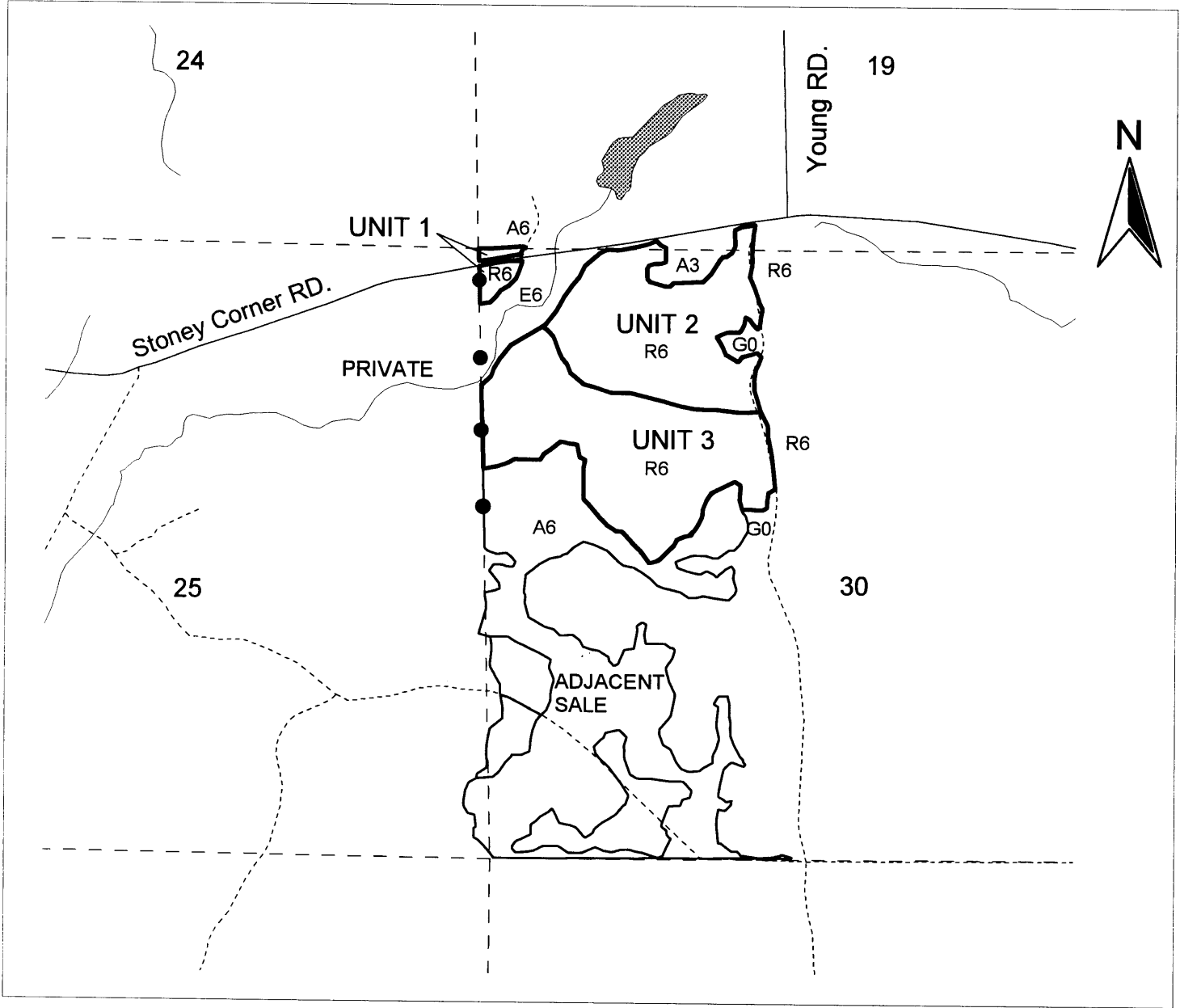

LEGEND

- Unit Boundary (Red Line)
- Private Boundary (Blue Line)
- Forest Road
- Road

UNIT 1	3 ac	Redstone Pine
UNIT 2	43ac	Missaukee Co.
UNIT 3	56ac	
TOTAL	102ac	102 ac.



Sale Specific Conditions & Requirements

Sale Name: Redstone Pine Sale Number: 63-023-08-01

1 - Sale Area

1.2 - Boundaries

1.2.1 - Painted boundaries (6/05)

The sale boundary and Payment Unit boundaries are marked and identified by RED and BLUE paint. Exterior sale boundary lines against private property are marked with BLUE paint. Exterior sale boundary lines against state are marked with RED paint. Do not cut painted boundary line trees unless also marked with ORANGE paint.

2 - Timber Specifications

2.1 - Included Timber

2.1.1 - Clearcut unit(s) with unmerchantable trees (2/04)

Within Payment Unit(s) #1, cut all trees that are two (2) inches or more in diameter measured at a point of four and one-half (4-1/2) feet above ground level regardless of merchantability

2.1.3 - Cut tree marked unit(s) (8/04)

Within Payment Unit(s) #'s 2-3, all trees are designated for cutting when marked with ORANGE paint above and below stump height, regardless of merchantability. IN ADDITION, within UNIT #3 CUT ALL MAPLE, CHERRY, and ASPEN.

2.1.11 - Description of timber note (2/04)

Note that mixed Aspen includes Quaking and Bigtoothed. Also, the Mixed Hardwood pulp volumes by species is estimated below:

Red Maple 129 cds
BAM 8 cds
Black Cherry 20 cds

2.2 - Utilization

2.2.7 - Uncut designated trees (2/04)

Liquidated damages of \$5.00 per tree will be assessed for every marked tree not cut.

3 - Payments

3.3 - Pre-measured Sales

3.3.1 - Order of cutting (6/04)

Payment Units shall be cut in numerical order unless approved by the Unit Manager or their representative.

Sale Name: Redstone Pine Sale Number: 63-023-08-01

3.3.4 - Dividing payment units (7/05)

Payment unit(s) may be divided at the request of the purchaser and upon approval of the Unit Manager. Dividing payment units is a contract modification which requires a Timber Sale Contract Supplement.

4 - Transportation

4.1 - Construction

4.1.7 - Road closure (4/07)

All new roads built into the sale must be blocked to vehicle traffic upon completion of the sale. Overgrown roads that are reopened shall be considered new roads. In general, this will require constructing double earthen berms at strategic locations. These roads must be rendered impassable to cars and trucks. All stumps from road building and landing construction must be reserved to block any newly constructed roads upon completion of the sale. These stumps must be scattered along the road system to prohibit vehicular movement. Temporary berms may be required if no sale activity occurs for 30 or more consecutive days.

4.1.12 - No new roads (5/07)

No new roads will be permitted in any Payment Unit. All operations are limited to existing roads.

4.2 - Maintenance

4.2.4 - Grading (5/08)

Roads must be graded after the sale is completed. In general, this will require a road grader or bull dozer to shape up the roads after forest products have been hauled off site. The grading equipment to be used must be approved by the Unit Manager or their representative.

4.2.5 - Two wheel drive condition (2/04)

All existing trail roads on and adjacent to the sale area must be passable by two-wheel drive traffic for the duration of the sale.

4.3 - Public Right-of-Way

4.3.2 - County R-O-W (12/06)

The county must be contacted prior to crossing or harvesting in the county road R-O-W. This applies to Stoney Corner RD.

5 - Operations

5.1 - Notification

5.1.1 - Pre-sale conference (2/08)

A pre-sale conference on site between the Purchaser and sale administrator is required prior to beginning any operations to determine landing locations. The Unit Manager or their representative must be contacted at least 5 working days in advance to schedule the conference.

5.2 - Conduct of Operations

5.2.1 - Slash

5.2.1.1 - Slash within sale area (2/04)

No trees are to be felled outside the sale area and all slash is to be kept at least 10 feet back from the BLUE paint line.

5.2.1.7 - Slash must be scattered (2/04)

Unless otherwise directed, slash and logging debris shall be uniformly scattered over the sale area and not left in piles or windrows. Slash shall not be allowed to accumulate at the landings. All slash work shall be done concurrently with harvesting.

5.2.2 - Snags

5.2.2.1 - Den trees (2/04)

Obvious hollow and/or den trees shall be protected and left standing unless they are a safety hazard.

5.2.12 - Bark slippage restriction (3/07)

Within Payment Unit(s) #'s 2-3, cutting, skidding, and hauling are not permitted during the period of April 15 to July 15. This restriction is because of bark slippage.

5.2.15 - Bark beetle restriction (2/04)

In the event drought creates a high risk of pine bark beetle infestation, pine is not to be cut during the period March 1 through July 1, unless all portions of trees greater than two inches in diameter are removed from the sale area, reduced to chips, or treated to the satisfaction of the Unit Manager or their representative, within fifteen days of being severed from the stump. Pine logs, pulpwood piles and treetop piles for chipping that are decked in the fall or winter within a 1/4 mile of susceptible sites must be removed before March 15. Residual slash must not be placed in piles or rows and must be spread over the site for quick drying. The Department of Natural Resources will exercise this option if the risk of damage warrants.

5.2.29 - Shrub protection (9/07)

Do not cut or damage hawthorn, witch-hazel, dogwood or junberry. These woody-shrub plants are highly beneficial to various wildlife species.

5.2.38 - No decking against live trees (2/04)

Cut products may not be decked against unmarked or designated leave trees.

6 - Safety and Fire Prevention

6.2 - Signing

6.2.1 - Road posting (5/05)

The purchaser is responsible for posting and maintaining caution signs on Stoney Corner RD prior to beginning operations. The road must be posted 200 feet from the sale area to warn of logging activity and truck traffic. Signs must be removed when harvest operations are suspended or completed.

DEERPAW MIX (024-08-01)

A timber sale contract for this LUMP SUM SEALED timber sale will be awarded the responsible bidder offering the highest sealed bid price. Bids must be at or above the following appraised price for each species:

<u>SPECIES</u>	<u>ESTIMATED VOLUME*</u>	<u>APPRAISED PRICE</u>
SAWLOGS		
RED OAK	133.30 MBF	\$ 200.00/MBF
RED PINE	58.90 MBF	\$ 130.00/MBF
MIX HARDWD	77.20 MBF	\$ 90.00/MBF
PULPWOOD		
MIX HARDWD	1210.00 CORDS	\$ 12.00/CORD

In addition, the successful bidder agrees to purchase the following species at the indicated appraised price:

<u>SPECIES</u>	<u>ESTIMATED VOLUME*</u>	<u>APPRAISED PRICE</u>
SAWLOGS		
WHITE OAK	11.00 MBF	\$ 75.00/MBF
MIX ASPEN	22.20 MBF	\$ 60.00/MBF
PULPWOOD		
WHITE PINE	55.00 CORDS	\$ 5.00/CORD
RED PINE	59.00 CORDS	\$ 40.00/CORD
MIXED OAK	277.00 CORDS	\$ 7.00/CORD
MIX ASPEN	373.00 CORDS	\$ 18.00/CORD

*The volumes are statistically estimated within plus (+) or minus (-) 8.10 percent. These estimated volumes are final and not subject to adjustment. Prospective bidders are urged to examine this timber and to make their own estimates of quantity and quality.

BOND AND PAYMENT SCHEDULE:

1. A bond in the amount of \$3,500.00 to insure faithful performance of the conditions of the contract, will be deposited by the successful bidder within 21 days of the sale award.
2. Cutting in any sale or unit without the required advance payment would be considered a trespass.
3. Total payment may be paid in advance or according to the following schedule:
 - (a) Ten percent (10%) of the sale value must be paid within 21 days of the sale award.
 - (b) The 10% down payment will be credited towards the first unit cut.
 - (c) Payment for each of the following units must be made before cutting begins in that unit:

PAYMENT UNIT NUMBER	PERCENT OF TOTAL SALE VALUE
1	05%
2	05%
3	90%
4. If no cutting takes place, the 10% down payment will not be refunded.
5. Operations on the contract issued will terminate on March 31, 2011.

Michigan Department of Natural Resources-Forest Management Division
TIMBER SALE MAP

This information provided under authority of Part 525, Act 451 of 1994, as amended.

Sale No.	Year	Sale Type
63-024-08-01	08	01

State Forest and Forest Management Unit: Cadillac		Mapped By/ Cruised By: Andy Church		Comp. 104 YOE 2008 Stands 10,15,16,19	
Township 21N	Range 05W	Section(s) 30	Subdivision W1/2 Sec. 30		Scale: 1:15840

Cover Type				Density		
A=Aspen	H=Hemlock	P=Lowland Poplar	V=Bog or Marsh	1=Non Stocked	7=Saw Timber Poor	
B=Paper Birch	J=Jack Pine	Q=Mixed Swamp Cnfr	W=White Pine	2=Seedling Sapling Poor	8=Saw Timber Medium	
C=Cedar	L=Lowland Brush	R=Red Pine	X=Non Stocked	3=Seedling Sapling Well	9=Saw Timber Well	
E=Swamp Hdwoods	M=Mpl, Bch, Brch	S=Black Spruce	Z=Water	4=Pole Timber Poor		
F=Spruce Fir	N=Marsh	T=Tamarack		5=Pole Timber Medium		
G=Grass	O=Oak	U=Upland Brush		6=Pole Timber Well		

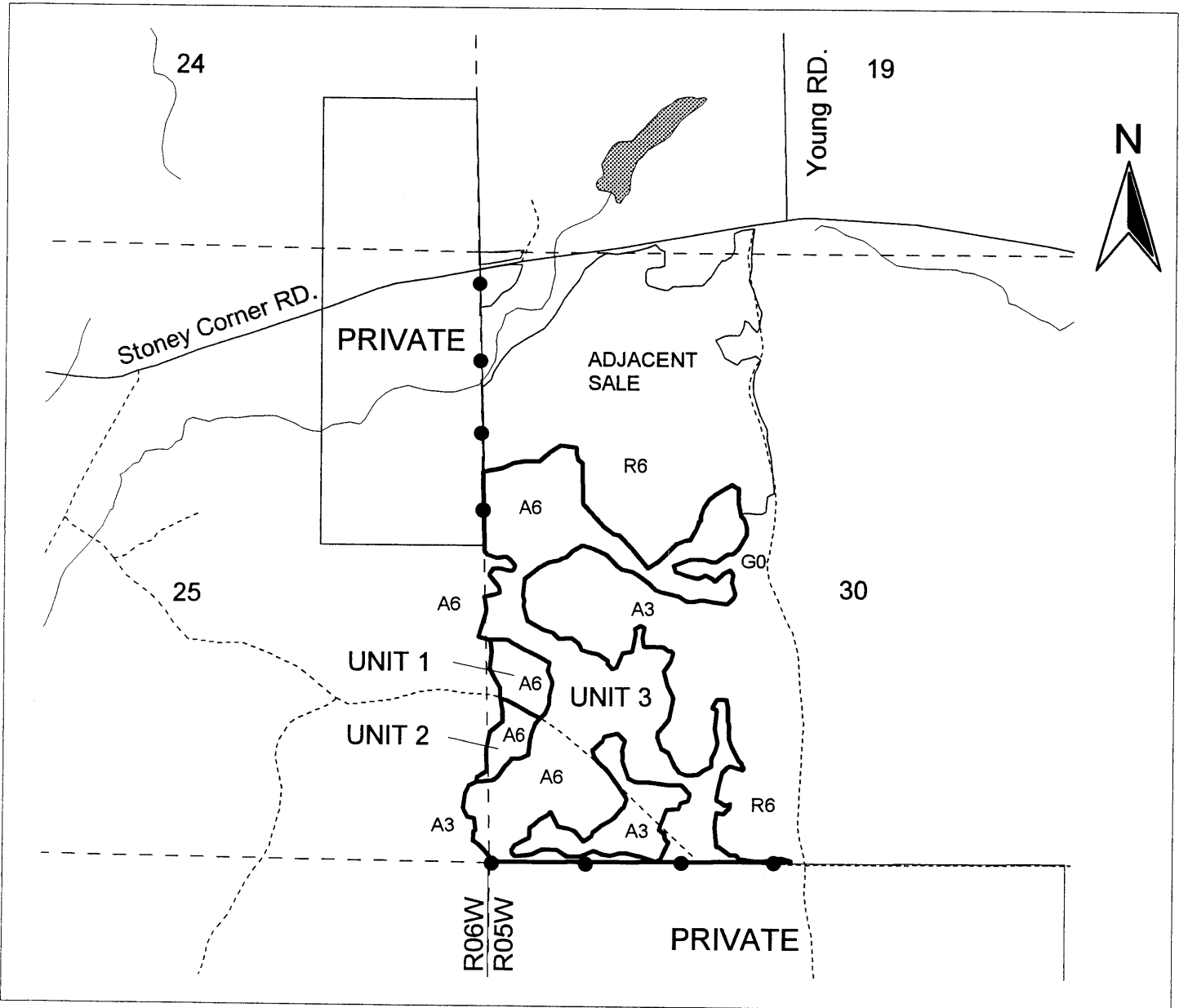

LEGEND

Unit Boundary (Red Line)	
Private Boundary (Blue Line)	
Forest Road	
Road	

UNIT 1	5ac	Deerpaw Mix Missaukee Co. 100 ac.
UNIT 2	5ac	
UNIT 3	90ac	
TOTAL	100ac	



Sale Specific Conditions & Requirements

Sale Name: Deerpaw Mix Sale Number: 63-024-08-01

1 - Sale Area

1.2 - Boundaries

1.2.1 - Painted boundaries (6/05)

The sale boundary and Payment Unit boundaries are marked and identified by BLUE, and RED paint. Exterior sale boundary lines against private property are marked with BLUE paint. Exterior sale boundary lines against state are marked with RED paint. Do not cut painted boundary line trees unless also marked with orange paint.

2 - Timber Specifications

2.1 - Included Timber

2.1.1 - Clearcut unit(s) with unmerchantable trees (2/04)

Within Payment Unit(s) #2, cut all trees that are two (2) inches or more in diameter measured at a point of four and one-half (4-1/2) feet above ground level regardless of merchantability EXCEPT OAK.

2.1.3 - Cut tree marked unit(s) (8/04)

Within Payment Unit(s) #1, all trees are designated for cutting when marked with ORANGE paint above and below stump height, regardless of merchantability. In addition, CUT ALL MAPLE and ASPEN.

2.1.7 - Leave tree marked unit(s) (8/04)

Within Payment Unit(s) #3, all trees, which meet minimum piece specifications in 2.2 Utilization, are designated for cutting EXCEPT trees marked with GREEN paint above and below stump height.

2.1.11 - Description of timber note (2/04)

Note that Mixed Aspen includes Big Tooth and Quaking. Also, the Mixed Hardwood and Mixed Oak volumes by species is estimated below:

Mixed Hardwood

Red Maple 74.8 mbf, 1173 cds

White Ash 1.4 mbf, 9 cds

White Birch 1.0 mbf, 14 cds

Beech 7 cds

Black Cherry 7 cds

Mixed Oak

Red Oak 220 cds

White Oak 57 cds

3 - Payments

3.3 - Pre-measured Sales

Sale Name: Deerpaw Mix Sale Number: 63-024-08-01

3.3.4 - Dividing payment units (7/05)

Payment unit(s) #3 may be divided at the request of the purchaser and upon approval of the Unit Manager. Dividing payment units is a contract modification which requires a Timber Sale Contract Supplement.

4 - Transportation

4.1 - Construction

4.1.6 - Road construction (6/07)

Construction of new roads or improvements of existing roads shall be done in such a way as to minimize the environmental and visual impacts. Merchantable trees shall be cut and utilized unless otherwise directed. Non-merchantable trees shall be severed and laid flat on the ground. Slash shall be chipped, utilized or otherwise removed from the sale. Stumps shall be set upright, not left on edge, and be moved at least 10 feet away from the road edge. Disturbed soil shall be feathered into the woods and not left in berms or windrows.

4.1.7 - Road closure (4/07)

All new roads built into the sale must be blocked to vehicle traffic upon completion of the sale. Overgrown roads that are reopened shall be considered new roads. In general, this will require constructing a four (4') foot high berm constructed of stumps and logs covered with earth. These roads must be rendered impassable to cars and trucks. All stumps from road building and landing construction must be reserved to block any newly constructed roads upon completion of the sale. These stumps must be scattered along the road system to prohibit vehicular movement. Contact the sale administrator for specific details of design and placement.

4.2 - Maintenance

4.2.4 - Grading (5/08)

Roads must be graded after the sale is completed. In general, this will require a road grader or bull dozer to shape up the roads after forest products have been hauled off site. The grading equipment to be used must be approved by the Unit Manager or their representative.

4.2.5 - Two wheel drive condition (2/04)

All existing trail roads on and adjacent to the sale area must be passable by two-wheel drive traffic for the duration of the sale.

5 - Operations

5.1 - Notification

5.1.1 - Pre-sale conference (2/08)

A pre-sale conference on site between the Purchaser and sale administrator is required prior to beginning any operations to determine landing size and location. Also to determine road locations. The Unit Manager or their representative must be contacted at least 5 working days in advance to schedule the conference.

Sale Name: Deerpaw Mix Sale Number: 63-024-08-01

5.1.4 - Post-sale conference (2/04)

A post-sale conference on site between the Purchaser and sale administrator is required 5 days prior to the completion of active logging operations to determine clean-up and repair of landings, road edges, and the fulfillment of other contract specifications.

5.2 - Conduct of Operations

5.2.1 - Slash

5.2.1.1 - Slash within sale area (2/04)

No trees are to be felled outside the sale area and all slash is to be kept at least 10 feet back from the BLUE paint line.

5.2.1.7 - Slash must be scattered (2/04)

Unless otherwise directed, slash and logging debris shall be uniformly scattered over the sale area and not left in piles or windrows. Slash shall not be allowed to accumulate at the landings. All slash work shall be done concurrently with harvesting.

5.2.13 - Oak wilt restriction (5/08)

Within Payment Unit(s) , unless changed by written agreement, cutting, skidding, and hauling are not permitted during the period of April 15 to July 15. This is necessary to reduce the spread of oak wilt. For more information, contact the Unit Manager.

5.2.28 - Coppice regeneration protection (2/04)

Any post harvest operations, such as chipping, must be completed before sprouting of regeneration occurs. If it is anticipated that chipping will be delayed, then tops shall be carried to one central location or left unchipped. The Unit Manager or their representative may cease such operations if sprouting occurs before the operation is complete.

5.2.38 - No decking against live trees (2/04)

Cut products may not be decked against unmarked or designated leave trees.

6 - Safety and Fire Prevention

6.2 - Signing

6.2.1 - Road posting (5/05)

The purchaser is responsible for posting and maintaining caution signs on Stoney Corner RD. prior to beginning operations. The road must be posted at appropriate distances from the sale area to warn of logging activity and truck traffic. Signs must be removed when harvest operations are suspended or completed.

TIMBER SALE / SEALED BID
STATE OF MICHIGAN / DNR

CADILLAC MANAGEMENT UNIT
MANTON OFFICE

6 RD MIX (010-07-01)
T24N, R11W, SEC. 11, SWSW.
T24N, R11W, SEC. 14, NWMW.
WEXFORD COUNTY

In response to the notice of sale to be held 03:00 p.m. on February 02, 2009, I am hereby submitting my sealed bid (firm offer) for the following forest products to be cut. Bids for individual species and total bid value must be at or above the appraised price. All non-responsive bid forms may be rejected.

<u>SPECIES</u>	<u>APPRAISED PRICE</u>	<u>BID PRICE</u>	<u>ESTIMATED VOLUME* = VALUE</u>
SAWLOGS			
MIX ASPEN	\$ 60.00/MBF	\$ _____ X	7.10 MBF = \$ _____
PULPWOOD			
WHITE PINE	\$ 5.10/CORD	\$ _____ X	327.00 CORDS = \$ _____
MIX ASPEN	\$ 13.25/CORD	\$ _____ X	211.00 CORDS = \$ _____
			SUBTOTAL 1 \$ _____

In addition, the successful bidder agrees to purchase the following species at the appraised price:

<u>SPECIES</u>	<u>APPRAISED PRICE</u>	<u>ESTIMATED VOLUME*</u>	<u>VALUE</u>
SAWLOGS			
WHITE PINE	\$ 55.00/MBF	6.70 MBF	= \$ 368.50
MIX HARDWD	\$ 87.00/MBF	3.80 MBF	= \$ 330.60
PULPWOOD			
MIX HARDWD	\$ 8.95/CORD	31.00 CORDS	= \$ 277.45
			SUBTOTAL 2 \$ <u>976.55</u>

SUBTOTAL 1 + SUBTOTAL 2 = TOTAL BID VALUE \$ _____

*These volumes are statistically estimated within plus (+) or minus (-) 13.77%. These estimated volumes are final and not subject to adjustment. Prospective bidders are urged to examine this timber and to make their own estimates of quantity and quality.

I understand that any or all bids may be rejected, and that the individual unit bid price will be the basis to determine total bid value. All bids must be signed and all bid items must be bid or the bid form may be rejected. I also understand that consideration and awarding a contract will be based upon my past performance and ability to complete the contract based upon equipment and manpower subject to my control.

(bidder's printed name)

(bidder's signature)

Address/Telephone _____

THE WINNING BIDDER MUST COMPLETE THE FORM ON THE REVERSE SIDE
WITHIN 21 DAYS OF SALE AWARD



FOR DEPARTMENT USE ONLY

**TIMBER SALE
VERIFICATION OF WORKER'S DISABILITY
COMPENSATION ACT COMPLIANCE**

*As required by Act 317, P.A. 1969 (Worker's Compensation) and Part 525
of Act 451 of 1994, as amended.*

Sale or Permit No

Year:

Type:

Forest Area:

VERIFICATION OF WORKER'S DISABILITY COMPENSATION ACT COMPLIANCE

- This verification must be completed and submitted within 21 days of contract award and prior to the issuance of the timber sale contract.
- In addition, if boxes 2B or 2C are checked, then Notice of Exclusion or Certificate of Insurance must be submitted within 21 days of the contract award and prior to the issuance of the timber sale contract.
- All Information must be typed or printed except for written signatures.

Please Check Appropriate Categories:

1. My business is organized as (you must check one of the boxes below):

- A. Sole Proprietorship (individual)
- B. Partnership
- C. Corporation

2. You must check one of the boxes below:

- A. I certify that my business is a sole proprietorship and it has no employees but the sole proprietor. I am not subject to the Worker's Compensation Laws.
- B. I certify that my business has satisfied its obligation to the Worker's Compensation Act through the use of an approved Notice of Exclusion (BWC-337, Rev. 5/96). I will provide a copy of the Notice of Exclusion within 21 days of the contract award. (For questions or a copy of the BWC-337, please call the Worker's Compensation Bureau at 517-322-1195).
- C. I certify that my business has a Worker's Compensation Policy. I will provide an original Certificate of Insurance within 21 days of the contract award.

3. If you have checked item 2(A) or 2(B), you **must** indicate the number of **both** full and part time employees other than yourself including family members and active partners (if none, you must enter "0").

_____ Full Time Employees

_____ Part Time Employees

Name of Business

Federal ID (or) Social Security No.

Address

Telephone No.
()

City

State

Zip + 4

I hereby certify that the above information is true and correct. I agree to notify the DNR of any changes that occur in factors affecting my coverage during any of my present and future operations.

Signature of Owner or Authorized Representative

Title

Date

TIMBER SALE / SEALED BID
STATE OF MICHIGAN / DNR

CADILLAC MANAGEMENT UNIT
MANTON OFFICE

REDSTONE PINE (023-08-01)
T21N, R05W, SEC. 30, NW.
MISSAUKEE COUNTY

In response to the notice of sale to be held 03:00 p.m. on February 02, 2009, I am hereby submitting my sealed bid (firm offer) for the following forest products to be cut. Bids for individual species and total bid value must be at or above the appraised price. All non-responsive bid forms may be rejected.

<u>SPECIES</u>	<u>APPRAISED PRICE</u>	<u>BID PRICE</u>	<u>ESTIMATED VOLUME* = VALUE</u>
SAWLOGS			
RED PINE	\$ 130.00/MBF	\$ _____ X	595.20 MBF = \$ _____
PULPWOOD			
RED PINE	\$ 45.00/CORD	\$ _____ X	636.00 CORDS = \$ _____
			SUBTOTAL 1 \$ _____

In addition, the successful bidder agrees to purchase the following species at the appraised price:

<u>SPECIES</u>	<u>APPRAISED PRICE</u>	<u>ESTIMATED VOLUME*</u>	<u>VALUE</u>
SAWLOGS			
RED MAPLE	\$ 95.00/MBF	12.70 MBF	= \$ 1,206.50
MIX ASPEN	\$ 60.00/MBF	27.50 MBF	= \$ 1,650.00
PULPWOOD			
MIX ASPEN	\$ 18.00/CORD	163.00 CORDS	= \$ 2,934.00
MIX HARDWD	\$ 8.00/CORD	157.00 CORDS	= \$ 1,256.00
			SUBTOTAL 2 \$ 7,046.50

SUBTOTAL 1 + SUBTOTAL 2 = TOTAL BID VALUE \$ _____

These volumes are statistically estimated within plus (+) or minus (-) 9.69%. These estimated volumes are final and not subject to adjustment. Prospective bidders are urged to examine this timber and to make their own estimates of quantity and quality.

I understand that any or all bids may be rejected, and that the individual unit bid price will be the basis to determine total bid value. All bids must be signed and all bid items must be bid or the bid form may be rejected. I also understand that consideration and awarding a contract will be based upon my past performance and ability to complete the contract based upon equipment and manpower subject to my control.

(bidder's printed name)

(bidder's signature)

Address/Telephone _____

THE WINNING BIDDER MUST COMPLETE THE FORM ON THE REVERSE SIDE
WITHIN 21 DAYS OF SALE AWARD



FOR DEPARTMENT USE ONLY	
Sale or Permit No	
Year:	Type:
Forest Area:	

**TIMBER SALE
VERIFICATION OF WORKER'S DISABILITY
COMPENSATION ACT COMPLIANCE**

As required by Act 317, P.A. 1969 (Worker's Compensation) and Part 525 of Act 451 of 1994, as amended.

VERIFICATION OF WORKER'S DISABILITY COMPENSATION ACT COMPLIANCE

- This verification must be completed and submitted within 21 days of contract award and prior to the issuance of the timber sale contract.
- In addition, if boxes 2B or 2C are checked, then Notice of Exclusion or Certificate of Insurance must be submitted within 21 days of the contract award and prior to the issuance of the timber sale contract.
- All information must be typed or printed except for written signatures.

Please Check Appropriate Categories:

1. My business is organized as (you **must** check one of the boxes below):
 - A. Sole Proprietorship (individual)
 - B. Partnership
 - C. Corporation
2. You **must** check one of the boxes below:
 - A. I certify that my business is a sole proprietorship and it has no employees but the sole proprietor. I am not subject to the Worker's Compensation Laws.
 - B. I certify that my business has satisfied its obligation to the Worker's Compensation Act through the use of an approved Notice of Exclusion (BWC-337, Rev. 5/96). I will provide a copy of the Notice of Exclusion within 21 days of the contract award. (For questions or a copy of the BWC-337, please call the Worker's Compensation Bureau at 517-322-1195).
 - C. I certify that my business has a Worker's Compensation Policy. I will provide an original Certificate of Insurance within 21 days of the contract award.
3. If you have checked item 2(A) or 2(B), you **must** indicate the number of **both** full and part time employees other than yourself including family members and active partners (if none, you must enter "0").

_____ Full Time Employees

_____ Part Time Employees

Name of Business		Federal ID (or) Social Security No.	
Address		Telephone No. ()	
City	State	Zip + 4	

I hereby certify that the above information is true and correct. I agree to notify the DNR of any changes that occur in factors affecting my coverage during any of my present and future operations.

Signature of Owner or Authorized Representative

Title

Date

TIMBER SALE / SEALED BID
STATE OF MICHIGAN / DNR

CADILLAC MANAGEMENT UNIT
MANTON OFFICE

DEERPAW MIX (024-08-01)
T21N, R05W, SEC. 30, W1/2.
MISSAUKEE COUNTY

In response to the notice of sale to be held 03:00 p.m. on February 02, 2009, I am hereby submitting my sealed bid (firm offer) for the following forest products to be cut. Bids for individual species and total bid value must be at or above the appraised price. All non-responsive bid forms may be rejected.

<u>SPECIES</u>	<u>APPRAISED PRICE</u>	<u>BID PRICE</u>	<u>ESTIMATED VOLUME* = VALUE</u>
<u>SAWLOGS</u>			
RED OAK	\$ 200.00/MBF	\$ _____ X	133.30 MBF = \$ _____
RED PINE	\$ 130.00/MBF	\$ _____ X	58.90 MBF = \$ _____
MIX HARDWD	\$ 90.00/MBF	\$ _____ X	77.20 MBF = \$ _____
<u>PULPWOOD</u>			
MIX HARDWD	\$ 12.00/CORD	\$ _____ X	1210.00 CORDS = \$ _____
SUBTOTAL 1			\$ _____

In addition, the successful bidder agrees to purchase the following species at the appraised price:

<u>SPECIES</u>	<u>APPRAISED PRICE</u>	<u>ESTIMATED VOLUME*</u>	<u>VALUE</u>
<u>SAWLOGS</u>			
WHITE OAK	\$ 75.00/MBF	11.00 MBF	= \$ 825.00
MIX ASPEN	\$ 60.00/MBF	22.20 MBF	= \$ 1,332.00
<u>PULPWOOD</u>			
WHITE PINE	\$ 5.00/CORD	55.00 CORDS	= \$ 275.00
RED PINE	\$ 40.00/CORD	59.00 CORDS	= \$ 2,360.00
MIXED OAK	\$ 7.00/CORD	277.00 CORDS	= \$ 1,939.00
MIX ASPEN	\$ 18.00/CORD	373.00 CORDS	= \$ 6,714.00
SUBTOTAL 2			\$ 13,445.00

SUBTOTAL 1 + SUBTOTAL 2 = TOTAL BID VALUE \$ _____

*These volumes are statistically estimated within plus (+) or minus (-) 8.10%. These estimated volumes are final and not subject to adjustment. Prospective bidders are urged to examine this timber and to make their own estimates of quantity and quality.

I understand that any or all bids may be rejected, and that the individual unit bid price will be the basis to determine total bid value. All bids must be signed and all bid items must be bid or the bid form may be rejected. I also understand that consideration and awarding a contract will be based upon my past performance and ability to complete the contract based upon equipment and manpower subject to my control.

(bidder's printed name)

(bidder's signature)

Address/Telephone _____

THE WINNING BIDDER MUST COMPLETE THE FORM ON THE REVERSE SIDE
WITHIN 21 DAYS OF SALE AWARD



FOR DEPARTMENT USE ONLY

**TIMBER SALE
VERIFICATION OF WORKER'S DISABILITY
COMPENSATION ACT COMPLIANCE**

*As required by Act 317, P.A. 1969 (Worker's Compensation) and Part 525
of Act 451 of 1994, as amended.*

Sale or Permit No

Year:

Type:

Forest Area:

VERIFICATION OF WORKER'S DISABILITY COMPENSATION ACT COMPLIANCE

- **This verification must be completed and submitted within 21 days of contract award and prior to the issuance of the timber sale contract.**
- **In addition, if boxes 2B or 2C are checked, then Notice of Exclusion or Certificate of Insurance must be submitted within 21 days of the contract award and prior to the issuance of the timber sale contract.**
- **All Information must be typed or printed except for written signatures.**

Please Check Appropriate Categories:

1. My business is organized as (you **must** check one of the boxes below):

- A. Sole Proprietorship (individual)
- B. Partnership
- C. Corporation

2. You **must** check one of the boxes below:

- A. I certify that my business is a sole proprietorship and it has no employees but the sole proprietor. I am not subject to the Worker's Compensation Laws.
- B. I certify that my business has satisfied its obligation to the Worker's Compensation Act through the use of an approved Notice of Exclusion (BWC-337, Rev. 5/96). I will provide a copy of the Notice of Exclusion within 21 days of the contract award. (For questions or a copy of the BWC-337, please call the Worker's Compensation Bureau at 517-322-1195).
- C. I certify that my business has a Worker's Compensation Policy. I will provide an original Certificate of Insurance within 21 days of the contract award.

3. If you have checked item 2(A) or 2(B), you **must** indicate the number of **both** full and part time employees other than yourself including family members and active partners (if none, you must enter "0").

_____ Full Time Employees

_____ Part Time Employees

Name of Business		Federal ID (or) Social Security No.	
Address		Telephone No. ()	
City	State	Zip + 4	

I hereby certify that the above information is true and correct. I agree to notify the DNR of any changes that occur in factors affecting my coverage during any of my present and future operations.

Signature of Owner or Authorized Representative

Title

Date