



DEPARTMENT OF NATURAL RESOURCES
STATE OF MICHIGAN

TIMBER SALE PROSPECTUS

Notice is hereby given that bids will be received by the Unit Manager,
CADILLAC MANAGEMENT UNIT, MANTON OFFICE, for certain timber on the following described
lands:

WEST 80 PINE / T24N, R10W, SEC. 03, W1/2SE.
WEXFORD COUNTY (Appr. \$17,237.45)

CLAM RIVER OAK / T22N, R09W, SEC. 23, NWNW,NENW,N1/2NE.
T22N, R09W, SEC. 24, N1/2NW,NE.
T22N, R09W, SEC. 14, NESE.
WEXFORD COUNTY (Appr. \$59,685.70)

HONEYMOON HARDWOODS / T24N, R07W, SEC. 13, S1/2NW.
T24N, R07W, SEC. 13, NENW, NWSW.
T24N, R07W, SEC. 14, S1/2NE.
T24N, R07W, SEC. 14, NENE.
MISSAUKEE COUNTY (Appr. \$16,693.30)

SALE DATE AND TIME: 3:00 p.m. on July 27, 2009.

MANTON

BID INSTRUCTIONS (Ver. 06/23/2008):

1. Bid Location, Date, and Time: Bids must be received by the Unit Manager, Cadillac Management Unit, Manton Field Office, 521 N Michigan, Manton, MI 49663, no later than 3:00 p.m. on July 27, 2009. For further information concerning this sale, contact the Unit Manager at 231-824-3591.
2. Bidder's Qualifications: Purchaser shall obtain workers compensation insurance to cover claims under Michigan's Worker's Disability Compensation Act of 1969 or similar employee benefit act of any other state applicable to an employee. If all or part of a timber sale was prepared by a private contractor, that contractor and that contractor's company are not permitted to bid on the timber sale contract. Bids will not be accepted from individuals or companies appearing on the DNR/EMFM No-Bid List. This list contains the names of purchasers who previously failed to execute a contract within 21-days or who have a history of poor performance.
3. Preparation of Sealed Bids: Bids shall be manually signed in ink; bid prices must be entered for each species and product in the Bid Price column for all material subject to bidding; and all fill-in blanks must be completed. If erasures or other changes appear on the forms, each erasure or change must be initialed by the person signing the bid.
4. Submission of Sealed Bids: Bid forms may be obtained from the Unit Manager. All bids must be submitted on the bid form and in an envelope clearly identified as described in this section. NOTE: Only one bid form per bid envelope. Sealed bids must be submitted to the Unit office designated in the prospectus and must be submitted at or prior to the time established in the prospectus. The envelope should show on the outside (a) that it is a "Bid for Timber," and (b) the sale name or number, and (c) the date and time of bid opening as shown in the prospectus. Bids received after the time specified in the sale prospectus are late bids and will be rejected.
5. Public Opening of Sealed Bids: If conditions permit, the sealed bids will be publicly opened and posted at the time and place set in the prospectus.
6. Award of Contract: Award of the contract will be made to the Bidder whose bid, conforming to the prospectus, is most advantageous to the State of Michigan on the basis of total value at rates bid for the estimated quantities. The State reserves the right to reject any bid or waive any minor irregularity in bids received. A written award mailed (or otherwise furnished) to the successful Bidder shall be deemed to result in a binding contract without further action by either party.
7. Down Payment: The Bidder to whom award is made must make a down payment within 21 days of the sale award. The amount of the down payment will be calculated as shown in the Bond and Payment Schedule of this prospectus. Only cash may be used to meet this requirement.
8. Performance Security: As guarantee of faithful performance, a cash bond, certificate of deposit, surety bond or irrevocable letter of credit (LOC) is required within 21 days of the sale award. The amount of the performance security is shown in the Bond and Payment Schedule of this prospectus. If an LOC or surety is used, the coverage must extend for at least 6 months beyond the contract expiration.
9. Timber Sale Contract: Additional conditions and requirements common to all timber sales are listed on the timber sale contract (R4031) and are available on line at www.michigan.gov/dnr. Contact the Unit Manager for additional information or a sample contract. Within 21 days of the date of the award letter, the bidder must sign the contract and provide the required down payment, performance security, and verification of worker's disability compensation. The down payment and performance security shall be in accordance with the provisions of the timber sale contract, in the sums stated in this prospectus. If these actions are not taken, then the Bidder, the Bidder's corporation, and the corporation's principals may not be permitted to bid on State timber sales for a period of 1 year. In addition, the Bidder certifies that if awarded this contract, the Bidder will complete the timber sale contract in accordance with its terms and any modifications thereof including requirements to purchase, cut, and remove the included timber by the termination date.

10. Disclaimer of Estimates and Bidder's Warranty of Inspection: Before submitting this bid, the Bidder is advised and cautioned to inspect the sale area, review the requirements of the sale contract, and take other steps as may be reasonably necessary to ascertain the location, estimated volumes, construction estimates, and operating costs of the proposed sale. Failure to do so will not relieve the Bidder from responsibility for completing the contract.

The Bidder warrants that this bid is submitted solely on the basis of the Bidder's examination and inspection of the quality and quantity of the timber offered for sale and the Bidder's opinion of the value thereof and the costs of recovery. No reliance should be placed on the State of Michigan's estimates of timber quality, quantity or costs of recovery. Bidder further acknowledges that the State of Michigan: (i) expressly disclaims any warranty of fitness of timber for any purpose; (ii) offers this timber as is without any warranty of quality (merchantability) or quantity and (iii) expressly disclaims any warranty as to the quantity or quality of timber sold.

11. Certification and Chain-of-Custody: Unless otherwise indicated in the contract under section 7 - Other Conditions of the Sale Specific Conditions & Requirements, the area encompassed by this timber sale is certified to the standards of the Forest Stewardship Council (FSC) - Certificate #SCS-FM/COC-090N and the Sustainable Forestry Initiative (SFI) - Certificate # NSF-SFIS-5Y031-S1. Forest products from this sale may be delivered to the mill as "FSC and / or SFI certified" as long as the contractor hauling the forest products is chain-of-custody (COC) certified or covered under a COC certificate from the destination mill. The purchaser is responsible for maintaining COC after leaving the sale area.

REBECCA A. HUMPHRIES
Director

WEST 80 PINE (005-09-01)

A timber sale contract for this LUMP SUM SEALED timber sale will be awarded the responsible bidder offering the highest sealed bid price. Bids must be at or above the following appraised price for each species:

<u>SPECIES</u>	<u>ESTIMATED VOLUME*</u>	<u>APPRAISED PRICE</u>
SAWLOGS		
RED PINE	59.30 MBF	\$ 128.00/MBF
PULPWOOD		
RED PINE	204.00 CORDS	\$ 43.50/CORD

In addition, the successful bidder agrees to purchase the following species at the indicated appraised price:

<u>SPECIES</u>	<u>ESTIMATED VOLUME*</u>	<u>APPRAISED PRICE</u>
PULPWOOD		
RED MAPLE	25.00 CORDS	\$ 11.40/CORD
MIX ASPEN	43.00 CORDS	\$ 11.35/CORD

*The volumes are statistically estimated within plus (+) or minus (-) 22.98 percent. These estimated volumes are final and not subject to adjustment. Prospective bidders are urged to examine this timber and to make their own estimates of quantity and quality.

BOND AND PAYMENT SCHEDULE:

1. A bond in the amount of \$1,000.00 to insure faithful performance of the conditions of the contract, will be deposited by the successful bidder within 21 days of the sale award.
2. Cutting in any sale or unit without the required advance payment would be considered a trespass.
3. Total payment may be paid in advance or according to the following schedule:
 - (a) Ten percent (10%) of the sale value must be paid within 21 days of the sale award.
 - (b) The 10% down payment will be credited towards the first unit cut.
 - (c) Payment for each of the following units must be made before cutting begins in that unit:

<u>PAYMENT UNIT NUMBER</u>	<u>PERCENT OF TOTAL SALE VALUE</u>
1	15%
2	50%
3	35%
4. If no cutting takes place, the 10% down payment will not be refunded.
5. Operations on the contract issued will terminate on September 30, 2011.

Michigan Department of Natural Resources-Forest Management Division
TIMBER SALE MAP

This information provided under authority of Part 525, Act 451 of 1994, as amended.



Sale No.	Year	Sale Type
63-005-09-01	09	01

State Forest and Forest Management Unit: Cadillac		Mapped By/ Cruised By: Andy Church		Comp. 127	YOE 2009
Township 24N	Range 10W	Section(s) 3	Subdivision W1/2SE Sec. 3	Stands 116,117,120,121	
				Scale: 1:15840	

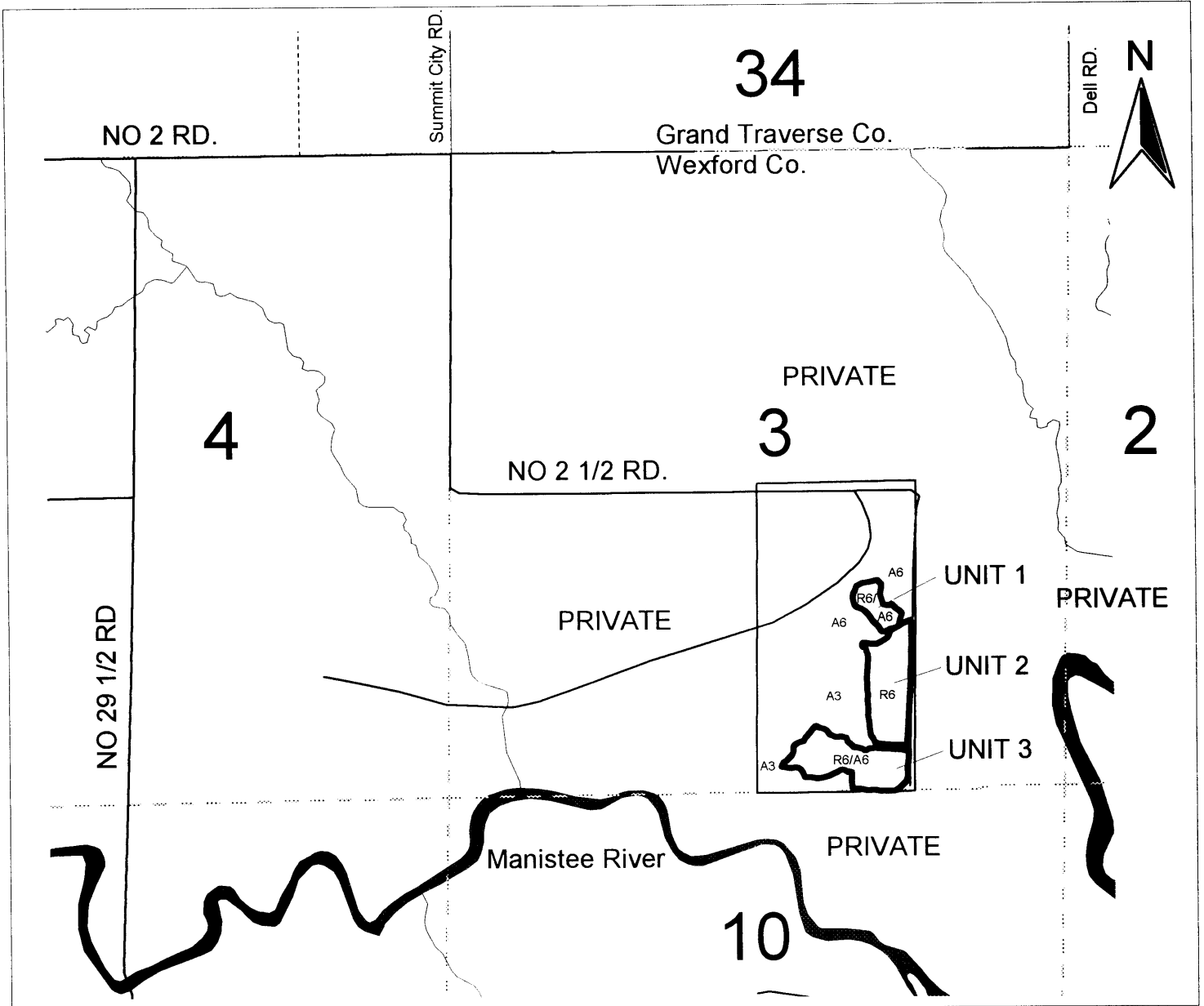
Cover Type				Density		
A=Aspen	H=Hemlock	P=Lowland Poplar	V=Bog or Marsh	1=Non Stocked	7=Saw Timber Poor	
B=Paper Birch	J=Jack Pine	Q=Mixed Swamp Cnfr	W=White Pine	2=Seedling Sapling Poor	8=Saw Timber Medium	
C=Cedar	L=Lowland Brush	R=Red Pine	X=Non Stocked	3=Seedling Sapling Well	9=Saw Timber Well	
E=Swamp Hdwoods	M=Mpl, Bch, Brch	S=Black Spruce	Z=Water	4=Pole Timber Poor		
F=Spruce Fir	N=Marsh	T=Tamarack		5=Pole Timber Medium		
G=Grass	O=Oak	U=Upland Brush		6=Pole Timber Well		



LEGEND

Sale Boundary (Red Paint) 
 County Road 

UNIT 1	2 ac.
UNIT 2	8 ac.
UNIT 3	8 ac.
TOTAL	18 ac.

West 80 Pine
Wexford Co.
18 acres



Sale Specific Conditions & Requirements

Sale Name: West 80 Pine Sale Number: 63-005-09-01

1 - Sale Area

1.2 - Boundaries

1.2.1 - Painted boundaries (6/05)

The sale boundary and Payment Unit boundaries are marked and identified by RED paint. Exterior sale boundary lines against state are marked with RED paint. Do not cut painted boundary line trees.

2 - Timber Specifications

2.1 - Included Timber

2.1.1 - Clearcut unit(s) with unmerchantable trees (2/04)

Within Payment Unit(s) 1, cut all trees that are two (2) inches or more in diameter measured at a point of four and one-half (4-1/2) feet above ground level regardless of merchantability.

2.1.3 - Cut tree marked unit(s) (8/04)

Within Payment Unit(s) 2-3, all trees are designated for cutting when marked with ORANGE paint above and below stump height, regardless of merchantability. IN ADDITION, CUT ALL ASPEN, BALSAM, MAPLE, and CHERRY.

4 - Transportation

4.1 - Construction

4.1.12 - No new roads (5/07)

No new roads will be permitted in any Payment Unit. All operations are limited to existing roads.

4.2 - Maintenance

4.2.5 - Two wheel drive condition (2/04)

All existing trail roads on and adjacent to the sale area must be passable by two-wheel drive traffic for the duration of the sale.

5 - Operations

5.1 - Notification

5.1.1 - Pre-sale conference (2/08)

A pre-sale conference on site between the Purchaser and sale administrator is required prior to beginning any operations to determine landing size and location. The Unit Manager or their representative must be contacted at least 3 working days in advance to schedule the conference.

5.2 - Conduct of Operations

5.2.1 - Slash

5.2.1.1 - Slash within sale area (2/04)

No trees are to be felled outside the sale area and all slash is to be kept at least 10 feet back from the RED paint line.

5.2.1.7 - Slash must be scattered (2/04)

Unless otherwise directed, slash and logging debris shall be uniformly scattered over the sale area and not left in piles or windrows. Slash shall not be allowed to accumulate at the landings. All slash work shall be done concurrently with harvesting.

5.2.12 - Bark slippage restriction (3/07)

Within Payment Unit(s) 2-3, cutting, skidding, and hauling are not permitted during the period of April 15 to July 15. This restriction is because of bark slippage.

5.2.15 - Bark beetle restriction (2/04)

In the event drought creates a high risk of pine bark beetle infestation, pine is not to be cut during the period March 1 through July 1, unless all portions of trees greater than two inches in diameter are removed from the sale area, reduced to chips, or treated to the satisfaction of the Unit Manager or their representative, within fifteen days of being severed from the stump. Pine logs, pulpwood piles and treetop piles for chipping that are decked in the fall or winter within a 1/4 mile of susceptible sites must be removed before March 15. Residual slash must not be placed in piles or rows and must be spread over the site for quick drying. The Department of Natural Resources will exercise this option if the risk of damage warrants.

5.2.20 - Equipment width (2/04)

Equipment used to remove designated rows must be capable of moving through cut rows without damaging residual trees.

5.2.29 - Shrub protection (9/07)

Do not cut or damage hawthorn, witch-hazel, dogwood or juneberry. These woody-shrub plants are highly beneficial to various wildlife species.

5.2.38 - No decking against live trees (2/04)

Cut products may not be decked against unmarked or designated leave trees.

5.4 - Soil Protection

5.4.1 - Rutting restriction, general (5/08)

Operations are to cease immediately if equipment and weather conditions result in rutting of roads which is 12 inches or greater in depth and 50 feet in length. In addition, operations are to cease immediately if equipment and weather conditions result in rutting on skid trails which is 12 inches or greater in depth and 50 feet in length. The Unit Manager or their representative may restrict hauling and/or skidding if ruts exceed the specified depth. With the Unit Manager or their representative's approval, the Purchaser may return to the area when the weather conditions have changed and/or the risk of rutting has decreased.

CLAM RIVER OAK (038-08-01)

A timber sale contract for this LUMP SUM SEALED timber sale will be awarded the responsible bidder offering the highest sealed bid price. Bids must be at or above the following appraised price for each species:

<u>SPECIES</u>	<u>ESTIMATED VOLUME*</u>	<u>APPRAISED PRICE</u>
SAWLOGS		
RED OAK	146.60 MBF	\$ 171.00/MBF
PULPWOOD		
RED MAPLE	1486.00 CORDS	\$ 13.60/CORD

In addition, the successful bidder agrees to purchase the following species at the indicated appraised price:

<u>SPECIES</u>	<u>ESTIMATED VOLUME*</u>	<u>APPRAISED PRICE</u>
SAWLOGS		
RED MAPLE	49.50 MBF	\$ 76.00/MBF
B.T. ASPEN	21.00 MBF	\$ 64.00/MBF
RED PINE	4.50 MBF	\$ 115.00/MBF
PULPWOOD		
RED OAK	321.00 CORDS	\$ 8.65/CORD
B.T. ASPEN	312.00 CORDS	\$ 15.60/CORD
W. SPRUCE	12.00 CORDS	\$ 2.75/CORD
WHITE PINE	49.00 CORDS	\$ 2.75/CORD
RED PINE	22.00 CORDS	\$ 44.20/CORD

*The volumes are statistically estimated within plus (+) or minus (-) 8.14 percent. These estimated volumes are final and not subject to adjustment. Prospective bidders are urged to examine this timber and to make their own estimates of quantity and quality.

BOND AND PAYMENT SCHEDULE:

1. A bond in the amount of \$3,000.00 to insure faithful performance of the conditions of the contract, will be deposited by the successful bidder within 21 days of the sale award.
2. Cutting in any sale or unit without the required advance payment would be considered a trespass.
3. Total payment may be paid in advance or according to the following schedule:
 - (a) Ten percent (10%) of the sale value must be paid within 21 days of the sale award.
 - (b) The 10% down payment will be credited towards the first unit cut.
 - (c) Payment for each of the following units must be made before cutting begins in that unit:

<u>PAYMENT UNIT NUMBER</u>	<u>PERCENT OF TOTAL SALE VALUE</u>
1	20%
2	35%
3	25%
4	20%
4. If no cutting takes place, the 10% down payment will not be refunded.
5. Operations on the contract issued will terminate on September 30, 2011.

Michigan Department of Natural Resources-Forest Management Division

TIMBER SALE MAP

This information provided under authority of Part 525, Act 451 of 1994, as amended.

Sale No.	Year	Sale Type
38	08	01

State Forest and Forest Management Unit: Cadillac Management Unit		Mapped By: Crusied By: David Fisher		Date: 9/30/2008
Township 22N	Range 09W	Section(s) 23,24	Subdivision Various	Scale: 1:21120

Cover Type

A=Aspen	H=Hemlock	P=Lowland Poplar	V=Bog or Marsh
B=Paper Birch	J=Jack Pine	Q=Mixed Swamp Cnfr	W=White Pine
C=Cedar	L=Lowland Brush	R=Red Pine	X=Non Stocked
E=Swamp Hdwoods	M=Mpl, Bch, Brch	S=Black Spruce	Z=Water
F=Spruce Fir	N=Marsh	T=Tamarack	
G=Grass	O=Oak	U=Upland Brush	

Density

1=Non Stocked	7=Saw Timber Poor
2=Seedling Sapling Poor	8=Saw Timber Medium
3=Seedling Sapling Well	9=Saw Timber Well
4=Pole Timber Poor	
5=Pole Timber Medium	
6=Pole Timber Well	

Clam River Oak 196 Acres Wexford County

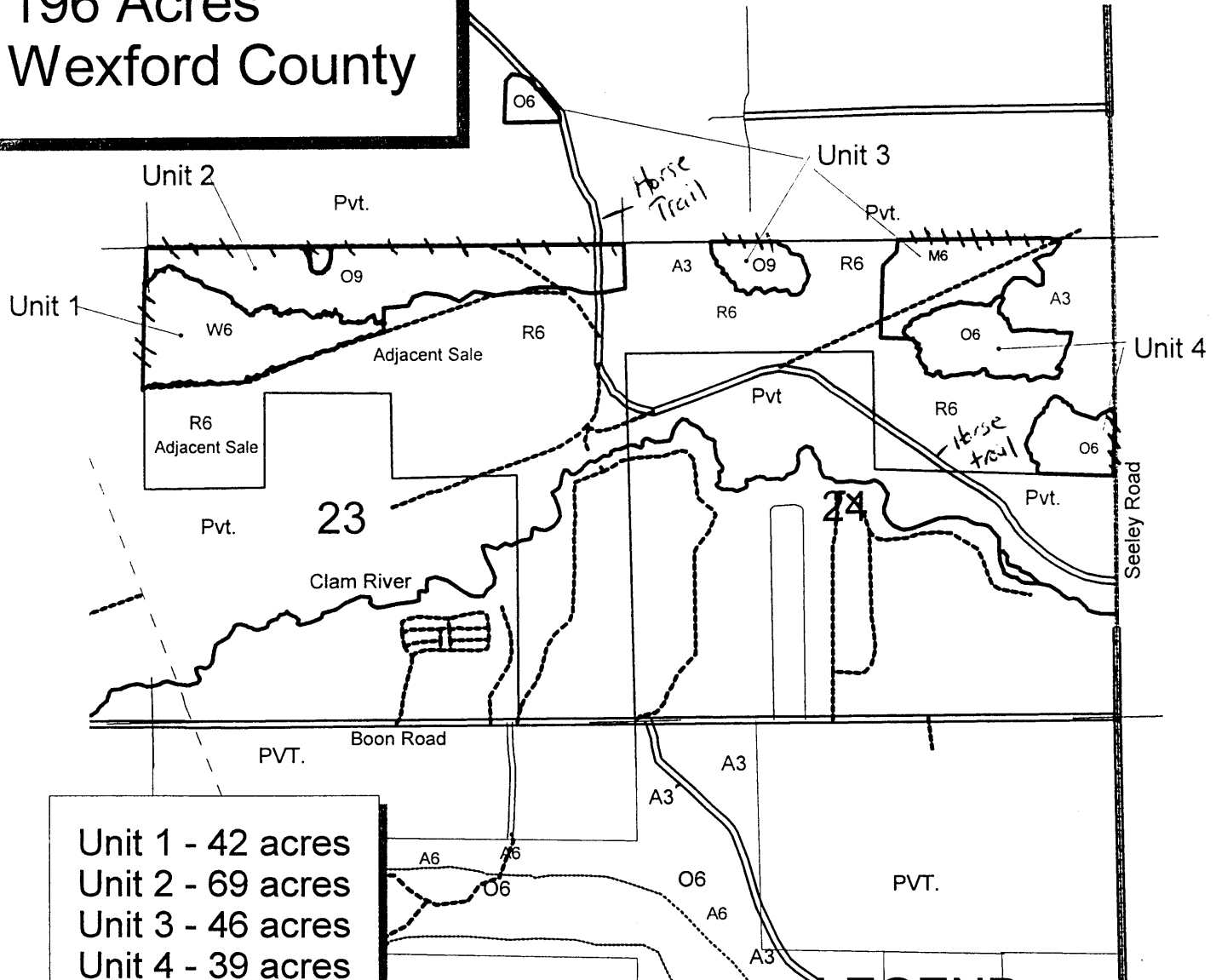

Unit 1 - 42 acres
Unit 2 - 69 acres
Unit 3 - 46 acres
Unit 4 - 39 acres

LEGEND

- Sale Boundary (red paint)
- Sale Boundary (blue paint)
- Two-Track Road
- County Road

Sale Specific Conditions & Requirements

Sale Name: Clam River Oak Sale Number: 63-038-08-01

1 - Sale Area

1.2 - Boundaries

1.2.1 - Painted boundaries (12/08)

The sale boundary and Payment Unit boundaries are marked and identified by blue and red paint. Exterior sale boundary lines against private property are marked with blue paint. Exterior sale boundary lines against state and interior Payment Unit boundaries are marked with red paint.

2 - Timber Specifications

2.1 - Included Timber

2.1.3 - Cut tree marked unit(s) (8/04)

Within Payment Unit(s) 1,2,3 and 4, trees are designated for cutting when marked with orange paint above and below stump height, regardless of merchantability. IN ADDITION: Cut all aspen and red maple. Do NOT CUT any trees marked with green paint.

WITHIN PAYMENT UNIT 4: Harvest white spruce as needed to allow for access.

2.2 - Utilization

2.2.3 - Stump heights (4/07)

Stump heights within the Sale Area shall not exceed 12 inches for trees greater than 10 inches DBH and 4 inches for trees smaller than 10 inches DBH.

3 - Payments

3.3 - Pre-measured Sales

3.3.4 - Dividing payment units (7/05)

Payment unit(s) 1-4 may be divided at the request of the purchaser and upon approval of the Unit Manager.

Dividing payment units is a contract modification which requires a Timber Sale Contract Supplement.

4 - Transportation

4.1 - Construction

Sale Name: Clam River Oak Sale Number: 63-038-08-01

4.1.7 - Road closure (4/07)

All new roads built into the sale must be blocked to vehicle traffic upon completion of the sale. Overgrown roads that are reopened shall be considered new roads. In general, this will require constructing a four (4') foot high berm constructed of stumps and logs covered with earth. Stumps and brush must be placed along the remainder of the trail. These roads must be rendered impassable to cars and trucks. All stumps from road building and landing construction must be reserved to block any newly constructed roads upon completion of the sale. These stumps must be scattered along the road system to prohibit vehicular movement. Contact the sale administrator for specific details of design and placement.

5 - Operations

5.1 - Notification

5.1.1 - Pre-sale conference (2/08)

A pre-sale conference on site between the Purchaser and sale administrator is required prior to beginning any operations to determine landing and road locations. The Unit Manager or their representative must be contacted at least 10 days in advance to schedule the conference.

5.1.4 - Post-sale conference (2/04)

A post-sale conference on site between the Purchaser and sale administrator is required 5 days prior to the completion of active logging operations to determine clean-up and repair of landings, road edges, and the fulfillment of other contract specifications.

5.2 - Conduct of Operations

5.2.1 - Slash

5.2.1.7 - Slash must be scattered (2/04)

Unless otherwise directed, slash and logging debris shall be uniformly scattered over the sale area and not left in piles or windrows. Slash shall not be allowed to accumulate at the landings. All slash work shall be done concurrently with harvesting.

5.2.2 - Hazard Trees/Snags

5.2.2.1 - Den trees (2/04)

Obvious hollow and/or den trees shall be protected and left standing unless they are a safety hazard.

5.2.4 - Dead and Down Creation

5.2.4.3 - Dead and down creation, dead trees (6/07)

Except as provided for in General Condition and Requirement 5.2.2, no dead trees, standing or down, are to be cut, skidded, or processed.

Sale Name: Clam River Oak Sale Number: 63-038-08-01

5.2.13 - Oak wilt restriction (9/08)

Within Payment Unit(s) 1-4, unless changed by written agreement, cutting and skidding are not permitted during the period of April 15 to July 15. This is necessary to reduce the spread of oak wilt. For more information, contact the Unit Manager or their representative.

5.2.38 - No decking against live trees (2/04)

Cut products may not be decked against unmarked or designated leave trees.

HONEYMOON HARDWOODS (069-06-01)

A timber sale contract for this LUMP SUM SEALED timber sale will be awarded the responsible bidder offering the highest sealed bid price. Bids must be at or above the following appraised price for each species:

<u>SPECIES</u>	<u>ESTIMATED VOLUME*</u>	<u>APPRAISED PRICE</u>
SAWLOGS		
SUG. MAPLE	21.20 MBF	\$ 202.00/MBF
Q. ASPEN	50.70 MBF	\$ 43.00/MBF
PULPWOOD		
Q. ASPEN	414.00 CORDS	\$ 11.20/CORD
MIX HARDWD	549.00 CORDS	\$ 7.00/CORD

In addition, the successful bidder agrees to purchase the following species at the indicated appraised price:

<u>SPECIES</u>	<u>ESTIMATED VOLUME*</u>	<u>APPRAISED PRICE</u>
SAWLOGS		
MIX HARDWD	20.00 MBF	\$ 52.00/MBF
PULPWOOD		
W. SPRUCE	237.00 CORDS	\$ 3.00/CORD

*The volumes are statistically estimated within plus (+) or minus (-) 9.30 percent. These estimated volumes are final and not subject to adjustment. Prospective bidders are urged to examine this timber and to make their own estimates of quantity and quality.

BOND AND PAYMENT SCHEDULE:

1. A bond in the amount of \$1,000.00 to insure faithful performance of the conditions of the contract, will be deposited by the successful bidder within 21 days of the sale award.
2. Cutting in any sale or unit without the required advance payment would be considered a trespass.
3. Total payment may be paid in advance or according to the following schedule:
 - (a) Ten percent (10%) of the sale value must be paid within 21 days of the sale award.
 - (b) The 10% down payment will be credited towards the first unit cut.
 - (c) Payment for each of the following units must be made before cutting begins in that unit:

PAYMENT UNIT NUMBER	PERCENT OF TOTAL SALE VALUE
1	30%
2	60%
3	10%
4. If no cutting takes place, the 10% down payment will not be refunded.
5. Operations on the contract issued will terminate on September 30, 2011.

Michigan Department of Natural Resources-Forest Management Division
TIMBER SALE MAP

This information provided under authority of Part 525, Act 451 of 1994, as amended.

Sale No.	Year	Sale Type
63-069-06-01	06	01

State Forest and Forest Management Unit: Cadillac		Mapped By/ Cruised By: Andy Church		Comp. 121 YOE 2006 Stands 95,97,100,102-108,111	
Township 24N	Range 07W	Section(s) 13,14	Subdivision S1/2NW,NENW,NWSW Sec. 13 S1/2NE,NENE Sec. 14	Scale: 1:15840	

Cover Type				Density		
A=Aspen	H=Hemlock	P=Lowland Poplar	V=Bog or Marsh	1=Non Stocked	7=Saw Timber Poor	
B=Paper Birch	J=Jack Pine	Q=Mixed Swamp Cnfr	W=White Pine	2=Seedling Sapling Poor	8=Saw Timber Medium	
C=Cedar	L=Lowland Brush	R=Red Pine	X=Non Stocked	3=Seedling Sapling Well	9=Saw Timber Well	
E=Swamp Hdwoods	M=Mpl, Bch, Brch	S=Black Spruce	Z=Water	4=Pole Timber Poor		
F=Spruce Fir	N=Marsh	T=Tamarack		5=Pole Timber Medium		
G=Grass	O=Oak	U=Upland Brush		6=Pole Timber Well		

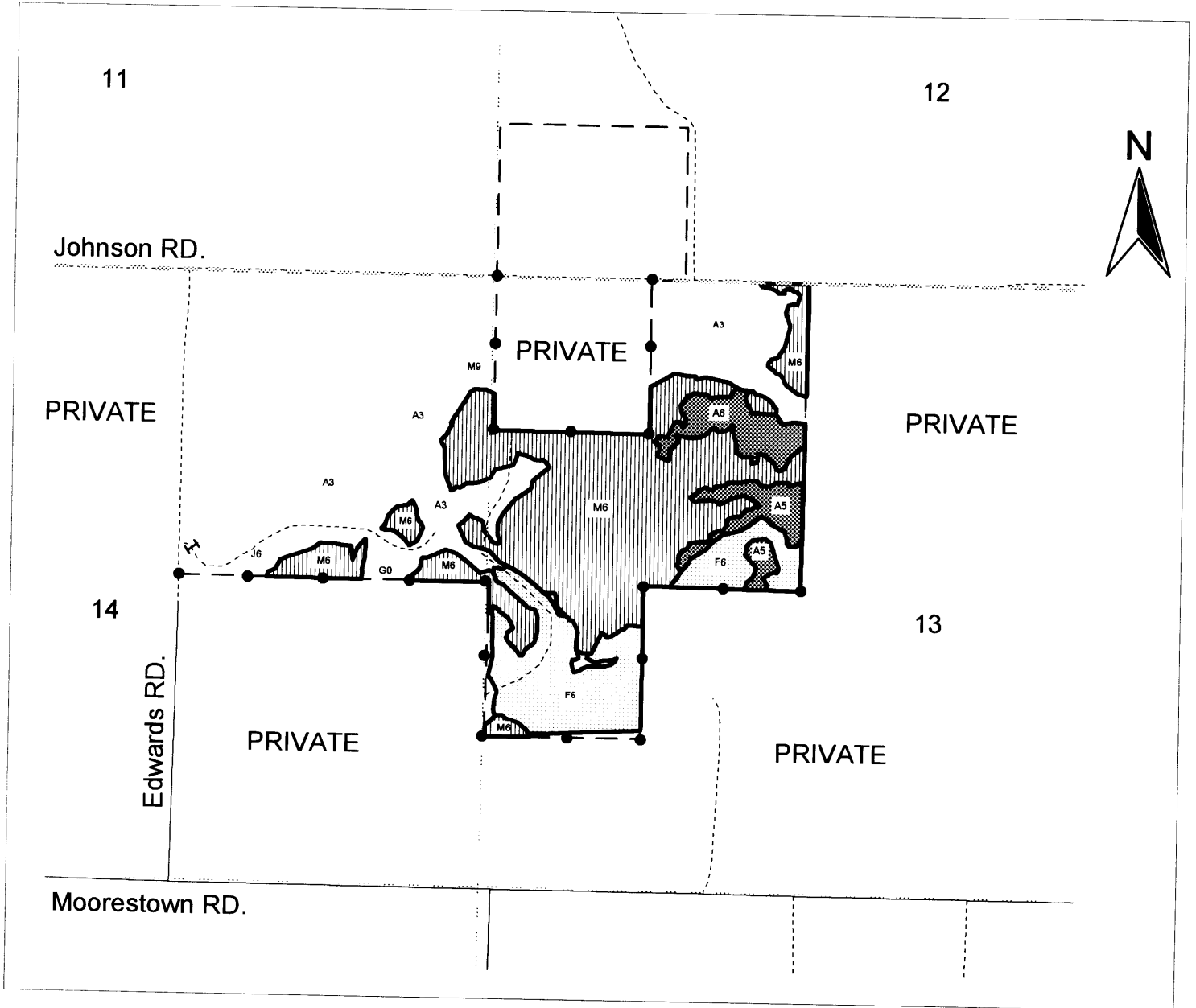

LEGEND			UNIT 1	18ac	Honeymoon Hardwoods Missaukee Co. 144 ac.
Unit Boundary (Red Line)			UNIT 2	94ac	
Private Boundary (Blue Line)			UNIT 3	32ac	
Forest Road			TOTAL	144ac	
Road					
Berm					



Sale Specific Conditions & Requirements

Sale Name: Honeymoon Hardwoods Sale Number: 63-069-06-01

1 - Sale Area

1.2 - Boundaries

1.2.1 - Painted boundaries (6/05)

The sale boundary and Payment Unit boundaries are marked and identified by BLUE and RED paint. Exterior sale boundary lines against private property are marked with BLUE paint. Exterior sale boundary lines against state are marked with RED paint. Interior unit boundary lines are marked with RED paint. Do not cut painted boundary line trees unless also marked with orange paint.

2 - Timber Specifications

2.1 - Included Timber

2.1.1 - Clearcut unit(s) with unmerchantable trees (2/04)

Within Payment Unit(s) #1, cut all trees that are two (2) inches or more in diameter measured at a point of four and one-half (4-1/2) feet above ground level regardless of merchantability.

2.1.3 - Cut tree marked unit(s) (8/04)

Within Payment Unit(s) #2 all trees are designated for cutting when marked with ORANGE paint above and below stump height, regardless of merchantability. In addition, CUT ALL ASPEN and IRONWOOD. Also, trees marked with the letter "G" are designated for girdling. Sub-merchantable trees are marked with a vertical slash and are not counted in volume estimations. These trees are to be cut or removed. If driven over, trees must not be left partially sprung.

2.1.8 - Designated plantation row unit(s) (11/04)

Within Payment Unit(s) #3, all trees which meet minimum piece specifications in 2.2 Utilization, within designated plantation rows are designated for cutting. Plantation rows designated for cutting begin with harvesting the fourth and fifth rows in from the outside of the plantation, leave three rows, remove two rows, then leave three rows, then remove two rows, and so on (take two, leave three). Because of the variability of row direction, it shall be the responsibility of the producer to maintain the take two, leave three rows sequence. CUT ALL other species when possible without damaging residual stems.

Sale Name: Honeymoon Hardwoods Sale Number: 63-069-06-01

2.1.11 - Description of timber note (2/04)

Note that the Mixed Hardwood volumes are as follows:

Sugar Maple-278 cds
Red Maple-0.9 mbf
Basswood-16.6 mbf, 121 cds
White Ash-1.8 mbf, 14 cds
Beech-0.7 mbf, 32 cds
Black Cherry-11 cds
Rock Elm-19 cds
Ironwood-74 cds

2.2 - Utilization

2.2.7 - Uncut designated trees (2/04)

Liquidated damages of \$5.00 per tree will be assessed for every marked tree not cut.

3 - Payments

3.3 - Pre-measured Sales

3.3.4 - Dividing payment units (7/05)

Payment unit(s) may be divided at the request of the purchaser and upon approval of the Unit Manager. Dividing payment units is a contract modification which requires a Timber Sale Contract Supplement.

3.4 - Damaged Timber

3.4.1 - Damaged timber (6/05)

General Condition and Requirement 3.4 Damaged Timber, defines liquidated damages for undesignated live merchantable trees which are cut or injured. In addition, extreme care should be taken to avoid damage to tree seedlings and saplings. Damage to residual trees (defined as breaking of the cambium layer, broken tops or bending of trees from their natural position) is not acceptable.

Within the sale area, if more than 25% of the tree seedlings or saplings (1/4" to 4.5" DBH) within a specified portion of the sale area are damaged, liquidated damages will be assessed at \$250 per acre for all acreage within that specified portion of the sale area that was damaged.

No damage is acceptable to merchantable trees. Within the sale area, if more than 5% of trees (> 4.5" DBH) within a specified area of the sale are damaged, liquidated damages will be assessed for all trees damaged. Rates will be in accordance with General Condition and Requirement 3.4 Damaged Timber, or at a rate of \$50 per sawtimber tree and \$15 per pole sized tree, whichever is greater.

4 - Transportation

4.1 - Construction

4.1.6 - Road construction (8/04)

Construction of new roads or improvements of existing roads shall be done in such a way as to minimize the environmental and visual impacts. Merchantable trees shall be cut and utilized unless otherwise directed. Non-merchantable trees shall be severed and laid flat on the ground. Slash shall be scattered, and not left in windrows and kept a minimum of 10 feet back from the road edge. Stumps shall be set upright, not left on edge, and be moved at least 10 feet away from the road edge. Disturbed soil shall be feathered into the woods and not left in berms or windrows.

4.1.7 - Road closure (8/04)

All new roads built into the sale must be blocked to vehicle traffic within 30 days of completion of hauling. Overgrown roads that are reopened shall be considered new roads. In general, this will require constructing a four (4') foot high berm constructed of stumps and logs covered with earth. These roads must be rendered impassable to cars and trucks. All stumps from road building and landing construction must be reserved to block any newly constructed roads upon completion of the sale. These stumps must be scattered along the road system to prohibit vehicular movement. Temporary berms may be required if no sale activity occurs for 30 or more consecutive days. Contact the sale administrator for specific details of design and placement.

4.1.8 - Road work (1) (2/04)

The following road work is required: Destruction of berm, Haul road to connect with existing forest road, Reconstruction of berm when hauling is complete.

4.2 - Maintenance

4.2.4 - Grading (2/04)

Roads must be graded after the sale is completed. The grading equipment to be used must be approved by the Unit Manager or their representative.

4.2.5 - Two wheel drive condition (2/04)

All existing trail roads on and adjacent to the sale area must be passable by two-wheel drive traffic for the duration of the sale.

5 - Operations

5.1 - Notification

5.1.1 - Pre-sale conference (6/04)

A pre-sale conference on site between the Purchaser and sale administrator is required prior to beginning any operations to determine landing size and landing location. Also, to discuss road locations. The Unit Manager or their representative must be contacted at least 5 working days in advance to schedule the conference.

5.1.4 - Post-sale conference (2/04)

A post-sale conference on site between the Purchaser and sale administrator is required 5 days prior to the completion of active logging operations to determine clean-up and repair of landings, road edges, and the fulfillment of other contract specifications.

5.2 - Conduct of Operations

5.2.1 - Slash

5.2.1.1 - Slash within sale area (2/04)

No trees are to be felled outside the sale area and all slash is to be kept at least 10 feet back from the BLUE paint line.

5.2.1.7 - Slash must be scattered (2/04)

Unless otherwise directed, slash and logging debris shall be uniformly scattered over the sale area and not left in piles or windrows. Slash shall not be allowed to accumulate at the landings. All slash work shall be done concurrently with harvesting.

5.2.12 - Bark slippage restriction (10/05)

Within Sale Area, unless changed by written agreement, within Payment Unit(s) #'s 1-3, cutting, skidding, and hauling are not permitted during the period of April 15 to July 15. This restriction is because of bark slippage.

5.2.29 - Shrub protection (2/04)

Do not cut or damage hawthorn, witch-hazel, dogwood or juneberry. These woody-shrub plants are highly beneficial to various wildlife species.

5.2.38 - No decking against live trees (2/04)

Cut products may not be decked against unmarked or designated leave trees.

5.4 - Soil Protection

5.4.1 - Rutting restriction (2/04)

Operations are to cease immediately if equipment and weather conditions result in rutting of 6 inches or greater in depth. With the Unit Manager or their representative's approval, the Purchaser may return to the area when the weather conditions have changed and the risk of rutting has decreased.

WEST 80 PINE (005-09-01)
T24N, R10W, SEC. 03, W1/2SE.
WEXFORD COUNTY

In response to the notice of sale to be held 3:00 p.m. on July 27, 2009, I am hereby submitting my sealed bid (firm offer) for the following forest products to be cut. Bids for individual species and total bid value must be at or above the appraised price. All non-responsive bid forms may be rejected.

<u>SPECIES</u>	<u>APPRAISED PRICE</u>	<u>BID PRICE</u>	<u>ESTIMATED VOLUME* = VALUE</u>
<u>SAWLOGS</u>			
RED PINE	\$ 128.00/MBF	\$ _____ X	59.30 MBF = \$ _____
<u>PULPWOOD</u>			
RED PINE	\$ 43.50/CORD	\$ _____ X	204.00 CORDS = \$ _____
			SUBTOTAL 1 \$ _____

In addition, the successful bidder agrees to purchase the following species at the appraised price:

<u>SPECIES</u>	<u>APPRAISED PRICE</u>	<u>ESTIMATED VOLUME*</u>	<u>VALUE</u>
<u>PULPWOOD</u>			
RED MAPLE	\$ 11.40/CORD	25.00 CORDS	= \$ 285.00
MIX ASPEN	\$ 11.35/CORD	43.00 CORDS	= \$ 488.05
			SUBTOTAL 2 \$ 773.05

SUBTOTAL 1 + SUBTOTAL 2 = TOTAL BID VALUE \$ _____

*These volumes are statistically estimated within plus (+) or minus (-) 22.98%. These estimated volumes are final and not subject to adjustment. Prospective bidders are urged to examine this timber and to make their own estimates of quantity and quality.

I understand that any or all bids may be rejected, and that the individual unit bid price will be the basis to determine total bid value. All bids must be signed and all bid items must be bid or the bid form may be rejected. I also understand that consideration and awarding a contract will be based upon my past performance and ability to complete the contract based upon equipment and manpower subject to my control.

(bidder's printed name)

(bidder's signature)

Address/Telephone _____

THE WINNING BIDDER MUST COMPLETE THE FORM ON THE REVERSE SIDE
WITHIN 21 DAYS OF SALE AWARD



FOR DEPARTMENT USE ONLY	
Sale or Permit No	
Year:	Type:
Forest Area:	

**TIMBER SALE
VERIFICATION OF WORKER'S DISABILITY
COMPENSATION ACT COMPLIANCE**

As required by Act 317, P.A. 1969 (Worker's Compensation) and Part 525 of Act 451 of 1994, as amended.

VERIFICATION OF WORKER'S DISABILITY COMPENSATION ACT COMPLIANCE

- This verification must be completed and submitted within 21 days of contract award and prior to the issuance of the timber sale contract.
- In addition, if boxes 2B or 2C are checked, then Notice of Exclusion or Certificate of Insurance must be submitted within 21 days of the contract award and prior to the issuance of the timber sale contract.
- All Information must be typed or printed except for written signatures.

Please Check Appropriate Categories:

1. My business is organized as (you **must** check one of the boxes below):
 - A. Sole Proprietorship (individual)
 - B. Partnership
 - C. Corporation
2. You **must** check one of the boxes below:
 - A. I certify that my business is a sole proprietorship and it has no employees but the sole proprietor. I am not subject to the Worker's Compensation Laws.
 - B. I certify that my business has satisfied its obligation to the Worker's Compensation Act through the use of an approved Notice of Exclusion (BWC-337, Rev. 5/96). I will provide a copy of the Notice of Exclusion within 21 days of the contract award. (For questions or a copy of the BWC-337, please call the Worker's Compensation Bureau at 517-322-1195).
 - C. I certify that my business has a Worker's Compensation Policy. I will provide an original Certificate of Insurance within 21 days of the contract award.
3. If you have checked item 2(A) or 2(B), you **must** indicate the number of **both** full and part time employees other than yourself including family members and active partners (if none, you must enter "0").

_____ Full Time Employees

_____ Part Time Employees

Name of Business		Federal ID (or) Social Security No.	
Address		Telephone No. ()	
City	State	Zip + 4	

I hereby certify that the above information is true and correct. I agree to notify the DNR of any changes that occur in factors affecting my coverage during any of my present and future operations.

Signature of Owner or Authorized Representative

Title

Date

CLAM RIVER OAK (038-08-01)
T22N, R09W, SEC. 23, NWNW, NENW, N1/2NE.
T22N, R09W, SEC. 24, N1/2NW, NE.
T22N, R09W, SEC. 14, NESE.
WEXFORD COUNTY

In response to the notice of sale to be held 3:00 p.m. on July 27, 2009, I am hereby submitting my sealed bid (firm offer) for the following forest products to be cut. Bids for individual species and total bid value must be at or above the appraised price. All non-responsive bid forms may be rejected.

<u>SPECIES</u>	<u>APPRAISED PRICE</u>	<u>BID PRICE</u>	<u>ESTIMATED VOLUME* = VALUE</u>
<u>SAWLOGS</u>			
RED OAK	\$ 171.00/MBF	\$ _____ X	146.60 MBF = \$ _____
<u>PULPWOOD</u>			
RED MAPLE	\$ 13.60/CORD	\$ _____ X	1486.00 CORDS = \$ _____
			SUBTOTAL 1 \$ _____

In addition, the successful bidder agrees to purchase the following species at the appraised price:

<u>SPECIES</u>	<u>APPRAISED PRICE</u>	<u>ESTIMATED VOLUME*</u>	<u>VALUE</u>
<u>SAWLOGS</u>			
RED MAPLE	\$ 76.00/MBF	49.50 MBF	= \$ 3,762.00
B.T. ASPEN	\$ 64.00/MBF	21.00 MBF	= \$ 1,344.00
RED PINE	\$ 115.00/MBF	4.50 MBF	= \$ 517.50
<u>PULPWOOD</u>			
RED OAK	\$ 8.65/CORD	321.00 CORDS	= \$ 2,776.65
B.T. ASPEN	\$ 15.60/CORD	312.00 CORDS	= \$ 4,867.20
W. SPRUCE	\$ 2.75/CORD	12.00 CORDS	= \$ 33.00
WHITE PINE	\$ 2.75/CORD	49.00 CORDS	= \$ 134.75
RED PINE	\$ 44.20/CORD	22.00 CORDS	= \$ 972.40
			SUBTOTAL 2 \$ <u>14,407.50</u>
SUBTOTAL 1 + SUBTOTAL 2 = TOTAL BID VALUE \$ _____			

*These volumes are statistically estimated within plus (+) or minus (-) 8.14%. These estimated volumes are final and not subject to adjustment. Prospective bidders are urged to examine this timber and to make their own estimates of quantity and quality.

I understand that any or all bids may be rejected, and that the individual unit bid price will be the basis to determine total bid value. All bids must be signed and all bid items must be bid or the bid form may be rejected. I also understand that consideration and awarding a contract will be based upon my past performance and ability to complete the contract based upon equipment and manpower subject to my control.

(bidder's printed name)

(bidder's signature)

Address/Telephone _____

THE WINNING BIDDER MUST COMPLETE THE FORM ON THE REVERSE SIDE
WITHIN 21 DAYS OF SALE AWARD



FOR DEPARTMENT USE ONLY

**TIMBER SALE
VERIFICATION OF WORKER'S DISABILITY
COMPENSATION ACT COMPLIANCE**

*As required by Act 317, P.A. 1969 (Worker's Compensation) and Part 525
of Act 451 of 1994, as amended.*

Sale or Permit No	
Year:	Type:
Forest Area:	

VERIFICATION OF WORKER'S DISABILITY COMPENSATION ACT COMPLIANCE

- This verification must be completed and submitted within 21 days of contract award and prior to the issuance of the timber sale contract.
- In addition, if boxes 2B or 2C are checked, then Notice of Exclusion or Certificate of Insurance must be submitted within 21 days of the contract award and prior to the issuance of the timber sale contract.
- All Information must be typed or printed except for written signatures.

Please Check Appropriate Categories:

- My business is organized as (you **must** check one of the boxes below):
 - Sole Proprietorship (individual)
 - Partnership
 - Corporation
- You **must** check one of the boxes below:
 - I certify that my business is a sole proprietorship and it has no employees but the sole proprietor. I am not subject to the Worker's Compensation Laws.
 - I certify that my business has satisfied its obligation to the Worker's Compensation Act through the use of an approved Notice of Exclusion (BWC-337, Rev. 5/96). I will provide a copy of the Notice of Exclusion within 21 days of the contract award. (For questions or a copy of the BWC-337, please call the Worker's Compensation Bureau at 517-322-1195).
 - I certify that my business has a Worker's Compensation Policy. I will provide an original Certificate of Insurance within 21 days of the contract award.
- If you have checked item 2(A) or 2(B), you **must** indicate the number of **both** full and part time employees other than yourself including family members and active partners (if none, you must enter "0").

_____ Full Time Employees

_____ Part Time Employees

Name of Business		Federal ID (or) Social Security No.	
Address		Telephone No. ()	
City	State	Zip + 4	

I hereby certify that the above information is true and correct. I agree to notify the DNR of any changes that occur in factors affecting my coverage during any of my present and future operations.

Signature of Owner or Authorized Representative

Title

Date

PATHWAY OAK (043-08-01)
T22N, R09W, SEC. 26, N1/2SW.S1/2NE.
T22N, R09W, SEC. 25, SWNW.
T22N, R09W, SEC. 36, NENE.
WEXFORD COUNTY

In response to the notice of sale to be held 3:00 p.m. on July 27, 2009, I am hereby submitting my sealed bid (firm offer) for the following forest products to be cut. Bids for individual species and total bid value must be at or above the appraised price. All non-responsive bid forms may be rejected.

<u>SPECIES</u>	<u>APPRAISED PRICE</u>	<u>BID PRICE</u>	<u>ESTIMATED VOLUME* = VALUE</u>	
SAWLOGS				
SUG. MAPLE	\$ 286.00/MBF	\$ _____ X	1.00 MBF	= \$ _____
RED MAPLE	\$ 82.00/MBF	\$ _____ X	15.30 MBF	= \$ _____
BEECH	\$ 92.00/MBF	\$ _____ X	6.90 MBF	= \$ _____
PULPWOOD				
RED MAPLE	\$ 10.75/CORD	\$ _____ X	166.00 CORDS	= \$ _____
B.T. ASPEN	\$ 13.80/CORD	\$ _____ X	380.00 CORDS	= \$ _____
			SUBTOTAL 1	\$ _____

In addition, the successful bidder agrees to purchase the following species at the appraised price:

<u>SPECIES</u>	<u>APPRAISED PRICE</u>	<u>ESTIMATED VOLUME*</u>	<u>VALUE</u>
SAWLOGS			
RED OAK	\$ 207.00/MBF	10.70 MBF	= \$ 2,214.90
B.T. ASPEN	\$ 68.00/MBF	30.00 MBF	= \$ 2,040.00
MIXED OAK	\$ 81.00/MBF	33.50 MBF	= \$ 2,713.50
PULPWOOD			
BEECH	\$ 7.00/CORD	57.00 CORDS	= \$ 399.00
RED OAK	\$ 7.60/CORD	21.00 CORDS	= \$ 159.60
MIXED OAK	\$ 7.60/CORD	120.00 CORDS	= \$ 912.00
			SUBTOTAL 2 \$ 8,439.00

SUBTOTAL 1 + SUBTOTAL 2 = TOTAL BID VALUE \$ _____

*These volumes are statistically estimated within plus (+) or minus (-) 18.31%. These estimated volumes are final and not subject to adjustment. Prospective bidders are urged to examine this timber and to make their own estimates of quantity and quality.

I understand that any or all bids may be rejected, and that the individual unit bid price will be the basis to determine total bid value. All bids must be signed and all bid items must be bid or the bid form may be rejected. I also understand that consideration and awarding a contract will be based upon my past performance and ability to complete the contract based upon equipment and manpower subject to my control.

(bidder's printed name)

(bidder's signature)

Address/Telephone _____

THE WINNING BIDDER MUST COMPLETE THE FORM ON THE REVERSE SIDE
WITHIN 21 DAYS OF SALE AWARD



FOR DEPARTMENT USE ONLY	
Sale or Permit No	
Year:	Type:
Forest Area:	

**TIMBER SALE
VERIFICATION OF WORKER'S DISABILITY
COMPENSATION ACT COMPLIANCE**

*As required by Act 317, P.A. 1969 (Worker's Compensation) and Part 525
of Act 451 of 1994, as amended.*

VERIFICATION OF WORKER'S DISABILITY COMPENSATION ACT COMPLIANCE

- This verification must be completed and submitted within 21 days of contract award and prior to the issuance of the timber sale contract.
- In addition, if boxes 2B or 2C are checked, then Notice of Exclusion or Certificate of Insurance must be submitted within 21 days of the contract award and prior to the issuance of the timber sale contract.
- All Information must be typed or printed except for written signatures.

Please Check Appropriate Categories:

- My business is organized as (you **must** check one of the boxes below):
 - Sole Proprietorship (individual)
 - Partnership
 - Corporation
- You **must** check one of the boxes below:
 - I certify that my business is a sole proprietorship and it has no employees but the sole proprietor. I am not subject to the Worker's Compensation Laws.
 - I certify that my business has satisfied its obligation to the Worker's Compensation Act through the use of an approved Notice of Exclusion (BWC-337, Rev. 5/96). I will provide a copy of the Notice of Exclusion within 21 days of the contract award. (For questions or a copy of the BWC-337, please call the Worker's Compensation Bureau at 517-322-1195).
 - I certify that my business has a Worker's Compensation Policy. I will provide an original Certificate of Insurance within 21 days of the contract award.
- If you have checked item 2(A) or 2(B), you **must** indicate the number of **both** full and part time employees other than yourself including family members and active partners (if none, you must enter "0").

_____ Full Time Employees

_____ Part Time Employees

Name of Business		Federal ID (or) Social Security No.	
Address		Telephone No. ()	
City	State	Zip + 4	

I hereby certify that the above information is true and correct. I agree to notify the DNR of any changes that occur in factors affecting my coverage during any of my present and future operations.

Signature of Owner or Authorized Representative

Title

Date

HONEYMOON HARDWOODS (069-06-01)
T24N, R07W, SEC. 13, S1/2NW.
T24N, R07W, SEC. 13, NENW, NWSW.
T24N, R07W, SEC. 14, S1/2NE.
T24N, R07W, SEC. 14, NENE.
MISSAUKEE COUNTY

In response to the notice of sale to be held 3:00 p.m. on July 27, 2009, I am hereby submitting my sealed bid (firm offer) for the following forest products to be cut. Bids for individual species and total bid value must be at or above the appraised price. All non-responsive bid forms may be rejected.

<u>SPECIES</u>	<u>APPRAISED PRICE</u>	<u>BID PRICE</u>	<u>ESTIMATED VOLUME* = VALUE</u>
<u>SAWLOGS</u>			
SUG. MAPLE	\$ 202.00/MBF	\$ _____ X	21.20 MBF = \$ _____
Q. ASPEN	\$ 43.00/MBF	\$ _____ X	50.70 MBF = \$ _____
<u>PULPWOOD</u>			
Q. ASPEN	\$ 11.20/CORD	\$ _____ X	414.00 CORDS = \$ _____
MIX HARDWD	\$ 7.00/CORD	\$ _____ X	549.00 CORDS = \$ _____
SUBTOTAL 1			\$ _____

In addition, the successful bidder agrees to purchase the following species at the appraised price:

<u>SPECIES</u>	<u>APPRAISED PRICE</u>	<u>ESTIMATED VOLUME*</u>	<u>VALUE</u>
<u>SAWLOGS</u>			
MIX HARDWD	\$ 52.00/MBF	20.00 MBF	= \$ 1,040.00
<u>PULPWOOD</u>			
W. SPRUCE	\$ 3.00/CORD	237.00 CORDS	= \$ 711.00
SUBTOTAL 2			\$ 1,751.00
SUBTOTAL 1 + SUBTOTAL 2 = TOTAL BID VALUE \$ _____			

*These volumes are statistically estimated within plus (+) or minus (-) 9.30%. These estimated volumes are final and not subject to adjustment. Prospective bidders are urged to examine this timber and to make their own estimates of quantity and quality.

I understand that any or all bids may be rejected, and that the individual unit bid price will be the basis to determine total bid value. All bids must be signed and all bid items must be bid or the bid form may be rejected. I also understand that consideration and awarding a contract will be based upon my past performance and ability to complete the contract based upon equipment and manpower subject to my control.

(bidder's printed name)

(bidder's signature)

Address/Telephone _____

THE WINNING BIDDER MUST COMPLETE THE FORM ON THE REVERSE SIDE
WITHIN 21 DAYS OF SALE AWARD



FOR DEPARTMENT USE ONLY

**TIMBER SALE
VERIFICATION OF WORKER'S DISABILITY
COMPENSATION ACT COMPLIANCE**

As required by Act 317, P.A. 1969 (Worker's Compensation) and Part 525 of Act 451 of 1994, as amended.

Sale or Permit No

Year:

Type:

Forest Area:

VERIFICATION OF WORKER'S DISABILITY COMPENSATION ACT COMPLIANCE

- This verification must be completed and submitted within 21 days of contract award and prior to the issuance of the timber sale contract.
- In addition, if boxes 2B or 2C are checked, then Notice of Exclusion or Certificate of Insurance must be submitted within 21 days of the contract award and prior to the issuance of the timber sale contract.
- All information must be typed or printed except for written signatures.

Please Check Appropriate Categories:

1. My business is organized as (you **must** check one of the boxes below):
 - A. Sole Proprietorship (individual)
 - B. Partnership
 - C. Corporation
2. You **must** check one of the boxes below:
 - A. I certify that my business is a sole proprietorship and it has no employees but the sole proprietor. I am not subject to the Worker's Compensation Laws.
 - B. I certify that my business has satisfied its obligation to the Worker's Compensation Act through the use of an approved Notice of Exclusion (BWC-337, Rev. 5/96). I will provide a copy of the Notice of Exclusion within 21 days of the contract award. (For questions or a copy of the BWC-337, please call the Worker's Compensation Bureau at 517-322-1195).
 - C. I certify that my business has a Worker's Compensation Policy. I will provide an original Certificate of Insurance within 21 days of the contract award.
3. If you have checked item 2(A) or 2(B), you **must** indicate the number of **both** full and part time employees other than yourself including family members and active partners (if none, you must enter "0").

_____ Full Time Employees

_____ Part Time Employees

Name of Business		Federal ID (or) Social Security No.	
Address		Telephone No. ()	
City	State	Zip + 4	

I hereby certify that the above information is true and correct. I agree to notify the DNR of any changes that occur in factors affecting my coverage during any of my present and future operations.

Signature of Owner or Authorized Representative

Title

Date