



DEPARTMENT OF NATURAL RESOURCES
STATE OF MICHIGAN

TIMBER SALE PROSPECTUS

Notice is hereby given that bids will be received by the Unit Manager,
TRAVERSE CITY MANAGEMENT UNIT, for certain timber on the following described lands:

CANINE RED PINE / T27N, R14W, SEC. 24, N1/2 NE, W1/2 SE.
BENZIE COUNTY (Appr. \$5,922.70)

COMPARTMENT 3 RPP / T28N, R14W, SEC. 36, N1/2NW.
LEELANAU COUNTY (Appr. \$72,392.70)

GNARLY MAPLE / T25N, R14W, SEC. 08, S1/2NE, SE.
T25N, R14W, SEC. 17, NENE.
BENZIE COUNTY (Appr. \$56,674.07)

HOOSEGOW PINE / T25N, R09W, SEC. 29, N1/2NW; NENE.
GRAND TRAVERSE COUNTY (Appr. \$9,018.20)

////////////////////

SALE DATE AND TIME: 2:00 p.m. on May 14, 2009.

TRAVERSE CITY

BID INSTRUCTIONS (Ver. 06/23/2008):

1. **Bid Location, Date, and Time:** Bids must be received by the Unit Manager, Traverse City Management Unit, 970 Emerson, Traverse City, MI 49686, no later than 2:00 p.m. on May 14, 2009. For further information concerning this sale, contact the Unit Manager at 231-922-5280.
2. **Bidder's Qualifications:** Purchaser shall obtain workers compensation insurance to cover claims under Michigan's Worker's Disability Compensation Act of 1969 or similar employee benefit act of any other state applicable to an employee. If all or part of a timber sale was prepared by a private contractor, that contractor and that contractor's company are not permitted to bid on the timber sale contract. Bids will not be accepted from individuals or companies appearing on the DNR/FMFM No-Bid List. This list contains the names of purchasers who previously failed to execute a contract within 21-days or who have a history of poor performance.
3. **Preparation of Sealed Bids:** Bids shall be manually signed in ink; bid prices must be entered for each species and product in the Bid Price column for all material subject to bidding; and all fill-in blanks must be completed. If erasures or other changes appear on the forms, each erasure or change must be initialed by the person signing the bid.
4. **Submission of Sealed Bids:** Bid forms may be obtained from the Unit Manager. All bids must be submitted on the bid form and in an envelope clearly identified as described in this section. NOTE: Only one bid form per bid envelope. Sealed bids must be submitted to the Unit office designated in the prospectus and must be submitted at or prior to the time established in the prospectus. The envelope should show on the outside (a) that it is a "Bid for Timber," and (b) the sale name or number, and (c) the date and time of bid opening as shown in the prospectus. Bids received after the time specified in the sale prospectus are late bids and will be rejected.
5. **Public Opening of Sealed Bids:** If conditions permit, the sealed bids will be publicly opened and posted at the time and place set in the prospectus.
6. **Award of Contract:** Award of the contract will be made to the Bidder whose bid, conforming to the prospectus, is most advantageous to the State of Michigan on the basis of total value at rates bid for the estimated quantities. The State reserves the right to reject any bid or waive any minor irregularity in bids received. A written award mailed (or otherwise furnished) to the successful Bidder shall be deemed to result in a binding contract without further action by either party.
7. **Down Payment:** The Bidder to whom award is made must make a down payment within 21 days of the sale award. The amount of the down payment will be calculated as shown in the Bond and Payment Schedule of this prospectus. Only cash may be used to meet this requirement.
8. **Performance Security:** As guarantee of faithful performance, a cash bond, certificate of deposit, surety bond or irrevocable letter of credit (LOC) is required within 21 days of the sale award. The amount of the performance security is shown in the Bond and Payment Schedule of this prospectus. If an LOC or surety is used, the coverage must extend for at least 6 months beyond the contract expiration.
9. **Timber Sale Contract:** Additional conditions and requirements common to all timber sales are listed on the timber sale contract (R4031) and are available on line at www.michigan.gov/dnr. Contact the Unit Manager for additional information or a sample contract. Within 21 days of the date of the award letter, the bidder must sign the contract and provide the required down payment, performance security, and verification of worker's disability compensation. The down payment and performance security shall be in accordance with the provisions of the timber sale contract, in the sums stated in this prospectus. If these actions are not taken, then the Bidder, the Bidder's corporation, and the corporation's principals may not be permitted to bid on State timber sales for a period of 1 year. In addition, the Bidder certifies that if awarded this contract, the Bidder will complete the timber sale contract in accordance with its terms and any modifications thereof including requirements to purchase, cut, and remove the included timber by the termination date.

10. Disclaimer of Estimates and Bidder's Warranty of Inspection: Before submitting this bid, the Bidder is advised and cautioned to inspect the sale area, review the requirements of the sale contract, and take other steps as may be reasonably necessary to ascertain the location, estimated volumes, construction estimates, and operating costs of the proposed sale. Failure to do so will not relieve the Bidder from responsibility for completing the contract.

The Bidder warrants that this bid is submitted solely on the basis of the Bidder's examination and inspection of the quality and quantity of the timber offered for sale and the Bidder's opinion of the value thereof and the costs of recovery. No reliance should be placed on the State of Michigan's estimates of timber quality, quantity or costs of recovery. Bidder further acknowledges that the State of Michigan: (i) expressly disclaims any warranty of fitness of timber for any purpose; (ii) offers this timber as is without any warranty of quality (merchantability) or quantity and (iii) expressly disclaims any warranty as to the quantity or quality of timber sold.

11. Certification and Chain-of-Custody: Unless otherwise indicated in the contract under section 7 - Other Conditions of the Sale Specific Conditions & Requirements, the area encompassed by this timber sale is certified to the standards of the Forest Stewardship Council (FSC) - Certificate #SCS-FM/COC-090N and the Sustainable Forestry Initiative (SFI) - Certificate # NSF-SFIS-5Y031-S1. Forest products from this sale may be delivered to the mill as "FSC and / or SFI certified" as long as the contractor hauling the forest products is chain-of-custody (COC) certified or covered under a COC certificate from the destination mill. The purchaser is responsible for maintaining COC after leaving the sale area.

REBECCA A. HUMPHRIES
Director

CANINE RED PINE (021-07-01)

A timber sale contract for this LUMP SUM SEALED timber sale will be awarded the responsible bidder offering the highest sealed bid price. Bids must be at or above the following appraised price for each species:

<u>SPECIES</u>	<u>ESTIMATED VOLUME*</u>	<u>APPRAISED PRICE</u>
SAWLOGS		
RED PINE	11.80 MBF	\$ 62.00/MBF
PULPWOOD		
RED PINE	175.00 CORDS	\$ 29.00/CORD

In addition, the successful bidder agrees to purchase the following species at the indicated appraised price:

<u>SPECIES</u>	<u>ESTIMATED VOLUME*</u>	<u>APPRAISED PRICE</u>
PULPWOOD		
Q. ASPEN	18.00 CORDS	\$ 6.45/CORD

*The volumes are statistically estimated within plus (+) or minus (-) 18.96 percent. These estimated volumes are final and not subject to adjustment. Prospective bidders are urged to examine this timber and to make their own estimates of quantity and quality.

BOND AND PAYMENT SCHEDULE:

1. A bond in the amount of \$296.00 to insure faithful performance of the conditions of the contract, will be deposited by the successful bidder within 21 days of the sale award.
2. Cutting in any sale or unit without the required advance payment would be considered a trespass.
3. Total payment may be paid in advance or according to the following schedule:
 - (a) Ten percent (10%) of the sale value must be paid within 21 days of the sale award.
 - (b) The 10% down payment will be credited towards the first unit cut.
 - (c) Payment for each of the following units must be made before cutting begins in that unit:

<u>PAYMENT UNIT NUMBER</u>	<u>PERCENT OF TOTAL SALE VALUE</u>
1	40%
2	60%

4. If no cutting takes place, the 10% down payment will not be refunded.
5. Operations on the contract issued will terminate on June 30, 2011.



Michigan Department of Natural Resources-Forest Management Division
TIMBER SALE MAP

This information provided under authority of Part 525, Act 451 of 1994, as amended.

Sale No.	Year	Sale Type
021	07	01

State Forest and Forest Management Unit:
Pere Marquette - Traverse City

Mapped By: **Tim Webb**
 Marked By: **Tim Webb**

Date:
February 5, 2007

Township **27N** Range **14W** Section(s) **24** Subdivision **N1/2 NE, W1/2 SE**

Scale: **1:15,840** 4" = 1 mile

Cover Type				Density		
A=Aspen	H=Hemlock	P=Lowland Poplar	V=Bog or Marsh	1=Non Stocked	7=Saw Timber Poor	
B=Paper Birch	J=Jack Pine	Q=Mixed Swamp Ctr	W=White Pine	2=Seeding Sapling Poor	8=Saw Timber Medium	
C=Cedar	L=Lowland Brush	R=Red Pine	X=Non Stocked	3=Seeding Sapling Well	9=Saw Timber Well	
E=Swamp Hdwoods	M=Map, Bch, Brch	S=Black Spruce	Z=Water	4=Pole Timber Poor		
F=Spruce Fir	N=Marsh	T=Tamarack		5=Pole Timber Medium		
G=Grass	O=Oak	U=Upland Brush		6=Pole Timber Well		

- sale area
- red painted boundary line
- Shore-to-Shore Trail

Canine Red Pine

unit 1: 7.9 acres
 unit 2: 9.3 acres
 Total: 17.2 acres

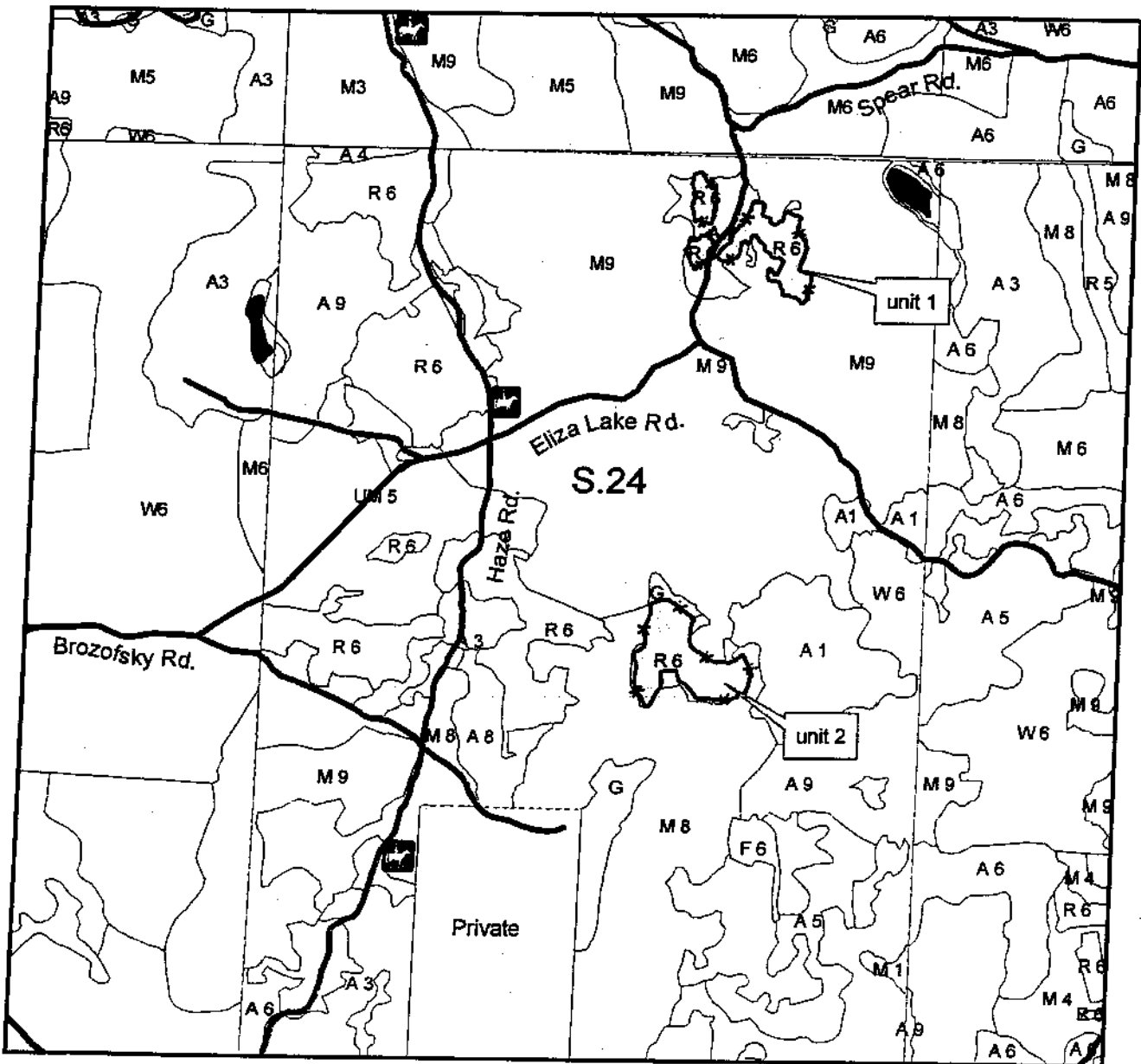

Sale Specific Conditions & Requirements

Sale Name: Canine Red Pine Sale Number: 61-021-07-01

1 - Sale Area

1.2 - Boundaries

1.2.1 - Painted boundaries (6/05)

The sale boundary is marked and identified by red paint.

2 - Timber Specifications

2.1 - Included Timber

2.1.8 - Designated plantation row unit(s) (11/04)

Within Payment Unit(s) 1 and 2, all red pine and aspen trees which meet minimum piece specifications in 2.2

Utilization, within designated plantation rows are designated for cutting. Plantation rows designated for cutting are every third row. Begin with the third row in from the outside of the plantation, then continue every third row.

Hardwood trees may be felled only if necessary to facilitate harvest of included timber, and shall be lopped to within three (3') feet of the ground and left in place.

2.2 - Utilization

2.2.6 - Roundwood operation required (6/04)

The skidding of whole trees or tree segments with limbs attached is prohibited . All products must be produced as roundwood and forwarded to existing roads or landing areas in final product length.

4 - Transportation

4.1 - Construction

4.1.3 - Slash and earthen piles (8/04)

Piles or windrows of earth along roads and landings that have been widened or constructed shall be leveled. Slash from road maintenance or construction, including stumps, shall be dispersed throughout the sale.

4.1.7 - Road closure (8/04)

All new roads built into the sale must be blocked to vehicle traffic upon completion of the sale. In general, this will require constructing a four (4') foot high berm constructed of stumps and logs covered with earth. Contact the sale administrator for specific details of design and placement.

5 - Operations

5.2 - Conduct of Operations

5.2.1 - Slash

Sale Name: Canine Red Pine Sale Number: 61-021-07-01

No slash or tree tops may exceed 24 inches in height.

5.2.3 - Operating Restrictions

5.2.3.1 - Operating restrictions (12/04)

Within Sale Area, unless changed by written agreement, within Payment Unit(s) I, cutting, skidding, and hauling are not permitted during the period of March 1 to August 31. This restriction is to protect a nearby active red-shouldered hawk nest.

5.2.15 - Bark beetle restriction (2/04)

In the event drought creates a high risk of pine bark beetle infestation, pine is not to be cut during the period March 1 through July 1, unless all portions of trees greater than two inches in diameter are removed from the sale area, reduced to chips, or treated to the satisfaction of the Unit Manager or their representative, within fifteen days of being severed from the stump. Pine logs, pulpwood piles and treetop piles for chipping that are decked in the fall or winter within a 1/4 mile of susceptible sites must be removed before March 15. Residual slash must not be placed in piles or rows and must be spread over the site for quick drying. The Department of Natural Resources will exercise this option if the risk of damage warrants.

5.2.38 - No decking against live trees (2/04)

Cut products may not be decked against unmarked or designated leave trees.

5.4 - Soil Protection

5.4.3 - Erosion control (2/04)

Skid trails or haul roads may require erosion control structures or berms per direction of the Unit Manager or their representative.

COMPARTMENT 3 RPP (037-08-01)

A timber sale contract for this LUMP SUM SEALED timber sale will be awarded the responsible bidder offering the highest sealed bid price. Bids must be at or above the following appraised price for each species:

<u>SPECIES</u>	<u>ESTIMATED VOLUME*</u>	<u>APPRAISED PRICE</u>
SAWLOGS		
RED PINE	149.50 MBF	\$ 131.00/MBF
PULPWOOD		
RED PINE	958.00 CORDS	\$ 48.15/CORD

In addition, the successful bidder agrees to purchase the following species at the indicated appraised price:

<u>SPECIES</u>	<u>ESTIMATED VOLUME*</u>	<u>APPRAISED PRICE</u>
PULPWOOD		
JACK PINE	841.00 CORDS	\$ 7.75/CORD
MIX HARDWD	21.00 CORDS	\$ 7.75/CORD

*The volumes are statistically estimated within plus (+) or minus (-) 13.30 percent. These estimated volumes are final and not subject to adjustment. Prospective bidders are urged to examine this timber and to make their own estimates of quantity and quality.

BOND AND PAYMENT SCHEDULE:

1. A bond in the amount of \$3,620.00 to insure faithful performance of the conditions of the contract, will be deposited by the successful bidder within 21 days of the sale award.
2. Cutting in any sale or unit without the required advance payment would be considered a trespass.
3. Total payment may be paid in advance or according to the following schedule:
 - (a) Ten percent (10%) of the sale value must be paid within 21 days of the sale award.
 - (b) The 10% down payment will be credited towards the first unit cut.
 - (c) Payment for each of the following units must be made before cutting begins in that unit:

<u>PAYMENT UNIT NUMBER</u>	<u>PERCENT OF TOTAL SALE VALUE</u>
1	06%
2	17%
3	20%
4	30%
5	27%

4. If no cutting takes place, the 10% down payment will not be refunded.
5. Operations on the contract issued will terminate on June 30, 2011.



Michigan Department of Natural Resources-Forest Management Division

TIMBER SALE MAP

This information provided under authority of Part 525, Act 451 of 1994, as amended.

Sale No.	Year	Sale Type
037	08	01

State Forest and Forest Management Unit: Pere Marquette - Traverse City		Mapped By: Tim Webb Marked By: Tim Webb		Date: Sept. 5, 2008	
Township 28N	Range 14W	Section(s) 36	Subdivision N1/2 NW		Scale: 1:7,920 8" = 1 mile

Cover Type				Density		
A=Aspen	H=Hemlock	P=Lowland Poplar	V=Bog or Marsh	1=Non Stocked	7=Saw Timber Poor	
B=Paper Birch	J=Jack Pine	O=Mixed Swamp Conif	W=White Pine	2=Seedling Sapling Poor	8=Saw Timber Medium	
C=Cedar	L=Lowland Brush	R=Red Pine	X=Non Stocked	3=Seedling Sapling Well	9=Saw Timber Well	
E=Swamp Hardwoods	M=Mpl, Boh, Brch	S=Black Spruce	Z=Water	4=Pole Timber Poor		
F=Spruce Fir	N=Marsh	T=Tamarack	UM=Upl Mixed	5=Pole Timber Medium		
G=Grass	O=Oak	U=Upland Brush	MD=Mixed Dead	6=Pole Timber Well		
			MC=Mixed Conif			

Compartment 3 RPP

- sale area
- red painted sale boundary line
- blue painted sale boundary line
- yellow painted unit line
- trail

- unit 1: 4.3 acres
- unit 2: 11.7 acres
- unit 3: 13.2 acres
- unit 4: 20.0 acres
- unit 5: 18.1 acres
- Total: 67.3 acres

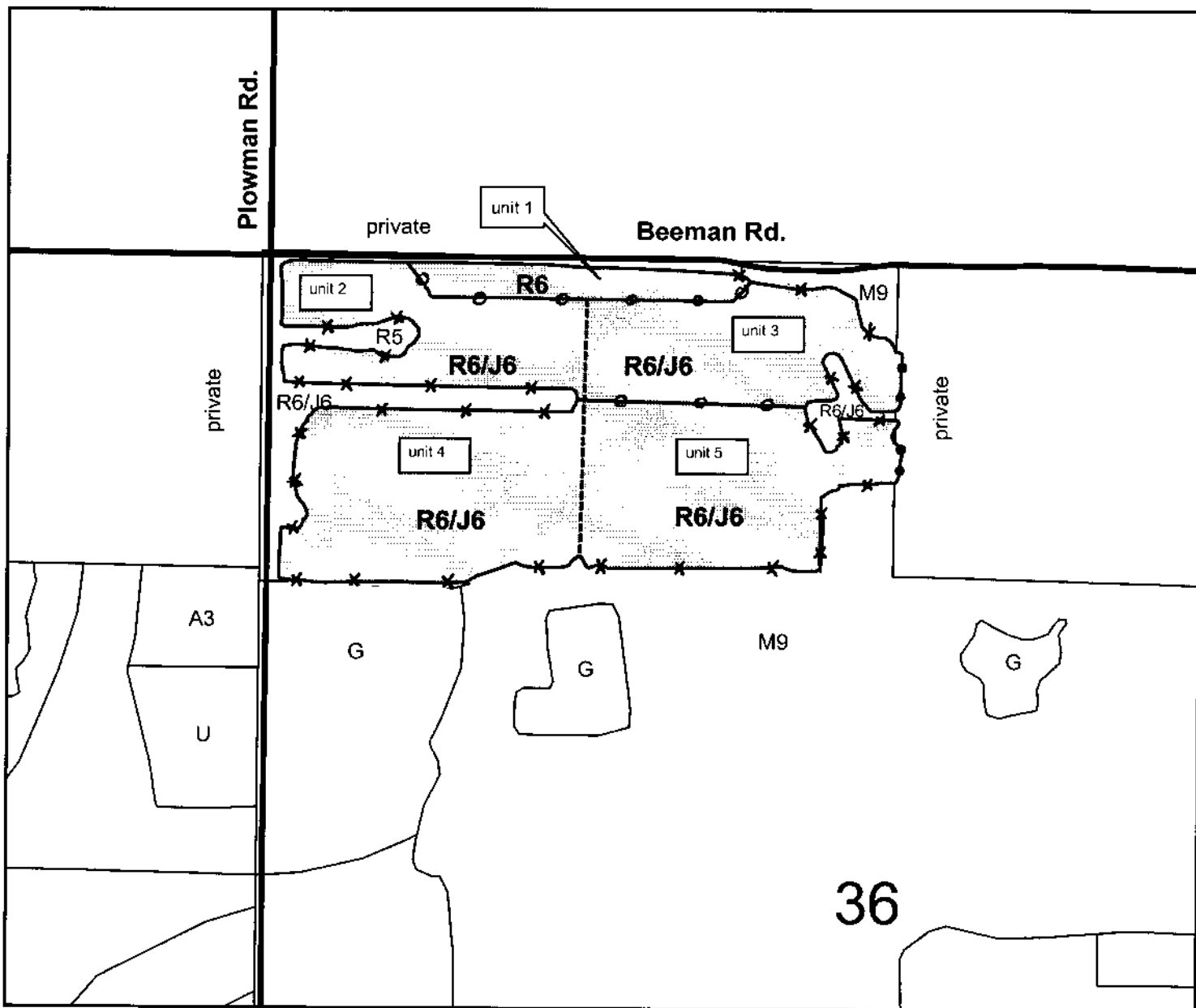

Sale Specific Conditions & Requirements

Sale Name: Compartment 3 Rpp Sale Number: 61-037-08-01

1 - Sale Area

1.2 - Boundaries

1.2.1 - Painted boundaries (6/05)

The sale boundary and Payment Unit boundaries are marked and identified by blue, red and yellow paint. Exterior sale boundary lines against private property are marked with blue paint. Exterior sale boundary lines against state land are marked with red paint. Interior Payment Unit boundaries along the south side of unit 1 and between units 3 and 5 are marked with yellow paint. A north-south foot trail/open lane separates units 2 & 3 and units 4 & 5, as shown on map. Yellow painted trees designating the interior Payment Unit boundary between units 3 & 5 are only to be cut when both of these Payment Units have been paid. Yellow painted trees designating the south boundary of payment unit 1 are not to be cut.

2 - Timber Specifications

2.1 - Included Timber

2.1.1 - Clearcut unit(s) with unmerchantable trees (2/04)

Within Payment Unit(s) 2 through 5, cut all trees that are two (2) inches or more in diameter measured at a point of four and one-half (4-1/2) feet above ground level regardless of merchantability.

2.1.4 - Species designation unit(s) (5/07)

Within Payment Unit(s) 1, every third living red pine tree, beginning with the third tree in from the end of each plantation row, is designated for cutting regardless of merchantability.

2.1.11 - Description of timber note (2/04)

Note that mixed hardwood pulpwood consists of black cherry, white ash, and sugar maple.

2.2 - Utilization

2.2.2 - Chipping (5/07)

Jack pine trees must be chip harvested to facilitate subsequent planting operations. The purchaser has the option to produce sawlogs or pulpwood bolts, but the remaining portion of the trees must be chipped and hauled to meet silvicultural requirements.

4 - Transportation

4.1 - Construction

Sale Name: Compartment 3 Rpp Sale Number: 61-037-08-01

4.1.3 - Slash and earthen piles (8/04)

Piles or windrows of earth along roads and landings that have been widened or constructed shall be leveled. Slash from road maintenance or construction, including stumps, shall be dispersed throughout the sale, chipped, utilized or otherwise removed from the sale.

4.1.7 - Road closure (4/07)

All new roads built into the sale must be blocked to vehicle traffic upon completion of the sale. In general, this will require constructing a four (4') foot high berm constructed of stumps and logs covered with earth. Contact the sale administrator for specific details of design and placement.

5 - Operations

5.2 - Conduct of Operations

5.2.1 - Slash

5.2.1.8 - Slash height (2/04)

No slash or tree tops may exceed 24 inches in height.

5.2.15 - Bark beetle restriction (2/04)

In the event drought creates a high risk of pine bark beetle infestation, pine is not to be cut during the period March 1 through July 1, unless all portions of trees greater than two inches in diameter are removed from the sale area, reduced to chips, or treated to the satisfaction of the Unit Manager or their representative, within fifteen days of being severed from the stump. Pine logs, pulpwood piles and treetop piles for chipping that are decked in the fall or winter within a 1/4 mile of susceptible sites must be removed before March 15. Residual slash must not be placed in piles or rows and must be spread over the site for quick drying. The Department of Natural Resources will exercise this option if the risk of damage warrants.

GNARLY MAPLE (066-08-01)

A timber sale contract for this LUMP SUM SEALED timber sale will be awarded the responsible bidder offering the highest sealed bid price. Bids must be at or above the following appraised price for each species:

<u>SPECIES</u>	<u>ESTIMATED VOLUME*</u>	<u>APPRAISED PRICE</u>
SAWLOGS		
SUG. MAPLE	38.20 MBF	\$ 346.00/MBF
RED MAPLE	94.30 MBF	\$ 95.00/MBF
B.T. ASPEN	84.70 MBF	\$ 69.00/MBF
PULPWOOD		
RED MAPLE	556.80 CORDS	\$ 11.80/CORD
B.T. ASPEN	543.40 CORDS	\$ 16.80/CORD

In addition, the successful bidder agrees to purchase the following species at the indicated appraised price:

<u>SPECIES</u>	<u>ESTIMATED VOLUME*</u>	<u>APPRAISED PRICE</u>
SAWLOGS		
BLK CHERRY	24.30 MBF	\$ 145.00/MBF
MIX HARDWD	33.60 MBF	\$ 103.00/MBF
PULPWOOD		
SUG. MAPLE	301.00 CORDS	\$ 9.20/CORD
BLK CHERRY	310.90 CORDS	\$ 7.40/CORD
MIX HARDWD	108.50 CORDS	\$ 8.30/CORD

*The volumes are statistically estimated within plus (+) or minus (-) 14.99 percent. These estimated volumes are final and not subject to adjustment. Prospective bidders are urged to examine this timber and to make their own estimates of quantity and quality.

BOND AND PAYMENT SCHEDULE:

1. A bond in the amount of \$2,834.00 to insure faithful performance of the conditions of the contract, will be deposited by the successful bidder within 21 days of the sale award.
2. Cutting in any sale or unit without the required advance payment would be considered a trespass.
3. Total payment may be paid in advance or according to the following schedule:
 - (a) Ten percent (10%) of the sale value must be paid within 21 days of the sale award.
 - (b) The 10% down payment will be credited towards the first unit cut.
 - (c) Payment for each of the following units must be made before cutting begins in that unit:

<u>PAYMENT UNIT NUMBER</u>	<u>PERCENT OF TOTAL SALE VALUE</u>
1	28%
2	18%
3	23%
4	31%
4. If no cutting takes place, the 10% down payment will not be refunded.
5. Operations on the contract issued will terminate on December 31, 2010.



TIMBER SALE MAP

This information provided under authority of Part 525, Act 451 of 1994, as amended.

Sale No. 61-066	Year 08	Sale Type 01
--------------------	------------	-----------------

State Forest and Forest Management Unit: Traverse City Forest Management Unit		Cruised and Mapped By: Craig Allen		Date: 09/02/2008
Township 25N	Range 14W	Section(s) 8 17	Subdivision S1/2NE, SE NENE	Scale: 1 inch = 1,030 feet

Cover Type

A = Aspen	H = Hemlock	P = Lowland Poplar	V = Bog or Marsh
B = Paper Birch	J = Jack Pine	Q = Mixed Swamp Cnfr	W = White Pine
C = Cedar	L = Lowland Brush	R = Red Pine	X = Non Stocked
E = Swamp Hdwoods	M = Mpl, Bch, Brch	S = Black Spruce	Z = Water
F = Spruce Fir	N = Marsh	T = Tamarack	
G = Grass	O = Oak	U = Upland Brush	

Density

1 = Non Stocked	7 = Saw Timber Poor
2 = Seedling Sapling Poor	8 = Saw Timber Medium
3 = Seedling Sapling Well	9 = Saw Timber Well
4 = Pole Timber Poor	
5 = Pole Timber Medium	
6 = Pole Timber Well	



"Gnarly Maple"
 Unit 1 = 39 acres
 Unit 2 = 25 acres
 Unit 3 = 33 acres
 Unit 4 = 44 acres
 Total = 141 acres

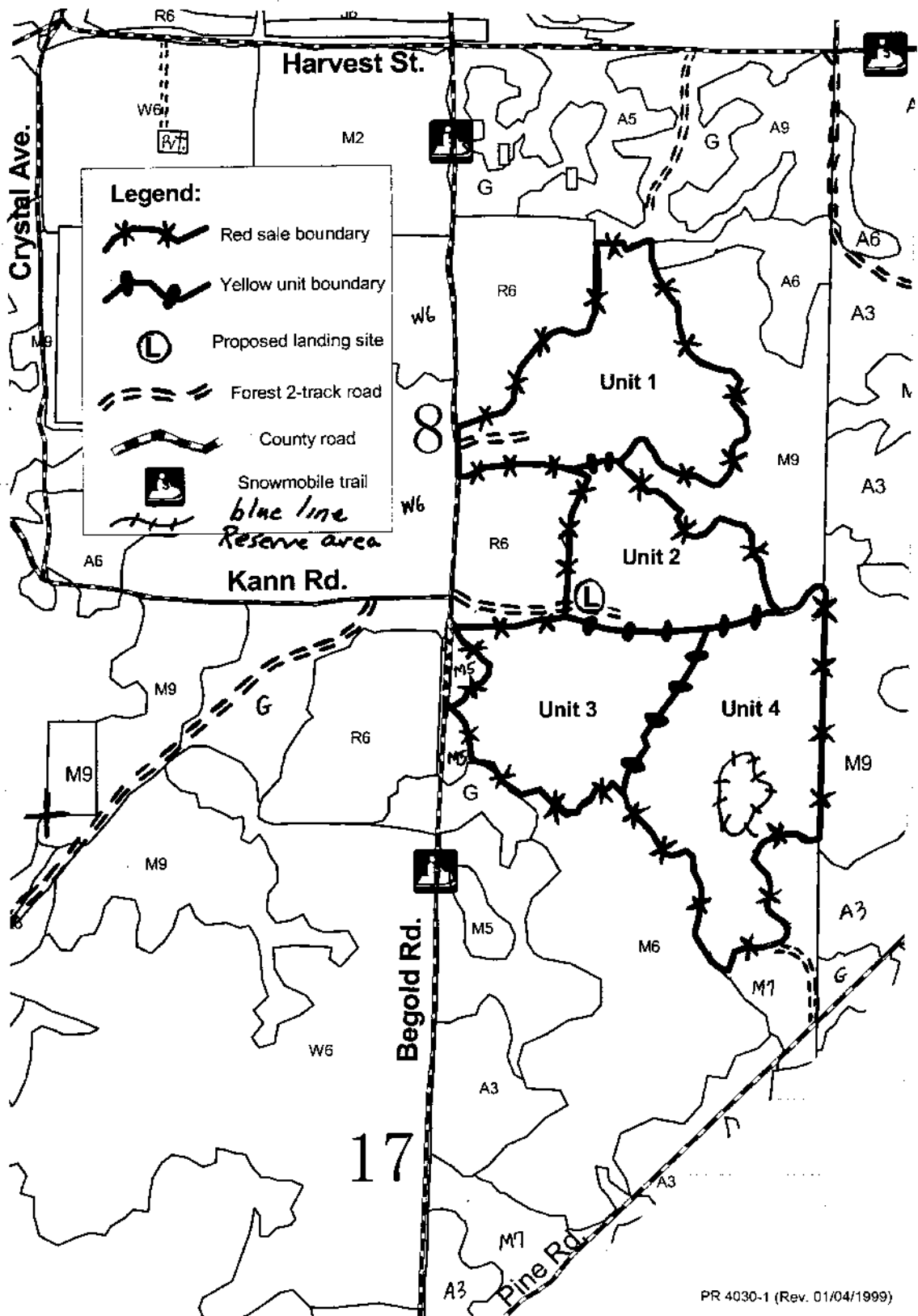

Sale Specific Conditions & Requirements

Sale Name: Gnarly Maple Sale Number: 61-066-08-01

1 - Sale Area

1.2 - Boundaries

1.2.1 - Painted boundaries (6/05)

The sale boundary is marked and identified by red paint and Begold Road on the west side of Payment Unit 1. The interior payment unit boundaries are marked and identified by yellow paint. The reserve areas are marked in blue paint. Do not cut painted boundary line trees.

2 - Timber Specifications

2.1 - Included Timber

2.1.4 - Species designation unit(s) (5/07)

Within Payment Unit(s) 1, 2, 3, and 4 all maple, aspen, cherry, basswood and ironwood trees are designated for cutting regardless of merchantability, EXCEPT those trees marked with green paint. Do not cut any other tree species.

2.1.11 - Description of timber note (2/04)

Note that "Mixed Hardwood" = basswood and ironwood.

2.1.12 - Reserve trees (2/04)

The Purchaser shall not cut live or dead reserve trees within cutting units or clearings. Reserve trees are any tree marked with green paint. The Purchaser shall protect reserve trees from damage by the Purchaser's operations. If the Purchaser's operations have cut or damaged reserve trees through carelessness, the Purchaser shall pay \$100 as fixed, agreed and liquidated damages for each reserve tree cut or damaged. Such payment does not constitute ownership of the undesignated timber.

2.1.13 - Reserve areas (6/07)

The Purchaser shall protect reserve areas from damage by the Purchaser's operations. Reserve areas are marked with a blue boundary line and are small areas located in Payment Units 2, 3, and 4. The Purchaser shall not cut live or dead trees within reserve areas nor operate any harvesting equipment within these areas, unless authorized by DNR sale administrator.

2.2 - Utilization

2.2.4 - Skidding length (2/04)

Skidding of unlimbed tops or lengths over 17 feet is not permissible unless approved by the Unit Manager or their representative.

5 - Operations

5.2 - Conduct of Operations

5.2.1 - Slash

5.2.1.7 - Slash must be scattered (2/04)

Unless otherwise directed, slash and logging debris shall be uniformly scattered over the sale area and not left in piles or windrows. Slash shall not be allowed to accumulate at the landings. All slash work shall be done concurrently with harvesting.

5.2.1.8 - Slash height (2/04)

No slash or tree tops left on the ground may exceed 36 inches in height.

5.2.2 - Hazard Trees/Snags

5.2.2.1 - Den trees (2/04)

Obvious hollow and/or den trees shall be protected and left standing unless they are a safety hazard.

5.2.4 - Dead and Down Creation

5.2.4.3 - Dead and down creation, dead trees (6/07)

Except as provided for in General Condition and Requirement 5.2.2, no dead trees, standing or down, are to be cut, skidded, or processed.

5.2.4.4 - Dead and down creation, grouse (9/05)

To encourage grouse use and other wildlife, in unit(s) 1, 2, 3, and 4 leave a total of 60 trees, 12" diameter or larger log-length (8 foot minimum) piece on the ground. They must be cut at least 4 feet above the ground leaving a snag. These trees should be left standing until all merchantable trees are moved to the landing, at which time they are to be cut, felled and left on the ground next to the snag. These will be evenly scattered throughout the cut unit. This can be an unmerchantable 8 foot or longer piece or a full tree.

5.2.31 - Landing locations (6/08)

Recommended landing areas are marked on the timber sale map with the letter "L". Landings must be confined to these designated sites unless otherwise authorized by the Unit Manager or their representative.

5.2.41 - Snowmobile trail protection (4/07)

Begold road is a snowmobile trail and is shown on the Timber Sale Map. If the trail is used, it must be maintained throughout the sale and restored to a condition equal to or better than before the sale. Do not cut or damage posts with orange trail markers or traffic control signs. Maintain a [20] foot wide slash, debris, and rut free zone daily using the snowmobile trail as the centerline. If the trail is used for hauling, it must be graded to the satisfaction of the Unit Manager or their representative prior to December 1st. The snowmobile trail may not be used for any timber sale operations from December 1 to March 31. No decking of forest products will be permitted along the snowmobile trail. All stumps within 20 feet of the snowmobile trail must be cut at ground level.

HOOSEGOW PINE (088-08-01)

A timber sale contract for this LUMP SUM SEALED timber sale will be awarded the responsible bidder offering the highest sealed bid price. Bids must be at or above the following appraised price for each species:

<u>SPECIES</u>	<u>ESTIMATED VOLUME*</u>	<u>APPRAISED PRICE</u>
SAWLOGS		
RED PINE	26.80 MBF	\$ 133.00/MBF
PULPWOOD		
RED PINE	102.00 CORDS	\$ 48.15/CORD

In addition, the successful bidder agrees to purchase the following species at the indicated appraised price:

<u>SPECIES</u>	<u>ESTIMATED VOLUME*</u>	<u>APPRAISED PRICE</u>
PULPWOOD		
JACK PINE	62.00 CORDS	\$ 8.75/CORD

*The volumes are statistically estimated within plus (+) or minus (-) 22.55 percent. These estimated volumes are final and not subject to adjustment. Prospective bidders are urged to examine this timber and to make their own estimates of quantity and quality.

BOND AND PAYMENT SCHEDULE:

1. A bond in the amount of \$451.00 to insure faithful performance of the conditions of the contract, will be deposited by the successful bidder within 21 days of the sale award.
2. Cutting in any sale or unit without the required advance payment would be considered a trespass.
3. Total payment may be paid in advance or according to the following schedule:
 - (a) Ten percent (10%) of the sale value must be paid within 21 days of the sale award.
 - (b) The 10% down payment will be credited towards the first unit cut.
 - (c) Payment for each of the following units must be made before cutting begins in that unit:

<u>PAYMENT UNIT NUMBER</u>	<u>PERCENT OF TOTAL SALE VALUE</u>
1	94%
2	06%

4. If no cutting takes place, the 10% down payment will not be refunded.
5. Operations on the contract issued will terminate on June 30, 2011.



Michigan Department of Natural Resources-Forest Management Division
TIMBER SALE MAP

This information provided under authority of Part 525, Act 451 of 1994, as amended.

Sale No.	Year	Sale Type
088	08	01



State Forest and Forest Management Unit: Pere Marquette - Traverse City		Mapped By: Tim Webb		Date: Sept. 30, 2008	
Marked By: Tim Webb					
Township	Range	Section(s)	Subdivision	Scale:	
25N	9W	29	N1/2 NW; NENE	1:7,920	8" = 1 mile

Cover Type

Density

A=Aspen	H=Hemlock	P=Lowland Poplar	V=Bog or Marsh	1=Non Stocked	7=Saw Timber Poor
B=Paper Birch	J=Jack Pine	Q=Mixed Swamp Cnfr	W=White Pine	2=Seedling Sapling Poor	8=Saw Timber Medium
C=Cedar	L=Lowland Brush	R=Red Pine	X=Non Stocked	3=Seedling Sapling Well	9=Saw Timber Well
E=Swamp Howwoods	M=Mpl, Bch, Birch	S=Black Spruce	Z=Water	4=Pole Timber Poor	
F=Spruce Fir	N=Marsh	T=Tamarack	UM=Upl. Mixed	5=Pole Timber Medium	
G=Grass	O=Oak	U=Upland Brush	MD=Mixed Decid.	6=Pole Timber Well	
			MC=Mixed Conif		

Hoosegow Pine

-  sale area - final harvest
-  sale area - thinning
-  red painted sale boundary line

unit 1: 20.4 acres
 unit 2: 4.8 acres
 Total: 25.2 acres

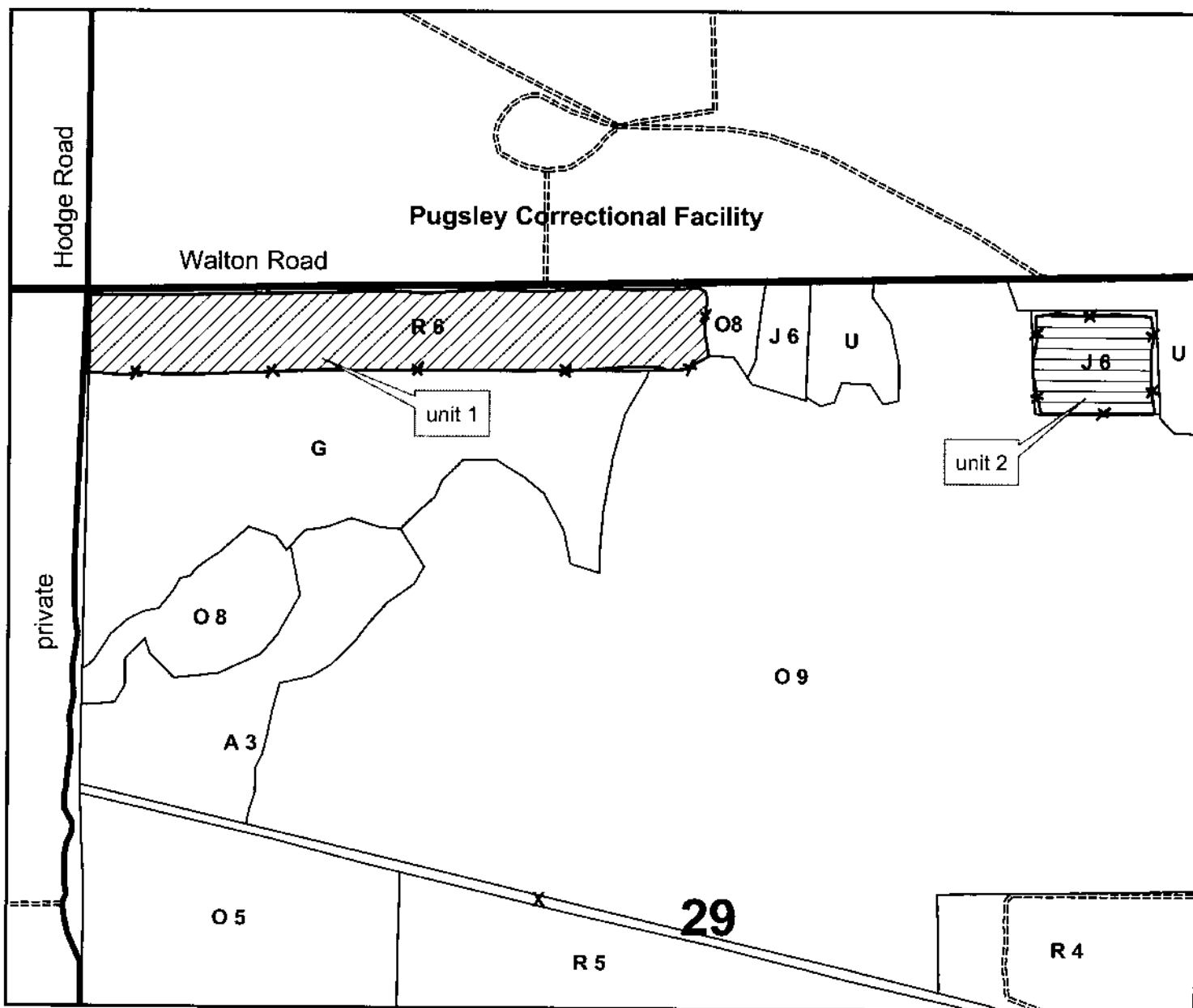

Sale Specific Conditions & Requirements

Sale Name: Hoosegow Pine Sale Number: 61-088-08-01

1 - Sale Area

1.2 - Boundaries

1.2.1 - Painted boundaries (6/05)

The sale boundary for payment unit 2 is marked and identified by red paint. The boundary for payment unit 1 is marked with red paint on the south and east sides; Walton Road and Hodge Road are the north and west boundaries respectively.

2 - Timber Specifications

2.1 - Included Timber

2.1.1 - Clearcut unit(s) with unmerchantable trees (2/04)

Within Payment Unit(s) 2, cut all jack pine trees that are two (2) inches or more in diameter measured at a point of four and one-half (4-1/2) feet above ground level regardless of merchantability. Do not cut any other species.

2.1.3 - Cut tree marked unit(s) (8/04)

Within Payment Unit(s) 1, all red pine trees are designated for cutting when marked with orange paint above and below stump height, regardless of merchantability.

4 - Transportation

4.1 - Construction

4.1.7 - Road closure (4/07)

All new roads built into the sale must be blocked to vehicle traffic upon completion of the sale. In general, this will require constructing a four (4') foot high berm constructed of stumps and logs covered with earth. Contact the sale administrator for specific details of design and placement.

5 - Operations

5.2 - Conduct of Operations

5.2.1 - Slash

5.2.1.8 - Slash height (2/04)

No slash or tree tops may exceed 24 inches in height.

Sale Name: Hoosegow Pine Sale Number: 61-088-08-01

5.2.15 - Bark beetle restriction (2/04)

In the event drought creates a high risk of pine bark beetle infestation, pine is not to be cut during the period March 1 through July 1, unless all portions of trees greater than two inches in diameter are removed from the sale area, reduced to chips, or treated to the satisfaction of the Unit Manager or their representative, within fifteen days of being severed from the stump. Pine logs, pulpwood piles and treetop piles for chipping that are decked in the fall or winter within a 1/4 mile of susceptible sites must be removed before March 15. Residual slash must not be placed in piles or rows and must be spread over the site for quick drying. The Department of Natural Resources will exercise this option if the risk of damage warrants.

CANINE RED PINE (021-07-01)
 T27N, R14W, SEC. 24, N1/2 NE, W1/2 SE.
 BENZIE COUNTY

In response to the notice of sale to be held 2:00 p.m. on May 14, 2009, I am hereby submitting my sealed bid (firm offer) for the following forest products to be cut. Bids for individual species and total bid value must be at or above the appraised price. All non-responsive bid forms may be rejected.

<u>SPECIES</u>	<u>APPRAISED PRICE</u>	<u>BID PRICE</u>	<u>ESTIMATED VOLUME* = VALUE</u>
SAWLOGS			
RED PINE	\$ 62.00/MBF	\$ _____ X	11.80 MBF = \$ _____
PULPWOOD			
RED PINE	\$ 29.00/CORD	\$ _____ X	175.00 CORDS = \$ _____
			SUBTOTAL 1 \$ _____

In addition, the successful bidder agrees to purchase the following species at the appraised price:

<u>SPECIES</u>	<u>APPRAISED PRICE</u>	<u>ESTIMATED VOLUME*</u>	<u>VALUE</u>
PULPWOOD			
Q. ASPEN	\$ 6.45/CORD	18.00 CORDS	= \$ 116.10
			SUBTOTAL 2 \$ 116.10
SUBTOTAL 1 + SUBTOTAL 2 = TOTAL BID VALUE \$ _____			

*These volumes are statistically estimated within plus (+) or minus (-) 18.96%. These estimated volumes are final and not subject to adjustment. Prospective bidders are urged to examine this timber and to make their own estimates of quantity and quality.

I understand that any or all bids may be rejected, and that the individual unit bid price will be the basis to determine total bid value. All bids must be signed and all bid items must be bid or the bid form may be rejected. I also understand that consideration and awarding a contract will be based upon my past performance and ability to complete the contract based upon equipment and manpower subject to my control.

 (bidder's printed name)

 (bidder's signature)

Address/Telephone _____

THE WINNING BIDDER MUST COMPLETE THE FORM ON THE REVERSE SIDE
 WITHIN 21 DAYS OF SALE AWARD



FOR DEPARTMENT USE ONLY

**TIMBER SALE
VERIFICATION OF WORKER'S DISABILITY
COMPENSATION ACT COMPLIANCE**

As required by Act 317, P.A. 1969 (Worker's Compensation) and Part 525 of Act 451 of 1994, as amended.

Sale or Permit No

Year:

Type:

Forest Area:

VERIFICATION OF WORKER'S DISABILITY COMPENSATION ACT COMPLIANCE

- This verification must be completed and submitted within 21 days of contract award and prior to the issuance of the timber sale contract.
- In addition, if boxes 2B or 2C are checked, then Notice of Exclusion or Certificate of Insurance must be submitted within 21 days of the contract award and prior to the issuance of the timber sale contract.
- All information must be typed or printed except for written signatures.

Please Check Appropriate Categories:

1. My business is organized as (you must check one of the boxes below):

- A. Sole Proprietorship (individual)
- B. Partnership
- C. Corporation

2. You must check one of the boxes below:

- A. I certify that my business is a sole proprietorship and it has no employees but the sole proprietor. I am not subject to the Worker's Compensation Laws.
- B. I certify that my business has satisfied its obligation to the Worker's Compensation Act through the use of an approved Notice of Exclusion (BWC-337, Rev. 5/96). I will provide a copy of the Notice of Exclusion within 21 days of the contract award. (For questions or a copy of the BWC-337, please call the Worker's Compensation Bureau at 517-322-1195).
- C. I certify that my business has a Worker's Compensation Policy. I will provide an original Certificate of Insurance within 21 days of the contract award.

3. If you have checked item 2(A) or 2(B), you must indicate the number of both full and part time employees other than yourself including family members and active partners (if none, you must enter "0").

_____ Full Time Employees

_____ Part Time Employees

Name of Business		Federal ID (or) Social Security No.	
Address		Telephone No. ()	
City	State	Zip + 4	

I hereby certify that the above information is true and correct. I agree to notify the DNR of any changes that occur in factors affecting my coverage during any of my present and future operations.

Signature of Owner or Authorized Representative

Title

Date

COMPARTMENT 3 RPP (037-08-01)
T28N, R14W, SEC. 36, N1/2NW.
 LEELANAU COUNTY

In response to the notice of sale to be held 2:00 p.m. on May 14, 2009, I am hereby submitting my sealed bid (firm offer) for the following forest products to be cut. Bids for individual species and total bid value must be at or above the appraised price. All non-responsive bid forms may be rejected.

<u>SPECIES</u>	<u>APPRAISED PRICE</u>	<u>BID PRICE</u>	<u>ESTIMATED VOLUME*</u>	<u>= VALUE</u>
<u>SAWLOGS</u>				
RED PINE	\$ 131.00/MBF	\$ _____ X	149.50 MBF	= \$ _____
<u>PULPWOOD</u>				
RED PINE	\$ 48.15/CORD	\$ _____ X	958.00 CORDS	= \$ _____
SUBTOTAL 1				\$ _____

In addition, the successful bidder agrees to purchase the following species at the appraised price:

<u>SPECIES</u>	<u>APPRAISED PRICE</u>	<u>ESTIMATED VOLUME*</u>	<u>VALUE</u>
<u>PULPWOOD</u>			
JACK PINE	\$ 7.75/CORD	841.00 CORDS	= \$ 6,517.75
MIX HARDWD	\$ 7.75/CORD	21.00 CORDS	= \$ 162.75
SUBTOTAL 2			\$ <u>6,680.50</u>
SUBTOTAL 1 + SUBTOTAL 2 = TOTAL BID VALUE \$ _____			

*These volumes are statistically estimated within plus (+) or minus (-) 13.30%. These estimated volumes are final and not subject to adjustment. Prospective bidders are urged to examine this timber and to make their own estimates of quantity and quality.

I understand that any or all bids may be rejected, and that the individual unit bid price will be the basis to determine total bid value. All bids must be signed and all bid items must be bid or the bid form may be rejected. I also understand that consideration and awarding a contract will be based upon my past performance and ability to complete the contract based upon equipment and manpower subject to my control.

 (bidder's printed name)

 (bidder's signature)

Address/Telephone _____

THE WINNING BIDDER MUST COMPLETE THE FORM ON THE REVERSE SIDE
 WITHIN 21 DAYS OF SALE AWARD



FOR DEPARTMENT USE ONLY

**TIMBER SALE
VERIFICATION OF WORKER'S DISABILITY
COMPENSATION ACT COMPLIANCE**

*As required by Act 317, P.A. 1969 (Worker's Compensation) and Part 525
of Act 451 of 1994, as amended.*

Sale or Permit No	
Year:	Type:
Forest Area:	

VERIFICATION OF WORKER'S DISABILITY COMPENSATION ACT COMPLIANCE

- This verification must be completed and submitted within 21 days of contract award and prior to the issuance of the timber sale contract.
- In addition, if boxes 2B or 2C are checked, then Notice of Exclusion or Certificate of Insurance must be submitted within 21 days of the contract award and prior to the issuance of the timber sale contract.
- All information must be typed or printed except for written signatures.

Please Check Appropriate Categories:

1. My business is organized as (you must check one of the boxes below):
 - A. Sole Proprietorship (individual)
 - B. Partnership
 - C. Corporation
2. You must check one of the boxes below:
 - A. I certify that my business is a sole proprietorship and it has no employees but the sole proprietor. I am not subject to the Worker's Compensation Laws.
 - B. I certify that my business has satisfied its obligation to the Worker's Compensation Act through the use of an approved Notice of Exclusion (BWC-337, Rev. 5/96). I will provide a copy of the Notice of Exclusion within 21 days of the contract award. (For questions or a copy of the BWC-337, please call the Worker's Compensation Bureau at 517-322-1195).
 - C. I certify that my business has a Worker's Compensation Policy. I will provide an original Certificate of Insurance within 21 days of the contract award.
3. If you have checked item 2(A) or 2(B), you must indicate the number of **both** full and part time employees other than yourself including family members and active partners (if none, you must enter "0").

_____ Full Time Employees

_____ Part Time Employees

Name of Business		Federal ID (or) Social Security No.	
Address		Telephone No. ()	
City	State	Zip + 4	

I hereby certify that the above information is true and correct. I agree to notify the DNR of any changes that occur in factors affecting my coverage during any of my present and future operations.

Signature of Owner or Authorized Representative

Title

Date

GNARLY MAPLE (066-08-01)
T25N, R14W, SEC. 08, S1/2NE, SE.
T25N, R14W, SEC. 17, NENE.
BENZIE COUNTY

In response to the notice of sale to be held 2:00 p.m. on May 14, 2009, I am hereby submitting my sealed bid (firm offer) for the following forest products to be cut. Bids for individual species and total bid value must be at or above the appraised price. All non-responsive bid forms may be rejected.

<u>SPECIES</u>	<u>APPRAISED PRICE</u>	<u>BID PRICE</u>	<u>ESTIMATED VOLUME*</u>	<u>= VALUE</u>
SAWLOGS				
SUG. MAPLE	\$ 346.00/MBF	\$ _____ X	38.20 MBF	= \$ _____
RED MAPLE	\$ 95.00/MBF	\$ _____ X	94.30 MBF	= \$ _____
B.T. ASPEN	\$ 69.00/MBF	\$ _____ X	84.70 MBF	= \$ _____
PULPWOOD				
RED MAPLE	\$ 11.80/CORD	\$ _____ X	556.80 CORDS	= \$ _____
B.T. ASPEN	\$ 16.80/CORD	\$ _____ X	543.40 CORDS	= \$ _____
SUBTOTAL 1				\$ _____

In addition, the successful bidder agrees to purchase the following species at the appraised price:

<u>SPECIES</u>	<u>APPRAISED PRICE</u>	<u>ESTIMATED VOLUME*</u>	<u>VALUE</u>
SAWLOGS			
BLK CHERRY	\$ 145.00/MBF	24.30 MBF	= \$ 3,523.50
MIX HARDWD	\$ 103.00/MBF	33.60 MBF	= \$ 3,460.80
PULPWOOD			
SUG. MAPLE	\$ 9.20/CORD	301.00 CORDS	= \$ 2,769.20
BLK CHERRY	\$ 7.40/CORD	310.90 CORDS	= \$ 2,300.66
MIX HARDWD	\$ 8.30/CORD	108.50 CORDS	= \$ 900.55
SUBTOTAL 2			\$ <u>12,954.71</u>

SUBTOTAL 1 + SUBTOTAL 2 = TOTAL BID VALUE \$ _____

*These volumes are statistically estimated within plus (+) or minus (-) 14.99%. These estimated volumes are final and not subject to adjustment. Prospective bidders are urged to examine this timber and to make their own estimates of quantity and quality.

I understand that any or all bids may be rejected, and that the individual unit bid price will be the basis to determine total bid value. All bids must be signed and all bid items must be bid or the bid form may be rejected. I also understand that consideration and awarding a contract will be based upon my past performance and ability to complete the contract based upon equipment and manpower subject to my control.

(bidder's printed name)

(bidder's signature)

Address/Telephone _____

THE WINNING BIDDER MUST COMPLETE THE FORM ON THE REVERSE SIDE
WITHIN 21 DAYS OF SALE AWARD



Michigan Department of Natural Resources
Forest, Mineral and Fire Management

FOR DEPARTMENT USE ONLY

**TIMBER SALE
VERIFICATION OF WORKER'S DISABILITY
COMPENSATION ACT COMPLIANCE**

*As required by Act 317, P.A. 1969 (Worker's Compensation) and Part 525
of Act 451 of 1994, as amended.*

Sale or Permit No

Year:

Type:

Forest Area:

VERIFICATION OF WORKER'S DISABILITY COMPENSATION ACT COMPLIANCE

- This verification must be completed and submitted within 21 days of contract award and prior to the issuance of the timber sale contract.
- In addition, if boxes 2B or 2C are checked, then Notice of Exclusion or Certificate of Insurance must be submitted within 21 days of the contract award and prior to the issuance of the timber sale contract.
- All information must be typed or printed except for written signatures.

Please Check Appropriate Categories:

1. My business is organized as (you must check one of the boxes below):

- A. Sole Proprietorship (individual)
- B. Partnership
- C. Corporation

2. You must check one of the boxes below:

- A. I certify that my business is a sole proprietorship and it has no employees but the sole proprietor. I am not subject to the Worker's Compensation Laws.
- B. I certify that my business has satisfied its obligation to the Worker's Compensation Act through the use of an approved Notice of Exclusion (BWC-337, Rev. 5/96). I will provide a copy of the Notice of Exclusion within 21 days of the contract award. (For questions or a copy of the BWC-337, please call the Worker's Compensation Bureau at 517-322-1195).
- C. I certify that my business has a Worker's Compensation Policy. I will provide an original Certificate of Insurance within 21 days of the contract award.

3. If you have checked item 2(A) or 2(B), you must indicate the number of **both** full and part time employees other than yourself including family members and active partners (if none, you must enter "0").

_____ Full Time Employees

_____ Part Time Employees

Name of Business		Federal ID (or) Social Security No.	
Address		Telephone No. ()	
City	State	Zip + 4	

I hereby certify that the above information is true and correct. I agree to notify the DNR of any changes that occur in factors affecting my coverage during any of my present and future operations.

Signature of Owner or Authorized Representative

Title

Date

HOOSEGOW PINE (088-08-01)
T25N, R09W, SEC. 29, N1/2NW; NENE.
GRAND TRAVERSE COUNTY

In response to the notice of sale to be held 2:00 p.m. on May 14, 2009, I am hereby submitting my sealed bid (firm offer) for the following forest products to be cut. Bids for individual species and total bid value must be at or above the appraised price. All non-responsive bid forms may be rejected.

<u>SPECIES</u>	<u>APPRAISED PRICE</u>	<u>BID PRICE</u>	<u>ESTIMATED VOLUME*</u>	<u>= VALUE</u>
SAWLOGS				
RED PINE	\$ 133.00/MBF	\$ _____ X	26.80 MBF	= \$ _____
PULPWOOD				
RED PINE	\$ 48.15/CORD	\$ _____ X	102.00 CORDS	= \$ _____
			SUBTOTAL 1	\$ _____

In addition, the successful bidder agrees to purchase the following species at the appraised price:

<u>SPECIES</u>	<u>APPRAISED PRICE</u>	<u>ESTIMATED VOLUME*</u>	<u>VALUE</u>
PULPWOOD			
JACK PINE	\$ 8.75/CORD	62.00 CORDS	= \$ 542.50
			SUBTOTAL 2 \$ 542.50
SUBTOTAL 1 + SUBTOTAL 2 = TOTAL BID VALUE \$ _____			

*These volumes are statistically estimated within plus (+) or minus (-) 22.55%. These estimated volumes are final and not subject to adjustment. Prospective bidders are urged to examine this timber and to make their own estimates of quantity and quality.

I understand that any or all bids may be rejected, and that the individual unit bid price will be the basis to determine total bid value. All bids must be signed and all bid items must be bid or the bid form may be rejected. I also understand that consideration and awarding a contract will be based upon my past performance and ability to complete the contract based upon equipment and manpower subject to my control.

(bidder's printed name)

(bidder's signature)

Address/Telephone _____

THE WINNING BIDDER MUST COMPLETE THE FORM ON THE REVERSE SIDE
WITHIN 21 DAYS OF SALE AWARD



FOR DEPARTMENT USE ONLY	
Sale or Permit No	
Year:	Type:
Forest Area:	

**TIMBER SALE
VERIFICATION OF WORKER'S DISABILITY
COMPENSATION ACT COMPLIANCE**

As required by Act 317, P.A. 1969 (Worker's Compensation) and Part 525 of Act 451 of 1994, as amended.

VERIFICATION OF WORKER'S DISABILITY COMPENSATION ACT COMPLIANCE

- This verification must be completed and submitted within 21 days of contract award and prior to the issuance of the timber sale contract.
- In addition, if boxes 2B or 2C are checked, then Notice of Exclusion or Certificate of Insurance must be submitted within 21 days of the contract award and prior to the issuance of the timber sale contract.
- All information must be typed or printed except for written signatures.

Please Check Appropriate Categories:

1. My business is organized as (you must check one of the boxes below):
 - A. Sole Proprietorship (individual)
 - B. Partnership
 - C. Corporation
2. You must check one of the boxes below:
 - A. I certify that my business is a sole proprietorship and it has no employees but the sole proprietor. I am not subject to the Worker's Compensation Laws.
 - B. I certify that my business has satisfied its obligation to the Worker's Compensation Act through the use of an approved Notice of Exclusion (BWC-337, Rev. 5/96). I will provide a copy of the Notice of Exclusion within 21 days of the contract award. (For questions or a copy of the BWC-337, please call the Worker's Compensation Bureau at 517-322-1195).
 - C. I certify that my business has a Worker's Compensation Policy. I will provide an original Certificate of Insurance within 21 days of the contract award.
3. If you have checked item 2(A) or 2(B), you must indicate the number of both full and part time employees other than yourself including family members and active partners (if none, you must enter "0").

_____ Full Time Employees

_____ Part Time Employees

Name of Business		Federal ID (or) Social Security No.	
Address		Telephone No. ()	
City	State	Zip + 4	

I hereby certify that the above information is true and correct. I agree to notify the DNR of any changes that occur in factors affecting my coverage during any of my present and future operations.

Signature of Owner or Authorized Representative

Title

Date