



DEPARTMENT OF NATURAL RESOURCES  
STATE OF MICHIGAN

TIMBER SALE PROSPECTUS

Notice is hereby given that bids will be received by the Unit Manager,  
TRAVERSE CITY MANAGEMENT UNIT, for certain timber on the following described lands:

POTTER RED MAPLE / T23N, R14W, SEC. 09, N1/2NWNE.  
MANISTEE COUNTY (Appr. \$4,063.00)

SITTING MOOSE / T25N, R14W, SEC. 07, S1/2SE.  
T25N, R14W, SEC. 18, N1/2NE, NWSE.  
BENZIE COUNTY (Appr. \$28,284.01)

SUPPLY OAK / T27N, R10W, SEC. 35, N1/2NE.  
T27N, R10W, SEC. 36, NWNW.  
GRAND TRAVERSE COUNTY (Appr. \$12,411.10)

4836 OAK / T27N, R10W, SEC. 36, E1/2NW1/4.  
GRAND TRAVERSE COUNTY (Appr. \$12,855.00)

5320 OAK / T26N, R09W, SEC. 20, NENW, NWNE.  
GRAND TRAVERSE COUNTY (Appr. \$1,149.20)

HIGH VOLTAGE PINE / T24N, R14W, SEC. 26, NWSW.  
MANISTEE COUNTY (Appr. \$10,685.00)

-----

SALE DATE AND TIME: 2:00 p.m. on July 30, 2009.

**TRAVERSE CITY**



BID INSTRUCTIONS (Ver. 06/23/2008):

1. Bid Location, Date, and Time: Bids must be received by the Unit Manager, Traverse City Management Unit, 970 Emerson, Traverse City, MI 49686, no later than 11:00 a.m. on July 30, 2009. For further information concerning this sale, contact the Unit Manager at 231-922-5280.
2. Bidder's Qualifications: Purchaser shall obtain workers compensation insurance to cover claims under Michigan's Worker's Disability Compensation Act of 1969 or similar employee benefit act of any other state applicable to an employee. If all or part of a timber sale was prepared by a private contractor, that contractor and that contractor's company are not permitted to bid on the timber sale contract. Bids will not be accepted from individuals or companies appearing on the DNR/EMEM No-Bid List. This list contains the names of purchasers who previously failed to execute a contract within 21-days or who have a history of poor performance.
3. Preparation of Sealed Bids: Bids shall be manually signed in ink; bid prices must be entered for each species and product in the Bid Price column for all material subject to bidding; and all fill-in blanks must be completed. If erasures or other changes appear on the forms, each erasure or change must be initialed by the person signing the bid.
4. Submission of Sealed Bids: Bid forms may be obtained from the Unit Manager. All bids must be submitted on the bid form and in an envelope clearly identified as described in this section. NOTE: Only one bid form per bid envelope. Sealed bids must be submitted to the Unit office designated in the prospectus and must be submitted at or prior to the time established in the prospectus. The envelope should show on the outside (a) that it is a "Bid for Timber," and (b) the sale name or number, and (c) the date and time of bid opening as shown in the prospectus. Bids received after the time specified in the sale prospectus are late bids and will be rejected.
5. Public Opening of Sealed Bids: If conditions permit, the sealed bids will be publicly opened and posted at the time and place set in the prospectus.
6. Award of Contract: Award of the contract will be made to the Bidder whose bid, conforming to the prospectus, is most advantageous to the State of Michigan on the basis of total value at rates bid for the estimated quantities. The State reserves the right to reject any bid or waive any minor irregularity in bids received. A written award mailed (or otherwise furnished) to the successful Bidder shall be deemed to result in a binding contract without further action by either party.
7. Down Payment: The Bidder to whom award is made must make a down payment within 21 days of the sale award. The amount of the down payment will be calculated as shown in the Bond and Payment Schedule of this prospectus. Only cash may be used to meet this requirement.
8. Performance Security: As guarantee of faithful performance, a cash bond, certificate of deposit, surety bond or irrevocable letter of credit (LOC) is required within 21 days of the sale award. The amount of the performance security is shown in the Bond and Payment Schedule of this prospectus. If an LOC or surety is used, the coverage must extend for at least 6 months beyond the contract expiration.
9. Timber Sale Contract: Additional conditions and requirements common to all timber sales are listed on the timber sale contract (R4031) and are available on line at [www.michigan.gov/dnr](http://www.michigan.gov/dnr). Contact the Unit Manager for additional information or a sample contract. Within 21 days of the date of the award letter, the bidder must sign the contract and provide the required down payment, performance security, and verification of worker's disability compensation. The down payment and performance security shall be in accordance with the provisions of the timber sale contract, in the sums stated in this prospectus. If these actions are not taken, then the Bidder, the Bidder's corporation, and the corporation's principals may not be permitted to bid on State timber sales for a period of 1 year. In addition, the Bidder certifies that if awarded this contract, the Bidder will complete the timber sale contract in accordance with its terms and any modifications thereof including requirements to purchase, cut, and remove the included timber by the termination date.

10. Disclaimer of Estimates and Bidder's Warranty of Inspection: Before submitting this bid, the Bidder is advised and cautioned to inspect the sale area, review the requirements of the sale contract, and take other steps as may be reasonably necessary to ascertain the location, estimated volumes, construction estimates, and operating costs of the proposed sale. Failure to do so will not relieve the Bidder from responsibility for completing the contract.

The Bidder warrants that this bid is submitted solely on the basis of the Bidder's examination and inspection of the quality and quantity of the timber offered for sale and the Bidder's opinion of the value thereof and the costs of recovery. No reliance should be placed on the State of Michigan's estimates of timber quality, quantity or costs of recovery. Bidder further acknowledges that the State of Michigan: (i) expressly disclaims any warranty of fitness of timber for any purpose; (ii) offers this timber as is without any warranty of quality (merchantability) or quantity and (iii) expressly disclaims any warranty as to the quantity or quality of timber sold.

11. Certification and Chain-of-Custody: Unless otherwise indicated in the contract under section 7 - Other Conditions of the Sale Specific Conditions & Requirements, the area encompassed by this timber sale is certified to the standards of the Forest Stewardship Council (FSC) - Certificate #SCS-FM/COC-090N and the Sustainable Forestry Initiative (SFI) - Certificate # NSF-SFIS-5Y031-S1. Forest products from this sale may be delivered to the mill as "FSC and / or SFI certified" as long as the contractor hauling the forest products is chain-of-custody (COC) certified or covered under a COC certificate from the destination mill. The purchaser is responsible for maintaining COC after leaving the sale area.

REBECCA A. HUMPHRIES  
Director

POTTER RED MAPLE (008-09-01)

A timber sale contract for this LUMP SUM SEALED timber sale will be awarded the responsible bidder offering the highest sealed bid price. Bids must be at or above the following appraised price for each species:

<u>SPECIES</u>	<u>ESTIMATED VOLUME*</u>	<u>APPRAISED PRICE</u>
SAWLOGS		
RED MAPLE	26.60 MBF	\$ 102.00/MBF
PULPWOOD		
RED MAPLE	112.00 CORDS	\$ 11.90/CORD

In addition, the successful bidder agrees to purchase the following species at the indicated appraised price:

<u>SPECIES</u>	<u>ESTIMATED VOLUME*</u>	<u>APPRAISED PRICE</u>
PULPWOOD		
MIX HARDWD	2.00 CORDS	\$ 8.50/CORD

\*The volumes are statistically estimated within plus (+) or minus (-) 27.76 percent. These estimated volumes are final and not subject to adjustment. Prospective bidders are urged to examine this timber and to make their own estimates of quantity and quality.

BOND AND PAYMENT SCHEDULE:

1. A bond in the amount of \$203.00 to insure faithful performance of the conditions of the contract, will be deposited by the successful bidder within 21 days of the sale award.
2. Cutting in any sale or unit without the required advance payment would be considered a trespass.
3. Total payment may be paid in advance or according to the following schedule:
  - (a) Ten percent (10%) of the sale value must be paid within 21 days of the sale award.
  - (b) The remainder is due before cutting begins.
4. If no cutting takes place, the 10% down payment will not be refunded.
5. Operations on the contract issued will terminate on September 30, 2009.



Michigan Department of Natural Resources-Forest Management Division  
**TIMBER SALE MAP**

This information provided under authority of Part 525, Act 451 of 1994, as amended.

Sale No.	Year	Sale Type
08	09	01

State Forest and Forest Management Unit: <b>Pere Marquette-Traverse City</b>		Mapped By: <b>Scott Lint</b>		Date: <b>November 10, 2008</b>	
Township <b>23N</b>	Range <b>14W</b>	Section(s) <b>9</b>	Subdivision <b>N1/2NWNE</b>	Scale: <b>1:15840</b>	

Cover Type				Density		
A=Aspen	H=Hemlock	P=Lowland Poplar	V=Bog or Marsh	1=Non Stocked	7=Saw Timber Poor	
B=Paper Birch	J=Jack Pine	Q=Mixed Swamp Cnfr	W=White Pine	2=Seedling Sapling Poor	8=Saw Timber Medium	
C=Cedar	L=Lowland Brush	R=Red Pine	X=Non Stocked	3=Seedling Sapling Well	9=Saw Timber Well	
E=Swamp Hdwoods	M=Mpl, Bch, Brch	S=Black Spruce	Z=Water	4=Pole Timber Poor		
F=Spruce Fir	N=Marsh	T=Tamarack		5=Pole Timber Medium		
G=Grass	O=Oak	U=Upland Brush		6=Pole Timber Well		

= sale area  
 = survey corner/witness trees  
 = snowmobile trail

# Potter Red Maple

sale area: 8 acres

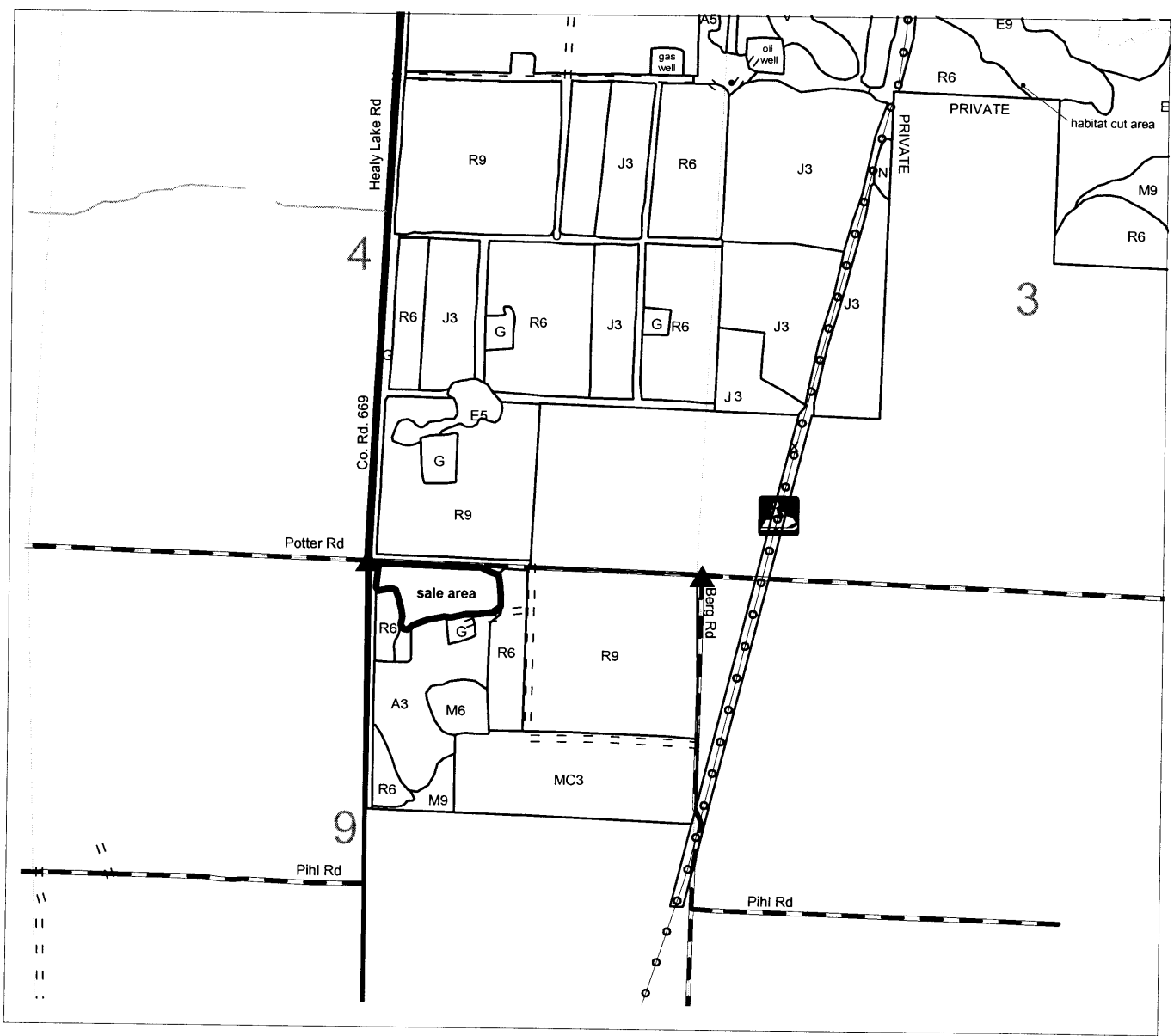

## Sale Specific Conditions & Requirements

Sale Name: Potter Red Maple Sale Number: 61-008-09-01

### 1 - Sale Area

#### 1.2 - Boundaries

##### 1.2.1 - Painted boundaries (6/05)

The sale boundary is marked and identified by red paint.

### 2 - Timber Specifications

#### 2.1 - Included Timber

##### 2.1.3 - Cut tree marked unit(s) (8/04)

Within Payment Unit(s) trees are designated for cutting when marked with orange paint above and below stump height, regardless of merchantability.

### 5 - Operations

#### 5.2 - Conduct of Operations

##### 5.2.1 - Slash

###### 5.2.1.7 - Slash must be scattered (2/04)

Unless otherwise directed, slash and logging debris shall be uniformly scattered over the sale area and not left in piles or windrows. Slash shall not be allowed to accumulate at the landings. All slash work shall be done concurrently with harvesting.

###### 5.2.1.8 - Slash height (2/04)

No slash or tree tops may exceed 36 inches in height.

###### 5.2.12 - Bark slippage restriction (3/07)

Within Payment Unit(s), unless changed by written agreement, cutting and skidding are not permitted during the period of April 15 to July 15. This restriction is because of bark slippage.





SITTING MOOSE (067-08-01)

A timber sale contract for this LUMP SUM SEALED timber sale will be awarded the responsible bidder offering the highest sealed bid price. Bids must be at or above the following appraised price for each species:

<u>SPECIES</u>	<u>ESTIMATED VOLUME*</u>	<u>APPRAISED PRICE</u>
SAWLOGS		
RED MAPLE	31.20 MBF	\$ 93.00/MBF
B.T. ASPEN	156.20 MBF	\$ 68.00/MBF
OT. C. SP.	20.30 MBF	\$ 100.00/MBF
PULPWOOD		
RED MAPLE	197.40 CORDS	\$ 11.00/CORD
B.T. ASPEN	620.30 CORDS	\$ 15.60/CORD

In addition, the successful bidder agrees to purchase the following species at the indicated appraised price:

<u>SPECIES</u>	<u>ESTIMATED VOLUME*</u>	<u>APPRAISED PRICE</u>
PULPWOOD		
OT. C. SP.	113.90 CORDS	\$ 7.75/CORD

\*The volumes are statistically estimated within plus (+) or minus (-) 13.38 percent. These estimated volumes are final and not subject to adjustment. Prospective bidders are urged to examine this timber and to make their own estimates of quantity and quality.

BOND AND PAYMENT SCHEDULE:

1. A bond in the amount of \$1,414.00 to insure faithful performance of the conditions of the contract, will be deposited by the successful bidder within 21 days of the sale award.
2. Cutting in any sale or unit without the required advance payment would be considered a trespass.
3. Total payment may be paid in advance or according to the following schedule:
  - (a) Ten percent (10%) of the sale value must be paid within 21 days of the sale award.
  - (b) The 10% down payment will be credited towards the first unit cut.
  - (c) Payment for each of the following units must be made before cutting begins in that unit:

<u>PAYMENT UNIT NUMBER</u>	<u>PERCENT OF TOTAL SALE VALUE</u>
1	85%
2	15%

4. If no cutting takes place, the 10% down payment will not be refunded.
5. Operations on the contract issued will terminate on December 31, 2010.



**TIMBER SALE MAP**

*This information provided under authority of Part 525, Act 451 of 1994, as amended.*

Sale No. 61-067	Year 08	Sale Type 01
--------------------	------------	-----------------

State Forest and Forest Management Unit: Traverse City Forest Management Unit		Cruised and Mapped By: Craig Allen		Date: 08/28/2008
Township 25N	Range 14W	Section(s) 7 18	Subdivision S1/2 SE N1/2NE NWSE	Scale: 1 inch = 1,060 feet

**Cover Type**

**Density**

- |                   |                    |                      |                  |                           |                       |
|-------------------|--------------------|----------------------|------------------|---------------------------|-----------------------|
| A = Aspen         | H = Hemlock        | P = Lowland Poplar   | V = Bog or Marsh | 1 = Non Stocked           | 7 = Saw Timber Poor   |
| B = Paper Birch   | J = Jack Pine      | Q = Mixed Swamp Cnfr | W = White Pine   | 2 = Seedling Sapling Poor | 8 = Saw Timber Medium |
| C = Cedar         | L = Lowland Brush  | R = Red Pine         | X = Non Stocked  | 3 = Seedling Sapling Well | 9 = Saw Timber Well   |
| E = Swamp Hdwoods | M = Mpl, Bch, Brch | S = Black Spruce     | Z = Water        | 4 = Pole Timber Poor      |                       |
| F = Spruce Fir    | N = Marsh          | T = Tamarack         |                  | 5 = Pole Timber Medium    |                       |
| G = Grass         | O = Oak            | U = Upland Brush     |                  | 6 = Pole Timber Well      |                       |

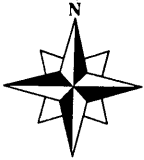

**"Sitting Moose" sale**

Unit 1 = 50 acres  
Unit 2 = 9 acres

Total = 59 acres

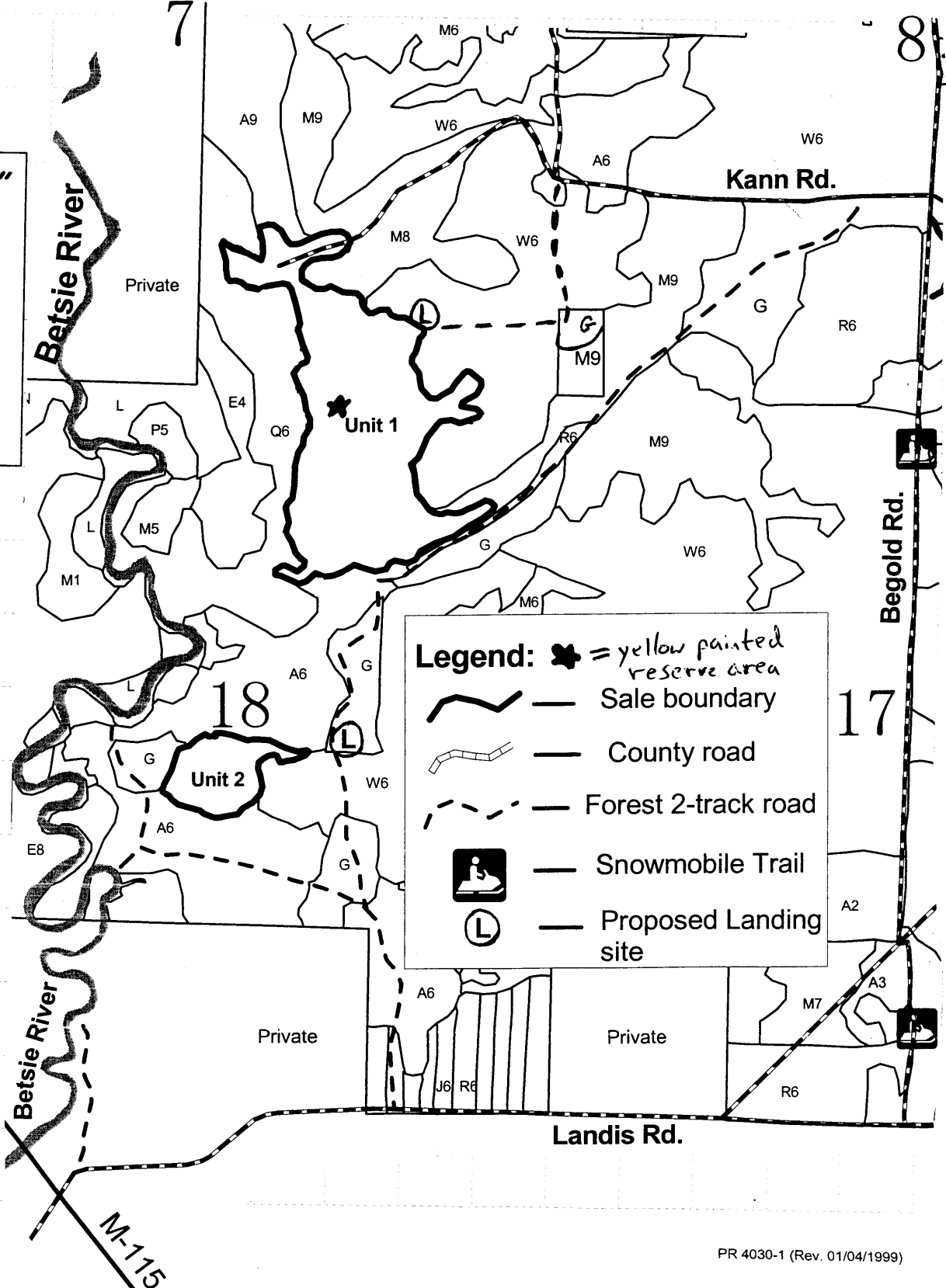

**Legend:**

- = yellow painted reserve area
- = Sale boundary
- = County road
- = Forest 2-track road
- = Snowmobile Trail
- = Proposed Landing site

## Sale Specific Conditions & Requirements

**Sale Name: Sitting Moose    Sale Number: 61-067-08-01**

### 1 - Sale Area

#### 1.2 - Boundaries

##### 1.2.1 - Painted boundaries (6/05)

The sale boundary is marked and identified by red paint. Do not cut painted boundary line trees.

### 2 - Timber Specifications

#### 2.1 - Included Timber

##### 2.1.4 - Species designation unit(s) (5/07)

Within Payment Unit(s) 1 and 2 all maple, aspen, basswood and ironwood trees are designated for cutting regardless of merchantability, EXCEPT those trees marked with green paint. Do not cut any other tree species.

##### 2.1.11 - Description of timber note (2/04)

Note that "Other Comm. Sp." = basswood, sugar maple and ironwood.

##### 2.1.12 - Reserve trees (2/04)

The Purchaser shall not cut live or dead reserve trees within cutting units or clearings. Reserve trees are any tree marked with green paint. The Purchaser shall protect reserve trees from damage by the Purchaser's operations. If the Purchaser's operations have cut or damaged reserve trees through carelessness, the Purchaser shall pay \$300 as fixed, agreed and liquidated damages for each reserve tree cut or damaged. Such payment does not constitute ownership of the undesignated timber.

##### 2.1.13 - Reserve areas (6/07)

The Purchaser shall protect reserve areas from damage by the Purchaser's operations. Reserve areas are marked with a yellow boundary line. The Purchaser shall not cut live or dead trees within reserve areas nor operate any harvesting equipment within these areas, unless authorized by DNR sale administrator. If Purchaser's operations have damaged reserve areas through carelessness, the Purchaser shall pay \$1000 as fixed, agreed and liquidated damages for each acre or part thereof cut or damaged. Such payment does not constitute ownership of the undesignated timber.

### 5 - Operations

#### 5.2 - Conduct of Operations

##### 5.2.1 - Slash

##### 5.2.1.7 - Slash must be scattered (2/04)

Unless otherwise directed, slash and logging debris shall be uniformly scattered over the sale area and not left in piles or windrows. Slash shall not be allowed to accumulate at the landings. All slash work shall be done concurrently with harvesting.

5.2.1.8 - Slash height (2/04)

No slash or tree tops left on the ground may exceed 36 inches in height.

**5.2.2 - Hazard Trees/Snags**

5.2.2.1 - Den trees (2/04)

Obvious hollow and/or den trees shall be protected and left standing unless they are a safety hazard.

**5.2.4 - Dead and Down Creation**

5.2.4.3 - Dead and down creation, dead trees (6/07)

Except as provided for in General Condition and Requirement 5.2.2, no dead trees, standing or down, are to be cut, skidded, or processed.

5.2.4.4 - Dead and down creation, grouse (9/05)

To encourage grouse use and other wildlife, in unit(s) 1 and 2 leave a total of 30 trees (unit 1=25, unit 2=5), 12" diameter or larger log-length (8 foot minimum) piece on the ground. They must be cut at least 4 feet above the ground leaving a snag. These trees should be left standing until all merchantable trees are moved to the landing, at which time they are to be cut, felled and left on the ground next to the snag. These will be evenly scattered throughout the cut unit. This can be an unmerchantable 8 foot or longer piece or a full tree.

5.2.31 - Landing locations (6/08)

Recommended landing areas are marked on the timber sale map with the letter "L". Landings must be confined to these designated sites unless otherwise authorized by the Unit Manager or their representative.

5.2.41 - Snowmobile trail protection (4/07)

Begold road is a snowmobile trail and is shown on the Timber Sale Map. If the trail is used, it must be maintained throughout the sale and restored to a condition equal to or better than before the sale. Do not cut or damage posts with orange trail markers or traffic control signs. If the trail is used for hauling, it must be graded to the satisfaction of the Unit Manager or their representative prior to December 1st. The snowmobile trail may not be used for any timber sale operations from December 1 to March 31.

**5.4 - Soil Protection**

5.4.2 - Skid trails (2/04)

Skid trails up and down slopes should be avoided. If however this is unavoidable, these trails will be left in a non-erodible condition using water bars, logs, and slash. Placing of slash on these skid trails while logging is ongoing may alleviate need for any further action. At the direction of the sale administrator, seed, fertilizer, and mulch may also be required.

SUPPLY OAK (074-08-01)

A timber sale contract for this LUMP SUM SEALED timber sale will be awarded the responsible bidder offering the highest sealed bid price. Bids must be at or above the following appraised price for each species:

<u>SPECIES</u>	<u>ESTIMATED VOLUME*</u>	<u>APPRAISED PRICE</u>
SAWLOGS		
RED OAK	18.90 MBF	\$ 200.00/MBF
WHITE OAK	9.40 MBF	\$ 65.00/MBF
MIXED OAK	43.40 MBF	\$ 105.00/MBF
PULPWOOD		
MIXED OAK	189.40 CORDS	\$ 9.00/CORD

In addition, the successful bidder agrees to purchase the following species at the indicated appraised price:

<u>SPECIES</u>	<u>ESTIMATED VOLUME*</u>	<u>APPRAISED PRICE</u>
SAWLOGS		
WHITE PINE	2.40 MBF	\$ 46.00/MBF
RED PINE	3.00 MBF	\$ 135.00/MBF
PULPWOOD		
RED MAPLE	56.30 CORDS	\$ 13.00/CORD
WHITE PINE	67.80 CORDS	\$ 4.00/CORD
MIX SOFTWD	15.00 CORDS	\$ 16.00/CORD

\*The volumes are statistically estimated within plus (+) or minus (-) 15.51 percent. These estimated volumes are final and not subject to adjustment. Prospective bidders are urged to examine this timber and to make their own estimates of quantity and quality.

BOND AND PAYMENT SCHEDULE:

1. A bond in the amount of \$621.00 to insure faithful performance of the conditions of the contract, will be deposited by the successful bidder within 21 days of the sale award.
2. Cutting in any sale or unit without the required advance payment would be considered a trespass.
3. Total payment may be paid in advance or according to the following schedule:
  - (a) Ten percent (10%) of the sale value must be paid within 21 days of the sale award.
  - (b) The remainder is due before cutting begins.
4. If no cutting takes place, the 10% down payment will not be refunded.
5. Operations on the contract issued will terminate on September 30, 2009.

Michigan Department of Natural Resources-Forest Management Division  
**TIMBER SALE MAP**

*This information provided under authority of Part 525, Act 451 of 1994, as amended.*

Sale No.	Year	Sale Type
074	08	01

State Forest and Forest Management Unit:  
**Pere Marquette - Traverse City**

Mapped By: **Patrick Ruppen**  
 Marked By:

Date: **September 30, 2008**

Township **27N** Range **10W** Section(s) **35 // 36**

Subdivision **N1/2NE // NWNW**

Scale: **1:15,840**

Cover Type				Density		
A=Aspen	H=Hemlock	P=Lowland Poplar	V=Bog or Marsh	1=Non Stocked	7=Saw Timber Poor	
B=Paper Birch	J=Jack Pine	Q=Mixed Swamp Onfr	W=White Pine	2=Seeding Sapling Poor	8=Saw Timber Medium	
C=Cedar	L=Lowland Brush	R=Red Pine	X=Non Stocked	3=Seeding Sapling Well	9=Saw Timber Well	
E=Swamp Hdwoods	M=Mpl, Bch, Brch	S=Black Spruce	Z=Water	4=Pole Timber Poor		
F=Spruce Fir	N=Marsh	T=Tamarack		5=Pole Timber Medium		
G=Grass	O=Oak	U=Upland Brush		6=Pole Timber Well		

# Supply Oak

## Sale Area 29 Acre

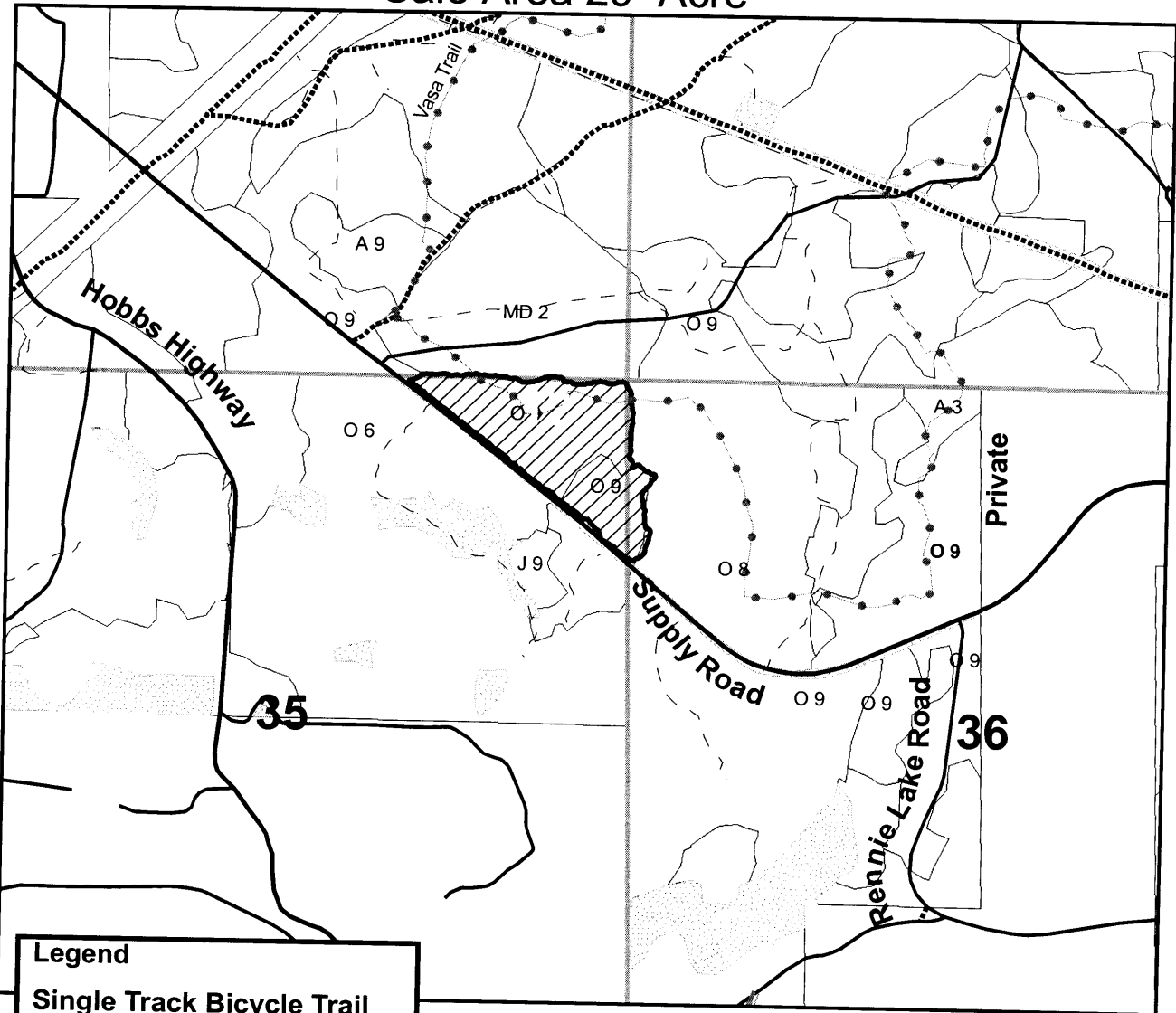

**Legend**

**Single Track Bicycle Trail**

**Trail Designation**

- Bicycle Trail
- - - Horse Trail
- Sale area
- Two track
- - - - - Poor quality road

## Sale Specific Conditions & Requirements

**Sale Name: Supply Oak    Sale Number: 61-074-08-01**

### 1 - Sale Area

#### 1.2 - Boundaries

##### 1.2.1 - Painted boundaries (6/05)

The sale boundary is marked and identified by red paint. Do not cut painted boundary line trees.

### 2 - Timber Specifications

#### 2.1 - Included Timber

##### 2.1.1 - Clearcut unit(s) with unmerchantable trees (2/04)

Within Payment Unit(s) , cut all trees that are two (2) inches or more in diameter measured at a point of four and one-half (4-1/2) feet above ground level regardless of merchantability Reserve trees identified in accordance with

2.1.12- Reserve Trees within clearcutting boundaries, are not Included Timber and are to be protected.

##### 2.1.11 - Description of timber note (2/04)

Note that mixed softwood pulpwood is red pine and jack pine.

##### 2.1.12 - Reserve trees (2/04)

The Purchaser shall not cut live or dead reserve trees within cutting units or clearings. Reserve trees are marked with Green paint. The Purchaser shall protect reserve trees from damage by the Purchaser's operations. If the Purchaser's operations have cut or damaged reserve trees through carelessness, the Purchaser shall pay \$50.00 as fixed, agreed and liquidated damages for each reserve tree cut or damaged. Such payment does not constitute ownership of the undesignated timber.

### 4 - Transportation

#### 4.1 - Construction

##### 4.1.7 - Road closure (4/07)

All new roads built into the sale must be blocked to vehicle traffic upon completion of the sale. In general, this will require constructing double earthen berms at strategic locations. Stumps and brush must be placed along the remainder of the trail. These roads must be rendered impassable to cars and trucks. All stumps from road building and landing construction must be reserved to block any newly constructed roads upon completion of the sale. These stumps must be scattered along the road system to prohibit vehicular movement.

### 5 - Operations

#### 5.1 - Notification

**Sale Name: Supply Oak Sale Number: 61-074-08-01**

**5.1.1 - Pre-sale conference (2/08)**

A pre-sale conference on site between the Purchaser and sale administrator is required prior to beginning any operations to determine landing and road locations. The Unit Manager or their representative must be contacted at least 3 days in advance to schedule the conference.

**5.1.4 - Post-sale conference (2/04)**

A post-sale conference on site between the Purchaser and sale administrator is required 5 days prior to the completion of active logging operations to determine clean-up and repair of landings, road edges, and the fulfillment of other contract specifications.

**5.2 - Conduct of Operations**

**5.2.1 - Slash**

**5.2.1.7 - Slash must be scattered (2/04)**

Unless otherwise directed, slash and logging debris shall be uniformly scattered over the sale area and not left in piles or windrows. Slash shall not be allowed to accumulate at the landings. All slash work shall be done concurrently with harvesting.

**5.2.1.8 - Slash height (2/04)**

No slash or tree tops may exceed 30 inches in height.

**5.2.1.12 - Slash for prescribed burning (1/05)**

To facilitate prescribed burning, slash shall be moved at least 20 feet inside the sale boundary. Slash cannot be piled or placed near residual trees.

**5.2.2 - Hazard Trees/Snags**

**5.2.2.1 - Den trees (2/04)**

Obvious hollow and/or den trees shall be protected and left standing unless they are a safety hazard.

**5.2.13 - Oak wilt restriction (9/08)**

Within Payment Unit(s), unless changed by written agreement, cutting and skidding are not permitted during the period of April 15 to July 15. This is necessary to reduce the spread of oak wilt. For more information, contact the Unit Manager or their representative.

**5.2.38 - No decking against live trees (2/04)**

Cut products may not be decked against unmarked or designated leave trees.

**5.2.40 - Pathway protection (9/07)**

The Vasa Single Track Bicycle Trail is shown on the Timber Sale Map. Do not cut trees or damage posts with blue pathway markers. Maintain a 20-foot wide slash, debris, and rut free zone daily, using the pathway as the centerline. Do not run equipment down the pathway. Skidding across the trail may only occur in locations approved by the sale administrator.

**5.4 - Soil Protection**



**Sale Name: Supply Oak    Sale Number: 61-074-08-01**

**5.4.1 - Rutting restriction, general (12/08)**

Operations are to cease immediately if equipment and weather conditions result in rutting of roads which is 12 inches or greater in depth and 50 feet in length. In addition, operations are to cease immediately if equipment and weather conditions result in rutting on skid trails which is 12 inches or greater in depth and 50 feet in length. The Unit Manager or their representative may restrict hauling and/or skidding if ruts exceed the specified depth. With the Unit Manager or their representative's approval, the Purchaser may return to the area when the weather conditions have changed and/or the risk of rutting has decreased.

**6 - Safety and Fire Prevention**

**6.2 - Signing**

**6.2.1 - Road posting (9/08)**

The purchaser is responsible for posting and maintaining caution signs on Supply Road prior to beginning operations. The road must be posted at appropriate distances from the sale area to warn of logging activity and truck traffic. Signs must be removed when harvest operations are suspended or completed. The Purchaser will provide these signs for use on State-owned land.

**6.2.3 - Recreational trail posting (9/08)**

The purchaser is responsible for posting and maintaining caution signs on the Vasa Single Track Bicycle trail prior to beginning operations. The trail must be posted at appropriate distances from the sale area to warn of logging activity and truck traffic at both ends of the trail. The purchaser must maintain the signs for the duration of the sale. The Purchaser will provide these signs for use on State-owned land.



4836 OAK (076-08-01)

A timber sale contract for this LUMP SUM SEALED timber sale will be awarded the responsible bidder offering the highest sealed bid price. Bids must be at or above the following appraised price for each species:

<u>SPECIES</u>	<u>ESTIMATED VOLUME*</u>	<u>APPRAISED PRICE</u>
SAWLOGS		
MIXED OAK	66.00 MBF	\$ 105.00/MBF
PULPWOOD		
MIXED OAK	335.00 CORDS	\$ 9.00/CORD

In addition, the successful bidder agrees to purchase the following species at the indicated appraised price:

<u>SPECIES</u>	<u>ESTIMATED VOLUME*</u>	<u>APPRAISED PRICE</u>
SAWLOGS		
RED OAK	4.40 MBF	\$ 200.00/MBF
WHITE OAK	9.40 MBF	\$ 60.00/MBF
PULPWOOD		
RED MAPLE	41.00 CORDS	\$ 13.00/CORD
B.T. ASPEN	23.00 CORDS	\$ 18.00/CORD
WHITE PINE	51.00 CORDS	\$ 4.00/CORD
RED PINE	9.00 CORDS	\$ 20.00/CORD
JACK PINE	15.00 CORDS	\$ 9.00/CORD

\*The volumes are statistically estimated within plus (+) or minus (-) 12.91 percent. These estimated volumes are final and not subject to adjustment. Prospective bidders are urged to examine this timber and to make their own estimates of quantity and quality.

BOND AND PAYMENT SCHEDULE:

1. A bond in the amount of \$643.00 to insure faithful performance of the conditions of the contract, will be deposited by the successful bidder within 21 days of the sale award.
2. Cutting in any sale or unit without the required advance payment would be considered a trespass.
3. Total payment may be paid in advance or according to the following schedule:
  - (a) Ten percent (10%) of the sale value must be paid within 21 days of the sale award.
  - (b) The remainder is due before cutting begins.
4. If no cutting takes place, the 10% down payment will not be refunded.
5. Operations on the contract issued will terminate on September 30, 2009.

Michigan Department of Natural Resources-Forest Management Division  
**TIMBER SALE MAP**

*This information provided under authority of Part 525, Act 451 of 1994, as amended.*

Sale No.	Year	Sale Type
076	08	01

State Forest and Forest Management Unit: <b>Pere Marquette - Traverse City</b>			Mapped By: <b>Patrick Ruppen</b>	Date: <b>September 30, 2008</b>
Township <b>27N</b>	Range <b>10W</b>	Section(s) <b>36</b>	Subdivision <b>E1/2NW1/4</b>	Scale: <b>1:15,840</b>

Cover Type				Density		
A=Aspen	H=Hemlock	P=Lowland Poplar	V=Bog or Marsh	1=Non Stocked	7=Saw Timber Poor	
B=Paper Birch	J=Jack Pine	Q=Mixed Swamp Cnfr	W=White Pine	2=Seeding Sapling Poor	8=Saw Timber Medium	
C=Cedar	L=Lowland Brush	R=Red Pine	X=Non Stocked	3=Seeding Sapling Well	9=Saw Timber Well	
E=Swamp Hdwoods	M=Mpl, Bch, Brch	S=Black Spruce	Z=Water	4=Pole Timber Poor		
F=Spruce Fir	N=Marsh	T=Tamarack		5=Pole Timber Medium		
G=Grass	O=Oak	U=Upland Brush		6=Pole Timber Well		

# 4836 Oak

Sale Area 34.7 Acre

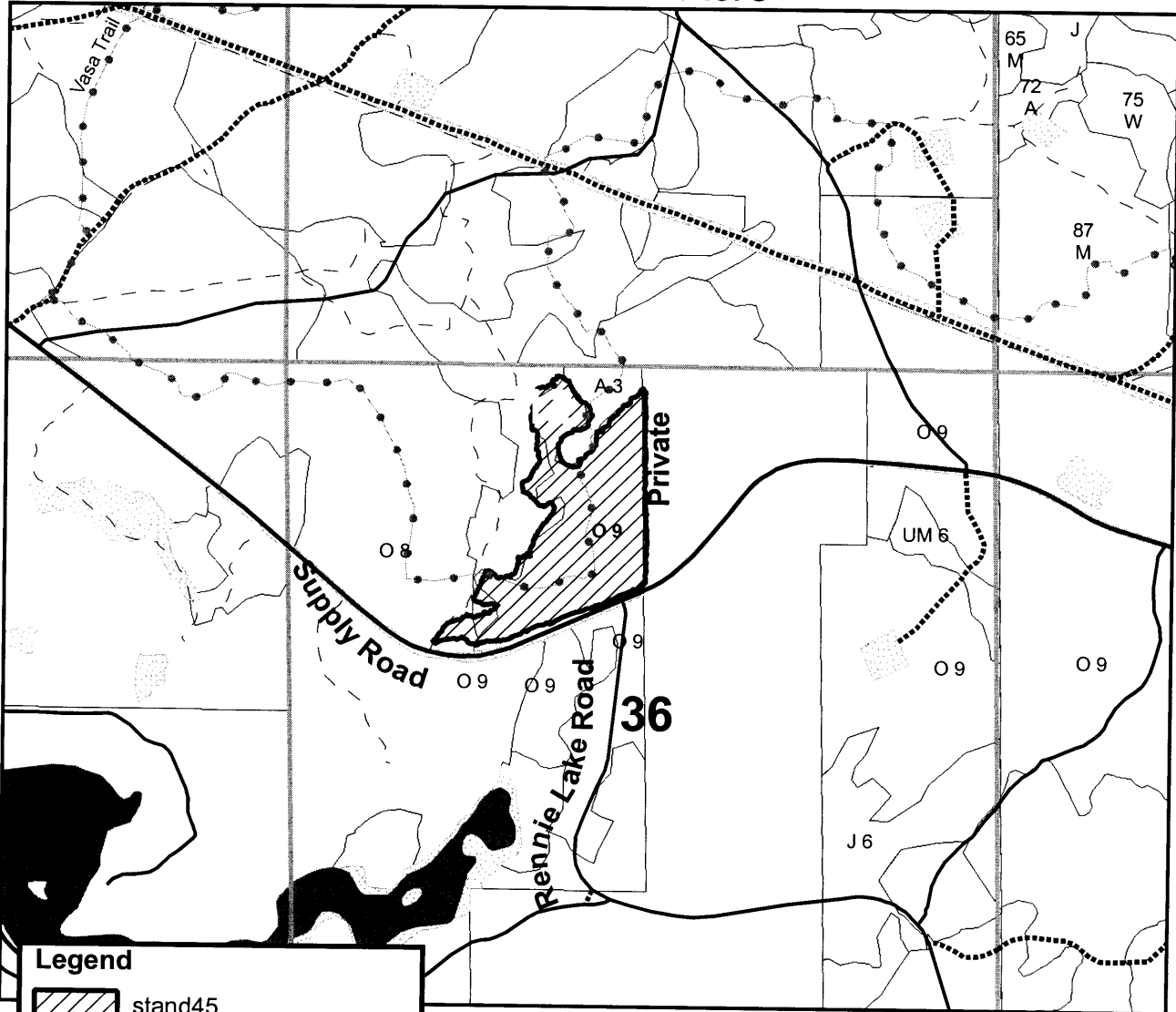

**Legend**

stand45

**Single Track Bicycle Trail**

**Trail Designation**

Bicycle Trail

Horse Trail

Two track

Poor quality road

## Sale Specific Conditions & Requirements

**Sale Name: 4836 Oak    Sale Number: 61-076-08-01**

### 1 - Sale Area

#### 1.2 - Boundaries

##### 1.2.1 - Painted boundaries (6/05)

The sale boundary is marked and identified by blue and red paint. Exterior sale boundary lines against private property are marked with blue paint. Exterior sale boundary lines against state are marked with red paint.

### 2 - Timber Specifications

#### 2.1 - Included Timber

##### 2.1.2 - Clearcut unit(s) w/o unmerchantable trees (5/07)

Within Payment Unit(s), cut all trees which meet minimum piece specifications in 2.2 Utilization. Reserve trees identified in accordance with 2.1.12 - Reserve trees, within clearcutting unit boundaries, are not Included Timber and are to be protected.

##### 2.1.11 - Description of timber note (2/04)

Note that mixed oak sawlogs are pin oak. Mixed oak pulpwood is red, white and pin oak.

##### 2.1.12 - Reserve trees (2/04)

The Purchaser shall not cut live or dead reserve trees within cutting units or clearings. Reserve trees are marked with green paint. The Purchaser shall protect reserve trees from damage by the Purchaser's operations. If the Purchaser's operations have cut or damaged reserve trees through carelessness, the Purchaser shall pay \$50.00 as fixed, agreed and liquidated damages for each reserve tree cut or damaged. Such payment does not constitute ownership of the undesignated timber.

### 4 - Transportation

#### 4.1 - Construction

##### 4.1.7 - Road closure (4/07)

All new roads built into the sale must be blocked to vehicle traffic upon completion of the sale. Overgrown roads that are reopened shall be considered new roads. In general, this will require constructing double earthen berms at strategic locations. Stumps and brush must be placed along the remainder of the trail. These roads must be rendered impassable to cars and trucks. All stumps from road building and landing construction must be reserved to block any newly constructed roads upon completion of the sale. These stumps must be scattered along the road system to prohibit vehicular movement.

### 5 - Operations

#### 5.1 - Notification

**Sale Name: 4836 Oak    Sale Number: 61-076-08-01**

**5.1.1 - Pre-sale conference (2/08)**

A pre-sale conference on site between the Purchaser and sale administrator is required prior to beginning any operations each sale Payment Unit to determine landing and road locations. The Unit Manager or their representative must be contacted at least 3 days in advance to schedule the conference.

**5.1.4 - Post-sale conference (2/04)**

A post-sale conference on site between the Purchaser and sale administrator is required 5 days prior to the completion of active logging operations to determine clean-up and repair of landings, road edges, and the fulfillment of other contract specifications.

**5.2 - Conduct of Operations**

**5.2.1 - Slash**

**5.2.1.7 - Slash must be scattered (2/04)**

Unless otherwise directed, slash and logging debris shall be uniformly scattered over the sale area and not left in piles or windrows. Slash shall not be allowed to accumulate at the landings. All slash work shall be done concurrently with harvesting.

**5.2.1.8 - Slash height (2/04)**

No slash or tree tops may exceed 36 inches in height.

**5.2.2 - Hazard Trees/Snags**

**5.2.2.1 - Den trees (2/04)**

Obvious hollow and/or den trees shall be protected and left standing unless they are a safety hazard.

**5.2.4 - Dead and Down Creation**

**5.2.4.1 - Dead and down creation, marked trees (2/05)**

All trees marked with a green xxx must be felled and left on site for wildlife. These trees have been taken off the timber tally.

**5.2.13 - Oak wilt restriction (9/08)**

Within Payment Unit(s) , unless changed by written agreement, cutting and skidding are not permitted during the period of April 15 to July 15. This is necessary to reduce the spread of oak wilt. For more information, contact the Unit Manager or their representative.

**5.2.38 - No decking against live trees (2/04)**

Cut products may not be decked against unmarked or designated leave trees.

**5.2.40 - Pathway protection (9/07)**

Vasa Single Track Bicycle Trail and is shown on the Timber Sale Map. Do not cut trees or damage posts with blue pathway markers. Maintain a 20-foot wide slash, debris, and rut free zone daily, using the pathway as the centerline. Do not run equipment down the pathway. Skidding across the trail may only occur in locations approved by the sale administrator.

**5.4 - Soil Protection**

**5.4.1 - Rutting restriction, general (12/08)**

Operations are to cease immediately if equipment and weather conditions result in rutting of roads which is 12 inches or greater in depth and 50 feet in length. In addition, operations are to cease immediately if equipment and weather conditions result in rutting on skid trails which is 12 inches or greater in depth and 50 feet in length. The Unit Manager or their representative may restrict hauling and/or skidding if ruts exceed the specified depth. With the Unit Manager or their representative's approval, the Purchaser may return to the area when the weather conditions have changed and/or the risk of rutting has decreased.

**6 - Safety and Fire Prevention**

**6.2 - Signing**

**6.2.1 - Road posting (9/08)**

The purchaser is responsible for posting and maintaining caution signs on Supply Road prior to beginning operations.

The road must be posted at appropriate distances from the sale area to warn of logging activity and truck traffic.

Signs must be removed when harvest operations are suspended or completed. The Purchaser will provide these signs for use on State-owned land.

**6.2.3 - Recreational trail posting (9/08)**

The purchaser is responsible for posting and maintaining caution signs on the Vasa Single Track Bicycle Trail trail

prior to beginning operations. The trail must be posted at appropriate distances from the sale area to warn of logging activity and truck traffic at both ends of the trail. The purchaser must maintain the signs until the sale is closed.

The Purchaser will provide these signs for use on State-owned land.





5320 OAK (083-07-01)

A timber sale contract for this LUMP SUM SEALED timber sale will be awarded the responsible bidder offering the highest sealed bid price. Bids must be at or above the following appraised price for each species:

<u>SPECIES</u>	<u>ESTIMATED VOLUME*</u>	<u>APPRAISED PRICE</u>
SAWLOGS		
MIXED OAK	4.90 MBF	\$ 50.00/MBF
PULPWOOD		
RED MAPLE	36.00 CORDS	\$ 6.60/CORD
MIXED OAK	101.00 CORDS	\$ 6.60/CORD

\*The volumes are statistically estimated within plus (+) or minus (-) 43.24 percent. These estimated volumes are final and not subject to adjustment. Prospective bidders are urged to examine this timber and to make their own estimates of quantity and quality.

BOND AND PAYMENT SCHEDULE:

1. A bond in the amount of \$57.55 to insure faithful performance of the conditions of the contract, will be deposited by the successful bidder within 21 days of the sale award.
2. Cutting in any sale or unit without the required advance payment would be considered a trespass.
3. Total payment may be paid in advance or according to the following schedule:
  - (a) Ten percent (10%) of the sale value must be paid within 21 days of the sale award.
  - (b) The remainder is due before cutting begins.
4. If no cutting takes place, the 10% down payment will not be refunded.
5. Operations on the contract issued will terminate on September 30, 2009.



Michigan Department of Natural Resources-Forest Management Division  
**TIMBER SALE MAP**

*This information provided under authority of Part 525, Act 451 of 1994, as amended.*

Sale No.	Year	Sale Type
083	07	01

State Forest and Forest Management Unit: <b>Pere Marquette - Traverse City</b>		Mapped By: <b>Patrick Ruppen</b>		Date: <b>August 15, 2007</b>
Township <b>26N</b>	Range <b>9W</b>	Section(s) <b>20</b>	Subdivision <b>NENW, NWNE</b>	Scale: <b>1:15,840</b>

Cover Type				Density		
A=Aspen	H=Hemlock	P=Lowland Poplar	V=Bog or Marsh	1=Non Stocked	7=Saw Timber Poor	
B=Paper Birch	J=Jack Pine	Q=Mixed Swamp Cnfr	W=White Pine	2=Seedling Sapling Poor	8=Saw Timber Medium	
C=Cedar	L=Lowland Brush	R=Red Pine	X=Non Stocked	3=Seedling Sapling Well	9=Saw Timber Well	
E=Swamp Howwoods	M=Mpl, Bch, Brch	S=Black Spruce	Z=Water	4=Pole Timber Poor		
F=Spruce Fir	N=Marsh	T=Tamarack		5=Pole Timber Medium		
G=Grass	O=Oak	U=Upland Brush		6=Pole Timber Well		



# 5320 Oak

sale area: 17 acres

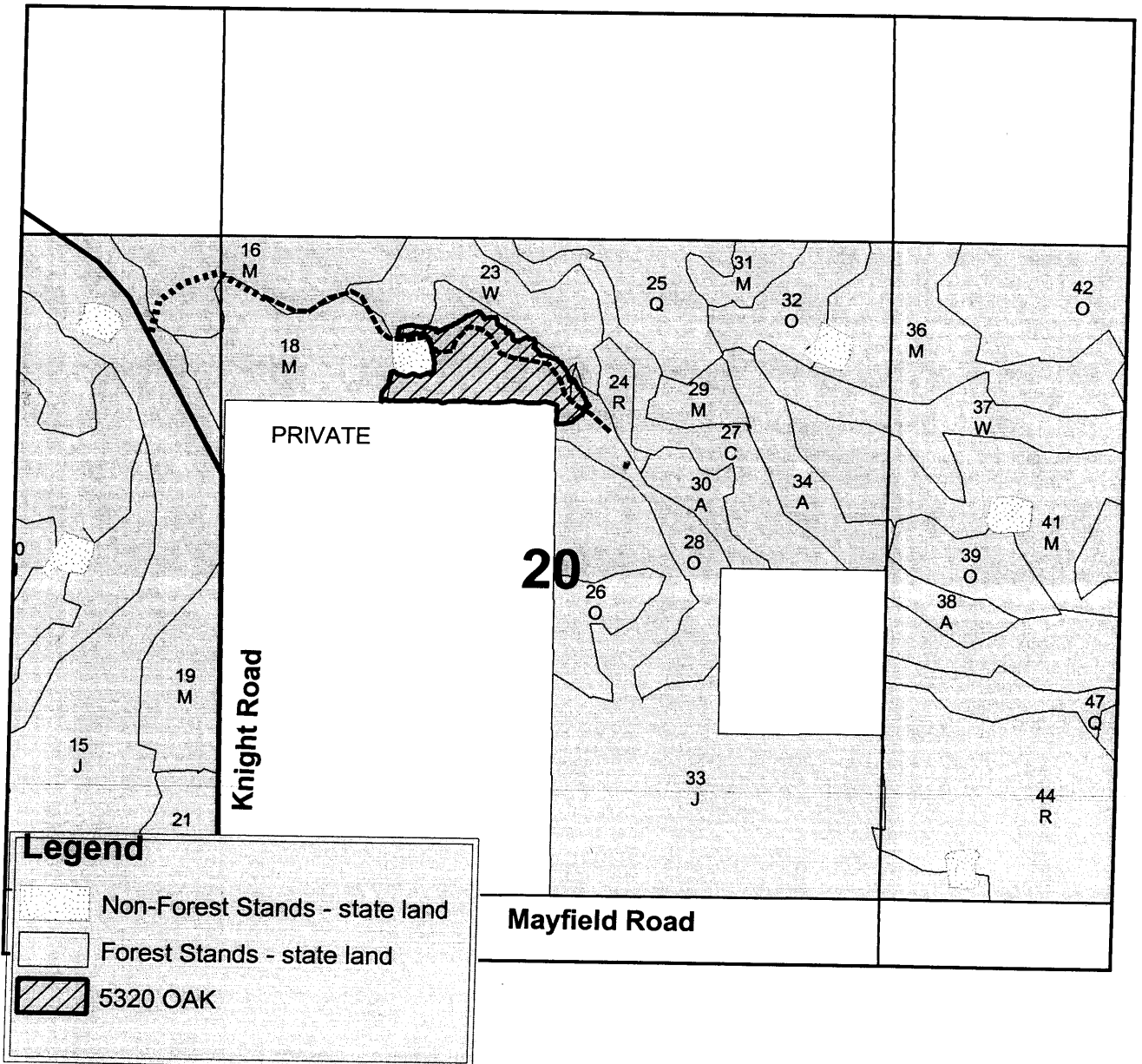

## Sale Specific Conditions & Requirements

Sale Name: 5320 Oak Sale Number: 61-083-07-01

### 1 - Sale Area

#### 1.2 - Boundaries

##### 1.2.1 - Painted boundaries (6/05)

The sale boundary is marked and identified by blue and red paint. Exterior sale boundary lines against private property are marked with blue paint. Exterior sale boundary lines against state are marked with red paint.

### 2 - Timber Specifications

#### 2.1 - Included Timber

##### 2.1.3 - Cut tree marked unit(s) (8/04)

Within Payment Unit(s) all trees are designated for cutting when marked with orange paint above and below stump height, regardless of merchantability. In addition cut all red maple trees that meet minimum piece specification (2.2 Utilization)

##### 2.1.11 - Description of timber note (2/04)

Note that mixed oak sawlogs and pulp is nearly all white oak. The remainder is pin oak.

### 4 - Transportation

#### 4.2 - Maintenance

##### 4.2.5 - Two wheel drive condition (2/04)

All existing trail roads on and adjacent to the sale area must be passable by two-wheel drive traffic for the duration of the sale.

### 5 - Operations

#### 5.1 - Notification

##### 5.1.1 - Pre-sale conference (6/04)

A pre-sale conference on site between the Purchaser and sale administrator is required prior to beginning any operations. The Unit Manager or their representative must be contacted at least 3 days in advance to schedule the conference.

##### 5.1.4 - Post-sale conference (2/04)

A post-sale conference on site between the Purchaser and sale administrator is required 5 days prior to the completion of active logging operations to determine clean-up and repair of landings, road edges, and the fulfillment of other contract specifications.

#### 5.2 - Conduct of Operations

**5.2.1 - Slash**

5.2.1.7 - Slash must be scattered (2/04)

Unless otherwise directed, slash and logging debris shall be uniformly scattered over the sale area and not left in piles or windrows. Slash shall not be allowed to accumulate at the landings. All slash work shall be done concurrently with harvesting.

5.2.1.8 - Slash height (2/04)

No slash or tree tops may exceed 36 inches in height.

**5.2.2 - Hazard Trees/Snags**

5.2.2.1 - Den trees (2/04)

Obvious hollow and/or den trees shall be protected and left standing unless they are a safety hazard.

**5.4 - Soil Protection**

5.4.1 - Rutting restriction (1/07)

Operations are to cease immediately if equipment and weather conditions result in rutting of 12 inches or greater in depth. The Unit Manager or their representative may restrict hauling and/or skidding if ruts exceed the specified depth. With the Unit Manager or their representative's approval, the Purchaser may return to the area when the weather conditions have changed and/or the risk of rutting has decreased.

5.4.3 - Erosion control (2/04)

Skid trails or haul roads may require erosion control structures or berms per direction of the Unit Manager or their representative.

5.4.5 - Soil caution (11/04)

Care must be taken to minimize soil damage due to the sandy soils.

HIGH VOLTAGE PINE (094-08-01)

A timber sale contract for this LUMP SUM SEALED timber sale will be awarded the responsible bidder offering the highest sealed bid price. Bids must be at or above the following appraised price for each species:

<u>SPECIES</u>	<u>ESTIMATED VOLUME*</u>	<u>APPRAISED PRICE</u>
SAWLOGS		
SUG. MAPLE	14.00 MBF	\$ 258.00/MBF
RED MAPLE	14.90 MBF	\$ 71.00/MBF
BLK CHERRY	17.00 MBF	\$ 108.00/MBF
PULPWOOD		
WHITE PINE	575.00 CORDS	\$ 3.30/CORD

In addition, the successful bidder agrees to purchase the following species at the indicated appraised price:

<u>SPECIES</u>	<u>ESTIMATED VOLUME*</u>	<u>APPRAISED PRICE</u>
SAWLOGS		
WHITE PINE	8.90 MBF	\$ 30.00/MBF
PULPWOOD		
SUG. MAPLE	46.00 CORDS	\$ 7.70/CORD
RED MAPLE	78.00 CORDS	\$ 9.90/CORD
BEECH	13.00 CORDS	\$ 10.00/CORD
B.T. ASPEN	5.00 CORDS	\$ 14.00/CORD
BLK CHERRY	111.00 CORDS	\$ 6.20/CORD

\*The volumes are statistically estimated within plus (+) or minus (-) 13.70 percent. These estimated volumes are final and not subject to adjustment. Prospective bidders are urged to examine this timber and to make their own estimates of quantity and quality.

BOND AND PAYMENT SCHEDULE:

1. A bond in the amount of \$534.00 to insure faithful performance of the conditions of the contract, will be deposited by the successful bidder within 21 days of the sale award.
2. Cutting in any sale or unit without the required advance payment would be considered a trespass.
3. Total payment may be paid in advance or according to the following schedule:
  - (a) Ten percent (10%) of the sale value must be paid within 21 days of the sale award.
  - (b) The remainder is due before cutting begins.
4. If no cutting takes place, the 10% down payment will not be refunded.
5. Operations on the contract issued will terminate on September 30, 2009.



Michigan Department of Natural Resources-Forest Management Division  
**TIMBER SALE MAP**

*This information provided under authority of Part 525, Act 451 of 1994, as amended.*

Sale No.	Year	Sale Type
94	08	01

State Forest and Forest Management Unit: <b>Pere Marquette-Traverse City</b>		Mapped By: Marked/Cruised By: <b>Scott Lint</b>		Date: <b>September 29, 2008</b>	
Township <b>24N</b>	Range <b>14W</b>	Section(s) <b>26</b>	Subdivision <b>NWSW</b>	Scale: 1:15840	

Cover Type			Density		
A=Aspen	H=Hemlock	P=Lowland Poplar	V=Bog or Marsh	1=Non Stocked	7=Saw Timber Poor
B=Paper Birch	J=Jack Pine	Q=Mixed Swamp Cnfr	W=White Pine	2=Seedling Sapling Poor	8=Saw Timber Medium
C=Cedar	L=Lowland Brush	R=Red Pine	X=Non Stocked	3=Seedling Sapling Well	9=Saw Timber Well
E=Swamp Hdwoods	M=Mpl, Bch, Brch	S=Black Spruce	Z=Water	4=Pole Timber Poor	
F=Spruce Fir	N=Marsh	T=Tamarack		5=Pole Timber Medium	
G=Grass	O=Oak	U=Upland Brush		6=Pole Timber Well	

= sale area  
 = snowmobile trail  
 = survey corner/witness trees  
 no private lands are adjacent to this sale area

# High Voltage Pine

sale area: 24 acres

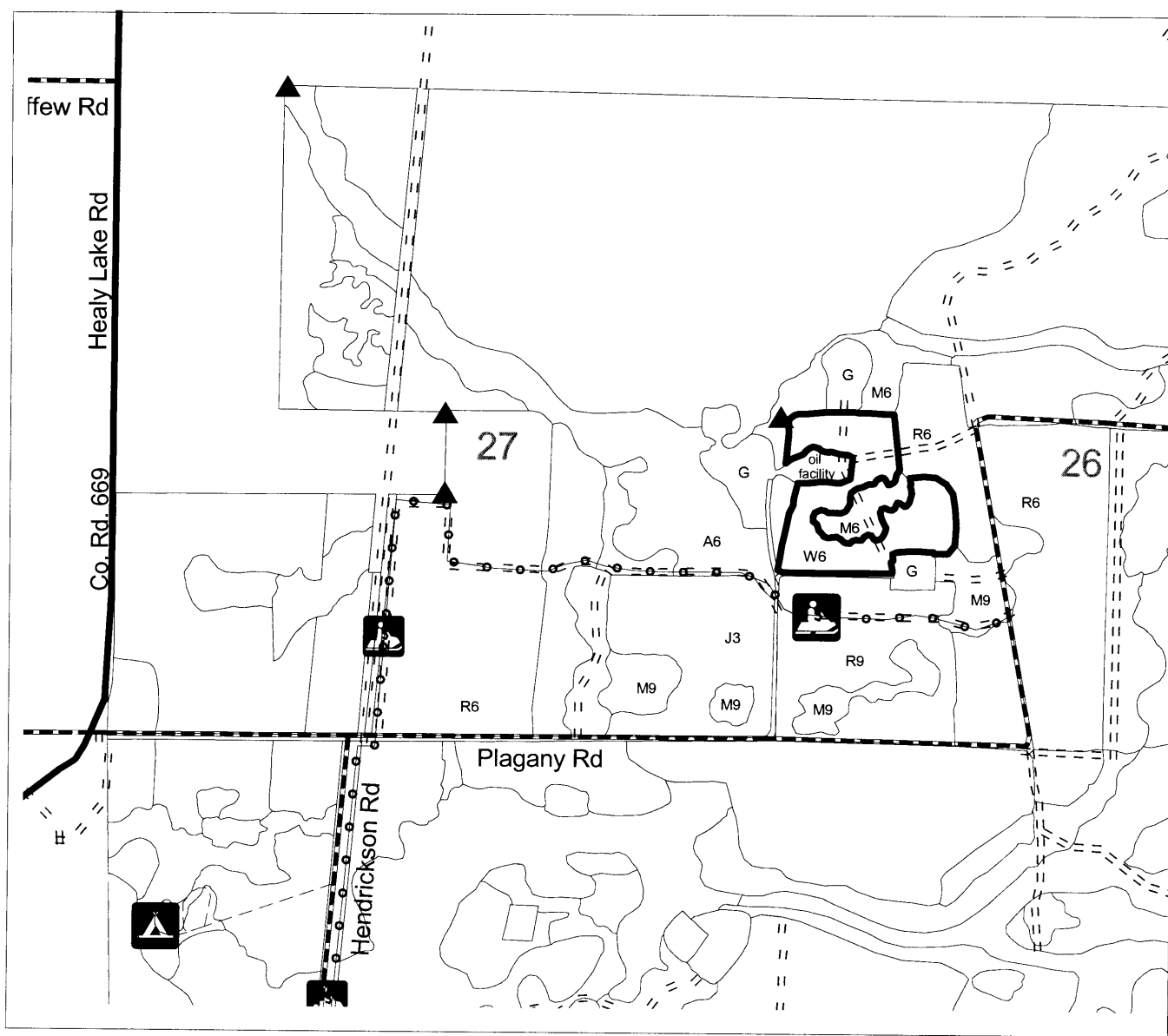

## Sale Specific Conditions & Requirements

Sale Name: High Voltage Pine Sale Number: 61-094-08-01

### 2 - Timber Specifications

#### 2.1 - Included Timber

##### 2.1.1 - Clearcut unit(s) with unmerchantable trees (2/04)

Within Payment Unit(s), cut all trees that are two (2) inches or more in diameter measured at a point of four and one-half (4-1/2) feet above ground level regardless of merchantability except for trees marked with green paint. Reserve trees identified in accordance with 2.1.12 - Reserve trees, within clearcutting unit boundaries, are not Included Timber and are to be protected.

##### 2.1.12 - Reserve trees (2/04)

The Purchaser shall not cut live or dead reserve trees within cutting units or clearings. Reserve trees are marked with green paint. The Purchaser shall protect reserve trees from damage by the Purchaser's operations. If the Purchaser's operations have cut or damaged reserve trees through carelessness, the Purchaser shall pay \$25.00 as fixed, agreed and liquidated damages for each reserve tree cut or damaged. Such payment does not constitute ownership of the undesignated timber.

### 5 - Operations

#### 5.1 - Notification

##### 5.1.3 - Well heads and natural gas pipelines (7/07)

The Purchaser is responsible for contacting the gas or pipeline company prior to operating equipment in the vicinity of well heads or natural gas pipelines.

#### 5.2 - Conduct of Operations

##### 5.2.1 - Slash

##### 5.2.1.7 - Slash must be scattered (2/04)

Unless otherwise directed, slash and logging debris shall be uniformly scattered over the sale area and not left in piles or windrows. Slash shall not be allowed to accumulate at the landings. All slash work shall be done concurrently with harvesting.

##### 5.2.1.8 - Slash height (2/04)

No slash or tree tops may exceed 24 inches in height.

##### 5.2.12 - Bark slippage restriction (3/07)

Within Payment Unit(s), cutting, skidding, and hauling are not permitted during the period of April 15 to July 15. This restriction is because of bark slippage.





TIMBER SALE / SEALED BID  
STATE OF MICHIGAN / DNR

TRAVERSE CITY MANAGEMENT UNIT  
TRAVERSE CITY

POTTER RED MAPLE (008-09-01)  
T23N, R14W, SEC. 09, N1/2NWNE.  
MANISTEE COUNTY

In response to the notice of sale to be held 2:00 p.m. on July 30, 2009, I am hereby submitting my sealed bid (firm offer) for the following forest products to be cut. Bids for individual species and total bid value must be at or above the appraised price. All non-responsive bid forms may be rejected.

<u>SPECIES</u>	<u>APPRAISED PRICE</u>	<u>BID PRICE</u>	<u>ESTIMATED VOLUME*</u>	<u>= VALUE</u>
SAWLOGS				
RED MAPLE	\$ 102.00/MBF	\$ _____ X	26.60 MBF	= \$ _____
PULPWOOD				
RED MAPLE	\$ 11.90/CORD	\$ _____ X	112.00 CORDS	= \$ _____
			SUBTOTAL 1	\$ _____

In addition, the successful bidder agrees to purchase the following species at the appraised price:

<u>SPECIES</u>	<u>APPRAISED PRICE</u>	<u>ESTIMATED VOLUME*</u>	<u>VALUE</u>
PULPWOOD			
MIX HARDWD	\$ 8.50/CORD	2.00 CORDS	= \$ 17.00
			SUBTOTAL 2 \$ 17.00
			SUBTOTAL 1 + SUBTOTAL 2 = TOTAL BID VALUE \$ _____

\*These volumes are statistically estimated within plus (+) or minus (-) 27.76%. These estimated volumes are final and not subject to adjustment. Prospective bidders are urged to examine this timber and to make their own estimates of quantity and quality.

I understand that any or all bids may be rejected, and that the individual unit bid price will be the basis to determine total bid value. All bids must be signed and all bid items must be bid or the bid form may be rejected. I also understand that consideration and awarding a contract will be based upon my past performance and ability to complete the contract based upon equipment and manpower subject to my control.

\_\_\_\_\_  
(bidder's printed name)

\_\_\_\_\_  
(bidder's signature)

Address/Telephone \_\_\_\_\_

THE WINNING BIDDER MUST COMPLETE THE FORM ON THE REVERSE SIDE  
WITHIN 21 DAYS OF SALE AWARD



**TIMBER SALE  
VERIFICATION OF WORKER'S DISABILITY  
COMPENSATION ACT COMPLIANCE**

*As required by Act 317, P.A. 1969 (Worker's Compensation) and Part 525  
of Act 451 of 1994, as amended.*

FOR DEPARTMENT USE ONLY	
Sale or Permit No	
Year:	Type:
Forest Area:	

**VERIFICATION OF WORKER'S DISABILITY COMPENSATION ACT COMPLIANCE**

- This verification must be completed and submitted within 21 days of contract award and prior to the issuance of the timber sale contract.
- In addition, if boxes 2B or 2C are checked, then Notice of Exclusion or Certificate of Insurance must be submitted within 21 days of the contract award and prior to the issuance of the timber sale contract.
- All Information must be typed or printed except for written signatures.

Please Check Appropriate Categories:

1. My business is organized as (you **must** check one of the boxes below):
  - A.  Sole Proprietorship (individual)
  - B.  Partnership
  - C.  Corporation
2. You **must** check one of the boxes below:
  - A.  I certify that my business is a sole proprietorship and it has no employees but the sole proprietor. I am not subject to the Worker's Compensation Laws.
  - B.  I certify that my business has satisfied its obligation to the Worker's Compensation Act through the use of an approved Notice of Exclusion (BWC-337, Rev. 5/96). I will provide a copy of the Notice of Exclusion within 21 days of the contract award. (For questions or a copy of the BWC-337, please call the Worker's Compensation Bureau at 517-322-1195).
  - C.  I certify that my business has a Worker's Compensation Policy. I will provide an original Certificate of Insurance within 21 days of the contract award.
3. If you have checked item 2(A) or 2(B), you **must** indicate the number of **both** full and part time employees other than yourself including family members and active partners (if none, you must enter "0").

\_\_\_\_\_ Full Time Employees

\_\_\_\_\_ Part Time Employees

Name of Business		Federal ID (or) Social Security No.	
Address		Telephone No. (        )	
City	State	Zip + 4	

I hereby certify that the above information is true and correct. I agree to notify the DNR of any changes that occur in factors affecting my coverage during any of my present and future operations.

\_\_\_\_\_  
Signature of Owner or Authorized Representative

\_\_\_\_\_  
Title

\_\_\_\_\_  
Date

TIMBER SALE / SEALED BID  
STATE OF MICHIGAN / DNR

TRAVERSE CITY MANAGEMENT UNIT  
TRAVERSE CITY

SITTING MOOSE (067-08-01)  
T25N, R14W, SEC. 07, S1/2SE.  
T25N, R14W, SEC. 18, N1/2NE, NWSE.  
BENZIE COUNTY

In response to the notice of sale to be held 2:00 p.m. on July 30, 2009, I am hereby submitting my sealed bid (firm offer) for the following forest products to be cut. Bids for individual species and total bid value must be at or above the appraised price. All non-responsive bid forms may be rejected.

<u>SPECIES</u>	<u>APPRAISED PRICE</u>	<u>BID PRICE</u>	<u>ESTIMATED VOLUME*</u>	<u>= VALUE</u>
SAWLOGS				
RED MAPLE	\$ 93.00/MBF	\$ _____ X	31.20 MBF	= \$ _____
B.T. ASPEN	\$ 68.00/MBF	\$ _____ X	156.20 MBF	= \$ _____
OT. C. SP.	\$ 100.00/MBF	\$ _____ X	20.30 MBF	= \$ _____
PULPWOOD				
RED MAPLE	\$ 11.00/CORD	\$ _____ X	197.40 CORDS	= \$ _____
B.T. ASPEN	\$ 15.60/CORD	\$ _____ X	620.30 CORDS	= \$ _____
			SUBTOTAL 1	\$ _____

In addition, the successful bidder agrees to purchase the following species at the appraised price:

<u>SPECIES</u>	<u>APPRAISED PRICE</u>	<u>ESTIMATED VOLUME*</u>	<u>VALUE</u>	
PULPWOOD				
OT. C. SP.	\$ 7.75/CORD	113.90 CORDS	= \$ 882.73	
			SUBTOTAL 2	\$ 882.73
SUBTOTAL 1 + SUBTOTAL 2 = TOTAL BID VALUE \$ _____				

\*these volumes are statistically estimated within plus (+) or minus (-) 13.38%. These estimated volumes are final and not subject to adjustment. Prospective bidders are urged to examine this timber and to make their own estimates of quantity and quality.

I understand that any or all bids may be rejected, and that the individual unit bid price will be the basis to determine total bid value. All bids must be signed and all bid items must be bid or the bid form may be rejected. I also understand that consideration and awarding a contract will be based upon my past performance and ability to complete the contract based upon equipment and manpower subject to my control.

\_\_\_\_\_  
(bidder's printed name)

\_\_\_\_\_  
(bidder's signature)

Address/Telephone \_\_\_\_\_

THE WINNING BIDDER MUST COMPLETE THE FORM ON THE REVERSE SIDE  
WITHIN 21 DAYS OF SALE AWARD



**FOR DEPARTMENT USE ONLY**

Sale or Permit No

Year:

Type:

Forest Area:

**TIMBER SALE  
VERIFICATION OF WORKER'S DISABILITY  
COMPENSATION ACT COMPLIANCE**

*As required by Act 317, P.A. 1969 (Worker's Compensation) and Part 525  
of Act 451 of 1994, as amended.*

**VERIFICATION OF WORKER'S DISABILITY COMPENSATION ACT COMPLIANCE**

- This verification must be completed and submitted within 21 days of contract award and prior to the issuance of the timber sale contract.
- In addition, if boxes 2B or 2C are checked, then Notice of Exclusion or Certificate of Insurance must be submitted within 21 days of the contract award and prior to the issuance of the timber sale contract.
- All Information must be typed or printed except for written signatures.

Please Check Appropriate Categories:

1. My business is organized as (you must check one of the boxes below):
  - A.  Sole Proprietorship (individual)
  - B.  Partnership
  - C.  Corporation
2. You must check one of the boxes below:
  - A.  I certify that my business is a sole proprietorship and it has no employees but the sole proprietor. I am not subject to the Worker's Compensation Laws.
  - B.  I certify that my business has satisfied its obligation to the Worker's Compensation Act through the use of an approved Notice of Exclusion (BWC-337, Rev. 5/96). I will provide a copy of the Notice of Exclusion within 21 days of the contract award. (For questions or a copy of the BWC-337, please call the Worker's Compensation Bureau at 517-322-1195).
  - C.  I certify that my business has a Worker's Compensation Policy. I will provide an original Certificate of Insurance within 21 days of the contract award.
3. If you have checked item 2(A) or 2(B), you must indicate the number of both full and part time employees other than yourself including family members and active partners (if none, you must enter "0").

\_\_\_\_\_ Full Time Employees

\_\_\_\_\_ Part Time Employees

Name of Business		Federal ID (or) Social Security No.	
Address		Telephone No. (       )	
City	State	Zip + 4	

I hereby certify that the above information is true and correct. I agree to notify the DNR of any changes that occur in factors affecting my coverage during any of my present and future operations.

\_\_\_\_\_  
Signature of Owner or Authorized Representative

\_\_\_\_\_  
Title

\_\_\_\_\_  
Date

TIMBER SALE / SEALED BID  
 STATE OF MICHIGAN / DNR

TRAVERSE CITY MANAGEMENT UNIT  
 TRAVERSE CITY

SUPPLY OAK (074-08-01)  
 T27N, R10W, SEC. 35, N1/2NE.  
 T27N, R10W, SEC. 36, NWNW.  
 GRAND TRAVERSE COUNTY

In response to the notice of sale to be held 2:00 p.m. on July 30, 2009, I am hereby submitting my sealed bid (firm offer) for the following forest products to be cut. Bids for individual species and total bid value must be at or above the appraised price. All non-responsive bid forms may be rejected.

<u>SPECIES</u>	<u>APPRAISED PRICE</u>	<u>BID PRICE</u>	<u>ESTIMATED VOLUME*</u>	<u>= VALUE</u>
<u>SAWLOGS</u>				
RED OAK	\$ 200.00/MBF	\$ _____ X	18.90 MBF	= \$ _____
WHITE OAK	\$ 65.00/MBF	\$ _____ X	9.40 MBF	= \$ _____
MIXED OAK	\$ 105.00/MBF	\$ _____ X	43.40 MBF	= \$ _____
<u>PULPWOOD</u>				
MIXED OAK	\$ 9.00/CORD	\$ _____ X	189.40 CORDS	= \$ _____
SUBTOTAL 1				\$ _____

In addition, the successful bidder agrees to purchase the following species at the appraised price:

<u>SPECIES</u>	<u>APPRAISED PRICE</u>	<u>ESTIMATED VOLUME*</u>	<u>VALUE</u>
<u>SAWLOGS</u>			
WHITE PINE	\$ 46.00/MBF	2.40 MBF	= \$ 110.40
RED PINE	\$ 135.00/MBF	3.00 MBF	= \$ 405.00
<u>PULPWOOD</u>			
RED MAPLE	\$ 13.00/CORD	56.30 CORDS	= \$ 731.90
WHITE PINE	\$ 4.00/CORD	67.80 CORDS	= \$ 271.20
MIX SOFTWD	\$ 16.00/CORD	15.00 CORDS	= \$ 240.00
SUBTOTAL 2			\$ 1,758.50

SUBTOTAL 1 + SUBTOTAL 2 = TOTAL BID VALUE \$ \_\_\_\_\_

\*These volumes are statistically estimated within plus (+) or minus (-) 15.51%. These estimated volumes are final and not subject to adjustment. Prospective bidders are urged to examine this timber and to make their own estimates of quantity and quality.

I understand that any or all bids may be rejected, and that the individual unit bid price will be the basis to determine total bid value. All bids must be signed and all bid items must be bid or the bid form may be rejected. I also understand that consideration and awarding a contract will be based upon my past performance and ability to complete the contract based upon equipment and manpower subject to my control.

\_\_\_\_\_  
 (bidder's printed name)

\_\_\_\_\_  
 (bidder's signature)

Address/Telephone \_\_\_\_\_

THE WINNING BIDDER MUST COMPLETE THE FORM ON THE REVERSE SIDE  
 WITHIN 21 DAYS OF SALE AWARD



**TIMBER SALE  
VERIFICATION OF WORKER'S DISABILITY  
COMPENSATION ACT COMPLIANCE**

*As required by Act 317, P.A. 1969 (Worker's Compensation) and Part 525  
of Act 451 of 1994, as amended.*

**FOR DEPARTMENT USE ONLY**

Sale or Permit No

Year:

Type:

Forest Area:

**VERIFICATION OF WORKER'S DISABILITY COMPENSATION ACT COMPLIANCE**

- This verification must be completed and submitted within 21 days of contract award and prior to the issuance of the timber sale contract.
- In addition, if boxes 2B or 2C are checked, then Notice of Exclusion or Certificate of Insurance must be submitted within 21 days of the contract award and prior to the issuance of the timber sale contract.
- All Information must be typed or printed except for written signatures.

Please Check Appropriate Categories:

1. My business is organized as (you must check one of the boxes below):
  - A.  Sole Proprietorship (individual)
  - B.  Partnership
  - C.  Corporation
2. You must check one of the boxes below:
  - A.  I certify that my business is a sole proprietorship and it has no employees but the sole proprietor. I am not subject to the Worker's Compensation Laws.
  - B.  I certify that my business has satisfied its obligation to the Worker's Compensation Act through the use of an approved Notice of Exclusion (BWC-337, Rev. 5/96). I will provide a copy of the Notice of Exclusion within 21 days of the contract award. (For questions or a copy of the BWC-337, please call the Worker's Compensation Bureau at 517-322-1195).
  - C.  I certify that my business has a Worker's Compensation Policy. I will provide an original Certificate of Insurance within 21 days of the contract award.
3. If you have checked item 2(A) or 2(B), you must indicate the number of both full and part time employees other than yourself including family members and active partners (if none, you must enter "0").

\_\_\_\_\_ Full Time Employees

\_\_\_\_\_ Part Time Employees

Name of Business		Federal ID (or) Social Security No.	
Address		Telephone No. (       )	
City	State	Zip + 4	

I hereby certify that the above information is true and correct. I agree to notify the DNR of any changes that occur in factors affecting my coverage during any of my present and future operations.

\_\_\_\_\_  
Signature of Owner or Authorized Representative

\_\_\_\_\_  
Title

\_\_\_\_\_  
Date

TIMBER SALE / SEALED BID  
 STATE OF MICHIGAN / DNR

TRAVERSE CITY MANAGEMENT UNIT  
 TRAVERSE CITY

4836 OAK (076-08-01)  
 T27N, R10W, SEC. 36, E1/2NW1/4.  
 GRAND TRAVERSE COUNTY

In response to the notice of sale to be held 2:00 p.m. on July 30, 2009, I am hereby submitting my sealed bid (firm offer) for the following forest products to be cut. Bids for individual species and total bid value must be at or above the appraised price. All non-responsive bid forms may be rejected.

<u>SPECIES</u>	<u>APPRAISED PRICE</u>	<u>BID PRICE</u>	<u>ESTIMATED VOLUME*</u>	<u>= VALUE</u>
SAWLOGS				
MIXED OAK	\$ 105.00/MBF	\$ _____ X	66.00 MBF	= \$ _____
PULPWOOD				
MIXED OAK	\$ 9.00/CORD	\$ _____ X	335.00 CORDS	= \$ _____
SUBTOTAL 1				\$ _____

In addition, the successful bidder agrees to purchase the following species at the appraised price:

<u>SPECIES</u>	<u>APPRAISED PRICE</u>	<u>ESTIMATED VOLUME*</u>	<u>VALUE</u>
SAWLOGS			
RED OAK	\$ 200.00/MBF	4.40 MBF	= \$ 880.00
WHITE OAK	\$ 60.00/MBF	9.40 MBF	= \$ 564.00
PULPWOOD			
RED MAPLE	\$ 13.00/CORD	41.00 CORDS	= \$ 533.00
B.T. ASPEN	\$ 18.00/CORD	23.00 CORDS	= \$ 414.00
WHITE PINE	\$ 4.00/CORD	51.00 CORDS	= \$ 204.00
RED PINE	\$ 20.00/CORD	9.00 CORDS	= \$ 180.00
JACK PINE	\$ 9.00/CORD	15.00 CORDS	= \$ 135.00
SUBTOTAL 2			\$ <u>2,910.00</u>

SUBTOTAL 1 + SUBTOTAL 2 = TOTAL BID VALUE \$ \_\_\_\_\_

\*These volumes are statistically estimated within plus (+) or minus (-) 12.91%. These estimated volumes are final and not subject to adjustment. Prospective bidders are urged to examine this timber and to make their own estimates of quantity and quality.

I understand that any or all bids may be rejected, and that the individual unit bid price will be the basis to determine total bid value. All bids must be signed and all bid items must be bid or the bid form may be rejected. I also understand that consideration and awarding a contract will be based upon my past performance and ability to complete the contract based upon equipment and manpower subject to my control.

\_\_\_\_\_  
 (bidder's printed name)

\_\_\_\_\_  
 (bidder's signature)

Address/Telephone \_\_\_\_\_

THE WINNING BIDDER MUST COMPLETE THE FORM ON THE REVERSE SIDE  
 WITHIN 21 DAYS OF SALE AWARD



**FOR DEPARTMENT USE ONLY**

**TIMBER SALE  
VERIFICATION OF WORKER'S DISABILITY  
COMPENSATION ACT COMPLIANCE**

*As required by Act 317, P.A. 1969 (Worker's Compensation) and Part 525  
of Act 451 of 1994, as amended.*

Sale or Permit No

Year:

Type:

Forest Area:

**VERIFICATION OF WORKER'S DISABILITY COMPENSATION ACT COMPLIANCE**

- This verification must be completed and submitted within 21 days of contract award and prior to the issuance of the timber sale contract.
- In addition, if boxes 2B or 2C are checked, then Notice of Exclusion or Certificate of Insurance must be submitted within 21 days of the contract award and prior to the issuance of the timber sale contract.
- All information must be typed or printed except for written signatures.

Please Check Appropriate Categories:

1. My business is organized as (you must check one of the boxes below):
  - A.  Sole Proprietorship (individual)
  - B.  Partnership
  - C.  Corporation
2. You must check one of the boxes below:
  - A.  I certify that my business is a sole proprietorship and it has no employees but the sole proprietor. I am not subject to the Worker's Compensation Laws.
  - B.  I certify that my business has satisfied its obligation to the Worker's Compensation Act through the use of an approved Notice of Exclusion (BWC-337, Rev. 5/96). I will provide a copy of the Notice of Exclusion within 21 days of the contract award. (For questions or a copy of the BWC-337, please call the Worker's Compensation Bureau at 517-322-1195).
  - C.  I certify that my business has a Worker's Compensation Policy. I will provide an original Certificate of Insurance within 21 days of the contract award.
3. If you have checked item 2(A) or 2(B), you must indicate the number of **both** full and part time employees other than yourself including family members and active partners (if none, you must enter "0").

\_\_\_\_\_ Full Time Employees

\_\_\_\_\_ Part Time Employees

Name of Business		Federal ID (or) Social Security No.	
Address		Telephone No. (       )	
City	State	Zip + 4	

I hereby certify that the above information is true and correct. I agree to notify the DNR of any changes that occur in factors affecting my coverage during any of my present and future operations.

\_\_\_\_\_  
Signature of Owner or Authorized Representative

\_\_\_\_\_  
Title

\_\_\_\_\_  
Date



TIMBER SALE / SEALED BID  
STATE OF MICHIGAN / DNR

TRAVERSE CITY MANAGEMENT UNIT  
TRAVERSE CITY

5320 OAK (083-07-01)  
T26N, R09W, SEC. 20, NENW, NWNE.  
GRAND TRAVERSE COUNTY

In response to the notice of sale to be held 2:00 p.m. on July 30, 2009, I am hereby submitting my sealed bid (firm offer) for the following forest products to be cut. Bids for individual species and total bid value must be at or above the appraised price. All non-responsive bid forms may be rejected.

<u>SPECIES</u>	<u>APPRAISED PRICE</u>	<u>BID PRICE</u>	<u>ESTIMATED VOLUME* = VALUE</u>
SAWLOGS			
MIXED OAK	\$ 50.00/MBF	\$ _____ X	4.90 MBF = \$ _____
PULPWOOD			
RED MAPLE	\$ 6.60/CORD	\$ _____ X	36.00 CORDS = \$ _____
MIXED OAK	\$ 6.60/CORD	\$ _____ X	101.00 CORDS = \$ _____
			TOTAL BID VALUE \$ _____

\*These volumes are statistically estimated within plus (+) or minus (-) 43.24%. These estimated volumes are final and not subject to adjustment. Prospective bidders are urged to examine this timber and to make their own estimates of quantity and quality.

I understand that any or all bids may be rejected, and that the individual unit bid price will be the basis to determine total bid value. All bids must be signed and all bid items must be bid or the bid form may be rejected. I also understand that consideration and awarding a contract will be based upon my past performance and ability to complete the contract based upon equipment and manpower subject to my control.

\_\_\_\_\_  
(bidder's printed name)

\_\_\_\_\_  
(bidder's signature)

Address/Telephone \_\_\_\_\_

THE WINNING BIDDER MUST COMPLETE THE FORM ON THE REVERSE SIDE  
WITHIN 21 DAYS OF SALE AWARD



TIMBER SALE / SEALED BID  
STATE OF MICHIGAN / DNR

TRAVERSE CITY MANAGEMENT UNIT  
TRAVERSE CITY

HIGH VOLTAGE PINE (094-08-01)  
T24N, R14W, SEC. 26, NWSW.  
MANISTEE COUNTY

In response to the notice of sale to be held 2:00 p.m. on July 30, 2009, I am hereby submitting my sealed bid (firm offer) for the following forest products to be cut. Bids for individual species and total bid value must be at or above the appraised price. All non-responsive bid forms may be rejected.

<u>SPECIES</u>	<u>APPRAISED PRICE</u>	<u>BID PRICE</u>	<u>ESTIMATED VOLUME*</u>	<u>VALUE</u>
SAWLOGS				
SUG. MAPLE	\$ 258.00/MBF	\$ _____ X	14.00 MBF	= \$ _____
RED MAPLE	\$ 71.00/MBF	\$ _____ X	14.90 MBF	= \$ _____
BLK CHERRY	\$ 108.00/MBF	\$ _____ X	17.00 MBF	= \$ _____
PULPWOOD				
WHITE PINE	\$ 3.30/CORD	\$ _____ X	575.00 CORDS	= \$ _____
			SUBTOTAL 1	\$ _____

In addition, the successful bidder agrees to purchase the following species at the appraised price:

<u>SPECIES</u>	<u>APPRAISED PRICE</u>	<u>ESTIMATED VOLUME*</u>	<u>VALUE</u>
SAWLOGS			
WHITE PINE	\$ 30.00/MBF	8.90 MBF	= \$ 267.00
PULPWOOD			
SUG. MAPLE	\$ 7.70/CORD	46.00 CORDS	= \$ 354.20
RED MAPLE	\$ 9.90/CORD	78.00 CORDS	= \$ 772.20
BEECH	\$ 10.00/CORD	13.00 CORDS	= \$ 130.00
B.T. ASPEN	\$ 14.00/CORD	5.00 CORDS	= \$ 70.00
BLK CHERRY	\$ 6.20/CORD	111.00 CORDS	= \$ 688.20
		SUBTOTAL 2	\$ 2,281.60

SUBTOTAL 1 + SUBTOTAL 2 = TOTAL BID VALUE \$ \_\_\_\_\_

\*These volumes are statistically estimated within plus (+) or minus (-) 13.70%. These estimated volumes are final and not subject to adjustment. Prospective bidders are urged to examine this timber and to make their own estimates of quantity and quality.

I understand that any or all bids may be rejected, and that the individual unit bid price will be the basis to determine total bid value. All bids must be signed and all bid items must be bid or the bid form may be rejected. I also understand that consideration and awarding a contract will be based upon my past performance and ability to complete the contract based upon equipment and manpower subject to my control.

\_\_\_\_\_  
(bidder's printed name)

\_\_\_\_\_  
(bidder's signature)

Address/Telephone \_\_\_\_\_

THE WINNING BIDDER MUST COMPLETE THE FORM ON THE REVERSE SIDE  
WITHIN 21 DAYS OF SALE AWARD



FOR DEPARTMENT USE ONLY	
Sale or Permit No	
Year:	Type:
Forest Area:	

**TIMBER SALE  
VERIFICATION OF WORKER'S DISABILITY  
COMPENSATION ACT COMPLIANCE**

*As required by Act 317, P.A. 1969 (Worker's Compensation) and Part 525 of Act 451 of 1994, as amended.*

**VERIFICATION OF WORKER'S DISABILITY COMPENSATION ACT COMPLIANCE**

- This verification must be completed and submitted within 21 days of contract award and prior to the issuance of the timber sale contract.
- In addition, if boxes 2B or 2C are checked, then Notice of Exclusion or Certificate of Insurance must be submitted within 21 days of the contract award and prior to the issuance of the timber sale contract.
- All Information must be typed or printed except for written signatures.

Please Check Appropriate Categories:

1. My business is organized as (you **must** check one of the boxes below):
  - A.  Sole Proprietorship (individual)
  - B.  Partnership
  - C.  Corporation
2. You **must** check one of the boxes below:
  - A.  I certify that my business is a sole proprietorship and it has no employees but the sole proprietor. I am not subject to the Worker's Compensation Laws.
  - B.  I certify that my business has satisfied its obligation to the Worker's Compensation Act through the use of an approved Notice of Exclusion (BWC-337, Rev. 5/96). I will provide a copy of the Notice of Exclusion within 21 days of the contract award. (For questions or a copy of the BWC-337, please call the Worker's Compensation Bureau at 517-322-1195).
  - C.  I certify that my business has a Worker's Compensation Policy. I will provide an original Certificate of Insurance within 21 days of the contract award.
3. If you have checked item 2(A) or 2(B), you **must** indicate the number of **both** full and part time employees other than yourself including family members and active partners (if none, you must enter "0").

\_\_\_\_\_ Full Time Employees

\_\_\_\_\_ Part Time Employees

Name of Business		Federal ID (or) Social Security No.	
Address		Telephone No. (       )	
City	State	Zip + 4	

I hereby certify that the above information is true and correct. I agree to notify the DNR of any changes that occur in factors affecting my coverage during any of my present and future operations.

\_\_\_\_\_  
Signature of Owner or Authorized Representative

\_\_\_\_\_  
Title

\_\_\_\_\_  
Date