



DEPARTMENT OF NATURAL RESOURCES
STATE OF MICHIGAN

TIMBER SALE PROSPECTUS

Notice is hereby given that bids will be received by the Unit Manager, GRAYLING MANAGEMENT UNIT, for certain timber on the following described lands:

TOWN LINE KW / T27N, R01E, SEC. 01, NE1/4, E1/2SE, NWSE, E1/2NW.
T27N, R01E, SEC. 01, NWNW.
OSCODA COUNTY (Appr. \$145,620.65)
SALE ACRES: 275

COMP 206 CONTRACT / T27N, R04W, SEC. 24, NW1/4, NE1/4, NESW, N1/2SE.
T27N, R04W, SEC. 24, SESE.
CRAWFORD COUNTY (Appr. \$100,966.45)
SALE ACRES: 187

BIG "V" ASPEN / T28N, R01E, SEC. 36, NW1/4, W1/2NE, NWSW.
OSCODA COUNTY (Appr. \$31,402.80)
SALE ACRES: 124

HEHIR TRAIL RED PINE / T27N, R01W, SEC. 21, NE1/4, NESE.
CRAWFORD COUNTY (Appr. \$32,851.00)
SALE ACRES: 76

BIG BURN JACK / T25N, R04W, SEC. 06, W1/2, N1/2NE, SWNE.
CRAWFORD COUNTY (Appr. \$38,012.50)
SALE ACRES: 241

STONEHENGE OAK & RED PINE / T28N, R02W, SEC. 23, E1/2SE.
CRAWFORD COUNTY (Appr. \$27,126.50)
SALE ACRES: 41

SALE DATE AND TIME: 3:00 p.m. on March 30, 2010.

GRAYLING

BID INSTRUCTIONS (Ver. 06/23/2008):

1. Bid Location, Date, and Time: Bids must be received by the Unit Manager, Grayling Management Unit, 1955 N. I-75 BL, Grayling, Michigan 49738, no later than 3:00 p.m., on March 30, 2010. For further information concerning this sale, contact the Unit Manager at 989-348-6371.
2. Bidder's Qualifications: Purchaser shall obtain workers compensation insurance to cover claims under Michigan's Worker's Disability Compensation Act of 1969 or similar employee benefit act of any other state applicable to an employee. If all or part of a timber sale was prepared by a private contractor, that contractor and that contractor's company are not permitted to bid on the timber sale contract. Bids will not be accepted from individuals or companies appearing on the DNR/FMFM No-Bid List. This list contains the names of purchasers who previously failed to execute a contract within 21-days or who have a history of poor performance.
3. Preparation of Sealed Bids: Bids shall be manually signed in ink; bid prices must be entered for each species and product in the Bid Price column for all material subject to bidding; and all fill-in blanks must be completed. If erasures or other changes appear on the forms, each erasure or change must be initialed by the person signing the bid.
4. Submission of Sealed Bids: Bid forms may be obtained from the Unit Manager. All bids must be submitted on the bid form and in an envelope clearly identified as described in this section. NOTE: Only one bid form per bid envelope. Sealed bids must be submitted to the Unit office designated in the prospectus and must be submitted at or prior to the time established in the prospectus. The envelope should show on the outside (a) that it is a "Bid for Timber," and (b) the sale name or number, and (c) the date and time of bid opening as shown in the prospectus. Bids received after the time specified in the sale prospectus are late bids and will be rejected.
5. Public Opening of Sealed Bids: If conditions permit, the sealed bids will be publicly opened and posted at the time and place set in the prospectus.
6. Award of Contract: Award of the contract will be made to the Bidder whose bid, conforming to the prospectus, is most advantageous to the State of Michigan on the basis of total value at rates bid for the estimated quantities. The State reserves the right to reject any bid or waive any minor irregularity in bids received. A written award mailed (or otherwise furnished) to the successful Bidder shall be deemed to result in a binding contract without further action by either party.
7. Down Payment: The Bidder to whom award is made must make a down payment within 21 days of the sale award. The amount of the down payment will be calculated as shown in the Bond and Payment Schedule of this prospectus. Only cash may be used to meet this requirement.
8. Performance Security: As guarantee of faithful performance, a cash bond, certificate of deposit, surety bond or irrevocable letter of credit (LOC) is required within 21 days of the sale award. The amount of the performance security is shown in the Bond and Payment Schedule of this prospectus. If an LOC or surety is used, the coverage must extend for at least 6 months beyond the contract expiration.
9. Timber Sale Contract: Additional conditions and requirements common to all timber sales are listed on the timber sale contract (R4031) and are available on line at www.michigan.gov/dnr. Contact the Unit Manager for additional information or a sample contract. Within 21 days of the date of the award letter, the bidder must sign the contract and provide the required down payment, performance security, and verification of worker's disability compensation. The down payment and performance security shall be in accordance with the provisions of the timber sale contract, in the sums stated in this prospectus. If these actions are not taken, then the Bidder, the Bidder's corporation, and the corporation's principals may not be permitted to bid on State timber sales for a period of 1 year. In addition, the Bidder certifies that if awarded this contract, the Bidder will complete the timber sale contract in accordance with its terms and any modifications thereof including requirements to purchase, cut, and remove the included timber by the termination date.

10. Disclaimer of Estimates and Bidder's Warranty of Inspection: Before submitting this bid, the Bidder is advised and cautioned to inspect the sale area, review the requirements of the sale contract, and take other steps as may be reasonably necessary to ascertain the location, estimated volumes, construction estimates, and operating costs of the proposed sale. Failure to do so will not relieve the Bidder from responsibility for completing the contract.

The Bidder warrants that this bid is submitted solely on the basis of the Bidder's examination and inspection of the quality and quantity of the timber offered for sale and the Bidder's opinion of the value thereof and the costs of recovery. No reliance should be placed on the State of Michigan's estimates of timber quality, quantity or costs of recovery. Bidder further acknowledges that the State of Michigan: (i) expressly disclaims any warranty of fitness of timber for any purpose; (ii) offers this timber as is without any warranty of quality (merchantability) or quantity and (iii) expressly disclaims any warranty as to the quantity or quality of timber sold.

11. Certification and Chain-of-Custody: Unless otherwise indicated in the contract under section 7 - Other Conditions of the Sale Specific Conditions & Requirements, the area encompassed by this timber sale is certified to the standards of the Forest Stewardship Council (FSC) - Certificate #SCS-EM/COC-090N and the Sustainable Forestry Initiative (SFI) - Certificate # NSF-SFIS-5Y031-S1. Forest products from this sale may be delivered to the mill as "FSC and / or SFI certified" as long as the contractor hauling the forest products is chain-of-custody (COC) certified or covered under a COC certificate from the destination mill. The purchaser is responsible for maintaining COC after leaving the sale area.

REBECCA A. HUMPHRIES
Director

TOWN LINE KW (010-10-01)

A timber sale contract for this LUMP SUM SEALED timber sale will be awarded the responsible bidder offering the highest sealed bid price. Bids must be at or above the following appraised price for each species:

| <u>SPECIES</u> | <u>ESTIMATED VOLUME*</u> | <u>APPRAISED PRICE</u> |
|----------------|--------------------------|------------------------|
| SAWLOGS | | |
| RED PINE | 577.40 MBF | \$ 146.00/MBF |
| PULPWOOD | | |
| RED PINE | 841.00 CORDS | \$ 31.70/CORD |
| JACK PINE | 1,943.00 CORDS | \$ 10.40/CORD |

In addition, the successful bidder agrees to purchase the following species at the indicated appraised price:

| <u>SPECIES</u> | <u>ESTIMATED VOLUME*</u> | <u>APPRAISED PRICE</u> |
|----------------|--------------------------|------------------------|
| SAWLOGS | | |
| WHITE PINE | 97.40 MBF | \$ 44.00/MBF |
| JACK PINE | 76.50 MBF | \$ 44.00/MBF |
| PULPWOOD | | |
| RED MAPLE | 109.00 CORDS | \$ 5.75/CORD |
| WHITE PINE | 336.00 CORDS | \$ 4.95/CORD |
| MIXED OAK | 328.00 CORDS | \$ 8.80/CORD |
| MIX ASPEN | 189.00 CORDS | \$ 8.60/CORD |

*The volumes are statistically estimated within plus (+) or minus (-) 6.73 percent. These estimated volumes are final and not subject to adjustment. Prospective bidders are urged to examine this timber and to make their own estimates of quantity and quality.

BOND AND PAYMENT SCHEDULE:

1. A bond in the amount of \$7,500.00, to insure faithful performance of the conditions of the contract, will be deposited by the successful bidder within 21 days of the sale award.
2. Cutting in any sale or unit without the required advance payment would be considered a trespass.
3. Total payment may be paid in advance or according to the following schedule:
 - (a) Ten percent (10%) of the sale value must be paid within 21 days of the sale award.
 - (b) The 10% down payment will be credited towards the first unit cut.
 - (c) Payment for each of the following units must be made before cutting begins in that unit:

| <u>PAYMENT UNIT NUMBER</u> | <u>PERCENT OF TOTAL SALE VALUE</u> |
|----------------------------|------------------------------------|
| 1 | 08% |
| 2 | 15% |
| 3 | 15% |
| 4 | 21% |
| 5 | 06% |
| 6 | 06% |
| 7 | 11% |
| 8 | 06% |
| 9 | 07% |
| 10 | 05% |

4. If no cutting takes place, the 10% down payment will not be refunded.
5. Operations on the contract issued will terminate on March 31, 2012.

Sale Specific Conditions & Requirements

Sale Name: Town Line Kw Sale Number: 72-010-10-01

1 - Sale Area

1.2 - Boundaries

1.2.1 - Painted boundaries (12/08)

The sale boundary and Payment Unit boundaries are marked and identified by blue, red and yellow paint. Exterior sale boundary lines against private property are marked with blue paint. Exterior sale boundary lines against state are marked with red paint. Interior Payment Unit boundaries are marked with yellow paint. Leave/retention islands are marked with orange paint. Do not cut painted boundary line trees (including yellow painted trees).

2 - Timber Specifications

2.1 - Included Timber

2.1.1 - Clearcut unit(s) with unmerchantable trees (4/09)

Within Payment Unit(s) 1, 2, 3, 4, 5, 6, 7, 8, 9, and 10, cut all trees that are two (2) inches or more in diameter measured at a point four and one-half (4-1/2) feet above ground level regardless of merchantability. Exceptions: Do not cut trees marked with green paint. Do not cut boundary trees, including unit line trees. Do not cut or enter the retention areas identified by orange paint.

2.1.15 - Hazard trees near county roads (4/05)

Cut and remove all standing dead trees within 100 feet of the cleared portion of designated county roads. These cut snags must be scattered back into the sale area.

2.2 - Utilization

2.2.2 - Chipping required (9/09)

This sale must be chip harvested to meet Kirtland's warbler habitat requirements. The purchaser has the option to produce sawlogs or pulpwood bolts, but the remaining portion of the trees must be chipped and hauled. Products may be produced as roundwood and forwarded to decking areas in final product length, but the tops must be left intact and skidded to the landing for chipping in order to minimize the amount of residual slash. De-limbing will be allowed at landing locations only.

2.2.3 - Stump heights (4/07)

Stump heights within the Sale Area shall not exceed 6 inches for all trees. This is in order to facilitate planting operations.

3 - Payments

3.3 - Pre-measured Sales

3.3.4 - Dividing payment units (12/08)

Payment unit(s) 2, 3, 4, and 7 may be divided at the request of the purchaser and upon approval of the Unit Manager. Dividing payment units is a contract modification which requires a Timber Sale Contract Supplement.

3.4 - Damaged Timber

3.4.1 - Damaged timber (6/05)

General Condition and Requirement 3.4 Damaged Timber, defines liquidated damages for undesignated live merchantable trees which are cut or injured. Damage to residual trees (defined as breaking of the cambium layer, broken tops or bending of trees from their natural position) is not acceptable.

Damage is not acceptable to merchantable trees. Within the sale area, if more than 2% of trees (> 4.5" DBH) within a specified area of the sale are damaged, liquidated damages will be assessed for all trees damaged. Rates will be in accordance with General Condition and Requirement 3.4 Damaged Timber.

4 - Transportation

4.1 - Construction

4.1.3 - Slash and earthen piles (8/04)

Piles or windrows of earth along roads and landings that have been widened or constructed shall be leveled. Slash from road maintenance or construction, including stumps, shall be used to block newly created roads.

4.1.7 - Road closure (4/07)

All new roads built into the sale must be blocked to vehicle traffic upon completion of the sale. Overgrown roads that are reopened shall be considered new roads. Stumps and brush must be placed along the trails. These roads must be rendered impassable to cars and trucks.

4.1.11 - Permits (5/07)

The Purchaser will secure any necessary permits that may be required.

4.2 - Maintenance

4.2.5 - Two wheel drive condition (2/04)

All existing trail roads on and adjacent to the sale area must be passable by two-wheel drive traffic for the duration of the sale.

5 - Operations

5.1 - Notification

5.1.4 - Post-sale conference (9/09)

A post-sale conference on site between the Purchaser and sale administrator is required 5 days prior to the completion of active logging operations to determine clean-up and repair of landings, road edges, and the fulfillment of other contract specifications.

5.2 - Conduct of Operations

5.2.1 - Slash

5.2.1.8 - Slash height (12/08)

No slash or chip debris may exceed 18 inches in height.

5.2.1.13 - Dispose of slash as directed (12/05)

Slash is to be disposed of as directed by the sale administrator.

5.2.2 - Hazard Trees/Snags

5.2.2.1 - Den trees (2/04)

Obvious hollow and/or den trees shall be protected and left standing unless they are a safety hazard.

5.2.2.3 - Snag tree creation (2) (2/04)

Special consideration is given to snags because they are an important part of the habitat requirement for many species of wildlife. The logger is to leave or create at least five (5) wildlife snags per acre throughout the sale area. Snags consist of leaving a dead standing tree that is not deemed a safety hazard by the Purchaser, or trees with a minimum diameter of six (6) inches measured at a point to 4.5 feet above ground level which can be girdled the full circumference of the tree.

5.2.3 - Operating Restrictions

5.2.3.6 - Bark beetle restriction (12/08)

In the event drought creates a high risk of pine bark beetle infestation, pine is not to be cut during the period March 1 through July 1, unless all portions of trees greater than two inches in diameter are removed from the sale area, reduced to chips, or treated to the satisfaction of the Unit Manager or his/her representative, within fifteen days of being severed from the stump. Pine log decks, pulpwood piles and treetops that are piled for chipping in the fall or winter within a 1/4 mile of susceptible sites must be removed before March 15. Residual slash must not be placed in piles or rows and must be spread over the site for quick drying. The Department of Natural Resources will exercise this specification if the risk of damage warrants.

5.2.29 - Shrub protection (9/07)

Do not cut or damage hawthorn, witch-hazel, or junberry. These woody-shrub plants are highly beneficial to various wildlife species.

5.2.38 - No decking against live trees (2/04)

Cut products may not be decked against unmarked or designated leave trees.

5.4 - Soil Protection

5.4.1 - Rutting restriction, general (1/09)

Operations are to cease immediately if equipment and weather conditions result in rutting of roads and skid trails which is 12 inches or greater in depth and 50 feet in length. The Unit Manager or his/her representative may restrict hauling and/or skidding if ruts exceed the specified depth. With the Unit Manager or his/her representative's approval, the Purchaser may return to the area when the risk of rutting has decreased.

5.8 - Protection of Endangered Species

5.8.1 - Kirtland's warbler (1) (2/04)

This sale is adjacent to a young jack pine stand which may be used by the endangered Kirtland's Warbler. The Department reserves the right to temporarily restrict all harvesting operations in a buffer zone of up to 500 feet if it is determined that Warbler territory has been established in the adjacent stand. The restricted period, if put into effect, would apply from May 1st - September 30th.

COMP 206 CONTRACT (015-09-01)

A timber sale contract for this LUMP SUM SEALED timber sale will be awarded the responsible bidder offering the highest sealed bid price. Bids must be at or above the following appraised price for each species:

| <u>SPECIES</u> | <u>ESTIMATED VOLUME*</u> | <u>APPRAISED PRICE</u> |
|----------------|--------------------------|------------------------|
| SAWLOGS | | |
| RED PINE | 147.00 MBF | \$ 191.00/MBF |
| MIXED OAK | 248.60 MBF | \$ 189.00/MBF |
| PULPWOOD | | |
| RED PINE | 268.00 CORDS | \$ 31.25/CORD |
| MIXED OAK | 506.00 CORDS | \$ 9.50/CORD |
| MIX ASPEN | 441.00 CORDS | \$ 11.35/CORD |

In addition, the successful bidder agrees to purchase the following species at the indicated appraised price:

| <u>SPECIES</u> | <u>ESTIMATED VOLUME*</u> | <u>APPRAISED PRICE</u> |
|----------------|--------------------------|------------------------|
| SAWLOGS | | |
| MIX ASPEN | 39.30 MBF | \$ 56.00/MBF |
| PULPWOOD | | |
| RED MAPLE | 358.00 CORDS | \$ 7.70/CORD |
| WHITE PINE | 41.00 CORDS | \$ 4.90/CORD |
| JACK PINE | 208.00 CORDS | \$ 12.30/CORD |

*The volumes are statistically estimated within plus (+) or minus (-) 9.51 percent. These estimated volumes are final and not subject to adjustment. Prospective bidders are urged to examine this timber and to make their own estimates of quantity and quality.

BOND AND PAYMENT SCHEDULE:

1. A bond in the amount of \$5,100.00, to insure faithful performance of the conditions of the contract, will be deposited by the successful bidder within 21 days of the sale award.
2. Cutting in any sale or unit without the required advance payment would be considered a trespass.
3. Total payment may be paid in advance or according to the following schedule:
 - (a) Ten percent (10%) of the sale value must be paid within 21 days of the sale award.
 - (b) The 10% down payment will be credited towards the first unit cut.
 - (c) Payment for each of the following units must be made before cutting begins in that unit:

| <u>PAYMENT UNIT NUMBER</u> | <u>PERCENT OF TOTAL SALE VALUE</u> |
|----------------------------|------------------------------------|
| 1 | 10% |
| 2 | 19% |
| 3 | 12% |
| 4 | 12% |
| 5 | 24% |
| 6 | 15% |
| 7 | 08% |
4. If no cutting takes place, the 10% down payment will not be refunded.
5. Operations on the contract issued will terminate on September 30, 2012.



Michigan Department of Natural Resources – Forest, Mineral & Fire Management
TIMBER SALE MAP

This information is provided by authority of Part 525 of Act 451, PA 1994, as amended.

| | |
|-------------|------|
| SALE NUMBER | YEAR |
| 72 - 015 | 09 |

| | | | | | |
|--|--------------------|---|-------------------|---------------------------|---------|
| FOREST MANAGEMENT UNIT Grayling Management Unit | COUNTY CRAWFORD | MAPPED BY MERRICK | DATE 6/12/2009 | PAGE 1 | OF 1 |
| TOWNSHIP 27N | RANGE 04W | SECTION(S) AND SUBDIVISION(S) SECTION 24: NW1/4, NE1/4, NESW, N1/2SE, SESE | | SCALE 1 inch = 0.25 miles | |

| Cover Type | | | | Density | |
|-------------------|--------------------|----------------------|------------------|-----------------------------|------------------------|
| A = Aspen | H = Hemlock | P = Lowland Poplar | V = Bog or Marsh | 0 = Non Stocked | 5 = Pole Timber Medium |
| B = Paper Birch | J = Jack Pine | Q = Mixed Swamp Cnfr | W = White Pine | 1 = Seedling Sapling Poor | 6 = Pole Timber Well |
| C = Cedar | L = Lowland Brush | R = Red Pine | X = Non Stocked | 2 = Seedling Sapling Medium | 7 = Saw Timber Poor |
| E = Swamp Hdwoods | M = Mpl. Bch, Brch | S = Black Spruce | Z = Water | 3 = Seedling Sapling Well | 8 = Saw Timber Medium |
| F = Spruce Fir | N = Marsh | T = Tamarack | | 4 = Pole Timber Poor | 9 = Saw Timber Well |
| G = Grass | O = Oak | U = Upland Brush | | | |

COMP 206 CONTRACT
 Crawford County
 Compartment 206
 187 harvest acres

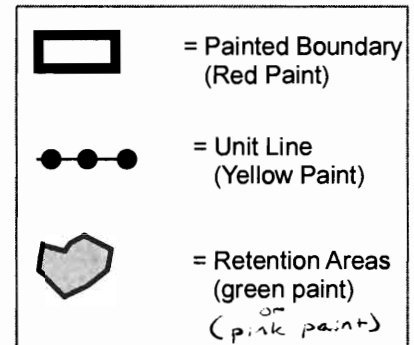
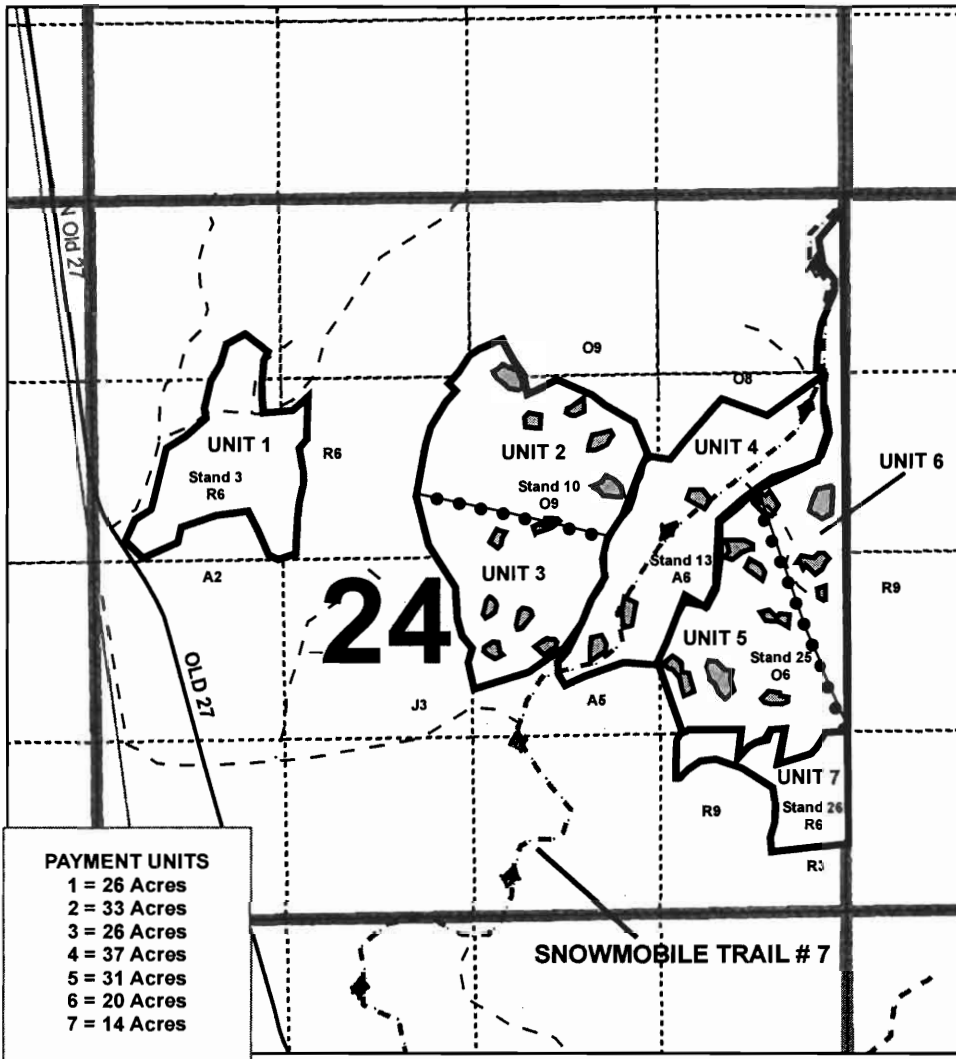

Locator Map
 1:100,000

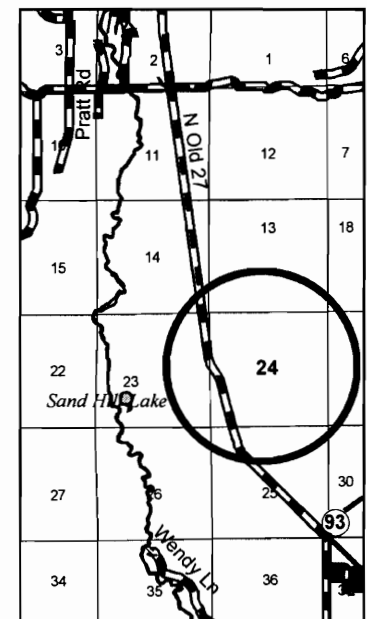

PAYMENT UNITS

- 1 = 26 Acres
- 2 = 33 Acres
- 3 = 26 Acres
- 4 = 37 Acres
- 5 = 31 Acres
- 6 = 20 Acres
- 7 = 14 Acres

DO NOT CUT GREEN PAINTED TREES.

THE LEAVE ISLANDS IN UNITS 2 AND 3 ARE IDENTIFIED BY PINK PAINTED TREES.
 DO NOT ENTER LEAVE ISLANDS OR CUT PINK PAINTED TREES.

Sale Specific Conditions & Requirements

Sale Name: Comp 206 Contract Sale Number: 72-015-09-01

1 - Sale Area

1.2 - Boundaries

1.2.1 - Painted boundaries (12/08)

The sale boundary and Payment Unit boundaries are marked and identified by red and yellow paint. Exterior sale boundary lines against state are marked with red paint. Interior Payment Unit boundaries are marked with yellow paint. Do not cut painted boundary line trees unless also marked with orange paint. Yellow painted trees designating an interior Payment Unit boundary are only to be cut when all surrounding Payment Units have been paid.

2 - Timber Specifications

2.1 - Included Timber

2.1.1 - Clearcut unit(s) with unmerchantable trees (4/09)

Within Payment Unit(s) 4, 5, and 6, cut all trees that are two (2) inches or more in diameter measured at a point four and one-half (4-1/2) feet above ground level regardless of merchantability. Retention islands are identified by green painted trees. Do not enter leave islands. Do not cut green painted trees.

2.1.3 - Cut tree marked unit(s) (12/08)

Within Payment Unit(s) 1 and 7, pine and oak are designated for cutting when marked with orange paint above and below stump height, regardless of merchantability. All aspen and red maple that are two (2) inches or greater at dbh (4.5 feet) are also designated for harvest.

2.1.7 - Leave tree marked unit(s) (12/08)

Within Payment Unit(s) 2 and 3, all trees, which meet minimum piece specifications in 2.2 Utilization, are designated for cutting except trees marked with green paint above and below stump height and pine trees 20" inches or greater at dbh (4.5 feet). Leave islands are identified by pink painted trees. Do not enter leave islands. Do not cut trees with pink paint.

2.2 - Utilization

2.2.7 - Uncut designated trees (2/04)

Liquidated damages of \$5.00 per tree will be assessed for every marked tree not cut.

3 - Payments

3.3 - Pre-measured Sales

3.3.4 - Dividing payment units (12/08)

Payment unit(s) may be divided at the request of the purchaser and upon approval of the Unit Manager. Dividing payment units is a contract modification which requires a Timber Sale Contract Supplement.

3.4 - Damaged Timber

3.4.1 - Damaged timber (6/05)

General Condition and Requirement 3.4 Damaged Timber, defines liquidated damages for undesignated live merchantable trees which are cut or injured. In addition, extreme care should be taken to avoid damage to tree seedlings and saplings. Damage to residual trees (defined as breaking of the cambium layer, broken tops or bending of trees from their natural position) is not acceptable.

Within the sale area, if more than 25% of the tree seedlings or saplings (1/4" to 4.5" DBH) within a specified portion of the sale area are damaged, liquidated damages will be assessed at \$200.00 per acre for all acreage within that specified portion of the sale area that was damaged.

No damage is acceptable to merchantable trees. Within the sale area, if more than 5% of trees (> 4.5" DBH) within a specified area of the sale are damaged, liquidated damages will be assessed for all trees damaged. Rates will be in accordance with General Condition and Requirement 3.4 Damaged Timber.

4 - Transportation

4.1 - Construction

4.1.3 - Slash and earthen piles (8/04)

Piles or windrows of earth along roads and landings that have been widened or constructed shall be leveled. Slash from road maintenance or construction, including stumps, shall be dispersed in a manner directed by the timber sale administrator.

4.1.7 - Road closure (4/07)

All new roads built into the sale must be blocked to vehicle traffic upon completion of the sale. Overgrown roads that are reopened shall be considered new roads. In general, this will require constructing a four (4') foot high berm constructed of stumps and logs covered with earth. Stumps and brush must be placed along the remainder of the trail. These roads must be rendered impassable to cars and trucks. Contact the sale administrator for specific details of design and placement.

4.1.11 - Permits (5/07)

The Purchaser will secure any necessary permits that may be required.

4.2 - Maintenance

4.2.1 - Hauling restriction (12/08)

Hauling may be restricted on forest roads by the Unit Manager or his/her representative. The restriction may occur during wet weather conditions.

4.2.5 - Two wheel drive condition (2/04)

All existing trail roads on and adjacent to the sale area must be passable by two-wheel drive traffic for the duration of the sale.

5 - Operations

5.1 - Notification

5.1.4 - Post-sale conference (9/09)

A post-sale conference on site between the Purchaser and sale administrator is required 5 days prior to the completion of active logging operations to determine clean-up and repair of landings, road edges, and the fulfillment of other contract specifications.

5.2 - Conduct of Operations

5.2.1 - Slash

5.2.1.8 - Slash height (12/08)

No slash or tree tops may exceed 30" inches in height.

5.2.2 - Hazard Trees/Snags

5.2.2.1 - Den trees (2/04)

Obvious hollow and/or den trees shall be protected and left standing unless they are a safety hazard.

5.2.3 - Operating Restrictions

5.2.3.3 - Bark slippage restriction (3/09)

Within Payment Unit(s) 1 and 7, unless changed by written agreement, cutting and skidding are not permitted during the period of April 15 to July 15. This restriction is because of bark slippage.

5.2.3.4 - Oak wilt restriction (12/08)

Within Payment Unit(s) 2 and 3, unless changed by written agreement, cutting, skidding, and hauling are not permitted during the period of April 15 to July 15. This is necessary to reduce the spread of oak wilt. For more information, contact the Unit Manager or his/her representative.

5.2.3.6 - Bark beetle restriction (12/08)

In the event drought creates a high risk of pine bark beetle infestation, pine is not to be cut during the period March 1 through July 1, unless all portions of trees greater than two inches in diameter are removed from the sale area, reduced to chips, or treated to the satisfaction of the Unit Manager or his/her representative, within fifteen days of being severed from the stump. Pine log decks, pulpwood piles and treetops that are piled for chipping in the fall or winter within a 1/4 mile of susceptible sites must be removed before March 15. Residual slash must not be placed in piles or rows and must be spread over the site for quick drying. The Department of Natural Resources will exercise this specification if the risk of damage warrants.

5.2.4 - Dead and Down Creation

5.2.4.2 - Dead and down creation, hare and grouse (12/08)

To improve habitat for snowshoe hare, grouse, and other species, the Purchaser is to leave two trees, nine (9)

inches or larger in diameter on the ground for every two acres. If possible, the logs or trees should be felled so they overlap. Note these pieces should have a minimum length of five feet. They can be of any tree species and can be an un-merchantable piece of wood or a full tree.

5.2.29 - Shrub protection (9/07)

Do not cut or damage hawthorn, witch-hazel, or juneberry. These woody-shrub plants are highly beneficial to various wildlife species.

5.2.38 - No decking against live trees (2/04)

Cut products may not be decked against unmarked or designated leave trees.

5.2.41 - Snowmobile trail protection (8/09)

The trail through Unit 4 is a designated snowmobile trail (#7) and is shown on the Timber Sale Map. The snowmobile trail may not be used for any timber sale operations from December 1 through March 31 without prior written permission from the Unit Manager or their representative. Do not cut or damage posts with orange trail markers or traffic control signs. If the trail is used, it must be maintained and restored to a condition equal to or better than before the sale. The road maintenance/restoration must be done prior to December 1. If the trail is used for hauling, it must be graded to the satisfaction of the Unit Manager or his/her representative prior to December 1st. The snowmobile trail may only be crossed at right angles. Maintain a 20 foot wide slash, debris, and rut free zone daily using the snowmobile trail as the centerline. No decking of forest products will be permitted along the snowmobile trail. All stumps within 20 feet of the snowmobile trail must be cut at ground level.

5.4 - Soil Protection

5.4.1 - Rutting restriction, general (1/09)

Operations are to cease immediately if equipment and weather conditions result in rutting of roads and skid trails which is 12 inches or greater in depth and 50 feet in length. The Unit Manager or his/her representative may restrict hauling and/or skidding if ruts exceed the specified depth. With the Unit Manager or his/her representative's approval, the Purchaser may return to the area when the risk of rutting has decreased.

5.8 - Protection of Endangered Species

5.8.5 - Protection of raptor nests (4/09)

All trees with raptor nests will be protected if found during harvesting operations. Notification will be made to the Unit Manager or his/her representative who will notify the Wildlife Biologist so an on-site evaluation and recommendation can be made, if necessary.

6 - Safety and Fire Prevention

6.2 - Signing

Sale Name: Comp 206 Contract Sale Number: 72-015-09-01

6.2.2 - Snowmobile trail posting (1/09)

The Purchaser is responsible for posting and maintaining caution signs on snowmobile trail #7 prior to beginning operations during the snowmobile season (approximately December 1 to March 31). The trail must be posted at appropriate distances from the sale area to warn of logging activity and truck traffic. Signs must be removed when harvest operations are suspended or completed. The Purchaser will provide these signs.

BIG "V" ASPEN (027-09-01)

A timber sale contract for this LUMP SUM SEALED timber sale will be awarded the responsible bidder offering the highest sealed bid price. Bids must be at or above the following appraised price for each species:

| <u>SPECIES</u> | <u>ESTIMATED VOLUME*</u> | <u>APPRAISED PRICE</u> |
|----------------|--------------------------|------------------------|
| SAWLOGS | | |
| RED PINE | 38.60 MBF | \$ 178.00/MBF |
| MIXED OAK | 17.00 MBF | \$ 155.00/MBF |
| MIX ASPEN | 58.80 MBF | \$ 55.00/MBF |
| PULPWOOD | | |
| MIX ASPEN | 988.00 CORDS | \$ 12.50/CORD |
| MIX SOFTWD | 444.00 CORDS | \$ 6.05/CORD |

In addition, the successful bidder agrees to purchase the following species at the indicated appraised price:

| <u>SPECIES</u> | <u>ESTIMATED VOLUME*</u> | <u>APPRAISED PRICE</u> |
|----------------|--------------------------|------------------------|
| SAWLOGS | | |
| RED MAPLE | 20.10 MBF | \$ 100.00/MBF |
| PULPWOOD | | |
| RED MAPLE | 180.00 CORDS | \$ 7.50/CORD |
| MIXED OAK | 58.00 CORDS | \$ 4.60/CORD |

*The volumes are statistically estimated within plus (+) or minus (-) 12.92 percent. These estimated volumes are final and not subject to adjustment. Prospective bidders are urged to examine this timber and to make their own estimates of quantity and quality.

BOND AND PAYMENT SCHEDULE:

1. A bond in the amount of \$2,000.00, to insure faithful performance of the conditions of the contract, will be deposited by the successful bidder within 21 days of the sale award.
2. Cutting in any sale or unit without the required advance payment would be considered a trespass.
3. Total payment may be paid in advance or according to the following schedule:
 - (a) Ten percent (10%) of the sale value must be paid within 21 days of the sale award.
 - (b) The 10% down payment will be credited towards the first unit cut.
 - (c) Payment for each of the following units must be made before cutting begins in that unit:

| <u>PAYMENT UNIT NUMBER</u> | <u>PERCENT OF TOTAL SALE VALUE</u> |
|----------------------------|------------------------------------|
| 1 | 20% |
| 2 | 12% |
| 3 | 25% |
| 4 | 18% |
| 5 | 25% |

4. If no cutting takes place, the 10% down payment will not be refunded.
5. Operations on the contract issued will terminate on September 30, 2012.



Michigan Department of Natural Resources – Forest, Mineral & Fire Management
TIMBER SALE MAP

This information is provided by authority of Part 525 of Act 451, PA 1994, as amended.

| | |
|-------------|------|
| SALE NUMBER | YEAR |
| 72 - 027 | 09 |

| | | | | | |
|--------------------------|--------|----------------------|-----------|------|----|
| FOREST MANAGEMENT UNIT | COUNTY | MAPPED BY | DATE | PAGE | OF |
| Grayling Management Unit | OSCODA | MERRICK | 6/29/2009 | 1 | 1 |
| | | CRUISED BY | | | |
| | | Merrick, Ventimiglia | | | |

| | | | |
|----------|-------|-------------------------------|---------------------|
| TOWNSHIP | RANGE | SECTION(S) AND SUBDIVISION(S) | SCALE |
| 28N | 01E | SEC 36: NW1/4, W1/2NE, NWSW | 1 inch = 0.25 miles |

| Cover Type | | | | Density | |
|-------------------|--------------------|----------------------|------------------|-----------------------------|------------------------|
| A = Aspen | H = Hemlock | P = Lowland Poplar | V = Bog or Marsh | 0 = Non Stocked | 5 = Pole Timber Medium |
| B = Paper Birch | J = Jack Pine | Q = Mixed Swamp Cnfr | W = White Pine | 1 = Seedling Sapling Poor | 6 = Pole Timber Well |
| C = Cedar | L = Lowland Brush | R = Red Pine | X = Non Stocked | 2 = Seedling Sapling Medium | 7 = Saw Timber Poor |
| E = Swamp Hdwoods | M = Mpl. Bch, Brch | S = Black Spruce | Z = Water | 3 = Seedling Sapling Well | 8 = Saw Timber Medium |
| F = Spruce Fir | N = Marsh | T = Tamarack | | 4 = Pole Timber Poor | 9 = Saw Timber Well |
| G = Grass | O = Oak | U = Upland Brush | | | |

BIG "V" ASPEN
 Oscoda County
 Compartment 019
 124 harvest acres

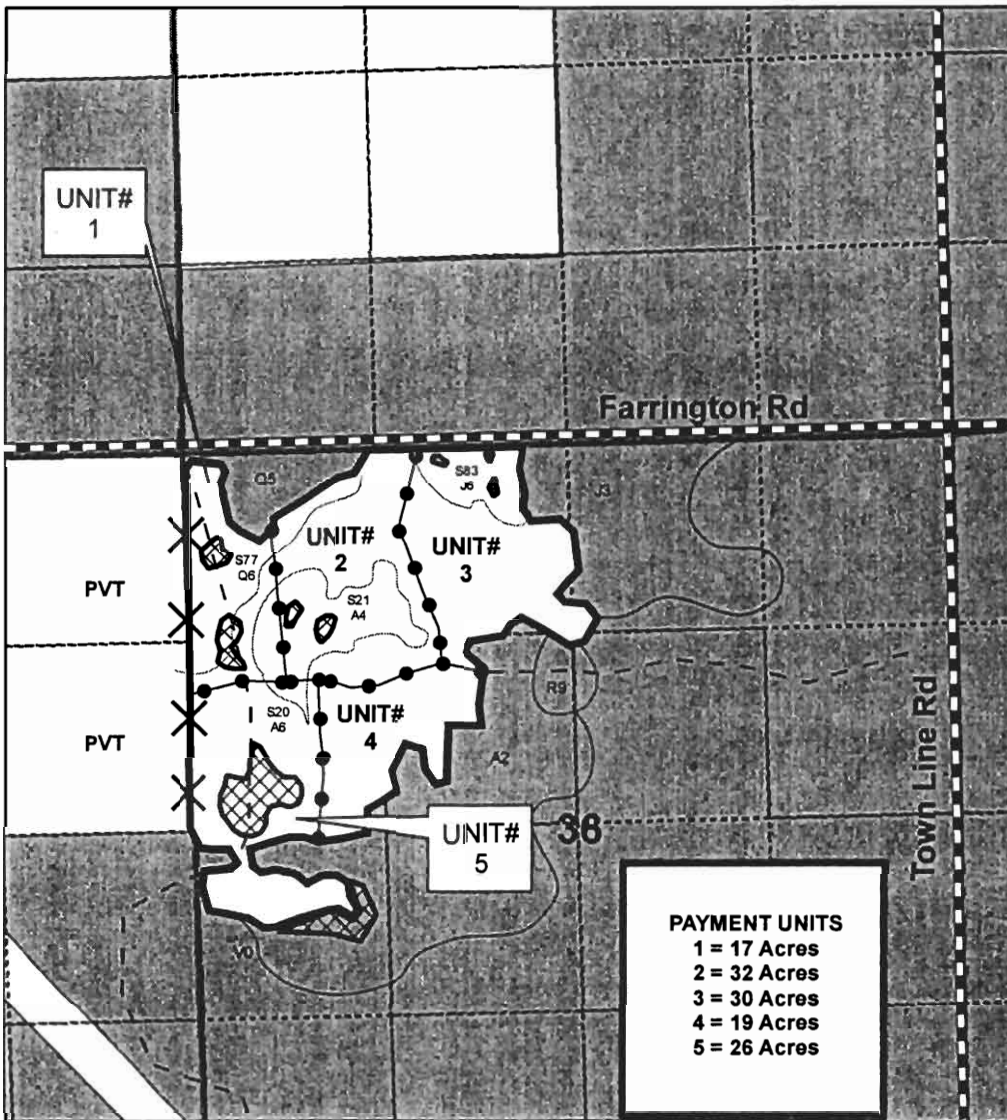

| | |
|--|---------------------------------|
| | = Painted Boundary (Red Paint) |
| | = Painted Boundary (Blue Paint) |
| | = Unit Line (Yellow Paint) |
| | = Retention Area (green paint) |

Locator Map
 1:100,000

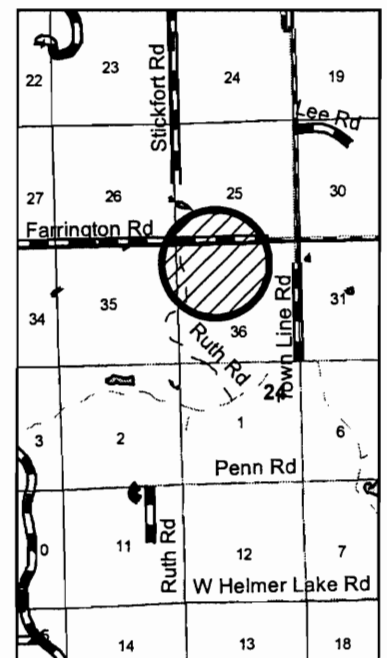

| PAYMENT UNITS | |
|---------------|------------|
| 1 | = 17 Acres |
| 2 | = 32 Acres |
| 3 | = 30 Acres |
| 4 | = 19 Acres |
| 5 | = 26 Acres |

DO NOT ENTER GREEN PAINTED ISLANDS.

Sale Specific Conditions & Requirements

Sale Name: Big "v" Aspen Sale Number: 72-027-09-01

1 - Sale Area

1.2 - Boundaries

1.2.1 - Painted boundaries (12/08)

The sale boundary and Payment Unit boundaries are marked and identified by blue, red and yellow paint. Exterior sale boundary lines against private property are marked with blue paint. Exterior sale boundary lines against state are marked with red paint. Interior Payment Unit boundaries are marked with yellow paint. Do not cut painted boundary line trees. Yellow painted trees designating an interior Payment Unit boundary are only to be cut when all surrounding Payment Units have been paid. Green painted trees designate retention/leave islands.

2 - Timber Specifications

2.1 - Included Timber

2.1.1 - Clearcut unit(s) with unmerchantable trees (4/09)

Within Payment Unit(s) 1, 2, 3, 4, and 5, cut all trees that are two (2) inches or more in diameter measured at a point four and one-half (4-1/2) feet above ground level regardless of merchantability, except for oak. **DO NOT CUT OAK UNDER 4" INCHES IN DIAMETER.** Trees identified with pink paint are to be cut and left adjacent to the stump. These trees are to remain in the sale area and may not be utilized. Retention/leave islands are identified with green paint. Do not enter the retention/leave islands.

2.1.15 - Hazard trees near county roads (4/05)

Cut and remove all standing dead trees within 100 feet of the cleared portion of designated county roads. These cut snags must be scattered back into the sale area.

3 - Payments

3.4 - Damaged Timber

3.4.1 - Damaged timber (6/05)

General Condition and Requirement 3.4 Damaged Timber, defines liquidated damages for undesignated live merchantable trees which are cut or injured. In addition, extreme care should be taken to avoid damage to oak seedlings and saplings. Damage to residual trees (defined as breaking of the cambium layer, broken tops or bending of trees from their natural position) is not acceptable.

Within the sale area, if more than 20% of the oak seedlings or saplings (1/4" to 4" DBH) within a specified portion of the sale area are damaged, liquidated damages will be assessed at \$300.00 per acre for all acreage within that specified portion of the sale area that was damaged.

No damage is acceptable to merchantable trees. Within the sale area, if more than 2% of trees (> 4.5" DBH) within a specified area of the sale are damaged, liquidated damages will be assessed for all trees damaged. Rates will be in accordance with General Condition and Requirement 3.4 Damaged Timber..

4 - Transportation

4.1 - Construction

4.1.3 - Slash and earthen piles (8/04)

Piles or windrows of earth along roads and landings that have been widened or constructed shall be leveled. Slash from road maintenance or construction, including stumps, shall be dispersed throughout the sale.

4.1.7 - Road closure (4/07)

All new roads built into the sale must be blocked to vehicle traffic upon completion of the sale. Overgrown roads that are reopened shall be considered new roads. In general, this will require constructing a four (4') foot high berm constructed of stumps and logs covered with earth. Stumps and brush must be placed along the remainder of the trail. These roads must be rendered impassable to cars and trucks.

4.1.11 - Permits (5/07)

The Purchaser will secure any necessary permits that may be required.

4.2 - Maintenance

4.2.5 - Two wheel drive condition (2/04)

All existing trail roads on and adjacent to the sale area must be passable by two-wheel drive traffic for the duration of the sale.

5 - Operations

5.1 - Notification

5.1.1 - Pre-sale conference (12/08)

A pre-sale conference on site between the Purchaser and sale administrator is required prior to beginning each sale Payment Unit. The Unit Manager or his/her representative must be contacted at least 2 days in advance to schedule the conference.

5.1.4 - Post-sale conference (2/04)

A post-sale conference on site between the Purchaser and sale administrator is required 5 days prior to the completion of active logging operations to determine clean-up and repair of landings, road edges, and the fulfillment of other contract specifications.

5.2 - Conduct of Operations

5.2.1 - Slash

5.2.1.8 - Slash height (12/08)

No slash may exceed 30" inches in height.

5.2.2 - Hazard Trees/Snags

5.2.2.1 - Den trees (2/04)

Obvious hollow and/or den trees shall be protected and left standing unless they are a safety hazard.

5.2.4 - Dead and Down Creation

5.2.4.2 - Dead and down creation, hare and grouse (12/08)

To improve habitat for snowshoe hare, grouse, and other species, the Purchaser is to leave two trees, eight (8) inches or larger in diameter on the ground for every two acres. If possible, the logs or trees should be felled so they overlap. Note these pieces should have a minimum length of five feet. They can be of any tree species and can be an un-merchantable piece of wood or a full tree.

5.2.29 - Shrub protection (9/07)

Do not cut or damage hawthorn, witch-hazel, dogwood or junberry. These woody-shrub plants are highly beneficial to various wildlife species.

5.2.38 - No decking against live trees (2/04)

Cut products may not be decked against unmarked or designated leave trees.

5.4 - Soil Protection

5.4.1 - Rutting restriction, general (1/09)

Operations are to cease immediately if equipment and weather conditions result in rutting on skid trails which is 12 inches or greater in depth and 50 feet in length. The Unit Manager or his/her representative may restrict hauling and/or skidding if ruts exceed the specified depth. With the Unit Manager or his/her representative's approval, the Purchaser may return to the area when the risk of rutting has decreased.

5.8 - Protection of Endangered Species

5.8.5 - Protection of raptor nests (4/09)

All trees with raptor nests will be protected if found during harvesting operations. Notification will be made to the Unit Manager or his/her representative who will notify the Wildlife Biologist so an on-site evaluation and recommendation can be made, if necessary.

HEHIR TRAIL RED PINE (030-09-01)

A timber sale contract for this LUMP SUM SEALED timber sale will be awarded the responsible bidder offering the highest sealed bid price. Bids must be at or above the following appraised price for each species:

| <u>SPECIES</u> | <u>ESTIMATED VOLUME*</u> | <u>APPRAISED PRICE</u> |
|----------------|--------------------------|------------------------|
| SAWLOGS | | |
| RED PINE | 37.00 MBF | \$ 188.00/MBF |
| PULPWOOD | | |
| RED PINE | 696.00 CORDS | \$ 31.90/CORD |
| JACK PINE | 313.00 CORDS | \$ 10.20/CORD |

In addition, the successful bidder agrees to purchase the following species at the indicated appraised price:

| <u>SPECIES</u> | <u>ESTIMATED VOLUME*</u> | <u>APPRAISED PRICE</u> |
|----------------|--------------------------|------------------------|
| PULPWOOD | | |
| MIXED OAK | 36.00 CORDS | \$ 10.00/CORD |
| MIX ASPEN | 14.00 CORDS | \$ 10.00/CORD |

*The volumes are statistically estimated within plus (+) or minus (-) 10.98 percent. These estimated volumes are final and not subject to adjustment. Prospective bidders are urged to examine this timber and to make their own estimates of quantity and quality.

BOND AND PAYMENT SCHEDULE:

1. A bond in the amount of \$2,000.00, to insure faithful performance of the conditions of the contract, will be deposited by the successful bidder within 21 days of the sale award.
2. Cutting in any sale or unit without the required advance payment would be considered a trespass.
3. Total payment may be paid in advance or according to the following schedule:
 - (a) Ten percent (10%) of the sale value must be paid within 21 days of the sale award.
 - (b) The 10% down payment will be credited towards the first unit cut.
 - (c) Payment for each of the following units must be made before cutting begins in that unit:

| <u>PAYMENT UNIT NUMBER</u> | <u>PERCENT OF TOTAL SALE VALUE</u> |
|----------------------------|------------------------------------|
| 1 | 33% |
| 2 | 39% |
| 3 | 28% |
4. If no cutting takes place, the 10% down payment will not be refunded.
5. Operations on the contract issued will terminate on March 31, 2012.



TIMBER SALE MAP

This information is provided by authority of Part 525 of Act 451, PA 1994, as amended.

| | |
|-------------|---------|
| SALE NUMBER | YEAR |
| 030 | 2009 |
| DATE | PAGE OF |
| 7/29/09 | 1 1 |

| | | | | |
|---|---------------------------|---|--|--|
| FOREST MANAGEMENT UNIT Grayling | COUNTY Crawford | MAPPED BY Patrick Cotant | DATE 7/29/09 | |
| TOWNSHIP T27N | RANGE R1W | CRUISED BY Patrick Cotant, Lucas Merrick & Joe Ventimiglia | SECTION(S) AND SUBDIVISION(S) Sec 21-NE1/4, NESE | |
| | | | 1:15,840 | |

| Cover Type | | | | Density | |
|-------------------|--------------------|----------------------|------------------|-----------------------------|------------------------|
| A = Aspen | H = Hemlock | P = Lowland Poplar | V = Bog or Marsh | 0 = Non Stocked | 5 = Pole Timber Medium |
| B = Paper Birch | J = Jack Pine | Q = Mixed Swamp Cnfr | W = White Pine | 1 = Seedling Sapling Poor | 6 = Pole Timber Well |
| C = Cedar | L = Lowland Brush | R = Red Pine | X = Non Stocked | 2 = Seedling Sapling Medium | 7 = Saw Timber Poor |
| E = Swamp Hdwoods | M = Mpl, Bch, Brch | S = Black Spruce | Z = Water | 3 = Seedling Sapling Well | 8 = Saw Timber Medium |
| F = Spruce Fir | N = Marsh | T = Tamarack | | 4 = Pole Timber Poor | 9 = Saw Timber Well |
| G = Grass | O = Oak | U = Upland Brush | | | |

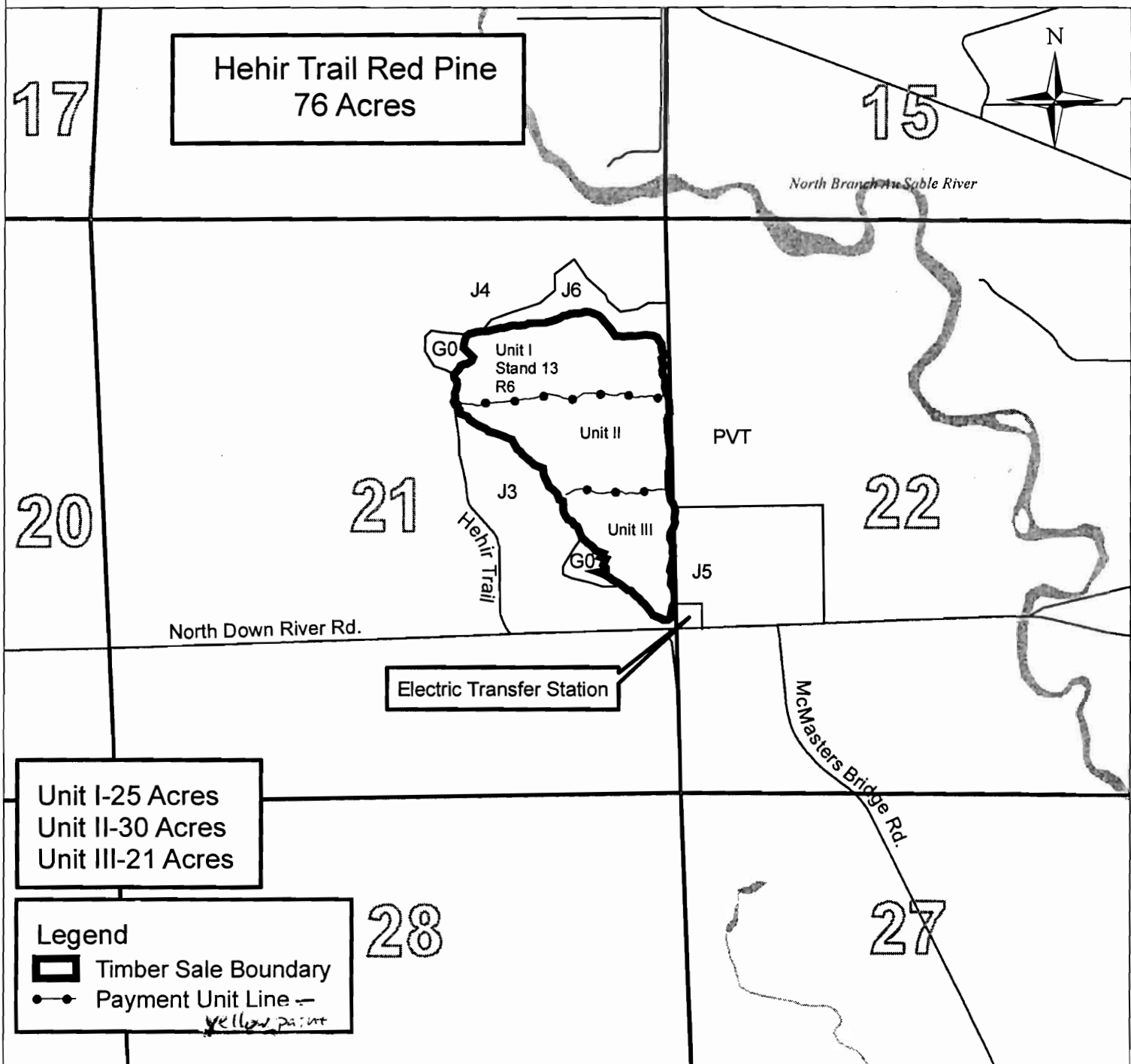

Unit I-25 Acres
 Unit II-30 Acres
 Unit III-21 Acres

Legend
 Timber Sale Boundary
 Payment Unit Line
yellow paint

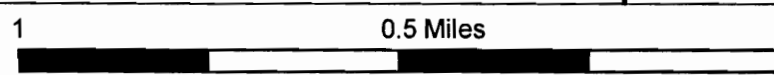

Sale Specific Conditions & Requirements

Sale Name: Hehir Trail Red Pine Sale Number: 72-030-09-01

1 - Sale Area

1.2 - Boundaries

1.2.1 - Painted boundaries (12/08)

The sale boundary and Payment Unit boundaries are marked and identified by red and yellow paint. Exterior sale boundary lines against state are marked with red paint. Interior Payment Unit boundaries are marked with yellow paint. Yellow painted trees designating an interior Payment Unit boundary are only to be cut when all surrounding Payment Units have been paid.

2 - Timber Specifications

2.1 - Included Timber

2.1.8 - Designated plantation row unit(s) (12/08)

Within Payment Unit(s) I, II and III, all red pine trees which meet minimum piece specifications in 2.2 Utilization, within designated plantation rows are designated for cutting. Designated plantation rows begin with the third row in from the outside of the plantation, then continue every third row. Because of the variability of row direction, it shall be the responsibility of the producer to maintain the third row sequence. In addition, ALL jack pine, aspen and oak species are designated for harvest.

2.2 - Utilization

2.2.3 - Stump heights (4/07)

Stump heights within the Sale Area shall not exceed 6 inches for all trees. This is in order to facilitate planting operations.

3 - Payments

3.4 - Damaged Timber

3.4.1 - Damaged timber (6/05)

General Condition and Requirement 3.4 Damaged Timber, defines liquidated damages for undesignated live merchantable trees which are cut or injured. Damage to residual trees (defined as breaking of the cambium layer, broken tops or bending of trees from their natural position) is not acceptable.

No damage is acceptable to merchantable trees. Within the sale area, if more than 10% of trees (> 4.5" DBH) within a specified area of the sale are damaged, liquidated damages will be assessed for all trees damaged. Rates will be in accordance with General Condition and Requirement 3.4 Damaged Timber.

3.6 - Payment Unit Cutting Schedule

3.6.1 - Order of cutting (1/09)

Payment Units shall be cut in the following order; III, II and I unless the sale is paid in full.

4 - Transportation

4.1 - Construction

4.1.3 - Slash and earthen piles (8/04)

Piles or windrows of earth along roads and landings that have been widened or constructed shall be leveled. Slash from road maintenance or construction, including stumps, shall be dispersed throughout the sale.

4.1.11 - Permits (5/07)

The Purchaser will secure any necessary permits that may be required.

4.1.12 - No new roads (12/08)

No new roads will be permitted in any Payment Unit. All operations are limited to existing roads.

4.2 - Maintenance

4.2.5 - Two wheel drive condition (2/04)

All existing trail roads on and adjacent to the sale area must be passable by two-wheel drive traffic for the duration of the sale.

5 - Operations

5.1 - Notification

5.1.4 - Post-sale conference (9/09)

A post-sale conference on site between the Purchaser and sale administrator is required 5 days prior to the completion of active logging operations to determine clean-up and repair of landings, road edges, and the fulfillment of other contract specifications.

5.1.6 - Utility R.O.W. (10/08)

It is the responsibility of the purchaser to obtain permission from the utility company to utilize the power line R.O.W. for operations.

5.2 - Conduct of Operations

5.2.1 - Slash

5.2.1.8 - Slash height (12/08)

No slash or tree tops may exceed 36 inches in height.

5.2.1.9 - No Slash:pipe/powerline, oil/gas sites (2/04)

All pipelines, power lines, oil or gas storage sites and related access roads are to remain free of slash at all times.

5.2.2 - Hazard Trees/Snags

5.2.2.1 - Den trees (2/04)

Obvious hollow and/or den trees shall be protected and left standing unless they are a safety hazard.

5.2.3 - Operating Restrictions

5.2.3.3 - Bark slippage restriction (3/09)

Within Payment Unit(s) I, II and III, unless changed by written agreement, cutting and skidding are not permitted during the period of April 15 to July 15. This restriction is because of bark slippage.

5.2.3.6 - Bark beetle restriction (12/08)

In the event drought creates a high risk of pine bark beetle infestation, pine is not to be cut during the period March 1 through July 1, unless all portions of trees greater than two inches in diameter are removed from the sale area, reduced to chips, or treated to the satisfaction of the Unit Manager or his/her representative, within fifteen days of being severed from the stump. Pine log decks, pulpwood piles and treetops that are piled for chipping in the fall or winter within a 1/4 mile of susceptible sites must be removed before March 15. Residual slash must not be placed in piles or rows and must be spread over the site for quick drying. The Department of Natural Resources will exercise this specification if the risk of damage warrants.

5.2.29 - Shrub protection (9/07)

Do not cut or damage hawthorn or juneberry. These woody-shrub plants are highly beneficial to various wildlife species.

5.2.38 - No decking against live trees (2/04)

Cut products may not be decked against unmarked or designated leave trees.

5.4 - Soil Protection

5.4.1 - Rutting restriction, general (1/09)

Operations are to cease immediately if equipment and weather conditions result in rutting of roads and skid trails which is 12 inches or greater in depth and 50 feet in length. The Unit Manager or his/her representative may restrict hauling and/or skidding if ruts exceed the specified depth. With the Unit Manager or his/her representative's approval, the Purchaser may return to the area when the risk of rutting has decreased.

5.8 - Protection of Endangered Species

5.8.1 - Kirtland's warbler (1) (2/04)

This sale is adjacent to a young jack pine stand which may be used by the endangered Kirtland's Warbler. The Department reserves the right to temporarily restrict all harvesting operations in a buffer zone of up to 500 feet if it is determined that Warbler territory has been established in the adjacent stand. The restricted period, if put into effect, would apply from 4/15 to 9/30.

5.8.5 - Protection of raptor nests (4/09)

All trees with raptor nests will be protected if found during harvesting operations. Notification will be made to the Unit Manager or his/her representative who will notify the Wildlife Biologist so an on-site evaluation and recommendation can be made, if necessary.

BIG BURN JACK (605-10-01)

A timber sale contract for this LUMP SUM SEALED timber sale will be awarded the responsible bidder offering the highest sealed bid price. Bids must be at or above the following appraised price for each species:

| <u>SPECIES</u> | <u>ESTIMATED VOLUME*</u> | <u>APPRAISED PRICE</u> |
|----------------|--------------------------|------------------------|
| SAWLOGS | | |
| JACK PINE | 75.10 MBF | \$ 47.00/MBF |
| MIXED OAK | 66.40 MBF | \$ 146.00/MBF |
| PULPWOOD | | |
| JACK PINE | 1,791.00 CORDS | \$ 10.40/CORD |
| MIXED OAK | 593.00 CORDS | \$ 9.45/CORD |

In addition, the successful bidder agrees to purchase the following species at the indicated appraised price:

| <u>SPECIES</u> | <u>ESTIMATED VOLUME*</u> | <u>APPRAISED PRICE</u> |
|----------------|--------------------------|------------------------|
| PULPWOOD | | |
| RED MAPLE | 35.00 CORDS | \$ 5.75/CORD |
| MIX ASPEN | 43.00 CORDS | \$ 8.30/CORD |

*The volumes are statistically estimated within plus (+) or minus (-) 10.4 percent. These estimated volumes are final and not subject to adjustment. Prospective bidders are urged to examine this timber and to make their own estimates of quantity and quality.

BOND AND PAYMENT SCHEDULE:

1. A bond in the amount of \$2,000.00, to insure faithful performance of the conditions of the contract, will be deposited by the successful bidder within 21 days of the sale award.
2. Cutting in any sale or unit without the required advance payment would be considered a trespass.
3. Total payment may be paid in advance or according to the following schedule:
 - (a) Ten percent (10%) of the sale value must be paid within 21 days of the sale award.
 - (b) The 10% down payment will be credited towards the first unit cut.
 - (c) Payment for each of the following units must be made before cutting begins in that unit:

| <u>PAYMENT UNIT NUMBER</u> | <u>PERCENT OF TOTAL SALE VALUE</u> |
|----------------------------|------------------------------------|
| 1 | 20% |
| 2 | 26% |
| 3 | 20% |
| 4 | 17% |
| 5 | 17% |

4. If no cutting takes place, the 10% down payment will not be refunded.
5. Operations on the contract issued will terminate on March 31, 2012.



Michigan Department of Natural Resources – Forest, Mineral & Fire Management
TIMBER SALE MAP

This information is provided by authority of Part 525 of Act 451, PA 1994, as amended.

| | |
|-------------|---------|
| SALE NUMBER | YEAR |
| 72 - 605 | 10 |
| DATE | PAGE OF |
| 11/24/2009 | 1 1 |

| | | | |
|---|--------------------|-----------------------|---------------------------|
| FOREST MANAGEMENT UNIT Grayling Management Unit | COUNTY CRAWFORD | MAPPED BY MERRICK | DATE 11/24/2009 |
| TOWNSHIP 25N | RANGE 04W | CRUISED BY MERRICK | PAGE OF 1 1 |
| SECTION(S) AND SUBDIVISION(S) SEC 06: W1/2, N1/2NE, SWNE | | | SCALE 1 inch = 0.25 miles |

| Cover Type | | | | Density | |
|-------------------|--------------------|----------------------|------------------|-----------------------------|------------------------|
| A = Aspen | H = Hemlock | P = Lowland Poplar | V = Bog or Marsh | 0 = Non Stocked | 5 = Pole Timber Medium |
| B = Paper Birch | J = Jack Pine | Q = Mixed Swamp Cnfr | W = White Pine | 1 = Seedling Sapling Poor | 6 = Pole Timber Well |
| C = Cedar | L = Lowland Brush | R = Red Pine | X = Non Stocked | 2 = Seedling Sapling Medium | 7 = Saw Timber Poor |
| E = Swamp Hdwoods | M = Mpl, Bch, Brch | S = Black Spruce | Z = Water | 3 = Seedling Sapling Well | 8 = Saw Timber Medium |
| F = Spruce Fir | N = Marsh | T = Tamarack | | 4 = Pole Timber Poor | 9 = Saw Timber Well |
| G = Grass | O = Oak | U = Upland Brush | | | |

BIG BURN JACK
 Crawford County
 Compartment 187
 241 harvest acres

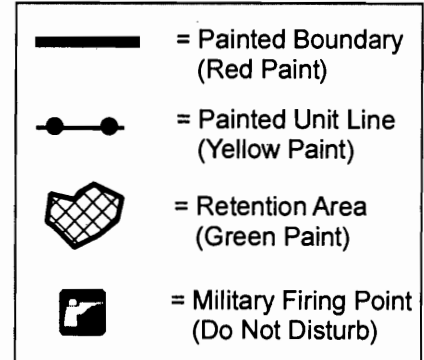
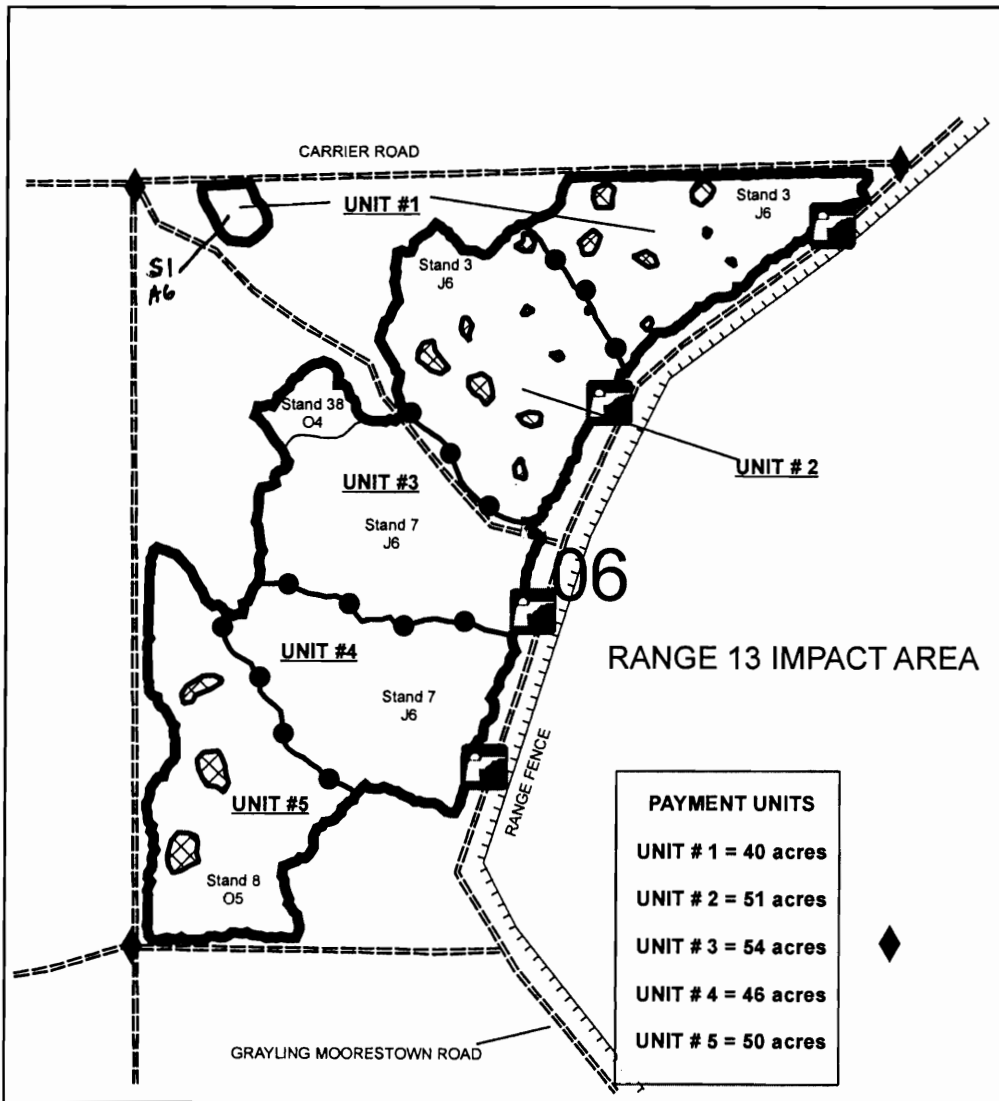

PAYMENT UNITS

| | |
|----------|------------|
| UNIT # 1 | = 40 acres |
| UNIT # 2 | = 51 acres |
| UNIT # 3 | = 54 acres |
| UNIT # 4 | = 46 acres |
| UNIT # 5 | = 50 acres |

Locator Map
1:100,000

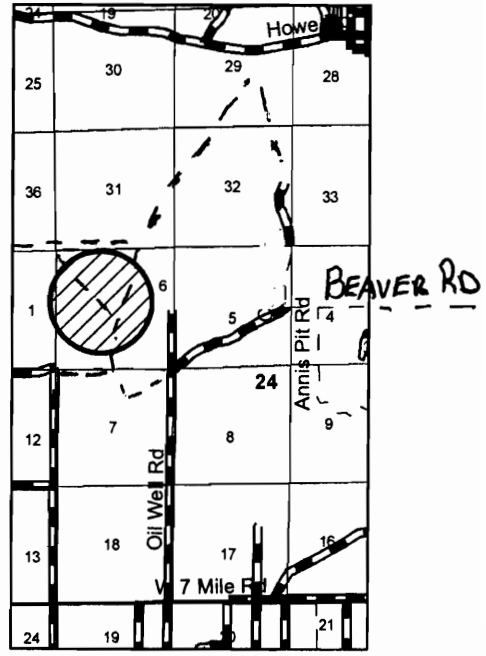

DO NOT ENTER GREEN PAINTED RETENTION / LEAVE ISLANDS.
 DO NOT CUT TREES MARKED WITH PINK PAINT.
 DO NOT CUT RED OR WHITE PINE

Sale Specific Conditions & Requirements

Sale Name: Big Burn Jack Sale Number: 72-605-10-01

1 - Sale Area

1.2 - Boundaries

1.2.1 - Painted boundaries (12/08)

The sale boundary and Payment Unit boundaries are marked and identified by red and yellow paint. Exterior sale boundary lines against state are marked with red paint. Interior Payment Unit boundaries are marked with yellow paint. Do not cut painted exterior boundary line trees. Yellow painted trees designating an interior Payment Unit boundary are only to be cut when all surrounding Payment Units have been paid. Leave/retention islands are marked with green paint.

2 - Timber Specifications

2.1 - Included Timber

2.1.1 - Clearcut unit(s) with unmerchantable trees (4/09)

Within Payment Unit(s) 1, 2, 3, 4, and 5, cut all trees that are two (2) inches or more in diameter measured at a point four and one-half (4-1/2) feet above ground level regardless of merchantability. Exceptions: DO NOT CUT RED OR WHITE PINE. DO NOT CUT TREES MARKED WITH PINK PAINT.

2.2 - Utilization

2.2.2 - Chipping required (9/09)

Payment Units 1, 2, and 5 must be chip harvested to meet National Guard requirements. The purchaser has the option to produce sawlogs or pulpwood bolts, but the remaining portion of the trees must be chipped and hauled.

2.2.3 - Stump heights (4/07)

Stump heights within the Sale Area shall not exceed 12 inches for trees greater than 10 inches DBH and 4 inches for trees smaller than 10 inches DBH. This is in order to facilitate military requirements.

2.2.10 - No chipping tops and limbs (12/08)

Within Payment Unit(s) 3 and 4, chipping of the bole, 2-inches in diameter or greater, is allowed. Chipping of limbs or portions of the tree less than 2-inches in diameter is not permitted. Limbs and the remaining top must be left on site and scattered.

3 - Payments

3.4 - Damaged Timber

3.4.1 - Damaged timber (6/05)

General Condition and Requirement 3.4 Damaged Timber, defines liquidated damages for undesignated live merchantable trees which are cut or injured. Damage to residual trees (defined as breaking of the cambium layer, broken tops or bending of trees from their natural position) is not acceptable.

Damage is not acceptable to merchantable trees. Within the sale area, if more than 2% of trees (> 4.5" DBH) within a specified area of the sale are damaged, liquidated damages will be assessed for all trees damaged. Rates will be in accordance with General Condition and Requirement 3.4 Damaged Timber.

4 - Transportation

4.1 - Construction

4.1.7 - Road closure (4/07)

All new roads built into the sale must be blocked to vehicle traffic upon completion of the sale. Overgrown roads that are reopened shall be considered new roads. In general, this will require constructing a four (4') foot high berm constructed of stumps and logs covered with earth. Stumps and brush must be placed along the remainder of the trail. These roads must be rendered impassable to cars and trucks. Contact the sale administrator for specific details of design and placement.

4.1.11 - Permits (5/07)

The Purchaser will secure any necessary permits that may be required.

4.2 - Maintenance

4.2.5 - Two wheel drive condition (2/04)

All existing trail roads on and adjacent to the sale area must be passable by two-wheel drive traffic for the duration of the sale.

5 - Operations

5.1 - Notification

5.1.4 - Post-sale conference (9/09)

A post-sale conference on site between the Purchaser and sale administrator is required 5 days prior to the completion of active logging operations to determine clean-up and repair of landings, road edges, and the fulfillment of other contract specifications.

5.2 - Conduct of Operations

5.2.1 - Slash

5.2.1.8 - Slash height (12/08)

No slash may exceed 24 inches in height.

5.2.1.12 - Slash for prescribed burning (1/05)

Sale Name: Big Burn Jack Sale Number: 72-605-10-01

To facilitate prescribed burning, slash shall be moved at least 10 feet inside the sale boundary. Slash may not be piled or placed near residual trees.

5.2.1.13 - Dispose of slash as directed (12/05)

Slash is to be disposed of as directed by the sale administrator.

5.2.2 - Hazard Trees/Snags

5.2.2.1 - Den trees (2/04)

Obvious hollow and/or den trees shall be protected and left standing unless they are a safety hazard.

5.2.3 - Operating Restrictions

5.2.3.4 - Oak wilt restriction (12/08)

Within Payment Unit(s) 1, 2, 3, 4, and 5, unless changed by written agreement, cutting, skidding, and hauling are not permitted during the period of April 15 to July 15. This is necessary to reduce the spread of oak wilt. For more information, contact the Unit Manager or his/her representative.

5.2.3.7 - National Guard training restriction (1/09)

Operations on this contract will not be allowed during National Guard training operations. All harvest equipment must be removed from the sale area during the period of May 1 to October 31.

5.2.37 - No decking areas (12/08)

No decking is allowed within 50 feet of a military firing point.

5.4 - Soil Protection

5.4.1 - Rutting restriction, general (1/09)

Operations are to cease immediately if equipment and weather conditions result in rutting of roads and skid trails which is 12 inches or greater in depth and 50 feet in length. The Unit Manager or his/her representative may restrict hauling and/or skidding if ruts exceed the specified depth. With the Unit Manager or his/her representative's approval, the Purchaser may return to the area when the risk of rutting has decreased.

5.8 - Protection of Endangered Species

5.8.5 - Protection of raptor nests (4/09)

All trees with raptor nests will be protected if found during harvesting operations. Notification will be made to the Unit Manager or his/her representative who will notify the Wildlife Biologist so an on-site evaluation and recommendation can be made, if necessary.

7 - Other Conditions

7.10 - Certified Timber

Sale Name: Big Burn Jack Sale Number: 72-605-10-01

7.10.1 - Non-certified timber (12/05)

The area encompassed by this timber sale is not certified to the standards of the Forest Stewardship Council (FSC) or the Sustainable Forestry Initiative (SFI). Forest products from this sale may not be delivered to the mill as "FSC and / or SFI certified". The lands within this sale are managed for military training.

STONEHENGE OAK & RED PINE (632-09-01)

A timber sale contract for this LUMP SUM SEALED timber sale will be awarded the responsible bidder offering the highest sealed bid price. Bids must be at or above the following appraised price for each species:

| <u>SPECIES</u> | <u>ESTIMATED VOLUME*</u> | <u>APPRAISED PRICE</u> |
|----------------|--------------------------|------------------------|
| SAWLOGS | | |
| RED PINE | 46.60 MBF | \$ 204.00/MBF |
| MIXED OAK | 54.60 MBF | \$ 176.00/MBF |
| PULPWOOD | | |
| RED PINE | 129.00 CORDS | \$ 35.00/CORD |
| MIXED OAK | 325.00 CORDS | \$ 10.30/CORD |

In addition, the successful bidder agrees to purchase the following species at the indicated appraised price:

| <u>SPECIES</u> | <u>ESTIMATED VOLUME*</u> | <u>APPRAISED PRICE</u> |
|----------------|--------------------------|------------------------|
| PULPWOOD | | |
| B.T. ASPEN | 10.00 CORDS | \$ 14.80/CORD |

*The volumes are statistically estimated within plus (+) or minus (-) 22.03 percent. These estimated volumes are final and not subject to adjustment. Prospective bidders are urged to examine this timber and to make their own estimates of quantity and quality.

BOND AND PAYMENT SCHEDULE:

1. A bond in the amount of \$1,500.00, to insure faithful performance of the conditions of the contract, will be deposited by the successful bidder within 21 days of the sale award.
2. Cutting in any sale or unit without the required advance payment would be considered a trespass.
3. Total payment may be paid in advance or according to the following schedule:
 - (a) Ten percent (10%) of the sale value must be paid within 21 days of the sale award.
 - (b) The 10% down payment will be credited towards the first unit cut.
 - (c) Payment for each of the following units must be made before cutting begins in that unit:

| <u>PAYMENT UNIT NUMBER</u> | <u>PERCENT OF TOTAL SALE VALUE</u> |
|----------------------------|------------------------------------|
| 1 | 85% |
| 2 | 15% |

4. If no cutting takes place, the 10% down payment will not be refunded.
5. Operations on the contract issued will terminate on September 30, 2012.



Michigan Department of Natural Resources – Forest, Mineral & Fire Management
TIMBER SALE MAP

This information is provided by authority of Part 525 of Act 451, PA 1994, as amended.

| | |
|-------------|-------------|
| SALE NUMBER | YEAR |
| 632 | 2009 |

| | | | | | |
|---|---------------------------|-----------------------------|-----------------|---|---------|
| FOREST MANAGEMENT UNIT Grayling | COUNTY Crawford | MAPPED BY Patrick Cotant | DATE 8/17/09 | PAGE 1 | OF 1 |
| TOWNSHIP T28N | | RANGE R2W | | SECTION(S) AND SUBDIVISION(S) Section 23-E1/2SE | |

| | | | |
|-------------------------|---------------------|---|--------------------------|
| TOWNSHIP T28N | RANGE R2W | SECTION(S) AND SUBDIVISION(S) Section 23-E1/2SE | SCALE 1:15,840 |
|-------------------------|---------------------|---|--------------------------|

| Cover Type | | | | Density | |
|-------------------|--------------------|----------------------|------------------|-----------------------------|------------------------|
| A = Aspen | H = Hemlock | P = Lowland Poplar | V = Bog or Marsh | 0 = Non Stocked | 5 = Pole Timber Medium |
| B = Paper Birch | J = Jack Pine | Q = Mixed Swamp Cnfr | W = White Pine | 1 = Seedling Sapling Poor | 6 = Pole Timber Well |
| C = Cedar | L = Lowland Brush | R = Red Pine | X = Non Stocked | 2 = Seedling Sapling Medium | 7 = Saw Timber Poor |
| E = Swamp Hdwoods | M = Mpl, Bch. Brch | S = Black Spruce | Z = Water | 3 = Seedling Sapling Well | 8 = Saw Timber Medium |
| F = Spruce Fir | N = Marsh | T = Tamarack | | 4 = Pole Timber Poor | 9 = Saw Timber Well |
| G = Grass | O = Oak | U = Upland Brush | | | |

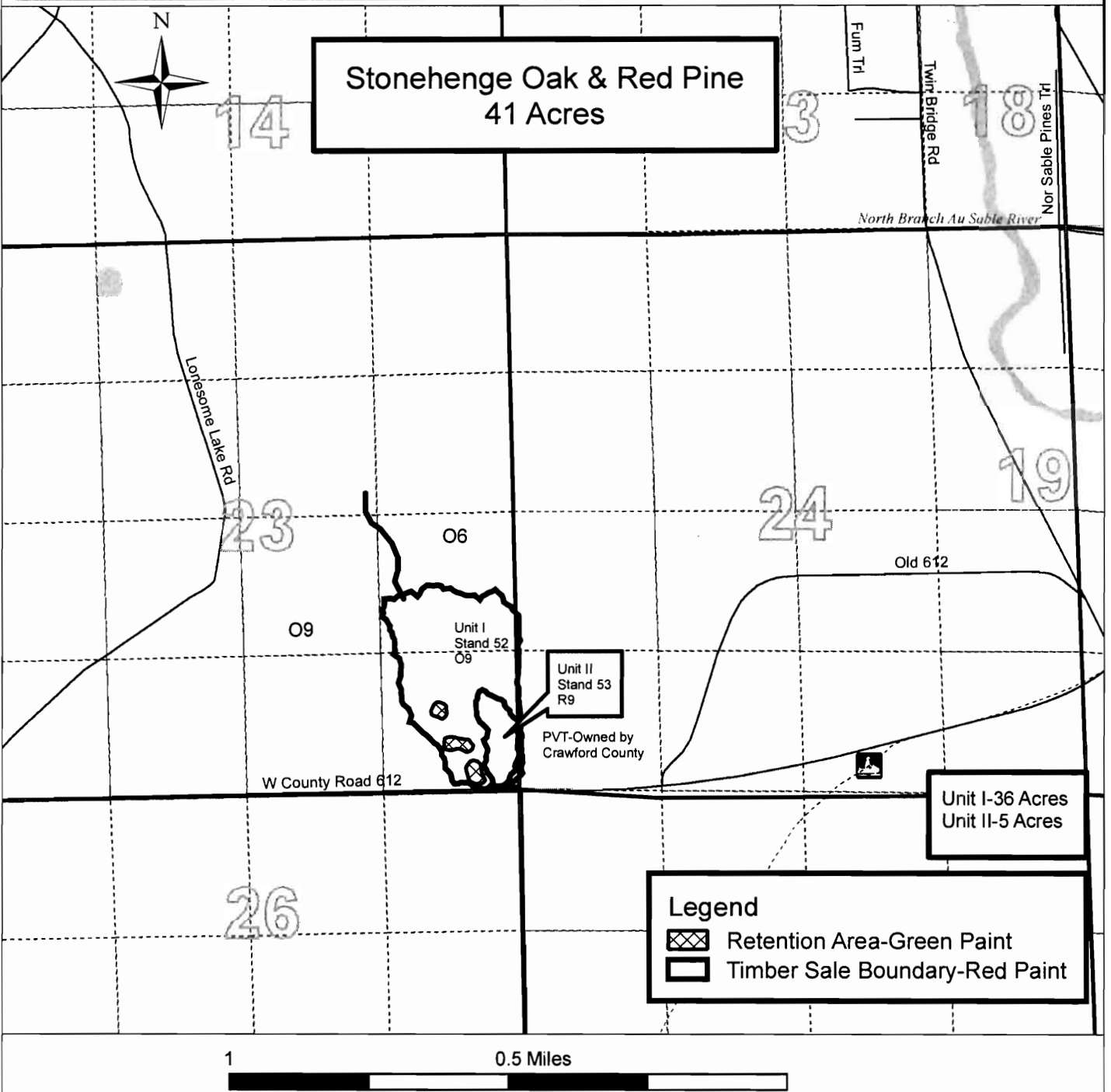

Stonehenge Oak & Red Pine
41 Acres

Unit I-36 Acres
Unit II-5 Acres

Legend

- Retention Area-Green Paint
- Timber Sale Boundary-Red Paint

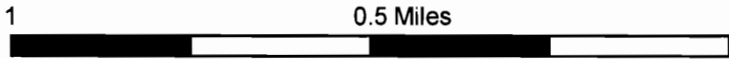

Sale Specific Conditions & Requirements

Sale Name: Stonehenge Oak & Red Pine Sale Number: 72-632-09-01

1 - Sale Area

1.2 - Boundaries

1.2.1 - Painted boundaries (12/08)

The sale boundary is marked and identified by red paint. Exterior sale boundary lines against state and county owned land are marked with red paint. Interior Payment Unit boundaries are marked with red paint. Do not cut painted boundary line trees unless also marked with orange paint.

2 - Timber Specifications

2.1 - Included Timber

2.1.2 - Clearcut unit(s) w/o unmerchantable trees (12/08)

Within Payment Unit(s) I, cut all trees which meet minimum piece specifications in 2.2 Utilization, except for aspen and red pine, which are only to be harvested if the DBH is equal to or greater than 6". Leave islands within this unit are delineated by green paint and are not to be entered.

2.1.3 - Cut tree marked unit(s) (12/08)

Within Payment Unit(s) II, all trees are designated for cutting when marked with orange paint above and below stump height, regardless of merchantability. In addition, all oak and aspen are designated for harvest.

2.1.11 - Description of timber note (2/04)

Note that Big Tooth Aspen contains 5 cords of red maple pulp.

2.2 - Utilization

2.2.2 - Chipping (6/09)

This area must be chip harvested to meet National Guard requirements. The purchaser has the option to produce sawlogs or pulpwood bolts, but the remaining portion of the trees must be chipped and hauled. Products may be produced as roundwood and forwarded to decking areas in final product length, but the tops must be left intact and skidded to the landing for chipping in order to minimize the amount of residual slash left in Military training areas.

2.2.3 - Stump heights (4/07)

Stump heights within the Sale Area shall not exceed 6 inches for all trees. This is in order to facilitate military requirements.

3 - Payments

3.3 - Pre-measured Sales

3.3.4 - Dividing payment units (12/08)

Payment unit(s) may be divided at the request of the purchaser and upon approval of the Unit Manager. Dividing payment units is a contract modification which requires a Timber Sale Contract Supplement.

3.4 - Damaged Timber

3.4.1 - Damaged timber (6/05)

General Condition and Requirement 3.4 Damaged Timber, defines liquidated damages for undesignated live merchantable trees which are cut or injured. In addition, extreme care should be taken to avoid damage to tree seedlings and saplings. Damage to residual trees (defined as breaking of the cambium layer, broken tops or bending of trees from their natural position) is not acceptable.

Within the sale area, if more than 25% of the tree seedlings or saplings (1/4" to 4.5" DBH) within a specified portion of the sale area are damaged, liquidated damages will be assessed at \$100.00 per acre for all acreage within that specified portion of the sale area that was damaged.

No damage is acceptable to merchantable trees. Within the sale area, if more than 5% of trees (> 4.5" DBH) within a specified area of the sale are damaged, liquidated damages will be assessed for all trees damaged. Rates will be in accordance with General Condition and Requirement 3.4 Damaged Timber.

4 - Transportation

4.1 - Construction

4.1.3 - Slash and earthen piles (8/04)

Piles or windrows of earth along roads and landings that have been widened or constructed shall be leveled. Slash from road maintenance or construction, including stumps, shall be chipped, utilized or otherwise removed from the sale.

4.1.6 - Road construction (1/09)

Construction of new roads or improvements of existing roads shall be done in such a way as to minimize the environmental and visual impacts. Merchantable trees shall be cut and utilized unless otherwise directed. Non-merchantable trees shall be severed and laid flat on the ground. Slash shall be scattered, and not left in windrows and kept a minimum of 10 feet back from the road edge. Stumps shall be set upright, not left on edge, and be moved at least 10 feet away from the road edge. Disturbed soil shall be feathered into the woods and not left in berms or windrows.

4.1.7 - Road closure (4/07)

All new roads built into the sale must be blocked to vehicle traffic upon completion of the sale. Overgrown roads that are reopened shall be considered new roads. In general, this will require constructing double earthen berms at strategic locations. Stumps and brush must be placed along the remainder of the trail. Contact the sale administrator for specific details of design and placement.

4.1.11 - Permits (5/07)

The Purchaser will secure any necessary permits that may be required.

4.2 - Maintenance

4.2.5 - Two wheel drive condition (2/04)

All existing trail roads on and adjacent to the sale area must be passable by two-wheel drive traffic for the duration of the sale.

5 - Operations

5.1 - Notification

5.1.4 - Post-sale conference (9/09)

A post-sale conference on site between the Purchaser and sale administrator is required 5 days prior to the completion of active logging operations to determine clean-up and repair of landings, road edges, and the fulfillment of other contract specifications.

5.1.5 - National Guard notification (7/04)

This sale is upon Military Board Lands that are administrated by the Michigan National Guard - Camp Grayling. A minimum of three days prior to opening this sale, the producer must request that the sale administrator contact the military for information regarding training plans that may impact sale operations.

5.2 - Conduct of Operations

5.2.1 - Slash

5.2.1.1 - Slash within sale area (2/04)

No trees are to be felled outside the sale area and all slash is to be kept at least 15 feet back from the red paint line.

5.2.2 - Hazard Trees/Snags

5.2.2.1 - Den trees (2/04)

Obvious hollow and/or den trees shall be protected and left standing unless they are a safety hazard.

5.2.3 - Operating Restrictions

5.2.3.3 - Bark slippage restriction (3/09)

Within Payment Unit(s) II, unless changed by written agreement, cutting and skidding are not permitted during the period of April 15 to July 15. This restriction is because of bark slippage.

5.2.3.6 - Bark beetle restriction (12/08)

In the event drought creates a high risk of pine bark beetle infestation, pine is not to be cut during the period March 1 through July 1, unless all portions of trees greater than two inches in diameter are removed from the sale area, reduced to chips, or treated to the satisfaction of the Unit Manager or his/her representative, within fifteen days of being severed from the stump. Pine log decks, pulpwood piles and treetops that are piled for chipping in the fall or winter within a 1/4 mile of susceptible sites must be removed before March 15. Residual slash must not be placed in piles or rows and must be spread over the site for quick drying. The Department of Natural Resources will exercise this specification if the risk of damage warrants.

5.2.3.7 - National Guard training restriction (1/09)

Operations on this contract may not be allowed during National Guard training operations. Typically, the restricted period is from May 1 to October 31. The contractor must check with the Unit Manager who will coordinate the cutting schedule with the Military. All harvest equipment and timber products must be removed from the sale area during the period of May 1 to October 31.

5.2.4 - Dead and Down Creation

5.2.4.2 - Dead and down creation, hare and grouse (12/08)

To improve habitat for snowshoe hare, grouse, and other species, the Purchaser is to leave two trees, nine (9) inches or larger in diameter on the ground for every two acres. They should be scattered throughout the sale or positioned per the sale administrators instructions. If possible, the logs or trees should be felled so they overlap. Note these pieces should have a minimum length of five feet. They can be of any tree species and can be an un-merchantable piece of wood or a full tree.

5.2.29 - Shrub protection (9/07)

Do not cut or damage hawthorn, witch-hazel or juneberry. These woody-shrub plants are highly beneficial to various wildlife species.

5.4 - Soil Protection

5.4.1 - Rutting restriction, general (1/09)

Operations are to cease immediately if equipment and weather conditions result in rutting of roads and skid trails which is 12 inches or greater in depth and 50 feet in length. The Unit Manager or his/her representative may restrict hauling and/or skidding if ruts exceed the specified depth. With the Unit Manager or his/her representative's approval, the Purchaser may return to the area when the risk of rutting has decreased.

5.8 - Protection of Endangered Species

5.8.5 - Protection of raptor nests (4/09)

All trees with raptor nests will be protected if found during harvesting operations. Notification will be made to the Unit Manager or his/her representative who will notify the Wildlife Biologist so an on-site evaluation and recommendation can be made, if necessary.

7 - Other Conditions

7.10 - Certified Timber

7.10.1 - Non-certified timber (12/05)

The area encompassed by this timber sale is not certified to the standards of the Forest Stewardship Council (FSC) or the Sustainable Forestry Initiative (SFI). Forest products from this sale may not be delivered to the mill as "FSC and / or SFI certified". The lands within this sale are managed for military training.

TOWN LINE KW (010-10-01)
T27N, R01E, SEC. 01, NE1/4, E1/2SE, NWSE, E1/2NW.
T27N, R01E, SEC. 01, NWNW.
OSCODA COUNTY

In response to the notice of sale to be held 3:00 p.m. on March 30, 2010, I am hereby submitting my sealed bid (firm offer) for the following forest products to be cut. Bids for individual species and total bid value must be at or above the appraised price. All non-responsive bid forms may be rejected.

| <u>SPECIES</u> | <u>APPRAISED PRICE</u> | <u>BID PRICE</u> | <u>ESTIMATED VOLUME*</u> | <u>VALUE</u> |
|-----------------|------------------------|------------------|--------------------------|--------------|
| <u>SAWLOGS</u> | | | | |
| RED PINE | \$ 146.00/MBF | \$ _____ X | 577.40 MBF | = \$ _____ |
| <u>PULPWOOD</u> | | | | |
| RED PINE | \$ 31.70/CORD | \$ _____ X | 841.00 CORDS | = \$ _____ |
| JACK PINE | \$ 10.40/CORD | \$ _____ X | 1,943.00 CORDS | = \$ _____ |
| SUBTOTAL 1 | | | | \$ _____ |

In addition, the successful bidder agrees to purchase the following species at the appraised price:

| <u>SPECIES</u> | <u>APPRAISED PRICE</u> | <u>ESTIMATED VOLUME*</u> | <u>VALUE</u> |
|-----------------|------------------------|--------------------------|---------------------|
| <u>SAWLOGS</u> | | | |
| WHITE PINE | \$ 44.00/MBF | 97.40 MBF | = \$ 4,285.60 |
| JACK PINE | \$ 44.00/MBF | 76.50 MBF | = \$ 3,366.00 |
| <u>PULPWOOD</u> | | | |
| RED MAPLE | \$ 5.75/CORD | 109.00 CORDS | = \$ 626.75 |
| WHITE PINE | \$ 4.95/CORD | 336.00 CORDS | = \$ 1,663.20 |
| MIXED OAK | \$ 8.80/CORD | 328.00 CORDS | = \$ 2,886.40 |
| MIX ASPEN | \$ 8.60/CORD | 189.00 CORDS | = \$ 1,625.40 |
| SUBTOTAL 2 | | | \$ <u>14,453.35</u> |

SUBTOTAL 1 + SUBTOTAL 2 = TOTAL BID VALUE \$ _____

*These volumes are statistically estimated within plus (+) or minus (-) 6.73%. These estimated volumes are final and not subject to adjustment. Prospective bidders are urged to examine this timber and to make their own estimates of quantity and quality.

I understand that any or all bids may be rejected, and that the individual unit bid price will be the basis to determine total bid value. All bids must be signed and all bid items must be bid or the bid form may be rejected. I also understand that consideration and awarding a contract will be based upon my past performance and ability to complete the contract based upon equipment and manpower subject to my control.

(bidder's printed name)

(bidder's signature)

Address/Telephone _____

THE WINNING BIDDER MUST COMPLETE THE FORM ON THE REVERSE SIDE
WITHIN 21 DAYS OF SALE AWARD



FOR DEPARTMENT USE ONLY

**TIMBER SALE
VERIFICATION OF WORKER'S DISABILITY
COMPENSATION ACT COMPLIANCE**

*As required by Act 317, P.A. 1969 (Worker's Compensation) and Part 525
of Act 451 of 1994, as amended.*

Sale or Permit No

Year:

Type:

Forest Area:

VERIFICATION OF WORKER'S DISABILITY COMPENSATION ACT COMPLIANCE

- This verification must be completed and submitted within 21 days of contract award and prior to the issuance of the timber sale contract.
- In addition, if boxes 2B or 2C are checked, then Notice of Exclusion or Certificate of Insurance must be submitted within 21 days of the contract award and prior to the issuance of the timber sale contract.
- All Information must be typed or printed except for written signatures.

Please Check Appropriate Categories:

1. My business is organized as (you must check one of the boxes below):

- A. Sole Proprietorship (individual)
- B. Partnership
- C. Corporation

2. You must check one of the boxes below:

- A. I certify that my business is a sole proprietorship and it has no employees but the sole proprietor. I am not subject to the Worker's Compensation Laws.
- B. I certify that my business has satisfied its obligation to the Worker's Compensation Act through the use of an approved Notice of Exclusion (BWC-337, Rev. 5/96). I will provide a copy of the Notice of Exclusion within 21 days of the contract award. (For questions or a copy of the BWC-337, please call the Worker's Compensation Bureau at 517-322-1195).
- C. I certify that my business has a Worker's Compensation Policy. I will provide an original Certificate of Insurance within 21 days of the contract award.

3. If you have checked item 2(A) or 2(B), you must indicate the number of both full and part time employees other than yourself including family members and active partners (if none, you must enter "0").

_____ Full Time Employees

_____ Part Time Employees

Name of Business

Federal ID (or) Social Security No.

Address

Telephone No.
()

City

State

Zip + 4

I hereby certify that the above information is true and correct. I agree to notify the DNR of any changes that occur in factors affecting my coverage during any of my present and future operations.

Signature of Owner or Authorized Representative

Title

Date

COMP 206 CONTRACT (015-09-01)
T27N, R04W, SEC. 24, NW1/4, NE1/4, NESW, N1/2SE.
T27N, R04W, SEC. 24, SESE.
CRAWFORD COUNTY

In response to the notice of sale to be held 3:00 p.m. on March 30, 2010, I am hereby submitting my sealed bid (firm offer) for the following forest products to be cut. Bids for individual species and total bid value must be at or above the appraised price. All non-responsive bid forms may be rejected.

| <u>SPECIES</u> | <u>APPRAISED PRICE</u> | <u>BID PRICE</u> | <u>ESTIMATED VOLUME*</u> | <u>= VALUE</u> |
|-----------------|------------------------|------------------|--------------------------|----------------|
| <u>SAWLOGS</u> | | | | |
| RED PINE | \$ 191.00/MBF | \$ _____ X | 147.00 MBF | = \$ _____ |
| MIXED OAK | \$ 189.00/MBF | \$ _____ X | 248.60 MBF | = \$ _____ |
| <u>PULPWOOD</u> | | | | |
| RED PINE | \$ 31.25/CORD | \$ _____ X | 268.00 CORDS | = \$ _____ |
| MIXED OAK | \$ 9.50/CORD | \$ _____ X | 506.00 CORDS | = \$ _____ |
| MIX ASPEN | \$ 11.35/CORD | \$ _____ X | 441.00 CORDS | = \$ _____ |
| SUBTOTAL 1 | | | | \$ _____ |

In addition, the successful bidder agrees to purchase the following species at the appraised price:

| <u>SPECIES</u> | <u>APPRAISED PRICE</u> | <u>ESTIMATED VOLUME*</u> | <u>VALUE</u> |
|--|------------------------|--------------------------|---------------|
| <u>SAWLOGS</u> | | | |
| MIX ASPEN | \$ 56.00/MBF | 39.30 MBF | = \$ 2,200.80 |
| <u>PULPWOOD</u> | | | |
| RED MAPLE | \$ 7.70/CORD | 358.00 CORDS | = \$ 2,756.60 |
| WHITE PINE | \$ 4.90/CORD | 41.00 CORDS | = \$ 200.90 |
| JACK PINE | \$ 12.30/CORD | 208.00 CORDS | = \$ 2,558.40 |
| SUBTOTAL 2 | | | \$ 7,716.70 |
| SUBTOTAL 1 + SUBTOTAL 2 = TOTAL BID VALUE \$ _____ | | | |

*These volumes are statistically estimated within plus (+) or minus (-) 9.51%. These estimated volumes are final and not subject to adjustment. Prospective bidders are urged to examine this timber and to make their own estimates of quantity and quality.

I understand that any or all bids may be rejected, and that the individual unit bid price will be the basis to determine total bid value. All bids must be signed and all bid items must be bid or the bid form may be rejected. I also understand that consideration and awarding a contract will be based upon my past performance and ability to complete the contract based upon equipment and manpower subject to my control.

(bidder's printed name)

(bidder's signature)

Address/Telephone _____

THE WINNING BIDDER MUST COMPLETE THE FORM ON THE REVERSE SIDE
WITHIN 21 DAYS OF SALE AWARD



**TIMBER SALE
VERIFICATION OF WORKER'S DISABILITY
COMPENSATION ACT COMPLIANCE**

*As required by Act 317, P.A. 1969 (Worker's Compensation) and Part 525
of Act 451 of 1994, as amended.*

| FOR DEPARTMENT USE ONLY | |
|-------------------------|-------|
| Sale or Permit No | |
| Year: | Type: |
| Forest Area: | |

VERIFICATION OF WORKER'S DISABILITY COMPENSATION ACT COMPLIANCE

- This verification must be completed and submitted within 21 days of contract award and prior to the issuance of the timber sale contract.
- In addition, if boxes 2B or 2C are checked, then Notice of Exclusion or Certificate of Insurance must be submitted within 21 days of the contract award and prior to the issuance of the timber sale contract.
- All Information must be typed or printed except for written signatures.

Please Check Appropriate Categories:

1. My business is organized as (you must check one of the boxes below):
 - A. Sole Proprietorship (individual)
 - B. Partnership
 - C. Corporation
2. You must check one of the boxes below:
 - A. I certify that my business is a sole proprietorship and it has no employees but the sole proprietor. I am not subject to the Worker's Compensation Laws.
 - B. I certify that my business has satisfied its obligation to the Worker's Compensation Act through the use of an approved Notice of Exclusion (BWC-337, Rev. 5/96). I will provide a copy of the Notice of Exclusion within 21 days of the contract award. (For questions or a copy of the BWC-337, please call the Worker's Compensation Bureau at 517-322-1195).
 - C. I certify that my business has a Worker's Compensation Policy. I will provide an original Certificate of Insurance within 21 days of the contract award.
3. If you have checked item 2(A) or 2(B), you **must** indicate the number of **both** full and part time employees other than yourself including family members and active partners (if none, you must enter "0").

_____ Full Time Employees

_____ Part Time Employees

| | | | |
|------------------|-------|-------------------------------------|--|
| Name of Business | | Federal ID (or) Social Security No. | |
| Address | | Telephone No. () | |
| City | State | Zip + 4 | |

I hereby certify that the above information is true and correct. I agree to notify the DNR of any changes that occur in factors affecting my coverage during any of my present and future operations.

Signature of Owner or Authorized Representative

Title

Date

BIG "V" ASPEN (027-09-01)
T28N, R01E, SEC. 36, NW1/4, W1/2NE, NWSW.
OSCODA COUNTY

In response to the notice of sale to be held 3:00 p.m. on March 30, 2010, I am hereby submitting my sealed bid (firm offer) for the following forest products to be cut. Bids for individual species and total bid value must be at or above the appraised price. All non-responsive bid forms may be rejected.

| <u>SPECIES</u> | <u>APPRAISED PRICE</u> | <u>BID PRICE</u> | <u>ESTIMATED VOLUME*</u> | <u>= VALUE</u> |
|-----------------|------------------------|------------------|--------------------------|----------------|
| <u>SAWLOGS</u> | | | | |
| RED PINE | \$ 178.00/MBF | \$ _____ X | 38.60 MBF | = \$ _____ |
| MIXED OAK | \$ 155.00/MBF | \$ _____ X | 17.00 MBF | = \$ _____ |
| MIX ASPEN | \$ 55.00/MBF | \$ _____ X | 58.80 MBF | = \$ _____ |
| <u>PULPWOOD</u> | | | | |
| MIX ASPEN | \$ 12.50/CORD | \$ _____ X | 988.00 CORDS | = \$ _____ |
| MIX SOFTWD | \$ 6.05/CORD | \$ _____ X | 444.00 CORDS | = \$ _____ |
| SUBTOTAL 1 | | | | \$ _____ |

In addition, the successful bidder agrees to purchase the following species at the appraised price:

| <u>SPECIES</u> | <u>APPRAISED PRICE</u> | <u>ESTIMATED VOLUME*</u> | <u>VALUE</u> |
|--|------------------------|--------------------------|--------------------|
| <u>SAWLOGS</u> | | | |
| RED MAPLE | \$ 100.00/MBF | 20.10 MBF | = \$ 2,010.00 |
| <u>PULPWOOD</u> | | | |
| RED MAPLE | \$ 7.50/CORD | 180.00 CORDS | = \$ 1,350.00 |
| MIXED OAK | \$ 4.60/CORD | 58.00 CORDS | = \$ 266.80 |
| SUBTOTAL 2 | | | \$ <u>3,626.80</u> |
| SUBTOTAL 1 + SUBTOTAL 2 = TOTAL BID VALUE \$ _____ | | | |

*These volumes are statistically estimated within plus (+) or minus (-) 12.92%. These estimated volumes are final and not subject to adjustment. Prospective bidders are urged to examine this timber and to make their own estimates of quantity and quality.

I understand that any or all bids may be rejected, and that the individual unit bid price will be the basis to determine total bid value. All bids must be signed and all bid items must be bid or the bid form may be rejected. I also understand that consideration and awarding a contract will be based upon my past performance and ability to complete the contract based upon equipment and manpower subject to my control.

(bidder's printed name)

(bidder's signature)

Address/Telephone _____

THE WINNING BIDDER MUST COMPLETE THE FORM ON THE REVERSE SIDE
WITHIN 21 DAYS OF SALE AWARD



Michigan Department of Natural Resources
Forest, Mineral and Fire Management

FOR DEPARTMENT USE ONLY

**TIMBER SALE
VERIFICATION OF WORKER'S DISABILITY
COMPENSATION ACT COMPLIANCE**

*As required by Act 317, P.A. 1969 (Worker's Compensation) and Part 525
of Act 451 of 1994, as amended.*

Sale or Permit No

Year:

Type:

Forest Area:

VERIFICATION OF WORKER'S DISABILITY COMPENSATION ACT COMPLIANCE

- This verification must be completed and submitted within 21 days of contract award and prior to the issuance of the timber sale contract.
- In addition, if boxes 2B or 2C are checked, then Notice of Exclusion or Certificate of Insurance must be submitted within 21 days of the contract award and prior to the issuance of the timber sale contract.
- All information must be typed or printed except for written signatures.

Please Check Appropriate Categories:

1. My business is organized as (you **must** check one of the boxes below):

- A. Sole Proprietorship (individual)
- B. Partnership
- C. Corporation

2. You **must** check one of the boxes below:

- A. I certify that my business is a sole proprietorship and it has no employees but the sole proprietor. I am not subject to the Worker's Compensation Laws.
- B. I certify that my business has satisfied its obligation to the Worker's Compensation Act through the use of an approved Notice of Exclusion (BWC-337, Rev. 5/96). I will provide a copy of the Notice of Exclusion within 21 days of the contract award. (For questions or a copy of the BWC-337, please call the Worker's Compensation Bureau at 517-322-1195).
- C. I certify that my business has a Worker's Compensation Policy. I will provide an original Certificate of Insurance within 21 days of the contract award.

3. If you have checked item 2(A) or 2(B), you **must** indicate the number of **both** full and part time employees other than yourself including family members and active partners (if none, you must enter "0").

_____ Full Time Employees

_____ Part Time Employees

Name of Business

Federal ID (or) Social Security No.

Address

Telephone No.

()

City

State

Zip + 4

I hereby certify that the above information is true and correct. I agree to notify the DNR of any changes that occur in factors affecting my coverage during any of my present and future operations.

Signature of Owner or Authorized Representative

Title

Date



FOR DEPARTMENT USE ONLY

**TIMBER SALE
VERIFICATION OF WORKER'S DISABILITY
COMPENSATION ACT COMPLIANCE**

*As required by Act 317, P.A. 1969 (Worker's Compensation) and Part 525
of Act 451 of 1994, as amended.*

Sale or Permit No

Year:

Type:

Forest Area:

VERIFICATION OF WORKER'S DISABILITY COMPENSATION ACT COMPLIANCE

- **This verification must be completed and submitted within 21 days of contract award and prior to the issuance of the timber sale contract.**
- **In addition, if boxes 2B or 2C are checked, then Notice of Exclusion or Certificate of Insurance must be submitted within 21 days of the contract award and prior to the issuance of the timber sale contract.**
- **All Information must be typed or printed except for written signatures.**

Please Check Appropriate Categories:

1. My business is organized as (you **must** check one of the boxes below):

- A. Sole Proprietorship (individual)
- B. Partnership
- C. Corporation

2. You **must** check one of the boxes below:

- A. I certify that my business is a sole proprietorship and it has no employees but the sole proprietor. I am not subject to the Worker's Compensation Laws.
- B. I certify that my business has satisfied its obligation to the Worker's Compensation Act through the use of an approved Notice of Exclusion (BWC-337, Rev. 5/96). I will provide a copy of the Notice of Exclusion within 21 days of the contract award. (For questions or a copy of the BWC-337, please call the Worker's Compensation Bureau at 517-322-1195).
- C. I certify that my business has a Worker's Compensation Policy. I will provide an original Certificate of Insurance within 21 days of the contract award.

3. If you have checked item 2(A) or 2(B), you **must** indicate the number of **both** full and part time employees other than yourself including family members and active partners (if none, you must enter "0").

_____ Full Time Employees

_____ Part Time Employees

| | | | |
|------------------|-------|-------------------------------------|--|
| Name of Business | | Federal ID (or) Social Security No. | |
| Address | | Telephone No. () | |
| City | State | Zip + 4 | |

I hereby certify that the above information is true and correct. I agree to notify the DNR of any changes that occur in factors affecting my coverage during any of my present and future operations.

Signature of Owner or Authorized Representative

Title

Date

BIG BURN JACK (605-10-01)
T25N, R04W, SEC. 06, W1/2, N1/2NE, SWNE.
CRAWFORD COUNTY

In response to the notice of sale to be held 3:00 p.m. on March 30, 2010, I am hereby submitting my sealed bid (firm offer) for the following forest products to be cut. Bids for individual species and total bid value must be at or above the appraised price. All non-responsive bid forms may be rejected.

| <u>SPECIES</u> | <u>APPRAISED PRICE</u> | <u>BID PRICE</u> | <u>ESTIMATED VOLUME* = VALUE</u> |
|-----------------|------------------------|------------------|----------------------------------|
| <u>SAWLOGS</u> | | | |
| JACK PINE | \$ 47.00/MBF | \$ _____ X | 75.10 MBF = \$ _____ |
| MIXED OAK | \$ 146.00/MBF | \$ _____ X | 66.40 MBF = \$ _____ |
| <u>PULPWOOD</u> | | | |
| JACK PINE | \$ 10.40/CORD | \$ _____ X | 1,791.00 CORDS = \$ _____ |
| MIXED OAK | \$ 9.45/CORD | \$ _____ X | 593.00 CORDS = \$ _____ |
| SUBTOTAL 1 | | | \$ _____ |

In addition, the successful bidder agrees to purchase the following species at the appraised price:

| <u>SPECIES</u> | <u>APPRAISED PRICE</u> | <u>ESTIMATED VOLUME*</u> | <u>VALUE</u> |
|-----------------|------------------------|--------------------------|--------------|
| <u>PULPWOOD</u> | | | |
| RED MAPLE | \$ 5.75/CORD | 35.00 CORDS | = \$ 201.25 |
| MIX ASPEN | \$ 8.30/CORD | 43.00 CORDS | = \$ 356.90 |
| SUBTOTAL 2 | | | \$ 558.15 |

SUBTOTAL 1 + SUBTOTAL 2 = TOTAL BID VALUE \$ _____

*These volumes are statistically estimated within plus (+) or minus (-) 10.4%. These estimated volumes are final and not subject to adjustment. Prospective bidders are urged to examine this timber and to make their own estimates of quantity and quality.

I understand that any or all bids may be rejected, and that the individual unit bid price will be the basis to determine total bid value. All bids must be signed and all bid items must be bid or the bid form may be rejected. I also understand that consideration and awarding a contract will be based upon my past performance and ability to complete the contract based upon equipment and manpower subject to my control.

(bidder's printed name)

(bidder's signature)

Address/Telephone _____

THE WINNING BIDDER MUST COMPLETE THE FORM ON THE REVERSE SIDE
WITHIN 21 DAYS OF SALE AWARD



Michigan Department of Natural Resources
Forest, Mineral and Fire Management

**TIMBER SALE
VERIFICATION OF WORKER'S DISABILITY
COMPENSATION ACT COMPLIANCE**

*As required by Act 317, P.A. 1969 (Worker's Compensation) and Part 525
of Act 451 of 1994, as amended.*

FOR DEPARTMENT USE ONLY

Sale or Permit No

Year:

Type:

Forest Area:

VERIFICATION OF WORKER'S DISABILITY COMPENSATION ACT COMPLIANCE

- This verification must be completed and submitted within 21 days of contract award and prior to the issuance of the timber sale contract.
- In addition, if boxes 2B or 2C are checked, then Notice of Exclusion or Certificate of Insurance must be submitted within 21 days of the contract award and prior to the issuance of the timber sale contract.
- All information must be typed or printed except for written signatures.

Please Check Appropriate Categories:

1. My business is organized as (you **must** check one of the boxes below):

- A. Sole Proprietorship (individual)
- B. Partnership
- C. Corporation

2. You **must** check one of the boxes below:

- A. I certify that my business is a sole proprietorship and it has no employees but the sole proprietor. I am not subject to the Worker's Compensation Laws.
- B. I certify that my business has satisfied its obligation to the Worker's Compensation Act through the use of an approved Notice of Exclusion (BWC-337, Rev. 5/96). I will provide a copy of the Notice of Exclusion within 21 days of the contract award. (For questions or a copy of the BWC-337, please call the Worker's Compensation Bureau at 517-322-1195).
- C. I certify that my business has a Worker's Compensation Policy. I will provide an original Certificate of Insurance within 21 days of the contract award.

3. If you have checked item 2(A) or 2(B), you **must** indicate the number of **both** full and part time employees other than yourself including family members and active partners (if none, you must enter "0").

_____ Full Time Employees

_____ Part Time Employees

| | | | |
|------------------|-------|-------------------------------------|--|
| Name of Business | | Federal ID (or) Social Security No. | |
| Address | | Telephone No. () | |
| City | State | Zip + 4 | |

I hereby certify that the above information is true and correct. I agree to notify the DNR of any changes that occur in factors affecting my coverage during any of my present and future operations.

Signature of Owner or Authorized Representative

Title

Date

STONEHENGE OAK & RED PINE (632-09-01)
T28N, R02W, SEC. 23, E1/2SE.
CRAWFORD COUNTY

In response to the notice of sale to be held 3:00 p.m. on March 30, 2010, I am hereby submitting my sealed bid (firm offer) for the following forest products to be cut. Bids for individual species and total bid value must be at or above the appraised price. All non-responsive bid forms may be rejected.

| <u>SPECIES</u> | <u>APPRAISED PRICE</u> | <u>BID PRICE</u> | <u>ESTIMATED VOLUME*</u> | <u>= VALUE</u> |
|-----------------|------------------------|------------------|--------------------------|----------------|
| <u>SAWLOGS</u> | | | | |
| RED PINE | \$ 204.00/MBF | \$ _____ X | 46.60 MBF | = \$ _____ |
| MIXED OAK | \$ 176.00/MBF | \$ _____ X | 54.60 MBF | = \$ _____ |
| <u>PULPWOOD</u> | | | | |
| RED PINE | \$ 35.00/CORD | \$ _____ X | 129.00 CORDS | = \$ _____ |
| MIXED OAK | \$ 10.30/CORD | \$ _____ X | 325.00 CORDS | = \$ _____ |
| SUBTOTAL 1 | | | | \$ _____ |

In addition, the successful bidder agrees to purchase the following species at the appraised price:

| <u>SPECIES</u> | <u>APPRAISED PRICE</u> | <u>ESTIMATED VOLUME*</u> | <u>VALUE</u> |
|--|------------------------|--------------------------|--------------|
| <u>PULPWOOD</u> | | | |
| B.T. ASPEN | \$ 14.80/CORD | 10.00 CORDS | = \$ 148.00 |
| SUBTOTAL 2 | | | \$ 148.00 |
| SUBTOTAL 1 + SUBTOTAL 2 = TOTAL BID VALUE \$ _____ | | | |

*These volumes are statistically estimated within plus (+) or minus (-) 22.03%. These estimated volumes are final and not subject to adjustment. Prospective bidders are urged to examine this timber and to make their own estimates of quantity and quality.

I understand that any or all bids may be rejected, and that the individual unit bid price will be the basis to determine total bid value. All bids must be signed and all bid items must be bid or the bid form may be rejected. I also understand that consideration and awarding a contract will be based upon my past performance and ability to complete the contract based upon equipment and manpower subject to my control.

(bidder's printed name)

(bidder's signature)

Address/Telephone _____

THE WINNING BIDDER MUST COMPLETE THE FORM ON THE REVERSE SIDE
WITHIN 21 DAYS OF SALE AWARD



FOR DEPARTMENT USE ONLY

**TIMBER SALE
VERIFICATION OF WORKER'S DISABILITY
COMPENSATION ACT COMPLIANCE**

*As required by Act 317, P.A. 1969 (Worker's Compensation) and Part 525
of Act 451 of 1994, as amended.*

Sale or Permit No

Year:

Type:

Forest Area:

VERIFICATION OF WORKER'S DISABILITY COMPENSATION ACT COMPLIANCE

- This verification must be completed and submitted within 21 days of contract award and prior to the issuance of the timber sale contract.
- In addition, if boxes 2B or 2C are checked, then Notice of Exclusion or Certificate of Insurance must be submitted within 21 days of the contract award and prior to the issuance of the timber sale contract.
- All Information must be typed or printed except for written signatures.

Please Check Appropriate Categories:

1. My business is organized as (you **must** check one of the boxes below):

- A. Sole Proprietorship (individual)
- B. Partnership
- C. Corporation

2. You **must** check one of the boxes below:

- A. I certify that my business is a sole proprietorship and it has no employees but the sole proprietor. I am not subject to the Worker's Compensation Laws.
- B. I certify that my business has satisfied its obligation to the Worker's Compensation Act through the use of an approved Notice of Exclusion (BWC-337, Rev. 5/96). I will provide a copy of the Notice of Exclusion within 21 days of the contract award. (For questions or a copy of the BWC-337, please call the Worker's Compensation Bureau at 517-322-1195).
- C. I certify that my business has a Worker's Compensation Policy. I will provide an original Certificate of Insurance within 21 days of the contract award.

3. If you have checked item 2(A) or 2(B), you **must** indicate the number of **both** full and part time employees other than yourself including family members and active partners (if none, you must enter "0").

_____ Full Time Employees

_____ Part Time Employees

| | | | |
|------------------|-------|-------------------------------------|--|
| Name of Business | | Federal ID (or) Social Security No. | |
| Address | | Telephone No. () | |
| City | State | Zip + 4 | |

I hereby certify that the above information is true and correct. I agree to notify the DNR of any changes that occur in factors affecting my coverage during any of my present and future operations.

Signature of Owner or Authorized Representative

Title

Date