



DEPARTMENT OF NATURAL RESOURCES
STATE OF MICHIGAN

TIMBER SALE PROSPECTUS

Notice is hereby given that bids will be received by the Unit Manager, GAYLORD MANAGEMENT UNIT, for certain timber on the following described lands:

BLASTEN ASPEN / T34N, R01W, SEC. 14, N1/2NW, W1/2NE.
T34N, R01W, SEC. 12, S1/2SW, SWSE.
T34N, R01W, SEC. 11, E1/2SW, NW1/4.
T34N, R01W, SEC. 02, S1/2SW.
CHEBOYGAN COUNTY (Appr. \$86,539.00)

JOHNSON PINE / T34N, R04W, SEC. 31, S1/2SE, NESE, N1/2SW, SESW, S1/2NW, NWSE.
EMMET COUNTY (Appr. \$113,779.95)

MAXWELL ASPEN / T34N, R04W, SEC. 31, NE1/4, NESE.
T34N, R04W, SEC. 32, NWNW, N1/2SW, SENW, NWSE, SWNE.
EMMET COUNTY (Appr. \$59,487.70)

OLD 33 ASPEN / T34N, R01W, SEC. 01, E1/2SW, SE.
T34N, R01W, SEC. 12, W1/2NE, E1/2NW, AND W1/2SE.
CHEBOYGAN COUNTY (Appr. \$54,736.30)

MILLIGAN CREEK ASPEN / T34N, R01W, SEC. 12, SESE.
T34N, R01W, SEC. 13, N1/2NE, SENE.
CHEBOYGAN COUNTY (Appr. \$25,164.95)

SALE DATE AND TIME: 3:00 p.m. on November 10, 2009.

INDIAN RIVER

BID INSTRUCTIONS (Ver. 06/23/2008):

1. Bid Location, Date, and Time: Bids must be received by the Unit Manager, Gaylord Management Unit, Indian River Field Office, 6984 Wilson Road, Indian River, 49749, no later than 3:00 p.m. on November 10, 2009. For further information concerning this sale, contact the Unit Manager at 231-238-9314.
2. Bidder's Qualifications: Purchaser shall obtain workers compensation insurance to cover claims under Michigan's Worker's Disability Compensation Act of 1969 or similar employee benefit act of any other state applicable to an employee. If all or part of a timber sale was prepared by a private contractor, that contractor and that contractor's company are not permitted to bid on the timber sale contract. Bids will not be accepted from individuals or companies appearing on the DNR/FMFM No-Bid List. This list contains the names of purchasers who previously failed to execute a contract within 21-days or who have a history of poor performance.
3. Preparation of Sealed Bids: Bids shall be manually signed in ink; bid prices must be entered for each species and product in the Bid Price column for all material subject to bidding; and all fill-in blanks must be completed. If erasures or other changes appear on the forms, each erasure or change must be initialed by the person signing the bid.
4. Submission of Sealed Bids: Bid forms may be obtained from the Unit Manager. All bids must be submitted on the bid form and in an envelope clearly identified as described in this section. NOTE: Only one bid form per bid envelope. Sealed bids must be submitted to the Unit office designated in the prospectus and must be submitted at or prior to the time established in the prospectus. The envelope should show on the outside (a) that it is a "Bid for Timber," and (b) the sale name or number, and (c) the date and time of bid opening as shown in the prospectus. Bids received after the time specified in the sale prospectus are late bids and will be rejected.
5. Public Opening of Sealed Bids: If conditions permit, the sealed bids will be publicly opened and posted at the time and place set in the prospectus.
6. Award of Contract: Award of the contract will be made to the Bidder whose bid, conforming to the prospectus, is most advantageous to the State of Michigan on the basis of total value at rates bid for the estimated quantities. The State reserves the right to reject any bid or waive any minor irregularity in bids received. A written award mailed (or otherwise furnished) to the successful Bidder shall be deemed to result in a binding contract without further action by either party.
7. Down Payment: The Bidder to whom award is made must make a down payment within 21 days of the sale award. The amount of the down payment will be calculated as shown in the Bond and Payment Schedule of this prospectus. Only cash may be used to meet this requirement.
8. Performance Security: As guarantee of faithful performance, a cash bond, certificate of deposit, surety bond or irrevocable letter of credit (LOC) is required within 21 days of the sale award. The amount of the performance security is shown in the Bond and Payment Schedule of this prospectus. If an LOC or surety is used, the coverage must extend for at least 6 months beyond the contract expiration.
9. Timber Sale Contract: Additional conditions and requirements common to all timber sales are listed on the timber sale contract (R4031) and are available on line at www.michigan.gov/dnr. Contact the Unit Manager for additional information or a sample contract. Within 21 days of the date of the award letter, the bidder must sign the contract and provide the required down payment, performance security, and verification of worker's disability compensation. The down payment and performance security shall be in accordance with the provisions of the timber sale contract, in the sums stated in this prospectus. If these actions are not taken, then the Bidder, the Bidder's corporation, and the corporation's principals may not be permitted to bid on State timber sales for a period of 1 year. In addition, the Bidder certifies that if awarded this contract, the Bidder will complete the timber sale contract in accordance with its terms and any modifications thereof including requirements to purchase, cut, and remove the included timber by the termination date.

10. Disclaimer of Estimates and Bidder's Warranty of Inspection: Before submitting this bid, the Bidder is advised and cautioned to inspect the sale area, review the requirements of the sale contract, and take other steps as may be reasonably necessary to ascertain the location, estimated volumes, construction estimates, and operating costs of the proposed sale. Failure to do so will not relieve the Bidder from responsibility for completing the contract.

The Bidder warrants that this bid is submitted solely on the basis of the Bidder's examination and inspection of the quality and quantity of the timber offered for sale and the Bidder's opinion of the value thereof and the costs of recovery. No reliance should be placed on the State of Michigan's estimates of timber quality, quantity or costs of recovery. Bidder further acknowledges that the State of Michigan: (i) expressly disclaims any warranty of fitness of timber for any purpose; (ii) offers this timber as is without any warranty of quality (merchantability) or quantity and (iii) expressly disclaims any warranty as to the quantity or quality of timber sold.

11. Certification and Chain-of-Custody: Unless otherwise indicated in the contract under section 7 - Other Conditions of the Sale Specific Conditions & Requirements, the area encompassed by this timber sale is certified to the standards of the Forest Stewardship Council (FSC) - Certificate #SCS-FM/COC-090N and the Sustainable Forestry Initiative (SFI) - Certificate # NSF-SFIS-5Y031-S1. Forest products from this sale may be delivered to the mill as "FSC and / or SFI certified" as long as the contractor hauling the forest products is chain-of-custody (COC) certified or covered under a COC certificate from the destination mill. The purchaser is responsible for maintaining COC after leaving the sale area.

REBECCA A. HUMPHRIES
Director

BLASTEN ASPEN (103-09-01)

A timber sale contract for this LUMP SUM SEALED timber sale will be awarded the responsible bidder offering the highest sealed bid price. Bids must be at or above the following appraised price for each species:

<u>SPECIES</u>	<u>ESTIMATED VOLUME*</u>	<u>APPRAISED PRICE</u>
SAWLOGS		
B.T. ASPEN	234.20 MBF	\$ 88.00/MBF
PULPWOOD		
B.T. ASPEN	2,121.00 CORDS	\$ 20.45/CORD

In addition, the successful bidder agrees to purchase the following species at the indicated appraised price:

<u>SPECIES</u>	<u>ESTIMATED VOLUME*</u>	<u>APPRAISED PRICE</u>
SAWLOGS		
RED MAPLE	45.80 MBF	\$ 81.00/MBF
BASSWOOD	3.90 MBF	\$ 53.00/MBF
BEECH	3.50 MBF	\$ 32.00/MBF
P. BIRCH	12.50 MBF	\$ 137.00/MBF
W. SPRUCE	3.50 MBF	\$ 15.00/MBF
WHITE PINE	6.80 MBF	\$ 65.00/MBF
RED PINE	12.20 MBF	\$ 125.00/MBF
PULPWOOD		
SUG. MAPLE	173.00 CORDS	\$ 4.75/CORD
RED MAPLE	761.00 CORDS	\$ 9.10/CORD
BASSWOOD	42.00 CORDS	\$ 6.05/CORD
WHITE ASH	57.00 CORDS	\$ 7.00/CORD
BEECH	34.00 CORDS	\$ 7.85/CORD
P. BIRCH	170.00 CORDS	\$ 7.50/CORD
B. POPLAR	91.00 CORDS	\$ 7.25/CORD
BALSAM FIR	391.00 CORDS	\$ 3.05/CORD
W. SPRUCE	26.00 CORDS	\$ 7.50/CORD
WHITE PINE	100.00 CORDS	\$ 4.00/CORD
RED PINE	67.00 CORDS	\$ 35.90/CORD

*The volumes are statistically estimated within plus (+) or minus (-) 8.20 percent. These estimated volumes are final and not subject to adjustment. Prospective bidders are urged to examine this timber and to make their own estimates of quantity and quality.

BOND AND PAYMENT SCHEDULE:

1. A bond in the amount of \$4,400.00 to insure faithful performance of the conditions of the contract, will be deposited by the successful bidder within 21 days of the sale award.
2. Cutting in any sale or unit without the required advance payment would be considered a trespass.
3. Total payment may be paid in advance or according to the following schedule:
 - (a) Ten percent (10%) of the sale value must be paid within 21 days of the sale award.
 - (b) The 10% down payment will be credited towards the first unit cut.
 - (c) Payment for each of the following units must be made before cutting begins in that unit:

<u>PAYMENT UNIT NUMBER</u>	<u>PERCENT OF TOTAL SALE VALUE</u>
1	42%
2	14%
3	08%
4	14%
5	12%
6	10%

4. If no cutting takes place, the 10% down payment will not be refunded.
5. Operations on the contract issued will terminate on December 31, 2013.



TIMBER SALE MAP

This information is provided by authority of Part 525 of Act 451, PA 1994, as amended.

SALE NUMBER	YEAR
52-103-09-01	09

FOREST MANAGEMENT UNIT Gaylord Management Unit	COUNTY Cheboygan	MAPPED BY Coy	DATE 05/29/09	PAGE 1	OF 3
		CRUISED BY Dave Neff (Contractor)			

TOWNSHIP 34N	RANGE 1W	SECTION(S) AND SUBDIVISION(S) 2- S1/2SW 11- E1/2SW; NW1/4 12- S1/2SW; SWSE 14- N1/2NW; W1/2NE	SCALE 1:15,840
------------------------	--------------------	---	-----------------------

Cover Type				Density	
A = Aspen	H = Hemlock	P = Lowland Poplar	V = Bog or Marsh	0 = Non Stocked	5 = Pole Timber Medium
B = Paper Birch	J = Jack Pine	Q = Mixed Swamp Cnfr	W = White Pine	1 = Seedling Sapling Poor	6 = Pole Timber Well
C = Cedar	L = Lowland Brush	R = Red Pine	X = Non Stocked	2 = Seedling Sapling Medium	7 = Saw Timber Poor
E = Swamp Hdwoods	M = Mpl, Bch, Brch	S = Black Spruce	Z = Water	3 = Seedling Sapling Well	8 = Saw Timber Medium
F = Spruce Fir	N = Marsh	T = Tamarack		4 = Pole Timber Poor	9 = Saw Timber Well
G = Grass	O = Oak	U = Upland Brush			

PU#	ACRES
1	48
2	33
3	18
4	33
5	27
6	15

Blasten Aspen
Cheboygan County
Compartment 183
174 Acres

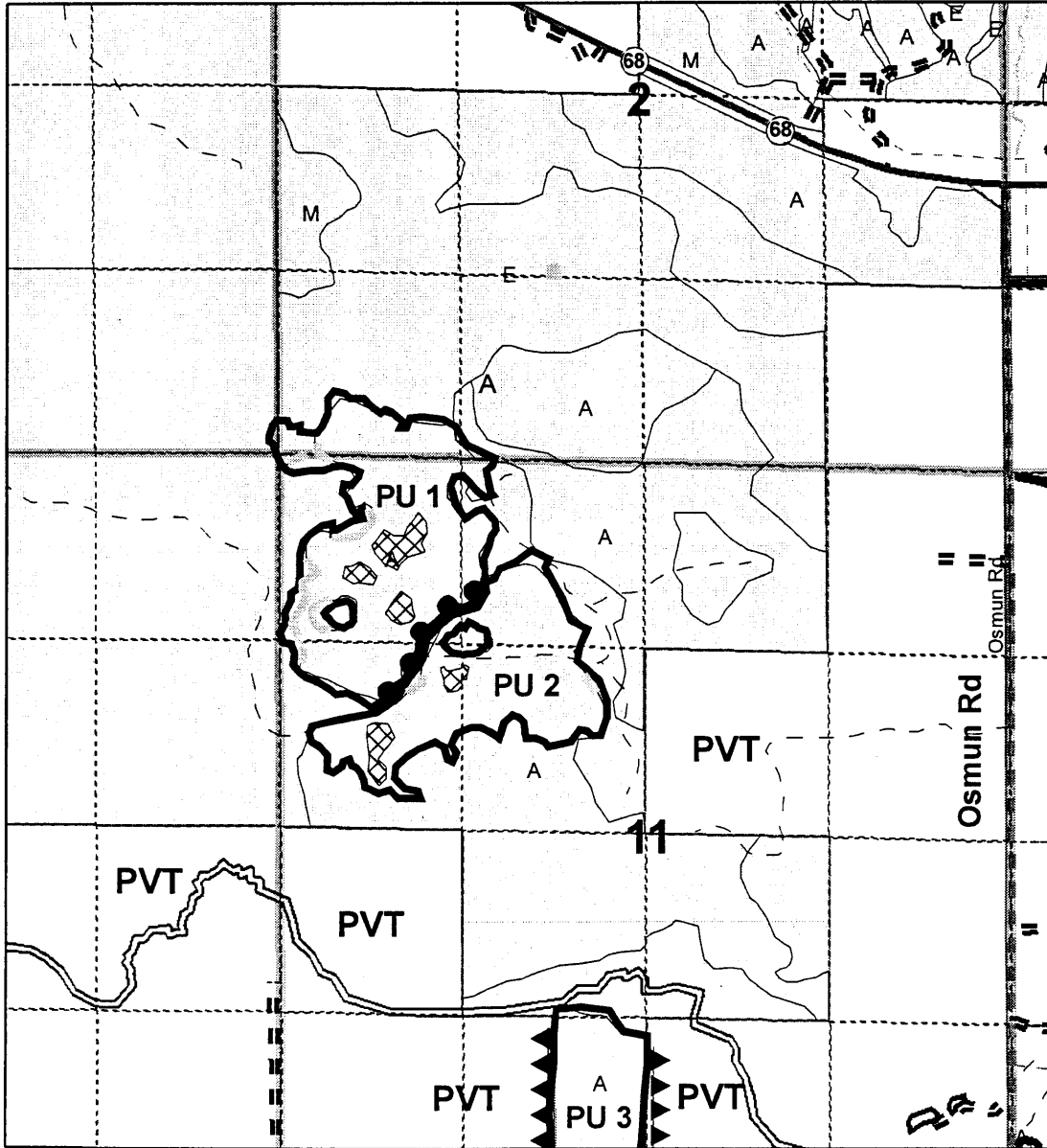
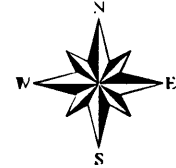

Legend	
	Sale Boundary- Red Paint
	Retention Pocket- Red Paint
	Unit Line - Yellow Paint
	Private Boundary - Blue Paint
	Adj. Stand Boundaries
	Sections
	Quarter Quarter Sections

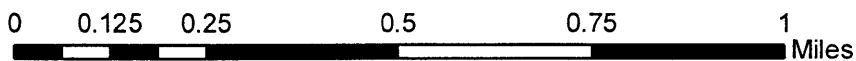



TIMBER SALE MAP

This information is provided by authority of Part 525 of Act 451, PA 1994, as amended.

SALE NUMBER	YEAR
52-103-09-01	09

FOREST MANAGEMENT UNIT Gaylord Management Unit	COUNTY Cheboygan	MAPPED BY Coy	DATE 05/29/09	PAGE 2	OF 3
		CRUISED BY Dave Neff (Contractor)			

TOWNSHIP 34N	RANGE 1W	SECTION(S) AND SUBDIVISION(S) 2- S1/2SW 11- E1/2SW; NW1/4 12- S1/2SW; SWSE 14- N1/2NW; W1/2NE	SCALE 1:15,840
-----------------	-------------	--	-------------------

Cover Type				Density	
A = Aspen	H = Hemlock	P = Lowland Poplar	V = Bog or Marsh	0 = Non Stocked	5 = Pole Timber Medium
B = Paper Birch	J = Jack Pine	Q = Mixed Swamp Cnfr	W = White Pine	1 = Seedling Sapling Poor	6 = Pole Timber Well
C = Cedar	L = Lowland Brush	R = Red Pine	X = Non Stocked	2 = Seedling Sapling Medium	7 = Saw Timber Poor
E = Swamp Hdwoods	M = Mpl, Bch, Brch	S = Black Spruce	Z = Water	3 = Seedling Sapling Well	8 = Saw Timber Medium
F = Spruce Fir	N = Marsh	T = Tamarack		4 = Pole Timber Poor	9 = Saw Timber Well
G = Grass	O = Oak	U = Upland Brush			

PU#	ACRES
1	48
2	33
3	18
4	33
5	27
6	15

Blasten Aspen

Cheboygan County

Compartment 183

174 Acres

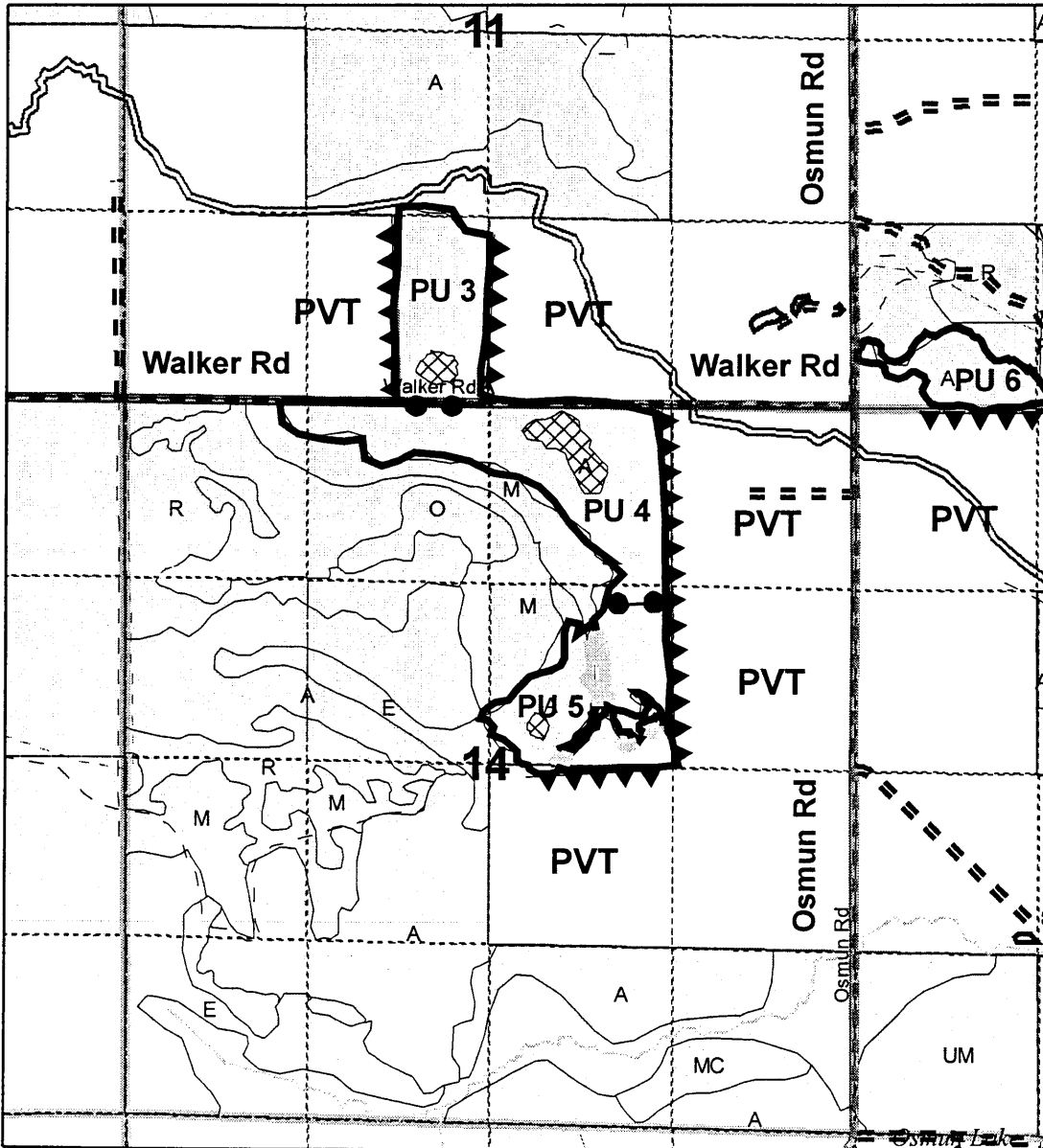
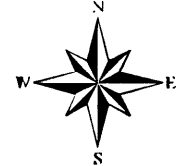

Legend

- Sale Boundary- Red Paint
- Retention Pocket- Red Paint
- Unit Line - Yellow Paint
- Private Boundary - Blue Paint
- Adj. Stand Boundaries
- Sections
- Quarter Quarter Sections

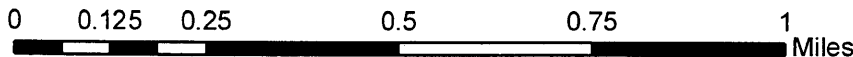



TIMBER SALE MAP

This information is provided by authority of Part 525 of Act 451, PA 1994, as amended.

SALE NUMBER	YEAR
52-103-09-01	09

FOREST MANAGEMENT UNIT Gaylord Management Unit	COUNTY Cheboygan	MAPPED BY Coy	DATE 05/29/09	PAGE 3	OF 3
TOWNSHIP 34N		RANGE 1W		SECTION(S) AND SUBDIVISION(S) 2- S1/2SW 11- E1/2SW; NW1/4 12- S1/2SW; SWSE 14- N1/2NW; W1/2NE	

SCALE 1:15,840

Cover Type				Density	
A = Aspen	H = Hemlock	P = Lowland Poplar	V = Bog or Marsh	0 = Non Stocked	5 = Pole Timber Medium
B = Paper Birch	J = Jack Pine	Q = Mixed Swamp Cnfr	W = White Pine	1 = Seedling Sapling Poor	6 = Pole Timber Well
C = Cedar	L = Lowland Brush	R = Red Pine	X = Non Stocked	2 = Seedling Sapling Medium	7 = Saw Timber Poor
E = Swamp Hdwoods	M = Mpl, Bch, Brch	S = Black Spruce	Z = Water	3 = Seedling Sapling Well	8 = Saw Timber Medium
F = Spruce Fir	N = Marsh	T = Tamarack		4 = Pole Timber Poor	9 = Saw Timber Well
G = Grass	O = Oak	U = Upland Brush			

PU#	ACRES
1	48
2	33
3	18
4	33
5	27
6	15

Blasten Aspen

Cheboygan County

Compartment 183

174 Acres

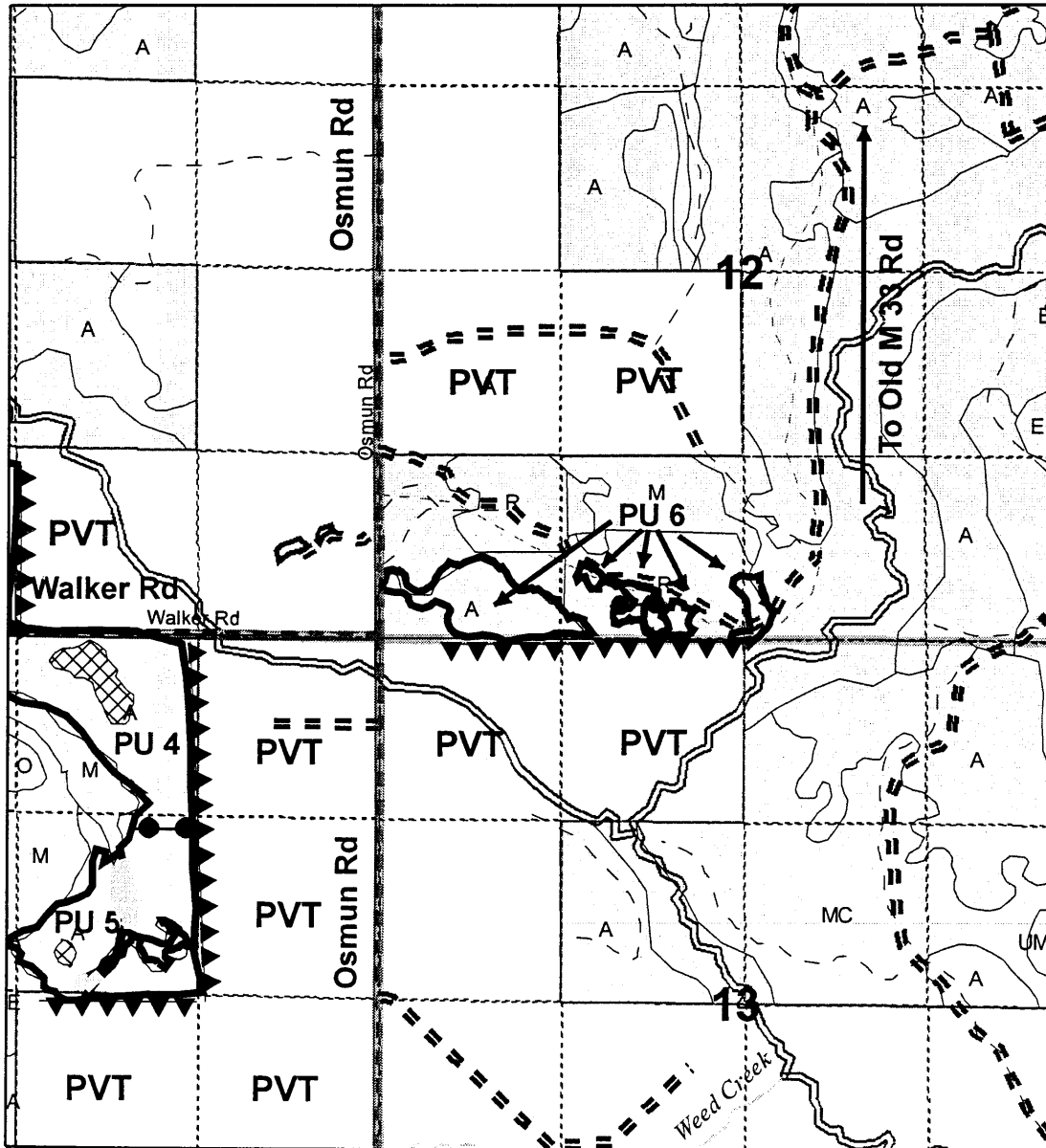
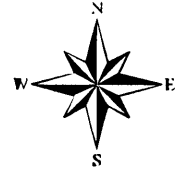

Legend

- Sale Boundary- Red Paint
- Retention Pocket- Red Paint
- Unit Line - Yellow Paint
- Private Boundary - Blue Paint
- Adj. Stand Boundaries
- Sections
- Quarter Quarter Sections

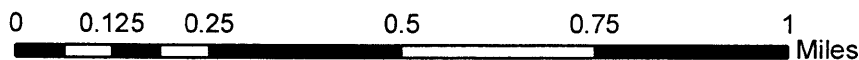

Sale Specific Conditions & Requirements

Sale Name: **Blasten Aspen** Sale Number: **52-103-09-01**

1 - Sale Area

1.2 - Boundaries

1.2.1 - Painted boundaries (12/08)

The sale boundary and Payment Unit boundaries are marked and identified by blue, red and yellow paint. Exterior sale boundary lines against private property are marked with blue paint. Exterior sale boundary lines against state are marked with red paint. Interior Payment Unit boundaries are marked with yellow paint. Yellow painted trees designating an interior Payment Unit boundary are only to be cut when all surrounding Payment Units have been paid.

2 - Timber Specifications

2.1 - Included Timber

2.1.1 - Clearcut unit(s) with unmerchantable trees (4/09)

Within Payment Unit(s) 1-6, cut all trees that are two (2) inches or more in diameter measured at a point four and one-half (4-1/2) feet above ground level regardless of merchantability except Cedar, Hemlock, and Oak.

3 - Payments

3.3 - Pre-measured Sales

3.3.4 - Dividing payment units (12/08)

Payment unit(s) may be divided at the request of the purchaser and upon approval of the Unit Manager. Dividing payment units is a contract modification which requires a Timber Sale Contract Supplement.

4 - Transportation

4.1 - Construction

4.1.3 - Slash and earthen piles (8/04)

Piles or windrows of earth along roads and landings that have been widened or constructed shall be leveled. Slash from road maintenance or construction, including stumps, shall be dispersed throughout the sale.

4.1.6 - Road construction (1/09)

Construction of new roads or improvements of existing roads shall be done in such a way as to minimize the environmental and visual impacts. Merchantable trees shall be cut and utilized unless otherwise directed. Non-merchantable trees shall be severed and laid flat on the ground. Slash shall be scattered, and not left in windrows and kept a minimum of 10 feet back from the road edge. Stumps shall be set upright, not left on edge, and be moved at least 10 feet away from the road edge. Disturbed soil shall be feathered into the woods and not left in berms or windrows.

4.1.7 - Road closure (4/07)

All new roads built into the sale must be blocked to vehicle traffic upon completion of the sale. In general, this will require constructing a four (4') foot high berm constructed of stumps and logs covered with earth. These roads must be rendered impassable to cars and trucks. Temporary berms may be required if no sale activity occurs for 30 or more consecutive days.

4.2 - Maintenance

4.2.5 - Two wheel drive condition (2/04)

All existing trail roads on and adjacent to the sale area must be passable by two-wheel drive traffic for the duration of the sale.

5 - Operations

5.1 - Notification

5.1.1 - Pre-sale conference (12/08)

A pre-sale conference on site between the Purchaser and sale administrator is required prior to beginning any operations to determine landing and road locations.

5.2 - Conduct of Operations

5.2.1 - Slash

5.2.1.1 - Slash within sale area (2/04)

No trees are to be felled outside the sale area and all slash is to be kept at least 10 feet back from the blue paint line.

5.2.2 - Hazard Trees/Snags

5.2.2.1 - Den trees (2/04)

Obvious hollow and/or den trees shall be protected and left standing unless they are a safety hazard.

5.2.37 - No decking areas (12/08)

No decking is allowed within 50 feet of Osmun or Walker roads without permission of the Unit Manager or his/her representative.

5.2.38 - No decking against live trees (2/04)

Cut products may not be decked against unmarked or designated leave trees.

5.4 - Soil Protection

Sale Name: Blasten Aspen Sale Number: 52-103-09-01

5.4.1 - Rutting restriction, general (1/09)

Operations are to cease immediately if equipment and weather conditions result in rutting of roads and skid trails which is 12 inches or greater in depth and 50 feet in length. The Unit Manager or his/her representative may restrict hauling and/or skidding if ruts exceed the specified depth. With the Unit Manager or his/her representative's approval, the Purchaser may return to the area when the risk of rutting has decreased.

5.8 - Protection of Endangered Species

5.8.5 - Protection of raptor nests (4/09)

All trees with raptor nests will be protected if found during harvesting operations. Notification will be made to the Unit Manager or his/her representative who will notify the Wildlife Biologist so an on-site evaluation and recommendation can be made, if necessary.

6 - Safety and Fire Prevention

6.2 - Signing

6.2.1 - Road posting (1/09)

The purchaser is responsible for posting and maintaining caution signs on Walker and Osmun roads prior to beginning operations. The road must be posted at appropriate distances from the sale area to warn of logging activity and truck traffic. Signs must be removed when harvest operations are suspended or completed. The Purchaser will provide these signs.

JOHNSON PINE (117-09-01)

A timber sale contract for this LUMP SUM SEALED timber sale will be awarded the responsible bidder offering the highest sealed bid price. Bids must be at or above the following appraised price for each species:

<u>SPECIES</u>	<u>ESTIMATED VOLUME*</u>	<u>APPRAISED PRICE</u>
SAWLOGS		
RED PINE	666.00 MBF	\$ 113.00/MBF
PULPWOOD		
RED PINE	904.00 CORDS	\$ 40.05/CORD

In addition, the successful bidder agrees to purchase the following species at the indicated appraised price:

<u>SPECIES</u>	<u>ESTIMATED VOLUME*</u>	<u>APPRAISED PRICE</u>
PULPWOOD		
BASSWOOD	51.00 CORDS	\$ 7.30/CORD
B.T. ASPEN	51.00 CORDS	\$ 22.00/CORD
JACK PINE	5.00 CORDS	\$ 14.00/CORD
MIX HARDWD	101.00 CORDS	\$ 7.45/CORD

*The volumes are statistically estimated within plus (+) or minus (-) 10.16 percent. These estimated volumes are final and not subject to adjustment. Prospective bidders are urged to examine this timber and to make their own estimates of quantity and quality.

BOND AND PAYMENT SCHEDULE:

1. A bond in the amount of \$7,000.00 to insure faithful performance of the conditions of the contract, will be deposited by the successful bidder within 21 days of the sale award.
2. Cutting in any sale or unit without the required advance payment would be considered a trespass.
3. Total payment may be paid in advance or according to the following schedule:
 - (a) Ten percent (10%) of the sale value must be paid within 21 days of the sale award.
 - (b) The 10% down payment will be credited towards the first unit cut.
 - (c) Payment for each of the following units must be made before cutting begins in that unit:

<u>PAYMENT UNIT NUMBER</u>	<u>PERCENT OF TOTAL SALE VALUE</u>
1	50%
2	50%
4. If no cutting takes place, the 10% down payment will not be refunded.
5. Operations on the contract issued will terminate on March 31, 2013.



Michigan Department of Natural Resources – Forest, Mineral & Fire Management
TIMBER SALE MAP

This information is provided by authority of Part 525 of Act 451, PA 1994, as amended.

SALE NUMBER	YEAR
52-117-09-01	09
DATE	PAGE OF
5/23/09	1 1

FOREST MANAGEMENT UNIT Gaylord Management Unit		COUNTY Emmet	MAPPED BY Hang
TOWNSHIP 34N		RANGE 04W	SECTION(S) AND SUBDIVISION(S) 31: S1/2SE, NESE, N1/2SW, SESW, S1/2NW, NWSE
		CRUISED BY Contractors	

SCALE 1:15,840

Cover Type

A = Aspen	H = Hemlock	P = Lowland Poplar	V = Bog or Marsh
B = Paper Birch	J = Jack Pine	Q = Mixed Swamp Cnfr	W = White Pine
C = Cedar	L = Lowland Brush	R = Red Pine	X = Non Stocked
E = Swamp Hdwoods	M = Mpi, Bch, Brch	S = Black Spruce	Z = Water
F = Spruce Fir	N = Marsh	T = Tamarack	
G = Grass	O = Oak	U = Upland Brush	

Density

0 = Non Stocked	5 = Pole Timber Medium
1 = Seedling Sapling Poor	6 = Pole Timber Well
2 = Seedling Sapling Medium	7 = Saw Timber Poor
3 = Seedling Sapling Well	8 = Saw Timber Medium
4 = Pole Timber Poor	9 = Saw Timber Well

Johnson Pine
Emmet County
Compartment 127
63 Acres

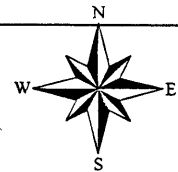

PU#	ACRES
1	32
2	31

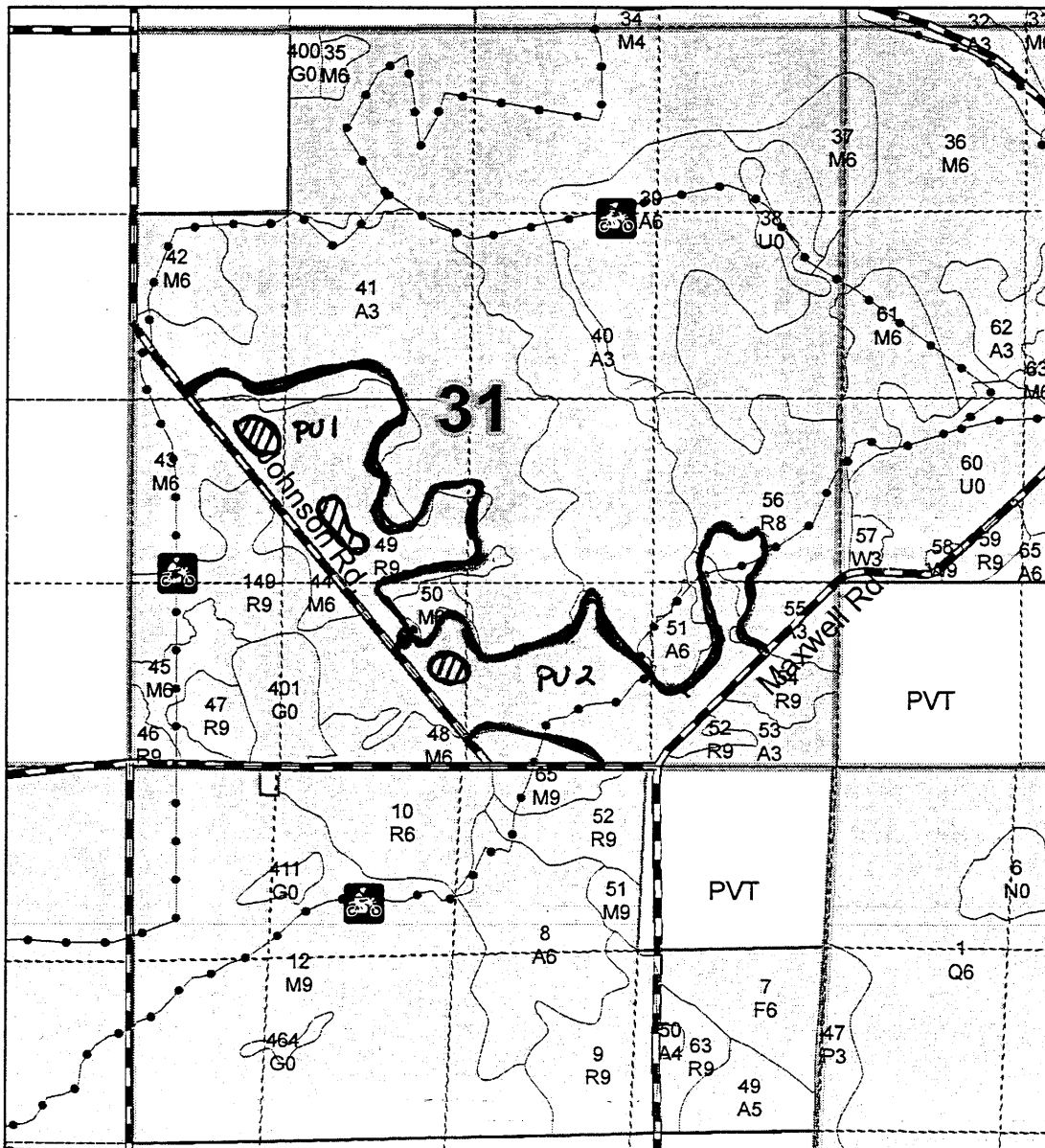

Legend

- Sale Boundary - Red Paint
- Unit Line - Yellow Paint
- Retention Pocket - Red Paint
- Adj. Stand Boundaries
- Sections
- Quarter Quarter Sections
- Motorcycle (DNR License)

Locator Map
1:100,000

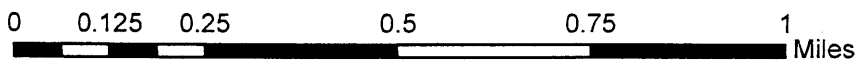
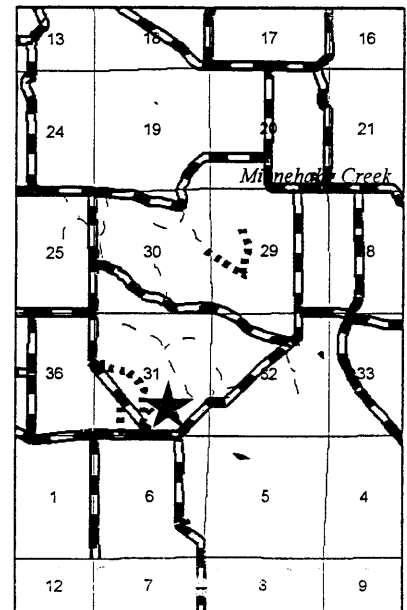

Sale Specific Conditions & Requirements

Sale Name: Johnson Pine Sale Number: 52-117-09-01

1 - Sale Area

1.2 - Boundaries

1.2.1 - Painted boundaries (12/08)

The sale boundary and Payment Unit boundaries are marked and identified by red and yellow paint. Exterior sale boundary lines against state are marked with red paint. Interior Payment Unit boundaries are marked with yellow paint. Yellow painted trees designating an interior Payment Unit boundary are only to be cut when all surrounding Payment Units have been paid.

2 - Timber Specifications

2.1 - Included Timber

2.1.1 - Clearcut unit(s) with unmerchantable trees (4/09)

Within Payment Unit(s) 1 and 2, cut all trees that are two (2) inches or more in diameter measured at a point four and one-half (4-1/2) feet above ground level regardless of merchantability.

3 - Payments

3.3 - Pre-measured Sales

3.3.4 - Dividing payment units (12/08)

Payment unit(s) 1 and 2 may be divided at the request of the purchaser and upon approval of the Unit Manager. Dividing payment units is a contract modification which requires a Timber Sale Contract Supplement.

3.6 - Payment Unit Cutting Schedule

3.6.2 - One active unit (12/08)

Each Payment Unit must be completed to the satisfaction of the Unit Manager or his/her representative before the next unit may be opened.

4 - Transportation

4.1 - Construction

4.1.3 - Slash and earthen piles (8/04)

Piles or windrows of earth along roads and landings that have been widened or constructed shall be leveled. Slash from road maintenance or construction, including stumps, shall be dispersed throughout the sale.

4.1.7 - Road closure (4/07)

All new roads built into the sale must be blocked to vehicle traffic upon completion of the sale. In general, this will require constructing a four (4') foot high berm constructed of stumps and logs covered with earth. All stumps from road building and landing construction must be reserved to block any newly constructed roads upon completion of the sale. These stumps must be scattered along the road system to prohibit vehicular movement. Temporary berms may be required if no sale activity occurs for 30 or more consecutive days. Contact the sale administrator for specific details of design and placement.

4.2 - Maintenance

4.2.5 - Two wheel drive condition (2/04)

All existing trail roads on and adjacent to the sale area must be passable by two-wheel drive traffic for the duration of the sale.

5 - Operations

5.1 - Notification

5.1.1 - Pre-sale conference (12/08)

A pre-sale conference on site between the Purchaser and sale administrator is required prior to beginning any operations to determine landing and road locations. The Unit Manager or his/her representative must be contacted at least 3 days in advance to schedule the conference.

5.2 - Conduct of Operations

5.2.2 - Hazard Trees/Snags

5.2.2.1 - Den trees (2/04)

Obvious hollow and/or den trees shall be protected and left standing unless they are a safety hazard.

5.2.3 - Operating Restrictions

5.2.3.6 - Bark beetle restriction (12/08)

In the event drought creates a high risk of pine bark beetle infestation, pine is not to be cut during the period March 1 through July 1, unless all portions of trees greater than two inches in diameter are removed from the sale area, reduced to chips, or treated to the satisfaction of the Unit Manager or his/her representative, within fifteen days of being severed from the stump. Pine log decks, pulpwood piles and treetops that are piled for chipping in the fall or winter within a 1/4 mile of susceptible sites must be removed before March 15. Residual slash must not be placed in piles or rows and must be spread over the site for quick drying. The Department of Natural Resources will exercise this specification if the risk of damage warrants.

5.2.39 - ORV trail/route protection (1/09)

The ORV trail is shown on the Timber Sale Map. Do not cut trees or damage posts with orange ORV markers. Maintain a 20 foot wide slash, debris, and rut free zone daily using the ORV trail or route as the centerline. Do not run equipment down the ORV trail or route. Skidding across the trail or route may only occur in locations approved by the sale administrator.

5.4 - Soil Protection

5.4.1 - Rutting restriction, general (1/09)

Operations are to cease immediately if equipment and weather conditions result in rutting of roads and skid trails which is 12 inches or greater in depth and 50 feet in length. Operations are to cease immediately if equipment and weather conditions result in rutting of roads which is 12 inches or greater in depth and 50 feet in length. In addition, operations are to cease immediately if equipment and weather conditions result in rutting on skid trails which is 12 inches or greater in depth and 50 feet in length. The Unit Manager or his/her representative may restrict hauling and/or skidding if ruts exceed the specified depth. With the Unit Manager or his/her representative's approval, the Purchaser may return to the area when the risk of rutting has decreased.

5.8 - Protection of Endangered Species

5.8.5 - Protection of raptor nests (4/09)

All trees with raptor nests will be protected if found during harvesting operations. Notification will be made to the Unit Manager or his/her representative who will notify the Wildlife Biologist so an on-site evaluation and recommendation can be made, if necessary.

MAXWELL ASPEN (118-09-01)

A timber sale contract for this LUMP SUM SEALED timber sale will be awarded the responsible bidder offering the highest sealed bid price. Bids must be at or above the following appraised price for each species:

<u>SPECIES</u>	<u>ESTIMATED VOLUME*</u>	<u>APPRAISED PRICE</u>
SAWLOGS		
SUG. MAPLE	56.80 MBF	\$ 244.00/MBF
B.T. ASPEN	160.00 MBF	\$ 75.00/MBF
PULPWOOD		
B.T. ASPEN	1,283.00 CORDS	\$ 18.25/CORD

In addition, the successful bidder agrees to purchase the following species at the indicated appraised price:

<u>SPECIES</u>	<u>ESTIMATED VOLUME*</u>	<u>APPRAISED PRICE</u>
SAWLOGS		
RED MAPLE	.90 MBF	\$ 71.00/MBF
BASSWOOD	59.00 MBF	\$ 44.00/MBF
WHITE ASH	5.70 MBF	\$ 106.00/MBF
BEECH	6.30 MBF	\$ 26.00/MBF
WHITE PINE	10.30 MBF	\$ 57.00/MBF
PULPWOOD		
SUG. MAPLE	440.00 CORDS	\$ 4.05/CORD
RED MAPLE	42.00 CORDS	\$ 8.35/CORD
BASSWOOD	302.00 CORDS	\$ 5.10/CORD
WHITE ASH	88.00 CORDS	\$ 6.85/CORD
BEECH	111.00 CORDS	\$ 6.85/CORD
BALSAM FIR	29.00 CORDS	\$ 3.10/CORD
B. SPRUCE	42.00 CORDS	\$ 13.60/CORD
TAMARACK	21.00 CORDS	\$ 5.05/CORD
WHITE PINE	33.00 CORDS	\$ 3.85/CORD
RED PINE	6.00 CORDS	\$ 27.55/CORD
BLK CHERRY	12.00 CORDS	\$ 8.60/CORD

*The volumes are statistically estimated within plus (+) or minus (-) 11.50 percent. These estimated volumes are final and not subject to adjustment. Prospective bidders are urged to examine this timber and to make their own estimates of quantity and quality.

BOND AND PAYMENT SCHEDULE:

1. A bond in the amount of \$3,000.00 to insure faithful performance of the conditions of the contract, will be deposited by the successful bidder within 21 days of the sale award.
2. Cutting in any sale or unit without the required advance payment would be considered a trespass.
3. Total payment may be paid in advance or according to the following schedule:
 - (a) Ten percent (10%) of the sale value must be paid within 21 days of the sale award.
 - (b) The 10% down payment will be credited towards the first unit cut.
 - (c) Payment for each of the following units must be made before cutting begins in that unit:

<u>PAYMENT UNIT NUMBER</u>	<u>PERCENT OF TOTAL SALE VALUE</u>
1	39%
2	39%
3	22%
4. If no cutting takes place, the 10% down payment will not be refunded.
5. Operations on the contract issued will terminate on March 31, 2013.



Michigan Department of Natural Resources – Forest, Mineral & Fire Management
TIMBER SALE MAP

This information is provided by authority of Part 525 of Act 451, PA 1994, as amended.

SALE NUMBER	YEAR
52-118-09-01	09
DATE	PAGE OF
5/23/09	1 1

FOREST MANAGEMENT UNIT		COUNTY	MAPPED BY
Gaylord Management Unit		Emmet	Harig
TOWNSHIP		SECTION(S) AND SUBDIVISION(S)	CRUISED BY
34N	RANGE	31: NE1/4, NE3/4	Contractors
	04W	32: NWNW, N1/2SW, SENW, NWSE	

SCALE 1:15,840

Cover Type				Density	
A = Aspen	H = Hemlock	P = Lowland Poplar	V = Bog or Marsh	0 = Non Stocked	5 = Pole Timber Medium
B = Paper Birch	J = Jack Pine	Q = Mixed Swamp Cnfr	W = White Pine	1 = Seedling Sapling Poor	6 = Pole Timber Well
C = Cedar	L = Lowland Brush	R = Red Pine	X = Non Stocked	2 = Seedling Sapling Medium	7 = Saw Timber Poor
E = Swamp Hdwoods	M = Mpl, Bch, Brch	S = Black Spruce	Z = Water	3 = Seedling Sapling Well	8 = Saw Timber Medium
F = Spruce Fir	N = Marsh	T = Tamarack		4 = Pole Timber Poor	9 = Saw Timber Well
G = Grass	O = Oak	U = Upland Brush			

Maxwell Aspen
Emmet County
Compartment 127
100 Acres

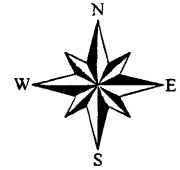

PU#	ACRES
1	39
2	39
3	22

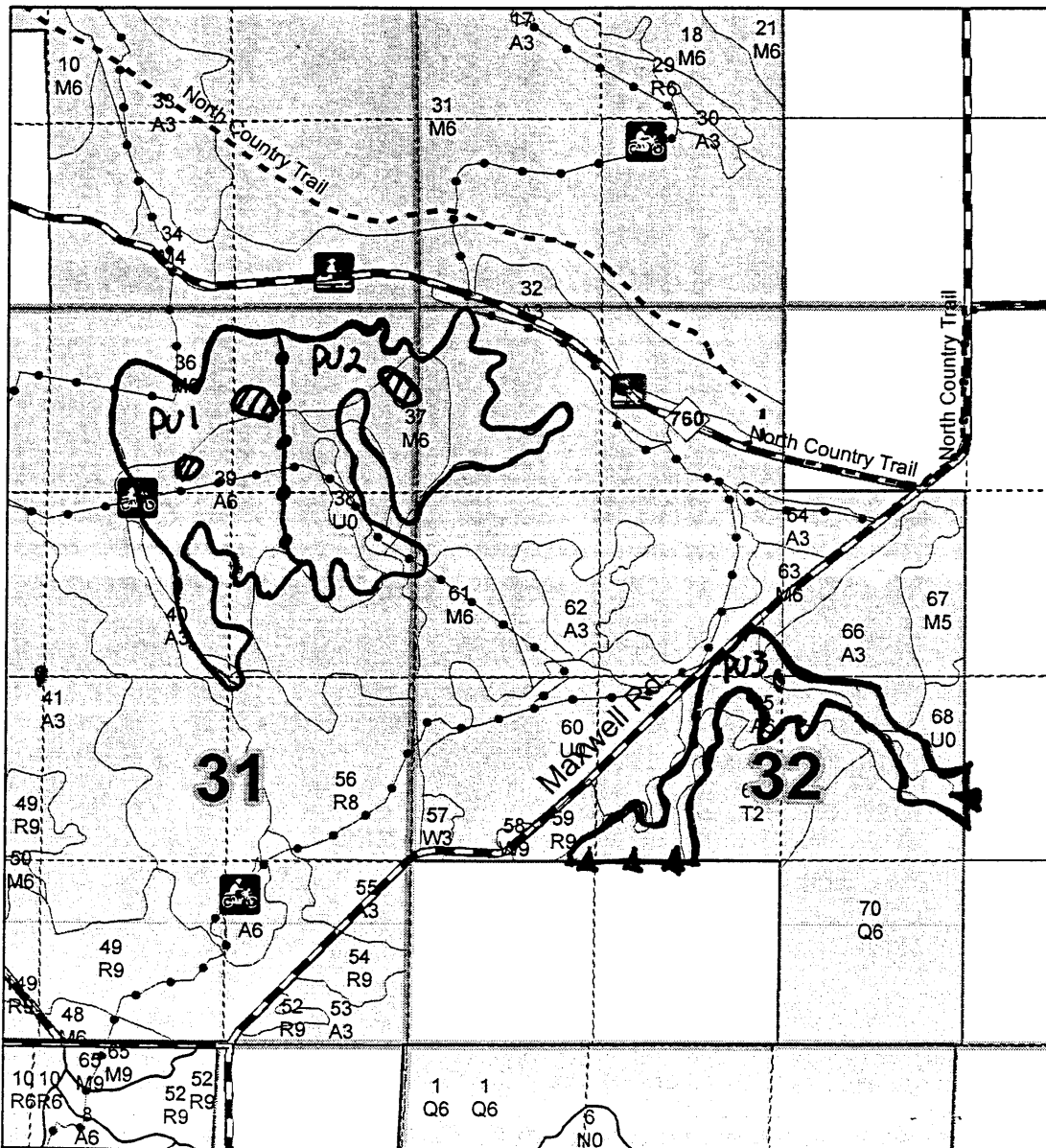

Legend

- Sale Boundary - Red Paint
- Private Boundary - Blue Paint
- Unit Line - Yellow Paint
- Retention Pocket - Red Paint
- Adj. Stand Boundaries
- Sections
- Quarter Quarter Sections
- Motorcycle (DNR License)
- Snowmobile Trail

Locator Map
1:100,000

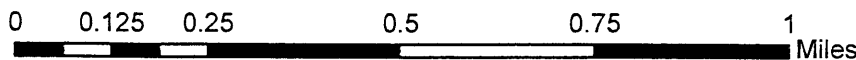
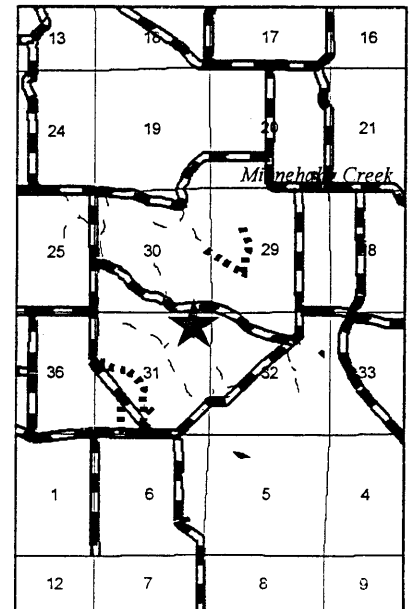

Sale Specific Conditions & Requirements

Sale Name: Maxwell Aspen Sale Number: 52-118-09-01

1 - Sale Area

1.2 - Boundaries

1.2.1 - Painted boundaries (12/08)

The sale boundary and Payment Unit boundaries are marked and identified by blue, red and yellow paint. Exterior sale boundary lines against private property are marked with blue paint. Exterior sale boundary lines against state are marked with red paint. Interior Payment Unit boundaries are marked with yellow paint. Yellow painted trees designating an interior Payment Unit boundary are only to be cut when all surrounding Payment Units have been paid.

2 - Timber Specifications

2.1 - Included Timber

2.1.1 - Clearcut unit(s) with unmerchantable trees (4/09)

Within Payment Unit(s) 1, 2 and 3, cut all trees that are two (2) inches or more in diameter measured at a point four and one-half (4-1/2) feet above ground level regardless of merchantability except oak. Reserve areas identified in accordance with 2.4.3 - Reserve areas, within clearcutting unit boundaries, are not Included Timber and are to be protected.

2.4 - Special Protection

2.4.3 - Reserve areas (1/09)

The Purchaser shall protect reserve areas from damage by the Purchaser's operations. Reserve areas are marked with a green boundary line. The Purchaser shall not cut live or dead trees within reserve areas. If the Purchaser's operations have cut or damaged reserve areas through carelessness, the Purchaser shall pay \$350.00 as fixed, agreed and liquidated damages for each acre or part thereof cut or damaged. Such payment does not constitute ownership of the undesignated timber.

3 - Payments

3.3 - Pre-measured Sales

3.3.4 - Dividing payment units (12/08)

Payment unit(s) 1, 2 and 3, may be divided at the request of the purchaser and upon approval of the Unit Manager. Dividing payment units is a contract modification which requires a Timber Sale Contract Supplement.

4 - Transportation

4.1 - Construction

4.1.6 - Road construction (1/09)

Construction of new roads or improvements of existing roads shall be done in such a way as to minimize the environmental and visual impacts. Merchantable trees shall be cut and utilized unless otherwise directed. Non-merchantable trees shall be severed and laid flat on the ground. Slash shall be scattered, and not left in windrows and kept a minimum of 10 feet back from the road edge. Stumps shall be set upright, not left on edge, and be moved at least 10 feet away from the road edge. Disturbed soil shall be feathered into the woods and not left in berms or windrows.

4.1.7 - Road closure (4/07)

All new roads built into the sale must be blocked to vehicle traffic upon completion of the sale. In general, this will require constructing a four (4') foot high berm constructed of stumps and logs covered with earth. These roads must be rendered impassable to cars and trucks. All stumps from road building and landing construction must be reserved to block any newly constructed roads upon completion of the sale. These stumps must be scattered along the road system to prohibit vehicular movement. Contact the sale administrator for specific details of design and placement.

4.2 - Maintenance

4.2.5 - Two wheel drive condition (2/04)

All existing trail roads on and adjacent to the sale area must be passable by two-wheel drive traffic for the duration of the sale.

5 - Operations

5.1 - Notification

5.1.1 - Pre-sale conference (12/08)

A pre-sale conference on site between the Purchaser and sale administrator is required prior to beginning any operations. The Unit Manager or his/her representative must be contacted at least 3 days in advance to schedule the conference.

5.2 - Conduct of Operations

5.2.2 - Hazard Trees/Snags

5.2.2.1 - Den trees (2/04)

Obvious hollow and/or den trees shall be protected and left standing unless they are a safety hazard.

5.2.39 - ORV trail/route protection (1/09)

The ORV trail is shown on the Timber Sale Map. Do not cut trees or damage posts with orange ORV markers. Maintain a 20 foot wide slash, debris, and rut free zone daily using the ORV trail or route as the centerline. Do not run equipment down the ORV trail or route. Skidding across the trail or route may only occur in locations approved by the sale administrator.

5.4 - Soil Protection

5.4.1 - Rutting restriction, general (1/09)

Operations are to cease immediately if equipment and weather conditions result in rutting of roads and skid trails which is 12 inches or greater in depth and 50 feet in length. The Unit Manager or his/her representative may restrict hauling and/or skidding if ruts exceed the specified depth. With the Unit Manager or his/her representative's approval, the Purchaser may return to the area when the risk of rutting has decreased.

5.8 - Protection of Endangered Species

5.8.5 - Protection of raptor nests (4/09)

All trees with raptor nests will be protected if found during harvesting operations. Notification will be made to the Unit Manager or his/her representative who will notify the Wildlife Biologist so an on-site evaluation and recommendation can be made, if necessary.

6 - Safety and Fire Prevention

6.2 - Signing

6.2.3 - Recreational trail posting (1/09)

The Purchaser is responsible for posting caution signs on the ORV trail prior to beginning operations. The trail must be posted at appropriate distances from the sale area to warn of logging activity and truck traffic at both ends of the trail. Signs must be removed when harvest operations are suspended or completed. The Purchaser must maintain the signs for the duration of the sale. The Purchaser will provide these signs.

OLD 33 ASPEN (122-09-01)

A timber sale contract for this LUMP SUM SEALED timber sale will be awarded the responsible bidder offering the highest sealed bid price. Bids must be at or above the following appraised price for each species:

<u>SPECIES</u>	<u>ESTIMATED VOLUME*</u>	<u>APPRAISED PRICE</u>
SAWLOGS		
B.T. ASPEN	143.00 MBF	\$ 114.00/MBF
PULPWOOD		
B.T. ASPEN	1,739.00 CORDS	\$ 20.10/CORD

In addition, the successful bidder agrees to purchase the following species at the indicated appraised price:

<u>SPECIES</u>	<u>ESTIMATED VOLUME*</u>	<u>APPRAISED PRICE</u>
PULPWOOD		
BALSAM FIR	66.00 CORDS	\$ 6.95/CORD
MIX HARDWD	451.00 CORDS	\$ 6.70/CORD

*The volumes are statistically estimated within plus (+) or minus (-) 10.30 percent. These estimated volumes are final and not subject to adjustment. Prospective bidders are urged to examine this timber and to make their own estimates of quantity and quality.

BOND AND PAYMENT SCHEDULE:

1. A bond in the amount of \$2,750.00 to insure faithful performance of the conditions of the contract, will be deposited by the successful bidder within 21 days of the sale award.
2. Cutting in any sale or unit without the required advance payment would be considered a trespass.
3. Total payment may be paid in advance or according to the following schedule:
 - (a) Ten percent (10%) of the sale value must be paid within 21 days of the sale award.
 - (b) The 10% down payment will be credited towards the first unit cut.
 - (c) Payment for each of the following units must be made before cutting begins in that unit:

<u>PAYMENT UNIT NUMBER</u>	<u>PERCENT OF TOTAL SALE VALUE</u>
1	46%
2	44%
3	10%
4. If no cutting takes place, the 10% down payment will not be refunded.
5. Operations on the contract issued will terminate on March 31, 2012.



Michigan Department of Natural Resources – Forest, Mineral & Fire Management
TIMBER SALE MAP

This information is provided by authority of Part 525 of Act 451, PA 1994, as amended.

SALE NUMBER	YEAR
52-122-09-01	09
DATE	PAGE OF
05/13/2009	1 1

FOREST MANAGEMENT UNIT	COUNTY	MAPPED BY
Gaylord Management Unit	Cheboygan	Scheele
		CRUISED BY Scheele

TOWNSHIP	RANGE	SECTION(S) AND SUBDIVISION(S)
34N	01W	Section 1 E1/2SW, SE and Section 12 W1/2NE, E1/2NW, W1/2SE

SCALE 1:15,840

Cover Type				Density	
A = Aspen	H = Hemlock	P = Lowland Poplar	V = Bog or Marsh	0 = Non Stocked	5 = Pole Timber Medium
B = Paper Birch	J = Jack Pine	Q = Mixed Swamp Cnfr	W = White Pine	1 = Seedling Sapling Poor	6 = Pole Timber Well
C = Cedar	L = Lowland Brush	R = Red Pine	X = Non Stocked	2 = Seedling Sapling Medium	7 = Saw Timber Poor
E = Swamp Hdwoods	M = Mpl, Bch, Brch	S = Black Spruce	Z = Water	3 = Seedling Sapling Well	8 = Saw Timber Medium
F = Spruce Fir	N = Marsh	T = Tamarack		4 = Pole Timber Poor	9 = Saw Timber Well
G = Grass	O = Oak	U = Upland Brush			

Old 33 Aspen
Cheboygan County
98 Acres

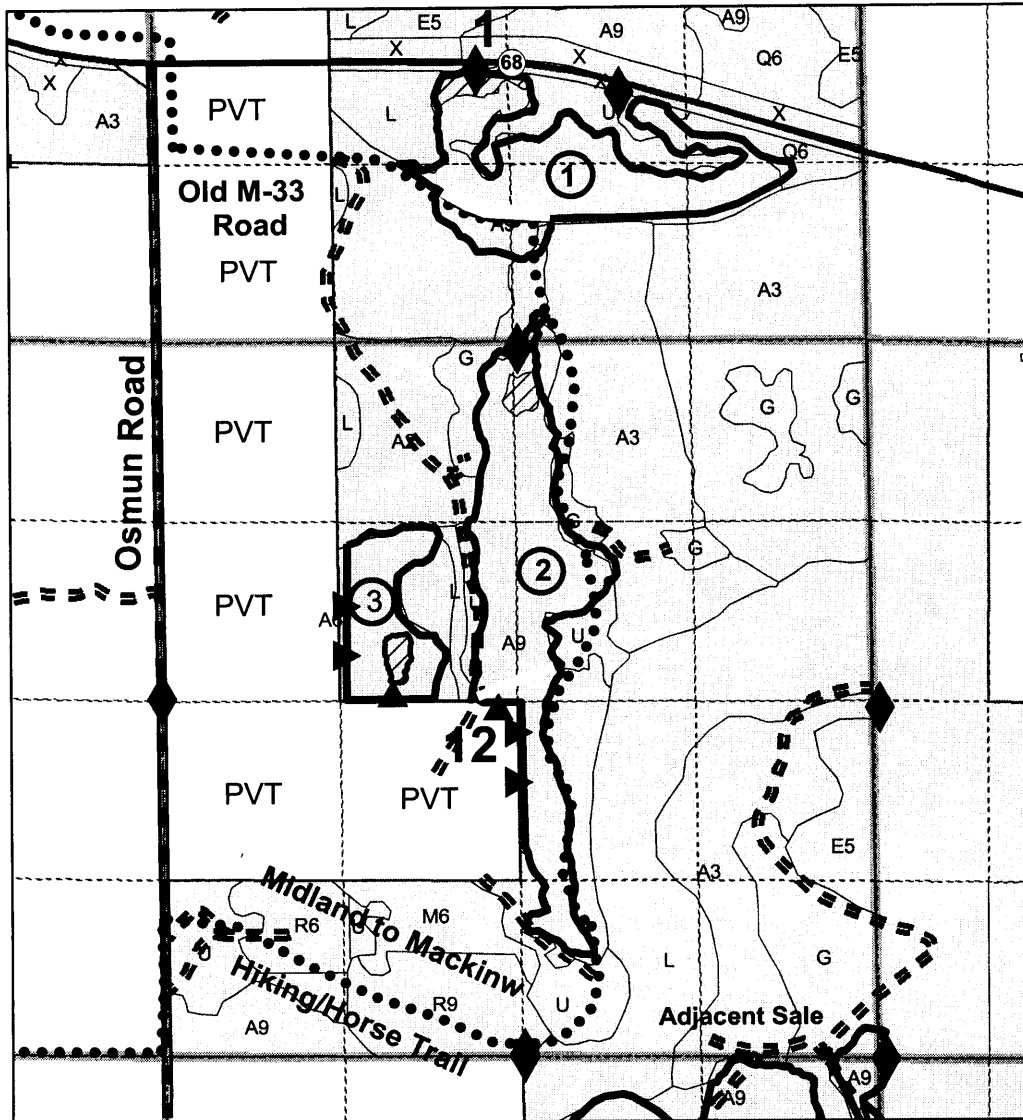
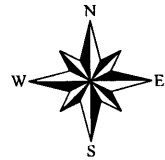

Legend

- Timber Sale Boundary (Red Paint)
- Retention Pocket (Teal Paint)
- Private Line (Blue Paint)
- Survey Corner
- Adj. Stand Boundaries
- Sections
- Quarter Quarter Sections
- Hiking Trail

Payment Unit Acres

1	37
2	47
3	14

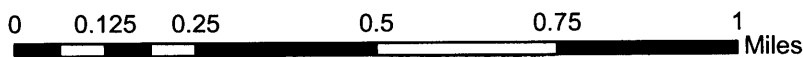

Sale Specific Conditions & Requirements

Sale Name: Old 33 Aspen Sale Number: 52-122-09-01

1 - Sale Area

1.2 - Boundaries

1.2.1 - Painted boundaries (12/08)

The sale boundary is marked and identified by blue and red paint. Exterior sale boundary lines against private property are marked with blue paint. Exterior sale boundary lines against state are marked with red paint.

2 - Timber Specifications

2.1 - Included Timber

2.1.1 - Clearcut unit(s) with unmerchantable trees (4/09)

Within Payment Unit(s) 1, 2, and 3, cut all trees that are two (2) inches or more in diameter measured at a point four and one-half (4-1/2) feet above ground level regardless of merchantability. Do not cut OAK, PINE, SPRUCE, OR HEMLOCK species. Reserve areas identified in accordance with 2.4.3 - Reserve areas, within clearcutting unit boundaries, are not Included Timber and are to be protected.

2.1.11 - Description of timber note (2/04)

Note that MIXED HARDWOOD includes red maple and paper birch.

2.4 - Special Protection

2.4.3 - Reserve areas (1/09)

The Purchaser shall protect reserve areas from damage by the Purchaser's operations. Reserve areas are marked with a Teal boundary line. The Purchaser shall not cut live or dead trees within reserve areas. If the Purchaser's operations have cut or damaged reserve areas through carelessness, the Purchaser shall pay \$500 as fixed, agreed and liquidated damages for each acre or part thereof cut or damaged. Such payment does not constitute ownership of the undesignated timber.

3 - Payments

3.3 - Pre-measured Sales

3.3.4 - Dividing payment units (12/08)

Payment unit(s) 1 or 2 may be divided at the request of the purchaser and upon approval of the Unit Manager. Dividing payment units is a contract modification which requires a Timber Sale Contract Supplement.

4 - Transportation

4.1 - Construction

4.1.3 - Slash and earthen piles (8/04)

Piles or windrows of earth along roads and landings that have been widened or constructed shall be leveled. Slash from road maintenance or construction, including stumps, shall be dispersed throughout the sale.

4.1.6 - Road construction (1/09)

Construction of new roads or improvements of existing roads shall be done in such a way as to minimize the environmental and visual impacts. Merchantable trees shall be cut and utilized unless otherwise directed. Non-merchantable trees shall be severed and laid flat on the ground. Slash shall be scattered, and not left in windrows and kept a minimum of 10 feet back from the road edge. Stumps shall be set upright, not left on edge, and be moved at least 10 feet away from the road edge. Disturbed soil shall be feathered into the woods and not left in berms or windrows.

4.1.7 - Road closure (4/07)

All new roads built into the sale must be blocked to vehicle traffic upon completion of the sale. In general, this will require constructing a four (4') foot high berm constructed of stumps and logs covered with earth. These roads must be rendered impassable to cars and trucks. Temporary berms may be required if no sale activity occurs for 30 or more consecutive days. Contact the sale administrator for specific details of design and placement.

4.2 - Maintenance

4.2.4 - Grading (12/08)

Roads must be graded after the sale is completed. In general, this will require a road grader or bull dozer to shape up the roads after forest products have been hauled off site, if necessary. The grading equipment to be used must be approved by the Unit Manager or his/her representative.

4.2.5 - Two wheel drive condition (2/04)

All existing trail roads on and adjacent to the sale area must be passable by two-wheel drive traffic for the duration of the sale.

5 - Operations

5.1 - Notification

5.1.1 - Pre-sale conference (12/08)

A pre-sale conference on site between the Purchaser and sale administrator is required prior to beginning any operations to determine landing and road locations.

5.2 - Conduct of Operations

5.2.1 - Slash

5.2.1.1 - Slash within sale area (2/04)

No trees are to be felled outside the sale area and all slash is to be kept at least 10 feet back from the blue paint line.

5.2.2 - Hazard Trees/Snags

5.2.2.1 - Den trees (2/04)

Obvious hollow and/or den trees shall be protected and left standing unless they are a safety hazard.

5.2.40 - Pathway protection (9/07)

The MIDLAND TO MACKINAW HIKING/HORSE TRAIL is shown on the Timber Sale Map. Do not cut trees or damage posts with blue pathway markers. Maintain a 20-foot wide slash, debris, and rut free zone daily, using the pathway as the centerline. Do not run equipment down the pathway. Skidding across the trail may only occur in locations approved by the sale administrator.

5.4 - Soil Protection

5.4.1 - Rutting restriction, general (1/09)

Operations are to cease immediately if equipment and weather conditions result in rutting of roads and skid trails which is 12 inches or greater in depth and 50 feet in length. The Unit Manager or his/her representative may restrict hauling and/or skidding if ruts exceed the specified depth. With the Unit Manager or his/her representative's approval, the Purchaser may return to the area when the risk of rutting has decreased.

5.8 - Protection of Endangered Species

5.8.5 - Protection of raptor nests (4/09)

All trees with raptor nests will be protected if found during harvesting operations. Notification will be made to the Unit Manager or his/her representative who will notify the Wildlife Biologist so an on-site evaluation and recommendation can be made, if necessary.

6 - Safety and Fire Prevention

6.2 - Signing

6.2.1 - Road posting (1/09)

The purchaser is responsible for posting and maintaining caution signs on OLD M-33 ROAD prior to beginning operations. The road must be posted at appropriate distances from the sale area to warn of logging activity and truck traffic. Signs must be removed when harvest operations are suspended or completed. The Purchaser will provide these signs.

6.2.3 - Recreational trail posting (1/09)

The Purchaser is responsible for posting caution signs on the MIDLAND TO MACKINAW HIKING/HORSE TRAIL prior to beginning operations. The trail must be posted at appropriate distances from the sale area to warn of logging activity and truck traffic at both ends of the trail. Signs must be removed when harvest operations are suspended or completed. The Purchaser must maintain the signs during harvest operations. The Purchaser will provide these signs.

MILLIGAN CREEK ASPEN (123-09-01)

A timber sale contract for this LUMP SUM SEALED timber sale will be awarded the responsible bidder offering the highest sealed bid price. Bids must be at or above the following appraised price for each species:

<u>SPECIES</u>	<u>ESTIMATED VOLUME*</u>	<u>APPRAISED PRICE</u>
SAWLOGS		
B.T. ASPEN	32.00 MBF	\$ 86.00/MBF
PULPWOOD		
B.T. ASPEN	1,039.00 CORDS	\$ 20.45/CORD

In addition, the successful bidder agrees to purchase the following species at the indicated appraised price:

<u>SPECIES</u>	<u>ESTIMATED VOLUME*</u>	<u>APPRAISED PRICE</u>
PULPWOOD		
RED MAPLE	113.00 CORDS	\$ 8.80/CORD
P. BIRCH	38.00 CORDS	\$ 4.50/CORD

*The volumes are statistically estimated within plus (+) or minus (-) 23.39 percent. These estimated volumes are final and not subject to adjustment. Prospective bidders are urged to examine this timber and to make their own estimates of quantity and quality.

BOND AND PAYMENT SCHEDULE:

1. A bond in the amount of \$1,300.00 to insure faithful performance of the conditions of the contract, will be deposited by the successful bidder within 21 days of the sale award.
2. Cutting in any sale or unit without the required advance payment would be considered a trespass.
3. Total payment may be paid in advance or according to the following schedule:
 - (a) Ten percent (10%) of the sale value must be paid within 21 days of the sale award.
 - (b) The 10% down payment will be credited towards the first unit cut.
 - (c) Payment for each of the following units must be made before cutting begins in that unit:

<u>PAYMENT UNIT NUMBER</u>	<u>PERCENT OF TOTAL SALE VALUE</u>
1	90%
2	10%
4. If no cutting takes place, the 10% down payment will not be refunded.
5. Operations on the contract issued will terminate on December 31, 2011.



TIMBER SALE MAP

This information is provided by authority of Part 525 of Act 451, PA 1994, as amended.

SALE NUMBER	YEAR
52-123-09-01	09

FOREST MANAGEMENT UNIT	COUNTY	MAPPED BY	DATE	PAGE	OF
Gaylord Management Unit	Cheboygan	Scheele	05/20/2009	1	1
		CRUISED BY			
		Scheele			

TOWNSHIP	RANGE	SECTION(S) AND SUBDIVISION(S)	SCALE
34N	01W	Section 12 SESE and Section 13 N1/2 NE and SENE	1:15,840

Cover Type				Density	
A = Aspen	H = Hemlock	P = Lowland Poplar	V = Bog or Marsh	0 = Non Stocked	5 = Pole Timber Medium
B = Paper Birch	J = Jack Pine	Q = Mixed Swamp Cnfr	W = White Pine	1 = Seedling Sapling Poor	6 = Pole Timber Well
C = Cedar	L = Lowland Brush	R = Red Pine	X = Non Stocked	2 = Seedling Sapling Medium	7 = Saw Timber Poor
E = Swamp Hdwoods	M = Mpl, Bch, Brch	S = Black Spruce	Z = Water	3 = Seedling Sapling Well	8 = Saw Timber Medium
F = Spruce Fir	N = Marsh	T = Tamarack		4 = Pole Timber Poor	9 = Saw Timber Well
G = Grass	O = Oak	U = Upland Brush			

Milligan Creek Aspen
Cheboygan County
62 Acres

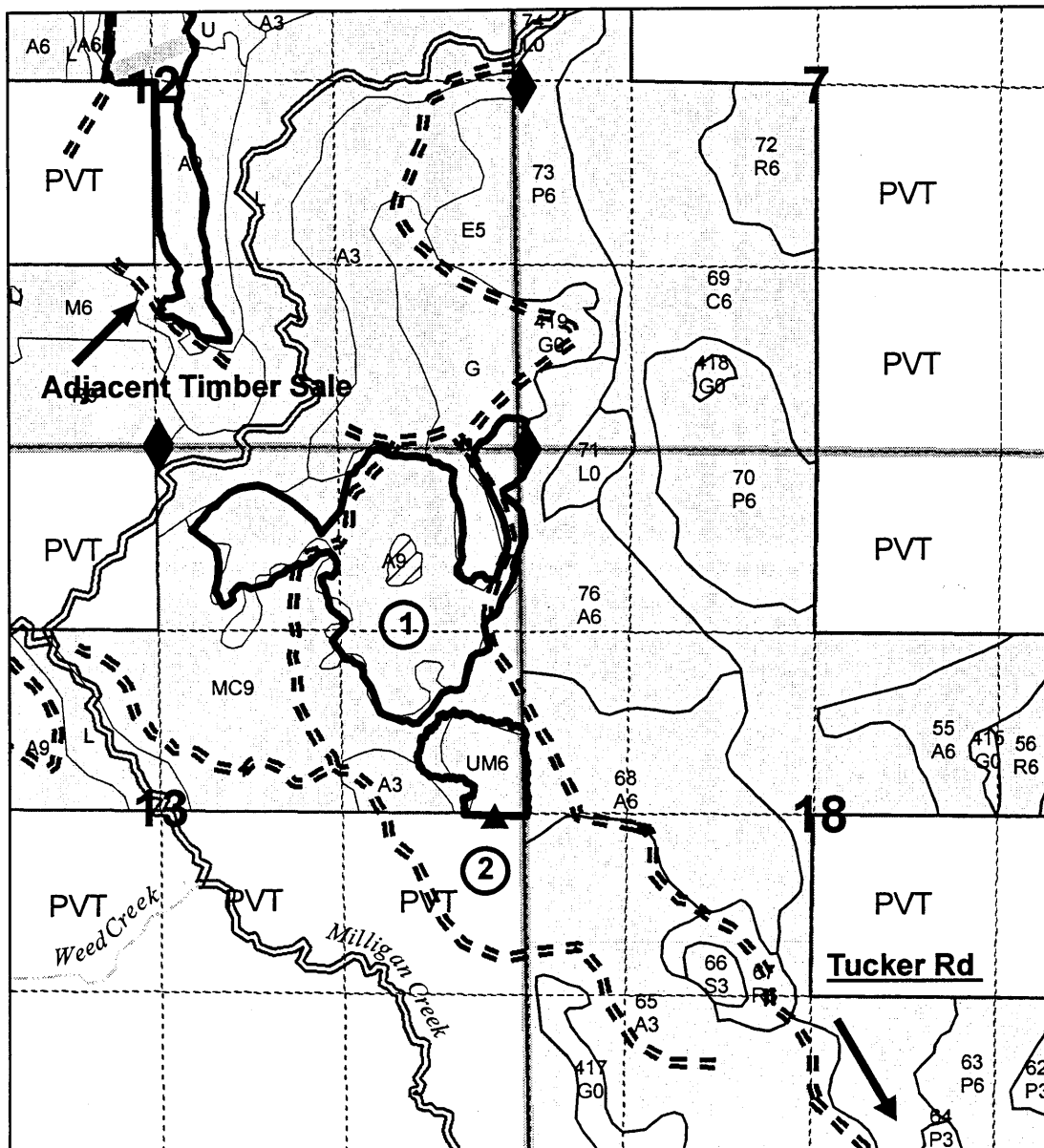
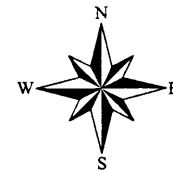

Legend

- Timber Sale Boundary (Red Paint)
- Retention Pocket (Teal Paint)
- Private Line (Blue Paint)
- Survey Corner
- Adj. Stand Boundaries
- Sections
- Quarter Quarter Sections

Payment Unit	Acres
1	52
2	10

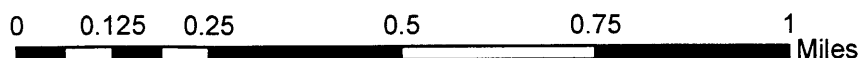

Sale Specific Conditions & Requirements

Sale Name: Milligan Creek Aspen Sale Number: 52-123-09-01

1 - Sale Area

1.2 - Boundaries

1.2.1 - Painted boundaries (12/08)

The sale boundary is marked and identified by blue and red paint. Exterior sale boundary lines against private property are marked with blue paint. Exterior sale boundary lines against state are marked with red paint.

2 - Timber Specifications

2.1 - Included Timber

2.1.1 - Clearcut unit(s) with unmerchantable trees (4/09)

Within Payment Unit(s) 1 and 2, cut all trees that are two (2) inches or more in diameter measured at a point four and one-half (4-1/2) feet above ground level regardless of merchantability except PINE AND OAK species. Reserve areas identified in accordance with 2.4.3 - Reserve areas, within clearcutting unit boundaries, are not Included Timber and are to be protected.

2.4 - Special Protection

2.4.3 - Reserve areas (1/09)

The Purchaser shall protect reserve areas from damage by the Purchaser's operations. Reserve areas are marked with a Teal boundary line. The Purchaser shall not cut live or dead trees within reserve areas. If the Purchaser's operations have cut or damaged reserve areas through carelessness, the Purchaser shall pay \$400 as fixed, agreed and liquidated damages for each acre or part thereof cut or damaged. Such payment does not constitute ownership of the undesignated timber.

3 - Payments

3.3 - Pre-measured Sales

3.3.4 - Dividing payment units (12/08)

Payment unit(s) may be divided at the request of the purchaser and upon approval of the Unit Manager. Dividing payment units is a contract modification which requires a Timber Sale Contract Supplement.

4 - Transportation

4.1 - Construction

4.1.3 - Slash and earthen piles (8/04)

Piles or windrows of earth along roads and landings that have been widened or constructed shall be leveled. Slash from road maintenance or construction, including stumps, shall be dispersed throughout the sale.

4.1.6 - Road construction (1/09)

Construction of new roads or improvements of existing roads shall be done in such a way as to minimize the environmental and visual impacts. Merchantable trees shall be cut and utilized unless otherwise directed. Non-merchantable trees shall be severed and laid flat on the ground. Slash shall be scattered, and not left in windrows and kept a minimum of 10 feet back from the road edge. Stumps shall be set upright, not left on edge, and be moved at least 10 feet away from the road edge. Disturbed soil shall be feathered into the woods and not left in berms or windrows.

4.1.7 - Road closure (4/07)

All new roads built into the sale must be blocked to vehicle traffic upon completion of the sale. All new roads built into the sale must be blocked to vehicle traffic within 30 days of completion of hauling. In general, this will require constructing a four (4') foot high berm constructed of stumps and logs covered with earth. These roads must be rendered impassable to cars and trucks. Temporary berms may be required if no sale activity occurs for 30 or more consecutive days. Contact the sale administrator for specific details of design and placement.

4.1.12 - No new roads (12/08)

No new roads will be permitted in any Payment Unit. All operations are limited to existing roads.

4.2 - Maintenance

4.2.4 - Grading (12/08)

Roads must be graded after the sale is completed. In general, this will require a road grader or bull dozer to shape the roads after forest products have been hauled off site. The grading equipment to be used must be approved by the Unit Manager or his/her representative.

4.2.5 - Two wheel drive condition (2/04)

All existing trail roads on and adjacent to the sale area must be passable by two-wheel drive traffic for the duration of the sale.

5 - Operations

5.1 - Notification

5.1.1 - Pre-sale conference (12/08)

A pre-sale conference on site between the Purchaser and sale administrator is required prior to beginning any operations to determine landing and road locations.

5.2 - Conduct of Operations

5.2.1 - Slash

5.2.1.1 - Slash within sale area (2/04)

No trees are to be felled outside the sale area and all slash is to be kept at least 10 feet back from the blue paint line.

5.2.2 - Hazard Trees/Snags

5.2.2.1 - Den trees (2/04)

Obvious hollow and/or den trees shall be protected and left standing unless they are a safety hazard.

5.4 - Soil Protection

5.4.1 - Rutting restriction, general (1/09)

Operations are to cease immediately if equipment and weather conditions result in rutting of roads and skid trails which is 12 inches or greater in depth and 50 feet in length. The Unit Manager or his/her representative may restrict hauling and/or skidding if ruts exceed the specified depth. With the Unit Manager or his/her representative's approval, the Purchaser may return to the area when the risk of rutting has decreased.

5.8 - Protection of Endangered Species

5.8.5 - Protection of raptor nests (4/09)

All trees with raptor nests will be protected if found during harvesting operations. Notification will be made to the Unit Manager or his/her representative who will notify the Wildlife Biologist so an on-site evaluation and recommendation can be made, if necessary.

6 - Safety and Fire Prevention

6.2 - Signing

6.2.1 - Road posting (1/09)

The purchaser is responsible for posting and maintaining caution signs on Brady and/or Tucker Road prior to beginning operations. The road must be posted at appropriate distances from the sale area to warn of logging activity and truck traffic. Signs must be removed when harvest operations are suspended or completed. The Purchaser will provide these signs.

BLASTEN ASPEN (103-09-01)
T34N, R01W, SEC. 14, N1/2NW, W1/2NE.
T34N, R01W, SEC. 12, S1/2SW, SWSE.
T34N, R01W, SEC. 11, E1/2SW, NW1/4.
T34N, R01W, SEC. 02, S1/2SW.
CHEBOYGAN COUNTY

In response to the notice of sale to be held 3:00 p.m. on November 10, 2009, I am hereby submitting my sealed bid (firm offer) for the following forest products to be cut. Bids for individual species and total bid value must be at or above the appraised price. All non-responsive bid forms may be rejected.

<u>SPECIES</u>	<u>APPRAISED PRICE</u>	<u>BID PRICE</u>	<u>ESTIMATED VOLUME*</u>	<u>= VALUE</u>
SAWLOGS				
B.T. ASPEN	\$ 88.00/MBF	\$ _____ X	234.20 MBF	= \$ _____
PULPWOOD				
B.T. ASPEN	\$ 20.45/CORD	\$ _____ X	2,121.00 CORDS	= \$ _____
SUBTOTAL 1				\$ _____

In addition, the successful bidder agrees to purchase the following species at the appraised price:

<u>SPECIES</u>	<u>APPRAISED PRICE</u>	<u>ESTIMATED VOLUME*</u>	<u>VALUE</u>
SAWLOGS			
RED MAPLE	\$ 81.00/MBF	45.80 MBF	= \$ 3,709.80
BASSWOOD	\$ 53.00/MBF	3.90 MBF	= \$ 206.70
BEECH	\$ 32.00/MBF	3.50 MBF	= \$ 112.00
P. BIRCH	\$ 137.00/MBF	12.50 MBF	= \$ 1,712.50
W. SPRUCE	\$ 15.00/MBF	3.50 MBF	= \$ 52.50
WHITE PINE	\$ 65.00/MBF	6.80 MBF	= \$ 442.00
RED PINE	\$ 125.00/MBF	12.20 MBF	= \$ 1,525.00
PULPWOOD			
SUG. MAPLE	\$ 4.75/CORD	173.00 CORDS	= \$ 821.75
RED MAPLE	\$ 9.10/CORD	761.00 CORDS	= \$ 6,925.10
BASSWOOD	\$ 6.05/CORD	42.00 CORDS	= \$ 254.10
WHITE ASH	\$ 7.00/CORD	57.00 CORDS	= \$ 399.00
BEECH	\$ 7.85/CORD	34.00 CORDS	= \$ 266.90
P. BIRCH	\$ 7.50/CORD	170.00 CORDS	= \$ 1,275.00
B. POPLAR	\$ 7.25/CORD	91.00 CORDS	= \$ 659.75
BALSAM FIR	\$ 3.05/CORD	391.00 CORDS	= \$ 1,192.55
W. SPRUCE	\$ 7.50/CORD	26.00 CORDS	= \$ 195.00
WHITE PINE	\$ 4.00/CORD	100.00 CORDS	= \$ 400.00
RED PINE	\$ 35.90/CORD	67.00 CORDS	= \$ 2,405.30
SUBTOTAL 2			\$ 22,554.95

SUBTOTAL 1 + SUBTOTAL 2 = TOTAL BID VALUE \$ _____

*These volumes are statistically estimated within plus (+) or minus (-)8.20%. These estimated volumes are final and not subject to adjustment. Prospective bidders are urged to examine this timber and to make their own estimates of quantity and quality.

I understand that any or all bids may be rejected, and that the individual unit bid price will be the basis to determine total bid value. All bids must be signed and all bid items must be bid or the bid form may be rejected. I also understand that consideration and awarding a contract will be based upon my past performance and ability to complete the contract based upon equipment and manpower subject to my control.

(bidder's printed name)

(bidder's signature)

Address/Telephone _____

THE WINNING BIDDER MUST COMPLETE THE FORM ON THE REVERSE SIDE WITHIN 21 DAYS OF SALE AWARD



FOR DEPARTMENT USE ONLY	
Sale or Permit No	
Year:	Type:
Forest Area:	

**TIMBER SALE
VERIFICATION OF WORKER'S DISABILITY
COMPENSATION ACT COMPLIANCE**

As required by Act 317, P.A. 1969 (Worker's Compensation) and Part 525 of Act 451 of 1994, as amended.

VERIFICATION OF WORKER'S DISABILITY COMPENSATION ACT COMPLIANCE

- This verification must be completed and submitted within 21 days of contract award and prior to the issuance of the timber sale contract.
- In addition, if boxes 2B or 2C are checked, then Notice of Exclusion or Certificate of Insurance must be submitted within 21 days of the contract award and prior to the issuance of the timber sale contract.
- All Information must be typed or printed except for written signatures.

Please Check Appropriate Categories:

1. My business is organized as (you **must** check one of the boxes below):
 - A. Sole Proprietorship (individual)
 - B. Partnership
 - C. Corporation
2. You **must** check one of the boxes below:
 - A. I certify that my business is a sole proprietorship and it has no employees but the sole proprietor. I am not subject to the Worker's Compensation Laws.
 - B. I certify that my business has satisfied its obligation to the Worker's Compensation Act through the use of an approved Notice of Exclusion (BWC-337, Rev. 5/96). I will provide a copy of the Notice of Exclusion within 21 days of the contract award. (For questions or a copy of the BWC-337, please call the Worker's Compensation Bureau at 517-322-1195).
 - C. I certify that my business has a Worker's Compensation Policy. I will provide an original Certificate of Insurance within 21 days of the contract award.
3. If you have checked item 2(A) or 2(B), you **must** indicate the number of **both** full and part time employees other than yourself including family members and active partners (if none, you must enter "0").

_____ Full Time Employees

_____ Part Time Employees

Name of Business		Federal ID (or) Social Security No.	
Address		Telephone No. ()	
City	State	Zip + 4	

I hereby certify that the above information is true and correct. I agree to notify the DNR of any changes that occur in factors affecting my coverage during any of my present and future operations.

Signature of Owner or Authorized Representative

Title

Date

JOHNSON PINE (117-09-01)

T34N, R04W, SEC. 31, S1/2SE, NESE, N1/2SW, SESW, S1/2NW, NWSE.
EMMET COUNTY

In response to the notice of sale to be held 3:00 p.m. on November 10, 2009, I am hereby submitting my sealed bid (firm offer) for the following forest products to be cut. Bids for individual species and total bid value must be at or above the appraised price. All non-responsive bid forms may be rejected.

<u>SPECIES</u>	<u>APPRAISED PRICE</u>	<u>BID PRICE</u>	<u>ESTIMATED VOLUME*</u>	<u>= VALUE</u>
<u>SAWLOGS</u>				
RED PINE	\$ 113.00/MBF	\$ _____ X	666.00 MBF	= \$ _____
<u>PULPWOOD</u>				
RED PINE	\$ 40.05/CORD	\$ _____ X	904.00 CORDS	= \$ _____
SUBTOTAL 1				\$ _____

In addition, the successful bidder agrees to purchase the following species at the appraised price:

<u>SPECIES</u>	<u>APPRAISED PRICE</u>	<u>ESTIMATED VOLUME*</u>	<u>VALUE</u>
<u>PULPWOOD</u>			
BASSWOOD	\$ 7.30/CORD	51.00 CORDS	= \$ 372.30
B.T. ASPEN	\$ 22.00/CORD	51.00 CORDS	= \$ 1,122.00
JACK PINE	\$ 14.00/CORD	5.00 CORDS	= \$ 70.00
MIX HARDWD	\$ 7.45/CORD	101.00 CORDS	= \$ 752.45
SUBTOTAL 2			\$ <u>2,316.75</u>

SUBTOTAL 1 + SUBTOTAL 2 = TOTAL BID VALUE \$ _____

*These volumes are statistically estimated within plus (+) or minus (-)10.16%. These estimated volumes are final and not subject to adjustment. Prospective bidders are urged to examine this timber and to make their own estimates of quantity and quality.

I understand that any or all bids may be rejected, and that the individual unit bid price will be the basis to determine total bid value. All bids must be signed and all bid items must be bid or the bid form may be rejected. I also understand that consideration and awarding a contract will be based upon my past performance and ability to complete the contract based upon equipment and manpower subject to my control.

(bidder's printed name)

(bidder's signature)

Address/Telephone _____

THE WINNING BIDDER MUST COMPLETE THE FORM ON THE REVERSE SIDE
WITHIN 21 DAYS OF SALE AWARD



FOR DEPARTMENT USE ONLY

**TIMBER SALE
VERIFICATION OF WORKER'S DISABILITY
COMPENSATION ACT COMPLIANCE**

*As required by Act 317, P.A. 1969 (Worker's Compensation) and Part 525
of Act 451 of 1994, as amended.*

Sale or Permit No	
Year:	Type:
Forest Area:	

VERIFICATION OF WORKER'S DISABILITY COMPENSATION ACT COMPLIANCE

- This verification must be completed and submitted within 21 days of contract award and prior to the issuance of the timber sale contract.
- In addition, if boxes 2B or 2C are checked, then Notice of Exclusion or Certificate of Insurance must be submitted within 21 days of the contract award and prior to the issuance of the timber sale contract.
- All Information must be typed or printed except for written signatures.

Please Check Appropriate Categories:

1. My business is organized as (you **must** check one of the boxes below):
 - A. Sole Proprietorship (individual)
 - B. Partnership
 - C. Corporation
2. You **must** check one of the boxes below:
 - A. I certify that my business is a sole proprietorship and it has no employees but the sole proprietor. I am not subject to the Worker's Compensation Laws.
 - B. I certify that my business has satisfied its obligation to the Worker's Compensation Act through the use of an approved Notice of Exclusion (BWC-337, Rev. 5/96). I will provide a copy of the Notice of Exclusion within 21 days of the contract award. (For questions or a copy of the BWC-337, please call the Worker's Compensation Bureau at 517-322-1195).
 - C. I certify that my business has a Worker's Compensation Policy. I will provide an original Certificate of Insurance within 21 days of the contract award.
3. If you have checked item 2(A) or 2(B), you **must** indicate the number of **both** full and part time employees other than yourself including family members and active partners (if none, you must enter "0").

_____ Full Time Employees

_____ Part Time Employees

Name of Business		Federal ID (or) Social Security No.	
Address		Telephone No. ()	
City	State	Zip + 4	

I hereby certify that the above information is true and correct. I agree to notify the DNR of any changes that occur in factors affecting my coverage during any of my present and future operations.

Signature of Owner or Authorized Representative

Title

Date

MAXWELL ASPEN (118-09-01)

T34N, R04W, SEC. 31, NE1/4, NESE.

T34N, R04W, SEC. 32, NWNW, N1/2SW, SENW, NWSE, SWNE.

EMMET COUNTY

In response to the notice of sale to be held 3:00 p.m. on November 10, 2009, I am hereby submitting my sealed bid (firm offer) for the following forest products to be cut. Bids for individual species and total bid value must be at or above the appraised price. All non-responsive bid forms may be rejected.

<u>SPECIES</u>	<u>APPRAISED PRICE</u>	<u>BID PRICE</u>	<u>ESTIMATED VOLUME*</u>	<u>= VALUE</u>
SAWLOGS				
SUG. MAPLE	\$ 244.00/MBF	\$ _____ X	56.80 MBF	= \$ _____
B.T. ASPEN	\$ 75.00/MBF	\$ _____ X	160.00 MBF	= \$ _____
PULPWOOD				
B.T. ASPEN	\$ 18.25/CORD	\$ _____ X	1,283.00 CORDS	= \$ _____
SUBTOTAL 1				\$ _____

In addition, the successful bidder agrees to purchase the following species at the appraised price:

<u>SPECIES</u>	<u>APPRAISED PRICE</u>	<u>ESTIMATED VOLUME*</u>	<u>VALUE</u>
SAWLOGS			
RED MAPLE	\$ 71.00/MBF	.90 MBF	= \$ 63.90
BASSWOOD	\$ 44.00/MBF	59.00 MBF	= \$ 2,596.00
WHITE ASH	\$ 106.00/MBF	5.70 MBF	= \$ 604.20
BEECH	\$ 26.00/MBF	6.30 MBF	= \$ 163.80
WHITE PINE	\$ 57.00/MBF	10.30 MBF	= \$ 587.10
PULPWOOD			
SUG. MAPLE	\$ 4.05/CORD	440.00 CORDS	= \$ 1,782.00
RED MAPLE	\$ 8.35/CORD	42.00 CORDS	= \$ 350.70
BASSWOOD	\$ 5.10/CORD	302.00 CORDS	= \$ 1,540.20
WHITE ASH	\$ 6.85/CORD	88.00 CORDS	= \$ 602.80
BEECH	\$ 6.85/CORD	111.00 CORDS	= \$ 760.35
BALSAM FIR	\$ 3.10/CORD	29.00 CORDS	= \$ 89.90
B. SPRUCE	\$ 13.60/CORD	42.00 CORDS	= \$ 571.20
TAMARACK	\$ 5.05/CORD	21.00 CORDS	= \$ 106.05
WHITE PINE	\$ 3.85/CORD	33.00 CORDS	= \$ 127.05
RED PINE	\$ 27.55/CORD	6.00 CORDS	= \$ 165.30
BLK CHERRY	\$ 8.60/CORD	12.00 CORDS	= \$ 103.20
SUBTOTAL 2			\$ <u>10,213.75</u>

SUBTOTAL 1 + SUBTOTAL 2 = TOTAL BID VALUE \$ _____

*These volumes are statistically estimated within plus (+) or minus (-)11.50%. These estimated volumes are final and not subject to adjustment. Prospective bidders are urged to examine this timber and to make their own estimates of quantity and quality.

I understand that any or all bids may be rejected, and that the individual unit bid price will be the basis to determine total bid value. All bids must be signed and all bid items must be bid or the bid form may be rejected. I also understand that consideration and awarding a contract will be based upon my past performance and ability to complete the contract based upon equipment and manpower subject to my control.

(bidder's printed name)

(bidder's signature)

Address/Telephone _____

THE WINNING BIDDER MUST COMPLETE THE FORM ON THE REVERSE SIDE WITHIN 21 DAYS OF SALE AWARD



FOR DEPARTMENT USE ONLY

**TIMBER SALE
VERIFICATION OF WORKER'S DISABILITY
COMPENSATION ACT COMPLIANCE**

*As required by Act 317, P.A. 1969 (Worker's Compensation) and Part 525
of Act 451 of 1994, as amended.*

Sale or Permit No	
Year:	Type:
Forest Area:	

VERIFICATION OF WORKER'S DISABILITY COMPENSATION ACT COMPLIANCE

- This verification must be completed and submitted within 21 days of contract award and prior to the issuance of the timber sale contract.
- In addition, if boxes 2B or 2C are checked, then Notice of Exclusion or Certificate of Insurance must be submitted within 21 days of the contract award and prior to the issuance of the timber sale contract.
- All Information must be typed or printed except for written signatures.

Please Check Appropriate Categories:

1. My business is organized as (you **must** check one of the boxes below):
 - A. Sole Proprietorship (individual)
 - B. Partnership
 - C. Corporation
2. You **must** check one of the boxes below:
 - A. I certify that my business is a sole proprietorship and it has no employees but the sole proprietor. I am not subject to the Worker's Compensation Laws.
 - B. I certify that my business has satisfied its obligation to the Worker's Compensation Act through the use of an approved Notice of Exclusion (BWC-337, Rev. 5/96). I will provide a copy of the Notice of Exclusion within 21 days of the contract award. (For questions or a copy of the BWC-337, please call the Worker's Compensation Bureau at 517-322-1195).
 - C. I certify that my business has a Worker's Compensation Policy. I will provide an original Certificate of Insurance within 21 days of the contract award.
3. If you have checked item 2(A) or 2(B), you **must** indicate the number of **both** full and part time employees other than yourself including family members and active partners (if none, you must enter "0").

_____ Full Time Employees

_____ Part Time Employees

Name of Business		Federal ID (or) Social Security No.	
Address		Telephone No. ()	
City	State	Zip + 4	

I hereby certify that the above information is true and correct. I agree to notify the DNR of any changes that occur in factors affecting my coverage during any of my present and future operations.

Signature of Owner or Authorized Representative

Title

Date

OLD 33 ASPEN (122-09-01)
T34N, R01W, SEC. 01, E1/2SW, SE.
T34N, R01W, SEC. 12, W1/2NE, E1/2NW, AND W1/2SE.
CHEBOYGAN COUNTY

In response to the notice of sale to be held 3:00 p.m. on November 10, 2009, I am hereby submitting my sealed bid (firm offer) for the following forest products to be cut. Bids for individual species and total bid value must be at or above the appraised price. All non-responsive bid forms may be rejected.

<u>SPECIES</u>	<u>APPRAISED PRICE</u>	<u>BID PRICE</u>	<u>ESTIMATED VOLUME* = VALUE</u>
<u>SAWLOGS</u>			
B.T. ASPEN	\$ 114.00/MBF	\$ _____ X	143.00 MBF = \$ _____
<u>PULPWOOD</u>			
B.T. ASPEN	\$ 20.10/CORD	\$ _____ X	1,739.00 CORDS = \$ _____
SUBTOTAL 1			\$ _____

In addition, the successful bidder agrees to purchase the following species at the appraised price:

<u>SPECIES</u>	<u>APPRAISED PRICE</u>	<u>ESTIMATED VOLUME*</u>	<u>VALUE</u>
<u>PULPWOOD</u>			
BALSAM FIR	\$ 6.95/CORD	66.00 CORDS	= \$ 458.70
MIX HARDWD	\$ 6.70/CORD	451.00 CORDS	= \$ 3,021.70
SUBTOTAL 2			\$ <u>3,480.40</u>
SUBTOTAL 1 + SUBTOTAL 2 = TOTAL BID VALUE \$ _____			

These volumes are statistically estimated within plus (+) or minus (-)10.30%. These estimated volumes are final and not subject to adjustment. Prospective bidders are urged to examine this timber and to make their own estimates of quantity and quality.

I understand that any or all bids may be rejected, and that the individual unit bid price will be the basis to determine total bid value. All bids must be signed and all bid items must be bid or the bid form may be rejected. I also understand that consideration and awarding a contract will be based upon my past performance and ability to complete the contract based upon equipment and manpower subject to my control.

(bidder's printed name)

(bidder's signature)

Address/Telephone _____

THE WINNING BIDDER MUST COMPLETE THE FORM ON THE REVERSE SIDE
WITHIN 21 DAYS OF SALE AWARD



FOR DEPARTMENT USE ONLY

**TIMBER SALE
VERIFICATION OF WORKER'S DISABILITY
COMPENSATION ACT COMPLIANCE**

*As required by Act 317, P.A. 1969 (Worker's Compensation) and Part 525
of Act 451 of 1994, as amended.*

Sale or Permit No	
Year:	Type:
Forest Area:	

VERIFICATION OF WORKER'S DISABILITY COMPENSATION ACT COMPLIANCE

- This verification must be completed and submitted within 21 days of contract award and prior to the issuance of the timber sale contract.
- In addition, if boxes 2B or 2C are checked, then Notice of Exclusion or Certificate of Insurance must be submitted within 21 days of the contract award and prior to the issuance of the timber sale contract.
- All Information must be typed or printed except for written signatures.

Please Check Appropriate Categories:

1. My business is organized as (you **must** check one of the boxes below):
 - A. Sole Proprietorship (individual)
 - B. Partnership
 - C. Corporation
2. You **must** check one of the boxes below:
 - A. I certify that my business is a sole proprietorship and it has no employees but the sole proprietor. I am not subject to the Worker's Compensation Laws.
 - B. I certify that my business has satisfied its obligation to the Worker's Compensation Act through the use of an approved Notice of Exclusion (BWC-337, Rev. 5/96). I will provide a copy of the Notice of Exclusion within 21 days of the contract award. (For questions or a copy of the BWC-337, please call the Worker's Compensation Bureau at 517-322-1195).
 - C. I certify that my business has a Worker's Compensation Policy. I will provide an original Certificate of Insurance within 21 days of the contract award.
3. If you have checked item 2(A) or 2(B), you **must** indicate the number of **both** full and part time employees other than yourself including family members and active partners (if none, you must enter "0").

_____ Full Time Employees

_____ Part Time Employees

Name of Business		Federal ID (or) Social Security No.	
Address		Telephone No. ()	
City	State	Zip + 4	

I hereby certify that the above information is true and correct. I agree to notify the DNR of any changes that occur in factors affecting my coverage during any of my present and future operations.

Signature of Owner or Authorized Representative

Title

Date

MILLIGAN CREEK ASPEN (123-09-01)
T34N, R01W, SEC. 12, SESE.
T34N, R01W, SEC. 13, N1/2NE, SENE.
CHEBOYGAN COUNTY

In response to the notice of sale to be held 3:00 p.m. on November 10, 2009, I am hereby submitting my sealed bid (firm offer) for the following forest products to be cut. Bids for individual species and total bid value must be at or above the appraised price. All non-responsive bid forms may be rejected.

<u>SPECIES</u>	<u>APPRAISED PRICE</u>	<u>BID PRICE</u>	<u>ESTIMATED VOLUME*</u>	<u>= VALUE</u>
SAWLOGS				
B.T. ASPEN	\$ 86.00/MBF	\$ _____ X	32.00 MBF	= \$ _____
PULPWOOD				
B.T. ASPEN	\$ 20.45/CORD	\$ _____ X	1,039.00 CORDS	= \$ _____
			SUBTOTAL 1	\$ _____

In addition, the successful bidder agrees to purchase the following species at the appraised price:

<u>SPECIES</u>	<u>APPRAISED PRICE</u>	<u>ESTIMATED VOLUME*</u>	<u>VALUE</u>
PULPWOOD			
RED MAPLE	\$ 8.80/CORD	113.00 CORDS	= \$ 994.40
P. BIRCH	\$ 4.50/CORD	38.00 CORDS	= \$ 171.00
			SUBTOTAL 2 \$ 1,165.40
			SUBTOTAL 1 + SUBTOTAL 2 = TOTAL BID VALUE \$ _____

*These volumes are statistically estimated within plus (+) or minus (-)23.39%. These estimated volumes are final and not subject to adjustment. Prospective bidders are urged to examine this timber and to make their own estimates of quantity and quality.

I understand that any or all bids may be rejected, and that the individual unit bid price will be the basis to determine total bid value. All bids must be signed and all bid items must be bid or the bid form may be rejected. I also understand that consideration and awarding a contract will be based upon my past performance and ability to complete the contract based upon equipment and manpower subject to my control.

(bidder's printed name)

(bidder's signature)

Address/Telephone _____

THE WINNING BIDDER MUST COMPLETE THE FORM ON THE REVERSE SIDE
WITHIN 21 DAYS OF SALE AWARD



FOR DEPARTMENT USE ONLY

**TIMBER SALE
VERIFICATION OF WORKER'S DISABILITY
COMPENSATION ACT COMPLIANCE**

*As required by Act 317, P.A. 1969 (Worker's Compensation) and Part 525
of Act 451 of 1994, as amended.*

Sale or Permit No	
Year:	Type:
Forest Area:	

VERIFICATION OF WORKER'S DISABILITY COMPENSATION ACT COMPLIANCE

- This verification must be completed and submitted within 21 days of contract award and prior to the issuance of the timber sale contract.
- In addition, if boxes 2B or 2C are checked, then Notice of Exclusion or Certificate of Insurance must be submitted within 21 days of the contract award and prior to the issuance of the timber sale contract.
- All information must be typed or printed except for written signatures.

Please Check Appropriate Categories:

1. My business is organized as (you **must** check one of the boxes below):
 - A. Sole Proprietorship (individual)
 - B. Partnership
 - C. Corporation
2. You **must** check one of the boxes below:
 - A. I certify that my business is a sole proprietorship and it has no employees but the sole proprietor. I am not subject to the Worker's Compensation Laws.
 - B. I certify that my business has satisfied its obligation to the Worker's Compensation Act through the use of an approved Notice of Exclusion (BWC-337, Rev. 5/96). I will provide a copy of the Notice of Exclusion within 21 days of the contract award. (For questions or a copy of the BWC-337, please call the Worker's Compensation Bureau at 517-322-1195).
 - C. I certify that my business has a Worker's Compensation Policy. I will provide an original Certificate of Insurance within 21 days of the contract award.
3. If you have checked item 2(A) or 2(B), you **must** indicate the number of **both** full and part time employees other than yourself including family members and active partners (if none, you must enter "0").

_____ Full Time Employees

_____ Part Time Employees

Name of Business		Federal ID (or) Social Security No.	
Address		Telephone No. ()	
City	State	Zip + 4	

I hereby certify that the above information is true and correct. I agree to notify the DNR of any changes that occur in factors affecting my coverage during any of my present and future operations.

Signature of Owner or Authorized Representative

Title

Date