



DEPARTMENT OF NATURAL RESOURCES & ENVIRONMENT
STATE OF MICHIGAN

TIMBER SALE PROSPECTUS

SALE TIME, DATE AND LOCATION

3:00 p.m. October 25, 2010

GWINN

Notice is hereby given that bids will be received by the Unit Manager, GWINN MANAGEMENT UNIT, for certain timber on the following described lands. The Bidder is advised to inspect the sale area and review the location, estimated volumes, operating costs, and sale contract terms of the proposed sale.

LIARS LODGE HARDWOODS / T43N, R26W, SEC. 20, NW1/4, NESW.

MARQUETTE COUNTY (Appr. \$11,454.85)

SALE ACRES: 64

No designated recreation site such as a trail, pathway, or campground is within the sale area.

Access may be through private land.

ROSS CREEK HARDWOODS / T43N, R26W, SEC. 21, NW1/4, NWNE.

T43N, R26W, SEC. 16, SWSE, SWSW.

MARQUETTE COUNTY (Appr. \$21,237.75)

SALE ACRES: 116

No designated recreation site such as a trail, pathway, or campground is within the sale area.

Access may be through private or state forest land.

SICK DOG MIX / T43N, R26W, SEC. 29, S1/2SW, NESW.

MARQUETTE COUNTY (Appr. \$5,840.85)

SALE ACRES: 14

No designated recreation site such as a trail, pathway, or campground is within the sale area.

Access may be through state forest land.

Please be aware that some landowners may request 60 days or more notice for forest harvesting access across their land.

BID INSTRUCTIONS (Ver. 06/23/2008):

1. Bid Location, Date, and Time: Bids must be received by the Unit Manager, Gwinn Management Unit, 410 West M-35, Gwinn, Michigan 49841, no later than 3:00 p.m. on October 25, 2010. For further information concerning this sale, contact the Unit Manager at 906-346-9201.
2. Bidder's Qualifications: Purchaser shall obtain workers compensation insurance to cover claims under Michigan's Worker's Disability Compensation Act of 1969 or similar employee benefit act of any other state applicable to an employee. If all or part of a timber sale was prepared by a private contractor, that contractor and that contractor's company are not permitted to bid on the timber sale contract. Bids will not be accepted from individuals or companies appearing on the DNR/FMFM No-Bid List. This list contains the names of purchasers who previously failed to execute a contract within 21-days or who have a history of poor performance.
3. Preparation of Sealed Bids: Bids shall be manually signed in ink; bid prices must be entered for each species and product in the Bid Price column for all material subject to bidding; and all fill-in blanks must be completed. If erasures or other changes appear on the forms, each erasure or change must be initialed by the person signing the bid.
4. Submission of Sealed Bids: Bid forms may be obtained from the Unit Manager. All bids must be submitted on the bid form and in an envelope clearly identified as described in this section. NOTE: Only one bid form per bid envelope. Sealed bids must be submitted to the Unit office designated in the prospectus and must be submitted at or prior to the time established in the prospectus. The envelope should show on the outside (a) that it is a "Bid for Timber," and (b) the sale name or number, and (c) the date and time of bid opening as shown in the prospectus. Bids received after the time specified in the sale prospectus are late bids and will be rejected.
5. Public Opening of Sealed Bids: If conditions permit, the sealed bids will be publicly opened and posted at the time and place set in the prospectus.
6. Award of Contract: Award of the contract will be made to the Bidder whose bid, conforming to the prospectus, is most advantageous to the State of Michigan on the basis of total value at rates bid for the estimated quantities. The State reserves the right to reject any bid or waive any minor irregularity in bids received. A written award mailed (or otherwise furnished) to the successful Bidder shall be deemed to result in a binding contract without further action by either party.
7. Down Payment: The Bidder to whom award is made must make a down payment within 21 days of the sale award. The amount of the down payment will be calculated as shown in the Bond and Payment Schedule of this prospectus. Only cash may be used to meet this requirement.
8. Performance Security: As guarantee of faithful performance, a cash bond, certificate of deposit, surety bond or irrevocable letter of credit (LOC) is required within 21 days of the sale award. The amount of the performance security is shown in the Bond and Payment Schedule of this prospectus. If an LOC or surety is used, the coverage must extend for at least 6 months beyond the contract expiration.
9. Timber Sale Contract: Additional conditions and requirements common to all timber sales are listed on the timber sale contract (R4031) and are available on line at www.michigan.gov/dnr. Contact the Unit Manager for additional information or a sample contract. Within 21 days of the date of the award letter, the bidder must sign the contract and provide the required down payment, performance security, and verification of worker's disability compensation. The down payment and performance security shall be in accordance with the provisions of the timber sale contract, in the sums stated in this prospectus. If these actions are not taken, then the Bidder, the Bidder's corporation, and the corporation's principals may not be permitted to bid on State timber sales for a period of 1 year. In addition, the Bidder certifies that if awarded this contract, the Bidder will complete the timber sale contract in accordance with its terms and any modifications thereof including requirements to purchase, cut, and remove the included timber by the termination date.

10. Disclaimer of Estimates and Bidder's Warranty of Inspection: Before submitting this bid, the Bidder is advised and cautioned to inspect the sale area, review the requirements of the sale contract, and take other steps as may be reasonably necessary to ascertain the location, estimated volumes, construction estimates, and operating costs of the proposed sale. Failure to do so will not relieve the Bidder from responsibility for completing the contract.

The Bidder warrants that this bid is submitted solely on the basis of the Bidder's examination and inspection of the quality and quantity of the timber offered for sale and the Bidder's opinion of the value thereof and the costs of recovery. No reliance should be placed on the State of Michigan's estimates of timber quality, quantity or costs of recovery. Bidder further acknowledges that the State of Michigan: (i) expressly disclaims any warranty of fitness of timber for any purpose; (ii) offers this timber as is without any warranty of quality (merchantability) or quantity and (iii) expressly disclaims any warranty as to the quantity or quality of timber sold.

11. Certification and Chain-of-Custody: Unless otherwise indicated in the contract under section 7 - Other Conditions of the Sale Specific Conditions & Requirements, the area encompassed by this timber sale is certified to the standards of the Forest Stewardship Council (FSC) - Certificate #SCS-FM/COC-090N and the Sustainable Forestry Initiative (SFI) - Certificate # NSF-SFIS-5Y031-S1. Forest products from this sale may be delivered to the mill as "FSC and / or SFI certified" as long as the contractor hauling the forest products is chain-of-custody (COC) certified or covered under a COC certificate from the destination mill. The purchaser is responsible for maintaining COC after leaving the sale area.

REBECCA A. HUMPHRIES
Director

LIARS LODGE HARDWOODS (008-10-01)

A timber sale contract for this LUMP SUM SEALED timber sale will be awarded the responsible bidder offering the highest sealed bid price. Bids must be at or above the following appraised price for each species:

<u>SPECIES</u>	<u>ESTIMATED VOLUME*</u>	<u>APPRAISED PRICE</u>
SAWLOGS		
SUG. MAPLE	12.80 MBF	\$ 243.00/MBF
BASSWOOD	28.40 MBF	\$ 51.00/MBF
PULPWOOD		
MIX HARDWD	323.00 CORDS	\$ 21.35/CORD

*The volumes are statistically estimated within plus (+) or minus (-) 17.8 percent. These estimated volumes are final and not subject to adjustment. Prospective bidders are urged to examine this timber and to make their own estimates of quantity and quality.

BOND AND PAYMENT SCHEDULE:

1. A bond in the amount of \$573.00, to insure faithful performance of the conditions of the contract, will be deposited by the successful bidder within 21 days of the sale award.
2. Cutting in any sale or unit without the required advance payment would be considered a trespass.
3. Total payment may be paid in advance or according to the following schedule:
 - (a) Ten percent (10%) of the sale value must be paid within 21 days of the sale award.
 - (b) The 10% down payment will be credited towards the first unit cut.
 - (c) Payment for each of the following units must be made before cutting begins in that unit:

<u>PAYMENT UNIT NUMBER</u>	<u>PERCENT OF TOTAL SALE VALUE</u>
1	54%
2	46%

4. If no cutting takes place, the 10% down payment will not be refunded.
5. Operations on the contract issued will terminate on May 31, 2013.



Forest Management Unit Gwinn		County Marquette	Mapped By T. Sysol	Date 10/12/09	Page 1	of 1
Township 43N	Range 26W	Section(s) and Subdivision(s) 20 NW 1/4, NESW		Cruised By LaBumbard, Sysol		

Cover Type				Density	
A = Aspen	G = Grass	O = Oak	U = Upland Brush	0 = Non Stocked	5 = Pole Timber Medium
B = Paper Birch	H = Hemlock	P = Lowland Poplar	V = Bog or Marsh	1 = Seedling Sapling Poor	6 = Pole Timber Well
C = Cedar	J = Jack Pine	Q = Mixed Swamp Cnfr	W = White Pine	2 = Seedling Sapling Medium	7 = Saw Timber Poor
D = Treed Bog	L = Lowland Brush	R = Red Pine	X = Non Stocked	3 = Seedling Sapling Well	8 = Saw Timber Medium
E = Swamp Hdwoods	M = Mpl, Bch, Brch	S = Black Spruce	Z = Water	4 = Pole Timber Poor	9 = Saw Timber Well
F = Spruce Fir	N = Marsh	T = Tamarack			

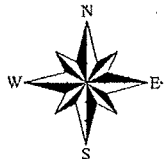

LIARS LODGE HARDWOODS

64 acres

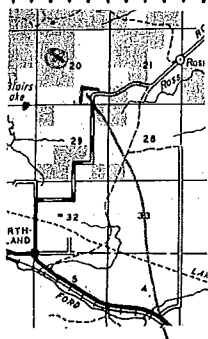
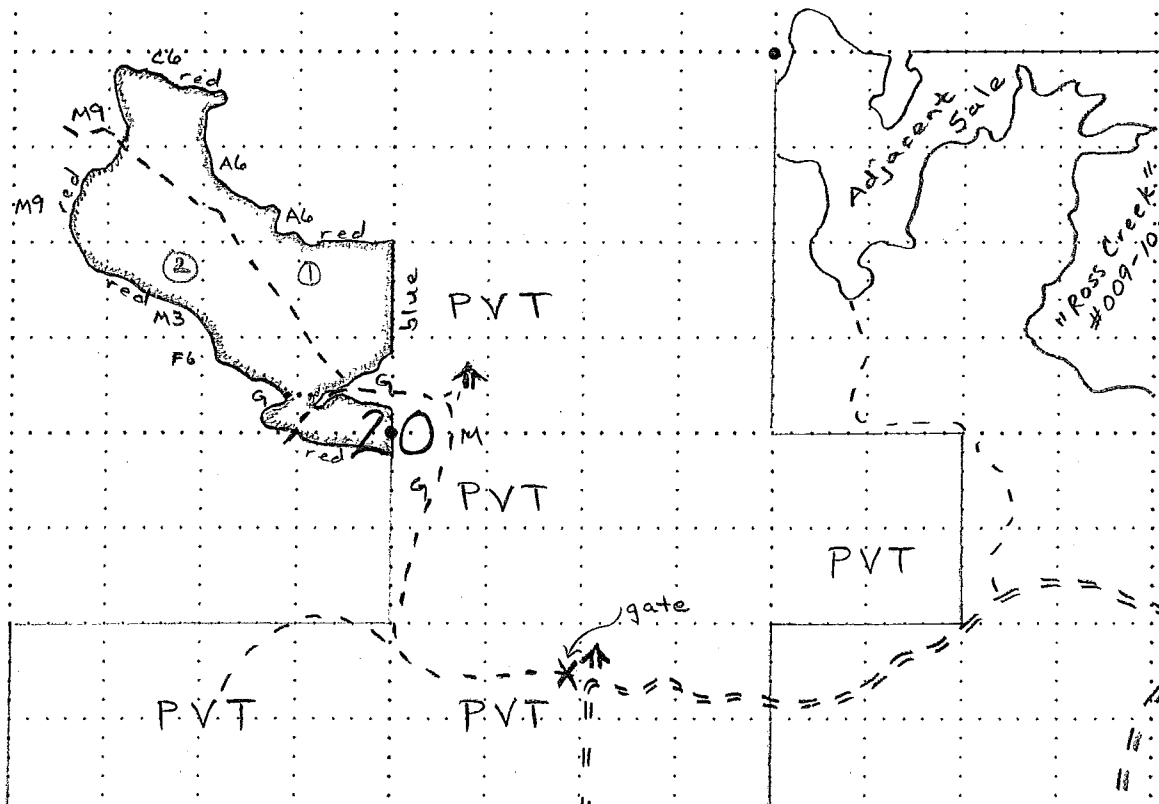

Sale Area (red, blue)
 County Dirt Road ==
 Two-Track Road - - -
 Camps ↑
 Survey Pipe ●
 Gate X
 Unit Number ①

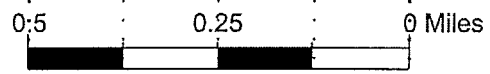

County Road S.H. ==
 to Northland
 ↓ ≈ 2 miles

Sale Location ⊗

Sale Specific Conditions & Requirements

Sale Name: Liars Lodge Hardwoods Sale Number: 32-008-10-01

1 - Sale Area

1.2 - Boundaries

1.2.1 - Painted boundaries (12/08)

The sale boundary is marked and identified by blue and red paint. Exterior sale boundary lines against private property are marked with blue paint. Exterior sale boundary lines against state are marked with red paint. Interior Payment Unit boundary is the NW angling trail road which cuts through the stand. Do not cut painted boundary line trees unless also marked with orange paint.

2 - Timber Specifications

2.1 - Included Timber

2.1.3 - Cut tree marked unit(s) (12/08)

Within Payment Unit(s) 1 and 2, all trees are designated for cutting when marked with orange paint above and below stump height, regardless of merchantability.

2.2 - Utilization

2.2.4 - Skidding length (2/09)

Skidding of unlimbed tops or lengths over 17 feet is not permissible.

2.2.9 - No chipping permitted (12/08)

Within Payment Unit(s) 1 and 2, all wood must be removed by roundwood. No chipping is permitted.

3 - Payments

3.3 - Pre-measured Sales

3.3.4 - Dividing payment units (12/08)

Payment unit(s) 1 and 2 may be divided at the request of the purchaser and upon approval of the Unit Manager. Dividing payment units is a contract modification which requires a Timber Sale Contract Supplement.

3.4 - Damaged Timber

3.4.1 - Damaged timber (6/05)

General Condition and Requirement 3.4 Damaged Timber, defines liquidated damages for undesigned live merchantable trees which are cut or injured. In addition, extreme care should be taken to avoid damage to tree seedlings and saplings. Damage to residual trees (defined as breaking of the cambium layer, broken tops or bending of trees from their natural position) is not acceptable.

4 - Transportation

4.1 - Construction

4.1.3 - Slash and earthen piles (8/04)

Piles or windrows of earth along roads and landings that have been widened or constructed shall be leveled. Slash from road maintenance or construction, including stumps, shall be dispersed throughout the sale.

4.1.4 - Timber removed for construction (12/09)

Trees cut or damaged in the process of pre-approved road, landing or skid trail construction will be decked in an area separate from other designated timber and not removed until measured by the sale administrator. Payment will be made at the specified Purchase Unit Price.

4.1.8 - Road work (1) (8/07)

In accordance with general specification 4.2, additional leveling, grading and/or blading of access roads may be required if roads are not left in satisfactory shape to the landowner granting access upon completion of the sale.

4.2 - Maintenance

4.2.1 - Hauling restriction (12/08)

Hauling may be restricted on access roads by the Unit Manager or his/her representative. The restriction may occur during spring breakup or during wet weather conditions.

4.4 - Access

4.4.1 - Private property access (12/08)

Permission for access across private land has been obtained by the DNR. This includes an operating restriction of December 1st - March 15th.

4.4.3 - Access gate (12/08)

The access gate must be closed at all times. This is to prevent someone other than the purchaser from going through the gate and being locked in.

5 - Operations

5.1 - Notification

5.1.4 - Post-sale conference (9/09)

A post-sale conference on site between the Purchaser and sale administrator is required 5 days prior to the completion of active logging operations to determine clean-up and repair of landings, road edges, and the fulfillment of other contract specifications.

5.2 - Conduct of Operations

5.2.1 - Slash

5.2.1.2.6 - Slash removal, general (7/05)

All slash must be removed from the blue paint line and from the cleared right-of-way of forest roads.

5.2.2 - Hazard Trees/Snags

5.2.2.1 - Den trees (2/04)

Obvious hollow and/or den trees shall be protected and left standing unless they are a safety hazard.

5.2.3 - Operating Restrictions

5.2.3.1 - Operating restrictions (12/08)

Within Payment Unit(s) 1 and 2, unless changed by written agreement, cutting, skidding, and hauling are limited to the period of December 1st to March 15th. This restriction is due to acquired access granted by private landowner.

5.2.3.2 - Decking/landing restoration (2/04)

All decking and landing areas must have the surface area restored to a condition equal to or better than before. This is to insure the proper regeneration of the stand.

5.4 - Soil Protection

5.4.1 - Rutting restriction, general (1/09)

Operations are to cease immediately if equipment and weather conditions result in rutting of roads and skid trails which is 12 inches or greater in depth and 50 feet in length. The Unit Manager or his/her representative may restrict hauling and/or skidding if ruts exceed the specified depth. With the Unit Manager or his/her representative's approval, the Purchaser may return to the area when the risk of rutting has decreased.

ROSS CREEK HARDWOODS (009-10-01)

A timber sale contract for this LUMP SUM SEALED timber sale will be awarded the responsible bidder offering the highest sealed bid price. Bids must be at or above the following appraised price for each species:

<u>SPECIES</u>	<u>ESTIMATED VOLUME*</u>	<u>APPRAISED PRICE</u>
SAWLOGS		
SUG. MAPLE	9.50 MBF	\$ 389.00/MBF
BASSWOOD	30.60 MBF	\$ 70.00/MBF
PULPWOOD		
Q. ASPEN	199.00 CORDS	\$ 19.40/CORD
MIX HARDWD	347.00 CORDS	\$ 19.95/CORD

In addition, the successful bidder agrees to purchase the following species at the indicated appraised price:

<u>SPECIES</u>	<u>ESTIMATED VOLUME*</u>	<u>APPRAISED PRICE</u>
SAWLOGS		
P. BIRCH	2.70 MBF	\$ 106.00/MBF
PULPWOOD		
BASSWOOD	90.00 CORDS	\$ 22.65/CORD
P. BIRCH	96.00 CORDS	\$ 18.15/CORD
B. POPLAR	19.00 CORDS	\$ 15.20/CORD
MIX SOFTWD	14.00 CORDS	\$ 18.65/CORD

*The volumes are statistically estimated within plus (+) or minus (-) 12.15 percent. These estimated volumes are final and not subject to adjustment. Prospective bidders are urged to examine this timber and to make their own estimates of quantity and quality.

BOND AND PAYMENT SCHEDULE:

1. A bond in the amount of \$1,062.00, to insure faithful performance of the conditions of the contract, will be deposited by the successful bidder within 21 days of the sale award.
2. Cutting in any sale or unit without the required advance payment would be considered a trespass.
3. Total payment may be paid in advance or according to the following schedule:
 - (a) Ten percent (10%) of the sale value must be paid within 21 days of the sale award.
 - (b) The 10% down payment will be credited towards the first unit cut.
 - (c) Payment for each of the following units must be made before cutting begins in that unit:

<u>PAYMENT UNIT NUMBER</u>	<u>PERCENT OF TOTAL SALE VALUE</u>
1	31%
2	37%
3	19%
4	13%
4. If no cutting takes place, the 10% down payment will not be refunded.
5. Operations on the contract issued will terminate on May 31, 2013.



Michigan Department of Natural Resources - Forest, Mineral & Fire Management
TIMBER SALE MAP
 This information provided by authority of Part 525 of Act 451, PA 1994, as amended.

Sale Number	Year
32 - 009	10

Forest Management Unit Gwinn		County Marquette	Mapped By T Sysol	Date 03/15/10	Page 1	of 1	
Township 43N	Range 26W	Section(s) and Subdivision(s) 21 NW 1/4, NWNE 16 SWSE, SWSW					
Cover Type			Density				
A = Aspen B = Paper Birch C = Cedar D = Treed Bog E = Swamp Hdwoods F = Spruce Fir	G = Grass H = Hemlock J = Jack Pine L = Lowland Brush M = Mpl, Bch, Brch N = Marsh	O = Oak P = Lowland Poplar Q = Mixed Swamp Cnfr R = Red Pine S = Black Spruce T = Tamarack	U = Upland Brush V = Bog or Marsh W = White Pine X = Non Stocked Z = Water	0 = Non Stocked 1 = Seedling Sapling Poor 2 = Seedling Sapling Medium 3 = Seedling Sapling Well 4 = Pole Timber Poor	5 = Pole Timber Medium 6 = Pole Timber Well 7 = Saw Timber Poor 8 = Saw Timber Medium 9 = Saw Timber Well		

ROSS CREEK HARDWOODS
 116 acres

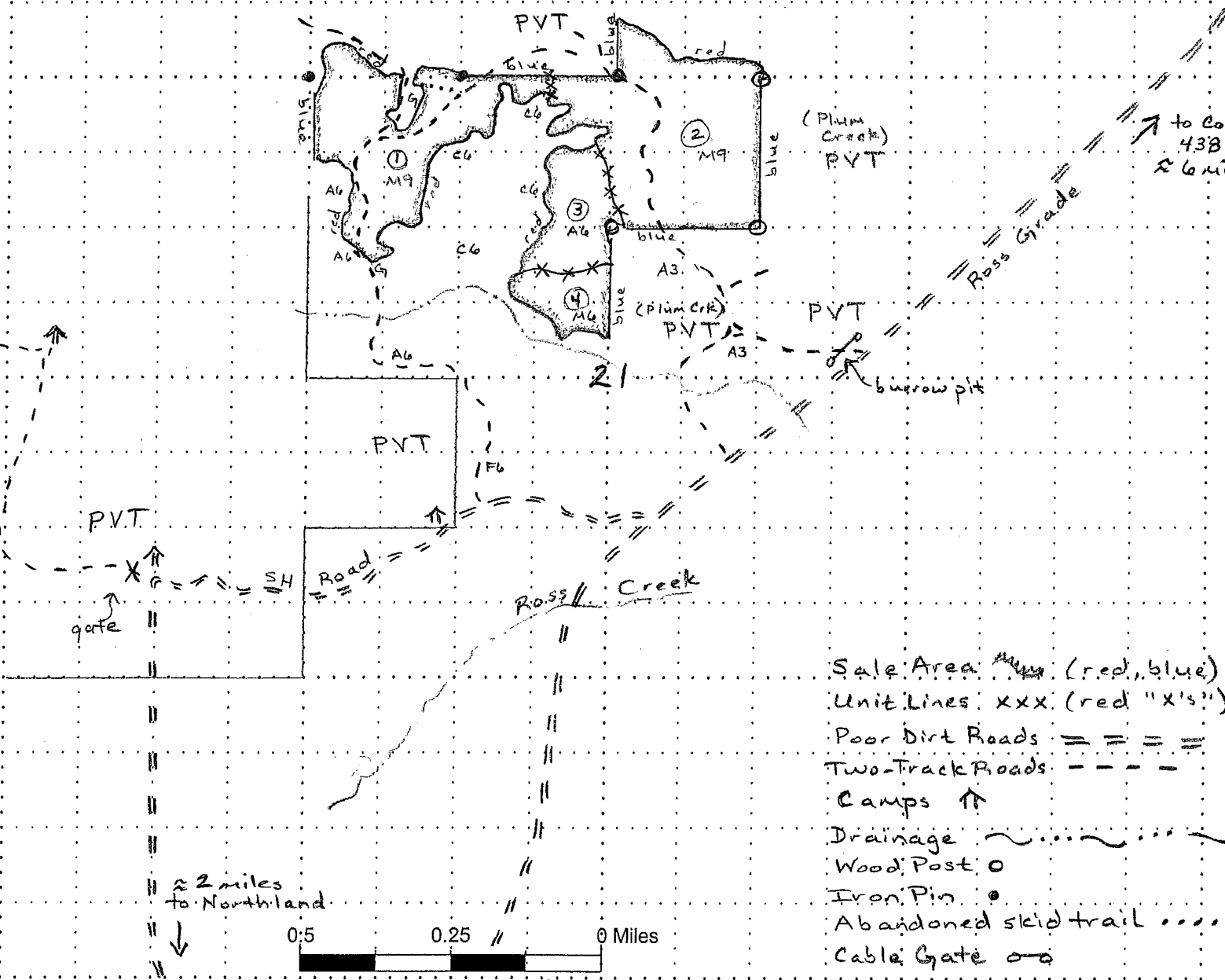
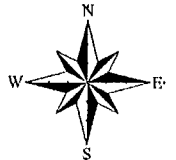

Sale Specific Conditions & Requirements

Sale Name: Ross Creek Hardwoods Sale Number: 32-009-10-01

1 - Sale Area

1.2 - Boundaries

1.2.1 - Painted boundaries (12/08)

The sale boundary is marked and identified by blue and red paint. Exterior sale boundary lines against private property are marked with blue paint. Exterior sale boundary lines against state are marked with red paint. Interior Payment Unit boundaries are red painted "x's", as shown on map. Do not cut the painted boundary line trees unless also marked with orange paint.

2 - Timber Specifications

2.1 - Included Timber

2.1.2 - Clearcut unit(s) w/o unmerchantable trees (12/08)

Within Payment Unit(s) 3, cut all aspen, balsam poplar, paper birch, balsam fir, spruce, red and sugar maple trees which meet minimum piece specifications in 2.2 Utilization. DO NOT CUT ANY YELLOW BIRCH, CEDAR, OR ASH. In addition, DO NOT CUT ANY PAPER BIRCH RESERVE TREES painted with red x's on the unit line between units 3 and 4. Reserve trees identified in accordance with 2.4.2 - Reserve trees, within clearcutting unit boundaries, are not Included Timber and are to be protected.

2.1.3 - Cut tree marked unit(s) (12/08)

Within Payment Unit(s) 1 and 2, all trees are designated for cutting when marked with orange paint above and below stump height, regardless of merchantability.

2.1.4 - Species designation unit(s) (12/08)

Within Payment Unit(s) 4, all paper birch, aspen, balsam fir and spruce are designated for cutting which meet minimum piece specifications in 2.2 Utilization. All other species will be left. In addition, all paper birch unit line trees marked with red paint will be left.

2.2 - Utilization

2.2.4 - Skidding length (2/09)

Skidding of unlimbed tops or lengths over 17 feet is not permissible.

2.2.9 - No chipping permitted (12/08)

Within Payment Unit(s) 1, 2 and 4, all wood must be removed by roundwood. No chipping is permitted.

3 - Payments

3.3 - Pre-measured Sales

3.3.4 - Dividing payment units (12/08)

Payment unit(s) 1 and 2 may be divided at the request of the purchaser and upon approval of the Unit Manager. Dividing payment units is a contract modification which requires a Timber Sale Contract Supplement.

3.4 - Damaged Timber

3.4.1 - Damaged timber (6/05)

General Condition and Requirement 3.4 Damaged Timber, defines liquidated damages for undesignated live merchantable trees which are cut or injured. In addition, extreme care should be taken to avoid damage to tree seedlings and saplings. Damage to residual trees (defined as breaking of the cambium layer, broken tops or bending of trees from their natural position) is not acceptable.

4 - Transportation

4.1 - Construction

4.1.3 - Slash and earthen piles (8/04)

Piles or windrows of earth along roads and landings that have been widened or constructed shall be leveled. Slash from road maintenance or construction, including stumps, shall be dispersed throughout the sale.

4.1.4 - Timber removed for construction (12/09)

Trees cut or damaged in the process of pre-approved road, landing or skid trail construction will be decked in an area separate from other designated timber and not removed until measured by the sale administrator. Payment will be made at the specified Purchase Unit Price.

4.1.6 - Road construction (1/09)

Construction of new roads or improvements of existing roads shall be done in such a way as to minimize the environmental and visual impacts. Merchantable trees shall be cut and utilized unless otherwise directed. Non-merchantable trees shall be severed and laid flat on the ground. Slash shall be scattered, and not left in windrows and kept a minimum of 10 feet back from the road edge. Stumps shall be set upright, not left on edge, and be moved at least 10 feet away from the road edge. Disturbed soil shall be feathered into the woods and not left in berms or windrows.

4.1.8 - Road work (1) (8/07)

In accordance with general specification 4.2, additional leveling, grading and/or blading of access roads may be required if roads are not left in satisfactory shape to the landowner granting access upon completion of the sale.

4.2 - Maintenance

4.2.1 - Hauling restriction (12/08)

Hauling may be restricted on access roads by the Unit Manager or his/her representative. The restriction may occur during spring breakup or during wet weather conditions.

4.4 - Access

Sale Name: Ross Creek Hardwoods Sale Number: 32-009-10-01

4.4.1 - Private property access (12/08)

Permission for access across private land is the responsibility of the purchaser. A copy of the written permission from the private landowner must be given to the Unit office prior to the beginning of operations. Permission to cross private land must include access for DNR representatives to inspect the sale at any time.

4.4.3 - Access gate (12/08)

The access gate should be closed at all times. This is to prevent someone other than the purchaser from going through the gate.

5 - Operations

5.2 - Conduct of Operations

5.2.1 - Slash

5.2.1.2 - Slash Removal

5.2.1.2.6 - Slash removal, general (7/05)

All slash must be removed from the blue paint line and from the cleared right-of-way of forest roads.

5.2.2 - Hazard Trees/Snags

5.2.2.1 - Den trees (2/04)

Obvious hollow and/or den trees shall be protected and left standing unless they are a safety hazard.

5.2.3 - Operating Restrictions

5.2.3.1 - Operating restrictions (12/08)

Within Payment Unit(s) 1, 2, and 4, unless changed by written agreement, cutting and skidding are not permitted during the period of April 15 to July 15. This restriction is because of bark slippage.

5.2.3.2 - Decking/landing restoration (2/04)

All decking and landing areas must have the surface area restored to a condition equal to or better than before. This is to insure the proper regeneration of the stand.

5.4 - Soil Protection

5.4.1 - Rutting restriction, general (1/09)

Operations are to cease immediately if equipment and weather conditions result in rutting of roads and skid trails which is 12 inches or greater in depth and 50 feet in length. The Unit Manager or his/her representative may restrict hauling and/or skidding if ruts exceed the specified depth. With the Unit Manager or his/her representative's approval, the Purchaser may return to the area when the risk of rutting has decreased.

Sale Name: Ross Creek Hardwoods Sale Number: 32-009-10-01

5.4.5 - Soil caution (11/04)

Care must be taken to minimize soil damage due to seasonally wet/saturated soils within Unit 3 and also between Units 1 and 2. This may require operating only during frozen conditions and/or modifying road construction (install temporary culverts) and skid trails to protect soil quality.

SICK DOG MIX (010-10-01)

A timber sale contract for this LUMP SUM SEALED timber sale will be awarded the responsible bidder offering the highest sealed bid price. Bids must be at or above the following appraised price for each species:

<u>SPECIES</u>	<u>ESTIMATED VOLUME*</u>	<u>APPRAISED PRICE</u>
PULPWOOD		
Q. ASPEN	103.00 CORDS	\$ 27.80/CORD
MIX HARDWD	69.00 CORDS	\$ 24.40/CORD

In addition, the successful bidder agrees to purchase the following species at the indicated appraised price:

<u>SPECIES</u>	<u>ESTIMATED VOLUME*</u>	<u>APPRAISED PRICE</u>
PULPWOOD		
P. BIRCH	25.00 CORDS	\$ 18.65/CORD
BALSAM FIR	23.00 CORDS	\$ 23.20/CORD
W. SPRUCE	14.00 CORDS	\$ 21.00/CORD

*These estimated volumes are final and not subject to adjustment. Prospective bidders are urged to examine this timber and to make their own estimates of quantity and quality.

BOND AND PAYMENT SCHEDULE:

1. A bond in the amount of \$292.00, to insure faithful performance of the conditions of the contract, will be deposited by the successful bidder within 21 days of the sale award.
2. Cutting in any sale or unit without the required advance payment would be considered a trespass.
3. Total payment may be paid in advance or according to the following schedule:
 - (a) Ten percent (10%) of the sale value must be paid within 21 days of the sale award.
 - (b) The remainder is due before cutting begins.
4. If no cutting takes place, the 10% down payment will not be refunded.
5. Operations on the contract issued will terminate on May 31, 2013.



Michigan Department of Natural Resources - Forest, Mineral & Fire Management
TIMBER SALE MAP
 This information provided by authority of Part 525 of Act 451, PA 1994, as amended.

Sale Number	Year
32-010	10

Forest Management Unit Gwinn	County Marquette	Mapped By T Sysol	Date 3/15/10	Page 1	of 1
Township 43N	Range 26W	Section(s) and Subdivision(s) 29 S ¹ / ₂ SW, NESW			

Cover Type				Density	
A = Aspen	G = Grass	O = Oak	U = Upland Brush	0 = Non Stocked	5 = Pole Timber Medium
B = Paper Birch	H = Hemlock	P = Lowland Poplar	V = Bog or Marsh	1 = Seedling Sapling Poor	6 = Pole Timber Well
C = Cedar	J = Jack Pine	Q = Mixed Swamp Cnfr	W = White Pine	2 = Seedling Sapling Medium	7 = Saw Timber Poor
D = Treed Bog	L = Lowland Brush	R = Red Pine	X = Non Stocked	3 = Seedling Sapling Well	8 = Saw Timber Medium
E = Swamp Hdwoods	M = Mpl, Bch, Brch	S = Black Spruce	Z = Water	4 = Pole Timber Poor	9 = Saw Timber Well
F = Spruce Fir	N = Marsh	T = Tamarack			

SICK DOG MIX
14 acres

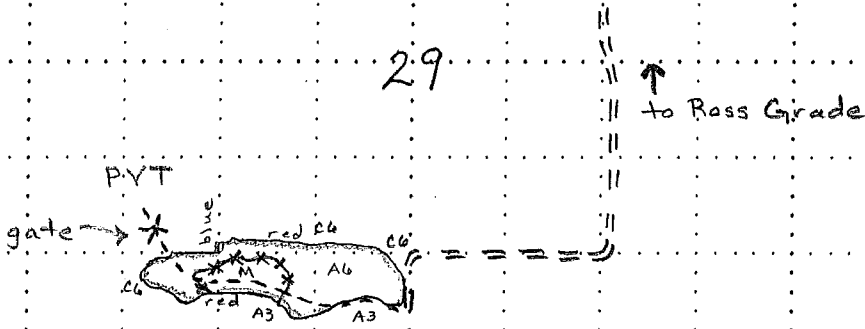
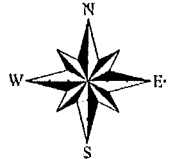

SI Road

3.2

Sale Area (red, blue)
 Paved Road =====
 Dirt Road = = = =
 Two-Track Road - - - -
 Marked hardwood Area (M) xxx (red x's)

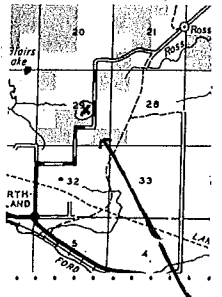

to Northland

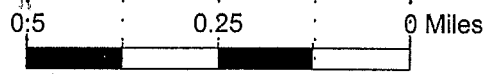

Sale location

Sale Specific Conditions & Requirements

Sale Name: Sick Dog Mix Sale Number: 32-010-10-01

2 - Timber Specifications

2.1 - Included Timber

2.1.2 - Clearcut unit(s) w/o unmerchantable trees (12/08)

Within Payment Unit(s) 1, cut all aspen, paper birch, balsam fir, spruce, red and sugar maple trees which meet minimum piece specifications in 2.2 Utilization. DO NOT CUT leave trees marked with green paint (east end of unit). DO NOT CUT ANY CEDAR, YELLOW BIRCH OR HEMLOCK. In addition, within the M type boundary, which is shown on map and designated with red X's, cut only those trees marked with orange paint.

2.2 - Utilization

2.2.9 - No chipping permitted (12/08)

Within Payment Unit(s) 1, all wood must be removed by roundwood. No chipping is permitted.

4 - Transportation

4.1 - Construction

4.1.3 - Slash and earthen piles (8/04)

Piles or windrows of earth along roads and landings that have been widened or constructed shall be leveled. Slash from road maintenance or construction, including stumps, shall be dispersed throughout the sale.

4.1.12 - No new roads (12/08)

No new roads will be permitted. All operations are limited to existing roads.

5 - Operations

5.2 - Conduct of Operations

5.2.1 - Slash

5.2.1.2 - Slash Removal

5.2.1.2.6 - Slash removal, general (7/05)

All slash must be removed from existing roads and the blue private line.

5.2.2 - Hazard Trees/Snags

5.2.2.1 - Den trees (2/04)

Obvious hollow and/or den trees shall be protected and left standing unless they are a safety hazard.

Sale Name: Sick Dog Mix Sale Number: 32-010-10-01

5.2.32 - Decking/landing restoration (2/04)

All decking and landing areas must have the surface area restored to a condition equal to or better than before. This is to insure the proper regeneration of the stand.

5.4 - Soil Protection

5.4.1 - Rutting restriction, general (1/09)

Operations are to cease immediately if equipment and weather conditions result in rutting of roads and skid trails which is 12 inches or greater in depth and 50 feet in length. The Unit Manager or his/her representative may restrict hauling and/or skidding if ruts exceed the specified depth. With the Unit Manager or his/her representative's approval, the Purchaser may return to the area when the risk of rutting has decreased.

LIARS LODGE HARDWOODS (008-10-01)
T43N, R26W, SEC. 20, NW1/4, NESW.
MARQUETTE COUNTY

In response to the notice of sale to be held 3:00 p.m. on October 25, 2010, I am hereby submitting my sealed bid (firm offer) for the following forest products to be cut. Bids for individual species and total bid value must be at or above the appraised price. All non-responsive bid forms may be rejected.

<u>SPECIES</u>	<u>APPRAISED PRICE</u>	<u>BID PRICE</u>	<u>ESTIMATED VOLUME*</u>	<u>= VALUE</u>
<u>SAWLOGS</u>				
SUG. MAPLE	\$ 243.00/MBF	\$ _____ X	12.80 MBF	= \$ _____
BASSWOOD	\$ 51.00/MBF	\$ _____ X	28.40 MBF	= \$ _____
<u>PULPWOOD</u>				
MIX HARDWD	\$ 21.35/CORD	\$ _____ X	323.00 CORDS	= \$ _____
TOTAL BID VALUE \$				_____

*These volumes are statistically estimated within plus (+) or minus (-) 17.8%. These estimated volumes are final and not subject to adjustment. Prospective bidders are urged to examine this timber and to make their own estimates of quantity and quality.

I understand that any or all bids may be rejected, and that the individual unit bid price will be the basis to determine total bid value. All bids must be signed and all bid items must be bid or the bid form may be rejected. I also understand that consideration and awarding a contract will be based upon my past performance and ability to complete the contract based upon equipment and manpower subject to my control.

(bidder's printed name)

(bidder's signature)

Address/Telephone _____

THE WINNING BIDDER MUST COMPLETE THE FORM ON THE REVERSE SIDE
WITHIN 21 DAYS OF SALE AWARD



TIMBER SALE
VERIFICATION OF WORKER'S DISABILITY
COMPENSATION ACT COMPLIANCE

*As required by Act 317, P.A. 1969 (Worker's Compensation) and
Part 525 of Act 451 of 1994, as amended.*

FOR DEPARTMENT USE ONLY	
Sale Number (XX - XXX - XX - XX)	
Forest Management Unit:	

VERIFICATION OF WORKER'S DISABILITY COMPENSATION ACT COMPLIANCE

- This verification must be completed and submitted within 21 days of contract award and prior to the issuance of the timber sale contract.
- In addition, if boxes 2B or 2C are checked, then Notice of Exclusion or Certificate of Insurance must be submitted within 21 days of the contract award and prior to the issuance of the timber sale contract.
- All information must be typed or printed except for written signatures.

Please Check Appropriate Categories:

1. My business is organized as (you **must** check one of the boxes below):

- A. Sole Proprietorship (individual)
- B. Partnership
- C. Corporation

2. You **must** check one of the boxes below:

- A. I certify that my business is a sole proprietorship and it has no employees but the sole proprietor. I am not subject to the Worker's Compensation Laws.
- B. I certify that my business has satisfied its obligation to the Worker's Compensation Act through the use of an approved Notice of Exclusion (BWC-337, Rev. 5/96). I will provide a copy of the Notice of Exclusion within 21 days of the contract award. (For questions or a copy of the BWC-337, please call the Worker's Compensation Bureau at 517-322-1195).
- C. I certify that my business has a Worker's Compensation Policy. I will provide an original Certificate of Insurance within 21 days of the contract award.

3. If you have checked item 2(A) or 2(B), you **must** indicate the number of **both** full-time and part-time employees, other than yourself, including family members and active partners (if none, you must enter "0").

_____ Full-time Employees

_____ Part-time Employees

Name of Business		Federal ID (or) Social Security No.	
Address		Telephone ()	
City	State	ZIP	

I hereby certify that the above information is true and correct. I agree to notify the Michigan DNRE of any changes that occur in factors affecting my coverage during any of my present and future operations.

Signature of Owner or Authorized Representative

Title

Date

ROSS CREEK HARDWOODS (009-10-01)
T43N, R26W, SEC. 21, NW1/4, NWNE.
T43N, R26W, SEC. 16, SWSE, SWSW.
MARQUETTE COUNTY

In response to the notice of sale to be held 3:00 p.m. on October 25, 2010, I am hereby submitting my sealed bid (firm offer) for the following forest products to be cut. Bids for individual species and total bid value must be at or above the appraised price. All non-responsive bid forms may be rejected.

<u>SPECIES</u>	<u>APPRAISED PRICE</u>	<u>BID PRICE</u>	<u>ESTIMATED VOLUME*</u>	<u>= VALUE</u>
<u>SAWLOGS</u>				
SUG. MAPLE	\$ 389.00/MBF	\$ _____ X	9.50 MBF	= \$ _____
BASSWOOD	\$ 70.00/MBF	\$ _____ X	30.60 MBF	= \$ _____
<u>PULPWOOD</u>				
Q. ASPEN	\$ 19.40/CORD	\$ _____ X	199.00 CORDS	= \$ _____
MIX HARDWD	\$ 19.95/CORD	\$ _____ X	347.00 CORDS	= \$ _____
SUBTOTAL 1				\$ _____

In addition, the successful bidder agrees to purchase the following species at the appraised price:

<u>SPECIES</u>	<u>APPRAISED PRICE</u>	<u>ESTIMATED VOLUME*</u>	<u>VALUE</u>
<u>SAWLOGS</u>			
P. BIRCH	\$ 106.00/MBF	2.70 MBF	= \$ 286.20
<u>PULPWOOD</u>			
BASSWOOD	\$ 22.65/CORD	90.00 CORDS	= \$ 2,038.50
P. BIRCH	\$ 18.15/CORD	96.00 CORDS	= \$ 1,742.40
B. POPLAR	\$ 15.20/CORD	19.00 CORDS	= \$ 288.80
MIX SOFTWD	\$ 18.65/CORD	14.00 CORDS	= \$ 261.10
SUBTOTAL 2			\$ <u>4,617.00</u>

SUBTOTAL 1 + SUBTOTAL 2 = TOTAL BID VALUE \$ _____

*These volumes are statistically estimated within plus (+) or minus (-) 12.15%. These estimated volumes are final and not subject to adjustment. Prospective bidders are urged to examine this timber and to make their own estimates of quantity and quality.

I understand that any or all bids may be rejected, and that the individual unit bid price will be the basis to determine total bid value. All bids must be signed and all bid items must be bid or the bid form may be rejected. I also understand that consideration and awarding a contract will be based upon my past performance and ability to complete the contract based upon equipment and manpower subject to my control.

(bidder's printed name)

(bidder's signature)

Address/Telephone _____

THE WINNING BIDDER MUST COMPLETE THE FORM ON THE REVERSE SIDE
WITHIN 21 DAYS OF SALE AWARD



TIMBER SALE VERIFICATION OF WORKER'S DISABILITY COMPENSATION ACT COMPLIANCE

As required by Act 317, P.A. 1969 (Worker's Compensation) and
Part 525 of Act 451 of 1994, as amended.

FOR DEPARTMENT USE ONLY	
Sale Number (XX - XXX - XX - XX)	
Forest Management Unit:	

VERIFICATION OF WORKER'S DISABILITY COMPENSATION ACT COMPLIANCE

- This verification must be completed and submitted within 21 days of contract award and prior to the issuance of the timber sale contract.
- In addition, if boxes 2B or 2C are checked, then Notice of Exclusion or Certificate of Insurance must be submitted within 21 days of the contract award and prior to the issuance of the timber sale contract.
- All information must be typed or printed except for written signatures.

Please Check Appropriate Categories:

1. My business is organized as (you **must** check one of the boxes below):

- A. Sole Proprietorship (individual)
- B. Partnership
- C. Corporation

2. You **must** check one of the boxes below:

- A. I certify that my business is a sole proprietorship and it has no employees but the sole proprietor. I am not subject to the Worker's Compensation Laws.
- B. I certify that my business has satisfied its obligation to the Worker's Compensation Act through the use of an approved Notice of Exclusion (BWC-337, Rev. 5/96). I will provide a copy of the Notice of Exclusion within 21 days of the contract award. (For questions or a copy of the BWC-337, please call the Worker's Compensation Bureau at 517-322-1195).
- C. I certify that my business has a Worker's Compensation Policy. I will provide an original Certificate of Insurance within 21 days of the contract award.

3. If you have checked item 2(A) or 2(B), you **must** indicate the number of **both** full-time and part-time employees, other than yourself, including family members and active partners (if none, you must enter "0").

_____ Full-time Employees

_____ Part-time Employees

Name of Business		Federal ID (or) Social Security No.
Address		Telephone ()
City	State	ZIP

I hereby certify that the above information is true and correct. I agree to notify the Michigan DNRE of any changes that occur in factors affecting my coverage during any of my present and future operations.

Signature of Owner or Authorized Representative

Title

Date

SICK DOG MIX (010-10-01)
 T43N, R26W, SEC. 29, S1/2SW, NESW.
 MARQUETTE COUNTY

In response to the notice of sale to be held 3:00 p.m. on October 25, 2010, I am hereby submitting my sealed bid (firm offer) for the following forest products to be cut. Bids for individual species and total bid value must be at or above the appraised price. All non-responsive bid forms may be rejected.

<u>SPECIES</u>	<u>APPRAISED PRICE</u>	<u>BID PRICE</u>	<u>ESTIMATED VOLUME*</u>	<u>= VALUE</u>
PULPWOOD				
Q. ASPEN	\$ 27.80/CORD	\$ _____ X	103.00 CORDS	= \$ _____
MIX HARDWD	\$ 24.40/CORD	\$ _____ X	69.00 CORDS	= \$ _____
			SUBTOTAL 1	\$ _____

In addition, the successful bidder agrees to purchase the following species at the appraised price:

<u>SPECIES</u>	<u>APPRAISED PRICE</u>	<u>ESTIMATED VOLUME*</u>	<u>VALUE</u>
PULPWOOD			
P. BIRCH	\$ 18.65/CORD	25.00 CORDS	= \$ 466.25
BALSAM FIR	\$ 23.20/CORD	23.00 CORDS	= \$ 533.60
W. SPRUCE	\$ 21.00/CORD	14.00 CORDS	= \$ 294.00
		SUBTOTAL 2	\$ <u>1,293.85</u>

SUBTOTAL 1 + SUBTOTAL 2 = TOTAL BID VALUE \$ _____

*These estimated volumes are final and not subject to adjustment. Prospective bidders are urged to examine this timber and to make their own estimates of quantity and quality.

I understand that any or all bids may be rejected, and that the individual unit bid price will be the basis to determine total bid value. All bids must be signed and all bid items must be bid or the bid form may be rejected. I also understand that consideration and awarding a contract will be based upon my past performance and ability to complete the contract based upon equipment and manpower subject to my control.

 (bidder's printed name)

 (bidder's signature)

Address/Telephone _____

THE WINNING BIDDER MUST COMPLETE THE FORM ON THE REVERSE SIDE
 WITHIN 21 DAYS OF SALE AWARD



TIMBER SALE
VERIFICATION OF WORKER'S DISABILITY
COMPENSATION ACT COMPLIANCE

*As required by Act 317, P.A. 1969 (Worker's Compensation) and
Part 525 of Act 451 of 1994, as amended.*

FOR DEPARTMENT USE ONLY	
Sale Number (XX - XXX - XX - XX)	
Forest Management Unit:	

VERIFICATION OF WORKER'S DISABILITY COMPENSATION ACT COMPLIANCE

- This verification must be completed and submitted within 21 days of contract award and prior to the issuance of the timber sale contract.
- In addition, if boxes 2B or 2C are checked, then Notice of Exclusion or Certificate of Insurance must be submitted within 21 days of the contract award and prior to the issuance of the timber sale contract.
- All information must be typed or printed except for written signatures.

Please Check Appropriate Categories:

1. My business is organized as (you **must** check one of the boxes below):
 - A. Sole Proprietorship (individual)
 - B. Partnership
 - C. Corporation
2. You **must** check one of the boxes below:
 - A. I certify that my business is a sole proprietorship and it has no employees but the sole proprietor. I am not subject to the Worker's Compensation Laws.
 - B. I certify that my business has satisfied its obligation to the Worker's Compensation Act through the use of an approved Notice of Exclusion (BWC-337, Rev. 5/96). I will provide a copy of the Notice of Exclusion within 21 days of the contract award. (For questions or a copy of the BWC-337, please call the Worker's Compensation Bureau at 517-322-1195).
 - C. I certify that my business has a Worker's Compensation Policy. I will provide an original Certificate of Insurance within 21 days of the contract award.
3. If you have checked item 2(A) or 2(B), you **must** indicate the number of **both** full-time and part-time employees, other than yourself, including family members and active partners (if none, you must enter "0").

_____ Full-time Employees

_____ Part-time Employees

Name of Business		Federal ID (or) Social Security No.	
Address		Telephone ()	
City	State	ZIP	

I hereby certify that the above information is true and correct. I agree to notify the Michigan DNRE of any changes that occur in factors affecting my coverage during any of my present and future operations.

Signature of Owner or Authorized Representative

Title

Date