



DEPARTMENT OF NATURAL RESOURCES & ENVIRONMENT  
STATE OF MICHIGAN

TIMBER SALE PROSPECTUS

SALE TIME, DATE AND LOCATION  
3:00 p.m. on January 4, 2011  
INDIAN RIVER

Notice is hereby given that bids will be received by the Unit Manager, GAYLORD MANAGEMENT UNIT, for certain timber on the following described lands. The Bidder is advised to inspect the sale area and review the location, estimated volumes, operating costs, and sale contract terms of the proposed sale.

SOUTH HACKLEBURG ASPEN / T35N, R02W, SEC. 11, SENW, E1/2SW, W1/2SE, SWNE.

T35N, R02W, SEC. 12, E1/2NW, NESW.

T35N, R02W, SEC. 12, E1/2NW, NESW.

CHEBOYGAN COUNTY (Appr. \$24,024.75)

SALE ACRES: 104

No designated recreation site such as a trail, pathway, or campground is within the sale area.

Access may be through state forest land.

HACKLEBURG RED PINE / T35N, R02W, SEC. 01, NE1/4, SWSW.

T35N, R02W, SEC. 02, E1/2NE.

T35N, R02W, SEC. 11, N1/2NE.

T35N, R02W, SEC. 12, S1/2NW, N1/2SW, NWNW.

CHEBOYGAN COUNTY (Appr. \$19,224.25)

SALE ACRES: 66

No designated recreation site such as a trail, pathway, or campground is within the sale area.

Access may be through state forest land.

NORTH HACKLEBURG ASPEN / T35N, R02W, SEC. 01, W1/2NE, E1/2NW, NESW, NWSE.

CHEBOYGAN COUNTY (Appr. \$33,783.30)

SALE ACRES: 49

No designated recreation site such as a trail, pathway, or campground is within the sale area.

Access may be through state forest land.

OLD MACKINAW ASPEN / T38N, R02W, SEC. 07, SESE.

T38N, R02W, SEC. 08, SWSW, SESW.

T38N, R02W, SEC. 16, NWNE, NENW.

CHEBOYGAN COUNTY (Appr. \$14,486.70)

SALE ACRES: 75

No designated recreation site such as a trail, pathway, or campground is within the sale area.

Access may be through state forest land.

Please be aware that some landowners may request 60 days or more notice for forest harvesting access across their land.



BID INSTRUCTIONS (Ver. 06/23/2008):

1. Bid Location, Date, and Time: Bids must be received by the Unit Manager, Gaylord Management Unit, Indian River Field Office, 6984 Wilson Road, Indian River, MI 49749 no later than 3:00 p.m. on January 4, 2011. For further information concerning this sale, contact the Unit Manager at 231-238-9314.
2. Bidder's Qualifications: Purchaser shall obtain workers compensation insurance to cover claims under Michigan's Worker's Disability Compensation Act of 1969 or similar employee benefit act of any other state applicable to an employee. If all or part of a timber sale was prepared by a private contractor, that contractor and that contractor's company are not permitted to bid on the timber sale contract. Bids will not be accepted from individuals or companies appearing on the DNRE/FMD No-Bid List. This list contains the names of purchasers who previously failed to execute a contract within 21-days or who have a history of poor performance.
3. Preparation of Sealed Bids: Bids shall be manually signed in ink; bid prices must be entered for each species and product in the Bid Price column for all material subject to bidding; and all fill-in blanks must be completed. If erasures or other changes appear on the forms, each erasure or change must be initialed by the person signing the bid.
4. Submission of Sealed Bids: Bid forms may be obtained from the Unit Manager. All bids must be submitted on the bid form and in an envelope clearly identified as described in this section. NOTE: Only one bid form per bid envelope. Sealed bids must be submitted to the Unit office designated in the prospectus and must be submitted at or prior to the time established in the prospectus. The envelope should show on the outside (a) that it is a "Bid for Timber," and (b) the sale name or number, and (c) the date and time of bid opening as shown in the prospectus. Bids received after the time specified in the sale prospectus are late bids and will be rejected.
5. Public Opening of Sealed Bids: If conditions permit, the sealed bids will be publicly opened and posted at the time and place set in the prospectus.
6. Award of Contract: Award of the contract will be made to the Bidder whose bid, conforming to the prospectus, is most advantageous to the State of Michigan on the basis of total value at rates bid for the estimated quantities. The State reserves the right to reject any bid or waive any minor irregularity in bids received. A written award mailed (or otherwise furnished) to the successful Bidder shall be deemed to result in a binding contract without further action by either party.
7. Down Payment: The Bidder to whom award is made must make a down payment within 21 days of the sale award. The amount of the down payment will be calculated as shown in the Bond and Payment Schedule of this prospectus. Only cash may be used to meet this requirement.
8. Performance Security: As guarantee of faithful performance, a cash bond, certificate of deposit, surety bond or irrevocable letter of credit (LOC) is required within 21 days of the sale award. The amount of the performance security is shown in the Bond and Payment Schedule of this prospectus. If an LOC or surety is used, the coverage must extend for at least 6 months beyond the contract expiration.
9. Timber Sale Contract: Additional conditions and requirements common to all timber sales are listed on the timber sale contract (R4031) and are available on line at [www.michigan.gov/dnr](http://www.michigan.gov/dnr). Contact the Unit Manager for additional information or a sample contract. Within 21 days of the date of the award letter, the bidder must sign the contract and provide the required down payment, performance security, and verification of worker's disability compensation. The down payment and performance security shall be in accordance with the provisions of the timber sale contract, in the sums stated in this prospectus. If these actions are not taken, then the Bidder, the Bidder's corporation, and the corporation's principals may not be permitted to bid on State timber sales for a period of 1 year. In addition, the Bidder certifies that if awarded this contract, the Bidder will complete the timber sale contract in accordance with its terms and any modifications thereof including requirements to purchase, cut, and remove the included timber by the termination date.

10. Disclaimer of Estimates and Bidder's Warranty of Inspection: Before submitting this bid, the Bidder is advised and cautioned to inspect the sale area, review the requirements of the sale contract, and take other steps as may be reasonably necessary to ascertain the location, estimated volumes, construction estimates, and operating costs of the proposed sale. Failure to do so will not relieve the Bidder from responsibility for completing the contract.

The Bidder warrants that this bid is submitted solely on the basis of the Bidder's examination and inspection of the quality and quantity of the timber offered for sale and the Bidder's opinion of the value thereof and the costs of recovery. No reliance should be placed on the State of Michigan's estimates of timber quality, quantity or costs of recovery. Bidder further acknowledges that the State of Michigan: (i) expressly disclaims any warranty of fitness of timber for any purpose; (ii) offers this timber as is without any warranty of quality (merchantability) or quantity and (iii) expressly disclaims any warranty as to the quantity or quality of timber sold.

11. Certification and Chain-of-Custody: Unless otherwise indicated in the contract under section 7 - Other Conditions of the Sale Specific Conditions & Requirements, the area encompassed by this timber sale is certified to the standards of the Forest Stewardship Council (FSC) - Certificate #SCS-FM/COC-090N and the Sustainable Forestry Initiative (SFI) - Certificate # NSF-SFIS-5Y031-S1. Forest products from this sale may be delivered to the mill as "FSC and / or SFI certified" as long as the contractor hauling the forest products is chain-of-custody (COC) certified or covered under a COC certificate from the destination mill. The purchaser is responsible for maintaining COC after leaving the sale area.

REBECCA A. HUMPHRIES  
Director

SOUTH HACKLEBURG ASPEN (105-10-01)

A timber sale contract for this LUMP SUM SEALED timber sale will be awarded the responsible bidder offering the highest sealed bid price. Bids must be at or above the following appraised price for each species:

<u>SPECIES</u>	<u>ESTIMATED VOLUME*</u>	<u>APPRAISED PRICE</u>
SAWLOGS		
B.T. ASPEN	51.50 MBF	\$ 92.00/MBF
PULPWOOD		
RED MAPLE	318.00 CORDS	\$ 9.85/CORD
Q. ASPEN	313.00 CORDS	\$ 11.90/CORD
B.T. ASPEN	578.00 CORDS	\$ 19.00/CORD

In addition, the successful bidder agrees to purchase the following species at the indicated appraised price:

<u>SPECIES</u>	<u>ESTIMATED VOLUME*</u>	<u>APPRAISED PRICE</u>
SAWLOGS		
RED MAPLE	2.10 MBF	\$ 76.00/MBF
WHITE ASH	1.10 MBF	\$ 110.00/MBF
P. BIRCH	1.40 MBF	\$ 82.00/MBF
Q. ASPEN	8.80 MBF	\$ 30.00/MBF
PULPWOOD		
WHITE ASH	10.00 CORDS	\$ 8.20/CORD
P. BIRCH	27.00 CORDS	\$ 8.05/CORD
BALSAM FIR	46.00 CORDS	\$ 3.50/CORD
B. SPRUCE	19.00 CORDS	\$ 4.00/CORD
JACK PINE	20.00 CORDS	\$ 12.60/CORD

\*The volumes are statistically estimated within plus (+) or minus (-) 10.46 percent. These estimated volumes are final and not subject to adjustment. Prospective bidders are urged to examine this timber and to make their own estimates of quantity and quality.

BOND AND PAYMENT SCHEDULE:

1. A bond in the amount of \$1,300.00, to insure faithful performance of the conditions of the contract, will be deposited by the successful bidder within 21 days of the sale award.
2. Cutting in any sale or unit without the required advance payment would be considered a trespass.
3. Total payment may be paid in advance or according to the following schedule:
  - (a) Ten percent (10%) of the sale value must be paid within 21 days of the sale award.
  - (b) The 10% down payment will be credited towards the first unit cut.
  - (c) Payment for each of the following units must be made before cutting begins in that unit:

<u>PAYMENT UNIT NUMBER</u>	<u>PERCENT OF TOTAL SALE VALUE</u>
1	20%
2	14%
3	66%
4. If no cutting takes place, the 10% down payment will not be refunded.
5. Operations on the contract issued will terminate on June 11, 2013.



Michigan Department of Natural Resources – Forest, Mineral & Fire Management  
**TIMBER SALE MAP**

This information is provided by authority of Part 525 of Act 451, PA 1994, as amended.

SALE NUMBER	YEAR
52-105-10-01	10
DATE	PAGE OF
12/09/09	1 1

FOREST MANAGEMENT UNIT Gaylord Management Unit		COUNTY Cheboygan	MAPPED BY Coy	DATE	PAGE OF
			CRUISED BY Coy	12/09/09	1 1
TOWNSHIP 35N	RANGE 2W	SECTION(S) AND SUBDIVISION(S) 11- SENW, E1/2SW, W1/2SE, SWNE 12- E1/2NW, NESW		SCALE 1:15,840	

Cover Type				Density			
A = Aspen	H = Hemlock	P = Lowland Poplar	V = Bog or Marsh	0 = Non Stocked	5 = Pole Timber Medium		
B = Paper Birch	J = Jack Pine	Q = Mixed Swamp Cnfr	W = White Pine	1 = Seedling Sapling Poor	6 = Pole Timber Well		
C = Cedar	L = Lowland Brush	R = Red Pine	X = Non Stocked	2 = Seedling Sapling Medium	7 = Saw Timber Poor		
E = Swamp Hdwoods	M = Mpl, Bch, Brch	S = Black Spruce	Z = Water	3 = Seedling Sapling Well	8 = Saw Timber Medium		
F = Spruce Fir	N = Marsh	T = Tamarack		4 = Pole Timber Poor	9 = Saw Timber Well		
G = Grass	O = Oak	U = Upland Brush					

PU#	ACRES
1	22
2	26
3	56

**South Hackleburg Aspen**  
 Cheboygan County  
 Compartment 177  
 104 Acres

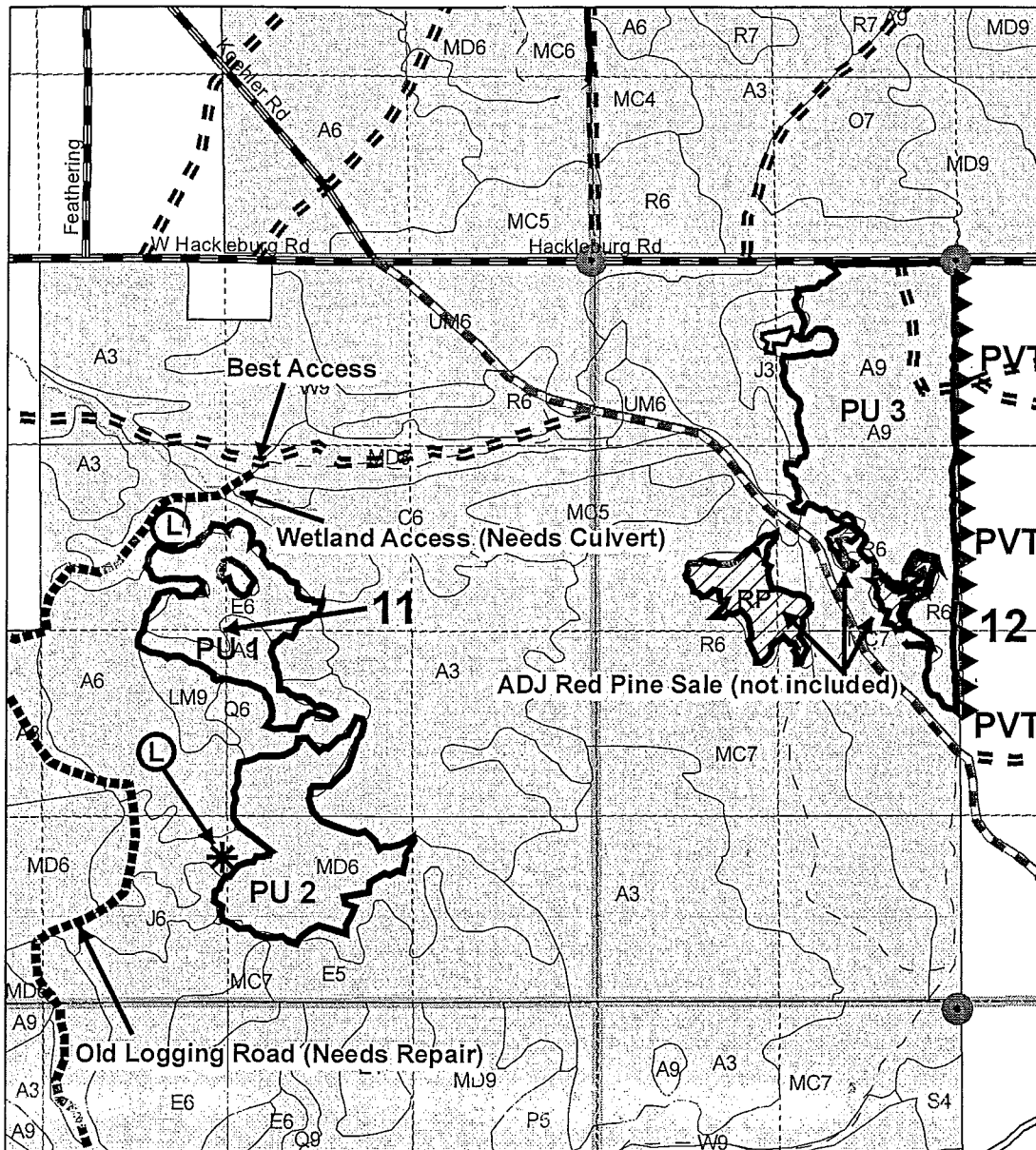
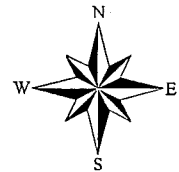

Legend	
	Sale Boundary- Red Paint
	Private Boundary- Blue Paint
	Forested
	Survey Corner
	Two Track
	Sections
	Quarter Quarter Sections

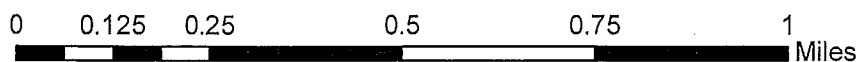

## Sale Specific Conditions & Requirements

Sale Name: South Hackleburg Aspen Sale Number: 52-105-10-01

### 1 - Sale Area

#### 1.2 - Boundaries

##### 1.2.1 - Painted boundaries (12/08)

The sale boundary and Payment Unit boundaries are marked and identified by blue and red paint. Exterior sale boundary lines against private property are marked with blue paint. Exterior sale boundary lines against state are marked with red paint. Interior Payment Unit boundaries are marked with yellow paint. Yellow painted trees designating an interior Payment Unit boundary are only to be cut when all surrounding Payment Units have been paid.

### 2 - Timber Specifications

#### 2.1 - Included Timber

##### 2.1.1 - Clearcut unit(s) with unmerchantable trees (4/09)

Within Payment Unit(s) 1, 2, and 3, cut all trees that are 2 inches or more in diameter measured at a point four and one-half (4-1/2) feet above ground level regardless of merchantability. Do Not Cut Red Pine, White Pine, Oak, Hemlock, Cedar, or Cherry trees.

### 3 - Payments

#### 3.3 - Pre-measured Sales

##### 3.3.4 - Dividing payment units (12/08)

Payment unit(s) may be divided at the request of the purchaser and upon approval of the Unit Manager. Dividing payment units is a contract modification which requires a Timber Sale Contract Supplement.

### 4 - Transportation

#### 4.1 - Construction

##### 4.1.3 - Slash and earthen piles (8/04)

Piles or windrows of earth along roads and landings that have been widened or constructed shall be leveled. Slash from road maintenance or construction, including stumps, shall be dispersed throughout the sale.

**4.1.5 - Culverts (1/09)**

Roads may require the installation of culverts at cross drainages on wet soils, or across natural drainage-ways. Culverts shall be placed in locations specified by the sale administrator and shall be new, corrugated metal or plastic gauge. Culverts will be a minimum of 12 inches in diameter and 24 feet in length. Culverts will be installed and removed (with administrator approval) by the purchaser. Culverts shall be installed prior to use of the road. If culverts are removed, fill shall be removed from wetland soils as specified. Soils shall be maintained and left in a non-erodible condition, with water bars, seed, fertilizer, mulch, and slash installed as directed by the sale administrator and as specified in the BMP manual. Stream crossing permits, if needed, will be obtained by the DNR.

**4.1.6 - Road construction (1/09)**

Construction of new roads or improvements of existing roads shall be done in such a way as to minimize the environmental and visual impacts. Merchantable trees shall be cut and utilized unless otherwise directed. Non-merchantable trees shall be severed and laid flat on the ground. Slash shall be scattered, and not left in windrows and kept a minimum of 10 feet back from the road edge. Stumps shall be set upright, not left on edge, and be moved at least 10 feet away from the road edge. Disturbed soil shall be feathered into the woods and not left in berms or windrows.

**4.1.7 - Road closure (4/07)**

All new roads built into the sale must be blocked to vehicle traffic upon completion of the sale. Overgrown roads that are reopened shall be considered new roads. In general, this will require constructing a four (4') foot high berm constructed of stumps and logs covered with earth. These roads must be rendered impassable to cars and trucks. All stumps from road building and landing construction must be reserved to block any newly constructed roads upon completion of the sale. These stumps must be scattered along the road system to prohibit vehicular movement. Temporary berms may be required if no sale activity occurs for 30 or more consecutive days. Contact the sale administrator for specific details of design and placement.

**4.2 - Maintenance**

**4.2.4 - Grading (12/08)**

Roads must be graded after the sale is completed. In general, this will require a road grader or bull dozer to shape up the roads after forest products have been hauled off site. The grading equipment to be used must be approved by the Unit Manager or his/her representative.

**4.2.5 - Two wheel drive condition (2/04)**

All existing trail roads on and adjacent to the sale area must be passable by two-wheel drive traffic for the duration of the sale.

**5 - Operations**

**5.1 - Notification**



5.1.1 - Pre-sale conference (12/08)

A pre-sale conference on site between the Purchaser and sale administrator is required prior to beginning any operations each sale Payment Unit to determine landing and road locations. The Unit Manager or his/her representative must be contacted at least 10 days in advance to schedule the conference.

**5.2 - Conduct of Operations**

**5.2.1 - Slash**

5.2.1.1 - Slash within sale area (2/04)

No trees are to be felled outside the sale area and all slash is to be kept at least 10 feet back from the blue paint line.

**5.2.2 - Hazard Trees/Snags**

5.2.2.1 - Den trees (2/04)

Obvious hollow and/or den trees shall be protected and left standing unless they are a safety hazard.

5.2.31 - Landing locations (10/09)

Recommended landing areas are marked on the timber sale map with the letter "L". Landings must be confined to these designated sites unless otherwise authorized by the Unit Manager or his/her representative.

5.2.37 - No decking areas (12/08)

No decking is allowed within 50 feet of Hackleburg Road without permission of the Unit Manager or his/her representative.

5.2.38 - No decking against live trees (2/04)

Cut products may not be decked against unmarked or designated leave trees.

**5.4 - Soil Protection**

5.4.1 - Rutting restriction, general (1/09)

Operations are to cease immediately if equipment and weather conditions result in rutting of roads and skid trails which is 12 inches or greater in depth and 50 feet in length. The Unit Manager or his/her representative may restrict hauling and/or skidding if ruts exceed the specified depth. With the Unit Manager or his/her representative's approval, the Purchaser may return to the area when the risk of rutting has decreased.

**5.8 - Protection of Endangered Species**

5.8.5 - Protection of raptor nests (4/09)

All trees with raptor nests will be protected if found during harvesting operations. Notification will be made to the Unit Manager or his/her representative who will notify the Wildlife Biologist so an on-site evaluation and recommendation can be made, if necessary.

**6 - Safety and Fire Prevention**

**6.2 - Signing**

6.2.1 - Road posting (9/09)

The purchaser is responsible for posting and maintaining caution signs on Silver and Hackleburg Road prior to beginning operations. The road must be posted at appropriate distances from the sale area to warn of logging activity and truck traffic. Signs must be removed when harvest operations are suspended or completed. The Purchaser will provide these signs.

HACKLEBURG RED PINE (108-10-01)

A timber sale contract for this LUMP SUM SEALED timber sale will be awarded the responsible bidder offering the highest sealed bid price. Bids must be at or above the following appraised price for each species:

<u>SPECIES</u>	<u>ESTIMATED VOLUME*</u>	<u>APPRAISED PRICE</u>
PULPWOOD		
RED PINE	535.00 CORDS	\$ 31.15/CORD
JACK PINE	117.00 CORDS	\$ 11.90/CORD

In addition, the successful bidder agrees to purchase the following species at the indicated appraised price:

<u>SPECIES</u>	<u>ESTIMATED VOLUME*</u>	<u>APPRAISED PRICE</u>
SAWLOGS		
RED PINE	4.50 MBF	\$ 105.00/MBF
PULPWOOD		
B.T. ASPEN	38.00 CORDS	\$ 15.30/CORD
WHITE PINE	6.00 CORDS	\$ 18.80/CORD

\*The volumes are statistically estimated within plus (+) or minus (-) 16.48 percent. These estimated volumes are final and not subject to adjustment. Prospective bidders are urged to examine this timber and to make their own estimates of quantity and quality.

BOND AND PAYMENT SCHEDULE:

1. A bond in the amount of \$1,000.00, to insure faithful performance of the conditions of the contract, will be deposited by the successful bidder within 21 days of the sale award.
2. Cutting in any sale or unit without the required advance payment would be considered a trespass.
3. Total payment may be paid in advance or according to the following schedule:
  - (a) Ten percent (10%) of the sale value must be paid within 21 days of the sale award.
  - (b) The 10% down payment will be credited towards the first unit cut.
  - (c) Payment for each of the following units must be made before cutting begins in that unit:

<u>PAYMENT</u>	<u>UNIT NUMBER</u>	<u>PERCENT OF TOTAL SALE VALUE</u>
	1	35%
	2	10%
	3	15%
	4	25%
	5	15%

4. If no cutting takes place, the 10% down payment will not be refunded.
5. Operations on the contract issued will terminate on June 30, 2013.





Michigan Department of Natural Resources – Forest, Mineral & Fire Management  
**TIMBER SALE MAP**

This information is provided by authority of Part 525 of Act 451, PA 1994, as amended.

SALE NUMBER	YEAR
52-108-10-01	10
DATE	PAGE OF
01/09/10	1 2

FOREST MANAGEMENT UNIT Gaylord Management Unit		COUNTY Cheboygan	MAPPED BY Coy	DATE 01/09/10
RANGE 2W		SECTION(S) AND SUBDIVISION(S) 1- NE1/4 & SWSW 2- E1/2NE 36- SESE		SCALE 1:15,840
TOWNSHIP 35N & 36N				

Cover Type				Density	
A = Aspen	H = Hemlock	P = Lowland Poplar	V = Bog or Marsh	0 = Non Stocked	5 = Pole Timber Medium
B = Paper Birch	J = Jack Pine	Q = Mixed Swamp Cnfr	W = White Pine	1 = Seedling Sapling Poor	6 = Pole Timber Well
C = Cedar	L = Lowland Brush	R = Red Pine	X = Non Stocked	2 = Seedling Sapling Medium	7 = Saw Timber Poor
E = Swamp Hdwoods	M = Mpl, Bch, Brch	S = Black Spruce	Z = Water	3 = Seedling Sapling Well	8 = Saw Timber Medium
F = Spruce Fir	N = Marsh	T = Tamarack		4 = Pole Timber Poor	9 = Saw Timber Well
G = Grass	O = Oak	U = Upland Brush			

PU#	ACRES
1	24
2	8
3	11
4	12
5	11

# Hackleburg Red Pine

## Cheboygan County

### Compartment 177

#### 66 Acres

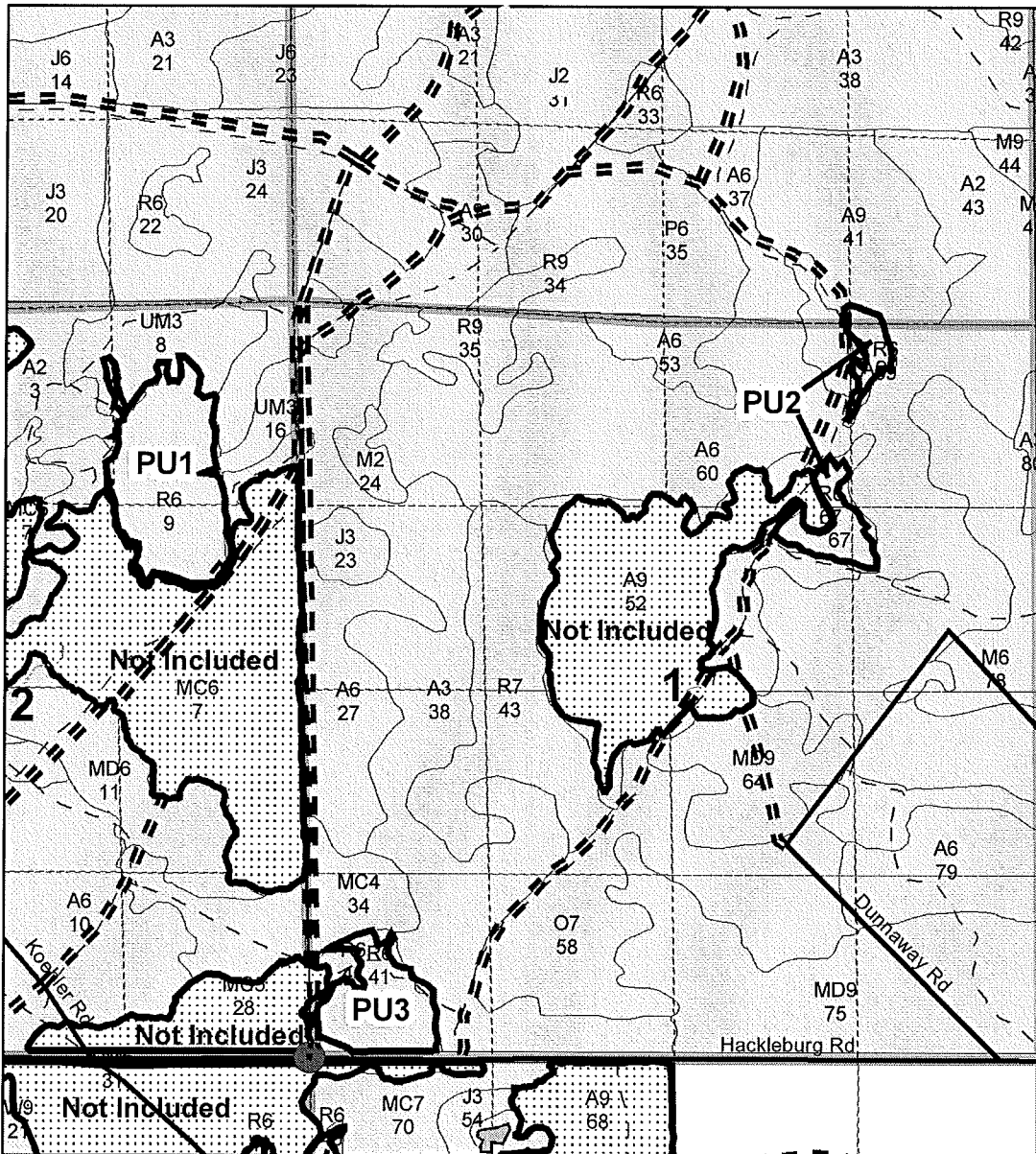
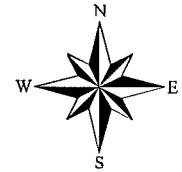

**Legend**

- Sale Boundary- Red Paint
- Adjacent Timber Sales- Not Included
- Two Track
- Forested
- Sections
- Quarter Quarter Sections
- Survey Corner

**Total Sale Acres- 66**  
**Cut Acres- 66**  
**Retention Acres- 0**





Michigan Department of Natural Resources - Forest, Mineral & Fire Management  
**TIMBER SALE MAP**  
 This information provided by authority of Part 525 of Act 451, PA 1994, as amended.

Sale Number	Year
52-108-10-01	10

Forest Management Unit	County	Mapped By	Date	Page	of
Gaylord Management Unit	Cheboygan	Coy	01/09/10	2	2
Township	Range	Section(s) and Subdivision(s)	SCALE 1:15,840		
35N	2W	1- SWSW 11- N1/2NE 12- S1/2NW, N1/2SW, & NWNW			

Cover Type				Density	
A = Aspen	G = Grass	O = Oak	U = Upland Brush	0 = Non Stocked	5 = Pole Timber Medium
B = Paper Birch	H = Hemlock	P = Lowland Poplar	V = Bog or Marsh	1 = Seedling Sapling Poor	6 = Pole Timber Well
C = Cedar	J = Jack Pine	Q = Mixed Swamp Cnfr	W = White Pine	2 = Seedling Sapling Medium	7 = Saw Timber Poor
D = Treed Bog	L = Lowland Brush	R = Red Pine	X = Non Stocked	3 = Seedling Sapling Well	8 = Saw Timber Medium
E = Swamp Hdwoods	M = Mpl, Bch, Brch	S = Black Spruce	Z = Water	4 = Pole Timber Poor	9 = Saw Timber Well
F = Spruce Fir	N = Marsh	T = Tamarack			

PU#	ACRES
1	24
2	8
3	11
4	12
5	11

# Hackleburg Red Pine

## Cheboygan County

### Compartment 177

#### 66 Acres

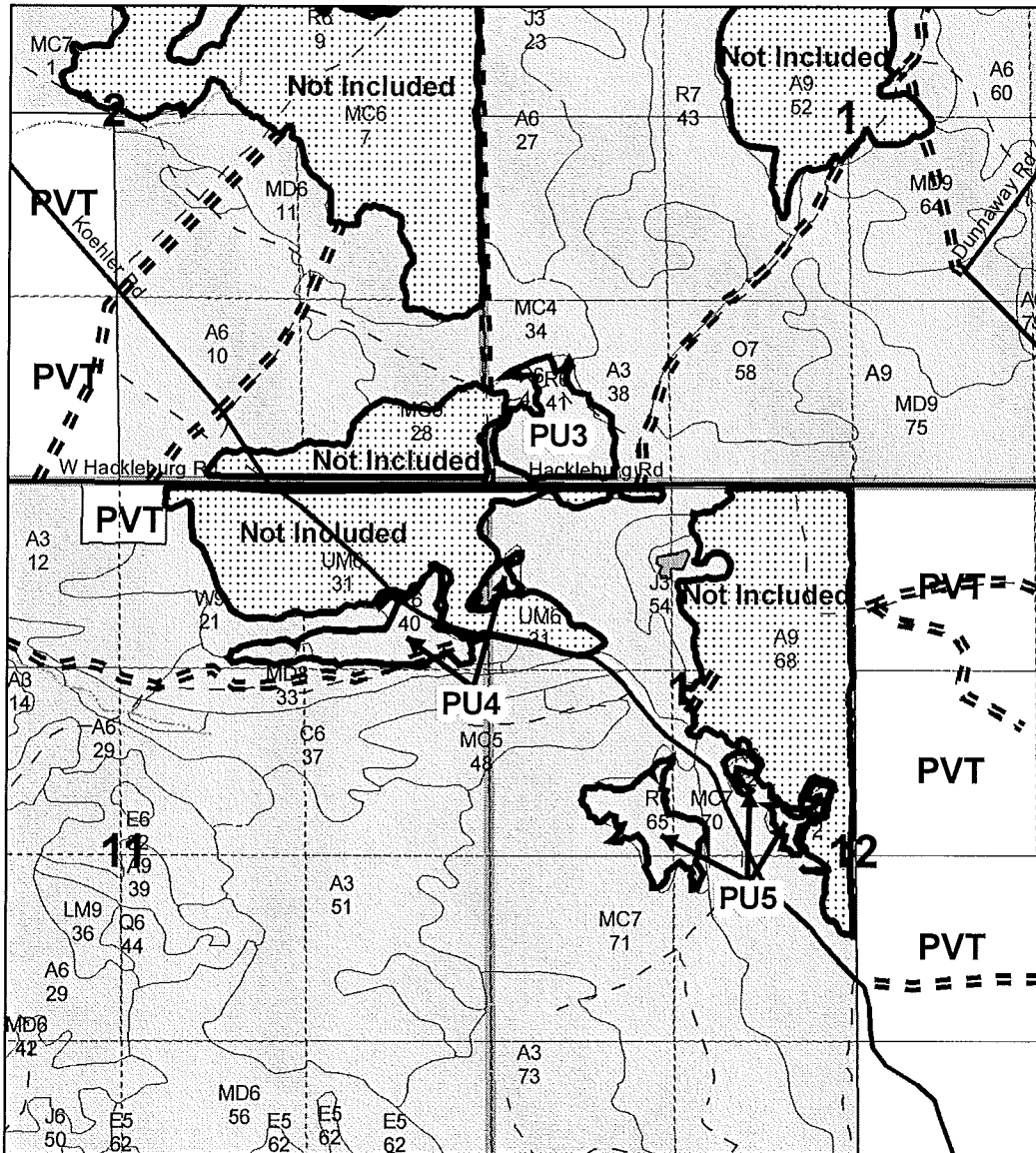
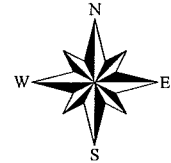

**Legend**

- Sale Boundary- Red Paint
- Adjacent Timber Sales- Not Included
- Two Track
- Forested
- Sections
- Quarter Quarter Sections

**Total Sale Acres- 66**  
**Cut Acres- 66**  
**Retention Acres- 0**



## Sale Specific Conditions & Requirements

Sale Name: Hackleburg Red Pine Sale Number: 52-108-10-01

### 1 - Sale Area

#### 1.2 - Boundaries

##### 1.2.1 - Painted boundaries (12/08)

The sale boundary and Payment Unit boundaries are marked and identified by red paint. Exterior sale boundary lines against state are marked with red paint.

### 2 - Timber Specifications

#### 2.1 - Included Timber

##### 2.1.3 - Cut tree marked unit(s) (12/08)

Within Payment Unit(s) 2 and 5, all trees are designated for cutting when marked with orange (Payment Units 2 & 5) or yellow (Payment Unit 5) paint above and below stump height, regardless of merchantability. Also, any northern hardwood, white pine, jack pine or mixed aspen, within the timber sale, that obstructs equipment in the felling of marked red pine, may be cut and utilized or left on-site as coarse woody debris. DO NOT CUT OAK IN PAYMENT UNIT 5.

##### 2.1.8 - Designated plantation row unit(s) (12/08)

Within Payment Unit(s) 1, 3, & 4, all trees which meet minimum piece specifications in 2.2 Utilization, within designated plantation rows are designated for cutting. Designated plantation rows begin with the third row in from the outside of the plantation, then continue every third row. Because of the variability of row direction, it shall be the responsibility of the producer to maintain the third row sequence. Also, any northern hardwood, white pine, jack pine or mixed aspen, within the timber sale, that obstructs equipment felling within the red pine row, may be cut and utilized or left on-site as coarse woody debris. Within Payment Unit 1 cut all jack pine trees. DO NOT CUT OAK TREES IN PAYMENT UNITS 1 & 3.

### 3 - Payments

#### 3.3 - Pre-measured Sales

##### 3.3.4 - Dividing payment units (12/08)

Payment unit(s) 1 may be divided at the request of the purchaser and upon approval of the Unit Manager. Dividing payment units is a contract modification which requires a Timber Sale Contract Supplement.

#### 3.4 - Damaged Timber

**3.4.1 - Damaged timber (6/05)**

General Condition and Requirement 3.4 Damaged Timber, defines liquidated damages for undesignted live merchantable trees which are cut or injured. Damage to residual trees (defined as breaking of the cambium layer, broken tops or bending of trees from their natural position) is not acceptable.

No damage is acceptable to merchantable trees. Within the sale area, if more than 5% of trees (> 4.5" DBH) within a specified area of the sale are damaged, liquidated damages will be assessed for all trees damaged. Rates will be in accordance with General Condition and Requirement 3.4 Damaged Timber, or at a rate of \$20 per sawtimber tree and \$15 per pole sized tree, whichever is greater. **EXTREME CARE SHOULD BE TAKEN IF TREE LENGTH SKIDDING OCCURS.**

**4 - Transportation**

**4.1 - Construction**

**4.1.3 - Slash and earthen piles (8/04)**

Piles or windrows of earth along roads and landings that have been widened or constructed shall be leveled. Slash from road maintenance or construction, including stumps, shall be dispersed throughout the sale area.

**4.1.12 - No new roads (12/08)**

No new roads will be permitted in any Payment Unit. All operations are limited to existing roads.

**4.2 - Maintenance**

**4.2.4 - Grading (12/08)**

Roads must be graded after the sale is completed. The grading equipment to be used must be approved by the Unit Manager or his/her representative.

**4.2.5 - Two wheel drive condition (2/04)**

All existing trail roads on and adjacent to the sale area must be passable by two-wheel drive traffic for the duration of the sale.

**5 - Operations**

**5.1 - Notification**

**5.1.1 - Pre-sale conference (12/08)**

A pre-sale conference on site between the Purchaser and sale administrator is required prior to beginning any operations to determine landing and road locations. The Unit Manager or his/her representative must be contacted at least 10 days in advance to schedule the conference.

**5.2 - Conduct of Operations**

**5.2.1 - Slash**

**5.2.1.9 - No Slash:pipe/powerline, oil/gas sites (2/04)**



**Sale Name: Hackleburg Red Pine Sale Number: 52-108-10-01**

All pipelines, power lines, oil or gas storage sites and related access roads are to remain free of slash at all times.

**5.2.2 - Hazard Trees/Snags**

5.2.2.1 - Den trees (2/04)

Obvious hollow and/or den trees shall be protected and left standing unless they are a safety hazard.

**5.2.3 - Operating Restrictions**

5.2.3.6 - Bark beetle restriction (12/08)

In the event drought creates a high risk of pine bark beetle infestation, pine is not to be cut during the period March 1 through July 1, unless all portions of trees greater than two inches in diameter are removed from the sale area, reduced to chips, or treated to the satisfaction of the Unit Manager or his/her representative, within fifteen days of being severed from the stump. Pine log decks, pulpwood piles and treetops that are piled for chipping in the fall or winter within a 1/4 mile of susceptible sites must be removed before March 15. Residual slash must not be placed in piles or rows and must be spread over the site for quick drying. The Department of Natural Resources will exercise this specification if the risk of damage warrants.

5.2.20 - Equipment width (2/04)

Equipment used to remove designated rows must be capable of moving through cut rows without damaging residual trees.

5.2.38 - No decking against live trees (2/04)

Cut products may not be decked against unmarked or designated leave trees.

**5.4 - Soil Protection**

5.4.1 - Rutting restriction, general (1/09)

Operations are to cease immediately if equipment and weather conditions result in rutting of roads and skid trails which is 12 inches or greater in depth and 50 feet in length. The Unit Manager or his/her representative may restrict hauling and/or skidding if ruts exceed the specified depth. With the Unit Manager or his/her representative's approval, the Purchaser may return to the area when the risk of rutting has decreased.

**5.8 - Protection of Endangered Species**

5.8.5 - Protection of raptor nests (4/09)

All trees with raptor nests will be protected if found during harvesting operations. Notification will be made to the Unit Manager or his/her representative who will notify the Wildlife Biologist so an on-site evaluation and recommendation can be made, if necessary.

**6 - Safety and Fire Prevention**

**6.2 - Signing**

**Sale Name: Hackleburg Red Pine    Sale Number: 52-108-10-01**

6.2.1 - Road posting (9/09)

The purchaser is responsible for posting and maintaining caution signs on Silver and Hackleburg roads prior to beginning operations. The road must be posted at appropriate distances from the sale area to warn of logging activity and truck traffic. Signs must be removed when harvest operations are suspended or completed. The Purchaser will provide these signs.

NORTH HACKLEBURG ASPEN (109-10-01)

A timber sale contract for this LUMP SUM SEALED timber sale will be awarded the responsible bidder offering the highest sealed bid price. Bids must be at or above the following appraised price for each species:

<u>SPECIES</u>	<u>ESTIMATED VOLUME*</u>	<u>APPRAISED PRICE</u>
SAWLOGS		
SUG. MAPLE	32.30 MBF	\$ 290.00/MBF
B.T. ASPEN	46.40 MBF	\$ 96.00/MBF
PULPWOOD		
B.T. ASPEN	644.00 CORDS	\$ 21.15/CORD

In addition, the successful bidder agrees to purchase the following species at the indicated appraised price:

<u>SPECIES</u>	<u>ESTIMATED VOLUME*</u>	<u>APPRAISED PRICE</u>
SAWLOGS		
BASSWOOD	30.30 MBF	\$ 55.00/MBF
BEECH	.80 MBF	\$ 36.00/MBF
PULPWOOD		
SUG. MAPLE	274.00 CORDS	\$ 5.30/CORD
RED MAPLE	8.00 CORDS	\$ 9.85/CORD
BASSWOOD	118.00 CORDS	\$ 6.00/CORD
WHITE ASH	15.00 CORDS	\$ 9.50/CORD
BEECH	11.00 CORDS	\$ 8.70/CORD
Q. ASPEN	122.00 CORDS	\$ 14.25/CORD
RED PINE	13.00 CORDS	\$ 33.10/CORD

\*The volumes are statistically estimated within plus (+) or minus (-) 10.92 percent. These estimated volumes are final and not subject to adjustment. Prospective bidders are urged to examine this timber and to make their own estimates of quantity and quality.

BOND AND PAYMENT SCHEDULE:

1. A bond in the amount of \$1,700.00, to insure faithful performance of the conditions of the contract, will be deposited by the successful bidder within 21 days of the sale award.
2. Cutting in any sale or unit without the required advance payment would be considered a trespass.
3. Total payment may be paid in advance or according to the following schedule:
  - (a) Ten percent (10%) of the sale value must be paid within 21 days of the sale award.
  - (b) The remainder is due before cutting begins.
4. If no cutting takes place, the 10% down payment will not be refunded.
5. Operations on the contract issued will terminate on June 30, 2013.



Michigan Department of Natural Resources – Forest, Mineral & Fire Management  
**TIMBER SALE MAP**

This information is provided by authority of Part 525 of Act 451, PA 1994, as amended.

SALE NUMBER	YEAR
52-109-10-01	10
DATE	PAGE OF
02/03/10	1 1

FOREST MANAGEMENT UNIT Gaylord Management Unit		COUNTY Cheboygan	MAPPED BY Coy CRUISED BY Coy	SCALE 1:15,840
TOWNSHIP 35N	RANGE 2W	SECTION(S) AND SUBDIVISION(S) 1- W1/2NE, E1/2NW, NESW, & NWSE		

Cover Type				Density	
A = Aspen	H = Hemlock	P = Lowland Poplar	V = Bog or Marsh	0 = Non Stocked	5 = Pole Timber Medium
B = Paper Birch	J = Jack Pine	Q = Mixed Swamp Cnfr	W = White Pine	1 = Seedling Sapling Poor	6 = Pole Timber Well
C = Cedar	L = Lowland Brush	R = Red Pine	X = Non Stocked	2 = Seedling Sapling Medium	7 = Saw Timber Poor
E = Swamp Hdwoods	M = Mpl, Bch, Brch	S = Black Spruce	Z = Water	3 = Seedling Sapling Well	8 = Saw Timber Medium
F = Spruce Fir	N = Marsh	T = Tamarack		4 = Pole Timber Poor	9 = Saw Timber Well
G = Grass	O = Oak	U = Upland Brush			

PU# ACRES  
1 49

**North Hackleburg Aspen**  
**Cheboygan County**  
**Compartment 177**  
**49 Acres**

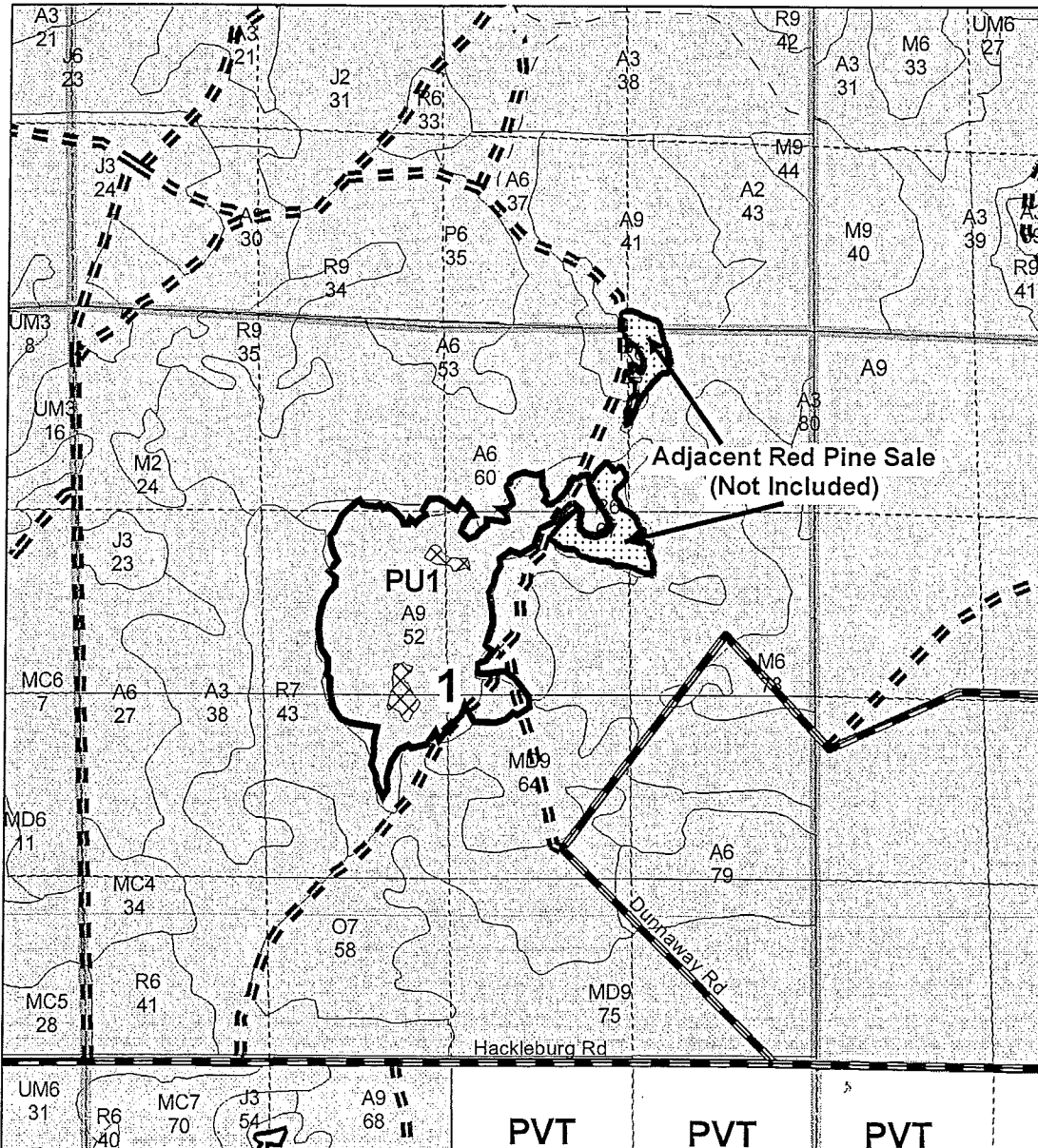
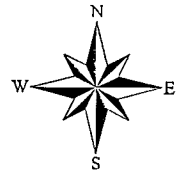

Legend	
	Sale Boundary- Red Paint
	Retention Pockets- Green Paint
	Adjacent Timber Sale- Not Included
	Forested
	Sections
	Quarter Quarter Sections

Total Sale Acres- 51  
 Cut Acres- 49  
 Retention Acres- 2

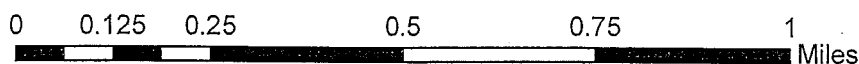

## Sale Specific Conditions & Requirements

**Sale Name: North Hackleburg Aspen    Sale Number: 52-109-10-01**

### 1 - Sale Area

#### 1.2 - Boundaries

##### 1.2.1 - Painted boundaries (12/08)

The sale boundary is marked and identified by red paint. Retention area (no cut) boundaries are marked and identified by green paint. Exterior sale boundary lines against state are marked with red paint.

### 2 - Timber Specifications

#### 2.1 - Included Timber

##### 2.1.1 - Clearcut unit(s) with unmerchantable trees (4/09)

Within Payment Unit(s) 1, cut all trees that are two (2) inches or more in diameter measured at a point four and one-half (4-1/2) feet above ground level regardless of merchantability except oak and pine, unless marked with orange paint above and below stump height. NO TREES are to be cut within RETENTION AREA boundaries marked with green paint.

### 3 - Payments

#### 3.3 - Pre-measured Sales

##### 3.3.4 - Dividing payment units (12/08)

Payment unit(s) may be divided at the request of the purchaser and upon approval of the Unit Manager. Dividing payment units is a contract modification which requires a Timber Sale Contract Supplement.

### 4 - Transportation

#### 4.1 - Construction

##### 4.1.3 - Slash and earthen piles (8/04)

Piles or windrows of earth along roads and landings that have been widened or constructed shall be leveled. Slash from road maintenance or construction, including stumps, shall be dispersed throughout the sale.

##### 4.1.6 - Road construction (1/09)

Construction of new roads or improvements of existing roads shall be done in such a way as to minimize the environmental and visual impacts. Merchantable trees shall be cut and utilized unless otherwise directed. Non-merchantable trees shall be severed and laid flat on the ground. Slash shall be scattered, and not left in windrows and kept a minimum of 10 feet back from the road edge. Stumps shall be set upright, not left on edge, and be moved at least 10 feet away from the road edge. Disturbed soil shall be feathered into the woods and not left in berms or windrows.

**4.1.7 - Road closure (4/07)**

All new roads built into the sale must be blocked to vehicle traffic upon completion of the sale. All new roads built into the sale must be blocked to vehicle traffic within 30 days of completion of hauling. In general, this will require constructing a four (4') foot high berm constructed of stumps and logs covered with earth. These roads and the existing two-track must be rendered impassable to cars and trucks.

**4.2 - Maintenance**

**4.2.4 - Grading (12/08)**

Roads must be graded after the sale is completed. The grading equipment to be used must be approved by the Unit Manager or his/her representative.

**4.2.5 - Two wheel drive condition (2/04)**

All existing trail roads on and adjacent to the sale area must be passable by two-wheel drive traffic for the duration of the sale.

**5 - Operations**

**5.1 - Notification**

**5.1.1 - Pre-sale conference (12/08)**

A pre-sale conference on site between the Purchaser and sale administrator is required prior to beginning any operations to determine landing and road locations.

**5.2 - Conduct of Operations**

**5.2.2 - Hazard Trees/Snags**

**5.2.2.1 - Den trees (2/04)**

Obvious hollow and/or den trees shall be protected and left standing unless they are a safety hazard.

**5.2.3 - Operating Restrictions**

**5.2.3.9 - Beech hauling restriction (8/09)**

American beech wood products with bark still attached, other than chips, are not to be transported from stands infested with beech bark disease to or through uninfested beech areas or to the lower peninsula from July 15 to November 15. Beech scale is mobile at this time of year and can move from infested wood to live beech. (See Map of current beech scale distribution on the DNR Forest Health Website, [www.michigan.gov/dnr](http://www.michigan.gov/dnr).)

**5.2.38 - No decking against live trees (2/04)**

Cut products may not be decked against unmarked or designated leave trees.

**5.4 - Soil Protection**

**Sale Name: North Hackleburg Aspen    Sale Number: 52-109-10-01**

5.4.1 - Rutting restriction, general (1/09)

Operations are to cease immediately if equipment and weather conditions result in rutting of roads and skid trails which is 12 inches or greater in depth and 50 feet in length. The Unit Manager or his/her representative may restrict hauling and/or skidding if ruts exceed the specified depth. With the Unit Manager or his/her representative's approval, the Purchaser may return to the area when the risk of rutting has decreased.

**6 - Safety and Fire Prevention**

**6.2 - Signing**

6.2.1 - Road posting (9/09)

The purchaser is responsible for posting and maintaining caution signs on Dunnaway & Hackleburg roads prior to beginning operations. The road must be posted at appropriate distances from the sale area to warn of logging activity and truck traffic. Signs must be removed when harvest operations are suspended or completed. The Purchaser will provide these signs.





OLD MACKINAW ASPEN (115-10-01)

A timber sale contract for this LUMP SUM SEALED timber sale will be awarded the responsible bidder offering the highest sealed bid price. Bids must be at or above the following appraised price for each species:

<u>SPECIES</u>	<u>ESTIMATED VOLUME*</u>	<u>APPRAISED PRICE</u>
SAWLOGS		
B.T. ASPEN	21.30 MBF	\$ 76.00/MBF
PULPWOOD		
Q. ASPEN	589.00 CORDS	\$ 11.35/CORD
B.T. ASPEN	110.00 CORDS	\$ 15.65/CORD
MIX HARDWD	230.00 CORDS	\$ 7.90/CORD

In addition, the successful bidder agrees to purchase the following species at the indicated appraised price:

<u>SPECIES</u>	<u>ESTIMATED VOLUME*</u>	<u>APPRAISED PRICE</u>
SAWLOGS		
WHITE ASH	1.50 MBF	\$ 73.00/MBF
Q. ASPEN	10.20 MBF	\$ 25.00/MBF
RED PINE	4.00 MBF	\$ 109.00/MBF
MIX HARDWD	5.60 MBF	\$ 81.00/MBF
PULPWOOD		
WHITE ASH	7.00 CORDS	\$ 7.90/CORD
RED PINE	21.00 CORDS	\$ 31.40/CORD
MIX SOFTWD	171.00 CORDS	\$ 3.95/CORD

\*The volumes are statistically estimated within plus (+) or minus (-) 18.03 percent. These estimated volumes are final and not subject to adjustment. Prospective bidders are urged to examine this timber and to make their own estimates of quantity and quality.

BOND AND PAYMENT SCHEDULE:

1. A bond in the amount of \$800.00, to insure faithful performance of the conditions of the contract, will be deposited by the successful bidder within 21 days of the sale award.
2. Cutting in any sale or unit without the required advance payment would be considered a trespass.
3. Total payment may be paid in advance or according to the following schedule:
  - (a) Ten percent (10%) of the sale value must be paid within 21 days of the sale award.
  - (b) The 10% down payment will be credited towards the first unit cut.
  - (c) Payment for each of the following units must be made before cutting begins in that unit:

PAYMENT UNIT NUMBER	PERCENT OF TOTAL SALE VALUE
1	70%
2	30%
4. If no cutting takes place, the 10% down payment will not be refunded.
5. Operations on the contract issued will terminate on October 31, 2013.





Michigan Department of Natural Resources – Forest, Mineral & Fire Management  
**TIMBER SALE MAP**

This information is provided by authority of Part 525 of Act 451, PA 1994, as amended.

SALE NUMBER	YEAR
52-115-10-01	10
DATE	PAGE OF
03/30/10	1 2

FOREST MANAGEMENT UNIT		COUNTY	MAPPED BY	DATE	PAGE	OF
Gaylord Management Unit		Cheboygan	Coy	03/30/10	1	2
TOWNSHIP	RANGE	SECTION(S) AND SUBDIVISION(S)			SCALE	
38N	2W	7- SESE 8- SWSW & SESW 16- NWNW & NENW			1:15,840	

Cover Type				Density	
A = Aspen	H = Hemlock	P = Lowland Poplar	V = Bog or Marsh	0 = Non Stocked	5 = Pole Timber Medium
B = Paper Birch	J = Jack Pine	Q = Mixed Swamp Cnfr	W = White Pine	1 = Seedling Sapling Poor	6 = Pole Timber Well
C = Cedar	L = Lowland Brush	R = Red Pine	X = Non Stocked	2 = Seedling Sapling Medium	7 = Saw Timber Poor
E = Swamp Hdwoods	M = Mpl, Bch, Brch	S = Black Spruce	Z = Water	3 = Seedling Sapling Well	8 = Saw Timber Medium
F = Spruce Fir	N = Marsh	T = Tamarack		4 = Pole Timber Poor	9 = Saw Timber Well
G = Grass	O = Oak	U = Upland Brush			

PU#	ACRES
1	57
2	18

**Old Mackinaw Aspen**  
 Cheboygan County  
 Compartment 165  
 75 Acres

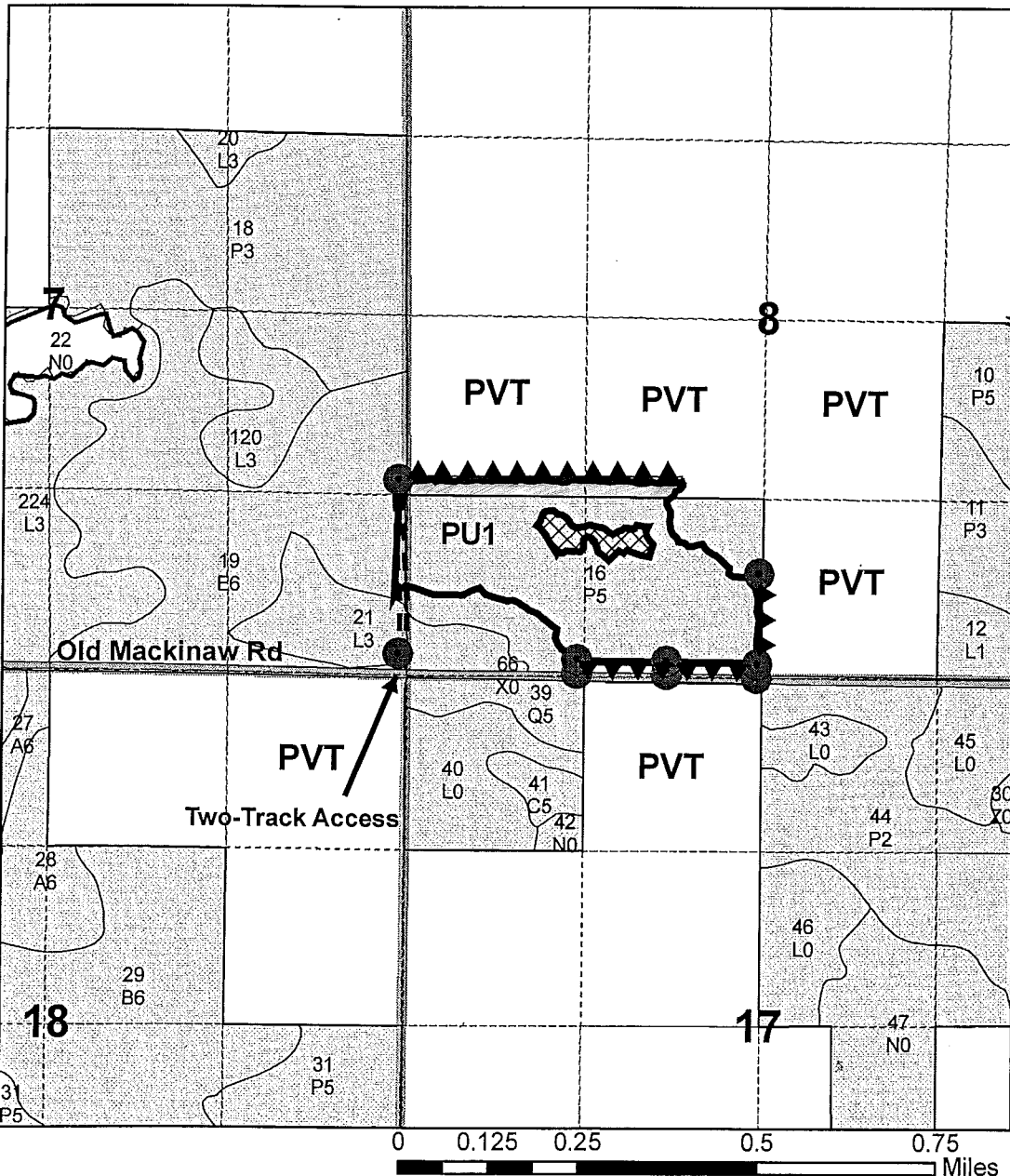
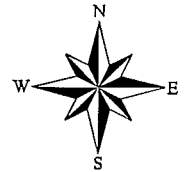

**Legend**

- Sale Boundary- Red Paint
- Retention Pocket- Red Paint
- Private Boundary- Blue Paint
- Survey Corner
- Two-Track
- Forested
- Non Forested
- Sections
- Quarter Quarter Sections

**Total Sale Acres- 78**  
**Cut Acres- 75**  
**Retention Acres- 3**





Michigan Department of Natural Resources – Forest, Mineral & Fire Management  
**TIMBER SALE MAP**

This information is provided by authority of Part 525 of Act 451, PA 1994, as amended.

SALE NUMBER	YEAR
52-115-10-01	10
DATE	PAGE OF
03/30/10	2 2

FOREST MANAGEMENT UNIT	COUNTY	MAPPED BY
Gaylord Management Unit	Cheboygan	Coy
		CRUISED BY
		Coy

TOWNSHIP	RANGE	SECTION(S) AND SUBDIVISION(S)
38N	2W	7- SESE 8- SWSW & SESW 16- NWNE & NENW

SCALE 1:15,840

Cover Type				Density	
A = Aspen	H = Hemlock	P = Lowland Poplar	V = Bog or Marsh	0 = Non Stocked	5 = Pole Timber Medium
B = Paper Birch	J = Jack Pine	Q = Mixed Swamp Cnfr	W = White Pine	1 = Seedling Sapling Poor	6 = Pole Timber Well
C = Cedar	L = Lowland Brush	R = Red Pine	X = Non Stocked	2 = Seedling Sapling Medium	7 = Saw Timber Poor
E = Swamp Hdwoods	M = Mpl, Bch, Brch	S = Black Spruce	Z = Water	3 = Seedling Sapling Well	8 = Saw Timber Medium
F = Spruce Fir	N = Marsh	T = Tamarack		4 = Pole Timber Poor	9 = Saw Timber Well
G = Grass	O = Oak	U = Upland Brush			

PU#	ACRES
1	57
2	18

**Old Mackinaw Aspen**  
**Cheboygan County**  
**Compartment 165**  
**75 Acres**

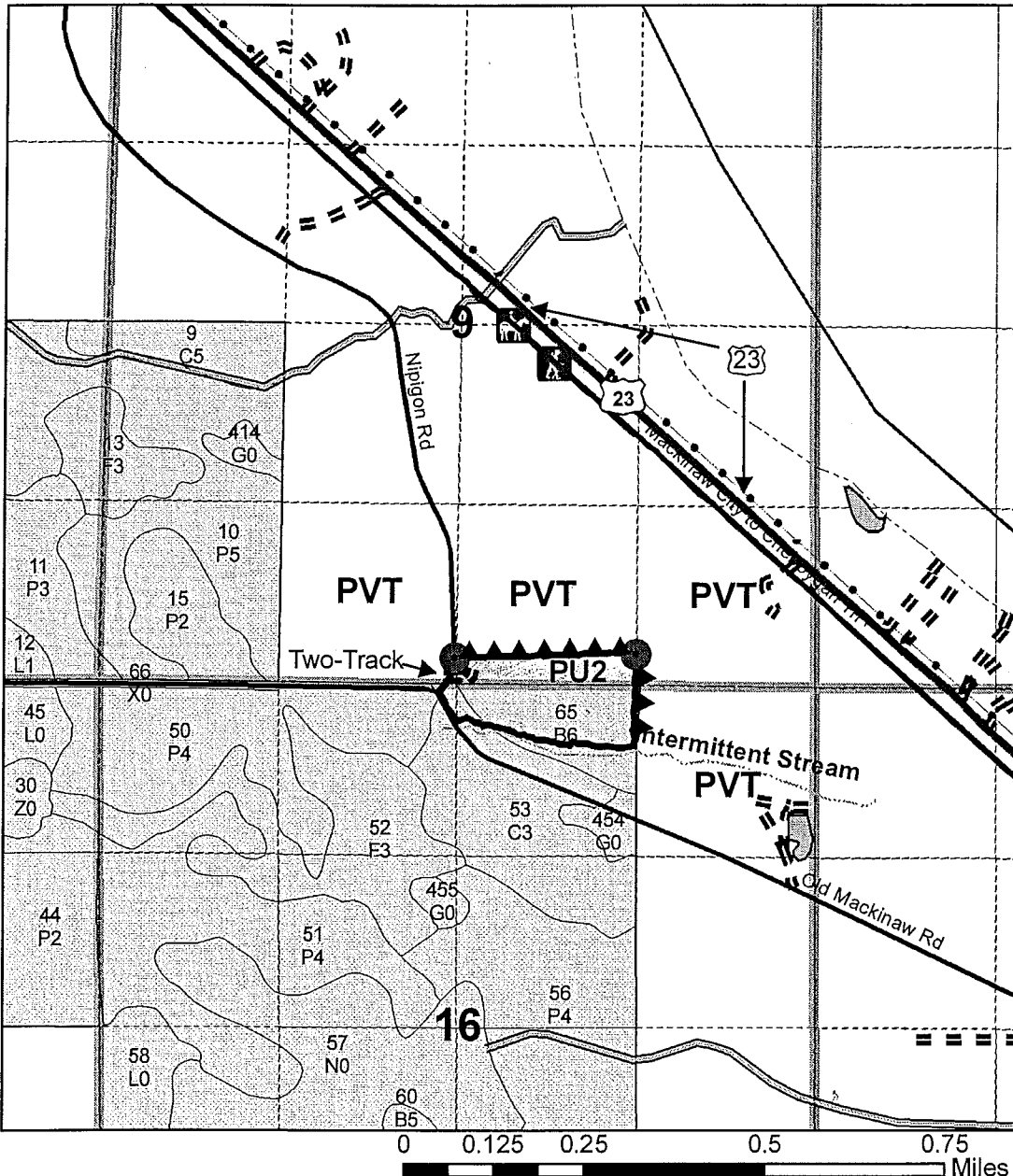
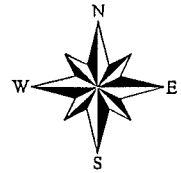

Legend	
	Sale Boundary- Red Paint
	Private Boundary- Blue Paint
	Survey Corner
	Two-Track
	Forested
	Non Forested
	Sections
	Quarter Quarter Sections

**Total Sale Acres- 78**  
**Cut Acres- 75**  
**Retention Acres- 3**



## Sale Specific Conditions & Requirements

**Sale Name: Old Mackinaw Aspen    Sale Number: 52-115-10-01**

### 1 - Sale Area

#### 1.2 - Boundaries

##### 1.2.1 - Painted boundaries (12/08)

The sale boundary is marked and identified by red paint. Exterior sale boundary lines against state are marked with red paint. Exterior sale lines against private property are marked with blue paint. Retention area (no cut) boundaries within the sale area are marked and identified by red paint.

### 2 - Timber Specifications

#### 2.1 - Included Timber

##### 2.1.1 - Clearcut unit(s) with unmerchantable trees (4/09)

Within Payment Unit(s) 1, cut all trees that are two (2) inches or more in diameter measured at a point four and one-half (4-1/2) feet above ground level regardless of merchantability. Within Payment Unit 1, NO TREES are to be cut within RETENTION AREA boundaries marked with red paint.

##### 2.1.5 - Overstory removal unit(s) (12/08)

Within Payment Unit(s) 2, all trees with DBH equal to or greater than 4 inches which meet minimum piece specifications in 2.2 Utilization, are designated for cutting. Do not cut white pine trees.

##### 2.1.11 - Description of timber note (2/04)

Note that Mixed Hardwood includes Sugar Maple, Red Maple, and Paper Birch trees. Mixed Softwood includes Balsam Fir, Black Spruce, and White Spruce trees. Payment Units are highly variable containing scattered individual and clumps of trees with a dense fir understory. All Payment Units were point cruised for pulpwood and sawlogs.

### 3 - Payments

#### 3.3 - Pre-measured Sales

##### 3.3.4 - Dividing payment units (12/08)

Payment unit(s) may be divided at the request of the purchaser and upon approval of the Unit Manager. Dividing payment units is a contract modification which requires a Timber Sale Contract Supplement.

### 4 - Transportation

#### 4.1 - Construction

##### 4.1.3 - Slash and earthen piles (8/04)

Piles or windrows of earth along roads and landings that have been widened or constructed shall be leveled. Slash from road maintenance or construction, including stumps, shall be dispersed throughout the sale.

**4.1.6 - Road construction (1/09)**

Construction of new roads or improvements of existing roads shall be done in such a way as to minimize the environmental and visual impacts. Merchantable trees shall be cut and utilized unless otherwise directed. Non-merchantable trees shall be severed and laid flat on the ground. Slash shall be scattered, and not left in windrows and kept a minimum of 10 feet back from the road edge. Stumps shall be set upright, not left on edge, and be moved at least 10 feet away from the road edge. Disturbed soil shall be feathered into the woods and not left in berms or windrows.

**4.1.7 - Road closure (4/07)**

With administrator approval, all new roads built into the sale must be blocked to vehicle traffic within 30 days of completion of hauling. In general, this will require constructing a four (4') foot high berm constructed of stumps and logs covered with earth. These roads and the existing two-track must be rendered impassable to cars and trucks.

**4.2 - Maintenance**

**4.2.5 - Two wheel drive condition (2/04)**

All existing trail roads on and adjacent to the sale area must be passable by two-wheel drive traffic for the duration of the sale.

**5 - Operations**

**5.1 - Notification**

**5.1.1 - Pre-sale conference (12/08)**

A pre-sale conference on site between the Purchaser and sale administrator is required prior to beginning any operations to determine landing and road locations.

**5.2 - Conduct of Operations**

**5.2.1 - Slash**

**5.2.1.1 - Slash within sale area (2/04)**

No trees are to be felled outside the sale area and all slash is to be kept at least 10 feet back from the blue paint line.

**5.2.2 - Hazard Trees/Snags**

**5.2.2.1 - Den trees (2/04)**

Obvious hollow and/or den trees shall be protected and left standing unless they are a safety hazard.

**5.4 - Soil Protection**

5.4.1 - Rutting restriction, general (1/09)

Operations are to cease immediately if equipment and weather conditions result in rutting of roads and skid trails which is 12 inches or greater in depth and 50 feet in length. The Unit Manager or his/her representative may restrict hauling and/or skidding if ruts exceed the specified depth. With the Unit Manager or his/her representative's approval, the Purchaser may return to the area when the risk of rutting has decreased.

**6 - Safety and Fire Prevention**

**6.2 - Signing**

6.2.1 - Road posting (9/09)

The purchaser is responsible for posting and maintaining caution signs on Old Mackinaw and Nipigon roads prior to beginning operations. The road must be posted at appropriate distances from the sale area to warn of logging activity and truck traffic. Signs must be removed when harvest operations are suspended or completed. The Purchaser will provide these signs.





SOUTH HACKLEBURG ASPEN (105-10-01)  
T35N, R02W, SEC. 11, SENW, E1/2SW, W1/2SE, SWNE.  
T35N, R02W, SEC. 12, E1/2NW, NESW.  
CHEBOYGAN COUNTY

In response to the notice of sale to be held 3:00 p.m. on January 4, 2011, I am hereby submitting my sealed bid (firm offer) for the following forest products to be cut. Bids for individual species and total bid value must be at or above the appraised price. All non-responsive bid forms may be rejected.

<u>SPECIES</u>	<u>APPRAISED PRICE</u>	<u>BID PRICE</u>	<u>ESTIMATED VOLUME* = VALUE</u>
<u>SAWLOGS</u>			
B.T. ASPEN	\$ 92.00/MBF	\$ _____ X	51.50 MBF = \$ _____
<u>PULPWOOD</u>			
RED MAPLE	\$ 9.85/CORD	\$ _____ X	318.00 CORDS = \$ _____
Q. ASPEN	\$ 11.90/CORD	\$ _____ X	313.00 CORDS = \$ _____
B.T. ASPEN	\$ 19.00/CORD	\$ _____ X	578.00 CORDS = \$ _____
SUBTOTAL 1			\$ _____

In addition, the successful bidder agrees to purchase the following species at the appraised price:

<u>SPECIES</u>	<u>APPRAISED PRICE</u>	<u>ESTIMATED VOLUME*</u>	<u>VALUE</u>
<u>SAWLOGS</u>			
RED MAPLE	\$ 76.00/MBF	2.10 MBF	= \$ 159.60
WHITE ASH	\$ 110.00/MBF	1.10 MBF	= \$ 121.00
P. BIRCH	\$ 82.00/MBF	1.40 MBF	= \$ 114.80
Q. ASPEN	\$ 30.00/MBF	8.80 MBF	= \$ 264.00
<u>PULPWOOD</u>			
WHITE ASH	\$ 8.20/CORD	10.00 CORDS	= \$ 82.00
P. BIRCH	\$ 8.05/CORD	27.00 CORDS	= \$ 217.35
BALSAM FIR	\$ 3.50/CORD	46.00 CORDS	= \$ 161.00
B. SPRUCE	\$ 4.00/CORD	19.00 CORDS	= \$ 76.00
JACK PINE	\$ 12.60/CORD	20.00 CORDS	= \$ 252.00
SUBTOTAL 2			\$ 1,447.75

SUBTOTAL 1 + SUBTOTAL 2 = TOTAL BID VALUE \$ \_\_\_\_\_

\*These volumes are statistically estimated within plus (+) or minus (-) 10.46%. These estimated volumes are final and not subject to adjustment. Prospective bidders are urged to examine this timber and to make their own estimates of quantity and quality.

I understand that any or all bids may be rejected, and that the individual unit bid price will be the basis to determine total bid value. All bids must be signed and all bid items must be bid or the bid form may be rejected. I also understand that consideration and awarding a contract will be based upon my past performance and ability to complete the contract based upon equipment and manpower subject to my control.

\_\_\_\_\_  
(bidder's printed name)

\_\_\_\_\_  
(bidder's signature)

Address/Telephone \_\_\_\_\_

THE WINNING BIDDER MUST COMPLETE THE FORM ON THE REVERSE SIDE  
WITHIN 21 DAYS OF SALE AWARD



<b>FOR DEPARTMENT USE ONLY</b>
Sale Number (XX - XXX - XX - XX)
Forest Management Unit:

## TIMBER SALE VERIFICATION OF WORKER'S DISABILITY COMPENSATION ACT COMPLIANCE

*As required by Act 317, P.A. 1969 (Worker's Compensation) and  
Part 525 of Act 451 of 1994, as amended.*

### VERIFICATION OF WORKER'S DISABILITY COMPENSATION ACT COMPLIANCE

- This verification must be completed and submitted within 21 days of contract award and prior to the issuance of the timber sale contract.
- In addition, if boxes 2B or 2C are checked, then Notice of Exclusion or Certificate of Insurance must be submitted within 21 days of the contract award and prior to the issuance of the timber sale contract.
- All Information must be typed or printed except for written signatures.

Please Check Appropriate Categories:

1. My business is organized as (you **must** check one of the boxes below):
  - A.  Sole Proprietorship (individual)
  - B.  Partnership
  - C.  Corporation
  
2. You **must** check one of the boxes below:
  - A.  I certify that my business is a sole proprietorship and it has no employees but the sole proprietor. I am not subject to the Worker's Compensation Laws.
  - B.  I certify that my business has satisfied its obligation to the Worker's Compensation Act through the use of an approved Notice of Exclusion (BWC-337, Rev. 5/96). I will provide a copy of the Notice of Exclusion within 21 days of the contract award. (For questions or a copy of the BWC-337, please call the Worker's Compensation Bureau at 517-322-1195).
  - C.  I certify that my business has a Worker's Compensation Policy. I will provide an original Certificate of Insurance within 21 days of the contract award.
  
3. If you have checked item 2(A) or 2(B), you **must** indicate the number of **both** full-time and part-time employees, other than yourself, including family members and active partners (if none, you must enter "0").

\_\_\_\_\_ Full-time Employees

\_\_\_\_\_ Part-time Employees

Name of Business		Federal ID (or) Social Security No.	
Address		Telephone (       )	
City	State	ZIP	

*I hereby certify that the above information is true and correct. I agree to notify the Michigan DNRE of any changes that occur in factors affecting my coverage during any of my present and future operations.*

\_\_\_\_\_  
Signature of Owner or Authorized Representative

\_\_\_\_\_  
Title

\_\_\_\_\_  
Date

HACKLEBURG RED PINE (108-10-01)  
 T35N, R02W, SEC. 01, NE1/4, SWSW.  
 T35N, R02W, SEC. 02, E1/2NE.  
 T35N, R02W, SEC. 11, N1/2NE.  
 T35N, R02W, SEC. 12, S1/2NW, N1/2SW, NWNW.  
 CHEBOYGAN COUNTY

In response to the notice of sale to be held 3:00 p.m. on January 4, 2011, I am hereby submitting my sealed bid (firm offer) for the following forest products to be cut. Bids for individual species and total bid value must be at or above the appraised price. All non-responsive bid forms may be rejected.

<u>SPECIES</u>	<u>APPRAISED PRICE</u>	<u>BID PRICE</u>	<u>ESTIMATED VOLUME* = VALUE</u>
<u>PULPWOOD</u>			
RED PINE	\$ 31.15/CORD	\$ _____ X	535.00 CORDS = \$ _____
JACK PINE	\$ 11.90/CORD	\$ _____ X	117.00 CORDS = \$ _____
			SUBTOTAL 1 \$ _____

In addition, the successful bidder agrees to purchase the following species at the appraised price:

<u>SPECIES</u>	<u>APPRAISED PRICE</u>	<u>ESTIMATED VOLUME*</u>	<u>VALUE</u>
<u>SAWLOGS</u>			
RED PINE	\$ 105.00/MBF	4.50 MBF	= \$ 472.50
<u>PULPWOOD</u>			
B.T. ASPEN	\$ 15.30/CORD	38.00 CORDS	= \$ 581.40
WHITE PINE	\$ 18.80/CORD	6.00 CORDS	= \$ 112.80
			SUBTOTAL 2 \$ <u>1,166.70</u>
SUBTOTAL 1 + SUBTOTAL 2 = TOTAL BID VALUE \$ _____			

\*These volumes are statistically estimated within plus (+) or minus (-) 16.48%. These estimated volumes are final and not subject to adjustment. Prospective bidders are urged to examine this timber and to make their own estimates of quantity and quality.

I understand that any or all bids may be rejected, and that the individual unit bid price will be the basis to determine total bid value. All bids must be signed and all bid items must be bid or the bid form may be rejected. I also understand that consideration and awarding a contract will be based upon my past performance and ability to complete the contract based upon equipment and manpower subject to my control.

\_\_\_\_\_  
 (bidder's printed name)

\_\_\_\_\_  
 (bidder's signature)

Address/Telephone \_\_\_\_\_

THE WINNING BIDDER MUST COMPLETE THE FORM ON THE REVERSE SIDE  
 WITHIN 21 DAYS OF SALE AWARD



**TIMBER SALE  
VERIFICATION OF WORKER'S DISABILITY  
COMPENSATION ACT COMPLIANCE**

*As required by Act 317, P.A. 1969 (Worker's Compensation) and Part 525  
of Act 451 of 1994, as amended.*

**FOR DEPARTMENT USE ONLY**

Sale or Permit No

Year:

Type:

Forest Area:

**VERIFICATION OF WORKER'S DISABILITY COMPENSATION ACT COMPLIANCE**

- This verification must be completed and submitted within 21 days of contract award and prior to the issuance of the timber sale contract.
- In addition, if boxes 2B or 2C are checked, then Notice of Exclusion or Certificate of Insurance must be submitted within 21 days of the contract award and prior to the issuance of the timber sale contract.
- All Information must be typed or printed except for written signatures.

Please Check Appropriate Categories:

1. My business is organized as (you **must** check one of the boxes below):

- A.  Sole Proprietorship (individual)
- B.  Partnership
- C.  Corporation

2. You **must** check one of the boxes below:

- A.  I certify that my business is a sole proprietorship and it has no employees but the sole proprietor. I am not subject to the Worker's Compensation Laws.
- B.  I certify that my business has satisfied its obligation to the Worker's Compensation Act through the use of an approved Notice of Exclusion (BWC-337, Rev. 5/96). I will provide a copy of the Notice of Exclusion within 21 days of the contract award. (For questions or a copy of the BWC-337, please call the Worker's Compensation Bureau at 517-322-1195).
- C.  I certify that my business has a Worker's Compensation Policy. I will provide an original Certificate of Insurance within 21 days of the contract award.

3. If you have checked item 2(A) or 2(B), you **must** indicate the number of **both** full and part time employees other than yourself including family members and active partners (if none, you must enter "0").

\_\_\_\_\_ Full Time Employees

\_\_\_\_\_ Part Time Employees

Name of Business		Federal ID (or) Social Security No.	
Address		Telephone No. (       )	
City	State	Zip + 4	

I hereby certify that the above information is true and correct. I agree to notify the DNR of any changes that occur in factors affecting my coverage during any of my present and future operations.

\_\_\_\_\_  
Signature of Owner or Authorized Representative

\_\_\_\_\_  
Title

\_\_\_\_\_  
Date

NORTH HACKLEBURG ASPEN (109-10-01)  
T35N, R02W, SEC. 01, W1/2NE, E1/2NW, NESW, NWSE.  
CHEBOYGAN COUNTY

In response to the notice of sale to be held 3:00 p.m. on January 4, 2011, I am hereby submitting my sealed bid (firm offer) for the following forest products to be cut. Bids for individual species and total bid value must be at or above the appraised price. All non-responsive bid forms may be rejected.

<u>SPECIES</u>	<u>APPRAISED PRICE</u>	<u>BID PRICE</u>	<u>ESTIMATED VOLUME*</u>	<u>VALUE</u>
<b>SAWLOGS</b>				
SUG. MAPLE	\$ 290.00/MBF	\$ _____ X	32.30 MBF	= \$ _____
B.T. ASPEN	\$ 96.00/MBF	\$ _____ X	46.40 MBF	= \$ _____
<b>PULPWOOD</b>				
B.T. ASPEN	\$ 21.15/CORD	\$ _____ X	644.00 CORDS	= \$ _____
SUBTOTAL 1				\$ _____

In addition, the successful bidder agrees to purchase the following species at the appraised price:

<u>SPECIES</u>	<u>APPRAISED PRICE</u>	<u>ESTIMATED VOLUME*</u>	<u>VALUE</u>
<b>SAWLOGS</b>			
BASSWOOD	\$ 55.00/MBF	30.30 MBF	= \$ 1,666.50
BEECH	\$ 36.00/MBF	.80 MBF	= \$ 28.80
<b>PULPWOOD</b>			
SUG. MAPLE	\$ 5.30/CORD	274.00 CORDS	= \$ 1,452.20
RED MAPLE	\$ 9.85/CORD	8.00 CORDS	= \$ 78.80
BASSWOOD	\$ 6.00/CORD	118.00 CORDS	= \$ 708.00
WHITE ASH	\$ 9.50/CORD	15.00 CORDS	= \$ 142.50
BEECH	\$ 8.70/CORD	11.00 CORDS	= \$ 95.70
Q. ASPEN	\$ 14.25/CORD	122.00 CORDS	= \$ 1,738.50
RED PINE	\$ 33.10/CORD	13.00 CORDS	= \$ 430.30
SUBTOTAL 2			\$ <u>6,341.30</u>

SUBTOTAL 1 + SUBTOTAL 2 = TOTAL BID VALUE \$ \_\_\_\_\_

\*These volumes are statistically estimated within plus (+) or minus (-) 10.92%. These estimated volumes are final and not subject to adjustment. Prospective bidders are urged to examine this timber and to make their own estimates of quantity and quality.

I understand that any or all bids may be rejected, and that the individual unit bid price will be the basis to determine total bid value. All bids must be signed and all bid items must be bid or the bid form may be rejected. I also understand that consideration and awarding a contract will be based upon my past performance and ability to complete the contract based upon equipment and manpower subject to my control.

\_\_\_\_\_  
(bidder's printed name)

\_\_\_\_\_  
(bidder's signature)

Address/Telephone \_\_\_\_\_

THE WINNING BIDDER MUST COMPLETE THE FORM ON THE REVERSE SIDE  
WITHIN 21 DAYS OF SALE AWARD



**TIMBER SALE**  
**VERIFICATION OF WORKER'S DISABILITY**  
**COMPENSATION ACT COMPLIANCE**

*As required by Act 317, P.A. 1969 (Worker's Compensation) and  
Part 525 of Act 451 of 1994, as amended.*

FOR DEPARTMENT USE ONLY	
Sale Number (XX - XXX - XX - XX)	
Forest Management Unit:	

**VERIFICATION OF WORKER'S DISABILITY COMPENSATION ACT COMPLIANCE**

- This verification must be completed and submitted within 21 days of contract award and prior to the issuance of the timber sale contract.
- In addition, if boxes 2B or 2C are checked, then Notice of Exclusion or Certificate of Insurance must be submitted within 21 days of the contract award and prior to the issuance of the timber sale contract.
- All Information must be typed or printed except for written signatures.

Please Check Appropriate Categories:

1. My business is organized as (you **must** check one of the boxes below):
  - A.  Sole Proprietorship (individual)
  - B.  Partnership
  - C.  Corporation
2. You **must** check one of the boxes below:
  - A.  I certify that my business is a sole proprietorship and it has no employees but the sole proprietor. I am not subject to the Worker's Compensation Laws.
  - B.  I certify that my business has satisfied its obligation to the Worker's Compensation Act through the use of an approved Notice of Exclusion (BWC-337, Rev. 5/96). I will provide a copy of the Notice of Exclusion within 21 days of the contract award. (For questions or a copy of the BWC-337, please call the Worker's Compensation Bureau at 517-322-1195).
  - C.  I certify that my business has a Worker's Compensation Policy. I will provide an original Certificate of Insurance within 21 days of the contract award.
3. If you have checked item 2(A) or 2(B), you **must** indicate the number of **both** full-time and part-time employees, other than yourself, including family members and active partners (if none, you must enter "0").

\_\_\_\_\_ Full-time Employees

\_\_\_\_\_ Part-time Employees

Name of Business		Federal ID (or) Social Security No.	
Address		Telephone (       )	
City	State	ZIP	

*I hereby certify that the above information is true and correct. I agree to notify the Michigan DNRE of any changes that occur in factors affecting my coverage during any of my present and future operations.*

\_\_\_\_\_  
Signature of Owner or Authorized Representative

\_\_\_\_\_  
Title

\_\_\_\_\_  
Date

OLD MACKINAW ASPEN (115-10-01)  
T38N, R02W, SEC. 07, SESE.  
T38N, R02W, SEC. 08, SWSW, SESW.  
T38N, R02W, SEC. 16, NWNW, NENW.  
CHEBOYGAN COUNTY

In response to the notice of sale to be held 3:00 p.m. on January 4, 2011, I am hereby submitting my sealed bid (firm offer) for the following forest products to be cut. Bids for individual species and total bid value must be at or above the appraised price. All non-responsive bid forms may be rejected.

<u>SPECIES</u>	<u>APPRAISED PRICE</u>	<u>BID PRICE</u>	<u>ESTIMATED VOLUME*</u>	<u>= VALUE</u>
<u>SAWLOGS</u>				
B.T. ASPEN	\$ 76.00/MBF	\$ _____ X	21.30 MBF	= \$ _____
<u>PULPWOOD</u>				
Q. ASPEN	\$ 11.35/CORD	\$ _____ X	589.00 CORDS	= \$ _____
B.T. ASPEN	\$ 15.65/CORD	\$ _____ X	110.00 CORDS	= \$ _____
MIX HARDWD	\$ 7.90/CORD	\$ _____ X	230.00 CORDS	= \$ _____
SUBTOTAL 1				\$ _____

In addition, the successful bidder agrees to purchase the following species at the appraised price:

<u>SPECIES</u>	<u>APPRAISED PRICE</u>	<u>ESTIMATED VOLUME*</u>	<u>VALUE</u>
<u>SAWLOGS</u>			
WHITE ASH	\$ 73.00/MBF	1.50 MBF	= \$ 109.50
Q. ASPEN	\$ 25.00/MBF	10.20 MBF	= \$ 255.00
RED PINE	\$ 109.00/MBF	4.00 MBF	= \$ 436.00
MIX HARDWD	\$ 81.00/MBF	5.60 MBF	= \$ 453.60
<u>PULPWOOD</u>			
WHITE ASH	\$ 7.90/CORD	7.00 CORDS	= \$ 55.30
RED PINE	\$ 31.40/CORD	21.00 CORDS	= \$ 659.40
MIX SOFTWD	\$ 3.95/CORD	171.00 CORDS	= \$ 675.45
SUBTOTAL 2			\$ 2,644.25

SUBTOTAL 1 + SUBTOTAL 2 = TOTAL BID VALUE \$ \_\_\_\_\_

\*These volumes are statistically estimated within plus (+) or minus (-) 18.03%. These estimated volumes are final and not subject to adjustment. Prospective bidders are urged to examine this timber and to make their own estimates of quantity and quality.

I understand that any or all bids may be rejected, and that the individual unit bid price will be the basis to determine total bid value. All bids must be signed and all bid items must be bid or the bid form may be rejected. I also understand that consideration and awarding a contract will be based upon my past performance and ability to complete the contract based upon equipment and manpower subject to my control.

\_\_\_\_\_  
(bidder's printed name)

\_\_\_\_\_  
(bidder's signature)

Address/Telephone \_\_\_\_\_

THE WINNING BIDDER MUST COMPLETE THE FORM ON THE REVERSE SIDE  
WITHIN 21 DAYS OF SALE AWARD



<b>FOR DEPARTMENT USE ONLY</b>	
Sale Number (XX – XXX – XX – XX)	
Forest Management Unit:	

**TIMBER SALE**  
**VERIFICATION OF WORKER'S DISABILITY**  
**COMPENSATION ACT COMPLIANCE**

*As required by Act 317, P.A. 1969 (Worker's Compensation) and  
Part 525 of Act 451 of 1994, as amended.*

**VERIFICATION OF WORKER'S DISABILITY COMPENSATION ACT COMPLIANCE**

- This verification must be completed and submitted within 21 days of contract award and prior to the issuance of the timber sale contract.
- In addition, if boxes 2B or 2C are checked, then Notice of Exclusion or Certificate of Insurance must be submitted within 21 days of the contract award and prior to the issuance of the timber sale contract.
- All Information must be typed or printed except for written signatures.

Please Check Appropriate Categories:

1. My business is organized as (you **must** check one of the boxes below):
  - A.  Sole Proprietorship (individual)
  - B.  Partnership
  - C.  Corporation
2. You **must** check one of the boxes below:
  - A.  I certify that my business is a sole proprietorship and it has no employees but the sole proprietor. I am not subject to the Worker's Compensation Laws.
  - B.  I certify that my business has satisfied its obligation to the Worker's Compensation Act through the use of an approved Notice of Exclusion (BWC-337, Rev. 5/96). I will provide a copy of the Notice of Exclusion within 21 days of the contract award. (For questions or a copy of the BWC-337, please call the Worker's Compensation Bureau at 517-322-1195).
  - C.  I certify that my business has a Worker's Compensation Policy. I will provide an original Certificate of Insurance within 21 days of the contract award.
3. If you have checked item 2(A) or 2(B), you **must** indicate the number of **both** full-time and part-time employees, other than yourself, including family members and active partners (if none, you must enter "0").

\_\_\_\_\_ Full-time Employees

\_\_\_\_\_ Part-time Employees

Name of Business		Federal ID (or) Social Security No.	
Address		Telephone (       )	
City	State	ZIP	

*I hereby certify that the above information is true and correct. I agree to notify the Michigan DNRE of any changes that occur in factors affecting my coverage during any of my present and future operations.*

\_\_\_\_\_  
Signature of Owner or Authorized Representative

\_\_\_\_\_  
Title

\_\_\_\_\_  
Date