



**DEPARTMENT OF NATURAL RESOURCES AND
ENVIRONMENT
STATE OF MICHIGAN**

CORRECTION NOTICE #1 - June 01, 2011

The following changes have been made to the prospectus whose original scheduled bid date, time and location are Monday, 06/23/2011 at 2:00PM local time in the Traverse City Office.

The sale map for the ROOTS LAKE SOUTH timber sale (61-082-10-01) has been updated. Please use the attached sale map when bidding on this sale and disregard the original sale map sent with the prospectus.

We apologize for any inconvenience this may have caused. If you need assistance, please contact Dave Lemmien at 231-922-5280.

Sale No.	Year	Sale Type
082	10	01

This information provided under authority of Part 525, Act 451 of 1994, as amended.

State Forest and Forest Management Unit: Pere Marquette - Traverse City		Mapped By: Marked By: Patrick Ruppen	Date: September 30, 2010
Township 27N	Range 9W	Section(s) 14	Subdivision W1/2SW1/4 W1/2NE1/4SW1/4 W1/2SE1/4NW1/4 Scale: 1:7,920

Cover Type					Density
A=Aspen	H=Hemlock	P=Lowland Poplar	V=Bog or Marsh	1=Non Stocked	7=Saw Timber Poor
B=Paper Birch	J=Jack Pine	Q=Mixed Swamp Cnfr	W=White Pine	2=Seedling Sapling Poor	8=Saw Timber Medium
C=Cedar	L=Lowland Brush	R=Red Pine	X=Non Stocked	3=Seedling Sapling Well	9=Saw Timber Well
E=Swamp Hdwoods	M=Mpl, Bch, Brch	S=Black Spruce	Z=Water	4=Pole Timber Poor	
F=Spruce Fir	N=Marsh	T=Tamarack		5=Pole Timber Medium	
G=Grass	O=Oak	U=Upland Brush		6=Pole Timber Well	

Roots Lake South

Sale Area 70.3 Acre

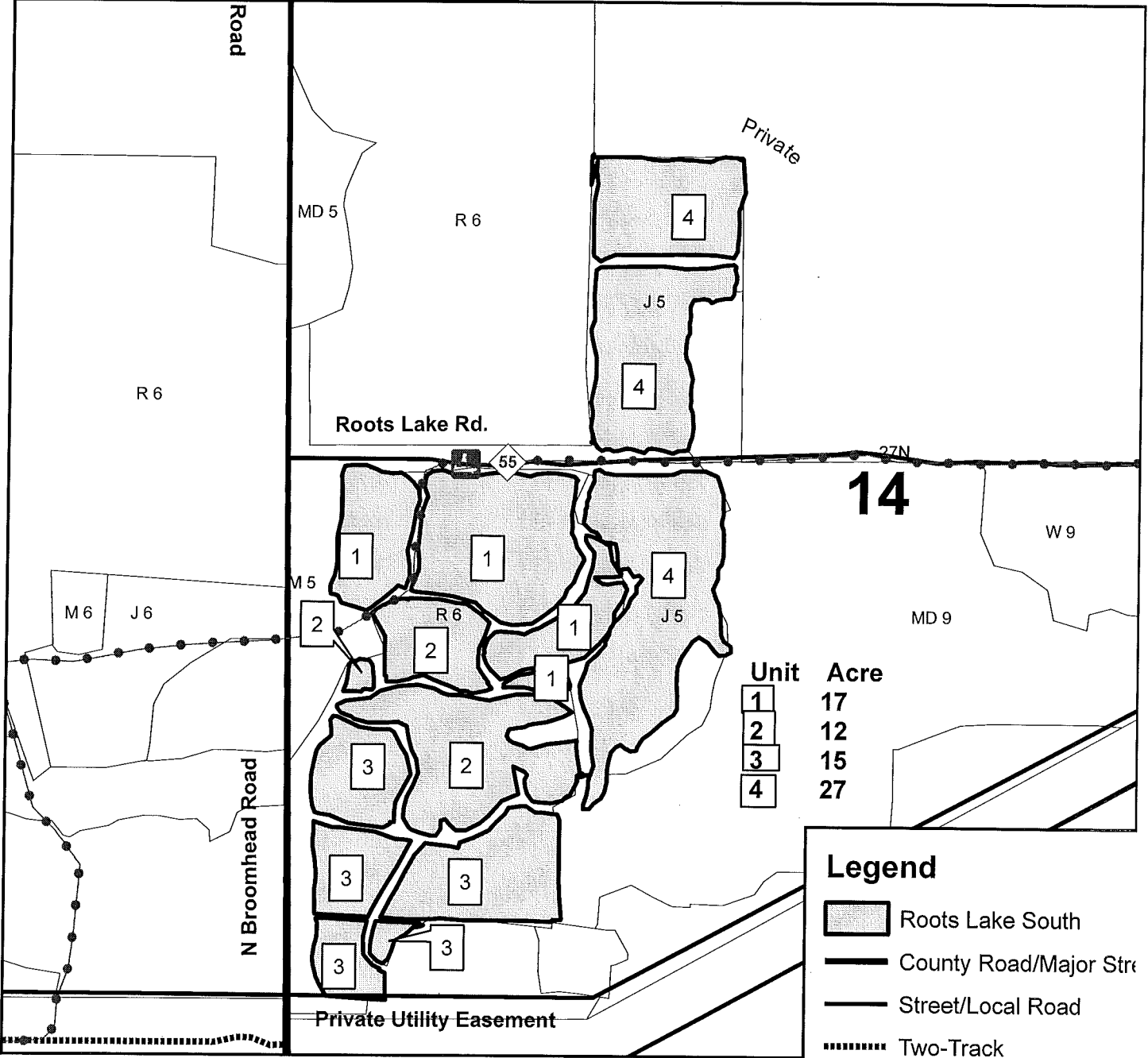

Legend

- Roots Lake South
- County Road/Major Street
- Street/Local Road
- Two-Track

Trail Designation

- Snowmobile Trail