



**DEPARTMENT OF NATURAL RESOURCES
STATE OF MICHIGAN**

TIMBER SALE PROSPECTUS #5917

SCHEDULED SALE DATE AND TIME: 3:00 p.m. (local time) on May 25, 2017.

LOCATION: NEWBERRY MGMT UNIT, PO BOX 428, 5666 STATE HWY M-123, NEWBERRY, MI 49868.

PROSPECTUS NOTE: All sales on this prospectus are part of a research project. They must be harvested promptly. Please read ALL of the Sale Specs carefully, as each sale has different requirements.

The bidder is advised to inspect the sale area and review the location, estimated volumes, operating costs and contract terms of proposed sales. Please be aware that some landowners may request 60 days or more notice for access across their land.

Notice is hereby given that bids will be received by the Unit Manager, NEWBERRY MANAGEMENT UNIT, for certain timber on the following described lands:

M-117 MWR (42-004-17)

Luce County, Advertised Price \$110,541.40, 89.5 Acres, Hardwood, Sugar Maple.

SALE NOTE: This sale is part of a research project and should be harvested promptly.

Harvesting is limited to August 15, 2017 to March 15, 2018.

Within Payment Unit 2, cut all trees that are two inches or more at DBH within designated patch-cut areas (bounded by yellow paint). See Sale Spec 2.1.1 for additional info.

Within Payment Units 1 and 3, cut all trees that are two (2) inches or more at DBH except trees marked with green paint above & below stump height. See Sale Spec 2.1.7.

Payment Units 1, 2 and 3 must be chip harvested or slashed removed in manner consistent to each Payment Units prescription and in manner acceptable to sale administrator to facilitate follow-up scarification. See Sale Spec 2.2.2 and 2.2.8 for additional info.

No new roads permitted.

Since this is a research sale with a short contract length, one (1) contract extension may be applied to one other State Forest Timber Sale Contract owned by Purchaser. See Sale Spec 7.2.7 for additional info.

A recreation site such as a trail, pathway, or campground is within the sale area or the vicinity. Certain restrictions/specifications may be applicable including time restrictions.

Camp 7 MWR (42-005-17)

Luce County, Advertised Price \$72,627.60, 59.0 Acres, Hardwood, Sugar Maple.

SALE NOTE: This sale is part of a research project and should be harvested promptly.

For Payment Unit 1, harvesting is limited to December 1, 2017 to March 15, 2018.

For Payment Unit 2, harvesting is limited to August 15, 2017 to March 15, 2018.

In Payment Unit 1, slash less than nine inches may not be removed from the sale area. See Sale Spec 2.2.8 for additional restrictions.

Payment Unit 2 must be chip harvested or slash removed in a manner acceptable to the sale administrator, to facilitate follow-up scarification. See Sale Spec 2.2.2 for additional requirements.

Since this is a research sale with a short contract length, one (1) contract extension may be applied to one other State Forest Timber Sale Contract owned by the Purchaser. See Sale Spec 7.2.7 for additional information.

A recreation site such as a trail, pathway, or campground is within the sale area or the vicinity. Certain restrictions/specifications may be applicable including time restrictions.

Next to Joe's MWR (42-006-17)

Luce County, Advertised Price \$30,549.00, 75.7 Acres, Hardwood, Spruce/Fir/Tamarack.

SALE NOTE: This sale is part of a research project and should be harvested promptly.

For Payment Unit 1, harvesting is limited to December 1, 2017 to March 15, 2018.

For Payment Unit 2, harvesting is limited to August 15, 2017 to March 15, 2018.

In Payment Unit 1, slash less than nine inches may not be removed from the sale area. See Sale Spec 2.2.8 for additional restrictions.

Payment Unit 2 must be chip harvested or slash removed in a manner acceptable to the sale administrator, to facilitate follow-up scarification. See Sale Spec 2.2.2 for additional requirements.

No new roads will be permitted.

Since this is a research sale with a short contract length, one (1) contract extension may be applied to one other State Forest Timber Sale Contract owned by the Purchaser. See Sale Spec 7.2.7 for additional information.

A recreation site such as a trail, pathway, or campground is within the sale area or the vicinity. Certain restrictions/specifications may be applicable including time restrictions.

Kelly Lake MWR (42-007-17)

Luce County, Advertised Price \$27,503.50, 81.5 Acres, Hardwood, Sugar Maple.

SALE NOTE: Payment Unit #1 is part of a research project and should be harvested promptly. Harvesting is limited to August 15, 2017 to March 15, 2018.

The patch cuts (bounded by yellow paint) within Payment Unit # 1 must be chip harvested or slash removed in a manner acceptable to the sale administrator, to facilitate follow-up scarification. See Sale Spec 2.2.2 and 2.2.8 for additional requirements.

Within Payment Units 2 - 5, harvesting is not permitted during the period of April 15 to July 15 due to bark slippage.

Since this is a research sale with a short contract length, one (1) contract extension may be applied to one other State Forest Timber Sale Contract owned by the Purchaser. See Sale Spec 7.2.7 for additional information.

BID INSTRUCTIONS (VER. 09/02/2016):

1. Scheduled Bid Location, Date, and Time (2/11)

Bids must be received by the Unit Manager, NEWBERRY OFFICE, PO BOX 428 5666 STATE HWY M-123, NEWBERRY, MI 49868, no later than 3:00 p.m. (local time) on May 25, 2017. For further information concerning this sale, contact Keith Magnusson at 906-293-3293 extension 4740.

2. Bidder's Qualifications (5/16)

Purchaser shall obtain workers compensation insurance to cover claims under Michigan's Worker's Disability Compensation Act of 1969 or similar employee benefit act of any other state applicable to an employee. If all or part of a timber sale was prepared by a private contractor, the contractor and that contractor's company are not permitted to bid on the timber sale contract. Bids will not be accepted from individuals or companies appearing on the DNR/FRD No-Bid List. This list contains the names of purchasers who previously failed to execute a contract within 21-days or who have a history of poor performance.

3. Preparation of Sealed Bids (5/16)

Bid Forms may be completed online thru Michigan DNR Timber Sale Online Bidding (OLB) at www.michigan.gov/timberbidding or by completing the hardcopy Bid Form found in the Timber Sale Prospectus. Hardcopy Bid Forms shall be manually signed in ink. Registration in OLB is considered your 'signature' for all bids submitted thru that system. Bid prices must be entered for each species and product in the Bid Price column for all material subject to bidding and all fill-in blanks must be completed. If erasures or other changes appear on the hardcopy Bid Form, each erasure or change must be initialed by the person signing the bid.

4. Submission of Sealed Bids (5/16)

Bid forms may be obtained from the Unit Manager or thru OLB. Bids may be submitted hardcopy or thru OLB. All hardcopy bids must be submitted on the bid form and in an envelope clearly identified as described in this section. NOTE: Only one bid form per bid envelope. Sealed bids must be submitted to the Unit office designated in the prospectus and must be submitted at or prior to the time established in the prospectus. The envelope should show on the outside (a) the sale name or number and (b) the date and time of bid opening, as shown in the prospectus. Bids received after the time specified in the sale prospectus are late bids and will be rejected.

It is possible for a bidder to submit multiple bids on a single sale. For example, a bid may be submitted hardcopy and a bid may be submitted thru OLB. Or, two bidders from the same company could both submit bids on the same sale. If this were to happen, the State would accept all bids received and award the contract accordingly. All bidding and contractual requirements would apply to all bids received.

5. Public Opening of Sealed Bids (7/16)

If conditions permit, the sealed bids will be publicly opened and posted at the time and place set in the prospectus.

If a bidder, present at a bid opening, has submitted bids on more than one sale, that bidder may withdraw their unopened bid envelopes or announce the withdrawal of their online bid after being declared the successful bidder on one sale.

6. Award of Contract (1/11)

Award of the contract will be made to the Bidder whose bid, conforming to the prospectus, is most advantageous to the State of Michigan on the basis of total value at rates bid for the estimated quantities. The State reserves the right to reject any bid or waive any minor irregularity in bids received. A written award mailed (or otherwise furnished) to the successful Bidder shall be deemed to result in a binding contract without further action by either party.

7. Down Payment (1/11)

The Bidder to whom award is made must make a down payment within 21 days of the sale award. The amount of the down payment will be calculated as shown in the Bond and Payment Schedule of this prospectus. Only cash may be used to meet this requirement.

8. Performance Security (1/11)

As guarantee of faithful performance, a cash bond, certificate of deposit, surety bond or irrevocable letter of credit (LOC) is required within 21 days of the sale award. The amount of the performance security is shown in the Bond and

Payment Schedule of this prospectus. If an LOC or surety is used, the coverage must extend for at least 6 months beyond the contract expiration.

9. Timber Sale Contract (9/14)

Additional conditions and requirements common to all timber sales are listed on the timber sale contract (R4031) and are available on line at www.michigan.gov/timber. Contact the Unit Manager for additional information or a sample contract. Within 21 days of the date of the award letter, the bidder must sign the contract and provide the required down payment, performance security, and verification of worker's disability compensation. The down payment and performance security shall be in accordance with the provisions of the timber sale contract, in the sums stated in this prospectus. If these actions are not taken, then the Bidder, the Bidder's corporation, and the corporation's principals may not be permitted to bid on State timber sales for a period of 1 year. In addition, the Bidder certifies that if awarded this contract, the Bidder will complete the timber sale contract in accordance with its terms and any modifications thereof including requirements to purchase, cut, and remove the included timber by the expiration date.

10. Disclaimer of Estimates and Bidder's Warranty of Inspection (7/16)

Before submitting this bid, the Bidder is advised and cautioned to inspect the sale area, review the requirements of the sale contract, and take other steps as may be reasonably necessary to ascertain the location, estimated volumes, construction estimates, and operating costs of the proposed sale. Failure to do so will not relieve the Bidder from responsibility for completing the contract.

The Bidder warrants that this bid is submitted solely on the basis of the Bidder's examination and inspection of the quality and quantity of the timber offered for sale and the Bidder's opinion of the value thereof and the costs of recovery. No reliance should be placed on the State of Michigan's estimates of timber quality, quantity or costs of recovery. Bidder further acknowledges that the State of Michigan: (i) expressly disclaims any warranty of fitness of timber for any purpose; (ii) offers this timber as is without any warranty of quality (merchantability) or quantity and (iii) expressly disclaims any warranty as to the quantity or quality of timber sold.

11. Certification and Chain-of-Custody (10/14)

Unless otherwise indicated in the contract under section 7 – Other Conditions of the Sale Specific Conditions & Requirements, the area encompassed by this timber sale is certified to the standards of the Forest Stewardship Council (FSC) - Certificate #SCS-FM/COC-00090N and the Sustainable Forestry Initiative (SFI) - Certificate # NSF-SFIS-5Y031-SF5. Forest products from this sale may be delivered to the mill as "FSC 100% and / or SFI certified" as long as the contractor hauling the forest products is chain-of-custody (COC) certified or covered under a COC certificate from the destination mill. The purchaser is responsible for maintaining COC after leaving the sale area.

12. Good Neighbor Authority (GNA) Requirements (7/16)

If the name of this timber sales contains the acronym GNA, it is authorized by the Good Neighbor Authority (GNA) and covered by various agreements between the U.S. Forest Service and the State. The timber sale occurs on federal land and the following conditions apply:

GNA contracts on US Forest Service land will not be awarded to purchasers on the Federal list of excluded parties. The System for Award Management (SAM) will be checked for active excluded parties prior to award of contract. In addition, the Bidder to whom award is made must complete an Assurance Regarding Felony Conviction or Tax Delinquent Status for Corporate Applicants (AD-3031).

13. Good Neighbor Authority (GNA) Requirements, con't (9/16)

Bidder certifies, by signing this bid form, that to the best of Bidder's knowledge that the following representations are accurate and complete.

- a. That the Bidder and its principals are not presently debarred, suspended, proposed for debarment, declared ineligible, or voluntary excluded from timber sales (covered transactions) by any Federal department or agency.
- b. That the Bidder and its principals have not within a 3-year period preceding this bid been convicted of or had a civil judgment rendered against them for commission of fraud or a criminal offense in connection with obtaining, attempting to obtain, or performing a public (Federal, State, or local) transaction or contract under a public transaction; violation of Federal or State antitrust statutes or commission of embezzlement, theft, forgery, bribery, falsification or destruction of records, making false statements, or receiving stolen property.

c. That the Bidder and its principals are not presently indicted for or otherwise criminally or civilly charged by a governmental entity (Federal, State, or local) with commission of any of the offenses enumerated in paragraph b of this certification.

d. That the Bidder and its principals have not within a 3-year period preceding this bid had one or more public transactions (Federal, State, or local) terminated for breach or default of a timber or forest product contract.

Bidders that cannot certify this requirement, in whole or in part, shall submit an explanation with their bid.

KEITH CREAGH

Director

TIMBER SALE INFORMATION

M-117 MWR (42-004-17)

Luce County (Advertised Price \$110,541.40)

SALE NOTE: This sale is part of a research project and should be harvested promptly.

Harvesting is limited to August 15, 2017 to March 15, 2018.

Within Payment Unit 2, cut all trees that are two inches or more at DBH within designated patch-cut areas (bounded by yellow paint). See Sale Spec 2.1.1 for additional info.

Within Payment Units 1 and 3, cut all trees that are two (2) inches or more at DBH except trees marked with green paint above & below stump height. See Sale Spec 2.1.7.

Payment Units 1, 2 and 3 must be chip harvested or slashed removed in manner consistent to each Payment Units prescription and in manner acceptable to sale administrator to facilitate follow-up scarification. See Sale Spec 2.2.2 and 2.2.8 for additional info.

No new roads permitted.

Since this is a research sale with a short contract length, one (1) contract extension may be applied to one other State Forest Timber Sale Contract owned by Purchaser. See Sale Spec 7.2.7 for additional info.

A recreation site such as a trail, pathway, or campground is within the sale area or the vicinity. Certain restrictions/specifications may be applicable including time restrictions.

A timber sale contract for this lump sum, sealed bid timber sale will be awarded to the responsible bidder offering the highest sealed bid price. Bids must be at or above the following advertised price for each species:

<u>PRODUCTS & SPECIES</u>	<u>ESTIMATED UNITS*</u>	<u>ADVERTISED PRICE</u>
Sawtimber		
Basswood	6.30 MBF	\$ 133.00 / MBF
Black Cherry	37.90 MBF	\$ 111.00 / MBF
Red Maple	50.90 MBF	\$ 114.00 / MBF
Sugar Maple	168.70 MBF	\$ 424.00 / MBF
Pulpwood		
Balsam Fir	15.00 Cords	\$ 11.80 / Cord
Mixed Aspen	18.00 Cords	\$ 21.95 / Cord
Mixed Hardwood	1,426.00 Cords	\$ 19.35 / Cord

* The total volume is statistically estimated within plus (+) or minus (-) 14.19 percent. The estimated units are final and not subject to adjustment. Prospective bidders are urged to examine this timber and to make their own estimates of quantity and quality.

BOND AND PAYMENT SCHEDULE:

1. A bond in the amount of \$5,527.00 to insure faithful performance of the conditions of the contract will be deposited by the successful bidder within 21 days of the sale award.
2. Cutting in any sale or unit without the required advance payment would be considered a trespass.
3. Total payment must be paid in advance or according to the following schedule:
 - (a) Ten percent (10%) of the sale value must be paid within 21 days of the sale award.
 - (b) The 10% down payment will be credited towards the first unit cut.
4. If no cutting takes place, the 10% down payment will not be refunded.
5. Operations on the contract issued will terminate on 06/30/2018.

Description of Timber by Payment Unit (PU)

PU	MARKET GROUP	PRODUCT	QUANTITY	UNIT	ACRES	ADVERTISE PRICE
1	Basswood	Sawtimber	6.3	MBF	29.4	\$22,351.80
	Black Cherry		0.5	MBF		
	Sugar Maple		31.7	MBF		
	Balsam Fir	Pulpwood	13.0	Cords		
	Mixed Aspen		18.0	Cords		
	<i>Quaking Aspen</i>		18.0	<i>Cords</i>		
	Mixed Hardwood		386.0	Cords		
	<i>Basswood</i>		27.0	<i>Cords</i>		
	<i>Beech</i>		21.0	<i>Cords</i>		
	<i>Black Cherry</i>		12.0	<i>Cords</i>		
	<i>Ironwood</i>		22.0	<i>Cords</i>		
	<i>Sugar Maple</i>		304.0	<i>Cords</i>		
	2	Black Cherry	Sawtimber	7.0		
Red Maple			18.3	MBF		
Sugar Maple			60.8	MBF		
Balsam Fir		Pulpwood	2.0	Cords		
Mixed Hardwood			279.0	Cords		
<i>Yellow Birch</i>		<i>Sawtimber</i>	1.8	<i>MBF</i>		
<i>Beech</i>		<i>Pulpwood</i>	17.0	<i>Cords</i>		
<i>Black Cherry</i>			40.0	<i>Cords</i>		
<i>Red Maple</i>			41.0	<i>Cords</i>		
<i>Sugar Maple</i>			174.0	<i>Cords</i>		
<i>Yellow Birch</i>			3.0	<i>Cords</i>		
3		Black Cherry	Sawtimber	30.4	MBF	29.9
	Red Maple		32.6	MBF		
	Sugar Maple		76.2	MBF		
	Mixed Hardwood	Pulpwood	761.0	Cords		
	<i>Black Cherry</i>		98.0	<i>Cords</i>		
	<i>Red Maple</i>		192.0	<i>Cords</i>		
	<i>Sugar Maple</i>		468.0	<i>Cords</i>		
	<i>Yellow Birch</i>		3.0	<i>Cords</i>		
TOTAL:			263.8	MBF		
TOTAL:			1,459.0	Cords		

Sale Specific Conditions & Requirements

Sale Name: M-117 MWR

Sale Number: 42-004-17 Seq#: 1

1 - Sale Area

1.2 - Boundaries

1.2.1 - Painted boundaries (1/14)

The sale boundary is marked and identified by red and yellow paint. Exterior sale boundary lines against state are marked with red paint. Interior sale boundaries are marked with yellow paint, designating patch cuts (Payment Unit 2). The painted boundary line trees are not Included Timber and are to be protected.

2 - Timber Specifications

2.1 - Included Timber

2.1.1 - Clearcut unit(s) with unmerchantable trees (6/14)

Within Payment Unit(s) 2, cut all trees that are two (2) inches or more at DBH within designated patch-cut areas (bounded by yellow paint). Yellow painted boundary trees are not to be harvested. The total area of the patch cuts is 11.7 acres with patches ranging from 1/3 acre to 1 acre. 18 patch cut areas are located within the 30 acre treatment area bounded by red paint. No trees will be harvested outside of the designated patch cut areas unless needed for maneuverability between patch cut areas. These trees will be decked separately and scaled by the sale administrator.

2.1.7 - Leave tree marked unit(s) (6/14)

Within Payment Unit(s) 1 and 3, cut all trees that are two (2) inches or more at DBH except trees marked with green paint above and below stump height.

2.2 - Utilization

2.2.2 - Chipping required (5/14)

Payment Units 1, 2 and 3 must be chip harvested or have slash removed in a manner consistent to each Payment Units prescription and in a manner acceptable to the sale administrator, to facilitate follow-up scarification. Products may be produced as roundwood and forwarded to decking areas in final product length, but the tops must be left intact and skidded to the landing for chipping. If market conditions limit the practicality of chipping, the producer may skid all remaining topwood out of these payment units and scatter in locations approved by the sale administrator.

In Payment Unit 2, all slash needs to be treated (chipped or removed) within the patch cuts bounded by yellow paint.

In Payment Units 1 and 3, slash needs to be treated (chipped or removed) from the entire Payment Unit. If not chipped, all slash must be hauled outside of the red paint boundary.

Chipping or slash removal must be completed by March 15, 2018. If the deadline is not met, damages will be collected at a rate determined by the cost for the Department to hire a contractor to complete this specification. The requirement to retain approximately 1/6 to 1/3 of tree tops and limbs less than four inches in diameter does not apply (G. C. & R. 2.2). This is due to the research nature of these units.

2.2.3 - Stump heights (4/07)

Stump heights within Payment Unit(s) 1, 2 and 3 shall not exceed 12 inches for trees greater than 10 inches DBH and 4 inches for trees smaller than 10 inches DBH. A written waiver of this requirement may be obtained if snow levels make these heights unobtainable.

2.2.8 - Utilization and removal (5/14)

Payment Units 1, 2 and 3 are part of a research project. In Payment Units 1 and 3, all slash and all forest products meeting standards set forth in General Condition and Requirement 2.2 - Utilization must be removed from the sale area. In Payment Unit 2, all slash and all forest products meeting standards set forth in General Condition and Requirement 2.2 - Utilization must be removed from the patch cut areas bounded by yellow paint. The slash must be chipped unless another option is negotiated with the Unit Manager or their representative to reduce, eliminate, and/or disperse the slash into the surrounding area. Chipping or slash removal must be completed by March 15, 2018. This is because of the research nature of this project.

3 - Payments

3.4 - Damaged Timber

3.4.1 - Damaged timber (6/14)

General Condition and Requirement 3.4 Damaged Timber, defines liquidated damages for undesignated live merchantable trees which are cut or injured. No damage is acceptable to residual merchantable trees. Within the sale area, if more than 5% of trees (> 4.5" DBH) within a specified area of the sale are damaged, liquidated damages will be assessed for all trees damaged. Rates will be in accordance with General Condition and Requirement 3.4 Damaged Timber, or at a rate of \$50 per sawtimber tree and \$5 per pole sized tree, whichever is greater.

4 - Transportation

4.1 - Construction

4.1.7 - Road closure (10/11)

All new roads built into the sale must be blocked to vehicle traffic upon completion of the sale. Overgrown roads that are reopened shall be considered new roads. In general, this will require constructing a four (4') foot high berm of stumps and logs covered with earth at the beginning of any new road course. Stumps and brush must be placed along the road for a minimum of 200 feet, effectively obliterating it. These roads must be rendered impassable to cars, trucks and ORV's. Stumps from road building and landing construction can be reserved to meet the above road closure specifications. Contact the sale administrator for specific details of design and placement.

4.1.12 - No new roads (1/12)

No new roads will be permitted in Payment Units 1 and 2. All operations are limited to existing roads. Skid trails only will be allowed.

4.2 - Maintenance

4.2.5 - Two wheel drive condition (2/04)

All existing trail roads on and adjacent to the sale area must be passable by two-wheel drive traffic for the duration of the sale.

5 - Operations

5.1 - Notification

5.1.1 - Pre-sale conference (10/16)

A pre-sale conference between the Purchaser and sale administrator is required prior to beginning any operations. The Unit Manager or his/her representative must be contacted at least 5 days in advance to schedule the conference.

5.1.4 - Post-sale conference (10/16)

A post-sale conference on site between the Purchaser and sale administrator is required 5 days prior to the completion of active logging operations to determine clean-up and repair of landings, road edges, and the fulfillment of other contract specifications.

5.2 - Conduct of Operations

5.2.2 - Hazard Trees/Snags

5.2.2.1 - Den trees (10/16)

Obvious hollow and/or den trees shall be protected and left standing unless they are a safety hazard.

5.2.3 - Operating Restrictions

5.2.3.1 - Operating restrictions (9/11)

Within Payment Unit(s) 1, 2, and 3, unless changed by written agreement, cutting and skidding is limited to the period from August 15th, 2017 to March 15th, 2018. Payments must be received and operations must begin no later than February, 1st 2018. This restriction is due to the necessity of assuring that all operations are on schedule for timely completion of the research project.

5.2.37 - No decking areas (12/08)

No decking is allowed within 30 feet of the groomed snowmobile trail.

5.2.38 - No decking against live trees (2/04)

Cut products may not be decked against unmarked or designated leave trees.

5.2.41 - Snowmobile trail protection (9/11)

Trail 45 is a snowmobile trail and is shown on the Timber Sale Map. Do not cut or damage posts with orange trail markers or traffic control signs. If the trail is used for hauling prior to snowmobile season, it must be graded to the satisfaction of the Unit Manager or his/her representative prior to December 1. If the trail road is to be used for hauling during the snowmobile season, then a snow covered base must be left on the trail. Maintain a 20 foot wide slash, debris, and rut free zone daily using the snowmobile trail as the centerline. No decking of forest products will be permitted along the snowmobile trail. All stumps within 20 feet of the snowmobile trail must be cut at ground level.

5.4 - Soil Protection

5.4.1 - Rutting restriction, general (7/16)

Operations are to cease immediately if equipment and weather conditions result in rutting of roads and/or skid trails which is 12 inches or greater in depth and 50 feet in length. The Unit Manager or his/her representative may restrict hauling and/or skidding if ruts exceed the specified depth. With the Unit Manager or his/her representative's approval, the Purchaser may return to the area when the risk of rutting has decreased.

6 - Safety and Fire Prevention

6.2 - Signing

6.2.2 - Snowmobile trail posting (8/09)

The Purchaser is responsible for posting and maintaining caution signs on the snowmobile trail prior to beginning operations during the snowmobile season (approximately December 1 to March 31). The trail must be posted at appropriate distances from the sale area to warn of logging activity and truck traffic. Signs must be removed when harvest operations are suspended or completed.

7 - Other Conditions

7.2 - Extensions

7.2.7 - Research extension (12/16)

This is a research sale with a short contract length. The sale must be harvested promptly. One (1), twelve (12) month extension can be applied to one (1) other State Forest Timber Sale Contract owned by the purchaser or owned by one (1) designated sub-contractor of the Purchaser that works this contract. To qualify, the contract expiration date of the contract to be extended must be within twelve (12) months from the issue date of this contract. If this is the first extension on the other State Forest Timber Sale Contract, then the 5% extension fee will be waived. If this is an additional extension, the 10% fee will be reduced to 5%. The salvage extension must be used before this contract is closed-out. This specification does not alleviate the purchaser from any contractual obligations of the extended State Forest Timber Sale Contract. Per General Condition & Requirement 7.2, extensions are at the sole discretion of the DNR.



TIMBER SALE MAP

This information provided by authority of Part 525, 1994 PA 451, as amended.

Forest Management Unit Newberry	County Luce	Mapped By Payment	Date 2/23/17	Page 1	of 2
Township 45N	Range 10W 11W	Section(s) and Subdivision(s) Sec 31 SESW, Sec 33 SW1/4; Sec 35 SENE, Sec36 SWNW	Scale 1:15,840		

Cover Type				Density	
A = Aspen	H = Hemlock	N = Marsh	U = Upland Brush	0 = Non Stocked	5 = Pole Timber Medium
B = Paper Birch	J = Jack Pine	O = Oak	UM = Upland Mixed	1 = Seedling Sapling Poor	6 = Pole Timber Well
C = Cedar	L = Lowland Brush	P = Lowland Poplar	V = Bog or Marsh	2 = Seedling Sapling Medium	7 = Saw Timber Poor
D = Treed Bog	LM = Lowland Mixed	Q = Mixed Swamp Conifer	W = White Pine	3 = Seedling Sapling Well	8 = Saw Timber Medium
E = Swamp Hdwoods	M = Mpl, Bch, Brch	R = Red Pine	X = Non Stocked	4 = Pole Timber Poor	9 = Saw Timber Well
F = Spruce Fir	MC = Mixed Conifer	S = Black Spruce	Z = Water		
G = Grass	MD = Mixed Deciduous	T = Tamarack			

PU	Acres
1	29.4
2	30.2
3	29.9

M-117 MWR

Compartment 108 / 109

89.5 Acres

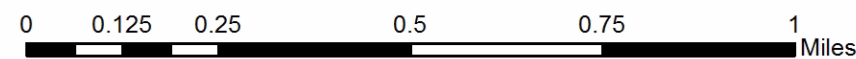
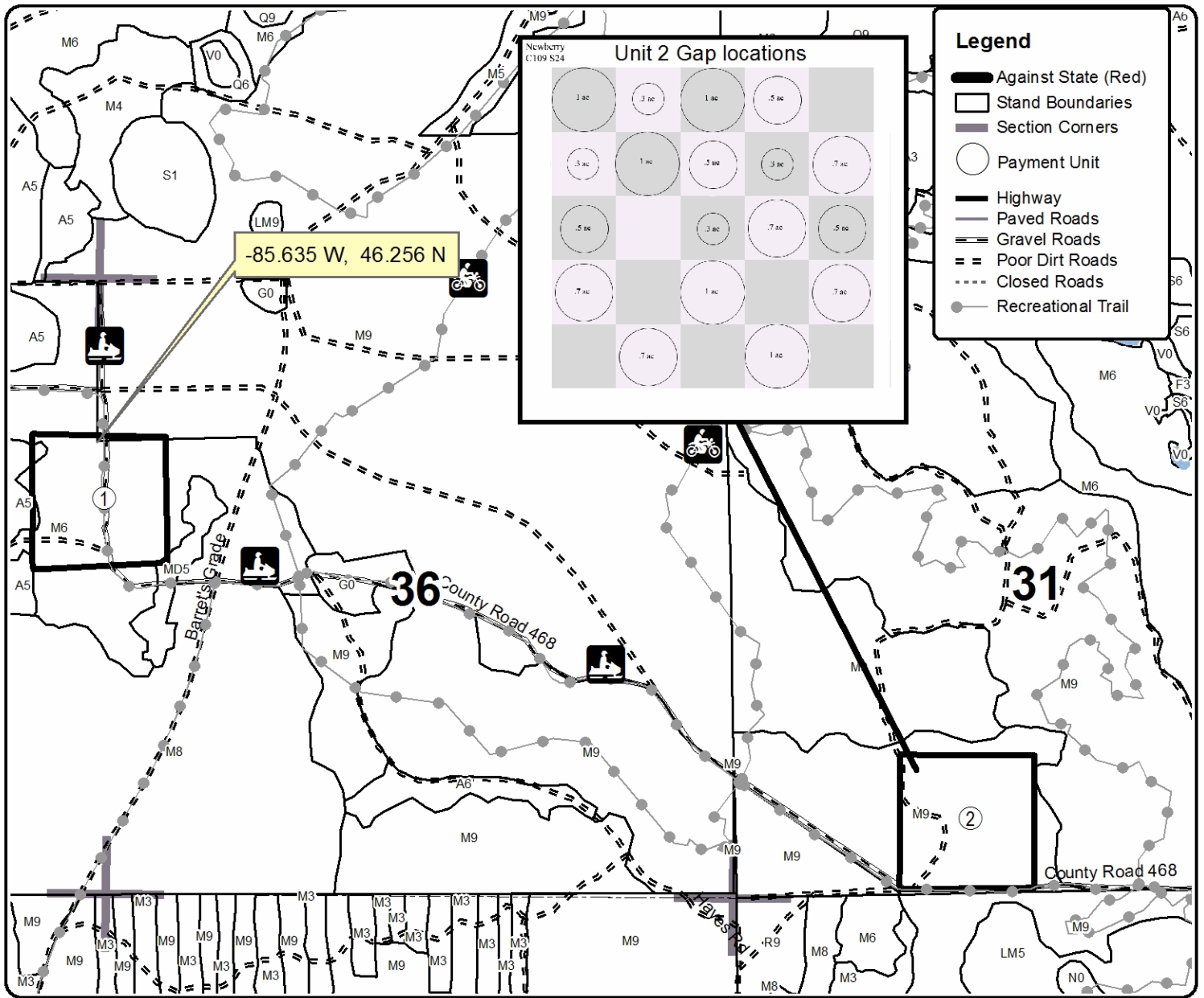



TIMBER SALE MAP

This information provided by authority of Part 525, 1994 PA 451, as amended.

Forest Management Unit Newberry	County Luce	Mapped By Payment	Date 2/23/17	Page 2	of 2
Township 45N	Range 10W 11W	Section(s) and Subdivision(s) Sec 31 SESW, Sec 33 SW1/4; Sec 35 SENE, Sec36 SWNW	Cruised By Unit Staff		
Scale 1:15,840					

Cover Type				Density	
A = Aspen	H = Hemlock	N = Marsh	U = Upland Brush	0 = Non Stocked	5 = Pole Timber Medium
B = Paper Birch	J = Jack Pine	O = Oak	UM = Upland Mixed	1 = Seedling Sapling Poor	6 = Pole Timber Well
C = Cedar	L = Lowland Brush	P = Lowland Poplar	V = Bog or Marsh	2 = Seedling Sapling Medium	7 = Saw Timber Poor
D = Treed Bog	LM = Lowland Mixed	Q = Mixed Swamp Conifer	W = White Pine	3 = Seedling Sapling Well	8 = Saw Timber Medium
E = Swamp Hdwoods	M = Mpl, Bch, Brch	R = Red Pine	X = Non Stocked	4 = Pole Timber Poor	9 = Saw Timber Well
F = Spruce Fir	MC = Mixed Conifer	S = Black Spruce	Z = Water		
G = Grass	MD = Mixed Deciduous	T = Tamarack			

PU	Acres
1	29.4
2	30.2
3	29.9

M-117 MWR

Compartment 108 / 109

89.5 Acres

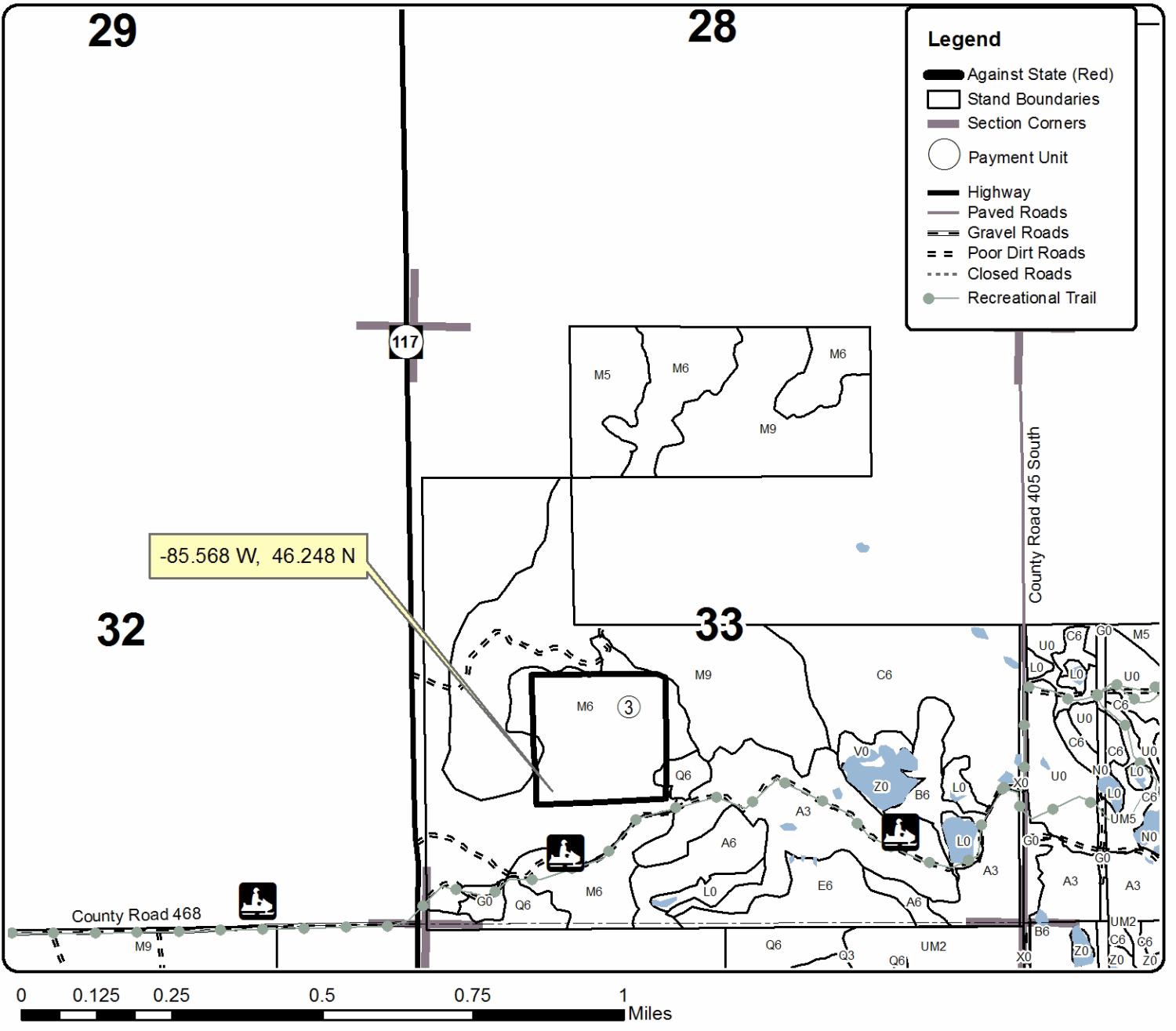
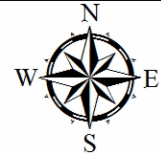

TIMBER SALE INFORMATION

Camp 7 MWR (42-005-17)

Luce County (Advertised Price \$72,627.60)

SALE NOTE: This sale is part of a research project and should be harvested promptly.

For Payment Unit 1, harvesting is limited to December 1, 2017 to March 15, 2018.

For Payment Unit 2, harvesting is limited to August 15, 2017 to March 15, 2018.

In Payment Unit 1, slash less than nine inches may not be removed from the sale area. See Sale Spec 2.2.8 for additional restrictions.

Payment Unit 2 must be chip harvested or slash removed in a manner acceptable to the sale administrator, to facilitate follow-up scarification. See Sale Spec 2.2.2 for additional requirements.

Since this is a research sale with a short contract length, one (1) contract extension may be applied to one other State Forest Timber Sale Contract owned by the Purchaser. See Sale Spec 7.2.7 for additional information.

A recreation site such as a trail, pathway, or campground is within the sale area or the vicinity. Certain restrictions/specifications may be applicable including time restrictions.

A timber sale contract for this lump sum, sealed bid timber sale will be awarded to the responsible bidder offering the highest sealed bid price. Bids must be at or above the following advertised price for each species:

<u>PRODUCTS & SPECIES</u>	<u>ESTIMATED UNITS*</u>	<u>ADVERTISED PRICE</u>
Sawtimber		
Red Maple	17.00 MBF	\$ 114.00 / MBF
Sugar Maple	145.70 MBF	\$ 424.00 / MBF
Pulpwood		
Balsam Fir	1.00 Cords	\$ 11.80 / Cord
Mixed Hardwood	460.00 Cords	\$ 19.35 / Cord

* The total volume is statistically estimated within plus (+) or minus (-) 10.11 percent. The estimated units are final and not subject to adjustment. Prospective bidders are urged to examine this timber and to make their own estimates of quantity and quality.

BOND AND PAYMENT SCHEDULE:

1. A bond in the amount of \$3,631.00 to insure faithful performance of the conditions of the contract will be deposited by the successful bidder within 21 days of the sale award.
2. Cutting in any sale or unit without the required advance payment would be considered a trespass.
3. Total payment must be paid in advance or according to the following schedule:
 - (a) Ten percent (10%) of the sale value must be paid within 21 days of the sale award.
 - (b) The 10% down payment will be credited towards the first unit cut.
4. If no cutting takes place, the 10% down payment will not be refunded.
5. Operations on the contract issued will terminate on 06/30/2018.

Description of Timber by Payment Unit (PU)

PU	MARKET GROUP	PRODUCT	QUANTITY	UNIT	ACRES	ADVERTISE PRICE
1	Red Maple	Sawtimber	17.0	MBF	29.3	\$41,032.75
	Sugar Maple		86.5	MBF		
	Mixed Hardwood	Pulpwood	125.0	Cords		
	<i>American Elm</i>		1.0	<i>Cords</i>		
	<i>Beech</i>		1.0	<i>Cords</i>		
	<i>Red Maple</i>		27.0	<i>Cords</i>		
	<i>Sugar Maple</i>		96.0	<i>Cords</i>		
2	Sugar Maple	Sawtimber	59.2	MBF	29.7	\$31,594.85
	Balsam Fir	Pulpwood	1.0	Cords		
	Mixed Hardwood		335.0	Cords		
	<i>Beech</i>		9.0	<i>Cords</i>		
	<i>Sugar Maple</i>		326.0	<i>Cords</i>		
TOTAL:			162.7	MBF		
TOTAL:			461.0	Cords		

Sale Specific Conditions & Requirements

Sale Name: Camp 7 MWR

Sale Number: 42-005-17 Seq#: 1

1 - Sale Area

1.2 - Boundaries

1.2.1 - Painted boundaries (1/14)

The sale boundary is marked and identified by red paint. Exterior sale boundary lines against state are marked with red paint. Payment Unit #2 has large group/patch cuts. Interior sale boundaries within Payment Unit #2 are marked with yellow paint, designating patch cuts. The painted boundary line trees are not Included Timber and are to be protected.

2 - Timber Specifications

2.1 - Included Timber

2.1.1 - Clearcut unit(s) with unmerchantable trees (6/14)

Within Payment Unit(s) #2, cut all trees that are two (2) inches or more at DBH within designated patch-cut areas (bounded by yellow paint). Yellow painted boundary trees are not to be harvested. The total area of the patch cuts is 12.5 acres with patches ranging from 1/3 acre to 1 acre. Twenty (20) patch cut areas are located within the 30 acre treatment area bounded by red paint. No trees will be harvested outside of the designated patch cut areas unless needed to maneuver to the next patch cut. These trees will be decked separately for scaling by the sale administrator.

2.1.7 - Leave tree marked unit(s) (6/14)

Within Payment Unit(s) #1, cut all trees that are two (2) inches or more at DBH EXCEPT trees marked with green paint above and below stump height.

2.1.11 - Description of timber note (2/04)

Note that Mixed Hardwood pulp includes sugar maple, red maple, beech and elm.

2.2 - Utilization

2.2.2 - Chipping required (5/14)

Payment Unit #2 must be chip harvested or have slash removed from the patch cuts in a manner acceptable to the sale administrator, to facilitate follow-up scarification. Products may be produced as roundwood and forwarded to decking areas in final product length, but the tops must be left intact and skidded to the landing for chipping, unless other slash removal techniques have been approved. If market conditions limit the practicality of chipping, the producer may skid all remaining topwood out of these payment units and scatter in locations approved by the sale administrator. Slash only needs to be treated (chipped or removed) within the patch cuts bounded by yellow paint. Chipping or slash removal must be completed by March 15, 2018. If the deadline is not met, damages will be collected at a rate determined by the cost for the Department to hire a contractor to complete this specification. The requirement to retain approximately 1/6 to 1/3 of tree tops and limbs less than four inches in diameter does not apply (G. C. & R. 2.2). This is due to the research nature of these units.

2.2.3 - Stump heights (4/07)

Stump heights within Payment Unit #2 shall not exceed 12 inches for trees greater than 10 inches DBH and 4 inches for trees smaller than 10 inches DBH. A written waiver of this requirement may be obtained if snow levels make these heights unobtainable.

2.2.8 - Utilization and removal (5/14)

In Payment Units #1, all slash less than nine inches (<9") top diameter outside bark at the small end may not be removed from the sale area, e.g. tops. These tops are to be left intact where they fall with branches remaining upright.

Payment Unit #2 is part of a research project. All slash and all forest products meeting standards set forth in General Condition and Requirement 2.2 - Utilization must be removed from the patch cut (gaps) areas bounded by yellow paint. The slash must be chipped unless another option is negotiated with the Unit Manager or their representative to reduce, eliminate, and/or disperse the slash into the surrounding area. Chipping or slash removal must be completed by March 15, 2018. This is because of the research nature of this project.

3 - Payments

3.4 - Damaged Timber

3.4.1 - Damaged timber (6/14)

General Condition and Requirement 3.4 Damaged Timber, defines liquidated damages for undesignated live merchantable trees which are cut or injured. No damage is acceptable to residual merchantable trees. Within the sale area, if more than 5% of trees (> 4.5" DBH) within a specified area of the sale are damaged, liquidated damages will be assessed for all trees damaged. Rates will be in accordance with General Condition and Requirement 3.4 Damaged Timber, or at a rate of \$50 per sawtimber tree and \$5 per pole sized tree, whichever is greater.

4 - Transportation

4.1 - Construction

4.1.12 - No new roads (1/12)

No new roads will be permitted in any Payment Unit. All operations are limited to existing roads.

4.2 - Maintenance

4.2.5 - Two wheel drive condition (2/04)

All existing trail roads on and adjacent to the sale area must be passable by two-wheel drive traffic for the duration of the sale.

5 - Operations

5.1 - Notification

5.1.1 - Pre-sale conference (10/16)

A pre-sale conference between the Purchaser and sale administrator is required prior to beginning any operations to discuss sale specifications. The Unit Manager or his/her representative must be contacted at least 5 days in advance to schedule the conference.

5.1.4 - Post-sale conference (10/16)

A post-sale conference on site between the Purchaser and sale administrator is required at least 3 days prior to the completion of active logging operations to determine clean-up and repair of landings, road edges, and the fulfillment of other contract specifications.

5.2 - Conduct of Operations

5.2.2 - Hazard Trees/Snags

5.2.2.1 - Den trees (10/16)

Obvious hollow and/or den trees shall be protected and left standing unless they are a safety hazard.

5.2.3 - Operating Restrictions

5.2.3.1 - Operating restrictions (9/11)

Within Payment Unit(s) #2, unless changed by written agreement, cutting and skidding is limited to the period from August 15th, 2017 to March 15th, 2018.

Within Payment Unit(s) #1, unless changed by written agreement, cutting and skidding is limited to the period of December 1st, 2017 to March 15th, 2018.

Payments must be received and operations must begin no later than February, 1st 2018. This restriction is due to the necessity of assuring that all operations are on schedule for timely completion of the research project.

5.2.37 - No decking areas (12/08)

No decking is allowed within 50 feet of the snowmobile trail during snowmobile season.

5.2.38 - No decking against live trees (2/04)

Cut products may not be decked against unmarked or designated leave trees.

5.2.41 - Snowmobile trail protection (9/11)

The snowmobile trail is shown on the Timber Sale Map. Do not cut or damage posts with orange trail markers or traffic control signs. If the trail is used, it must be maintained and restored to a condition equal to or better than before the sale. If the trail is used for hauling prior to the snowmobile season, it must be graded to the satisfaction of the Unit Manager or his/her representative prior to December 1. If the trail road is to be used for hauling during the snowmobile season, then a snow covered base must be left on the trail. Maintain a 20 foot wide slash, debris, and rut free zone daily using the snowmobile trail as the centerline. No decking of forest products will be permitted along the snowmobile trail. All stumps within 20 feet of the snowmobile trail must be cut at ground level.

5.4 - Soil Protection

5.4.1 - Rutting restriction, general (7/16)

Operations are to cease immediately if equipment and weather conditions result in rutting of roads and/or skid trails which is 12 inches or greater in depth and 50 feet in length. The Unit Manager or his/her representative may restrict hauling and/or skidding if ruts exceed the specified depth. With the Unit Manager or his/her representative's approval, the Purchaser may return to the area when the risk of rutting has decreased.

6 - Safety and Fire Prevention

6.2 - Signing

6.2.2 - Snowmobile trail posting (8/09)

The Purchaser is responsible for posting and maintaining caution signs on the snowmobile trail prior to beginning operations during the snowmobile season (approximately December 1 to March 31). The trail must be posted at appropriate distances from the sale area to warn of logging activity and truck traffic. Signs must be removed when harvest operations are suspended or completed.

7 - Other Conditions

7.2 - Extensions

7.2.7 - Research extension (12/16)

This is a research sale with a short contract length. The sale must be harvested promptly. One (1), twelve (12) month extension can be applied to one (1) other State Forest Timber Sale Contract owned by the purchaser or owned by one (1) designated sub-contractor of the Purchaser that works this contract. To qualify, the contract expiration date of the contract to be extended must be within twelve (12) months from the issue date of this contract. If this is the first extension on the other State Forest Timber Sale Contract, then the 5% extension fee will be waived. If this is an additional extension, the 10% fee will be reduced to 5%. The salvage extension must be used before this contract is closed-out. This specification does not alleviate the purchaser from any contractual obligations of the extended State Forest Timber Sale Contract. Per General Condition & Requirement 7.2, extensions are at the sole discretion of the DNR.



TIMBER SALE MAP

This information provided by authority of Part 525, 1994 PA 451, as amended.

Sale Number	Year
42 - 005	17

Forest Management Unit Newberry	County Luce	Mapped By Douglass	Date 03/10/2017	Page 1	of 1
Township 48N	Range 08W	Section(s) and Subdivision(s) Sec. 7 - E1/2SW, W1/2SE; Sec. 18 - N1/2SE	Cruised By Magnusson		
			Scale 1:15,840		

Cover Type

A = Aspen	H = Hemlock	N = Marsh	U = Upland Brush
B = Paper Birch	J = Jack Pine	O = Oak	UM = Upland Mixed
C = Cedar	L = Lowland Brush	P = Lowland Poplar	V = Bog or Marsh
D = Treed Bog	LM = Lowland Mixed	Q = Mixed Swamp Conifer	W = White Pine
E = Swamp Hdwoods	M = Mpl, Bch, Brch	R = Red Pine	X = Non Stocked
F = Spruce Fir	MC = Mixed Conifer	S = Black Spruce	Z = Water
G = Grass	MD = Mixed Deciduous	T = Tamarack	

Density

0 = Non Stocked	5 = Pole Timber Medium
1 = Seedling Sapling Poor	6 = Pole Timber Well
2 = Seedling Sapling Medium	7 = Saw Timber Poor
3 = Seedling Sapling Well	8 = Saw Timber Medium
4 = Pole Timber Poor	9 = Saw Timber Well

PU	Acres
1	29.3
2	29.7

Camp 7 MWR
Compartments 46/48
59.0 Acres

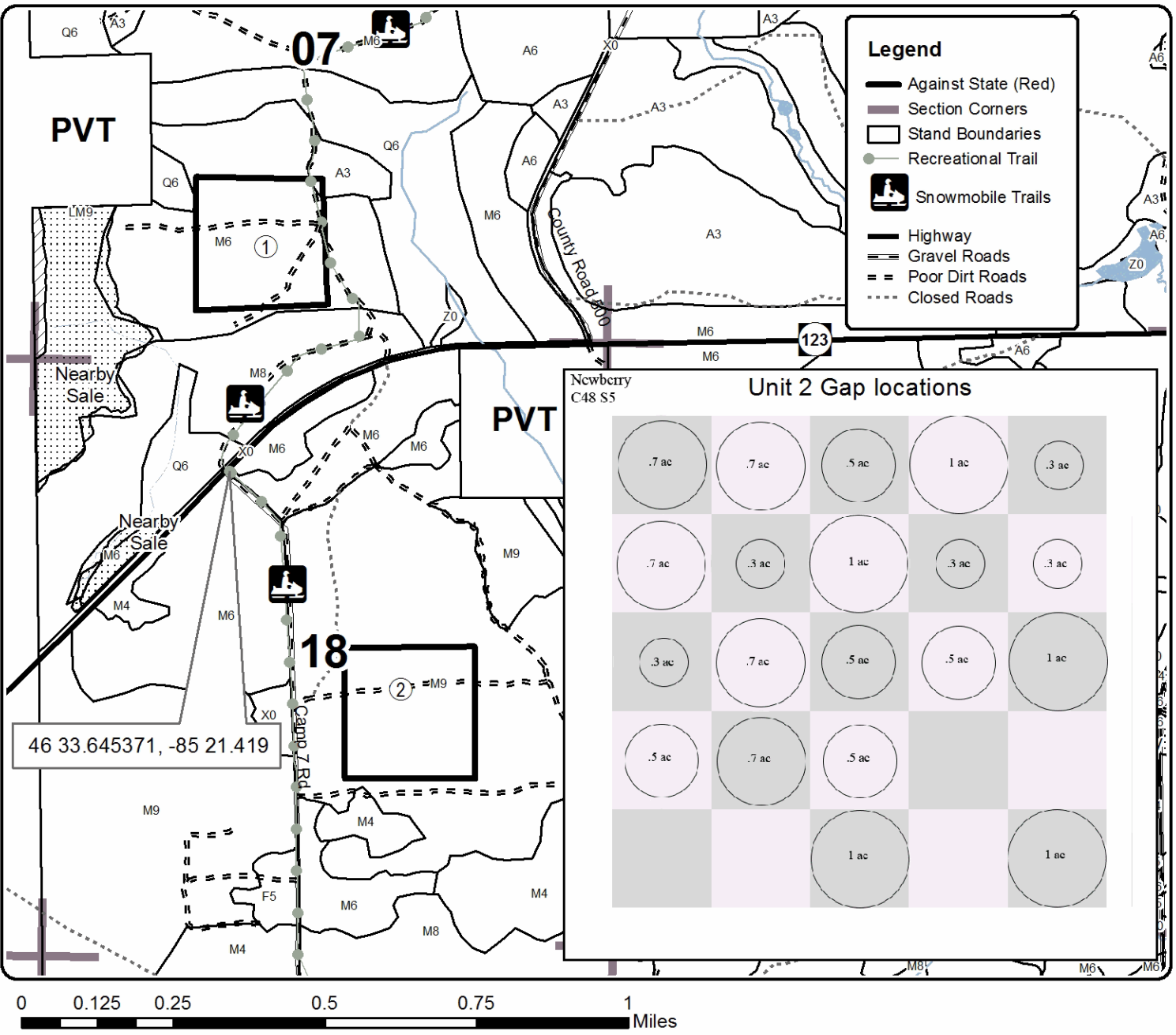

TIMBER SALE INFORMATION

Next to Joe's MWR (42-006-17)

Luce County (Advertised Price \$30,549.00)

SALE NOTE: This sale is part of a research project and should be harvested promptly.

For Payment Unit 1, harvesting is limited to December 1, 2017 to March 15, 2018.

For Payment Unit 2, harvesting is limited to August 15, 2017 to March 15, 2018.

In Payment Unit 1, slash less than nine inches may not be removed from the sale area. See Sale Spec 2.2.8 for additional restrictions.

Payment Unit 2 must be chip harvested or slash removed in a manner acceptable to the sale administrator, to facilitate follow-up scarification. See Sale Spec 2.2.2 for additional requirements.

No new roads will be permitted.

Since this is a research sale with a short contract length, one (1) contract extension may be applied to one other State Forest Timber Sale Contract owned by the Purchaser. See Sale Spec 7.2.7 for additional information.

A recreation site such as a trail, pathway, or campground is within the sale area or the vicinity. Certain restrictions/specifications may be applicable including time restrictions.

A timber sale contract for this lump sum, sealed bid timber sale will be awarded to the responsible bidder offering the highest sealed bid price. Bids must be at or above the following advertised price for each species:

<u>PRODUCTS & SPECIES</u>	<u>ESTIMATED UNITS*</u>	<u>ADVERTISED PRICE</u>
Sawtimber		
Black Cherry	1.00 MBF	\$ 111.00 / MBF
Red Maple	80.40 MBF	\$ 114.00 / MBF
Sugar Maple	9.20 MBF	\$ 424.00 / MBF
Pulpwood		
Balsam Fir	124.00 Cords	\$ 11.80 / Cord
Hemlock	9.00 Cords	\$ 7.55 / Cord
Mixed Hardwood	802.00 Cords	\$ 19.35 / Cord
White Spruce	13.00 Cords	\$ 24.75 / Cord

* The total volume is statistically estimated within plus (+) or minus (-) 14.18 percent. The estimated units are final and not subject to adjustment. Prospective bidders are urged to examine this timber and to make their own estimates of quantity and quality.

BOND AND PAYMENT SCHEDULE:

1. A bond in the amount of \$1,527.00 to insure faithful performance of the conditions of the contract will be deposited by the successful bidder within 21 days of the sale award.
2. Cutting in any sale or unit without the required advance payment would be considered a trespass.
3. Total payment must be paid in advance or according to the following schedule:
 - (a) Ten percent (10%) of the sale value must be paid within 21 days of the sale award.
 - (b) The 10% down payment will be credited towards the first unit cut.
4. If no cutting takes place, the 10% down payment will not be refunded.
5. Operations on the contract issued will terminate on 06/30/2020.

Sale Specific Conditions & Requirements

Sale Name: Next to Joe's MWR

Sale Number: 42-006-17 Seq#: 1

1 - Sale Area

1.2 - Boundaries

1.2.1 - Painted boundaries (1/14)

The sale boundary and Payment Unit boundaries are marked and identified by blue and red paint. Exterior sale boundary lines against private property are marked with blue paint. Exterior sale boundary lines against state are marked with red paint. Interior Payment Unit boundaries are marked with red paint. Within Payment Unit #1, interior sale boundaries are marked with yellow paint, designating patch cuts. The painted boundary line trees are not Included Timber and are to be protected.

2 - Timber Specifications

2.1 - Included Timber

2.1.1 - Clearcut unit(s) with unmerchantable trees (6/14)

Within Payment Unit(s) #1, cut all trees that are two (2) inches or more at DBH within designated patch-cut areas (bounded by yellow paint). Yellow painted boundary trees are not to be harvested. The total area of the patch cuts is 12.5 acres with patches ranging from 1/3 acre to 1 acre. 20 patch cut areas are located within the 30 acre treatment area bounded by red paint. No trees will be harvested outside of the designated patch cut areas unless needed to maneuver to the next patch cut. These trees will be decked separately for scaling by the sale administrator.

2.1.7 - Leave tree marked unit(s) (6/14)

Within Payment Unit(s) #2, cut all trees that are two (2) inches or more at DBH except trees marked with green paint above and below stump height.

Within Payment Unit #3, cut all trees that are two (2) inches or more at DBH except hemlock, white spruce, white pine, yellow birch and trees marked with green paint above and below stump height.

2.1.11 - Description of timber note (2/04)

Note that Mixed Hardwood pulp includes red maple, sugar maple, beech, cherry and yellow birch.

2.2 - Utilization

2.2.2 - Chipping required (5/14)

Payment Unit #2 must be chip harvested to facilitate follow-up scarification. Products may be produced as roundwood and forwarded to decking areas in final product length, but the tops must be left intact and skidded to the landing for chipping. If market conditions limit the practicality of chipping, the producer may skid all remaining topwood out of this payment unit and scatter in locations approved by the sale administrator. Chipping or slash removal must be completed by March 15th 2018. If the deadline is not met, damages will be collected at a rate determined by the cost for the Department to hire a contractor to complete this specification. The requirement to retain approximately 1/6 to 1/3 of tree tops and limbs less than four inches in diameter does not apply (G. C. & R. 2.2). This is due to the research nature of this unit.

2.2.3 - Stump heights (4/07)

Stump heights within Payment Unit #2 shall not exceed 12 inches for trees greater than 10 inches DBH and 4 inches for trees smaller than 10 inches DBH. A written waiver of this requirement may be obtained if snow levels make these heights unobtainable.

2.2.8 - Utilization and removal (5/14)

In Payment Unit(s) #1, all slash less than nine inches (<9") top diameter outside bark at the small end may not be removed from the sale area, e.g. tops. These tops are to be left intact where they fall with branches remaining upright.

Payment Unit #2 is part of a research project. All slash and all forest products meeting standards set forth in General Condition and Requirement 2.2 - Utilization must be removed from the sale area. The slash must be chipped unless another option is negotiated with the Unit Manager or their representative to reduce, eliminate, and/or disperse the slash into the surrounding area. Chipping or slash removal must be completed by March 15, 2018. This is because of the research nature of this project.

3 - Payments

3.4 - Damaged Timber

3.4.1 - Damaged timber (6/14)

General Condition and Requirement 3.4 Damaged Timber, defines liquidated damages for undesignated live merchantable trees which are cut or injured. No damage is acceptable to residual merchantable trees. Within the sale area, if more than 5% of trees (> 4.5" DBH) within a specified area of the sale are damaged, liquidated damages will be assessed for all trees damaged. Rates will be in accordance with General Condition and Requirement 3.4 Damaged Timber, or at a rate of \$50 per sawtimber tree and \$5 per pole sized tree, whichever is greater.

4 - Transportation

4.1 - Construction

4.1.6 - Road construction (1/09)

Construction of new roads or improvements of existing roads shall be done in such a way as to minimize the environmental and visual impacts. Merchantable trees shall be cut and utilized unless otherwise directed. Non-merchantable trees shall be severed and laid flat on the ground. Slash shall be scattered, and not left in windrows and kept a minimum of 10 feet back from the road edge or be chipped, utilized or otherwise removed from the sale. Stumps shall be set upright, not left on edge, and be moved at least 10 feet away from the road edge. Disturbed soil shall be feathered into the woods and not left in berms or windrows.

4.1.7 - Road closure (10/11)

All new roads built into the sale must be blocked to vehicle traffic upon completion of the sale. Overgrown roads that are reopened shall be considered new roads. In general, this will require constructing double earthen berms at strategic locations. Stumps and brush must be placed along the remainder of the trail. These roads must be rendered impassable to cars and trucks. All stumps from road building and landing construction must be reserved to block any newly constructed roads upon completion of the sale. These stumps must be scattered along the road system to prohibit vehicular movement. Contact the sale administrator for specific details of design and placement.

4.1.12 - No new roads (1/12)

No new roads will be permitted in Payment Unit(s) #'s 1 or 2.

5 - Operations

5.1 - Notification

5.1.1 - Pre-sale conference (10/16)

A pre-sale conference between the Purchaser and sale administrator is required prior to beginning any operations to discuss sale specifications. The Unit Manager or his/her representative must be contacted at least 5 days in advance to schedule the conference.

5.1.4 - Post-sale conference (10/16)

A post-sale conference on site between the Purchaser and sale administrator is required at least 3 days prior to the completion of active logging operations to determine clean-up and repair of landings, road edges, and the fulfillment of other contract specifications.

5.2 - Conduct of Operations

5.2.2 - Hazard Trees/Snags

5.2.2.1 - Den trees (10/16)

Obvious hollow and/or den trees shall be protected and left standing unless they are a safety hazard.

5.2.3 - Operating Restrictions

5.2.3.1 - Operating restrictions (9/11)

Within Payment Unit(s) #2, unless changed by written agreement, cutting and skidding is limited to the period from August 15th, 2017 to March 15th, 2018.

Within Payment Unit(s) #1, unless changed by written agreement, cutting and skidding is limited to the period of December 1st, 2017 to March 15th, 2018.

Payments must be received and operations must begin no later than February, 1st 2018. This restriction is due to the necessity of assuring that all operations are on schedule for timely completion of the research project.

5.2.38 - No decking against live trees (2/04)

Cut products may not be decked against unmarked or designated leave trees.

5.2.41 - Snowmobile trail protection (9/11)

The snowmobile trail is shown on the Timber Sale Map. Do not cut or damage posts with orange trail markers or traffic control signs. If the trail is used, it must be maintained and restored to a condition equal to or better than before the sale. The road maintenance/restoration must be done prior to December 1. If the trail road is to be used for hauling during the snowmobile season, then a snow covered base must be left on the trail. No decking of forest products will be permitted along the snowmobile trail. All stumps within 20 feet of the snowmobile trail must be cut at ground level.

5.4 - Soil Protection

5.4.1 - Rutting restriction, general (7/16)

Operations are to cease immediately if equipment and weather conditions result in rutting of roads and/or skid trails which is 12 inches or greater in depth and 50 feet in length. The Unit Manager or his/her representative may restrict hauling and/or skidding if ruts exceed the specified depth. With the Unit Manager or his/her representative's approval, the Purchaser may return to the area when the risk of rutting has decreased.

5.8 - Protection of Endangered Species

5.8.5 - Protection of raptor nests (3/13)

This specification applies to Payment Unit #3. All trees with raptor nests will be protected if found during harvesting operations. Notification will be made to the Unit Manager or his/her representative who will notify the Wildlife Biologist so an on-site evaluation and recommendation can be made, if necessary.

6 - Safety and Fire Prevention

6.2 - Signing

6.2.1 - Road posting (9/09)

The Purchaser is responsible for posting and maintaining caution signs on County Road 422 prior to beginning operations. The road must be posted at appropriate distances from the sale area to warn of logging activity and truck traffic. Signs must be removed when harvest operations are suspended or completed.

6.2.2 - Snowmobile trail posting (8/09)

The Purchaser is responsible for posting and maintaining caution signs on the snowmobile trail prior to beginning operations during the snowmobile season (approximately December 1 to March 31). The trail must be posted at appropriate distances from the sale area to warn of logging activity and truck traffic. Signs must be removed when harvest operations are suspended or completed.

7 - Other Conditions

7.2 - Extensions

7.2.7 - Research extension (12/16)

This is a research sale with a short contract length. The sale must be harvested promptly. One (1), twelve (12) month extension can be applied to one (1) other State Forest Timber Sale Contract owned by the purchaser or owned by one (1) designated sub-contractor of the Purchaser that works this contract. To qualify, the contract expiration date of the contract to be extended must be within twelve (12) months from the issue date of this contract. If this is the first extension on the other State Forest Timber Sale Contract, then the 5% extension fee will be waived. If this is an additional extension, the 10% fee will be reduced to 5%. The salvage extension must be used before this contract is closed-out. This specification does not alleviate the purchaser from any contractual obligations of the extended State Forest Timber Sale Contract. Per General Condition & Requirement 7.2, extensions are at the sole discretion of the DNR.

7.3 - Contract Modifications

7.3.3 - Modification for reforestation (8/05)

When contractual work of Purchaser has been accepted for any Payment Unit identified on Sale Area Map, Payment Unit will be eliminated from the Sale Area on written notice so that reforestation operations can begin.

TIMBER SALE INFORMATION

Kelly Lake MWR (42-007-17)

Luce County (Advertised Price \$27,503.50)

SALE NOTE: Payment Unit #1 is part of a research project and should be harvested promptly. Harvesting is limited to August 15, 2017 to March 15, 2018.

The patch cuts (bounded by yellow paint) within Payment Unit # 1 must be chip harvested or slash removed in a manner acceptable to the sale administrator, to facilitate follow-up scarification. See Sale Spec 2.2.2 and 2.2.8 for additional requirements.

Within Payment Units 2 - 5, harvesting is not permitted during the period of April 15 to July 15 due to bark slippage.

Since this is a research sale with a short contract length, one (1) contract extension may be applied to one other State Forest Timber Sale Contract owned by the Purchaser. See Sale Spec 7.2.7 for additional information.

A timber sale contract for this lump sum, sealed bid timber sale will be awarded to the responsible bidder offering the highest sealed bid price. Bids must be at or above the following advertised price for each species:

<u>PRODUCTS & SPECIES</u>	<u>ESTIMATED UNITS*</u>	<u>ADVERTISED PRICE</u>
Sawtimber		
Red Maple	14.30 MBF	\$ 126.00 / MBF
Sugar Maple	23.70 MBF	\$ 467.00 / MBF
Pulpwood		
Balsam Fir	4.00 Cords	\$ 13.00 / Cord
Mixed Hardwood	638.00 Cords	\$ 21.30 / Cord
Quaking Aspen	36.00 Cords	\$ 24.15 / Cord
White Pine	6.00 Cords	\$ 20.50 / Cord

* The total volume is statistically estimated within plus (+) or minus (-) 13.72 percent. The estimated units are final and not subject to adjustment. Prospective bidders are urged to examine this timber and to make their own estimates of quantity and quality.

BOND AND PAYMENT SCHEDULE:

1. A bond in the amount of \$1,375.00 to insure faithful performance of the conditions of the contract will be deposited by the successful bidder within 21 days of the sale award.
2. Cutting in any sale or unit without the required advance payment would be considered a trespass.
3. Total payment must be paid in advance or according to the following schedule:
 - (a) Ten percent (10%) of the sale value must be paid within 21 days of the sale award.
 - (b) The 10% down payment will be credited towards the first unit cut.
4. If no cutting takes place, the 10% down payment will not be refunded.
5. Operations on the contract issued will terminate on 06/30/2020.

Description of Timber by Payment Unit (PU)

PU	MARKET GROUP	PRODUCT	QUANTITY	UNIT	ACRES	ADVERTISE PRICE
1	Red Maple	Sawtimber	5.3	MBF	29.8	\$8,019.10
	Sugar Maple		5.9	MBF		
	Mixed Hardwood	Pulpwood	210.0	Cords		
	<i>Beech</i>		26.0	<i>Cords</i>		
	<i>Black Cherry</i>		12.0	<i>Cords</i>		
	<i>Red Maple</i>		66.0	<i>Cords</i>		
	<i>Sugar Maple</i>		106.0	<i>Cords</i>		
	White Pine		6.0	Cords		
2	Red Maple	Sawtimber	3.1	MBF	25.7	\$4,497.15
	Sugar Maple		2.5	MBF		
	Balsam Fir	Pulpwood	4.0	Cords		
	Mixed Hardwood		114.0	Cords		
	<i>Red Maple</i>		82.0	<i>Cords</i>		
	<i>Sugar Maple</i>		32.0	<i>Cords</i>		
	Quaking Aspen		19.0	Cords		
	3	Red Maple	Sawtimber	0.8		
Sugar Maple			3.2	MBF		
Mixed Hardwood		Pulpwood	52.0	Cords		
<i>Red Maple</i>			8.0	<i>Cords</i>		
<i>Sugar Maple</i>			44.0	<i>Cords</i>		
Quaking Aspen			3.0	Cords		
4		Red Maple	Sawtimber	2.4	MBF	6.1
	Sugar Maple		10.1	MBF		
	Mixed Hardwood	Pulpwood	104.0	Cords		
	<i>Red Maple</i>		19.0	<i>Cords</i>		
	<i>Sugar Maple</i>		85.0	<i>Cords</i>		
5	Red Maple	Sawtimber	2.7	MBF	13.7	\$4,977.70
	Sugar Maple		2.0	MBF		
	Mixed Hardwood	Pulpwood	158.0	Cords		
	<i>Black Cherry</i>		11.0	<i>Cords</i>		
	<i>Paper Birch</i>		3.0	<i>Cords</i>		
	<i>Red Maple</i>		76.0	<i>Cords</i>		
	<i>Sugar Maple</i>		68.0	<i>Cords</i>		
	Quaking Aspen		14.0	Cords		
	TOTAL:			38.0		
TOTAL:			684.0	Cords		

Sale Specific Conditions & Requirements

Sale Name: Kelly Lake MWR

Sale Number: 42-007-17 Seq#: 1

1 - Sale Area

1.2 - Boundaries

1.2.1 - Painted boundaries (1/14)

The sale boundary and Payment Unit boundaries are marked and identified by blue, red and yellow paint. Exterior sale boundary lines against private property are marked with blue paint. Exterior sale boundary lines against state are marked with red paint. Interior Payment Unit boundaries are marked with red paint. Within Payment Unit #1, interior sale boundaries are marked with yellow paint, designating patch cuts. The painted boundary line trees are not Included Timber and are to be protected unless marked with orange paint.

2 - Timber Specifications

2.1 - Included Timber

2.1.3 - Cut tree marked unit(s) (12/08)

Within Payment Unit(s) # 1 - 5, all trees are designated for cutting when marked with orange paint above and below stump height, regardless of merchantability. ALSO, within Payment Unit # 1, cut all trees that are two (2) inches or more at DBH within designated patch-cut areas (bounded by yellow paint). Yellow painted boundary trees are not to be harvested. The total area of the patch cuts is 1.95 acres with each patch being 0.15 acres in size. Thirteen (13) patch cut areas are located within the 30 acre treatment area bounded by red paint.

2.1.11 - Description of timber note (2/04)

Note that Mixed Hardwood pulp includes sugar maple, red maple, beech, paper birch and black cherry.

2.2 - Utilization

2.2.2 - Chipping required (5/14)

The patch cuts (bounded by yellow paint) within Payment Unit #1 must be chip harvested or have slash removed in a manner acceptable to the sale administrator, to facilitate follow-up scarification. Products may be produced as roundwood and forwarded to decking areas in final product length, but the tops must be left intact and skidded to the landing for chipping, unless other slash removal techniques have been approved. If market conditions limit the practicality of chipping, the producer may skid all remaining topwood out of these payment units and scatter in locations approved by the sale administrator. Chipping or slash removal must be completed by March 15, 2018. If the deadline is not met, damages will be collected at a rate determined by the cost for the Department to hire a contractor to complete this specification. The requirement to retain approximately 1/6 to 1/3 of tree tops and limbs less than four inches in diameter does not apply (G. C. & R. 2.2). This is due to the research nature of these units.

2.2.3 - Stump heights (4/07)

Stump heights within Payment Unit #1 shall not exceed 12 inches for trees greater than 10 inches DBH and 4 inches for trees smaller than 10 inches DBH. A written waiver of this requirement may be obtained if snow levels make these heights unobtainable.

2.2.4 - Skidding length (2/14)

Skidding of unlimbed tops or lengths over 17 feet is not permissible unless approved by the Unit Manager or his/her representative.

2.2.8 - Utilization and removal (5/14)

Payment Unit # 1 is part of a research project. All slash and all forest products meeting standards set forth in General Condition and Requirement 2.2 - Utilization must be removed from the small patch cut areas bounded by yellow paint. The slash must be chipped unless another option is negotiated with the Unit Manager or their representative to reduce, eliminate, and/or disperse the slash into the surrounding area. Chipping or slash removal must be completed by March 15, 2018. This is because of the research nature of this project.

3 - Payments

3.4 - Damaged Timber

3.4.1 - Damaged timber (6/14)

General Condition and Requirement 3.4 Damaged Timber, defines liquidated damages for undesignated live merchantable trees which are cut or injured. No damage is acceptable to residual merchantable trees. Within the sale area, if more than 5% of trees (> 4.5" DBH) within a specified area of the sale are damaged, liquidated damages will be assessed for all trees damaged. Rates will be in accordance with General Condition and Requirement 3.4 Damaged Timber, or at a rate of \$50 per sawtimber tree and \$5 per pole sized tree, whichever is greater.

4 - Transportation

4.1 - Construction

4.1.6 - Road construction (1/09)

Construction of new roads or improvements of existing roads shall be done in such a way as to minimize the environmental and visual impacts. Merchantable trees shall be cut and utilized unless otherwise directed. Non-merchantable trees shall be severed and laid flat on the ground. Slash shall be scattered, and not left in windrows and kept a minimum of 10 feet back from the road edge. Stumps shall be set upright, not left on edge, and be moved at least 10 feet away from the road edge. Disturbed soil shall be feathered into the woods and not left in berms or windrows.

4.1.7 - Road closure (10/11)

All new roads built into the sale must be blocked to vehicle traffic upon completion of the sale. Overgrown roads that are reopened shall be considered new roads. In general, this will require constructing double earthen berms at strategic locations. Stumps and brush must be placed along the remainder of the trail. These roads must be rendered impassable to cars and trucks. All stumps from road building and landing construction must be reserved to block any newly constructed roads upon completion of the sale. These stumps must be scattered along the road system to prohibit vehicular movement. Contact the sale administrator for specific details of design and placement.

4.2 - Maintenance

4.2.5 - Two wheel drive condition (2/04)

All existing trail roads on and adjacent to the sale area must be passable by two-wheel drive traffic for the duration of the sale.

5 - Operations

5.1 - Notification

5.1.1 - Pre-sale conference (10/16)

A pre-sale conference between the Purchaser and sale administrator is required prior to beginning any operations to discuss sale specifications, and to determine landing and road locations. The Unit Manager or his/her representative must be contacted at least 5 days in advance to schedule the conference.

5.1.4 - Post-sale conference (10/16)

A post-sale conference on site between the Purchaser and sale administrator is required 3 days prior to the completion of active logging operations to determine clean-up and repair of landings, road edges, and the fulfillment of other contract specifications.

5.2 - Conduct of Operations

5.2.2 - Hazard Trees/Snags

5.2.2.1 - Den trees (10/16)

Obvious hollow and/or den trees shall be protected and left standing unless they are a safety hazard.

5.2.3 - Operating Restrictions

5.2.3.1 - Operating restrictions (9/11)

Within Payment Unit(s) #1, unless changed by written agreement, cutting and skidding is limited to the period from August 15th, 2017 to March 15th, 2018. Payments must be received and operations must begin no later than February, 1st 2018. This restriction is due to the necessity of assuring that all operations are on schedule for timely completion of the research project.

5.2.3.3 - Bark slippage restriction (3/09)

Within Payment Unit(s) #'s 2 - 5, unless changed by written agreement, cutting and skidding are not permitted during the period of April 15 to July 15. This restriction is because of bark slippage.

5.2.38 - No decking against live trees (2/04)

Cut products may not be decked against unmarked or designated leave trees.

5.4 - Soil Protection

5.4.1 - Rutting restriction, general (7/16)

Operations are to cease immediately if equipment and weather conditions result in rutting of roads and/or skid trails which is 12 inches or greater in depth and 50 feet in length. The Unit Manager or his/her representative may restrict hauling and/or skidding if ruts exceed the specified depth. With the Unit Manager or his/her representative's approval, the Purchaser may return to the area when the risk of rutting has decreased.

5.8 - Protection of Endangered Species

5.8.5 - Protection of raptor nests (3/13)

This specification applies to Payment Unit #'s 2 - 5. All trees with raptor nests will be protected if found during harvesting operations. Notification will be made to the Unit Manager or his/her representative who will notify the Wildlife Biologist so an on-site evaluation and recommendation can be made, if necessary.

6 - Safety and Fire Prevention

6.2 - Signing

6.2.1 - Road posting (9/09)

The Purchaser is responsible for posting and maintaining caution signs on County Road 455 prior to beginning operations. The road must be posted at appropriate distances from the sale area to warn of logging activity and truck traffic. Signs must be removed when harvest operations are suspended or completed.

7 - Other Conditions

7.2 - Extensions

7.2.7 - Research extension (12/16)

This is a research sale with a short contract length. The sale must be harvested promptly. One (1), twelve (12) month extension can be applied to one (1) other State Forest Timber Sale Contract owned by the purchaser or owned by one (1) designated sub-contractor of the Purchaser that works this contract. To qualify, the contract expiration date of the contract to be extended must be within twelve (12) months from the issue date of this contract. If this is the first extension on the other State Forest Timber Sale Contract, then the 5% extension fee will be waived. If this is an additional extension, the 10% fee will be reduced to 5%. The salvage extension must be used before this contract is closed-out. This specification does not alleviate the purchaser from any contractual obligations of the extended State Forest Timber Sale Contract. Per General Condition & Requirement 7.2, extensions are at the sole discretion of the DNR.

7.3 - Contract Modifications

7.3.3 - Modification for reforestation (8/05)

When contractual work of Purchaser has been accepted for any Payment Unit identified on Sale Area Map, Payment Unit will be eliminated from the Sale Area on written notice so that reforestation operations can begin.



TIMBER SALE MAP

This information provided by authority of Part 525, 1994 PA 451, as amended.

Forest Management Unit Newberry	County Luce	Mapped By Douglass	Date 03/24/2017	Page 1	of 1
Township 47N	Range 11W	Section(s) and Subdivision(s) Sec 26 - NESE, S1/2SE; Sec 35 - E1/2NE; Sec 36 - NW1/4	Cruised By Newberry Staff		
Scale 1:15,840					

Cover Type

A = Aspen	H = Hemlock	N = Marsh	U = Upland Brush
B = Paper Birch	J = Jack Pine	O = Oak	UM = Upland Mixed
C = Cedar	L = Lowland Brush	P = Lowland Poplar	V = Bog or Marsh
D = Tread Bog	LM = Lowland Mixed	Q = Mixed Swamp Conifer	W = White Pine
E = Swamp Hdwoods	M = Mpl, Bch, Brch	R = Red Pine	X = Non Stocked
F = Spruce Fir	MC = Mixed Conifer	S = Black Spruce	Z = Water
G = Grass	MD = Mixed Deciduous	T = Tamarack	

Density

0 = Non Stocked	5 = Pole Timber Medium
1 = Seedling Sapling Poor	6 = Pole Timber Well
2 = Seedling Sapling Medium	7 = Saw Timber Poor
3 = Seedling Sapling Well	8 = Saw Timber Medium
4 = Pole Timber Poor	9 = Saw Timber Well

PU	Acres	PU	Acres
1	29.8	4	6.1
2	25.7	5	13.7
3	6.2		

Kelly Lake MWR

Compartment 90

81.5 Acres

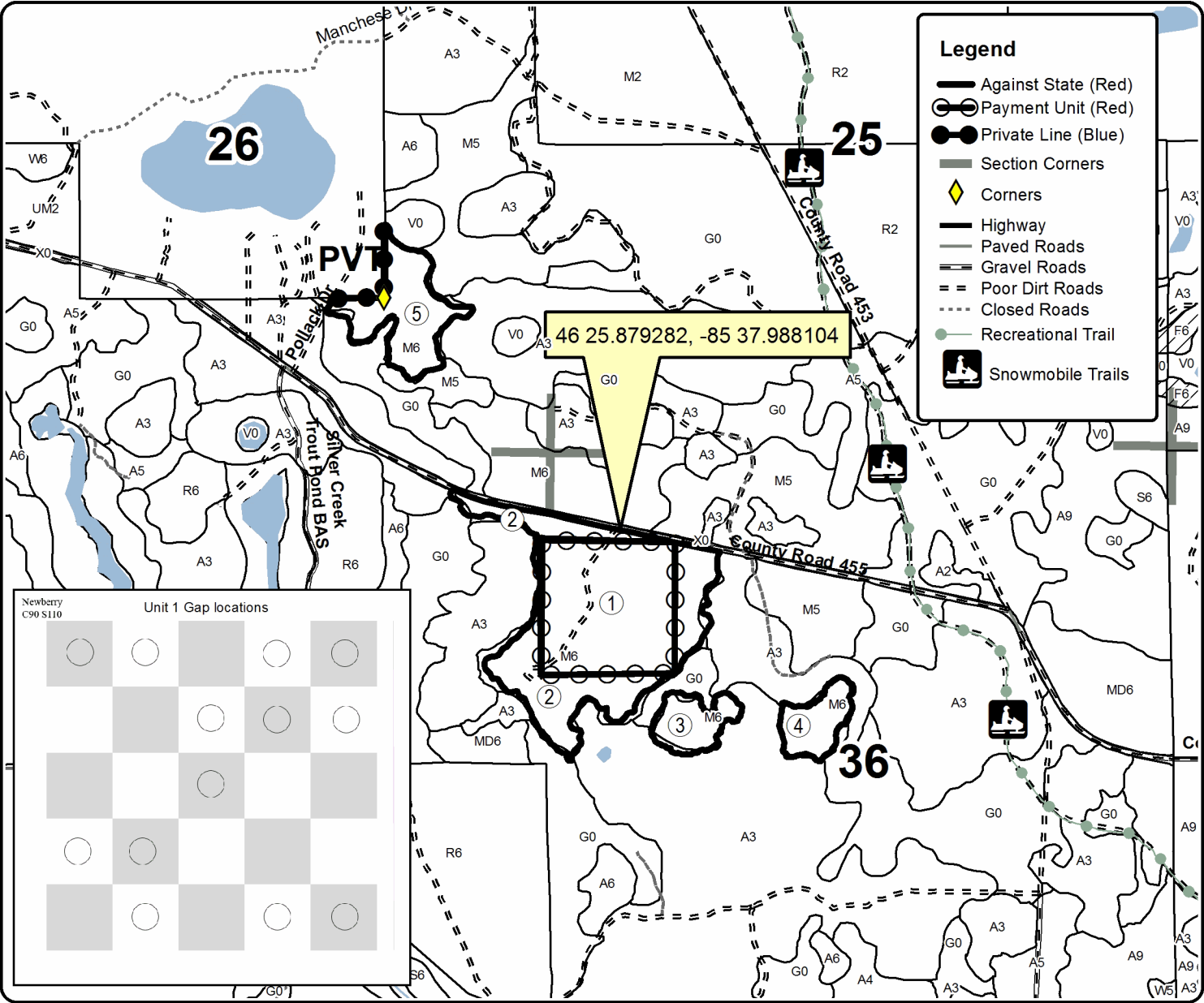
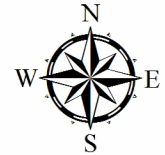

Legend

- Against State (Red)
- Payment Unit (Red)
- Private Line (Blue)
- Section Corners
- ◆ Corners
- Highway
- Paved Roads
- Gravel Roads
- - - Poor Dirt Roads
- - - Closed Roads
- Recreational Trail
- Snowmobile Trails

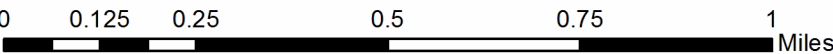

M-117 MWR (42-004-17)
 ; Luce COUNTY

In response to the notice of sale to be held 3:00 p.m. (local time) on May 25, 2017, I am hereby submitting my sealed bid (firm offer) for the following forest products to be cut. Bids for individual species must be at or above the advertised price. All non-responsive bid forms may be rejected.

<u>PRODUCTS & SPECIES</u>	<u>ESTIMATED VOLUME*</u>	<u>ADVERTISED PRICE</u>	<u>BID PRICE</u>
Sawtimber			
Basswood	6.30 MBF	\$ 133.00/MBF	\$ _____
Black Cherry	37.90 MBF	\$ 111.00/MBF	\$ _____
Red Maple	50.90 MBF	\$ 114.00/MBF	\$ _____
Sugar Maple	168.70 MBF	\$ 424.00/MBF	\$ _____
Pulpwood			
Balsam Fir	15.00 Cords	\$ 11.80/Cord	\$ _____
Mixed Aspen	18.00 Cords	\$ 21.95/Cord	\$ _____
Mixed Hardwood	1,426.00 Cords	\$ 19.35/Cord	\$ _____

*The volumes are statistically estimated within plus (+) or minus (-) 14.19 percent. These estimated volumes are final and not subject to adjustment. Prospective bidders are urged to examine this timber and to make their own estimates of quantity and quality.

I understand that any or all bids may be rejected. All bids must be signed and all bid items must be bid or the bid form may be rejected. I also understand that consideration and awarding a contract will be based upon my past performance and ability to complete the contract based upon equipment and staffing subject to my control.

FEDERAL ID: _____ or SOCIAL SECURITY NUMBER: _____

Company or individual bidding: _____

Company representative's name: _____

Address: _____

City: _____ State: _____ Zip: _____

IF AVAILABLE, PLEASE PLACE THE PERSONALIZED LABEL FROM YOUR PROSPECTUS IN THE ABOVE BOX.

Individual or company representative's signature: _____ Date: _____

Phone number : _____ Email (optional): _____

THE WINNING BIDDER MUST COMPLETE THE VERIFICATION OF WORKER'S DISABILITY COMPENSATION ACT COMPLIANCE (ON REVERSE SIDE IF DOUBLE SIDED) WITHIN 21 DAYS OF SALE AWARD DATE

Camp 7 MWR (42-005-17)
; Luce COUNTY

In response to the notice of sale to be held 3:00 p.m. (local time) on May 25, 2017, I am hereby submitting my sealed bid (firm offer) for the following forest products to be cut. Bids for individual species must be at or above the advertised price. All non-responsive bid forms may be rejected.

<u>PRODUCTS & SPECIES</u>	<u>ESTIMATED VOLUME*</u>	<u>ADVERTISED PRICE</u>	<u>BID PRICE</u>
Sawtimber			
Red Maple	17.00 MBF	\$ 114.00/MBF	\$ _____
Sugar Maple	145.70 MBF	\$ 424.00/MBF	\$ _____
Pulpwood			
Balsam Fir	1.00 Cords	\$ 11.80/Cord	\$ _____
Mixed Hardwood	460.00 Cords	\$ 19.35/Cord	\$ _____

*The volumes are statistically estimated within plus (+) or minus (-) 10.11 percent. These estimated volumes are final and not subject to adjustment. Prospective bidders are urged to examine this timber and to make their own estimates of quantity and quality.

I understand that any or all bids may be rejected. All bids must be signed and all bid items must be bid or the bid form may be rejected. I also understand that consideration and awarding a contract will be based upon my past performance and ability to complete the contract based upon equipment and staffing subject to my control.

FEDERAL ID: _____ or SOCIAL SECURITY NUMBER: _____

Company or individual bidding: _____

Company representative's name: _____

Address: _____

City: _____ State: _____ Zip: _____

IF AVAILABLE, PLEASE PLACE THE PERSONALIZED LABEL FROM YOUR PROSPECTUS IN THE ABOVE BOX.

Individual or company representative's signature: _____ Date: _____

Phone number : _____ Email (optional): _____

THE WINNING BIDDER MUST COMPLETE THE VERIFICATION OF WORKER'S DISABILITY COMPENSATION ACT COMPLIANCE (ON REVERSE SIDE IF DOUBLE SIDED) WITHIN 21 DAYS OF SALE AWARD DATE



FOR DEPARTMENT USE ONLY
Sale Number (XX - XXX - XX - XX)
Forest Management Unit:

TIMBER SALE VERIFICATION OF WORKER'S DISABILITY COMPENSATION ACT COMPLIANCE

*As required by Act 317, P.A. 1969 (Worker's Compensation) and
Part 5 of Act 451 of 1994, as amended.*

VERIFICATION OF WORKER'S DISABILITY COMPENSATION ACT COMPLIANCE

- This verification must be completed and submitted within 21 days of contract award and prior to the issuance of the timber sale contract.
- In addition, if boxes 2B or 2C are checked, then Notice of Exclusion or Certificate of Insurance must be submitted within twenty-one (21) days of the contract award and prior to the issuance of the timber sale contract.
- All information must be typed or printed except for written signatures.

Please Check Appropriate Categories:

1. My business is organized as (you **must** check one of the boxes below):
 - A. Sole Proprietorship (individual)
 - B. Partnership
 - C. Corporation

2. You **must** check one of the boxes below:
 - A. I certify my business is a sole proprietorship and it has no employees but the sole proprietor. I am not subject to the Worker's Compensation Laws.
 - B. I certify my business has satisfied its obligation to the Worker's Compensation Act through the use of an approved Notice of Exclusion (BWC-337, Rev. 5/96). I will provide a copy of the Notice of Exclusion within 21 days of the contract award. (For questions or a copy of the BWC-337, please call the Worker's Compensation Bureau at 517-322-1195).
 - C. I certify my business has a Worker's Compensation Policy. I will provide an original Certificate of Insurance within twenty-one (21) days of the contract award.

3. If you have checked item 2(A) or 2(B), you **must** indicate the number of **both** full-time and part-time employees, other than yourself, including family members and active partners (if none, you must enter "0").

_____ Full-time Employees

_____ Part-time Employees

Name of Business		Federal ID (or) Social Security No.	
Address		Telephone ()	
City	State	ZIP	

I hereby certify that the above information is true and correct. I agree to notify the Michigan DNR of any changes that occur in factors affecting my coverage during any of my present and future operations.

Signature of Owner or Authorized Representative

Title

Date

Please complete the "SEALED BID" information on the next page

Kelly Lake MWR (42-007-17)
 ; Luce COUNTY

In response to the notice of sale to be held 3:00 p.m. (local time) on May 25, 2017, I am hereby submitting my sealed bid (firm offer) for the following forest products to be cut. Bids for individual species must be at or above the advertised price. All non-responsive bid forms may be rejected.

<u>PRODUCTS & SPECIES</u>	<u>ESTIMATED VOLUME*</u>	<u>ADVERTISED PRICE</u>	<u>BID PRICE</u>
Sawtimber			
Red Maple	14.30 MBF	\$ 126.00/MBF	\$ _____
Sugar Maple	23.70 MBF	\$ 467.00/MBF	\$ _____
Pulpwood			
Balsam Fir	4.00 Cords	\$ 13.00/Cord	\$ _____
Mixed Hardwood	638.00 Cords	\$ 21.30/Cord	\$ _____
Quaking Aspen	36.00 Cords	\$ 24.15/Cord	\$ _____
White Pine	6.00 Cords	\$ 20.50/Cord	\$ _____

*The volumes are statistically estimated within plus (+) or minus (-) 13.72 percent. These estimated volumes are final and not subject to adjustment. Prospective bidders are urged to examine this timber and to make their own estimates of quantity and quality.

I understand that any or all bids may be rejected. All bids must be signed and all bid items must be bid or the bid form may be rejected. I also understand that consideration and awarding a contract will be based upon my past performance and ability to complete the contract based upon equipment and staffing subject to my control.

FEDERAL ID: ____ - ____ - ____ or SOCIAL SECURITY NUMBER: ____ - ____ - ____

Company or individual bidding: _____

Company representative's name: _____

Address: _____

City: _____ State: _____ Zip: _____

IF AVAILABLE, PLEASE PLACE THE PERSONALIZED LABEL FROM YOUR PROSPECTUS IN THE ABOVE BOX.

Individual or company representative's signature: _____ Date: _____

Phone number : _____ Email (optional): _____

THE WINNING BIDDER MUST COMPLETE THE VERIFICATION OF WORKER'S DISABILITY COMPENSATION ACT COMPLIANCE (ON REVERSE SIDE IF DOUBLE SIDED) WITHIN 21 DAYS OF SALE AWARD DATE



FOR DEPARTMENT USE ONLY
Sale Number (XX - XXX - XX - XX)
Forest Management Unit:

TIMBER SALE VERIFICATION OF WORKER'S DISABILITY COMPENSATION ACT COMPLIANCE

*As required by Act 317, P.A. 1969 (Worker's Compensation) and
Part 5 of Act 451 of 1994, as amended.*

VERIFICATION OF WORKER'S DISABILITY COMPENSATION ACT COMPLIANCE

- This verification must be completed and submitted within 21 days of contract award and prior to the issuance of the timber sale contract.
- In addition, if boxes 2B or 2C are checked, then Notice of Exclusion or Certificate of Insurance must be submitted within twenty-one (21) days of the contract award and prior to the issuance of the timber sale contract.
- All information must be typed or printed except for written signatures.

Please Check Appropriate Categories:

1. My business is organized as (you **must** check one of the boxes below):
 - A. Sole Proprietorship (individual)
 - B. Partnership
 - C. Corporation
2. You **must** check one of the boxes below:
 - A. I certify my business is a sole proprietorship and it has no employees but the sole proprietor. I am not subject to the Worker's Compensation Laws.
 - B. I certify my business has satisfied its obligation to the Worker's Compensation Act through the use of an approved Notice of Exclusion (BWC-337, Rev. 5/96). I will provide a copy of the Notice of Exclusion within 21 days of the contract award. (For questions or a copy of the BWC-337, please call the Worker's Compensation Bureau at 517-322-1195).
 - C. I certify my business has a Worker's Compensation Policy. I will provide an original Certificate of Insurance within twenty-one (21) days of the contract award.
3. If you have checked item 2(A) or 2(B), you **must** indicate the number of **both** full-time and part-time employees, other than yourself, including family members and active partners (if none, you must enter "0").

_____ Full-time Employees

_____ Part-time Employees

Name of Business		Federal ID (or) Social Security No.	
Address		Telephone ()	
City	State	ZIP	

I hereby certify that the above information is true and correct. I agree to notify the Michigan DNR of any changes that occur in factors affecting my coverage during any of my present and future operations.

Signature of Owner or Authorized Representative

Title

Date

Please complete the "SEALED BID" information on the next page

Next to Joe's MWR (42-006-17)
 ; Luce COUNTY

In response to the notice of sale to be held 3:00 p.m. (local time) on May 25, 2017, I am hereby submitting my sealed bid (firm offer) for the following forest products to be cut. Bids for individual species must be at or above the advertised price. All non-responsive bid forms may be rejected.

<u>PRODUCTS & SPECIES</u>	<u>ESTIMATED VOLUME*</u>	<u>ADVERTISED PRICE</u>	<u>BID PRICE</u>
Sawtimber			
Black Cherry	1.00 MBF	\$ 111.00/MBF	\$ _____
Red Maple	80.40 MBF	\$ 114.00/MBF	\$ _____
Sugar Maple	9.20 MBF	\$ 424.00/MBF	\$ _____
Pulpwood			
Balsam Fir	124.00 Cords	\$ 11.80/Cord	\$ _____
Hemlock	9.00 Cords	\$ 7.55/Cord	\$ _____
Mixed Hardwood	802.00 Cords	\$ 19.35/Cord	\$ _____
White Spruce	13.00 Cords	\$ 24.75/Cord	\$ _____

*The volumes are statistically estimated within plus (+) or minus (-) 14.18 percent. These estimated volumes are final and not subject to adjustment. Prospective bidders are urged to examine this timber and to make their own estimates of quantity and quality.

I understand that any or all bids may be rejected. All bids must be signed and all bid items must be bid or the bid form may be rejected. I also understand that consideration and awarding a contract will be based upon my past performance and ability to complete the contract based upon equipment and staffing subject to my control.

FEDERAL ID: _____ or SOCIAL SECURITY NUMBER: _____
 Company or individual bidding: _____
 Company representative's name: _____
 Address: _____
 City: _____ State: _____ Zip: _____

IF AVAILABLE, PLEASE PLACE THE PERSONALIZED LABEL FROM YOUR PROSPECTUS IN THE ABOVE BOX.

Individual or company representative's signature: _____ Date: _____

Phone number : _____ Email (optional): _____

THE WINNING BIDDER MUST COMPLETE THE VERIFICATION OF WORKER'S DISABILITY COMPENSATION ACT COMPLIANCE (ON REVERSE SIDE IF DOUBLE SIDED) WITHIN 21 DAYS OF SALE AWARD DATE



FOR DEPARTMENT USE ONLY
Sale Number (XX – XXX – XX – XX)
Forest Management Unit:

TIMBER SALE VERIFICATION OF WORKER'S DISABILITY COMPENSATION ACT COMPLIANCE

*As required by Act 317, P.A. 1969 (Worker's Compensation) and
Part 5 of Act 451 of 1994, as amended.*

VERIFICATION OF WORKER'S DISABILITY COMPENSATION ACT COMPLIANCE

- This verification must be completed and submitted within 21 days of contract award and prior to the issuance of the timber sale contract.
- In addition, if boxes 2B or 2C are checked, then Notice of Exclusion or Certificate of Insurance must be submitted within twenty-one (21) days of the contract award and prior to the issuance of the timber sale contract.
- All information must be typed or printed except for written signatures.

Please Check Appropriate Categories:

1. My business is organized as (you **must** check one of the boxes below):
 - A. Sole Proprietorship (individual)
 - B. Partnership
 - C. Corporation

2. You **must** check one of the boxes below:
 - A. I certify my business is a sole proprietorship and it has no employees but the sole proprietor. I am not subject to the Worker's Compensation Laws.
 - B. I certify my business has satisfied its obligation to the Worker's Compensation Act through the use of an approved Notice of Exclusion (BWC-337, Rev. 5/96). I will provide a copy of the Notice of Exclusion within 21 days of the contract award. (For questions or a copy of the BWC-337, please call the Worker's Compensation Bureau at 517-322-1195).
 - C. I certify my business has a Worker's Compensation Policy. I will provide an original Certificate of Insurance within twenty-one (21) days of the contract award.

3. If you have checked item 2(A) or 2(B), you **must** indicate the number of **both** full-time and part-time employees, other than yourself, including family members and active partners (if none, you must enter "0").

_____ Full-time Employees

_____ Part-time Employees

Name of Business		Federal ID (or) Social Security No.	
Address		Telephone ()	
City	State	ZIP	

I hereby certify that the above information is true and correct. I agree to notify the Michigan DNR of any changes that occur in factors affecting my coverage during any of my present and future operations.

Signature of Owner or Authorized Representative

Title

Date

Please complete the "SEALED BID" information on the next page