



**DEPARTMENT OF NATURAL RESOURCES
STATE OF MICHIGAN**

TIMBER SALE PROSPECTUS #5821

SCHEDULED SALE DATE AND TIME: 10:00 a.m. (local time) on July 25, 2017.

LOCATION: ATLANTA MGMT UNIT, 13501 M-33, ATLANTA, MI 49709.

PROSPECTUS NOTE: The bidder is advised to inspect the sale area and review the location, estimated volumes, operating costs and contract terms of proposed sales. Please be aware that some landowners may request 60 days or more notice for access across their land.

Notice is hereby given that bids will be received by the Unit Manager, ATLANTA MANAGEMENT UNIT, for certain timber on the following described lands:

Andor Junction Mix (54-016-16)

Alpena County, Advertised Price \$56,523.45, 87.3 Acres, Aspen, Hardwood.

Spruce Road Mix (54-017-16)

Alpena County, Advertised Price \$54,421.70, 75.1 Acres, Aspen, Hardwood.

SALE NOTE: There is dead standing ash in this sale that should be harvested as soon as possible.

Access through private land to Payment Units 5, 6, and 7 is the responsibility of the producer. See timber sale spec. 4.4.1, Private Property Access.

Spec. 5.2.17 requires the use of Crane Mats/Timber Mats.

A recreation site such as a trail, pathway, or campground is within the sale area or the vicinity. Certain restrictions/specifications may be applicable including time restrictions. Access may be through private or other public land.

TBR Mile Mix (54-026-16)

Alpena County, Advertised Price \$50,554.15, 73.9 Acres, Hardwood, Spruce/Fir/Tamarack.

SALE NOTE: Spec. 4.1.8 Requires culverts are installed on access route.

The following road work is required: Three (3) to four (4) culverts will need to be placed along the stretch of forest trail that runs from the west end of Eagling Road south to the railroad grade.

Time Traveler Aspen & Oak (54-037-16)

Alpena County, Advertised Price \$102,813.95, 185.3 Acres, Aspen, Hardwood.

SALE NOTE: This is a 3 year contract with no extensions (spec. 7.2.2).

Payment units adjacent to the recreation trails are restricted from 12/15-3/31 (spec. 5.2.3.1). Payment units may be divided to work around this seasonal restriction (spec. 3.3.4). In addition, all marked to cut units are restricted from 4/1-7/15 for bark slip and oak wilt concerns (spec. 5.2.3.3 & 5.2.3.4).

A recreation site such as a trail, pathway, or campground is within the sale area or the vicinity. Certain restrictions/specifications may be applicable including time restrictions.

2 Four D Pine (54-051-16)

Alpena County, Advertised Price \$46,577.05, 39.2 Acres, Red Pine, White Pine.

SALE NOTE: A recreation site such as a trail, pathway, or campground is within the sale area or the vicinity. Certain restrictions/specifications may be applicable including time restrictions.

BID INSTRUCTIONS (VER. 09/02/2016):

1. Scheduled Bid Location, Date, and Time (2/11)

Bids must be received by the Unit Manager, ATLANTA OFFICE, 13501 M-33, ATLANTA, MI 49709, no later than 10:00 a.m. (local time) on July 25, 2017. For further information concerning this sale, contact Cody Stevens at 989-785-4251 extension 5240.

2. Bidder's Qualifications (5/16)

Purchaser shall obtain workers compensation insurance to cover claims under Michigan's Worker's Disability Compensation Act of 1969 or similar employee benefit act of any other state applicable to an employee. If all or part of a timber sale was prepared by a private contractor, the contractor and that contractor's company are not permitted to bid on the timber sale contract. Bids will not be accepted from individuals or companies appearing on the DNR/FRD No-Bid List. This list contains the names of purchasers who previously failed to execute a contract within 21-days or who have a history of poor performance.

3. Preparation of Sealed Bids (5/16)

Bid Forms may be completed online thru Michigan DNR Timber Sale Online Bidding (OLB) at www.michigan.gov/timberbidding or by completing the hardcopy Bid Form found in the Timber Sale Prospectus. Hardcopy Bid Forms shall be manually signed in ink. Registration in OLB is considered your 'signature' for all bids submitted thru that system. Bid prices must be entered for each species and product in the Bid Price column for all material subject to bidding and all fill-in blanks must be completed. If erasures or other changes appear on the hardcopy Bid Form, each erasure or change must be initialed by the person signing the bid.

4. Submission of Sealed Bids (5/16)

Bid forms may be obtained from the Unit Manager or thru OLB. Bids may be submitted hardcopy or thru OLB. All hardcopy bids must be submitted on the bid form and in an envelope clearly identified as described in this section. NOTE: Only one bid form per bid envelope. Sealed bids must be submitted to the Unit office designated in the prospectus and must be submitted at or prior to the time established in the prospectus. The envelope should show on the outside (a) the sale name or number and (b) the date and time of bid opening, as shown in the prospectus. Bids received after the time specified in the sale prospectus are late bids and will be rejected.

It is possible for a bidder to submit multiple bids on a single sale. For example, a bid may be submitted hardcopy and a bid may be submitted thru OLB. Or, two bidders from the same company could both submit bids on the same sale. If this were to happen, the State would accept all bids received and award the contract accordingly. All bidding and contractual requirements would apply to all bids received.

5. Public Opening of Sealed Bids (7/16)

If conditions permit, the sealed bids will be publicly opened and posted at the time and place set in the prospectus.

If a bidder, present at a bid opening, has submitted bids on more than one sale, that bidder may withdraw their unopened bid envelopes or announce the withdrawal of their online bid after being declared the successful bidder on one sale.

6. Award of Contract (1/11)

Award of the contract will be made to the Bidder whose bid, conforming to the prospectus, is most advantageous to the State of Michigan on the basis of total value at rates bid for the estimated quantities. The State reserves the right to reject any bid or waive any minor irregularity in bids received. A written award mailed (or otherwise furnished) to the successful Bidder shall be deemed to result in a binding contract without further action by either party.

7. Down Payment (1/11)

The Bidder to whom award is made must make a down payment within 21 days of the sale award. The amount of the down payment will be calculated as shown in the Bond and Payment Schedule of this prospectus. Only cash may be used to meet this requirement.

8. Performance Security (1/11)

As guarantee of faithful performance, a cash bond, certificate of deposit, surety bond or irrevocable letter of credit (LOC) is required within 21 days of the sale award. The amount of the performance security is shown in the Bond and

Payment Schedule of this prospectus. If an LOC or surety is used, the coverage must extend for at least 6 months beyond the contract expiration.

9. Timber Sale Contract (9/14)

Additional conditions and requirements common to all timber sales are listed on the timber sale contract (R4031) and are available on line at www.michigan.gov/timber. Contact the Unit Manager for additional information or a sample contract. Within 21 days of the date of the award letter, the bidder must sign the contract and provide the required down payment, performance security, and verification of worker's disability compensation. The down payment and performance security shall be in accordance with the provisions of the timber sale contract, in the sums stated in this prospectus. If these actions are not taken, then the Bidder, the Bidder's corporation, and the corporation's principals may not be permitted to bid on State timber sales for a period of 1 year. In addition, the Bidder certifies that if awarded this contract, the Bidder will complete the timber sale contract in accordance with its terms and any modifications thereof including requirements to purchase, cut, and remove the included timber by the expiration date.

10. Disclaimer of Estimates and Bidder's Warranty of Inspection (7/16)

Before submitting this bid, the Bidder is advised and cautioned to inspect the sale area, review the requirements of the sale contract, and take other steps as may be reasonably necessary to ascertain the location, estimated volumes, construction estimates, and operating costs of the proposed sale. Failure to do so will not relieve the Bidder from responsibility for completing the contract.

The Bidder warrants that this bid is submitted solely on the basis of the Bidder's examination and inspection of the quality and quantity of the timber offered for sale and the Bidder's opinion of the value thereof and the costs of recovery. No reliance should be placed on the State of Michigan's estimates of timber quality, quantity or costs of recovery. Bidder further acknowledges that the State of Michigan: (i) expressly disclaims any warranty of fitness of timber for any purpose; (ii) offers this timber as is without any warranty of quality (merchantability) or quantity and (iii) expressly disclaims any warranty as to the quantity or quality of timber sold.

11. Certification and Chain-of-Custody (10/14)

Unless otherwise indicated in the contract under section 7 – Other Conditions of the Sale Specific Conditions & Requirements, the area encompassed by this timber sale is certified to the standards of the Forest Stewardship Council (FSC) - Certificate #SCS-FM/COC-00090N and the Sustainable Forestry Initiative (SFI) - Certificate #NSF-SFIS-5Y031-SF5. Forest products from this sale may be delivered to the mill as "FSC 100% and / or SFI certified" as long as the contractor hauling the forest products is chain-of-custody (COC) certified or covered under a COC certificate from the destination mill. The purchaser is responsible for maintaining COC after leaving the sale area.

12. Good Neighbor Authority (GNA) Requirements (7/16)

If the name of this timber sales contains the acronym GNA, it is authorized by the Good Neighbor Authority (GNA) and covered by various agreements between the U.S. Forest Service and the State. The timber sale occurs on federal land and the following conditions apply:

GNA contracts on US Forest Service land will not be awarded to purchasers on the Federal list of excluded parties. The System for Award Management (SAM) will be checked for active excluded parties prior to award of contract. In addition, the Bidder to whom award is made must complete an Assurance Regarding Felony Conviction or Tax Delinquent Status for Corporate Applicants (AD-3031).

13. Good Neighbor Authority (GNA) Requirements, con't (9/16)

Bidder certifies, by signing this bid form, that to the best of Bidder's knowledge that the following representations are accurate and complete.

- a. That the Bidder and its principals are not presently debarred, suspended, proposed for debarment, declared ineligible, or voluntary excluded from timber sales (covered transactions) by any Federal department or agency.
- b. That the Bidder and its principals have not within a 3-year period preceding this bid been convicted of or had a civil judgment rendered against them for commission of fraud or a criminal offense in connection with obtaining, attempting to obtain, or performing a public (Federal, State, or local) transaction or contract under a public transaction; violation of Federal or State antitrust statutes or commission of embezzlement, theft, forgery, bribery, falsification or destruction of records, making false statements, or receiving stolen property.

c. That the Bidder and its principals are not presently indicted for or otherwise criminally or civilly charged by a governmental entity (Federal, State, or local) with commission of any of the offenses enumerated in paragraph b of this certification.

d. That the Bidder and its principals have not within a 3-year period preceding this bid had one or more public transactions (Federal, State, or local) terminated for breach or default of a timber or forest product contract.

Bidders that cannot certify this requirement, in whole or in part, shall submit an explanation with their bid.

KEITH CREAGH

Director

TIMBER SALE INFORMATION

Andor Junction Mix (54-016-16)

Alpena County (Advertised Price \$56,523.45)

A timber sale contract for this lump sum, sealed bid timber sale will be awarded to the responsible bidder offering the highest sealed bid price. Bids must be at or above the following advertised price for each species:

<u>PRODUCTS & SPECIES</u>	<u>ESTIMATED UNITS*</u>	<u>ADVERTISED PRICE</u>
Sawtimber		
Basswood	66.60 MBF	\$ 77.00 / MBF
Mixed Aspen	25.50 MBF	\$ 78.00 / MBF
Red Oak	47.20 MBF	\$ 145.00 / MBF
Sugar Maple	26.60 MBF	\$ 392.00 / MBF
White Oak	0.60 MBF	\$ 72.00 / MBF
Pulpwood		
Balsam Fir	26.00 Cords	\$ 28.25 / Cord
Basswood	359.00 Cords	\$ 12.80 / Cord
Beech	35.00 Cords	\$ 18.90 / Cord
Misc. Species 1	149.00 Cords	\$ 4.45 / Cord
Mixed Aspen	372.00 Cords	\$ 20.95 / Cord
Mixed Hardwood	638.00 Cords	\$ 18.90 / Cord
Mixed Oak	175.00 Cords	\$ 18.45 / Cord
Paper Birch	99.00 Cords	\$ 21.65 / Cord
White Pine	6.00 Cords	\$ 35.65 / Cord

* The total volume is statistically estimated within plus (+) or minus (-) 10.97 percent. The estimated units are final and not subject to adjustment. Prospective bidders are urged to examine this timber and to make their own estimates of quantity and quality.

BOND AND PAYMENT SCHEDULE:

1. A bond in the amount of \$2,826.00 to insure faithful performance of the conditions of the contract will be deposited by the successful bidder within 21 days of the sale award.
2. Cutting in any sale or unit without the required advance payment would be considered a trespass.
3. Total payment must be paid in advance or according to the following schedule:
 - (a) Ten percent (10%) of the sale value must be paid within 21 days of the sale award.
 - (b) The 10% down payment will be credited towards the first unit cut.
4. If no cutting takes place, the 10% down payment will not be refunded.
5. Operations on the contract issued will terminate on 12/31/2019.

Description of Timber by Payment Unit (PU)

PU	MARKET GROUP	PRODUCT	QUANTITY	UNIT	ACRES	ADVERTISE PRICE
1	Mixed Aspen	Sawtimber	0.6	MBF	9.5	\$6,145.60
	<i>B. T. Aspen</i>		0.6	<i>MBF</i>		
	Red Oak		13.7	MBF		
	White Oak		0.6	MBF		
	Balsam Fir	Pulpwood	20.0	Cords		
	Beech		4.0	Cords		
	Mixed Aspen		7.0	Cords		
	<i>B. T. Aspen</i>		4.0	<i>Cords</i>		
	<i>Quaking Aspen</i>		3.0	<i>Cords</i>		
	Mixed Hardwood		64.0	Cords		
	<i>Red Maple</i>	<i>Sawtimber</i>	1.5	<i>MBF</i>		
	<i>Red Maple</i>	<i>Pulpwood</i>	55.0	<i>Cords</i>		
	<i>Sugar Maple</i>		6.0	<i>Cords</i>		
	Mixed Oak		62.0	Cords		
	<i>Red Oak</i>		56.0	<i>Cords</i>		
	<i>White Oak</i>		6.0	<i>Cords</i>		
	Paper Birch		33.0	Cords		
	<i>Paper Birch</i>	<i>Sawtimber</i>	0.6	<i>MBF</i>		
	<i>Paper Birch</i>	<i>Pulpwood</i>	32.0	<i>Cords</i>		
	White Pine		6.0	Cords		
	<i>White Pine</i>	<i>Sawtimber</i>	1.3	<i>MBF</i>		
<i>White Pine</i>	<i>Pulpwood</i>	3.0	<i>Cords</i>			
2	Red Oak	Sawtimber	8.7	MBF	10.0	\$2,758.10
	Sugar Maple		0.4	MBF		
	Mixed Aspen	Pulpwood	6.0	Cords		
	<i>B. T. Aspen</i>		6.0	<i>Cords</i>		
	Mixed Hardwood		33.0	Cords		
	<i>Red Maple</i>		2.0	<i>Cords</i>		
	<i>Sugar Maple</i>		31.0	<i>Cords</i>		
	Mixed Oak		32.0	Cords		
	<i>Red Oak</i>		32.0	<i>Cords</i>		
3	Basswood	Sawtimber	2.2	MBF	5.5	\$2,596.80
	Mixed Aspen		1.6	MBF		
	<i>Quaking Aspen</i>		1.6	<i>MBF</i>		
	Sugar Maple		1.2	MBF		
	Basswood	Pulpwood	7.0	Cords		
	Misc. Species 1		9.0	Cords		
	<i>White Ash</i>		9.0	<i>Cords</i>		
	Mixed Aspen		55.0	Cords		
	<i>Quaking Aspen</i>		55.0	<i>Cords</i>		
	Mixed Hardwood		18.0	Cords		
	<i>Red Maple</i>		3.0	<i>Cords</i>		
	<i>Sugar Maple</i>		15.0	<i>Cords</i>		
	Mixed Oak		2.0	Cords		
	<i>Red Oak</i>		1.0	<i>Cords</i>		
	<i>White Oak</i>		1.0	<i>Cords</i>		
	Paper Birch		8.0	Cords		
<i>Paper Birch</i>	<i>Sawtimber</i>	0.6	<i>MBF</i>			
<i>Paper Birch</i>	<i>Pulpwood</i>	7.0	<i>Cords</i>			
4	Basswood	Sawtimber	18.1	MBF	16.1	\$11,131.90
	Mixed Aspen		2.9	MBF		
	<i>B. T. Aspen</i>		2.6	<i>MBF</i>		
	<i>Quaking Aspen</i>		0.3	<i>MBF</i>		
	Red Oak		6.1	MBF		
	Sugar Maple		6.4	MBF		
	Balsam Fir	Pulpwood	2.0	Cords		

Description of Timber by Payment Unit (PU), con't

PU	MARKET GROUP	PRODUCT	QUANTITY	UNIT	ACRES	ADVERTISE PRICE
4 con't	Basswood	Pulpwood	99.0	Cords		
	Beech		9.0	Cords		
	Misc. Species 1		36.0	Cords		
	<i>White Ash</i>		36.0	<i>Cords</i>		
	Mixed Aspen		48.0	Cords		
	<i>B. T. Aspen</i>		34.0	<i>Cords</i>		
	<i>Balsam Poplar</i>		1.0	<i>Cords</i>		
	<i>Quaking Aspen</i>		13.0	<i>Cords</i>		
	Mixed Hardwood		145.0	Cords		
	<i>Ironwood</i>		2.0	<i>Cords</i>		
	<i>Red Maple</i>		1.0	<i>Cords</i>		
	<i>Sugar Maple</i>		142.0	<i>Cords</i>		
	Mixed Oak		19.0	Cords		
	<i>Red Oak</i>		19.0	<i>Cords</i>		
	Paper Birch	17.0	Cords			
<i>Paper Birch</i>	<i>Sawtimber</i>	0.9	<i>MBF</i>			
<i>Paper Birch</i>	<i>Pulpwood</i>	15.0	<i>Cords</i>			
5	Basswood	Sawtimber	23.8	MBF	21.1	\$14,487.60
	Mixed Aspen		3.6	MBF		
	<i>B. T. Aspen</i>		3.3	<i>MBF</i>		
	<i>Quaking Aspen</i>		0.3	<i>MBF</i>		
	Red Oak	8.0	MBF			
	Sugar Maple	8.3	MBF			
	Balsam Fir	Pulpwood	2.0	Cords		
	Basswood		131.0	Cords		
	Beech		11.0	Cords		
	Misc. Species 1		48.0	Cords		
	<i>White Ash</i>		48.0	<i>Cords</i>		
	Mixed Aspen		62.0	Cords		
	<i>B. T. Aspen</i>		44.0	<i>Cords</i>		
	<i>Balsam Poplar</i>		1.0	<i>Cords</i>		
	<i>Quaking Aspen</i>		17.0	<i>Cords</i>		
	Mixed Hardwood		190.0	Cords		
	<i>Ironwood</i>		3.0	<i>Cords</i>		
	<i>Red Maple</i>		2.0	<i>Cords</i>		
	<i>Sugar Maple</i>		185.0	<i>Cords</i>		
	Mixed Oak		25.0	Cords		
	<i>Red Oak</i>		25.0	<i>Cords</i>		
Paper Birch	21.0		Cords			
<i>Paper Birch</i>	<i>Sawtimber</i>		1.1	<i>MBF</i>		
<i>Paper Birch</i>	<i>Pulpwood</i>	19.0	<i>Cords</i>			
6	Basswood	Sawtimber	21.9	MBF	19.5	\$13,437.95
	Mixed Aspen		3.4	MBF		
	<i>B. T. Aspen</i>		3.1	<i>MBF</i>		
	<i>Quaking Aspen</i>		0.3	<i>MBF</i>		
	Red Oak	7.4	MBF			
	Sugar Maple	7.7	MBF			
	Balsam Fir	Pulpwood	2.0	Cords		
	Basswood		120.0	Cords		
	Beech		11.0	Cords		
	Misc. Species 1		44.0	Cords		
	<i>White Ash</i>		44.0	<i>Cords</i>		
	Mixed Aspen		58.0	Cords		
	<i>B. T. Aspen</i>		41.0	<i>Cords</i>		
	<i>Balsam Poplar</i>		1.0	<i>Cords</i>		
	<i>Quaking Aspen</i>		16.0	<i>Cords</i>		

Description of Timber by Payment Unit (PU), con't

PU	MARKET GROUP	PRODUCT	QUANTITY	UNIT	ACRES	ADVERTISE PRICE			
6 con't	Mixed Hardwood	Pulpwood	176.0	Cords					
	<i>Ironwood</i>		2.0	<i>Cords</i>					
	<i>Red Maple</i>		2.0	<i>Cords</i>					
	<i>Sugar Maple</i>		172.0	<i>Cords</i>					
	Mixed Oak		23.0	Cords					
	<i>Red Oak</i>		23.0	<i>Cords</i>					
	Paper Birch		20.0	Cords					
	<i>Paper Birch</i>	<i>Sawtimber</i>	1.0	<i>MBF</i>					
	<i>Paper Birch</i>	<i>Pulpwood</i>	18.0	<i>Cords</i>					
7	Basswood	Sawtimber	0.6	MBF	5.6	\$5,965.50			
	Mixed Aspen		13.4	MBF					
	<i>B. T. Aspen</i>		13.4	<i>MBF</i>					
	Red Oak		3.3	MBF					
	Sugar Maple		2.6	MBF					
	Basswood	Pulpwood	2.0	Cords					
	Misc. Species 1		12.0	Cords					
	<i>White Ash</i>		12.0	<i>Cords</i>					
	Mixed Aspen		136.0	Cords					
	<i>B. T. Aspen</i>		136.0	<i>Cords</i>					
	Mixed Hardwood		12.0	Cords					
	<i>Red Maple</i>		3.0	<i>Cords</i>					
	<i>Sugar Maple</i>		9.0	<i>Cords</i>					
	Mixed Oak		12.0	Cords					
	<i>Red Oak</i>		12.0	<i>Cords</i>					
	TOTAL:			166.5			MBF		
	TOTAL:			1,859.0			Cords		

Sale Specific Conditions & Requirements

Sale Name: Andor Junction Mix

Sale Number: 54-016-16 Seq#: 1

1 - Sale Area

1.2 - Boundaries

1.2.1 - Painted boundaries (1/14)

The sale boundary and Payment Unit boundaries are marked and identified by blue, red and yellow paint. Exterior sale boundary lines against private property are marked with blue paint. Exterior sale boundary lines against state are marked with red paint. Interior retention boundaries are marked with red paint. Interior Payment Unit boundaries are marked with yellow paint. The painted boundary line trees are not Included Timber and are to be protected. Yellow painted trees designating an interior Payment Unit boundary are only to be cut when all surrounding Payment Units have been paid.

2 - Timber Specifications

2.1 - Included Timber

2.1.1 - Clearcut unit(s) with unmerchantable trees (6/14)

Within Payment Unit(s) 1 and 3-7, cut all trees that are two (2) inches or more at DBH, except do not cut green marked trees in Payments Units 1 and 3-6, and do not cut red pine in Payment Unit 7.

2.1.7 - Leave tree marked unit(s) (6/14)

Within Payment Unit(s) 2, cut all trees that are two (2) inches or more at DBH, except oak less than 4.5 inches in DBH and trees marked with green paint above and below stump height. In addition, do not cut any white pine.

2.1.11 - Description of timber note (2/04)

Note that mixed aspen sawtimber is quaking aspen and bigtooth aspen. Mixed aspen pulpwood is quaking aspen, bigtooth aspen, and balsam poplar. Mixed hardwood is red maple, ironwood, and sugar maple. Mixed oak is red and white oak. The ash are standing dead trees and are designated for cutting.

3 - Payments

3.3 - Pre-measured Sales

3.3.4 - Dividing payment units (7/14)

Payment Unit(s) 5 and 6 may be divided at the request of the Purchaser and upon approval of the Unit Manager. Dividing Payment Units is a contract modification which requires a Timber Sale Contract Supplement. There will be only one division per Payment Unit.

3.4 - Damaged Timber

3.4.1 - Damaged timber (6/14)

General Condition and Requirement 3.4 Damaged Timber, defines liquidated damages for undesignated live merchantable trees which are cut or injured. In addition, extreme care should be taken to avoid damage to oak seedlings and saplings in Payment Unit 2.

Within Payment Unit 2, if more than 25% of the oak seedlings or saplings (1/4" to 4.5" DBH) within a specified portion of the sale area are damaged, liquidated damages will be assessed at \$150 per acre for all acreage within that specified portion of the sale area that was damaged.

No damage is acceptable to undesignated merchantable trees. Within the sale area, if more than 5% of trees (> 4.5" DBH) within a specified area of the sale are damaged, liquidated damages will be assessed for all trees damaged. Rates will be in accordance with General Condition and Requirement 3.4 Damaged Timber.

4 - Transportation

4.1 - Construction

4.1.3 - Slash and earthen piles (8/04)

Piles or windrows of earth along roads and landings that have been widened or constructed shall be leveled. Slash from road maintenance or construction, including stumps, shall be dispersed throughout the sale.

4.1.6 - Road construction (1/09)

Improvements of existing roads shall be done in such a way as to minimize the environmental and visual impacts. Merchantable trees shall be cut and utilized unless otherwise directed. Non-merchantable trees shall be severed and laid flat on the ground. Slash shall be scattered, and not left in windrows and kept a minimum of 10 feet back from the road edge. Stumps shall be set upright, not left on edge, and be moved at least 10 feet away from the road edge. Disturbed soil shall be feathered into the woods and not left in berms or windrows.

4.1.12 - No new roads (1/12)

No new roads will be permitted in any Payment Unit. All operations are limited to existing roads. Skid trails only will be allowed.

5 - Operations

5.1 - Notification

5.1.1 - Pre-sale conference (10/11)

A pre-sale conference on site between the Purchaser and sale administrator is required prior to beginning any operations in a Payment Unit to determine landing and road locations. The Unit Manager or his/her representative must be contacted at least 10 days in advance to schedule the conference.

5.1.3 - Well heads and natural gas pipelines (11/15)

The Purchaser is responsible for contacting the gas or pipeline company prior to operating equipment in the vicinity of well heads or natural gas pipelines.

5.1.4 - Post-sale conference (6/11)

A post-sale conference on site between the Purchaser and sale administrator is required 5 days prior to the completion of active logging operations to determine clean-up and repair of landings, road edges, and the fulfillment of other contract specifications.

5.2 - Conduct of Operations

5.2.1 - Slash

5.2.1.10 - No slash in openings (5/10)

No brush or logging debris is to be left in the maintained wildlife opening which is indicated by G0 on the Timber Sale Map. Any damage to the opening shall be repaired according to specifications of the Unit Manager or his/her representative.

5.2.2 - Hazard Trees/Snags

5.2.2.1 - Den trees (2/04)

Obvious hollow and/or den trees shall be protected and left standing unless they are a safety hazard.

5.2.3 - Operating Restrictions

5.2.3.4 - Oak wilt restriction (6/10)

Within Payment Unit(s) 2, unless changed by written agreement, cutting, skidding, and hauling are not permitted during the period of April 15 to July 15. This is necessary to reduce the spread of oak wilt. For more information, contact the Unit Manager or his/her representative.

5.2.3.11 - Coppice regeneration protection (4/10)

Timber harvesting in any Payment Unit must be completed before significant sprouting occurs in that Payment Unit so as to minimize damage to the new regeneration. Any post harvest operations, such as chipping, must be completed before sprouting of regeneration occurs. If it is anticipated that chipping will be delayed, then tops shall be carried to one central location or left unchipped. The Unit Manager or his/her representative may cease such operations if sprouting occurs before the operation is complete.

5.2.4 - Dead and Down Creation

5.2.4.4 - Dead and down creation, grouse (8/13)

To encourage grouse and other wildlife, in Payment Unit(s) 3 and 7, leave one, 10" diameter or larger log-length (8 foot minimum) piece on the ground for every 2 acres. These will be evenly scattered throughout the unit. This can be an unmerchantable piece or a full tree.

5.2.32 - Decking/landing restoration (9/13)

All decking and landing areas must have the surface area restored to a condition equal to or better than before. This is to ensure the proper regeneration of the stand. Wood debris, chips and "cookies" from trimmings must be removed or scattered away from landing and loading areas and may not be windrowed on the edge.

5.2.33 - Gas well re-vegetation (12/08)

In the event that the gas well is utilized for a landing, the site must be re-vegetated with a seeding mixture specified by the Unit Manager or his/her representative.

5.2.38 - No decking against live trees (2/04)

Cut products may not be decked against unmarked or designated leave trees.

5.4 - Soil Protection

5.4.1 - Rutting restriction, general (7/16)

Operations are to cease immediately if equipment and weather conditions result in rutting of roads and/or skid trails which is 12 inches or greater in depth and 50 feet in length. The Unit Manager or his/her representative may restrict hauling and/or skidding if ruts exceed the specified depth. With the Unit Manager or his/her representative's approval, the Purchaser may return to the area when the risk of rutting has decreased.

6 - Safety and Fire Prevention

6.2 - Signing

6.2.1 - Road posting (9/09)

The Purchaser is responsible for posting and maintaining caution signs on forest roads prior to beginning operations. The road must be posted at appropriate distances from the sale area to warn of logging activity and truck traffic. Signs must be removed when harvest operations are suspended or completed. The Purchaser will provide these signs.

7 - Other Conditions

7.5 - Loss

7.5.1 - Deteriorating timber (7/09)

The sale area has received damage from Emerald Ash Borer. The Purchaser should harvest the wood as soon as possible. The Department of Natural Resources is held free of responsibility of any further damage or deterioration due to delay in harvesting.



TIMBER SALE MAP

This information provided by authority of Part 525, 1994 PA 451, as amended.

Forest Management Unit Atlanta		County Alpena	Mapped By D. Parris		Date 8/24/2016	Page 1	of 1
Township 29N	Range 06E	Section(s) and Subdivision(s) Sec 17 NWNW, SWNW, NWSW, SESW, SWSW			Scale 1:15,840		
Cruised By D. Parris							

Cover Type				Density			
A = Aspen	H = Hemlock	N = Marsh	U = Upland Brush	0 = Non Stocked	5 = Pole Timber Medium		
B = Paper Birch	J = Jack Pine	O = Oak	UM = Upland Mixed	1 = Seedling Sapling Poor	6 = Pole Timber Well		
C = Cedar	L = Lowland Brush	P = Lowland Poplar	V = Bog or Marsh	2 = Seedling Sapling Medium	7 = Saw Timber Poor		
D = Treed Bog	LM = Lowland Mixed	Q = Mixed Swamp Conifer	W = White Pine	3 = Seedling Sapling Well	8 = Saw Timber Medium		
E = Swamp Hdwoods	M = Mpl, Bch, Brch	R = Red Pine	X = Non Stocked	4 = Pole Timber Poor	9 = Saw Timber Well		
F = Spruce Fir	MC = Mixed Conifer	S = Black Spruce	Z = Water				
G = Grass	MD = Mixed Deciduous	T = Tamarack					

PU	Acres	Stand(s)	PU	Acres	Stand(s)
1	9.5	49	5	21.1	76
2	10.0	60	6	19.5	76
3	5.5	66	7	5.6	84
4	16.1	76			

Andor Junction Mix Compartment 80 87.3 Acres

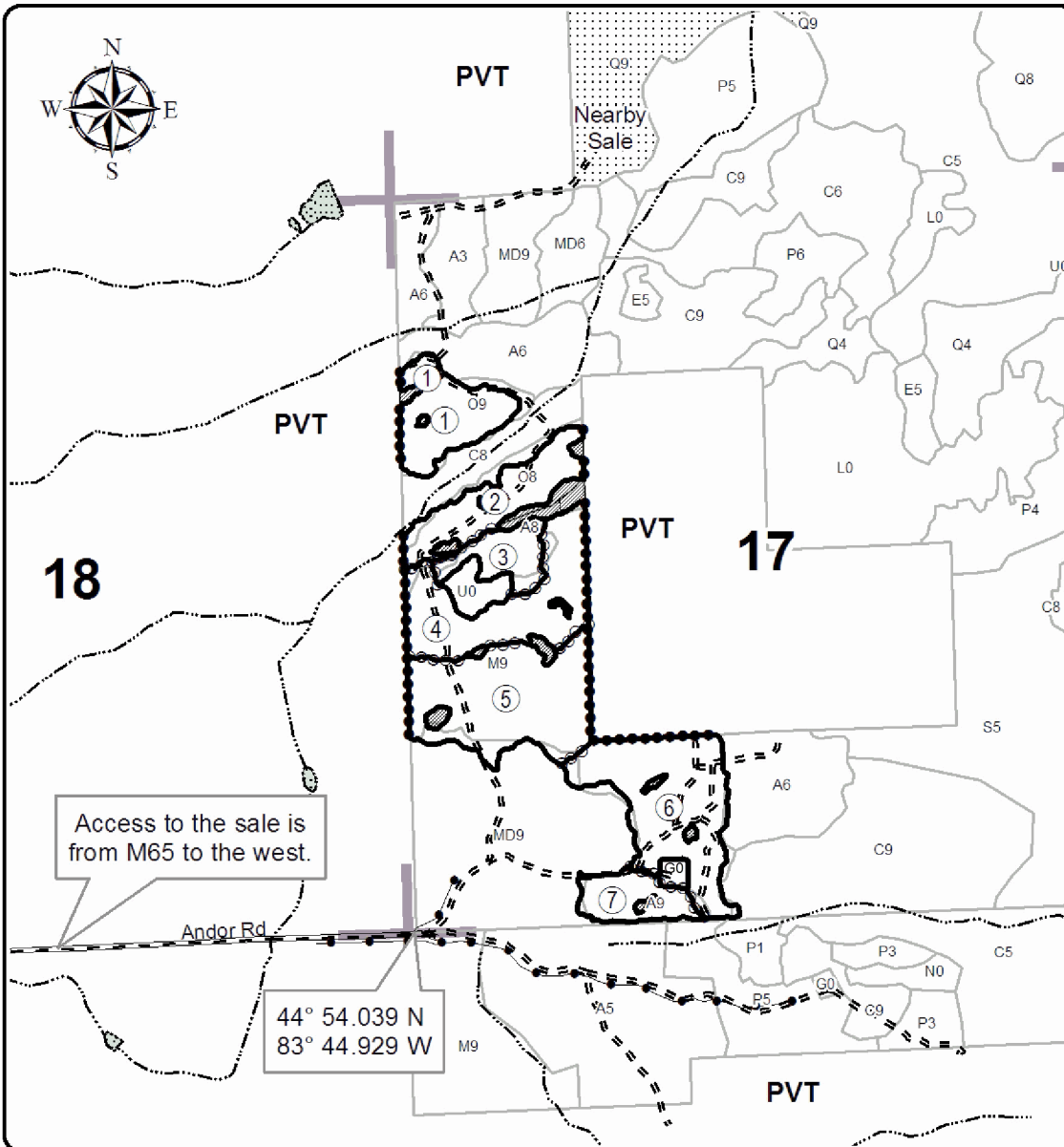

Legend

- Against State (Red)
- Payment Unit (Yellow)
- Private Line (Blue)
- Payment Unit
- ▨ Retention Area (Red)
- ⋯ Nearby Timber Sales
- Stand Boundaries
- Pipeline; Powerline
- Gravel Roads
- ⋯ Poor Dirt Roads
- ▨ Lakes and Rivers All
- ⋯ Streams
- Section Corners

Locator Map
1:200,000

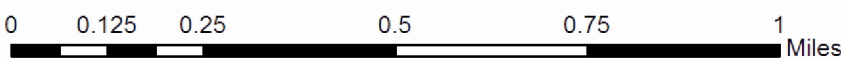
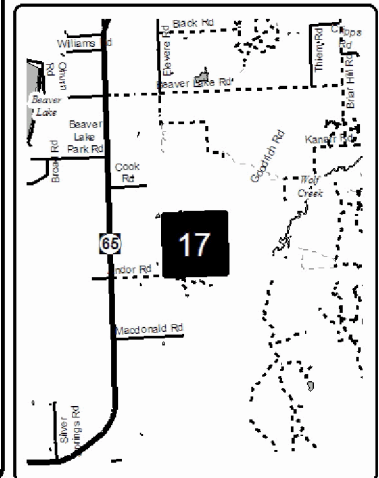

TIMBER SALE INFORMATION

Spruce Road Mix (54-017-16)

Alpena County (Advertised Price \$54,421.70)

SALE NOTE: There is dead standing ash in this sale that should be harvested as soon as possible.

Access through private land to Payment Units 5, 6, and 7 is the responsibility of the producer. See timber sale spec. 4.4.1, Private Property Access.

Spec. 5.2.17 requires the use of Crane Mats/Timber Mats.

A recreation site such as a trail, pathway, or campground is within the sale area or the vicinity. Certain restrictions/specifications may be applicable including time restrictions. Access may be through private or other public land.

A timber sale contract for this lump sum, sealed bid timber sale will be awarded to the responsible bidder offering the highest sealed bid price. Bids must be at or above the following advertised price for each species:

<u>PRODUCTS & SPECIES</u>	<u>ESTIMATED UNITS*</u>	<u>ADVERTISED PRICE</u>
Sawtimber		
Mixed Aspen	64.90 MBF	\$ 78.00 / MBF
Red Oak	15.50 MBF	\$ 145.00 / MBF
Red Pine	44.70 MBF	\$ 128.00 / MBF
Sugar Maple	3.90 MBF	\$ 392.00 / MBF
White Pine	21.10 MBF	\$ 84.00 / MBF
Pulpwood		
Balsam Fir	14.00 Cords	\$ 28.25 / Cord
Basswood	5.00 Cords	\$ 12.80 / Cord
Jack Pine	19.00 Cords	\$ 24.25 / Cord
Misc. Species 1	85.00 Cords	\$ 4.40 / Cord
Mixed Aspen	913.00 Cords	\$ 20.95 / Cord
Mixed Hardwood	243.00 Cords	\$ 18.90 / Cord
Paper Birch	28.00 Cords	\$ 21.65 / Cord
Red Oak	80.00 Cords	\$ 18.45 / Cord
Red Pine	97.00 Cords	\$ 50.25 / Cord
White Ash	26.00 Cords	\$ 18.90 / Cord
White Pine	151.00 Cords	\$ 35.65 / Cord
White Spruce	6.00 Cords	\$ 40.65 / Cord

* The total volume is statistically estimated within plus (+) or minus (-) 10.43 percent. The estimated units are final and not subject to adjustment. Prospective bidders are urged to examine this timber and to make their own estimates of quantity and quality.

BOND AND PAYMENT SCHEDULE:

1. A bond in the amount of \$2,721.00 to insure faithful performance of the conditions of the contract will be deposited by the successful bidder within 21 days of the sale award.
2. Cutting in any sale or unit without the required advance payment would be considered a trespass.
3. Total payment must be paid in advance or according to the following schedule:
 - (a) Ten percent (10%) of the sale value must be paid within 21 days of the sale award.
 - (b) The 10% down payment will be credited towards the first unit cut.
4. If no cutting takes place, the 10% down payment will not be refunded.
5. Operations on the contract issued will terminate on 12/31/2019.

Description of Timber by Payment Unit (PU)

PU	MARKET GROUP	PRODUCT	QUANTITY	UNIT	ACRES	ADVERTISE PRICE			
1	Mixed Aspen	Sawtimber	2.4	MBF	4.9	\$2,706.00			
	<i>B. T. Aspen</i>		2.4	<i>MBF</i>					
	Red Oak		1.3	MBF					
	Red Pine		0.6	MBF					
	White Pine		1.8	MBF					
	Mixed Aspen		Pulpwood	74.0			Cords		
	<i>B. T. Aspen</i>			74.0			<i>Cords</i>		
	Mixed Hardwood			12.0			Cords		
	<i>Red Maple</i>			12.0			<i>Cords</i>		
	Paper Birch			1.0			Cords		
	<i>Paper Birch</i>			1.0			<i>Cords</i>		
	Red Oak			6.0			Cords		
	Red Pine			1.0			Cords		
	White Pine			4.0			Cords		
2	Mixed Aspen	Sawtimber		5.4	MBF	4.3	\$2,686.05		
	<i>B. T. Aspen</i>		5.4	<i>MBF</i>					
	Red Pine		1.6	MBF					
	Mixed Aspen		Pulpwood	66.0	Cords				
	<i>B. T. Aspen</i>			66.0	<i>Cords</i>				
	Mixed Hardwood			12.0	Cords				
	<i>Red Maple</i>			12.0	<i>Cords</i>				
	Red Pine			4.0	Cords				
	White Pine			7.0	Cords				
3	Mixed Aspen	Sawtimber	3.6	MBF	4.6	\$3,106.50			
	<i>B. T. Aspen</i>		3.6	<i>MBF</i>					
	Red Oak		2.1	MBF					
	Red Pine		1.1	MBF					
	White Pine		1.6	MBF					
	Balsam Fir		Pulpwood	4.0			Cords		
	Jack Pine			2.0			Cords		
	<i>Jack Pine</i>			2.0			<i>Cords</i>		
	Mixed Aspen			63.0			Cords		
	<i>B. T. Aspen</i>			63.0			<i>Cords</i>		
	Mixed Hardwood			12.0			Cords		
	<i>Red Maple</i>			12.0			<i>Cords</i>		
	Paper Birch			1.0			Cords		
	<i>Paper Birch</i>			1.0			<i>Cords</i>		
	Red Oak			4.0			Cords		
Red Pine	1.0	Cords							
White Pine	11.0	Cords							
4	Mixed Aspen	Sawtimber	11.2	MBF	7.3	\$6,879.15			
	<i>B. T. Aspen</i>		0.3	<i>MBF</i>					
	<i>Quaking Aspen</i>		10.9	<i>MBF</i>					
	Red Oak		5.7	MBF					
	Sugar Maple		1.6	MBF					
	Mixed Aspen		Pulpwood	135.0			Cords		
	<i>B. T. Aspen</i>			4.0			<i>Cords</i>		
	<i>Quaking Aspen</i>			131.0			<i>Cords</i>		
	Mixed Hardwood			52.0			Cords		
	<i>American Elm</i>			Sawtimber			0.5	<i>MBF</i>	
	<i>American Elm</i>						Pulpwood	1.0	<i>Cords</i>
	<i>Beech</i>							6.0	<i>Cords</i>
	<i>Ironwood</i>							1.0	<i>Cords</i>
	<i>Sugar Maple</i>							43.0	<i>Cords</i>
	Paper Birch							11.0	Cords
	<i>Paper Birch</i>		11.0	<i>Cords</i>					

Description of Timber by Payment Unit (PU), con't

PU	MARKET GROUP	PRODUCT	QUANTITY	UNIT	ACRES	ADVERTISE PRICE
4 con't	Red Oak	Pulpwood	17.0	Cords		
	White Ash		10.0	Cords		
5	Mixed Aspen	Sawtimber	4.5	MBF	13.8	\$2,927.55
	<i>B. T. Aspen</i>		4.5	<i>MBF</i>		
	Sugar Maple		1.7	MBF		
	Misc. Species 1	Pulpwood	85.0	Cords		
	Mixed Aspen		21.0	Cords		
	<i>B. T. Aspen</i>		21.0	<i>Cords</i>		
	Mixed Hardwood		51.0	Cords		
	<i>Beech</i>		1.0	<i>Cords</i>		
	<i>Black Cherry</i>		3.0	<i>Cords</i>		
	<i>Sugar Maple</i>		47.0	<i>Cords</i>		
	White Ash		7.0	Cords		
6	Mixed Aspen	Sawtimber	8.8	MBF	11.7	\$10,490.40
	<i>B. T. Aspen</i>		5.8	<i>MBF</i>		
	<i>Quaking Aspen</i>		3.0	<i>MBF</i>		
	Red Oak		2.9	MBF		
	Red Pine		14.5	MBF		
	Sugar Maple		0.6	MBF		
	White Pine		3.7	MBF		
	Balsam Fir	Pulpwood	7.0	Cords		
	Basswood		5.0	Cords		
	<i>Basswood</i>	<i>Sawtimber</i>	0.3	<i>MBF</i>		
	<i>Basswood</i>	<i>Pulpwood</i>	4.0	<i>Cords</i>		
	Mixed Aspen		125.0	Cords		
	<i>B. T. Aspen</i>		76.0	<i>Cords</i>		
	<i>Quaking Aspen</i>		49.0	<i>Cords</i>		
	Mixed Hardwood		44.0	Cords		
	<i>Red Maple</i>	<i>Sawtimber</i>	0.6	<i>MBF</i>		
	<i>Beech</i>	<i>Pulpwood</i>	4.0	<i>Cords</i>		
	<i>Black Ash</i>		1.0	<i>Cords</i>		
	<i>Red Maple</i>		25.0	<i>Cords</i>		
	<i>Sugar Maple</i>		9.0	<i>Cords</i>		
	<i>Yellow Birch</i>		4.0	<i>Cords</i>		
	Paper Birch		15.0	Cords		
	<i>Paper Birch</i>	<i>Sawtimber</i>	0.3	<i>MBF</i>		
	<i>Paper Birch</i>	<i>Pulpwood</i>	14.0	<i>Cords</i>		
	Red Oak		23.0	Cords		
	Red Pine		34.0	Cords		
	White Ash		9.0	Cords		
	White Pine		18.0	Cords		
	7	Mixed Aspen	Sawtimber	0.1		
<i>B. T. Aspen</i>			0.1	<i>MBF</i>		
Red Pine			4.3	MBF		
White Pine			0.4	MBF		
Mixed Aspen		Pulpwood	1.0	Cords		
<i>B. T. Aspen</i>			1.0	<i>Cords</i>		
Mixed Hardwood			11.0	Cords		
<i>Red Maple</i>			11.0	<i>Cords</i>		
Red Oak			1.0	Cords		
Red Pine			16.0	Cords		
White Pine		4.0	Cords			
8	Mixed Aspen	Sawtimber	18.6	MBF	12.2	\$7,281.10
	<i>B. T. Aspen</i>		18.6	<i>MBF</i>		
	Red Oak		3.5	MBF		
	Red Pine		1.6	MBF		

Description of Timber by Payment Unit (PU), con't

PU	MARKET GROUP	PRODUCT	QUANTITY	UNIT	ACRES	ADVERTISE PRICE
8 con't	Balsam Fir	Pulpwood	3.0	Cords		
	Jack Pine		8.0	Cords		
	<i>Jack Pine</i>	<i>Sawtimber</i>	0.4	<i>MBF</i>		
	<i>Jack Pine</i>	<i>Pulpwood</i>	7.0	<i>Cords</i>		
	Mixed Aspen		166.0	Cords		
	<i>B. T. Aspen</i>		159.0	<i>Cords</i>		
	<i>Balsam Poplar</i>		1.0	<i>Cords</i>		
	<i>Quaking Aspen</i>		6.0	<i>Cords</i>		
	Mixed Hardwood		25.0	Cords		
	<i>Red Maple</i>	<i>Sawtimber</i>	0.4	<i>MBF</i>		
	<i>Beech</i>	<i>Pulpwood</i>	2.0	<i>Cords</i>		
	<i>Red Maple</i>		22.0	<i>Cords</i>		
	Red Oak		29.0	Cords		
	Red Pine		3.0	Cords		
	White Spruce		5.0	Cords		
	9	Mixed Aspen	Sawtimber	10.3	MBF	13.0
<i>B. T. Aspen</i>			10.3	<i>MBF</i>		
Red Pine			21.0	MBF		
White Pine			13.6	MBF		
Jack Pine		Pulpwood	9.0	Cords		
<i>Jack Pine</i>			9.0	<i>Cords</i>		
Mixed Aspen			262.0	Cords		
<i>B. T. Aspen</i>			262.0	<i>Cords</i>		
Mixed Hardwood			24.0	Cords		
<i>Beech</i>			9.0	<i>Cords</i>		
<i>Red Maple</i>			11.0	<i>Cords</i>		
<i>Sugar Maple</i>			4.0	<i>Cords</i>		
Red Pine			38.0	Cords		
White Pine			107.0	Cords		
White Spruce		1.0	Cords			
TOTAL:			150.1	MBF		
TOTAL:			1,667.0	Cords		

Sale Specific Conditions & Requirements

Sale Name: Spruce Road Mix

Sale Number: 54-017-16 Seq#: 1

1 - Sale Area

1.2 - Boundaries

1.2.1 - Painted boundaries (1/14)

The sale boundary and Payment Unit boundaries are marked and identified by blue, red and yellow paint. Exterior sale boundary lines against private property are marked with blue paint. Exterior sale boundary lines against state are marked with red paint. Retention areas are marked with red paint. Interior Payment Unit boundaries are marked with yellow paint, except in Payment Units 8 and 9, where yellow marked trees are leave trees. The painted boundary line trees are not Included Timber and are to be protected. Yellow painted trees designating an interior Payment Unit boundary are only to be cut when all surrounding Payment Units have been paid.

2 - Timber Specifications

2.1 - Included Timber

2.1.1 - Clearcut unit(s) with unmerchantable trees (6/14)

Within Payment Unit(s) 1-4, 6, 8, and 9, cut all trees that are two (2) inches or more at DBH, except do not cut any red pine or white pine in Payment Units 1 and 2; white pine in Payment Unit 3; oak in Payment Units 4 and 6; yellow marked trees and white pine in Payment Unit 8; and yellow marked trees and oak in Payment Unit 9. In addition, do not cut any hemlock or cedar in any Payment Unit.

2.1.3 - Cut tree marked unit(s) (12/08)

Within Payment Unit(s) 5 and 7, all trees are designated for cutting when marked with orange paint above and below stump height, regardless of merchantability. In addition, all ash and beech are designated for harvest, except when marked with green paint.

2.1.11 - Description of timber note (2/04)

Note that Mixed Aspen Sawtimber includes quaking aspen, and bigtooth aspen. Mixed Aspen Pulpwood includes quaking aspen, bigtooth aspen, and balsam poplar. Mixed Hardwood includes red maple, sugar maple, black cherry, yellow birch, beech, ironwood, American elm, and black ash. Misc. Species 1 is dead standing ash, which is designated for cutting.

2.2 - Utilization

2.2.6 - Roundwood operation required (5/07)

The skidding of whole trees or tree segments with limbs attached is prohibited within Payment Unit(s) 5, 6, and 7. All products must be produced as roundwood and forwarded to existing roads or landing areas in final product length.

2.2.9 - No chipping permitted (12/08)

Within Payment Unit(s) 5, 6, and 7, no chipping is permitted.

3 - Payments

3.3 - Pre-measured Sales

3.3.4 - Dividing payment units (7/14)

Payment Unit(s) 9 may be divided at the request of the Purchaser and upon approval of the Unit Manager. Dividing Payment Units is a contract modification which requires a Timber Sale Contract Supplement. There will be only one division per Payment Unit.

3.4 - Damaged Timber

3.4.1 - Damaged timber (6/14)

General Condition and Requirement 3.4 Damaged Timber, defines liquidated damages for undesignated live merchantable trees which are cut or injured. In addition, extreme care should be taken to avoid damage to pine seedlings and saplings in Payment Units 1, 2, and 3; and oak and pine seedlings and saplings in Payment Units 4, 6, 8, and 9.

Within the sale area, if more than 25% of oak and pine seedlings or saplings (1/4" to 4.5" DBH) within a specified portion of the sale area are damaged, liquidated damages will be assessed at \$150 per acre for all acreage within that specified portion of the sale area that was damaged.

No damage is acceptable to undesignated merchantable trees. Within the sale area, if more than 5% of trees (> 4.5" DBH) within a specified area of the sale are damaged, liquidated damages will be assessed for all trees damaged. Rates will be in accordance with General Condition and Requirement 3.4 Damaged Timber.

4 - Transportation

4.1 - Construction

4.1.3 - Slash and earthen piles (8/04)

Piles or windrows of earth along roads and landings that have been widened or constructed shall be leveled. Slash from road maintenance or construction, including stumps, shall be dispersed throughout the sale.

4.1.6 - Road construction (1/09)

Improvements of existing roads shall be done in such a way as to minimize the environmental and visual impacts. Merchantable trees shall be cut and utilized unless otherwise directed. Non-merchantable trees shall be severed and laid flat on the ground. Slash shall be scattered, and not left in windrows and kept a minimum of 10 feet back from the road edge. Stumps shall be set upright, not left on edge, and be moved at least 10 feet away from the road edge. Disturbed soil shall be feathered into the woods and not left in berms or windrows.

4.1.12 - No new roads (1/12)

No new roads will be permitted in any Payment Unit. All operations are limited to existing roads. Skid trails only will be allowed.

4.2 - Maintenance

4.2.5 - Two wheel drive condition (2/04)

All existing trail roads on and adjacent to the sale area must be passable by two-wheel drive traffic for the duration of the sale.

4.4 - Access

4.4.1 - Private property access (3/11)

Permission for access across private land is the responsibility of the Purchaser. A copy of the written permission from the private landowner must be given to the Unit Manager within 30 days of the bid opening and prior to the beginning of operations.

For private land owner contact information, contact Michigan DNR Forester Dale Parris at (989) 785-4251, Ext. 5242.

5 - Operations

5.1 - Notification

5.1.1 - Pre-sale conference (10/11)

A pre-sale conference on site between the Purchaser and sale administrator is required prior to beginning any operations within a Payment Unit to determine landing and access road locations. Landing locations must be far enough away from bodies of water and other supplies of groundwater to avoid contaminating ground water. The Unit Manager or his/her representative must be contacted at least 10 days in advance to schedule the conference.

5.1.4 - Post-sale conference (6/11)

A post-sale conference on site between the Purchaser and sale administrator is required 5 days prior to the completion of active logging operations to determine clean-up and repair of landings, road edges, and the fulfillment of other contract specifications.

5.1.6 - Utility R.O.W. (1/15)

It is the responsibility of the Purchaser to obtain permission from the utility company to utilize the power line R.O.W. for operations.

5.2 - Conduct of Operations

5.2.2 - Hazard Trees/Snags

5.2.2.1 - Den trees (2/04)

Obvious hollow and/or den trees shall be protected and left standing unless they are a safety hazard.

5.2.3 - Operating Restrictions

5.2.3.1 - Operating restrictions (9/11)

Within Payment Unit(s) 5, 6, and 7, unless changed by written agreement, cutting, skidding, and hauling are limited to the periods of July 15 to October 1 and January 1 to March 15. This restriction is because of sensitive and seasonably saturated soils.

5.2.3.3 - Bark slippage restriction (3/09)

Within Payment Unit(s) 5 and 7, unless changed by written agreement, cutting and skidding are not permitted during the period of April 15 to July 15. This restriction is because of bark slippage.

5.2.3.11 - Coppice regeneration protection (4/10)

Timber harvesting in any Payment Unit must be completed before significant sprouting occurs in that Payment Unit so as to minimize damage to the new regeneration. Any post harvest operations, such as chipping, must be completed before sprouting of regeneration occurs. If it is anticipated that chipping will be delayed, then tops shall be carried to one central location or left unchipped. The Unit Manager or his/her representative may cease such operations if sprouting occurs before the operation is complete.

5.2.4 - Dead and Down Creation

5.2.4.4 - Dead and down creation, grouse (8/13)

To encourage grouse and other wildlife, in Payment Unit(s) 1, 2, 3, 4, 6, and 8, leave one, 10" diameter or larger log-length (8 foot minimum) piece on the ground for every 2 acres. These will be evenly scattered throughout the unit. This can be an unmerchantable piece or a full tree.

5.2.17 - Crane Mats/Timber Mats (10/14)

Some roads, skid trails, and streams may require extra protection such as that afforded by Crane Mats/Timber Mats. Crane Mats\Timber Mats must be used for crossing the 2 streams in Payment Unit 5 where indicated on the Timber Sale Map. In addition, crane mats may be required in areas of Payment Units 5 and 6 (and other Payment Units) if sensitive soils warrant or new streams appear. If available, Crane Mats/Timber Mats may be borrowed from the DNR and are located at the Marquette ICC and the Grayling Field Office. Contact the sale administrator for specific details. A Timber Sale Contract Supplement will be used to document the Purchaser's use of the DNR's Crane Mats/Timber Mats. It is the responsibility of the Purchaser to contact the sale administrator to schedule pick up and drop off. In addition, all mats must be cleaned prior to drop off. A charge of \$350.00 NLP will be assessed for all damaged or non-returned mats. Damage is defined as misuse resulting in three or more broken cants.

5.2.32 - Decking/landing restoration (9/13)

All decking and landing areas must have the surface area restored to a condition equal to or better than before. This is to ensure the proper regeneration of the stand. Wood debris, chips and "cookies" from trimmings must be removed or scattered away from landing and loading areas and may not be windrowed on the edge.

5.2.38 - No decking against live trees (2/04)

Cut products may not be decked against unmarked or designated leave trees.

5.2.41 - Snowmobile trail protection (9/11)

Snowmobile trail number 461 is shown on the Timber Sale Map. Do not cut or damage posts with orange trail markers or traffic control signs. This trail must be maintained and restored to a condition equal to or better than before the sale. The road maintenance/restoration must be done prior to December 1. The snowmobile trail may not be used for any timber sale operations from December 1 to March 31. Maintain a 20 foot wide slash, debris, and rut free zone daily using the snowmobile trail as the centerline. All stumps within 10 feet of the snowmobile trail must be cut at ground level.

5.2.43 - Opening protection (12/08)

No activities are permitted in openings marked on the Timber Sale Map with the letter "G". Any damage to the openings shall

be repaired according to specifications of the Unit Manager or his/her representative.

5.4 - Soil Protection

5.4.1 - Rutting restriction, general (7/16)

Operations are to cease immediately if equipment and weather conditions result in rutting of roads and/or skid trails which is 6 inches or greater in depth and 25 feet in length. The Unit Manager or his/her representative may restrict hauling and/or skidding if ruts exceed the specified depth. With the Unit Manager or his/her representative's approval, the Purchaser may return to the area when the risk of rutting has decreased.

5.8 - Protection of Endangered Species

5.8.5 - Protection of raptor nests (3/13)

All trees with raptor nests will be protected if found during harvesting operations. Notification will be made to the Unit Manager or his/her representative who will notify the Wildlife Biologist so an on-site evaluation and recommendation can be made, if necessary.

6 - Safety and Fire Prevention

6.2 - Signing

6.2.1 - Road posting (9/09)

The Purchaser is responsible for posting and maintaining caution signs on forest roads/snowmobile trail number 461 prior to beginning operations. The road must be posted at appropriate distances from the sale area to warn of logging activity and truck traffic. Signs must be removed when harvest operations are suspended or completed. The Purchaser will provide these signs.

7 - Other Conditions

7.5 - Loss

7.5.1 - Deteriorating timber (7/09)

The sale area has received damage from the Emerald Ash Borer. The Purchaser should harvest the wood as soon as possible. The Department of Natural Resources is held free of responsibility of any further damage or deterioration due to delay in harvesting.



TIMBER SALE MAP

This information provided by authority of Part 525, 1994 PA 451, as amended.

Forest Management Unit Atlanta		County Alpena	Mapped By D. Parris		Date 8/31/2016	Page 1	of 1
Township 30N	Range 08E	Section(s) and Subdivision(s) Sec 19 SWSE, Sec 19 SWSE, Sec 31 SENW		Scale 1:15,840			

Cover Type			
A = Aspen	H = Hemlock	N = Marsh	U = Upland Brush
B = Paper Birch	J = Jack Pine	O = Oak	UM = Upland Mixed
C = Cedar	L = Lowland Brush	P = Lowland Poplar	V = Bog or Marsh
D = Tread Bog	LM = Lowland Mixed	Q = Mixed Swamp Conifer	W = White Pine
E = Swamp Hdwoods	M = Mpl, Bch, Brch	R = Red Pine	X = Non Stocked
F = Spruce Fir	MC = Mixed Conifer	S = Black Spruce	Z = Water
G = Grass	MD = Mixed Deciduous	T = Tamarack	

Density	
0 = Non Stocked	5 = Pole Timber Medium
1 = Seedling Sapling Poor	6 = Pole Timber Well
2 = Seedling Sapling Medium	7 = Saw Timber Poor
3 = Seedling Sapling Well	8 = Saw Timber Medium
4 = Pole Timber Poor	9 = Saw Timber Well

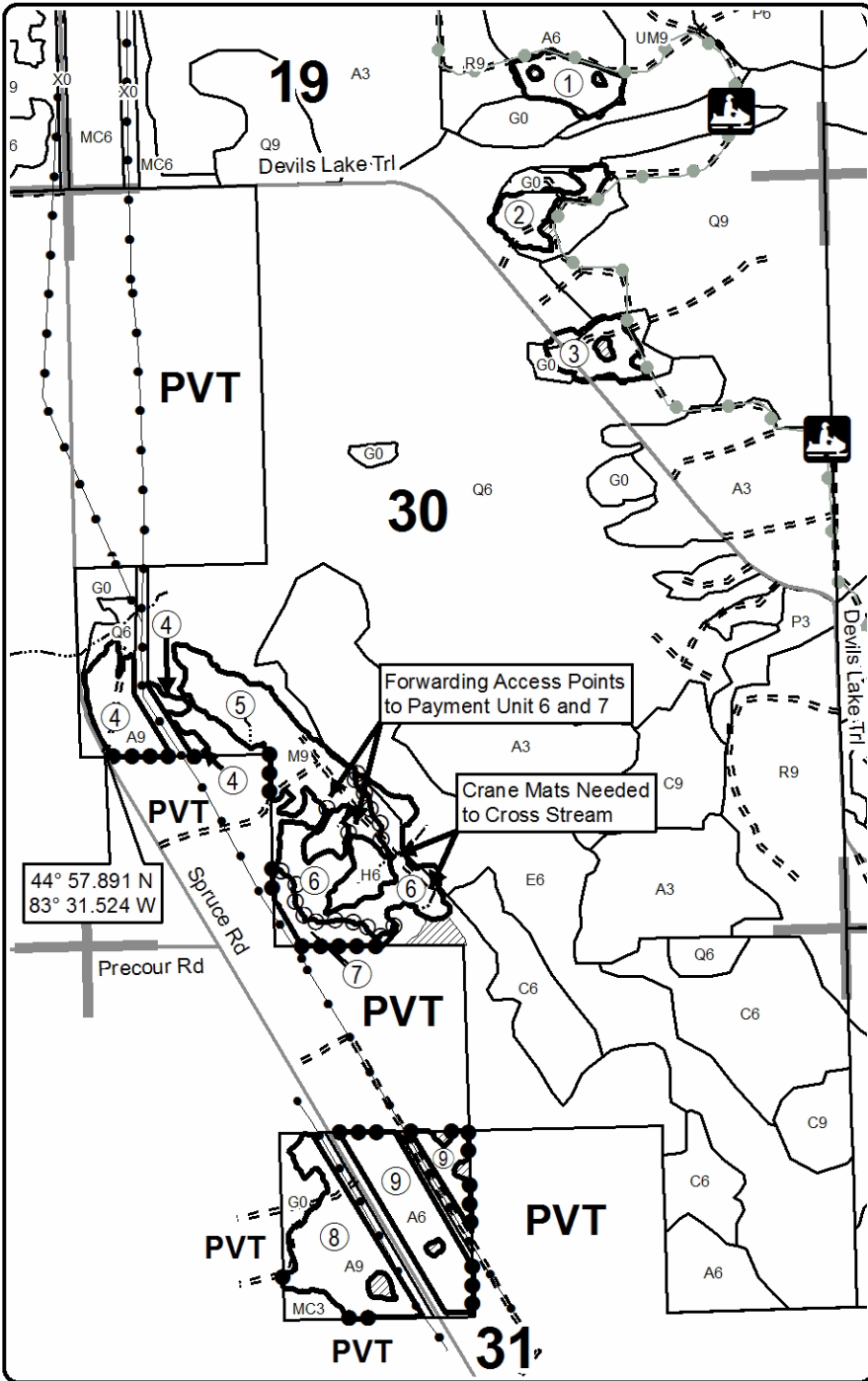

Spruce Road Mix Compartment 91 75.1 Acres

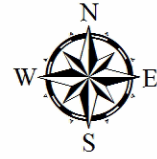

PU	Acres	Stand	PU	Acres	Stand
1	4.9	21	6	11.7	43
2	4.3	28	7	3.3	43
3	4.6	31	8	12.2	57
4	7.3	38	9	13.0	54
5	13.8	45			

Locator Map
1:200,000

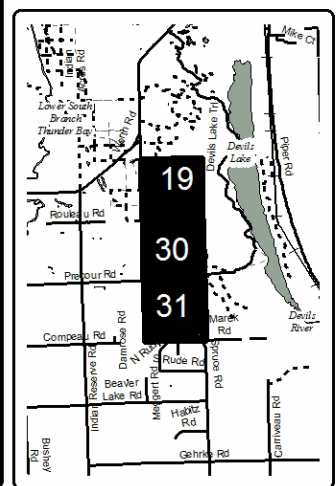

Legend	
	Against State (Red)
	Payment Unit (Yellow)
	Private Line (Blue)
	Payment Unit
	Retention (Red)
	Stand Boundaries
	Recreational Trail
	Paved Roads
	Poor Dirt Roads
	Pipeline; Powerline
	Streams
	Lakes and Rivers
	All
	Section Corners

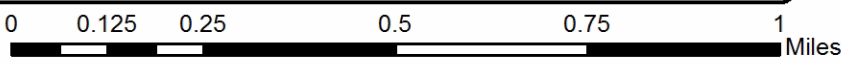

TIMBER SALE INFORMATION

TBR Mile Mix (54-026-16)

Alpena County (Advertised Price \$50,554.15)

SALE NOTE: Spec. 4.1.8 Requires culverts are installed on access route.

The following road work is required: Three (3) to four (4) culverts will need to be placed along the stretch of forest trail that runs from the west end of Eagling Road south to the railroad grade.

A timber sale contract for this lump sum, sealed bid timber sale will be awarded to the responsible bidder offering the highest sealed bid price. Bids must be at or above the following advertised price for each species:

<u>PRODUCTS & SPECIES</u>	<u>ESTIMATED UNITS*</u>	<u>ADVERTISED PRICE</u>
Sawtimber		
B. T. Aspen	5.10 MBF	\$ 78.00 / MBF
Mixed Spruce	39.40 MBF	\$ 81.00 / MBF
Red Maple	16.80 MBF	\$ 123.00 / MBF
Red Pine	41.60 MBF	\$ 128.00 / MBF
White Pine	15.40 MBF	\$ 84.00 / MBF
Pulpwood		
Balsam Fir	95.00 Cords	\$ 28.25 / Cord
Mixed Aspen	410.00 Cords	\$ 20.95 / Cord
Mixed Hardwood	441.00 Cords	\$ 18.90 / Cord
Mixed Spruce	259.00 Cords	\$ 40.65 / Cord
Paper Birch	41.00 Cords	\$ 21.65 / Cord
Red Pine	77.00 Cords	\$ 50.25 / Cord
White Pine	95.00 Cords	\$ 35.65 / Cord

* The total volume is statistically estimated within plus (+) or minus (-) 11.13 percent. The estimated units are final and not subject to adjustment. Prospective bidders are urged to examine this timber and to make their own estimates of quantity and quality.

BOND AND PAYMENT SCHEDULE:

1. A bond in the amount of \$2,528.00 to insure faithful performance of the conditions of the contract will be deposited by the successful bidder within 21 days of the sale award.
2. Cutting in any sale or unit without the required advance payment would be considered a trespass.
3. Total payment must be paid in advance or according to the following schedule:
 - (a) Ten percent (10%) of the sale value must be paid within 21 days of the sale award.
 - (b) The 10% down payment will be credited towards the first unit cut.
4. If no cutting takes place, the 10% down payment will not be refunded.
5. Operations on the contract issued will terminate on 12/31/2019.

Description of Timber by Payment Unit (PU)

PU	MARKET GROUP	PRODUCT	QUANTITY	UNIT	ACRES	ADVERTISE PRICE	
1	B. T. Aspen	Sawtimber	2.3	MBF	15.0	\$5,946.05	
	Mixed Spruce		0.8	MBF			
	<i>White Spruce</i>		0.8	<i>MBF</i>			
	Red Maple		3.3	MBF			
	Red Pine		0.5	MBF			
	White Pine		0.5	MBF			
	Balsam Fir		Pulpwood	5.0			Cords
	Mixed Aspen			118.0			Cords
	<i>B. T. Aspen</i>			115.0			<i>Cords</i>
	<i>Quaking Aspen</i>			3.0			<i>Cords</i>
	Mixed Hardwood			104.0			Cords
	<i>Red Maple</i>			104.0			<i>Cords</i>
	Mixed Spruce			8.0			Cords
	<i>White Spruce</i>			8.0			<i>Cords</i>
	Paper Birch			1.0			Cords
	<i>Paper Birch</i>			1.0			<i>Cords</i>
	Red Pine		1.0	Cords			
White Pine	6.0	Cords					
2	Red Maple	Sawtimber	0.6	MBF	7.3	\$9,628.50	
	Red Pine		33.3	MBF			
	White Pine		2.2	MBF			
	Balsam Fir		Pulpwood	3.0			Cords
	Mixed Aspen			60.0			Cords
	<i>B. T. Aspen</i>			60.0			<i>Cords</i>
	Mixed Hardwood			9.0			Cords
	<i>Red Maple</i>			9.0			<i>Cords</i>
	Paper Birch			12.0			Cords
	<i>Paper Birch</i>			12.0			<i>Cords</i>
	Red Pine			60.0			Cords
White Pine	9.0	Cords					
3	B. T. Aspen	Sawtimber		1.2	MBF	5.6	\$6,147.40
	Mixed Spruce		2.9	MBF			
	<i>White Spruce</i>		2.9	<i>MBF</i>			
	Red Maple		0.5	MBF			
	Red Pine		4.6	MBF			
	White Pine		9.0	MBF			
	Mixed Aspen		Pulpwood	60.0	Cords		
	<i>B. T. Aspen</i>			60.0	<i>Cords</i>		
	Mixed Hardwood			26.0	Cords		
	<i>Red Maple</i>			26.0	<i>Cords</i>		
	Mixed Spruce			4.0	Cords		
	<i>White Spruce</i>			4.0	<i>Cords</i>		
	Paper Birch			13.0	Cords		
	<i>Paper Birch</i>			13.0	<i>Cords</i>		
Red Pine	8.0	Cords					
White Pine	51.0	Cords					
4	B. T. Aspen	Sawtimber	0.8	MBF	21.5	\$13,169.80	
	Mixed Spruce		15.6	MBF			
	<i>Black Spruce</i>		0.4	<i>MBF</i>			
	<i>White Spruce</i>		15.2	<i>MBF</i>			
	Red Maple		6.6	MBF			
	Red Pine		1.7	MBF			
	White Pine		2.0	MBF			
	Balsam Fir		Pulpwood	32.0			Cords
	Mixed Aspen			76.0			Cords
	<i>B. T. Aspen</i>			37.0			<i>Cords</i>

Description of Timber by Payment Unit (PU), con't

PU	MARKET GROUP	PRODUCT	QUANTITY	UNIT	ACRES	ADVERTISE PRICE
4 con't	<i>Quaking Aspen</i>	<i>Pulpwood</i>	39.0	<i>Cords</i>		
	Mixed Hardwood		153.0	Cords		
	<i>Red Maple</i>		153.0	<i>Cords</i>		
	Mixed Spruce		107.0	Cords		
	<i>Black Spruce</i>		1.0	<i>Cords</i>		
	<i>White Spruce</i>		106.0	<i>Cords</i>		
	Paper Birch		8.0	Cords		
	<i>Paper Birch</i>	<i>Sawtimber</i>	0.3	<i>MBF</i>		
	<i>Paper Birch</i>	<i>Pulpwood</i>	7.0	<i>Cords</i>		
	Red Pine		4.0	Cords		
	White Pine		15.0	Cords		
5	B. T. Aspen	Sawtimber	0.8	MBF	19.0	\$11,675.55
	Mixed Spruce		13.8	MBF		
	<i>Black Spruce</i>		0.4	<i>MBF</i>		
	<i>White Spruce</i>		13.4	<i>MBF</i>		
	Red Maple		5.8	MBF		
	Red Pine		1.5	MBF		
	White Pine		1.7	MBF		
	Balsam Fir	Pulpwood	29.0	Cords		
	Mixed Aspen		67.0	Cords		
	<i>B. T. Aspen</i>		33.0	<i>Cords</i>		
	<i>Quaking Aspen</i>		34.0	<i>Cords</i>		
	Mixed Hardwood		135.0	Cords		
	<i>Red Maple</i>		135.0	<i>Cords</i>		
	Mixed Spruce		94.0	Cords		
	<i>Black Spruce</i>		1.0	<i>Cords</i>		
	<i>White Spruce</i>		93.0	<i>Cords</i>		
	Paper Birch		7.0	Cords		
	<i>Paper Birch</i>	<i>Sawtimber</i>	0.2	<i>MBF</i>		
	<i>Paper Birch</i>	<i>Pulpwood</i>	7.0	<i>Cords</i>		
	Red Pine		4.0	Cords		
	White Pine		14.0	Cords		
6	Mixed Spruce	Sawtimber	6.3	MBF	5.5	\$3,986.85
	<i>White Spruce</i>		6.3	<i>MBF</i>		
	Balsam Fir	Pulpwood	26.0	Cords		
	Mixed Aspen		29.0	Cords		
	<i>B. T. Aspen</i>		18.0	<i>Cords</i>		
	<i>Quaking Aspen</i>		11.0	<i>Cords</i>		
	Mixed Hardwood		14.0	Cords		
	<i>Black Cherry</i>		4.0	<i>Cords</i>		
	<i>Red Maple</i>		10.0	<i>Cords</i>		
	Mixed Spruce		46.0	Cords		
	<i>White Spruce</i>		46.0	<i>Cords</i>		
TOTAL:			118.3	MBF		
TOTAL:			1,418.0	Cords		

Sale Specific Conditions & Requirements

Sale Name: TBR Mile Mix

Sale Number: 54-026-16 Seq#: 1

1 - Sale Area

1.2 - Boundaries

1.2.1 - Painted boundaries (1/14)

The sale boundary and Payment Unit boundaries are marked and identified by red and yellow paint. Exterior sale boundary lines against state are marked with red paint. Interior Payment Unit boundaries are marked with yellow paint. The painted boundary line trees are not Included Timber and are to be protected. Yellow painted trees designating an interior Payment Unit boundary are only to be cut when all surrounding Payment Units have been paid.

2 - Timber Specifications

2.1 - Included Timber

2.1.1 - Clearcut unit(s) with unmerchantable trees (6/14)

Within Payment Unit(s) 1-6, cut all trees that are two (2) inches or more at DBH, except do not cut trees marked with green paint. Special protection trees identified in accordance with condition 3.4.2, within clearcutting unit boundaries, are not Included Timber and are to be protected.

2.1.11 - Description of timber note (2/04)

Note that Mixed Spruce Pulpwood/Sawtimber is white and black spruce. Mixed Aspen Pulpwood is bigtooth and quaking aspen. Mixed Hardwood Pulpwood is red maple and minimal black cherry.

3 - Payments

3.4 - Damaged Timber

3.4.1 - Damaged timber (6/14)

General Condition and Requirement 3.4 Damaged Timber, defines liquidated damages for undesignated live merchantable trees which are cut or injured. In addition, extreme care should be taken to avoid damage to spruce, oak, and pine seedlings and saplings in Payment Unit 1-6.

No damage is acceptable to undesignated merchantable trees. Within the sale area, if more than 5% of trees (> 4.5" DBH) within a specified area of the sale are damaged, liquidated damages will be assessed for all trees damaged. Rates will be in accordance with General Condition and Requirement 3.4 Damaged Timber.

3.4.2 - Special Protection Trees (4/14)

The Purchaser shall not cut live or dead special protection trees within cutting units or clearings. Special protection trees are marked with green paint and are 26 inches or greater in DBH. If the Purchaser's operations have cut or damaged special protection trees through carelessness, the Purchaser shall pay \$150 as fixed, agreed and liquidated damages for each special protection tree cut or damaged. Such payment does not constitute ownership of the undesignated timber.

4 - Transportation

4.1 - Construction

4.1.3 - Slash and earthen piles (8/04)

Piles or windrows of earth along roads and landings that have been widened or constructed shall be leveled. Slash from road maintenance or construction, including stumps, shall be dispersed throughout the sale.

4.1.6 - Road construction (1/09)

Construction of new roads or improvements of existing roads must have the prior approval of the Unit Manager or his/her representative before work can start and shall be done in such a way as to minimize the environmental and visual impacts. Merchantable trees shall be cut and utilized unless otherwise directed. Non-merchantable trees shall be severed and laid flat on the ground. Slash shall be scattered, and not left in windrows and kept a minimum of 10 feet back from the road edge.

Stumps shall be set upright, not left on edge, and be moved at least 10 feet away from the road edge. Disturbed soil shall be feathered into the woods and not left in berms or windrows.

4.1.7 - Road closure (10/11)

All new roads built into the sale must be blocked to vehicle traffic within 30 days of completion of hauling. Overgrown roads that are reopened shall be considered new roads. In general, this will require constructing a four (4') foot high berm of stumps and logs covered with earth. These roads must be rendered impassable to cars and trucks. All stumps from road building and landing construction must be reserved to block any newly constructed roads upon completion of the sale. Temporary berms may be required if no sale activity occurs for 30 or more consecutive days. Contact the sale administrator for specific details of design and placement.

4.1.8 - Road work (1) (8/07)

The following road work is required: Three (3) to four (4) culverts will need to be placed along the stretch of forest trail that runs from the west end of Eagling Road south to the railroad grade. These culverts will need to be placed in accordance with the State of Michigan "Sustainable Soil and Water Quality Practices on Forest Land" guidelines. The road fill material to be used will be specified by the Sale Administrator or Unit Manager at the time that the roadwork is being done, and will be based on the condition of this forest trail. The culverts must be left in place after the sale is finished.

4.2 - Maintenance

4.2.2 - Fill material (4/07)

To maintain roads, fill material may be needed in areas where "holes" exist or may be expected to develop. This fill material should be placed before trucking begins. This fill material must be crushed rock or cobble, and may not contain clay.

4.2.5 - Two wheel drive condition (2/04)

All existing trail roads on and adjacent to the sale area must be passable by two-wheel drive traffic for the duration of the sale.

4.4 - Access

4.4.3 - Access gate (12/08)

The access gate must be locked at the completion of each day unless otherwise approved by the Unit Manager or his/her representative. The access gate is located near the west end of Eagling Road to the south on a forest road. Contact the Unit Manager or his/her representative for the access key.

5 - Operations

5.1 - Notification

5.1.1 - Pre-sale conference (10/11)

A pre-sale conference on site between the Purchaser and sale administrator is required prior to beginning any operations within a Payment Unit to determine landing and road locations. Landing locations must be far enough away from the Thunder Bay River and other supplies of groundwater to avoid contaminating ground water. The Unit Manager or his/her representative must be contacted at least 10 days in advance to schedule the conference.

5.1.4 - Post-sale conference (6/11)

A post-sale conference on site between the Purchaser and sale administrator is required 5 days prior to the completion of active logging operations to determine clean-up and repair of landings, road edges, and the fulfillment of other contract specifications.

5.2 - Conduct of Operations

5.2.2 - Hazard Trees/Snags

5.2.2.1 - Den trees (2/04)

Obvious hollow and/or den trees shall be protected and left standing unless they are a safety hazard.

5.2.3 - Operating Restrictions

5.2.3.1 - Operating restrictions (9/11)

Within Payment Unit(s) 1-6, unless changed by written agreement, cutting, skidding, and hauling are limited to the period of June 15 to November 1. This restriction is in place because of the presence of a snowmobile trail and low ground

conditions.

5.2.3.6 - Bark beetle restriction (12/08)

In the event drought creates a high risk of pine bark beetle infestation, pine is not to be cut during the period March 1 through July 1, unless all portions of trees greater than two inches in diameter are removed from the sale area, reduced to chips, or treated to the satisfaction of the Unit Manager or his/her representative, within fifteen days of being severed from the stump. Pine log decks, pulpwood piles and treetops that are piled for chipping in the fall or winter within a 1/4 mile of susceptible sites must be removed before March 15. Residual slash must not be placed in piles or rows and must be spread over the site for quick drying. The Department of Natural Resources will exercise this specification if the risk of damage warrants.

5.2.3.11 - Coppice regeneration protection (4/10)

Timber harvesting in any Payment Unit must be completed before significant sprouting occurs in that Payment Unit so as to minimize damage to the new regeneration. Any post harvest operations, such as chipping, must be completed before sprouting of regeneration occurs. If it is anticipated that chipping will be delayed, then tops shall be carried to one central location or left unchipped. The Unit Manager or his/her representative may cease such operations if sprouting occurs before the operation is complete.

5.2.4 - Dead and Down Creation

5.2.4.4 - Dead and down creation, grouse (8/13)

To encourage grouse and other wildlife, in Payment Unit(s) 1 and 4, leave one, 12" diameter or larger log-length (8 foot minimum) piece on the ground for every 2 acres. These will be evenly scattered throughout the unit. This can be an unmerchantable piece or a full tree.

5.2.32 - Decking/landing restoration (9/13)

All decking and landing areas must have the surface area restored to a condition equal to or better than before. This is to ensure the proper regeneration of the stand. Wood debris, chips and "cookies" from trimmings must be removed or scattered away from landing and loading areas and may not be windrowed on the edge.

5.2.38 - No decking against live trees (2/04)

Cut products may not be decked against unmarked or designated leave trees.

5.2.41 - Snowmobile trail protection (9/11)

Snowmobile trail 4 is shown on the Timber Sale Map. Do not cut or damage posts with orange trail markers or traffic control signs. If the trail is used, it must be maintained and restored to a condition equal to or better than before the sale. The road maintenance/restoration must be done prior to December 1. Any rutting or holes created during the sale operations must be repaired using crushed limestone/gravel that is pre-approved by the sale administrator or Unit Manager. After the trail is used for hauling, it must be graded to the satisfaction of the Unit Manager or his/her representative prior to December 1st. Maintain a 20 foot wide slash, debris, and rut free zone daily using the snowmobile trail as the centerline. No decking of forest products will be permitted along the snowmobile trail. All stumps within 20 feet of the snowmobile trail must be cut at ground level.

5.4 - Soil Protection

5.4.1 - Rutting restriction, general (7/16)

Operations are to cease immediately if equipment and weather conditions result in rutting of roads and/or skid trails which is 12 inches or greater in depth and 50 feet in length. The Unit Manager or his/her representative may restrict hauling and/or skidding if ruts exceed the specified depth. With the Unit Manager or his/her representative's approval, the Purchaser may return to the area when the risk of rutting has decreased.

5.8 - Protection of Endangered Species

5.8.5 - Protection of raptor nests (3/13)

All trees with raptor nests will be protected if found during harvesting operations. Notification will be made to the Unit Manager or his/her representative who will notify the Wildlife Biologist so an on-site evaluation and recommendation can be made, if necessary.

6 - Safety and Fire Prevention

6.2 - Signing

6.2.1 - Road posting (9/09)

The Purchaser is responsible for posting and maintaining caution signs on the Alpena to Hillman forest road/snowmobile trail prior to beginning operations. The road must be posted at appropriate distances from the sale area to warn of logging activity and truck traffic. Signs must be removed when harvest operations are suspended or completed. The Purchaser will provide these signs.



TIMBER SALE MAP

This information provided by authority of Part 525, 1994 PA 451, as amended.

Forest Management Unit Atlanta	County Alpena	Mapped By D. Parris	Date 9/8/2016	Page 1	of 1
Township 31N	Range 5E	Section(s) and Subdivision(s) Sec 14 NWSW, SWSW; Sec 15 NESE, NWSE, SESE, SWSE, NESW, NWSW, SESW	Scale 1:15,840		

Cover Type			Density		
-------------------	--	--	----------------	--	--

- | | | | | | |
|-------------------|----------------------|-------------------------|-------------------|-----------------------------|------------------------|
| A = Aspen | H = Hemlock | N = Marsh | U = Upland Brush | 0 = Non Stocked | 5 = Pole Timber Medium |
| B = Paper Birch | J = Jack Pine | O = Oak | UM = Upland Mixed | 1 = Seedling Sapling Poor | 6 = Pole Timber Well |
| C = Cedar | L = Lowland Brush | P = Lowland Poplar | V = Bog or Marsh | 2 = Seedling Sapling Medium | 7 = Saw Timber Poor |
| D = Tread Bog | LM = Lowland Mixed | Q = Mixed Swamp Conifer | W = White Pine | 3 = Seedling Sapling Well | 8 = Saw Timber Medium |
| E = Swamp Hdwoods | M = Mpl. Bch, Brch | R = Red Pine | X = Non Stocked | 4 = Pole Timber Poor | 9 = Saw Timber Well |
| F = Spruce Fir | MC = Mixed Conifer | S = Black Spruce | Z = Water | | |
| G = Grass | MD = Mixed Deciduous | T = Tamarack | | | |

PU	Stand	Acres	PU	Stand	Acres
1	78	15.0	4	84, 85, 88	21.5
2	81	7.3	5	88, 13	19.0
3	81	5.6	6	82, 8	5.5

TBR Mile Mix

Compartment 95
73.9 Acres

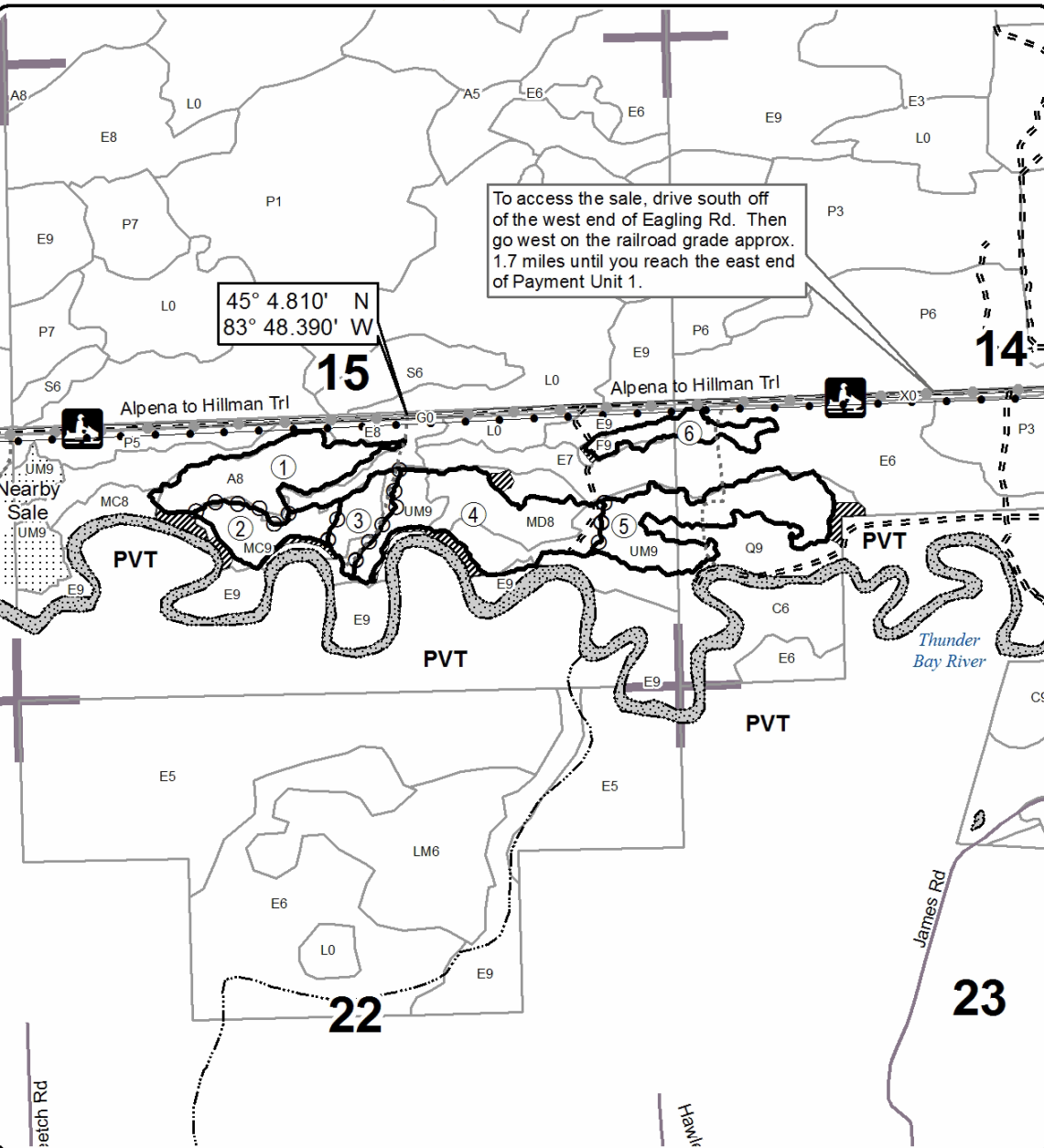
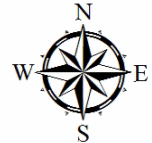

Legend

- Against State (Red)
- ○ ○ Payment Unit (Yellow)
- Payment Unit
- ▨ Retention Area
- ▭ Stand Boundaries
- ⋯ Nearby Sales
- Recreational Trail
- Paved Roads
- - - Gravel Roads
- ⋯ Poor Dirt Roads
- ⋯ Closed Roads
- Pipeline; Powerline
- ⋯ Streams
- ▨ Lakes and Rivers All
- Section Corners

Locator Map
1:200,000

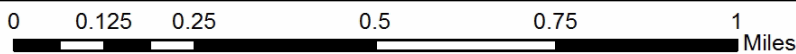
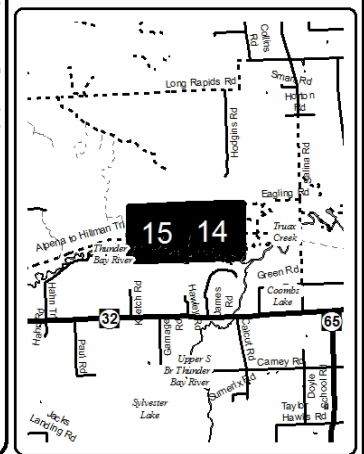

TIMBER SALE INFORMATION

Time Traveler Aspen & Oak (54-037-16)

Alpena County (Advertised Price \$102,813.95)

SALE NOTE: This is a 3 year contract with no extensions (spec. 7.2.2).

Payment units adjacent to the recreation trails are restricted from 12/15-3/31 (spec. 5.2.3.1). Payment units may be divided to work around this seasonal restriction (spec. 3.3.4). In addition, all marked to cut units are restricted from 4/1-7/15 for bark slip and oak wilt concerns (spec. 5.2.3.3 & 5.2.3.4).

A recreation site such as a trail, pathway, or campground is within the sale area or the vicinity. Certain restrictions/specifications may be applicable including time restrictions.

A timber sale contract for this lump sum, sealed bid timber sale will be awarded to the responsible bidder offering the highest sealed bid price. Bids must be at or above the following advertised price for each species:

<u>PRODUCTS & SPECIES</u>	<u>ESTIMATED UNITS*</u>	<u>ADVERTISED PRICE</u>
Sawtimber		
Mixed Aspen	352.20 MBF	\$ 78.00 / MBF
Red Maple	19.00 MBF	\$ 123.00 / MBF
Red Oak	193.20 MBF	\$ 145.00 / MBF
White Oak	0.80 MBF	\$ 72.00 / MBF
Pulpwood		
Mixed Aspen	878.00 Cords	\$ 20.95 / Cord
Mixed Hardwood	880.00 Cords	\$ 18.90 / Cord
Mixed Oak	537.00 Cords	\$ 18.45 / Cord

* The total volume is statistically estimated within plus (+) or minus (-) 16.06 percent. The estimated units are final and not subject to adjustment. Prospective bidders are urged to examine this timber and to make their own estimates of quantity and quality.

BOND AND PAYMENT SCHEDULE:

1. A bond in the amount of \$5,141.00 to insure faithful performance of the conditions of the contract will be deposited by the successful bidder within 21 days of the sale award.
2. Cutting in any sale or unit without the required advance payment would be considered a trespass.
3. Total payment must be paid in advance or according to the following schedule:
 - (a) Ten percent (10%) of the sale value must be paid within 21 days of the sale award.
 - (b) The 10% down payment will be credited towards the first unit cut.
4. If no cutting takes place, the 10% down payment will not be refunded.
5. Operations on the contract issued will terminate on 12/15/2020.

Description of Timber by Payment Unit (PU)

PU	MARKET GROUP	PRODUCT	QUANTITY	UNIT	ACRES	ADVERTISE PRICE
1	Mixed Aspen	Sawtimber	22.6	MBF	10.6	\$5,874.80
	Red Maple		0.3	MBF		
	Red Oak		11.1	MBF		
	Mixed Aspen	Pulpwood	47.0	Cords		
	Mixed Hardwood		52.0	Cords		
	Mixed Oak		27.0	Cords		
2	Mixed Aspen	Sawtimber	12.6	MBF	5.9	\$3,275.95
	Red Maple		0.2	MBF		
	Red Oak		6.2	MBF		
	Mixed Aspen	Pulpwood	26.0	Cords		
	Mixed Hardwood		29.0	Cords		
	Mixed Oak		15.0	Cords		
3	Mixed Aspen	Sawtimber	23.6	MBF	11.1	\$6,142.35
	Red Maple		0.3	MBF		
	Red Oak		11.6	MBF		
	Mixed Aspen	Pulpwood	49.0	Cords		
	Mixed Hardwood		55.0	Cords		
	Mixed Oak		28.0	Cords		
4	Mixed Aspen	Sawtimber	78.9	MBF	37.1	\$20,531.55
	Red Maple		1.0	MBF		
	Red Oak		38.8	MBF		
	Mixed Aspen	Pulpwood	164.0	Cords		
	Mixed Hardwood		182.0	Cords		
	Mixed Oak		95.0	Cords		
5	Mixed Aspen	Sawtimber	20.7	MBF	9.7	\$5,385.30
	Red Maple		0.3	MBF		
	Red Oak		10.1	MBF		
	Mixed Aspen	Pulpwood	43.0	Cords		
	Mixed Hardwood		48.0	Cords		
	Mixed Oak		25.0	Cords		
6	Mixed Aspen	Sawtimber	76.9	MBF	36.8	\$18,682.40
	Red Maple		4.0	MBF		
	Red Oak		29.0	MBF		
	Mixed Aspen	Pulpwood	168.0	Cords		
	Mixed Hardwood		129.0	Cords		
	Mixed Oak		110.0	Cords		
7	Mixed Aspen	Sawtimber	27.4	MBF	13.1	\$6,646.80
	Red Maple		1.4	MBF		
	Red Oak		10.3	MBF		
	Mixed Aspen	Pulpwood	59.0	Cords		
	Mixed Hardwood		47.0	Cords		
	Mixed Oak		39.0	Cords		
8	Mixed Aspen	Sawtimber	52.3	MBF	25.0	\$12,663.85
	Red Maple		2.7	MBF		
	Red Oak		19.7	MBF		
	Mixed Aspen	Pulpwood	113.0	Cords		
	Mixed Hardwood		88.0	Cords		
	Mixed Oak		74.0	Cords		
9	Mixed Aspen	Sawtimber	21.6	MBF	9.5	\$14,784.30
	Red Oak		52.4	MBF		
	White Oak		0.8	MBF		
	Mixed Aspen	Pulpwood	82.0	Cords		
	Mixed Hardwood		80.0	Cords		
	Mixed Oak		120.0	Cords		
10	Mixed Aspen	Sawtimber	6.1	MBF	11.6	\$3,095.95

Description of Timber by Payment Unit (PU), con't

PU	MARKET GROUP	PRODUCT	QUANTITY	UNIT	ACRES	ADVERTISE PRICE
10 con't	Red Maple	Sawtimber	2.1	MBF		
	Mixed Aspen	Pulpwood	55.0	Cords		
	Mixed Hardwood		64.0	Cords		
11	Mixed Aspen	Sawtimber	9.5	MBF	14.9	\$5,730.70
	Red Maple		6.7	MBF		
	Red Oak		4.0	MBF		
	Mixed Aspen	Pulpwood	72.0	Cords		
	Mixed Hardwood		106.0	Cords		
	Mixed Oak		4.0	Cords		
TOTAL:			565.2	MBF		
TOTAL:			2,295.0	Cords		

Sale Specific Conditions & Requirements

Sale Name: Time Traveler Aspen & Oak

Sale Number: 54-037-16 Seq#: 2

1 - Sale Area

1.2 - Boundaries

1.2.1 - Painted boundaries (1/14)

The sale boundary and Payment Unit boundaries are marked and identified by blue, red and green paint. Exterior sale boundary lines against private property are marked with blue paint. Exterior sale boundary lines against state are marked with red paint. Interior Payment Unit boundaries are marked with green paint. The painted boundary line trees are not Included Timber and are to be protected unless marked with orange or pink paint.

2 - Timber Specifications

2.1 - Included Timber

2.1.1 - Clearcut unit(s) with unmerchantable trees (6/14)

Within Payment Unit(s) 9 and 10, cut all trees that are two (2) inches or more at DBH.

2.1.3 - Cut tree marked unit(s) (12/08)

Within Payment Unit(s) 1-8 and 11, all trees are designated for cutting when marked with orange or pink paint above and below stump height, regardless of merchantability. In addition, all aspen trees are designated for cutting. Any trees marked with orange paint outside of the sale boundary are not Included Timber.

2.1.11 - Description of timber note (2/04)

Note that mixed aspen includes quaking and big tooth. Mixed oak pulp includes red and white oak. Mixed hardwood pulp includes red maple, sugar maple, and ash.

2.2 - Utilization

2.2.3 - Stump heights (4/07)

Stump heights within the Sale Area shall not exceed 12 inches, with the following exception: Trees that are marked with pink paint along the recreation trails must be left with a 2 ft (24") stump or greater. This is for future widening of the trail.

2.2.6 - Roundwood operation required (5/07)

The skidding of whole trees or tree segments with limbs attached is prohibited. All products must be produced as roundwood and forwarded to existing roads or landing areas in final product length.

2.2.7 - Uncut designated trees (2/04)

Liquidated damages of \$25.00 per tree will be assessed for every marked tree not cut. This will only apply toward trees marked with pink paint along recreation trails.

3 - Payments

3.3 - Pre-measured Sales

3.3.4 - Dividing payment units (7/14)

Payment Unit(s) 4 and 6 may be divided at the request of the Purchaser and upon approval of the Unit Manager. Dividing Payment Units is a contract modification which requires a Timber Sale Contract Supplement. There will be only one division per Payment Unit. Payment Units 1-3, 5, and 7-11 may be divided in order to facilitate harvesting around restricted periods along the recreation trails.

3.4 - Damaged Timber

3.4.1 - Damaged timber (6/14)

General Condition and Requirement 3.4 Damaged Timber, defines liquidated damages for undesignated live merchantable trees which are cut or injured. In addition, extreme care should be taken to avoid damage to tree seedlings and saplings.

Within the sale area, if more than 25% of the conifer seedlings or saplings (1/4" to 4.5" DBH) within a specified portion of the sale area are damaged, liquidated damages will be assessed at \$100 per acre for all acreage within that specified portion of

the sale area that was damaged.

No damage is acceptable to merchantable trees. Within the sale area, if more than 5% of trees (> 4.5" DBH) within a specified area of the sale are damaged, liquidated damages will be assessed for all trees damaged. Rates will be in accordance with General Condition and Requirement 3.4 Damaged Timber.

3.6 - Payment Unit Cutting Schedule

3.6.2 - One active unit (12/08)

Each Payment Unit must be completed to the satisfaction of the Unit Manager or his/her representative before the next unit may be opened. The Purchaser must give a one week notice before finishing a unit to allow for inspection.

4 - Transportation

4.1 - Construction

4.1.3 - Slash and earthen piles (8/04)

Piles or windrows of earth along roads and landings that have been widened or constructed shall be leveled. Slash from road maintenance or construction, including stumps, shall be dispersed throughout the sale.

4.1.6 - Road construction (1/09)

Construction of new roads or improvements of existing roads shall be done in such a way as to minimize the environmental and visual impacts. Merchantable trees shall be cut and utilized unless otherwise directed. Non-merchantable trees shall be severed and laid flat on the ground. Slash shall be scattered, and not left in windrows and kept a minimum of 30 feet back from the road edge. Stumps shall be set upright, not left on edge, and be moved at least 30 feet away from the road edge. Disturbed soil shall be feathered into the woods and not left in berms or windrows.

4.1.7 - Road closure (10/11)

All new roads built into the sale must be blocked to vehicle traffic upon completion of the sale. Overgrown roads that are reopened shall be considered new roads. In general, this will require constructing a four (4') foot high berm of stumps and logs covered with earth. These roads must be rendered impassable to cars and trucks. All stumps from road building and landing construction must be reserved to block any newly constructed roads upon completion of the sale. Contact the sale administrator for specific details of design and placement.

4.2 - Maintenance

4.2.5 - Two wheel drive condition (2/04)

All existing trail roads on and adjacent to the sale area must be passable by two-wheel drive traffic for the duration of the sale.

5 - Operations

5.1 - Notification

5.1.1 - Pre-sale conference (10/11)

A pre-sale conference on site between the Purchaser and sale administrator is required prior to beginning any operations and before the start of each Payment Unit to determine access, trail locations, landing and road locations. The Unit Manager or his/her representative must be contacted at least 10 days in advance to schedule the conference.

5.1.3 - Well heads and natural gas pipelines (11/15)

The Purchaser is responsible for contacting the gas or pipeline company 30 days prior to operating equipment in the vicinity of well heads or natural gas pipelines.

5.1.4 - Post-sale conference (6/11)

A post-sale conference on site between the Purchaser and sale administrator is required 5 days prior to the completion of active logging operations to determine clean-up and repair of landings, road edges, and the fulfillment of other contract specifications. This conference will coincide with the pre-sale conference of each new payment unit.

5.2 - Conduct of Operations

5.2.1 - Slash

5.2.1.2 - Slash Removal

5.2.1.2.1 - Slash removal, right-of-way (9/16)

All slash must be removed at least 30 feet from the cleared right-of-way of forest roads.

5.2.1.8 - Slash height (12/08)

No slash or tree tops may exceed 30 inches in height. This requirement is for the area within 100 feet of any recreation trail.

5.2.3 - Operating Restrictions

5.2.3.1 - Operating restrictions (9/11)

Within Payment Unit(s) 1-10, cutting, skidding, and hauling are not permitted during the period of December 15 to March 31. This restriction is to reduce user conflict along the Chippewa Hills Pathway. Payment Units may be split to avoid this conflict per spec 3.3.4.

5.2.3.3 - Bark slippage restriction (3/09)

Within Payment Unit(s) 1-8 and 11, cutting and skidding are not permitted during the period of April 1 to July 15. This restriction is because of bark slippage.

5.2.3.4 - Oak wilt restriction (4/17)

Within Payment Unit(s) 1-8 and 11, unless changed by written agreement, cutting, skidding, and hauling are not permitted during the period of April 15 to July 15. Operations may be allowed if specific steps are taken to prevent damaging uncut oak during the high risk period. Those steps include completing all road brushing before April 15th, clearing a tree-length buffer along uncut oak cover before April 15th or leaving an uncut buffer there until after July 15th. This is necessary to reduce the spread of oak wilt. For more information, contact the Unit Manager or his/her representative.

5.2.4 - Dead and Down Creation

5.2.4.4 - Dead and down creation, grouse (8/13)

To encourage grouse and other wildlife, in Payment Unit(s) 9 and 10, leave one, 12" diameter or larger log-length (8 foot minimum) piece on the ground for every 2 acres. These will be evenly scattered throughout the unit. This can be an unmerchantable piece or a full tree.

5.2.32 - Decking/landing restoration (9/13)

All decking and landing areas must have the surface area restored to a condition equal to or better than before. This is to ensure the proper regeneration of the stand. Wood debris, chips and "cookies" from trimmings must be removed or scattered away from landing and loading areas and may not be windrowed on the edge.

5.2.33 - Gas well re-vegetation (12/08)

In the event that the gas well is utilized for a landing, the site must be re-vegetated with a seeding mixture specified by the Unit Manager or his/her representative.

5.2.37 - No decking areas (12/08)

No decking is allowed within 50 feet of any recreation trails without permission of the Unit Manager or his/her representative.

5.2.38 - No decking against live trees (2/04)

Cut products may not be decked against unmarked or designated leave trees.

5.2.40 - Pathway protection (10/10)

The Chippewa Hills Trail System is a multiple use trail and is shown on the Timber Sale Map. Do not cut trees or damage posts with blue pathway markers unless trees are also also marked with pink and/or orange paint. Maintain a 60-foot wide slash, debris, and rut free zone daily, using the pathway as the centerline. Do not run equipment down the pathway. Skidding across the trail may only occur in locations approved by the sale administrator.

5.4 - Soil Protection

5.4.1 - Rutting restriction, general (7/16)

Operations are to cease immediately if equipment and weather conditions result in rutting of roads and/or skid trails which is 12 inches or greater in depth and 50 feet in length. The Unit Manager or his/her representative may restrict hauling and/or skidding if ruts exceed the specified depth. With the Unit Manager or his/her representative's approval, the Purchaser may return to the area when the risk of rutting has decreased.

5.8 - Protection of Endangered Species

5.8.5 - Protection of raptor nests (3/13)

All trees with raptor nests will be protected if found during harvesting operations. Notification will be made to the Unit Manager or his/her representative who will notify the Wildlife Biologist so an on-site evaluation and recommendation can be made, if necessary.

6 - Safety and Fire Prevention

6.2 - Signing

6.2.3 - Recreational trail posting (2/10)

The Purchaser is responsible for posting and maintaining caution signs on Chippewa Hills Trail System prior to beginning operations. The trail must be posted at both trail heads (shown as P on the sale map) and at appropriate distances from the active sale area to warn of logging activity and truck traffic at both ends of the trail. Signs must be removed when harvest operations are suspended or completed. The DNR will provide these signs and assist in sign placement.

7 - Other Conditions

7.2 - Extensions

7.2.2 - No extensions (3/09)

There will be no extensions granted on this contract. This is to avoid prolonged user conflict along the recreation trails. This sale has a three year contract.



TIMBER SALE MAP

This information provided by authority of Part 525, 1994 PA 451, as amended.

Forest Management Unit Atlanta	County Alpena	Mapped By Fate	Date 09/23/2016	Page 1	of 1
Township 29N	Range 06E	Section(s) and Subdivision(s) Sec. 14: SWSE Sec. 23: NE/4, NW/4, N/2SE, SESE, S/2SW Sec. 25: SENW	Scale 1:15,840		

Cover Type			Density		
-------------------	--	--	----------------	--	--

- | | | | | | |
|-------------------|----------------------|-------------------------|-------------------|-----------------------------|------------------------|
| A = Aspen | H = Hemlock | N = Marsh | U = Upland Brush | 0 = Non Stocked | 5 = Pole Timber Medium |
| B = Paper Birch | J = Jack Pine | O = Oak | UM = Upland Mixed | 1 = Seedling Sapling Poor | 6 = Pole Timber Well |
| C = Cedar | L = Lowland Brush | P = Lowland Poplar | V = Bog or Marsh | 2 = Seedling Sapling Medium | 7 = Saw Timber Poor |
| D = Tread Bog | LM = Lowland Mixed | Q = Mixed Swamp Conifer | W = White Pine | 3 = Seedling Sapling Well | 8 = Saw Timber Medium |
| E = Swamp Hdwoods | M = Mpl, Bch, Brch | R = Red Pine | X = Non Stocked | 4 = Pole Timber Poor | 9 = Saw Timber Well |
| F = Spruce Fir | MC = Mixed Conifer | S = Black Spruce | Z = Water | | |
| G = Grass | MD = Mixed Deciduous | T = Tamarack | | | |

PU	Acres	PU	Acres	PU	Acres
1	10.6	5	9.7	9	9.5
2	5.9	6	36.8	10	11.6
3	11.1	7	13.1	11	14.9
4	37.1	8	25.0		

Time Traveler Aspen & Oak Compartment 082 185.3 Acres

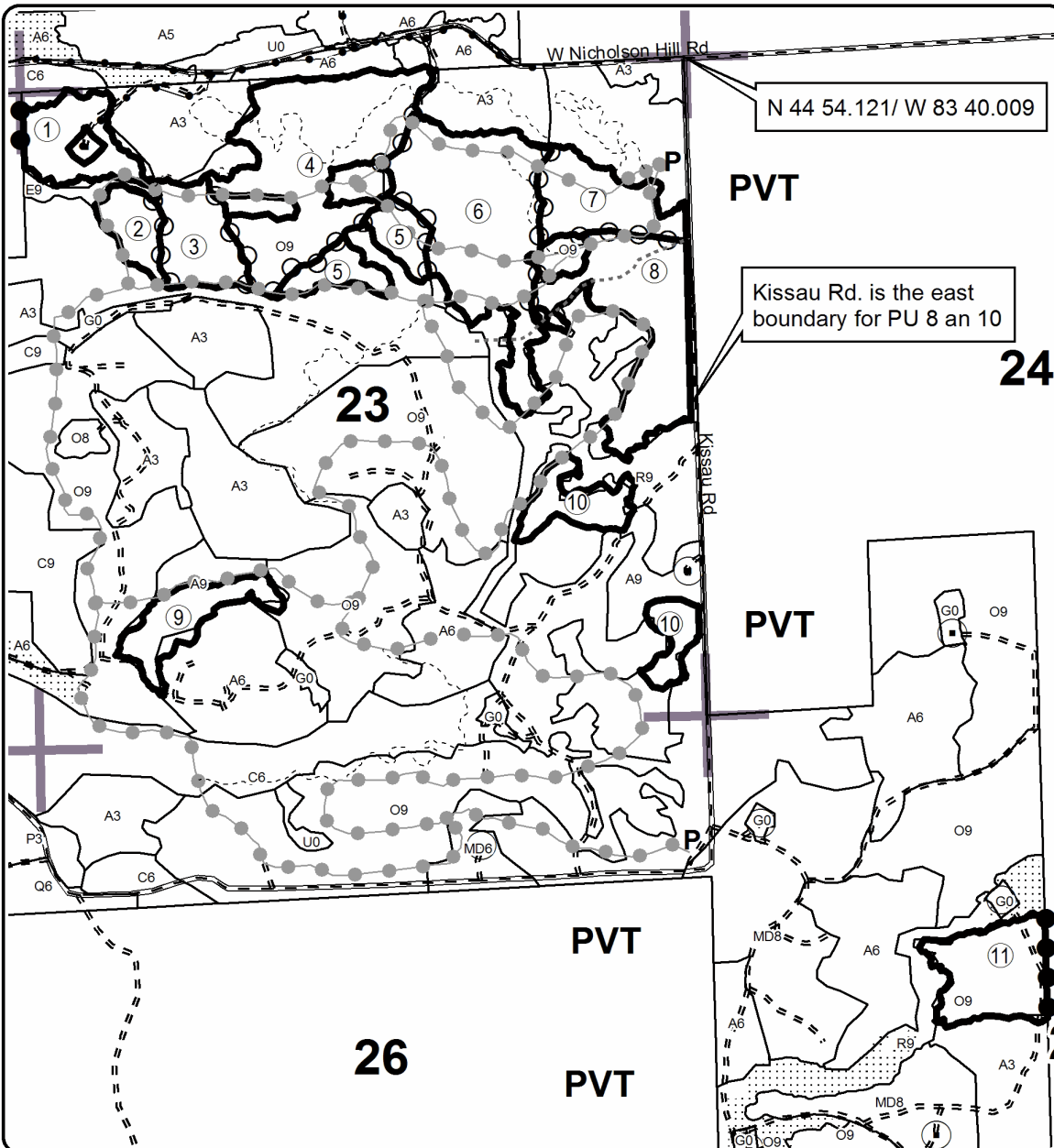

Legend

- Against State (Red)
- Payment Unit (Green)
- Private Line (Blue)
- Stand Boundaries
- ⋯ Nearby Sales
- Section Corners
- Oil & Gas Well Surface Locations
- Pipeline; Powerline
- Recreational Ski Trail
- Recreational Bike Trails
- Gravel Roads
- == Poor Dirt Roads
- Closed Roads
- Recreation Trail
- P Parking

Locator Map
1:200,000

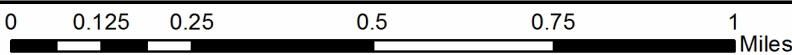
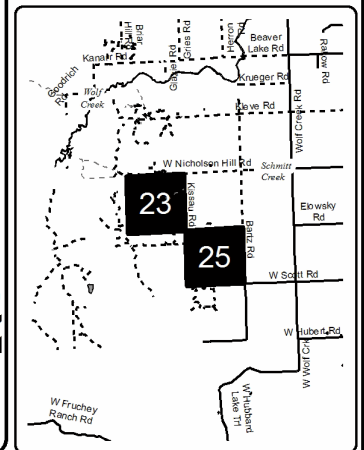

TIMBER SALE INFORMATION

2 Four D Pine (54-051-16)

Alpena County (Advertised Price \$46,577.05)

SALE NOTE: A recreation site such as a trail, pathway, or campground is within the sale area or the vicinity. Certain restrictions/specifications may be applicable including time restrictions.

A timber sale contract for this lump sum, sealed bid timber sale will be awarded to the responsible bidder offering the highest sealed bid price. Bids must be at or above the following advertised price for each species:

<u>PRODUCTS & SPECIES</u>	<u>ESTIMATED UNITS*</u>	<u>ADVERTISED PRICE</u>
Sawtimber		
B. T. Aspen	1.40 MBF	\$ 78.00 / MBF
Bl/R/Hybrid Oak	5.50 MBF	\$ 118.00 / MBF
Red Maple	2.60 MBF	\$ 123.00 / MBF
Red Pine	54.80 MBF	\$ 128.00 / MBF
White Pine	67.20 MBF	\$ 84.00 / MBF
Pulpwood		
Bl/R/Hybrid Oak	62.00 Cords	\$ 18.45 / Cord
Black Spruce	9.00 Cords	\$ 40.65 / Cord
Jack Pine	18.00 Cords	\$ 24.25 / Cord
Mixed Aspen	37.00 Cords	\$ 20.95 / Cord
Red Maple	17.00 Cords	\$ 18.90 / Cord
Red Pine	422.00 Cords	\$ 50.25 / Cord
White Pine	241.00 Cords	\$ 35.65 / Cord

* The total volume is statistically estimated within plus (+) or minus (-) 24.60 percent. The estimated units are final and not subject to adjustment. Prospective bidders are urged to examine this timber and to make their own estimates of quantity and quality.

BOND AND PAYMENT SCHEDULE:

1. A bond in the amount of \$2,329.00 to insure faithful performance of the conditions of the contract will be deposited by the successful bidder within 21 days of the sale award.
2. Cutting in any sale or unit without the required advance payment would be considered a trespass.
3. Total payment must be paid in advance or according to the following schedule:
 - (a) Ten percent (10%) of the sale value must be paid within 21 days of the sale award.
 - (b) The 10% down payment will be credited towards the first unit cut.
4. If no cutting takes place, the 10% down payment will not be refunded.
5. Operations on the contract issued will terminate on 12/31/2019.

Description of Timber by Payment Unit (PU)

PU	MARKET GROUP	PRODUCT	QUANTITY	UNIT	ACRES	ADVERTISE PRICE
1	BI/R/Hybrid Oak	Sawtimber	5.5	MBF	8.9	\$11,444.05
	Red Pine		14.6	MBF		
	BI/R/Hybrid Oak	Pulpwood	59.0	Cords		
	Jack Pine		2.0	Cords		
	<i>Jack Pine</i>		2.0	<i>Cords</i>		
	Mixed Aspen		18.0	Cords		
	<i>B. T. Aspen</i>		18.0	<i>Cords</i>		
	Red Maple		4.0	Cords		
	Red Pine		146.0	Cords		
2	B. T. Aspen	Sawtimber	0.3	MBF	4.7	\$4,554.35
	Red Pine		11.9	MBF		
	White Pine		0.2	MBF		
	BI/R/Hybrid Oak	Pulpwood	1.0	Cords		
	Jack Pine		1.0	Cords		
	<i>Jack Pine</i>		1.0	<i>Cords</i>		
	Mixed Aspen		2.0	Cords		
	<i>B. T. Aspen</i>		2.0	<i>Cords</i>		
	Red Pine		55.0	Cords		
White Pine		4.0	Cords			
3	B. T. Aspen	Sawtimber	0.4	MBF	6.4	\$6,275.50
	Red Pine		16.2	MBF		
	White Pine		0.3	MBF		
	BI/R/Hybrid Oak	Pulpwood	2.0	Cords		
	Jack Pine		2.0	Cords		
	<i>Jack Pine</i>		2.0	<i>Cords</i>		
	Mixed Aspen		3.0	Cords		
	<i>B. T. Aspen</i>		3.0	<i>Cords</i>		
	Red Pine		76.0	Cords		
White Pine		5.0	Cords			
4	Red Pine	Sawtimber	0.7	MBF	6.0	\$2,522.65
	Red Pine	Pulpwood	47.0	Cords		
	White Pine		2.0	Cords		
5	Red Pine	Sawtimber	6.7	MBF	6.1	\$5,916.55
	Jack Pine	Pulpwood	7.0	Cords		
	<i>Jack Pine</i>		7.0	<i>Cords</i>		
	Mixed Aspen		10.0	Cords		
	<i>Quaking Aspen</i>		10.0	<i>Cords</i>		
	Red Pine		91.0	Cords		
White Pine		3.0	Cords			
6	B. T. Aspen	Sawtimber	0.7	MBF	7.1	\$15,863.95
	Red Maple		2.6	MBF		
	Red Pine		4.7	MBF		
	White Pine		66.7	MBF		
	Black Spruce	Pulpwood	9.0	Cords		
	Jack Pine		6.0	Cords		
	<i>Jack Pine</i>	<i>Sawtimber</i>	0.8	<i>MBF</i>		
	<i>Jack Pine</i>	<i>Pulpwood</i>	4.0	<i>Cords</i>		
	Mixed Aspen		4.0	Cords		
	<i>B. T. Aspen</i>		4.0	<i>Cords</i>		
	Red Maple		13.0	Cords		
	Red Pine		7.0	Cords		
	White Pine		227.0	Cords		
	TOTAL:			131.5		
TOTAL:			806.0	Cords		

Sale Specific Conditions & Requirements

Sale Name: 2 Four D Pine

Sale Number: 54-051-16 Seq#: 2

1 - Sale Area

1.2 - Boundaries

1.2.1 - Painted boundaries (1/14)

The sale boundary and Payment Unit boundaries are marked and identified by red and yellow paint. Exterior sale boundary lines against state are marked with red paint. Interior Payment Unit boundaries are marked with yellow paint. The painted boundary line trees are not Included Timber and are to be protected unless marked with orange paint. Yellow painted trees designating an interior Payment Unit boundary are only to be cut when all surrounding Payment Units have been paid.

2 - Timber Specifications

2.1 - Included Timber

2.1.1 - Clearcut unit(s) with unmerchantable trees (6/14)

Within Payment Unit(s) 1, cut all species trees that are two (2) inches or more at DBH.

2.1.3 - Cut tree marked unit(s) (12/08)

Within Payment Unit(s) 2, 3, and 4, all trees are designated for cutting when marked with orange paint above and below stump height, regardless of merchantability.

2.1.7 - Leave tree marked unit(s) (6/14)

Within Payment Unit(s) 6, all trees, which meet minimum piece specifications in 2.2 Utilization, are designated for cutting except trees marked with green paint above and below stump height. Special protection trees identified in accordance with condition 3.4.2, within clearcutting unit boundaries, are not Included Timber and are to be protected.

2.1.8 - Designated plantation row unit(s) (12/08)

Within Payment Unit(s) 5, all trees which meet minimum piece specifications in 2.2 Utilization, within designated plantation rows are designated for cutting. Designated plantation rows are every third row. Begin with the third row in from the outside of the plantation, then continue every third row. Because of the variability of row direction, it shall be the responsibility of the producer to maintain the third row sequence.

2.2 - Utilization

2.2.2 - Chipping required (5/14)

Payment Unit 1 must be chip harvested to facilitate subsequent planting operations. Do not chip 1/6 to 1/3 of the slash from harvested trees (tree tops and limbs less than four inches in diameter).

2.2.3 - Stump heights (4/07)

Stump heights within Payment Unit 1 shall not exceed 6 inches for all trees. This is in order to facilitate planting operations.

2.2.4 - Skidding length (2/14)

Tree length skidding is required for Payment Unit 6.

2.2.6 - Roundwood operation required (5/07)

The skidding of whole trees or tree segments with limbs attached is prohibited within Payment Unit(s) 2, 3, 4, and 5. All products must be produced as roundwood and forwarded to existing roads or landing areas in final product length.

2.2.7 - Uncut designated trees (2/04)

Liquidated damages of \$50.00 per tree will be assessed for every marked tree not cut.

3 - Payments

3.4 - Damaged Timber

3.4.1 - Damaged timber (6/14)

General Condition and Requirement 3.4 Damaged Timber, defines liquidated damages for undesignated live merchantable trees which are cut or injured.

No damage is acceptable to merchantable trees. Within the sale area, if more than 5% of trees (> 4.5" DBH) within a specified area of the sale are damaged, liquidated damages will be assessed for all trees damaged. Rates will be in accordance with General Condition and Requirement 3.4 Damaged Timber.

3.4.2 - Special Protection Trees (4/14)

The Purchaser shall not cut live or dead special protection trees within cutting units or clearings. Special protection trees are marked with green paint. If the Purchaser's operations have cut or damaged special protection trees through carelessness, the Purchaser shall pay \$200 as fixed, agreed and liquidated damages for each special protection tree cut or damaged. Such payment does not constitute ownership of the undesignated timber.

4 - Transportation

4.1 - Construction

4.1.12 - No new roads (1/12)

No new roads will be permitted in any Payment Unit. Skid trails only will be allowed.

4.2 - Maintenance

4.2.5 - Two wheel drive condition (2/04)

All existing trail roads on and adjacent to the sale area must be passable by two-wheel drive traffic for the duration of the sale.

5 - Operations

5.1 - Notification

5.1.1 - Pre-sale conference (10/11)

A pre-sale conference between the Purchaser and sale administrator is required prior to beginning any operations to determine landing and road locations. The Unit Manager or his/her representative must be contacted at least 10 days in advance to schedule the conference.

5.1.4 - Post-sale conference (6/11)

A post-sale conference on site between the Purchaser and sale administrator is required 5 days prior to the completion of active logging operations to determine clean-up and repair of landings, road edges, and the fulfillment of other contract specifications.

5.2 - Conduct of Operations

5.2.2 - Hazard Trees/Snags

5.2.2.1 - Den trees (2/04)

Obvious hollow and/or den trees shall be protected and left standing unless they are a safety hazard.

5.2.3 - Operating Restrictions

5.2.3.1 - Operating restrictions (9/11)

Within Payment Unit(s) 6, cutting and skidding are not permitted during snow and/or frozen ground on conditions. This restriction is because of snow trail use and to scarify the soil.

5.2.3.3 - Bark slippage restriction (3/09)

Within Payment Unit(s) 2, 3, 4, 5, and 6, unless changed by written agreement, cutting and skidding are not permitted during the period of April 15 to July 1. This restriction is because of bark slippage.

5.2.3.6 - Bark beetle restriction (12/08)

In the event drought creates a high risk of pine bark beetle infestation, pine is not to be cut during the period March 1 through July 1, unless all portions of trees greater than two inches in diameter are removed from the sale area, reduced to chips, or treated to the satisfaction of the Unit Manager or his/her representative, within fifteen days of being severed from the stump. Pine log decks, pulpwood piles and treetops that are piled for chipping in the fall or winter within a 1/4

mile of susceptible sites must be removed before March 15. Residual slash must not be placed in piles or rows and must be spread over the site for quick drying. The Department of Natural Resources will exercise this specification if the risk of damage warrants.

5.2.20 - Equipment width (2/04)

Equipment used to remove designated rows must be capable of moving through cut rows without damaging residual trees.

5.2.32 - Decking/landing restoration (9/13)

All decking and landing areas must have the surface area restored to a condition equal to or better than before. This is to ensure the proper regeneration of the stand. Wood debris, chips and "cookies" from trimmings must be removed or scattered away from landing and loading areas and may not be windrowed on the edge.

5.2.38 - No decking against live trees (2/04)

Cut products may not be decked against unmarked or designated leave trees.

5.2.41 - Snowmobile trail protection (9/11)

The snowmobile trail is shown on the Timber Sale Map. Do not cut or damage posts with orange trail markers or traffic control signs. If the trail is used, it must be maintained and restored to a condition equal to or better than before the sale. The road maintenance/restoration must be done prior to December 1. The snowmobile trail may not be used for any timber sale operations from December 1 to March 31. Maintain a 20 foot wide slash, debris, and rut free zone daily using the snowmobile trail as the centerline. No decking of forest products will be permitted along the snowmobile trail. All stumps within 20 feet of the snowmobile trail must be cut at ground level.

5.4 - Soil Protection

5.4.1 - Rutting restriction, general (7/16)

Operations are to cease immediately if equipment and weather conditions result in rutting of roads and/or skid trails which is 12 inches or greater in depth and 50 feet in length. The Unit Manager or his/her representative may restrict hauling and/or skidding if ruts exceed the specified depth. With the Unit Manager or his/her representative's approval, the Purchaser may return to the area when the risk of rutting has decreased.

5.7 - Protection of Historical Sites

5.7.2 - Potential historical site(s) (9/06)

The State Historic Preservation Office has identified the potential for a historic site within the boundary of this timber sale. Note that if the site is discovered during operations, General Condition and Requirement 5.7 - Protection of Historical Sites will apply.

5.8 - Protection of Endangered Species

5.8.5 - Protection of raptor nests (3/13)

All trees with raptor nests will be protected if found during harvesting operations. Notification will be made to the Unit Manager or his/her representative who will notify the Wildlife Biologist so an on-site evaluation and recommendation can be made, if necessary.

6 - Safety and Fire Prevention

6.2 - Signing

6.2.2 - Snowmobile trail posting (8/09)

The Purchaser is responsible for posting and maintaining caution signs on snowmobile trail prior to beginning operations during the snowmobile season (approximately December 1 to March 31). The trail must be posted at appropriate distances from the sale area to warn of logging activity and truck traffic. Signs must be removed when harvest operations are suspended or completed. The Purchaser will provide these signs.

8 - Performance and Settlement

8.3 - Uncompleted or Terminated Contracts

8.3.1 - Completion of contract, chipping (1/16)

In addition to cutting, all chipping must be completed by the contract expiration date. If chipping has not been completed, an extension fee or damages may be charged per General Condition & Requirement 7.2 and 8.3.



TIMBER SALE MAP

This information provided by authority of Part 525, 1994 PA 451, as amended.

Sale Number	Year
54-051	16

Forest Management Unit	County	Mapped By	Date	Page	of
Atlanta	Alpena	D. Parris	9/29/16	1	1
Township	Range	Section(s) and Subdivision(s)	Scale		
31N	07E	T31N R07E Sec 27 NESW, NWSE, SENW, SESE, SESW, SWNE, SWNW, SWSE	1:15,840		

Cover Type

A = Aspen	H = Hemlock	N = Marsh	U = Upland Brush
B = Paper Birch	J = Jack Pine	O = Oak	UM = Upland Mixed
C = Cedar	L = Lowland Brush	P = Lowland Poplar	V = Bog or Marsh
D = Tread Bog	LM = Lowland Mixed	Q = Mixed Swamp Conifer	W = White Pine
E = Swamp Hdwoods	M = Mpl, Bch, Brch	R = Red Pine	X = Non Stocked
F = Spruce Fir	MC = Mixed Conifer	S = Black Spruce	Z = Water
G = Grass	MD = Mixed Deciduous	T = Tamarack	

Density

0 = Non Stocked	5 = Pole Timber Medium
1 = Seedling Sapling Poor	6 = Pole Timber Well
2 = Seedling Sapling Medium	7 = Saw Timber Poor
3 = Seedling Sapling Well	8 = Saw Timber Medium
4 = Pole Timber Poor	9 = Saw Timber Well

PU	Stand	Acres	PU	Stand	Acres
1	4	8.9	4	22	6.0
2	10	4.7	5	35	6.1
3	10	6.4	6	37	7.1

2 Four D Pine

Compartment 104
39.2 Acres

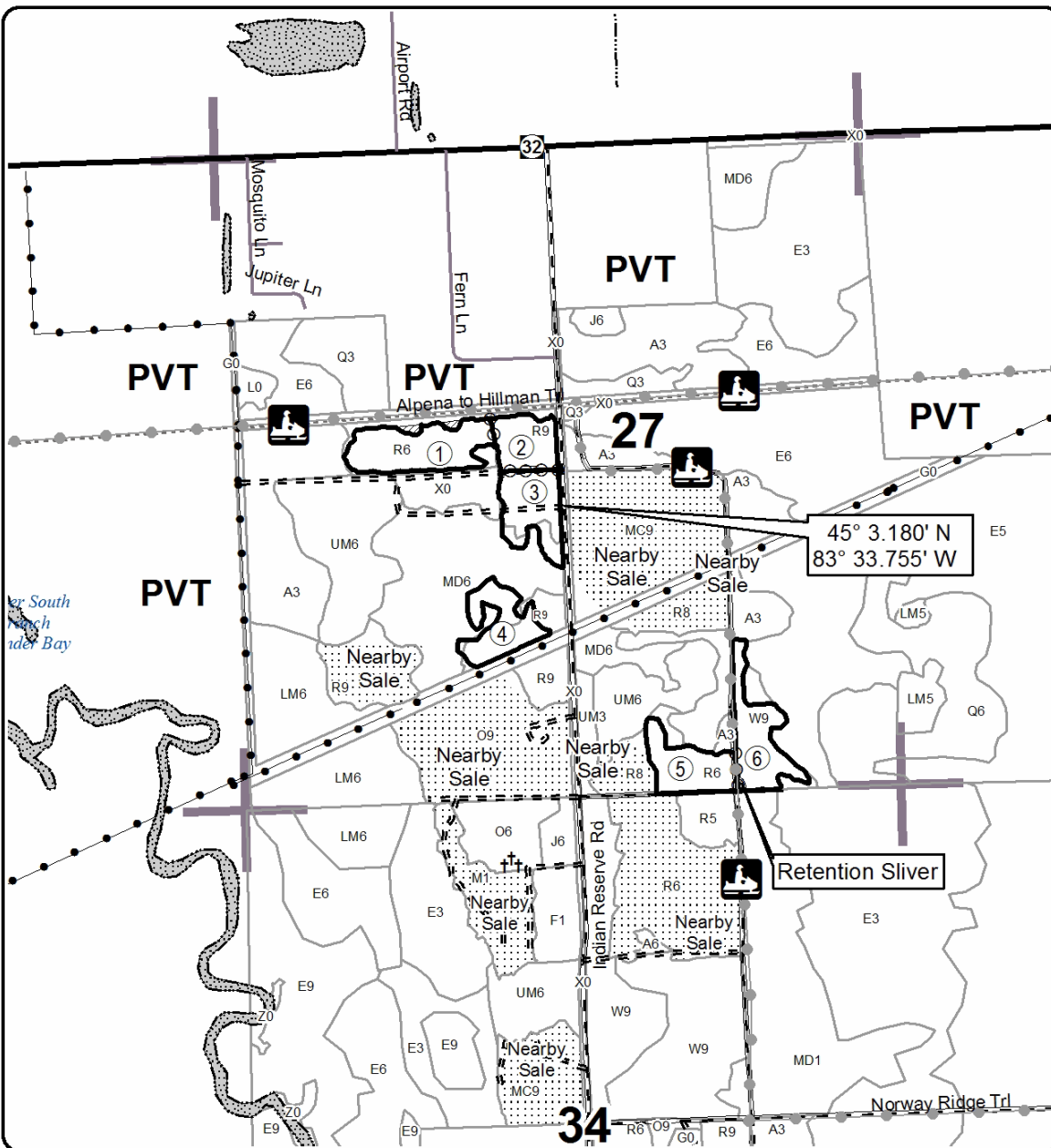

Legend

- Against State (Red)
- Payment Unit (Yellow)
- Payment Unit No.
- Retention Area
- Nearby Timber Sale
- Stand Boundaries
- Recreational Trail
- Pipeline; Powerline
- Highway
- Paved Roads
- Gravel Roads
- Poor Dirt Roads
- Closed Roads
- Lakes and Rivers
- All
- Section Corners

Locator Map
1:200,000

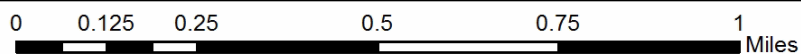
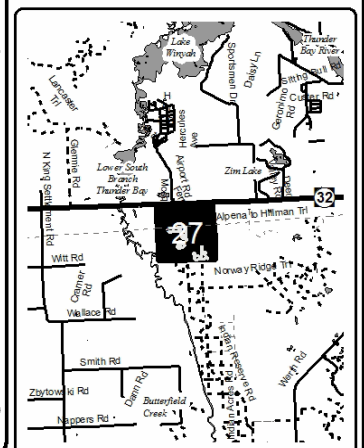

Andor Junction Mix (54-016-16)
 ; Alpena COUNTY

In response to the notice of sale to be held 10:00 a.m. (local time) on July 25, 2017, I am hereby submitting my sealed bid (firm offer) for the following forest products to be cut. Bids for individual species must be at or above the advertised price. All non-responsive bid forms may be rejected.

<u>PRODUCTS & SPECIES</u>	<u>ESTIMATED VOLUME*</u>	<u>ADVERTISED PRICE</u>	<u>BID PRICE</u>
Sawtimber			
Basswood	66.60 MBF	\$ 77.00/MBF	\$ _____
Mixed Aspen	25.50 MBF	\$ 78.00/MBF	\$ _____
Red Oak	47.20 MBF	\$ 145.00/MBF	\$ _____
Sugar Maple	26.60 MBF	\$ 392.00/MBF	\$ _____
White Oak	0.60 MBF	\$ 72.00/MBF	\$ _____
Pulpwood			
Balsam Fir	26.00 Cords	\$ 28.25/Cord	\$ _____
Basswood	359.00 Cords	\$ 12.80/Cord	\$ _____
Beech	35.00 Cords	\$ 18.90/Cord	\$ _____
Misc. Species 1	149.00 Cords	\$ 4.45/Cord	\$ _____
Mixed Aspen	372.00 Cords	\$ 20.95/Cord	\$ _____
Mixed Hardwood	638.00 Cords	\$ 18.90/Cord	\$ _____
Mixed Oak	175.00 Cords	\$ 18.45/Cord	\$ _____
Paper Birch	99.00 Cords	\$ 21.65/Cord	\$ _____
White Pine	6.00 Cords	\$ 35.65/Cord	\$ _____

*The volumes are statistically estimated within plus (+) or minus (-) 10.97 percent. These estimated volumes are final and not subject to adjustment. Prospective bidders are urged to examine this timber and to make their own estimates of quantity and quality.

I understand that any or all bids may be rejected. All bids must be signed and all bid items must be bid or the bid form may be rejected. I also understand that consideration and awarding a contract will be based upon my past performance and ability to complete the contract based upon equipment and staffing subject to my control.

FEDERAL ID: _____ or SOCIAL SECURITY NUMBER: _____

Company or individual bidding: _____

Company representative's name: _____

Address: _____

City: _____ State: _____ Zip: _____

IF AVAILABLE, PLEASE PLACE THE PERSONALIZED LABEL FROM YOUR PROSPECTUS IN THE ABOVE BOX.

Individual or company representative's signature: _____ Date: _____

Phone number : _____ Email (optional): _____

THE WINNING BIDDER MUST COMPLETE THE VERIFICATION OF WORKER'S DISABILITY COMPENSATION ACT COMPLIANCE (ON REVERSE SIDE IF DOUBLE SIDED) WITHIN 21 DAYS OF SALE AWARD DATE



FOR DEPARTMENT USE ONLY
Sale Number (XX – XXX – XX – XX)
Forest Management Unit:

TIMBER SALE VERIFICATION OF WORKER'S DISABILITY COMPENSATION ACT COMPLIANCE

*As required by Act 317, P.A. 1969 (Worker's Compensation) and
Part 5 of Act 451 of 1994, as amended.*

VERIFICATION OF WORKER'S DISABILITY COMPENSATION ACT COMPLIANCE

- This verification must be completed and submitted within 21 days of contract award and prior to the issuance of the timber sale contract.
- In addition, if boxes 2B or 2C are checked, then Notice of Exclusion or Certificate of Insurance must be submitted within twenty-one (21) days of the contract award and prior to the issuance of the timber sale contract.
- All information must be typed or printed except for written signatures.

Please Check Appropriate Categories:

1. My business is organized as (you **must** check one of the boxes below):
 - A. Sole Proprietorship (individual)
 - B. Partnership
 - C. Corporation

2. You **must** check one of the boxes below:
 - A. I certify my business is a sole proprietorship and it has no employees but the sole proprietor. I am not subject to the Worker's Compensation Laws.
 - B. I certify my business has satisfied its obligation to the Worker's Compensation Act through the use of an approved Notice of Exclusion (BWC-337, Rev. 5/96). I will provide a copy of the Notice of Exclusion within 21 days of the contract award. (For questions or a copy of the BWC-337, please call the Worker's Compensation Bureau at 517-322-1195).
 - C. I certify my business has a Worker's Compensation Policy. I will provide an original Certificate of Insurance within twenty-one (21) days of the contract award.

3. If you have checked item 2(A) or 2(B), you **must** indicate the number of **both** full-time and part-time employees, other than yourself, including family members and active partners (if none, you must enter "0").

_____ Full-time Employees

_____ Part-time Employees

Name of Business		Federal ID (or) Social Security No.	
Address		Telephone ()	
City	State	ZIP	

I hereby certify that the above information is true and correct. I agree to notify the Michigan DNR of any changes that occur in factors affecting my coverage during any of my present and future operations.

Signature of Owner or Authorized Representative

Title

Date

Please complete the "SEALED BID" information on the next page

Spruce Road Mix (54-017-16)
 ; Alpena COUNTY

In response to the notice of sale to be held 10:00 a.m. (local time) on July 25, 2017, I am hereby submitting my sealed bid (firm offer) for the following forest products to be cut. Bids for individual species must be at or above the advertised price. All non-responsive bid forms may be rejected.

<u>PRODUCTS & SPECIES</u>	<u>ESTIMATED VOLUME*</u>	<u>ADVERTISED PRICE</u>	<u>BID PRICE</u>
Sawtimber			
Mixed Aspen	64.90 MBF	\$ 78.00/MBF	\$ _____
Red Oak	15.50 MBF	\$ 145.00/MBF	\$ _____
Red Pine	44.70 MBF	\$ 128.00/MBF	\$ _____
Sugar Maple	3.90 MBF	\$ 392.00/MBF	\$ _____
White Pine	21.10 MBF	\$ 84.00/MBF	\$ _____
Pulpwood			
Balsam Fir	14.00 Cords	\$ 28.25/Cord	\$ _____
Basswood	5.00 Cords	\$ 12.80/Cord	\$ _____
Jack Pine	19.00 Cords	\$ 24.25/Cord	\$ _____
Misc. Species 1	85.00 Cords	\$ 4.40/Cord	\$ _____
Mixed Aspen	913.00 Cords	\$ 20.95/Cord	\$ _____
Mixed Hardwood	243.00 Cords	\$ 18.90/Cord	\$ _____
Paper Birch	28.00 Cords	\$ 21.65/Cord	\$ _____
Red Oak	80.00 Cords	\$ 18.45/Cord	\$ _____
Red Pine	97.00 Cords	\$ 50.25/Cord	\$ _____
White Ash	26.00 Cords	\$ 18.90/Cord	\$ _____
White Pine	151.00 Cords	\$ 35.65/Cord	\$ _____
White Spruce	6.00 Cords	\$ 40.65/Cord	\$ _____

*The volumes are statistically estimated within plus (+) or minus (-) 10.43 percent. These estimated volumes are final and not subject to adjustment. Prospective bidders are urged to examine this timber and to make their own estimates of quantity and quality.

I understand that any or all bids may be rejected. All bids must be signed and all bid items must be bid or the bid form may be rejected. I also understand that consideration and awarding a contract will be based upon my past performance and ability to complete the contract based upon equipment and staffing subject to my control.

FEDERAL ID: _____ or SOCIAL SECURITY NUMBER: _____

Company or individual bidding: _____

Company representative's name: _____

Address: _____

City: _____ State: _____ Zip: _____

IF AVAILABLE, PLEASE PLACE THE PERSONALIZED LABEL FROM YOUR PROSPECTUS IN THE ABOVE BOX.

Individual or company representative's signature: _____ Date: _____

Phone number : _____ Email (optional): _____

THE WINNING BIDDER MUST COMPLETE THE VERIFICATION OF WORKER'S DISABILITY COMPENSATION ACT COMPLIANCE (ON REVERSE SIDE IF DOUBLE SIDED) WITHIN 21 DAYS OF SALE AWARD DATE



FOR DEPARTMENT USE ONLY	
Sale Number (XX - XXX - XX - XX)	
Forest Management Unit:	

TIMBER SALE VERIFICATION OF WORKER'S DISABILITY COMPENSATION ACT COMPLIANCE

As required by Act 317, P.A. 1969 (Worker's Compensation) and
Part 5 of Act 451 of 1994, as amended.

VERIFICATION OF WORKER'S DISABILITY COMPENSATION ACT COMPLIANCE

- This verification must be completed and submitted within 21 days of contract award and prior to the issuance of the timber sale contract.
- In addition, if boxes 2B or 2C are checked, then Notice of Exclusion or Certificate of Insurance must be submitted within twenty-one (21) days of the contract award and prior to the issuance of the timber sale contract.
- All information must be typed or printed except for written signatures.

Please Check Appropriate Categories:

1. My business is organized as (you **must** check one of the boxes below):
 - A. Sole Proprietorship (individual)
 - B. Partnership
 - C. Corporation
2. You **must** check one of the boxes below:
 - A. I certify my business is a sole proprietorship and it has no employees but the sole proprietor. I am not subject to the Worker's Compensation Laws.
 - B. I certify my business has satisfied its obligation to the Worker's Compensation Act through the use of an approved Notice of Exclusion (BWC-337, Rev. 5/96). I will provide a copy of the Notice of Exclusion within 21 days of the contract award. (For questions or a copy of the BWC-337, please call the Worker's Compensation Bureau at 517-322-1195).
 - C. I certify my business has a Worker's Compensation Policy. I will provide an original Certificate of Insurance within twenty-one (21) days of the contract award.
3. If you have checked item 2(A) or 2(B), you **must** indicate the number of **both** full-time and part-time employees, other than yourself, including family members and active partners (if none, you must enter "0").

_____ Full-time Employees

_____ Part-time Employees

Name of Business		Federal ID (or) Social Security No.	
Address		Telephone ()	
City	State	ZIP	

I hereby certify that the above information is true and correct. I agree to notify the Michigan DNR of any changes that occur in factors affecting my coverage during any of my present and future operations.

Signature of Owner or Authorized Representative

Title

Date

Please complete the "SEALED BID" information on the next page

TBR Mile Mix (54-026-16)
 ; Alpena COUNTY

In response to the notice of sale to be held 10:00 a.m. (local time) on July 25, 2017, I am hereby submitting my sealed bid (firm offer) for the following forest products to be cut. Bids for individual species must be at or above the advertised price. All non-responsive bid forms may be rejected.

<u>PRODUCTS & SPECIES</u>	<u>ESTIMATED VOLUME*</u>	<u>ADVERTISED PRICE</u>	<u>BID PRICE</u>
Sawtimber			
B. T. Aspen	5.10 MBF	\$ 78.00/MBF	\$ _____
Mixed Spruce	39.40 MBF	\$ 81.00/MBF	\$ _____
Red Maple	16.80 MBF	\$ 123.00/MBF	\$ _____
Red Pine	41.60 MBF	\$ 128.00/MBF	\$ _____
White Pine	15.40 MBF	\$ 84.00/MBF	\$ _____
Pulpwood			
Balsam Fir	95.00 Cords	\$ 28.25/Cord	\$ _____
Mixed Aspen	410.00 Cords	\$ 20.95/Cord	\$ _____
Mixed Hardwood	441.00 Cords	\$ 18.90/Cord	\$ _____
Mixed Spruce	259.00 Cords	\$ 40.65/Cord	\$ _____
Paper Birch	41.00 Cords	\$ 21.65/Cord	\$ _____
Red Pine	77.00 Cords	\$ 50.25/Cord	\$ _____
White Pine	95.00 Cords	\$ 35.65/Cord	\$ _____

*The volumes are statistically estimated within plus (+) or minus (-) 11.13 percent. These estimated volumes are final and not subject to adjustment. Prospective bidders are urged to examine this timber and to make their own estimates of quantity and quality.

I understand that any or all bids may be rejected. All bids must be signed and all bid items must be bid or the bid form may be rejected. I also understand that consideration and awarding a contract will be based upon my past performance and ability to complete the contract based upon equipment and staffing subject to my control.

FEDERAL ID: ____ - ____ - ____ or SOCIAL SECURITY NUMBER: ____ - ____ - ____

Company or individual bidding: _____

Company representative's name: _____

Address: _____

City: _____ State: _____ Zip: _____

IF AVAILABLE, PLEASE PLACE THE PERSONALIZED LABEL FROM YOUR PROSPECTUS IN THE ABOVE BOX.

Individual or company representative's signature: _____ Date: _____

Phone number : _____ Email (optional): _____

THE WINNING BIDDER MUST COMPLETE THE VERIFICATION OF WORKER'S DISABILITY COMPENSATION ACT COMPLIANCE (ON REVERSE SIDE IF DOUBLE SIDED) WITHIN 21 DAYS OF SALE AWARD DATE



FOR DEPARTMENT USE ONLY
Sale Number (XX - XXX - XX - XX)
Forest Management Unit:

TIMBER SALE VERIFICATION OF WORKER'S DISABILITY COMPENSATION ACT COMPLIANCE

*As required by Act 317, P.A. 1969 (Worker's Compensation) and
Part 5 of Act 451 of 1994, as amended.*

VERIFICATION OF WORKER'S DISABILITY COMPENSATION ACT COMPLIANCE

- This verification must be completed and submitted within 21 days of contract award and prior to the issuance of the timber sale contract.
- In addition, if boxes 2B or 2C are checked, then Notice of Exclusion or Certificate of Insurance must be submitted within twenty-one (21) days of the contract award and prior to the issuance of the timber sale contract.
- All information must be typed or printed except for written signatures.

Please Check Appropriate Categories:

1. My business is organized as (you **must** check one of the boxes below):
 - A. Sole Proprietorship (individual)
 - B. Partnership
 - C. Corporation

2. You **must** check one of the boxes below:
 - A. I certify my business is a sole proprietorship and it has no employees but the sole proprietor. I am not subject to the Worker's Compensation Laws.
 - B. I certify my business has satisfied its obligation to the Worker's Compensation Act through the use of an approved Notice of Exclusion (BWC-337, Rev. 5/96). I will provide a copy of the Notice of Exclusion within 21 days of the contract award. (For questions or a copy of the BWC-337, please call the Worker's Compensation Bureau at 517-322-1195).
 - C. I certify my business has a Worker's Compensation Policy. I will provide an original Certificate of Insurance within twenty-one (21) days of the contract award.

3. If you have checked item 2(A) or 2(B), you **must** indicate the number of **both** full-time and part-time employees, other than yourself, including family members and active partners (if none, you must enter "0").

_____ Full-time Employees

_____ Part-time Employees

Name of Business		Federal ID (or) Social Security No.	
Address		Telephone ()	
City	State	ZIP	

I hereby certify that the above information is true and correct. I agree to notify the Michigan DNR of any changes that occur in factors affecting my coverage during any of my present and future operations.

Signature of Owner or Authorized Representative

Title

Date

Please complete the "SEALED BID" information on the next page

Time Traveler Aspen & Oak (54-037-16)
; Alpena COUNTY

In response to the notice of sale to be held 10:00 a.m. (local time) on July 25, 2017, I am hereby submitting my sealed bid (firm offer) for the following forest products to be cut. Bids for individual species must be at or above the advertised price. All non-responsive bid forms may be rejected.

<u>PRODUCTS & SPECIES</u>	<u>ESTIMATED VOLUME*</u>	<u>ADVERTISED PRICE</u>	<u>BID PRICE</u>
Sawtimber			
Mixed Aspen	352.20 MBF	\$ 78.00/MBF	\$ _____
Red Maple	19.00 MBF	\$ 123.00/MBF	\$ _____
Red Oak	193.20 MBF	\$ 145.00/MBF	\$ _____
White Oak	0.80 MBF	\$ 72.00/MBF	\$ _____
Pulpwood			
Mixed Aspen	878.00 Cords	\$ 20.95/Cord	\$ _____
Mixed Hardwood	880.00 Cords	\$ 18.90/Cord	\$ _____
Mixed Oak	537.00 Cords	\$ 18.45/Cord	\$ _____

*The volumes are statistically estimated within plus (+) or minus (-) 16.06 percent. These estimated volumes are final and not subject to adjustment. Prospective bidders are urged to examine this timber and to make their own estimates of quantity and quality.

I understand that any or all bids may be rejected. All bids must be signed and all bid items must be bid or the bid form may be rejected. I also understand that consideration and awarding a contract will be based upon my past performance and ability to complete the contract based upon equipment and staffing subject to my control.

FEDERAL ID: _____ or SOCIAL SECURITY NUMBER: _____

Company or individual bidding: _____

Company representative's name: _____

Address: _____

City: _____ State: _____ Zip: _____

IF AVAILABLE, PLEASE PLACE THE PERSONALIZED LABEL FROM YOUR PROSPECTUS IN THE ABOVE BOX.

Individual or company representative's signature: _____ Date: _____

Phone number : _____ Email (optional): _____

THE WINNING BIDDER MUST COMPLETE THE VERIFICATION OF WORKER'S DISABILITY COMPENSATION ACT COMPLIANCE (ON REVERSE SIDE IF DOUBLE SIDED) WITHIN 21 DAYS OF SALE AWARD DATE



FOR DEPARTMENT USE ONLY
Sale Number (XX - XXX - XX - XX)
Forest Management Unit:

TIMBER SALE VERIFICATION OF WORKER'S DISABILITY COMPENSATION ACT COMPLIANCE

*As required by Act 317, P.A. 1969 (Worker's Compensation) and
Part 5 of Act 451 of 1994, as amended.*

VERIFICATION OF WORKER'S DISABILITY COMPENSATION ACT COMPLIANCE

- This verification must be completed and submitted within 21 days of contract award and prior to the issuance of the timber sale contract.
- In addition, if boxes 2B or 2C are checked, then Notice of Exclusion or Certificate of Insurance must be submitted within twenty-one (21) days of the contract award and prior to the issuance of the timber sale contract.
- All information must be typed or printed except for written signatures.

Please Check Appropriate Categories:

1. My business is organized as (you **must** check one of the boxes below):
 - A. Sole Proprietorship (individual)
 - B. Partnership
 - C. Corporation

2. You **must** check one of the boxes below:
 - A. I certify my business is a sole proprietorship and it has no employees but the sole proprietor. I am not subject to the Worker's Compensation Laws.
 - B. I certify my business has satisfied its obligation to the Worker's Compensation Act through the use of an approved Notice of Exclusion (BWC-337, Rev. 5/96). I will provide a copy of the Notice of Exclusion within 21 days of the contract award. (For questions or a copy of the BWC-337, please call the Worker's Compensation Bureau at 517-322-1195).
 - C. I certify my business has a Worker's Compensation Policy. I will provide an original Certificate of Insurance within twenty-one (21) days of the contract award.

3. If you have checked item 2(A) or 2(B), you **must** indicate the number of **both** full-time and part-time employees, other than yourself, including family members and active partners (if none, you must enter "0").

_____ Full-time Employees

_____ Part-time Employees

Name of Business		Federal ID (or) Social Security No.	
Address		Telephone ()	
City	State	ZIP	

I hereby certify that the above information is true and correct. I agree to notify the Michigan DNR of any changes that occur in factors affecting my coverage during any of my present and future operations.

Signature of Owner or Authorized Representative

Title

Date

Please complete the "SEALED BID" information on the next page

2 Four D Pine (54-051-16)
 ; Alpena COUNTY

In response to the notice of sale to be held 10:00 a.m. (local time) on July 25, 2017, I am hereby submitting my sealed bid (firm offer) for the following forest products to be cut. Bids for individual species must be at or above the advertised price. All non-responsive bid forms may be rejected.

<u>PRODUCTS & SPECIES</u>	<u>ESTIMATED VOLUME*</u>	<u>ADVERTISED PRICE</u>	<u>BID PRICE</u>
Sawtimber			
B. T. Aspen	1.40 MBF	\$ 78.00/MBF	\$ _____
Bl/R/Hybrid Oak	5.50 MBF	\$ 118.00/MBF	\$ _____
Red Maple	2.60 MBF	\$ 123.00/MBF	\$ _____
Red Pine	54.80 MBF	\$ 128.00/MBF	\$ _____
White Pine	67.20 MBF	\$ 84.00/MBF	\$ _____
Pulpwood			
Bl/R/Hybrid Oak	62.00 Cords	\$ 18.45/Cord	\$ _____
Black Spruce	9.00 Cords	\$ 40.65/Cord	\$ _____
Jack Pine	18.00 Cords	\$ 24.25/Cord	\$ _____
Mixed Aspen	37.00 Cords	\$ 20.95/Cord	\$ _____
Red Maple	17.00 Cords	\$ 18.90/Cord	\$ _____
Red Pine	422.00 Cords	\$ 50.25/Cord	\$ _____
White Pine	241.00 Cords	\$ 35.65/Cord	\$ _____

*The volumes are statistically estimated within plus (+) or minus (-) 24.60 percent. These estimated volumes are final and not subject to adjustment. Prospective bidders are urged to examine this timber and to make their own estimates of quantity and quality.

I understand that any or all bids may be rejected. All bids must be signed and all bid items must be bid or the bid form may be rejected. I also understand that consideration and awarding a contract will be based upon my past performance and ability to complete the contract based upon equipment and staffing subject to my control.

FEDERAL ID: ____ - ____ - ____ or SOCIAL SECURITY NUMBER: ____ - ____ - ____

Company or individual bidding: _____

Company representative's name: _____

Address: _____

City: _____ State: _____ Zip: _____

IF AVAILABLE, PLEASE PLACE THE PERSONALIZED LABEL FROM YOUR PROSPECTUS IN THE ABOVE BOX.

Individual or company representative's signature: _____ Date: _____

Phone number : _____ Email (optional): _____

THE WINNING BIDDER MUST COMPLETE THE VERIFICATION OF WORKER'S DISABILITY COMPENSATION ACT COMPLIANCE (ON REVERSE SIDE IF DOUBLE SIDED) WITHIN 21 DAYS OF SALE AWARD DATE



FOR DEPARTMENT USE ONLY
Sale Number (XX - XXX - XX - XX)
Forest Management Unit:

TIMBER SALE VERIFICATION OF WORKER'S DISABILITY COMPENSATION ACT COMPLIANCE

*As required by Act 317, P.A. 1969 (Worker's Compensation) and
Part 5 of Act 451 of 1994, as amended.*

VERIFICATION OF WORKER'S DISABILITY COMPENSATION ACT COMPLIANCE

- This verification must be completed and submitted within 21 days of contract award and prior to the issuance of the timber sale contract.
- In addition, if boxes 2B or 2C are checked, then Notice of Exclusion or Certificate of Insurance must be submitted within twenty-one (21) days of the contract award and prior to the issuance of the timber sale contract.
- All information must be typed or printed except for written signatures.

Please Check Appropriate Categories:

1. My business is organized as (you **must** check one of the boxes below):
 - A. Sole Proprietorship (individual)
 - B. Partnership
 - C. Corporation
2. You **must** check one of the boxes below:
 - A. I certify my business is a sole proprietorship and it has no employees but the sole proprietor. I am not subject to the Worker's Compensation Laws.
 - B. I certify my business has satisfied its obligation to the Worker's Compensation Act through the use of an approved Notice of Exclusion (BWC-337, Rev. 5/96). I will provide a copy of the Notice of Exclusion within 21 days of the contract award. (For questions or a copy of the BWC-337, please call the Worker's Compensation Bureau at 517-322-1195).
 - C. I certify my business has a Worker's Compensation Policy. I will provide an original Certificate of Insurance within twenty-one (21) days of the contract award.
3. If you have checked item 2(A) or 2(B), you **must** indicate the number of **both** full-time and part-time employees, other than yourself, including family members and active partners (if none, you must enter "0").

_____ Full-time Employees

_____ Part-time Employees

Name of Business		Federal ID (or) Social Security No.	
Address		Telephone ()	
City	State	ZIP	

I hereby certify that the above information is true and correct. I agree to notify the Michigan DNR of any changes that occur in factors affecting my coverage during any of my present and future operations.

Signature of Owner or Authorized Representative

Title

Date

Please complete the "SEALED BID" information on the next page