



**DEPARTMENT OF NATURAL RESOURCES
STATE OF MICHIGAN**

TIMBER SALE PROSPECTUS #5822

SCHEDULED SALE DATE AND TIME: 10:00 a.m. (local time) on August 29, 2017.

LOCATION: ATLANTA MGMT UNIT, 13501 M-33, ATLANTA, MI 49709.

PROSPECTUS NOTE: The bidder is advised to inspect the sale area and review the location, estimated volumes, operating costs and contract terms of proposed sales. Please be aware that some landowners may request 60 days or more notice for access across their land.

Notice is hereby given that bids will be received by the Unit Manager, ATLANTA MANAGEMENT UNIT, for certain timber on the following described lands:

Hardwood Hill Country Mix (54-011-16)

Montmorency County, Advertised Price \$136,094.40, 187.9 Acres, Hardwood, Red Oak.

Rollin Rolands Mix (54-012-16)

Montmorency County, Advertised Price \$209,262.00, 269.5 Acres, Hardwood, Red Oak.

SALE NOTE: Access may be through private or other public land.

1 in 5 RP (54-023-16)

Montmorency County, Advertised Price \$15,484.10, 22.4 Acres, Red Pine.

Lil Hilly Mix (54-024-16)

Montmorency County, Advertised Price \$38,115.05, 67.7 Acres, Aspen, Hardwood.

BID INSTRUCTIONS (VER. 09/02/2016):

1. Scheduled Bid Location, Date, and Time (2/11)

Bids must be received by the Unit Manager, ATLANTA OFFICE, 13501 M-33, ATLANTA, MI 49709, no later than 10:00 a.m. (local time) on August 29, 2017. For further information concerning this sale, contact Cody Stevens at 989-785-4251 extension 5240.

2. Bidder's Qualifications (5/16)

Purchaser shall obtain workers compensation insurance to cover claims under Michigan's Worker's Disability Compensation Act of 1969 or similar employee benefit act of any other state applicable to an employee. If all or part of a timber sale was prepared by a private contractor, the contractor and that contractor's company are not permitted to bid on the timber sale contract. Bids will not be accepted from individuals or companies appearing on the DNR/FRD No-Bid List. This list contains the names of purchasers who previously failed to execute a contract within 21-days or who have a history of poor performance.

3. Preparation of Sealed Bids (5/16)

Bid Forms may be completed online thru Michigan DNR Timber Sale Online Bidding (OLB) at www.michigan.gov/timberbidding or by completing the hardcopy Bid Form found in the Timber Sale Prospectus. Hardcopy Bid Forms shall be manually signed in ink. Registration in OLB is considered your 'signature' for all bids submitted thru that system. Bid prices must be entered for each species and product in the Bid Price column for all material subject to bidding and all fill-in blanks must be completed. If erasures or other changes appear on the hardcopy Bid Form, each erasure or change must be initialed by the person signing the bid.

4. Submission of Sealed Bids (5/16)

Bid forms may be obtained from the Unit Manager or thru OLB. Bids may be submitted hardcopy or thru OLB. All hardcopy bids must be submitted on the bid form and in an envelope clearly identified as described in this section. NOTE: Only one bid form per bid envelope. Sealed bids must be submitted to the Unit office designated in the prospectus and must be submitted at or prior to the time established in the prospectus. The envelope should show on the outside (a) the sale name or number and (b) the date and time of bid opening, as shown in the prospectus. Bids received after the time specified in the sale prospectus are late bids and will be rejected.

It is possible for a bidder to submit multiple bids on a single sale. For example, a bid may be submitted hardcopy and a bid may be submitted thru OLB. Or, two bidders from the same company could both submit bids on the same sale. If this were to happen, the State would accept all bids received and award the contract accordingly. All bidding and contractual requirements would apply to all bids received.

5. Public Opening of Sealed Bids (7/16)

If conditions permit, the sealed bids will be publicly opened and posted at the time and place set in the prospectus.

If a bidder, present at a bid opening, has submitted bids on more than one sale, that bidder may withdraw their unopened bid envelopes or announce the withdrawal of their online bid after being declared the successful bidder on one sale.

6. Award of Contract (1/11)

Award of the contract will be made to the Bidder whose bid, conforming to the prospectus, is most advantageous to the State of Michigan on the basis of total value at rates bid for the estimated quantities. The State reserves the right to reject any bid or waive any minor irregularity in bids received. A written award mailed (or otherwise furnished) to the successful Bidder shall be deemed to result in a binding contract without further action by either party.

7. Down Payment (1/11)

The Bidder to whom award is made must make a down payment within 21 days of the sale award. The amount of the down payment will be calculated as shown in the Bond and Payment Schedule of this prospectus. Only cash may be used to meet this requirement.

8. Performance Security (1/11)

As guarantee of faithful performance, a cash bond, certificate of deposit, surety bond or irrevocable letter of credit (LOC) is required within 21 days of the sale award. The amount of the performance security is shown in the Bond and

Payment Schedule of this prospectus. If an LOC or surety is used, the coverage must extend for at least 6 months beyond the contract expiration.

9. Timber Sale Contract (9/14)

Additional conditions and requirements common to all timber sales are listed on the timber sale contract (R4031) and are available on line at www.michigan.gov/timber. Contact the Unit Manager for additional information or a sample contract. Within 21 days of the date of the award letter, the bidder must sign the contract and provide the required down payment, performance security, and verification of worker's disability compensation. The down payment and performance security shall be in accordance with the provisions of the timber sale contract, in the sums stated in this prospectus. If these actions are not taken, then the Bidder, the Bidder's corporation, and the corporation's principals may not be permitted to bid on State timber sales for a period of 1 year. In addition, the Bidder certifies that if awarded this contract, the Bidder will complete the timber sale contract in accordance with its terms and any modifications thereof including requirements to purchase, cut, and remove the included timber by the expiration date.

10. Disclaimer of Estimates and Bidder's Warranty of Inspection (7/16)

Before submitting this bid, the Bidder is advised and cautioned to inspect the sale area, review the requirements of the sale contract, and take other steps as may be reasonably necessary to ascertain the location, estimated volumes, construction estimates, and operating costs of the proposed sale. Failure to do so will not relieve the Bidder from responsibility for completing the contract.

The Bidder warrants that this bid is submitted solely on the basis of the Bidder's examination and inspection of the quality and quantity of the timber offered for sale and the Bidder's opinion of the value thereof and the costs of recovery. No reliance should be placed on the State of Michigan's estimates of timber quality, quantity or costs of recovery. Bidder further acknowledges that the State of Michigan: (i) expressly disclaims any warranty of fitness of timber for any purpose; (ii) offers this timber as is without any warranty of quality (merchantability) or quantity and (iii) expressly disclaims any warranty as to the quantity or quality of timber sold.

11. Certification and Chain-of-Custody (10/14)

Unless otherwise indicated in the contract under section 7 – Other Conditions of the Sale Specific Conditions & Requirements, the area encompassed by this timber sale is certified to the standards of the Forest Stewardship Council (FSC) - Certificate #SCS-FM/COC-00090N and the Sustainable Forestry Initiative (SFI) - Certificate #NSF-SFIS-5Y031-SF5. Forest products from this sale may be delivered to the mill as "FSC 100% and / or SFI certified" as long as the contractor hauling the forest products is chain-of-custody (COC) certified or covered under a COC certificate from the destination mill. The purchaser is responsible for maintaining COC after leaving the sale area.

12. Good Neighbor Authority (GNA) Requirements (7/16)

If the name of this timber sales contains the acronym GNA, it is authorized by the Good Neighbor Authority (GNA) and covered by various agreements between the U.S. Forest Service and the State. The timber sale occurs on federal land and the following conditions apply:

GNA contracts on US Forest Service land will not be awarded to purchasers on the Federal list of excluded parties. The System for Award Management (SAM) will be checked for active excluded parties prior to award of contract. In addition, the Bidder to whom award is made must complete an Assurance Regarding Felony Conviction or Tax Delinquent Status for Corporate Applicants (AD-3031).

13. Good Neighbor Authority (GNA) Requirements, con't (9/16)

Bidder certifies, by signing this bid form, that to the best of Bidder's knowledge that the following representations are accurate and complete.

- a. That the Bidder and its principals are not presently debarred, suspended, proposed for debarment, declared ineligible, or voluntary excluded from timber sales (covered transactions) by any Federal department or agency.
- b. That the Bidder and its principals have not within a 3-year period preceding this bid been convicted of or had a civil judgment rendered against them for commission of fraud or a criminal offense in connection with obtaining, attempting to obtain, or performing a public (Federal, State, or local) transaction or contract under a public transaction; violation of Federal or State antitrust statutes or commission of embezzlement, theft, forgery, bribery, falsification or destruction of records, making false statements, or receiving stolen property.

c. That the Bidder and its principals are not presently indicted for or otherwise criminally or civilly charged by a governmental entity (Federal, State, or local) with commission of any of the offenses enumerated in paragraph b of this certification.

d. That the Bidder and its principals have not within a 3-year period preceding this bid had one or more public transactions (Federal, State, or local) terminated for breach or default of a timber or forest product contract.

Bidders that cannot certify this requirement, in whole or in part, shall submit an explanation with their bid.

KEITH CREAGH

Director

TIMBER SALE INFORMATION

Hardwood Hill Country Mix (54-011-16)

Montmorency County (Advertised Price \$136,094.40)

A timber sale contract for this lump sum, sealed bid timber sale will be awarded to the responsible bidder offering the highest sealed bid price. Bids must be at or above the following advertised price for each species:

<u>PRODUCTS & SPECIES</u>	<u>ESTIMATED UNITS*</u>	<u>ADVERTISED PRICE</u>
Sawtimber		
B. T. Aspen	4.60 MBF	\$ 82.00 / MBF
Basswood	87.50 MBF	\$ 84.00 / MBF
Beech	14.20 MBF	\$ 79.00 / MBF
Paper Birch	8.10 MBF	\$ 58.00 / MBF
Red Maple	44.20 MBF	\$ 131.00 / MBF
Red Oak	290.20 MBF	\$ 165.00 / MBF
Sugar Maple	55.10 MBF	\$ 418.00 / MBF
White Ash	149.30 MBF	\$ 79.00 / MBF
White Pine	1.30 MBF	\$ 81.00 / MBF
Pulpwood		
B. T. Aspen	4.00 Cords	\$ 21.30 / Cord
Basswood	195.00 Cords	\$ 14.60 / Cord
Misc. Species 1	438.00 Cords	\$ 4.40 / Cord
Mixed Hardwood	821.00 Cords	\$ 19.70 / Cord
Paper Birch	62.00 Cords	\$ 22.90 / Cord
Red Oak	520.00 Cords	\$ 20.65 / Cord
White Ash	245.00 Cords	\$ 19.70 / Cord
White Pine	4.00 Cords	\$ 38.30 / Cord

* The total volume is statistically estimated within plus (+) or minus (-) 9.87 percent. The estimated units are final and not subject to adjustment. Prospective bidders are urged to examine this timber and to make their own estimates of quantity and quality.

BOND AND PAYMENT SCHEDULE:

1. A bond in the amount of \$6,805.00 to insure faithful performance of the conditions of the contract will be deposited by the successful bidder within 21 days of the sale award.
2. Cutting in any sale or unit without the required advance payment would be considered a trespass.
3. Total payment must be paid in advance or according to the following schedule:
 - (a) Ten percent (10%) of the sale value must be paid within 21 days of the sale award.
 - (b) The 10% down payment will be credited towards the first unit cut.
4. If no cutting takes place, the 10% down payment will not be refunded.
5. Operations on the contract issued will terminate on 12/31/2019.

Description of Timber by Payment Unit (PU)

PU	MARKET GROUP	PRODUCT	QUANTITY	UNIT	ACRES	ADVERTISE PRICE
1	Basswood Beech Paper Birch Red Maple Red Oak Sugar Maple White Ash White Pine	Sawtimber	4.9	MBF	22.5	\$18,523.85
			1.0	MBF		
			1.0	MBF		
			11.9	MBF		
			46.7	MBF		
			6.5	MBF		
			6.0	MBF		
			0.5	MBF		
			Pulpwood	13.0		
		17.0		Cords		
		134.0		Cords		
		<i>Beech</i>		<i>Cords</i>		
		<i>Red Maple</i>		<i>Cords</i>		
		<i>Sugar Maple</i>		<i>Cords</i>		
		14.0		Cords		
		44.0		Cords		
		76.0		Cords		
		12.0		Cords		
		101.0	Cords			
7.0	Cords					
2.0	Cords					
2	Basswood Beech Paper Birch Red Maple Red Oak Sugar Maple White Ash White Pine	Sawtimber	7.0	MBF	31.9	\$26,225.00
			1.3	MBF		
			1.5	MBF		
			16.9	MBF		
			66.2	MBF		
			9.2	MBF		
			8.6	MBF		
			0.8	MBF		
			Pulpwood	18.0		
		23.0		Cords		
		190.0		Cords		
		<i>Beech</i>		<i>Cords</i>		
		<i>Red Maple</i>		<i>Cords</i>		
		<i>Sugar Maple</i>		<i>Cords</i>		
		21.0		Cords		
		62.0		Cords		
		107.0		Cords		
		16.0		Cords		
		144.0	Cords			
10.0	Cords					
2.0	Cords					
3	Basswood Paper Birch Red Oak Sugar Maple White Ash	Sawtimber	1.4	MBF	10.6	\$3,807.50
			1.6	MBF		
			6.9	MBF		
			1.2	MBF		
			1.5	MBF		
		Pulpwood	6.0	Cords		
			16.0	Cords		
			31.0	Cords		
			<i>Beech</i>	<i>Cords</i>		
			<i>Ironwood</i>	<i>Cords</i>		
			<i>Sugar Maple</i>	<i>Cords</i>		
			7.0	Cords		
			1.0	Cords		
			23.0	Cords		
15.0	Cords					
18.0	Cords					
18.0	Cords					
4	Basswood Beech Paper Birch Red Maple Red Oak Sugar Maple	Sawtimber	13.1	MBF	21.5	\$19,878.90
			0.2	MBF		
			1.1	MBF		
			4.2	MBF		
			60.1	MBF		
			7.1	MBF		

Description of Timber by Payment Unit (PU), con't

PU	MARKET GROUP	PRODUCT	QUANTITY	UNIT	ACRES	ADVERTISE PRICE
4 con't	White Ash	Sawtimber	8.6	MBF		
	Basswood	Pulpwood	29.0	Cords		
	Misc. Species 1		40.0	Cords		
	Mixed Hardwood		101.0	Cords		
	<i>Beech</i>		17.0	<i>Cords</i>		
	<i>Ironwood</i>		1.0	<i>Cords</i>		
	<i>Red Maple</i>		16.0	<i>Cords</i>		
	<i>Sugar Maple</i>		67.0	<i>Cords</i>		
	Paper Birch		4.0	Cords		
	Red Oak		76.0	Cords		
	White Ash		17.0	Cords		
5	Basswood	Sawtimber	18.0	MBF	29.4	\$27,163.80
	Beech		0.3	MBF		
	Paper Birch		1.4	MBF		
	Red Maple		5.8	MBF		
	Red Oak		82.2	MBF		
	Sugar Maple		9.7	MBF		
	White Ash		11.7	MBF		
	Basswood	Pulpwood	39.0	Cords		
	Misc. Species 1		55.0	Cords		
	Mixed Hardwood		138.0	Cords		
	<i>Beech</i>		23.0	<i>Cords</i>		
	<i>Ironwood</i>		1.0	<i>Cords</i>		
	<i>Red Maple</i>		23.0	<i>Cords</i>		
	<i>Sugar Maple</i>		91.0	<i>Cords</i>		
	Paper Birch		5.0	Cords		
	Red Oak		104.0	Cords		
	White Ash		23.0	Cords		
6	Beech	Sawtimber	3.9	MBF	34.4	\$5,242.10
	White Ash		30.0	MBF		
	Misc. Species 1	Pulpwood	135.0	Cords		
	Mixed Hardwood		29.0	Cords		
	<i>Beech</i>		25.0	<i>Cords</i>		
	<i>Sugar Maple</i>		4.0	<i>Cords</i>		
	White Ash		71.0	Cords		
7	B. T. Aspen	Sawtimber	4.6	MBF	37.6	\$35,253.25
	Basswood		43.1	MBF		
	Beech		7.5	MBF		
	Paper Birch		1.5	MBF		
	Red Maple		5.4	MBF		
	Red Oak		28.1	MBF		
	Sugar Maple		21.4	MBF		
	White Ash		82.9	MBF		
	B. T. Aspen	Pulpwood	4.0	Cords		
	Basswood		90.0	Cords		
	Misc. Species 1		152.0	Cords		
	Mixed Hardwood		198.0	Cords		
	<i>Beech</i>		69.0	<i>Cords</i>		
	<i>Ironwood</i>		1.0	<i>Cords</i>		
	<i>Red Maple</i>		33.0	<i>Cords</i>		
	<i>Sugar Maple</i>		95.0	<i>Cords</i>		
	Paper Birch		10.0	Cords		
	Red Oak		77.0	Cords		
	White Ash		99.0	Cords		
TOTAL:			654.5	MBF		

TOTAL:	2,289.0	Cords
--------	---------	-------

Sale Specific Conditions & Requirements

Sale Name: Hardwood Hill Country Mix

Sale Number: 54-011-16 Seq#: 1

1 - Sale Area

1.2 - Boundaries

1.2.1 - Painted boundaries (1/14)

The sale boundary and Payment Unit boundaries are marked and identified by blue, red and yellow paint. Exterior sale boundary lines against private property are marked with blue paint. Exterior sale boundary lines against state are marked with red paint. Interior Payment Unit boundaries are marked with yellow paint. The painted boundary line trees are not Included Timber and are to be protected. Yellow painted trees designating an interior Payment Unit boundary are only to be cut when all surrounding Payment Units have been paid.

2 - Timber Specifications

2.1 - Included Timber

2.1.3 - Cut tree marked unit(s) (12/08)

Within Payment Unit(s) 1-7, all trees are designated for cutting when marked with orange paint above and below stump height, regardless of merchantability. In addition, all ash and beech are designated for cutting, except do not cut trees marked with pink paint.

2.1.11 - Description of timber note (2/04)

Note that Mixed Hardwood Pulpwood is composed of sugar maple, red maple, beech, and ironwood. Misc. Species 1 is dead standing ash.

2.2 - Utilization

2.2.6 - Roundwood operation required (5/07)

The skidding of whole trees or tree segments with limbs attached is prohibited. All products must be produced as roundwood and forwarded to existing roads or landing areas in final product length.

3 - Payments

3.3 - Pre-measured Sales

3.3.4 - Dividing payment units (7/14)

Payment Unit(s) 2, 5, and 7 may be divided at the request of the Purchaser and upon approval of the Unit Manager. Dividing Payment Units is a contract modification which requires a Timber Sale Contract Supplement. These Payment Units may be divided as many times as needed to drop the price of the Payment Unit division to \$25,000.

3.4 - Damaged Timber

3.4.1 - Damaged timber (6/14)

General Condition and Requirement 3.4 Damaged Timber, defines liquidated damages for undesignated live merchantable trees which are cut or injured. No damage is acceptable to undesignated merchantable trees. Within the sale area, if more than 5% of trees (> 4.5" DBH) within a specified area of the sale are damaged, liquidated damages will be assessed for all trees damaged. Rates will be in accordance with General Condition and Requirement 3.4 Damaged Timber.

4 - Transportation

4.1 - Construction

4.1.3 - Slash and earthen piles (8/04)

Piles or windrows of earth along roads and landings that have been widened or constructed shall be leveled. Slash from road maintenance or construction, including stumps, shall be dispersed throughout the sale.

4.1.6 - Road construction (1/09)

Improvements of existing roads shall be done in such a way as to minimize the environmental and visual impacts. Merchantable trees shall be cut and utilized unless otherwise directed. Non-merchantable trees shall be severed and laid flat

on the ground. Slash shall be scattered, and not left in windrows and kept a minimum of 10 feet back from the road edge. Stumps shall be set upright, not left on edge, and be moved at least 10 feet away from the road edge. Disturbed soil shall be feathered into the woods and not left in berms or windrows.

4.1.7 - Road closure (10/11)

All overgrown roads used during the sale will be treated as new roads and must be blocked to vehicle traffic upon completion of the sale. In general, this will require constructing a four (4') foot high berm of stumps and logs covered with earth. These roads must be rendered impassable to cars and trucks. Contact the sale administrator for specific details of design and placement.

4.1.12 - No new roads (1/12)

No new roads will be permitted in any Payment Unit. All operations are limited to existing roads. Skid trails only will be allowed.

4.2 - Maintenance

4.2.5 - Two wheel drive condition (2/04)

All existing trail roads on and adjacent to the sale area must be passable by two-wheel drive traffic for the duration of the sale.

5 - Operations

5.1 - Notification

5.1.1 - Pre-sale conference (10/11)

A pre-sale conference on site between the Purchaser and sale administrator is required prior to beginning any operations within a Payment Unit to determine landing and road locations. The Unit Manager or his/her representative must be contacted at least 10 days in advance to schedule the conference.

5.1.3 - Well heads and natural gas pipelines (11/15)

The Purchaser is responsible for contacting the gas or pipeline company 30 days prior to operating equipment in the vicinity of well heads or natural gas pipelines.

5.1.4 - Post-sale conference (6/11)

A post-sale conference on site between the Purchaser and sale administrator is required 5 days prior to the completion of active logging operations to determine clean-up and repair of landings, road edges, and the fulfillment of other contract specifications.

5.2 - Conduct of Operations

5.2.1 - Slash

5.2.1.10 - No slash in openings (5/10)

No brush or logging debris is to be left in the maintained wildlife openings or on oil well pads which are indicated by G0 on the Timber Sale Map. Any damage to the opening shall be repaired according to specifications of the Unit Manager or his/her representative.

5.2.3 - Operating Restrictions

5.2.3.1 - Operating restrictions (9/11)

Within Payment Unit(s) 1-7, unless changed by written agreement, cutting, and skidding are not permitted during the period of 3/15 to 7/15. This restriction is because of bark slippage, oak wilt, and the presence of sensitive soils and slopes.

5.2.32 - Decking/landing restoration (9/13)

All decking and landing areas must have the surface area restored to a condition equal to or better than before. This is to ensure the proper regeneration of the stand. Wood debris, chips and "cookies" from trimmings must be removed or scattered away from landing and loading areas and may not be windrowed on the edge.

5.2.33 - Gas well re-vegetation (12/08)

In the event that the gas well is utilized for a landing, the site must be re-vegetated with a seeding mixture specified by the Unit Manager or his/her representative.

5.2.38 - No decking against live trees (2/04)

Cut products may not be decked against unmarked or designated leave trees.

5.4 - Soil Protection

5.4.1 - Rutting restriction, general (7/16)

Operations are to cease immediately if equipment and weather conditions result in rutting of roads and/or skid trails which is 12 inches or greater in depth and 50 feet in length. The Unit Manager or his/her representative may restrict hauling and/or skidding if ruts exceed the specified depth. With the Unit Manager or his/her representative's approval, the Purchaser may return to the area when the risk of rutting has decreased.

5.4.3 - Erosion control (12/08)

Skid trails or haul roads may require erosion control structures or berms per direction of the Unit Manager or his/her representative.

5.4.4 - Slope protection (5/15)

Skid trails and roads on slopes shall be water barred with slash, stumps, and/or clean straw bales native to the area as soon as use is complete to prevent erosion.

5.8 - Protection of Endangered Species

5.8.5 - Protection of raptor nests (3/13)

All trees with raptor nests will be protected if found during harvesting operations. Notification will be made to the Unit Manager or his/her representative who will notify the Wildlife Biologist so an on-site evaluation and recommendation can be made, if necessary.

6 - Safety and Fire Prevention

6.2 - Signing

6.2.1 - Road posting (9/09)

The Purchaser is responsible for posting and maintaining caution signs on forest roads prior to beginning operations. The road must be posted at appropriate distances from the sale area to warn of logging activity and truck traffic. Signs must be removed when harvest operations are suspended or completed. The Purchaser will provide these signs.

7 - Other Conditions

7.5 - Loss

7.5.1 - Deteriorating timber (7/09)

The sale area has received damage from Emerald Ash Borer. The Purchaser should harvest the wood as soon as possible. The Department of Natural Resources is held free of responsibility of any further damage or deterioration due to delay in harvesting.



TIMBER SALE MAP

This information provided by authority of Part 525, 1994 PA 451, as amended.

Sale Number	Year
54-011	16

Forest Management Unit	County	Mapped By	Date	Page	of
Atlanta	Montmorency	D. Parris	9/15/2016	1	1
Township	Range	Section(s) and Subdivision(s)	Scale		
31N	01E	Sec. 32 NWNW, NWSW, SWNW, SWSW; Sec. 31 NENE, NENW, NESE, NESW, NWNE, NWSE, SENE, SENW, SESE, SWNE, SWSE;	1:15,840		

Cover Type				Density	
A = Aspen	H = Hemlock	N = Marsh	U = Upland Brush	0 = Non Stocked	5 = Pole Timber Medium
B = Paper Birch	J = Jack Pine	O = Oak	UM = Upland Mixed	1 = Seedling Sapling Poor	6 = Pole Timber Well
C = Cedar	L = Lowland Brush	P = Lowland Poplar	V = Bog or Marsh	2 = Seedling Sapling Medium	7 = Saw Timber Poor
D = Tread Bog	LM = Lowland Mixed	Q = Mixed Swamp Conifer	W = White Pine	3 = Seedling Sapling Well	8 = Saw Timber Medium
E = Swamp Hdwoods	M = Mpl, Bch, Brch	R = Red Pine	X = Non Stocked	4 = Pole Timber Poor	9 = Saw Timber Well
F = Spruce Fir	MC = Mixed Conifer	S = Black Spruce	Z = Water		
G = Grass	MD = Mixed Deciduous	T = Tamarack			

Hardwood Hill Country Mix

Compartment 33

187.9 Acres

PU	Stand	Acres	PU	Stand	Acres
1	60	22.5	5	32	29.4
2	60	31.9	6	56	34.4
3	28	10.6	7	25	37.6
4	32	21.5			

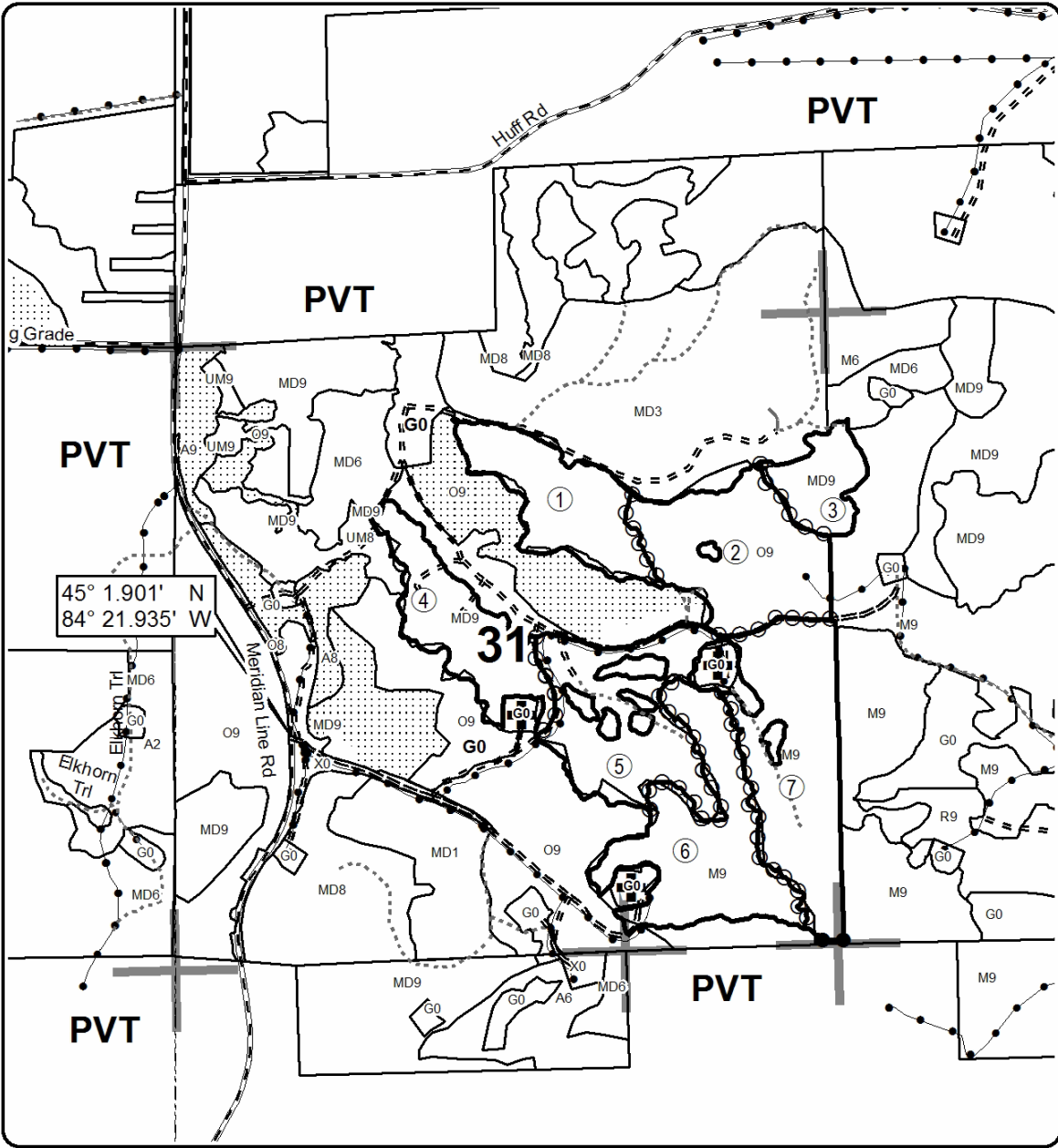

45° 1.901' N
84° 21.935' W



Legend

- Against State (Red)
- Payment Unit (Yellow)
- Private Line (Blue)
- Payment Unit
- Nearby Sales
- Stand Boundaries
- Gravel Roads
- Poor Dirt Roads
- Closed Roads
- Sale Adjacent Oil Well Pad
- Pipeline, Powerline
- Section Corners

Locator Map
1:200,000

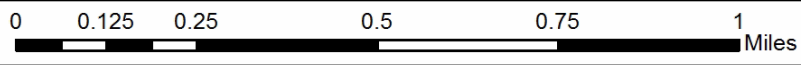
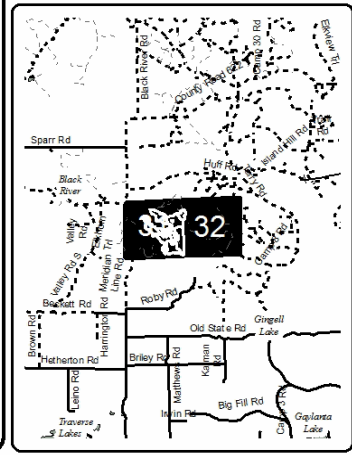

TIMBER SALE INFORMATION

Rollin Roluids Mix (54-012-16)

Montmorency County (Advertised Price \$209,262.00)

SALE NOTE: Access may be through private or other public land.

A timber sale contract for this lump sum, sealed bid timber sale will be awarded to the responsible bidder offering the highest sealed bid price. Bids must be at or above the following advertised price for each species:

<u>PRODUCTS & SPECIES</u>	<u>ESTIMATED UNITS*</u>	<u>ADVERTISED PRICE</u>
Sawtimber		
Basswood	260.90 MBF	\$ 84.00 / MBF
Beech	98.90 MBF	\$ 79.00 / MBF
Mixed Aspen	107.60 MBF	\$ 82.00 / MBF
Red Oak	280.40 MBF	\$ 165.00 / MBF
Sugar Maple	145.50 MBF	\$ 418.00 / MBF
Pulpwood		
Basswood	648.00 Cords	\$ 14.60 / Cord
Beech	503.00 Cords	\$ 19.70 / Cord
Misc. Species 1	868.00 Cords	\$ 4.45 / Cord
Mixed Aspen	156.00 Cords	\$ 21.30 / Cord
Mixed Hardwood	1,389.00 Cords	\$ 19.70 / Cord
Red Oak	436.00 Cords	\$ 20.65 / Cord
Red Pine	5.00 Cords	\$ 50.00 / Cord
White Ash	23.00 Cords	\$ 19.70 / Cord

* The total volume is statistically estimated within plus (+) or minus (-) 8.15 percent. The estimated units are final and not subject to adjustment. Prospective bidders are urged to examine this timber and to make their own estimates of quantity and quality.

BOND AND PAYMENT SCHEDULE:

1. A bond in the amount of \$10,463.00 to insure faithful performance of the conditions of the contract will be deposited by the successful bidder within 21 days of the sale award.
2. Cutting in any sale or unit without the required advance payment would be considered a trespass.
3. Total payment must be paid in advance or according to the following schedule:
 - (a) Ten percent (10%) of the sale value must be paid within 21 days of the sale award.
 - (b) The 10% down payment will be credited towards the first unit cut.
4. If no cutting takes place, the 10% down payment will not be refunded.
5. Operations on the contract issued will terminate on 12/31/2020.

Description of Timber by Payment Unit (PU)

PU	MARKET GROUP	PRODUCT	QUANTITY	UNIT	ACRES	ADVERTISE PRICE
1	Basswood	Sawtimber	46.2	MBF	46.5	\$24,287.20
	Beech		17.3	MBF		
	Red Oak		2.9	MBF		
	Sugar Maple		21.4	MBF		
	Basswood	Pulpwood	145.0	Cords		
	Beech		108.0	Cords		
	Misc. Species 1		188.0	Cords		
	Mixed Hardwood		220.0	Cords		
	<i>Paper Birch</i>	<i>Sawtimber</i>	<i>0.7</i>	<i>MBF</i>		
	<i>Ironwood</i>	<i>Pulpwood</i>	<i>27.0</i>	<i>Cords</i>		
	<i>Paper Birch</i>		<i>2.0</i>	<i>Cords</i>		
	<i>Sugar Maple</i>		<i>190.0</i>	<i>Cords</i>		
	Red Oak		4.0	Cords		
	White Ash		6.0	Cords		
	<i>White Ash</i>	<i>Sawtimber</i>	<i>1.6</i>	<i>MBF</i>		
	<i>White Ash</i>	<i>Pulpwood</i>	<i>3.0</i>	<i>Cords</i>		
2	Basswood	Sawtimber	49.0	MBF	48.3	\$25,153.30
	Beech		18.0	MBF		
	Red Oak		2.9	MBF		
	Sugar Maple		21.9	MBF		
	Basswood	Pulpwood	150.0	Cords		
	Beech		112.0	Cords		
	Misc. Species 1		192.0	Cords		
	Mixed Hardwood		230.0	Cords		
	<i>Paper Birch</i>	<i>Sawtimber</i>	<i>0.8</i>	<i>MBF</i>		
	<i>Ironwood</i>	<i>Pulpwood</i>	<i>29.0</i>	<i>Cords</i>		
	<i>Paper Birch</i>		<i>2.0</i>	<i>Cords</i>		
	<i>Sugar Maple</i>		<i>197.0</i>	<i>Cords</i>		
	Red Oak		4.0	Cords		
	White Ash		6.0	Cords		
	<i>White Ash</i>	<i>Sawtimber</i>	<i>1.6</i>	<i>MBF</i>		
	<i>White Ash</i>	<i>Pulpwood</i>	<i>3.0</i>	<i>Cords</i>		
3	Basswood	Sawtimber	46.5	MBF	36.5	\$18,215.95
	Beech		13.8	MBF		
	Red Oak		1.6	MBF		
	Sugar Maple		14.0	MBF		
	Basswood	Pulpwood	110.0	Cords		
	Beech		76.0	Cords		
	Misc. Species 1		115.0	Cords		
	Mixed Hardwood		172.0	Cords		
	<i>Paper Birch</i>	<i>Sawtimber</i>	<i>1.7</i>	<i>MBF</i>		
	<i>Ironwood</i>	<i>Pulpwood</i>	<i>21.0</i>	<i>Cords</i>		
	<i>Paper Birch</i>		<i>4.0</i>	<i>Cords</i>		
	<i>Sugar Maple</i>		<i>144.0</i>	<i>Cords</i>		
	Red Oak		2.0	Cords		
	White Ash		3.0	Cords		
	<i>White Ash</i>	<i>Sawtimber</i>	<i>0.9</i>	<i>MBF</i>		
	<i>White Ash</i>	<i>Pulpwood</i>	<i>1.0</i>	<i>Cords</i>		
4	Basswood	Sawtimber	11.7	MBF	23.2	\$14,469.20
	Beech		0.7	MBF		
	Red Oak		44.8	MBF		
	Sugar Maple		4.5	MBF		
	Basswood	Pulpwood	45.0	Cords		
	Beech		9.0	Cords		
	Misc. Species 1		81.0	Cords		
	Mixed Hardwood		76.0	Cords		

Description of Timber by Payment Unit (PU), con't

PU	MARKET GROUP	PRODUCT	QUANTITY	UNIT	ACRES	ADVERTISE PRICE
4 con't	<i>Ironwood</i>	<i>Sawtimber</i>	0.2	<i>MBF</i>		
	<i>Ironwood</i>	<i>Pulpwood</i>	5.0	<i>Cords</i>		
	<i>Sugar Maple</i>		71.0	<i>Cords</i>		
	Red Oak		71.0	Cords		
5	Basswood	Sawtimber	23.8	MBF	47.0	\$29,408.70
	Beech		1.3	MBF		
	Red Oak		90.7	MBF		
	Sugar Maple		9.2	MBF		
	Basswood	Pulpwood	91.0	Cords		
	Beech		19.0	Cords		
	Misc. Species 1		163.0	Cords		
	Mixed Hardwood		156.0	Cords		
	<i>Ironwood</i>	<i>Sawtimber</i>	0.4	<i>MBF</i>		
	<i>Ironwood</i>	<i>Pulpwood</i>	10.0	<i>Cords</i>		
	<i>Sugar Maple</i>		145.0	<i>Cords</i>		
	Red Oak		145.0	Cords		
6	Basswood	Sawtimber	30.4	MBF	13.6	\$16,011.75
	Beech		14.9	MBF		
	Sugar Maple		22.2	MBF		
	Basswood	Pulpwood	36.0	Cords		
	Beech		47.0	Cords		
	Misc. Species 1		3.0	Cords		
	Mixed Hardwood		74.0	Cords		
	<i>Ironwood</i>		4.0	<i>Cords</i>		
	<i>Sugar Maple</i>		70.0	<i>Cords</i>		
	White Ash		4.0	Cords		
	<i>White Ash</i>		4.0	<i>Cords</i>		
	7	Basswood	Sawtimber	31.3		
Beech			19.3	MBF		
Mixed Aspen			107.5	MBF		
<i>B. T. Aspen</i>			99.6	<i>MBF</i>		
<i>Quaking Aspen</i>			7.9	<i>MBF</i>		
Red Oak			136.1	MBF		
Sugar Maple			51.2	MBF		
Basswood		Pulpwood	53.0	Cords		
Beech			69.0	Cords		
Misc. Species 1			64.0	Cords		
Mixed Aspen			156.0	Cords		
<i>B. T. Aspen</i>			139.0	<i>Cords</i>		
<i>Quaking Aspen</i>			17.0	<i>Cords</i>		
Mixed Hardwood			443.0	Cords		
<i>Red Maple</i>		<i>Sawtimber</i>	1.4	<i>MBF</i>		
<i>Ironwood</i>		<i>Pulpwood</i>	11.0	<i>Cords</i>		
<i>Red Maple</i>			1.0	<i>Cords</i>		
<i>Sugar Maple</i>			428.0	<i>Cords</i>		
Red Oak			207.0	Cords		
Red Pine			5.0	Cords		
<i>Red Pine</i>		<i>Sawtimber</i>	1.8	<i>MBF</i>		
<i>Red Pine</i>		<i>Pulpwood</i>	1.0	<i>Cords</i>		
White Ash			4.0	Cords		
<i>White Ash</i>		<i>Sawtimber</i>	1.4	<i>MBF</i>		
<i>White Ash</i>	<i>Pulpwood</i>	1.0	<i>Cords</i>			
8	Basswood	Sawtimber	22.0	MBF	9.6	\$5,789.85
	Beech		13.6	MBF		
	Red Oak		1.4	MBF		
	Sugar Maple		1.1	MBF		

Description of Timber by Payment Unit (PU), con't

PU	MARKET GROUP	PRODUCT	QUANTITY	UNIT	ACRES	ADVERTISE PRICE
8 con't	Basswood	Pulpwood	18.0	Cords		
	Beech		63.0	Cords		
	Misc. Species 1		62.0	Cords		
	Mixed Hardwood		17.0	Cords		
	<i>Ironwood</i>		2.0	<i>Cords</i>		
	<i>Sugar Maple</i>		15.0	<i>Cords</i>		
	Red Oak		3.0	Cords		
TOTAL:			893.2	MBF		
TOTAL:			4,027.0	Cords		

Sale Specific Conditions & Requirements

Sale Name: Rollin Roluids Mix

Sale Number: 54-012-16 Seq#: 1

1 - Sale Area

1.2 - Boundaries

1.2.1 - Painted boundaries (1/14)

The sale boundary and Payment Unit boundaries are marked and identified by blue, red and yellow paint. Exterior sale boundary lines against private property are marked with blue paint. Exterior sale boundary lines against state are marked with red paint. The interior retention area is marked with red paint. Interior Payment Unit boundaries are marked with yellow paint. The painted boundary line trees are not Included Timber and are to be protected, unless marked with orange paint. Yellow painted trees designating an interior Payment Unit boundary are only to be cut when all surrounding Payment Units have been paid.

2 - Timber Specifications

2.1 - Included Timber

2.1.1 - Clearcut unit(s) with unmerchantable trees (6/14)

Within Payment Unit(s) 7, cut all trees that are two (2) inches or more at DBH except trees marked with pink paint and all hemlock.

2.1.3 - Cut tree marked unit(s) (12/08)

Within Payment Unit(s) 1-6 and 8, all trees are designated for cutting when marked with orange paint above and below stump height, regardless of merchantability. In addition, all ash, ironwood, and beech trees are designated to be cut, except do not cut trees that are marked with pink paint.

2.1.11 - Description of timber note (2/04)

Note that mixed aspen includes quaking and bigtooth aspen. Mixed hardwood pulp includes sugar maple, red maple, paper birch, and ironwood. Misc. Species 1 includes dead white ash.

2.2 - Utilization

2.2.6 - Roundwood operation required (5/07)

The skidding of whole trees or tree segments with limbs attached is prohibited within Payment Units 1-6 and 8. All products must be produced as roundwood and forwarded to existing roads or landing areas in final product length.

3 - Payments

3.3 - Pre-measured Sales

3.3.4 - Dividing payment units (7/14)

Payment Unit(s) 1, 2, 5, and 7 may be divided at the request of the Purchaser and upon approval of the Unit Manager.

Dividing Payment Units is a contract modification which requires a Timber Sale Contract Supplement. There will be only one division per Payment Unit.

3.4 - Damaged Timber

3.4.1 - Damaged timber (6/14)

General Condition and Requirement 3.4 Damaged Timber, defines liquidated damages for undesignated live merchantable trees which are cut or injured. No damage is acceptable to merchantable trees. Within the sale area, if more than 5% of trees (> 4.5" DBH) within a specified area of the sale are damaged, liquidated damages will be assessed for all trees damaged. Rates will be in accordance with General Condition and Requirement 3.4 Damaged Timber.

4 - Transportation

4.1 - Construction

4.1.3 - Slash and earthen piles (8/04)

Piles or windrows of earth along roads and landings that have been widened or constructed shall be leveled. Slash from road

maintenance or construction, including stumps, shall be dispersed throughout the sale.

4.1.6 - Road construction (1/09)

Construction or improvements of existing roads shall be done in such a way as to minimize the environmental and visual impacts. Merchantable trees shall be cut and utilized unless otherwise directed. Non-merchantable trees shall be severed and laid flat on the ground. Slash shall be scattered, and not left in windrows and kept a minimum of 10 feet back from the road edge. Stumps shall be set upright, not left on edge, and be moved at least 10 feet away from the road edge. Disturbed soil shall be feathered into the woods and not left in berms or windrows.

4.1.7 - Road closure (10/11)

All new roads built into the sale must be blocked to vehicle traffic upon completion of the sale. Overgrown roads that are reopened shall be considered new roads. In general, this will require constructing a four (4') foot high berm of stumps and logs covered with earth. These roads must be rendered impassable to cars and trucks. Contact the sale administrator for specific details of design and placement.

4.2 - Maintenance

4.2.5 - Two wheel drive condition (2/04)

All existing trail roads on and adjacent to the sale area must be passable by two-wheel drive traffic for the duration of the sale.

4.4 - Access

4.4.1 - Private property access (3/11)

Permission for access across private land is the responsibility of the Purchaser. Should the Purchaser desire to cross private land, a copy of the written permission from the private land-owner is required by the DNR.

5 - Operations

5.1 - Notification

5.1.1 - Pre-sale conference (10/11)

A pre-sale conference on site between the Purchaser and sale administrator is required prior to beginning any operations to determine landing and road locations. The Unit Manager or his/her representative must be contacted at least 10 days in advance to schedule the conference.

5.1.3 - Well heads and natural gas pipelines (11/15)

The Purchaser is responsible for contacting the Delta Oil and Force Antrim Dev. gas companies within 30 days prior to operating equipment in the vicinity of well heads or natural gas pipelines.

5.1.4 - Post-sale conference (6/11)

A post-sale conference on site between the Purchaser and sale administrator is required 5 days prior to the completion of active logging operations to determine clean-up and repair of landings, road edges, and the fulfillment of other contract specifications.

5.2 - Conduct of Operations

5.2.1 - Slash

5.2.1.10 - No slash in openings (5/10)

No brush or logging debris is to be left in the maintained wildlife opening which is indicated by G on the Timber Sale Map. Any damage to the opening shall be repaired according to specifications of the Unit Manager or his/her representative.

5.2.2 - Hazard Trees/Snags

5.2.2.1 - Den trees (2/04)

Obvious hollow and/or den trees shall be protected and left standing unless they are a safety hazard.

5.2.3 - Operating Restrictions

5.2.3.1 - Operating restrictions (9/11)

Within Payment Unit(s) 1-6 and 8, unless changed by written agreement, cutting, skidding, and hauling are limited to the

period of 7/16-12/1 with snow off and unfrozen ground. This restriction is to improve hardwood regeneration, reduce the spread of oak wilt, and bark slip.

5.2.3.11 - Coppice regeneration protection (4/10)

Timber harvesting in any Payment Unit must be completed before significant deciduous seedling sprouting occurs in that Payment Unit so as to minimize damage to the new regeneration.

5.2.32 - Decking/landing restoration (9/13)

All decking and landing areas must have the surface area restored to a condition equal to or better than before. This is to ensure the proper regeneration of the stand. Wood debris, chips and "cookies" from trimmings must be removed or scattered away from landing and loading areas and may not be windrowed on the edge.

5.2.33 - Gas well re-vegetation (12/08)

In the event that the gas well is utilized for a landing, the site must be re-vegetated with a seeding mixture specified by the Unit Manager or his/her representative.

5.2.38 - No decking against live trees (2/04)

Cut products may not be decked against unmarked or designated leave trees.

5.4 - Soil Protection

5.4.2 - Skid trails (2/04)

Skid trails up and down slopes should be avoided. If however this is unavoidable, these trails will be left in a non-erodible condition using water bars, logs, and slash. Placing of slash on these skid trails while logging is ongoing may alleviate need for any further action. At the direction of the sale administrator, seed, fertilizer, and mulch may also be required.

5.8 - Protection of Endangered Species

5.8.5 - Protection of raptor nests (3/13)

All trees with raptor nests will be protected if found during harvesting operations. Notification will be made to the Unit Manager or his/her representative who will notify the Wildlife Biologist so an on-site evaluation and recommendation can be made, if necessary.

7 - Other Conditions

7.3 - Contract Modifications

7.3.1 - Emerald Ash Borer

7.3.1.2 - Emerald ash borer, ash or firewood on sale (2/05)

There is ash and/or "firewood" in this sale and it is located within an emerald ash borer quarantined area. The Director of the Michigan Department of Agriculture (MDA) by the authority of Act No. 72 of the Public Acts of 1945, as amended, and Quarantine Regulation No. 620, has promulgated this quarantine to prevent the further spread of this pest and sets forth: definitions, regulated articles, regulated areas, conditions of movement, violations and penalties, and special exemptions. The Purchaser must comply with this quarantine. Contact the MDA for further information.

7.5 - Loss

7.5.1 - Deteriorating timber (7/09)

The sale area has received damage from emerald ash borer. The Purchaser should harvest the wood as soon as possible. The Department of Natural Resources is held free of responsibility of any further damage or deterioration due to delay in harvesting.



TIMBER SALE MAP

This information provided by authority of Part 525, 1994 PA 451, as amended.

Forest Management Unit		County	Mapped By		Date	Page of	
Atlanta Management Unit		Montmorency	D. Coy		07/29/2016	1	1
Township	Range	Section(s) and Subdivision(s)			Scale		
31N	02E	31- E2NE & NESE 32- W2			1:15,840		

Cover Type				Density			
A = Aspen	H = Hemlock	N = Marsh	U = Upland Brush	0 = Non Stocked	5 = Pole Timber Medium		
B = Paper Birch	J = Jack Pine	O = Oak	UM = Upland Mixed	1 = Seedling Sapling Poor	6 = Pole Timber Well		
C = Cedar	L = Lowland Brush	P = Lowland Poplar	V = Bog or Marsh	2 = Seedling Sapling Medium	7 = Saw Timber Poor		
D = Tread Bog	LM = Lowland Mixed	Q = Mixed Swamp Conifer	W = White Pine	3 = Seedling Sapling Well	8 = Saw Timber Medium		
E = Swamp Hdwoods	M = Mpl, Bch, Brch	R = Red Pine	X = Non Stocked	4 = Pole Timber Poor	9 = Saw Timber Well		
F = Spruce Fir	MC = Mixed Conifer	S = Black Spruce	Z = Water				
G = Grass	MD = Mixed Deciduous	T = Tamarack					

PU	Acres	PU	Acres
1	46.5	5	47.0
2	48.3	6	13.6
3	36.5	7	44.8
4	23.2	8	9.6

Rollin Roloids Mix

Compartments 42 & 43

269.5 Acres

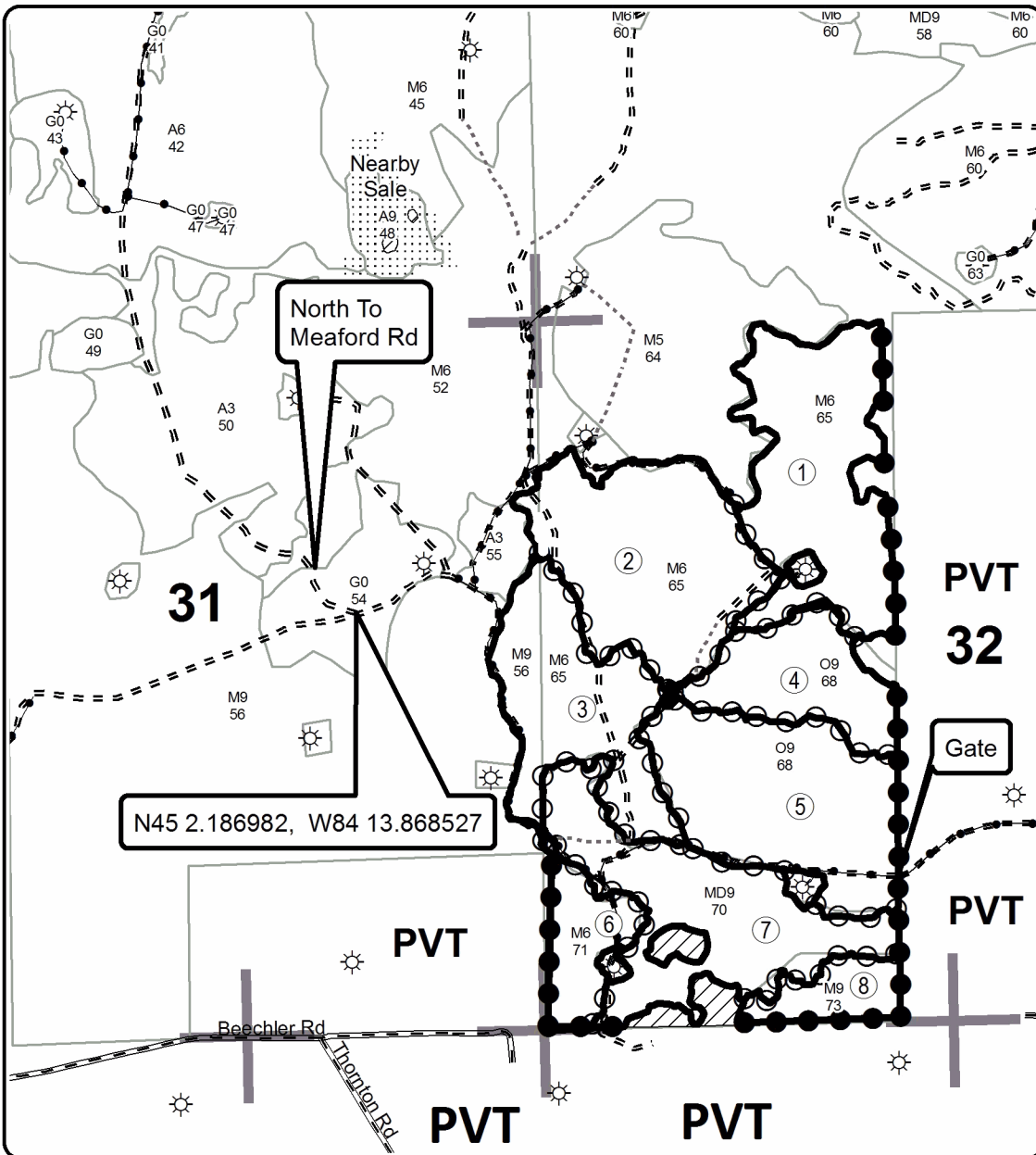
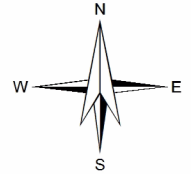

Legend

- Against State (Red)
- Payment Unit (Yellow)
- Private Line (Blue)
- ▨ Retention Area (Red)
- ⋯ Nearby Timber Sale
- Stand Boundaries
- Payment Unit
- ☀ Gas Well
- Section Corners
- Pipeline; Powerline
- Gravel Roads
- == Poor Dirt Roads
- Closed Roads

Locator Map
1:150,000

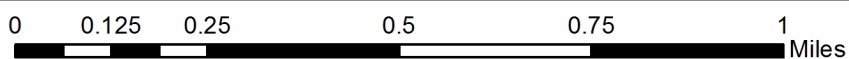
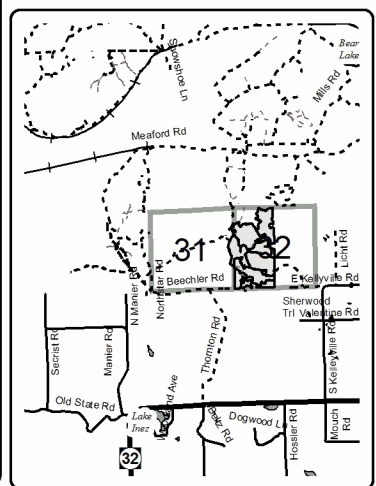

TIMBER SALE INFORMATION

1 in 5 RP (54-023-16)

Montmorency County (Advertised Price \$15,484.10)

A timber sale contract for this lump sum, sealed bid timber sale will be awarded to the responsible bidder offering the highest sealed bid price. Bids must be at or above the following advertised price for each species:

<u>PRODUCTS & SPECIES</u>	<u>ESTIMATED UNITS*</u>	<u>ADVERTISED PRICE</u>
Sawtimber		
Red Pine	27.30 MBF	\$ 119.00 / MBF
Pulpwood		
Red Pine	262.00 Cords	\$ 46.70 / Cord

* The total volume is statistically estimated within plus (+) or minus (-) 21.11 percent. The estimated units are final and not subject to adjustment. Prospective bidders are urged to examine this timber and to make their own estimates of quantity and quality.

BOND AND PAYMENT SCHEDULE:

1. A bond in the amount of \$774.00 to insure faithful performance of the conditions of the contract will be deposited by the successful bidder within 21 days of the sale award.
2. Cutting in any sale or unit without the required advance payment would be considered a trespass.
3. Total payment must be paid in advance or according to the following schedule:
 - (a) Ten percent (10%) of the sale value must be paid within 21 days of the sale award.
 - (b) The 10% down payment will be credited towards the first unit cut.
4. If no cutting takes place, the 10% down payment will not be refunded.
5. Operations on the contract issued will terminate on 12/31/2019.

Description of Timber by Payment Unit (PU)

PU	MARKET GROUP	PRODUCT	QUANTITY	UNIT	ACRES	ADVERTISE PRICE
1	Red Pine	Sawtimber	21.7	MBF	13.8	\$10,381.20
	Red Pine	Pulpwood	167.0	Cords		
2	Red Pine	Sawtimber	5.6	MBF	8.6	\$5,102.90
	Red Pine	Pulpwood	95.0	Cords		
TOTAL:			27.3	MBF		
TOTAL:			262.0	Cords		

Sale Specific Conditions & Requirements

Sale Name: 1 in 5 RP

Sale Number: 54-023-16 Seq#: 1

1 - Sale Area

1.2 - Boundaries

1.2.1 - Painted boundaries (1/14)

The sale boundaries are marked and identified by red paint. Exterior sale boundary lines against state are marked with red paint. The painted boundary line trees are not Included Timber and are to be protected unless marked with orange paint.

2 - Timber Specifications

2.1 - Included Timber

2.1.3 - Cut tree marked unit(s) (12/08)

Within Payment Unit(s) 1 & 2, all trees are designated for cutting when marked with orange paint above and below stump height, regardless of merchantability.

2.1.11 - Description of timber note (2/04)

Note that within Payment Unit 1, orange dots on cut trees indicate direction of travel for harvest equipment where row width is below 10' 4", and all or a significant portion of the row is being cut. Dots are being used to assist operations and minimize damage to residual trees.

2.2 - Utilization

2.2.4 - Skidding length (2/14)

Skidding of unlimbed tops or lengths over 17 feet is not permissible.

3 - Payments

3.4 - Damaged Timber

3.4.1 - Damaged timber (6/14)

General Condition and Requirement 3.4 Damaged Timber, defines liquidated damages for undesignated live merchantable trees which are cut or injured.

No damage is acceptable to UNDESIGNATED merchantable trees. Within the sale area, if more than 5% of trees (> 4.5" DBH) within a specified area of the sale are damaged, liquidated damages will be assessed for all trees damaged. Rates will be in accordance with General Condition and Requirement 3.4 Damaged Timber.

4 - Transportation

4.1 - Construction

4.1.3 - Slash and earthen piles (8/04)

Piles or windrows of earth along roads and landings that have been widened or constructed shall be leveled. Slash from road maintenance or construction, including stumps, shall be dispersed throughout the sale.

4.1.12 - No new roads (1/12)

No new roads will be permitted in any Payment Unit. All operations are limited to existing roads. Skid trails only will be allowed.

4.2 - Maintenance

4.2.5 - Two wheel drive condition (2/04)

All existing trail roads on and adjacent to the sale area must be passable by two-wheel drive traffic for the duration of the sale.

5 - Operations

5.1 - Notification

5.1.1 - Pre-sale conference (10/11)

A pre-sale conference between the Purchaser and sale administrator is required prior to beginning any operations to determine landing and road locations. The Unit Manager or his/her representative must be contacted at least 10 days in advance to schedule the conference.

5.1.3 - Well heads and natural gas pipelines (11/15)

The Purchaser is responsible for contacting the Terra Energy, LTD gas or pipeline company 30 days prior to operating equipment in the vicinity of well heads or natural gas pipelines.

5.1.4 - Post-sale conference (6/11)

A post-sale conference on site between the Purchaser and sale administrator is required 5 days prior to the completion of active logging operations to determine clean-up and repair of landings, road edges, and the fulfillment of other contract specifications.

5.2 - Conduct of Operations

5.2.1 - Slash

5.2.1.10 - No slash in openings (5/10)

No brush or logging debris is to be left in the maintained wildlife opening which is indicated by G0 on the Timber Sale Map. Any damage to the opening shall be repaired according to specifications of the Unit Manager or his/her representative.

5.2.3 - Operating Restrictions

5.2.3.3 - Bark slippage restriction (3/09)

Within Payment Unit(s) 1 & 2, unless changed by written agreement, cutting and skidding are not permitted during the period of April 15 to July 15. This restriction is because of bark slippage.

5.2.3.6 - Bark beetle restriction (12/08)

In the event drought creates a high risk of pine bark beetle infestation, pine is not to be cut during the period March 1 through July 1, unless all portions of trees greater than two inches in diameter are removed from the sale area, reduced to chips, or treated to the satisfaction of the Unit Manager or his/her representative, within fifteen days of being severed from the stump. Pine log decks, pulpwood piles and treetops that are piled for chipping in the fall or winter within a 1/4 mile of susceptible sites must be removed before March 15. Residual slash must not be placed in piles or rows and must be spread over the site for quick drying. The Department of Natural Resources will exercise this specification if the risk of damage warrants.

5.2.31 - Landing locations (9/13)

Landing areas are marked on the Timber Sale Map with the letter "L". Landings must be confined to these designated sites unless otherwise authorized by the Unit Manager or his/her representative.

5.2.32 - Decking/landing restoration (9/13)

All decking and landing areas must have the surface area restored to a condition equal to or better than before. This is to ensure the proper regeneration of the stand. Wood debris, chips and "cookies" from trimmings must be removed or scattered away from landing and loading areas and may not be windrowed on the edge.

5.2.38 - No decking against live trees (2/04)

Cut products may not be decked against unmarked or designated leave trees.

5.4 - Soil Protection

5.4.1 - Rutting restriction, general (1/09)

Operations are to cease immediately if equipment and weather conditions result in rutting of roads and skid trails which is 12 inches or greater in depth and 50 feet in length. The Unit Manager or his/her representative may restrict hauling and/or skidding if ruts exceed the specified depth. With the Unit Manager or his/her representative's approval, the Purchaser may return to the area when the risk of rutting has decreased.

5.8 - Protection of Endangered Species

5.8.5 - Protection of raptor nests (3/13)

All trees with raptor nests will be protected if found during harvesting operations. Notification will be made to the Unit Manager or his/her representative who will notify the Wildlife Biologist so an on-site evaluation and recommendation can be made, if necessary.



TIMBER SALE MAP

This information provided by authority of Part 525, 1994 PA 451, as amended.

Sale Number	Year
54 - 023	16

Forest Management Unit	County	Mapped By	Date	Page	of
Atlanta Management Unit	Montmorency	D. Coy	06/15/2016	1	1
Township	Range	Section(s) and Subdivision(s)	Scale		
31N	02E	28- NWNW 29- NENE & N2NW	1:15,840		

Cover Type				Density	
A = Aspen	H = Hemlock	N = Marsh	U = Upland Brush	0 = Non Stocked	5 = Pole Timber Medium
B = Paper Birch	J = Jack Pine	O = Oak	UM = Upland Mixed	1 = Seedling Sapling Poor	6 = Pole Timber Well
C = Cedar	L = Lowland Brush	P = Lowland Poplar	V = Bog or Marsh	2 = Seedling Sapling Medium	7 = Saw Timber Poor
D = Tread Bog	LM = Lowland Mixed	Q = Mixed Swamp Conifer	W = White Pine	3 = Seedling Sapling Well	8 = Saw Timber Medium
E = Swamp Hdwoods	M = Mpl, Bch, Brch	R = Red Pine	X = Non Stocked	4 = Pole Timber Poor	9 = Saw Timber Well
F = Spruce Fir	MC = Mixed Conifer	S = Black Spruce	Z = Water		
G = Grass	MD = Mixed Deciduous	T = Tamarack			

PU Acres

1	13.8
2	8.6

1 in 5 RP
Compartment 43
22.4 Acres

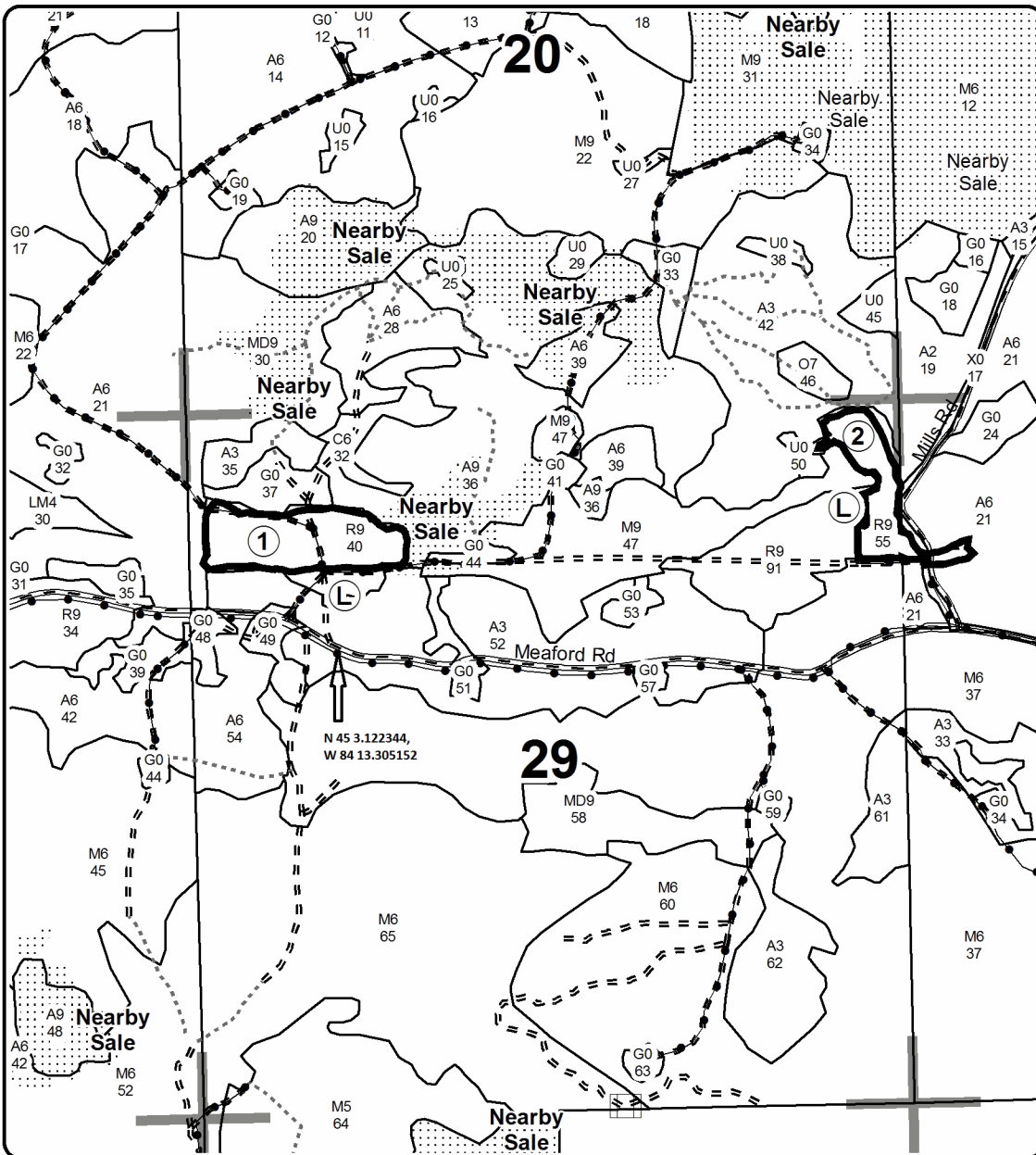
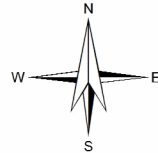

Legend

Sale Boundary

- Against State (Red)
- ⋯ Adjacent Timber Sale
- ▭ Adjacent Stand Boundaries
- Payment Unit Label
- Ⓛ Landing
- ▬ Section Corners
- Pipeline; Powerline
- ▬ Gravel Roads
- ▬ Poor Dirt Roads
- ⋯ Closed Roads

Locator Map
1:200,000

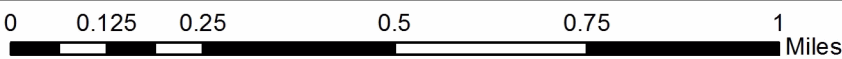
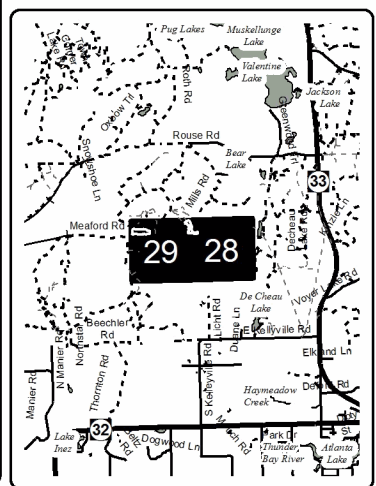

TIMBER SALE INFORMATION

Lil Hilly Mix (54-024-16)

Montmorency County (Advertised Price \$38,115.05)

A timber sale contract for this lump sum, sealed bid timber sale will be awarded to the responsible bidder offering the highest sealed bid price. Bids must be at or above the following advertised price for each species:

<u>PRODUCTS & SPECIES</u>	<u>ESTIMATED UNITS*</u>	<u>ADVERTISED PRICE</u>
Sawtimber		
B. T. Aspen	29.70 MBF	\$ 82.00 / MBF
Basswood	29.60 MBF	\$ 84.00 / MBF
Red Maple	2.90 MBF	\$ 131.00 / MBF
Red Oak	28.10 MBF	\$ 165.00 / MBF
Sugar Maple	11.10 MBF	\$ 418.00 / MBF
Pulpwood		
B. T. Aspen	536.00 Cords	\$ 21.30 / Cord
Basswood	130.00 Cords	\$ 14.60 / Cord
Beech	22.00 Cords	\$ 19.70 / Cord
Mixed Hardwood	341.00 Cords	\$ 19.70 / Cord
Paper Birch	25.00 Cords	\$ 22.90 / Cord
Red Oak	121.00 Cords	\$ 20.65 / Cord

* The total volume is statistically estimated within plus (+) or minus (-) 15.46 percent. The estimated units are final and not subject to adjustment. Prospective bidders are urged to examine this timber and to make their own estimates of quantity and quality.

BOND AND PAYMENT SCHEDULE:

1. A bond in the amount of \$1,906.00 to insure faithful performance of the conditions of the contract will be deposited by the successful bidder within 21 days of the sale award.
2. Cutting in any sale or unit without the required advance payment would be considered a trespass.
3. Total payment must be paid in advance or according to the following schedule:
 - (a) Ten percent (10%) of the sale value must be paid within 21 days of the sale award.
 - (b) The 10% down payment will be credited towards the first unit cut.
4. If no cutting takes place, the 10% down payment will not be refunded.
5. Operations on the contract issued will terminate on 12/31/2019.

Description of Timber by Payment Unit (PU)

PU	MARKET GROUP	PRODUCT	QUANTITY	UNIT	ACRES	ADVERTISE PRICE
1	Basswood	Sawtimber Pulpwood	25.6	MBF	24.5	\$12,613.90
	Red Oak		1.1	MBF		
	Sugar Maple		7.0	MBF		
	B. T. Aspen		103.0	Cords		
	Basswood		80.0	Cords		
	Beech		14.0	Cords		
	Mixed Hardwood		148.0	Cords		
	<i>Red Maple</i>		22.0	<i>Cords</i>		
	<i>Sugar Maple</i>		126.0	<i>Cords</i>		
	Paper Birch		8.0	Cords		
	Red Oak		30.0	Cords		
2	B. T. Aspen	Sawtimber Pulpwood	2.9	MBF	4.9	\$2,826.00
	Sugar Maple		0.7	MBF		
	B. T. Aspen		74.0	Cords		
	Basswood		5.0	Cords		
	Mixed Hardwood		27.0	Cords		
	<i>Sugar Maple</i>		27.0	<i>Cords</i>		
	Paper Birch		5.0	Cords		
3	B. T. Aspen	Sawtimber Pulpwood	18.1	MBF	25.9	\$15,355.90
	Basswood		2.7	MBF		
	Red Maple		2.0	MBF		
	Red Oak		18.3	MBF		
	Sugar Maple		2.3	MBF		
	B. T. Aspen		243.0	Cords		
	Basswood		30.0	Cords		
	Beech		5.0	Cords		
	Mixed Hardwood		113.0	Cords		
	<i>Red Maple</i>		76.0	<i>Cords</i>		
	<i>Sugar Maple</i>		37.0	<i>Cords</i>		
	Paper Birch		8.0	Cords		
	Red Oak		62.0	Cords		
4	B. T. Aspen	Sawtimber Pulpwood	8.7	MBF	12.4	\$7,319.25
	Basswood		1.3	MBF		
	Red Maple		0.9	MBF		
	Red Oak		8.7	MBF		
	Sugar Maple		1.1	MBF		
	B. T. Aspen		116.0	Cords		
	Basswood		15.0	Cords		
	Beech		3.0	Cords		
	Mixed Hardwood		53.0	Cords		
	<i>Red Maple</i>		36.0	<i>Cords</i>		
	<i>Sugar Maple</i>		17.0	<i>Cords</i>		
	Paper Birch		4.0	Cords		
	Red Oak		29.0	Cords		
	TOTAL:			101.4		
TOTAL:			1,175.0	Cords		

Sale Specific Conditions & Requirements

Sale Name: Lil Hilly Mix

Sale Number: 54-024-16 Seq#: 1

1 - Sale Area

1.2 - Boundaries

1.2.1 - Painted boundaries (1/14)

The sale and Payment Unit boundaries are marked and identified by red and green paint. Exterior sale boundary lines against State are marked with red paint. Interior Payment Unit boundaries are marked with green paint. The painted boundary line trees are not Included Timber and are to be protected. Green painted trees designating an interior Payment Unit boundary are only to be cut when all surrounding Payment Units have been paid.

2 - Timber Specifications

2.1 - Included Timber

2.1.1 - Clearcut unit(s) with unmerchantable trees (6/14)

Within Payment Unit(s) 1-4, cut all trees that are two (2) inches or more at DBH except, do not cut any red pine, white pine or trees marked with yellow paint above and below stump height within Payment Units 1, 3, and 4. Special protection trees identified in accordance with condition 3.4.2, within clearcutting unit boundaries, are not Included Timber and are to be protected.

2.2 - Utilization

2.2.5 - Limbed tree skidding (1/09)

The skidding of whole trees or tree segments with limbs attached is prohibited within Payment Units 1 and 3, unless approved by the Unit Manager or his/her representative. This is to protect side slopes and reduce erosion concerns within areas of hilly terrain.

3 - Payments

3.4 - Damaged Timber

3.4.1 - Damaged timber (6/14)

General Condition and Requirement 3.4 Damaged Timber, defines liquidated damages for undesignated live merchantable trees which are cut or injured.

No damage is acceptable to UNDESIGNATED trees. Within the sale area, if more than 5% of the trees (> 4.5" DBH) within a specified area of the sale are damaged, liquidated damages will be assessed for all trees damaged. Rates will be in accordance with General Condition and Requirement 3.4 Damaged Timber.

3.4.2 - Special Protection Trees (4/14)

The Purchaser shall not cut live or dead special protection trees within cutting units or clearings. Special protection trees are marked with yellow paint and greater than 26 inches in DBH. If the Purchaser's operations have cut or damaged special protection trees through carelessness, the Purchaser shall pay \$150 as fixed, agreed and liquidated damages for each special protection tree cut or damaged. Such payment does not constitute ownership of the undesignated timber.

4 - Transportation

4.1 - Construction

4.1.3 - Slash and earthen piles (8/04)

Piles or windrows of earth along roads and landings that have been widened or constructed shall be leveled. Slash from road maintenance or construction, including stumps, shall be chipped, utilized or otherwise removed from the sale.

4.1.5 - Culverts (5/14)

Access to Payment Unit 2 may require the installation of a culvert for an existing intermittent natural drainage-way. If a culvert is needed at the location shown on the Timber Sale Map, its placement will be specified by the sale administrator and it shall be installed prior to hauling. The culvert shall be new, corrugated metal or plastic gauge. The culvert will be a minimum

of 12 inches in diameter and 18 feet in length. If a culvert is needed/used, it will be removed after the unit is complete. Soils shall be maintained and left in a non-erodible condition, with water bars, seed, fertilizer, mulch, and slash installed as directed by the sale administrator and as specified in the BMP manual.

4.1.6 - Road construction (1/09)

Construction or improvements of existing roads shall be done in such a way as to minimize the environmental and visual impacts. Merchantable trees shall be cut and utilized unless otherwise directed. Non-merchantable trees shall be severed and laid flat on the ground. Slash shall be scattered, and not left in windrows and kept a minimum of 10 feet back from the road edge. Stumps shall be set upright, not left on edge, and be moved at least 10 feet away from the road edge. Disturbed soil shall be feathered into the woods and not left in berms or windrows. Re-opened and new skidding access routes near Payment Units 1 and 2 (as shown on map) will need to be designated/flagged in by the sale administrator before use begins.

4.1.7 - Road closure (10/11)

All new roads built into the sale must be blocked to vehicle traffic upon completion of the sale. Overgrown roads that are reopened shall be considered new roads. In general, this will require constructing a four (4') foot high berm of stumps and logs covered with earth. These roads must be rendered impassable to cars and trucks. Contact the sale administrator for specific details of design and placement.

4.2 - Maintenance

4.2.5 - Two wheel drive condition (2/04)

All existing trail roads on and adjacent to the sale area must be passable by two-wheel drive traffic for the duration of the sale.

5 - Operations

5.1 - Notification

5.1.1 - Pre-sale conference (10/11)

A pre-sale conference between the Purchaser and sale administrator is required prior to beginning any operations to determine landing and road locations. The Unit Manager or his/her representative must be contacted at least 10 days in advance to schedule the conference.

5.1.3 - Well heads and natural gas pipelines (11/15)

The Purchaser is responsible for contacting the Delta Oil Company prior to operating equipment in the vicinity of well heads or natural gas pipelines.

5.1.4 - Post-sale conference (6/11)

A post-sale conference on site between the Purchaser and sale administrator is required 5 days prior to the completion of active logging operations to determine clean-up and repair of landings, road edges, and the fulfillment of other contract specifications.

5.2 - Conduct of Operations

5.2.1 - Slash

5.2.1.10 - No slash in openings (5/10)

No brush or logging debris is to be left in the maintained wildlife openings which are indicated by G0 on the Timber Sale Map. Any damage to the opening shall be repaired according to specifications of the Unit Manager or his/her representative.

5.2.2 - Hazard Trees/Snags

5.2.2.1 - Den trees (2/04)

Obvious hollow and/or den trees shall be protected and left standing unless they are a safety hazard.

5.2.3 - Operating Restrictions

5.2.3.1 - Operating restrictions (9/11)

Within Payment Unit(s) 2, unless changed by written agreement, cutting, skidding, and hauling is limited to the period of July 1st - March 15th. This restriction is to prevent unnecessary compaction and rutting soil damage to the access route and adjacent hardwood stand.

5.2.3.11 - Coppice regeneration protection (4/10)

Timber harvesting in Payment Units 1-4 must be completed before significant deciduous seedling sprouting occurs so as to minimize damage to the new regeneration.

5.2.4 - Dead and Down Creation

5.2.4.4 - Dead and down creation, grouse (8/13)

To encourage grouse and other wildlife, in Payment Unit(s) 1-4, leave one, 12" diameter or larger log-length (8 foot minimum) piece on the ground for every 2 acres. These will be evenly scattered throughout the unit. This can be an unmerchantable piece or a full tree.

5.2.31 - Landing locations (9/13)

Landing areas are marked on the timber sale map with the letter "L". Landings must be confined to these designated sites unless otherwise authorized by the Unit Manager or his/her representative.

5.2.32 - Decking/landing restoration (9/13)

All decking and landing areas must have the surface area restored to a condition equal to or better than before. This is to ensure the proper regeneration of the stand. Wood debris, chips and "cookies" from trimmings must be removed or scattered away from landing and loading areas and may not be windrowed on the edge.

5.2.38 - No decking against live trees (2/04)

Cut products may not be decked against unmarked or designated leave trees.

5.4 - Soil Protection

5.4.1 - Rutting restriction, general (1/09)

Operations are to cease immediately if equipment and weather conditions result in rutting of roads and skid trails which is 12 inches or greater in depth and 50 feet in length. The Unit Manager or his/her representative may restrict hauling and/or skidding if ruts exceed the specified depth. With the Unit Manager or his/her representative's approval, the Purchaser may return to the area when the risk of rutting has decreased.

5.4.2 - Skid trails (2/04)

Skid trails up and down slopes should be avoided. If however this is unavoidable, these trails will be left in a non-erodible condition using water bars, logs, and slash. Placing of slash on these skid trails while logging is ongoing may alleviate need for any further action. At the direction of the sale administrator, seed, fertilizer, and mulch may also be required.

5.8 - Protection of Endangered Species

5.8.5 - Protection of raptor nests (3/13)

All trees with raptor nests will be protected if found during harvesting operations. Notification will be made to the Unit Manager or his/her representative who will notify the Wildlife Biologist so an on-site evaluation and recommendation can be made, if necessary.



TIMBER SALE MAP

This information provided by authority of Part 525, 1994 PA 451, as amended.

Sale Number	Year
54 - 024	16

Forest Management Unit	County	Mapped By	Date	Page	of
Atlanta Management Unit	Montmorency	D. Coy	06/17/2016	1	1
Township	Range	Section(s) and Subdivision(s)	Scale		
31N	02E	20- SENE, SWSE, & SW4 29- NWNE & N2NW	1:15,840		

Cover Type				Density				
A = Aspen	H = Hemlock	N = Marsh	U = Upland Brush	0 = Non Stocked	5 = Pole Timber Medium			
B = Paper Birch	J = Jack Pine	O = Oak	UM = Upland Mixed	1 = Seedling Sapling Poor	6 = Pole Timber Well			
C = Cedar	L = Lowland Brush	P = Lowland Poplar	V = Bog or Marsh	2 = Seedling Sapling Medium	7 = Saw Timber Poor			
D = Tread Bog	LM = Lowland Mixed	Q = Mixed Swamp Conifer	W = White Pine	3 = Seedling Sapling Well	8 = Saw Timber Medium			
E = Swamp Hdwoods	M = Mpl, Bch, Brch	R = Red Pine	X = Non Stocked	4 = Pole Timber Poor	9 = Saw Timber Well			
F = Spruce Fir	MC = Mixed Conifer	S = Black Spruce	Z = Water					
G = Grass	MD = Mixed Deciduous	T = Tamarack						

PU	Acres	PU	Acres
1	24.5	4	12.4
2	4.9		
3	25.9		

Lil Hilly Mix Compartment 43 67.7 Acres

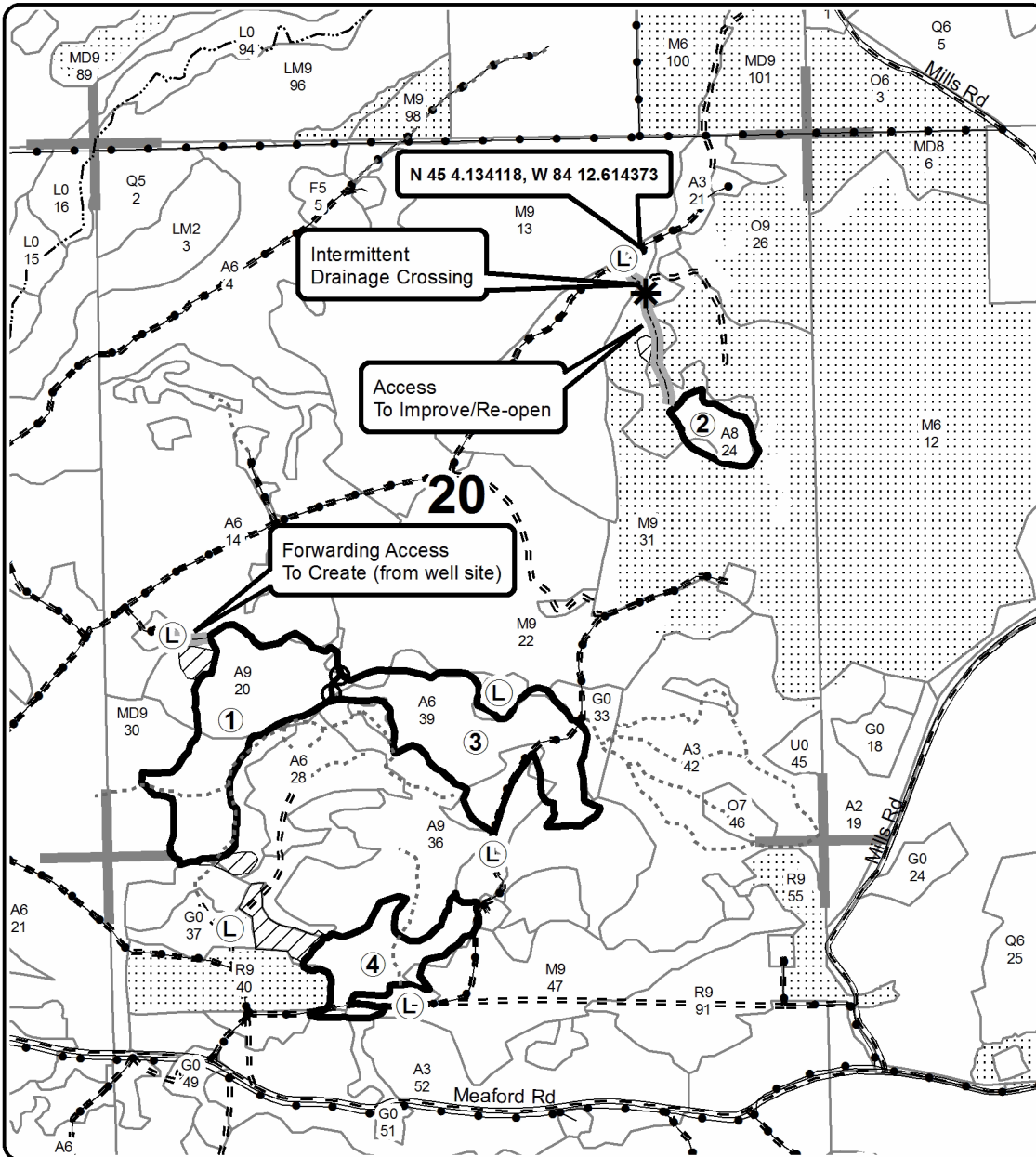
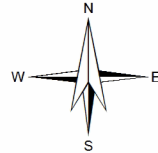

Legend

- Sale Boundary**
 - Against State (Red)
 - Payment Unit (Green)
- Adjacent Timber Sale (Dotted pattern)
- Adjacent Stand Boundaries (Thin solid line)
- Retention Area (Hatched pattern)
- Payment Unit (Circle with number)
- Landing (Circle with 'L')
- Existing Berm (Star symbol)
- Section Corners (Thick solid line)
- Pipeline; Powerline (Line with dots)
- Streams (Wavy line)
- Access Route (Dashed line)
- Gravel Roads (Thick solid line)
- Poor Dirt Roads (Thin solid line)
- Closed Roads (Dotted line)

Locator Map
1:200,000

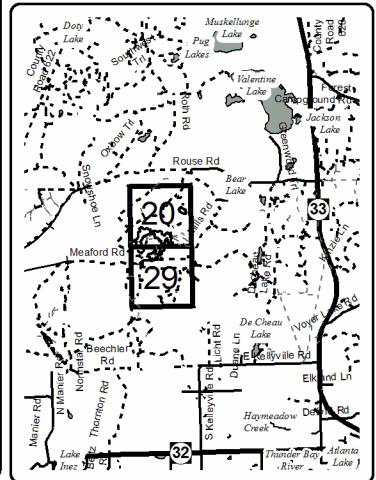

1 in 5 RP (54-023-16)
; Montmorency COUNTY

In response to the notice of sale to be held 10:00 a.m. (local time) on August 29, 2017, I am hereby submitting my sealed bid (firm offer) for the following forest products to be cut. Bids for individual species must be at or above the advertised price. All non-responsive bid forms may be rejected.

<u>PRODUCTS & SPECIES</u>	<u>ESTIMATED VOLUME*</u>	<u>ADVERTISED PRICE</u>	<u>BID PRICE</u>
Sawtimber			
Red Pine	27.30 MBF	\$ 119.00/MBF	\$ _____
Pulpwood			
Red Pine	262.00 Cords	\$ 46.70/Cord	\$ _____

*The volumes are statistically estimated within plus (+) or minus (-) 21.11 percent. These estimated volumes are final and not subject to adjustment. Prospective bidders are urged to examine this timber and to make their own estimates of quantity and quality.

I understand that any or all bids may be rejected. All bids must be signed and all bid items must be bid or the bid form may be rejected. I also understand that consideration and awarding a contract will be based upon my past performance and ability to complete the contract based upon equipment and staffing subject to my control.

FEDERAL ID: ____ - ____ - ____ or SOCIAL SECURITY NUMBER: ____ - ____ - ____

Company or individual bidding: _____

Company representative's name: _____

Address: _____

City: _____ State: _____ Zip: _____

IF AVAILABLE, PLEASE PLACE THE PERSONALIZED LABEL FROM YOUR PROSPECTUS IN THE ABOVE BOX.

Individual or company representative's signature: _____ Date: _____

Phone number : _____ Email (optional): _____

THE WINNING BIDDER MUST COMPLETE THE VERIFICATION OF WORKER'S DISABILITY COMPENSATION ACT COMPLIANCE (ON REVERSE SIDE IF DOUBLE SIDED) WITHIN 21 DAYS OF SALE AWARD DATE



FOR DEPARTMENT USE ONLY
Sale Number (XX - XXX - XX - XX)
Forest Management Unit:

TIMBER SALE VERIFICATION OF WORKER'S DISABILITY COMPENSATION ACT COMPLIANCE

*As required by Act 317, P.A. 1969 (Worker's Compensation) and
Part 5 of Act 451 of 1994, as amended.*

VERIFICATION OF WORKER'S DISABILITY COMPENSATION ACT COMPLIANCE

- This verification must be completed and submitted within 21 days of contract award and prior to the issuance of the timber sale contract.
- In addition, if boxes 2B or 2C are checked, then Notice of Exclusion or Certificate of Insurance must be submitted within twenty-one (21) days of the contract award and prior to the issuance of the timber sale contract.
- All information must be typed or printed except for written signatures.

Please Check Appropriate Categories:

1. My business is organized as (you **must** check one of the boxes below):
 - A. Sole Proprietorship (individual)
 - B. Partnership
 - C. Corporation

2. You **must** check one of the boxes below:
 - A. I certify my business is a sole proprietorship and it has no employees but the sole proprietor. I am not subject to the Worker's Compensation Laws.
 - B. I certify my business has satisfied its obligation to the Worker's Compensation Act through the use of an approved Notice of Exclusion (BWC-337, Rev. 5/96). I will provide a copy of the Notice of Exclusion within 21 days of the contract award. (For questions or a copy of the BWC-337, please call the Worker's Compensation Bureau at 517-322-1195).
 - C. I certify my business has a Worker's Compensation Policy. I will provide an original Certificate of Insurance within twenty-one (21) days of the contract award.

3. If you have checked item 2(A) or 2(B), you **must** indicate the number of **both** full-time and part-time employees, other than yourself, including family members and active partners (if none, you must enter "0").

_____ Full-time Employees

_____ Part-time Employees

Name of Business		Federal ID (or) Social Security No.	
Address		Telephone ()	
City	State	ZIP	

I hereby certify that the above information is true and correct. I agree to notify the Michigan DNR of any changes that occur in factors affecting my coverage during any of my present and future operations.

Signature of Owner or Authorized Representative

Title

Date

Please complete the "SEALED BID" information on the next page

Lil Hilly Mix (54-024-16)
 ; Montmorency COUNTY

In response to the notice of sale to be held 10:00 a.m. (local time) on August 29, 2017, I am hereby submitting my sealed bid (firm offer) for the following forest products to be cut. Bids for individual species must be at or above the advertised price. All non-responsive bid forms may be rejected.

<u>PRODUCTS & SPECIES</u>	<u>ESTIMATED VOLUME*</u>	<u>ADVERTISED PRICE</u>	<u>BID PRICE</u>
Sawtimber			
B. T. Aspen	29.70 MBF	\$ 82.00/MBF	\$ _____
Basswood	29.60 MBF	\$ 84.00/MBF	\$ _____
Red Maple	2.90 MBF	\$ 131.00/MBF	\$ _____
Red Oak	28.10 MBF	\$ 165.00/MBF	\$ _____
Sugar Maple	11.10 MBF	\$ 418.00/MBF	\$ _____
Pulpwood			
B. T. Aspen	536.00 Cords	\$ 21.30/Cord	\$ _____
Basswood	130.00 Cords	\$ 14.60/Cord	\$ _____
Beech	22.00 Cords	\$ 19.70/Cord	\$ _____
Mixed Hardwood	341.00 Cords	\$ 19.70/Cord	\$ _____
Paper Birch	25.00 Cords	\$ 22.90/Cord	\$ _____
Red Oak	121.00 Cords	\$ 20.65/Cord	\$ _____

*The volumes are statistically estimated within plus (+) or minus (-) 15.46 percent. These estimated volumes are final and not subject to adjustment. Prospective bidders are urged to examine this timber and to make their own estimates of quantity and quality.

I understand that any or all bids may be rejected. All bids must be signed and all bid items must be bid or the bid form may be rejected. I also understand that consideration and awarding a contract will be based upon my past performance and ability to complete the contract based upon equipment and staffing subject to my control.

FEDERAL ID: _____ or SOCIAL SECURITY NUMBER: _____

Company or individual bidding: _____

Company representative's name: _____

Address: _____

City: _____ State: _____ Zip: _____

IF AVAILABLE, PLEASE PLACE THE PERSONALIZED LABEL FROM YOUR PROSPECTUS IN THE ABOVE BOX.

Individual or company representative's signature: _____ Date: _____

Phone number : _____ Email (optional): _____

THE WINNING BIDDER MUST COMPLETE THE VERIFICATION OF WORKER'S DISABILITY COMPENSATION ACT COMPLIANCE (ON REVERSE SIDE IF DOUBLE SIDED) WITHIN 21 DAYS OF SALE AWARD DATE



FOR DEPARTMENT USE ONLY
Sale Number (XX - XXX - XX - XX)
Forest Management Unit:

TIMBER SALE VERIFICATION OF WORKER'S DISABILITY COMPENSATION ACT COMPLIANCE

*As required by Act 317, P.A. 1969 (Worker's Compensation) and
Part 5 of Act 451 of 1994, as amended.*

VERIFICATION OF WORKER'S DISABILITY COMPENSATION ACT COMPLIANCE

- This verification must be completed and submitted within 21 days of contract award and prior to the issuance of the timber sale contract.
- In addition, if boxes 2B or 2C are checked, then Notice of Exclusion or Certificate of Insurance must be submitted within twenty-one (21) days of the contract award and prior to the issuance of the timber sale contract.
- All information must be typed or printed except for written signatures.

Please Check Appropriate Categories:

1. My business is organized as (you **must** check one of the boxes below):
 - A. Sole Proprietorship (individual)
 - B. Partnership
 - C. Corporation
2. You **must** check one of the boxes below:
 - A. I certify my business is a sole proprietorship and it has no employees but the sole proprietor. I am not subject to the Worker's Compensation Laws.
 - B. I certify my business has satisfied its obligation to the Worker's Compensation Act through the use of an approved Notice of Exclusion (BWC-337, Rev. 5/96). I will provide a copy of the Notice of Exclusion within 21 days of the contract award. (For questions or a copy of the BWC-337, please call the Worker's Compensation Bureau at 517-322-1195).
 - C. I certify my business has a Worker's Compensation Policy. I will provide an original Certificate of Insurance within twenty-one (21) days of the contract award.
3. If you have checked item 2(A) or 2(B), you **must** indicate the number of **both** full-time and part-time employees, other than yourself, including family members and active partners (if none, you must enter "0").

_____ Full-time Employees

_____ Part-time Employees

Name of Business		Federal ID (or) Social Security No.	
Address		Telephone ()	
City	State	ZIP	

I hereby certify that the above information is true and correct. I agree to notify the Michigan DNR of any changes that occur in factors affecting my coverage during any of my present and future operations.

Signature of Owner or Authorized Representative

Title

Date

Please complete the "SEALED BID" information on the next page

Rollin Roloids Mix (54-012-16)
; Montmorency COUNTY

In response to the notice of sale to be held 10:00 a.m. (local time) on August 29, 2017, I am hereby submitting my sealed bid (firm offer) for the following forest products to be cut. Bids for individual species must be at or above the advertised price. All non-responsive bid forms may be rejected.

<u>PRODUCTS & SPECIES</u>	<u>ESTIMATED VOLUME*</u>	<u>ADVERTISED PRICE</u>	<u>BID PRICE</u>
Sawtimber			
Basswood	260.90 MBF	\$ 84.00/MBF	\$ _____
Beech	98.90 MBF	\$ 79.00/MBF	\$ _____
Mixed Aspen	107.60 MBF	\$ 82.00/MBF	\$ _____
Red Oak	280.40 MBF	\$ 165.00/MBF	\$ _____
Sugar Maple	145.50 MBF	\$ 418.00/MBF	\$ _____
Pulpwood			
Basswood	648.00 Cords	\$ 14.60/Cord	\$ _____
Beech	503.00 Cords	\$ 19.70/Cord	\$ _____
Misc. Species 1	868.00 Cords	\$ 4.45/Cord	\$ _____
Mixed Aspen	156.00 Cords	\$ 21.30/Cord	\$ _____
Mixed Hardwood	1,389.00 Cords	\$ 19.70/Cord	\$ _____
Red Oak	436.00 Cords	\$ 20.65/Cord	\$ _____
Red Pine	5.00 Cords	\$ 50.00/Cord	\$ _____
White Ash	23.00 Cords	\$ 19.70/Cord	\$ _____

*The volumes are statistically estimated within plus (+) or minus (-) 8.15 percent. These estimated volumes are final and not subject to adjustment. Prospective bidders are urged to examine this timber and to make their own estimates of quantity and quality.

I understand that any or all bids may be rejected. All bids must be signed and all bid items must be bid or the bid form may be rejected. I also understand that consideration and awarding a contract will be based upon my past performance and ability to complete the contract based upon equipment and staffing subject to my control.

FEDERAL ID: _____ or SOCIAL SECURITY NUMBER: _____

Company or individual bidding: _____

Company representative's name: _____

Address: _____

City: _____ State: _____ Zip: _____

IF AVAILABLE, PLEASE PLACE THE PERSONALIZED LABEL FROM YOUR PROSPECTUS IN THE ABOVE BOX.

Individual or company representative's signature: _____ Date: _____

Phone number : _____ Email (optional): _____

THE WINNING BIDDER MUST COMPLETE THE VERIFICATION OF WORKER'S DISABILITY COMPENSATION ACT COMPLIANCE (ON REVERSE SIDE IF DOUBLE SIDED) WITHIN 21 DAYS OF SALE AWARD DATE



FOR DEPARTMENT USE ONLY	
Sale Number (XX - XXX - XX - XX)	
Forest Management Unit:	

TIMBER SALE VERIFICATION OF WORKER'S DISABILITY COMPENSATION ACT COMPLIANCE

As required by Act 317, P.A. 1969 (Worker's Compensation) and
Part 5 of Act 451 of 1994, as amended.

VERIFICATION OF WORKER'S DISABILITY COMPENSATION ACT COMPLIANCE

- This verification must be completed and submitted within 21 days of contract award and prior to the issuance of the timber sale contract.
- In addition, if boxes 2B or 2C are checked, then Notice of Exclusion or Certificate of Insurance must be submitted within twenty-one (21) days of the contract award and prior to the issuance of the timber sale contract.
- All information must be typed or printed except for written signatures.

Please Check Appropriate Categories:

1. My business is organized as (you **must** check one of the boxes below):
 - A. Sole Proprietorship (individual)
 - B. Partnership
 - C. Corporation
2. You **must** check one of the boxes below:
 - A. I certify my business is a sole proprietorship and it has no employees but the sole proprietor. I am not subject to the Worker's Compensation Laws.
 - B. I certify my business has satisfied its obligation to the Worker's Compensation Act through the use of an approved Notice of Exclusion (BWC-337, Rev. 5/96). I will provide a copy of the Notice of Exclusion within 21 days of the contract award. (For questions or a copy of the BWC-337, please call the Worker's Compensation Bureau at 517-322-1195).
 - C. I certify my business has a Worker's Compensation Policy. I will provide an original Certificate of Insurance within twenty-one (21) days of the contract award.
3. If you have checked item 2(A) or 2(B), you **must** indicate the number of **both** full-time and part-time employees, other than yourself, including family members and active partners (if none, you must enter "0").

_____ Full-time Employees

_____ Part-time Employees

Name of Business		Federal ID (or) Social Security No.	
Address		Telephone ()	
City	State	ZIP	

I hereby certify that the above information is true and correct. I agree to notify the Michigan DNR of any changes that occur in factors affecting my coverage during any of my present and future operations.

Signature of Owner or Authorized Representative

Title

Date

Please complete the "SEALED BID" information on the next page

Hardwood Hill Country Mix (54-011-16)
 ; Montmorency COUNTY

In response to the notice of sale to be held 10:00 a.m. (local time) on August 29, 2017, I am hereby submitting my sealed bid (firm offer) for the following forest products to be cut. Bids for individual species must be at or above the advertised price. All non-responsive bid forms may be rejected.

<u>PRODUCTS & SPECIES</u>	<u>ESTIMATED VOLUME*</u>	<u>ADVERTISED PRICE</u>	<u>BID PRICE</u>
Sawtimber			
B. T. Aspen	4.60 MBF	\$ 82.00/MBF	\$ _____
Basswood	87.50 MBF	\$ 84.00/MBF	\$ _____
Beech	14.20 MBF	\$ 79.00/MBF	\$ _____
Paper Birch	8.10 MBF	\$ 58.00/MBF	\$ _____
Red Maple	44.20 MBF	\$ 131.00/MBF	\$ _____
Red Oak	290.20 MBF	\$ 165.00/MBF	\$ _____
Sugar Maple	55.10 MBF	\$ 418.00/MBF	\$ _____
White Ash	149.30 MBF	\$ 79.00/MBF	\$ _____
White Pine	1.30 MBF	\$ 81.00/MBF	\$ _____
Pulpwood			
B. T. Aspen	4.00 Cords	\$ 21.30/Cord	\$ _____
Basswood	195.00 Cords	\$ 14.60/Cord	\$ _____
Misc. Species 1	438.00 Cords	\$ 4.40/Cord	\$ _____
Mixed Hardwood	821.00 Cords	\$ 19.70/Cord	\$ _____
Paper Birch	62.00 Cords	\$ 22.90/Cord	\$ _____
Red Oak	520.00 Cords	\$ 20.65/Cord	\$ _____
White Ash	245.00 Cords	\$ 19.70/Cord	\$ _____
White Pine	4.00 Cords	\$ 38.30/Cord	\$ _____

*The volumes are statistically estimated within plus (+) or minus (-) 9.87 percent. These estimated volumes are final and not subject to adjustment. Prospective bidders are urged to examine this timber and to make their own estimates of quantity and quality.

I understand that any or all bids may be rejected. All bids must be signed and all bid items must be bid or the bid form may be rejected. I also understand that consideration and awarding a contract will be based upon my past performance and ability to complete the contract based upon equipment and staffing subject to my control.

FEDERAL ID: _____ or SOCIAL SECURITY NUMBER: _____

Company or individual bidding: _____

Company representative's name: _____

Address: _____

City: _____ State: _____ Zip: _____

IF AVAILABLE, PLEASE PLACE THE PERSONALIZED LABEL FROM YOUR PROSPECTUS IN THE ABOVE BOX.

Individual or company representative's signature: _____ Date: _____

Phone number : _____ Email (optional): _____

THE WINNING BIDDER MUST COMPLETE THE VERIFICATION OF WORKER'S DISABILITY COMPENSATION ACT COMPLIANCE (ON REVERSE SIDE IF DOUBLE SIDED) WITHIN 21 DAYS OF SALE AWARD DATE



FOR DEPARTMENT USE ONLY
Sale Number (XX - XXX - XX - XX)
Forest Management Unit:

TIMBER SALE VERIFICATION OF WORKER'S DISABILITY COMPENSATION ACT COMPLIANCE

*As required by Act 317, P.A. 1969 (Worker's Compensation) and
Part 5 of Act 451 of 1994, as amended.*

VERIFICATION OF WORKER'S DISABILITY COMPENSATION ACT COMPLIANCE

- This verification must be completed and submitted within 21 days of contract award and prior to the issuance of the timber sale contract.
- In addition, if boxes 2B or 2C are checked, then Notice of Exclusion or Certificate of Insurance must be submitted within twenty-one (21) days of the contract award and prior to the issuance of the timber sale contract.
- All information must be typed or printed except for written signatures.

Please Check Appropriate Categories:

1. My business is organized as (you **must** check one of the boxes below):
 - A. Sole Proprietorship (individual)
 - B. Partnership
 - C. Corporation

2. You **must** check one of the boxes below:
 - A. I certify my business is a sole proprietorship and it has no employees but the sole proprietor. I am not subject to the Worker's Compensation Laws.
 - B. I certify my business has satisfied its obligation to the Worker's Compensation Act through the use of an approved Notice of Exclusion (BWC-337, Rev. 5/96). I will provide a copy of the Notice of Exclusion within 21 days of the contract award. (For questions or a copy of the BWC-337, please call the Worker's Compensation Bureau at 517-322-1195).
 - C. I certify my business has a Worker's Compensation Policy. I will provide an original Certificate of Insurance within twenty-one (21) days of the contract award.

3. If you have checked item 2(A) or 2(B), you **must** indicate the number of **both** full-time and part-time employees, other than yourself, including family members and active partners (if none, you must enter "0").

_____ Full-time Employees

_____ Part-time Employees

Name of Business		Federal ID (or) Social Security No.	
Address		Telephone ()	
City	State	ZIP	

I hereby certify that the above information is true and correct. I agree to notify the Michigan DNR of any changes that occur in factors affecting my coverage during any of my present and future operations.

Signature of Owner or Authorized Representative

Title

Date

Please complete the "SEALED BID" information on the next page