



**DEPARTMENT OF NATURAL RESOURCES  
STATE OF MICHIGAN**

**TIMBER SALE PROSPECTUS #6000**

SCHEDULED SALE DATE AND TIME: 3:00 p.m. (local time) on August 29, 2017.

LOCATION: ESCANABA OFFICE, 6833 HWY 2, 41 & M-35, GLADSTONE, MI 49837.

PROSPECTUS NOTE: The bidder is advised to inspect the sale area and review the location, estimated volumes, operating costs and contract terms of proposed sales. Please be aware that some landowners may request 60 days or more notice for access across their land.

Notice is hereby given that bids will be received by the Unit Manager, ESCANABA MANAGEMENT UNIT, for certain timber on the following described lands:

Broken Chimney (33-005-17)

Delta County, Advertised Price \$136,321.10, 158.0 Acres, Aspen, Hardwood.

SALE NOTE: Units 1, 2, 3, 4, 7 and 8 are restricted to winter operations only.

TWO TECHNICIANS (33-006-17)

Delta County, Advertised Price \$46,729.55, 38.7 Acres, Aspen, Hardwood.

Dry Creek SBW (33-030-17)

Menominee County, Advertised Price \$70,125.50, 82.9 Acres, Hardwood, N White Cedar.

SALE NOTE: Payment Units 2-6 will be accessed through private property. It is the responsibility of the purchaser to obtain written permission, which must include access for the DNR. Spruce budworm is present within the sale area, but at this time no mortality has occurred.

Access may be through private land.

Berg Farm ELB (33-031-17)

Menominee County, Advertised Price \$69,128.45, 110.5 Acres, N White Cedar, Spruce/Fir/Tamarack.

SALE NOTE: All payment units can be accessed through state land, but the best access into payment units 1-6 is through private property. The purchaser is responsible for obtaining written permission, which must include access for the DNR. The eastern larch beetle has caused significant mortality within payment unit 2, with some of the other payment units having some small pockets of mortality.

Access may be through private land.

Westman Pit (33-032-17)

Menominee County, Advertised Price \$71,831.20, 73.3 Acres, Aspen, Hardwood.

SALE NOTE: Payment Units 1 and 2 will be accessed off of County Road 366 and Payment Units 3 - 6 will be accessed off of the Westman Dam Road.

## BID INSTRUCTIONS (VER. 09/02/2016):

### 1. Scheduled Bid Location, Date, and Time (2/11)

Bids must be received by the Unit Manager, ESCANABA OFFICE, 6833 HWY 2, 41 & M-35, GLADSTONE, MI 49837, no later than 3:00 p.m. (local time) on August 29, 2017. For further information concerning this sale, contact Eric Thompson at 906-786-2354.

### 2. Bidder's Qualifications (5/16)

Purchaser shall obtain workers compensation insurance to cover claims under Michigan's Worker's Disability Compensation Act of 1969 or similar employee benefit act of any other state applicable to an employee. If all or part of a timber sale was prepared by a private contractor, the contractor and that contractor's company are not permitted to bid on the timber sale contract. Bids will not be accepted from individuals or companies appearing on the DNR/FRD No-Bid List. This list contains the names of purchasers who previously failed to execute a contract within 21-days or who have a history of poor performance.

### 3. Preparation of Sealed Bids (5/16)

Bid Forms may be completed online thru Michigan DNR Timber Sale Online Bidding (OLB) at [www.michigan.gov/timberbidding](http://www.michigan.gov/timberbidding) or by completing the hardcopy Bid Form found in the Timber Sale Prospectus. Hardcopy Bid Forms shall be manually signed in ink. Registration in OLB is considered your 'signature' for all bids submitted thru that system. Bid prices must be entered for each species and product in the Bid Price column for all material subject to bidding and all fill-in blanks must be completed. If erasures or other changes appear on the hardcopy Bid Form, each erasure or change must be initialed by the person signing the bid.

### 4. Submission of Sealed Bids (5/16)

Bid forms may be obtained from the Unit Manager or thru OLB. Bids may be submitted hardcopy or thru OLB. All hardcopy bids must be submitted on the bid form and in an envelope clearly identified as described in this section. NOTE: Only one bid form per bid envelope. Sealed bids must be submitted to the Unit office designated in the prospectus and must be submitted at or prior to the time established in the prospectus. The envelope should show on the outside (a) the sale name or number and (b) the date and time of bid opening, as shown in the prospectus. Bids received after the time specified in the sale prospectus are late bids and will be rejected.

It is possible for a bidder to submit multiple bids on a single sale. For example, a bid may be submitted hardcopy and a bid may be submitted thru OLB. Or, two bidders from the same company could both submit bids on the same sale. If this were to happen, the State would accept all bids received and award the contract accordingly. All bidding and contractual requirements would apply to all bids received.

### 5. Public Opening of Sealed Bids (7/16)

If conditions permit, the sealed bids will be publicly opened and posted at the time and place set in the prospectus.

If a bidder, present at a bid opening, has submitted bids on more than one sale, that bidder may withdraw their unopened bid envelopes or announce the withdrawal of their online bid after being declared the successful bidder on one sale.

### 6. Award of Contract (1/11)

Award of the contract will be made to the Bidder whose bid, conforming to the prospectus, is most advantageous to the State of Michigan on the basis of total value at rates bid for the estimated quantities. The State reserves the right to reject any bid or waive any minor irregularity in bids received. A written award mailed (or otherwise furnished) to the successful Bidder shall be deemed to result in a binding contract without further action by either party.

### 7. Down Payment (1/11)

The Bidder to whom award is made must make a down payment within 21 days of the sale award. The amount of the down payment will be calculated as shown in the Bond and Payment Schedule of this prospectus. Only cash may be used to meet this requirement.

### 8. Performance Security (1/11)

As guarantee of faithful performance, a cash bond, certificate of deposit, surety bond or irrevocable letter of credit (LOC) is required within 21 days of the sale award. The amount of the performance security is shown in the Bond and

Payment Schedule of this prospectus. If an LOC or surety is used, the coverage must extend for at least 6 months beyond the contract expiration.

#### 9. Timber Sale Contract (9/14)

Additional conditions and requirements common to all timber sales are listed on the timber sale contract (R4031) and are available on line at [www.michigan.gov/timber](http://www.michigan.gov/timber). Contact the Unit Manager for additional information or a sample contract. Within 21 days of the date of the award letter, the bidder must sign the contract and provide the required down payment, performance security, and verification of worker's disability compensation. The down payment and performance security shall be in accordance with the provisions of the timber sale contract, in the sums stated in this prospectus. If these actions are not taken, then the Bidder, the Bidder's corporation, and the corporation's principals may not be permitted to bid on State timber sales for a period of 1 year. In addition, the Bidder certifies that if awarded this contract, the Bidder will complete the timber sale contract in accordance with its terms and any modifications thereof including requirements to purchase, cut, and remove the included timber by the expiration date.

#### 10. Disclaimer of Estimates and Bidder's Warranty of Inspection (7/16)

Before submitting this bid, the Bidder is advised and cautioned to inspect the sale area, review the requirements of the sale contract, and take other steps as may be reasonably necessary to ascertain the location, estimated volumes, construction estimates, and operating costs of the proposed sale. Failure to do so will not relieve the Bidder from responsibility for completing the contract.

The Bidder warrants that this bid is submitted solely on the basis of the Bidder's examination and inspection of the quality and quantity of the timber offered for sale and the Bidder's opinion of the value thereof and the costs of recovery. No reliance should be placed on the State of Michigan's estimates of timber quality, quantity or costs of recovery. Bidder further acknowledges that the State of Michigan: (i) expressly disclaims any warranty of fitness of timber for any purpose; (ii) offers this timber as is without any warranty of quality (merchantability) or quantity and (iii) expressly disclaims any warranty as to the quantity or quality of timber sold.

#### 11. Certification and Chain-of-Custody (10/14)

Unless otherwise indicated in the contract under section 7 – Other Conditions of the Sale Specific Conditions & Requirements, the area encompassed by this timber sale is certified to the standards of the Forest Stewardship Council (FSC) - Certificate #SCS-FM/COC-00090N and the Sustainable Forestry Initiative (SFI) - Certificate #NSF-SFIS-5Y031-SF5. Forest products from this sale may be delivered to the mill as "FSC 100% and / or SFI certified" as long as the contractor hauling the forest products is chain-of-custody (COC) certified or covered under a COC certificate from the destination mill. The purchaser is responsible for maintaining COC after leaving the sale area.

#### 12. Good Neighbor Authority (GNA) Requirements (7/16)

If the name of this timber sales contains the acronym GNA, it is authorized by the Good Neighbor Authority (GNA) and covered by various agreements between the U.S. Forest Service and the State. The timber sale occurs on federal land and the following conditions apply:

GNA contracts on US Forest Service land will not be awarded to purchasers on the Federal list of excluded parties. The System for Award Management (SAM) will be checked for active excluded parties prior to award of contract. In addition, the Bidder to whom award is made must complete an Assurance Regarding Felony Conviction or Tax Delinquent Status for Corporate Applicants (AD-3031).

#### 13. Good Neighbor Authority (GNA) Requirements, con't (9/16)

Bidder certifies, by signing this bid form, that to the best of Bidder's knowledge that the following representations are accurate and complete.

- a. That the Bidder and its principals are not presently debarred, suspended, proposed for debarment, declared ineligible, or voluntary excluded from timber sales (covered transactions) by any Federal department or agency.
- b. That the Bidder and its principals have not within a 3-year period preceding this bid been convicted of or had a civil judgment rendered against them for commission of fraud or a criminal offense in connection with obtaining, attempting to obtain, or performing a public (Federal, State, or local) transaction or contract under a public transaction; violation of Federal or State antitrust statutes or commission of embezzlement, theft, forgery, bribery, falsification or destruction of records, making false statements, or receiving stolen property.

c. That the Bidder and its principals are not presently indicted for or otherwise criminally or civilly charged by a governmental entity (Federal, State, or local) with commission of any of the offenses enumerated in paragraph b of this certification.

d. That the Bidder and its principals have not within a 3-year period preceding this bid had one or more public transactions (Federal, State, or local) terminated for breach or default of a timber or forest product contract.

Bidders that cannot certify this requirement, in whole or in part, shall submit an explanation with their bid.

KEITH CREAGH

Director

# TIMBER SALE INFORMATION

## Broken Chimney (33-005-17)

Delta County (Advertised Price \$136,321.10)

SALE NOTE: Units 1, 2, 3, 4, 7 and 8 are restricted to winter operations only.

A timber sale contract for this lump sum, sealed bid timber sale will be awarded to the responsible bidder offering the highest sealed bid price. Bids must be at or above the following advertised price for each species:

<u>PRODUCTS &amp; SPECIES</u>	<u>ESTIMATED UNITS*</u>	<u>ADVERTISED PRICE</u>
Sawtimber		
Black Ash	3.00 MBF	\$ 94.00 / MBF
Paper Birch	1.10 MBF	\$ 84.00 / MBF
Red Maple	35.30 MBF	\$ 243.00 / MBF
Sugar Maple	22.70 MBF	\$ 373.00 / MBF
White Ash	1.10 MBF	\$ 71.00 / MBF
Yellow Birch	5.70 MBF	\$ 122.00 / MBF
Pulpwood		
Balsam Fir	212.00 Cords	\$ 27.75 / Cord
Mixed Hardwood	991.00 Cords	\$ 35.30 / Cord
Mixed Spruce	62.00 Cords	\$ 25.90 / Cord
N. White Cedar	150.00 Cords	\$ 27.85 / Cord
Quaking Aspen	2,153.00 Cords	\$ 33.20 / Cord

\* The total volume is statistically estimated within plus (+) or minus (-) 8.46 percent. The estimated units are final and not subject to adjustment. Prospective bidders are urged to examine this timber and to make their own estimates of quantity and quality.

### **BOND AND PAYMENT SCHEDULE:**

1. A bond in the amount of \$6,816.00 to insure faithful performance of the conditions of the contract will be deposited by the successful bidder within 21 days of the sale award.
2. Cutting in any sale or unit without the required advance payment would be considered a trespass.
3. Total payment must be paid in advance or according to the following schedule:
  - (a) Ten percent (10%) of the sale value must be paid within 21 days of the sale award.
  - (b) The 10% down payment will be credited towards the first unit cut.
4. If no cutting takes place, the 10% down payment will not be refunded.
5. Operations on the contract issued will terminate on 09/30/2020.



**Description of Timber by Payment Unit (PU), con't**

PU	MARKET GROUP	PRODUCT	QUANTITY	UNIT	ACRES	ADVERTISE PRICE
6 con't	<i>Red Maple</i>	<i>Pulpwood</i>	68.0	<i>Cords</i>		
	<i>Sugar Maple</i>		44.0	<i>Cords</i>		
	Mixed Spruce		10.0	Cords		
	<i>White Spruce</i>		10.0	<i>Cords</i>		
7	Black Ash	Sawtimber	0.6	MBF	18.7	\$8,740.70
	Paper Birch		0.6	MBF		
	Balsam Fir	Pulpwood	66.0	Cords		
	Mixed Hardwood		108.0	Cords		
	<i>Balsam Poplar</i>		4.0	<i>Cords</i>		
	<i>Black Ash</i>		15.0	<i>Cords</i>		
	<i>Paper Birch</i>		89.0	<i>Cords</i>		
	Mixed Spruce		31.0	Cords		
	<i>Black Spruce</i>		22.0	<i>Cords</i>		
	<i>White Spruce</i>		9.0	<i>Cords</i>		
	N. White Cedar		38.0	Cords		
	Quaking Aspen		34.0	Cords		
	8		Paper Birch	Sawtimber		
Red Maple		0.5	MBF			
Balsam Fir		Pulpwood	24.0	Cords		
Mixed Hardwood			123.0	Cords		
<i>Balsam Poplar</i>			8.0	<i>Cords</i>		
<i>Black Ash</i>			63.0	<i>Cords</i>		
<i>Paper Birch</i>			15.0	<i>Cords</i>		
<i>Red Maple</i>			22.0	<i>Cords</i>		
<i>Yellow Birch</i>			15.0	<i>Cords</i>		
Mixed Spruce			7.0	Cords		
<i>White Spruce</i>			7.0	<i>Cords</i>		
N. White Cedar			63.0	Cords		
TOTAL:			68.9	MBF		
TOTAL:			3,568.0	Cords		

## Sale Specific Conditions & Requirements

**Sale Name: Broken Chimney**

**Sale Number: 33-005-17 Seq#: 1**

### 1 - Sale Area

#### 1.2 - Boundaries

##### 1.2.1 - Painted boundaries (1/14)

The sale boundary and Payment Unit boundaries are marked and identified by blue, red and yellow paint, along with a county road. Exterior sale boundary lines against private property are marked with blue paint. Exterior sale boundary lines against state are marked with red paint, with the exception of the east side of Payment Unit 8, which is identified by the County Road 432 ROW. Interior Payment Unit boundaries are marked with yellow paint. Retention areas are bounded by red painted X marks; do not cut or damage any trees within these areas. The painted boundary line trees are not Included Timber and are to be protected unless marked with orange paint. Yellow painted trees designating an interior Payment Unit boundary are only to be cut when all surrounding Payment Units have been paid.

### 2 - Timber Specifications

#### 2.1 - Included Timber

##### 2.1.1 - Clearcut unit(s) with unmerchantable trees (6/14)

Within Payment Unit(s) 1, 2, 3 and 4, cut all trees that are three (3) inches or more at DBH

##### 2.1.2 - Clearcut unit(s) w/o unmerchantable trees (8/11)

Within Payment Unit(s) 7 and 8, cut all trees which meet minimum piece specifications in 2.2 Utilization with 2 or more pulpwood sticks.

##### 2.1.3 - Cut tree marked unit(s) (12/08)

Within Payment Unit(s) 5, all trees are designated for cutting when marked with orange paint above and below stump height, regardless of merchantability.

##### 2.1.7 - Leave tree marked unit(s) (6/14)

Within Payment Unit(s) 6, all trees, which meet minimum piece specifications in 2.2 Utilization, are designated for cutting except do not cut any cedar, yellow birch and trees marked with green paint above and below stump height.

#### 2.2 - Utilization

##### 2.2.9 - No chipping permitted (12/08)

Within Payment Unit(s) 1, 2, 3, 4 and 7, tops may not be chipped. The reason for this specification is to protect and enhance wildlife values.

### 3 - Payments

#### 3.3 - Pre-measured Sales

##### 3.3.4 - Dividing payment units (7/14)

Payment Unit(s) with a bid value of \$15,000 dollars and greater may be divided at the request of the Purchaser and upon approval of the Unit Manager. Dividing Payment Units is a contract modification which requires a Timber Sale Contract Supplement. There will be only one division per Payment Unit.

### 4 - Transportation

#### 4.1 - Construction

##### 4.1.6 - Road construction (1/09)

Construction of new roads or improvements of existing roads shall be done in such a way as to minimize the environmental and visual impacts. Merchantable trees shall be cut and utilized unless otherwise directed. Non-merchantable trees shall be severed and laid flat on the ground. Slash shall be scattered, and not left in windrows and kept a minimum of 10 feet back from the road edge. Stumps shall be set upright, not left on edge, and be moved at least 10 feet away from the road edge. Disturbed soil shall be feathered into the woods and not left in berms or windrows.



#### 4.1.7 - Road closure (10/11)

All new roads built into the sale must be blocked to vehicle traffic upon completion of the sale. Overgrown roads that are reopened shall be considered new roads. In general, this will require constructing a four (4') foot high berm of stumps and logs covered with earth. Contact the sale administrator for specific details of design and placement.

### 4.2 - Maintenance

#### 4.2.1 - Hauling restriction (12/08)

Hauling may be restricted on forest roads by the Unit Manager or his/her representative. The restriction may occur during spring breakup.

#### 4.2.2 - Fill material (4/07)

To maintain roads, fill material may be needed in areas where "holes" exist or may be expected to develop. This fill material should be placed before trucking begins. Contact the sale administrator regarding the availability of onsite sand or gravel from adjacent State-owned lands.

#### 4.2.4 - Grading (10/16)

For completion of the sale, state forest roads must be graded. In general, this will require a road grader or bull dozer to shape up the roads after forest products have been hauled off site. This includes cleaning of drainage areas, grading, crowning and filling with gravel, if necessary. The grading equipment to be used must be approved by the Unit Manager or his/her representative.

## 5 - Operations

### 5.2 - Conduct of Operations

#### 5.2.3 - Operating Restrictions

##### 5.2.3.1 - Operating restrictions (9/11)

Within Payment Unit(s) 1, 2, 3, 4, 7 and 8, unless changed by written agreement, cutting, skidding, and hauling are limited to the period of 12/01 to 03/31. This restriction is for wildlife benefits within Payment Units 1, 2, 3 and 4, and the low and wet nature of Payment Units 7 and 8.

##### 5.2.3.3 - Bark slippage restriction (3/09)

Within Payment Unit(s) 6, unless changed by written agreement, cutting and skidding are not permitted during the period of April 15 to July 15. This restriction is because of bark slippage.

#### 5.2.37 - No decking areas (12/08)

No decking is allowed within 50 feet of County Road 432 without permission of the Delta County Road Commission.

### 5.4 - Soil Protection

#### 5.4.1 - Rutting restriction, general (7/16)

Operations are to cease immediately if equipment and weather conditions result in rutting of roads and/or skid trails which is 12 inches or greater in depth and 50 feet in length. The Unit Manager or his/her representative may restrict hauling and/or skidding if ruts exceed the specified depth. With the Unit Manager or his/her representative's approval, the Purchaser may return to the area when the risk of rutting has decreased.

## 6 - Safety and Fire Prevention

### 6.2 - Signing

#### 6.2.1 - Road posting (9/09)

The Purchaser is responsible for posting and maintaining caution signs on County Road 432 prior to beginning operations. The road must be posted at appropriate distances from the sale area to warn of logging activity and truck traffic. Signs must be removed when harvest operations are suspended or completed. The Purchaser will provide these signs.

## 7 - Other Conditions

### 7.3 - Contract Modifications

#### 7.3.1 - Emerald Ash Borer

7.3.1.2 - Emerald ash borer, ash or firewood on sale (2/05)

There is ash and/or "firewood" in this sale and it is located within an emerald ash borer quarantined area. The Director of the Michigan Department of Agriculture (MDA) by the authority of Act No. 72 of the Public Acts of 1945, as amended, and Quarantine Regulation No. 620, has promulgated this quarantine to prevent the further spread of this pest and sets forth: definitions, regulated articles, regulated areas, conditions of movement, violations and penalties, and special exemptions. The Purchaser must comply with this quarantine. Contact the MDA for further information.



# TIMBER SALE MAP

This information provided by authority of Part 525, 1994 PA 451, as amended.

Sale Number	Year
33 - 005	17

Forest Management Unit Escanaba	County Delta	Mapped By Jacob Siler	Date 05/17/2017	Page 1	of 1
Township 43N	Range 22W	Section(s) and Subdivision(s) 21) NWNW,SENW,SWNW,W1/2SE,SW1/4 28) NENE,NWNE,SENE	Cruised By Dan Racine	Scale 1:15,840	

Cover Type				Density	
A = Aspen	H = Hemlock	N = Marsh	U = Upland Brush	0 = Non Stocked	5 = Pole Timber Medium
B = Paper Birch	J = Jack Pine	O = Oak	UM = Upland Mixed	1 = Seeding Sapling Poor	6 = Pole Timber Well
C = Cedar	L = Lowland Brush	P = Lowland Poplar	V = Bog or Marsh	2 = Seeding Sapling Medium	7 = Saw Timber Poor
D = Treed Bog	LM = Lowland Mixed	Q = Mixed Swamp Conifer	W = White Pine	3 = Seeding Sapling Well	8 = Saw Timber Medium
E = Swamp Hdwoods	M = Mpl, Bch, Bich	R = Red Pine	X = Non Stocked	4 = Pole Timber Poor	9 = Saw Timber Well
F = Spruce Fir	MC = Mixed Conifer	S = Black Spruce	Z = Water		
G = Grass	MD = Mixed Deciduous	T = Tamarack			

PU	Acres	PU	Acres
1	24.9	5	13.6
2	15.0	6	9.5
3	23.7	7	18.7
4	38.9	8	13.7

## Broken Chimney Compartment 97 158 Acres

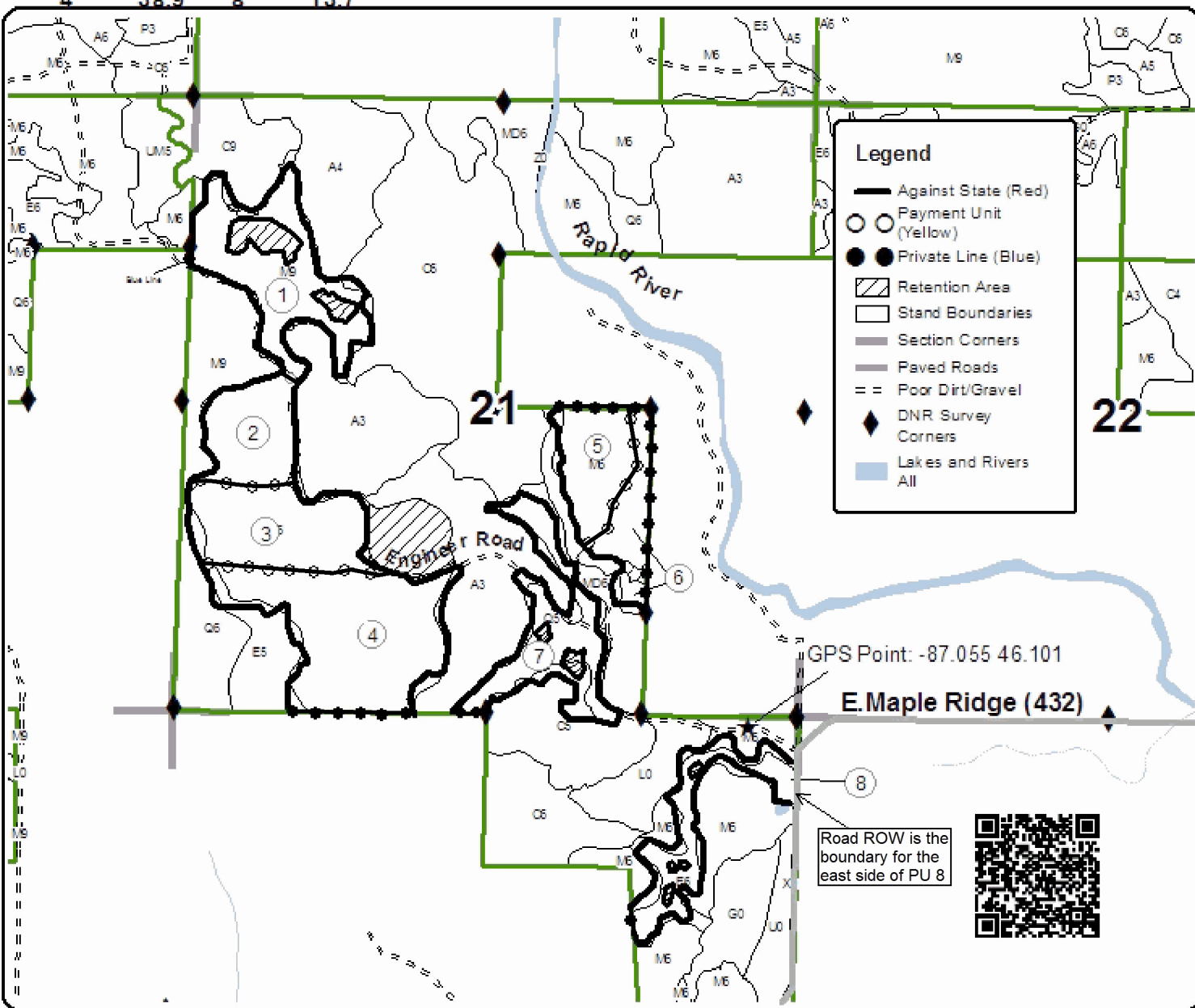

Road ROW is the boundary for the east side of PU 8

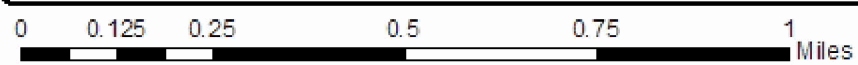



# TIMBER SALE INFORMATION

## TWO TECHNICIANS (33-006-17)

Delta County (Advertised Price \$46,729.55)

A timber sale contract for this lump sum, sealed bid timber sale will be awarded to the responsible bidder offering the highest sealed bid price. Bids must be at or above the following advertised price for each species:

<u>PRODUCTS &amp; SPECIES</u>	<u>ESTIMATED UNITS*</u>	<u>ADVERTISED PRICE</u>
Sawtimber		
Basswood	0.40 MBF	\$ 127.00 / MBF
Black Ash	0.70 MBF	\$ 94.00 / MBF
Paper Birch	1.90 MBF	\$ 84.00 / MBF
Red Maple	2.40 MBF	\$ 243.00 / MBF
Sugar Maple	18.40 MBF	\$ 373.00 / MBF
Yellow Birch	1.10 MBF	\$ 122.00 / MBF
Pulpwood		
Balsam Fir	186.00 Cords	\$ 27.75 / Cord
Mixed Hardwood	464.00 Cords	\$ 35.30 / Cord
N. White Cedar	65.00 Cords	\$ 27.85 / Cord
Quaking Aspen	441.00 Cords	\$ 33.20 / Cord
White Spruce	34.00 Cords	\$ 25.90 / Cord

\* The total volume is statistically estimated within plus (+) or minus (-) 11.07 percent. The estimated units are final and not subject to adjustment. Prospective bidders are urged to examine this timber and to make their own estimates of quantity and quality.

### **BOND AND PAYMENT SCHEDULE:**

1. A bond in the amount of \$2,336.00 to insure faithful performance of the conditions of the contract will be deposited by the successful bidder within 21 days of the sale award.
2. Cutting in any sale or unit without the required advance payment would be considered a trespass.
3. Total payment must be paid in advance or according to the following schedule:
  - (a) Ten percent (10%) of the sale value must be paid within 21 days of the sale award.
  - (b) The 10% down payment will be credited towards the first unit cut.
4. If no cutting takes place, the 10% down payment will not be refunded.
5. Operations on the contract issued will terminate on 09/30/2020.

**Description of Timber by Payment Unit (PU)**

PU	MARKET GROUP	PRODUCT	QUANTITY	UNIT	ACRES	ADVERTISE PRICE	
1	Basswood	Sawtimber	0.4	MBF	6.0	\$6,411.20	
	Paper Birch		0.4	MBF			
	Red Maple		0.6	MBF			
	Sugar Maple		1.9	MBF			
	Balsam Fir		Pulpwood	38.0			Cords
	Mixed Hardwood			90.0			Cords
	<i>Balsam Poplar</i>			1.0			<i>Cords</i>
	<i>Basswood</i>			3.0			<i>Cords</i>
	<i>Black Ash</i>			9.0			<i>Cords</i>
	<i>Ironwood</i>			4.0			<i>Cords</i>
	<i>Paper Birch</i>			1.0			<i>Cords</i>
	<i>Red Maple</i>			37.0			<i>Cords</i>
	<i>Sugar Maple</i>			33.0			<i>Cords</i>
	<i>Yellow Birch</i>			2.0			<i>Cords</i>
	N. White Cedar			24.0			Cords
	Quaking Aspen			11.0			Cords
White Spruce	8.0	Cords					
2	Red Maple	Sawtimber		1.8	MBF	23.4	\$31,554.05
	Sugar Maple			16.5	MBF		
	Balsam Fir		Pulpwood	101.0	Cords		
	Mixed Hardwood			226.0	Cords		
	<i>Balsam Poplar</i>			34.0	<i>Cords</i>		
	<i>Basswood</i>			17.0	<i>Cords</i>		
	<i>Red Maple</i>			37.0	<i>Cords</i>		
	<i>Sugar Maple</i>			132.0	<i>Cords</i>		
	<i>Yellow Birch</i>			6.0	<i>Cords</i>		
	N. White Cedar			4.0	Cords		
	Quaking Aspen			416.0	Cords		
	White Spruce			10.0	Cords		
3	Black Ash	Sawtimber		0.7	MBF	9.3	\$8,764.30
	Paper Birch		1.5	MBF			
	Yellow Birch		1.1	MBF			
	Balsam Fir		Pulpwood	47.0	Cords		
	Mixed Hardwood			148.0	Cords		
	<i>Balsam Poplar</i>			34.0	<i>Cords</i>		
	<i>Black Ash</i>			85.0	<i>Cords</i>		
	<i>Paper Birch</i>			2.0	<i>Cords</i>		
	<i>Red Maple</i>			14.0	<i>Cords</i>		
	<i>Yellow Birch</i>			13.0	<i>Cords</i>		
	N. White Cedar			37.0	Cords		
	Quaking Aspen			14.0	Cords		
	White Spruce			16.0	Cords		
	TOTAL:			24.9	MBF		
TOTAL:				1,190.0	Cords		

# Sale Specific Conditions & Requirements

**Sale Name: TWO TECHNICIANS**

**Sale Number: 33-006-17 Seq#: 1**

## 1 - Sale Area

### 1.2 - Boundaries

#### 1.2.1 - Painted boundaries (1/14)

The sale boundary and Payment Unit boundaries are marked and identified by blue, red and yellow paint, along with a County Road. Exterior sale boundary lines against private property are marked with blue paint and located along the north western portion of Payment Unit 1, and the north eastern portion of Payment Unit 3. Exterior sale boundary lines against state are marked with red paint. The northern boundary for Payment Units 2 and 3 is identified by E Maple Ridge 37th Rd (CR 432). Red dots are placed on the trees along the road and these trees may be cut. Interior Payment Unit boundaries are marked with yellow paint. The interior retention area in Payment Unit 3 is marked with red painted X marks; no operations shall occur within this area. Yellow painted trees designating an interior Payment Unit boundary are only to be cut when all surrounding Payment Units have been paid.

## 2 - Timber Specifications

### 2.1 - Included Timber

#### 2.1.1 - Clearcut unit(s) with unmerchantable trees (6/14)

Within Payment Unit(s) 1, 2, and 3, cut all trees that are three (3) inches or more at DBH with the following exceptions: Within Payment Unit 1, do not cut any cedar, and Within Payment Unit 2, do not cut any elm.

### 2.2 - Utilization

#### 2.2.9 - No chipping permitted (12/08)

Within Payment Unit(s) 1 and 2, all wood must be removed by whole tree, tree segment, or roundwood. No chipping is permitted.

## 3 - Payments

### 3.3 - Pre-measured Sales

#### 3.3.4 - Dividing payment units (7/14)

Payment Unit(s) with a bid value of \$15,000 dollars or greater may be divided at the request of the Purchaser and upon approval of the Unit Manager. Dividing Payment Units is a contract modification which requires a Timber Sale Contract Supplement.

## 4 - Transportation

### 4.1 - Construction

#### 4.1.6 - Road construction (1/09)

Construction of new roads or improvements of existing roads shall be done in such a way as to minimize the environmental and visual impacts. Merchantable trees shall be cut and utilized unless otherwise directed. Non-merchantable trees shall be severed and laid flat on the ground. Slash shall be scattered, and not left in windrows and kept a minimum of 10 feet back from the road edge. Stumps shall be set upright, not left on edge, and be moved at least 10 feet away from the road edge. Disturbed soil shall be feathered into the woods and not left in berms or windrows.

#### 4.1.7 - Road closure (10/11)

All new roads built into the sale must be blocked to vehicle traffic upon completion of the sale. Overgrown roads that are reopened shall be considered new roads. In general, this will require constructing a four (4') foot high berm of stumps and logs covered with earth. Contact the sale administrator for specific details of design and placement.

### 4.2 - Maintenance

#### 4.2.2 - Fill material (4/07)

To maintain roads, fill material may be needed in areas where "holes" exist or may be expected to develop. This fill material

should be placed before trucking begins. Contact the sale administrator regarding the availability of onsite sand or gravel from adjacent State-owned lands.

#### 4.2.4 - Grading (10/16)

For completion of the sale, state forest roads must be graded. In general, this will require a road grader or bull dozer to shape up the roads after forest products have been hauled off site. This includes cleaning of drainage areas, grading, crowning and filling with gravel, if necessary. The grading equipment to be used must be approved by the Unit Manager or his/her representative.

### 5 - Operations

#### 5.2 - Conduct of Operations

##### 5.2.3 - Operating Restrictions

###### 5.2.3.1 - Operating restrictions (9/11)

Within Payment Unit(s) 1 and 2, unless changed by written agreement, cutting, skidding, and hauling are limited to the period of 12/01 to 03/31 or frozen ground conditions. This restriction is because wildlife values are being enhanced utilizing winter harvesting.

##### 5.2.22 - Operating Caution

###### 5.2.22.1 - Operating caution (6/11)

It is recommended, but not required, that within Payment Unit(s) 3, cutting, skidding, and hauling occur during dry summer or frozen winter conditions. The reason for the recommendation is because the majority of this unit is low and wet conditions.

#### 5.4 - Soil Protection

##### 5.4.1 - Rutting restriction, general (7/16)

Operations are to cease immediately if equipment and weather conditions result in rutting of roads and/or skid trails which is 12 inches or greater in depth and 50 feet in length. The Unit Manager or his/her representative may restrict hauling and/or skidding if ruts exceed the specified depth. With the Unit Manager or his/her representative's approval, the Purchaser may return to the area when the risk of rutting has decreased.

### 6 - Safety and Fire Prevention

#### 6.2 - Signing

##### 6.2.1 - Road posting (9/09)

The Purchaser is responsible for posting and maintaining caution signs on the Maki and E Maple Ridge 37th Rd (CR 432) prior to beginning operations. The road must be posted at appropriate distances from the sale area to warn of logging activity and truck traffic. Signs must be removed when harvest operations are suspended or completed. The Purchaser will provide these signs.





### TIMBER SALE MAP

This information provided by authority of Part 525, 1994 PA 451, as amended.

Forest Management Unit Escanaba	County Delta	Mapped By Racine	Date 6/15/2017	Page 1	of 1
Township 43N	Range 22W	Section(s) and Subdivision(s) 32) NENE 33) NWNE, NENW, NWNW, SENW	Scale 1:15,840		
Cruised By Racine, Collins					

#### Cover Type

A = Aspen	H = Hemlock	N = Marsh	U = Upland Brush
B = Paper Birch	J = Jack Pine	O = Oak	UM = Upland Mixed
C = Cedar	L = Lowland Brush	P = Lowland Poplar	V = Bog or Marsh
D = Treed Bog	LM = Lowland Mixed	Q = Mixed Swamp Conifer	W = White Pine
E = Swamp Hardwoods	M = Mpl, Bch, Bich	R = Red Pine	X = Non Stocked
F = Spruce Fir	MC = Mixed Conifer	S = Black Spruce	Z = Water
G = Grass	MD = Mixed Deciduous	T = Tamarack	

#### Density

0 = Non Stocked	5 = Pole Timber Medium
1 = Seeding Sapling Poor	6 = Pole Timber Well
2 = Seeding Sapling Medium	7 = Saw Timber Poor
3 = Seeding Sapling Well	8 = Saw Timber Medium
4 = Pole Timber Poor	9 = Saw Timber Well

PU	Acres
1	6.0
2	23.4
3	9.3

**Two Technicians**  
**Compartment 097**  
**38.7 Acres**

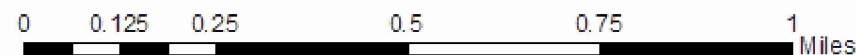
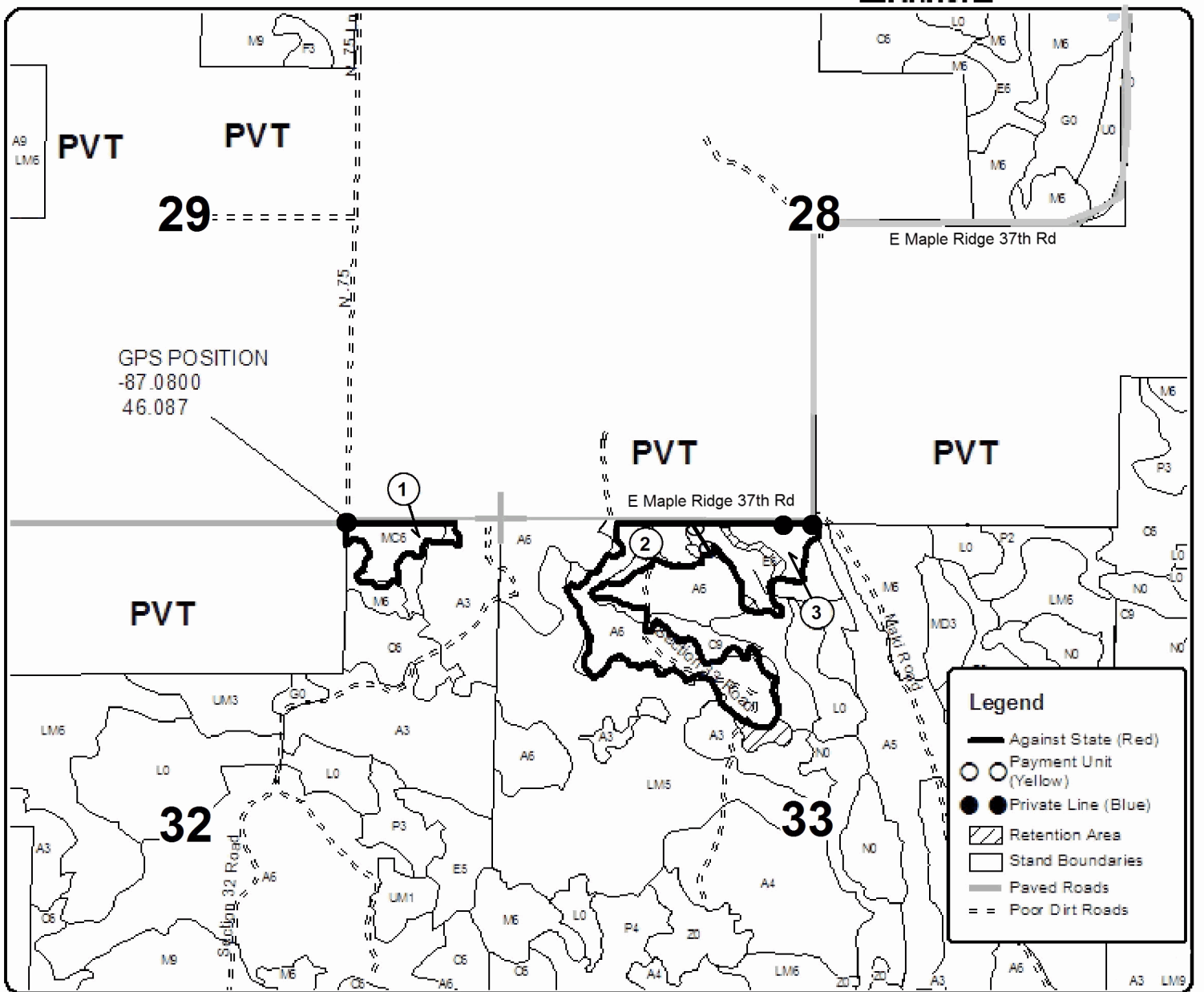



# TIMBER SALE INFORMATION

## Dry Creek SBW (33-030-17)

Menominee County (Advertised Price \$70,125.50)

SALE NOTE: Payment Units 2-6 will be accessed through private property. It is the responsibility of the purchaser to obtain written permission, which must include access for the DNR. Spruce budworm is present within the sale area, but at this time no mortality has occurred.

Access may be through private land.

A timber sale contract for this lump sum, sealed bid timber sale will be awarded to the responsible bidder offering the highest sealed bid price. Bids must be at or above the following advertised price for each species:

<u>PRODUCTS &amp; SPECIES</u>	<u>ESTIMATED UNITS*</u>	<u>ADVERTISED PRICE</u>
Sawtimber		
Basswood	3.20 MBF	\$ 110.00 / MBF
Paper Birch	6.10 MBF	\$ 73.00 / MBF
Red Maple	1.50 MBF	\$ 211.00 / MBF
Sugar Maple	35.00 MBF	\$ 323.00 / MBF
White Ash	22.10 MBF	\$ 61.00 / MBF
Pulpwood		
Balsam Fir	76.00 Cords	\$ 24.05 / Cord
Mixed Aspen	81.00 Cords	\$ 28.80 / Cord
Mixed Hardwood	969.00 Cords	\$ 30.60 / Cord
N. White Cedar	902.00 Cords	\$ 24.15 / Cord
White Spruce	34.00 Cords	\$ 22.45 / Cord

\* The total volume is statistically estimated within plus (+) or minus (-) 17.62 percent. The estimated units are final and not subject to adjustment. Prospective bidders are urged to examine this timber and to make their own estimates of quantity and quality.

### **BOND AND PAYMENT SCHEDULE:**

1. A bond in the amount of \$3,506.00 to insure faithful performance of the conditions of the contract will be deposited by the successful bidder within 21 days of the sale award.
2. Cutting in any sale or unit without the required advance payment would be considered a trespass.
3. Total payment must be paid in advance or according to the following schedule:
  - (a) Ten percent (10%) of the sale value must be paid within 21 days of the sale award.
  - (b) The 10% down payment will be credited towards the first unit cut.
4. If no cutting takes place, the 10% down payment will not be refunded.
5. Operations on the contract issued will terminate on 06/30/2020.

**Description of Timber by Payment Unit (PU)**

PU	MARKET GROUP	PRODUCT	QUANTITY	UNIT	ACRES	ADVERTISE PRICE
1	Mixed Aspen	Pulpwood	10.0	Cords	21.0	\$20,185.65
	<i>Quaking Aspen</i>		10.0	<i>Cords</i>		
	Mixed Hardwood		315.0	Cords		
	<i>Balsam Poplar</i>		3.0	<i>Cords</i>		
	<i>Basswood</i>		8.0	<i>Cords</i>		
	<i>Black Ash</i>		117.0	<i>Cords</i>		
	<i>Green Ash</i>		49.0	<i>Cords</i>		
	<i>Paper Birch</i>		95.0	<i>Cords</i>		
	<i>Red Maple</i>		32.0	<i>Cords</i>		
	<i>Yellow Birch</i>		11.0	<i>Cords</i>		
	N. White Cedar		422.0	Cords		
	White Spruce		3.0	Cords		
	2		Paper Birch	Sawtimber		
Mixed Hardwood		Pulpwood	149.0	Cords		
<i>Black Ash</i>			10.0	<i>Cords</i>		
<i>Green Ash</i>			27.0	<i>Cords</i>		
<i>Paper Birch</i>			112.0	<i>Cords</i>		
N. White Cedar			426.0	Cords		
White Spruce			4.0	Cords		
3	Balsam Fir	Pulpwood	1.0	Cords	2.7	\$3,410.80
	Mixed Aspen		66.0	Cords		
	<i>B. T. Aspen</i>		27.0	<i>Cords</i>		
	<i>Quaking Aspen</i>		39.0	<i>Cords</i>		
	Mixed Hardwood		10.0	Cords		
	<i>Green Ash</i>		4.0	<i>Cords</i>		
	<i>Ironwood</i>		1.0	<i>Cords</i>		
	<i>Paper Birch</i>		1.0	<i>Cords</i>		
	<i>Red Maple</i>		3.0	<i>Cords</i>		
	<i>Sugar Maple</i>		1.0	<i>Cords</i>		
	N. White Cedar		47.0	Cords		
	White Spruce		2.0	Cords		
4	Basswood	Sawtimber	3.2	MBF	32.8	\$21,795.80
	Sugar Maple		30.1	MBF		
	White Ash		22.1	MBF		
	Mixed Hardwood	Pulpwood	339.0	Cords		
	<i>Basswood</i>		15.0	<i>Cords</i>		
	<i>Beech</i>		4.0	<i>Cords</i>		
	<i>Ironwood</i>		1.0	<i>Cords</i>		
	<i>Red Maple</i>		3.0	<i>Cords</i>		
	<i>Sugar Maple</i>		249.0	<i>Cords</i>		
	<i>White Ash</i>		67.0	<i>Cords</i>		
	5		Balsam Fir	Pulpwood		
Mixed Hardwood		46.0	Cords			
<i>Balsam Poplar</i>		15.0	<i>Cords</i>			
<i>Black Cherry</i>		11.0	<i>Cords</i>			
<i>Paper Birch</i>		6.0	<i>Cords</i>			
<i>White Ash</i>		14.0	<i>Cords</i>			
White Spruce		11.0	Cords			
6	Red Maple	Sawtimber	1.5	MBF	13.7	\$7,167.20
	Sugar Maple	Pulpwood	4.9	MBF		
	Balsam Fir		53.0	Cords		
	Mixed Aspen		5.0	Cords		
	<i>Quaking Aspen</i>		5.0	<i>Cords</i>		
	Mixed Hardwood		110.0	Cords		
	<i>Balsam Poplar</i>		1.0	<i>Cords</i>		
	<i>Black Ash</i>		11.0	<i>Cords</i>		

**Description of Timber by Payment Unit (PU), con't**

PU	MARKET GROUP	PRODUCT	QUANTITY	UNIT	ACRES	ADVERTISE PRICE
6 con't	<i>Green Ash</i>	<i>Pulpwood</i>	34.0	<i>Cords</i>		
	<i>Red Maple</i>		21.0	<i>Cords</i>		
	<i>Sugar Maple</i>		43.0	<i>Cords</i>		
	N. White Cedar		7.0	Cords		
	White Spruce		14.0	Cords		
TOTAL:			67.9	MBF		
TOTAL:			2,062.0	Cords		

## Sale Specific Conditions & Requirements

**Sale Name: Dry Creek SBW**

**Sale Number: 33-030-17 Seq#: 1**

### 1 - Sale Area

#### 1.2 - Boundaries

##### 1.2.1 - Painted boundaries (1/14)

The sale boundary and Payment Unit boundaries are marked and identified by blue, red and yellow paint. Exterior sale boundary lines against private property are marked with blue paint. Exterior sale boundary lines against state are marked with red paint. Interior Payment Unit boundaries are marked with yellow paint. The painted boundary line trees are not Included Timber and are to be protected. Yellow painted trees designating an interior Payment Unit boundary are only to be cut when all surrounding Payment Units have been paid for.

### 2 - Timber Specifications

#### 2.1 - Included Timber

##### 2.1.1 - Clearcut unit(s) with unmerchantable trees (6/14)

Within Payment Unit(s) 1, 2, 3, and 5, cut all trees that are two (2) inches or more at DBH; except within Payment Unit 5, do not cut elm.

Within Payment Unit(s) 6, cut all balsam, spruce, aspen, ash, maple and ironwood that are two (2) inches or more at DBH; except do not cut trees marked with green paint. In addition, cut all cedar greater than eight (8) inches at DBH.

##### 2.1.3 - Cut tree marked unit(s) (12/08)

Within Payment Unit(s) 4, all trees are designated for cutting when marked with orange paint above and below stump height, regardless of merchantability.

#### 2.2 - Utilization

##### 2.2.4 - Skidding length (2/14)

Skidding of unlimbed tops or lengths over 17 feet is not permissible within Payment Unit 4.

### 3 - Payments

#### 3.3 - Pre-measured Sales

##### 3.3.4 - Dividing payment units (7/14)

Payment Unit(s) \$18,000 in value or greater may be divided at the request of the Purchaser and upon approval of the Unit Manager. Dividing Payment Units is a contract modification which requires a Timber Sale Contract Supplement. There will be only one division per Payment Unit.

### 4 - Transportation

#### 4.1 - Construction

##### 4.1.1 - Stream crossings, general (3/11)

All stream crossing structures will be temporary and therefore, shall be provided by the Purchaser, and must be removed upon completion of the sale. All permits for stream crossings will be provided by the purchaser. This specification would apply for any crossing across Dry Creek.

#### 4.2 - Maintenance

##### 4.2.1 - Hauling restriction (12/08)

Hauling may be restricted on forest roads by the Unit Manager or his/her representative. The restriction may occur during spring breakup or during other wet weather conditions.

##### 4.2.4 - Grading (10/16)

For completion of the sale, state forest roads must be graded. In general, this will require a road grader or bull dozer to shape up the roads after forest products have been hauled off site. This includes cleaning of drainage areas, grading, crowning and

filling with gravel, if necessary. The grading equipment to be used must be approved by the Unit Manager or his/her representative.

#### 4.4 - Access

##### 4.4.1 - Private property access (3/11)

Permission for access across private land is the responsibility of the Purchaser. A copy of the written permission from the private landowner must be provided to the Unit Manager prior to the beginning of operations. The written permission must include access for the DNR.

### 5 - Operations

#### 5.2 - Conduct of Operations

##### 5.2.3 - Operating Restrictions

###### 5.2.3.1 - Operating restrictions (9/11)

Within Payment Unit(s) 1 and 2, cutting and skidding are limited to the period of December 1st to March 31st, unless there is an extended dry or frozen period and the sale administrator approves of harvesting during that time period. This restriction is because of low wet ground within each of the Payment Units.

###### 5.2.3.3 - Bark slippage restriction (3/09)

Within Payment Unit(s) 4, unless changed by written agreement, cutting and skidding are not permitted during the period of April 15 to July 15. This restriction is because of bark slippage.

##### 5.2.22 - Operating Caution

###### 5.2.22.1 - Operating caution (6/11)

It is recommended, but not required, that within Payment Unit(s) 5 and 6, cutting and skidding occur during dry summer or frozen winter conditions. The reason for the recommendation is because of access into Payment Unit 5 and the southern end of Payment Unit 6 has some low wet ash swales.

#### 5.3 - Stream Protection

##### 5.3.1 - Operating near stream (7/04)

No tracked or wheeled vehicles shall be operated within 50 feet of Dry Creek, except at an approved crossing.

#### 5.4 - Soil Protection

##### 5.4.1 - Rutting restriction, general (7/16)

Operations are to cease immediately if equipment and weather conditions result in rutting of roads and/or skid trails which is 12 inches or greater in depth and 50 feet in length. The Unit Manager or his/her representative may restrict hauling and/or skidding if ruts exceed the specified depth. With the Unit Manager or his/her representative's approval, the Purchaser may return to the area when the risk of rutting has decreased.

### 7 - Other Conditions

#### 7.5 - Loss

##### 7.5.1 - Deteriorating timber (7/09)

The sale area has received damage from the spruce budworm. At this time there has only been some defoliation, no mortality has occurred. The Purchaser should harvest the wood as soon as possible. The Department of Natural Resources is held free of responsibility of any further damage or deterioration due to delay in harvesting.



# TIMBER SALE MAP

This information provided by authority of Part 525, 1994 PA 451, as amended.

Sale Number	Year
33-030	17

Forest Management Unit Escanaba Management Unit	County Menominee County	Mapped By Beaudo	Date 5/23/2017	Page 1	of 1
Township 36N	Range 26W	Section(s) and Subdivision(s) Sec 13 - SWSE; Sec 23 - NENE & SENE; Sec 24 - SWNW, NENW, NWNE & SWNE.	Scale 1:15,840		

Cover Type				Density	
A = Aspen	H = Hemlock	N = Marsh	U = Upland Brush	0 = Non Stocked	5 = Pole Timber Medium
B = Paper Birch	J = Jack Pine	O = Oak	UM = Upland Mixed	1 = Seedling Sapling Poor	6 = Pole Timber Well
C = Cedar	L = Lowland Brush	P = Lowland Poplar	V = Bog or Marsh	2 = Seedling Sapling Medium	7 = Saw Timber Poor
D = Tread Bog	LM = Lowland Mixed	Q = Mixed Swamp Conifer	W = White Pine	3 = Seedling Sapling Well	8 = Saw Timber Medium
E = Swamp Hdwoods	M = Mpl, Bch, Brch	R = Red Pine	X = Non Stocked	4 = Pole Timber Poor	9 = Saw Timber Well
F = Spruce Fir	MC = Mixed Conifer	S = Black Spruce	Z = Water		
G = Grass	MD = Mixed Deciduous	T = Tamarack			

PU	Acres	PU	Acres
1	21.0	4	32.8
2	9.2	5	3.5
3	2.7	6	13.7

**Dry Creek SBW**  
**Compartment 108**  
**82.9 Acres**



QR Code opens map in PDF Maps App

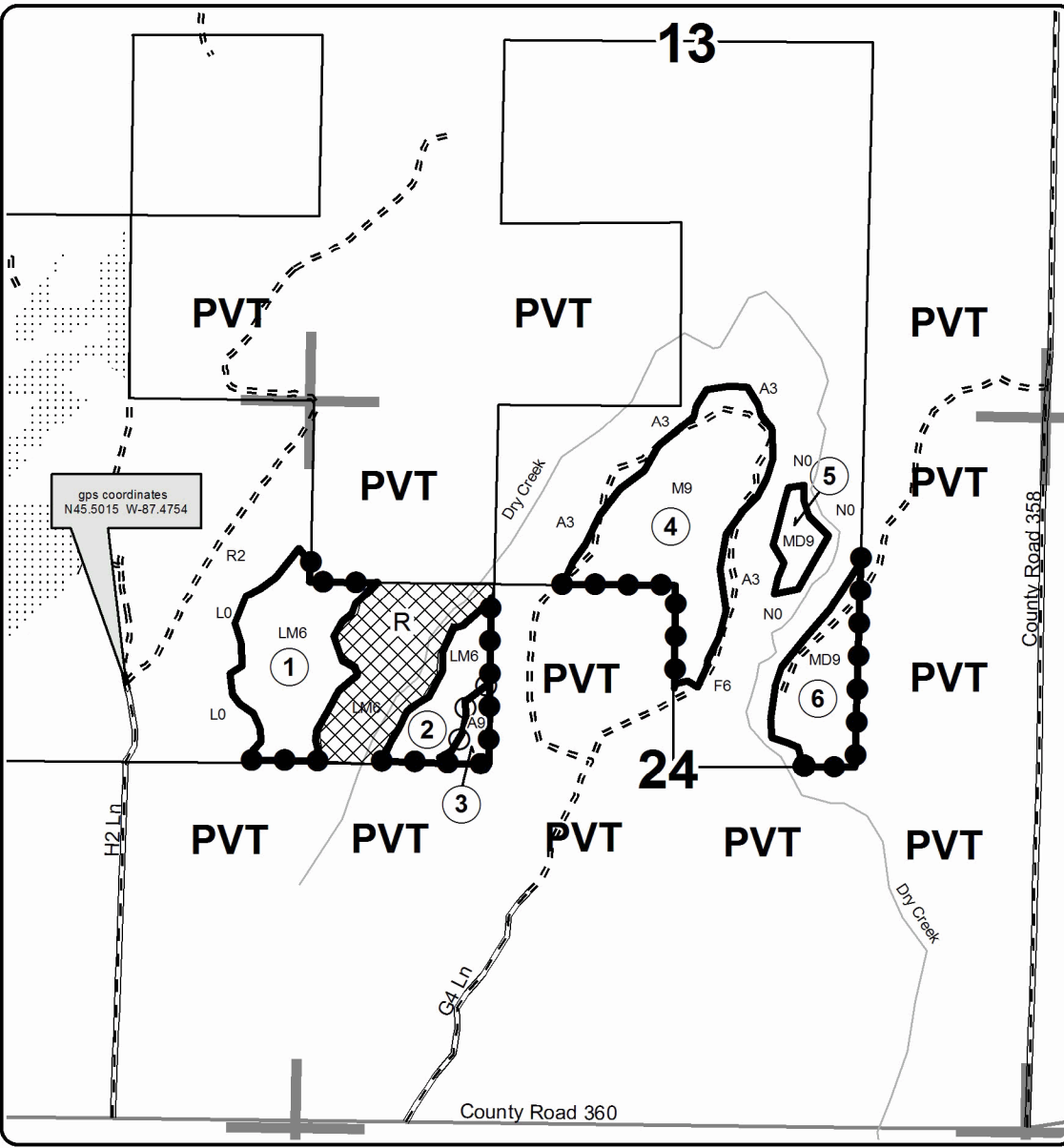

**Legend**

- Against State (Red)
- Payment Unit (Yellow)
- Private Line (Blue)
- Section Corners
- 24 Section Number
- Stream
- Paved Roads
- Gravel Roads
- Poor Dirt Roads
- ① Payment Unit
- PVT Private Property
- State Land Boundary
- ⊠ Retention Area
- ▨ Adjacent Timber Sale

Locator Map  
1:200,000

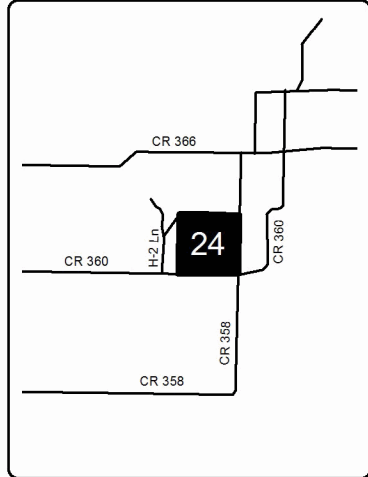



# TIMBER SALE INFORMATION

## Berg Farm ELB (33-031-17)

Menominee County (Advertised Price \$69,128.45)

SALE NOTE: All payment units can be accessed through state land, but the best access into payment units 1-6 is through private property. The purchaser is responsible for obtaining written permission, which must include access for the DNR. The eastern larch beetle has caused significant mortality within payment unit 2, with some of the other payment units having some small pockets of mortality.

Access may be through private land.

A timber sale contract for this lump sum, sealed bid timber sale will be awarded to the responsible bidder offering the highest sealed bid price. Bids must be at or above the following advertised price for each species:

<u>PRODUCTS &amp; SPECIES</u>	<u>ESTIMATED UNITS*</u>	<u>ADVERTISED PRICE</u>
Sawtimber		
Red Maple	1.50 MBF	\$ 243.00 / MBF
Sugar Maple	14.60 MBF	\$ 373.00 / MBF
Pulpwood		
Balsam Fir	157.00 Cords	\$ 27.75 / Cord
Mixed Aspen	181.00 Cords	\$ 33.20 / Cord
Mixed Hardwood	599.00 Cords	\$ 35.30 / Cord
Mixed Spruce	237.00 Cords	\$ 25.90 / Cord
N. White Cedar	754.00 Cords	\$ 27.85 / Cord
Tamarack	262.00 Cords	\$ 17.55 / Cord
White Pine	2.00 Cords	\$ 36.10 / Cord

\* The total volume is statistically estimated within plus (+) or minus (-) 10.49 percent. The estimated units are final and not subject to adjustment. Prospective bidders are urged to examine this timber and to make their own estimates of quantity and quality.

### **BOND AND PAYMENT SCHEDULE:**

1. A bond in the amount of \$3,456.00 to insure faithful performance of the conditions of the contract will be deposited by the successful bidder within 21 days of the sale award.
2. Cutting in any sale or unit without the required advance payment would be considered a trespass.
3. Total payment must be paid in advance or according to the following schedule:
  - (a) Ten percent (10%) of the sale value must be paid within 21 days of the sale award.
  - (b) The 10% down payment will be credited towards the first unit cut.
4. If no cutting takes place, the 10% down payment will not be refunded.
5. Operations on the contract issued will terminate on 06/30/2020.

**Description of Timber by Payment Unit (PU)**

PU	MARKET GROUP	PRODUCT	QUANTITY	UNIT	ACRES	ADVERTISE PRICE	
1	Balsam Fir	Pulpwood	6.0	Cords	3.9	\$1,956.80	
	Mixed Aspen		3.0	Cords			
	<i>Quaking Aspen</i>		3.0	<i>Cords</i>			
	Mixed Hardwood		1.0	Cords			
	<i>Black Ash</i>		1.0	<i>Cords</i>			
	Mixed Spruce		8.0	Cords			
	<i>White Spruce</i>		8.0	<i>Cords</i>			
	N. White Cedar		52.0	Cords			
2	Red Maple	Sawtimber	1.5	MBF	10.5	\$6,435.15	
	Balsam Fir	Pulpwood	1.0	Cords			
	Mixed Hardwood		10.0	Cords			
	<i>Black Ash</i>		1.0	<i>Cords</i>			
	<i>Red Maple</i>		9.0	<i>Cords</i>			
	N. White Cedar		191.0	Cords			
	Tamarack		17.0	Cords			
	White Pine		2.0	Cords			
3	Sugar Maple		Sawtimber	2.7	MBF	5.3	\$4,821.95
	Balsam Fir	Pulpwood	4.0	Cords			
	Mixed Hardwood		71.0	Cords			
	<i>Black Ash</i>		38.0	<i>Cords</i>			
	<i>Sugar Maple</i>		27.0	<i>Cords</i>			
	<i>White Ash</i>		6.0	<i>Cords</i>			
	N. White Cedar		43.0	Cords			
	4		Mixed Hardwood	Pulpwood	10.0		
<i>Balsam Poplar</i>			3.0		<i>Cords</i>		
<i>Black Ash</i>		3.0	<i>Cords</i>				
<i>Paper Birch</i>		4.0	<i>Cords</i>				
Mixed Spruce		29.0	Cords				
<i>Black Spruce</i>		29.0	<i>Cords</i>				
N. White Cedar		109.0	Cords				
Tamarack		191.0	Cords				
5	Balsam Fir	Pulpwood	11.0	Cords	4.2	\$3,689.70	
	Mixed Hardwood		10.0	Cords			
	<i>Balsam Poplar</i>		5.0	<i>Cords</i>			
	<i>Black Cherry</i>		2.0	<i>Cords</i>			
	<i>Red Maple</i>		3.0	<i>Cords</i>			
	Mixed Spruce		45.0	Cords			
	<i>White Spruce</i>		45.0	<i>Cords</i>			
	N. White Cedar		67.0	Cords			
6	Balsam Fir	Pulpwood	4.0	Cords	24.9	\$13,255.40	
	Mixed Aspen		44.0	Cords			
	<i>Quaking Aspen</i>		44.0	<i>Cords</i>			
	Mixed Hardwood		19.0	Cords			
	<i>Balsam Poplar</i>		4.0	<i>Cords</i>			
	<i>Black Ash</i>		5.0	<i>Cords</i>			
	<i>Paper Birch</i>		8.0	<i>Cords</i>			
	<i>Red Maple</i>		2.0	<i>Cords</i>			
	Mixed Spruce		137.0	Cords			
	<i>Black Spruce</i>		137.0	<i>Cords</i>			
	N. White Cedar		234.0	Cords			
	Tamarack		54.0	Cords			
7	Balsam Fir	Pulpwood	88.0	Cords	16.3	\$7,628.70	
	Mixed Aspen		27.0	Cords			
	<i>Quaking Aspen</i>		27.0	<i>Cords</i>			
	Mixed Hardwood		112.0	Cords			
	<i>American Elm</i>		2.0	<i>Cords</i>			

Description of Timber by Payment Unit (PU), con't

PU	MARKET GROUP	PRODUCT	QUANTITY	UNIT	ACRES	ADVERTISE PRICE
	<i>Black Ash</i>		8.0	<i>Cords</i>		
	<i>Black Cherry</i>		4.0	<i>Cords</i>		
	<i>Green Ash</i>		8.0	<i>Cords</i>		
	<i>Paper Birch</i>		1.0	<i>Cords</i>		
	<i>Red Maple</i>		72.0	<i>Cords</i>		
	<i>Sugar Maple</i>		17.0	<i>Cords</i>		
	Mixed Spruce		13.0	Cords		
	<i>White Spruce</i>		13.0	<i>Cords</i>		
8	Sugar Maple	Sawtimber	5.6	MBF	7.4	\$9,067.55
	Balsam Fir	Pulpwood	2.0	Cords		
	Mixed Aspen		56.0	Cords		
	<i>B. T. Aspen</i>		7.0	<i>Cords</i>		
	<i>Quaking Aspen</i>		49.0	<i>Cords</i>		
	Mixed Hardwood		119.0	Cords		
	<i>Ironwood</i>		16.0	<i>Cords</i>		
	<i>Paper Birch</i>		59.0	<i>Cords</i>		
	<i>Sugar Maple</i>		35.0	<i>Cords</i>		
	<i>White Ash</i>		9.0	<i>Cords</i>		
	N. White Cedar		31.0	Cords		
9	Sugar Maple	Sawtimber	1.8	MBF	5.1	\$5,029.25
	Balsam Fir	Pulpwood	38.0	Cords		
	Mixed Aspen		51.0	Cords		
	<i>B. T. Aspen</i>		17.0	<i>Cords</i>		
	<i>Quaking Aspen</i>		34.0	<i>Cords</i>		
	Mixed Hardwood		26.0	Cords		
	<i>Ironwood</i>		2.0	<i>Cords</i>		
	<i>Paper Birch</i>		8.0	<i>Cords</i>		
	<i>Red Maple</i>		9.0	<i>Cords</i>		
	<i>Sugar Maple</i>		7.0	<i>Cords</i>		
	Mixed Spruce		2.0	Cords		
	<i>White Spruce</i>		2.0	<i>Cords</i>		
	N. White Cedar		23.0	Cords		
10	Sugar Maple	Sawtimber	4.5	MBF	20.9	\$9,752.15
	Balsam Fir	Pulpwood	3.0	Cords		
	Mixed Hardwood		221.0	Cords		
	<i>Beech</i>		19.0	<i>Cords</i>		
	<i>Ironwood</i>		17.0	<i>Cords</i>		
	<i>Sugar Maple</i>		182.0	<i>Cords</i>		
	<i>White Ash</i>		3.0	<i>Cords</i>		
	Mixed Spruce		3.0	Cords		
	<i>White Spruce</i>		3.0	<i>Cords</i>		
	N. White Cedar		4.0	Cords		
TOTAL:			16.1	MBF		
TOTAL:			2,192.0	Cords		

## Sale Specific Conditions & Requirements

**Sale Name: Berg Farm ELB**

**Sale Number: 33-031-17 Seq#: 1**

### 1 - Sale Area

#### 1.2 - Boundaries

##### 1.2.1 - Painted boundaries (1/14)

The sale boundary and Payment Unit boundaries are marked and identified by blue, red and yellow paint. Exterior sale boundary lines against private property are marked with blue paint. Exterior sale boundary lines against state are marked with red paint. Interior Payment Unit boundaries are marked with yellow paint. Retention patches are bounded by red paint and need to be protected; no harvesting activities may occur within these areas. Yellow painted trees designating an interior Payment Unit boundary are only to be cut when all surrounding Payment Units have been paid for.

### 2 - Timber Specifications

#### 2.1 - Included Timber

##### 2.1.1 - Clearcut unit(s) with unmerchantable trees (6/14)

Within Payment Unit(s) 2, 4, 6, 7, 8, and 9, cut all trees that are two (2) inches or more at DBH with the following exceptions: Do not cut beech, hemlock, and yellow birch within Payment Units 7 and 9. In addition, do not cut beech within Payment Unit 8.

Within Payment Unit(s) 10, cut all trees that are greater than one (1) inch at DBH.

##### 2.1.3 - Cut tree marked unit(s) (12/08)

Within Payment Unit(s) 3, all trees are designated for cutting when marked with orange paint above and below stump height, regardless of merchantability. In addition, cut all aspen, ash, spruce, and balsam fir greater than four (4) inches at DBH. Also, cut all cedar greater than ten (10) inches at DBH.

##### 2.1.4 - Designated timber unit(s) (6/17)

Within Payment Unit(s) 1 and 5, all trees are designated for cutting that are greater than four (4) inches at DBH; except within Payment Unit 5, do not cut cedar eight (8) inches at DBH or less, or any hemlock.

#### 2.2 - Utilization

##### 2.2.4 - Skidding length (2/14)

Skidding of unlimbed tops or lengths over 17 feet is not permissible within Payment Unit 3.

### 3 - Payments

#### 3.3 - Pre-measured Sales

##### 3.3.4 - Dividing payment units (7/14)

Payment Unit(s) \$18,000 in value or greater may be divided at the request of the Purchaser and upon approval of the Unit Manager. Dividing Payment Units is a contract modification which requires a Timber Sale Contract Supplement. There will be only one division per Payment Unit.

### 4 - Transportation

#### 4.2 - Maintenance

##### 4.2.1 - Hauling restriction (12/08)

Hauling may be restricted on forest roads by the Unit Manager or his/her representative. The restriction may occur during spring breakup or during other wet weather conditions.

##### 4.2.4 - Grading (10/16)

For completion of the sale, state forest roads must be graded. In general, this will require a road grader or bull dozer to shape up the roads after forest products have been hauled off site. This includes cleaning of drainage areas, grading, crowning and filling with gravel, if necessary. The grading equipment to be used must be approved by the Unit Manager or his/her representative.

#### 4.4 - Access

##### 4.4.1 - Private property access (3/11)

Permission for access across private land is the responsibility of the Purchaser. Should the Purchaser desire to cross private land, a copy of the written permission from the private land-owner may be required by the DNR. The written permission must include access for the DNR.

### 5 - Operations

#### 5.2 - Conduct of Operations

##### 5.2.3 - Operating Restrictions

###### 5.2.3.1 - Operating restrictions (9/11)

Within Payment Unit(s) 2, 4, and 6, cutting and skidding are limited to the period of December 1st to March 31st, unless there is an extended dry or frozen period and the sale administrator approves of harvesting during that time period. This restriction is because of low wet ground within each of the Payment Units.

###### 5.2.3.3 - Bark slippage restriction (3/09)

Within Payment Unit(s) 3, unless changed by written agreement, cutting and skidding are not permitted during the period of April 15 to July 15. This restriction is because of bark slippage.

###### 5.2.3.11 - Coppice regeneration protection (4/10)

To promote aspen regeneration, harvesting is limited to October 1st through March 31st, within Payment Units 8 and 9. Timber harvesting in either of these Payment Units must be completed before significant aspen sprouting occurs in that Payment Unit so as to minimize damage to the new regeneration.

##### 5.2.22 - Operating Caution

###### 5.2.22.1 - Operating caution (6/11)

It is recommended, but not required, that within Payment Unit(s) 5 and 7, cutting and skidding occur during dry summer or frozen winter conditions. The reason for the recommendation is because of some low wet pockets within each of the Payment Units.

#### 5.4 - Soil Protection

##### 5.4.1 - Rutting restriction, general (7/16)

Operations are to cease immediately if equipment and weather conditions result in rutting of roads and/or skid trails which is 12 inches or greater in depth and 50 feet in length. The Unit Manager or his/her representative may restrict hauling and/or skidding if ruts exceed the specified depth. With the Unit Manager or his/her representative's approval, the Purchaser may return to the area when the risk of rutting has decreased.

##### 5.4.2 - Skid trails (2/04)

Skid trails up and down slopes should be avoided. If however this is unavoidable, these trails will be left in a non-erodible condition using water bars, logs, and slash. Placing of slash on these skid trails while logging is ongoing may alleviate need for any further action. At the direction of the sale administrator, seed, fertilizer, and mulch may also be required.

### 7 - Other Conditions

#### 7.5 - Loss

##### 7.5.1 - Deteriorating timber (7/09)

The sale area has received damage from the Eastern Larch Beetle. There are some pockets of mortality, especially within Payment Unit 2. The Purchaser should harvest the wood as soon as possible. The Department of Natural Resources is held free of responsibility of any further damage or deterioration due to delay in harvesting.



# TIMBER SALE MAP

This information provided by authority of Part 525, 1994 PA 451, as amended.

Sale Number	Year
33-031	17

Forest Management Unit Escanaba Management Unit	County Menominee County	Mapped By Beaudo	Date 5/31/2017	Page 1	of 1
Township 36N	Range 26W	Section(s) and Subdivision(s) Sec 14 - SWSE & SWSW; Sec 15 - SESE; Sec 22 - NENE; Sec 23 - NENW, NWNE, NWNW, SWNE & SWNW.	Scale 1:15,840		

### Cover Type

A = Aspen	H = Hemlock	N = Marsh	U = Upland Brush
B = Paper Birch	J = Jack Pine	O = Oak	UM = Upland Mixed
C = Cedar	L = Lowland Brush	P = Lowland Poplar	V = Bog or Marsh
D = Tread Bog	LM = Lowland Mixed	Q = Mixed Swamp Conifer	W = White Pine
E = Swamp Hdwoods	M = Mpl, Bch, Brch	R = Red Pine	X = Non Stocked
F = Spruce Fir	MC = Mixed Conifer	S = Black Spruce	Z = Water
G = Grass	MD = Mixed Deciduous	T = Tamarack	

### Density

0 = Non Stocked	5 = Pole Timber Medium
1 = Seedling Sapling Poor	6 = Pole Timber Well
2 = Seedling Sapling Medium	7 = Saw Timber Poor
3 = Seedling Sapling Well	8 = Saw Timber Medium
4 = Pole Timber Poor	9 = Saw Timber Well

**Berg Farm ELB**  
**Compartment 108**  
**110.5 Acres**



QR Code opens map in PDF Maps App

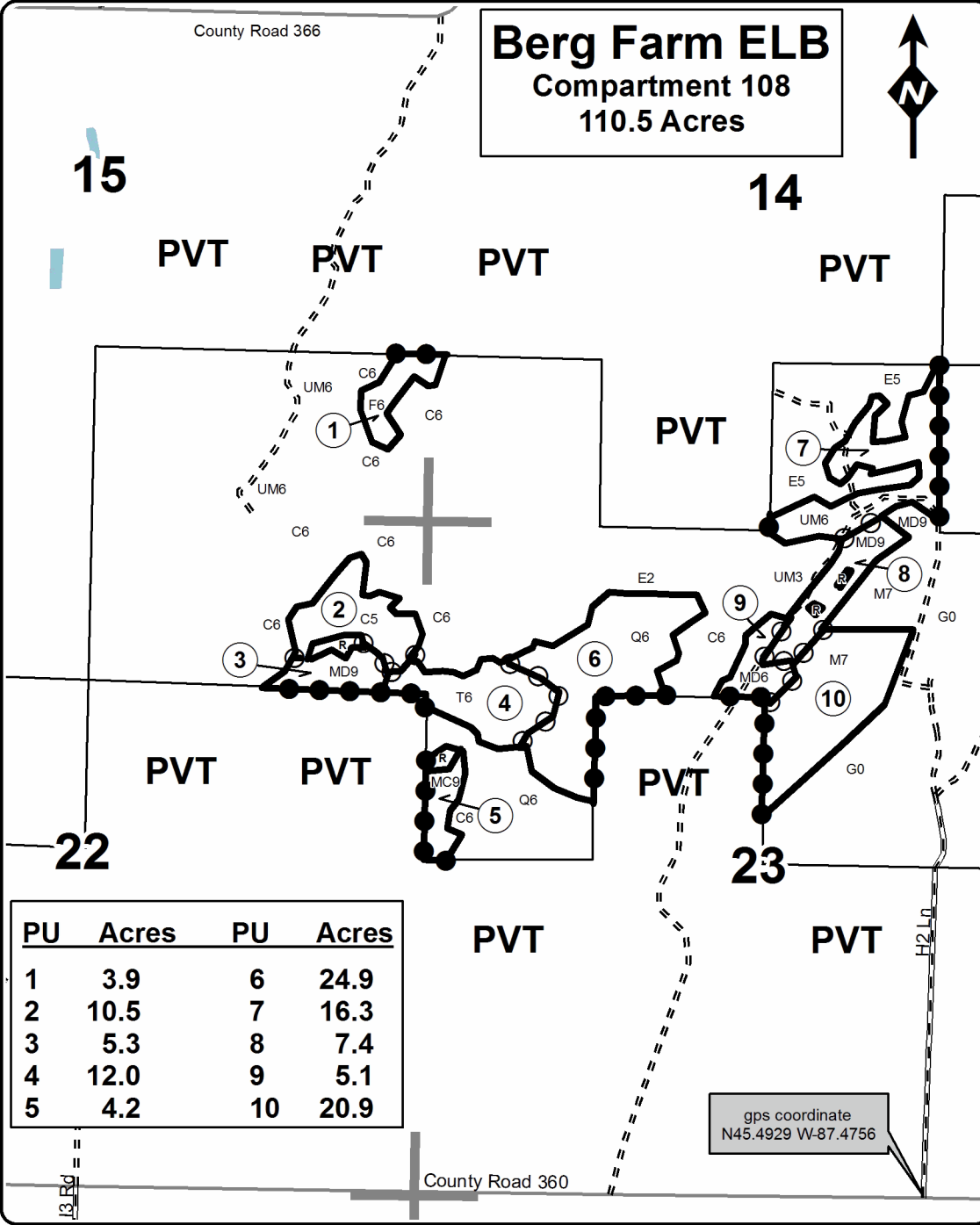

### Legend

- Against State (Red)
- Payment Unit (Yellow)
- Private Line (Blue)
- Section Corners
- 14 Section Number
- Paved Roads
- Gravel Roads
- Poor Dirt Roads
- State Land Boundary
- PVT Private Property
- R Retention Patch
- ① Payment Unit

PU	Acres	PU	Acres
1	3.9	6	24.9
2	10.5	7	16.3
3	5.3	8	7.4
4	12.0	9	5.1
5	4.2	10	20.9

gps coordinate  
 N45.4929 W-87.4756

Locator Map  
1:200,000

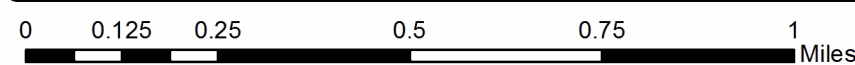
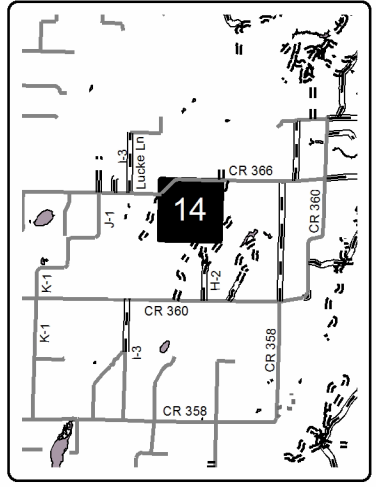

# TIMBER SALE INFORMATION

## Westman Pit (33-032-17)

Menominee County (Advertised Price \$71,831.20)

SALE NOTE: Payment Units 1 and 2 will be accessed off of County Road 366 and Payment Units 3 - 6 will be accessed off of the Westman Dam Road.

A timber sale contract for this lump sum, sealed bid timber sale will be awarded to the responsible bidder offering the highest sealed bid price. Bids must be at or above the following advertised price for each species:

<u>PRODUCTS &amp; SPECIES</u>	<u>ESTIMATED UNITS*</u>		<u>ADVERTISED PRICE</u>
Sawtimber			
Basswood	18.70	MBF	\$ 127.00 / MBF
Red Maple	15.20	MBF	\$ 243.00 / MBF
Sugar Maple	11.10	MBF	\$ 373.00 / MBF
White Ash	0.50	MBF	\$ 75.00 / MBF
White Pine	4.90	MBF	\$ 72.00 / MBF
Yellow Birch	0.50	MBF	\$ 122.00 / MBF
Pulpwood			
Balsam Fir	246.00	Cords	\$ 27.75 / Cord
Hemlock	20.00	Cords	\$ 11.50 / Cord
Mixed Aspen	541.00	Cords	\$ 33.20 / Cord
Mixed Hardwood	878.00	Cords	\$ 35.30 / Cord
N. White Cedar	160.00	Cords	\$ 27.85 / Cord
White Pine	3.00	Cords	\$ 36.10 / Cord
White Spruce	23.00	Cords	\$ 25.90 / Cord

\* The total volume is statistically estimated within plus (+) or minus (-) 11.91 percent. The estimated units are final and not subject to adjustment. Prospective bidders are urged to examine this timber and to make their own estimates of quantity and quality.

### **BOND AND PAYMENT SCHEDULE:**

1. A bond in the amount of \$3,592.00 to insure faithful performance of the conditions of the contract will be deposited by the successful bidder within 21 days of the sale award.
2. Cutting in any sale or unit without the required advance payment would be considered a trespass.
3. Total payment must be paid in advance or according to the following schedule:
  - (a) Ten percent (10%) of the sale value must be paid within 21 days of the sale award.
  - (b) The 10% down payment will be credited towards the first unit cut.
4. If no cutting takes place, the 10% down payment will not be refunded.
5. Operations on the contract issued will terminate on 09/30/2020.

**Description of Timber by Payment Unit (PU)**

PU	MARKET GROUP	PRODUCT	QUANTITY	UNIT	ACRES	ADVERTISE PRICE
1	Red Maple	Sawtimber	2.5	MBF	8.5	\$7,162.65
	White Pine		4.9	MBF		
	Balsam Fir	Pulpwood	11.0	Cords		
	Hemlock		7.0	Cords		
	Mixed Aspen		5.0	Cords		
	<i>Quaking Aspen</i>		5.0	Cords		
	Mixed Hardwood		86.0	Cords		
	<i>American Elm</i>		1.0	Cords		
	<i>Balsam Poplar</i>		8.0	Cords		
	<i>Black Ash</i>		52.0	Cords		
	<i>Red Maple</i>		25.0	Cords		
	N. White Cedar		90.0	Cords		
	White Pine		3.0	Cords		
	2	Red Maple	Sawtimber	4.7		
Yellow Birch			0.5	MBF		
Balsam Fir		Pulpwood	78.0	Cords		
Hemlock			10.0	Cords		
Mixed Aspen			118.0	Cords		
<i>Quaking Aspen</i>			118.0	Cords		
Mixed Hardwood			192.0	Cords		
<i>Basswood</i>			6.0	Cords		
<i>Beech</i>			2.0	Cords		
<i>Black Ash</i>			20.0	Cords		
<i>Black Cherry</i>			1.0	Cords		
<i>Ironwood</i>			2.0	Cords		
<i>Red Maple</i>			154.0	Cords		
<i>White Ash</i>			2.0	Cords		
<i>Yellow Birch</i>			5.0	Cords		
N. White Cedar			46.0	Cords		
White Spruce			19.0	Cords		
3	Basswood	Sawtimber	1.1	MBF	15.8	\$20,642.85
	Red Maple		6.5	MBF		
	Sugar Maple		4.4	MBF		
	Balsam Fir	Pulpwood	43.0	Cords		
	Mixed Aspen		236.0	Cords		
	<i>B. T. Aspen</i>		126.0	Cords		
	<i>Quaking Aspen</i>		110.0	Cords		
	Mixed Hardwood		215.0	Cords		
	<i>Balsam Poplar</i>		2.0	Cords		
	<i>Basswood</i>		6.0	Cords		
	<i>Beech</i>		9.0	Cords		
	<i>Black Ash</i>		5.0	Cords		
	<i>Black Cherry</i>		1.0	Cords		
	<i>Green Ash</i>		7.0	Cords		
	<i>Ironwood</i>		2.0	Cords		
	<i>Red Maple</i>		120.0	Cords		
	<i>Sugar Maple</i>		59.0	Cords		
	<i>White Ash</i>		2.0	Cords		
	<i>Yellow Birch</i>		2.0	Cords		
	N. White Cedar		22.0	Cords		
White Spruce		2.0	Cords			
4	Basswood	Sawtimber	2.4	MBF	8.7	\$5,212.00
	Sugar Maple		2.1	MBF		
	White Ash		0.5	MBF		
	Mixed Aspen	Pulpwood	4.0	Cords		
	<i>B. T. Aspen</i>		4.0	Cords		



Description of Timber by Payment Unit (PU), con't

PU	MARKET GROUP	PRODUCT	QUANTITY	UNIT	ACRES	ADVERTISE PRICE			
4 con't	Mixed Hardwood	Pulpwood	112.0	Cords					
	<i>Basswood</i>		34.0	<i>Cords</i>					
	<i>Beech</i>		10.0	<i>Cords</i>					
	<i>Ironwood</i>		3.0	<i>Cords</i>					
	<i>Red Maple</i>		3.0	<i>Cords</i>					
	<i>Sugar Maple</i>		42.0	<i>Cords</i>					
	<i>White Ash</i>		20.0	<i>Cords</i>					
5	Basswood	Sawtimber	14.0	MBF	11.4	\$7,066.40			
	Sugar Maple		3.2	MBF					
	Mixed Hardwood	Pulpwood	116.0	Cords					
	<i>Basswood</i>		63.0	<i>Cords</i>					
	<i>Beech</i>		10.0	<i>Cords</i>					
	<i>Black Cherry</i>		2.0	<i>Cords</i>					
	<i>Ironwood</i>		1.0	<i>Cords</i>					
	<i>Sugar Maple</i>		40.0	<i>Cords</i>					
	6	Basswood	Sawtimber	1.2			MBF	16.0	\$15,796.30
Red Maple			1.5	MBF					
Sugar Maple			1.4	MBF					
Balsam Fir		Pulpwood	114.0	Cords					
Hemlock			3.0	Cords					
Mixed Aspen			178.0	Cords					
<i>B. T. Aspen</i>			48.0	<i>Cords</i>					
<i>Quaking Aspen</i>			130.0	<i>Cords</i>					
Mixed Hardwood			157.0	Cords					
<i>American Elm</i>			2.0	<i>Cords</i>					
<i>Balsam Poplar</i>			2.0	<i>Cords</i>					
<i>Basswood</i>			8.0	<i>Cords</i>					
<i>Beech</i>			11.0	<i>Cords</i>					
<i>Black Ash</i>			4.0	<i>Cords</i>					
<i>Ironwood</i>			3.0	<i>Cords</i>					
<i>Red Maple</i>			70.0	<i>Cords</i>					
<i>Sugar Maple</i>			39.0	<i>Cords</i>					
<i>White Ash</i>			16.0	<i>Cords</i>					
<i>Yellow Birch</i>			2.0	<i>Cords</i>					
N. White Cedar			2.0	Cords					
White Spruce			2.0	Cords					
TOTAL:			50.9	MBF					
TOTAL:			1,871.0	Cords					

# Sale Specific Conditions & Requirements

**Sale Name: Westman Pit**

**Sale Number: 33-032-17 Seq#: 1**

## 1 - Sale Area

### 1.2 - Boundaries

#### 1.2.1 - Painted boundaries (1/14)

The sale boundary and Payment Unit boundaries are marked and identified by blue, red and/or yellow paint. Exterior sale boundary lines against private property are marked with blue paint. Exterior sale boundary lines against state are marked with red paint. Interior Payment Unit boundaries are marked with yellow paint. Retention patches are bounded by a red paint line and need to be protected; no harvesting activities may occur within these areas. The painted boundary line trees are not Included Timber and are to be protected, unless marked with orange paint. Yellow painted trees designating an interior Payment Unit boundary are only to be cut when all surrounding Payment Units have been paid for.

## 2 - Timber Specifications

### 2.1 - Included Timber

#### 2.1.1 - Clearcut unit(s) with unmerchantable trees (6/14)

Within Payment Unit(s) 1, 2, 3, and 6, cut all trees that are three (3) inches or more at DBH, except within Payment Unit 1, do not cut trees marked with green paint.

#### 2.1.3 - Cut tree marked unit(s) (12/08)

Within Payment Unit(s) 4 and 5, all trees are designated for cutting when marked with orange paint above and below stump height, regardless of merchantability. In addition, cut all ironwood greater than two (2) inches at DBH. Also, within Payment Unit 4, cut all aspen which meet minimum piece specifications in 2.2 Utilization.

### 2.2 - Utilization

#### 2.2.4 - Skidding length (2/14)

Skidding of unlimbed tops or lengths over 17 feet is not permissible within Payment Units 4 and 5.

## 3 - Payments

### 3.3 - Pre-measured Sales

#### 3.3.4 - Dividing payment units (7/14)

Payment Unit(s) \$18,000 in value or greater may be divided at the request of the Purchaser and upon approval of the Unit Manager. Dividing Payment Units is a contract modification which requires a Timber Sale Contract Supplement. There will be only one division per Payment Unit.

## 4 - Transportation

### 4.2 - Maintenance

#### 4.2.1 - Hauling restriction (12/08)

Hauling may be restricted on forest roads by the Unit Manager or his/her representative. The restriction may occur during spring breakup or during other wet weather conditions.

#### 4.2.4 - Grading (10/16)

For completion of the sale, state forest roads must be graded. In general, this will require a road grader or bull dozer to shape up the roads after forest products have been hauled off site. This includes cleaning of drainage areas, grading, crowning and filling with gravel, if necessary. The grading equipment to be used must be approved by the Unit Manager or his/her representative.

## 5 - Operations

### 5.2 - Conduct of Operations

#### 5.2.3 - Operating Restrictions

#### 5.2.3.1 - Operating restrictions (9/11)

Within Payment Unit(s) 1, cutting and skidding are limited to the period of December 1st to March 31st, unless there is an extended dry or frozen period and the sale administrator approves of harvesting during that time period. This restriction is because of low wet ground throughout the Payment Unit.

#### 5.2.3.3 - Bark slippage restriction (3/09)

Within Payment Unit(s) 4 and 5, unless changed by written agreement, cutting and skidding are not permitted during the period of April 15 to July 15. This restriction is because of bark slippage.

#### 5.2.22 - Operating Caution

##### 5.2.22.1 - Operating caution (6/11)

It is recommended, but not required, that within Payment Unit(s) 2, 3, and 6, cutting and skidding occur during dry summer or frozen winter conditions. The reason for the recommendation is because of some wet drains/pockets within each of the Payment Units.

#### 5.3 - Stream Protection

##### 5.3.1 - Operating near stream (7/04)

No tracked or wheeled vehicles shall be operated within 30 feet of the intermittent creek/drain between the two parts of Payment Unit 2; except at an approved crossing.

There is an intermittent creek/drain between the two parts of Payment Unit 6, that needs to be protected. No crossing will be permitted across this creek. Each part of Payment Unit 6 is accessed by a separate road.

#### 5.4 - Soil Protection

##### 5.4.1 - Rutting restriction, general (7/16)

Operations are to cease immediately if equipment and weather conditions result in rutting of roads and/or skid trails which is 12 inches or greater in depth and 50 feet in length. The Unit Manager or his/her representative may restrict hauling and/or skidding if ruts exceed the specified depth. With the Unit Manager or his/her representative's approval, the Purchaser may return to the area when the risk of rutting has decreased.

##### 5.4.2 - Skid trails (2/04)

Skid trails up and down slopes should be avoided. If however this is unavoidable, these trails will be left in a non-erodible condition using water bars, logs, and slash. Placing of slash on these skid trails while logging is ongoing may alleviate need for any further action. At the direction of the sale administrator, seed, fertilizer, and mulch may also be required.



# TIMBER SALE MAP

This information provided by authority of Part 525, 1994 PA 451, as amended.

Forest Management Unit Escanaba Management Unit	County Menominee County	Mapped By Beaudou	Date 6/14/2017	Page 1	of 1
Township 36N	Range 25W	Section(s) and Subdivision(s) Sec 17 - SENW, NESW, SWSW, SESW, NWSE, NENW & SWSE	Scale 1:15,840		

Cover Type				Density	
A = Aspen	H = Hemlock	N = Marsh	U = Upland Brush	0 = Non Stocked	5 = Pole Timber Medium
B = Paper Birch	J = Jack Pine	O = Oak	UM = Upland Mixed	1 = Seedling Sapling Poor	6 = Pole Timber Well
C = Cedar	L = Lowland Brush	P = Lowland Poplar	V = Bog or Marsh	2 = Seedling Sapling Medium	7 = Saw Timber Poor
D = Treed Bog	LM = Lowland Mixed	Q = Mixed Swamp Conifer	W = White Pine	3 = Seedling Sapling Well	8 = Saw Timber Medium
E = Swamp Hdwoods	M = Mpl, Bch, Brch	R = Red Pine	X = Non Stocked	4 = Pole Timber Poor	9 = Saw Timber Well
F = Spruce Fir	MC = Mixed Conifer	S = Black Spruce	Z = Water		
G = Grass	MD = Mixed Deciduous	T = Tamarack			

PU	Acres	PU	Acres
1	8.5	4	8.7
2	12.9	5	11.4
3	15.8	6	16.0

**Westman Pit**  
**Compartment 42**  
**73.3 Acres**



QR Code opens map in PDF Maps App

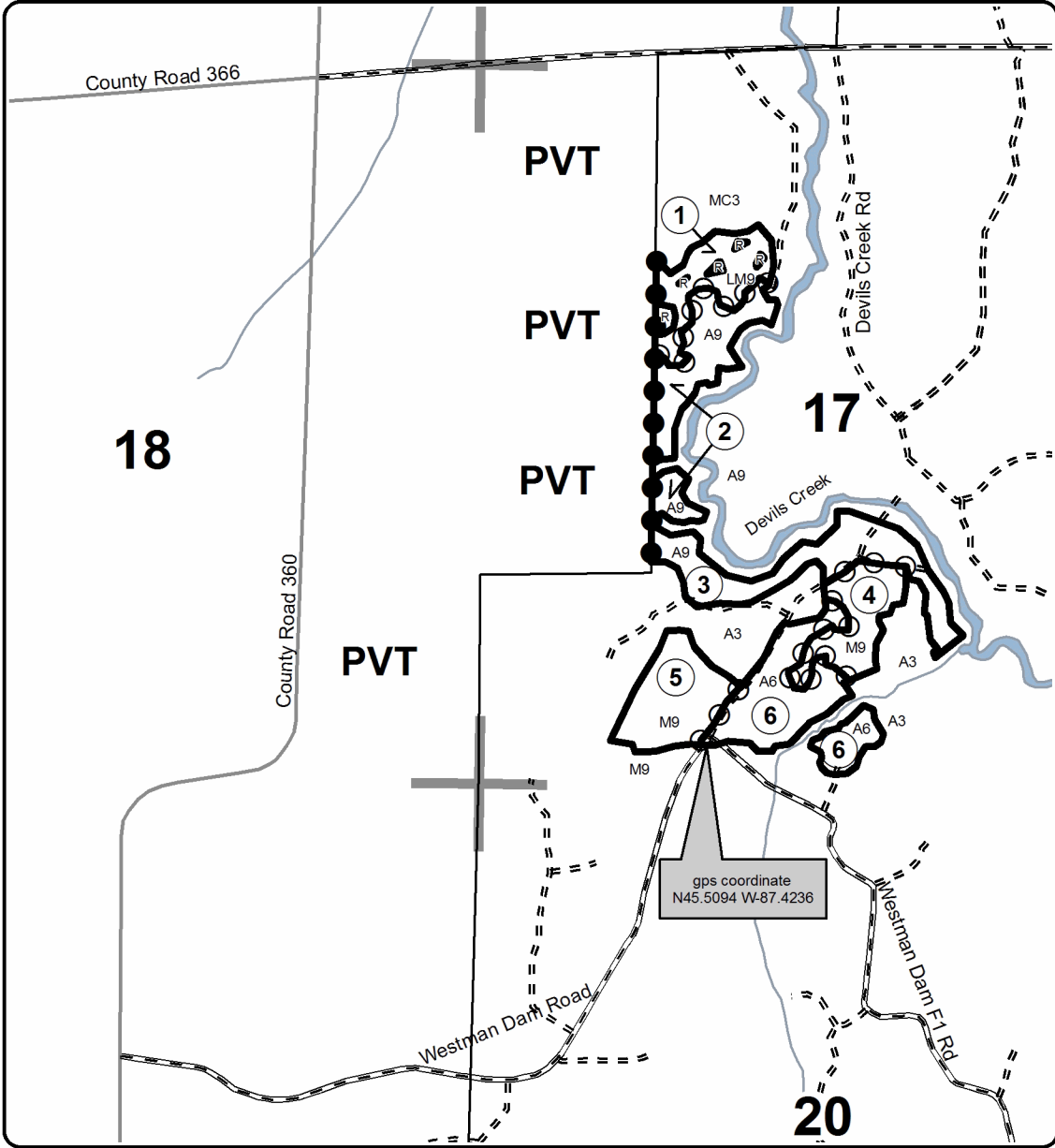

**Legend**

- Against State (Red)
- Payment Unit (Yellow)
- Private Line (Blue)
- Section Corners
- 17** Section Number
- Paved Roads
- Gravel Roads
- Poor Dirt Roads
- State Land Boundary
- PVT** Private Property
- Payment Unit
- Stream
- Creek/Seasonal Drainage
- Retention Patch

Locator Map  
1:200,000

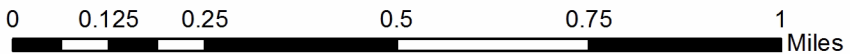
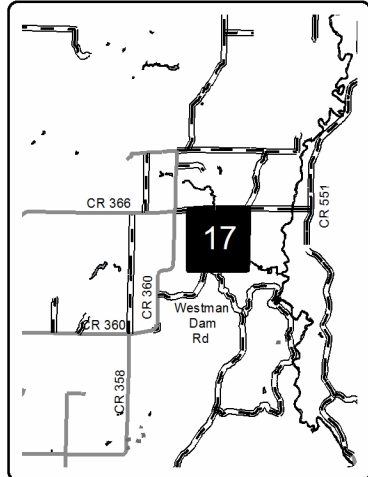

Dry Creek SBW (33-030-17)  
 ; Menominee COUNTY

In response to the notice of sale to be held 3:00 p.m. (local time) on August 29, 2017, I am hereby submitting my sealed bid (firm offer) for the following forest products to be cut. Bids for individual species must be at or above the advertised price. All non-responsive bid forms may be rejected.

<u>PRODUCTS &amp; SPECIES</u>	<u>ESTIMATED VOLUME*</u>	<u>ADVERTISED PRICE</u>	<u>BID PRICE</u>
<b>Sawtimber</b>			
Basswood	3.20 MBF	\$ 110.00/MBF	\$ _____
Paper Birch	6.10 MBF	\$ 73.00/MBF	\$ _____
Red Maple	1.50 MBF	\$ 211.00/MBF	\$ _____
Sugar Maple	35.00 MBF	\$ 323.00/MBF	\$ _____
White Ash	22.10 MBF	\$ 61.00/MBF	\$ _____
<b>Pulpwood</b>			
Balsam Fir	76.00 Cords	\$ 24.05/Cord	\$ _____
Mixed Aspen	81.00 Cords	\$ 28.80/Cord	\$ _____
Mixed Hardwood	969.00 Cords	\$ 30.60/Cord	\$ _____
N. White Cedar	902.00 Cords	\$ 24.15/Cord	\$ _____
White Spruce	34.00 Cords	\$ 22.45/Cord	\$ _____

\*The volumes are statistically estimated within plus (+) or minus (-) 17.62 percent. These estimated volumes are final and not subject to adjustment. Prospective bidders are urged to examine this timber and to make their own estimates of quantity and quality.

I understand that any or all bids may be rejected. All bids must be signed and all bid items must be bid or the bid form may be rejected. I also understand that consideration and awarding a contract will be based upon my past performance and ability to complete the contract based upon equipment and staffing subject to my control.

FEDERAL ID: \_\_\_\_\_ or SOCIAL SECURITY NUMBER: \_\_\_\_\_

Company or individual bidding: \_\_\_\_\_

Company representative's name: \_\_\_\_\_

Address: \_\_\_\_\_

City: \_\_\_\_\_ State: \_\_\_\_\_ Zip: \_\_\_\_\_

IF AVAILABLE, PLEASE PLACE THE PERSONALIZED LABEL FROM YOUR PROSPECTUS IN THE ABOVE BOX.

Individual or company representative's signature: \_\_\_\_\_ Date: \_\_\_\_\_

Phone number : \_\_\_\_\_ Email (optional): \_\_\_\_\_

**THE WINNING BIDDER MUST COMPLETE THE VERIFICATION OF WORKER'S DISABILITY COMPENSATION ACT COMPLIANCE (ON REVERSE SIDE IF DOUBLE SIDED) WITHIN 21 DAYS OF SALE AWARD DATE**



FOR DEPARTMENT USE ONLY	
Sale Number (XX - XXX - XX - XX)	
Forest Management Unit:	

# TIMBER SALE VERIFICATION OF WORKER'S DISABILITY COMPENSATION ACT COMPLIANCE

As required by Act 317, P.A. 1969 (Worker's Compensation) and  
Part 5 of Act 451 of 1994, as amended.

## VERIFICATION OF WORKER'S DISABILITY COMPENSATION ACT COMPLIANCE

- This verification must be completed and submitted within 21 days of contract award and prior to the issuance of the timber sale contract.
- In addition, if boxes 2B or 2C are checked, then Notice of Exclusion or Certificate of Insurance must be submitted within twenty-one (21) days of the contract award and prior to the issuance of the timber sale contract.
- All information must be typed or printed except for written signatures.

Please Check Appropriate Categories:

1. My business is organized as (you **must** check one of the boxes below):
  - A.  Sole Proprietorship (individual)
  - B.  Partnership
  - C.  Corporation
2. You **must** check one of the boxes below:
  - A.  I certify my business is a sole proprietorship and it has no employees but the sole proprietor. I am not subject to the Worker's Compensation Laws.
  - B.  I certify my business has satisfied its obligation to the Worker's Compensation Act through the use of an approved Notice of Exclusion (BWC-337, Rev. 5/96). I will provide a copy of the Notice of Exclusion within 21 days of the contract award. (For questions or a copy of the BWC-337, please call the Worker's Compensation Bureau at 517-322-1195).
  - C.  I certify my business has a Worker's Compensation Policy. I will provide an original Certificate of Insurance within twenty-one (21) days of the contract award.
3. If you have checked item 2(A) or 2(B), you **must** indicate the number of **both** full-time and part-time employees, other than yourself, including family members and active partners (if none, you must enter "0").

\_\_\_\_\_ Full-time Employees

\_\_\_\_\_ Part-time Employees

Name of Business		Federal ID (or) Social Security No.	
Address		Telephone (       )	
City	State	ZIP	

*I hereby certify that the above information is true and correct. I agree to notify the Michigan DNR of any changes that occur in factors affecting my coverage during any of my present and future operations.*

\_\_\_\_\_  
Signature of Owner or Authorized Representative

\_\_\_\_\_  
Title

\_\_\_\_\_  
Date

Please complete the "SEALED BID" information on the next page

Broken Chimney (33-005-17)  
 ; Delta COUNTY

In response to the notice of sale to be held 3:00 p.m. (local time) on August 29, 2017, I am hereby submitting my sealed bid (firm offer) for the following forest products to be cut. Bids for individual species must be at or above the advertised price. All non-responsive bid forms may be rejected.

<u>PRODUCTS &amp; SPECIES</u>	<u>ESTIMATED VOLUME*</u>	<u>ADVERTISED PRICE</u>	<u>BID PRICE</u>
<b>Sawtimber</b>			
Black Ash	3.00 MBF	\$ 94.00/MBF	\$ _____
Paper Birch	1.10 MBF	\$ 84.00/MBF	\$ _____
Red Maple	35.30 MBF	\$ 243.00/MBF	\$ _____
Sugar Maple	22.70 MBF	\$ 373.00/MBF	\$ _____
White Ash	1.10 MBF	\$ 71.00/MBF	\$ _____
Yellow Birch	5.70 MBF	\$ 122.00/MBF	\$ _____
<b>Pulpwood</b>			
Balsam Fir	212.00 Cords	\$ 27.75/Cord	\$ _____
Mixed Hardwood	991.00 Cords	\$ 35.30/Cord	\$ _____
Mixed Spruce	62.00 Cords	\$ 25.90/Cord	\$ _____
N. White Cedar	150.00 Cords	\$ 27.85/Cord	\$ _____
Quaking Aspen	2,153.00 Cords	\$ 33.20/Cord	\$ _____

\*The volumes are statistically estimated within plus (+) or minus (-) 8.46 percent. These estimated volumes are final and not subject to adjustment. Prospective bidders are urged to examine this timber and to make their own estimates of quantity and quality.

I understand that any or all bids may be rejected. All bids must be signed and all bid items must be bid or the bid form may be rejected. I also understand that consideration and awarding a contract will be based upon my past performance and ability to complete the contract based upon equipment and staffing subject to my control.

FEDERAL ID: \_\_\_\_\_ or SOCIAL SECURITY NUMBER: \_\_\_\_\_

Company or individual bidding: \_\_\_\_\_

Company representative's name: \_\_\_\_\_

Address: \_\_\_\_\_

City: \_\_\_\_\_ State: \_\_\_\_\_ Zip: \_\_\_\_\_

IF AVAILABLE, PLEASE PLACE THE PERSONALIZED LABEL FROM YOUR PROSPECTUS IN THE ABOVE BOX.

Individual or company representative's signature: \_\_\_\_\_ Date: \_\_\_\_\_

Phone number : \_\_\_\_\_ Email (optional): \_\_\_\_\_

**THE WINNING BIDDER MUST COMPLETE THE VERIFICATION OF WORKER'S DISABILITY COMPENSATION ACT COMPLIANCE (ON REVERSE SIDE IF DOUBLE SIDED) WITHIN 21 DAYS OF SALE AWARD DATE**



FOR DEPARTMENT USE ONLY	
Sale Number (XX - XXX - XX - XX)	
Forest Management Unit:	

# TIMBER SALE VERIFICATION OF WORKER'S DISABILITY COMPENSATION ACT COMPLIANCE

As required by Act 317, P.A. 1969 (Worker's Compensation) and  
Part 5 of Act 451 of 1994, as amended.

## VERIFICATION OF WORKER'S DISABILITY COMPENSATION ACT COMPLIANCE

- This verification must be completed and submitted within 21 days of contract award and prior to the issuance of the timber sale contract.
- In addition, if boxes 2B or 2C are checked, then Notice of Exclusion or Certificate of Insurance must be submitted within twenty-one (21) days of the contract award and prior to the issuance of the timber sale contract.
- All information must be typed or printed except for written signatures.

Please Check Appropriate Categories:

1. My business is organized as (you **must** check one of the boxes below):
  - A.  Sole Proprietorship (individual)
  - B.  Partnership
  - C.  Corporation
2. You **must** check one of the boxes below:
  - A.  I certify my business is a sole proprietorship and it has no employees but the sole proprietor. I am not subject to the Worker's Compensation Laws.
  - B.  I certify my business has satisfied its obligation to the Worker's Compensation Act through the use of an approved Notice of Exclusion (BWC-337, Rev. 5/96). I will provide a copy of the Notice of Exclusion within 21 days of the contract award. (For questions or a copy of the BWC-337, please call the Worker's Compensation Bureau at 517-322-1195).
  - C.  I certify my business has a Worker's Compensation Policy. I will provide an original Certificate of Insurance within twenty-one (21) days of the contract award.
3. If you have checked item 2(A) or 2(B), you **must** indicate the number of **both** full-time and part-time employees, other than yourself, including family members and active partners (if none, you must enter "0").

\_\_\_\_\_ Full-time Employees

\_\_\_\_\_ Part-time Employees

Name of Business		Federal ID (or) Social Security No.	
Address		Telephone (       )	
City	State	ZIP	

*I hereby certify that the above information is true and correct. I agree to notify the Michigan DNR of any changes that occur in factors affecting my coverage during any of my present and future operations.*

\_\_\_\_\_  
Signature of Owner or Authorized Representative

\_\_\_\_\_  
Title

\_\_\_\_\_  
Date

Please complete the "SEALED BID" information on the next page



TWO TECHNICIANS (33-006-17)  
; Delta COUNTY

In response to the notice of sale to be held 3:00 p.m. (local time) on August 29, 2017, I am hereby submitting my sealed bid (firm offer) for the following forest products to be cut. Bids for individual species must be at or above the advertised price. All non-responsive bid forms may be rejected.

<u>PRODUCTS &amp; SPECIES</u>	<u>ESTIMATED VOLUME*</u>	<u>ADVERTISED PRICE</u>	<u>BID PRICE</u>
<b>Sawtimber</b>			
Basswood	0.40 MBF	\$ 127.00/MBF	\$ _____
Black Ash	0.70 MBF	\$ 94.00/MBF	\$ _____
Paper Birch	1.90 MBF	\$ 84.00/MBF	\$ _____
Red Maple	2.40 MBF	\$ 243.00/MBF	\$ _____
Sugar Maple	18.40 MBF	\$ 373.00/MBF	\$ _____
Yellow Birch	1.10 MBF	\$ 122.00/MBF	\$ _____
<b>Pulpwood</b>			
Balsam Fir	186.00 Cords	\$ 27.75/Cord	\$ _____
Mixed Hardwood	464.00 Cords	\$ 35.30/Cord	\$ _____
N. White Cedar	65.00 Cords	\$ 27.85/Cord	\$ _____
Quaking Aspen	441.00 Cords	\$ 33.20/Cord	\$ _____
White Spruce	34.00 Cords	\$ 25.90/Cord	\$ _____

\*The volumes are statistically estimated within plus (+) or minus (-) 11.07 percent. These estimated volumes are final and not subject to adjustment. Prospective bidders are urged to examine this timber and to make their own estimates of quantity and quality.

I understand that any or all bids may be rejected. All bids must be signed and all bid items must be bid or the bid form may be rejected. I also understand that consideration and awarding a contract will be based upon my past performance and ability to complete the contract based upon equipment and staffing subject to my control.

FEDERAL ID: \_\_\_\_\_ or SOCIAL SECURITY NUMBER: \_\_\_\_\_

Company or individual bidding: \_\_\_\_\_

Company representative's name: \_\_\_\_\_

Address: \_\_\_\_\_

City: \_\_\_\_\_ State: \_\_\_\_\_ Zip: \_\_\_\_\_

IF AVAILABLE, PLEASE PLACE THE PERSONALIZED LABEL FROM YOUR PROSPECTUS IN THE ABOVE BOX.

Individual or company representative's signature: \_\_\_\_\_ Date: \_\_\_\_\_

Phone number : \_\_\_\_\_ Email (optional): \_\_\_\_\_

**THE WINNING BIDDER MUST COMPLETE THE VERIFICATION OF WORKER'S DISABILITY COMPENSATION ACT COMPLIANCE (ON REVERSE SIDE IF DOUBLE SIDED) WITHIN 21 DAYS OF SALE AWARD DATE**



<b>FOR DEPARTMENT USE ONLY</b>
Sale Number (XX - XXX - XX - XX)
Forest Management Unit:

## TIMBER SALE VERIFICATION OF WORKER'S DISABILITY COMPENSATION ACT COMPLIANCE

*As required by Act 317, P.A. 1969 (Worker's Compensation) and  
Part 5 of Act 451 of 1994, as amended.*

### VERIFICATION OF WORKER'S DISABILITY COMPENSATION ACT COMPLIANCE

- This verification must be completed and submitted within 21 days of contract award and prior to the issuance of the timber sale contract.
- In addition, if boxes 2B or 2C are checked, then Notice of Exclusion or Certificate of Insurance must be submitted within twenty-one (21) days of the contract award and prior to the issuance of the timber sale contract.
- All information must be typed or printed except for written signatures.

Please Check Appropriate Categories:

1. My business is organized as (you **must** check one of the boxes below):
  - A.  Sole Proprietorship (individual)
  - B.  Partnership
  - C.  Corporation
2. You **must** check one of the boxes below:
  - A.  I certify my business is a sole proprietorship and it has no employees but the sole proprietor. I am not subject to the Worker's Compensation Laws.
  - B.  I certify my business has satisfied its obligation to the Worker's Compensation Act through the use of an approved Notice of Exclusion (BWC-337, Rev. 5/96). I will provide a copy of the Notice of Exclusion within 21 days of the contract award. (For questions or a copy of the BWC-337, please call the Worker's Compensation Bureau at 517-322-1195).
  - C.  I certify my business has a Worker's Compensation Policy. I will provide an original Certificate of Insurance within twenty-one (21) days of the contract award.
3. If you have checked item 2(A) or 2(B), you **must** indicate the number of **both** full-time and part-time employees, other than yourself, including family members and active partners (if none, you must enter "0").

\_\_\_\_\_ Full-time Employees

\_\_\_\_\_ Part-time Employees

Name of Business		Federal ID (or) Social Security No.	
Address		Telephone (       )	
City	State	ZIP	

*I hereby certify that the above information is true and correct. I agree to notify the Michigan DNR of any changes that occur in factors affecting my coverage during any of my present and future operations.*

\_\_\_\_\_  
Signature of Owner or Authorized Representative

\_\_\_\_\_  
Title

\_\_\_\_\_  
Date

**Please complete the "SEALED BID" information on the next page**

Berg Farm ELB (33-031-17)  
 ; Menominee COUNTY

In response to the notice of sale to be held 3:00 p.m. (local time) on August 29, 2017, I am hereby submitting my sealed bid (firm offer) for the following forest products to be cut. Bids for individual species must be at or above the advertised price. All non-responsive bid forms may be rejected.

<u>PRODUCTS &amp; SPECIES</u>	<u>ESTIMATED VOLUME*</u>	<u>ADVERTISED PRICE</u>	<u>BID PRICE</u>
<b>Sawtimber</b>			
Red Maple	1.50 MBF	\$ 243.00/MBF	\$ _____
Sugar Maple	14.60 MBF	\$ 373.00/MBF	\$ _____
<b>Pulpwood</b>			
Balsam Fir	157.00 Cords	\$ 27.75/Cord	\$ _____
Mixed Aspen	181.00 Cords	\$ 33.20/Cord	\$ _____
Mixed Hardwood	599.00 Cords	\$ 35.30/Cord	\$ _____
Mixed Spruce	237.00 Cords	\$ 25.90/Cord	\$ _____
N. White Cedar	754.00 Cords	\$ 27.85/Cord	\$ _____
Tamarack	262.00 Cords	\$ 17.55/Cord	\$ _____
White Pine	2.00 Cords	\$ 36.10/Cord	\$ _____

\*The volumes are statistically estimated within plus (+) or minus (-) 10.49 percent. These estimated volumes are final and not subject to adjustment. Prospective bidders are urged to examine this timber and to make their own estimates of quantity and quality.

I understand that any or all bids may be rejected. All bids must be signed and all bid items must be bid or the bid form may be rejected. I also understand that consideration and awarding a contract will be based upon my past performance and ability to complete the contract based upon equipment and staffing subject to my control.

FEDERAL ID: \_\_\_\_ - \_\_\_\_ - \_\_\_\_ or SOCIAL SECURITY NUMBER: \_\_\_\_ - \_\_\_\_ - \_\_\_\_  
 Company or individual bidding: \_\_\_\_\_  
 Company representative's name: \_\_\_\_\_  
 Address: \_\_\_\_\_  
 City: \_\_\_\_\_ State: \_\_\_\_\_ Zip: \_\_\_\_\_

IF AVAILABLE, PLEASE PLACE THE PERSONALIZED LABEL FROM YOUR PROSPECTUS IN THE ABOVE BOX.

Individual or company representative's signature: \_\_\_\_\_ Date: \_\_\_\_\_  
 Phone number : \_\_\_\_\_ Email (optional): \_\_\_\_\_

**THE WINNING BIDDER MUST COMPLETE THE VERIFICATION OF WORKER'S DISABILITY COMPENSATION ACT COMPLIANCE (ON REVERSE SIDE IF DOUBLE SIDED) WITHIN 21 DAYS OF SALE AWARD DATE**



Westman Pit (33-032-17)  
 ; Menominee COUNTY

In response to the notice of sale to be held 3:00 p.m. (local time) on August 29, 2017, I am hereby submitting my sealed bid (firm offer) for the following forest products to be cut. Bids for individual species must be at or above the advertised price. All non-responsive bid forms may be rejected.

<u>PRODUCTS &amp; SPECIES</u>	<u>ESTIMATED VOLUME*</u>	<u>ADVERTISED PRICE</u>	<u>BID PRICE</u>
<b>Sawtimber</b>			
Basswood	18.70 MBF	\$ 127.00/MBF	\$ _____
Red Maple	15.20 MBF	\$ 243.00/MBF	\$ _____
Sugar Maple	11.10 MBF	\$ 373.00/MBF	\$ _____
White Ash	0.50 MBF	\$ 75.00/MBF	\$ _____
White Pine	4.90 MBF	\$ 72.00/MBF	\$ _____
Yellow Birch	0.50 MBF	\$ 122.00/MBF	\$ _____
<b>Pulpwood</b>			
Balsam Fir	246.00 Cords	\$ 27.75/Cord	\$ _____
Hemlock	20.00 Cords	\$ 11.50/Cord	\$ _____
Mixed Aspen	541.00 Cords	\$ 33.20/Cord	\$ _____
Mixed Hardwood	878.00 Cords	\$ 35.30/Cord	\$ _____
N. White Cedar	160.00 Cords	\$ 27.85/Cord	\$ _____
White Pine	3.00 Cords	\$ 36.10/Cord	\$ _____
White Spruce	23.00 Cords	\$ 25.90/Cord	\$ _____

\*The volumes are statistically estimated within plus (+) or minus (-) 11.91 percent. These estimated volumes are final and not subject to adjustment. Prospective bidders are urged to examine this timber and to make their own estimates of quantity and quality.

I understand that any or all bids may be rejected. All bids must be signed and all bid items must be bid or the bid form may be rejected. I also understand that consideration and awarding a contract will be based upon my past performance and ability to complete the contract based upon equipment and staffing subject to my control.

FEDERAL ID: \_\_\_\_\_ or SOCIAL SECURITY NUMBER: \_\_\_\_\_

Company or individual bidding: \_\_\_\_\_

Company representative's name: \_\_\_\_\_

Address: \_\_\_\_\_

City: \_\_\_\_\_ State: \_\_\_\_\_ Zip: \_\_\_\_\_

IF AVAILABLE, PLEASE PLACE THE PERSONALIZED LABEL FROM YOUR PROSPECTUS IN THE ABOVE BOX.

Individual or company representative's signature: \_\_\_\_\_ Date: \_\_\_\_\_

Phone number : \_\_\_\_\_ Email (optional): \_\_\_\_\_

**THE WINNING BIDDER MUST COMPLETE THE VERIFICATION OF WORKER'S DISABILITY COMPENSATION ACT COMPLIANCE (ON REVERSE SIDE IF DOUBLE SIDED) WITHIN 21 DAYS OF SALE AWARD DATE**



<b>FOR DEPARTMENT USE ONLY</b>
Sale Number (XX - XXX - XX - XX)
Forest Management Unit:

## TIMBER SALE VERIFICATION OF WORKER'S DISABILITY COMPENSATION ACT COMPLIANCE

*As required by Act 317, P.A. 1969 (Worker's Compensation) and  
Part 5 of Act 451 of 1994, as amended.*

### VERIFICATION OF WORKER'S DISABILITY COMPENSATION ACT COMPLIANCE

- This verification must be completed and submitted within 21 days of contract award and prior to the issuance of the timber sale contract.
- In addition, if boxes 2B or 2C are checked, then Notice of Exclusion or Certificate of Insurance must be submitted within twenty-one (21) days of the contract award and prior to the issuance of the timber sale contract.
- All information must be typed or printed except for written signatures.

Please Check Appropriate Categories:

1. My business is organized as (you **must** check one of the boxes below):
  - A.  Sole Proprietorship (individual)
  - B.  Partnership
  - C.  Corporation
2. You **must** check one of the boxes below:
  - A.  I certify my business is a sole proprietorship and it has no employees but the sole proprietor. I am not subject to the Worker's Compensation Laws.
  - B.  I certify my business has satisfied its obligation to the Worker's Compensation Act through the use of an approved Notice of Exclusion (BWC-337, Rev. 5/96). I will provide a copy of the Notice of Exclusion within 21 days of the contract award. (For questions or a copy of the BWC-337, please call the Worker's Compensation Bureau at 517-322-1195).
  - C.  I certify my business has a Worker's Compensation Policy. I will provide an original Certificate of Insurance within twenty-one (21) days of the contract award.
3. If you have checked item 2(A) or 2(B), you **must** indicate the number of **both** full-time and part-time employees, other than yourself, including family members and active partners (if none, you must enter "0").

\_\_\_\_\_ Full-time Employees

\_\_\_\_\_ Part-time Employees

Name of Business		Federal ID (or) Social Security No.	
Address		Telephone (       )	
City	State	ZIP	

*I hereby certify that the above information is true and correct. I agree to notify the Michigan DNR of any changes that occur in factors affecting my coverage during any of my present and future operations.*

\_\_\_\_\_  
Signature of Owner or Authorized Representative

\_\_\_\_\_  
Title

\_\_\_\_\_  
Date

**Please complete the "SEALED BID" information on the next page**