



**DEPARTMENT OF NATURAL RESOURCES
STATE OF MICHIGAN**

TIMBER SALE PROSPECTUS #6161

SCHEDULED SALE DATE AND TIME: 3:00 p.m. (local time) on June 26, 2018.

LOCATION: INDIAN RIVER FIELD OFFICE, 6984 WILSON RD, INDIAN RIVER, MI 49749.

PROSPECTUS NOTE: The bidder is advised to inspect the sale area and review the location, estimated volumes, operating costs and contract terms of proposed sales. Please be aware that some landowners may request 60 days or more notice for access across their land.

Notice is hereby given that bids will be received by the Unit Manager, GAYLORD MANAGEMENT UNIT, for certain timber on the following described lands:

Clean Crumley Mix (52-108-17)

Cheboygan County, Advertised Price \$221,979.45, 226.8 Acres, Aspen, Hardwood.

SALE NOTE: A recreation site such as a trail, pathway, or campground is within the sale area or the vicinity. Certain restrictions/specifications may be applicable including time restrictions.

COMP 180 MIX (52-134-17)

Cheboygan County, Advertised Price \$175,784.30, 222.4 Acres, Aspen, Hardwood.

SALE NOTE: Good volumes, good access, large acreage.

Early Start Mix (52-137-17)

Cheboygan County, Advertised Price \$6,454.70, 27.0 Acres, Red Pine, White Pine.

SALE NOTE: Good access to entirety of sale off of county roads.

BID INSTRUCTIONS (VER. 11/28/2017):

1. Scheduled Bid Location, Date, and Time (2/11)

Bids must be received by the Unit Manager, INDIAN RIVER OFFICE, 6984 WILSON RD, INDIAN RIVER, MI 49749, no later than 3:00 p.m. (local time) on June 26, 2018. For further information concerning this sale, contact Joyce Angel at 989-732-3541 extension 5440.

2. Bidder's Qualifications (5/16)

Purchaser shall obtain workers compensation insurance to cover claims under Michigan's Worker's Disability Compensation Act of 1969 or similar employee benefit act of any other state applicable to an employee. If all or part of a timber sale was prepared by a private contractor, the contractor and that contractor's company are not permitted to bid on the timber sale contract. Bids will not be accepted from individuals or companies appearing on the DNR/FRD No-Bid List. This list contains the names of purchasers who previously failed to execute a contract within 21-days or who have a history of poor performance.

3. Preparation of Sealed Bids (5/16)

Bid Forms may be completed online thru Michigan DNR Timber Sale Online Bidding (OLB) at www.michigan.gov/timberbidding or by completing the hardcopy Bid Form found in the Timber Sale Prospectus. Hardcopy Bid Forms shall be manually signed in ink. Registration in OLB is considered your 'signature' for all bids submitted thru that system. Bid prices must be entered for each species and product in the Bid Price column for all material subject to bidding and all fill-in blanks must be completed. If erasures or other changes appear on the hardcopy Bid Form, each erasure or change must be initialed by the person signing the bid.

4. Submission of Sealed Bids (5/16)

Bid forms may be obtained from the Unit Manager or thru OLB. Bids may be submitted hardcopy or thru OLB. All hardcopy bids must be submitted on the bid form and in an envelope clearly identified as described in this section. NOTE: Only one bid form per bid envelope. Sealed bids must be submitted to the Unit office designated in the prospectus and must be submitted at or prior to the time established in the prospectus. The envelope should show on the outside (a) the sale name or number and (b) the date and time of bid opening, as shown in the prospectus. Bids received after the time specified in the sale prospectus are late bids and will be rejected.

It is possible for a bidder to submit multiple bids on a single sale. For example, a bid may be submitted hardcopy and a bid may be submitted thru OLB. Or, two bidders from the same company could both submit bids on the same sale. If this were to happen, the State would accept all bids received and award the contract accordingly. All bidding and contractual requirements would apply to all bids received.

5. Public Opening of Sealed Bids (7/16)

If conditions permit, the sealed bids will be publicly opened and posted at the time and place set in the prospectus.

If a bidder, present at a bid opening, has submitted bids on more than one sale, that bidder may withdraw their unopened bid envelopes or announce the withdrawal of their online bid after being declared the successful bidder on one sale.

6. Award of Contract (1/11)

Award of the contract will be made to the Bidder whose bid, conforming to the prospectus, is most advantageous to the State of Michigan on the basis of total value at rates bid for the estimated quantities. The State reserves the right to reject any bid or waive any minor irregularity in bids received. A written award mailed (or otherwise furnished) to the successful Bidder shall be deemed to result in a binding contract without further action by either party.

7. Down Payment (1/11)

The Bidder to whom award is made must make a down payment within 21 days of the sale award. The amount of the down payment will be calculated as shown in the Bond and Payment Schedule of this prospectus. Only cash may be used to meet this requirement.

8. Performance Security (1/11)

As guarantee of faithful performance, a cash bond, certificate of deposit, surety bond or irrevocable letter of credit (LOC) is required within 21 days of the sale award. The amount of the performance security is shown in the Bond and

Payment Schedule of this prospectus. If an LOC or surety is used, the coverage must extend for at least 6 months beyond the contract expiration.

9. Timber Sale Contract (11/17)

Additional conditions and requirements common to all timber sales are listed on the timber sale contract (R4031) and are available on line at www.michigan.gov/timber. Contact the Unit Manager for additional information or a sample contract. Within 21 days of the date of the award letter, the bidder must sign the contract and provide the required down payment, performance security, and verification of worker's disability compensation. The down payment and performance security shall be in accordance with the provisions of the timber sale contract, in the sums stated in this prospectus. If these actions are not taken, then the Bidder, the Bidder's corporation, and the corporation's principals may not be permitted to bid on State timber sales for a period of 1 year. In addition, the Bidder certifies that if awarded this contract, the Bidder will complete the timber sale contract in accordance with its terms and any modifications thereof including requirements to purchase, cut, and remove the included timber by the expiration date.

Payment Unit values in the State Forest Timber Sale Contract are calculated based on the advertised value of the Payment Unit as a percentage of the total advertised value of the contract. The advertised value of each Payment Unit is given in the Description of Timber by Payment Unit table on the Timber Sale Information page. For example, if the value of Payment Unit 1 is advertised as \$1,500 and the total Timber Sale value is advertised as \$10,000, the contract price for Payment Unit 1 will be 15% of the total bid price ($\$1,500/\$10,000 * 100$).

10. Disclaimer of Estimates and Bidder's Warranty of Inspection (7/16)

Before submitting this bid, the Bidder is advised and cautioned to inspect the sale area, review the requirements of the sale contract, and take other steps as may be reasonably necessary to ascertain the location, estimated volumes, construction estimates, and operating costs of the proposed sale. Failure to do so will not relieve the Bidder from responsibility for completing the contract.

The Bidder warrants that this bid is submitted solely on the basis of the Bidder's examination and inspection of the quality and quantity of the timber offered for sale and the Bidder's opinion of the value thereof and the costs of recovery. No reliance should be placed on the State of Michigan's estimates of timber quality, quantity or costs of recovery. Bidder further acknowledges that the State of Michigan: (i) expressly disclaims any warranty of fitness of timber for any purpose; (ii) offers this timber as is without any warranty of quality (merchantability) or quantity and (iii) expressly disclaims any warranty as to the quantity or quality of timber sold.

11. Certification and Chain-of-Custody (10/14)

Unless otherwise indicated in the contract under section 7 – Other Conditions of the Sale Specific Conditions & Requirements, the area encompassed by this timber sale is certified to the standards of the Forest Stewardship Council (FSC) - Certificate #SCS-FM/COC-00090N and the Sustainable Forestry Initiative (SFI) - Certificate # NSF-SFIS-5Y031-SF5. Forest products from this sale may be delivered to the mill as "FSC 100% and / or SFI certified" as long as the contractor hauling the forest products is chain-of-custody (COC) certified or covered under a COC certificate from the destination mill. The purchaser is responsible for maintaining COC after leaving the sale area.

12. Good Neighbor Authority (GNA) Requirements (7/16)

If the name of this timber sales contains the acronym GNA, it is authorized by the Good Neighbor Authority (GNA) and covered by various agreements between the U.S. Forest Service and the State. The timber sale occurs on federal land and the following conditions apply:

GNA contracts on US Forest Service land will not be awarded to purchasers on the Federal list of excluded parties. The System for Award Management (SAM) will be checked for active excluded parties prior to award of contract. In addition, the Bidder to whom award is made must complete an Assurance Regarding Felony Conviction or Tax Delinquent Status for Corporate Applicants (AD-3031).

13. Good Neighbor Authority (GNA) Requirements, con't (9/16)

Bidder certifies, by signing this bid form, that to the best of Bidder's knowledge that the following representations are accurate and complete.

a. That the Bidder and its principals are not presently debarred, suspended, proposed for debarment, declared ineligible, or voluntary excluded from timber sales (covered transactions) by any Federal department or agency.

b. That the Bidder and its principals have not within a 3-year period preceding this bid been convicted of or had a civil judgment rendered against them for commission of fraud or a criminal offense in connection with obtaining, attempting to obtain, or performing a public (Federal, State, or local) transaction or contract under a public transaction; violation of Federal or State antitrust statutes or commission of embezzlement, theft, forgery, bribery, falsification or destruction of records, making false statements, or receiving stolen property.

c. That the Bidder and its principals are not presently indicted for or otherwise criminally or civilly charged by a governmental entity (Federal, State, or local) with commission of any of the offenses enumerated in paragraph b of this certification.

d. That the Bidder and its principals have not within a 3-year period preceding this bid had one or more public transactions (Federal, State, or local) terminated for breach or default of a timber or forest product contract.

Bidders that cannot certify this requirement, in whole or in part, shall submit an explanation with their bid.

KEITH CREAGH

Director

TIMBER SALE INFORMATION

Clean Crumley Mix (52-108-17)

Cheboygan County (Advertised Price \$221,979.45)

SALE NOTE: A recreation site such as a trail, pathway, or campground is within the sale area or the vicinity. Certain restrictions/specifications may be applicable including time restrictions.

A timber sale contract for this lump sum, sealed bid timber sale will be awarded to the responsible bidder offering the highest sealed bid price. Bids must be at or above the following advertised price for each species:

<u>PRODUCTS & SPECIES</u>	<u>ESTIMATED UNITS*</u>		<u>ADVERTISED PRICE</u>
Sawtimber			
Mixed Aspen	74.60	MBF	\$ 58.00 / MBF
Mixed Oak	220.40	MBF	\$ 105.00 / MBF
N. White Cedar	30.80	MBF	\$ 49.00 / MBF
Paper Birch	13.90	MBF	\$ 61.00 / MBF
Red Maple	59.30	MBF	\$ 140.00 / MBF
Red Pine	205.00	MBF	\$ 107.00 / MBF
White Pine	79.90	MBF	\$ 57.00 / MBF
Pulpwood			
Balsam Fir	152.00	Cords	\$ 22.20 / Cord
Jack Pine	367.00	Cords	\$ 28.60 / Cord
Mixed Aspen	1,398.00	Cords	\$ 20.35 / Cord
Mixed Hardwood	837.00	Cords	\$ 24.65 / Cord
Mixed Oak	1,978.00	Cords	\$ 24.10 / Cord
Mixed Spruce	173.00	Cords	\$ 37.00 / Cord
N. White Cedar	158.00	Cords	\$ 25.00 / Cord
Red Pine	438.00	Cords	\$ 45.80 / Cord
White Pine	577.00	Cords	\$ 28.30 / Cord

* The total volume is statistically estimated within plus (+) or minus (-) 5.97 percent. The estimated units are final and not subject to adjustment. Prospective bidders are urged to examine this timber and to make their own estimates of quantity and quality.

BOND AND PAYMENT SCHEDULE:

1. A bond in the amount of \$11,099.00 to insure faithful performance of the conditions of the contract will be deposited by the successful bidder within 21 days of the sale award.
2. Cutting in any sale or unit without the required advance payment would be considered a trespass.
3. Total payment must be paid in advance or according to the following schedule:
 - (a) Ten percent (10%) of the sale value must be paid within 21 days of the sale award.
 - (b) The 10% down payment will be credited towards the first unit cut.
 - (c) Payment for each of the following units must be made before cutting begins in that unit:

PAYMENT UNIT NUMBER	PERCENT OF TOTAL SALE VALUE
01	17.5%
02	6.2%
03	11.7%
04	21.7%
05	8.6%
06	16.4%
07	17.9%

4. If no cutting takes place, the 10% down payment will not be refunded.
5. Operations on the contract issued will terminate on 09/30/2021.

Description of Timber by Payment Unit (PU)

PU	MARKET GROUP	PRODUCT	QUANTITY	UNIT	ACRES	ADVERTISE PRICE	
1	Mixed Aspen	Sawtimber	3.3	MBF	34.2	\$38,830.00	
	<i>B. T. Aspen</i>		3.3	<i>MBF</i>			
	Mixed Oak		4.3	MBF			
	<i>Red Oak</i>		4.3	<i>MBF</i>			
	Red Pine		117.4	MBF			
	Balsam Fir		Pulpwood	9.0			Cords
	Jack Pine			285.0			Cords
	<i>Jack Pine</i>		<i>Sawtimber</i>	1.1			<i>MBF</i>
	<i>Jack Pine</i>		<i>Pulpwood</i>	283.0			<i>Cords</i>
	Mixed Aspen		265.0	Cords			
	<i>B. T. Aspen</i>		265.0	<i>Cords</i>			
	Mixed Hardwood		5.0	Cords			
	<i>Red Maple</i>		5.0	<i>Cords</i>			
	Mixed Oak		49.0	Cords			
	<i>Red Oak</i>		49.0	<i>Cords</i>			
	Red Pine		205.0	Cords			
White Pine	42.0	Cords					
2	Mixed Aspen	Sawtimber	12.6	MBF	18.9	\$13,862.45	
	<i>B. T. Aspen</i>		12.6	<i>MBF</i>			
	Red Maple		2.2	MBF			
	Red Pine		12.0	MBF			
	White Pine		3.4	MBF			
	Balsam Fir		Pulpwood	16.0			Cords
	Jack Pine			20.0			Cords
	<i>Jack Pine</i>		20.0	<i>Cords</i>			
	Mixed Aspen		300.0	Cords			
	<i>B. T. Aspen</i>		300.0	<i>Cords</i>			
	Mixed Hardwood		63.0	Cords			
	<i>Red Maple</i>		63.0	<i>Cords</i>			
	Red Pine		30.0	Cords			
White Pine	49.0	Cords					
3	Mixed Aspen	Sawtimber	23.7	MBF	35.4	\$25,963.70	
	<i>B. T. Aspen</i>		23.7	<i>MBF</i>			
	Red Maple		4.2	MBF			
	Red Pine		22.4	MBF			
	White Pine		6.3	MBF			
	Balsam Fir		Pulpwood	29.0			Cords
	Jack Pine			38.0			Cords
	<i>Jack Pine</i>		38.0	<i>Cords</i>			
	Mixed Aspen		561.0	Cords			
	<i>B. T. Aspen</i>		561.0	<i>Cords</i>			
	Mixed Hardwood		117.0	Cords			
	<i>Red Maple</i>		117.0	<i>Cords</i>			
	Red Pine		57.0	Cords			
White Pine	92.0	Cords					
4	Mixed Aspen	Sawtimber	1.8	MBF	46.9	\$48,062.45	
	<i>Quaking Aspen</i>		1.8	<i>MBF</i>			
	Mixed Oak		2.1	MBF			
	<i>Red Oak</i>		2.1	<i>MBF</i>			
	N. White Cedar		30.8	MBF			
	Paper Birch		13.9	MBF			
	Red Maple		52.9	MBF			
	Red Pine		32.8	MBF			
	White Pine		29.5	MBF			
	Balsam Fir		Pulpwood	98.0			Cords
	Mixed Aspen			27.0			Cords

Description of Timber by Payment Unit (PU), con't

PU	MARKET GROUP	PRODUCT	QUANTITY	UNIT	ACRES	ADVERTISE PRICE					
4 con't	<i>Quaking Aspen</i>	<i>Pulpwood</i>	27.0	<i>Cords</i>							
	Mixed Hardwood		564.0	Cords							
	<i>Paper Birch</i>		103.0	<i>Cords</i>							
	<i>Red Maple</i>		461.0	<i>Cords</i>							
	Mixed Oak		33.0	Cords							
	<i>Red Oak</i>		33.0	<i>Cords</i>							
	Mixed Spruce		173.0	Cords							
	<i>Black Spruce</i>		<i>Sawtimber</i>	15.4			<i>MBF</i>				
	<i>Black Spruce</i>			142.0			<i>Cords</i>				
	N. White Cedar		<i>Pulpwood</i>	158.0			Cords				
	Red Pine			55.0			Cords				
	White Pine			88.0			Cords				
5	Mixed Aspen	Sawtimber	7.1	MBF	20.0	\$19,178.95					
	<i>B. T. Aspen</i>		7.1	<i>MBF</i>							
	Mixed Oak		47.7	MBF							
	<i>Red Oak</i>		47.7	<i>MBF</i>							
	Red Pine		3.6	MBF							
	White Pine		2.5	MBF							
	Jack Pine		Pulpwood	24.0			Cords				
	<i>Jack Pine</i>			24.0			<i>Cords</i>				
	Mixed Aspen			30.0			Cords				
	<i>B. T. Aspen</i>			30.0			<i>Cords</i>				
	Mixed Hardwood			19.0			Cords				
	<i>Red Maple</i>			19.0			<i>Cords</i>				
	Mixed Oak			357.0			Cords				
	<i>Red Oak</i>			344.0			<i>Cords</i>				
	<i>White Oak</i>			13.0			<i>Cords</i>				
	Red Pine			18.0			Cords				
	White Pine			72.0			Cords				
	6			Mixed Aspen			Sawtimber	12.5	MBF	34.2	\$36,425.90
<i>B. T. Aspen</i>		12.5		<i>MBF</i>							
Mixed Oak		79.6		MBF							
<i>Red Oak</i>		62.9		<i>MBF</i>							
<i>White Oak</i>		16.7		<i>MBF</i>							
Red Pine		8.0		MBF							
White Pine		18.3		MBF							
Mixed Aspen		Pulpwood	103.0	Cords							
<i>B. T. Aspen</i>			103.0	<i>Cords</i>							
Mixed Hardwood			33.0	Cords							
<i>Red Maple</i>			33.0	<i>Cords</i>							
Mixed Oak			737.0	Cords							
<i>Red Oak</i>			586.0	<i>Cords</i>							
<i>White Oak</i>			151.0	<i>Cords</i>							
Red Pine			35.0	Cords							
White Pine			112.0	Cords							
7			Mixed Aspen	Sawtimber	13.6	MBF		37.2	\$39,656.00		
			<i>B. T. Aspen</i>		13.6	<i>MBF</i>					
	Mixed Oak		86.7		MBF						
	<i>Red Oak</i>		68.5		<i>MBF</i>						
	<i>White Oak</i>		18.2		<i>MBF</i>						
	Red Pine		8.8		MBF						
	White Pine		19.9		MBF						
	Mixed Aspen		Pulpwood		112.0	Cords					
	<i>B. T. Aspen</i>				112.0	<i>Cords</i>					
	Mixed Hardwood	36.0			Cords						
	<i>Red Maple</i>	36.0			<i>Cords</i>						

Description of Timber by Payment Unit (PU), con't

PU	MARKET GROUP	PRODUCT	QUANTITY	UNIT	ACRES	ADVERTISE PRICE
7 con't	Mixed Oak	Pulpwood	802.0	Cords		
	<i>Red Oak</i>		637.0	<i>Cords</i>		
	<i>White Oak</i>		165.0	<i>Cords</i>		
	Red Pine		38.0	Cords		
	White Pine		122.0	Cords		
TOTAL:			683.9	MBF		
TOTAL:			6,078.0	Cords		

Sale Specific Conditions & Requirements

Sale Name: Clean Crumley Mix

Sale Number: 52-108-17 Seq#: 1

1 - Sale Area

1.2 - Boundaries

1.2.1 - Painted boundaries (1/14)

The sale boundary and Payment Unit boundaries are marked and identified by blue, red and yellow paint. Exterior sale boundary lines against private property are marked with blue paint. Exterior sale boundary lines against state are marked with red paint. Interior Payment Unit boundaries are marked with yellow paint. The painted boundary line trees are not Included Timber and are to be protected.

2 - Timber Specifications

2.1 - Included Timber

2.1.1 - Clearcut unit(s) with unmerchantable trees (6/14)

Within Payment Unit(s) 1-7, cut all trees that are two (2) inches or more at DBH, except do not cut trees marked with green paint.

2.2 - Utilization

2.2.2 - Chipping required (5/14)

Payment Units 1, 6 and 7 must be chip harvested to facilitate subsequent prescribed burning and planting operations. The Purchaser has the option to produce sawlogs or pulpwood bolts, but the remaining portion of the trees must be chipped and hauled. Do not chip 1/6 to 1/3 of the slash from harvested trees (tree tops and limbs less than four inches in diameter).

2.2.3 - Stump heights (4/07)

Stump heights within Payment Unit(s) 1 shall not exceed 12 inches for trees greater than 10 inches DBH and 4 inches for trees smaller than 10 inches DBH. This is in order to facilitate planting operations.

3 - Payments

3.3 - Pre-measured Sales

3.3.4 - Dividing payment units (7/14)

Payment Unit(s) 1-7 may be divided at the request of the Purchaser and upon approval of the Unit Manager. Dividing Payment Units is a contract modification which requires a Timber Sale Contract Supplement. There will be only one division per Payment Unit.

3.4 - Damaged Timber

3.4.1 - Damaged timber (6/14)

General Condition and Requirement 3.4 Damaged Timber, defines liquidated damages for undesignated live merchantable trees which are cut or injured. In addition, extreme care should be taken to avoid damage to tree seedlings and saplings.

Within the regenerating blocks adjacent to Payment Unit 5, if more than 5% of the tree seedlings or saplings (1/4" to 4.5" DBH) are damaged, liquidated damages will be assessed at \$300.00 per acre for all acreage within that specified portion of the sale area that was damaged.

No damage is acceptable to merchantable trees. Within the sale area, if more than 5% of trees (> 4.5" DBH) within a specified area of the sale are damaged, liquidated damages will be assessed for all trees damaged. Rates will be in accordance with General Condition and Requirement 3.4 Damaged Timber.

4 - Transportation

4.1 - Construction

4.1.4 - Timber removed for construction (12/09)

Trees cut or damaged in the process of pre-approved road, landing or skid trail construction will be decked in an area separate from other Designated Timber and not removed until measured by the sale administrator. Payment will be made at the specified Purchase Unit Price.

4.1.6 - Road construction (1/09)

Construction of new roads or improvements of existing roads shall be done in such a way as to minimize the environmental and visual impacts. Merchantable trees shall be cut and utilized unless otherwise directed. Non-merchantable trees shall be severed and laid flat on the ground. Slash shall be scattered, and not left in windrows and kept a minimum of 10 feet back from the road edge. Stumps shall be set upright, not left on edge, and be moved at least 10 feet away from the road edge. Disturbed soil shall be feathered into the woods and not left in berms or windrows.

4.1.7 - Road closure (10/11)

All new roads built into the sale must be blocked to vehicle traffic upon completion of the sale. In general, this will require constructing a four (4') foot high berm of stumps and logs covered with earth. Stumps and brush must be placed along the remainder of the trail. These roads must be rendered impassable to cars and trucks. All stumps from road building and landing construction must be reserved to block any newly constructed roads upon completion of the sale. These stumps must be scattered along the road system to prohibit vehicular movement. Contact the sale administrator for specific details of design and placement.

4.2 - Maintenance

4.2.5 - Two wheel drive condition (2/04)

All existing trail roads on and adjacent to the sale area must be passable by two-wheel drive traffic for the duration of the sale.

5 - Operations

5.1 - Notification

5.1.1 - Pre-sale conference (10/16)

A pre-sale conference on site between the Purchaser and sale administrator is required prior to beginning any operations to determine landing and road locations. The Unit Manager or his/her representative must be contacted at least 3 days in advance to schedule the conference.

5.1.6 - Utility R.O.W. (1/15)

It is the responsibility of the Purchaser to obtain permission from the utility company to utilize the power line R.O.W. for operations.

5.2 - Conduct of Operations

5.2.2 - Hazard Trees/Snags

5.2.2.1 - Den trees (10/16)

Obvious hollow and/or den trees shall be protected and left standing unless they are a safety hazard.

5.2.3 - Operating Restrictions

5.2.3.4 - Oak wilt restriction (4/17)

Within Payment Unit(s) 2-7, unless changed by written agreement, cutting, skidding, and hauling are not permitted during the period of April 15 to July 15. This is necessary to reduce the spread of oak wilt. For more information, contact the Unit Manager or his/her representative.

5.2.3.6 - Bark beetle restriction (12/08)

In the event drought creates a high risk of pine bark beetle infestation, pine is not to be cut during the period March 1 through July 1, unless all portions of trees greater than two inches in diameter are removed from the sale area, reduced to chips, or treated to the satisfaction of the Unit Manager or his/her representative, within fifteen days of being severed from the stump. Pine log decks, pulpwood piles and treetops that are piled for chipping in the fall or winter within a 1/4 mile of susceptible sites must be removed before March 15. Residual slash must not be placed in piles or rows and must be spread over the site for quick drying. The Department of Natural Resources will exercise this specification if the risk of damage warrants.

5.2.22 - Operating Caution

5.2.22.1 - Operating caution (6/11)

It is recommended, but not required, that within Payment Unit(s) 4, cutting and skidding occur during dry summer or frozen winter conditions. The reason for the recommendation is because of seasonally wet soils.

5.2.39 - ORV trail/route protection (12/12)

Crumley Creek Road is an ORV trail and is shown on the Timber Sale Map. Do not damage posts with orange ORV markers. Trees with orange ORV markers shall be cut off above the markers and at least 5 feet above ground. Maintain a 20 foot wide slash, debris, and rut free zone daily using the ORV trail or route as the centerline.

5.4 - Soil Protection

5.4.1 - Rutting restriction, general (7/16)

Operations are to cease immediately if equipment and weather conditions result in rutting of roads and/or skid trails which is 12 inches or greater in depth and 50 feet in length. The Unit Manager or his/her representative may restrict hauling and/or skidding if ruts exceed the specified depth. With the Unit Manager or his/her representative's approval, the Purchaser may return to the area when the risk of rutting has decreased.

5.8 - Protection of Endangered Species

5.8.5 - Protection of raptor nests (3/13)

All trees with raptor nests will be protected if found during harvesting operations. Notification will be made to the Unit Manager or his/her representative who will notify the Wildlife Biologist so an on-site evaluation and recommendation can be made, if necessary.

6 - Safety and Fire Prevention

6.2 - Signing

6.2.3 - Recreational trail posting (2/10)

The Purchaser is responsible for posting and maintaining caution signs on Crumley Creek Road prior to beginning operations. The trail must be posted at appropriate distances from the sale area to warn of logging activity and truck traffic at both ends of the trail. Signs must be removed when harvest operations are suspended or completed. The Purchaser will provide these signs.



TIMBER SALE MAP

This information provided by authority of Part 525, 1994 PA 451, as amended.

Forest Management Unit GFMU - Indian River Field Office		County Cheboygan	Mapped By Harig	Date 08/22/2017	Page 1	of 2
Township 34N	Range 02W	Section(s) and Subdivision(s) Parts of sections 4, 8, 9 and 16.			Scale 1:15,840	

Cover Type				Density			
A = Aspen	H = Hemlock	N = Marsh	U = Upland Brush	0 = Non Stocked	5 = Pole Timber Medium		
B = Paper Birch	J = Jack Pine	O = Oak	UM = Upland Mixed	1 = Seedling Sapling Poor	6 = Pole Timber Well		
C = Cedar	L = Lowland Brush	P = Lowland Poplar	V = Bog or Marsh	2 = Seedling Sapling Medium	7 = Saw Timber Poor		
D = Tread Bog	LM = Lowland Mixed	Q = Mixed Swamp Conifer	W = White Pine	3 = Seedling Sapling Well	8 = Saw Timber Medium		
E = Swamp Hdwoods	M = Mpl, Bch, Brch	R = Red Pine	X = Non Stocked	4 = Pole Timber Poor	9 = Saw Timber Well		
F = Spruce Fir	MC = Mixed Conifer	S = Black Spruce	Z = Water				
G = Grass	MD = Mixed Deciduous	T = Tamarack					

PU	Acres	PU	Acres
1	34.2	5	20.0
2	18.9	6	34.2
3	35.4	7	37.2
4	46.9		

Clean Crumley Mix

Compartment 169

226.8 Acres

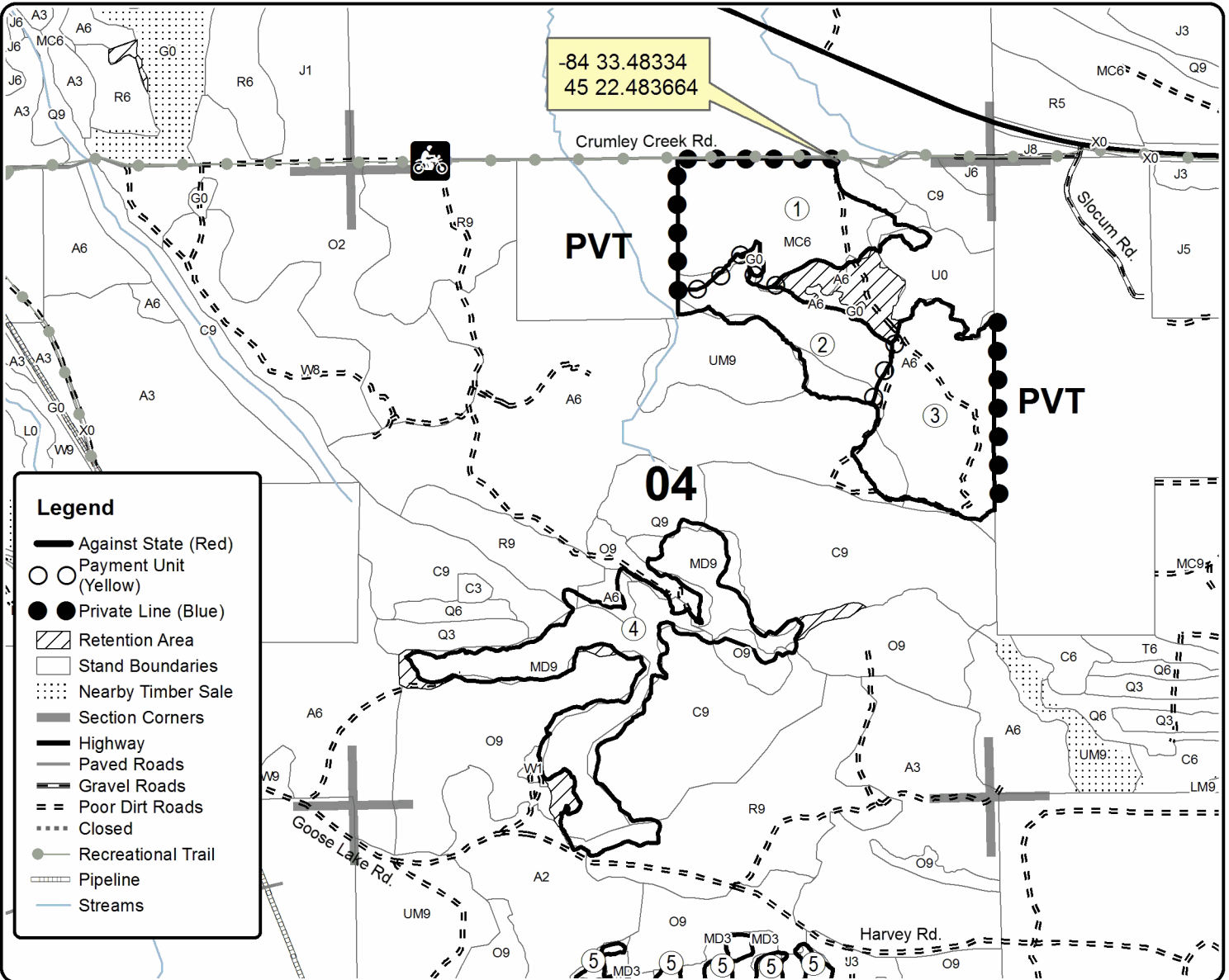



TIMBER SALE MAP

This information provided by authority of Part 525, 1994 PA 451, as amended.

Forest Management Unit Your Management Unit	County County Name	Mapped By Ruppen	Date 09/20/2017	Page 2	of 2
Cruised By VanOss Forestry Services		Scale 1:25,000			

Township 27 N	Range 9 W	Section(s) and Subdivision(s) Sec 19 NENW NWNW	Scale 1:25,000
------------------	--------------	---	-------------------

Cover Type				Density			
A = Aspen	H = Hemlock	N = Marsh	U = Upland Brush	0 = Non Stocked	5 = Pole Timber Medium		
B = Paper Birch	J = Jack Pine	O = Oak	UM = Upland Mixed	1 = Seedling Sapling Poor	6 = Pole Timber Well		
C = Cedar	L = Lowland Brush	P = Lowland Poplar	V = Bog or Marsh	2 = Seedling Sapling Medium	7 = Saw Timber Poor		
D = Treed Bog	LM = Lowland Mixed	Q = Mixed Swamp Conifer	W = White Pine	3 = Seedling Sapling Well	8 = Saw Timber Medium		
E = Swamp Hdwoods	M = Mpl, Bch, Brch	R = Red Pine	X = Non Stocked	4 = Pole Timber Poor	9 = Saw Timber Well		
F = Spruce Fir	MC = Mixed Conifer	S = Black Spruce	Z = Water				
G = Grass	MD = Mixed Deciduous	T = Tamarack					

PU	Acres
1	13
2	14.1

Corner Pocket Mix

Compartment 043

27.1 Acres

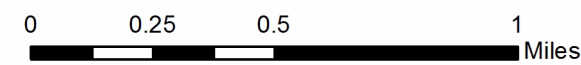
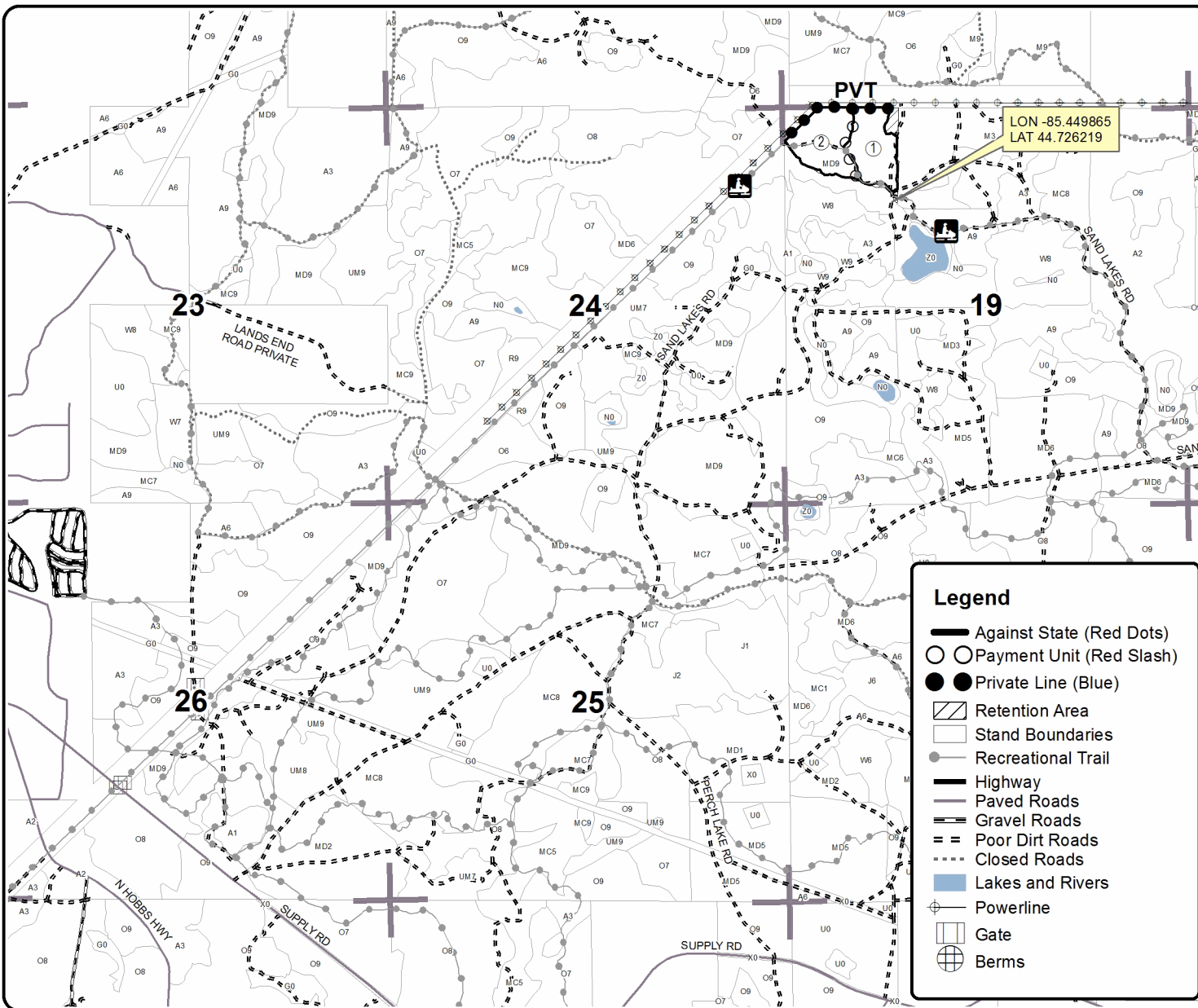
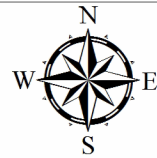

TIMBER SALE INFORMATION

COMP 180 MIX (52-134-17)

Cheboygan County (Advertised Price \$175,784.30)

SALE NOTE: Good volumes, good access, large acreage.

A timber sale contract for this lump sum, sealed bid timber sale will be awarded to the responsible bidder offering the highest sealed bid price. Bids must be at or above the following advertised price for each species:

<u>PRODUCTS & SPECIES</u>	<u>ESTIMATED UNITS*</u>	<u>ADVERTISED PRICE</u>
Sawtimber		
Basswood	60.50 MBF	\$ 57.00 / MBF
Beech	38.90 MBF	\$ 56.00 / MBF
Mixed Aspen	652.90 MBF	\$ 58.00 / MBF
Red Maple	34.90 MBF	\$ 140.00 / MBF
Red Oak	116.00 MBF	\$ 230.00 / MBF
Red Pine	15.60 MBF	\$ 107.00 / MBF
Sugar Maple	96.30 MBF	\$ 303.00 / MBF
White Pine	11.40 MBF	\$ 57.00 / MBF
Pulpwood		
Basswood	188.00 Cords	\$ 6.60 / Cord
Mixed Aspen	908.00 Cords	\$ 20.35 / Cord
Mixed Hardwood	1,750.00 Cords	\$ 24.65 / Cord
Red Oak	202.00 Cords	\$ 24.10 / Cord
Red Pine	13.00 Cords	\$ 45.80 / Cord
White Pine	32.00 Cords	\$ 28.30 / Cord

* The total volume is statistically estimated within plus (+) or minus (-) 9.34 percent. The estimated units are final and not subject to adjustment. Prospective bidders are urged to examine this timber and to make their own estimates of quantity and quality.

BOND AND PAYMENT SCHEDULE:

1. A bond in the amount of \$12,305.00 to insure faithful performance of the conditions of the contract will be deposited by the successful bidder within 21 days of the sale award.
2. Cutting in any sale or unit without the required advance payment would be considered a trespass.
3. Total payment must be paid in advance or according to the following schedule:
 - (a) Ten percent (10%) of the sale value must be paid within 21 days of the sale award.
 - (b) The 10% down payment will be credited towards the first unit cut.
 - (c) Payment for each of the following units must be made before cutting begins in that unit:

<u>PAYMENT UNIT NUMBER</u>	<u>PERCENT OF TOTAL SALE VALUE</u>
01	4.7%
02	19.2%
03	26.0%
04	27.2%
05	8.6%
06	14.3%

4. If no cutting takes place, the 10% down payment will not be refunded.
5. Operations on the contract issued will terminate on 09/30/2021.

Description of Timber by Payment Unit (PU)

PU	MARKET GROUP	PRODUCT	QUANTITY	UNIT	ACRES	ADVERTISE PRICE			
1	Basswood	Sawtimber	8.9	MBF	29.0	\$8,211.90			
	Beech		11.3	MBF					
	Mixed Aspen		7.0	MBF					
	<i>Quaking Aspen</i>		7.0	<i>MBF</i>					
	Sugar Maple	5.8	MBF						
	Basswood	Pulpwood	25.0	Cords					
	Mixed Aspen		9.0	Cords					
	<i>Quaking Aspen</i>		9.0	<i>Cords</i>					
	Mixed Hardwood		185.0	Cords					
	<i>Beech</i>		50.0	<i>Cords</i>					
	<i>Ironwood</i>		2.0	<i>Cords</i>					
	<i>Sugar Maple</i>		133.0	<i>Cords</i>					
	2		Basswood	Sawtimber			28.4	MBF	42.3
Beech			11.0		MBF				
Mixed Aspen		45.4	MBF						
<i>B. T. Aspen</i>		44.6	<i>MBF</i>						
<i>Quaking Aspen</i>		0.8	<i>MBF</i>						
Red Maple		8.4	MBF						
Red Pine		4.4	MBF						
Sugar Maple		42.5	MBF						
White Pine		6.3	MBF						
Basswood		Pulpwood	62.0		Cords				
Mixed Aspen			98.0		Cords				
<i>B. T. Aspen</i>			78.0		<i>Cords</i>				
<i>Quaking Aspen</i>			20.0		<i>Cords</i>				
Mixed Hardwood			448.0		Cords				
<i>American Elm</i>			5.0		<i>Cords</i>				
<i>Beech</i>			50.0		<i>Cords</i>				
<i>Ironwood</i>			7.0		<i>Cords</i>				
<i>Paper Birch</i>			22.0		<i>Cords</i>				
<i>Red Maple</i>			53.0		<i>Cords</i>				
<i>Sugar Maple</i>			311.0	<i>Cords</i>					
Red Pine	4.0	Cords							
White Pine	12.0	Cords							
3	Basswood	Sawtimber	15.4	MBF	60.4	\$45,652.00			
	Beech		12.6	MBF					
	Mixed Aspen		234.1	MBF					
	<i>B. T. Aspen</i>		206.2	<i>MBF</i>					
	<i>Quaking Aspen</i>		27.9	<i>MBF</i>					
	Red Maple		11.9	MBF					
	Sugar Maple		30.5	MBF					
	White Pine		2.1	MBF					
	Basswood		Pulpwood	68.0			Cords		
	Mixed Aspen			364.0			Cords		
	<i>B. T. Aspen</i>			324.0			<i>Cords</i>		
	<i>Quaking Aspen</i>			40.0			<i>Cords</i>		
	Mixed Hardwood			464.0			Cords		
	<i>Paper Birch</i>			<i>Sawtimber</i>			1.5	<i>MBF</i>	
	<i>Beech</i>						<i>Pulpwood</i>	64.0	<i>Cords</i>
	<i>Ironwood</i>							7.0	<i>Cords</i>
	<i>Paper Birch</i>							11.0	<i>Cords</i>
	<i>Red Maple</i>							77.0	<i>Cords</i>
	<i>Sugar Maple</i>			302.0			<i>Cords</i>		
	White Pine	6.0	Cords						
4	Basswood	Sawtimber	7.8	MBF	47.9	\$47,828.55			
	Beech		4.0	MBF					

Description of Timber by Payment Unit (PU), con't

PU	MARKET GROUP	PRODUCT	QUANTITY	UNIT	ACRES	ADVERTISE PRICE
4 con't	Mixed Aspen	Sawtimber	77.8	MBF		
	<i>B. T. Aspen</i>		68.6	<i>MBF</i>		
	<i>Quaking Aspen</i>		9.2	<i>MBF</i>		
	Red Maple		12.1	MBF		
	Red Oak		87.4	MBF		
	Sugar Maple		17.5	MBF		
	Basswood	Pulpwood	33.0	Cords		
	Mixed Aspen		144.0	Cords		
	<i>B. T. Aspen</i>		77.0	<i>Cords</i>		
	<i>Quaking Aspen</i>		67.0	<i>Cords</i>		
	Mixed Hardwood		375.0	Cords		
	<i>Paper Birch</i>		<i>Sawtimber</i> <i>Pulpwood</i>	1.0	<i>MBF</i>	
	<i>Beech</i>	69.0		<i>Cords</i>		
	<i>Paper Birch</i>	5.0		<i>Cords</i>		
	<i>Red Maple</i>	76.0		<i>Cords</i>		
	<i>Sugar Maple</i>	223.0		<i>Cords</i>		
	Red Oak	131.0		Cords		
	5	Mixed Aspen	Sawtimber	32.5	MBF	19.4
<i>B. T. Aspen</i>			32.5	<i>MBF</i>		
Red Maple			1.5	MBF		
Red Oak			28.6	MBF		
Mixed Aspen		Pulpwood	65.0	Cords		
<i>B. T. Aspen</i>			65.0	<i>Cords</i>		
Mixed Hardwood			141.0	Cords		
<i>Beech</i>			17.0	<i>Cords</i>		
<i>Red Maple</i>			115.0	<i>Cords</i>		
<i>Sugar Maple</i>			9.0	<i>Cords</i>		
Red Oak	71.0	Cords				
6	Mixed Aspen	Sawtimber	256.1	MBF	23.4	\$25,188.45
	<i>B. T. Aspen</i>		235.0	<i>MBF</i>		
	<i>Quaking Aspen</i>		21.1	<i>MBF</i>		
	Red Maple		1.0	MBF		
	Red Pine		11.2	MBF		
	White Pine		3.0	MBF		
	Mixed Aspen	Pulpwood	228.0	Cords		
	<i>B. T. Aspen</i>		214.0	<i>Cords</i>		
	<i>Quaking Aspen</i>		14.0	<i>Cords</i>		
	Mixed Hardwood		137.0	Cords		
	<i>Red Maple</i>		114.0	<i>Cords</i>		
	<i>Sugar Maple</i>		23.0	<i>Cords</i>		
	Red Pine		9.0	Cords		
	White Pine		14.0	Cords		
TOTAL:			1,026.5	MBF		
TOTAL:			3,093.0	Cords		

Sale Specific Conditions & Requirements

Sale Name: COMP 180 MIX

Sale Number: 52-134-17 Seq#: 1

1 - Sale Area

1.2 - Boundaries

1.2.1 - Painted boundaries (1/14)

The sale boundary and Payment Unit boundaries are marked and identified by red and yellow paint. Exterior sale boundary lines against state are marked with red paint. Interior Payment Unit boundaries are marked with yellow paint, with the exception of the boundaries between Payment Units 1 & 2 and 4 & 5, which are marked with red paint. The painted boundary line trees are not Included Timber and are to be protected unless marked with orange paint. Yellow and red painted trees designating an interior Payment Unit boundary are only to be cut when all surrounding Payment Units have been paid.

2 - Timber Specifications

2.1 - Included Timber

2.1.1 - Clearcut unit(s) with unmerchantable trees (6/14)

Within Payment Unit(s) 2, 3, and 6, cut all trees that are two (2) inches or more at DBH, except do not cut oak.

2.1.3 - Cut tree marked unit(s) (12/08)

Within Payment Unit(s) 1 and 5, all trees are designated for cutting when marked with orange paint above and below stump height, regardless of merchantability. In addition, within Payment Unit 1, all beech trees two (2) inches or greater at DBH are designated for cutting. Also, within Payment Unit 5, all trees within the pink painted regen gap boundaries are designated for cutting. There are 5 gaps ranging from 1 to 2 acres in size.

2.1.7 - Leave tree marked unit(s) (6/14)

Within Payment Unit(s) 4, cut all trees that are two (2) inches or more at DBH, except white pine, red pine, and trees marked with green paint above and below stump height.

3 - Payments

3.3 - Pre-measured Sales

3.3.4 - Dividing payment units (7/14)

Payment Unit(s) may be divided at the request of the Purchaser and upon approval of the Unit Manager. Dividing Payment Units is a contract modification which requires a Timber Sale Contract Supplement.

3.4 - Damaged Timber

3.4.1 - Damaged timber (6/14)

General Condition and Requirement 3.4 Damaged Timber, defines liquidated damages for undesignated live merchantable trees which are cut or injured.

No damage is acceptable to merchantable trees. Within the sale area, if more than 5% of trees (> 4.5" DBH) within a specified area of the sale are damaged, liquidated damages will be assessed for all trees damaged. Rates will be in accordance with General Condition and Requirement 3.4 Damaged Timber.

4 - Transportation

4.1 - Construction

4.1.6 - Road construction (1/09)

Construction of new roads or improvements of existing roads shall be done in such a way as to minimize the environmental and visual impacts. Merchantable trees shall be cut and utilized unless otherwise directed. Non-merchantable trees shall be severed and laid flat on the ground. Slash shall be scattered, and not left in windrows and kept a minimum of 10 feet back from the road edge. Stumps shall be set upright, not left on edge, and be moved at least 10 feet away from the road edge.

Disturbed soil shall be feathered into the woods and not left in berms or windrows.

4.1.7 - Road closure (10/11)

All new roads built into the sale must be blocked to vehicle traffic upon completion of the sale. Overgrown roads that are reopened shall be considered new roads. In general, this will require constructing a four (4') foot high berm of stumps and logs covered with earth. Stumps and brush must be placed along the remainder of the trail. These roads must be rendered impassable to cars and trucks. Contact the sale administrator for specific details of design and placement.

4.2 - Maintenance

4.2.1 - Hauling restriction (12/08)

Hauling may be restricted on forest roads by the Unit Manager or his/her representative. The restriction may occur during wet weather conditions.

5 - Operations

5.1 - Notification

5.1.4 - Post-sale conference (10/16)

A post-sale conference on site between the Purchaser and sale administrator is required 5 days prior to the completion of active logging operations to determine clean-up and repair of landings, road edges, and the fulfillment of other contract specifications.

5.2 - Conduct of Operations

5.2.1 - Slash

5.2.1.13 - Dispose of slash as directed (12/05)

Slash is to be disposed of as directed by DNR sale administrator.

5.2.2 - Hazard Trees/Snags

5.2.2.1 - Den trees (10/16)

Obvious hollow and/or den trees shall be protected and left standing unless they are a safety hazard.

5.2.3 - Operating Restrictions

5.2.3.3 - Bark slippage restriction (3/09)

Within Payment Unit(s) 1 and 5, cutting and skidding are not permitted during the period of April 15 to July 15. This restriction is because of bark slippage.

5.2.3.4 - Oak wilt restriction (9/17)

Within Payment Unit(s) 1-6, cutting, skidding, hauling and brushing of access roads are not permitted during the period of April 15 to July 15. This is necessary to reduce the spread of oak wilt. For more information, contact the Unit Manager or his/her representative.

5.2.4 - Dead and Down Creation

5.2.4.2 - Dead and down creation, hare and grouse (1/14)

To improve habitat for snowshoe hare, grouse, and other species, the Purchaser is to leave two trees, nine (9) inches or larger in diameter on the ground for every two acres. If possible, the logs or trees should be felled so they overlap. Note these pieces should have a minimum length of five feet. They can be of any tree species and can be an un-merchantable piece of wood or a full tree.

5.2.29 - Shrub protection (9/07)

Do not cut or damage hawthorn, witch-hazel, dogwood or junberry. These woody-shrub plants are highly beneficial to various wildlife species.

5.2.38 - No decking against live trees (2/04)

Cut products may not be decked against unmarked or designated leave trees.

5.4 - Soil Protection

5.4.1 - Rutting restriction, general (7/16)

Operations are to cease immediately if equipment and weather conditions result in rutting of roads and/or skid trails which is 12 inches or greater in depth and 50 feet in length. The Unit Manager or his/her representative may restrict hauling and/or skidding if ruts exceed the specified depth. With the Unit Manager or his/her representative's approval, the Purchaser may return to the area when the risk of rutting has decreased.

5.8 - Protection of Endangered Species

5.8.5 - Protection of raptor nests (3/13)

All trees with raptor nests will be protected if found during harvesting operations. Notification will be made to the Unit Manager or his/her representative who will notify the Wildlife Biologist so an on-site evaluation and recommendation can be made, if necessary.

6 - Safety and Fire Prevention

6.2 - Signing

6.2.1 - Road posting (9/09)

The Purchaser is responsible for posting and maintaining caution signs on roads used for hauling prior to beginning operations. The road must be posted at appropriate distances from the sale area to warn of logging activity and truck traffic. Signs must be removed when harvest operations are suspended or completed.



TIMBER SALE MAP

This information provided by authority of Part 525, 1994 PA 451, as amended.

Forest Management Unit GAYLORD (INDIAN RIVER)	County CHEBOYGAN	Mapped By MERRICK	Date 09/24/2017	Page 1	of 1
Township 35N	Range 01W	Section(s) and Subdivision(s) 36N 01W SEC 31: SESE SEC 5: NW1/4, N1/2SW, SWSW. SEC 6: E1/2E1/2, SWNE, NWSE, NESW, SENW.	Scale 1:15,840		
Cruised By GAYLORD					

Cover Type

A = Aspen	H = Hemlock	N = Marsh	U = Upland Brush
B = Paper Birch	J = Jack Pine	O = Oak	UM = Upland Mixed
C = Cedar	L = Lowland Brush	P = Lowland Poplar	V = Bog or Marsh
D = Tread Bog	LM = Lowland Mixed	Q = Mixed Swamp Conifer	W = White Pine
E = Swamp Hdwoods	M = Mpl, Bch, Brch	R = Red Pine	X = Non Stocked
F = Spruce Fir	MC = Mixed Conifer	S = Black Spruce	Z = Water
G = Grass	MD = Mixed Deciduous	T = Tamarack	

Density

0 = Non Stocked	5 = Pole Timber Medium
1 = Seedling Sapling Poor	6 = Pole Timber Well
2 = Seedling Sapling Medium	7 = Saw Timber Poor
3 = Seedling Sapling Well	8 = Saw Timber Medium
4 = Pole Timber Poor	9 = Saw Timber Well

PU	Acres	PU	Acres
1	29.0	4	47.9
2	42.3	5	19.4
3	60.4	6	23.4

COMP 180 MIX
Compartment 180
222.4 Acres

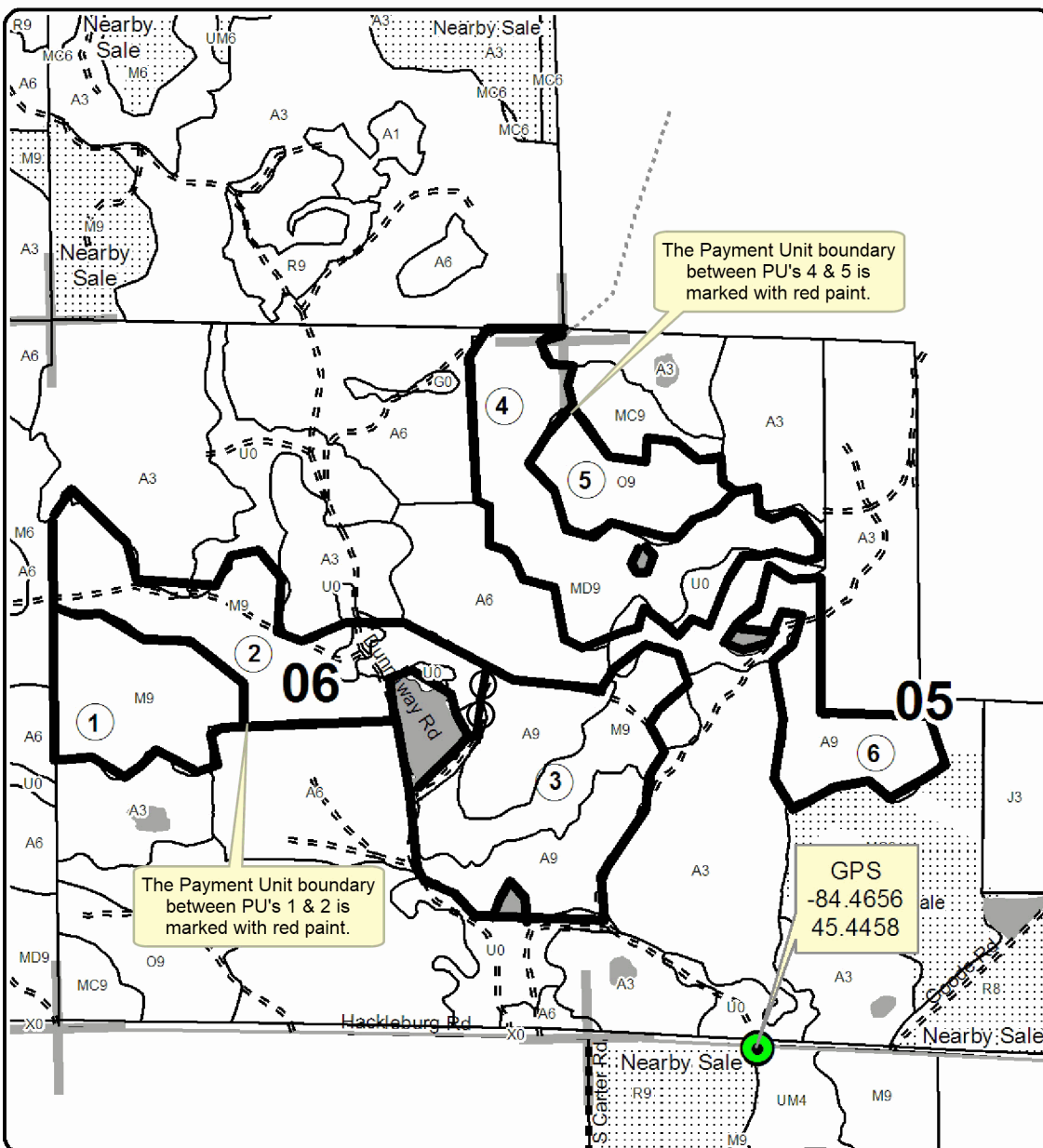
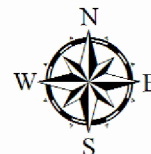

Legend

- Against State (Red)
- Payment Unit (Yellow)
- Section Corners
- Nearby Timber Sale
- Retention Area
- Stand Boundaries
- Paved Roads
- Poor Dirt Roads
- Closed Roads

Locator Map
1:200,000

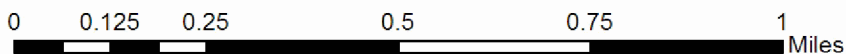
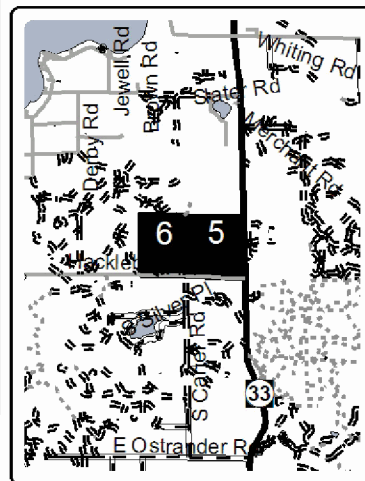

TIMBER SALE INFORMATION

Early Start Mix (52-137-17)

Cheboygan County (Advertised Price \$6,454.70)

SALE NOTE: Good access to entirety of sale off of county roads.

A timber sale contract for this lump sum, sealed bid timber sale will be awarded to the responsible bidder offering the highest sealed bid price. Bids must be at or above the following advertised price for each species:

<u>PRODUCTS & SPECIES</u>	<u>ESTIMATED UNITS*</u>	<u>ADVERTISED PRICE</u>
Sawtimber		
Red Pine	20.50 MBF	\$ 107.00 / MBF
White Pine	3.80 MBF	\$ 57.00 / MBF
Pulpwood		
B. T. Aspen	2.00 Cords	\$ 20.35 / Cord
Jack Pine	17.00 Cords	\$ 28.60 / Cord
Red Pine	49.00 Cords	\$ 45.80 / Cord
White Pine	45.00 Cords	\$ 28.30 / Cord

* The estimated units are final and not subject to adjustment. Prospective bidders are urged to examine this timber and to make their own estimates of quantity and quality.

BOND AND PAYMENT SCHEDULE:

- A bond in the amount of \$323.00 to insure faithful performance of the conditions of the contract will be deposited by the successful bidder within 21 days of the sale award.
- Cutting in any sale or unit without the required advance payment would be considered a trespass.
- Total payment must be paid in advance or according to the following schedule:
 - Ten percent (10%) of the sale value must be paid within 21 days of the sale award.
 - The remainder is due before cutting begins.
 - Payment for each of the following units must be made before cutting begins in that unit:

PAYMENT UNIT NUMBER	PERCENT OF TOTAL SALE VALUE
01	100.0%
- If no cutting takes place, the 10% down payment will not be refunded.
- Operations on the contract issued will terminate on 09/30/2021.

Description of Timber by Payment Unit (PU)

PU	MARKET GROUP	PRODUCT	QUANTITY	UNIT	ACRES	ADVERTISE PRICE
1	Red Pine	Sawtimber	20.5	MBF	27.0	\$6,454.70
	White Pine		3.8	MBF		
	B. T. Aspen	Pulpwood	2.0	Cords		
	Jack Pine		17.0	Cords		
	Red Pine		49.0	Cords		
	White Pine		45.0	Cords		
TOTAL:			24.3	MBF		
TOTAL:			113.0	Cords		

Sale Specific Conditions & Requirements

Sale Name: Early Start Mix

Sale Number: 52-137-17 Seq#: 1

1 - Sale Area

1.2 - Boundaries

1.2.1 - Painted boundaries (1/14)

The sale boundary and Payment Unit boundaries are marked and identified by red and teal paint. Exterior sale boundary lines against state are marked with red paint. Interior retention areas are marked with timber teal paint.

2 - Timber Specifications

2.1 - Included Timber

2.1.5 - Overstory removal unit(s) (8/11)

Within Payment Unit(s) 1, all trees which meet minimum piece specifications in 2.2 Utilization, are designated for cutting.

2.2 - Utilization

2.2.3 - Stump heights (4/07)

Stump heights within the Sale Area shall not exceed 6 inches. This is in order to facilitate planting operations.

3 - Payments

3.3 - Pre-measured Sales

3.3.4 - Dividing payment units (7/14)

Payment Unit(s) may be divided at the request of the Purchaser and upon approval of the Unit Manager. Dividing Payment Units is a contract modification which requires a Timber Sale Contract Supplement. There will be only one division per Payment Unit.

3.4 - Damaged Timber

3.4.1 - Damaged timber (6/14)

General Condition and Requirement 3.4 Damaged Timber, defines liquidated damages for undesignated live merchantable trees which are cut or injured. In addition, extreme care should be taken to avoid damage to tree seedlings and saplings.

No damage is acceptable to merchantable trees. Within the sale area, if more than 10% of trees (> 4.5" DBH) within a specified area of the sale are damaged, liquidated damages will be assessed for all trees damaged. Rates will be in accordance with General Condition and Requirement 3.4 Damaged Timber.

4 - Transportation

4.1 - Construction

4.1.12 - No new roads (1/12)

No new roads will be permitted in any Payment Unit. All operations are limited to existing roads. Skid trails only will be allowed.

4.2 - Maintenance

4.2.5 - Two wheel drive condition (2/04)

All existing trail roads on and adjacent to the sale area must be passable by two-wheel drive traffic for the duration of the sale.

5 - Operations

5.1 - Notification

5.1.1 - Pre-sale conference (10/16)

A pre-sale conference on site between the Purchaser and sale administrator is required prior to beginning any operations to

determine landing locations. The Unit Manager or his/her representative must be contacted at least 5 days in advance to schedule the conference.

5.1.4 - Post-sale conference (10/16)

A post-sale conference on site between the Purchaser and sale administrator is required 5 days prior to the completion of active logging operations to determine clean-up and repair of landings, road edges, and the fulfillment of other contract specifications.

5.2 - Conduct of Operations

5.2.1 - Slash

5.2.1.8 - Slash height (12/08)

No slash or tree tops may exceed 24 inches in height.

5.2.2 - Hazard Trees/Snags

5.2.2.1 - Den trees (10/16)

Obvious hollow and/or den trees shall be protected and left standing unless they are a safety hazard.

5.2.3 - Operating Restrictions

5.2.3.6 - Bark beetle restriction (12/08)

In the event drought creates a high risk of pine bark beetle infestation, pine is not to be cut during the period March 1 through July 1, unless all portions of trees greater than two inches in diameter are removed from the sale area, reduced to chips, or treated to the satisfaction of the Unit Manager or his/her representative, within fifteen days of being severed from the stump. Pine log decks, pulpwood piles and treetops that are piled for chipping in the fall or winter within a 1/4 mile of susceptible sites must be removed before March 15. Residual slash must not be placed in piles or rows and must be spread over the site for quick drying. The Department of Natural Resources will exercise this specification if the risk of damage warrants.

5.4 - Soil Protection

5.4.1 - Rutting restriction, general (7/16)

Operations are to cease immediately if equipment and weather conditions result in rutting of roads and/or skid trails which is 12 inches or greater in depth and 50 feet in length. The Unit Manager or his/her representative may restrict hauling and/or skidding if ruts exceed the specified depth. With the Unit Manager or his/her representative's approval, the Purchaser may return to the area when the risk of rutting has decreased.

5.8 - Protection of Endangered Species

5.8.5 - Protection of raptor nests (3/13)

All trees with raptor nests will be protected if found during harvesting operations. Notification will be made to the Unit Manager or his/her representative who will notify the Wildlife Biologist so an on-site evaluation and recommendation can be made, if necessary.

6 - Safety and Fire Prevention

6.2 - Signing

6.2.1 - Road posting (9/09)

The Purchaser is responsible for posting and maintaining caution signs on Branch Trail prior to beginning operations. The road must be posted at appropriate distances from the sale area to warn of logging activity and truck traffic. Signs must be removed when harvest operations are suspended or completed. The Purchaser will provide these signs.



TIMBER SALE MAP

This information provided by authority of Part 525, 1994 PA 451, as amended.

Forest Management Unit Gaylord Management Unit	County Cheboygan	Mapped By Wells	Date 9/27/2017	Page 1	of 1
Township 35N	Range 02W	Section(s) and Subdivision(s) Sec. 23 SENE, NESE Sec 24, W1/2SW, SWNW	Scale 1:15,840		

Cover Type				Density	
A = Aspen	H = Hemlock	N = Marsh	U = Upland Brush	0 = Non Stocked	5 = Pole Timber Medium
B = Paper Birch	J = Jack Pine	O = Oak	UM = Upland Mixed	1 = Seedling Sapling Poor	6 = Pole Timber Well
C = Cedar	L = Lowland Brush	P = Lowland Poplar	V = Bog or Marsh	2 = Seedling Sapling Medium	7 = Saw Timber Poor
D = Tread Bog	LM = Lowland Mixed	Q = Mixed Swamp Conifer	W = White Pine	3 = Seedling Sapling Well	8 = Saw Timber Medium
E = Swamp Hdwoods	M = Mpl, Bch, Brch	R = Red Pine	X = Non Stocked	4 = Pole Timber Poor	9 = Saw Timber Well
F = Spruce Fir	MC = Mixed Conifer	S = Black Spruce	Z = Water		
G = Grass	MD = Mixed Deciduous	T = Tamarack			

PU	Acres
1	27

Early Start Mix

Compartment 175

27 Acres

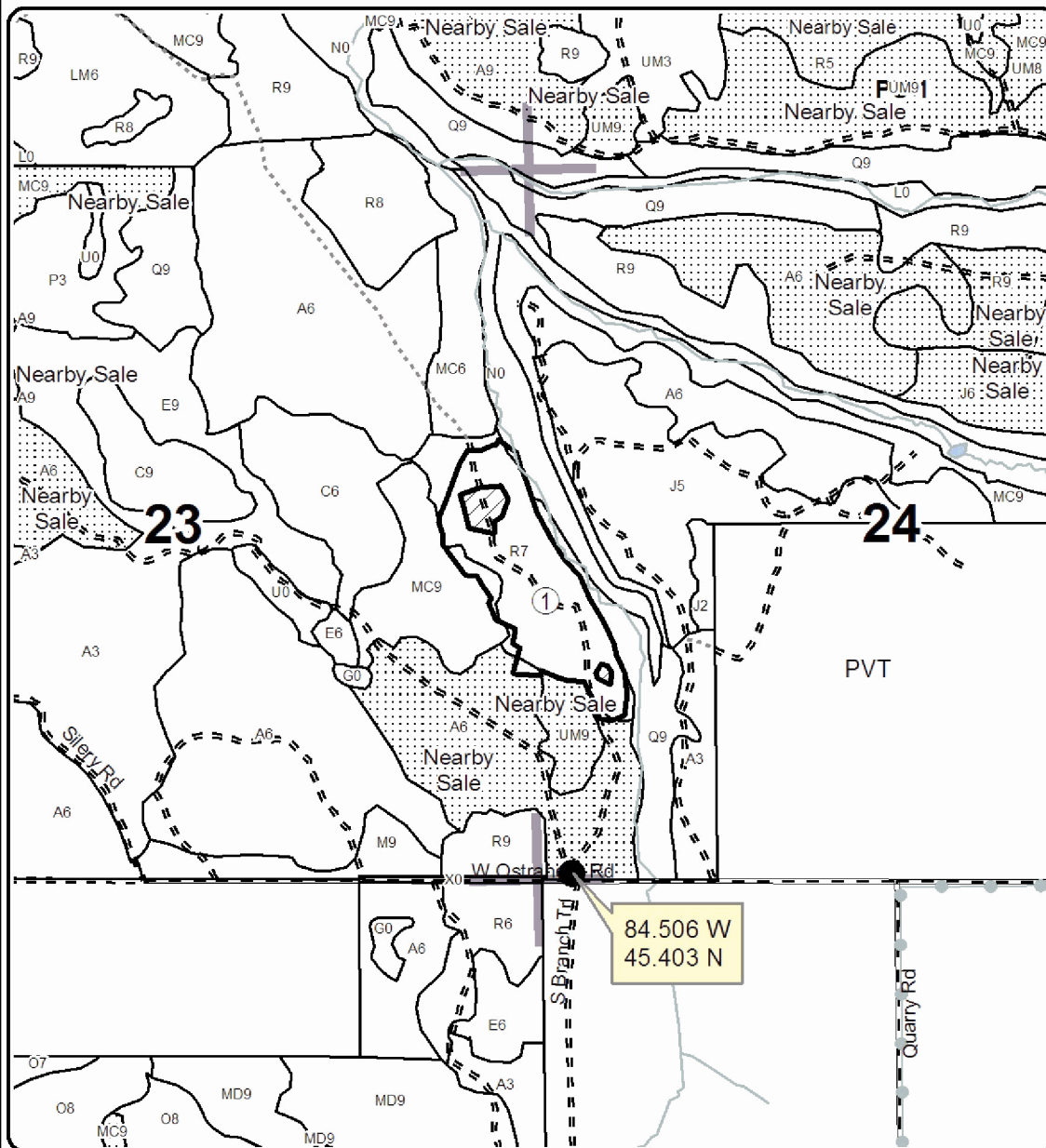
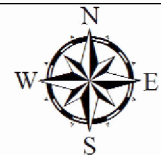

Legend

- Against State (Red)
- Retention Area (Teal)
- Nearby Timber Sale
- Stand Boundaries
- Section Corners
- Highway
- Paved Roads
- Gravel Roads
- Poor Dirt Roads
- Closed Roads
- Streams
- Recreational Trail

Locator Map
1:200,000

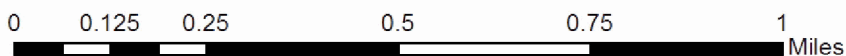
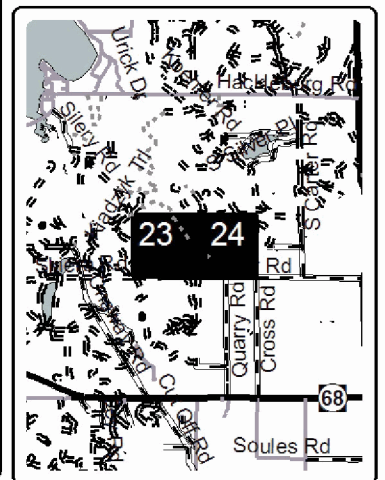

Clean Crumley Mix (52-108-17)
; Cheboygan COUNTY

In response to the notice of sale to be held 3:00 p.m. (local time) on June 26, 2018, I am hereby submitting my sealed bid (firm offer) for the following forest products to be cut. Bids for individual species must be at or above the advertised price. All non-responsive bid forms may be rejected.

<u>PRODUCTS & SPECIES</u>	<u>ESTIMATED VOLUME*</u>	<u>ADVERTISED PRICE</u>	<u>BID PRICE/UNIT</u>
Sawtimber			
Mixed Aspen	74.60 MBF	\$ 58.00/MBF	\$ _____
Mixed Oak	220.40 MBF	\$ 105.00/MBF	\$ _____
N. White Cedar	30.80 MBF	\$ 49.00/MBF	\$ _____
Paper Birch	13.90 MBF	\$ 61.00/MBF	\$ _____
Red Maple	59.30 MBF	\$ 140.00/MBF	\$ _____
Red Pine	205.00 MBF	\$ 107.00/MBF	\$ _____
White Pine	79.90 MBF	\$ 57.00/MBF	\$ _____
Pulpwood			
Balsam Fir	152.00 Cords	\$ 22.20/Cord	\$ _____
Jack Pine	367.00 Cords	\$ 28.60/Cord	\$ _____
Mixed Aspen	1,398.00 Cords	\$ 20.35/Cord	\$ _____
Mixed Hardwood	837.00 Cords	\$ 24.65/Cord	\$ _____
Mixed Oak	1,978.00 Cords	\$ 24.10/Cord	\$ _____
Mixed Spruce	173.00 Cords	\$ 37.00/Cord	\$ _____
N. White Cedar	158.00 Cords	\$ 25.00/Cord	\$ _____
Red Pine	438.00 Cords	\$ 45.80/Cord	\$ _____
White Pine	577.00 Cords	\$ 28.30/Cord	\$ _____

*The volumes are statistically estimated within plus (+) or minus (-) 5.97 percent. These estimated volumes are final and not subject to adjustment. Prospective bidders are urged to examine this timber and to make their own estimates of quantity and quality.

I understand that any or all bids may be rejected. All bids must be signed and all bid items must be bid or the bid form may be rejected. I also understand that consideration and awarding a contract will be based upon my past performance and ability to complete the contract based upon equipment and staffing subject to my control.

FEDERAL ID: ____ - ____ - ____ or SOCIAL SECURITY NUMBER: ____ - ____ - ____

Company or individual bidding: _____

Company representative's name: _____

Address: _____

City: _____ State: _____ Zip: _____

IF AVAILABLE, PLEASE PLACE THE PERSONALIZED LABEL FROM YOUR PROSPECTUS IN THE ABOVE BOX.

Individual or company representative's signature: _____ Date: _____

Phone number : _____ Email (optional): _____

THE WINNING BIDDER MUST COMPLETE THE VERIFICATION OF WORKER'S DISABILITY COMPENSATION ACT COMPLIANCE (ON REVERSE SIDE IF DOUBLE SIDED) WITHIN 21 DAYS OF SALE AWARD DATE



FOR DEPARTMENT USE ONLY
Sale Number (XX - XXX - XX - XX)
Forest Management Unit:

TIMBER SALE VERIFICATION OF WORKER'S DISABILITY COMPENSATION ACT COMPLIANCE

*As required by Act 317, P.A. 1969 (Worker's Compensation) and
Part 5 of Act 451 of 1994, as amended.*

VERIFICATION OF WORKER'S DISABILITY COMPENSATION ACT COMPLIANCE

- This verification must be completed and submitted within 21 days of contract award and prior to the issuance of the timber sale contract.
- In addition, if boxes 2B or 2C are checked, then Notice of Exclusion or Certificate of Insurance must be submitted within twenty-one (21) days of the contract award and prior to the issuance of the timber sale contract.
- All information must be typed or printed except for written signatures.

Please Check Appropriate Categories:

1. My business is organized as (you **must** check one of the boxes below):
 - A. Sole Proprietorship (individual)
 - B. Partnership
 - C. Corporation

2. You **must** check one of the boxes below:
 - A. I certify my business is a sole proprietorship and it has no employees but the sole proprietor. I am not subject to the Worker's Compensation Laws.
 - B. I certify my business has satisfied its obligation to the Worker's Compensation Act through the use of an approved Notice of Exclusion (BWC-337, Rev. 5/96). I will provide a copy of the Notice of Exclusion within 21 days of the contract award. (For questions or a copy of the BWC-337, please call the Worker's Compensation Bureau at 517-322-1195).
 - C. I certify my business has a Worker's Compensation Policy. I will provide an original Certificate of Insurance within twenty-one (21) days of the contract award.

3. If you have checked item 2(A) or 2(B), you **must** indicate the number of **both** full-time and part-time employees, other than yourself, including family members and active partners (if none, you must enter "0").

_____ Full-time Employees

_____ Part-time Employees

Name of Business		Federal ID (or) Social Security No.	
Address		Telephone ()	
City	State	ZIP	

I hereby certify that the above information is true and correct. I agree to notify the Michigan DNR of any changes that occur in factors affecting my coverage during any of my present and future operations.

Signature of Owner or Authorized Representative

Title

Date

Please complete the "SEALED BID" information on the next page

COMP 180 MIX (52-134-17)
; Cheboygan COUNTY

In response to the notice of sale to be held 3:00 p.m. (local time) on June 26, 2018, I am hereby submitting my sealed bid (firm offer) for the following forest products to be cut. Bids for individual species must be at or above the advertised price. All non-responsive bid forms may be rejected.

<u>PRODUCTS & SPECIES</u>	<u>ESTIMATED VOLUME*</u>	<u>ADVERTISED PRICE</u>	<u>BID PRICE/UNIT</u>
Sawtimber			
Basswood	60.50 MBF	\$ 57.00/MBF	\$ _____
Beech	38.90 MBF	\$ 56.00/MBF	\$ _____
Mixed Aspen	652.90 MBF	\$ 58.00/MBF	\$ _____
Red Maple	34.90 MBF	\$ 140.00/MBF	\$ _____
Red Oak	116.00 MBF	\$ 230.00/MBF	\$ _____
Red Pine	15.60 MBF	\$ 107.00/MBF	\$ _____
Sugar Maple	96.30 MBF	\$ 303.00/MBF	\$ _____
White Pine	11.40 MBF	\$ 57.00/MBF	\$ _____
Pulpwood			
Basswood	188.00 Cords	\$ 6.60/Cord	\$ _____
Mixed Aspen	908.00 Cords	\$ 20.35/Cord	\$ _____
Mixed Hardwood	1,750.00 Cords	\$ 24.65/Cord	\$ _____
Red Oak	202.00 Cords	\$ 24.10/Cord	\$ _____
Red Pine	13.00 Cords	\$ 45.80/Cord	\$ _____
White Pine	32.00 Cords	\$ 28.30/Cord	\$ _____

*The volumes are statistically estimated within plus (+) or minus (-) 9.34 percent. These estimated volumes are final and not subject to adjustment. Prospective bidders are urged to examine this timber and to make their own estimates of quantity and quality.

I understand that any or all bids may be rejected. All bids must be signed and all bid items must be bid or the bid form may be rejected. I also understand that consideration and awarding a contract will be based upon my past performance and ability to complete the contract based upon equipment and staffing subject to my control.

FEDERAL ID: _____ or SOCIAL SECURITY NUMBER: _____

Company or individual bidding: _____

Company representative's name: _____

Address: _____

City: _____ State: _____ Zip: _____

IF AVAILABLE, PLEASE PLACE THE PERSONALIZED LABEL FROM YOUR PROSPECTUS IN THE ABOVE BOX.

Individual or company representative's signature: _____ Date: _____

Phone number : _____ Email (optional): _____

THE WINNING BIDDER MUST COMPLETE THE VERIFICATION OF WORKER'S DISABILITY COMPENSATION ACT COMPLIANCE (ON REVERSE SIDE IF DOUBLE SIDED) WITHIN 21 DAYS OF SALE AWARD DATE



FOR DEPARTMENT USE ONLY
Sale Number (XX - XXX - XX - XX)
Forest Management Unit:

TIMBER SALE VERIFICATION OF WORKER'S DISABILITY COMPENSATION ACT COMPLIANCE

*As required by Act 317, P.A. 1969 (Worker's Compensation) and
Part 5 of Act 451 of 1994, as amended.*

VERIFICATION OF WORKER'S DISABILITY COMPENSATION ACT COMPLIANCE

- This verification must be completed and submitted within 21 days of contract award and prior to the issuance of the timber sale contract.
- In addition, if boxes 2B or 2C are checked, then Notice of Exclusion or Certificate of Insurance must be submitted within twenty-one (21) days of the contract award and prior to the issuance of the timber sale contract.
- All information must be typed or printed except for written signatures.

Please Check Appropriate Categories:

1. My business is organized as (you **must** check one of the boxes below):
 - A. Sole Proprietorship (individual)
 - B. Partnership
 - C. Corporation

2. You **must** check one of the boxes below:
 - A. I certify my business is a sole proprietorship and it has no employees but the sole proprietor. I am not subject to the Worker's Compensation Laws.
 - B. I certify my business has satisfied its obligation to the Worker's Compensation Act through the use of an approved Notice of Exclusion (BWC-337, Rev. 5/96). I will provide a copy of the Notice of Exclusion within 21 days of the contract award. (For questions or a copy of the BWC-337, please call the Worker's Compensation Bureau at 517-322-1195).
 - C. I certify my business has a Worker's Compensation Policy. I will provide an original Certificate of Insurance within twenty-one (21) days of the contract award.

3. If you have checked item 2(A) or 2(B), you **must** indicate the number of **both** full-time and part-time employees, other than yourself, including family members and active partners (if none, you must enter "0").

_____ Full-time Employees

_____ Part-time Employees

Name of Business		Federal ID (or) Social Security No.	
Address		Telephone ()	
City	State	ZIP	

I hereby certify that the above information is true and correct. I agree to notify the Michigan DNR of any changes that occur in factors affecting my coverage during any of my present and future operations.

Signature of Owner or Authorized Representative

Title

Date

Please complete the "SEALED BID" information on the next page

Early Start Mix (52-137-17)
; Cheboygan COUNTY

In response to the notice of sale to be held 3:00 p.m. (local time) on June 26, 2018, I am hereby submitting my sealed bid (firm offer) for the following forest products to be cut. Bids for individual species must be at or above the advertised price. All non-responsive bid forms may be rejected.

<u>PRODUCTS & SPECIES</u>	<u>ESTIMATED VOLUME*</u>	<u>ADVERTISED PRICE</u>	<u>BID PRICE/UNIT</u>
Sawtimber			
Red Pine	20.50 MBF	\$ 107.00/MBF	\$ _____
White Pine	3.80 MBF	\$ 57.00/MBF	\$ _____
Pulpwood			
B. T. Aspen	2.00 Cords	\$ 20.35/Cord	\$ _____
Jack Pine	17.00 Cords	\$ 28.60/Cord	\$ _____
Red Pine	49.00 Cords	\$ 45.80/Cord	\$ _____
White Pine	45.00 Cords	\$ 28.30/Cord	\$ _____

*These estimated volumes are final and not subject to adjustment. Prospective bidders are urged to examine this timber and to make their own estimates of quantity and quality.

I understand that any or all bids may be rejected. All bids must be signed and all bid items must be bid or the bid form may be rejected. I also understand that consideration and awarding a contract will be based upon my past performance and ability to complete the contract based upon equipment and staffing subject to my control.

FEDERAL ID: _____ or SOCIAL SECURITY NUMBER: _____

Company or individual bidding: _____

Company representative's name: _____

Address: _____

City: _____ State: _____ Zip: _____

IF AVAILABLE, PLEASE PLACE THE PERSONALIZED LABEL FROM YOUR PROSPECTUS IN THE ABOVE BOX.

Individual or company representative's signature: _____ Date: _____

Phone number : _____ Email (optional): _____

THE WINNING BIDDER MUST COMPLETE THE VERIFICATION OF WORKER'S DISABILITY COMPENSATION ACT COMPLIANCE (ON REVERSE SIDE IF DOUBLE SIDED) WITHIN 21 DAYS OF SALE AWARD DATE



FOR DEPARTMENT USE ONLY
Sale Number (XX - XXX - XX - XX)
Forest Management Unit:

TIMBER SALE VERIFICATION OF WORKER'S DISABILITY COMPENSATION ACT COMPLIANCE

*As required by Act 317, P.A. 1969 (Worker's Compensation) and
Part 5 of Act 451 of 1994, as amended.*

VERIFICATION OF WORKER'S DISABILITY COMPENSATION ACT COMPLIANCE

- This verification must be completed and submitted within 21 days of contract award and prior to the issuance of the timber sale contract.
- In addition, if boxes 2B or 2C are checked, then Notice of Exclusion or Certificate of Insurance must be submitted within twenty-one (21) days of the contract award and prior to the issuance of the timber sale contract.
- All information must be typed or printed except for written signatures.

Please Check Appropriate Categories:

1. My business is organized as (you **must** check one of the boxes below):
 - A. Sole Proprietorship (individual)
 - B. Partnership
 - C. Corporation
2. You **must** check one of the boxes below:
 - A. I certify my business is a sole proprietorship and it has no employees but the sole proprietor. I am not subject to the Worker's Compensation Laws.
 - B. I certify my business has satisfied its obligation to the Worker's Compensation Act through the use of an approved Notice of Exclusion (BWC-337, Rev. 5/96). I will provide a copy of the Notice of Exclusion within 21 days of the contract award. (For questions or a copy of the BWC-337, please call the Worker's Compensation Bureau at 517-322-1195).
 - C. I certify my business has a Worker's Compensation Policy. I will provide an original Certificate of Insurance within twenty-one (21) days of the contract award.
3. If you have checked item 2(A) or 2(B), you **must** indicate the number of **both** full-time and part-time employees, other than yourself, including family members and active partners (if none, you must enter "0").

_____ Full-time Employees

_____ Part-time Employees

Name of Business		Federal ID (or) Social Security No.	
Address		Telephone ()	
City	State	ZIP	

I hereby certify that the above information is true and correct. I agree to notify the Michigan DNR of any changes that occur in factors affecting my coverage during any of my present and future operations.

Signature of Owner or Authorized Representative

Title

Date

Please complete the "SEALED BID" information on the next page