



**DEPARTMENT OF NATURAL RESOURCES
STATE OF MICHIGAN**

TIMBER SALE PROSPECTUS #6143

SCHEDULED SALE DATE AND TIME: 4:00 p.m. (local time) on April 5, 2018.

LOCATION: TRAVERSE CITY MGMT UNIT, 2122 M 37 SOUTH, TRAVERSE CITY, MI 49685.

PROSPECTUS NOTE: The bidder is advised to inspect the sale area and review the location, estimated volumes, operating costs and contract terms of proposed sales. Please be aware that some landowners may request 60 days or more notice for access across their land.

Notice is hereby given that bids will be received by the Unit Manager, TRAVERSE CITY MANAGEMENT UNIT, for certain timber on the following described lands:

Petobego Aspen (61-001-18)

Grand Traverse County, Advertised Price \$8,496.35, 18.6 Acres, Aspen, White Pine.

Wreath Aspen (61-004-18)

Benzie County, Advertised Price \$19,257.25, 29.2 Acres, Aspen, Hardwood.

SALE NOTE: A recreation site such as a trail, pathway, or campground is within the sale area or the vicinity. Certain restrictions/specifications may be applicable including time restrictions.

Alchemy Hardwoods (61-033-17)

Manistee County, Advertised Price \$83,939.50, 66.4 Acres, Aspen, Hardwood.

SALE NOTE: Access to the sale will be from a powerline ROW. Landing areas and the specific location for haul route on or near the ROW will need to be approved by the sale administrator during pre-sale activities.

Lee Side Hardwood (61-058-17)

Benzie County, Advertised Price \$75,949.00, 58.8 Acres, Hardwood, Sugar Maple.

SALE NOTE: A recreation site such as a trail, pathway, or campground is within the sale area or the vicinity. Certain restrictions/specifications may be applicable including time restrictions.

Iron Hardwood (61-059-17)

Benzie County, Advertised Price \$93,607.75, 166.1 Acres, Aspen, Hardwood.

SALE NOTE: A recreation site such as a trail, pathway, or campground is within the sale area or the vicinity. Certain restrictions/specifications may be applicable including time restrictions.

BID INSTRUCTIONS (VER. 11/28/2017):

1. Scheduled Bid Location, Date, and Time (2/11)

Bids must be received by the Unit Manager, TRAVERSE CITY OFFICE, 2122 M 37 SOUTH, TRAVERSE CITY, MI 49685, no later than 4:00 p.m. (local time) on April 5, 2018. For further information concerning this sale, contact David Lemmien at 231-922-5280 extension 6840.

2. Bidder's Qualifications (5/16)

Purchaser shall obtain workers compensation insurance to cover claims under Michigan's Worker's Disability Compensation Act of 1969 or similar employee benefit act of any other state applicable to an employee. If all or part of a timber sale was prepared by a private contractor, the contractor and that contractor's company are not permitted to bid on the timber sale contract. Bids will not be accepted from individuals or companies appearing on the DNR/FRD No-Bid List. This list contains the names of purchasers who previously failed to execute a contract within 21-days or who have a history of poor performance.

3. Preparation of Sealed Bids (5/16)

Bid Forms may be completed online thru Michigan DNR Timber Sale Online Bidding (OLB) at www.michigan.gov/timberbidding or by completing the hardcopy Bid Form found in the Timber Sale Prospectus. Hardcopy Bid Forms shall be manually signed in ink. Registration in OLB is considered your 'signature' for all bids submitted thru that system. Bid prices must be entered for each species and product in the Bid Price column for all material subject to bidding and all fill-in blanks must be completed. If erasures or other changes appear on the hardcopy Bid Form, each erasure or change must be initialed by the person signing the bid.

4. Submission of Sealed Bids (5/16)

Bid forms may be obtained from the Unit Manager or thru OLB. Bids may be submitted hardcopy or thru OLB. All hardcopy bids must be submitted on the bid form and in an envelope clearly identified as described in this section. NOTE: Only one bid form per bid envelope. Sealed bids must be submitted to the Unit office designated in the prospectus and must be submitted at or prior to the time established in the prospectus. The envelope should show on the outside (a) the sale name or number and (b) the date and time of bid opening, as shown in the prospectus. Bids received after the time specified in the sale prospectus are late bids and will be rejected.

It is possible for a bidder to submit multiple bids on a single sale. For example, a bid may be submitted hardcopy and a bid may be submitted thru OLB. Or, two bidders from the same company could both submit bids on the same sale. If this were to happen, the State would accept all bids received and award the contract accordingly. All bidding and contractual requirements would apply to all bids received.

5. Public Opening of Sealed Bids (7/16)

If conditions permit, the sealed bids will be publicly opened and posted at the time and place set in the prospectus.

If a bidder, present at a bid opening, has submitted bids on more than one sale, that bidder may withdraw their unopened bid envelopes or announce the withdrawal of their online bid after being declared the successful bidder on one sale.

6. Award of Contract (1/11)

Award of the contract will be made to the Bidder whose bid, conforming to the prospectus, is most advantageous to the State of Michigan on the basis of total value at rates bid for the estimated quantities. The State reserves the right to reject any bid or waive any minor irregularity in bids received. A written award mailed (or otherwise furnished) to the successful Bidder shall be deemed to result in a binding contract without further action by either party.

7. Down Payment (1/11)

The Bidder to whom award is made must make a down payment within 21 days of the sale award. The amount of the down payment will be calculated as shown in the Bond and Payment Schedule of this prospectus. Only cash may be used to meet this requirement.

8. Performance Security (1/11)

As guarantee of faithful performance, a cash bond, certificate of deposit, surety bond or irrevocable letter of credit (LOC) is required within 21 days of the sale award. The amount of the performance security is shown in the Bond and

Payment Schedule of this prospectus. If an LOC or surety is used, the coverage must extend for at least 6 months beyond the contract expiration.

9. Timber Sale Contract (11/17)

Additional conditions and requirements common to all timber sales are listed on the timber sale contract (R4031) and are available on line at www.michigan.gov/timber. Contact the Unit Manager for additional information or a sample contract. Within 21 days of the date of the award letter, the bidder must sign the contract and provide the required down payment, performance security, and verification of worker's disability compensation. The down payment and performance security shall be in accordance with the provisions of the timber sale contract, in the sums stated in this prospectus. If these actions are not taken, then the Bidder, the Bidder's corporation, and the corporation's principals may not be permitted to bid on State timber sales for a period of 1 year. In addition, the Bidder certifies that if awarded this contract, the Bidder will complete the timber sale contract in accordance with its terms and any modifications thereof including requirements to purchase, cut, and remove the included timber by the expiration date.

Payment Unit values in the State Forest Timber Sale Contract are calculated based on the advertised value of the Payment Unit as a percentage of the total advertised value of the contract. The advertised value of each Payment Unit is given in the Description of Timber by Payment Unit table on the Timber Sale Information page. For example, if the value of Payment Unit 1 is advertised as \$1,500 and the total Timber Sale value is advertised as \$10,000, the contract price for Payment Unit 1 will be 15% of the total bid price ($\$1,500/\$10,000 * 100$).

10. Disclaimer of Estimates and Bidder's Warranty of Inspection (7/16)

Before submitting this bid, the Bidder is advised and cautioned to inspect the sale area, review the requirements of the sale contract, and take other steps as may be reasonably necessary to ascertain the location, estimated volumes, construction estimates, and operating costs of the proposed sale. Failure to do so will not relieve the Bidder from responsibility for completing the contract.

The Bidder warrants that this bid is submitted solely on the basis of the Bidder's examination and inspection of the quality and quantity of the timber offered for sale and the Bidder's opinion of the value thereof and the costs of recovery. No reliance should be placed on the State of Michigan's estimates of timber quality, quantity or costs of recovery. Bidder further acknowledges that the State of Michigan: (i) expressly disclaims any warranty of fitness of timber for any purpose; (ii) offers this timber as is without any warranty of quality (merchantability) or quantity and (iii) expressly disclaims any warranty as to the quantity or quality of timber sold.

11. Certification and Chain-of-Custody (10/14)

Unless otherwise indicated in the contract under section 7 – Other Conditions of the Sale Specific Conditions & Requirements, the area encompassed by this timber sale is certified to the standards of the Forest Stewardship Council (FSC) - Certificate #SCS-FM/COC-00090N and the Sustainable Forestry Initiative (SFI) - Certificate # NSF-SFIS-5Y031-SF5. Forest products from this sale may be delivered to the mill as "FSC 100% and / or SFI certified" as long as the contractor hauling the forest products is chain-of-custody (COC) certified or covered under a COC certificate from the destination mill. The purchaser is responsible for maintaining COC after leaving the sale area.

12. Good Neighbor Authority (GNA) Requirements (7/16)

If the name of this timber sales contains the acronym GNA, it is authorized by the Good Neighbor Authority (GNA) and covered by various agreements between the U.S. Forest Service and the State. The timber sale occurs on federal land and the following conditions apply:

GNA contracts on US Forest Service land will not be awarded to purchasers on the Federal list of excluded parties. The System for Award Management (SAM) will be checked for active excluded parties prior to award of contract. In addition, the Bidder to whom award is made must complete an Assurance Regarding Felony Conviction or Tax Delinquent Status for Corporate Applicants (AD-3031).

13. Good Neighbor Authority (GNA) Requirements, con't (9/16)

Bidder certifies, by signing this bid form, that to the best of Bidder's knowledge that the following representations are accurate and complete.

a. That the Bidder and its principals are not presently debarred, suspended, proposed for debarment, declared ineligible, or voluntary excluded from timber sales (covered transactions) by any Federal department or agency.

b. That the Bidder and its principals have not within a 3-year period preceding this bid been convicted of or had a civil judgment rendered against them for commission of fraud or a criminal offense in connection with obtaining, attempting to obtain, or performing a public (Federal, State, or local) transaction or contract under a public transaction; violation of Federal or State antitrust statutes or commission of embezzlement, theft, forgery, bribery, falsification or destruction of records, making false statements, or receiving stolen property.

c. That the Bidder and its principals are not presently indicted for or otherwise criminally or civilly charged by a governmental entity (Federal, State, or local) with commission of any of the offenses enumerated in paragraph b of this certification.

d. That the Bidder and its principals have not within a 3-year period preceding this bid had one or more public transactions (Federal, State, or local) terminated for breach or default of a timber or forest product contract.

Bidders that cannot certify this requirement, in whole or in part, shall submit an explanation with their bid.

KEITH CREAGH

Director

TIMBER SALE INFORMATION

Petobego Aspen (61-001-18)

Grand Traverse County (Advertised Price \$8,496.35)

A timber sale contract for this lump sum, sealed bid timber sale will be awarded to the responsible bidder offering the highest sealed bid price. Bids must be at or above the following advertised price for each species:

<u>PRODUCTS & SPECIES</u>	<u>ESTIMATED UNITS*</u>	<u>ADVERTISED PRICE</u>
Sawtimber		
Mixed Aspen	24.80 MBF	\$ 88.00 / MBF
Red Maple	3.30 MBF	\$ 97.00 / MBF
Red Pine	4.20 MBF	\$ 93.00 / MBF
Sugar Maple	2.00 MBF	\$ 215.00 / MBF
White Pine	21.90 MBF	\$ 52.00 / MBF
Pulpwood		
Mixed Aspen	123.00 Cords	\$ 16.80 / Cord
Mixed Hardwood	44.00 Cords	\$ 16.30 / Cord
Red Oak	5.00 Cords	\$ 13.95 / Cord
Red Pine	15.00 Cords	\$ 33.90 / Cord
White Pine	57.00 Cords	\$ 11.80 / Cord

* The total volume is statistically estimated within plus (+) or minus (-) 40.93 percent. The estimated units are final and not subject to adjustment. Prospective bidders are urged to examine this timber and to make their own estimates of quantity and quality.

BOND AND PAYMENT SCHEDULE:

1. A bond in the amount of \$425.00 to insure faithful performance of the conditions of the contract will be deposited by the successful bidder within 21 days of the sale award.
2. Cutting in any sale or unit without the required advance payment would be considered a trespass.
3. Total payment must be paid in advance or according to the following schedule:
 - (a) Ten percent (10%) of the sale value must be paid within 21 days of the sale award.
 - (b) The 10% down payment will be credited towards the first unit cut.
4. If no cutting takes place, the 10% down payment will not be refunded.
5. Operations on the contract issued will terminate on 06/30/2020.

Description of Timber by Payment Unit (PU)

PU	MARKET GROUP	PRODUCT	QUANTITY	UNIT	ACRES	ADVERTISE PRICE	
1	Mixed Aspen	Sawtimber	20.4	MBF	14.3	\$7,290.55	
	<i>B. T. Aspen</i>		20.4	<i>MBF</i>			
	Red Maple		3.3	MBF			
	Red Pine		4.2	MBF			
	Sugar Maple		2.0	MBF			
	White Pine		19.9	MBF			
	Mixed Aspen		Pulpwood	91.0			Cords
	<i>B. T. Aspen</i>			91.0			<i>Cords</i>
	Mixed Hardwood			44.0			Cords
	<i>Paper Birch</i>			1.0			<i>Cords</i>
	<i>Red Maple</i>			40.0			<i>Cords</i>
	<i>Sugar Maple</i>			3.0			<i>Cords</i>
	Red Oak			5.0			Cords
	Red Pine			15.0			Cords
White Pine	42.0	Cords					
2	Mixed Aspen	Sawtimber	4.4	MBF	4.3	\$1,205.80	
	<i>B. T. Aspen</i>		3.3	<i>MBF</i>			
	<i>Quaking Aspen</i>		1.1	<i>MBF</i>			
	White Pine		2.0	MBF			
	Mixed Aspen		Pulpwood	32.0			Cords
	<i>B. T. Aspen</i>			14.0			<i>Cords</i>
	<i>Quaking Aspen</i>			18.0			<i>Cords</i>
White Pine	15.0	Cords					
TOTAL:			56.2	MBF			
TOTAL:			244.0	Cords			

Sale Specific Conditions & Requirements

Sale Name: Petobego Aspen

Sale Number: 61-001-18 Seq#: 1

1 - Sale Area

1.2 - Boundaries

1.2.1 - Painted boundaries (1/14)

Exterior sale boundary lines are marked with red paint, with the following exception: The narrow roadside portions of Payment Unit 1, extending beyond the wider patches of the unit, are unpainted and identified by 25 feet on either side of the access road extending from the west edge of Payment Unit 2, southwest to the steel gate (see Timber Sale Map).

2 - Timber Specifications

2.1 - Included Timber

2.1.1 - Clearcut unit(s) with unmerchantable trees (6/14)

Within Payment Unit(s) 1, cut all trees that are two (2) inches or more at DBH except do not cut oak, red pine and white pine greater than 18" at DBH, along with any hemlock, birch, cedar, and trees marked with green paint. In addition, cut all trees marked with orange paint, which are located within 25 feet of the access road from the west edge of Payment Unit 2 southwest to the steel gate. Also, fallen aspen and red maple are Included Timber and are to be utilized.

2.1.3 - Cut tree marked unit(s) (12/08)

Within Payment Unit(s) 2, all trees are designated for cutting when marked with orange paint above and below stump height, regardless of merchantability. In addition, cut all aspen regardless of merchantability. Also, fallen aspen and red maple are Included Timber and are to be utilized.

4 - Transportation

4.1 - Construction

4.1.3 - Slash and earthen piles (8/04)

Piles or windrows of earth along roads and landings that have been widened or constructed shall be leveled. Slash from road maintenance or construction, including stumps, shall be chipped, utilized or dispersed throughout the sale. This includes all previously fallen trees or tree segments over 6 inches in diameter within 10 feet of the centerline of the road.

4.1.12 - No new roads (1/12)

No new roads will be permitted in any Payment Unit. All operations are limited to existing roads. Skidding/forwarding trails only will be allowed.

5 - Operations

5.2 - Conduct of Operations

5.2.1 - Slash

5.2.1.8 - Slash height (12/08)

No slash or tree tops may exceed 36 inches in height.

5.2.2 - Hazard Trees/Snags

5.2.2.1 - Den trees (10/16)

Obvious hollow and/or den trees shall be protected and left standing unless they are a safety hazard.

5.2.3 - Operating Restrictions

5.2.3.4 - Oak wilt restriction (9/17)

Within Payment Unit(s) 1 and 2, unless changed by written agreement, cutting, skidding, and brushing of access roads are not permitted during the period of April 15 to July 15. This is necessary to reduce the spread of oak wilt. For more information, contact the Unit Manager or his/her representative.

5.2.3.6 - Bark beetle restriction (12/08)

In the event drought creates a high risk of pine bark beetle infestation, pine is not to be cut during the period March 1 through July 1, unless all portions of trees greater than two inches in diameter are removed from the sale area, reduced to chips, or treated to the satisfaction of the Unit Manager or his/her representative, within fifteen days of being severed from the stump. Pine log decks, pulpwood piles and treetops that are piled for chipping in the fall or winter within a 1/4 mile of susceptible sites must be removed before March 15. Residual slash must not be placed in piles or rows and must be spread over the site for quick drying. The Department of Natural Resources will exercise this specification if the risk of damage warrants.

5.4 - Soil Protection

5.4.1 - Rutting restriction, general (7/16)

Operations are to cease immediately if equipment and weather conditions result in rutting of roads and/or skid trails which is 12 inches or greater in depth and 50 feet in length. The Unit Manager or his/her representative may restrict hauling and/or skidding if ruts exceed the specified depth. With the Unit Manager or his/her representative's approval, the Purchaser may return to the area when the risk of rutting has decreased.

5.4.3 - Erosion control (12/08)

Skid trails or haul roads may require erosion control structures or berms per direction of the Unit Manager or his/her representative.

6 - Safety and Fire Prevention

6.2 - Signing

6.2.1 - Road posting (9/09)

The Purchaser is responsible for posting and maintaining caution signs on U.S. 31 prior to beginning operations. The road must be posted at appropriate distances from the sale area to warn of logging activity and truck traffic. Signs must be removed when harvest operations are suspended or completed. The Purchaser will provide these signs.

7 - Other Conditions

7.5 - Loss

7.5.1 - Deteriorating timber (7/09)

The sale area has received damage from windthrow. The Purchaser should harvest the wood as soon as possible. The Department of Natural Resources is held free of responsibility of any further damage or deterioration due to delay in harvesting.



TIMBER SALE MAP

This information provided by authority of Part 525, 1994 PA 451, as amended.

Forest Management Unit Traverse City FMU		County Grand Traverse	Mapped By Tim Webb	Date 11/03/2017	Page 1	of 1
Township 28N	Range 9W	Section(s) and Subdivision(s) Sec. 5: SWNW; Sec. 6: N1/2SE, SENE		Scale 1:7,920		

Cover Type

A = Aspen	H = Hemlock	N = Marsh	U = Upland Brush
B = Paper Birch	J = Jack Pine	O = Oak	UM = Upland Mixed
C = Cedar	L = Lowland Brush	P = Lowland Poplar	V = Bog or Marsh
D = Treed Bog	LM = Lowland Mixed	Q = Mixed Swamp Conifer	W = White Pine
E = Swamp Hdwoods	M = Mpl, Bch, Brch	R = Red Pine	X = Non Stocked
F = Spruce Fir	MC = Mixed Conifer	S = Black Spruce	Z = Water
G = Grass	MD = Mixed Deciduous	T = Tamarack	

Density

0 = Non Stocked	5 = Pole Timber Medium
1 = Seedling Sapling Poor	6 = Pole Timber Well
2 = Seedling Sapling Medium	7 = Saw Timber Poor
3 = Seedling Sapling Well	8 = Saw Timber Medium
4 = Pole Timber Poor	9 = Saw Timber Well

PU Acres

1	14.3
2	4.3

Petobego Aspen

Petobego State Game Area

18.6 acres

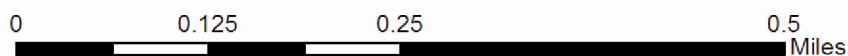
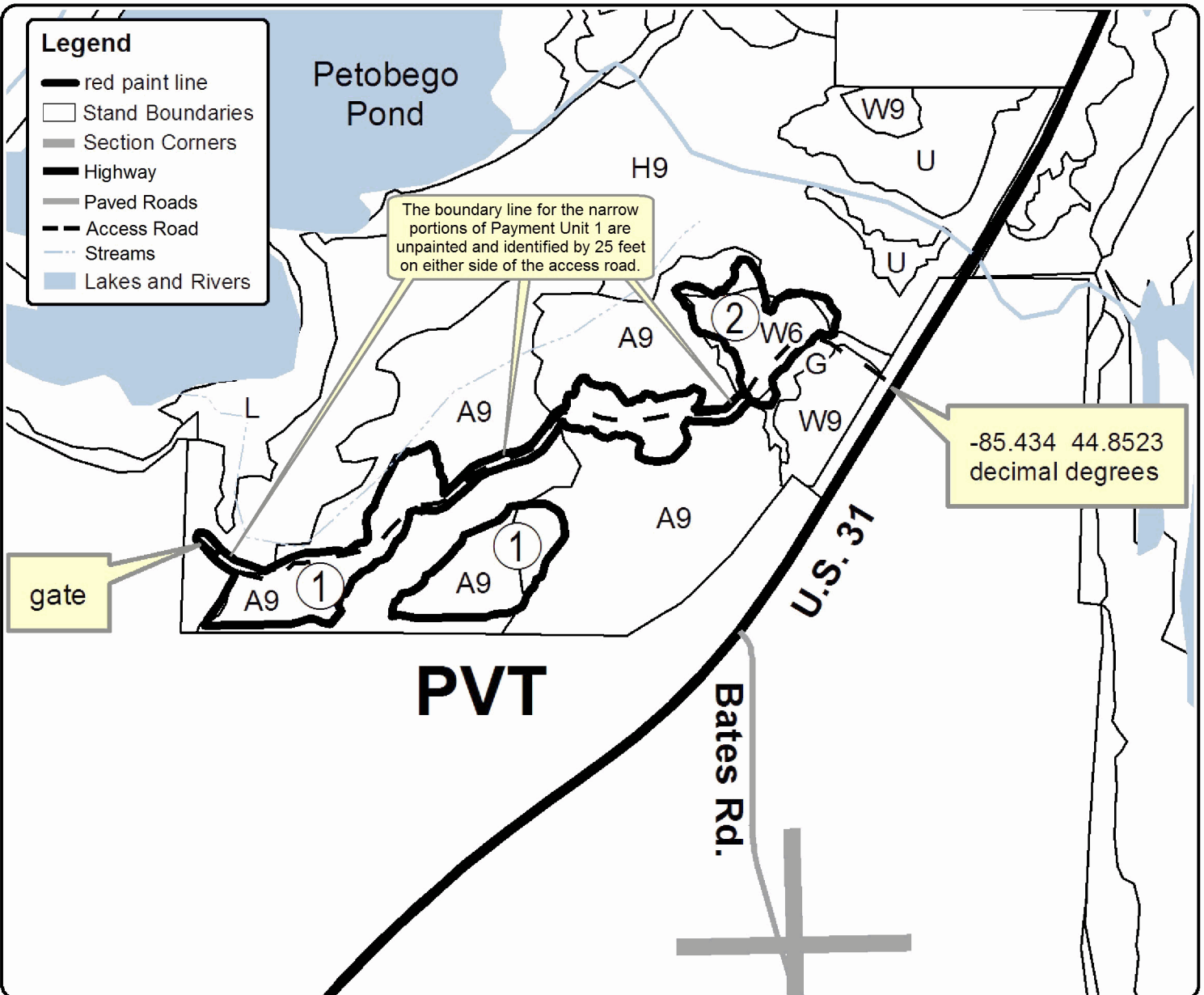

TIMBER SALE INFORMATION

Wreath Aspen (61-004-18)

Benzie County (Advertised Price \$19,257.25)

SALE NOTE: A recreation site such as a trail, pathway, or campground is within the sale area or the vicinity. Certain restrictions/specifications may be applicable including time restrictions.

A timber sale contract for this lump sum, sealed bid timber sale will be awarded to the responsible bidder offering the highest sealed bid price. Bids must be at or above the following advertised price for each species:

<u>PRODUCTS & SPECIES</u>	<u>ESTIMATED UNITS*</u>	<u>ADVERTISED PRICE</u>
Sawtimber		
Mixed Aspen	43.10 MBF	\$ 110.00 / MBF
Sugar Maple	21.80 MBF	\$ 269.00 / MBF
White Pine	1.40 MBF	\$ 65.00 / MBF
Pulpwood		
Mixed Aspen	262.00 Cords	\$ 21.00 / Cord
Mixed Hardwood	142.00 Cords	\$ 20.40 / Cord
White Pine	11.00 Cords	\$ 14.75 / Cord

* The total volume is statistically estimated within plus (+) or minus (-) 26.66 percent. The estimated units are final and not subject to adjustment. Prospective bidders are urged to examine this timber and to make their own estimates of quantity and quality.

BOND AND PAYMENT SCHEDULE:

1. A bond in the amount of \$963.00 to insure faithful performance of the conditions of the contract will be deposited by the successful bidder within 21 days of the sale award.
2. Cutting in any sale or unit without the required advance payment would be considered a trespass.
3. Total payment must be paid in advance or according to the following schedule:
 - (a) Ten percent (10%) of the sale value must be paid within 21 days of the sale award.
 - (b) The 10% down payment will be credited towards the first unit cut.
4. If no cutting takes place, the 10% down payment will not be refunded.
5. Operations on the contract issued will terminate on 06/30/2020.

Description of Timber by Payment Unit (PU)

PU	MARKET GROUP	PRODUCT	QUANTITY	UNIT	ACRES	ADVERTISE PRICE	
1	Mixed Aspen	Sawtimber	16.6	MBF	15.7	\$12,052.95	
	<i>B. T. Aspen</i>		14.1	<i>MBF</i>			
	<i>Quaking Aspen</i>		2.5	<i>MBF</i>			
	Sugar Maple		15.7	MBF			
	White Pine		1.4	MBF			
	Mixed Aspen		Pulpwood	200.0			Cords
	<i>B. T. Aspen</i>			195.0			<i>Cords</i>
	<i>Quaking Aspen</i>			5.0			<i>Cords</i>
	Mixed Hardwood			76.0			Cords
	<i>Black Cherry</i>			9.0			<i>Cords</i>
	<i>Ironwood</i>			6.0			<i>Cords</i>
	<i>Red Maple</i>			8.0			<i>Cords</i>
	<i>Sugar Maple</i>			53.0			<i>Cords</i>
	White Pine			11.0			Cords
2	Mixed Aspen	Sawtimber		22.8	MBF	6.0	\$6,196.10
	<i>B. T. Aspen</i>		21.3	<i>MBF</i>			
	<i>Quaking Aspen</i>		1.5	<i>MBF</i>			
	Sugar Maple		6.1	MBF			
	Mixed Aspen		Pulpwood	46.0	Cords		
	<i>B. T. Aspen</i>			24.0	<i>Cords</i>		
	<i>Quaking Aspen</i>			22.0	<i>Cords</i>		
	Mixed Hardwood			53.0	Cords		
	<i>Black Cherry</i>			3.0	<i>Cords</i>		
	<i>Ironwood</i>			4.0	<i>Cords</i>		
	<i>Sugar Maple</i>			46.0	<i>Cords</i>		
3	Mixed Aspen	Sawtimber	3.7	MBF	7.5	\$1,008.20	
	<i>B. T. Aspen</i>		3.7	<i>MBF</i>			
	Mixed Aspen	Pulpwood	16.0	Cords			
	<i>B. T. Aspen</i>		16.0	<i>Cords</i>			
	Mixed Hardwood		13.0	Cords			
	<i>Ironwood</i>		1.0	<i>Cords</i>			
	<i>Red Maple</i>		3.0	<i>Cords</i>			
<i>Sugar Maple</i>	9.0	<i>Cords</i>					
TOTAL:			66.3	MBF			
TOTAL:			415.0	Cords			

Sale Specific Conditions & Requirements

Sale Name: Wreath Aspen

Sale Number: 61-004-18 Seq#: 1

1 - Sale Area

1.2 - Boundaries

1.2.1 - Painted boundaries (1/14)

The sale boundary and Payment Unit boundaries are marked and identified by red and yellow paint. Exterior sale boundary lines against state land are marked with red paint. Interior Payment Unit boundaries are marked with yellow paint. Retention patches within Payment Unit 1 are marked with double red paint marks. Painted boundary line trees are not Included Timber and are to be protected.

2 - Timber Specifications

2.1 - Included Timber

2.1.1 - Clearcut unit(s) with unmerchantable trees (6/14)

Within Payment Unit(s) 1 and 2, cut all trees that are two (2) inches or more at DBH, except the following:

Within Payment Unit 1, do not cut any white pine greater than 16 inches at DBH or any elm.

Within Payment Unit 2, do not cut any conifers or any trees marked with green paint.

2.1.3 - Cut tree marked unit(s) (12/08)

Within Payment Unit(s) 3, all trees are designated for cutting when marked with orange paint above and below stump height, regardless of merchantability. In addition, cut all aspen trees unless marked with green paint. Ironwood saplings (<4.5" DBH) may be cut as necessary to facilitate harvest of designated timber.

2.2 - Utilization

2.2.4 - Skidding length (2/14)

Within Payment Unit 3, skidding of unlimbed tops or lengths over 17 feet is not permissible unless approved by the Unit Manager or his/her representative.

4 - Transportation

4.1 - Construction

4.1.3 - Slash and earthen piles (8/04)

Piles or windrows of earth along roads and landings that have been widened or constructed shall be leveled. Slash from road maintenance or construction, including stumps, shall be dispersed throughout the sale.

4.1.12 - No new roads (1/12)

No new roads will be permitted. All operations are limited to existing roads. Skidding/forwarding trails only will be allowed.

5 - Operations

5.2 - Conduct of Operations

5.2.1 - Slash

5.2.1.8 - Slash height (12/08)

No slash or tree tops may exceed 24 inches in height.

5.2.3 - Operating Restrictions

5.2.3.3 - Bark slippage restriction (3/09)

Within Payment Unit(s) 3, unless changed by written agreement, cutting and skidding are not permitted during the period of April 15 to July 15. This restriction is because of bark slippage.

5.2.4 - Dead and Down Creation

5.2.4.1 - Dead and down creation, marked trees (10/13)

All trees marked with an orange "X" must be felled and left on site for wildlife. Either cut these trees at 4 feet above ground level and place the cut trunk against the resulting high stump, or cut at ground level and place the cut trunk against a small nearby tree retained for this purpose.

5.2.38 - No decking against live trees (2/04)

Cut products may not be decked against unmarked or designated leave trees.

5.2.41 - Snowmobile trail protection (9/11)

The Platte River snowmobile trail is shown on the Timber Sale Map, abutting the south edge of Payment Unit 3 along Oakley Road. Do not cut or damage posts with orange trail markers or traffic control signs. If the trail is used, it must be maintained and restored to a condition equal to or better than before the sale. The road maintenance/restoration must be done prior to December 1. If the trail road is to be used for hauling during the snowmobile season, then a snow covered base must be left on the trail. Maintain a 20 foot wide slash, debris, and rut free zone daily using the snowmobile trail as the centerline. All stumps within 20 feet of the snowmobile trail must be cut at ground level. In addition, any trees cut within 5 feet of the trail must have the stumps removed and be disposed of according to the direction of the Unit Manager or his/her representative.

5.4 - Soil Protection

5.4.3 - Erosion control (12/08)

Skid trails or haul roads may require erosion control structures or berms per direction of the Unit Manager or his/her representative.

6 - Safety and Fire Prevention

6.2 - Signing

6.2.2 - Snowmobile trail posting (8/09)

The Purchaser is responsible for posting and maintaining caution signs on the snowmobile trail prior to beginning operations during the snowmobile season (approximately December 1 to March 31). The trail must be posted at appropriate distances from the sale area to warn of logging activity and truck traffic. Signs must be removed when harvest operations are suspended or completed. The Purchaser will provide these signs.



TIMBER SALE MAP

This information provided by authority of Part 525, 1994 PA 451, as amended.

Forest Management Unit Traverse City FMU		County Benzie	Mapped By Tim Webb	Date 11/20/2017	Page 1	of 1
Township 27N	Range 13W	Section(s) and Subdivision(s) Sec. 31: SW1/4, SENW		Scale 1:7,920		
Cruised By Tim Webb						

Cover Type				Density	
A = Aspen	H = Hemlock	N = Marsh	U = Upland Brush	0 = Non Stocked	5 = Pole Timber Medium
B = Paper Birch	J = Jack Pine	O = Oak	UM = Upland Mixed	1 = Seedling Sapling Poor	6 = Pole Timber Well
C = Cedar	L = Lowland Brush	P = Lowland Poplar	V = Bog or Marsh	2 = Seedling Sapling Medium	7 = Saw Timber Poor
D = Treed Bog	LM = Lowland Mixed	Q = Mixed Swamp Conifer	W = White Pine	3 = Seedling Sapling Well	8 = Saw Timber Medium
E = Swamp Hdwoods	M = Mpl, Bch, Brch	R = Red Pine	X = Non Stocked	4 = Pole Timber Poor	9 = Saw Timber Well
F = Spruce Fir	MC = Mixed Conifer	S = Black Spruce	Z = Water		
G = Grass	MD = Mixed Deciduous	T = Tamarack			

PU	Acres
1	15.7
2	6.0
3	7.5

Wreath Aspen

Compartment 10

29.2 acres



-85.9292 44.6986
decimal degrees

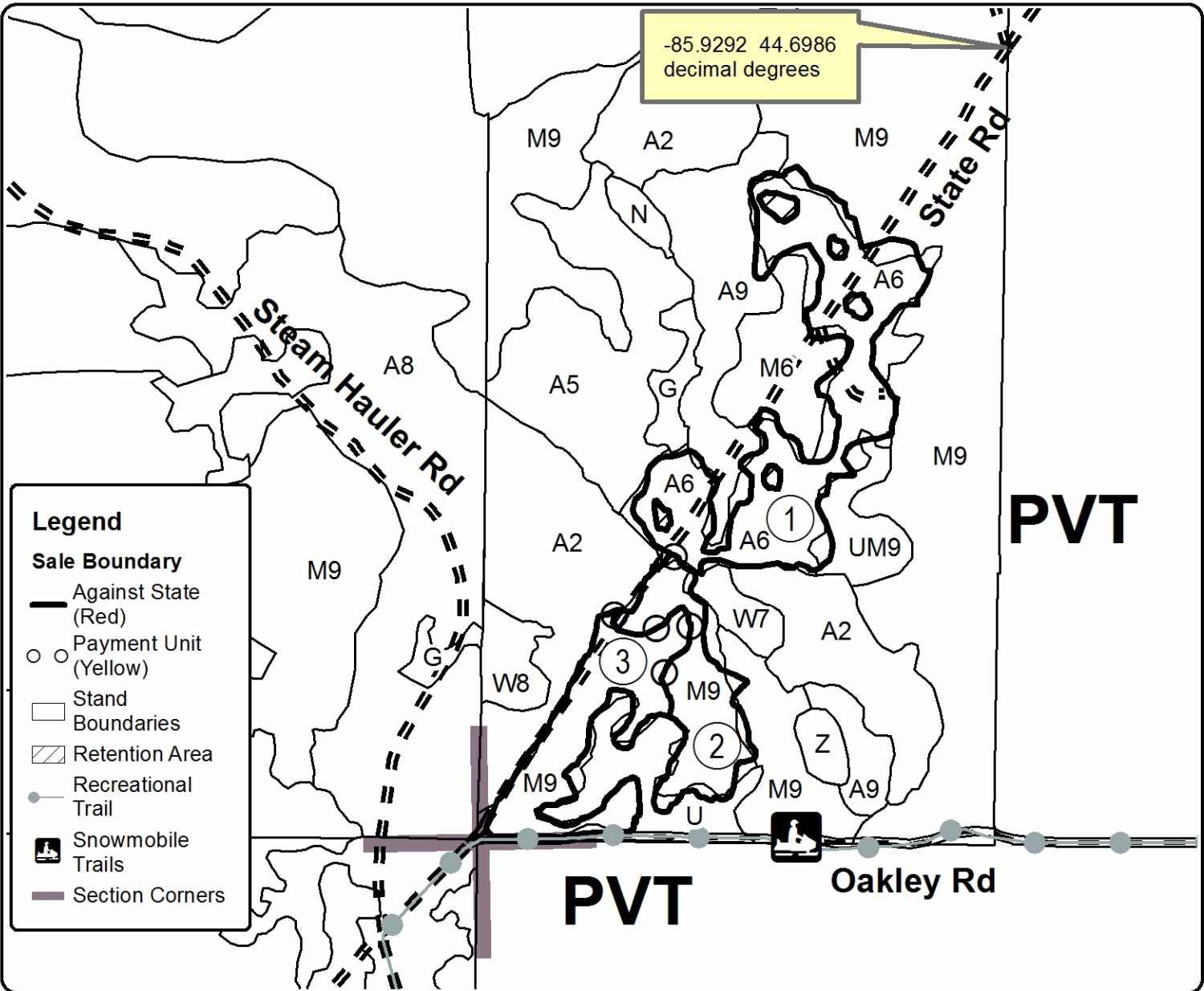

Legend

Sale Boundary

- Against State (Red)
- Payment Unit (Yellow)
- Stand Boundaries
- Retention Area
- Recreational Trail
- Snowmobile Trails
- Section Corners

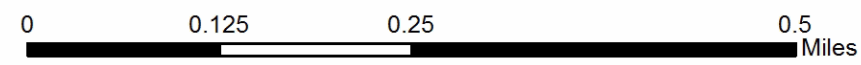

TIMBER SALE INFORMATION

Alchemy Hardwoods (61-033-17)

Manistee County (Advertised Price \$83,939.50)

SALE NOTE: Access to the sale will be from a powerline ROW. Landing areas and the specific location for haul route on or near the ROW will need to be approved by the sale administrator during pre-sale activities.

A timber sale contract for this lump sum, sealed bid timber sale will be awarded to the responsible bidder offering the highest sealed bid price. Bids must be at or above the following advertised price for each species:

<u>PRODUCTS & SPECIES</u>	<u>ESTIMATED UNITS*</u>	<u>ADVERTISED PRICE</u>
Sawtimber		
Beech	27.30 MBF	\$ 104.00 / MBF
Black Cherry	31.10 MBF	\$ 179.00 / MBF
Red Maple	377.40 MBF	\$ 122.00 / MBF
Sugar Maple	7.20 MBF	\$ 269.00 / MBF
Pulpwood		
Mixed Aspen	57.00 Cords	\$ 21.00 / Cord
Mixed Hardwood	1,292.00 Cords	\$ 20.40 / Cord

* The total volume is statistically estimated within plus (+) or minus (-) 11.18 percent. The estimated units are final and not subject to adjustment. Prospective bidders are urged to examine this timber and to make their own estimates of quantity and quality.

BOND AND PAYMENT SCHEDULE:

1. A bond in the amount of \$4,197.00 to insure faithful performance of the conditions of the contract will be deposited by the successful bidder within 21 days of the sale award.
2. Cutting in any sale or unit without the required advance payment would be considered a trespass.
3. Total payment must be paid in advance or according to the following schedule:
 - (a) Ten percent (10%) of the sale value must be paid within 21 days of the sale award.
 - (b) The 10% down payment will be credited towards the first unit cut.
4. If no cutting takes place, the 10% down payment will not be refunded.
5. Operations on the contract issued will terminate on 06/30/2020.

Description of Timber by Payment Unit (PU)

PU	MARKET GROUP	PRODUCT	QUANTITY	UNIT	ACRES	ADVERTISE PRICE
1	Beech	Sawtimber	13.9	MBF	32.2	\$29,925.00
	Black Cherry		13.9	MBF		
	Red Maple		119.5	MBF		
	Sugar Maple		3.9	MBF		
	Mixed Hardwood	Pulpwood	508.0	Cords		
	<i>Beech</i>		<i>76.0</i>	<i>Cords</i>		
	<i>Black Cherry</i>		<i>73.0</i>	<i>Cords</i>		
	<i>Red Maple</i>		<i>279.0</i>	<i>Cords</i>		
	<i>Sugar Maple</i>		<i>80.0</i>	<i>Cords</i>		
	2	Beech	Sawtimber	6.0		
Black Cherry			15.3	MBF		
Red Maple			151.8	MBF		
Sugar Maple			3.3	MBF		
Mixed Hardwood		Pulpwood	473.0	Cords		
<i>Beech</i>			<i>17.0</i>	<i>Cords</i>		
<i>Black Cherry</i>			<i>61.0</i>	<i>Cords</i>		
<i>Ironwood</i>			<i>2.0</i>	<i>Cords</i>		
<i>Red Maple</i>			<i>339.0</i>	<i>Cords</i>		
<i>Sugar Maple</i>			<i>54.0</i>	<i>Cords</i>		
3	Beech	Sawtimber	7.4	MBF	10.8	\$21,595.30
	Black Cherry		1.9	MBF		
	Red Maple		106.1	MBF		
	Mixed Aspen	Pulpwood	57.0	Cords		
	<i>B. T. Aspen</i>	<i>Sawtimber</i>	<i>14.8</i>	<i>MBF</i>		
	<i>B. T. Aspen</i>	<i>Pulpwood</i>	<i>27.0</i>	<i>Cords</i>		
	Mixed Hardwood		311.0	Cords		
	<i>Beech</i>		<i>35.0</i>	<i>Cords</i>		
	<i>Black Cherry</i>		<i>29.0</i>	<i>Cords</i>		
	<i>Red Maple</i>		<i>247.0</i>	<i>Cords</i>		
TOTAL:			443.0	MBF		
TOTAL:			1,349.0	Cords		

Sale Specific Conditions & Requirements

Sale Name: Alchemy Hardwoods

Sale Number: 61-033-17 Seq#: 1

1 - Sale Area

1.2 - Boundaries

1.2.1 - Painted boundaries (1/14)

The sale boundary and Payment Unit boundaries are marked and identified by blue, red and yellow paint. Exterior sale boundary lines against private property are marked with blue paint. Exterior sale boundary lines against state are marked with red paint. Interior Payment Unit boundaries are marked with yellow paint. The painted boundary line trees are not Included Timber and are to be protected unless marked with orange paint. Yellow painted trees designating an interior Payment Unit boundary are only to be cut when also marked with orange paint, and only when all surrounding Payment Units have been paid.

2 - Timber Specifications

2.1 - Included Timber

2.1.3 - Cut tree marked unit(s) (12/08)

Within Payment Unit(s) 1 & 2, all trees are designated for cutting when marked with orange paint above and below stump height, regardless of merchantability. In addition, all beech trees are to be harvested unless marked with green paint.

2.1.7 - Leave tree marked unit(s) (6/14)

Within Payment Unit(s) 3, all trees, which meet minimum piece specifications in 2.2 Utilization, are designated for cutting except sugar maple and trees marked with green paint above and below stump height.

2.2 - Utilization

2.2.5 - Limbed tree skidding (1/09)

The skidding of whole trees or tree segments with limbs attached is prohibited.

3 - Payments

3.4 - Damaged Timber

3.4.1 - Damaged timber (6/14)

General Condition and Requirement 3.4 Damaged Timber, defines liquidated damages for undesignated live merchantable trees which are cut or injured. In addition, extreme care should be taken to avoid damage to tree seedlings and saplings.

Within the sale area, if more than 25% of the tree seedlings or saplings (1/4" to 4.5" DBH) within a specified portion of the sale area are damaged, liquidated damages will be assessed at 100\$ per acre for all acreage within that specified portion of the sale area that was damaged.

No damage is acceptable to merchantable trees. Within the sale area, if more than 10% of trees (> 4.5" DBH) within a specified area of the sale are damaged, liquidated damages will be assessed for all trees damaged. Rates will be in accordance with General Condition and Requirement 3.4 Damaged Timber.

4 - Transportation

4.1 - Construction

4.1.11 - Permits (2/12)

The Purchaser will secure any necessary permits that may be required.

4.1.12 - No new roads (1/12)

No new roads will be permitted in any Payment Unit. All operations are limited to existing roads. Skid trails only will be allowed.

4.4 - Access

4.4.1 - Private property access (3/11)

Permission for access across private land is the responsibility of the Purchaser. Should the Purchaser desire to cross private land, a copy of the written permission from the private land-owner will be required by the DNR.

5 - Operations

5.2 - Conduct of Operations

5.2.1 - Slash

5.2.1.8 - Slash height (12/08)

No slash or tree tops may exceed 36 inches in height.

5.2.2 - Hazard Trees/Snags

5.2.2.1 - Den trees (10/16)

Obvious hollow and/or den trees shall be protected and left standing unless they are a safety hazard.

5.2.3 - Operating Restrictions

5.2.3.3 - Bark slippage restriction (3/09)

Within Payment Unit(s) 1, 2 & 3, cutting and skidding are not permitted during the period of April 15 to July 15. This restriction is because of bark slippage.

5.2.4 - Dead and Down Creation

5.2.4.2 - Dead and down creation, hare and grouse (1/14)

To improve habitat for snowshoe hare, grouse, and other species, the Purchaser is to leave two 12 inch diameter or larger log size pieces on the ground for every two acres. The pieces should be scattered throughout the sale with more specific instructions being given by the sale administrator during sale operations. Note these pieces should have a minimum length of eight feet. They can be of any tree species and can be an un-merchantable piece of wood or a full tree.

5.2.29 - Shrub protection (9/07)

Do not cut or damage hawthorn, witch-hazel or juneberry. These woody-shrub plants are highly beneficial to various wildlife species.

5.4 - Soil Protection

5.4.1 - Rutting restriction, general (7/16)

Operations are to cease immediately if equipment and weather conditions result in rutting of roads and/or skid trails which is 12 inches or greater in depth and 50 feet in length. The Unit Manager or his/her representative may restrict hauling and/or skidding if ruts exceed the specified depth. With the Unit Manager or his/her representative's approval, the Purchaser may return to the area when the risk of rutting has decreased.

6 - Safety and Fire Prevention

6.2 - Signing

6.2.1 - Road posting (9/09)

The Purchaser is responsible for posting and maintaining caution signs on Benton Rd. prior to beginning operations. The road must be posted at appropriate distances from the sale area to warn of logging activity and truck traffic. Signs must be removed when harvest operations are suspended or completed. The Purchaser will provide these signs.



TIMBER SALE MAP

This information provided by authority of Part 525, 1994 PA 451, as amended.

Forest Management Unit Traverse City FMU	County Manistee	Mapped By Patrick Cotant	Date 9/28/2017	Page 1	of 1
Township 23N	Range 13W	Section(s) and Subdivision(s) Sec 1 - SE1/4	Scale 1:15,840		

Cover Type				Density			
A = Aspen	H = Hemlock	N = Marsh	U = Upland Brush	0 = Non Stocked	5 = Pole Timber Medium		
B = Paper Birch	J = Jack Pine	O = Oak	UM = Upland Mixed	1 = Seeding Sapling Poor	6 = Pole Timber Well		
C = Cedar	L = Lowland Brush	P = Lowland Poplar	V = Bog or Marsh	2 = Seeding Sapling Medium	7 = Saw Timber Poor		
D = Tread Bog	LM = Lowland Mixed	Q = Mixed Swamp Conifer	W = White Pine	3 = Seeding Sapling Well	8 = Saw Timber Medium		
E = Swamp Hdwoods	M = Mpl, Bch, Bich	R = Red Pine	X = Non Stocked	4 = Pole Timber Poor	9 = Saw Timber Well		
F = Spruce Fir	MC = Mixed Conifer	S = Black Spruce	Z = Water				
G = Grass	MD = Mixed Deciduous	T = Tamarack					

PU	Acres
1	32.2
2	23.4
3	10.8

Alchemy Hardwoods

Compartment 037

66.4 Acres

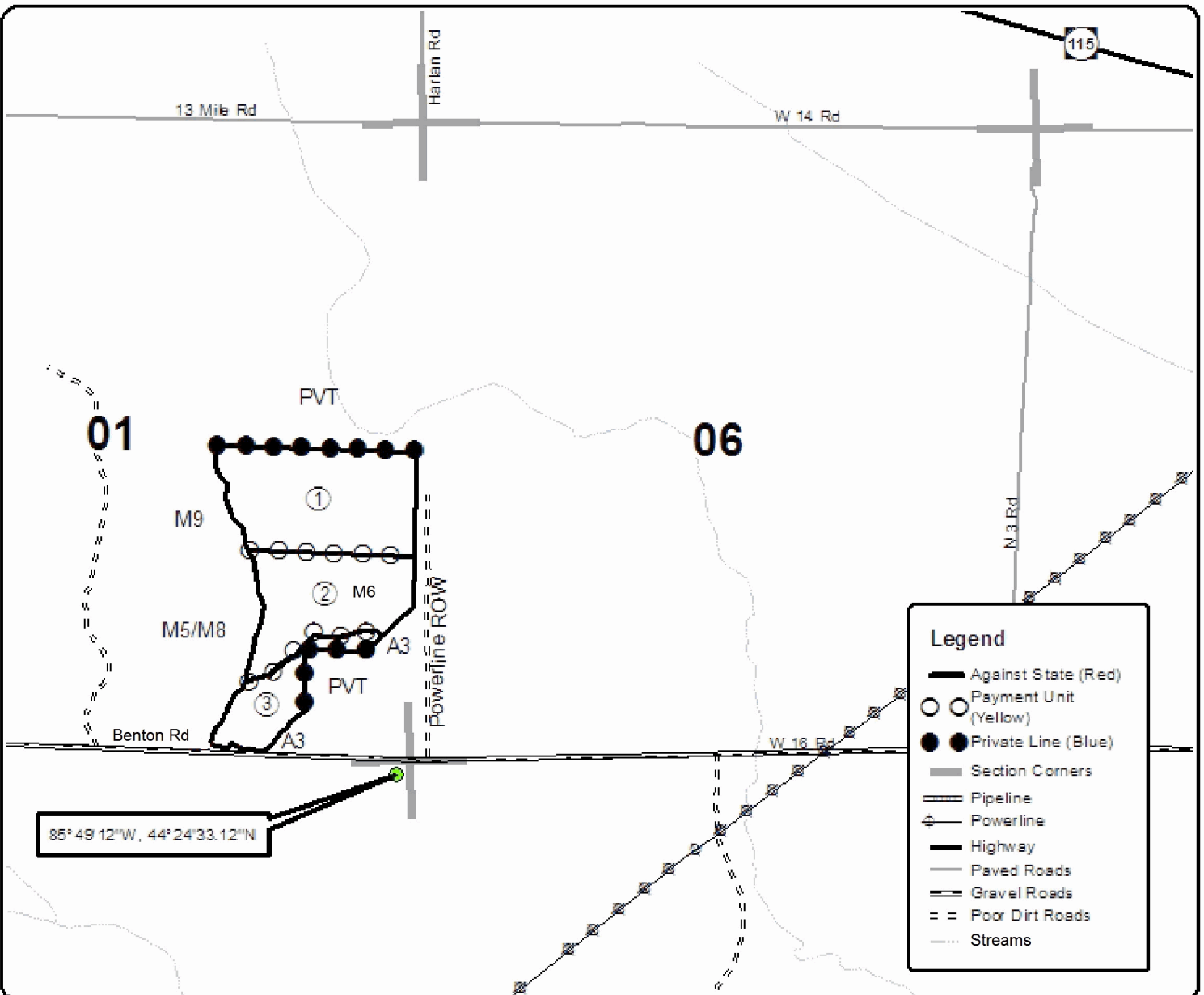
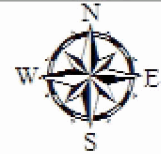

TIMBER SALE INFORMATION

Lee Side Hardwood (61-058-17)

Benzie County (Advertised Price \$75,949.00)

SALE NOTE: A recreation site such as a trail, pathway, or campground is within the sale area or the vicinity. Certain restrictions/specifications may be applicable including time restrictions.

A timber sale contract for this lump sum, sealed bid timber sale will be awarded to the responsible bidder offering the highest sealed bid price. Bids must be at or above the following advertised price for each species:

<u>PRODUCTS & SPECIES</u>	<u>ESTIMATED UNITS*</u>		<u>ADVERTISED PRICE</u>
Sawtimber			
Basswood	138.70	MBF	\$ 120.00 / MBF
Beech	23.70	MBF	\$ 104.00 / MBF
Mixed Aspen	55.80	MBF	\$ 110.00 / MBF
Red Pine	5.40	MBF	\$ 116.00 / MBF
Sugar Maple	128.90	MBF	\$ 269.00 / MBF
Pulpwood			
Basswood	130.00	Cords	\$ 30.35 / Cord
Mixed Aspen	77.00	Cords	\$ 21.00 / Cord
Mixed Hardwood	474.00	Cords	\$ 20.40 / Cord
Red Pine	4.00	Cords	\$ 42.40 / Cord

* The total volume is statistically estimated within plus (+) or minus (-) 16.03 percent. The estimated units are final and not subject to adjustment. Prospective bidders are urged to examine this timber and to make their own estimates of quantity and quality.

BOND AND PAYMENT SCHEDULE:

1. A bond in the amount of \$3,797.00 to insure faithful performance of the conditions of the contract will be deposited by the successful bidder within 21 days of the sale award.
2. Cutting in any sale or unit without the required advance payment would be considered a trespass.
3. Total payment must be paid in advance or according to the following schedule:
 - (a) Ten percent (10%) of the sale value must be paid within 21 days of the sale award.
 - (b) The 10% down payment will be credited towards the first unit cut.
4. If no cutting takes place, the 10% down payment will not be refunded.
5. Operations on the contract issued will terminate on 06/30/2020.

Description of Timber by Payment Unit (PU)

PU	MARKET GROUP	PRODUCT	QUANTITY	UNIT	ACRES	ADVERTISE PRICE	
1	Basswood	Sawtimber	126.4	MBF	47.3	\$51,628.90	
	Beech		21.5	MBF			
	Mixed Aspen		11.9	MBF			
	<i>Quaking Aspen</i>		11.9	<i>MBF</i>			
	Sugar Maple		82.7	MBF			
	Basswood		Pulpwood	116.0			Cords
	Mixed Aspen			15.0			Cords
	<i>Quaking Aspen</i>			15.0			<i>Cords</i>
	Mixed Hardwood			335.0			Cords
	<i>Beech</i>			81.0			<i>Cords</i>
	<i>Ironwood</i>	9.0		<i>Cords</i>			
	<i>Sugar Maple</i>	245.0	<i>Cords</i>				
	2	Basswood	Sawtimber	12.3	MBF	8.5	\$17,587.10
Beech		2.2		MBF			
Red Pine		5.4		MBF			
Sugar Maple		44.0		MBF			
Basswood		Pulpwood		14.0	Cords		
Mixed Aspen				17.0	Cords		
<i>Quaking Aspen</i>				17.0	<i>Cords</i>		
Mixed Hardwood				121.0	Cords		
<i>Beech</i>				3.0	<i>Cords</i>		
<i>Sugar Maple</i>				118.0	<i>Cords</i>		
Red Pine				4.0	Cords		
3	Mixed Aspen	Sawtimber	43.9	MBF	3.0	\$6,733.00	
	<i>B. T. Aspen</i>		43.9	<i>MBF</i>			
	Sugar Maple	Pulpwood	2.2	MBF			
	Mixed Aspen		45.0	Cords			
	<i>B. T. Aspen</i>		42.0	<i>Cords</i>			
	<i>Quaking Aspen</i>		3.0	<i>Cords</i>			
	Mixed Hardwood		18.0	Cords			
	<i>Ironwood</i>		7.0	<i>Cords</i>			
<i>Sugar Maple</i>	11.0	<i>Cords</i>					
TOTAL:			352.5	MBF			
TOTAL:			685.0	Cords			

Sale Specific Conditions & Requirements

Sale Name: Lee Side Hardwood

Sale Number: 61-058-17 Seq#: 1

1 - Sale Area

1.2 - Boundaries

1.2.1 - Painted boundaries (1/14)

The sale boundary and Payment Unit boundaries are marked and identified by blue, red and yellow paint. Exterior sale boundary lines against private property are marked with blue paint. Exterior sale boundary lines against state land are marked with red paint. Interior Payment Unit boundaries are marked with yellow paint. The painted boundary line trees are not Included Timber and are to be protected unless marked with orange paint.

2 - Timber Specifications

2.1 - Included Timber

2.1.1 - Clearcut unit(s) with unmerchantable trees (6/14)

Within Payment Unit(s) 3, cut all trees that are two (2) inches or more at DBH except trees marked with green paint.

2.1.3 - Cut tree marked unit(s) (12/08)

Within Payment Unit(s) 1, all trees are designated for cutting when marked with orange paint above and below stump height, regardless of merchantability. In addition, cut all beech and aspen trees which meet minimum piece specifications in 2.2 Utilization, unless marked with green paint. Also, unmerchantable beech and ironwood trees may be cut as needed to facilitate harvesting of designated timber, but must be severed at ground level and laid flat on the ground; not just broken, bent, or pushed over.

2.1.7 - Leave tree marked unit(s) (6/14)

Within Payment Unit(s) 2, cut all trees that are two (2) inches or more at DBH except trees marked with green paint above and below stump height.

2.2 - Utilization

2.2.4 - Skidding length (2/14)

Skidding of unlimbed tops or lengths over 17 feet is not permissible within Payment Unit 1.

4 - Transportation

4.1 - Construction

4.1.3 - Slash and earthen piles (8/04)

Piles or windrows of earth along roads and landings that have been widened or constructed shall be leveled. Slash from road maintenance or construction, including stumps, shall be dispersed throughout the sale.

4.1.7 - Road closure (10/11)

All new roads built into the sale must be blocked to vehicle traffic upon completion of the sale. Overgrown or bermed roads that are reopened shall be considered new roads. In general, this will require constructing a four (4') foot high berm of stumps and logs covered with earth. Contact the sale administrator for specific details of design and placement.

5 - Operations

5.2 - Conduct of Operations

5.2.1 - Slash

5.2.1.8 - Slash height (12/08)

No slash or tree tops may exceed 36 inches in height.

5.2.3 - Operating Restrictions

5.2.3.3 - Bark slippage restriction (3/09)

Within Payment Unit(s) 1, cutting, forwarding and skidding are not permitted during the period of April 15 to July 15. This

restriction is because of bark slippage.

5.2.4 - Dead and Down Creation

5.2.4.1 - Dead and down creation, marked trees (10/13)

All trees marked with an orange "X" must be felled and left on site for wildlife.

5.2.38 - No decking against live trees (2/04)

Cut products may not be decked against unmarked or designated leave trees.

5.2.40 - Pathway protection (10/10)

The Shore to Shore riding/hiking trail is shown on the Timber Sale Map. Do not cut trees or damage posts with blue pathway markers. Maintain a 20-foot wide slash, debris, and rut free zone daily, using the trail as the centerline. The trail lies on Hooker and Haze roads and will be used for hauling. The trail must be graded periodically during the sale. In addition, if an organized trail ride is to occur while the sale is active, the sale administrator has the authority to limit harvest and hauling activities on the day of the ride. The sale administrator will provide at least 1 week notice if this is to occur.

5.2.41 - Snowmobile trail protection (9/11)

The Platte River snowmobile trail is shown on the Timber Sale Map following Haze Road. Do not cut or damage posts with orange trail markers or traffic control signs. If the trail is used for hauling, it must be graded to the satisfaction of the Unit Manager or his/her representative prior to December 1st. If the trail road is to be used for hauling during the snowmobile season, then a snow covered base must be left on the trail. Maintain a 20 foot wide slash, debris, and rut free zone daily using the snowmobile trail as the centerline.

5.4 - Soil Protection

5.4.3 - Erosion control (12/08)

Skid trails or haul roads may require erosion control structures or berms per direction of the Unit Manager or his/her representative.

6 - Safety and Fire Prevention

6.2 - Signing

6.2.1 - Road posting (9/09)

The Purchaser is responsible for posting and maintaining caution signs on Hooker Road prior to beginning operations. The road must be posted at appropriate distances from the sale area to warn of logging activity and truck traffic. Signs must be removed when harvest operations are suspended or completed. The Purchaser will provide these signs.



TIMBER SALE MAP

This information provided by authority of Part 525, 1994 PA 451, as amended.

Forest Management Unit Traverse City FMU		County Benzie	Mapped By Tim Webb	Date 09/29/2017	Page 1	of 1
Township 27N	Range 14W	Section(s) and Subdivision(s) Sec. 25: SW1/4		Scale 1:15,840		

Cover Type				Density	
A = Aspen	H = Hemlock	N = Marsh	U = Upland Brush	0 = Non Stocked	5 = Pole Timber Medium
B = Paper Birch	J = Jack Pine	O = Oak	UM = Upland Mixed	1 = Seedling Sapling Poor	6 = Pole Timber Well
C = Cedar	L = Lowland Brush	P = Lowland Poplar	V = Bog or Marsh	2 = Seedling Sapling Medium	7 = Saw Timber Poor
D = Treed Bog	LM = Lowland Mixed	Q = Mixed Swamp Conifer	W = White Pine	3 = Seedling Sapling Well	8 = Saw Timber Medium
E = Swamp Hdwoods	M = Mpl, Bch, Brch	R = Red Pine	X = Non Stocked	4 = Pole Timber Poor	9 = Saw Timber Well
F = Spruce Fir	MC = Mixed Conifer	S = Black Spruce	Z = Water		
G = Grass	MD = Mixed Deciduous	T = Tamarack			

PU	Acres
1	47.3
2	8.5
3	3.0

Lee Side Hardwood

Compartment 9

58.8 acres

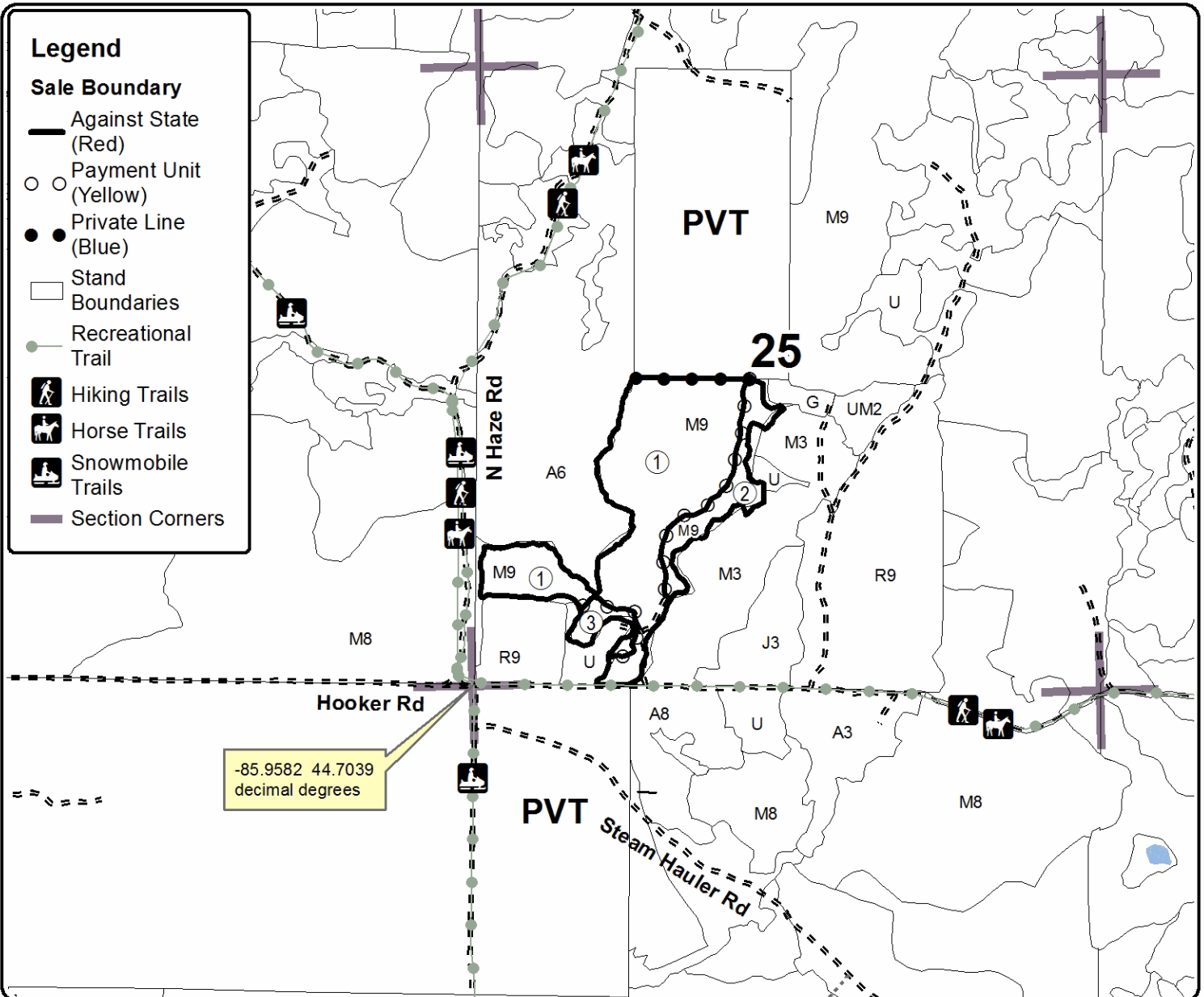

TIMBER SALE INFORMATION

Iron Hardwood (61-059-17)

Benzie County (Advertised Price \$93,607.75)

SALE NOTE: A recreation site such as a trail, pathway, or campground is within the sale area or the vicinity. Certain restrictions/specifications may be applicable including time restrictions.

A timber sale contract for this lump sum, sealed bid timber sale will be awarded to the responsible bidder offering the highest sealed bid price. Bids must be at or above the following advertised price for each species:

<u>PRODUCTS & SPECIES</u>	<u>ESTIMATED UNITS*</u>	<u>ADVERTISED PRICE</u>
Sawtimber		
Basswood	93.10 MBF	\$ 120.00 / MBF
Beech	33.30 MBF	\$ 104.00 / MBF
Black Cherry	9.40 MBF	\$ 179.00 / MBF
Mixed Aspen	65.10 MBF	\$ 110.00 / MBF
Red Maple	89.00 MBF	\$ 122.00 / MBF
Sugar Maple	117.00 MBF	\$ 269.00 / MBF
Pulpwood		
Basswood	169.00 Cords	\$ 30.35 / Cord
Jack Pine	2.00 Cords	\$ 15.40 / Cord
Mixed Aspen	160.00 Cords	\$ 21.00 / Cord
Mixed Hardwood	945.00 Cords	\$ 20.40 / Cord

* The total volume is statistically estimated within plus (+) or minus (-) 16.23 percent. The estimated units are final and not subject to adjustment. Prospective bidders are urged to examine this timber and to make their own estimates of quantity and quality.

BOND AND PAYMENT SCHEDULE:

1. A bond in the amount of \$4,680.00 to insure faithful performance of the conditions of the contract will be deposited by the successful bidder within 21 days of the sale award.
2. Cutting in any sale or unit without the required advance payment would be considered a trespass.
3. Total payment must be paid in advance or according to the following schedule:
 - (a) Ten percent (10%) of the sale value must be paid within 21 days of the sale award.
 - (b) The 10% down payment will be credited towards the first unit cut.
4. If no cutting takes place, the 10% down payment will not be refunded.
5. Operations on the contract issued will terminate on 06/30/2020.

Description of Timber by Payment Unit (PU)

PU	MARKET GROUP	PRODUCT	QUANTITY	UNIT	ACRES	ADVERTISE PRICE
1	Red Maple	Sawtimber	0.4	MBF	17.5	\$1,125.60
	Sugar Maple		0.4	MBF		
	Jack Pine	Pulpwood	2.0	Cords		
	Mixed Hardwood		46.0	Cords		
	<i>Black Cherry</i>		29.0	<i>Cords</i>		
	<i>Red Maple</i>		6.0	<i>Cords</i>		
	<i>Sugar Maple</i>		11.0	<i>Cords</i>		
2	Black Cherry	Sawtimber	1.1	MBF	12.7	\$1,760.50
	Sugar Maple	Pulpwood	2.4	MBF		
	Mixed Hardwood		45.0	Cords		
	<i>Black Cherry</i>		18.0	<i>Cords</i>		
	<i>Red Maple</i>		6.0	<i>Cords</i>		
	<i>Sugar Maple</i>		21.0	<i>Cords</i>		
3	Basswood	Sawtimber	65.3	MBF	52.7	\$45,367.95
	Beech		31.2	MBF		
	Mixed Aspen		25.9	MBF		
	<i>B. T. Aspen</i>	9.4	<i>MBF</i>			
	<i>Quaking Aspen</i>	16.5	<i>MBF</i>			
	Red Maple	18.4	MBF			
	Sugar Maple	69.8	MBF			
	Basswood	Pulpwood	101.0	Cords		
	Mixed Aspen		47.0	Cords		
	<i>B. T. Aspen</i>		14.0	<i>Cords</i>		
	<i>Quaking Aspen</i>		33.0	<i>Cords</i>		
	Mixed Hardwood		312.0	Cords		
	<i>Beech</i>		72.0	<i>Cords</i>		
	<i>Black Cherry</i>		5.0	<i>Cords</i>		
	<i>Ironwood</i>		16.0	<i>Cords</i>		
	<i>Red Maple</i>		25.0	<i>Cords</i>		
	<i>Sugar Maple</i>		194.0	<i>Cords</i>		
4	Basswood	Sawtimber	10.7	MBF	34.1	\$28,090.40
	Beech		2.1	MBF		
	Black Cherry		1.7	MBF		
	Mixed Aspen	35.0	MBF			
	<i>B. T. Aspen</i>	8.4	<i>MBF</i>			
	<i>Quaking Aspen</i>	26.6	<i>MBF</i>			
	Red Maple	60.1	MBF			
	Sugar Maple	24.9	MBF			
	Basswood	Pulpwood	32.0	Cords		
	Mixed Aspen		79.0	Cords		
	<i>B. T. Aspen</i>		5.0	<i>Cords</i>		
	<i>Quaking Aspen</i>		74.0	<i>Cords</i>		
	Mixed Hardwood		283.0	Cords		
	<i>Beech</i>		12.0	<i>Cords</i>		
	<i>Black Cherry</i>		10.0	<i>Cords</i>		
	<i>Ironwood</i>		19.0	<i>Cords</i>		
<i>Red Maple</i>	107.0		<i>Cords</i>			
<i>Sugar Maple</i>	135.0		<i>Cords</i>			
5	Basswood	Sawtimber	17.1	MBF	20.6	\$10,261.20
	Black Cherry		2.6	MBF		
	Mixed Aspen		3.1	MBF		
	<i>Quaking Aspen</i>		3.1	<i>MBF</i>		
	Red Maple	1.2	MBF			
	Sugar Maple	13.8	MBF			
	Basswood	Pulpwood	36.0	Cords		
	Mixed Aspen		6.0	Cords		

Description of Timber by Payment Unit (PU), con't

PU	MARKET GROUP	PRODUCT	QUANTITY	UNIT	ACRES	ADVERTISE PRICE
5 con't	<i>Quaking Aspen</i>	<i>Pulpwood</i>	6.0	<i>Cords</i>		
	Mixed Hardwood		114.0	Cords		
	<i>Black Cherry</i>		8.0	<i>Cords</i>		
	<i>Ironwood</i>		59.0	<i>Cords</i>		
	<i>Red Maple</i>		1.0	<i>Cords</i>		
	<i>Sugar Maple</i>		46.0	<i>Cords</i>		
6	Black Cherry	Sawtimber	0.4	MBF	6.5	\$2,589.20
	Red Maple		7.4	MBF		
	Sugar Maple		1.6	MBF		
	Mixed Aspen	<i>Pulpwood</i>	2.0	Cords		
	<i>Quaking Aspen</i>		2.0	<i>Cords</i>		
	Mixed Hardwood		56.0	Cords		
	<i>Black Cherry</i>		6.0	<i>Cords</i>		
	<i>Ironwood</i>		2.0	<i>Cords</i>		
	<i>Red Maple</i>		34.0	<i>Cords</i>		
	<i>Sugar Maple</i>		14.0	<i>Cords</i>		
	7		Black Cherry	Sawtimber		
Mixed Aspen		0.7	MBF			
<i>Quaking Aspen</i>		0.7	<i>MBF</i>			
Red Maple		<i>Pulpwood</i>	0.4	MBF		
Sugar Maple			4.1	MBF		
Mixed Aspen			25.0	Cords		
<i>Quaking Aspen</i>			25.0	<i>Cords</i>		
Mixed Hardwood			25.0	Cords		
<i>Beech</i>			1.0	<i>Cords</i>		
<i>Black Cherry</i>			4.0	<i>Cords</i>		
<i>Red Maple</i>			5.0	<i>Cords</i>		
<i>Sugar Maple</i>	15.0	<i>Cords</i>				
8	Black Cherry	Sawtimber	2.2	MBF	13.3	\$1,898.60
	Mixed Aspen		0.4	MBF		
	<i>Quaking Aspen</i>		0.4	<i>MBF</i>		
	Red Maple	<i>Pulpwood</i>	1.1	MBF		
	Mixed Aspen		1.0	Cords		
	<i>Quaking Aspen</i>		1.0	<i>Cords</i>		
	Mixed Hardwood		64.0	Cords		
	<i>Black Cherry</i>		51.0	<i>Cords</i>		
	<i>Red Maple</i>		10.0	<i>Cords</i>		
	<i>Sugar Maple</i>		3.0	<i>Cords</i>		
	TOTAL:			406.9		
TOTAL:			1,276.0	Cords		

Sale Specific Conditions & Requirements

Sale Name: Iron Hardwood

Sale Number: 61-059-17 Seq#: 1

1 - Sale Area

1.2 - Boundaries

1.2.1 - Painted boundaries (1/14)

The sale boundary and Payment Unit boundaries are marked and identified by blue, red and yellow paint. Exterior sale boundary lines against private property are marked with blue paint. Exterior sale boundary lines against state land are marked with red paint. Interior Payment Unit boundaries are marked with yellow paint. The painted boundary line trees are not Included Timber and are to be protected unless marked with orange paint.

2 - Timber Specifications

2.1 - Included Timber

2.1.2 - Clearcut unit(s) w/o unmerchantable trees (8/11)

Within Payment Unit(s) 7, cut all trees which meet minimum piece specifications in 2.2 Utilization, unless marked with green paint. In addition, unmerchantable trees may be cut as necessary to facilitate harvest of designated timber, but must be severed at ground level and laid flat on the ground; not just broken, bent, or pushed over.

2.1.3 - Cut tree marked unit(s) (12/08)

Within Payment Unit(s) 2 - 6, all trees are designated for cutting when marked with orange paint above and below stump height, regardless of merchantability. In addition, within Payment Units 3 and 4, cut all beech and aspen trees which meet minimum piece specifications in 2.2 Utilization, unless marked with green paint. Within Payment Units 5 and 6, cut all ironwood greater than 4 inches at DBH. Also, unmerchantable trees may be cut as necessary to facilitate harvest of designated timber, but must be severed at ground level and laid flat on the ground; not just broken, bent, or pushed over.

2.1.5 - Overstory removal unit(s) (8/11)

Within Payment Unit(s) 1 and 8, all deciduous trees which meet minimum piece specifications in 2.2 Utilization, are designated for cutting, except for elm, junberry, or any trees marked with green paint. In addition, cut all jack pine and scotch pine greater than 1 inch at DBH. Also, unmerchantable trees may be cut as necessary to facilitate harvest of designated timber, but must be severed at ground level and laid flat on the ground; not just broken, bent, or pushed over.

2.2 - Utilization

2.2.4 - Skidding length (2/14)

Skidding of unlimbed tops or lengths over 17 feet is not permissible within Payment Units 2, 3, 4, 5, and 6 unless approved by the Unit Manager or his/her representative.

3 - Payments

3.4 - Damaged Timber

3.4.1 - Damaged timber (6/14)

General Condition and Requirement 3.4 Damaged Timber, defines liquidated damages for undesignated live merchantable trees which are cut or injured. In addition, extreme care should be taken to avoid damage to tree seedlings and saplings within Payment Units 1, 2, 7 and 8. Within these units, if more than 50 percent of the tree seedlings or saplings (1/4" to 4.5" DBH) within a specified portion of the sale area are damaged, liquidated damages will be assessed at \$150 per acre for all acreage within that specified portion of the sale area that was damaged.

No damage is acceptable to merchantable trees. Within the sale area, if more than 10 percent of trees (> 4.5" DBH) within a specified area of the sale are damaged, liquidated damages will be assessed for all trees damaged. Rates will be in accordance with General Condition and Requirement 3.4 Damaged Timber.

4 - Transportation

4.1 - Construction

4.1.3 - Slash and earthen piles (8/04)

Piles or windrows of earth along roads and landings that have been widened or constructed shall be leveled. Slash from road maintenance or construction, including stumps, shall be dispersed throughout the sale.

4.1.7 - Road closure (10/11)

All new roads built into the sale must be blocked to vehicle traffic upon completion of the sale. Overgrown roads that are reopened shall be considered new roads. In general, this will require constructing a four (4') foot high berm of stumps and logs covered with earth. Contact the sale administrator for specific details of design and placement.

5 - Operations

5.2 - Conduct of Operations

5.2.1 - Slash

5.2.1.8 - Slash height (12/08)

No slash or tree tops may exceed 36 inches in height. Exception: within Payment Units 1 and 8, slash must be chipped and removed from the site, or placed in scattered, compacted piles not exceeding 5 feet in height.

5.2.3 - Operating Restrictions

5.2.3.3 - Bark slippage restriction (3/09)

Within Payment Unit(s) 2, 3, 4, 5, and 6, unless changed by written agreement, cutting, forwarding and skidding are not permitted during the period of April 15 to July 15. This restriction is because of bark slippage.

5.2.4 - Dead and Down Creation

5.2.4.1 - Dead and down creation, marked trees (10/13)

All trees marked with an orange "X" must be felled and left on site for wildlife.

5.2.18 - Equipment requirements (1/09)

Because dense saplings surround much of the designated timber in Payment Units 1, 2, 7, and 8, it is highly recommended, but not required, that a feller-buncher be used to approach, cut and pile the trees for subsequent in-woods processing and forwarding.

5.2.29 - Shrub protection (9/07)

Do not cut or damage hawthorn or juneberry. These woody-shrub plants are highly beneficial to various wildlife species.

5.2.38 - No decking against live trees (2/04)

Cut products may not be decked against unmarked or designated leave trees.

5.2.40 - Pathway protection (10/10)

The Shore to Shore riding/hiking trail runs on Hooker Road along the north side of Payment Unit 1, as shown on the Timber Sale Map. Do not cut trees or damage posts with blue pathway markers. Maintain a 20-foot wide slash, debris, and rut free zone daily, using the pathway as the centerline. No decking will be allowed along the trail. The trail must be graded periodically during the sale. In addition, if an organized trail ride is to occur while the sale is active, the sale administrator has the authority to limit harvest and hauling activities on the day of the ride. The sale administrator will provide at least 1 week notice if this is to occur.

5.2.41 - Snowmobile trail protection (9/11)

The Platte River snowmobile trail runs along N. Haze Road west of the sale and along Oakley Road southeast of Payment Unit 5, as shown on the Timber Sale Map. Do not cut or damage posts with orange trail markers or traffic control signs. If the trail is used for hauling, it must be graded to the satisfaction of the Unit Manager or his/her representative prior to December 1st. If the trail road is to be used for hauling during the snowmobile season, then a snow covered base must be left on the trail. Maintain a 20 foot wide slash, debris, and rut free zone daily using the snowmobile trail as the centerline. No decking of forest products will be permitted along the snowmobile trail between December 1 and March 31. All stumps within 20 feet of the snowmobile trail must be cut at ground level. In addition, any trees cut within 5 feet of the trail must have the stumps removed and be disposed of according to the direction of the Unit Manager or his/her representative.

5.4 - Soil Protection

5.4.3 - Erosion control (12/08)

Skid trails or haul roads may require erosion control structures or berms per direction of the Unit Manager or his/her representative.

6 - Safety and Fire Prevention

6.2 - Signing

6.2.1 - Road posting (9/09)

The Purchaser is responsible for posting and maintaining caution signs on N. Haze, Hooker, Steam Hauler, and Oakley roads prior to beginning operations. The road must be posted at appropriate distances from the sale area to warn of logging activity and truck traffic. Signs must be removed when harvest operations are suspended or completed. The Purchaser will provide these signs.



TIMBER SALE MAP

This information provided by authority of Part 525, 1994 PA 451, as amended.

Forest Management Unit Traverse City FMU		County Benzie	Mapped By Tim Webb	Date 09/29/2017	Page 1	of 1
Township 27N	Range 14W	Section(s) and Subdivision(s) Sec. 35: SESE; Sec. 36: W1/2NE, E1/2NW, S1/2		Scale 1:15,840		

Cover Type				Density			
A = Aspen	H = Hemlock	N = Marsh	U = Upland Brush	0 = Non Stocked	5 = Pole Timber Medium		
B = Paper Birch	J = Jack Pine	O = Oak	UM = Upland Mixed	1 = Seedling Sapling Poor	6 = Pole Timber Well		
C = Cedar	L = Lowland Brush	P = Lowland Poplar	V = Bog or Marsh	2 = Seedling Sapling Medium	7 = Saw Timber Poor		
D = Treed Bog	LM = Lowland Mixed	Q = Mixed Swamp Conifer	W = White Pine	3 = Seedling Sapling Well	8 = Saw Timber Medium		
E = Swamp Hdwoods	M = Mpl, Bch, Brch	R = Red Pine	X = Non Stocked	4 = Pole Timber Poor	9 = Saw Timber Well		
F = Spruce Fir	MC = Mixed Conifer	S = Black Spruce	Z = Water				
G = Grass	MD = Mixed Deciduous	T = Tamarack					

PU	Acres	PU	Acres	PU	Acres
1	17.5	4	34.1	7	8.7
2	12.7	5	20.6	8	13.3
3	52.7	6	6.5		

Iron Hardwood

Compartment 9

166.1 acres

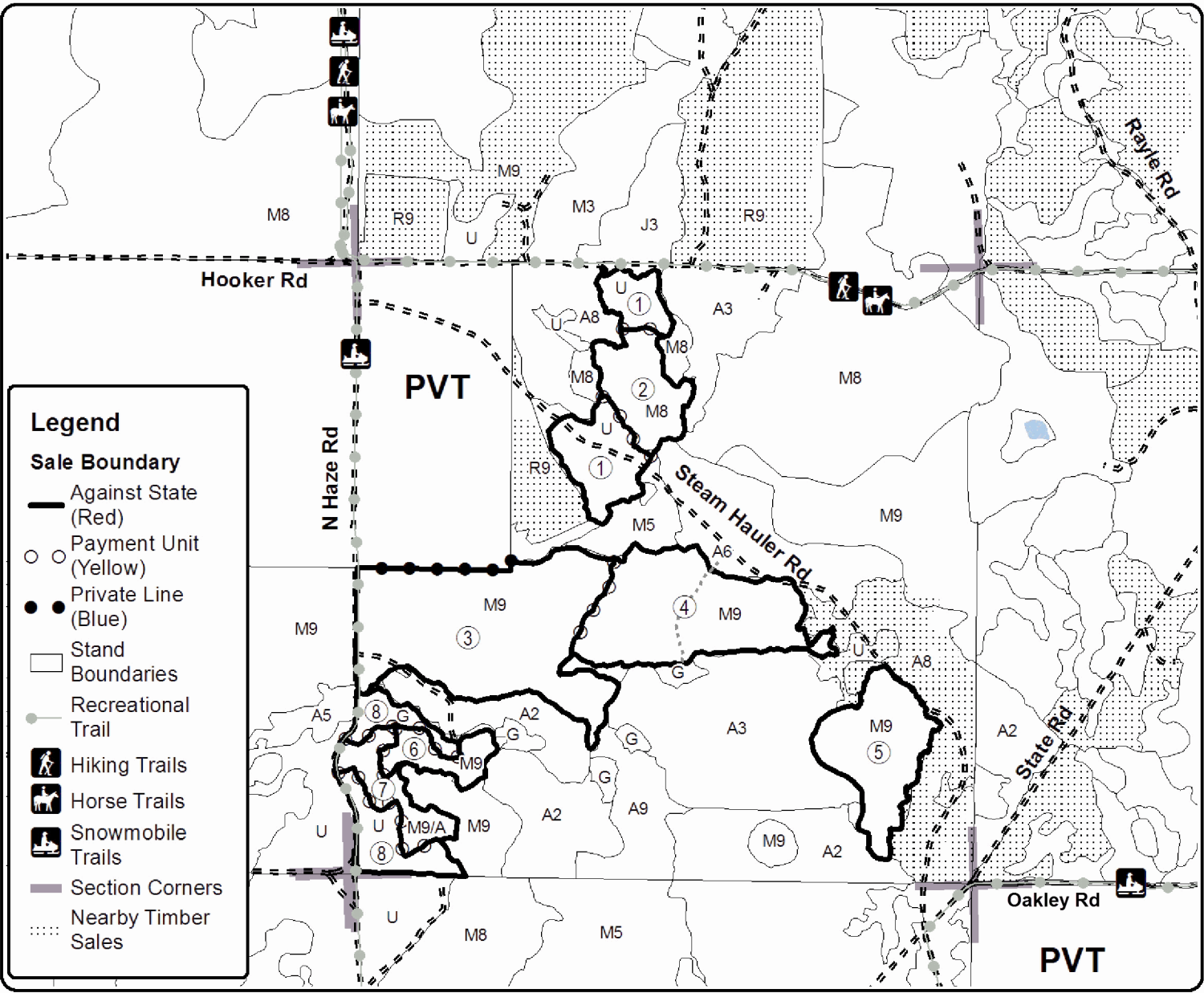
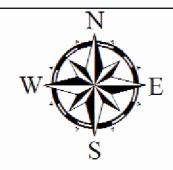

Legend

Sale Boundary

- Against State (Red)
- Payment Unit (Yellow)
- Private Line (Blue)
- Stand Boundaries
- Recreational Trail
- Hiking Trails
- Horse Trails
- Snowmobile Trails
- Section Corners
- Nearby Timber Sales

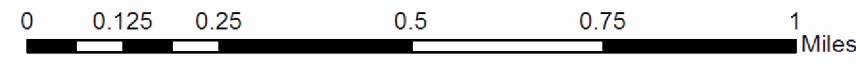

Alchemy Hardwoods (61-033-17)
; Manistee COUNTY

In response to the notice of sale to be held 4:00 p.m. (local time) on April 5, 2018, I am hereby submitting my sealed bid (firm offer) for the following forest products to be cut. Bids for individual species must be at or above the advertised price. All non-responsive bid forms may be rejected.

<u>PRODUCTS & SPECIES</u>	<u>ESTIMATED VOLUME*</u>	<u>ADVERTISED PRICE</u>	<u>BID PRICE/UNIT</u>
Sawtimber			
Beech	27.30 MBF	\$ 104.00/MBF	\$ _____
Black Cherry	31.10 MBF	\$ 179.00/MBF	\$ _____
Red Maple	377.40 MBF	\$ 122.00/MBF	\$ _____
Sugar Maple	7.20 MBF	\$ 269.00/MBF	\$ _____
Pulpwood			
Mixed Aspen	57.00 Cords	\$ 21.00/Cord	\$ _____
Mixed Hardwood	1,292.00 Cords	\$ 20.40/Cord	\$ _____

*The volumes are statistically estimated within plus (+) or minus (-) 11.18 percent. These estimated volumes are final and not subject to adjustment. Prospective bidders are urged to examine this timber and to make their own estimates of quantity and quality.

I understand that any or all bids may be rejected. All bids must be signed and all bid items must be bid or the bid form may be rejected. I also understand that consideration and awarding a contract will be based upon my past performance and ability to complete the contract based upon equipment and staffing subject to my control.

FEDERAL ID: _____ or SOCIAL SECURITY NUMBER: _____

Company or individual bidding: _____

Company representative's name: _____

Address: _____

City: _____ State: _____ Zip: _____

IF AVAILABLE, PLEASE PLACE THE PERSONALIZED LABEL FROM YOUR PROSPECTUS IN THE ABOVE BOX.

Individual or company representative's signature: _____ Date: _____

Phone number : _____ Email (optional): _____

THE WINNING BIDDER MUST COMPLETE THE VERIFICATION OF WORKER'S DISABILITY COMPENSATION ACT COMPLIANCE (ON REVERSE SIDE IF DOUBLE SIDED) WITHIN 21 DAYS OF SALE AWARD DATE



FOR DEPARTMENT USE ONLY
Sale Number (XX - XXX - XX - XX)
Forest Management Unit:

TIMBER SALE VERIFICATION OF WORKER'S DISABILITY COMPENSATION ACT COMPLIANCE

*As required by Act 317, P.A. 1969 (Worker's Compensation) and
Part 5 of Act 451 of 1994, as amended.*

VERIFICATION OF WORKER'S DISABILITY COMPENSATION ACT COMPLIANCE

- This verification must be completed and submitted within 21 days of contract award and prior to the issuance of the timber sale contract.
- In addition, if boxes 2B or 2C are checked, then Notice of Exclusion or Certificate of Insurance must be submitted within twenty-one (21) days of the contract award and prior to the issuance of the timber sale contract.
- All information must be typed or printed except for written signatures.

Please Check Appropriate Categories:

1. My business is organized as (you **must** check one of the boxes below):
 - A. Sole Proprietorship (individual)
 - B. Partnership
 - C. Corporation
2. You **must** check one of the boxes below:
 - A. I certify my business is a sole proprietorship and it has no employees but the sole proprietor. I am not subject to the Worker's Compensation Laws.
 - B. I certify my business has satisfied its obligation to the Worker's Compensation Act through the use of an approved Notice of Exclusion (BWC-337, Rev. 5/96). I will provide a copy of the Notice of Exclusion within 21 days of the contract award. (For questions or a copy of the BWC-337, please call the Worker's Compensation Bureau at 517-322-1195).
 - C. I certify my business has a Worker's Compensation Policy. I will provide an original Certificate of Insurance within twenty-one (21) days of the contract award.
3. If you have checked item 2(A) or 2(B), you **must** indicate the number of **both** full-time and part-time employees, other than yourself, including family members and active partners (if none, you must enter "0").

_____ Full-time Employees

_____ Part-time Employees

Name of Business		Federal ID (or) Social Security No.	
Address		Telephone ()	
City	State	ZIP	

I hereby certify that the above information is true and correct. I agree to notify the Michigan DNR of any changes that occur in factors affecting my coverage during any of my present and future operations.

Signature of Owner or Authorized Representative

Title

Date

Please complete the "SEALED BID" information on the next page

Iron Hardwood (61-059-17)
; Benzie COUNTY

In response to the notice of sale to be held 4:00 p.m. (local time) on April 5, 2018, I am hereby submitting my sealed bid (firm offer) for the following forest products to be cut. Bids for individual species must be at or above the advertised price. All non-responsive bid forms may be rejected.

<u>PRODUCTS & SPECIES</u>	<u>ESTIMATED VOLUME*</u>	<u>ADVERTISED PRICE</u>	<u>BID PRICE/UNIT</u>
Sawtimber			
Basswood	93.10 MBF	\$ 120.00/MBF	\$ _____
Beech	33.30 MBF	\$ 104.00/MBF	\$ _____
Black Cherry	9.40 MBF	\$ 179.00/MBF	\$ _____
Mixed Aspen	65.10 MBF	\$ 110.00/MBF	\$ _____
Red Maple	89.00 MBF	\$ 122.00/MBF	\$ _____
Sugar Maple	117.00 MBF	\$ 269.00/MBF	\$ _____
Pulpwood			
Basswood	169.00 Cords	\$ 30.35/Cord	\$ _____
Jack Pine	2.00 Cords	\$ 15.40/Cord	\$ _____
Mixed Aspen	160.00 Cords	\$ 21.00/Cord	\$ _____
Mixed Hardwood	945.00 Cords	\$ 20.40/Cord	\$ _____

*The volumes are statistically estimated within plus (+) or minus (-) 16.23 percent. These estimated volumes are final and not subject to adjustment. Prospective bidders are urged to examine this timber and to make their own estimates of quantity and quality.

I understand that any or all bids may be rejected. All bids must be signed and all bid items must be bid or the bid form may be rejected. I also understand that consideration and awarding a contract will be based upon my past performance and ability to complete the contract based upon equipment and staffing subject to my control.

FEDERAL ID: _____ or SOCIAL SECURITY NUMBER: _____

Company or individual bidding: _____

Company representative's name: _____

Address: _____

City: _____ State: _____ Zip: _____

IF AVAILABLE, PLEASE PLACE THE PERSONALIZED LABEL FROM YOUR PROSPECTUS IN THE ABOVE BOX.

Individual or company representative's signature: _____ Date: _____

Phone number : _____ Email (optional): _____

THE WINNING BIDDER MUST COMPLETE THE VERIFICATION OF WORKER'S DISABILITY COMPENSATION ACT COMPLIANCE (ON REVERSE SIDE IF DOUBLE SIDED) WITHIN 21 DAYS OF SALE AWARD DATE



FOR DEPARTMENT USE ONLY
Sale Number (XX - XXX - XX - XX)
Forest Management Unit:

TIMBER SALE VERIFICATION OF WORKER'S DISABILITY COMPENSATION ACT COMPLIANCE

*As required by Act 317, P.A. 1969 (Worker's Compensation) and
Part 5 of Act 451 of 1994, as amended.*

VERIFICATION OF WORKER'S DISABILITY COMPENSATION ACT COMPLIANCE

- This verification must be completed and submitted within 21 days of contract award and prior to the issuance of the timber sale contract.
- In addition, if boxes 2B or 2C are checked, then Notice of Exclusion or Certificate of Insurance must be submitted within twenty-one (21) days of the contract award and prior to the issuance of the timber sale contract.
- All information must be typed or printed except for written signatures.

Please Check Appropriate Categories:

- My business is organized as (you **must** check one of the boxes below):
 - Sole Proprietorship (individual)
 - Partnership
 - Corporation
- You **must** check one of the boxes below:
 - I certify my business is a sole proprietorship and it has no employees but the sole proprietor. I am not subject to the Worker's Compensation Laws.
 - I certify my business has satisfied its obligation to the Worker's Compensation Act through the use of an approved Notice of Exclusion (BWC-337, Rev. 5/96). I will provide a copy of the Notice of Exclusion within 21 days of the contract award. (For questions or a copy of the BWC-337, please call the Worker's Compensation Bureau at 517-322-1195).
 - I certify my business has a Worker's Compensation Policy. I will provide an original Certificate of Insurance within twenty-one (21) days of the contract award.
- If you have checked item 2(A) or 2(B), you **must** indicate the number of **both** full-time and part-time employees, other than yourself, including family members and active partners (if none, you must enter "0").

_____ Full-time Employees

_____ Part-time Employees

Name of Business		Federal ID (or) Social Security No.	
Address		Telephone ()	
City	State	ZIP	

I hereby certify that the above information is true and correct. I agree to notify the Michigan DNR of any changes that occur in factors affecting my coverage during any of my present and future operations.

Signature of Owner or Authorized Representative

Title

Date

Please complete the "SEALED BID" information on the next page

Lee Side Hardwood (61-058-17)
; Benzie COUNTY

In response to the notice of sale to be held 4:00 p.m. (local time) on April 5, 2018, I am hereby submitting my sealed bid (firm offer) for the following forest products to be cut. Bids for individual species must be at or above the advertised price. All non-responsive bid forms may be rejected.

<u>PRODUCTS & SPECIES</u>	<u>ESTIMATED VOLUME*</u>	<u>ADVERTISED PRICE</u>	<u>BID PRICE/UNIT</u>
Sawtimber			
Basswood	138.70 MBF	\$ 120.00/MBF	\$ _____
Beech	23.70 MBF	\$ 104.00/MBF	\$ _____
Mixed Aspen	55.80 MBF	\$ 110.00/MBF	\$ _____
Red Pine	5.40 MBF	\$ 116.00/MBF	\$ _____
Sugar Maple	128.90 MBF	\$ 269.00/MBF	\$ _____
Pulpwood			
Basswood	130.00 Cords	\$ 30.35/Cord	\$ _____
Mixed Aspen	77.00 Cords	\$ 21.00/Cord	\$ _____
Mixed Hardwood	474.00 Cords	\$ 20.40/Cord	\$ _____
Red Pine	4.00 Cords	\$ 42.40/Cord	\$ _____

*The volumes are statistically estimated within plus (+) or minus (-) 16.03 percent. These estimated volumes are final and not subject to adjustment. Prospective bidders are urged to examine this timber and to make their own estimates of quantity and quality.

I understand that any or all bids may be rejected. All bids must be signed and all bid items must be bid or the bid form may be rejected. I also understand that consideration and awarding a contract will be based upon my past performance and ability to complete the contract based upon equipment and staffing subject to my control.

FEDERAL ID: ____ - ____ - ____ or SOCIAL SECURITY NUMBER: ____ - ____ - ____

Company or individual bidding: _____

Company representative's name: _____

Address: _____

City: _____ State: _____ Zip: _____

IF AVAILABLE, PLEASE PLACE THE PERSONALIZED LABEL FROM YOUR PROSPECTUS IN THE ABOVE BOX.

Individual or company representative's signature: _____ Date: _____

Phone number : _____ Email (optional): _____

THE WINNING BIDDER MUST COMPLETE THE VERIFICATION OF WORKER'S DISABILITY COMPENSATION ACT COMPLIANCE (ON REVERSE SIDE IF DOUBLE SIDED) WITHIN 21 DAYS OF SALE AWARD DATE



FOR DEPARTMENT USE ONLY
Sale Number (XX - XXX - XX - XX)
Forest Management Unit:

TIMBER SALE VERIFICATION OF WORKER'S DISABILITY COMPENSATION ACT COMPLIANCE

*As required by Act 317, P.A. 1969 (Worker's Compensation) and
Part 5 of Act 451 of 1994, as amended.*

VERIFICATION OF WORKER'S DISABILITY COMPENSATION ACT COMPLIANCE

- This verification must be completed and submitted within 21 days of contract award and prior to the issuance of the timber sale contract.
- In addition, if boxes 2B or 2C are checked, then Notice of Exclusion or Certificate of Insurance must be submitted within twenty-one (21) days of the contract award and prior to the issuance of the timber sale contract.
- All information must be typed or printed except for written signatures.

Please Check Appropriate Categories:

1. My business is organized as (you **must** check one of the boxes below):
 - A. Sole Proprietorship (individual)
 - B. Partnership
 - C. Corporation

2. You **must** check one of the boxes below:
 - A. I certify my business is a sole proprietorship and it has no employees but the sole proprietor. I am not subject to the Worker's Compensation Laws.
 - B. I certify my business has satisfied its obligation to the Worker's Compensation Act through the use of an approved Notice of Exclusion (BWC-337, Rev. 5/96). I will provide a copy of the Notice of Exclusion within 21 days of the contract award. (For questions or a copy of the BWC-337, please call the Worker's Compensation Bureau at 517-322-1195).
 - C. I certify my business has a Worker's Compensation Policy. I will provide an original Certificate of Insurance within twenty-one (21) days of the contract award.

3. If you have checked item 2(A) or 2(B), you **must** indicate the number of **both** full-time and part-time employees, other than yourself, including family members and active partners (if none, you must enter "0").

_____ Full-time Employees

_____ Part-time Employees

Name of Business		Federal ID (or) Social Security No.	
Address		Telephone ()	
City	State	ZIP	

I hereby certify that the above information is true and correct. I agree to notify the Michigan DNR of any changes that occur in factors affecting my coverage during any of my present and future operations.

Signature of Owner or Authorized Representative

Title

Date

Please complete the "SEALED BID" information on the next page

Petobego Aspen (61-001-18)
; Grand Traverse COUNTY

In response to the notice of sale to be held 4:00 p.m. (local time) on April 5, 2018, I am hereby submitting my sealed bid (firm offer) for the following forest products to be cut. Bids for individual species must be at or above the advertised price. All non-responsive bid forms may be rejected.

<u>PRODUCTS & SPECIES</u>	<u>ESTIMATED VOLUME*</u>	<u>ADVERTISED PRICE</u>	<u>BID PRICE/UNIT</u>
Sawtimber			
Mixed Aspen	24.80 MBF	\$ 88.00/MBF	\$ _____
Red Maple	3.30 MBF	\$ 97.00/MBF	\$ _____
Red Pine	4.20 MBF	\$ 93.00/MBF	\$ _____
Sugar Maple	2.00 MBF	\$ 215.00/MBF	\$ _____
White Pine	21.90 MBF	\$ 52.00/MBF	\$ _____
Pulpwood			
Mixed Aspen	123.00 Cords	\$ 16.80/Cord	\$ _____
Mixed Hardwood	44.00 Cords	\$ 16.30/Cord	\$ _____
Red Oak	5.00 Cords	\$ 13.95/Cord	\$ _____
Red Pine	15.00 Cords	\$ 33.90/Cord	\$ _____
White Pine	57.00 Cords	\$ 11.80/Cord	\$ _____

*The volumes are statistically estimated within plus (+) or minus (-) 40.93 percent. These estimated volumes are final and not subject to adjustment. Prospective bidders are urged to examine this timber and to make their own estimates of quantity and quality.

I understand that any or all bids may be rejected. All bids must be signed and all bid items must be bid or the bid form may be rejected. I also understand that consideration and awarding a contract will be based upon my past performance and ability to complete the contract based upon equipment and staffing subject to my control.

FEDERAL ID: _____ or SOCIAL SECURITY NUMBER: _____

Company or individual bidding: _____

Company representative's name: _____

Address: _____

City: _____ State: _____ Zip: _____

IF AVAILABLE, PLEASE PLACE THE PERSONALIZED LABEL FROM YOUR PROSPECTUS IN THE ABOVE BOX.

Individual or company representative's signature: _____ Date: _____

Phone number : _____ Email (optional): _____

THE WINNING BIDDER MUST COMPLETE THE VERIFICATION OF WORKER'S DISABILITY COMPENSATION ACT COMPLIANCE (ON REVERSE SIDE IF DOUBLE SIDED) WITHIN 21 DAYS OF SALE AWARD DATE



FOR DEPARTMENT USE ONLY
Sale Number (XX - XXX - XX - XX)
Forest Management Unit:

TIMBER SALE VERIFICATION OF WORKER'S DISABILITY COMPENSATION ACT COMPLIANCE

*As required by Act 317, P.A. 1969 (Worker's Compensation) and
Part 5 of Act 451 of 1994, as amended.*

VERIFICATION OF WORKER'S DISABILITY COMPENSATION ACT COMPLIANCE

- This verification must be completed and submitted within 21 days of contract award and prior to the issuance of the timber sale contract.
- In addition, if boxes 2B or 2C are checked, then Notice of Exclusion or Certificate of Insurance must be submitted within twenty-one (21) days of the contract award and prior to the issuance of the timber sale contract.
- All information must be typed or printed except for written signatures.

Please Check Appropriate Categories:

1. My business is organized as (you **must** check one of the boxes below):
 - A. Sole Proprietorship (individual)
 - B. Partnership
 - C. Corporation

2. You **must** check one of the boxes below:
 - A. I certify my business is a sole proprietorship and it has no employees but the sole proprietor. I am not subject to the Worker's Compensation Laws.
 - B. I certify my business has satisfied its obligation to the Worker's Compensation Act through the use of an approved Notice of Exclusion (BWC-337, Rev. 5/96). I will provide a copy of the Notice of Exclusion within 21 days of the contract award. (For questions or a copy of the BWC-337, please call the Worker's Compensation Bureau at 517-322-1195).
 - C. I certify my business has a Worker's Compensation Policy. I will provide an original Certificate of Insurance within twenty-one (21) days of the contract award.

3. If you have checked item 2(A) or 2(B), you **must** indicate the number of **both** full-time and part-time employees, other than yourself, including family members and active partners (if none, you must enter "0").

_____ Full-time Employees

_____ Part-time Employees

Name of Business		Federal ID (or) Social Security No.	
Address		Telephone ()	
City	State	ZIP	

I hereby certify that the above information is true and correct. I agree to notify the Michigan DNR of any changes that occur in factors affecting my coverage during any of my present and future operations.

Signature of Owner or Authorized Representative

Title

Date

Please complete the "SEALED BID" information on the next page

Wreath Aspen (61-004-18)
; Benzie COUNTY

In response to the notice of sale to be held 4:00 p.m. (local time) on April 5, 2018, I am hereby submitting my sealed bid (firm offer) for the following forest products to be cut. Bids for individual species must be at or above the advertised price. All non-responsive bid forms may be rejected.

<u>PRODUCTS & SPECIES</u>	<u>ESTIMATED VOLUME*</u>	<u>ADVERTISED PRICE</u>	<u>BID PRICE/UNIT</u>
Sawtimber			
Mixed Aspen	43.10 MBF	\$ 110.00/MBF	\$ _____
Sugar Maple	21.80 MBF	\$ 269.00/MBF	\$ _____
White Pine	1.40 MBF	\$ 65.00/MBF	\$ _____
Pulpwood			
Mixed Aspen	262.00 Cords	\$ 21.00/Cord	\$ _____
Mixed Hardwood	142.00 Cords	\$ 20.40/Cord	\$ _____
White Pine	11.00 Cords	\$ 14.75/Cord	\$ _____

*The volumes are statistically estimated within plus (+) or minus (-) 26.66 percent. These estimated volumes are final and not subject to adjustment. Prospective bidders are urged to examine this timber and to make their own estimates of quantity and quality.

I understand that any or all bids may be rejected. All bids must be signed and all bid items must be bid or the bid form may be rejected. I also understand that consideration and awarding a contract will be based upon my past performance and ability to complete the contract based upon equipment and staffing subject to my control.

FEDERAL ID: ____ - ____ - ____ or SOCIAL SECURITY NUMBER: ____ - ____ - ____

Company or individual bidding: _____

Company representative's name: _____

Address: _____

City: _____ State: _____ Zip: _____

IF AVAILABLE, PLEASE PLACE THE PERSONALIZED LABEL FROM YOUR PROSPECTUS IN THE ABOVE BOX.

Individual or company representative's signature: _____ Date: _____

Phone number : _____ Email (optional): _____

THE WINNING BIDDER MUST COMPLETE THE VERIFICATION OF WORKER'S DISABILITY COMPENSATION ACT COMPLIANCE (ON REVERSE SIDE IF DOUBLE SIDED) WITHIN 21 DAYS OF SALE AWARD DATE



FOR DEPARTMENT USE ONLY
Sale Number (XX - XXX - XX - XX)
Forest Management Unit:

TIMBER SALE VERIFICATION OF WORKER'S DISABILITY COMPENSATION ACT COMPLIANCE

*As required by Act 317, P.A. 1969 (Worker's Compensation) and
Part 5 of Act 451 of 1994, as amended.*

VERIFICATION OF WORKER'S DISABILITY COMPENSATION ACT COMPLIANCE

- This verification must be completed and submitted within 21 days of contract award and prior to the issuance of the timber sale contract.
- In addition, if boxes 2B or 2C are checked, then Notice of Exclusion or Certificate of Insurance must be submitted within twenty-one (21) days of the contract award and prior to the issuance of the timber sale contract.
- All information must be typed or printed except for written signatures.

Please Check Appropriate Categories:

1. My business is organized as (you **must** check one of the boxes below):
 - A. Sole Proprietorship (individual)
 - B. Partnership
 - C. Corporation

2. You **must** check one of the boxes below:
 - A. I certify my business is a sole proprietorship and it has no employees but the sole proprietor. I am not subject to the Worker's Compensation Laws.
 - B. I certify my business has satisfied its obligation to the Worker's Compensation Act through the use of an approved Notice of Exclusion (BWC-337, Rev. 5/96). I will provide a copy of the Notice of Exclusion within 21 days of the contract award. (For questions or a copy of the BWC-337, please call the Worker's Compensation Bureau at 517-322-1195).
 - C. I certify my business has a Worker's Compensation Policy. I will provide an original Certificate of Insurance within twenty-one (21) days of the contract award.

3. If you have checked item 2(A) or 2(B), you **must** indicate the number of **both** full-time and part-time employees, other than yourself, including family members and active partners (if none, you must enter "0").

_____ Full-time Employees

_____ Part-time Employees

Name of Business		Federal ID (or) Social Security No.	
Address		Telephone ()	
City	State	ZIP	

I hereby certify that the above information is true and correct. I agree to notify the Michigan DNR of any changes that occur in factors affecting my coverage during any of my present and future operations.

Signature of Owner or Authorized Representative

Title

Date

Please complete the "SEALED BID" information on the next page