



**DEPARTMENT OF NATURAL RESOURCES  
STATE OF MICHIGAN**

**TIMBER SALE PROSPECTUS #5985**

SCHEDULED SALE DATE AND TIME: 3:00 p.m. (local time) on October 24, 2017.

LOCATION: INDIAN RIVER FIELD OFFICE, 6984 WILSON RD, INDIAN RIVER, MI 49749.

PROSPECTUS NOTE: The bidder is advised to inspect the sale area and review the location, estimated volumes, operating costs and contract terms of proposed sales. Please be aware that some landowners may request 60 days or more notice for access across their land.

Notice is hereby given that bids will be received by the Unit Manager, GAYLORD MANAGEMENT UNIT, for certain timber on the following described lands:

Stafford for President RP Mix (52-124-16)

Cheboygan County, Advertised Price \$177,734.20, 188.8 Acres, Red Pine, White Pine.

SALE NOTE: A recreation site such as a trail, pathway, or campground is within the sale area or the vicinity. Certain restrictions/specifications may be applicable including time restrictions.

Michigan State Road Aspen (52-130-16)

Cheboygan County, Advertised Price \$43,205.15, 113.1 Acres, Aspen, Hardwood.

SALE NOTE: Good Access to all units.

Harvest operations in Payment Unit 2 are limited to a period of December 1 - April 1 and June 1 - October 1, due to wetter soil types.

A recreation site such as a trail, pathway, or campground is within the sale area or the vicinity. Certain restrictions/specifications may be applicable including time restrictions.

Nest Trail Pine Mix (52-131-16)

Cheboygan County, Advertised Price \$47,431.55, 96.3 Acres, Hardwood, Red Pine.

SALE NOTE: Within Payment Units 1 - 4, harvest operations are not permitted during the period of April 15th to July 15th.

Within Payment Units 5 - 7, harvest operations are limited to a period of December 1st to March 15th.

The North East State Trail will be used to access Payment Units 5, 6, and 7.

A recreation site such as a trail, pathway, or campground is within the sale area or the vicinity. Certain restrictions/specifications may be applicable including time restrictions.

Old Mackinaw Road Aspen (52-132-16)

Cheboygan County, Advertised Price \$41,635.60, 123.6 Acres, Aspen, Spruce/Fir/Tamarack.

SALE NOTE: Harvesting operations are limited to the period of December 1 to April 1 and June 1 to October 1, due to wetter soils. Access to Payment Unit 4 may be through private property.

Access may be through private or other public land.

Nipigon Road Aspen (52-134-16)

Cheboygan County, Advertised Price \$44,374.30, 140.3 Acres, Aspen, Spruce/Fir/Tamarack.

SALE NOTE: Harvesting operations are limited to the period of December 1 to April 1 and June 1 to October 1, due to the wetter soil types. Access to Payment Units 1 and 2 may be through private ownership.

Access may be through private or other public land.

## BID INSTRUCTIONS (VER. 09/02/2016):

### 1. Scheduled Bid Location, Date, and Time (2/11)

Bids must be received by the Unit Manager, INDIAN RIVER OFFICE, 6984 WILSON RD, INDIAN RIVER, MI 49749, no later than 3:00 p.m. (local time) on October 24, 2017. For further information concerning this sale, contact Joyce Angel at 989-732-3541 extension 5440.

### 2. Bidder's Qualifications (5/16)

Purchaser shall obtain workers compensation insurance to cover claims under Michigan's Worker's Disability Compensation Act of 1969 or similar employee benefit act of any other state applicable to an employee. If all or part of a timber sale was prepared by a private contractor, the contractor and that contractor's company are not permitted to bid on the timber sale contract. Bids will not be accepted from individuals or companies appearing on the DNR/FRD No-Bid List. This list contains the names of purchasers who previously failed to execute a contract within 21-days or who have a history of poor performance.

### 3. Preparation of Sealed Bids (5/16)

Bid Forms may be completed online thru Michigan DNR Timber Sale Online Bidding (OLB) at [www.michigan.gov/timberbidding](http://www.michigan.gov/timberbidding) or by completing the hardcopy Bid Form found in the Timber Sale Prospectus. Hardcopy Bid Forms shall be manually signed in ink. Registration in OLB is considered your 'signature' for all bids submitted thru that system. Bid prices must be entered for each species and product in the Bid Price column for all material subject to bidding and all fill-in blanks must be completed. If erasures or other changes appear on the hardcopy Bid Form, each erasure or change must be initialed by the person signing the bid.

### 4. Submission of Sealed Bids (5/16)

Bid forms may be obtained from the Unit Manager or thru OLB. Bids may be submitted hardcopy or thru OLB. All hardcopy bids must be submitted on the bid form and in an envelope clearly identified as described in this section. NOTE: Only one bid form per bid envelope. Sealed bids must be submitted to the Unit office designated in the prospectus and must be submitted at or prior to the time established in the prospectus. The envelope should show on the outside (a) the sale name or number and (b) the date and time of bid opening, as shown in the prospectus. Bids received after the time specified in the sale prospectus are late bids and will be rejected.

It is possible for a bidder to submit multiple bids on a single sale. For example, a bid may be submitted hardcopy and a bid may be submitted thru OLB. Or, two bidders from the same company could both submit bids on the same sale. If this were to happen, the State would accept all bids received and award the contract accordingly. All bidding and contractual requirements would apply to all bids received.

### 5. Public Opening of Sealed Bids (7/16)

If conditions permit, the sealed bids will be publicly opened and posted at the time and place set in the prospectus.

If a bidder, present at a bid opening, has submitted bids on more than one sale, that bidder may withdraw their unopened bid envelopes or announce the withdrawal of their online bid after being declared the successful bidder on one sale.

### 6. Award of Contract (1/11)

Award of the contract will be made to the Bidder whose bid, conforming to the prospectus, is most advantageous to the State of Michigan on the basis of total value at rates bid for the estimated quantities. The State reserves the right to reject any bid or waive any minor irregularity in bids received. A written award mailed (or otherwise furnished) to the successful Bidder shall be deemed to result in a binding contract without further action by either party.

### 7. Down Payment (1/11)

The Bidder to whom award is made must make a down payment within 21 days of the sale award. The amount of the down payment will be calculated as shown in the Bond and Payment Schedule of this prospectus. Only cash may be used to meet this requirement.

### 8. Performance Security (1/11)

As guarantee of faithful performance, a cash bond, certificate of deposit, surety bond or irrevocable letter of credit (LOC) is required within 21 days of the sale award. The amount of the performance security is shown in the Bond and

Payment Schedule of this prospectus. If an LOC or surety is used, the coverage must extend for at least 6 months beyond the contract expiration.

#### 9. Timber Sale Contract (9/14)

Additional conditions and requirements common to all timber sales are listed on the timber sale contract (R4031) and are available on line at [www.michigan.gov/timber](http://www.michigan.gov/timber). Contact the Unit Manager for additional information or a sample contract. Within 21 days of the date of the award letter, the bidder must sign the contract and provide the required down payment, performance security, and verification of worker's disability compensation. The down payment and performance security shall be in accordance with the provisions of the timber sale contract, in the sums stated in this prospectus. If these actions are not taken, then the Bidder, the Bidder's corporation, and the corporation's principals may not be permitted to bid on State timber sales for a period of 1 year. In addition, the Bidder certifies that if awarded this contract, the Bidder will complete the timber sale contract in accordance with its terms and any modifications thereof including requirements to purchase, cut, and remove the included timber by the expiration date.

#### 10. Disclaimer of Estimates and Bidder's Warranty of Inspection (7/16)

Before submitting this bid, the Bidder is advised and cautioned to inspect the sale area, review the requirements of the sale contract, and take other steps as may be reasonably necessary to ascertain the location, estimated volumes, construction estimates, and operating costs of the proposed sale. Failure to do so will not relieve the Bidder from responsibility for completing the contract.

The Bidder warrants that this bid is submitted solely on the basis of the Bidder's examination and inspection of the quality and quantity of the timber offered for sale and the Bidder's opinion of the value thereof and the costs of recovery. No reliance should be placed on the State of Michigan's estimates of timber quality, quantity or costs of recovery. Bidder further acknowledges that the State of Michigan: (i) expressly disclaims any warranty of fitness of timber for any purpose; (ii) offers this timber as is without any warranty of quality (merchantability) or quantity and (iii) expressly disclaims any warranty as to the quantity or quality of timber sold.

#### 11. Certification and Chain-of-Custody (10/14)

Unless otherwise indicated in the contract under section 7 – Other Conditions of the Sale Specific Conditions & Requirements, the area encompassed by this timber sale is certified to the standards of the Forest Stewardship Council (FSC) - Certificate #SCS-FM/COC-00090N and the Sustainable Forestry Initiative (SFI) - Certificate # NSF-SFIS-5Y031-SF5. Forest products from this sale may be delivered to the mill as "FSC 100% and / or SFI certified" as long as the contractor hauling the forest products is chain-of-custody (COC) certified or covered under a COC certificate from the destination mill. The purchaser is responsible for maintaining COC after leaving the sale area.

#### 12. Good Neighbor Authority (GNA) Requirements (7/16)

If the name of this timber sales contains the acronym GNA, it is authorized by the Good Neighbor Authority (GNA) and covered by various agreements between the U.S. Forest Service and the State. The timber sale occurs on federal land and the following conditions apply:

GNA contracts on US Forest Service land will not be awarded to purchasers on the Federal list of excluded parties. The System for Award Management (SAM) will be checked for active excluded parties prior to award of contract. In addition, the Bidder to whom award is made must complete an Assurance Regarding Felony Conviction or Tax Delinquent Status for Corporate Applicants (AD-3031).

#### 13. Good Neighbor Authority (GNA) Requirements, con't (9/16)

Bidder certifies, by signing this bid form, that to the best of Bidder's knowledge that the following representations are accurate and complete.

- a. That the Bidder and its principals are not presently debarred, suspended, proposed for debarment, declared ineligible, or voluntary excluded from timber sales (covered transactions) by any Federal department or agency.
- b. That the Bidder and its principals have not within a 3-year period preceding this bid been convicted of or had a civil judgment rendered against them for commission of fraud or a criminal offense in connection with obtaining, attempting to obtain, or performing a public (Federal, State, or local) transaction or contract under a public transaction; violation of Federal or State antitrust statutes or commission of embezzlement, theft, forgery, bribery, falsification or destruction of records, making false statements, or receiving stolen property.

c. That the Bidder and its principals are not presently indicted for or otherwise criminally or civilly charged by a governmental entity (Federal, State, or local) with commission of any of the offenses enumerated in paragraph b of this certification.

d. That the Bidder and its principals have not within a 3-year period preceding this bid had one or more public transactions (Federal, State, or local) terminated for breach or default of a timber or forest product contract.

Bidders that cannot certify this requirement, in whole or in part, shall submit an explanation with their bid.

KEITH CREAGH

Director



# TIMBER SALE INFORMATION

Stafford for President RP Mix (52-124-16)

Cheboygan County (Advertised Price \$177,734.20)

SALE NOTE: A recreation site such as a trail, pathway, or campground is within the sale area or the vicinity. Certain restrictions/specifications may be applicable including time restrictions.

A timber sale contract for this lump sum, sealed bid timber sale will be awarded to the responsible bidder offering the highest sealed bid price. Bids must be at or above the following advertised price for each species:

<u>PRODUCTS &amp; SPECIES</u>	<u>ESTIMATED UNITS*</u>	<u>ADVERTISED PRICE</u>
Sawtimber		
B. T. Aspen	26.50 MBF	\$ 49.00 / MBF
Red Oak	9.30 MBF	\$ 219.00 / MBF
Red Pine	589.70 MBF	\$ 116.00 / MBF
White Oak	5.00 MBF	\$ 116.00 / MBF
White Pine	133.70 MBF	\$ 72.00 / MBF
Pulpwood		
B. T. Aspen	484.00 Cords	\$ 17.70 / Cord
Jack Pine	128.00 Cords	\$ 25.20 / Cord
Mixed Hardwood	129.00 Cords	\$ 20.25 / Cord
Red Oak	53.00 Cords	\$ 24.75 / Cord
Red Pine	1,379.00 Cords	\$ 47.25 / Cord
White Oak	32.00 Cords	\$ 24.75 / Cord
White Pine	395.00 Cords	\$ 35.75 / Cord

\* The total volume is statistically estimated within plus (+) or minus (-) 11.75 percent. The estimated units are final and not subject to adjustment. Prospective bidders are urged to examine this timber and to make their own estimates of quantity and quality.

## **BOND AND PAYMENT SCHEDULE:**

1. A bond in the amount of \$8,887.00 to insure faithful performance of the conditions of the contract will be deposited by the successful bidder within 21 days of the sale award.
2. Cutting in any sale or unit without the required advance payment would be considered a trespass.
3. Total payment must be paid in advance or according to the following schedule:
  - (a) Ten percent (10%) of the sale value must be paid within 21 days of the sale award.
  - (b) The 10% down payment will be credited towards the first unit cut.
4. If no cutting takes place, the 10% down payment will not be refunded.
5. Operations on the contract issued will terminate on 12/31/2020.

**Description of Timber by Payment Unit (PU)**

PU	MARKET GROUP	PRODUCT	QUANTITY	UNIT	ACRES	ADVERTISE PRICE
1	B. T. Aspen	Sawtimber	22.0	MBF	61.9	\$83,677.30
	Red Oak		5.0	MBF		
	Red Pine		257.6	MBF		
	White Oak		5.0	MBF		
	White Pine		115.1	MBF		
	B. T. Aspen	Pulpwood	407.0	Cords		
	<i>B. T. Aspen</i>		<i>407.0</i>	<i>Cords</i>		
	Jack Pine		128.0	Cords		
	<i>Jack Pine</i>	<i>Sawtimber</i>	<i>4.6</i>	<i>MBF</i>		
	<i>Jack Pine</i>	<i>Pulpwood</i>	<i>119.0</i>	<i>Cords</i>		
	Mixed Hardwood		36.0	Cords		
	<i>Red Maple</i>		<i>36.0</i>	<i>Cords</i>		
	Red Oak		37.0	Cords		
	Red Pine		395.0	Cords		
	White Oak		32.0	Cords		
	White Pine		314.0	Cords		
2	B. T. Aspen	Sawtimber	4.5	MBF	16.4	\$13,429.95
	Red Oak		4.3	MBF		
	Red Pine		27.9	MBF		
	White Pine		18.6	MBF		
	B. T. Aspen	Pulpwood	77.0	Cords		
	<i>B. T. Aspen</i>		<i>70.0</i>	<i>Cords</i>		
	<i>Quaking Aspen</i>		<i>7.0</i>	<i>Cords</i>		
	Mixed Hardwood		17.0	Cords		
	<i>Red Maple</i>		<i>17.0</i>	<i>Cords</i>		
	Red Oak		16.0	Cords		
	Red Pine		57.0	Cords		
	White Pine		81.0	Cords		
3	Red Pine	Sawtimber	125.2	MBF	50.0	\$25,012.70
	Red Pine	Pulpwood	222.0	Cords		
4	Red Pine	Sawtimber	179.0	MBF	56.4	\$54,075.25
	Red Pine	Pulpwood	705.0	Cords		
5	Mixed Hardwood	Pulpwood	76.0	Cords	4.1	\$1,539.00
	<i>Basswood</i>	<i>Sawtimber</i>	<i>7.5</i>	<i>MBF</i>		
	<i>Sugar Maple</i>		<i>2.4</i>	<i>MBF</i>		
	<i>Basswood</i>	<i>Pulpwood</i>	<i>26.0</i>	<i>Cords</i>		
	<i>Ironwood</i>		<i>9.0</i>	<i>Cords</i>		
	<i>Red Maple</i>		<i>2.0</i>	<i>Cords</i>		
	<i>Sugar Maple</i>		<i>19.0</i>	<i>Cords</i>		
TOTAL:			764.2	MBF		
TOTAL:			2,600.0	Cords		



## Sale Specific Conditions & Requirements

**Sale Name: Stafford for President RP Mix**

**Sale Number: 52-124-16 Seq#: 1**

### 1 - Sale Area

#### 1.2 - Boundaries

##### 1.2.1 - Painted boundaries (1/14)

The sale boundary and Payment Unit boundaries are marked and identified by blue, red, green, and purple paint. Exterior sale boundary lines against private property are marked with blue paint. Exterior sale boundary lines against state are marked with red paint, and in some cases may be marked in purple and green paint. Interior Payment Unit boundaries are marked with red paint, with the exception of the boundary between Payment Units 1 and 2, which is marked with green paint. The protected area is marked with purple paint. The painted exterior and interior boundary line trees are not Included Timber and are to be protected.

### 2 - Timber Specifications

#### 2.1 - Included Timber

##### 2.1.1 - Clearcut unit(s) with unmerchantable trees (6/14)

Within Payment Unit(s) 1 and 2, cut all trees that are two (2) inches or more at DBH except the following:

Within Payment Unit(s) 1, do not cut any trees marked with yellow paint. In addition, do not cut the following species if they are 26 inches or more at DBH: red pine, white pine, and any oak.

Within Payment Unit(s) 2, do not cut white oak and any trees marked with yellow paint. In addition, do not cut the following species if they are 26 inches or more at DBH: red pine, white pine, and any other oak.

Special protection trees identified in accordance with condition 3.4.2, within clearcutting unit boundaries, are not Included Timber and are to be protected.

##### 2.1.3 - Cut tree marked unit(s) (12/08)

Within Payment Unit(s) 4 and 5, all trees are designated for cutting when marked with orange paint above and below stump height, regardless of merchantability.

##### 2.1.8 - Designated plantation row unit(s) (12/08)

Within Payment Unit(s) 3, all red pine trees which meet minimum piece specifications in 2.2 Utilization, within designated plantation rows are designated for cutting. Designated plantation rows are every third row, beginning with the third row in from the outside of the plantation, then continuing every third row. If there is variability in row direction, it shall be the responsibility of the producer to maintain the third row sequence. Deciduous trees within the designated cut rows shall be decked separately at the landing to be scaled by the sale administrator. Payment will be made at the specified Purchase Unit Price. No tree, regardless of species, is to be cut outside of the third row designated pattern.

##### 2.1.11 - Description of timber note (2/04)

Note that the Purchaser will have the opportunity to purchase an additional Payment Unit in the event that an abandoned nest is deemed inactive. Adding a Payment Unit is a contract modification which will require a Timber Sale Contract Supplement. Payment Unit boundaries and volumes for the potential unit have been pre-determined.

#### 2.2 - Utilization

##### 2.2.2 - Chipping required (5/14)

Payment Unit 1 must be chip harvested to facilitate subsequent planting operations. The requirement to retain approximately 1/6 to 1/3 of tree tops and limbs less than four inches in diameter does not apply (G. C. & R. 2.2). This is to facilitate subsequent planting operations.

##### 2.2.3 - Stump heights (4/07)

Stump heights within Payment Unit 1 shall not exceed 6 inches for all trees. This is in order to facilitate planting operations.

### 3 - Payments

### 3.3 - Pre-measured Sales

#### 3.3.4 - Dividing payment units (7/14)

Payment Unit(s) 1, 3, and 4 may be divided at the request of the Purchaser and upon approval of the Unit Manager. Dividing Payment Units is a contract modification which requires a Timber Sale Contract Supplement. There will be only one division per Payment Unit.

### 3.4 - Damaged Timber

#### 3.4.2 - Special Protection Trees (4/14)

The Purchaser shall not cut live or dead special protection trees within cutting units or clearings. Special protection trees are any yellow marked trees and any pine or oak 26 inches DBH or greater within Payment Units 1 and 2. If the Purchaser's operations have cut or damaged special protection trees through carelessness, the Purchaser shall pay \$100 as fixed, agreed and liquidated damages for each special protection tree cut or damaged. Such payment does not constitute ownership of the undesignated timber.

## 4 - Transportation

### 4.1 - Construction

#### 4.1.3 - Slash and earthen piles (8/04)

Piles or windrows of earth along roads and landings that have been widened or constructed shall be leveled. Slash from road maintenance or construction, including stumps, shall be chipped, utilized, or otherwise evenly distributed throughout the sale.

#### 4.1.4 - Timber removed for construction (12/09)

Trees cut or damaged in the process of pre-approved road, landing or skid trail construction will be decked in an area separate from other Designated Timber and not removed until measured by the sale administrator. Payment will be made at the specified Purchase Unit Price.

#### 4.1.6 - Road construction (1/09)

Construction of new roads or improvements of existing roads shall be done in such a way as to minimize the environmental and visual impacts. Merchantable trees shall be cut and utilized unless otherwise directed. Non-merchantable trees shall be severed and laid flat on the ground. Slash shall be scattered, and not left in windrows and kept a minimum of 10 feet back from the road edge. Stumps shall be set upright, not left on edge, and be moved at least 10 feet away from the road edge. Disturbed soil shall be feathered into the woods and not left in berms or windrows.

#### 4.1.7 - Road closure (10/11)

All new roads built into the sale must be blocked to vehicle traffic upon completion of the sale. Overgrown roads that are reopened shall be considered new roads. In general, this will require constructing a four (4') foot high berm of stumps and logs covered with earth. These roads must be rendered impassable to cars and trucks. Contact the sale administrator for specific details of design and placement.

### 4.2 - Maintenance

#### 4.2.5 - Two wheel drive condition (2/04)

All existing trail roads on and adjacent to the sale area must be passable by two-wheel drive traffic for the duration of the sale.

## 5 - Operations

### 5.1 - Notification

#### 5.1.1 - Pre-sale conference (10/11)

A pre-sale conference between the Purchaser and sale administrator is required prior to beginning a Payment Unit to determine landing and road locations. The Unit Manager or his/her representative must be contacted at least 5 days in advance to schedule the conference.

### 5.2 - Conduct of Operations

#### 5.2.2 - Hazard Trees/Snags

##### 5.2.2.1 - Den trees (2/04)

Obvious hollow and/or den trees shall be protected and left standing unless they are a safety hazard.

### 5.2.3 - Operating Restrictions

#### 5.2.3.1 - Operating restrictions (9/11)

Within Payment Unit(s) 1 and 2, unless changed by written agreement, cutting, skidding, and hauling are not permitted during the period of 03/15 to 07/15. This restriction is to protect an existing nest. In the event that the nest is deemed inactive, this restriction may be lifted.

#### 5.2.3.3 - Bark slippage restriction (3/09)

Within Payment Unit(s) 5, unless changed by written agreement, cutting and skidding are not permitted during the period of April 15 to July 15. This restriction is because of bark slippage.

#### 5.2.3.4 - Oak wilt restriction (6/10)

Within Payment Unit(s) 2, cutting and skidding are not permitted during the period of April 15 to July 15. Oak wilt has been confirmed within a 5 mile radius of this sale. If there is oak in any other Payment Units, it is the responsibility of the Purchaser to notify the sale administrator if any symptoms of oak wilt appear during operations. This is necessary to reduce the spread of oak wilt. For more information, contact the Unit Manager or his/her representative.

#### 5.2.31 - Landing locations (9/13)

Landing locations are to be agreed upon by the Purchaser and sale administrator prior to beginning any operations. In general, this will require an on-site meeting between the Purchaser and sale administrator prior to any operations in each Payment Unit. The sale administrator shall be contacted no fewer than 5 days in advance of opening a new Payment Unit.

#### 5.2.32 - Decking/landing restoration (9/13)

All decking and landing areas must have the surface area restored to a condition equal to or better than before. This is to ensure the proper regeneration of the stand. Wood debris, chips and "cookies" from trimmings must be removed or scattered away from landing and loading areas and may not be windrowed or piled on the edge or within the landing.

#### 5.2.38 - No decking against live trees (2/04)

Cut products may not be decked against unmarked or designated leave trees.

#### 5.2.39 - ORV trail/route protection (12/12)

The Tomahawk MCCCT, Tomahawk A Loop, and Indian River Route are ORV and/or motorcycle trails and are shown on the Timber Sale Map. Do not damage posts with orange trail markers. Trees with orange trail markers shall be cut off above the markers and at least 5 feet above ground. All stumps within 5 feet of the trail must be cut flush with the ground or at least 5 feet above ground level. Do not run equipment down these trails or routes. Skidding across the trails or routes may only occur in locations approved by the sale administrator.

#### 5.2.41 - Snowmobile trail protection (9/11)

Trail 76 is a snowmobile trail and is shown on the Timber Sale Map. Do not cut or damage posts with orange trail markers or traffic control signs. If the trail is used for hauling, it must be graded to the satisfaction of the Unit Manager or his/her representative prior to December 1. In addition, if the trail is used during the period of December 1 to March 31, it must be graded at the close of business nightly. Maintain a 20 foot wide slash, debris, and rut free zone daily using the snowmobile trail as the centerline. No decking of forest products will be permitted along the snowmobile trail. Upon completion of the sale, the trail must be restored to a condition equal to or better than before the sale.

### 5.4 - Soil Protection

#### 5.4.1 - Rutting restriction, general (7/16)

Operations are to cease immediately if equipment and weather conditions result in rutting of roads and/or skid trails which is 12 inches or greater in depth and 50 feet in length. The Unit Manager or his/her representative may restrict hauling and/or skidding if ruts exceed the specified depth. With the Unit Manager or his/her representative's approval, the Purchaser may return to the area when the risk of rutting has decreased.

### 5.8 - Protection of Endangered Species

#### 5.8.3 - Red shoulder hawk or goshawk (2/16)

In the event that an active red shoulder hawk or goshawk nest is found, the contract may be amended to protect the nest site until the nest is determined to be inactive. The value of the trees in this excluded area will be refunded or credited to the Purchaser. The nest will be buffered with a five-chain radius (eight acre) protection area, centered on the nest tree, in which

there will be no cutting or new roads constructed. Avoid human disturbance, including loading and skidding, in the protection area.

An additional zone of five chains (ten chains centered on the active nest tree) will be established in which there is no management activity from March 15 to July 15. Limit biomass harvesting and chipping operations within this ten-chain zone, retain the maximum one-third of residues per the Woody Biomass Harvesting Guidelines (Michigan DNR 2010). Nests determined to be inactive will be protected with a one-chain no-harvest buffer.

## **6 - Safety and Fire Prevention**

### **6.2 - Signing**

#### **6.2.1 - Road posting (9/09)**

The Purchaser is responsible for posting and maintaining caution signs on travel and/or haul routes prior to beginning operations. The road must be posted at appropriate distances from the sale area to warn of logging activity and truck traffic. Signs must be removed when harvest operations are suspended or completed. The Purchaser will provide these signs.

#### **6.2.2 - Snowmobile trail posting (8/09)**

The Purchaser is responsible for posting and maintaining caution signs on Trail 76 prior to beginning operations during the snowmobile season (approximately December 1 to March 31). The trail must be posted at appropriate distances from the sale area to warn of logging activity and truck traffic. Signs must be removed when harvest operations are suspended or completed. The Purchaser will provide these signs.

#### **6.2.3 - Recreational trail posting (2/10)**

The Purchaser is responsible for posting and maintaining caution signs on any ATV trails affected by an active Payment Unit prior to beginning operations. The trail must be posted at appropriate distances from the sale area to warn of logging activity and truck traffic at both ends of the trail. Signs must be removed when harvest operations are suspended or completed. The Purchaser will provide these signs. It is the responsibility of the Purchaser to post these trails before operations occur. It is recommended that the Purchaser work with the sale administrator regarding the location of the trails.

## **7 - Other Conditions**

### **7.3 - Contract Modifications**

#### **7.3.2 - Modification for oak wilt (2/05)**

Within the sale area, there may be patches of oak wilt. If oak wilt is identified within the sale area, this contract may be modified. The following modifications could occur: time of cutting, species to cut, volume to harvest, or various others dealing with the treatment of oak wilt. If a species is not specified in this contract, it shall be paid for at the average price received for that species and product.



Sale Number	Year
52 - 124	16

# TIMBER SALE MAP

This information provided by authority of Part 525, 1994 PA 451, as amended.

Forest Management Unit	County	Mapped By	Date	Page	of
Gaylord Management Unit	Cheboygan	TSP	09/13/2016	1	2
Township	Range	Section(s) and Subdivision(s)	Scale		
34N	03W	4: S1/2SE; 9: NE1/4, NESE, S1/2SW; 16: NW1/4; SW1/4 except NWSW; SE1/4 except SESE, NWNE	1:15,840		

### Cover Type

A = Aspen	H = Hemlock	N = Marsh	U = Upland Brush
B = Paper Birch	J = Jack Pine	O = Oak	UM = Upland Mixed
C = Cedar	L = Lowland Brush	P = Lowland Poplar	V = Bog or Marsh
D = Tread Bog	LM = Lowland Mixed	Q = Mixed Swamp Conifer	W = White Pine
E = Swamp Hdwoods	M = Mpl, Bch, Brch	R = Red Pine	X = Non Stocked
F = Spruce Fir	MC = Mixed Conifer	S = Black Spruce	Z = Water
G = Grass	MD = Mixed Deciduous	T = Tamarack	

### Density

0 = Non Stocked	5 = Pole Timber Medium
1 = Seedling Sapling Poor	6 = Pole Timber Well
2 = Seedling Sapling Medium	7 = Saw Timber Poor
3 = Seedling Sapling Well	8 = Saw Timber Medium
4 = Pole Timber Poor	9 = Saw Timber Well

PU	Acres	PU	Acres
1	61.9	4	56.4
2	16.4	5	4.1
3	50		

## Stafford for President RP Mix

### Compartment 150

### 188.8 Acres

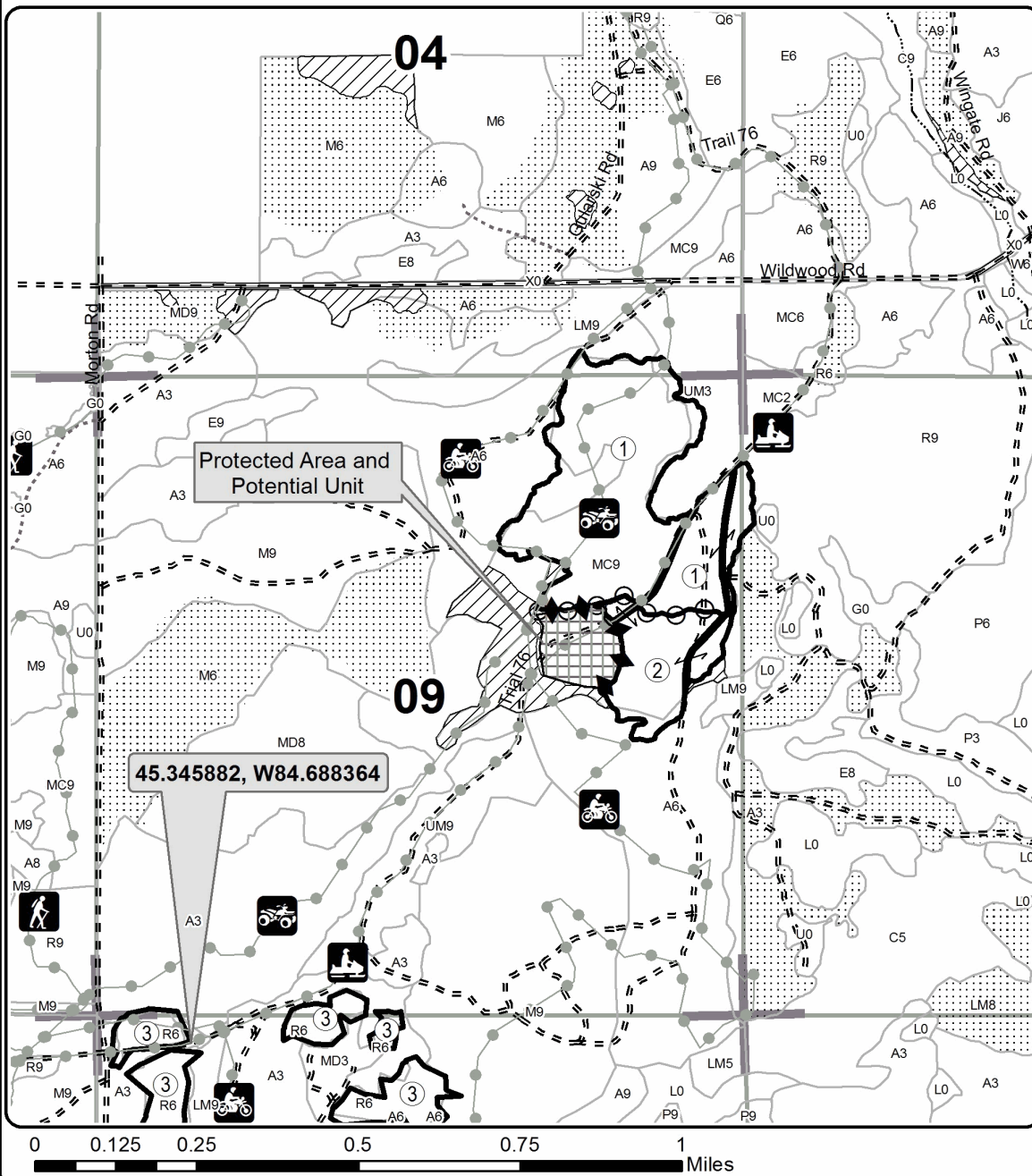

### Legend

- Against State (Red)
- Payment Unit (Green)
- Private Line (Blue)
- ◆ Protected Area Line (Purple)
- ▨ Protected Area
- ⋯ Nearby Timber Sale
- ▨ Retention Area
- ▭ Stand Boundaries
- Section Corners
- Paved Roads
- Gravel Roads
- Poor Dirt Roads
- Closed Roads
- 👤 Hiking Trails
- 🏍️ Motorcycle Trails
- 🏍️ ORV Trails
- 👤 Snowmobile Trails

Locator Map  
1:200,000

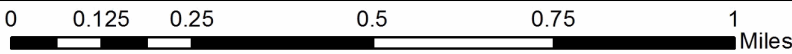
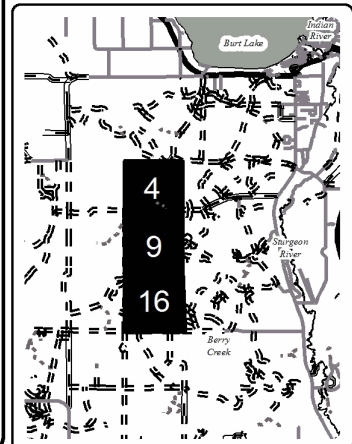



Sale Number	Year
52 - 124	16

# TIMBER SALE MAP

This information provided by authority of Part 525, 1994 PA 451, as amended.

Forest Management Unit		County	Mapped By	Date	Page	of
Gaylord Management Unit		Cheboygan	TSP	09/13/2016	2	2
Township	Range	Section(s) and Subdivision(s): 4: S1/2SE; 9: NE1/4, NESE, S1/2SW;			Scale	
34N	03W	16: NW1/4; SW1/4 except NWSW; SE1/4 except SESE, NWNE			1:15,840	

Cover Type				Density	
A = Aspen	H = Hemlock	N = Marsh	U = Upland Brush	0 = Non Stocked	5 = Pole Timber Medium
B = Paper Birch	J = Jack Pine	O = Oak	UM = Upland Mixed	1 = Seedling Sapling Poor	6 = Pole Timber Well
C = Cedar	L = Lowland Brush	P = Lowland Poplar	V = Bog or Marsh	2 = Seedling Sapling Medium	7 = Saw Timber Poor
D = Treed Bog	LM = Lowland Mixed	Q = Mixed Swamp Conifer	W = White Pine	3 = Seedling Sapling Well	8 = Saw Timber Medium
E = Swamp Hdwoods	M = Mpl, Bch, Brch	R = Red Pine	X = Non Stocked	4 = Pole Timber Poor	9 = Saw Timber Well
F = Spruce Fir	MC = Mixed Conifer	S = Black Spruce	Z = Water		
G = Grass	MD = Mixed Deciduous	T = Tamarack			

PU	Acres	PU	Acres
1	61.9	4	56.4
2	16.4	5	4.1
3	50		

## Stafford for President RP Mix

### Compartment 150

188.8 Acres

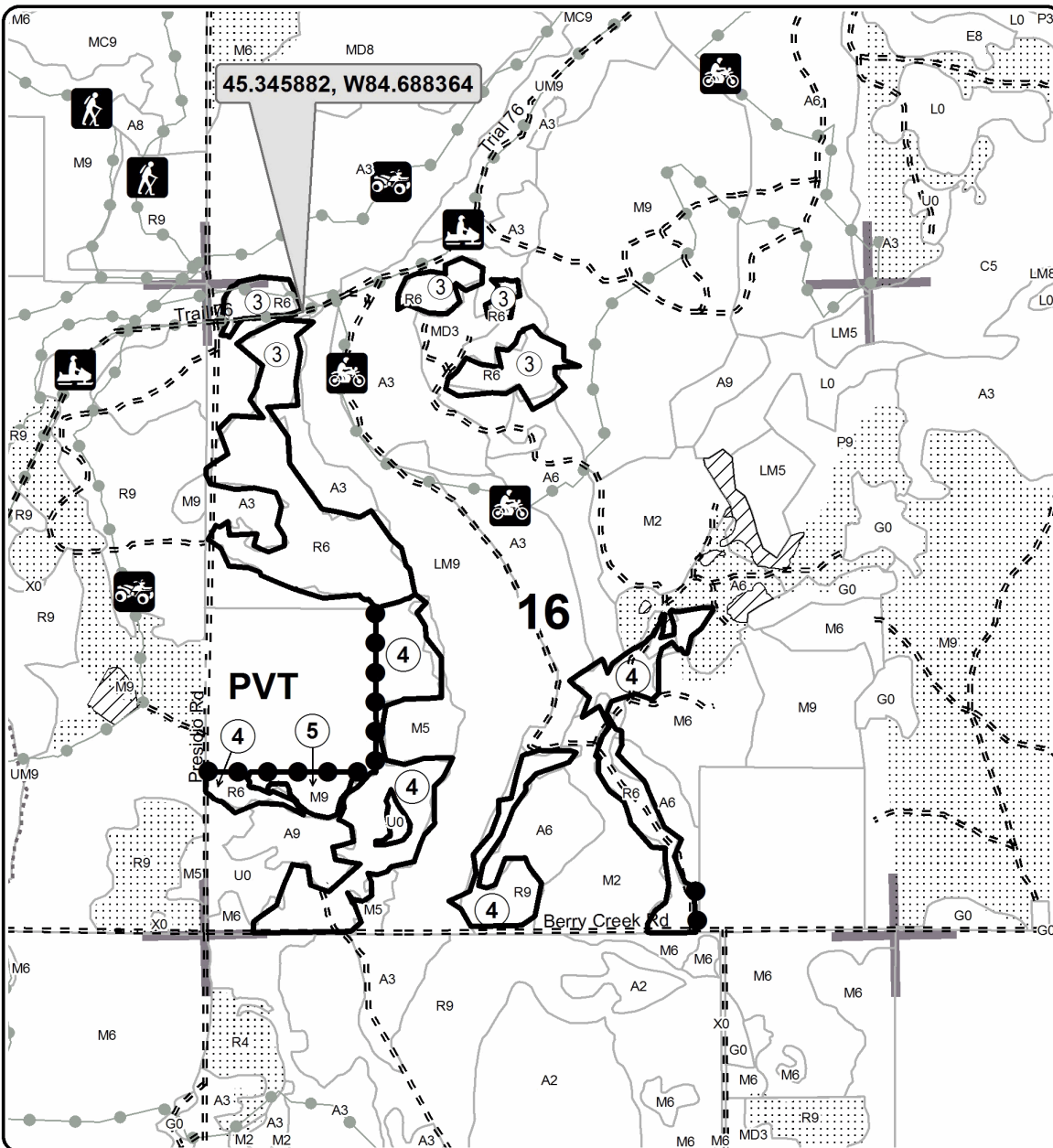

### Legend

- Against State (Red)
- Payment Unit (Green)
- Private Line (Blue)
- ◆ Protected Area Line (Purple)
- ▭ Protected Area
- ⋯ Nearby Timber Sale
- ▨ Retention Area
- ▭ Stand Boundaries
- Section Corners
- Paved Roads
- Gravel Roads
- == Poor Dirt Roads
- Closed Roads
- 👤 Hiking Trails
- 🏍️ Motorcycle Trails
- 🚙 ORV Trails
- 🚗 Snowmobile Trails

Locator Map  
1:200,000

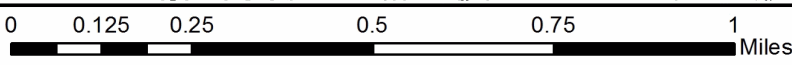
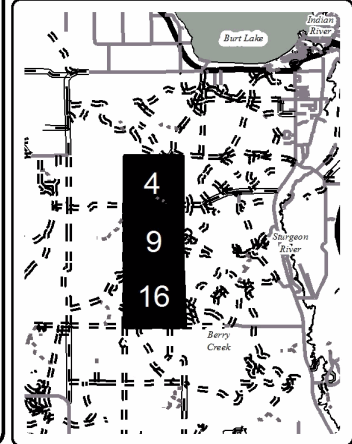

# TIMBER SALE INFORMATION

## Michigan State Road Aspen (52-130-16)

Cheboygan County (Advertised Price \$43,205.15)

SALE NOTE: Good Access to all units.

Harvest operations in Payment Unit 2 are limited to a period of December 1 - April 1 and June 1 - October 1, due to wetter soil types.

A recreation site such as a trail, pathway, or campground is within the sale area or the vicinity. Certain restrictions/specifications may be applicable including time restrictions.

A timber sale contract for this lump sum, sealed bid timber sale will be awarded to the responsible bidder offering the highest sealed bid price. Bids must be at or above the following advertised price for each species:

<u>PRODUCTS &amp; SPECIES</u>	<u>ESTIMATED UNITS*</u>		<u>ADVERTISED PRICE</u>
Sawtimber			
B. T. Aspen	86.30	MBF	\$ 49.00 / MBF
Quaking Aspen	45.40	MBF	\$ 49.00 / MBF
Pulpwood			
B. T. Aspen	866.00	Cords	\$ 17.70 / Cord
Balsam Fir	162.00	Cords	\$ 22.10 / Cord
Balsam Poplar	66.00	Cords	\$ 17.70 / Cord
BI/R/Hybrid Oak	37.00	Cords	\$ 24.75 / Cord
Jack Pine	31.00	Cords	\$ 25.20 / Cord
Paper Birch	14.00	Cords	\$ 14.20 / Cord
Quaking Aspen	405.00	Cords	\$ 17.70 / Cord
Red Maple	181.00	Cords	\$ 20.25 / Cord
Red Pine	14.00	Cords	\$ 47.25 / Cord
White Ash	3.00	Cords	\$ 20.25 / Cord
White Oak	34.00	Cords	\$ 24.75 / Cord
White Pine	16.00	Cords	\$ 35.75 / Cord
White Spruce	50.00	Cords	\$ 36.20 / Cord

\* The total volume is statistically estimated within plus (+) or minus (-) 10.68 percent. The estimated units are final and not subject to adjustment. Prospective bidders are urged to examine this timber and to make their own estimates of quantity and quality.

### **BOND AND PAYMENT SCHEDULE:**

1. A bond in the amount of \$2,160.00 to insure faithful performance of the conditions of the contract will be deposited by the successful bidder within 21 days of the sale award.
2. Cutting in any sale or unit without the required advance payment would be considered a trespass.
3. Total payment must be paid in advance or according to the following schedule:
  - (a) Ten percent (10%) of the sale value must be paid within 21 days of the sale award.
  - (b) The 10% down payment will be credited towards the first unit cut.
4. If no cutting takes place, the 10% down payment will not be refunded.
5. Operations on the contract issued will terminate on 12/31/2020.

**Description of Timber by Payment Unit (PU)**

PU	MARKET GROUP	PRODUCT	QUANTITY	UNIT	ACRES	ADVERTISE PRICE
1	B. T. Aspen	Sawtimber	60.5	MBF	36.7	\$18,734.00
	Quaking Aspen		22.1	MBF		
	B. T. Aspen	Pulpwood	509.0	Cords		
	Balsam Fir		19.0	Cords		
	Balsam Poplar		14.0	Cords		
	<i>Balsam Poplar</i>		14.0	<i>Cords</i>		
	Paper Birch		8.0	Cords		
	Quaking Aspen		162.0	Cords		
	Red Maple		65.0	Cords		
	White Ash		3.0	Cords		
	White Spruce		18.0	Cords		
	2	B. T. Aspen	Sawtimber	1.0		
Quaking Aspen			17.7	MBF		
B. T. Aspen		Pulpwood	8.0	Cords		
Balsam Fir			27.0	Cords		
Balsam Poplar			20.0	Cords		
<i>Balsam Poplar</i>			20.0	<i>Cords</i>		
Paper Birch			4.0	Cords		
Quaking Aspen			154.0	Cords		
Red Maple			6.0	Cords		
3		B. T. Aspen	Sawtimber	0.7	MBF	4.1
	B. T. Aspen	Pulpwood	5.0	Cords		
	Balsam Fir		8.0	Cords		
	Red Maple		29.0	Cords		
4	B. T. Aspen	Sawtimber	24.1	MBF	46.3	\$14,517.65
	Quaking Aspen		5.6	MBF		
	B. T. Aspen	Pulpwood	287.0	Cords		
	Balsam Fir		108.0	Cords		
	Balsam Poplar		32.0	Cords		
	<i>Balsam Poplar</i>	<i>Sawtimber</i>	3.2	<i>MBF</i>		
	<i>Balsam Poplar</i>	<i>Pulpwood</i>	26.0	<i>Cords</i>		
	Jack Pine		7.0	Cords		
	Paper Birch		2.0	Cords		
	Quaking Aspen		89.0	Cords		
	Red Maple		75.0	Cords		
	White Pine		16.0	Cords		
	White Spruce		32.0	Cords		
	5	B. T. Aspen	Pulpwood	57.0		
BI/R/Hybrid Oak			37.0	Cords		
<i>BI/R/Hybrid Oak</i>			28.0	<i>Cords</i>		
<i>Red Oak</i>			9.0	<i>Cords</i>		
Jack Pine			24.0	Cords		
Red Maple			6.0	Cords		
Red Pine			14.0	Cords		
White Oak			34.0	Cords		
TOTAL:			131.7	MBF		
TOTAL:			1,879.0	Cords		



## Sale Specific Conditions & Requirements

Sale Name: Michigan State Road Aspen

Sale Number: 52-130-16 Seq#: 1

### 1 - Sale Area

#### 1.2 - Boundaries

##### 1.2.1 - Painted boundaries (1/14)

The sale boundary and Payment Unit boundaries are marked and identified by blue, red and teal paint. Exterior sale boundary lines against private property are marked with blue paint. Exterior sale boundary lines against state are marked with red paint. Interior retention areas are marked with teal paint; no operations are to take place in these areas. The painted boundary line trees are not Included Timber and are to be protected.

### 2 - Timber Specifications

#### 2.1 - Included Timber

##### 2.1.2 - Clearcut unit(s) w/o unmerchantable trees (8/11)

Within Payment Unit(s) 1 - 5, cut all trees which meet minimum piece specifications in 2.2 Utilization, with the following exceptions:

Within Payment Unit(s) 1 and 2, do not cut oak and white pine.

Within Payment Unit(s) 3, do not cut oak and cedar.

Within Payment Unit(s) 4, do not cut oak, cedar, and red pine.

Within Payment Unit(s) 5, do not cut white pine and trees marked with teal paint.

### 3 - Payments

#### 3.3 - Pre-measured Sales

##### 3.3.4 - Dividing payment units (7/14)

Payment Unit(s) 1 and 4 may be divided at the request of the Purchaser and upon approval of the Unit Manager. Dividing Payment Units is a contract modification which requires a Timber Sale Contract Supplement.

#### 3.4 - Damaged Timber

##### 3.4.2 - Special Protection Trees (4/14)

The Purchaser shall not cut live or dead special protection trees within cutting units or clearings. Special protection trees are marked with teal paint. If the Purchaser's operations have cut or damaged special protection trees through carelessness, the Purchaser shall pay \$100 as fixed, agreed and liquidated damages for each special protection tree cut or damaged. Such payment does not constitute ownership of the undesignated timber.

### 4 - Transportation

#### 4.1 - Construction

##### 4.1.3 - Slash and earthen piles (8/04)

Piles or windrows of earth along roads and landings that have been widened or constructed shall be leveled. Slash from road maintenance or construction, including stumps, shall be dispersed throughout the sale.

##### 4.1.6 - Road construction (1/09)

Construction of new roads or improvements of existing roads shall be done in such a way as to minimize the environmental and visual impacts. Merchantable trees shall be cut and utilized unless otherwise directed. Non-merchantable trees shall be severed and laid flat on the ground. Slash shall be scattered, and not left in windrows and kept a minimum of 10 feet back from the road edge. Stumps shall be set upright, not left on edge, and be moved at least 10 feet away from the road edge. Disturbed soil shall be feathered into the woods and not left in berms or windrows.

##### 4.1.7 - Road closure (10/11)

All new roads built into the sale must be blocked to vehicle traffic upon completion of the sale. In general, this will require constructing a four (4') foot high berm of stumps and logs covered with earth. Contact the sale administrator for specific

details of design and placement.

## 4.2 - Maintenance

### 4.2.4 - Grading (12/14)

For completion of the sale, state forest roads must be graded. In general, this will require a road grader or bull dozer to shape up the roads after forest products have been hauled off site. The grading equipment to be used must be approved by the Unit Manager or his/her representative.

## 5 - Operations

### 5.1 - Notification

#### 5.1.1 - Pre-sale conference (10/11)

A pre-sale conference on site between the Purchaser and sale administrator is required prior to beginning any operations to determine landing and road locations. The Unit Manager or his/her representative must be contacted at least 2 days in advance to schedule the conference.

#### 5.1.4 - Post-sale conference (6/11)

A post-sale conference on site between the Purchaser and sale administrator is required 5 days prior to the completion of active logging operations to determine clean-up and repair of landings, road edges, and the fulfillment of other contract specifications.

### 5.2 - Conduct of Operations

#### 5.2.2 - Hazard Trees/Snags

##### 5.2.2.1 - Den trees (2/04)

Obvious hollow and/or den trees shall be protected and left standing unless they are a safety hazard.

#### 5.2.3 - Operating Restrictions

##### 5.2.3.1 - Operating restrictions (9/11)

Within Payment Unit(s) 2, unless changed by written agreement, cutting, skidding, and hauling are limited to the period of 12/1 to 4/1 and 6/1 to 10/1. This restriction is because of the wet soil types and the potential for excessive rutting concerns.

#### 5.2.32 - Decking/landing restoration (9/13)

All decking and landing areas must have the surface area restored to a condition equal to or better than before. This is to ensure the proper regeneration of the stand.

#### 5.2.39 - ORV trail/route protection (12/12)

The Michigan Cross Country Cycle Trail (MCCCT) and the Red Bridge Trail are ORV trails and are shown on the Timber Sale Map. Do not cut trees or damage posts with orange or yellow ORV markers. Maintain a 20 foot wide slash, debris, and rut free zone daily using the ORV trail or route as the centerline. Do not run equipment down the ORV trail or route. Skidding across the trail or route may only occur in locations approved by the sale administrator.

#### 5.2.40 - Pathway protection (10/10)

The Midland to Mackinaw Trail is a bike/hiking trail and is shown on the Timber Sale Map. Do not cut trees or damage posts with blue pathway markers. Maintain a 20-foot wide slash, debris, and rut free zone daily, using the pathway as the centerline.

### 5.4 - Soil Protection

#### 5.4.1 - Rutting restriction, general (7/16)

Operations are to cease immediately if equipment and weather conditions result in rutting of roads and/or skid trails which is 12 inches or greater in depth and 50 feet in length. The Unit Manager or his/her representative may restrict hauling and/or skidding if ruts exceed the specified depth. With the Unit Manager or his/her representative's approval, the Purchaser may return to the area when the risk of rutting has decreased.

### 5.8 - Protection of Endangered Species

#### 5.8.5 - Protection of raptor nests (3/13)

All trees with raptor nests will be protected if found during harvesting operations. Notification will be made to the Unit Manager or his/her representative who will notify the Wildlife Biologist so an on-site evaluation and recommendation can be made, if necessary.

### **6 - Safety and Fire Prevention**

#### 6.2 - Signing

##### 6.2.3 - Recreational trail posting (2/10)

The Purchaser is responsible for posting and maintaining caution signs on Michigan State Road (MCCCT & Midland to Mackinaw Trail) and the Red Bridge Trail prior to beginning operations. The trail must be posted at appropriate distances from the sale area to warn of logging activity and truck traffic at both ends of the trail. Signs must be removed when harvest operations are suspended or completed.



# TIMBER SALE MAP

This information provided by authority of Part 525, 1994 PA 451, as amended.

Sale Number	Year
52 - 130	16

Forest Management Unit	County	Mapped By	TSP	Date	Page	of
Gaylord Management Unit	Cheboygan	Cruised By	Scheele	09/27/2016	1	2
Township	Range	Section(s) and Subdivision(s)	T35N R01W: Sec 24: NENE.	Scale		
35N	01E and 01W	T35N R01E: Sec 19: NW, NESE; 20: SW, SWNW; 21: E1/2NE		1:15,840		

Cover Type				Density			
A = Aspen	H = Hemlock	N = Marsh	U = Upland Brush	0 = Non Stocked	5 = Pole Timber Medium		
B = Paper Birch	J = Jack Pine	O = Oak	UM = Upland Mixed	1 = Seedling Sapling Poor	6 = Pole Timber Well		
C = Cedar	L = Lowland Brush	P = Lowland Poplar	V = Bog or Marsh	2 = Seedling Sapling Medium	7 = Saw Timber Poor		
D = Tread Bog	LM = Lowland Mixed	Q = Mixed Swamp Conifer	W = White Pine	3 = Seedling Sapling Well	8 = Saw Timber Medium		
E = Swamp Hdwoods	M = Mpl, Bch, Broh	R = Red Pine	X = Non Stocked	4 = Pole Timber Poor	9 = Saw Timber Well		
F = Spruce Fir	MC = Mixed Conifer	S = Black Spruce	Z = Water				
G = Grass	MD = Mixed Deciduous	T = Tamarack					

PU	Acres	PU	Acres
1	36.7	4	46.3
2	14.3	5	11.7
3	4.1		

## Michigan State Road Aspen

### Compartment 209

113.1 Acres

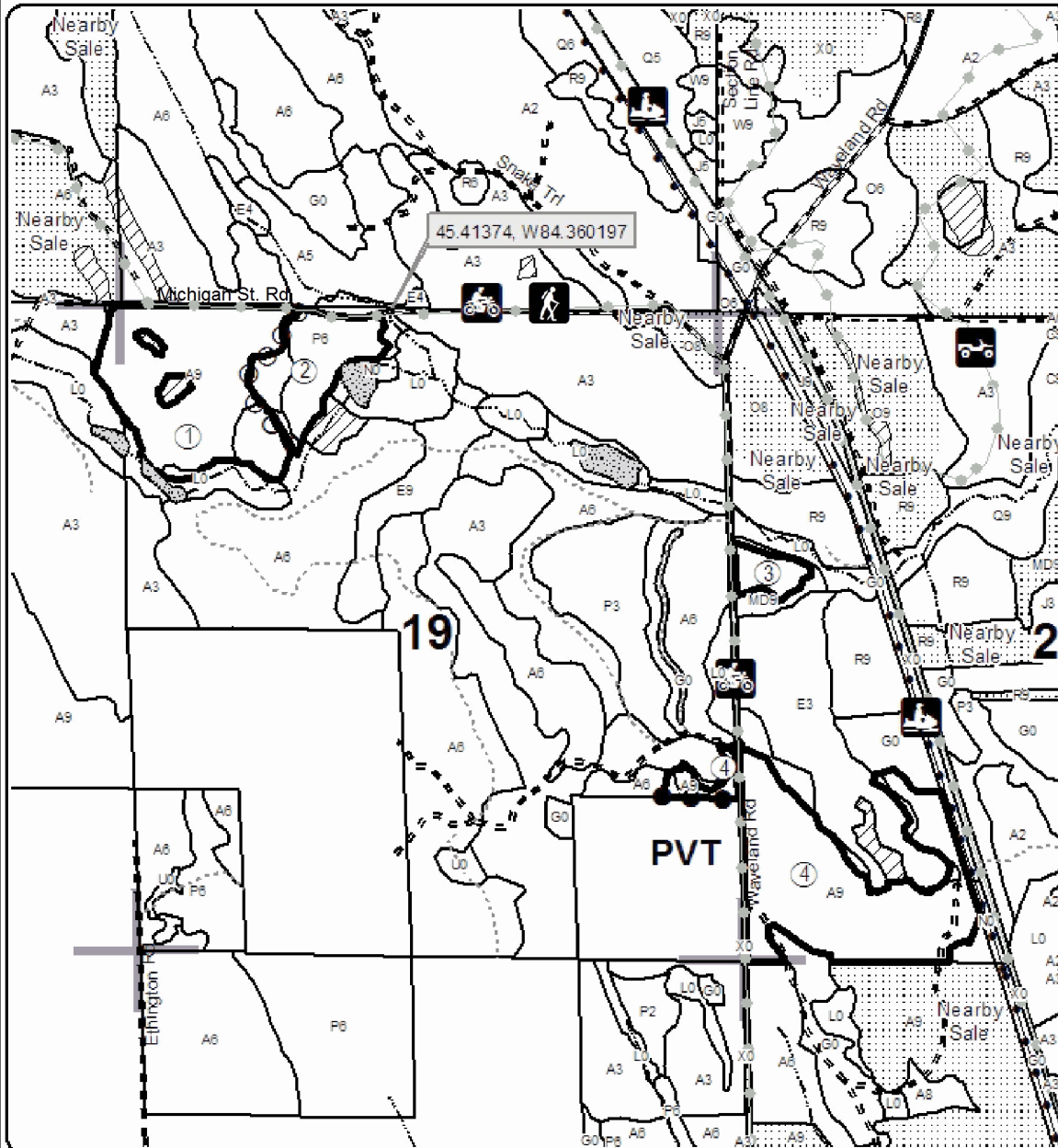

### Legend

- Against State (Red)
- ○ Payment Unit (Yellow)
- ● Private Line (Blue)
- Stand Boundaries
- ▨ Retention Area
- ⋯ Nearby Timber Sale
- Section Corners
- Paved Roads
- Gravel Roads
- Poor Dirt Roads
- Closed Roads
- Streams
- Recreational Trail
- 🚶 Walking Trail
- 🛵 ORV Routes
- 🏍 Motorcycle Trails
- 🚙 Snowmobile Trails

Locator Map  
1:200,000

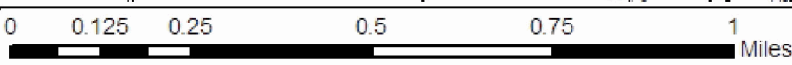
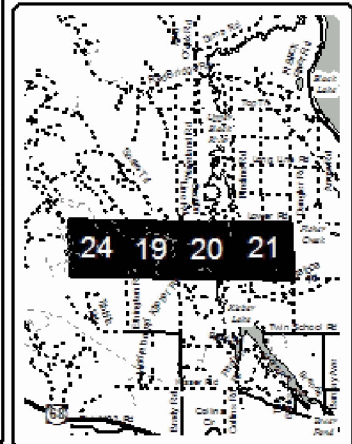



# TIMBER SALE MAP

This information provided by authority of Part 525, 1994 PA 451, as amended.

Sale Number	Year
52 - 130	16
Date	Page of
09/27/2016	2 of 2

Forest Management Unit	County	Mapped By	TSP	Date	Page	of
Gaylord Management Unit	Cheboygan	Cruised By	Scheele	09/27/2016	2	2
Township	Range	Section(s) and Subdivision(s)	T35N R01W: Sec 24: NENE.	Scale		
35N	01E and 01W	T35N R01E: Sec 19: NW, NESE; 20: SW, SWNW; 21: E1/2NE		1:15,840		

Cover Type				Density			
A = Aspen	H = Hemlock	N = Marsh	U = Upland Brush	0 = Non Stocked	5 = Pole Timber Medium		
B = Paper Birch	J = Jack Pine	O = Oak	UM = Upland Mixed	1 = Seedling Sapling Poor	8 = Pole Timber Well		
C = Cedar	L = Lowland Brush	P = Lowland Poplar	V = Bog or Marsh	2 = Seedling Sapling Medium	7 = Saw Timber Poor		
D = Tread Bog	LM = Lowland Mixed	Q = Mixed Swamp Conifer	W = White Pine	3 = Seedling Sapling Well	8 = Saw Timber Medium		
E = Swamp Hdwoods	M = Mpl, Boh, Broh	R = Red Pine	X = Non Stocked	4 = Pole Timber Poor	9 = Saw Timber Well		
F = Spruce Fir	MC = Mixed Conifer	S = Black Spruce	Z = Water				
G = Grass	MD = Mixed Deciduous	T = Tamarack					

PU	Acres	PU	Acres
1	36.7	4	46.3
2	14.3	5	11.7
3	4.1		

## Michigan State Road Aspen

### Compartment 209

113.2 Acres

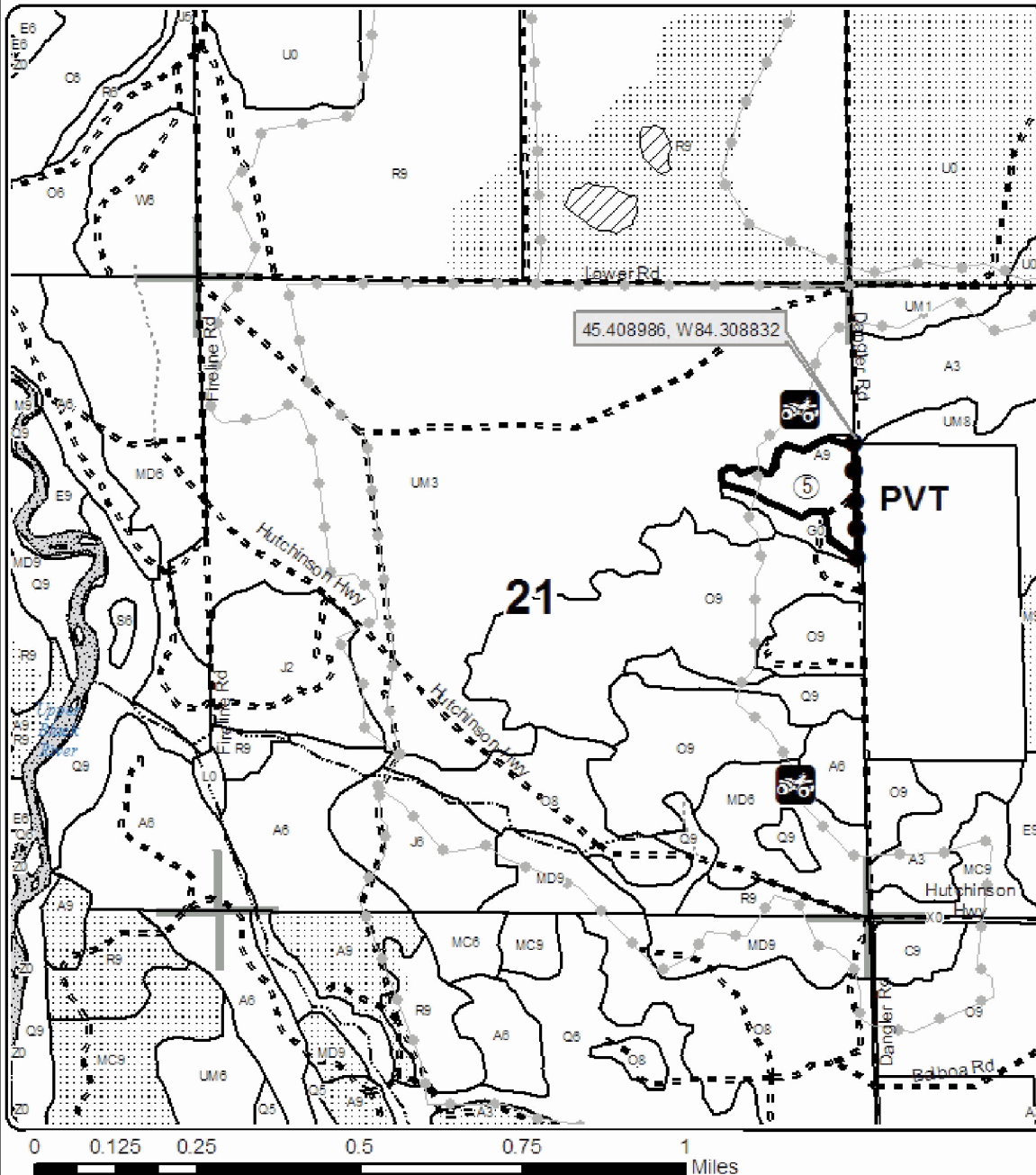
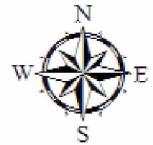

**Legend**

- Against State (Red)
- Private Line (Blue)
- Stand Boundaries
- ▨ Retention Area
- ⋯ Nearby Timber Sale
- 🛵 ORV Trails
- Section Corners
- Recreational Trail
- Paved Roads
- Gravel Roads
- Poor Dirt Roads
- Closed Roads
- Streams

Locator Map  
1:200,000

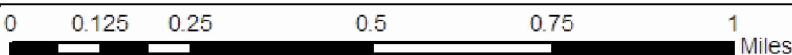
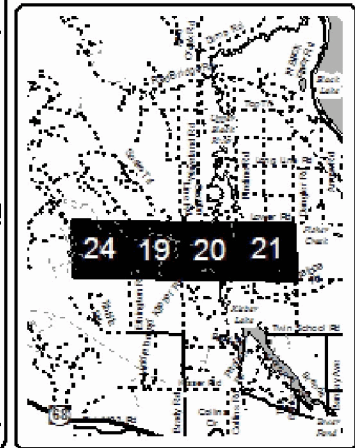



# TIMBER SALE INFORMATION

## Nest Trail Pine Mix (52-131-16)

Cheboygan County (Advertised Price \$47,431.55)

SALE NOTE: Within Payment Units 1 - 4, harvest operations are not permitted during the period of April 15th to July 15th.

Within Payment Units 5 - 7, harvest operations are limited to a period of December 1st to March 15th.

The North East State Trail will be used to access Payment Units 5, 6, and 7.

A recreation site such as a trail, pathway, or campground is within the sale area or the vicinity. Certain restrictions/specifications may be applicable including time restrictions.

A timber sale contract for this lump sum, sealed bid timber sale will be awarded to the responsible bidder offering the highest sealed bid price. Bids must be at or above the following advertised price for each species:

<u>PRODUCTS &amp; SPECIES</u>	<u>ESTIMATED UNITS*</u>	<u>ADVERTISED PRICE</u>
Sawtimber		
B. T. Aspen	16.50 MBF	\$ 49.00 / MBF
Bl/R/Hybrid Oak	7.00 MBF	\$ 119.00 / MBF
Red Oak	9.70 MBF	\$ 219.00 / MBF
Red Pine	138.80 MBF	\$ 116.00 / MBF
White Oak	6.90 MBF	\$ 116.00 / MBF
Pulpwood		
B. T. Aspen	83.00 Cords	\$ 17.70 / Cord
Balsam Fir	10.00 Cords	\$ 22.10 / Cord
Bl/R/Hybrid Oak	113.00 Cords	\$ 24.75 / Cord
Jack Pine	40.00 Cords	\$ 25.20 / Cord
Quaking Aspen	11.00 Cords	\$ 17.70 / Cord
Red Maple	33.00 Cords	\$ 20.25 / Cord
Red Oak	61.00 Cords	\$ 24.75 / Cord
Red Pine	339.00 Cords	\$ 47.25 / Cord
White Oak	73.00 Cords	\$ 24.75 / Cord
White Pine	30.00 Cords	\$ 35.75 / Cord

\* The total volume is statistically estimated within plus (+) or minus (-) 15.35 percent. The estimated units are final and not subject to adjustment. Prospective bidders are urged to examine this timber and to make their own estimates of quantity and quality.

### **BOND AND PAYMENT SCHEDULE:**

1. A bond in the amount of \$2,372.00 to insure faithful performance of the conditions of the contract will be deposited by the successful bidder within 21 days of the sale award.
2. Cutting in any sale or unit without the required advance payment would be considered a trespass.
3. Total payment must be paid in advance or according to the following schedule:
  - (a) Ten percent (10%) of the sale value must be paid within 21 days of the sale award.
  - (b) The 10% down payment will be credited towards the first unit cut.
4. If no cutting takes place, the 10% down payment will not be refunded.
5. Operations on the contract issued will terminate on 12/31/2020.

**Description of Timber by Payment Unit (PU)**

PU	MARKET GROUP	PRODUCT	QUANTITY	UNIT	ACRES	ADVERTISE PRICE
1	Red Oak	Sawtimber	6.9	MBF	15.9	\$4,456.05
	White Oak		3.3	MBF		
	B. T. Aspen	Pulpwood	2.0	Cords		
	Bl/R/Hybrid Oak		14.0	Cords		
	Red Maple		5.0	Cords		
	Red Oak		48.0	Cords		
	White Oak		36.0	Cords		
	2	Jack Pine	Pulpwood	28.0		
Red Pine			3.0	Cords		
3	Bl/R/Hybrid Oak	Sawtimber	5.8	MBF	21.5	\$4,077.80
	White Oak		3.6	MBF		
	Bl/R/Hybrid Oak	Pulpwood	83.0	Cords		
	White Oak		37.0	Cords		
4	Red Pine	Sawtimber	10.7	MBF	5.0	\$2,327.95
	Red Pine	Pulpwood	23.0	Cords		
5	Red Pine	Sawtimber	48.6	MBF	8.1	\$10,598.85
	Red Pine	Pulpwood	105.0	Cords		
6	B. T. Aspen	Sawtimber	16.5	MBF	20.0	\$6,959.05
	Bl/R/Hybrid Oak		1.2	MBF		
	Red Oak		2.8	MBF		
	Red Pine		3.4	MBF		
	B. T. Aspen	Pulpwood	81.0	Cords		
	Balsam Fir		10.0	Cords		
	Bl/R/Hybrid Oak		16.0	Cords		
	Jack Pine		5.0	Cords		
	Quaking Aspen		6.0	Cords		
	Red Maple		28.0	Cords		
	Red Oak		13.0	Cords		
	Red Pine		16.0	Cords		
	White Pine		30.0	Cords		
	7	Red Pine	Sawtimber	76.1		
Jack Pine		Pulpwood	7.0	Cords		
Quaking Aspen			5.0	Cords		
Red Pine			192.0	Cords		
TOTAL:			178.9	MBF		
TOTAL:			793.0	Cords		



# Sale Specific Conditions & Requirements

**Sale Name: Nest Trail Pine Mix**

**Sale Number: 52-131-16 Seq#: 1**

## 1 - Sale Area

### 1.2 - Boundaries

#### 1.2.1 - Painted boundaries (1/14)

The sale boundary and Payment Unit boundaries are marked and identified by red paint. Exterior sale boundary lines against state are marked with red paint.

## 2 - Timber Specifications

### 2.1 - Included Timber

#### 2.1.2 - Clearcut unit(s) w/o unmerchantable trees (8/11)

Within Payment Unit(s) 1, 2, 3, and 6, cut all trees which meet minimum piece specifications in 2.2 Utilization except trees marked with TEAL paint. Also, do not cut OAK species in Unit 2. Special protection trees identified in accordance with condition 3.4.2, within clearcutting unit boundaries, are not Included Timber and are to be protected. Special protection areas identified in accordance with condition 3.4.3, within clearcutting unit boundaries, are not Included Timber and are to be protected.

#### 2.1.3 - Cut tree marked unit(s) (12/08)

Within Payment Unit(s) 4 and 5, all trees are designated for cutting when marked with orange paint above and below stump height, regardless of merchantability.

#### 2.1.8 - Designated plantation row unit(s) (12/08)

Within Payment Unit(s) 7, all trees which meet minimum piece specifications in 2.2 Utilization, within designated plantation rows are designated for cutting. In addition, cut all jack pine. Designated plantation rows begin with the third row in from the outside of the plantation, then continue every third row. Because of the variability of row direction, it shall be the responsibility of the producer to maintain the third row sequence. Assistance by the sale administrator may be requested to determine which rows should be designated for removal.

## 3 - Payments

### 3.3 - Pre-measured Sales

#### 3.3.4 - Dividing payment units (7/14)

Payment Unit(s) may be divided at the request of the Purchaser and upon approval of the Unit Manager. Dividing Payment Units is a contract modification which requires a Timber Sale Contract Supplement.

### 3.4 - Damaged Timber

#### 3.4.1 - Damaged timber (6/14)

General Condition and Requirement 3.4 Damaged Timber, defines liquidated damages for undesignated live merchantable trees which are cut or injured. In addition, extreme care should be taken to avoid damage to tree seedlings and saplings.

## 4 - Transportation

### 4.1 - Construction

#### 4.1.3 - Slash and earthen piles (8/04)

Piles or windrows of earth along roads and landings that have been widened or constructed shall be leveled. Slash from road maintenance or construction, including stumps, shall be dispersed throughout the sale.

#### 4.1.6 - Road construction (1/09)

Improvements of existing roads shall be done in such a way as to minimize the environmental and visual impacts. Merchantable trees shall be cut and utilized unless otherwise directed. Non-merchantable trees shall be severed and laid flat on the ground. Slash shall be scattered, and not left in windrows and kept a minimum of 10 feet back from the road edge. Stumps shall be set upright, not left on edge, and be moved at least 10 feet away from the road edge. Disturbed soil shall be feathered into the woods and not left in berms or windrows.

#### 4.1.12 - No new roads (1/12)

No new roads will be permitted in any Payment Unit. All operations are limited to existing roads.

### 4.2 - Maintenance

#### 4.2.4 - Grading (12/14)

For completion of the sale, state forest roads must be graded. In general, this will require a road grader or bull dozer to shape up the roads after forest products have been hauled off site. The grading equipment to be used must be approved by the Unit Manager or his/her representative.

## 5 - Operations

### 5.1 - Notification

#### 5.1.1 - Pre-sale conference (10/11)

A pre-sale conference on site between the Purchaser and sale administrator is required prior to beginning any operations to determine landing and road locations. The Unit Manager or his/her representative must be contacted at least 3 days in advance to schedule the conference.

#### 5.1.4 - Post-sale conference (6/11)

A post-sale conference on site between the Purchaser and sale administrator is required 3 days prior to the completion of active logging operations to determine clean-up and repair of landings, road edges, and the fulfillment of other contract specifications.

### 5.2 - Conduct of Operations

#### 5.2.1 - Slash

##### 5.2.1.1 - Slash within sale area (9/16)

No trees are to be felled outside the sale area and all slash is to be kept at least 10 feet back from the red paint line. If sale boundary lines are along a public road or highway, then slash must be removed 50' from these lines per General Condition & Requirement 5.2.1.

#### 5.2.2 - Hazard Trees/Snags

##### 5.2.2.1 - Den trees (2/04)

Obvious hollow and/or den trees shall be protected and left standing unless they are a safety hazard.

#### 5.2.3 - Operating Restrictions

##### 5.2.3.1 - Operating restrictions (9/11)

Within Payment Unit(s) 5, 6, and 7, unless changed by written agreement, cutting, skidding, and hauling is limited to the period of 10/1 to 3/15. This restriction is to protect the snowmobile trail from damage during trucking.

##### 5.2.3.2 - Operating restrictions (9/11)

Within Payment Unit(s) 7, cutting, skidding, and hauling are not permitted during the period of 3/15 to 7/15. This restriction is to meet guideline requirement of a 10-chain protection area surround a raptor nest.

##### 5.2.3.4 - Oak wilt restriction (6/10)

Within Payment Unit(s) 1 - 4, unless changed by written agreement, cutting, skidding, and hauling are not permitted during the period of April 15 to July 15. This is necessary to reduce the spread of oak wilt. For more information, contact the Unit Manager or his/her representative.

##### 5.2.3.6 - Bark beetle restriction (12/08)

In the event drought creates a high risk of pine bark beetle infestation, pine is not to be cut during the period March 1 through July 1, unless all portions of trees greater than two inches in diameter are removed from the sale area, reduced to chips, or treated to the satisfaction of the Unit Manager or his/her representative, within fifteen days of being severed from the stump. Pine log decks, pulpwood piles and treetops that are piled for chipping in the fall or winter within a 1/4 mile of susceptible sites must be removed before March 15. Residual slash must not be placed in piles or rows and must be spread over the site for quick drying. The Department of Natural Resources will exercise this specification if the risk of damage warrants.

#### 5.2.32 - Decking/landing restoration (9/13)

All decking and landing areas must have the surface area restored to a condition equal to or better than before. This is to ensure the proper regeneration of the stand. Wood debris, chips and "cookies" from trimmings must be removed or scattered away from landing and loading areas and may not be windrowed on the edge.

#### 5.2.39 - ORV trail/route protection (12/12)

The Red Bridge Trail and Michigan Cross Country Cycle Trail (MCCCT) are ORV trails and are shown on the Timber Sale Map. Do not cut trees or damage posts with orange or yellow ORV markers. Do not run equipment down the ORV trails. Skidding across the trail or route may only occur in locations approved by the sale administrator.

#### 5.2.40 - Pathway protection (10/10)

The Midland to Mackinaw Trail is a hiking/horse trail and is shown on the Timber Sale Map. Do not cut trees or damage posts with blue pathway markers.

#### 5.2.41 - Snowmobile trail protection (9/11)

The North Eastern State Trail is a snowmobile trail and is shown on the Timber Sale Map. Do not cut or damage posts with orange trail markers or traffic control signs. If the trail is to be used for hauling during the snowmobile season, then a snow covered base must be left on the trail. No decking of forest products will be permitted along the snowmobile trail.

### 5.4 - Soil Protection

#### 5.4.1 - Rutting restriction, general (7/16)

Operations are to cease immediately if equipment and weather conditions result in rutting of roads and/or skid trails which is 12 inches or greater in depth and 50 feet in length. The Unit Manager or his/her representative may restrict hauling and/or skidding if ruts exceed the specified depth. With the Unit Manager or his/her representative's approval, the Purchaser may return to the area when the risk of rutting has decreased.

### 5.8 - Protection of Endangered Species

#### 5.8.5 - Protection of raptor nests (3/13)

All trees with raptor nests will be protected if found during harvesting operations. Notification will be made to the Unit Manager or his/her representative who will notify the Wildlife Biologist so an on-site evaluation and recommendation can be made, if necessary.

## 6 - Safety and Fire Prevention

### 6.2 - Signing

#### 6.2.2 - Snowmobile trail posting (8/09)

The Purchaser is responsible for posting and maintaining caution signs on the North Eastern State Trail prior to beginning operations during the snowmobile season (approximately December 1 to March 31). The trail must be posted at appropriate distances from the sale area to warn of logging activity and truck traffic. Signs must be removed when harvest operations are suspended or completed. The Purchaser will provide these signs.

#### 6.2.3 - Recreational trail posting (2/10)

The Purchaser is responsible for posting and maintaining caution signs on the Red Bridge Trail and the MCCCT prior to beginning operations. The trail must be posted at appropriate distances from the sale area to warn of logging activity and truck traffic at both ends of the trail. Signs must be removed when harvest operations are suspended or completed.



# TIMBER SALE MAP

This information provided by authority of Part 525, 1994 PA 451, as amended.

Forest Management Unit <b>Gaylord Managemnt Unit</b>		County <b>Cheboygan</b>	Mapped By Scheele	Date 9/27/2016	Page 1	of 1
Township 35N	Range 01E	Section(s) and Subdivision(s) Section 20 - W1/2NE, NW1/4, NESW, and W1/2SE		Scale 1:15,840		

Cover Type				Density			
A = Aspen	H = Hemlock	N = Marsh	U = Upland Brush	0 = Non Stocked	5 = Pole Timber Medium		
B = Paper Birch	J = Jack Pine	O = Oak	UM = Upland Mixed	1 = Seedling Sapling Poor	6 = Pole Timber Well		
C = Cedar	L = Lowland Brush	P = Lowland Poplar	V = Bog or Marsh	2 = Seedling Sapling Medium	7 = Saw Timber Poor		
D = Treed Bog	LM = Lowland Mixed	Q = Mixed Swamp Conifer	W = White Pine	3 = Seedling Sapling Well	8 = Saw Timber Medium		
E = Swamp Hdwoods	M = Mpl, Ech, Broh	R = Red Pine	X = Non Stocked	4 = Pole Timber Poor	9 = Saw Timber Well		
F = Spruce Fir	MC = Mixed Conifer	S = Black Spruce	Z = Water				
G = Grass	MD = Mixed Deciduous	T = Tamarack					

PU	Acres	PU	Acres
1	15.9	5	8.1
2	3.5	6	20.0
3	21.5	7	22.3
4	5.0		

## Nest Trail Pine Mix

### Compartment 209

96.3 Acres

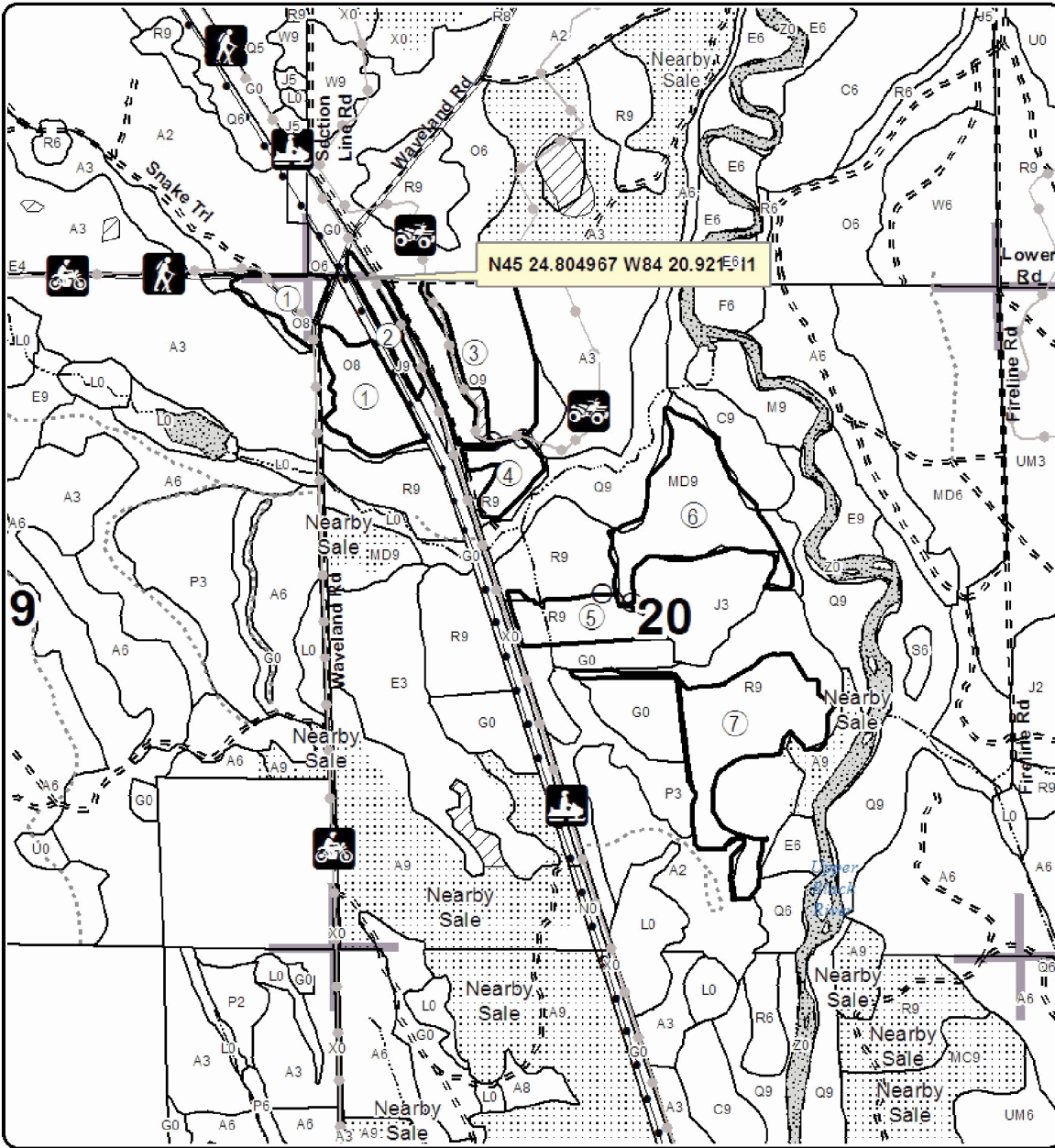
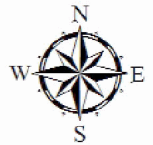

### Legend

- Against State (Red)
- Payment Unit (Red)
- Retention Area
- Recreational Trail
- Nearby Timber Sale
- Section Corners
- Paved Roads
- Gravel Roads
- Poor Dirt Roads
- Closed Roads
- Lakes and Rivers
- Streams
- Pipeline; Powerline

Locator Map  
1:200,000

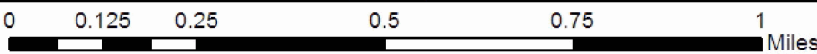
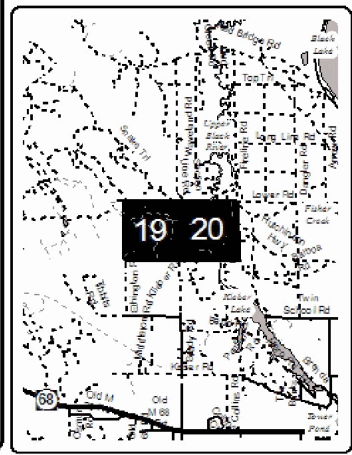

# TIMBER SALE INFORMATION

## Old Mackinaw Road Aspen (52-132-16)

Cheboygan County (Advertised Price \$41,635.60)

SALE NOTE: Harvesting operations are limited to the period of December 1 to April 1 and June 1 to October 1, due to wetter soils. Access to Payment Unit 4 may be through private property.

Access may be through private or other public land.

A timber sale contract for this lump sum, sealed bid timber sale will be awarded to the responsible bidder offering the highest sealed bid price. Bids must be at or above the following advertised price for each species:

<u>PRODUCTS &amp; SPECIES</u>	<u>ESTIMATED UNITS*</u>	<u>ADVERTISED PRICE</u>
Sawtimber		
B. T. Aspen	36.00 MBF	\$ 49.00 / MBF
Quaking Aspen	10.90 MBF	\$ 49.00 / MBF
Red Maple	13.40 MBF	\$ 150.00 / MBF
Pulpwood		
B. T. Aspen	104.00 Cords	\$ 17.70 / Cord
Balsam Fir	464.00 Cords	\$ 22.10 / Cord
Balsam Poplar	23.00 Cords	\$ 17.70 / Cord
Black Ash	20.00 Cords	\$ 20.25 / Cord
Paper Birch	171.00 Cords	\$ 14.20 / Cord
Quaking Aspen	803.00 Cords	\$ 17.70 / Cord
Red Maple	318.00 Cords	\$ 20.25 / Cord
White Spruce	37.00 Cords	\$ 36.20 / Cord

\* The total volume is statistically estimated within plus (+) or minus (-) 11.28 percent. The estimated units are final and not subject to adjustment. Prospective bidders are urged to examine this timber and to make their own estimates of quantity and quality.

### **BOND AND PAYMENT SCHEDULE:**

1. A bond in the amount of \$2,082.00 to insure faithful performance of the conditions of the contract will be deposited by the successful bidder within 21 days of the sale award.
2. Cutting in any sale or unit without the required advance payment would be considered a trespass.
3. Total payment must be paid in advance or according to the following schedule:
  - (a) Ten percent (10%) of the sale value must be paid within 21 days of the sale award.
  - (b) The 10% down payment will be credited towards the first unit cut.
4. If no cutting takes place, the 10% down payment will not be refunded.
5. Operations on the contract issued will terminate on 12/31/2020.

**Description of Timber by Payment Unit (PU)**

PU	MARKET GROUP	PRODUCT	QUANTITY	UNIT	ACRES	ADVERTISE PRICE
1	Quaking Aspen	Sawtimber	1.7	MBF	8.0	\$2,828.80
	Balsam Fir	Pulpwood	60.0	Cords		
	Black Ash		3.0	Cords		
	<i>White Ash</i>		3.0	<i>Cords</i>		
	Paper Birch		2.0	Cords		
	Quaking Aspen		58.0	Cords		
	Red Maple		15.0	Cords		
2	Balsam Fir	Pulpwood	33.0	Cords	3.4	\$941.70
	Quaking Aspen		12.0	Cords		
3	B. T. Aspen	Sawtimber	36.0	MBF	30.0	\$14,680.35
	Quaking Aspen		9.2	MBF		
	Red Maple		8.0	MBF		
	B. T. Aspen	Pulpwood	104.0	Cords		
	Balsam Fir		122.0	Cords		
	Paper Birch		149.0	Cords		
	Quaking Aspen		134.0	Cords		
	Red Maple		91.0	Cords		
	White Spruce		11.0	Cords		
	<i>White Spruce</i>	<i>Sawtimber</i>	3.2	<i>MBF</i>		
<i>White Spruce</i>	<i>Pulpwood</i>	5.0	<i>Cords</i>			
4	Balsam Fir	Pulpwood	47.0	Cords	26.5	\$7,461.00
	Paper Birch		8.0	Cords		
	Quaking Aspen		187.0	Cords		
	Red Maple		132.0	Cords		
	White Spruce		9.0	Cords		
	<i>White Spruce</i>		9.0	<i>Cords</i>		
	5	Red Maple	Sawtimber	5.4		
Balsam Fir		Pulpwood	196.0	Cords		
Balsam Poplar			23.0	Cords		
Black Ash			17.0	Cords		
<i>Black Ash</i>			17.0	<i>Cords</i>		
Paper Birch			12.0	Cords		
Quaking Aspen			364.0	Cords		
Red Maple			79.0	Cords		
White Spruce			17.0	Cords		
<i>White Spruce</i>			17.0	<i>Cords</i>		
6	Balsam Fir	Pulpwood	6.0	Cords	4.8	\$1,002.45
	Quaking Aspen		48.0	Cords		
	Red Maple		1.0	Cords		
TOTAL:			60.3	MBF		
TOTAL:			1,940.0	Cords		

## Sale Specific Conditions & Requirements

**Sale Name: Old Mackinaw Road Aspen**

**Sale Number: 52-132-16 Seq#: 1**

### 1 - Sale Area

#### 1.2 - Boundaries

##### 1.2.1 - Painted boundaries (1/14)

The sale boundary and Payment Unit boundaries are marked and identified by blue, red and teal paint. Exterior sale boundary lines against private property are marked with blue paint. Exterior sale boundary lines against state are marked with red paint. Interior retention areas are marked with teal paint; no operations are to take place in these areas.

### 2 - Timber Specifications

#### 2.1 - Included Timber

##### 2.1.2 - Clearcut unit(s) w/o unmerchantable trees (8/11)

Within Payment Unit(s) 1 - 6, cut all trees which meet minimum piece specifications in 2.2 Utilization except do not cut cedar in Payment Units 3, 4, and 5. In addition, do not cut hemlock or white pine in Payment Unit 3.

### 3 - Payments

#### 3.3 - Pre-measured Sales

##### 3.3.4 - Dividing payment units (7/14)

Payment Unit(s) 3, 4, and 5 may be divided at the request of the Purchaser and upon approval of the Unit Manager. Dividing Payment Units is a contract modification which requires a Timber Sale Contract Supplement.

### 4 - Transportation

#### 4.1 - Construction

##### 4.1.3 - Slash and earthen piles (8/04)

Piles or windrows of earth along roads and landings that have been widened or constructed shall be leveled. Slash from road maintenance or construction, including stumps, shall be dispersed throughout the sale.

##### 4.1.6 - Road construction (1/09)

Construction of new roads or improvements of existing roads shall be done in such a way as to minimize the environmental and visual impacts. Merchantable trees shall be cut and utilized unless otherwise directed. Non-merchantable trees shall be severed and laid flat on the ground. Slash shall be scattered, and not left in windrows and kept a minimum of 10 feet back from the road edge. Stumps shall be set upright, not left on edge, and be moved at least 10 feet away from the road edge. Disturbed soil shall be feathered into the woods and not left in berms or windrows.

##### 4.1.7 - Road closure (10/11)

All new roads built into the sale must be blocked to vehicle traffic upon completion of the sale. In general, this will require constructing a four (4') foot high berm of stumps and logs covered with earth. Contact the sale administrator for specific details of design and placement.

#### 4.2 - Maintenance

##### 4.2.4 - Grading (12/14)

For completion of the sale, state forest roads must be graded. In general, this will require a road grader or bull dozer to shape up the roads after forest products have been hauled off site. The grading equipment to be used must be approved by the Unit Manager or his/her representative.

#### 4.4 - Access

##### 4.4.1 - Private property access (3/11)

Permission for access across private land is the responsibility of the Purchaser.

### 5 - Operations

## 5.1 - Notification

### 5.1.1 - Pre-sale conference (10/11)

A pre-sale conference on site between the Purchaser and sale administrator is required prior to beginning any operations to determine landing and road locations. The Unit Manager or his/her representative must be contacted at least 2 days in advance to schedule the conference.

### 5.1.4 - Post-sale conference (6/11)

A post-sale conference on site between the Purchaser and sale administrator is required 5 days prior to the completion of active logging operations to determine clean-up and repair of landings, road edges, and the fulfillment of other contract specifications.

## 5.2 - Conduct of Operations

### 5.2.2 - Hazard Trees/Snags

#### 5.2.2.1 - Den trees (2/04)

Obvious hollow and/or den trees shall be protected and left standing unless they are a safety hazard.

### 5.2.3 - Operating Restrictions

#### 5.2.3.1 - Operating restrictions (9/11)

Within Payment Unit(s) 1 - 6, unless changed by written agreement, cutting, skidding, and hauling are limited to the period of 12/1 to 4/1 and 6/1 to 10/1. This restriction is because of the wet soil types and the potential for excessive rutting concerns.

### 5.2.17 - Crane Mats/Timber Mats (10/14)

Some roads or skid trails may require extra protection such as that afforded by Crane Mats/Timber Mats. If available, Crane Mats/Timber Mats may be borrowed from the DNR and are located at the Marquette ICC and the Grayling Field Office. Contact the sale administrator for specific details. A Timber Sale Contract Supplement will be used to document the Purchaser's use of the DNR's Crane Mats/Timber Mats. It is the responsibility of the Purchaser to contact the sale administrator to schedule pick up and drop off. In addition, all mats must be cleaned prior to drop off. A charge of \$350.00 will be assessed for all damaged or non-returned mats. Damage is defined as misuse resulting in three or more broken cants.

### 5.2.32 - Decking/landing restoration (9/13)

All decking and landing areas must have the surface area restored to a condition equal to or better than before. This is to ensure the proper regeneration of the stand.

## 5.4 - Soil Protection

### 5.4.1 - Rutting restriction, general (7/16)

Operations are to cease immediately if equipment and weather conditions result in rutting of roads and/or skid trails which is 12 inches or greater in depth and 50 feet in length. The Unit Manager or his/her representative may restrict hauling and/or skidding if ruts exceed the specified depth. With the Unit Manager or his/her representative's approval, the Purchaser may return to the area when the risk of rutting has decreased.

## 5.8 - Protection of Endangered Species

### 5.8.5 - Protection of raptor nests (3/13)

All trees with raptor nests will be protected if found during harvesting operations. Notification will be made to the Unit Manager or his/her representative who will notify the Wildlife Biologist so an on-site evaluation and recommendation can be made, if necessary.

## 6 - Safety and Fire Prevention

### 6.2 - Signing

#### 6.2.1 - Road posting (9/09)

The Purchaser is responsible for posting and maintaining caution signs on Old Mackinaw Road prior to beginning operations. The road must be posted at appropriate distances from the sale area to warn of logging activity and truck traffic. Signs must be removed when harvest operations are suspended or completed.







# TIMBER SALE MAP

This information provided by authority of Part 525, 1994 PA 451, as amended.

Sale Number	Year
52 - 132	16

Forest Management Unit	County	Mapped By	Date	Page	of
Gaylord Management Unit	Cheboygan	John Scheele	09/27/2016	1	1
Township	Range	Section(s) and Subdivision(s)	Scale		
35N	02W	Section 7: S1/2SW, SE1/4 Section 17: NWNW Section 18: NENW and W1/2NW	1:15,840		

Cover Type				Density	
A = Aspen	H = Hemlock	N = Marsh	U = Upland Brush	0 = Non Stocked	5 = Pole Timber Medium
B = Paper Birch	J = Jack Pine	O = Oak	UM = Upland Mixed	1 = Seedling Sapling Poor	6 = Pole Timber Well
C = Cedar	L = Lowland Brush	P = Lowland Poplar	V = Bog or Marsh	2 = Seedling Sapling Medium	7 = Saw Timber Poor
D = Treed Bog	LM = Lowland Mixed	Q = Mixed Swamp Conifer	W = White Pine	3 = Seedling Sapling Well	8 = Saw Timber Medium
E = Swamp Hdwoods	M = Mpl, Bch, Brch	R = Red Pine	X = Non Stocked	4 = Pole Timber Poor	9 = Saw Timber Well
F = Spruce Fir	MC = Mixed Conifer	S = Black Spruce	Z = Water		
G = Grass	MD = Mixed Deciduous	T = Tamarack			

PU	Acres	PU	Acres
1	8.0	4	26.5
2	3.4	5	50.9
3	30.0	6	4.8

## Old Mackinaw Road Aspen Compartment 165 123.6 Acres



**Legend**

- Against State (Red)
- Payment Unit (Yellow)
- Private Line (Blue)
- ▨ Retention Area
- Stand Boundaries
- ⋯ Nearby Timber Sale
- Section Corners
- Gravel Roads
- == Poor Dirt Roads
- ⋯ Closed Roads

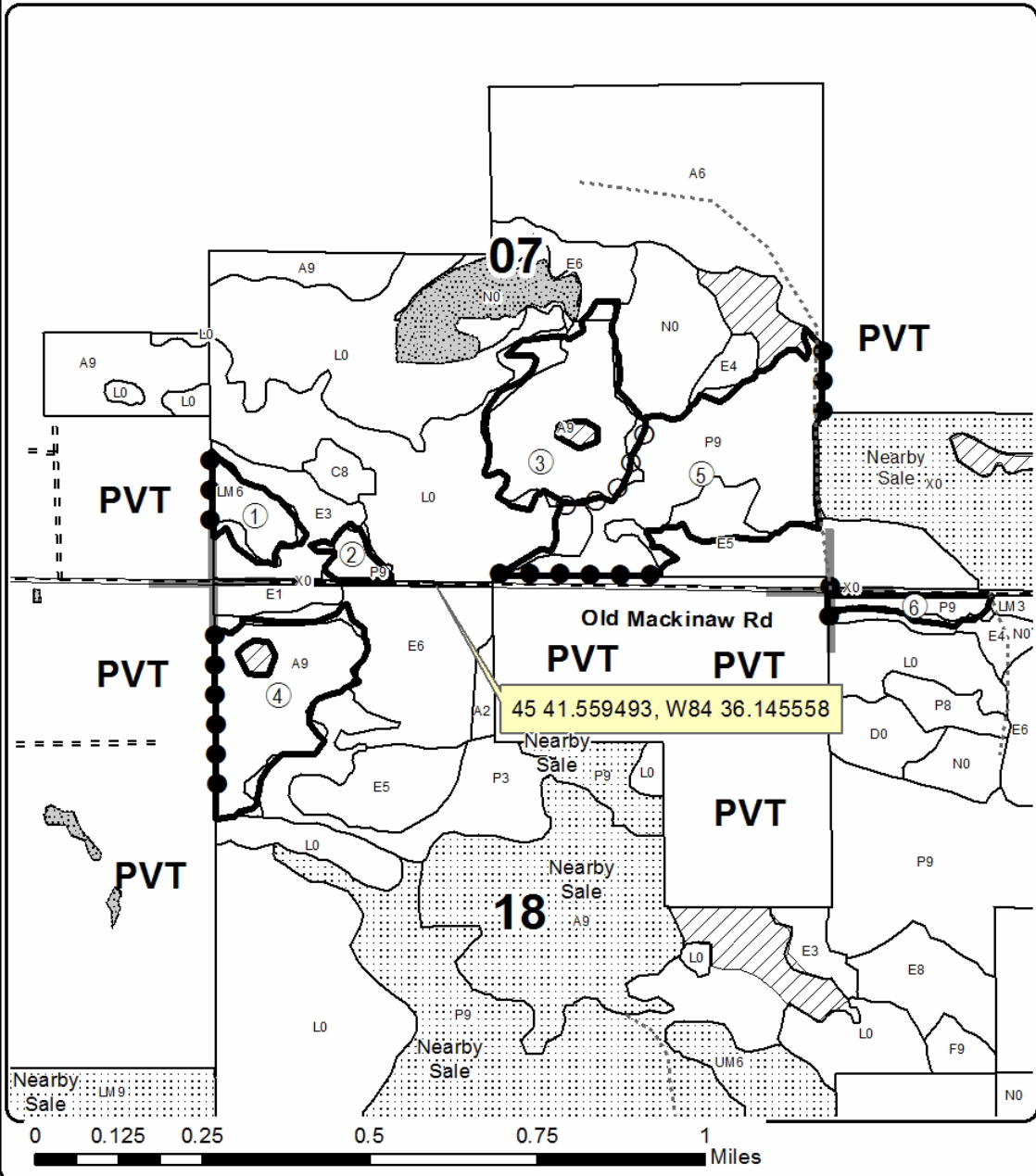

Locator Map  
1:200,000

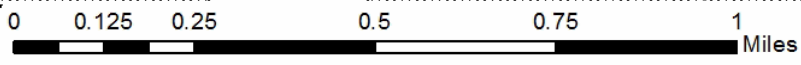
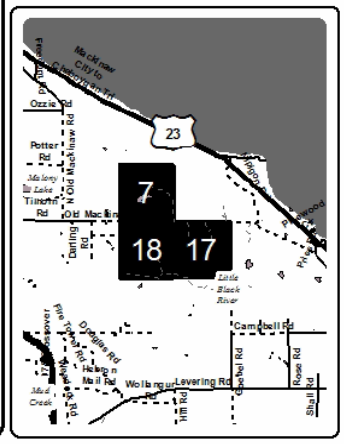

# TIMBER SALE INFORMATION

Nipigon Road Aspen (52-134-16)

Cheboygan County (Advertised Price \$44,374.30)

SALE NOTE: Harvesting operations are limited to the period of December 1 to April 1 and June 1 to October 1, due to the wetter soil types. Access to Payment Units 1 and 2 may be through private ownership.

Access may be through private or other public land.

A timber sale contract for this lump sum, sealed bid timber sale will be awarded to the responsible bidder offering the highest sealed bid price. Bids must be at or above the following advertised price for each species:

<u>PRODUCTS &amp; SPECIES</u>	<u>ESTIMATED UNITS*</u>	<u>ADVERTISED PRICE</u>
Pulpwood		
Balsam Fir	652.00 Cords	\$ 22.10 / Cord
Balsam Poplar	117.00 Cords	\$ 17.70 / Cord
N. White Cedar	76.00 Cords	\$ 20.20 / Cord
Paper Birch	71.00 Cords	\$ 14.20 / Cord
Quaking Aspen	1,045.00 Cords	\$ 17.70 / Cord
Red Maple	90.00 Cords	\$ 20.25 / Cord
White Spruce	139.00 Cords	\$ 36.20 / Cord

\* The total volume is statistically estimated within plus (+) or minus (-) 10.17 percent. The estimated units are final and not subject to adjustment. Prospective bidders are urged to examine this timber and to make their own estimates of quantity and quality.

## **BOND AND PAYMENT SCHEDULE:**

1. A bond in the amount of \$2,219.00 to insure faithful performance of the conditions of the contract will be deposited by the successful bidder within 21 days of the sale award.
2. Cutting in any sale or unit without the required advance payment would be considered a trespass.
3. Total payment must be paid in advance or according to the following schedule:
  - (a) Ten percent (10%) of the sale value must be paid within 21 days of the sale award.
  - (b) The 10% down payment will be credited towards the first unit cut.
4. If no cutting takes place, the 10% down payment will not be refunded.
5. Operations on the contract issued will terminate on 12/31/2020.

**Description of Timber by Payment Unit (PU)**

PU	MARKET GROUP	PRODUCT	QUANTITY	UNIT	ACRES	ADVERTISE PRICE
1	Balsam Fir	Pulpwood	328.0	Cords	48.3	\$18,873.90
	Balsam Poplar		89.0	Cords		
	Paper Birch		29.0	Cords		
	Quaking Aspen		452.0	Cords		
	Red Maple		4.0	Cords		
	White Spruce		43.0	Cords		
2	Balsam Fir	Pulpwood	95.0	Cords	15.3	\$5,169.60
	Paper Birch		2.0	Cords		
	Quaking Aspen		155.0	Cords		
	Red Maple		4.0	Cords		
	White Spruce		6.0	Cords		
3	Balsam Fir	Pulpwood	48.0	Cords	8.8	\$3,278.10
	Balsam Poplar		23.0	Cords		
	Quaking Aspen		90.0	Cords		
	White Spruce		6.0	Cords		
4	Balsam Fir	Pulpwood	134.0	Cords	24.8	\$8,340.05
	Balsam Poplar		5.0	Cords		
	Paper Birch		40.0	Cords		
	Quaking Aspen		158.0	Cords		
	Red Maple		79.0	Cords		
	White Spruce		9.0	Cords		
5	Balsam Fir	Pulpwood	47.0	Cords	43.1	\$8,712.65
	N. White Cedar		76.0	Cords		
	Quaking Aspen		190.0	Cords		
	Red Maple		3.0	Cords		
	White Spruce		75.0	Cords		
TOTAL:			2,190.0	Cords		

## Sale Specific Conditions & Requirements

**Sale Name: Nipigon Road Aspen**

**Sale Number: 52-134-16 Seq#: 1**

### 1 - Sale Area

#### 1.2 - Boundaries

##### 1.2.1 - Painted boundaries (1/14)

The sale boundary and Payment Unit boundaries are marked and identified by blue, red and teal paint. Exterior sale boundary lines against private property are marked with blue paint. Exterior sale boundary lines against state are marked with red and teal paint. Interior retention areas are marked with teal paint; no operations are to take place in these areas.

### 2 - Timber Specifications

#### 2.1 - Included Timber

##### 2.1.2 - Clearcut unit(s) w/o unmerchantable trees (8/11)

Within Payment Unit(s) 1 - 5, cut all trees which meet minimum piece specifications in 2.2 Utilization except do not cut white pine in Payment Units 2 and 5. In addition, do not cut teal marked trees in Payment Unit 5.

### 3 - Payments

#### 3.3 - Pre-measured Sales

##### 3.3.4 - Dividing payment units (7/14)

Payment Unit(s) 1 and 5 may be divided at the request of the Purchaser and upon approval of the Unit Manager. Dividing Payment Units is a contract modification which requires a Timber Sale Contract Supplement.

#### 3.4 - Damaged Timber

##### 3.4.2 - Special Protection Trees (4/14)

The Purchaser shall not cut live or dead special protection trees within cutting units or clearings. Special protection trees are marked with teal paint in Payment Unit 5. If the Purchaser's operations have cut or damaged special protection trees through carelessness, the Purchaser shall pay \$100 as fixed, agreed and liquidated damages for each special protection tree cut or damaged. Such payment does not constitute ownership of the undesignated timber.

### 4 - Transportation

#### 4.1 - Construction

##### 4.1.3 - Slash and earthen piles (8/04)

Piles or windrows of earth along roads and landings that have been widened or constructed shall be leveled. Slash from road maintenance or construction, including stumps, shall be dispersed throughout the sale.

##### 4.1.6 - Road construction (1/09)

Construction of new roads or improvements of existing roads shall be done in such a way as to minimize the environmental and visual impacts. Merchantable trees shall be cut and utilized unless otherwise directed. Non-merchantable trees shall be severed and laid flat on the ground. Slash shall be scattered, and not left in windrows and kept a minimum of 10 feet back from the road edge. Stumps shall be set upright, not left on edge, and be moved at least 10 feet away from the road edge. Disturbed soil shall be feathered into the woods and not left in berms or windrows.

##### 4.1.7 - Road closure (10/11)

All new roads built into the sale must be blocked to vehicle traffic upon completion of the sale. In general, this will require constructing a four (4') foot high berm of stumps and logs covered with earth. Contact the sale administrator for specific details of design and placement.

#### 4.2 - Maintenance

##### 4.2.4 - Grading (12/14)

For completion of the sale, state forest roads must be graded. In general, this will require a road grader or bull dozer to shape up the roads after forest products have been hauled off site. The grading equipment to be used must be approved by the Unit

Manager or his/her representative.

#### 4.4 - Access

##### 4.4.1 - Private property access (3/11)

Permission for access across private land has been obtained by the DNR to access the north part of Payment Unit 1. Access to the south part of Payment Unit 1 may also be available through private land, but is the responsibility of the Purchaser.

### 5 - Operations

#### 5.1 - Notification

##### 5.1.1 - Pre-sale conference (10/11)

A pre-sale conference on site between the Purchaser and sale administrator is required prior to beginning any operations to determine landing and road locations. The Unit Manager or his/her representative must be contacted at least 2 days in advance to schedule the conference.

##### 5.1.4 - Post-sale conference (6/11)

A post-sale conference on site between the Purchaser and sale administrator is required 5 days prior to the completion of active logging operations to determine clean-up and repair of landings, road edges, and the fulfillment of other contract specifications.

#### 5.2 - Conduct of Operations

##### 5.2.2 - Hazard Trees/Snags

###### 5.2.2.1 - Den trees (2/04)

Obvious hollow and/or den trees shall be protected and left standing unless they are a safety hazard.

##### 5.2.3 - Operating Restrictions

###### 5.2.3.1 - Operating restrictions (9/11)

Within Payment Unit(s) 1 - 5, unless changed by written agreement, cutting, skidding, and hauling are limited to the period of 12/1 to 4/1 and 6/1 to 10/1. This restriction is because of the wet soil types and the potential for excessive rutting concerns.

##### 5.2.17 - Crane Mats/Timber Mats (10/14)

Some roads or skid trails may require extra protection such as that afforded by Crane Mats/Timber Mats. If available, Crane Mats/Timber Mats may be borrowed from the DNR and are located at the Marquette ICC and the Grayling Field Office. Contact the sale administrator for specific details. A Timber Sale Contract Supplement will be used to document the Purchaser's use of the DNR's Crane Mats/Timber Mats. It is the responsibility of the Purchaser to contact the sale administrator to schedule pick up and drop off. In addition, all mats must be cleaned prior to drop off. A charge of \$350.00 will be assessed for all damaged or non-returned mats. Damage is defined as misuse resulting in three or more broken cants.

##### 5.2.32 - Decking/landing restoration (9/13)

All decking and landing areas must have the surface area restored to a condition equal to or better than before. This is to ensure the proper regeneration of the stand.

#### 5.4 - Soil Protection

##### 5.4.1 - Rutting restriction, general (7/16)

Operations are to cease immediately if equipment and weather conditions result in rutting of roads and/or skid trails which is 12 inches or greater in depth and 50 feet in length. The Unit Manager or his/her representative may restrict hauling and/or skidding if ruts exceed the specified depth. With the Unit Manager or his/her representative's approval, the Purchaser may return to the area when the risk of rutting has decreased.

#### 5.8 - Protection of Endangered Species

##### 5.8.5 - Protection of raptor nests (3/13)

All trees with raptor nests will be protected if found during harvesting operations. Notification will be made to the Unit Manager or his/her representative who will notify the Wildlife Biologist so an on-site evaluation and recommendation can be made, if necessary.

## **6 - Safety and Fire Prevention**

### **6.2 - Signing**

#### **6.2.1 - Road posting (9/09)**

The Purchaser is responsible for posting and maintaining caution signs on Nipigon and Old Mackinaw Road prior to beginning operations. The road must be posted at appropriate distances from the sale area to warn of logging activity and truck traffic. Signs must be removed when harvest operations are suspended or completed.



# TIMBER SALE MAP

This information provided by authority of Part 525, 1994 PA 451, as amended.

Sale Number	Year
52 - 134	16

Forest Management Unit	County	Mapped By	Date	Page	of
Gaylord Management Unit	Cheboygan	John Scheele	09/27/2016	1	1
Township	Range	Section(s) and Subdivision(s)	Scale		
38N	02W	Section 9: W1/2SW Section 16: W1/2NE and E1/2NW	1:15,840		

Cover Type				Density	
A = Aspen	H = Hemlock	N = Marsh	U = Upland Brush	0 = Non Stocked	5 = Pole Timber Medium
B = Paper Birch	J = Jack Pine	O = Oak	UM = Upland Mixed	1 = Seedling Sapling Poor	6 = Pole Timber Well
C = Cedar	L = Lowland Brush	P = Lowland Poplar	V = Bog or Marsh	2 = Seedling Sapling Medium	7 = Saw Timber Poor
D = Treed Bog	LM = Lowland Mixed	Q = Mixed Swamp Conifer	W = White Pine	3 = Seedling Sapling Well	8 = Saw Timber Medium
E = Swamp Hdwoods	M = Mpl, Bch, Brch	R = Red Pine	X = Non Stocked	4 = Pole Timber Poor	9 = Saw Timber Well
F = Spruce Fir	MC = Mixed Conifer	S = Black Spruce	Z = Water		
G = Grass	MD = Mixed Deciduous	T = Tamarack			

PU	Acres	PU	Acres
1	48.3	4	24.8
2	15.3	5	43.1
3	8.8		

## Nipigon Road Aspen

### Compartment 165

140.3 Acres

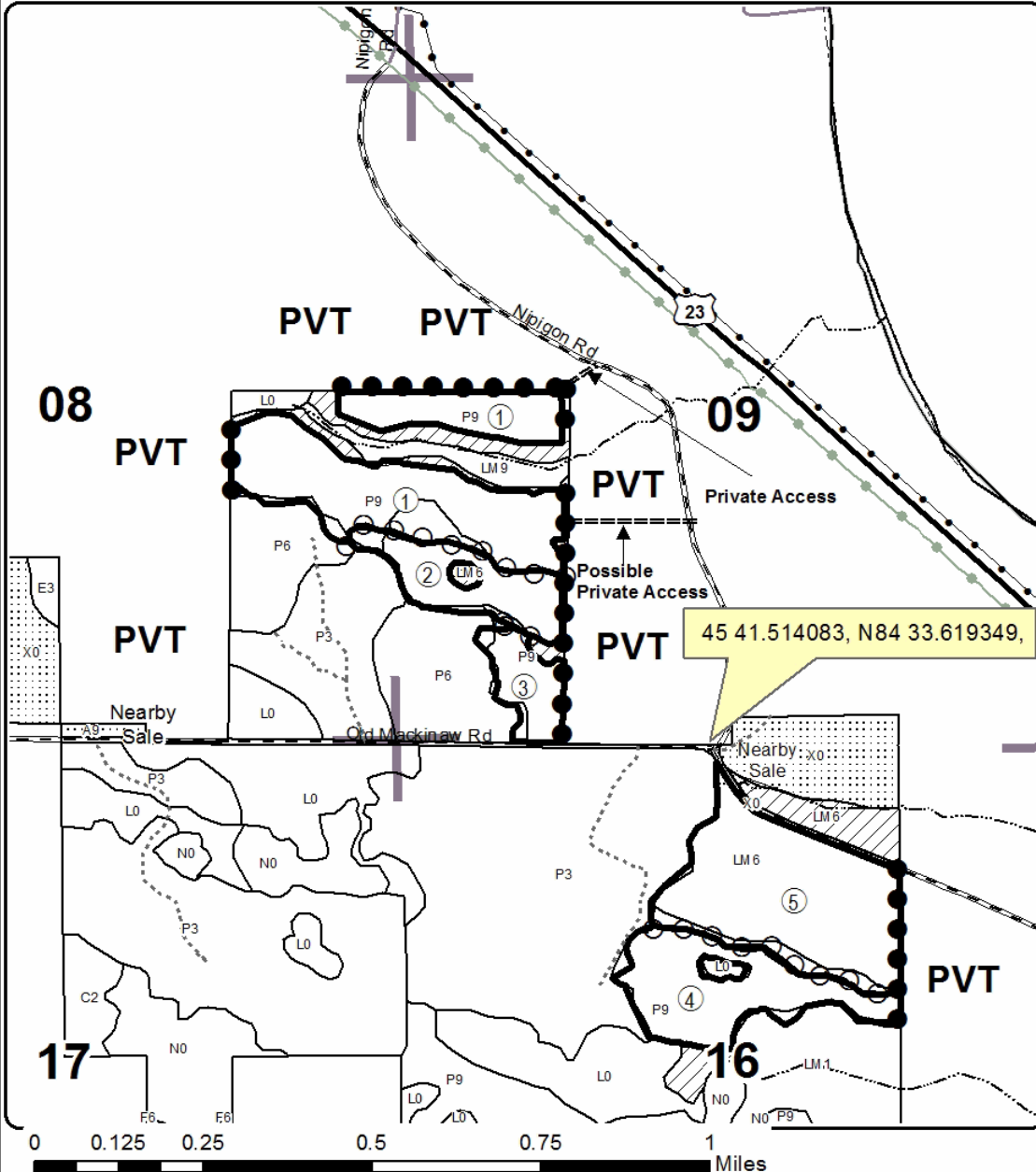

**Legend**

- Against State (Red)
- Payment Unit (Yellow)
- Private Line (Blue)
- ⋯ Nearby Timber Sale
- Section Corners
- ▨ Retention Area
- ▭ Stand Boundaries
- Highway
- Paved Roads
- Gravel Roads
- Poor Dirt Roads
- ⋯ Closed Roads
- Streams
- Recreational Trail
- Pipeline; Powerline

Locator Map  
1:200,000

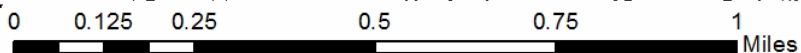
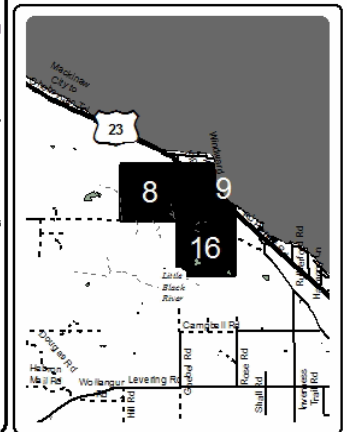



Stafford for President RP Mix (52-124-16)  
; Cheboygan COUNTY

In response to the notice of sale to be held 3:00 p.m. (local time) on October 24, 2017, I am hereby submitting my sealed bid (firm offer) for the following forest products to be cut. Bids for individual species must be at or above the advertised price. All non-responsive bid forms may be rejected.

<u>PRODUCTS &amp; SPECIES</u>	<u>ESTIMATED VOLUME*</u>	<u>ADVERTISED PRICE</u>	<u>BID PRICE/UNIT</u>
<b>Sawtimber</b>			
B. T. Aspen	26.50 MBF	\$ 49.00/MBF	\$ _____
Red Oak	9.30 MBF	\$ 219.00/MBF	\$ _____
Red Pine	589.70 MBF	\$ 116.00/MBF	\$ _____
White Oak	5.00 MBF	\$ 116.00/MBF	\$ _____
White Pine	133.70 MBF	\$ 72.00/MBF	\$ _____
<b>Pulpwood</b>			
B. T. Aspen	484.00 Cords	\$ 17.70/Cord	\$ _____
Jack Pine	128.00 Cords	\$ 25.20/Cord	\$ _____
Mixed Hardwood	129.00 Cords	\$ 20.25/Cord	\$ _____
Red Oak	53.00 Cords	\$ 24.75/Cord	\$ _____
Red Pine	1,379.00 Cords	\$ 47.25/Cord	\$ _____
White Oak	32.00 Cords	\$ 24.75/Cord	\$ _____
White Pine	395.00 Cords	\$ 35.75/Cord	\$ _____

\*The volumes are statistically estimated within plus (+) or minus (-) 11.75 percent. These estimated volumes are final and not subject to adjustment. Prospective bidders are urged to examine this timber and to make their own estimates of quantity and quality.

I understand that any or all bids may be rejected. All bids must be signed and all bid items must be bid or the bid form may be rejected. I also understand that consideration and awarding a contract will be based upon my past performance and ability to complete the contract based upon equipment and staffing subject to my control.

FEDERAL ID: \_\_\_\_ - \_\_\_\_ - \_\_\_\_ or SOCIAL SECURITY NUMBER: \_\_\_\_ - \_\_\_\_ - \_\_\_\_

Company or individual bidding: \_\_\_\_\_

Company representative's name: \_\_\_\_\_

Address: \_\_\_\_\_

City: \_\_\_\_\_ State: \_\_\_\_\_ Zip: \_\_\_\_\_

IF AVAILABLE, PLEASE PLACE THE PERSONALIZED LABEL FROM YOUR PROSPECTUS IN THE ABOVE BOX.

Individual or company representative's signature: \_\_\_\_\_ Date: \_\_\_\_\_

Phone number : \_\_\_\_\_ Email (optional): \_\_\_\_\_

**THE WINNING BIDDER MUST COMPLETE THE VERIFICATION OF WORKER'S DISABILITY COMPENSATION ACT COMPLIANCE (ON REVERSE SIDE IF DOUBLE SIDED) WITHIN 21 DAYS OF SALE AWARD DATE**



<b>FOR DEPARTMENT USE ONLY</b>
Sale Number (XX - XXX - XX - XX)
Forest Management Unit:

## TIMBER SALE VERIFICATION OF WORKER'S DISABILITY COMPENSATION ACT COMPLIANCE

*As required by Act 317, P.A. 1969 (Worker's Compensation) and  
Part 5 of Act 451 of 1994, as amended.*

### VERIFICATION OF WORKER'S DISABILITY COMPENSATION ACT COMPLIANCE

- This verification must be completed and submitted within 21 days of contract award and prior to the issuance of the timber sale contract.
- In addition, if boxes 2B or 2C are checked, then Notice of Exclusion or Certificate of Insurance must be submitted within twenty-one (21) days of the contract award and prior to the issuance of the timber sale contract.
- All information must be typed or printed except for written signatures.

Please Check Appropriate Categories:

1. My business is organized as (you **must** check one of the boxes below):
  - A.  Sole Proprietorship (individual)
  - B.  Partnership
  - C.  Corporation
  
2. You **must** check one of the boxes below:
  - A.  I certify my business is a sole proprietorship and it has no employees but the sole proprietor. I am not subject to the Worker's Compensation Laws.
  - B.  I certify my business has satisfied its obligation to the Worker's Compensation Act through the use of an approved Notice of Exclusion (BWC-337, Rev. 5/96). I will provide a copy of the Notice of Exclusion within 21 days of the contract award. (For questions or a copy of the BWC-337, please call the Worker's Compensation Bureau at 517-322-1195).
  - C.  I certify my business has a Worker's Compensation Policy. I will provide an original Certificate of Insurance within twenty-one (21) days of the contract award.
  
3. If you have checked item 2(A) or 2(B), you **must** indicate the number of **both** full-time and part-time employees, other than yourself, including family members and active partners (if none, you must enter "0").

\_\_\_\_\_ Full-time Employees

\_\_\_\_\_ Part-time Employees

Name of Business		Federal ID (or) Social Security No.	
Address		Telephone (       )	
City	State	ZIP	

*I hereby certify that the above information is true and correct. I agree to notify the Michigan DNR of any changes that occur in factors affecting my coverage during any of my present and future operations.*

\_\_\_\_\_  
Signature of Owner or Authorized Representative

\_\_\_\_\_  
Title

\_\_\_\_\_  
Date

**Please complete the "SEALED BID" information on the next page**

Michigan State Road Aspen (52-130-16)  
; Cheboygan COUNTY

In response to the notice of sale to be held 3:00 p.m. (local time) on October 24, 2017, I am hereby submitting my sealed bid (firm offer) for the following forest products to be cut. Bids for individual species must be at or above the advertised price. All non-responsive bid forms may be rejected.

<u>PRODUCTS &amp; SPECIES</u>	<u>ESTIMATED VOLUME*</u>	<u>ADVERTISED PRICE</u>	<u>BID PRICE/UNIT</u>
<b>Sawtimber</b>			
B. T. Aspen	86.30 MBF	\$ 49.00/MBF	\$ _____
Quaking Aspen	45.40 MBF	\$ 49.00/MBF	\$ _____
<b>Pulpwood</b>			
B. T. Aspen	866.00 Cords	\$ 17.70/Cord	\$ _____
Balsam Fir	162.00 Cords	\$ 22.10/Cord	\$ _____
Balsam Poplar	66.00 Cords	\$ 17.70/Cord	\$ _____
Bl/R/Hybrid Oak	37.00 Cords	\$ 24.75/Cord	\$ _____
Jack Pine	31.00 Cords	\$ 25.20/Cord	\$ _____
Paper Birch	14.00 Cords	\$ 14.20/Cord	\$ _____
Quaking Aspen	405.00 Cords	\$ 17.70/Cord	\$ _____
Red Maple	181.00 Cords	\$ 20.25/Cord	\$ _____
Red Pine	14.00 Cords	\$ 47.25/Cord	\$ _____
White Ash	3.00 Cords	\$ 20.25/Cord	\$ _____
White Oak	34.00 Cords	\$ 24.75/Cord	\$ _____
White Pine	16.00 Cords	\$ 35.75/Cord	\$ _____
White Spruce	50.00 Cords	\$ 36.20/Cord	\$ _____

\*The volumes are statistically estimated within plus (+) or minus (-) 10.68 percent. These estimated volumes are final and not subject to adjustment. Prospective bidders are urged to examine this timber and to make their own estimates of quantity and quality.

I understand that any or all bids may be rejected. All bids must be signed and all bid items must be bid or the bid form may be rejected. I also understand that consideration and awarding a contract will be based upon my past performance and ability to complete the contract based upon equipment and staffing subject to my control.

FEDERAL ID: \_\_\_\_\_ or SOCIAL SECURITY NUMBER: \_\_\_\_\_

Company or individual bidding: \_\_\_\_\_

Company representative's name: \_\_\_\_\_

Address: \_\_\_\_\_

City: \_\_\_\_\_ State: \_\_\_\_\_ Zip: \_\_\_\_\_

IF AVAILABLE, PLEASE PLACE THE PERSONALIZED LABEL FROM YOUR PROSPECTUS IN THE ABOVE BOX.

Individual or company representative's signature: \_\_\_\_\_ Date: \_\_\_\_\_

Phone number : \_\_\_\_\_ Email (optional): \_\_\_\_\_

**THE WINNING BIDDER MUST COMPLETE THE VERIFICATION OF WORKER'S DISABILITY COMPENSATION ACT COMPLIANCE (ON REVERSE SIDE IF DOUBLE SIDED) WITHIN 21 DAYS OF SALE AWARD DATE**



<b>FOR DEPARTMENT USE ONLY</b>
Sale Number (XX - XXX - XX - XX)
Forest Management Unit:

## TIMBER SALE VERIFICATION OF WORKER'S DISABILITY COMPENSATION ACT COMPLIANCE

*As required by Act 317, P.A. 1969 (Worker's Compensation) and  
Part 5 of Act 451 of 1994, as amended.*

### VERIFICATION OF WORKER'S DISABILITY COMPENSATION ACT COMPLIANCE

- This verification must be completed and submitted within 21 days of contract award and prior to the issuance of the timber sale contract.
- In addition, if boxes 2B or 2C are checked, then Notice of Exclusion or Certificate of Insurance must be submitted within twenty-one (21) days of the contract award and prior to the issuance of the timber sale contract.
- All information must be typed or printed except for written signatures.

Please Check Appropriate Categories:

1. My business is organized as (you **must** check one of the boxes below):
  - A.  Sole Proprietorship (individual)
  - B.  Partnership
  - C.  Corporation
2. You **must** check one of the boxes below:
  - A.  I certify my business is a sole proprietorship and it has no employees but the sole proprietor. I am not subject to the Worker's Compensation Laws.
  - B.  I certify my business has satisfied its obligation to the Worker's Compensation Act through the use of an approved Notice of Exclusion (BWC-337, Rev. 5/96). I will provide a copy of the Notice of Exclusion within 21 days of the contract award. (For questions or a copy of the BWC-337, please call the Worker's Compensation Bureau at 517-322-1195).
  - C.  I certify my business has a Worker's Compensation Policy. I will provide an original Certificate of Insurance within twenty-one (21) days of the contract award.
3. If you have checked item 2(A) or 2(B), you **must** indicate the number of **both** full-time and part-time employees, other than yourself, including family members and active partners (if none, you must enter "0").

\_\_\_\_\_ Full-time Employees

\_\_\_\_\_ Part-time Employees

Name of Business		Federal ID (or) Social Security No.	
Address		Telephone (       )	
City	State	ZIP	

*I hereby certify that the above information is true and correct. I agree to notify the Michigan DNR of any changes that occur in factors affecting my coverage during any of my present and future operations.*

\_\_\_\_\_  
Signature of Owner or Authorized Representative

\_\_\_\_\_  
Title

\_\_\_\_\_  
Date

**Please complete the "SEALED BID" information on the next page**

Nipigon Road Aspen (52-134-16)  
; Cheboygan COUNTY

In response to the notice of sale to be held 3:00 p.m. (local time) on October 24, 2017, I am hereby submitting my sealed bid (firm offer) for the following forest products to be cut. Bids for individual species must be at or above the advertised price. All non-responsive bid forms may be rejected.

<u>PRODUCTS &amp; SPECIES</u>	<u>ESTIMATED VOLUME*</u>	<u>ADVERTISED PRICE</u>	<u>BID PRICE/UNIT</u>
Pulpwood			
Balsam Fir	652.00 Cords	\$ 22.10/Cord	\$ _____
Balsam Poplar	117.00 Cords	\$ 17.70/Cord	\$ _____
N. White Cedar	76.00 Cords	\$ 20.20/Cord	\$ _____
Paper Birch	71.00 Cords	\$ 14.20/Cord	\$ _____
Quaking Aspen	1,045.00 Cords	\$ 17.70/Cord	\$ _____
Red Maple	90.00 Cords	\$ 20.25/Cord	\$ _____
White Spruce	139.00 Cords	\$ 36.20/Cord	\$ _____

\*The volumes are statistically estimated within plus (+) or minus (-) 10.17 percent. These estimated volumes are final and not subject to adjustment. Prospective bidders are urged to examine this timber and to make their own estimates of quantity and quality.

I understand that any or all bids may be rejected. All bids must be signed and all bid items must be bid or the bid form may be rejected. I also understand that consideration and awarding a contract will be based upon my past performance and ability to complete the contract based upon equipment and staffing subject to my control.

FEDERAL ID: \_\_\_\_ - \_\_\_\_ - \_\_\_\_ or SOCIAL SECURITY NUMBER: \_\_\_\_ - \_\_\_\_ - \_\_\_\_

Company or individual bidding: \_\_\_\_\_

Company representative's name: \_\_\_\_\_

Address: \_\_\_\_\_

City: \_\_\_\_\_ State: \_\_\_\_\_ Zip: \_\_\_\_\_

IF AVAILABLE, PLEASE PLACE THE PERSONALIZED LABEL FROM YOUR PROSPECTUS IN THE ABOVE BOX.

Individual or company representative's signature: \_\_\_\_\_ Date: \_\_\_\_\_

Phone number : \_\_\_\_\_ Email (optional): \_\_\_\_\_

**THE WINNING BIDDER MUST COMPLETE THE VERIFICATION OF WORKER'S DISABILITY COMPENSATION ACT COMPLIANCE (ON REVERSE SIDE IF DOUBLE SIDED) WITHIN 21 DAYS OF SALE AWARD DATE**



<b>FOR DEPARTMENT USE ONLY</b>
Sale Number (XX – XXX – XX – XX)
Forest Management Unit:

## TIMBER SALE VERIFICATION OF WORKER'S DISABILITY COMPENSATION ACT COMPLIANCE

*As required by Act 317, P.A. 1969 (Worker's Compensation) and  
Part 5 of Act 451 of 1994, as amended.*

### VERIFICATION OF WORKER'S DISABILITY COMPENSATION ACT COMPLIANCE

- This verification must be completed and submitted within 21 days of contract award and prior to the issuance of the timber sale contract.
- In addition, if boxes 2B or 2C are checked, then Notice of Exclusion or Certificate of Insurance must be submitted within twenty-one (21) days of the contract award and prior to the issuance of the timber sale contract.
- All information must be typed or printed except for written signatures.

Please Check Appropriate Categories:

1. My business is organized as (you **must** check one of the boxes below):
  - A.  Sole Proprietorship (individual)
  - B.  Partnership
  - C.  Corporation
2. You **must** check one of the boxes below:
  - A.  I certify my business is a sole proprietorship and it has no employees but the sole proprietor. I am not subject to the Worker's Compensation Laws.
  - B.  I certify my business has satisfied its obligation to the Worker's Compensation Act through the use of an approved Notice of Exclusion (BWC-337, Rev. 5/96). I will provide a copy of the Notice of Exclusion within 21 days of the contract award. (For questions or a copy of the BWC-337, please call the Worker's Compensation Bureau at 517-322-1195).
  - C.  I certify my business has a Worker's Compensation Policy. I will provide an original Certificate of Insurance within twenty-one (21) days of the contract award.
3. If you have checked item 2(A) or 2(B), you **must** indicate the number of **both** full-time and part-time employees, other than yourself, including family members and active partners (if none, you must enter "0").

\_\_\_\_\_ Full-time Employees

\_\_\_\_\_ Part-time Employees

Name of Business		Federal ID (or) Social Security No.	
Address		Telephone (       )	
City	State	ZIP	

*I hereby certify that the above information is true and correct. I agree to notify the Michigan DNR of any changes that occur in factors affecting my coverage during any of my present and future operations.*

\_\_\_\_\_  
Signature of Owner or Authorized Representative

\_\_\_\_\_  
Title

\_\_\_\_\_  
Date

**Please complete the "SEALED BID" information on the next page**

Old Mackinaw Road Aspen (52-132-16)  
; Cheboygan COUNTY

In response to the notice of sale to be held 3:00 p.m. (local time) on October 24, 2017, I am hereby submitting my sealed bid (firm offer) for the following forest products to be cut. Bids for individual species must be at or above the advertised price. All non-responsive bid forms may be rejected.

<u>PRODUCTS &amp; SPECIES</u>	<u>ESTIMATED VOLUME*</u>	<u>ADVERTISED PRICE</u>	<u>BID PRICE/UNIT</u>
<b>Sawtimber</b>			
B. T. Aspen	36.00 MBF	\$ 49.00/MBF	\$ _____
Quaking Aspen	10.90 MBF	\$ 49.00/MBF	\$ _____
Red Maple	13.40 MBF	\$ 150.00/MBF	\$ _____
<b>Pulpwood</b>			
B. T. Aspen	104.00 Cords	\$ 17.70/Cord	\$ _____
Balsam Fir	464.00 Cords	\$ 22.10/Cord	\$ _____
Balsam Poplar	23.00 Cords	\$ 17.70/Cord	\$ _____
Black Ash	20.00 Cords	\$ 20.25/Cord	\$ _____
Paper Birch	171.00 Cords	\$ 14.20/Cord	\$ _____
Quaking Aspen	803.00 Cords	\$ 17.70/Cord	\$ _____
Red Maple	318.00 Cords	\$ 20.25/Cord	\$ _____
White Spruce	37.00 Cords	\$ 36.20/Cord	\$ _____

\*The volumes are statistically estimated within plus (+) or minus (-) 11.28 percent. These estimated volumes are final and not subject to adjustment. Prospective bidders are urged to examine this timber and to make their own estimates of quantity and quality.

I understand that any or all bids may be rejected. All bids must be signed and all bid items must be bid or the bid form may be rejected. I also understand that consideration and awarding a contract will be based upon my past performance and ability to complete the contract based upon equipment and staffing subject to my control.

FEDERAL ID: \_\_\_\_\_ or SOCIAL SECURITY NUMBER: \_\_\_\_\_

Company or individual bidding: \_\_\_\_\_

Company representative's name: \_\_\_\_\_

Address: \_\_\_\_\_

City: \_\_\_\_\_ State: \_\_\_\_\_ Zip: \_\_\_\_\_

IF AVAILABLE, PLEASE PLACE THE PERSONALIZED LABEL FROM YOUR PROSPECTUS IN THE ABOVE BOX.

Individual or company representative's signature: \_\_\_\_\_ Date: \_\_\_\_\_

Phone number : \_\_\_\_\_ Email (optional): \_\_\_\_\_

**THE WINNING BIDDER MUST COMPLETE THE VERIFICATION OF WORKER'S DISABILITY COMPENSATION ACT COMPLIANCE (ON REVERSE SIDE IF DOUBLE SIDED) WITHIN 21 DAYS OF SALE AWARD DATE**



<b>FOR DEPARTMENT USE ONLY</b>
Sale Number (XX - XXX - XX - XX)
Forest Management Unit:

## TIMBER SALE VERIFICATION OF WORKER'S DISABILITY COMPENSATION ACT COMPLIANCE

*As required by Act 317, P.A. 1969 (Worker's Compensation) and  
Part 5 of Act 451 of 1994, as amended.*

### VERIFICATION OF WORKER'S DISABILITY COMPENSATION ACT COMPLIANCE

- This verification must be completed and submitted within 21 days of contract award and prior to the issuance of the timber sale contract.
- In addition, if boxes 2B or 2C are checked, then Notice of Exclusion or Certificate of Insurance must be submitted within twenty-one (21) days of the contract award and prior to the issuance of the timber sale contract.
- All information must be typed or printed except for written signatures.

Please Check Appropriate Categories:

1. My business is organized as (you **must** check one of the boxes below):
  - A.  Sole Proprietorship (individual)
  - B.  Partnership
  - C.  Corporation
  
2. You **must** check one of the boxes below:
  - A.  I certify my business is a sole proprietorship and it has no employees but the sole proprietor. I am not subject to the Worker's Compensation Laws.
  - B.  I certify my business has satisfied its obligation to the Worker's Compensation Act through the use of an approved Notice of Exclusion (BWC-337, Rev. 5/96). I will provide a copy of the Notice of Exclusion within 21 days of the contract award. (For questions or a copy of the BWC-337, please call the Worker's Compensation Bureau at 517-322-1195).
  - C.  I certify my business has a Worker's Compensation Policy. I will provide an original Certificate of Insurance within twenty-one (21) days of the contract award.
  
3. If you have checked item 2(A) or 2(B), you **must** indicate the number of **both** full-time and part-time employees, other than yourself, including family members and active partners (if none, you must enter "0").

\_\_\_\_\_ Full-time Employees

\_\_\_\_\_ Part-time Employees

Name of Business		Federal ID (or) Social Security No.	
Address		Telephone (       )	
City	State	ZIP	

*I hereby certify that the above information is true and correct. I agree to notify the Michigan DNR of any changes that occur in factors affecting my coverage during any of my present and future operations.*

\_\_\_\_\_  
Signature of Owner or Authorized Representative

\_\_\_\_\_  
Title

\_\_\_\_\_  
Date

**Please complete the "SEALED BID" information on the next page**



Nest Trail Pine Mix (52-131-16)  
; Cheboygan COUNTY

In response to the notice of sale to be held 3:00 p.m. (local time) on October 24, 2017, I am hereby submitting my sealed bid (firm offer) for the following forest products to be cut. Bids for individual species must be at or above the advertised price. All non-responsive bid forms may be rejected.

<u>PRODUCTS &amp; SPECIES</u>	<u>ESTIMATED VOLUME*</u>	<u>ADVERTISED PRICE</u>	<u>BID PRICE/UNIT</u>
<b>Sawtimber</b>			
B. T. Aspen	16.50 MBF	\$ 49.00/MBF	\$ _____
Bl/R/Hybrid Oak	7.00 MBF	\$ 119.00/MBF	\$ _____
Red Oak	9.70 MBF	\$ 219.00/MBF	\$ _____
Red Pine	138.80 MBF	\$ 116.00/MBF	\$ _____
White Oak	6.90 MBF	\$ 116.00/MBF	\$ _____
<b>Pulpwood</b>			
B. T. Aspen	83.00 Cords	\$ 17.70/Cord	\$ _____
Balsam Fir	10.00 Cords	\$ 22.10/Cord	\$ _____
Bl/R/Hybrid Oak	113.00 Cords	\$ 24.75/Cord	\$ _____
Jack Pine	40.00 Cords	\$ 25.20/Cord	\$ _____
Quaking Aspen	11.00 Cords	\$ 17.70/Cord	\$ _____
Red Maple	33.00 Cords	\$ 20.25/Cord	\$ _____
Red Oak	61.00 Cords	\$ 24.75/Cord	\$ _____
Red Pine	339.00 Cords	\$ 47.25/Cord	\$ _____
White Oak	73.00 Cords	\$ 24.75/Cord	\$ _____
White Pine	30.00 Cords	\$ 35.75/Cord	\$ _____

\*The volumes are statistically estimated within plus (+) or minus (-) 15.35 percent. These estimated volumes are final and not subject to adjustment. Prospective bidders are urged to examine this timber and to make their own estimates of quantity and quality.

I understand that any or all bids may be rejected. All bids must be signed and all bid items must be bid or the bid form may be rejected. I also understand that consideration and awarding a contract will be based upon my past performance and ability to complete the contract based upon equipment and staffing subject to my control.

FEDERAL ID: \_\_\_\_\_ or SOCIAL SECURITY NUMBER: \_\_\_\_\_

Company or individual bidding: \_\_\_\_\_

Company representative's name: \_\_\_\_\_

Address: \_\_\_\_\_

City: \_\_\_\_\_ State: \_\_\_\_\_ Zip: \_\_\_\_\_

IF AVAILABLE, PLEASE PLACE THE PERSONALIZED LABEL FROM YOUR PROSPECTUS IN THE ABOVE BOX.

Individual or company representative's signature: \_\_\_\_\_ Date: \_\_\_\_\_

Phone number : \_\_\_\_\_ Email (optional): \_\_\_\_\_

**THE WINNING BIDDER MUST COMPLETE THE VERIFICATION OF WORKER'S DISABILITY COMPENSATION ACT COMPLIANCE (ON REVERSE SIDE IF DOUBLE SIDED) WITHIN 21 DAYS OF SALE AWARD DATE**

