



**DEPARTMENT OF NATURAL RESOURCES
STATE OF MICHIGAN**

TIMBER SALE PROSPECTUS #6046

SCHEDULED SALE DATE AND TIME: 3:00 p.m. (local time) on December 19, 2017.

LOCATION: ESCANABA OFFICE, 6833 HWY 2, 41 & M-35, GLADSTONE, MI 49837.

PROSPECTUS NOTE: The bidder is advised to inspect the sale area and review the location, estimated volumes, operating costs and contract terms of proposed sales. Please be aware that some landowners may request 60 days or more notice for access across their land.

Notice is hereby given that bids will be received by the Unit Manager, ESCANABA MANAGEMENT UNIT, for certain timber on the following described lands:

Southern GEM (33-034-17)

Menominee County, Advertised Price \$63,025.65, 109.4 Acres, Aspen, Hardwood.

SALE NOTE: This contract is only for two years, this is to improve the aspen age class distribution within the GEM (Grouse Enhancement Management Area).

Walking Trail GEM (33-035-17)

Menominee County, Advertised Price \$40,786.80, 84.9 Acres, Aspen, Spruce/Fir/Tamarack.

SALE NOTE: This contract is only for two years, this is to improve the aspen age class distribution within the GEM (Grouse Enhancement Management Area).

Johnson Lake SBW (33-036-17)

Menominee County, Advertised Price \$36,640.00, 54.7 Acres, Aspen, Hardwood.

SALE NOTE: Payment Units 1 and 2 can be accessed through state land from the north, but the best access is through private property to the southwest. Payment Units 3 and 4 can only be accessed through private property. There is more than one access route into each of the units. The spruce budworm is present and has caused balsam fir and spruce defoliation, with minimal mortality at this time.

Access may be through private or other public land.

Pile of Bones SBW (33-040-17)

Menominee County, Advertised Price \$65,224.95, 195.4 Acres, N White Cedar, Spruce/Fir/Tamarack.

SALE NOTE: The tamarack within the sale is being defoliated by the eastern larch beetle. There are some small pockets of mortality at this time. The spruce budworm is also present, causing defoliation of the spruce/fir. There has been some mortality.

Wiregrass Conifer (33-041-17)

Menominee County, Advertised Price \$31,191.55, 65.3 Acres, N White Cedar, Spruce/Fir/Tamarack.

SALE NOTE: The spruce budworm and eastern larch beetle has caused some defoliation, but only a very small amount of mortality, at this time.

BID INSTRUCTIONS (VER. 09/02/2016):

1. Scheduled Bid Location, Date, and Time (2/11)

Bids must be received by the Unit Manager, ESCANABA OFFICE, 6833 HWY 2, 41 & M-35, GLADSTONE, MI 49837, no later than 3:00 p.m. (local time) on December 19, 2017. For further information concerning this sale, contact Eric Thompson at 906-786-2354.

2. Bidder's Qualifications (5/16)

Purchaser shall obtain workers compensation insurance to cover claims under Michigan's Worker's Disability Compensation Act of 1969 or similar employee benefit act of any other state applicable to an employee. If all or part of a timber sale was prepared by a private contractor, the contractor and that contractor's company are not permitted to bid on the timber sale contract. Bids will not be accepted from individuals or companies appearing on the DNR/FRD No-Bid List. This list contains the names of purchasers who previously failed to execute a contract within 21-days or who have a history of poor performance.

3. Preparation of Sealed Bids (5/16)

Bid Forms may be completed online thru Michigan DNR Timber Sale Online Bidding (OLB) at www.michigan.gov/timberbidding or by completing the hardcopy Bid Form found in the Timber Sale Prospectus. Hardcopy Bid Forms shall be manually signed in ink. Registration in OLB is considered your 'signature' for all bids submitted thru that system. Bid prices must be entered for each species and product in the Bid Price column for all material subject to bidding and all fill-in blanks must be completed. If erasures or other changes appear on the hardcopy Bid Form, each erasure or change must be initialed by the person signing the bid.

4. Submission of Sealed Bids (5/16)

Bid forms may be obtained from the Unit Manager or thru OLB. Bids may be submitted hardcopy or thru OLB. All hardcopy bids must be submitted on the bid form and in an envelope clearly identified as described in this section. NOTE: Only one bid form per bid envelope. Sealed bids must be submitted to the Unit office designated in the prospectus and must be submitted at or prior to the time established in the prospectus. The envelope should show on the outside (a) the sale name or number and (b) the date and time of bid opening, as shown in the prospectus. Bids received after the time specified in the sale prospectus are late bids and will be rejected.

It is possible for a bidder to submit multiple bids on a single sale. For example, a bid may be submitted hardcopy and a bid may be submitted thru OLB. Or, two bidders from the same company could both submit bids on the same sale. If this were to happen, the State would accept all bids received and award the contract accordingly. All bidding and contractual requirements would apply to all bids received.

5. Public Opening of Sealed Bids (7/16)

If conditions permit, the sealed bids will be publicly opened and posted at the time and place set in the prospectus.

If a bidder, present at a bid opening, has submitted bids on more than one sale, that bidder may withdraw their unopened bid envelopes or announce the withdrawal of their online bid after being declared the successful bidder on one sale.

6. Award of Contract (1/11)

Award of the contract will be made to the Bidder whose bid, conforming to the prospectus, is most advantageous to the State of Michigan on the basis of total value at rates bid for the estimated quantities. The State reserves the right to reject any bid or waive any minor irregularity in bids received. A written award mailed (or otherwise furnished) to the successful Bidder shall be deemed to result in a binding contract without further action by either party.

7. Down Payment (1/11)

The Bidder to whom award is made must make a down payment within 21 days of the sale award. The amount of the down payment will be calculated as shown in the Bond and Payment Schedule of this prospectus. Only cash may be used to meet this requirement.

8. Performance Security (1/11)

As guarantee of faithful performance, a cash bond, certificate of deposit, surety bond or irrevocable letter of credit (LOC) is required within 21 days of the sale award. The amount of the performance security is shown in the Bond and

Payment Schedule of this prospectus. If an LOC or surety is used, the coverage must extend for at least 6 months beyond the contract expiration.

9. Timber Sale Contract (9/14)

Additional conditions and requirements common to all timber sales are listed on the timber sale contract (R4031) and are available on line at www.michigan.gov/timber. Contact the Unit Manager for additional information or a sample contract. Within 21 days of the date of the award letter, the bidder must sign the contract and provide the required down payment, performance security, and verification of worker's disability compensation. The down payment and performance security shall be in accordance with the provisions of the timber sale contract, in the sums stated in this prospectus. If these actions are not taken, then the Bidder, the Bidder's corporation, and the corporation's principals may not be permitted to bid on State timber sales for a period of 1 year. In addition, the Bidder certifies that if awarded this contract, the Bidder will complete the timber sale contract in accordance with its terms and any modifications thereof including requirements to purchase, cut, and remove the included timber by the expiration date.

10. Disclaimer of Estimates and Bidder's Warranty of Inspection (7/16)

Before submitting this bid, the Bidder is advised and cautioned to inspect the sale area, review the requirements of the sale contract, and take other steps as may be reasonably necessary to ascertain the location, estimated volumes, construction estimates, and operating costs of the proposed sale. Failure to do so will not relieve the Bidder from responsibility for completing the contract.

The Bidder warrants that this bid is submitted solely on the basis of the Bidder's examination and inspection of the quality and quantity of the timber offered for sale and the Bidder's opinion of the value thereof and the costs of recovery. No reliance should be placed on the State of Michigan's estimates of timber quality, quantity or costs of recovery. Bidder further acknowledges that the State of Michigan: (i) expressly disclaims any warranty of fitness of timber for any purpose; (ii) offers this timber as is without any warranty of quality (merchantability) or quantity and (iii) expressly disclaims any warranty as to the quantity or quality of timber sold.

11. Certification and Chain-of-Custody (10/14)

Unless otherwise indicated in the contract under section 7 – Other Conditions of the Sale Specific Conditions & Requirements, the area encompassed by this timber sale is certified to the standards of the Forest Stewardship Council (FSC) - Certificate #SCS-FM/COC-00090N and the Sustainable Forestry Initiative (SFI) - Certificate #NSF-SFIS-5Y031-SF5. Forest products from this sale may be delivered to the mill as "FSC 100% and / or SFI certified" as long as the contractor hauling the forest products is chain-of-custody (COC) certified or covered under a COC certificate from the destination mill. The purchaser is responsible for maintaining COC after leaving the sale area.

12. Good Neighbor Authority (GNA) Requirements (7/16)

If the name of this timber sales contains the acronym GNA, it is authorized by the Good Neighbor Authority (GNA) and covered by various agreements between the U.S. Forest Service and the State. The timber sale occurs on federal land and the following conditions apply:

GNA contracts on US Forest Service land will not be awarded to purchasers on the Federal list of excluded parties. The System for Award Management (SAM) will be checked for active excluded parties prior to award of contract. In addition, the Bidder to whom award is made must complete an Assurance Regarding Felony Conviction or Tax Delinquent Status for Corporate Applicants (AD-3031).

13. Good Neighbor Authority (GNA) Requirements, con't (9/16)

Bidder certifies, by signing this bid form, that to the best of Bidder's knowledge that the following representations are accurate and complete.

- a. That the Bidder and its principals are not presently debarred, suspended, proposed for debarment, declared ineligible, or voluntary excluded from timber sales (covered transactions) by any Federal department or agency.
- b. That the Bidder and its principals have not within a 3-year period preceding this bid been convicted of or had a civil judgment rendered against them for commission of fraud or a criminal offense in connection with obtaining, attempting to obtain, or performing a public (Federal, State, or local) transaction or contract under a public transaction; violation of Federal or State antitrust statutes or commission of embezzlement, theft, forgery, bribery, falsification or destruction of records, making false statements, or receiving stolen property.

c. That the Bidder and its principals are not presently indicted for or otherwise criminally or civilly charged by a governmental entity (Federal, State, or local) with commission of any of the offenses enumerated in paragraph b of this certification.

d. That the Bidder and its principals have not within a 3-year period preceding this bid had one or more public transactions (Federal, State, or local) terminated for breach or default of a timber or forest product contract.

Bidders that cannot certify this requirement, in whole or in part, shall submit an explanation with their bid.

KEITH CREAGH

Director

TIMBER SALE INFORMATION

Southern GEM (33-034-17)

Menominee County (Advertised Price \$63,025.65)

SALE NOTE: This contract is only for two years, this is to improve the aspen age class distribution within the GEM (Grouse Enhancement Management Area).

A timber sale contract for this lump sum, sealed bid timber sale will be awarded to the responsible bidder offering the highest sealed bid price. Bids must be at or above the following advertised price for each species:

<u>PRODUCTS & SPECIES</u>	<u>ESTIMATED UNITS*</u>	<u>ADVERTISED PRICE</u>
Sawtimber		
Red Maple	4.70 MBF	\$ 247.00 / MBF
White Pine	26.70 MBF	\$ 66.00 / MBF
Pulpwood		
Balsam Fir	124.00 Cords	\$ 29.45 / Cord
Mixed Aspen	910.00 Cords	\$ 32.15 / Cord
Mixed Hardwood	616.00 Cords	\$ 32.45 / Cord
Mixed Spruce	30.00 Cords	\$ 25.90 / Cord
N. White Cedar	17.00 Cords	\$ 25.25 / Cord
Red Pine	8.00 Cords	\$ 65.10 / Cord
White Pine	165.00 Cords	\$ 33.20 / Cord

* The total volume is statistically estimated within plus (+) or minus (-) 10.12 percent. The estimated units are final and not subject to adjustment. Prospective bidders are urged to examine this timber and to make their own estimates of quantity and quality.

BOND AND PAYMENT SCHEDULE:

1. A bond in the amount of \$3,151.00 to insure faithful performance of the conditions of the contract will be deposited by the successful bidder within 21 days of the sale award.
2. Cutting in any sale or unit without the required advance payment would be considered a trespass.
3. Total payment must be paid in advance or according to the following schedule:
 - (a) Ten percent (10%) of the sale value must be paid within 21 days of the sale award.
 - (b) The 10% down payment will be credited towards the first unit cut.
4. If no cutting takes place, the 10% down payment will not be refunded.
5. Operations on the contract issued will terminate on 09/30/2019.

Description of Timber by Payment Unit (PU)

PU	MARKET GROUP	PRODUCT	QUANTITY	UNIT	ACRES	ADVERTISE PRICE
1	Balsam Fir	Pulpwood	45.0	Cords	4.8	\$2,257.50
	Mixed Aspen		24.0	Cords		
	<i>Quaking Aspen</i>		24.0	<i>Cords</i>		
	Mixed Hardwood		1.0	Cords		
	<i>Green Ash</i>		1.0	<i>Cords</i>		
	Mixed Spruce		3.0	Cords		
	<i>White Spruce</i>		3.0	<i>Cords</i>		
	N. White Cedar		2.0	Cords		
2	Balsam Fir	Pulpwood	30.0	Cords	15.7	\$9,857.50
	Mixed Aspen		238.0	Cords		
	<i>B. T. Aspen</i>		21.0	<i>Cords</i>		
	<i>Quaking Aspen</i>		217.0	<i>Cords</i>		
	Mixed Hardwood		36.0	Cords		
	<i>Balsam Poplar</i>		4.0	<i>Cords</i>		
	<i>Black Cherry</i>		2.0	<i>Cords</i>		
	<i>Green Ash</i>		16.0	<i>Cords</i>		
	<i>Red Maple</i>		14.0	<i>Cords</i>		
	Mixed Spruce		4.0	Cords		
	<i>White Spruce</i>		4.0	<i>Cords</i>		
	N. White Cedar		2.0	Cords		
	3		Red Maple	Sawtimber		
Mixed Aspen		Pulpwood	280.0	Cords		
<i>B. T. Aspen</i>			111.0	<i>Cords</i>		
<i>Quaking Aspen</i>			169.0	<i>Cords</i>		
Mixed Hardwood			116.0	Cords		
<i>Black Cherry</i>			2.0	<i>Cords</i>		
<i>Paper Birch</i>			10.0	<i>Cords</i>		
<i>Red Maple</i>			104.0	<i>Cords</i>		
4	Red Maple		Sawtimber	0.5	MBF	18.9
	White Pine	Pulpwood	11.3	MBF		
	Balsam Fir		5.0	Cords		
	Mixed Aspen		77.0	Cords		
	<i>B. T. Aspen</i>		3.0	<i>Cords</i>		
	<i>Quaking Aspen</i>		74.0	<i>Cords</i>		
	Mixed Hardwood		80.0	Cords		
	<i>Balsam Poplar</i>		2.0	<i>Cords</i>		
	<i>Black Cherry</i>		7.0	<i>Cords</i>		
	<i>Green Ash</i>		15.0	<i>Cords</i>		
	<i>Red Maple</i>		56.0	<i>Cords</i>		
	Mixed Spruce		3.0	Cords		
	<i>White Spruce</i>		3.0	<i>Cords</i>		
	Red Pine		8.0	Cords		
	White Pine		81.0	Cords		
5	White Pine		Sawtimber	15.4	MBF	19.5
	Balsam Fir	Pulpwood	9.0	Cords		
	Mixed Aspen		161.0	Cords		
	<i>B. T. Aspen</i>		45.0	<i>Cords</i>		
	<i>Quaking Aspen</i>		116.0	<i>Cords</i>		
	Mixed Hardwood		126.0	Cords		
	<i>Green Ash</i>		14.0	<i>Cords</i>		
	<i>Red Maple</i>		112.0	<i>Cords</i>		
	Mixed Spruce		6.0	Cords		
	<i>Black Spruce</i>		6.0	<i>Cords</i>		
	White Pine		82.0	Cords		
6	Red Maple		Sawtimber	1.0	MBF	34.4
	Balsam Fir	Pulpwood	35.0	Cords		

Description of Timber by Payment Unit (PU), con't

PU	MARKET GROUP	PRODUCT	QUANTITY	UNIT	ACRES	ADVERTISE PRICE
6 con't	Mixed Aspen	Pulpwood	130.0	Cords		
	<i>B. T. Aspen</i>		37.0	<i>Cords</i>		
	<i>Quaking Aspen</i>		93.0	<i>Cords</i>		
	Mixed Hardwood		257.0	Cords		
	<i>Balsam Poplar</i>		9.0	<i>Cords</i>		
	<i>Black Ash</i>		24.0	<i>Cords</i>		
	<i>Green Ash</i>		61.0	<i>Cords</i>		
	<i>Paper Birch</i>		8.0	<i>Cords</i>		
	<i>Red Maple</i>		155.0	<i>Cords</i>		
	Mixed Spruce		14.0	Cords		
	<i>Black Spruce</i>		13.0	<i>Cords</i>		
	<i>White Spruce</i>		1.0	<i>Cords</i>		
	N. White Cedar		13.0	Cords		
	White Pine		2.0	Cords		
	TOTAL:			31.4	MBF	
TOTAL:			1,870.0	Cords		

Sale Specific Conditions & Requirements

Sale Name: Southern GEM

Sale Number: 33-034-17 Seq#: 1

1 - Sale Area

1.2 - Boundaries

1.2.1 - Painted boundaries (1/14)

The sale boundary and Payment Unit boundaries are marked and identified by red and yellow paint. Exterior sale boundary lines against state are marked with red paint. Interior Payment Unit boundaries are marked with yellow paint. Retention areas within Payment Units 3, 4, and 5 are bounded by red paint and need to be protected; no harvesting activities may occur within these areas. Yellow painted trees designating an interior Payment Unit boundary are only to be cut when all surrounding Payment Units have been paid for.

2 - Timber Specifications

2.1 - Included Timber

2.1.1 - Clearcut unit(s) with unmerchantable trees (6/14)

Within Payment Unit(s) 1 - 6, cut all trees that are three (3) inches or more at DBH.

2.1.16 - Timber along county or forest roads (6/14)

Cut and remove all standing trees 2" at DBH or greater within 15 feet of the blue paint line that runs from Payment Unit 3 north through Payment Unit 5, as shown on the Timber Sale Map. All trees must be decked separately by species and product and will be scaled by the sale administrator. All slash will be laid along the outside edge of the cleared strip. This cleared strip will become a future hunter walking trail.

3 - Payments

3.3 - Pre-measured Sales

3.3.4 - Dividing payment units (7/14)

Payment Unit(s) \$18,000 in value or greater may be divided at the request of the Purchaser and upon approval of the Unit Manager. Dividing Payment Units is a contract modification which requires a Timber Sale Contract Supplement. There will be only one division per Payment Unit.

4 - Transportation

4.2 - Maintenance

4.2.1 - Hauling restriction (12/08)

Hauling may be restricted on forest roads by the Unit Manager or his/her representative. The restriction may occur during spring breakup or during other wet weather conditions.

4.2.4 - Grading (10/16)

For completion of the sale, state forest roads must be graded. In general, this will require a road grader or bull dozer to shape up the roads after forest products have been hauled off site. This includes cleaning of drainage areas, grading, crowning and filling with gravel, if necessary. The grading equipment to be used must be approved by the Unit Manager or his/her representative.

4.4 - Access

4.4.3 - Access gate (12/08)

The access gates must be locked at the completion of each day unless otherwise approved by the Unit Manager or his/her representative.

5 - Operations

5.2 - Conduct of Operations

5.2.3 - Operating Restrictions

5.2.3.1 - Operating restrictions (9/11)

Within Payment Unit(s) 6, cutting and skidding are limited to the period of December 1st to March 31st, unless there is an extended dry or frozen period and the sale administrator approves of harvesting during that time period. This restriction is because of numerous low wet pockets throughout the Payment Unit and access routes.

5.2.22 - Operating Caution

5.2.22.1 - Operating caution (6/11)

It is recommended, but not required, that within Payment Unit(s) 1, 2, 4, and 5, cutting and skidding occur during dry summer or frozen winter conditions. The reason for the recommendation is because of some low wet ground within the Payment Units.

5.4 - Soil Protection

5.4.1 - Rutting restriction, general (7/16)

Operations are to cease immediately if equipment and weather conditions result in rutting of roads and/or skid trails which is 12 inches or greater in depth and 50 feet in length. The Unit Manager or his/her representative may restrict hauling and/or skidding if ruts exceed the specified depth. With the Unit Manager or his/her representative's approval, the Purchaser may return to the area when the risk of rutting has decreased.

6 - Safety and Fire Prevention

6.2 - Signing

6.2.1 - Road posting (9/09)

The Purchaser is responsible for posting and maintaining caution signs on the Westman Dam Road prior to beginning operations. The road must be posted at appropriate distances from the sale area to warn of logging activity and truck traffic. Signs must be removed when harvest operations are suspended or completed. The Purchaser will provide these signs.



TIMBER SALE MAP

This information provided by authority of Part 525, 1994 PA 451, as amended.

Forest Management Unit Escanaba Management Unit	County Menominee County	Mapped By Beaudo	Date 7/6/2017	Page 1	of 1
Cruised By Salter, Beaudo					

Township 35N	Range 25W	Section(s) and Subdivision(s) Sec 7 - SE 1/4, NWSW, SENE, SESW, SWNE, SWSW; Sec 8 - NESW, NWSW, SWNW, SWSW; Sec 18 - NWNE & NWNW	Scale 1:15,840
-----------------	--------------	---	-------------------

Cover Type				Density			
A = Aspen	H = Hemlock	N = Marsh	U = Upland Brush	0 = Non Stocked	5 = Pole Timber Medium		
B = Paper Birch	J = Jack Pine	O = Oak	UM = Upland Mixed	1 = Seedling Sapling Poor	6 = Pole Timber Well		
C = Cedar	L = Lowland Brush	P = Lowland Poplar	V = Bog or Marsh	2 = Seedling Sapling Medium	7 = Saw Timber Poor		
D = Treed Bog	LM = Lowland Mixed	Q = Mixed Swamp Conifer	W = White Pine	3 = Seedling Sapling Well	8 = Saw Timber Medium		
E = Swamp Hdwoods	M = Mpl, Bch, Brch	R = Red Pine	X = Non Stocked	4 = Pole Timber Poor	9 = Saw Timber Well		
F = Spruce Fir	MC = Mixed Conifer	S = Black Spruce	Z = Water				
G = Grass	MD = Mixed Deciduous	T = Tamarack					

PU	Acres	PU	Acres
1	4.8	4	18.9
2	15.7	5	19.5
3	16.1	6	34.4

Southern GEM
Compartment 52
109.4 Acres

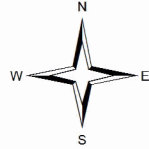

QR Code opens map in PDF Maps App

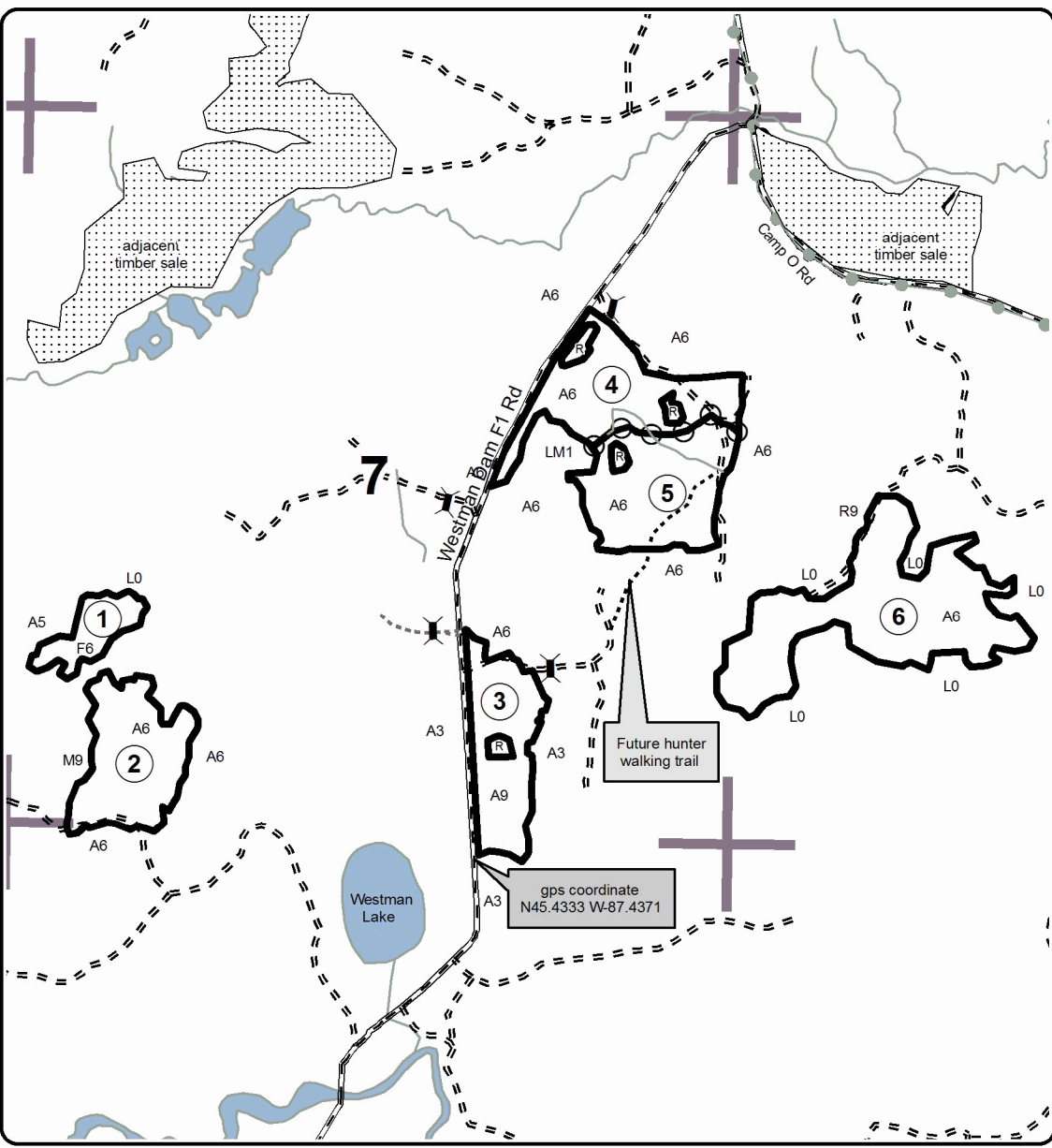

Legend

- Against State (Red)
- Payment Unit (Yellow)
- Section Corners
- 7 Section Number
- Paved Roads
- Gravel Roads
- ... Poor Dirt Roads
- State Land Boundary
- ① Payment Unit
- R Retention Patch
- ⊘ Gate
- ~ Creek/Seasonal Drain
- Rivers
- ORV Route

Locator Map 1:200,000

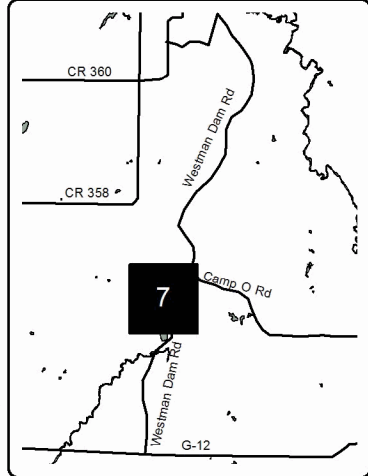

TIMBER SALE INFORMATION

Walking Trail GEM (33-035-17)

Menominee County (Advertised Price \$40,786.80)

SALE NOTE: This contract is only for two years, this is to improve the aspen age class distribution within the GEM (Grouse Enhancement Management Area).

A timber sale contract for this lump sum, sealed bid timber sale will be awarded to the responsible bidder offering the highest sealed bid price. Bids must be at or above the following advertised price for each species:

<u>PRODUCTS & SPECIES</u>	<u>ESTIMATED UNITS*</u>	<u>ADVERTISED PRICE</u>
Pulpwood		
Balsam Fir	274.00 Cords	\$ 25.55 / Cord
Hemlock	2.00 Cords	\$ 10.25 / Cord
Mixed Aspen	614.00 Cords	\$ 27.85 / Cord
Mixed Hardwood	289.00 Cords	\$ 28.15 / Cord
Mixed Spruce	216.00 Cords	\$ 22.45 / Cord
N. White Cedar	29.00 Cords	\$ 21.85 / Cord
White Pine	106.00 Cords	\$ 28.75 / Cord

* The total volume is statistically estimated within plus (+) or minus (-) 12.96 percent. The estimated units are final and not subject to adjustment. Prospective bidders are urged to examine this timber and to make their own estimates of quantity and quality.

BOND AND PAYMENT SCHEDULE:

1. A bond in the amount of \$2,039.00 to insure faithful performance of the conditions of the contract will be deposited by the successful bidder within 21 days of the sale award.
2. Cutting in any sale or unit without the required advance payment would be considered a trespass.
3. Total payment must be paid in advance or according to the following schedule:
 - (a) Ten percent (10%) of the sale value must be paid within 21 days of the sale award.
 - (b) The 10% down payment will be credited towards the first unit cut.
4. If no cutting takes place, the 10% down payment will not be refunded.
5. Operations on the contract issued will terminate on 09/30/2019.

Description of Timber by Payment Unit (PU)

PU	MARKET GROUP	PRODUCT	QUANTITY	UNIT	ACRES	ADVERTISE PRICE
1	Balsam Fir	Pulpwood	54.0	Cords	11.9	\$6,280.10
	Mixed Aspen		161.0	Cords		
	<i>B. T. Aspen</i>		26.0	<i>Cords</i>		
	<i>Quaking Aspen</i>		135.0	<i>Cords</i>		
	Mixed Hardwood		14.0	Cords		
	<i>Balsam Poplar</i>		3.0	<i>Cords</i>		
	<i>Red Maple</i>		11.0	<i>Cords</i>		
	Mixed Spruce		1.0	Cords		
	<i>White Spruce</i>		1.0	<i>Cords</i>		
	2		Mixed Spruce	Pulpwood		
<i>Black Spruce</i>		100.0	<i>Cords</i>			
White Pine		1.0	Cords			
3	Balsam Fir	Pulpwood	17.0	Cords	19.6	\$5,866.55
	Mixed Aspen		115.0	Cords		
	<i>Quaking Aspen</i>		115.0	<i>Cords</i>		
	Mixed Hardwood		16.0	Cords		
	<i>Green Ash</i>		6.0	<i>Cords</i>		
	<i>Red Maple</i>		10.0	<i>Cords</i>		
	Mixed Spruce		69.0	Cords		
	<i>Black Spruce</i>		61.0	<i>Cords</i>		
	<i>White Spruce</i>		8.0	<i>Cords</i>		
	White Pine		8.0	Cords		
	4		Balsam Fir	Pulpwood		
Mixed Aspen		101.0	Cords			
<i>Quaking Aspen</i>		101.0	<i>Cords</i>			
Mixed Hardwood		38.0	Cords			
<i>Black Ash</i>		20.0	<i>Cords</i>			
<i>Paper Birch</i>		5.0	<i>Cords</i>			
<i>Red Maple</i>		13.0	<i>Cords</i>			
Mixed Spruce		41.0	Cords			
<i>Black Spruce</i>		23.0	<i>Cords</i>			
<i>White Spruce</i>		18.0	<i>Cords</i>			
White Pine		93.0	Cords			
5		Balsam Fir	Pulpwood		143.0	Cords
	Hemlock	2.0		Cords		
	Mixed Aspen	237.0		Cords		
	<i>B. T. Aspen</i>	61.0		<i>Cords</i>		
	<i>Quaking Aspen</i>	176.0		<i>Cords</i>		
	Mixed Hardwood	221.0		Cords		
	<i>American Elm</i>	2.0		<i>Cords</i>		
	<i>Balsam Poplar</i>	22.0		<i>Cords</i>		
	<i>Green Ash</i>	101.0		<i>Cords</i>		
	<i>Paper Birch</i>	2.0		<i>Cords</i>		
	<i>Red Maple</i>	89.0		<i>Cords</i>		
	<i>Yellow Birch</i>	5.0		<i>Cords</i>		
	Mixed Spruce	5.0		Cords		
	<i>White Spruce</i>	5.0		<i>Cords</i>		
	N. White Cedar	29.0		Cords		
	White Pine	4.0		Cords		
TOTAL:			1,530.0	Cords		

Sale Specific Conditions & Requirements

Sale Name: Walking Trail GEM

Sale Number: 33-035-17 Seq#: 1

1 - Sale Area

1.2 - Boundaries

1.2.1 - Painted boundaries (1/14)

The sale boundary and Payment Unit boundaries are marked and identified by red and yellow paint. Exterior sale boundary lines against state are marked with red paint. Interior Payment Unit boundaries are marked with yellow paint. The retention area within Payment Unit 5 is bounded by red paint and needs to be protected; no harvesting activities may occur within this area. Yellow painted trees designating an interior Payment Unit boundary are only to be cut when all surrounding Payment Units have been paid for.

2 - Timber Specifications

2.1 - Included Timber

2.1.1 - Clearcut unit(s) with unmerchantable trees (6/14)

Within Payment Unit(s) 1 - 5, cut all trees that are three (3) inches or more at DBH.

3 - Payments

3.3 - Pre-measured Sales

3.3.4 - Dividing payment units (7/14)

Payment Unit(s) \$18,000 in value or greater may be divided at the request of the Purchaser and upon approval of the Unit Manager. Dividing Payment Units is a contract modification which requires a Timber Sale Contract Supplement. There will be only one division per Payment Unit.

4 - Transportation

4.2 - Maintenance

4.2.1 - Hauling restriction (12/08)

Hauling may be restricted on forest roads by the Unit Manager or his/her representative. The restriction may occur during spring breakup or during other wet weather conditions.

4.2.4 - Grading (10/16)

For completion of the sale, state forest roads must be graded. In general, this will require a road grader or bull dozer to shape up the roads after forest products have been hauled off site. This includes cleaning of drainage areas, grading, crowning and filling with gravel, if necessary. The grading equipment to be used must be approved by the Unit Manager or his/her representative.

4.4 - Access

4.4.3 - Access gate (12/08)

The access gates must be locked at the completion of each day unless otherwise approved by the Unit Manager or his/her representative.

5 - Operations

5.2 - Conduct of Operations

5.2.3 - Operating Restrictions

5.2.3.1 - Operating restrictions (9/11)

Within Payment Unit(s) 2, cutting and skidding are limited to the period of December 1st to March 31st, unless there is an extended dry or frozen period and the sale administrator approves of harvesting during that time period. This restriction is because of low wet ground throughout the Payment Unit.

5.2.22 - Operating Caution

5.2.22.1 - Operating caution (6/11)

It is recommended, but not required, that within Payment Unit(s) 3, 4, and 5, cutting and skidding occur during dry summer or frozen winter conditions. The reason for the recommendation is because of some low wet ground within the Payment Units.

5.4 - Soil Protection

5.4.1 - Rutting restriction, general (7/16)

Operations are to cease immediately if equipment and weather conditions result in rutting of roads and/or skid trails which is 12 inches or greater in depth and 50 feet in length. The Unit Manager or his/her representative may restrict hauling and/or skidding if ruts exceed the specified depth. With the Unit Manager or his/her representative's approval, the Purchaser may return to the area when the risk of rutting has decreased.

6 - Safety and Fire Prevention

6.2 - Signing

6.2.1 - Road posting (9/09)

The Purchaser is responsible for posting and maintaining caution signs on the Westman Dam and the Camp "O" Roads prior to beginning operations. The road must be posted at appropriate distances from the sale area to warn of logging activity and truck traffic. Signs must be removed when harvest operations are suspended or completed. The Purchaser will provide these signs.



TIMBER SALE MAP

This information provided by authority of Part 525, 1994 PA 451, as amended.

Forest Management Unit Escanaba Management Unit		County Menominee County	Mapped By Bealdo		Date 7/20/2017	Page 1	of 1
Township 35N	Range 25W	Section(s) and Subdivision(s) Sec 7 - NENW, NWNE, NWNW & SWNW; Sec 6 - NESW, NWSW, SESW & SWSW; Sec 8 - NENW & NWNW.			Scale 1:15,840		

Cover Type

A = Aspen	H = Hemlock	N = Marsh	U = Upland Brush
B = Paper Birch	J = Jack Pine	O = Oak	UM = Upland Mixed
C = Cedar	L = Lowland Brush	P = Lowland Poplar	V = Bog or Marsh
D = Tread Bog	LM = Lowland Mixed	Q = Mixed Swamp Conifer	W = White Pine
E = Swamp Hdwoods	M = Mpl, Bch, Brch	R = Red Pine	X = Non Stocked
F = Spruce Fir	MC = Mixed Conifer	S = Black Spruce	Z = Water
G = Grass	MD = Mixed Deciduous	T = Tamarack	

Density

0 = Non Stocked	5 = Pole Timber Medium
1 = Seedling Sapling Poor	6 = Pole Timber Well
2 = Seedling Sapling Medium	7 = Saw Timber Poor
3 = Seedling Sapling Well	8 = Saw Timber Medium
4 = Pole Timber Poor	9 = Saw Timber Well

PU	Acres	PU	Acres
1	11.9	4	20.6
2	8.4	5	24.4
3	19.6		

Walking Trail GEM
 Compartment 52
 84.9 Acres



QR Code opens map in PDF Maps App

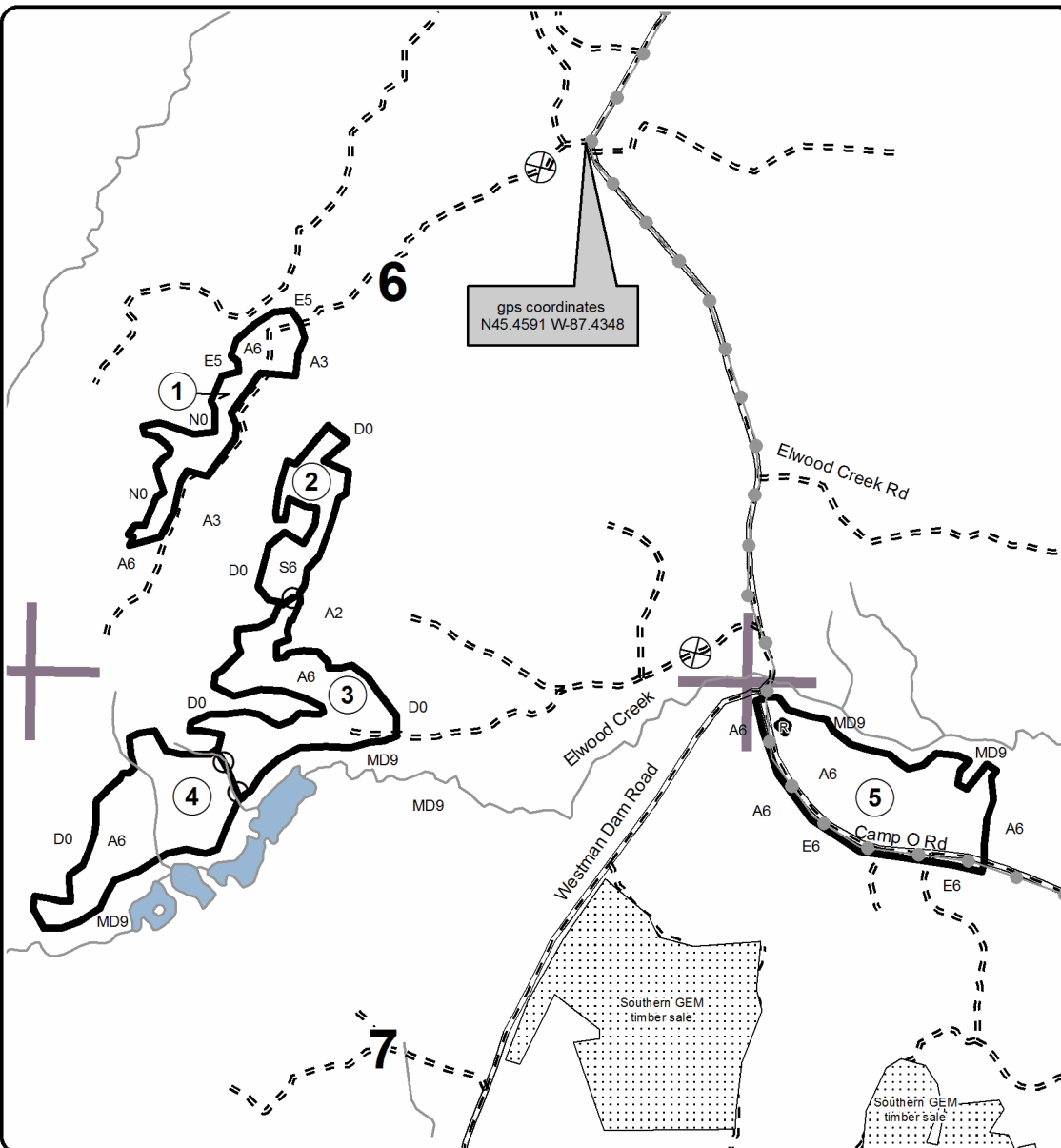

Legend

- Against State (Red)
- Payment Unit (Yellow)
- Section Corners
- 6** Section Number
- Gravel Roads
- Poor Dirt Roads
- Gate
- R** Retention Patch
- 1** Payment Unit
- Creek/Seasonal Drainage
- ORV Route

Locator Map
1:200,000

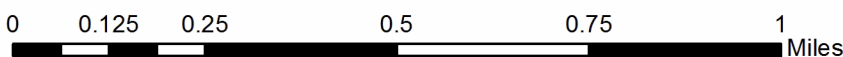
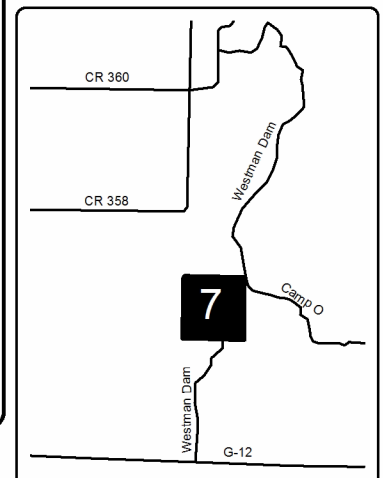

TIMBER SALE INFORMATION

Johnson Lake SBW (33-036-17)

Menominee County (Advertised Price \$36,640.00)

SALE NOTE: Payment Units 1 and 2 can be accessed through state land from the north, but the best access is through private property to the southwest. Payment Units 3 and 4 can only be accessed through private property. There is more than one access route into each of the units. The spruce budworm is present and has caused balsam fir and spruce defoliation, with minimal mortality at this time.

Access may be through private or other public land.

A timber sale contract for this lump sum, sealed bid timber sale will be awarded to the responsible bidder offering the highest sealed bid price. Bids must be at or above the following advertised price for each species:

<u>PRODUCTS & SPECIES</u>	<u>ESTIMATED UNITS*</u>	<u>ADVERTISED PRICE</u>
Sawtimber		
Red Maple	0.50 MBF	\$ 231.00 / MBF
Red Oak	10.80 MBF	\$ 225.00 / MBF
White Oak	1.20 MBF	\$ 66.00 / MBF
White Pine	23.30 MBF	\$ 62.00 / MBF
Pulpwood		
Balsam Fir	99.00 Cords	\$ 27.50 / Cord
Hemlock	3.00 Cords	\$ 11.05 / Cord
Mixed Aspen	436.00 Cords	\$ 30.00 / Cord
Mixed Hardwood	292.00 Cords	\$ 30.30 / Cord
Mixed Oak	62.00 Cords	\$ 17.85 / Cord
N. White Cedar	54.00 Cords	\$ 23.55 / Cord
White Pine	75.00 Cords	\$ 30.95 / Cord
White Spruce	132.00 Cords	\$ 24.15 / Cord

* The total volume is statistically estimated within plus (+) or minus (-) 10.17 percent. The estimated units are final and not subject to adjustment. Prospective bidders are urged to examine this timber and to make their own estimates of quantity and quality.

BOND AND PAYMENT SCHEDULE:

1. A bond in the amount of \$1,832.00 to insure faithful performance of the conditions of the contract will be deposited by the successful bidder within 21 days of the sale award.
2. Cutting in any sale or unit without the required advance payment would be considered a trespass.
3. Total payment must be paid in advance or according to the following schedule:
 - (a) Ten percent (10%) of the sale value must be paid within 21 days of the sale award.
 - (b) The 10% down payment will be credited towards the first unit cut.
4. If no cutting takes place, the 10% down payment will not be refunded.
5. Operations on the contract issued will terminate on 06/30/2020.

Description of Timber by Payment Unit (PU)

PU	MARKET GROUP	PRODUCT	QUANTITY	UNIT	ACRES	ADVERTISE PRICE
1	Red Maple	Sawtimber	0.5	MBF	9.7	\$6,725.75
	Red Oak		0.8	MBF		
	White Oak		1.2	MBF		
	White Pine		2.7	MBF		
	Balsam Fir	Pulpwood	45.0	Cords		
	Hemlock		3.0	Cords		
	Mixed Aspen		50.0	Cords		
	<i>Quaking Aspen</i>		50.0	<i>Cords</i>		
	Mixed Hardwood		33.0	Cords		
	<i>Balsam Poplar</i>		5.0	<i>Cords</i>		
	<i>Paper Birch</i>		6.0	<i>Cords</i>		
	<i>Red Maple</i>		22.0	<i>Cords</i>		
	Mixed Oak		10.0	Cords		
	<i>Red Oak</i>		3.0	<i>Cords</i>		
	<i>White Oak</i>		7.0	<i>Cords</i>		
	N. White Cedar		24.0	Cords		
	White Pine		4.0	Cords		
	White Spruce		64.0	Cords		
	2	Red Oak	Sawtimber	0.4		
Balsam Fir		Pulpwood	8.0	Cords		
Mixed Aspen			75.0	Cords		
<i>B. T. Aspen</i>			18.0	<i>Cords</i>		
<i>Quaking Aspen</i>			57.0	<i>Cords</i>		
Mixed Hardwood			33.0	Cords		
<i>American Elm</i>			2.0	<i>Cords</i>		
<i>Balsam Poplar</i>			5.0	<i>Cords</i>		
<i>Black Cherry</i>			2.0	<i>Cords</i>		
<i>Paper Birch</i>			3.0	<i>Cords</i>		
<i>Red Maple</i>			21.0	<i>Cords</i>		
Mixed Oak			10.0	Cords		
<i>Red Oak</i>			10.0	<i>Cords</i>		
N. White Cedar			2.0	Cords		
White Pine			21.0	Cords		
White Spruce		13.0	Cords			
3	White Pine	Sawtimber	1.1	MBF	17.2	\$10,026.05
	Balsam Fir	Pulpwood	28.0	Cords		
	Mixed Aspen		217.0	Cords		
	<i>B. T. Aspen</i>		28.0	<i>Cords</i>		
	<i>Quaking Aspen</i>		189.0	<i>Cords</i>		
	Mixed Hardwood		66.0	Cords		
	<i>Black Ash</i>		1.0	<i>Cords</i>		
	<i>Black Cherry</i>		3.0	<i>Cords</i>		
	<i>Red Maple</i>		62.0	<i>Cords</i>		
	N. White Cedar		2.0	Cords		
	White Pine		4.0	Cords		
	White Spruce		21.0	Cords		
	4	Red Oak	Sawtimber	9.6		
White Pine			19.5	MBF		
Balsam Fir		Pulpwood	18.0	Cords		
Mixed Aspen			94.0	Cords		
<i>B. T. Aspen</i>			29.0	<i>Cords</i>		
<i>Quaking Aspen</i>			65.0	<i>Cords</i>		
Mixed Hardwood			160.0	Cords		
<i>American Elm</i>			6.0	<i>Cords</i>		
<i>Balsam Poplar</i>			10.0	<i>Cords</i>		
<i>Paper Birch</i>			10.0	<i>Cords</i>		

Description of Timber by Payment Unit (PU), con't

PU	MARKET GROUP	PRODUCT	QUANTITY	UNIT	ACRES	ADVERTISE PRICE
4 con't	<i>Red Maple</i>	<i>Pulpwood</i>	134.0	<i>Cords</i>		
	Mixed Oak		42.0	Cords		
	<i>Red Oak</i>		42.0	<i>Cords</i>		
	N. White Cedar		26.0	Cords		
	White Pine		46.0	Cords		
	White Spruce		34.0	Cords		
TOTAL:			35.8	MBF		
TOTAL:			1,153.0	Cords		

Sale Specific Conditions & Requirements

Sale Name: Johnson Lake SBW

Sale Number: 33-036-17 Seq#: 1

1 - Sale Area

1.2 - Boundaries

1.2.1 - Painted boundaries (1/14)

The sale boundary and Payment Unit boundaries are marked and identified by blue, red and yellow paint. Exterior sale boundary lines against private property are marked with blue paint. Exterior sale boundary lines against state are marked with red paint. Interior Payment Unit boundaries are marked with yellow paint. Yellow painted trees designating an interior Payment Unit boundary are only to be cut when all surrounding Payment Units have been paid for.

2 - Timber Specifications

2.1 - Included Timber

2.1.1 - Clearcut unit(s) with unmerchantable trees (6/14)

Within Payment Unit(s) 1 - 4, cut all trees that are three (3) inches or more at DBH.

3 - Payments

3.3 - Pre-measured Sales

3.3.4 - Dividing payment units (7/14)

Payment Unit(s) \$18,000 in value or greater may be divided at the request of the Purchaser and upon approval of the Unit Manager. Dividing Payment Units is a contract modification which requires a Timber Sale Contract Supplement. There will be only one division per Payment Unit.

4 - Transportation

4.2 - Maintenance

4.2.1 - Hauling restriction (12/08)

Hauling may be restricted on forest roads by the Unit Manager or his/her representative. The restriction may occur during spring breakup or during other wet weather conditions.

4.2.4 - Grading (10/16)

For completion of the sale, state forest roads must be graded. In general, this will require a road grader or bull dozer to shape up the roads after forest products have been hauled off site. This includes cleaning of drainage areas, grading, crowning and filling with gravel, if necessary. The grading equipment to be used must be approved by the Unit Manager or his/her representative.

4.4 - Access

4.4.1 - Private property access (3/11)

Permission for access across private land is the responsibility of the Purchaser. Should the Purchaser desire to cross private land, a copy of the written permission from the private land-owner will be required by the DNR. A copy of the written permission from each of the private landowners must be given to the Unit Manager prior to the beginning of operations in a given Payment Unit.

5 - Operations

5.2 - Conduct of Operations

5.2.22 - Operating Caution

5.2.22.1 - Operating caution (6/11)

It is recommended, but not required, that within Payment Unit(s) 1 and 2, cutting and skidding occur during dry summer or frozen winter conditions. The reason for the recommendation is because of some low wet ground within each of the Payment Units and also on the access routes.

5.4 - Soil Protection

5.4.1 - Rutting restriction, general (7/16)

Operations are to cease immediately if equipment and weather conditions result in rutting of roads and/or skid trails which is 12 inches or greater in depth and 50 feet in length. The Unit Manager or his/her representative may restrict hauling and/or skidding if ruts exceed the specified depth. With the Unit Manager or his/her representative's approval, the Purchaser may return to the area when the risk of rutting has decreased.

7 - Other Conditions

7.5 - Loss

7.5.1 - Deteriorating timber (7/09)

The sale area has received damage from the spruce budworm. The Purchaser should harvest the wood as soon as possible. The Department of Natural Resources is held free of responsibility of any further damage or deterioration due to delay in harvesting.



TIMBER SALE MAP

This information provided by authority of Part 525, 1994 PA 451, as amended.

Sale Number	Year
33-036	17

Forest Management Unit Escanaba Management Unit	County Menominee County	Mapped By Bealdo	Date 7/17/2017	Page 1	of 1
Cruised By Salter, Bealdo					

Township 35N	Range 28W	Section(s) and Subdivision(s) Sec 2 - NWSE, SWSE, SESE & SWSW; Sec 3 - SWNE & NWNE	Scale 1:15,840
-----------------	--------------	---	-------------------

Cover Type				Density	
A = Aspen	H = Hemlock	N = Marsh	U = Upland Brush	0 = Non Stocked	5 = Pole Timber Medium
B = Paper Birch	J = Jack Pine	O = Oak	UM = Upland Mixed	1 = Seedling Sapling Poor	6 = Pole Timber Well
C = Cedar	L = Lowland Brush	P = Lowland Poplar	V = Bog or Marsh	2 = Seedling Sapling Medium	7 = Saw Timber Poor
D = Tread Bog	LM = Lowland Mixed	Q = Mixed Swamp Conifer	W = White Pine	3 = Seedling Sapling Well	8 = Saw Timber Medium
E = Swamp Hdwoods	M = Mpl, Bch, Brch	R = Red Pine	X = Non Stocked	4 = Pole Timber Poor	9 = Saw Timber Well
F = Spruce Fir	MC = Mixed Conifer	S = Black Spruce	Z = Water		
G = Grass	MD = Mixed Deciduous	T = Tamarack			

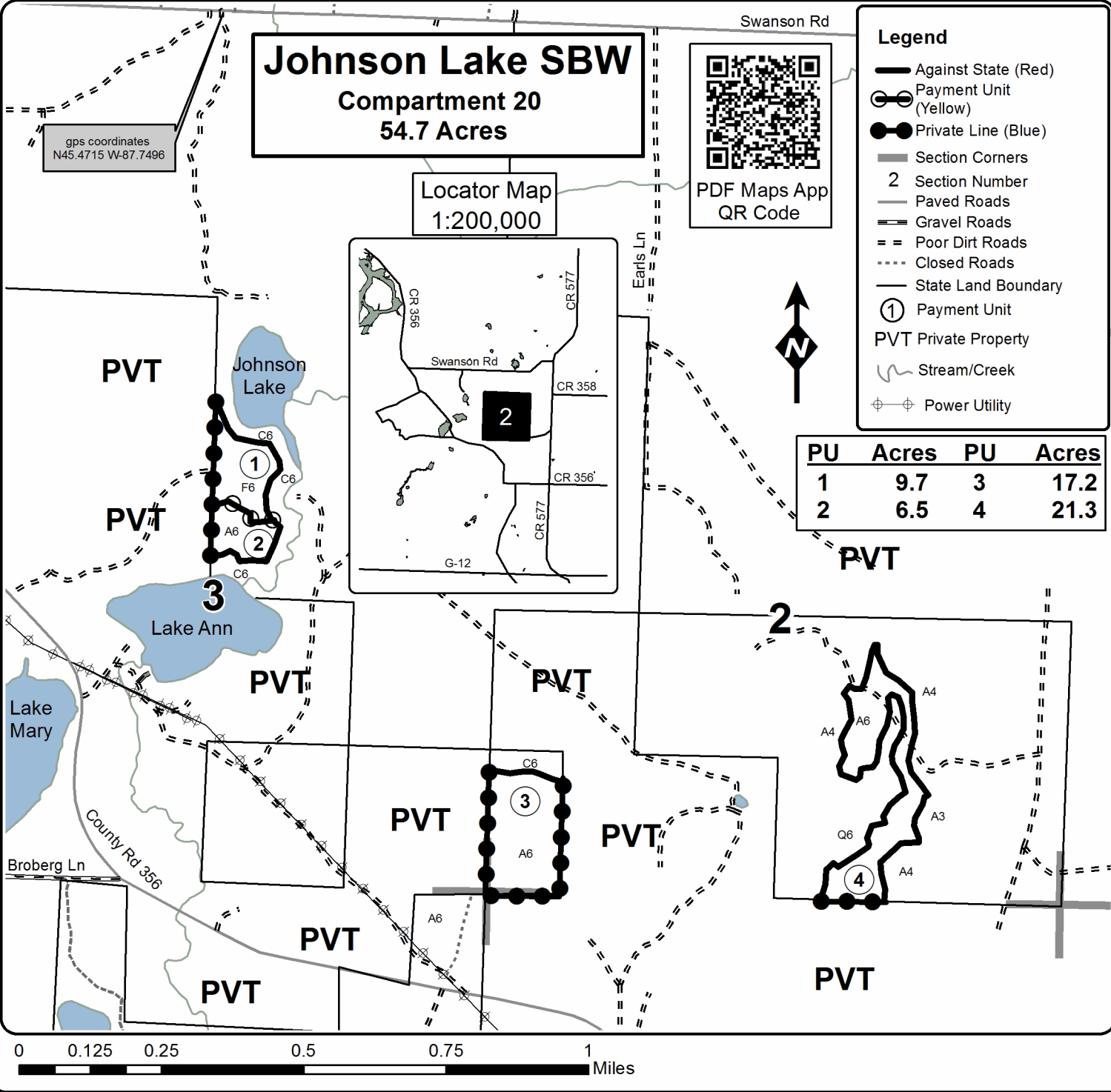

TIMBER SALE INFORMATION

File of Bones SBW (33-040-17)

Menominee County (Advertised Price \$65,224.95)

SALE NOTE: The tamarack within the sale is being defoliated by the eastern larch beetle. There are some small pockets of mortality at this time. The spruce budworm is also present, causing defoliation of the spruce/fir. There has been some mortality.

A timber sale contract for this lump sum, sealed bid timber sale will be awarded to the responsible bidder offering the highest sealed bid price. Bids must be at or above the following advertised price for each species:

<u>PRODUCTS & SPECIES</u>	<u>ESTIMATED UNITS*</u>	<u>ADVERTISED PRICE</u>
Sawtimber		
White Pine	2.60 MBF	\$ 49.00 / MBF
Pulpwood		
Balsam Fir	29.00 Cords	\$ 21.60 / Cord
Mixed Aspen	69.00 Cords	\$ 23.60 / Cord
Mixed Hardwood	132.00 Cords	\$ 23.80 / Cord
Mixed Spruce	728.00 Cords	\$ 19.00 / Cord
N. White Cedar	1,694.00 Cords	\$ 18.50 / Cord
Red Pine	13.00 Cords	\$ 47.75 / Cord
Tamarack	1,048.00 Cords	\$ 12.25 / Cord
White Pine	44.00 Cords	\$ 24.35 / Cord

* The total volume is statistically estimated within plus (+) or minus (-) 11.37 percent. The estimated units are final and not subject to adjustment. Prospective bidders are urged to examine this timber and to make their own estimates of quantity and quality.

BOND AND PAYMENT SCHEDULE:

1. A bond in the amount of \$3,261.00 to insure faithful performance of the conditions of the contract will be deposited by the successful bidder within 21 days of the sale award.
2. Cutting in any sale or unit without the required advance payment would be considered a trespass.
3. Total payment must be paid in advance or according to the following schedule:
 - (a) Ten percent (10%) of the sale value must be paid within 21 days of the sale award.
 - (b) The 10% down payment will be credited towards the first unit cut.
4. If no cutting takes place, the 10% down payment will not be refunded.
5. Operations on the contract issued will terminate on 06/30/2020.

Description of Timber by Payment Unit (PU)

PU	MARKET GROUP	PRODUCT	QUANTITY	UNIT	ACRES	ADVERTISE PRICE
1	Balsam Fir	Pulpwood	1.0	Cords	27.1	\$9,835.70
	Mixed Aspen		1.0	Cords		
	<i>Quaking Aspen</i>		1.0	<i>Cords</i>		
	Mixed Hardwood		6.0	Cords		
	<i>Balsam Poplar</i>		3.0	<i>Cords</i>		
	<i>Black Ash</i>		1.0	<i>Cords</i>		
	<i>Paper Birch</i>		2.0	<i>Cords</i>		
	Mixed Spruce		113.0	Cords		
	<i>Black Spruce</i>		113.0	<i>Cords</i>		
	N. White Cedar		277.0	Cords		
	Tamarack		190.0	Cords		
	White Pine		2.0	Cords		
	2		Balsam Fir	Pulpwood		
Mixed Aspen		1.0	Cords			
<i>Quaking Aspen</i>		1.0	<i>Cords</i>			
Mixed Hardwood		7.0	Cords			
<i>Balsam Poplar</i>		4.0	<i>Cords</i>			
<i>Black Ash</i>		1.0	<i>Cords</i>			
<i>Paper Birch</i>		2.0	<i>Cords</i>			
Mixed Spruce		151.0	Cords			
<i>Black Spruce</i>		151.0	<i>Cords</i>			
N. White Cedar		371.0	Cords			
Tamarack		255.0	Cords			
White Pine		2.0	Cords			
3		Mixed Hardwood	Pulpwood		2.0	Cords
	<i>Balsam Poplar</i>	1.0		<i>Cords</i>		
	<i>Paper Birch</i>	1.0		<i>Cords</i>		
	Mixed Spruce	58.0		Cords		
	<i>Black Spruce</i>	58.0		<i>Cords</i>		
	N. White Cedar	143.0		Cords		
	Tamarack	98.0		Cords		
	White Pine	1.0		Cords		
4	Balsam Fir	Pulpwood	1.0	Cords	16.9	\$6,148.20
	Mixed Aspen		1.0	Cords		
	<i>Quaking Aspen</i>		1.0	<i>Cords</i>		
	Mixed Hardwood		3.0	Cords		
	<i>Balsam Poplar</i>		2.0	<i>Cords</i>		
	<i>Paper Birch</i>		1.0	<i>Cords</i>		
	Mixed Spruce		71.0	Cords		
	<i>Black Spruce</i>		71.0	<i>Cords</i>		
	N. White Cedar		173.0	Cords		
	Tamarack		119.0	Cords		
	White Pine		1.0	Cords		
5	Balsam Fir	Pulpwood	1.0	Cords	28.0	\$10,170.20
	Mixed Aspen		1.0	Cords		
	<i>Quaking Aspen</i>		1.0	<i>Cords</i>		
	Mixed Hardwood		6.0	Cords		
	<i>Balsam Poplar</i>		3.0	<i>Cords</i>		
	<i>Black Ash</i>		1.0	<i>Cords</i>		
	<i>Paper Birch</i>		2.0	<i>Cords</i>		
	Mixed Spruce		117.0	Cords		
	<i>Black Spruce</i>		117.0	<i>Cords</i>		
	N. White Cedar		287.0	Cords		
	Tamarack		196.0	Cords		
	White Pine		2.0	Cords		
	6		Balsam Fir	Pulpwood		

Description of Timber by Payment Unit (PU), con't

PU	MARKET GROUP	PRODUCT	QUANTITY	UNIT	ACRES	ADVERTISE PRICE
6 con't	Mixed Aspen	Pulpwood	1.0	Cords		
	<i>Quaking Aspen</i>		1.0	<i>Cords</i>		
	Mixed Hardwood		3.0	Cords		
	<i>Balsam Poplar</i>		2.0	<i>Cords</i>		
	<i>Paper Birch</i>		1.0	<i>Cords</i>		
	Mixed Spruce		85.0	Cords		
	<i>Black Spruce</i>		85.0	<i>Cords</i>		
	N. White Cedar		208.0	Cords		
	Tamarack		142.0	Cords		
	White Pine		1.0	Cords		
7	Mixed Hardwood	Pulpwood	28.0	Cords	7.6	\$4,444.90
	<i>Balsam Poplar</i>		10.0	<i>Cords</i>		
	<i>Black Ash</i>		16.0	<i>Cords</i>		
	<i>Paper Birch</i>		2.0	<i>Cords</i>		
	Mixed Spruce		15.0	Cords		
	<i>Black Spruce</i>		15.0	<i>Cords</i>		
	N. White Cedar		165.0	Cords		
	Tamarack		36.0	Cords		
8	Mixed Hardwood	Pulpwood	48.0	Cords	4.1	\$1,365.90
	<i>Balsam Poplar</i>		2.0	<i>Cords</i>		
	<i>Black Ash</i>		46.0	<i>Cords</i>		
	Mixed Spruce		3.0	Cords		
	<i>White Spruce</i>		3.0	<i>Cords</i>		
	N. White Cedar		9.0	Cords		
9	White Pine	Sawtimber	1.5	MBF	10.5	\$1,411.55
	Balsam Fir	Pulpwood	5.0	Cords		
	Mixed Aspen		8.0	Cords		
	<i>Quaking Aspen</i>		8.0	<i>Cords</i>		
	Mixed Hardwood		8.0	Cords		
	<i>American Elm</i>		1.0	<i>Cords</i>		
	<i>Balsam Poplar</i>		3.0	<i>Cords</i>		
	<i>Black Ash</i>		2.0	<i>Cords</i>		
	<i>Red Maple</i>		2.0	<i>Cords</i>		
	Mixed Spruce		19.0	Cords		
	<i>White Spruce</i>		19.0	<i>Cords</i>		
	N. White Cedar		12.0	Cords		
	White Pine		11.0	Cords		
10	White Pine	Sawtimber	1.1	MBF	18.2	\$3,093.45
	Balsam Fir	Pulpwood	8.0	Cords		
	Mixed Aspen		31.0	Cords		
	<i>B. T. Aspen</i>		2.0	<i>Cords</i>		
	<i>Quaking Aspen</i>		29.0	<i>Cords</i>		
	Mixed Hardwood		8.0	Cords		
	<i>American Elm</i>		2.0	<i>Cords</i>		
	<i>Balsam Poplar</i>		1.0	<i>Cords</i>		
	<i>Black Ash</i>		3.0	<i>Cords</i>		
	<i>Northern Pin Oak</i>		2.0	<i>Cords</i>		
	Mixed Spruce		58.0	Cords		
	<i>White Spruce</i>		58.0	<i>Cords</i>		
	Red Pine		10.0	Cords		
	White Pine		15.0	Cords		
11	Balsam Fir	Pulpwood	11.0	Cords	12.5	\$3,274.90
	Mixed Aspen		25.0	Cords		
	<i>Quaking Aspen</i>		25.0	<i>Cords</i>		
	Mixed Hardwood		13.0	Cords		
	<i>Balsam Poplar</i>		4.0	<i>Cords</i>		

Description of Timber by Payment Unit (PU), con't

PU	MARKET GROUP	PRODUCT	QUANTITY	UNIT	ACRES	ADVERTISE PRICE
11 con't	<i>Black Cherry</i>	<i>Pulpwood</i>	1.0	<i>Cords</i>		
	<i>Northern Pin Oak</i>		1.0	<i>Cords</i>		
	<i>Paper Birch</i>		7.0	<i>Cords</i>		
	Mixed Spruce		38.0	Cords		
	<i>Black Spruce</i>		13.0	<i>Cords</i>		
	<i>White Spruce</i>		25.0	<i>Cords</i>		
	N. White Cedar		49.0	Cords		
	Red Pine		3.0	Cords		
	Tamarack		12.0	Cords		
	White Pine		9.0	Cords		
TOTAL:			2.6	MBF		
TOTAL:			3,757.0	Cords		

Sale Specific Conditions & Requirements

Sale Name: File of Bones SBW

Sale Number: 33-040-17 Seq#: 1

1 - Sale Area

1.2 - Boundaries

1.2.1 - Painted boundaries (1/14)

The sale boundary and Payment Unit boundaries are marked and identified by blue, red and yellow paint. Exterior sale boundary lines against private property are marked with blue paint. Exterior sale boundary lines against state are marked with red paint. Interior Payment Unit boundaries are marked with yellow paint. Retention patches are bounded by red paint and need to be protected; no harvesting activities may occur within these areas. The painted boundary line trees are not Included Timber and are to be protected. Yellow painted trees designating an interior Payment Unit boundary are only to be cut when all surrounding Payment Units have been paid for.

2 - Timber Specifications

2.1 - Included Timber

2.1.1 - Clearcut unit(s) with unmerchantable trees (6/14)

Within Payment Unit(s) 1 - 8, and 11, cut all trees that are three (3) inches or more at DBH; except do not cut trees marked with green paint within Payment Units 1 - 7 and 11.

2.1.2 - Clearcut unit(s) w/o unmerchantable trees (8/11)

Within Payment Unit(s) 9 and 10, cut all trees which meet minimum piece specifications in 2.2 Utilization; except do not cut trees marked with green paint. In addition, do not cut cedar within Payment Unit 10.

2.2 - Utilization

2.2.4 - Skidding length (2/14)

Skidding of unlimbed tops or lengths over 17 feet is not permissible within Payment Units 9 and 10. This is to protect the advanced regeneration throughout the Payment Units.

3 - Payments

3.3 - Pre-measured Sales

3.3.4 - Dividing payment units (7/14)

Payment Unit(s) \$18,000 in value or greater may be divided at the request of the Purchaser and upon approval of the Unit Manager. Dividing Payment Units is a contract modification which requires a Timber Sale Contract Supplement. There will be only one division per Payment Unit.

3.4 - Damaged Timber

3.4.1 - Damaged timber (6/14)

General Condition and Requirement 3.4 Damaged Timber, defines liquidated damages for undesignated live merchantable trees which are cut or injured. In addition, extreme care should be taken to avoid damage to tree seedlings and saplings.

Within Payment Units 9 and 10, if more than 40% of the tree seedlings or saplings (1/4" to 4.5" DBH) within a specified portion of the sale area are damaged, liquidated damages will be assessed at \$500 per acre for all acreage within that specified portion of the sale area that was damaged.

4 - Transportation

4.1 - Construction

4.1.2 - Stream crossings, specific (3/11)

There is an intermittent stream that runs between the two parts of Payment Unit 10 and along the northern edge, within the retention patch, as shown on the Timber Sale Map. Crossing this stream will not be permitted. The Payment Units are accessible without the necessity of crossing the stream.

4.1.7 - Road closure (10/11)

All new roads built into the sale must be blocked to vehicle traffic upon completion of the sale. Overgrown roads that are reopened shall be considered new roads. In general, this will require constructing a four (4') foot high berm of stumps and logs covered with earth. These roads must be rendered impassable to cars and trucks. Contact the sale administrator for specific details of design and placement.

4.2 - Maintenance

4.2.1 - Hauling restriction (12/08)

Hauling may be restricted on forest roads by the Unit Manager or his/her representative. The restriction may occur during spring breakup or during other wet weather conditions.

4.2.4 - Grading (10/16)

For completion of the sale, state forest roads must be graded. In general, this will require a road grader or bull dozer to shape up the roads after forest products have been hauled off site. This includes cleaning of drainage areas, grading, crowning and filling with gravel, if necessary. The grading equipment to be used must be approved by the Unit Manager or his/her representative.

5 - Operations

5.2 - Conduct of Operations

5.2.3 - Operating Restrictions

5.2.3.1 - Operating restrictions (9/11)

Within Payment Unit(s) 1 - 8, cutting and skidding are limited to the period of December 1st to March 31st, unless there is an extended dry or frozen period and the sale administrator approves of harvesting at that time. This restriction is because of low wet ground throughout the Payment Units.

5.2.3.11 - Coppice regeneration protection (4/10)

Within Payment Unit 11, harvesting is limited to October 1st through April 15th. This is to promote aspen regeneration.

5.2.22 - Operating Caution

5.2.22.1 - Operating caution (6/11)

It is recommended, but not required, that within Payment Unit(s) 9, cutting and skidding occur during dry summer or frozen winter conditions. The reason for the recommendation is because of some low wet ground within the Payment Unit.

5.4 - Soil Protection

5.4.1 - Rutting restriction, general (7/16)

Operations are to cease immediately if equipment and weather conditions result in rutting of roads and/or skid trails which is 12 inches or greater in depth and 50 feet in length. The Unit Manager or his/her representative may restrict hauling and/or skidding if ruts exceed the specified depth. With the Unit Manager or his/her representative's approval, the Purchaser may return to the area when the risk of rutting has decreased.

6 - Safety and Fire Prevention

6.2 - Signing

6.2.1 - Road posting (9/09)

The Purchaser is responsible for posting and maintaining caution signs on the Houte's Spur Road prior to beginning operations. The road must be posted at appropriate distances from the sale area to warn of logging activity and truck traffic. Signs must be removed when harvest operations are suspended or completed. The Purchaser will provide these signs.

7 - Other Conditions

7.2 - Extensions

7.2.5 - Weather related extension (1/13)

If weather conditions during the operating period of this contract prevent harvesting, this sale may qualify for a weather related extension. If approved, the normal extension fee would be waived. To qualify, there must be a documented attempt each year to harvest in the difficult portion of the sale.

7.5 - Loss

7.5.1 - Deteriorating timber (7/09)

The sale area has received damage from the spruce budworm and the eastern larch beetle. The Purchaser should harvest the wood as soon as possible. The Department of Natural Resources is held free of responsibility of any further damage or deterioration due to delay in harvesting. There is a minor amount of mortality at this time.



TIMBER SALE MAP

This information provided by authority of Part 525, 1994 PA 451, as amended.

Sale Number	Year
33-040	17

Forest Management Unit Escanaba Management Unit	County Menominee County	Mapped By Beaudo	Date 9/20/2017	Page 1	of 1
		Cruised By Salter, Beaudo			

Township 37N	Range 28W	Section(s) and Subdivision(s) Sec 9 - NESE, NWSE, SESE, SWSE; Sec 10 - NENE, NENW, NESE, NWNE, NWSW, SENE, SENW, SESE, SWNE, SWNW, SWSW; Sec 15 - NWNW, Sec 16 - NWNE	Scale 1:15,840
-----------------	--------------	--	-------------------

Cover Type				Density			
A = Aspen	H = Hemlock	N = Marsh	U = Upland Brush	0 = Non Stocked	5 = Pole Timber Medium		
B = Paper Birch	J = Jack Pine	O = Oak	UM = Upland Mixed	1 = Seedling Sapling Poor	6 = Pole Timber Well		
C = Cedar	L = Lowland Brush	P = Lowland Poplar	V = Bog or Marsh	2 = Seedling Sapling Medium	7 = Saw Timber Poor		
D = Treed Bog	LM = Lowland Mixed	Q = Mixed Swamp Conifer	W = White Pine	3 = Seedling Sapling Well	8 = Saw Timber Medium		
E = Swamp Hdwoods	M = Mpl, Bch, Brch	R = Red Pine	X = Non Stocked	4 = Pole Timber Poor	9 = Saw Timber Well		
F = Spruce Fir	MC = Mixed Conifer	S = Black Spruce	Z = Water				
G = Grass	MD = Mixed Deciduous	T = Tamarack					

PU	Acres	PU	Acres
1	27.1	7	7.6
2	36.2	8	4.1
3	14.0	9	10.5
4	16.9	10	18.2
5	28.0	11	12.5
6	20.3		

Pile of Bones SBW
Compartment 7
195.4 Acres

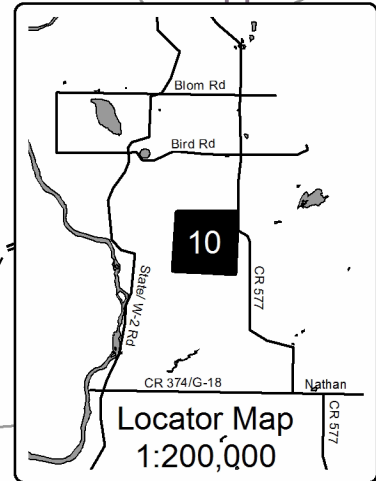

Legend

- Against State (Red)
- Payment Unit (Yellow)
- Private Line (Blue)
- Section Corners
- 10 Section Number
- Paved Roads
- Gravel Roads
- == Poor Dirt Roads
- Closed Roads
- State Land Boundary
- ① Payment Unit
- Ⓡ Retention Patch
- ~ Creek/Seasonal Drain

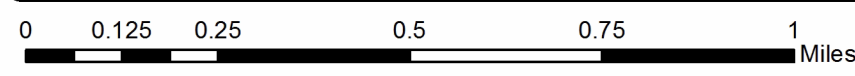
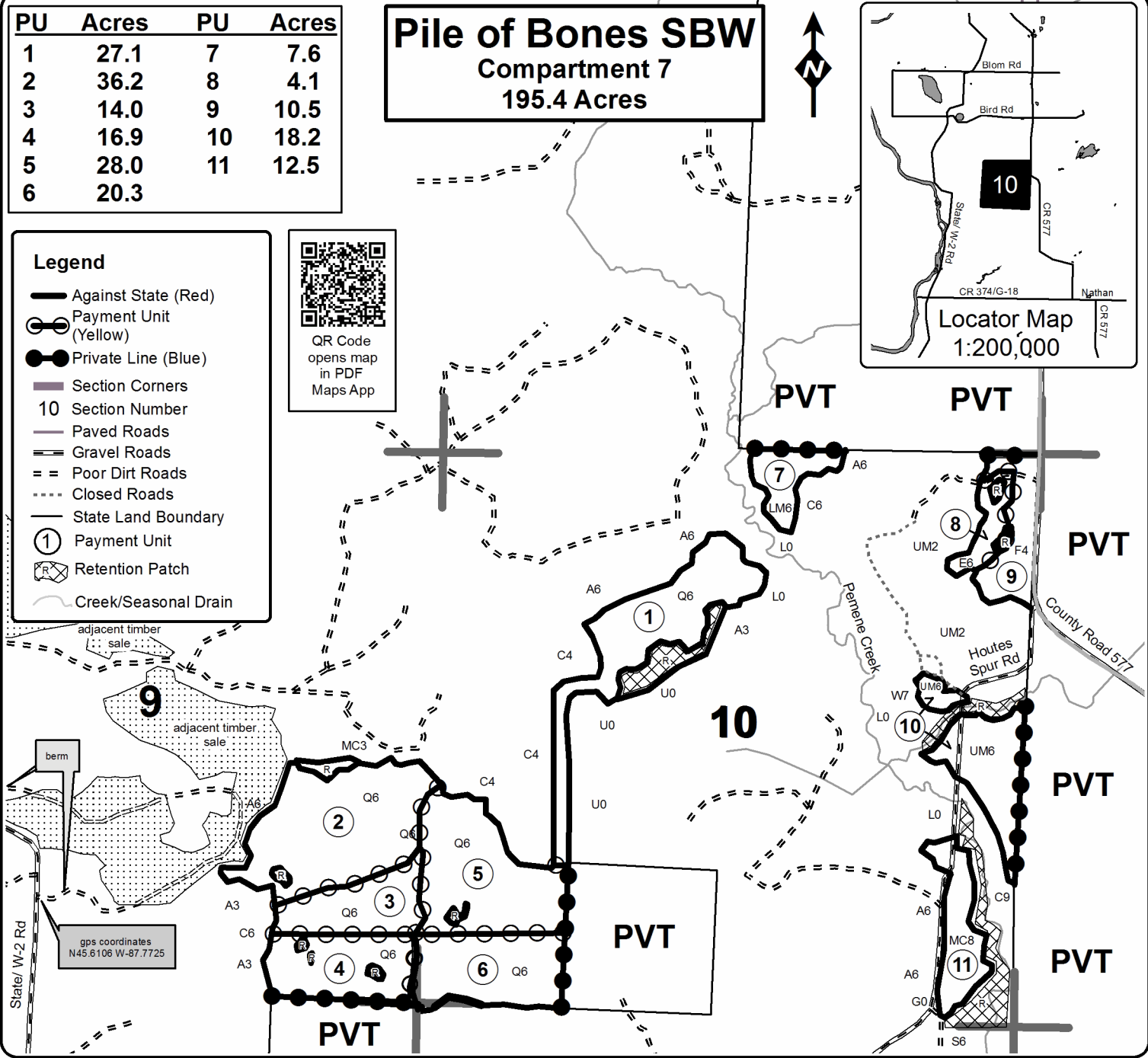

TIMBER SALE INFORMATION

Wiregrass Conifer (33-041-17)

Menominee County (Advertised Price \$31,191.55)

SALE NOTE: The spruce budworm and eastern larch beetle has caused some defoliation, but only a very small amount of mortality, at this time.

A timber sale contract for this lump sum, sealed bid timber sale will be awarded to the responsible bidder offering the highest sealed bid price. Bids must be at or above the following advertised price for each species:

<u>PRODUCTS & SPECIES</u>	<u>ESTIMATED UNITS*</u>	<u>ADVERTISED PRICE</u>
Pulpwood		
Balsam Fir	7.00 Cords	\$ 27.50 / Cord
Black Spruce	700.00 Cords	\$ 24.15 / Cord
Mixed Hardwood	47.00 Cords	\$ 30.30 / Cord
N. White Cedar	372.00 Cords	\$ 23.55 / Cord
Quaking Aspen	8.00 Cords	\$ 30.00 / Cord
Tamarack	230.00 Cords	\$ 15.55 / Cord
White Pine	3.00 Cords	\$ 30.95 / Cord

* The total volume is statistically estimated within plus (+) or minus (-) 13.09 percent. The estimated units are final and not subject to adjustment. Prospective bidders are urged to examine this timber and to make their own estimates of quantity and quality.

BOND AND PAYMENT SCHEDULE:

1. A bond in the amount of \$1,560.00 to insure faithful performance of the conditions of the contract will be deposited by the successful bidder within 21 days of the sale award.
2. Cutting in any sale or unit without the required advance payment would be considered a trespass.
3. Total payment must be paid in advance or according to the following schedule:
 - (a) Ten percent (10%) of the sale value must be paid within 21 days of the sale award.
 - (b) The 10% down payment will be credited towards the first unit cut.
4. If no cutting takes place, the 10% down payment will not be refunded.
5. Operations on the contract issued will terminate on 06/30/2020.

Description of Timber by Payment Unit (PU)

PU	MARKET GROUP	PRODUCT	QUANTITY	UNIT	ACRES	ADVERTISE PRICE
1	Black Spruce	Pulpwood	125.0	Cords	15.5	\$4,932.15
	Mixed Hardwood		2.0	Cords		
	<i>Red Maple</i>		2.0	<i>Cords</i>		
	N. White Cedar		45.0	Cords		
	Tamarack		51.0	Cords		
2	Balsam Fir	Pulpwood	5.0	Cords	14.5	\$6,371.60
	Black Spruce		44.0	Cords		
	Mixed Hardwood		30.0	Cords		
	<i>Balsam Poplar</i>		7.0	<i>Cords</i>		
	<i>Black Ash</i>		19.0	<i>Cords</i>		
	<i>Red Maple</i>		4.0	<i>Cords</i>		
	N. White Cedar		141.0	Cords		
	Quaking Aspen		6.0	Cords		
	Tamarack		49.0	Cords		
3	Black Spruce	Pulpwood	162.0	Cords	16.5	\$7,955.25
	Mixed Hardwood		1.0	Cords		
	<i>Black Ash</i>		1.0	<i>Cords</i>		
	N. White Cedar		107.0	Cords		
	Tamarack		96.0	Cords		
4	Balsam Fir	Pulpwood	2.0	Cords	18.8	\$11,932.55
	Black Spruce		369.0	Cords		
	Mixed Hardwood		14.0	Cords		
	<i>Black Ash</i>		3.0	<i>Cords</i>		
	<i>Paper Birch</i>		3.0	<i>Cords</i>		
	<i>Red Maple</i>		8.0	<i>Cords</i>		
	N. White Cedar		79.0	Cords		
	Quaking Aspen		2.0	Cords		
	Tamarack		34.0	Cords		
	White Pine		3.0	Cords		
TOTAL:			1,367.0	Cords		

Sale Specific Conditions & Requirements

Sale Name: Wiregrass Conifer

Sale Number: 33-041-17 Seq#: 1

1 - Sale Area

1.2 - Boundaries

1.2.1 - Painted boundaries (1/14)

The sale boundary and Payment Unit boundaries are marked and identified by red and yellow paint. Exterior sale boundary lines against state are marked with red paint. Interior Payment Unit boundaries are marked with yellow paint. The retention patch within Payment Unit 4 is bounded by red paint and needs to be protected; no harvesting activities may occur within this area. Yellow painted trees designating an interior Payment Unit boundary are only to be cut when all surrounding Payment Units have been paid for.

2 - Timber Specifications

2.1 - Included Timber

2.1.1 - Clearcut unit(s) with unmerchantable trees (6/14)

Within Payment Unit(s) 1 - 4, cut all trees that are three (3) inches or more at DBH; except cedar marked with green paint.

3 - Payments

3.3 - Pre-measured Sales

3.3.4 - Dividing payment units (7/14)

Payment Unit(s) \$18,000 in value or greater may be divided at the request of the Purchaser and upon approval of the Unit Manager. Dividing Payment Units is a contract modification which requires a Timber Sale Contract Supplement. There will be only one division per Payment Unit.

4 - Transportation

4.2 - Maintenance

4.2.1 - Hauling restriction (12/08)

Hauling may be restricted on forest roads by the Unit Manager or his/her representative. The restriction may occur during spring breakup or during other wet weather conditions.

4.2.4 - Grading (10/16)

For completion of the sale, state forest roads must be graded. In general, this will require a road grader or bull dozer to shape up the roads after forest products have been hauled off site. This includes cleaning of drainage areas, grading, crowning and filling with gravel, if necessary. The grading equipment to be used must be approved by the Unit Manager or his/her representative.

5 - Operations

5.2 - Conduct of Operations

5.2.3 - Operating Restrictions

5.2.3.1 - Operating restrictions (9/11)

Within Payment Unit(s) 1 - 4, cutting and skidding are limited to the period of December 1st to March 31st, unless there is an extended dry or frozen period and the sale administrator approves of harvesting during that time period. This restriction is because of low wet ground throughout all Payment Units.

5.4 - Soil Protection

5.4.1 - Rutting restriction, general (7/16)

Operations are to cease immediately if equipment and weather conditions result in rutting of roads and/or skid trails which is 12 inches or greater in depth and 50 feet in length. The Unit Manager or his/her representative may restrict hauling and/or skidding if ruts exceed the specified depth. With the Unit Manager or his/her representative's approval, the Purchaser may

return to the area when the risk of rutting has decreased.



TIMBER SALE MAP

This information provided by authority of Part 525, 1994 PA 451, as amended.

Forest Management Unit Escanaba Management Unit		County Menominee County	Mapped By Bealdo	Date 8/30/2017	Page 1	of 1
Township 36N	Range 27W	Section(s) and Subdivision(s) Sec 5 - NENW, NWNE, SENW & SWNE		Scale 1:15,840		

Cover Type

A = Aspen	H = Hemlock	N = Marsh	U = Upland Brush
B = Paper Birch	J = Jack Pine	O = Oak	UM = Upland Mixed
C = Cedar	L = Lowland Brush	P = Lowland Poplar	V = Bog or Marsh
D = Treed Bog	LM = Lowland Mixed	Q = Mixed Swamp Conifer	W = White Pine
E = Swamp Hdwoods	M = Mpl, Bch, Brch	R = Red Pine	X = Non Stocked
F = Spruce Fir	MC = Mixed Conifer	S = Black Spruce	Z = Water
G = Grass	MD = Mixed Deciduous	T = Tamarack	

Density

0 = Non Stocked	5 = Pole Timber Medium
1 = Seedling Sapling Poor	6 = Pole Timber Well
2 = Seedling Sapling Medium	7 = Saw Timber Poor
3 = Seedling Sapling Well	8 = Saw Timber Medium
4 = Pole Timber Poor	9 = Saw Timber Well

PU	Acres	PU	Acres
1	15.5	3	16.5
2	14.5	4	18.8

Wiregrass Conifer
Compartment 13
65.3 Acres



QR Code opens map in PDF Maps App

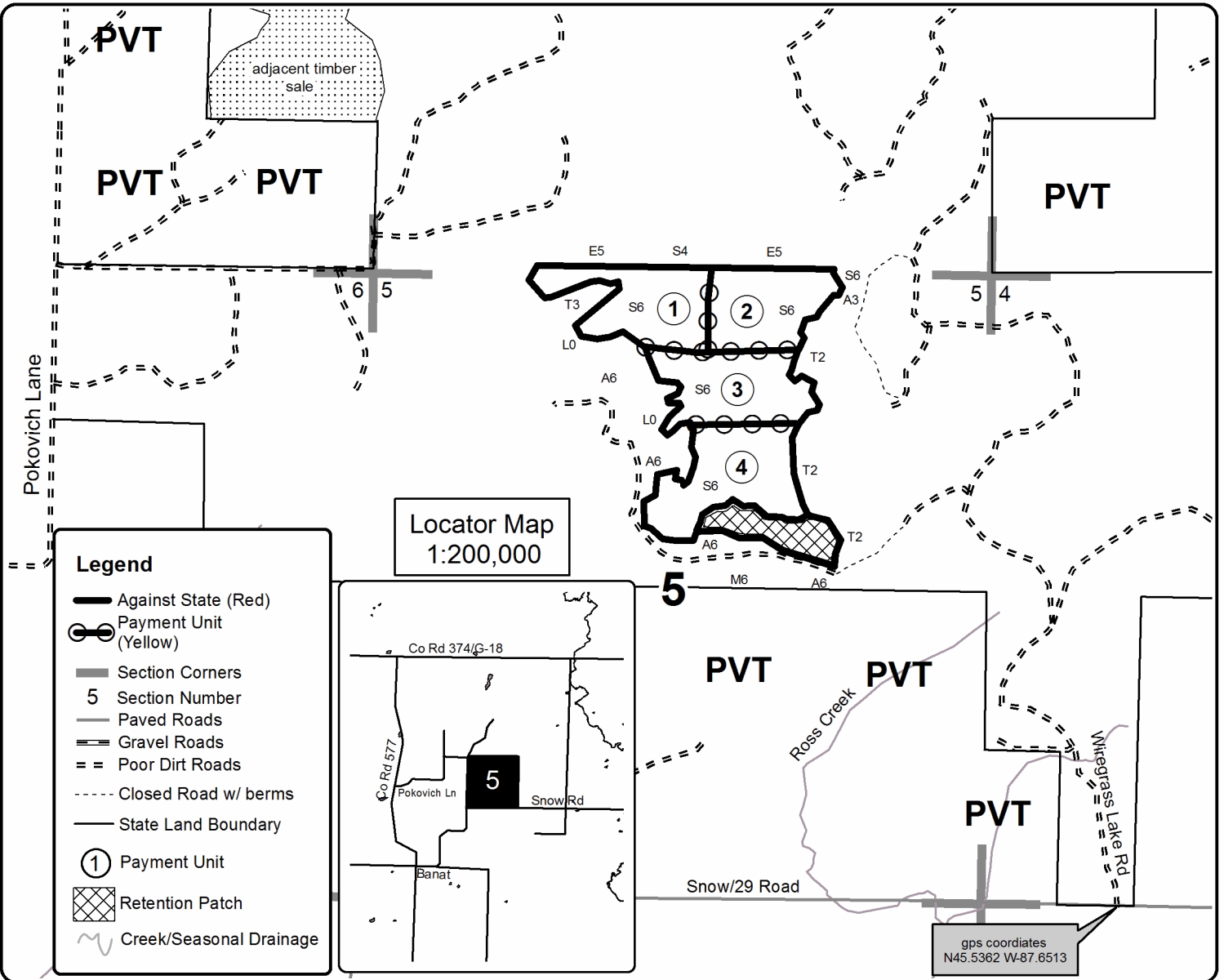

Locator Map 1:200,000

Legend

- Against State (Red)
- Payment Unit (Yellow)
- Section Corners
- 5** Section Number
- Paved Roads
- Gravel Roads
- Poor Dirt Roads
- Closed Road w/ berms
- State Land Boundary
- Payment Unit
- Retention Patch
- Creek/Seasonal Drainage

gps coordinates
N45.5362 W-87.6513

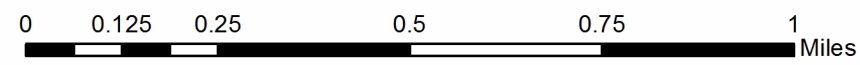

Southern GEM (33-034-17)
; Menominee COUNTY

In response to the notice of sale to be held 3:00 p.m. (local time) on December 19, 2017, I am hereby submitting my sealed bid (firm offer) for the following forest products to be cut. Bids for individual species must be at or above the advertised price. All non-responsive bid forms may be rejected.

<u>PRODUCTS & SPECIES</u>	<u>ESTIMATED VOLUME*</u>	<u>ADVERTISED PRICE</u>	<u>BID PRICE/UNIT</u>
Sawtimber			
Red Maple	4.70 MBF	\$ 247.00/MBF	\$ _____
White Pine	26.70 MBF	\$ 66.00/MBF	\$ _____
Pulpwood			
Balsam Fir	124.00 Cords	\$ 29.45/Cord	\$ _____
Mixed Aspen	910.00 Cords	\$ 32.15/Cord	\$ _____
Mixed Hardwood	616.00 Cords	\$ 32.45/Cord	\$ _____
Mixed Spruce	30.00 Cords	\$ 25.90/Cord	\$ _____
N. White Cedar	17.00 Cords	\$ 25.25/Cord	\$ _____
Red Pine	8.00 Cords	\$ 65.10/Cord	\$ _____
White Pine	165.00 Cords	\$ 33.20/Cord	\$ _____

*The volumes are statistically estimated within plus (+) or minus (-) 10.12 percent. These estimated volumes are final and not subject to adjustment. Prospective bidders are urged to examine this timber and to make their own estimates of quantity and quality.

I understand that any or all bids may be rejected. All bids must be signed and all bid items must be bid or the bid form may be rejected. I also understand that consideration and awarding a contract will be based upon my past performance and ability to complete the contract based upon equipment and staffing subject to my control.

FEDERAL ID: ____ - ____ - ____ or SOCIAL SECURITY NUMBER: ____ - ____ - ____

Company or individual bidding: _____

Company representative's name: _____

Address: _____

City: _____ State: _____ Zip: _____

IF AVAILABLE, PLEASE PLACE THE PERSONALIZED LABEL FROM YOUR PROSPECTUS IN THE ABOVE BOX.

Individual or company representative's signature: _____ Date: _____

Phone number : _____ Email (optional): _____

THE WINNING BIDDER MUST COMPLETE THE VERIFICATION OF WORKER'S DISABILITY COMPENSATION ACT COMPLIANCE (ON REVERSE SIDE IF DOUBLE SIDED) WITHIN 21 DAYS OF SALE AWARD DATE



FOR DEPARTMENT USE ONLY	
Sale Number (XX - XXX - XX - XX)	
Forest Management Unit:	

TIMBER SALE VERIFICATION OF WORKER'S DISABILITY COMPENSATION ACT COMPLIANCE

As required by Act 317, P.A. 1969 (Worker's Compensation) and
Part 5 of Act 451 of 1994, as amended.

VERIFICATION OF WORKER'S DISABILITY COMPENSATION ACT COMPLIANCE

- This verification must be completed and submitted within 21 days of contract award and prior to the issuance of the timber sale contract.
- In addition, if boxes 2B or 2C are checked, then Notice of Exclusion or Certificate of Insurance must be submitted within twenty-one (21) days of the contract award and prior to the issuance of the timber sale contract.
- All information must be typed or printed except for written signatures.

Please Check Appropriate Categories:

1. My business is organized as (you **must** check one of the boxes below):
 - A. Sole Proprietorship (individual)
 - B. Partnership
 - C. Corporation
2. You **must** check one of the boxes below:
 - A. I certify my business is a sole proprietorship and it has no employees but the sole proprietor. I am not subject to the Worker's Compensation Laws.
 - B. I certify my business has satisfied its obligation to the Worker's Compensation Act through the use of an approved Notice of Exclusion (BWC-337, Rev. 5/96). I will provide a copy of the Notice of Exclusion within 21 days of the contract award. (For questions or a copy of the BWC-337, please call the Worker's Compensation Bureau at 517-322-1195).
 - C. I certify my business has a Worker's Compensation Policy. I will provide an original Certificate of Insurance within twenty-one (21) days of the contract award.
3. If you have checked item 2(A) or 2(B), you **must** indicate the number of **both** full-time and part-time employees, other than yourself, including family members and active partners (if none, you must enter "0").

_____ Full-time Employees

_____ Part-time Employees

Name of Business		Federal ID (or) Social Security No.	
Address		Telephone ()	
City	State	ZIP	

I hereby certify that the above information is true and correct. I agree to notify the Michigan DNR of any changes that occur in factors affecting my coverage during any of my present and future operations.

Signature of Owner or Authorized Representative

Title

Date

Please complete the "SEALED BID" information on the next page

Walking Trail GEM (33-035-17)
; Menominee COUNTY

In response to the notice of sale to be held 3:00 p.m. (local time) on December 19, 2017, I am hereby submitting my sealed bid (firm offer) for the following forest products to be cut. Bids for individual species must be at or above the advertised price. All non-responsive bid forms may be rejected.

<u>PRODUCTS & SPECIES</u>	<u>ESTIMATED VOLUME*</u>	<u>ADVERTISED PRICE</u>	<u>BID PRICE/UNIT</u>
Pulpwood			
Balsam Fir	274.00 Cords	\$ 25.55/Cord	\$ _____
Hemlock	2.00 Cords	\$ 10.25/Cord	\$ _____
Mixed Aspen	614.00 Cords	\$ 27.85/Cord	\$ _____
Mixed Hardwood	289.00 Cords	\$ 28.15/Cord	\$ _____
Mixed Spruce	216.00 Cords	\$ 22.45/Cord	\$ _____
N. White Cedar	29.00 Cords	\$ 21.85/Cord	\$ _____
White Pine	106.00 Cords	\$ 28.75/Cord	\$ _____

*The volumes are statistically estimated within plus (+) or minus (-) 12.96 percent. These estimated volumes are final and not subject to adjustment. Prospective bidders are urged to examine this timber and to make their own estimates of quantity and quality.

I understand that any or all bids may be rejected. All bids must be signed and all bid items must be bid or the bid form may be rejected. I also understand that consideration and awarding a contract will be based upon my past performance and ability to complete the contract based upon equipment and staffing subject to my control.

FEDERAL ID: ____ - ____ - ____ or SOCIAL SECURITY NUMBER: ____ - ____ - ____

Company or individual bidding: _____

Company representative's name: _____

Address: _____

City: _____ State: _____ Zip: _____

IF AVAILABLE, PLEASE PLACE THE PERSONALIZED LABEL FROM YOUR PROSPECTUS IN THE ABOVE BOX.

Individual or company representative's signature: _____ Date: _____

Phone number : _____ Email (optional): _____

THE WINNING BIDDER MUST COMPLETE THE VERIFICATION OF WORKER'S DISABILITY COMPENSATION ACT COMPLIANCE (ON REVERSE SIDE IF DOUBLE SIDED) WITHIN 21 DAYS OF SALE AWARD DATE



FOR DEPARTMENT USE ONLY	
Sale Number (XX - XXX - XX - XX)	
Forest Management Unit:	

TIMBER SALE VERIFICATION OF WORKER'S DISABILITY COMPENSATION ACT COMPLIANCE

As required by Act 317, P.A. 1969 (Worker's Compensation) and
Part 5 of Act 451 of 1994, as amended.

VERIFICATION OF WORKER'S DISABILITY COMPENSATION ACT COMPLIANCE

- This verification must be completed and submitted within 21 days of contract award and prior to the issuance of the timber sale contract.
- In addition, if boxes 2B or 2C are checked, then Notice of Exclusion or Certificate of Insurance must be submitted within twenty-one (21) days of the contract award and prior to the issuance of the timber sale contract.
- All information must be typed or printed except for written signatures.

Please Check Appropriate Categories:

1. My business is organized as (you **must** check one of the boxes below):
 - A. Sole Proprietorship (individual)
 - B. Partnership
 - C. Corporation
2. You **must** check one of the boxes below:
 - A. I certify my business is a sole proprietorship and it has no employees but the sole proprietor. I am not subject to the Worker's Compensation Laws.
 - B. I certify my business has satisfied its obligation to the Worker's Compensation Act through the use of an approved Notice of Exclusion (BWC-337, Rev. 5/96). I will provide a copy of the Notice of Exclusion within 21 days of the contract award. (For questions or a copy of the BWC-337, please call the Worker's Compensation Bureau at 517-322-1195).
 - C. I certify my business has a Worker's Compensation Policy. I will provide an original Certificate of Insurance within twenty-one (21) days of the contract award.
3. If you have checked item 2(A) or 2(B), you **must** indicate the number of **both** full-time and part-time employees, other than yourself, including family members and active partners (if none, you must enter "0").

_____ Full-time Employees

_____ Part-time Employees

Name of Business		Federal ID (or) Social Security No.	
Address		Telephone ()	
City	State	ZIP	

I hereby certify that the above information is true and correct. I agree to notify the Michigan DNR of any changes that occur in factors affecting my coverage during any of my present and future operations.

Signature of Owner or Authorized Representative

Title

Date

Please complete the "SEALED BID" information on the next page

Johnson Lake SBW (33-036-17)
; Menominee COUNTY

In response to the notice of sale to be held 3:00 p.m. (local time) on December 19, 2017, I am hereby submitting my sealed bid (firm offer) for the following forest products to be cut. Bids for individual species must be at or above the advertised price. All non-responsive bid forms may be rejected.

<u>PRODUCTS & SPECIES</u>	<u>ESTIMATED VOLUME*</u>	<u>ADVERTISED PRICE</u>	<u>BID PRICE/UNIT</u>
Sawtimber			
Red Maple	0.50 MBF	\$ 231.00/MBF	\$ _____
Red Oak	10.80 MBF	\$ 225.00/MBF	\$ _____
White Oak	1.20 MBF	\$ 66.00/MBF	\$ _____
White Pine	23.30 MBF	\$ 62.00/MBF	\$ _____
Pulpwood			
Balsam Fir	99.00 Cords	\$ 27.50/Cord	\$ _____
Hemlock	3.00 Cords	\$ 11.05/Cord	\$ _____
Mixed Aspen	436.00 Cords	\$ 30.00/Cord	\$ _____
Mixed Hardwood	292.00 Cords	\$ 30.30/Cord	\$ _____
Mixed Oak	62.00 Cords	\$ 17.85/Cord	\$ _____
N. White Cedar	54.00 Cords	\$ 23.55/Cord	\$ _____
White Pine	75.00 Cords	\$ 30.95/Cord	\$ _____
White Spruce	132.00 Cords	\$ 24.15/Cord	\$ _____

*The volumes are statistically estimated within plus (+) or minus (-) 10.17 percent. These estimated volumes are final and not subject to adjustment. Prospective bidders are urged to examine this timber and to make their own estimates of quantity and quality.

I understand that any or all bids may be rejected. All bids must be signed and all bid items must be bid or the bid form may be rejected. I also understand that consideration and awarding a contract will be based upon my past performance and ability to complete the contract based upon equipment and staffing subject to my control.

FEDERAL ID: ____ - ____ - ____ or SOCIAL SECURITY NUMBER: ____ - ____ - ____

Company or individual bidding: _____

Company representative's name: _____

Address: _____

City: _____ State: _____ Zip: _____

IF AVAILABLE, PLEASE PLACE THE PERSONALIZED LABEL FROM YOUR PROSPECTUS IN THE ABOVE BOX.

Individual or company representative's signature: _____ Date: _____

Phone number : _____ Email (optional): _____

THE WINNING BIDDER MUST COMPLETE THE VERIFICATION OF WORKER'S DISABILITY COMPENSATION ACT COMPLIANCE (ON REVERSE SIDE IF DOUBLE SIDED) WITHIN 21 DAYS OF SALE AWARD DATE



FOR DEPARTMENT USE ONLY	
Sale Number (XX - XXX - XX - XX)	
Forest Management Unit:	

TIMBER SALE VERIFICATION OF WORKER'S DISABILITY COMPENSATION ACT COMPLIANCE

As required by Act 317, P.A. 1969 (Worker's Compensation) and
Part 5 of Act 451 of 1994, as amended.

VERIFICATION OF WORKER'S DISABILITY COMPENSATION ACT COMPLIANCE

- This verification must be completed and submitted within 21 days of contract award and prior to the issuance of the timber sale contract.
- In addition, if boxes 2B or 2C are checked, then Notice of Exclusion or Certificate of Insurance must be submitted within twenty-one (21) days of the contract award and prior to the issuance of the timber sale contract.
- All information must be typed or printed except for written signatures.

Please Check Appropriate Categories:

1. My business is organized as (you **must** check one of the boxes below):
 - A. Sole Proprietorship (individual)
 - B. Partnership
 - C. Corporation
2. You **must** check one of the boxes below:
 - A. I certify my business is a sole proprietorship and it has no employees but the sole proprietor. I am not subject to the Worker's Compensation Laws.
 - B. I certify my business has satisfied its obligation to the Worker's Compensation Act through the use of an approved Notice of Exclusion (BWC-337, Rev. 5/96). I will provide a copy of the Notice of Exclusion within 21 days of the contract award. (For questions or a copy of the BWC-337, please call the Worker's Compensation Bureau at 517-322-1195).
 - C. I certify my business has a Worker's Compensation Policy. I will provide an original Certificate of Insurance within twenty-one (21) days of the contract award.
3. If you have checked item 2(A) or 2(B), you **must** indicate the number of **both** full-time and part-time employees, other than yourself, including family members and active partners (if none, you must enter "0").

_____ Full-time Employees

_____ Part-time Employees

Name of Business		Federal ID (or) Social Security No.	
Address		Telephone ()	
City	State	ZIP	

I hereby certify that the above information is true and correct. I agree to notify the Michigan DNR of any changes that occur in factors affecting my coverage during any of my present and future operations.

Signature of Owner or Authorized Representative

Title

Date

Please complete the "SEALED BID" information on the next page

Wiregrass Conifer (33-041-17)
; Menominee COUNTY

In response to the notice of sale to be held 3:00 p.m. (local time) on December 19, 2017, I am hereby submitting my sealed bid (firm offer) for the following forest products to be cut. Bids for individual species must be at or above the advertised price. All non-responsive bid forms may be rejected.

<u>PRODUCTS & SPECIES</u>	<u>ESTIMATED VOLUME*</u>	<u>ADVERTISED PRICE</u>	<u>BID PRICE/UNIT</u>
Pulpwood			
Balsam Fir	7.00 Cords	\$ 27.50/Cord	\$ _____
Black Spruce	700.00 Cords	\$ 24.15/Cord	\$ _____
Mixed Hardwood	47.00 Cords	\$ 30.30/Cord	\$ _____
N. White Cedar	372.00 Cords	\$ 23.55/Cord	\$ _____
Quaking Aspen	8.00 Cords	\$ 30.00/Cord	\$ _____
Tamarack	230.00 Cords	\$ 15.55/Cord	\$ _____
White Pine	3.00 Cords	\$ 30.95/Cord	\$ _____

*The volumes are statistically estimated within plus (+) or minus (-) 13.09 percent. These estimated volumes are final and not subject to adjustment. Prospective bidders are urged to examine this timber and to make their own estimates of quantity and quality.

I understand that any or all bids may be rejected. All bids must be signed and all bid items must be bid or the bid form may be rejected. I also understand that consideration and awarding a contract will be based upon my past performance and ability to complete the contract based upon equipment and staffing subject to my control.

FEDERAL ID: ___ - ___ - ___ or SOCIAL SECURITY NUMBER: ___ - ___ - ___

Company or individual bidding: _____

Company representative's name: _____

Address: _____

City: _____ State: _____ Zip: _____

IF AVAILABLE, PLEASE PLACE THE PERSONALIZED LABEL FROM YOUR PROSPECTUS IN THE ABOVE BOX.

Individual or company representative's signature: _____ Date: _____

Phone number : _____ Email (optional): _____

THE WINNING BIDDER MUST COMPLETE THE VERIFICATION OF WORKER'S DISABILITY COMPENSATION ACT COMPLIANCE (ON REVERSE SIDE IF DOUBLE SIDED) WITHIN 21 DAYS OF SALE AWARD DATE



FOR DEPARTMENT USE ONLY	
Sale Number (XX - XXX - XX - XX)	
Forest Management Unit:	

TIMBER SALE VERIFICATION OF WORKER'S DISABILITY COMPENSATION ACT COMPLIANCE

As required by Act 317, P.A. 1969 (Worker's Compensation) and
Part 5 of Act 451 of 1994, as amended.

VERIFICATION OF WORKER'S DISABILITY COMPENSATION ACT COMPLIANCE

- This verification must be completed and submitted within 21 days of contract award and prior to the issuance of the timber sale contract.
- In addition, if boxes 2B or 2C are checked, then Notice of Exclusion or Certificate of Insurance must be submitted within twenty-one (21) days of the contract award and prior to the issuance of the timber sale contract.
- All information must be typed or printed except for written signatures.

Please Check Appropriate Categories:

1. My business is organized as (you **must** check one of the boxes below):
 - A. Sole Proprietorship (individual)
 - B. Partnership
 - C. Corporation
2. You **must** check one of the boxes below:
 - A. I certify my business is a sole proprietorship and it has no employees but the sole proprietor. I am not subject to the Worker's Compensation Laws.
 - B. I certify my business has satisfied its obligation to the Worker's Compensation Act through the use of an approved Notice of Exclusion (BWC-337, Rev. 5/96). I will provide a copy of the Notice of Exclusion within 21 days of the contract award. (For questions or a copy of the BWC-337, please call the Worker's Compensation Bureau at 517-322-1195).
 - C. I certify my business has a Worker's Compensation Policy. I will provide an original Certificate of Insurance within twenty-one (21) days of the contract award.
3. If you have checked item 2(A) or 2(B), you **must** indicate the number of **both** full-time and part-time employees, other than yourself, including family members and active partners (if none, you must enter "0").

_____ Full-time Employees

_____ Part-time Employees

Name of Business		Federal ID (or) Social Security No.	
Address		Telephone ()	
City	State	ZIP	

I hereby certify that the above information is true and correct. I agree to notify the Michigan DNR of any changes that occur in factors affecting my coverage during any of my present and future operations.

Signature of Owner or Authorized Representative

Title

Date

Please complete the "SEALED BID" information on the next page

Pile of Bones SBW (33-040-17)
; Menominee COUNTY

In response to the notice of sale to be held 3:00 p.m. (local time) on December 19, 2017, I am hereby submitting my sealed bid (firm offer) for the following forest products to be cut. Bids for individual species must be at or above the advertised price. All non-responsive bid forms may be rejected.

<u>PRODUCTS & SPECIES</u>	<u>ESTIMATED VOLUME*</u>	<u>ADVERTISED PRICE</u>	<u>BID PRICE/UNIT</u>
Sawtimber			
White Pine	2.60 MBF	\$ 49.00/MBF	\$ _____
Pulpwood			
Balsam Fir	29.00 Cords	\$ 21.60/Cord	\$ _____
Mixed Aspen	69.00 Cords	\$ 23.60/Cord	\$ _____
Mixed Hardwood	132.00 Cords	\$ 23.80/Cord	\$ _____
Mixed Spruce	728.00 Cords	\$ 19.00/Cord	\$ _____
N. White Cedar	1,694.00 Cords	\$ 18.50/Cord	\$ _____
Red Pine	13.00 Cords	\$ 47.75/Cord	\$ _____
Tamarack	1,048.00 Cords	\$ 12.25/Cord	\$ _____
White Pine	44.00 Cords	\$ 24.35/Cord	\$ _____

*The volumes are statistically estimated within plus (+) or minus (-) 11.37 percent. These estimated volumes are final and not subject to adjustment. Prospective bidders are urged to examine this timber and to make their own estimates of quantity and quality.

I understand that any or all bids may be rejected. All bids must be signed and all bid items must be bid or the bid form may be rejected. I also understand that consideration and awarding a contract will be based upon my past performance and ability to complete the contract based upon equipment and staffing subject to my control.

FEDERAL ID: ____ - ____ - ____ or SOCIAL SECURITY NUMBER: ____ - ____ - ____

Company or individual bidding: _____

Company representative's name: _____

Address: _____

City: _____ State: _____ Zip: _____

IF AVAILABLE, PLEASE PLACE THE PERSONALIZED LABEL FROM YOUR PROSPECTUS IN THE ABOVE BOX.

Individual or company representative's signature: _____ Date: _____

Phone number : _____ Email (optional): _____

THE WINNING BIDDER MUST COMPLETE THE VERIFICATION OF WORKER'S DISABILITY COMPENSATION ACT COMPLIANCE (ON REVERSE SIDE IF DOUBLE SIDED) WITHIN 21 DAYS OF SALE AWARD DATE



FOR DEPARTMENT USE ONLY
Sale Number (XX - XXX - XX - XX)
Forest Management Unit:

TIMBER SALE VERIFICATION OF WORKER'S DISABILITY COMPENSATION ACT COMPLIANCE

*As required by Act 317, P.A. 1969 (Worker's Compensation) and
Part 5 of Act 451 of 1994, as amended.*

VERIFICATION OF WORKER'S DISABILITY COMPENSATION ACT COMPLIANCE

- This verification must be completed and submitted within 21 days of contract award and prior to the issuance of the timber sale contract.
- In addition, if boxes 2B or 2C are checked, then Notice of Exclusion or Certificate of Insurance must be submitted within twenty-one (21) days of the contract award and prior to the issuance of the timber sale contract.
- All information must be typed or printed except for written signatures.

Please Check Appropriate Categories:

1. My business is organized as (you **must** check one of the boxes below):
 - A. Sole Proprietorship (individual)
 - B. Partnership
 - C. Corporation
2. You **must** check one of the boxes below:
 - A. I certify my business is a sole proprietorship and it has no employees but the sole proprietor. I am not subject to the Worker's Compensation Laws.
 - B. I certify my business has satisfied its obligation to the Worker's Compensation Act through the use of an approved Notice of Exclusion (BWC-337, Rev. 5/96). I will provide a copy of the Notice of Exclusion within 21 days of the contract award. (For questions or a copy of the BWC-337, please call the Worker's Compensation Bureau at 517-322-1195).
 - C. I certify my business has a Worker's Compensation Policy. I will provide an original Certificate of Insurance within twenty-one (21) days of the contract award.
3. If you have checked item 2(A) or 2(B), you **must** indicate the number of **both** full-time and part-time employees, other than yourself, including family members and active partners (if none, you must enter "0").

_____ Full-time Employees

_____ Part-time Employees

Name of Business		Federal ID (or) Social Security No.	
Address		Telephone ()	
City	State	ZIP	

I hereby certify that the above information is true and correct. I agree to notify the Michigan DNR of any changes that occur in factors affecting my coverage during any of my present and future operations.

Signature of Owner or Authorized Representative

Title

Date

Please complete the "SEALED BID" information on the next page