



**DEPARTMENT OF NATURAL RESOURCES
STATE OF MICHIGAN**

TIMBER SALE PROSPECTUS #6088

SCHEDULED SALE DATE AND TIME: 3:00 p.m. (local time) on January 30, 2018.

LOCATION: ESCANABA OFFICE, 6833 HWY 2, 41 & M-35, GLADSTONE, MI 49837.

PROSPECTUS NOTE: The bidder is advised to inspect the sale area and review the location, estimated volumes, operating costs and contract terms of proposed sales. Please be aware that some landowners may request 60 days or more notice for access across their land.

Notice is hereby given that bids will be received by the Unit Manager, ESCANABA MANAGEMENT UNIT, for certain timber on the following described lands:

426 Split (33-010-17)

Delta County, Advertised Price \$59,463.15, 185.3 Acres, Aspen, Spruce/Fir/Tamarack.

SALE NOTE: Signs will be required prior to beginning operations for those units that require access off and hauling directly onto County Road 426.

Top Down (33-011-17)

Menominee County, Advertised Price \$129,781.10, 172.1 Acres, N White Cedar, Spruce/Fir/Tamarack.

SALE NOTE: The access to this sale will be through private property. It is recommended to contact the Escanaba Forest Resources Division Office for a list of private land owners.

Access may be through private land.

MACK 32 (33-012-17)

Menominee County, Advertised Price \$41,440.70, 54.5 Acres, Hardwood, Spruce/Fir/Tamarack.

Oak Hill Mix (33-037-17)

Menominee County, Advertised Price \$107,382.75, 183.5 Acres, Hardwood, N White Cedar.

SALE NOTE: The eastern larch beetle is present within Payment Units 6, 10, and 11. There has been some tamarack mortality, the Purchaser should harvest these Payment Units as soon as possible.

Blue Bus SBW (33-042-17)

Menominee County, Advertised Price \$10,511.85, 41.6 Acres, Aspen, Spruce/Fir/Tamarack.

SALE NOTE: The spruce budworm has caused some spruce/fir defoliation, but no mortality at this time.

BID INSTRUCTIONS (VER. 11/28/2017):

1. Scheduled Bid Location, Date, and Time (2/11)

Bids must be received by the Unit Manager, ESCANABA OFFICE, 6833 HWY 2, 41 & M-35, GLADSTONE, MI 49837, no later than 3:00 p.m. (local time) on January 30, 2018. For further information concerning this sale, contact Eric Thompson at 906-786-2354.

2. Bidder's Qualifications (5/16)

Purchaser shall obtain workers compensation insurance to cover claims under Michigan's Worker's Disability Compensation Act of 1969 or similar employee benefit act of any other state applicable to an employee. If all or part of a timber sale was prepared by a private contractor, the contractor and that contractor's company are not permitted to bid on the timber sale contract. Bids will not be accepted from individuals or companies appearing on the DNR/FRD No-Bid List. This list contains the names of purchasers who previously failed to execute a contract within 21-days or who have a history of poor performance.

3. Preparation of Sealed Bids (5/16)

Bid Forms may be completed online thru Michigan DNR Timber Sale Online Bidding (OLB) at www.michigan.gov/timberbidding or by completing the hardcopy Bid Form found in the Timber Sale Prospectus. Hardcopy Bid Forms shall be manually signed in ink. Registration in OLB is considered your 'signature' for all bids submitted thru that system. Bid prices must be entered for each species and product in the Bid Price column for all material subject to bidding and all fill-in blanks must be completed. If erasures or other changes appear on the hardcopy Bid Form, each erasure or change must be initialed by the person signing the bid.

4. Submission of Sealed Bids (5/16)

Bid forms may be obtained from the Unit Manager or thru OLB. Bids may be submitted hardcopy or thru OLB. All hardcopy bids must be submitted on the bid form and in an envelope clearly identified as described in this section. NOTE: Only one bid form per bid envelope. Sealed bids must be submitted to the Unit office designated in the prospectus and must be submitted at or prior to the time established in the prospectus. The envelope should show on the outside (a) the sale name or number and (b) the date and time of bid opening, as shown in the prospectus. Bids received after the time specified in the sale prospectus are late bids and will be rejected.

It is possible for a bidder to submit multiple bids on a single sale. For example, a bid may be submitted hardcopy and a bid may be submitted thru OLB. Or, two bidders from the same company could both submit bids on the same sale. If this were to happen, the State would accept all bids received and award the contract accordingly. All bidding and contractual requirements would apply to all bids received.

5. Public Opening of Sealed Bids (7/16)

If conditions permit, the sealed bids will be publicly opened and posted at the time and place set in the prospectus.

If a bidder, present at a bid opening, has submitted bids on more than one sale, that bidder may withdraw their unopened bid envelopes or announce the withdrawal of their online bid after being declared the successful bidder on one sale.

6. Award of Contract (1/11)

Award of the contract will be made to the Bidder whose bid, conforming to the prospectus, is most advantageous to the State of Michigan on the basis of total value at rates bid for the estimated quantities. The State reserves the right to reject any bid or waive any minor irregularity in bids received. A written award mailed (or otherwise furnished) to the successful Bidder shall be deemed to result in a binding contract without further action by either party.

7. Down Payment (1/11)

The Bidder to whom award is made must make a down payment within 21 days of the sale award. The amount of the down payment will be calculated as shown in the Bond and Payment Schedule of this prospectus. Only cash may be used to meet this requirement.

8. Performance Security (1/11)

As guarantee of faithful performance, a cash bond, certificate of deposit, surety bond or irrevocable letter of credit (LOC) is required within 21 days of the sale award. The amount of the performance security is shown in the Bond and

Payment Schedule of this prospectus. If an LOC or surety is used, the coverage must extend for at least 6 months beyond the contract expiration.

9. Timber Sale Contract (11/17)

Additional conditions and requirements common to all timber sales are listed on the timber sale contract (R4031) and are available on line at www.michigan.gov/timber. Contact the Unit Manager for additional information or a sample contract. Within 21 days of the date of the award letter, the bidder must sign the contract and provide the required down payment, performance security, and verification of worker's disability compensation. The down payment and performance security shall be in accordance with the provisions of the timber sale contract, in the sums stated in this prospectus. If these actions are not taken, then the Bidder, the Bidder's corporation, and the corporation's principals may not be permitted to bid on State timber sales for a period of 1 year. In addition, the Bidder certifies that if awarded this contract, the Bidder will complete the timber sale contract in accordance with its terms and any modifications thereof including requirements to purchase, cut, and remove the included timber by the expiration date.

Payment Unit values in the State Forest Timber Sale Contract are calculated based on the advertised value of the Payment Unit as a percentage of the total advertised value of the contract. The advertised value of each Payment Unit is given in the Description of Timber by Payment Unit table on the Timber Sale Information page. For example, if the value of Payment Unit 1 is advertised as \$1,500 and the total Timber Sale value is advertised as \$10,000, the contract price for Payment Unit 1 will be 15% of the total bid price ($\$1,500/\$10,000 * 100$).

10. Disclaimer of Estimates and Bidder's Warranty of Inspection (7/16)

Before submitting this bid, the Bidder is advised and cautioned to inspect the sale area, review the requirements of the sale contract, and take other steps as may be reasonably necessary to ascertain the location, estimated volumes, construction estimates, and operating costs of the proposed sale. Failure to do so will not relieve the Bidder from responsibility for completing the contract.

The Bidder warrants that this bid is submitted solely on the basis of the Bidder's examination and inspection of the quality and quantity of the timber offered for sale and the Bidder's opinion of the value thereof and the costs of recovery. No reliance should be placed on the State of Michigan's estimates of timber quality, quantity or costs of recovery. Bidder further acknowledges that the State of Michigan: (i) expressly disclaims any warranty of fitness of timber for any purpose; (ii) offers this timber as is without any warranty of quality (merchantability) or quantity and (iii) expressly disclaims any warranty as to the quantity or quality of timber sold.

11. Certification and Chain-of-Custody (10/14)

Unless otherwise indicated in the contract under section 7 – Other Conditions of the Sale Specific Conditions & Requirements, the area encompassed by this timber sale is certified to the standards of the Forest Stewardship Council (FSC) - Certificate #SCS-FM/COC-00090N and the Sustainable Forestry Initiative (SFI) - Certificate # NSF-SFIS-5Y031-SF5. Forest products from this sale may be delivered to the mill as "FSC 100% and / or SFI certified" as long as the contractor hauling the forest products is chain-of-custody (COC) certified or covered under a COC certificate from the destination mill. The purchaser is responsible for maintaining COC after leaving the sale area.

12. Good Neighbor Authority (GNA) Requirements (7/16)

If the name of this timber sales contains the acronym GNA, it is authorized by the Good Neighbor Authority (GNA) and covered by various agreements between the U.S. Forest Service and the State. The timber sale occurs on federal land and the following conditions apply:

GNA contracts on US Forest Service land will not be awarded to purchasers on the Federal list of excluded parties. The System for Award Management (SAM) will be checked for active excluded parties prior to award of contract. In addition, the Bidder to whom award is made must complete an Assurance Regarding Felony Conviction or Tax Delinquent Status for Corporate Applicants (AD-3031).

13. Good Neighbor Authority (GNA) Requirements, con't (9/16)

Bidder certifies, by signing this bid form, that to the best of Bidder's knowledge that the following representations are accurate and complete.

a. That the Bidder and its principals are not presently debarred, suspended, proposed for debarment, declared ineligible, or voluntary excluded from timber sales (covered transactions) by any Federal department or agency.

b. That the Bidder and its principals have not within a 3-year period preceding this bid been convicted of or had a civil judgment rendered against them for commission of fraud or a criminal offense in connection with obtaining, attempting to obtain, or performing a public (Federal, State, or local) transaction or contract under a public transaction; violation of Federal or State antitrust statutes or commission of embezzlement, theft, forgery, bribery, falsification or destruction of records, making false statements, or receiving stolen property.

c. That the Bidder and its principals are not presently indicted for or otherwise criminally or civilly charged by a governmental entity (Federal, State, or local) with commission of any of the offenses enumerated in paragraph b of this certification.

d. That the Bidder and its principals have not within a 3-year period preceding this bid had one or more public transactions (Federal, State, or local) terminated for breach or default of a timber or forest product contract.

Bidders that cannot certify this requirement, in whole or in part, shall submit an explanation with their bid.

KEITH CREAGH

Director

TIMBER SALE INFORMATION

426 Split (33-010-17)

Delta County (Advertised Price \$59,463.15)

SALE NOTE: Signs will be required prior to beginning operations for those units that require access off and hauling directly onto County Road 426.

A timber sale contract for this lump sum, sealed bid timber sale will be awarded to the responsible bidder offering the highest sealed bid price. Bids must be at or above the following advertised price for each species:

<u>PRODUCTS & SPECIES</u>	<u>ESTIMATED UNITS*</u>	<u>ADVERTISED PRICE</u>
Sawtimber		
Paper Birch	2.00 MBF	\$ 83.00 / MBF
Red Maple	13.40 MBF	\$ 197.00 / MBF
Sugar Maple	9.60 MBF	\$ 337.00 / MBF
White Ash	2.50 MBF	\$ 72.00 / MBF
Pulpwood		
Balsam Fir	394.00 Cords	\$ 29.20 / Cord
Mixed Aspen	525.00 Cords	\$ 30.45 / Cord
Mixed Hardwood	244.00 Cords	\$ 30.05 / Cord
Mixed Spruce	154.00 Cords	\$ 23.90 / Cord
N. White Cedar	121.00 Cords	\$ 23.90 / Cord
Paper Birch	24.00 Cords	\$ 28.20 / Cord
Tamarack	537.00 Cords	\$ 20.80 / Cord

* The total volume is statistically estimated within plus (+) or minus (-) 12.67 percent. The estimated units are final and not subject to adjustment. Prospective bidders are urged to examine this timber and to make their own estimates of quantity and quality.

BOND AND PAYMENT SCHEDULE:

1. A bond in the amount of \$2,973.00 to insure faithful performance of the conditions of the contract will be deposited by the successful bidder within 21 days of the sale award.
2. Cutting in any sale or unit without the required advance payment would be considered a trespass.
3. Total payment must be paid in advance or according to the following schedule:
 - (a) Ten percent (10%) of the sale value must be paid within 21 days of the sale award.
 - (b) The 10% down payment will be credited towards the first unit cut.
4. If no cutting takes place, the 10% down payment will not be refunded.
5. Operations on the contract issued will terminate on 03/31/2021.

Description of Timber by Payment Unit (PU)

PU	MARKET GROUP	PRODUCT	QUANTITY	UNIT	ACRES	ADVERTISE PRICE
1	Balsam Fir	Pulpwood	3.0	Cords	7.8	\$3,187.65
	Mixed Aspen		31.0	Cords		
	<i>Quaking Aspen</i>		31.0	<i>Cords</i>		
	Mixed Spruce		42.0	Cords		
	<i>Black Spruce</i>		42.0	<i>Cords</i>		
	N. White Cedar		7.0	Cords		
	Paper Birch		1.0	Cords		
	Tamarack		46.0	Cords		
2	Red Maple	Sawtimber	11.6	MBF	28.0	\$18,730.80
	Balsam Fir	Pulpwood	115.0	Cords		
	Mixed Aspen		246.0	Cords		
	<i>Balsam Poplar</i>		17.0	<i>Cords</i>		
	<i>Quaking Aspen</i>		229.0	<i>Cords</i>		
	Mixed Hardwood		134.0	Cords		
	<i>Black Ash</i>		9.0	<i>Cords</i>		
	<i>Red Maple</i>		96.0	<i>Cords</i>		
	<i>Sugar Maple</i>		24.0	<i>Cords</i>		
	<i>Yellow Birch</i>		5.0	<i>Cords</i>		
	N. White Cedar		48.0	Cords		
	Paper Birch		15.0	Cords		
	3		Red Maple	Sawtimber		
White Ash			2.5	MBF		
Balsam Fir		Pulpwood	232.0	Cords		
Mixed Aspen			137.0	Cords		
<i>Balsam Poplar</i>			106.0	<i>Cords</i>		
<i>Quaking Aspen</i>			31.0	<i>Cords</i>		
Mixed Hardwood			43.0	Cords		
<i>Black Ash</i>			14.0	<i>Cords</i>		
<i>Red Maple</i>			22.0	<i>Cords</i>		
<i>White Ash</i>			7.0	<i>Cords</i>		
N. White Cedar			14.0	Cords		
4	Mixed Aspen	Pulpwood	2.0	Cords	17.3	\$4,246.20
	<i>Quaking Aspen</i>		2.0	<i>Cords</i>		
	Mixed Spruce		49.0	Cords		
	<i>Black Spruce</i>		49.0	<i>Cords</i>		
	N. White Cedar		10.0	Cords		
	Paper Birch		4.0	Cords		
	Tamarack		128.0	Cords		
5	Balsam Fir	Pulpwood	37.0	Cords	10.8	\$5,430.55
	Mixed Aspen		107.0	Cords		
	<i>Quaking Aspen</i>		107.0	<i>Cords</i>		
	Mixed Hardwood		26.0	Cords		
	<i>Red Maple</i>		26.0	<i>Cords</i>		
	Mixed Spruce		8.0	Cords		
	<i>White Spruce</i>		8.0	<i>Cords</i>		
N. White Cedar	5.0	Cords				
6	Balsam Fir	Pulpwood	5.0	Cords	13.9	\$3,959.20
	Mixed Spruce		39.0	Cords		
	<i>Black Spruce</i>		39.0	<i>Cords</i>		
	N. White Cedar		37.0	Cords		
	Tamarack		96.0	Cords		
7	Sugar Maple	Sawtimber	9.6	MBF	4.7	\$4,279.95
	Balsam Fir	Pulpwood	1.0	Cords		
	Mixed Hardwood		33.0	Cords		
	<i>Sugar Maple</i>		33.0	<i>Cords</i>		
	Mixed Spruce		1.0	Cords		

Description of Timber by Payment Unit (PU), con't

PU	MARKET GROUP	PRODUCT	QUANTITY	UNIT	ACRES	ADVERTISE PRICE
	<i>White Spruce</i>		1.0	<i>Cords</i>		
8	Paper Birch	Sawtimber	2.0	MBF	68.1	\$6,521.40
	Balsam Fir	Pulpwood	1.0	Cords		
	Mixed Aspen		2.0	Cords		
	<i>Balsam Poplar</i>		2.0	<i>Cords</i>		
	Mixed Hardwood		8.0	Cords		
	<i>Red Maple</i>		8.0	<i>Cords</i>		
	Mixed Spruce		15.0	Cords		
	<i>Black Spruce</i>		11.0	<i>Cords</i>		
	<i>White Spruce</i>		4.0	<i>Cords</i>		
	Paper Birch		4.0	Cords		
	Tamarack		267.0	Cords		
TOTAL:			27.5	MBF		
TOTAL:			1,999.0	Cords		

Sale Specific Conditions & Requirements

Sale Name: 426 Split

Sale Number: 33-010-17 Seq#: 1

1 - Sale Area

1.2 - Boundaries

1.2.1 - Painted boundaries (1/14)

The sale boundary and Payment Unit boundaries are marked and identified by blue, red and yellow paint. Exterior sale boundary lines against private property are marked with blue paint. Exterior sale boundary lines against state are marked with red paint. Retention patches within Payment Units 1, 2, and 3 are bounded by red paint; no operations shall occur within these areas. Interior Payment Unit boundaries are marked with yellow paint. The painted boundary line trees are not Included Timber and are to be protected unless marked with orange paint. Yellow painted trees designating an interior Payment Unit boundary are only to be cut when all surrounding Payment Units have been paid.

2 - Timber Specifications

2.1 - Included Timber

2.1.1 - Clearcut unit(s) with unmerchantable trees (6/14)

Within Payment Unit(s) 1, 2, 3, 5, and 6, cut all trees that are three (3) inches or more at DBH, except do not cut any white pine trees in Payment Unit 5.

2.1.3 - Cut tree marked unit(s) (12/08)

Within Payment Unit(s) 7, all trees are designated for cutting when marked with orange paint above and below stump height, regardless of merchantability.

2.1.7 - Leave tree marked unit(s) (6/14)

Within Payment Unit(s) 4 and 8, all trees, which meet minimum piece specifications in 2.2 Utilization, are designated for cutting, except do not cut trees marked with green paint above and below stump height.

3 - Payments

3.3 - Pre-measured Sales

3.3.4 - Dividing payment units (7/14)

Payment Unit(s) with a contract purchase value of \$15,000 dollars or greater may be divided at the request of the Purchaser and upon approval of the Unit Manager. Dividing Payment Units is a contract modification which requires a Timber Sale Contract Supplement.

4 - Transportation

4.1 - Construction

4.1.6 - Road construction (1/09)

Construction of new roads or improvements of existing roads shall be done in such a way as to minimize the environmental and visual impacts. Merchantable trees shall be cut and utilized unless otherwise directed. Non-merchantable trees shall be severed and laid flat on the ground. Slash shall be scattered, and not left in windrows and kept a minimum of 10 feet back from the road edge, or be chipped, utilized or otherwise removed from the sale. Stumps shall be set upright, not left on edge, and be moved at least 10 feet away from the road edge. Disturbed soil shall be feathered into the woods and not left in berms or windrows.

4.1.7 - Road closure (10/11)

All new roads built into the sale must be blocked to vehicle traffic upon completion of the sale. In general, this will require constructing a four (4') foot high berm of stumps and logs covered with earth. These roads must be rendered impassable to cars and trucks. Contact the sale administrator for specific details of design and placement.

4.2 - Maintenance

4.2.2 - Fill material (4/07)

To maintain roads, fill material may be needed in areas where "holes" exist or may be expected to develop. This fill material

should be placed before trucking begins. Contact the sale administrator regarding the availability of onsite sand or gravel from adjacent State-owned lands.

4.3 - Public Right-of-Way

4.3.2 - County R-O-W (12/06)

The county must be contacted prior to crossing or harvesting in the county road R-O-W. This applies to Payment Unit 6 and County Road 426.

5 - Operations

5.2 - Conduct of Operations

5.2.2 - Hazard Trees/Snags

5.2.2.1 - Den trees (10/16)

Obvious hollow and/or den trees shall be protected and left standing unless they are a safety hazard.

5.2.3 - Operating Restrictions

5.2.3.1 - Operating restrictions (9/11)

Within Payment Unit(s) 4, 6, 7, and 8, unless changed by written agreement, cutting, skidding, and hauling are limited to the period of 12/01 to 03/15 or frozen ground conditions. This restriction is because the area within and access to these units are low and wet.

5.2.22 - Operating Caution

5.2.22.1 - Operating caution (6/11)

It is recommended, but not required, that within Payment Unit(s) 1, 2, and 3, cutting, skidding, and hauling occur during dry summer or frozen winter conditions. The reason for the recommendation is because the access into these units have low and wet areas.

5.4 - Soil Protection

5.4.1 - Rutting restriction, general (7/16)

Operations are to cease immediately if equipment and weather conditions result in rutting of roads and/or skid trails which is 12 inches or greater in depth and 50 feet in length. The Unit Manager or his/her representative may restrict hauling and/or skidding if ruts exceed the specified depth. With the Unit Manager or his/her representative's approval, the Purchaser may return to the area when the risk of rutting has decreased.

6 - Safety and Fire Prevention

6.2 - Signing

6.2.1 - Road posting (9/09)

The Purchaser is responsible for posting and maintaining caution signs on County Road 426 prior to beginning operations. The road must be posted at appropriate distances from the sale area to warn of logging activity and truck traffic. Signs must be removed when harvest operations are suspended or completed. The Purchaser will provide these signs.

7 - Other Conditions

7.3 - Contract Modifications

7.3.1 - Emerald Ash Borer

7.3.1.2 - Emerald ash borer, ash or firewood on sale (2/05)

There is ash and/or "firewood" in this sale and it is located within an emerald ash borer quarantined area. The Director of the Michigan Department of Agriculture (MDA) by the authority of Act No. 72 of the Public Acts of 1945, as amended, and Quarantine Regulation No. 620, has promulgated this quarantine to prevent the further spread of this pest and sets forth: definitions, regulated articles, regulated areas, conditions of movement, violations and penalties, and special exemptions. The Purchaser must comply with this quarantine. Contact the MDA for further information.



TIMBER SALE MAP

This information provided by authority of Part 525, 1994 PA 451, as amended.

Sale Number	Year
33-010	17

Forest Management Unit Escanaba	County Delta	Mapped By Racine	Date 9/22/2017	Page 1	of 1
Township 41N	Range 24W	Section(s) and Subdivision(s) 10) E1/2SW, SWSW 16) NE1/4, W1/2NW, NENW W1/2SW, SESW, NESE 17) SENE, NESE 9) SWSE, SESW	Scale 1:15,840		

Cover Type				Density			
A = Aspen	H = Hemlock	N = Marsh	U = Upland Brush	0 = Non Stocked	5 = Pole Timber Medium		
B = Paper Birch	J = Jack Pine	O = Oak	UM = Upland Mixed	1 = Seedling Sapling Poor	6 = Pole Timber Well		
C = Cedar	L = Lowland Brush	P = Lowland Poplar	V = Bog or Marsh	2 = Seedling Sapling Medium	7 = Saw Timber Poor		
D = Treed Bog	LM = Lowland Mixed	Q = Mixed Swamp Conifer	W = White Pine	3 = Seedling Sapling Well	8 = Saw Timber Medium		
E = Swamp Hdwoods	M = Mpl, Bch, Brch	R = Red Pine	X = Non Stocked	4 = Pole Timber Poor	9 = Saw Timber Well		
F = Spruce Fir	MC = Mixed Conifer	S = Black Spruce	Z = Water				
G = Grass	MD = Mixed Deciduous	T = Tamarack					

PU	Acres	PU	Acres
1	7.8	5	10.8
2	28	6	13.9
3	34.7	7	4.7
4	17.3	8	68.1

426 Split
Compartment 85
185.3 Acres

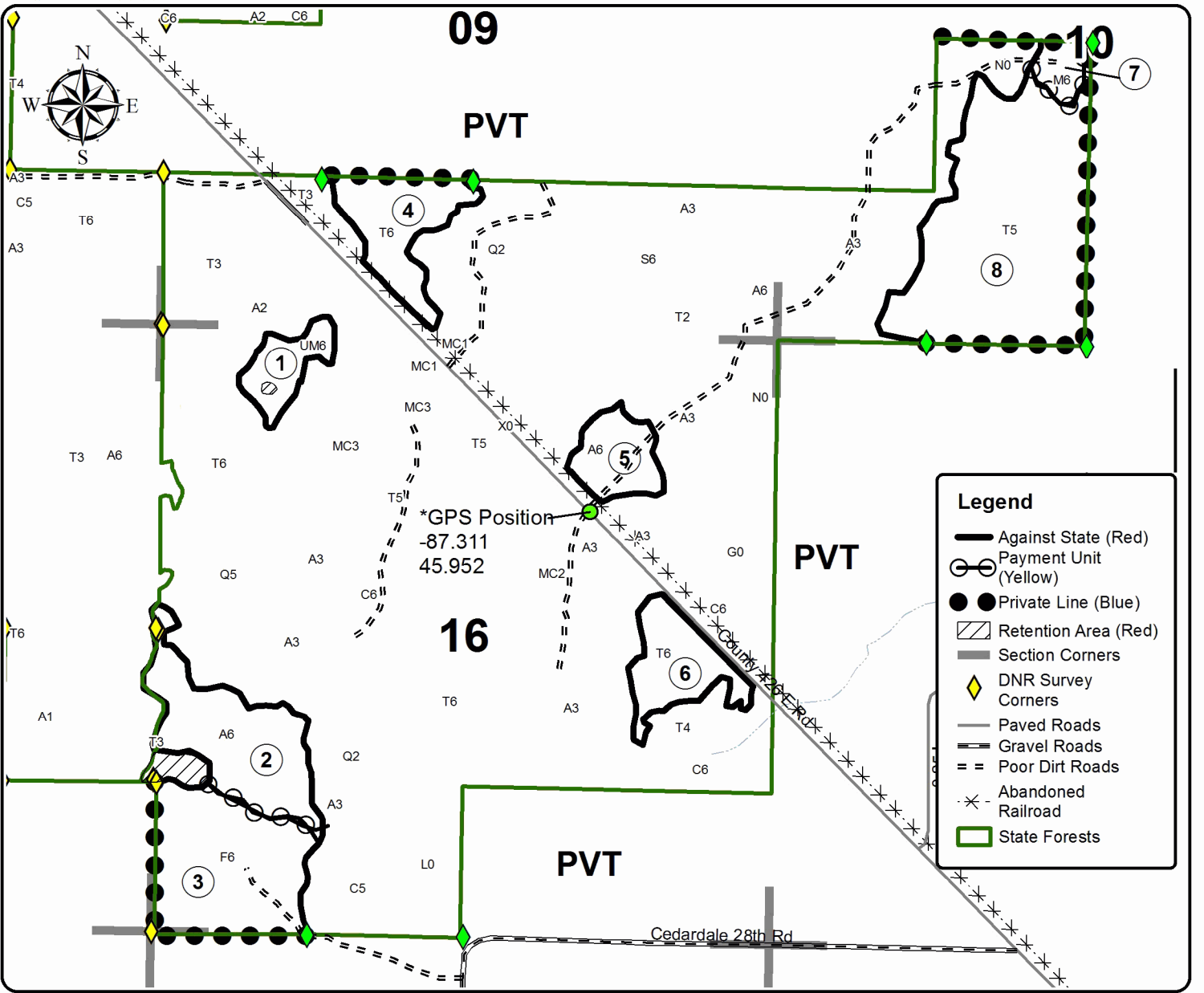

Legend

- Against State (Red)
- Payment Unit (Yellow)
- Private Line (Blue)
- ▨ Retention Area (Red)
- Section Corners
- ◆ DNR Survey Corners
- Paved Roads
- Gravel Roads
- Poor Dirt Roads
- Abandoned Railroad
- ▭ State Forests

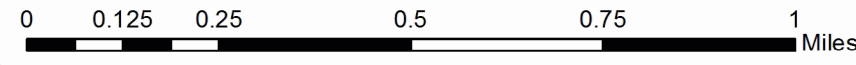

TIMBER SALE INFORMATION

Top Down (33-011-17)

Menominee County (Advertised Price \$129,781.10)

SALE NOTE: The access to this sale will be through private property. It is recommended to contact the Escanaba Forest Resources Division Office for a list of private land owners.

Access may be through private land.

A timber sale contract for this lump sum, sealed bid timber sale will be awarded to the responsible bidder offering the highest sealed bid price. Bids must be at or above the following advertised price for each species:

<u>PRODUCTS & SPECIES</u>	<u>ESTIMATED UNITS*</u>		<u>ADVERTISED PRICE</u>
Sawtimber			
Basswood	1.40	MBF	\$ 116.00 / MBF
Beech	1.00	MBF	\$ 79.00 / MBF
Paper Birch	7.80	MBF	\$ 83.00 / MBF
Red Maple	21.10	MBF	\$ 197.00 / MBF
Sugar Maple	61.80	MBF	\$ 337.00 / MBF
White Ash	35.30	MBF	\$ 72.00 / MBF
Yellow Birch	0.60	MBF	\$ 117.00 / MBF
Pulpwood			
Balsam Fir	75.00	Cords	\$ 29.20 / Cord
Balsam Poplar	2.00	Cords	\$ 30.45 / Cord
Basswood	1.00	Cords	\$ 12.60 / Cord
Black Spruce	992.00	Cords	\$ 23.90 / Cord
Mixed Hardwood	730.00	Cords	\$ 30.05 / Cord
N. White Cedar	1,331.00	Cords	\$ 23.90 / Cord
Paper Birch	101.00	Cords	\$ 28.20 / Cord
Tamarack	792.00	Cords	\$ 20.80 / Cord
White Pine	73.00	Cords	\$ 30.90 / Cord

* The total volume is statistically estimated within plus (+) or minus (-) 13.13 percent. The estimated units are final and not subject to adjustment. Prospective bidders are urged to examine this timber and to make their own estimates of quantity and quality.

BOND AND PAYMENT SCHEDULE:

1. A bond in the amount of \$6,489.00 to insure faithful performance of the conditions of the contract will be deposited by the successful bidder within 21 days of the sale award.
2. Cutting in any sale or unit without the required advance payment would be considered a trespass.
3. Total payment must be paid in advance or according to the following schedule:
 - (a) Ten percent (10%) of the sale value must be paid within 21 days of the sale award.
 - (b) The 10% down payment will be credited towards the first unit cut.
4. If no cutting takes place, the 10% down payment will not be refunded.
5. Operations on the contract issued will terminate on 03/31/2021.

Description of Timber by Payment Unit (PU)

PU	MARKET GROUP	PRODUCT	QUANTITY	UNIT	ACRES	ADVERTISE PRICE
1	Red Maple	Sawtimber	11.9	MBF	8.6	\$7,524.25
	Sugar Maple		4.8	MBF		
	Balsam Fir	Pulpwood	20.0	Cords		
	Mixed Hardwood		95.0	Cords		
	<i>Ironwood</i>		5.0	<i>Cords</i>		
	<i>Red Maple</i>		77.0	<i>Cords</i>		
	<i>Sugar Maple</i>		13.0	<i>Cords</i>		
	White Pine		4.0	Cords		
	2	Red Maple	Sawtimber	1.1		
Balsam Fir		Pulpwood	9.0	Cords		
Black Spruce			36.0	Cords		
Mixed Hardwood			6.0	Cords		
<i>Red Maple</i>			6.0	<i>Cords</i>		
N. White Cedar			105.0	Cords		
Paper Birch			2.0	Cords		
Tamarack			36.0	Cords		
3	Basswood	Sawtimber	0.2	MBF	10.6	\$6,021.55
	Beech		0.1	MBF		
	Paper Birch		1.1	MBF		
	Red Maple		1.1	MBF		
	Sugar Maple		7.8	MBF		
	White Ash		4.8	MBF		
	Yellow Birch		0.1	MBF		
	Balsam Fir	Pulpwood	5.0	Cords		
	Mixed Hardwood		83.0	Cords		
	<i>Beech</i>		3.0	<i>Cords</i>		
	<i>Ironwood</i>		2.0	<i>Cords</i>		
	<i>Red Maple</i>		17.0	<i>Cords</i>		
	<i>Sugar Maple</i>		48.0	<i>Cords</i>		
	<i>White Ash</i>		12.0	<i>Cords</i>		
	<i>Yellow Birch</i>		1.0	<i>Cords</i>		
	Paper Birch		2.0	Cords		
	4	Basswood	Sawtimber	0.4		
Beech			0.3	MBF		
Paper Birch			2.0	MBF		
Red Maple			2.1	MBF		
Sugar Maple			14.9	MBF		
White Ash			9.2	MBF		
Yellow Birch			0.2	MBF		
Balsam Fir		Pulpwood	9.0	Cords		
Balsam Poplar			1.0	Cords		
Mixed Hardwood			158.0	Cords		
<i>Beech</i>			6.0	<i>Cords</i>		
<i>Ironwood</i>			4.0	<i>Cords</i>		
<i>Red Maple</i>			32.0	<i>Cords</i>		
<i>Sugar Maple</i>			91.0	<i>Cords</i>		
<i>White Ash</i>			23.0	<i>Cords</i>		
<i>Yellow Birch</i>			2.0	<i>Cords</i>		
Paper Birch			3.0	Cords		
5	Basswood	Sawtimber	0.5	MBF	30.6	\$17,426.95
	Beech		0.4	MBF		
	Paper Birch		3.1	MBF		
	Red Maple		3.2	MBF		
	Sugar Maple		22.5	MBF		
	White Ash		14.0	MBF		
	Yellow Birch		0.2	MBF		

Description of Timber by Payment Unit (PU), con't

PU	MARKET GROUP	PRODUCT	QUANTITY	UNIT	ACRES	ADVERTISE PRICE
5 con't	Balsam Fir	Pulpwood	13.0	Cords		
	Balsam Poplar		1.0	Cords		
	Basswood		1.0	Cords		
	Mixed Hardwood		242.0	Cords		
	<i>Beech</i>		10.0	<i>Cords</i>		
	<i>Ironwood</i>		5.0	<i>Cords</i>		
	<i>Red Maple</i>		49.0	<i>Cords</i>		
	<i>Sugar Maple</i>		139.0	<i>Cords</i>		
	<i>White Ash</i>		36.0	<i>Cords</i>		
	<i>Yellow Birch</i>		3.0	<i>Cords</i>		
Paper Birch	5.0	Cords				
6	Basswood	Sawtimber	0.3	MBF	16.0	\$9,077.45
	Beech		0.2	MBF		
	Paper Birch		1.6	MBF		
	Red Maple		1.7	MBF		
	Sugar Maple		11.8	MBF		
	White Ash		7.3	MBF		
	Yellow Birch		0.1	MBF		
	Balsam Fir	Pulpwood	7.0	Cords		
	Mixed Hardwood		125.0	Cords		
	<i>Beech</i>		5.0	<i>Cords</i>		
	<i>Ironwood</i>		3.0	<i>Cords</i>		
	<i>Red Maple</i>		25.0	<i>Cords</i>		
	<i>Sugar Maple</i>		72.0	<i>Cords</i>		
	<i>White Ash</i>		19.0	<i>Cords</i>		
	<i>Yellow Birch</i>		1.0	<i>Cords</i>		
	Paper Birch		3.0	Cords		
	7		Balsam Fir	Pulpwood		
Black Spruce		68.0	Cords			
Mixed Hardwood		5.0	Cords			
<i>Black Ash</i>		5.0	<i>Cords</i>			
N. White Cedar		615.0	Cords			
Paper Birch		56.0	Cords			
Tamarack		378.0	Cords			
8	Black Spruce	Pulpwood	593.0	Cords	31.4	\$16,183.60
	N. White Cedar		18.0	Cords		
	Tamarack		24.0	Cords		
	White Pine		35.0	Cords		
9	Black Spruce	Pulpwood	4.0	Cords	3.8	\$1,985.50
	Mixed Hardwood		16.0	Cords		
	<i>Red Maple</i>		16.0	<i>Cords</i>		
	N. White Cedar		15.0	Cords		
	White Pine		34.0	Cords		
10	Black Spruce	Pulpwood	134.0	Cords	18.1	\$24,872.40
	N. White Cedar		578.0	Cords		
	Paper Birch		30.0	Cords		
	Tamarack		337.0	Cords		
11	Black Spruce	Pulpwood	157.0	Cords	9.5	\$4,105.90
	Tamarack		17.0	Cords		
TOTAL:			129.0	MBF		
TOTAL:			4,097.0	Cords		

Sale Specific Conditions & Requirements

Sale Name: Top Down

Sale Number: 33-011-17 Seq#: 1

1 - Sale Area

1.2 - Boundaries

1.2.1 - Painted boundaries (1/14)

The sale boundary and Payment Unit boundaries are marked and identified by blue, red, yellow and green paint. Exterior sale boundary lines against private property are marked with blue paint. Exterior sale boundary lines against state are marked with red paint. Interior Payment Unit boundaries are marked with yellow paint. Seed tree areas within Payment Units 8 and 11 are marked with green paint. The painted boundary line trees are not Included Timber and are to be protected unless marked with orange paint. Yellow painted trees designating an interior Payment Unit boundary are only to be cut when all surrounding Payment Units have been paid.

2 - Timber Specifications

2.1 - Included Timber

2.1.1 - Clearcut unit(s) with unmerchantable trees (6/14)

Within Payment Unit(s) 2, 7, 8, 9, 10 and 11, cut all trees that are three (3) inches or more at DBH, with the following exceptions:

Within Payment Unit 2, do not cut any white pine greater than 26 inches at DBH.

Within Payment Unit 8, seed trees are designated with a green paint line. Do not cut any trees marked with green paint or those inside of green painted areas.

Within Payment Unit 11, seed trees are designated with a green paint line. Do not cut any trees marked with green paint or those inside of green painted areas. In addition, within Payment Unit 11, do not cut any cedar or hemlock.

2.1.3 - Cut tree marked unit(s) (12/08)

Within Payment Unit(s) 3, 4, 5, and 6, all trees are designated for cutting when marked with orange paint above and below stump height, regardless of merchantability. In addition, all merchantable spruce and balsam fir are designated for cutting.

2.1.4 - Designated timber unit(s) (6/17)

Within Payment Unit(s) 1, all trees are designated for cutting which meet minimum piece specifications in 2.2 - Utilization, except do not cut any cedar, hemlock and trees marked with green paint.

3 - Payments

3.3 - Pre-measured Sales

3.3.4 - Dividing payment units (7/14)

Payment Unit(s) with a contract value of \$15,000 dollars or greater may be divided at the request of the Purchaser and upon approval of the Unit Manager. Dividing Payment Units is a contract modification which requires a Timber Sale Contract Supplement.

4 - Transportation

4.1 - Construction

4.1.6 - Road construction (1/09)

Construction of new roads or improvements of existing roads shall be done in such a way as to minimize the environmental and visual impacts. Merchantable trees shall be cut and utilized unless otherwise directed. Non-merchantable trees shall be severed and laid flat on the ground. Slash shall be scattered, and not left in windrows and kept a minimum of 10 feet back from the road edge. Stumps shall be set upright, not left on edge, and be moved at least 10 feet away from the road edge. Disturbed soil shall be feathered into the woods and not left in berms or windrows.

4.2 - Maintenance

4.2.2 - Fill material (4/07)

To maintain roads, fill material may be needed in areas where "holes" exist or may be expected to develop. This fill material should be placed before trucking begins. Contact the sale administrator regarding the availability of onsite sand or gravel from adjacent State-owned lands.

4.2.4 - Grading (10/16)

For completion of the sale, state forest roads must be graded. In general, this will require a road grader or bull dozer to shape up the roads after forest products have been hauled off site. This includes cleaning of drainage areas, grading, crowning and filling with gravel, if necessary. The grading equipment to be used must be approved by the Unit Manager or his/her representative.

4.4 - Access

4.4.1 - Private property access (3/11)

Permission for access across private land is the responsibility of the Purchaser. Contact the Escanaba Forest Resource Office for land owner contact information.

5 - Operations

5.2 - Conduct of Operations

5.2.2 - Hazard Trees/Snags

5.2.2.1 - Den trees (10/16)

Obvious hollow and/or den trees shall be protected and left standing unless they are a safety hazard.

5.2.3 - Operating Restrictions

5.2.3.1 - Operating restrictions (9/11)

Within Payment Unit(s) 7, 8, 10 and 11, unless changed by written agreement, cutting, skidding, and hauling are limited to the period of 12/1 to 3/15. This restriction is because the area within and access to these units are low and wet.

5.2.3.3 - Bark slippage restriction (3/09)

Within Payment Unit(s) 3, 4, 5 and 6, unless changed by written agreement, cutting and skidding are not permitted during the period of April 15 to July 15. This restriction is because of bark slippage.

5.4 - Soil Protection

5.4.1 - Rutting restriction, general (7/16)

Operations are to cease immediately if equipment and weather conditions result in rutting of roads and/or skid trails which is 12 inches or greater in depth and 50 feet in length. The Unit Manager or his/her representative may restrict hauling and/or skidding if ruts exceed the specified depth. With the Unit Manager or his/her representative's approval, the Purchaser may return to the area when the risk of rutting has decreased.



TIMBER SALE MAP

This information provided by authority of Part 525, 1994 PA 451, as amended.

Sale Number	Year
33 - 011	17

Forest Management Unit Escanaba Management Unit	County Menominee	Mapped By Collins	Date 09/25/2017	Page 1	of 1
Township 40N	Range 25W & 26W	Section(s) and Subdivision(s) 40N 25W sec30 - SWSE sec 31 - NWNE, SWNE, NENW, NESE & SESE	Cruised By Collins, Racine		
				Scale 1:15,840	

Cover Type				Density	
A = Aspen	H = Hemlock	N = Marsh	U = Upland Brush	0 = Non Stocked	5 = Pole Timber Medium
B = Paper Birch	J = Jack Pine	O = Oak	UM = Upland Mixed	1 = Seedling Sapling Poor	6 = Pole Timber Well
C = Cedar	L = Lowland Brush	P = Lowland Poplar	V = Bog or Marsh	2 = Seedling Sapling Medium	7 = Saw Timber Poor
D = Treed Bog	LM = Lowland Mixed	Q = Mixed Swamp Conifer	W = White Pine	3 = Seedling Sapling Well	8 = Saw Timber Medium
E = Swamp Hdwoods	M = Mpl, Bch, Brch	R = Red Pine	X = Non Stocked	4 = Pole Timber Poor	9 = Saw Timber Well
F = Spruce Fir	MC = Mixed Conifer	S = Black Spruce	Z = Water		
G = Grass	MD = Mixed Deciduous	T = Tamarack			

PU	Acres	PU	Acres	PU	Acres	PU	Acres
1	8.6	4	20.2	7	19.7	10	18.1
2	3.6	5	30.6	8	31.4	11	9.5
3	10.6	6	16	9	3.8		

Top Down
Compartment 69, 70 & 71
172.1 Acres

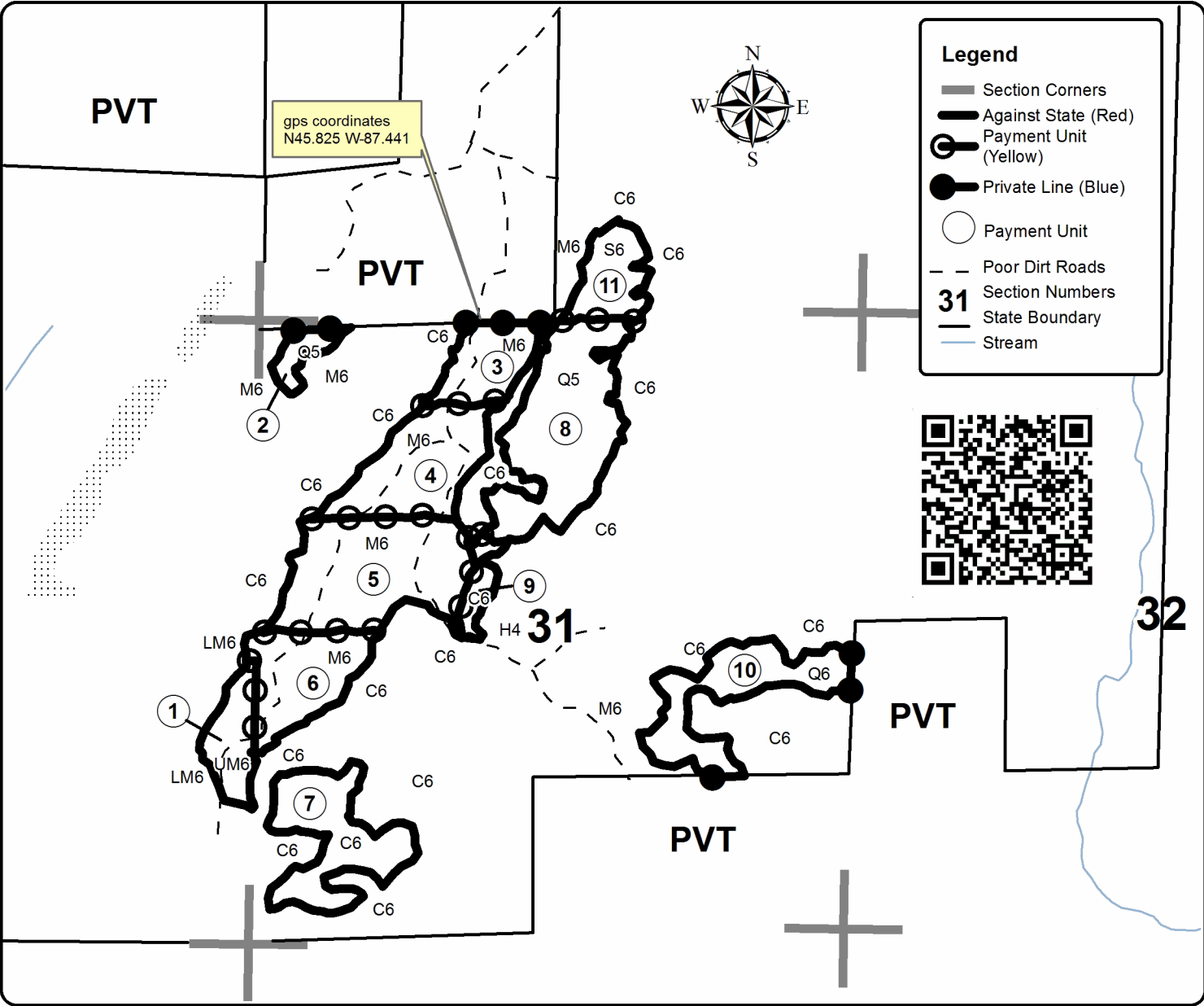

TIMBER SALE INFORMATION

MACK 32 (33-012-17)

Menominee County (Advertised Price \$41,440.70)

A timber sale contract for this lump sum, sealed bid timber sale will be awarded to the responsible bidder offering the highest sealed bid price. Bids must be at or above the following advertised price for each species:

<u>PRODUCTS & SPECIES</u>	<u>ESTIMATED UNITS*</u>	<u>ADVERTISED PRICE</u>
Sawtimber		
Black Ash	2.80 MBF	\$ 89.00 / MBF
Black Cherry	1.10 MBF	\$ 153.00 / MBF
Paper Birch	5.50 MBF	\$ 83.00 / MBF
Red Maple	21.90 MBF	\$ 197.00 / MBF
Pulpwood		
Balsam Fir	415.00 Cords	\$ 29.20 / Cord
Mixed Hardwood	511.00 Cords	\$ 30.05 / Cord
Mixed Spruce	35.00 Cords	\$ 23.90 / Cord
N. White Cedar	150.00 Cords	\$ 23.90 / Cord
Quaking Aspen	139.00 Cords	\$ 30.45 / Cord
Tamarack	6.00 Cords	\$ 20.80 / Cord

* The total volume is statistically estimated within plus (+) or minus (-) 14.35 percent. The estimated units are final and not subject to adjustment. Prospective bidders are urged to examine this timber and to make their own estimates of quantity and quality.

BOND AND PAYMENT SCHEDULE:

1. A bond in the amount of \$2,072.00 to insure faithful performance of the conditions of the contract will be deposited by the successful bidder within 21 days of the sale award.
2. Cutting in any sale or unit without the required advance payment would be considered a trespass.
3. Total payment must be paid in advance or according to the following schedule:
 - (a) Ten percent (10%) of the sale value must be paid within 21 days of the sale award.
 - (b) The 10% down payment will be credited towards the first unit cut.
4. If no cutting takes place, the 10% down payment will not be refunded.
5. Operations on the contract issued will terminate on 12/31/2020.

Description of Timber by Payment Unit (PU)

PU	MARKET GROUP	PRODUCT	QUANTITY	UNIT	ACRES	ADVERTISE PRICE
1	Balsam Fir	Pulpwood	9.0	Cords	4.3	\$3,136.80
	Mixed Hardwood		19.0	Cords		
	<i>Black Cherry</i>		4.0	<i>Cords</i>		
	<i>Paper Birch</i>		11.0	<i>Cords</i>		
	<i>Red Maple</i>		4.0	<i>Cords</i>		
	Mixed Spruce		5.0	Cords		
	<i>White Spruce</i>		5.0	<i>Cords</i>		
	N. White Cedar		6.0	Cords		
	Quaking Aspen		67.0	Cords		
2	Balsam Fir	Pulpwood	143.0	Cords	9.2	\$4,799.80
	Mixed Hardwood		16.0	Cords		
	<i>Black Ash</i>		3.0	<i>Cords</i>		
	<i>Red Maple</i>		13.0	<i>Cords</i>		
	Mixed Spruce		6.0	Cords		
	<i>White Spruce</i>		6.0	<i>Cords</i>		
3	Black Ash	Sawtimber	2.8	MBF	23.7	\$19,314.75
	Black Cherry		1.1	MBF		
	Paper Birch		3.5	MBF		
	Red Maple		16.4	MBF		
	Balsam Fir		Pulpwood	111.0		
	Mixed Hardwood	292.0		Cords		
	<i>Balsam Poplar</i>	21.0		<i>Cords</i>		
	<i>Black Ash</i>	132.0		<i>Cords</i>		
	<i>Black Cherry</i>	16.0		<i>Cords</i>		
	<i>Paper Birch</i>	11.0		<i>Cords</i>		
	<i>Red Maple</i>	105.0		<i>Cords</i>		
	<i>Sugar Maple</i>	7.0		<i>Cords</i>		
	Mixed Spruce	15.0		Cords		
	<i>Black Spruce</i>	7.0		<i>Cords</i>		
	<i>White Spruce</i>	8.0		<i>Cords</i>		
	N. White Cedar	81.0		Cords		
	Quaking Aspen	35.0	Cords			
4	Paper Birch	Sawtimber	1.0	MBF	14.6	\$12,437.20
	Red Maple		5.5	MBF		
	Balsam Fir	Pulpwood	141.0	Cords		
	Mixed Hardwood		161.0	Cords		
	<i>Black Ash</i>		39.0	<i>Cords</i>		
	<i>Black Cherry</i>		16.0	<i>Cords</i>		
	<i>Paper Birch</i>		4.0	<i>Cords</i>		
	<i>Red Maple</i>		102.0	<i>Cords</i>		
	Mixed Spruce		7.0	Cords		
	<i>White Spruce</i>		7.0	<i>Cords</i>		
	N. White Cedar		63.0	Cords		
	Quaking Aspen		17.0	Cords		
Tamarack	6.0	Cords				
5	Paper Birch	Sawtimber	1.0	MBF	2.7	\$1,752.15
	Balsam Fir	Pulpwood	11.0	Cords		
	Mixed Hardwood		23.0	Cords		
	<i>Paper Birch</i>		5.0	<i>Cords</i>		
	<i>Red Maple</i>		16.0	<i>Cords</i>		
	<i>Yellow Birch</i>		2.0	<i>Cords</i>		
	Mixed Spruce		2.0	Cords		
	<i>White Spruce</i>		2.0	<i>Cords</i>		
	Quaking Aspen		20.0	Cords		
TOTAL:			31.3	MBF		

TOTAL:	1,256.0	Cords
--------	---------	-------

Sale Specific Conditions & Requirements

Sale Name: MACK 32

Sale Number: 33-012-17 Seq#: 1

1 - Sale Area

1.2 - Boundaries

1.2.1 - Painted boundaries (1/14)

The sale boundary and Payment Unit boundaries are marked and identified by blue, red and yellow paint.

Exterior sale boundary lines against private property are marked with blue paint, with the following exceptions:

The eastern boundary of Payment Units 2, 3, and 4 is the Mack Road centerline and marked with red paint; these trees are Included Timber. The eastern boundary of Payment Unit 5 is along a fence line into an open field and marked with red paint; these trees are not Included Timber and are to be protected.

Exterior sale boundary lines against state are marked with red paint.

Interior Payment Unit boundaries are marked with yellow paint. Yellow painted trees designating an interior Payment Unit boundary are only to be cut when all surrounding Payment Units have been paid.

Retention areas are marked with red painted x's and no operations are to occur within these areas.

2 - Timber Specifications

2.1 - Included Timber

2.1.1 - Clearcut unit(s) with unmerchantable trees (6/14)

Within Payment Unit(s) 1, 2, 3, 4, and 5, cut all trees that are three (3) inches or more at DBH, except do not cut any cedar, hemlock, and beech within Payment Unit 2.

4 - Transportation

4.1 - Construction

4.1.6 - Road construction (1/09)

Construction of new roads or improvements of existing roads shall be done in such a way as to minimize the environmental and visual impacts. Merchantable trees shall be cut and utilized unless otherwise directed. Non-merchantable trees shall be severed and laid flat on the ground. Slash shall be scattered, and not left in windrows and kept a minimum of 10 feet back from the road edge. Stumps shall be set upright, not left on edge, and be moved at least 10 feet away from the road edge. Disturbed soil shall be feathered into the woods and not left in berms or windrows.

4.1.7 - Road closure (10/11)

All new roads built into the sale must be blocked to vehicle traffic upon completion of the sale. In general, this will require constructing a four (4') foot high berm of stumps and logs covered with earth. Contact the sale administrator for specific details of design and placement.

4.2 - Maintenance

4.2.2 - Fill material (4/07)

To maintain roads, fill material may be needed in areas where "holes" exist or may be expected to develop. This fill material should be placed before trucking begins. Contact the sale administrator regarding the availability of onsite sand or gravel from adjacent State-owned lands.

4.3 - Public Right-of-Way

4.3.2 - County R-O-W (12/06)

The county must be contacted prior to harvesting in the county road R-O-W. This applies to Payment Units 2, 3, and 4.

5 - Operations

5.2 - Conduct of Operations

5.2.3 - Operating Restrictions

5.2.3.1 - Operating restrictions (9/11)

Within Payment Unit(s) 3, unless changed by written agreement, cutting, skidding, and hauling are limited to the period of 12/01/ to 03/15. This restriction is because this unit is significantly lowland ash.

5.2.22 - Operating Caution

5.2.22.1 - Operating caution (6/11)

It is recommended, but not required, that within Payment Unit(s) 4, cutting, skidding, and hauling occur during dry summer or frozen winter conditions. The reason for the recommendation is because several areas of this unit are cedar and lowland ash.

5.4 - Soil Protection

5.4.1 - Rutting restriction, general (7/16)

Operations are to cease immediately if equipment and weather conditions result in rutting of roads and/or skid trails which is 12 inches or greater in depth and 50 feet in length. The Unit Manager or his/her representative may restrict hauling and/or skidding if ruts exceed the specified depth. With the Unit Manager or his/her representative's approval, the Purchaser may return to the area when the risk of rutting has decreased.

6 - Safety and Fire Prevention

6.2 - Signing

6.2.1 - Road posting (9/09)

The Purchaser is responsible for posting and maintaining caution signs on the Mack Road and 32 Road prior to beginning operations. The road must be posted at appropriate distances from the sale area to warn of logging activity and truck traffic. Signs must be removed when harvest operations are suspended or completed. The Purchaser will provide these signs.



TIMBER SALE MAP

This information provided by authority of Part 525, 1994 PA 451, as amended.

Forest Management Unit Escanaba		County Menominee	Mapped By Racine	Date 09/26/2017	Page 1	of 1
Township 37N	Range 25W	Section(s) and Subdivision(s) 28) SWNW, NESE 33) NENE, NWNE		Scale 1:15,840		

Cover Type

A = Aspen	H = Hemlock	N = Marsh	U = Upland Brush
B = Paper Birch	J = Jack Pine	O = Oak	UM = Upland Mixed
C = Cedar	L = Lowland Brush	P = Lowland Poplar	V = Bog or Marsh
D = Treed Bog	LM = Lowland Mixed	Q = Mixed Swamp Conifer	W = White Pine
E = Swamp Hdwoods	M = Mpl, Bch, Brch	R = Red Pine	X = Non Stocked
F = Spruce Fir	MC = Mixed Conifer	S = Black Spruce	Z = Water
G = Grass	MD = Mixed Deciduous	T = Tamarack	

Density

0 = Non Stocked	5 = Pole Timber Medium
1 = Seedling Sapling Poor	6 = Pole Timber Well
2 = Seedling Sapling Medium	7 = Saw Timber Poor
3 = Seedling Sapling Well	8 = Saw Timber Medium
4 = Pole Timber Poor	9 = Saw Timber Well

PU	Acres	PU	Acres
1	4.3	4	14.6
2	9.2	5	2.7
3	23.7		

MACK 32
Compartment 036
54.5 Acres

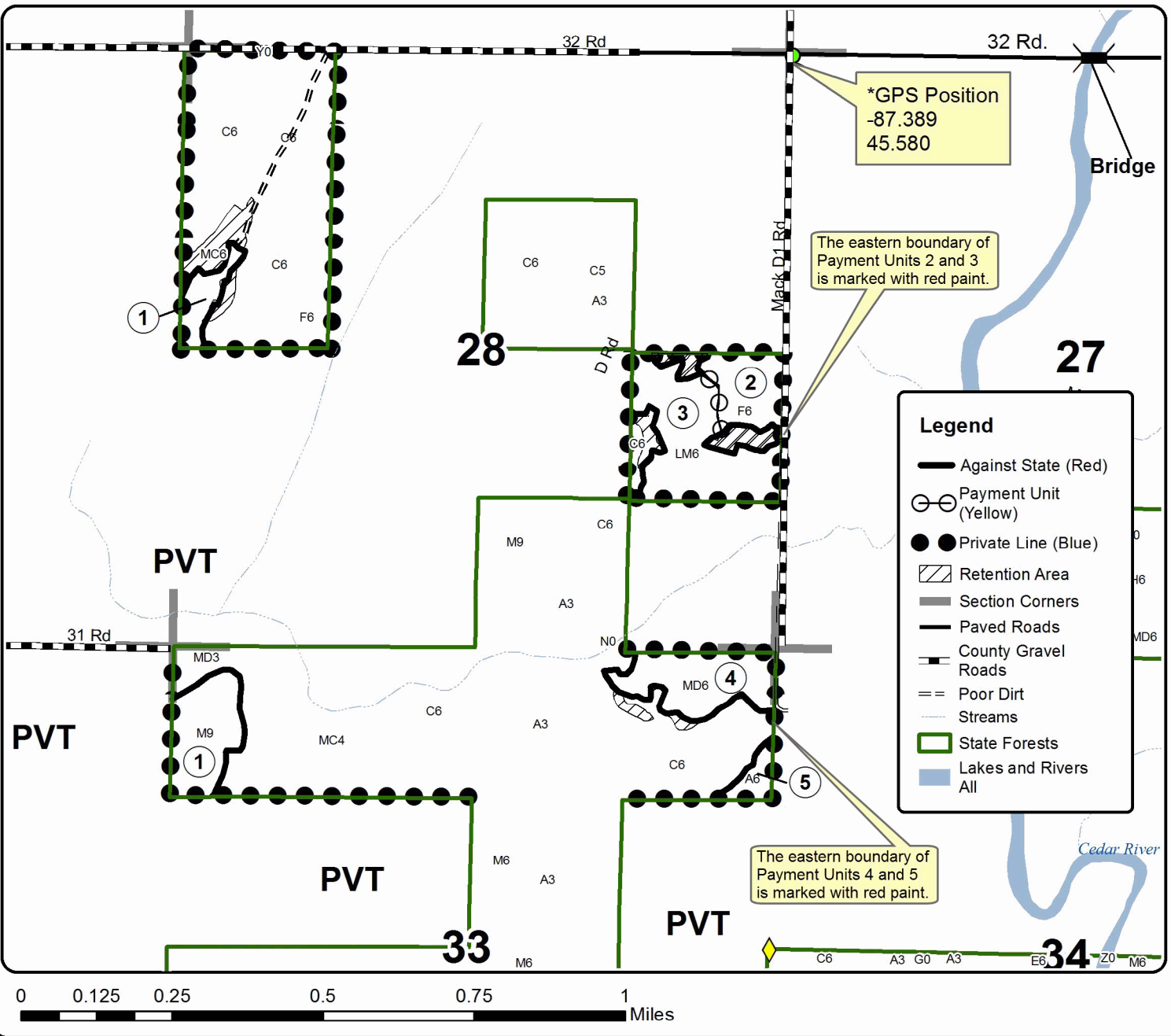
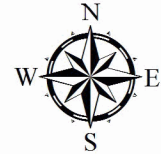

TIMBER SALE INFORMATION

Oak Hill Mix (33-037-17)

Menominee County (Advertised Price \$107,382.75)

SALE NOTE: The eastern larch beetle is present within Payment Units 6, 10, and 11. There has been some tamarack mortality, the Purchaser should harvest these Payment Units as soon as possible.

A timber sale contract for this lump sum, sealed bid timber sale will be awarded to the responsible bidder offering the highest sealed bid price. Bids must be at or above the following advertised price for each species:

<u>PRODUCTS & SPECIES</u>	<u>ESTIMATED UNITS*</u>	<u>ADVERTISED PRICE</u>
Sawtimber		
Northern Pin Oak	12.00 MBF	\$ 145.00 / MBF
Red Maple	2.00 MBF	\$ 184.00 / MBF
Red Oak	46.20 MBF	\$ 252.00 / MBF
Sugar Maple	1.20 MBF	\$ 315.00 / MBF
White Oak	4.20 MBF	\$ 64.00 / MBF
White Pine	117.70 MBF	\$ 60.00 / MBF
Pulpwood		
Balsam Fir	95.00 Cords	\$ 27.25 / Cord
Jack Pine	2.00 Cords	\$ 44.65 / Cord
Mixed Aspen	355.00 Cords	\$ 28.40 / Cord
Mixed Hardwood	839.00 Cords	\$ 28.05 / Cord
Mixed Oak	385.00 Cords	\$ 18.65 / Cord
Mixed Spruce	120.00 Cords	\$ 22.30 / Cord
N. White Cedar	978.00 Cords	\$ 22.30 / Cord
Red Pine	44.00 Cords	\$ 61.15 / Cord
Tamarack	243.00 Cords	\$ 19.40 / Cord
White Pine	366.00 Cords	\$ 28.85 / Cord

* The total volume is statistically estimated within plus (+) or minus (-) 10.48 percent. The estimated units are final and not subject to adjustment. Prospective bidders are urged to examine this timber and to make their own estimates of quantity and quality.

BOND AND PAYMENT SCHEDULE:

1. A bond in the amount of \$5,369.00 to insure faithful performance of the conditions of the contract will be deposited by the successful bidder within 21 days of the sale award.
2. Cutting in any sale or unit without the required advance payment would be considered a trespass.
3. Total payment must be paid in advance or according to the following schedule:
 - (a) Ten percent (10%) of the sale value must be paid within 21 days of the sale award.
 - (b) The 10% down payment will be credited towards the first unit cut.
4. If no cutting takes place, the 10% down payment will not be refunded.
5. Operations on the contract issued will terminate on 09/30/2020.

Description of Timber by Payment Unit (PU)

PU	MARKET GROUP	PRODUCT	QUANTITY	UNIT	ACRES	ADVERTISE PRICE		
1	Red Maple	Sawtimber	1.1	MBF	16.7	\$14,821.05		
	Red Oak		23.0	MBF				
	Sugar Maple		1.2	MBF				
	White Pine		29.4	MBF				
	Balsam Fir		Pulpwood	2.0			Cords	
	Mixed Aspen			15.0			Cords	
	<i>B. T. Aspen</i>			15.0			<i>Cords</i>	
	Mixed Hardwood			112.0			Cords	
	<i>White Ash</i>			Sawtimber			0.5	<i>MBF</i>
	<i>Balsam Poplar</i>						Pulpwood	2.0
	<i>Basswood</i>			17.0				<i>Cords</i>
	<i>Black Ash</i>			3.0				<i>Cords</i>
	<i>Green Ash</i>			7.0				<i>Cords</i>
	<i>Paper Birch</i>			1.0				<i>Cords</i>
	<i>Red Maple</i>		61.0	<i>Cords</i>				
	<i>Sugar Maple</i>		18.0	<i>Cords</i>				
	<i>White Ash</i>		2.0	<i>Cords</i>				
	Mixed Oak		48.0	Cords				
	<i>Red Oak</i>		45.0	<i>Cords</i>				
	<i>White Oak</i>		3.0	<i>Cords</i>				
	N. White Cedar		33.0	Cords				
	Red Pine		4.0	Cords				
	White Pine		41.0	Cords				
2	Northern Pin Oak	Sawtimber	2.2	MBF	9.5	\$6,975.15		
	Red Oak		6.4	MBF				
	White Pine		5.0	MBF				
	Balsam Fir		Pulpwood	3.0			Cords	
	Mixed Aspen			30.0			Cords	
	<i>B. T. Aspen</i>			18.0			<i>Cords</i>	
	<i>Quaking Aspen</i>			12.0			<i>Cords</i>	
	Mixed Hardwood			81.0			Cords	
	<i>Balsam Poplar</i>			2.0			<i>Cords</i>	
	<i>Basswood</i>			7.0			<i>Cords</i>	
	<i>Paper Birch</i>			6.0			<i>Cords</i>	
	<i>Red Maple</i>			66.0			<i>Cords</i>	
	Mixed Oak			33.0			Cords	
	<i>Northern Pin Oak</i>		14.0	<i>Cords</i>				
	<i>Red Oak</i>		10.0	<i>Cords</i>				
	<i>White Oak</i>		9.0	<i>Cords</i>				
	Mixed Spruce		9.0	Cords				
	<i>White Spruce</i>		9.0	<i>Cords</i>				
	N. White Cedar		22.0	Cords				
	White Pine		8.0	Cords				
3	White Oak	Sawtimber	0.4	MBF	8.8	\$6,982.35		
	White Pine		1.0	MBF				
	Balsam Fir		Pulpwood	3.0			Cords	
	Mixed Hardwood			155.0			Cords	
	<i>Basswood</i>			9.0			<i>Cords</i>	
	<i>Black Ash</i>			56.0			<i>Cords</i>	
	<i>Green Ash</i>			26.0			<i>Cords</i>	
	<i>Paper Birch</i>			10.0			<i>Cords</i>	
	<i>Red Maple</i>			48.0			<i>Cords</i>	
	<i>Yellow Birch</i>			6.0			<i>Cords</i>	
	Mixed Oak			4.0			Cords	
	<i>White Oak</i>			4.0			<i>Cords</i>	
	Mixed Spruce		11.0	Cords				

Description of Timber by Payment Unit (PU), con't

PU	MARKET GROUP	PRODUCT	QUANTITY	UNIT	ACRES	ADVERTISE PRICE
3 con't	<i>Black Spruce</i> N. White Cedar White Pine	<i>Pulpwood</i>	11.0 95.0 1.0	<i>Cords</i> Cords Cords		
4	Northern Pin Oak White Oak White Pine Balsam Fir Jack Pine Mixed Aspen <i>B. T. Aspen</i> <i>Quaking Aspen</i> Mixed Hardwood <i>Balsam Poplar</i> <i>Red Maple</i> Mixed Oak <i>Northern Pin Oak</i> <i>White Oak</i> Mixed Spruce <i>White Spruce</i> Red Pine White Pine	Sawtimber Pulpwood	7.6 3.3 11.6 13.0 2.0 115.0 16.0 99.0 53.0 3.0 50.0 123.0 101.0 22.0 6.0 6.0 13.0 33.0	MBF MBF MBF Cords Cords Cords <i>Cords</i> <i>Cords</i> Cords <i>Cords</i> <i>Cords</i> Cords <i>Cords</i> <i>Cords</i> Cords <i>Cords</i> Cords Cords Cords	20.2	\$11,380.15
5	White Pine Balsam Fir Mixed Aspen <i>B. T. Aspen</i> <i>Quaking Aspen</i> Mixed Hardwood <i>Black Cherry</i> <i>Paper Birch</i> <i>Red Maple</i> Mixed Oak <i>Northern Pin Oak</i> Mixed Spruce <i>White Spruce</i> Red Pine White Pine	Sawtimber Pulpwood	0.1 13.0 128.0 13.0 115.0 30.0 3.0 4.0 23.0 29.0 29.0 3.0 3.0 8.0 52.0	MBF Cords Cords <i>Cords</i> <i>Cords</i> Cords <i>Cords</i> <i>Cords</i> <i>Cords</i> Cords <i>Cords</i> Cords <i>Cords</i> Cords Cords	15.2	\$7,434.10
6	Red Oak White Oak White Pine Balsam Fir Mixed Aspen <i>Quaking Aspen</i> Mixed Hardwood <i>American Elm</i> <i>Balsam Poplar</i> <i>Black Ash</i> <i>Green Ash</i> <i>Paper Birch</i> <i>Red Maple</i> Mixed Oak <i>Red Oak</i> <i>White Oak</i> Mixed Spruce <i>Black Spruce</i> <i>White Spruce</i> N. White Cedar	Sawtimber Pulpwood	2.9 0.5 50.7 15.0 4.0 4.0 142.0 5.0 3.0 59.0 16.0 11.0 48.0 22.0 20.0 2.0 10.0 7.0 3.0 217.0	MBF MBF MBF Cords Cords <i>Cords</i> Cords <i>Cords</i> <i>Cords</i> <i>Cords</i> <i>Cords</i> <i>Cords</i> <i>Cords</i> Cords <i>Cords</i> <i>Cords</i> <i>Cords</i> Cords <i>Cords</i> <i>Cords</i> Cords	20.8	\$19,850.05

Description of Timber by Payment Unit (PU), con't

PU	MARKET GROUP	PRODUCT	QUANTITY	UNIT	ACRES	ADVERTISE PRICE	
6 con't	Red Pine	Pulpwood	3.0	Cords			
	Tamarack		49.0	Cords			
	White Pine		171.0	Cords			
7	Northern Pin Oak	Sawtimber	2.2	MBF	23.4	\$6,974.65	
	Red Oak		9.5	MBF			
	White Pine		10.3	MBF			
	Mixed Hardwood		27.0	Cords			
	<i>Basswood</i>		0.5	MBF			
	<i>Basswood</i>		2.0	Cords			
	<i>Red Maple</i>		24.0	Cords			
	Mixed Oak		66.0	Cords			
	<i>Northern Pin Oak</i>		21.0	Cords			
	<i>Red Oak</i>		43.0	Cords			
	<i>White Oak</i>		2.0	Cords			
	Mixed Spruce		6.0	Cords			
	<i>White Spruce</i>		6.0	Cords			
	N. White Cedar		2.0	Cords			
	Red Pine		10.0	Cords			
	White Pine		30.0	Cords			
	8		Red Oak	Sawtimber			1.0
White Pine		3.8	MBF				
Balsam Fir		Pulpwood	1.0		Cords		
Mixed Aspen			4.0		Cords		
<i>B. T. Aspen</i>			4.0		Cords		
Mixed Hardwood			26.0		Cords		
<i>Red Maple</i>			26.0		Cords		
Mixed Oak			37.0		Cords		
<i>Northern Pin Oak</i>			13.0		Cords		
<i>Red Oak</i>			24.0		Cords		
Mixed Spruce			8.0		Cords		
<i>White Spruce</i>			8.0		Cords		
N. White Cedar			7.0		Cords		
White Pine	6.0		Cords				
9	Red Maple		Sawtimber	0.9	MBF	5.5	\$4,739.20
	Red Oak	3.4		MBF			
	White Pine	2.4		MBF			
	Balsam Fir	Pulpwood		23.0	Cords		
	Mixed Aspen			34.0	Cords		
	<i>B. T. Aspen</i>			9.0	Cords		
	<i>Quaking Aspen</i>			25.0	Cords		
	Mixed Hardwood			39.0	Cords		
	<i>Paper Birch</i>			2.0	Cords		
	<i>Red Maple</i>			37.0	Cords		
	Mixed Oak			14.0	Cords		
	<i>Red Oak</i>			14.0	Cords		
	Mixed Spruce			3.0	Cords		
	<i>White Spruce</i>			3.0	Cords		
Red Pine	3.0		Cords				
White Pine	13.0		Cords				
10	White Pine		Sawtimber	0.8	MBF	26.5	\$10,696.20
	Balsam Fir	Pulpwood	7.0	Cords			
	Mixed Hardwood		53.0	Cords			
	<i>Balsam Poplar</i>		2.0	Cords			
	<i>Black Ash</i>		27.0	Cords			
	<i>Paper Birch</i>		18.0	Cords			
	<i>Red Maple</i>		6.0	Cords			

Description of Timber by Payment Unit (PU), con't

PU	MARKET GROUP	PRODUCT	QUANTITY	UNIT	ACRES	ADVERTISE PRICE
10 con't	Mixed Spruce	Pulpwood	36.0	Cords		
	<i>Black Spruce</i>		34.0	<i>Cords</i>		
	<i>White Spruce</i>		2.0	<i>Cords</i>		
	N. White Cedar		228.0	Cords		
	Tamarack		153.0	Cords		
	White Pine		4.0	Cords		
11	White Pine	Sawtimber	2.1	MBF	24.6	\$13,589.90
	Balsam Fir	Pulpwood	5.0	Cords		
	Mixed Hardwood		116.0	Cords		
	<i>Balsam Poplar</i>		3.0	<i>Cords</i>		
	<i>Black Ash</i>		65.0	<i>Cords</i>		
	<i>Paper Birch</i>		28.0	<i>Cords</i>		
	<i>Red Maple</i>		20.0	<i>Cords</i>		
	Mixed Oak		2.0	Cords		
	<i>Northern Pin Oak</i>		2.0	<i>Cords</i>		
	Mixed Spruce		27.0	Cords		
	<i>Black Spruce</i>		27.0	<i>Cords</i>		
	N. White Cedar		374.0	Cords		
	Red Pine		3.0	Cords		
	Tamarack		41.0	Cords		
	White Pine		4.0	Cords		
12	White Pine	Sawtimber	0.5	MBF	1.8	\$1,392.15
	Balsam Fir	Pulpwood	10.0	Cords		
	Mixed Aspen		25.0	Cords		
	<i>Quaking Aspen</i>		25.0	<i>Cords</i>		
	Mixed Hardwood		5.0	Cords		
	<i>Red Maple</i>		5.0	<i>Cords</i>		
	Mixed Oak		7.0	Cords		
	<i>Northern Pin Oak</i>		7.0	<i>Cords</i>		
	Mixed Spruce		1.0	Cords		
	<i>White Spruce</i>		1.0	<i>Cords</i>		
	White Pine		3.0	Cords		
TOTAL:			183.3	MBF		
TOTAL:			3,427.0	Cords		

Sale Specific Conditions & Requirements

Sale Name: Oak Hill Mix

Sale Number: 33-037-17 Seq#: 1

1 - Sale Area

1.2 - Boundaries

1.2.1 - Painted boundaries (1/14)

The sale boundary and Payment Unit boundaries are marked and identified by blue, red and yellow paint. Exterior sale boundary lines against private property are marked with blue paint. Exterior sale boundary lines against state are marked with red paint. Retention patches within Payment Units 3 and 5 are marked with red paint; no harvesting operations may occur within these areas. Interior Payment Unit boundaries are marked with yellow paint. The painted boundary line trees are not Included Timber and are to be protected. Yellow painted trees designating an interior Payment Unit boundary are only to be cut when all surrounding Payment Units have been paid for.

2 - Timber Specifications

2.1 - Included Timber

2.1.1 - Clearcut unit(s) with unmerchantable trees (6/14)

Within Payment Unit(s) 3, 4, 5, 6, 9, 10, 11, and 12, cut all trees that are three (3) inches or more at DBH, except hemlock and the following:

Within Payment Units 4, 5, 6, and 9, do not cut trees marked with orange paint.

Within Payment Units 10 and 11, do not cut trees marked with green paint.

2.1.2 - Clearcut unit(s) w/o unmerchantable trees (8/11)

Within Payment Unit(s) 1, 2, 7, and 8, cut all trees which meet minimum piece specifications in 2.2 Utilization; except hemlock and trees marked with orange paint.

2.2 - Utilization

2.2.4 - Skidding length (2/14)

Skidding of unlimbed tops or lengths over 17 feet is not permissible within Payment Units 1, 2, 7, and 8, unless approved by the Unit Manager or his/her representative.

3 - Payments

3.3 - Pre-measured Sales

3.3.4 - Dividing payment units (7/14)

Payment Unit(s) \$18,000 in value or greater may be divided at the request of the Purchaser and upon approval of the Unit Manager. Dividing Payment Units is a contract modification which requires a Timber Sale Contract Supplement. There will be only one division per Payment Unit.

3.4 - Damaged Timber

3.4.1 - Damaged timber (6/14)

General Condition and Requirement 3.4 Damaged Timber, defines liquidated damages for undesignated live merchantable trees which are cut or injured. In addition, extreme care should be taken to avoid damage to tree seedlings and saplings.

Within Payment Units 1, 2, 7 and 8, if more than 50% of the tree seedlings or saplings (1/4" to 4.5" DBH) within a specified portion of the sale area are damaged, liquidated damages will be assessed at \$500 per acre for all acreage within that specified portion of the sale area that was damaged.

4 - Transportation

4.1 - Construction

4.1.8 - Road work (1) (8/07)

The following road work is required: The Purchaser must haul and spread 110 yards of pit run gravel on the Oak Hill Road. The exact locations will be identified during the pre-sale meeting. The gravel is available from a state pit, that is about 6 miles away.

4.2 - Maintenance

4.2.1 - Hauling restriction (12/08)

Hauling may be restricted on forest roads by the Unit Manager or his/her representative. The restriction may occur during spring breakup or during other wet weather conditions.

4.2.4 - Grading (10/16)

For completion of the sale, state forest roads must be graded. In general, this will require a road grader or bull dozer to shape up the roads after forest products have been hauled off site. This includes cleaning of drainage areas, grading, crowning and filling with gravel, if necessary. The grading equipment to be used must be approved by the Unit Manager or his/her representative.

5 - Operations

5.2 - Conduct of Operations

5.2.3 - Operating Restrictions

5.2.3.1 - Operating restrictions (9/11)

Within Payment Unit(s) 3, 6, 10, and 11, cutting and skidding are limited to the period of December 1st to March 31st, unless there is an extended dry or frozen period and the sale administrator allows harvesting during that time period. This restriction is because of low wet ground throughout the Payment Units.

5.2.22 - Operating Caution

5.2.22.1 - Operating caution (6/11)

It is recommended, but not required, that within Payment Unit(s) 1, 8, and 9, cutting and skidding occur during dry summer or frozen winter conditions. The reason for the recommendation is because of some low wet pockets within Payment Units 1 and 8, and low access into Payment Unit 9.

5.2.37 - No decking areas (12/08)

No decking is allowed along #19 Road without permission from the Menominee County Road Commission.

5.4 - Soil Protection

5.4.1 - Rutting restriction, general (7/16)

Operations are to cease immediately if equipment and weather conditions result in rutting of roads and/or skid trails which is 12 inches or greater in depth and 50 feet in length. The Unit Manager or his/her representative may restrict hauling and/or skidding if ruts exceed the specified depth. With the Unit Manager or his/her representative's approval, the Purchaser may return to the area when the risk of rutting has decreased.

6 - Safety and Fire Prevention

6.2 - Signing

6.2.1 - Road posting (9/09)

The Purchaser is responsible for posting and maintaining caution signs on #19 Road prior to beginning operations. The road must be posted at appropriate distances from the sale area to warn of logging activity and truck traffic. Signs must be removed when harvest operations are suspended or completed. The Purchaser will provide these signs.

7 - Other Conditions

7.3 - Contract Modifications

7.3.2 - Modification for oak wilt (2/05)

Within the sale area, there may be patches of oak wilt. If oak wilt is identified within the sale area, this contract may be modified. The following modifications could occur: time of cutting, species to cut, volume to harvest, or various others dealing

with the treatment of oak wilt. If a species is not specified in this contract, it shall be paid for at the average price received for that species and product.

7.5 - Loss

7.5.1 - Deteriorating timber (7/09)

The sale area has received damage from the eastern larch beetle. Some mortality has occurred within Payment Units 10 and 11. The Purchaser should harvest the wood as soon as possible. The Department of Natural Resources is held free of responsibility of any further damage or deterioration due to delay in harvesting.



TIMBER SALE MAP

This information provided by authority of Part 525, 1994 PA 451, as amended.

Forest Management Unit Escanaba Management Unit	County Menominee County	Mapped By Beaudo	Date 7/17/2017	Page 1	of 1
Township 34N 35N	Range 29W	Section(s) and Subdivision(s) Sec 1 - NWNW; Sec 2 - NENE; Sec 34 - NESE; Sec 35 - NWSW, SESW, NWSE, SWSE, SENE, SWNE & NESE; Sec 36 - NESW, SESW & SWSW	Scale 1:15,840		

Cover Type

A = Aspen	H = Hemlock	N = Marsh	U = Upland Brush
B = Paper Birch	J = Jack Pine	O = Oak	UM = Upland Mixed
C = Cedar	L = Lowland Brush	P = Lowland Poplar	V = Bog or Marsh
D = Tread Bog	LM = Lowland Mixed	Q = Mixed Swamp Conifer	W = White Pine
E = Swamp Hdwoods	M = Mpl, Bch, Brch	R = Red Pine	X = Non Stocked
F = Spruce Fir	MC = Mixed Conifer	S = Black Spruce	Z = Water
G = Grass	MD = Mixed Deciduous	T = Tamarack	

Density

0 = Non Stocked	5 = Pole Timber Medium
1 = Seedling Sapling Poor	6 = Pole Timber Well
2 = Seedling Sapling Medium	7 = Saw Timber Poor
3 = Seedling Sapling Well	8 = Saw Timber Medium
4 = Pole Timber Poor	9 = Saw Timber Well

PU	Acres
1	16.7
2	9.5
3	8.8
4	20.2
5	15.2
6	20.8
7	23.4
8	10.5
9	5.5
10	26.5
11	24.6
12	1.8

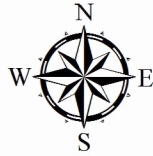

Oak Hill Mix
Compartment 27
183.5 Acres



QR Code
 opens map in
 PDF Maps App

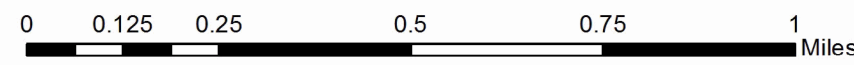
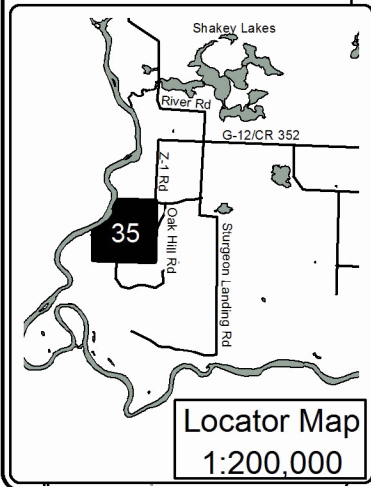
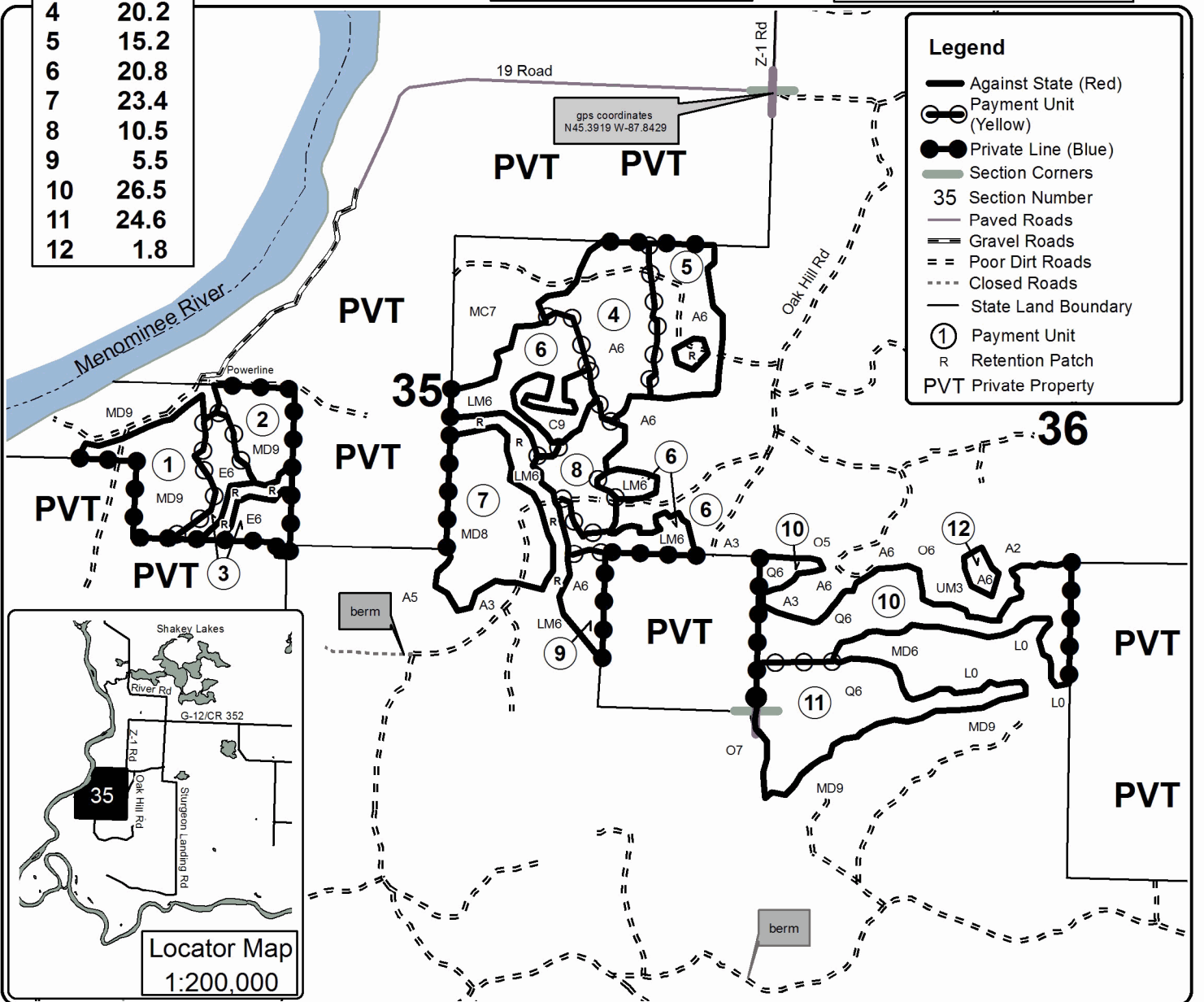

TIMBER SALE INFORMATION

Blue Bus SBW (33-042-17)

Menominee County (Advertised Price \$10,511.85)

SALE NOTE: The spruce budworm has caused some spruce/fir defoliation, but no mortality at this time.

A timber sale contract for this lump sum, sealed bid timber sale will be awarded to the responsible bidder offering the highest sealed bid price. Bids must be at or above the following advertised price for each species:

<u>PRODUCTS & SPECIES</u>	<u>ESTIMATED UNITS*</u>	<u>ADVERTISED PRICE</u>
Sawtimber		
White Pine	0.80 MBF	\$ 52.00 / MBF
Pulpwood		
Balsam Fir	112.00 Cords	\$ 23.35 / Cord
Mixed Aspen	205.00 Cords	\$ 24.35 / Cord
Mixed Spruce	52.00 Cords	\$ 19.15 / Cord
Paper Birch	29.00 Cords	\$ 22.55 / Cord
Red Maple	25.00 Cords	\$ 24.00 / Cord
Red Pine	6.00 Cords	\$ 52.40 / Cord
Tamarack	15.00 Cords	\$ 16.65 / Cord
White Pine	2.00 Cords	\$ 24.70 / Cord

* The total volume is statistically estimated within plus (+) or minus (-) 19.00 percent. The estimated units are final and not subject to adjustment. Prospective bidders are urged to examine this timber and to make their own estimates of quantity and quality.

BOND AND PAYMENT SCHEDULE:

1. A bond in the amount of \$526.00 to insure faithful performance of the conditions of the contract will be deposited by the successful bidder within 21 days of the sale award.
2. Cutting in any sale or unit without the required advance payment would be considered a trespass.
3. Total payment must be paid in advance or according to the following schedule:
 - (a) Ten percent (10%) of the sale value must be paid within 21 days of the sale award.
 - (b) The 10% down payment will be credited towards the first unit cut.
4. If no cutting takes place, the 10% down payment will not be refunded.
5. Operations on the contract issued will terminate on 12/31/2019.

Description of Timber by Payment Unit (PU)

PU	MARKET GROUP	PRODUCT	QUANTITY	UNIT	ACRES	ADVERTISE PRICE
1	White Pine	Sawtimber	0.8	MBF	20.4	\$4,918.40
	Balsam Fir	Pulpwood	70.0	Cords		
	Mixed Aspen		74.0	Cords		
	<i>Quaking Aspen</i>		74.0	<i>Cords</i>		
	Mixed Spruce		6.0	Cords		
	<i>Black Spruce</i>		4.0	<i>Cords</i>		
	<i>White Spruce</i>		2.0	<i>Cords</i>		
	Paper Birch		13.0	Cords		
	Red Maple		23.0	Cords		
	Red Pine		6.0	Cords		
	Tamarack		7.0	Cords		
	White Pine		2.0	Cords		
	2	Balsam Fir	Pulpwood	42.0		
Mixed Aspen			131.0	Cords		
<i>Balsam Poplar</i>			6.0	<i>Cords</i>		
<i>Quaking Aspen</i>			125.0	<i>Cords</i>		
Mixed Spruce			46.0	Cords		
<i>Black Spruce</i>			26.0	<i>Cords</i>		
<i>White Spruce</i>			20.0	<i>Cords</i>		
Paper Birch			16.0	Cords		
Red Maple			2.0	Cords		
Tamarack			8.0	Cords		
TOTAL:			0.8	MBF		
TOTAL:			446.0	Cords		

Sale Specific Conditions & Requirements

Sale Name: Blue Bus SBW

Sale Number: 33-042-17 Seq#: 1

1 - Sale Area

1.2 - Boundaries

1.2.1 - Painted boundaries (1/14)

The sale boundary and Payment Unit boundaries are marked and identified by red and yellow paint. Exterior sale boundary lines against state are marked with red paint. Interior Payment Unit boundaries are marked with yellow paint. The painted boundary line trees are not Included Timber and are to be protected. Yellow painted trees designating an interior Payment Unit boundary are only to be cut when all surrounding Payment Units have been paid for.

2 - Timber Specifications

2.1 - Included Timber

2.1.1 - Clearcut unit(s) with unmerchantable trees (6/14)

Within Payment Unit(s) 1 and 2, cut all trees that are three (3) inches or more at DBH; except do not cut cedar, hemlock, and trees marked with green paint.

3 - Payments

3.3 - Pre-measured Sales

3.3.4 - Dividing payment units (7/14)

Payment Unit(s) \$18,000 in value or greater may be divided at the request of the Purchaser and upon approval of the Unit Manager. Dividing Payment Units is a contract modification which requires a Timber Sale Contract Supplement. There will be only one division per Payment Unit.

4 - Transportation

4.2 - Maintenance

4.2.1 - Hauling restriction (12/08)

Hauling may be restricted on forest roads by the Unit Manager or his/her representative. The restriction may occur during spring breakup or during other wet weather conditions.

4.2.4 - Grading (10/16)

For completion of the sale, state forest roads must be graded. In general, this will require a road grader or bull dozer to shape up the roads after forest products have been hauled off site. This includes cleaning of drainage areas, grading, crowning and filling with gravel, if necessary. The grading equipment to be used must be approved by the Unit Manager or his/her representative.

5 - Operations

5.4 - Soil Protection

5.4.1 - Rutting restriction, general (7/16)

Operations are to cease immediately if equipment and weather conditions result in rutting of roads and/or skid trails which is 12 inches or greater in depth and 50 feet in length. The Unit Manager or his/her representative may restrict hauling and/or skidding if ruts exceed the specified depth. With the Unit Manager or his/her representative's approval, the Purchaser may return to the area when the risk of rutting has decreased.

7 - Other Conditions

7.5 - Loss

7.5.1 - Deteriorating timber (7/09)

The sale area has received damage from the spruce budworm. The Purchaser should harvest the wood as soon as possible. The Department of Natural Resources is held free of responsibility of any further damage or deterioration due to delay in

harvesting.



TIMBER SALE MAP

This information provided by authority of Part 525, 1994 PA 451, as amended.

Forest Management Unit Escanaba Management Unit	County Menominee County	Mapped By Bealdo	Date 9/22/2017	Page 1	of 1
Township 40N	Range 26W	Section(s) and Subdivision(s) Sec 25 - NWSW, SWSW; Sec 26 - SESE; Sec 35 - NENE, SENE; Sec 36 - NWNW	Scale 1:15,840		

Cover Type				Density	
A = Aspen	H = Hemlock	N = Marsh	U = Upland Brush	0 = Non Stocked	5 = Pole Timber Medium
B = Paper Birch	J = Jack Pine	O = Oak	UM = Upland Mixed	1 = Seedling Sapling Poor	6 = Pole Timber Well
C = Cedar	L = Lowland Brush	P = Lowland Poplar	V = Bog or Marsh	2 = Seedling Sapling Medium	7 = Saw Timber Poor
D = Treed Bog	LM = Lowland Mixed	Q = Mixed Swamp Conifer	W = White Pine	3 = Seedling Sapling Well	8 = Saw Timber Medium
E = Swamp Hdwoods	M = Mpl, Bch, Brch	R = Red Pine	X = Non Stocked	4 = Pole Timber Poor	9 = Saw Timber Well
F = Spruce Fir	MC = Mixed Conifer	S = Black Spruce	Z = Water		
G = Grass	MD = Mixed Deciduous	T = Tamarack			

PU	Acres
1	20.4
2	21.2



Blue Bus SBW
Compartment 70
41.6 Acres

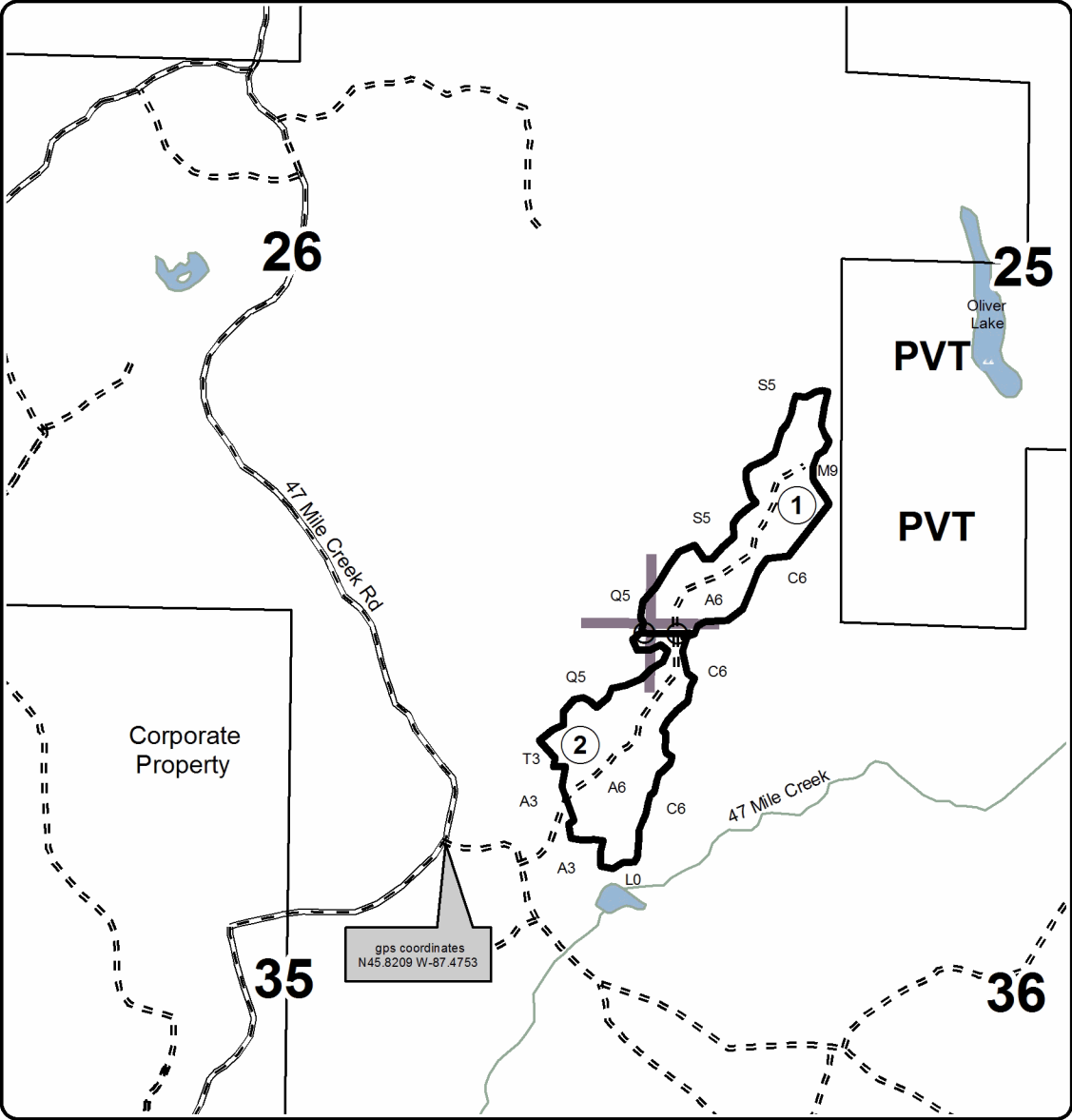

Legend

- Against State (Red)
- ⊕ Payment Unit (Yellow)
- ⊕ Section Corners
- 25 Section Number
- Gravel Roads
- - - Poor Dirt Roads
- State Land Boundary
- ⊕ Payment Unit
- ~ Creek/Seasonal Drain
- PVT Private Property

Locator Map
1:200,000

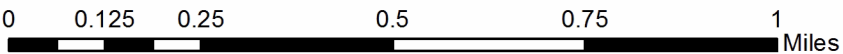
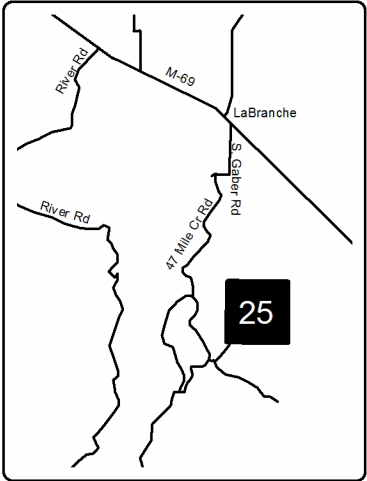

Oak Hill Mix (33-037-17)
; Menominee COUNTY

In response to the notice of sale to be held 3:00 p.m. (local time) on January 30, 2018, I am hereby submitting my sealed bid (firm offer) for the following forest products to be cut. Bids for individual species must be at or above the advertised price. All non-responsive bid forms may be rejected.

<u>PRODUCTS & SPECIES</u>	<u>ESTIMATED VOLUME*</u>	<u>ADVERTISED PRICE</u>	<u>BID PRICE/UNIT</u>
Sawtimber			
Northern Pin Oak	12.00 MBF	\$ 145.00/MBF	\$ _____
Red Maple	2.00 MBF	\$ 184.00/MBF	\$ _____
Red Oak	46.20 MBF	\$ 252.00/MBF	\$ _____
Sugar Maple	1.20 MBF	\$ 315.00/MBF	\$ _____
White Oak	4.20 MBF	\$ 64.00/MBF	\$ _____
White Pine	117.70 MBF	\$ 60.00/MBF	\$ _____
Pulpwood			
Balsam Fir	95.00 Cords	\$ 27.25/Cord	\$ _____
Jack Pine	2.00 Cords	\$ 44.65/Cord	\$ _____
Mixed Aspen	355.00 Cords	\$ 28.40/Cord	\$ _____
Mixed Hardwood	839.00 Cords	\$ 28.05/Cord	\$ _____
Mixed Oak	385.00 Cords	\$ 18.65/Cord	\$ _____
Mixed Spruce	120.00 Cords	\$ 22.30/Cord	\$ _____
N. White Cedar	978.00 Cords	\$ 22.30/Cord	\$ _____
Red Pine	44.00 Cords	\$ 61.15/Cord	\$ _____
Tamarack	243.00 Cords	\$ 19.40/Cord	\$ _____
White Pine	366.00 Cords	\$ 28.85/Cord	\$ _____

*The volumes are statistically estimated within plus (+) or minus (-) 10.48 percent. These estimated volumes are final and not subject to adjustment. Prospective bidders are urged to examine this timber and to make their own estimates of quantity and quality.

I understand that any or all bids may be rejected. All bids must be signed and all bid items must be bid or the bid form may be rejected. I also understand that consideration and awarding a contract will be based upon my past performance and ability to complete the contract based upon equipment and staffing subject to my control.

FEDERAL ID: ____ - ____ - ____ or SOCIAL SECURITY NUMBER: ____ - ____ - ____

Company or individual bidding: _____

Company representative's name: _____

Address: _____

City: _____ State: _____ Zip: _____

IF AVAILABLE, PLEASE PLACE THE PERSONALIZED LABEL FROM YOUR PROSPECTUS IN THE ABOVE BOX.

Individual or company representative's signature: _____ Date: _____

Phone number : _____ Email (optional): _____

THE WINNING BIDDER MUST COMPLETE THE VERIFICATION OF WORKER'S DISABILITY COMPENSATION ACT COMPLIANCE (ON REVERSE SIDE IF DOUBLE SIDED) WITHIN 21 DAYS OF SALE AWARD DATE



FOR DEPARTMENT USE ONLY
Sale Number (XX - XXX - XX - XX)
Forest Management Unit:

TIMBER SALE
VERIFICATION OF WORKER'S DISABILITY
COMPENSATION ACT COMPLIANCE

As required by Act 317, P.A. 1969 (Worker's Compensation) and
Part 5 of Act 451 of 1994, as amended.

VERIFICATION OF WORKER'S DISABILITY COMPENSATION ACT COMPLIANCE

- This verification must be completed and submitted within 21 days of contract award and prior to the issuance of the timber sale contract.
In addition, if boxes 2B or 2C are checked, then Notice of Exclusion or Certificate of Insurance must be submitted within twenty-one (21) days of the contract award and prior to the issuance of the timber sale contract.
All information must be typed or printed except for written signatures.

Please Check Appropriate Categories:

- 1. My business is organized as (you must check one of the boxes below):
A. Sole Proprietorship (individual)
B. Partnership
C. Corporation
2. You must check one of the boxes below:
A. I certify my business is a sole proprietorship and it has no employees but the sole proprietor. I am not subject to the Worker's Compensation Laws.
B. I certify my business has satisfied its obligation to the Worker's Compensation Act through the use of an approved Notice of Exclusion (BWC-337, Rev. 5/96). I will provide a copy of the Notice of Exclusion within 21 days of the contract award. (For questions or a copy of the BWC-337, please call the Worker's Compensation Bureau at 517-322-1195).
C. I certify my business has a Worker's Compensation Policy. I will provide an original Certificate of Insurance within twenty-one (21) days of the contract award.
3. If you have checked item 2(A) or 2(B), you must indicate the number of both full-time and part-time employees, other than yourself, including family members and active partners (if none, you must enter "0").

Full-time Employees

Part-time Employees

Name of Business Federal ID (or) Social Security No.
Address Telephone
City State ZIP

I hereby certify that the above information is true and correct. I agree to notify the Michigan DNR of any changes that occur in factors affecting my coverage during any of my present and future operations.

Signature of Owner or Authorized Representative

Title

Date

Please complete the "SEALED BID" information on the next page

Blue Bus SBW (33-042-17)
; Menominee COUNTY

In response to the notice of sale to be held 3:00 p.m. (local time) on January 30, 2018, I am hereby submitting my sealed bid (firm offer) for the following forest products to be cut. Bids for individual species must be at or above the advertised price. All non-responsive bid forms may be rejected.

<u>PRODUCTS & SPECIES</u>	<u>ESTIMATED VOLUME*</u>	<u>ADVERTISED PRICE</u>	<u>BID PRICE/UNIT</u>
Sawtimber			
White Pine	0.80 MBF	\$ 52.00/MBF	\$ _____
Pulpwood			
Balsam Fir	112.00 Cords	\$ 23.35/Cord	\$ _____
Mixed Aspen	205.00 Cords	\$ 24.35/Cord	\$ _____
Mixed Spruce	52.00 Cords	\$ 19.15/Cord	\$ _____
Paper Birch	29.00 Cords	\$ 22.55/Cord	\$ _____
Red Maple	25.00 Cords	\$ 24.00/Cord	\$ _____
Red Pine	6.00 Cords	\$ 52.40/Cord	\$ _____
Tamarack	15.00 Cords	\$ 16.65/Cord	\$ _____
White Pine	2.00 Cords	\$ 24.70/Cord	\$ _____

*The volumes are statistically estimated within plus (+) or minus (-) 19.00 percent. These estimated volumes are final and not subject to adjustment. Prospective bidders are urged to examine this timber and to make their own estimates of quantity and quality.

I understand that any or all bids may be rejected. All bids must be signed and all bid items must be bid or the bid form may be rejected. I also understand that consideration and awarding a contract will be based upon my past performance and ability to complete the contract based upon equipment and staffing subject to my control.

FEDERAL ID: ____ - ____ - ____ or SOCIAL SECURITY NUMBER: ____ - ____ - ____

Company or individual bidding: _____

Company representative's name: _____

Address: _____

City: _____ State: _____ Zip: _____

IF AVAILABLE, PLEASE PLACE THE PERSONALIZED LABEL FROM YOUR PROSPECTUS IN THE ABOVE BOX.

Individual or company representative's signature: _____ Date: _____
Phone number : _____ Email (optional): _____

THE WINNING BIDDER MUST COMPLETE THE VERIFICATION OF WORKER'S DISABILITY COMPENSATION ACT COMPLIANCE (ON REVERSE SIDE IF DOUBLE SIDED) WITHIN 21 DAYS OF SALE AWARD DATE



FOR DEPARTMENT USE ONLY
Sale Number (XX - XXX - XX - XX)
Forest Management Unit:

TIMBER SALE VERIFICATION OF WORKER'S DISABILITY COMPENSATION ACT COMPLIANCE

*As required by Act 317, P.A. 1969 (Worker's Compensation) and
Part 5 of Act 451 of 1994, as amended.*

VERIFICATION OF WORKER'S DISABILITY COMPENSATION ACT COMPLIANCE

- This verification must be completed and submitted within 21 days of contract award and prior to the issuance of the timber sale contract.
- In addition, if boxes 2B or 2C are checked, then Notice of Exclusion or Certificate of Insurance must be submitted within twenty-one (21) days of the contract award and prior to the issuance of the timber sale contract.
- All information must be typed or printed except for written signatures.

Please Check Appropriate Categories:

1. My business is organized as (you **must** check one of the boxes below):
 - A. Sole Proprietorship (individual)
 - B. Partnership
 - C. Corporation
2. You **must** check one of the boxes below:
 - A. I certify my business is a sole proprietorship and it has no employees but the sole proprietor. I am not subject to the Worker's Compensation Laws.
 - B. I certify my business has satisfied its obligation to the Worker's Compensation Act through the use of an approved Notice of Exclusion (BWC-337, Rev. 5/96). I will provide a copy of the Notice of Exclusion within 21 days of the contract award. (For questions or a copy of the BWC-337, please call the Worker's Compensation Bureau at 517-322-1195).
 - C. I certify my business has a Worker's Compensation Policy. I will provide an original Certificate of Insurance within twenty-one (21) days of the contract award.
3. If you have checked item 2(A) or 2(B), you **must** indicate the number of **both** full-time and part-time employees, other than yourself, including family members and active partners (if none, you must enter "0").

_____ Full-time Employees

_____ Part-time Employees

Name of Business		Federal ID (or) Social Security No.	
Address		Telephone ()	
City	State	ZIP	

I hereby certify that the above information is true and correct. I agree to notify the Michigan DNR of any changes that occur in factors affecting my coverage during any of my present and future operations.

Signature of Owner or Authorized Representative

Title

Date

Please complete the "SEALED BID" information on the next page

426 Split (33-010-17)
; Delta COUNTY

In response to the notice of sale to be held 3:00 p.m. (local time) on January 30, 2018, I am hereby submitting my sealed bid (firm offer) for the following forest products to be cut. Bids for individual species must be at or above the advertised price. All non-responsive bid forms may be rejected.

<u>PRODUCTS & SPECIES</u>	<u>ESTIMATED VOLUME*</u>	<u>ADVERTISED PRICE</u>	<u>BID PRICE/UNIT</u>
Sawtimber			
Paper Birch	2.00 MBF	\$ 83.00/MBF	\$ _____
Red Maple	13.40 MBF	\$ 197.00/MBF	\$ _____
Sugar Maple	9.60 MBF	\$ 337.00/MBF	\$ _____
White Ash	2.50 MBF	\$ 72.00/MBF	\$ _____
Pulpwood			
Balsam Fir	394.00 Cords	\$ 29.20/Cord	\$ _____
Mixed Aspen	525.00 Cords	\$ 30.45/Cord	\$ _____
Mixed Hardwood	244.00 Cords	\$ 30.05/Cord	\$ _____
Mixed Spruce	154.00 Cords	\$ 23.90/Cord	\$ _____
N. White Cedar	121.00 Cords	\$ 23.90/Cord	\$ _____
Paper Birch	24.00 Cords	\$ 28.20/Cord	\$ _____
Tamarack	537.00 Cords	\$ 20.80/Cord	\$ _____

*The volumes are statistically estimated within plus (+) or minus (-) 12.67 percent. These estimated volumes are final and not subject to adjustment. Prospective bidders are urged to examine this timber and to make their own estimates of quantity and quality.

I understand that any or all bids may be rejected. All bids must be signed and all bid items must be bid or the bid form may be rejected. I also understand that consideration and awarding a contract will be based upon my past performance and ability to complete the contract based upon equipment and staffing subject to my control.

FEDERAL ID: _____ or SOCIAL SECURITY NUMBER: _____

Company or individual bidding: _____

Company representative's name: _____

Address: _____

City: _____ State: _____ Zip: _____

IF AVAILABLE, PLEASE PLACE THE PERSONALIZED LABEL FROM YOUR PROSPECTUS IN THE ABOVE BOX.

Individual or company representative's signature: _____ Date: _____

Phone number : _____ Email (optional): _____

THE WINNING BIDDER MUST COMPLETE THE VERIFICATION OF WORKER'S DISABILITY COMPENSATION ACT COMPLIANCE (ON REVERSE SIDE IF DOUBLE SIDED) WITHIN 21 DAYS OF SALE AWARD DATE



FOR DEPARTMENT USE ONLY
Sale Number (XX – XXX – XX – XX)
Forest Management Unit:

TIMBER SALE VERIFICATION OF WORKER'S DISABILITY COMPENSATION ACT COMPLIANCE

As required by Act 317, P.A. 1969 (Worker's Compensation) and
Part 5 of Act 451 of 1994, as amended.

VERIFICATION OF WORKER'S DISABILITY COMPENSATION ACT COMPLIANCE

- This verification must be completed and submitted within 21 days of contract award and prior to the issuance of the timber sale contract.
- In addition, if boxes 2B or 2C are checked, then Notice of Exclusion or Certificate of Insurance must be submitted within twenty-one (21) days of the contract award and prior to the issuance of the timber sale contract.
- All information must be typed or printed except for written signatures.

Please Check Appropriate Categories:

1. My business is organized as (you **must** check one of the boxes below):
 - A. Sole Proprietorship (individual)
 - B. Partnership
 - C. Corporation
2. You **must** check one of the boxes below:
 - A. I certify my business is a sole proprietorship and it has no employees but the sole proprietor. I am not subject to the Worker's Compensation Laws.
 - B. I certify my business has satisfied its obligation to the Worker's Compensation Act through the use of an approved Notice of Exclusion (BWC-337, Rev. 5/96). I will provide a copy of the Notice of Exclusion within 21 days of the contract award. (For questions or a copy of the BWC-337, please call the Worker's Compensation Bureau at 517-322-1195).
 - C. I certify my business has a Worker's Compensation Policy. I will provide an original Certificate of Insurance within twenty-one (21) days of the contract award.
3. If you have checked item 2(A) or 2(B), you **must** indicate the number of **both** full-time and part-time employees, other than yourself, including family members and active partners (if none, you must enter "0").

_____ Full-time Employees

_____ Part-time Employees

Name of Business		Federal ID (or) Social Security No.	
Address		Telephone ()	
City	State	ZIP	

I hereby certify that the above information is true and correct. I agree to notify the Michigan DNR of any changes that occur in factors affecting my coverage during any of my present and future operations.

Signature of Owner or Authorized Representative

Title

Date

Please complete the "SEALED BID" information on the next page

Top Down (33-011-17)
; Menominee COUNTY

In response to the notice of sale to be held 3:00 p.m. (local time) on January 30, 2018, I am hereby submitting my sealed bid (firm offer) for the following forest products to be cut. Bids for individual species must be at or above the advertised price. All non-responsive bid forms may be rejected.

<u>PRODUCTS & SPECIES</u>	<u>ESTIMATED VOLUME*</u>	<u>ADVERTISED PRICE</u>	<u>BID PRICE/UNIT</u>
Sawtimber			
Basswood	1.40 MBF	\$ 116.00/MBF	\$ _____
Beech	1.00 MBF	\$ 79.00/MBF	\$ _____
Paper Birch	7.80 MBF	\$ 83.00/MBF	\$ _____
Red Maple	21.10 MBF	\$ 197.00/MBF	\$ _____
Sugar Maple	61.80 MBF	\$ 337.00/MBF	\$ _____
White Ash	35.30 MBF	\$ 72.00/MBF	\$ _____
Yellow Birch	0.60 MBF	\$ 117.00/MBF	\$ _____
Pulpwood			
Balsam Fir	75.00 Cords	\$ 29.20/Cord	\$ _____
Balsam Poplar	2.00 Cords	\$ 30.45/Cord	\$ _____
Basswood	1.00 Cords	\$ 12.60/Cord	\$ _____
Black Spruce	992.00 Cords	\$ 23.90/Cord	\$ _____
Mixed Hardwood	730.00 Cords	\$ 30.05/Cord	\$ _____
N. White Cedar	1,331.00 Cords	\$ 23.90/Cord	\$ _____
Paper Birch	101.00 Cords	\$ 28.20/Cord	\$ _____
Tamarack	792.00 Cords	\$ 20.80/Cord	\$ _____
White Pine	73.00 Cords	\$ 30.90/Cord	\$ _____

*The volumes are statistically estimated within plus (+) or minus (-) 13.13 percent. These estimated volumes are final and not subject to adjustment. Prospective bidders are urged to examine this timber and to make their own estimates of quantity and quality.

I understand that any or all bids may be rejected. All bids must be signed and all bid items must be bid or the bid form may be rejected. I also understand that consideration and awarding a contract will be based upon my past performance and ability to complete the contract based upon equipment and staffing subject to my control.

FEDERAL ID: ____ - ____ - ____ or SOCIAL SECURITY NUMBER: ____ - ____ - ____

Company or individual bidding: _____

Company representative's name: _____

Address: _____

City: _____ State: _____ Zip: _____

IF AVAILABLE, PLEASE PLACE THE PERSONALIZED LABEL FROM YOUR PROSPECTUS IN THE ABOVE BOX.

Individual or company representative's signature: _____ Date: _____

Phone number : _____ Email (optional): _____

THE WINNING BIDDER MUST COMPLETE THE VERIFICATION OF WORKER'S DISABILITY COMPENSATION ACT COMPLIANCE (ON REVERSE SIDE IF DOUBLE SIDED) WITHIN 21 DAYS OF SALE AWARD DATE



FOR DEPARTMENT USE ONLY
Sale Number (XX - XXX - XX - XX)
Forest Management Unit:

TIMBER SALE VERIFICATION OF WORKER'S DISABILITY COMPENSATION ACT COMPLIANCE

*As required by Act 317, P.A. 1969 (Worker's Compensation) and
Part 5 of Act 451 of 1994, as amended.*

VERIFICATION OF WORKER'S DISABILITY COMPENSATION ACT COMPLIANCE

- This verification must be completed and submitted within 21 days of contract award and prior to the issuance of the timber sale contract.
- In addition, if boxes 2B or 2C are checked, then Notice of Exclusion or Certificate of Insurance must be submitted within twenty-one (21) days of the contract award and prior to the issuance of the timber sale contract.
- All information must be typed or printed except for written signatures.

Please Check Appropriate Categories:

1. My business is organized as (you **must** check one of the boxes below):
 - A. Sole Proprietorship (individual)
 - B. Partnership
 - C. Corporation

2. You **must** check one of the boxes below:
 - A. I certify my business is a sole proprietorship and it has no employees but the sole proprietor. I am not subject to the Worker's Compensation Laws.
 - B. I certify my business has satisfied its obligation to the Worker's Compensation Act through the use of an approved Notice of Exclusion (BWC-337, Rev. 5/96). I will provide a copy of the Notice of Exclusion within 21 days of the contract award. (For questions or a copy of the BWC-337, please call the Worker's Compensation Bureau at 517-322-1195).
 - C. I certify my business has a Worker's Compensation Policy. I will provide an original Certificate of Insurance within twenty-one (21) days of the contract award.

3. If you have checked item 2(A) or 2(B), you **must** indicate the number of **both** full-time and part-time employees, other than yourself, including family members and active partners (if none, you must enter "0").

_____ Full-time Employees

_____ Part-time Employees

Name of Business		Federal ID (or) Social Security No.	
Address		Telephone ()	
City	State	ZIP	

I hereby certify that the above information is true and correct. I agree to notify the Michigan DNR of any changes that occur in factors affecting my coverage during any of my present and future operations.

Signature of Owner or Authorized Representative

Title

Date

Please complete the "SEALED BID" information on the next page

MACK 32 (33-012-17)
; Menominee COUNTY

In response to the notice of sale to be held 3:00 p.m. (local time) on January 30, 2018, I am hereby submitting my sealed bid (firm offer) for the following forest products to be cut. Bids for individual species must be at or above the advertised price. All non-responsive bid forms may be rejected.

<u>PRODUCTS & SPECIES</u>	<u>ESTIMATED VOLUME*</u>	<u>ADVERTISED PRICE</u>	<u>BID PRICE/UNIT</u>
Sawtimber			
Black Ash	2.80 MBF	\$ 89.00/MBF	\$ _____
Black Cherry	1.10 MBF	\$ 153.00/MBF	\$ _____
Paper Birch	5.50 MBF	\$ 83.00/MBF	\$ _____
Red Maple	21.90 MBF	\$ 197.00/MBF	\$ _____
Pulpwood			
Balsam Fir	415.00 Cords	\$ 29.20/Cord	\$ _____
Mixed Hardwood	511.00 Cords	\$ 30.05/Cord	\$ _____
Mixed Spruce	35.00 Cords	\$ 23.90/Cord	\$ _____
N. White Cedar	150.00 Cords	\$ 23.90/Cord	\$ _____
Quaking Aspen	139.00 Cords	\$ 30.45/Cord	\$ _____
Tamarack	6.00 Cords	\$ 20.80/Cord	\$ _____

*The volumes are statistically estimated within plus (+) or minus (-) 14.35 percent. These estimated volumes are final and not subject to adjustment. Prospective bidders are urged to examine this timber and to make their own estimates of quantity and quality.

I understand that any or all bids may be rejected. All bids must be signed and all bid items must be bid or the bid form may be rejected. I also understand that consideration and awarding a contract will be based upon my past performance and ability to complete the contract based upon equipment and staffing subject to my control.

FEDERAL ID: _____ or SOCIAL SECURITY NUMBER: _____ Company or individual bidding: _____ Company representative's name: _____ Address: _____ City: _____ State: _____ Zip: _____

IF AVAILABLE, PLEASE PLACE THE PERSONALIZED LABEL FROM YOUR PROSPECTUS IN THE ABOVE BOX.

Individual or company representative's signature: _____ Date: _____

Phone number : _____ Email (optional): _____

THE WINNING BIDDER MUST COMPLETE THE VERIFICATION OF WORKER'S DISABILITY COMPENSATION ACT COMPLIANCE (ON REVERSE SIDE IF DOUBLE SIDED) WITHIN 21 DAYS OF SALE AWARD DATE



FOR DEPARTMENT USE ONLY	
Sale Number (XX - XXX - XX - XX)	
Forest Management Unit:	

TIMBER SALE VERIFICATION OF WORKER'S DISABILITY COMPENSATION ACT COMPLIANCE

As required by Act 317, P.A. 1969 (Worker's Compensation) and
Part 5 of Act 451 of 1994, as amended.

VERIFICATION OF WORKER'S DISABILITY COMPENSATION ACT COMPLIANCE

- This verification must be completed and submitted within 21 days of contract award and prior to the issuance of the timber sale contract.
- In addition, if boxes 2B or 2C are checked, then Notice of Exclusion or Certificate of Insurance must be submitted within twenty-one (21) days of the contract award and prior to the issuance of the timber sale contract.
- All information must be typed or printed except for written signatures.

Please Check Appropriate Categories:

1. My business is organized as (you **must** check one of the boxes below):
 - A. Sole Proprietorship (individual)
 - B. Partnership
 - C. Corporation
2. You **must** check one of the boxes below:
 - A. I certify my business is a sole proprietorship and it has no employees but the sole proprietor. I am not subject to the Worker's Compensation Laws.
 - B. I certify my business has satisfied its obligation to the Worker's Compensation Act through the use of an approved Notice of Exclusion (BWC-337, Rev. 5/96). I will provide a copy of the Notice of Exclusion within 21 days of the contract award. (For questions or a copy of the BWC-337, please call the Worker's Compensation Bureau at 517-322-1195).
 - C. I certify my business has a Worker's Compensation Policy. I will provide an original Certificate of Insurance within twenty-one (21) days of the contract award.
3. If you have checked item 2(A) or 2(B), you **must** indicate the number of **both** full-time and part-time employees, other than yourself, including family members and active partners (if none, you must enter "0").

_____ Full-time Employees

_____ Part-time Employees

Name of Business		Federal ID (or) Social Security No.	
Address		Telephone ()	
City	State	ZIP	

I hereby certify that the above information is true and correct. I agree to notify the Michigan DNR of any changes that occur in factors affecting my coverage during any of my present and future operations.

Signature of Owner or Authorized Representative

Title

Date

Please complete the "SEALED BID" information on the next page