



**DEPARTMENT OF NATURAL RESOURCES
STATE OF MICHIGAN**

TIMBER SALE PROSPECTUS #6096

SCHEDULED SALE DATE AND TIME: 10:00 a.m. (local time) on April 24, 2018.

LOCATION: ATLANTA MGMT UNIT, 13501 M-33, ATLANTA, MI 49709.

PROSPECTUS NOTE: The bidder is advised to inspect the sale area and review the location, estimated volumes, operating costs and contract terms of proposed sales. Please be aware that some landowners may request 60 days or more notice for access across their land.

Notice is hereby given that bids will be received by the Unit Manager, ATLANTA MANAGEMENT UNIT, for certain timber on the following described lands:

Brilinski Red Pine (54-027-17)

Alpena County, Advertised Price \$214,338.15, 66.5 Acres, Hardwood, Red Pine.

SALE NOTE: A recreation site such as a trail, pathway, or campground is within the sale area or the vicinity. Certain restrictions/specifications may be applicable including time restrictions.

Spruce Werth Mix (54-028-17)

Alpena County, Advertised Price \$54,942.75, 60.5 Acres, Aspen, Hardwood.

SALE NOTE: A recreation site such as a trail, pathway, or campground is within the sale area or the vicinity. Certain restrictions/specifications may be applicable including time restrictions. Access may be through other public land.

Long Swamp Deciduous Mix (54-031-17)

Alpena County, Advertised Price \$28,887.65, 57.2 Acres, Aspen, Hardwood.

BID INSTRUCTIONS (VER. 11/28/2017):

1. Scheduled Bid Location, Date, and Time (2/11)

Bids must be received by the Unit Manager, ATLANTA OFFICE, 13501 M-33, ATLANTA, MI 49709, no later than 10:00 a.m. (local time) on April 24, 2018. For further information concerning this sale, contact Cody Stevens at 989-785-4251 extension 5240.

2. Bidder's Qualifications (5/16)

Purchaser shall obtain workers compensation insurance to cover claims under Michigan's Worker's Disability Compensation Act of 1969 or similar employee benefit act of any other state applicable to an employee. If all or part of a timber sale was prepared by a private contractor, the contractor and that contractor's company are not permitted to bid on the timber sale contract. Bids will not be accepted from individuals or companies appearing on the DNR/FRD No-Bid List. This list contains the names of purchasers who previously failed to execute a contract within 21-days or who have a history of poor performance.

3. Preparation of Sealed Bids (5/16)

Bid Forms may be completed online thru Michigan DNR Timber Sale Online Bidding (OLB) at www.michigan.gov/timberbidding or by completing the hardcopy Bid Form found in the Timber Sale Prospectus. Hardcopy Bid Forms shall be manually signed in ink. Registration in OLB is considered your 'signature' for all bids submitted thru that system. Bid prices must be entered for each species and product in the Bid Price column for all material subject to bidding and all fill-in blanks must be completed. If erasures or other changes appear on the hardcopy Bid Form, each erasure or change must be initialed by the person signing the bid.

4. Submission of Sealed Bids (5/16)

Bid forms may be obtained from the Unit Manager or thru OLB. Bids may be submitted hardcopy or thru OLB. All hardcopy bids must be submitted on the bid form and in an envelope clearly identified as described in this section. NOTE: Only one bid form per bid envelope. Sealed bids must be submitted to the Unit office designated in the prospectus and must be submitted at or prior to the time established in the prospectus. The envelope should show on the outside (a) the sale name or number and (b) the date and time of bid opening, as shown in the prospectus. Bids received after the time specified in the sale prospectus are late bids and will be rejected.

It is possible for a bidder to submit multiple bids on a single sale. For example, a bid may be submitted hardcopy and a bid may be submitted thru OLB. Or, two bidders from the same company could both submit bids on the same sale. If this were to happen, the State would accept all bids received and award the contract accordingly. All bidding and contractual requirements would apply to all bids received.

5. Public Opening of Sealed Bids (7/16)

If conditions permit, the sealed bids will be publicly opened and posted at the time and place set in the prospectus.

If a bidder, present at a bid opening, has submitted bids on more than one sale, that bidder may withdraw their unopened bid envelopes or announce the withdrawal of their online bid after being declared the successful bidder on one sale.

6. Award of Contract (1/11)

Award of the contract will be made to the Bidder whose bid, conforming to the prospectus, is most advantageous to the State of Michigan on the basis of total value at rates bid for the estimated quantities. The State reserves the right to reject any bid or waive any minor irregularity in bids received. A written award mailed (or otherwise furnished) to the successful Bidder shall be deemed to result in a binding contract without further action by either party.

7. Down Payment (1/11)

The Bidder to whom award is made must make a down payment within 21 days of the sale award. The amount of the down payment will be calculated as shown in the Bond and Payment Schedule of this prospectus. Only cash may be used to meet this requirement.

8. Performance Security (1/11)

As guarantee of faithful performance, a cash bond, certificate of deposit, surety bond or irrevocable letter of credit (LOC) is required within 21 days of the sale award. The amount of the performance security is shown in the Bond and

Payment Schedule of this prospectus. If an LOC or surety is used, the coverage must extend for at least 6 months beyond the contract expiration.

9. Timber Sale Contract (11/17)

Additional conditions and requirements common to all timber sales are listed on the timber sale contract (R4031) and are available on line at www.michigan.gov/timber. Contact the Unit Manager for additional information or a sample contract. Within 21 days of the date of the award letter, the bidder must sign the contract and provide the required down payment, performance security, and verification of worker's disability compensation. The down payment and performance security shall be in accordance with the provisions of the timber sale contract, in the sums stated in this prospectus. If these actions are not taken, then the Bidder, the Bidder's corporation, and the corporation's principals may not be permitted to bid on State timber sales for a period of 1 year. In addition, the Bidder certifies that if awarded this contract, the Bidder will complete the timber sale contract in accordance with its terms and any modifications thereof including requirements to purchase, cut, and remove the included timber by the expiration date.

Payment Unit values in the State Forest Timber Sale Contract are calculated based on the advertised value of the Payment Unit as a percentage of the total advertised value of the contract. The advertised value of each Payment Unit is given in the Description of Timber by Payment Unit table on the Timber Sale Information page. For example, if the value of Payment Unit 1 is advertised as \$1,500 and the total Timber Sale value is advertised as \$10,000, the contract price for Payment Unit 1 will be 15% of the total bid price ($\$1,500/\$10,000 * 100$).

10. Disclaimer of Estimates and Bidder's Warranty of Inspection (7/16)

Before submitting this bid, the Bidder is advised and cautioned to inspect the sale area, review the requirements of the sale contract, and take other steps as may be reasonably necessary to ascertain the location, estimated volumes, construction estimates, and operating costs of the proposed sale. Failure to do so will not relieve the Bidder from responsibility for completing the contract.

The Bidder warrants that this bid is submitted solely on the basis of the Bidder's examination and inspection of the quality and quantity of the timber offered for sale and the Bidder's opinion of the value thereof and the costs of recovery. No reliance should be placed on the State of Michigan's estimates of timber quality, quantity or costs of recovery. Bidder further acknowledges that the State of Michigan: (i) expressly disclaims any warranty of fitness of timber for any purpose; (ii) offers this timber as is without any warranty of quality (merchantability) or quantity and (iii) expressly disclaims any warranty as to the quantity or quality of timber sold.

11. Certification and Chain-of-Custody (10/14)

Unless otherwise indicated in the contract under section 7 – Other Conditions of the Sale Specific Conditions & Requirements, the area encompassed by this timber sale is certified to the standards of the Forest Stewardship Council (FSC) - Certificate #SCS-FM/COC-00090N and the Sustainable Forestry Initiative (SFI) - Certificate #NSF-SFIS-5Y031-SF5. Forest products from this sale may be delivered to the mill as "FSC 100% and / or SFI certified" as long as the contractor hauling the forest products is chain-of-custody (COC) certified or covered under a COC certificate from the destination mill. The purchaser is responsible for maintaining COC after leaving the sale area.

12. Good Neighbor Authority (GNA) Requirements (7/16)

If the name of this timber sales contains the acronym GNA, it is authorized by the Good Neighbor Authority (GNA) and covered by various agreements between the U.S. Forest Service and the State. The timber sale occurs on federal land and the following conditions apply:

GNA contracts on US Forest Service land will not be awarded to purchasers on the Federal list of excluded parties. The System for Award Management (SAM) will be checked for active excluded parties prior to award of contract. In addition, the Bidder to whom award is made must complete an Assurance Regarding Felony Conviction or Tax Delinquent Status for Corporate Applicants (AD-3031).

13. Good Neighbor Authority (GNA) Requirements, con't (9/16)

Bidder certifies, by signing this bid form, that to the best of Bidder's knowledge that the following representations are accurate and complete.

a. That the Bidder and its principals are not presently debarred, suspended, proposed for debarment, declared ineligible, or voluntary excluded from timber sales (covered transactions) by any Federal department or agency.

b. That the Bidder and its principals have not within a 3-year period preceding this bid been convicted of or had a civil judgment rendered against them for commission of fraud or a criminal offense in connection with obtaining, attempting to obtain, or performing a public (Federal, State, or local) transaction or contract under a public transaction; violation of Federal or State antitrust statutes or commission of embezzlement, theft, forgery, bribery, falsification or destruction of records, making false statements, or receiving stolen property.

c. That the Bidder and its principals are not presently indicted for or otherwise criminally or civilly charged by a governmental entity (Federal, State, or local) with commission of any of the offenses enumerated in paragraph b of this certification.

d. That the Bidder and its principals have not within a 3-year period preceding this bid had one or more public transactions (Federal, State, or local) terminated for breach or default of a timber or forest product contract.

Bidders that cannot certify this requirement, in whole or in part, shall submit an explanation with their bid.

KEITH CREAGH
Director

TIMBER SALE INFORMATION

Brilinski Red Pine (54-027-17)

Alpena County (Advertised Price \$214,338.15)

SALE NOTE: A recreation site such as a trail, pathway, or campground is within the sale area or the vicinity. Certain restrictions/specifications may be applicable including time restrictions.

A timber sale contract for this lump sum, sealed bid timber sale will be awarded to the responsible bidder offering the highest sealed bid price. Bids must be at or above the following advertised price for each species:

<u>PRODUCTS & SPECIES</u>	<u>ESTIMATED UNITS*</u>	<u>ADVERTISED PRICE</u>
Sawtimber		
BI/R/Hybrid Oak	1.90 MBF	\$ 110.00 / MBF
Red Maple	6.10 MBF	\$ 138.00 / MBF
Red Pine	1,207.30 MBF	\$ 121.00 / MBF
White Pine	5.50 MBF	\$ 97.00 / MBF
Pulpwood		
B. T. Aspen	21.00 Cords	\$ 23.95 / Cord
Jack Pine	6.00 Cords	\$ 22.45 / Cord
Mixed Oak	28.00 Cords	\$ 21.55 / Cord
Mixed Spruce	10.00 Cords	\$ 34.20 / Cord
Paper Birch	5.00 Cords	\$ 22.75 / Cord
Red Maple	89.00 Cords	\$ 20.00 / Cord
Red Pine	1,164.00 Cords	\$ 50.15 / Cord
Scotch Pine	17.00 Cords	\$ 26.45 / Cord
White Pine	90.00 Cords	\$ 48.55 / Cord

* The total volume is statistically estimated within plus (+) or minus (-) 11.20 percent. The estimated units are final and not subject to adjustment. Prospective bidders are urged to examine this timber and to make their own estimates of quantity and quality.

BOND AND PAYMENT SCHEDULE:

1. A bond in the amount of \$10,717.00 to insure faithful performance of the conditions of the contract will be deposited by the successful bidder within 21 days of the sale award.
2. Cutting in any sale or unit without the required advance payment would be considered a trespass.
3. Total payment must be paid in advance or according to the following schedule:
 - (a) Ten percent (10%) of the sale value must be paid within 21 days of the sale award.
 - (b) The 10% down payment will be credited towards the first unit cut.
 - (c) Payment for each of the following units must be made before cutting begins in that unit:

PAYMENT UNIT NUMBER	PERCENT OF TOTAL SALE VALUE
01	9.9%
02	16.3%
03	22.0%
04	16.2%
05	7.7%
06	9.4%
07	18.5%

4. If no cutting takes place, the 10% down payment will not be refunded.
5. Operations on the contract issued will terminate on 12/31/2020.

Description of Timber by Payment Unit (PU)

PU	MARKET GROUP	PRODUCT	QUANTITY	UNIT	ACRES	ADVERTISE PRICE
1	Red Pine	Sawtimber	76.4	MBF	7.9	\$21,134.35
	White Pine		3.0	MBF		
	B. T. Aspen	Pulpwood	21.0	Cords		
	Jack Pine		6.0	Cords		
	Mixed Oak		4.0	Cords		
	<i>Red Oak</i>		4.0	<i>Cords</i>		
	Mixed Spruce		10.0	Cords		
	<i>Black Spruce</i>	<i>Sawtimber</i>	1.1	<i>MBF</i>		
	<i>Black Spruce</i>	<i>Pulpwood</i>	8.0	<i>Cords</i>		
	Red Maple		6.0	Cords		
	Red Pine		136.0	Cords		
	White Pine		74.0	Cords		
	2	BI/R/Hybrid Oak	Sawtimber	0.3		
Red Maple			1.1	MBF		
Red Pine			204.6	MBF		
White Pine			0.5	MBF		
Mixed Oak		Pulpwood	5.0	Cords		
<i>BI/R/Hybrid Oak</i>			3.0	<i>Cords</i>		
<i>Red Oak</i>			2.0	<i>Cords</i>		
Paper Birch			1.0	Cords		
Red Maple			15.0	Cords		
Red Pine			186.0	Cords		
Scotch Pine			3.0	Cords		
<i>Scotch Pine</i>		<i>Sawtimber</i>	0.2	<i>MBF</i>		
<i>Scotch Pine</i>		<i>Pulpwood</i>	3.0	<i>Cords</i>		
White Pine			3.0	Cords		
3	BI/R/Hybrid Oak	Sawtimber	0.5	MBF	14.4	\$47,401.75
	Red Maple		1.6	MBF		
	Red Pine		277.9	MBF		
	White Pine		0.6	MBF		
	Mixed Oak	Pulpwood	5.0	Cords		
	<i>BI/R/Hybrid Oak</i>		3.0	<i>Cords</i>		
	<i>Red Oak</i>		2.0	<i>Cords</i>		
	Paper Birch		1.0	Cords		
	Red Maple		20.0	Cords		
	Red Pine		252.0	Cords		
	Scotch Pine		3.0	Cords		
	<i>Scotch Pine</i>	<i>Sawtimber</i>	0.2	<i>MBF</i>		
	<i>Scotch Pine</i>	<i>Pulpwood</i>	3.0	<i>Cords</i>		
	White Pine		4.0	Cords		
4	BI/R/Hybrid Oak	Sawtimber	0.3	MBF	10.5	\$34,621.30
	Red Maple		1.1	MBF		
	Red Pine		202.6	MBF		
	White Pine		0.4	MBF		
	Mixed Oak	Pulpwood	5.0	Cords		
	<i>BI/R/Hybrid Oak</i>		3.0	<i>Cords</i>		
	<i>Red Oak</i>		2.0	<i>Cords</i>		
	Paper Birch		1.0	Cords		
	Red Maple		15.0	Cords		
	Red Pine		184.0	Cords		
	Scotch Pine		3.0	Cords		
	<i>Scotch Pine</i>	<i>Sawtimber</i>	0.2	<i>MBF</i>		
	<i>Scotch Pine</i>	<i>Pulpwood</i>	3.0	<i>Cords</i>		
	White Pine		3.0	Cords		
5	BI/R/Hybrid Oak	Sawtimber	0.2	MBF	5.0	\$16,458.20
	Red Maple		0.5	MBF		

Description of Timber by Payment Unit (PU), con't

PU	MARKET GROUP	PRODUCT	QUANTITY	UNIT	ACRES	ADVERTISE PRICE
5 con't	Red Pine	Sawtimber	96.5	MBF		
	White Pine		0.2	MBF		
	Mixed Oak	Pulpwood	2.0	Cords		
	<i>BI/R/Hybrid Oak</i>		1.0	<i>Cords</i>		
	<i>Red Oak</i>		1.0	<i>Cords</i>		
	Red Maple		7.0	Cords		
	Red Pine		88.0	Cords		
	Scotch Pine		1.0	Cords		
	<i>Scotch Pine</i>	<i>Sawtimber</i>	0.1	<i>MBF</i>		
	<i>Scotch Pine</i>	<i>Pulpwood</i>	1.0	<i>Cords</i>		
	White Pine		1.0	Cords		
6	BI/R/Hybrid Oak	Sawtimber	0.2	MBF	6.1	\$20,137.50
	Red Maple		0.6	MBF		
	Red Pine		117.7	MBF		
	White Pine		0.3	MBF		
	Mixed Oak	Pulpwood	2.0	Cords		
	<i>BI/R/Hybrid Oak</i>		1.0	<i>Cords</i>		
	<i>Red Oak</i>		1.0	<i>Cords</i>		
	Paper Birch		1.0	Cords		
	Red Maple		9.0	Cords		
	Red Pine		107.0	Cords		
	Scotch Pine		2.0	Cords		
	<i>Scotch Pine</i>	<i>Sawtimber</i>	0.1	<i>MBF</i>		
	<i>Scotch Pine</i>	<i>Pulpwood</i>	2.0	<i>Cords</i>		
	White Pine		2.0	Cords		
7	BI/R/Hybrid Oak	Sawtimber	0.4	MBF	12.0	\$39,558.85
	Red Maple		1.2	MBF		
	Red Pine		231.6	MBF		
	White Pine		0.5	MBF		
	Mixed Oak	Pulpwood	5.0	Cords		
	<i>BI/R/Hybrid Oak</i>		3.0	<i>Cords</i>		
	<i>Red Oak</i>		2.0	<i>Cords</i>		
	Paper Birch		1.0	Cords		
	Red Maple		17.0	Cords		
	Red Pine		211.0	Cords		
	Scotch Pine		3.0	Cords		
	<i>Scotch Pine</i>	<i>Sawtimber</i>	0.2	<i>MBF</i>		
	<i>Scotch Pine</i>	<i>Pulpwood</i>	3.0	<i>Cords</i>		
White Pine		3.0	Cords			
TOTAL:			1,220.8	MBF		
TOTAL:			1,428.0	Cords		

Sale Specific Conditions & Requirements

Sale Name: Brilinski Red Pine

Sale Number: 54-027-17 Seq#: 1

1 - Sale Area

1.2 - Boundaries

1.2.1 - Painted boundaries (1/14)

The sale boundary and Payment Unit boundaries are marked and identified by blue, red and yellow paint. Exterior sale boundary lines against private property are marked with blue paint. Exterior sale boundary lines against state are marked with red paint. Interior Payment Unit boundaries are marked with yellow paint. The painted boundary line trees are not Included Timber and are to be protected. Yellow painted trees designating an interior Payment Unit boundary are only to be cut when all surrounding Payment Units have been paid.

2 - Timber Specifications

2.1 - Included Timber

2.1.1 - Clearcut unit(s) with unmerchantable trees (6/14)

Within Payment Unit(s) 1-7, cut all trees that are two (2) inches or more at DBH.

2.2 - Utilization

2.2.2 - Chipping required (5/14)

All Payment Units must be chip harvested to facilitate subsequent planting operations. The Purchaser has the option to produce sawlogs or pulpwood bolts, but the remaining portion of the trees must be chipped and hauled. Do not chip 1/6 to 1/3 of the slash from harvested trees (tree tops and limbs less than four inches in diameter).

2.2.3 - Stump heights (4/07)

Stump heights within all Payment Units shall not exceed 6 inches for all trees. This is in order to facilitate planting operations.

3 - Payments

3.3 - Pre-measured Sales

3.3.4 - Dividing payment units (7/14)

Payment Unit(s) \$20,000 in value or greater may be divided at the request of the Purchaser and upon approval of the Unit Manager. Dividing Payment Units is a contract modification which requires a Timber Sale Contract Supplement.

4 - Transportation

4.1 - Construction

4.1.3 - Slash and earthen piles (8/04)

Piles or windrows of earth along roads and landings that have been widened or constructed shall be leveled. Slash from road maintenance or construction, including stumps, shall be dispersed throughout the sale.

4.1.8 - Road work (1) (8/07)

The following road work is required: 23A crushed limestone must be placed in low areas along the snowmobile trail that are otherwise likely to incur damage during timber sale operations. This must be completed to the satisfaction of the Sale Administrator or Unit Manager prior to the beginning of any operations on the designated snowmobile trail. The snowmobile trail is shown on the Timber Sale Map.

4.1.12 - No new roads (1/12)

No new roads will be permitted in any Payment Unit. All operations are limited to existing roads. Skid trails only will be allowed.

4.2 - Maintenance

4.2.2 - Fill material (4/07)

To maintain roads, fill material may be needed in areas where "holes" exist or may be expected to develop. This fill material should be placed before trucking begins. Material used to upgrade roads must be approved by the Sale Administrator or Unit

Manager before being placed.

5 - Operations

5.1 - Notification

5.1.1 - Pre-sale conference (10/16)

A pre-sale conference on site between the Purchaser and sale administrator is required prior to beginning any operations within a Payment Unit to determine landing and road locations.

5.1.4 - Post-sale conference (10/16)

A post-sale conference on site between the Purchaser and sale administrator is required prior to the completion of active logging operations to determine clean-up and repair of landings, road edges, and the fulfillment of other contract specifications.

5.2 - Conduct of Operations

5.2.3 - Operating Restrictions

5.2.3.1 - Operating restrictions (9/11)

Within Payment Unit(s) 2-7, unless approved by the Unit Manager, hauling is not permitted from 5:00 P.M. Friday evening through 6:00 A.M. Monday morning during the period of 12/1 to 3/31. This restriction is due to the necessity of using the snowmobile trail for hauling wood from the sale.

5.2.3.6 - Bark beetle restriction (12/08)

In the event drought creates a high risk of pine bark beetle infestation, pine is not to be cut during the period March 1 through July 1, unless all portions of trees greater than two inches in diameter are removed from the sale area, reduced to chips, or treated to the satisfaction of the Unit Manager or his/her representative, within fifteen days of being severed from the stump. Pine log decks, pulpwood piles and treetops that are piled for chipping in the fall or winter within a 1/4 mile of susceptible sites must be removed before March 15. Residual slash must not be placed in piles or rows and must be spread over the site for quick drying. The Department of Natural Resources will exercise this specification if the risk of damage warrants.

5.2.32 - Decking/landing restoration (9/13)

All decking and landing areas must have the surface area restored to a condition equal to or better than before. This is to ensure the proper regeneration of the stand. Wood debris, chips and "cookies" from trimmings must be removed or scattered away from landing and loading areas and may not be windrowed on the edge.

5.2.38 - No decking against live trees (2/04)

Cut products may not be decked against unmarked or designated leave trees.

5.2.41 - Snowmobile trail protection (9/11)

The snowmobile trail is shown on the Timber Sale Map. Do not cut or damage posts with orange trail markers or traffic control signs. If the trail is used, it must be maintained and restored to a condition equal to or better than before the sale. The road maintenance/restoration must be done prior to December 1. If the trail is used for hauling, it must be graded to the satisfaction of the Unit Manager or his/her representative prior to December 1. If the trail road is to be used for hauling during the snowmobile season, then a snow covered base must be left on the trail. The snowmobile trail may only be crossed at right angles. Maintain a 20 foot wide slash, debris, and rut free zone daily using the snowmobile trail as the centerline. If operations occur during the December 1 to March 31 period, all wood must be decked at least 20 feet back from the centerline of the snowmobile trail. The snowmobile trail may not be used for any timber sale operations on weekends during the period of December 1 to March 31 unless approved by the Unit Manager or his/her representative. All stumps within 10 feet of the snowmobile trail must be cut at ground level.

5.4 - Soil Protection

5.4.1 - Rutting restriction, general (7/16)

Operations are to cease immediately if equipment and weather conditions result in rutting of roads and/or skid trails which is 12 inches or greater in depth and 50 feet in length. The Unit Manager or his/her representative may restrict hauling and/or skidding if ruts exceed the specified depth. With the Unit Manager or his/her representative's approval, the Purchaser may return to the area when the risk of rutting has decreased.

5.8 - Protection of Endangered Species

5.8.3 - Red shoulder hawk or goshawk (2/16)

In the event that an active red shoulder hawk or goshawk nest is found, the contract may be amended to protect the nest site until the nest is determined to be inactive. The value of the trees in this excluded area will be refunded or credited to the Purchaser. The nest will be buffered with a five-chain radius (eight acre) protection area, centered on the nest tree, in which there will be no cutting or new roads constructed. Avoid human disturbance, including loading and skidding, in the protection area.

An additional zone of five chains (ten chains centered on the active nest tree) will be established in which there is no management activity from March 15 to July 15. Limit biomass harvesting and chipping operations within this ten-chain zone, retain the maximum one-third of residues per the Woody Biomass Harvesting Guidelines (Michigan DNR 2010). Nests determined to be inactive will be protected with a one-chain no-harvest buffer.

5.8.5 - Protection of raptor nests (3/13)

All trees with raptor nests will be protected if found during harvesting operations. Notification will be made to the Unit Manager or his/her representative who will notify the Wildlife Biologist so an on-site evaluation and recommendation can be made, if necessary.

6 - Safety and Fire Prevention

6.2 - Signing

6.2.1 - Road posting (9/09)

The Purchaser is responsible for posting and maintaining caution signs on forest roads prior to beginning operations. The road must be posted at appropriate distances from the sale area to warn of logging activity and truck traffic. Signs must be removed when harvest operations are suspended or completed. The Purchaser will provide these signs.

6.2.2 - Snowmobile trail posting (8/09)

The Purchaser is responsible for posting and maintaining caution signs on the snowmobile trail prior to beginning operations during the snowmobile season (approximately December 1 to March 31). The trail must be posted at appropriate distances from the sale area to warn of logging activity and truck traffic. Signs must be removed when harvest operations are suspended or completed. The Purchaser will provide these signs.



TIMBER SALE MAP

This information provided by authority of Part 525, 1994 PA 451, as amended.

Forest Management Unit Atlanta		County Alpena	Mapped By D. Parris		Date 8/14/2017	Page 1	of 1
Township 30N	Range 07E	Section(s) and Subdivision(s) Sec. 12 SESW, SWSW Sec. 13 NESW, NWSE, SENW, SESW			Scale 1:15,840		
Cruised By D. Parris							

Cover Type

A = Aspen	H = Hemlock	N = Marsh	U = Upland Brush
B = Paper Birch	J = Jack Pine	O = Oak	UM = Upland Mixed
C = Cedar	L = Lowland Brush	P = Lowland Poplar	V = Bog or Marsh
D = Tread Bog	LM = Lowland Mixed	Q = Mixed Swamp Conifer	W = White Pine
E = Swamp Hdwoods	M = Mpl, Bch, Brch	R = Red Pine	X = Non Stocked
F = Spruce Fir	MC = Mixed Conifer	S = Black Spruce	Z = Water
G = Grass	MD = Mixed Deciduous	T = Tamarack	

Density

0 = Non Stocked	5 = Pole Timber Medium
1 = Seedling Sapling Poor	6 = Pole Timber Well
2 = Seedling Sapling Medium	7 = Saw Timber Poor
3 = Seedling Sapling Well	8 = Saw Timber Medium
4 = Pole Timber Poor	9 = Saw Timber Well

PU	Stand	Acres	PU	Stand	Acres
1	117	7.9	5	34, 109	5.0
2	28	10.6	6	24, 109	6.1
3	28	14.4	7	28	12.0
4	28	10.5			

Brilinski Red Pine

Compartment 87

66.5 Acres

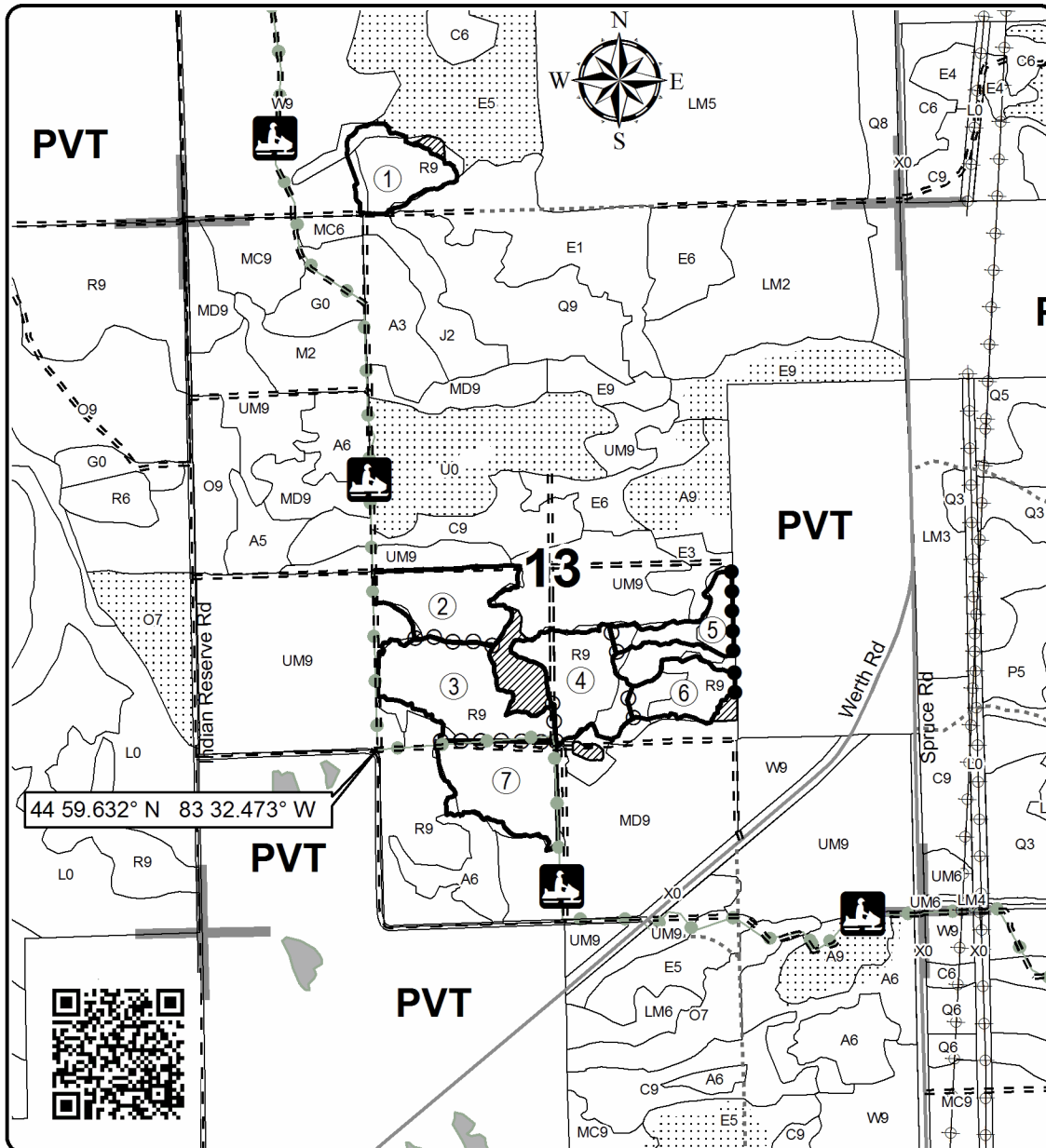

Legend

- Against State (Red)
- Payment Unit (Yellow)
- Private Line (Blue)
- Payment Unit
- Retention Area
- Stand Boundaries
- Nearby Timber Sale
- Highway
- Paved Roads
- Gravel Roads
- Poor Dirt Roads
- Closed Roads
- Recreational Trail
- Powerline
- Lakes and Rivers All
- Section Corners

Locator Map
1:200,000

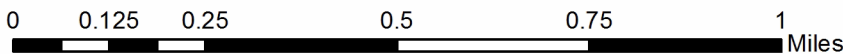
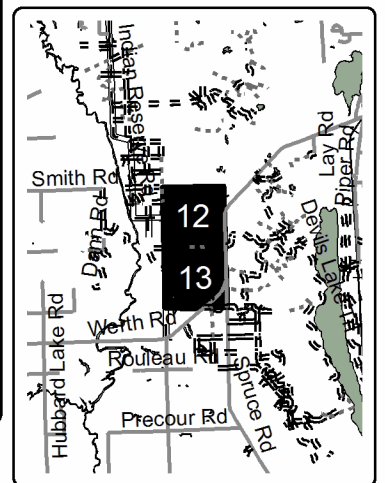

TIMBER SALE INFORMATION

Spruce Werth Mix (54-028-17)

Alpena County (Advertised Price \$54,942.75)

SALE NOTE: A recreation site such as a trail, pathway, or campground is within the sale area or the vicinity. Certain restrictions/specifications may be applicable including time restrictions. Access may be through other public land.

A timber sale contract for this lump sum, sealed bid timber sale will be awarded to the responsible bidder offering the highest sealed bid price. Bids must be at or above the following advertised price for each species:

<u>PRODUCTS & SPECIES</u>	<u>ESTIMATED UNITS*</u>		<u>ADVERTISED PRICE</u>
Sawtimber			
B. T. Aspen	25.10	MBF	\$ 90.00 / MBF
Red Maple	16.00	MBF	\$ 138.00 / MBF
Red Pine	68.40	MBF	\$ 121.00 / MBF
White Pine	52.50	MBF	\$ 97.00 / MBF
Pulpwood			
Balsam Fir	36.00	Cords	\$ 31.70 / Cord
Jack Pine	30.00	Cords	\$ 22.45 / Cord
Mixed Aspen	431.00	Cords	\$ 23.95 / Cord
Mixed Hardwood	424.00	Cords	\$ 20.00 / Cord
Mixed Spruce	3.00	Cords	\$ 34.20 / Cord
Paper Birch	52.00	Cords	\$ 22.75 / Cord
Red Pine	96.00	Cords	\$ 50.15 / Cord
White Pine	214.00	Cords	\$ 48.55 / Cord

* The total volume is statistically estimated within plus (+) or minus (-) 13.60 percent. The estimated units are final and not subject to adjustment. Prospective bidders are urged to examine this timber and to make their own estimates of quantity and quality.

BOND AND PAYMENT SCHEDULE:

1. A bond in the amount of \$2,747.00 to insure faithful performance of the conditions of the contract will be deposited by the successful bidder within 21 days of the sale award.
2. Cutting in any sale or unit without the required advance payment would be considered a trespass.
3. Total payment must be paid in advance or according to the following schedule:
 - (a) Ten percent (10%) of the sale value must be paid within 21 days of the sale award.
 - (b) The 10% down payment will be credited towards the first unit cut.
 - (c) Payment for each of the following units must be made before cutting begins in that unit:

PAYMENT UNIT NUMBER	PERCENT OF TOTAL SALE VALUE
01	7.8%
02	8.4%
03	13.2%
04	20.3%
05	50.3%

4. If no cutting takes place, the 10% down payment will not be refunded.
5. Operations on the contract issued will terminate on 06/30/2020.

Description of Timber by Payment Unit (PU)

PU	MARKET GROUP	PRODUCT	QUANTITY	UNIT	ACRES	ADVERTISE PRICE
1	B. T. Aspen	Sawtimber	3.8	MBF	9.9	\$4,265.00
	Red Maple		2.2	MBF		
	Balsam Fir	Pulpwood	18.0	Cords		
	<i>Balsam Fir</i>	<i>Sawtimber</i>	0.4	<i>MBF</i>		
	<i>Balsam Fir</i>	<i>Pulpwood</i>	17.0	<i>Cords</i>		
	Mixed Aspen		28.0	Cords		
	<i>B. T. Aspen</i>		28.0	<i>Cords</i>		
	Mixed Hardwood		99.0	Cords		
	<i>Red Maple</i>		99.0	<i>Cords</i>		
	Mixed Spruce		1.0	Cords		
	<i>White Spruce</i>		1.0	<i>Cords</i>		
	Paper Birch		16.0	Cords		
	<i>Paper Birch</i>		16.0	<i>Cords</i>		
2	B. T. Aspen	Sawtimber	8.7	MBF	6.9	\$4,637.65
	Red Maple		2.6	MBF		
	Mixed Aspen	Pulpwood	96.0	Cords		
	<i>B. T. Aspen</i>		96.0	<i>Cords</i>		
	Mixed Hardwood		53.0	Cords		
	<i>Red Maple</i>		53.0	<i>Cords</i>		
	Mixed Spruce		2.0	Cords		
	<i>Black Spruce</i>		2.0	<i>Cords</i>		
	Paper Birch		3.0	Cords		
	<i>Paper Birch</i>		3.0	<i>Cords</i>		
3	B. T. Aspen	Sawtimber	8.1	MBF	8.9	\$7,239.80
	Red Maple		1.2	MBF		
	White Pine		1.0	MBF		
	Balsam Fir	Pulpwood	10.0	Cords		
	<i>Balsam Fir</i>		10.0	<i>Cords</i>		
	Jack Pine		11.0	Cords		
	Mixed Aspen		127.0	Cords		
	<i>B. T. Aspen</i>		127.0	<i>Cords</i>		
	Mixed Hardwood		25.0	Cords		
	<i>Red Maple</i>		25.0	<i>Cords</i>		
	Red Pine		4.0	Cords		
	White Pine		40.0	Cords		
4	B. T. Aspen	Sawtimber	2.8	MBF	16.2	\$11,166.80
	Red Maple		8.7	MBF		
	White Pine		5.0	MBF		
	Balsam Fir	Pulpwood	8.0	Cords		
	<i>Balsam Fir</i>		8.0	<i>Cords</i>		
	Mixed Aspen		120.0	Cords		
	<i>B. T. Aspen</i>		120.0	<i>Cords</i>		
	Mixed Hardwood		202.0	Cords		
	<i>Beech</i>		2.0	<i>Cords</i>		
	<i>Red Maple</i>		200.0	<i>Cords</i>		
	Paper Birch		33.0	Cords		
	<i>Paper Birch</i>	<i>Sawtimber</i>	0.7	<i>MBF</i>		
	<i>Paper Birch</i>	<i>Pulpwood</i>	32.0	<i>Cords</i>		
	White Pine		27.0	Cords		
5	B. T. Aspen	Sawtimber	1.7	MBF	18.6	\$27,633.50
	Red Maple		1.3	MBF		
	Red Pine		68.4	MBF		
	White Pine		46.5	MBF		
	Jack Pine	Pulpwood	19.0	Cords		
	Mixed Aspen		60.0	Cords		
	<i>B. T. Aspen</i>		56.0	<i>Cords</i>		

Description of Timber by Payment Unit (PU), con't

PU	MARKET GROUP	PRODUCT	QUANTITY	UNIT	ACRES	ADVERTISE PRICE
5 con't	<i>Quaking Aspen</i>	<i>Pulpwood</i>	4.0	<i>Cords</i>		
	Mixed Hardwood		45.0	Cords		
	<i>Red Maple</i>		45.0	<i>Cords</i>		
	Red Pine		92.0	Cords		
	White Pine		147.0	Cords		
TOTAL:			162.0	MBF		
TOTAL:			1,286.0	Cords		

Sale Specific Conditions & Requirements

Sale Name: Spruce Werth Mix

Sale Number: 54-028-17 Seq#: 1

1 - Sale Area

1.2 - Boundaries

1.2.1 - Painted boundaries (1/14)

The sale boundaries are marked and identified by blue and red paint, along with a road. Exterior sale boundary lines against private property are marked with blue paint. Exterior sale boundary lines against state are marked with red paint, with the exception of the west boundary of Payment Unit 5, which is unpainted and identified by Indian Reserve Road. The painted boundary line trees are not Included Timber and are to be protected.

2 - Timber Specifications

2.1 - Included Timber

2.1.1 - Clearcut unit(s) with unmerchantable trees (6/14)

Within Payment Unit(s) 1 - 5, cut all trees that are two (2) inches or more at DBH, except the following:

Within Payment Unit 1, do not cut red pine, white pine, oak, and cedar.

Within Payment Unit 2, do not cut white pine and oak.

Within Payment Unit 3, do not cut oak and green marked trees.

Within Payment Unit 4, do not cut red pine, oak, hemlock, cedar, and yellow marked trees.

Within Payment Unit 5, do not cut oak and green marked trees

2.1.11 - Description of timber note (2/04)

Note that Mixed Aspen Pulpwood is bigtooth and quaking aspen. Mixed Hardwood Pulpwood is mostly red maple with trace beech. Mixed Spruce Pulpwood is white and black spruce.

2.2 - Utilization

2.2.6 - Roundwood operation required (5/07)

The skidding of whole trees or tree segments with limbs attached is prohibited within Payments 1, 2, 4 and 5. All products must be produced as roundwood and forwarded to existing roads or landing areas in final product length.

3 - Payments

3.4 - Damaged Timber

3.4.1 - Damaged timber (6/14)

General Condition and Requirement 3.4 Damaged Timber, defines liquidated damages for undesignated live merchantable trees which are cut or injured. In addition, extreme care should be taken to avoid damage to tree seedlings and saplings.

Within Payment Unit 5, if more than 25% of the white pine and oak seedlings or saplings (1/4" to 4.5" DBH) within a specified portion of the sale area are damaged, liquidated damages will be assessed at \$50 per acre for all acreage within that specified portion of the sale area that was damaged.

No damage is acceptable to undesignated merchantable trees. Within the sale area, if more than 5% of trees (> 4.5" DBH) within a specified area of the sale are damaged, liquidated damages will be assessed for all trees damaged. Rates will be in accordance with General Condition and Requirement 3.4 Damaged Timber.

4 - Transportation

4.1 - Construction

4.1.3 - Slash and earthen piles (8/04)

Piles or windrows of earth along roads and landings that have been widened or constructed shall be leveled. Slash from road maintenance or construction, including stumps, shall be dispersed throughout the sale.

4.1.8 - Road work (1) (8/07)

The following road work is required: 23A crushed limestone must be placed in low areas along the snowmobile trail that are otherwise likely to incur damage during timber sale operations. This must be completed to the satisfaction of the Sale Administrator or Unit Manager prior to the beginning of any operations on the designated snowmobile trail. The snowmobile trail is shown on the Timber Sale Map.

4.1.12 - No new roads (1/12)

No new roads will be permitted in any Payment Unit. All operations are limited to existing roads. Skid trails only will be allowed.

4.2 - Maintenance

4.2.2 - Fill material (4/07)

To maintain roads, fill material may be needed in areas where "holes" exist or may be expected to develop. This fill material should be placed before trucking begins. Material used to upgrade roads must be approved by the Sale Administrator or Unit Manager before being placed.

4.4 - Access

4.4.3 - Access gate (12/08)

The access gate(s) to Payment Unit 3 must be locked at the completion of each day unless otherwise approved by the Unit Manager or his/her representative.

5 - Operations

5.1 - Notification

5.1.1 - Pre-sale conference (10/16)

A pre-sale conference on site between the Purchaser and sale administrator is required prior to beginning any operations within a Payment Unit to determine landing and road locations.

5.1.4 - Post-sale conference (10/16)

A post-sale conference on site between the Purchaser and sale administrator is required prior to the completion of active logging operations to determine clean-up and repair of landings, road edges, and the fulfillment of other contract specifications.

5.2 - Conduct of Operations

5.2.2 - Hazard Trees/Snags

5.2.2.1 - Den trees (10/16)

Obvious hollow and/or den trees shall be protected and left standing unless they are a safety hazard.

5.2.3 - Operating Restrictions

5.2.3.1 - Operating restrictions (9/11)

Within Payment Unit(s) 3 and 5, unless changed by written agreement, cutting, skidding, and hauling are not permitted during the period of 12/1 to 3/31. This restriction is because a snowmobile trail is required to access the Payment Unit.

5.2.3.4 - Oak wilt restriction (9/17)

Within Payment Unit(s) 5, unless changed by written agreement, cutting, skidding, hauling and brushing of access roads are not permitted during the period of April 15 to July 15. This is necessary to reduce the spread of oak wilt. For more information, contact the Unit Manager or his/her representative.

5.2.3.11 - Coppice regeneration protection (4/10)

Timber harvesting in any Payment Unit must be completed before significant sprouting occurs in that Payment Unit so as to minimize damage to the new regeneration. Any post harvest operations, such as chipping, must be completed before sprouting of regeneration occurs. If it is anticipated that chipping will be delayed, then tops shall be carried to one central location or left unchipped. The Unit Manager or his/her representative may cease such operations if sprouting occurs before the operation is complete.

5.2.4 - Dead and Down Creation

5.2.4.4 - Dead and down creation, grouse (8/13)

To encourage grouse and other wildlife, in Payment Unit(s) 2 and 3, leave one, 10" diameter or larger log-length (8 foot minimum) piece on the ground for every 2 acres. These will be evenly scattered throughout the unit. This can be an unmerchantable piece or a full tree.

5.2.17 - Crane Mats/Timber Mats (10/14)

Crane mats may be required along the skid trail required between Payment Units 1 and 2, and in two locations along the forest road that runs north-south through Payment Unit 4 to protect soils and hydrology. These three areas range from 50 to 100 feet in length. The Unit Manager or his/her representative will determine the need for crane mats at the time of harvest. If available, Crane Mats/Timber Mats may be borrowed from the DNR and are located at the Marquette ICC and the Grayling Field Office. Contact the sale administrator for specific details. A Timber Sale Contract Supplement will be used to document the Purchaser's use of the DNR's Crane Mats/Timber Mats. It is the responsibility of the Purchaser to contact the sale administrator to schedule pick up and drop off. In addition, all mats must be cleaned prior to drop off. A charge of \$350.00 will be assessed for all damaged or non-returned mats. Damage is defined as misuse resulting in three or more broken cants.

5.2.22 - Operating Caution

5.2.22.1 - Operating caution (6/11)

It is recommended, but not required, that within Payment Unit(s) 4, cutting, skidding, and hauling occur during dry summer or frozen winter conditions. The reason for the recommendation is because the soils within this stand are poorly drained.

5.2.32 - Decking/landing restoration (9/13)

All decking and landing areas must have the surface area restored to a condition equal to or better than before. This is to ensure the proper regeneration of the stand. Wood debris, chips and "cookies" from trimmings must be removed or scattered away from landing and loading areas and may not be windrowed on the edge.

5.2.38 - No decking against live trees (2/04)

Cut products may not be decked against unmarked or designated leave trees.

5.2.41 - Snowmobile trail protection (9/11)

A snowmobile trail is shown on the Timber Sale Map. Do not cut or damage posts with orange trail markers or traffic control signs. If the trail is used, it must be maintained and restored to a condition equal to or better than before the sale. The road maintenance/restoration must be done prior to December 1. If the trail is used for hauling, it must be graded to the satisfaction of the Unit Manager or his/her representative prior to December 1st. The snowmobile trail may not be used for any timber sale operations from December 1 to March 31. The snowmobile trail may only be crossed at right angles. Maintain a 20 foot wide slash, debris, and rut free zone daily using the snowmobile trail as the centerline. All stumps within 5 feet of the snowmobile trail must be cut at ground level.

5.4 - Soil Protection

5.4.1 - Rutting restriction, general (7/16)

Operations are to cease immediately if equipment and weather conditions result in rutting of roads and/or skid trails which is 12 inches or greater in depth and 50 feet in length. The Unit Manager or his/her representative may restrict hauling and/or skidding if ruts exceed the specified depth. With the Unit Manager or his/her representative's approval, the Purchaser may return to the area when the risk of rutting has decreased.

5.8 - Protection of Endangered Species

5.8.5 - Protection of raptor nests (3/13)

All trees with raptor nests will be protected if found during harvesting operations. Notification will be made to the Unit Manager or his/her representative who will notify the Wildlife Biologist so an on-site evaluation and recommendation can be made, if necessary.

6 - Safety and Fire Prevention

6.2 - Signing

6.2.1 - Road posting (9/09)

The Purchaser is responsible for posting and maintaining caution signs on forest roads prior to beginning operations. The road must be posted at appropriate distances from the sale area to warn of logging activity and truck traffic. Signs must be removed when harvest operations are suspended or completed. The Purchaser will provide these signs.



TIMBER SALE MAP

This information provided by authority of Part 525, 1994 PA 451, as amended.

Sale Number	Year
54-028	17

Forest Management Unit Atlanta	County Alpena	Mapped By D. Parris	Date 8/14/2017	Page 1	of 2
Township 30N	Range 07E	Section(s) and Subdivision(s) Sec 12 NWSW, SWNW Sec 13 NENE, NWNE, SESE, SWNE; Sec 24 NENE, SENE, SWNE	Scale 1:15,840		

Cover Type				Density			
A = Aspen	H = Hemlock	N = Marsh	U = Upland Brush	0 = Non Stocked	5 = Pole Timber Medium		
B = Paper Birch	J = Jack Pine	O = Oak	UM = Upland Mixed	1 = Seedling Sapling Poor	6 = Pole Timber Well		
C = Cedar	L = Lowland Brush	P = Lowland Poplar	V = Bog or Marsh	2 = Seedling Sapling Medium	7 = Saw Timber Poor		
D = Tread Bog	LM = Lowland Mixed	Q = Mixed Swamp Conifer	W = White Pine	3 = Seedling Sapling Well	8 = Saw Timber Medium		
E = Swamp Hdwoods	M = Mpl, Bch, Brch	R = Red Pine	X = Non Stocked	4 = Pole Timber Poor	9 = Saw Timber Well		
F = Spruce Fir	MC = Mixed Conifer	S = Black Spruce	Z = Water				
G = Grass	MD = Mixed Deciduous	T = Tamarack					

PU	Stand	Acres
1	106	9.9
2	39	6.9
3	12	8.9
4	102	16.2
5	118	18.6

Spruce Werth Mix Compartment 87 60.5 Acres

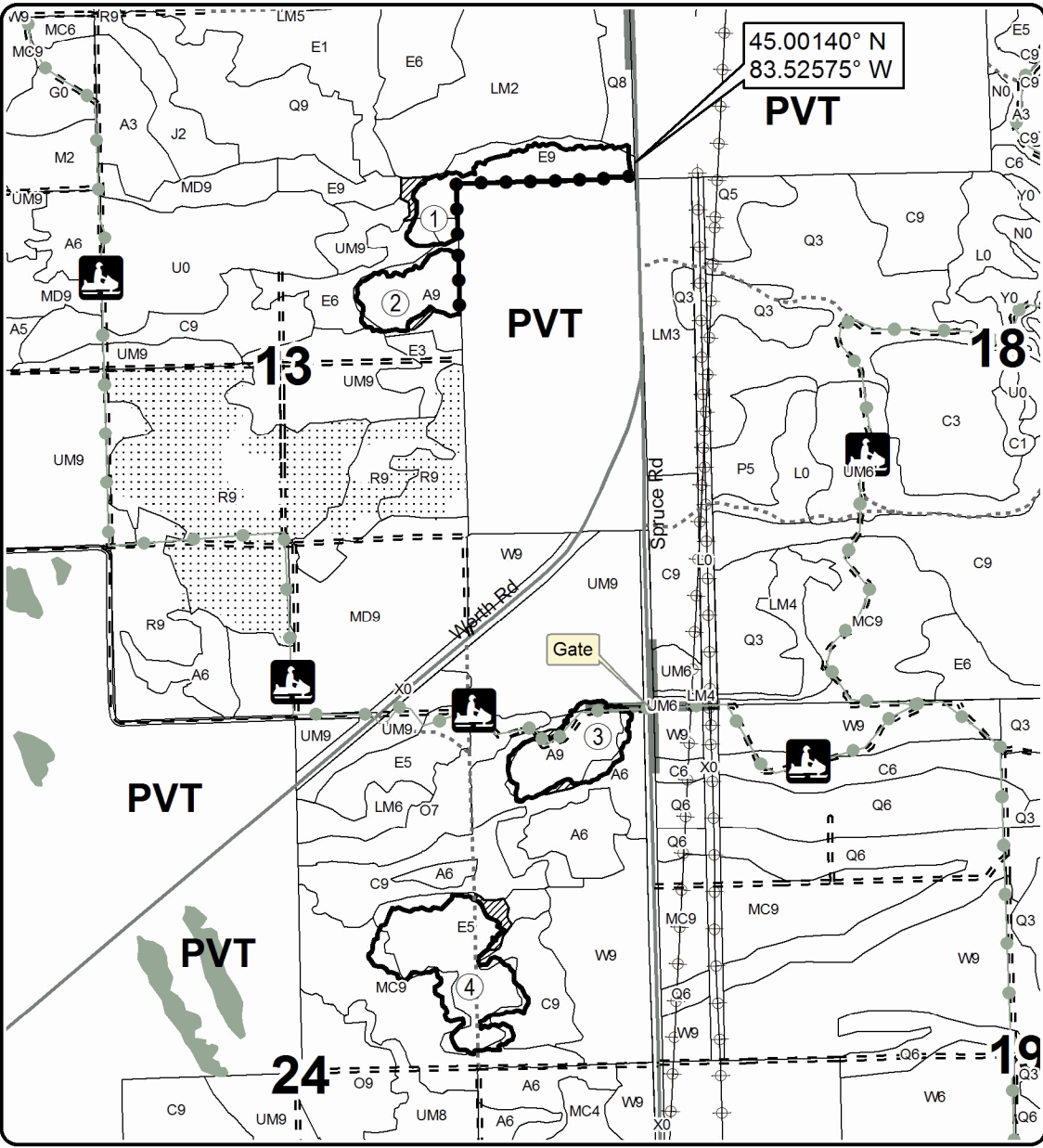

Legend

- Against State (Red)
- Private Line (Blue)
- ⋯ Nearby Sales
- ▨ Retention Area
- Stand Boundaries
- Highway
- Paved Roads
- Gravel Roads
- Poor Dirt Roads
- Closed Roads
- Recreational Trail
- ⊕ Powerline
- Lakes
- Section Corners



Locator Map
1:200,000

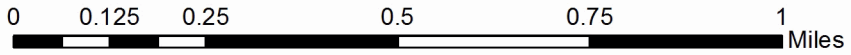
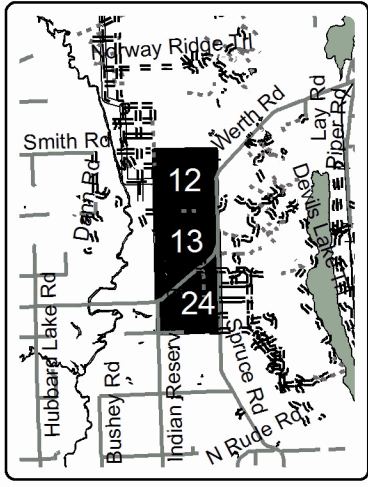



TIMBER SALE MAP

This information provided by authority of Part 525, 1994 PA 451, as amended.

Forest Management Unit Atlanta		County Alpena	Mapped By D. Parris	Date 8/14/2017	Page 2	of 2
Township 30N	Range 07E	Section(s) and Subdivision(s) Sec 12 NWSW, SWNW Sec 13 NENE, NWNE, SESE, SWNE; Sec 24 NENE, SENE, SWNE		Scale 1:15,840		

Cover Type

A = Aspen	H = Hemlock	N = Marsh	U = Upland Brush
B = Paper Birch	J = Jack Pine	O = Oak	UM = Upland Mixed
C = Cedar	L = Lowland Brush	P = Lowland Poplar	V = Bog or Marsh
D = Tread Bog	LM = Lowland Mixed	Q = Mixed Swamp Conifer	W = White Pine
E = Swamp Hdwoods	M = Mpl, Bch, Brch	R = Red Pine	X = Non Stocked
F = Spruce Fir	MC = Mixed Conifer	S = Black Spruce	Z = Water
G = Grass	MD = Mixed Deciduous	T = Tamarack	

Density

0 = Non Stocked	5 = Pole Timber Medium
1 = Seedling Sapling Poor	6 = Pole Timber Well
2 = Seedling Sapling Medium	7 = Saw Timber Poor
3 = Seedling Sapling Well	8 = Saw Timber Medium
4 = Pole Timber Poor	9 = Saw Timber Well

PU	Stand	Acres
1	106	9.9
2	39	6.9
3	12	8.9
4	102	16.2
5	118	18.6

Spruce Werth Mix

Compartment 87

60.5 Acres

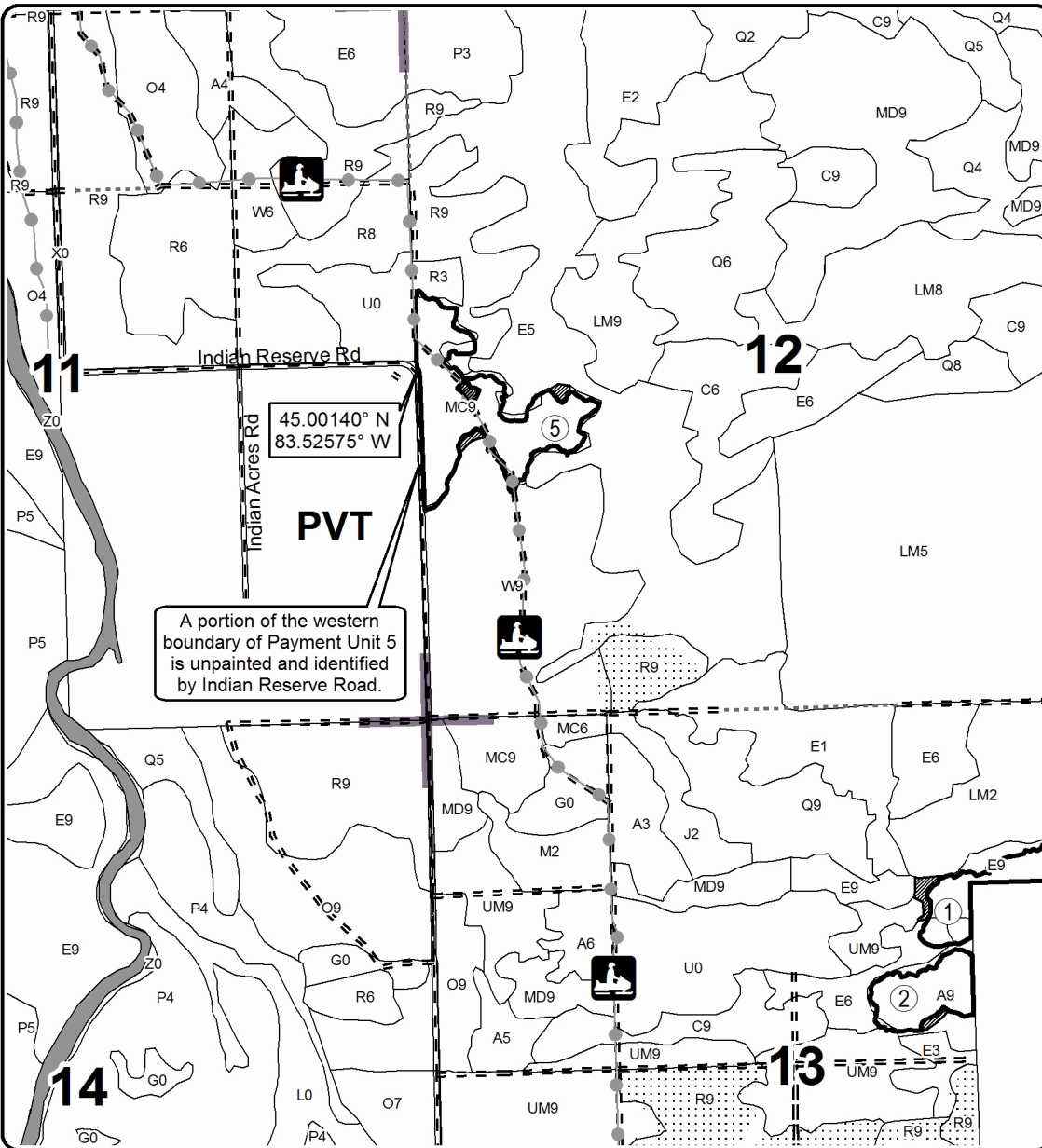

Legend

- Against State (Red)
- Retention Area
- Stand Boundaries
- Nearby Sales
- Gravel Roads
- Poor Dirt Roads
- Closed Roads
- Recreational Trail
- Lakes and Rivers
- Section Corners



Locator Map
1:200,000

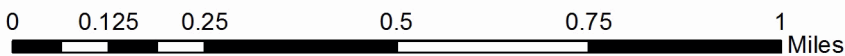
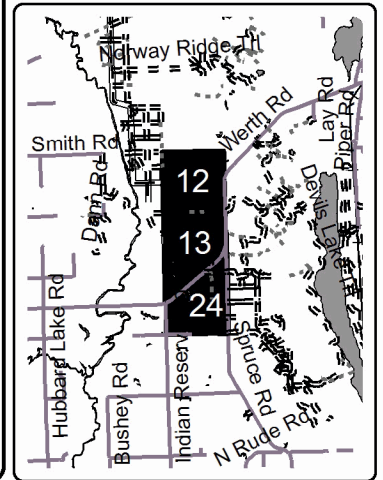

TIMBER SALE INFORMATION

Long Swamp Deciduous Mix (54-031-17)

Alpena County (Advertised Price \$28,887.65)

A timber sale contract for this lump sum, sealed bid timber sale will be awarded to the responsible bidder offering the highest sealed bid price. Bids must be at or above the following advertised price for each species:

<u>PRODUCTS & SPECIES</u>	<u>ESTIMATED UNITS*</u>	<u>ADVERTISED PRICE</u>
Sawtimber		
Mixed Aspen	5.90 MBF	\$ 90.00 / MBF
Red Maple	55.00 MBF	\$ 138.00 / MBF
White Spruce	9.40 MBF	\$ 68.00 / MBF
Pulpwood		
Jack Pine	11.00 Cords	\$ 22.45 / Cord
Mixed Aspen	190.00 Cords	\$ 23.95 / Cord
Mixed Hardwood	650.00 Cords	\$ 20.00 / Cord
Paper Birch	26.00 Cords	\$ 22.75 / Cord
Red Pine	2.00 Cords	\$ 50.15 / Cord
Tamarack	16.00 Cords	\$ 31.85 / Cord
White Spruce	33.00 Cords	\$ 34.20 / Cord

* The total volume is statistically estimated within plus (+) or minus (-) 14.36 percent. The estimated units are final and not subject to adjustment. Prospective bidders are urged to examine this timber and to make their own estimates of quantity and quality.

BOND AND PAYMENT SCHEDULE:

1. A bond in the amount of \$1,444.00 to insure faithful performance of the conditions of the contract will be deposited by the successful bidder within 21 days of the sale award.
2. Cutting in any sale or unit without the required advance payment would be considered a trespass.
3. Total payment must be paid in advance or according to the following schedule:
 - (a) Ten percent (10%) of the sale value must be paid within 21 days of the sale award.
 - (b) The 10% down payment will be credited towards the first unit cut.
 - (c) Payment for each of the following units must be made before cutting begins in that unit:

<u>PAYMENT UNIT NUMBER</u>	<u>PERCENT OF TOTAL SALE VALUE</u>
01	86.9%
02	5.1%
03	8.0%
4. If no cutting takes place, the 10% down payment will not be refunded.
5. Operations on the contract issued will terminate on 06/30/2021.

Description of Timber by Payment Unit (PU)

PU	MARKET GROUP	PRODUCT	QUANTITY	UNIT	ACRES	ADVERTISE PRICE
1	Mixed Aspen	Sawtimber	3.6	MBF	45.0	\$25,112.25
	<i>B. T. Aspen</i>		0.8	<i>MBF</i>		
	<i>Quaking Aspen</i>		2.8	<i>MBF</i>		
	Red Maple		49.8	MBF		
	White Spruce		9.4	MBF		
	Jack Pine	Pulpwood	7.0	Cords		
	<i>Jack Pine</i>	<i>Sawtimber</i>	3.1	<i>MBF</i>		
	<i>Jack Pine</i>	<i>Pulpwood</i>	1.0	<i>Cords</i>		
	Mixed Aspen		116.0	Cords		
	<i>B. T. Aspen</i>		23.0	<i>Cords</i>		
	<i>Balsam Poplar</i>		17.0	<i>Cords</i>		
	<i>Quaking Aspen</i>		76.0	<i>Cords</i>		
	Mixed Hardwood		609.0	Cords		
	<i>Black Cherry</i>		13.0	<i>Cords</i>		
	<i>Red Maple</i>		596.0	<i>Cords</i>		
	Paper Birch		26.0	Cords		
	<i>Paper Birch</i>	<i>Sawtimber</i>	0.9	<i>MBF</i>		
	<i>Paper Birch</i>	<i>Pulpwood</i>	24.0	<i>Cords</i>		
	Tamarack		16.0	Cords		
	<i>Tamarack</i>	<i>Sawtimber</i>	3.0	<i>MBF</i>		
	<i>Tamarack</i>	<i>Pulpwood</i>	10.0	<i>Cords</i>		
	White Spruce		31.0	Cords		
	2	Mixed Aspen	Sawtimber	1.9		
<i>Quaking Aspen</i>			1.9	<i>MBF</i>		
Mixed Aspen		Pulpwood	54.0	Cords		
<i>Balsam Poplar</i>			5.0	<i>Cords</i>		
<i>Quaking Aspen</i>			49.0	<i>Cords</i>		
3	Mixed Aspen	Sawtimber	0.4	MBF	8.0	\$2,311.10
	<i>Quaking Aspen</i>		0.4	<i>MBF</i>		
	Red Maple		5.2	MBF		
	Jack Pine	Pulpwood	4.0	Cords		
	<i>Jack Pine</i>		4.0	<i>Cords</i>		
	Mixed Aspen		20.0	Cords		
	<i>Quaking Aspen</i>		20.0	<i>Cords</i>		
	Mixed Hardwood		41.0	Cords		
	<i>Black Cherry</i>		1.0	<i>Cords</i>		
	<i>Red Maple</i>		40.0	<i>Cords</i>		
	Red Pine		2.0	Cords		
White Spruce		2.0	Cords			
TOTAL:			70.3	MBF		
TOTAL:			928.0	Cords		

Sale Specific Conditions & Requirements

Sale Name: Long Swamp Deciduous Mix

Sale Number: 54-031-17 Seq#: 1

1 - Sale Area

1.2 - Boundaries

1.2.1 - Painted boundaries (1/14)

The sale boundaries are marked and identified by blue and red paint, along with a road. Exterior sale boundary lines against private property are marked with blue paint. Exterior sale boundary lines against state are marked with red paint, with the exception of the northern boundaries of Payment Units 2 and 3, which are unpainted and identified by Long Rapids Road. The painted boundary line trees are not Included Timber and are to be protected.

2 - Timber Specifications

2.1 - Included Timber

2.1.1 - Clearcut unit(s) with unmerchantable trees (6/14)

Within Payment Unit(s) 1-3, cut all trees that are two (2) inches or more at DBH, except do not cut or damage green marked trees in Payment Unit 1. Green marked special protection trees identified in accordance with condition 3.4.2, within clearcutting unit boundaries, are not Included Timber and are to be protected.

2.1.11 - Description of timber note (2/04)

Note that dead ash (defined as loose bark and no live branches) may be cut throughout the sale area. If cut, it must be skidded and piled separately on the landing. The sale administrator will measure the dead ash and the wood cannot be hauled prior to scaling. The Purchaser will be invoiced at \$5.00 per cord. The contractor has 30 days to pay from the date of the invoice.

In addition, note that Mixed Aspen Sawtimber is bigtooth and quaking aspen. Mixed Aspen Pulpwood is bigtooth aspen, quaking aspen, and balsam poplar. Mixed Hardwood Pulpwood is black cherry and red maple.

2.2 - Utilization

2.2.6 - Roundwood operation required (5/07)

The skidding of whole trees or tree segments with limbs attached is prohibited within all Payment Units. All products must be produced as roundwood and forwarded to existing roads or landing areas in final product length. Slash from tops must be evenly distributed and used for all drive over operations to minimize rutting.

3 - Payments

3.3 - Pre-measured Sales

3.3.4 - Dividing payment units (7/14)

Payment Unit(s) 1 may be divided at the request of the Purchaser and upon approval of the Unit Manager. Dividing Payment Units is a contract modification which requires a Timber Sale Contract Supplement. There will be only one division per Payment Unit.

3.4 - Damaged Timber

3.4.1 - Damaged timber (6/14)

General Condition and Requirement 3.4 Damaged Timber, defines liquidated damages for undesignated live merchantable trees which are cut or injured. In addition, extreme care should be taken to avoid damage to tree seedlings and saplings.

Within Payment Unit 3, if more than 25% of the spruce seedlings or saplings (1/4" to 4.5" DBH) within a specified portion of the sale area are damaged, liquidated damages will be assessed at \$50 per acre for all acreage within that specified portion of the sale area that was damaged.

3.4.2 - Special Protection Trees (4/14)

The Purchaser shall not cut live or dead special protection trees within cutting units or clearings. Special protection trees are marked with green paint. If the Purchaser's operations have cut or damaged special protection trees through carelessness, the Purchaser shall pay \$150 as fixed, agreed and liquidated damages for each special protection tree cut or damaged. Such

payment does not constitute ownership of the undesignated timber.

4 - Transportation

4.1 - Construction

4.1.3 - Slash and earthen piles (8/04)

Piles or windrows of earth along roads and landings that have been widened or constructed shall be leveled. Slash from road maintenance or construction, including stumps, shall be dispersed throughout the sale.

4.1.12 - No new roads (1/12)

No new roads will be permitted in any Payment Unit. All operations are limited to existing roads. Skid trails only will be allowed.

5 - Operations

5.1 - Notification

5.1.1 - Pre-sale conference (10/16)

A pre-sale conference on site between the Purchaser and sale administrator is required prior to beginning any operations in a Payment Unit to determine landing and road locations.

5.1.4 - Post-sale conference (10/16)

A post-sale conference on site between the Purchaser and sale administrator is required prior to the completion of active logging operations to determine clean-up and repair of landings, road edges, and the fulfillment of other contract specifications.

5.2 - Conduct of Operations

5.2.2 - Hazard Trees/Snags

5.2.2.1 - Den trees (10/16)

Obvious hollow and/or den trees shall be protected and left standing unless they are a safety hazard.

5.2.3 - Operating Restrictions

5.2.3.1 - Operating restrictions (9/11)

Within Payment Unit(s) 1-3, unless changed by written agreement, cutting, skidding, and hauling are not permitted during the period of 3/1 to 7/1. This restriction is due to low ground and seasonably wet soils. Cutting, skidding, and/or hauling will only be allowed during this period if approved by the Unit Manager or his/her representative.

5.2.3.1.1 - Coppice regeneration protection (4/10)

Timber harvesting in any Payment Unit must be completed before significant sprouting occurs in that Payment Unit so as to minimize damage to the new regeneration. Any post harvest operations, such as chipping, must be completed before sprouting of regeneration occurs. If it is anticipated that chipping will be delayed, then tops shall be carried to one central location or left unchipped. The Unit Manager or his/her representative may cease such operations if sprouting occurs before the operation is complete.

5.2.4 - Dead and Down Creation

5.2.4.4 - Dead and down creation, grouse (8/13)

To encourage grouse and other wildlife, in Payment Unit(s) 1 and 2, leave one, 9" diameter or larger log-length (8 foot minimum) piece on the ground for every 2 acres. These will be evenly scattered throughout the unit. This can be an unmerchantable piece or a full tree.

5.2.32 - Decking/landing restoration (9/13)

All decking and landing areas must have the surface area restored to a condition equal to or better than before. This is to ensure the proper regeneration of the stand. Wood debris, chips and "cookies" from trimmings must be removed or scattered away from landing and loading areas and may not be windrowed on the edge.

5.2.38 - No decking against live trees (2/04)

Cut products may not be decked against unmarked or designated leave trees.

5.4 - Soil Protection

5.4.1 - Rutting restriction, general (7/16)

Operations are to cease immediately if equipment and weather conditions result in rutting of roads and/or skid trails which is 12 inches or greater in depth and 50 feet in length. The Unit Manager or his/her representative may restrict hauling and/or skidding if ruts exceed the specified depth. With the Unit Manager or his/her representative's approval, the Purchaser may return to the area when the risk of rutting has decreased.

5.4.6 - Wet area protection (5/10)

No harvesting operations, including skidding and felling, are to take place within the vernal pond areas. When harvesting occurs, there should be no disturbance to the vernal pond depression. All equipment, trees and tops should be kept out of this area. Within 100 feet of the pond, equipment should only be used when the soil is in a dry or frozen condition. All equipment is to be stored/parked more than 100 feet from vernal ponds and low areas that hold water on a seasonal basis to prevent oil spill and other types of contamination in these areas. Care must be taken by the Purchaser to identify and avoid operating in these areas of the timber sale.

5.8 - Protection of Endangered Species

5.8.5 - Protection of raptor nests (3/13)

All trees with raptor nests will be protected if found during harvesting operations. Notification will be made to the Unit Manager or his/her representative who will notify the Wildlife Biologist so an on-site evaluation and recommendation can be made, if necessary.



TIMBER SALE MAP

This information provided by authority of Part 525, 1994 PA 451, as amended.

Forest Management Unit Atlanta		County Alpena	Mapped By D. Parris	Date 8/31/2017	Page 1	of 2
Township 31N	Range 05E	Section(s) and Subdivision(s) Sec 3 NENW, NWNE, NWNW; Sec 4 SWNW; Sec 5 NENE, SENE, SWNE		Scale 1:15,840		

Cover Type				Density	
A = Aspen	H = Hemlock	N = Marsh	U = Upland Brush	0 = Non Stocked	5 = Pole Timber Medium
B = Paper Birch	J = Jack Pine	O = Oak	UM = Upland Mixed	1 = Seedling Sapling Poor	6 = Pole Timber Well
C = Cedar	L = Lowland Brush	P = Lowland Poplar	V = Bog or Marsh	2 = Seedling Sapling Medium	7 = Saw Timber Poor
D = Tread Bog	LM = Lowland Mixed	Q = Mixed Swamp Conifer	W = White Pine	3 = Seedling Sapling Well	8 = Saw Timber Medium
E = Swamp Hdwoods	M = Mpl, Bch, Brch	R = Red Pine	X = Non Stocked	4 = Pole Timber Poor	9 = Saw Timber Well
F = Spruce Fir	MC = Mixed Conifer	S = Black Spruce	Z = Water		
G = Grass	MD = Mixed Deciduous	T = Tamarack			

PU	Stand	Acres
1	5, 6	45.0
2	4	4.2
3	24	8.0

Long Swamp Deciduous Mix

Compartment 95 and 97
57.2 Acres

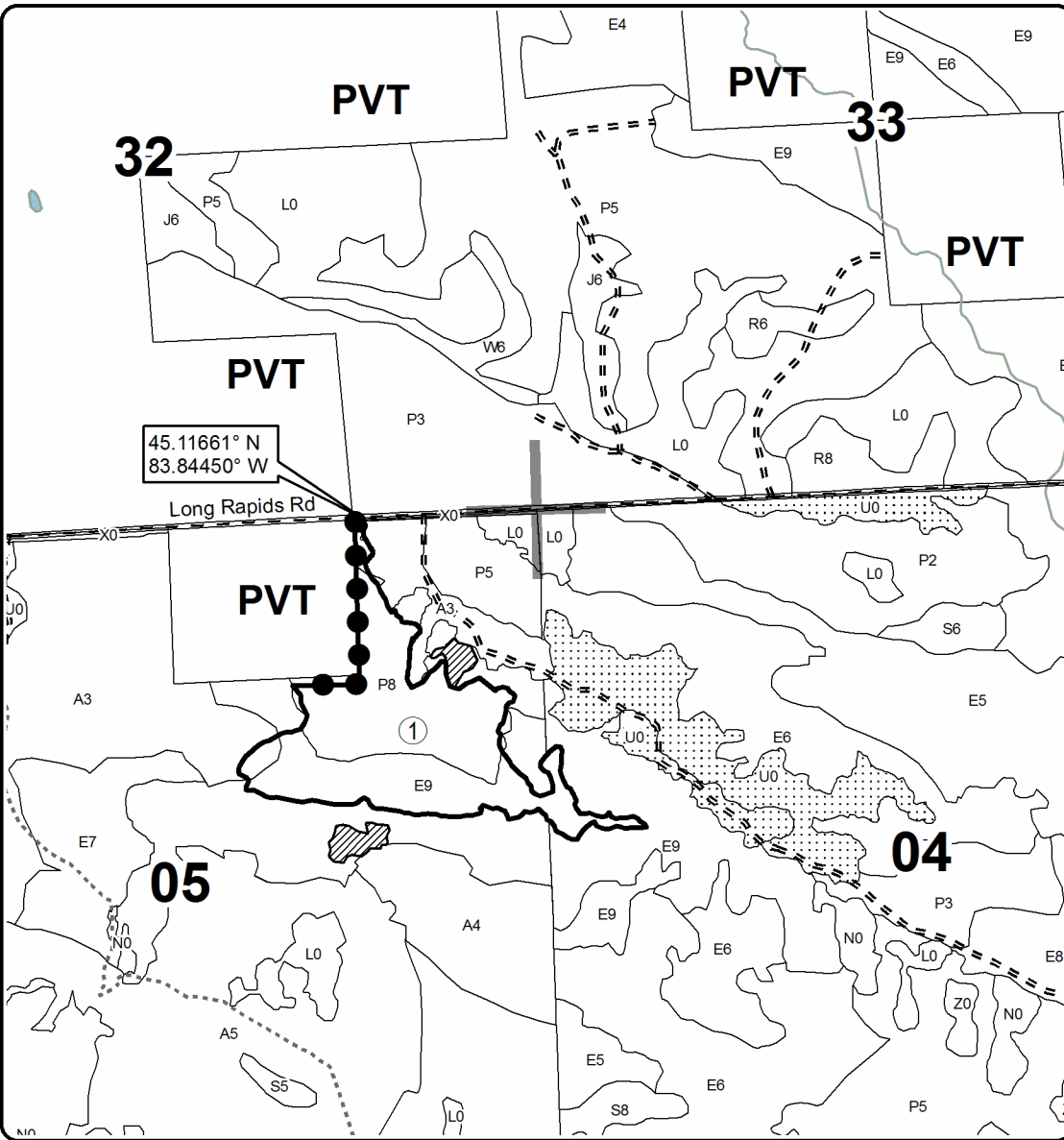

Legend

- Against State (Red)
- Private Line (Blue)
- Payment Unit
- Retention Area
- Stand Boundaries
- Nearby Timber Sale
- Highway
- Paved Roads
- Gravel Roads
- Poor Dirt Roads
- Closed Roads
- Streams
- Section Corners

Locator Map
1:200,000

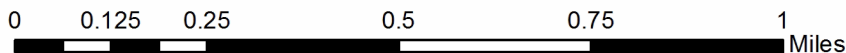
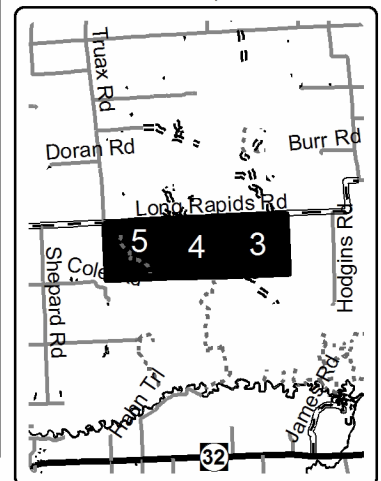



TIMBER SALE MAP

This information provided by authority of Part 525, 1994 PA 451, as amended.

Sale Number	Year
54-031	17

Forest Management Unit Atlanta	County Alpena	Mapped By D. Parris	Date 8/31/2017	Page 2	of 2
		Cruised By D. Parris			

Township 31N	Range 05E	Section(s) and Subdivision(s) Sec 3 NENW, NWNE, NWNW; Sec 4 SWNW; Sec 5 NENE, SENE, SWNE	Scale 1:15,840
-----------------	--------------	---	-------------------

Cover Type

A = Aspen	H = Hemlock	N = Marsh	U = Upland Brush
B = Paper Birch	J = Jack Pine	O = Oak	UM = Upland Mixed
C = Cedar	L = Lowland Brush	P = Lowland Poplar	V = Bog or Marsh
D = Treed Bog	LM = Lowland Mixed	Q = Mixed Swamp Conifer	W = White Pine
E = Swamp Hdwoods	M = Mpl, Bch, Brch	R = Red Pine	X = Non Stocked
F = Spruce Fir	MC = Mixed Conifer	S = Black Spruce	Z = Water
G = Grass	MD = Mixed Deciduous	T = Tamarack	

Density

0 = Non Stocked	5 = Pole Timber Medium
1 = Seedling Sapling Poor	6 = Pole Timber Well
2 = Seedling Sapling Medium	7 = Saw Timber Poor
3 = Seedling Sapling Well	8 = Saw Timber Medium
4 = Pole Timber Poor	9 = Saw Timber Well

PU	Stand	Acres
1	5, 6	45.0
2	4	4.2
3	24	8.0

Long Swamp Deciduous Mix

Compartment 95 and 97

57.2 Acres

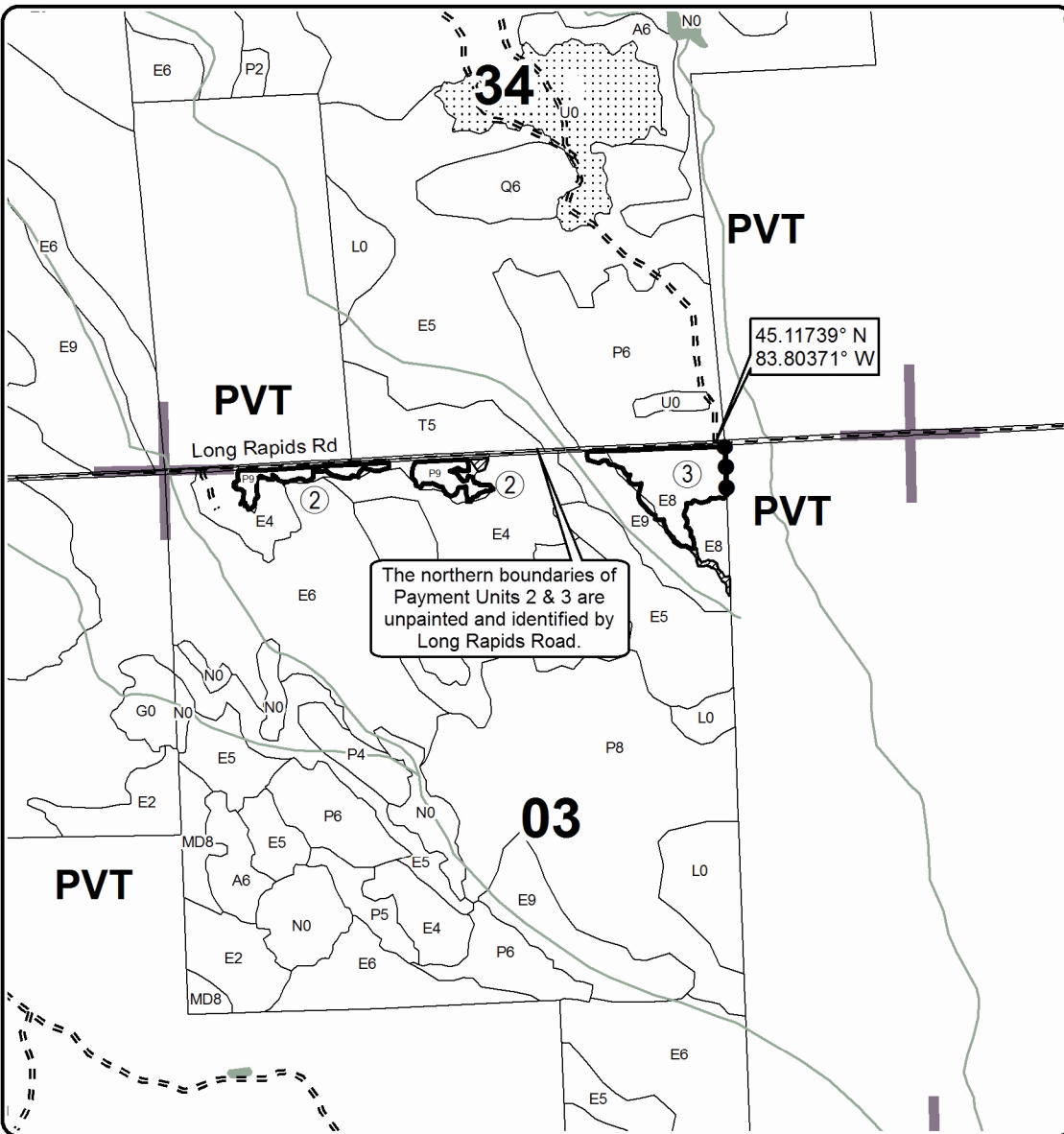
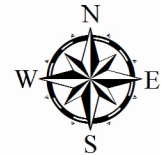

Legend

- Against State (Red)
- Private Line (Blue)
- Payment Unit
- Retention Area
- Stand Boundaries
- Nearby Timber Sale
- Highway
- Paved Roads
- Gravel Roads
- Poor Dirt Roads
- Closed Roads
- Streams
- Section Corners

Locator Map
1:200,000

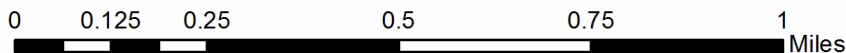
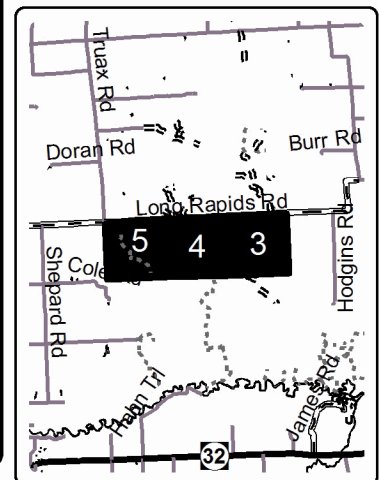

Spruce Werth Mix (54-028-17)
; Alpena COUNTY

In response to the notice of sale to be held 10:00 a.m. (local time) on April 24, 2018, I am hereby submitting my sealed bid (firm offer) for the following forest products to be cut. Bids for individual species must be at or above the advertised price. All non-responsive bid forms may be rejected.

<u>PRODUCTS & SPECIES</u>	<u>ESTIMATED VOLUME*</u>	<u>ADVERTISED PRICE</u>	<u>BID PRICE/UNIT</u>
Sawtimber			
B. T. Aspen	25.10 MBF	\$ 90.00/MBF	\$ _____
Red Maple	16.00 MBF	\$ 138.00/MBF	\$ _____
Red Pine	68.40 MBF	\$ 121.00/MBF	\$ _____
White Pine	52.50 MBF	\$ 97.00/MBF	\$ _____
Pulpwood			
Balsam Fir	36.00 Cords	\$ 31.70/Cord	\$ _____
Jack Pine	30.00 Cords	\$ 22.45/Cord	\$ _____
Mixed Aspen	431.00 Cords	\$ 23.95/Cord	\$ _____
Mixed Hardwood	424.00 Cords	\$ 20.00/Cord	\$ _____
Mixed Spruce	3.00 Cords	\$ 34.20/Cord	\$ _____
Paper Birch	52.00 Cords	\$ 22.75/Cord	\$ _____
Red Pine	96.00 Cords	\$ 50.15/Cord	\$ _____
White Pine	214.00 Cords	\$ 48.55/Cord	\$ _____

*The volumes are statistically estimated within plus (+) or minus (-) 13.60 percent. These estimated volumes are final and not subject to adjustment. Prospective bidders are urged to examine this timber and to make their own estimates of quantity and quality.

I understand that any or all bids may be rejected. All bids must be signed and all bid items must be bid or the bid form may be rejected. I also understand that consideration and awarding a contract will be based upon my past performance and ability to complete the contract based upon equipment and staffing subject to my control.

FEDERAL ID: _____ or SOCIAL SECURITY NUMBER: _____

Company or individual bidding: _____

Company representative's name: _____

Address: _____

City: _____ State: _____ Zip: _____

IF AVAILABLE, PLEASE PLACE THE PERSONALIZED LABEL FROM YOUR PROSPECTUS IN THE ABOVE BOX.

Individual or company representative's signature: _____ Date: _____

Phone number : _____ Email (optional): _____

THE WINNING BIDDER MUST COMPLETE THE VERIFICATION OF WORKER'S DISABILITY COMPENSATION ACT COMPLIANCE (ON REVERSE SIDE IF DOUBLE SIDED) WITHIN 21 DAYS OF SALE AWARD DATE



FOR DEPARTMENT USE ONLY	
Sale Number (XX - XXX - XX - XX)	
Forest Management Unit:	

TIMBER SALE VERIFICATION OF WORKER'S DISABILITY COMPENSATION ACT COMPLIANCE

As required by Act 317, P.A. 1969 (Worker's Compensation) and
Part 5 of Act 451 of 1994, as amended.

VERIFICATION OF WORKER'S DISABILITY COMPENSATION ACT COMPLIANCE

- This verification must be completed and submitted within 21 days of contract award and prior to the issuance of the timber sale contract.
- In addition, if boxes 2B or 2C are checked, then Notice of Exclusion or Certificate of Insurance must be submitted within twenty-one (21) days of the contract award and prior to the issuance of the timber sale contract.
- All information must be typed or printed except for written signatures.

Please Check Appropriate Categories:

1. My business is organized as (you **must** check one of the boxes below):
 - A. Sole Proprietorship (individual)
 - B. Partnership
 - C. Corporation
2. You **must** check one of the boxes below:
 - A. I certify my business is a sole proprietorship and it has no employees but the sole proprietor. I am not subject to the Worker's Compensation Laws.
 - B. I certify my business has satisfied its obligation to the Worker's Compensation Act through the use of an approved Notice of Exclusion (BWC-337, Rev. 5/96). I will provide a copy of the Notice of Exclusion within 21 days of the contract award. (For questions or a copy of the BWC-337, please call the Worker's Compensation Bureau at 517 -322-1195).
 - C. I certify my business has a Worker's Compensation Policy. I will provide an original Certificate of Insurance within twenty-one (21) days of the contract award.
3. If you have checked item 2(A) or 2(B), you **must** indicate the number of **both** full-time and part-time employees, other than yourself, including family members and active partners (if none, you must enter "0").

_____ Full-time Employees

_____ Part-time Employees

Name of Business		Federal ID (or) Social Security No.	
Address		Telephone ()	
City	State	ZIP	

I hereby certify that the above information is true and correct. I agree to notify the Michigan DNR of any changes that occur in factors affecting my coverage during any of my present and future operations.

Signature of Owner or Authorized Representative

Title

Date

Please complete the "SEALED BID" information on the next page

Brilinski Red Pine (54-027-17)
; Alpena COUNTY

In response to the notice of sale to be held 10:00 a.m. (local time) on April 24, 2018, I am hereby submitting my sealed bid (firm offer) for the following forest products to be cut. Bids for individual species must be at or above the advertised price. All non-responsive bid forms may be rejected.

<u>PRODUCTS & SPECIES</u>	<u>ESTIMATED VOLUME*</u>	<u>ADVERTISED PRICE</u>	<u>BID PRICE/UNIT</u>
Sawtimber			
Bl/R/Hybrid Oak	1.90 MBF	\$ 110.00/MBF	\$ _____
Red Maple	6.10 MBF	\$ 138.00/MBF	\$ _____
Red Pine	1,207.30 MBF	\$ 121.00/MBF	\$ _____
White Pine	5.50 MBF	\$ 97.00/MBF	\$ _____
Pulpwood			
B. T. Aspen	21.00 Cords	\$ 23.95/Cord	\$ _____
Jack Pine	6.00 Cords	\$ 22.45/Cord	\$ _____
Mixed Oak	28.00 Cords	\$ 21.55/Cord	\$ _____
Mixed Spruce	10.00 Cords	\$ 34.20/Cord	\$ _____
Paper Birch	5.00 Cords	\$ 22.75/Cord	\$ _____
Red Maple	89.00 Cords	\$ 20.00/Cord	\$ _____
Red Pine	1,164.00 Cords	\$ 50.15/Cord	\$ _____
Scotch Pine	17.00 Cords	\$ 26.45/Cord	\$ _____
White Pine	90.00 Cords	\$ 48.55/Cord	\$ _____

*The volumes are statistically estimated within plus (+) or minus (-) 11.20 percent. These estimated volumes are final and not subject to adjustment. Prospective bidders are urged to examine this timber and to make their own estimates of quantity and quality.

I understand that any or all bids may be rejected. All bids must be signed and all bid items must be bid or the bid form may be rejected. I also understand that consideration and awarding a contract will be based upon my past performance and ability to complete the contract based upon equipment and staffing subject to my control.

FEDERAL ID: _____ - _____ or SOCIAL SECURITY NUMBER: _____ - _____ - _____

Company or individual bidding: _____

Company representative's name: _____

Address: _____

City: _____ State: _____ Zip: _____

IF AVAILABLE, PLEASE PLACE THE PERSONALIZED LABEL FROM YOUR PROSPECTUS IN THE ABOVE BOX.

Individual or company representative's signature: _____ Date: _____

Phone number : _____ Email (optional): _____

THE WINNING BIDDER MUST COMPLETE THE VERIFICATION OF WORKER'S DISABILITY COMPENSATION ACT COMPLIANCE (ON REVERSE SIDE IF DOUBLE SIDED) WITHIN 21 DAYS OF SALE AWARD DATE



FOR DEPARTMENT USE ONLY	
Sale Number (XX - XXX - XX - XX)	
Forest Management Unit:	

TIMBER SALE VERIFICATION OF WORKER'S DISABILITY COMPENSATION ACT COMPLIANCE

As required by Act 317, P.A. 1969 (Worker's Compensation) and
Part 5 of Act 451 of 1994, as amended.

- VERIFICATION OF WORKER'S DISABILITY COMPENSATION ACT COMPLIANCE**
- This verification must be completed and submitted within 21 days of contract award and prior to the issuance of the timber sale contract.
 - In addition, if boxes 2B or 2C are checked, then Notice of Exclusion or Certificate of Insurance must be submitted within twenty-one (21) days of the contract award and prior to the issuance of the timber sale contract.
 - All information must be typed or printed except for written signatures.

Please Check Appropriate Categories:

1. My business is organized as (you **must** check one of the boxes below):
 - A. Sole Proprietorship (individual)
 - B. Partnership
 - C. Corporation
2. You **must** check one of the boxes below:
 - A. I certify my business is a sole proprietorship and it has no employees but the sole proprietor. I am not subject to the Worker's Compensation Laws.
 - B. I certify my business has satisfied its obligation to the Worker's Compensation Act through the use of an approved Notice of Exclusion (BWC-337, Rev. 5/96). I will provide a copy of the Notice of Exclusion within 21 days of the contract award. (For questions or a copy of the BWC-337, please call the Worker's Compensation Bureau at 517 -322-1195).
 - C. I certify my business has a Worker's Compensation Policy. I will provide an original Certificate of Insurance within twenty-one (21) days of the contract award.
3. If you have checked item 2(A) or 2(B), you **must** indicate the number of **both** full-time and part-time employees, other than yourself, including family members and active partners (if none, you must enter "0").

_____ Full-time Employees

_____ Part-time Employees

Name of Business		Federal ID (or) Social Security No.	
Address		Telephone ()	
City	State	ZIP	

I hereby certify that the above information is true and correct. I agree to notify the Michigan DNR of any changes that occur in factors affecting my coverage during any of my present and future operations.

Signature of Owner or Authorized Representative

Title

Date

Please complete the "SEALED BID" information on the next page

Long Swamp Deciduous Mix (54-031-17)
; Alpena COUNTY

In response to the notice of sale to be held 10:00 a.m. (local time) on April 24, 2018, I am hereby submitting my sealed bid (firm offer) for the following forest products to be cut. Bids for individual species must be at or above the advertised price. All non-responsive bid forms may be rejected.

<u>PRODUCTS & SPECIES</u>	<u>ESTIMATED VOLUME*</u>	<u>ADVERTISED PRICE</u>	<u>BID PRICE/UNIT</u>
Sawtimber			
Mixed Aspen	5.90 MBF	\$ 90.00/MBF	\$ _____
Red Maple	55.00 MBF	\$ 138.00/MBF	\$ _____
White Spruce	9.40 MBF	\$ 68.00/MBF	\$ _____
Pulpwood			
Jack Pine	11.00 Cords	\$ 22.45/Cord	\$ _____
Mixed Aspen	190.00 Cords	\$ 23.95/Cord	\$ _____
Mixed Hardwood	650.00 Cords	\$ 20.00/Cord	\$ _____
Paper Birch	26.00 Cords	\$ 22.75/Cord	\$ _____
Red Pine	2.00 Cords	\$ 50.15/Cord	\$ _____
Tamarack	16.00 Cords	\$ 31.85/Cord	\$ _____
White Spruce	33.00 Cords	\$ 34.20/Cord	\$ _____

*The volumes are statistically estimated within plus (+) or minus (-) 14.36 percent. These estimated volumes are final and not subject to adjustment. Prospective bidders are urged to examine this timber and to make their own estimates of quantity and quality.

I understand that any or all bids may be rejected. All bids must be signed and all bid items must be bid or the bid form may be rejected. I also understand that consideration and awarding a contract will be based upon my past performance and ability to complete the contract based upon equipment and staffing subject to my control.

FEDERAL ID: _____ - _____ or SOCIAL SECURITY NUMBER: _____ - _____ - _____

Company or individual bidding: _____

Company representative's name: _____

Address: _____

City: _____ State: _____ Zip: _____

IF AVAILABLE, PLEASE PLACE THE PERSONALIZED LABEL FROM YOUR PROSPECTUS IN THE ABOVE BOX.

Individual or company representative's signature: _____ Date: _____

Phone number : _____ Email (optional): _____

THE WINNING BIDDER MUST COMPLETE THE VERIFICATION OF WORKER'S DISABILITY COMPENSATION ACT COMPLIANCE (ON REVERSE SIDE IF DOUBLE SIDED) WITHIN 21 DAYS OF SALE AWARD DATE



TIMBER SALE VERIFICATION OF WORKER'S DISABILITY COMPENSATION ACT COMPLIANCE

As required by Act 317, P.A. 1969 (Worker's Compensation) and
Part 5 of Act 451 of 1994, as amended.

FOR DEPARTMENT USE ONLY	
Sale Number (XX - XXX - XX - XX)	
Forest Management Unit:	

VERIFICATION OF WORKER'S DISABILITY COMPENSATION ACT COMPLIANCE

- This verification must be completed and submitted within 21 days of contract award and prior to the issuance of the timber sale contract.
- In addition, if boxes 2B or 2C are checked, then Notice of Exclusion or Certificate of Insurance must be submitted within twenty-one (21) days of the contract award and prior to the issuance of the timber sale contract.
- All information must be typed or printed except for written signatures.

Please Check Appropriate Categories:

1. My business is organized as (you **must** check one of the boxes below):
 - A. Sole Proprietorship (individual)
 - B. Partnership
 - C. Corporation
2. You **must** check one of the boxes below:
 - A. I certify my business is a sole proprietorship and it has no employees but the sole proprietor. I am not subject to the Worker's Compensation Laws.
 - B. I certify my business has satisfied its obligation to the Worker's Compensation Act through the use of an approved Notice of Exclusion (BWC-337, Rev. 5/96). I will provide a copy of the Notice of Exclusion within 21 days of the contract award. (For questions or a copy of the BWC-337, please call the Worker's Compensation Bureau at 517 -322-1195).
 - C. I certify my business has a Worker's Compensation Policy. I will provide an original Certificate of Insurance within twenty-one (21) days of the contract award.
3. If you have checked item 2(A) or 2(B), you **must** indicate the number of **both** full-time and part-time employees, other than yourself, including family members and active partners (if none, you must enter "0").

_____ Full-time Employees

_____ Part-time Employees

Name of Business		Federal ID (or) Social Security No.	
Address		Telephone ()	
City	State	ZIP	

I hereby certify that the above information is true and correct. I agree to notify the Michigan DNR of any changes that occur in factors affecting my coverage during any of my present and future operations.

Signature of Owner or Authorized Representative

Title

Date

Please complete the "SEALED BID" information on the next page