



**DEPARTMENT OF NATURAL RESOURCES  
STATE OF MICHIGAN**

**TIMBER SALE PROSPECTUS #6335**

SCHEDULED SALE DATE AND TIME: 10:00 a.m. (local time) on February 26, 2019.

LOCATION: ATLANTA MGMT UNIT, 13501 M 33, ATLANTA, MI 49709.

PROSPECTUS NOTE: The bidder is advised to inspect the sale area and review the location, estimated volumes, operating costs and contract terms of proposed sales. Please be aware that some landowners may request 60 days or more notice for access across their land.

Notice is hereby given that bids will be received by the Unit Manager, ATLANTA MANAGEMENT UNIT, for certain timber on the following described lands:

Karsty Mckarsterson Aspen/oak (54-011-18) / T33N, R02E, SEC. 14, S1/2SE.

T33N, R02E, SEC. 22, NENW,NE.

T33N, R02E, SEC. 23, N1/2NW,SWNW,NE,S1/2SE.

T33N, R02E, SEC. 24, SENW,SWNE,NWSE.

Presque Isle County, Advertised Price \$180,984.40, 207.3 Acres, Aspen, Red Oak.

SALE NOTE: A recreation site such as a trail, pathway, or campground is within the sale area or the vicinity. Certain restrictions/specifications may be applicable including time restrictions.

Looney Tunes Aspen (54-015-18) / T33N, R02E, SEC. 14, NWSW.

T33N, R02E, SEC. 15, SENE,NESE.

Presque Isle County, Advertised Price \$9,195.75, 10.2 Acres, Aspen, Red Pine.

Shoe Hawk Jack Pine (54-016-18) / T33N, R02E, SEC. 13, SWSW.

T33N, R02E, SEC. 14, S1/2SE.

T33N, R02E, SEC. 22, E1/2SE.

T33N, R02E, SEC. 23, N1/2NW,SEW,NENE,S1/2NE,NWSW.

T33N, R02E, SEC. 23, NESE.

T33N, R02E, SEC. 24, NENW,S1/2NW.

Presque Isle County, Advertised Price \$59,427.85, 133.9 Acres, Jack Pine, Hardwood.

SALE NOTE: A recreation site such as a trail, pathway, or campground is within the sale area or the vicinity. Certain restrictions/specifications may be applicable including time restrictions.

Collin All Red Pine (54-018-18) / T33N, R02E, SEC. 13, SWSW.

T33N, R02E, SEC. 22, SENE.

T33N, R02E, SEC. 23, NENE,SESW,S1/2SE.

T33N, R02E, SEC. 24, N1/2NW.

Presque Isle County, Advertised Price \$92,731.30, 94.8 Acres, Red Pine, Jack Pine.

SALE NOTE: A recreation site such as a trail, pathway, or campground is within the sale area or the vicinity. Certain restrictions/specifications may be applicable including time restrictions.

## BID INSTRUCTIONS (VER. 07/02/2018):

### 1. Scheduled Bid Location, Date, and Time (2/11)

Bids must be received by the Unit Manager, ATLANTA OFFICE, 13501 M 33, ATLANTA, MI 49709, no later than 10:00 a.m. (local time) on February 26, 2019. For further information concerning this sale, contact Cody Stevens at 989-785-4251 extension 5240.

### 2. Bidder's Qualifications (5/16)

Purchaser shall obtain workers compensation insurance to cover claims under Michigan's Worker's Disability Compensation Act of 1969 or similar employee benefit act of any other state applicable to an employee. If all or part of a timber sale was prepared by a private contractor, the contractor and that contractor's company are not permitted to bid on the timber sale contract. Bids will not be accepted from individuals or companies appearing on the DNR/FRD No-Bid List. This list contains the names of purchasers who previously failed to execute a contract within 21-days or who have a history of poor performance.

### 3. Preparation of Sealed Bids (5/16)

Bid Forms may be completed online thru Michigan DNR Timber Sale Online Bidding (OLB) at [www.michigan.gov/timberbidding](http://www.michigan.gov/timberbidding) or by completing the hardcopy Bid Form found in the Timber Sale Prospectus. Hardcopy Bid Forms shall be manually signed in ink. Registration in OLB is considered your 'signature' for all bids submitted thru that system. Bid prices must be entered for each species and product in the Bid Price column for all material subject to bidding and all fill-in blanks must be completed. If erasures or other changes appear on the hardcopy Bid Form, each erasure or change must be initialed by the person signing the bid.

### 4. Submission of Sealed Bids (5/16)

Bid forms may be obtained from the Unit Manager or thru OLB. Bids may be submitted hardcopy or thru OLB. All hardcopy bids must be submitted on the bid form and in an envelope clearly identified as described in this section. NOTE: Only one bid form per bid envelope. Sealed bids must be submitted to the Unit office designated in the prospectus and must be submitted at or prior to the time established in the prospectus. The envelope should show on the outside (a) the sale name or number and (b) the date and time of bid opening, as shown in the prospectus. Bids received after the time specified in the sale prospectus are late bids and will be rejected.

It is possible for a bidder to submit multiple bids on a single sale. For example, a bid may be submitted hardcopy and a bid may be submitted thru OLB. Or, two bidders from the same company could both submit bids on the same sale. If this were to happen, the State would accept all bids received and award the contract accordingly. All bidding and contractual requirements would apply to all bids received.

### 5. Public Opening of Sealed Bids (7/16)

If conditions permit, the sealed bids will be publicly opened and posted at the time and place set in the prospectus.

If a bidder, present at a bid opening, has submitted bids on more than one sale, that bidder may withdraw their unopened bid envelopes or announce the withdrawal of their online bid after being declared the successful bidder on one sale.

### 6. Award of Contract (1/11)

Award of the contract will be made to the Bidder whose bid, conforming to the prospectus, is most advantageous to the State of Michigan on the basis of total value at rates bid for the estimated quantities. The State reserves the right to reject any bid or waive any minor irregularity in bids received. A written award mailed (or otherwise furnished) to the successful Bidder shall be deemed to result in a binding contract without further action by either party.

### 7. Down Payment (1/11)

The Bidder to whom award is made must make a down payment within 21 days of the sale award. The amount of the down payment will be calculated as shown in the Bond and Payment Schedule of this prospectus. Only cash may be used to meet this requirement.

### 8. Performance Security (1/11)

As guarantee of faithful performance, a cash bond, certificate of deposit, surety bond or irrevocable letter of credit (LOC) is required within 21 days of the sale award. The amount of the performance security is shown in the Bond and

Payment Schedule of this prospectus. If an LOC or surety is used, the coverage must extend for at least 6 months beyond the contract expiration.

#### 9. Timber Sale Contract (7/18)

Additional conditions and requirements common to all timber sales are listed on the timber sale contract (R4031) and are available on line at [www.michigan.gov/timber](http://www.michigan.gov/timber). Contact the Unit Manager for additional information or a sample contract. Within 21 days of the date of the award letter, the bidder must sign the contract and provide the required down payment, performance security, and verification of worker's disability compensation. The down payment and performance security shall be in accordance with the provisions of the timber sale contract, in the sums stated in this prospectus. If these actions are not taken, then the Bidder, the Bidder's corporation, and the corporation's principals may not be permitted to bid on State timber sales for a period of 3 months after the first offense, 6 months after the second offense, and 1 year after the third offense. An offense will only be counted against the Bidder for 5 years. In addition, the Bidder certifies that if awarded this contract, the Bidder will complete the timber sale contract in accordance with its terms and any modifications thereof including requirements to purchase, cut, and remove the included timber by the expiration date.

Payment Unit values in the State Forest Timber Sale Contract are calculated based on the advertised value of the Payment Unit as a percentage of the total advertised value of the contract. The advertised value of each Payment Unit is given in the Description of Timber by Payment Unit table on the Timber Sale Information page. For example, if the value of Payment Unit 1 is advertised as \$1,500 and the total Timber Sale value is advertised as \$10,000, the contract price for Payment Unit 1 will be 15% of the total bid price ( $\$1,500/\$10,000 * 100$ ).

#### 10. Disclaimer of Estimates and Bidder's Warranty of Inspection (7/16)

Before submitting this bid, the Bidder is advised and cautioned to inspect the sale area, review the requirements of the sale contract, and take other steps as may be reasonably necessary to ascertain the location, estimated volumes, construction estimates, and operating costs of the proposed sale. Failure to do so will not relieve the Bidder from responsibility for completing the contract.

The Bidder warrants that this bid is submitted solely on the basis of the Bidder's examination and inspection of the quality and quantity of the timber offered for sale and the Bidder's opinion of the value thereof and the costs of recovery. No reliance should be placed on the State of Michigan's estimates of timber quality, quantity or costs of recovery. Bidder further acknowledges that the State of Michigan: (i) expressly disclaims any warranty of fitness of timber for any purpose; (ii) offers this timber as is without any warranty of quality (merchantability) or quantity and (iii) expressly disclaims any warranty as to the quantity or quality of timber sold.

#### 11. Certification and Chain-of-Custody (10/14)

Unless otherwise indicated in the contract under section 7 – Other Conditions of the Sale Specific Conditions & Requirements, the area encompassed by this timber sale is certified to the standards of the Forest Stewardship Council (FSC) - Certificate #SCS-FM/COC-00090N and the Sustainable Forestry Initiative (SFI) - Certificate #NSF-SFIS-5Y031-SF5. Forest products from this sale may be delivered to the mill as "FSC 100% and / or SFI certified" as long as the contractor hauling the forest products is chain-of-custody (COC) certified or covered under a COC certificate from the destination mill. The purchaser is responsible for maintaining COC after leaving the sale area.

#### 12. Good Neighbor Authority (GNA) Requirements (7/16)

If the name of this timber sales contains the acronym GNA, it is authorized by the Good Neighbor Authority (GNA) and covered by various agreements between the U.S. Forest Service and the State. The timber sale occurs on federal land and the following conditions apply:

GNA contracts on US Forest Service land will not be awarded to purchasers on the Federal list of excluded parties. The System for Award Management (SAM) will be checked for active excluded parties prior to award of contract. In addition, the Bidder to whom award is made must complete an Assurance Regarding Felony Conviction or Tax Delinquent Status for Corporate Applicants (AD-3031).

#### 13. Good Neighbor Authority (GNA) Requirements, con't (9/16)

Bidder certifies, by signing this bid form, that to the best of Bidder's knowledge that the following representations are accurate and complete.

- a. That the Bidder and its principals are not presently debarred, suspended, proposed for debarment, declared ineligible, or voluntary excluded from timber sales (covered transactions) by any Federal department or agency.
- b. That the Bidder and its principals have not within a 3-year period preceding this bid been convicted of or had a civil judgment rendered against them for commission of fraud or a criminal offense in connection with obtaining, attempting to obtain, or performing a public (Federal, State, or local) transaction or contract under a public transaction; violation of Federal or State antitrust statutes or commission of embezzlement, theft, forgery, bribery, falsification or destruction of records, making false statements, or receiving stolen property.
- c. That the Bidder and its principals are not presently indicted for or otherwise criminally or civilly charged by a governmental entity (Federal, State, or local) with commission of any of the offenses enumerated in paragraph b of this certification.
- d. That the Bidder and its principals have not within a 3-year period preceding this bid had one or more public transactions (Federal, State, or local) terminated for breach or default of a timber or forest product contract.

Bidders that cannot certify this requirement, in whole or in part, shall submit an explanation with their bid.

DAN EICHINGER  
Director

**TIMBER SALE INFORMATION**

Karsty Mckarsterson Aspen/oak (54-011-18)

T33N, R02E, SEC. 14; T33N, R02E, SEC. 22; T33N, R02E, SEC. 23; T33N, R02E, SEC. 24.  
Presque Isle County (Advertised Price \$180,984.40)

SALE NOTE: A recreation site such as a trail, pathway, or campground is within the sale area or the vicinity. Certain restrictions/specifications may be applicable including time restrictions.

A timber sale contract for this lump sum, sealed bid timber sale will be awarded to the responsible bidder offering the highest sealed bid price. Bids must be at or above the following advertised price for each species:

<u>PRODUCTS &amp; SPECIES</u>	<u>ESTIMATED UNITS*</u>	<u>ADVERTISED PRICE</u>
<b>Sawtimber</b>		
BI/R/Hybrid Oak	52.80 MBF	\$ 104.00 / MBF
Red Oak	147.50 MBF	\$ 180.00 / MBF
Red Pine	7.40 MBF	\$ 122.00 / MBF
White Oak	10.60 MBF	\$ 73.00 / MBF
<b>Pulpwood</b>		
BI/R/Hybrid Oak	827.00 Cords	\$ 20.35 / Cord
Jack Pine	304.00 Cords	\$ 25.80 / Cord
Mixed Aspen	3,319.00 Cords	\$ 27.00 / Cord
Mixed Hardwood	187.00 Cords	\$ 21.35 / Cord
Red Oak	1,106.00 Cords	\$ 20.35 / Cord
Red Pine	39.00 Cords	\$ 47.30 / Cord
White Oak	170.00 Cords	\$ 20.35 / Cord
White Pine	24.00 Cords	\$ 49.05 / Cord

\* The total volume is statistically estimated within plus (+) or minus (-) 8.48 percent. The estimated units are final and not subject to adjustment. Prospective bidders are urged to examine this timber and to make their own estimates of quantity and quality.

**BOND AND PAYMENT SCHEDULE:**

1. A bond in the amount of \$9,049.00 to insure faithful performance of the conditions of the contract will be deposited by the successful bidder within 21 days of the sale award.
2. Cutting in any sale or unit without the required advance payment would be considered a trespass.
3. Total payment must be paid in advance or according to the following schedule:
  - (a) Ten percent (10%) of the sale value must be paid within 21 days of the sale award.
  - (b) The 10% down payment will be credited towards the first unit cut.
  - (c) Payment for each of the following units must be made before cutting begins in that unit:
 

<u>PAYMENT UNIT NUMBER</u>	<u>PERCENT OF TOTAL SALE VALUE</u>
01	4.8%
02	17.7%
03	12.3%
04	19.7%
05	16.8%
06	7.3%
07	6.5%
08	9.3%
09	5.6%
4. If no cutting takes place, the 10% down payment will not be refunded.
5. Operations on the contract issued will terminate on 06/30/2021.

**Description of Timber by Payment Unit (PU)**

PU	MARKET GROUP	PRODUCT	QUANTITY	UNIT	ACRES	ADVERTISE PRICE
1	BI/R/Hybrid Oak	Sawtimber	14.0	MBF	11.3	\$8,764.45
	<i>BI/R/Hybrid Oak</i>		14.0	<i>MBF</i>		
	Red Oak		6.5	MBF		
	White Oak		0.8	MBF		
	BI/R/Hybrid Oak	Pulpwood	181.0	Cords		
	<i>BI/R/Hybrid Oak</i>		181.0	<i>Cords</i>		
	Mixed Aspen		57.0	Cords		
	<i>B. T. Aspen</i>		57.0	<i>Cords</i>		
	Mixed Hardwood		3.0	Cords		
	<i>Red Maple</i>		3.0	<i>Cords</i>		
	Red Oak		22.0	Cords		
	White Oak		17.0	Cords		
2	BI/R/Hybrid Oak		Sawtimber	4.7	MBF	32.7
	<i>BI/R/Hybrid Oak</i>	3.5		<i>MBF</i>		
	<i>Northern Pin Oak</i>	1.2		<i>MBF</i>		
	Red Pine		2.5	MBF		
	White Oak		1.0	MBF		
	BI/R/Hybrid Oak	Pulpwood	127.0	Cords		
	<i>BI/R/Hybrid Oak</i>		117.0	<i>Cords</i>		
	<i>Northern Pin Oak</i>		10.0	<i>Cords</i>		
	Jack Pine		14.0	Cords		
	<i>Jack Pine</i>		14.0	<i>Cords</i>		
	Mixed Aspen		978.0	Cords		
	<i>B. T. Aspen</i>		978.0	<i>Cords</i>		
	Mixed Hardwood		12.0	Cords		
	<i>Red Maple</i>		12.0	<i>Cords</i>		
	Red Pine		19.0	Cords		
	White Oak		23.0	Cords		
White Pine	4.0		Cords			
3	BI/R/Hybrid Oak		Sawtimber	3.3	MBF	22.7
	<i>BI/R/Hybrid Oak</i>	2.5		<i>MBF</i>		
	<i>Northern Pin Oak</i>	0.8		<i>MBF</i>		
	Red Pine		1.7	MBF		
	White Oak		0.7	MBF		
	BI/R/Hybrid Oak	Pulpwood	89.0	Cords		
	<i>BI/R/Hybrid Oak</i>		82.0	<i>Cords</i>		
	<i>Northern Pin Oak</i>		7.0	<i>Cords</i>		
	Jack Pine		10.0	Cords		
	<i>Jack Pine</i>		10.0	<i>Cords</i>		
	Mixed Aspen		679.0	Cords		
	<i>B. T. Aspen</i>		679.0	<i>Cords</i>		
	Mixed Hardwood		9.0	Cords		
	<i>Red Maple</i>		9.0	<i>Cords</i>		
	Red Pine		14.0	Cords		
	White Oak		16.0	Cords		
White Pine	3.0		Cords			
4	Red Oak		Sawtimber	62.4	MBF	32.3
	White Oak		3.4	MBF		
	Jack Pine	Pulpwood	4.0	Cords		
	<i>Jack Pine</i>		4.0	<i>Cords</i>		
	Mixed Aspen		462.0	Cords		
	<i>B. T. Aspen</i>		462.0	<i>Cords</i>		
	Mixed Hardwood		24.0	Cords		
	<i>Red Maple</i>		24.0	<i>Cords</i>		
	Red Oak		483.0	Cords		
Red Pine	2.0	Cords				

Description of Timber by Payment Unit (PU), con't

PU	MARKET GROUP	PRODUCT	QUANTITY	UNIT	ACRES	ADVERTISE PRICE		
4 con't	White Oak	Pulpwood	51.0	Cords				
	White Pine		2.0	Cords				
5	Red Oak	Sawtimber	53.2	MBF	27.5	\$30,353.15		
	White Oak		2.9	MBF				
	Jack Pine		Pulpwood	4.0			Cords	
	<i>Jack Pine</i>			4.0			<i>Cords</i>	
	Mixed Aspen			393.0			Cords	
	<i>B. T. Aspen</i>			393.0			<i>Cords</i>	
	Mixed Hardwood			21.0			Cords	
	<i>Red Maple</i>			21.0			<i>Cords</i>	
	Red Oak			412.0			Cords	
	Red Pine			2.0			Cords	
	White Oak			43.0			Cords	
White Pine	1.0	Cords						
6	Red Oak	Sawtimber	25.4	MBF	17.2	\$13,138.40		
	White Oak		0.9	MBF				
	Jack Pine		Pulpwood	28.0			Cords	
	<i>Jack Pine</i>			28.0			<i>Cords</i>	
	Mixed Aspen			126.0			Cords	
	<i>B. T. Aspen</i>			126.0			<i>Cords</i>	
	Red Oak			189.0			Cords	
	White Oak			14.0			Cords	
	White Pine			5.0			Cords	
7	Bl/R/Hybrid Oak	Sawtimber		16.6	MBF	13.1	\$11,710.30	
	<i>Bl/R/Hybrid Oak</i>		16.3	<i>MBF</i>				
	<i>Northern Pin Oak</i>		0.3	<i>MBF</i>				
	White Oak		0.9	MBF				
	Bl/R/Hybrid Oak		Pulpwood	79.0	Cords			
	<i>Bl/R/Hybrid Oak</i>			77.0	<i>Cords</i>			
	<i>Northern Pin Oak</i>			2.0	<i>Cords</i>			
	Jack Pine			5.0	Cords			
	<i>Jack Pine</i>			<i>Sawtimber</i>	0.3			<i>MBF</i>
	<i>Jack Pine</i>			<i>Pulpwood</i>	4.0			<i>Cords</i>
	Mixed Aspen			277.0	Cords			
	<i>B. T. Aspen</i>			<i>Sawtimber</i>	10.3			<i>MBF</i>
	<i>B. T. Aspen</i>			<i>Pulpwood</i>	256.0			<i>Cords</i>
	Mixed Hardwood			31.0	Cords			
	<i>Red Maple</i>			31.0	<i>Cords</i>			
White Oak	2.0	Cords						
8	Bl/R/Hybrid Oak	Pulpwood		238.0	Cords	33.4	\$16,861.15	
	<i>Bl/R/Hybrid Oak</i>			238.0	<i>Cords</i>			
	Jack Pine		231.0	Cords				
	<i>Jack Pine</i>		231.0	<i>Cords</i>				
	Mixed Aspen		222.0	Cords				
	<i>B. T. Aspen</i>		218.0	<i>Cords</i>				
	<i>Quaking Aspen</i>		4.0	<i>Cords</i>				
	Mixed Hardwood		3.0	Cords				
	<i>Sugar Maple</i>		3.0	<i>Cords</i>				
9	Bl/R/Hybrid Oak	Sawtimber	14.2	MBF	17.1	\$10,159.00		
	<i>Bl/R/Hybrid Oak</i>		14.2	<i>MBF</i>				
	Red Pine		3.2	MBF				
	Bl/R/Hybrid Oak		Pulpwood	113.0			Cords	
	<i>Bl/R/Hybrid Oak</i>			113.0			<i>Cords</i>	
	Jack Pine			8.0			Cords	
	<i>Jack Pine</i>			8.0			<i>Cords</i>	
Mixed Aspen	125.0	Cords						

**Description of Timber by Payment Unit (PU), con't**

PU	MARKET GROUP	PRODUCT	QUANTITY	UNIT	ACRES	ADVERTISE PRICE
9 con't	<i>B. T. Aspen</i>	<i>Pulpwood</i>	125.0	<i>Cords</i>		
	Mixed Hardwood		84.0	Cords		
	<i>Red Maple</i>	<i>Sawtimber</i>	0.9	<i>MBF</i>		
	<i>Red Maple</i>	<i>Pulpwood</i>	82.0	<i>Cords</i>		
	Red Pine		2.0	Cords		
	White Oak		4.0	Cords		
	White Pine		9.0	Cords		
TOTAL:			218.3	MBF		
TOTAL:			5,976.0	Cords		



## Sale Specific Conditions & Requirements

**Sale Name: Karsty Mckarsterson Aspen/oak**

**Sale Number: 54-011-18 Seq#: 1**

### 1 - Sale Area

#### 1.2 - Boundaries

##### 1.2.1 - Painted boundaries (1/14)

The sale boundary and Payment Unit boundaries are marked and identified by blue, red and yellow paint. Exterior sale boundary lines against private property are marked with blue paint. Exterior sale boundary lines against state are marked with red paint. Interior Payment Unit boundaries are marked with yellow paint. The painted boundary line trees are not Included Timber and are to be protected. Yellow painted trees designating an interior Payment Unit boundary are only to be cut when all surrounding Payment Units have been paid.

### 2 - Timber Specifications

#### 2.1 - Included Timber

##### 2.1.1 - Clearcut unit(s) with unmerchantable trees (6/14)

Within Payment Unit(s) 1-9, cut all trees that are two (2) inches or more at DBH.

##### 2.1.15 - Hazard trees near roads (7/13)

Cut and remove all standing dead trees within 100 feet of the cleared portion of Shoepac Lake Road and Tomahawk Lake Road. These trees may be utilized or must be scattered back into the sale area.

### 3 - Payments

#### 3.3 - Pre-measured Sales

##### 3.3.4 - Dividing payment units (7/14)

Payment Unit(s) may be divided at the request of the Purchaser and upon approval of the Unit Manager. Dividing Payment Units is a contract modification which requires a Timber Sale Contract Supplement. There will be only one division per Payment Unit.

### 4 - Transportation

#### 4.1 - Construction

##### 4.1.3 - Slash and earthen piles (8/04)

Piles or windrows of earth along roads and landings that have been widened or constructed shall be leveled. Slash from road maintenance or construction, including stumps, shall be dispersed throughout the sale.

##### 4.1.6 - Road construction (1/09)

Construction of new roads or improvements of existing roads shall be done in such a way as to minimize the environmental and visual impacts. Merchantable trees shall be cut and utilized unless otherwise directed. Non-merchantable trees shall be severed and laid flat on the ground. Slash shall be scattered, and not left in windrows and kept a minimum of 10 feet back from the road edge. Stumps shall be set upright, not left on edge, and be moved at least 10 feet away from the road edge. Disturbed soil shall be feathered into the woods and not left in berms or windrows.

#### 4.2 - Maintenance

##### 4.2.5 - Two wheel drive condition (2/04)

All existing trail roads on and adjacent to the sale area must be passable by two-wheel drive traffic for the duration of the sale.

### 5 - Operations

#### 5.1 - Notification

##### 5.1.1 - Pre-sale conference (10/16)

A pre-sale conference on site between the Purchaser and sale administrator is required prior to beginning any operations to

determine landing and road locations. The Unit Manager or his/her representative must be contacted at least 10 days in advance to schedule the conference.

#### 5.1.4 - Post-sale conference (10/16)

A post-sale conference on site between the Purchaser and sale administrator is required 5 days prior to the completion of active logging operations to determine clean-up and repair of landings, road edges, and the fulfillment of other contract specifications.

### 5.2 - Conduct of Operations

#### 5.2.1 - Slash

##### 5.2.1.8 - Slash height (12/08)

No slash or tree tops may exceed 24 inches in height. This applies to Payment Units 1 and 2.

#### 5.2.2 - Hazard Trees/Snags

##### 5.2.2.1 - Den trees (10/16)

Obvious hollow and/or den trees shall be protected and left standing unless they are a safety hazard.

#### 5.2.3 - Operating Restrictions

##### 5.2.3.1 - Operating restrictions (9/11)

Within Payment Unit(s) 1 and 2, unless changed by written agreement, cutting, skidding, and hauling are limited to the period of October 1 to April 15. This restriction is because of the close proximity to Shoepac campground.

##### 5.2.3.5 - Oak wilt restriction (1/18)

Within Payment Unit(s) 1 and 4 - 8, unless changed by written agreement, cutting, skidding, hauling within the sale and brushing of access roads to the sale are not permitted during the period of April 15 to July 15. Operations may be allowed if specific steps are taken to prevent damaging uncut oak during the high risk period. Those steps may include completing all road brushing before April 15th and clearing a tree-length buffer along uncut oak cover before April 15th. This is necessary to reduce the spread of oak wilt. For more information, contact the Unit Manager or his/her representative.

#### 5.2.4 - Dead and Down Creation

##### 5.2.4.4 - Dead and down creation, grouse (6/18)

To encourage grouse and other wildlife, in Payment Unit(s) 1-9, leave one, 12" diameter or larger log-length (8 foot minimum) piece on the ground for every 2 acres. These will be evenly scattered throughout the unit. This can be an unmerchantable piece or a full tree.

#### 5.2.32 - Decking/landing restoration (9/13)

All decking and landing areas must have the surface area restored to a condition equal to or better than before. This is to ensure the proper regeneration of the stand. Wood debris, chips and "cookies" from trimmings must be removed or scattered away from landing and loading areas and may not be windrowed on the edge.

#### 5.2.40 - Pathway protection (10/10)

The Sink Hole Trail is a hiking trail and is shown on the Timber Sale Map. Do not cut trees or damage posts with blue pathway markers. Maintain a 20-foot wide slash, debris, and rut free zone daily, using the pathway as the centerline. Do not run equipment down the pathway. Skidding across the trail may only occur in locations approved by the sale administrator.

### 5.4 - Soil Protection

#### 5.4.1 - Rutting restriction, general (7/16)

Operations are to cease immediately if equipment and weather conditions result in rutting of roads and/or skid trails which is 12 inches or greater in depth and 50 feet in length. The Unit Manager or his/her representative may restrict hauling and/or skidding if ruts exceed the specified depth. With the Unit Manager or his/her representative's approval, the Purchaser may return to the area when the risk of rutting has decreased.

### 5.8 - Protection of Endangered Species

#### 5.8.5 - Protection of raptor nests (3/13)

All trees with raptor nests will be protected if found during harvesting operations. Notification will be made to the Unit Manager or his/her representative who will notify the Wildlife Biologist so an on-site evaluation and recommendation can be made, if necessary.

## **6 - Safety and Fire Prevention**

### 6.2 - Signing

#### 6.2.1 - Road posting (9/09)

The Purchaser is responsible for posting and maintaining caution signs on Shoepac Lake Rd prior to beginning operations. The road must be posted 200 feet from the sale area to warn of logging activity and truck traffic. Signs must be removed when harvest operations are suspended or completed. The Purchaser will provide these signs.

#### 6.2.3 - Recreational trail posting (2/10)

The Purchaser is responsible for posting and maintaining caution signs on the Sink Hole Pathway prior to beginning operations. The trail must be posted 200 feet from the sale area to warn of logging activity and truck traffic at both ends of the trail. Signs must be removed when harvest operations are suspended or completed. The Purchaser will provide these signs.



# TIMBER SALE MAP

This information provided by authority of Part 525, 1994 PA 451, as amended.

Sale Number	Year
54-011	18

Forest Management Unit Atlanta	County Presque Isle	Mapped By R. Zimmerman	Date 7/31/2018	Page 1	of 2
Township 33N	Range 02E	Section(s) and Subdivision(s) Sec 14:S1/2SE Sec 22:NENW,NE Sec 23: Various Sec 24:Various	Scale 1:15,840		

Cover Type				Density			
A = Aspen	H = Hemlock	N = Marsh	U = Upland Brush	0 = Non Stocked	5 = Pole Timber Medium		
B = Paper Birch	J = Jack Pine	O = Oak	UM = Upland Mixed	1 = Seedling Sapling Poor	6 = Pole Timber Well		
C = Cedar	L = Lowland Brush	P = Lowland Poplar	V = Bog or Marsh	2 = Seedling Sapling Medium	7 = Saw Timber Poor		
D = Treed Bog	LM = Lowland Mixed	Q = Mixed Swamp Conifer	W = White Pine	3 = Seedling Sapling Well	8 = Saw Timber Medium		
E = Swamp Hdwoods	M = Mpl, Bch, Brch	R = Red Pine	X = Non Stocked	4 = Pole Timber Poor	9 = Saw Timber Well		
F = Spruce Fir	MC = Mixed Conifer	S = Black Spruce	Z = Water				
G = Grass	MD = Mixed Deciduous	T = Tamarack					

PU	Acres	PU	Acres
1	11.3	6	17.2
2	32.7	7	13.1
3	22.7	8	33.4
4	32.3	9	17.1
5	27.5		

## Karsty Mckarsterson Aspen/Oak

Compartment 123  
207.3 Acres

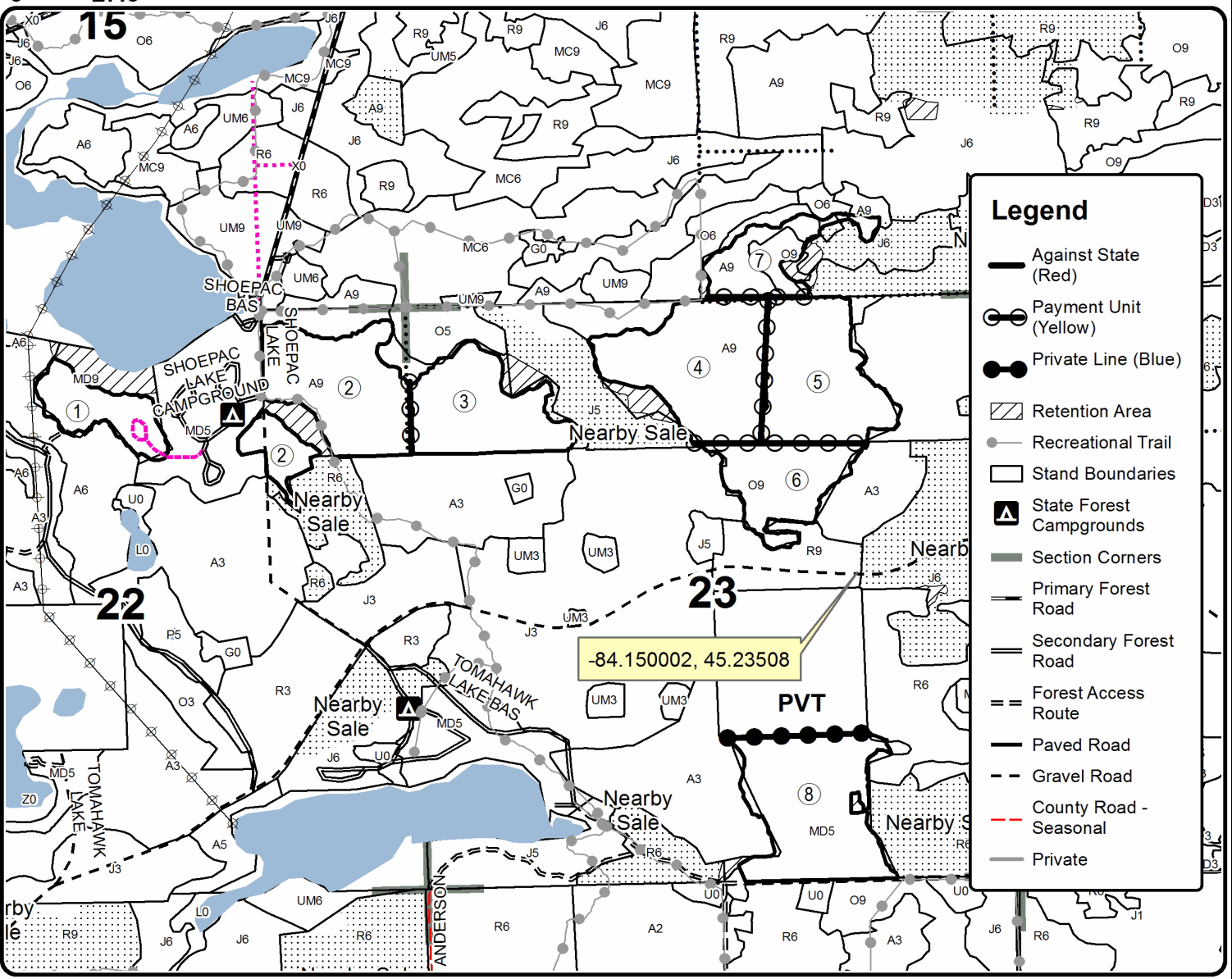



# TIMBER SALE MAP

This information provided by authority of Part 525, 1994 PA 451, as amended.

Sale Number	Year
54-011	18

Forest Management Unit Atlanta	County Presque Isle	Mapped By R. Zimmerman	Date 7/31/2018	Page 1	of 2
Township 33N	Range 02E	Section(s) and Subdivision(s) Sec 14:S1/2SE Sec 22:NENW,NE Sec 23: Various Sec 24:Varipus	Scale 1:15,840		

Cover Type				Density			
A = Aspen	H = Hemlock	N = Marsh	U = Upland Brush	0 = Non Stocked	5 = Pole Timber Medium		
B = Paper Birch	J = Jack Pine	O = Oak	UM = Upland Mixed	1 = Seedling Sapling Poor	6 = Pole Timber Well		
C = Cedar	L = Lowland Brush	P = Lowland Poplar	V = Bog or Marsh	2 = Seedling Sapling Medium	7 = Saw Timber Poor		
D = Treed Bog	LM = Lowland Mixed	Q = Mixed Swamp Conifer	W = White Pine	3 = Seedling Sapling Well	8 = Saw Timber Medium		
E = Swamp Hdwoods	M = Mpl, Bch, Brch	R = Red Pine	X = Non Stocked	4 = Pole Timber Poor	9 = Saw Timber Well		
F = Spruce Fir	MC = Mixed Conifer	S = Black Spruce	Z = Water				
G = Grass	MD = Mixed Deciduous	T = Tamarack					

PU	Acres	PU	Acres
1	11.3	6	17.2
2	32.7	7	13.1
3	22.7	8	33.4
4	32.3	9	17.1
5	27.5		

## Karsty Mckarsterson Aspen/Oak

Compartment 123  
207.3 Acres

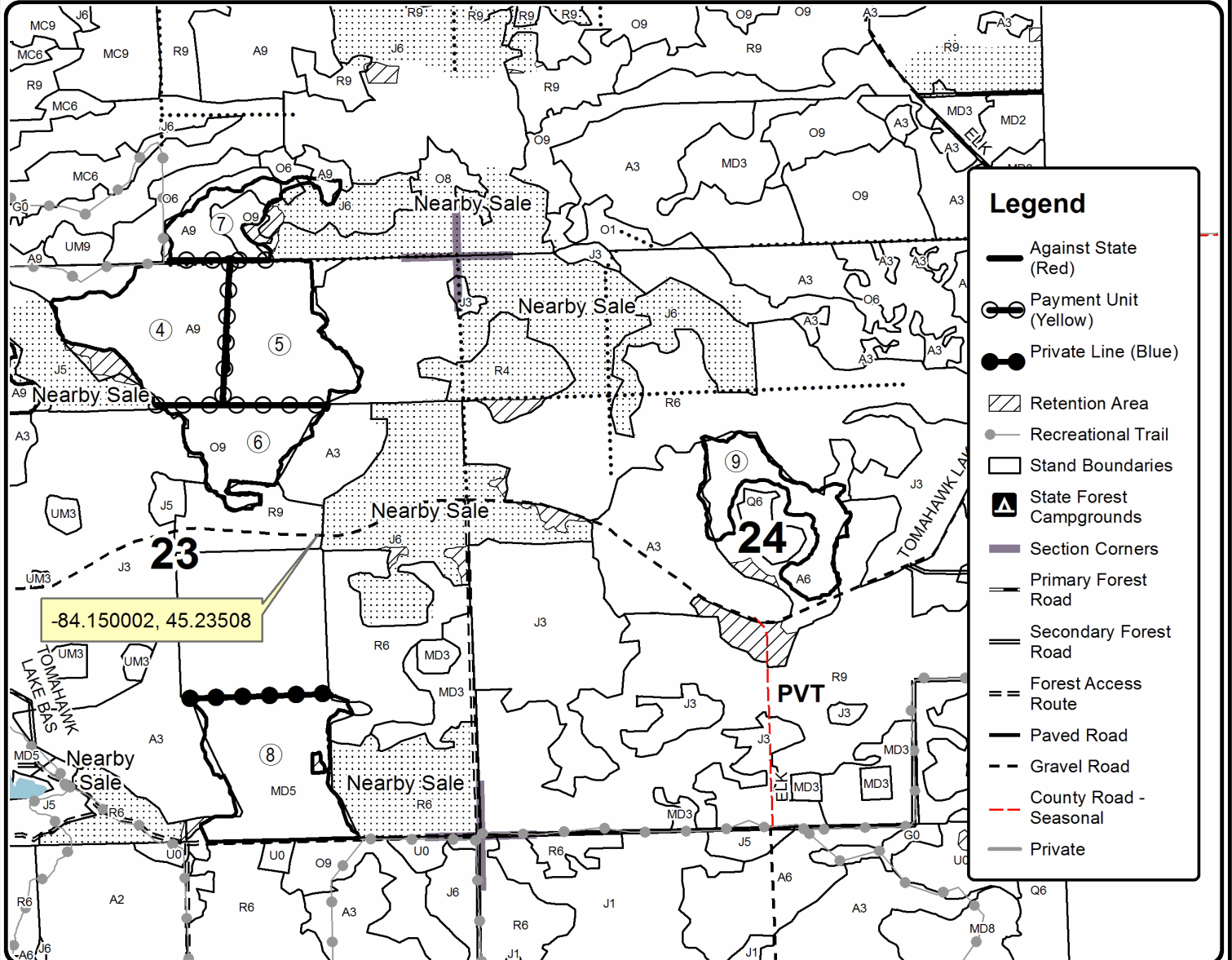
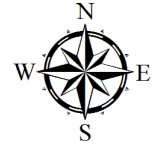

### Legend

- Against State (Red)
- Payment Unit (Yellow)
- Private Line (Blue)
- ▨ Retention Area
- Recreational Trail
- Stand Boundaries
- ▲ State Forest Campgrounds
- Section Corners
- Primary Forest Road
- Secondary Forest Road
- == Forest Access Route
- Paved Road
- - Gravel Road
- - County Road - Seasonal
- Private

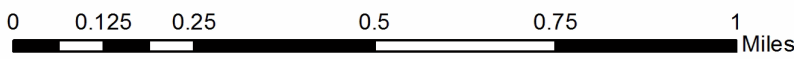



**TIMBER SALE INFORMATION**

Looney Tunes Aspen (54-015-18)  
 T33N, R02E, SEC. 14; T33N, R02E, SEC. 15.  
 Presque Isle County (Advertised Price \$9,195.75)

A timber sale contract for this lump sum, sealed bid timber sale will be awarded to the responsible bidder offering the highest sealed bid price. Bids must be at or above the following advertised price for each species:

<u>PRODUCTS &amp; SPECIES</u>	<u>ESTIMATED UNITS*</u>	<u>ADVERTISED PRICE</u>
Sawtimber		
B. T. Aspen	16.80 MBF	\$ 96.00 / MBF
Red Oak	2.00 MBF	\$ 180.00 / MBF
Pulpwood		
B. T. Aspen	186.00 Cords	\$ 27.00 / Cord
Jack Pine	3.00 Cords	\$ 25.80 / Cord
Mixed Oak	23.00 Cords	\$ 20.35 / Cord
Red Pine	35.00 Cords	\$ 47.30 / Cord

\* The total volume is statistically estimated within plus (+) or minus (-) 28.52 percent. The estimated units are final and not subject to adjustment. Prospective bidders are urged to examine this timber and to make their own estimates of quantity and quality.

**BOND AND PAYMENT SCHEDULE:**

- A bond in the amount of \$460.00 to insure faithful performance of the conditions of the contract will be deposited by the successful bidder within 21 days of the sale award.
- Cutting in any sale or unit without the required advance payment would be considered a trespass.
- Total payment must be paid in advance or according to the following schedule:
  - Ten percent (10%) of the sale value must be paid within 21 days of the sale award.
  - The 10% down payment will be credited towards the first unit cut.
  - Payment for each of the following units must be made before cutting begins in that unit:
 

PAYMENT UNIT NUMBER	PERCENT OF TOTAL SALE VALUE
01	63.0%
02	37.0%
- If no cutting takes place, the 10% down payment will not be refunded.
- Operations on the contract issued will terminate on 12/31/2021.

**Description of Timber by Payment Unit (PU)**

PU	MARKET GROUP	PRODUCT	QUANTITY	UNIT	ACRES	ADVERTISE PRICE
1	B. T. Aspen	Sawtimber	5.6	MBF	5.5	\$5,792.05
	Red Oak		2.0	MBF		
	B. T. Aspen	Pulpwood	112.0	Cords		
	Jack Pine		2.0	Cords		
	Mixed Oak		15.0	Cords		
	<i>Northern Pin Oak</i>		7.0	<i>Cords</i>		
	<i>Red Oak</i>		8.0	<i>Cords</i>		
	Red Pine		32.0	Cords		
	<i>Red Pine</i>	<i>Sawtimber</i>	2.1	<i>MBF</i>		
	<i>Red Pine</i>	<i>Pulpwood</i>	28.0	<i>Cords</i>		
2	B. T. Aspen	Sawtimber	11.2	MBF	4.7	\$3,403.70
	B. T. Aspen	Pulpwood	74.0	Cords		
	Jack Pine		1.0	Cords		
	Mixed Oak		8.0	Cords		
	<i>Northern Pin Oak</i>		8.0	<i>Cords</i>		
	Red Pine		3.0	Cords		
	<i>Red Pine</i>		3.0	<i>Cords</i>		
	TOTAL:			18.8		
TOTAL:			247.0	Cords		

## Sale Specific Conditions & Requirements

**Sale Name: Looney Tunes Aspen**

**Sale Number: 54-015-18 Seq#: 1**

### 1 - Sale Area

#### 1.2 - Boundaries

##### 1.2.1 - Painted boundaries (1/14)

The sale boundary and Payment Unit boundaries are marked and identified by blue and red paint, along with a road. Exterior sale boundary lines against private property are marked with blue paint. Exterior sale boundary lines against state are marked with red paint, with the exception of the southern boundary of Payment Unit 1, which is unpainted and identified by County Highway 634. The painted boundary line trees are not Included Timber and are to be protected.

### 2 - Timber Specifications

#### 2.1 - Included Timber

##### 2.1.1 - Clearcut unit(s) with unmerchantable trees (6/14)

Within Payment Unit(s) 1 & 2, cut all trees that are two (2) inches or more at DBH, except do not cut green painted trees. Green painted trees are special protection trees identified in accordance with condition 3.4.2, and are not Included Timber and are to be protected.

##### 2.1.15 - Hazard trees near roads (7/13)

Cut and remove all standing dead trees within 66 feet of the cleared portion of county roads. These trees must be scattered back into the sale area.

#### 2.2 - Utilization

##### 2.2.6 - Roundwood operation required (5/07)

The skidding of whole trees or tree segments with limbs attached is prohibited within Payment Unit 2. All products must be produced as roundwood and forwarded to existing roads or landing areas in final product length.

### 3 - Payments

#### 3.4 - Damaged Timber

##### 3.4.2 - Special Protection Trees (4/14)

The Purchaser shall not cut live or dead special protection trees within cutting units or clearings. Special protection trees are marked with green paint. If the Purchaser's operations have cut or damaged special protection trees through carelessness, the Purchaser shall pay \$250 as fixed, agreed and liquidated damages for each special protection tree cut or damaged. Such payment does not constitute ownership of the undesignated timber.

### 4 - Transportation

#### 4.1 - Construction

##### 4.1.3 - Slash and earthen piles (8/04)

Piles or windrows of earth along roads and landings that have been widened or constructed shall be leveled. Slash from road maintenance or construction, including stumps, shall be dispersed throughout the sale.

##### 4.1.4 - Timber removed for construction (12/09)

Trees cut or damaged in the process of pre-approved road, landing or skid trail construction will be decked in an area separate from other Designated Timber and not removed until measured by the sale administrator. Payment will be made at the specified Purchase Unit Price. If products cut in the process of road or landing construction are not identified in the contract, then payment will be made at the average unit price.

##### 4.1.6 - Road construction (1/09)

Construction of new roads or improvements of existing roads shall be done in such a way as to minimize the environmental and visual impacts. Merchantable trees shall be cut and utilized unless otherwise directed. Non-merchantable trees shall be severed and laid flat on the ground. Slash shall be scattered, and not left in windrows and kept a minimum of 10 feet back from the road edge. Stumps shall be set upright, not left on edge, and be moved at least 10 feet away from the road edge.



Disturbed soil shall be feathered into the woods and not left in berms or windrows.

#### 4.1.7 - Road closure (10/11)

All new roads built into the sale must be blocked to vehicle traffic upon completion of the sale. All new roads built into the sale must be blocked to vehicle traffic within 30 days of completion of hauling. In general, this will require constructing a four (4') foot high berm of stumps and logs covered with earth. All stumps from road building and landing construction must be reserved to block any newly constructed roads upon completion of the sale. These stumps must be scattered along the road system to prohibit vehicular movement. Contact the sale administrator for specific details of design and placement.

### 4.2 - Maintenance

#### 4.2.2 - Fill material (4/07)

To maintain roads, fill material may be needed in areas where "holes" exist or may be expected to develop. This fill material should be placed before trucking begins. This fill material shall not contain clay or organic material and must be approved by the Unit Manager or his/her representative.

#### 4.2.5 - Two wheel drive condition (2/04)

All existing trail roads on and adjacent to the sale area must be passable by two-wheel drive traffic for the duration of the sale.

## 5 - Operations

### 5.1 - Notification

#### 5.1.1 - Pre-sale conference (10/16)

A pre-sale conference between the Purchaser and sale administrator is required prior to beginning any operations to determine landing and road locations. The Unit Manager or his/her representative must be contacted at least 10 days in advance to schedule the conference.

#### 5.1.4 - Post-sale conference (10/16)

A post-sale conference on site between the Purchaser and sale administrator is required 5 days prior to the completion of active logging operations to determine clean-up and repair of landings, road edges, and the fulfillment of other contract specifications.

#### 5.1.6 - Utility R.O.W. (1/15)

It is the responsibility of the Purchaser to obtain permission from the utility company to utilize the power line R.O.W. for operations. Contact Shell Pipeline Corporation, LP and Presque Isle Electric and Gas Cooperative.

### 5.2 - Conduct of Operations

#### 5.2.2 - Hazard Trees/Snags

##### 5.2.2.1 - Den trees (10/16)

Obvious hollow and/or den trees shall be protected and left standing unless they are a safety hazard.

#### 5.2.3 - Operating Restrictions

##### 5.2.3.4 - Oak wilt restriction, no exceptions (1/18)

Within Payment Unit 1, cutting, skidding, hauling within the sale and brushing of access roads to the sale are not permitted during the period of April 15 to July 15. No exceptions will be granted. This is necessary to reduce the spread of oak wilt.

##### 5.2.3.11 - Coppice regeneration protection (4/10)

Any post harvest operations, such as chipping, skidding/forwarding and processing, must be completed either before deciduous sprouting occurs or within 30 calendar days of severing/cutting stem(s). If it is anticipated that these practices will be delayed, then merchantable material shall be carried to one central location or left forfeit within the Payment Unit. The Unit Manager or his/her representative may cease such operations if sprouting occurs before the operation is complete. Liquidated damages will be assessed according to specification 3.4.1 if the purchaser reenters the Payment Unit to retrieve merchantable material after sprouting begins.

#### 5.2.4 - Dead and Down Creation

#### 5.2.4.4 - Dead and down creation, grouse (6/18)

To encourage grouse and other wildlife, in Payment Unit(s) 1 & 2, leave one, 12" diameter or larger log-length (8 foot minimum) piece on the ground for every 2 acres. These will be evenly scattered throughout the unit.

#### 5.2.32 - Decking/landing restoration (9/13)

All decking and landing areas must have the surface area restored to a condition equal to or better than before. This is to ensure the proper regeneration of the stand. Wood debris, chips and "cookies" from trimmings must be removed or scattered away from landing and loading areas and may not be windrowed on the edge.

#### 5.2.38 - No decking against live trees (2/04)

Cut products may not be decked against unmarked or designated leave trees.

### 5.4 - Soil Protection

#### 5.4.1 - Rutting restriction, general (7/16)

Operations are to cease immediately if equipment and weather conditions result in rutting of roads and/or skid trails which is 12 inches or greater in depth and 50 feet in length. The Unit Manager or his/her representative may restrict hauling and/or skidding if ruts exceed the specified depth. With the Unit Manager or his/her representative's approval, the Purchaser may return to the area when the risk of rutting has decreased.

### 5.8 - Protection of Endangered Species

#### 5.8.5 - Protection of raptor nests (3/13)

All trees with raptor nests will be protected if found during harvesting operations. Notification will be made to the Unit Manager or his/her representative who will notify the Wildlife Biologist so an on-site evaluation and recommendation can be made, if necessary.

#### 5.8.8 - Protected species, other (2/12)

Within Payment Unit(s) 1, the harvesting time period may be altered if a loon occupies Loon Lake during the critical nesting period of April 15 to August 15. This restriction is because of potential loon habitat. If a loon nest is present or suspected, notification will be made to the Unit Manager or his/her representative who will notify the Wildlife Biologist so an on-site evaluation and recommendation can be made, if necessary.



# TIMBER SALE MAP

This information provided by authority of Part 525, 1994 PA 451, as amended.

Sale Number	Year
54 - 015	18

Forest Management Unit Atlanta Management Unit	County Presque Isle	Mapped By Natzke	Date 07/24/2018	Page 1	of 1
Township 33N	Range 02E	Section(s) and Subdivision(s) Sec: 14 NWSW; Sec 15: SENE, NESE	Cruised By Natzke	Scale 1:7,920	

Cover Type				Density			
A = Aspen	H = Hemlock	N = Marsh	U = Upland Brush	0 = Non Stocked	5 = Pole Timber Medium		
B = Paper Birch	J = Jack Pine	O = Oak	UM = Upland Mixed	1 = Seedling Sapling Poor	6 = Pole Timber Well		
C = Cedar	L = Lowland Brush	P = Lowland Poplar	V = Bog or Marsh	2 = Seedling Sapling Medium	7 = Saw Timber Poor		
D = Treed Bog	LM = Lowland Mixed	Q = Mixed Swamp Conifer	W = White Pine	3 = Seedling Sapling Well	8 = Saw Timber Medium		
E = Swamp Hdwoods	M = Mpl, Bch, Brch	R = Red Pine	X = Non Stocked	4 = Pole Timber Poor	9 = Saw Timber Well		
F = Spruce Fir	MC = Mixed Conifer	S = Black Spruce	Z = Water				
G = Grass	MD = Mixed Deciduous	T = Tamarack					

PU	Acres
1	5.5
2	4.7

## Looney Tunes Aspen Compartment 120 10.2 Acres

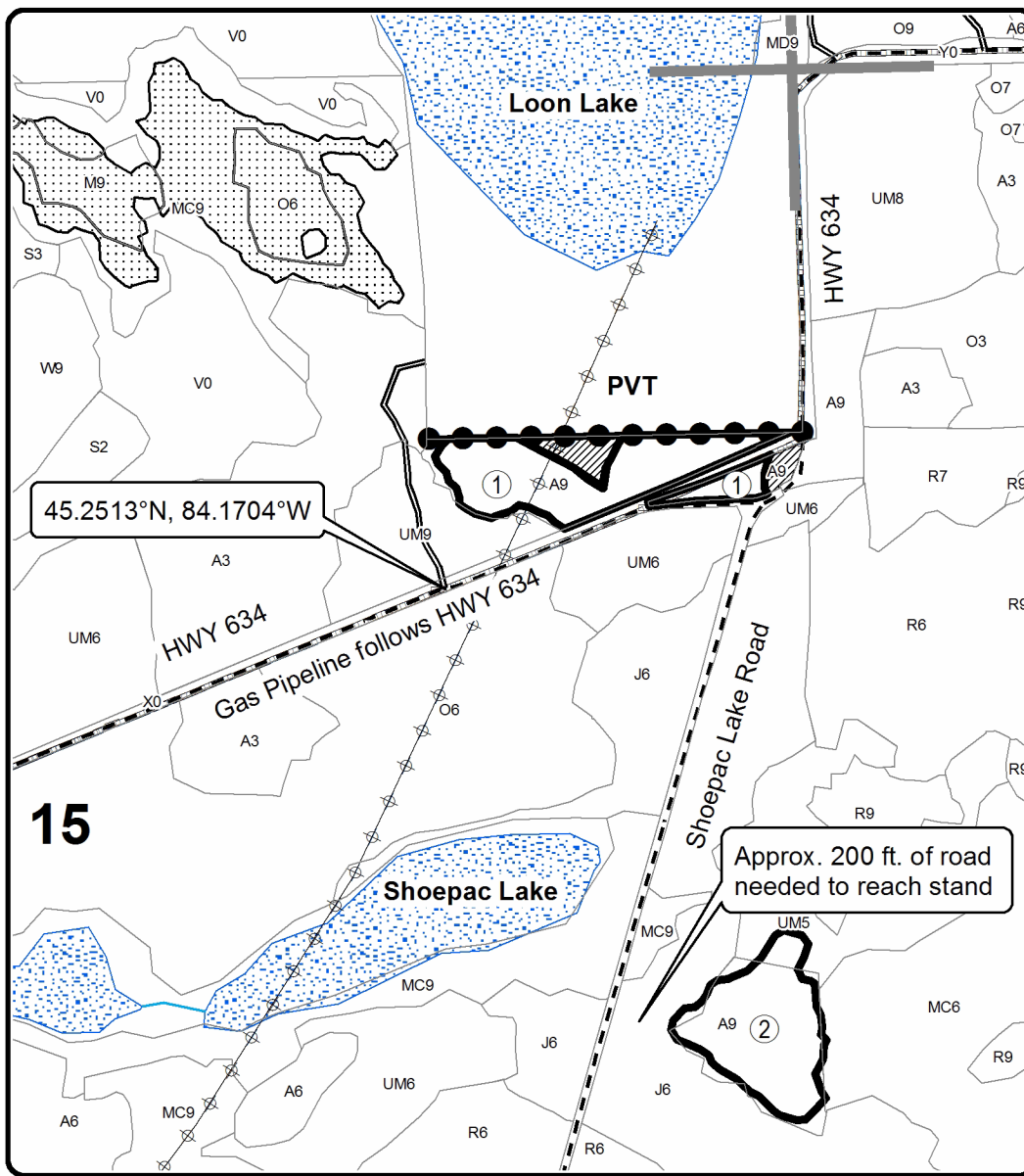

### Legend

- Against State (Red)
- Private Line (Blue)
- Nearby Timber Sales
- Payment Unit
- Retention Area
- Stand Boundaries
- Lakes
- Streams
- Poor Dirt Road
- Gravel Road
- Pipeline
- Powerline
- Section Corners

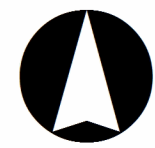

Locator Map  
1:100,000

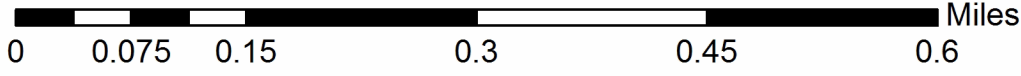
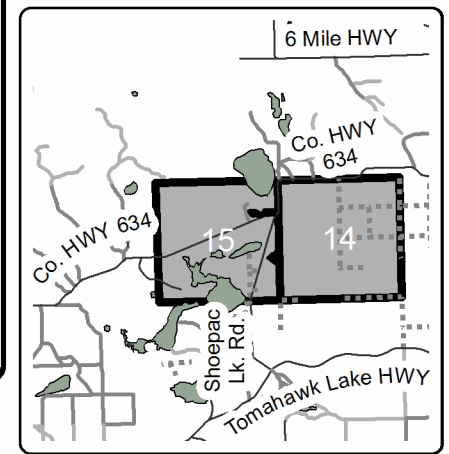



**TIMBER SALE INFORMATION**

Shoe Hawk Jack Pine (54-016-18)

T33N, R02E, SEC. 13; T33N, R02E, SEC. 14; T33N, R02E, SEC. 22; T33N, R02E, SEC. 23; T33N, R02E, SEC. 24.  
Presque Isle County (Advertised Price \$59,427.85)

SALE NOTE: A recreation site such as a trail, pathway, or campground is within the sale area or the vicinity. Certain restrictions/specifications may be applicable including time restrictions.

A timber sale contract for this lump sum, sealed bid timber sale will be awarded to the responsible bidder offering the highest sealed bid price. Bids must be at or above the following advertised price for each species:

<u>PRODUCTS &amp; SPECIES</u>	<u>ESTIMATED UNITS*</u>	<u>ADVERTISED PRICE</u>
Sawtimber		
Red Pine	29.40 MBF	\$ 122.00 / MBF
Pulpwood		
Jack Pine	1,920.00 Cords	\$ 25.80 / Cord
Mixed Aspen	25.00 Cords	\$ 27.00 / Cord
Mixed Hardwood	6.00 Cords	\$ 21.35 / Cord
Mixed Oak	126.00 Cords	\$ 20.35 / Cord
Red Pine	59.00 Cords	\$ 47.30 / Cord
White Pine	3.00 Cords	\$ 49.05 / Cord

\* The total volume is statistically estimated within plus (+) or minus (-) 12.10 percent. The estimated units are final and not subject to adjustment. Prospective bidders are urged to examine this timber and to make their own estimates of quantity and quality.

**BOND AND PAYMENT SCHEDULE:**

1. A bond in the amount of \$2,971.00 to insure faithful performance of the conditions of the contract will be deposited by the successful bidder within 21 days of the sale award.
2. Cutting in any sale or unit without the required advance payment would be considered a trespass.
3. Total payment must be paid in advance or according to the following schedule:
  - (a) Ten percent (10%) of the sale value must be paid within 21 days of the sale award.
  - (b) The 10% down payment will be credited towards the first unit cut.
  - (c) Payment for each of the following units must be made before cutting begins in that unit:

<u>PAYMENT UNIT NUMBER</u>	<u>PERCENT OF TOTAL SALE VALUE</u>
01	8.1%
02	10.1%
03	12.9%
04	24.8%
05	23.8%
06	8.2%
07	12.1%

4. If no cutting takes place, the 10% down payment will not be refunded.
5. Operations on the contract issued will terminate on 06/30/2021.

**Description of Timber by Payment Unit (PU)**

PU	MARKET GROUP	PRODUCT	QUANTITY	UNIT	ACRES	ADVERTISE PRICE			
1	Red Pine	Sawtimber	6.3	MBF	17.2	\$4,838.65			
	Jack Pine	Pulpwood	109.0	Cords					
	<i>Jack Pine</i>	<i>Sawtimber</i>	5.5	<i>MBF</i>					
	<i>Jack Pine</i>	<i>Pulpwood</i>	98.0	<i>Cords</i>					
	Mixed Aspen		12.0	Cords					
	<i>Quaking Aspen</i>		12.0	<i>Cords</i>					
	Mixed Hardwood		6.0	Cords					
	<i>Black Cherry</i>		1.0	<i>Cords</i>					
	<i>Red Maple</i>		5.0	<i>Cords</i>					
	Mixed Oak		21.0	Cords					
	<i>BI/R/Hybrid Oak</i>	<i>Sawtimber</i>	0.8	<i>MBF</i>					
	<i>Northern Pin Oak</i>		0.1	<i>MBF</i>					
	<i>BI/R/Hybrid Oak</i>	<i>Pulpwood</i>	17.0	<i>Cords</i>					
	<i>Northern Pin Oak</i>		2.0	<i>Cords</i>					
	Red Pine		8.0	Cords					
2	Red Pine	Sawtimber	7.7	MBF	21.0	\$6,022.85			
	Jack Pine	Pulpwood	159.0	Cords					
	<i>Jack Pine</i>	<i>Sawtimber</i>	9.3	<i>MBF</i>					
	<i>Balsam Fir</i>	<i>Pulpwood</i>	1.0	<i>Cords</i>					
	<i>Jack Pine</i>		139.0	<i>Cords</i>					
	Mixed Aspen		1.0	Cords					
	<i>Quaking Aspen</i>		1.0	<i>Cords</i>					
	Mixed Oak		19.0	Cords					
	<i>BI/R/Hybrid Oak</i>	<i>Sawtimber</i>	2.1	<i>MBF</i>					
	<i>Northern Pin Oak</i>		0.3	<i>MBF</i>					
	<i>BI/R/Hybrid Oak</i>	<i>Pulpwood</i>	11.0	<i>Cords</i>					
	<i>Northern Pin Oak</i>		3.0	<i>Cords</i>					
	Red Pine		12.0	Cords					
	3	Red Pine	Sawtimber	4.3			MBF	17.1	\$7,651.60
		Jack Pine	Pulpwood	207.0			Cords		
<i>Jack Pine</i>			207.0	<i>Cords</i>					
Mixed Oak			32.0	Cords					
<i>BI/R/Hybrid Oak</i>			32.0	<i>Cords</i>					
Red Pine			24.0	Cords					
4	Red Pine	Sawtimber	5.6	MBF	24.5	\$14,676.70			
	Jack Pine	Pulpwood	523.0	Cords					
	<i>Jack Pine</i>		523.0	<i>Cords</i>					
	Mixed Aspen		3.0	Cords					
	<i>B. T. Aspen</i>		3.0	<i>Cords</i>					
	Mixed Oak		2.0	Cords					
	<i>BI/R/Hybrid Oak</i>		2.0	<i>Cords</i>					
	Red Pine		8.0	Cords					
5	Red Pine	Sawtimber	5.5	MBF	23.7	\$14,158.25			
	Jack Pine	Pulpwood	506.0	Cords					
	<i>Jack Pine</i>		506.0	<i>Cords</i>					
	Mixed Aspen		3.0	Cords					
	<i>B. T. Aspen</i>		3.0	<i>Cords</i>					
	Mixed Oak		1.0	Cords					
	<i>BI/R/Hybrid Oak</i>		1.0	<i>Cords</i>					
	Red Pine		7.0	Cords					
6	Jack Pine	Pulpwood	183.0	Cords	12.0	\$4,868.55			
	<i>Jack Pine</i>		183.0	<i>Cords</i>					
	White Pine		3.0	Cords					
7	Jack Pine	Pulpwood	233.0	Cords	18.4	\$7,211.25			
	<i>Jack Pine</i>		233.0	<i>Cords</i>					
	Mixed Aspen		6.0	Cords					

**Description of Timber by Payment Unit (PU), con't**

PU	MARKET GROUP	PRODUCT	QUANTITY	UNIT	ACRES	ADVERTISE PRICE
	<i>B. T. Aspen</i>		6.0	<i>Cords</i>		
	Mixed Oak		51.0	Cords		
	<i>Bl/R/Hybrid Oak</i>		42.0	<i>Cords</i>		
	<i>White Oak</i>		9.0	<i>Cords</i>		
TOTAL:			29.4	MBF		
TOTAL:			2,139.0	Cords		

## Sale Specific Conditions & Requirements

**Sale Name: Shoe Hawk Jack Pine**

**Sale Number: 54-016-18 Seq#: 1**

### 1 - Sale Area

#### 1.2 - Boundaries

##### 1.2.1 - Painted boundaries (1/14)

The sale boundary and Payment Unit boundaries are marked and identified by red and yellow paint. Exterior sale boundary lines against state are marked with red paint. Interior Payment Unit boundaries are marked with yellow paint. The painted boundary line trees are not Included Timber and are to be protected. Yellow painted trees designating an interior Payment Unit boundary are only to be cut when all surrounding Payment Units have been paid.

### 2 - Timber Specifications

#### 2.1 - Included Timber

##### 2.1.1 - Clearcut unit(s) with unmerchantable trees (6/14)

Within Payment Unit(s) 1-7, cut all trees that are two (2) inches or more at DBH.

#### 2.2 - Utilization

##### 2.2.2 - Chipping required (2/18)

Payment Unit 6 must be chip harvested to facilitate subsequent planting operations. The Purchaser has the option to produce sawlogs or pulpwood bolts, but the remaining portion of the trees must be chipped and hauled within 60 days of severing stem(s). Products may be produced as roundwood and forwarded to decking areas in final product length, but the tops must be left intact and skidded to the landing for chipping in order to minimize the amount of residual slash. If the chipping deadline is not met/delayed, tops must be moved to a centralized location or damages will be determined and collected by the cost to complete the work. The requirement to retain approximately 1/6 to 1/3 of tree tops and limbs less than four inches in diameter is still applicable (G. C. & R. 2.2).

##### 2.2.3 - Stump heights (4/07)

Stump heights within Payment Unit 6 shall not exceed 6 inches for all trees. This is in order to facilitate planting operations.

##### 2.2.11 - Chipping restriction (9/14)

If chipping occurs on this sale, then no woody debris present on the ground at the start of the sale may be chipped. In addition, brush or chips may not be stored or stockpiled on-site for more than 30 days.

### 4 - Transportation

#### 4.1 - Construction

##### 4.1.3 - Slash and earthen piles (8/04)

Piles or windrows of earth along roads and landings that have been widened or constructed shall be leveled. Slash from road maintenance or construction, including stumps, shall be dispersed throughout the sale.

##### 4.1.6 - Road construction (1/09)

Construction of new roads or improvements of existing roads shall be done in such a way as to minimize the environmental and visual impacts. Merchantable trees shall be cut and utilized unless otherwise directed. Non-merchantable trees shall be severed and laid flat on the ground. Slash shall be scattered, and not left in windrows and kept a minimum of 10 feet back from the road edge. Stumps shall be set upright, not left on edge, and be moved at least 10 feet away from the road edge. Disturbed soil shall be feathered into the woods and not left in berms or windrows.

##### 4.1.7 - Road closure (10/11)

All new roads built into the sale must be blocked to vehicle traffic upon completion of the sale. Overgrown roads that are reopened shall be considered new roads. In general, this will require constructing a four (4') foot high berm of stumps and logs covered with earth. These roads must be rendered impassable to cars and trucks. All stumps from road building and landing construction must be reserved to block any newly constructed roads upon completion of the sale. These stumps must be scattered along the road system to prohibit vehicular movement. Temporary berms may be required if no sale activity occurs for 30 or more consecutive days.



## 5 - Operations

### 5.1 - Notification

#### 5.1.1 - Pre-sale conference (10/16)

A pre-sale conference on site between the Purchaser and sale administrator is required prior to beginning any operations to determine landing and road locations. The Unit Manager or his/her representative must be contacted at least 10 days in advance to schedule the conference.

#### 5.1.4 - Post-sale conference (10/16)

A post-sale conference on site between the Purchaser and sale administrator is required 5 days prior to the completion of active logging operations to determine clean-up and repair of landings, road edges, and the fulfillment of other contract specifications.

### 5.2 - Conduct of Operations

#### 5.2.1 - Slash

##### 5.2.1.8 - Slash height (12/08)

No slash or tree tops may exceed 36 inches in height. This applies to Payment Unit 6.

#### 5.2.2 - Hazard Trees/Snags

##### 5.2.2.1 - Den trees (10/16)

Obvious hollow and/or den trees shall be protected and left standing unless they are a safety hazard.

#### 5.2.3 - Operating Restrictions

##### 5.2.3.1 - Operating restrictions (9/11)

Within Payment Unit(s) 6, unless changed by written agreement, cutting, skidding, and hauling are limited to the period of November 1 to March 31. This restriction is because of the proximity of Tomahawk Lake Campground.

##### 5.2.3.5 - Oak wilt restriction (1/18)

Within Payment Unit(s) 1-3 and 7, unless changed by written agreement, cutting, skidding, hauling within the sale and brushing of access roads to the sale are not permitted during the period of April 15 to July 15. Operations may be allowed if specific steps are taken to prevent damaging uncut oak during the high risk period. Those steps may include completing all road brushing before April 15th and clearing a tree-length buffer along uncut oak cover before April 15th. This is necessary to reduce the spread of oak wilt. For more information, contact the Unit Manager or his/her representative.

#### 5.2.4 - Dead and Down Creation

##### 5.2.4.4 - Dead and down creation, grouse (6/18)

To encourage grouse and other wildlife, in Payment Unit(s) 2, leave one, 12" diameter or larger log-length (8 foot minimum) piece on the ground for every 2 acres. These will be evenly scattered throughout the unit. This can be an unmerchantable piece or a full tree.

#### 5.2.32 - Decking/landing restoration (9/13)

All decking and landing areas must have the surface area restored to a condition equal to or better than before. This is to ensure the proper regeneration of the stand. Wood debris, chips, and "cookies" from trimmings must be removed or scattered away from landing and loading areas and may not be windrowed on the edge.

### 5.4 - Soil Protection

#### 5.4.1 - Rutting restriction, general (7/16)

Operations are to cease immediately if equipment and weather conditions result in rutting of roads and/or skid trails which is 12 inches or greater in depth and 50 feet in length. The Unit Manager or his/her representative may restrict hauling and/or skidding if ruts exceed the specified depth. With the Unit Manager or his/her representative's approval, the Purchaser may return to the area when the risk of rutting has decreased.

### 5.8 - Protection of Endangered Species

#### 5.8.5 - Protection of raptor nests (3/13)

All trees with raptor nests will be protected if found during harvesting operations. Notification will be made to the Unit Manager or his/her representative who will notify the Wildlife Biologist so an on-site evaluation and recommendation can be made, if necessary.

### **6 - Safety and Fire Prevention**

#### 6.2 - Signing

##### 6.2.1 - Road posting (9/09)

The Purchaser is responsible for posting and maintaining caution signs on Tomahawk Lake Rd. prior to beginning operations. The road must be posted at appropriate distances from the sale area to warn of logging activity and truck traffic. Signs must be removed when harvest operations are suspended or completed. The Purchaser will provide these signs.



# TIMBER SALE MAP

This information provided by authority of Part 525, 1994 PA 451, as amended.

Forest Management Unit Atlanta	County Presque Isle	Mapped By Zimmerman, Natzke	Date 08/06/2018	Page 1	of 1
Township 33N	Range 02E	Section(s) and Subdivision(s) Sec 13: SWSW, Sec 14: S1/2SE, Sec22:E1/2SE, Sec23: Various, Sec24: NENW, S1/2NW	Scale 1:15,840		

Cover Type				Density			
A = Aspen	H = Hemlock	N = Marsh	U = Upland Brush	0 = Non Stocked	5 = Pole Timber Medium		
B = Paper Birch	J = Jack Pine	O = Oak	UM = Upland Mixed	1 = Seedling Sapling Poor	6 = Pole Timber Well		
C = Cedar	L = Lowland Brush	P = Lowland Poplar	V = Bog or Marsh	2 = Seedling Sapling Medium	7 = Saw Timber Poor		
D = Treed Bog	LM = Lowland Mixed	Q = Mixed Swamp Conifer	W = White Pine	3 = Seedling Sapling Well	8 = Saw Timber Medium		
E = Swamp Hdwoods	M = Mpl, Bch, Brch	R = Red Pine	X = Non Stocked	4 = Pole Timber Poor	9 = Saw Timber Well		
F = Spruce Fir	MC = Mixed Conifer	S = Black Spruce	Z = Water				
G = Grass	MD = Mixed Deciduous	T = Tamarack					

PU	Acres	PU	Acres
1	17.2	5	23.7
2	21.0	6	12.0
3	17.1	7	18.4
4	24.5		

## Shoe Hawk Jack Pine

### Compartment 120 & 123

### 133.9 Acres

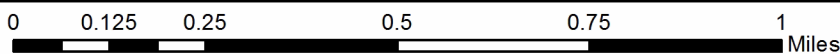
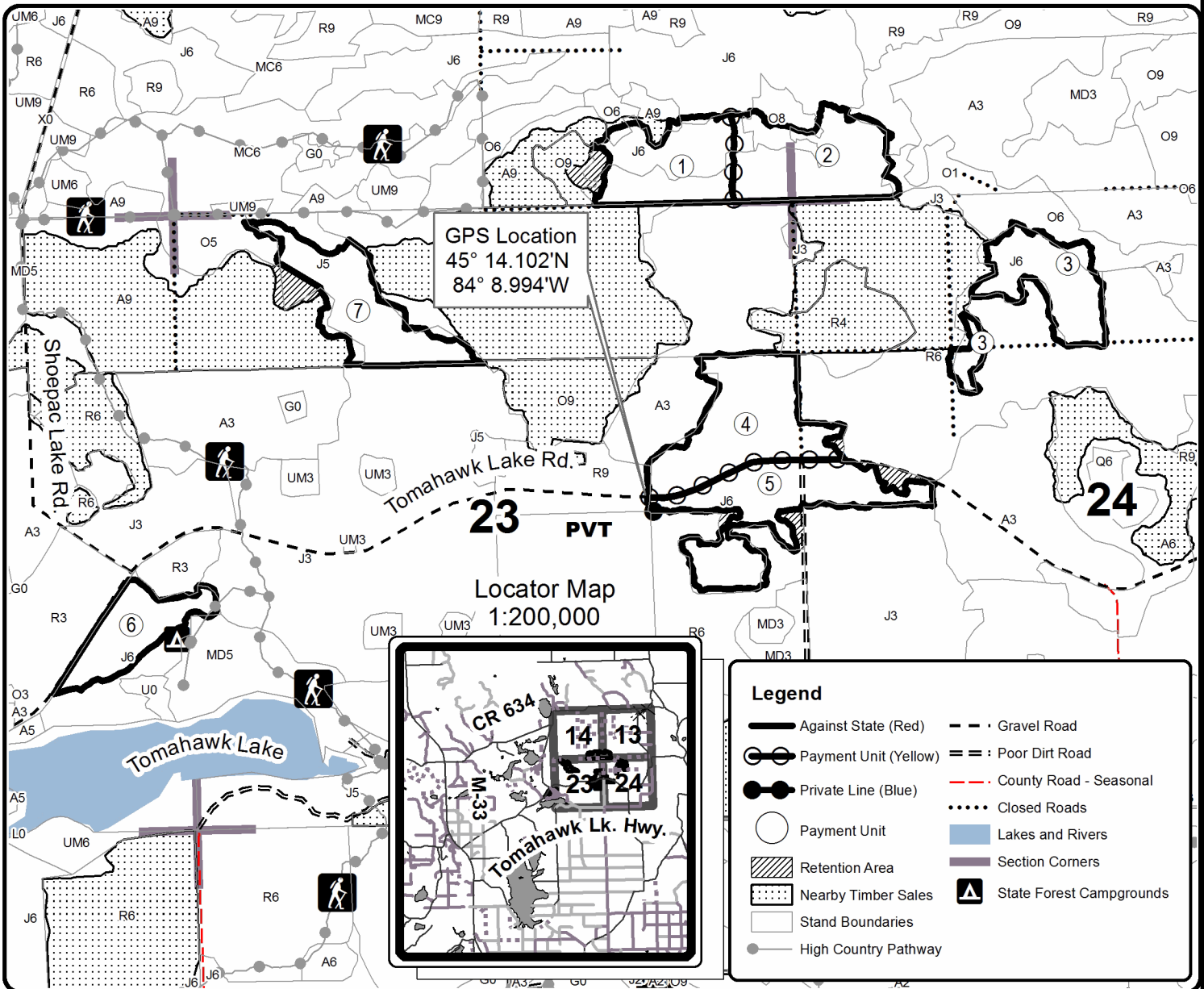
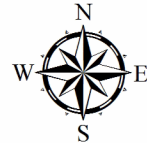



**TIMBER SALE INFORMATION**

Collin All Red Pine (54-018-18)

T33N, R02E, SEC. 13; T33N, R02E, SEC. 22; T33N, R02E, SEC. 23; T33N, R02E, SEC. 24.  
Presque Isle County (Advertised Price \$92,731.30)

SALE NOTE: A recreation site such as a trail, pathway, or campground is within the sale area or the vicinity. Certain restrictions/specifications may be applicable including time restrictions.

A timber sale contract for this lump sum, sealed bid timber sale will be awarded to the responsible bidder offering the highest sealed bid price. Bids must be at or above the following advertised price for each species:

<u>PRODUCTS &amp; SPECIES</u>	<u>ESTIMATED UNITS*</u>	<u>ADVERTISED PRICE</u>
Sawtimber		
Red Pine	187.10 MBF	\$ 122.00 / MBF
Pulpwood		
Jack Pine	20.00 Cords	\$ 25.80 / Cord
Red Pine	1,467.00 Cords	\$ 47.30 / Cord

\* The total volume is statistically estimated within plus (+) or minus (-) 16.09 percent. The estimated units are final and not subject to adjustment. Prospective bidders are urged to examine this timber and to make their own estimates of quantity and quality.

**BOND AND PAYMENT SCHEDULE:**

- A bond in the amount of \$4,637.00 to insure faithful performance of the conditions of the contract will be deposited by the successful bidder within 21 days of the sale award.
- Cutting in any sale or unit without the required advance payment would be considered a trespass.
- Total payment must be paid in advance or according to the following schedule:
  - Ten percent (10%) of the sale value must be paid within 21 days of the sale award.
  - The 10% down payment will be credited towards the first unit cut.
  - Payment for each of the following units must be made before cutting begins in that unit:
 

PAYMENT UNIT NUMBER	PERCENT OF TOTAL SALE VALUE
01	12.7%
02	9.6%
03	19.1%
04	58.6%
- If no cutting takes place, the 10% down payment will not be refunded.
- Operations on the contract issued will terminate on 12/31/2021.

**Description of Timber by Payment Unit (PU)**

PU	MARKET GROUP	PRODUCT	QUANTITY	UNIT	ACRES	ADVERTISE PRICE
1	Red Pine	Sawtimber	10.0	MBF	13.8	\$11,767.90
	Red Pine	Pulpwood	223.0	Cords		
2	Red Pine	Sawtimber	5.1	MBF	10.3	\$8,899.70
	Red Pine	Pulpwood	175.0	Cords		
3	Red Pine	Sawtimber	18.8	MBF	24.5	\$17,666.10
	Red Pine	Pulpwood	325.0	Cords		
4	Red Pine	Sawtimber	153.2	MBF	46.2	\$54,397.60
	Jack Pine	Pulpwood	20.0	Cords		
	Red Pine		744.0	Cords		
TOTAL:			187.1	MBF		
TOTAL:			1,487.0	Cords		

## Sale Specific Conditions & Requirements

**Sale Name: Collin All Red Pine**

**Sale Number: 54-018-18 Seq#: 1**

### 1 - Sale Area

#### 1.2 - Boundaries

##### 1.2.1 - Painted boundaries (1/14)

The sale boundaries are marked and identified by red paint. Exterior sale boundary lines against state are marked with red paint. The painted boundary line trees are not Included Timber and are to be protected.

### 2 - Timber Specifications

#### 2.1 - Included Timber

##### 2.1.1 - Clearcut unit(s) with unmerchantable trees (6/14)

Within Payment Unit(s) 4, cut all trees that are two (2) inches or more at DBH

##### 2.1.8 - Designated plantation row unit(s) (12/08)

Within Payment Unit(s) 1, 2, and 3, all trees which meet minimum piece specifications in 2.2 Utilization, within designated plantation rows are designated for cutting. Designated plantation rows are as follows:

- Within Payment Units 1 and 2, follow a take two, leave three pattern. Because of the variability of row direction, it shall be the responsibility of the producer to maintain the take two leave three pattern.

- Within Payment Unit 3, every third row is designated for cutting. Begin with the third row in from the outside of the plantation, then continue every third row. Because of the variability of row direction, it shall be the responsibility of the producer to maintain the third row sequence.

#### 2.2 - Utilization

##### 2.2.2 - Chipping required (2/18)

Payment Unit 4 must be chip harvested to facilitate subsequent planting operations. The Purchaser has the option to produce sawlogs or pulpwood bolts, but the remaining portion of the trees must be chipped and hauled within 60 days of severing/cutting stem(s). Products may be produced as roundwood and forwarded to decking areas in final product length, but the tops must be left intact and skidded to the landing for chipping in order to minimize the amount of residual slash. If the chipping deadline is not met/delayed, tops must be moved to a centralized location or damages will be determined and collected by the cost to complete the work. The requirement to retain approximately 1/6 to 1/3 of tree tops and limbs less than four inches in diameter is still applicable (G. C. & R. 2.2).

##### 2.2.3 - Stump heights (4/07)

Stump heights within the Sale Area shall not exceed 6 inches for all trees. This is in order to facilitate planting operations.

### 3 - Payments

#### 3.4 - Damaged Timber

##### 3.4.1 - Damaged timber (6/14)

General Condition and Requirement 3.4 Damaged Timber, defines liquidated damages for undesigned live merchantable trees which are cut or injured.

No damage is acceptable to merchantable trees. Within the sale area, if more than 5% of trees (> 4.5" DBH) within a specified area of the sale are damaged, liquidated damages will be assessed for all trees damaged. Rates will be in accordance with General Condition and Requirement 3.4 Damaged Timber.

### 4 - Transportation

#### 4.1 - Construction

##### 4.1.3 - Slash and earthen piles (8/04)

Piles or windrows of earth along roads and landings that have been widened or constructed shall be leveled. Slash from road maintenance or construction, including stumps, shall be dispersed throughout the sale.

#### 4.1.6 - Road construction (1/09)

Construction of new roads or improvements of existing roads shall be done in such a way as to minimize the environmental and visual impacts. Merchantable trees shall be cut and utilized unless otherwise directed. Non-merchantable trees shall be severed and laid flat on the ground. Slash shall be scattered, and not left in windrows and kept a minimum of 10 feet back from the road edge. Stumps shall be set upright, not left on edge, and be moved at least 10 feet away from the road edge. Disturbed soil shall be feathered into the woods and not left in berms or windrows.

#### 4.1.7 - Road closure (10/11)

All new roads built into the sale must be blocked to vehicle traffic upon completion of the sale. Overgrown roads that are reopened shall be considered new roads. In general, this will require constructing a four (4') foot high berm of stumps and logs covered with earth. These roads must be rendered impassable to cars and trucks. All stumps from road building and landing construction must be reserved to block any newly constructed roads upon completion of the sale. These stumps must be scattered along the road system to prohibit vehicular movement. Temporary berms may be required if no sale activity occurs for 30 or more consecutive days. Contact the sale administrator for specific details of design and placement.

### 4.2 - Maintenance

#### 4.2.5 - Two wheel drive condition (2/04)

All existing trail roads on and adjacent to the sale area must be passable by two-wheel drive traffic for the duration of the sale.

## 5 - Operations

### 5.1 - Notification

#### 5.1.1 - Pre-sale conference (10/16)

A pre-sale conference on site between the Purchaser and sale administrator is required prior to beginning any operations to determine landing and road locations. The Unit Manager or his/her representative must be contacted at least 10 days in advance to schedule the conference.

#### 5.1.4 - Post-sale conference (10/16)

A post-sale conference on site between the Purchaser and sale administrator is required 5 days prior to the completion of active logging operations to determine clean-up and repair of landings, road edges, and the fulfillment of other contract specifications.

### 5.2 - Conduct of Operations

#### 5.2.2 - Hazard Trees/Snags

##### 5.2.2.1 - Den trees (10/16)

Obvious hollow and/or den trees shall be protected and left standing unless they are a safety hazard.

#### 5.2.3 - Operating Restrictions

##### 5.2.3.3 - Bark slippage restriction (3/09)

Within Payment Unit(s) 1-3, unless changed by written agreement, cutting and skidding are not permitted during the period of April 15 to July 15. This restriction is because of bark slippage.

##### 5.2.3.6 - Bark beetle restriction (12/08)

In the event drought creates a high risk of pine bark beetle infestation, pine is not to be cut during the period March 1 through July 1, unless all portions of trees greater than two inches in diameter are removed from the sale area, reduced to chips, or treated to the satisfaction of the Unit Manager or his/her representative, within fifteen days of being severed from the stump. Pine log decks, pulpwood piles and treetops that are piled for chipping in the fall or winter within a 1/4 mile of susceptible sites must be removed before March 15. Residual slash must not be placed in piles or rows and must be spread over the site for quick drying. The Department of Natural Resources will exercise this specification if the risk of damage warrants.

##### 5.2.32 - Decking/landing restoration (9/13)

All decking and landing areas must have the surface area restored to a condition equal to or better than before. This is to ensure the proper regeneration of the stand. Wood debris, chips and "cookies" from trimmings must be removed or scattered away from landing and loading areas and may not be windrowed on the edge.

#### 5.2.39 - ORV trail/route protection (4/18)

The Atlanta Trail is an ORV route and is shown on the Timber Sale Map. Do not cut trees or damage posts with yellow ORV markers. All stumps within 5 feet of the trail must be cut flush with the ground. Maintain a 20 foot wide slash, debris, and rut free zone daily using the ORV trail or route as the centerline. Do not run equipment down the ORV trail or route. Skidding across the trail or route may only occur in locations approved by the sale administrator.

#### 5.2.40 - Pathway protection (10/10)

The trail is a bike, hiking, horse, and ski trail and is shown on the Timber Sale Map. Do not cut trees with a trail marker or damage posts with blue pathway markers. Maintain a 20-foot wide slash, debris, and rut free zone daily, using the pathway as the centerline. Do not run equipment down the pathway. Skidding across the trail may only occur in locations approved by the sale administrator.

### 5.4 - Soil Protection

#### 5.4.1 - Rutting restriction, general (7/16)

Operations are to cease immediately if equipment and weather conditions result in rutting of roads and/or skid trails which is 12 inches or greater in depth and 50 feet in length. The Unit Manager or his/her representative may restrict hauling and/or skidding if ruts exceed the specified depth. With the Unit Manager or his/her representative's approval, the Purchaser may return to the area when the risk of rutting has decreased.

### 5.8 - Protection of Endangered Species

#### 5.8.5 - Protection of raptor nests (3/13)

All trees with raptor nests will be protected if found during harvesting operations. Notification will be made to the Unit Manager or his/her representative who will notify the Wildlife Biologist so an on-site evaluation and recommendation can be made, if necessary.

## 6 - Safety and Fire Prevention

### 6.2 - Signing

#### 6.2.3 - Recreational trail posting (2/10)

The Purchaser is responsible for posting and maintaining caution signs on trails prior to beginning operations. The trail must be posted at appropriate distances from the sale area to warn of logging activity and truck traffic at both ends of the trail. Signs must be removed when harvest operations are suspended or completed. The Purchaser will provide these signs.





# TIMBER SALE MAP

This information provided by authority of Part 525, 1994 PA 451, as amended.

Sale Number	Year
54-018	18

Forest Management Unit Atlanta	County Presque Isle	Mapped By R. Zimmerman	Date 8/14/2018	Page 1	of 1
Township 33N	Range 02E	Section(s) and Subdivision(s)	Scale 1:15,840		

Cover Type				Density	
A = Aspen	H = Hemlock	N = Marsh	U = Upland Brush	0 = Non Stocked	5 = Pole Timber Medium
B = Paper Birch	J = Jack Pine	O = Oak	UM = Upland Mixed	1 = Seedling Sapling Poor	6 = Pole Timber Well
C = Cedar	L = Lowland Brush	P = Lowland Poplar	V = Bog or Marsh	2 = Seedling Sapling Medium	7 = Saw Timber Poor
D = Treed Bog	LM = Lowland Mixed	Q = Mixed Swamp Conifer	W = White Pine	3 = Seedling Sapling Well	8 = Saw Timber Medium
E = Swamp Hdwoods	M = Mpl, Bch, Brch	R = Red Pine	X = Non Stocked	4 = Pole Timber Poor	9 = Saw Timber Well
F = Spruce Fir	MC = Mixed Conifer	S = Black Spruce	Z = Water		
G = Grass	MD = Mixed Deciduous	T = Tamarack			

PU	Acres	PU	Acres
1	13.8	4	46.2
2	10.3		
3	24.5		

## Collin All Red Pine

### Compartment 123

### 94.8 Acres

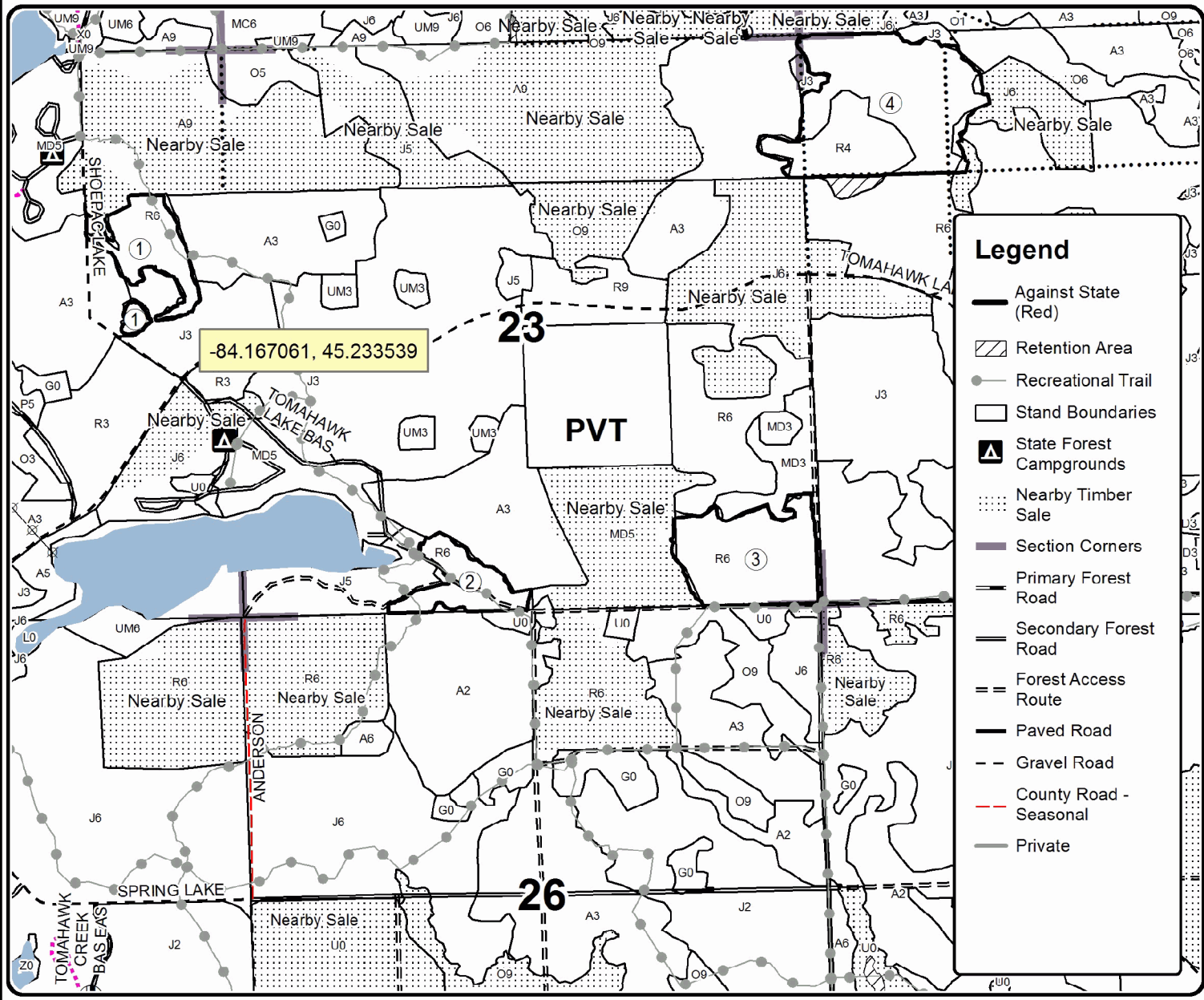
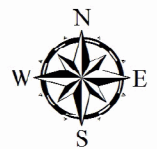

### Legend

- Against State (Red)
- Retention Area
- Recreational Trail
- Stand Boundaries
- State Forest Campgrounds
- Nearby Timber Sale
- Section Corners
- Primary Forest Road
- Secondary Forest Road
- Forest Access Route
- Paved Road
- Gravel Road
- County Road - Seasonal
- Private

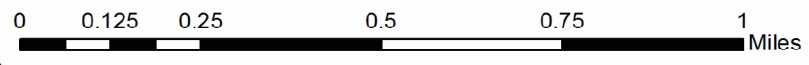



Karsty Mckarsterson Aspen/oak (54-011-18)

T33N, R02E, SEC. 14; T33N, R02E, SEC. 22; T33N, R02E, SEC. 23; T33N, R02E,

In response to the notice of sale to be held 10:00 a.m. (local time) on February 26, 2019, I am hereby submitting my sealed bid (firm offer) for the following forest products to be cut. Bids for individual species must be at or above the advertised price. All non-responsive bid forms may be rejected.

<u>PRODUCTS &amp; SPECIES</u>	<u>ESTIMATED VOLUME*</u>	<u>ADVERTISED PRICE</u>	<u>BID PRICE/UNIT</u>
<b>Sawtimber</b>			
Bl/R/Hybrid Oak	52.80 MBF	\$ 104.00/MBF	\$ _____
Red Oak	147.50 MBF	\$ 180.00/MBF	\$ _____
Red Pine	7.40 MBF	\$ 122.00/MBF	\$ _____
White Oak	10.60 MBF	\$ 73.00/MBF	\$ _____
<b>Pulpwood</b>			
Bl/R/Hybrid Oak	827.00 Cords	\$ 20.35/Cord	\$ _____
Jack Pine	304.00 Cords	\$ 25.80/Cord	\$ _____
Mixed Aspen	3,319.00 Cords	\$ 27.00/Cord	\$ _____
Mixed Hardwood	187.00 Cords	\$ 21.35/Cord	\$ _____
Red Oak	1,106.00 Cords	\$ 20.35/Cord	\$ _____
Red Pine	39.00 Cords	\$ 47.30/Cord	\$ _____
White Oak	170.00 Cords	\$ 20.35/Cord	\$ _____
White Pine	24.00 Cords	\$ 49.05/Cord	\$ _____

\*The volumes are statistically estimated within plus (+) or minus (-) 8.48 percent. These estimated volumes are final and not subject to adjustment. Prospective bidders are urged to examine this timber and to make their own estimates of quantity and quality.

I understand that any or all bids may be rejected. All bids must be signed and all bid items must be bid or the bid form may be rejected. I also understand that consideration and awarding a contract will be based upon my past performance and ability to complete the contract based upon equipment and staffing subject to my control.

FEDERAL ID: \_\_\_\_\_ or SOCIAL SECURITY NUMBER: \_\_\_\_\_

Company or individual bidding: \_\_\_\_\_

Company representative's name: \_\_\_\_\_

Address: \_\_\_\_\_

City: \_\_\_\_\_ State: \_\_\_\_\_ Zip: \_\_\_\_\_

IF AVAILABLE, PLEASE PLACE THE PERSONALIZED LABEL FROM YOUR PROSPECTUS IN THE ABOVE BOX.

Individual or company representative's signature: \_\_\_\_\_ Date: \_\_\_\_\_

Phone number : \_\_\_\_\_ Email (optional): \_\_\_\_\_

**THE WINNING BIDDER MUST COMPLETE THE VERIFICATION OF WORKER'S DISABILITY COMPENSATION ACT COMPLIANCE (ON REVERSE SIDE IF DOUBLE SIDED) WITHIN 21 DAYS OF SALE AWARD DATE**



Looney Tunes Aspen (54-015-18)  
T33N, R02E, SEC. 14; T33N, R02E, SEC. 15; Presque Isle COUNTY

In response to the notice of sale to be held 10:00 a.m. (local time) on February 26, 2019, I am hereby submitting my sealed bid (firm offer) for the following forest products to be cut. Bids for individual species must be at or above the advertised price. All non-responsive bid forms may be rejected.

<u>PRODUCTS &amp; SPECIES</u>	<u>ESTIMATED VOLUME*</u>	<u>ADVERTISED PRICE</u>	<u>BID PRICE/UNIT</u>
<b>Sawtimber</b>			
B. T. Aspen	16.80 MBF	\$ 96.00/MBF	\$ _____
Red Oak	2.00 MBF	\$ 180.00/MBF	\$ _____
<b>Pulpwood</b>			
B. T. Aspen	186.00 Cords	\$ 27.00/Cord	\$ _____
Jack Pine	3.00 Cords	\$ 25.80/Cord	\$ _____
Mixed Oak	23.00 Cords	\$ 20.35/Cord	\$ _____
Red Pine	35.00 Cords	\$ 47.30/Cord	\$ _____

\*The volumes are statistically estimated within plus (+) or minus (-) 28.52 percent. These estimated volumes are final and not subject to adjustment. Prospective bidders are urged to examine this timber and to make their own estimates of quantity and quality.

I understand that any or all bids may be rejected. All bids must be signed and all bid items must be bid or the bid form may be rejected. I also understand that consideration and awarding a contract will be based upon my past performance and ability to complete the contract based upon equipment and staffing subject to my control.

FEDERAL ID: \_\_\_\_\_ or SOCIAL SECURITY NUMBER: \_\_\_\_\_

Company or individual bidding: \_\_\_\_\_

Company representative's name: \_\_\_\_\_

Address: \_\_\_\_\_

City: \_\_\_\_\_ State: \_\_\_\_\_ Zip: \_\_\_\_\_

IF AVAILABLE, PLEASE PLACE THE PERSONALIZED LABEL FROM YOUR PROSPECTUS IN THE ABOVE BOX.

Individual or company representative's signature: \_\_\_\_\_ Date: \_\_\_\_\_

Phone number : \_\_\_\_\_ Email (optional): \_\_\_\_\_

**THE WINNING BIDDER MUST COMPLETE THE VERIFICATION OF WORKER'S DISABILITY COMPENSATION ACT COMPLIANCE (ON REVERSE SIDE IF DOUBLE SIDED) WITHIN 21 DAYS OF SALE AWARD DATE**



FOR DEPARTMENT USE ONLY	
Sale Number (XX - XXX - XX - XX)	
Forest Management Unit:	

## TIMBER SALE VERIFICATION OF WORKER'S DISABILITY COMPENSATION ACT COMPLIANCE

As required by Act 317, P.A. 1969 (Worker's Compensation) and  
Part 5 of Act 451 of 1994, as amended.

### VERIFICATION OF WORKER'S DISABILITY COMPENSATION ACT COMPLIANCE

- This verification must be completed and submitted within 21 days of contract award and prior to the issuance of the timber sale contract.
- In addition, if boxes 2B or 2C are checked, then Notice of Exclusion or Certificate of Insurance must be submitted within twenty-one (21) days of the contract award and prior to the issuance of the timber sale contract.
- All information must be typed or printed except for written signatures.

Please Check Appropriate Categories:

1. My business is organized as (you **must** check one of the boxes below):
  - A.  Sole Proprietorship (individual)
  - B.  Partnership
  - C.  Corporation
2. You **must** check one of the boxes below:
  - A.  I certify my business is a sole proprietorship and it has no employees but the sole proprietor. I am not subject to the Worker's Compensation Laws.
  - B.  I certify my business has satisfied its obligation to the Worker's Compensation Act through the use of an approved Notice of Exclusion (BWC-337, Rev. 5/96). I will provide a copy of the Notice of Exclusion within 21 days of the contract award. (For questions or a copy of the BWC-337, please call the Worker's Compensation Bureau at 517-322-1195).
  - C.  I certify my business has a Worker's Compensation Policy. I will provide an original Certificate of Insurance within twenty-one (21) days of the contract award.
3. If you have checked item 2(A) or 2(B), you **must** indicate the number of **both** full-time and part-time employees, other than yourself, including family members and active partners (if none, you must enter "0").

\_\_\_\_\_ Full-time Employees

\_\_\_\_\_ Part-time Employees

Name of Business		Federal ID (or) Social Security No.	
Address		Telephone (       )	
City	State	ZIP	

*I hereby certify that the above information is true and correct. I agree to notify the Michigan DNR of any changes that occur in factors affecting my coverage during any of my present and future operations.*

\_\_\_\_\_  
Signature of Owner or Authorized Representative

\_\_\_\_\_  
Title

\_\_\_\_\_  
Date

Please complete the "SEALED BID" information on the next page

Shoe Hawk Jack Pine (54-016-18)  
T33N, R02E, SEC. 13; T33N, R02E, SEC. 14; T33N, R02E, SEC. 22; T33N, R02E,

In response to the notice of sale to be held 10:00 a.m. (local time) on February 26, 2019, I am hereby submitting my sealed bid (firm offer) for the following forest products to be cut. Bids for individual species must be at or above the advertised price. All non-responsive bid forms may be rejected.

<u>PRODUCTS &amp; SPECIES</u>	<u>ESTIMATED VOLUME*</u>	<u>ADVERTISED PRICE</u>	<u>BID PRICE/UNIT</u>
Sawtimber			
Red Pine	29.40 MBF	\$ 122.00/MBF	\$ _____
Pulpwood			
Jack Pine	1,920.00 Cords	\$ 25.80/Cord	\$ _____
Mixed Aspen	25.00 Cords	\$ 27.00/Cord	\$ _____
Mixed Hardwood	6.00 Cords	\$ 21.35/Cord	\$ _____
Mixed Oak	126.00 Cords	\$ 20.35/Cord	\$ _____
Red Pine	59.00 Cords	\$ 47.30/Cord	\$ _____
White Pine	3.00 Cords	\$ 49.05/Cord	\$ _____

\*The volumes are statistically estimated within plus (+) or minus (-) 12.10 percent. These estimated volumes are final and not subject to adjustment. Prospective bidders are urged to examine this timber and to make their own estimates of quantity and quality.

I understand that any or all bids may be rejected. All bids must be signed and all bid items must be bid or the bid form may be rejected. I also understand that consideration and awarding a contract will be based upon my past performance and ability to complete the contract based upon equipment and staffing subject to my control.

FEDERAL ID: \_\_\_\_\_ or SOCIAL SECURITY NUMBER: \_\_\_\_\_

Company or individual bidding: \_\_\_\_\_

Company representative's name: \_\_\_\_\_

Address: \_\_\_\_\_

City: \_\_\_\_\_ State: \_\_\_\_\_ Zip: \_\_\_\_\_

IF AVAILABLE, PLEASE PLACE THE PERSONALIZED LABEL FROM YOUR PROSPECTUS IN THE ABOVE BOX.

Individual or company representative's signature: \_\_\_\_\_ Date: \_\_\_\_\_

Phone number : \_\_\_\_\_ Email (optional): \_\_\_\_\_

**THE WINNING BIDDER MUST COMPLETE THE VERIFICATION OF WORKER'S DISABILITY COMPENSATION ACT COMPLIANCE (ON REVERSE SIDE IF DOUBLE SIDED) WITHIN 21 DAYS OF SALE AWARD DATE**



<b>FOR DEPARTMENT USE ONLY</b>
Sale Number (XX - XXX - XX - XX)
Forest Management Unit:

## TIMBER SALE VERIFICATION OF WORKER'S DISABILITY COMPENSATION ACT COMPLIANCE

*As required by Act 317, P.A. 1969 (Worker's Compensation) and  
Part 5 of Act 451 of 1994, as amended.*

### VERIFICATION OF WORKER'S DISABILITY COMPENSATION ACT COMPLIANCE

- This verification must be completed and submitted within 21 days of contract award and prior to the issuance of the timber sale contract.
- In addition, if boxes 2B or 2C are checked, then Notice of Exclusion or Certificate of Insurance must be submitted within twenty-one (21) days of the contract award and prior to the issuance of the timber sale contract.
- All information must be typed or printed except for written signatures.

Please Check Appropriate Categories:

1. My business is organized as (you **must** check one of the boxes below):
  - A.  Sole Proprietorship (individual)
  - B.  Partnership
  - C.  Corporation
  
2. You **must** check one of the boxes below:
  - A.  I certify my business is a sole proprietorship and it has no employees but the sole proprietor. I am not subject to the Worker's Compensation Laws.
  - B.  I certify my business has satisfied its obligation to the Worker's Compensation Act through the use of an approved Notice of Exclusion (BWC-337, Rev. 5/96). I will provide a copy of the Notice of Exclusion within 21 days of the contract award. (For questions or a copy of the BWC-337, please call the Worker's Compensation Bureau at 517-322-1195).
  - C.  I certify my business has a Worker's Compensation Policy. I will provide an original Certificate of Insurance within twenty-one (21) days of the contract award.
  
3. If you have checked item 2(A) or 2(B), you **must** indicate the number of **both** full-time and part-time employees, other than yourself, including family members and active partners (if none, you must enter "0").

\_\_\_\_\_ Full-time Employees

\_\_\_\_\_ Part-time Employees

Name of Business		Federal ID (or) Social Security No.	
Address		Telephone (       )	
City	State	ZIP	

*I hereby certify that the above information is true and correct. I agree to notify the Michigan DNR of any changes that occur in factors affecting my coverage during any of my present and future operations.*

\_\_\_\_\_  
Signature of Owner or Authorized Representative

\_\_\_\_\_  
Title

\_\_\_\_\_  
Date

**Please complete the "SEALED BID" information on the next page**



Collin All Red Pine (54-018-18)

T33N, R02E, SEC. 13; T33N, R02E, SEC. 22; T33N, R02E, SEC. 23; T33N, R02E,

In response to the notice of sale to be held 10:00 a.m. (local time) on February 26, 2019, I am hereby submitting my sealed bid (firm offer) for the following forest products to be cut. Bids for individual species must be at or above the advertised price. All non-responsive bid forms may be rejected.

<u>PRODUCTS &amp; SPECIES</u>	<u>ESTIMATED VOLUME*</u>	<u>ADVERTISED PRICE</u>	<u>BID PRICE/UNIT</u>
Sawtimber			
Red Pine	187.10 MBF	\$ 122.00/MBF	\$ _____
Pulpwood			
Jack Pine	20.00 Cords	\$ 25.80/Cord	\$ _____
Red Pine	1,467.00 Cords	\$ 47.30/Cord	\$ _____

\*The volumes are statistically estimated within plus (+) or minus (-) 16.09 percent. These estimated volumes are final and not subject to adjustment. Prospective bidders are urged to examine this timber and to make their own estimates of quantity and quality.

I understand that any or all bids may be rejected. All bids must be signed and all bid items must be bid or the bid form may be rejected. I also understand that consideration and awarding a contract will be based upon my past performance and ability to complete the contract based upon equipment and staffing subject to my control.

FEDERAL ID: \_\_\_\_\_ or SOCIAL SECURITY NUMBER: \_\_\_\_\_

Company or individual bidding: \_\_\_\_\_

Company representative's name: \_\_\_\_\_

Address: \_\_\_\_\_

City: \_\_\_\_\_ State: \_\_\_\_\_ Zip: \_\_\_\_\_

IF AVAILABLE, PLEASE PLACE THE PERSONALIZED LABEL FROM YOUR PROSPECTUS IN THE ABOVE BOX.

Individual or company representative's signature: \_\_\_\_\_ Date: \_\_\_\_\_

Phone number : \_\_\_\_\_ Email (optional): \_\_\_\_\_

**THE WINNING BIDDER MUST COMPLETE THE VERIFICATION OF WORKER'S DISABILITY COMPENSATION ACT COMPLIANCE (ON REVERSE SIDE IF DOUBLE SIDED) WITHIN 21 DAYS OF SALE AWARD DATE**



<b>FOR DEPARTMENT USE ONLY</b>
Sale Number (XX - XXX - XX - XX)
Forest Management Unit:

## TIMBER SALE VERIFICATION OF WORKER'S DISABILITY COMPENSATION ACT COMPLIANCE

*As required by Act 317, P.A. 1969 (Worker's Compensation) and  
Part 5 of Act 451 of 1994, as amended.*

### VERIFICATION OF WORKER'S DISABILITY COMPENSATION ACT COMPLIANCE

- This verification must be completed and submitted within 21 days of contract award and prior to the issuance of the timber sale contract.
- In addition, if boxes 2B or 2C are checked, then Notice of Exclusion or Certificate of Insurance must be submitted within twenty-one (21) days of the contract award and prior to the issuance of the timber sale contract.
- All information must be typed or printed except for written signatures.

Please Check Appropriate Categories:

1. My business is organized as (you **must** check one of the boxes below):
  - A.  Sole Proprietorship (individual)
  - B.  Partnership
  - C.  Corporation
2. You **must** check one of the boxes below:
  - A.  I certify my business is a sole proprietorship and it has no employees but the sole proprietor. I am not subject to the Worker's Compensation Laws.
  - B.  I certify my business has satisfied its obligation to the Worker's Compensation Act through the use of an approved Notice of Exclusion (BWC-337, Rev. 5/96). I will provide a copy of the Notice of Exclusion within 21 days of the contract award. (For questions or a copy of the BWC-337, please call the Worker's Compensation Bureau at 517-322-1195).
  - C.  I certify my business has a Worker's Compensation Policy. I will provide an original Certificate of Insurance within twenty-one (21) days of the contract award.
3. If you have checked item 2(A) or 2(B), you **must** indicate the number of **both** full-time and part-time employees, other than yourself, including family members and active partners (if none, you must enter "0").

\_\_\_\_\_ Full-time Employees

\_\_\_\_\_ Part-time Employees

Name of Business		Federal ID (or) Social Security No.	
Address		Telephone (       )	
City	State	ZIP	

*I hereby certify that the above information is true and correct. I agree to notify the Michigan DNR of any changes that occur in factors affecting my coverage during any of my present and future operations.*

\_\_\_\_\_  
Signature of Owner or Authorized Representative

\_\_\_\_\_  
Title

\_\_\_\_\_  
Date

**Please complete the "SEALED BID" information on the next page**