



**DEPARTMENT OF NATURAL RESOURCES
STATE OF MICHIGAN**

TIMBER SALE PROSPECTUS #6468

SCHEDULED SALE DATE AND TIME: 3:00 p.m. (local time) on August 28, 2019.

LOCATION: BALDWIN FIELD OFFICE, 2468 W 24TH STREET, BALDWIN, MI 49304.

PROSPECTUS NOTE: The bidder is advised to inspect the sale area and review the location, estimated volumes, operating costs and contract terms of proposed sales. Please be aware that some landowners may request 60 days or more notice for access across their land.

Notice is hereby given that bids will be received by the Unit Manager, CADILLAC MANAGEMENT UNIT, for certain timber on the following described lands:

Pioneer Mix (63-005-19) / T24N, R07W, SEC. 11, N1/2NW,SWNW,N1/2NE.

T24N, R07W, SEC. 2 , NESW,S1/2SW,SE.

Missaukee County, Advertised Price \$143,742.30, 170.9 Acres, Hardwood, Red Oak.

SALE NOTE: A recreation site such as a trail, pathway, or campground is within the sale area or the vicinity. Certain restrictions/specifications may be applicable including time restrictions.

Pioneer Aspen (63-006-19) / T24N, R07W, SEC. 1 , NE,N1/2SW,SWSW,N1/2SE.

T24N, R07W, SEC. 11, NENE.

T24N, R07W, SEC. 12, E1/2NW,E1/2SW.

T24N, R07W, SEC. 2 , E1/2SE.

Missaukee County, Advertised Price \$159,363.35, 146.3 Acres, Aspen, Hardwood.

SALE NOTE: A recreation site such as a trail, pathway, or campground is within the sale area or the vicinity. Certain restrictions/specifications may be applicable including time restrictions.

Pioneer Pine (63-007-19) / T24N, R07W, SEC. 2 , NW,SW.

Missaukee County, Advertised Price \$85,287.45, 95.8 Acres, Aspen, Red Oak.

SALE NOTE: A recreation site such as a trail, pathway, or campground is within the sale area or the vicinity. Certain restrictions/specifications may be applicable including time restrictions.

BID INSTRUCTIONS (VER. 07/02/2018):

1. Scheduled Bid Location, Date, and Time (2/11)

Bids must be received by the Unit Manager, BALDWIN FIELD OFFICE, 2468 W 24th Street, Baldwin, MI 49304, no later than 3:00 p.m. (local time) on August 28, 2019. For further information concerning this sale, contact Joe Ventinglia at 231-824-3591 extension 11.

2. Bidder's Qualifications (5/16)

Purchaser shall obtain workers compensation insurance to cover claims under Michigan's Worker's Disability Compensation Act of 1969 or similar employee benefit act of any other state applicable to an employee. If all or part of a timber sale was prepared by a private contractor, the contractor and that contractor's company are not permitted to bid on the timber sale contract. Bids will not be accepted from individuals or companies appearing on the DNR/FRD No-Bid List. This list contains the names of purchasers who previously failed to execute a contract within 21-days or who have a history of poor performance.

3. Preparation of Sealed Bids (5/16)

Bid Forms may be completed online thru Michigan DNR Timber Sale Online Bidding (OLB) at www.michigan.gov/timberbidding or by completing the hardcopy Bid Form found in the Timber Sale Prospectus. Hardcopy Bid Forms shall be manually signed in ink. Registration in OLB is considered your 'signature' for all bids submitted thru that system. Bid prices must be entered for each species and product in the Bid Price column for all material subject to bidding and all fill-in blanks must be completed. If erasures or other changes appear on the hardcopy Bid Form, each erasure or change must be initialed by the person signing the bid.

4. Submission of Sealed Bids (5/16)

Bid forms may be obtained from the Unit Manager or thru OLB. Bids may be submitted hardcopy or thru OLB. All hardcopy bids must be submitted on the bid form and in an envelope clearly identified as described in this section. NOTE: Only one bid form per bid envelope. Sealed bids must be submitted to the Unit office designated in the prospectus and must be submitted at or prior to the time established in the prospectus. The envelope should show on the outside (a) the sale name or number and (b) the date and time of bid opening, as shown in the prospectus. Bids received after the time specified in the sale prospectus are late bids and will be rejected.

It is possible for a bidder to submit multiple bids on a single sale. For example, a bid may be submitted hardcopy and a bid may be submitted thru OLB. Or, two bidders from the same company could both submit bids on the same sale. If this were to happen, the State would accept all bids received and award the contract accordingly. All bidding and contractual requirements would apply to all bids received.

5. Public Opening of Sealed Bids (7/16)

If conditions permit, the sealed bids will be publicly opened and posted at the time and place set in the prospectus.

If a bidder, present at a bid opening, has submitted bids on more than one sale, that bidder may withdraw their unopened bid envelopes or announce the withdrawal of their online bid after being declared the successful bidder on one sale.

6. Award of Contract (1/11)

Award of the contract will be made to the Bidder whose bid, conforming to the prospectus, is most advantageous to the State of Michigan on the basis of total value at rates bid for the estimated quantities. The State reserves the right to reject any bid or waive any minor irregularity in bids received. A written award mailed (or otherwise furnished) to the successful Bidder shall be deemed to result in a binding contract without further action by either party.

7. Down Payment (1/11)

The Bidder to whom award is made must make a down payment within 21 days of the sale award. The amount of the down payment will be calculated as shown in the Bond and Payment Schedule of this prospectus. Only cash may be used to meet this requirement.

8. Performance Security (1/11)

As guarantee of faithful performance, a cash bond, certificate of deposit, surety bond or irrevocable letter of credit (LOC) is required within 21 days of the sale award. The amount of the performance security is shown in the Bond and

Payment Schedule of this prospectus. If an LOC or surety is used, the coverage must extend for at least 6 months beyond the contract expiration.

9. Timber Sale Contract (7/18)

Additional conditions and requirements common to all timber sales are listed on the timber sale contract (R4031) and are available on line at www.michigan.gov/timber. Contact the Unit Manager for additional information or a sample contract. Within 21 days of the date of the award letter, the bidder must sign the contract and provide the required down payment, performance security, and verification of worker's disability compensation. The down payment and performance security shall be in accordance with the provisions of the timber sale contract, in the sums stated in this prospectus. If these actions are not taken, then the Bidder, the Bidder's corporation, and the corporation's principals may not be permitted to bid on State timber sales for a period of 3 months after the first offense, 6 months after the second offense, and 1 year after the third offense. An offense will only be counted against the Bidder for 5 years. In addition, the Bidder certifies that if awarded this contract, the Bidder will complete the timber sale contract in accordance with its terms and any modifications thereof including requirements to purchase, cut, and remove the included timber by the expiration date.

Payment Unit values in the State Forest Timber Sale Contract are calculated based on the advertised value of the Payment Unit as a percentage of the total advertised value of the contract. The advertised value of each Payment Unit is given in the Description of Timber by Payment Unit table on the Timber Sale Information page. For example, if the value of Payment Unit 1 is advertised as \$1,500 and the total Timber Sale value is advertised as \$10,000, the contract price for Payment Unit 1 will be 15% of the total bid price ($\$1,500/\$10,000 * 100$).

10. Disclaimer of Estimates and Bidder's Warranty of Inspection (7/16)

Before submitting this bid, the Bidder is advised and cautioned to inspect the sale area, review the requirements of the sale contract, and take other steps as may be reasonably necessary to ascertain the location, estimated volumes, construction estimates, and operating costs of the proposed sale. Failure to do so will not relieve the Bidder from responsibility for completing the contract.

The Bidder warrants that this bid is submitted solely on the basis of the Bidder's examination and inspection of the quality and quantity of the timber offered for sale and the Bidder's opinion of the value thereof and the costs of recovery. No reliance should be placed on the State of Michigan's estimates of timber quality, quantity or costs of recovery. Bidder further acknowledges that the State of Michigan: (i) expressly disclaims any warranty of fitness of timber for any purpose; (ii) offers this timber as is without any warranty of quality (merchantability) or quantity and (iii) expressly disclaims any warranty as to the quantity or quality of timber sold.

11. Certification and Chain-of-Custody (10/14)

Unless otherwise indicated in the contract under section 7 – Other Conditions of the Sale Specific Conditions & Requirements, the area encompassed by this timber sale is certified to the standards of the Forest Stewardship Council (FSC) - Certificate #SCS-FM/COC-00090N and the Sustainable Forestry Initiative (SFI) - Certificate #NSF-SFIS-5Y031-SF5. Forest products from this sale may be delivered to the mill as "FSC 100% and / or SFI certified" as long as the contractor hauling the forest products is chain-of-custody (COC) certified or covered under a COC certificate from the destination mill. The purchaser is responsible for maintaining COC after leaving the sale area.

12. Good Neighbor Authority (GNA) Requirements (7/16)

If the name of this timber sales contains the acronym GNA, it is authorized by the Good Neighbor Authority (GNA) and covered by various agreements between the U.S. Forest Service and the State. The timber sale occurs on federal land and the following conditions apply:

GNA contracts on US Forest Service land will not be awarded to purchasers on the Federal list of excluded parties. The System for Award Management (SAM) will be checked for active excluded parties prior to award of contract. In addition, the Bidder to whom award is made must complete an Assurance Regarding Felony Conviction or Tax Delinquent Status for Corporate Applicants (AD-3031).

13. Good Neighbor Authority (GNA) Requirements, con't (9/16)

Bidder certifies, by signing this bid form, that to the best of Bidder's knowledge that the following representations are accurate and complete.

- a. That the Bidder and its principals are not presently debarred, suspended, proposed for debarment, declared ineligible, or voluntary excluded from timber sales (covered transactions) by any Federal department or agency.
- b. That the Bidder and its principals have not within a 3-year period preceding this bid been convicted of or had a civil judgment rendered against them for commission of fraud or a criminal offense in connection with obtaining, attempting to obtain, or performing a public (Federal, State, or local) transaction or contract under a public transaction; violation of Federal or State antitrust statutes or commission of embezzlement, theft, forgery, bribery, falsification or destruction of records, making false statements, or receiving stolen property.
- c. That the Bidder and its principals are not presently indicted for or otherwise criminally or civilly charged by a governmental entity (Federal, State, or local) with commission of any of the offenses enumerated in paragraph b of this certification.
- d. That the Bidder and its principals have not within a 3-year period preceding this bid had one or more public transactions (Federal, State, or local) terminated for breach or default of a timber or forest product contract.

Bidders that cannot certify this requirement, in whole or in part, shall submit an explanation with their bid.

DAN EICHINGER
Director

TIMBER SALE INFORMATION

Pioneer Mix (63-005-19)

T24N, R07W, SEC. 11; T24N, R07W, SEC. 2.
Missaukee County (Advertised Price \$143,742.30)

SALE NOTE: A recreation site such as a trail, pathway, or campground is within the sale area or the vicinity. Certain restrictions/specifications may be applicable including time restrictions.

A timber sale contract for this lump sum, sealed bid timber sale will be awarded to the responsible bidder offering the highest sealed bid price. Bids must be at or above the following advertised price for each species:

<u>PRODUCTS & SPECIES</u>	<u>ESTIMATED UNITS*</u>		<u>ADVERTISED PRICE</u>
Sawtimber			
B. T. Aspen	18.50	MBF	\$ 94.00 / MBF
Basswood	85.70	MBF	\$ 100.00 / MBF
Beech	53.00	MBF	\$ 73.00 / MBF
Red Maple	230.70	MBF	\$ 95.00 / MBF
Red Oak	320.60	MBF	\$ 190.00 / MBF
Sugar Maple	43.50	MBF	\$ 346.00 / MBF
Pulpwood			
B. T. Aspen	44.00	Cords	\$ 17.05 / Cord
Basswood	112.00	Cords	\$ 17.00 / Cord
Mixed Hardwood	1,230.00	Cords	\$ 14.55 / Cord
Red Oak	558.00	Cords	\$ 19.95 / Cord

* The total volume is statistically estimated within plus (+) or minus (-) 10.84 percent. The estimated units are final and not subject to adjustment. Prospective bidders are urged to examine this timber and to make their own estimates of quantity and quality.

BOND AND PAYMENT SCHEDULE:

1. A bond in the amount of \$7,187.00 to insure faithful performance of the conditions of the contract will be deposited by the successful bidder within 21 days of the sale award.
2. Cutting in any sale or unit without the required advance payment would be considered a trespass.
3. Total payment must be paid in advance or according to the following schedule:
 - (a) Ten percent (10%) of the sale value must be paid within 21 days of the sale award.
 - (b) The 10% down payment will be credited towards the first unit cut.
 - (c) Payment for each of the following units must be made before cutting begins in that unit:

PAYMENT UNIT NUMBER	PERCENT OF TOTAL SALE VALUE
01	39.8%
02	60.2%
4. If no cutting takes place, the 10% down payment will not be refunded.
5. Operations on the contract issued will terminate on 09/30/2021.

Description of Timber by Payment Unit (PU)

PU	MARKET GROUP	PRODUCT	QUANTITY	UNIT	ACRES	ADVERTISE PRICE
1	B. T. Aspen	Sawtimber	7.4	MBF	68.0	\$57,212.45
	Basswood		34.1	MBF		
	Beech		21.1	MBF		
	Red Maple		91.8	MBF		
	Red Oak		127.6	MBF		
	Sugar Maple		17.3	MBF		
	B. T. Aspen	Pulpwood	18.0	Cords		
	Basswood		45.0	Cords		
	Mixed Hardwood		489.0	Cords		
	<i>Black Cherry</i>	<i>Sawtimber</i>	3.6	<i>MBF</i>		
	<i>Beech</i>	<i>Pulpwood</i>	112.0	<i>Cords</i>		
	<i>Black Cherry</i>		11.0	<i>Cords</i>		
	<i>Ironwood</i>		4.0	<i>Cords</i>		
	<i>Red Maple</i>		273.0	<i>Cords</i>		
	<i>Sugar Maple</i>		82.0	<i>Cords</i>		
	Red Oak		222.0	Cords		
2	B. T. Aspen	Sawtimber	11.1	MBF	102.9	\$86,529.85
	Basswood		51.6	MBF		
	Beech		31.9	MBF		
	Red Maple		138.9	MBF		
	Red Oak		193.0	MBF		
	Sugar Maple		26.2	MBF		
	B. T. Aspen	Pulpwood	26.0	Cords		
	Basswood		67.0	Cords		
	Mixed Hardwood		741.0	Cords		
	<i>Black Cherry</i>	<i>Sawtimber</i>	5.4	<i>MBF</i>		
	<i>Beech</i>	<i>Pulpwood</i>	169.0	<i>Cords</i>		
	<i>Black Cherry</i>		17.0	<i>Cords</i>		
	<i>Ironwood</i>		6.0	<i>Cords</i>		
	<i>Red Maple</i>		413.0	<i>Cords</i>		
	<i>Sugar Maple</i>		125.0	<i>Cords</i>		
	Red Oak		336.0	Cords		
TOTAL:			752.0	MBF		
TOTAL:			1,944.0	Cords		

Sale Specific Conditions & Requirements

Sale Name: Pioneer Mix

Sale Number: 63-005-19 Seq#: 1

1 - Sale Area

1.2 - Boundaries

1.2.1 - Painted boundaries (1/14)

The sale boundary and Payment Unit boundaries are marked and identified by red and pink paint. Exterior sale boundary lines against state are marked with red paint. Interior Payment Unit boundaries are marked with pink paint. The painted boundary line trees are not Included Timber and are to be protected.

2 - Timber Specifications

2.1 - Included Timber

2.1.3 - Cut tree marked unit(s) (12/08)

Within Payment Unit(s) 1 and 2, all trees are designated for cutting when marked with orange paint above and below stump height, regardless of merchantability. In addition, cut all aspen, ash, beech, and ironwood, regardless of merchantability.

2.2 - Utilization

2.2.6 - Roundwood operation required (5/07)

The skidding of whole trees or tree segments with limbs attached is prohibited. All products must be produced as roundwood and forwarded to existing roads or landing areas in final product length.

3 - Payments

3.3 - Pre-measured Sales

3.3.4 - Dividing payment units (7/14)

Payment Unit(s) 1 and 2 may be divided at the request of the Purchaser and upon approval of the Unit Manager. Dividing Payment Units is a contract modification which requires a Timber Sale Contract Supplement.

4 - Transportation

4.1 - Construction

4.1.7 - Road closure (10/11)

All new roads built into the sale must be blocked to vehicle traffic upon completion of the sale. Overgrown roads that are reopened shall be considered new roads. In general, this will require constructing double earthen berms at strategic locations. Stumps and brush must be placed along the remainder of the trail. These roads must be rendered impassable to cars and trucks. All stumps from road building and landing construction must be reserved to block any newly constructed roads upon completion of the sale. These stumps must be scattered along the road system to prohibit vehicular movement. Contact the sale administrator for specific details of design and placement.

4.2 - Maintenance

4.2.5 - Two wheel drive condition (2/04)

All existing trail roads on and adjacent to the sale area must be passable by two-wheel drive traffic for the duration of the sale.

5 - Operations

5.1 - Notification

5.1.1 - Pre-sale conference (10/16)

A pre-sale conference on site between the Purchaser and sale administrator is required prior to beginning a Payment Unit to determine landing and road locations. The Unit Manager or his/her representative must be contacted at least 3 days in advance to schedule the conference.

5.2 - Conduct of Operations

5.2.3 - Operating Restrictions

5.2.3.4 - Oak wilt restriction, no exceptions (1/18)

Within Payment Unit(s) 1 and 2, cutting, skidding, hauling within the sale and brushing of access roads to the sale are not permitted during the period of April 15 to July 15. No exceptions will be granted. This is necessary to reduce the spread of oak wilt.

5.2.39 - ORV trail/route protection (4/18)

The ORV trail runs through a portion of the sale, as shown on the Timber Sale Map. Do not cut trees or damage posts with yellow ORV markers. All stumps within 5 feet of the trail must be cut flush with the ground. Maintain a 20 foot wide slash, debris, and rut free zone daily using the ORV trail or route as the centerline. Do not run equipment down the ORV trail or route. Skidding across the trail or route may only occur in locations approved by the sale administrator.

5.4 - Soil Protection

5.4.1 - Rutting restriction, general (7/16)

Operations are to cease immediately if equipment and weather conditions result in rutting of roads and/or skid trails which is 12 inches or greater in depth and 50 feet in length. The Unit Manager or his/her representative may restrict hauling and/or skidding if ruts exceed the specified depth. With the Unit Manager or his/her representative's approval, the Purchaser may return to the area when the risk of rutting has decreased. Add any additional text here.

6 - Safety and Fire Prevention

6.2 - Signing

6.2.1 - Road posting (9/09)

The Purchaser is responsible for posting and maintaining caution signs on timber access roads prior to beginning operations. The road must be posted at appropriate distances from the sale area to warn of logging activity and truck traffic. Signs must be removed when harvest operations are suspended or completed. The Purchaser will provide these signs.

6.2.3 - Recreational trail posting (2/10)

The Purchaser is responsible for posting and maintaining caution signs on ORV trail prior to beginning operations. The trail must be posted at appropriate distances from the sale area to warn of logging activity and truck traffic at both ends of the trail. Signs must be removed when harvest operations are suspended or completed. The Purchaser will provide these signs.



TIMBER SALE MAP

This information provided by authority of Part 525, 1994 PA 451, as amended.

Sale Number	Year
63-005-19	19

Forest Management Unit	County	Mapped By	Date	Page	of
Cadillac	Missaukee	Ventimiglia	05/20/19	1	1
Township	Range	Section(s) and Subdivision(s)	Scale		
24N	07W	Section 2 and 11 (various)	1:15,840		

Cover Type				Density	
A = Aspen	H = Hemlock	N = Marsh	U = Upland Brush	0 = Non Stocked	5 = Pole Timber Medium
B = Paper Birch	J = Jack Pine	O = Oak	UM = Upland Mixed	1 = Seedling Sapling Poor	6 = Pole Timber Well
C = Cedar	L = Lowland Brush	P = Lowland Poplar	V = Bog or Marsh	2 = Seedling Sapling Medium	7 = Saw Timber Poor
D = Treed Bog	LM = Lowland Mixed	Q = Mixed Swamp Conifer	W = White Pine	3 = Seedling Sapling Well	8 = Saw Timber Medium
E = Swamp Hdwoods	M = Mpl, Bch, Brch	R = Red Pine	X = Non Stocked	4 = Pole Timber Poor	9 = Saw Timber Well
F = Spruce Fir	MC = Mixed Conifer	S = Black Spruce	Z = Water		
G = Grass	MD = Mixed Deciduous	T = Tamarack			

PU	Acres
1	68
2	102.9

Pioneer Mix

Compartment 122

170.9 Acres

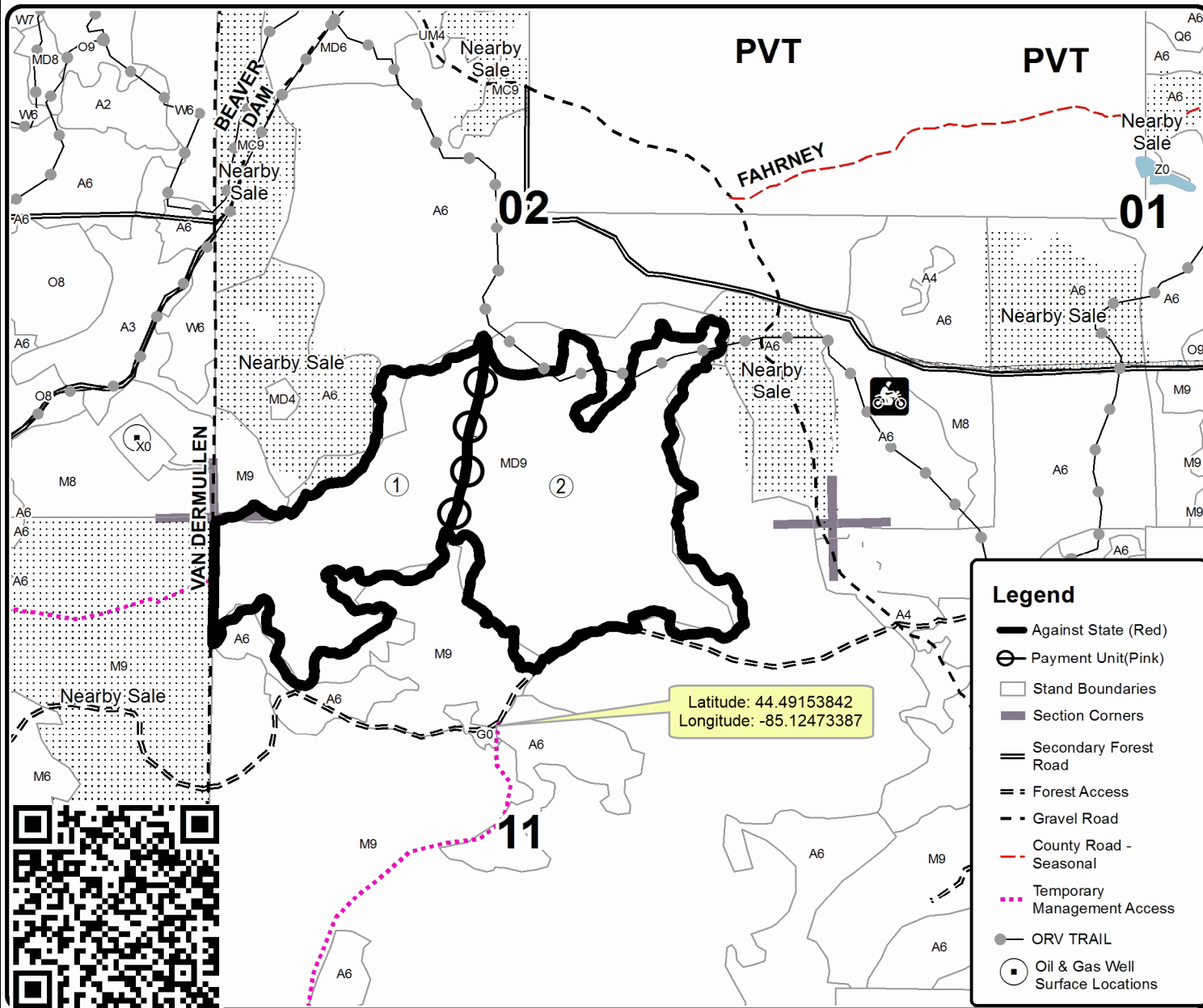
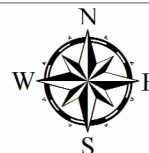

Legend

- Against State (Red)
- Payment Unit (Pink)
- Stand Boundaries
- Section Corners
- Secondary Forest Road
- Forest Access
- Gravel Road
- County Road - Seasonal
- Temporary Management Access
- ORV TRAIL
- Oil & Gas Well Surface Locations

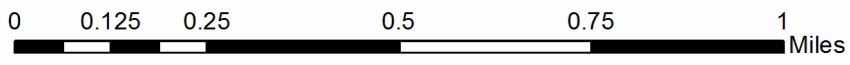

TIMBER SALE INFORMATION

Pioneer Aspen (63-006-19)

T24N, R07W, SEC. 1; T24N, R07W, SEC. 11; T24N, R07W, SEC. 12; T24N, R07W, SEC. 2.
Missaukee County (Advertised Price \$159,363.35)

SALE NOTE: A recreation site such as a trail, pathway, or campground is within the sale area or the vicinity. Certain restrictions/specifications may be applicable including time restrictions.

A timber sale contract for this lump sum, sealed bid timber sale will be awarded to the responsible bidder offering the highest sealed bid price. Bids must be at or above the following advertised price for each species:

<u>PRODUCTS & SPECIES</u>	<u>ESTIMATED UNITS*</u>	<u>ADVERTISED PRICE</u>
Sawtimber		
B. T. Aspen	526.70 MBF	\$ 101.00 / MBF
Basswood	25.30 MBF	\$ 108.00 / MBF
Beech	7.50 MBF	\$ 79.00 / MBF
Red Maple	92.20 MBF	\$ 103.00 / MBF
Red Oak	56.00 MBF	\$ 205.00 / MBF
Sugar Maple	14.00 MBF	\$ 372.00 / MBF
White Pine	170.80 MBF	\$ 115.00 / MBF
Pulpwood		
B. T. Aspen	1,832.00 Cords	\$ 18.40 / Cord
Basswood	65.00 Cords	\$ 18.30 / Cord
Jack Pine	7.00 Cords	\$ 14.45 / Cord
Mixed Hardwood	753.00 Cords	\$ 15.65 / Cord
Red Oak	203.00 Cords	\$ 21.50 / Cord
Red Pine	7.00 Cords	\$ 36.10 / Cord
White Pine	269.00 Cords	\$ 19.95 / Cord
White Spruce	15.00 Cords	\$ 16.50 / Cord

* The total volume is statistically estimated within plus (+) or minus (-) 10.02 percent. The estimated units are final and not subject to adjustment. Prospective bidders are urged to examine this timber and to make their own estimates of quantity and quality.

BOND AND PAYMENT SCHEDULE:

- A bond in the amount of \$7,968.00 to insure faithful performance of the conditions of the contract will be deposited by the successful bidder within 21 days of the sale award.
- Cutting in any sale or unit without the required advance payment would be considered a trespass.
- Total payment must be paid in advance or according to the following schedule:
 - Ten percent (10%) of the sale value must be paid within 21 days of the sale award.
 - The 10% down payment will be credited towards the first unit cut.
 - Payment for each of the following units must be made before cutting begins in that unit:

<u>PAYMENT UNIT NUMBER</u>	<u>PERCENT OF TOTAL SALE VALUE</u>
01	28.2%
02	26.8%
03	12.4%
04	12.4%
05	9.6%
06	10.6%
- If no cutting takes place, the 10% down payment will not be refunded.
- Operations on the contract issued will terminate on 09/30/2021.

Description of Timber by Payment Unit (PU)

PU	MARKET GROUP	PRODUCT	QUANTITY	UNIT	ACRES	ADVERTISE PRICE
1	B. T. Aspen	Sawtimber	133.7	MBF	32.5	\$45,114.80
	Basswood		18.2	MBF		
	Beech		4.3	MBF		
	Red Maple		56.5	MBF		
	Red Oak		31.2	MBF		
	Sugar Maple		14.0	MBF		
	B. T. Aspen	Pulpwood	287.0	Cords		
	<i>B. T. Aspen</i>		<i>287.0</i>	<i>Cords</i>		
	Basswood		30.0	Cords		
	Jack Pine		7.0	Cords		
	Mixed Hardwood		269.0	Cords		
	<i>Black Cherry</i>	<i>Sawtimber</i>	<i>1.0</i>	<i>MBF</i>		
	<i>Beech</i>	<i>Pulpwood</i>	<i>16.0</i>	<i>Cords</i>		
	<i>Black Cherry</i>		<i>3.0</i>	<i>Cords</i>		
	<i>Red Maple</i>		<i>210.0</i>	<i>Cords</i>		
	<i>Sugar Maple</i>		<i>38.0</i>	<i>Cords</i>		
	Red Oak		81.0	Cords		
2	B. T. Aspen	Sawtimber	221.2	MBF	31.7	\$42,683.90
	Red Maple		4.7	MBF		
	Red Oak		4.4	MBF		
	B. T. Aspen	Pulpwood	881.0	Cords		
	<i>B. T. Aspen</i>		<i>881.0</i>	<i>Cords</i>		
	Mixed Hardwood		148.0	Cords		
	<i>Beech</i>		<i>22.0</i>	<i>Cords</i>		
	<i>Black Cherry</i>		<i>10.0</i>	<i>Cords</i>		
	<i>Red Maple</i>		<i>116.0</i>	<i>Cords</i>		
	Red Oak		20.0	Cords		
	3	B. T. Aspen	Sawtimber	94.6		
Basswood			7.1	MBF		
Beech			3.2	MBF		
Red Maple			6.0	MBF		
B. T. Aspen		Pulpwood	315.0	Cords		
<i>B. T. Aspen</i>			<i>315.0</i>	<i>Cords</i>		
Basswood			35.0	Cords		
Mixed Hardwood			132.0	Cords		
<i>American Elm</i>		<i>Sawtimber</i>	<i>2.1</i>	<i>MBF</i>		
<i>Black Cherry</i>			<i>1.2</i>	<i>MBF</i>		
<i>Paper Birch</i>			<i>1.5</i>	<i>MBF</i>		
<i>American Elm</i>		<i>Pulpwood</i>	<i>9.0</i>	<i>Cords</i>		
<i>Beech</i>			<i>43.0</i>	<i>Cords</i>		
<i>Black Cherry</i>			<i>10.0</i>	<i>Cords</i>		
<i>Ironwood</i>			<i>20.0</i>	<i>Cords</i>		
<i>Paper Birch</i>			<i>4.0</i>	<i>Cords</i>		
<i>Red Maple</i>			<i>33.0</i>	<i>Cords</i>		
<i>White Ash</i>		<i>4.0</i>	<i>Cords</i>			
4	B. T. Aspen	Sawtimber	9.5	MBF	11.8	\$19,724.70
	Red Maple		5.9	MBF		
	Red Oak		5.0	MBF		
	White Pine		99.1	MBF		
	B. T. Aspen	Pulpwood	94.0	Cords		
	<i>Quaking Aspen</i>	<i>Sawtimber</i>	<i>1.3</i>	<i>MBF</i>		
	<i>B. T. Aspen</i>	<i>Pulpwood</i>	<i>88.0</i>	<i>Cords</i>		
	<i>Quaking Aspen</i>		<i>3.0</i>	<i>Cords</i>		
	Mixed Hardwood		59.0	Cords		
	<i>Hemlock</i>	<i>Sawtimber</i>	<i>3.5</i>	<i>MBF</i>		
	<i>Paper Birch</i>		<i>2.0</i>	<i>MBF</i>		

Description of Timber by Payment Unit (PU), con't

PU	MARKET GROUP	PRODUCT	QUANTITY	UNIT	ACRES	ADVERTISE PRICE
4 con't	<i>Paper Birch</i>	<i>Pulpwood</i>	9.0	<i>Cords</i>		
	<i>Red Maple</i>		39.0	<i>Cords</i>		
	Red Oak		6.0	Cords		
	Red Pine		7.0	Cords		
	<i>Red Pine</i>	<i>Sawtimber</i>	3.1	<i>MBF</i>		
	<i>Red Pine</i>	<i>Pulpwood</i>	1.0	<i>Cords</i>		
	White Pine		123.0	Cords		
	White Spruce		15.0	Cords		
	<i>White Spruce</i>	<i>Sawtimber</i>	5.0	<i>MBF</i>		
	<i>White Spruce</i>	<i>Pulpwood</i>	5.0	<i>Cords</i>		
	5	B. T. Aspen	Sawtimber	32.1	MBF	16.5
Red Maple			9.1	MBF		
Red Oak			7.3	MBF		
White Pine			34.0	MBF		
B. T. Aspen		Pulpwood	121.0	Cords		
<i>B. T. Aspen</i>			121.0	<i>Cords</i>		
Mixed Hardwood			68.0	Cords		
<i>Black Cherry</i>			2.0	<i>Cords</i>		
<i>Red Maple</i>			66.0	<i>Cords</i>		
Red Oak			46.0	Cords		
White Pine			69.0	Cords		
6	B. T. Aspen	Sawtimber	35.6	MBF	18.3	\$16,903.40
	Red Maple		10.0	MBF		
	Red Oak		8.1	MBF		
	White Pine		37.7	MBF		
	B. T. Aspen	Pulpwood	134.0	Cords		
	<i>B. T. Aspen</i>		134.0	<i>Cords</i>		
	Mixed Hardwood		77.0	Cords		
	<i>Black Cherry</i>		3.0	<i>Cords</i>		
	<i>Red Maple</i>		74.0	<i>Cords</i>		
	Red Oak		50.0	Cords		
	White Pine		77.0	Cords		
TOTAL:			892.5	MBF		
TOTAL:			3,151.0	Cords		

Sale Specific Conditions & Requirements

Sale Name: Pioneer Aspen

Sale Number: 63-006-19 Seq#: 1

1 - Sale Area

1.2 - Boundaries

1.2.1 - Painted boundaries (1/14)

The sale boundary is marked in red and blue paint. Exterior sale boundary lines against private property are marked with blue paint. Exterior sale boundary lines against state are marked with red paint. Retention islands are marked with red paint. The painted boundary line trees are not Included Timber and are to be protected.

2 - Timber Specifications

2.1 - Included Timber

2.1.1 - Clearcut unit(s) with unmerchantable trees (6/14)

Within Payment Unit(s) 1, 2, 5 and 6, cut all trees that are two (2) inches or more at DBH, except do not cut any trees marked in green paint.

2.1.2 - Clearcut unit(s) w/o unmerchantable trees (8/11)

Within Payment Unit(s) 3, cut all trees which meet minimum piece specifications in 2.2 Utilization, except do not cut oak and sugar maple.

2.1.4 - Designated timber unit(s) (6/17)

Within Payment Unit(s) 4, all trees are designated for cutting, regardless of merchantability, except do not cut pine less than 10 inches at DBH, or any hemlock or cedar.

4 - Transportation

4.1 - Construction

4.1.12 - No new roads (1/12)

No new roads will be permitted in any Payment Unit. All operations are limited to existing roads. Skid trails only will be allowed.

4.2 - Maintenance

4.2.5 - Two wheel drive condition (2/04)

All existing trail roads on and adjacent to the sale area must be passable by two-wheel drive traffic for the duration of the sale.

5 - Operations

5.1 - Notification

5.1.1 - Pre-sale conference (10/16)

A pre-sale conference on site between the Purchaser and sale administrator is required prior to beginning a Payment Unit to determine landing and road locations. The Unit Manager or his/her representative must be contacted at least 3 days in advance to schedule the conference.

5.1.4 - Post-sale conference (10/16)

A post-sale conference on site between the Purchaser and sale administrator is required 3 days prior to the completion of active logging operations to determine clean-up and repair of landings, road edges, and the fulfillment of other contract specifications.

5.2 - Conduct of Operations

5.2.3 - Operating Restrictions

5.2.3.4 - Oak wilt restriction, no exceptions (1/18)

Within Payment Unit(s) 3, cutting, skidding, hauling within the sale and brushing of access roads to the sale are not

permitted during the period of April 15 to July 15. No exceptions will be granted. This is necessary to reduce the spread of oak wilt.

5.2.3.11 - Coppice regeneration protection (4/10)

Any post harvest operations, such as chipping, must be completed before sprouting of regeneration occurs. If it is anticipated that chipping will be delayed, then tops shall be carried to one central location or left unchipped. The Unit Manager or his/her representative may cease such operations if sprouting occurs before the operation is complete.

5.2.4 - Dead and Down Creation

5.2.4.2 - Dead and down creation, hare and grouse (1/14)

To improve habitat for snowshoe hare, grouse, and other species, the Purchaser is to leave two, 10 inch diameter or larger log size pieces on the ground for every four acres. They should be scattered throughout the sale or positioned per the sale administrators instructions. If possible, the logs or trees should be felled so they overlap. Note these pieces should have a minimum length of five feet. They can be of any tree species and can be an un-merchantable piece of wood or a full tree.

5.2.39 - ORV trail/route protection (4/18)

An ORV trail runs through Payment Units 1, 2, and 6. All stumps within 5 feet of the trail must be cut flush with the ground. Maintain a 20 foot wide slash, debris, and rut free zone daily using the ORV trail or route as the centerline. Do not run equipment down the ORV trail or route. Skidding across the trail or route may only occur in locations approved by the sale administrator.

5.4 - Soil Protection

5.4.1 - Rutting restriction, general (7/16)

Operations are to cease immediately if equipment and weather conditions result in rutting of roads and/or skid trails which is 12 inches or greater in depth and 50 feet in length. The Unit Manager or his/her representative may restrict hauling and/or skidding if ruts exceed the specified depth. With the Unit Manager or his/her representative's approval, the Purchaser may return to the area when the risk of rutting has decreased.

6 - Safety and Fire Prevention

6.2 - Signing

6.2.1 - Road posting (9/09)

The Purchaser is responsible for posting and maintaining caution signs on access logging roads prior to beginning operations. The road must be posted at appropriate distances from the sale area to warn of logging activity and truck traffic. Signs must be removed when harvest operations are suspended or completed. The Purchaser will provide these signs.

6.2.3 - Recreational trail posting (2/10)

The Purchaser is responsible for posting and maintaining caution signs on all ORV trails that run through the sale area prior to beginning operations. The trail must be posted at appropriate distances from the sale area to warn of logging activity and truck traffic at both ends of the trail. Signs must be removed when harvest operations are suspended or completed. The Purchaser will provide these signs.



Sale Number	Year
63-006-19	19

TIMBER SALE MAP

This information provided by authority of Part 525, 1994 PA 451, as amended.

Forest Management Unit Cadillac		County Missaukee	Mapped By Ventimiglia	Date 05/20/19	Page 1	of 1
Township 24N	Range 07W	Section(s) and Subdivision(s) Section 1 2 and 12 (various)		Scale 1:16,840		

Cover Type				Density	
A = Aspen	H = Hemlock	N = Marsh	U = Upland Brush	0 = Non Stocked	5 = Pole Timber Medium
B = Paper Birch	J = Jack Pine	O = Oak	UM = Upland Mixed	1 = Seedling Sapling Poor	6 = Pole Timber Well
C = Cedar	L = Lowland Brush	P = Lowland Poplar	V = Bog or Marsh	2 = Seedling Sapling Medium	7 = Saw Timber Poor
D = Treed Bog	LM = Lowland Mixed	Q = Mixed Swamp Conifer	W = White Pine	3 = Seedling Sapling Well	8 = Saw Timber Medium
E = Swamp Hdwoods	M = Mpl, Bch, Brch	R = Red Pine	X = Non Stocked	4 = Pole Timber Poor	9 = Saw Timber Well
F = Spruce Fir	MC = Mixed Conifer	S = Black Spruce	Z = Water		
G = Grass	MD = Mixed Deciduous	T = Tamarack			

PU	Acres	PU	Acres
1	32.5	4	11.8
2	31.7	5	16.5
3	35.5	6	18.3

Pioneer Aspen

Compartment 122

146.3 Acres

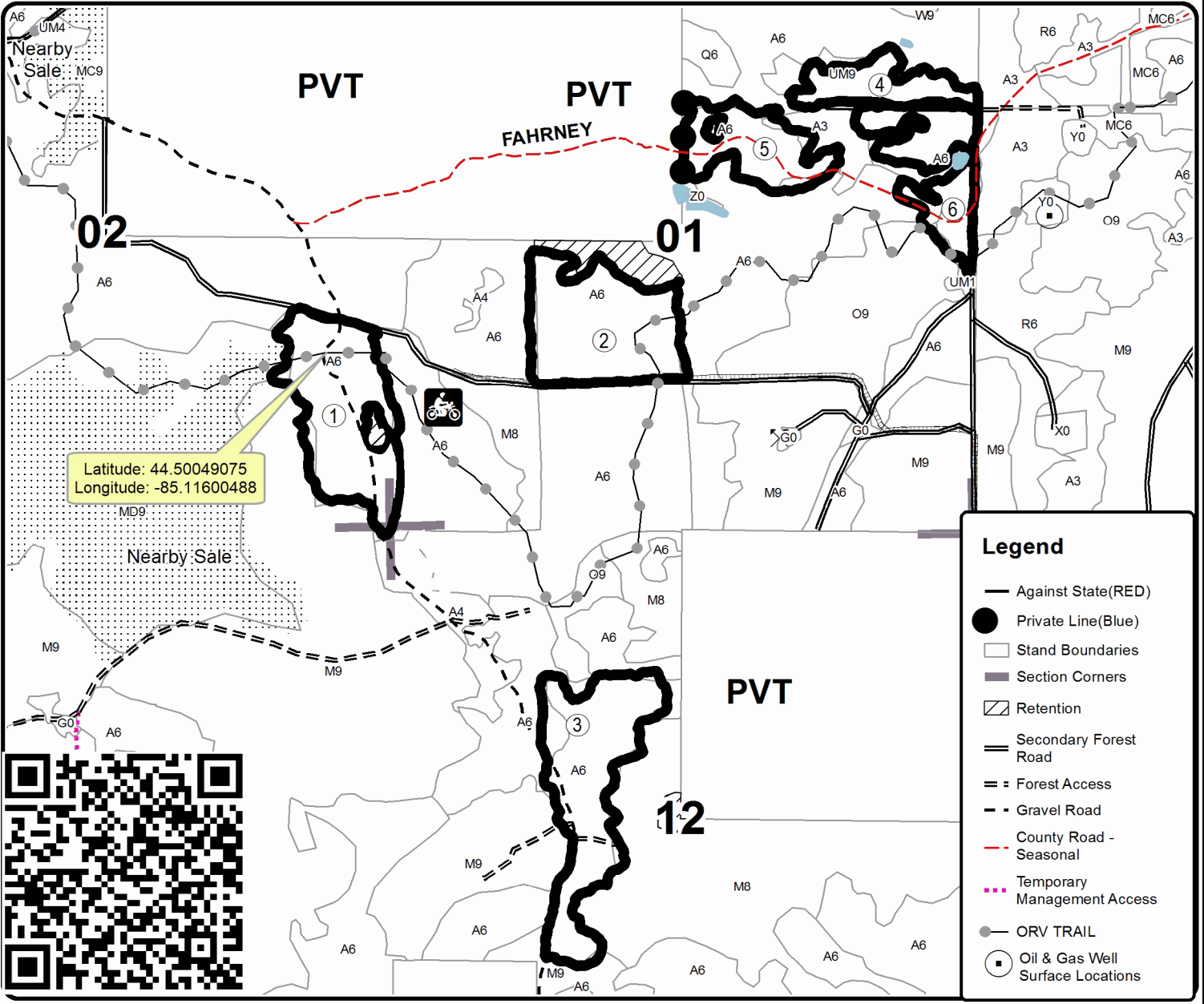
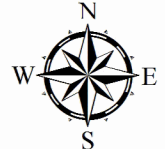

Legend

- Against State(RED)
- Private Line(Blue)
- Stand Boundaries
- Section Corners
- Retention
- Secondary Forest Road
- Forest Access
- Gravel Road
- County Road - Seasonal
- Temporary Management Access
- ORV TRAIL
- Oil & Gas Well Surface Locations

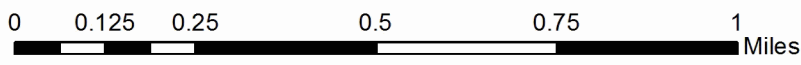

TIMBER SALE INFORMATION

Pioneer Pine (63-007-19)

T24N, R07W, SEC. 2.

Missaukee County (Advertised Price \$85,287.45)

SALE NOTE: A recreation site such as a trail, pathway, or campground is within the sale area or the vicinity. Certain restrictions/specifications may be applicable including time restrictions.

A timber sale contract for this lump sum, sealed bid timber sale will be awarded to the responsible bidder offering the highest sealed bid price. Bids must be at or above the following advertised price for each species:

<u>PRODUCTS & SPECIES</u>	<u>ESTIMATED UNITS*</u>		<u>ADVERTISED PRICE</u>
Sawtimber			
Mixed Aspen	239.20	MBF	\$ 94.00 / MBF
Red Maple	47.10	MBF	\$ 95.00 / MBF
Red Oak	111.50	MBF	\$ 190.00 / MBF
Red Pine	29.50	MBF	\$ 109.00 / MBF
Sugar Maple	5.70	MBF	\$ 346.00 / MBF
White Pine	63.70	MBF	\$ 107.00 / MBF
Pulpwood			
B. T. Aspen	677.00	Cords	\$ 17.05 / Cord
Mixed Hardwood	273.00	Cords	\$ 14.55 / Cord
Red Oak	189.00	Cords	\$ 19.95 / Cord
Red Pine	44.00	Cords	\$ 33.55 / Cord
White Pine	236.00	Cords	\$ 18.55 / Cord

* The total volume is statistically estimated within plus (+) or minus (-) 15.20 percent. The estimated units are final and not subject to adjustment. Prospective bidders are urged to examine this timber and to make their own estimates of quantity and quality.

BOND AND PAYMENT SCHEDULE:

1. A bond in the amount of \$4,264.00 to insure faithful performance of the conditions of the contract will be deposited by the successful bidder within 21 days of the sale award.
2. Cutting in any sale or unit without the required advance payment would be considered a trespass.
3. Total payment must be paid in advance or according to the following schedule:
 - (a) Ten percent (10%) of the sale value must be paid within 21 days of the sale award.
 - (b) The 10% down payment will be credited towards the first unit cut.
 - (c) Payment for each of the following units must be made before cutting begins in that unit:

PAYMENT UNIT NUMBER	PERCENT OF TOTAL SALE VALUE
01	17.4%
02	67.8%
03	14.8%

4. If no cutting takes place, the 10% down payment will not be refunded.
5. Operations on the contract issued will terminate on 09/30/2021.

Description of Timber by Payment Unit (PU)

PU	MARKET GROUP	PRODUCT	QUANTITY	UNIT	ACRES	ADVERTISE PRICE		
1	Mixed Aspen	Sawtimber	53.0	MBF	31.3	\$14,803.30		
	<i>B. T. Aspen</i>		38.6	<i>MBF</i>				
	<i>Quaking Aspen</i>		14.4	<i>MBF</i>				
	Red Maple		9.5	MBF				
	Red Pine		9.7	MBF				
	White Pine		12.5	MBF				
	B. T. Aspen		Pulpwood	199.0			Cords	
	<i>B. T. Aspen</i>			144.0			<i>Cords</i>	
	<i>Quaking Aspen</i>			55.0			<i>Cords</i>	
	Mixed Hardwood			74.0			Cords	
	<i>Beech</i>			4.0			<i>Cords</i>	
	<i>Red Maple</i>			70.0			<i>Cords</i>	
	Red Pine			17.0			Cords	
	White Pine			80.0			Cords	
	2			Mixed Aspen			Sawtimber	184.3
<i>B. T. Aspen</i>		184.3	<i>MBF</i>					
Red Maple		32.3	MBF					
Red Oak		111.5	MBF					
Sugar Maple		5.7	MBF					
White Pine		2.8	MBF					
B. T. Aspen		Pulpwood	420.0	Cords				
<i>B. T. Aspen</i>			420.0	<i>Cords</i>				
Mixed Hardwood			185.0	Cords				
<i>Basswood</i>			<i>Sawtimber</i>	1.6	<i>MBF</i>			
<i>Beech</i>				1.6	<i>MBF</i>			
<i>Basswood</i>				<i>Pulpwood</i>	4.0	<i>Cords</i>		
<i>Beech</i>			15.0		<i>Cords</i>			
<i>Black Cherry</i>			5.0		<i>Cords</i>			
<i>Paper Birch</i>			5.0		<i>Cords</i>			
<i>Red Maple</i>			106.0	<i>Cords</i>				
<i>Sugar Maple</i>			44.0	<i>Cords</i>				
Red Oak			189.0	Cords				
White Pine			20.0	Cords				
3		Mixed Aspen	Sawtimber	1.9	MBF	25.1		\$12,640.35
	<i>Quaking Aspen</i>	1.9		<i>MBF</i>				
	Red Maple	5.3		MBF				
	Red Pine	19.8		MBF				
	White Pine	48.4		MBF				
	B. T. Aspen	Pulpwood		58.0	Cords			
	<i>B. T. Aspen</i>			26.0	<i>Cords</i>			
	<i>Quaking Aspen</i>			32.0	<i>Cords</i>			
	Mixed Hardwood			14.0	Cords			
	<i>Red Maple</i>			14.0	<i>Cords</i>			
	Red Pine			27.0	Cords			
White Pine	136.0	Cords						
TOTAL:			496.7	MBF				
TOTAL:			1,419.0	Cords				

Sale Specific Conditions & Requirements

Sale Name: Pioneer Pine

Sale Number: 63-007-19 Seq#: 1

1 - Sale Area

1.2 - Boundaries

1.2.1 - Painted boundaries (1/14)

The sale boundary is marked and identified by blue and red paint. Exterior sale boundary lines against private are marked with blue paint. Exterior sale boundary lines against state are marked with red paint. Retention islands are marked with red paint.

2 - Timber Specifications

2.1 - Included Timber

2.1.2 - Clearcut unit(s) w/o unmerchantable trees (8/11)

Within Payment Unit(s) 2, cut all trees which meet minimum piece specifications in 2.2 Utilization, except do not cut trees marked in green paint.

2.1.3 - Cut tree marked unit(s) (12/08)

Within Payment Unit(s) 1 and 3, all trees are designated for cutting when marked with orange paint above and below stump height, regardless of merchantability. In addition, cut all aspen, maple and cherry, regardless of merchantability.

2.2 - Utilization

2.2.6 - Roundwood operation required (5/07)

The skidding of whole trees or tree segments with limbs attached is prohibited within Payment Unit(s) 1 and 3. All products must be produced as roundwood and forwarded to existing roads or landing areas in final product length.

3 - Payments

3.3 - Pre-measured Sales

3.3.4 - Dividing payment units (7/14)

Payment Unit(s) 1-3 may be divided at the request of the Purchaser and upon approval of the Unit Manager. Dividing Payment Units is a contract modification which requires a Timber Sale Contract Supplement. There will be only one division per Payment Unit.

4 - Transportation

4.1 - Construction

4.1.12 - No new roads (1/12)

No new roads will be permitted in any Payment Unit. All operations are limited to existing roads. Skid trails only will be allowed.

4.2 - Maintenance

4.2.5 - Two wheel drive condition (2/04)

All existing trail roads on and adjacent to the sale area must be passable by two-wheel drive traffic for the duration of the sale.

5 - Operations

5.1 - Notification

5.1.1 - Pre-sale conference (10/16)

A pre-sale conference between the Purchaser and sale administrator is required prior to beginning a Payment Unit to determine landing and road locations. The Unit Manager or his/her representative must be contacted at least 3 days in advance to schedule the conference.

5.1.4 - Post-sale conference (10/16)

A post-sale conference on site between the Purchaser and sale administrator is required 3 days prior to the completion of active logging operations to determine clean-up and repair of landings, road edges, and the fulfillment of other contract specifications.

5.2 - Conduct of Operations

5.2.4 - Dead and Down Creation

5.2.4.2 - Dead and down creation, hare and grouse (1/14)

To improve habitat for snowshoe hare, grouse, and other species, the Purchaser is to leave two, 10 inch diameter or larger log size pieces on the ground for every four acres. They should be scattered throughout the sale or positioned per the sale administrators instructions. If possible, the logs or trees should be felled so they overlap. Note these pieces should have a minimum length of five feet. They can be of any tree species and can be an un-merchantable piece of wood or a full tree.

5.2.39 - ORV trail/route protection (4/18)

An ORV trails runs through Payment Unit 1, as shown on the Timber Sale Map. Do not cut trees or damage posts with yellow ORV markers. All stumps within 5 feet of the trail must be cut flush with the ground. Maintain a 20 foot wide slash, debris, and rut free zone daily using the ORV trail or route as the centerline. Do not run equipment down the ORV trail or route. Skidding across the trail or route may only occur in locations approved by the sale administrator.

5.2.41 - Snowmobile trail protection (9/11)

The snowmobile trail runs through Payment Unit 1 and 3, and is shown on the Timber Sale Map. Do not cut or damage posts with orange trail markers or traffic control signs. If the trail is used, it must be maintained and restored to a condition equal to or better than before the sale. If the trail road is to be used for hauling during the snowmobile season, then a snow covered base must be left on the trail. The snowmobile trail may only be crossed at right angles. Maintain a 20 foot wide slash, debris, and rut free zone daily using the snowmobile trail as the centerline. All stumps within 20 feet of the snowmobile trail must be cut at ground level. In addition, any trees cut within 5 feet of the trail must have the stumps removed and be disposed of according to the direction of the Unit Manager or his/her representative.

6 - Safety and Fire Prevention

6.2 - Signing

6.2.2 - Snowmobile trail posting (8/09)

The Purchaser is responsible for posting and maintaining caution signs on the snowmobile trail prior to beginning operations during the snowmobile season (approximately December 1 to March 31). The trail must be posted at appropriate distances from the sale area to warn of logging activity and truck traffic. Signs must be removed when harvest operations are suspended or completed. The Purchaser will provide these signs.

6.2.3 - Recreational trail posting (2/10)

The Purchaser is responsible for posting and maintaining caution signs on the ORV trail prior to beginning operations. The trail must be posted at appropriate distances from the sale area to warn of logging activity and truck traffic at both ends of the trail. Signs must be removed when harvest operations are suspended or completed. The Purchaser will provide these signs.



TIMBER SALE MAP

This information provided by authority of Part 525, 1994 PA 451, as amended.

Sale Number	Year
63-007-19	19

Forest Management Unit	County	Mapped By	Date	Page	of
Cadillac	Missaukee	Ventimiglia	05/20/19	1	1
Township	Range	Section(s) and Subdivision(s)	Scale		
24N	07W	Section 2 (various)	1:15,840		

Cover Type				Density	
A = Aspen	H = Hemlock	N = Marsh	U = Upland Brush	0 = Non Stocked	5 = Pole Timber Medium
B = Paper Birch	J = Jack Pine	O = Oak	UM = Upland Mixed	1 = Seedling Sapling Poor	6 = Pole Timber Well
C = Cedar	L = Lowland Brush	P = Lowland Poplar	V = Bog or Marsh	2 = Seedling Sapling Medium	7 = Saw Timber Poor
D = Treed Bog	LM = Lowland Mixed	Q = Mixed Swamp Conifer	W = White Pine	3 = Seedling Sapling Well	8 = Saw Timber Medium
E = Swamp Hdwoods	M = Mpl, Bch, Brch	R = Red Pine	X = Non Stocked	4 = Pole Timber Poor	9 = Saw Timber Well
F = Spruce Fir	MC = Mixed Conifer	S = Black Spruce	Z = Water		
G = Grass	MD = Mixed Deciduous	T = Tamarack			

PU	Acres
1	31.3
2	39.4
3	25.1

Pioneer Pine

Compartment 122

95.8 Acres

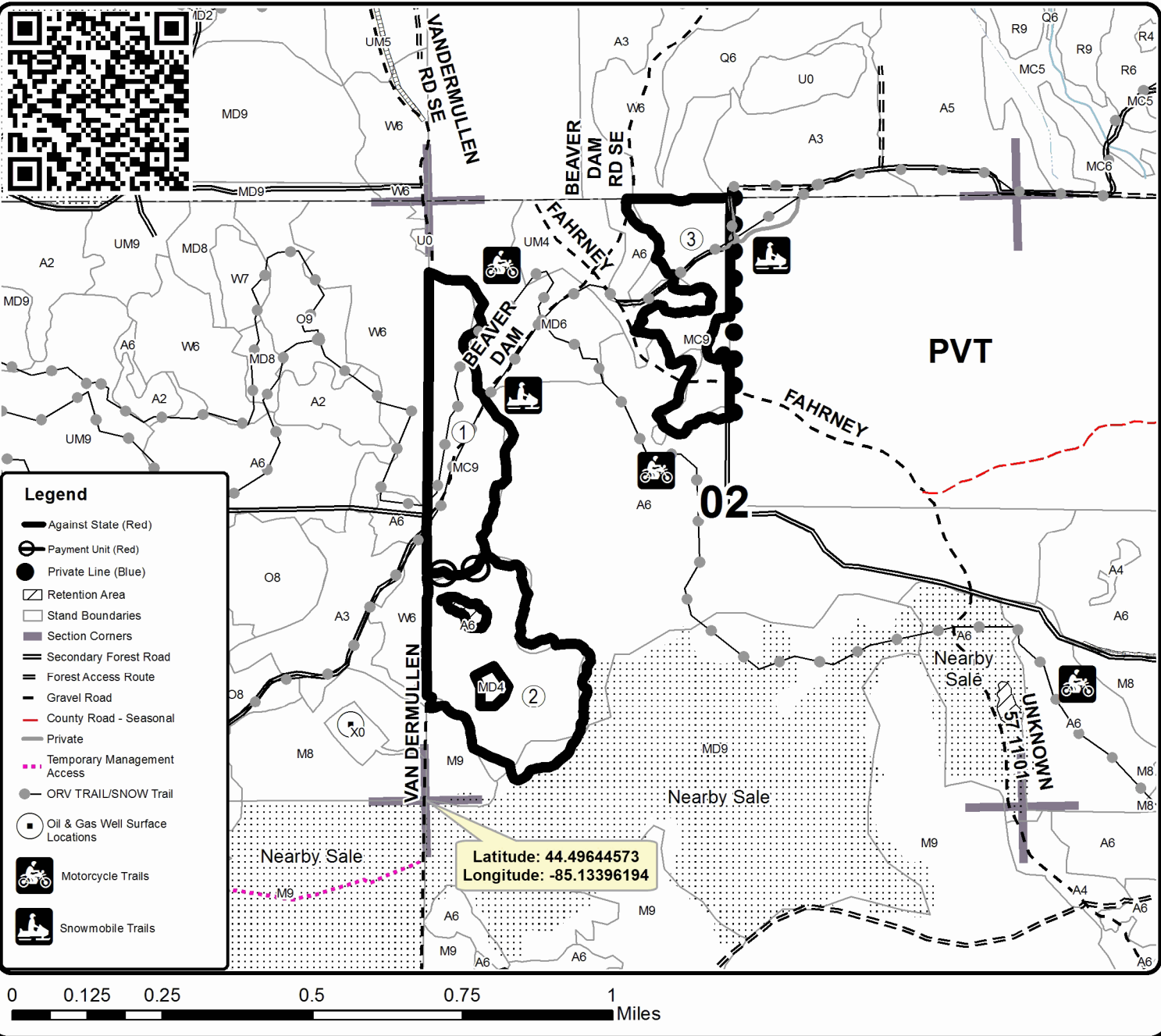

Pioneer Mix (63-005-19)
T24N, R07W, SEC. 11; T24N, R07W, SEC. 2; Missaukee COUNTY

In response to the notice of sale to be held 3:00 p.m. (local time) on August 28, 2019, I am hereby submitting my sealed bid (firm offer) for the following forest products to be cut. Bids for individual species must be at or above the advertised price. All non-responsive bid forms may be rejected.

<u>PRODUCTS & SPECIES</u>	<u>ESTIMATED VOLUME*</u>	<u>ADVERTISED PRICE</u>	<u>BID PRICE/UNIT</u>
Sawtimber			
B. T. Aspen	18.50 MBF	\$ 94.00/MBF	\$ _____
Basswood	85.70 MBF	\$ 100.00/MBF	\$ _____
Beech	53.00 MBF	\$ 73.00/MBF	\$ _____
Red Maple	230.70 MBF	\$ 95.00/MBF	\$ _____
Red Oak	320.60 MBF	\$ 190.00/MBF	\$ _____
Sugar Maple	43.50 MBF	\$ 346.00/MBF	\$ _____
Pulpwood			
B. T. Aspen	44.00 Cords	\$ 17.05/Cord	\$ _____
Basswood	112.00 Cords	\$ 17.00/Cord	\$ _____
Mixed Hardwood	1,230.00 Cords	\$ 14.55/Cord	\$ _____
Red Oak	558.00 Cords	\$ 19.95/Cord	\$ _____

*The volumes are statistically estimated within plus (+) or minus (-) 10.84 percent. These estimated volumes are final and not subject to adjustment. Prospective bidders are urged to examine this timber and to make their own estimates of quantity and quality.

I understand that any or all bids may be rejected. All bids must be signed and all bid items must be bid or the bid form may be rejected. I also understand that consideration and awarding a contract will be based upon my past performance and ability to complete the contract based upon equipment and staffing subject to my control.

FEDERAL ID: _____ or SOCIAL SECURITY NUMBER: _____

Company or individual bidding: _____

Company representative's name: _____

Address: _____

City: _____ State: _____ Zip: _____

IF AVAILABLE, PLEASE PLACE THE PERSONALIZED LABEL FROM YOUR PROSPECTUS IN THE ABOVE BOX.

Individual or company representative's signature: _____ Date: _____

Phone number : _____ Email (optional): _____

THE WINNING BIDDER MUST COMPLETE THE VERIFICATION OF WORKER'S DISABILITY COMPENSATION ACT COMPLIANCE (ON REVERSE SIDE IF DOUBLE SIDED) WITHIN 21 DAYS OF SALE AWARD DATE

Pioneer Aspen (63-006-19)

T24N, R07W, SEC. 1; T24N, R07W, SEC. 11; T24N, R07W, SEC. 12; T24N, R07W,

In response to the notice of sale to be held 3:00 p.m. (local time) on August 28, 2019, I am hereby submitting my sealed bid (firm offer) for the following forest products to be cut. Bids for individual species must be at or above the advertised price. All non-responsive bid forms may be rejected.

<u>PRODUCTS & SPECIES</u>	<u>ESTIMATED VOLUME*</u>	<u>ADVERTISED PRICE</u>	<u>BID PRICE/UNIT</u>
Sawtimber			
B. T. Aspen	526.70 MBF	\$ 101.00/MBF	\$ _____
Basswood	25.30 MBF	\$ 108.00/MBF	\$ _____
Beech	7.50 MBF	\$ 79.00/MBF	\$ _____
Red Maple	92.20 MBF	\$ 103.00/MBF	\$ _____
Red Oak	56.00 MBF	\$ 205.00/MBF	\$ _____
Sugar Maple	14.00 MBF	\$ 372.00/MBF	\$ _____
White Pine	170.80 MBF	\$ 115.00/MBF	\$ _____
Pulpwood			
B. T. Aspen	1,832.00 Cords	\$ 18.40/Cord	\$ _____
Basswood	65.00 Cords	\$ 18.30/Cord	\$ _____
Jack Pine	7.00 Cords	\$ 14.45/Cord	\$ _____
Mixed Hardwood	753.00 Cords	\$ 15.65/Cord	\$ _____
Red Oak	203.00 Cords	\$ 21.50/Cord	\$ _____
Red Pine	7.00 Cords	\$ 36.10/Cord	\$ _____
White Pine	269.00 Cords	\$ 19.95/Cord	\$ _____
White Spruce	15.00 Cords	\$ 16.50/Cord	\$ _____

*The volumes are statistically estimated within plus (+) or minus (-) 10.02 percent. These estimated volumes are final and not subject to adjustment. Prospective bidders are urged to examine this timber and to make their own estimates of quantity and quality.

I understand that any or all bids may be rejected. All bids must be signed and all bid items must be bid or the bid form may be rejected. I also understand that consideration and awarding a contract will be based upon my past performance and ability to complete the contract based upon equipment and staffing subject to my control.

FEDERAL ID: _____ or SOCIAL SECURITY NUMBER: _____

Company or individual bidding: _____

Company representative's name: _____

Address: _____

City: _____ State: _____ Zip: _____

IF AVAILABLE, PLEASE PLACE THE PERSONALIZED LABEL FROM YOUR PROSPECTUS IN THE ABOVE BOX.

Individual or company representative's signature: _____ Date: _____

Phone number : _____ Email (optional): _____

THE WINNING BIDDER MUST COMPLETE THE VERIFICATION OF WORKER'S DISABILITY COMPENSATION ACT COMPLIANCE (ON REVERSE SIDE IF DOUBLE SIDED) WITHIN 21 DAYS OF SALE AWARD DATE



FOR DEPARTMENT USE ONLY
Sale Number (XX - XXX - XX - XX)
Forest Management Unit:

TIMBER SALE VERIFICATION OF WORKER'S DISABILITY COMPENSATION ACT COMPLIANCE

*As required by Act 317, P.A. 1969 (Worker's Compensation) and
Part 5 of Act 451 of 1994, as amended.*

VERIFICATION OF WORKER'S DISABILITY COMPENSATION ACT COMPLIANCE

- This verification must be completed and submitted within 21 days of contract award and prior to the issuance of the timber sale contract.
- In addition, if boxes 2B or 2C are checked, then Notice of Exclusion or Certificate of Insurance must be submitted within twenty-one (21) days of the contract award and prior to the issuance of the timber sale contract.
- All information must be typed or printed except for written signatures.

Please Check Appropriate Categories:

1. My business is organized as (you **must** check one of the boxes below):
 - A. Sole Proprietorship (individual)
 - B. Partnership
 - C. Corporation

2. You **must** check one of the boxes below:
 - A. I certify my business is a sole proprietorship and it has no employees but the sole proprietor. I am not subject to the Worker's Compensation Laws.
 - B. I certify my business has satisfied its obligation to the Worker's Compensation Act through the use of an approved Notice of Exclusion (BWC-337, Rev. 5/96). I will provide a copy of the Notice of Exclusion within 21 days of the contract award. (For questions or a copy of the BWC-337, please call the Worker's Compensation Bureau at 517-322-1195).
 - C. I certify my business has a Worker's Compensation Policy. I will provide an original Certificate of Insurance within twenty-one (21) days of the contract award.

3. If you have checked item 2(A) or 2(B), you **must** indicate the number of **both** full-time and part-time employees, other than yourself, including family members and active partners (if none, you must enter "0").

_____ Full-time Employees

_____ Part-time Employees

Name of Business		Federal ID (or) Social Security No.	
Address		Telephone ()	
City	State	ZIP	

I hereby certify that the above information is true and correct. I agree to notify the Michigan DNR of any changes that occur in factors affecting my coverage during any of my present and future operations.

Signature of Owner or Authorized Representative

Title

Date

Please complete the "SEALED BID" information on the next page

Pioneer Pine (63-007-19)
T24N, R07W, SEC. 2; Missaukee COUNTY

In response to the notice of sale to be held 3:00 p.m. (local time) on August 28, 2019, I am hereby submitting my sealed bid (firm offer) for the following forest products to be cut. Bids for individual species must be at or above the advertised price. All non-responsive bid forms may be rejected.

<u>PRODUCTS & SPECIES</u>	<u>ESTIMATED VOLUME*</u>	<u>ADVERTISED PRICE</u>	<u>BID PRICE/UNIT</u>
Sawtimber			
Mixed Aspen	239.20 MBF	\$ 94.00/MBF	\$ _____
Red Maple	47.10 MBF	\$ 95.00/MBF	\$ _____
Red Oak	111.50 MBF	\$ 190.00/MBF	\$ _____
Red Pine	29.50 MBF	\$ 109.00/MBF	\$ _____
Sugar Maple	5.70 MBF	\$ 346.00/MBF	\$ _____
White Pine	63.70 MBF	\$ 107.00/MBF	\$ _____
Pulpwood			
B. T. Aspen	677.00 Cords	\$ 17.05/Cord	\$ _____
Mixed Hardwood	273.00 Cords	\$ 14.55/Cord	\$ _____
Red Oak	189.00 Cords	\$ 19.95/Cord	\$ _____
Red Pine	44.00 Cords	\$ 33.55/Cord	\$ _____
White Pine	236.00 Cords	\$ 18.55/Cord	\$ _____

*The volumes are statistically estimated within plus (+) or minus (-) 15.20 percent. These estimated volumes are final and not subject to adjustment. Prospective bidders are urged to examine this timber and to make their own estimates of quantity and quality.

I understand that any or all bids may be rejected. All bids must be signed and all bid items must be bid or the bid form may be rejected. I also understand that consideration and awarding a contract will be based upon my past performance and ability to complete the contract based upon equipment and staffing subject to my control.

FEDERAL ID: _____ or SOCIAL SECURITY NUMBER: _____

Company or individual bidding: _____

Company representative's name: _____

Address: _____

City: _____ State: _____ Zip: _____

IF AVAILABLE, PLEASE PLACE THE PERSONALIZED LABEL FROM YOUR PROSPECTUS IN THE ABOVE BOX.

Individual or company representative's signature: _____ Date: _____

Phone number : _____ Email (optional): _____

THE WINNING BIDDER MUST COMPLETE THE VERIFICATION OF WORKER'S DISABILITY COMPENSATION ACT COMPLIANCE (ON REVERSE SIDE IF DOUBLE SIDED) WITHIN 21 DAYS OF SALE AWARD DATE



FOR DEPARTMENT USE ONLY
Sale Number (XX - XXX - XX - XX)
Forest Management Unit:

TIMBER SALE VERIFICATION OF WORKER'S DISABILITY COMPENSATION ACT COMPLIANCE

*As required by Act 317, P.A. 1969 (Worker's Compensation) and
Part 5 of Act 451 of 1994, as amended.*

VERIFICATION OF WORKER'S DISABILITY COMPENSATION ACT COMPLIANCE

- This verification must be completed and submitted within 21 days of contract award and prior to the issuance of the timber sale contract.
- In addition, if boxes 2B or 2C are checked, then Notice of Exclusion or Certificate of Insurance must be submitted within twenty-one (21) days of the contract award and prior to the issuance of the timber sale contract.
- All information must be typed or printed except for written signatures.

Please Check Appropriate Categories:

1. My business is organized as (you **must** check one of the boxes below):
 - A. Sole Proprietorship (individual)
 - B. Partnership
 - C. Corporation
2. You **must** check one of the boxes below:
 - A. I certify my business is a sole proprietorship and it has no employees but the sole proprietor. I am not subject to the Worker's Compensation Laws.
 - B. I certify my business has satisfied its obligation to the Worker's Compensation Act through the use of an approved Notice of Exclusion (BWC-337, Rev. 5/96). I will provide a copy of the Notice of Exclusion within 21 days of the contract award. (For questions or a copy of the BWC-337, please call the Worker's Compensation Bureau at 517-322-1195).
 - C. I certify my business has a Worker's Compensation Policy. I will provide an original Certificate of Insurance within twenty-one (21) days of the contract award.
3. If you have checked item 2(A) or 2(B), you **must** indicate the number of **both** full-time and part-time employees, other than yourself, including family members and active partners (if none, you must enter "0").

_____ Full-time Employees

_____ Part-time Employees

Name of Business		Federal ID (or) Social Security No.	
Address		Telephone ()	
City	State	ZIP	

I hereby certify that the above information is true and correct. I agree to notify the Michigan DNR of any changes that occur in factors affecting my coverage during any of my present and future operations.

Signature of Owner or Authorized Representative

Title

Date

Please complete the "SEALED BID" information on the next page