



**DEPARTMENT OF NATURAL RESOURCES  
STATE OF MICHIGAN**

**TIMBER SALE PROSPECTUS #6492**

SCHEDULED SALE DATE AND TIME: 10:00 a.m. (local time) on August 19, 2019.

LOCATION: SE REGION-WILD, 3580 STATE PARK DRIVE, BAY CITY, MI 48706.

PROSPECTUS NOTE: The bidder is advised to inspect the sale area and review the location, estimated volumes, operating costs and contract terms of proposed sales. Please be aware that some landowners may request 60 days or more notice for access across their land.

Notice is hereby given that bids will be received by the Game Area Manager, CASS CITY FIELD OFFICE, for certain timber on the following described lands:

Sandy Ridge Aspen (55-116-19) / T12N, R10E, SEC. 1 , S1/2NW,NESW,S1/2SW,NWSE,S1/2SE.  
Tuscola County, Advertised Price \$36,121.75, 70.3 Acres, Aspen, Hardwood.

SALE NOTE: Access may be through other public land.

Cleland Aspen (55-117-19) / T14N, R12E, SEC. 10, S1/2SE.  
T14N, R12E, SEC. 11, SWSW.  
T14N, R12E, SEC. 15, NESW,NWSE.  
Sanilac County, Advertised Price \$14,018.55, 32.7 Acres, Aspen, Hardwood.

SALE NOTE: A recreation site such as a trail, pathway, or campground is within the sale area or the vicinity. Certain restrictions/specifications may be applicable including time restrictions. Access may be through other public land.

Vassar Aspen (55-118-19) / T12N, R08E, SEC. 22, S1/2SE.  
T12N, R08E, SEC. 23, E1/2SW,W1/2SE.  
T12N, R08E, SEC. 24, S1/2SW.  
T12N, R08E, SEC. 25, NWNW.  
T12N, R08E, SEC. 26, NENW,S1/2NW,N1/2SW,NWSE.  
T12N, R08E, SEC. 27, NENW,W1/2NE.  
Tuscola County, Advertised Price \$96,112.25, 176.3 Acres, Aspen, Hardwood.

SALE NOTE: A recreation site such as a trail, pathway, or campground is within the sale area or the vicinity. Certain restrictions/specifications may be applicable including time restrictions. Access may be through other public land.

Sanilac Aspen (55-119-19) / T14N, R12E, SEC. 22, NE,NESE.  
T14N, R12E, SEC. 23, N1/2NW,SWNW,NWSW,N1/2SE.  
Sanilac County, Advertised Price \$67,088.50, 110.3 Acres, Aspen, Hardwood.

SALE NOTE: Sale requires dry or frozen ground harvest only. No cutting, skidding, hauling from April 1 to July 15.

Access may be through other public land.

Ashmore Mix (55-120-19) / T14N, R09E, SEC. 10, S1/2SE.

Tuscola County, Advertised Price \$6,051.20, 14.3 Acres, Hardwood, Aspen.

SALE NOTE: Access may be through other public land.

## BID INSTRUCTIONS (VER. 07/02/2018):

### 1. Scheduled Bid Location, Date, and Time (2/11)

Bids must be received by the Unit Manager, BAY CITY OFFICE, 3580 STATE PARK DRIVE, BAY CITY, MI 48706, no later than 10:00 a.m. (local time) on August 19, 2019. For further information concerning this sale, contact Don Bonnette at 989-686-2634.

### 2. Bidder's Qualifications (5/16)

Purchaser shall obtain workers compensation insurance to cover claims under Michigan's Worker's Disability Compensation Act of 1969 or similar employee benefit act of any other state applicable to an employee. If all or part of a timber sale was prepared by a private contractor, the contractor and that contractor's company are not permitted to bid on the timber sale contract. Bids will not be accepted from individuals or companies appearing on the DNR/FRD No-Bid List. This list contains the names of purchasers who previously failed to execute a contract within 21-days or who have a history of poor performance.

### 3. Preparation of Sealed Bids (5/16)

Bid Forms may be completed online thru Michigan DNR Timber Sale Online Bidding (OLB) at [www.michigan.gov/timberbidding](http://www.michigan.gov/timberbidding) or by completing the hardcopy Bid Form found in the Timber Sale Prospectus. Hardcopy Bid Forms shall be manually signed in ink. Registration in OLB is considered your 'signature' for all bids submitted thru that system. Bid prices must be entered for each species and product in the Bid Price column for all material subject to bidding and all fill-in blanks must be completed. If erasures or other changes appear on the hardcopy Bid Form, each erasure or change must be initialed by the person signing the bid.

### 4. Submission of Sealed Bids (5/16)

Bid forms may be obtained from the Unit Manager or thru OLB. Bids may be submitted hardcopy or thru OLB. All hardcopy bids must be submitted on the bid form and in an envelope clearly identified as described in this section. NOTE: Only one bid form per bid envelope. Sealed bids must be submitted to the Unit office designated in the prospectus and must be submitted at or prior to the time established in the prospectus. The envelope should show on the outside (a) the sale name or number and (b) the date and time of bid opening, as shown in the prospectus. Bids received after the time specified in the sale prospectus are late bids and will be rejected.

It is possible for a bidder to submit multiple bids on a single sale. For example, a bid may be submitted hardcopy and a bid may be submitted thru OLB. Or, two bidders from the same company could both submit bids on the same sale. If this were to happen, the State would accept all bids received and award the contract accordingly. All bidding and contractual requirements would apply to all bids received.

### 5. Public Opening of Sealed Bids (7/16)

If conditions permit, the sealed bids will be publicly opened and posted at the time and place set in the prospectus.

If a bidder, present at a bid opening, has submitted bids on more than one sale, that bidder may withdraw their unopened bid envelopes or announce the withdrawal of their online bid after being declared the successful bidder on one sale.

### 6. Award of Contract (1/11)

Award of the contract will be made to the Bidder whose bid, conforming to the prospectus, is most advantageous to the State of Michigan on the basis of total value at rates bid for the estimated quantities. The State reserves the right to reject any bid or waive any minor irregularity in bids received. A written award mailed (or otherwise furnished) to the successful Bidder shall be deemed to result in a binding contract without further action by either party.

### 7. Down Payment (1/11)

The Bidder to whom award is made must make a down payment within 21 days of the sale award. The amount of the down payment will be calculated as shown in the Bond and Payment Schedule of this prospectus. Only cash may be used to meet this requirement.

### 8. Performance Security (1/11)

As guarantee of faithful performance, a cash bond, certificate of deposit, surety bond or irrevocable letter of credit (LOC) is required within 21 days of the sale award. The amount of the performance security is shown in the Bond and

Payment Schedule of this prospectus. If an LOC or surety is used, the coverage must extend for at least 6 months beyond the contract expiration.

#### 9. Timber Sale Contract (7/18)

Additional conditions and requirements common to all timber sales are listed on the timber sale contract (R4031) and are available on line at [www.michigan.gov/timber](http://www.michigan.gov/timber). Contact the Unit Manager for additional information or a sample contract. Within 21 days of the date of the award letter, the bidder must sign the contract and provide the required down payment, performance security, and verification of worker's disability compensation. The down payment and performance security shall be in accordance with the provisions of the timber sale contract, in the sums stated in this prospectus. If these actions are not taken, then the Bidder, the Bidder's corporation, and the corporation's principals may not be permitted to bid on State timber sales for a period of 3 months after the first offense, 6 months after the second offense, and 1 year after the third offense. An offense will only be counted against the Bidder for 5 years. In addition, the Bidder certifies that if awarded this contract, the Bidder will complete the timber sale contract in accordance with its terms and any modifications thereof including requirements to purchase, cut, and remove the included timber by the expiration date.

Payment Unit values in the State Forest Timber Sale Contract are calculated based on the advertised value of the Payment Unit as a percentage of the total advertised value of the contract. The advertised value of each Payment Unit is given in the Description of Timber by Payment Unit table on the Timber Sale Information page. For example, if the value of Payment Unit 1 is advertised as \$1,500 and the total Timber Sale value is advertised as \$10,000, the contract price for Payment Unit 1 will be 15% of the total bid price ( $\$1,500/\$10,000 * 100$ ).

#### 10. Disclaimer of Estimates and Bidder's Warranty of Inspection (7/16)

Before submitting this bid, the Bidder is advised and cautioned to inspect the sale area, review the requirements of the sale contract, and take other steps as may be reasonably necessary to ascertain the location, estimated volumes, construction estimates, and operating costs of the proposed sale. Failure to do so will not relieve the Bidder from responsibility for completing the contract.

The Bidder warrants that this bid is submitted solely on the basis of the Bidder's examination and inspection of the quality and quantity of the timber offered for sale and the Bidder's opinion of the value thereof and the costs of recovery. No reliance should be placed on the State of Michigan's estimates of timber quality, quantity or costs of recovery. Bidder further acknowledges that the State of Michigan: (i) expressly disclaims any warranty of fitness of timber for any purpose; (ii) offers this timber as is without any warranty of quality (merchantability) or quantity and (iii) expressly disclaims any warranty as to the quantity or quality of timber sold.

#### 11. Certification and Chain-of-Custody (10/14)

Unless otherwise indicated in the contract under section 7 – Other Conditions of the Sale Specific Conditions & Requirements, the area encompassed by this timber sale is certified to the standards of the Forest Stewardship Council (FSC) - Certificate #SCS-FM/COC-00090N and the Sustainable Forestry Initiative (SFI) - Certificate #NSF-SFIS-5Y031-SF5. Forest products from this sale may be delivered to the mill as "FSC 100% and / or SFI certified" as long as the contractor hauling the forest products is chain-of-custody (COC) certified or covered under a COC certificate from the destination mill. The purchaser is responsible for maintaining COC after leaving the sale area.

#### 12. Good Neighbor Authority (GNA) Requirements (7/16)

If the name of this timber sales contains the acronym GNA, it is authorized by the Good Neighbor Authority (GNA) and covered by various agreements between the U.S. Forest Service and the State. The timber sale occurs on federal land and the following conditions apply:

GNA contracts on US Forest Service land will not be awarded to purchasers on the Federal list of excluded parties. The System for Award Management (SAM) will be checked for active excluded parties prior to award of contract. In addition, the Bidder to whom award is made must complete an Assurance Regarding Felony Conviction or Tax Delinquent Status for Corporate Applicants (AD-3031).

#### 13. Good Neighbor Authority (GNA) Requirements, con't (9/16)

Bidder certifies, by signing this bid form, that to the best of Bidder's knowledge that the following representations are accurate and complete.

- a. That the Bidder and its principals are not presently debarred, suspended, proposed for debarment, declared ineligible, or voluntary excluded from timber sales (covered transactions) by any Federal department or agency.
- b. That the Bidder and its principals have not within a 3-year period preceding this bid been convicted of or had a civil judgment rendered against them for commission of fraud or a criminal offense in connection with obtaining, attempting to obtain, or performing a public (Federal, State, or local) transaction or contract under a public transaction; violation of Federal or State antitrust statutes or commission of embezzlement, theft, forgery, bribery, falsification or destruction of records, making false statements, or receiving stolen property.
- c. That the Bidder and its principals are not presently indicted for or otherwise criminally or civilly charged by a governmental entity (Federal, State, or local) with commission of any of the offenses enumerated in paragraph b of this certification.
- d. That the Bidder and its principals have not within a 3-year period preceding this bid had one or more public transactions (Federal, State, or local) terminated for breach or default of a timber or forest product contract.

Bidders that cannot certify this requirement, in whole or in part, shall submit an explanation with their bid.

DAN EICHINGER  
Director



# TIMBER SALE INFORMATION

Sandy Ridge Aspen (55-116-19)  
 T12N, R10E, SEC. 1.  
 Tuscola County (Advertised Price \$36,121.75)

SALE NOTE: Access may be through other public land.

A timber sale contract for this lump sum, sealed bid timber sale will be awarded to the responsible bidder offering the highest sealed bid price. Bids must be at or above the following advertised price for each species:

<u>PRODUCTS &amp; SPECIES</u>	<u>ESTIMATED UNITS*</u>	<u>ADVERTISED PRICE</u>
Sawtimber		
Black Cherry	18.30 MBF	\$ 83.00 / MBF
Green Ash	8.50 MBF	\$ 30.00 / MBF
Mixed Aspen	291.40 MBF	\$ 34.00 / MBF
Paper Birch	2.00 MBF	\$ 30.00 / MBF
Red Maple	115.50 MBF	\$ 38.00 / MBF
Pulpwood		
Mixed Aspen	842.00 Cords	\$ 11.25 / Cord
Mixed Hardwood	825.00 Cords	\$ 12.75 / Cord

\* The estimated units are final and not subject to adjustment. Prospective bidders are urged to examine this timber and to make their own estimates of quantity and quality.

**BOND AND PAYMENT SCHEDULE:**

1. A bond in the amount of \$1,806.00 to insure faithful performance of the conditions of the contract will be deposited by the successful bidder within 21 days of the sale award.
2. Cutting in any sale or unit without the required advance payment would be considered a trespass.
3. Total payment must be paid in advance or according to the following schedule:
  - (a) Ten percent (10%) of the sale value must be paid within 21 days of the sale award.
  - (b) The 10% down payment will be credited towards the first unit cut.
  - (c) Payment for each of the following units must be made before cutting begins in that unit:
 

PAYMENT UNIT NUMBER	PERCENT OF TOTAL SALE VALUE
01	27.1%
02	31.8%
03	28.7%
04	12.4%
4. If no cutting takes place, the 10% down payment will not be refunded.
5. Operations on the contract issued will terminate on 12/31/2021.

**Description of Timber by Payment Unit (PU)**

PU	MARKET GROUP	PRODUCT	QUANTITY	UNIT	ACRES	ADVERTISE PRICE	
1	Black Cherry	Sawtimber	4.9	MBF	18.9	\$9,783.50	
	Mixed Aspen		52.4	MBF			
	<i>B. T. Aspen</i>		46.7	<i>MBF</i>			
	<i>Cottonwood</i>		5.7	<i>MBF</i>			
	Red Maple		34.4	MBF			
	Mixed Aspen		Pulpwood	279.0			Cords
	<i>B. T. Aspen</i>			271.0			<i>Cords</i>
	<i>Cottonwood</i>			8.0			<i>Cords</i>
	Mixed Hardwood			247.0			Cords
	<i>Black Cherry</i>			16.0			<i>Cords</i>
	<i>Paper Birch</i>			6.0			<i>Cords</i>
	<i>Red Maple</i>			225.0			<i>Cords</i>
	2		Black Cherry	Sawtimber			7.0
Green Ash		3.5	MBF				
Mixed Aspen		93.6	MBF				
<i>B. T. Aspen</i>		80.5	<i>MBF</i>				
<i>Balsam Poplar</i>		1.3	<i>MBF</i>				
<i>Cottonwood</i>		1.9	<i>MBF</i>				
<i>Quaking Aspen</i>		9.9	<i>MBF</i>				
Paper Birch		1.1	MBF				
Red Maple		40.9	MBF				
Mixed Aspen		Pulpwood	216.0		Cords		
<i>B. T. Aspen</i>			175.0		<i>Cords</i>		
<i>Balsam Poplar</i>			1.0		<i>Cords</i>		
<i>Cottonwood</i>			2.0		<i>Cords</i>		
<i>Quaking Aspen</i>			38.0		<i>Cords</i>		
Mixed Hardwood			282.0		Cords		
<i>Black Cherry</i>			16.0		<i>Cords</i>		
<i>Green Ash</i>			15.0		<i>Cords</i>		
<i>Paper Birch</i>			6.0		<i>Cords</i>		
<i>Red Maple</i>			245.0		<i>Cords</i>		
3	Black Cherry	Sawtimber	6.4	MBF	20.9	\$10,362.30	
	Green Ash		3.2	MBF			
	Mixed Aspen		84.3	MBF			
	<i>B. T. Aspen</i>		72.5	<i>MBF</i>			
	<i>Balsam Poplar</i>		1.2	<i>MBF</i>			
	<i>Cottonwood</i>		1.7	<i>MBF</i>			
	<i>Quaking Aspen</i>		8.9	<i>MBF</i>			
	Paper Birch		0.9	MBF			
	Red Maple		36.8	MBF			
	Mixed Aspen		Pulpwood	196.0			Cords
	<i>B. T. Aspen</i>			158.0			<i>Cords</i>
	<i>Balsam Poplar</i>			1.0			<i>Cords</i>
	<i>Cottonwood</i>			2.0			<i>Cords</i>
	<i>Quaking Aspen</i>			35.0			<i>Cords</i>
	Mixed Hardwood			254.0			Cords
	<i>Black Cherry</i>			15.0			<i>Cords</i>
	<i>Green Ash</i>			13.0			<i>Cords</i>
<i>Paper Birch</i>	5.0	<i>Cords</i>					
<i>Red Maple</i>	221.0	<i>Cords</i>					
4	Green Ash	Sawtimber	1.8	MBF	7.3	\$4,494.85	
	Mixed Aspen		61.1	MBF			
	<i>B. T. Aspen</i>		61.1	<i>MBF</i>			
	Red Maple		3.4	MBF			
	Mixed Aspen		Pulpwood	151.0			Cords
	<i>B. T. Aspen</i>			151.0			<i>Cords</i>



**Description of Timber by Payment Unit (PU), con't**

PU	MARKET GROUP	PRODUCT	QUANTITY	UNIT	ACRES	ADVERTISE PRICE
4 con't	Mixed Hardwood	Pulpwood	42.0	Cords		
	<i>Black Cherry</i>		15.0	<i>Cords</i>		
	<i>Green Ash</i>		2.0	<i>Cords</i>		
	<i>Red Maple</i>		25.0	<i>Cords</i>		
TOTAL:			435.7	MBF		
TOTAL:			1,667.0	Cords		

## Sale Specific Conditions & Requirements

**Sale Name: Sandy Ridge Aspen**

**Sale Number: 55-116-19 Seq#: 1**

### 1 - Sale Area

#### 1.2 - Boundaries

##### 1.2.1 - Painted boundaries (1/14)

The sale boundary and Payment Unit boundaries are marked and identified by red and yellow paint. Exterior sale boundary lines against state are marked with red paint. Interior Payment Unit boundaries are marked with yellow paint. The painted boundary line trees are not Included Timber and are to be protected.

### 2 - Timber Specifications

#### 2.1 - Included Timber

##### 2.1.1 - Clearcut unit(s) with unmerchantable trees (6/14)

Within Payment Unit(s) 1-4, cut all trees that are two (2) inches or more at DBH, except do not cut white pine, hemlock, beech, oak, white spruce, apple and trees marked with green paint. Special protection trees identified in accordance with condition 3.4.2, within clearcutting unit boundaries, are not Included Timber and are to be protected.

#### 2.2 - Utilization

##### 2.2.3 - Stump heights (4/07)

Stump heights within the Sale Area shall not exceed 12 inches.

##### 2.2.10 - No chipping tops and limbs (8/16)

Within Payment Unit(s) 1-4, chipping of the bole, 4-inches in diameter or greater, is allowed. Chipping of limbs or portions of the tree less than 4-inches in diameter is not permitted. Limbs and the remaining top must be left on site and scattered.

### 3 - Payments

#### 3.4 - Damaged Timber

##### 3.4.2 - Special Protection Trees (4/14)

The Purchaser shall not cut live or dead special protection trees within cutting units or clearings. Special protection trees are oak, white pine, apple and trees marked with green paint. If the Purchaser's operations have cut or damaged special protection trees through carelessness, the Purchaser shall pay \$100 as fixed, agreed and liquidated damages for each special protection tree cut or damaged. Such payment does not constitute ownership of the undesignated timber.

#### 3.6 - Payment Unit Cutting Schedule

##### 3.6.2 - One active unit (12/08)

Each Payment Unit must be completed to the satisfaction of the Unit Manager or his/her representative before the next unit may be opened. The Purchaser must give a one week notice before finishing a unit to allow for inspection.

### 4 - Transportation

#### 4.1 - Construction

##### 4.1.3 - Slash and earthen piles (8/04)

Piles or windrows of earth along roads and landings that have been widened or constructed shall be leveled. Slash from road maintenance or construction, including stumps, shall be distributed within the sale boundaries.

##### 4.1.12 - No new roads (1/12)

No new roads will be permitted in any Payment Unit. All operations are limited to skid trails or existing trails.

#### 4.2 - Maintenance

##### 4.2.3 - Road maintenance (8/13)

The following road maintenance is required if the Purchaser uses the utility right-of-way to access Payment Units 2 and 3: The road must be maintained and graded and must be accessible to two-wheel drive vehicles. This includes cleaning of

drainage areas, grading, crowning and filling with gravel, if necessary. Damages will be assessed if grading/repair does not occur.

#### 4.4 - Access

##### 4.4.3 - Access gate (12/08)

Access to Payment Unit 2 and 3 may be through the vehicle gate at the corner of Dodge and Mushroom Roads from the utility right-of-way. Gates must be closed and locked at the end of each day, and should remain closed during daytime hours. This is to prevent someone other than the Purchaser from going through the gate and being locked in.

Alternative access to Payment Units 2 and 3 may be from Froede Road, which will require the construction of a temporary driveway and placing a tube in the ditch. It is the responsibility of the Purchaser to secure permits from Wells Township or Tuscola County. Any temporary driveways and tubes must be removed when harvesting and hauling operations are complete.

## 5 - Operations

#### 5.1 - Notification

##### 5.1.1 - Pre-sale conference (10/16)

A pre-sale conference on site between the Purchaser and sale administrator is required prior to beginning any operations to determine access, landing and skid trail locations. The Unit Manager or his/her representative must be contacted at least 10 days in advance to schedule the conference.

##### 5.1.4 - Post-sale conference (10/16)

A post-sale conference on site between the Purchaser and sale administrator is required 10 days prior to the completion of active logging operations to determine clean-up and repair of landings, road edges, and the fulfillment of other contract specifications.

##### 5.1.6 - Utility R.O.W. (1/15)

It is the responsibility of the Purchaser to obtain permission from the utility company to utilize the power line R.O.W. for operations. See the sale administrator for utility company contact information.

#### 5.2 - Conduct of Operations

##### 5.2.1 - Slash

###### 5.2.1.8 - Slash height (12/08)

No slash may exceed 48 inches in height.

###### 5.2.1.11 - Slash for reforestation (5/07)

To facilitate reforestation, the sale area shall be left with slash evenly distributed. Bunched tops within the cutting area shall be broken up and scattered. Stumps shall be cut low to the ground. Processing sites shall not be left with a compacted layer of slash; tops from these sites shall be hauled back into the cut area and scattered.

##### 5.2.2 - Hazard Trees/Snags

###### 5.2.2.1 - Den trees (10/16)

Obvious hollow and/or den trees shall be protected and left standing unless they are a safety hazard.

##### 5.2.3 - Operating Restrictions

###### 5.2.3.1 - Operating restrictions (9/11)

Within Payment Unit(s) 1-4, unless changed by written agreement, cutting, skidding, and hauling are not permitted during the period of April 1 to June 15. In addition, within Payment Unit 2, all harvest activities within 300 feet of Morse Drain (see Timber Sale Map) must be conducted during dry or frozen ground conditions. This restriction is required to prevent damage to saturated soils, minimize rutting, maximize regeneration, and prevent bark slip.

###### 5.2.3.2 - Operating restrictions (9/11)

Within Payment Unit(s) 1-4, the number of skid trails must be minimized. This restriction is necessary to protect sensitive soils and maximize regeneration.

#### 5.2.3.12 - Hunting operating restriction (1/18)

No Payment unit may be started during the period of November 10 to November 30 without permission of the Unit Manager or his/her representative. In addition, cutting, skidding and hauling are not permitted during the period of November 15 to November 20.

#### 5.2.4 - Dead and Down Creation

##### 5.2.4.4 - Dead and down creation, grouse (6/18)

To encourage grouse and other wildlife, in Payment Unit(s) 1-4, leave one, 12" or larger diameter whole tree on the ground for every 3 acres. Trees should scattered throughout the sale and at least two chains from any roads, two-tracks, or trails open to vehicles, or positioned per the sale administrators instructions. Trees must be marked with a solid band of orangepaint. Stumps must be at least 3 feet tall.

##### 5.2.31 - Landing locations (9/13)

Landings must be confined to designated sites determined by the sale administrator unless otherwise authorized by the Unit Manager or his/her representative. In general, landings are limited to a "T" turnaround which will accommodate a truck with a 50 foot trailer.

##### 5.2.32 - Decking/landing restoration (9/13)

All decking and landing areas must have the surface area restored to a condition equal to or better than before. This is to ensure the proper regeneration of the stand. Wood debris, chips and "cookies" from trimmings must be removed or scattered within the sale boundary away from landing and loading areas and may not be windrowed on the edge.

##### 5.2.37 - No decking areas (12/08)

No decking is allowed in any parking area. In addition, no equipment storage is allowed in any parking area.

##### 5.2.38 - No decking against live trees (2/04)

Cut products may not be decked against unmarked or designated leave trees.

#### 5.4 - Soil Protection

##### 5.4.1 - Rutting restriction, general (7/16)

Operations are to cease immediately if equipment and weather conditions result in rutting of roads and/or skid trails which is 8 inches or greater in depth and 50 feet in length. The Unit Manager or his/her representative may restrict hauling and/or skidding if ruts exceed the specified depth. With the Unit Manager or his/her representative's approval, the Purchaser may return to the area when the risk of rutting has decreased.

##### 5.4.6 - Wet area protection (5/10)

No harvesting operations, including skidding and felling, are to take place within vernal pond areas or drainages when standing or flowing water is present. When harvesting occurs, there should be no disturbance to the vernal pond depression. All equipment, trees and tops should be kept out of this area. Within 100 feet of the pond, equipment should only be used when the soil is in a dry or frozen condition. Care must be taken by the Purchaser to identify and avoid operating in these areas of the timber sale.

#### 7 - Other Conditions

##### 7.10 - Certified Timber

###### 7.10.1 - Non-certified timber (2/16)

The area encompassed by this timber sale is not certified to the standards of the Forest Stewardship Council (FSC) or the Sustainable Forestry Initiative (SFI). Forest products from this sale may not be delivered to the mill as "FSC and / or SFI certified". The lands within this sale are managed as a State Game Area.



# TIMBER SALE MAP

This information provided by authority of Part 525, 1994 PA 451, as amended.

Forest Management Unit Deford State Game Area	County Tuscola	Mapped By DJ Bonnette	Date 02/06/2019	Page 1	of 1
Township 12N	Range 10E	Section(s) and Subdivision(s) Section 1; S1/2NW,NESW,S1/2SW,NWSE,S1/2SE	Scale 1:15,840		

Cover Type				Density	
A = Aspen	H = Hemlock	N = Marsh	U = Upland Brush	0 = Non Stocked	5 = Pole Timber Medium
B = Paper Birch	J = Jack Pine	O = Oak	UM = Upland Mixed	1 = Seedling Sapling Poor	6 = Pole Timber Well
C = Cedar	L = Lowland Brush	P = Lowland Poplar	V = Bog or Marsh	2 = Seedling Sapling Medium	7 = Saw Timber Poor
D = Treed Bog	LM = Lowland Mixed	Q = Mixed Swamp Conifer	W = White Pine	3 = Seedling Sapling Well	8 = Saw Timber Medium
E = Swamp Hdwoods	M = Mpl. Bch, Brch	R = Red Pine	X = Non Stocked	4 = Pole Timber Poor	9 = Saw Timber Well
F = Spruce Fir	MC = Mixed Conifer	S = Black Spruce	Z = Water		
G = Grass	MD = Mixed Deciduous	T = Tamarack			

PU	Acres	PU	Acres
1	18.9	4	7.3
2	23.2		
3	20.9		

## Sandy Ridge Aspen 70.3 Acres

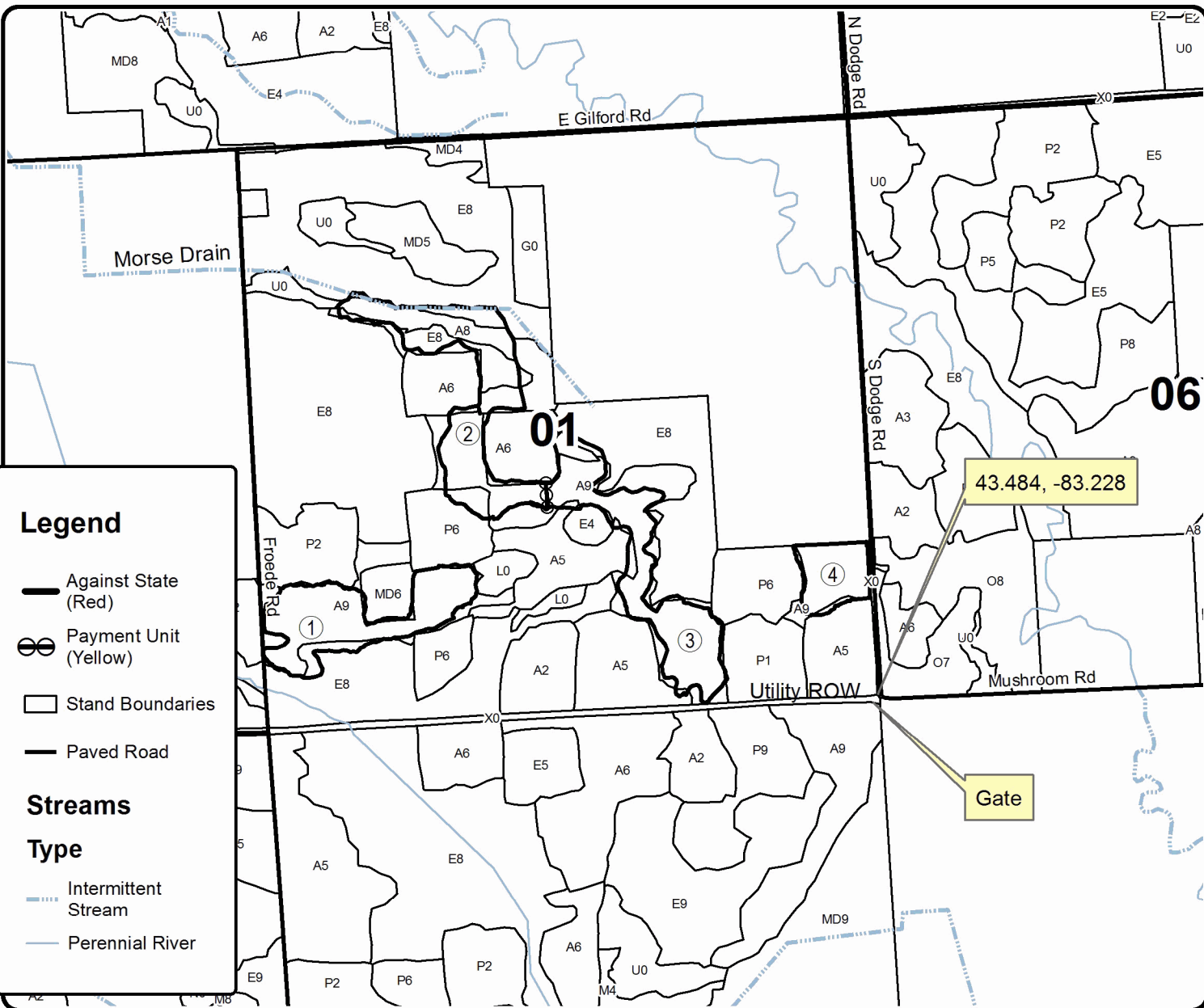

**Legend**

- Against State (Red)
- ⊕ Payment Unit (Yellow)
- Stand Boundaries
- Paved Road

**Streams**

**Type**

- Intermittent Stream
- Perennial River

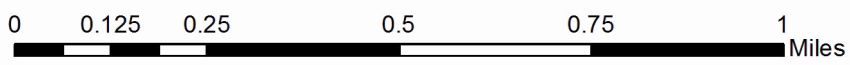



**TIMBER SALE INFORMATION**

Cleland Aspen (55-117-19)

T14N, R12E, SEC. 10; T14N, R12E, SEC. 11; T14N, R12E, SEC. 15.  
Sanilac County (Advertised Price \$14,018.55)

SALE NOTE: A recreation site such as a trail, pathway, or campground is within the sale area or the vicinity. Certain restrictions/specifications may be applicable including time restrictions. Access may be through other public land.

A timber sale contract for this lump sum, sealed bid timber sale will be awarded to the responsible bidder offering the highest sealed bid price. Bids must be at or above the following advertised price for each species:

<u>PRODUCTS &amp; SPECIES</u>	<u>ESTIMATED UNITS*</u>	<u>ADVERTISED PRICE</u>
Sawtimber		
Basswood	4.50 MBF	\$ 30.00 / MBF
Black Cherry	13.40 MBF	\$ 83.00 / MBF
Green Ash	8.30 MBF	\$ 30.00 / MBF
Mixed Aspen	112.20 MBF	\$ 34.00 / MBF
Paper Birch	1.40 MBF	\$ 30.00 / MBF
Red Maple	27.10 MBF	\$ 38.00 / MBF
Sugar Maple	3.00 MBF	\$ 83.00 / MBF
Pulpwood		
Mixed Aspen	320.00 Cords	\$ 11.25 / Cord
Mixed Hardwood	297.00 Cords	\$ 12.75 / Cord

\* The estimated units are final and not subject to adjustment. Prospective bidders are urged to examine this timber and to make their own estimates of quantity and quality.

**BOND AND PAYMENT SCHEDULE:**

1. A bond in the amount of \$701.00 to insure faithful performance of the conditions of the contract will be deposited by the successful bidder within 21 days of the sale award.
2. Cutting in any sale or unit without the required advance payment would be considered a trespass.
3. Total payment must be paid in advance or according to the following schedule:
  - (a) Ten percent (10%) of the sale value must be paid within 21 days of the sale award.
  - (b) The 10% down payment will be credited towards the first unit cut.
  - (c) Payment for each of the following units must be made before cutting begins in that unit:
 

<u>PAYMENT UNIT NUMBER</u>	<u>PERCENT OF TOTAL SALE VALUE</u>
01	70.5%
02	29.5%
4. If no cutting takes place, the 10% down payment will not be refunded.
5. Operations on the contract issued will terminate on 12/31/2021.

**Description of Timber by Payment Unit (PU)**

PU	MARKET GROUP	PRODUCT	QUANTITY	UNIT	ACRES	ADVERTISE PRICE	
1	Basswood	Sawtimber	2.7	MBF	23.8	\$9,878.90	
	Black Cherry		9.3	MBF			
	Green Ash		5.7	MBF			
	Mixed Aspen		83.9	MBF			
	<i>B. T. Aspen</i>		45.3	<i>MBF</i>			
	<i>Cottonwood</i>		10.8	<i>MBF</i>			
	<i>Quaking Aspen</i>		27.8	<i>MBF</i>			
	Paper Birch		1.4	MBF			
	Red Maple		10.1	MBF			
	Sugar Maple		2.2	MBF			
	Mixed Aspen		Pulpwood	263.0			Cords
	<i>B. T. Aspen</i>			141.0			<i>Cords</i>
	<i>Cottonwood</i>			13.0			<i>Cords</i>
	<i>Quaking Aspen</i>			109.0			<i>Cords</i>
	Mixed Hardwood	191.0		Cords			
	<i>American Elm</i>	4.0		<i>Cords</i>			
	<i>Basswood</i>	12.0		<i>Cords</i>			
	<i>Black Cherry</i>	41.0		<i>Cords</i>			
	<i>Green Ash</i>	52.0		<i>Cords</i>			
	<i>Paper Birch</i>	30.0		<i>Cords</i>			
	<i>Red Maple</i>	26.0	<i>Cords</i>				
<i>Sugar Maple</i>	26.0	<i>Cords</i>					
2	Basswood	Sawtimber	1.8	MBF	8.9	\$4,139.65	
	Black Cherry		4.1	MBF			
	Green Ash		2.6	MBF			
	Mixed Aspen		28.3	MBF			
	<i>Cottonwood</i>		6.1	<i>MBF</i>			
	<i>Quaking Aspen</i>		22.2	<i>MBF</i>			
	Red Maple		17.0	MBF			
	Sugar Maple		0.8	MBF			
	Mixed Aspen		Pulpwood	57.0			Cords
	<i>Cottonwood</i>			7.0			<i>Cords</i>
	<i>Quaking Aspen</i>	50.0		<i>Cords</i>			
	Mixed Hardwood	106.0		Cords			
	<i>American Elm</i>	2.0		<i>Cords</i>			
	<i>Basswood</i>	7.0		<i>Cords</i>			
	<i>Black Cherry</i>	6.0		<i>Cords</i>			
	<i>Green Ash</i>	29.0		<i>Cords</i>			
	<i>Red Maple</i>	52.0		<i>Cords</i>			
	<i>Sugar Maple</i>	10.0	<i>Cords</i>				
	TOTAL:			169.9			MBF
TOTAL:			617.0	Cords			



## Sale Specific Conditions & Requirements

**Sale Name: Cleland Aspen**

**Sale Number: 55-117-19 Seq#: 1**

### 1 - Sale Area

#### 1.2 - Boundaries

##### 1.2.1 - Painted boundaries (1/14)

The sale boundaries are marked and identified by red and blue paint. Exterior sale boundary lines against state are marked with red paint. Exterior sale boundary lines against private property are marked with blue paint. The painted boundary line trees are not Included Timber and are to be protected.

### 2 - Timber Specifications

#### 2.1 - Included Timber

##### 2.1.1 - Clearcut unit(s) with unmerchantable trees (6/14)

Within Payment Unit(s) 1 and 2, cut all trees that are two (2) inches or more at DBH, except do not cut white pine, hemlock, beech, oak, apple, hickory and trees marked with green paint. Special protection trees identified in accordance with condition 3.4.2, within clearcutting unit boundaries, are not Included Timber and are to be protected.

#### 2.2 - Utilization

##### 2.2.3 - Stump heights (4/07)

Stump heights within the Sale Area shall not exceed 12 inches.

##### 2.2.10 - No chipping tops and limbs (8/16)

Within Payment Unit(s) 1 and 2, chipping of the bole, 4-inches in diameter or greater, is allowed. Chipping of limbs or portions of the tree less than 4-inches in diameter is not permitted. Limbs and the remaining top must be left on site and scattered.

### 3 - Payments

#### 3.4 - Damaged Timber

##### 3.4.2 - Special Protection Trees (4/14)

The Purchaser shall not cut live or dead special protection trees within cutting units or clearings. Special protection trees are oak, apple and trees marked with green paint. If the Purchaser's operations have cut or damaged special protection trees through carelessness, the Purchaser shall pay \$100 as fixed, agreed and liquidated damages for each special protection tree cut or damaged. Such payment does not constitute ownership of the undesignated timber.

#### 3.6 - Payment Unit Cutting Schedule

##### 3.6.2 - One active unit (12/08)

Each Payment Unit must be completed to the satisfaction of the Unit Manager or his/her representative before the next unit may be opened. The Purchaser must give a one week notice before finishing a unit to allow for inspection.

### 4 - Transportation

#### 4.1 - Construction

##### 4.1.3 - Slash and earthen piles (8/04)

Piles or windrows of earth along roads and landings that have been widened or constructed shall be leveled. Slash from road maintenance or construction, including stumps, shall be distributed within the sale boundaries.

##### 4.1.12 - No new roads (1/12)

No new roads will be permitted in any Payment Unit. All operations are limited to skid trails or existing trails.

### 5 - Operations

#### 5.1 - Notification

##### 5.1.1 - Pre-sale conference (10/16)

A pre-sale conference on site between the Purchaser and sale administrator is required prior to beginning any operations to determine landing and road locations. The Unit Manager or his/her representative must be contacted at least 10 days in advance to schedule the conference.

#### 5.1.4 - Post-sale conference (10/16)

A post-sale conference on site between the Purchaser and sale administrator is required 10 days prior to the completion of active logging operations to determine clean-up and repair of landings, road edges, and the fulfillment of other contract specifications.

### 5.2 - Conduct of Operations

#### 5.2.1 - Slash

##### 5.2.1.8 - Slash height (12/08)

No slash may exceed 48 inches in height.

##### 5.2.1.11 - Slash for reforestation (5/07)

To facilitate reforestation, the sale area shall be left with slash evenly distributed. Bunched tops within the cutting area shall be broken up and scattered. Stumps shall be cut low to the ground. Processing sites shall not be left with a compacted layer of slash; tops from these sites shall be hauled back into the cut area and scattered.

#### 5.2.2 - Hazard Trees/Snags

##### 5.2.2.1 - Den trees (10/16)

Obvious hollow and/or den trees shall be protected and left standing unless they are a safety hazard.

#### 5.2.3 - Operating Restrictions

##### 5.2.3.1 - Operating restrictions (9/11)

Within Payment Unit(s) 1 and 2, unless changed by written agreement, cutting, skidding, and hauling are not permitted during the period of April 1 to July 1. This restriction is required to prevent damage to saturated soils, minimize rutting and to maximize regeneration.

##### 5.2.3.2 - Operating restrictions (9/11)

Within Payment Unit(s) 1 and 2, the number of skid trails must be minimized. This restriction is necessary to protect sensitive soils, maximize regeneration and protect the trail network.

##### 5.2.3.12 - Hunting operating restriction (1/18)

No Payment unit may be started during the period of November 10 to November 30 without permission of the Unit Manager or his/her representative. In addition, cutting, skidding or hauling are not permitted during the period of November 15 to November 20.

#### 5.2.4 - Dead and Down Creation

##### 5.2.4.4 - Dead and down creation, grouse (6/18)

To encourage grouse and other wildlife, in Payment Unit(s) 1 and 2, leave one, 12" or larger diameter whole tree on the ground for every 3 acres. Trees should be scattered throughout the sale and at least two chains from any roads, two-tracks, or trails open to vehicles, or positioned per the sale administrator's instructions. Trees must be marked with a solid band of orange paint. Stumps must be at least 3 feet tall.

#### 5.2.22 - Operating Caution

##### 5.2.22.1 - Operating caution (6/11)

It is recommended, but not required, that within Payment Unit(s) 1 and 2, cutting, skidding, and hauling occur during dry or frozen ground conditions. The reason for the recommendation is because access roads and soils within the unit are prone to rutting.

#### 5.2.31 - Landing locations (9/13)

Landings must be confined to designated sites determined by the sale administrator unless otherwise authorized by the Unit Manager or his/her representative. In general, landings are limited to a "T" turnaround which will accommodate a truck with a 50 foot trailer.

#### 5.2.32 - Decking/landing restoration (9/13)

All decking and landing areas must have the surface area restored to a condition equal to or better than before. This is to ensure the proper regeneration of the stand. Wood debris, chips and "cookies" from trimmings must be removed or scattered within the sale boundary away from landing and loading areas and may not be windrowed on the edge.

#### 5.2.37 - No decking areas (12/08)

No decking is allowed in any parking area. In addition, no equipment storage is allowed in any parking area.

#### 5.2.38 - No decking against live trees (2/04)

Cut products may not be decked against unmarked or designated leave trees.

### 5.4 - Soil Protection

#### 5.4.1 - Rutting restriction, general (7/16)

Operations are to cease immediately if equipment and weather conditions result in rutting of roads and/or skid trails which is 8 inches or greater in depth and 50 feet in length. The Unit Manager or his/her representative may restrict hauling and/or skidding if ruts exceed the specified depth. With the Unit Manager or his/her representative's approval, the Purchaser may return to the area when the risk of rutting has decreased.

#### 5.4.6 - Wet area protection (5/10)

No harvesting operations, including skidding and felling, are to take place within vernal pond areas or drainages when standing or flowing water is present. When harvesting occurs, there should be no disturbance to the vernal pond depression. All equipment, trees and tops should be kept out of this area. Within 100 feet of the pond, equipment should only be used when the soil is in a dry or frozen condition. Care must be taken by the Purchaser to identify and avoid operating in these areas of the timber sale.

### 5.7 - Protection of Historical Sites

#### 5.7.2 - Potential historical site(s) (9/06)

The State Historic Preservation Office has identified the potential for a historic site within the boundary of this timber sale. Note that if the site is discovered during operations, General Condition and Requirement 5.7 - Protection of Historical Sites will apply.

## 7 - Other Conditions

### 7.10 - Certified Timber

#### 7.10.1 - Non-certified timber (2/16)

The area encompassed by this timber sale is not certified to the standards of the Forest Stewardship Council (FSC) or the Sustainable Forestry Initiative (SFI). Forest products from this sale may not be delivered to the mill as "FSC and / or SFI certified". The lands within this sale are managed as a State Game Area.



# TIMBER SALE MAP

This information provided by authority of Part 525, 1994 PA 451, as amended.

Forest Management Unit Sanilac State Game Area	County Sanilac	Mapped By DJ Bonnette	Date 02/08/2019	Page 1	of 1
Township 14N	Range 12E	Section(s) and Subdivision(s) Sec. 10 S1/2 SE; Sec. 11 SWSW, Sec. 15 NESW, NWSE	Scale 1:15,840		

Cover Type				Density	
A = Aspen	H = Hemlock	N = Marsh	U = Upland Brush	0 = Non Stocked	5 = Pole Timber Medium
B = Paper Birch	J = Jack Pine	O = Oak	UM = Upland Mixed	1 = Seedling Sapling Poor	6 = Pole Timber Well
C = Cedar	L = Lowland Brush	P = Lowland Poplar	V = Bog or Marsh	2 = Seedling Sapling Medium	7 = Saw Timber Poor
D = Treed Bog	LM = Lowland Mixed	Q = Mixed Swamp Conifer	W = White Pine	3 = Seedling Sapling Well	8 = Saw Timber Medium
E = Swamp Hdwoods	M = Mpl, Bch, Brch	R = Red Pine	X = Non Stocked	4 = Pole Timber Poor	9 = Saw Timber Well
F = Spruce Fir	MC = Mixed Conifer	S = Black Spruce	Z = Water		
G = Grass	MD = Mixed Deciduous	T = Tamarack			

## PU Acres

1	23.8
2	8.9

# Cleland Aspen

## 32.7 Acres

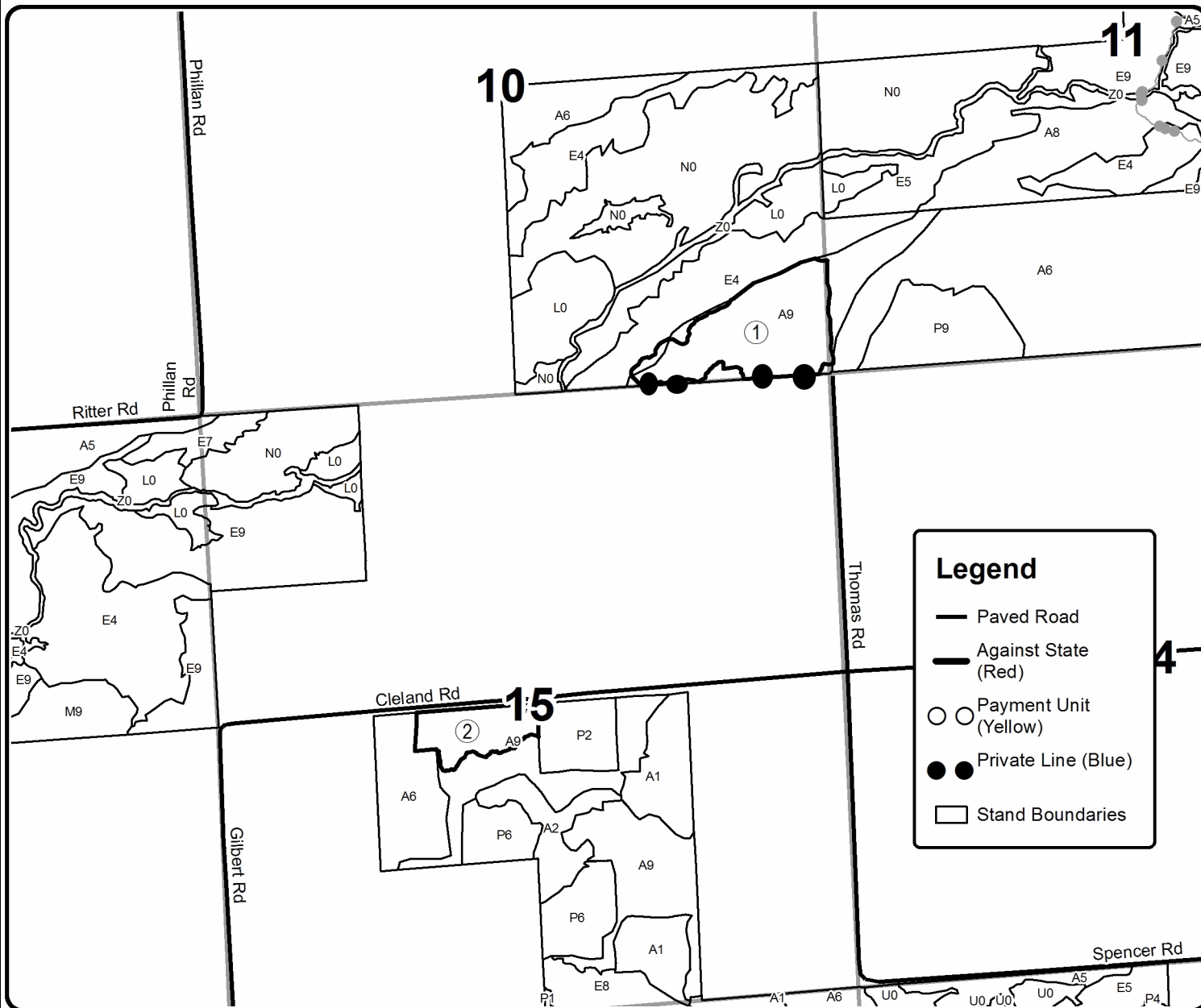
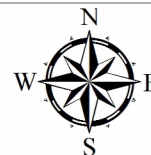

**Legend**

- Paved Road
- Against State (Red)
- ○ Payment Unit (Yellow)
- ● Private Line (Blue)
- Stand Boundaries

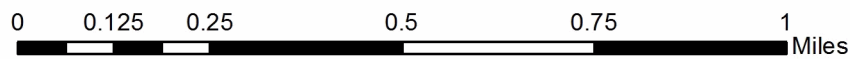

**TIMBER SALE INFORMATION**

Vassar Aspen (55-118-19)

T12N, R08E, SEC. 22; T12N, R08E, SEC. 23; T12N, R08E, SEC. 24; T12N, R08E, SEC. 25; T12N, R08E, SEC. 26; T12N, R08E, SEC. 27.

SALE NOTE: A recreation site such as a trail, pathway, or campground is within the sale area or the vicinity. Certain restrictions/specifications may be applicable including time restrictions. Access may be through other public land.

A timber sale contract for this lump sum, sealed bid timber sale will be awarded to the responsible bidder offering the highest sealed bid price. Bids must be at or above the following advertised price for each species:

<u>PRODUCTS &amp; SPECIES</u>	<u>ESTIMATED UNITS*</u>	<u>ADVERTISED PRICE</u>
<b>Sawtimber</b>		
American Elm	1.80 MBF	\$ 30.00 / MBF
Black Cherry	23.20 MBF	\$ 83.00 / MBF
Mixed Aspen	1,153.80 MBF	\$ 34.00 / MBF
Paper Birch	9.00 MBF	\$ 30.00 / MBF
Red Maple	121.00 MBF	\$ 38.00 / MBF
Red Pine	61.40 MBF	\$ 38.00 / MBF
<b>Pulpwood</b>		
Jack Pine	22.00 Cords	\$ 11.25 / Cord
Mixed Aspen	2,856.00 Cords	\$ 11.25 / Cord
Mixed Hardwood	974.00 Cords	\$ 12.75 / Cord
Red Pine	155.00 Cords	\$ 18.75 / Cord

\* The estimated units are final and not subject to adjustment. Prospective bidders are urged to examine this timber and to make their own estimates of quantity and quality.

**BOND AND PAYMENT SCHEDULE:**

1. A bond in the amount of \$4,806.00 to insure faithful performance of the conditions of the contract will be deposited by the successful bidder within 21 days of the sale award.
2. Cutting in any sale or unit without the required advance payment would be considered a trespass.
3. Total payment must be paid in advance or according to the following schedule:
  - (a) Ten percent (10%) of the sale value must be paid within 21 days of the sale award.
  - (b) The 10% down payment will be credited towards the first unit cut.
  - (c) Payment for each of the following units must be made before cutting begins in that unit:
 

<u>PAYMENT UNIT NUMBER</u>	<u>PERCENT OF TOTAL SALE VALUE</u>
01	23.1%
02	25.2%
03	32.0%
04	19.7%
4. If no cutting takes place, the 10% down payment will not be refunded.
5. Operations on the contract issued will terminate on 12/31/2021.

**Description of Timber by Payment Unit (PU)**

PU	MARKET GROUP	PRODUCT	QUANTITY	UNIT	ACRES	ADVERTISE PRICE	
1	Mixed Aspen	Sawtimber	249.2	MBF	32.2	\$22,220.60	
	<i>B. T. Aspen</i>		249.2	<i>MBF</i>			
	Red Maple		17.2	MBF			
	Red Pine		61.4	MBF			
	Jack Pine		Pulpwood	22.0			Cords
	Mixed Aspen			564.0			Cords
	<i>B. T. Aspen</i>			564.0			<i>Cords</i>
	Mixed Hardwood			99.0			Cords
	<i>Green Ash</i>			10.0			<i>Cords</i>
	<i>Red Maple</i>			89.0			<i>Cords</i>
Red Pine	155.0	Cords					
2	American Elm	Sawtimber	0.9	MBF	49.3	\$24,205.80	
	Black Cherry		10.1	MBF			
	Mixed Aspen		226.4	MBF			
	<i>B. T. Aspen</i>		203.9	<i>MBF</i>			
	<i>Quaking Aspen</i>		22.5	<i>MBF</i>			
	Paper Birch		7.1	MBF			
	Red Maple		87.3	MBF			
	Mixed Aspen		Pulpwood	544.0			Cords
	<i>B. T. Aspen</i>			494.0			<i>Cords</i>
	<i>Quaking Aspen</i>			50.0			<i>Cords</i>
	Mixed Hardwood			470.0			Cords
	<i>American Elm</i>			4.0			<i>Cords</i>
	<i>Black Cherry</i>			70.0			<i>Cords</i>
	<i>Paper Birch</i>			20.0			<i>Cords</i>
	<i>Red Maple</i>			376.0			<i>Cords</i>
3	Black Cherry	Sawtimber		10.5	MBF	60.2	\$30,745.55
	Mixed Aspen		466.4	MBF			
	<i>B. T. Aspen</i>		419.9	<i>MBF</i>			
	<i>Cottonwood</i>		46.5	<i>MBF</i>			
	Red Maple		12.9	MBF			
	Mixed Aspen		Pulpwood	1,021.0	Cords		
	<i>B. T. Aspen</i>			890.0	<i>Cords</i>		
	<i>Cottonwood</i>			131.0	<i>Cords</i>		
	Mixed Hardwood			160.0	Cords		
	<i>Black Cherry</i>			45.0	<i>Cords</i>		
<i>Green Ash</i>	2.0	<i>Cords</i>					
<i>Red Maple</i>	113.0	<i>Cords</i>					
4	American Elm	Sawtimber	0.9	MBF	34.6	\$18,940.30	
	Black Cherry		2.6	MBF			
	Mixed Aspen		211.8	MBF			
	<i>B. T. Aspen</i>		159.6	<i>MBF</i>			
	<i>Balsam Poplar</i>		3.0	<i>MBF</i>			
	<i>Cottonwood</i>		11.8	<i>MBF</i>			
	<i>Quaking Aspen</i>		37.4	<i>MBF</i>			
	Paper Birch		1.9	MBF			
	Red Maple		3.6	MBF			
	Mixed Aspen		Pulpwood	727.0			Cords
	<i>B. T. Aspen</i>			564.0			<i>Cords</i>
	<i>Balsam Poplar</i>			11.0			<i>Cords</i>
	<i>Cottonwood</i>			10.0			<i>Cords</i>
	<i>Quaking Aspen</i>			142.0			<i>Cords</i>
	Mixed Hardwood			245.0			Cords
	<i>American Elm</i>			15.0			<i>Cords</i>
<i>Black Cherry</i>	118.0	<i>Cords</i>					
<i>Green Ash</i>	4.0	<i>Cords</i>					

**Description of Timber by Payment Unit (PU), con't**

PU	MARKET GROUP	PRODUCT	QUANTITY	UNIT	ACRES	ADVERTISE PRICE
4 con't	<i>Paper Birch</i>	<i>Pulpwood</i>	11.0	<i>Cords</i>		
	<i>Red Maple</i>		97.0	<i>Cords</i>		
TOTAL:			1,370.2	MBF		
TOTAL:			4,007.0	Cords		

## Sale Specific Conditions & Requirements

**Sale Name: Vassar Aspen**

**Sale Number: 55-118-19 Seq#: 1**

### 1 - Sale Area

#### 1.2 - Boundaries

##### 1.2.1 - Painted boundaries (1/14)

The sale boundaries are marked and identified by red paint. Exterior sale boundary lines against state are marked with red paint. The painted boundary line trees are not Included Timber and are to be protected.

### 2 - Timber Specifications

#### 2.1 - Included Timber

##### 2.1.1 - Clearcut unit(s) with unmerchantable trees (6/14)

Within Payment Unit(s) 1, cut all trees that are two (2) inches or more at DBH, except do not cut oak, unmarked red pine, white pine, hemlock, spruce, cedar, oak, beech, walnut, apple and hickory. In addition, all red pine marked with orange paint above and below stump height are designated for cutting.

Within Payment Unit(s) 2-4, cut all trees that are two (2) inches or more at DBH, except do not cut oak, red pine, white pine, hemlock, spruce, cedar, oak, beech, walnut, apple and hickory.

Special protection trees identified in accordance with condition 3.4.2, within clearcutting unit boundaries, are not Included Timber and are to be protected.

#### 2.2 - Utilization

##### 2.2.3 - Stump heights (4/07)

Stump heights within all Payment Units shall not exceed 12 inches for trees greater than 10 inches DBH and 4 inches for trees smaller than 10 inches DBH.

##### 2.2.10 - No chipping tops and limbs (8/16)

Within Payment Unit(s) 1-4, chipping of the bole, 2-inches in diameter or greater, is allowed. Chipping of limbs or portions of the tree less than 2-inches in diameter is not permitted. Limbs and the remaining top must be left on site and scattered.

### 3 - Payments

#### 3.4 - Damaged Timber

##### 3.4.2 - Special Protection Trees (4/14)

The Purchaser shall not cut live or dead special protection trees within cutting units or clearings. Special protection trees are oak, walnut, hickory, hemlock and white pine. If the Purchaser's operations have cut or damaged special protection trees through carelessness, the Purchaser shall pay \$100 as fixed, agreed and liquidated damages for each special protection tree cut or damaged. Such payment does not constitute ownership of the undesignated timber.

#### 3.6 - Payment Unit Cutting Schedule

##### 3.6.2 - One active unit (12/08)

Each Payment Unit must be completed to the satisfaction of the Unit Manager or his/her representative before the next unit may be opened. The Purchaser must give a one week notice before finishing a unit to allow for inspection.

### 4 - Transportation

#### 4.1 - Construction

##### 4.1.3 - Slash and earthen piles (8/04)

Piles or windrows of earth along roads and landings that have been widened or constructed shall be leveled. Slash from road maintenance or construction, including stumps, shall be dispersed throughout the sale.

##### 4.1.7 - Road closure (10/11)



Access roads/trails to landings must be closed upon completing any Payment Unit. In general, this will require constructing a four (4') foot high berm of stumps and logs covered with earth. These roads/trails must be rendered impassable to cars and trucks. Temporary berms may be required if no sale activity occurs for 30 or more consecutive days. Contact the sale administrator for specific details of design and placement.

#### 4.1.12 - No new roads (1/12)

No new roads will be permitted in any Payment Unit. All operations are limited to existing trails.

### 4.4 - Access

#### 4.4.3 - Access gate (12/08)

The access gate to Payment Unit 4 must be locked at the completion of each day unless otherwise approved by the Unit Manager or his/her representative.

## 5 - Operations

### 5.1 - Notification

#### 5.1.6 - Utility R.O.W. (4/19)

It is the responsibility of the Purchaser to obtain permission from the utility company to utilize the power line R.O.W. for operations. This applies to Payment Unit 2 only.

### 5.2 - Conduct of Operations

#### 5.2.1 - Slash

##### 5.2.1.8 - Slash height (12/08)

No slash or tree tops may exceed 48 inches in height.

##### 5.2.1.11 - Slash for reforestation (5/07)

To facilitate reforestation, the sale area shall be left with slash evenly distributed. Bunched tops within the cutting area shall be broken up and scattered. Stumps shall be cut low to the ground. Processing sites shall not be left with a compacted layer of slash; tops from these sites shall be hauled back into the cut area and scattered.

#### 5.2.2 - Hazard Trees/Snags

##### 5.2.2.1 - Den trees (10/16)

Obvious hollow and/or den trees shall be protected and left standing unless they are a safety hazard.

#### 5.2.3 - Operating Restrictions

##### 5.2.3.2 - Operating restrictions (9/11)

Within Payment Unit(s) 1-4, unless changed by written agreement, cutting, skidding, and hauling are not permitted during the period of March 1 to July 15. This restriction is necessary to protect sensitive soils, protect the trail network, and prevent bark slip and oak wilt.

##### 5.2.3.12 - Hunting operating restriction (1/18)

No Payment unit may be started during the period of November 10 thru November 30 without permission of the Unit Manager or his/her representative.

#### 5.2.4 - Dead and Down Creation

##### 5.2.4.3 - Dead and down creation, dead trees (6/07)

Except as provided for in General Condition and Requirement 5.2.2, no dead trees, standing or down, are to be cut, skidded, or processed.

##### 5.2.4.4 - Dead and down creation, grouse (6/18)

To encourage grouse and other wildlife, in Payment Unit(s) 1-4, leave one 12" or larger diameter whole tree on the ground for every 3 acres. Trees should be scattered throughout the sale. Trees must be marked with a solid band of red paint. Stumps must be at least 3 feet tall.

#### 5.2.31 - Landing locations (9/13)

Landing areas are marked on the Timber Sale Map with the letter "L". Landings must be confined to these designated sites

unless otherwise authorized by the Unit Manager or his/her representative. In general, landings are limited to a "T" turnaround which will accommodate a truck with a 50 foot trailer.

#### 5.2.32 - Decking/landing restoration (9/13)

All decking and landing areas must have the surface area restored to a condition equal to or better than before. This is to ensure the proper regeneration of the stand. Wood debris, chips and "cookies" from trimmings must be removed and scattered within the sale boundaries away from landing and loading areas and may not be windrowed on the edge.

#### 5.2.37 - No decking areas (12/08)

No decking is allowed in any designated parking area.

#### 5.2.38 - No decking against live trees (2/04)

Cut products may not be decked against unmarked or designated leave trees.

#### 5.2.40 - Pathway protection (10/10)

The trail in Payment Unit 1 is a hiking trail and is shown on the Timber Sale Map. Maintain a 20-foot wide slash, debris, and rut free zone daily, using the pathway as the centerline.

### 5.4 - Soil Protection

#### 5.4.1 - Rutting restriction, general (7/16)

Operations are to cease immediately if equipment and weather conditions result in rutting of roads and/or skid trails which is 8 inches or greater in depth and 50 feet in length. The Unit Manager or his/her representative may restrict hauling and/or skidding if ruts exceed the specified depth. With the Unit Manager or his/her representative's approval, the Purchaser may return to the area when the risk of rutting has decreased.

#### 5.4.5 - Soil caution (11/04)

Care must be taken to minimize soil damage due to the sandy soils.

### 5.6 - Debris and Waste Material

#### 5.6.3 - Equipment cleaning (12/17)

For purposes of this provision, "Off-Road Equipment" includes all logging and construction machinery, except for log trucks, chip vans, service vehicles, water trucks, pickup trucks, cars, and similar vehicles. Off-Road Equipment brought on site must be clean and free from plant material and soil prior to arrival on any Payment Unit. Off-Road Equipment shall be cleaned of plant material and dirt prior to being moved to a new stand within the sale. Plant material includes leaves, stems, roots and seeds. Equipment shall be considered clean when a visual inspection does not disclose seeds, soil, vegetative matter, and other debris that could contain or hold seeds. This is to prevent the spread of invasive plant species.

### 5.7 - Protection of Historical Sites

#### 5.7.2 - Potential historical site(s) (9/06)

The State Historic Preservation Office has identified the potential for a historic site within the boundary of this timber sale. Note that if the site is discovered during operations, General Condition and Requirement 5.7 - Protection of Historical Sites will apply.

### 5.8 - Protection of Endangered Species

#### 5.8.5 - Protection of raptor nests (3/13)

All trees with raptor nests will be protected if found during harvesting operations. Notification will be made to the Unit Manager or his/her representative who will notify the Wildlife Biologist so an on-site evaluation and recommendation can be made, if necessary.

## 6 - Safety and Fire Prevention

### 6.2 - Signing

#### 6.2.1 - Road posting (9/09)

The Purchaser is responsible for posting and maintaining caution signs on Wilder Rd (Payment Units 2-4) and Sheridan Rd (Payment Unit 1) prior to beginning operations. The road must be posted 200 feet in either direction from where trucks and/or vehicles enter the road way from the sale to warn of logging activity and truck traffic. Signs must be removed when harvest operations are suspended or completed. The Purchaser will provide these signs.

## **7 - Other Conditions**

### 7.2 - Extensions

#### 7.2.2 - No extensions (3/09)

There will be no extensions granted on this contract. The purpose of this sale is to create habitat for a variety of wildlife species. Other wildlife habitat work in the area is dependent upon the timely completion of this sale.

### 7.10 - Certified Timber

#### 7.10.1 - Non-certified timber (2/16)

The area encompassed by this timber sale is not certified to the standards of the Forest Stewardship Council (FSC) or the Sustainable Forestry Initiative (SFI). Forest products from this sale may not be delivered to the mill as "FSC and / or SFI certified". The lands within this sale are managed as a State Game Area.



# TIMBER SALE MAP

This information provided by authority of Part 525, 1994 PA 451, as amended.

Forest Management Unit Vassar State Game Area	County Tuscola	Mapped By DJ Bonnette	Date 05/30/2019	Page 1	of 2
Township 12N	Range 8E	Section(s) and Subdivision(s) S1/2SE Sec. 22; E1/2SW, W1/2SE Sec. 23; S1/2SW Sec. 24; NWNW Sec. 25; NENW, S1/2NW, N1/2SW, NWSE Sec. 26; NENW, W1/2NE Sec. 27	Scale 1:15,840		

Cover Type				Density	
A = Aspen	H = Hemlock	N = Marsh	U = Upland Brush	0 = Non Stocked	5 = Pole Timber Medium
B = Paper Birch	J = Jack Pine	O = Oak	UM = Upland Mixed	1 = Seedling Sapling Poor	6 = Pole Timber Well
C = Cedar	L = Lowland Brush	P = Lowland Poplar	V = Bog or Marsh	2 = Seedling Sapling Medium	7 = Saw Timber Poor
D = Treed Bog	LM = Lowland Mixed	Q = Mixed Swamp Conifer	W = White Pine	3 = Seedling Sapling Well	8 = Saw Timber Medium
E = Swamp Hdwoods	M = Mpl, Bch, Brch	R = Red Pine	X = Non Stocked	4 = Pole Timber Poor	9 = Saw Timber Well
F = Spruce Fir	MC = Mixed Conifer	S = Black Spruce	Z = Water		
G = Grass	MD = Mixed Deciduous	T = Tamarack			

PU	Acres	PU	Acres
1	32.2	4	34.6
2	49.3		
3	60.2		

## Vassar Aspen

176.3 Acres

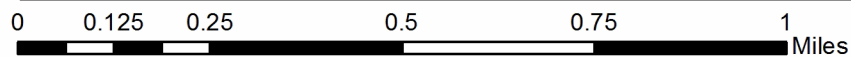
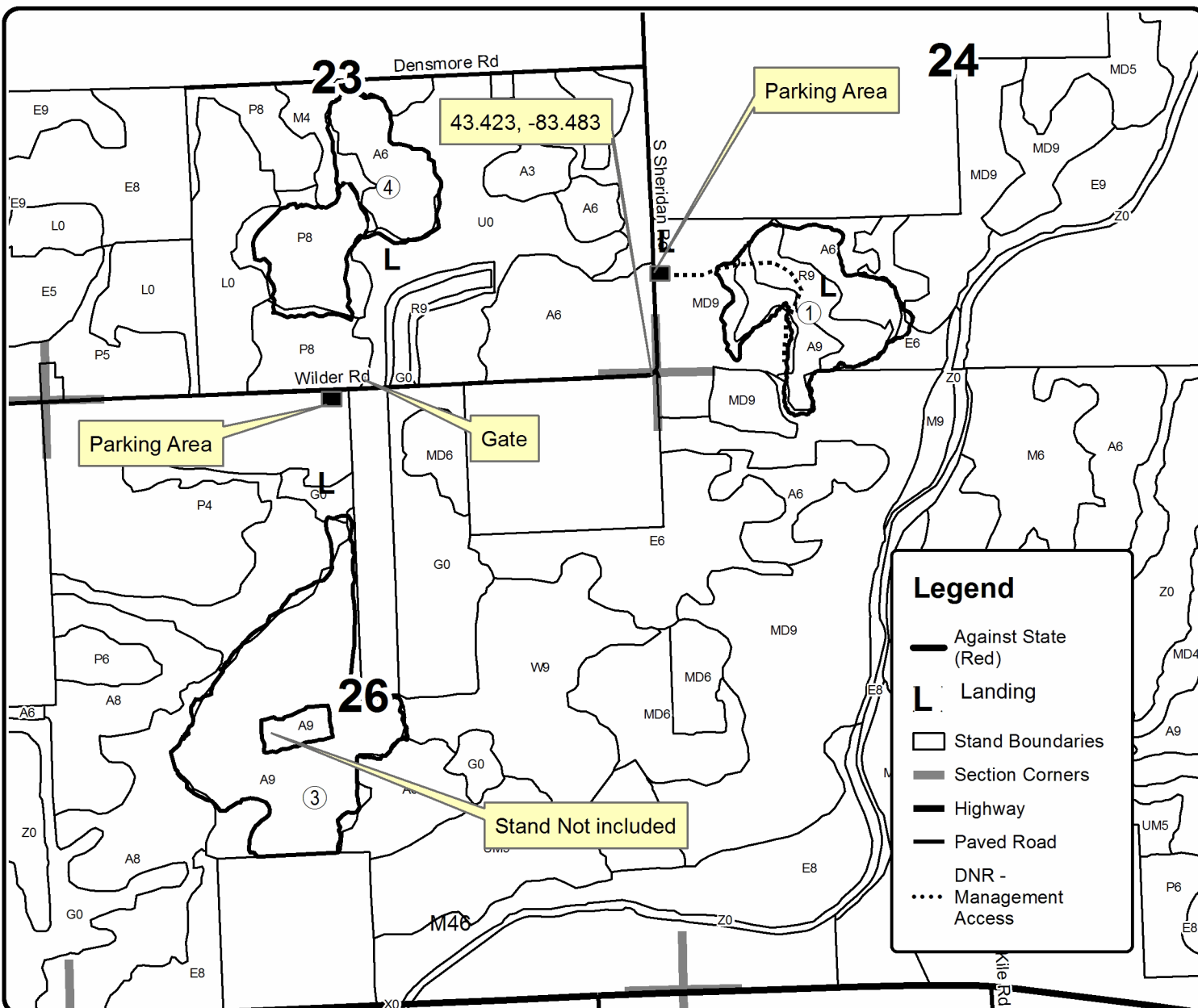
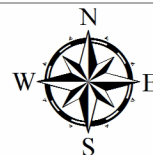



# TIMBER SALE MAP

This information provided by authority of Part 525, 1994 PA 451, as amended.

Sale Number	Year
55-118-19	2019

Forest Management Unit	County	Mapped By	Date	Page	of
Vassar State Game Area	Tuscola	DJ Bonnette	05/30/2019	2	2
Township	Range	Section(s) and Subdivision(s)	Scale		
12N	8E	S1/2SE Sec. 22; E1/2SW, W1/2SE Sec. 23; S1/2SW Sec. 24; NWNW Sec. 25; NENW, S1/2NW, N1/2SW, NWSE Sec. 26; NENW, W1/2NE Sec. 27	1:15,840		

### Cover Type

A = Aspen	H = Hemlock	N = Marsh	U = Upland Brush
B = Paper Birch	J = Jack Pine	O = Oak	UM = Upland Mixed
C = Cedar	L = Lowland Brush	P = Lowland Poplar	V = Bog or Marsh
D = Treed Bog	LM = Lowland Mixed	Q = Mixed Swamp Conifer	W = White Pine
E = Swamp Hdwoods	M = Mpl, Bch, Brch	R = Red Pine	X = Non Stocked
F = Spruce Fir	MC = Mixed Conifer	S = Black Spruce	Z = Water
G = Grass	MD = Mixed Deciduous	T = Tamarack	

### Density

0 = Non Stocked	5 = Pole Timber Medium
1 = Seedling Sapling Poor	6 = Pole Timber Well
2 = Seedling Sapling Medium	7 = Saw Timber Poor
3 = Seedling Sapling Well	8 = Saw Timber Medium
4 = Pole Timber Poor	9 = Saw Timber Well

PU	Acres	PU	Acres
1	32.2	4	34.6
2	49.3		
3	60.2		

## Vassar Aspen

176.3 Acres

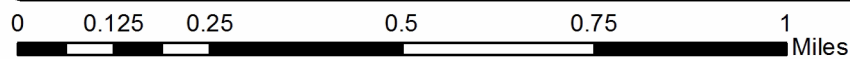
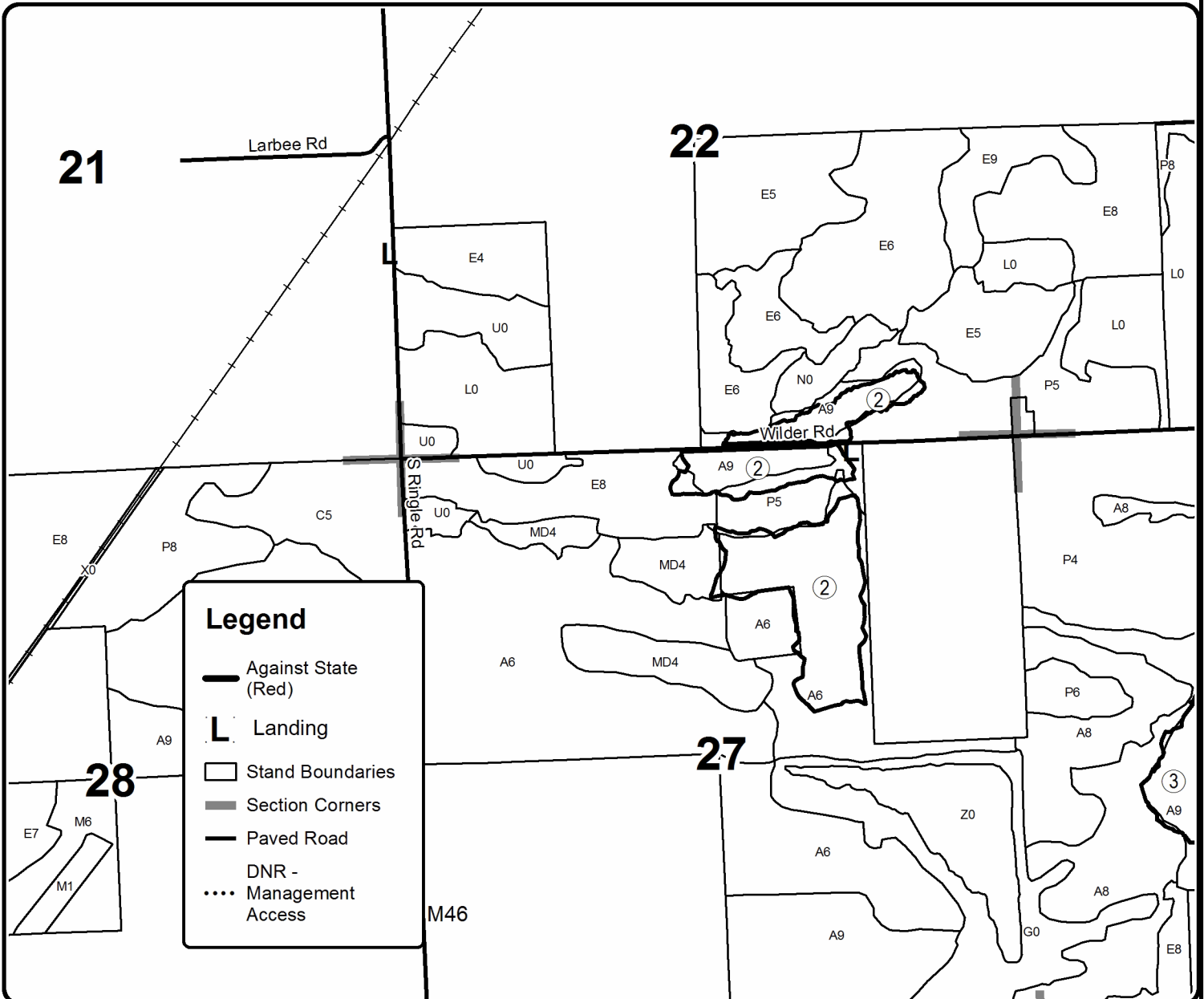



**TIMBER SALE INFORMATION**

Sanilac Aspen (55-119-19)  
 T14N, R12E, SEC. 22; T14N, R12E, SEC. 23.  
 Sanilac County (Advertised Price \$67,088.50)

SALE NOTE: Sale requires dry or frozen ground harvest only. No cutting, skidding, hauling from April 1 to July 15.

Access may be through other public land.

A timber sale contract for this lump sum, sealed bid timber sale will be awarded to the responsible bidder offering the highest sealed bid price. Bids must be at or above the following advertised price for each species:

<u>PRODUCTS &amp; SPECIES</u>	<u>ESTIMATED UNITS*</u>	<u>ADVERTISED PRICE</u>
<b>Sawtimber</b>		
American Elm	0.90 MBF	\$ 30.00 / MBF
Basswood	4.80 MBF	\$ 30.00 / MBF
Black Cherry	83.70 MBF	\$ 83.00 / MBF
Green Ash	3.20 MBF	\$ 30.00 / MBF
Mixed Aspen	571.60 MBF	\$ 34.00 / MBF
Paper Birch	7.60 MBF	\$ 30.00 / MBF
Red Maple	22.90 MBF	\$ 38.00 / MBF
Sugar Maple	19.10 MBF	\$ 83.00 / MBF
White Ash	1.80 MBF	\$ 30.00 / MBF
<b>Pulpwood</b>		
Mixed Aspen	2,252.00 Cords	\$ 11.25 / Cord
Mixed Hardwood	970.00 Cords	\$ 12.75 / Cord

\* The estimated units are final and not subject to adjustment. Prospective bidders are urged to examine this timber and to make their own estimates of quantity and quality.

**BOND AND PAYMENT SCHEDULE:**

1. A bond in the amount of \$3,354.00 to insure faithful performance of the conditions of the contract will be deposited by the successful bidder within 21 days of the sale award.
2. Cutting in any sale or unit without the required advance payment would be considered a trespass.
3. Total payment must be paid in advance or according to the following schedule:
  - (a) Ten percent (10%) of the sale value must be paid within 21 days of the sale award.
  - (b) The 10% down payment will be credited towards the first unit cut.
  - (c) Payment for each of the following units must be made before cutting begins in that unit:
 

<u>PAYMENT UNIT NUMBER</u>	<u>PERCENT OF TOTAL SALE VALUE</u>
01	22.1%
02	47.9%
03	30.0%
4. If no cutting takes place, the 10% down payment will not be refunded.
5. Operations on the contract issued will terminate on 01/01/2022.

**Description of Timber by Payment Unit (PU)**

PU	MARKET GROUP	PRODUCT	QUANTITY	UNIT	ACRES	ADVERTISE PRICE	
1	American Elm	Sawtimber	0.9	MBF	34.1	\$14,812.90	
	Basswood		3.0	MBF			
	Black Cherry		6.0	MBF			
	Mixed Aspen		138.1	MBF			
	<i>B. T. Aspen</i>		75.4	<i>MBF</i>			
	<i>Quaking Aspen</i>		62.7	<i>MBF</i>			
	Paper Birch		7.6	MBF			
	Red Maple		19.3	MBF			
	Sugar Maple		6.2	MBF			
	White Ash		1.8	MBF			
	Mixed Aspen		Pulpwood	363.0			Cords
	<i>B. T. Aspen</i>			181.0			<i>Cords</i>
	<i>Quaking Aspen</i>			182.0			<i>Cords</i>
	Mixed Hardwood			305.0			Cords
	<i>American Elm</i>	28.0		<i>Cords</i>			
	<i>Basswood</i>	11.0		<i>Cords</i>			
	<i>Black Cherry</i>	39.0		<i>Cords</i>			
	<i>Green Ash</i>	19.0	<i>Cords</i>				
	<i>Paper Birch</i>	85.0	<i>Cords</i>				
	<i>Red Maple</i>	100.0	<i>Cords</i>				
	<i>Sugar Maple</i>	18.0	<i>Cords</i>				
<i>White Ash</i>	5.0	<i>Cords</i>					
2	Black Cherry	Sawtimber	69.1	MBF	42.4	\$32,141.80	
	Green Ash		2.3	MBF			
	Mixed Aspen		269.0	MBF			
	<i>B. T. Aspen</i>		269.0	<i>MBF</i>			
	Sugar Maple	3.0	MBF				
	Mixed Aspen	Pulpwood	1,013.0	Cords			
	<i>B. T. Aspen</i>		1,013.0	<i>Cords</i>			
	Mixed Hardwood		435.0	Cords			
	<i>American Elm</i>		3.0	<i>Cords</i>			
	<i>Basswood</i>		32.0	<i>Cords</i>			
	<i>Black Cherry</i>		265.0	<i>Cords</i>			
	<i>Green Ash</i>		22.0	<i>Cords</i>			
	<i>Red Maple</i>		33.0	<i>Cords</i>			
	<i>Sugar Maple</i>		80.0	<i>Cords</i>			
3	Basswood		Sawtimber	1.8	MBF	33.8	\$20,133.80
	Black Cherry	8.6		MBF			
	Green Ash	0.9		MBF			
	Mixed Aspen	164.5		MBF			
	<i>B. T. Aspen</i>	151.3		<i>MBF</i>			
	<i>Quaking Aspen</i>	13.2	<i>MBF</i>				
	Red Maple	3.6	MBF				
	Sugar Maple	9.9	MBF				
	Mixed Aspen	Pulpwood	876.0	Cords			
	<i>B. T. Aspen</i>		808.0	<i>Cords</i>			
	<i>Quaking Aspen</i>		68.0	<i>Cords</i>			
	Mixed Hardwood		230.0	Cords			
	<i>American Elm</i>		5.0	<i>Cords</i>			
	<i>Basswood</i>		20.0	<i>Cords</i>			
	<i>Black Cherry</i>		52.0	<i>Cords</i>			
<i>Green Ash</i>	83.0		<i>Cords</i>				
<i>Red Maple</i>	50.0		<i>Cords</i>				
<i>Sugar Maple</i>	20.0		<i>Cords</i>				
TOTAL:			715.6	MBF			



TOTAL:	3,222.0	Cords
--------	---------	-------

# Sale Specific Conditions & Requirements

**Sale Name: Sanilac Aspen**

**Sale Number: 55-119-19 Seq#: 1**

## 1 - Sale Area

### 1.2 - Boundaries

#### 1.2.1 - Painted boundaries (1/14)

The sale boundaries are marked and identified by red paint. Exterior sale boundary lines against private property are marked with blue paint. The painted boundary line trees are not Included Timber and are to be protected.

## 2 - Timber Specifications

### 2.1 - Included Timber

#### 2.1.1 - Clearcut unit(s) with unmerchantable trees (6/14)

Within Payment Unit(s) 1-3, cut all trees that are two (2) inches or more at DBH, except do not cut trees marked with green paint, or any apple, hemlock, white pine, cedar, hickory, or American beech. Special protection trees identified in accordance with condition 3.4.2, within clearcutting unit boundaries, are not Included Timber and are to be protected.

### 2.2 - Utilization

#### 2.2.3 - Stump heights (4/07)

Stump heights within the Sale Area shall not exceed 12 inches for trees greater than 10 inches DBH and 4 inches for trees smaller than 10 inches DBH.

#### 2.2.4 - Skidding length (2/14)

Skidding of unlimbed tops is not permissible.

#### 2.2.10 - No chipping tops and limbs (8/16)

Within Payment Unit(s) 1-3, chipping of the bole, 2-inches in diameter or greater, is allowed. Chipping of limbs or portions of the tree less than 2-inches in diameter is not permitted. Limbs and the remaining top must be left on site and scattered.

## 3 - Payments

### 3.4 - Damaged Timber

#### 3.4.2 - Special Protection Trees (4/14)

The Purchaser shall not cut live or dead special protection trees within cutting units or clearings. Special protection trees are apple, hemlock and hickory. If the Purchaser's operations have cut or damaged special protection trees through carelessness, the Purchaser shall pay \$100 as fixed, agreed and liquidated damages for each special protection tree cut or damaged. Such payment does not constitute ownership of the undesignated timber.

### 3.6 - Payment Unit Cutting Schedule

#### 3.6.2 - One active unit (12/08)

Each Payment Unit must be completed to the satisfaction of the Unit Manager or his/her representative before the next unit may be opened. The Purchaser must give a one week notice before finishing a unit to allow for inspection.

## 4 - Transportation

### 4.1 - Construction

#### 4.1.3 - Slash and earthen piles (8/04)

Piles or windrows of earth along roads and landings that have been widened or constructed shall be leveled. Slash from road maintenance or construction, including stumps, shall be dispersed throughout the sale.

#### 4.1.7 - Road closure (10/11)

Access roads/trails to landings must be closed upon completing any Payment Unit. In general, this will require constructing a four (4') foot high berm of stumps and logs covered with earth. These roads/trails must be rendered impassable to cars and trucks. Temporary berms may be required if no sale activity occurs for 30 or more consecutive days. Contact the sale

administrator for specific details of design and placement.

#### 4.1.12 - No new roads (1/12)

No new roads will be permitted in any Payment Unit. All operations are limited to existing trails. Skid trails only will be allowed.

## 5 - Operations

### 5.1 - Notification

#### 5.1.1 - Pre-sale conference (10/16)

A pre-sale conference on site between the Purchaser and sale administrator is required prior to beginning any operations to determine landing and road locations. The Unit Manager or his/her representative must be contacted at least 10 days in advance to schedule the conference.

### 5.2 - Conduct of Operations

#### 5.2.1 - Slash

##### 5.2.1.8 - Slash height (12/08)

No slash or tree tops may exceed 48 inches in height.

##### 5.2.1.11 - Slash for reforestation (5/07)

To facilitate reforestation, the sale area shall be left with slash evenly distributed. Bunched tops within the cutting area shall be broken up and scattered. Stumps shall be cut low to the ground. Processing sites shall not be left with a compacted layer of slash; tops from these sites shall be hauled back into the cut area and scattered.

#### 5.2.2 - Hazard Trees/Snags

##### 5.2.2.1 - Den trees (10/16)

Obvious hollow and/or den trees shall be protected and left standing unless they are a safety hazard.

#### 5.2.3 - Operating Restrictions

##### 5.2.3.2 - Operating restrictions (9/11)

Within Payment Unit(s) 1-3, cutting, skidding, and hauling are restricted to dry or frozen ground conditions. In addition, cutting, skidding, and hauling are not permitted during the period of April 1 to July 15, regardless of ground conditions. The Sale Administrator will determine what constitutes dry or frozen ground conditions. This restriction is necessary to protect sensitive soils, reduce the risk of rutting, prevent runoff to adjacent waterways, prevent bark slip and protect the trail network.

##### 5.2.3.12 - Hunting operating restriction (1/18)

No Payment unit may be started during the period of November 10 through November 30 without permission of the Unit Manager or his/her representative. The Unit Manager may restrict harvesting during this period to specific days depending upon hunting pressure on the area.

#### 5.2.4 - Dead and Down Creation

##### 5.2.4.3 - Dead and down creation, dead trees (6/07)

Except as provided for in General Condition and Requirement 5.2.2, no dead trees, standing or down, are to be cut, skidded, or processed.

##### 5.2.4.4 - Dead and down creation, grouse (6/18)

To encourage grouse and other wildlife, in Payment Unit(s) 1-3, leave one, 12" or larger diameter whole tree on the ground for every 2 acres. Trees should scattered throughout the sale or positioned per the sale administrators instructions. Trees must be marked with a solid band of red paint. Stumps must be at least 3 feet tall.

#### 5.2.29 - Shrub protection (9/07)

Do not cut or damage dogwood or hawthorn within Payment Unit 1 (to the extent possible) during harvest operations. These woody-shrub plants are highly beneficial to various wildlife species.

#### 5.2.31 - Landing locations (9/13)

Landing areas are marked on the Timber Sale Map with the letter "L". Landings must be confined to these designated sites unless otherwise authorized by the Unit Manager or his/her representative. In general, landings are limited to a "T" turnaround which will accommodate a truck with a 50 foot trailer.

#### 5.2.32 - Decking/landing restoration (9/13)

All decking and landing areas must have the surface area restored to a condition equal to or better than before. This is to ensure the proper regeneration of the stand. Wood debris, chips and "cookies" from trimmings must be removed or scattered within the sale boundary away from landing and loading areas and may not be windrowed on the edge.

#### 5.2.37 - No decking areas (12/08)

No decking is allowed in any designated parking area.

#### 5.2.38 - No decking against live trees (2/04)

Cut products may not be decked against unmarked or designated leave trees.

### 5.4 - Soil Protection

#### 5.4.1 - Rutting restriction, general (7/16)

Operations are to cease immediately if equipment and weather conditions result in rutting of roads and/or skid trails which is 12 inches or greater in depth and 50 feet in length. The Unit Manager or his/her representative may restrict hauling and/or skidding if ruts exceed the specified depth. With the Unit Manager or his/her representative's approval, the Purchaser may return to the area when the risk of rutting has decreased.

#### 5.4.3 - Erosion control (12/08)

Skid trails or haul roads may require erosion control structures or berms per direction of the Unit Manager or his/her representative.

### 5.7 - Protection of Historical Sites

#### 5.7.2 - Potential historical site(s) (9/06)

The State Historic Preservation Office has identified the potential for a historic site within the boundary of this timber sale. Note that if the site is discovered during operations, General Condition and Requirement 5.7 - Protection of Historical Sites will apply.

## 7 - Other Conditions

### 7.10 - Certified Timber

#### 7.10.1 - Non-certified timber (2/16)

The area encompassed by this timber sale is not certified to the standards of the Forest Stewardship Council (FSC) or the Sustainable Forestry Initiative (SFI). Forest products from this sale may not be delivered to the mill as "FSC and / or SFI certified". The lands within this sale are managed as a State Game Area.



# TIMBER SALE MAP

This information provided by authority of Part 525, 1994 PA 451, as amended.

Forest Management Unit Sanilac State Game Area		County Sanilac	Mapped By DJ Bonnette	Date 06/18/2019	Page 1	of 1
Township 14N	Range 12E	Section(s) and Subdivision(s) NE, NESE Sec. 22; N1/2NW, SWNW, NWSW, N1/2SE		Scale 1:15,840		

Cover Type				Density	
A = Aspen	H = Hemlock	N = Marsh	U = Upland Brush	0 = Non Stocked	5 = Pole Timber Medium
B = Paper Birch	J = Jack Pine	O = Oak	UM = Upland Mixed	1 = Seedling Sapling Poor	6 = Pole Timber Well
C = Cedar	L = Lowland Brush	P = Lowland Poplar	V = Bog or Marsh	2 = Seedling Sapling Medium	7 = Saw Timber Poor
D = Treed Bog	LM = Lowland Mixed	Q = Mixed Swamp Conifer	W = White Pine	3 = Seedling Sapling Well	8 = Saw Timber Medium
E = Swamp Hdwoods	M = Mpl, Bch, Brch	R = Red Pine	X = Non Stocked	4 = Pole Timber Poor	9 = Saw Timber Well
F = Spruce Fir	MC = Mixed Conifer	S = Black Spruce	Z = Water		
G = Grass	MD = Mixed Deciduous	T = Tamarack			

## PU Acres

1	34.1
2	42.4
3	33.8

## Sanilac Aspen

110.3 Acres

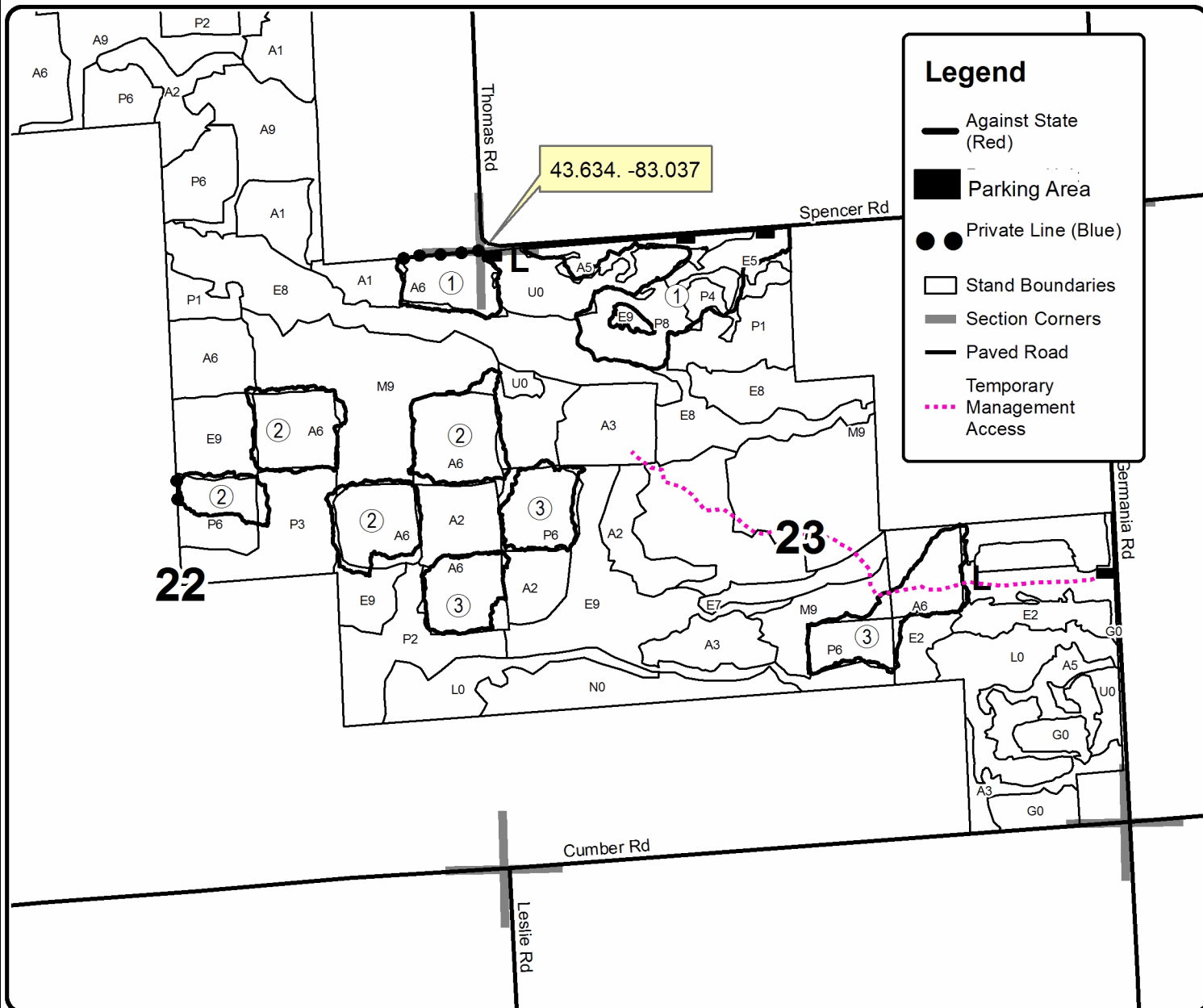
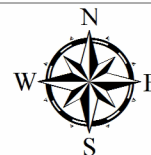



**TIMBER SALE INFORMATION**

Ashmore Mix (55-120-19)

T14N, R09E, SEC. 10.

Tuscola County (Advertised Price \$6,051.20)

SALE NOTE: Access may be through other public land.

A timber sale contract for this lump sum, sealed bid timber sale will be awarded to the responsible bidder offering the highest sealed bid price. Bids must be at or above the following advertised price for each species:

<u>PRODUCTS &amp; SPECIES</u>	<u>ESTIMATED UNITS*</u>	<u>ADVERTISED PRICE</u>
Sawtimber		
Green Ash	0.90 MBF	\$ 30.00 / MBF
Mixed Aspen	49.40 MBF	\$ 34.00 / MBF
Paper Birch	2.40 MBF	\$ 30.00 / MBF
Red Maple	30.70 MBF	\$ 38.00 / MBF
Sugar Maple	2.00 MBF	\$ 83.00 / MBF
Pulpwood		
Mixed Aspen	53.00 Cords	\$ 11.25 / Cord
Mixed Hardwood	181.00 Cords	\$ 12.75 / Cord
Scotch Pine	4.00 Cords	\$ 9.00 / Cord

\* The estimated units are final and not subject to adjustment. Prospective bidders are urged to examine this timber and to make their own estimates of quantity and quality.

**BOND AND PAYMENT SCHEDULE:**

1. A bond in the amount of \$303.00 to insure faithful performance of the conditions of the contract will be deposited by the successful bidder within 21 days of the sale award.
2. Cutting in any sale or unit without the required advance payment would be considered a trespass.
3. Total payment must be paid in advance or according to the following schedule:
  - (a) Ten percent (10%) of the sale value must be paid within 21 days of the sale award.
  - (b) The remainder is due before cutting begins.
  - (c) Payment for each of the following units must be made before cutting begins in that unit:
 

PAYMENT UNIT NUMBER	PERCENT OF TOTAL SALE VALUE
01	100.0%
4. If no cutting takes place, the 10% down payment will not be refunded.
5. Operations on the contract issued will terminate on 12/31/2021.

**Description of Timber by Payment Unit (PU)**

PU	MARKET GROUP	PRODUCT	QUANTITY	UNIT	ACRES	ADVERTISE PRICE	
1	Green Ash	Sawtimber	0.9	MBF	14.3	\$6,051.20	
	Mixed Aspen		49.4	MBF			
	<i>B. T. Aspen</i>		14.6	<i>MBF</i>			
	<i>Cottonwood</i>		17.1	<i>MBF</i>			
	<i>Quaking Aspen</i>		17.7	<i>MBF</i>			
	Paper Birch		2.4	MBF			
	Red Maple		30.7	MBF			
	Sugar Maple		2.0	MBF			
	Mixed Aspen		Pulpwood	53.0			Cords
	<i>B. T. Aspen</i>			19.0			<i>Cords</i>
	<i>Cottonwood</i>			17.0			<i>Cords</i>
	<i>Quaking Aspen</i>			17.0			<i>Cords</i>
	Mixed Hardwood			181.0			Cords
	<i>American Elm</i>			18.0			<i>Cords</i>
	<i>Black Cherry</i>	16.0		<i>Cords</i>			
	<i>Green Ash</i>	32.0		<i>Cords</i>			
	<i>Paper Birch</i>	20.0		<i>Cords</i>			
	<i>Red Maple</i>	91.0		<i>Cords</i>			
	<i>Sugar Maple</i>	4.0	<i>Cords</i>				
	Scotch Pine	4.0	Cords				
TOTAL:			85.4	MBF			
TOTAL:			238.0	Cords			



# Sale Specific Conditions & Requirements

**Sale Name: Ashmore Mix**

**Sale Number: 55-120-19 Seq#: 1**

## 1 - Sale Area

### 1.2 - Boundaries

#### 1.2.1 - Painted boundaries (1/14)

The sale boundaries are marked and identified by red paint. Exterior sale boundary lines against private property are marked with blue paint. The painted boundary line trees are not Included Timber and are to be protected.

## 2 - Timber Specifications

### 2.1 - Included Timber

#### 2.1.1 - Clearcut unit(s) with unmerchantable trees (6/14)

Within Payment Unit(s) 1, cut all trees that are two (2) inches or more at DBH, except do not cut trees marked with green paint, or any oak or apple. Special protection trees identified in accordance with condition 3.4.2, within clearcutting unit boundaries, are not Included Timber and are to be protected.

### 2.2 - Utilization

#### 2.2.3 - Stump heights (4/07)

Stump heights within the Sale Area shall not exceed 12 inches for trees greater than 10 inches DBH and 4 inches for trees smaller than 10 inches DBH.

#### 2.2.4 - Skidding length (2/14)

Skidding of unlimbed tops is not permissible.

#### 2.2.10 - No chipping tops and limbs (8/16)

Within Payment Unit(s) 1, chipping of the bole, 2 inches in diameter or greater, is allowed. Chipping of limbs or portions of the tree less than 2 inches in diameter is not permitted. Limbs and the remaining top must be left on site and scattered.

## 3 - Payments

### 3.4 - Damaged Timber

#### 3.4.2 - Special Protection Trees (4/14)

The Purchaser shall not cut live or dead special protection trees within cutting units or clearings. Special protection trees are oak and apple. If the Purchaser's operations have cut or damaged special protection trees through carelessness, the Purchaser shall pay \$100 as fixed, agreed and liquidated damages for each special protection tree cut or damaged. Such payment does not constitute ownership of the undesignated timber.

## 4 - Transportation

### 4.1 - Construction

#### 4.1.3 - Slash and earthen piles (8/04)

Piles or windrows of earth along roads and landings that have been widened or constructed shall be leveled. Slash from road maintenance or construction, including stumps, shall be dispersed throughout the sale.

#### 4.1.7 - Road closure (10/11)

Access trails built into the sale must be blocked to vehicle traffic upon completion of the sale. Contact the sale administrator for specific details on trail closure requirements.

#### 4.1.12 - No new roads (1/12)

No new roads will be permitted. Skid trails only will be allowed.

## 5 - Operations

### 5.1 - Notification

#### 5.1.1 - Pre-sale conference (10/16)

A pre-sale conference on site between the Purchaser and sale administrator is required prior to beginning any operations to determine landing and road locations. The Unit Manager or his/her representative must be contacted at least 10 days in advance to schedule the conference.

### 5.2 - Conduct of Operations

#### 5.2.1 - Slash

##### 5.2.1.8 - Slash height (12/08)

No slash or tree tops may exceed 48 inches in height.

##### 5.2.1.11 - Slash for reforestation (5/07)

To facilitate reforestation, the sale area shall be left with slash evenly distributed. Bunched tops within the cutting area shall be broken up and scattered. Stumps shall be cut low to the ground. Processing sites shall not be left with a compacted layer of slash; tops from these sites shall be hauled back into the cut area and scattered.

#### 5.2.2 - Hazard Trees/Snags

##### 5.2.2.1 - Den trees (10/16)

Obvious hollow and/or den trees shall be protected and left standing unless they are a safety hazard.

#### 5.2.3 - Operating Restrictions

##### 5.2.3.2 - Operating restrictions (9/11)

Within Payment Unit(s) 1, cutting, skidding, and hauling are limited to dry or frozen ground conditions. In addition, cutting, skidding, and hauling are not permitted during the period of April 1 to July 1, regardless of ground conditions. This restriction is necessary to protect sensitive soils, reduce rutting risk and prevent bark slip.

##### 5.2.3.12 - Hunting operating restriction (1/18)

No Payment unit may be started during the period of October 20 to 25 and November 10 to 30 without permission of the Unit Manager or his/her representative. In addition, the Unit Manager may prohibit and/or restrict harvesting and hauling operations during these periods to specific days depending upon hunting pressure on the area.

#### 5.2.4 - Dead and Down Creation

##### 5.2.4.3 - Dead and down creation, dead trees (6/07)

Except as provided for in General Condition and Requirement 5.2.2, no dead trees, standing or down, are to be cut, skidded, or processed.

#### 5.2.29 - Shrub protection (9/07)

Do not cut or damage dogwood and juneberry anymore than necessary during harvest operations. These woody-shrub plants are highly beneficial to various wildlife species.

#### 5.2.31 - Landing locations (9/13)

Landing areas are marked on the Timber Sale Map with the letter "L". Landings must be confined to these designated sites unless otherwise authorized by the Unit Manager or his/her representative. In general, landings are limited to a "T" turnaround which will accommodate a truck with a 50 foot trailer.

#### 5.2.32 - Decking/landing restoration (9/13)

All decking and landing areas must have the surface area restored to a condition equal to or better than before. This is to ensure the proper regeneration of the stand. Wood debris, chips and "cookies" from trimmings must be removed or scattered within the sale boundaries and may not be windrowed on the edge.

#### 5.2.37 - No decking areas (12/08)

No decking is allowed within any designated parking area.

### 5.4 - Soil Protection

#### 5.4.1 - Rutting restriction, general (7/16)

Operations are to cease immediately if equipment and weather conditions result in rutting of roads and/or skid trails which is 12 inches or greater in depth and 50 feet in length. The Unit Manager or his/her representative may restrict hauling and/or

skidding if ruts exceed the specified depth. With the Unit Manager or his/her representative's approval, the Purchaser may return to the area when the risk of rutting has decreased.

#### 5.4.6 - Wet area protection (5/10)

No harvesting operations, including skidding and felling, are to take place within the vernal pond areas or drainages. When harvesting occurs, there should be no disturbance to the vernal pond depression. All equipment, trees and tops should be kept out of this area. Within 100 feet of the pond, equipment should only be used when the soil is in a dry or frozen condition. Care must be taken by the Purchaser to identify and avoid operating in these areas of the timber sale.

### **7 - Other Conditions**

#### 7.10 - Certified Timber

##### 7.10.1 - Non-certified timber (2/16)

The area encompassed by this timber sale is not certified to the standards of the Forest Stewardship Council (FSC) or the Sustainable Forestry Initiative (SFI). Forest products from this sale may not be delivered to the mill as "FSC and / or SFI certified". The lands within this sale are managed as a State Game Area.



# TIMBER SALE MAP

This information provided by authority of Part 525, 1994 PA 451, as amended.

Forest Management Unit Columbia Twp. SGA	County Tuscola	Mapped By DJ Bonnette	Date 06/27/2019	Page 1	of 1
Township 14N	Range 09E	Section(s) and Subdivision(s) S 1/2 SE; Section 10	Scale 1:15,840		

Cover Type				Density	
A = Aspen	H = Hemlock	N = Marsh	U = Upland Brush	0 = Non Stocked	5 = Pole Timber Medium
B = Paper Birch	J = Jack Pine	O = Oak	UM = Upland Mixed	1 = Seedling Sapling Poor	6 = Pole Timber Well
C = Cedar	L = Lowland Brush	P = Lowland Poplar	V = Bog or Marsh	2 = Seedling Sapling Medium	7 = Saw Timber Poor
D = Treed Bog	LM = Lowland Mixed	Q = Mixed Swamp Conifer	W = White Pine	3 = Seedling Sapling Well	8 = Saw Timber Medium
E = Swamp Hdwoods	M = Mpl, Bch, Brch	R = Red Pine	X = Non Stocked	4 = Pole Timber Poor	9 = Saw Timber Well
F = Spruce Fir	MC = Mixed Conifer	S = Black Spruce	Z = Water		
G = Grass	MD = Mixed Deciduous	T = Tamarack			

**PU Acres**  
1 14.3

## Ashmore Mix

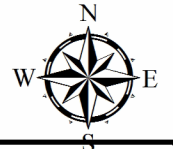

14.3 Acres

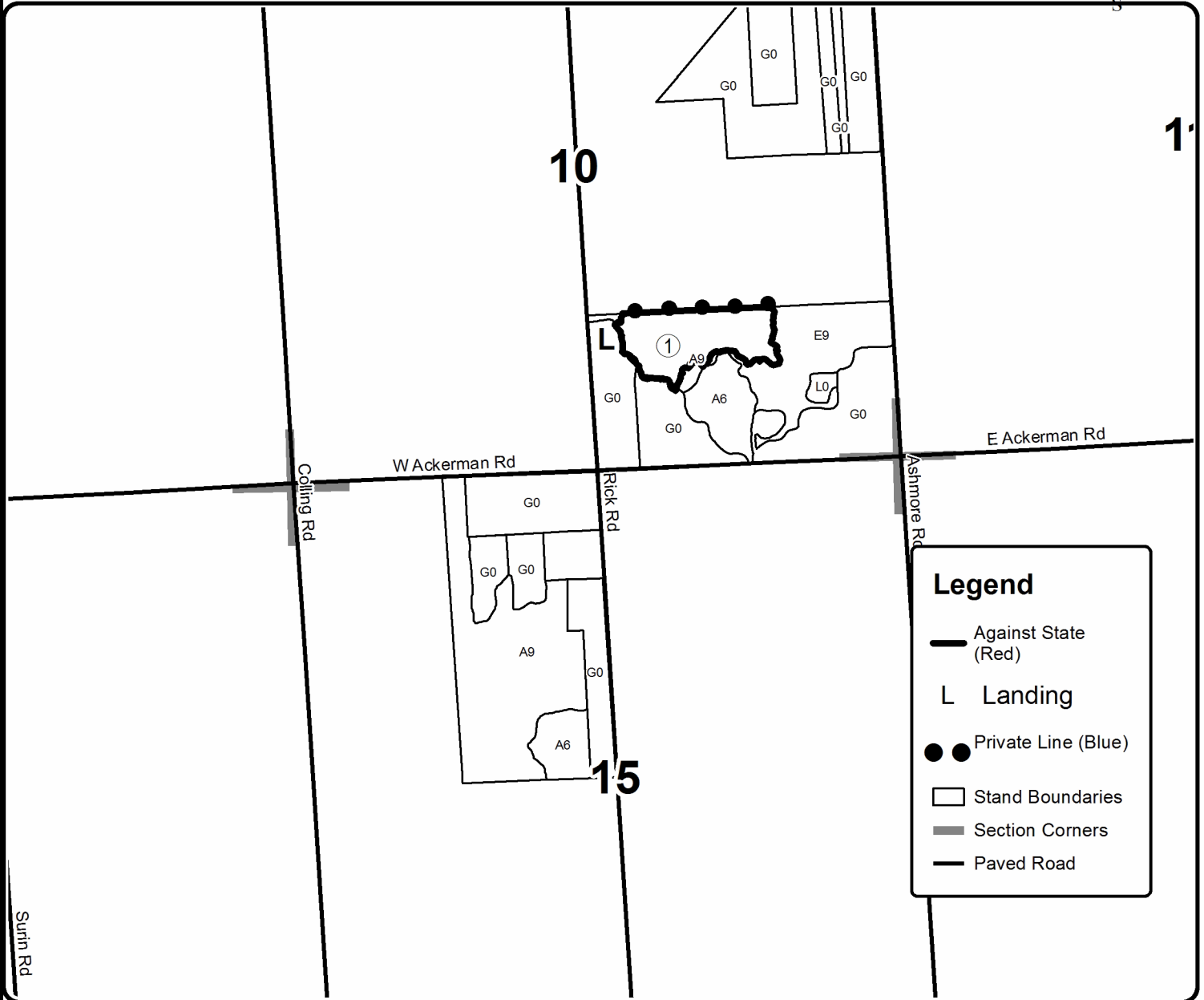

**Legend**

- Against State (Red)
- Landing
- Private Line (Blue)
- Stand Boundaries
- Section Corners
- Paved Road

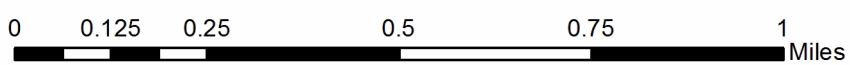

Sandy Ridge Aspen (55-116-19)  
T12N, R10E, SEC. 1; Tuscola COUNTY

In response to the notice of sale to be held 10:00 a.m. (local time) on August 19, 2019, I am hereby submitting my sealed bid (firm offer) for the following forest products to be cut. Bids for individual species must be at or above the advertised price. All non-responsive bid forms may be rejected.

<u>PRODUCTS &amp; SPECIES</u>	<u>ESTIMATED VOLUME*</u>	<u>ADVERTISED PRICE</u>	<u>BID PRICE/UNIT</u>
<b>Sawtimber</b>			
Black Cherry	18.30 MBF	\$ 83.00/MBF	\$ _____
Green Ash	8.50 MBF	\$ 30.00/MBF	\$ _____
Mixed Aspen	291.40 MBF	\$ 34.00/MBF	\$ _____
Paper Birch	2.00 MBF	\$ 30.00/MBF	\$ _____
Red Maple	115.50 MBF	\$ 38.00/MBF	\$ _____
<b>Pulpwood</b>			
Mixed Aspen	842.00 Cords	\$ 11.25/Cord	\$ _____
Mixed Hardwood	825.00 Cords	\$ 12.75/Cord	\$ _____

\*These estimated volumes are final and not subject to adjustment. Prospective bidders are urged to examine this timber and to make their own estimates of quantity and quality.

I understand that any or all bids may be rejected. All bids must be signed and all bid items must be bid or the bid form may be rejected. I also understand that consideration and awarding a contract will be based upon my past performance and ability to complete the contract based upon equipment and staffing subject to my control.

FEDERAL ID: \_\_\_\_\_ or SOCIAL SECURITY NUMBER: \_\_\_\_\_

Company or individual bidding: \_\_\_\_\_

Company representative's name: \_\_\_\_\_

Address: \_\_\_\_\_

City: \_\_\_\_\_ State: \_\_\_\_\_ Zip: \_\_\_\_\_

IF AVAILABLE, PLEASE PLACE THE PERSONALIZED LABEL FROM YOUR PROSPECTUS IN THE ABOVE BOX.

Individual or company representative's signature: \_\_\_\_\_ Date: \_\_\_\_\_

Phone number : \_\_\_\_\_ Email (optional): \_\_\_\_\_

**THE WINNING BIDDER MUST COMPLETE THE VERIFICATION OF WORKER'S DISABILITY COMPENSATION ACT COMPLIANCE (ON REVERSE SIDE IF DOUBLE SIDED) WITHIN 21 DAYS OF SALE AWARD DATE**



<b>FOR DEPARTMENT USE ONLY</b>
Sale Number (XX - XXX - XX - XX)
Forest Management Unit:

## TIMBER SALE VERIFICATION OF WORKER'S DISABILITY COMPENSATION ACT COMPLIANCE

*As required by Act 317, P.A. 1969 (Worker's Compensation) and  
Part 5 of Act 451 of 1994, as amended.*

### VERIFICATION OF WORKER'S DISABILITY COMPENSATION ACT COMPLIANCE

- This verification must be completed and submitted within 21 days of contract award and prior to the issuance of the timber sale contract.
- In addition, if boxes 2B or 2C are checked, then Notice of Exclusion or Certificate of Insurance must be submitted within twenty-one (21) days of the contract award and prior to the issuance of the timber sale contract.
- All information must be typed or printed except for written signatures.

Please Check Appropriate Categories:

1. My business is organized as (you **must** check one of the boxes below):
  - A.  Sole Proprietorship (individual)
  - B.  Partnership
  - C.  Corporation
  
2. You **must** check one of the boxes below:
  - A.  I certify my business is a sole proprietorship and it has no employees but the sole proprietor. I am not subject to the Worker's Compensation Laws.
  - B.  I certify my business has satisfied its obligation to the Worker's Compensation Act through the use of an approved Notice of Exclusion (BWC-337, Rev. 5/96). I will provide a copy of the Notice of Exclusion within 21 days of the contract award. (For questions or a copy of the BWC-337, please call the Worker's Compensation Bureau at 517-322-1195).
  - C.  I certify my business has a Worker's Compensation Policy. I will provide an original Certificate of Insurance within twenty-one (21) days of the contract award.
  
3. If you have checked item 2(A) or 2(B), you **must** indicate the number of **both** full-time and part-time employees, other than yourself, including family members and active partners (if none, you must enter "0").

\_\_\_\_\_ Full-time Employees

\_\_\_\_\_ Part-time Employees

Name of Business		Federal ID (or) Social Security No.	
Address		Telephone (       )	
City	State	ZIP	

*I hereby certify that the above information is true and correct. I agree to notify the Michigan DNR of any changes that occur in factors affecting my coverage during any of my present and future operations.*

\_\_\_\_\_  
Signature of Owner or Authorized Representative

\_\_\_\_\_  
Title

\_\_\_\_\_  
Date

**Please complete the "SEALED BID" information on the next page**

Cleland Aspen (55-117-19)

T14N, R12E, SEC. 10; T14N, R12E, SEC. 11; T14N, R12E, SEC. 15; Sanilac

In response to the notice of sale to be held 10:00 a.m. (local time) on August 19, 2019, I am hereby submitting my sealed bid (firm offer) for the following forest products to be cut. Bids for individual species must be at or above the advertised price. All non-responsive bid forms may be rejected.

<u>PRODUCTS &amp; SPECIES</u>	<u>ESTIMATED VOLUME*</u>	<u>ADVERTISED PRICE</u>	<u>BID PRICE/UNIT</u>
<b>Sawtimber</b>			
Basswood	4.50 MBF	\$ 30.00/MBF	\$ _____
Black Cherry	13.40 MBF	\$ 83.00/MBF	\$ _____
Green Ash	8.30 MBF	\$ 30.00/MBF	\$ _____
Mixed Aspen	112.20 MBF	\$ 34.00/MBF	\$ _____
Paper Birch	1.40 MBF	\$ 30.00/MBF	\$ _____
Red Maple	27.10 MBF	\$ 38.00/MBF	\$ _____
Sugar Maple	3.00 MBF	\$ 83.00/MBF	\$ _____
<b>Pulpwood</b>			
Mixed Aspen	320.00 Cords	\$ 11.25/Cord	\$ _____
Mixed Hardwood	297.00 Cords	\$ 12.75/Cord	\$ _____

\*These estimated volumes are final and not subject to adjustment. Prospective bidders are urged to examine this timber and to make their own estimates of quantity and quality.

I understand that any or all bids may be rejected. All bids must be signed and all bid items must be bid or the bid form may be rejected. I also understand that consideration and awarding a contract will be based upon my past performance and ability to complete the contract based upon equipment and staffing subject to my control.

FEDERAL ID: \_\_\_\_ - \_\_\_\_ - \_\_\_\_ or SOCIAL SECURITY NUMBER: \_\_\_\_ - \_\_\_\_ - \_\_\_\_

Company or individual bidding: \_\_\_\_\_

Company representative's name: \_\_\_\_\_

Address: \_\_\_\_\_

City: \_\_\_\_\_ State: \_\_\_\_\_ Zip: \_\_\_\_\_

IF AVAILABLE, PLEASE PLACE THE PERSONALIZED LABEL FROM YOUR PROSPECTUS IN THE ABOVE BOX.

Individual or company representative's signature: \_\_\_\_\_ Date: \_\_\_\_\_

Phone number : \_\_\_\_\_ Email (optional): \_\_\_\_\_

**THE WINNING BIDDER MUST COMPLETE THE VERIFICATION OF WORKER'S DISABILITY COMPENSATION ACT COMPLIANCE (ON REVERSE SIDE IF DOUBLE SIDED) WITHIN 21 DAYS OF SALE AWARD DATE**



<b>FOR DEPARTMENT USE ONLY</b>
Sale Number (XX – XXX – XX – XX)
Forest Management Unit:

## TIMBER SALE VERIFICATION OF WORKER'S DISABILITY COMPENSATION ACT COMPLIANCE

*As required by Act 317, P.A. 1969 (Worker's Compensation) and  
Part 5 of Act 451 of 1994, as amended.*

### VERIFICATION OF WORKER'S DISABILITY COMPENSATION ACT COMPLIANCE

- This verification must be completed and submitted within 21 days of contract award and prior to the issuance of the timber sale contract.
- In addition, if boxes 2B or 2C are checked, then Notice of Exclusion or Certificate of Insurance must be submitted within twenty-one (21) days of the contract award and prior to the issuance of the timber sale contract.
- All information must be typed or printed except for written signatures.

Please Check Appropriate Categories:

1. My business is organized as (you **must** check one of the boxes below):
  - A.  Sole Proprietorship (individual)
  - B.  Partnership
  - C.  Corporation
  
2. You **must** check one of the boxes below:
  - A.  I certify my business is a sole proprietorship and it has no employees but the sole proprietor. I am not subject to the Worker's Compensation Laws.
  - B.  I certify my business has satisfied its obligation to the Worker's Compensation Act through the use of an approved Notice of Exclusion (BWC-337, Rev. 5/96). I will provide a copy of the Notice of Exclusion within 21 days of the contract award. (For questions or a copy of the BWC-337, please call the Worker's Compensation Bureau at 517-322-1195).
  - C.  I certify my business has a Worker's Compensation Policy. I will provide an original Certificate of Insurance within twenty-one (21) days of the contract award.
  
3. If you have checked item 2(A) or 2(B), you **must** indicate the number of **both** full-time and part-time employees, other than yourself, including family members and active partners (if none, you must enter "0").

\_\_\_\_\_ Full-time Employees

\_\_\_\_\_ Part-time Employees

Name of Business		Federal ID (or) Social Security No.	
Address		Telephone (       )	
City	State	ZIP	

*I hereby certify that the above information is true and correct. I agree to notify the Michigan DNR of any changes that occur in factors affecting my coverage during any of my present and future operations.*

\_\_\_\_\_  
Signature of Owner or Authorized Representative

\_\_\_\_\_  
Title

\_\_\_\_\_  
Date

**Please complete the "SEALED BID" information on the next page**



Vassar Aspen (55-118-19)

T12N, R08E, SEC. 22; T12N, R08E, SEC. 23; T12N, R08E, SEC. 24; T12N, R08E,

In response to the notice of sale to be held 10:00 a.m. (local time) on August 19, 2019, I am hereby submitting my sealed bid (firm offer) for the following forest products to be cut. Bids for individual species must be at or above the advertised price. All non-responsive bid forms may be rejected.

<u>PRODUCTS &amp; SPECIES</u>	<u>ESTIMATED VOLUME*</u>	<u>ADVERTISED PRICE</u>	<u>BID PRICE/UNIT</u>
<b>Sawtimber</b>			
American Elm	1.80 MBF	\$ 30.00/MBF	\$ _____
Black Cherry	23.20 MBF	\$ 83.00/MBF	\$ _____
Mixed Aspen	1,153.80 MBF	\$ 34.00/MBF	\$ _____
Paper Birch	9.00 MBF	\$ 30.00/MBF	\$ _____
Red Maple	121.00 MBF	\$ 38.00/MBF	\$ _____
Red Pine	61.40 MBF	\$ 38.00/MBF	\$ _____
<b>Pulpwood</b>			
Jack Pine	22.00 Cords	\$ 11.25/Cord	\$ _____
Mixed Aspen	2,856.00 Cords	\$ 11.25/Cord	\$ _____
Mixed Hardwood	974.00 Cords	\$ 12.75/Cord	\$ _____
Red Pine	155.00 Cords	\$ 18.75/Cord	\$ _____

\*These estimated volumes are final and not subject to adjustment. Prospective bidders are urged to examine this timber and to make their own estimates of quantity and quality.

I understand that any or all bids may be rejected. All bids must be signed and all bid items must be bid or the bid form may be rejected. I also understand that consideration and awarding a contract will be based upon my past performance and ability to complete the contract based upon equipment and staffing subject to my control.

FEDERAL ID: \_\_\_\_\_ or SOCIAL SECURITY NUMBER: \_\_\_\_\_

Company or individual bidding: \_\_\_\_\_

Company representative's name: \_\_\_\_\_

Address: \_\_\_\_\_

City: \_\_\_\_\_ State: \_\_\_\_\_ Zip: \_\_\_\_\_

IF AVAILABLE, PLEASE PLACE THE PERSONALIZED LABEL FROM YOUR PROSPECTUS IN THE ABOVE BOX.

Individual or company representative's signature: \_\_\_\_\_ Date: \_\_\_\_\_

Phone number : \_\_\_\_\_ Email (optional): \_\_\_\_\_

**THE WINNING BIDDER MUST COMPLETE THE VERIFICATION OF WORKER'S DISABILITY COMPENSATION ACT COMPLIANCE (ON REVERSE SIDE IF DOUBLE SIDED) WITHIN 21 DAYS OF SALE AWARD DATE**



<b>FOR DEPARTMENT USE ONLY</b>
Sale Number (XX – XXX – XX – XX)
Forest Management Unit:

## TIMBER SALE VERIFICATION OF WORKER'S DISABILITY COMPENSATION ACT COMPLIANCE

*As required by Act 317, P.A. 1969 (Worker's Compensation) and  
Part 5 of Act 451 of 1994, as amended.*

### VERIFICATION OF WORKER'S DISABILITY COMPENSATION ACT COMPLIANCE

- This verification must be completed and submitted within 21 days of contract award and prior to the issuance of the timber sale contract.
- In addition, if boxes 2B or 2C are checked, then Notice of Exclusion or Certificate of Insurance must be submitted within twenty-one (21) days of the contract award and prior to the issuance of the timber sale contract.
- All information must be typed or printed except for written signatures.

Please Check Appropriate Categories:

1. My business is organized as (you **must** check one of the boxes below):
  - A.  Sole Proprietorship (individual)
  - B.  Partnership
  - C.  Corporation
  
2. You **must** check one of the boxes below:
  - A.  I certify my business is a sole proprietorship and it has no employees but the sole proprietor. I am not subject to the Worker's Compensation Laws.
  - B.  I certify my business has satisfied its obligation to the Worker's Compensation Act through the use of an approved Notice of Exclusion (BWC-337, Rev. 5/96). I will provide a copy of the Notice of Exclusion within 21 days of the contract award. (For questions or a copy of the BWC-337, please call the Worker's Compensation Bureau at 517-322-1195).
  - C.  I certify my business has a Worker's Compensation Policy. I will provide an original Certificate of Insurance within twenty-one (21) days of the contract award.
  
3. If you have checked item 2(A) or 2(B), you **must** indicate the number of **both** full-time and part-time employees, other than yourself, including family members and active partners (if none, you must enter "0").

\_\_\_\_\_ Full-time Employees

\_\_\_\_\_ Part-time Employees

Name of Business		Federal ID (or) Social Security No.	
Address		Telephone (       )	
City	State	ZIP	

*I hereby certify that the above information is true and correct. I agree to notify the Michigan DNR of any changes that occur in factors affecting my coverage during any of my present and future operations.*

\_\_\_\_\_  
Signature of Owner or Authorized Representative

\_\_\_\_\_  
Title

\_\_\_\_\_  
Date

**Please complete the "SEALED BID" information on the next page**

Sanilac Aspen (55-119-19)  
T14N, R12E, SEC. 22; T14N, R12E, SEC. 23; Sanilac COUNTY

In response to the notice of sale to be held 10:00 a.m. (local time) on August 19, 2019, I am hereby submitting my sealed bid (firm offer) for the following forest products to be cut. Bids for individual species must be at or above the advertised price. All non-responsive bid forms may be rejected.

<u>PRODUCTS &amp; SPECIES</u>	<u>ESTIMATED VOLUME*</u>	<u>ADVERTISED PRICE</u>	<u>BID PRICE/UNIT</u>
<b>Sawtimber</b>			
American Elm	0.90 MBF	\$ 30.00/MBF	\$ _____
Basswood	4.80 MBF	\$ 30.00/MBF	\$ _____
Black Cherry	83.70 MBF	\$ 83.00/MBF	\$ _____
Green Ash	3.20 MBF	\$ 30.00/MBF	\$ _____
Mixed Aspen	571.60 MBF	\$ 34.00/MBF	\$ _____
Paper Birch	7.60 MBF	\$ 30.00/MBF	\$ _____
Red Maple	22.90 MBF	\$ 38.00/MBF	\$ _____
Sugar Maple	19.10 MBF	\$ 83.00/MBF	\$ _____
White Ash	1.80 MBF	\$ 30.00/MBF	\$ _____
<b>Pulpwood</b>			
Mixed Aspen	2,252.00 Cords	\$ 11.25/Cord	\$ _____
Mixed Hardwood	970.00 Cords	\$ 12.75/Cord	\$ _____

\*These estimated volumes are final and not subject to adjustment. Prospective bidders are urged to examine this timber and to make their own estimates of quantity and quality.

I understand that any or all bids may be rejected. All bids must be signed and all bid items must be bid or the bid form may be rejected. I also understand that consideration and awarding a contract will be based upon my past performance and ability to complete the contract based upon equipment and staffing subject to my control.

FEDERAL ID: \_\_\_\_\_ or SOCIAL SECURITY NUMBER: \_\_\_\_\_

Company or individual bidding: \_\_\_\_\_

Company representative's name: \_\_\_\_\_

Address: \_\_\_\_\_

City: \_\_\_\_\_ State: \_\_\_\_\_ Zip: \_\_\_\_\_

IF AVAILABLE, PLEASE PLACE THE PERSONALIZED LABEL FROM YOUR PROSPECTUS IN THE ABOVE BOX.

Individual or company representative's signature: \_\_\_\_\_ Date: \_\_\_\_\_

Phone number : \_\_\_\_\_ Email (optional): \_\_\_\_\_

**THE WINNING BIDDER MUST COMPLETE THE VERIFICATION OF WORKER'S DISABILITY COMPENSATION ACT COMPLIANCE (ON REVERSE SIDE IF DOUBLE SIDED) WITHIN 21 DAYS OF SALE AWARD DATE**



<b>FOR DEPARTMENT USE ONLY</b>
Sale Number (XX - XXX - XX - XX)
Forest Management Unit:

## TIMBER SALE VERIFICATION OF WORKER'S DISABILITY COMPENSATION ACT COMPLIANCE

*As required by Act 317, P.A. 1969 (Worker's Compensation) and  
Part 5 of Act 451 of 1994, as amended.*

### VERIFICATION OF WORKER'S DISABILITY COMPENSATION ACT COMPLIANCE

- This verification must be completed and submitted within 21 days of contract award and prior to the issuance of the timber sale contract.
- In addition, if boxes 2B or 2C are checked, then Notice of Exclusion or Certificate of Insurance must be submitted within twenty-one (21) days of the contract award and prior to the issuance of the timber sale contract.
- All information must be typed or printed except for written signatures.

Please Check Appropriate Categories:

1. My business is organized as (you **must** check one of the boxes below):
  - A.  Sole Proprietorship (individual)
  - B.  Partnership
  - C.  Corporation
2. You **must** check one of the boxes below:
  - A.  I certify my business is a sole proprietorship and it has no employees but the sole proprietor. I am not subject to the Worker's Compensation Laws.
  - B.  I certify my business has satisfied its obligation to the Worker's Compensation Act through the use of an approved Notice of Exclusion (BWC-337, Rev. 5/96). I will provide a copy of the Notice of Exclusion within 21 days of the contract award. (For questions or a copy of the BWC-337, please call the Worker's Compensation Bureau at 517-322-1195).
  - C.  I certify my business has a Worker's Compensation Policy. I will provide an original Certificate of Insurance within twenty-one (21) days of the contract award.
3. If you have checked item 2(A) or 2(B), you **must** indicate the number of **both** full-time and part-time employees, other than yourself, including family members and active partners (if none, you must enter "0").

\_\_\_\_\_ Full-time Employees

\_\_\_\_\_ Part-time Employees

Name of Business		Federal ID (or) Social Security No.	
Address		Telephone (        )	
City	State	ZIP	

*I hereby certify that the above information is true and correct. I agree to notify the Michigan DNR of any changes that occur in factors affecting my coverage during any of my present and future operations.*

\_\_\_\_\_  
Signature of Owner or Authorized Representative

\_\_\_\_\_  
Title

\_\_\_\_\_  
Date

**Please complete the "SEALED BID" information on the next page**

Ashmore Mix (55-120-19)  
T14N, R09E, SEC. 10; Tuscola COUNTY

In response to the notice of sale to be held 10:00 a.m. (local time) on August 19, 2019, I am hereby submitting my sealed bid (firm offer) for the following forest products to be cut. Bids for individual species must be at or above the advertised price. All non-responsive bid forms may be rejected.

<u>PRODUCTS &amp; SPECIES</u>	<u>ESTIMATED VOLUME*</u>	<u>ADVERTISED PRICE</u>	<u>BID PRICE/UNIT</u>
<b>Sawtimber</b>			
Green Ash	0.90 MBF	\$ 30.00/MBF	\$ _____
Mixed Aspen	49.40 MBF	\$ 34.00/MBF	\$ _____
Paper Birch	2.40 MBF	\$ 30.00/MBF	\$ _____
Red Maple	30.70 MBF	\$ 38.00/MBF	\$ _____
Sugar Maple	2.00 MBF	\$ 83.00/MBF	\$ _____
<b>Pulpwood</b>			
Mixed Aspen	53.00 Cords	\$ 11.25/Cord	\$ _____
Mixed Hardwood	181.00 Cords	\$ 12.75/Cord	\$ _____
Scotch Pine	4.00 Cords	\$ 9.00/Cord	\$ _____

\*These estimated volumes are final and not subject to adjustment. Prospective bidders are urged to examine this timber and to make their own estimates of quantity and quality.

I understand that any or all bids may be rejected. All bids must be signed and all bid items must be bid or the bid form may be rejected. I also understand that consideration and awarding a contract will be based upon my past performance and ability to complete the contract based upon equipment and staffing subject to my control.

FEDERAL ID: \_\_\_\_ - \_\_\_\_ - \_\_\_\_ or SOCIAL SECURITY NUMBER: \_\_\_\_ - \_\_\_\_ - \_\_\_\_

Company or individual bidding: \_\_\_\_\_

Company representative's name: \_\_\_\_\_

Address: \_\_\_\_\_

City: \_\_\_\_\_ State: \_\_\_\_\_ Zip: \_\_\_\_\_

IF AVAILABLE, PLEASE PLACE THE PERSONALIZED LABEL FROM YOUR PROSPECTUS IN THE ABOVE BOX.

Individual or company representative's signature: \_\_\_\_\_ Date: \_\_\_\_\_

Phone number : \_\_\_\_\_ Email (optional): \_\_\_\_\_

**THE WINNING BIDDER MUST COMPLETE THE VERIFICATION OF WORKER'S DISABILITY COMPENSATION ACT COMPLIANCE (ON REVERSE SIDE IF DOUBLE SIDED) WITHIN 21 DAYS OF SALE AWARD DATE**



<b>FOR DEPARTMENT USE ONLY</b>	
Sale Number (XX - XXX - XX - XX)	
Forest Management Unit:	

## TIMBER SALE VERIFICATION OF WORKER'S DISABILITY COMPENSATION ACT COMPLIANCE

As required by Act 317, P.A. 1969 (Worker's Compensation) and  
Part 5 of Act 451 of 1994, as amended.

### VERIFICATION OF WORKER'S DISABILITY COMPENSATION ACT COMPLIANCE

- This verification must be completed and submitted within 21 days of contract award and prior to the issuance of the timber sale contract.
- In addition, if boxes 2B or 2C are checked, then Notice of Exclusion or Certificate of Insurance must be submitted within twenty-one (21) days of the contract award and prior to the issuance of the timber sale contract.
- All information must be typed or printed except for written signatures.

Please Check Appropriate Categories:

1. My business is organized as (you **must** check one of the boxes below):
  - A.  Sole Proprietorship (individual)
  - B.  Partnership
  - C.  Corporation
2. You **must** check one of the boxes below:
  - A.  I certify my business is a sole proprietorship and it has no employees but the sole proprietor. I am not subject to the Worker's Compensation Laws.
  - B.  I certify my business has satisfied its obligation to the Worker's Compensation Act through the use of an approved Notice of Exclusion (BWC-337, Rev. 5/96). I will provide a copy of the Notice of Exclusion within 21 days of the contract award. (For questions or a copy of the BWC-337, please call the Worker's Compensation Bureau at 517-322-1195).
  - C.  I certify my business has a Worker's Compensation Policy. I will provide an original Certificate of Insurance within twenty-one (21) days of the contract award.
3. If you have checked item 2(A) or 2(B), you **must** indicate the number of **both** full-time and part-time employees, other than yourself, including family members and active partners (if none, you must enter "0").

\_\_\_\_\_ Full-time Employees

\_\_\_\_\_ Part-time Employees

Name of Business		Federal ID (or) Social Security No.	
Address		Telephone (       )	
City	State	ZIP	

*I hereby certify that the above information is true and correct. I agree to notify the Michigan DNR of any changes that occur in factors affecting my coverage during any of my present and future operations.*

\_\_\_\_\_  
Signature of Owner or Authorized Representative

\_\_\_\_\_  
Title

\_\_\_\_\_  
Date

Please complete the "SEALED BID" information on the next page