



**DEPARTMENT OF NATURAL RESOURCES
STATE OF MICHIGAN**

TIMBER SALE PROSPECTUS #6359

SCHEDULED SALE DATE AND TIME: 8:30 a.m. (local time) on March 6, 2019.

LOCATION: CRYSTAL FALLS MGMT UNIT, 1420 US 2 WEST, CRYSTAL FALLS, MI 49920.

PROSPECTUS NOTE: The bidder is advised to inspect the sale area and review the location, estimated volumes, operating costs and contract terms of proposed sales. Please be aware that some landowners may request 60 days or more notice for access across their land.

Notice is hereby given that bids will be received by the Unit Manager, CRYSTAL FALLS MANAGEMENT UNIT, for certain timber on the following described lands:

Skunk Bone (12-015-18) / T40N, R30W, SEC. 3 , E1/2NW,NE.

T40N, R30W, SEC. 4 , NW,N1/2NE,SWNE,NWSW.

T41N, R30W, SEC. 36, S1/2SW.

Dickinson County, Advertised Price \$156,240.90, 198.9 Acres, Aspen, Hardwood.

SALE NOTE: Dieback has been observed in birch and maple in this sale.

This sale has several operation restrictions:

- Bark slippage restriction in Payment Units 2 and 3 from 4/15 to 7/15.
- Oak Wilt restriction in Payment Units 2-9 & 11 from 4/15 to 7/15.
- Deer Season restriction in Payment Units 1-11 from 11/15 to 11/20.

Partridge Haven (12-018-18) / T41N, R28W, SEC. 11, N1/2NW,NWNE.

T41N, R28W, SEC. 2 , S1/2SW.

T41N, R28W, SEC. 3 , SW,S1/2SE.

T41N, R28W, SEC. 4 , N1/2SE,SESE.

T41N, R28W, SEC. 4 , SENW,S1/2NE,NESW,S1/2SW.

T41N, R28W, SEC. 9 , NENE.

Dickinson County, Advertised Price \$86,046.05, 231.6 Acres, Aspen, Hardwood.

SALE NOTE: Access will be through several private landowners. Payment Units 7, 8, 11 & 12 are winter harvest only.

Access may be through private land.

BID INSTRUCTIONS (VER. 07/02/2018):

1. Scheduled Bid Location, Date, and Time (2/11)

Bids must be received by the Unit Manager, CRYSTAL FALLS OFFICE, 1420 US 2 West, Crystal Falls, MI 49920, no later than 8:30 a.m. (local time) on March 6, 2019. For further information concerning this sale, contact Dan McNamee at 906-875-6622.

2. Bidder's Qualifications (5/16)

Purchaser shall obtain workers compensation insurance to cover claims under Michigan's Worker's Disability Compensation Act of 1969 or similar employee benefit act of any other state applicable to an employee. If all or part of a timber sale was prepared by a private contractor, the contractor and that contractor's company are not permitted to bid on the timber sale contract. Bids will not be accepted from individuals or companies appearing on the DNR/FRD No-Bid List. This list contains the names of purchasers who previously failed to execute a contract within 21-days or who have a history of poor performance.

3. Preparation of Sealed Bids (5/16)

Bid Forms may be completed online thru Michigan DNR Timber Sale Online Bidding (OLB) at www.michigan.gov/timberbidding or by completing the hardcopy Bid Form found in the Timber Sale Prospectus. Hardcopy Bid Forms shall be manually signed in ink. Registration in OLB is considered your 'signature' for all bids submitted thru that system. Bid prices must be entered for each species and product in the Bid Price column for all material subject to bidding and all fill-in blanks must be completed. If erasures or other changes appear on the hardcopy Bid Form, each erasure or change must be initialed by the person signing the bid.

4. Submission of Sealed Bids (5/16)

Bid forms may be obtained from the Unit Manager or thru OLB. Bids may be submitted hardcopy or thru OLB. All hardcopy bids must be submitted on the bid form and in an envelope clearly identified as described in this section. NOTE: Only one bid form per bid envelope. Sealed bids must be submitted to the Unit office designated in the prospectus and must be submitted at or prior to the time established in the prospectus. The envelope should show on the outside (a) the sale name or number and (b) the date and time of bid opening, as shown in the prospectus. Bids received after the time specified in the sale prospectus are late bids and will be rejected.

It is possible for a bidder to submit multiple bids on a single sale. For example, a bid may be submitted hardcopy and a bid may be submitted thru OLB. Or, two bidders from the same company could both submit bids on the same sale. If this were to happen, the State would accept all bids received and award the contract accordingly. All bidding and contractual requirements would apply to all bids received.

5. Public Opening of Sealed Bids (7/16)

If conditions permit, the sealed bids will be publicly opened and posted at the time and place set in the prospectus.

If a bidder, present at a bid opening, has submitted bids on more than one sale, that bidder may withdraw their unopened bid envelopes or announce the withdrawal of their online bid after being declared the successful bidder on one sale.

6. Award of Contract (1/11)

Award of the contract will be made to the Bidder whose bid, conforming to the prospectus, is most advantageous to the State of Michigan on the basis of total value at rates bid for the estimated quantities. The State reserves the right to reject any bid or waive any minor irregularity in bids received. A written award mailed (or otherwise furnished) to the successful Bidder shall be deemed to result in a binding contract without further action by either party.

7. Down Payment (1/11)

The Bidder to whom award is made must make a down payment within 21 days of the sale award. The amount of the down payment will be calculated as shown in the Bond and Payment Schedule of this prospectus. Only cash may be used to meet this requirement.

8. Performance Security (1/11)

As guarantee of faithful performance, a cash bond, certificate of deposit, surety bond or irrevocable letter of credit (LOC) is required within 21 days of the sale award. The amount of the performance security is shown in the Bond and

Payment Schedule of this prospectus. If an LOC or surety is used, the coverage must extend for at least 6 months beyond the contract expiration.

9. Timber Sale Contract (7/18)

Additional conditions and requirements common to all timber sales are listed on the timber sale contract (R4031) and are available on line at www.michigan.gov/timber. Contact the Unit Manager for additional information or a sample contract. Within 21 days of the date of the award letter, the bidder must sign the contract and provide the required down payment, performance security, and verification of worker's disability compensation. The down payment and performance security shall be in accordance with the provisions of the timber sale contract, in the sums stated in this prospectus. If these actions are not taken, then the Bidder, the Bidder's corporation, and the corporation's principals may not be permitted to bid on State timber sales for a period of 3 months after the first offense, 6 months after the second offense, and 1 year after the third offense. An offense will only be counted against the Bidder for 5 years. In addition, the Bidder certifies that if awarded this contract, the Bidder will complete the timber sale contract in accordance with its terms and any modifications thereof including requirements to purchase, cut, and remove the included timber by the expiration date.

Payment Unit values in the State Forest Timber Sale Contract are calculated based on the advertised value of the Payment Unit as a percentage of the total advertised value of the contract. The advertised value of each Payment Unit is given in the Description of Timber by Payment Unit table on the Timber Sale Information page. For example, if the value of Payment Unit 1 is advertised as \$1,500 and the total Timber Sale value is advertised as \$10,000, the contract price for Payment Unit 1 will be 15% of the total bid price ($\$1,500/\$10,000 * 100$).

10. Disclaimer of Estimates and Bidder's Warranty of Inspection (7/16)

Before submitting this bid, the Bidder is advised and cautioned to inspect the sale area, review the requirements of the sale contract, and take other steps as may be reasonably necessary to ascertain the location, estimated volumes, construction estimates, and operating costs of the proposed sale. Failure to do so will not relieve the Bidder from responsibility for completing the contract.

The Bidder warrants that this bid is submitted solely on the basis of the Bidder's examination and inspection of the quality and quantity of the timber offered for sale and the Bidder's opinion of the value thereof and the costs of recovery. No reliance should be placed on the State of Michigan's estimates of timber quality, quantity or costs of recovery. Bidder further acknowledges that the State of Michigan: (i) expressly disclaims any warranty of fitness of timber for any purpose; (ii) offers this timber as is without any warranty of quality (merchantability) or quantity and (iii) expressly disclaims any warranty as to the quantity or quality of timber sold.

11. Certification and Chain-of-Custody (10/14)

Unless otherwise indicated in the contract under section 7 – Other Conditions of the Sale Specific Conditions & Requirements, the area encompassed by this timber sale is certified to the standards of the Forest Stewardship Council (FSC) - Certificate #SCS-FM/COC-00090N and the Sustainable Forestry Initiative (SFI) - Certificate #NSF-SFIS-5Y031-SF5. Forest products from this sale may be delivered to the mill as "FSC 100% and / or SFI certified" as long as the contractor hauling the forest products is chain-of-custody (COC) certified or covered under a COC certificate from the destination mill. The purchaser is responsible for maintaining COC after leaving the sale area.

12. Good Neighbor Authority (GNA) Requirements (7/16)

If the name of this timber sales contains the acronym GNA, it is authorized by the Good Neighbor Authority (GNA) and covered by various agreements between the U.S. Forest Service and the State. The timber sale occurs on federal land and the following conditions apply:

GNA contracts on US Forest Service land will not be awarded to purchasers on the Federal list of excluded parties. The System for Award Management (SAM) will be checked for active excluded parties prior to award of contract. In addition, the Bidder to whom award is made must complete an Assurance Regarding Felony Conviction or Tax Delinquent Status for Corporate Applicants (AD-3031).

13. Good Neighbor Authority (GNA) Requirements, con't (9/16)

Bidder certifies, by signing this bid form, that to the best of Bidder's knowledge that the following representations are accurate and complete.

- a. That the Bidder and its principals are not presently debarred, suspended, proposed for debarment, declared ineligible, or voluntary excluded from timber sales (covered transactions) by any Federal department or agency.
- b. That the Bidder and its principals have not within a 3-year period preceding this bid been convicted of or had a civil judgment rendered against them for commission of fraud or a criminal offense in connection with obtaining, attempting to obtain, or performing a public (Federal, State, or local) transaction or contract under a public transaction; violation of Federal or State antitrust statutes or commission of embezzlement, theft, forgery, bribery, falsification or destruction of records, making false statements, or receiving stolen property.
- c. That the Bidder and its principals are not presently indicted for or otherwise criminally or civilly charged by a governmental entity (Federal, State, or local) with commission of any of the offenses enumerated in paragraph b of this certification.
- d. That the Bidder and its principals have not within a 3-year period preceding this bid had one or more public transactions (Federal, State, or local) terminated for breach or default of a timber or forest product contract.

Bidders that cannot certify this requirement, in whole or in part, shall submit an explanation with their bid.

DAN EICHINGER
Director

TIMBER SALE INFORMATION

Skunk Bone (12-015-18)

T40N, R30W, SEC. 3; T40N, R30W, SEC. 4; T41N, R30W, SEC. 36.
Dickinson County (Advertised Price \$156,240.90)

SALE NOTE: Dieback has been observed in birch and maple in this sale.

This sale has several operation restrictions:

- Bark slippage restriction in Payment Units 2 and 3 from 4/15 to 7/15.
- Oak Wilt restriction in Payment Units 2-9 & 11 from 4/15 to 7/15.
- Deer Season restriction in Payment Units 1-11 from 11/15 to 11/20.

A timber sale contract for this lump sum, sealed bid timber sale will be awarded to the responsible bidder offering the highest sealed bid price. Bids must be at or above the following advertised price for each species:

<u>PRODUCTS & SPECIES</u>	<u>ESTIMATED UNITS*</u>	<u>ADVERTISED PRICE</u>
Sawtimber		
Paper Birch	17.20 MBF	\$ 78.00 / MBF
Red Maple	1.10 MBF	\$ 139.00 / MBF
Red Oak	17.60 MBF	\$ 187.00 / MBF
Red Pine	20.70 MBF	\$ 142.00 / MBF
Sugar Maple	0.60 MBF	\$ 391.00 / MBF
Pulpwood		
Jack Pine	26.00 Cords	\$ 35.05 / Cord
Mixed Aspen	2,551.00 Cords	\$ 42.45 / Cord
Mixed Hardwood	594.00 Cords	\$ 22.60 / Cord
Paper Birch	408.00 Cords	\$ 24.85 / Cord
Red Pine	255.00 Cords	\$ 60.85 / Cord

* The total volume is statistically estimated within plus (+) or minus (-) 11.19 percent. The estimated units are final and not subject to adjustment. Prospective bidders are urged to examine this timber and to make their own estimates of quantity and quality.

BOND AND PAYMENT SCHEDULE:

1. A bond in the amount of \$12,499.00 to insure faithful performance of the conditions of the contract will be deposited by the successful bidder within 21 days of the sale award.
2. Cutting in any sale or unit without the required advance payment would be considered a trespass.
3. Total payment must be paid in advance or according to the following schedule:
 - (a) Ten percent (10%) of the sale value must be paid within 21 days of the sale award.
 - (b) The 10% down payment will be credited towards the first unit cut.
 - (c) Payment for each of the following units must be made before cutting begins in that unit:

<u>PAYMENT UNIT NUMBER</u>	<u>PERCENT OF TOTAL SALE VALUE</u>
01	20.0%
02	3.9%
03	6.3%
04	9.1%
05	19.0%
06	19.7%
07	0.6%
08	4.0%
09	9.3%
10	5.6%
11	2.5%

4. If no cutting takes place, the 10% down payment will not be refunded.
5. Operations on the contract issued will terminate on 06/30/2022.

Description of Timber by Payment Unit (PU)

PU	MARKET GROUP	PRODUCT	QUANTITY	UNIT	ACRES	ADVERTISE PRICE
1	Mixed Aspen	Pulpwood	716.0	Cords	14.3	\$31,388.60
	<i>B. T. Aspen</i>		716.0	<i>Cords</i>		
	Mixed Hardwood		44.0	Cords		
	<i>Red Maple</i>		44.0	<i>Cords</i>		
2	Paper Birch	Sawtimber	0.5	MBF	21.3	\$6,088.65
	Red Oak		1.9	MBF		
	Mixed Aspen	Pulpwood	89.0	Cords		
	<i>B. T. Aspen</i>		43.0	<i>Cords</i>		
	<i>Quaking Aspen</i>		46.0	<i>Cords</i>		
	Mixed Hardwood		65.0	Cords		
	<i>Red Maple</i>		41.0	<i>Cords</i>		
	<i>Red Oak</i>		24.0	<i>Cords</i>		
	Paper Birch		18.0	Cords		
3	Red Oak	Sawtimber	12.1	MBF	26.4	\$9,863.25
	Mixed Aspen	Pulpwood	101.0	Cords		
	<i>B. T. Aspen</i>		97.0	<i>Cords</i>		
	<i>Quaking Aspen</i>		4.0	<i>Cords</i>		
	Mixed Hardwood		140.0	Cords		
	<i>Red Maple</i>		88.0	<i>Cords</i>		
	<i>Red Oak</i>		52.0	<i>Cords</i>		
	Paper Birch		6.0	Cords		
	4		Paper Birch	Sawtimber		
Red Maple			0.5	MBF		
Mixed Aspen		Pulpwood	223.0	Cords		
<i>B. T. Aspen</i>			70.0	<i>Cords</i>		
<i>Quaking Aspen</i>			153.0	<i>Cords</i>		
Mixed Hardwood			67.0	Cords		
<i>Red Maple</i>			67.0	<i>Cords</i>		
Paper Birch			111.0	Cords		
5	Paper Birch	Sawtimber	8.6	MBF	30.8	\$29,670.35
	Red Maple		0.6	MBF		
	Mixed Aspen	Pulpwood	533.0	Cords		
	<i>B. T. Aspen</i>		441.0	<i>Cords</i>		
	<i>Quaking Aspen</i>		92.0	<i>Cords</i>		
	Mixed Hardwood		109.0	Cords		
	<i>Red Maple</i>		101.0	<i>Cords</i>		
	<i>Sugar Maple</i>		8.0	<i>Cords</i>		
	Paper Birch		154.0	Cords		
6	Paper Birch	Sawtimber	2.7	MBF	30.3	\$30,745.70
	Sugar Maple		0.6	MBF		
	Mixed Aspen	Pulpwood	619.0	Cords		
	<i>B. T. Aspen</i>		386.0	<i>Cords</i>		
	<i>Quaking Aspen</i>		233.0	<i>Cords</i>		
	Mixed Hardwood		56.0	Cords		
	<i>Red Maple</i>		53.0	<i>Cords</i>		
	<i>Sugar Maple</i>		3.0	<i>Cords</i>		
	Paper Birch		111.0	Cords		
7	Jack Pine	Pulpwood	26.0	Cords	1.4	\$911.30
8	Red Oak	Sawtimber	3.6	MBF	8.8	\$6,195.95
	Mixed Aspen	Pulpwood	89.0	Cords		
	<i>B. T. Aspen</i>		89.0	<i>Cords</i>		
	Mixed Hardwood		75.0	Cords		
	<i>Red Maple</i>		34.0	<i>Cords</i>		
	<i>Red Oak</i>		41.0	<i>Cords</i>		
Paper Birch	2.0	Cords				

Description of Timber by Payment Unit (PU), con't

PU	MARKET GROUP	PRODUCT	QUANTITY	UNIT	ACRES	ADVERTISE PRICE
9	Red Pine	Sawtimber	19.1	MBF	23.7	\$14,545.75
	Mixed Aspen	Pulpwood	93.0	Cords		
	<i>B. T. Aspen</i>		36.0	<i>Cords</i>		
	<i>Quaking Aspen</i>		57.0	<i>Cords</i>		
	Mixed Hardwood		30.0	Cords		
	<i>Red Maple</i>		30.0	<i>Cords</i>		
	Paper Birch		6.0	Cords		
	Red Pine		116.0	Cords		
10	Red Pine	Sawtimber	1.6	MBF	13.9	\$8,685.35
	Red Pine	Pulpwood	139.0	Cords		
11	Mixed Aspen	Pulpwood	88.0	Cords	2.2	\$3,916.40
	<i>B. T. Aspen</i>		36.0	<i>Cords</i>		
	<i>Quaking Aspen</i>		52.0	<i>Cords</i>		
	Mixed Hardwood		8.0	Cords		
	<i>Red Maple</i>		8.0	<i>Cords</i>		
TOTAL:			57.2	MBF		
TOTAL:			3,834.0	Cords		

Sale Specific Conditions & Requirements

Sale Name: Skunk Bone

Sale Number: 12-015-18 Seq#: 1

1 - Sale Area

1.2 - Boundaries

1.2.1 - Painted boundaries (1/14)

The sale boundary and Payment Unit boundaries are marked and identified by blue, red and yellow paint. Exterior sale boundary lines against private property are marked with blue paint. Exterior sale boundary lines against state are marked with red paint. Interior Payment Unit boundaries are marked with yellow paint. The painted boundary line trees are not Included Timber and are to be protected unless marked with orange paint. Yellow painted trees designating an interior Payment Unit boundary are only to be cut when all surrounding Payment Units have been paid.

2 - Timber Specifications

2.1 - Included Timber

2.1.1 - Clearcut unit(s) with unmerchantable trees (6/14)

Within Payment Unit(s) 1, 4, 5, 6 and 11, cut all aspen, maple and birch trees that are two (2) inches or more at DBH, except do not cut trees marked with green paint in Payment Units 5 and 6.

Within Payment Unit(s) 7, cut all jack pine trees that are (2) inches or more at DBH. Only cut as much sub-merchantable aspen as needed to get to jack pine.

Within Payment Unit(s) 8, cut all trees that are (2) inches or more at DBH, except do not cut trees marked with green paint. In addition, do not cut white pine, if found.

2.1.3 - Cut tree marked unit(s) (12/08)

Within Payment Unit(s) 9 and 10, all red pine trees are designated for cutting when marked with orange paint above and below stump height, regardless of merchantability. In addition, cut all aspen and jack pine that are (2) inches or greater at DBH.

Within Payment Unit(s) 2 and 3, all trees are designated for cutting when marked with orange paint above and below stump height, regardless of merchantability. In addition, within Payment Unit 2, all aspen is designated for cutting.

2.2 - Utilization

2.2.11 - Chipping restriction (9/14)

If chipping occurs on this sale, then no woody debris present on the ground at the start of the sale may be chipped. In addition, brush or chips may not be stored or stockpiled on-site for more than 30 days.

3 - Payments

3.3 - Pre-measured Sales

3.3.4 - Dividing payment units (7/14)

Payment Unit(s) 1, 5 and 6 may be divided at the request of the Purchaser and upon approval of the Unit Manager. Dividing Payment Units is a contract modification which requires a Timber Sale Contract Supplement. There will be only one division per Payment Unit.

3.4 - Damaged Timber

3.4.1 - Damaged timber (6/14)

General Condition and Requirement 3.4 Damaged Timber, defines liquidated damages for undesignated live merchantable trees which are cut or injured. In addition, extreme care should be taken to avoid damage to aspen, oak and conifer seedlings and saplings.

Within the sale area, if more than 20% of the tree seedlings or saplings (1/4" to 4.5" DBH) within a specified portion of the

sale area are damaged, liquidated damages will be assessed at \$100 per acre for all acreage within that specified portion of the sale area that was damaged.

No damage is acceptable to merchantable trees. Within the sale area, if more than 10% of trees (> 4.5" DBH) within a specified area of the sale are damaged, liquidated damages will be assessed for all trees damaged. Rates will be in accordance with General Condition and Requirement 3.4 Damaged Timber.

4 - Transportation

4.1 - Construction

4.1.3 - Slash and earthen piles (8/04)

Piles or windrows of earth along roads and landings that have been widened or constructed shall be leveled. Slash from road maintenance or construction, including stumps, shall be dispersed throughout the sale.

4.1.4 - Timber removed for construction (12/09)

Trees cut or damaged in the process of pre-approved road, landing or skid trail construction will be decked in an area separate from other Designated Timber and not removed until measured by the sale administrator. Payment will be made at the specified Purchase Unit Price.

4.1.6 - Road construction (1/09)

Improvements of existing roads shall be done in such a way as to minimize the environmental and visual impacts. Merchantable trees shall be cut and utilized unless otherwise directed. Non-merchantable trees shall be severed and laid flat on the ground. Slash shall be scattered, and not left in windrows and kept a minimum of 10 feet back from the road edge, or be chipped, utilized or otherwise removed from the sale. Stumps shall be set upright, not left on edge, and be moved at least 10 feet away from the road edge. Disturbed soil shall be feathered into the woods and not left in berms or windrows.

4.1.12 - No new roads (1/12)

No new roads will be permitted in any Payment Unit. All operations are limited to existing roads. Skid trails only will be allowed.

4.2 - Maintenance

4.2.1 - Hauling restriction (12/08)

Hauling may be restricted on forest roads by the Unit Manager or his/her representative. The restriction may occur during spring breakup or during wet weather conditions.

4.2.5 - Two wheel drive condition (2/04)

All existing trail roads on and adjacent to the sale area must be passable by two-wheel drive traffic for the duration of the sale.

4.3 - Public Right-of-Way

4.3.2 - County R-O-W (12/06)

The county must be contacted prior to harvesting in the county road R-O-W. This applies to all Payment Units along county roads.

4.4 - Access

4.4.1 - Private property access (3/11)

Permission for access across private land is the responsibility of the Purchaser. Should the Purchaser desire to cross private land, a copy of the written permission from the private landowner is required by the DNR before any harvesting operations begin.

5 - Operations

5.1 - Notification

5.1.1 - Pre-sale conference (10/16)

A pre-sale conference between the Purchaser and sale administrator is required prior to beginning any operations to determine landing, road locations and general operations. The Unit Manager or his/her representative must be contacted at least 5 days in advance to schedule the conference.

5.2 - Conduct of Operations

5.2.1 - Slash

5.2.1.13 - Dispose of slash as directed (12/05)

Slash is to be disposed of as directed by the sale administrator.

5.2.2 - Hazard Trees/Snags

5.2.2.1 - Den trees (10/16)

Obvious hollow and/or den trees shall be protected and left standing unless they are a safety hazard.

5.2.3 - Operating Restrictions

5.2.3.2 - Operating restrictions (9/11)

Within Payment Unit(s) 1-11, unless changed by written agreement, cutting, skidding, and hauling are not permitted during the period of November 15 to November 20. This restriction is because of deer season.

5.2.3.3 - Bark slippage restriction (3/09)

Within Payment Unit(s) 2 and 3, unless changed by written agreement, cutting and skidding are not permitted during the period of April 15 to July 15. This restriction is because of bark slippage.

5.2.3.4 - Oak wilt restriction, no exceptions (1/18)

Within Payment Unit(s) 2-9 and 11, cutting, skidding, hauling within the sale and brushing of access roads to the sale are not permitted during the period of April 15 to July 15. No exceptions will be granted. This is necessary to reduce the spread of oak wilt.

5.2.32 - Decking/landing restoration (9/13)

All decking and landing areas must have the surface area restored to a condition equal to or better than before. This is to ensure the proper regeneration of the stand. Wood debris, chips and "cookies" from trimmings must be removed or scattered away from landing and loading areas and may not be windrowed on the edge.

5.2.37 - No decking areas (12/08)

No decking is allowed along any adjacent county roads without the permission of the Dickinson County Road Commission and the Unit Manager or his/her representative.

5.4 - Soil Protection

5.4.1 - Rutting restriction, general (7/16)

Operations are to cease immediately if equipment and weather conditions result in rutting of roads and/or skid trails which is 12 inches or greater in depth and 50 feet in length. The Unit Manager or his/her representative may restrict hauling and/or skidding if ruts exceed the specified depth. With the Unit Manager or his/her representative's approval, the Purchaser may return to the area when the risk of rutting has decreased.

5.4.3 - Erosion control (12/08)

Skid trails or haul roads may require erosion control structures or berms per direction of the Unit Manager or his/her representative.

5.8 - Protection of Endangered Species

5.8.5 - Protection of raptor nests (3/13)

All trees with raptor nests will be protected if found during harvesting operations. Notification will be made to the Unit Manager or his/her representative who will notify the Wildlife Biologist so an on-site evaluation and recommendation can be made, if necessary.

6 - Safety and Fire Prevention

6.2 - Signing

6.2.1 - Road posting (9/09)

The Purchaser is responsible for posting and maintaining caution signs on Old Carney lake Rd and Rock Dam Rd prior to beginning operations. The road must be posted at appropriate distances from the sale area to warn of logging activity and

truck traffic. Signs must be removed when harvest operations are suspended or completed. The Purchaser will provide these signs.



TIMBER SALE MAP

This information provided by authority of Part 525, 1994 PA 451, as amended.

Forest Management Unit Crystal Falls		County Dickinson	Mapped By Jacob Siler		Date 09/26/2017	Page 1	of 2
Township 40N	Range 30W	Section(s) and Subdivision(s) SEC3: E1/2NW NE, SEC4: NW N1/2NE SWNE NWSW, SEC36 S1/2SW			Scale 1:15,840		

Cover Type				Density			
A = Aspen	H = Hemlock	N = Marsh	U = Upland Brush	0 = Non Stocked	5 = Pole Timber Medium		
B = Paper Birch	J = Jack Pine	O = Oak	UM = Upland Mixed	1 = Seedling Sapling Poor	6 = Pole Timber Well		
C = Cedar	L = Lowland Brush	P = Lowland Poplar	V = Bog or Marsh	2 = Seedling Sapling Medium	7 = Saw Timber Poor		
D = Treed Bog	LM = Lowland Mixed	Q = Mixed Swamp Conifer	W = White Pine	3 = Seedling Sapling Well	8 = Saw Timber Medium		
E = Swamp Hdwoods	M = Mpl, Bch, Brch	R = Red Pine	X = Non Stocked	4 = Pole Timber Poor	9 = Saw Timber Well		
F = Spruce Fir	MC = Mixed Conifer	S = Black Spruce	Z = Water				
G = Grass	MD = Mixed Deciduous	T = Tamarack					

PU	Acres	PU	Acres	PU	Acres
1:	14.3	5:	30.8	9:	23.7
2:	21.3	6:	30.3	10:	13.9
3:	26.4	7:	1.4	11:	2.2
4:	25.8	8:	8.8		

Skunk Bone Compartment 102 198.9 Acres

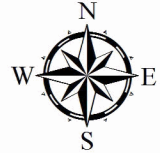

GPS:
45.895
-88.002
Decimal Degrees

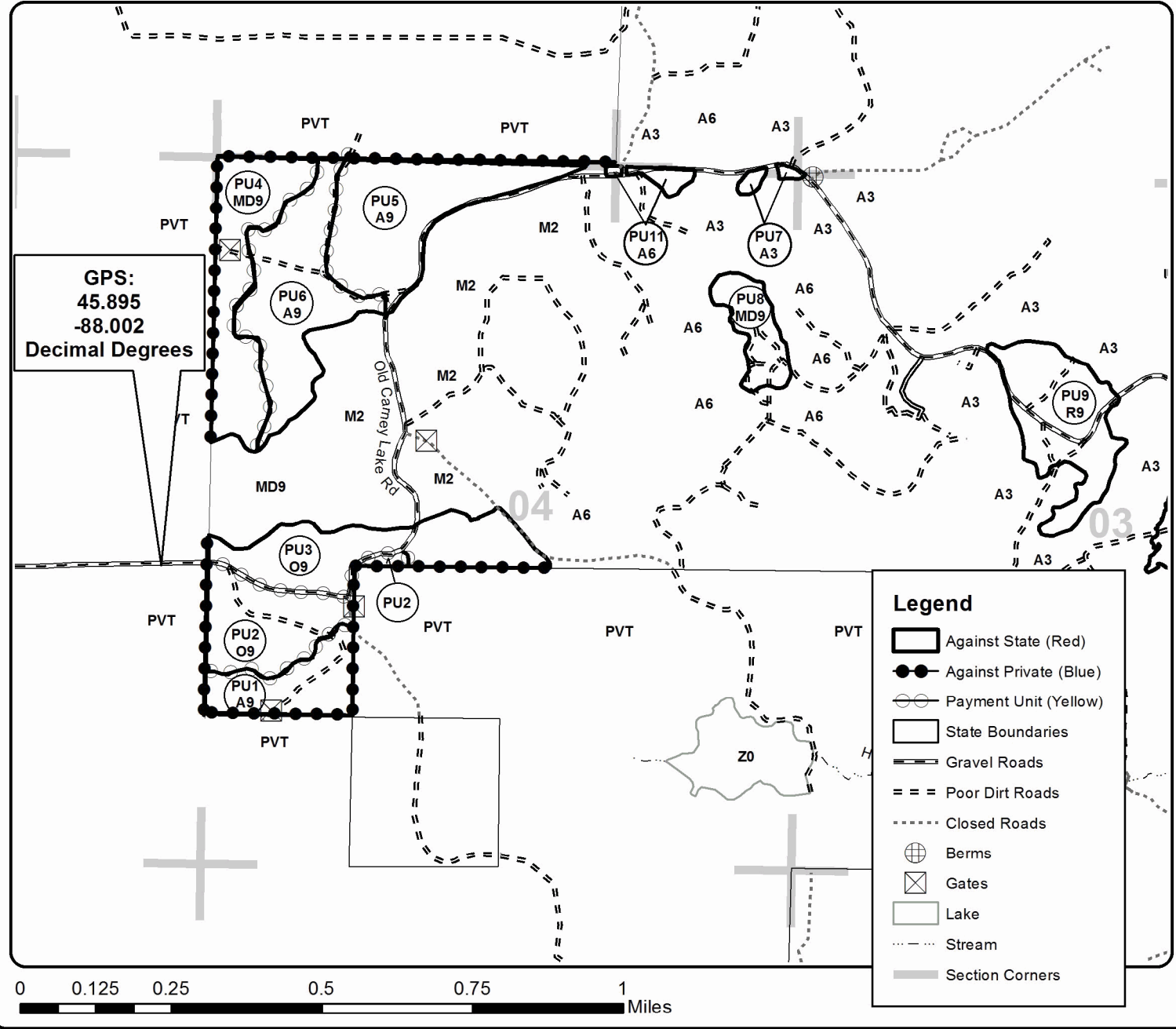



Sale Number	Year
12-015	18

TIMBER SALE MAP

This information provided by authority of Part 525, 1994 PA 451, as amended.

Forest Management Unit Crystal Falls	County Dickinson	Mapped By Jacob Siler	Date 09/26/2017	Page 2	of 2
Township 40N	Range 30W	Section(s) and Subdivision(s) SEC3: E1/2NW NE, SEC4: NW N1/2NE SWNE NWSW, SEC36 S1/2SW	Scale 1:15,840		

Cover Type

A = Aspen	H = Hemlock	N = Marsh	U = Upland Brush
B = Paper Birch	J = Jack Pine	O = Oak	UM = Upland Mixed
C = Cedar	L = Lowland Brush	P = Lowland Poplar	V = Bog or Marsh
D = Treed Bog	LM = Lowland Mixed	Q = Mixed Swamp Conifer	W = White Pine
E = Swamp Hdwoods	M = Mpl, Bch, Brch	R = Red Pine	X = Non Stocked
F = Spruce Fir	MC = Mixed Conifer	S = Black Spruce	Z = Water
G = Grass	MD = Mixed Deciduous	T = Tamarack	

Density

0 = Non Stocked	5 = Pole Timber Medium
1 = Seedling Sapling Poor	6 = Pole Timber Well
2 = Seedling Sapling Medium	7 = Saw Timber Poor
3 = Seedling Sapling Well	8 = Saw Timber Medium
4 = Pole Timber Poor	9 = Saw Timber Well

PU	Acres	PU	Acres	PU	Acres
1:	14.3	5:	30.8	9:	23.7
2:	21.3	6:	30.3	10:	13.9
3:	26.4	7:	1.4	11:	2.2
4:	25.8	8:	8.8		

Skunk Bone Compartment 102 198.9 Acres



GPS:
45.895
-88.002
Decimal Degrees

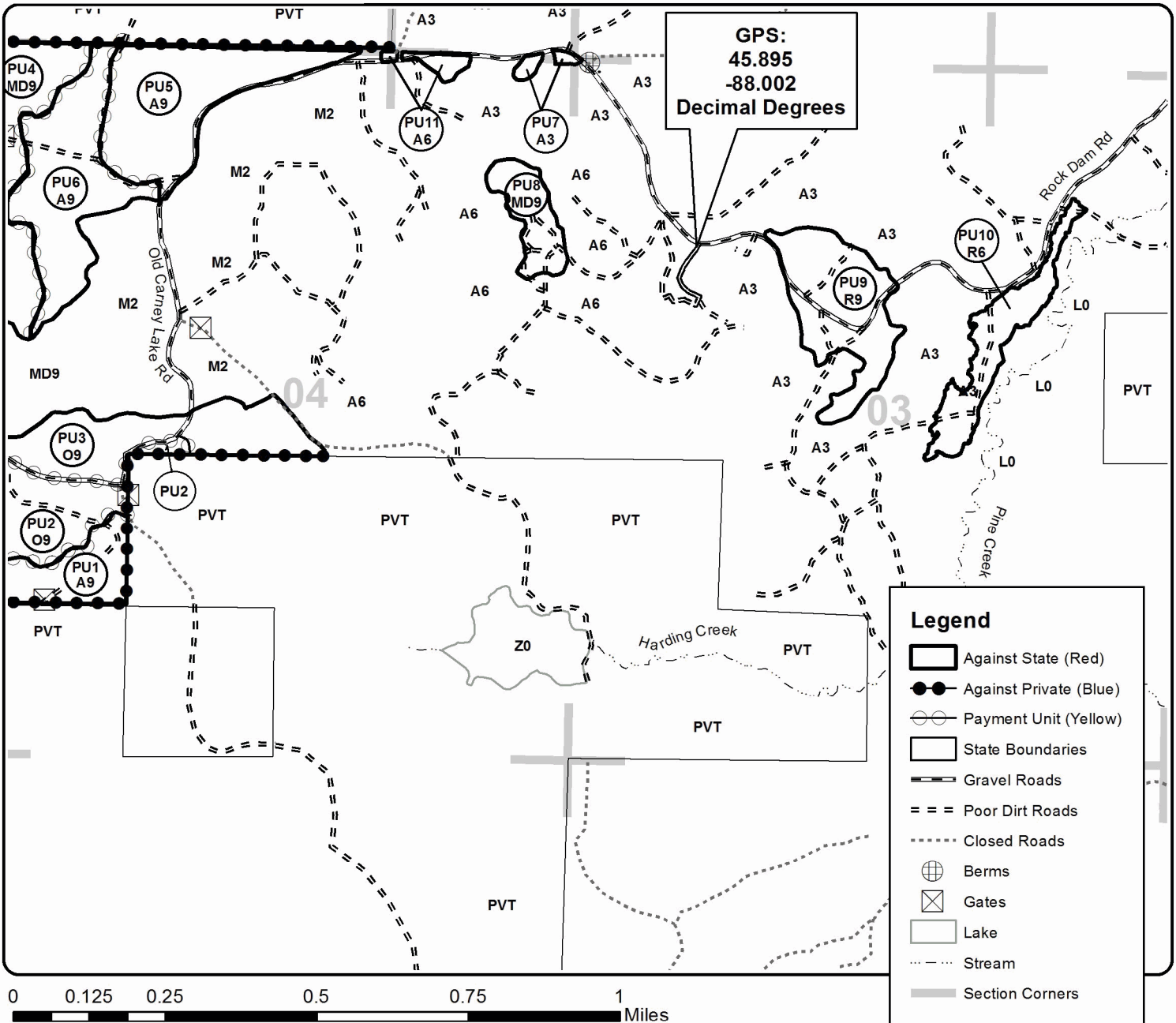

TIMBER SALE INFORMATION

Partridge Haven (12-018-18)

T41N, R28W, SEC. 11; T41N, R28W, SEC. 2; T41N, R28W, SEC. 3; T41N, R28W, SEC. 4; T41N, R28W, SEC. 9.
Dickinson County (Advertised Price \$86,046.05)

SALE NOTE: Access will be through several private landowners. Payment Units 7, 8, 11 & 12 are winter harvest only.

Access may be through private land.

A timber sale contract for this lump sum, sealed bid timber sale will be awarded to the responsible bidder offering the highest sealed bid price. Bids must be at or above the following advertised price for each species:

<u>PRODUCTS & SPECIES</u>	<u>ESTIMATED UNITS*</u>		<u>ADVERTISED PRICE</u>
Sawtimber			
Basswood	16.00	MBF	\$ 163.00 / MBF
Paper Birch	11.50	MBF	\$ 58.00 / MBF
Red Maple	18.90	MBF	\$ 102.00 / MBF
Sugar Maple	16.40	MBF	\$ 220.00 / MBF
White Ash	2.90	MBF	\$ 74.00 / MBF
Pulpwood			
Balsam Fir	375.00	Cords	\$ 15.75 / Cord
Basswood	57.00	Cords	\$ 9.10 / Cord
Mixed Aspen	1,554.00	Cords	\$ 31.15 / Cord
Mixed Hardwood	891.00	Cords	\$ 16.60 / Cord
Mixed Spruce	327.00	Cords	\$ 18.70 / Cord
Tamarack	91.00	Cords	\$ 14.10 / Cord

* The total volume is statistically estimated within plus (+) or minus (-) 7.75 percent. The estimated units are final and not subject to adjustment. Prospective bidders are urged to examine this timber and to make their own estimates of quantity and quality.

BOND AND PAYMENT SCHEDULE:

1. A bond in the amount of \$6,884.00 to insure faithful performance of the conditions of the contract will be deposited by the successful bidder within 21 days of the sale award.
2. Cutting in any sale or unit without the required advance payment would be considered a trespass.
3. Total payment must be paid in advance or according to the following schedule:
 - (a) Ten percent (10%) of the sale value must be paid within 21 days of the sale award.
 - (b) The 10% down payment will be credited towards the first unit cut.
 - (c) Payment for each of the following units must be made before cutting begins in that unit:

PAYMENT UNIT NUMBER	PERCENT OF TOTAL SALE VALUE
01	9.4%
02	12.8%
03	18.5%
04	3.9%
05	17.2%
06	5.8%
07	1.4%
08	6.3%
09	3.6%
10	0.7%
11	8.4%
12	12.0%

4. If no cutting takes place, the 10% down payment will not be refunded.
5. Operations on the contract issued will terminate on 06/30/2022.

Description of Timber by Payment Unit (PU)

PU	MARKET GROUP	PRODUCT	QUANTITY	UNIT	ACRES	ADVERTISE PRICE
1	Paper Birch	Sawtimber	4.5	MBF	12.5	\$8,081.75
	Balsam Fir	Pulpwood	42.0	Cords		
	Basswood		2.0	Cords		
	Mixed Aspen		195.0	Cords		
	<i>B. T. Aspen</i>		23.0	<i>Cords</i>		
	<i>Quaking Aspen</i>		172.0	<i>Cords</i>		
	Mixed Hardwood		53.0	Cords		
	<i>Balsam Poplar</i>		5.0	<i>Cords</i>		
	<i>Black Cherry</i>		1.0	<i>Cords</i>		
	<i>Ironwood</i>		1.0	<i>Cords</i>		
	<i>Paper Birch</i>		35.0	<i>Cords</i>		
	<i>Red Maple</i>		3.0	<i>Cords</i>		
	<i>Sugar Maple</i>		8.0	<i>Cords</i>		
	Mixed Spruce		10.0	Cords		
	<i>Black Spruce</i>		2.0	<i>Cords</i>		
	<i>White Spruce</i>		8.0	<i>Cords</i>		
2	Paper Birch	Sawtimber	3.4	MBF	22.7	\$10,990.40
	Red Maple		6.0	MBF		
	Balsam Fir	Pulpwood	26.0	Cords		
	Mixed Aspen		262.0	Cords		
	<i>B. T. Aspen</i>		125.0	<i>Cords</i>		
	<i>Quaking Aspen</i>		137.0	<i>Cords</i>		
	Mixed Hardwood		88.0	Cords		
	<i>Balsam Poplar</i>		7.0	<i>Cords</i>		
	<i>Black Cherry</i>		4.0	<i>Cords</i>		
	<i>Ironwood</i>		3.0	<i>Cords</i>		
	<i>Paper Birch</i>		13.0	<i>Cords</i>		
	<i>Red Maple</i>		60.0	<i>Cords</i>		
	<i>Sugar Maple</i>		1.0	<i>Cords</i>		
	Mixed Spruce		8.0	Cords		
	<i>White Spruce</i>		8.0	<i>Cords</i>		
	3	Basswood	Sawtimber	0.6		
Paper Birch			0.6	MBF		
Red Maple			4.6	MBF		
Sugar Maple			4.6	MBF		
White Ash			2.4	MBF		
Balsam Fir		Pulpwood	41.0	Cords		
Basswood			1.0	Cords		
Mixed Aspen			351.0	Cords		
<i>B. T. Aspen</i>			87.0	<i>Cords</i>		
<i>Quaking Aspen</i>			264.0	<i>Cords</i>		
Mixed Hardwood			119.0	Cords		
<i>Balsam Poplar</i>			8.0	<i>Cords</i>		
<i>Black Ash</i>			4.0	<i>Cords</i>		
<i>Black Cherry</i>			8.0	<i>Cords</i>		
<i>Ironwood</i>			6.0	<i>Cords</i>		
<i>Paper Birch</i>			8.0	<i>Cords</i>		
<i>Red Maple</i>			40.0	<i>Cords</i>		
<i>Sugar Maple</i>			23.0	<i>Cords</i>		
<i>White Ash</i>			22.0	<i>Cords</i>		
Mixed Spruce			31.0	Cords		
<i>White Spruce</i>		31.0	<i>Cords</i>			
4	Paper Birch	Sawtimber	0.5	MBF	8.7	\$3,333.35
	White Ash		0.5	MBF		
	Balsam Fir	Pulpwood	18.0	Cords		
	Mixed Aspen		79.0	Cords		

Description of Timber by Payment Unit (PU), con't

PU	MARKET GROUP	PRODUCT	QUANTITY	UNIT	ACRES	ADVERTISE PRICE
4 con't	<i>B. T. Aspen</i>	<i>Pulpwood</i>	14.0	<i>Cords</i>		
	<i>Quaking Aspen</i>		65.0	<i>Cords</i>		
	Mixed Hardwood		27.0	<i>Cords</i>		
	<i>American Elm</i>		1.0	<i>Cords</i>		
	<i>Balsam Poplar</i>		5.0	<i>Cords</i>		
	<i>Black Cherry</i>		7.0	<i>Cords</i>		
	<i>Paper Birch</i>		2.0	<i>Cords</i>		
	<i>White Ash</i>		12.0	<i>Cords</i>		
	Mixed Spruce		4.0	<i>Cords</i>		
	<i>Black Spruce</i>		4.0	<i>Cords</i>		
5	Paper Birch	Sawtimber	0.9	MBF	44.1	\$14,825.50
	Red Maple		4.9	MBF		
	Sugar Maple		1.5	MBF		
	Balsam Fir	Pulpwood	50.0	Cords		
	Basswood		2.0	Cords		
	Mixed Aspen		260.0	Cords		
	<i>B. T. Aspen</i>		104.0	<i>Cords</i>		
	<i>Quaking Aspen</i>		156.0	<i>Cords</i>		
	Mixed Hardwood		272.0	<i>Cords</i>		
	<i>American Elm</i>	<i>Sawtimber</i>	0.7	<i>MBF</i>		
	<i>American Elm</i>	<i>Pulpwood</i>	2.0	<i>Cords</i>		
	<i>Balsam Poplar</i>		12.0	<i>Cords</i>		
	<i>Black Cherry</i>		32.0	<i>Cords</i>		
	<i>Ironwood</i>		9.0	<i>Cords</i>		
	<i>Paper Birch</i>		13.0	<i>Cords</i>		
	<i>Red Maple</i>		146.0	<i>Cords</i>		
	<i>Sugar Maple</i>		38.0	<i>Cords</i>		
	<i>White Ash</i>		17.0	<i>Cords</i>		
	<i>Yellow Birch</i>		2.0	<i>Cords</i>		
	Mixed Spruce		28.0	<i>Cords</i>		
	<i>Black Spruce</i>		5.0	<i>Cords</i>		
<i>White Spruce</i>		23.0	<i>Cords</i>			
6	Basswood	Sawtimber	5.3	MBF	23.0	\$4,949.60
	Sugar Maple		7.6	MBF		
	Basswood	Pulpwood	29.0	Cords		
	Mixed Aspen		4.0	Cords		
	<i>Quaking Aspen</i>		4.0	<i>Cords</i>		
	Mixed Hardwood		122.0	<i>Cords</i>		
	<i>Ironwood</i>		16.0	<i>Cords</i>		
	<i>Sugar Maple</i>		106.0	<i>Cords</i>		
7	Balsam Fir	Pulpwood	1.0	Cords	4.4	\$1,246.75
	Mixed Hardwood		6.0	Cords		
	<i>Balsam Poplar</i>		6.0	<i>Cords</i>		
	Mixed Spruce		13.0	Cords		
	<i>Black Spruce</i>		13.0	<i>Cords</i>		
	Tamarack		63.0	Cords		
8	Balsam Fir	Pulpwood	42.0	Cords	20.6	\$5,420.35
	Mixed Aspen		121.0	Cords		
	<i>B. T. Aspen</i>		16.0	<i>Cords</i>		
	<i>Quaking Aspen</i>		105.0	<i>Cords</i>		
	Mixed Hardwood		23.0	<i>Cords</i>		
	<i>Balsam Poplar</i>		2.0	<i>Cords</i>		
	<i>Black Cherry</i>		7.0	<i>Cords</i>		
	<i>Ironwood</i>		1.0	<i>Cords</i>		
	<i>Paper Birch</i>		1.0	<i>Cords</i>		
	<i>Red Maple</i>		12.0	<i>Cords</i>		

Description of Timber by Payment Unit (PU), con't

PU	MARKET GROUP	PRODUCT	QUANTITY	UNIT	ACRES	ADVERTISE PRICE
8 con't	Mixed Spruce <i>Black Spruce</i> <i>White Spruce</i> Tamarack	Pulpwood	31.0 11.0 20.0 2.0	Cords <i>Cords</i> <i>Cords</i> Cords		
9	Paper Birch Red Maple Balsam Fir Mixed Aspen <i>Quaking Aspen</i> Mixed Hardwood <i>Black Cherry</i> <i>Paper Birch</i> <i>Red Maple</i> Mixed Spruce <i>White Spruce</i>	Sawtimber Pulpwood	1.6 0.5 36.0 62.0 62.0 11.0 6.0 4.0 1.0 14.0 14.0	MBF MBF Cords Cords <i>Cords</i> Cords <i>Cords</i> <i>Cords</i> <i>Cords</i> Cords <i>Cords</i>	7.7	\$3,086.50
10	Basswood Basswood Mixed Hardwood <i>Sugar Maple</i>	Sawtimber Pulpwood	2.2 4.0 14.0 14.0	MBF Cords Cords <i>Cords</i>	3.3	\$627.40
11	Basswood Red Maple Balsam Fir Basswood Mixed Aspen <i>Quaking Aspen</i> Mixed Hardwood <i>Balsam Poplar</i> <i>Black Cherry</i> <i>Paper Birch</i> <i>Red Maple</i> <i>Sugar Maple</i> Mixed Spruce <i>Black Spruce</i> <i>White Spruce</i>	Sawtimber Pulpwood	7.9 0.5 53.0 16.0 86.0 86.0 60.0 2.0 15.0 4.0 21.0 18.0 66.0 8.0 58.0	MBF MBF Cords Cords Cords <i>Cords</i> Cords <i>Cords</i> <i>Cords</i> <i>Cords</i> <i>Cords</i> <i>Cords</i> Cords <i>Cords</i> <i>Cords</i>	17.0	\$7,228.15
12	Red Maple Sugar Maple Balsam Fir Basswood Mixed Aspen <i>Quaking Aspen</i> Mixed Hardwood <i>Balsam Poplar</i> <i>Black Cherry</i> <i>Paper Birch</i> <i>Red Maple</i> <i>Sugar Maple</i> <i>Yellow Birch</i> Mixed Spruce <i>Black Spruce</i> <i>White Spruce</i> Tamarack	Sawtimber Pulpwood	2.4 2.7 66.0 3.0 134.0 134.0 96.0 5.0 56.0 8.0 9.0 16.0 2.0 122.0 57.0 65.0 26.0	MBF MBF Cords Cords Cords <i>Cords</i> Cords <i>Cords</i> <i>Cords</i> <i>Cords</i> <i>Cords</i> <i>Cords</i> <i>Cords</i> Cords <i>Cords</i> <i>Cords</i> Cords	31.5	\$10,321.30
TOTAL:			65.7	MBF		
TOTAL:			3,295.0	Cords		

Sale Specific Conditions & Requirements

Sale Name: Partridge Haven

Sale Number: 12-018-18 Seq#: 1

1 - Sale Area

1.2 - Boundaries

1.2.1 - Painted boundaries (1/14)

The sale boundary and Payment Unit boundaries are marked and identified by blue, red and yellow paint. Exterior sale boundary lines against private property are marked with blue paint. Exterior sale boundary lines against state are marked with red paint. Interior Payment Unit boundaries are marked with yellow paint. Yellow painted trees designating an interior Payment Unit boundary are only to be cut when all surrounding Payment Units have been paid.

2 - Timber Specifications

2.1 - Included Timber

2.1.1 - Clearcut unit(s) with unmerchantable trees (6/14)

Within Payment Unit(s) 1-5, 7-9, and 11-12, cut all trees that are two (2) inches or more at DBH, except do not cut cedar, pine and hemlock (if found). In addition, within Payment Units 2-5, 7-9 and 11, do not cut any live submerchantable conifers. Also, within Payment Units 2 and 3, do not cut any submerchantable cherry.

2.1.3 - Cut tree marked unit(s) (12/08)

Within Payment Unit(s) 6 and 10, all trees are designated for cutting when marked with orange paint above and below stump height, regardless of merchantability.

4 - Transportation

4.1 - Construction

4.1.1 - Stream crossings, general (3/11)

All stream crossing structures will be temporary and therefore, shall be provided by the Purchaser, and must be removed upon completion of the sale. All permits for stream crossings will be provided by the purchaser.

4.1.4 - Timber removed for construction (12/09)

Trees cut or damaged in the process of pre-approved road, landing or skid trail construction will be decked in an area separate from other Designated Timber and not removed until measured by the sale administrator. Payment will be made at the specified Purchase Unit Price.

4.1.6 - Road construction (1/09)

Construction of new roads or improvements of existing roads shall be done in such a way as to minimize the environmental and visual impacts. Merchantable trees shall be cut and utilized unless otherwise directed. Non-merchantable trees shall be severed and laid flat on the ground. Slash shall be scattered, and not left in windrows and kept a minimum of 10 feet back from the road edge, or be chipped, utilized, scattered or otherwise removed from the sale. Stumps shall be set upright, not left on edge, and be moved at least 10 feet away from the road edge. Disturbed soil shall be feathered into the woods and not left in berms or windrows.

4.1.7 - Road closure (10/11)

All new roads built into the sale must be blocked to vehicle traffic upon completion of the sale. Overgrown roads that are reopened shall be considered new roads. Some existing roads may also need to be closed, see the Timber Sale Map for locations. In general, this will require constructing a four (4') foot high berm of stumps and logs covered with earth. These roads must be rendered impassable to cars and trucks. Temporary berms may be required if no sale activity occurs for 30 or more consecutive days. Contact the sale administrator for specific details of design and placement.

4.2 - Maintenance

4.2.1 - Hauling restriction (12/08)

Hauling may be restricted on forest roads by the Unit Manager or his/her representative. The restriction may occur during spring breakup or prolonged wet weather conditions.

4.4 - Access

4.4.1 - Private property access (3/11)

Permission for access across private land is the responsibility of the Purchaser. Should the Purchaser desire to cross private land, a copy of the written permission from the private land-owner will be required by the DNR. A copy of the written permission from the private landowner must be given to the Unit Manager within 30 days of the bid opening and prior to the beginning of operations.

5 - Operations

5.2 - Conduct of Operations

5.2.1 - Slash

5.2.1.13 - Dispose of slash as directed (12/05)

Slash is to be disposed of as directed by sale administrator.

5.2.3 - Operating Restrictions

5.2.3.1 - Operating restrictions (9/11)

Within Payment Unit(s) 7, 8, 11 and 12, unless changed by written agreement, cutting and skidding are limited to frozen ground conditions. This restriction is because of the wet soils.

5.2.3.3 - Bark slippage restriction (3/09)

Within Payment Unit(s) 6, unless changed by written agreement, cutting and skidding are not permitted during the period of April 1 to July 15. This restriction is because of bark slippage.

5.2.32 - Decking/landing restoration (9/13)

All decking and landing areas must have the surface area restored to a condition equal to or better than before. This is to ensure the proper regeneration of the stand. Wood debris, chips and "cookies" from trimmings must be removed or scattered away from landing and loading areas and may not be windrowed on the edge.

5.4 - Soil Protection

5.4.1 - Rutting restriction, general (7/16)

Operations are to cease immediately if equipment and weather conditions result in rutting of roads and/or skid trails which is 12 inches or greater in depth and 50 feet in length. The Unit Manager or his/her representative may restrict hauling and/or skidding if ruts exceed the specified depth. With the Unit Manager or his/her representative's approval, the Purchaser may return to the area when the risk of rutting has decreased.

7 - Other Conditions

7.5 - Loss

7.5.1 - Deteriorating timber (7/09)

The sale area has received damage from spruce budworm. The Purchaser should harvest the wood as soon as possible. The Department of Natural Resources is held free of responsibility of any further damage or deterioration due to delay in harvesting.



TIMBER SALE MAP

This information provided by authority of Part 525, 1994 PA 451, as amended.

Sale Number	Year
12-018	18

Forest Management Unit Crystal Falls Management Unit	County Dickinson Co.	Mapped By Jake Siler	Date 9/21/2018	Page 1	of 2
Township 41N	Range 28W	Section(s) and Subdivision(s) Sec 2: S1/2SW Sec 3: SW1/4,S1/2SE Sec 4: S1/2NE,SENW,NESW,N1/2SE,S1/2SW,SESE Sec 9: NENE Sec 11: N1/2NW,NWNE	Scale 1:15,840		

Cover Type				Density			
A = Aspen	H = Hemlock	N = Marsh	U = Upland Brush	0 = Non Stocked	5 = Pole Timber Medium		
B = Paper Birch	J = Jack Pine	O = Oak	UM = Upland Mixed	1 = Seedling Sapling Poor	6 = Pole Timber Well		
C = Cedar	L = Lowland Brush	P = Lowland Poplar	V = Bog or Marsh	2 = Seedling Sapling Medium	7 = Saw Timber Poor		
D = Tread Bog	LM = Lowland Mixed	Q = Mixed Swamp Conifer	W = White Pine	3 = Seedling Sapling Well	8 = Saw Timber Medium		
E = Swamp Hdwoods	M = Mpl, Bch, Brch	R = Red Pine	X = Non Stocked	4 = Pole Timber Poor	9 = Saw Timber Well		
F = Spruce Fir	MC = Mixed Conifer	S = Black Spruce	Z = Water				
G = Grass	MD = Mixed Deciduous	T = Tamarack					

PU	Acres	PU	Acres	PU	Acres
1	12.5	5	44.1	9	7.7
2	22.7	6	23.0	10	3.3
3	36.1	7	4.4	11	17.0
4	8.7	8	20.6	12	31.5

Partridge Haven
Compartment 69
231.6 acres

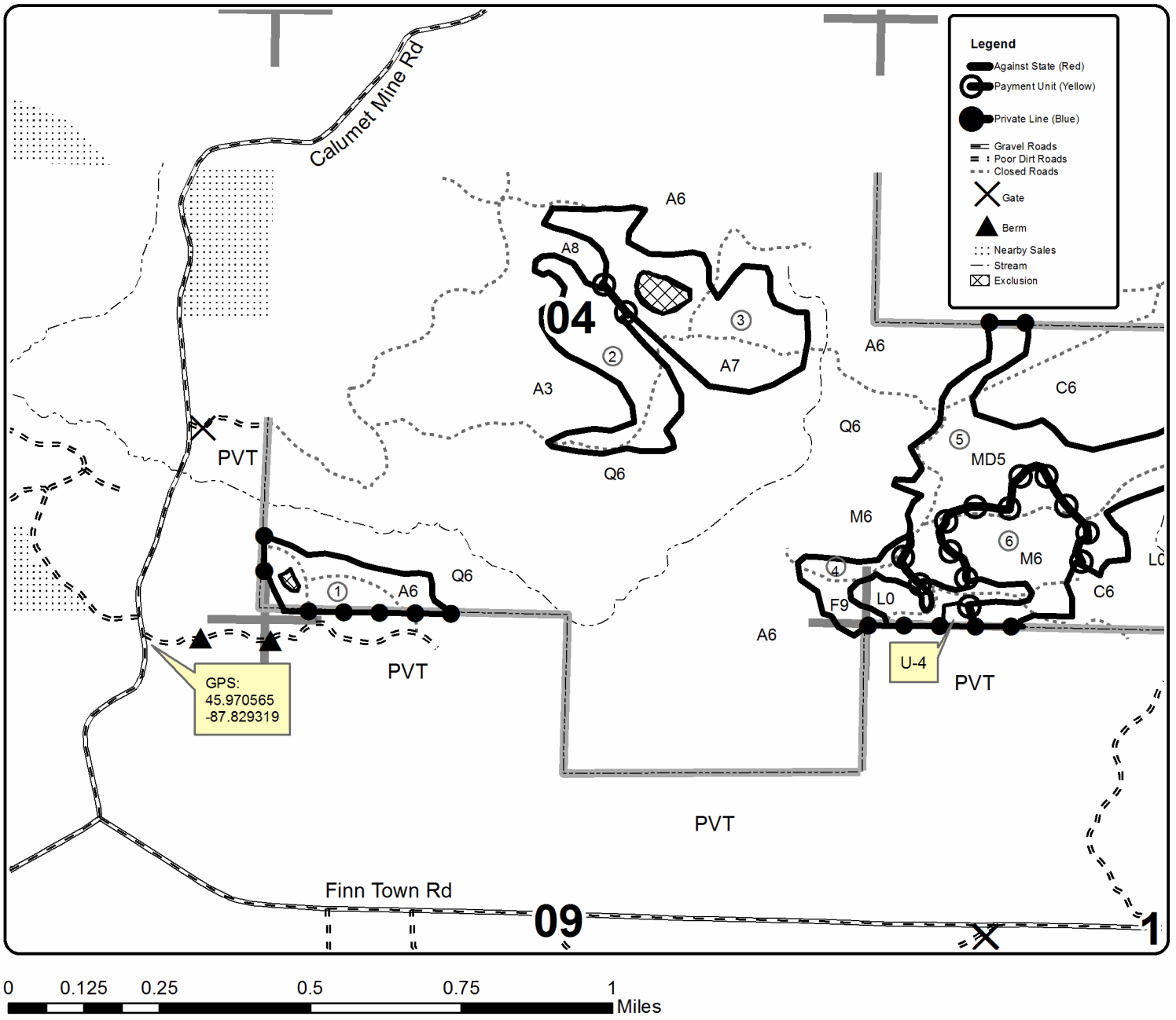



TIMBER SALE MAP

This information provided by authority of Part 525, 1994 PA 451, as amended.

Sale Number	Year
12-018	18

Forest Management Unit Crystal Falls Management Unit	County Dickinson Co.	Mapped By Jake Siler	Date 9/21/2018	Page 2	of 2
		Cruised By J Siler & R. Goupell			

Township 41N	Range 28W	Section(s) and Subdivision(s) Sec 2: S1/2SW Sec 3: SW1/4,S1/2SE Sec 4: S1/2NE,SENW,NESW,N1/2SE,S1/2SW,SESE Sec 9: NENE Sec 11: N1/2NW,NWNE	Scale 1:15,840
-----------------	--------------	--	-------------------

Cover Type				Density				
A = Aspen	H = Hemlock	N = Marsh	U = Upland Brush	0 = Non Stocked	5 = Pole Timber Medium			
B = Paper Birch	J = Jack Pine	O = Oak	UM = Upland Mixed	1 = Seedling Sapling Poor	6 = Pole Timber Well			
C = Cedar	L = Lowland Brush	P = Lowland Poplar	V = Bog or Marsh	2 = Seedling Sapling Medium	7 = Saw Timber Poor			
D = Treed Bog	LM = Lowland Mixed	Q = Mixed Swamp Conifer	W = White Pine	3 = Seedling Sapling Well	8 = Saw Timber Medium			
E = Swamp Hdwoods	M = Mpl, Bch, Brch	R = Red Pine	X = Non Stocked	4 = Pole Timber Poor	9 = Saw Timber Well			
F = Spruce Fir	MC = Mixed Conifer	S = Black Spruce	Z = Water					
G = Grass	MD = Mixed Deciduous	T = Tamarack						

PU	Acres	PU	Acres	PU	Acres
1	12.5	5	44.1	9	7.7
2	22.7	6	23.0	10	3.3
3	36.1	7	4.4	11	17.0
4	8.7	8	20.6	12	31.5

Partridge Haven
Compartment 69
231.6 acres

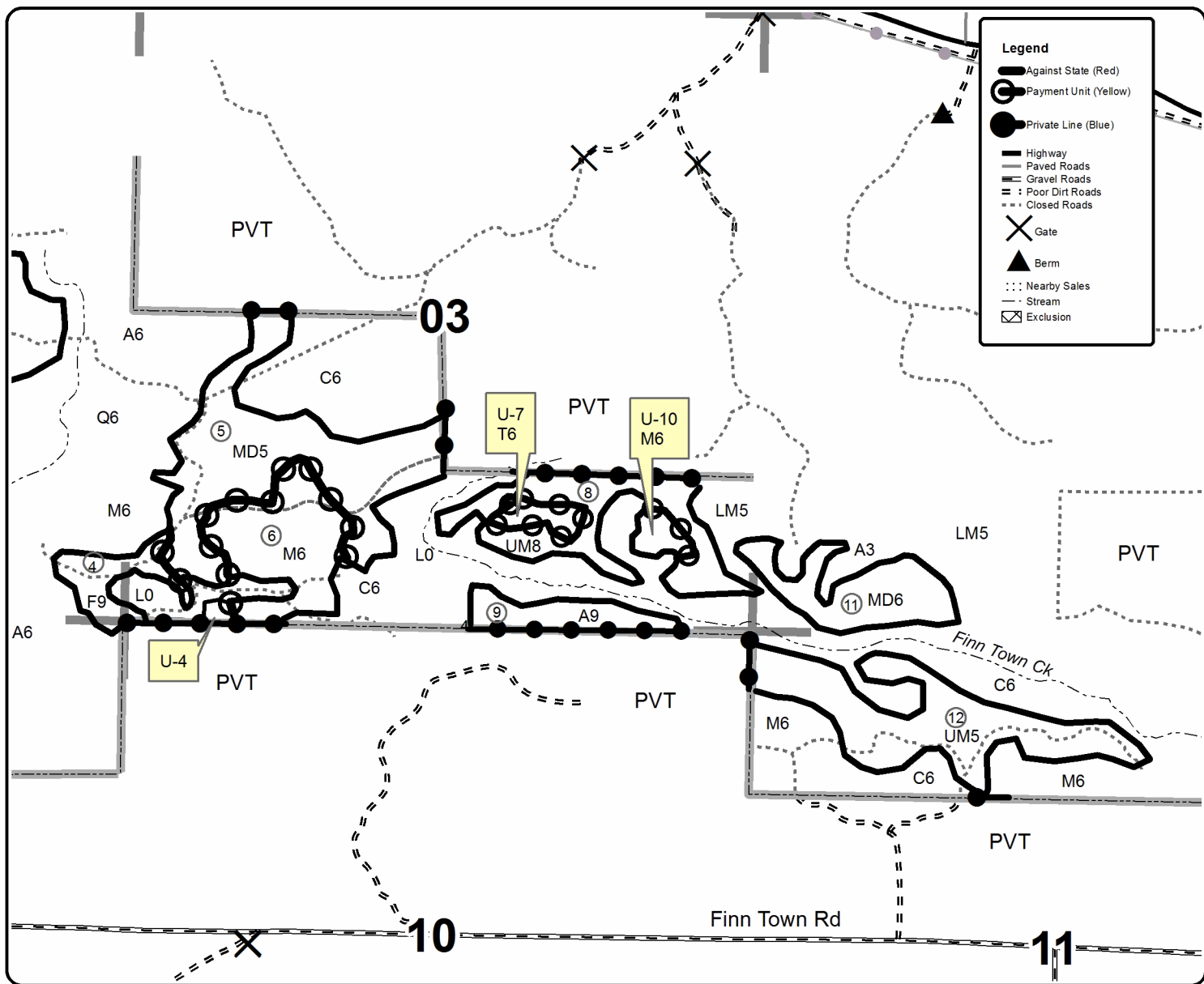

Skunk Bone (12-015-18)

T40N, R30W, SEC. 3; T40N, R30W, SEC. 4; T41N, R30W, SEC. 36; Dickinson

In response to the notice of sale to be held 8:30 a.m. (local time) on March 6, 2019, I am hereby submitting my sealed bid (firm offer) for the following forest products to be cut. Bids for individual species must be at or above the advertised price. All non-responsive bid forms may be rejected.

<u>PRODUCTS & SPECIES</u>	<u>ESTIMATED VOLUME*</u>	<u>ADVERTISED PRICE</u>	<u>BID PRICE/UNIT</u>
Sawtimber			
Paper Birch	17.20 MBF	\$ 78.00/MBF	\$ _____
Red Maple	1.10 MBF	\$ 139.00/MBF	\$ _____
Red Oak	17.60 MBF	\$ 187.00/MBF	\$ _____
Red Pine	20.70 MBF	\$ 142.00/MBF	\$ _____
Sugar Maple	0.60 MBF	\$ 391.00/MBF	\$ _____
Pulpwood			
Jack Pine	26.00 Cords	\$ 35.05/Cord	\$ _____
Mixed Aspen	2,551.00 Cords	\$ 42.45/Cord	\$ _____
Mixed Hardwood	594.00 Cords	\$ 22.60/Cord	\$ _____
Paper Birch	408.00 Cords	\$ 24.85/Cord	\$ _____
Red Pine	255.00 Cords	\$ 60.85/Cord	\$ _____

*The volumes are statistically estimated within plus (+) or minus (-) 11.19 percent. These estimated volumes are final and not subject to adjustment. Prospective bidders are urged to examine this timber and to make their own estimates of quantity and quality.

I understand that any or all bids may be rejected. All bids must be signed and all bid items must be bid or the bid form may be rejected. I also understand that consideration and awarding a contract will be based upon my past performance and ability to complete the contract based upon equipment and staffing subject to my control.

FEDERAL ID: _____ or SOCIAL SECURITY NUMBER: _____

Company or individual bidding: _____

Company representative's name: _____

Address: _____

City: _____ State: _____ Zip: _____

IF AVAILABLE, PLEASE PLACE THE PERSONALIZED LABEL FROM YOUR PROSPECTUS IN THE ABOVE BOX.

Individual or company representative's signature: _____ Date: _____

Phone number : _____ Email (optional): _____

THE WINNING BIDDER MUST COMPLETE THE VERIFICATION OF WORKER'S DISABILITY COMPENSATION ACT COMPLIANCE (ON REVERSE SIDE IF DOUBLE SIDED) WITHIN 21 DAYS OF SALE AWARD DATE



FOR DEPARTMENT USE ONLY
Sale Number (XX - XXX - XX - XX)
Forest Management Unit:

TIMBER SALE VERIFICATION OF WORKER'S DISABILITY COMPENSATION ACT COMPLIANCE

*As required by Act 317, P.A. 1969 (Worker's Compensation) and
Part 5 of Act 451 of 1994, as amended.*

VERIFICATION OF WORKER'S DISABILITY COMPENSATION ACT COMPLIANCE

- This verification must be completed and submitted within 21 days of contract award and prior to the issuance of the timber sale contract.
- In addition, if boxes 2B or 2C are checked, then Notice of Exclusion or Certificate of Insurance must be submitted within twenty-one (21) days of the contract award and prior to the issuance of the timber sale contract.
- All information must be typed or printed except for written signatures.

Please Check Appropriate Categories:

1. My business is organized as (you **must** check one of the boxes below):
 - A. Sole Proprietorship (individual)
 - B. Partnership
 - C. Corporation
2. You **must** check one of the boxes below:
 - A. I certify my business is a sole proprietorship and it has no employees but the sole proprietor. I am not subject to the Worker's Compensation Laws.
 - B. I certify my business has satisfied its obligation to the Worker's Compensation Act through the use of an approved Notice of Exclusion (BWC-337, Rev. 5/96). I will provide a copy of the Notice of Exclusion within 21 days of the contract award. (For questions or a copy of the BWC-337, please call the Worker's Compensation Bureau at 517-322-1195).
 - C. I certify my business has a Worker's Compensation Policy. I will provide an original Certificate of Insurance within twenty-one (21) days of the contract award.
3. If you have checked item 2(A) or 2(B), you **must** indicate the number of **both** full-time and part-time employees, other than yourself, including family members and active partners (if none, you must enter "0").

_____ Full-time Employees

_____ Part-time Employees

Name of Business		Federal ID (or) Social Security No.	
Address		Telephone ()	
City	State	ZIP	

I hereby certify that the above information is true and correct. I agree to notify the Michigan DNR of any changes that occur in factors affecting my coverage during any of my present and future operations.

Signature of Owner or Authorized Representative

Title

Date

Please complete the "SEALED BID" information on the next page

Partridge Haven (12-018-18)

T41N, R28W, SEC. 11; T41N, R28W, SEC. 2; T41N, R28W, SEC. 3; T41N, R28W,

In response to the notice of sale to be held 8:30 a.m. (local time) on March 6, 2019, I am hereby submitting my sealed bid (firm offer) for the following forest products to be cut. Bids for individual species must be at or above the advertised price. All non-responsive bid forms may be rejected.

<u>PRODUCTS & SPECIES</u>	<u>ESTIMATED VOLUME*</u>	<u>ADVERTISED PRICE</u>	<u>BID PRICE/UNIT</u>
Sawtimber			
Basswood	16.00 MBF	\$ 163.00/MBF	\$ _____
Paper Birch	11.50 MBF	\$ 58.00/MBF	\$ _____
Red Maple	18.90 MBF	\$ 102.00/MBF	\$ _____
Sugar Maple	16.40 MBF	\$ 220.00/MBF	\$ _____
White Ash	2.90 MBF	\$ 74.00/MBF	\$ _____
Pulpwood			
Balsam Fir	375.00 Cords	\$ 15.75/Cord	\$ _____
Basswood	57.00 Cords	\$ 9.10/Cord	\$ _____
Mixed Aspen	1,554.00 Cords	\$ 31.15/Cord	\$ _____
Mixed Hardwood	891.00 Cords	\$ 16.60/Cord	\$ _____
Mixed Spruce	327.00 Cords	\$ 18.70/Cord	\$ _____
Tamarack	91.00 Cords	\$ 14.10/Cord	\$ _____

*The volumes are statistically estimated within plus (+) or minus (-) 7.75 percent. These estimated volumes are final and not subject to adjustment. Prospective bidders are urged to examine this timber and to make their own estimates of quantity and quality.

I understand that any or all bids may be rejected. All bids must be signed and all bid items must be bid or the bid form may be rejected. I also understand that consideration and awarding a contract will be based upon my past performance and ability to complete the contract based upon equipment and staffing subject to my control.

FEDERAL ID: _____ or SOCIAL SECURITY NUMBER: _____

Company or individual bidding: _____

Company representative's name: _____

Address: _____

City: _____ State: _____ Zip: _____

IF AVAILABLE, PLEASE PLACE THE PERSONALIZED LABEL FROM YOUR PROSPECTUS IN THE ABOVE BOX.

Individual or company representative's signature: _____ Date: _____

Phone number : _____ Email (optional): _____

THE WINNING BIDDER MUST COMPLETE THE VERIFICATION OF WORKER'S DISABILITY COMPENSATION ACT COMPLIANCE (ON REVERSE SIDE IF DOUBLE SIDED) WITHIN 21 DAYS OF SALE AWARD DATE



FOR DEPARTMENT USE ONLY
Sale Number (XX - XXX - XX - XX)
Forest Management Unit:

TIMBER SALE VERIFICATION OF WORKER'S DISABILITY COMPENSATION ACT COMPLIANCE

*As required by Act 317, P.A. 1969 (Worker's Compensation) and
Part 5 of Act 451 of 1994, as amended.*

VERIFICATION OF WORKER'S DISABILITY COMPENSATION ACT COMPLIANCE

- This verification must be completed and submitted within 21 days of contract award and prior to the issuance of the timber sale contract.
- In addition, if boxes 2B or 2C are checked, then Notice of Exclusion or Certificate of Insurance must be submitted within twenty-one (21) days of the contract award and prior to the issuance of the timber sale contract.
- All information must be typed or printed except for written signatures.

Please Check Appropriate Categories:

1. My business is organized as (you **must** check one of the boxes below):
 - A. Sole Proprietorship (individual)
 - B. Partnership
 - C. Corporation
2. You **must** check one of the boxes below:
 - A. I certify my business is a sole proprietorship and it has no employees but the sole proprietor. I am not subject to the Worker's Compensation Laws.
 - B. I certify my business has satisfied its obligation to the Worker's Compensation Act through the use of an approved Notice of Exclusion (BWC-337, Rev. 5/96). I will provide a copy of the Notice of Exclusion within 21 days of the contract award. (For questions or a copy of the BWC-337, please call the Worker's Compensation Bureau at 517-322-1195).
 - C. I certify my business has a Worker's Compensation Policy. I will provide an original Certificate of Insurance within twenty-one (21) days of the contract award.
3. If you have checked item 2(A) or 2(B), you **must** indicate the number of **both** full-time and part-time employees, other than yourself, including family members and active partners (if none, you must enter "0").

_____ Full-time Employees

_____ Part-time Employees

Name of Business		Federal ID (or) Social Security No.	
Address		Telephone ()	
City	State	ZIP	

I hereby certify that the above information is true and correct. I agree to notify the Michigan DNR of any changes that occur in factors affecting my coverage during any of my present and future operations.

Signature of Owner or Authorized Representative

Title

Date

Please complete the "SEALED BID" information on the next page