



**DEPARTMENT OF NATURAL RESOURCES  
STATE OF MICHIGAN**

**TIMBER SALE PROSPECTUS #6490**

SCHEDULED SALE DATE AND TIME: 10:00 a.m. (local time) on August 27, 2019.

LOCATION: GLADWIN MGMT UNIT, 801 NORTH SILVERLEAF, GLADWIN, MI 48624.

PROSPECTUS NOTE: The bidder is advised to inspect the sale area and review the location, estimated volumes, operating costs and contract terms of proposed sales. Please be aware that some landowners may request 60 days or more notice for access across their land.

Notice is hereby given that bids will be received by the Unit Manager, GLADWIN MANAGEMENT UNIT, for certain timber on the following described lands:

Corlew Oak-Aspen (73-007-18) / T20N, R02W, SEC. 2 , S1/2NE,SW,SE.

Gladwin County, Advertised Price \$141,854.10, 115.2 Acres, Aspen, Hardwood.

SALE NOTE: The oak in the sale is of mixed quality, going from grade 3 to grade 1.

Shaw Rd Harvest (73-009-18) / T20N, R02W, SEC. 15, SW.

T20N, R02W, SEC. 16, SESE.

T20N, R02W, SEC. 21, SENE,NESE.

T20N, R02W, SEC. 22, N1/2NW.

Gladwin County, Advertised Price \$70,407.35, 113.6 Acres, Aspen, Hardwood.

SALE NOTE: The access to Payment Units 1-4 is through a state owned gate. The trail will need to be maintained in as good or better conditions after the harvest. The wildlife opening will not be used as a landing. There are numerous existing trails within the sale area that will need to be maintained and kept clear of logging slash during and after the harvest.

3 Lakes Aspen (73-014-18) / T20N, R02W, SEC. 19, NESW,SESE.

T20N, R02W, SEC. 21, NWNW,S1/2NW,NESW.

T20N, R02W, SEC. 29, S1/2NE.

Gladwin County, Advertised Price \$42,725.20, 74.0 Acres, Aspen, Hardwood.

SALE NOTE: Some of the Payment Units are hilly. In addition, temporary culverts will need to be installed to cross some of the intermittent drains.

Access may be through private or other public land.

## BID INSTRUCTIONS (VER. 07/02/2018):

### 1. Scheduled Bid Location, Date, and Time (2/11)

Bids must be received by the Unit Manager, GLADWIN OFFICE, 801 NORTH SILVERLEAF, GLADWIN, MI 48624, no later than 10:00 a.m. (local time) on August 27, 2019. For further information concerning this sale, contact Patrick Mohney at 989-426-9205 extension 7640.

### 2. Bidder's Qualifications (5/16)

Purchaser shall obtain workers compensation insurance to cover claims under Michigan's Worker's Disability Compensation Act of 1969 or similar employee benefit act of any other state applicable to an employee. If all or part of a timber sale was prepared by a private contractor, the contractor and that contractor's company are not permitted to bid on the timber sale contract. Bids will not be accepted from individuals or companies appearing on the DNR/FRD No-Bid List. This list contains the names of purchasers who previously failed to execute a contract within 21-days or who have a history of poor performance.

### 3. Preparation of Sealed Bids (5/16)

Bid Forms may be completed online thru Michigan DNR Timber Sale Online Bidding (OLB) at [www.michigan.gov/timberbidding](http://www.michigan.gov/timberbidding) or by completing the hardcopy Bid Form found in the Timber Sale Prospectus. Hardcopy Bid Forms shall be manually signed in ink. Registration in OLB is considered your 'signature' for all bids submitted thru that system. Bid prices must be entered for each species and product in the Bid Price column for all material subject to bidding and all fill-in blanks must be completed. If erasures or other changes appear on the hardcopy Bid Form, each erasure or change must be initialed by the person signing the bid.

### 4. Submission of Sealed Bids (5/16)

Bid forms may be obtained from the Unit Manager or thru OLB. Bids may be submitted hardcopy or thru OLB. All hardcopy bids must be submitted on the bid form and in an envelope clearly identified as described in this section. NOTE: Only one bid form per bid envelope. Sealed bids must be submitted to the Unit office designated in the prospectus and must be submitted at or prior to the time established in the prospectus. The envelope should show on the outside (a) the sale name or number and (b) the date and time of bid opening, as shown in the prospectus. Bids received after the time specified in the sale prospectus are late bids and will be rejected.

It is possible for a bidder to submit multiple bids on a single sale. For example, a bid may be submitted hardcopy and a bid may be submitted thru OLB. Or, two bidders from the same company could both submit bids on the same sale. If this were to happen, the State would accept all bids received and award the contract accordingly. All bidding and contractual requirements would apply to all bids received.

### 5. Public Opening of Sealed Bids (7/16)

If conditions permit, the sealed bids will be publicly opened and posted at the time and place set in the prospectus.

If a bidder, present at a bid opening, has submitted bids on more than one sale, that bidder may withdraw their unopened bid envelopes or announce the withdrawal of their online bid after being declared the successful bidder on one sale.

### 6. Award of Contract (1/11)

Award of the contract will be made to the Bidder whose bid, conforming to the prospectus, is most advantageous to the State of Michigan on the basis of total value at rates bid for the estimated quantities. The State reserves the right to reject any bid or waive any minor irregularity in bids received. A written award mailed (or otherwise furnished) to the successful Bidder shall be deemed to result in a binding contract without further action by either party.

### 7. Down Payment (1/11)

The Bidder to whom award is made must make a down payment within 21 days of the sale award. The amount of the down payment will be calculated as shown in the Bond and Payment Schedule of this prospectus. Only cash may be used to meet this requirement.

### 8. Performance Security (1/11)

As guarantee of faithful performance, a cash bond, certificate of deposit, surety bond or irrevocable letter of credit (LOC) is required within 21 days of the sale award. The amount of the performance security is shown in the Bond and

Payment Schedule of this prospectus. If an LOC or surety is used, the coverage must extend for at least 6 months beyond the contract expiration.

#### 9. Timber Sale Contract (7/18)

Additional conditions and requirements common to all timber sales are listed on the timber sale contract (R4031) and are available on line at [www.michigan.gov/timber](http://www.michigan.gov/timber). Contact the Unit Manager for additional information or a sample contract. Within 21 days of the date of the award letter, the bidder must sign the contract and provide the required down payment, performance security, and verification of worker's disability compensation. The down payment and performance security shall be in accordance with the provisions of the timber sale contract, in the sums stated in this prospectus. If these actions are not taken, then the Bidder, the Bidder's corporation, and the corporation's principals may not be permitted to bid on State timber sales for a period of 3 months after the first offense, 6 months after the second offense, and 1 year after the third offense. An offense will only be counted against the Bidder for 5 years. In addition, the Bidder certifies that if awarded this contract, the Bidder will complete the timber sale contract in accordance with its terms and any modifications thereof including requirements to purchase, cut, and remove the included timber by the expiration date.

Payment Unit values in the State Forest Timber Sale Contract are calculated based on the advertised value of the Payment Unit as a percentage of the total advertised value of the contract. The advertised value of each Payment Unit is given in the Description of Timber by Payment Unit table on the Timber Sale Information page. For example, if the value of Payment Unit 1 is advertised as \$1,500 and the total Timber Sale value is advertised as \$10,000, the contract price for Payment Unit 1 will be 15% of the total bid price ( $\$1,500/\$10,000 * 100$ ).

#### 10. Disclaimer of Estimates and Bidder's Warranty of Inspection (7/16)

Before submitting this bid, the Bidder is advised and cautioned to inspect the sale area, review the requirements of the sale contract, and take other steps as may be reasonably necessary to ascertain the location, estimated volumes, construction estimates, and operating costs of the proposed sale. Failure to do so will not relieve the Bidder from responsibility for completing the contract.

The Bidder warrants that this bid is submitted solely on the basis of the Bidder's examination and inspection of the quality and quantity of the timber offered for sale and the Bidder's opinion of the value thereof and the costs of recovery. No reliance should be placed on the State of Michigan's estimates of timber quality, quantity or costs of recovery. Bidder further acknowledges that the State of Michigan: (i) expressly disclaims any warranty of fitness of timber for any purpose; (ii) offers this timber as is without any warranty of quality (merchantability) or quantity and (iii) expressly disclaims any warranty as to the quantity or quality of timber sold.

#### 11. Certification and Chain-of-Custody (10/14)

Unless otherwise indicated in the contract under section 7 – Other Conditions of the Sale Specific Conditions & Requirements, the area encompassed by this timber sale is certified to the standards of the Forest Stewardship Council (FSC) - Certificate #SCS-FM/COC-00090N and the Sustainable Forestry Initiative (SFI) - Certificate #NSF-SFIS-5Y031-SF5. Forest products from this sale may be delivered to the mill as "FSC 100% and / or SFI certified" as long as the contractor hauling the forest products is chain-of-custody (COC) certified or covered under a COC certificate from the destination mill. The purchaser is responsible for maintaining COC after leaving the sale area.

#### 12. Good Neighbor Authority (GNA) Requirements (7/16)

If the name of this timber sales contains the acronym GNA, it is authorized by the Good Neighbor Authority (GNA) and covered by various agreements between the U.S. Forest Service and the State. The timber sale occurs on federal land and the following conditions apply:

GNA contracts on US Forest Service land will not be awarded to purchasers on the Federal list of excluded parties. The System for Award Management (SAM) will be checked for active excluded parties prior to award of contract. In addition, the Bidder to whom award is made must complete an Assurance Regarding Felony Conviction or Tax Delinquent Status for Corporate Applicants (AD-3031).

#### 13. Good Neighbor Authority (GNA) Requirements, con't (9/16)

Bidder certifies, by signing this bid form, that to the best of Bidder's knowledge that the following representations are accurate and complete.

- a. That the Bidder and its principals are not presently debarred, suspended, proposed for debarment, declared ineligible, or voluntary excluded from timber sales (covered transactions) by any Federal department or agency.
- b. That the Bidder and its principals have not within a 3-year period preceding this bid been convicted of or had a civil judgment rendered against them for commission of fraud or a criminal offense in connection with obtaining, attempting to obtain, or performing a public (Federal, State, or local) transaction or contract under a public transaction; violation of Federal or State antitrust statutes or commission of embezzlement, theft, forgery, bribery, falsification or destruction of records, making false statements, or receiving stolen property.
- c. That the Bidder and its principals are not presently indicted for or otherwise criminally or civilly charged by a governmental entity (Federal, State, or local) with commission of any of the offenses enumerated in paragraph b of this certification.
- d. That the Bidder and its principals have not within a 3-year period preceding this bid had one or more public transactions (Federal, State, or local) terminated for breach or default of a timber or forest product contract.

Bidders that cannot certify this requirement, in whole or in part, shall submit an explanation with their bid.

DAN EICHINGER  
Director

**TIMBER SALE INFORMATION**

Corlew Oak-Aspen (73-007-18)

T20N, R02W, SEC. 2.

Gladwin County (Advertised Price \$141,854.10)

SALE NOTE: The oak in the sale is of mixed quality, going from grade 3 to grade 1.

A timber sale contract for this lump sum, sealed bid timber sale will be awarded to the responsible bidder offering the highest sealed bid price. Bids must be at or above the following advertised price for each species:

<u>PRODUCTS &amp; SPECIES</u>	<u>ESTIMATED UNITS*</u>	<u>ADVERTISED PRICE</u>
Sawtimber		
Red Maple	27.80 MBF	\$ 39.00 / MBF
Red Oak	326.20 MBF	\$ 277.00 / MBF
White Oak	83.80 MBF	\$ 75.00 / MBF
White Pine	2.10 MBF	\$ 44.00 / MBF
Pulpwood		
Mixed Oak	966.00 Cords	\$ 12.85 / Cord
Quaking Aspen	1,571.00 Cords	\$ 16.15 / Cord
Red Maple	389.00 Cords	\$ 13.05 / Cord
White Pine	91.00 Cords	\$ 12.90 / Cord

\* The total volume is statistically estimated within plus (+) or minus (-) 11.12 percent. The estimated units are final and not subject to adjustment. Prospective bidders are urged to examine this timber and to make their own estimates of quantity and quality.

**BOND AND PAYMENT SCHEDULE:**

1. A bond in the amount of \$7,093.00 to insure faithful performance of the conditions of the contract will be deposited by the successful bidder within 21 days of the sale award.
2. Cutting in any sale or unit without the required advance payment would be considered a trespass.
3. Total payment must be paid in advance or according to the following schedule:
  - (a) Ten percent (10%) of the sale value must be paid within 21 days of the sale award.
  - (b) The 10% down payment will be credited towards the first unit cut.
  - (c) Payment for each of the following units must be made before cutting begins in that unit:

<u>PAYMENT UNIT NUMBER</u>	<u>PERCENT OF TOTAL SALE VALUE</u>
01	39.0%
02	36.9%
03	10.0%
04	14.1%

4. If no cutting takes place, the 10% down payment will not be refunded.
5. Operations on the contract issued will terminate on 09/30/2021.

**Description of Timber by Payment Unit (PU)**

PU	MARKET GROUP	PRODUCT	QUANTITY	UNIT	ACRES	ADVERTISE PRICE
1	Red Maple	Sawtimber	12.3	MBF	38.3	\$55,291.55
	Red Oak		138.3	MBF		
	White Oak		35.5	MBF		
	Mixed Oak	Pulpwood	403.0	Cords		
	<i>Red Oak</i>		286.0	<i>Cords</i>		
	<i>White Oak</i>		117.0	<i>Cords</i>		
	Quaking Aspen		403.0	Cords		
	Red Maple		165.0	Cords		
2	Red Maple	Sawtimber	11.7	MBF	36.2	\$52,276.55
	Red Oak		130.8	MBF		
	White Oak		33.6	MBF		
	Mixed Oak	Pulpwood	381.0	Cords		
	<i>Red Oak</i>		271.0	<i>Cords</i>		
	<i>White Oak</i>		110.0	<i>Cords</i>		
	Quaking Aspen		380.0	Cords		
	Red Maple		156.0	Cords		
3	Red Oak	Sawtimber	7.1	MBF	20.7	\$14,226.40
	White Oak		2.8	MBF		
	Mixed Oak	Pulpwood	17.0	Cords		
	<i>Red Oak</i>		11.0	<i>Cords</i>		
	<i>White Oak</i>		6.0	<i>Cords</i>		
	Quaking Aspen		714.0	Cords		
	Red Maple		23.0	Cords		
	4	Red Maple	Sawtimber	3.8		
Red Oak			50.0	MBF		
White Oak			11.9	MBF		
White Pine			2.1	MBF		
Mixed Oak		Pulpwood	165.0	Cords		
<i>Red Oak</i>			133.0	<i>Cords</i>		
<i>White Oak</i>			32.0	<i>Cords</i>		
Quaking Aspen			74.0	Cords		
Red Maple			45.0	Cords		
White Pine			91.0	Cords		
TOTAL:			439.9	MBF		
TOTAL:			3,017.0	Cords		

# Sale Specific Conditions & Requirements

**Sale Name: Corlew Oak-Aspen**

**Sale Number: 73-007-18 Seq#: 1**

## 1 - Sale Area

### 1.2 - Boundaries

#### 1.2.1 - Painted boundaries (1/14)

The sale boundary and Payment Unit boundaries are marked and identified by red and yellow paint. Exterior sale boundary lines against state are marked with red paint. Interior Payment Unit boundaries are marked with yellow paint. Yellow painted trees are only to be cut when all surrounding Payment Units have been paid.

## 2 - Timber Specifications

### 2.1 - Included Timber

#### 2.1.1 - Clearcut unit(s) with unmerchantable trees (6/14)

Within Payment Unit(s) 1-4, cut all trees that are two (2) inches or more at DBH, except do not cut any trees marked with green paint above and below stump height. In addition, within Payment Units 1, 2, and 3, do not cut any conifers. Also, within Payment Unit 4, do not cut any cedar.

### 2.2 - Utilization

#### 2.2.3 - Stump heights (4/07)

Stump heights within the Sale Area shall not exceed 12 inches for trees greater than 10 inches DBH and 4 inches for trees smaller than 10 inches DBH.

## 3 - Payments

### 3.3 - Pre-measured Sales

#### 3.3.4 - Dividing payment units (7/14)

Payment Unit(s) 1 and 2 may be divided at the request of the Purchaser and upon approval of the Unit Manager. Dividing Payment Units is a contract modification which requires a Timber Sale Contract Supplement.

### 3.4 - Damaged Timber

#### 3.4.1 - Damaged timber (6/14)

General Condition and Requirement 3.4 Damaged Timber, defines liquidated damages for undesignated live merchantable trees which are cut or injured. In addition, extreme care should be taken to avoid damage to conifer seedlings and saplings in Payment Units 1-3, and cedar seedlings and saplings in Payment Unit 4.

Within the sale area, if more than 25% of the tree seedlings or saplings (1/4" to 4.5" DBH) within a specified portion of the sale area are damaged, liquidated damages will be assessed at \$300 per acre for all acreage within that specified portion of the sale area that was damaged.

No damage is acceptable to merchantable trees. Within the sale area, if more than 5% of trees (> 4.5" DBH) within a specified area of the sale are damaged, liquidated damages will be assessed for all trees damaged. Rates will be in accordance with General Condition and Requirement 3.4 Damaged Timber.

## 4 - Transportation

### 4.1 - Construction

#### 4.1.12 - No new roads (1/12)

No new roads will be permitted in any Payment Unit. All operations are limited to existing roads. Skid trails only will be allowed.

### 4.2 - Maintenance

#### 4.2.5 - Two wheel drive condition (2/04)

All existing trail roads on and adjacent to the sale area must be passable by two-wheel drive traffic for the duration of the sale.

#### 4.4 - Access

##### 4.4.3 - Access gate (12/08)

The access gate must be locked at the completion of each day unless otherwise approved by the Unit Manager or his/her representative.

### 5 - Operations

#### 5.2 - Conduct of Operations

##### 5.2.2 - Hazard Trees/Snags

###### 5.2.2.1 - Den trees (10/16)

Obvious hollow and/or den trees shall be protected and left standing unless they are a safety hazard.

##### 5.2.3 - Operating Restrictions

###### 5.2.3.4 - Oak wilt restriction, no exceptions (1/18)

Within Payment Unit(s) 1-4, cutting and skidding are not permitted during the period of April 15 to July 15. No exceptions will be granted. This is necessary to reduce the spread of oak wilt.

##### 5.2.4 - Dead and Down Creation

###### 5.2.4.4 - Dead and down creation, grouse (6/18)

To encourage grouse and other wildlife, in Payment Unit(s) 1-4, leave one, 12" or larger diameter whole tree on the ground for every 3 acres. Trees should be scattered throughout the sale and at least two chains from any roads, two-tracks, or trails open to vehicles, or positioned per the sale administrators instructions. Stumps must be at least 3 feet tall.

#### 5.4 - Soil Protection

##### 5.4.1 - Rutting restriction, general (7/16)

Operations are to cease immediately if equipment and weather conditions result in rutting of roads and/or skid trails which is 12 inches or greater in depth and 50 feet in length. The Unit Manager or his/her representative may restrict hauling and/or skidding if ruts exceed the specified depth. With the Unit Manager or his/her representative's approval, the Purchaser may return to the area when the risk of rutting has decreased.





# TIMBER SALE MAP

This information provided by authority of Part 525, 1994 PA 451, as amended.

Sale Number	Year
73 - 007	18

Forest Management Unit Gladwin Management Unit	County Gladwin	Mapped By Steven Nyhoff	Date 08/17/2018	Page 1	of 1
Township 20N	Range 02W	Section(s) and Subdivision(s) Section 2 SW 1/4; N 1/2 SE	Scale 1:15,840		

Cover Type				Density	
A = Aspen	H = Hemlock	N = Marsh	U = Upland Brush	0 = Non Stocked	5 = Pole Timber Medium
B = Paper Birch	J = Jack Pine	O = Oak	UM = Upland Mixed	1 = Seedling Sapling Poor	6 = Pole Timber Well
C = Cedar	L = Lowland Brush	P = Lowland Poplar	V = Bog or Marsh	2 = Seedling Sapling Medium	7 = Saw Timber Poor
D = Treed Bog	LM = Lowland Mixed	Q = Mixed Swamp Conifer	W = White Pine	3 = Seedling Sapling Well	8 = Saw Timber Medium
E = Swamp Hdwoods	M = Mpl, Bch, Brch	R = Red Pine	X = Non Stocked	4 = Pole Timber Poor	9 = Saw Timber Well
F = Spruce Fir	MC = Mixed Conifer	S = Black Spruce	Z = Water		
G = Grass	MD = Mixed Deciduous	T = Tamarack			

PU	Acres
1	38.2
2	36.3
3	20.7
4	20.0

## Corlew Oak-Aspen

### Compartment 26

115.2 Acres

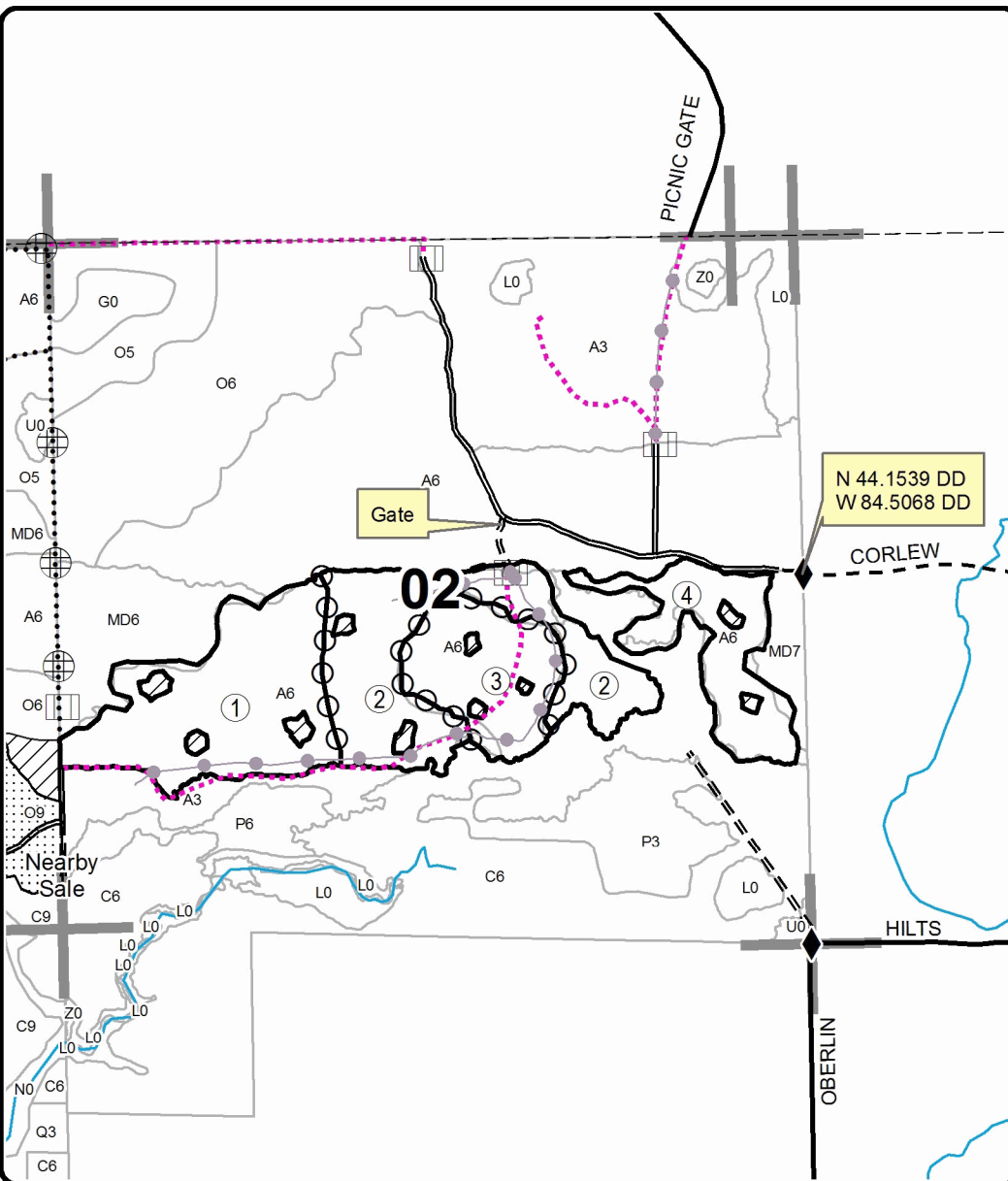
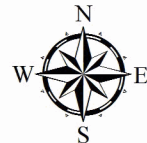

### Legend

- Against State (Red)
- Payment Unit (Yellow)
- Retention Area
- Secondary Forest Road
- Forest Access Route
- Paved Road
- Gravel Road
- DNR - Management Access (NLP)
- Temporary Management Access
- Perennial River
- Hunter Walking Trail
- Berm
- Gate
- Nearby Timber Sales
- Section Corners
- Stand Boundaries
- Survey Corners
- Field Grade Corners

### Locator Map

1:200,000

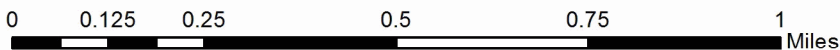
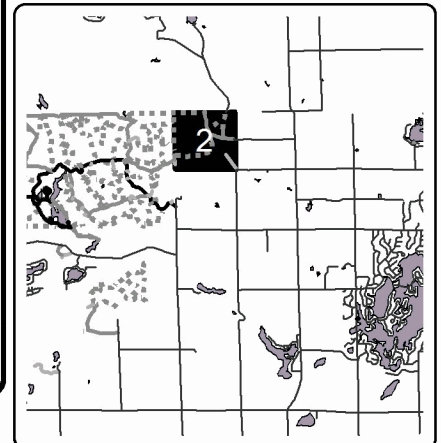



**TIMBER SALE INFORMATION**

Shaw Rd Harvest (73-009-18)

T20N, R02W, SEC. 15; T20N, R02W, SEC. 16; T20N, R02W, SEC. 21; T20N, R02W, SEC. 22.  
Gladwin County (Advertised Price \$70,407.35)

SALE NOTE: The access to Payment Units 1-4 is through a state owned gate. The trail will need to be maintained in as good or better conditions after the harvest. The wildlife opening will not be used as a landing. There are numerous existing trails within the sale area that will need to be maintained and kept clear of logging slash during and after the harvest.

A timber sale contract for this lump sum, sealed bid timber sale will be awarded to the responsible bidder offering the highest sealed bid price. Bids must be at or above the following advertised price for each species:

<u>PRODUCTS &amp; SPECIES</u>	<u>ESTIMATED UNITS*</u>	<u>ADVERTISED PRICE</u>
Sawtimber		
Beech	0.70 MBF	\$ 84.00 / MBF
Red Maple	9.20 MBF	\$ 39.00 / MBF
Red Oak	27.50 MBF	\$ 277.00 / MBF
White Oak	3.10 MBF	\$ 75.00 / MBF
Pulpwood		
Mixed Aspen	3,270.00 Cords	\$ 16.15 / Cord
Mixed Hardwood	518.00 Cords	\$ 13.05 / Cord
Mixed Oak	145.00 Cords	\$ 12.85 / Cord
Paper Birch	46.00 Cords	\$ 15.35 / Cord

\* The total volume is statistically estimated within plus (+) or minus (-) 14.57 percent. The estimated units are final and not subject to adjustment. Prospective bidders are urged to examine this timber and to make their own estimates of quantity and quality.

**BOND AND PAYMENT SCHEDULE:**

1. A bond in the amount of \$3,520.00 to insure faithful performance of the conditions of the contract will be deposited by the successful bidder within 21 days of the sale award.
2. Cutting in any sale or unit without the required advance payment would be considered a trespass.
3. Total payment must be paid in advance or according to the following schedule:
  - (a) Ten percent (10%) of the sale value must be paid within 21 days of the sale award.
  - (b) The 10% down payment will be credited towards the first unit cut.
  - (c) Payment for each of the following units must be made before cutting begins in that unit:

<u>PAYMENT UNIT NUMBER</u>	<u>PERCENT OF TOTAL SALE VALUE</u>
01	14.8%
02	28.7%
03	25.7%
04	24.7%
05	1.8%
06	4.3%

4. If no cutting takes place, the 10% down payment will not be refunded.
5. Operations on the contract issued will terminate on 09/30/2021.

**Description of Timber by Payment Unit (PU)**

PU	MARKET GROUP	PRODUCT	QUANTITY	UNIT	ACRES	ADVERTISE PRICE
1	Red Maple	Sawtimber	0.8	MBF	15.4	\$10,401.65
	Red Oak		3.2	MBF		
	White Oak		0.5	MBF		
	Mixed Aspen	Pulpwood	505.0	Cords		
	<i>B. T. Aspen</i>		444.0	<i>Cords</i>		
	<i>Quaking Aspen</i>		61.0	<i>Cords</i>		
	Mixed Hardwood		70.0	Cords		
	<i>Black Cherry</i>		9.0	<i>Cords</i>		
	<i>Red Maple</i>		61.0	<i>Cords</i>		
	Mixed Oak		21.0	Cords		
	<i>Red Oak</i>		20.0	<i>Cords</i>		
	<i>White Oak</i>		1.0	<i>Cords</i>		
	Paper Birch		7.0	Cords		
2	Red Maple	Sawtimber	1.7	MBF	30.1	\$20,241.75
	Red Oak		6.2	MBF		
	White Oak		1.0	MBF		
	Mixed Aspen	Pulpwood	985.0	Cords		
	<i>B. T. Aspen</i>		867.0	<i>Cords</i>		
	<i>Quaking Aspen</i>		118.0	<i>Cords</i>		
	Mixed Hardwood		135.0	Cords		
	<i>Black Cherry</i>		17.0	<i>Cords</i>		
	<i>Red Maple</i>		118.0	<i>Cords</i>		
	Mixed Oak		40.0	Cords		
	<i>Red Oak</i>		39.0	<i>Cords</i>		
	<i>White Oak</i>		1.0	<i>Cords</i>		
	Paper Birch		13.0	Cords		
3	Red Maple	Sawtimber	1.5	MBF	26.8	\$18,060.40
	Red Oak		5.5	MBF		
	White Oak		0.8	MBF		
	Mixed Aspen	Pulpwood	878.0	Cords		
	<i>B. T. Aspen</i>		773.0	<i>Cords</i>		
	<i>Quaking Aspen</i>		105.0	<i>Cords</i>		
	Mixed Hardwood		121.0	Cords		
	<i>Black Cherry</i>		16.0	<i>Cords</i>		
	<i>Red Maple</i>		105.0	<i>Cords</i>		
	Mixed Oak		37.0	Cords		
	<i>Red Oak</i>		35.0	<i>Cords</i>		
	<i>White Oak</i>		2.0	<i>Cords</i>		
	Paper Birch		12.0	Cords		
4	Red Maple	Sawtimber	1.4	MBF	25.8	\$17,406.40
	Red Oak		5.3	MBF		
	White Oak		0.8	MBF		
	Mixed Aspen	Pulpwood	846.0	Cords		
	<i>B. T. Aspen</i>		744.0	<i>Cords</i>		
	<i>Quaking Aspen</i>		102.0	<i>Cords</i>		
	Mixed Hardwood		117.0	Cords		
	<i>Black Cherry</i>		15.0	<i>Cords</i>		
	<i>Red Maple</i>		102.0	<i>Cords</i>		
	Mixed Oak		35.0	Cords		
	<i>Red Oak</i>		33.0	<i>Cords</i>		
	<i>White Oak</i>		2.0	<i>Cords</i>		
	Paper Birch		12.0	Cords		
5	Mixed Aspen	Pulpwood	43.0	Cords	6.3	\$1,281.70
	<i>B. T. Aspen</i>		13.0	<i>Cords</i>		
	<i>Quaking Aspen</i>		30.0	<i>Cords</i>		
	Mixed Hardwood		45.0	Cords		

**Description of Timber by Payment Unit (PU), con't**

PU	MARKET GROUP	PRODUCT	QUANTITY	UNIT	ACRES	ADVERTISE PRICE
5 con't	<i>Black Cherry</i>	<i>Pulpwood</i>	11.0	<i>Cords</i>		
	<i>Red Maple</i>		34.0	<i>Cords</i>		
6	Beech	Sawtimber	0.7	MBF	9.2	\$3,015.45
	Red Maple		3.8	MBF		
	Red Oak		7.3	MBF		
	Mixed Aspen	Pulpwood	13.0	Cords		
	<i>B. T. Aspen</i>	<i>Sawtimber</i>	1.9	<i>MBF</i>		
	<i>B. T. Aspen</i>	<i>Pulpwood</i>	9.0	<i>Cords</i>		
	Mixed Hardwood		30.0	Cords		
	<i>Beech</i>		5.0	<i>Cords</i>		
	<i>Red Maple</i>		22.0	<i>Cords</i>		
	<i>Sugar Maple</i>		3.0	<i>Cords</i>		
	Mixed Oak		12.0	Cords		
	<i>Red Oak</i>		12.0	<i>Cords</i>		
	Paper Birch		2.0	Cords		
	TOTAL:			40.5		
TOTAL:			3,979.0	Cords		

## Sale Specific Conditions & Requirements

**Sale Name: Shaw Rd Harvest**

**Sale Number: 73-009-18 Seq#: 1**

### 1 - Sale Area

#### 1.2 - Boundaries

##### 1.2.1 - Painted boundaries (1/14)

The sale boundary and Payment Unit boundaries are marked and identified by blue, red and yellow paint. Exterior sale boundary lines against private property are marked with blue paint. Exterior sale boundary lines against state are marked with red paint. Interior Payment Unit boundaries are marked with yellow paint. Yellow painted trees designating an interior Payment Unit boundary are only to be cut when all surrounding Payment Units have been paid.

### 2 - Timber Specifications

#### 2.1 - Included Timber

##### 2.1.1 - Clearcut unit(s) with unmerchantable trees (6/14)

Within Payment Unit(s) 1-5, cut all trees that are two (2) inches or more at DBH, except within Payment Units 1, 2, 3, and 4, do not cut trees that are marked with green paint above and below stump height. In addition, within Payment Unit 5, do not cut any oak or conifers.

##### 2.1.3 - Cut tree marked unit(s) (12/08)

Within Payment Unit(s) 6, all trees are designated for cutting when marked with orange paint above and below stump height, regardless of merchantability.

### 3 - Payments

#### 3.4 - Damaged Timber

##### 3.4.1 - Damaged timber (6/14)

General Condition and Requirement 3.4 Damaged Timber, defines liquidated damages for undesignated live merchantable trees which are cut or injured. In addition, extreme care should be taken to avoid damage to tree seedlings and saplings.

Within Payment Units 5 and 6, if more than 25% of the tree seedlings or saplings (1/4" to 4.5" DBH) within a specified portion of the sale area are damaged, liquidated damages will be assessed at \$300 per acre for all acreage within that specified portion of the sale area that was damaged.

No damage is acceptable to merchantable trees. Within the sale area, if more than 5% of trees (> 4.5" DBH) within a specified area of the sale are damaged, liquidated damages will be assessed for all trees damaged. Rates will be in accordance with General Condition and Requirement 3.4 Damaged Timber.

### 4 - Transportation

#### 4.1 - Construction

##### 4.1.12 - No new roads (1/12)

No new roads will be permitted in any Payment Unit. All operations are limited to existing roads and trails. Skid trails only will be allowed.

#### 4.2 - Maintenance

##### 4.2.5 - Two wheel drive condition (2/04)

All existing trail roads on and adjacent to the sale area must be passable by two-wheel drive traffic for the duration of the sale.

#### 4.4 - Access

##### 4.4.3 - Access gate (12/08)

The access gate must be locked at the completion of each day unless otherwise approved by the Unit Manager or his/her

representative.

## 5 - Operations

### 5.2 - Conduct of Operations

#### 5.2.2 - Hazard Trees/Snags

##### 5.2.2.1 - Den trees (10/16)

Obvious hollow and/or den trees shall be protected and left standing unless they are a safety hazard.

#### 5.2.3 - Operating Restrictions

##### 5.2.3.1 - Operating restrictions (9/11)

Within Payment Unit(s) 1, 2, 3, and 4, unless changed by written agreement, cutting, skidding, and hauling are limited to the period of October 1 to March 31. This restriction is to minimize deer browse on regeneration.

##### 5.2.3.5 - Oak wilt restriction (1/18)

Within Payment Unit(s) 3, 4, 5, and 6, unless changed by written agreement, cutting, skidding, hauling within the sale and brushing of access roads to the sale are not permitted during the period of April 15 to July 15. Operations may be allowed if specific steps are taken to prevent damaging uncut oak during the high risk period. Those steps may include completing all road brushing before April 15th and clearing a tree-length buffer along uncut oak cover before April 15th. This is necessary to reduce the spread of oak wilt. For more information, contact the Unit Manager or his/her representative.

#### 5.2.4 - Dead and Down Creation

##### 5.2.4.4 - Dead and down creation, grouse (6/18)

To encourage grouse and other wildlife, in Payment Unit(s) 1, 2, 3, and 4, leave one, 12" or larger diameter whole tree on the ground for every 3 acres. Trees should scattered throughout the sale and at least two chains from any roads, two-tracks, or trails open to vehicles, or positioned per the sale administrators instructions. Stumps must be at least 3 feet tall.

### 5.4 - Soil Protection

#### 5.4.1 - Rutting restriction, general (7/16)

Operations are to cease immediately if equipment and weather conditions result in rutting of roads and/or skid trails which is 12 inches or greater in depth and 50 feet in length. The Unit Manager or his/her representative may restrict hauling and/or skidding if ruts exceed the specified depth. With the Unit Manager or his/her representative's approval, the Purchaser may return to the area when the risk of rutting has decreased.



# TIMBER SALE MAP

This information provided by authority of Part 525, 1994 PA 451, as amended.

Forest Management Unit Gladwin Managemnet Unit	County Gladwin	Mapped By Steven Nyhoff	Date 09/13/2018	Page 1	of 1
		Cruised By Steven Nyhoff			

Township 20N	Range 02W	Section(s) and Subdivision(s) S15, SW1/4; S16, E1/2SE; S21, SENE, NESE; S22, N1/2NW	Scale 1:15,840
-----------------	--------------	----------------------------------------------------------------------------------------	-------------------

### Cover Type

A = Aspen	H = Hemlock	N = Marsh	U = Upland Brush
B = Paper Birch	J = Jack Pine	O = Oak	UM = Upland Mixed
C = Cedar	L = Lowland Brush	P = Lowland Poplar	V = Bog or Marsh
D = Treed Bog	LM = Lowland Mixed	Q = Mixed Swamp Conifer	W = White Pine
E = Swamp Hdwoods	M = Mpl, Bch, Brch	R = Red Pine	X = Non Stocked
F = Spruce Fir	MC = Mixed Conifer	S = Black Spruce	Z = Water
G = Grass	MD = Mixed Deciduous	T = Tamarack	

### Density

0 = Non Stocked	5 = Pole Timber Medium
1 = Seedling Sapling Poor	6 = Pole Timber Well
2 = Seedling Sapling Medium	7 = Saw Timber Poor
3 = Seedling Sapling Well	8 = Saw Timber Medium
4 = Pole Timber Poor	9 = Saw Timber Well

PU	Acres	PU	Acres
1	15.4	4	25.8
2	30.1	5	6.3
3	26.8	6	9.2

## Shaw Rd. Harvest

### Compartment 26

113.6 Acres

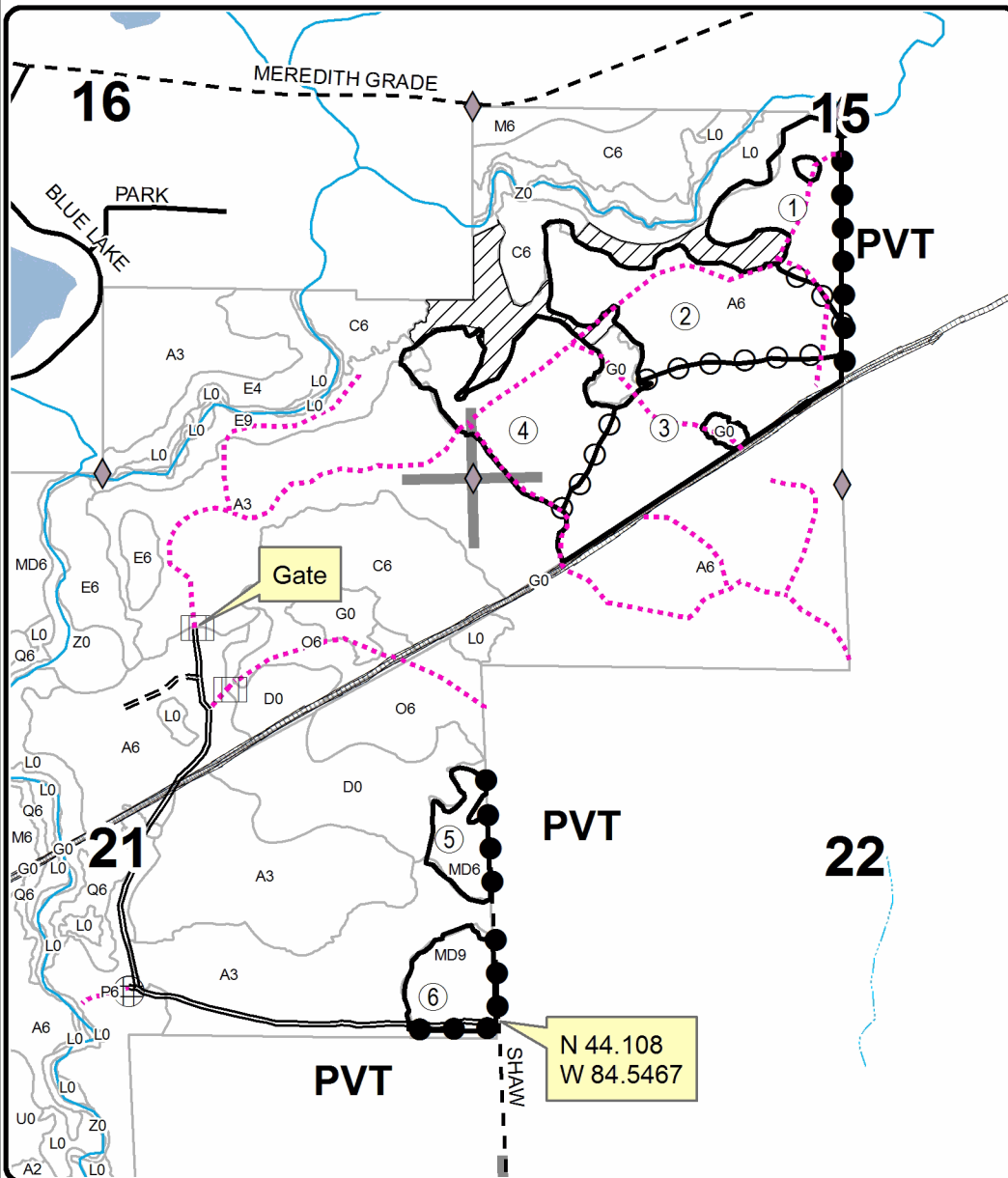
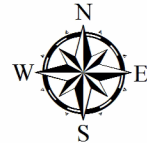

### Legend

- Field Grade Corners
- Secondary Forest Road
- Forest Access Route
- Paved Road
- Gravel Road
- Temporary Management Access
- Intermittent Stream
- Perennial River
- Lakes and Rivers
- Retention Area
- Against State (Red)
- Payment Unit (Yellow)
- Private Line (Blue)
- Section Corners
- Stand Boundaries

Locator Map  
1:200,000

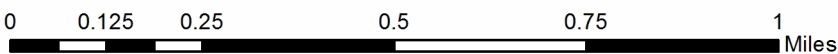
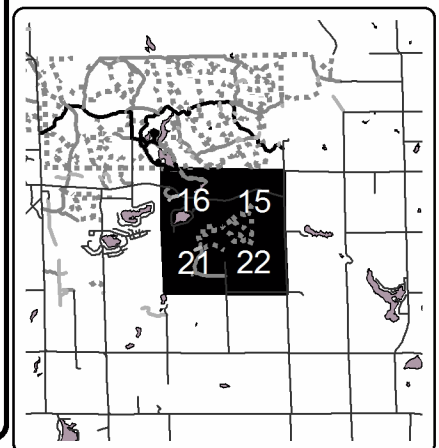



**TIMBER SALE INFORMATION**

3 Lakes Aspen (73-014-18)

T20N, R02W, SEC. 19; T20N, R02W, SEC. 21; T20N, R02W, SEC. 29.  
Gladwin County (Advertised Price \$42,725.20)

SALE NOTE: Some of the Payment Units are hilly. In addition, temporary culverts will need to be installed to cross some of the intermittent drains.

Access may be through private or other public land.

A timber sale contract for this lump sum, sealed bid timber sale will be awarded to the responsible bidder offering the highest sealed bid price. Bids must be at or above the following advertised price for each species:

<u>PRODUCTS &amp; SPECIES</u>	<u>ESTIMATED UNITS*</u>	<u>ADVERTISED PRICE</u>
Sawtimber		
Red Maple	4.70 MBF	\$ 36.00 / MBF
Red Oak	10.80 MBF	\$ 258.00 / MBF
White Oak	1.50 MBF	\$ 70.00 / MBF
Pulpwood		
Mixed Aspen	2,300.00 Cords	\$ 15.05 / Cord
Mixed Hardwood	218.00 Cords	\$ 12.20 / Cord
Mixed Oak	200.00 Cords	\$ 11.95 / Cord

\* The total volume is statistically estimated within plus (+) or minus (-) 9.64 percent. The estimated units are final and not subject to adjustment. Prospective bidders are urged to examine this timber and to make their own estimates of quantity and quality.

**BOND AND PAYMENT SCHEDULE:**

1. A bond in the amount of \$2,136.00 to insure faithful performance of the conditions of the contract will be deposited by the successful bidder within 21 days of the sale award.
2. Cutting in any sale or unit without the required advance payment would be considered a trespass.
3. Total payment must be paid in advance or according to the following schedule:
  - (a) Ten percent (10%) of the sale value must be paid within 21 days of the sale award.
  - (b) The 10% down payment will be credited towards the first unit cut.
  - (c) Payment for each of the following units must be made before cutting begins in that unit:
 

<u>PAYMENT UNIT NUMBER</u>	<u>PERCENT OF TOTAL SALE VALUE</u>
01	15.8%
02	14.5%
03	24.5%
04	26.3%
05	18.9%
4. If no cutting takes place, the 10% down payment will not be refunded.
5. Operations on the contract issued will terminate on 09/30/2021.

**Description of Timber by Payment Unit (PU)**

PU	MARKET GROUP	PRODUCT	QUANTITY	UNIT	ACRES	ADVERTISE PRICE			
1	Red Maple	Sawtimber	2.0	MBF	13.1	\$6,769.55			
	Red Oak		4.1	MBF					
	Mixed Aspen	Pulpwood	277.0	Cords					
	<i>B. T. Aspen</i>	<i>Sawtimber</i>	5.9	<i>MBF</i>					
	<i>B. T. Aspen</i>	<i>Pulpwood</i>	265.0	<i>Cords</i>					
	Mixed Hardwood		52.0	Cords					
	<i>Basswood</i>		4.0	<i>Cords</i>					
	<i>Red Maple</i>		46.0	<i>Cords</i>					
	<i>White Ash</i>		2.0	<i>Cords</i>					
	Mixed Oak		70.0	Cords					
	<i>BI/R/Hybrid Oak</i>	<i>Sawtimber</i>	0.8	<i>MBF</i>					
	<i>BI/R/Hybrid Oak</i>	<i>Pulpwood</i>	10.0	<i>Cords</i>					
	<i>Red Oak</i>		58.0	<i>Cords</i>					
	2	Red Maple	Sawtimber	1.8			MBF	12.1	\$6,207.30
Red Oak			3.7	MBF					
Mixed Aspen		Pulpwood	255.0	Cords					
<i>B. T. Aspen</i>		<i>Sawtimber</i>	5.4	<i>MBF</i>					
<i>B. T. Aspen</i>		<i>Pulpwood</i>	244.0	<i>Cords</i>					
Mixed Hardwood			47.0	Cords					
<i>Basswood</i>			3.0	<i>Cords</i>					
<i>Red Maple</i>			43.0	<i>Cords</i>					
<i>White Ash</i>			1.0	<i>Cords</i>					
Mixed Oak			65.0	Cords					
<i>BI/R/Hybrid Oak</i>		<i>Sawtimber</i>	0.8	<i>MBF</i>					
<i>BI/R/Hybrid Oak</i>		<i>Pulpwood</i>	10.0	<i>Cords</i>					
<i>Red Oak</i>			53.0	<i>Cords</i>					
3		Red Maple	Sawtimber	0.9	MBF	17.4	\$10,488.25		
	Red Oak		3.0	MBF					
	White Oak		1.5	MBF					
	Mixed Aspen	Pulpwood	543.0	Cords					
	<i>B. T. Aspen</i>		543.0	<i>Cords</i>					
	Mixed Hardwood		74.0	Cords					
	<i>Paper Birch</i>		2.0	<i>Cords</i>					
	<i>Red Maple</i>		72.0	<i>Cords</i>					
	Mixed Oak		42.0	Cords					
	<i>Red Oak</i>		37.0	<i>Cords</i>					
	<i>White Oak</i>		5.0	<i>Cords</i>					
	4	Mixed Aspen	Pulpwood	720.0	Cords			17.4	\$11,187.80
		<i>B. T. Aspen</i>	<i>Sawtimber</i>	16.5	<i>MBF</i>				
<i>Cottonwood</i>			5.0	<i>MBF</i>					
<i>B. T. Aspen</i>		<i>Pulpwood</i>	669.0	<i>Cords</i>					
<i>Cottonwood</i>			8.0	<i>Cords</i>					
Mixed Hardwood			21.0	Cords					
<i>Red Maple</i>			21.0	<i>Cords</i>					
Mixed Oak			8.0	Cords					
<i>Red Oak</i>			8.0	<i>Cords</i>					
5	Mixed Aspen	Pulpwood	505.0	Cords	14.0	\$8,084.25			
	<i>B. T. Aspen</i>		505.0	<i>Cords</i>					
	Mixed Hardwood		24.0	Cords					
	<i>Black Cherry</i>		3.0	<i>Cords</i>					
	<i>Paper Birch</i>		2.0	<i>Cords</i>					
	<i>Red Maple</i>		19.0	<i>Cords</i>					
	Mixed Oak		16.0	Cords					
	<i>Red Oak</i>		16.0	<i>Cords</i>					
	TOTAL:			17.0			MBF		

TOTAL: 2,719.0 Cords
----------------------

# Sale Specific Conditions & Requirements

**Sale Name: 3 Lakes Aspen**

**Sale Number: 73-014-18 Seq#: 1**

## 1 - Sale Area

### 1.2 - Boundaries

#### 1.2.1 - Painted boundaries (1/14)

The sale boundary and Payment Unit boundaries are marked and identified by blue, red and yellow paint. Exterior sale boundary lines against private property are marked with blue paint. Exterior sale boundary lines against state are marked with red paint. Interior Payment Unit boundaries are marked with yellow paint. Yellow painted trees designating an interior Payment Unit boundary are only to be cut when all surrounding Payment Units have been paid.

## 2 - Timber Specifications

### 2.1 - Included Timber

#### 2.1.1 - Clearcut unit(s) with unmerchantable trees (6/14)

Within Payment Unit(s) 1-5, cut all trees that are two (2) inches or more at DBH, except do not cut any conifers or trees marked with green paint above and below stump height.

## 3 - Payments

### 3.4 - Damaged Timber

#### 3.4.1 - Damaged timber (6/14)

General Condition and Requirement 3.4 Damaged Timber, defines liquidated damages for undesignated live merchantable trees which are cut or injured. In addition, extreme care should be taken to avoid damage to tree seedlings and saplings.

Within the sale area, if more than 25% of the tree seedlings or saplings (1/4" to 4.5" DBH) within a specified portion of the sale area are damaged, liquidated damages will be assessed at \$300 per acre for all acreage within that specified portion of the sale area that was damaged.

No damage is acceptable to merchantable trees. Within the sale area, if more than 5% of trees (> 4.5" DBH) within a specified area of the sale are damaged, liquidated damages will be assessed for all trees damaged. Rates will be in accordance with General Condition and Requirement 3.4 Damaged Timber.

## 4 - Transportation

### 4.1 - Construction

#### 4.1.5 - Culverts (5/14)

Roads may require the installation of culverts for cross drainage or at natural drainage-ways. If culverts are needed in these locations, their placement will be specified by the sale administrator and they shall be installed prior to hauling. The culverts shall be, corrugated metal or plastic gauge. Culverts will be a minimum of 12 inches in diameter and 24 feet in length. Installed culverts are to be removed, fill shall be removed from wetland soils as specified. Soils shall be maintained and left in a non-erodible condition, with water bars, seed, fertilizer, mulch, and slash installed as directed by the sale administrator and as specified in the BMP manual. Stream crossing permits, if needed, will be obtained by the DNR.

#### 4.1.6 - Road construction (1/09)

Construction of new roads or improvements of existing roads shall be done in such a way as to minimize the environmental and visual impacts. Merchantable trees shall be cut and utilized unless otherwise directed. Non-merchantable trees shall be severed and laid flat on the ground. Slash shall be scattered, and not left in windrows and kept a minimum of 10 feet back from the road edge. Stumps shall be set upright, not left on edge, and be moved at least 10 feet away from the road edge. Disturbed soil shall be feathered into the woods and not left in berms or windrows.

### 4.2 - Maintenance

#### 4.2.5 - Two wheel drive condition (2/04)

All existing trail roads on and adjacent to the sale area must be passable by two-wheel drive traffic for the duration of the

sale.

#### 4.4 - Access

##### 4.4.1 - Private property access (3/11)

Permission for access across private land has been obtained by the DNR. If the Purchaser desires to use a portion of the private trails system beyond what the DNR has obtained, it will be the responsibility of the Purchaser to obtain permission.

##### 4.4.3 - Access gate (12/08)

The access gate must be closed at the completion of each day unless otherwise approved by the Unit Manager or his/her representative.

### 5 - Operations

#### 5.2 - Conduct of Operations

##### 5.2.2 - Hazard Trees/Snags

###### 5.2.2.1 - Den trees (10/16)

Obvious hollow and/or den trees shall be protected and left standing unless they are a safety hazard.

##### 5.2.4 - Dead and Down Creation

###### 5.2.4.4 - Dead and down creation, grouse (6/18)

To encourage grouse and other wildlife, in Payment Unit(s) 1-5, leave one, 12" or larger diameter whole tree on the ground for every 3 acres. Trees should be scattered throughout the sale and at least two chains from any roads, two-tracks, or trails open to vehicles, or positioned per the sale administrator's instructions.

##### 5.2.22 - Operating Caution

###### 5.2.22.1 - Operating caution (6/11)

It is recommended, but not required, that within Payment Unit(s) 1, 2, and 4, cutting, skidding, and hauling occur during dry summer or frozen winter conditions. The reason for the recommendation is because portions of the units are seasonally wet.

#### 5.4 - Soil Protection

##### 5.4.1 - Rutting restriction, general (7/16)

Operations are to cease immediately if equipment and weather conditions result in rutting of roads and/or skid trails which is 12 inches or greater in depth and 50 feet in length. The Unit Manager or his/her representative may restrict hauling and/or skidding if ruts exceed the specified depth. With the Unit Manager or his/her representative's approval, the Purchaser may return to the area when the risk of rutting has decreased.



# TIMBER SALE MAP

This information provided by authority of Part 525, 1994 PA 451, as amended.

Sale Number	Year
73 - 014	18

Forest Management Unit Gladwin Management Unit	County Gladwin	Mapped By Steven Nyhoff	Date 09/25/2018	Page 1	of 2
Cruised By Steven Nyhoff					

Township 20N	Range 02W	Section(s) and Subdivision(s) S19, NESW, SESE; S21, S1/2NW; S29, N1/2NE	Scale 1:15,840
-----------------	--------------	----------------------------------------------------------------------------	-------------------

Cover Type				Density	
A = Aspen	H = Hemlock	N = Marsh	U = Upland Brush	0 = Non Stocked	5 = Pole Timber Medium
B = Paper Birch	J = Jack Pine	O = Oak	UM = Upland Mixed	1 = Seedling Sapling Poor	6 = Pole Timber Well
C = Cedar	L = Lowland Brush	P = Lowland Poplar	V = Bog or Marsh	2 = Seedling Sapling Medium	7 = Saw Timber Poor
D = Treed Bog	LM = Lowland Mixed	Q = Mixed Swamp Conifer	W = White Pine	3 = Seedling Sapling Well	8 = Saw Timber Medium
E = Swamp Hdwoods	M = Mpl, Bch, Brch	R = Red Pine	X = Non Stocked	4 = Pole Timber Poor	9 = Saw Timber Well
F = Spruce Fir	MC = Mixed Conifer	S = Black Spruce	Z = Water		
G = Grass	MD = Mixed Deciduous	T = Tamarack			

PU	Acres	PU	Acres
1	13.1	4	17.4
2	12.1	5	14.0
3	17.4		

## 3 Lakes Aspen

### Compartment 26

74 Acres

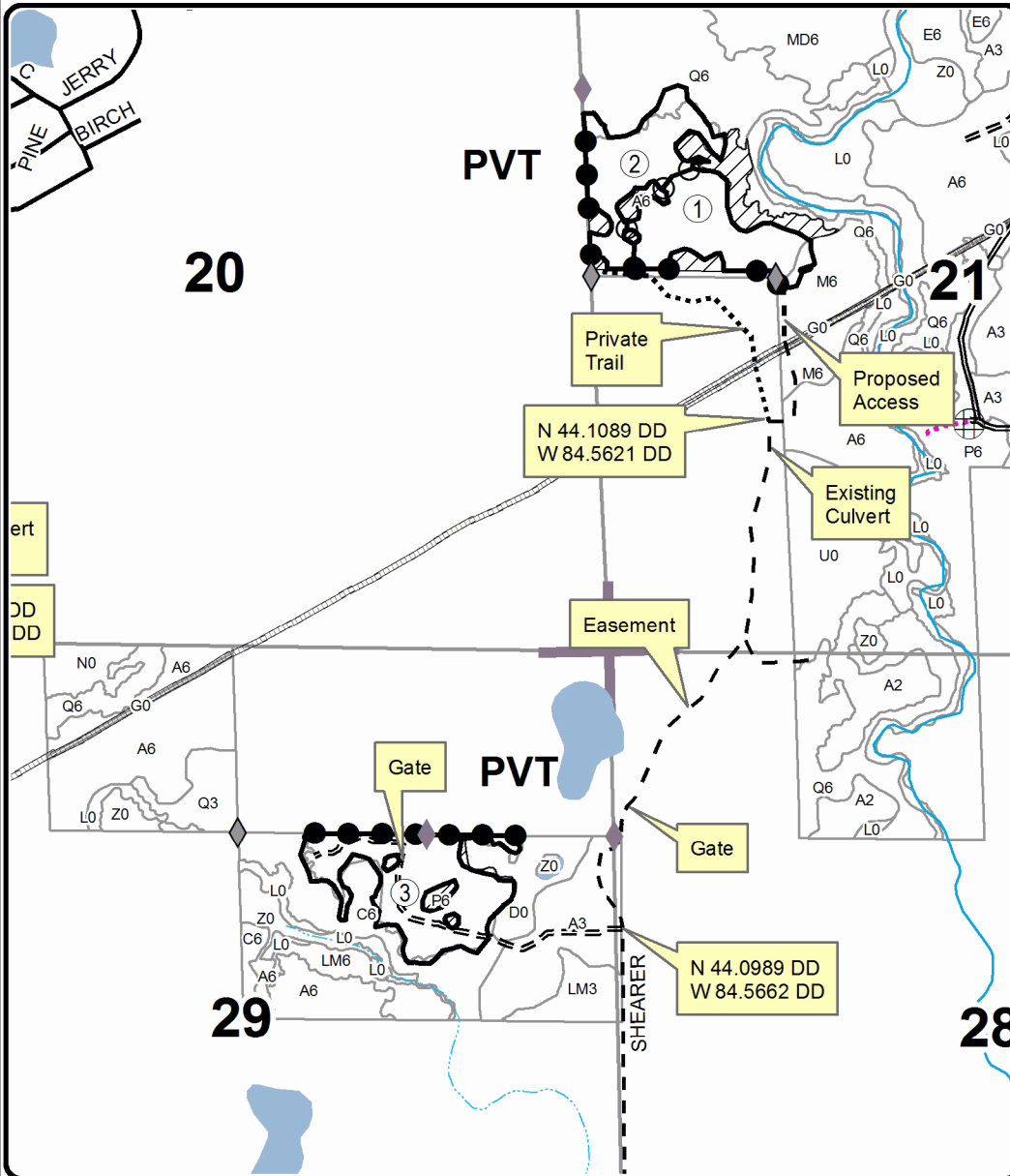
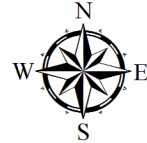

### Legend

- ◆ Field Grade Corners
- == Secondary Forest Road
- == Forest Access Route
- Paved Road
- - - Gravel Road
- ⋯ Temporary Management Access
- ⋯ Intermittent Stream
- Perennial River
- Lakes and Rivers
- ▨ Retention Area
- Against State (Red)
- ○ Payment Unit (Yellow)
- ● Private Line (Blue)
- Section Corners
- Stand Boundaries

Locator Map  
1:200,000

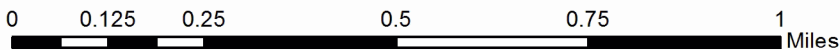
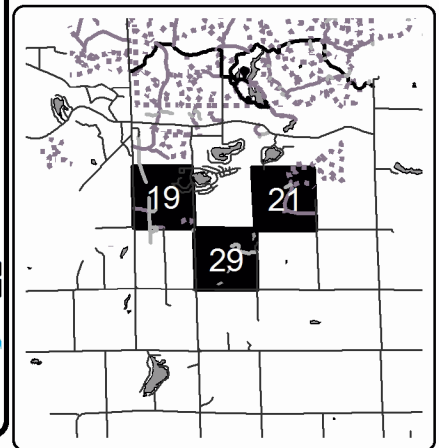



# TIMBER SALE MAP

This information provided by authority of Part 525, 1994 PA 451, as amended.

Sale Number	Year
73 - 014	18

Forest Management Unit Gladwin Management Unit	County Gladwin	Mapped By Steven Nyhoff	Date 09/25/2018	Page 2	of 2
Township 20N	Range 02W	Section(s) and Subdivision(s) S19, NESW, SESE; S21, S1/2NW; S29, N1/2NE	Scale 1:15,840		

Cover Type				Density			
A = Aspen	H = Hemlock	N = Marsh	U = Upland Brush	0 = Non Stocked	5 = Pole Timber Medium		
B = Paper Birch	J = Jack Pine	O = Oak	UM = Upland Mixed	1 = Seedling Sapling Poor	6 = Pole Timber Well		
C = Cedar	L = Lowland Brush	P = Lowland Poplar	V = Bog or Marsh	2 = Seedling Sapling Medium	7 = Saw Timber Poor		
D = Treed Bog	LM = Lowland Mixed	Q = Mixed Swamp Conifer	W = White Pine	3 = Seedling Sapling Well	8 = Saw Timber Medium		
E = Swamp Hdwoods	M = Mpl, Bch, Brch	R = Red Pine	X = Non Stocked	4 = Pole Timber Poor	9 = Saw Timber Well		
F = Spruce Fir	MC = Mixed Conifer	S = Black Spruce	Z = Water				
G = Grass	MD = Mixed Deciduous	T = Tamarack					

PU	Acres	PU	Acres
1	13.1	4	17.4
2	12.1	5	14.0
3	17.4		

## 3 Lakes Aspen

### Compartment 26

74 Acres

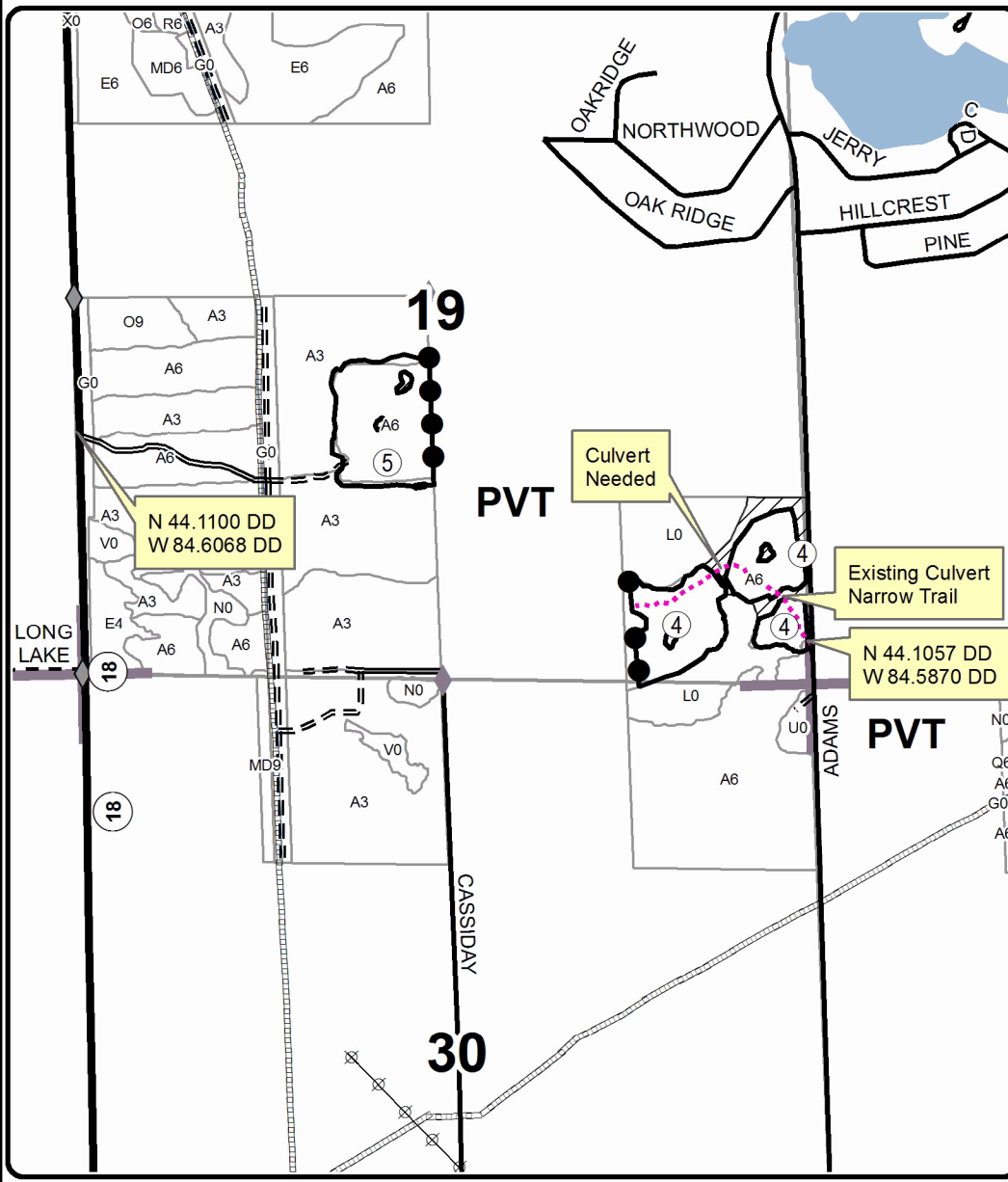
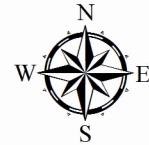

### Legend

- ◆ Field Grade Corners
- Highway
- Secondary Forest Road
- Forest Access Route
- Paved Road
- - Gravel Road
- ⋯ Temporary Management Access
- Lakes and Rivers
- ▨ Retention Area
- Against State (Red)
- Private Line (Blue)
- Section Corners
- Stand Boundaries

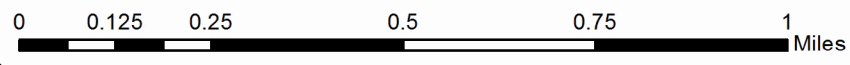
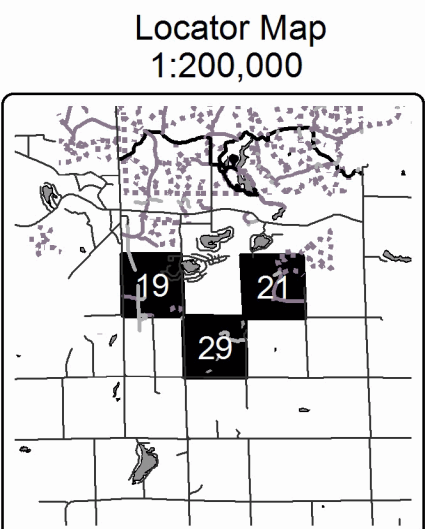





Corlew Oak-Aspen (73-007-18)  
T20N, R02W, SEC. 2; Gladwin COUNTY

In response to the notice of sale to be held 10:00 a.m. (local time) on August 27, 2019, I am hereby submitting my sealed bid (firm offer) for the following forest products to be cut. Bids for individual species must be at or above the advertised price. All non-responsive bid forms may be rejected.

<u>PRODUCTS &amp; SPECIES</u>	<u>ESTIMATED VOLUME*</u>	<u>ADVERTISED PRICE</u>	<u>BID PRICE/UNIT</u>
<b>Sawtimber</b>			
Red Maple	27.80 MBF	\$ 39.00/MBF	\$ _____
Red Oak	326.20 MBF	\$ 277.00/MBF	\$ _____
White Oak	83.80 MBF	\$ 75.00/MBF	\$ _____
White Pine	2.10 MBF	\$ 44.00/MBF	\$ _____
<b>Pulpwood</b>			
Mixed Oak	966.00 Cords	\$ 12.85/Cord	\$ _____
Quaking Aspen	1,571.00 Cords	\$ 16.15/Cord	\$ _____
Red Maple	389.00 Cords	\$ 13.05/Cord	\$ _____
White Pine	91.00 Cords	\$ 12.90/Cord	\$ _____

\*The volumes are statistically estimated within plus (+) or minus (-) 11.12 percent. These estimated volumes are final and not subject to adjustment. Prospective bidders are urged to examine this timber and to make their own estimates of quantity and quality.

I understand that any or all bids may be rejected. All bids must be signed and all bid items must be bid or the bid form may be rejected. I also understand that consideration and awarding a contract will be based upon my past performance and ability to complete the contract based upon equipment and staffing subject to my control.

FEDERAL ID: \_\_\_\_\_ - \_\_\_\_\_ or SOCIAL SECURITY NUMBER: \_\_\_\_\_ - \_\_\_\_\_ - \_\_\_\_\_

Company or individual bidding: \_\_\_\_\_

Company representative's name: \_\_\_\_\_

Address: \_\_\_\_\_

City: \_\_\_\_\_ State: \_\_\_\_\_ Zip: \_\_\_\_\_

IF AVAILABLE, PLEASE PLACE THE PERSONALIZED LABEL FROM YOUR PROSPECTUS IN THE ABOVE BOX.

Individual or company representative's signature: \_\_\_\_\_ Date: \_\_\_\_\_

Phone number : \_\_\_\_\_ Email (optional): \_\_\_\_\_

**THE WINNING BIDDER MUST COMPLETE THE VERIFICATION OF WORKER'S DISABILITY COMPENSATION ACT COMPLIANCE (ON REVERSE SIDE IF DOUBLE SIDED) WITHIN 21 DAYS OF SALE AWARD DATE**



<b>FOR DEPARTMENT USE ONLY</b>
Sale Number (XX - XXX - XX - XX)
Forest Management Unit:

## TIMBER SALE VERIFICATION OF WORKER'S DISABILITY COMPENSATION ACT COMPLIANCE

*As required by Act 317, P.A. 1969 (Worker's Compensation) and  
Part 5 of Act 451 of 1994, as amended.*

### VERIFICATION OF WORKER'S DISABILITY COMPENSATION ACT COMPLIANCE

- This verification must be completed and submitted within 21 days of contract award and prior to the issuance of the timber sale contract.
- In addition, if boxes 2B or 2C are checked, then Notice of Exclusion or Certificate of Insurance must be submitted within twenty-one (21) days of the contract award and prior to the issuance of the timber sale contract.
- All information must be typed or printed except for written signatures.

Please Check Appropriate Categories:

1. My business is organized as (you **must** check one of the boxes below):
  - A.  Sole Proprietorship (individual)
  - B.  Partnership
  - C.  Corporation
  
2. You **must** check one of the boxes below:
  - A.  I certify my business is a sole proprietorship and it has no employees but the sole proprietor. I am not subject to the Worker's Compensation Laws.
  - B.  I certify my business has satisfied its obligation to the Worker's Compensation Act through the use of an approved Notice of Exclusion (BWC-337, Rev. 5/96). I will provide a copy of the Notice of Exclusion within 21 days of the contract award. (For questions or a copy of the BWC-337, please call the Worker's Compensation Bureau at 517-322-1195).
  - C.  I certify my business has a Worker's Compensation Policy. I will provide an original Certificate of Insurance within twenty-one (21) days of the contract award.
  
3. If you have checked item 2(A) or 2(B), you **must** indicate the number of **both** full-time and part-time employees, other than yourself, including family members and active partners (if none, you must enter "0").

\_\_\_\_\_ Full-time Employees

\_\_\_\_\_ Part-time Employees

Name of Business		Federal ID (or) Social Security No.	
Address		Telephone (       )	
City	State	ZIP	

*I hereby certify that the above information is true and correct. I agree to notify the Michigan DNR of any changes that occur in factors affecting my coverage during any of my present and future operations.*

\_\_\_\_\_  
Signature of Owner or Authorized Representative

\_\_\_\_\_  
Title

\_\_\_\_\_  
Date

**Please complete the "SEALED BID" information on the next page**

Shaw Rd Harvest (73-009-18)  
T20N, R02W, SEC. 15; T20N, R02W, SEC. 16; T20N, R02W, SEC. 21; T20N,

In response to the notice of sale to be held 10:00 a.m. (local time) on August 27, 2019, I am hereby submitting my sealed bid (firm offer) for the following forest products to be cut. Bids for individual species must be at or above the advertised price. All non-responsive bid forms may be rejected.

<u>PRODUCTS &amp; SPECIES</u>	<u>ESTIMATED VOLUME*</u>	<u>ADVERTISED PRICE</u>	<u>BID PRICE/UNIT</u>
<b>Sawtimber</b>			
Beech	0.70 MBF	\$ 84.00/MBF	\$ _____
Red Maple	9.20 MBF	\$ 39.00/MBF	\$ _____
Red Oak	27.50 MBF	\$ 277.00/MBF	\$ _____
White Oak	3.10 MBF	\$ 75.00/MBF	\$ _____
<b>Pulpwood</b>			
Mixed Aspen	3,270.00 Cords	\$ 16.15/Cord	\$ _____
Mixed Hardwood	518.00 Cords	\$ 13.05/Cord	\$ _____
Mixed Oak	145.00 Cords	\$ 12.85/Cord	\$ _____
Paper Birch	46.00 Cords	\$ 15.35/Cord	\$ _____

\*The volumes are statistically estimated within plus (+) or minus (-) 14.57 percent. These estimated volumes are final and not subject to adjustment. Prospective bidders are urged to examine this timber and to make their own estimates of quantity and quality.

I understand that any or all bids may be rejected. All bids must be signed and all bid items must be bid or the bid form may be rejected. I also understand that consideration and awarding a contract will be based upon my past performance and ability to complete the contract based upon equipment and staffing subject to my control.

FEDERAL ID: \_\_\_\_ - \_\_\_\_ - \_\_\_\_ or SOCIAL SECURITY NUMBER: \_\_\_\_ - \_\_\_\_ - \_\_\_\_

Company or individual bidding: \_\_\_\_\_

Company representative's name: \_\_\_\_\_

Address: \_\_\_\_\_

City: \_\_\_\_\_ State: \_\_\_\_\_ Zip: \_\_\_\_\_

IF AVAILABLE, PLEASE PLACE THE PERSONALIZED LABEL FROM YOUR PROSPECTUS IN THE ABOVE BOX.

Individual or company representative's signature: \_\_\_\_\_ Date: \_\_\_\_\_

Phone number : \_\_\_\_\_ Email (optional): \_\_\_\_\_

**THE WINNING BIDDER MUST COMPLETE THE VERIFICATION OF WORKER'S DISABILITY COMPENSATION ACT COMPLIANCE (ON REVERSE SIDE IF DOUBLE SIDED) WITHIN 21 DAYS OF SALE AWARD DATE**



<b>FOR DEPARTMENT USE ONLY</b>
Sale Number (XX - XXX - XX - XX)
Forest Management Unit:

## TIMBER SALE VERIFICATION OF WORKER'S DISABILITY COMPENSATION ACT COMPLIANCE

*As required by Act 317, P.A. 1969 (Worker's Compensation) and  
Part 5 of Act 451 of 1994, as amended.*

### VERIFICATION OF WORKER'S DISABILITY COMPENSATION ACT COMPLIANCE

- This verification must be completed and submitted within 21 days of contract award and prior to the issuance of the timber sale contract.
- In addition, if boxes 2B or 2C are checked, then Notice of Exclusion or Certificate of Insurance must be submitted within twenty-one (21) days of the contract award and prior to the issuance of the timber sale contract.
- All information must be typed or printed except for written signatures.

Please Check Appropriate Categories:

1. My business is organized as (you **must** check one of the boxes below):
  - A.  Sole Proprietorship (individual)
  - B.  Partnership
  - C.  Corporation
  
2. You **must** check one of the boxes below:
  - A.  I certify my business is a sole proprietorship and it has no employees but the sole proprietor. I am not subject to the Worker's Compensation Laws.
  - B.  I certify my business has satisfied its obligation to the Worker's Compensation Act through the use of an approved Notice of Exclusion (BWC-337, Rev. 5/96). I will provide a copy of the Notice of Exclusion within 21 days of the contract award. (For questions or a copy of the BWC-337, please call the Worker's Compensation Bureau at 517-322-1195).
  - C.  I certify my business has a Worker's Compensation Policy. I will provide an original Certificate of Insurance within twenty-one (21) days of the contract award.
  
3. If you have checked item 2(A) or 2(B), you **must** indicate the number of **both** full-time and part-time employees, other than yourself, including family members and active partners (if none, you must enter "0").

\_\_\_\_\_ Full-time Employees

\_\_\_\_\_ Part-time Employees

Name of Business		Federal ID (or) Social Security No.	
Address		Telephone (       )	
City	State	ZIP	

*I hereby certify that the above information is true and correct. I agree to notify the Michigan DNR of any changes that occur in factors affecting my coverage during any of my present and future operations.*

\_\_\_\_\_  
Signature of Owner or Authorized Representative

\_\_\_\_\_  
Title

\_\_\_\_\_  
Date

**Please complete the "SEALED BID" information on the next page**

3 Lakes Aspen (73-014-18)

T20N, R02W, SEC. 19; T20N, R02W, SEC. 21; T20N, R02W, SEC. 29; Gladwin

In response to the notice of sale to be held 10:00 a.m. (local time) on August 27, 2019, I am hereby submitting my sealed bid (firm offer) for the following forest products to be cut. Bids for individual species must be at or above the advertised price. All non-responsive bid forms may be rejected.

<u>PRODUCTS &amp; SPECIES</u>	<u>ESTIMATED VOLUME*</u>	<u>ADVERTISED PRICE</u>	<u>BID PRICE/UNIT</u>
<b>Sawtimber</b>			
Red Maple	4.70 MBF	\$ 36.00/MBF	\$ _____
Red Oak	10.80 MBF	\$ 258.00/MBF	\$ _____
White Oak	1.50 MBF	\$ 70.00/MBF	\$ _____
<b>Pulpwood</b>			
Mixed Aspen	2,300.00 Cords	\$ 15.05/Cord	\$ _____
Mixed Hardwood	218.00 Cords	\$ 12.20/Cord	\$ _____
Mixed Oak	200.00 Cords	\$ 11.95/Cord	\$ _____

\*The volumes are statistically estimated within plus (+) or minus (-) 9.64 percent. These estimated volumes are final and not subject to adjustment. Prospective bidders are urged to examine this timber and to make their own estimates of quantity and quality.

I understand that any or all bids may be rejected. All bids must be signed and all bid items must be bid or the bid form may be rejected. I also understand that consideration and awarding a contract will be based upon my past performance and ability to complete the contract based upon equipment and staffing subject to my control.

FEDERAL ID: \_\_\_\_\_ or SOCIAL SECURITY NUMBER: \_\_\_\_\_

Company or individual bidding: \_\_\_\_\_

Company representative's name: \_\_\_\_\_

Address: \_\_\_\_\_

City: \_\_\_\_\_ State: \_\_\_\_\_ Zip: \_\_\_\_\_

IF AVAILABLE, PLEASE PLACE THE PERSONALIZED LABEL FROM YOUR PROSPECTUS IN THE ABOVE BOX.

Individual or company representative's signature: \_\_\_\_\_ Date: \_\_\_\_\_

Phone number : \_\_\_\_\_ Email (optional): \_\_\_\_\_

**THE WINNING BIDDER MUST COMPLETE THE VERIFICATION OF WORKER'S DISABILITY COMPENSATION ACT COMPLIANCE (ON REVERSE SIDE IF DOUBLE SIDED) WITHIN 21 DAYS OF SALE AWARD DATE**



<b>FOR DEPARTMENT USE ONLY</b>
Sale Number (XX - XXX - XX - XX)
Forest Management Unit:

## TIMBER SALE VERIFICATION OF WORKER'S DISABILITY COMPENSATION ACT COMPLIANCE

*As required by Act 317, P.A. 1969 (Worker's Compensation) and  
Part 5 of Act 451 of 1994, as amended.*

### VERIFICATION OF WORKER'S DISABILITY COMPENSATION ACT COMPLIANCE

- This verification must be completed and submitted within 21 days of contract award and prior to the issuance of the timber sale contract.
- In addition, if boxes 2B or 2C are checked, then Notice of Exclusion or Certificate of Insurance must be submitted within twenty-one (21) days of the contract award and prior to the issuance of the timber sale contract.
- All information must be typed or printed except for written signatures.

Please Check Appropriate Categories:

1. My business is organized as (you **must** check one of the boxes below):
  - A.  Sole Proprietorship (individual)
  - B.  Partnership
  - C.  Corporation
2. You **must** check one of the boxes below:
  - A.  I certify my business is a sole proprietorship and it has no employees but the sole proprietor. I am not subject to the Worker's Compensation Laws.
  - B.  I certify my business has satisfied its obligation to the Worker's Compensation Act through the use of an approved Notice of Exclusion (BWC-337, Rev. 5/96). I will provide a copy of the Notice of Exclusion within 21 days of the contract award. (For questions or a copy of the BWC-337, please call the Worker's Compensation Bureau at 517-322-1195).
  - C.  I certify my business has a Worker's Compensation Policy. I will provide an original Certificate of Insurance within twenty-one (21) days of the contract award.
3. If you have checked item 2(A) or 2(B), you **must** indicate the number of **both** full-time and part-time employees, other than yourself, including family members and active partners (if none, you must enter "0").

\_\_\_\_\_ Full-time Employees

\_\_\_\_\_ Part-time Employees

Name of Business		Federal ID (or) Social Security No.	
Address		Telephone (       )	
City	State	ZIP	

*I hereby certify that the above information is true and correct. I agree to notify the Michigan DNR of any changes that occur in factors affecting my coverage during any of my present and future operations.*

\_\_\_\_\_  
Signature of Owner or Authorized Representative

\_\_\_\_\_  
Title

\_\_\_\_\_  
Date

**Please complete the "SEALED BID" information on the next page**