



**DEPARTMENT OF NATURAL RESOURCES
STATE OF MICHIGAN**

TIMBER SALE PROSPECTUS #6289

SCHEDULED SALE DATE AND TIME: 9:00 a.m. (local time) on October 30, 2018.

LOCATION: GRAYLING MGMT UNIT, 1955 HARTWICK PINES ROAD, GRAYLING, MI 49738.

PROSPECTUS NOTE: The bidder is advised to inspect the sale area and review the location, estimated volumes, operating costs and contract terms of proposed sales. Please be aware that some landowners may request 60 days or more notice for access across their land.

Notice is hereby given that bids will be received by the Unit Manager, GRAYLING MANAGEMENT UNIT, for certain timber on the following described lands:

Big Storm Mix (72-032-17) / T25N, R01W, SEC. 18, SENW,NENE,S1/2NE,E1/2SW,SE.
T25N, R01W, SEC. 7 , SESE.

Crawford County, Advertised Price \$106,679.70, 164.0 Acres, Red Pine, Aspen.

SALE NOTE: There is visible old paint throughout the sale which is to be disregarded. Payment Units 3 and 6 are lowland stands that are seasonally wet, so caution is advised during certain parts of the year to prevent rutting. This sale uses USFS roads to access the state land on which the sale is located. Payment Unit 1 may need to have a short distance of road built to it across USFS lands. The Purchaser will need to work with the sale administrator and USFS regarding use of these roads.

Access may be through other public land.

Conners Mixed Conifers (72-639-17) / T26N, R01W, SEC. 6 , NENW.
T26N, R02W, SEC. 1 , E1/2NE,N1/2SW,N1/2SE.
T27N, R02W, SEC. 36, SESW,SWSE.

Crawford County, Advertised Price \$52,810.85, 79.4 Acres, Red Pine, Hardwood.

SALE NOTE: Payment Units 1 & 2 are on Military lands. The boundaries of Payment Units 1, 2, 4, 5 & 7 were run to pick up the denser spruce/fir cover on the transition ground edge of the adjacent swamps. That edge ground will likely not be operable in the spring. The boundaries of Payment Units 3, 4 & 5 pick up two acres total of immature jack pine in order to provide room for landing/haul route construction on leveler ground near the existing access road.

AuSable Trail Oak (72-633-16) / T26N, R04W, SEC. 2 , E1/2NE,NESE.
T26N, R04W, SEC. 3 , N1/2NW,N1/2NE.

Crawford County, Advertised Price \$24,569.15, 74.4 Acres, Hardwood, Jack Pine.

SALE NOTE: Oak wilt restrictions apply to this sale - no exceptions will be granted. This sale has a lot of dead/dying oak that should be harvested as soon as possible.

A recreation site such as a trail, pathway, or campground is within the sale area or the vicinity. Certain restrictions/specifications may be applicable including time restrictions.

204 Painted Firewood (72-634-16) / T26N, R04W, SEC. 2 , S1/2SW,SWSE.

T26N, R04W, SEC. 3 , SESW,S1/2SE.

Crawford County, Advertised Price \$17,423.00, 65.5 Acres, Hardwood, Jack Pine.

SALE NOTE: This sale has oak wilt restrictions and a lot of dead/dying oak. It is encouraged this sale be harvested as soon as possible. The oak wilt restrictions will not be waived or adjusted on this sale due to the presence of oak wilt in the area of the sale.

A recreation site such as a trail, pathway, or campground is within the sale area or the vicinity. Certain restrictions/specifications may be applicable including time restrictions.

Jamaican Jack (72-635-16)

Crawford County, Advertised Price \$25,284.70, 77.5 Acres, Jack Pine, Aspen.

SALE NOTE: A recreation site such as a trail, pathway, or campground is within the sale area or the vicinity. Certain restrictions/specifications may be applicable including time restrictions.

SCALE SALE LOWLAND (72-009-15) / T28N, R01W, SEC. 09, W1/2SE, E1/2SW.

T28N, R01W, SEC. 16, NENE,NENW.

Crawford County, Advertised Price \$7,640.00, 80.0 Acres, Spruce/Fir/Tamarack.

BID INSTRUCTIONS (VER. 07/02/2018):

1. Scheduled Bid Location, Date, and Time (2/11)

Bids must be received by the Unit Manager, GRAYLING OFFICE, 1955 HARTWICK PINES ROAD, GRAYLING, MI 49738, no later than 9:00 a.m. (local time) on October 30, 2018. For further information concerning this sale, contact Susan Thiel at 989-348-6371 extension 7440.

2. Bidder's Qualifications (5/16)

Purchaser shall obtain workers compensation insurance to cover claims under Michigan's Worker's Disability Compensation Act of 1969 or similar employee benefit act of any other state applicable to an employee. If all or part of a timber sale was prepared by a private contractor, the contractor and that contractor's company are not permitted to bid on the timber sale contract. Bids will not be accepted from individuals or companies appearing on the DNR/FRD No-Bid List. This list contains the names of purchasers who previously failed to execute a contract within 21-days or who have a history of poor performance.

3. Preparation of Sealed Bids (5/16)

Bid Forms may be completed online thru Michigan DNR Timber Sale Online Bidding (OLB) at www.michigan.gov/timberbidding or by completing the hardcopy Bid Form found in the Timber Sale Prospectus. Hardcopy Bid Forms shall be manually signed in ink. Registration in OLB is considered your 'signature' for all bids submitted thru that system. Bid prices must be entered for each species and product in the Bid Price column for all material subject to bidding and all fill-in blanks must be completed. If erasures or other changes appear on the hardcopy Bid Form, each erasure or change must be initialed by the person signing the bid.

4. Submission of Sealed Bids (5/16)

Bid forms may be obtained from the Unit Manager or thru OLB. Bids may be submitted hardcopy or thru OLB. All hardcopy bids must be submitted on the bid form and in an envelope clearly identified as described in this section. NOTE: Only one bid form per bid envelope. Sealed bids must be submitted to the Unit office designated in the prospectus and must be submitted at or prior to the time established in the prospectus. The envelope should show on the outside (a) the sale name or number and (b) the date and time of bid opening, as shown in the prospectus. Bids received after the time specified in the sale prospectus are late bids and will be rejected.

It is possible for a bidder to submit multiple bids on a single sale. For example, a bid may be submitted hardcopy and a bid may be submitted thru OLB. Or, two bidders from the same company could both submit bids on the same sale. If this were to happen, the State would accept all bids received and award the contract accordingly. All bidding and contractual requirements would apply to all bids received.

5. Public Opening of Sealed Bids (7/16)

If conditions permit, the sealed bids will be publicly opened and posted at the time and place set in the prospectus.

If a bidder, present at a bid opening, has submitted bids on more than one sale, that bidder may withdraw their unopened bid envelopes or announce the withdrawal of their online bid after being declared the successful bidder on one sale.

6. Award of Contract (1/11)

Award of the contract will be made to the Bidder whose bid, conforming to the prospectus, is most advantageous to the State of Michigan on the basis of total value at rates bid for the estimated quantities. The State reserves the right to reject any bid or waive any minor irregularity in bids received. A written award mailed (or otherwise furnished) to the successful Bidder shall be deemed to result in a binding contract without further action by either party.

7. Down Payment (1/11)

The Bidder to whom award is made must make a down payment within 21 days of the sale award. The amount of the down payment will be calculated as shown in the Bond and Payment Schedule of this prospectus. Only cash may be used to meet this requirement.

8. Performance Security (1/11)

As guarantee of faithful performance, a cash bond, certificate of deposit, surety bond or irrevocable letter of credit (LOC) is required within 21 days of the sale award. The amount of the performance security is shown in the Bond and

Payment Schedule of this prospectus. If an LOC or surety is used, the coverage must extend for at least 6 months beyond the contract expiration.

9. Timber Sale Contract (7/18)

Additional conditions and requirements common to all timber sales are listed on the timber sale contract (R4031) and are available on line at www.michigan.gov/timber. Contact the Unit Manager for additional information or a sample contract. Within 21 days of the date of the award letter, the bidder must sign the contract and provide the required down payment, performance security, and verification of worker's disability compensation. The down payment and performance security shall be in accordance with the provisions of the timber sale contract, in the sums stated in this prospectus. If these actions are not taken, then the Bidder, the Bidder's corporation, and the corporation's principals may not be permitted to bid on State timber sales for a period of 3 months after the first offense, 6 months after the second offense, and 1 year after the third offense. An offense will only be counted against the Bidder for 5 years. In addition, the Bidder certifies that if awarded this contract, the Bidder will complete the timber sale contract in accordance with its terms and any modifications thereof including requirements to purchase, cut, and remove the included timber by the expiration date.

Payment Unit values in the State Forest Timber Sale Contract are calculated based on the advertised value of the Payment Unit as a percentage of the total advertised value of the contract. The advertised value of each Payment Unit is given in the Description of Timber by Payment Unit table on the Timber Sale Information page. For example, if the value of Payment Unit 1 is advertised as \$1,500 and the total Timber Sale value is advertised as \$10,000, the contract price for Payment Unit 1 will be 15% of the total bid price ($\$1,500/\$10,000 * 100$).

10. Disclaimer of Estimates and Bidder's Warranty of Inspection (7/16)

Before submitting this bid, the Bidder is advised and cautioned to inspect the sale area, review the requirements of the sale contract, and take other steps as may be reasonably necessary to ascertain the location, estimated volumes, construction estimates, and operating costs of the proposed sale. Failure to do so will not relieve the Bidder from responsibility for completing the contract.

The Bidder warrants that this bid is submitted solely on the basis of the Bidder's examination and inspection of the quality and quantity of the timber offered for sale and the Bidder's opinion of the value thereof and the costs of recovery. No reliance should be placed on the State of Michigan's estimates of timber quality, quantity or costs of recovery. Bidder further acknowledges that the State of Michigan: (i) expressly disclaims any warranty of fitness of timber for any purpose; (ii) offers this timber as is without any warranty of quality (merchantability) or quantity and (iii) expressly disclaims any warranty as to the quantity or quality of timber sold.

11. Certification and Chain-of-Custody (10/14)

Unless otherwise indicated in the contract under section 7 – Other Conditions of the Sale Specific Conditions & Requirements, the area encompassed by this timber sale is certified to the standards of the Forest Stewardship Council (FSC) - Certificate #SCS-FM/COC-00090N and the Sustainable Forestry Initiative (SFI) - Certificate #NSF-SFIS-5Y031-SF5. Forest products from this sale may be delivered to the mill as "FSC 100% and / or SFI certified" as long as the contractor hauling the forest products is chain-of-custody (COC) certified or covered under a COC certificate from the destination mill. The purchaser is responsible for maintaining COC after leaving the sale area.

12. Good Neighbor Authority (GNA) Requirements (7/16)

If the name of this timber sales contains the acronym GNA, it is authorized by the Good Neighbor Authority (GNA) and covered by various agreements between the U.S. Forest Service and the State. The timber sale occurs on federal land and the following conditions apply:

GNA contracts on US Forest Service land will not be awarded to purchasers on the Federal list of excluded parties. The System for Award Management (SAM) will be checked for active excluded parties prior to award of contract. In addition, the Bidder to whom award is made must complete an Assurance Regarding Felony Conviction or Tax Delinquent Status for Corporate Applicants (AD-3031).

13. Good Neighbor Authority (GNA) Requirements, con't (9/16)

Bidder certifies, by signing this bid form, that to the best of Bidder's knowledge that the following representations are accurate and complete.

- a. That the Bidder and its principals are not presently debarred, suspended, proposed for debarment, declared ineligible, or voluntary excluded from timber sales (covered transactions) by any Federal department or agency.
- b. That the Bidder and its principals have not within a 3-year period preceding this bid been convicted of or had a civil judgment rendered against them for commission of fraud or a criminal offense in connection with obtaining, attempting to obtain, or performing a public (Federal, State, or local) transaction or contract under a public transaction; violation of Federal or State antitrust statutes or commission of embezzlement, theft, forgery, bribery, falsification or destruction of records, making false statements, or receiving stolen property.
- c. That the Bidder and its principals are not presently indicted for or otherwise criminally or civilly charged by a governmental entity (Federal, State, or local) with commission of any of the offenses enumerated in paragraph b of this certification.
- d. That the Bidder and its principals have not within a 3-year period preceding this bid had one or more public transactions (Federal, State, or local) terminated for breach or default of a timber or forest product contract.

Bidders that cannot certify this requirement, in whole or in part, shall submit an explanation with their bid.

KEITH CREAGH
Director

TIMBER SALE INFORMATION

Big Storm Mix (72-032-17)
 T25N, R01W, SEC. 18; T25N, R01W, SEC. 7.
 Crawford County (Advertised Price \$106,679.70)

SALE NOTE: There is visible old paint throughout the sale which is to be disregarded. Payment Units 3 and 6 are lowland stands that are seasonally wet, so caution is advised during certain parts of the year to prevent rutting. This sale uses USFS roads to access the state land on which the sale is located. Payment Unit 1 may need to have a short distance of road built to it across USFS lands. The Purchaser will need to work with the sale administrator and USFS regarding use of these roads.

Access may be through other public land.

A timber sale contract for this lump sum, sealed bid timber sale will be awarded to the responsible bidder offering the highest sealed bid price. Bids must be at or above the following advertised price for each species:

<u>PRODUCTS & SPECIES</u>	<u>ESTIMATED UNITS*</u>		<u>ADVERTISED PRICE</u>
Sawtimber			
Mixed Aspen	76.10	MBF	\$ 80.00 / MBF
Red Maple	10.70	MBF	\$ 50.00 / MBF
Red Pine	166.20	MBF	\$ 128.00 / MBF
Pulpwood			
Balsam Fir	290.00	Cords	\$ 12.90 / Cord
Jack Pine	191.00	Cords	\$ 15.60 / Cord
Mixed Aspen	772.00	Cords	\$ 22.60 / Cord
Mixed Hardwood	288.00	Cords	\$ 25.60 / Cord
Mixed Oak	26.00	Cords	\$ 19.05 / Cord
Mixed Spruce	95.00	Cords	\$ 26.55 / Cord
N. White Cedar	32.00	Cords	\$ 28.10 / Cord
Red Pine	889.00	Cords	\$ 46.05 / Cord
Tamarack	10.00	Cords	\$ 20.20 / Cord
White Pine	82.00	Cords	\$ 26.65 / Cord

* The total volume is statistically estimated within plus (+) or minus (-) 10.72 percent. The estimated units are final and not subject to adjustment. Prospective bidders are urged to examine this timber and to make their own estimates of quantity and quality.

BOND AND PAYMENT SCHEDULE:

1. A bond in the amount of \$5,334.00 to insure faithful performance of the conditions of the contract will be deposited by the successful bidder within 21 days of the sale award.
2. Cutting in any sale or unit without the required advance payment would be considered a trespass.
3. Total payment must be paid in advance or according to the following schedule:
 - (a) Ten percent (10%) of the sale value must be paid within 21 days of the sale award.
 - (b) The 10% down payment will be credited towards the first unit cut.
 - (c) Payment for each of the following units must be made before cutting begins in that unit:

PAYMENT UNIT NUMBER	PERCENT OF TOTAL SALE VALUE
01	30.4%
02	4.4%
03	21.7%
04	8.0%
05	25.2%
06	10.3%

4. If no cutting takes place, the 10% down payment will not be refunded.
5. Operations on the contract issued will terminate on 09/30/2021.

Description of Timber by Payment Unit (PU)

PU	MARKET GROUP	PRODUCT	QUANTITY	UNIT	ACRES	ADVERTISE PRICE
1	Mixed Aspen	Sawtimber	29.6	MBF	24.7	\$32,534.65
	<i>B. T. Aspen</i>		29.6	<i>MBF</i>		
	Red Maple		0.9	MBF		
	Red Pine		83.8	MBF		
	Balsam Fir	Pulpwood	80.0	Cords		
	<i>Balsam Fir</i>		80.0	<i>Cords</i>		
	Mixed Aspen		272.0	Cords		
	<i>B. T. Aspen</i>		257.0	<i>Cords</i>		
	<i>Balsam Poplar</i>		15.0	<i>Cords</i>		
	Mixed Hardwood		89.0	Cords		
	<i>Paper Birch</i>		4.0	<i>Cords</i>		
	<i>Red Maple</i>		85.0	<i>Cords</i>		
	Mixed Spruce		17.0	Cords		
	<i>Black Spruce</i>		17.0	<i>Cords</i>		
Red Pine		206.0	Cords			
2	Mixed Aspen	Sawtimber	16.1	MBF	6.1	\$4,656.30
	<i>B. T. Aspen</i>		16.1	<i>MBF</i>		
	Red Maple		0.9	MBF		
	Red Pine		6.9	MBF		
	Balsam Fir	Pulpwood	15.0	Cords		
	<i>Balsam Fir</i>		15.0	<i>Cords</i>		
	Mixed Aspen		51.0	Cords		
	<i>B. T. Aspen</i>		51.0	<i>Cords</i>		
	Mixed Hardwood		17.0	Cords		
	<i>Red Maple</i>		17.0	<i>Cords</i>		
	Mixed Spruce		4.0	Cords		
	<i>Black Spruce</i>		2.0	<i>Cords</i>		
	<i>White Spruce</i>		2.0	<i>Cords</i>		
	Red Pine		12.0	Cords		
3	Mixed Aspen	Sawtimber	29.3	MBF	51.1	\$23,119.70
	<i>B. T. Aspen</i>		12.0	<i>MBF</i>		
	<i>Quaking Aspen</i>		17.3	<i>MBF</i>		
	Red Maple		5.3	MBF		
	Red Pine		21.9	MBF		
	Balsam Fir	Pulpwood	168.0	Cords		
	<i>Balsam Fir</i>	<i>Sawtimber</i>	1.0	<i>MBF</i>		
	<i>Balsam Fir</i>	<i>Pulpwood</i>	166.0	<i>Cords</i>		
	Jack Pine		5.0	Cords		
	<i>Jack Pine</i>		5.0	<i>Cords</i>		
	Mixed Aspen		428.0	Cords		
	<i>B. T. Aspen</i>		244.0	<i>Cords</i>		
	<i>Balsam Poplar</i>		16.0	<i>Cords</i>		
	<i>Quaking Aspen</i>		168.0	<i>Cords</i>		
	Mixed Hardwood		54.0	Cords		
	<i>American Elm</i>		2.0	<i>Cords</i>		
	<i>Black Cherry</i>		7.0	<i>Cords</i>		
	<i>Paper Birch</i>		4.0	<i>Cords</i>		
	<i>Red Maple</i>		41.0	<i>Cords</i>		
	Mixed Oak		15.0	Cords		
	<i>Northern Pin Oak</i>	<i>Sawtimber</i>	1.6	<i>MBF</i>		
	<i>Northern Pin Oak</i>	<i>Pulpwood</i>	12.0	<i>Cords</i>		
	Mixed Spruce		8.0	Cords		
	<i>Black Spruce</i>		8.0	<i>Cords</i>		
	N. White Cedar		28.0	Cords		
	<i>N. White Cedar</i>	<i>Sawtimber</i>	7.6	<i>MBF</i>		
<i>N. White Cedar</i>	<i>Pulpwood</i>	13.0	<i>Cords</i>			

Description of Timber by Payment Unit (PU), con't

PU	MARKET GROUP	PRODUCT	QUANTITY	UNIT	ACRES	ADVERTISE PRICE	
3 con't	Red Pine	Pulpwood	42.0	Cords			
	Tamarack		10.0	Cords			
	White Pine		37.0	Cords			
	<i>White Pine</i>		37.0	<i>Cords</i>			
4	Red Pine	Sawtimber	12.4	MBF	21.9	\$8,545.20	
	Balsam Fir	Pulpwood	1.0	Cords			
	<i>Balsam Fir</i>		1.0	<i>Cords</i>			
	Jack Pine	Sawtimber	179.0	Cords			
	<i>Jack Pine</i>		4.4	<i>MBF</i>			
	<i>Jack Pine</i>		170.0	<i>Cords</i>			
	Mixed Hardwood	Pulpwood	7.0	Cords			
	<i>Red Maple</i>		7.0	<i>Cords</i>			
	Mixed Oak		11.0	Cords			
	<i>Northern Pin Oak</i>		10.0	<i>Cords</i>			
	<i>White Oak</i>		1.0	<i>Cords</i>			
	Red Pine		80.0	Cords			
	White Pine		3.0	Cords			
	<i>White Pine</i>		3.0	<i>Cords</i>			
5	Red Pine		Sawtimber	21.5	MBF	47.3	\$26,853.45
	Jack Pine		Pulpwood	6.0	Cords		
	<i>Jack Pine</i>	6.0		<i>Cords</i>			
	Mixed Hardwood	1.0		Cords			
	<i>Red Maple</i>	1.0	<i>Cords</i>				
	Red Pine	515.0	Cords				
	White Pine	10.0	Cords				
	<i>White Pine</i>	0.9	<i>MBF</i>				
	<i>White Pine</i>	8.0	<i>Cords</i>				
	6	Mixed Aspen	Sawtimber	1.1	MBF		
<i>B. T. Aspen</i>		1.1		<i>MBF</i>			
Red Maple		Pulpwood	3.6	MBF			
Red Pine			19.7	MBF			
Balsam Fir			26.0	Cords			
<i>Balsam Fir</i>			26.0	<i>Cords</i>			
Jack Pine			1.0	Cords			
<i>Jack Pine</i>			1.0	<i>Cords</i>			
Mixed Aspen			21.0	Cords			
<i>B. T. Aspen</i>			19.0	<i>Cords</i>			
<i>Quaking Aspen</i>			2.0	<i>Cords</i>			
Mixed Hardwood			120.0	Cords			
<i>Red Maple</i>			120.0	<i>Cords</i>			
Mixed Spruce			66.0	Cords			
<i>Black Spruce</i>			1.2	<i>MBF</i>			
<i>Black Spruce</i>			59.0	<i>Cords</i>			
<i>White Spruce</i>			5.0	<i>Cords</i>			
N. White Cedar			4.0	Cords			
<i>N. White Cedar</i>			4.0	<i>Cords</i>			
Red Pine			34.0	Cords			
White Pine			32.0	Cords			
<i>White Pine</i>	32.0	<i>Cords</i>					
TOTAL:			253.0	MBF			
TOTAL:			2,675.0	Cords			

Sale Specific Conditions & Requirements

Sale Name: Big Storm Mix

Sale Number: 72-032-17 Seq#: 2

1 - Sale Area

1.2 - Boundaries

1.2.1 - Painted boundaries (1/14)

The sale boundary and Payment Unit boundaries are marked and identified by blue, red and yellow paint. Exterior sale boundary lines against private property are marked with blue paint. Exterior sale boundary lines against state are marked with red paint. Interior Payment Unit boundaries are marked with yellow paint. The painted boundary line trees are not Included Timber and are to be protected. Yellow painted trees designating an interior Payment Unit boundary are only to be cut when all surrounding Payment Units have been paid.

2 - Timber Specifications

2.1 - Included Timber

2.1.1 - Clearcut unit(s) with unmerchantable trees (6/14)

Within Payment Unit(s) 3, 4, and 6, cut all trees that are two (2) inches or more at DBH, except do not cut white and red pine 26 inches or more at DBH within Payment Units 3 and 6.

2.1.7 - Leave tree marked unit(s) (6/14)

Within Payment Unit(s) 1 and 2, cut all trees that are two (2) inches or more at DBH, except do not cut any red pine trees marked with green paint above and below stump height. In addition, do not cut any white pine and oak.

2.1.8 - Designated plantation row unit(s) (12/08)

Within Payment Unit(s) 5, all red pine trees which meet minimum piece specifications in 2.2 Utilization, within designated plantation rows are designated for cutting. Designated plantation rows begin with the third row in from the outside of the plantation, then continue every third row. Because of the variability of row direction, it shall be the responsibility of the producer to maintain the third row sequence.

2.2 - Utilization

2.2.3 - Stump heights (4/07)

Stump heights within Payment Unit 5 shall not exceed 6 inches for all trees. A written waiver of this requirement may be obtained if wet summer weather makes winter logging necessary.

2.2.6 - Roundwood operation required (5/07)

The skidding of whole trees or tree segments with limbs attached is prohibited within Payment Unit 5. All products must be produced as roundwood and forwarded to existing roads or landing areas in final product length.

3 - Payments

3.3 - Pre-measured Sales

3.3.4 - Dividing payment units (7/14)

Payment Unit(s) may be divided at the request of the Purchaser and upon approval of the Unit Manager. Dividing Payment Units is a contract modification which requires a Timber Sale Contract Supplement.

3.4 - Damaged Timber

3.4.1 - Damaged timber (6/14)

General Condition and Requirement 3.4 Damaged Timber, defines liquidated damages for undesignated live merchantable trees which are cut or injured. In addition, extreme care should be taken to avoid damage to tree seedlings and saplings.

No damage is acceptable to merchantable trees. Within the sale area, if more than 5% of trees (> 4.5" DBH) within a specified area of the sale are damaged, liquidated damages will be assessed for all trees damaged. Rates will be in

accordance with General Condition and Requirement 3.4 Damaged Timber.

4 - Transportation

4.1 - Construction

4.1.6 - Road construction (1/09)

Construction of new roads or improvements of existing roads shall be done in such a way as to minimize the environmental and visual impacts. Merchantable trees shall be cut and utilized unless otherwise directed. Non-merchantable trees shall be severed and laid flat on the ground. Slash shall be scattered, and not left in windrows and kept a minimum of 10 feet back from the road edge. Stumps shall be set upright, not left on edge, and be moved at least 10 feet away from the road edge. Disturbed soil shall be feathered into the woods and not left in berms or windrows.

4.1.7 - Road closure (10/11)

All new roads built into the sale must be blocked to vehicle traffic upon completion of the sale. Overgrown roads that are reopened shall be considered new roads. In general, this will require constructing a four (4') foot high berm of stumps and logs covered with earth. These roads must be rendered impassable to cars and trucks. Contact the sale administrator for specific details of design and placement.

4.1.11 - Permits (2/12)

The Purchaser will secure any necessary permits that may be required.

4.4 - Access

4.4.5 - Federal property access (3/11)

Permission for access across federal land is the responsibility of the DNR.

5 - Operations

5.1 - Notification

5.1.1 - Pre-sale conference (10/16)

A pre-sale conference on site between the Purchaser and sale administrator is required prior to beginning any operations to determine landing and road locations. The Unit Manager or his/her representative must be contacted at least 10 days in advance to schedule the conference.

5.1.4 - Post-sale conference (10/16)

A post-sale conference on site between the Purchaser and sale administrator is required prior to the completion of active logging operations to determine clean-up and repair of landings, road edges, and the fulfillment of other contract specifications.

5.2 - Conduct of Operations

5.2.2 - Hazard Trees/Snags

5.2.2.1 - Den trees (10/16)

Obvious hollow and/or den trees shall be protected and left standing unless they are a safety hazard.

5.2.3 - Operating Restrictions

5.2.3.1 - Operating restrictions (9/11)

Within Payment Unit(s) 1-6, unless changed by written agreement, cutting, skidding, and hauling are limited to the period of November 1 to April 1. This restriction is because the sale area is part of the Mason Tract. This restriction also serves the purpose of preventing the risk of spreading oak wilt and the risk of thinning in Payment Unit 5 during bark slip.

5.2.4 - Dead and Down Creation

5.2.4.4 - Dead and down creation, grouse (8/13)

To encourage grouse and other wildlife, in Payment Unit(s) 3, leave at least six (6) large tops in a single pile and at least one pile per acre. These will be evenly scattered throughout the unit.

5.2.22 - Operating Caution

5.2.22.2 - Operating caution (6/11)

It is recommended, but not required, that within Payment Unit(s) 3 and 6, cutting and skidding occur during dry summer or frozen winter conditions. The reason for the recommendation is that there are seasonally wet areas within these payment units.

5.2.32 - Decking/landing restoration (9/13)

All decking and landing areas must have the surface area restored to a condition equal to or better than before. This is to ensure the proper regeneration of the stand. Wood debris, chips and "cookies" from trimmings must be removed or scattered away from landing and loading areas and may not be windrowed on the edge.

5.2.38 - No decking against live trees (2/04)

Cut products may not be decked against unmarked or designated leave trees.

5.4 - Soil Protection

5.4.1 - Rutting restriction, general (7/16)

Operations are to cease immediately if equipment and weather conditions result in rutting of roads and/or skid trails which is 12 inches or greater in depth and 50 feet in length. The Unit Manager or his/her representative may restrict hauling and/or skidding if ruts exceed the specified depth. With the Unit Manager or his/her representative's approval, the Purchaser may return to the area when the risk of rutting has decreased.



TIMBER SALE MAP

This information provided by authority of Part 525, 1994 PA 451, as amended.

Sale Number	Year
72-032	17

Forest Management Unit Grayling	County Crawford	Mapped By Martell	Date 9/5/17	Page 1	of 1
Township 25N	Range 01W	Section(s) and Subdivision(s) Sec. 18 - E1/2NE, SW1/4NE, SE1/4NW, SE, E1/2SW	Scale 1:15,840		

Cover Type				Density	
A = Aspen	H = Hemlock	N = Marsh	U = Upland Brush	0 = Non Stocked	5 = Pole Timber Medium
B = Paper Birch	J = Jack Pine	O = Oak	UM = Upland Mixed	1 = Seedling Sapling Poor	6 = Pole Timber Well
C = Cedar	L = Lowland Brush	P = Lowland Poplar	V = Bog or Marsh	2 = Seedling Sapling Medium	7 = Saw Timber Poor
D = Tread Bog	LM = Lowland Mixed	Q = Mixed Swamp Conifer	W = White Pine	3 = Seedling Sapling Well	8 = Saw Timber Medium
E = Swamp Hdwoods	M = Mpl, Bch, Brch	R = Red Pine	X = Non Stocked	4 = Pole Timber Poor	9 = Saw Timber Well
F = Spruce Fir	MC = Mixed Conifer	S = Black Spruce	Z = Water		
G = Grass	MD = Mixed Deciduous	T = Tamarack			

PU	Acres	PU	Acres
1	24.7	4	21.9
2	6.1	5	47.3
3	51.1	6	12.9

Big Storm Mix

Compartment 29

164 Acres

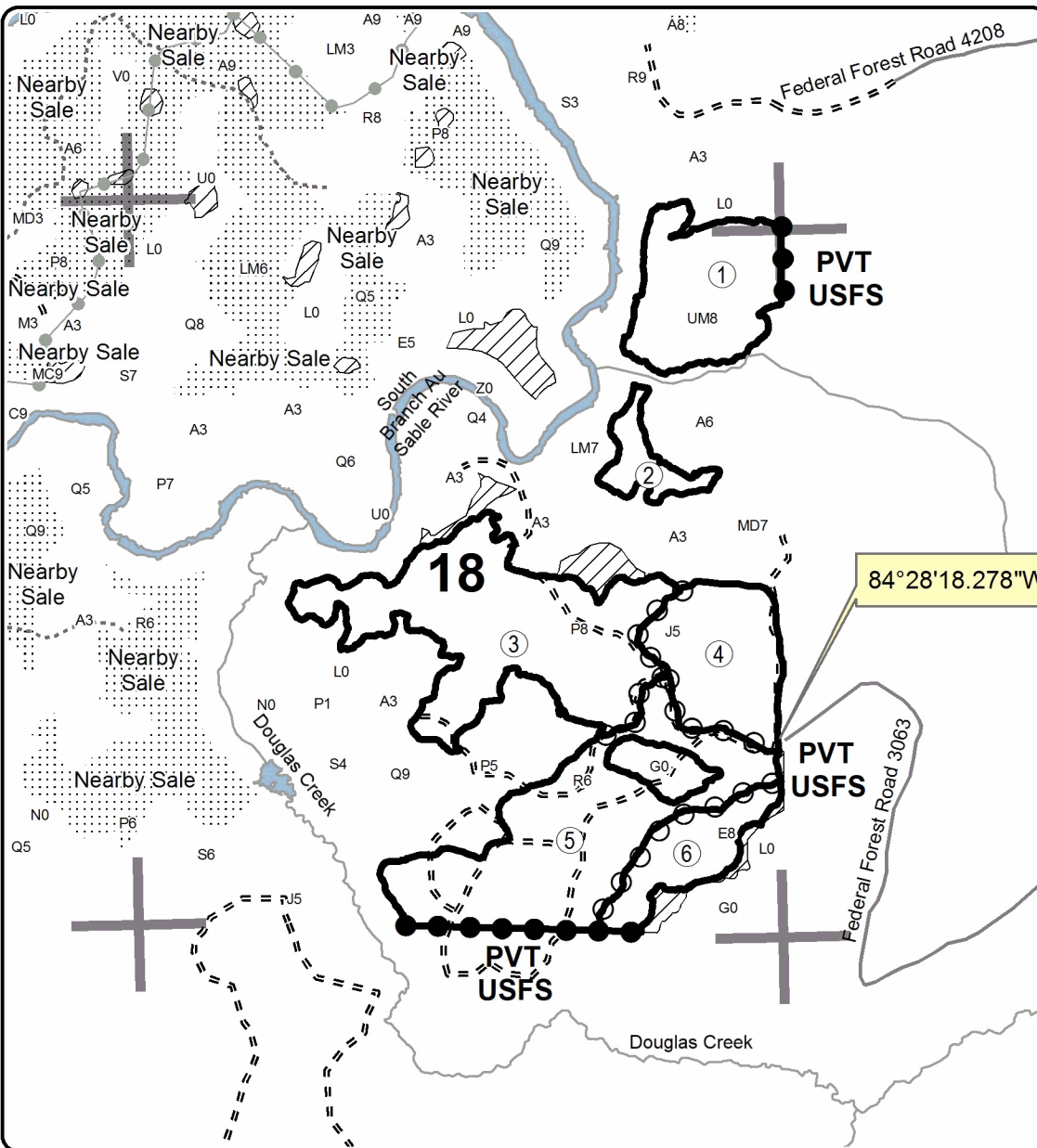

Legend

- Against State (Red)
- Payment Unit (Yellow)
- Private Line (Blue)
- ▨ Retention Area
- Section Corners
- Highway
- Paved Roads
- Gravel Roads
- - - Poor Dirt Roads
- ⋯ Closed Roads

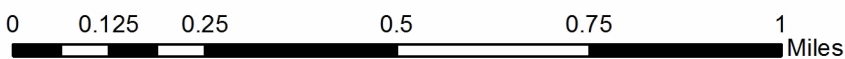
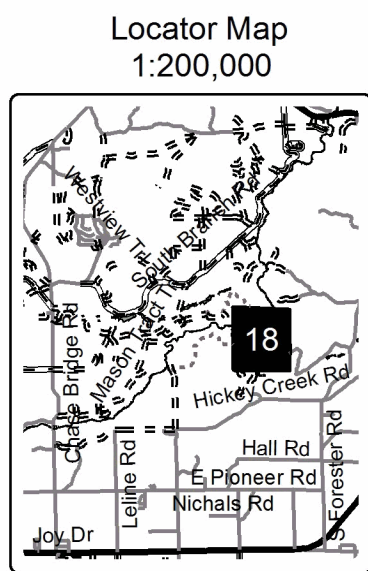

TIMBER SALE INFORMATION

Conners Mixed Conifers (72-639-17)

T26N, R01W, SEC. 6; T26N, R02W, SEC. 1; T27N, R02W, SEC. 36.
Crawford County (Advertised Price \$52,810.85)

SALE NOTE: Payment Units 1 & 2 are on Military lands. The boundaries of Payment Units 1, 2, 4, 5 & 7 were run to pick up the denser spruce/fir cover on the transition ground edge of the adjacent swamps. That edge ground will likely not be operable in the spring. The boundaries of Payment Units 3, 4 & 5 pick up two acres total of immature jack pine in order to provide room for landing/haul route construction on leveler ground near the existing access road.

A timber sale contract for this lump sum, sealed bid timber sale will be awarded to the responsible bidder offering the highest sealed bid price. Bids must be at or above the following advertised price for each species:

<u>PRODUCTS & SPECIES</u>	<u>ESTIMATED UNITS*</u>		<u>ADVERTISED PRICE</u>
Sawtimber			
Northern Pin Oak	13.90	MBF	\$ 171.00 / MBF
Red Pine	255.80	MBF	\$ 103.00 / MBF
White Pine	21.80	MBF	\$ 57.00 / MBF
Pulpwood			
Balsam Fir	55.00	Cords	\$ 10.30 / Cord
Black Spruce	133.00	Cords	\$ 21.25 / Cord
Jack Pine	142.00	Cords	\$ 12.50 / Cord
Mixed Aspen	35.00	Cords	\$ 18.10 / Cord
Mixed Hardwood	29.00	Cords	\$ 20.45 / Cord
Mixed Oak	161.00	Cords	\$ 15.25 / Cord
Red Pine	300.00	Cords	\$ 36.85 / Cord
White Pine	138.00	Cords	\$ 21.30 / Cord

* The total volume is statistically estimated within plus (+) or minus (-) 11.28 percent. The estimated units are final and not subject to adjustment. Prospective bidders are urged to examine this timber and to make their own estimates of quantity and quality.

BOND AND PAYMENT SCHEDULE:

1. A bond in the amount of \$2,641.00 to insure faithful performance of the conditions of the contract will be deposited by the successful bidder within 21 days of the sale award.
2. Cutting in any sale or unit without the required advance payment would be considered a trespass.
3. Total payment must be paid in advance or according to the following schedule:
 - (a) Ten percent (10%) of the sale value must be paid within 21 days of the sale award.
 - (b) The 10% down payment will be credited towards the first unit cut.
 - (c) Payment for each of the following units must be made before cutting begins in that unit:

PAYMENT UNIT NUMBER	PERCENT OF TOTAL SALE VALUE
01	12.8%
02	16.8%
03	16.8%
04	6.8%
05	20.0%
06	6.8%
07	20.0%

4. If no cutting takes place, the 10% down payment will not be refunded.
5. Operations on the contract issued will terminate on 03/31/2021.

Description of Timber by Payment Unit (PU)

PU	MARKET GROUP	PRODUCT	QUANTITY	UNIT	ACRES	ADVERTISE PRICE
1	Northern Pin Oak	Sawtimber	1.3	MBF	11.6	\$6,777.55
	Red Pine		25.2	MBF		
	White Pine		8.4	MBF		
	Balsam Fir	Pulpwood	15.0	Cords		
	<i>Balsam Fir</i>		15.0	<i>Cords</i>		
	Black Spruce		29.0	Cords		
	<i>Black Spruce</i>		29.0	<i>Cords</i>		
	Jack Pine		14.0	Cords		
	<i>Jack Pine</i>		14.0	<i>Cords</i>		
	Mixed Aspen		2.0	Cords		
	<i>Quaking Aspen</i>		2.0	<i>Cords</i>		
	Mixed Hardwood		6.0	Cords		
	<i>Paper Birch</i>		3.0	<i>Cords</i>		
	<i>Red Maple</i>		3.0	<i>Cords</i>		
	Mixed Oak		13.0	Cords		
	<i>Northern Pin Oak</i>		13.0	<i>Cords</i>		
	Red Pine		25.0	Cords		
White Pine		59.0	Cords			
2	Northern Pin Oak	Sawtimber	4.0	MBF	19.2	\$8,849.50
	Red Pine		17.7	MBF		
	White Pine		4.5	MBF		
	Balsam Fir	Pulpwood	20.0	Cords		
	<i>Balsam Fir</i>	<i>Sawtimber</i>	0.4	<i>MBF</i>		
	<i>Balsam Fir</i>	<i>Pulpwood</i>	19.0	<i>Cords</i>		
	Black Spruce		74.0	Cords		
	<i>Black Spruce</i>	<i>Sawtimber</i>	0.4	<i>MBF</i>		
	<i>Black Spruce</i>	<i>Pulpwood</i>	73.0	<i>Cords</i>		
	Jack Pine		48.0	Cords		
	<i>Jack Pine</i>	<i>Sawtimber</i>	7.0	<i>MBF</i>		
	<i>Jack Pine</i>	<i>Pulpwood</i>	34.0	<i>Cords</i>		
	Mixed Hardwood		20.0	Cords		
	<i>Red Maple</i>	<i>Sawtimber</i>	0.9	<i>MBF</i>		
	<i>Red Maple</i>	<i>Pulpwood</i>	18.0	<i>Cords</i>		
	Mixed Oak		49.0	Cords		
	<i>White Oak</i>	<i>Sawtimber</i>	0.9	<i>MBF</i>		
	<i>Northern Pin Oak</i>	<i>Pulpwood</i>	43.0	<i>Cords</i>		
	<i>White Oak</i>		4.0	<i>Cords</i>		
	Red Pine		49.0	Cords		
White Pine		35.0	Cords			
3	Northern Pin Oak	Sawtimber	4.5	MBF	14.2	\$8,892.25
	Red Pine		39.3	MBF		
	White Pine		1.2	MBF		
	Jack Pine	Pulpwood	30.0	Cords		
	<i>Jack Pine</i>	<i>Sawtimber</i>	0.7	<i>MBF</i>		
	<i>Jack Pine</i>	<i>Pulpwood</i>	29.0	<i>Cords</i>		
	Mixed Aspen		29.0	Cords		
	<i>B. T. Aspen</i>	<i>Sawtimber</i>	0.4	<i>MBF</i>		
	<i>B. T. Aspen</i>	<i>Pulpwood</i>	28.0	<i>Cords</i>		
	Mixed Hardwood		2.0	Cords		
	<i>Red Maple</i>		2.0	<i>Cords</i>		
	Mixed Oak		46.0	Cords		
	<i>White Oak</i>	<i>Sawtimber</i>	0.4	<i>MBF</i>		
	<i>Northern Pin Oak</i>	<i>Pulpwood</i>	44.0	<i>Cords</i>		
	<i>White Oak</i>		1.0	<i>Cords</i>		
	Red Pine		63.0	Cords		
White Pine		2.0	Cords			

Description of Timber by Payment Unit (PU), con't

PU	MARKET GROUP	PRODUCT	QUANTITY	UNIT	ACRES	ADVERTISE PRICE
4	Northern Pin Oak	Sawtimber	1.8	MBF	8.0	\$3,578.30
	Red Pine		19.3	MBF		
	White Pine		1.1	MBF		
	Balsam Fir	Pulpwood	11.0	Cords		
	<i>Balsam Fir</i>		<i>11.0</i>	<i>Cords</i>		
	Black Spruce		4.0	Cords		
	<i>Black Spruce</i>		<i>4.0</i>	<i>Cords</i>		
	Jack Pine		5.0	Cords		
	<i>Jack Pine</i>		<i>5.0</i>	<i>Cords</i>		
	Mixed Oak		18.0	Cords		
	<i>Northern Pin Oak</i>		<i>18.0</i>	<i>Cords</i>		
	Red Pine		18.0	Cords		
White Pine		1.0	Cords			
5	Northern Pin Oak	Sawtimber	0.4	MBF	10.9	\$10,585.95
	Red Pine		67.8	MBF		
	White Pine		2.0	MBF		
	Balsam Fir	Pulpwood	8.0	Cords		
	<i>Balsam Fir</i>		<i>8.0</i>	<i>Cords</i>		
	Black Spruce		19.0	Cords		
	<i>Black Spruce</i>	Sawtimber	<i>0.4</i>	<i>MBF</i>		
	<i>Black Spruce</i>	Pulpwood	<i>18.0</i>	<i>Cords</i>		
	Jack Pine		2.0	Cords		
	<i>Jack Pine</i>		<i>2.0</i>	<i>Cords</i>		
	Mixed Hardwood		1.0	Cords		
	<i>Black Cherry</i>		<i>1.0</i>	<i>Cords</i>		
	Mixed Oak		10.0	Cords		
	<i>Northern Pin Oak</i>		<i>10.0</i>	<i>Cords</i>		
	Red Pine		65.0	Cords		
White Pine		16.0	Cords			
6	Northern Pin Oak	Sawtimber	1.0	MBF	7.6	\$3,581.50
	Red Pine		17.6	MBF		
	Jack Pine	Pulpwood	41.0	Cords		
	<i>Jack Pine</i>	Sawtimber	<i>3.8</i>	<i>MBF</i>		
	<i>Jack Pine</i>	Pulpwood	<i>33.0</i>	<i>Cords</i>		
	Mixed Oak		18.0	Cords		
	<i>Northern Pin Oak</i>		<i>18.0</i>	<i>Cords</i>		
	Red Pine		22.0	Cords		
7	Northern Pin Oak	Sawtimber	0.9	MBF	7.9	\$10,545.80
	Red Pine		68.9	MBF		
	White Pine		4.6	MBF		
	Balsam Fir	Pulpwood	1.0	Cords		
	<i>Balsam Fir</i>		<i>1.0</i>	<i>Cords</i>		
	Black Spruce		7.0	Cords		
	<i>Black Spruce</i>		<i>7.0</i>	<i>Cords</i>		
	Jack Pine		2.0	Cords		
	<i>Jack Pine</i>	Sawtimber	<i>0.4</i>	<i>MBF</i>		
	<i>Jack Pine</i>	Pulpwood	<i>1.0</i>	<i>Cords</i>		
	Mixed Aspen		4.0	Cords		
	<i>B. T. Aspen</i>		<i>4.0</i>	<i>Cords</i>		
	Mixed Oak		7.0	Cords		
	<i>Northern Pin Oak</i>		<i>7.0</i>	<i>Cords</i>		
	Red Pine		58.0	Cords		
White Pine		25.0	Cords			
TOTAL:			291.5	MBF		

TOTAL:	993.0	Cords
--------	-------	-------

Sale Specific Conditions & Requirements

Sale Name: Conners Mixed Conifers

Sale Number: 72-639-17 Seq#: 1

1 - Sale Area

1.2 - Boundaries

1.2.1 - Painted boundaries (1/14)

The sale boundary and Payment Unit boundaries are marked and identified by blue, red and yellow paint. Exterior sale boundary lines against private property are marked with blue paint. Exterior sale boundary lines against state are marked with red paint. Interior Payment Unit boundaries are marked with yellow paint. Blue painted boundary line trees are not Included Timber and are to be protected. Red painted boundary line trees are designated for cutting unless they are cedar or marked with blue or green paint. Yellow painted trees designating an interior Payment Unit boundary are only to be cut when all surrounding Payment Units have been paid. Faded boundary paint remnants from previous timber sales are to be disregarded.

2 - Timber Specifications

2.1 - Included Timber

2.1.1 - Clearcut unit(s) with unmerchantable trees (6/14)

Within Payment Unit(s) 2, 3 & 6, cut all trees that are one inch or more at DBH, except trees marked with green paint.

2.1.4 - Designated timber unit(s) (6/17)

Within Payment Unit(s) 1, 4, 5 & 7, all trees which meet minimum piece specifications in 2.2 - Utilization are designated for cutting, except do not cut cedar and trees marked with green paint. In addition, within Payment Unit 1, do not cut white oak.

2.1.15 - Hazard trees near roads (7/13)

Cut and remove all standing dead trees within 100 feet of the cleared portion of mapped open roads and utility corridors. These trees may be utilized or must be scattered back into the sale area.

2.2 - Utilization

2.2.2 - Chipping required (5/14)

Payment Units 1, 2, 3 & 6 must be chip harvested to facilitate subsequent planting operations and/or to meet National Guard requirements. The Purchaser has the option to produce sawlogs or pulpwood bolts, but the remaining portion of the trees must be chipped and hauled. The requirement to retain approximately 1/6 to 1/3 of tree tops and limbs less than four inches in diameter (G. C. & R. 2.2) does not apply to Payment Units 1 & 2 because they are on Military lands. Within Payment Units 3 & 6, do not chip 1/6 to 1/3 of the slash from harvested trees (tree tops and limbs less than four inches in diameter). If Payment Units 4, 5 or 7 are chipped, 1/6 to 1/3 of the slash must be left as well.

2.2.3 - Stump heights (4/07)

Stump heights within Payment Unit(s) 1, 2, 3 & 6 shall not exceed 6 inches for all trees. This is in order to facilitate planting operations and/or to meet military requirements.

3 - Payments

3.4 - Damaged Timber

3.4.1 - Damaged timber (6/14)

General Condition and Requirement 3.4 Damaged Timber, defines liquidated damages for undesignated live merchantable trees which are cut or injured. In addition, reasonable care should be taken to avoid damage to tree seedlings and saplings.

Within Payment Units 1, 4, 5 & 7, if more than 30% of the tree seedlings or saplings (1/4" to 4.5" DBH) within a specified portion of the sale area are damaged, liquidated damages will be assessed at \$300 per acre for all acreage within that specified portion of the sale area that was damaged. Operable paths will have to be cut through patches of dense regen. If cut cleanly, those paths will not count toward damage assessments.

No damage is acceptable to merchantable trees. Within the sale area, if more than 10% of trees (> 4.5" DBH) within a specified area of the sale are damaged, liquidated damages will be assessed for all trees damaged. Rates will be in accordance with General Condition and Requirement 3.4 Damaged Timber.

3.4.2 - Special Protection Trees (4/14)

The Purchaser shall not cut live or dead special protection trees within cutting units or clearings. Special protection trees are red pine and white pine marked with green paint. If the Purchaser's operations have cut or damaged special protection trees through carelessness, the Purchaser shall pay \$300 as fixed, agreed and liquidated damages for each special protection tree cut or damaged. Such payment does not constitute ownership of the undesignated timber.

4 - Transportation

4.1 - Construction

4.1.3 - Slash and earthen piles (8/04)

Piles or windrows of earth along roads and landings that have been widened or constructed shall be leveled. Slash from road maintenance or construction, including stumps, shall be chipped, utilized or otherwise dispersed into the sale.

4.1.6 - Road construction (1/09)

Construction of new roads or improvements of existing roads shall be done in such a way as to minimize the environmental and visual impacts. Merchantable trees shall be cut and utilized unless otherwise directed. Non-merchantable trees shall be severed and laid flat on the ground. Slash shall be chipped, utilized or dispersed away from the road edge. Stumps shall be set upright, not left on edge, and be moved at least 10 feet away from the road edge. Disturbed soil shall be feathered into the woods and not left in berms or windrows.

4.1.7 - Road closure (10/11)

All new roads built into the sale must be blocked to vehicle traffic upon completion of the sale. Overgrown roads that are reopened shall be considered new roads. In general, closure may require constructing a four (4') foot high berm of stumps and logs covered with earth. Stumps and brush may also need to be placed along portions of the trail. Contact the sale administrator for specific details of design and placement.

4.1.11 - Permits (2/12)

The Purchaser will secure any necessary permits that may be required.

5 - Operations

5.1 - Notification

5.1.1 - Pre-sale conference (10/16)

A pre-sale conference between the Purchaser and sale administrator is required prior to beginning any operations to determine landing and road locations. The Unit Manager or his/her representative must be contacted at least 5 days in advance to schedule the conference.

5.1.4 - Post-sale conference (10/16)

A post-sale conference on site between the Purchaser and sale administrator is required prior to the completion of active logging operations to determine clean-up and repair of landings, road edges, and the fulfillment of other contract specifications.

5.1.5 - National Guard notification (2/15)

This sale is upon lands utilized for training by the Michigan National Guard - Camp Grayling. A minimum of five (5) business days prior to opening this sale, the producer must request that the sale administrator contact the military for information regarding training plans that may impact sale operations.

5.2 - Conduct of Operations

5.2.1 - Slash

5.2.1.13 - Dispose of slash as directed (12/05)

Slash is to be disposed of as directed by the sale administrator (ie: spreading out slash piles in Payment Units 2, 3 & 6). This is because of future planting operations.

5.2.3 - Operating Restrictions

5.2.3.3 - Bark slippage restriction (3/09)

Within Payment Unit(s) 1, 4, 5 & 7, unless changed by written agreement, cutting and skidding are not permitted during the period of April 15 to July 15. This restriction is because of bark slippage.

5.2.3.4 - Oak wilt restriction (9/17)

Within Payment Unit(s) 1-7, unless changed by written agreement, cutting, skidding, hauling and brushing of access roads are not permitted during the period of April 15 to July 15. Operations may be allowed if specific steps are taken to prevent damaging uncut oak during the high risk period. Those steps include completing all road brushing before April 15th, clearing a tree-length buffer along uncut oak cover before April 15th or leaving an uncut buffer there until after July 15th. This is necessary to reduce the spread of oak wilt. For more information, contact the Unit Manager or his/her representative.

5.2.3.6 - Bark beetle restriction (12/08)

In the event drought creates a high risk of pine bark beetle infestation, pine is not to be cut during the period March 1 through July 1, unless all portions of trees greater than two inches in diameter are removed from the sale area, reduced to chips, or treated to the satisfaction of the Unit Manager or his/her representative, within fifteen days of being severed from the stump. Pine log decks, pulpwood piles and treetops that are piled for chipping in the fall or winter within a 1/4 mile of susceptible sites must be removed before March 15. Residual slash must not be placed in piles or rows and must be spread over the site for quick drying. The Department of Natural Resources will exercise this specification if the risk of damage warrants.

5.2.3.7 - National Guard training restriction (1/09)

Operations on this contract for Payment Units 1 & 2 may not be allowed during National Guard training operations. Typically, the restricted period is from May 1 to October 31. The contractor must check with the Unit Manager who will coordinate the cutting schedule with the Military.

5.2.22 - Operating Caution

5.2.22.1 - Operating caution (6/11)

It is recommended, but not required, that within Payment Unit(s) 1, 2, 4, 5 & 7 along the swamp edges, cutting and skidding occur during dry summer or frozen winter conditions. The reason for the recommendation is because those units pick up transition ground edge near the lowlands that will be saturated in the spring.

5.2.38 - No decking against live trees (2/04)

Cut products may not be decked against unmarked or designated leave trees.

5.4 - Soil Protection

5.4.1 - Rutting restriction, general (7/16)

Operations are to cease immediately if equipment and weather conditions result in rutting of roads and/or skid trails which is 12 inches or greater in depth and 50 feet in length. The Unit Manager or his/her representative may restrict hauling and/or skidding if ruts exceed the specified depth. With the Unit Manager or his/her representative's approval, the Purchaser may return to the area when the risk of rutting has decreased.

6 - Safety and Fire Prevention

6.2 - Signing

6.2.1 - Road posting (9/09)

The Purchaser is responsible for posting and maintaining caution signs on the haul route north of Conners Flat Road prior to beginning operations. The road must be posted at appropriate distances from the sale area to warn of logging activity and truck traffic. Signs must be removed when harvest operations are suspended or completed. The Purchaser will provide these signs.

7 - Other Conditions

7.5 - Loss

7.5.1 - Deteriorating timber (7/09)

The sale area has received damage from age-related decline in the mature jack pine and oak. A component of the mature red pine is also starting to show symptoms of stress. The Purchaser should harvest the wood as soon as possible. The Department of Natural Resources is held free of responsibility of any further damage or deterioration due to delay in harvesting.

7.10 - Certified Timber

7.10.1 - Non-certified timber (2/16)

The area encompassed by this timber sale is not certified to the standards of the Forest Stewardship Council (FSC) or the Sustainable Forestry Initiative (SFI). Forest products from this sale may not be delivered to the mill as "FSC and / or SFI certified".



TIMBER SALE MAP

This information provided by authority of Part 525, 1994 PA 451, as amended.

Forest Management Unit Grayling		County Crawford		Mapped By Charlebois		Date 09/30/2017		Page 1 of 1	
Township	27N	Range	02W	Section(s) and Subdivision(s) Sec 36: SWSE, E1/2SW Sec 01: E1/2NE, N1/2SE, N1/2SW		Scale 1:15,840			
	26N		02W						

Cover Type				Density			
A = Aspen	H = Hemlock	N = Marsh	U = Upland Brush	0 = Non Stocked	5 = Pole Timber Medium		
B = Paper Birch	J = Jack Pine	O = Oak	UM = Upland Mixed	1 = Seedling Sapling Poor	6 = Pole Timber Well		
C = Cedar	L = Lowland Brush	P = Lowland Poplar	V = Bog or Marsh	2 = Seedling Sapling Medium	7 = Saw Timber Poor		
D = Tread Bog	LM = Lowland Mixed	Q = Mixed Swamp Conifer	W = White Pine	3 = Seedling Sapling Well	8 = Saw Timber Medium		
E = Swamp Hdwoods	M = Mpl, Bch, Brch	R = Red Pine	X = Non Stocked	4 = Pole Timber Poor	9 = Saw Timber Well		
F = Spruce Fir	MC = Mixed Conifer	S = Black Spruce	Z = Water				
G = Grass	MD = Mixed Deciduous	T = Tamarack					

PU	Acres	PU	Acres
1	11.6	5	10.9
2	19.2	6	7.6
3	14.2	7	7.9
4	8.0		

Conners Mixed Conifers

Compartment 279

79.4 Acres



QR code opens map in PDF maps app

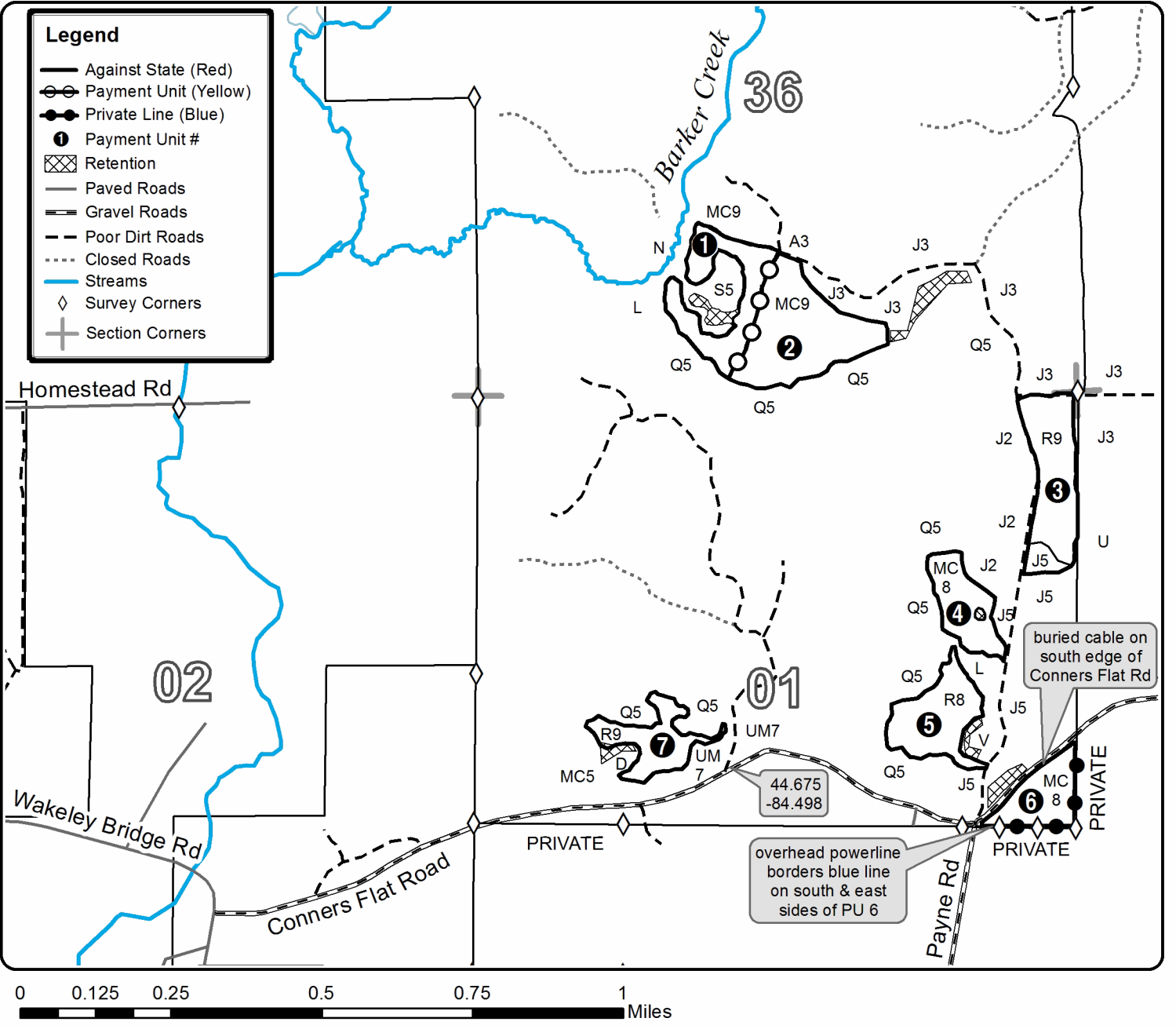

TIMBER SALE INFORMATION

AuSable Trail Oak (72-633-16)
 T26N, R04W, SEC. 2; T26N, R04W, SEC. 3.
 Crawford County (Advertised Price \$24,569.15)

SALE NOTE: Oak wilt restrictions apply to this sale - no exceptions will be granted. This sale has a lot of dead/dying oak that should be harvested as soon as possible.

A recreation site such as a trail, pathway, or campground is within the sale area or the vicinity. Certain restrictions/specifications may be applicable including time restrictions.

A timber sale contract for this lump sum, sealed bid timber sale will be awarded to the responsible bidder offering the highest sealed bid price. Bids must be at or above the following advertised price for each species:

<u>PRODUCTS & SPECIES</u>	<u>ESTIMATED UNITS*</u>	<u>ADVERTISED PRICE</u>
Sawtimber		
Mixed Oak	50.70 MBF	\$ 214.00 / MBF
Pulpwood		
Jack Pine	88.00 Cords	\$ 15.60 / Cord
Misc. Species 1	221.00 Cords	\$ 7.50 / Cord
Mixed Hardwood	49.00 Cords	\$ 25.60 / Cord
Mixed Oak	393.00 Cords	\$ 19.05 / Cord
Quaking Aspen	21.00 Cords	\$ 22.60 / Cord
Red Pine	21.00 Cords	\$ 46.05 / Cord
White Pine	19.00 Cords	\$ 26.65 / Cord

* The total volume is statistically estimated within plus (+) or minus (-) 14.90 percent. The estimated units are final and not subject to adjustment. Prospective bidders are urged to examine this timber and to make their own estimates of quantity and quality.

BOND AND PAYMENT SCHEDULE:

1. A bond in the amount of \$1,228.00 to insure faithful performance of the conditions of the contract will be deposited by the successful bidder within 21 days of the sale award.
2. Cutting in any sale or unit without the required advance payment would be considered a trespass.
3. Total payment must be paid in advance or according to the following schedule:
 - (a) Ten percent (10%) of the sale value must be paid within 21 days of the sale award.
 - (b) The 10% down payment will be credited towards the first unit cut.
 - (c) Payment for each of the following units must be made before cutting begins in that unit:

<u>PAYMENT UNIT NUMBER</u>	<u>PERCENT OF TOTAL SALE VALUE</u>
01	43.7%
02	56.3%

4. If no cutting takes place, the 10% down payment will not be refunded.
5. Operations on the contract issued will terminate on 03/31/2021.

Description of Timber by Payment Unit (PU)

PU	MARKET GROUP	PRODUCT	QUANTITY	UNIT	ACRES	ADVERTISE PRICE			
1	Mixed Oak	Sawtimber	23.8	MBF	31.7	\$10,738.70			
	<i>Northern Pin Oak</i>		23.8	<i>MBF</i>					
	Jack Pine	Pulpwood	66.0	Cords					
	<i>Jack Pine</i>	<i>Sawtimber</i>	3.5	<i>MBF</i>					
	<i>Jack Pine</i>	<i>Pulpwood</i>	59.0	<i>Cords</i>					
	Misc. Species 1		119.0	Cords					
	Mixed Hardwood		31.0	Cords					
	<i>Red Maple</i>		31.0	<i>Cords</i>					
	Mixed Oak		136.0	Cords					
	<i>Northern Pin Oak</i>		136.0	<i>Cords</i>					
	Quaking Aspen		15.0	Cords					
	2	Mixed Oak	Sawtimber	26.9			MBF	42.7	\$13,830.45
		<i>Northern Pin Oak</i>		21.0			<i>MBF</i>		
<i>White Oak</i>			5.9	<i>MBF</i>					
Jack Pine		Pulpwood	22.0	Cords					
<i>Jack Pine</i>		<i>Sawtimber</i>	0.4	<i>MBF</i>					
<i>Jack Pine</i>		<i>Pulpwood</i>	21.0	<i>Cords</i>					
Misc. Species 1			102.0	Cords					
Mixed Hardwood			18.0	Cords					
<i>Black Cherry</i>			6.0	<i>Cords</i>					
<i>Red Maple</i>			12.0	<i>Cords</i>					
Mixed Oak			257.0	Cords					
<i>Northern Pin Oak</i>			200.0	<i>Cords</i>					
<i>White Oak</i>			57.0	<i>Cords</i>					
Quaking Aspen			6.0	Cords					
Red Pine			21.0	Cords					
<i>Red Pine</i>		<i>Sawtimber</i>	1.5	<i>MBF</i>					
<i>Red Pine</i>		<i>Pulpwood</i>	18.0	<i>Cords</i>					
White Pine			19.0	Cords					
TOTAL:			50.7	MBF					
TOTAL:			812.0	Cords					

Sale Specific Conditions & Requirements

Sale Name: AuSable Trail Oak

Sale Number: 72-633-16 Seq#: 1

1 - Sale Area

1.2 - Boundaries

1.2.1 - Painted boundaries (1/14)

The sale boundary is marked and identified by blue and red paint, along with an unpainted road. Exterior sale boundary lines against private property are marked with blue paint. Exterior sale boundary lines against state are marked with red paint, with the exception of the east boundary of Payment Unit 1, which is unpainted and identified by the AuSable Trail. The painted boundary line trees are not Included Timber and are to be protected.

2 - Timber Specifications

2.1 - Included Timber

2.1.1 - Clearcut unit(s) with unmerchantable trees (6/14)

Within Payment Unit(s) 1 and 2, cut all trees that are two (2) inches or more at DBH, except do not cut red pine or white pine in Payment Unit 1.

2.1.11 - Description of timber note (2/04)

Note that Miscellaneous Species 1 = dead oak, which is designated for cutting.

2.2 - Utilization

2.2.2 - Chipping required (5/14)

Payment Unit 2 must be chip harvested to facilitate subsequent planting operations. The Purchaser has the option to produce sawlogs or pulpwood bolts, but the remaining portion of the trees must be chipped and hauled. Do not chip 1/6 to 1/3 of the slash from harvested trees (tree tops and limbs less than four inches in diameter).

2.2.3 - Stump heights (4/07)

Stump heights within Payment Unit 2 shall not exceed 6 inches for all trees. This is in order to facilitate planting operations.

3 - Payments

3.3 - Pre-measured Sales

3.3.4 - Dividing payment units (7/14)

Payment Unit(s) may be divided at the request of the Purchaser and upon approval of the Unit Manager. Dividing Payment Units is a contract modification which requires a Timber Sale Contract Supplement.

4 - Transportation

4.1 - Construction

4.1.3 - Slash and earthen piles (8/04)

Piles or windrows of earth along roads and landings that have been widened or constructed shall be leveled. Slash from road maintenance or construction, including stumps, shall be dispersed throughout the sale.

4.1.6 - Road construction (1/09)

Construction of new roads or improvements of existing roads shall be done in such a way as to minimize the environmental and visual impacts. Merchantable trees shall be cut and utilized unless otherwise directed. Non-merchantable trees shall be severed and laid flat on the ground. Slash shall be scattered, and not left in windrows and kept a minimum of 10 feet back from the road edge. Stumps shall be set upright, not left on edge, and be moved at least 10 feet away from the road edge. Disturbed soil shall be feathered into the woods and not left in berms or windrows.

4.1.7 - Road closure (10/11)

All new roads built into the sale must be blocked to vehicle traffic upon completion of the sale. Overgrown roads that are reopened shall be considered new roads. In general, this will require constructing a four (4') foot high berm of stumps and logs covered with earth. Stumps and brush must be placed along the remainder of the trail. These roads must be rendered

impassable to cars and trucks. Contact the sale administrator for specific details of design and placement.

5 - Operations

5.1 - Notification

5.1.1 - Pre-sale conference (10/11)

A pre-sale conference on site between the Purchaser and sale administrator is required prior to beginning any operations to determine landing and road locations. The Unit Manager or his/her representative must be contacted at least 5 days in advance to schedule the conference.

5.1.4 - Post-sale conference (6/11)

A post-sale conference on site between the Purchaser and sale administrator is required 5 days prior to the completion of active logging operations to determine clean-up and repair of landings, road edges, and the fulfillment of other contract specifications.

5.1.5 - National Guard notification (2/15)

This sale is upon lands utilized for training by the Michigan National Guard - Camp Grayling. A minimum of five (5) business days prior to opening this sale, the producer must request that the sale administrator contact the military for information regarding training plans that may impact sale operations.

5.2 - Conduct of Operations

5.2.2 - Hazard Trees/Snags

5.2.2.1 - Den trees (2/04)

Obvious hollow and/or den trees shall be protected and left standing unless they are a safety hazard.

5.2.3 - Operating Restrictions

5.2.3.4 - Oak wilt restriction, no exceptions (1/18)

Within Payment Unit(s) 1 and 2, cutting, skidding, hauling within the sale and brushing of access roads to the sale are not permitted during the period of April 15 to July 15. No exceptions will be granted. This is necessary to reduce the spread of oak wilt.

5.2.32 - Decking/landing restoration (9/13)

All decking and landing areas must have the surface area restored to a condition equal to or better than before. This is to ensure the proper regeneration of the stand. Wood debris, chips and "cookies" from trimmings must be removed or scattered away from landing and loading areas and may not be windrowed on the edge.

5.2.41 - Snowmobile trail protection (9/11)

The snowmobile trail is shown on the Timber Sale Map. Do not cut or damage posts with orange trail markers or traffic control signs. If the trail is used, it must be maintained and restored to a condition equal to or better than before the sale. The road maintenance/restoration must be done prior to December 1. If the trail road is to be used for hauling during the snowmobile season, then a snow covered base must be left on the trail. The snowmobile trail may not be used for any timber sale operations from December 1 to March 31 without written permission from the Unit Manager. The snowmobile trail may only be crossed at right angles. Maintain a 20 foot wide slash, debris, and rut free zone daily using the snowmobile trail as the centerline. No decking of forest products will be permitted along the snowmobile trail. All stumps within 20 feet of the snowmobile trail must be cut at ground level.

5.4 - Soil Protection

5.4.1 - Rutting restriction, general (1/09)

Operations are to cease immediately if equipment and weather conditions result in rutting of roads and skid trails which is 12 inches or greater in depth and 50 feet in length. The Unit Manager or his/her representative may restrict hauling and/or skidding if ruts exceed the specified depth. With the Unit Manager or his/her representative's approval, the Purchaser may return to the area when the risk of rutting has decreased.

6 - Safety and Fire Prevention

6.2 - Signing

6.2.1 - Road posting (9/09)

The Purchaser is responsible for posting and maintaining caution signs on AuSable Trail prior to beginning operations. The road must be posted at appropriate distances from the sale area to warn of logging activity and truck traffic. Signs must be removed when harvest operations are suspended or completed. The Purchaser will provide these signs.

6.2.2 - Snowmobile trail posting (8/09)

The Purchaser is responsible for posting and maintaining caution signs on the snowmobile trail prior to beginning operations during the snowmobile season (approximately December 1 to March 31). The trail must be posted at appropriate distances from the sale area to warn of logging activity and truck traffic. Signs must be removed when harvest operations are suspended or completed. The Purchaser will provide these signs.

7 - Other Conditions

7.5 - Loss

7.5.1 - Deteriorating timber (7/09)

The sale area has received damage from oak decline. The Purchaser should harvest the wood as soon as possible. The Department of Natural Resources is held free of responsibility of any further damage or deterioration due to delay in harvesting.

7.10 - Certified Timber

7.10.1 - Non-certified timber (2/16)

The area encompassed by this timber sale is not certified to the standards of the Forest Stewardship Council (FSC) or the Sustainable Forestry Initiative (SFI). Forest products from this sale may not be delivered to the mill as "FSC and / or SFI certified". The lands within this sale are managed for military training.



Sale Number	Year
72-633	2016

TIMBER SALE MAP

This information provided by authority of Part 525, 1994 PA 451, as amended.

Forest Management Unit Grayling		County Crawford	Mapped By Matt Foster		Date 06/28/2016	Page 1	of 2
Township 26N	Range 04W	Section(s) and Subdivision(s) Sec 3: N1/2N1/2, Sec 2: E1/2NE, NESE			Scale 1:15,840		
Cover Type				Density			
A = Aspen	H = Hemlock	N = Marsh	U = Upland Brush	0 = Non Stocked	5 = Pole Timber Medium		
B = Paper Birch	J = Jack Pine	O = Oak	UM = Upland Mixed	1 = Seedling Sapling Poor	6 = Pole Timber Well		
C = Cedar	L = Lowland Brush	P = Lowland Poplar	V = Bog or Marsh	2 = Seedling Sapling Medium	7 = Saw Timber Poor		
D = Tread Bog	LM = Lowland Mixed	Q = Mixed Swamp Conifer	W = White Pine	3 = Seedling Sapling Well	8 = Saw Timber Medium		
E = Swamp Hdwoods	M = Mpl, Bch, Brch	R = Red Pine	X = Non Stocked	4 = Pole Timber Poor	9 = Saw Timber Well		
F = Spruce Fir	MC = Mixed Conifer	S = Black Spruce	Z = Water				
G = Grass	MD = Mixed Deciduous	T = Tamarack					

PU	Acres
1	31.7
2	42.7

AuSable Trail Oak

Compartment 204

74.4 Acres

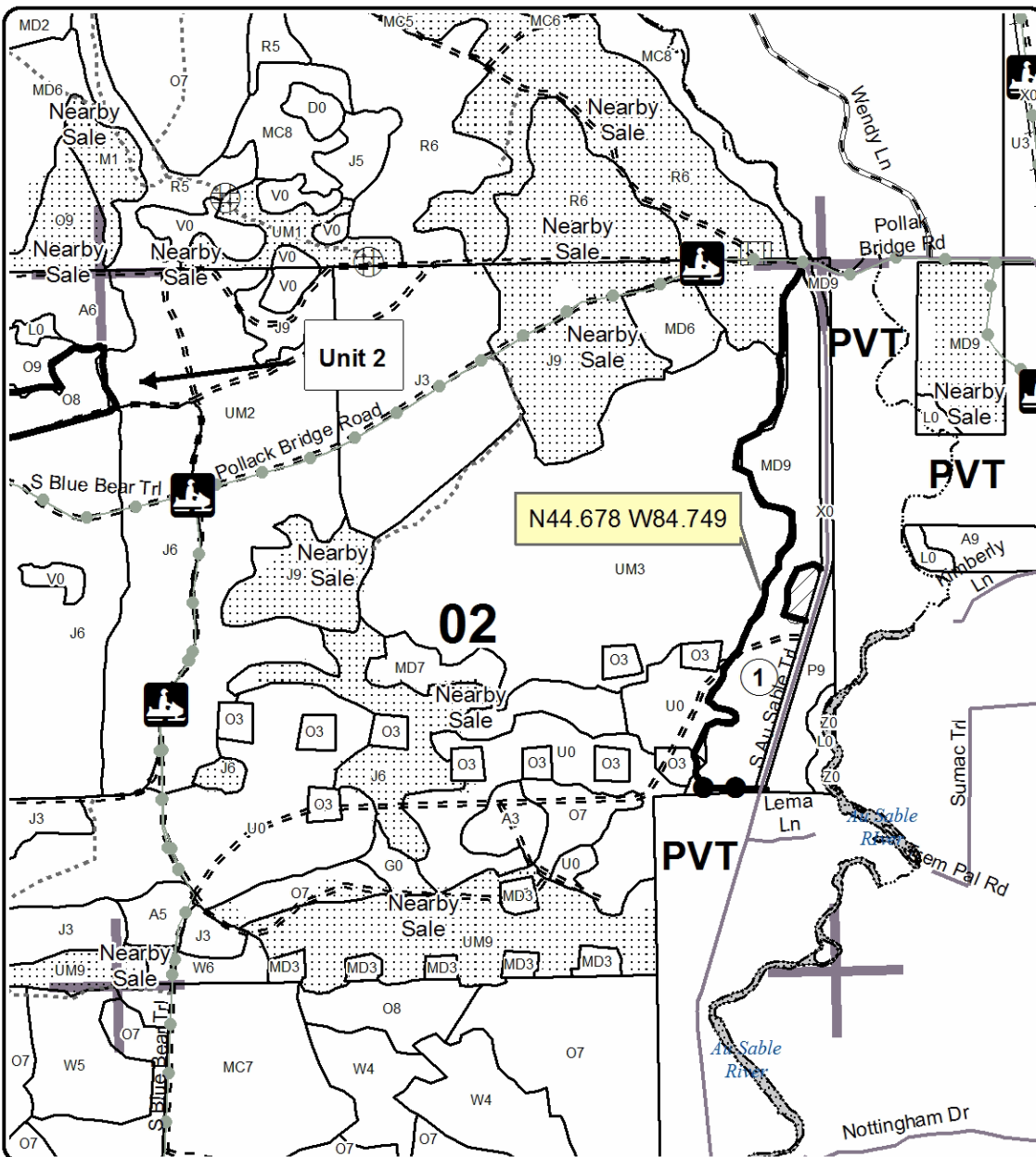
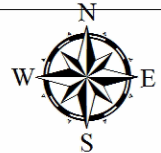

Legend

- Against State (Red)
- Private Line (Blue)
- ▨ Retention Area (Red)
- Section Corners
- Stand Boundaries
- Section Corners
- Paved Roads
- Gravel Roads
- Poor Dirt Roads
- Closed Roads
- Recreational Trail
- Lakes and Rivers
- PU_Label

Locator Map
1:200,000

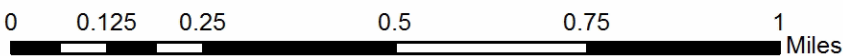
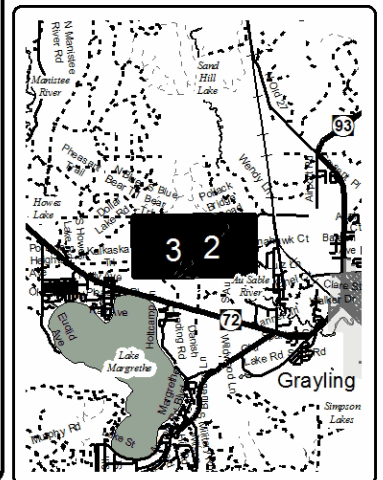



TIMBER SALE MAP

This information provided by authority of Part 525, 1994 PA 451, as amended.

Sale Number	Year
72-633	2016

Forest Management Unit	County	Mapped By	Date	Page	of
Grayling	Crawford	Matt Foster	06/28/2016	2	2
		Cruised By			
		Matt Foster, Tom Peterson			

Township	Range	Section(s) and Subdivision(s)	Scale
26N	04W	Sec 3: N1/2N1/2, Sec 2: E1/2NE, NESE	1:15,840

Cover Type				Density			
A = Aspen	H = Hemlock	N = Marsh	U = Upland Brush	0 = Non Stocked	5 = Pole Timber Medium		
B = Paper Birch	J = Jack Pine	O = Oak	UM = Upland Mixed	1 = Seedling Sapling Poor	6 = Pole Timber Well		
C = Cedar	L = Lowland Brush	P = Lowland Poplar	V = Bog or Marsh	2 = Seedling Sapling Medium	7 = Saw Timber Poor		
D = Treed Bog	LM = Lowland Mixed	Q = Mixed Swamp Conifer	W = White Pine	3 = Seedling Sapling Well	8 = Saw Timber Medium		
E = Swamp Hdwoods	M = Mpl, Bch, Brch	R = Red Pine	X = Non Stocked	4 = Pole Timber Poor	9 = Saw Timber Well		
F = Spruce Fir	MC = Mixed Conifer	S = Black Spruce	Z = Water				
G = Grass	MD = Mixed Deciduous	T = Tamarack					

PU Acres

1	31.7
2	42.7

AuSable Trail Oak

Compartment 204

74.4 Acres

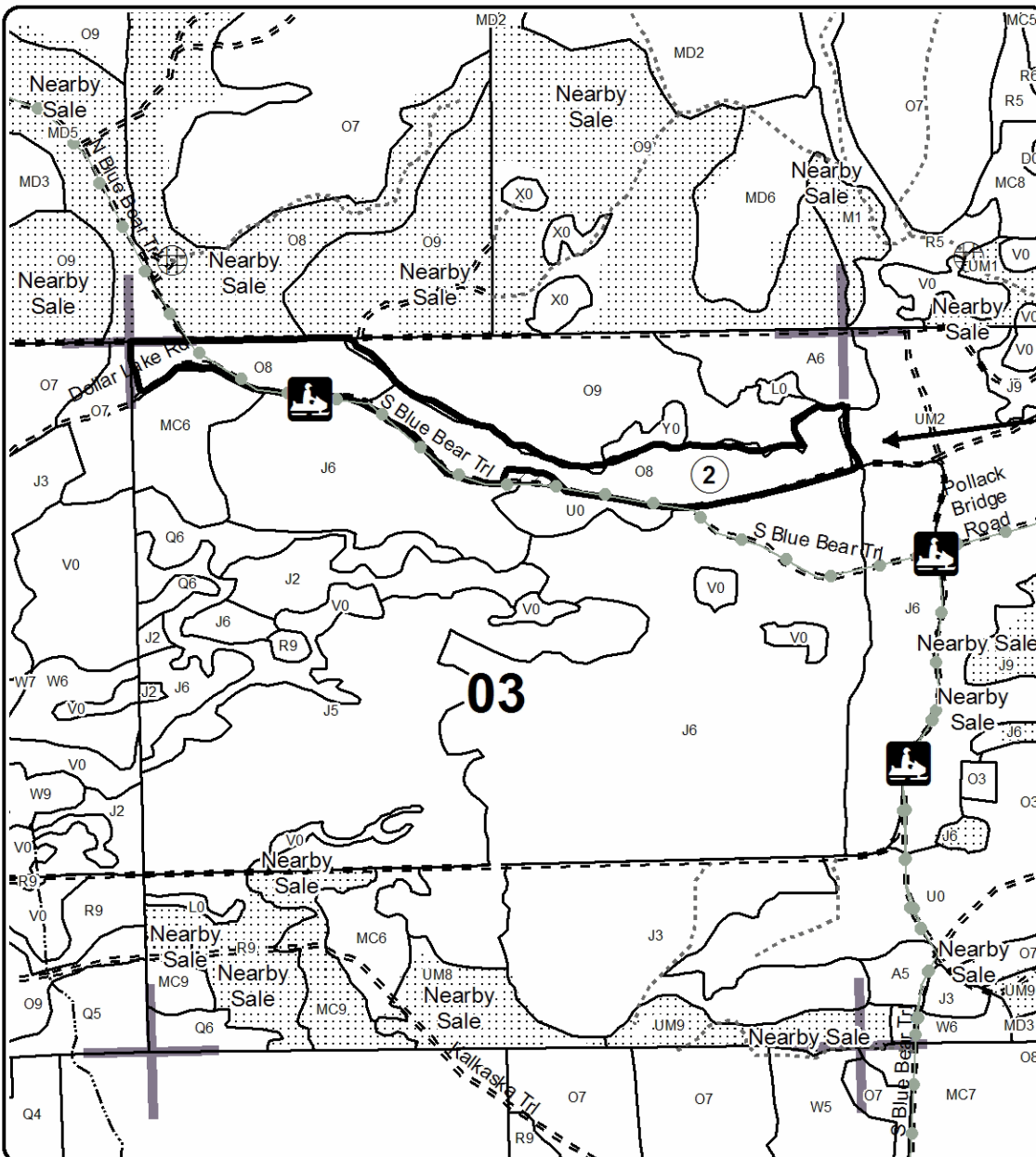
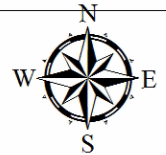

Legend

- Against State (Red)
- Retention Area (Red)
- Section Corners
- Stand Boundaries
- Section Corners
- Poor Dirt Roads
- Closed Roads
- Recreational Trail
- Lakes and Rivers
- PU_Label

Locator Map
1:200,000

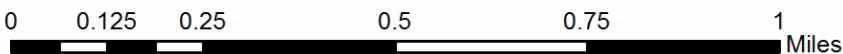
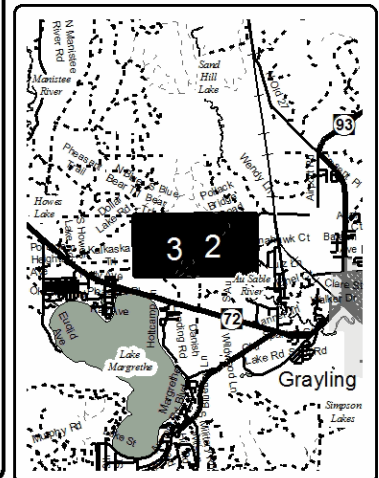

TIMBER SALE INFORMATION

204 Painted Firewood (72-634-16)
 T26N, R04W, SEC. 2; T26N, R04W, SEC. 3.
 Crawford County (Advertised Price \$17,423.00)

SALE NOTE: This sale has oak wilt restrictions and a lot of dead/dying oak. It is encouraged this sale be harvested as soon as possible. The oak wilt restrictions will not be waived or adjusted on this sale due to the presence of oak wilt in the area of the sale.

A recreation site such as a trail, pathway, or campground is within the sale area or the vicinity. Certain restrictions/specifications may be applicable including time restrictions.

A timber sale contract for this lump sum, sealed bid timber sale will be awarded to the responsible bidder offering the highest sealed bid price. Bids must be at or above the following advertised price for each species:

<u>PRODUCTS & SPECIES</u>	<u>ESTIMATED UNITS*</u>	<u>ADVERTISED PRICE</u>
Sawtimber		
Northern Pin Oak	50.10 MBF	\$ 186.00 / MBF
Pulpwood		
Jack Pine	51.00 Cords	\$ 13.55 / Cord
Misc. Species 1	289.00 Cords	\$ 6.50 / Cord
Mixed Aspen	19.00 Cords	\$ 19.60 / Cord
Northern Pin Oak	282.00 Cords	\$ 16.50 / Cord
Red Maple	23.00 Cords	\$ 22.15 / Cord

* The total volume is statistically estimated within plus (+) or minus (-) 12.89 percent. The estimated units are final and not subject to adjustment. Prospective bidders are urged to examine this timber and to make their own estimates of quantity and quality.

BOND AND PAYMENT SCHEDULE:

1. A bond in the amount of \$1,000.00 to insure faithful performance of the conditions of the contract will be deposited by the successful bidder within 21 days of the sale award.
2. Cutting in any sale or unit without the required advance payment would be considered a trespass.
3. Total payment must be paid in advance or according to the following schedule:
 - (a) Ten percent (10%) of the sale value must be paid within 21 days of the sale award.
 - (b) The 10% down payment will be credited towards the first unit cut.
 - (c) Payment for each of the following units must be made before cutting begins in that unit:

<u>PAYMENT UNIT NUMBER</u>	<u>PERCENT OF TOTAL SALE VALUE</u>
01	27.8%
02	22.1%
03	50.1%
4. If no cutting takes place, the 10% down payment will not be refunded.
5. Operations on the contract issued will terminate on 03/31/2021.

Description of Timber by Payment Unit (PU)

PU	MARKET GROUP	PRODUCT	QUANTITY	UNIT	ACRES	ADVERTISE PRICE
1	Northern Pin Oak	Sawtimber	13.3	MBF	15.0	\$4,848.90
	<i>Northern Pin Oak</i>		13.3	<i>MBF</i>		
	Jack Pine	Pulpwood	15.0	Cords		
	<i>Jack Pine</i>		15.0	<i>Cords</i>		
	Misc. Species 1		46.0	Cords		
	Northern Pin Oak		88.0	Cords		
	<i>Northern Pin Oak</i>		88.0	<i>Cords</i>		
	Red Maple		19.0	Cords		
2	Northern Pin Oak	Sawtimber	12.1	MBF	10.9	\$3,859.00
	<i>Northern Pin Oak</i>		11.7	<i>MBF</i>		
	<i>White Oak</i>		0.4	<i>MBF</i>		
	Jack Pine	Pulpwood	12.0	Cords		
	<i>Jack Pine</i>		12.0	<i>Cords</i>		
	Misc. Species 1		23.0	Cords		
	Mixed Aspen		3.0	Cords		
	<i>Quaking Aspen</i>		3.0	<i>Cords</i>		
	Northern Pin Oak		75.0	Cords		
	<i>Northern Pin Oak</i>		73.0	<i>Cords</i>		
	<i>White Oak</i>		2.0	<i>Cords</i>		
	3	Northern Pin Oak	Sawtimber	24.7		
<i>Northern Pin Oak</i>			24.7	<i>MBF</i>		
Jack Pine		Pulpwood	24.0	Cords		
<i>Jack Pine</i>		<i>Sawtimber</i>	1.4	<i>MBF</i>		
<i>Jack Pine</i>		<i>Pulpwood</i>	21.0	<i>Cords</i>		
Misc. Species 1			220.0	Cords		
Mixed Aspen			16.0	Cords		
<i>B. T. Aspen</i>			2.0	<i>Cords</i>		
<i>Quaking Aspen</i>			14.0	<i>Cords</i>		
Northern Pin Oak			119.0	Cords		
<i>Northern Pin Oak</i>			119.0	<i>Cords</i>		
Red Maple			4.0	Cords		
TOTAL:			50.1	MBF		
TOTAL:			664.0	Cords		

Sale Specific Conditions & Requirements

Sale Name: 204 Painted Firewood

Sale Number: 72-634-16 Seq#: 1

1 - Sale Area

1.2 - Boundaries

1.2.1 - Painted boundaries (1/14)

The sale boundary and Payment Unit boundaries are marked and identified by blue, red and yellow paint. Exterior sale boundary lines against private property are marked with blue paint. Exterior sale boundary lines against state are marked with red paint. Interior Payment Unit boundaries are marked with yellow paint. The painted boundary line trees are not Included Timber and are to be protected. Yellow painted trees designating an interior Payment Unit boundary are only to be cut when all surrounding Payment Units have been paid.

2 - Timber Specifications

2.1 - Included Timber

2.1.1 - Clearcut unit(s) with unmerchantable trees (6/14)

Within Payment Unit(s) 1 - 3, cut all trees that are two (2) inches or more at DBH, except do not cut any red pine and white pine, and the following:

Within Payment Unit 1, do not cut any white oak.

Within Payment Unit 2, do not cut any trees marked with green paint.

Within Payment Unit 3, do not cut any white oak and trees marked with green paint.

2.1.11 - Description of timber note (2/04)

Note that Misc. Species 1 = dead oak, which is designated for cutting.

3 - Payments

3.3 - Pre-measured Sales

3.3.4 - Dividing payment units (7/14)

Payment Unit(s) may be divided at the request of the Purchaser and upon approval of the Unit Manager. Dividing Payment Units is a contract modification which requires a Timber Sale Contract Supplement.

3.4 - Damaged Timber

3.4.1 - Damaged timber (6/14)

General Condition and Requirement 3.4 Damaged Timber, defines liquidated damages for undesignated live merchantable trees which are cut or injured.

No damage is acceptable to merchantable trees. Within the sale area, if more than 10% of trees (> 4.5" DBH) within a specified area of the sale are damaged, liquidated damages will be assessed for all trees damaged. Rates will be in accordance with General Condition and Requirement 3.4 Damaged Timber.

4 - Transportation

4.1 - Construction

4.1.3 - Slash and earthen piles (8/04)

Piles or windrows of earth along roads and landings that have been widened or constructed shall be leveled. Slash from road maintenance or construction, including stumps, shall be dispersed throughout the sale.

4.1.6 - Road construction (1/09)

Construction of new roads or improvements of existing roads shall be done in such a way as to minimize the environmental and visual impacts. Merchantable trees shall be cut and utilized unless otherwise directed. Non-merchantable trees shall be

severed and laid flat on the ground. Slash shall be scattered, and not left in windrows and kept a minimum of 10 feet back from the road edge. Stumps shall be set upright, not left on edge, and be moved at least 10 feet away from the road edge. Disturbed soil shall be feathered into the woods and not left in berms or windrows.

4.1.7 - Road closure (10/11)

All new roads built into the sale must be blocked to vehicle traffic upon completion of the sale. Overgrown roads that are reopened shall be considered new roads. In general, this will require constructing a four (4') foot high berm of stumps and logs covered with earth. Stumps and brush must be placed along the remainder of the trail. These roads must be rendered impassable to cars and trucks. Contact the sale administrator for specific details of design and placement.

5 - Operations

5.1 - Notification

5.1.1 - Pre-sale conference (10/11)

A pre-sale conference on site between the Purchaser and sale administrator is required prior to beginning any operations to determine landing and road locations. The Unit Manager or his/her representative must be contacted at least 5 days in advance to schedule the conference.

5.1.4 - Post-sale conference (6/11)

A post-sale conference on site between the Purchaser and sale administrator is required 5 days prior to the completion of active logging operations to determine clean-up and repair of landings, road edges, and the fulfillment of other contract specifications.

5.1.5 - National Guard notification (2/15)

This sale is upon lands utilized for training by the Michigan National Guard - Camp Grayling. A minimum of five (5) business days prior to opening this sale, the producer must request that the sale administrator contact the military for information regarding training plans that may impact sale operations.

5.2 - Conduct of Operations

5.2.1 - Slash

5.2.1.11 - Slash for reforestation (5/07)

To facilitate reforestation, the sale area shall be left with slash evenly distributed. Bunched tops within the cutting area shall be broken up and scattered. Stumps shall be cut low to the ground. Processing sites shall not be left with a compacted layer of slash; tops from these sites shall be hauled back into the cut area and scattered.

5.2.2 - Hazard Trees/Snags

5.2.2.1 - Den trees (2/04)

Obvious hollow and/or den trees shall be protected and left standing unless they are a safety hazard.

5.2.3 - Operating Restrictions

5.2.3.4 - Oak wilt restriction (6/10)

Within Payment Unit(s) 1 - 3, unless changed by written agreement, cutting, skidding, and hauling are not permitted during the period of April 15 to July 15. This is necessary to reduce the spread of oak wilt. For more information, contact the Unit Manager or his/her representative.

5.2.32 - Decking/landing restoration (9/13)

All decking and landing areas must have the surface area restored to a condition equal to or better than before. This is to ensure the proper regeneration of the stand. Wood debris, chips and "cookies" from trimmings must be removed or scattered away from landing and loading areas and may not be windrowed on the edge.

5.2.38 - No decking against live trees (2/04)

Cut products may not be decked against unmarked or designated leave trees.

5.2.41 - Snowmobile trail protection (9/11)

The snowmobile trail is shown on the Timber Sale Map. Do not cut or damage posts with orange trail markers or traffic control signs. If the trail is used, it must be maintained and restored to a condition equal to or better than before the sale. The road maintenance/restoration must be done prior to December 1. If the trail road is to be used for hauling during the

snowmobile season, then a snow covered base must be left on the trail. The snowmobile trail may not be used for any timber sale operations from December 1 to March 31 without written permission from the Unit Manager. The snowmobile trail may only be crossed at right angles. Maintain a 20 foot wide slash, debris, and rut free zone daily using the snowmobile trail as the centerline. No decking of forest products will be permitted along the snowmobile trail.

5.4 - Soil Protection

5.4.1 - Rutting restriction, general (1/09)

Operations are to cease immediately if equipment and weather conditions result in rutting of roads and skid trails which is 12 inches or greater in depth and 50 feet in length. The Unit Manager or his/her representative may restrict hauling and/or skidding if ruts exceed the specified depth. With the Unit Manager or his/her representative's approval, the Purchaser may return to the area when the risk of rutting has decreased.

6 - Safety and Fire Prevention

6.2 - Signing

6.2.2 - Snowmobile trail posting (8/09)

The Purchaser is responsible for posting and maintaining caution signs on the snowmobile trail prior to beginning operations during the snowmobile season (approximately December 1 to March 31). The trail must be posted at appropriate distances from the sale area to warn of logging activity and truck traffic. Signs must be removed when harvest operations are suspended or completed. The Purchaser will provide these signs.

7 - Other Conditions

7.5 - Loss

7.5.1 - Deteriorating timber (7/09)

The sale area has received damage from oak decline. The Purchaser should harvest the wood as soon as possible. The Department of Natural Resources is held free of responsibility of any further damage or deterioration due to delay in harvesting.

7.10 - Certified Timber

7.10.1 - Non-certified timber (2/16)

The area encompassed by this timber sale is not certified to the standards of the Forest Stewardship Council (FSC) or the Sustainable Forestry Initiative (SFI). Forest products from this sale may not be delivered to the mill as "FSC and / or SFI certified". The lands within this sale are managed for military training.



Sale Number	Year
72 - 634	16

TIMBER SALE MAP

This information provided by authority of Part 525, 1994 PA 451, as amended.

Forest Management Unit	County	Mapped By	Date	Page	of
Grayling	Crawford	Matt Foster	06/29/2016	1	1
Township	Range	Section(s) and Subdivision(s)	Scale		
26N	04W	Sec 3: S1/2SE, SESW Sec 2: S1/2SW, SWSE	1:15,840		

Cover Type				Density	
A = Aspen	H = Hemlock	N = Marsh	U = Upland Brush	0 = Non Stocked	5 = Pole Timber Medium
B = Paper Birch	J = Jack Pine	O = Oak	UM = Upland Mixed	1 = Seedling Sapling Poor	6 = Pole Timber Well
C = Cedar	L = Lowland Brush	P = Lowland Poplar	V = Bog or Marsh	2 = Seedling Sapling Medium	7 = Saw Timber Poor
D = Treed Bog	LM = Lowland Mixed	Q = Mixed Swamp Conifer	W = White Pine	3 = Seedling Sapling Well	8 = Saw Timber Medium
E = Swamp Hdwoods	M = Mpl, Bch, Brch	R = Red Pine	X = Non Stocked	4 = Pole Timber Poor	9 = Saw Timber Well
F = Spruce Fir	MC = Mixed Conifer	S = Black Spruce	Z = Water		
G = Grass	MD = Mixed Deciduous	T = Tamarack			

PU Acres

1	15
2	10.9
3	39.6

204 Painted Firewood

Compartment 204

65.5 Acres

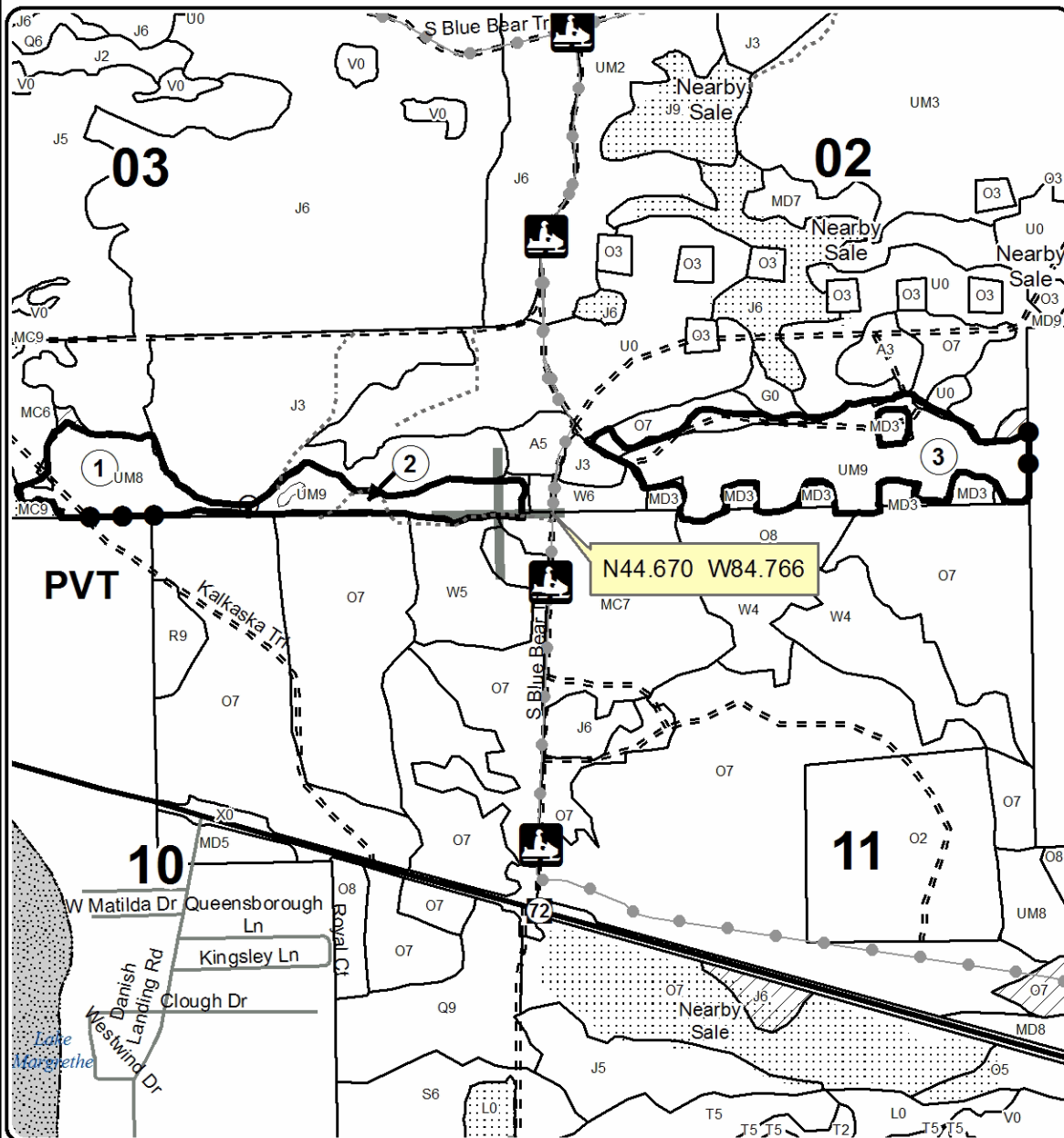
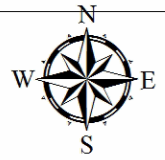

Legend

- Against State (Red)
- Payment Unit (Yellow)
- Private Line (Blue)
- ▨ Retention Area (Red)
- ⋯ Nearby Timber Sale
- ▭ Section Corners
- ▭ Stand Boundaries
- ▭ Section Corners
- Highway
- Paved Roads
- == Poor Dirt Roads
- Closed Roads
- Recreational Trail
- ▨ Lakes and Rivers
- PU_Label

Locator Map 1:200,000

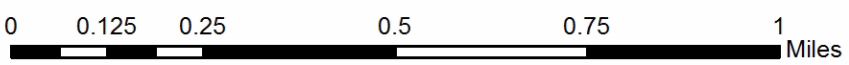
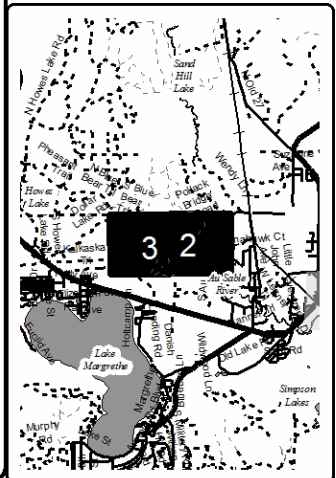

TIMBER SALE INFORMATION

Jamaican Jack (72-635-16)

Crawford County (Advertised Price \$25,284.70)

SALE NOTE: A recreation site such as a trail, pathway, or campground is within the sale area or the vicinity. Certain restrictions/specifications may be applicable including time restrictions.

A timber sale contract for this lump sum, sealed bid timber sale will be awarded to the responsible bidder offering the highest sealed bid price. Bids must be at or above the following advertised price for each species:

<u>PRODUCTS & SPECIES</u>	<u>ESTIMATED UNITS*</u>	<u>ADVERTISED PRICE</u>
Sawtimber		
Northern Pin Oak	37.20 MBF	\$ 214.00 / MBF
Pulpwood		
B. T. Aspen	39.00 Cords	\$ 22.60 / Cord
Jack Pine	631.00 Cords	\$ 15.60 / Cord
Misc. Species 1	116.00 Cords	\$ 6.00 / Cord
Mixed Hardwood	13.00 Cords	\$ 25.60 / Cord
Northern Pin Oak	284.00 Cords	\$ 19.05 / Cord
White Pine	6.00 Cords	\$ 26.65 / Cord

* The total volume is statistically estimated within plus (+) or minus (-) 11.74 percent. The estimated units are final and not subject to adjustment. Prospective bidders are urged to examine this timber and to make their own estimates of quantity and quality.

BOND AND PAYMENT SCHEDULE:

- A bond in the amount of \$1,264.00 to insure faithful performance of the conditions of the contract will be deposited by the successful bidder within 21 days of the sale award.
- Cutting in any sale or unit without the required advance payment would be considered a trespass.
- Total payment must be paid in advance or according to the following schedule:
 - Ten percent (10%) of the sale value must be paid within 21 days of the sale award.
 - The 10% down payment will be credited towards the first unit cut.
 - Payment for each of the following units must be made before cutting begins in that unit:

PAYMENT UNIT NUMBER	PERCENT OF TOTAL SALE VALUE
01	52.5%
02	47.5%
- If no cutting takes place, the 10% down payment will not be refunded.
- Operations on the contract issued will terminate on 03/31/2021.

Description of Timber by Payment Unit (PU)

PU	MARKET GROUP	PRODUCT	QUANTITY	UNIT	ACRES	ADVERTISE PRICE
1	Northern Pin Oak	Sawtimber	21.5	MBF	39.5	\$13,268.75
	B. T. Aspen	Pulpwood	37.0	Cords		
	Jack Pine		346.0	Cords		
	Misc. Species 1		32.0	Cords		
	Mixed Hardwood		2.0	Cords		
	Northern Pin Oak		115.0	Cords		
	2	Northern Pin Oak	Sawtimber	15.7		
B. T. Aspen	Pulpwood	2.0	Cords			
Jack Pine		285.0	Cords			
Misc. Species 1		84.0	Cords			
Mixed Hardwood		11.0	Cords			
Northern Pin Oak		169.0	Cords			
White Pine		6.0	Cords			
TOTAL:			37.2	MBF		
TOTAL:			1,089.0	Cords		

Sale Specific Conditions & Requirements

Sale Name: Jamaican Jack

Sale Number: 72-635-16 Seq#: 2

1 - Sale Area

1.2 - Boundaries

1.2.1 - Painted boundaries (1/14)

The sale boundary and Payment Unit boundaries are marked and identified by red paint, along with a road. Exterior sale boundary lines against state are marked with red paint, with the exception of the north boundary of Payment Unit 1, which is unpainted and identified by Pollack Bridge Road. The painted boundary line trees are not Included Timber and are to be protected.

2 - Timber Specifications

2.1 - Included Timber

2.1.1 - Clearcut unit(s) with unmerchantable trees (6/14)

Within Payment Unit(s) 1 and 2, cut all trees that are two (2) inches or more at DBH, except do not cut red pine or white pine in Payment Unit 1.

2.1.11 - Description of timber note (2/04)

Note that Misc. Species 1 = dead oak, which is designated for cutting.

2.2 - Utilization

2.2.2 - Chipping required (2/18)

This area must be chip harvested to facilitate subsequent planting operations. The requirement to retain approximately 1/6 to 1/3 of tree tops and limbs less than four inches in diameter is still applicable (G. C. & R. 2.2).

2.2.3 - Stump heights (4/07)

Stump heights within the Sale Area shall not exceed 6 inches for all trees. This is in order to facilitate planting operations.

2.2.4 - Skidding length (2/14)

Tree length skidding is required.

3 - Payments

3.3 - Pre-measured Sales

3.3.4 - Dividing payment units (7/14)

Payment Unit(s) may be divided at the request of the Purchaser and upon approval of the Unit Manager. Dividing Payment Units is a contract modification which requires a Timber Sale Contract Supplement.

4 - Transportation

4.1 - Construction

4.1.3 - Slash and earthen piles (8/04)

Piles or windrows of earth along roads and landings that have been widened or constructed shall be leveled. Slash from road maintenance or construction, including stumps, shall be dispersed throughout the sale.

4.1.6 - Road construction (1/09)

Construction of new roads or improvements of existing roads shall be done in such a way as to minimize the environmental and visual impacts. Merchantable trees shall be cut and utilized unless otherwise directed. Non-merchantable trees shall be severed and laid flat on the ground. Slash shall be scattered, and not left in windrows and kept a minimum of 10 feet back from the road edge. Stumps shall be set upright, not left on edge, and be moved at least 10 feet away from the road edge. Disturbed soil shall be feathered into the woods and not left in berms or windrows.

4.1.7 - Road closure (10/11)

All new roads built into the sale must be blocked to vehicle traffic upon completion of the sale. Overgrown roads that are reopened shall be considered new roads. In general, this will require constructing a four (4') foot high berm of stumps and

logs covered with earth. Stumps and brush must be placed along the remainder of the trail. These roads must be rendered impassable to cars and trucks. Contact the sale administrator for specific details of design and placement.

5 - Operations

5.1 - Notification

5.1.1 - Pre-sale conference (10/11)

A pre-sale conference on site between the Purchaser and sale administrator is required prior to beginning any operations to determine landing and road locations. The Unit Manager or his/her representative must be contacted at least 5 days in advance to schedule the conference.

5.1.4 - Post-sale conference (6/11)

A post-sale conference on site between the Purchaser and sale administrator is required 5 days prior to the completion of active logging operations to determine clean-up and repair of landings, road edges, and the fulfillment of other contract specifications.

5.1.5 - National Guard notification (2/15)

This sale is upon lands utilized for training by the Michigan National Guard - Camp Grayling. A minimum of five (5) business days prior to opening this sale, the producer must request that the sale administrator contact the military for information regarding training plans that may impact sale operations.

5.2 - Conduct of Operations

5.2.1 - Slash

5.2.1.11 - Slash for reforestation (5/07)

To facilitate reforestation, the sale area shall be left with slash evenly distributed. Bunched tops within the cutting area shall be broken up and scattered. Stumps shall be cut low to the ground. Processing sites shall not be left with a compacted layer of slash; tops from these sites shall be hauled back into the cut area and scattered.

5.2.2 - Hazard Trees/Snags

5.2.2.1 - Den trees (2/04)

Obvious hollow and/or den trees shall be protected and left standing unless they are a safety hazard.

5.2.3 - Operating Restrictions

5.2.3.5 - Oak wilt restriction (1/18)

Within Payment Unit(s) 1 and 2, unless changed by written agreement, cutting, skidding, hauling within the sale and brushing of access roads to the sale are not permitted during the period of April 15 to July 15. Operations may be allowed if specific steps are taken to prevent damaging uncut oak during the high risk period. Those steps may include completing all road brushing before April 15th and clearing a tree-length buffer along uncut oak cover before April 15th. This is necessary to reduce the spread of oak wilt. For more information, contact the Unit Manager or his/her representative.

5.2.32 - Decking/landing restoration (9/13)

All decking and landing areas must have the surface area restored to a condition equal to or better than before. This is to ensure the proper regeneration of the stand. Wood debris, chips and "cookies" from trimmings must be removed or scattered away from landing and loading areas and may not be windrowed on the edge.

5.2.38 - No decking against live trees (2/04)

Cut products may not be decked against unmarked or designated leave trees.

5.2.41 - Snowmobile trail protection (9/11)

The snowmobile trail is shown on the Timber Sale Map. Do not cut or damage posts with orange trail markers or traffic control signs. If the trail is used, it must be maintained and restored to a condition equal to or better than before the sale. The road maintenance/restoration must be done prior to December 1. If the trail is used for hauling, it must be graded to the satisfaction of the Unit Manager or his/her representative prior to December 1st. If the trail road is to be used for hauling during the snowmobile season, then a snow covered base must be left on the trail. The snowmobile trail may not be used for any timber sale operations from December 1 to March 31 without written permission from the Unit Manager. The

snowmobile trail may only be crossed at right angles. Maintain a 20 foot wide slash, debris, and rut free zone daily using the snowmobile trail as the centerline. No decking of forest products will be permitted along the snowmobile trail. All stumps within 20 feet of the snowmobile trail must be cut at ground level.

5.4 - Soil Protection

5.4.1 - Rutting restriction, general (7/16)

Operations are to cease immediately if equipment and weather conditions result in rutting of roads and/or skid trails which is 12 inches or greater in depth and 50 feet in length. The Unit Manager or his/her representative may restrict hauling and/or skidding if ruts exceed the specified depth. With the Unit Manager or his/her representative's approval, the Purchaser may return to the area when the risk of rutting has decreased.

6 - Safety and Fire Prevention

6.2 - Signing

6.2.1 - Road posting (9/09)

The Purchaser is responsible for posting and maintaining caution signs on Pollack Bridge Rd prior to beginning operations. The road must be posted at appropriate distances from the sale area to warn of logging activity and truck traffic. Signs must be removed when harvest operations are suspended or completed. The Purchaser will provide these signs.

6.2.2 - Snowmobile trail posting (8/09)

The Purchaser is responsible for posting and maintaining caution signs on the snowmobile trail prior to beginning operations during the snowmobile season (approximately December 1 to March 31). The trail must be posted at appropriate distances from the sale area to warn of logging activity and truck traffic. Signs must be removed when harvest operations are suspended or completed. The Purchaser will provide these signs.

7 - Other Conditions

7.10 - Certified Timber

7.10.1 - Non-certified timber (2/16)

The area encompassed by this timber sale is not certified to the standards of the Forest Stewardship Council (FSC) or the Sustainable Forestry Initiative (SFI). Forest products from this sale may not be delivered to the mill as "FSC and / or SFI certified". The lands within this sale are managed for military training.



Sale Number	Year
72 - 635	16

TIMBER SALE MAP

This information provided by authority of Part 525, 1994 PA 451, as amended.

Forest Management Unit	County	Mapped By	Date	Page	of
Grayling	Crawford	Matt Foster	07/25/2016	1	1
		Cruised By			
		Matt Foster, Tom Peterson			

Township	Range	Section(s) and Subdivision(s)	Scale
26N	04W	Section 2: N1/2NE, S1/2NW, SW1/4, NWSE, SWNE	1:15,840

Cover Type				Density	
A = Aspen	H = Hemlock	N = Marsh	U = Upland Brush	0 = Non Stocked	5 = Pole Timber Medium
B = Paper Birch	J = Jack Pine	O = Oak	UM = Upland Mixed	1 = Seedling Sapling Poor	6 = Pole Timber Well
C = Cedar	L = Lowland Brush	P = Lowland Poplar	V = Bog or Marsh	2 = Seedling Sapling Medium	7 = Saw Timber Poor
D = Tread Bog	LM = Lowland Mixed	Q = Mixed Swamp Conifer	W = White Pine	3 = Seedling Sapling Well	8 = Saw Timber Medium
E = Swamp Hdwoods	M = Mpl, Bch, Brch	R = Red Pine	X = Non Stocked	4 = Pole Timber Poor	9 = Saw Timber Well
F = Spruce Fir	MC = Mixed Conifer	S = Black Spruce	Z = Water		
G = Grass	MD = Mixed Deciduous	T = Tamarack			

PU Acres

1	39.5
2	38

Jamaican Jack

Compartment 204

77.5 Acres

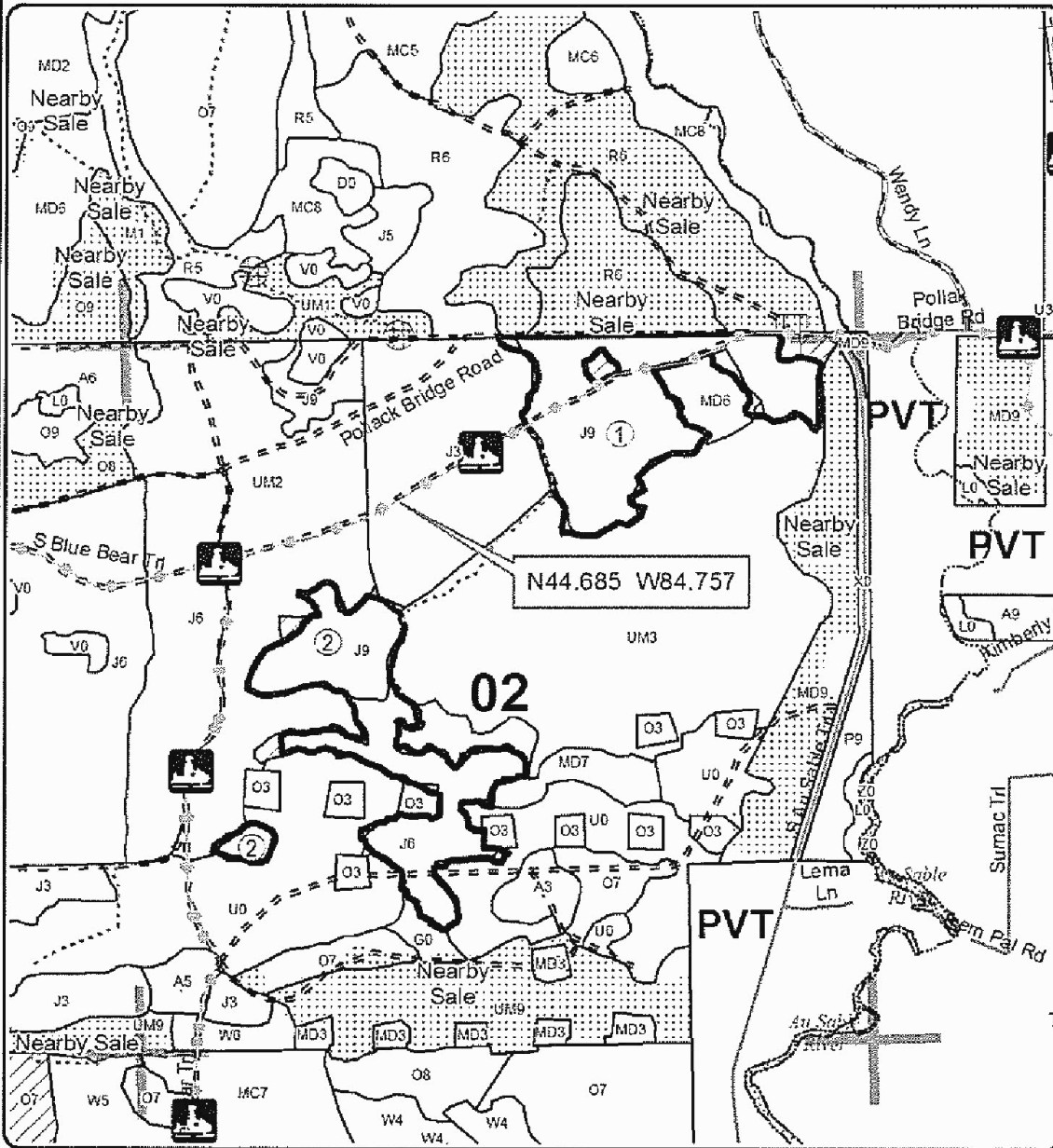
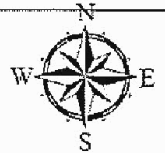

Legend	
	Against State (Red)
	Retention Area (Red)
	Section Corners
	Stand Boundaries
	Section Corners
	Paved Roads
	Gravel Roads
	Poor Dirt Roads
	Closed Roads
	Recreational Trail
	Lakes and Rivers

⊙ PU Label

Locator Map 1:200,000

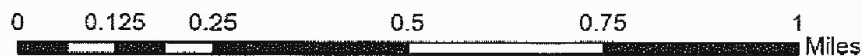
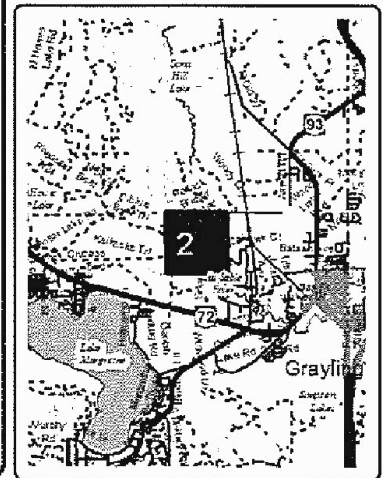

TIMBER SALE INFORMATION

SCALE SALE LOWLAND (72-009-15)
T28N, R01W, SEC. 09; T28N, R01W, SEC. 16.
Crawford County (Advertised Price \$7,640.00)

A timber sale contract for this scaled, sealed bid timber sale will be awarded to the responsible bidder offering the highest sealed bid price. Bids must be at or above the following advertised price for each species:

<u>PRODUCTS & SPECIES</u>	<u>ESTIMATED UNITS*</u>	<u>ADVERTISED PRICE</u>
Pulpwood		
Mixed Softwood	800.00 Cords	\$ 9.55 / Cord

* The total volume is statistically estimated within plus (+) or minus (-) 49.40 percent. The estimated units are final and not subject to adjustment. Prospective bidders are urged to examine this timber and to make their own estimates of quantity and quality.

BOND AND PAYMENT SCHEDULE:

1. A bond in the amount of \$1,000.00 to insure faithful performance of the conditions of the contract will be deposited by the successful bidder within 21 days of the sale award.
2. Cutting in any sale or unit without the required advance payment would be considered a trespass.
3. Total payment must be paid in advance or according to the following schedule:
 - (a) Ten percent (10%) of the sale value must be paid within 21 days of the sale award.
 - (b) The remainder is due before cutting begins.
 - (c) Payment for each of the following units must be made before cutting begins in that unit:

<u>PAYMENT UNIT NUMBER</u>	<u>PERCENT OF TOTAL SALE VALUE</u>
01	100.0%

4. If no cutting takes place, the 10% down payment will not be refunded.
5. Operations on the contract issued will terminate on 12/31/2021.

Sale Specific Conditions & Requirements

Sale Name: SCALE SALE LOWLAND

Sale Number: 72-009-15 Seq#: 2

1 - Sale Area

1.2 - Boundaries

1.2.1 - Painted boundaries (1/14)

The sale boundary will be marked and identified by blue and red paint after contract award. The sale is comprised of two stands for a total of eighty acres. This is a scale sale and the boundaries are identified on the map, no boundaries were painted in advance. The stand's natural boundaries will be followed, where possible. The DNR will put in the lines within three weeks of the bid opening. Exterior sale boundary lines against private property will be marked with blue paint. Exterior sale boundary lines against State will be marked with red paint. Do not cut painted boundary lines trees.

2 - Timber Specifications

2.1 - Included Timber

2.1.4 - Designated timber unit(s) (6/17)

Within Payment Unit(s) 1, all black spruce and tamarack are designated for cutting which meet minimum piece specifications in 2.2 - Utilization. In addition, no cedar are to be cut, and all regeneration 4 inches and under are to be protected as much as possible. See spec 5.2.1.8 for equipment requirements.

2.1.11 - Description of timber note (2/04)

Note that this is a scale sale. The volume of the contract will depend on the actual volume removed. The contract sale volume is a estimate based on a few cruise plots. The mixed softwood is a combination of black spruce and tamarack.

2.2 - Utilization

2.2.3 - Stump heights (4/07)

Stump heights within the Sale Area shall not exceed 6 inches for all trees. A written waiver of this requirement may be obtained if wet summer weather makes winter logging necessary.

2.2.9 - No chipping permitted (12/08)

Within Payment Unit(s) 1, tops may not be chipped.

3 - Payments

3.2 - Scaled Sales

3.2.1 - Scale location (2/04)

Forest products will be placed for measurement at designated landings. (No tops are to be chipped)

3.4 - Damaged Timber

3.4.1 - Damaged timber (6/14)

General Condition and Requirement 3.4 Damaged Timber, defines liquidated damages for undesignated live merchantable trees which are cut or injured. In addition, extreme care should be taken to avoid damage to tree seedlings and saplings.

Within the sale area, if more than 25% of the tree seedlings or saplings (1/4" to 4.5" DBH) within a specified portion of the sale area are damaged, liquidated damages will be assessed at \$300 per acre for all acreage within that specified portion of the sale area that was damaged.

No damage is acceptable to merchantable trees. Within the sale area, if more than 5% of trees (> 4.5" DBH) within a specified area of the sale are damaged, liquidated damages will be assessed for all trees damaged. Rates will be in accordance with General Condition and Requirement 3.4 Damaged Timber.

4 - Transportation

4.1 - Construction

4.1.3 - Slash and earthen piles (8/04)

Piles or windrows of earth along roads and landings that have been widened or constructed shall be leveled. Slash from road maintenance or construction, including stumps, shall be dispersed throughout the sale.

4.1.6 - Road construction (1/09)

Construction of new roads or improvements of existing roads shall be done in such a way as to minimize the environmental and visual impacts. Merchantable trees shall be cut and utilized unless otherwise directed. Non-merchantable trees shall be severed and laid flat on the ground. Slash shall be chipped, utilized or dispersed throughout the sale. Stumps shall be set upright, not left on edge, and be moved at least 10 feet away from the road edge. Disturbed soil shall be feathered into the woods and not left in berms or windrows.

4.1.7 - Road closure (10/11)

All new roads built into the sale must be blocked to vehicle traffic upon completion of the sale. Overgrown roads that are reopened shall be considered new roads. In general, this will require constructing a four (4') foot high berm of stumps and logs covered with earth. Stumps and brush must be placed along the remainder of the trail. Temporary berms may be required if no sale activity occurs for 30 or more consecutive days. Contact the sale administrator for specific details of design and placement.

4.1.11 - Permits (2/12)

The Purchaser will secure any necessary permits that may be required.

4.2 - Maintenance

4.2.5 - Two wheel drive condition (2/04)

All existing trail roads on and adjacent to the sale area must be passable by two-wheel drive traffic for the duration of the sale.

5 - Operations

5.1 - Notification

5.1.1 - Pre-sale conference (10/11)

A pre-sale conference on site between the Purchaser and sale administrator is required prior to beginning any operations to determine landing and road locations. The Unit Manager or his/her representative must be contacted at least 5 days in advance to schedule the conference.

5.1.4 - Post-sale conference (6/11)

A post-sale conference on site between the Purchaser and sale administrator is required 5 days prior to the completion of active logging operations to determine clean-up and repair of landings, road edges, and the fulfillment of other contract specifications.

5.2 - Conduct of Operations

5.2.2 - Hazard Trees/Snags

5.2.2.1 - Den trees (2/04)

Obvious hollow and/or den trees shall be protected and left standing unless they are a safety hazard.

5.2.4 - Dead and Down Creation

5.2.4.2 - Dead and down creation, hare and grouse (1/14)

To improve habitat for snowshoe hare, grouse, and other species, the Purchaser is to leave three conifer trees, with a minimum height of twenty feet (20 feet) per tree on the ground for every acre. A variety of different diameter trees are encouraged to be used. Habitat trees should be scattered throughout the sale or positioned per the sale administrators instructions. If possible, and if operations allow, ideally one end of the habitat should be left elevated off the ground 2-3 feet. They can be of any tree species and can be an un-merchantable piece of wood or a full tree. If scattered leave trees poses a hazard or interferes with operations, work with the sale administrator to find alternatives. The logs or trees should be felled so they overlap, if possible.

5.2.17 - Crane Mats/Timber Mats (10/14)

Some roads or skid trails may require extra protection such as that afforded by Crane Mats/Timber Mats. If available, Crane

Mats/Timber Mats may be borrowed from the DNR and are located at the Marquette ICC and the Grayling Field Office. Contact the sale administrator for specific details. A Timber Sale Contract Supplement will be used to document the Purchaser's use of the DNR's Crane Mats/Timber Mats. It is the responsibility of the Purchaser to contact the sale administrator to schedule pick up and drop off. In addition, all mats must be cleaned prior to drop off. A charge of \$350.00 NLP will be assessed for all damaged or non-returned mats. Damage is defined as misuse resulting in three or more broken cants.

5.2.18 - Equipment requirements (1/09)

All harvesting is to be done with "cut-to-length" tracked or 6-wheeled harvester. All forwarding is to be done with eight-tired articulated machinery, or six tired with high flotation tires in the front. All rubber-tired machines must be equipped with tracks over the tanderm tires. A written waiver of these requirement may be obtained from the Unit Manager.

5.2.38 - No decking against live trees (2/04)

Cut products may not be decked against unmarked or designated leave trees.

5.4 - Soil Protection

5.4.1 - Rutting restriction, general (1/09)

The sale is on low ground, with the water table at or near the surface. These saturated soil conditions pose a high risk of rutting, which may limit the type of equipment that can be used. The Unit manager or his/her representative must be contacted if equipment and weather conditions result in rutting of roads or skid trails which is 12 inches or greater in depth and 50 feet in length. The Unit Manager or his/her representative may restrict hauling and/or skidding if ruts exceed the specified depth. With the Unit Manager or his/her representative's approval, the Purchaser may return to the area when the risk of rutting has decreased.

6 - Safety and Fire Prevention

6.2 - Signing

6.2.1 - Road posting (9/09)

The Purchaser is responsible for posting and maintaining caution signs on Boondocks Road prior to beginning operations. The road must be posted at appropriate distances from the sale area to warn of logging activity and truck traffic. Signs must be removed when harvest operations are suspended or completed. The DNR will provide these signs.

7 - Other Conditions

7.2 - Extensions

7.2.5 - Weather related extension (1/13)

If weather conditions during the operating period of this contract prevent harvesting, this sale may qualify for a weather related extension. If approved, the normal extension fee would be waived. To qualify, there must be a documented attempt each year to harvest in the difficult portion of the sale.



TIMBER SALE MAP

This information provided by authority of Part 525, 1994 PA 451, as amended.

Forest Management Unit	County	Mapped By	Date	Page	of
Graying Management Unit	Crawford	Patrick L. Potter	12/30/2014	1	1
Township	Range	Section(s) and Subdivision(s)	Scale		
28N	01W	Sec 09 - W1/2SE & E1/2SW, Sec 16 - NWNE & NENW	1" = 115,840		

Cover Type				Density	
A = Aspen	J = Jack Pine	O = Oak	U = Upland Brush	0 = Non Stocked	5 = Pole Timber Medium
B = Paper Birch	K = Rock	P = Lowland Poplar	UM = Upland Mix Forest	1 = Seedling Sapling Poor	6 = Pole Timber Well
C = Cedar	L = Lowland Brush	Q = Mixed Swamp Conifer	V = Bog or Marsh	2 = Seedling Sapling Medium	7 = Saw Timber Poor
D = Treed Bog	LM = Lowland Mix Forest	R = Red Pine	W = White Pine	3 = Seedling Sapling Well	8 = Saw Timber Medium
E = Swamp Hardwoods	M = Maple, Beech, Birch	S = Black Spruce	X = Non Stocked	4 = Pole Timber Poor	9 = Saw Timber Well
F = Spruce/Fir	MC = Mixed Conifer	T = Tamarack	Y = Sand		
G = Grass	MD = Mixed Deciduous		Z = Water		
H = Hemlock	N = Marsh				

Stand #	Acres
10	47
14	33

SCALE SALE LOWLAND

Compartment 273

80 Acres

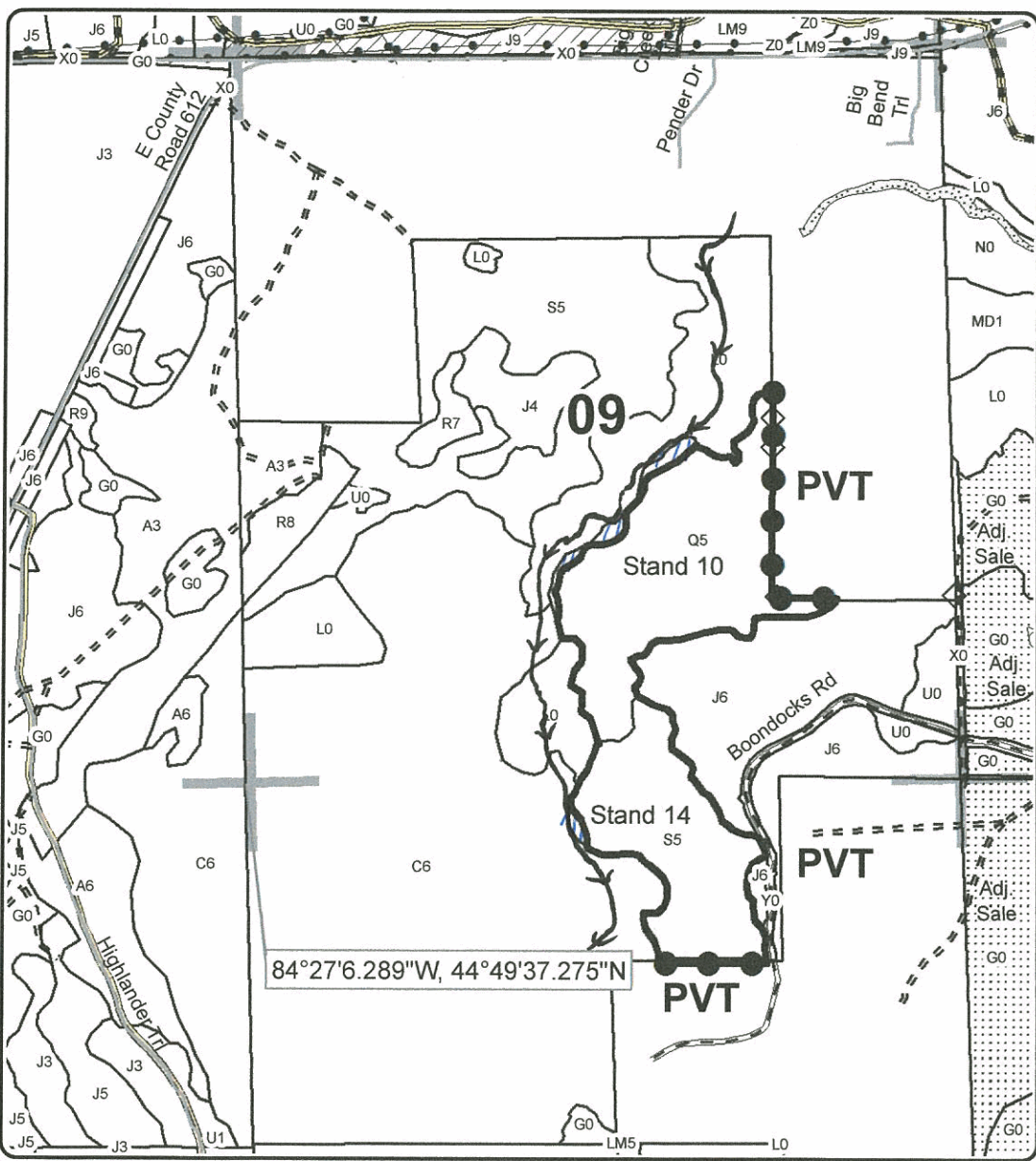

Sale Boundary

- Against State (Red)
- Private Line (Blue)
- ⋯ Adjacent Timber Sale
- ▣ Section Corners
- Paved
- ▨ Gravel
- - - Poor Dirt

retention
W. Br. Big Creek

Locator Map
1:200,000

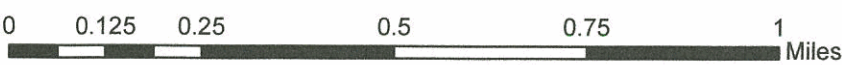
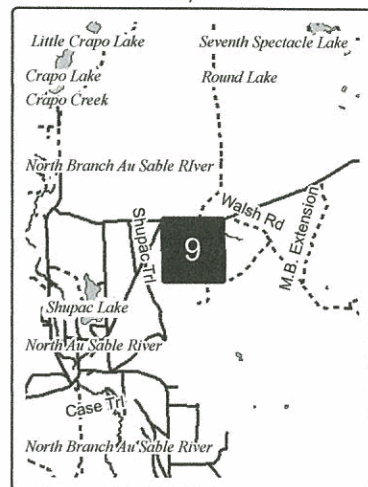

AuSable Trail Oak (72-633-16)
T26N, R04W, SEC. 2; T26N, R04W, SEC. 3; Crawford COUNTY

In response to the notice of sale to be held 9:00 a.m. (local time) on October 30, 2018, I am hereby submitting my sealed bid (firm offer) for the following forest products to be cut. Bids for individual species must be at or above the advertised price. All non-responsive bid forms may be rejected.

<u>PRODUCTS & SPECIES</u>	<u>ESTIMATED VOLUME*</u>	<u>ADVERTISED PRICE</u>	<u>BID PRICE/UNIT</u>
Sawtimber			
Mixed Oak	50.70 MBF	\$ 214.00/MBF	\$ _____
Pulpwood			
Jack Pine	88.00 Cords	\$ 15.60/Cord	\$ _____
Misc. Species 1	221.00 Cords	\$ 7.50/Cord	\$ _____
Mixed Hardwood	49.00 Cords	\$ 25.60/Cord	\$ _____
Mixed Oak	393.00 Cords	\$ 19.05/Cord	\$ _____
Quaking Aspen	21.00 Cords	\$ 22.60/Cord	\$ _____
Red Pine	21.00 Cords	\$ 46.05/Cord	\$ _____
White Pine	19.00 Cords	\$ 26.65/Cord	\$ _____

*The volumes are statistically estimated within plus (+) or minus (-) 14.90 percent. These estimated volumes are final and not subject to adjustment. Prospective bidders are urged to examine this timber and to make their own estimates of quantity and quality.

I understand that any or all bids may be rejected. All bids must be signed and all bid items must be bid or the bid form may be rejected. I also understand that consideration and awarding a contract will be based upon my past performance and ability to complete the contract based upon equipment and staffing subject to my control.

FEDERAL ID: ____ - ____ - ____ or SOCIAL SECURITY NUMBER: ____ - ____ - ____

Company or individual bidding: _____

Company representative's name: _____

Address: _____

City: _____ State: _____ Zip: _____

IF AVAILABLE, PLEASE PLACE THE PERSONALIZED LABEL FROM YOUR PROSPECTUS IN THE ABOVE BOX.

Individual or company representative's signature: _____ Date: _____

Phone number : _____ Email (optional): _____

THE WINNING BIDDER MUST COMPLETE THE VERIFICATION OF WORKER'S DISABILITY COMPENSATION ACT COMPLIANCE (ON REVERSE SIDE IF DOUBLE SIDED) WITHIN 21 DAYS OF SALE AWARD DATE

204 Painted Firewood (72-634-16)
T26N, R04W, SEC. 2; T26N, R04W, SEC. 3; Crawford COUNTY

In response to the notice of sale to be held 9:00 a.m. (local time) on October 30, 2018, I am hereby submitting my sealed bid (firm offer) for the following forest products to be cut. Bids for individual species must be at or above the advertised price. All non-responsive bid forms may be rejected.

<u>PRODUCTS & SPECIES</u>	<u>ESTIMATED VOLUME*</u>	<u>ADVERTISED PRICE</u>	<u>BID PRICE/UNIT</u>
Sawtimber			
Northern Pin Oak	50.10 MBF	\$ 186.00/MBF	\$ _____
Pulpwood			
Jack Pine	51.00 Cords	\$ 13.55/Cord	\$ _____
Misc. Species 1	289.00 Cords	\$ 6.50/Cord	\$ _____
Mixed Aspen	19.00 Cords	\$ 19.60/Cord	\$ _____
Northern Pin Oak	282.00 Cords	\$ 16.50/Cord	\$ _____
Red Maple	23.00 Cords	\$ 22.15/Cord	\$ _____

*The volumes are statistically estimated within plus (+) or minus (-) 12.89 percent. These estimated volumes are final and not subject to adjustment. Prospective bidders are urged to examine this timber and to make their own estimates of quantity and quality.

I understand that any or all bids may be rejected. All bids must be signed and all bid items must be bid or the bid form may be rejected. I also understand that consideration and awarding a contract will be based upon my past performance and ability to complete the contract based upon equipment and staffing subject to my control.

FEDERAL ID: _____ or SOCIAL SECURITY NUMBER: _____

Company or individual bidding: _____

Company representative's name: _____

Address: _____

City: _____ State: _____ Zip: _____

IF AVAILABLE, PLEASE PLACE THE PERSONALIZED LABEL FROM YOUR PROSPECTUS IN THE ABOVE BOX.

Individual or company representative's signature: _____ Date: _____

Phone number : _____ Email (optional): _____

THE WINNING BIDDER MUST COMPLETE THE VERIFICATION OF WORKER'S DISABILITY COMPENSATION ACT COMPLIANCE (ON REVERSE SIDE IF DOUBLE SIDED) WITHIN 21 DAYS OF SALE AWARD DATE



FOR DEPARTMENT USE ONLY
Sale Number (XX - XXX - XX - XX)
Forest Management Unit:

TIMBER SALE VERIFICATION OF WORKER'S DISABILITY COMPENSATION ACT COMPLIANCE

*As required by Act 317, P.A. 1969 (Worker's Compensation) and
Part 5 of Act 451 of 1994, as amended.*

VERIFICATION OF WORKER'S DISABILITY COMPENSATION ACT COMPLIANCE

- This verification must be completed and submitted within 21 days of contract award and prior to the issuance of the timber sale contract.
- In addition, if boxes 2B or 2C are checked, then Notice of Exclusion or Certificate of Insurance must be submitted within twenty-one (21) days of the contract award and prior to the issuance of the timber sale contract.
- All information must be typed or printed except for written signatures.

Please Check Appropriate Categories:

1. My business is organized as (you **must** check one of the boxes below):
 - A. Sole Proprietorship (individual)
 - B. Partnership
 - C. Corporation

2. You **must** check one of the boxes below:
 - A. I certify my business is a sole proprietorship and it has no employees but the sole proprietor. I am not subject to the Worker's Compensation Laws.
 - B. I certify my business has satisfied its obligation to the Worker's Compensation Act through the use of an approved Notice of Exclusion (BWC-337, Rev. 5/96). I will provide a copy of the Notice of Exclusion within 21 days of the contract award. (For questions or a copy of the BWC-337, please call the Worker's Compensation Bureau at 517-322-1195).
 - C. I certify my business has a Worker's Compensation Policy. I will provide an original Certificate of Insurance within twenty-one (21) days of the contract award.

3. If you have checked item 2(A) or 2(B), you **must** indicate the number of **both** full-time and part-time employees, other than yourself, including family members and active partners (if none, you must enter "0").

_____ Full-time Employees

_____ Part-time Employees

Name of Business		Federal ID (or) Social Security No.	
Address		Telephone ()	
City	State	ZIP	

I hereby certify that the above information is true and correct. I agree to notify the Michigan DNR of any changes that occur in factors affecting my coverage during any of my present and future operations.

Signature of Owner or Authorized Representative

Title

Date

Please complete the "SEALED BID" information on the next page

Conners Mixed Conifers (72-639-17)

T26N, R01W, SEC. 6; T26N, R02W, SEC. 1; T27N, R02W, SEC. 36; Crawford

In response to the notice of sale to be held 9:00 a.m. (local time) on October 30, 2018, I am hereby submitting my sealed bid (firm offer) for the following forest products to be cut. Bids for individual species must be at or above the advertised price. All non-responsive bid forms may be rejected.

<u>PRODUCTS & SPECIES</u>	<u>ESTIMATED VOLUME*</u>	<u>ADVERTISED PRICE</u>	<u>BID PRICE/UNIT</u>
Sawtimber			
Northern Pin Oak	13.90 MBF	\$ 171.00/MBF	\$ _____
Red Pine	255.80 MBF	\$ 103.00/MBF	\$ _____
White Pine	21.80 MBF	\$ 57.00/MBF	\$ _____
Pulpwood			
Balsam Fir	55.00 Cords	\$ 10.30/Cord	\$ _____
Black Spruce	133.00 Cords	\$ 21.25/Cord	\$ _____
Jack Pine	142.00 Cords	\$ 12.50/Cord	\$ _____
Mixed Aspen	35.00 Cords	\$ 18.10/Cord	\$ _____
Mixed Hardwood	29.00 Cords	\$ 20.45/Cord	\$ _____
Mixed Oak	161.00 Cords	\$ 15.25/Cord	\$ _____
Red Pine	300.00 Cords	\$ 36.85/Cord	\$ _____
White Pine	138.00 Cords	\$ 21.30/Cord	\$ _____

*The volumes are statistically estimated within plus (+) or minus (-) 11.28 percent. These estimated volumes are final and not subject to adjustment. Prospective bidders are urged to examine this timber and to make their own estimates of quantity and quality.

I understand that any or all bids may be rejected. All bids must be signed and all bid items must be bid or the bid form may be rejected. I also understand that consideration and awarding a contract will be based upon my past performance and ability to complete the contract based upon equipment and staffing subject to my control.

FEDERAL ID: _____ or SOCIAL SECURITY NUMBER: _____

Company or individual bidding: _____

Company representative's name: _____

Address: _____

City: _____ State: _____ Zip: _____

IF AVAILABLE, PLEASE PLACE THE PERSONALIZED LABEL FROM YOUR PROSPECTUS IN THE ABOVE BOX.

Individual or company representative's signature: _____ Date: _____

Phone number : _____ Email (optional): _____

THE WINNING BIDDER MUST COMPLETE THE VERIFICATION OF WORKER'S DISABILITY COMPENSATION ACT COMPLIANCE (ON REVERSE SIDE IF DOUBLE SIDED) WITHIN 21 DAYS OF SALE AWARD DATE



FOR DEPARTMENT USE ONLY	
Sale Number (XX - XXX - XX - XX)	
Forest Management Unit:	

TIMBER SALE VERIFICATION OF WORKER'S DISABILITY COMPENSATION ACT COMPLIANCE

As required by Act 317, P.A. 1969 (Worker's Compensation) and
Part 5 of Act 451 of 1994, as amended.

VERIFICATION OF WORKER'S DISABILITY COMPENSATION ACT COMPLIANCE

- This verification must be completed and submitted within 21 days of contract award and prior to the issuance of the timber sale contract.
- In addition, if boxes 2B or 2C are checked, then Notice of Exclusion or Certificate of Insurance must be submitted within twenty-one (21) days of the contract award and prior to the issuance of the timber sale contract.
- All information must be typed or printed except for written signatures.

Please Check Appropriate Categories:

1. My business is organized as (you **must** check one of the boxes below):
 - A. Sole Proprietorship (individual)
 - B. Partnership
 - C. Corporation
2. You **must** check one of the boxes below:
 - A. I certify my business is a sole proprietorship and it has no employees but the sole proprietor. I am not subject to the Worker's Compensation Laws.
 - B. I certify my business has satisfied its obligation to the Worker's Compensation Act through the use of an approved Notice of Exclusion (BWC-337, Rev. 5/96). I will provide a copy of the Notice of Exclusion within 21 days of the contract award. (For questions or a copy of the BWC-337, please call the Worker's Compensation Bureau at 517-322-1195).
 - C. I certify my business has a Worker's Compensation Policy. I will provide an original Certificate of Insurance within twenty-one (21) days of the contract award.
3. If you have checked item 2(A) or 2(B), you **must** indicate the number of **both** full-time and part-time employees, other than yourself, including family members and active partners (if none, you must enter "0").

_____ Full-time Employees

_____ Part-time Employees

Name of Business		Federal ID (or) Social Security No.	
Address		Telephone ()	
City	State	ZIP	

I hereby certify that the above information is true and correct. I agree to notify the Michigan DNR of any changes that occur in factors affecting my coverage during any of my present and future operations.

Signature of Owner or Authorized Representative

Title

Date

Please complete the "SEALED BID" information on the next page

Big Storm Mix (72-032-17)
T25N, R01W, SEC. 18; T25N, R01W, SEC. 7; Crawford COUNTY

In response to the notice of sale to be held 9:00 a.m. (local time) on October 30, 2018, I am hereby submitting my sealed bid (firm offer) for the following forest products to be cut. Bids for individual species must be at or above the advertised price. All non-responsive bid forms may be rejected.

<u>PRODUCTS & SPECIES</u>	<u>ESTIMATED VOLUME*</u>	<u>ADVERTISED PRICE</u>	<u>BID PRICE/UNIT</u>
Sawtimber			
Mixed Aspen	76.10 MBF	\$ 80.00/MBF	\$ _____
Red Maple	10.70 MBF	\$ 50.00/MBF	\$ _____
Red Pine	166.20 MBF	\$ 128.00/MBF	\$ _____
Pulpwood			
Balsam Fir	290.00 Cords	\$ 12.90/Cord	\$ _____
Jack Pine	191.00 Cords	\$ 15.60/Cord	\$ _____
Mixed Aspen	772.00 Cords	\$ 22.60/Cord	\$ _____
Mixed Hardwood	288.00 Cords	\$ 25.60/Cord	\$ _____
Mixed Oak	26.00 Cords	\$ 19.05/Cord	\$ _____
Mixed Spruce	95.00 Cords	\$ 26.55/Cord	\$ _____
N. White Cedar	32.00 Cords	\$ 28.10/Cord	\$ _____
Red Pine	889.00 Cords	\$ 46.05/Cord	\$ _____
Tamarack	10.00 Cords	\$ 20.20/Cord	\$ _____
White Pine	82.00 Cords	\$ 26.65/Cord	\$ _____

*The volumes are statistically estimated within plus (+) or minus (-) 10.72 percent. These estimated volumes are final and not subject to adjustment. Prospective bidders are urged to examine this timber and to make their own estimates of quantity and quality.

I understand that any or all bids may be rejected. All bids must be signed and all bid items must be bid or the bid form may be rejected. I also understand that consideration and awarding a contract will be based upon my past performance and ability to complete the contract based upon equipment and staffing subject to my control.

FEDERAL ID: _____ or SOCIAL SECURITY NUMBER: _____

Company or individual bidding: _____

Company representative's name: _____

Address: _____

City: _____ State: _____ Zip: _____

IF AVAILABLE, PLEASE PLACE THE PERSONALIZED LABEL FROM YOUR PROSPECTUS IN THE ABOVE BOX.

Individual or company representative's signature: _____ Date: _____

Phone number : _____ Email (optional): _____

THE WINNING BIDDER MUST COMPLETE THE VERIFICATION OF WORKER'S DISABILITY COMPENSATION ACT COMPLIANCE (ON REVERSE SIDE IF DOUBLE SIDED) WITHIN 21 DAYS OF SALE AWARD DATE



FOR DEPARTMENT USE ONLY
Sale Number (XX - XXX - XX - XX)
Forest Management Unit:

TIMBER SALE VERIFICATION OF WORKER'S DISABILITY COMPENSATION ACT COMPLIANCE

*As required by Act 317, P.A. 1969 (Worker's Compensation) and
Part 5 of Act 451 of 1994, as amended.*

VERIFICATION OF WORKER'S DISABILITY COMPENSATION ACT COMPLIANCE

- This verification must be completed and submitted within 21 days of contract award and prior to the issuance of the timber sale contract.
- In addition, if boxes 2B or 2C are checked, then Notice of Exclusion or Certificate of Insurance must be submitted within twenty-one (21) days of the contract award and prior to the issuance of the timber sale contract.
- All information must be typed or printed except for written signatures.

Please Check Appropriate Categories:

1. My business is organized as (you **must** check one of the boxes below):
 - A. Sole Proprietorship (individual)
 - B. Partnership
 - C. Corporation
2. You **must** check one of the boxes below:
 - A. I certify my business is a sole proprietorship and it has no employees but the sole proprietor. I am not subject to the Worker's Compensation Laws.
 - B. I certify my business has satisfied its obligation to the Worker's Compensation Act through the use of an approved Notice of Exclusion (BWC-337, Rev. 5/96). I will provide a copy of the Notice of Exclusion within 21 days of the contract award. (For questions or a copy of the BWC-337, please call the Worker's Compensation Bureau at 517-322-1195).
 - C. I certify my business has a Worker's Compensation Policy. I will provide an original Certificate of Insurance within twenty-one (21) days of the contract award.
3. If you have checked item 2(A) or 2(B), you **must** indicate the number of **both** full-time and part-time employees, other than yourself, including family members and active partners (if none, you must enter "0").

_____ Full-time Employees

_____ Part-time Employees

Name of Business		Federal ID (or) Social Security No.	
Address		Telephone ()	
City	State	ZIP	

I hereby certify that the above information is true and correct. I agree to notify the Michigan DNR of any changes that occur in factors affecting my coverage during any of my present and future operations.

Signature of Owner or Authorized Representative

Title

Date

Please complete the "SEALED BID" information on the next page

Jamaican Jack (72-635-16)
; Crawford COUNTY

In response to the notice of sale to be held 9:00 a.m. (local time) on October 30, 2018, I am hereby submitting my sealed bid (firm offer) for the following forest products to be cut. Bids for individual species must be at or above the advertised price. All non-responsive bid forms may be rejected.

<u>PRODUCTS & SPECIES</u>	<u>ESTIMATED VOLUME*</u>	<u>ADVERTISED PRICE</u>	<u>BID PRICE/UNIT</u>
Sawtimber			
Northern Pin Oak	37.20 MBF	\$ 214.00/MBF	\$ _____
Pulpwood			
B. T. Aspen	39.00 Cords	\$ 22.60/Cord	\$ _____
Jack Pine	631.00 Cords	\$ 15.60/Cord	\$ _____
Misc. Species 1	116.00 Cords	\$ 6.00/Cord	\$ _____
Mixed Hardwood	13.00 Cords	\$ 25.60/Cord	\$ _____
Northern Pin Oak	284.00 Cords	\$ 19.05/Cord	\$ _____
White Pine	6.00 Cords	\$ 26.65/Cord	\$ _____

*The volumes are statistically estimated within plus (+) or minus (-) 11.74 percent. These estimated volumes are final and not subject to adjustment. Prospective bidders are urged to examine this timber and to make their own estimates of quantity and quality.

I understand that any or all bids may be rejected. All bids must be signed and all bid items must be bid or the bid form may be rejected. I also understand that consideration and awarding a contract will be based upon my past performance and ability to complete the contract based upon equipment and staffing subject to my control.

FEDERAL ID: _____ or SOCIAL SECURITY NUMBER: _____

Company or individual bidding: _____

Company representative's name: _____

Address: _____

City: _____ State: _____ Zip: _____

IF AVAILABLE, PLEASE PLACE THE PERSONALIZED LABEL FROM YOUR PROSPECTUS IN THE ABOVE BOX.

Individual or company representative's signature: _____ Date: _____

Phone number : _____ Email (optional): _____

THE WINNING BIDDER MUST COMPLETE THE VERIFICATION OF WORKER'S DISABILITY COMPENSATION ACT COMPLIANCE (ON REVERSE SIDE IF DOUBLE SIDED) WITHIN 21 DAYS OF SALE AWARD DATE



FOR DEPARTMENT USE ONLY	
Sale Number (XX - XXX - XX - XX)	
Forest Management Unit:	

TIMBER SALE VERIFICATION OF WORKER'S DISABILITY COMPENSATION ACT COMPLIANCE

As required by Act 317, P.A. 1969 (Worker's Compensation) and
Part 5 of Act 451 of 1994, as amended.

VERIFICATION OF WORKER'S DISABILITY COMPENSATION ACT COMPLIANCE

- This verification must be completed and submitted within 21 days of contract award and prior to the issuance of the timber sale contract.
- In addition, if boxes 2B or 2C are checked, then Notice of Exclusion or Certificate of Insurance must be submitted within twenty-one (21) days of the contract award and prior to the issuance of the timber sale contract.
- All information must be typed or printed except for written signatures.

Please Check Appropriate Categories:

1. My business is organized as (you **must** check one of the boxes below):
 - A. Sole Proprietorship (individual)
 - B. Partnership
 - C. Corporation
2. You **must** check one of the boxes below:
 - A. I certify my business is a sole proprietorship and it has no employees but the sole proprietor. I am not subject to the Worker's Compensation Laws.
 - B. I certify my business has satisfied its obligation to the Worker's Compensation Act through the use of an approved Notice of Exclusion (BWC-337, Rev. 5/96). I will provide a copy of the Notice of Exclusion within 21 days of the contract award. (For questions or a copy of the BWC-337, please call the Worker's Compensation Bureau at 517-322-1195).
 - C. I certify my business has a Worker's Compensation Policy. I will provide an original Certificate of Insurance within twenty-one (21) days of the contract award.
3. If you have checked item 2(A) or 2(B), you **must** indicate the number of **both** full-time and part-time employees, other than yourself, including family members and active partners (if none, you must enter "0").

_____ Full-time Employees

_____ Part-time Employees

Name of Business		Federal ID (or) Social Security No.	
Address		Telephone ()	
City	State	ZIP	

I hereby certify that the above information is true and correct. I agree to notify the Michigan DNR of any changes that occur in factors affecting my coverage during any of my present and future operations.

Signature of Owner or Authorized Representative

Title

Date

Please complete the "SEALED BID" information on the next page

SCALE SALE LOWLAND (72-009-15)
T28N, R01W, SEC. 09; T28N, R01W, SEC. 16; Crawford COUNTY

In response to the notice of sale to be held 9:00 a.m. (local time) on October 30, 2018, I am hereby submitting my sealed bid (firm offer) for the following forest products to be cut. Bids for individual species must be at or above the advertised price. All non-responsive bid forms may be rejected.

<u>PRODUCTS & SPECIES</u>	<u>ESTIMATED VOLUME*</u>	<u>ADVERTISED PRICE</u>	<u>BID PRICE/UNIT</u>
Pulpwood Mixed Softwood	800.00 Cords	\$ 9.55/Cord	\$ _____

*The volumes are statistically estimated within plus (+) or minus (-) 49.40 percent. These estimated volumes are final and not subject to adjustment. Prospective bidders are urged to examine this timber and to make their own estimates of quantity and quality.

I understand that any or all bids may be rejected. All bids must be signed and all bid items must be bid or the bid form may be rejected. I also understand that consideration and awarding a contract will be based upon my past performance and ability to complete the contract based upon equipment and staffing subject to my control.

FEDERAL ID: ____ - ____ - ____ or SOCIAL SECURITY NUMBER: ____ - ____ - ____

Company or individual bidding: _____

Company representative's name: _____

Address: _____

City: _____ State: _____ Zip: _____

IF AVAILABLE, PLEASE PLACE THE PERSONALIZED LABEL FROM YOUR PROSPECTUS IN THE ABOVE BOX.

Individual or company representative's signature: _____ Date: _____

Phone number : _____ Email (optional): _____



FOR DEPARTMENT USE ONLY
Sale Number (XX - XXX - XX - XX)
Forest Management Unit:

TIMBER SALE VERIFICATION OF WORKER'S DISABILITY COMPENSATION ACT COMPLIANCE

*As required by Act 317, P.A. 1969 (Worker's Compensation) and
Part 5 of Act 451 of 1994, as amended.*

VERIFICATION OF WORKER'S DISABILITY COMPENSATION ACT COMPLIANCE

- This verification must be completed and submitted within 21 days of contract award and prior to the issuance of the timber sale contract.
- In addition, if boxes 2B or 2C are checked, then Notice of Exclusion or Certificate of Insurance must be submitted within twenty-one (21) days of the contract award and prior to the issuance of the timber sale contract.
- All information must be typed or printed except for written signatures.

Please Check Appropriate Categories:

1. My business is organized as (you **must** check one of the boxes below):
 - A. Sole Proprietorship (individual)
 - B. Partnership
 - C. Corporation
2. You **must** check one of the boxes below:
 - A. I certify my business is a sole proprietorship and it has no employees but the sole proprietor. I am not subject to the Worker's Compensation Laws.
 - B. I certify my business has satisfied its obligation to the Worker's Compensation Act through the use of an approved Notice of Exclusion (BWC-337, Rev. 5/96). I will provide a copy of the Notice of Exclusion within 21 days of the contract award. (For questions or a copy of the BWC-337, please call the Worker's Compensation Bureau at 517-322-1195).
 - C. I certify my business has a Worker's Compensation Policy. I will provide an original Certificate of Insurance within twenty-one (21) days of the contract award.
3. If you have checked item 2(A) or 2(B), you **must** indicate the number of **both** full-time and part-time employees, other than yourself, including family members and active partners (if none, you must enter "0").

_____ Full-time Employees

_____ Part-time Employees

Name of Business		Federal ID (or) Social Security No.	
Address		Telephone ()	
City	State	ZIP	

I hereby certify that the above information is true and correct. I agree to notify the Michigan DNR of any changes that occur in factors affecting my coverage during any of my present and future operations.

Signature of Owner or Authorized Representative

Title

Date

Please complete the "SEALED BID" information on the next page