



**DEPARTMENT OF NATURAL RESOURCES
STATE OF MICHIGAN**

TIMBER SALE PROSPECTUS #6270

SCHEDULED SALE DATE AND TIME: 9:00 a.m. (local time) on March 12, 2019.

LOCATION: GRAYLING MGMT UNIT, 1955 HARTWICK PINES ROAD, GRAYLING, MI 49738.

PROSPECTUS NOTE: The bidder is advised to inspect the sale area and review the location, estimated volumes, operating costs and contract terms of proposed sales. Please be aware that some landowners may request 60 days or more notice for access across their land.

Notice is hereby given that bids will be received by the Unit Manager, GRAYLING MANAGEMENT UNIT, for certain timber on the following described lands:

Panama Pine Mix (72-001-18) / T28N, R04W, SEC. 17, NWNW,SESE.

T28N, R04W, SEC. 18, E1/2NE.

T28N, R04W, SEC. 20, N1/2NE.

Crawford County, Advertised Price \$36,403.15, 50.8 Acres, Red Pine, Jack Pine.

SALE NOTE: The sale area includes a snowmobile trail that needs to be protected, oak wilt and bark slippage restrictions, and oil and gas wells and pipelines in the vicinity.

A recreation site such as a trail, pathway, or campground is within the sale area or the vicinity. Certain restrictions/specifications may be applicable including time restrictions.

Fosters Last Stands (72-006-18) / T26N, R03W, SEC. 27, N1/2SW,SESW,NWSE.

T26N, R03W, SEC. 34, NW.

Crawford County, Advertised Price \$39,316.75, 87.7 Acres, Hardwood, Jack Pine.

SALE NOTE: The sale is located off of Barker Lake Road and the unnamed county gravel pit road. Oak wilt specs are in effect for Payment Units 1 and 2.

Section 12 Mix (72-037-17) / T25N, R04W, SEC. 12, S1/2NW,NWNW,NE,N1/2SW,SWSW.

Crawford County, Advertised Price \$244,357.75, 159.3 Acres, Hardwood, Red Pine.

SALE NOTE: Oak Wilt restrictions apply to Payment Units 1-4.

A recreation site such as a trail, pathway, or campground is within the sale area or the vicinity. Certain restrictions/specifications may be applicable including time restrictions.

Feed Bucket Mix (72-040-17) / T25N, R03W, SEC. 2, E1/2NW,N1/2NE,SWNE.

Crawford County, Advertised Price \$50,165.60, 82.5 Acres, Hardwood, Aspen.

SALE NOTE: Sale has oak wilt restrictions (spec 5.2.3.4). A horse trail runs through the north side of the sale, parallel with 4 Mile Rd (see spec 5.2.40 and 6.2.3). Due to numerous roads in the area, the designated snowmobile trail should be avoided if possible for hauling.

A recreation site such as a trail, pathway, or campground is within the sale area or the vicinity. Certain restrictions/specifications may be applicable including time restrictions.

Railroad Mix (72-041-17) / T25N, R04W, SEC. 11, NE,NWSE.

T25N, R04W, SEC. 12, W1/2NW.

Crawford County, Advertised Price \$73,254.90, 88.1 Acres, Hardwood, Aspen.

SALE NOTE: The sale is accessed off of either W 5 Mile Road or S King Road. Oak wilt and bark slippage restrictions are in place.

A recreation site such as a trail, pathway, or campground is within the sale area or the vicinity. Certain restrictions/specifications may be applicable including time restrictions.

Hunter Walking Trail Oak Mix (72-042-17) / T25N, R04W, SEC. 10, S1/2NW,SW,SWSE.

Crawford County, Advertised Price \$127,246.90, 87.8 Acres, Hardwood, Red Oak.

SALE NOTE: Oak Wilt restrictions apply to this sale. Note that Military Road is weight restricted year round near the sale area. Contact the Crawford County Road Commission for more information.

BID INSTRUCTIONS (VER. 07/02/2018):

1. Scheduled Bid Location, Date, and Time (2/11)

Bids must be received by the Unit Manager, GRAYLING OFFICE, 1955 HARTWICK PINES ROAD, GRAYLING, MI 49738, no later than 9:00 a.m. (local time) on March 12, 2019. For further information concerning this sale, contact Susan Thiel at 989-348-6371 extension 7440.

2. Bidder's Qualifications (5/16)

Purchaser shall obtain workers compensation insurance to cover claims under Michigan's Worker's Disability Compensation Act of 1969 or similar employee benefit act of any other state applicable to an employee. If all or part of a timber sale was prepared by a private contractor, the contractor and that contractor's company are not permitted to bid on the timber sale contract. Bids will not be accepted from individuals or companies appearing on the DNR/FRD No-Bid List. This list contains the names of purchasers who previously failed to execute a contract within 21-days or who have a history of poor performance.

3. Preparation of Sealed Bids (5/16)

Bid Forms may be completed online thru Michigan DNR Timber Sale Online Bidding (OLB) at www.michigan.gov/timberbidding or by completing the hardcopy Bid Form found in the Timber Sale Prospectus. Hardcopy Bid Forms shall be manually signed in ink. Registration in OLB is considered your 'signature' for all bids submitted thru that system. Bid prices must be entered for each species and product in the Bid Price column for all material subject to bidding and all fill-in blanks must be completed. If erasures or other changes appear on the hardcopy Bid Form, each erasure or change must be initialed by the person signing the bid.

4. Submission of Sealed Bids (5/16)

Bid forms may be obtained from the Unit Manager or thru OLB. Bids may be submitted hardcopy or thru OLB. All hardcopy bids must be submitted on the bid form and in an envelope clearly identified as described in this section. NOTE: Only one bid form per bid envelope. Sealed bids must be submitted to the Unit office designated in the prospectus and must be submitted at or prior to the time established in the prospectus. The envelope should show on the outside (a) the sale name or number and (b) the date and time of bid opening, as shown in the prospectus. Bids received after the time specified in the sale prospectus are late bids and will be rejected.

It is possible for a bidder to submit multiple bids on a single sale. For example, a bid may be submitted hardcopy and a bid may be submitted thru OLB. Or, two bidders from the same company could both submit bids on the same sale. If this were to happen, the State would accept all bids received and award the contract accordingly. All bidding and contractual requirements would apply to all bids received.

5. Public Opening of Sealed Bids (7/16)

If conditions permit, the sealed bids will be publicly opened and posted at the time and place set in the prospectus.

If a bidder, present at a bid opening, has submitted bids on more than one sale, that bidder may withdraw their unopened bid envelopes or announce the withdrawal of their online bid after being declared the successful bidder on one sale.

6. Award of Contract (1/11)

Award of the contract will be made to the Bidder whose bid, conforming to the prospectus, is most advantageous to the State of Michigan on the basis of total value at rates bid for the estimated quantities. The State reserves the right to reject any bid or waive any minor irregularity in bids received. A written award mailed (or otherwise furnished) to the successful Bidder shall be deemed to result in a binding contract without further action by either party.

7. Down Payment (1/11)

The Bidder to whom award is made must make a down payment within 21 days of the sale award. The amount of the down payment will be calculated as shown in the Bond and Payment Schedule of this prospectus. Only cash may be used to meet this requirement.

8. Performance Security (1/11)

As guarantee of faithful performance, a cash bond, certificate of deposit, surety bond or irrevocable letter of credit (LOC) is required within 21 days of the sale award. The amount of the performance security is shown in the Bond and

Payment Schedule of this prospectus. If an LOC or surety is used, the coverage must extend for at least 6 months beyond the contract expiration.

9. Timber Sale Contract (7/18)

Additional conditions and requirements common to all timber sales are listed on the timber sale contract (R4031) and are available on line at www.michigan.gov/timber. Contact the Unit Manager for additional information or a sample contract. Within 21 days of the date of the award letter, the bidder must sign the contract and provide the required down payment, performance security, and verification of worker's disability compensation. The down payment and performance security shall be in accordance with the provisions of the timber sale contract, in the sums stated in this prospectus. If these actions are not taken, then the Bidder, the Bidder's corporation, and the corporation's principals may not be permitted to bid on State timber sales for a period of 3 months after the first offense, 6 months after the second offense, and 1 year after the third offense. An offense will only be counted against the Bidder for 5 years. In addition, the Bidder certifies that if awarded this contract, the Bidder will complete the timber sale contract in accordance with its terms and any modifications thereof including requirements to purchase, cut, and remove the included timber by the expiration date.

Payment Unit values in the State Forest Timber Sale Contract are calculated based on the advertised value of the Payment Unit as a percentage of the total advertised value of the contract. The advertised value of each Payment Unit is given in the Description of Timber by Payment Unit table on the Timber Sale Information page. For example, if the value of Payment Unit 1 is advertised as \$1,500 and the total Timber Sale value is advertised as \$10,000, the contract price for Payment Unit 1 will be 15% of the total bid price ($\$1,500/\$10,000 * 100$).

10. Disclaimer of Estimates and Bidder's Warranty of Inspection (7/16)

Before submitting this bid, the Bidder is advised and cautioned to inspect the sale area, review the requirements of the sale contract, and take other steps as may be reasonably necessary to ascertain the location, estimated volumes, construction estimates, and operating costs of the proposed sale. Failure to do so will not relieve the Bidder from responsibility for completing the contract.

The Bidder warrants that this bid is submitted solely on the basis of the Bidder's examination and inspection of the quality and quantity of the timber offered for sale and the Bidder's opinion of the value thereof and the costs of recovery. No reliance should be placed on the State of Michigan's estimates of timber quality, quantity or costs of recovery. Bidder further acknowledges that the State of Michigan: (i) expressly disclaims any warranty of fitness of timber for any purpose; (ii) offers this timber as is without any warranty of quality (merchantability) or quantity and (iii) expressly disclaims any warranty as to the quantity or quality of timber sold.

11. Certification and Chain-of-Custody (10/14)

Unless otherwise indicated in the contract under section 7 – Other Conditions of the Sale Specific Conditions & Requirements, the area encompassed by this timber sale is certified to the standards of the Forest Stewardship Council (FSC) - Certificate #SCS-FM/COC-00090N and the Sustainable Forestry Initiative (SFI) - Certificate #NSF-SFIS-5Y031-SF5. Forest products from this sale may be delivered to the mill as "FSC 100% and / or SFI certified" as long as the contractor hauling the forest products is chain-of-custody (COC) certified or covered under a COC certificate from the destination mill. The purchaser is responsible for maintaining COC after leaving the sale area.

12. Good Neighbor Authority (GNA) Requirements (7/16)

If the name of this timber sales contains the acronym GNA, it is authorized by the Good Neighbor Authority (GNA) and covered by various agreements between the U.S. Forest Service and the State. The timber sale occurs on federal land and the following conditions apply:

GNA contracts on US Forest Service land will not be awarded to purchasers on the Federal list of excluded parties. The System for Award Management (SAM) will be checked for active excluded parties prior to award of contract. In addition, the Bidder to whom award is made must complete an Assurance Regarding Felony Conviction or Tax Delinquent Status for Corporate Applicants (AD-3031).

13. Good Neighbor Authority (GNA) Requirements, con't (9/16)

Bidder certifies, by signing this bid form, that to the best of Bidder's knowledge that the following representations are accurate and complete.

- a. That the Bidder and its principals are not presently debarred, suspended, proposed for debarment, declared ineligible, or voluntary excluded from timber sales (covered transactions) by any Federal department or agency.
- b. That the Bidder and its principals have not within a 3-year period preceding this bid been convicted of or had a civil judgment rendered against them for commission of fraud or a criminal offense in connection with obtaining, attempting to obtain, or performing a public (Federal, State, or local) transaction or contract under a public transaction; violation of Federal or State antitrust statutes or commission of embezzlement, theft, forgery, bribery, falsification or destruction of records, making false statements, or receiving stolen property.
- c. That the Bidder and its principals are not presently indicted for or otherwise criminally or civilly charged by a governmental entity (Federal, State, or local) with commission of any of the offenses enumerated in paragraph b of this certification.
- d. That the Bidder and its principals have not within a 3-year period preceding this bid had one or more public transactions (Federal, State, or local) terminated for breach or default of a timber or forest product contract.

Bidders that cannot certify this requirement, in whole or in part, shall submit an explanation with their bid.

DAN EICHINGER
Director

TIMBER SALE INFORMATION

Panama Pine Mix (72-001-18)
 T28N, R04W, SEC. 17; T28N, R04W, SEC. 18; T28N, R04W, SEC. 20.
 Crawford County (Advertised Price \$36,403.15)

SALE NOTE: The sale area includes a snowmobile trail that needs to be protected, oak wilt and bark slippage restrictions, and oil and gas wells and pipelines in the vicinity.

A recreation site such as a trail, pathway, or campground is within the sale area or the vicinity. Certain restrictions/specifications may be applicable including time restrictions.

A timber sale contract for this lump sum, sealed bid timber sale will be awarded to the responsible bidder offering the highest sealed bid price. Bids must be at or above the following advertised price for each species:

| <u>PRODUCTS & SPECIES</u> | <u>ESTIMATED UNITS*</u> | <u>ADVERTISED PRICE</u> |
|-------------------------------|-------------------------|-------------------------|
| Sawtimber | | |
| Red Pine | 159.10 MBF | \$ 110.00 / MBF |
| Pulpwood | | |
| Jack Pine | 77.00 Cords | \$ 18.10 / Cord |
| Mixed Aspen | 18.00 Cords | \$ 23.50 / Cord |
| Mixed Hardwood | 20.00 Cords | \$ 31.90 / Cord |
| Mixed Oak | 35.00 Cords | \$ 20.90 / Cord |
| Red Pine | 397.00 Cords | \$ 39.45 / Cord |
| White Pine | 2.00 Cords | \$ 27.15 / Cord |

* The total volume is statistically estimated within plus (+) or minus (-) 12.74 percent. The estimated units are final and not subject to adjustment. Prospective bidders are urged to examine this timber and to make their own estimates of quantity and quality.

BOND AND PAYMENT SCHEDULE:

1. A bond in the amount of \$1,820.00 to insure faithful performance of the conditions of the contract will be deposited by the successful bidder within 21 days of the sale award.
2. Cutting in any sale or unit without the required advance payment would be considered a trespass.
3. Total payment must be paid in advance or according to the following schedule:
 - (a) Ten percent (10%) of the sale value must be paid within 21 days of the sale award.
 - (b) The 10% down payment will be credited towards the first unit cut.
 - (c) Payment for each of the following units must be made before cutting begins in that unit:

| PAYMENT UNIT NUMBER | PERCENT OF TOTAL SALE VALUE |
|---------------------|-----------------------------|
| 01 | 36.7% |
| 02 | 63.3% |
4. If no cutting takes place, the 10% down payment will not be refunded.
5. Operations on the contract issued will terminate on 09/30/2021.

Description of Timber by Payment Unit (PU)

| PU | MARKET GROUP | PRODUCT | QUANTITY | UNIT | ACRES | ADVERTISE PRICE |
|--------|------------------------|------------------|----------|--------------|-------|-----------------|
| 1 | Red Pine | Sawtimber | 62.9 | MBF | 33.7 | \$13,354.95 |
| | Jack Pine | Pulpwood | 77.0 | Cords | | |
| | <i>Jack Pine</i> | <i>Sawtimber</i> | 5.5 | <i>MBF</i> | | |
| | <i>Jack Pine</i> | <i>Pulpwood</i> | 66.0 | <i>Cords</i> | | |
| | Mixed Aspen | | 18.0 | Cords | | |
| | <i>B. T. Aspen</i> | | 12.0 | <i>Cords</i> | | |
| | <i>Quaking Aspen</i> | | 6.0 | <i>Cords</i> | | |
| | Mixed Hardwood | | 20.0 | Cords | | |
| | <i>Red Maple</i> | <i>Sawtimber</i> | 0.9 | <i>MBF</i> | | |
| | <i>Black Cherry</i> | <i>Pulpwood</i> | 3.0 | <i>Cords</i> | | |
| | <i>Red Maple</i> | | 15.0 | <i>Cords</i> | | |
| | Mixed Oak | | 35.0 | Cords | | |
| | <i>Bl/R/Hybrid Oak</i> | <i>Sawtimber</i> | 5.5 | <i>MBF</i> | | |
| | <i>White Oak</i> | | 1.4 | <i>MBF</i> | | |
| | <i>Bl/R/Hybrid Oak</i> | <i>Pulpwood</i> | 20.0 | <i>Cords</i> | | |
| | <i>White Oak</i> | | 1.0 | <i>Cords</i> | | |
| | Red Pine | | 81.0 | Cords | | |
| | White Pine | | 2.0 | Cords | | |
| | <i>White Pine</i> | <i>Sawtimber</i> | 0.5 | <i>MBF</i> | | |
| | <i>White Pine</i> | <i>Pulpwood</i> | 1.0 | <i>Cords</i> | | |
| 2 | Red Pine | Sawtimber | 96.2 | MBF | 17.1 | \$23,048.20 |
| | Red Pine | Pulpwood | 316.0 | Cords | | |
| TOTAL: | | | 159.1 | MBF | | |
| TOTAL: | | | 549.0 | Cords | | |

Sale Specific Conditions & Requirements

Sale Name: Panama Pine Mix

Sale Number: 72-001-18 Seq#: 1

1 - Sale Area

1.2 - Boundaries

1.2.1 - Painted boundaries (1/14)

The sale boundaries are marked and identified by red paint, along with Manistee River Road. Exterior sale boundary lines against state are marked with red paint, with the exception of the east boundary of the southwest portion of Payment Unit 1, which is unpainted and identified by Manistee River Road. The painted boundary line trees are not Included Timber and are to be protected unless marked with orange paint.

2 - Timber Specifications

2.1 - Included Timber

2.1.3 - Cut tree marked unit(s) (12/08)

Within Payment Unit(s) 2, all trees are designated for cutting when marked with orange paint above and below stump height, regardless of merchantability.

2.1.7 - Leave tree marked unit(s) (6/14)

Within Payment Unit(s) 1, cut all trees that are two (2) inches or more at DBH, except do not cut trees marked with green paint above and below stump height. There are a handful of large oak that are marked to leave.

2.2 - Utilization

2.2.3 - Stump heights (4/07)

Stump heights within the Sale Area shall not exceed 6 inches for all trees. A written waiver of this requirement may be obtained if wet summer weather makes winter logging necessary. Exceptions may be made by the sale administrator for large diameter and/or multiple stem clumps in Payment Unit 1.

2.2.6 - Roundwood operation required (5/07)

The skidding of whole trees or tree segments with limbs attached is prohibited within Payment Unit 2. All products must be produced as roundwood and forwarded to existing roads or landing areas in final product length.

3 - Payments

3.3 - Pre-measured Sales

3.3.4 - Dividing payment units (7/14)

Payment Unit(s) may be divided at the request of the Purchaser and upon approval of the Unit Manager. Dividing Payment Units is a contract modification which requires a Timber Sale Contract Supplement.

3.4 - Damaged Timber

3.4.1 - Damaged timber (6/14)

General Condition and Requirement 3.4 Damaged Timber, defines liquidated damages for undesignated live merchantable trees which are cut or injured. In addition, reasonable care should be taken to avoid damage to oak tree seedlings and saplings in Payment Unit 1.

Within the sale area, if more than 30% of the tree seedlings or saplings (1/4" to 4.5" DBH) within a specified portion of the sale area are damaged, liquidated damages will be assessed at \$300 per acre for all acreage within that specified portion of the sale area that was damaged. Where regeneration is dense, clean-cut paths to access mature timber are acceptable.

4 - Transportation

4.1 - Construction

4.1.6 - Road construction (1/09)

Construction of new roads or improvements of existing roads shall be done in such a way as to minimize the environmental

and visual impacts. Merchantable trees shall be cut and utilized unless otherwise directed. Non-merchantable trees shall be severed and laid flat on the ground. Slash shall be scattered, and not left in windrows and kept a minimum of 10 feet back from the road edge. Stumps shall be set upright, not left on edge, and be moved at least 10 feet away from the road edge. Disturbed soil shall be feathered into the woods and not left in berms or windrows.

4.1.7 - Road closure (10/11)

All new roads built into the sale must be blocked to vehicle traffic upon completion of the sale. Overgrown roads that are reopened shall be considered new roads. In general, this will require constructing a four (4') foot high berm of stumps and logs covered with earth. These roads must be rendered impassable to cars and trucks. Contact the sale administrator for specific details of design and placement.

4.1.11 - Permits (2/12)

The Purchaser will secure any necessary highway and stream crossing permits that may be required.

5 - Operations

5.1 - Notification

5.1.1 - Pre-sale conference (10/16)

A pre-sale conference on site between the Purchaser and sale administrator is required prior to beginning any operations to determine landing and road locations. The Unit Manager or his/her representative must be contacted at least 10 days in advance to schedule the conference.

5.1.3 - Well heads and natural gas pipelines (11/15)

The Purchaser is responsible for contacting the gas or pipeline company 15 days prior to operating equipment in the vicinity of well heads or natural gas pipelines.

5.1.4 - Post-sale conference (10/16)

A post-sale conference on site between the Purchaser and sale administrator is required 5 days prior to the completion of active logging operations to determine clean-up and repair of landings, road edges, and the fulfillment of other contract specifications.

5.2 - Conduct of Operations

5.2.1 - Slash

5.2.1.8 - Slash height (12/08)

No slash or tree tops may exceed 24 inches in height.

5.2.2 - Hazard Trees/Snags

5.2.2.1 - Den trees (10/16)

Obvious hollow and/or den trees shall be protected and left standing unless they are a safety hazard.

5.2.3 - Operating Restrictions

5.2.3.3 - Bark slippage restriction (3/09)

Within Payment Unit(s) 2, unless changed by written agreement, cutting and skidding are not permitted during the period of April 15 to July 15. This restriction is because of bark slippage.

5.2.3.4 - Oak wilt restriction (9/17)

Within Payment Units 1 and 2, unless changed by written agreement, cutting, skidding, hauling and brushing of access roads are not permitted during the period of April 15 to July 15. Operations may be allowed if specific steps are taken to prevent damaging uncut oak during the high risk period. Those steps include completing all road brushing before April 15th, clearing a tree-length buffer along uncut oak cover before April 15th or leaving an uncut buffer there until after July 15th. This is necessary to reduce the spread of oak wilt. For more information, contact the Unit Manager or his/her representative.

5.2.3.6 - Bark beetle restriction (12/08)

In the event drought creates a high risk of pine bark beetle infestation, pine is not to be cut during the period March 1 through July 1, unless all portions of trees greater than two inches in diameter are removed from the sale area, reduced to chips, or treated to the satisfaction of the Unit Manager or his/her representative, within fifteen days of being severed

from the stump. Pine log decks, pulpwood piles and treetops that are piled for chipping in the fall or winter within a 1/4 mile of susceptible sites must be removed before March 15. Residual slash must not be placed in piles or rows and must be spread over the site for quick drying. The Department of Natural Resources will exercise this specification if the risk of damage warrants.

5.2.32 - Decking/landing restoration (9/13)

All decking and landing areas must have the surface area restored to a condition equal to or better than before. This is to ensure the proper regeneration of the stand. Wood debris, chips and "cookies" from trimmings must be removed or scattered away from landing and loading areas and may not be windrowed on the edge.

5.2.38 - No decking against live trees (2/04)

Cut products may not be decked against unmarked or designated leave trees.

5.2.41 - Snowmobile trail protection (9/11)

The snowmobile trail #679 is shown on the Timber Sale Map. Do not cut or damage posts with orange trail markers or traffic control signs. If the trail is used, it must be maintained and restored to a condition equal to or better than before the sale. The road maintenance/restoration must be done prior to December 1. If the trail is used for hauling, it must be graded to the satisfaction of the Unit Manager or his/her representative prior to December 1st. If the trail road is to be used for hauling during the snowmobile season, written permission must be granted by the Unit Manager, and a snow covered base must be left on the trail. The snowmobile trail may only be crossed at right angles. Maintain a 20 foot wide slash, debris, and rut free zone daily using the snowmobile trail as the centerline.

5.2.43 - Opening protection (12/08)

No activities are permitted in openings marked on the Timber Sale Map with the letter "G". Any damage to the openings shall be repaired according to specifications of the Unit Manager or his/her representative.

5.4 - Soil Protection

5.4.1 - Rutting restriction, general (7/16)

Operations are to cease immediately if equipment and weather conditions result in rutting of roads and/or skid trails which is 12 inches or greater in depth and 50 feet in length. The Unit Manager or his/her representative may restrict hauling and/or skidding if ruts exceed the specified depth. With the Unit Manager or his/her representative's approval, the Purchaser may return to the area when the risk of rutting has decreased.

6 - Safety and Fire Prevention

6.2 - Signing

6.2.1 - Road posting (9/09)

The Purchaser is responsible for posting and maintaining caution signs on Manistee River Rd along Payment Unit 1 prior to beginning operations. The road must be posted at appropriate distances from the sale area to warn of logging activity and truck traffic. Signs must be removed when harvest operations are suspended or completed. The Purchaser will provide these signs.

6.2.2 - Snowmobile trail posting (8/09)

The Purchaser is responsible for posting and maintaining caution signs on snowmobile trail 679 prior to beginning operations during the snowmobile season (approximately December 1 to March 31). The trail must be posted at appropriate distances from the sale area to warn of logging activity and truck traffic. Signs must be removed when harvest operations are suspended or completed. The Purchaser will provide these signs.



TIMBER SALE MAP

This information provided by authority of Part 525, 1994 PA 451, as amended.

| | |
|-------------|------|
| Sale Number | Year |
| 72 - 001 | 18 |

| | | | | | |
|------------------------------------|--------------------|---|-----------------------|-------------------|---------|
| Forest Management Unit Grayling | County Crawford | Mapped By Martell | Date 10/23/17 | Page 1 | of 1 |
| Township 28N | Range 04W | Section(s) and Subdivision(s) Sec. 17 - W1/2NW, S1/2SE, Sec. 18 - E1/2NE, Sec. 20 - N1/2NE | Cruised By Martell | Scale 1:15,840 | |

| Cover Type | | | | Density | |
|-------------------|----------------------|-------------------------|-------------------|-----------------------------|------------------------|
| A = Aspen | H = Hemlock | N = Marsh | U = Upland Brush | 0 = Non Stocked | 5 = Pole Timber Medium |
| B = Paper Birch | J = Jack Pine | O = Oak | UM = Upland Mixed | 1 = Seedling Sapling Poor | 6 = Pole Timber Well |
| C = Cedar | L = Lowland Brush | P = Lowland Poplar | V = Bog or Marsh | 2 = Seedling Sapling Medium | 7 = Saw Timber Poor |
| D = Tread Bog | LM = Lowland Mixed | Q = Mixed Swamp Conifer | W = White Pine | 3 = Seedling Sapling Well | 8 = Saw Timber Medium |
| E = Swamp Hdwoods | M = Mpl, Bch, Brch | R = Red Pine | X = Non Stocked | 4 = Pole Timber Poor | 9 = Saw Timber Well |
| F = Spruce Fir | MC = Mixed Conifer | S = Black Spruce | Z = Water | | |
| G = Grass | MD = Mixed Deciduous | T = Tamarack | | | |

| PU | Acres |
|----|-------|
| 1 | 33.7 |
| 2 | 17.1 |

Panama Pine Mix

Compartments 171 and 172

50.8 Acres

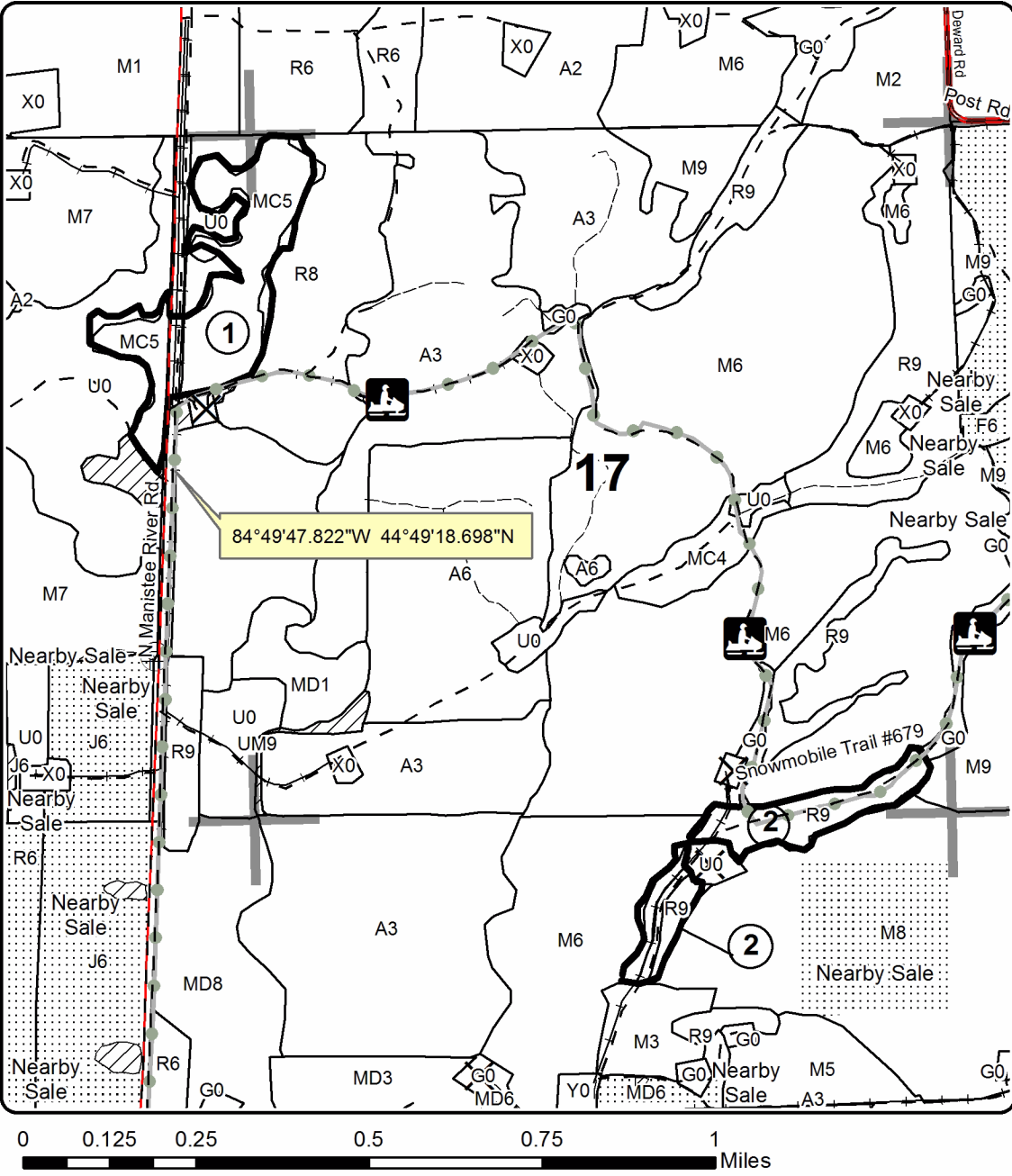

Legend

- Against State (Red)
- ▨ Retention Area
- Payment Unit
- Stand Boundaries
- Highway
- Paved Roads
- Gravel Roads
- Poor Dirt Roads
- Snowmobile Trail
- Pipeline
- ⊗ Oil & Gas Well
- ⊗ Surface Locations
- Section Corners

Locator Map
1:200,000

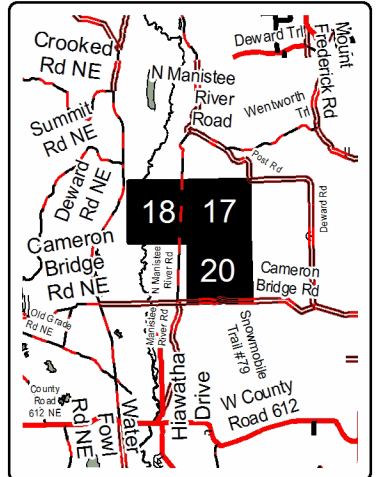

TIMBER SALE INFORMATION

Fosters Last Stands (72-006-18)
 T26N, R03W, SEC. 27; T26N, R03W, SEC. 34.
 Crawford County (Advertised Price \$39,316.75)

SALE NOTE: The sale is located off of Barker Lake Road and the unnamed county gravel pit road. Oak wilt specs are in effect for Payment Units 1 and 2.

A timber sale contract for this lump sum, sealed bid timber sale will be awarded to the responsible bidder offering the highest sealed bid price. Bids must be at or above the following advertised price for each species:

| <u>PRODUCTS & SPECIES</u> | <u>ESTIMATED UNITS*</u> | <u>ADVERTISED PRICE</u> |
|-------------------------------|-------------------------|-------------------------|
| Sawtimber | | |
| BI/R/Hybrid Oak | 84.10 MBF | \$ 199.00 / MBF |
| White Oak | 24.40 MBF | \$ 80.00 / MBF |
| Pulpwood | | |
| BI/R/Hybrid Oak | 458.00 Cords | \$ 20.90 / Cord |
| Jack Pine | 225.00 Cords | \$ 18.10 / Cord |
| Red Maple | 27.00 Cords | \$ 31.90 / Cord |
| Red Pine | 11.00 Cords | \$ 39.45 / Cord |
| White Oak | 267.00 Cords | \$ 20.90 / Cord |
| White Pine | 4.00 Cords | \$ 27.15 / Cord |

* The total volume is statistically estimated within plus (+) or minus (-) 10.29 percent. The estimated units are final and not subject to adjustment. Prospective bidders are urged to examine this timber and to make their own estimates of quantity and quality.

BOND AND PAYMENT SCHEDULE:

1. A bond in the amount of \$1,966.00 to insure faithful performance of the conditions of the contract will be deposited by the successful bidder within 21 days of the sale award.
2. Cutting in any sale or unit without the required advance payment would be considered a trespass.
3. Total payment must be paid in advance or according to the following schedule:
 - (a) Ten percent (10%) of the sale value must be paid within 21 days of the sale award.
 - (b) The 10% down payment will be credited towards the first unit cut.
 - (c) Payment for each of the following units must be made before cutting begins in that unit:

| <u>PAYMENT UNIT NUMBER</u> | <u>PERCENT OF TOTAL SALE VALUE</u> |
|----------------------------|------------------------------------|
| 01 | 82.6% |
| 02 | 6.6% |
| 03 | 10.8% |
4. If no cutting takes place, the 10% down payment will not be refunded.
5. Operations on the contract issued will terminate on 09/30/2021.

Description of Timber by Payment Unit (PU)

| PU | MARKET GROUP | PRODUCT | QUANTITY | UNIT | ACRES | ADVERTISE PRICE |
|--------|-----------------|-----------|----------|-------|-------|-----------------|
| 1 | BI/R/Hybrid Oak | Sawtimber | 79.5 | MBF | 57.8 | \$32,501.95 |
| | White Oak | | 18.0 | MBF | | |
| | BI/R/Hybrid Oak | Pulpwood | 444.0 | Cords | | |
| | Red Maple | | 15.0 | Cords | | |
| | Red Pine | | 11.0 | Cords | | |
| | White Oak | | 239.0 | Cords | | |
| | White Pine | | 2.0 | Cords | | |
| | | | | | | |
| 2 | BI/R/Hybrid Oak | Sawtimber | 4.6 | MBF | 7.2 | \$2,583.50 |
| | White Oak | | 6.4 | MBF | | |
| | BI/R/Hybrid Oak | Pulpwood | 11.0 | Cords | | |
| | Red Maple | | 12.0 | Cords | | |
| | White Oak | | 26.0 | Cords | | |
| | | | | | | |
| 3 | BI/R/Hybrid Oak | Pulpwood | 3.0 | Cords | 22.7 | \$4,231.30 |
| | Jack Pine | | 225.0 | Cords | | |
| | White Oak | | 2.0 | Cords | | |
| | White Pine | | 2.0 | Cords | | |
| | | | | | | |
| TOTAL: | | | 108.5 | MBF | | |
| TOTAL: | | | 992.0 | Cords | | |

Sale Specific Conditions & Requirements

Sale Name: Fosters Last Stands

Sale Number: 72-006-18 Seq#: 1

1 - Sale Area

1.2 - Boundaries

1.2.1 - Painted boundaries (1/14)

The sale boundary and Payment Unit boundaries are marked and identified by blue and red paint. Exterior sale boundary lines against private property are marked with blue paint. Exterior sale boundary lines against state are marked with red paint. The painted boundary line trees are not Included Timber and are to be protected.

2 - Timber Specifications

2.1 - Included Timber

2.1.1 - Clearcut unit(s) with unmerchantable trees (6/14)

Within Payment Unit(s) 1 - 3, cut all trees that are two (2) inches or more at DBH.

2.2 - Utilization

2.2.3 - Stump heights (4/07)

Stump heights within the Sale Area shall not exceed 12 inches for trees greater than 10 inches DBH and 4 inches for trees smaller than 10 inches DBH. However, if the sale is going to be chipped then stump heights shall not exceed 6 inches for all trees. A written waiver of this requirement may be obtained if wet summer weather makes winter logging necessary.

3 - Payments

3.3 - Pre-measured Sales

3.3.4 - Dividing payment units (7/14)

Payment Unit(s) 1 may be divided at the request of the Purchaser and upon approval of the Unit Manager. Dividing Payment Units is a contract modification which requires a Timber Sale Contract Supplement.

4 - Transportation

4.1 - Construction

4.1.6 - Road construction (1/09)

Construction of new roads or improvements of existing roads shall be done in such a way as to minimize the environmental and visual impacts. Merchantable trees shall be cut and utilized unless otherwise directed. Non-merchantable trees shall be severed and laid flat on the ground. Slash shall be chipped, utilized or otherwise dispersed throughout the sale. Stumps shall be set upright, not left on edge, and be moved at least 10 feet away from the road edge. Disturbed soil shall be feathered into the woods and not left in berms or windrows.

4.1.7 - Road closure (10/11)

All new roads built into the sale must be blocked to vehicle traffic upon completion of the sale. Overgrown roads that are reopened shall be considered new roads. In general, this will require constructing a four (4') foot high berm of stumps, logs or earth. Stumps and brush must be placed along the remainder of the trail. These roads must be rendered impassable to cars and trucks. All stumps from road building and landing construction must be reserved to block any newly constructed roads upon completion of the sale. These stumps must be scattered along the road system to prohibit vehicular movement. Contact the sale administrator for specific details of design and placement.

4.1.11 - Permits (2/12)

The Purchaser will secure any necessary permits that may be required.

4.2 - Maintenance

4.2.5 - Two wheel drive condition (2/04)

All existing trail roads on and adjacent to the sale area must be passable by two-wheel drive traffic for the duration of the sale.

5 - Operations

5.1 - Notification

5.1.3 - Well heads and natural gas pipelines (11/15)

The Purchaser is responsible for contacting the gas or pipeline company 30 days prior to operating equipment in the vicinity of well heads or natural gas pipelines. Contact DTE Energy at 1.800.363.9541.

5.2 - Conduct of Operations

5.2.1 - Slash

5.2.1.8 - Slash height (12/08)

No slash or tree tops may exceed 24 inches in height.

5.2.2 - Hazard Trees/Snags

5.2.2.1 - Den trees (10/16)

Obvious hollow and/or den trees shall be protected and left standing unless they are a safety hazard.

5.2.3 - Operating Restrictions

5.2.3.5 - Oak wilt restriction (1/18)

Within Payment Unit(s) 1 & 2, unless changed by written agreement, cutting, skidding, hauling within the sale and brushing of access roads to the sale are not permitted during the period of April 15 to July 15. Operations may be allowed if specific steps are taken to prevent damaging uncut oak during the high risk period. Those steps may include completing all road brushing before April 15th and clearing a tree-length buffer along uncut oak cover before April 15th. This is necessary to reduce the spread of oak wilt. For more information, contact the Unit Manager or his/her representative.

5.2.32 - Decking/landing restoration (9/13)

All decking and landing areas must have the surface area restored to a condition equal to or better than before. This is to ensure the proper regeneration of the stand. Wood debris, chips and "cookies" from trimmings must be removed or scattered away from landing and loading areas and may not be windrowed on the edge.

5.2.38 - No decking against live trees (2/04)

Cut products may not be decked against unmarked or designated leave trees.

5.4 - Soil Protection

5.4.1 - Rutting restriction, general (7/16)

Operations are to cease immediately if equipment and weather conditions result in rutting of roads and/or skid trails which is 12 inches or greater in depth and 50 feet in length. The Unit Manager or his/her representative may restrict hauling and/or skidding if ruts exceed the specified depth. With the Unit Manager or his/her representative's approval, the Purchaser may return to the area when the risk of rutting has decreased.

6 - Safety and Fire Prevention

6.2 - Signing

6.2.1 - Road posting (9/09)

The Purchaser is responsible for posting and maintaining caution signs on Barker Lake Road and the unnamed road to the county gravel pit prior to beginning operations. The road must be posted at appropriate distances from the sale area to warn of logging activity and truck traffic. Signs must be removed when harvest operations are suspended or completed. The Purchaser will provide these signs.



TIMBER SALE MAP

This information provided by authority of Part 525, 1994 PA 451, as amended.

| | |
|-------------|------|
| Sale Number | Year |
| 72-006 | 18 |

| | | | | | |
|------------------------------------|--------------------|---|-------------------|-----------|---------|
| Forest Management Unit Grayling | County Crawford | Mapped By Barnes | Date 9/24/2018 | Page 1 | of 1 |
| Township 26N | Range 03W | Section(s) and Subdivision(s) Sec 27 - N1/2SW, SESW, NWSE; Sec 34 - NW | Scale 1:15,840 | | |

| Cover Type | | | | Density | | | |
|-------------------|----------------------|-------------------------|-------------------|-----------------------------|------------------------|--|--|
| A = Aspen | H = Hemlock | N = Marsh | U = Upland Brush | 0 = Non Stocked | 5 = Pole Timber Medium | | |
| B = Paper Birch | J = Jack Pine | O = Oak | UM = Upland Mixed | 1 = Seedling Sapling Poor | 6 = Pole Timber Well | | |
| C = Cedar | L = Lowland Brush | P = Lowland Poplar | V = Bog or Marsh | 2 = Seedling Sapling Medium | 7 = Saw Timber Poor | | |
| D = Treed Bog | LM = Lowland Mixed | Q = Mixed Swamp Conifer | W = White Pine | 3 = Seedling Sapling Well | 8 = Saw Timber Medium | | |
| E = Swamp Hdwoods | M = Mpl, Bch, Brch | R = Red Pine | X = Non Stocked | 4 = Pole Timber Poor | 9 = Saw Timber Well | | |
| F = Spruce Fir | MC = Mixed Conifer | S = Black Spruce | Z = Water | | | | |
| G = Grass | MD = Mixed Deciduous | T = Tamarack | | | | | |

| PU | Acres | MBF | Cords |
|----|-------|------|-------|
| 1 | 57.8 | 97.5 | 711 |
| 2 | 7.2 | 11 | 49 |
| 3 | 22.7 | 000 | 232 |

Fosters Last Stands

Compartment 233

87.7 Acres

108.5MBF & 992 Cords

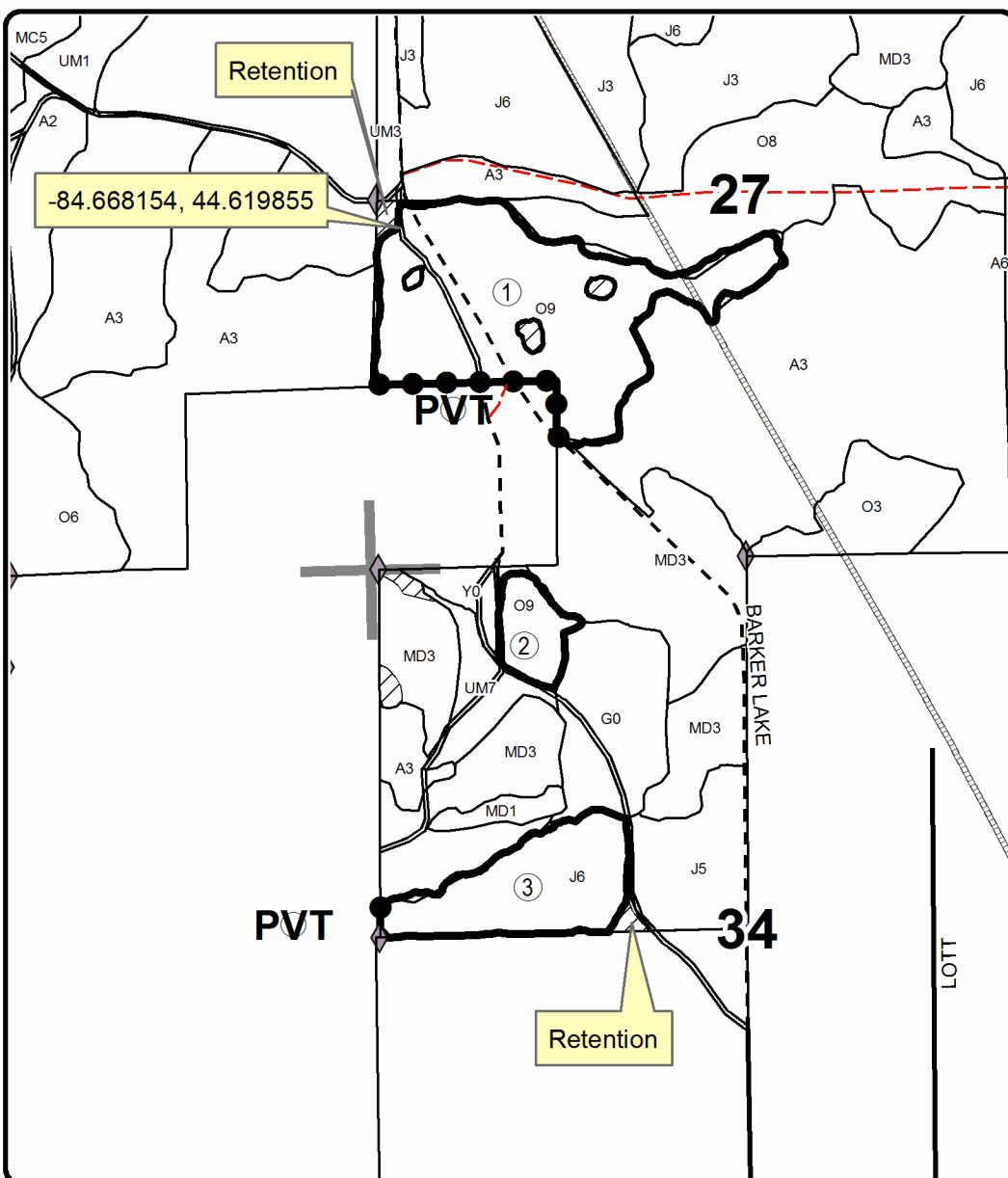
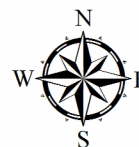

Legend

- Against State (Red)
- Private Line (Blue)
- ▨ Retention Area
- ▭ Stand Boundaries
- ◆ Field Grade Corners
- Secondary Forest Road
- Paved Road
- - Gravel Road
- - County Road - Seasonal
- Section Corners
- PU_Label
- ▬ Pipeline

Locator Map
1:200,000

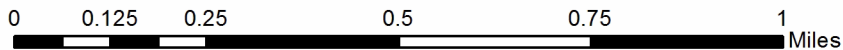
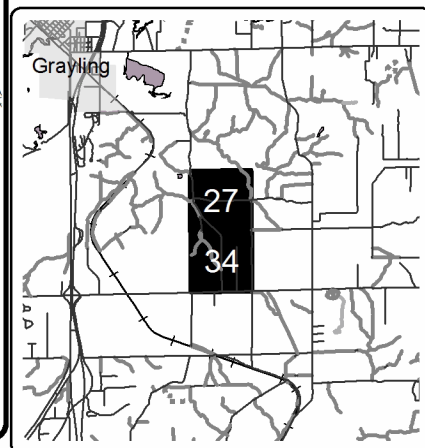

TIMBER SALE INFORMATION

Section 12 Mix (72-037-17)

T25N, R04W, SEC. 12.

Crawford County (Advertised Price \$244,357.75)

SALE NOTE: Oak Wilt restrictions apply to Payment Units 1-4.

A recreation site such as a trail, pathway, or campground is within the sale area or the vicinity. Certain restrictions/specifications may be applicable including time restrictions.

A timber sale contract for this lump sum, sealed bid timber sale will be awarded to the responsible bidder offering the highest sealed bid price. Bids must be at or above the following advertised price for each species:

| <u>PRODUCTS & SPECIES</u> | <u>ESTIMATED UNITS*</u> | <u>ADVERTISED PRICE</u> |
|-------------------------------|-------------------------|-------------------------|
| Sawtimber | | |
| Mixed Aspen | 116.20 MBF | \$ 84.00 / MBF |
| Mixed Oak | 58.50 MBF | \$ 213.00 / MBF |
| Red Oak | 291.00 MBF | \$ 297.00 / MBF |
| Red Pine | 527.90 MBF | \$ 118.00 / MBF |
| Pulpwood | | |
| Mixed Aspen | 884.00 Cords | \$ 25.10 / Cord |
| Mixed Hardwood | 410.00 Cords | \$ 34.05 / Cord |
| Mixed Oak | 814.00 Cords | \$ 22.30 / Cord |
| Red Pine | 441.00 Cords | \$ 42.10 / Cord |
| White Pine | 19.00 Cords | \$ 28.95 / Cord |

* The total volume is statistically estimated within plus (+) or minus (-) 6.58 percent. The estimated units are final and not subject to adjustment. Prospective bidders are urged to examine this timber and to make their own estimates of quantity and quality.

BOND AND PAYMENT SCHEDULE:

- A bond in the amount of \$12,218.00 to insure faithful performance of the conditions of the contract will be deposited by the successful bidder within 21 days of the sale award.
- Cutting in any sale or unit without the required advance payment would be considered a trespass.
- Total payment must be paid in advance or according to the following schedule:
 - Ten percent (10%) of the sale value must be paid within 21 days of the sale award.
 - The 10% down payment will be credited towards the first unit cut.
 - Payment for each of the following units must be made before cutting begins in that unit:

| <u>PAYMENT UNIT NUMBER</u> | <u>PERCENT OF TOTAL SALE VALUE</u> |
|----------------------------|------------------------------------|
| 01 | 26.5% |
| 02 | 10.3% |
| 03 | 16.5% |
| 04 | 5.3% |
| 05 | 7.9% |
| 06 | 33.5% |
- If no cutting takes place, the 10% down payment will not be refunded.
- Operations on the contract issued will terminate on 12/31/2021.

Description of Timber by Payment Unit (PU)

| PU | MARKET GROUP | PRODUCT | QUANTITY | UNIT | ACRES | ADVERTISE PRICE | |
|-------------------|-------------------------|--------------|------------------|-----------------|-------|-----------------|--------------|
| 1 | Mixed Aspen | Sawtimber | 16.6 | MBF | 35.6 | \$64,669.20 | |
| | <i>B. T. Aspen</i> | | 16.6 | <i>MBF</i> | | | |
| | Mixed Oak | | 16.4 | MBF | | | |
| | <i>Northern Pin Oak</i> | | 5.3 | <i>MBF</i> | | | |
| | <i>White Oak</i> | | 11.1 | <i>MBF</i> | | | |
| | Red Oak | 137.6 | MBF | | | | |
| | Mixed Aspen | Pulpwood | 160.0 | Cords | | | |
| | <i>B. T. Aspen</i> | | 160.0 | <i>Cords</i> | | | |
| | Mixed Hardwood | | 152.0 | Cords | | | |
| | <i>Beech</i> | | 2.0 | <i>Cords</i> | | | |
| | <i>Red Maple</i> | | 150.0 | <i>Cords</i> | | | |
| | Mixed Oak | | 436.0 | Cords | | | |
| | <i>Northern Pin Oak</i> | | 62.0 | <i>Cords</i> | | | |
| | <i>Red Oak</i> | | 302.0 | <i>Cords</i> | | | |
| | <i>White Oak</i> | | 72.0 | <i>Cords</i> | | | |
| 2 | Mixed Oak | | Sawtimber | 14.2 | MBF | 23.2 | \$25,103.60 |
| | <i>White Oak</i> | 14.2 | | <i>MBF</i> | | | |
| | Red Oak | 60.9 | MBF | | | | |
| | Mixed Oak | Pulpwood | 179.0 | Cords | | | |
| | <i>Red Oak</i> | | 123.0 | <i>Cords</i> | | | |
| <i>White Oak</i> | 56.0 | <i>Cords</i> | | | | | |
| 3 | Mixed Aspen | Sawtimber | 95.3 | MBF | 40.2 | \$40,375.45 | |
| | <i>B. T. Aspen</i> | | 92.6 | <i>MBF</i> | | | |
| | <i>Quaking Aspen</i> | | 2.7 | <i>MBF</i> | | | |
| | Mixed Oak | | 16.6 | MBF | | | |
| | <i>Northern Pin Oak</i> | | 10.8 | <i>MBF</i> | | | |
| | <i>White Oak</i> | 5.8 | <i>MBF</i> | | | | |
| | Red Oak | 7.5 | MBF | | | | |
| | Mixed Aspen | Pulpwood | 622.0 | Cords | | | |
| | <i>B. T. Aspen</i> | | 549.0 | <i>Cords</i> | | | |
| | <i>Quaking Aspen</i> | | 73.0 | <i>Cords</i> | | | |
| | Mixed Hardwood | | 244.0 | Cords | | | |
| | <i>Red Maple</i> | | <i>Sawtimber</i> | 8.7 | | | <i>MBF</i> |
| | <i>Black Cherry</i> | | | <i>Pulpwood</i> | | | 4.0 |
| | <i>Red Maple</i> | | 223.0 | | | | <i>Cords</i> |
| | Mixed Oak | | 101.0 | Cords | | | |
| | <i>Northern Pin Oak</i> | | 70.0 | <i>Cords</i> | | | |
| | <i>Red Oak</i> | | 14.0 | <i>Cords</i> | | | |
| | <i>White Oak</i> | | 17.0 | <i>Cords</i> | | | |
| | White Pine | | 15.0 | Cords | | | |
| | <i>Jack Pine</i> | | 4.0 | <i>Cords</i> | | | |
| <i>White Pine</i> | 11.0 | | <i>Cords</i> | | | | |
| 4 | Mixed Oak | | Sawtimber | 1.3 | MBF | 6.2 | \$12,982.00 |
| | <i>White Oak</i> | 1.3 | | <i>MBF</i> | | | |
| | Red Oak | 40.0 | MBF | | | | |
| | Mixed Oak | Pulpwood | 37.0 | Cords | | | |
| | <i>Red Oak</i> | | 36.0 | <i>Cords</i> | | | |
| <i>White Oak</i> | 1.0 | <i>Cords</i> | | | | | |
| 5 | Mixed Oak | Sawtimber | 10.0 | MBF | 11.8 | \$19,331.60 | |
| | <i>White Oak</i> | | 10.0 | <i>MBF</i> | | | |
| | Red Oak | | 45.0 | MBF | | | |
| | Red Pine | 9.8 | MBF | | | | |
| | Mixed Oak | Pulpwood | 56.0 | Cords | | | |
| | <i>Red Oak</i> | | 38.0 | <i>Cords</i> | | | |
| | <i>White Oak</i> | | 18.0 | <i>Cords</i> | | | |
| | Red Pine | | 34.0 | Cords | | | |

Description of Timber by Payment Unit (PU), con't

| PU | MARKET GROUP | PRODUCT | QUANTITY | UNIT | ACRES | ADVERTISE PRICE |
|--------|-------------------------|-----------|----------|--------------|-------|-----------------|
| 6 | Mixed Aspen | Sawtimber | 4.3 | MBF | 42.3 | \$81,895.90 |
| | <i>B. T. Aspen</i> | | 1.4 | <i>MBF</i> | | |
| | <i>Quaking Aspen</i> | | 2.9 | <i>MBF</i> | | |
| | Red Pine | | 518.1 | MBF | | |
| | Mixed Aspen | Pulpwood | 102.0 | Cords | | |
| | <i>B. T. Aspen</i> | | 60.0 | <i>Cords</i> | | |
| | <i>Quaking Aspen</i> | | 42.0 | <i>Cords</i> | | |
| | Mixed Hardwood | | 14.0 | Cords | | |
| | <i>Red Maple</i> | | 14.0 | <i>Cords</i> | | |
| | Mixed Oak | | 5.0 | Cords | | |
| | <i>Northern Pin Oak</i> | | 5.0 | <i>Cords</i> | | |
| | Red Pine | | 407.0 | Cords | | |
| | White Pine | | 4.0 | Cords | | |
| | <i>White Pine</i> | | 4.0 | <i>Cords</i> | | |
| | TOTAL: | | | 993.6 | | |
| TOTAL: | | | 2,568.0 | Cords | | |

Sale Specific Conditions & Requirements

Sale Name: Section 12 Mix

Sale Number: 72-037-17 Seq#: 1

1 - Sale Area

1.2 - Boundaries

1.2.1 - Painted boundaries (1/14)

The sale boundary and Payment Unit boundaries are marked and identified by blue, red and yellow paint, along with roads. Exterior sale boundary lines against private property are marked with blue paint. Exterior sale boundary lines against state are marked with red paint, with the exception of the north boundary of Payment Unit 1, which is unpainted and identified by W 5 Mile Rd, and the west boundary of Payment Units 4, 5, and 6, which is unpainted and identified by King Rd. Interior Payment Unit boundaries are marked with yellow paint. The painted boundary line trees are not Included Timber and are to be protected. Yellow painted trees designating an interior Payment Unit boundary are only to be cut when all surrounding Payment Units have been paid.

2 - Timber Specifications

2.1 - Included Timber

2.1.1 - Clearcut unit(s) with unmerchantable trees (6/14)

Within Payment Unit(s) 1 and 3, cut all trees that are two (2) inches or more at DBH, except do not cut pine and hemlock in Payment Unit 1.

Within Payment Unit(s) 6, cut all trees that are one (1) inch or more at DBH.

2.1.5 - Overstory removal unit(s) (8/11)

Within Payment Unit(s) 2, 4, and 5, all oak trees with a DBH equal to or greater than 5 inches, which meet minimum piece specifications in 2.2 Utilization, are designated for cutting. In addition, within Payment Unit 5, cut all red pine 5 inches or more at DBH.

2.2 - Utilization

2.2.2 - Chipping required (5/14)

Payment Unit 6 must be chip harvested to facilitate subsequent planting operations. The Purchaser has the option to produce sawlogs or pulpwood bolts, but the remaining portion of the trees must be chipped and hauled. Do not chip 1/6 to 1/3 of the slash from harvested trees (tree tops and limbs less than four inches in diameter).

2.2.3 - Stump heights (4/07)

Stump heights within Payment Unit 6 shall not exceed 12 inches for trees greater than 10 inches DBH and 4 inches for trees smaller than 10 inches DBH. This is in order to facilitate planting operations.

3 - Payments

3.3 - Pre-measured Sales

3.3.4 - Dividing payment units (7/14)

Payment Unit(s) may be divided at the request of the Purchaser and upon approval of the Unit Manager. Dividing Payment Units is a contract modification which requires a Timber Sale Contract Supplement.

3.4 - Damaged Timber

3.4.1 - Damaged timber (6/14)

General Condition and Requirement 3.4 Damaged Timber, defines liquidated damages for undesignated live merchantable trees which are cut or injured. In addition, extreme care should be taken to avoid damage to tree seedlings and saplings.

Within Payment Units 2, 4, and 5, if more than 30% of the tree seedlings or saplings (1/4" to 4.5" DBH) within a specified portion of the sale area are damaged, liquidated damages will be assessed at \$300 per acre for all acreage within that specified portion of the sale area that was damaged.

No damage is acceptable to merchantable trees. Within the sale area, if more than 10% of trees (> 4.5" DBH) within a specified area of the sale are damaged, liquidated damages will be assessed for all trees damaged. Rates will be in accordance with General Condition and Requirement 3.4 Damaged Timber.

4 - Transportation

4.1 - Construction

4.1.3 - Slash and earthen piles (8/04)

Piles or windrows of earth along roads and landings that have been widened or constructed shall be leveled. Slash from road maintenance or construction, including stumps, shall be dispersed throughout the sale.

4.1.6 - Road construction (1/09)

Construction of new roads or improvements of existing roads shall be done in such a way as to minimize the environmental and visual impacts. Merchantable trees shall be cut and utilized unless otherwise directed. Non-merchantable trees shall be severed and laid flat on the ground. Slash shall be scattered, and not left in windrows and kept a minimum of 10 feet back from the road edge. Stumps shall be set upright, not left on edge, and be moved at least 10 feet away from the road edge. Disturbed soil shall be feathered into the woods and not left in berms or windrows.

4.1.7 - Road closure (10/11)

All new roads built into the sale must be blocked to vehicle traffic upon completion of the sale. Overgrown roads that are reopened shall be considered new roads. In general, this will require constructing a four (4') foot high berm of stumps and logs covered with earth. Stumps and brush must be placed along the remainder of the trail. These roads must be rendered impassable to cars and trucks. Contact the sale administrator for specific details of design and placement.

5 - Operations

5.1 - Notification

5.1.1 - Pre-sale conference (10/16)

A pre-sale conference on site between the Purchaser and sale administrator is required prior to beginning any operations to determine landing and road locations. The Unit Manager or his/her representative must be contacted at least 5 days in advance to schedule the conference.

5.1.4 - Post-sale conference (10/16)

A post-sale conference on site between the Purchaser and sale administrator is required 5 days prior to the completion of active logging operations to determine clean-up and repair of landings, road edges, and the fulfillment of other contract specifications.

5.2 - Conduct of Operations

5.2.2 - Hazard Trees/Snags

5.2.2.1 - Den trees (10/16)

Obvious hollow and/or den trees shall be protected and left standing unless they are a safety hazard.

5.2.3 - Operating Restrictions

5.2.3.4 - Oak wilt restriction (4/17)

Within Payment Unit(s) 1-5, unless changed by written agreement, cutting, skidding, and hauling are not permitted during the period of April 15 to July 15. Operations may be allowed if specific steps are taken to prevent damaging uncut oak during the high risk period. Those steps include completing all road brushing before April 15th, clearing a tree-length buffer along uncut oak cover before April 15th or leaving an uncut buffer there until after July 15th. This is necessary to reduce the spread of oak wilt. For more information, contact the Unit Manager or his/her representative.

5.2.4 - Dead and Down Creation

5.2.4.4 - Dead and down creation, grouse (8/13)

To encourage grouse and other wildlife, in Payment Unit(s) 3, leave one, 12" diameter or larger log-length (8 foot minimum) piece on the ground for every 2 acres. These will be evenly scattered throughout the unit. This can be an unmerchantable piece or a full tree.

5.2.29 - Shrub protection (9/07)

Do not cut or damage hawthorn, witch-hazel, dogwood or juneberry. These woody-shrub plants are highly beneficial to various wildlife species.

5.2.32 - Decking/landing restoration (9/13)

All decking and landing areas must have the surface area restored to a condition equal to or better than before. This is to ensure the proper regeneration of the stand. Wood debris, chips and "cookies" from trimmings must be removed or scattered away from landing and loading areas and may not be windrowed on the edge.

5.2.39 - ORV trail/route protection (12/12)

The ORV trail or route is shown on the Timber Sale Map. Do not cut trees or damage posts with orange ORV markers. Maintain a 20 foot wide slash, debris, and rut free zone daily using the ORV trail or route as the centerline. Skidding across the trail or route may only occur in locations approved by the sale administrator.

5.2.41 - Snowmobile trail protection (9/11)

The snowmobile trail is shown on the Timber Sale Map. Do not cut or damage posts with orange trail markers or traffic control signs. If the trail is used, it must be maintained and restored to a condition equal to or better than before the sale. The road maintenance/restoration must be done prior to December 1. If the trail road is to be used for hauling during the snowmobile season, then a snow covered base must be left on the trail. The snowmobile trail may not be used for any timber sale operations from December 1 to March 31 without written permission from the Unit Manager. Maintain a 20 foot wide slash, debris, and rut free zone daily using the snowmobile trail as the centerline. No decking of forest products will be permitted along the snowmobile trail. All stumps within 20 feet of the snowmobile trail must be cut at ground level.

5.4 - Soil Protection

5.4.1 - Rutting restriction, general (7/16)

Operations are to cease immediately if equipment and weather conditions result in rutting of roads and/or skid trails which is 12 inches or greater in depth and 50 feet in length. The Unit Manager or his/her representative may restrict hauling and/or skidding if ruts exceed the specified depth. With the Unit Manager or his/her representative's approval, the Purchaser may return to the area when the risk of rutting has decreased.

6 - Safety and Fire Prevention

6.2 - Signing

6.2.1 - Road posting (9/09)

The Purchaser is responsible for posting and maintaining caution signs on W 5 Mile Road and King Road prior to beginning operations. The road must be posted at appropriate distances from the sale area to warn of logging activity and truck traffic. Signs must be removed when harvest operations are suspended or completed. The Purchaser will provide these signs.

6.2.2 - Snowmobile trail posting (8/09)

The Purchaser is responsible for posting and maintaining caution signs on the snowmobile trail prior to beginning operations during the snowmobile season (approximately December 1 to March 31). The trail must be posted at appropriate distances from the sale area to warn of logging activity and truck traffic. Signs must be removed when harvest operations are suspended or completed. The Purchaser will provide these signs.

6.2.3 - Recreational trail posting (2/10)

The Purchaser is responsible for posting and maintaining caution signs on the ORV trail prior to beginning operations. The trail must be posted at appropriate distances from the sale area to warn of logging activity and truck traffic at both ends of the trail. Signs must be removed when harvest operations are suspended or completed. The Purchaser will provide these signs.



TIMBER SALE MAP

This information provided by authority of Part 525, 1994 PA 451, as amended.

| | |
|-------------|------|
| Sale Number | Year |
| 72 - 037 | 17 |

| | | | | | |
|------------------------------------|--------------------|--------------------------|--------------------|--|---------|
| Forest Management Unit Grayling | County Crawford | Mapped By Matt Foster | Date 08/28/2017 | Page 1 | of 1 |
| Township 25N | | Range 04W | | Section(s) and Subdivision(s) Section 12: SW1/4, NW1/4, NE1/4 | |

| | |
|-------|----------|
| Scale | 1:15,840 |
|-------|----------|

| Cover Type | | | | Density | |
|-------------------|----------------------|-------------------------|-------------------|-----------------------------|------------------------|
| A = Aspen | H = Hemlock | N = Marsh | U = Upland Brush | 0 = Non Stocked | 5 = Pole Timber Medium |
| B = Paper Birch | J = Jack Pine | O = Oak | UM = Upland Mixed | 1 = Seedling Sapling Poor | 6 = Pole Timber Well |
| C = Cedar | L = Lowland Brush | P = Lowland Poplar | V = Bog or Marsh | 2 = Seedling Sapling Medium | 7 = Saw Timber Poor |
| D = Tread Bog | LM = Lowland Mixed | Q = Mixed Swamp Conifer | W = White Pine | 3 = Seedling Sapling Well | 8 = Saw Timber Medium |
| E = Swamp Hdwoods | M = Mpl, Bch, Brch | R = Red Pine | X = Non Stocked | 4 = Pole Timber Poor | 9 = Saw Timber Well |
| F = Spruce Fir | MC = Mixed Conifer | S = Black Spruce | Z = Water | | |
| G = Grass | MD = Mixed Deciduous | T = Tamarack | | | |

| PU | Acres | PU | Acres |
|----|-------|----|-------|
| 1 | 35.6 | 4 | 6.2 |
| 2 | 23.2 | 5 | 11.8 |
| 3 | 40.2 | 6 | 42.3 |

Section 12 Mix

Compartment 198

159.3 Acres

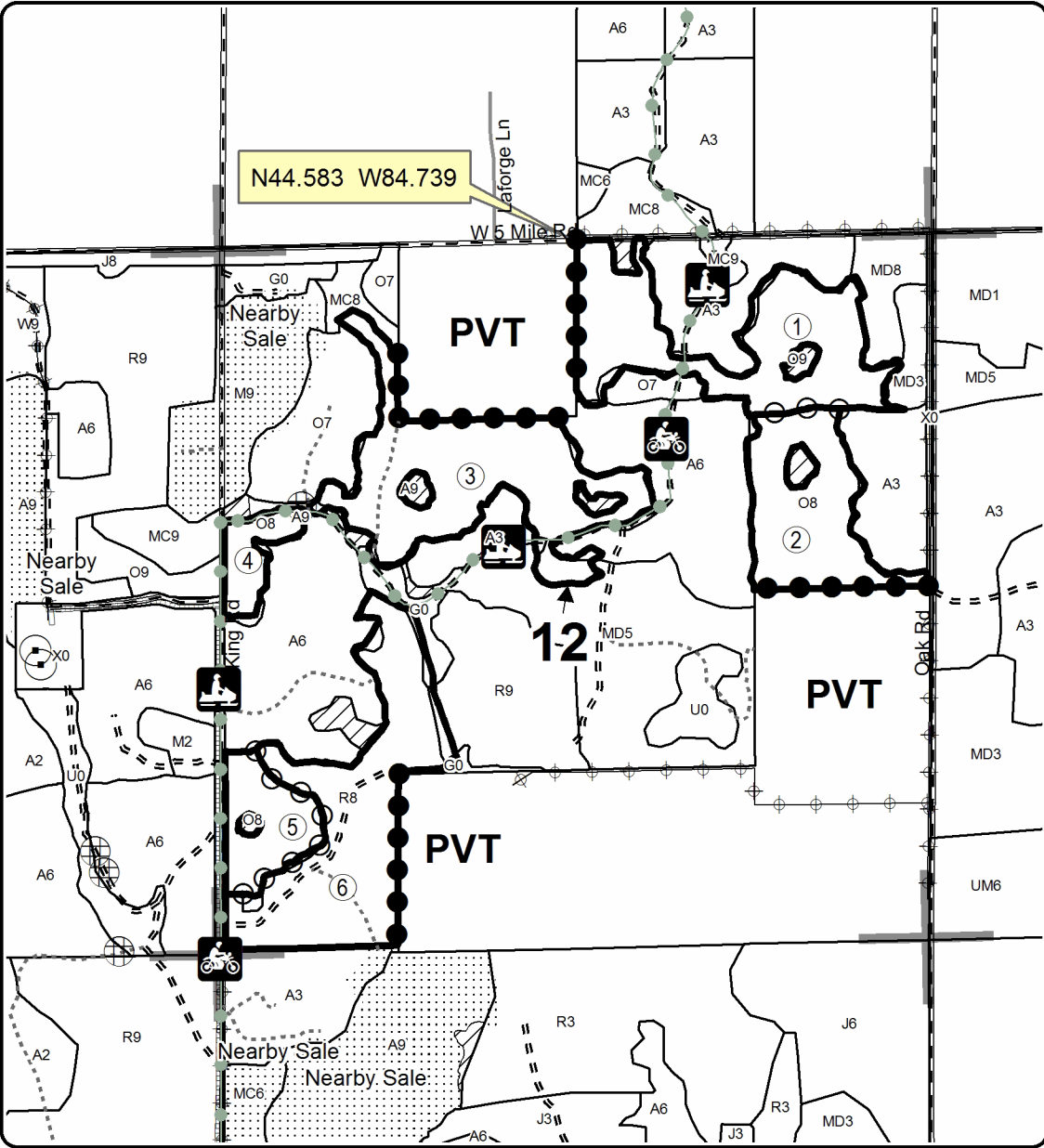

Legend

- Against State (Red)
- Payment Unit (Yellow)
- Private Line (Blue)
- ▨ Retention Area
- ▭ Stand Boundaries
- Section Corners
- Oil & Gas Well Surface Locations
- Highway
- Paved Roads
- Gravel Roads
- Poor Dirt Roads
- Closed Roads
- Recreational Trail

Locator Map
1:200,000

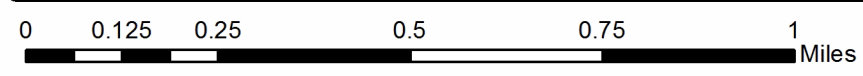
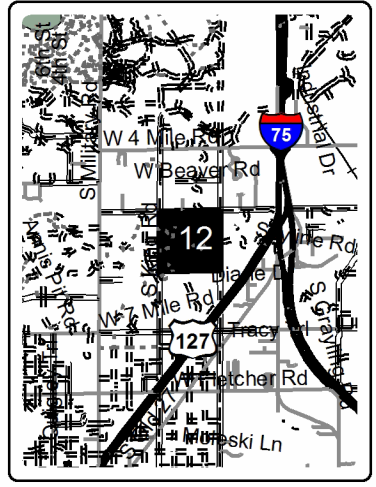

TIMBER SALE INFORMATION

Feed Bucket Mix (72-040-17)
 T25N, R03W, SEC. 2.
 Crawford County (Advertised Price \$50,165.60)

SALE NOTE: Sale has oak wilt restrictions (spec 5.2.3.4). A horse trail runs through the north side of the sale, parallel with 4 Mile Rd (see spec 5.2.40 and 6.2.3). Due to numerous roads in the area, the designated snowmobile trail should be avoided if possible for hauling.

A recreation site such as a trail, pathway, or campground is within the sale area or the vicinity. Certain restrictions/specifications may be applicable including time restrictions.

A timber sale contract for this lump sum, sealed bid timber sale will be awarded to the responsible bidder offering the highest sealed bid price. Bids must be at or above the following advertised price for each species:

| <u>PRODUCTS & SPECIES</u> | <u>ESTIMATED UNITS*</u> | <u>ADVERTISED PRICE</u> |
|-------------------------------|-------------------------|-------------------------|
| Sawtimber | | |
| Mixed Aspen | 38.50 MBF | \$ 78.00 / MBF |
| Mixed Oak | 57.50 MBF | \$ 199.00 / MBF |
| Red Pine | 67.10 MBF | \$ 110.00 / MBF |
| Pulpwood | | |
| Jack Pine | 300.00 Cords | \$ 18.10 / Cord |
| Mixed Aspen | 260.00 Cords | \$ 23.50 / Cord |
| Mixed Hardwood | 67.00 Cords | \$ 31.90 / Cord |
| Mixed Oak | 256.00 Cords | \$ 20.90 / Cord |
| Red Pine | 86.00 Cords | \$ 39.45 / Cord |
| White Pine | 218.00 Cords | \$ 27.15 / Cord |

* The total volume is statistically estimated within plus (+) or minus (-) 13.41 percent. The estimated units are final and not subject to adjustment. Prospective bidders are urged to examine this timber and to make their own estimates of quantity and quality.

BOND AND PAYMENT SCHEDULE:

- A bond in the amount of \$2,508.00 to insure faithful performance of the conditions of the contract will be deposited by the successful bidder within 21 days of the sale award.
- Cutting in any sale or unit without the required advance payment would be considered a trespass.
- Total payment must be paid in advance or according to the following schedule:
 - Ten percent (10%) of the sale value must be paid within 21 days of the sale award.
 - The remainder is due before cutting begins.
 - Payment for each of the following units must be made before cutting begins in that unit:

| PAYMENT UNIT NUMBER | PERCENT OF TOTAL SALE VALUE |
|---------------------|-----------------------------|
| 01 | 100.0% |
- If no cutting takes place, the 10% down payment will not be refunded.
- Operations on the contract issued will terminate on 09/30/2021.

Description of Timber by Payment Unit (PU)

| PU | MARKET GROUP | PRODUCT | QUANTITY | UNIT | ACRES | ADVERTISE PRICE |
|---------------|----------------|-----------|----------|-------|-------|-----------------|
| 1 | Mixed Aspen | Sawtimber | 38.5 | MBF | 82.5 | \$50,165.60 |
| | Mixed Oak | | 57.5 | MBF | | |
| | Red Pine | | 67.1 | MBF | | |
| | Jack Pine | Pulpwood | 300.0 | Cords | | |
| | Mixed Aspen | | 260.0 | Cords | | |
| | Mixed Hardwood | | 67.0 | Cords | | |
| | Mixed Oak | | 256.0 | Cords | | |
| | Red Pine | | 86.0 | Cords | | |
| | White Pine | | 218.0 | Cords | | |
| | TOTAL: | | | 163.1 | | |
| TOTAL: | | | 1,187.0 | Cords | | |

Sale Specific Conditions & Requirements

Sale Name: Feed Bucket Mix

Sale Number: 72-040-17 Seq#: 2

1 - Sale Area

1.2 - Boundaries

1.2.1 - Painted boundaries (1/14)

The sale boundary is marked and identified by red paint, along with a road. Exterior sale boundary lines against state are marked with red paint, with the exception of the north boundary, which is unpainted and identified by 4 Mile Road. The painted boundary line trees are not Included Timber and are to be protected.

2 - Timber Specifications

2.1 - Included Timber

2.1.1 - Clearcut unit(s) with unmerchantable trees (6/14)

Within Payment Unit(s) 1, cut all trees that are two (2) inches or more at DBH, except do not cut white pine and red pine 26 inches or more at DBH.

2.2 - Utilization

2.2.3 - Stump heights (4/07)

Stump heights within the Sale Area shall not exceed 12 inches for trees greater than 10 inches DBH and 4 inches for trees smaller than 10 inches DBH. A written waiver of this requirement may be obtained if wet summer weather makes winter logging necessary.

3 - Payments

3.3 - Pre-measured Sales

3.3.4 - Dividing payment units (7/14)

Payment Unit(s) 1 may be divided at the request of the Purchaser and upon approval of the Unit Manager. Dividing Payment Units is a contract modification which requires a Timber Sale Contract Supplement.

4 - Transportation

4.1 - Construction

4.1.3 - Slash and earthen piles (8/04)

Piles or windrows of earth along roads and landings that have been widened or constructed shall be leveled. Slash from road maintenance or construction, including stumps, shall be dispersed throughout the sale.

4.1.6 - Road construction (1/09)

Construction of new roads or improvements of existing roads shall be done in such a way as to minimize the environmental and visual impacts. Merchantable trees shall be cut and utilized unless otherwise directed. Non-merchantable trees shall be severed and laid flat on the ground. Slash shall be scattered, and not left in windrows and kept a minimum of 10 feet back from the road edge. Stumps shall be set upright, not left on edge, and be moved at least 10 feet away from the road edge. Disturbed soil shall be feathered into the woods and not left in berms or windrows.

4.1.7 - Road closure (10/11)

All new roads built into the sale must be blocked to vehicle traffic upon completion of the sale. In general, this will require constructing a four (4') foot high berm of stumps and logs covered with earth. These roads must be rendered impassable to cars and trucks. Contact the sale administrator for specific details of design and placement.

4.1.11 - Permits (2/12)

The Purchaser will secure any necessary permits that may be required.

5 - Operations

5.1 - Notification

5.1.1 - Pre-sale conference (10/16)

A pre-sale conference on site between the Purchaser and sale administrator is required prior to beginning any operations to determine landing and road locations. The Unit Manager or his/her representative must be contacted at least 10 days in advance to schedule the conference.

5.1.3 - Well heads and natural gas pipelines (11/15)

The Purchaser is responsible for contacting the gas or pipeline company 30 days prior to operating equipment in the vicinity of well heads or natural gas pipelines.

5.2 - Conduct of Operations

5.2.1 - Slash

5.2.1.8 - Slash height (12/08)

No slash or tree tops may exceed 24 inches in height.

5.2.2 - Hazard Trees/Snags

5.2.2.1 - Den trees (10/16)

Obvious hollow and/or den trees shall be protected and left standing unless they are a safety hazard.

5.2.3 - Operating Restrictions

5.2.3.4 - Oak wilt restriction (9/17)

Within Payment Unit 1, unless changed by written agreement, cutting, skidding, hauling and brushing of access roads are not permitted during the period of April 15 to July 15. Operations may be allowed if specific steps are taken to prevent damaging uncut oak during the high risk period. Those steps include completing all road brushing before April 15th, clearing a tree-length buffer along uncut oak cover before April 15th or leaving an uncut buffer there until after July 15th. This is necessary to reduce the spread of oak wilt. For more information, contact the Unit Manager or his/her representative.

5.2.32 - Decking/landing restoration (9/13)

All decking and landing areas must have the surface area restored to a condition equal to or better than before. This is to ensure the proper regeneration of the stand. Wood debris, chips and "cookies" from trimmings must be removed or scattered away from landing and loading areas and may not be windrowed on the edge.

5.2.38 - No decking against live trees (2/04)

Cut products may not be decked against unmarked or designated leave trees.

5.2.40 - Pathway protection (10/10)

There is a horse trail within the sale boundary which is shown on the Timber Sale Map. Do not cut trees or damage posts with blue pathway markers. Maintain a rut and slash free zone within 10 feet of the trail. Do not deck wood along the trail. Do not run equipment down the pathway. Do not operate equipment along the trail during scheduled trail rides. The sale administrator will provide a minimum of two weeks notice of when scheduled trail rides are to occur.

5.4 - Soil Protection

5.4.1 - Rutting restriction, general (7/16)

Operations are to cease immediately if equipment and weather conditions result in rutting of roads and/or skid trails which is 12 inches or greater in depth and 50 feet in length. The Unit Manager or his/her representative may restrict hauling and/or skidding if ruts exceed the specified depth. With the Unit Manager or his/her representative's approval, the Purchaser may return to the area when the risk of rutting has decreased.

6 - Safety and Fire Prevention

6.2 - Signing

6.2.1 - Road posting (9/09)

The Purchaser is responsible for posting and maintaining caution signs on 4 Mile Road prior to beginning operations. The road must be posted at appropriate distances from the sale area to warn of logging activity and truck traffic. Signs must be removed when harvest operations are suspended or completed. The Purchaser will provide these signs.

6.2.3 - Recreational trail posting (2/10)

The Purchaser is responsible for posting and maintaining caution signs on the horse trail prior to beginning operations. The trail must be posted at appropriate distances from the sale area to warn of logging activity and truck traffic at both ends of the trail. Signs must be removed when harvest operations are suspended or completed. The Purchaser will provide these signs.



TIMBER SALE MAP

This information provided by authority of Part 525, 1994 PA 451, as amended.

| | | | | | |
|------------------------------------|--------------------|----------------------|------------------|-----------|---------|
| Forest Management Unit Grayling | County Crawford | Mapped By Martell | Date 08/28/17 | Page 1 | of 1 |
| Cruised By Martell and Foster | | | | | |

| | | | |
|-----------------|--------------|--|-------------------|
| Township 25N | Range 03W | Section(s) and Subdivision(s) Sec. 2 - N1/2NE1/4, SW1/4NE1/4, E1/2NW1/4 | Scale 1:15,840 |
|-----------------|--------------|--|-------------------|

| Cover Type | | | | Density | | | |
|-------------------|----------------------|-------------------------|-------------------|-----------------------------|------------------------|--|--|
| A = Aspen | H = Hemlock | N = Marsh | U = Upland Brush | 0 = Non Stocked | 5 = Pole Timber Medium | | |
| B = Paper Birch | J = Jack Pine | O = Oak | UM = Upland Mixed | 1 = Seedling Sapling Poor | 6 = Pole Timber Well | | |
| C = Cedar | L = Lowland Brush | P = Lowland Poplar | V = Bog or Marsh | 2 = Seedling Sapling Medium | 7 = Saw Timber Poor | | |
| D = Tread Bog | LM = Lowland Mixed | Q = Mixed Swamp Conifer | W = White Pine | 3 = Seedling Sapling Well | 8 = Saw Timber Medium | | |
| E = Swamp Hdwoods | M = Mpl, Bch, Brch | R = Red Pine | X = Non Stocked | 4 = Pole Timber Poor | 9 = Saw Timber Well | | |
| F = Spruce Fir | MC = Mixed Conifer | S = Black Spruce | Z = Water | | | | |
| G = Grass | MD = Mixed Deciduous | T = Tamarack | | | | | |

PU Acres
1 82.5

Feed Bucket Mix Compartment 232 82.5 Acres

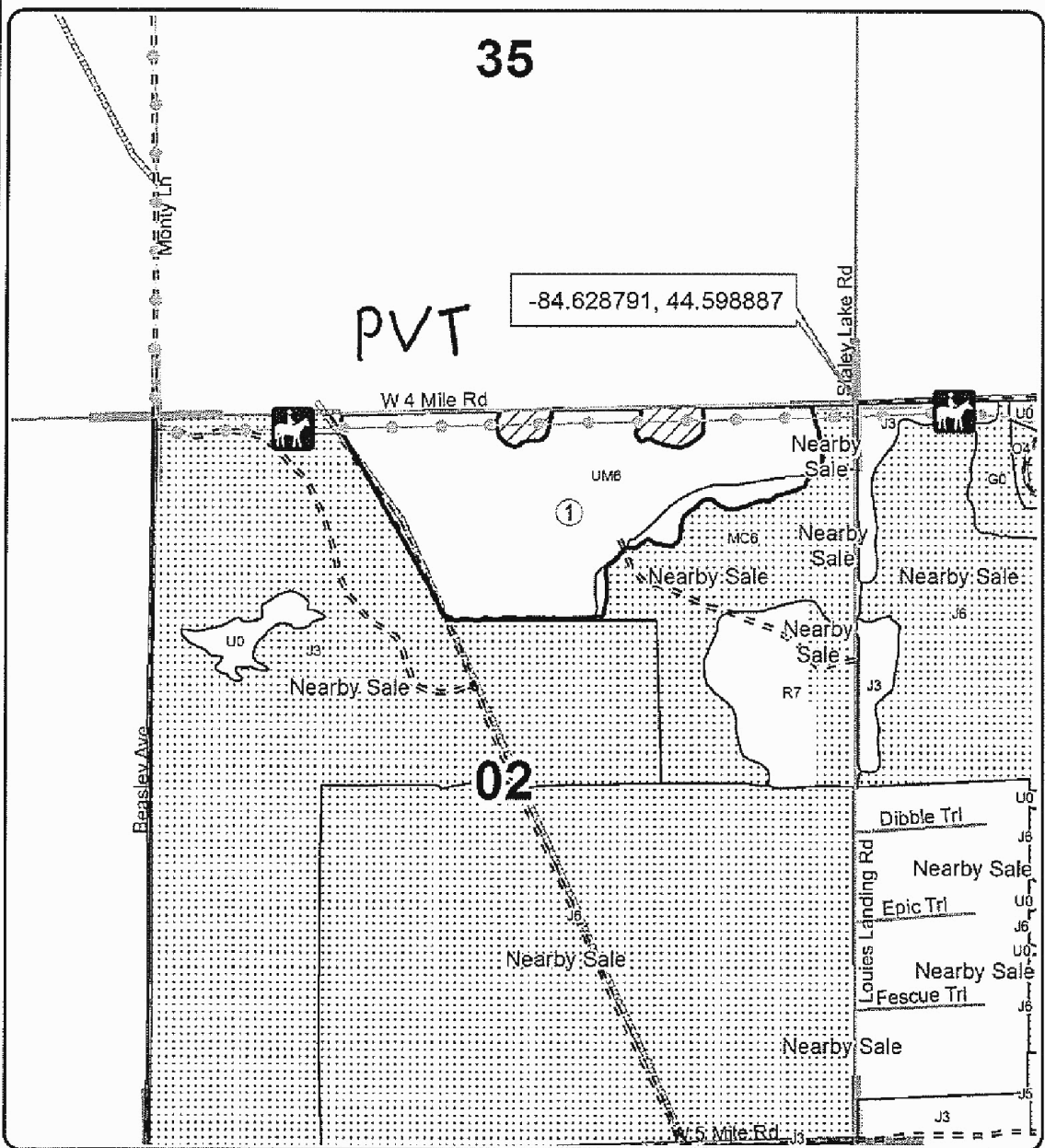
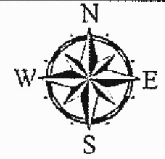

Legend

- Against State (Red)
- Payment Unit
- Retention Area
- Nearby Timber Sale
- Horse Trail
- Highway
- Paved Roads
- Gravel Roads
- Poor Dirt Roads
- Closed Roads
- Pipeline
- Section Corners

Locator Map
1:200,000

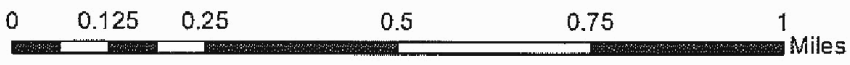
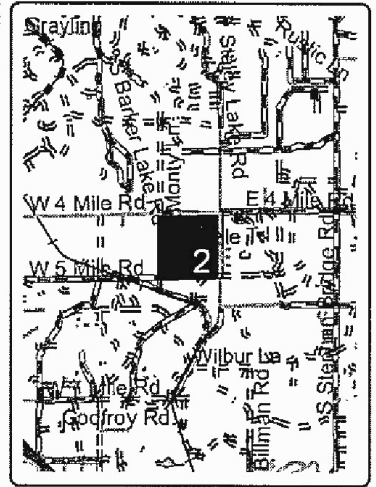

TIMBER SALE INFORMATION

Railroad Mix (72-041-17)

T25N, R04W, SEC. 11; T25N, R04W, SEC. 12.
Crawford County (Advertised Price \$73,254.90)

SALE NOTE: The sale is accessed off of either W 5 Mile Road or S King Road. Oak wilt and bark slippage restrictions are in place.

A recreation site such as a trail, pathway, or campground is within the sale area or the vicinity. Certain restrictions/specifications may be applicable including time restrictions.

A timber sale contract for this lump sum, sealed bid timber sale will be awarded to the responsible bidder offering the highest sealed bid price. Bids must be at or above the following advertised price for each species:

| <u>PRODUCTS & SPECIES</u> | <u>ESTIMATED UNITS*</u> | <u>ADVERTISED PRICE</u> |
|-------------------------------|-------------------------|-------------------------|
| Sawtimber | | |
| B. T. Aspen | 40.50 MBF | \$ 78.00 / MBF |
| Beech | 19.40 MBF | \$ 107.00 / MBF |
| Red Maple | 23.20 MBF | \$ 55.00 / MBF |
| Red Oak | 29.40 MBF | \$ 279.00 / MBF |
| Sugar Maple | 30.70 MBF | \$ 281.00 / MBF |
| Pulpwood | | |
| B. T. Aspen | 828.00 Cords | \$ 23.50 / Cord |
| Mixed Hardwood | 846.00 Cords | \$ 31.90 / Cord |
| Red Oak | 166.00 Cords | \$ 20.90 / Cord |

* The total volume is statistically estimated within plus (+) or minus (-) 12.49 percent. The estimated units are final and not subject to adjustment. Prospective bidders are urged to examine this timber and to make their own estimates of quantity and quality.

BOND AND PAYMENT SCHEDULE:

1. A bond in the amount of \$3,663.00 to insure faithful performance of the conditions of the contract will be deposited by the successful bidder within 21 days of the sale award.
2. Cutting in any sale or unit without the required advance payment would be considered a trespass.
3. Total payment must be paid in advance or according to the following schedule:
 - (a) Ten percent (10%) of the sale value must be paid within 21 days of the sale award.
 - (b) The 10% down payment will be credited towards the first unit cut.
 - (c) Payment for each of the following units must be made before cutting begins in that unit:

| <u>PAYMENT UNIT NUMBER</u> | <u>PERCENT OF TOTAL SALE VALUE</u> |
|----------------------------|------------------------------------|
| 01 | 28.0% |
| 02 | 24.2% |
| 03 | 40.9% |
| 04 | 6.9% |
4. If no cutting takes place, the 10% down payment will not be refunded.
5. Operations on the contract issued will terminate on 09/30/2021.

Description of Timber by Payment Unit (PU)

| PU | MARKET GROUP | PRODUCT | QUANTITY | UNIT | ACRES | ADVERTISE PRICE | |
|------------------------|------------------------|-------------|--------------|--------------|-------|-----------------|------|
| 1 | B. T. Aspen | Sawtimber | 7.9 | MBF | 10.6 | \$20,526.10 | |
| | Beech | | 4.6 | MBF | | | |
| | Red Maple | | 10.2 | MBF | | | |
| | Red Oak | | 0.9 | MBF | | | |
| | <i>Red Oak</i> | | <i>0.9</i> | <i>MBF</i> | | | |
| | Sugar Maple | 23.0 | MBF | | | | |
| | B. T. Aspen | Pulpwood | 24.0 | Cords | | | |
| | Mixed Hardwood | | 361.0 | Cords | | | |
| | <i>Beech</i> | | <i>56.0</i> | <i>Cords</i> | | | |
| | <i>Ironwood</i> | | <i>7.0</i> | <i>Cords</i> | | | |
| | <i>Red Maple</i> | | <i>139.0</i> | <i>Cords</i> | | | |
| | <i>Sugar Maple</i> | | <i>159.0</i> | <i>Cords</i> | | | |
| | Red Oak | | 3.0 | Cords | | | |
| | 2 | | B. T. Aspen | Sawtimber | | | 12.1 |
| Red Maple | | | 4.8 | | MBF | | |
| Red Oak | | 10.6 | MBF | | | | |
| <i>BI/R/Hybrid Oak</i> | | <i>0.4</i> | <i>MBF</i> | | | | |
| <i>Red Oak</i> | | <i>10.2</i> | <i>MBF</i> | | | | |
| Sugar Maple | | 2.9 | MBF | | | | |
| B. T. Aspen | | Pulpwood | 298.0 | Cords | | | |
| Mixed Hardwood | | | 140.0 | Cords | | | |
| <i>Beech</i> | | | <i>4.0</i> | <i>Cords</i> | | | |
| <i>BI/R/Hybrid Oak</i> | | | <i>1.0</i> | <i>Cords</i> | | | |
| <i>Black Cherry</i> | | | <i>5.0</i> | <i>Cords</i> | | | |
| <i>Ironwood</i> | | | <i>2.0</i> | <i>Cords</i> | | | |
| <i>Red Maple</i> | | | <i>107.0</i> | <i>Cords</i> | | | |
| <i>Sugar Maple</i> | | | <i>21.0</i> | <i>Cords</i> | | | |
| Red Oak | 60.0 | | Cords | | | | |
| 3 | B. T. Aspen | Sawtimber | 20.5 | MBF | 32.1 | \$29,965.00 | |
| | Red Maple | | 8.2 | MBF | | | |
| | Red Oak | | 17.9 | MBF | | | |
| | <i>BI/R/Hybrid Oak</i> | | <i>0.7</i> | <i>MBF</i> | | | |
| | <i>Red Oak</i> | | <i>17.2</i> | <i>MBF</i> | | | |
| | Sugar Maple | 4.8 | MBF | | | | |
| | B. T. Aspen | Pulpwood | 506.0 | Cords | | | |
| | Mixed Hardwood | | 236.0 | Cords | | | |
| | <i>Beech</i> | | <i>6.0</i> | <i>Cords</i> | | | |
| | <i>BI/R/Hybrid Oak</i> | | <i>3.0</i> | <i>Cords</i> | | | |
| | <i>Black Cherry</i> | | <i>8.0</i> | <i>Cords</i> | | | |
| | <i>Ironwood</i> | | <i>3.0</i> | <i>Cords</i> | | | |
| | <i>Red Maple</i> | | <i>181.0</i> | <i>Cords</i> | | | |
| | <i>Sugar Maple</i> | | <i>35.0</i> | <i>Cords</i> | | | |
| Red Oak | 103.0 | | Cords | | | | |
| 4 | Beech | Sawtimber | 14.8 | MBF | 26.5 | \$5,060.70 | |
| | Mixed Hardwood | Pulpwood | 109.0 | Cords | | | |
| | <i>Beech</i> | | <i>109.0</i> | <i>Cords</i> | | | |
| TOTAL: | | | 143.2 | MBF | | | |
| TOTAL: | | | 1,840.0 | Cords | | | |

Sale Specific Conditions & Requirements

Sale Name: Railroad Mix

Sale Number: 72-041-17 Seq#: 2

1 - Sale Area

1.2 - Boundaries

1.2.1 - Painted boundaries (1/14)

The sale boundary and Payment Unit boundaries are marked and identified by blue, red and yellow paint, along with roads. Exterior sale boundary lines against private property are marked with blue paint. Exterior sale boundary lines against state are marked with red paint, with the exception of the north boundary of Payment Unit 1, which is unpainted and identified by W 5 Mile Rd. The Payment Unit boundary between Payment Units 1 and 2 is marked with a red slash on top of a yellow slash. The Payment Unit boundary between Payment Units 2 and 3 is unpainted and identified by the closed road, as shown on Timber Sale Map. The painted boundary line trees are not Included Timber and are to be protected. Yellow and red painted trees designating an interior Payment Unit boundary are only to be cut when all surrounding Payment Units have been paid.

2 - Timber Specifications

2.1 - Included Timber

2.1.1 - Clearcut unit(s) with unmerchantable trees (6/14)

Within Payment Unit(s) 1, 2, and 3, cut all trees that are two (2) inches or more at DBH, except do not cut pine and hemlock.

2.1.4 - Designated timber unit(s) (6/17)

Within Payment Unit(s) 4, all beech trees are designated for cutting, regardless of merchantability.

2.2 - Utilization

2.2.3 - Stump heights (4/07)

Stump heights within the sale area shall not exceed 12 inches for trees greater than 10 inches DBH and 6 inches for trees smaller than 10 inches DBH. Stump heights for multiple stemmed trees can exceed 12 inches, but no more than 24 inches.

2.2.4 - Skidding length (2/14)

Skidding of unlimbed tops or lengths over 17 feet is not permissible within Payment Unit 4, unless approved by the Unit Manager or his/her representative. This is for the protection of thinning-level residual trees within the unit.

3 - Payments

3.3 - Pre-measured Sales

3.3.4 - Dividing payment units (7/14)

Payment Unit(s) 2, 3 and 4 may be divided at the request of the Purchaser and upon approval of the Unit Manager. Dividing Payment Units is a contract modification which requires a Timber Sale Contract Supplement.

3.4 - Damaged Timber

3.4.1 - Damaged timber (6/14)

General Condition and Requirement 3.4 Damaged Timber, defines liquidated damages for undesignated live merchantable trees which are cut or injured. In addition, reasonable care should be taken to avoid damage to white pine and hemlock seedlings and saplings.

No damage is acceptable to merchantable trees. Within the sale area, if more than 10% of trees (> 4.5" DBH) within a specified area of the sale are damaged, liquidated damages will be assessed for all trees damaged. Rates will be in accordance with General Condition and Requirement 3.4 Damaged Timber.

4 - Transportation

4.1 - Construction

4.1.3 - Slash and earthen piles (8/04)

Piles or windrows of earth along roads and landings that have been widened or constructed shall be leveled. Slash from road

maintenance or construction, including stumps, shall be chipped or dispersed throughout the sale.

4.1.6 - Road construction (1/09)

Construction of new roads or improvements of existing roads shall be done in such a way as to minimize the environmental and visual impacts. Merchantable trees shall be cut and utilized unless otherwise directed. Non-merchantable trees shall be severed and laid flat on the ground. Slash shall be scattered or chipped, and not left in windrows and kept a minimum of 10 feet back from the road edge. Stumps shall be set upright, not left on edge, and be moved at least 10 feet away from the road edge. Disturbed soil shall be feathered into the woods and not left in berms or windrows.

4.1.7 - Road closure (10/11)

All new roads built into the sale must be blocked to vehicle traffic upon completion of the sale. Overgrown roads that are reopened shall be considered new roads. In general, this will require constructing a four (4') foot high berm of stumps and logs covered with earth. Stumps and brush must be placed along the remainder of the trail. These roads must be rendered impassable to cars and trucks. Contact the sale administrator for specific details of design and placement.

4.1.11 - Permits (2/12)

The Purchaser will secure any necessary permits that may be required.

5 - Operations

5.1 - Notification

5.1.1 - Pre-sale conference (10/16)

A pre-sale conference between the Purchaser and sale administrator is required prior to beginning any operations to determine landing and road locations. The Unit Manager or his/her representative must be contacted at least 5 days in advance to schedule the conference.

5.2 - Conduct of Operations

5.2.3 - Operating Restrictions

5.2.3.3 - Bark slippage restriction (3/09)

Within Payment Unit(s) 4, unless changed by written agreement, cutting and skidding are not permitted during the period of April 15 to July 15. This restriction is because of bark slippage.

5.2.3.4 - Oak wilt restriction (4/17)

Within Payment Unit(s) 1, 2, 3, and 4, unless changed by written agreement, cutting, skidding, and hauling are not permitted during the period of April 15 to July 15. Operations may be allowed if specific steps are taken to prevent damaging uncut oak during the high risk period. Those steps include completing all road brushing before April 15th, clearing a tree-length buffer along uncut oak cover before April 15th or leaving an uncut buffer there until after July 15th. This is necessary to reduce the spread of oak wilt. For more information, contact the Unit Manager or his/her representative.

5.2.4 - Dead and Down Creation

5.2.4.4 - Dead and down creation, grouse (6/18)

To encourage grouse and other wildlife, in Payment Unit(s) 2 and 3, leave one, 12" or larger diameter (or largest diameter trees within stand) whole tree on the ground for every 2 acres, preferably a hardwood species such as oak or maple or if no hardwoods are present, a pine species (white or red). These trees will be evenly scattered throughout the unit, preferably at least two chains from any roads, two-tracks, or trails open to vehicles. This can be an unmerchantable piece or a full tree.

5.2.29 - Shrub protection (9/07)

Do not cut or damage witch-hazel and juneberry. These woody-shrub plants are highly beneficial to various wildlife species.

5.2.38 - No decking against live trees (2/04)

Cut products may not be decked against unmarked or designated leave trees.

5.2.43 - Opening protection (12/08)

No activities are permitted in openings marked on the Timber Sale Map with the letter "G". Any damage to the openings shall be repaired according to specifications of the Unit Manager or his/her representative.

5.4 - Soil Protection

5.4.1 - Rutting restriction, general (7/16)

Operations are to cease immediately if equipment and weather conditions result in rutting of roads and/or skid trails which is 12 inches or greater in depth and 50 feet in length. The Unit Manager or his/her representative may restrict hauling and/or skidding if ruts exceed the specified depth. With the Unit Manager or his/her representative's approval, the Purchaser may return to the area when the risk of rutting has decreased.

6 - Safety and Fire Prevention

6.2 - Signing

6.2.1 - Road posting (9/09)

The Purchaser is responsible for posting and maintaining caution signs on W 5 Mile Road and S King Road prior to beginning operations. The road must be posted at appropriate distances from the sale area to warn of logging activity and truck traffic. Signs must be removed when harvest operations are suspended or completed. The Purchaser will provide these signs.

7 - Other Conditions

7.5 - Loss

7.5.1 - Deteriorating timber (7/09)

The sale area has received damage from beech scale within Payment Units 1 and 4. The Purchaser should harvest the wood as soon as possible. The Department of Natural Resources is held free of responsibility of any further damage or deterioration due to delay in harvesting.

TIMBER SALE MAP

This information provided by authority of Part 525, 1994 PA 451, as amended.

| | |
|-------------|------|
| Sale Number | Year |
| 72-041 | 17 |

| | | | | | |
|------------------------------------|--------------------|---|--------------------|-----------|---------|
| Forest Management Unit Grayling | County Crawford | Mapped By Schmid | Date 09/01/2017 | Page 1 | of 1 |
| Township 25N | Range 04W | Section(s) and Subdivision(s) Sec 11 - NE, NWSE; Sec 12 - W1/2NW | Scale 1:15,840 | | |

| Cover Type | | | | Density | |
|-------------------|----------------------|-------------------------|-------------------|-----------------------------|------------------------|
| A = Aspen | H = Hemlock | N = Marsh | U = Upland Brush | 0 = Non Stocked | 5 = Pole Timber Medium |
| B = Paper Birch | J = Jack Pine | O = Oak | UM = Upland Mixed | 1 = Seedling Sapling Poor | 6 = Pole Timber Well |
| C = Cedar | L = Lowland Brush | P = Lowland Poplar | V = Bog or Marsh | 2 = Seedling Sapling Medium | 7 = Saw Timber Poor |
| D = Tread Bog | LM = Lowland Mixed | Q = Mixed Swamp Conifer | W = White Pine | 3 = Seedling Sapling Well | 8 = Saw Timber Medium |
| E = Swamp Hdwoods | M = Mpl, Bch, Brch | R = Red Pine | X = Non Stocked | 4 = Pole Timber Poor | 9 = Saw Timber Well |
| F = Spruce Fir | MC = Mixed Conifer | S = Black Spruce | Z = Water | | |
| G = Grass | MD = Mixed Deciduous | T = Tamarack | | | |

| PU | Acres | PU | Acres |
|----|-------|----|-------|
| 1 | 10.6 | 4 | 26.5 |
| 2 | 18.9 | | |
| 3 | 32.1 | | |

Railroad Mix Compartment 198 88.1 Acres

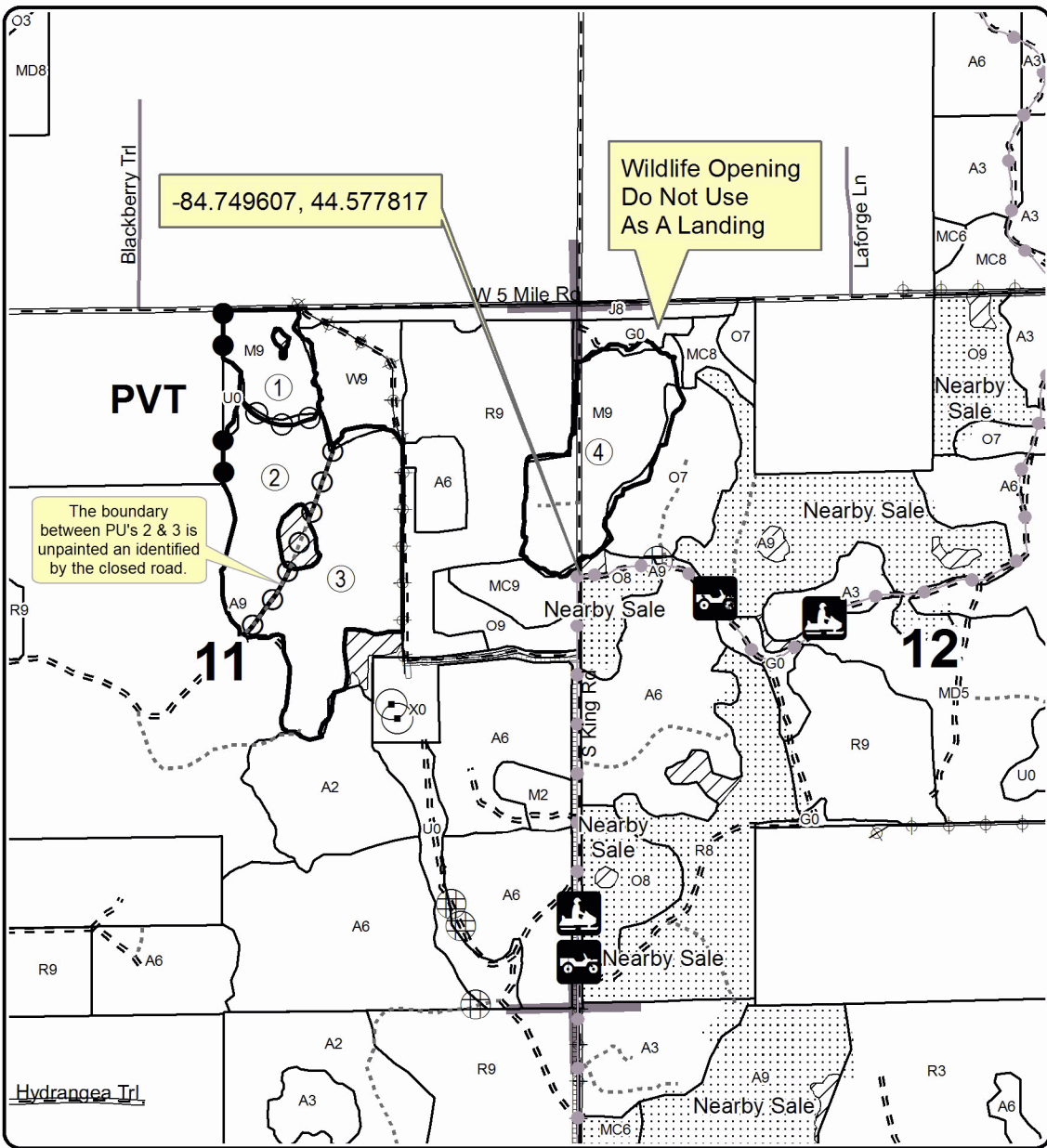

Legend

- Against State (Red)
- ○ Payment Unit (Yellow & Red)
- ● Private Line (Blue)
- PU_Label
- Section Corners
- ▨ Retention Area
- ▭ Stand Boundaries
- ⊕ Gate
- ⊕ Berms
- ⊙ Oil & Gas Well
- ⊙ Surface Locations
- Recreational Trail
- Pipeline
- Powerline
- Highway
- Paved Roads
- Gravel Roads
- Poor Dirt Roads
- Closed Roads

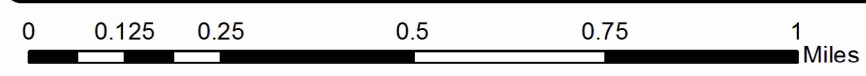

TIMBER SALE INFORMATION

Hunter Walking Trail Oak Mix (72-042-17)
 T25N, R04W, SEC. 10.
 Crawford County (Advertised Price \$127,246.90)

SALE NOTE: Oak Wilt restrictions apply to this sale. Note that Military Road is weight restricted year round near the sale area. Contact the Crawford County Road Commission for more information.

A timber sale contract for this lump sum, sealed bid timber sale will be awarded to the responsible bidder offering the highest sealed bid price. Bids must be at or above the following advertised price for each species:

| <u>PRODUCTS & SPECIES</u> | <u>ESTIMATED UNITS*</u> | <u>ADVERTISED PRICE</u> |
|-------------------------------|-------------------------|-------------------------|
| Sawtimber | | |
| B. T. Aspen | 39.10 MBF | \$ 68.00 / MBF |
| Red Oak | 335.20 MBF | \$ 241.00 / MBF |
| Sugar Maple | 23.90 MBF | \$ 243.00 / MBF |
| Pulpwood | | |
| B. T. Aspen | 150.00 Cords | \$ 20.40 / Cord |
| Basswood | 93.00 Cords | \$ 5.40 / Cord |
| Mixed Hardwood | 814.00 Cords | \$ 27.65 / Cord |
| Mixed Oak | 659.00 Cords | \$ 18.10 / Cord |

* The total volume is statistically estimated within plus (+) or minus (-) 8.21 percent. The estimated units are final and not subject to adjustment. Prospective bidders are urged to examine this timber and to make their own estimates of quantity and quality.

BOND AND PAYMENT SCHEDULE:

1. A bond in the amount of \$6,362.00 to insure faithful performance of the conditions of the contract will be deposited by the successful bidder within 21 days of the sale award.
2. Cutting in any sale or unit without the required advance payment would be considered a trespass.
3. Total payment must be paid in advance or according to the following schedule:
 - (a) Ten percent (10%) of the sale value must be paid within 21 days of the sale award.
 - (b) The 10% down payment will be credited towards the first unit cut.
 - (c) Payment for each of the following units must be made before cutting begins in that unit:

| <u>PAYMENT UNIT NUMBER</u> | <u>PERCENT OF TOTAL SALE VALUE</u> |
|----------------------------|------------------------------------|
| 01 | 90.0% |
| 02 | 10.0% |

4. If no cutting takes place, the 10% down payment will not be refunded.
5. Operations on the contract issued will terminate on 09/30/2021.

Description of Timber by Payment Unit (PU)

| PU | MARKET GROUP | PRODUCT | QUANTITY | UNIT | ACRES | ADVERTISE PRICE |
|--------|-------------------------|------------------|--------------|--------------|-------|-----------------|
| 1 | B. T. Aspen | Sawtimber | 39.1 | MBF | 74.0 | \$114,477.25 |
| | Red Oak | | 324.9 | MBF | | |
| | Sugar Maple | | 10.6 | MBF | | |
| | B. T. Aspen | Pulpwood | 133.0 | Cords | | |
| | <i>B. T. Aspen</i> | | <i>133.0</i> | <i>Cords</i> | | |
| | Basswood | | 83.0 | Cords | | |
| | Mixed Hardwood | | 591.0 | Cords | | |
| | <i>Red Maple</i> | <i>Sawtimber</i> | <i>9.8</i> | <i>MBF</i> | | |
| | <i>Beech</i> | <i>Pulpwood</i> | <i>30.0</i> | <i>Cords</i> | | |
| | <i>Paper Birch</i> | | <i>14.0</i> | <i>Cords</i> | | |
| | <i>Red Maple</i> | | <i>338.0</i> | <i>Cords</i> | | |
| | <i>Sugar Maple</i> | | <i>189.0</i> | <i>Cords</i> | | |
| | Mixed Oak | | 632.0 | Cords | | |
| | <i>White Oak</i> | <i>Sawtimber</i> | <i>10.3</i> | <i>MBF</i> | | |
| | <i>Northern Pin Oak</i> | <i>Pulpwood</i> | <i>12.0</i> | <i>Cords</i> | | |
| | <i>Red Oak</i> | | <i>573.0</i> | <i>Cords</i> | | |
| | <i>White Oak</i> | | <i>26.0</i> | <i>Cords</i> | | |
| 2 | Red Oak | Sawtimber | 10.3 | MBF | 13.8 | \$12,769.65 |
| | Sugar Maple | | 13.3 | MBF | | |
| | B. T. Aspen | Pulpwood | 17.0 | Cords | | |
| | <i>B. T. Aspen</i> | | <i>8.0</i> | <i>Cords</i> | | |
| | <i>Quaking Aspen</i> | | <i>9.0</i> | <i>Cords</i> | | |
| | Basswood | | 10.0 | Cords | | |
| | Mixed Hardwood | | 223.0 | Cords | | |
| | <i>Basswood</i> | <i>Sawtimber</i> | <i>4.5</i> | <i>MBF</i> | | |
| | <i>Beech</i> | | <i>0.7</i> | <i>MBF</i> | | |
| | <i>Red Maple</i> | | <i>1.4</i> | <i>MBF</i> | | |
| | <i>Beech</i> | <i>Pulpwood</i> | <i>5.0</i> | <i>Cords</i> | | |
| | <i>Black Cherry</i> | | <i>2.0</i> | <i>Cords</i> | | |
| | <i>Red Maple</i> | | <i>41.0</i> | <i>Cords</i> | | |
| | <i>Sugar Maple</i> | | <i>162.0</i> | <i>Cords</i> | | |
| | Mixed Oak | | 27.0 | Cords | | |
| | <i>Red Oak</i> | | <i>27.0</i> | <i>Cords</i> | | |
| | TOTAL: | | | 398.2 | | |
| TOTAL: | | | 1,716.0 | Cords | | |

Sale Specific Conditions & Requirements

Sale Name: Hunter Walking Trail Oak Mix

Sale Number: 72-042-17 Seq#: 2

1 - Sale Area

1.2 - Boundaries

1.2.1 - Painted boundaries (1/14)

The sale boundary and Payment Unit boundaries are marked and identified by blue and red paint, along with a powerline. Exterior sale boundary lines against private property are marked with blue paint. Exterior sale boundary lines against state are marked with red paint, with the exception of the north boundary of Payment Unit 1, which is unpainted and identified by the powerline. The painted boundary line trees are not Included Timber and are to be protected.

2 - Timber Specifications

2.1 - Included Timber

2.1.1 - Clearcut unit(s) with unmerchantable trees (6/14)

Within Payment Unit(s) 1, cut all trees that are two (2) inches or more at DBH, except do not cut any white and red pine and trees marked with green paint. A green-marked tree will have a camera mounted in it (see spec 5.5.3). In addition, extreme care should be taken to protect white pine regeneration (see spec 3.4.1).

Within Payment Unit(s) 2, cut all trees that are one (1) inch or more at DBH, except do not cut any trees marked with green paint.

3 - Payments

3.3 - Pre-measured Sales

3.3.4 - Dividing payment units (7/14)

Payment Unit(s) may be divided at the request of the Purchaser and upon approval of the Unit Manager. Dividing Payment Units is a contract modification which requires a Timber Sale Contract Supplement.

3.4 - Damaged Timber

3.4.1 - Damaged timber (6/14)

General Condition and Requirement 3.4 Damaged Timber, defines liquidated damages for undesignated live merchantable trees which are cut or injured. In addition, extreme care should be taken to avoid damage to white pine seedlings and saplings in Payment Unit 1.

Within Payment Unit 1, if more than 25% of the tree seedlings or saplings (1/4" to 4.5" DBH) within a specified portion of the sale area are damaged, liquidated damages will be assessed at \$250 per acre for all acreage within that specified portion of the sale area that was damaged.

4 - Transportation

4.1 - Construction

4.1.3 - Slash and earthen piles (8/04)

Piles or windrows of earth along roads and landings that have been widened or constructed shall be leveled. Slash from road maintenance or construction, including stumps, shall be dispersed throughout the sale.

4.1.6 - Road construction (1/09)

Construction of new roads or improvements of existing roads shall be done in such a way as to minimize the environmental and visual impacts. Merchantable trees shall be cut and utilized unless otherwise directed. Non-merchantable trees shall be severed and laid flat on the ground. Slash shall be scattered, and not left in windrows and kept a minimum of 10 feet back from the road edge. Stumps shall be set upright, not left on edge, and be moved at least 10 feet away from the road edge. Disturbed soil shall be feathered into the woods and not left in berms or windrows.

4.1.7 - Road closure (10/11)

All new roads built into the sale must be blocked to vehicle traffic upon completion of the sale. Overgrown roads that are reopened shall be considered new roads. In general, this will require constructing a four (4') foot high berm of stumps and logs covered with earth. Stumps and brush must be placed along the remainder of the trail. These roads must be rendered impassable to cars and trucks. Contact the sale administrator for specific details of design and placement.

5 - Operations

5.1 - Notification

5.1.1 - Pre-sale conference (10/16)

A pre-sale conference on site between the Purchaser and sale administrator is required prior to beginning any operations to determine landing and road locations. The Unit Manager or his/her representative must be contacted at least 5 days in advance to schedule the conference.

5.1.4 - Post-sale conference (10/16)

A post-sale conference on site between the Purchaser and sale administrator is required 5 days prior to the completion of active logging operations to determine clean-up and repair of landings, road edges, and the fulfillment of other contract specifications.

5.1.6 - Utility R.O.W. (1/15)

It is the responsibility of the Purchaser to obtain permission from the utility company to utilize the power line R.O.W. for operations.

5.2 - Conduct of Operations

5.2.2 - Hazard Trees/Snags

5.2.2.1 - Den trees (10/16)

Obvious hollow and/or den trees shall be protected and left standing unless they are a safety hazard.

5.2.3 - Operating Restrictions

5.2.3.4 - Oak wilt restriction (4/17)

Within Payment Unit(s) 1 and 2, unless changed by written agreement, cutting, skidding, and hauling are not permitted during the period of April 15 to July 15. Operations may be allowed if specific steps are taken to prevent damaging uncut oak during the high risk period. Those steps include completing all road brushing before April 15th, clearing a tree-length buffer along uncut oak cover before April 15th or leaving an uncut buffer there until after July 15th. This is necessary to reduce the spread of oak wilt. For more information, contact the Unit Manager or his/her representative.

5.2.4 - Dead and Down Creation

5.2.4.4 - Dead and down creation, grouse (6/18)

To encourage grouse and other wildlife, in Payment Unit(s) 1 and 2, leave one, 12" or larger diameter (or largest diameter trees within stand) whole tree on the ground for every 2 acres, preferably a hardwood species such as oak or maple or if no hardwoods are present, a pine species (white or red). These trees will be evenly scattered throughout the unit, preferably at least two chains from any roads, two-tracks, or trails open to vehicles. This can be an unmerchantable piece or a full tree.

5.2.29 - Shrub protection (9/07)

Do not cut or damage hawthorn, witch-hazel, dogwood or juneberry. These woody-shrub plants are highly beneficial to various wildlife species.

5.2.32 - Decking/landing restoration (9/13)

All decking and landing areas must have the surface area restored to a condition equal to or better than before. This is to ensure the proper regeneration of the stand. Wood debris, chips and "cookies" from trimmings must be removed or scattered away from landing and loading areas and may not be windrowed on the edge.

5.4 - Soil Protection

5.4.1 - Rutting restriction, general (7/16)

Operations are to cease immediately if equipment and weather conditions result in rutting of roads and/or skid trails which is 12 inches or greater in depth and 50 feet in length. The Unit Manager or his/her representative may restrict hauling and/or

skidding if ruts exceed the specified depth. With the Unit Manager or his/her representative's approval, the Purchaser may return to the area when the risk of rutting has decreased.

5.4.4 - Slope protection (5/15)

Skid trails and roads on slopes shall be water barred with slash, stumps, and/or clean straw bales native to the area as soon as use is complete to prevent erosion.

5.5 - Protection of Improvements

5.5.3 - Protection of improvements detail (10/13)

The following are specific protection measures for this sale: Protect the camera that is mounted on a tree in the northeast peninsula of Payment Unit 1. The tree it is attached to is ringed with green paint. This camera is part of the monitoring for an adjacent MWR Hardwoods Research Project harvest. The camera will be left in place through the year 2020.



TIMBER SALE MAP

This information provided by authority of Part 525, 1994 PA 451, as amended.

| | | | | | |
|------------------------------------|--------------------|--|--|-------------------|---------|
| Forest Management Unit Grayling | County Crawford | Mapped By Matt Foster | Date 09/05/2017 | Page 1 | of 1 |
| Township 25N | Range 04W | Section(s) and Subdivision(s) Section 10: S1/2NW, SW1/4, SWSE | Cruised By Matt Foster, Brian Martell | Scale 1:15,840 | |

| Cover Type | | | | Density | |
|-------------------|----------------------|-------------------------|-------------------|-----------------------------|------------------------|
| A = Aspen | H = Hemlock | N = Marsh | U = Upland Brush | 0 = Non Stocked | 5 = Pole Timber Medium |
| B = Paper Birch | J = Jack Pine | O = Oak | UM = Upland Mixed | 1 = Seedling Sapling Poor | 6 = Pole Timber Well |
| C = Cedar | L = Lowland Brush | P = Lowland Poplar | V = Bog or Marsh | 2 = Seedling Sapling Medium | 7 = Saw Timber Poor |
| D = Tread Bog | LM = Lowland Mixed | Q = Mixed Swamp Conifer | W = White Pine | 3 = Seedling Sapling Well | 8 = Saw Timber Medium |
| E = Swamp Hdwoods | M = Mpl, Bch, Brch | R = Red Pine | X = Non Stocked | 4 = Pole Timber Poor | 9 = Saw Timber Well |
| F = Spruce Fir | MC = Mixed Conifer | S = Black Spruce | Z = Water | | |
| G = Grass | MD = Mixed Deciduous | T = Tamarack | | | |

| PU | Acres |
|----|-------|
| 1 | 74 |
| 2 | 13.8 |

Hunter Walking Trail Oak Mix

Compartment 198

87.8 Acres

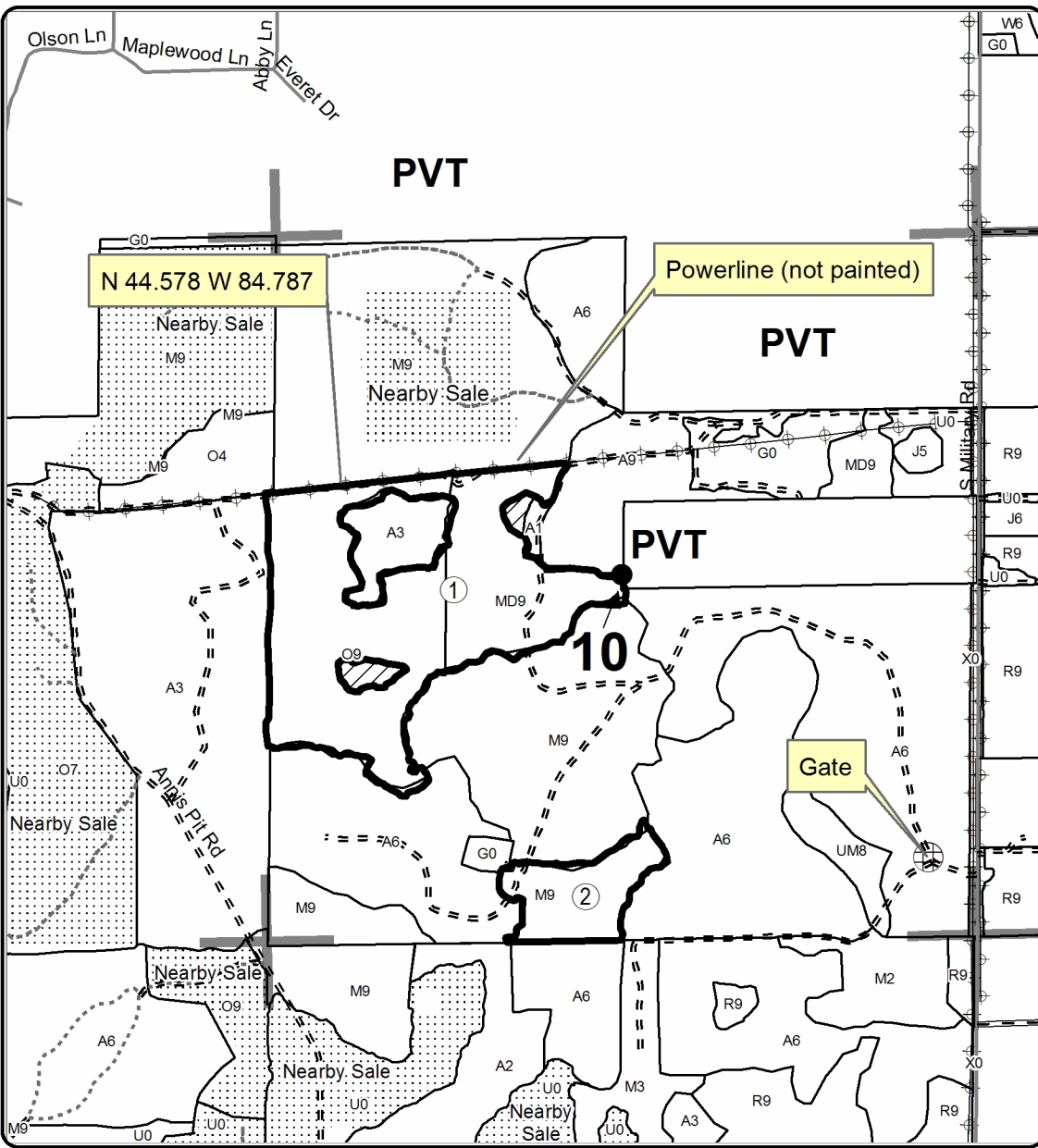

Legend

- Against State (Red)
- Private Line (Blue)
- Retention Area (Red)
- Stand Boundaries
- Nearby Timber Sale
- Section Corners
- Highway
- Paved Roads
- Gravel Roads
- Poor Dirt Roads
- Closed Roads
- Pipeline
- Powerline
- PU_Label

Locator Map
1:200,000

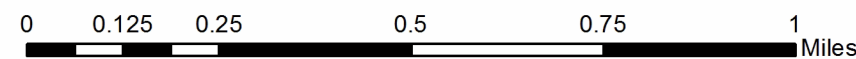
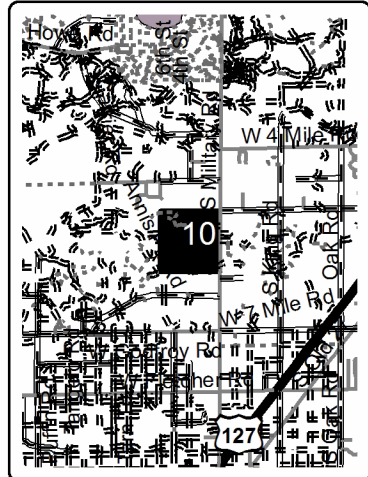

Section 12 Mix (72-037-17)
T25N, R04W, SEC. 12; Crawford COUNTY

In response to the notice of sale to be held 9:00 a.m. (local time) on March 12, 2019, I am hereby submitting my sealed bid (firm offer) for the following forest products to be cut. Bids for individual species must be at or above the advertised price. All non-responsive bid forms may be rejected.

| <u>PRODUCTS & SPECIES</u> | <u>ESTIMATED VOLUME*</u> | <u>ADVERTISED PRICE</u> | <u>BID PRICE/UNIT</u> |
|-------------------------------|--------------------------|-------------------------|-----------------------|
| Sawtimber | | | |
| Mixed Aspen | 116.20 MBF | \$ 84.00/MBF | \$ _____ |
| Mixed Oak | 58.50 MBF | \$ 213.00/MBF | \$ _____ |
| Red Oak | 291.00 MBF | \$ 297.00/MBF | \$ _____ |
| Red Pine | 527.90 MBF | \$ 118.00/MBF | \$ _____ |
| Pulpwood | | | |
| Mixed Aspen | 884.00 Cords | \$ 25.10/Cord | \$ _____ |
| Mixed Hardwood | 410.00 Cords | \$ 34.05/Cord | \$ _____ |
| Mixed Oak | 814.00 Cords | \$ 22.30/Cord | \$ _____ |
| Red Pine | 441.00 Cords | \$ 42.10/Cord | \$ _____ |
| White Pine | 19.00 Cords | \$ 28.95/Cord | \$ _____ |

*The volumes are statistically estimated within plus (+) or minus (-) 6.58 percent. These estimated volumes are final and not subject to adjustment. Prospective bidders are urged to examine this timber and to make their own estimates of quantity and quality.

I understand that any or all bids may be rejected. All bids must be signed and all bid items must be bid or the bid form may be rejected. I also understand that consideration and awarding a contract will be based upon my past performance and ability to complete the contract based upon equipment and staffing subject to my control.

FEDERAL ID: ____ - ____ - ____ or SOCIAL SECURITY NUMBER: ____ - ____ - ____

Company or individual bidding: _____

Company representative's name: _____

Address: _____

City: _____ State: _____ Zip: _____

IF AVAILABLE, PLEASE PLACE THE PERSONALIZED LABEL FROM YOUR PROSPECTUS IN THE ABOVE BOX.

Individual or company representative's signature: _____ Date: _____

Phone number : _____ Email (optional): _____

THE WINNING BIDDER MUST COMPLETE THE VERIFICATION OF WORKER'S DISABILITY COMPENSATION ACT COMPLIANCE (ON REVERSE SIDE IF DOUBLE SIDED) WITHIN 21 DAYS OF SALE AWARD DATE



| |
|----------------------------------|
| FOR DEPARTMENT USE ONLY |
| Sale Number (XX - XXX - XX - XX) |
| Forest Management Unit: |

TIMBER SALE VERIFICATION OF WORKER'S DISABILITY COMPENSATION ACT COMPLIANCE

*As required by Act 317, P.A. 1969 (Worker's Compensation) and
Part 5 of Act 451 of 1994, as amended.*

VERIFICATION OF WORKER'S DISABILITY COMPENSATION ACT COMPLIANCE

- This verification must be completed and submitted within 21 days of contract award and prior to the issuance of the timber sale contract.
- In addition, if boxes 2B or 2C are checked, then Notice of Exclusion or Certificate of Insurance must be submitted within twenty-one (21) days of the contract award and prior to the issuance of the timber sale contract.
- All information must be typed or printed except for written signatures.

Please Check Appropriate Categories:

1. My business is organized as (you **must** check one of the boxes below):
 - A. Sole Proprietorship (individual)
 - B. Partnership
 - C. Corporation

2. You **must** check one of the boxes below:
 - A. I certify my business is a sole proprietorship and it has no employees but the sole proprietor. I am not subject to the Worker's Compensation Laws.
 - B. I certify my business has satisfied its obligation to the Worker's Compensation Act through the use of an approved Notice of Exclusion (BWC-337, Rev. 5/96). I will provide a copy of the Notice of Exclusion within 21 days of the contract award. (For questions or a copy of the BWC-337, please call the Worker's Compensation Bureau at 517-322-1195).
 - C. I certify my business has a Worker's Compensation Policy. I will provide an original Certificate of Insurance within twenty-one (21) days of the contract award.

3. If you have checked item 2(A) or 2(B), you **must** indicate the number of **both** full-time and part-time employees, other than yourself, including family members and active partners (if none, you must enter "0").

_____ Full-time Employees

_____ Part-time Employees

| | | | |
|------------------|-------|-------------------------------------|--|
| Name of Business | | Federal ID (or) Social Security No. | |
| Address | | Telephone () | |
| City | State | ZIP | |

I hereby certify that the above information is true and correct. I agree to notify the Michigan DNR of any changes that occur in factors affecting my coverage during any of my present and future operations.

Signature of Owner or Authorized Representative

Title

Date

Please complete the "SEALED BID" information on the next page

Panama Pine Mix (72-001-18)
T28N, R04W, SEC. 17; T28N, R04W, SEC. 18; T28N, R04W, SEC. 20; Crawford

In response to the notice of sale to be held 9:00 a.m. (local time) on March 12, 2019, I am hereby submitting my sealed bid (firm offer) for the following forest products to be cut. Bids for individual species must be at or above the advertised price. All non-responsive bid forms may be rejected.

| <u>PRODUCTS & SPECIES</u> | <u>ESTIMATED VOLUME*</u> | <u>ADVERTISED PRICE</u> | <u>BID PRICE/UNIT</u> |
|-------------------------------|--------------------------|-------------------------|-----------------------|
| Sawtimber | | | |
| Red Pine | 159.10 MBF | \$ 110.00/MBF | \$ _____ |
| Pulpwood | | | |
| Jack Pine | 77.00 Cords | \$ 18.10/Cord | \$ _____ |
| Mixed Aspen | 18.00 Cords | \$ 23.50/Cord | \$ _____ |
| Mixed Hardwood | 20.00 Cords | \$ 31.90/Cord | \$ _____ |
| Mixed Oak | 35.00 Cords | \$ 20.90/Cord | \$ _____ |
| Red Pine | 397.00 Cords | \$ 39.45/Cord | \$ _____ |
| White Pine | 2.00 Cords | \$ 27.15/Cord | \$ _____ |

*The volumes are statistically estimated within plus (+) or minus (-) 12.74 percent. These estimated volumes are final and not subject to adjustment. Prospective bidders are urged to examine this timber and to make their own estimates of quantity and quality.

I understand that any or all bids may be rejected. All bids must be signed and all bid items must be bid or the bid form may be rejected. I also understand that consideration and awarding a contract will be based upon my past performance and ability to complete the contract based upon equipment and staffing subject to my control.

FEDERAL ID: _____ or SOCIAL SECURITY NUMBER: _____

Company or individual bidding: _____

Company representative's name: _____

Address: _____

City: _____ State: _____ Zip: _____

IF AVAILABLE, PLEASE PLACE THE PERSONALIZED LABEL FROM YOUR PROSPECTUS IN THE ABOVE BOX.

Individual or company representative's signature: _____ Date: _____

Phone number : _____ Email (optional): _____

THE WINNING BIDDER MUST COMPLETE THE VERIFICATION OF WORKER'S DISABILITY COMPENSATION ACT COMPLIANCE (ON REVERSE SIDE IF DOUBLE SIDED) WITHIN 21 DAYS OF SALE AWARD DATE



| |
|----------------------------------|
| FOR DEPARTMENT USE ONLY |
| Sale Number (XX – XXX – XX – XX) |
| Forest Management Unit: |

TIMBER SALE VERIFICATION OF WORKER'S DISABILITY COMPENSATION ACT COMPLIANCE

*As required by Act 317, P.A. 1969 (Worker's Compensation) and
Part 5 of Act 451 of 1994, as amended.*

VERIFICATION OF WORKER'S DISABILITY COMPENSATION ACT COMPLIANCE

- This verification must be completed and submitted within 21 days of contract award and prior to the issuance of the timber sale contract.
- In addition, if boxes 2B or 2C are checked, then Notice of Exclusion or Certificate of Insurance must be submitted within twenty-one (21) days of the contract award and prior to the issuance of the timber sale contract.
- All information must be typed or printed except for written signatures.

Please Check Appropriate Categories:

1. My business is organized as (you **must** check one of the boxes below):
 - A. Sole Proprietorship (individual)
 - B. Partnership
 - C. Corporation
2. You **must** check one of the boxes below:
 - A. I certify my business is a sole proprietorship and it has no employees but the sole proprietor. I am not subject to the Worker's Compensation Laws.
 - B. I certify my business has satisfied its obligation to the Worker's Compensation Act through the use of an approved Notice of Exclusion (BWC-337, Rev. 5/96). I will provide a copy of the Notice of Exclusion within 21 days of the contract award. (For questions or a copy of the BWC-337, please call the Worker's Compensation Bureau at 517-322-1195).
 - C. I certify my business has a Worker's Compensation Policy. I will provide an original Certificate of Insurance within twenty-one (21) days of the contract award.
3. If you have checked item 2(A) or 2(B), you **must** indicate the number of **both** full-time and part-time employees, other than yourself, including family members and active partners (if none, you must enter "0").

_____ Full-time Employees

_____ Part-time Employees

| | | | |
|------------------|-------|-------------------------------------|--|
| Name of Business | | Federal ID (or) Social Security No. | |
| Address | | Telephone () | |
| City | State | ZIP | |

I hereby certify that the above information is true and correct. I agree to notify the Michigan DNR of any changes that occur in factors affecting my coverage during any of my present and future operations.

Signature of Owner or Authorized Representative

Title

Date

Please complete the "SEALED BID" information on the next page

Hunter Walking Trail Oak Mix (72-042-17)
T25N, R04W, SEC. 10; Crawford COUNTY

In response to the notice of sale to be held 9:00 a.m. (local time) on March 12, 2019, I am hereby submitting my sealed bid (firm offer) for the following forest products to be cut. Bids for individual species must be at or above the advertised price. All non-responsive bid forms may be rejected.

| <u>PRODUCTS & SPECIES</u> | <u>ESTIMATED VOLUME*</u> | <u>ADVERTISED PRICE</u> | <u>BID PRICE/UNIT</u> |
|-------------------------------|--------------------------|-------------------------|-----------------------|
| Sawtimber | | | |
| B. T. Aspen | 39.10 MBF | \$ 68.00/MBF | \$ _____ |
| Red Oak | 335.20 MBF | \$ 241.00/MBF | \$ _____ |
| Sugar Maple | 23.90 MBF | \$ 243.00/MBF | \$ _____ |
| Pulpwood | | | |
| B. T. Aspen | 150.00 Cords | \$ 20.40/Cord | \$ _____ |
| Basswood | 93.00 Cords | \$ 5.40/Cord | \$ _____ |
| Mixed Hardwood | 814.00 Cords | \$ 27.65/Cord | \$ _____ |
| Mixed Oak | 659.00 Cords | \$ 18.10/Cord | \$ _____ |

*The volumes are statistically estimated within plus (+) or minus (-) 8.21 percent. These estimated volumes are final and not subject to adjustment. Prospective bidders are urged to examine this timber and to make their own estimates of quantity and quality.

I understand that any or all bids may be rejected. All bids must be signed and all bid items must be bid or the bid form may be rejected. I also understand that consideration and awarding a contract will be based upon my past performance and ability to complete the contract based upon equipment and staffing subject to my control.

FEDERAL ID: _____ or SOCIAL SECURITY NUMBER: _____

Company or individual bidding: _____

Company representative's name: _____

Address: _____

City: _____ State: _____ Zip: _____

IF AVAILABLE, PLEASE PLACE THE PERSONALIZED LABEL FROM YOUR PROSPECTUS IN THE ABOVE BOX.

Individual or company representative's signature: _____ Date: _____

Phone number : _____ Email (optional): _____

THE WINNING BIDDER MUST COMPLETE THE VERIFICATION OF WORKER'S DISABILITY COMPENSATION ACT COMPLIANCE (ON REVERSE SIDE IF DOUBLE SIDED) WITHIN 21 DAYS OF SALE AWARD DATE



| FOR DEPARTMENT USE ONLY | |
|----------------------------------|--|
| Sale Number (XX - XXX - XX - XX) | |
| Forest Management Unit: | |

TIMBER SALE VERIFICATION OF WORKER'S DISABILITY COMPENSATION ACT COMPLIANCE

As required by Act 317, P.A. 1969 (Worker's Compensation) and
Part 5 of Act 451 of 1994, as amended.

VERIFICATION OF WORKER'S DISABILITY COMPENSATION ACT COMPLIANCE

- This verification must be completed and submitted within 21 days of contract award and prior to the issuance of the timber sale contract.
- In addition, if boxes 2B or 2C are checked, then Notice of Exclusion or Certificate of Insurance must be submitted within twenty-one (21) days of the contract award and prior to the issuance of the timber sale contract.
- All information must be typed or printed except for written signatures.

Please Check Appropriate Categories:

1. My business is organized as (you **must** check one of the boxes below):
 - A. Sole Proprietorship (individual)
 - B. Partnership
 - C. Corporation
2. You **must** check one of the boxes below:
 - A. I certify my business is a sole proprietorship and it has no employees but the sole proprietor. I am not subject to the Worker's Compensation Laws.
 - B. I certify my business has satisfied its obligation to the Worker's Compensation Act through the use of an approved Notice of Exclusion (BWC-337, Rev. 5/96). I will provide a copy of the Notice of Exclusion within 21 days of the contract award. (For questions or a copy of the BWC-337, please call the Worker's Compensation Bureau at 517-322-1195).
 - C. I certify my business has a Worker's Compensation Policy. I will provide an original Certificate of Insurance within twenty-one (21) days of the contract award.
3. If you have checked item 2(A) or 2(B), you **must** indicate the number of **both** full-time and part-time employees, other than yourself, including family members and active partners (if none, you must enter "0").

_____ Full-time Employees

_____ Part-time Employees

| | | | |
|------------------|-------|-------------------------------------|--|
| Name of Business | | Federal ID (or) Social Security No. | |
| Address | | Telephone () | |
| City | State | ZIP | |

I hereby certify that the above information is true and correct. I agree to notify the Michigan DNR of any changes that occur in factors affecting my coverage during any of my present and future operations.

Signature of Owner or Authorized Representative

Title

Date

Please complete the "SEALED BID" information on the next page

Fosters Last Stands (72-006-18)
T26N, R03W, SEC. 27; T26N, R03W, SEC. 34; Crawford COUNTY

In response to the notice of sale to be held 9:00 a.m. (local time) on March 12, 2019, I am hereby submitting my sealed bid (firm offer) for the following forest products to be cut. Bids for individual species must be at or above the advertised price. All non-responsive bid forms may be rejected.

| <u>PRODUCTS & SPECIES</u> | <u>ESTIMATED VOLUME*</u> | <u>ADVERTISED PRICE</u> | <u>BID PRICE/UNIT</u> |
|-------------------------------|--------------------------|-------------------------|-----------------------|
| Sawtimber | | | |
| BI/R/Hybrid Oak | 84.10 MBF | \$ 199.00/MBF | \$ _____ |
| White Oak | 24.40 MBF | \$ 80.00/MBF | \$ _____ |
| Pulpwood | | | |
| BI/R/Hybrid Oak | 458.00 Cords | \$ 20.90/Cord | \$ _____ |
| Jack Pine | 225.00 Cords | \$ 18.10/Cord | \$ _____ |
| Red Maple | 27.00 Cords | \$ 31.90/Cord | \$ _____ |
| Red Pine | 11.00 Cords | \$ 39.45/Cord | \$ _____ |
| White Oak | 267.00 Cords | \$ 20.90/Cord | \$ _____ |
| White Pine | 4.00 Cords | \$ 27.15/Cord | \$ _____ |

*The volumes are statistically estimated within plus (+) or minus (-) 10.29 percent. These estimated volumes are final and not subject to adjustment. Prospective bidders are urged to examine this timber and to make their own estimates of quantity and quality.

I understand that any or all bids may be rejected. All bids must be signed and all bid items must be bid or the bid form may be rejected. I also understand that consideration and awarding a contract will be based upon my past performance and ability to complete the contract based upon equipment and staffing subject to my control.

FEDERAL ID: _____ or SOCIAL SECURITY NUMBER: _____

Company or individual bidding: _____

Company representative's name: _____

Address: _____

City: _____ State: _____ Zip: _____

IF AVAILABLE, PLEASE PLACE THE PERSONALIZED LABEL FROM YOUR PROSPECTUS IN THE ABOVE BOX.

Individual or company representative's signature: _____ Date: _____

Phone number : _____ Email (optional): _____

THE WINNING BIDDER MUST COMPLETE THE VERIFICATION OF WORKER'S DISABILITY COMPENSATION ACT COMPLIANCE (ON REVERSE SIDE IF DOUBLE SIDED) WITHIN 21 DAYS OF SALE AWARD DATE



| |
|----------------------------------|
| FOR DEPARTMENT USE ONLY |
| Sale Number (XX - XXX - XX - XX) |
| Forest Management Unit: |

TIMBER SALE VERIFICATION OF WORKER'S DISABILITY COMPENSATION ACT COMPLIANCE

*As required by Act 317, P.A. 1969 (Worker's Compensation) and
Part 5 of Act 451 of 1994, as amended.*

VERIFICATION OF WORKER'S DISABILITY COMPENSATION ACT COMPLIANCE

- This verification must be completed and submitted within 21 days of contract award and prior to the issuance of the timber sale contract.
- In addition, if boxes 2B or 2C are checked, then Notice of Exclusion or Certificate of Insurance must be submitted within twenty-one (21) days of the contract award and prior to the issuance of the timber sale contract.
- All information must be typed or printed except for written signatures.

Please Check Appropriate Categories:

1. My business is organized as (you **must** check one of the boxes below):
 - A. Sole Proprietorship (individual)
 - B. Partnership
 - C. Corporation
2. You **must** check one of the boxes below:
 - A. I certify my business is a sole proprietorship and it has no employees but the sole proprietor. I am not subject to the Worker's Compensation Laws.
 - B. I certify my business has satisfied its obligation to the Worker's Compensation Act through the use of an approved Notice of Exclusion (BWC-337, Rev. 5/96). I will provide a copy of the Notice of Exclusion within 21 days of the contract award. (For questions or a copy of the BWC-337, please call the Worker's Compensation Bureau at 517-322-1195).
 - C. I certify my business has a Worker's Compensation Policy. I will provide an original Certificate of Insurance within twenty-one (21) days of the contract award.
3. If you have checked item 2(A) or 2(B), you **must** indicate the number of **both** full-time and part-time employees, other than yourself, including family members and active partners (if none, you must enter "0").

_____ Full-time Employees

_____ Part-time Employees

| | | | |
|------------------|-------|-------------------------------------|--|
| Name of Business | | Federal ID (or) Social Security No. | |
| Address | | Telephone () | |
| City | State | ZIP | |

I hereby certify that the above information is true and correct. I agree to notify the Michigan DNR of any changes that occur in factors affecting my coverage during any of my present and future operations.

Signature of Owner or Authorized Representative

Title

Date

Please complete the "SEALED BID" information on the next page

Railroad Mix (72-041-17)
T25N, R04W, SEC. 11; T25N, R04W, SEC. 12; Crawford COUNTY

In response to the notice of sale to be held 9:00 a.m. (local time) on March 12, 2019, I am hereby submitting my sealed bid (firm offer) for the following forest products to be cut. Bids for individual species must be at or above the advertised price. All non-responsive bid forms may be rejected.

| <u>PRODUCTS & SPECIES</u> | <u>ESTIMATED VOLUME*</u> | <u>ADVERTISED PRICE</u> | <u>BID PRICE/UNIT</u> |
|-------------------------------|--------------------------|-------------------------|-----------------------|
| Sawtimber | | | |
| B. T. Aspen | 40.50 MBF | \$ 78.00/MBF | \$ _____ |
| Beech | 19.40 MBF | \$ 107.00/MBF | \$ _____ |
| Red Maple | 23.20 MBF | \$ 55.00/MBF | \$ _____ |
| Red Oak | 29.40 MBF | \$ 279.00/MBF | \$ _____ |
| Sugar Maple | 30.70 MBF | \$ 281.00/MBF | \$ _____ |
| Pulpwood | | | |
| B. T. Aspen | 828.00 Cords | \$ 23.50/Cord | \$ _____ |
| Mixed Hardwood | 846.00 Cords | \$ 31.90/Cord | \$ _____ |
| Red Oak | 166.00 Cords | \$ 20.90/Cord | \$ _____ |

*The volumes are statistically estimated within plus (+) or minus (-) 12.49 percent. These estimated volumes are final and not subject to adjustment. Prospective bidders are urged to examine this timber and to make their own estimates of quantity and quality.

I understand that any or all bids may be rejected. All bids must be signed and all bid items must be bid or the bid form may be rejected. I also understand that consideration and awarding a contract will be based upon my past performance and ability to complete the contract based upon equipment and staffing subject to my control.

FEDERAL ID: ____ - ____ - ____ or SOCIAL SECURITY NUMBER: ____ - ____ - ____

Company or individual bidding: _____

Company representative's name: _____

Address: _____

City: _____ State: _____ Zip: _____

IF AVAILABLE, PLEASE PLACE THE PERSONALIZED LABEL FROM YOUR PROSPECTUS IN THE ABOVE BOX.

Individual or company representative's signature: _____ Date: _____

Phone number : _____ Email (optional): _____

THE WINNING BIDDER MUST COMPLETE THE VERIFICATION OF WORKER'S DISABILITY COMPENSATION ACT COMPLIANCE (ON REVERSE SIDE IF DOUBLE SIDED) WITHIN 21 DAYS OF SALE AWARD DATE



| |
|----------------------------------|
| FOR DEPARTMENT USE ONLY |
| Sale Number (XX - XXX - XX - XX) |
| Forest Management Unit: |

TIMBER SALE VERIFICATION OF WORKER'S DISABILITY COMPENSATION ACT COMPLIANCE

*As required by Act 317, P.A. 1969 (Worker's Compensation) and
Part 5 of Act 451 of 1994, as amended.*

VERIFICATION OF WORKER'S DISABILITY COMPENSATION ACT COMPLIANCE

- This verification must be completed and submitted within 21 days of contract award and prior to the issuance of the timber sale contract.
- In addition, if boxes 2B or 2C are checked, then Notice of Exclusion or Certificate of Insurance must be submitted within twenty-one (21) days of the contract award and prior to the issuance of the timber sale contract.
- All information must be typed or printed except for written signatures.

Please Check Appropriate Categories:

1. My business is organized as (you **must** check one of the boxes below):
 - A. Sole Proprietorship (individual)
 - B. Partnership
 - C. Corporation
2. You **must** check one of the boxes below:
 - A. I certify my business is a sole proprietorship and it has no employees but the sole proprietor. I am not subject to the Worker's Compensation Laws.
 - B. I certify my business has satisfied its obligation to the Worker's Compensation Act through the use of an approved Notice of Exclusion (BWC-337, Rev. 5/96). I will provide a copy of the Notice of Exclusion within 21 days of the contract award. (For questions or a copy of the BWC-337, please call the Worker's Compensation Bureau at 517-322-1195).
 - C. I certify my business has a Worker's Compensation Policy. I will provide an original Certificate of Insurance within twenty-one (21) days of the contract award.
3. If you have checked item 2(A) or 2(B), you **must** indicate the number of **both** full-time and part-time employees, other than yourself, including family members and active partners (if none, you must enter "0").

_____ Full-time Employees _____ Part-time Employees

| | | | |
|------------------|-------|-------------------------------------|--|
| Name of Business | | Federal ID (or) Social Security No. | |
| Address | | Telephone () | |
| City | State | ZIP | |

I hereby certify that the above information is true and correct. I agree to notify the Michigan DNR of any changes that occur in factors affecting my coverage during any of my present and future operations.

Signature of Owner or Authorized Representative

Title

Date

Please complete the "SEALED BID" information on the next page

Feed Bucket Mix (72-040-17)
T25N, R03W, SEC. 2; Crawford COUNTY

In response to the notice of sale to be held 9:00 a.m. (local time) on March 12, 2019, I am hereby submitting my sealed bid (firm offer) for the following forest products to be cut. Bids for individual species must be at or above the advertised price. All non-responsive bid forms may be rejected.

| <u>PRODUCTS & SPECIES</u> | <u>ESTIMATED VOLUME*</u> | <u>ADVERTISED PRICE</u> | <u>BID PRICE/UNIT</u> |
|-------------------------------|--------------------------|-------------------------|-----------------------|
| Sawtimber | | | |
| Mixed Aspen | 38.50 MBF | \$ 78.00/MBF | \$ _____ |
| Mixed Oak | 57.50 MBF | \$ 199.00/MBF | \$ _____ |
| Red Pine | 67.10 MBF | \$ 110.00/MBF | \$ _____ |
| Pulpwood | | | |
| Jack Pine | 300.00 Cords | \$ 18.10/Cord | \$ _____ |
| Mixed Aspen | 260.00 Cords | \$ 23.50/Cord | \$ _____ |
| Mixed Hardwood | 67.00 Cords | \$ 31.90/Cord | \$ _____ |
| Mixed Oak | 256.00 Cords | \$ 20.90/Cord | \$ _____ |
| Red Pine | 86.00 Cords | \$ 39.45/Cord | \$ _____ |
| White Pine | 218.00 Cords | \$ 27.15/Cord | \$ _____ |

*The volumes are statistically estimated within plus (+) or minus (-) 13.41 percent. These estimated volumes are final and not subject to adjustment. Prospective bidders are urged to examine this timber and to make their own estimates of quantity and quality.

I understand that any or all bids may be rejected. All bids must be signed and all bid items must be bid or the bid form may be rejected. I also understand that consideration and awarding a contract will be based upon my past performance and ability to complete the contract based upon equipment and staffing subject to my control.

FEDERAL ID: ____ - ____ - ____ or SOCIAL SECURITY NUMBER: ____ - ____ - ____

Company or individual bidding: _____

Company representative's name: _____

Address: _____

City: _____ State: _____ Zip: _____

IF AVAILABLE, PLEASE PLACE THE PERSONALIZED LABEL FROM YOUR PROSPECTUS IN THE ABOVE BOX.

Individual or company representative's signature: _____ Date: _____

Phone number : _____ Email (optional): _____

THE WINNING BIDDER MUST COMPLETE THE VERIFICATION OF WORKER'S DISABILITY COMPENSATION ACT COMPLIANCE (ON REVERSE SIDE IF DOUBLE SIDED) WITHIN 21 DAYS OF SALE AWARD DATE



| |
|----------------------------------|
| FOR DEPARTMENT USE ONLY |
| Sale Number (XX - XXX - XX - XX) |
| Forest Management Unit: |

TIMBER SALE VERIFICATION OF WORKER'S DISABILITY COMPENSATION ACT COMPLIANCE

*As required by Act 317, P.A. 1969 (Worker's Compensation) and
Part 5 of Act 451 of 1994, as amended.*

VERIFICATION OF WORKER'S DISABILITY COMPENSATION ACT COMPLIANCE

- This verification must be completed and submitted within 21 days of contract award and prior to the issuance of the timber sale contract.
- In addition, if boxes 2B or 2C are checked, then Notice of Exclusion or Certificate of Insurance must be submitted within twenty-one (21) days of the contract award and prior to the issuance of the timber sale contract.
- All information must be typed or printed except for written signatures.

Please Check Appropriate Categories:

1. My business is organized as (you **must** check one of the boxes below):
 - A. Sole Proprietorship (individual)
 - B. Partnership
 - C. Corporation
2. You **must** check one of the boxes below:
 - A. I certify my business is a sole proprietorship and it has no employees but the sole proprietor. I am not subject to the Worker's Compensation Laws.
 - B. I certify my business has satisfied its obligation to the Worker's Compensation Act through the use of an approved Notice of Exclusion (BWC-337, Rev. 5/96). I will provide a copy of the Notice of Exclusion within 21 days of the contract award. (For questions or a copy of the BWC-337, please call the Worker's Compensation Bureau at 517-322-1195).
 - C. I certify my business has a Worker's Compensation Policy. I will provide an original Certificate of Insurance within twenty-one (21) days of the contract award.
3. If you have checked item 2(A) or 2(B), you **must** indicate the number of **both** full-time and part-time employees, other than yourself, including family members and active partners (if none, you must enter "0").

_____ Full-time Employees

_____ Part-time Employees

| | | | |
|------------------|-------|-------------------------------------|--|
| Name of Business | | Federal ID (or) Social Security No. | |
| Address | | Telephone () | |
| City | State | ZIP | |

I hereby certify that the above information is true and correct. I agree to notify the Michigan DNR of any changes that occur in factors affecting my coverage during any of my present and future operations.

Signature of Owner or Authorized Representative

Title

Date

Please complete the "SEALED BID" information on the next page