



**DEPARTMENT OF NATURAL RESOURCES
STATE OF MICHIGAN**

TIMBER SALE PROSPECTUS #6437

SCHEDULED SALE DATE AND TIME: 1:00 p.m. (local time) on May 20, 2019.

LOCATION: **GWINN MGMT UNIT, 410 WEST M 35, GWINN, MI 49841.**

PROSPECTUS NOTE: The bidder is advised to inspect the sale area and review the location, estimated volumes, operating costs and contract terms of proposed sales. Please be aware that some landowners may request 60 days or more notice for access across their land.

Notice is hereby given that bids will be received by the Unit Manager, GWINN MANAGEMENT UNIT, for certain timber on the following described lands:

Danger Mouse Sbw (32-007-18) / T46N, R29W, SEC. 24, W1/2SW.

Marquette County, Advertised Price \$7,422.25, 18.4 Acres, Spruce/Fir/Tamarack, Paper Birch.

SALE NOTE: Review specification 2.1.11 - Description of timber note
Review specification 7.5.1 - Deteriorating timber

Wild ELF Winter (32-011-18) / T45N, R28W, SEC. 27, S1/2NW, SWNE, SW, NWSE.

T45N, R28W, SEC. 28, SENE, NESE.

T45N, R28W, SEC. 34, N1/2NW, SENW, SW, NWSE.

Marquette County, Advertised Price \$80,515.80, 152.8 Acres, Aspen, Spruce/Fir/Tamarack.

SALE NOTE: This sale will require a temporary bridge. There will also be significant areas of winter road needed to access multiple units. Due to the winter road, Payment Units 4, 5, and 6 are restricted to winter operations. Payment Units 1, 2, and 3 have wet conifer inclusions and dry summer or winter operations are encouraged for these units. 100 yards of pit run will need to be placed on the Camp Hope Road to prepare it for hauling.

Sand River South 2.0 (32-013-18) / T46N, R23W, SEC. 2, SWSW.

T46N, R23W, SEC. 3, S1/2NE, SESW, SE.

T46N, R23W, SEC. 4, SWSW.

T46N, R23W, SEC. 5, SESE.

Marquette County, Advertised Price \$19,954.05, 97.3 Acres, Hardwood, Spruce/Fir/Tamarack.

SALE NOTE: This sale is limited to winter operations due to wet road conditions and wet conditions in the sale area. Road access into the sale will require 200 yards of fill. Material from State pits may be available.

Access may be through private or other public land.

Crispy Camry (32-018-18) / T46N, R28W, SEC. 10, N1/2NW, NWSW, S1/2SW.

T46N, R28W, SEC. 3, SWNW, S1/2NE, SW, W1/2SE.

T46N, R28W, SEC. 4, SENE, NESE.

Marquette County, Advertised Price \$59,396.35, 141.5 Acres, Aspen, Red Pine.

SALE NOTE: Roundwood operation required within Payment Units 1, 3, 4, 7, & 8.

Road work is required for the haul road into Payment Units 4-9. See spec 4.1.8 for more information.

Black River Fir SBW (32-104-17) / T46N, R28W, SEC. 8 , SE.

T46N, R28W, SEC. 9 , W1/2SW.

Marquette County, Advertised Price \$22,085.10, 58.7 Acres, Spruce/Fir/Tamarack, Aspen.

SALE NOTE: Access is though private land, road though private land may need some work, and fill to allow trucking. Spruce and fir has some damage from spruce budworm. Winter spec due to road access through a bog and wet areas within stands.

Access may be through private land.

BID INSTRUCTIONS (VER. 07/02/2018):

1. Scheduled Bid Location, Date, and Time (2/11)

Bids must be received by the Unit Manager, GWINN OFFICE, 410 WEST M 35, GWINN, MI 49841, no later than 1:00 p.m. (local time) on May 20, 2019. For further information concerning this sale, contact Tom Seablom at 906-346-9201.

2. Bidder's Qualifications (5/16)

Purchaser shall obtain workers compensation insurance to cover claims under Michigan's Worker's Disability Compensation Act of 1969 or similar employee benefit act of any other state applicable to an employee. If all or part of a timber sale was prepared by a private contractor, the contractor and that contractor's company are not permitted to bid on the timber sale contract. Bids will not be accepted from individuals or companies appearing on the DNR/FRD No-Bid List. This list contains the names of purchasers who previously failed to execute a contract within 21-days or who have a history of poor performance.

3. Preparation of Sealed Bids (5/16)

Bid Forms may be completed online thru Michigan DNR Timber Sale Online Bidding (OLB) at www.michigan.gov/timberbidding or by completing the hardcopy Bid Form found in the Timber Sale Prospectus. Hardcopy Bid Forms shall be manually signed in ink. Registration in OLB is considered your 'signature' for all bids submitted thru that system. Bid prices must be entered for each species and product in the Bid Price column for all material subject to bidding and all fill-in blanks must be completed. If erasures or other changes appear on the hardcopy Bid Form, each erasure or change must be initialed by the person signing the bid.

4. Submission of Sealed Bids (5/16)

Bid forms may be obtained from the Unit Manager or thru OLB. Bids may be submitted hardcopy or thru OLB. All hardcopy bids must be submitted on the bid form and in an envelope clearly identified as described in this section. NOTE: Only one bid form per bid envelope. Sealed bids must be submitted to the Unit office designated in the prospectus and must be submitted at or prior to the time established in the prospectus. The envelope should show on the outside (a) the sale name or number and (b) the date and time of bid opening, as shown in the prospectus. Bids received after the time specified in the sale prospectus are late bids and will be rejected.

It is possible for a bidder to submit multiple bids on a single sale. For example, a bid may be submitted hardcopy and a bid may be submitted thru OLB. Or, two bidders from the same company could both submit bids on the same sale. If this were to happen, the State would accept all bids received and award the contract accordingly. All bidding and contractual requirements would apply to all bids received.

5. Public Opening of Sealed Bids (7/16)

If conditions permit, the sealed bids will be publicly opened and posted at the time and place set in the prospectus.

If a bidder, present at a bid opening, has submitted bids on more than one sale, that bidder may withdraw their unopened bid envelopes or announce the withdrawal of their online bid after being declared the successful bidder on one sale.

6. Award of Contract (1/11)

Award of the contract will be made to the Bidder whose bid, conforming to the prospectus, is most advantageous to the State of Michigan on the basis of total value at rates bid for the estimated quantities. The State reserves the right to reject any bid or waive any minor irregularity in bids received. A written award mailed (or otherwise furnished) to the successful Bidder shall be deemed to result in a binding contract without further action by either party.

7. Down Payment (1/11)

The Bidder to whom award is made must make a down payment within 21 days of the sale award. The amount of the down payment will be calculated as shown in the Bond and Payment Schedule of this prospectus. Only cash may be used to meet this requirement.

8. Performance Security (1/11)

As guarantee of faithful performance, a cash bond, certificate of deposit, surety bond or irrevocable letter of credit (LOC) is required within 21 days of the sale award. The amount of the performance security is shown in the Bond and

Payment Schedule of this prospectus. If an LOC or surety is used, the coverage must extend for at least 6 months beyond the contract expiration.

9. Timber Sale Contract (7/18)

Additional conditions and requirements common to all timber sales are listed on the timber sale contract (R4031) and are available on line at www.michigan.gov/timber. Contact the Unit Manager for additional information or a sample contract. Within 21 days of the date of the award letter, the bidder must sign the contract and provide the required down payment, performance security, and verification of worker's disability compensation. The down payment and performance security shall be in accordance with the provisions of the timber sale contract, in the sums stated in this prospectus. If these actions are not taken, then the Bidder, the Bidder's corporation, and the corporation's principals may not be permitted to bid on State timber sales for a period of 3 months after the first offense, 6 months after the second offense, and 1 year after the third offense. An offense will only be counted against the Bidder for 5 years. In addition, the Bidder certifies that if awarded this contract, the Bidder will complete the timber sale contract in accordance with its terms and any modifications thereof including requirements to purchase, cut, and remove the included timber by the expiration date.

Payment Unit values in the State Forest Timber Sale Contract are calculated based on the advertised value of the Payment Unit as a percentage of the total advertised value of the contract. The advertised value of each Payment Unit is given in the Description of Timber by Payment Unit table on the Timber Sale Information page. For example, if the value of Payment Unit 1 is advertised as \$1,500 and the total Timber Sale value is advertised as \$10,000, the contract price for Payment Unit 1 will be 15% of the total bid price ($\$1,500/\$10,000 * 100$).

10. Disclaimer of Estimates and Bidder's Warranty of Inspection (7/16)

Before submitting this bid, the Bidder is advised and cautioned to inspect the sale area, review the requirements of the sale contract, and take other steps as may be reasonably necessary to ascertain the location, estimated volumes, construction estimates, and operating costs of the proposed sale. Failure to do so will not relieve the Bidder from responsibility for completing the contract.

The Bidder warrants that this bid is submitted solely on the basis of the Bidder's examination and inspection of the quality and quantity of the timber offered for sale and the Bidder's opinion of the value thereof and the costs of recovery. No reliance should be placed on the State of Michigan's estimates of timber quality, quantity or costs of recovery. Bidder further acknowledges that the State of Michigan: (i) expressly disclaims any warranty of fitness of timber for any purpose; (ii) offers this timber as is without any warranty of quality (merchantability) or quantity and (iii) expressly disclaims any warranty as to the quantity or quality of timber sold.

11. Certification and Chain-of-Custody (10/14)

Unless otherwise indicated in the contract under section 7 – Other Conditions of the Sale Specific Conditions & Requirements, the area encompassed by this timber sale is certified to the standards of the Forest Stewardship Council (FSC) - Certificate #SCS-FM/COC-00090N and the Sustainable Forestry Initiative (SFI) - Certificate #NSF-SFIS-5Y031-SF5. Forest products from this sale may be delivered to the mill as "FSC 100% and / or SFI certified" as long as the contractor hauling the forest products is chain-of-custody (COC) certified or covered under a COC certificate from the destination mill. The purchaser is responsible for maintaining COC after leaving the sale area.

12. Good Neighbor Authority (GNA) Requirements (7/16)

If the name of this timber sales contains the acronym GNA, it is authorized by the Good Neighbor Authority (GNA) and covered by various agreements between the U.S. Forest Service and the State. The timber sale occurs on federal land and the following conditions apply:

GNA contracts on US Forest Service land will not be awarded to purchasers on the Federal list of excluded parties. The System for Award Management (SAM) will be checked for active excluded parties prior to award of contract. In addition, the Bidder to whom award is made must complete an Assurance Regarding Felony Conviction or Tax Delinquent Status for Corporate Applicants (AD-3031).

13. Good Neighbor Authority (GNA) Requirements, con't (9/16)

Bidder certifies, by signing this bid form, that to the best of Bidder's knowledge that the following representations are accurate and complete.

- a. That the Bidder and its principals are not presently debarred, suspended, proposed for debarment, declared ineligible, or voluntary excluded from timber sales (covered transactions) by any Federal department or agency.
- b. That the Bidder and its principals have not within a 3-year period preceding this bid been convicted of or had a civil judgment rendered against them for commission of fraud or a criminal offense in connection with obtaining, attempting to obtain, or performing a public (Federal, State, or local) transaction or contract under a public transaction; violation of Federal or State antitrust statutes or commission of embezzlement, theft, forgery, bribery, falsification or destruction of records, making false statements, or receiving stolen property.
- c. That the Bidder and its principals are not presently indicted for or otherwise criminally or civilly charged by a governmental entity (Federal, State, or local) with commission of any of the offenses enumerated in paragraph b of this certification.
- d. That the Bidder and its principals have not within a 3-year period preceding this bid had one or more public transactions (Federal, State, or local) terminated for breach or default of a timber or forest product contract.

Bidders that cannot certify this requirement, in whole or in part, shall submit an explanation with their bid.

DAN EICHINGER
Director

TIMBER SALE INFORMATION

Danger Mouse Sbw (32-007-18)
 T46N, R29W, SEC. 24.
 Marquette County (Advertised Price \$7,422.25)

SALE NOTE: Review specification 2.1.11 - Description of timber note
 Review specification 7.5.1 - Deteriorating timber

A timber sale contract for this lump sum, sealed bid timber sale will be awarded to the responsible bidder offering the highest sealed bid price. Bids must be at or above the following advertised price for each species:

| <u>PRODUCTS & SPECIES</u> | <u>ESTIMATED UNITS*</u> | <u>ADVERTISED PRICE</u> |
|-------------------------------|-------------------------|-------------------------|
| Pulpwood | | |
| Balsam Fir | 190.00 Cords | \$ 20.00 / Cord |
| Black Spruce | 62.00 Cords | \$ 19.65 / Cord |
| Jack Pine | 41.00 Cords | \$ 30.10 / Cord |
| Paper Birch | 51.00 Cords | \$ 14.40 / Cord |
| Quaking Aspen | 15.00 Cords | \$ 26.20 / Cord |
| Red Maple | 3.00 Cords | \$ 14.15 / Cord |

* The total volume is statistically estimated within plus (+) or minus (-) 30.82 percent. The estimated units are final and not subject to adjustment. Prospective bidders are urged to examine this timber and to make their own estimates of quantity and quality.

BOND AND PAYMENT SCHEDULE:

1. A bond in the amount of \$750.00 to insure faithful performance of the conditions of the contract will be deposited by the successful bidder within 21 days of the sale award.
2. Cutting in any sale or unit without the required advance payment would be considered a trespass.
3. Total payment must be paid in advance or according to the following schedule:
 - (a) Ten percent (10%) of the sale value must be paid within 21 days of the sale award.
 - (b) The 10% down payment will be credited towards the first unit cut.
 - (c) Payment for each of the following units must be made before cutting begins in that unit:

| PAYMENT UNIT NUMBER | PERCENT OF TOTAL SALE VALUE |
|---------------------|-----------------------------|
| 01 | 40.8% |
| 02 | 59.2% |
4. If no cutting takes place, the 10% down payment will not be refunded.
5. Operations on the contract issued will terminate on 08/31/2021.

Description of Timber by Payment Unit (PU)

| PU | MARKET GROUP | PRODUCT | QUANTITY | UNIT | ACRES | ADVERTISE PRICE |
|---------------|---------------|----------|----------|-------|-------|-----------------|
| 1 | Balsam Fir | Pulpwood | 45.0 | Cords | 11.1 | \$3,026.95 |
| | Black Spruce | | 28.0 | Cords | | |
| | Jack Pine | | 19.0 | Cords | | |
| | Paper Birch | | 45.0 | Cords | | |
| | Quaking Aspen | | 12.0 | Cords | | |
| | Red Maple | | 3.0 | Cords | | |
| 2 | Balsam Fir | Pulpwood | 145.0 | Cords | 7.3 | \$4,395.30 |
| | Black Spruce | | 34.0 | Cords | | |
| | Jack Pine | | 22.0 | Cords | | |
| | Paper Birch | | 6.0 | Cords | | |
| | Quaking Aspen | | 3.0 | Cords | | |
| TOTAL: | | | 362.0 | Cords | | |

Sale Specific Conditions & Requirements

Sale Name: Danger Mouse Sbw

Sale Number: 32-007-18 Seq#: 2

1 - Sale Area

1.2 - Boundaries

1.2.1 - Painted boundaries (1/14)

The sale boundary is marked and identified by blue and red paint. Exterior sale boundary lines against private property are marked with blue paint. Exterior sale boundary lines against state are marked with red paint. The painted boundary line trees are not Included Timber and are to be protected.

2 - Timber Specifications

2.1 - Included Timber

2.1.1 - Clearcut unit(s) with unmerchantable trees (6/14)

Within Payment Unit(s) 1 & 2, cut all trees that are two (2) inches or more at DBH, except do not cut oak, pine, cedar, hemlock, and yellow birch.

2.1.11 - Description of timber note (2/04)

Note that Payment Unit 2 is optional due to a 550' stretch of low ground to access the unit. If the Purchaser cannot access this unit, the contract will be modified through a contract supplement to subtract the value of the uncut unit from the contract. The uncut unit will be dropped without any damages being assessed.

4 - Transportation

4.1 - Construction

4.1.3 - Slash and earthen piles (8/04)

Piles or windrows of earth along roads and landings that have been widened or constructed shall be leveled. Slash from road maintenance or construction, including stumps, shall be stockpiled and used for road closure purposes.

4.1.4 - Timber removed for construction (12/09)

Trees cut or damaged in the process of pre-approved road, landing or skid trail construction will be decked in an area separate from other Designated Timber and not removed until measured by the sale administrator. Payment will be made at the specified Purchase Unit Price.

4.1.6 - Road construction (1/09)

Construction of new roads or improvements of existing roads shall be done in such a way as to minimize the environmental and visual impacts. Merchantable trees shall be cut and utilized unless otherwise directed. Non-merchantable trees shall be severed and laid flat on the ground. Slash shall be scattered, and not left in windrows and kept a minimum of 10 feet back from the road edge. Stumps shall be set upright, not left on edge, and be moved at least 10 feet away from the road edge. Disturbed soil shall be feathered into the woods and not left in berms or windrows.

4.1.7 - Road closure (10/11)

All new roads built into the sale must be blocked to vehicle traffic upon completion of the sale. Overgrown roads that are reopened shall be considered new roads. In general, this will require stumps, tops, brush, and rocks to be placed in specific locations. Contact the sale administrator for specific details of design and placement.

4.2 - Maintenance

4.2.1 - Hauling restriction (12/08)

Hauling may be restricted on forest roads by the sale administrator. The restriction may occur during spring breakup or wet weather conditions.

4.2.5 - Two wheel drive condition (2/04)

All existing trail roads on and adjacent to the sale area must be passable by two-wheel drive traffic for the duration of the sale.

4.3 - Public Right-of-Way

4.3.2 - County R-O-W (12/06)

The county must be contacted prior to harvesting along the county road R-O-W. This applies to Payment Unit 1.

5 - Operations

5.1 - Notification

5.1.1 - Pre-sale conference (10/16)

A pre-sale conference between the Purchaser and sale administrator is required prior to beginning any operations. The sale administrator must be contacted at least 3 business days in advance to schedule the conference.

5.1.4 - Post-sale conference (10/16)

A post-sale conference on site between the Purchaser and sale administrator is required 3 business days prior to the completion of active logging operations to determine clean-up and repair of landings, road edges, and the fulfillment of other contract specifications.

5.2 - Conduct of Operations

5.2.1 - Slash

5.2.1.11 - Slash for reforestation (5/07)

To facilitate reforestation, the sale area shall be left with slash evenly distributed. Bunched tops within the cutting area shall be broken up and scattered. Stumps shall be cut low to the ground. Processing sites shall not be left with a compacted layer of slash; tops from these sites shall be hauled back into the cut area and scattered.

5.2.2 - Hazard Trees/Snags

5.2.2.1 - Den trees (10/16)

Obvious hollow and/or den trees shall be protected and left standing unless they are a safety hazard.

5.2.17 - Timber Mats and Interlocking Composite Mats (3/18)

Timber mats may be needed to access Payment Unit 2. If available, mats may be borrowed from the DNR. A Timber Sale Contract Supplement will be used to document the Purchaser's use of the DNR's mats. Contact the sale administrator regarding availability and pick-up. The Purchaser is responsible for picking up and hauling the mats to and from the site. All mats must be cleaned prior to drop off. This may include, but is not limited to, power washing and brushing to remove mud and debris. A charge of \$400.00 per timber mat will be assessed for all damaged or non-returned mats. Damage for the crane/timber mats is defined as three or more broken cants.

5.2.30 - Landing/road top soil protection (2/15)

Top soil on landings and new roads must be removed, stockpiled and saved. Upon completion of the timber sale, soil must be evenly distributed back over the area for revegetation.

5.2.31 - Landing locations (9/13)

In general, landings are limited to a "T" turnaround which will accommodate a truck with a 50 foot trailer.

5.2.32 - Decking/landing restoration (9/13)

All decking and landing areas must have the surface area restored to a condition equal to or better than before. This is to ensure the proper regeneration of the stand. Wood debris, chips and "cookies" from trimmings must be removed or scattered away from landing and loading areas and may not be windrowed on the edge.

5.2.37 - No decking areas (12/08)

No decking is allowed within 50 feet of County Road FFH.

5.2.38 - No decking against live trees (2/04)

Cut products may not be decked against unmarked or designated leave trees.

5.4 - Soil Protection

5.4.1 - Rutting restriction, general (7/16)

Operations are to cease immediately if equipment and weather conditions result in rutting of roads and/or skid trails which is 12 inches or greater in depth and 50 feet in length. The Unit Manager or his/her representative may restrict hauling and/or skidding if ruts exceed the specified depth. With the Unit Manager or his/her representative's approval, the Purchaser may

return to the area when the risk of rutting has decreased.

5.4.2 - Skid trails (2/04)

Skid trails up and down slopes should be avoided. If however this is unavoidable, these trails will be left in a non-erodible condition using water bars, logs, and slash. Placing of slash on these skid trails while logging is ongoing may alleviate need for any further action. At the direction of the sale administrator, seed, fertilizer, and mulch may also be required.

5.8 - Protection of Endangered Species

5.8.5 - Protection of raptor nests (3/13)

All trees with raptor nests will be protected if found during harvesting operations. Notification will be made to the Unit Manager or his/her representative who will notify the Wildlife Biologist so an on-site evaluation and recommendation can be made, if necessary.

6 - Safety and Fire Prevention

6.2 - Signing

6.2.1 - Road posting (9/09)

The Purchaser is responsible for posting and maintaining caution signs on County Road FFH prior to beginning operations. The road must be posted at appropriate distances from the sale area to warn of logging activity and truck traffic. Signs must be removed when harvest operations are suspended or completed. The Purchaser will provide these signs.

7 - Other Conditions

7.3 - Contract Modifications

7.3.1 - Emerald Ash Borer

7.3.1.2 - Emerald ash borer, ash or firewood on sale (2/05)

There is ash and/or "firewood" in this sale and it is located within an emerald ash borer quarantined area. The Director of the Michigan Department of Agriculture (MDA) by the authority of Act No. 72 of the Public Acts of 1945, as amended, and Quarantine Regulation No. 620, has promulgated this quarantine to prevent the further spread of this pest and sets forth: definitions, regulated articles, regulated areas, conditions of movement, violations and penalties, and special exemptions. The Purchaser must comply with this quarantine. Contact the MDA for further information.

7.5 - Loss

7.5.1 - Deteriorating timber (7/09)

The sale area has received damage from spruce budworm. The Purchaser should harvest the wood as soon as possible. The Department of Natural Resources is held free of responsibility of any further damage or deterioration due to delay in harvesting.



| | |
|-------------|------|
| Sale Number | Year |
| 32-007-18 | 2018 |

TIMBER SALE MAP

This information provided by authority of Part 525, 1994 PA 451, as amended.

| | | | | | |
|-------------------------------------|---------------------|---|-------------------|-----------|---------|
| Forest Management Unit Gwinn FMU | County Marquette | Mapped By Jason Caron | Date 4-23-18 | Page 1 | of 1 |
| Township 46N | Range 29W | Section(s) and Subdivision(s) See proposal | Scale 1:15,840 | | |

| Cover Type | | | | Density | |
|-------------------|----------------------|-------------------------|-------------------|-----------------------------|------------------------|
| A = Aspen | H = Hemlock | N = Marsh | U = Upland Brush | 0 = Non Stocked | 5 = Pole Timber Medium |
| B = Paper Birch | J = Jack Pine | O = Oak | UM = Upland Mixed | 1 = Seedling Sapling Poor | 6 = Pole Timber Well |
| C = Cedar | L = Lowland Brush | P = Lowland Poplar | V = Bog or Marsh | 2 = Seedling Sapling Medium | 7 = Saw Timber Poor |
| D = Treed Bog | LM = Lowland Mixed | Q = Mixed Swamp Conifer | W = White Pine | 3 = Seedling Sapling Well | 8 = Saw Timber Medium |
| E = Swamp Hdwoods | M = Mpl, Bch, Brch | R = Red Pine | X = Non Stocked | 4 = Pole Timber Poor | 9 = Saw Timber Well |
| F = Spruce Fir | MC = Mixed Conifer | S = Black Spruce | Z = Water | | |
| G = Grass | MD = Mixed Deciduous | T = Tamarack | | | |

| PU | Acres |
|----|-------|
| 1 | 11.1 |
| 2 | 7.3 |

Danger Mouse SBW

Compartment 224
18.4 Acres

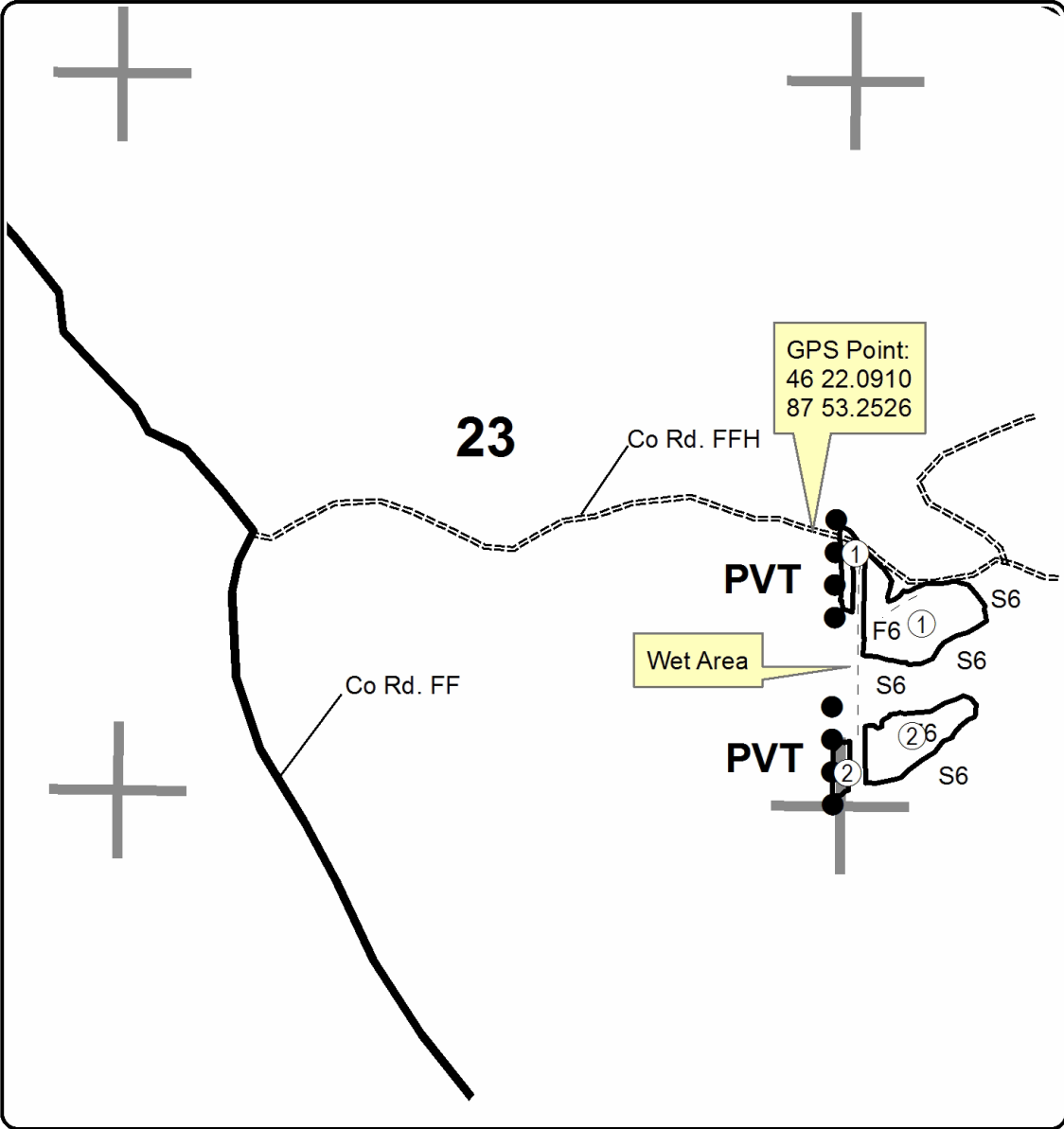
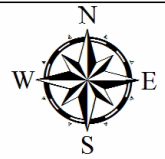

Legend

- Against State (Red)
- Private Line (Blue)
- Section Corners
- === Poor Dirt Rd
- - - Over Grown Road
- Good Gravel Rd



QR Code for PDF Maps

Locator Map
1:200,000

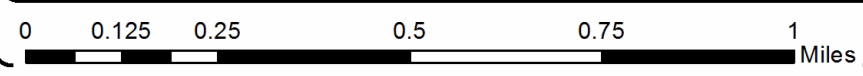
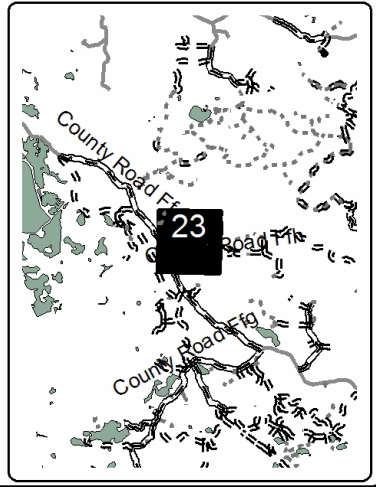

TIMBER SALE INFORMATION

Wild ELF Winter (32-011-18)

T45N, R28W, SEC. 27; T45N, R28W, SEC. 28; T45N, R28W, SEC. 34.
Marquette County (Advertised Price \$80,515.80)

SALE NOTE: This sale will require a temporary bridge. There will also be significant areas of winter road needed to access multiple units. Due to the winter road, Payment Units 4, 5, and 6 are restricted to winter operations. Payment Units 1, 2, and 3 have wet conifer inclusions and dry summer or winter operations are encouraged for these units. 100 yards of pit run will need to be placed on the Camp Hope Road to prepare it for hauling.

A timber sale contract for this lump sum, sealed bid timber sale will be awarded to the responsible bidder offering the highest sealed bid price. Bids must be at or above the following advertised price for each species:

| <u>PRODUCTS & SPECIES</u> | <u>ESTIMATED UNITS*</u> | <u>ADVERTISED PRICE</u> |
|-------------------------------|-------------------------|-------------------------|
| Pulpwood | | |
| Balsam Fir | 620.00 Cords | \$ 20.00 / Cord |
| Jack Pine | 2.00 Cords | \$ 30.10 / Cord |
| Mixed Aspen | 2,012.00 Cords | \$ 26.20 / Cord |
| Mixed Hardwood | 62.00 Cords | \$ 14.15 / Cord |
| Mixed Spruce | 554.00 Cords | \$ 19.65 / Cord |
| Paper Birch | 116.00 Cords | \$ 14.40 / Cord |
| Tamarack | 102.00 Cords | \$ 18.70 / Cord |

* The total volume is statistically estimated within plus (+) or minus (-) 10.62 percent. The estimated units are final and not subject to adjustment. Prospective bidders are urged to examine this timber and to make their own estimates of quantity and quality.

BOND AND PAYMENT SCHEDULE:

1. A bond in the amount of \$4,026.00 to insure faithful performance of the conditions of the contract will be deposited by the successful bidder within 21 days of the sale award.
2. Cutting in any sale or unit without the required advance payment would be considered a trespass.
3. Total payment must be paid in advance or according to the following schedule:
 - (a) Ten percent (10%) of the sale value must be paid within 21 days of the sale award.
 - (b) The 10% down payment will be credited towards the first unit cut.
 - (c) Payment for each of the following units must be made before cutting begins in that unit:

| PAYMENT UNIT NUMBER | PERCENT OF TOTAL SALE VALUE |
|---------------------|-----------------------------|
| 01 | 27.1% |
| 02 | 26.7% |
| 03 | 17.3% |
| 04 | 4.2% |
| 05 | 13.2% |
| 06 | 11.5% |
4. If no cutting takes place, the 10% down payment will not be refunded.
5. Operations on the contract issued will terminate on 08/31/2023.

Description of Timber by Payment Unit (PU)

| PU | MARKET GROUP | PRODUCT | QUANTITY | UNIT | ACRES | ADVERTISE PRICE |
|----------------------|----------------------|------------|--------------|--------------|-------|-----------------|
| 1 | Balsam Fir | Pulpwood | 93.0 | Cords | 46.3 | \$21,755.90 |
| | Jack Pine | | 2.0 | Cords | | |
| | Mixed Aspen | | 636.0 | Cords | | |
| | <i>B. T. Aspen</i> | | 20.0 | <i>Cords</i> | | |
| | <i>Balsam Poplar</i> | | 90.0 | <i>Cords</i> | | |
| | <i>Quaking Aspen</i> | | 526.0 | <i>Cords</i> | | |
| | Mixed Hardwood | | 17.0 | Cords | | |
| | <i>Black Cherry</i> | | 10.0 | <i>Cords</i> | | |
| | <i>Sugar Maple</i> | | 7.0 | <i>Cords</i> | | |
| | Mixed Spruce | | 109.0 | Cords | | |
| | <i>Black Spruce</i> | | 5.0 | <i>Cords</i> | | |
| | <i>White Spruce</i> | | 104.0 | <i>Cords</i> | | |
| | Paper Birch | | 25.0 | Cords | | |
| | Tamarack | | 23.0 | Cords | | |
| | 2 | | Balsam Fir | Pulpwood | | |
| Mixed Aspen | | 632.0 | Cords | | | |
| <i>Balsam Poplar</i> | | 59.0 | <i>Cords</i> | | | |
| <i>Quaking Aspen</i> | | 573.0 | <i>Cords</i> | | | |
| Mixed Hardwood | | 38.0 | Cords | | | |
| <i>Basswood</i> | | 3.0 | <i>Cords</i> | | | |
| <i>Black Cherry</i> | | 2.0 | <i>Cords</i> | | | |
| <i>Sugar Maple</i> | | 33.0 | <i>Cords</i> | | | |
| Mixed Spruce | | 87.0 | Cords | | | |
| <i>Black Spruce</i> | | 9.0 | <i>Cords</i> | | | |
| <i>White Spruce</i> | | 78.0 | <i>Cords</i> | | | |
| Paper Birch | | 21.0 | Cords | | | |
| Tamarack | | 4.0 | Cords | | | |
| 3 | | Balsam Fir | Pulpwood | | 115.0 | Cords |
| | Mixed Aspen | 402.0 | | Cords | | |
| | <i>Balsam Poplar</i> | 58.0 | | <i>Cords</i> | | |
| | <i>Quaking Aspen</i> | 344.0 | | <i>Cords</i> | | |
| | Mixed Hardwood | 7.0 | | Cords | | |
| | <i>Black Cherry</i> | 7.0 | | <i>Cords</i> | | |
| | Mixed Spruce | 44.0 | | Cords | | |
| | <i>White Spruce</i> | 44.0 | | <i>Cords</i> | | |
| | Tamarack | 8.0 | | Cords | | |
| | 4 | Balsam Fir | | Pulpwood | 28.0 | Cords |
| Mixed Aspen | | 59.0 | Cords | | | |
| <i>Quaking Aspen</i> | | 59.0 | <i>Cords</i> | | | |
| Mixed Spruce | | 57.0 | Cords | | | |
| <i>Black Spruce</i> | | 41.0 | <i>Cords</i> | | | |
| <i>White Spruce</i> | | 16.0 | <i>Cords</i> | | | |
| Paper Birch | | 5.0 | Cords | | | |
| Tamarack | | 5.0 | Cords | | | |
| 5 | Balsam Fir | Pulpwood | 102.0 | Cords | 24.9 | \$10,636.80 |
| | Mixed Aspen | | 195.0 | Cords | | |
| | <i>Quaking Aspen</i> | | 195.0 | <i>Cords</i> | | |
| | Mixed Spruce | | 128.0 | Cords | | |
| | <i>Black Spruce</i> | | 35.0 | <i>Cords</i> | | |
| | <i>White Spruce</i> | | 93.0 | <i>Cords</i> | | |
| | Paper Birch | | 13.0 | Cords | | |
| | Tamarack | | 42.0 | Cords | | |
| 6 | Balsam Fir | Pulpwood | 166.0 | Cords | 20.6 | \$9,283.25 |
| | Mixed Aspen | | 88.0 | Cords | | |
| | <i>Balsam Poplar</i> | | 4.0 | <i>Cords</i> | | |
| | <i>Quaking Aspen</i> | | 84.0 | <i>Cords</i> | | |

Description of Timber by Payment Unit (PU), con't

| PU | MARKET GROUP | PRODUCT | QUANTITY | UNIT | ACRES | ADVERTISE PRICE |
|---------|---------------------|----------|----------|--------------|-------|-----------------|
| 6 con't | Mixed Spruce | Pulpwood | 129.0 | Cords | | |
| | <i>Black Spruce</i> | | 16.0 | <i>Cords</i> | | |
| | <i>White Spruce</i> | | 113.0 | <i>Cords</i> | | |
| | Paper Birch | | 52.0 | Cords | | |
| | Tamarack | | 20.0 | Cords | | |
| TOTAL: | | | 3,468.0 | Cords | | |

Sale Specific Conditions & Requirements

Sale Name: Wild ELF Winter

Sale Number: 32-011-18 Seq#: 2

1 - Sale Area

1.2 - Boundaries

1.2.1 - Painted boundaries (1/14)

The sale boundary and Payment Unit boundaries are marked and identified by red paint. Exterior sale boundary lines against state are marked with red paint. The painted boundary line trees are not Included Timber and are to be protected.

2 - Timber Specifications

2.1 - Included Timber

2.1.1 - Clearcut unit(s) with unmerchantable trees (6/14)

Within Payment Unit(s) 1 - 6, cut all trees that are two (2) inches or more at DBH, except do not cut red pine, white pine, cedar, oak, and hemlock.

2.1.9 - Harvest exception (12/08)

Do not cut any cedar trees other than those that are necessary to remove in order to operate within the sale area. Every effort must be made to preserve the existing cedar and to leave an intact stand upon sale completion. All cut cedar shall be piled separately by products and scaled in the woods unless other scaling arrangements are agreed to by the Unit Manager or his/her representative. Stumpage price for cedar shall be \$40.00 per cord for posts and pulpwood, and \$90.00 per cord for bolts and sawlogs.

4 - Transportation

4.1 - Construction

4.1.2 - Stream crossings, specific (3/11)

A river crossing will require the installation of a culvert or portable bridge which may be borrowed from the DNR. This installation will be performed in accordance with the specifications on the appropriate permits which shall be provided by the DNR.

4.1.3 - Slash and earthen piles (8/04)

Piles or windrows of earth along roads and landings that have been widened or constructed shall be leveled. Slash from road maintenance or construction, including stumps, shall be dispersed throughout the sale.

4.1.4 - Timber removed for construction (12/09)

Trees cut or damaged in the process of pre-approved road, landing or skid trail construction will be decked in an area separate from other Designated Timber and not removed until measured by the sale administrator. Payment will be made at the specified Purchase Unit Price.

4.1.6 - Road construction (1/09)

Construction of new roads or improvements of existing roads shall be done in such a way as to minimize the environmental and visual impacts. Merchantable trees shall be cut and utilized unless otherwise directed. Non-merchantable trees shall be severed and laid flat on the ground. Slash shall be scattered, and not left in windrows and kept a minimum of 10 feet back from the road edge. Stumps shall be set upright, not left on edge, and be moved at least 10 feet away from the road edge. Disturbed soil shall be feathered into the woods and not left in berms or windrows.

4.1.7 - Road closure (10/11)

All new roads built into the sale must be blocked to vehicle traffic upon completion of the sale. Overgrown roads that are reopened shall be considered new roads. In general, this will require constructing a four (4') foot high berm of stumps and logs covered with earth. All stumps from road building and landing construction must be reserved to block any newly constructed roads upon completion of the sale. Temporary berms may be required if no sale activity occurs for 30 or more consecutive days. Contact the sale administrator for specific details of design and placement.

4.1.8 - Road work (1) (8/07)

The following road work is required: Place 100 yards of pit run in holes and other areas needed to prepare the Camp Hope

Road for hauling.

4.1.11 - Permits (2/12)

The DNR will secure any necessary stream crossing permits that may be required.

4.2 - Maintenance

4.2.1 - Hauling restriction (12/08)

Hauling may be restricted on forest roads by the Unit Manager or his/her representative. The restriction may occur during spring breakup, or may occur during wet weather conditions.

4.2.2 - Fill material (4/07)

To maintain roads, fill material may be needed in areas where "holes" exist or may be expected to develop. This fill material should be placed before trucking begins.

4.2.3 - Road maintenance (8/13)

The following road maintenance may be needed: Within 30 days of completion of hauling, or if no hauling occurs for 30 days, the road must be maintained and graded. This includes cleaning of drainage areas, grading, crowning and filling with gravel, if necessary. Damages will be assessed if grading/repair does not occur.

4.2.4 - Grading (10/16)

For completion of the sale, state forest roads must be graded. In general, this will require a road grader or bull dozer to shape up the roads after forest products have been hauled off site. This includes cleaning of drainage areas, grading, crowning and filling with gravel, if necessary. The grading equipment to be used must be approved by the Unit Manager or his/her representative.

5 - Operations

5.1 - Notification

5.1.1 - Pre-sale conference (10/16)

A pre-sale conference on site between the Purchaser and sale administrator is required prior to beginning any operations to determine landing and road locations. The sale administrator must be contacted at least 3 business days in advance to schedule the conference.

5.2 - Conduct of Operations

5.2.1 - Slash

5.2.1.11 - Slash for reforestation (5/07)

To facilitate reforestation, the sale area shall be left with slash evenly distributed. Bunched tops within the cutting area shall be broken up and scattered. Stumps shall be cut low to the ground. Processing sites shall not be left with a compacted layer of slash; tops from these sites shall be hauled back into the cut area and scattered.

5.2.2 - Hazard Trees/Snags

5.2.2.1 - Den trees (10/16)

Obvious hollow and/or den trees shall be protected and left standing unless they are a safety hazard.

5.2.3 - Operating Restrictions

5.2.3.1 - Operating restrictions (9/11)

Within Payment Unit(s) 4, 5, and 6, unless changed by written agreement, cutting, skidding, and hauling are limited to the period of December 1 to March 31. This restriction is because of wet soil conditions in units and access roads to these units

5.2.3.11 - Coppice regeneration protection (4/10)

Timber harvesting in any Payment Unit must be completed before significant aspen sprouting occurs in that Payment Unit so as to minimize damage to the new regeneration. Any post harvest operations, such as chipping, must be completed before sprouting of regeneration occurs. If it is anticipated that chipping will be delayed, then tops shall be carried to one central location or left unchipped. The Unit Manager or his/her representative may cease such operations if sprouting occurs before the operation is complete.

5.2.17 - Crane Mats/Timber Mats (9/17)

Some roads or skid trails may require extra protection such as that afforded by Crane Mats/Timber Mats. If available, Crane Mats/Timber Mats may be borrowed from the DNR and are located at the Marquette ICC, the Newberry Field Office and the Grayling Field Office. Contact the sale administrator for specific details. A Timber Sale Contract Supplement will be used to document the Purchaser's use of the DNR's Crane Mats/Timber Mats. It is the responsibility of the Purchaser to contact the sale administrator to schedule pick up and drop off. In addition, all mats must be cleaned prior to drop off. A charge of \$125.00 will be assessed for all damaged or non-returned mats. Damage is defined as misuse resulting in three or more broken cants.

5.2.22 - Operating Caution

5.2.22.1 - Operating caution (6/11)

It is recommended, but not required, that within Payment Unit(s) 1, 2, and 3, cutting, skidding, and hauling occur during dry summer or frozen winter conditions. The reason for the recommendation is due to inclusion of lowland conifer within these payment units.

5.2.32 - Decking/landing restoration (9/13)

All decking and landing areas must have the surface area restored to a condition equal to or better than before. This is to ensure the proper regeneration of the stand. Wood debris, chips and "cookies" from trimmings must be removed or scattered away from landing and loading areas and may not be windrowed on the edge.

5.2.38 - No decking against live trees (2/04)

Cut products may not be decked against unmarked or designated leave trees.

5.2.40 - Pathway protection (10/10)

The access road into Payment Units 1, 2, and 3 is a hunter hiking trail and is shown on the Timber Sale Map. Maintain a 20-foot wide slash, debris, and rut free zone daily, using the pathway as the centerline.

5.4 - Soil Protection

5.4.1 - Rutting restriction, general (7/16)

Operations are to cease immediately if equipment and weather conditions result in rutting of roads and/or skid trails which is 12 inches or greater in depth and 50 feet in length. The Unit Manager or his/her representative may restrict hauling and/or skidding if ruts exceed the specified depth. With the Unit Manager or his/her representative's approval, the Purchaser may return to the area when the risk of rutting has decreased.

5.4.2 - Skid trails (2/04)

Skid trails up and down slopes should be avoided. If however this is unavoidable, these trails will be left in a non-erodible condition using water bars, logs, and slash. Placing of slash on these skid trails while logging is ongoing may alleviate need for any further action. At the direction of the sale administrator, seed, fertilizer, and mulch may also be required.

5.4.3 - Erosion control (12/08)

Skid trails or haul roads may require erosion control structures or berms per direction of the Unit Manager or his/her representative.

5.8 - Protection of Endangered Species

5.8.5 - Protection of raptor nests (3/13)

All trees with raptor nests will be protected if found during harvesting operations. Notification will be made to the Unit Manager or his/her representative who will notify the Wildlife Biologist so an on-site evaluation and recommendation can be made, if necessary.

6 - Safety and Fire Prevention

6.2 - Signing

6.2.1 - Road posting (9/09)

The Purchaser is responsible for posting and maintaining caution signs on Camp Hope Road prior to beginning operations. The road must be posted at appropriate distances from the sale area to warn of logging activity and truck traffic. Signs must be removed when harvest operations are suspended or completed. The Purchaser will provide these signs.

7 - Other Conditions

7.3 - Contract Modifications

7.3.1 - Emerald Ash Borer

7.3.1.2 - Emerald ash borer, ash or firewood on sale (2/05)

There is ash and/or "firewood" in this sale and it is located within an emerald ash borer quarantined area. The Director of the Michigan Department of Agriculture (MDA) by the authority of Act No. 72 of the Public Acts of 1945, as amended, and Quarantine Regulation No. 620, has promulgated this quarantine to prevent the further spread of this pest and sets forth: definitions, regulated articles, regulated areas, conditions of movement, violations and penalties, and special exemptions. The Purchaser must comply with this quarantine. Contact the MDA for further information.

7.5 - Loss

7.5.1 - Deteriorating timber (7/09)

The sale area has received damage from spruce budworm. The Purchaser should harvest the wood as soon as possible. The Department of Natural Resources is held free of responsibility of any further damage or deterioration due to delay in harvesting.



TIMBER SALE MAP

This information provided by authority of Part 525, 1994 PA 451, as amended.

| | |
|-------------|------|
| Sale Number | Year |
| 32- 011 | 18 |

| | | | | | | | |
|-------------------------------------|--------------|--|------------------------|--|-------------------|-----------|---------|
| Forest Management Unit Gwinn FMU | | County Marquette | Mapped By Rick Hill | | Date 06/14/18 | Page 1 | of 1 |
| Township 45N | Range 28W | Section(s) and Subdivision(s) Sections 27, 28, and 34 | | | Scale 1:15,840 | | |
| Cruised By Rick Hill | | | | | | | |

| Cover Type | | | | Density | | | |
|-------------------|----------------------|-------------------------|-------------------|-----------------------------|------------------------|--|--|
| A = Aspen | H = Hemlock | N = Marsh | U = Upland Brush | 0 = Non Stocked | 5 = Pole Timber Medium | | |
| B = Paper Birch | J = Jack Pine | O = Oak | UM = Upland Mixed | 1 = Seedling Sapling Poor | 6 = Pole Timber Well | | |
| C = Cedar | L = Lowland Brush | P = Lowland Poplar | V = Bog or Marsh | 2 = Seedling Sapling Medium | 7 = Saw Timber Poor | | |
| D = Treed Bog | LM = Lowland Mixed | Q = Mixed Swamp Conifer | W = White Pine | 3 = Seedling Sapling Well | 8 = Saw Timber Medium | | |
| E = Swamp Hdwoods | M = Mpl. Bch. Birch | R = Red Pine | X = Non Stocked | 4 = Pole Timber Poor | 9 = Saw Timber Well | | |
| F = Spruce Fir | MC = Mixed Conifer | S = Black Spruce | Z = Water | | | | |
| G = Grass | MD = Mixed Deciduous | T = Tamarack | | | | | |

| PU | Acres | PU | Acres |
|----|-------|----|-------|
| 1 | 46.3 | 4 | 11.5 |
| 2 | 26.7 | 5 | 24.9 |
| 3 | 22.8 | 6 | 20.6 |

Wild ELF Winter
Compartment 238, 239
152.8 Acres

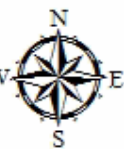

- ### Legend
- Recreational Trail
 - Poor Dirt Roads
 - Closed
 - Perennial River
 - Against State (Red)
 - Stand Boundaries
 - Section Corners
- QR code for PDF maps

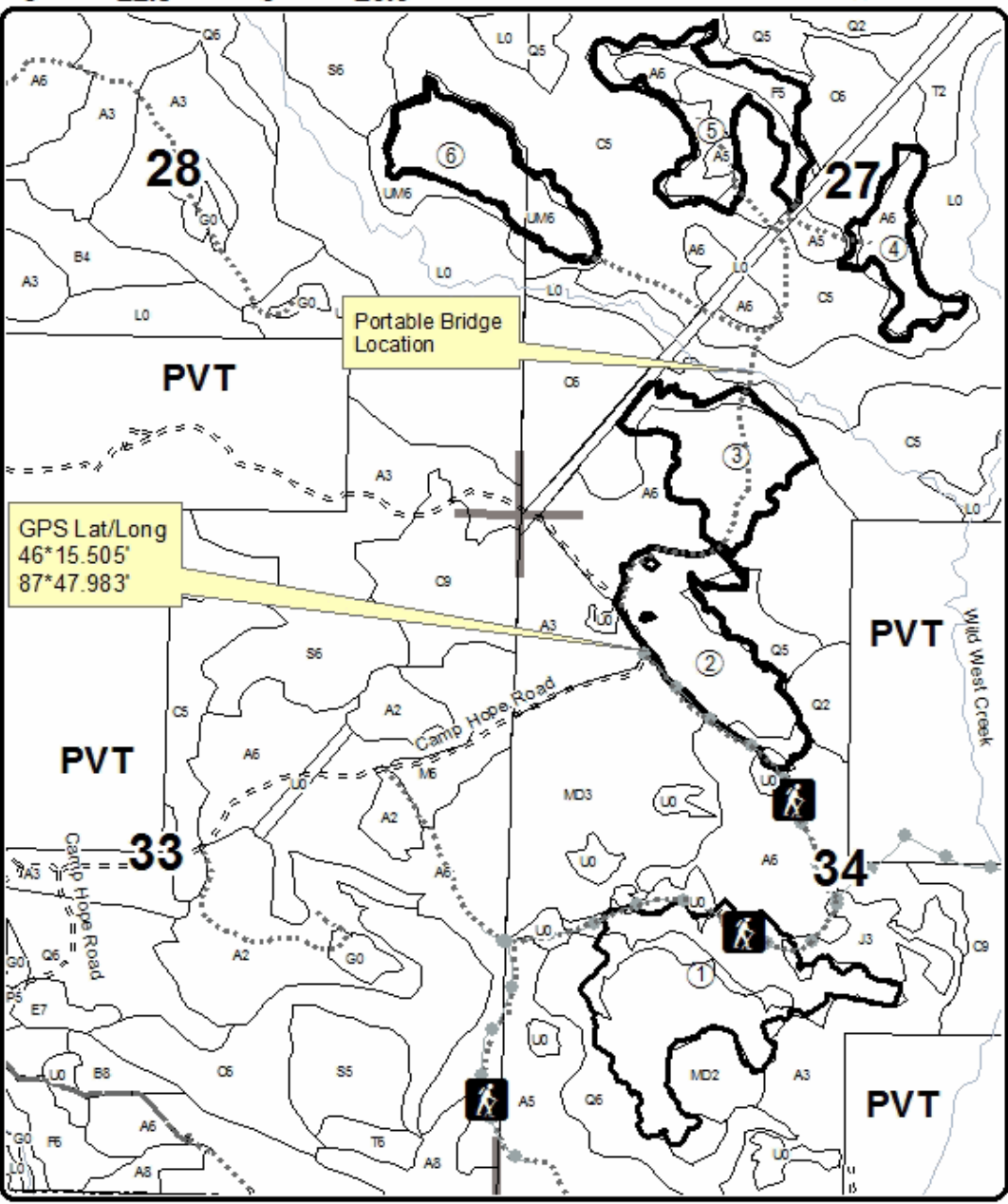

Locator Map
1:200,000

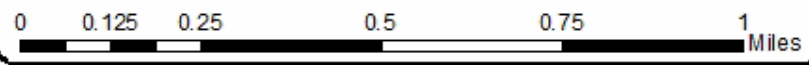
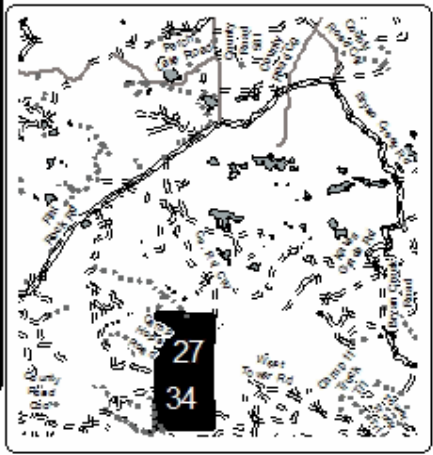

TIMBER SALE INFORMATION

Sand River South 2.0 (32-013-18)

T46N, R23W, SEC. 2; T46N, R23W, SEC. 3; T46N, R23W, SEC. 4; T46N, R23W, SEC. 5.
Marquette County (Advertised Price \$19,954.05)

SALE NOTE: This sale is limited to winter operations due to wet road conditions and wet conditions in the sale area. Road access into the sale will require 200 yards of fill. Material from State pits may be available.

Access may be through private or other public land.

A timber sale contract for this lump sum, sealed bid timber sale will be awarded to the responsible bidder offering the highest sealed bid price. Bids must be at or above the following advertised price for each species:

| <u>PRODUCTS & SPECIES</u> | <u>ESTIMATED UNITS*</u> | <u>ADVERTISED PRICE</u> |
|-------------------------------|-------------------------|-------------------------|
| Sawtimber | | |
| Basswood | 1.10 MBF | \$ 113.00 / MBF |
| Red Maple | 1.30 MBF | \$ 43.00 / MBF |
| Sugar Maple | 5.90 MBF | \$ 202.00 / MBF |
| White Ash | 2.40 MBF | \$ 52.00 / MBF |
| Pulpwood | | |
| Balsam Fir | 70.00 Cords | \$ 20.00 / Cord |
| Mixed Hardwood | 918.00 Cords | \$ 14.15 / Cord |
| Mixed Spruce | 167.00 Cords | \$ 19.65 / Cord |
| Quaking Aspen | 30.00 Cords | \$ 26.20 / Cord |

* The total volume is statistically estimated within plus (+) or minus (-) 18.90 percent. The estimated units are final and not subject to adjustment. Prospective bidders are urged to examine this timber and to make their own estimates of quantity and quality.

BOND AND PAYMENT SCHEDULE:

1. A bond in the amount of \$998.00 to insure faithful performance of the conditions of the contract will be deposited by the successful bidder within 21 days of the sale award.
2. Cutting in any sale or unit without the required advance payment would be considered a trespass.
3. Total payment must be paid in advance or according to the following schedule:
 - (a) Ten percent (10%) of the sale value must be paid within 21 days of the sale award.
 - (b) The 10% down payment will be credited towards the first unit cut.
 - (c) Payment for each of the following units must be made before cutting begins in that unit:

| <u>PAYMENT UNIT NUMBER</u> | <u>PERCENT OF TOTAL SALE VALUE</u> |
|----------------------------|------------------------------------|
| 01 | 35.5% |
| 02 | 14.9% |
| 03 | 38.2% |
| 04 | 11.4% |
4. If no cutting takes place, the 10% down payment will not be refunded.
5. Operations on the contract issued will terminate on 08/31/2022.

Description of Timber by Payment Unit (PU)

| PU | MARKET GROUP | PRODUCT | QUANTITY | UNIT | ACRES | ADVERTISE PRICE |
|---------------------|---------------------|-----------|--------------|--------------|-------|-----------------|
| 1 | Red Maple | Sawtimber | 1.3 | MBF | 42.1 | \$7,074.95 |
| | Sugar Maple | | 5.9 | MBF | | |
| | White Ash | | 2.4 | MBF | | |
| | Mixed Hardwood | | 403.0 | Cords | | |
| | <i>Red Maple</i> | | 86.0 | <i>Cords</i> | | |
| | <i>Sugar Maple</i> | | 294.0 | <i>Cords</i> | | |
| | <i>White Ash</i> | | 23.0 | <i>Cords</i> | | |
| 2 | Balsam Fir | Pulpwood | 10.0 | Cords | 33.0 | \$2,975.10 |
| | Mixed Hardwood | | 129.0 | Cords | | |
| | <i>Black Ash</i> | | 13.0 | <i>Cords</i> | | |
| | <i>Red Maple</i> | | 84.0 | <i>Cords</i> | | |
| | <i>Sugar Maple</i> | | 26.0 | <i>Cords</i> | | |
| | <i>White Ash</i> | | 6.0 | <i>Cords</i> | | |
| | Mixed Spruce | | 15.0 | Cords | | |
| | <i>Black Spruce</i> | | 3.0 | <i>Cords</i> | | |
| | <i>White Spruce</i> | | 12.0 | <i>Cords</i> | | |
| | Quaking Aspen | | 25.0 | Cords | | |
| | 3 | | Balsam Fir | Pulpwood | | |
| Mixed Hardwood | | 266.0 | Cords | | | |
| <i>Black Ash</i> | | 40.0 | <i>Cords</i> | | | |
| <i>Red Maple</i> | | 134.0 | <i>Cords</i> | | | |
| <i>Sugar Maple</i> | | 47.0 | <i>Cords</i> | | | |
| <i>White Ash</i> | | 45.0 | <i>Cords</i> | | | |
| Mixed Spruce | | 144.0 | Cords | | | |
| <i>Black Spruce</i> | | 97.0 | <i>Cords</i> | | | |
| <i>White Spruce</i> | | 47.0 | <i>Cords</i> | | | |
| 4 | Basswood | Sawtimber | 1.1 | MBF | 7.4 | \$2,270.50 |
| | Balsam Fir | Pulpwood | 8.0 | Cords | | |
| | Mixed Hardwood | | 120.0 | Cords | | |
| | <i>Basswood</i> | | 3.0 | <i>Cords</i> | | |
| | <i>Black Ash</i> | | 6.0 | <i>Cords</i> | | |
| | <i>Paper Birch</i> | | 4.0 | <i>Cords</i> | | |
| | <i>Red Maple</i> | | 59.0 | <i>Cords</i> | | |
| | <i>Sugar Maple</i> | | 48.0 | <i>Cords</i> | | |
| | Mixed Spruce | | 8.0 | Cords | | |
| | <i>White Spruce</i> | | 8.0 | <i>Cords</i> | | |
| | Quaking Aspen | | 5.0 | Cords | | |
| TOTAL: | | | 10.7 | MBF | | |
| TOTAL: | | | 1,185.0 | Cords | | |

Sale Specific Conditions & Requirements

Sale Name: Sand River South 2.0

Sale Number: 32-013-18 Seq#: 2

1 - Sale Area

1.2 - Boundaries

1.2.1 - Painted boundaries (1/14)

The sale boundary and Payment Unit boundaries are marked and identified by blue and red paint. Exterior sale boundary lines against private property are marked with blue paint. Exterior sale boundary lines against state are marked with red paint.

2 - Timber Specifications

2.1 - Included Timber

2.1.2 - Clearcut unit(s) w/o unmerchantable trees (8/11)

Within Payment Unit(s) 2, 3, and 4, cut all trees which meet minimum piece specifications in 2.2 Utilization, except do not cut yellow birch, hemlock, cedar, and white pine. In addition, do not cut white ash or black cherry within Payment Unit 4.

2.1.3 - Cut tree marked unit(s) (12/08)

Within Payment Unit(s) 1, all trees are designated for cutting when marked with orange paint above and below stump height, regardless of merchantability.

2.1.9 - Harvest exception (12/08)

Do not cut any hemlock trees other than those that are necessary to remove in order to operate within the sale area. Every effort must be made to preserve the existing hemlock and to leave an intact stand upon sale completion. All cut hemlock shall be piled separately by products and scaled in the woods unless other scaling arrangements are agreed to by the Unit Manager or his/her representative. Stumpage price for hemlock shall be \$50.00 per cord for posts and pulpwood, and \$100.00 per cord for bolts and sawlogs.

2.2 - Utilization

2.2.4 - Skidding length (2/14)

Skidding of unlimbed tops or lengths over 17 feet is not permissible, unless approved by the Unit Manager or his/her representative.

2.2.9 - No chipping permitted (12/08)

Within Payment Unit(s) 1, 2, 3, and 4, all wood must be removed by whole tree, tree segment, or roundwood. No chipping is permitted.

3 - Payments

3.4 - Damaged Timber

3.4.1 - Damaged timber (6/14)

General Condition and Requirement 3.4 Damaged Timber, defines liquidated damages for undesignated live merchantable trees which are cut or injured. In addition, extreme care should be taken to avoid damage to tree seedlings and saplings.

Within the sale area, if more than 25% of the tree seedlings or saplings (1/4" to 4.5" DBH) within a specified portion of the sale area are damaged, liquidated damages will be assessed at \$300 per acre for all acreage within that specified portion of the sale area that was damaged.

No damage is acceptable to merchantable trees. Within the sale area, if more than 5% of trees (> 4.5" DBH) within a specified area of the sale are damaged, liquidated damages will be assessed for all trees damaged. Rates will be in accordance with General Condition and Requirement 3.4 Damaged Timber.

4 - Transportation

4.1 - Construction

4.1.3 - Slash and earthen piles (8/04)

Piles or windrows of earth along roads and landings that have been widened or constructed shall be leveled. Slash from road maintenance or construction, including stumps, shall be dispersed throughout the sale.

4.1.4 - Timber removed for construction (12/09)

Trees cut or damaged in the process of pre-approved road, landing or skid trail construction will be decked in an area separate from other Designated Timber and not removed until measured by the sale administrator. Payment will be made at the specified Purchase Unit Price.

4.1.5 - Culverts (5/14)

Roads may require the installation of culverts for cross drainage or at natural drainage-ways. If culverts are needed in these locations, their placement will be specified by the sale administrator and they shall be installed prior to hauling. The culverts shall be new, corrugated metal or plastic gauge. Culverts will be a minimum of 12 inches in diameter and 24 feet in length. If culverts are removed, fill shall be removed from wetland soils as specified. Soils shall be maintained and left in a non-erodible condition, with water bars, seed, fertilizer, mulch, and slash installed as directed by the sale administrator and as specified in the BMP manual. Stream crossing permits, if needed, will be obtained by the DNR.

4.1.6 - Road construction (1/09)

Construction of new roads or improvements of existing roads shall be done in such a way as to minimize the environmental and visual impacts. Merchantable trees shall be cut and utilized unless otherwise directed. Non-merchantable trees shall be severed and laid flat on the ground. Slash shall be scattered, and not left in windrows and kept a minimum of 10 feet back from the road edge. Stumps shall be set upright, not left on edge, and be moved at least 10 feet away from the road edge. Disturbed soil shall be feathered into the woods and not left in berms or windrows.

4.1.7 - Road closure (10/11)

All new roads built into the sale must be blocked to vehicle traffic upon completion of the sale. Overgrown roads that are reopened shall be considered new roads. In general, this will require constructing a four (4') foot high berm of stumps and logs covered with earth. Contact the sale administrator for specific details of design and placement.

4.1.8 - Road work (1) (8/07)

The following road work is required: 200 yards of fill are required to prepare the Camp 4 Road and Sand River Road for hauling. This work must be completed before sale starts. Contact the sale administrator regarding the availability of onsite sand or gravel from adjacent State-owned lands.

4.2 - Maintenance

4.2.1 - Hauling restriction (12/08)

Hauling may be restricted on forest roads by the Unit Manager or his/her representative. The restriction may occur during wet weather conditions.

4.2.2 - Fill material (4/07)

To maintain roads, fill material may be needed in areas where "holes" exist or may be expected to develop. This fill material should be placed before trucking begins. Contact the sale administrator regarding the availability of onsite sand or gravel from adjacent State-owned lands.

4.2.3 - Road maintenance (8/13)

The following road maintenance may be needed: Within 60 days of completion of hauling, or if no hauling occurs for 60 days, the road may need to be maintained and graded. This includes cleaning of drainage areas, grading, crowning and filling with gravel, if necessary. Damages will be assessed if grading/repair is necessary, but does not occur.

4.2.4 - Grading (10/16)

For completion of the sale, state forest roads must be graded. In general, this will require a road grader or bull dozer to shape up the roads after forest products have been hauled off site. This includes cleaning of drainage areas, grading, crowning and filling with gravel, if necessary. The grading equipment to be used must be approved by the Unit Manager or his/her representative.

4.4 - Access

4.4.2 - Alternate route on private property (2/04)

It is the Purchaser's responsibility to obtain access across private land for any routes other than the route shown on the sale map.

5 - Operations

5.1 - Notification

5.1.1 - Pre-sale conference (10/16)

A pre-sale conference on site between the Purchaser and sale administrator is required prior to beginning any operations to determine landing and road locations. The sale administrator must be contacted at least 3 business days in advance to schedule the conference.

5.2 - Conduct of Operations

5.2.1 - Slash

5.2.1.11 - Slash for reforestation (5/07)

To facilitate reforestation, the sale area shall be left with slash evenly distributed. Bunched tops within the cutting area shall be broken up and scattered. Stumps shall be cut low to the ground. Processing sites shall not be left with a compacted layer of slash; tops from these sites shall be hauled back into the cut area and scattered.

5.2.2 - Hazard Trees/Snags

5.2.2.1 - Den trees (10/16)

Obvious hollow and/or den trees shall be protected and left standing unless they are a safety hazard.

5.2.3 - Operating Restrictions

5.2.3.1 - Operating restrictions (9/11)

Within Payment Unit(s) 1-4, unless changed by written agreement, cutting and skidding limited to the period of December 1 to March 31. This restriction is due to wet soil conditions in the sale area and winter haul roads to some of the units.

5.2.3.3 - Bark slippage restriction (3/09)

Within Payment Unit(s) 1, unless changed by written agreement, cutting and skidding are not permitted during the period of April 15 to July 15. This restriction is because of bark slippage.

5.2.37 - No decking areas (12/08)

No decking is allowed within 50 feet of Yalmer Road.

5.2.38 - No decking against live trees (2/04)

Cut products may not be decked against unmarked or designated leave trees.

5.4 - Soil Protection

5.4.1 - Rutting restriction, general (7/16)

Operations are to cease immediately if equipment and weather conditions result in rutting of roads and/or skid trails which is 12 inches or greater in depth and 50 feet in length. The Unit Manager or his/her representative may restrict hauling and/or skidding if ruts exceed the specified depth. With the Unit Manager or his/her representative's approval, the Purchaser may return to the area when the risk of rutting has decreased.

5.4.2 - Skid trails (2/04)

Skid trails up and down slopes should be avoided. If however this is unavoidable, these trails will be left in a non-erodible condition using water bars, logs, and slash. Placing of slash on these skid trails while logging is ongoing may alleviate need for any further action. At the direction of the sale administrator, seed, fertilizer, and mulch may also be required.

5.8 - Protection of Endangered Species

5.8.5 - Protection of raptor nests (3/13)

All trees with raptor nests will be protected if found during harvesting operations. Notification will be made to the Unit Manager or his/her representative who will notify the Wildlife Biologist so an on-site evaluation and recommendation can be made, if necessary.

6 - Safety and Fire Prevention

6.2 - Signing

6.2.1 - Road posting (9/09)

The Purchaser is responsible for posting and maintaining caution signs on Camp 4 Road and Yalmer Road prior to beginning operations. The road must be posted at appropriate distances from the sale area to warn of logging activity and truck traffic. Signs must be removed when harvest operations are suspended or completed. The Purchaser will provide these signs.

7 - Other Conditions

7.3 - Contract Modifications

7.3.1 - Emerald Ash Borer

7.3.1.2 - Emerald ash borer, ash or firewood on sale (2/05)

There is ash and/or "firewood" in this sale and it is located within an emerald ash borer quarantined area. The Director of the Michigan Department of Agriculture (MDA) by the authority of Act No. 72 of the Public Acts of 1945, as amended, and Quarantine Regulation No. 620, has promulgated this quarantine to prevent the further spread of this pest and sets forth: definitions, regulated articles, regulated areas, conditions of movement, violations and penalties, and special exemptions. The Purchaser must comply with this quarantine. Contact the MDA for further information.



TIMBER SALE MAP

This information provided by authority of Part 525, 1994 PA 451, as amended.

| | | | | | |
|-------------------------------------|---------------------|--|-------------------------------|-----------|---------|
| Forest Management Unit Gwinn FMU | County Marquette | Mapped By Rick Hill | Date 8/15/18 | Page 1 | of 2 |
| Township 46N | Range 23W | Section(s) and Subdivision(s) Sections 2, 3, 4, and 5 | Cruised By VanOss Forestry | | |
| Scale 1:15,840 | | | | | |

| Cover Type | | | | Density | | | |
|-------------------|----------------------|-------------------------|-------------------|-----------------------------|------------------------|--|--|
| A = Aspen | H = Hemlock | N = Marsh | U = Upland Brush | 0 = Non Stocked | 5 = Pole Timber Medium | | |
| D = Paper Birch | J = Jack Pine | O = Oak | UM = Upland Mixed | 1 = Seedling Sapling Poor | 6 = Pole Timber Well | | |
| C = Cedar | L = Lowland Brush | P = Lowland Poplar | V = Bog or Marsh | 2 = Seedling Sapling Medium | 7 = Saw Timber Poor | | |
| D = Tread Bog | LM = Lowland Mixed | Q = Mixed Swamp Conifer | W = White Pine | 3 = Seedling Sapling Well | 8 = Saw Timber Medium | | |
| E = Swamp Hdwoods | M = Mpl. Dec. Decid | R = Red Pine | X = Non Stocked | 4 = Pole Timber Poor | 9 = Saw Timber Well | | |
| F = Spruce Fir | MC = Mixed Conifer | S = Black Spruce | Z = Water | | | | |
| G = Grass | MD = Mixed Deciduous | T = Tamarack | | | | | |

| PU | Acres | PU | Acres | Sand River South 2.0 | |
|----|-------|----|-------|-----------------------|--|
| 1 | 42.1 | 4 | 07.4 | Compartments 292, 293 | |
| 2 | 33.0 | | | 97.3 Acres | |
| 3 | 14.8 | | | | |

Legend

- Stand Boundaries
- Forest Access Route
- Gravel Road
- Temporary Management Access
- Intermittent Stream
- Perennial River
- Lakes and Rivers
- Against State (Red)
- Private Line (Blue)
- Section Corners

QR code for PDF maps

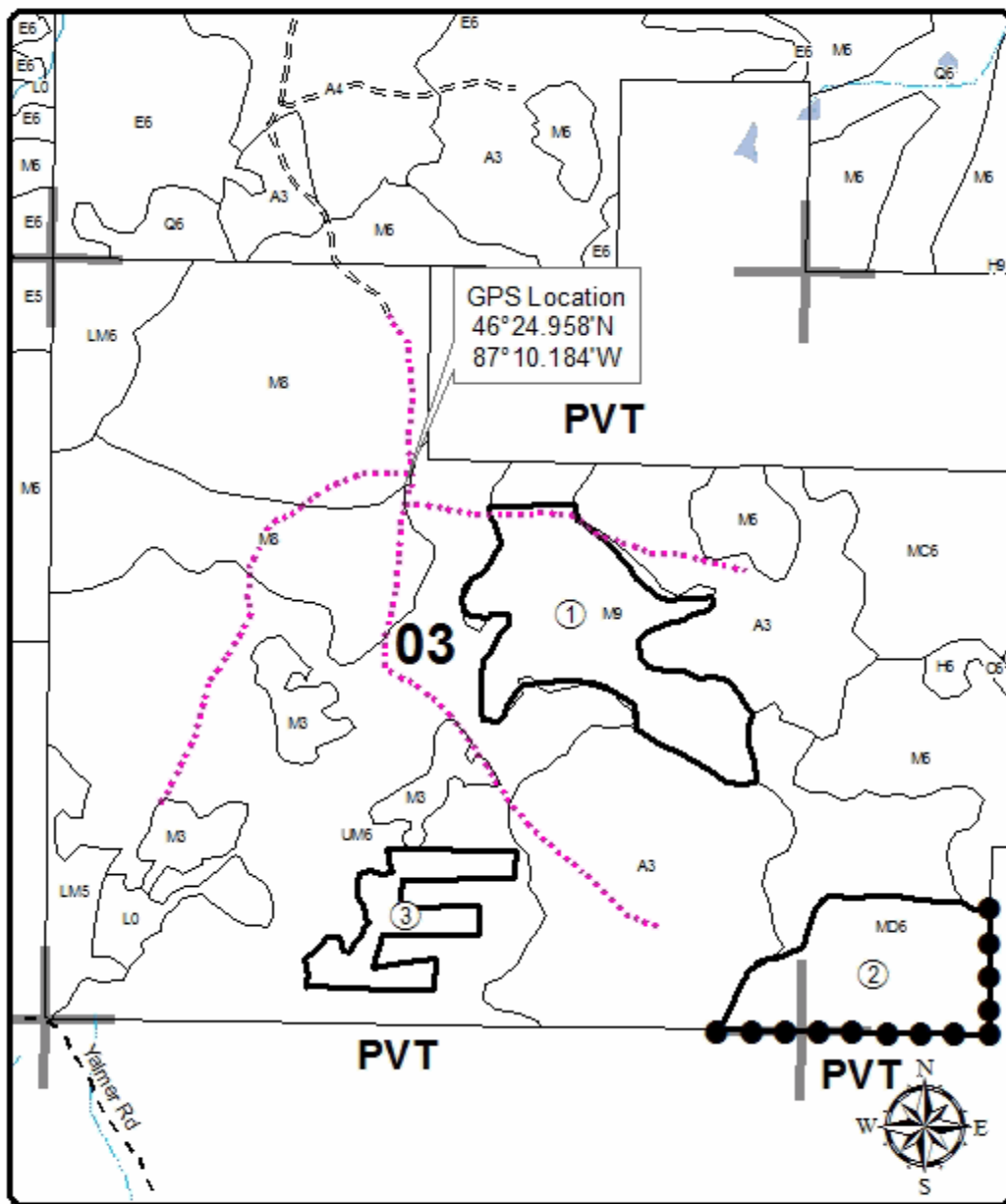

Locator Map
1:250,000

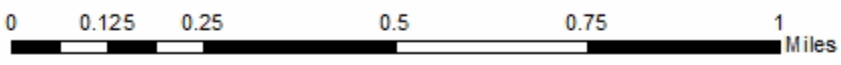
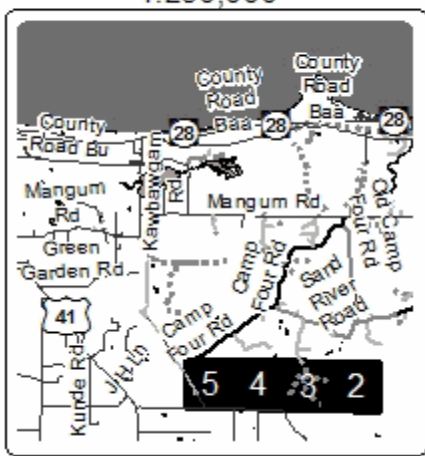



TIMBER SALE MAP

This information provided by authority of Part 525, 1994 PA 451, as amended.

| | |
|-------------|------|
| Sale Number | Year |
| 32- 013 | 18 |

| | | | | | |
|-------------------------------------|---------------------|------------------------|-----------------|-----------|---------|
| Forest Management Unit Gwinn FMU | County Marquette | Mapped By Rick Hill | Date 8/15/18 | Page 2 | of 2 |
| Cruised By VanOss Forestry | | | | | |

| | | | |
|-----------------|--------------|--|-------------------|
| Township 46N | Range 23W | Section(s) and Subdivision(s) Sections 2, 3, 4, and 5 | Scale 1:15,840 |
|-----------------|--------------|--|-------------------|

| Cover Type | | | | Density | |
|---------------------|----------------------|-------------------------|-------------------|-----------------------------|------------------------|
| A = Aspen | H = Hemlock | N = Marsh | U = Upland Brush | 0 = Non Stocked | 5 = Pole Timber Medium |
| D = Paper Birch | J = Jack Pine | O = Oak | UM = Upland Mixed | 1 = Seedling Sapling Poor | 6 = Pole Timber Well |
| C = Cedar | L = Lowland Brush | P = Lowland Poplar | V = Bog or Marsh | 2 = Seedling Sapling Medium | 7 = Saw Timber Poor |
| D = Treed Bog | LM = Lowland Mixed | Q = Mixed Swamp Conifer | W = White Pine | 3 = Seedling Sapling Well | 8 = Saw Timber Medium |
| E = Swamp Hardwoods | M = Mpl. Dec. Decid. | R = Red Pine | X = Non Stocked | 4 = Pole Timber Poor | 9 = Saw Timber Well |
| F = Spruce Fir | MC = Mixed Conifer | S = Black Spruce | Z = Water | | |
| G = Grass | MD = Mixed Deciduous | T = Tamarack | | | |

| PU | Acres | PU | Acres | Sand River South 2.0 | |
|----|-------|----|-------|-----------------------|--|
| 1 | 42.1 | 4 | 07.4 | Compartments 292, 293 | |
| 2 | 33.0 | | | 97.3 Acres | |
| 3 | 14.8 | | | | |

Legend

- Stand Boundaries
- Primary Forest Road
- Forest Access Route
- Paved Road
- Gravel Road
- Intermittent Stream
- Perennial River
- Lakes and Rivers
- Against State (Red)
- Section Corners

QR code for PDF maps

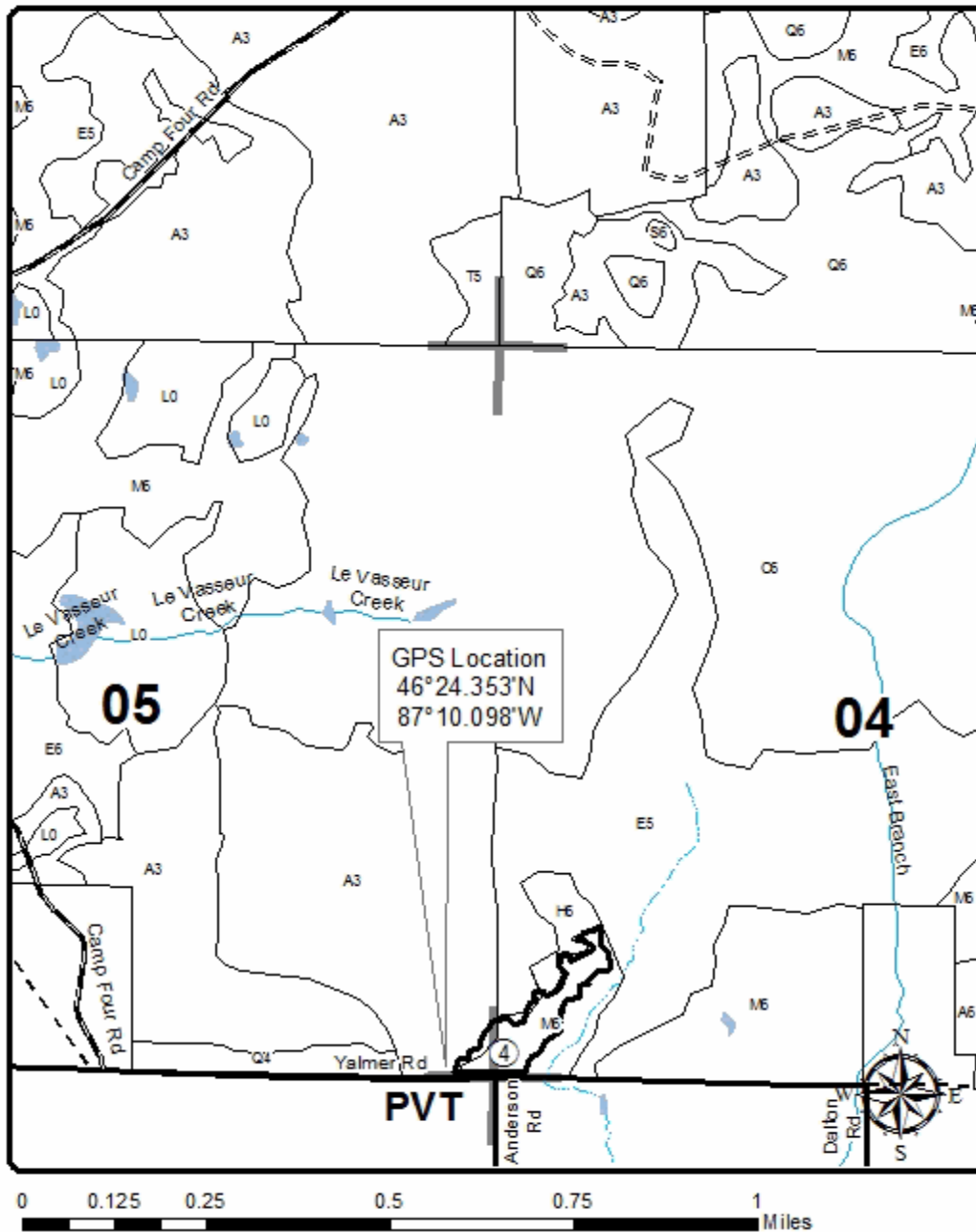

Locator Map
1:250,000

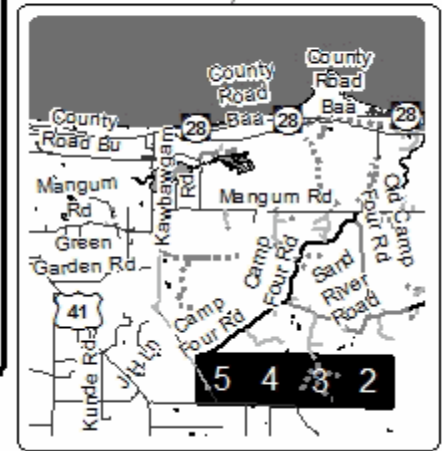

TIMBER SALE INFORMATION

Crispy Camry (32-018-18)

T46N, R28W, SEC. 10; T46N, R28W, SEC. 3; T46N, R28W, SEC. 4.
Marquette County (Advertised Price \$59,396.35)

SALE NOTE: Roundwood operation required within Payment Units 1, 3, 4, 7, & 8.

Road work is required for the haul road into Payment Units 4-9. See spec 4.1.8 for more information.

A timber sale contract for this lump sum, sealed bid timber sale will be awarded to the responsible bidder offering the highest sealed bid price. Bids must be at or above the following advertised price for each species:

| <u>PRODUCTS & SPECIES</u> | <u>ESTIMATED UNITS*</u> | | <u>ADVERTISED PRICE</u> |
|-------------------------------|-------------------------|-------|-------------------------|
| Sawtimber | | | |
| Red Pine | 36.60 | MBF | \$ 97.00 / MBF |
| Pulpwood | | | |
| Balsam Fir | 18.00 | Cords | \$ 20.00 / Cord |
| Jack Pine | 349.00 | Cords | \$ 30.10 / Cord |
| Mixed Hardwood | 383.00 | Cords | \$ 14.15 / Cord |
| Mixed Spruce | 157.00 | Cords | \$ 19.65 / Cord |
| Paper Birch | 146.00 | Cords | \$ 14.40 / Cord |
| Quaking Aspen | 692.00 | Cords | \$ 26.20 / Cord |
| Red Pine | 411.00 | Cords | \$ 38.45 / Cord |
| White Pine | 15.00 | Cords | \$ 29.40 / Cord |

* The total volume is statistically estimated within plus (+) or minus (-) 9.20 percent. The estimated units are final and not subject to adjustment. Prospective bidders are urged to examine this timber and to make their own estimates of quantity and quality.

BOND AND PAYMENT SCHEDULE:

1. A bond in the amount of \$2,970.00 to insure faithful performance of the conditions of the contract will be deposited by the successful bidder within 21 days of the sale award.
2. Cutting in any sale or unit without the required advance payment would be considered a trespass.
3. Total payment must be paid in advance or according to the following schedule:
 - (a) Ten percent (10%) of the sale value must be paid within 21 days of the sale award.
 - (b) The 10% down payment will be credited towards the first unit cut.

(c) Payment for each of the following units must be made before cutting begins in that unit:

| <u>PAYMENT UNIT NUMBER</u> | <u>PERCENT OF TOTAL SALE VALUE</u> |
|----------------------------|------------------------------------|
| 01 | 0.6% |
| 02 | 3.0% |
| 03 | 9.5% |
| 04 | 1.0% |
| 05 | 7.8% |
| 06 | 16.7% |
| 07 | 5.8% |
| 08 | 23.5% |
| 09 | 24.4% |
| 10 | 7.7% |

4. If no cutting takes place, the 10% down payment will not be refunded.
5. Operations on the contract issued will terminate on 08/31/2021.

Description of Timber by Payment Unit (PU)

| PU | MARKET GROUP | PRODUCT | QUANTITY | UNIT | ACRES | ADVERTISE PRICE |
|----|---|-----------------------|---|---|-------|-----------------|
| 1 | Red Pine | Pulpwood | 10.0 | Cords | 1.2 | \$384.50 |
| 2 | Jack Pine Quaking Aspen | Pulpwood | 21.0 43.0 | Cords Cords | 9.1 | \$1,758.70 |
| 3 | Red Pine Jack Pine Mixed Hardwood <i>Red Maple</i> Quaking Aspen Red Pine | Sawtimber Pulpwood | 3.4 87.0 6.0 6.0 27.0 50.0 | MBF Cords Cords <i>Cords</i> Cords Cords | 8.7 | \$5,663.30 |
| 4 | Mixed Hardwood <i>Red Maple</i> Quaking Aspen Red Pine | Pulpwood | 3.0 3.0 3.0 12.0 | Cords <i>Cords</i> Cords Cords | 2.1 | \$582.45 |
| 5 | Red Pine Mixed Hardwood <i>Red Maple</i> Mixed Spruce <i>Black Spruce</i> <i>White Spruce</i> Quaking Aspen Red Pine | Sawtimber Pulpwood | 9.2 34.0 34.0 7.0 2.0 5.0 60.0 40.0 | MBF Cords <i>Cords</i> Cords <i>Cords</i> <i>Cords</i> Cords Cords | 10.2 | \$4,621.05 |
| 6 | Red Pine Jack Pine Mixed Hardwood <i>Red Maple</i> Mixed Spruce <i>Black Spruce</i> <i>White Spruce</i> Paper Birch Quaking Aspen Red Pine | Sawtimber Pulpwood | 13.4 65.0 28.0 28.0 42.0 2.0 40.0 2.0 148.0 40.0 | MBF Cords Cords <i>Cords</i> Cords <i>Cords</i> <i>Cords</i> Cords Cords Cords | 38.2 | \$9,922.20 |
| 7 | Red Pine Jack Pine Mixed Hardwood <i>Black Cherry</i> Mixed Spruce <i>White Spruce</i> Quaking Aspen Red Pine | Sawtimber Pulpwood | 2.0 23.0 3.0 3.0 11.0 11.0 40.0 32.0 | MBF Cords Cords <i>Cords</i> Cords <i>Cords</i> Cords Cords | 12.5 | \$3,423.30 |
| 8 | Red Pine Balsam Fir Jack Pine Mixed Spruce <i>White Spruce</i> Quaking Aspen Red Pine | Sawtimber Pulpwood | 8.6 4.0 40.0 19.0 19.0 104.0 227.0 | MBF Cords Cords Cords <i>Cords</i> Cords Cords | 25.4 | \$13,944.50 |
| 9 | Balsam Fir Mixed Hardwood <i>Red Maple</i> Mixed Spruce <i>White Spruce</i> Paper Birch Quaking Aspen | Pulpwood | 14.0 305.0 305.0 52.0 52.0 140.0 262.0 | Cords Cords <i>Cords</i> Cords <i>Cords</i> Cords Cords | 26.2 | \$14,497.95 |
| 10 | Jack Pine Mixed Hardwood | Pulpwood | 113.0 4.0 | Cords Cords | 7.9 | \$4,598.40 |

Description of Timber by Payment Unit (PU), con't

| PU | MARKET GROUP | PRODUCT | QUANTITY | UNIT | ACRES | ADVERTISE PRICE |
|----------|---------------------|-----------------|----------|--------------|-------|-----------------|
| 10 con't | <i>Red Maple</i> | <i>Pulpwood</i> | 4.0 | <i>Cords</i> | | |
| | Mixed Spruce | | 26.0 | Cords | | |
| | <i>White Spruce</i> | | 26.0 | <i>Cords</i> | | |
| | Paper Birch | | 4.0 | Cords | | |
| | Quaking Aspen | | 5.0 | Cords | | |
| | White Pine | | 15.0 | Cords | | |
| TOTAL: | | | 36.6 | MBF | | |
| TOTAL: | | | 2,171.0 | Cords | | |

Sale Specific Conditions & Requirements

Sale Name: Crispy Camry

Sale Number: 32-018-18 Seq#: 3

1 - Sale Area

1.2 - Boundaries

1.2.1 - Painted boundaries (1/14)

The sale boundary and Payment Unit boundaries are marked and identified by red and yellow paint. Exterior sale boundary lines against state are marked with red paint. Payment Unit boundaries are marked with yellow paint. Yellow painted trees identifying the Payment Unit boundary cannot be cut.

2 - Timber Specifications

2.1 - Included Timber

2.1.1 - Clearcut unit(s) with unmerchantable trees (6/14)

Within Payment Unit(s) 2, 5, 6, 9, and 10, cut all trees that are two (2) inches or more at DBH, with the following exceptions:

- Within Payment Unit 2, do not cut oak, white pine and red pine.
- Within Payment Unit 5, do not cut oak and white pine.
- Within Payment Unit 6, do not cut oak, white pine, and trees marked with yellow paint.
- Within Payment Unit 9, do not cut pine, oak, and yellow birch.
- Within Payment Unit 10, do not cut oak.

Special protection trees identified in accordance with condition 3.4.2, within clearcutting unit boundaries, are not Included Timber and are to be protected.

2.1.3 - Cut tree marked unit(s) (12/08)

Within Payment Unit(s) 1, 3, 4, 7, and 8, all red pine trees are designated for cutting when marked with orange paint above and below stump height, regardless of merchantability. In addition, cut all cherry, aspen, spruce, red maple, paper birch, fir, and jack pine which meet minimum piece specifications in 2.2. Utilization.

2.2 - Utilization

2.2.3 - Stump heights (4/07)

Stump heights within Payment Unit(s) 2, 5, 6, & 10 shall not exceed 12 inches for trees greater than 10 inches DBH and 4 inches for trees smaller than 10 inches DBH. This is in order to facilitate planting operations.

2.2.6 - Roundwood operation required (5/07)

The skidding of whole trees or tree segments with limbs attached is prohibited within Payment Unit(s) 1, 3, 4, 7, & 8. All products must be produced as roundwood and forwarded to existing roads or landing areas in final product length.

3 - Payments

3.4 - Damaged Timber

3.4.1 - Damaged timber (6/14)

General Condition and Requirement 3.4 Damaged Timber, defines liquidated damages for undesignated live merchantable trees which are cut or injured. In addition, extreme care should be taken to avoid damage to tree seedlings and saplings.

No damage is acceptable to merchantable trees. Within the sale area, if more than 5% of trees (> 4.5" DBH) within a specified area of the sale are damaged, liquidated damages will be assessed for all trees damaged. Rates will be in accordance with General Condition and Requirement 3.4 Damaged Timber.

3.4.2 - Special Protection Trees (4/14)

The Purchaser shall not cut live or dead special protection trees within cutting units or clearings. Special protection trees are red pine trees 26" or greater at DBH within Payment Units 5 & 6, and white pine trees 26" or greater at DBH within

Payment Unit 10. If the Purchaser's operations have cut or damaged special protection trees through carelessness, the Purchaser shall pay \$300.00 as fixed, agreed and liquidated damages for each special protection tree cut or damaged. Such payment does not constitute ownership of the undesignated timber.

4 - Transportation

4.1 - Construction

4.1.3 - Slash and earthen piles (8/04)

Piles or windrows of earth along roads and landings that have been widened or constructed shall be leveled. Slash from road maintenance or construction, including stumps, shall be stockpiled and used for road & landing closure once the sale is complete.

4.1.4 - Timber removed for construction (12/09)

Trees cut or damaged in the process of pre-approved road, landing or skid trail construction will be decked in an area separate from other Designated Timber and not removed until measured by the sale administrator. Payment will be made at the specified Purchase Unit Price.

4.1.6 - Road construction (1/09)

Construction of new roads or improvements of existing roads shall be done in such a way as to minimize the environmental and visual impacts. Merchantable trees shall be cut and utilized unless otherwise directed. Non-merchantable trees shall be severed and laid flat on the ground. Slash shall be scattered, and not left in windrows and kept a minimum of 10 feet back from the road edge. Stumps shall be set upright, not left on edge, and be moved at least 10 feet away from the road edge. Disturbed soil shall be feathered into the woods and not left in berms or windrows.

4.1.7 - Road closure (10/11)

All new roads built into the sale must be blocked to vehicle traffic upon completion of the sale. Overgrown roads that are reopened shall be considered new roads. In general, this will require stumps, brush, tops, and available rocks to be placed within specified locations. All stumps from road building and landing construction must be reserved to block any newly constructed roads upon completion of the sale. Contact the sale administrator for specific details of design and placement.

4.1.8 - Road work (1) (8/07)

The following road work is required and materials are to be provided by the Purchaser: The haul road into Payment Units 4 - 9 will require 300 yards of pit run in specific locations along the road. This road work is required prior to hauling on this road. Contact the sale administrator for more specifics regarding this road work.

4.1.11 - Permits (2/12)

The DNR will secure any necessary stream crossing permits that may be required. The purchaser is responsible for securing any County Road driveway permits that may be required.

4.2 - Maintenance

4.2.1 - Hauling restriction (12/08)

Hauling may be restricted on forest roads by the sale administrator. The restriction may occur during spring breakup or during wet weather conditions.

4.2.3 - Road maintenance (8/13)

The following road maintenance may be needed: Within 30 days of completion of hauling, or if no hauling occurs for 30 days, the road must be maintained and graded. This includes cleaning of drainage areas, grading, crowning and filling with gravel, if necessary. Damages will be assessed if grading/repair does not occur.

4.2.4 - Grading (10/16)

For completion of the sale, state forest roads must be graded. In general, this will require a road grader or bull dozer to shape up the roads after forest products have been hauled off site. This includes cleaning of drainage areas, grading, crowning and filling with gravel, if necessary. The grading equipment to be used must be approved by the Unit Manager or his/her representative.

4.2.5 - Two wheel drive condition (2/04)

All existing trail roads on and adjacent to the sale area must be passable by two-wheel drive traffic for the duration of the sale.

4.3 - Public Right-of-Way

4.3.2 - County R-O-W (12/06)

The county must be contacted prior to harvesting along the county road R-O-W. This applies to Payment Units 1 & 2.

5 - Operations

5.1 - Notification

5.1.1 - Pre-sale conference (10/16)

A pre-sale conference between the Purchaser and sale administrator is required prior to beginning any operations. The sale administrator must be contacted at least 3 business days in advance to schedule the conference.

5.2 - Conduct of Operations

5.2.1 - Slash

5.2.1.11 - Slash for reforestation (5/07)

To facilitate reforestation, the sale area shall be left with slash evenly distributed. Bunched tops within the cutting area shall be broken up and scattered. Stumps shall be cut low to the ground. Processing sites shall not be left with a compacted layer of slash; tops from these sites shall be hauled back into the cut area and scattered.

5.2.2 - Hazard Trees/Snags

5.2.2.1 - Den trees (10/16)

Obvious hollow and/or den trees shall be protected and left standing unless they are a safety hazard.

5.2.3 - Operating Restrictions

5.2.3.6 - Bark beetle restriction (12/08)

In the event drought creates a high risk of pine bark beetle infestation, pine is not to be cut during the period March 1 through July 1, unless all portions of trees greater than two inches in diameter are removed from the sale area, reduced to chips, or treated to the satisfaction of the Unit Manager or his/her representative, within fifteen days of being severed from the stump. Pine log decks, pulpwood piles and treetops that are piled for chipping in the fall or winter within a 1/4 mile of susceptible sites must be removed before March 15. Residual slash must not be placed in piles or rows and must be spread over the site for quick drying. The Department of Natural Resources will exercise this specification if the risk of damage warrants.

5.2.20 - Equipment width (2/04)

Equipment used to remove designated rows must be capable of moving through cut rows without damaging residual trees. This specification applies to Payment Units 1, 3, 4, 7, & 8.

5.2.31 - Landing locations (9/13)

In general, landings are limited to a "T" turnaround which will accommodate a truck with a 50 foot trailer.

5.2.32 - Decking/landing restoration (9/13)

All decking and landing areas must have the surface area restored to a condition equal to or better than before. This is to ensure the proper regeneration of the stand. Wood debris, chips and "cookies" from trimmings must be removed or scattered away from landing and loading areas and may not be windrowed on the edge.

5.2.37 - No decking areas (12/08)

No decking is allowed within 50 feet of County Road CD (this applies to Payment Units 1 & 2). In addition, no decking is allowed within 50 feet of the existing road within Payment Unit 10.

5.2.38 - No decking against live trees (2/04)

Cut products may not be decked against unmarked or designated leave trees.

5.4 - Soil Protection

5.4.1 - Rutting restriction, general (7/16)

Operations are to cease immediately if equipment and weather conditions result in rutting of roads and/or skid trails which is 12 inches or greater in depth and 50 feet in length. The Unit Manager or his/her representative may restrict hauling and/or

skidding if ruts exceed the specified depth. With the Unit Manager or his/her representative's approval, the Purchaser may return to the area when the risk of rutting has decreased.

5.4.2 - Skid trails (2/04)

Skid trails up and down slopes should be avoided. If however this is unavoidable, these trails will be left in a non-erodible condition using water bars, logs, and slash. Placing of slash on these skid trails while logging is ongoing may alleviate need for any further action. At the direction of the sale administrator, seed, fertilizer, and mulch may also be required.

5.8 - Protection of Endangered Species

5.8.5 - Protection of raptor nests (3/13)

All trees with raptor nests will be protected if found during harvesting operations. Notification will be made to the Unit Manager or his/her representative who will notify the Wildlife Biologist so an on-site evaluation and recommendation can be made, if necessary.

6 - Safety and Fire Prevention

6.2 - Signing

6.2.1 - Road posting (9/09)

The Purchaser is responsible for posting and maintaining caution signs on haul roads prior to beginning operations. The road must be posted at appropriate distances from the sale area to warn of logging activity and truck traffic. Signs must be removed when harvest operations are suspended or completed. The Purchaser will provide these signs.

7 - Other Conditions

7.3 - Contract Modifications

7.3.1 - Emerald Ash Borer

7.3.1.2 - Emerald ash borer, ash or firewood on sale (2/05)

There is ash and/or "firewood" in this sale and it is located within an emerald ash borer quarantined area. The Director of the Michigan Department of Agriculture (MDA) by the authority of Act No. 72 of the Public Acts of 1945, as amended, and Quarantine Regulation No. 620, has promulgated this quarantine to prevent the further spread of this pest and sets forth: definitions, regulated articles, regulated areas, conditions of movement, violations and penalties, and special exemptions. The Purchaser must comply with this quarantine. Contact the MDA for further information.



| | |
|---------------|------|
| Sale Number | Year |
| 32 - 018 - 18 | 2018 |

TIMBER SALE MAP

This information provided by authority of Part 525, 1994 PA 451, as amended.

| | | | | | | |
|-------------------------------------|--------------|--|--------------------------|-------------------|-----------|---------|
| Forest Management Unit Gwinn FMU | | County Marquette | Mapped By Jason Caron | Date 8-6-18 | Page 1 | of 2 |
| Township 46N | Range 28W | Section(s) and Subdivision(s) 3, 10 | | Scale 1:15,840 | | |

| Cover Type | | | | Density | | | |
|-------------------|----------------------|-------------------------|-------------------|-----------------------------|------------------------|--|--|
| A = Aspen | H = Hemlock | N = Marsh | U = Upland Brush | 0 = Non Stocked | 5 = Pole Timber Medium | | |
| B = Paper Birch | J = Jack Pine | O = Oak | UM = Upland Mixed | 1 = Seedling Sapling Poor | 6 = Pole Timber Well | | |
| C = Cedar | L = Lowland Brush | P = Lowland Poplar | V = Bog or Marsh | 2 = Seedling Sapling Medium | 7 = Saw Timber Poor | | |
| D = Treed Bog | LM = Lowland Mixed | Q = Mixed Swamp Conifer | W = White Pine | 3 = Seedling Sapling Well | 8 = Saw Timber Medium | | |
| E = Swamp Hdwoods | M = Mpl, Bch, Brch | R = Red Pine | X = Non Stocked | 4 = Pole Timber Poor | 9 = Saw Timber Well | | |
| F = Spruce Fir | MC = Mixed Conifer | S = Black Spruce | Z = Water | | | | |
| G = Grass | MD = Mixed Deciduous | T = Tamarack | | | | | |

| PU | Acres | PU | Acres |
|----|-------|----|-------|
| 1 | 1.2 | 6 | 38.2 |
| 2 | 9.1 | 7 | 12.5 |
| 3 | 8.7 | 8 | 25.4 |
| 4 | 2.1 | 9 | 26.2 |
| 5 | 10.2 | | |

Crispy Camry

Compartment 218

141.5 Acres



Legend

- Against State (Red)
- Payment Unit (Yellow)
- Section Corners
- - - Poor Dirt Rd
- - - Over Grown Road
- County Road
- Lakes and Rivers
- All

QR Code for PDF Maps



Locator Map
1:200,000

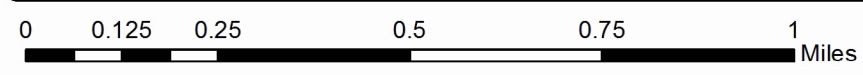
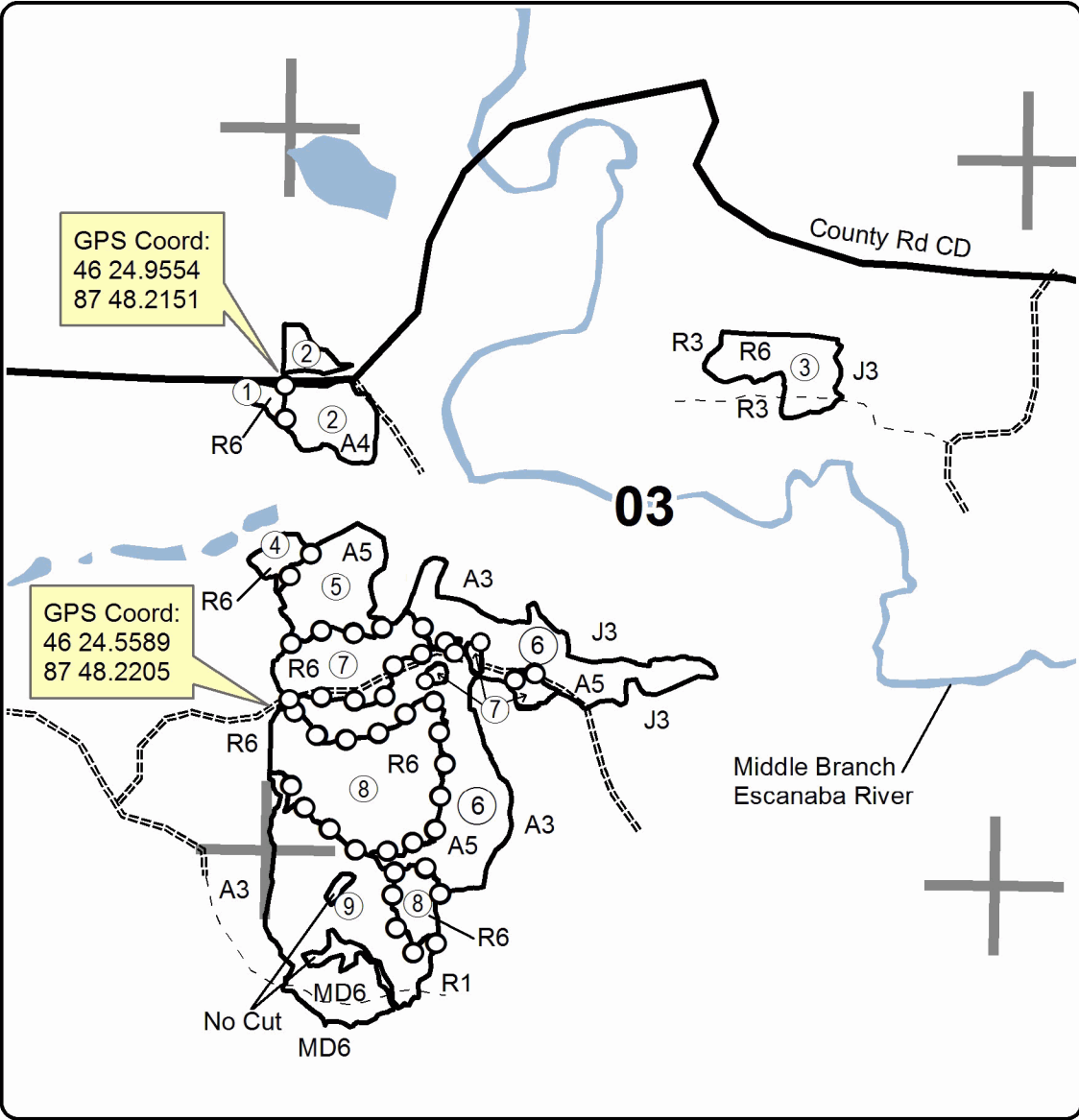
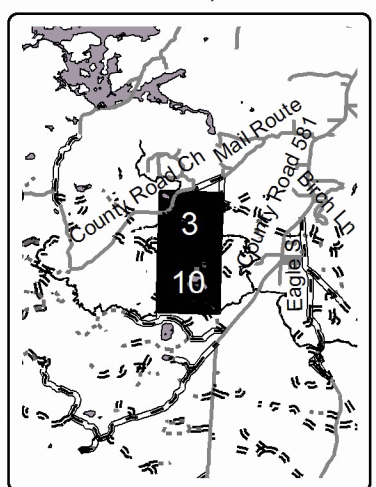



TIMBER SALE MAP

This information provided by authority of Part 525, 1994 PA 451, as amended.

| | |
|---------------|------|
| Sale Number | Year |
| 32 - 018 - 18 | 2018 |

| | | | | | | |
|-------------------------------------|--------------|-------------------------------------|--------------------------|-------------------|-----------|---------|
| Forest Management Unit Gwinn FMU | | County Marquette | Mapped By Jason Caron | Date 8-6-18 | Page 2 | of 2 |
| Township 46N | Range 28W | Section(s) and Subdivision(s) 10 | | Scale 1:15,840 | | |

| Cover Type | | | | Density | |
|-------------------|----------------------|-------------------------|-------------------|-----------------------------|------------------------|
| A = Aspen | H = Hemlock | N = Marsh | U = Upland Brush | 0 = Non Stocked | 5 = Pole Timber Medium |
| B = Paper Birch | J = Jack Pine | O = Oak | UM = Upland Mixed | 1 = Seedling Sapling Poor | 6 = Pole Timber Well |
| C = Cedar | L = Lowland Brush | P = Lowland Poplar | V = Bog or Marsh | 2 = Seedling Sapling Medium | 7 = Saw Timber Poor |
| D = Treed Bog | LM = Lowland Mixed | Q = Mixed Swamp Conifer | W = White Pine | 3 = Seedling Sapling Well | 8 = Saw Timber Medium |
| E = Swamp Hdwoods | M = Mpl, Bch, Brch | R = Red Pine | X = Non Stocked | 4 = Pole Timber Poor | 9 = Saw Timber Well |
| F = Spruce Fir | MC = Mixed Conifer | S = Black Spruce | Z = Water | | |
| G = Grass | MD = Mixed Deciduous | T = Tamarack | | | |

PU Acres
10 7.9

Crispy Camry Compartment 218 141.5 Acres

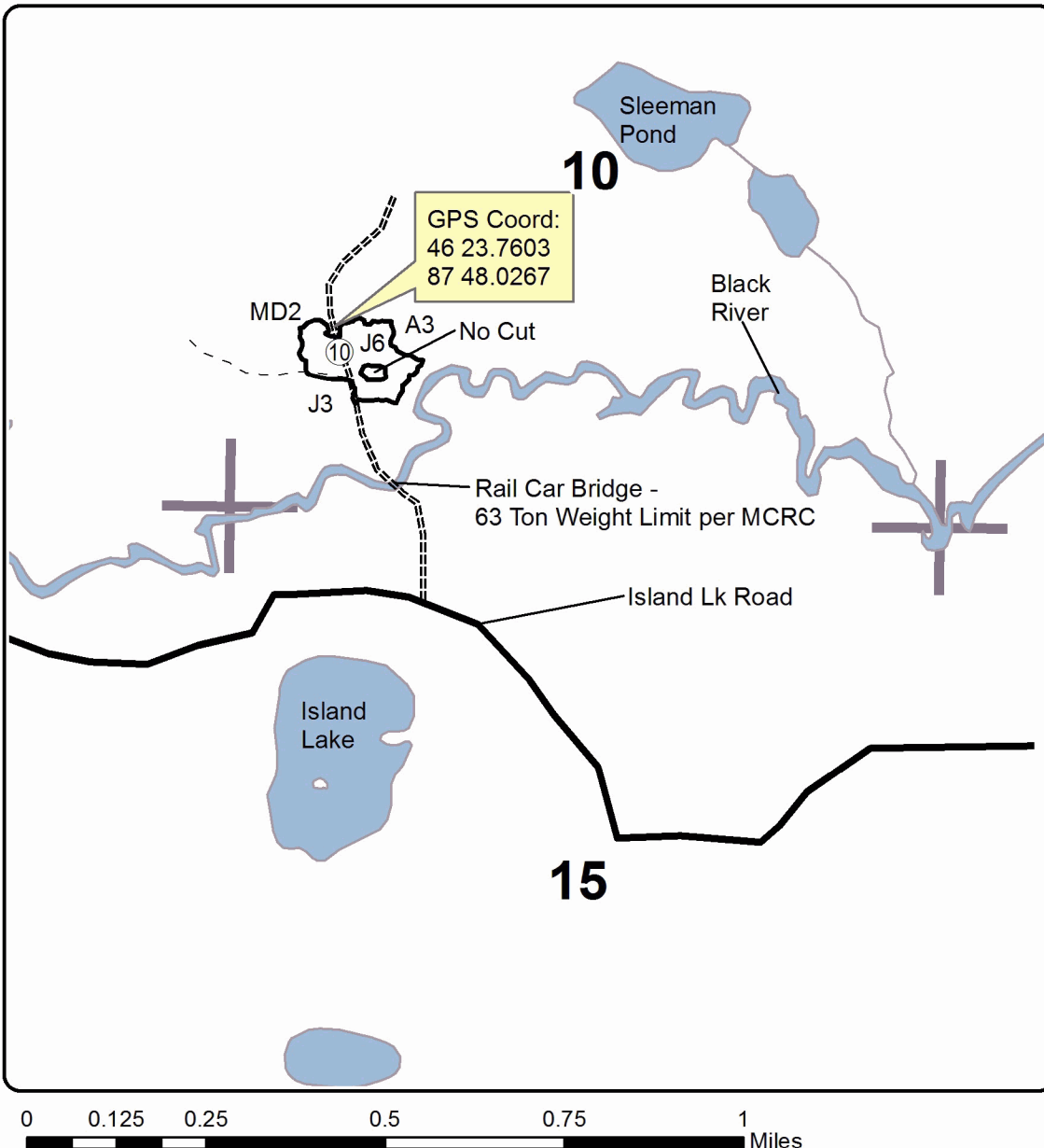

Legend

- Against State (Red)
- Section Corners
- Poor Dirt Rd
- Over Grown Road
- County Road
- Lakes and Rivers
- All

QR Code for PDF Maps



Locator Map
1:200,000

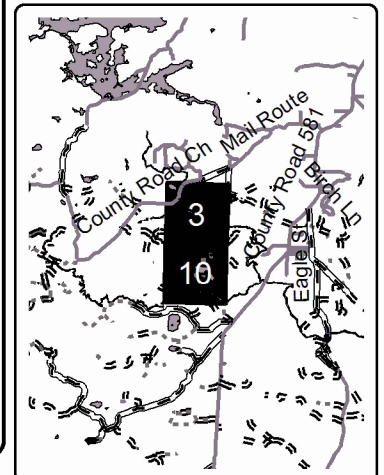

TIMBER SALE INFORMATION

Black River Fir SBW (32-104-17)
 T46N, R28W, SEC. 8; T46N, R28W, SEC. 9.
 Marquette County (Advertised Price \$22,085.10)

SALE NOTE: Access is through private land, road through private land may need some work, and fill to allow trucking. Spruce and fir has some damage from spruce budworm. Winter spec due to road access through a bog and wet areas within stands.

Access may be through private land.

A timber sale contract for this lump sum, sealed bid timber sale will be awarded to the responsible bidder offering the highest sealed bid price. Bids must be at or above the following advertised price for each species:

| <u>PRODUCTS & SPECIES</u> | <u>ESTIMATED UNITS*</u> | <u>ADVERTISED PRICE</u> |
|-------------------------------|-------------------------|-------------------------|
| Pulpwood | | |
| Balsam Fir | 260.00 Cords | \$ 20.00 / Cord |
| Jack Pine | 3.00 Cords | \$ 30.10 / Cord |
| Mixed Hardwood | 108.00 Cords | \$ 14.15 / Cord |
| Mixed Spruce | 388.00 Cords | \$ 19.65 / Cord |
| Paper Birch | 145.00 Cords | \$ 14.40 / Cord |
| Quaking Aspen | 212.00 Cords | \$ 26.20 / Cord |

* The total volume is statistically estimated within plus (+) or minus (-) 16.03 percent. The estimated units are final and not subject to adjustment. Prospective bidders are urged to examine this timber and to make their own estimates of quantity and quality.

BOND AND PAYMENT SCHEDULE:

1. A bond in the amount of \$1,104.00 to insure faithful performance of the conditions of the contract will be deposited by the successful bidder within 21 days of the sale award.
2. Cutting in any sale or unit without the required advance payment would be considered a trespass.
3. Total payment must be paid in advance or according to the following schedule:
 - (a) Ten percent (10%) of the sale value must be paid within 21 days of the sale award.
 - (b) The 10% down payment will be credited towards the first unit cut.
 - (c) Payment for each of the following units must be made before cutting begins in that unit:

| <u>PAYMENT UNIT NUMBER</u> | <u>PERCENT OF TOTAL SALE VALUE</u> |
|----------------------------|------------------------------------|
| 01 | 21.9% |
| 02 | 15.8% |
| 03 | 18.4% |
| 04 | 43.9% |

4. If no cutting takes place, the 10% down payment will not be refunded.
5. Operations on the contract issued will terminate on 08/31/2022.

Description of Timber by Payment Unit (PU)

| PU | MARKET GROUP | PRODUCT | QUANTITY | UNIT | ACRES | ADVERTISE PRICE |
|---------------|---------------------|----------|----------|--------------|-------|-----------------|
| 1 | Balsam Fir | Pulpwood | 52.0 | Cords | 17.0 | \$4,837.45 |
| | Mixed Hardwood | | 5.0 | Cords | | |
| | <i>Red Maple</i> | | 5.0 | <i>Cords</i> | | |
| | Mixed Spruce | | 134.0 | Cords | | |
| | <i>Black Spruce</i> | | 65.0 | <i>Cords</i> | | |
| | <i>White Spruce</i> | | 69.0 | <i>Cords</i> | | |
| | Paper Birch | | 25.0 | Cords | | |
| | Quaking Aspen | | 28.0 | Cords | | |
| 2 | Balsam Fir | Pulpwood | 57.0 | Cords | 7.2 | \$3,484.65 |
| | Mixed Spruce | | 49.0 | Cords | | |
| | <i>White Spruce</i> | | 49.0 | <i>Cords</i> | | |
| | Paper Birch | | 25.0 | Cords | | |
| | Quaking Aspen | | 39.0 | Cords | | |
| 3 | Balsam Fir | Pulpwood | 61.0 | Cords | 16.6 | \$4,073.05 |
| | Mixed Hardwood | | 60.0 | Cords | | |
| | <i>Red Maple</i> | | 60.0 | <i>Cords</i> | | |
| | Mixed Spruce | | 37.0 | Cords | | |
| | <i>White Spruce</i> | | 37.0 | <i>Cords</i> | | |
| | Paper Birch | | 25.0 | Cords | | |
| | Quaking Aspen | | 35.0 | Cords | | |
| 4 | Balsam Fir | Pulpwood | 90.0 | Cords | 17.9 | \$9,689.95 |
| | Jack Pine | | 3.0 | Cords | | |
| | Mixed Hardwood | | 43.0 | Cords | | |
| | <i>Black Cherry</i> | | 1.0 | <i>Cords</i> | | |
| | <i>Red Maple</i> | | 42.0 | <i>Cords</i> | | |
| | Mixed Spruce | | 168.0 | Cords | | |
| | <i>White Spruce</i> | | 168.0 | <i>Cords</i> | | |
| | Paper Birch | | 70.0 | Cords | | |
| Quaking Aspen | 110.0 | Cords | | | | |
| TOTAL: | | | 1,116.0 | Cords | | |

Sale Specific Conditions & Requirements

Sale Name: Black River Fir SBW

Sale Number: 32-104-17 Seq#: 3

1 - Sale Area

1.2 - Boundaries

1.2.1 - Painted boundaries (1/14)

The sale boundary and Payment Unit boundaries are marked and identified by blue, red and yellow paint. Exterior sale boundary lines against private property are marked with blue paint. Exterior sale boundary lines against state are marked with red paint. Interior Payment Unit boundaries are marked with yellow paint. Yellow painted trees designating an interior Payment Unit boundary are only to be cut when all surrounding Payment Units have been paid.

2 - Timber Specifications

2.1 - Included Timber

2.1.2 - Clearcut unit(s) w/o unmerchantable trees (8/11)

Within Payment Unit(s) 1, 2, 3, and 4, cut all trees which meet minimum piece specifications in 2.2 Utilization except DO NOT CUT red pine, white pine, and cedar.

4 - Transportation

4.1 - Construction

4.1.3 - Slash and earthen piles (8/04)

Piles or windrows of earth along roads and landings that have been widened or constructed shall be leveled. Slash from road maintenance or construction, including stumps, shall be dispersed throughout the sale.

4.1.4 - Timber removed for construction (12/09)

Trees cut or damaged in the process of pre-approved road, landing or skid trail construction will be decked in an area separate from other Designated Timber and not removed until measured by the sale administrator. Payment will be made at the specified Purchase Unit Price.

4.1.6 - Road construction (1/09)

Construction of new roads or improvements of existing roads shall be done in such a way as to minimize the environmental and visual impacts. Merchantable trees shall be cut and utilized unless otherwise directed. Non-merchantable trees shall be severed and laid flat on the ground. Slash shall be scattered, and not left in windrows and kept a minimum of 10 feet back from the road edge. Stumps shall be set upright, not left on edge, and be moved at least 10 feet away from the road edge. Disturbed soil shall be feathered into the woods and not left in berms or windrows.

4.1.7 - Road closure (10/11)

All new roads built into the sale must be blocked to vehicle traffic upon completion of the sale. Overgrown roads that are reopened shall be considered new roads. In general, this will require constructing a four (4') foot high berm of stumps and logs covered with earth. These roads must be rendered impassable to cars and trucks. Contact the sale administrator for specific details of design and placement.

4.2 - Maintenance

4.2.1 - Hauling restriction (12/08)

Hauling may be restricted on forest roads by the Unit Manager or his/her representative. The restriction may occur during spring breakup or during wet weather conditions.

4.2.2 - Fill material (4/07)

To maintain roads, fill material may be needed in areas where "holes" exist or may be expected to develop. This fill material should be placed before trucking begins.

4.2.4 - Grading (10/16)

For completion of the sale, state forest roads must be graded. In general, this will require a road grader or bull dozer to shape up the roads after forest products have been hauled off site. This includes cleaning of drainage areas, grading, crowning and

filling with gravel, if necessary. The grading equipment to be used must be approved by the Unit Manager or his/her representative.

4.4 - Access

4.4.1 - Private property access (3/11)

Permission for access across private land is the responsibility of the Purchaser.

5 - Operations

5.1 - Notification

5.1.1 - Pre-sale conference (10/16)

A pre-sale conference between the Purchaser and sale administrator is required prior to beginning any operations a Payment Unit to determine landing and road locations. The sale administrator or his/her representative must be contacted at least 3 days in advance to schedule the conference.

5.2 - Conduct of Operations

5.2.2 - Hazard Trees/Snags

5.2.2.1 - Den trees (10/16)

Obvious hollow and/or den trees shall be protected and left standing unless they are a safety hazard.

5.2.3 - Operating Restrictions

5.2.3.1 - Operating restrictions (9/11)

Within Payment Unit(s) 1, 2, 3, and 4, unless changed by written agreement, cutting, skidding, and hauling are limited to the period of 12/15 to 03/15. This restriction is because wet soil conditions on access road and within some of the units.

5.2.3.2 - Decking/landing restoration (9/13)

All decking and landing areas must have the surface area restored to a condition equal to or better than before. This is to ensure the proper regeneration of the stand. Wood debris, chips and "cookies" from trimmings must be removed or scattered away from landing and loading areas and may not be windrowed on the edge.

5.2.3.3 - No decking against live trees (2/04)

Cut products may not be decked against unmarked or designated leave trees.

5.4 - Soil Protection

5.4.1 - Rutting restriction, general (7/16)

Operations are to cease immediately if equipment and weather conditions result in rutting of roads and/or skid trails which is 12 inches or greater in depth and 50 feet in length. The Unit Manager or his/her representative may restrict hauling and/or skidding if ruts exceed the specified depth. With the Unit Manager or his/her representative's approval, the Purchaser may return to the area when the risk of rutting has decreased.

5.4.2 - Skid trails (2/04)

Skid trails up and down slopes should be avoided. If however this is unavoidable, these trails will be left in a non-erodible condition using water bars, logs, and slash. Placing of slash on these skid trails while logging is ongoing may alleviate need for any further action. At the direction of the sale administrator, seed, fertilizer, and mulch may also be required.

5.8 - Protection of Endangered Species

5.8.5 - Protection of raptor nests (3/13)

All trees with raptor nests will be protected if found during harvesting operations. Notification will be made to the Unit Manager or his/her representative who will notify the Wildlife Biologist so an on-site evaluation and recommendation can be made, if necessary.

6 - Safety and Fire Prevention

6.2 - Signing

6.2.1 - Road posting (9/09)

The Purchaser is responsible for posting and maintaining caution signs on County Road Ch and Co prior to beginning operations. The road must be posted at appropriate distances from the sale area to warn of logging activity and truck traffic. Signs must be removed when harvest operations are suspended or completed. The Purchaser will provide these signs.

7 - Other Conditions

7.3 - Contract Modifications

7.3.1 - Emerald Ash Borer

7.3.1.2 - Emerald ash borer, ash or firewood on sale (2/05)

There is ash and/or "firewood" in this sale and it is located within an emerald ash borer quarantined area. The Director of the Michigan Department of Agriculture (MDA) by the authority of Act No. 72 of the Public Acts of 1945, as amended, and Quarantine Regulation No. 620, has promulgated this quarantine to prevent the further spread of this pest and sets forth: definitions, regulated articles, regulated areas, conditions of movement, violations and penalties, and special exemptions. The Purchaser must comply with this quarantine. Contact the MDA for further information.

7.5 - Loss

7.5.1 - Deteriorating timber (7/09)

The sale area has received damage from Spruce Budworm. The Purchaser should harvest the wood as soon as possible. The Department of Natural Resources is held free of responsibility of any further damage or deterioration due to delay in harvesting.



| | |
|-------------|------|
| Sale Number | Year |
| 104 | 17 |

TIMBER SALE MAP

This information provided by authority of Part 525, 1994 PA 451, as amended.

| | | | | | | |
|-------------------------------------|--------------|---|------------------------|--------------------|-----------|---------|
| Forest Management Unit Gwinn FMU | | County Marquette | Mapped By Rick Hill | Date 03/06/2017 | Page 1 | of 1 |
| Township 46N | Range 28W | Section(s) and Subdivision(s) SE of Sec 8, SWSW, NWSW, SWSW of Sec 9 | | Scale 1:15,840 | | |

| Cover Type | | | | Density | | | |
|---------------------|----------------------|-------------------------|-------------------|-----------------------------|------------------------|--|--|
| A = Aspen | H = Hemlock | N = Marsh | U = Upland Brush | 0 = Non Stocked | 5 = Pole Timber Medium | | |
| B = Paper Birch | J = Jack Pine | O = Oak | UM = Upland Mixed | 1 = Seedling Sapling Poor | 6 = Pole Timber Well | | |
| C = Cedar | L = Lowland Brush | P = Lowland Poplar | V = Bog or Marsh | 2 = Seedling Sapling Medium | 7 = Saw Timber Poor | | |
| D = Treed Bog | LM = Lowland Mixed | Q = Mixed Swamp Conifer | W = White Pine | 3 = Seedling Sapling Well | 8 = Saw Timber Medium | | |
| E = Swamp Hardwoods | M = Mpl, Bch, Brch | R = Red Pine | X = Non Stocked | 4 = Pole Timber Poor | 9 = Saw Timber Well | | |
| F = Spruce Fir | MC = Mixed Conifer | S = Black Spruce | Z = Water | | | | |
| G = Grass | MD = Mixed Deciduous | T = Tamarack | | | | | |

| PU | Acres | PU | Acres |
|----|-------|----|-------|
| 1 | 17.0 | 4 | 17.9 |
| 2 | 07.2 | | |
| 3 | 16.6 | | |

Black River Fir SBW

Compartment 220
58.7 Acres

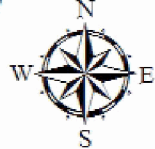

QR Code opens map in PDF Maps App

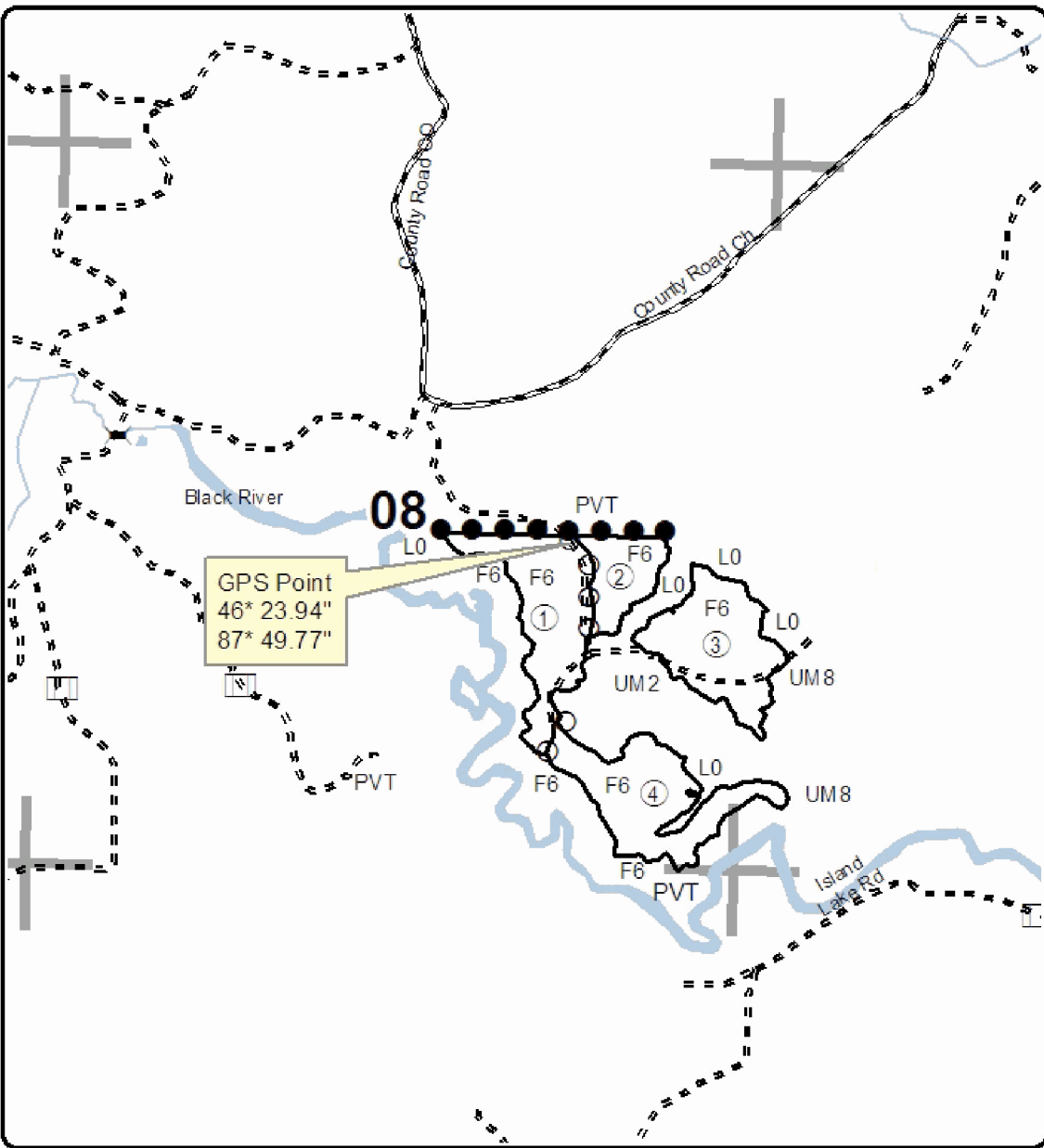

| Legend | |
|--------|-----------------------|
| | Against State (Red) |
| | Payment Unit (Yellow) |
| | Private Line (Blue) |
| | Section Corners |
| | Lakes and Rivers |
| | Gravel Roads |
| | Poor Dirt Roads |
| | Bridge |
| | Gate |

Locator Map
1:200,000

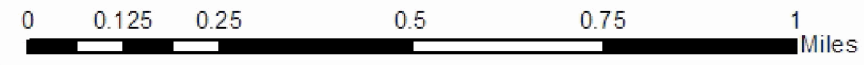
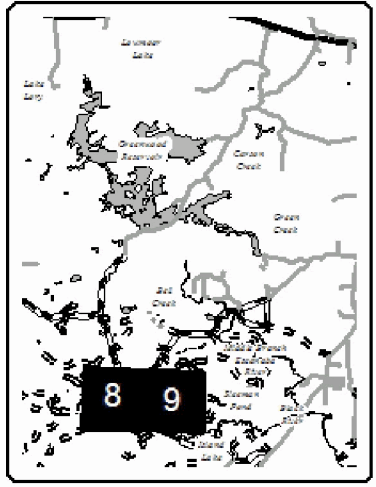

Crispy Camry (32-018-18)

T46N, R28W, SEC. 10; T46N, R28W, SEC. 3; T46N, R28W, SEC. 4; Marquette

In response to the notice of sale to be held 1:00 p.m. (local time) on May 20, 2019, I am hereby submitting my sealed bid (firm offer) for the following forest products to be cut. Bids for individual species must be at or above the advertised price. All non-responsive bid forms may be rejected.

| <u>PRODUCTS & SPECIES</u> | <u>ESTIMATED VOLUME*</u> | <u>ADVERTISED PRICE</u> | <u>BID PRICE/UNIT</u> |
|-------------------------------|--------------------------|-------------------------|-----------------------|
| Sawtimber | | | |
| Red Pine | 36.60 MBF | \$ 97.00/MBF | \$ _____ |
| Pulpwood | | | |
| Balsam Fir | 18.00 Cords | \$ 20.00/Cord | \$ _____ |
| Jack Pine | 349.00 Cords | \$ 30.10/Cord | \$ _____ |
| Mixed Hardwood | 383.00 Cords | \$ 14.15/Cord | \$ _____ |
| Mixed Spruce | 157.00 Cords | \$ 19.65/Cord | \$ _____ |
| Paper Birch | 146.00 Cords | \$ 14.40/Cord | \$ _____ |
| Quaking Aspen | 692.00 Cords | \$ 26.20/Cord | \$ _____ |
| Red Pine | 411.00 Cords | \$ 38.45/Cord | \$ _____ |
| White Pine | 15.00 Cords | \$ 29.40/Cord | \$ _____ |

*The volumes are statistically estimated within plus (+) or minus (-) 9.20 percent. These estimated volumes are final and not subject to adjustment. Prospective bidders are urged to examine this timber and to make their own estimates of quantity and quality.

I understand that any or all bids may be rejected. All bids must be signed and all bid items must be bid or the bid form may be rejected. I also understand that consideration and awarding a contract will be based upon my past performance and ability to complete the contract based upon equipment and staffing subject to my control.

FEDERAL ID: ____ - ____ - ____ or SOCIAL SECURITY NUMBER: ____ - ____ - ____

Company or individual bidding: _____

Company representative's name: _____

Address: _____

City: _____ State: _____ Zip: _____

IF AVAILABLE, PLEASE PLACE THE PERSONALIZED LABEL FROM YOUR PROSPECTUS IN THE ABOVE BOX.

Individual or company representative's signature: _____ Date: _____

Phone number : _____ Email (optional): _____

THE WINNING BIDDER MUST COMPLETE THE VERIFICATION OF WORKER'S DISABILITY COMPENSATION ACT COMPLIANCE (ON REVERSE SIDE IF DOUBLE SIDED) WITHIN 21 DAYS OF SALE AWARD DATE



| |
|----------------------------------|
| FOR DEPARTMENT USE ONLY |
| Sale Number (XX - XXX - XX - XX) |
| Forest Management Unit: |

TIMBER SALE VERIFICATION OF WORKER'S DISABILITY COMPENSATION ACT COMPLIANCE

*As required by Act 317, P.A. 1969 (Worker's Compensation) and
Part 5 of Act 451 of 1994, as amended.*

VERIFICATION OF WORKER'S DISABILITY COMPENSATION ACT COMPLIANCE

- This verification must be completed and submitted within 21 days of contract award and prior to the issuance of the timber sale contract.
- In addition, if boxes 2B or 2C are checked, then Notice of Exclusion or Certificate of Insurance must be submitted within twenty-one (21) days of the contract award and prior to the issuance of the timber sale contract.
- All information must be typed or printed except for written signatures.

Please Check Appropriate Categories:

1. My business is organized as (you **must** check one of the boxes below):
 - A. Sole Proprietorship (individual)
 - B. Partnership
 - C. Corporation

2. You **must** check one of the boxes below:
 - A. I certify my business is a sole proprietorship and it has no employees but the sole proprietor. I am not subject to the Worker's Compensation Laws.
 - B. I certify my business has satisfied its obligation to the Worker's Compensation Act through the use of an approved Notice of Exclusion (BWC-337, Rev. 5/96). I will provide a copy of the Notice of Exclusion within 21 days of the contract award. (For questions or a copy of the BWC-337, please call the Worker's Compensation Bureau at 517-322-1195).
 - C. I certify my business has a Worker's Compensation Policy. I will provide an original Certificate of Insurance within twenty-one (21) days of the contract award.

3. If you have checked item 2(A) or 2(B), you **must** indicate the number of **both** full-time and part-time employees, other than yourself, including family members and active partners (if none, you must enter "0").

_____ Full-time Employees

_____ Part-time Employees

| | | | |
|------------------|-------|-------------------------------------|--|
| Name of Business | | Federal ID (or) Social Security No. | |
| Address | | Telephone () | |
| City | State | ZIP | |

I hereby certify that the above information is true and correct. I agree to notify the Michigan DNR of any changes that occur in factors affecting my coverage during any of my present and future operations.

Signature of Owner or Authorized Representative

Title

Date

Please complete the "SEALED BID" information on the next page

Wild ELF Winter (32-011-18)
T45N, R28W, SEC. 27; T45N, R28W, SEC. 28; T45N, R28W, SEC. 34; Marquette

In response to the notice of sale to be held 1:00 p.m. (local time) on May 20, 2019, I am hereby submitting my sealed bid (firm offer) for the following forest products to be cut. Bids for individual species must be at or above the advertised price. All non-responsive bid forms may be rejected.

| <u>PRODUCTS & SPECIES</u> | <u>ESTIMATED VOLUME*</u> | <u>ADVERTISED PRICE</u> | <u>BID PRICE/UNIT</u> |
|-------------------------------|--------------------------|-------------------------|-----------------------|
| Pulpwood | | | |
| Balsam Fir | 620.00 Cords | \$ 20.00/Cord | \$ _____ |
| Jack Pine | 2.00 Cords | \$ 30.10/Cord | \$ _____ |
| Mixed Aspen | 2,012.00 Cords | \$ 26.20/Cord | \$ _____ |
| Mixed Hardwood | 62.00 Cords | \$ 14.15/Cord | \$ _____ |
| Mixed Spruce | 554.00 Cords | \$ 19.65/Cord | \$ _____ |
| Paper Birch | 116.00 Cords | \$ 14.40/Cord | \$ _____ |
| Tamarack | 102.00 Cords | \$ 18.70/Cord | \$ _____ |

*The volumes are statistically estimated within plus (+) or minus (-) 10.62 percent. These estimated volumes are final and not subject to adjustment. Prospective bidders are urged to examine this timber and to make their own estimates of quantity and quality.

I understand that any or all bids may be rejected. All bids must be signed and all bid items must be bid or the bid form may be rejected. I also understand that consideration and awarding a contract will be based upon my past performance and ability to complete the contract based upon equipment and staffing subject to my control.

FEDERAL ID: ___ - ___ - ___ or SOCIAL SECURITY NUMBER: ___ - ___ - ___

Company or individual bidding: _____

Company representative's name: _____

Address: _____

City: _____ State: _____ Zip: _____

IF AVAILABLE, PLEASE PLACE THE PERSONALIZED LABEL FROM YOUR PROSPECTUS IN THE ABOVE BOX.

Individual or company representative's signature: _____ Date: _____

Phone number : _____ Email (optional): _____

THE WINNING BIDDER MUST COMPLETE THE VERIFICATION OF WORKER'S DISABILITY COMPENSATION ACT COMPLIANCE (ON REVERSE SIDE IF DOUBLE SIDED) WITHIN 21 DAYS OF SALE AWARD DATE



| |
|----------------------------------|
| FOR DEPARTMENT USE ONLY |
| Sale Number (XX - XXX - XX - XX) |
| Forest Management Unit: |

TIMBER SALE VERIFICATION OF WORKER'S DISABILITY COMPENSATION ACT COMPLIANCE

*As required by Act 317, P.A. 1969 (Worker's Compensation) and
Part 5 of Act 451 of 1994, as amended.*

VERIFICATION OF WORKER'S DISABILITY COMPENSATION ACT COMPLIANCE

- This verification must be completed and submitted within 21 days of contract award and prior to the issuance of the timber sale contract.
- In addition, if boxes 2B or 2C are checked, then Notice of Exclusion or Certificate of Insurance must be submitted within twenty-one (21) days of the contract award and prior to the issuance of the timber sale contract.
- All information must be typed or printed except for written signatures.

Please Check Appropriate Categories:

1. My business is organized as (you **must** check one of the boxes below):
 - A. Sole Proprietorship (individual)
 - B. Partnership
 - C. Corporation

2. You **must** check one of the boxes below:
 - A. I certify my business is a sole proprietorship and it has no employees but the sole proprietor. I am not subject to the Worker's Compensation Laws.
 - B. I certify my business has satisfied its obligation to the Worker's Compensation Act through the use of an approved Notice of Exclusion (BWC-337, Rev. 5/96). I will provide a copy of the Notice of Exclusion within 21 days of the contract award. (For questions or a copy of the BWC-337, please call the Worker's Compensation Bureau at 517-322-1195).
 - C. I certify my business has a Worker's Compensation Policy. I will provide an original Certificate of Insurance within twenty-one (21) days of the contract award.

3. If you have checked item 2(A) or 2(B), you **must** indicate the number of **both** full-time and part-time employees, other than yourself, including family members and active partners (if none, you must enter "0").

_____ Full-time Employees

_____ Part-time Employees

| | | | |
|------------------|-------|-------------------------------------|--|
| Name of Business | | Federal ID (or) Social Security No. | |
| Address | | Telephone () | |
| City | State | ZIP | |

I hereby certify that the above information is true and correct. I agree to notify the Michigan DNR of any changes that occur in factors affecting my coverage during any of my present and future operations.

Signature of Owner or Authorized Representative

Title

Date

Please complete the "SEALED BID" information on the next page

Black River Fir SBW (32-104-17)
T46N, R28W, SEC. 8; T46N, R28W, SEC. 9; Marquette COUNTY

In response to the notice of sale to be held 1:00 p.m. (local time) on May 20, 2019, I am hereby submitting my sealed bid (firm offer) for the following forest products to be cut. Bids for individual species must be at or above the advertised price. All non-responsive bid forms may be rejected.

| <u>PRODUCTS & SPECIES</u> | <u>ESTIMATED VOLUME*</u> | <u>ADVERTISED PRICE</u> | <u>BID PRICE/UNIT</u> |
|-------------------------------|--------------------------|-------------------------|-----------------------|
| Pulpwood | | | |
| Balsam Fir | 260.00 Cords | \$ 20.00/Cord | \$ _____ |
| Jack Pine | 3.00 Cords | \$ 30.10/Cord | \$ _____ |
| Mixed Hardwood | 108.00 Cords | \$ 14.15/Cord | \$ _____ |
| Mixed Spruce | 388.00 Cords | \$ 19.65/Cord | \$ _____ |
| Paper Birch | 145.00 Cords | \$ 14.40/Cord | \$ _____ |
| Quaking Aspen | 212.00 Cords | \$ 26.20/Cord | \$ _____ |

*The volumes are statistically estimated within plus (+) or minus (-) 16.03 percent. These estimated volumes are final and not subject to adjustment. Prospective bidders are urged to examine this timber and to make their own estimates of quantity and quality.

I understand that any or all bids may be rejected. All bids must be signed and all bid items must be bid or the bid form may be rejected. I also understand that consideration and awarding a contract will be based upon my past performance and ability to complete the contract based upon equipment and staffing subject to my control.

FEDERAL ID: ___ - ___ - ___ or SOCIAL SECURITY NUMBER: ___ - ___ - ___

Company or individual bidding: _____

Company representative's name: _____

Address: _____

City: _____ State: _____ Zip: _____

IF AVAILABLE, PLEASE PLACE THE PERSONALIZED LABEL FROM YOUR PROSPECTUS IN THE ABOVE BOX.

Individual or company representative's signature: _____ Date: _____

Phone number : _____ Email (optional): _____

THE WINNING BIDDER MUST COMPLETE THE VERIFICATION OF WORKER'S DISABILITY COMPENSATION ACT COMPLIANCE (ON REVERSE SIDE IF DOUBLE SIDED) WITHIN 21 DAYS OF SALE AWARD DATE



| |
|----------------------------------|
| FOR DEPARTMENT USE ONLY |
| Sale Number (XX - XXX - XX - XX) |
| Forest Management Unit: |

TIMBER SALE VERIFICATION OF WORKER'S DISABILITY COMPENSATION ACT COMPLIANCE

*As required by Act 317, P.A. 1969 (Worker's Compensation) and
Part 5 of Act 451 of 1994, as amended.*

VERIFICATION OF WORKER'S DISABILITY COMPENSATION ACT COMPLIANCE

- This verification must be completed and submitted within 21 days of contract award and prior to the issuance of the timber sale contract.
- In addition, if boxes 2B or 2C are checked, then Notice of Exclusion or Certificate of Insurance must be submitted within twenty-one (21) days of the contract award and prior to the issuance of the timber sale contract.
- All information must be typed or printed except for written signatures.

Please Check Appropriate Categories:

1. My business is organized as (you **must** check one of the boxes below):
 - A. Sole Proprietorship (individual)
 - B. Partnership
 - C. Corporation
2. You **must** check one of the boxes below:
 - A. I certify my business is a sole proprietorship and it has no employees but the sole proprietor. I am not subject to the Worker's Compensation Laws.
 - B. I certify my business has satisfied its obligation to the Worker's Compensation Act through the use of an approved Notice of Exclusion (BWC-337, Rev. 5/96). I will provide a copy of the Notice of Exclusion within 21 days of the contract award. (For questions or a copy of the BWC-337, please call the Worker's Compensation Bureau at 517-322-1195).
 - C. I certify my business has a Worker's Compensation Policy. I will provide an original Certificate of Insurance within twenty-one (21) days of the contract award.
3. If you have checked item 2(A) or 2(B), you **must** indicate the number of **both** full-time and part-time employees, other than yourself, including family members and active partners (if none, you must enter "0").

_____ Full-time Employees

_____ Part-time Employees

| | | | |
|------------------|-------|-------------------------------------|--|
| Name of Business | | Federal ID (or) Social Security No. | |
| Address | | Telephone () | |
| City | State | ZIP | |

I hereby certify that the above information is true and correct. I agree to notify the Michigan DNR of any changes that occur in factors affecting my coverage during any of my present and future operations.

Signature of Owner or Authorized Representative

Title

Date

Please complete the "SEALED BID" information on the next page

Danger Mouse Sbw (32-007-18)
T46N, R29W, SEC. 24; Marquette COUNTY

In response to the notice of sale to be held 1:00 p.m. (local time) on May 20, 2019, I am hereby submitting my sealed bid (firm offer) for the following forest products to be cut. Bids for individual species must be at or above the advertised price. All non-responsive bid forms may be rejected.

| <u>PRODUCTS & SPECIES</u> | <u>ESTIMATED VOLUME*</u> | <u>ADVERTISED PRICE</u> | <u>BID PRICE/UNIT</u> |
|-------------------------------|--------------------------|-------------------------|-----------------------|
| Pulpwood | | | |
| Balsam Fir | 190.00 Cords | \$ 20.00/Cord | \$ _____ |
| Black Spruce | 62.00 Cords | \$ 19.65/Cord | \$ _____ |
| Jack Pine | 41.00 Cords | \$ 30.10/Cord | \$ _____ |
| Paper Birch | 51.00 Cords | \$ 14.40/Cord | \$ _____ |
| Quaking Aspen | 15.00 Cords | \$ 26.20/Cord | \$ _____ |
| Red Maple | 3.00 Cords | \$ 14.15/Cord | \$ _____ |

*The volumes are statistically estimated within plus (+) or minus (-) 30.82 percent. These estimated volumes are final and not subject to adjustment. Prospective bidders are urged to examine this timber and to make their own estimates of quantity and quality.

I understand that any or all bids may be rejected. All bids must be signed and all bid items must be bid or the bid form may be rejected. I also understand that consideration and awarding a contract will be based upon my past performance and ability to complete the contract based upon equipment and staffing subject to my control.

FEDERAL ID: ___ - ___ - ___ or SOCIAL SECURITY NUMBER: ___ - ___ - ___

Company or individual bidding: _____

Company representative's name: _____

Address: _____

City: _____ State: _____ Zip: _____

IF AVAILABLE, PLEASE PLACE THE PERSONALIZED LABEL FROM YOUR PROSPECTUS IN THE ABOVE BOX.

Individual or company representative's signature: _____ Date: _____

Phone number : _____ Email (optional): _____

THE WINNING BIDDER MUST COMPLETE THE VERIFICATION OF WORKER'S DISABILITY COMPENSATION ACT COMPLIANCE (ON REVERSE SIDE IF DOUBLE SIDED) WITHIN 21 DAYS OF SALE AWARD DATE



| |
|----------------------------------|
| FOR DEPARTMENT USE ONLY |
| Sale Number (XX - XXX - XX - XX) |
| Forest Management Unit: |

TIMBER SALE VERIFICATION OF WORKER'S DISABILITY COMPENSATION ACT COMPLIANCE

*As required by Act 317, P.A. 1969 (Worker's Compensation) and
Part 5 of Act 451 of 1994, as amended.*

VERIFICATION OF WORKER'S DISABILITY COMPENSATION ACT COMPLIANCE

- This verification must be completed and submitted within 21 days of contract award and prior to the issuance of the timber sale contract.
- In addition, if boxes 2B or 2C are checked, then Notice of Exclusion or Certificate of Insurance must be submitted within twenty-one (21) days of the contract award and prior to the issuance of the timber sale contract.
- All information must be typed or printed except for written signatures.

Please Check Appropriate Categories:

1. My business is organized as (you **must** check one of the boxes below):
 - A. Sole Proprietorship (individual)
 - B. Partnership
 - C. Corporation

2. You **must** check one of the boxes below:
 - A. I certify my business is a sole proprietorship and it has no employees but the sole proprietor. I am not subject to the Worker's Compensation Laws.
 - B. I certify my business has satisfied its obligation to the Worker's Compensation Act through the use of an approved Notice of Exclusion (BWC-337, Rev. 5/96). I will provide a copy of the Notice of Exclusion within 21 days of the contract award. (For questions or a copy of the BWC-337, please call the Worker's Compensation Bureau at 517-322-1195).
 - C. I certify my business has a Worker's Compensation Policy. I will provide an original Certificate of Insurance within twenty-one (21) days of the contract award.

3. If you have checked item 2(A) or 2(B), you **must** indicate the number of **both** full-time and part-time employees, other than yourself, including family members and active partners (if none, you must enter "0").

_____ Full-time Employees

_____ Part-time Employees

| | | | |
|------------------|-------|-------------------------------------|--|
| Name of Business | | Federal ID (or) Social Security No. | |
| Address | | Telephone () | |
| City | State | ZIP | |

I hereby certify that the above information is true and correct. I agree to notify the Michigan DNR of any changes that occur in factors affecting my coverage during any of my present and future operations.

Signature of Owner or Authorized Representative

Title

Date

Please complete the "SEALED BID" information on the next page

Sand River South 2.0 (32-013-18)
T46N, R23W, SEC. 2; T46N, R23W, SEC. 3; T46N, R23W, SEC. 4; T46N, R23W,

In response to the notice of sale to be held 1:00 p.m. (local time) on May 20, 2019, I am hereby submitting my sealed bid (firm offer) for the following forest products to be cut. Bids for individual species must be at or above the advertised price. All non-responsive bid forms may be rejected.

| <u>PRODUCTS & SPECIES</u> | <u>ESTIMATED VOLUME*</u> | <u>ADVERTISED PRICE</u> | <u>BID PRICE/UNIT</u> |
|-------------------------------|--------------------------|-------------------------|-----------------------|
| Sawtimber | | | |
| Basswood | 1.10 MBF | \$ 113.00/MBF | \$ _____ |
| Red Maple | 1.30 MBF | \$ 43.00/MBF | \$ _____ |
| Sugar Maple | 5.90 MBF | \$ 202.00/MBF | \$ _____ |
| White Ash | 2.40 MBF | \$ 52.00/MBF | \$ _____ |
| Pulpwood | | | |
| Balsam Fir | 70.00 Cords | \$ 20.00/Cord | \$ _____ |
| Mixed Hardwood | 918.00 Cords | \$ 14.15/Cord | \$ _____ |
| Mixed Spruce | 167.00 Cords | \$ 19.65/Cord | \$ _____ |
| Quaking Aspen | 30.00 Cords | \$ 26.20/Cord | \$ _____ |

*The volumes are statistically estimated within plus (+) or minus (-) 18.90 percent. These estimated volumes are final and not subject to adjustment. Prospective bidders are urged to examine this timber and to make their own estimates of quantity and quality.

I understand that any or all bids may be rejected. All bids must be signed and all bid items must be bid or the bid form may be rejected. I also understand that consideration and awarding a contract will be based upon my past performance and ability to complete the contract based upon equipment and staffing subject to my control.

FEDERAL ID: ____ - ____ - ____ or SOCIAL SECURITY NUMBER: ____ - ____ - ____

Company or individual bidding: _____

Company representative's name: _____

Address: _____

City: _____ State: _____ Zip: _____

IF AVAILABLE, PLEASE PLACE THE PERSONALIZED LABEL FROM YOUR PROSPECTUS IN THE ABOVE BOX.

Individual or company representative's signature: _____ Date: _____

Phone number : _____ Email (optional): _____

THE WINNING BIDDER MUST COMPLETE THE VERIFICATION OF WORKER'S DISABILITY COMPENSATION ACT COMPLIANCE (ON REVERSE SIDE IF DOUBLE SIDED) WITHIN 21 DAYS OF SALE AWARD DATE



| |
|----------------------------------|
| FOR DEPARTMENT USE ONLY |
| Sale Number (XX - XXX - XX - XX) |
| Forest Management Unit: |

TIMBER SALE VERIFICATION OF WORKER'S DISABILITY COMPENSATION ACT COMPLIANCE

*As required by Act 317, P.A. 1969 (Worker's Compensation) and
Part 5 of Act 451 of 1994, as amended.*

VERIFICATION OF WORKER'S DISABILITY COMPENSATION ACT COMPLIANCE

- This verification must be completed and submitted within 21 days of contract award and prior to the issuance of the timber sale contract.
- In addition, if boxes 2B or 2C are checked, then Notice of Exclusion or Certificate of Insurance must be submitted within twenty-one (21) days of the contract award and prior to the issuance of the timber sale contract.
- All information must be typed or printed except for written signatures.

Please Check Appropriate Categories:

1. My business is organized as (you **must** check one of the boxes below):
 - A. Sole Proprietorship (individual)
 - B. Partnership
 - C. Corporation
2. You **must** check one of the boxes below:
 - A. I certify my business is a sole proprietorship and it has no employees but the sole proprietor. I am not subject to the Worker's Compensation Laws.
 - B. I certify my business has satisfied its obligation to the Worker's Compensation Act through the use of an approved Notice of Exclusion (BWC-337, Rev. 5/96). I will provide a copy of the Notice of Exclusion within 21 days of the contract award. (For questions or a copy of the BWC-337, please call the Worker's Compensation Bureau at 517-322-1195).
 - C. I certify my business has a Worker's Compensation Policy. I will provide an original Certificate of Insurance within twenty-one (21) days of the contract award.
3. If you have checked item 2(A) or 2(B), you **must** indicate the number of **both** full-time and part-time employees, other than yourself, including family members and active partners (if none, you must enter "0").

_____ Full-time Employees

_____ Part-time Employees

| | | | |
|------------------|-------|-------------------------------------|--|
| Name of Business | | Federal ID (or) Social Security No. | |
| Address | | Telephone () | |
| City | State | ZIP | |

I hereby certify that the above information is true and correct. I agree to notify the Michigan DNR of any changes that occur in factors affecting my coverage during any of my present and future operations.

Signature of Owner or Authorized Representative

Title

Date

Please complete the "SEALED BID" information on the next page