



**DEPARTMENT OF NATURAL RESOURCES
STATE OF MICHIGAN**

TIMBER SALE PROSPECTUS #6403

SCHEDULED SALE DATE AND TIME: 4:00 p.m. (local time) on July 1, 2019.

LOCATION: KALKASKA FIELD OFFICE, 2089 NORTH BIRCH STREET, KALKASKA, MI 49646.

PROSPECTUS NOTE: The bidder is advised to inspect the sale area and review the location, estimated volumes, operating costs and contract terms of proposed sales. Please be aware that some landowners may request 60 days or more notice for access across their land.

Notice is hereby given that bids will be received by the Unit Manager, TRAVERSE CITY MANAGEMENT UNIT, for certain timber on the following described lands:

Sugar Beet Mix (61-107-19) / T27N, R08W, SEC. 32, NESW,S1/2SW,SE.

T27N, R08W, SEC. 33, E1/2NW,W1/2NE,NESW,NWSE.

Kalkaska County, Advertised Price \$45,264.00, 136.0 Acres, Jack Pine, Hardwood.

SALE NOTE: Chipping of jack pine limbs is not permitted. See spec 2.2.11 for details.

Holiday Hardwoods (61-108-19) / T27N, R08W, SEC. 8 , S1/2NW,S1/2NE,NESW,N1/2SE,SESE.

Kalkaska County, Advertised Price \$69,509.35, 119.2 Acres, Hardwood, Sugar Maple.

SALE NOTE: The north end of the sale is on some steep terrain.

Philip Pine (61-120-19) / T26N, R06W, SEC. 26, SESW,S1/2SE.

T26N, R06W, SEC. 34, E1/2NE.

T26N, R06W, SEC. 35, NW,W1/2NE.

Kalkaska County, Advertised Price \$65,964.20, 116.5 Acres, Red Pine, Aspen.

247 Creek n Coster (61-145-18) / T25N, R08W, SEC. 26, W1/2SW.

T25N, R08W, SEC. 27, SENE,E1/2SW,SE.

T25N, R08W, SEC. 34, E1/2NW,NE,NESW,SE.

T25N, R08W, SEC. 35, W1/2NW,NWSW.

Kalkaska County, Advertised Price \$136,239.20, 224.0 Acres, Aspen, White Pine.

BID INSTRUCTIONS (VER. 07/02/2018):

1. Scheduled Bid Location, Date, and Time (2/11)

Bids must be received by the Unit Manager, KALKASKA OFFICE, 2089 North Birch Street, Kalkaska, MI 49646, no later than 4:00 p.m. (local time) on July 1, 2019. For further information concerning this sale, contact Patrick Cotant at 231-922-6044.

2. Bidder's Qualifications (5/16)

Purchaser shall obtain workers compensation insurance to cover claims under Michigan's Worker's Disability Compensation Act of 1969 or similar employee benefit act of any other state applicable to an employee. If all or part of a timber sale was prepared by a private contractor, the contractor and that contractor's company are not permitted to bid on the timber sale contract. Bids will not be accepted from individuals or companies appearing on the DNR/FRD No-Bid List. This list contains the names of purchasers who previously failed to execute a contract within 21-days or who have a history of poor performance.

3. Preparation of Sealed Bids (5/16)

Bid Forms may be completed online thru Michigan DNR Timber Sale Online Bidding (OLB) at www.michigan.gov/timberbidding or by completing the hardcopy Bid Form found in the Timber Sale Prospectus. Hardcopy Bid Forms shall be manually signed in ink. Registration in OLB is considered your 'signature' for all bids submitted thru that system. Bid prices must be entered for each species and product in the Bid Price column for all material subject to bidding and all fill-in blanks must be completed. If erasures or other changes appear on the hardcopy Bid Form, each erasure or change must be initialed by the person signing the bid.

4. Submission of Sealed Bids (5/16)

Bid forms may be obtained from the Unit Manager or thru OLB. Bids may be submitted hardcopy or thru OLB. All hardcopy bids must be submitted on the bid form and in an envelope clearly identified as described in this section. NOTE: Only one bid form per bid envelope. Sealed bids must be submitted to the Unit office designated in the prospectus and must be submitted at or prior to the time established in the prospectus. The envelope should show on the outside (a) the sale name or number and (b) the date and time of bid opening, as shown in the prospectus. Bids received after the time specified in the sale prospectus are late bids and will be rejected.

It is possible for a bidder to submit multiple bids on a single sale. For example, a bid may be submitted hardcopy and a bid may be submitted thru OLB. Or, two bidders from the same company could both submit bids on the same sale. If this were to happen, the State would accept all bids received and award the contract accordingly. All bidding and contractual requirements would apply to all bids received.

5. Public Opening of Sealed Bids (7/16)

If conditions permit, the sealed bids will be publicly opened and posted at the time and place set in the prospectus.

If a bidder, present at a bid opening, has submitted bids on more than one sale, that bidder may withdraw their unopened bid envelopes or announce the withdrawal of their online bid after being declared the successful bidder on one sale.

6. Award of Contract (1/11)

Award of the contract will be made to the Bidder whose bid, conforming to the prospectus, is most advantageous to the State of Michigan on the basis of total value at rates bid for the estimated quantities. The State reserves the right to reject any bid or waive any minor irregularity in bids received. A written award mailed (or otherwise furnished) to the successful Bidder shall be deemed to result in a binding contract without further action by either party.

7. Down Payment (1/11)

The Bidder to whom award is made must make a down payment within 21 days of the sale award. The amount of the down payment will be calculated as shown in the Bond and Payment Schedule of this prospectus. Only cash may be used to meet this requirement.

8. Performance Security (1/11)

As guarantee of faithful performance, a cash bond, certificate of deposit, surety bond or irrevocable letter of credit (LOC) is required within 21 days of the sale award. The amount of the performance security is shown in the Bond and

Payment Schedule of this prospectus. If an LOC or surety is used, the coverage must extend for at least 6 months beyond the contract expiration.

9. Timber Sale Contract (7/18)

Additional conditions and requirements common to all timber sales are listed on the timber sale contract (R4031) and are available on line at www.michigan.gov/timber. Contact the Unit Manager for additional information or a sample contract. Within 21 days of the date of the award letter, the bidder must sign the contract and provide the required down payment, performance security, and verification of worker's disability compensation. The down payment and performance security shall be in accordance with the provisions of the timber sale contract, in the sums stated in this prospectus. If these actions are not taken, then the Bidder, the Bidder's corporation, and the corporation's principals may not be permitted to bid on State timber sales for a period of 3 months after the first offense, 6 months after the second offense, and 1 year after the third offense. An offense will only be counted against the Bidder for 5 years. In addition, the Bidder certifies that if awarded this contract, the Bidder will complete the timber sale contract in accordance with its terms and any modifications thereof including requirements to purchase, cut, and remove the included timber by the expiration date.

Payment Unit values in the State Forest Timber Sale Contract are calculated based on the advertised value of the Payment Unit as a percentage of the total advertised value of the contract. The advertised value of each Payment Unit is given in the Description of Timber by Payment Unit table on the Timber Sale Information page. For example, if the value of Payment Unit 1 is advertised as \$1,500 and the total Timber Sale value is advertised as \$10,000, the contract price for Payment Unit 1 will be 15% of the total bid price ($\$1,500/\$10,000 * 100$).

10. Disclaimer of Estimates and Bidder's Warranty of Inspection (7/16)

Before submitting this bid, the Bidder is advised and cautioned to inspect the sale area, review the requirements of the sale contract, and take other steps as may be reasonably necessary to ascertain the location, estimated volumes, construction estimates, and operating costs of the proposed sale. Failure to do so will not relieve the Bidder from responsibility for completing the contract.

The Bidder warrants that this bid is submitted solely on the basis of the Bidder's examination and inspection of the quality and quantity of the timber offered for sale and the Bidder's opinion of the value thereof and the costs of recovery. No reliance should be placed on the State of Michigan's estimates of timber quality, quantity or costs of recovery. Bidder further acknowledges that the State of Michigan: (i) expressly disclaims any warranty of fitness of timber for any purpose; (ii) offers this timber as is without any warranty of quality (merchantability) or quantity and (iii) expressly disclaims any warranty as to the quantity or quality of timber sold.

11. Certification and Chain-of-Custody (10/14)

Unless otherwise indicated in the contract under section 7 – Other Conditions of the Sale Specific Conditions & Requirements, the area encompassed by this timber sale is certified to the standards of the Forest Stewardship Council (FSC) - Certificate #SCS-FM/COC-00090N and the Sustainable Forestry Initiative (SFI) - Certificate #NSF-SFIS-5Y031-SF5. Forest products from this sale may be delivered to the mill as "FSC 100% and / or SFI certified" as long as the contractor hauling the forest products is chain-of-custody (COC) certified or covered under a COC certificate from the destination mill. The purchaser is responsible for maintaining COC after leaving the sale area.

12. Good Neighbor Authority (GNA) Requirements (7/16)

If the name of this timber sales contains the acronym GNA, it is authorized by the Good Neighbor Authority (GNA) and covered by various agreements between the U.S. Forest Service and the State. The timber sale occurs on federal land and the following conditions apply:

GNA contracts on US Forest Service land will not be awarded to purchasers on the Federal list of excluded parties. The System for Award Management (SAM) will be checked for active excluded parties prior to award of contract. In addition, the Bidder to whom award is made must complete an Assurance Regarding Felony Conviction or Tax Delinquent Status for Corporate Applicants (AD-3031).

13. Good Neighbor Authority (GNA) Requirements, con't (9/16)

Bidder certifies, by signing this bid form, that to the best of Bidder's knowledge that the following representations are accurate and complete.

- a. That the Bidder and its principals are not presently debarred, suspended, proposed for debarment, declared ineligible, or voluntary excluded from timber sales (covered transactions) by any Federal department or agency.
- b. That the Bidder and its principals have not within a 3-year period preceding this bid been convicted of or had a civil judgment rendered against them for commission of fraud or a criminal offense in connection with obtaining, attempting to obtain, or performing a public (Federal, State, or local) transaction or contract under a public transaction; violation of Federal or State antitrust statutes or commission of embezzlement, theft, forgery, bribery, falsification or destruction of records, making false statements, or receiving stolen property.
- c. That the Bidder and its principals are not presently indicted for or otherwise criminally or civilly charged by a governmental entity (Federal, State, or local) with commission of any of the offenses enumerated in paragraph b of this certification.
- d. That the Bidder and its principals have not within a 3-year period preceding this bid had one or more public transactions (Federal, State, or local) terminated for breach or default of a timber or forest product contract.

Bidders that cannot certify this requirement, in whole or in part, shall submit an explanation with their bid.

DAN EICHINGER
Director

TIMBER SALE INFORMATION

Sugar Beet Mix (61-107-19)

T27N, R08W, SEC. 32; T27N, R08W, SEC. 33.
Kalkaska County (Advertised Price \$45,264.00)

SALE NOTE: Chipping of jack pine limbs is not permitted. See spec 2.2.11 for details.

A timber sale contract for this lump sum, sealed bid timber sale will be awarded to the responsible bidder offering the highest sealed bid price. Bids must be at or above the following advertised price for each species:

<u>PRODUCTS & SPECIES</u>	<u>ESTIMATED UNITS*</u>	<u>ADVERTISED PRICE</u>
Sawtimber		
B. T. Aspen	9.40 MBF	\$ 122.00 / MBF
Red Maple	1.80 MBF	\$ 120.00 / MBF
Red Oak	23.40 MBF	\$ 200.00 / MBF
Red Pine	89.30 MBF	\$ 109.00 / MBF
White Oak	29.90 MBF	\$ 43.00 / MBF
White Pine	3.50 MBF	\$ 49.00 / MBF
Pulpwood		
Jack Pine	827.00 Cords	\$ 11.35 / Cord
Mixed Aspen	94.00 Cords	\$ 18.50 / Cord
Mixed Hardwood	269.00 Cords	\$ 16.20 / Cord
Mixed Oak	338.00 Cords	\$ 11.70 / Cord
Red Pine	212.00 Cords	\$ 33.85 / Cord
White Pine	103.00 Cords	\$ 13.75 / Cord

* The total volume is statistically estimated within plus (+) or minus (-) 9.90 percent. The estimated units are final and not subject to adjustment. Prospective bidders are urged to examine this timber and to make their own estimates of quantity and quality.

BOND AND PAYMENT SCHEDULE:

1. A bond in the amount of \$2,263.00 to insure faithful performance of the conditions of the contract will be deposited by the successful bidder within 21 days of the sale award.
2. Cutting in any sale or unit without the required advance payment would be considered a trespass.
3. Total payment must be paid in advance or according to the following schedule:
 - (a) Ten percent (10%) of the sale value must be paid within 21 days of the sale award.
 - (b) The 10% down payment will be credited towards the first unit cut.
 - (c) Payment for each of the following units must be made before cutting begins in that unit:

<u>PAYMENT UNIT NUMBER</u>	<u>PERCENT OF TOTAL SALE VALUE</u>
01	1.7%
02	49.5%
03	2.4%
04	15.6%
05	30.8%
4. If no cutting takes place, the 10% down payment will not be refunded.
5. Operations on the contract issued will terminate on 09/30/2021.

Description of Timber by Payment Unit (PU)

PU	MARKET GROUP	PRODUCT	QUANTITY	UNIT	ACRES	ADVERTISE PRICE			
1	Red Oak	Sawtimber	0.9	MBF	6.1	\$748.50			
	White Oak		5.0	MBF					
	Jack Pine	Pulpwood	1.0	Cords					
	Mixed Oak		24.0	Cords					
	<i>Red Oak</i>		5.0	<i>Cords</i>					
	<i>White Oak</i>		19.0	<i>Cords</i>					
	Red Pine		1.0	Cords					
	White Pine		2.0	Cords					
	2	B. T. Aspen	Sawtimber	3.0			MBF	51.0	\$22,416.25
Red Maple			1.8	MBF					
Red Oak			11.0	MBF					
Red Pine			59.4	MBF					
White Oak			10.9	MBF					
White Pine			1.8	MBF					
Jack Pine		Pulpwood	235.0	Cords					
Mixed Aspen			43.0	Cords					
<i>B. T. Aspen</i>			43.0	<i>Cords</i>					
Mixed Hardwood			173.0	Cords					
<i>Black Cherry</i>			12.0	<i>Cords</i>					
<i>Red Maple</i>			161.0	<i>Cords</i>					
Mixed Oak			150.0	Cords					
<i>Red Oak</i>			48.0	<i>Cords</i>					
<i>White Oak</i>			102.0	<i>Cords</i>					
Red Pine			124.0	Cords					
White Pine			28.0	Cords					
3		B. T. Aspen	Sawtimber	2.8	MBF	6.9	\$1,093.35		
		Red Oak		0.7	MBF				
	Jack Pine	Pulpwood	7.0	Cords					
	Mixed Aspen		17.0	Cords					
	<i>B. T. Aspen</i>		17.0	<i>Cords</i>					
	Mixed Hardwood		12.0	Cords					
	<i>Black Cherry</i>		1.0	<i>Cords</i>					
	<i>Red Maple</i>		11.0	<i>Cords</i>					
	Mixed Oak		2.0	Cords					
	<i>Red Oak</i>		2.0	<i>Cords</i>					
4	B. T. Aspen	Sawtimber	3.6	MBF	21.4	\$7,077.65			
	Red Oak		2.6	MBF					
	Red Pine		9.8	MBF					
	White Oak		3.5	MBF					
	White Pine		1.7	MBF					
	Jack Pine	Pulpwood	142.0	Cords					
	Mixed Aspen		24.0	Cords					
	<i>B. T. Aspen</i>		24.0	<i>Cords</i>					
	Mixed Hardwood		52.0	Cords					
	<i>Red Maple</i>		52.0	<i>Cords</i>					
	Mixed Oak		59.0	Cords					
	<i>Red Oak</i>		22.0	<i>Cords</i>					
	<i>White Oak</i>		37.0	<i>Cords</i>					
	Red Pine		18.0	Cords					
	White Pine		45.0	Cords					
5	Red Oak	Sawtimber	8.2	MBF	50.6	\$13,928.25			
	Red Pine		20.1	MBF					
	White Oak		10.5	MBF					
	Jack Pine	Pulpwood	442.0	Cords					
	Mixed Aspen		10.0	Cords					
	<i>Quaking Aspen</i>		10.0	<i>Cords</i>					

Description of Timber by Payment Unit (PU), con't

PU	MARKET GROUP	PRODUCT	QUANTITY	UNIT	ACRES	ADVERTISE PRICE
5 con't	Mixed Hardwood	Pulpwood	32.0	Cords		
	<i>Red Maple</i>		32.0	<i>Cords</i>		
	Mixed Oak		103.0	Cords		
	<i>Red Oak</i>		30.0	<i>Cords</i>		
	<i>White Oak</i>		73.0	<i>Cords</i>		
	Red Pine		69.0	Cords		
	White Pine		28.0	Cords		
TOTAL:			157.3	MBF		
TOTAL:			1,843.0	Cords		

Sale Specific Conditions & Requirements

Sale Name: Sugar Beet Mix

Sale Number: 61-107-19 Seq#: 1

1 - Sale Area

1.2 - Boundaries

1.2.1 - Painted boundaries (1/14)

The sale boundary and Payment Unit boundaries are marked and identified by red and yellow paint. Exterior sale boundary lines against state are marked with red paint. Interior Payment Unit boundaries are marked with yellow paint. The painted boundary line trees are not Included Timber and are to be protected. Yellow painted trees designating an interior Payment Unit boundary are only to be cut when all surrounding Payment Units have been paid.

2 - Timber Specifications

2.1 - Included Timber

2.1.1 - Clearcut unit(s) with unmerchantable trees (6/14)

Within Payment Unit(s) 1, cut all trees that are four (4) inches or more at DBH.

Within Payment Unit(s) 2-5, cut all trees that are two (2) inches or more at DBH, except within Payment Unit 3, do not cut white oak, red pine or white pine.

2.2 - Utilization

2.2.3 - Stump heights (4/07)

Stump heights within the Sale Area shall not exceed 6 inches for all trees.

2.2.11 - Chipping restriction (9/14)

If chipping occurs on this sale, the chipping of jack pine limbs is not permitted. All jack pine must be delimbed, and limbs must be scattered throughout the sale area. In addition, no woody debris present on the ground at the start of the sale may be chipped. Also, brush or chips may not be stored or stockpiled on-site for more than 30 days.

3 - Payments

3.3 - Pre-measured Sales

3.3.4 - Dividing payment units (7/14)

Payment Unit(s) over \$20,000 may be divided at the request of the Purchaser and upon approval of the Unit Manager.

Dividing Payment Units is a contract modification which requires a Timber Sale Contract Supplement. There will be only one division per Payment Unit.

3.4 - Damaged Timber

3.4.1 - Damaged timber (6/14)

General Condition and Requirement 3.4 Damaged Timber, defines liquidated damages for undesignated live merchantable trees which are cut or injured. In addition, extreme care should be taken to avoid damage to tree seedlings and saplings.

Within Payment Unit 1, if more than 60% of the tree seedlings or saplings (1/4" to 4.5" DBH) within a specified portion of the sale area are damaged, liquidated damages will be assessed at \$500 per acre for all acreage within that specified portion of the sale area that was damaged.

4 - Transportation

4.1 - Construction

4.1.3 - Slash and earthen piles (8/04)

Piles or windrows of earth along roads and landings that have been widened or constructed shall be leveled. Slash from road maintenance or construction, including stumps, shall be dispersed throughout the sale, and/or chipped, utilized or otherwise removed from the sale.

4.1.11 - Permits (2/12)

The Purchaser will secure any necessary Kalkaska County road permits that may be required.

4.2 - Maintenance

4.2.5 - Two wheel drive condition (2/04)

All existing trail roads on and adjacent to the sale area must be passable by two-wheel drive traffic for the duration of the sale.

5 - Operations

5.1 - Notification

5.1.1 - Pre-sale conference (10/16)

A pre-sale conference on site between the Purchaser and sale administrator is required prior to beginning any operations to determine landing and road locations. The Unit Manager or his/her representative must be contacted at least 5 days in advance to schedule the conference.

5.2 - Conduct of Operations

5.2.1 - Slash

5.2.1.11 - Slash for reforestation (5/07)

To facilitate reforestation, within Payment Units 2, 3, 4, and 5, all jack pine limbs shall be left with slash evenly distributed. Bunched tops within the cutting area shall be broken up and scattered. Stumps shall be cut low to the ground. Processing sites shall not be left with a compacted layer of slash; tops from these sites shall be hauled back into the cut area and scattered.

5.2.3 - Operating Restrictions

5.2.3.1 - Operating restrictions (9/11)

Within Payment Unit(s) 2, 3, 4, and 5, unless changed by written agreement, cutting and skidding is not permitted during snow off conditions. This restriction is to create scarification and soil disturbance to promote natural jack pine reforestation.

5.2.3.5 - Oak wilt restriction (1/18)

Within the Sale Area, unless changed by written agreement, cutting, skidding, hauling within the sale and brushing of access roads to the sale are not permitted during the period of April 15 to July 15. Operations may be allowed if specific steps are taken to prevent damaging uncut oak during the high risk period. Those steps may include completing all road brushing before April 15th and clearing a tree-length buffer along uncut oak cover before April 15th. This is necessary to reduce the spread of oak wilt. For more information, contact the Unit Manager or his/her representative.

5.2.32 - Decking/landing restoration (9/13)

All decking and landing areas must have the surface area restored to a condition equal to or better than before. This is to ensure the proper regeneration of the stand. Wood debris, chips and "cookies" from trimmings must be removed or scattered away from landing and loading areas and may not be windrowed on the edge.

5.2.39 - ORV trail/route protection (4/18)

The ORV trail or route and is shown on the Timber Sale Map. Do not cut trees or damage posts with yellow ORV markers. All stumps within 5 feet of the trail must be cut flush with the ground. Maintain a 20 foot wide slash, debris, and rut free zone daily using the ORV trail or route as the centerline. Do not run equipment down the ORV trail or route. Skidding across the trail or route may only occur in locations approved by the sale administrator.

5.2.41 - Snowmobile trail protection (9/11)

The snowmobile trail and is shown on the Timber Sale Map. Do not cut or damage posts with orange trail markers or traffic control signs. If the trail is used, it must be maintained and restored to a condition equal to or better than before the sale. The road maintenance/restoration must be done prior to December 1. If the trail is used for hauling, it must be graded to the satisfaction of the Unit Manager or his/her representative prior to December 1. If the trail road is to be used for hauling during the snowmobile season, then a snow covered base must be left on the trail. The snowmobile trail may only be crossed at right angles. Maintain a 20 foot wide slash, debris, and rut free zone daily using the snowmobile trail as the centerline. All

stumps within 20 feet of the snowmobile trail must be cut at ground level.

5.4 - Soil Protection

5.4.1 - Rutting restriction, general (7/16)

Operations are to cease immediately if equipment and weather conditions result in rutting of roads and/or skid trails which is 12 inches or greater in depth and 50 feet in length. The Unit Manager or his/her representative may restrict hauling and/or skidding if ruts exceed the specified depth. With the Unit Manager or his/her representative's approval, the Purchaser may return to the area when the risk of rutting has decreased.

6 - Safety and Fire Prevention

6.2 - Signing

6.2.1 - Road posting (9/09)

The Purchaser is responsible for posting and maintaining caution signs on all county and state roads prior to beginning operations. The road must be posted at appropriate distances from the sale area to warn of logging activity and truck traffic. Signs must be removed when harvest operations are suspended or completed. The Purchaser will provide these signs.

6.2.2 - Snowmobile trail posting (8/09)

The Purchaser is responsible for posting and maintaining caution signs on the snowmobile trail prior to beginning operations during the snowmobile season (approximately December 1 to March 31). The trail must be posted at appropriate distances from the sale area to warn of logging activity and truck traffic. Signs must be removed when harvest operations are suspended or completed. The Purchaser will provide these signs.

6.2.3 - Recreational trail posting (2/10)

The Purchaser is responsible for posting and maintaining caution signs on the ORV trail prior to beginning operations. The trail must be posted at appropriate distances from the sale area to warn of logging activity and truck traffic at both ends of the trail. Signs must be removed when harvest operations are suspended or completed. The Purchaser will provide these signs.



TIMBER SALE MAP

This information provided by authority of Part 525, 1994 PA 451, as amended.

Forest Management Unit Traverse City Management		County Kalaska	Mapped By Tom Peterson		Date 3/13/2019	Page 1 of 1	
Township 27N	Range 08W	Section(s) and Subdivision(s) Sec 32 - SE1/4, S1/2SW & Sec 33 - E1/2NW, W1/2NE NESW			Scale 1:15,820		

Cover Type				Density			
A = Aspen	H = Hemlock	N = Marsh	U = Upland Brush	0 = Non Stocked	5 = Pole Timber Medium		
B = Paper Birch	J = Jack Pine	O = Oak	UM = Upland Mixed	1 = Seedling Sapling Poor	6 = Pole Timber Well		
C = Cedar	L = Lowland Brush	P = Lowland Poplar	V = Bog or Marsh	2 = Seedling Sapling Medium	7 = Saw Timber Poor		
D = Treed Bog	LM = Lowland Mixed	Q = Mixed Swamp Conifer	W = White Pine	3 = Seedling Sapling Well	8 = Saw Timber Medium		
E = Swamp Hdwoods	M = Mpl. Bch, Brch	R = Red Pine	X = Non Stocked	4 = Pole Timber Poor	9 = Saw Timber Well		
F = Spruce Fir	MC = Mixed Conifer	S = Black Spruce	Z = Water				
G = Grass	MD = Mixed Deciduous	T = Tamarack					

PU	Acres	PU	Acres
1	6.1	4	21.4
2	51	5	50.6
3	6.9		

Sugar Beet Mix

Compartment 158

136 Acres

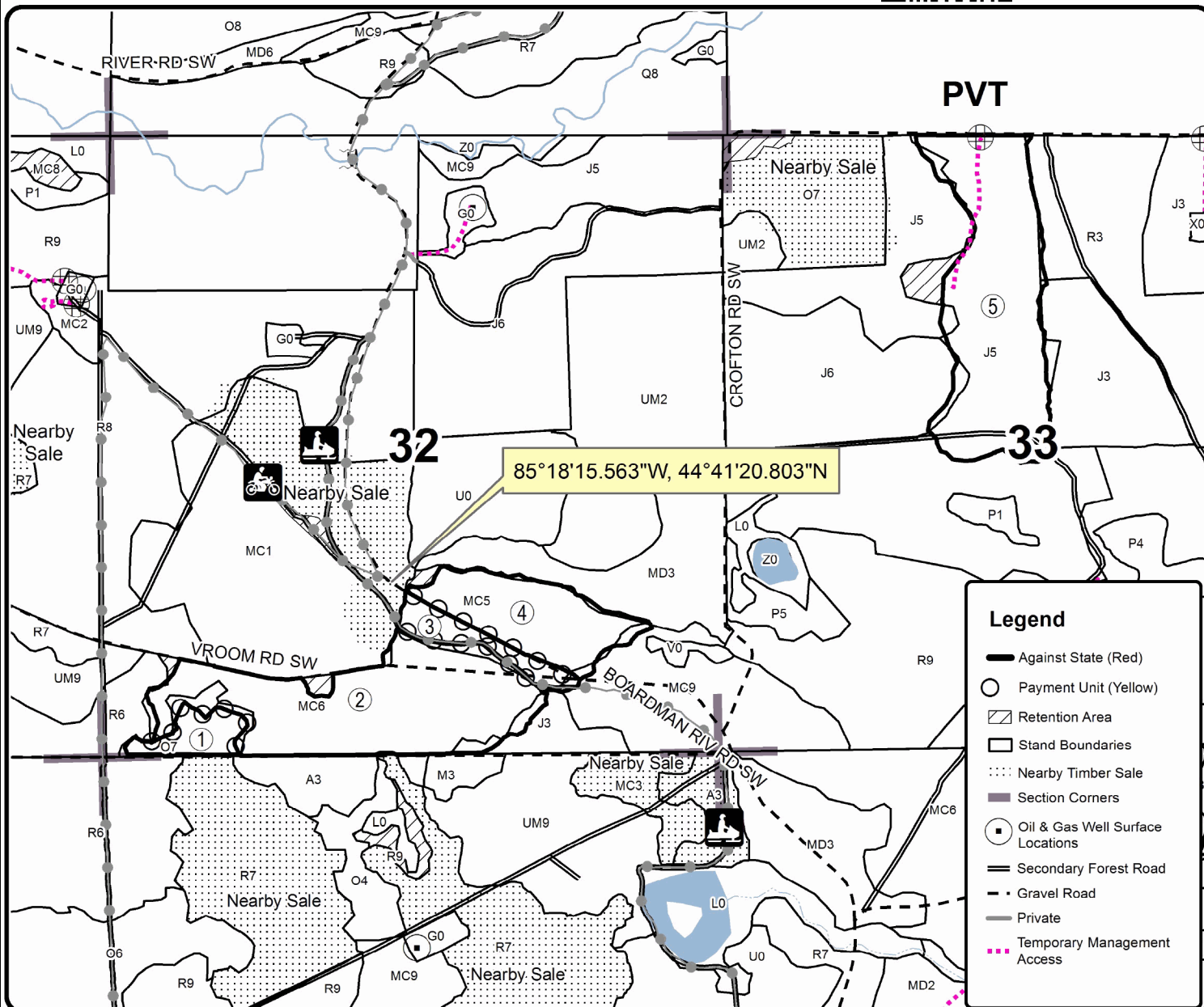
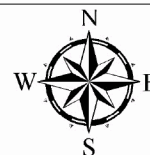

Legend

- Against State (Red)
- Payment Unit (Yellow)
- Retention Area
- Stand Boundaries
- Nearby Timber Sale
- Section Corners
- Oil & Gas Well Surface Locations
- Secondary Forest Road
- Gravel Road
- Private
- Temporary Management Access

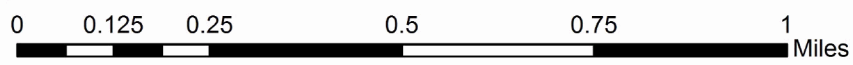

TIMBER SALE INFORMATION

Holiday Hardwoods (61-108-19)

T27N, R08W, SEC. 8.

Kalkaska County (Advertised Price \$69,509.35)

SALE NOTE: The north end of the sale is on some steep terrain.

A timber sale contract for this lump sum, sealed bid timber sale will be awarded to the responsible bidder offering the highest sealed bid price. Bids must be at or above the following advertised price for each species:

<u>PRODUCTS & SPECIES</u>	<u>ESTIMATED UNITS*</u>	<u>ADVERTISED PRICE</u>
Sawtimber		
Basswood	99.00 MBF	\$ 99.00 / MBF
Beech	19.40 MBF	\$ 87.00 / MBF
Black Cherry	31.50 MBF	\$ 124.00 / MBF
Red Maple	2.40 MBF	\$ 112.00 / MBF
Red Oak	1.70 MBF	\$ 186.00 / MBF
Red Pine	21.50 MBF	\$ 102.00 / MBF
Sugar Maple	134.70 MBF	\$ 259.00 / MBF
White Pine	3.60 MBF	\$ 46.00 / MBF
Pulpwood		
Basswood	126.00 Cords	\$ 17.65 / Cord
Mixed Aspen	32.00 Cords	\$ 17.25 / Cord
Mixed Hardwood	694.00 Cords	\$ 15.10 / Cord
Red Oak	8.00 Cords	\$ 10.90 / Cord
Red Pine	92.00 Cords	\$ 31.55 / Cord
White Pine	3.00 Cords	\$ 12.85 / Cord

* The total volume is statistically estimated within plus (+) or minus (-) 12.80 percent. The estimated units are final and not subject to adjustment. Prospective bidders are urged to examine this timber and to make their own estimates of quantity and quality.

BOND AND PAYMENT SCHEDULE:

1. A bond in the amount of \$3,475.00 to insure faithful performance of the conditions of the contract will be deposited by the successful bidder within 21 days of the sale award.
2. Cutting in any sale or unit without the required advance payment would be considered a trespass.
3. Total payment must be paid in advance or according to the following schedule:
 - (a) Ten percent (10%) of the sale value must be paid within 21 days of the sale award.
 - (b) The 10% down payment will be credited towards the first unit cut.
 - (c) Payment for each of the following units must be made before cutting begins in that unit:

<u>PAYMENT UNIT NUMBER</u>	<u>PERCENT OF TOTAL SALE VALUE</u>
01	18.9%
02	39.8%
03	41.3%

4. If no cutting takes place, the 10% down payment will not be refunded.
5. Operations on the contract issued will terminate on 04/15/2022.

Description of Timber by Payment Unit (PU)

PU	MARKET GROUP	PRODUCT	QUANTITY	UNIT	ACRES	ADVERTISE PRICE		
1	Basswood	Sawtimber	12.4	MBF	35.5	\$13,108.25		
	Beech		6.7	MBF				
	Black Cherry		7.4	MBF				
	Red Maple		1.9	MBF				
	Red Oak		1.7	MBF				
	Red Pine		7.7	MBF				
	Sugar Maple		15.8	MBF				
	Basswood		Pulpwood	15.0			Cords	
	Mixed Aspen			25.0			Cords	
	<i>B. T. Aspen</i>			<i>Sawtimber</i>			0.2	<i>MBF</i>
	<i>B. T. Aspen</i>			<i>Pulpwood</i>			1.0	<i>Cords</i>
	<i>Quaking Aspen</i>						24.0	<i>Cords</i>
	Mixed Hardwood						210.0	Cords
	<i>Beech</i>						34.0	<i>Cords</i>
	<i>Black Cherry</i>						53.0	<i>Cords</i>
	<i>Ironwood</i>			21.0			<i>Cords</i>	
	<i>Red Maple</i>			12.0			<i>Cords</i>	
	<i>Sugar Maple</i>		90.0	<i>Cords</i>				
	Red Oak		6.0	Cords				
	Red Pine		33.0	Cords				
2	Basswood	Sawtimber	47.4	MBF	31.3	\$27,664.85		
	Beech		3.8	MBF				
	Black Cherry		6.0	MBF				
	Red Maple		0.2	MBF				
	Red Pine		1.9	MBF				
	Sugar Maple		68.4	MBF				
	White Pine		3.6	MBF				
	Basswood		Pulpwood	54.0			Cords	
	Mixed Aspen			2.0			Cords	
	<i>B. T. Aspen</i>			<i>Sawtimber</i>			0.2	<i>MBF</i>
	<i>B. T. Aspen</i>			<i>Pulpwood</i>			1.0	<i>Cords</i>
	<i>Quaking Aspen</i>						1.0	<i>Cords</i>
	Mixed Hardwood						167.0	Cords
	<i>Beech</i>						10.0	<i>Cords</i>
	<i>Black Cherry</i>						23.0	<i>Cords</i>
	<i>Red Maple</i>						3.0	<i>Cords</i>
	<i>Sugar Maple</i>						131.0	<i>Cords</i>
	Red Pine			8.0			Cords	
White Pine		3.0	Cords					
3	Basswood	Sawtimber	39.2	MBF	52.4	\$28,736.25		
	Beech		8.9	MBF				
	Black Cherry		18.1	MBF				
	Red Maple		0.3	MBF				
	Red Pine		11.9	MBF				
	Sugar Maple		50.5	MBF				
	Basswood		Pulpwood	57.0			Cords	
	Mixed Aspen			5.0			Cords	
	<i>B. T. Aspen</i>			<i>Sawtimber</i>			0.3	<i>MBF</i>
	<i>Quaking Aspen</i>			<i>Pulpwood</i>			4.0	<i>Cords</i>
	Mixed Hardwood						317.0	Cords
	<i>Beech</i>						34.0	<i>Cords</i>
	<i>Black Cherry</i>						65.0	<i>Cords</i>
	<i>Ironwood</i>						3.0	<i>Cords</i>
	<i>Red Maple</i>						4.0	<i>Cords</i>
	<i>Sugar Maple</i>						211.0	<i>Cords</i>
	Red Oak			2.0			Cords	

Description of Timber by Payment Unit (PU), con't

PU	MARKET GROUP	PRODUCT	QUANTITY	UNIT	ACRES	ADVERTISE PRICE
3 con't	Red Pine	Pulpwood	51.0	Cords		
TOTAL:			313.8	MBF		
TOTAL:			955.0	Cords		

Sale Specific Conditions & Requirements

Sale Name: Holiday Hardwoods

Sale Number: 61-108-19 Seq#: 1

1 - Sale Area

1.2 - Boundaries

1.2.1 - Painted boundaries (1/14)

The sale boundary and Payment Unit boundaries are marked and identified by blue, red and yellow paint. Exterior sale boundary lines against private property are marked with blue paint. Exterior sale boundary lines against state are marked with red paint. Interior Payment Unit boundaries are marked with yellow paint. Clearcut patches are marked with pink paint and are shown on the Timber Sale Map. The painted boundary line trees and pink painted trees are not Included Timber and are to be protected unless marked with orange paint.

2 - Timber Specifications

2.1 - Included Timber

2.1.3 - Cut tree marked unit(s) (12/08)

Within Payment Unit(s) 1, 2 and 3, all trees are designated for cutting when marked with orange paint above and below stump height, regardless of merchantability. In addition, cut all aspen, ironwood and beech trees unless they are marked with an orange 'X'. Also, cut all trees within the pink painted clearcut patches (this includes saplings and unmerchantable trees).

3 - Payments

3.3 - Pre-measured Sales

3.3.4 - Dividing payment units (7/14)

Payment Unit(s) with a value greater than \$15,000 may be divided at the request of the Purchaser and upon approval of the Unit Manager. Dividing Payment Units is a contract modification which requires a Timber Sale Contract Supplement. There will be only one division per Payment Unit.

3.4 - Damaged Timber

3.4.1 - Damaged timber (6/14)

General Condition and Requirement 3.4 Damaged Timber, defines liquidated damages for undesignated live merchantable trees which are cut or injured.

No damage is acceptable to merchantable trees. Within the sale area, if more than 10% of trees (> 4.5" DBH) within a specified area of the sale are damaged, liquidated damages will be assessed for all trees damaged. Rates will be in accordance with General Condition and Requirement 3.4 Damaged Timber.

4 - Transportation

4.1 - Construction

4.1.6 - Road construction (1/09)

Construction of new roads or improvements of existing roads shall be done in such a way as to minimize the environmental and visual impacts. Merchantable trees shall be cut and utilized unless otherwise directed. Non-merchantable trees shall be severed and laid flat on the ground. Slash shall be scattered, and not left in windrows and kept a minimum of 10 feet back from the road edge. Stumps shall be set upright, not left on edge, and be moved at least 10 feet away from the road edge. Disturbed soil shall be feathered into the woods and not left in berms or windrows.

4.1.7 - Road closure (10/11)

All new roads built into the sale must be blocked to vehicle traffic within 30 days of completion of hauling. Overgrown roads that are reopened shall be considered new roads. In general, this will require constructing double earthen berms at strategic locations. Stumps and brush must be placed along the remainder of the trail. These roads must be rendered impassable to cars and trucks. Contact the sale administrator for specific details of design and placement.

5 - Operations

5.1 - Notification

5.1.6 - Utility R.O.W. (1/15)

It is the responsibility of the Purchaser to obtain permission from the utility company to utilize the power line R.O.W. for operations. Please contact Kara Plachta with Consumers Energy at (517) 499-5762.

5.2 - Conduct of Operations

5.2.1 - Slash

5.2.1.8 - Slash height (12/08)

No slash or tree tops may exceed 36" inches in height.

5.2.3 - Operating Restrictions

5.2.3.3 - Bark slippage restriction (3/09)

Within Payment Unit(s) 1, 2 and 3, cutting and skidding are not permitted during the period of April 15 to July 15. This restriction is because of bark slippage.

5.2.3.4 - Oak wilt restriction, no exceptions (1/18)

Within Payment Unit(s) 1, 2 and 3, cutting, skidding, hauling within the sale and brushing of access roads to the sale are not permitted during the period of April 15 to July 15. No exceptions will be granted. This is necessary to reduce the spread of oak wilt.

5.2.32 - Decking/landing restoration (9/13)

All decking and landing areas must have the surface area restored to a condition equal to or better than before. This is to ensure the proper regeneration of the stand. Wood debris, chips and "cookies" from trimmings must be removed or scattered away from landing and loading areas and may not be windrowed on the edge.

5.2.38 - No decking against live trees (2/04)

Cut products may not be decked against unmarked or designated leave trees.

5.4 - Soil Protection

5.4.1 - Rutting restriction, general (7/16)

Operations are to cease immediately if equipment and weather conditions result in rutting of roads and/or skid trails which is 12 inches or greater in depth and 50 feet in length. The Unit Manager or his/her representative may restrict hauling and/or skidding if ruts exceed the specified depth. With the Unit Manager or his/her representative's approval, the Purchaser may return to the area when the risk of rutting has decreased.

5.4.4 - Slope protection (5/15)

Skid trails and roads on slopes shall be water barred with slash, stumps, and/or clean straw bales native to the area as soon as use is complete to prevent erosion.

5.8 - Protection of Endangered Species

5.8.5 - Protection of raptor nests (3/13)

All trees with raptor nests will be protected if found during harvesting operations. Notification will be made to the Unit Manager or his/her representative who will notify the Wildlife Biologist so an on-site evaluation and recommendation can be made, if necessary.

6 - Safety and Fire Prevention

6.2 - Signing

6.2.1 - Road posting (9/09)

The Purchaser is responsible for posting and maintaining caution signs on Dockery Rd prior to beginning operations. The road must be posted at appropriate distances from the sale area to warn of logging activity and truck traffic. Signs must be removed when harvest operations are suspended or completed. The Purchaser will provide these signs.



TIMBER SALE MAP

This information provided by authority of Part 525, 1994 PA 451, as amended.

Forest Management Unit Traverse City		County Kalkaska	Mapped By Crigier		Date 12/28/2018	Page 1	of 1
Township 27N	Range 8W	Section(s) and Subdivision(s) Sec 8: S1/2NE, E1/2NE, NESW, SENW			Scale 1:15,840		

Cover Type				Density	
A = Aspen	H = Hemlock	N = Marsh	U = Upland Brush	0 = Non Stocked	5 = Pole Timber Medium
B = Paper Birch	J = Jack Pine	O = Oak	UM = Upland Mixed	1 = Seedling Sapling Poor	6 = Pole Timber Well
C = Cedar	L = Lowland Brush	P = Lowland Poplar	V = Bog or Marsh	2 = Seedling Sapling Medium	7 = Saw Timber Poor
D = Treed Bog	LM = Lowland Mixed	Q = Mixed Swamp Conifer	W = White Pine	3 = Seedling Sapling Well	8 = Saw Timber Medium
E = Swamp Hdwoods	M = Mpl. Bch, Brch	R = Red Pine	X = Non Stocked	4 = Pole Timber Poor	9 = Saw Timber Well
F = Spruce Fir	MC = Mixed Conifer	S = Black Spruce	Z = Water		
G = Grass	MD = Mixed Deciduous	T = Tamarack			

PU	Acres
1	35.5
2	31.3
3	52.4

Holiday Hardwoods

Compartment 266

119.2 Acres

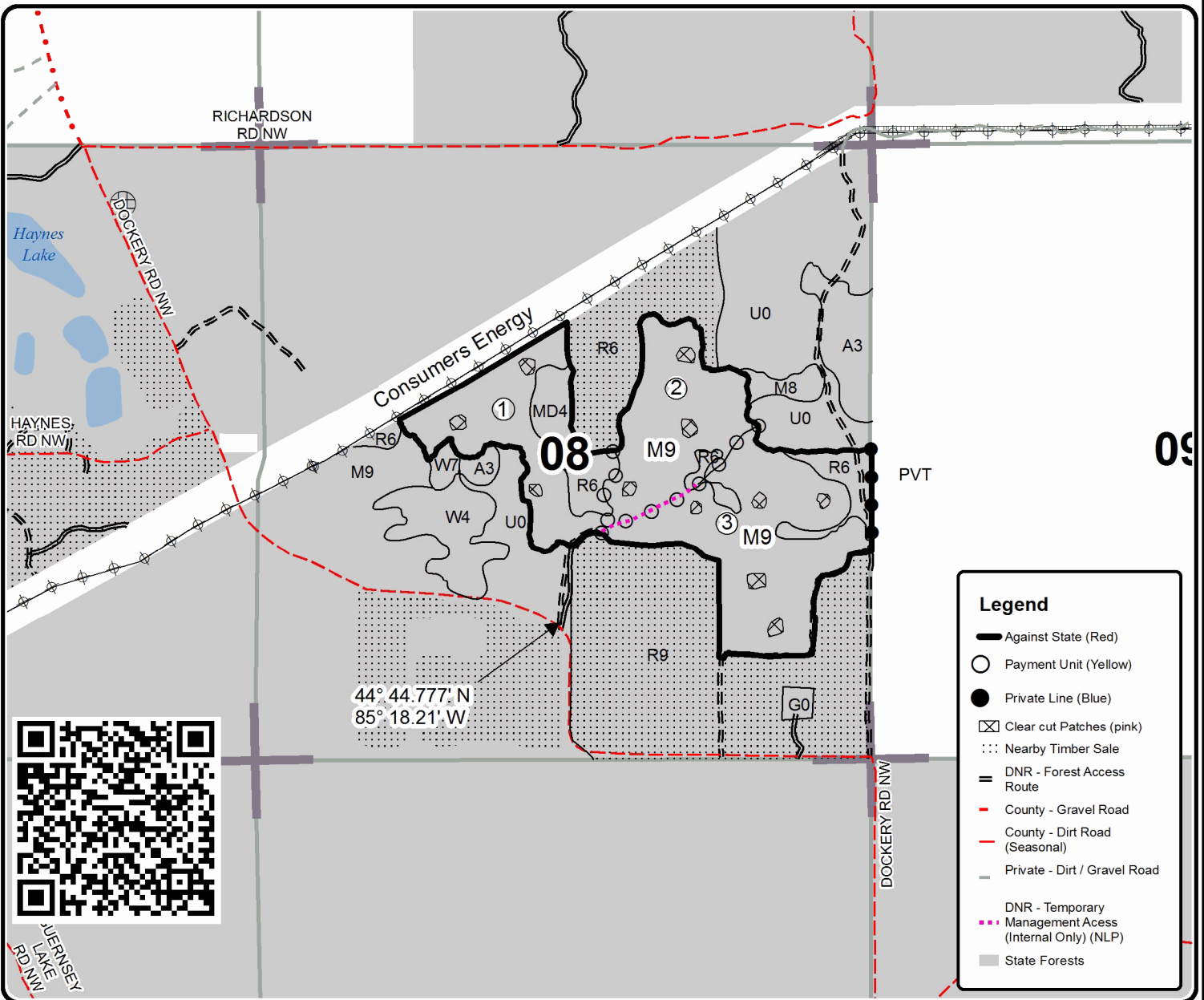
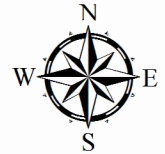

Legend

- Against State (Red)
- Payment Unit (Yellow)
- Private Line (Blue)
- ⊠ Clear cut Patches (pink)
- ⋯ Nearby Timber Sale
- ≡ DNR - Forest Access Route
- - - County - Gravel Road
- - - County - Dirt Road (Seasonal)
- - - Private - Dirt / Gravel Road
- DNR - Temporary Management Access (Internal Only) (NLP)
- State Forests

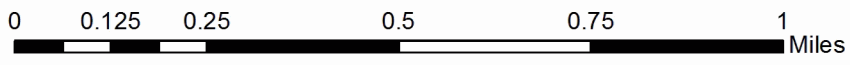

TIMBER SALE INFORMATION

Philip Pine (61-120-19)

T26N, R06W, SEC. 26; T26N, R06W, SEC. 34; T26N, R06W, SEC. 35.
Kalkaska County (Advertised Price \$65,964.20)

A timber sale contract for this lump sum, sealed bid timber sale will be awarded to the responsible bidder offering the highest sealed bid price. Bids must be at or above the following advertised price for each species:

<u>PRODUCTS & SPECIES</u>	<u>ESTIMATED UNITS*</u>	<u>ADVERTISED PRICE</u>
Sawtimber		
B. T. Aspen	11.10 MBF	\$ 122.00 / MBF
Red Maple	3.80 MBF	\$ 120.00 / MBF
Red Pine	338.90 MBF	\$ 109.00 / MBF
Pulpwood		
Jack Pine	1.00 Cords	\$ 11.35 / Cord
Mixed Aspen	167.00 Cords	\$ 18.50 / Cord
Red Maple	7.00 Cords	\$ 16.20 / Cord
Red Pine	709.00 Cords	\$ 33.85 / Cord

* The total volume is statistically estimated within plus (+) or minus (-) 10.73 percent. The estimated units are final and not subject to adjustment. Prospective bidders are urged to examine this timber and to make their own estimates of quantity and quality.

BOND AND PAYMENT SCHEDULE:

1. A bond in the amount of \$3,298.00 to insure faithful performance of the conditions of the contract will be deposited by the successful bidder within 21 days of the sale award.
2. Cutting in any sale or unit without the required advance payment would be considered a trespass.
3. Total payment must be paid in advance or according to the following schedule:
 - (a) Ten percent (10%) of the sale value must be paid within 21 days of the sale award.
 - (b) The 10% down payment will be credited towards the first unit cut.
 - (c) Payment for each of the following units must be made before cutting begins in that unit:

<u>PAYMENT UNIT NUMBER</u>	<u>PERCENT OF TOTAL SALE VALUE</u>
01	22.7%
02	7.0%
03	70.3%

4. If no cutting takes place, the 10% down payment will not be refunded.
5. Operations on the contract issued will terminate on 09/30/2022.

Description of Timber by Payment Unit (PU)

PU	MARKET GROUP	PRODUCT	QUANTITY	UNIT	ACRES	ADVERTISE PRICE
1	B. T. Aspen	Sawtimber	2.3	MBF	26.3	\$14,977.90
	Red Maple		0.9	MBF		
	Red Pine		77.3	MBF		
	Mixed Aspen	Pulpwood	35.0	Cords		
	<i>B. T. Aspen</i>		23.0	<i>Cords</i>		
	<i>Quaking Aspen</i>		12.0	<i>Cords</i>		
	Red Maple		2.0	Cords		
	Red Pine		162.0	Cords		
2	B. T. Aspen	Sawtimber	8.8	MBF	14.9	\$4,610.10
	Red Pine		5.9	MBF		
	Jack Pine	Pulpwood	1.0	Cords		
	Mixed Aspen		132.0	Cords		
	<i>B. T. Aspen</i>		85.0	<i>Cords</i>		
	<i>Quaking Aspen</i>		47.0	<i>Cords</i>		
	Red Pine		13.0	Cords		
3	Red Maple	Sawtimber	2.9	MBF	75.3	\$46,376.20
	Red Pine		255.7	MBF		
	Red Maple	Pulpwood	5.0	Cords		
	Red Pine		534.0	Cords		
TOTAL:			353.8	MBF		
TOTAL:			884.0	Cords		

Sale Specific Conditions & Requirements

Sale Name: Philip Pine

Sale Number: 61-120-19 Seq#: 1

1 - Sale Area

1.2 - Boundaries

1.2.1 - Painted boundaries (1/14)

The sale boundary and Payment Unit boundaries are marked and identified by blue, red and yellow paint. Exterior sale boundary lines against private property are marked with blue paint. Exterior sale boundary lines against state are marked with red paint. Interior Payment Unit boundaries are marked with yellow paint. The painted boundary line trees are not Included Timber and are to be protected.

2 - Timber Specifications

2.1 - Included Timber

2.1.1 - Clearcut unit(s) with unmerchantable trees (6/14)

Within Payment Unit(s) 2, cut all trees that are two (2) inches or more at DBH, except do not cut white pine.

2.1.8 - Designated plantation row unit(s) (12/08)

Within Payment Unit(s) 1 & 3, all red pine trees which meet minimum piece specifications in 2.2 Utilization, within designated plantation rows are designated for cutting. Designated plantation rows begin with the third row in from the outside of the plantation, then continue every third row. Because of the variability of row direction, it shall be the responsibility of the producer to maintain the third row sequence. In addition, cut all aspen and red maple.

2.2 - Utilization

2.2.4 - Skidding length (2/14)

Skidding of lengths over 17 feet is permissible as long as the timber sale administrator approves the method and machinery used. If at any point damage exceeds specification 3.4.1, all of the remaining wood must be skid in lengths less than 17 feet.

2.2.6 - Roundwood operation required (5/07)

The skidding of whole trees or tree segments with limbs attached is prohibited. All products must be produced as roundwood and forwarded to existing roads or landing areas in final product length.

3 - Payments

3.3 - Pre-measured Sales

3.3.4 - Dividing payment units (7/14)

Payment Unit(s) may be divided at the request of the Purchaser and upon approval of the Unit Manager. Dividing Payment Units is a contract modification which requires a Timber Sale Contract Supplement. There will be only one division per Payment Unit.

3.4 - Damaged Timber

3.4.1 - Damaged timber (6/14)

General Condition and Requirement 3.4 Damaged Timber, defines liquidated damages for undesignated live merchantable trees which are cut or injured.

No damage is acceptable to merchantable trees. Within the sale area, if more than 10% of trees (> 4.5" DBH) within a specified area of the sale are damaged, liquidated damages will be assessed for all trees damaged. Rates will be in accordance with General Condition and Requirement 3.4 Damaged Timber.

4 - Transportation

4.1 - Construction

4.1.6 - Road construction (1/09)

Construction of new roads or improvements of existing roads shall be done in such a way as to minimize the environmental

and visual impacts. Merchantable trees shall be cut and utilized unless otherwise directed. Non-merchantable trees shall be severed and laid flat on the ground. Slash shall be scattered, and not left in windrows and kept a minimum of 10 feet back from the road edge. Stumps shall be set upright, not left on edge, and be moved at least 10 feet away from the road edge. Disturbed soil shall be feathered into the woods and not left in berms or windrows.

4.2 - Maintenance

4.2.5 - Two wheel drive condition (2/04)

All existing trail roads on and adjacent to the sale area must be passable by two-wheel drive traffic for the duration of the sale.

5 - Operations

5.1 - Notification

5.1.1 - Pre-sale conference (10/16)

A pre-sale conference between the Purchaser and sale administrator is required prior to beginning any operations to determine landing and road locations. The Unit Manager or his/her representative must be contacted at least 5 days in advance to schedule the conference.

5.1.4 - Post-sale conference (10/16)

A post-sale conference on site between the Purchaser and sale administrator is required 5 days prior to the completion of active logging operations to determine clean-up and repair of landings, road edges, and the fulfillment of other contract specifications.

5.1.6 - Utility R.O.W. (1/15)

It is the responsibility of the Purchaser to obtain permission from the utility company to utilize the power line R.O.W. for operations. The utility line within Payment Unit 3 can be worked around, however, if it is used, the utility company must be contacted.

5.2 - Conduct of Operations

5.2.2 - Hazard Trees/Snags

5.2.2.1 - Den trees (10/16)

Obvious hollow and/or den trees shall be protected and left standing unless they are a safety hazard.

5.2.3 - Operating Restrictions

5.2.3.1 - Operating restrictions (9/11)

Within Payment Unit(s) 1, 2 & 3, unless changed by written agreement, cutting, skidding, and hauling are limited to the period of December 1 to April 1. This restriction is because of wet soil within the sale area.

5.2.3.3 - Bark slippage restriction (3/09)

Within Payment Unit(s) 1 & 3, unless changed by written agreement, cutting and skidding are not permitted during the period of April 15 to July 15. This restriction is because of bark slippage.

5.2.3.4 - Oak wilt restriction, no exceptions (1/18)

Within Payment Unit(s) 1, 2 & 3, cutting and skidding within the sale and brushing of access roads to the sale are not permitted during the period of April 15 to July 15. No exceptions will be granted. This is necessary to reduce the spread of oak wilt.

5.2.3.6 - Bark beetle restriction (12/08)

In the event drought creates a high risk of pine bark beetle infestation, pine is not to be cut during the period March 1 through July 1, unless all portions of trees greater than two inches in diameter are removed from the sale area, reduced to chips, or treated to the satisfaction of the Unit Manager or his/her representative, within fifteen days of being severed from the stump. Pine log decks, pulpwood piles and treetops that are piled for chipping in the fall or winter within a 1/4 mile of susceptible sites must be removed before March 15. Residual slash must not be placed in piles or rows and must be spread over the site for quick drying. The Department of Natural Resources will exercise this specification if the risk of damage warrants.

5.2.41 - Snowmobile trail protection (9/11)

The snowmobile trail is on Sunset Trail and is shown on the Timber Sale Map. Do not cut or damage posts with orange trail markers or traffic control signs.

5.4 - Soil Protection

5.4.1 - Rutting restriction, general (7/16)

Operations are to cease immediately if equipment and weather conditions result in rutting of roads and/or skid trails which is 12 inches or greater in depth and 50 feet in length. The Unit Manager or his/her representative may restrict hauling and/or skidding if ruts exceed the specified depth. With the Unit Manager or his/her representative's approval, the Purchaser may return to the area when the risk of rutting has decreased.

5.8 - Protection of Endangered Species

5.8.5 - Protection of raptor nests (3/13)

All trees with raptor nests will be protected if found during harvesting operations. Notification will be made to the Unit Manager or his/her representative who will notify the Wildlife Biologist so an on-site evaluation and recommendation can be made, if necessary.

6 - Safety and Fire Prevention

6.2 - Signing

6.2.1 - Road posting (9/09)

The Purchaser is responsible for posting and maintaining caution signs on Sunset Trail prior to beginning operations. The road must be posted at appropriate distances from the sale area to warn of logging activity and truck traffic. Signs must be removed when harvest operations are suspended or completed. The Purchaser will provide these signs.



Sale Number	Year
61-120	19

TIMBER SALE MAP

This information provided by authority of Part 525, 1994 PA 451, as amended.

Forest Management Unit Traverse City	County Kalkaska	Mapped By Roell	Date 04/11/2019	Page 1	of 1
Township 26N	Range 06W	Section(s) and Subdivision(s) SESW, S1/2SE S26; E1/2NE S34; NW1/4, NWNE S35	Scale 1:15,840		

Cover Type				Density	
A = Aspen	H = Hemlock	N = Marsh	U = Upland Brush	0 = Non Stocked	5 = Pole Timber Medium
B = Paper Birch	J = Jack Pine	O = Oak	UM = Upland Mixed	1 = Seeding Sapling Poor	6 = Pole Timber Well
C = Cedar	L = Lowland Birch	P = Lowland Poplar	V = Bog or Marsh	2 = Seeding Sapling Medium	7 = Saw Timber Poor
D = Treed Bog	LM = Lowland Mixed	Q = Mixed Swamp Conifer	W = White Pine	3 = Seeding Sapling Well	8 = Saw Timber Medium
E = Swamp Hardwoods	M = Mpl. Ech. Birch	R = Red Pine	X = Non Stocked	4 = Pole Timber Poor	9 = Saw Timber Well
F = Spruce Fir	MC = Mixed Conifer	S = Black Spruce	Z = Water		
G = Cress	MD = Mixed Deciduous	T = Tamarack			

PU	Acres
1	26.3
2	14.9
3	75.3

Philip Pine Compartment 128 116.5 Acres

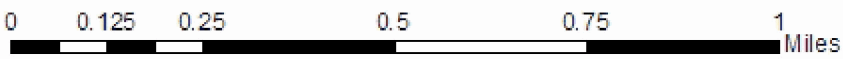
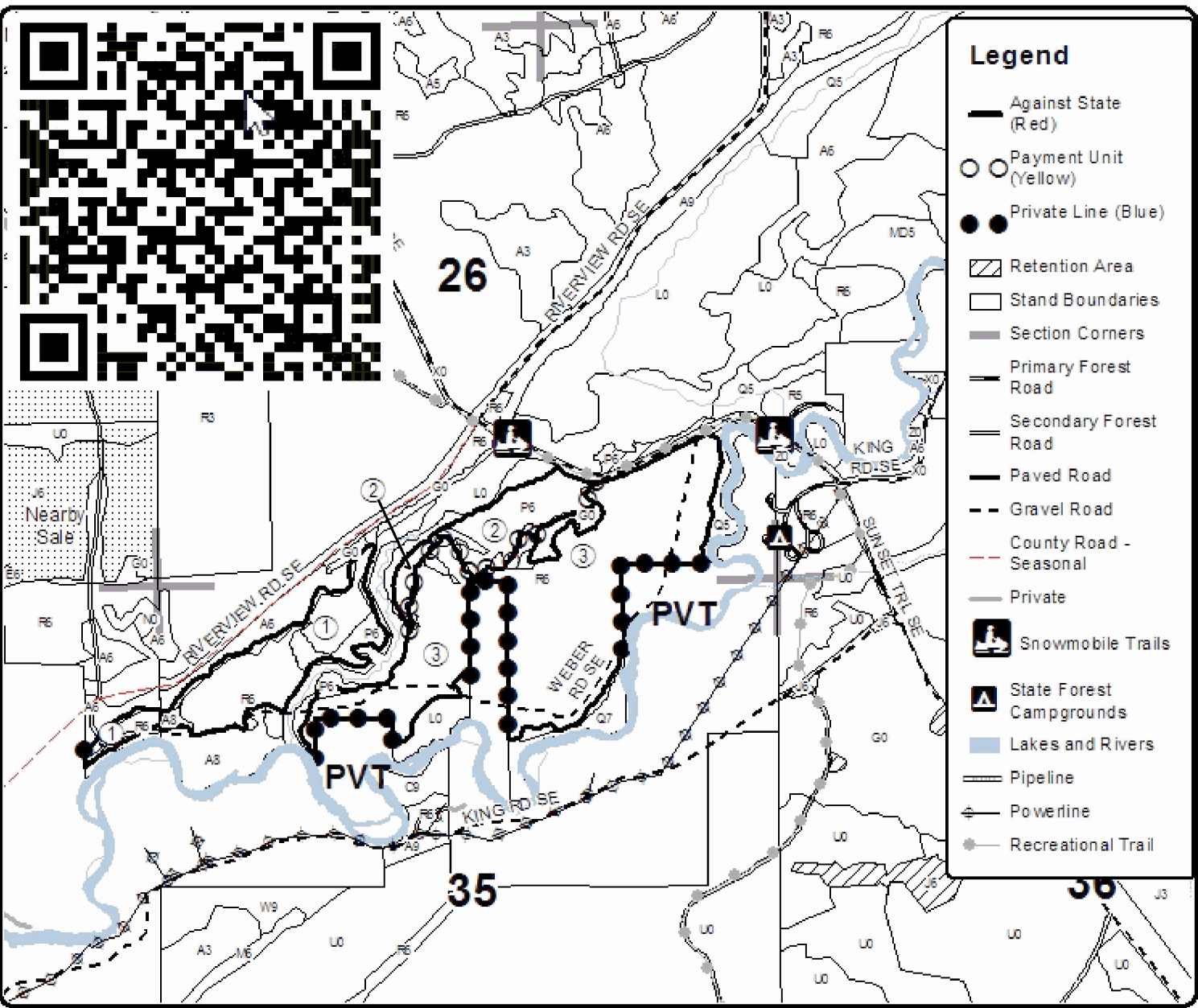
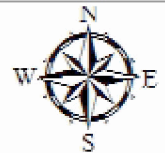

TIMBER SALE INFORMATION

247 Creek n Coster (61-145-18)

T25N, R08W, SEC. 26; T25N, R08W, SEC. 27; T25N, R08W, SEC. 34; T25N, R08W, SEC. 35.
Kalkaska County (Advertised Price \$136,239.20)

A timber sale contract for this lump sum, sealed bid timber sale will be awarded to the responsible bidder offering the highest sealed bid price. Bids must be at or above the following advertised price for each species:

<u>PRODUCTS & SPECIES</u>	<u>ESTIMATED UNITS*</u>	<u>ADVERTISED PRICE</u>
Sawtimber		
Basswood	3.50 MBF	\$ 106.00 / MBF
Mixed Aspen	182.20 MBF	\$ 122.00 / MBF
Paper Birch	4.40 MBF	\$ 44.00 / MBF
Red Maple	43.70 MBF	\$ 120.00 / MBF
Red Oak	12.30 MBF	\$ 200.00 / MBF
Red Pine	184.40 MBF	\$ 109.00 / MBF
White Pine	303.30 MBF	\$ 49.00 / MBF
Pulpwood		
Balsam Fir	663.00 Cords	\$ 10.95 / Cord
Basswood	11.00 Cords	\$ 18.90 / Cord
Mixed Aspen	1,636.00 Cords	\$ 18.50 / Cord
Mixed Hardwood	757.00 Cords	\$ 16.20 / Cord
Mixed Spruce	49.00 Cords	\$ 17.75 / Cord
Red Oak	42.00 Cords	\$ 11.70 / Cord
Red Pine	326.00 Cords	\$ 33.85 / Cord
White Pine	610.00 Cords	\$ 13.75 / Cord

* The total volume is statistically estimated within plus (+) or minus (-) 9.40 percent. The estimated units are final and not subject to adjustment. Prospective bidders are urged to examine this timber and to make their own estimates of quantity and quality.

BOND AND PAYMENT SCHEDULE:

1. A bond in the amount of \$6,812.00 to insure faithful performance of the conditions of the contract will be deposited by the successful bidder within 21 days of the sale award.
2. Cutting in any sale or unit without the required advance payment would be considered a trespass.
3. Total payment must be paid in advance or according to the following schedule:
 - (a) Ten percent (10%) of the sale value must be paid within 21 days of the sale award.
 - (b) The 10% down payment will be credited towards the first unit cut.
 - (c) Payment for each of the following units must be made before cutting begins in that unit:

<u>PAYMENT UNIT NUMBER</u>	<u>PERCENT OF TOTAL SALE VALUE</u>
01	8.2%
02	28.1%
03	9.4%
04	1.9%
05	4.6%
06	7.8%
07	28.6%
08	11.4%

4. If no cutting takes place, the 10% down payment will not be refunded.
5. Operations on the contract issued will terminate on 09/30/2022.

Description of Timber by Payment Unit (PU)

PU	MARKET GROUP	PRODUCT	QUANTITY	UNIT	ACRES	ADVERTISE PRICE
1	Mixed Aspen	Sawtimber Pulpwood	22.2	MBF	27.0	\$11,115.50
	<i>B. T. Aspen</i>		22.2	<i>MBF</i>		
	Red Maple		5.2	MBF		
	Balsam Fir		123.0	Cords		
	Mixed Aspen		207.0	Cords		
	<i>B. T. Aspen</i>		207.0	<i>Cords</i>		
	Mixed Hardwood		90.0	Cords		
	<i>Red Maple</i>		90.0	<i>Cords</i>		
	Mixed Spruce		41.0	Cords		
	<i>Black Spruce</i>		41.0	<i>Cords</i>		
	Red Pine		10.0	Cords		
White Pine	6.0	Cords				
2	Mixed Aspen	Sawtimber Pulpwood	122.7	MBF	52.0	\$38,285.30
	<i>B. T. Aspen</i>		118.7	<i>MBF</i>		
	<i>Quaking Aspen</i>		4.0	<i>MBF</i>		
	Paper Birch		3.3	MBF		
	Red Maple		12.1	MBF		
	White Pine		49.7	MBF		
	Balsam Fir		148.0	Cords		
	Mixed Aspen		695.0	Cords		
	<i>B. T. Aspen</i>		656.0	<i>Cords</i>		
	<i>Quaking Aspen</i>		39.0	<i>Cords</i>		
	Mixed Hardwood		164.0	Cords		
	<i>Paper Birch</i>		9.0	<i>Cords</i>		
	<i>Red Maple</i>		155.0	<i>Cords</i>		
	Red Oak		5.0	Cords		
	White Pine		152.0	Cords		
3	Mixed Aspen	Sawtimber Pulpwood	1.4	MBF	22.7	\$12,864.25
	<i>B. T. Aspen</i>		1.4	<i>MBF</i>		
	Red Maple		0.8	MBF		
	Red Pine		44.3	MBF		
	Mixed Aspen		15.0	Cords		
	<i>B. T. Aspen</i>		15.0	<i>Cords</i>		
	Mixed Hardwood		9.0	Cords		
	<i>Red Maple</i>		9.0	<i>Cords</i>		
Red Pine	217.0	Cords				
4	Mixed Aspen	Sawtimber Pulpwood	1.0	MBF	3.8	\$2,634.35
	<i>B. T. Aspen</i>		1.0	<i>MBF</i>		
	Red Maple		2.2	MBF		
	White Pine		19.2	MBF		
	Mixed Aspen		22.0	Cords		
	<i>B. T. Aspen</i>		22.0	<i>Cords</i>		
	Mixed Hardwood		14.0	Cords		
	<i>Red Maple</i>		14.0	<i>Cords</i>		
White Pine	49.0	Cords				
5	Mixed Aspen	Sawtimber Pulpwood	1.7	MBF	17.9	\$6,266.15
	<i>B. T. Aspen</i>		1.7	<i>MBF</i>		
	Paper Birch		1.1	MBF		
	Red Maple		4.1	MBF		
	Red Oak		1.1	MBF		
	White Pine		2.4	MBF		
	Balsam Fir		144.0	Cords		
	Basswood		4.0	Cords		
	Mixed Aspen		103.0	Cords		
	<i>B. T. Aspen</i>		5.0	<i>Cords</i>		
<i>Quaking Aspen</i>	98.0	<i>Cords</i>				

Description of Timber by Payment Unit (PU), con't

PU	MARKET GROUP	PRODUCT	QUANTITY	UNIT	ACRES	ADVERTISE PRICE
5 con't	Mixed Hardwood	Pulpwood	85.0	Cords		
	<i>Paper Birch</i>		2.0	<i>Cords</i>		
	<i>Red Maple</i>		83.0	<i>Cords</i>		
	Mixed Spruce		8.0	Cords		
	<i>White Spruce</i>		8.0	<i>Cords</i>		
	Red Oak		3.0	Cords		
	White Pine		5.0	Cords		
6	Mixed Aspen	Sawtimber	23.2	MBF	21.3	\$10,584.85
	<i>B. T. Aspen</i>		19.5	<i>MBF</i>		
	<i>Quaking Aspen</i>		3.7	<i>MBF</i>		
	Red Maple		2.7	MBF		
	Red Pine		2.1	MBF		
	White Pine		2.1	MBF		
	Balsam Fir	Pulpwood	72.0	Cords		
	Mixed Aspen		272.0	Cords		
	<i>B. T. Aspen</i>		187.0	<i>Cords</i>		
	<i>Quaking Aspen</i>		85.0	<i>Cords</i>		
	Mixed Hardwood		68.0	Cords		
	<i>Paper Birch</i>		6.0	<i>Cords</i>		
	<i>Red Maple</i>		62.0	<i>Cords</i>		
	Red Pine		4.0	Cords		
	White Pine		3.0	Cords		
7	Basswood	Sawtimber	3.5	MBF	57.6	\$38,965.75
	Mixed Aspen		10.0	MBF		
	<i>Quaking Aspen</i>		10.0	<i>MBF</i>		
	Red Maple		11.9	MBF		
	Red Oak		11.2	MBF		
	Red Pine		89.6	MBF		
	White Pine	145.9	MBF			
	Balsam Fir	Pulpwood	140.0	Cords		
	Basswood		7.0	Cords		
	Mixed Aspen		255.0	Cords		
	<i>B. T. Aspen</i>		11.0	<i>Cords</i>		
	<i>Quaking Aspen</i>		244.0	<i>Cords</i>		
	Mixed Hardwood		235.0	Cords		
	<i>Red Maple</i>		235.0	<i>Cords</i>		
	Red Oak		34.0	Cords		
Red Pine	74.0		Cords			
White Pine	269.0	Cords				
8	Red Maple	Sawtimber	4.7	MBF	21.7	\$15,523.05
	Red Pine		48.4	MBF		
	White Pine		84.0	MBF		
	Balsam Fir	Pulpwood	36.0	Cords		
	Mixed Aspen		67.0	Cords		
	<i>Quaking Aspen</i>		67.0	<i>Cords</i>		
	Mixed Hardwood		92.0	Cords		
	<i>Black Cherry</i>		46.0	<i>Cords</i>		
	<i>Red Maple</i>		46.0	<i>Cords</i>		
	Red Pine		21.0	Cords		
White Pine	126.0	Cords				
TOTAL:			733.8	MBF		
TOTAL:			4,094.0	Cords		

Sale Specific Conditions & Requirements

Sale Name: 247 Creek n Coster

Sale Number: 61-145-18 Seq#: 1

1 - Sale Area

1.2 - Boundaries

1.2.1 - Painted boundaries (1/14)

The sale boundary and Payment Unit boundaries are marked and identified by blue, red and yellow paint, along with cover type changes. Exterior sale boundary lines against private property are marked with blue paint. Exterior sale boundary lines against state are marked with red paint, with the exception of the boundaries for Payment Unit 3, which are unpainted and identified by the R6 type change. The Interior Payment Unit boundary for Payment Unit 4 is marked with yellow paint. Yellow painted trees designating an interior Payment Unit boundary are only to be cut when all surrounding Payment Units have been paid for and they are designated for removal in both adjacent payment units.

2 - Timber Specifications

2.1 - Included Timber

2.1.1 - Clearcut unit(s) with unmerchantable trees (6/14)

Within Payment Unit(s) 1, 2 & 6, cut all trees that are two (2) inches or more at DBH, except do not cut balsam fir or white pine under 4" at DBH. In addition, do not cut any oak, cedar, hemlock, yellow birch, red pine or trees marked with green paint. Note: there is no painted boundary between Payment Units 3 and 1, 2, & 6 - See spec 1.2.1.

2.1.3 - Cut tree marked unit(s) (12/08)

Within Payment Unit(s) 3, all trees are designated for cutting when marked with orange paint above and below stump height, regardless of merchantability. In addition, cut all red maple, cherry and aspen. Note: there is no painted boundary between Payment Units 3 and 1, 2, & 6 - See spec 1.2.1.

2.1.7 - Leave tree marked unit(s) (6/14)

Within Payment Unit(s) 4, 5, 7 & 8, cut all trees that are three (3) inches or more at DBH, except do not cut cedar, hemlock, yellow birch and trees marked with green paint above and below stump height.

3 - Payments

3.3 - Pre-measured Sales

3.3.4 - Dividing payment units (7/14)

Payment Unit(s) over \$20,000 in value may be divided at the request of the Purchaser and upon approval of the Unit Manager. Dividing Payment Units is a contract modification which requires a Timber Sale Contract Supplement.

4 - Transportation

4.1 - Construction

4.1.6 - Road construction (1/09)

Construction of new roads or improvements of existing roads shall be done in such a way as to minimize the environmental and visual impacts. Merchantable trees shall be cut and utilized unless otherwise directed. Non-merchantable trees shall be severed and laid flat on the ground. Slash shall be scattered, and not left in windrows and kept a minimum of 10 feet back from the road edge. Stumps shall be set upright, not left on edge, and be moved at least 10 feet away from the road edge. Disturbed soil shall be feathered into the woods and not left in berms or windrows.

4.1.7 - Road closure (10/11)

All new roads built into the sale must be blocked to vehicle traffic within 30 days of completion of hauling. Overgrown roads that are reopened shall be considered new roads. In general, this will require constructing a four (4') foot high berm of stumps and logs covered with earth. Stumps and brush must be placed along the remainder of the trail where they are readily available.

5 - Operations

5.2 - Conduct of Operations

5.2.2 - Hazard Trees/Snags

5.2.2.1 - Den trees (10/16)

Obvious hollow and/or den trees shall be protected and left standing unless they are a safety hazard.

5.2.3 - Operating Restrictions

5.2.3.1 - Operating restrictions (9/11)

Within Payment Unit(s) 5 & 8, unless changed by written agreement, cutting, skidding, and hauling are limited to extremely dry or frozen ground conditions. This will be at the discretion of the sale administrator and Unit manager. This restriction is because of wet ground within these units.

5.2.3.11 - Coppice regeneration protection (4/10)

Timber harvesting in any Payment Unit must be completed before significant aspen sprouting occurs in that Payment Unit so as to minimize damage to the new regeneration. Any post harvest operations, such as chipping, must be completed before sprouting of regeneration occurs. If it is anticipated that chipping will be delayed, then tops shall be carried to one central location or left unchipped. The Unit Manager or his/her representative may cease such operations if sprouting occurs before the operation is complete.

5.2.4 - Dead and Down Creation

5.2.4.2 - Dead and down creation, hare and grouse (1/14)

To improve habitat for snowshoe hare, grouse, and other species, the Purchaser is to leave at least one brush pile (10' length x 10' width x 5' height) on the ground for every two acres within Payment Unit(s) 1, 2, 5, 6, and 8. Larger cull pieces should be incorporated into the base of the brush piles. They should be scattered throughout the sale or positioned per the sale administrators instructions.

5.4 - Soil Protection

5.4.1 - Rutting restriction, general (7/16)

Operations are to cease immediately if equipment and weather conditions result in rutting of roads and/or skid trails which is 12 inches or greater in depth and 50 feet in length. The Unit Manager or his/her representative may restrict hauling and/or skidding if ruts exceed the specified depth. With the Unit Manager or his/her representative's approval, the Purchaser may return to the area when the risk of rutting has decreased.

6 - Safety and Fire Prevention

6.2 - Signing

6.2.1 - Road posting (9/09)

The Purchaser is responsible for posting and maintaining caution signs on Spring Creek Road prior to beginning operations. The road must be posted at appropriate distances from the sale area to warn of logging activity and truck traffic. Signs must be removed when harvest operations are suspended or completed. The Purchaser will provide these signs.



TIMBER SALE MAP

This information provided by authority of Part 525, 1994 PA 451, as amended.

Sale Number	Year
61-145	18

Forest Management Unit	County	Mapped By	Date	Page	of
Traverse city Mgmt Unit	Kalkaska	Standerfer	9/5/18	1	1
Township	Range	Section(s) and Subdivision(s)	Scale		
25N	08W	27 & 34 (see map below and sale proposal)	1:15,840		

Cover Type				Density	
A = Aspen	H = Hemlock	N = Marsh	U = Upland Brush	0 = Non Stocked	5 = Pole Timber Medium
B = Paper Birch	J = Jack Pine	O = Oak	UM = Upland Mixed	1 = Seedling Sapling Poor	6 = Pole Timber Well
C = Cedar	L = Lowland Brush	P = Lowland Poplar	V = Bog or Marsh	2 = Seedling Sapling Medium	7 = Saw Timber Poor
D = Tread Bog	LM = Lowland Mixed	Q = Mixed Swamp Conifer	W = White Pine	3 = Seedling Sapling Well	8 = Saw Timber Medium
E = Swamp Hdwoods	M = Mpl, Bch, Brch	R = Red Pine	X = Non Stocked	4 = Pole Timber Poor	9 = Saw Timber Well
F = Spruce Fir	MC = Mixed Conifer	S = Black Spruce	Z = Water		
G = Grass	MD = Mixed Deciduous	T = Tamarack			

247 Creek N Coster

Compartment 247
224 Acres

Lat:44.5410
Long: -85.2590

PU	Acres	PU	Acres
1	27 (A6)	6	21.3 (A6)
2	52 (A6)	7	57.6 (MC6)
3	22.7 (R6)	8	21.7 (MC6)
4	3.8 (W9)		
5	17.9 (LM6)		

1	27 (A6)	6	21.3 (A6)
2	52 (A6)	7	57.6 (MC6)
3	22.7 (R6)	8	21.7 (MC6)
4	3.8 (W9)		
5	17.9 (LM6)		

Note: The Payment Unit boundaries between PU 3 and adjacent units are unpainted and are identified by the R6 timber type change.

Legend

- Against State (Red / Type Change)
- ○ Payment Unit (Yellow)
- ● Private Line (Blue)
- ▨ Retention Area
- == Secondary Forest Road
- == Forest Access Route
- Paved Road
- - Gravel Road
- - County Road - Seasonal
- State Forests

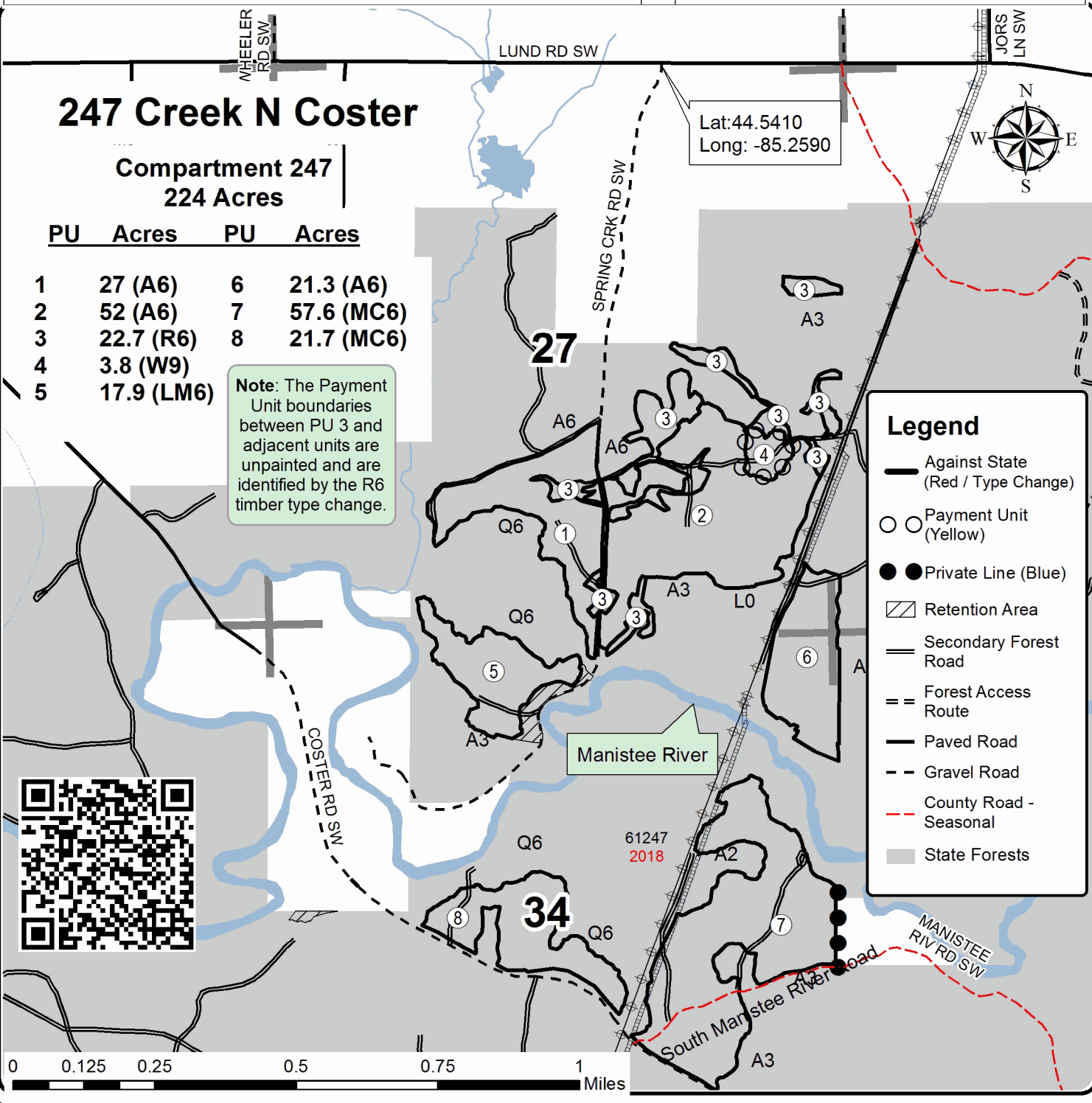

247 Creek n Coster (61-145-18)
T25N, R08W, SEC. 26; T25N, R08W, SEC. 27; T25N, R08W, SEC. 34; T25N,

In response to the notice of sale to be held 4:00 p.m. (local time) on July 1, 2019, I am hereby submitting my sealed bid (firm offer) for the following forest products to be cut. Bids for individual species must be at or above the advertised price. All non-responsive bid forms may be rejected.

<u>PRODUCTS & SPECIES</u>	<u>ESTIMATED VOLUME*</u>	<u>ADVERTISED PRICE</u>	<u>BID PRICE/UNIT</u>
Sawtimber			
Basswood	3.50 MBF	\$ 106.00/MBF	\$ _____
Mixed Aspen	182.20 MBF	\$ 122.00/MBF	\$ _____
Paper Birch	4.40 MBF	\$ 44.00/MBF	\$ _____
Red Maple	43.70 MBF	\$ 120.00/MBF	\$ _____
Red Oak	12.30 MBF	\$ 200.00/MBF	\$ _____
Red Pine	184.40 MBF	\$ 109.00/MBF	\$ _____
White Pine	303.30 MBF	\$ 49.00/MBF	\$ _____
Pulpwood			
Balsam Fir	663.00 Cords	\$ 10.95/Cord	\$ _____
Basswood	11.00 Cords	\$ 18.90/Cord	\$ _____
Mixed Aspen	1,636.00 Cords	\$ 18.50/Cord	\$ _____
Mixed Hardwood	757.00 Cords	\$ 16.20/Cord	\$ _____
Mixed Spruce	49.00 Cords	\$ 17.75/Cord	\$ _____
Red Oak	42.00 Cords	\$ 11.70/Cord	\$ _____
Red Pine	326.00 Cords	\$ 33.85/Cord	\$ _____
White Pine	610.00 Cords	\$ 13.75/Cord	\$ _____

*The volumes are statistically estimated within plus (+) or minus (-) 9.40 percent. These estimated volumes are final and not subject to adjustment. Prospective bidders are urged to examine this timber and to make their own estimates of quantity and quality.

I understand that any or all bids may be rejected. All bids must be signed and all bid items must be bid or the bid form may be rejected. I also understand that consideration and awarding a contract will be based upon my past performance and ability to complete the contract based upon equipment and staffing subject to my control.

FEDERAL ID: _____ or SOCIAL SECURITY NUMBER: _____

Company or individual bidding: _____

Company representative's name: _____

Address: _____

City: _____ State: _____ Zip: _____

IF AVAILABLE, PLEASE PLACE THE PERSONALIZED LABEL FROM YOUR PROSPECTUS IN THE ABOVE BOX.

Individual or company representative's signature: _____ Date: _____

Phone number : _____ Email (optional): _____

THE WINNING BIDDER MUST COMPLETE THE VERIFICATION OF WORKER'S DISABILITY COMPENSATION ACT COMPLIANCE (ON REVERSE SIDE IF DOUBLE SIDED) WITHIN 21 DAYS OF SALE AWARD DATE



FOR DEPARTMENT USE ONLY
Sale Number (XX - XXX - XX - XX)
Forest Management Unit:

TIMBER SALE VERIFICATION OF WORKER'S DISABILITY COMPENSATION ACT COMPLIANCE

*As required by Act 317, P.A. 1969 (Worker's Compensation) and
Part 5 of Act 451 of 1994, as amended.*

VERIFICATION OF WORKER'S DISABILITY COMPENSATION ACT COMPLIANCE

- This verification must be completed and submitted within 21 days of contract award and prior to the issuance of the timber sale contract.
- In addition, if boxes 2B or 2C are checked, then Notice of Exclusion or Certificate of Insurance must be submitted within twenty-one (21) days of the contract award and prior to the issuance of the timber sale contract.
- All information must be typed or printed except for written signatures.

Please Check Appropriate Categories:

1. My business is organized as (you **must** check one of the boxes below):
 - A. Sole Proprietorship (individual)
 - B. Partnership
 - C. Corporation

2. You **must** check one of the boxes below:
 - A. I certify my business is a sole proprietorship and it has no employees but the sole proprietor. I am not subject to the Worker's Compensation Laws.
 - B. I certify my business has satisfied its obligation to the Worker's Compensation Act through the use of an approved Notice of Exclusion (BWC-337, Rev. 5/96). I will provide a copy of the Notice of Exclusion within 21 days of the contract award. (For questions or a copy of the BWC-337, please call the Worker's Compensation Bureau at 517-322-1195).
 - C. I certify my business has a Worker's Compensation Policy. I will provide an original Certificate of Insurance within twenty-one (21) days of the contract award.

3. If you have checked item 2(A) or 2(B), you **must** indicate the number of **both** full-time and part-time employees, other than yourself, including family members and active partners (if none, you must enter "0").

_____ Full-time Employees _____ Part-time Employees

Name of Business		Federal ID (or) Social Security No.	
Address		Telephone ()	
City	State	ZIP	

I hereby certify that the above information is true and correct. I agree to notify the Michigan DNR of any changes that occur in factors affecting my coverage during any of my present and future operations.

Signature of Owner or Authorized Representative

Title

Date

Please complete the "SEALED BID" information on the next page

Sugar Beet Mix (61-107-19)
T27N, R08W, SEC. 32; T27N, R08W, SEC. 33; Kalkaska COUNTY

In response to the notice of sale to be held 4:00 p.m. (local time) on July 1, 2019, I am hereby submitting my sealed bid (firm offer) for the following forest products to be cut. Bids for individual species must be at or above the advertised price. All non-responsive bid forms may be rejected.

<u>PRODUCTS & SPECIES</u>	<u>ESTIMATED VOLUME*</u>	<u>ADVERTISED PRICE</u>	<u>BID PRICE/UNIT</u>
Sawtimber			
B. T. Aspen	9.40 MBF	\$ 122.00/MBF	\$ _____
Red Maple	1.80 MBF	\$ 120.00/MBF	\$ _____
Red Oak	23.40 MBF	\$ 200.00/MBF	\$ _____
Red Pine	89.30 MBF	\$ 109.00/MBF	\$ _____
White Oak	29.90 MBF	\$ 43.00/MBF	\$ _____
White Pine	3.50 MBF	\$ 49.00/MBF	\$ _____
Pulpwood			
Jack Pine	827.00 Cords	\$ 11.35/Cord	\$ _____
Mixed Aspen	94.00 Cords	\$ 18.50/Cord	\$ _____
Mixed Hardwood	269.00 Cords	\$ 16.20/Cord	\$ _____
Mixed Oak	338.00 Cords	\$ 11.70/Cord	\$ _____
Red Pine	212.00 Cords	\$ 33.85/Cord	\$ _____
White Pine	103.00 Cords	\$ 13.75/Cord	\$ _____

*The volumes are statistically estimated within plus (+) or minus (-) 9.90 percent. These estimated volumes are final and not subject to adjustment. Prospective bidders are urged to examine this timber and to make their own estimates of quantity and quality.

I understand that any or all bids may be rejected. All bids must be signed and all bid items must be bid or the bid form may be rejected. I also understand that consideration and awarding a contract will be based upon my past performance and ability to complete the contract based upon equipment and staffing subject to my control.

FEDERAL ID: ____ - ____ - ____ or SOCIAL SECURITY NUMBER: ____ - ____ - ____

Company or individual bidding: _____

Company representative's name: _____

Address: _____

City: _____ State: _____ Zip: _____

IF AVAILABLE, PLEASE PLACE THE PERSONALIZED LABEL FROM YOUR PROSPECTUS IN THE ABOVE BOX.

Individual or company representative's signature: _____ Date: _____

Phone number : _____ Email (optional): _____

THE WINNING BIDDER MUST COMPLETE THE VERIFICATION OF WORKER'S DISABILITY COMPENSATION ACT COMPLIANCE (ON REVERSE SIDE IF DOUBLE SIDED) WITHIN 21 DAYS OF SALE AWARD DATE



FOR DEPARTMENT USE ONLY
Sale Number (XX - XXX - XX - XX)
Forest Management Unit:

TIMBER SALE VERIFICATION OF WORKER'S DISABILITY COMPENSATION ACT COMPLIANCE

*As required by Act 317, P.A. 1969 (Worker's Compensation) and
Part 5 of Act 451 of 1994, as amended.*

VERIFICATION OF WORKER'S DISABILITY COMPENSATION ACT COMPLIANCE

- This verification must be completed and submitted within 21 days of contract award and prior to the issuance of the timber sale contract.
- In addition, if boxes 2B or 2C are checked, then Notice of Exclusion or Certificate of Insurance must be submitted within twenty-one (21) days of the contract award and prior to the issuance of the timber sale contract.
- All information must be typed or printed except for written signatures.

Please Check Appropriate Categories:

1. My business is organized as (you **must** check one of the boxes below):
 - A. Sole Proprietorship (individual)
 - B. Partnership
 - C. Corporation
2. You **must** check one of the boxes below:
 - A. I certify my business is a sole proprietorship and it has no employees but the sole proprietor. I am not subject to the Worker's Compensation Laws.
 - B. I certify my business has satisfied its obligation to the Worker's Compensation Act through the use of an approved Notice of Exclusion (BWC-337, Rev. 5/96). I will provide a copy of the Notice of Exclusion within 21 days of the contract award. (For questions or a copy of the BWC-337, please call the Worker's Compensation Bureau at 517-322-1195).
 - C. I certify my business has a Worker's Compensation Policy. I will provide an original Certificate of Insurance within twenty-one (21) days of the contract award.
3. If you have checked item 2(A) or 2(B), you **must** indicate the number of **both** full-time and part-time employees, other than yourself, including family members and active partners (if none, you must enter "0").

_____ Full-time Employees

_____ Part-time Employees

Name of Business		Federal ID (or) Social Security No.	
Address		Telephone ()	
City	State	ZIP	

I hereby certify that the above information is true and correct. I agree to notify the Michigan DNR of any changes that occur in factors affecting my coverage during any of my present and future operations.

Signature of Owner or Authorized Representative

Title

Date

Please complete the "SEALED BID" information on the next page

Holiday Hardwoods (61-108-19)
T27N, R08W, SEC. 8; Kalkaska COUNTY

In response to the notice of sale to be held 4:00 p.m. (local time) on July 1, 2019, I am hereby submitting my sealed bid (firm offer) for the following forest products to be cut. Bids for individual species must be at or above the advertised price. All non-responsive bid forms may be rejected.

<u>PRODUCTS & SPECIES</u>	<u>ESTIMATED VOLUME*</u>	<u>ADVERTISED PRICE</u>	<u>BID PRICE/UNIT</u>
Sawtimber			
Basswood	99.00 MBF	\$ 99.00/MBF	\$ _____
Beech	19.40 MBF	\$ 87.00/MBF	\$ _____
Black Cherry	31.50 MBF	\$ 124.00/MBF	\$ _____
Red Maple	2.40 MBF	\$ 112.00/MBF	\$ _____
Red Oak	1.70 MBF	\$ 186.00/MBF	\$ _____
Red Pine	21.50 MBF	\$ 102.00/MBF	\$ _____
Sugar Maple	134.70 MBF	\$ 259.00/MBF	\$ _____
White Pine	3.60 MBF	\$ 46.00/MBF	\$ _____
Pulpwood			
Basswood	126.00 Cords	\$ 17.65/Cord	\$ _____
Mixed Aspen	32.00 Cords	\$ 17.25/Cord	\$ _____
Mixed Hardwood	694.00 Cords	\$ 15.10/Cord	\$ _____
Red Oak	8.00 Cords	\$ 10.90/Cord	\$ _____
Red Pine	92.00 Cords	\$ 31.55/Cord	\$ _____
White Pine	3.00 Cords	\$ 12.85/Cord	\$ _____

*The volumes are statistically estimated within plus (+) or minus (-) 12.80 percent. These estimated volumes are final and not subject to adjustment. Prospective bidders are urged to examine this timber and to make their own estimates of quantity and quality.

I understand that any or all bids may be rejected. All bids must be signed and all bid items must be bid or the bid form may be rejected. I also understand that consideration and awarding a contract will be based upon my past performance and ability to complete the contract based upon equipment and staffing subject to my control.

FEDERAL ID: ____ - ____ - ____ or SOCIAL SECURITY NUMBER: ____ - ____ - ____

Company or individual bidding: _____

Company representative's name: _____

Address: _____

City: _____ State: _____ Zip: _____

IF AVAILABLE, PLEASE PLACE THE PERSONALIZED LABEL FROM YOUR PROSPECTUS IN THE ABOVE BOX.

Individual or company representative's signature: _____ Date: _____

Phone number : _____ Email (optional): _____

THE WINNING BIDDER MUST COMPLETE THE VERIFICATION OF WORKER'S DISABILITY COMPENSATION ACT COMPLIANCE (ON REVERSE SIDE IF DOUBLE SIDED) WITHIN 21 DAYS OF SALE AWARD DATE



FOR DEPARTMENT USE ONLY
Sale Number (XX - XXX - XX - XX)
Forest Management Unit:

TIMBER SALE VERIFICATION OF WORKER'S DISABILITY COMPENSATION ACT COMPLIANCE

*As required by Act 317, P.A. 1969 (Worker's Compensation) and
Part 5 of Act 451 of 1994, as amended.*

VERIFICATION OF WORKER'S DISABILITY COMPENSATION ACT COMPLIANCE

- This verification must be completed and submitted within 21 days of contract award and prior to the issuance of the timber sale contract.
- In addition, if boxes 2B or 2C are checked, then Notice of Exclusion or Certificate of Insurance must be submitted within twenty-one (21) days of the contract award and prior to the issuance of the timber sale contract.
- All information must be typed or printed except for written signatures.

Please Check Appropriate Categories:

1. My business is organized as (you **must** check one of the boxes below):
 - A. Sole Proprietorship (individual)
 - B. Partnership
 - C. Corporation

2. You **must** check one of the boxes below:
 - A. I certify my business is a sole proprietorship and it has no employees but the sole proprietor. I am not subject to the Worker's Compensation Laws.
 - B. I certify my business has satisfied its obligation to the Worker's Compensation Act through the use of an approved Notice of Exclusion (BWC-337, Rev. 5/96). I will provide a copy of the Notice of Exclusion within 21 days of the contract award. (For questions or a copy of the BWC-337, please call the Worker's Compensation Bureau at 517-322-1195).
 - C. I certify my business has a Worker's Compensation Policy. I will provide an original Certificate of Insurance within twenty-one (21) days of the contract award.

3. If you have checked item 2(A) or 2(B), you **must** indicate the number of **both** full-time and part-time employees, other than yourself, including family members and active partners (if none, you must enter "0").

_____ Full-time Employees

_____ Part-time Employees

Name of Business		Federal ID (or) Social Security No.	
Address		Telephone ()	
City	State	ZIP	

I hereby certify that the above information is true and correct. I agree to notify the Michigan DNR of any changes that occur in factors affecting my coverage during any of my present and future operations.

Signature of Owner or Authorized Representative

Title

Date

Please complete the "SEALED BID" information on the next page

Philip Pine (61-120-19)

T26N, R06W, SEC. 26; T26N, R06W, SEC. 34; T26N, R06W, SEC. 35; Kalkaska

In response to the notice of sale to be held 4:00 p.m. (local time) on July 1, 2019, I am hereby submitting my sealed bid (firm offer) for the following forest products to be cut. Bids for individual species must be at or above the advertised price. All non-responsive bid forms may be rejected.

<u>PRODUCTS & SPECIES</u>	<u>ESTIMATED VOLUME*</u>	<u>ADVERTISED PRICE</u>	<u>BID PRICE/UNIT</u>
Sawtimber			
B. T. Aspen	11.10 MBF	\$ 122.00/MBF	\$ _____
Red Maple	3.80 MBF	\$ 120.00/MBF	\$ _____
Red Pine	338.90 MBF	\$ 109.00/MBF	\$ _____
Pulpwood			
Jack Pine	1.00 Cords	\$ 11.35/Cord	\$ _____
Mixed Aspen	167.00 Cords	\$ 18.50/Cord	\$ _____
Red Maple	7.00 Cords	\$ 16.20/Cord	\$ _____
Red Pine	709.00 Cords	\$ 33.85/Cord	\$ _____

*The volumes are statistically estimated within plus (+) or minus (-) 10.73 percent. These estimated volumes are final and not subject to adjustment. Prospective bidders are urged to examine this timber and to make their own estimates of quantity and quality.

I understand that any or all bids may be rejected. All bids must be signed and all bid items must be bid or the bid form may be rejected. I also understand that consideration and awarding a contract will be based upon my past performance and ability to complete the contract based upon equipment and staffing subject to my control.

FEDERAL ID: _____ or SOCIAL SECURITY NUMBER: _____

Company or individual bidding: _____

Company representative's name: _____

Address: _____

City: _____ State: _____ Zip: _____

IF AVAILABLE, PLEASE PLACE THE PERSONALIZED LABEL FROM YOUR PROSPECTUS IN THE ABOVE BOX.

Individual or company representative's signature: _____ Date: _____

Phone number : _____ Email (optional): _____

THE WINNING BIDDER MUST COMPLETE THE VERIFICATION OF WORKER'S DISABILITY COMPENSATION ACT COMPLIANCE (ON REVERSE SIDE IF DOUBLE SIDED) WITHIN 21 DAYS OF SALE AWARD DATE



FOR DEPARTMENT USE ONLY	
Sale Number (XX - XXX - XX - XX)	
Forest Management Unit:	

TIMBER SALE VERIFICATION OF WORKER'S DISABILITY COMPENSATION ACT COMPLIANCE

As required by Act 317, P.A. 1969 (Worker's Compensation) and
Part 5 of Act 451 of 1994, as amended.

VERIFICATION OF WORKER'S DISABILITY COMPENSATION ACT COMPLIANCE

- This verification must be completed and submitted within 21 days of contract award and prior to the issuance of the timber sale contract.
- In addition, if boxes 2B or 2C are checked, then Notice of Exclusion or Certificate of Insurance must be submitted within twenty-one (21) days of the contract award and prior to the issuance of the timber sale contract.
- All information must be typed or printed except for written signatures.

Please Check Appropriate Categories:

1. My business is organized as (you **must** check one of the boxes below):
 - A. Sole Proprietorship (individual)
 - B. Partnership
 - C. Corporation
2. You **must** check one of the boxes below:
 - A. I certify my business is a sole proprietorship and it has no employees but the sole proprietor. I am not subject to the Worker's Compensation Laws.
 - B. I certify my business has satisfied its obligation to the Worker's Compensation Act through the use of an approved Notice of Exclusion (BWC-337, Rev. 5/96). I will provide a copy of the Notice of Exclusion within 21 days of the contract award. (For questions or a copy of the BWC-337, please call the Worker's Compensation Bureau at 517-322-1195).
 - C. I certify my business has a Worker's Compensation Policy. I will provide an original Certificate of Insurance within twenty-one (21) days of the contract award.
3. If you have checked item 2(A) or 2(B), you **must** indicate the number of **both** full-time and part-time employees, other than yourself, including family members and active partners (if none, you must enter "0").

_____ Full-time Employees

_____ Part-time Employees

Name of Business		Federal ID (or) Social Security No.	
Address		Telephone ()	
City	State	ZIP	

I hereby certify that the above information is true and correct. I agree to notify the Michigan DNR of any changes that occur in factors affecting my coverage during any of my present and future operations.

Signature of Owner or Authorized Representative

Title

Date

Please complete the "SEALED BID" information on the next page