



**DEPARTMENT OF NATURAL RESOURCES  
STATE OF MICHIGAN**

**TIMBER SALE PROSPECTUS #6398**

SCHEDULED SALE DATE AND TIME: 3:00 p.m. (local time) on June 11, 2019.

LOCATION: NAUBINWAY FIELD OFFICE, PO BOX 287, US 2 W11569, NAUBINWAY, MI 49762.

PROSPECTUS NOTE: The bidder is advised to inspect the sale area and review the location, estimated volumes, operating costs and contract terms of proposed sales. Please be aware that some landowners may request 60 days or more notice for access across their land.

Notice is hereby given that bids will be received by the Unit Manager, SAULT STE MARIE MANAGEMENT UNIT, for certain timber on the following described lands:

Hayfield Hardwood (45-101-18) / T44N, R10W, SEC. 7 , SWNW,NWSW.

T44N, R11W, SEC. 1 , S1/2SW.

T44N, R11W, SEC. 11, NENE.

T44N, R11W, SEC. 12, NW,NENE,S1/2NE,NESW,N1/2SE.

Mackinac County, Advertised Price \$240,093.60, 229.0 Acres, Sugar Maple, Hardwood.

SALE NOTE: Brushed in sale roads that are opened to facilitate harvesting activities will need to be closed after the purchaser is done using them. Contact sale administrator for further details.

A recreation site such as a trail, pathway, or campground is within the sale area or the vicinity. Certain restrictions/specifications may be applicable including time restrictions.

Swatter House HW (45-102-18) / T44N, R10W, SEC. 5 , S1/2NW.

T44N, R10W, SEC. 6 , NWNW,NWSW.

T44N, R11W, SEC. 1 , NW,N1/2NE,SWNE,SW,N1/2SE.

T44N, R11W, SEC. 2 , E1/2NE,E1/2SE.

T45N, R11W, SEC. 36, SESW,S1/2SE.

Mackinac County, Advertised Price \$290,844.70, 362.4 Acres, Hardwood, Sugar Maple.

SALE NOTE: A recreation site such as a trail, pathway, or campground is within the sale area or the vicinity. Certain restrictions/specifications may be applicable including time restrictions.

Baloneyville Mix (45-113-18) / T43N, R07W, SEC. 17, S1/2SW.

T43N, R07W, SEC. 18, SWSE.

T43N, R07W, SEC. 19, NW,NWNE,S1/2NE,N1/2SE.

T43N, R07W, SEC. 20, NW.

T43N, R07W, SEC. 21, E1/2SW.

T43N, R07W, SEC. 28, NENW.

Mackinac County, Advertised Price \$259,499.70, 146.7 Acres, Red Pine, Aspen.

SALE NOTE: A recreation site such as a trail, pathway, or campground is within the sale area or the vicinity. Certain restrictions/specifications may be applicable including time restrictions.

Thin It Again Rp (45-114-18) / T43N, R07W, SEC. 19, W1/2NW,NWSW.

T43N, R07W, SEC. 20, S1/2SW.

T43N, R08W, SEC. 24, SENE,NESE.

Mackinac County, Advertised Price \$63,287.10, 70.0 Acres, Red Pine, Hardwood.

SALE NOTE: A recreation site such as a trail, pathway, or campground is within the sale area or the vicinity. Certain restrictions/specifications may be applicable including time restrictions.

## BID INSTRUCTIONS (VER. 07/02/2018):

### 1. Scheduled Bid Location, Date, and Time (2/11)

Bids must be received by the Unit Manager, NAUBINWAY OFFICE, PO BOX 287 US 2 W11569, NAUBINWAY, MI 49762, no later than 3:00 p.m. (local time) on June 11, 2019. For further information concerning this sale, contact Karen Rodock at 906-477-6048 extension 2040.

### 2. Bidder's Qualifications (5/16)

Purchaser shall obtain workers compensation insurance to cover claims under Michigan's Worker's Disability Compensation Act of 1969 or similar employee benefit act of any other state applicable to an employee. If all or part of a timber sale was prepared by a private contractor, the contractor and that contractor's company are not permitted to bid on the timber sale contract. Bids will not be accepted from individuals or companies appearing on the DNR/FRD No-Bid List. This list contains the names of purchasers who previously failed to execute a contract within 21-days or who have a history of poor performance.

### 3. Preparation of Sealed Bids (5/16)

Bid Forms may be completed online thru Michigan DNR Timber Sale Online Bidding (OLB) at [www.michigan.gov/timberbidding](http://www.michigan.gov/timberbidding) or by completing the hardcopy Bid Form found in the Timber Sale Prospectus. Hardcopy Bid Forms shall be manually signed in ink. Registration in OLB is considered your 'signature' for all bids submitted thru that system. Bid prices must be entered for each species and product in the Bid Price column for all material subject to bidding and all fill-in blanks must be completed. If erasures or other changes appear on the hardcopy Bid Form, each erasure or change must be initialed by the person signing the bid.

### 4. Submission of Sealed Bids (5/16)

Bid forms may be obtained from the Unit Manager or thru OLB. Bids may be submitted hardcopy or thru OLB. All hardcopy bids must be submitted on the bid form and in an envelope clearly identified as described in this section. NOTE: Only one bid form per bid envelope. Sealed bids must be submitted to the Unit office designated in the prospectus and must be submitted at or prior to the time established in the prospectus. The envelope should show on the outside (a) the sale name or number and (b) the date and time of bid opening, as shown in the prospectus. Bids received after the time specified in the sale prospectus are late bids and will be rejected.

It is possible for a bidder to submit multiple bids on a single sale. For example, a bid may be submitted hardcopy and a bid may be submitted thru OLB. Or, two bidders from the same company could both submit bids on the same sale. If this were to happen, the State would accept all bids received and award the contract accordingly. All bidding and contractual requirements would apply to all bids received.

### 5. Public Opening of Sealed Bids (7/16)

If conditions permit, the sealed bids will be publicly opened and posted at the time and place set in the prospectus.

If a bidder, present at a bid opening, has submitted bids on more than one sale, that bidder may withdraw their unopened bid envelopes or announce the withdrawal of their online bid after being declared the successful bidder on one sale.

### 6. Award of Contract (1/11)

Award of the contract will be made to the Bidder whose bid, conforming to the prospectus, is most advantageous to the State of Michigan on the basis of total value at rates bid for the estimated quantities. The State reserves the right to reject any bid or waive any minor irregularity in bids received. A written award mailed (or otherwise furnished) to the successful Bidder shall be deemed to result in a binding contract without further action by either party.

### 7. Down Payment (1/11)

The Bidder to whom award is made must make a down payment within 21 days of the sale award. The amount of the down payment will be calculated as shown in the Bond and Payment Schedule of this prospectus. Only cash may be used to meet this requirement.

### 8. Performance Security (1/11)

As guarantee of faithful performance, a cash bond, certificate of deposit, surety bond or irrevocable letter of credit (LOC) is required within 21 days of the sale award. The amount of the performance security is shown in the Bond and

Payment Schedule of this prospectus. If an LOC or surety is used, the coverage must extend for at least 6 months beyond the contract expiration.

#### 9. Timber Sale Contract (7/18)

Additional conditions and requirements common to all timber sales are listed on the timber sale contract (R4031) and are available on line at [www.michigan.gov/timber](http://www.michigan.gov/timber). Contact the Unit Manager for additional information or a sample contract. Within 21 days of the date of the award letter, the bidder must sign the contract and provide the required down payment, performance security, and verification of worker's disability compensation. The down payment and performance security shall be in accordance with the provisions of the timber sale contract, in the sums stated in this prospectus. If these actions are not taken, then the Bidder, the Bidder's corporation, and the corporation's principals may not be permitted to bid on State timber sales for a period of 3 months after the first offense, 6 months after the second offense, and 1 year after the third offense. An offense will only be counted against the Bidder for 5 years. In addition, the Bidder certifies that if awarded this contract, the Bidder will complete the timber sale contract in accordance with its terms and any modifications thereof including requirements to purchase, cut, and remove the included timber by the expiration date.

Payment Unit values in the State Forest Timber Sale Contract are calculated based on the advertised value of the Payment Unit as a percentage of the total advertised value of the contract. The advertised value of each Payment Unit is given in the Description of Timber by Payment Unit table on the Timber Sale Information page. For example, if the value of Payment Unit 1 is advertised as \$1,500 and the total Timber Sale value is advertised as \$10,000, the contract price for Payment Unit 1 will be 15% of the total bid price ( $\$1,500/\$10,000 * 100$ ).

#### 10. Disclaimer of Estimates and Bidder's Warranty of Inspection (7/16)

Before submitting this bid, the Bidder is advised and cautioned to inspect the sale area, review the requirements of the sale contract, and take other steps as may be reasonably necessary to ascertain the location, estimated volumes, construction estimates, and operating costs of the proposed sale. Failure to do so will not relieve the Bidder from responsibility for completing the contract.

The Bidder warrants that this bid is submitted solely on the basis of the Bidder's examination and inspection of the quality and quantity of the timber offered for sale and the Bidder's opinion of the value thereof and the costs of recovery. No reliance should be placed on the State of Michigan's estimates of timber quality, quantity or costs of recovery. Bidder further acknowledges that the State of Michigan: (i) expressly disclaims any warranty of fitness of timber for any purpose; (ii) offers this timber as is without any warranty of quality (merchantability) or quantity and (iii) expressly disclaims any warranty as to the quantity or quality of timber sold.

#### 11. Certification and Chain-of-Custody (10/14)

Unless otherwise indicated in the contract under section 7 – Other Conditions of the Sale Specific Conditions & Requirements, the area encompassed by this timber sale is certified to the standards of the Forest Stewardship Council (FSC) - Certificate #SCS-FM/COC-00090N and the Sustainable Forestry Initiative (SFI) - Certificate #NSF-SFIS-5Y031-SF5. Forest products from this sale may be delivered to the mill as "FSC 100% and / or SFI certified" as long as the contractor hauling the forest products is chain-of-custody (COC) certified or covered under a COC certificate from the destination mill. The purchaser is responsible for maintaining COC after leaving the sale area.

#### 12. Good Neighbor Authority (GNA) Requirements (7/16)

If the name of this timber sales contains the acronym GNA, it is authorized by the Good Neighbor Authority (GNA) and covered by various agreements between the U.S. Forest Service and the State. The timber sale occurs on federal land and the following conditions apply:

GNA contracts on US Forest Service land will not be awarded to purchasers on the Federal list of excluded parties. The System for Award Management (SAM) will be checked for active excluded parties prior to award of contract. In addition, the Bidder to whom award is made must complete an Assurance Regarding Felony Conviction or Tax Delinquent Status for Corporate Applicants (AD-3031).

#### 13. Good Neighbor Authority (GNA) Requirements, con't (9/16)

Bidder certifies, by signing this bid form, that to the best of Bidder's knowledge that the following representations are accurate and complete.

- a. That the Bidder and its principals are not presently debarred, suspended, proposed for debarment, declared ineligible, or voluntary excluded from timber sales (covered transactions) by any Federal department or agency.
- b. That the Bidder and its principals have not within a 3-year period preceding this bid been convicted of or had a civil judgment rendered against them for commission of fraud or a criminal offense in connection with obtaining, attempting to obtain, or performing a public (Federal, State, or local) transaction or contract under a public transaction; violation of Federal or State antitrust statutes or commission of embezzlement, theft, forgery, bribery, falsification or destruction of records, making false statements, or receiving stolen property.
- c. That the Bidder and its principals are not presently indicted for or otherwise criminally or civilly charged by a governmental entity (Federal, State, or local) with commission of any of the offenses enumerated in paragraph b of this certification.
- d. That the Bidder and its principals have not within a 3-year period preceding this bid had one or more public transactions (Federal, State, or local) terminated for breach or default of a timber or forest product contract.

Bidders that cannot certify this requirement, in whole or in part, shall submit an explanation with their bid.

DAN EICHINGER  
Director



# TIMBER SALE INFORMATION

## Hayfield Hardwood (45-101-18)

T44N, R10W, SEC. 7; T44N, R11W, SEC. 1; T44N, R11W, SEC. 11; T44N, R11W, SEC. 12.

Mackinac County (Advertised Price \$240,093.60)

SALE NOTE: Brushed in sale roads that are opened to facilitate harvesting activities will need to be closed after the purchaser is done using them. Contact sale administrator for further details.

A recreation site such as a trail, pathway, or campground is within the sale area or the vicinity. Certain restrictions/specifications may be applicable including time restrictions.

A timber sale contract for this lump sum, sealed bid timber sale will be awarded to the responsible bidder offering the highest sealed bid price. Bids must be at or above the following advertised price for each species:

<u>PRODUCTS &amp; SPECIES</u>	<u>ESTIMATED UNITS*</u>		<u>ADVERTISED PRICE</u>
<b>Sawtimber</b>			
Basswood	46.20	MBF	\$ 130.00 / MBF
Beech	1.80	MBF	\$ 111.00 / MBF
Black Cherry	37.30	MBF	\$ 138.00 / MBF
Red Maple	14.80	MBF	\$ 117.00 / MBF
Sugar Maple	393.00	MBF	\$ 425.00 / MBF
<b>Pulpwood</b>			
Basswood	176.00	Cords	\$ 11.20 / Cord
Beech	130.00	Cords	\$ 21.55 / Cord
Black Cherry	194.00	Cords	\$ 21.55 / Cord
Red Maple	251.00	Cords	\$ 21.55 / Cord
Sugar Maple	2,117.00	Cords	\$ 21.55 / Cord

\* The total volume is statistically estimated within plus (+) or minus (-) 7.86 percent. The estimated units are final and not subject to adjustment. Prospective bidders are urged to examine this timber and to make their own estimates of quantity and quality.

### **BOND AND PAYMENT SCHEDULE:**

1. A bond in the amount of \$19,207.00 to insure faithful performance of the conditions of the contract will be deposited by the successful bidder within 21 days of the sale award.
2. Cutting in any sale or unit without the required advance payment would be considered a trespass.
3. Total payment must be paid in advance or according to the following schedule:
  - (a) Ten percent (10%) of the sale value must be paid within 21 days of the sale award.
  - (b) The 10% down payment will be credited towards the first unit cut.
  - (c) Payment for each of the following units must be made before cutting begins in that unit:

PAYMENT UNIT NUMBER	PERCENT OF TOTAL SALE VALUE
01	10.7%
02	9.9%
03	5.7%
04	17.4%
05	8.1%
06	13.9%
07	4.2%
08	10.5%
09	10.3%
10	9.3%

4. If no cutting takes place, the 10% down payment will not be refunded.
5. Operations on the contract issued will terminate on 12/31/2021.

**Description of Timber by Payment Unit (PU)**

PU	MARKET GROUP	PRODUCT	QUANTITY	UNIT	ACRES	ADVERTISE PRICE
1	Basswood Black Cherry Red Maple Sugar Maple Basswood Black Cherry Red Maple Sugar Maple	Sawtimber	15.3	MBF	24.7	\$25,627.40
			2.0	MBF		
			0.9	MBF		
		Pulpwood	37.1	MBF		
			53.0	Cords		
			36.0	Cords		
			22.0	Cords		
			262.0	Cords		
2	Basswood Black Cherry Red Maple Sugar Maple Basswood Beech Black Cherry Red Maple Sugar Maple	Sawtimber	11.5	MBF	25.1	\$23,789.95
			8.8	MBF		
			3.5	MBF		
			30.8	MBF		
		Pulpwood	40.0	Cords		
			18.0	Cords		
			30.0	Cords		
			41.0	Cords		
			242.0	Cords		
3	Basswood Black Cherry Red Maple Sugar Maple Basswood Beech Black Cherry Red Maple Sugar Maple	Sawtimber	7.5	MBF	18.5	\$13,671.20
			6.3	MBF		
			6.5	MBF		
			13.9	MBF		
		Pulpwood	45.0	Cords		
			15.0	Cords		
			14.0	Cords		
			99.0	Cords		
			88.0	Cords		
4	Basswood Black Cherry Sugar Maple Basswood Beech Black Cherry Red Maple Sugar Maple	Sawtimber	7.5	MBF	30.0	\$41,617.35
			9.4	MBF		
			76.4	MBF		
		Pulpwood	27.0	Cords		
			32.0	Cords		
			16.0	Cords		
			13.0	Cords		
			244.0	Cords		
5	Black Cherry Red Maple Sugar Maple Beech Black Cherry Red Maple Sugar Maple	Sawtimber	9.9	MBF	19.4	\$19,448.40
			1.4	MBF		
			30.6	MBF		
		Pulpwood	7.0	Cords		
			37.0	Cords		
			13.0	Cords		
			171.0	Cords		
6	Basswood Black Cherry Sugar Maple Basswood Beech Black Cherry Red Maple Sugar Maple	Sawtimber	4.4	MBF	26.6	\$33,462.65
			0.9	MBF		
			58.3	MBF		
		Pulpwood	11.0	Cords		
			7.0	Cords		
			22.0	Cords		
			24.0	Cords		
			312.0	Cords		
7	Red Maple Sugar Maple Red Maple Sugar Maple	Sawtimber	2.5	MBF	14.1	\$10,113.70
			15.3	MBF		
		Pulpwood	26.0	Cords		
			128.0	Cords		
8	Beech Sugar Maple Beech	Sawtimber	1.8	MBF	21.1	\$25,309.10
			46.1	MBF		
		Pulpwood	27.0	Cords		



**Description of Timber by Payment Unit (PU), con't**

PU	MARKET GROUP	PRODUCT	QUANTITY	UNIT	ACRES	ADVERTISE PRICE
	Black Cherry		12.0	Cords		
	Red Maple		13.0	Cords		
	Sugar Maple		204.0	Cords		
9	Sugar Maple	Sawtimber	47.4	MBF	20.0	\$24,778.25
	Black Cherry	Pulpwood	8.0	Cords		
	Sugar Maple		207.0	Cords		
10	Sugar Maple	Sawtimber	37.1	MBF	29.5	\$22,275.60
	Beech	Pulpwood	24.0	Cords		
	Black Cherry		19.0	Cords		
	Sugar Maple		259.0	Cords		
TOTAL:			493.1	MBF		
TOTAL:			2,868.0	Cords		

# Sale Specific Conditions & Requirements

**Sale Name: Hayfield Hardwood**

**Sale Number: 45-101-18 Seq#: 1**

## 1 - Sale Area

### 1.2 - Boundaries

#### 1.2.1 - Painted boundaries (1/14)

The sale boundary and Payment Unit boundaries are marked and identified by red, blue, and yellow paint, along with forest roads (see Timber Sale Map). Exterior sale boundary lines against state are marked with red paint. Exterior sale boundary lines against private land are marked with blue paint. Interior Payment Unit lines are marked with yellow paint. The painted boundary line trees are not included timber and are to be protected.

## 2 - Timber Specifications

### 2.1 - Included Timber

#### 2.1.3 - Cut tree marked unit(s) (12/08)

Within Payment Unit(s) 1 - 10, all trees are designated for cutting when marked with orange paint above and below stump height, regardless of merchantability.

### 2.2 - Utilization

#### 2.2.4 - Skidding length (2/14)

Skidding of unlimbed tops or lengths over 17 feet is not permissible in Payment Units 1 - 10, unless approved by the Unit Manager or his/her representative.

## 3 - Payments

### 3.3 - Pre-measured Sales

#### 3.3.4 - Dividing payment units (7/14)

Payment Unit(s) 1 - 10 may be divided at the request of the Purchaser and upon approval of the Unit Manager. Dividing Payment Units is a contract modification which requires a Timber Sale Contract Supplement.

## 4 - Transportation

### 4.1 - Construction

#### 4.1.7 - Road closure (10/11)

All new roads built into the sale must be blocked to vehicle traffic upon completion of the sale. Overgrown roads that are reopened shall be considered new roads. In general, this will require constructing a four (4') foot high berm of stumps and logs covered with earth. Contact the sale administrator for specific details of design and placement.

### 4.2 - Maintenance

#### 4.2.5 - Two wheel drive condition (2/04)

All existing trail roads on and adjacent to the sale area must be passable by two-wheel drive traffic for the duration of the sale.

## 5 - Operations

### 5.2 - Conduct of Operations

#### 5.2.2 - Hazard Trees/Snags

##### 5.2.2.1 - Den trees (10/16)

Obvious hollow and/or den trees shall be protected and left standing unless they are a safety hazard.

#### 5.2.3 - Operating Restrictions

##### 5.2.3.3 - Bark slippage restriction (3/09)

Within Payment Unit(s) 1 - 10, unless changed by written agreement, cutting and skidding are not permitted during the period of May 1 to June 30. This restriction is because of bark slippage.

#### 5.2.4 - Dead and Down Creation

##### 5.2.4.3 - Dead and down creation, dead trees (6/07)

Except as provided for in General Condition and Requirement 5.2.2, no dead trees, standing or down, are to be cut, skidded, or processed.

##### 5.2.38 - No decking against live trees (2/04)

Cut products may not be decked against unmarked or designated leave trees.

##### 5.2.39 - ORV trail/route protection (4/18)

The Sandtown Motorcycle Trail is an ORV trail or route and is shown on the Timber Sale Map. Do not cut trees or damage posts with yellow ORV markers. Trail must have Logging Ahead signs placed 200' before the sale area where the trail enters the sale area. All stumps within 5 feet of the trail must be cut flush with the ground. Maintain a 20 foot wide slash, debris, and rut free zone daily using the ORV trail or route as the centerline. Do not run equipment down the ORV trail or route.

Skidding across the trail or route may only occur in locations approved by the sale administrator.

#### 5.4 - Soil Protection

##### 5.4.1 - Rutting restriction, general (7/16)

Operations are to cease immediately if equipment and weather conditions result in rutting of roads and/or skid trails which is 12 inches or greater in depth and 50 feet in length. The Unit Manager or his/her representative may restrict hauling and/or skidding if ruts exceed the specified depth. With the Unit Manager or his/her representative's approval, the Purchaser may return to the area when the risk of rutting has decreased.

#### 5.8 - Protection of Endangered Species

##### 5.8.5 - Protection of raptor nests (3/13)

All trees with raptor nests will be protected if found during harvesting operations. Notification will be made to the Unit Manager or his/her representative who will notify the Wildlife Biologist so an on-site evaluation and recommendation can be made, if necessary.

### 7 - Other Conditions

#### 7.3 - Contract Modifications

##### 7.3.1 - Emerald Ash Borer

###### 7.3.1.2 - Emerald ash borer, ash or firewood on sale (2/05)

There is ash and/or "firewood" in this sale and it is located within an emerald ash borer quarantined area. The Director of the Michigan Department of Agriculture (MDA) by the authority of Act No. 72 of the Public Acts of 1945, as amended, and Quarantine Regulation No. 620, has promulgated this quarantine to prevent the further spread of this pest and sets forth: definitions, regulated articles, regulated areas, conditions of movement, violations and penalties, and special exemptions. The Purchaser must comply with this quarantine. Contact the MDA for further information.



# TIMBER SALE MAP

This information provided by authority of Part 525, 1994 PA 451, as amended.

Sale Number	Year
45 - 101	2018

Forest Management Unit Sault M.U. - Naubinway F.O.		County Mackinac	Mapped By Cory Luoto	Date 9/4/2018	Page 1	of 1
Township 44N	Range 11W	Section(s) and Subdivision(s) 12: NW1/4, S1/2NE, N1/2SE, NESW		Scale 1:15,840		

Cover Type				Density	
A = Aspen	H = Hemlock	N = Marsh	U = Upland Brush	0 = Non Stocked	5 = Pole Timber Medium
B = Paper Birch	J = Jack Pine	O = Oak	UM = Upland Mixed	1 = Seedling Sapling Poor	6 = Pole Timber Well
C = Cedar	L = Lowland Brush	P = Lowland Poplar	V = Bog or Marsh	2 = Seedling Sapling Medium	7 = Saw Timber Poor
D = Tread Bog	LM = Lowland Mixed	Q = Mixed Swamp Conifer	W = White Pine	3 = Seedling Sapling Well	8 = Saw Timber Medium
E = Swamp Hdwoods	M = Mpl, Bch, Brch	R = Red Pine	X = Non Stocked	4 = Pole Timber Poor	9 = Saw Timber Well
F = Spruce Fir	MC = Mixed Conifer	S = Black Spruce	Z = Water		
G = Grass	MD = Mixed Deciduous	T = Tamarack			

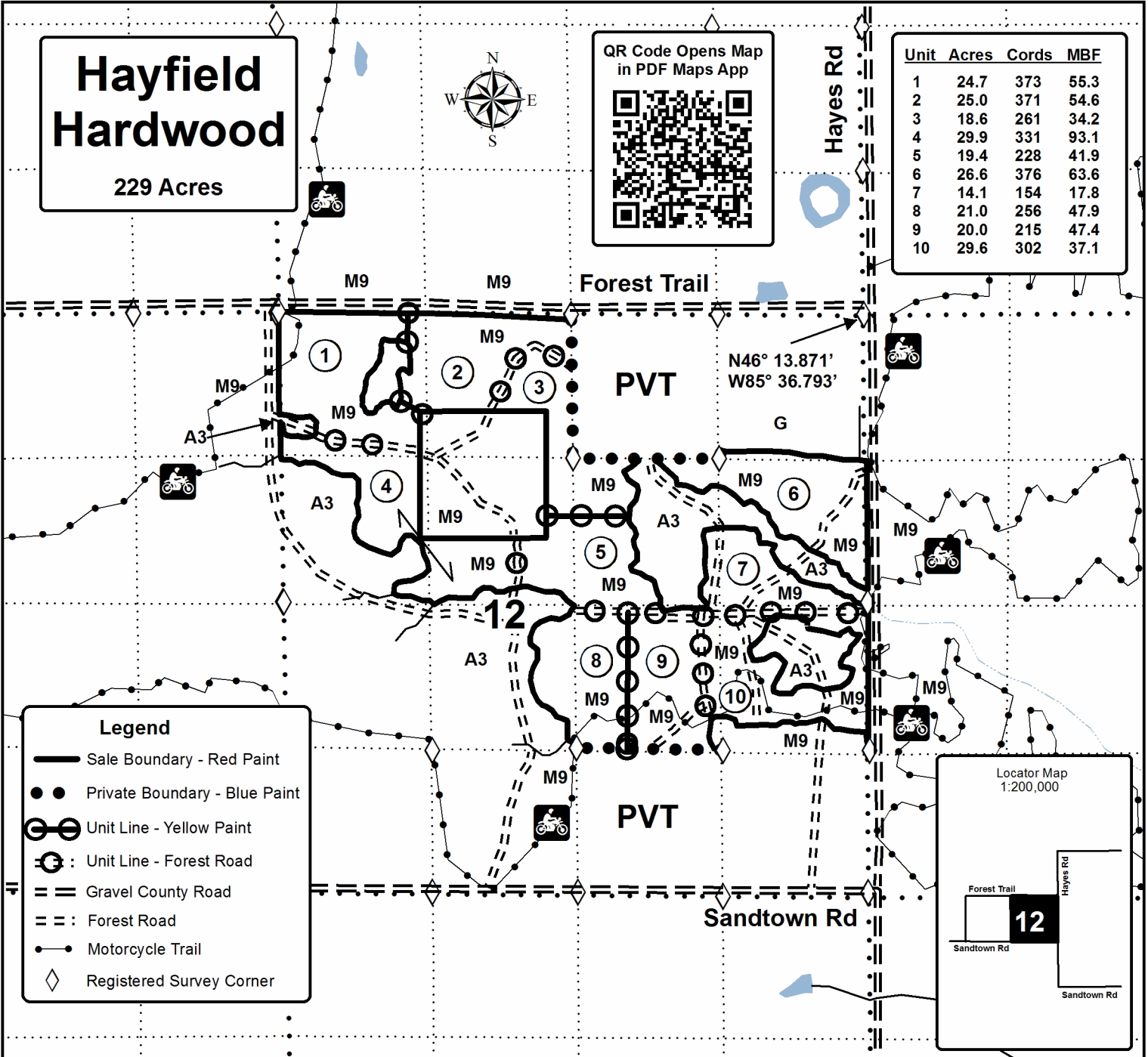

**TIMBER SALE INFORMATION**

Swatter House HW (45-102-18)

T44N, R10W, SEC. 5; T44N, R10W, SEC. 6; T44N, R11W, SEC. 1; T44N, R11W, SEC. 2; T45N, R11W, SEC. 36.  
Mackinac County (Advertised Price \$290,844.70)

SALE NOTE: A recreation site such as a trail, pathway, or campground is within the sale area or the vicinity. Certain restrictions/specifications may be applicable including time restrictions.

A timber sale contract for this lump sum, sealed bid timber sale will be awarded to the responsible bidder offering the highest sealed bid price. Bids must be at or above the following advertised price for each species:

<u>PRODUCTS &amp; SPECIES</u>	<u>ESTIMATED UNITS*</u>	<u>ADVERTISED PRICE</u>
Sawtimber		
Basswood	40.20 MBF	\$ 130.00 / MBF
Black Cherry	40.60 MBF	\$ 138.00 / MBF
Red Maple	87.90 MBF	\$ 117.00 / MBF
Sugar Maple	450.50 MBF	\$ 425.00 / MBF
Pulpwood		
Balsam Fir	5.00 Cords	\$ 16.10 / Cord
Basswood	48.00 Cords	\$ 11.20 / Cord
Mixed Hardwood	2,878.00 Cords	\$ 21.55 / Cord
Paper Birch	7.00 Cords	\$ 11.10 / Cord
White Spruce	659.00 Cords	\$ 23.60 / Cord

\* The total volume is statistically estimated within plus (+) or minus (-) 10.17 percent. The estimated units are final and not subject to adjustment. Prospective bidders are urged to examine this timber and to make their own estimates of quantity and quality.

**BOND AND PAYMENT SCHEDULE:**

1. A bond in the amount of \$23,268.00 to insure faithful performance of the conditions of the contract will be deposited by the successful bidder within 21 days of the sale award.
2. Cutting in any sale or unit without the required advance payment would be considered a trespass.
3. Total payment must be paid in advance or according to the following schedule:
  - (a) Ten percent (10%) of the sale value must be paid within 21 days of the sale award.
  - (b) The 10% down payment will be credited towards the first unit cut.
  - (c) Payment for each of the following units must be made before cutting begins in that unit:

<u>PAYMENT UNIT NUMBER</u>	<u>PERCENT OF TOTAL SALE VALUE</u>
01	8.5%
02	8.8%
03	10.7%
04	9.0%
05	9.9%
06	6.1%
07	4.0%
08	10.2%
09	7.5%
10	4.8%
11	11.4%
12	2.8%
13	1.2%
14	5.1%

4. If no cutting takes place, the 10% down payment will not be refunded.
5. Operations on the contract issued will terminate on 12/31/2021.

**Description of Timber by Payment Unit (PU)**

PU	MARKET GROUP	PRODUCT	QUANTITY	UNIT	ACRES	ADVERTISE PRICE			
1	Basswood	Sawtimber	4.3	MBF	30.2	\$24,638.05			
	Black Cherry		3.2	MBF					
	Red Maple		9.9	MBF					
	Sugar Maple		39.5	MBF					
	Basswood	Pulpwood	5.0	Cords					
	Mixed Hardwood		261.0	Cords					
	<i>Beech</i>	<i>Sawtimber</i>	<i>0.7</i>	<i>MBF</i>					
	<i>Yellow Birch</i>		<i>0.2</i>	<i>MBF</i>					
	<i>Beech</i>	<i>Pulpwood</i>	<i>8.0</i>	<i>Cords</i>					
	<i>Black Cherry</i>		<i>24.0</i>	<i>Cords</i>					
	<i>Ironwood</i>		<i>1.0</i>	<i>Cords</i>					
	<i>Red Maple</i>		<i>60.0</i>	<i>Cords</i>					
	<i>Sugar Maple</i>		<i>166.0</i>	<i>Cords</i>					
	<i>Yellow Birch</i>		<i>1.0</i>	<i>Cords</i>					
	Paper Birch		1.0	Cords					
2	Basswood	Sawtimber	4.5	MBF	31.5	\$25,709.70			
	Black Cherry		3.4	MBF					
	Red Maple		10.4	MBF					
	Sugar Maple		41.2	MBF					
	Basswood	Pulpwood	5.0	Cords					
	Mixed Hardwood		272.0	Cords					
	<i>Beech</i>	<i>Sawtimber</i>	<i>0.7</i>	<i>MBF</i>					
	<i>Yellow Birch</i>		<i>0.2</i>	<i>MBF</i>					
	<i>Beech</i>	<i>Pulpwood</i>	<i>8.0</i>	<i>Cords</i>					
	<i>Black Cherry</i>		<i>25.0</i>	<i>Cords</i>					
	<i>Ironwood</i>		<i>1.0</i>	<i>Cords</i>					
	<i>Red Maple</i>		<i>63.0</i>	<i>Cords</i>					
	<i>Sugar Maple</i>		<i>173.0</i>	<i>Cords</i>					
	<i>Yellow Birch</i>		<i>1.0</i>	<i>Cords</i>					
	Paper Birch		1.0	Cords					
3	Basswood	Sawtimber	5.4	MBF	38.1	\$31,170.70			
	Black Cherry		4.1	MBF					
	Red Maple		12.5	MBF					
	Sugar Maple		49.9	MBF					
	Basswood	Pulpwood	6.0	Cords					
	Mixed Hardwood		332.0	Cords					
	<i>Beech</i>	<i>Sawtimber</i>	<i>0.9</i>	<i>MBF</i>					
	<i>Yellow Birch</i>		<i>0.3</i>	<i>MBF</i>					
	<i>Beech</i>	<i>Pulpwood</i>	<i>10.0</i>	<i>Cords</i>					
	<i>Black Cherry</i>		<i>31.0</i>	<i>Cords</i>					
	<i>Ironwood</i>		<i>1.0</i>	<i>Cords</i>					
	<i>Red Maple</i>		<i>76.0</i>	<i>Cords</i>					
	<i>Sugar Maple</i>		<i>210.0</i>	<i>Cords</i>					
	<i>Yellow Birch</i>		<i>1.0</i>	<i>Cords</i>					
	Paper Birch		1.0	Cords					
4	Basswood	Sawtimber	1.9	MBF	25.9	\$26,300.95			
	Black Cherry		6.2	MBF					
	Red Maple		0.9	MBF					
	Sugar Maple		45.5	MBF					
	Basswood	Pulpwood	4.0	Cords					
	Mixed Hardwood		265.0	Cords					
	<i>Beech</i>		<i>13.0</i>	<i>Cords</i>					
	<i>Black Cherry</i>		<i>21.0</i>	<i>Cords</i>					
	<i>Red Maple</i>		<i>9.0</i>	<i>Cords</i>					
	<i>Sugar Maple</i>		<i>222.0</i>	<i>Cords</i>					
	5	Basswood	Sawtimber	2.0			MBF	28.4	\$28,834.45

Description of Timber by Payment Unit (PU), con't

PU	MARKET GROUP	PRODUCT	QUANTITY	UNIT	ACRES	ADVERTISE PRICE
5 con't	Black Cherry	Sawtimber	7.0	MBF		
	Red Maple		1.0	MBF		
	Sugar Maple		49.9	MBF		
	Basswood	Pulpwood	5.0	Cords		
	Mixed Hardwood		289.0	Cords		
	<i>Beech</i>		13.0	<i>Cords</i>		
	<i>Black Cherry</i>		22.0	<i>Cords</i>		
	<i>Red Maple</i>		10.0	<i>Cords</i>		
	<i>Sugar Maple</i>		244.0	<i>Cords</i>		
6	Basswood	Sawtimber	3.1	MBF	21.8	\$17,814.50
	Black Cherry		2.3	MBF		
	Red Maple		7.2	MBF		
	Sugar Maple		28.5	MBF		
	Basswood	Pulpwood	3.0	Cords		
	Mixed Hardwood		190.0	Cords		
	<i>Beech</i>	<i>Sawtimber</i>	0.5	<i>MBF</i>		
	<i>Yellow Birch</i>		0.2	<i>MBF</i>		
	<i>Beech</i>	<i>Pulpwood</i>	6.0	<i>Cords</i>		
	<i>Black Cherry</i>		18.0	<i>Cords</i>		
	<i>Ironwood</i>		1.0	<i>Cords</i>		
	<i>Red Maple</i>		43.0	<i>Cords</i>		
	<i>Sugar Maple</i>		120.0	<i>Cords</i>		
	<i>Yellow Birch</i>		1.0	<i>Cords</i>		
	Paper Birch		1.0	Cords		
7	Basswood	Sawtimber	2.0	MBF	14.4	\$11,744.60
	Black Cherry		1.5	MBF		
	Red Maple		4.7	MBF		
	Sugar Maple		18.8	MBF		
	Basswood	Pulpwood	2.0	Cords		
	Mixed Hardwood		126.0	Cords		
	<i>Beech</i>	<i>Sawtimber</i>	0.3	<i>MBF</i>		
	<i>Yellow Birch</i>		0.1	<i>MBF</i>		
	<i>Beech</i>	<i>Pulpwood</i>	4.0	<i>Cords</i>		
	<i>Black Cherry</i>		12.0	<i>Cords</i>		
	<i>Red Maple</i>		29.0	<i>Cords</i>		
	<i>Sugar Maple</i>		79.0	<i>Cords</i>		
	<i>Yellow Birch</i>		1.0	<i>Cords</i>		
8	Basswood	Sawtimber	5.2	MBF	36.4	\$29,757.85
	Black Cherry		3.9	MBF		
	Red Maple		12.0	MBF		
	Sugar Maple		47.6	MBF		
	Basswood	Pulpwood	6.0	Cords		
	Mixed Hardwood		317.0	Cords		
	<i>Beech</i>	<i>Sawtimber</i>	0.9	<i>MBF</i>		
	<i>Yellow Birch</i>		0.3	<i>MBF</i>		
	<i>Beech</i>	<i>Pulpwood</i>	10.0	<i>Cords</i>		
	<i>Black Cherry</i>		29.0	<i>Cords</i>		
	<i>Ironwood</i>		1.0	<i>Cords</i>		
	<i>Red Maple</i>		73.0	<i>Cords</i>		
	<i>Sugar Maple</i>		200.0	<i>Cords</i>		
	<i>Yellow Birch</i>		1.0	<i>Cords</i>		
	Paper Birch		1.0	Cords		
9	Basswood	Sawtimber	3.8	MBF	26.8	\$21,896.80
	Black Cherry		2.9	MBF		
	Red Maple		8.8	MBF		
	Sugar Maple		35.1	MBF		

**Description of Timber by Payment Unit (PU), con't**

PU	MARKET GROUP	PRODUCT	QUANTITY	UNIT	ACRES	ADVERTISE PRICE			
9 con't	Basswood	Pulpwood	4.0	Cords					
	Mixed Hardwood		232.0	Cords					
	<i>Beech</i>	<i>Sawtimber</i>	0.6	<i>MBF</i>					
	<i>Yellow Birch</i>		0.2	<i>MBF</i>					
	<i>Beech</i>	<i>Pulpwood</i>	7.0	<i>Cords</i>					
	<i>Black Cherry</i>		22.0	<i>Cords</i>					
	<i>Ironwood</i>		1.0	<i>Cords</i>					
	<i>Red Maple</i>		53.0	<i>Cords</i>					
	<i>Sugar Maple</i>		147.0	<i>Cords</i>					
	<i>Yellow Birch</i>		1.0	<i>Cords</i>					
	Paper Birch		1.0	Cords					
10	Basswood	Sawtimber	2.4	MBF	17.2	\$14,055.90			
	Black Cherry		1.8	MBF					
	Red Maple		5.7	MBF					
	Sugar Maple		22.5	MBF					
	Basswood	Pulpwood	3.0	Cords					
	Mixed Hardwood		150.0	Cords					
	<i>Beech</i>	<i>Sawtimber</i>	0.4	<i>MBF</i>					
	<i>Yellow Birch</i>		0.1	<i>MBF</i>					
	<i>Beech</i>	<i>Pulpwood</i>	5.0	<i>Cords</i>					
	<i>Black Cherry</i>		14.0	<i>Cords</i>					
	<i>Red Maple</i>		34.0	<i>Cords</i>					
	<i>Sugar Maple</i>		95.0	<i>Cords</i>					
	<i>Yellow Birch</i>		1.0	<i>Cords</i>					
	11	Basswood	Sawtimber	5.6			MBF	39.6	\$32,422.70
Black Cherry			4.3	MBF					
Red Maple			13.0	MBF					
Sugar Maple			52.0	MBF					
Basswood		Pulpwood	5.0	Cords					
Mixed Hardwood			344.0	Cords					
<i>Beech</i>		<i>Sawtimber</i>	1.0	<i>MBF</i>					
<i>Yellow Birch</i>			0.3	<i>MBF</i>					
<i>Beech</i>		<i>Pulpwood</i>	11.0	<i>Cords</i>					
<i>Black Cherry</i>			31.0	<i>Cords</i>					
<i>Red Maple</i>			79.0	<i>Cords</i>					
<i>Sugar Maple</i>			218.0	<i>Cords</i>					
<i>Yellow Birch</i>			2.0	<i>Cords</i>					
Paper Birch			1.0	Cords					
12		Red Maple	Sawtimber	1.8	MBF	20.8	\$8,238.35		
		Sugar Maple		16.1	MBF				
	Mixed Hardwood	Pulpwood	55.0	Cords					
	<i>Red Maple</i>		8.0	<i>Cords</i>					
	<i>Sugar Maple</i>		47.0	<i>Cords</i>					
13	Mixed Hardwood	Pulpwood	8.0	Cords	3.5	\$3,405.60			
	<i>Red Maple</i>		8.0	<i>Cords</i>					
	White Spruce		137.0	Cords					
14	Sugar Maple	Sawtimber	3.9	MBF	27.8	\$14,833.00			
	Balsam Fir	Pulpwood	5.0	Cords					
	Mixed Hardwood		36.0	Cords					
	<i>Yellow Birch</i>	<i>Sawtimber</i>	2.0	<i>MBF</i>					
	<i>Red Maple</i>	<i>Pulpwood</i>	5.0	<i>Cords</i>					
	<i>Sugar Maple</i>		23.0	<i>Cords</i>					
	<i>Yellow Birch</i>		4.0	<i>Cords</i>					
	White Spruce		522.0	Cords					
TOTAL:			619.2	MBF					



TOTAL:	3,596.0	Cords
--------	---------	-------

# Sale Specific Conditions & Requirements

**Sale Name: Swatter House HW**

**Sale Number: 45-102-18 Seq#: 1**

## 1 - Sale Area

### 1.2 - Boundaries

#### 1.2.1 - Painted boundaries (1/14)

The sale boundary and Payment Unit boundaries are marked and identified by blue, red and yellow paint. Exterior sale boundary lines against private property are marked with blue paint. Exterior sale boundary lines against state are marked with red paint. Interior Payment Unit boundaries are marked with yellow paint. The painted boundary line trees are not Included Timber and are to be protected unless marked with orange paint. Yellow painted trees designating an interior Payment Unit boundary are only to be cut when all surrounding Payment Units have been paid.

## 2 - Timber Specifications

### 2.1 - Included Timber

#### 2.1.1 - Clearcut unit(s) with unmerchantable trees (6/14)

Within Payment Unit(s) 13 and 14, cut all trees that are two (2) inches or more at DBH.

#### 2.1.3 - Cut tree marked unit(s) (12/08)

Within Payment Unit(s) 1-12, all trees are designated for cutting when marked with orange paint above and below stump height, regardless of merchantability.

### 2.2 - Utilization

#### 2.2.3 - Stump heights (4/07)

Stump heights within Payment Unit(s) 13 and 14 shall not exceed 6 inches for all trees. This is in order to facilitate planting operations.

#### 2.2.7 - Uncut designated trees (2/04)

Liquidated damages of \$10.00 per tree will be assessed for every marked tree not cut.

## 3 - Payments

### 3.3 - Pre-measured Sales

#### 3.3.4 - Dividing payment units (7/14)

Payment Unit(s) 1-14 may be divided at the request of the Purchaser and upon approval of the Unit Manager. Dividing Payment Units is a contract modification which requires a Timber Sale Contract Supplement.

### 3.4 - Damaged Timber

#### 3.4.1 - Damaged timber (6/14)

General Condition and Requirement 3.4 Damaged Timber, defines liquidated damages for undesignated live merchantable trees which are cut or injured. In addition, extreme care should be taken to avoid damage to tree seedlings and saplings.

No damage is acceptable to merchantable trees. Within the sale area, if more than 5% of trees (> 4.5" DBH) within a specified area of the sale are damaged, liquidated damages will be assessed for all trees damaged. Rates will be in accordance with General Condition and Requirement 3.4 Damaged Timber.

## 4 - Transportation

### 4.1 - Construction

#### 4.1.3 - Slash and earthen piles (8/04)

Piles or windrows of earth along roads and landings that have been widened or constructed shall be leveled. Slash from road maintenance or construction, including stumps, shall be dispersed throughout the sale.

### 4.2 - Maintenance

#### 4.2.5 - Two wheel drive condition (2/04)

All existing trail roads on and adjacent to the sale area must be passable by two-wheel drive traffic for the duration of the sale.

### 5 - Operations

#### 5.2 - Conduct of Operations

##### 5.2.1 - Slash

###### 5.2.1.8 - Slash height (12/08)

No slash or tree tops may exceed 24 inches in height.

##### 5.2.2 - Hazard Trees/Snags

###### 5.2.2.1 - Den trees (10/16)

Obvious hollow and/or den trees shall be protected and left standing unless they are a safety hazard.

##### 5.2.3 - Operating Restrictions

###### 5.2.3.3 - Bark slippage restriction (3/09)

Within Payment Unit(s) 1-12, unless changed by written agreement, cutting and skidding are not permitted during the period of May 1 to June 30. This restriction is because of bark slippage.

##### 5.2.4 - Dead and Down Creation

###### 5.2.4.3 - Dead and down creation, dead trees (6/07)

Except as provided for in General Condition and Requirement 5.2.2, no dead trees, standing or down, are to be cut, skidded, or processed.

##### 5.2.32 - Decking/landing restoration (9/13)

All decking and landing areas must have the surface area restored to a condition equal to or better than before. This is to ensure the proper regeneration of the stand. Wood debris, chips and "cookies" from trimmings must be removed or scattered away from landing and loading areas and may not be windrowed on the edge.

##### 5.2.38 - No decking against live trees (2/04)

Cut products may not be decked against unmarked or designated leave trees.

##### 5.2.39 - ORV trail/route protection (4/18)

The ORV trail or route and is shown on the Timber Sale Map. Do not cut trees or damage posts with ORV markers. All stumps within 5 feet of the trail must be cut flush with the ground. Maintain a 20 foot wide slash, debris, and rut free zone daily using the ORV trail or route as the centerline. Do not run equipment down the ORV trail or route.

##### 5.2.41 - Snowmobile trail protection (9/11)

A snowmobile trail and is shown on the Timber Sale Map. Do not cut or damage posts with orange trail markers or traffic control signs. If the trail is used, it must be maintained and restored to a condition equal to or better than before the sale. The road maintenance/restoration must be done prior to December 1. If the trail is used for hauling, it must be graded to the satisfaction of the Unit Manager or his/her representative prior to December 1st. If the trail road is to be used for hauling during the snowmobile season, then a snow covered base must be left on the trail. Maintain a 20 foot wide slash, debris, and rut free zone daily using the snowmobile trail as the centerline. All stumps within 20 feet of the snowmobile trail must be cut at ground level.

#### 5.4 - Soil Protection

##### 5.4.1 - Rutting restriction, general (7/16)

Operations are to cease immediately if equipment and weather conditions result in rutting of roads and/or skid trails which is 12 inches or greater in depth and 50 feet in length. The Unit Manager or his/her representative may restrict hauling and/or skidding if ruts exceed the specified depth. With the Unit Manager or his/her representative's approval, the Purchaser may return to the area when the risk of rutting has decreased.

#### 5.8 - Protection of Endangered Species

#### 5.8.5 - Protection of raptor nests (3/13)

All trees with raptor nests will be protected if found during harvesting operations. Notification will be made to the Unit Manager or his/her representative who will notify the Wildlife Biologist so an on-site evaluation and recommendation can be made, if necessary.

### **6 - Safety and Fire Prevention**

#### 6.2 - Signing

##### 6.2.1 - Road posting (9/09)

The Purchaser is responsible for posting and maintaining caution signs on county roads prior to beginning operations. The road must be posted at appropriate distances from the sale area to warn of logging activity and truck traffic. Signs must be removed when harvest operations are suspended or completed. The Purchaser will provide these signs.

##### 6.2.2 - Snowmobile trail posting (8/09)

The Purchaser is responsible for posting and maintaining caution signs on the snowmobile trail prior to beginning operations during the snowmobile season (approximately December 1 to March 31). The trail must be posted at appropriate distances from the sale area to warn of logging activity and truck traffic. Signs must be removed when harvest operations are suspended or completed. The Purchaser will provide these signs.

##### 6.2.3 - Recreational trail posting (2/10)

The Purchaser is responsible for posting and maintaining caution signs on the trail prior to beginning operations. The trail must be posted at appropriate distances from the sale area to warn of logging activity and truck traffic at both ends of the trail. Signs must be removed when harvest operations are suspended or completed. The Purchaser will provide these signs.



# TIMBER SALE MAP

This information provided by authority of Part 525, 1994 PA 451, as amended.

Forest Management Unit		County	Mapped By		Date	Page of	
Sault Ste Marie Management Unit		Mackinac & Luce	A Krugh		09/27/2018	1	1
Township	Range	Section(s) and Subdivision(s)			Scale		
44N & 45N	10W & 11W	5 S1/2NW 6 NWNW,NWSW 1 NW,N1/2NE,SWNE,SW,N1/2SE 2 E1/2NE,E1/2SE 36 SESW,S1/2SE			1:31,680		

Cover Type				Density			
A = Aspen	H = Hemlock	N = Marsh	U = Upland Brush	0 = Non Stocked	5 = Pole Timber Medium		
B = Paper Birch	J = Jack Pine	O = Oak	UM = Upland Mixed	1 = Seedling Sapling Poor	6 = Pole Timber Well		
C = Cedar	L = Lowland Brush	P = Lowland Poplar	V = Bog or Marsh	2 = Seedling Sapling Medium	7 = Saw Timber Poor		
D = Tread Bog	LM = Lowland Mixed	Q = Mixed Swamp Conifer	W = White Pine	3 = Seedling Sapling Well	8 = Saw Timber Medium		
E = Swamp Hdwoods	M = Mpl, Bch, Brch	R = Red Pine	X = Non Stocked	4 = Pole Timber Poor	9 = Saw Timber Well		
F = Spruce Fir	MC = Mixed Conifer	S = Black Spruce	Z = Water				
G = Grass	MD = Mixed Deciduous	T = Tamarack					

## Swatter House HW

### Compartment 181

### 362.4 Acres

PU	Acres	PU	Acres	PU	Acres	PU	Acres
1	30.2	5	28.4	9	26.8	13	3.5
2	31.5	6	21.8	10	17.2	14	27.8
3	38.1	7	14.4	11	39.6		
4	25.9	8	36.4	12	20.8		

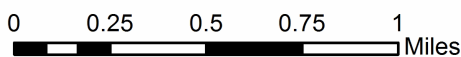
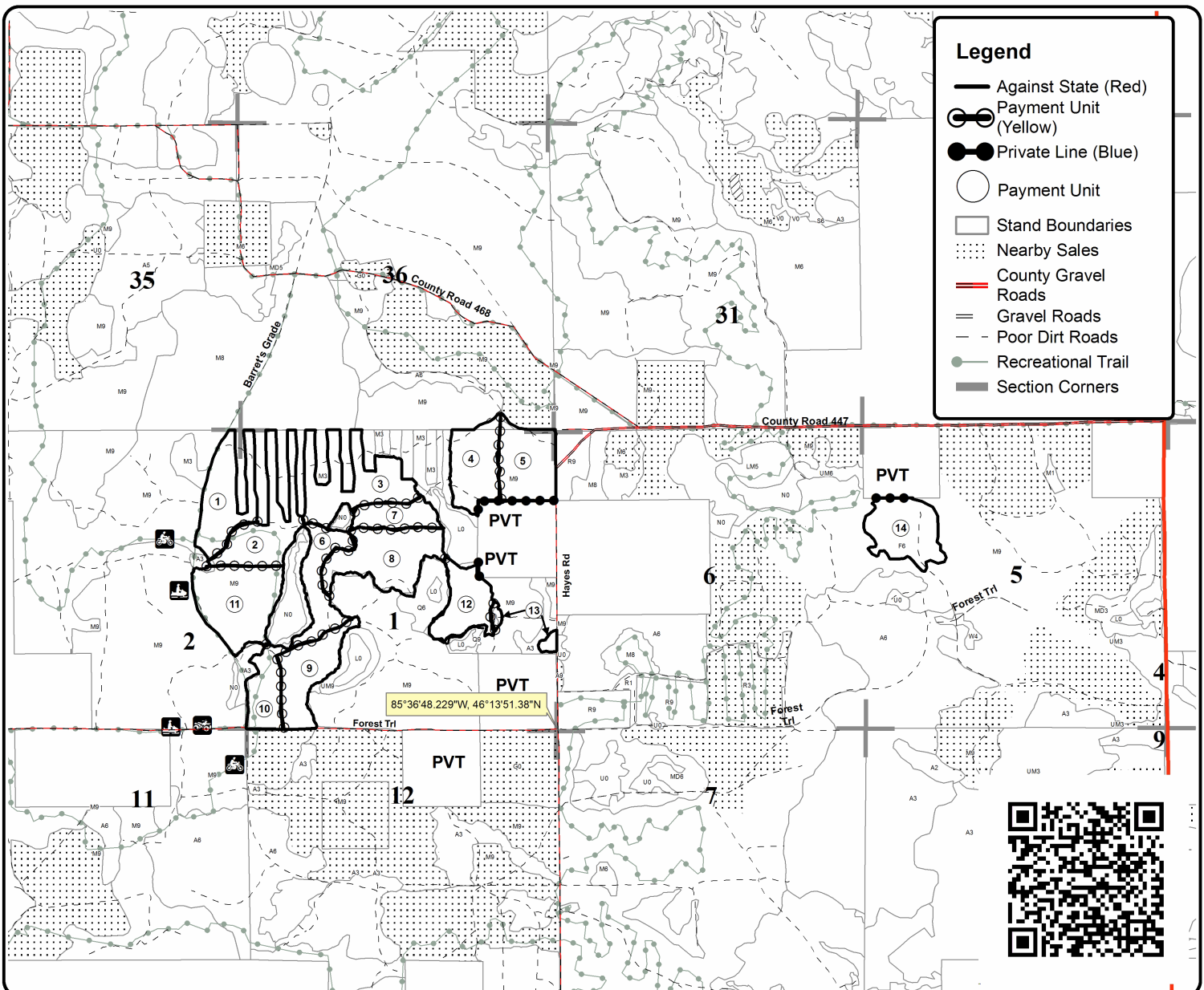
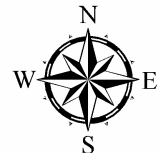



**TIMBER SALE INFORMATION**

Baloneyville Mix (45-113-18)

T43N, R07W, SEC. 17; T43N, R07W, SEC. 18; T43N, R07W, SEC. 19; T43N, R07W, SEC. 20; T43N, R07W, SEC. 21; T43N, R07W, SEC. 28.

SALE NOTE: A recreation site such as a trail, pathway, or campground is within the sale area or the vicinity. Certain restrictions/specifications may be applicable including time restrictions.

A timber sale contract for this lump sum, sealed bid timber sale will be awarded to the responsible bidder offering the highest sealed bid price. Bids must be at or above the following advertised price for each species:

<u>PRODUCTS &amp; SPECIES</u>	<u>ESTIMATED UNITS*</u>	<u>ADVERTISED PRICE</u>
Pulpwood		
Balsam Fir	200.00 Cords	\$ 16.10 / Cord
Jack Pine	6.00 Cords	\$ 38.65 / Cord
Mixed Aspen	855.00 Cords	\$ 32.65 / Cord
Paper Birch	40.00 Cords	\$ 11.10 / Cord
Red Maple	359.00 Cords	\$ 21.55 / Cord
Red Pine	2,622.00 Cords	\$ 79.10 / Cord
White Pine	450.00 Cords	\$ 22.70 / Cord
White Spruce	99.00 Cords	\$ 23.60 / Cord

\* The total volume is statistically estimated within plus (+) or minus (-) 9.47 percent. The estimated units are final and not subject to adjustment. Prospective bidders are urged to examine this timber and to make their own estimates of quantity and quality.

**BOND AND PAYMENT SCHEDULE:**

1. A bond in the amount of \$20,760.00 to insure faithful performance of the conditions of the contract will be deposited by the successful bidder within 21 days of the sale award.
2. Cutting in any sale or unit without the required advance payment would be considered a trespass.
3. Total payment must be paid in advance or according to the following schedule:
  - (a) Ten percent (10%) of the sale value must be paid within 21 days of the sale award.
  - (b) The 10% down payment will be credited towards the first unit cut.
  - (c) Payment for each of the following units must be made before cutting begins in that unit:

<u>PAYMENT UNIT NUMBER</u>	<u>PERCENT OF TOTAL SALE VALUE</u>
01	4.3%
02	5.9%
03	30.4%
04	26.3%
05	3.5%
06	29.6%

4. If no cutting takes place, the 10% down payment will not be refunded.
5. Operations on the contract issued will terminate on 12/31/2021.

**Description of Timber by Payment Unit (PU)**

PU	MARKET GROUP	PRODUCT	QUANTITY	UNIT	ACRES	ADVERTISE PRICE
1	Balsam Fir	Pulpwood	68.0	Cords	23.4	\$11,089.60
	Jack Pine		5.0	Cords		
	Mixed Aspen		137.0	Cords		
	<i>Quaking Aspen</i>		137.0	<i>Cords</i>		
	Paper Birch		6.0	Cords		
	<i>Paper Birch</i>		6.0	<i>Cords</i>		
	Red Maple		10.0	Cords		
	<i>Red Maple</i>		10.0	<i>Cords</i>		
	White Pine		188.0	Cords		
	White Spruce		33.0	Cords		
2	Balsam Fir	Pulpwood	54.0	Cords	14.0	\$15,365.20
	Jack Pine		1.0	Cords		
	Mixed Aspen		256.0	Cords		
	<i>Quaking Aspen</i>		8.5	<i>MBF</i>		
	<i>Quaking Aspen</i>		239.0	<i>Cords</i>		
	Paper Birch		15.0	Cords		
	<i>Paper Birch</i>		1.7	<i>MBF</i>		
	<i>Paper Birch</i>		12.0	<i>Cords</i>		
	Red Maple		11.0	Cords		
	<i>Red Maple</i>		0.7	<i>MBF</i>		
	<i>Red Maple</i>		10.0	<i>Cords</i>		
	Red Pine		72.0	Cords		
	<i>Red Pine</i>		22.3	<i>MBF</i>		
	<i>Red Pine</i>		27.0	<i>Cords</i>		
3	Balsam Fir	Pulpwood	5.0	Cords	29.0	\$79,431.50
	Mixed Aspen		84.0	Cords		
	<i>Quaking Aspen</i>		84.0	<i>Cords</i>		
	Red Maple		74.0	Cords		
	<i>Red Maple</i>		74.0	<i>Cords</i>		
	Red Pine		902.0	Cords		
	<i>Red Pine</i>		902.0	<i>Cords</i>		
	White Pine		149.0	Cords		
White Spruce	12.0	Cords				
4	Balsam Fir	Pulpwood	5.0	Cords	24.9	\$68,175.50
	Mixed Aspen		72.0	Cords		
	<i>Quaking Aspen</i>		72.0	<i>Cords</i>		
	Red Maple		64.0	Cords		
	<i>Red Maple</i>		64.0	<i>Cords</i>		
	Red Pine		774.0	Cords		
	<i>Red Pine</i>		774.0	<i>Cords</i>		
	White Pine		128.0	Cords		
White Spruce	10.0	Cords				
5	Balsam Fir	Pulpwood	68.0	Cords	16.0	\$9,156.30
	Mixed Aspen		155.0	Cords		
	<i>B. T. Aspen</i>		63.0	<i>Cords</i>		
	<i>Quaking Aspen</i>		92.0	<i>Cords</i>		
	Paper Birch		4.0	Cords		
	<i>Paper Birch</i>		4.0	<i>Cords</i>		
	Red Maple		89.0	Cords		
	<i>Red Maple</i>		89.0	<i>Cords</i>		
White Spruce	44.0	Cords				
6	Mixed Aspen	Pulpwood	151.0	Cords	39.4	\$76,894.50
	<i>Quaking Aspen</i>		151.0	<i>Cords</i>		
	Paper Birch		15.0	Cords		
	<i>Paper Birch</i>		15.0	<i>Cords</i>		
	Red Maple		111.0	Cords		



**Description of Timber by Payment Unit (PU), con't**

PU	MARKET GROUP	PRODUCT	QUANTITY	UNIT	ACRES	ADVERTISE PRICE
6 con't	<i>Red Maple</i>	<i>Pulpwood</i>	<i>111.0</i>	<i>Cords</i>		
	Red Pine		874.0	Cords		
	<i>Red Pine</i>		<i>874.0</i>	<i>Cords</i>		
	White Pine		12.0	Cords		
TOTAL:			4,658.0	Cords		

## Sale Specific Conditions & Requirements

**Sale Name: Baloneyville Mix**

**Sale Number: 45-113-18 Seq#: 1**

### 1 - Sale Area

#### 1.2 - Boundaries

##### 1.2.1 - Painted boundaries (1/14)

The sale boundary and Payment Unit boundaries are marked and identified by red and green paint. Exterior sale boundary lines against state are marked with red paint. Interior Payment Unit boundaries are marked with green paint. The painted boundary line trees are not Included Timber and are to be protected. Green painted trees designating an interior Payment Unit boundary are only to be cut when all surrounding Payment Units have been paid.

### 2 - Timber Specifications

#### 2.1 - Included Timber

##### 2.1.1 - Clearcut unit(s) with unmerchantable trees (6/14)

Within Payment Unit(s) 1, cut all deciduous trees that are two (2) inches or more at DBH. In addition, cut all conifer trees that are four (4) inches or more at DBH, except do not cut white pine. Only white pine between 4 and 12 inches at DBH are designated for cutting. Leave one representative, healthy, mature tree, spaced every 75 feet.

Within Payment Unit(s) 2, cut all deciduous trees that are two (2) inches or more at DBH, except do not cut cherry and yellow birch. In addition, cut all conifer trees that are four (4) inches or more at DBH, except do not cut hemlock, cedar, or white pine. Leave one representative, healthy, mature tree, spaced every 75 feet.

Within Payment Unit(s) 3, 4, and 6, cut all trees that are two (2) inches or more at DBH.

Within Payment Unit(s) 5, cut all deciduous trees that are two (2) inches or more at DBH. In addition, cut all conifer trees that are four (4) inches or more at DBH, except do not cut white pine, unless marked with orange paint. Leave one representative, healthy, mature tree, spaced every 75 feet.

#### 2.2 - Utilization

##### 2.2.2 - Chipping required (2/18)

Payment Units 3, 4, and 6 must be chip harvested to facilitate subsequent planting operations. The Purchaser has the option to produce sawlogs or pulpwood bolts, but the remaining portion of the trees must be chipped and hauled. If market conditions limit the practicality of chipping, tops and slash must be arranged in a way that will not inhibit future planting operations, as directed by the sale administrator. If the deadline is not met, damages will be collected determined by the cost to complete this work. The requirement to retain approximately 1/6 to 1/3 of tree tops and limbs less than four inches in diameter is still applicable (G. C. & R. 2.2).

##### 2.2.3 - Stump heights (4/07)

Stump heights within Payment Unit(s) 3, 4 and 6 shall not exceed 6 inches for all trees. This is in order to facilitate planting operations.

### 3 - Payments

#### 3.3 - Pre-measured Sales

##### 3.3.4 - Dividing payment units (7/14)

Payment Unit(s) may be divided at the request of the Purchaser and upon approval of the Unit Manager. Dividing Payment Units is a contract modification which requires a Timber Sale Contract Supplement. Payment Units can be split until the cost per unit is less than \$20,000.

### 4 - Transportation

#### 4.1 - Construction

##### 4.1.3 - Slash and earthen piles (8/04)

Piles or windrows of earth along roads and landings that have been widened or constructed shall be leveled. Slash from road maintenance or construction, including stumps, shall be dispersed throughout the sale.

#### 4.1.7 - Road closure (10/11)

All new roads built into the sale must be blocked to vehicle traffic within 30 days of completion of hauling. Overgrown roads that are reopened shall be considered new roads. In general, this will require constructing a four (4') foot high berm of stumps and logs covered with earth. Stumps and brush must be placed along the remainder of the trail. These roads must be rendered impassable to cars and trucks. Temporary berms may be required if no sale activity occurs for 30 or more consecutive days. Contact the sale administrator for specific details of design and placement.

### 4.2 - Maintenance

#### 4.2.5 - Two wheel drive condition (2/04)

All existing trail roads on and adjacent to the sale area must be passable by two-wheel drive traffic for the duration of the sale.

## 5 - Operations

### 5.2 - Conduct of Operations

#### 5.2.1 - Slash

##### 5.2.1.8 - Slash height (12/08)

No slash or tree tops may exceed 24 inches in height. This requirement only applies to Payment Units 3, 4 and 6.

#### 5.2.2 - Hazard Trees/Snags

##### 5.2.2.1 - Den trees (10/16)

Obvious hollow and/or den trees shall be protected and left standing unless they are a safety hazard.

#### 5.2.4 - Dead and Down Creation

##### 5.2.4.6 - Dead and down creation, other (9/09)

To improve habitat for wildlife, the Purchaser is to leave one brush pile on the ground for every two acres within Payment Units 1, 2 and 5. Piles must be at least 4 feet tall and scattered throughout the sale area. Note; piles can be created by encouraging limbing in piles during normal harvesting procedures, particularly near riparian areas.

#### 5.2.32 - Decking/landing restoration (9/13)

All decking and landing areas must have the surface area restored to a condition equal to or better than before. This is to ensure the proper regeneration of the stand. Wood debris, chips and "cookies" from trimmings must be removed or scattered away from landing and loading areas and may not be windrowed on the edge.

#### 5.2.41 - Snowmobile trail protection (9/11)

A snowmobile trail is shown on the Timber Sale Map. Do not cut or damage posts with orange trail markers or traffic control signs. If the trail is used, it must be maintained and restored to a condition equal to or better than before the sale. The road maintenance/restoration must be done prior to December 1. If the trail is used for hauling, it must be graded to the satisfaction of the Unit Manager or his/her representative prior to December 1st. If the trail road is to be used for hauling during the snowmobile season, then a snow covered base must be left on the trail. The snowmobile trail may only be crossed at right angles for skidding or forwarding to the landing. Maintain a 20 foot wide slash, debris, and rut free zone daily using the snowmobile trail as the centerline. All stumps within 20 feet of the snowmobile trail must be cut at ground level.

### 5.4 - Soil Protection

#### 5.4.1 - Rutting restriction, general (7/16)

Operations are to cease immediately if equipment and weather conditions result in rutting of roads and/or skid trails which is 12 inches or greater in depth and 50 feet in length. The Unit Manager or his/her representative may restrict hauling and/or skidding if ruts exceed the specified depth. With the Unit Manager or his/her representative's approval, the Purchaser may return to the area when the risk of rutting has decreased.

### 5.8 - Protection of Endangered Species

#### 5.8.5 - Protection of raptor nests (3/13)

All trees with raptor nests will be protected if found during harvesting operations. Notification will be made to the Unit Manager or his/her representative who will notify the Wildlife Biologist so an on-site evaluation and recommendation can be made, if necessary.

## **6 - Safety and Fire Prevention**

### 6.2 - Signing

#### 6.2.1 - Road posting (9/09)

The Purchaser is responsible for posting and maintaining caution signs on Sand lake Rd prior to beginning operations. The road must be posted at appropriate distances from the sale area to warn of logging activity and truck traffic. Signs must be removed when harvest operations are suspended or completed. The Purchaser will provide these signs.



# TIMBER SALE MAP

This information provided by authority of Part 525, 1994 PA 451, as amended.

Forest Management Unit		County	Mapped By		Date	Page of	
Sault Ste Marie Management Unit		Mackinac	A Krugh		09/27/2018	1	1
Township	Range	Section(s) and Subdivision(s)			Scale		
43N	7W	17 S1/2SW 18 SWSE 19 NW, NWNEM S1/2NE, N1/2SE 20 NW 21 E1/2SW 28 NENW			1:31,680		

Cover Type				Density			
A = Aspen	H = Hemlock	N = Marsh	U = Upland Brush	0 = Non Stocked	5 = Pole Timber Medium		
B = Paper Birch	J = Jack Pine	O = Oak	UM = Upland Mixed	1 = Seedling Sapling Poor	6 = Pole Timber Well		
C = Cedar	L = Lowland Brush	P = Lowland Poplar	V = Bog or Marsh	2 = Seedling Sapling Medium	7 = Saw Timber Poor		
D = Treed Bog	LM = Lowland Mixed	Q = Mixed Swamp Conifer	W = White Pine	3 = Seedling Sapling Well	8 = Saw Timber Medium		
E = Swamp Hdwoods	M = Mpl, Bch, Brch	R = Red Pine	X = Non Stocked	4 = Pole Timber Poor	9 = Saw Timber Well		
F = Spruce Fir	MC = Mixed Conifer	S = Black Spruce	Z = Water				
G = Grass	MD = Mixed Deciduous	T = Tamarack					

## Baloneyville Mix

### Compartment 138

146.7 Acres

PU	Acres	PU	Acres
1	23.4	4	24.9
2	14	5	16
3	29	6	39.4

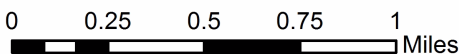
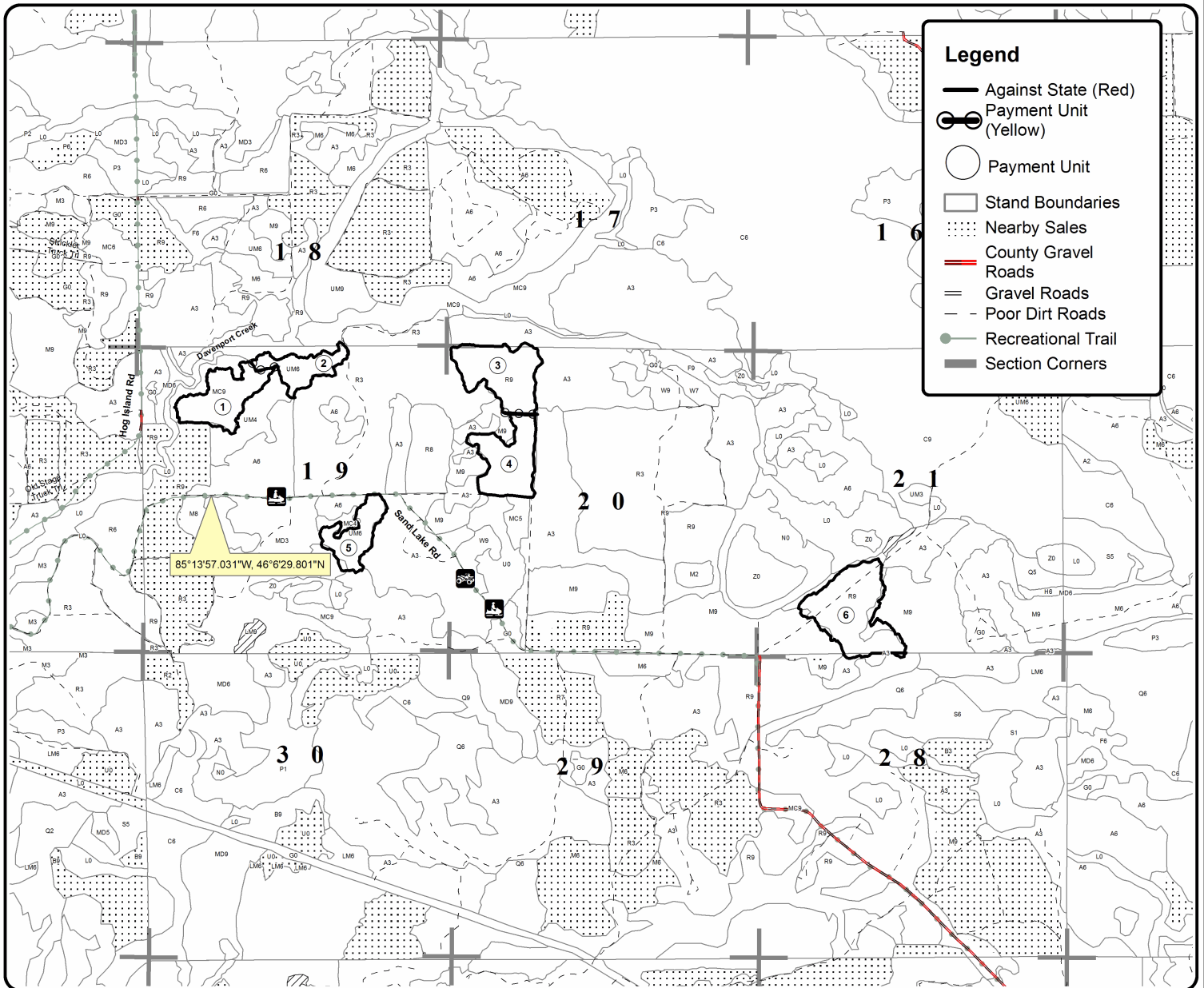



**TIMBER SALE INFORMATION**

Thin It Again Rp (45-114-18)

T43N, R07W, SEC. 19; T43N, R07W, SEC. 20; T43N, R08W, SEC. 24.  
Mackinac County (Advertised Price \$63,287.10)

SALE NOTE: A recreation site such as a trail, pathway, or campground is within the sale area or the vicinity. Certain restrictions/specifications may be applicable including time restrictions.

A timber sale contract for this lump sum, sealed bid timber sale will be awarded to the responsible bidder offering the highest sealed bid price. Bids must be at or above the following advertised price for each species:

<u>PRODUCTS &amp; SPECIES</u>	<u>ESTIMATED UNITS*</u>	<u>ADVERTISED PRICE</u>
Pulpwood		
Red Maple	4.00 Cords	\$ 21.55 / Cord
Red Pine	799.00 Cords	\$ 79.10 / Cord

\* The total volume is statistically estimated within plus (+) or minus (-) 15.05 percent. The estimated units are final and not subject to adjustment. Prospective bidders are urged to examine this timber and to make their own estimates of quantity and quality.

**BOND AND PAYMENT SCHEDULE:**

- A bond in the amount of \$5,063.00 to insure faithful performance of the conditions of the contract will be deposited by the successful bidder within 21 days of the sale award.
- Cutting in any sale or unit without the required advance payment would be considered a trespass.
- Total payment must be paid in advance or according to the following schedule:
  - Ten percent (10%) of the sale value must be paid within 21 days of the sale award.
  - The 10% down payment will be credited towards the first unit cut.
  - Payment for each of the following units must be made before cutting begins in that unit:
 

PAYMENT UNIT NUMBER	PERCENT OF TOTAL SALE VALUE
01	12.0%
02	35.9%
03	37.0%
04	15.1%
- If no cutting takes place, the 10% down payment will not be refunded.
- Operations on the contract issued will terminate on 12/31/2021.

**Description of Timber by Payment Unit (PU)**

PU	MARKET GROUP	PRODUCT	QUANTITY	UNIT	ACRES	ADVERTISE PRICE
1	Red Pine	Pulpwood	96.0	Cords	6.5	\$7,593.60
2	Red Pine	Pulpwood	287.0	Cords	19.5	\$22,701.70
3	Red Pine	Pulpwood	296.0	Cords	20.2	\$23,413.60
4	Red Maple	Pulpwood	4.0	Cords	23.8	\$9,578.20
	Red Pine		120.0	Cords		
<b>TOTAL:</b>			803.0	Cords		

## Sale Specific Conditions & Requirements

**Sale Name: Thin It Again Rp**

**Sale Number: 45-114-18 Seq#: 1**

### 1 - Sale Area

#### 1.2 - Boundaries

##### 1.2.1 - Painted boundaries (1/14)

The sale boundaries are marked by red and green paint. Exterior sale lines against state land are marked with red paint. Interior Payment Unit boundaries are marked with green paint. The painted boundary line trees are not Included Timber and are to be protected unless marked with orange paint.

### 2 - Timber Specifications

#### 2.1 - Included Timber

##### 2.1.3 - Cut tree marked unit(s) (12/08)

Within Payment Unit(s) 1-4, all trees are designated for cutting when marked with orange paint above and below stump height, regardless of merchantability.

#### 2.2 - Utilization

##### 2.2.4 - Skidding length (2/14)

Within Payment Units 1-4, skidding of lengths over 17 feet is permissible as long as the timber sale administrator approves the method and machinery used. If at any point damage exceeds specification 3.4.1, all of the remaining wood must be skid in lengths less than 17 feet.

### 3 - Payments

#### 3.3 - Pre-measured Sales

##### 3.3.4 - Dividing payment units (7/14)

Payment Unit(s) with a value over \$20,000 may be divided at the request of the Purchaser and upon approval of the Unit Manager. Dividing Payment Units is a contract modification which requires a Timber Sale Contract Supplement. There will be only one division per Payment Unit.

### 4 - Transportation

#### 4.1 - Construction

##### 4.1.7 - Road closure (10/11)

All new roads built into the sale must be blocked to vehicle traffic upon completion of the sale. Overgrown roads that are reopened shall be considered new roads. In general, this will require constructing a four (4') foot high berm of stumps and logs covered with earth. These roads must be rendered impassable to cars and trucks. Contact the sale administrator for specific details of design and placement.

#### 4.2 - Maintenance

##### 4.2.5 - Two wheel drive condition (2/04)

All existing trail roads on and adjacent to the sale area must be passable by two-wheel drive traffic for the duration of the sale.

### 5 - Operations

#### 5.2 - Conduct of Operations

##### 5.2.1 - Slash

###### 5.2.1.8 - Slash height (12/08)

No slash or tree tops may exceed 24 inches in height.

##### 5.2.2 - Hazard Trees/Snags



#### 5.2.2.1 - Den trees (10/16)

Obvious hollow and/or den trees shall be protected and left standing unless they are a safety hazard.

#### 5.2.3 - Operating Restrictions

##### 5.2.3.3 - Bark slippage restriction (3/09)

Within Payment Unit(s) 1-4, unless changed by written agreement, cutting and skidding are not permitted during the period of May 1 to July 1. This restriction is because of bark slippage.

##### 5.2.32 - Decking/landing restoration (9/13)

All decking and landing areas must have the surface area restored to a condition equal to or better than before. This is to ensure the proper regeneration of the stand. Wood debris, chips and "cookies" from trimmings must be removed or scattered away from landing and loading areas and may not be windrowed on the edge.

##### 5.2.38 - No decking against live trees (2/04)

Cut products may not be decked against unmarked or designated leave trees.

##### 5.2.41 - Snowmobile trail protection (9/11)

The snowmobile trail is shown on the Timber Sale Map. Do not cut or damage posts with orange trail markers or traffic control signs. All stumps within 20 feet of the snowmobile trail must be cut at ground level. The snowmobile trail may not be used for any timber sale operations from December 1 to March 31 unless approved by the Unit Manager or representative. If harvest operations are approved during this time period and the trail road is to be used for hauling, then a snow covered base must be left on the trail. If harvest operations are approved during this time, decking will not be permitted along the snowmobile trail. If harvest operations are approved during this time period, the Purchaser is responsible for posting and maintaining caution signs on the snowmobile trail prior to beginning operations. The trail must be posted at appropriate distances from the sale area to warn of logging activity and truck traffic. Signs must be removed when harvest operations are suspended or completed. The Purchaser will provide these signs.

#### 5.4 - Soil Protection

##### 5.4.1 - Rutting restriction, general (7/16)

Operations are to cease immediately if equipment and weather conditions result in rutting of roads and/or skid trails which is 12 inches or greater in depth and 50 feet in length. The Unit Manager or his/her representative may restrict hauling and/or skidding if ruts exceed the specified depth. With the Unit Manager or his/her representative's approval, the Purchaser may return to the area when the risk of rutting has decreased.

#### 5.8 - Protection of Endangered Species

##### 5.8.5 - Protection of raptor nests (3/13)

All trees with raptor nests will be protected if found during harvesting operations. Notification will be made to the Unit Manager or his/her representative who will notify the Wildlife Biologist so an on-site evaluation and recommendation can be made, if necessary.

### 6 - Safety and Fire Prevention

#### 6.2 - Signing

##### 6.2.1 - Road posting (9/09)

The Purchaser is responsible for posting and maintaining caution signs on all county roads prior to beginning operations. The road must be posted at appropriate distances from the sale area to warn of logging activity and truck traffic. Signs must be removed when harvest operations are suspended or completed. The Purchaser will provide these signs.



# TIMBER SALE MAP

This information provided by authority of Part 525, 1994 PA 451, as amended.

Forest Management Unit		County	Mapped By		Date	Page of	
Sault Ste Marie Management Unit		Mackinac	A Krugh		09/20/2018	1	1
Township	Range	Section(s) and Subdivision(s)			Scale		
43N	07W & 08W	Sec 19 W1/2NW, NWSW Sec 20 S1/2SW Sec 24 SENE, NESE			1:15,840		

Cover Type				Density			
A = Aspen	H = Hemlock	N = Marsh	U = Upland Brush	0 = Non Stocked	5 = Pole Timber Medium		
B = Paper Birch	J = Jack Pine	O = Oak	UM = Upland Mixed	1 = Seedling Sapling Poor	6 = Pole Timber Well		
C = Cedar	L = Lowland Brush	P = Lowland Poplar	V = Bog or Marsh	2 = Seedling Sapling Medium	7 = Saw Timber Poor		
D = Treed Bog	LM = Lowland Mixed	Q = Mixed Swamp Conifer	W = White Pine	3 = Seedling Sapling Well	8 = Saw Timber Medium		
E = Swamp Hdwoods	M = Mpl, Bch, Brch	R = Red Pine	X = Non Stocked	4 = Pole Timber Poor	9 = Saw Timber Well		
F = Spruce Fir	MC = Mixed Conifer	S = Black Spruce	Z = Water				
G = Grass	MD = Mixed Deciduous	T = Tamarack					

## Thin It Again

### Compartment 138

#### 70 Acres

PU	Acres
1	6.5
2	19.5
3	20.2
4	23.8

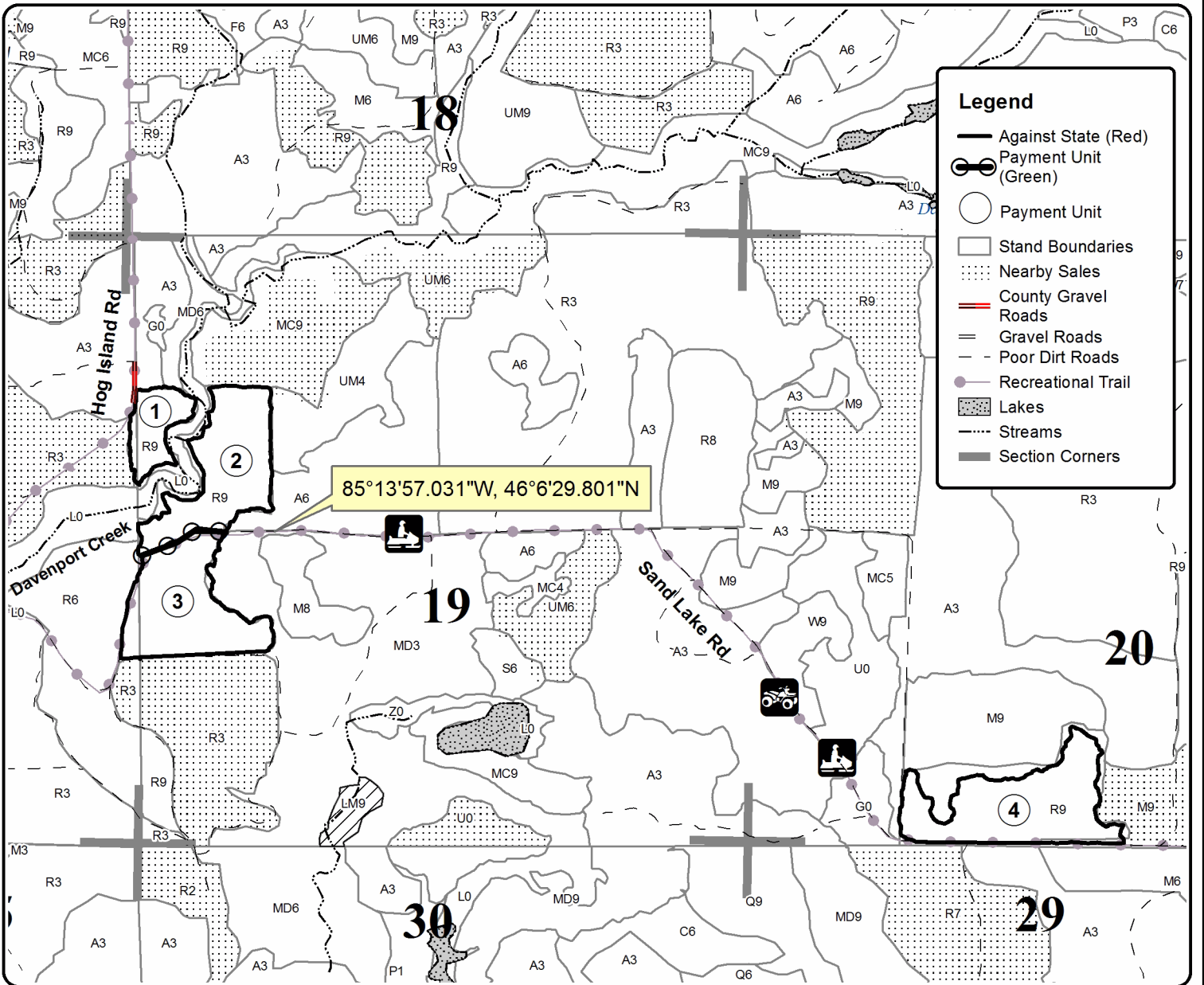

### Legend

- Against State (Red)
- Payment Unit (Green)
- Payment Unit
- Stand Boundaries
- ⋯ Nearby Sales
- County Gravel Roads
- Gravel Roads
- Poor Dirt Roads
- Recreational Trail
- ▨ Lakes
- Streams
- Section Corners

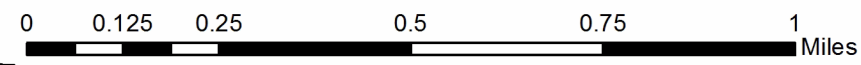

Hayfield Hardwood (45-101-18)

T44N, R10W, SEC. 7; T44N, R11W, SEC. 1; T44N, R11W, SEC. 11; T44N, R11W,

In response to the notice of sale to be held 3:00 p.m. (local time) on June 11, 2019, I am hereby submitting my sealed bid (firm offer) for the following forest products to be cut. Bids for individual species must be at or above the advertised price. All non-responsive bid forms may be rejected.

<u>PRODUCTS &amp; SPECIES</u>	<u>ESTIMATED VOLUME*</u>	<u>ADVERTISED PRICE</u>	<u>BID PRICE/UNIT</u>
<b>Sawtimber</b>			
Basswood	46.20 MBF	\$ 130.00/MBF	\$ _____
Beech	1.80 MBF	\$ 111.00/MBF	\$ _____
Black Cherry	37.30 MBF	\$ 138.00/MBF	\$ _____
Red Maple	14.80 MBF	\$ 117.00/MBF	\$ _____
Sugar Maple	393.00 MBF	\$ 425.00/MBF	\$ _____
<b>Pulpwood</b>			
Basswood	176.00 Cords	\$ 11.20/Cord	\$ _____
Beech	130.00 Cords	\$ 21.55/Cord	\$ _____
Black Cherry	194.00 Cords	\$ 21.55/Cord	\$ _____
Red Maple	251.00 Cords	\$ 21.55/Cord	\$ _____
Sugar Maple	2,117.00 Cords	\$ 21.55/Cord	\$ _____

\*The volumes are statistically estimated within plus (+) or minus (-) 7.86 percent. These estimated volumes are final and not subject to adjustment. Prospective bidders are urged to examine this timber and to make their own estimates of quantity and quality.

I understand that any or all bids may be rejected. All bids must be signed and all bid items must be bid or the bid form may be rejected. I also understand that consideration and awarding a contract will be based upon my past performance and ability to complete the contract based upon equipment and staffing subject to my control.

FEDERAL ID: \_\_\_\_\_ or SOCIAL SECURITY NUMBER: \_\_\_\_\_

Company or individual bidding: \_\_\_\_\_

Company representative's name: \_\_\_\_\_

Address: \_\_\_\_\_

City: \_\_\_\_\_ State: \_\_\_\_\_ Zip: \_\_\_\_\_

IF AVAILABLE, PLEASE PLACE THE PERSONALIZED LABEL FROM YOUR PROSPECTUS IN THE ABOVE BOX.

Individual or company representative's signature: \_\_\_\_\_ Date: \_\_\_\_\_

Phone number : \_\_\_\_\_ Email (optional): \_\_\_\_\_

**THE WINNING BIDDER MUST COMPLETE THE VERIFICATION OF WORKER'S DISABILITY COMPENSATION ACT COMPLIANCE (ON REVERSE SIDE IF DOUBLE SIDED) WITHIN 21 DAYS OF SALE AWARD DATE**



<b>FOR DEPARTMENT USE ONLY</b>
Sale Number (XX - XXX - XX - XX)
Forest Management Unit:

## TIMBER SALE VERIFICATION OF WORKER'S DISABILITY COMPENSATION ACT COMPLIANCE

*As required by Act 317, P.A. 1969 (Worker's Compensation) and  
Part 5 of Act 451 of 1994, as amended.*

### VERIFICATION OF WORKER'S DISABILITY COMPENSATION ACT COMPLIANCE

- This verification must be completed and submitted within 21 days of contract award and prior to the issuance of the timber sale contract.
- In addition, if boxes 2B or 2C are checked, then Notice of Exclusion or Certificate of Insurance must be submitted within twenty-one (21) days of the contract award and prior to the issuance of the timber sale contract.
- All information must be typed or printed except for written signatures.

Please Check Appropriate Categories:

1. My business is organized as (you **must** check one of the boxes below):
  - A.  Sole Proprietorship (individual)
  - B.  Partnership
  - C.  Corporation
  
2. You **must** check one of the boxes below:
  - A.  I certify my business is a sole proprietorship and it has no employees but the sole proprietor. I am not subject to the Worker's Compensation Laws.
  - B.  I certify my business has satisfied its obligation to the Worker's Compensation Act through the use of an approved Notice of Exclusion (BWC-337, Rev. 5/96). I will provide a copy of the Notice of Exclusion within 21 days of the contract award. (For questions or a copy of the BWC-337, please call the Worker's Compensation Bureau at 517-322-1195).
  - C.  I certify my business has a Worker's Compensation Policy. I will provide an original Certificate of Insurance within twenty-one (21) days of the contract award.
  
3. If you have checked item 2(A) or 2(B), you **must** indicate the number of **both** full-time and part-time employees, other than yourself, including family members and active partners (if none, you must enter "0").

\_\_\_\_\_ Full-time Employees                      \_\_\_\_\_ Part-time Employees

Name of Business		Federal ID (or) Social Security No.	
Address		Telephone (        )	
City	State	ZIP	

*I hereby certify that the above information is true and correct. I agree to notify the Michigan DNR of any changes that occur in factors affecting my coverage during any of my present and future operations.*

\_\_\_\_\_  
Signature of Owner or Authorized Representative

\_\_\_\_\_                      \_\_\_\_\_  
Title                                      Date

**Please complete the "SEALED BID" information on the next page**

Swatter House HW (45-102-18)  
T44N, R10W, SEC. 5; T44N, R10W, SEC. 6; T44N, R11W, SEC. 1; T44N, R11W,

In response to the notice of sale to be held 3:00 p.m. (local time) on June 11, 2019, I am hereby submitting my sealed bid (firm offer) for the following forest products to be cut. Bids for individual species must be at or above the advertised price. All non-responsive bid forms may be rejected.

<u>PRODUCTS &amp; SPECIES</u>	<u>ESTIMATED VOLUME*</u>	<u>ADVERTISED PRICE</u>	<u>BID PRICE/UNIT</u>
<b>Sawtimber</b>			
Basswood	40.20 MBF	\$ 130.00/MBF	\$ _____
Black Cherry	40.60 MBF	\$ 138.00/MBF	\$ _____
Red Maple	87.90 MBF	\$ 117.00/MBF	\$ _____
Sugar Maple	450.50 MBF	\$ 425.00/MBF	\$ _____
<b>Pulpwood</b>			
Balsam Fir	5.00 Cords	\$ 16.10/Cord	\$ _____
Basswood	48.00 Cords	\$ 11.20/Cord	\$ _____
Mixed Hardwood	2,878.00 Cords	\$ 21.55/Cord	\$ _____
Paper Birch	7.00 Cords	\$ 11.10/Cord	\$ _____
White Spruce	659.00 Cords	\$ 23.60/Cord	\$ _____

\*The volumes are statistically estimated within plus (+) or minus (-) 10.17 percent. These estimated volumes are final and not subject to adjustment. Prospective bidders are urged to examine this timber and to make their own estimates of quantity and quality.

I understand that any or all bids may be rejected. All bids must be signed and all bid items must be bid or the bid form may be rejected. I also understand that consideration and awarding a contract will be based upon my past performance and ability to complete the contract based upon equipment and staffing subject to my control.

FEDERAL ID: \_\_\_\_ - \_\_\_\_ - \_\_\_\_ or SOCIAL SECURITY NUMBER: \_\_\_\_ - \_\_\_\_ - \_\_\_\_

Company or individual bidding: \_\_\_\_\_

Company representative's name: \_\_\_\_\_

Address: \_\_\_\_\_

City: \_\_\_\_\_ State: \_\_\_\_\_ Zip: \_\_\_\_\_

IF AVAILABLE, PLEASE PLACE THE PERSONALIZED LABEL FROM YOUR PROSPECTUS IN THE ABOVE BOX.

Individual or company representative's signature: \_\_\_\_\_ Date: \_\_\_\_\_

Phone number : \_\_\_\_\_ Email (optional): \_\_\_\_\_

**THE WINNING BIDDER MUST COMPLETE THE VERIFICATION OF WORKER'S DISABILITY COMPENSATION ACT COMPLIANCE (ON REVERSE SIDE IF DOUBLE SIDED) WITHIN 21 DAYS OF SALE AWARD DATE**



<b>FOR DEPARTMENT USE ONLY</b>
Sale Number (XX - XXX - XX - XX)
Forest Management Unit:

## TIMBER SALE VERIFICATION OF WORKER'S DISABILITY COMPENSATION ACT COMPLIANCE

*As required by Act 317, P.A. 1969 (Worker's Compensation) and  
Part 5 of Act 451 of 1994, as amended.*

### VERIFICATION OF WORKER'S DISABILITY COMPENSATION ACT COMPLIANCE

- This verification must be completed and submitted within 21 days of contract award and prior to the issuance of the timber sale contract.
- In addition, if boxes 2B or 2C are checked, then Notice of Exclusion or Certificate of Insurance must be submitted within twenty-one (21) days of the contract award and prior to the issuance of the timber sale contract.
- All information must be typed or printed except for written signatures.

Please Check Appropriate Categories:

1. My business is organized as (you **must** check one of the boxes below):
  - A.  Sole Proprietorship (individual)
  - B.  Partnership
  - C.  Corporation
2. You **must** check one of the boxes below:
  - A.  I certify my business is a sole proprietorship and it has no employees but the sole proprietor. I am not subject to the Worker's Compensation Laws.
  - B.  I certify my business has satisfied its obligation to the Worker's Compensation Act through the use of an approved Notice of Exclusion (BWC-337, Rev. 5/96). I will provide a copy of the Notice of Exclusion within 21 days of the contract award. (For questions or a copy of the BWC-337, please call the Worker's Compensation Bureau at 517-322-1195).
  - C.  I certify my business has a Worker's Compensation Policy. I will provide an original Certificate of Insurance within twenty-one (21) days of the contract award.
3. If you have checked item 2(A) or 2(B), you **must** indicate the number of **both** full-time and part-time employees, other than yourself, including family members and active partners (if none, you must enter "0").

\_\_\_\_\_ Full-time Employees

\_\_\_\_\_ Part-time Employees

Name of Business		Federal ID (or) Social Security No.	
Address		Telephone (       )	
City	State	ZIP	

*I hereby certify that the above information is true and correct. I agree to notify the Michigan DNR of any changes that occur in factors affecting my coverage during any of my present and future operations.*

\_\_\_\_\_  
Signature of Owner or Authorized Representative

\_\_\_\_\_  
Title

\_\_\_\_\_  
Date

**Please complete the "SEALED BID" information on the next page**

Baloneyville Mix (45-113-18)  
T43N, R07W, SEC. 17; T43N, R07W, SEC. 18; T43N, R07W, SEC. 19; T43N,

In response to the notice of sale to be held 3:00 p.m. (local time) on June 11, 2019, I am hereby submitting my sealed bid (firm offer) for the following forest products to be cut. Bids for individual species must be at or above the advertised price. All non-responsive bid forms may be rejected.

<u>PRODUCTS &amp; SPECIES</u>	<u>ESTIMATED VOLUME*</u>	<u>ADVERTISED PRICE</u>	<u>BID PRICE/UNIT</u>
Pulpwood			
Balsam Fir	200.00 Cords	\$ 16.10/Cord	\$ _____
Jack Pine	6.00 Cords	\$ 38.65/Cord	\$ _____
Mixed Aspen	855.00 Cords	\$ 32.65/Cord	\$ _____
Paper Birch	40.00 Cords	\$ 11.10/Cord	\$ _____
Red Maple	359.00 Cords	\$ 21.55/Cord	\$ _____
Red Pine	2,622.00 Cords	\$ 79.10/Cord	\$ _____
White Pine	450.00 Cords	\$ 22.70/Cord	\$ _____
White Spruce	99.00 Cords	\$ 23.60/Cord	\$ _____

\*The volumes are statistically estimated within plus (+) or minus (-) 9.47 percent. These estimated volumes are final and not subject to adjustment. Prospective bidders are urged to examine this timber and to make their own estimates of quantity and quality.

I understand that any or all bids may be rejected. All bids must be signed and all bid items must be bid or the bid form may be rejected. I also understand that consideration and awarding a contract will be based upon my past performance and ability to complete the contract based upon equipment and staffing subject to my control.

FEDERAL ID: \_\_\_\_\_ - \_\_\_\_\_ or SOCIAL SECURITY NUMBER: \_\_\_\_\_ - \_\_\_\_\_ - \_\_\_\_\_

Company or individual bidding: \_\_\_\_\_

Company representative's name: \_\_\_\_\_

Address: \_\_\_\_\_

City: \_\_\_\_\_ State: \_\_\_\_\_ Zip: \_\_\_\_\_

IF AVAILABLE, PLEASE PLACE THE PERSONALIZED LABEL FROM YOUR PROSPECTUS IN THE ABOVE BOX.

Individual or company representative's signature: \_\_\_\_\_ Date: \_\_\_\_\_

Phone number : \_\_\_\_\_ Email (optional): \_\_\_\_\_

**THE WINNING BIDDER MUST COMPLETE THE VERIFICATION OF WORKER'S DISABILITY COMPENSATION ACT COMPLIANCE (ON REVERSE SIDE IF DOUBLE SIDED) WITHIN 21 DAYS OF SALE AWARD DATE**



<b>FOR DEPARTMENT USE ONLY</b>
Sale Number (XX - XXX - XX - XX)
Forest Management Unit:

## TIMBER SALE VERIFICATION OF WORKER'S DISABILITY COMPENSATION ACT COMPLIANCE

*As required by Act 317, P.A. 1969 (Worker's Compensation) and  
Part 5 of Act 451 of 1994, as amended.*

### VERIFICATION OF WORKER'S DISABILITY COMPENSATION ACT COMPLIANCE

- This verification must be completed and submitted within 21 days of contract award and prior to the issuance of the timber sale contract.
- In addition, if boxes 2B or 2C are checked, then Notice of Exclusion or Certificate of Insurance must be submitted within twenty-one (21) days of the contract award and prior to the issuance of the timber sale contract.
- All information must be typed or printed except for written signatures.

Please Check Appropriate Categories:

1. My business is organized as (you **must** check one of the boxes below):
  - A.  Sole Proprietorship (individual)
  - B.  Partnership
  - C.  Corporation
2. You **must** check one of the boxes below:
  - A.  I certify my business is a sole proprietorship and it has no employees but the sole proprietor. I am not subject to the Worker's Compensation Laws.
  - B.  I certify my business has satisfied its obligation to the Worker's Compensation Act through the use of an approved Notice of Exclusion (BWC-337, Rev. 5/96). I will provide a copy of the Notice of Exclusion within 21 days of the contract award. (For questions or a copy of the BWC-337, please call the Worker's Compensation Bureau at 517-322-1195).
  - C.  I certify my business has a Worker's Compensation Policy. I will provide an original Certificate of Insurance within twenty-one (21) days of the contract award.
3. If you have checked item 2(A) or 2(B), you **must** indicate the number of **both** full-time and part-time employees, other than yourself, including family members and active partners (if none, you must enter "0").

\_\_\_\_\_ Full-time Employees

\_\_\_\_\_ Part-time Employees

Name of Business		Federal ID (or) Social Security No.	
Address		Telephone (       )	
City	State	ZIP	

*I hereby certify that the above information is true and correct. I agree to notify the Michigan DNR of any changes that occur in factors affecting my coverage during any of my present and future operations.*

\_\_\_\_\_  
Signature of Owner or Authorized Representative

\_\_\_\_\_  
Title

\_\_\_\_\_  
Date

**Please complete the "SEALED BID" information on the next page**



Thin It Again Rp (45-114-18)  
T43N, R07W, SEC. 19; T43N, R07W, SEC. 20; T43N, R08W, SEC. 24; Mackinac

In response to the notice of sale to be held 3:00 p.m. (local time) on June 11, 2019, I am hereby submitting my sealed bid (firm offer) for the following forest products to be cut. Bids for individual species must be at or above the advertised price. All non-responsive bid forms may be rejected.

<u>PRODUCTS &amp; SPECIES</u>	<u>ESTIMATED VOLUME*</u>	<u>ADVERTISED PRICE</u>	<u>BID PRICE/UNIT</u>
Pulpwood			
Red Maple	4.00 Cords	\$ 21.55/Cord	\$ _____
Red Pine	799.00 Cords	\$ 79.10/Cord	\$ _____

\*The volumes are statistically estimated within plus (+) or minus (-) 15.05 percent. These estimated volumes are final and not subject to adjustment. Prospective bidders are urged to examine this timber and to make their own estimates of quantity and quality.

I understand that any or all bids may be rejected. All bids must be signed and all bid items must be bid or the bid form may be rejected. I also understand that consideration and awarding a contract will be based upon my past performance and ability to complete the contract based upon equipment and staffing subject to my control.

FEDERAL ID: \_\_\_\_\_ or SOCIAL SECURITY NUMBER: \_\_\_\_\_

Company or individual bidding: \_\_\_\_\_

Company representative's name: \_\_\_\_\_

Address: \_\_\_\_\_

City: \_\_\_\_\_ State: \_\_\_\_\_ Zip: \_\_\_\_\_

IF AVAILABLE, PLEASE PLACE THE PERSONALIZED LABEL FROM YOUR PROSPECTUS IN THE ABOVE BOX.

Individual or company representative's signature: \_\_\_\_\_ Date: \_\_\_\_\_

Phone number : \_\_\_\_\_ Email (optional): \_\_\_\_\_

**THE WINNING BIDDER MUST COMPLETE THE VERIFICATION OF WORKER'S DISABILITY COMPENSATION ACT COMPLIANCE (ON REVERSE SIDE IF DOUBLE SIDED) WITHIN 21 DAYS OF SALE AWARD DATE**



<b>FOR DEPARTMENT USE ONLY</b>
Sale Number (XX - XXX - XX - XX)
Forest Management Unit:

## TIMBER SALE VERIFICATION OF WORKER'S DISABILITY COMPENSATION ACT COMPLIANCE

*As required by Act 317, P.A. 1969 (Worker's Compensation) and  
Part 5 of Act 451 of 1994, as amended.*

### VERIFICATION OF WORKER'S DISABILITY COMPENSATION ACT COMPLIANCE

- This verification must be completed and submitted within 21 days of contract award and prior to the issuance of the timber sale contract.
- In addition, if boxes 2B or 2C are checked, then Notice of Exclusion or Certificate of Insurance must be submitted within twenty-one (21) days of the contract award and prior to the issuance of the timber sale contract.
- All information must be typed or printed except for written signatures.

Please Check Appropriate Categories:

1. My business is organized as (you **must** check one of the boxes below):
  - A.  Sole Proprietorship (individual)
  - B.  Partnership
  - C.  Corporation
2. You **must** check one of the boxes below:
  - A.  I certify my business is a sole proprietorship and it has no employees but the sole proprietor. I am not subject to the Worker's Compensation Laws.
  - B.  I certify my business has satisfied its obligation to the Worker's Compensation Act through the use of an approved Notice of Exclusion (BWC-337, Rev. 5/96). I will provide a copy of the Notice of Exclusion within 21 days of the contract award. (For questions or a copy of the BWC-337, please call the Worker's Compensation Bureau at 517-322-1195).
  - C.  I certify my business has a Worker's Compensation Policy. I will provide an original Certificate of Insurance within twenty-one (21) days of the contract award.
3. If you have checked item 2(A) or 2(B), you **must** indicate the number of **both** full-time and part-time employees, other than yourself, including family members and active partners (if none, you must enter "0").

\_\_\_\_\_ Full-time Employees                      \_\_\_\_\_ Part-time Employees

Name of Business		Federal ID (or) Social Security No.	
Address		Telephone (       )	
City	State	ZIP	

*I hereby certify that the above information is true and correct. I agree to notify the Michigan DNR of any changes that occur in factors affecting my coverage during any of my present and future operations.*

\_\_\_\_\_  
Signature of Owner or Authorized Representative

\_\_\_\_\_  
Title

\_\_\_\_\_  
Date

**Please complete the "SEALED BID" information on the next page**