



**DEPARTMENT OF NATURAL RESOURCES  
STATE OF MICHIGAN**

**TIMBER SALE PROSPECTUS #6503**

SCHEDULED SALE DATE AND TIME: 11:00 a.m. (local time) on September 17, 2019.

LOCATION: SW REGION-WILD, 621 NORTH 10TH STREET, PLAINWELL, MI 49080.

PROSPECTUS NOTE: The bidder is advised to inspect the sale area and review the location, estimated volumes, operating costs and contract terms of proposed sales. Please be aware that some landowners may request 60 days or more notice for access across their land.

Notice is hereby given that bids will be received by the Game Area Manager, CRANE POND SGA, for certain timber on the following described lands:

Keeler (21-001-19) / T04S, R16W, SEC. 18, NESW,SE.

Van Buren County, Advertised Price \$10,333.60, 12.6 Acres, Aspen, Hardwood.

SALE NOTE: Access may be through other public land.

Three Rivers 2018 (21-002-19) / T07S, R12W, SEC. 18, SWNE,W1/2SE.

T07S, R12W, SEC. 19, NWNE.

T07S, R12W, SEC. 7 , S1/2SE.

Saint Joseph County, Advertised Price \$17,972.00, 20.3 Acres, Red Pine, Hardwood.

SALE NOTE: Access may be through other public land.

Crane Pond 2019 (21-003-19) / T06S, R13W, SEC. 19, SWSE.

T06S, R13W, SEC. 26, SENW,SWNE.

Cass County, Advertised Price \$9,174.65, 14.2 Acres, Hardwood, Aspen.

SALE NOTE: Access may be through other public land.

Angling Pine (21-004-19) / T03S, R11W, SEC. 19, S1/2NW,N1/2SW.

Kalamazoo County, Advertised Price \$18,773.30, 23.8 Acres, Red Pine, Jack Pine.

SALE NOTE: Access may be through other public land.

## BID INSTRUCTIONS (VER. 07/02/2018):

### 1. Scheduled Bid Location, Date, and Time (2/11)

Bids must be received by the Unit Manager, PLAINWELL OFFICE, 621 North 10th Street, Plainwell, MI 49080, no later than 11:00 a.m. (local time) on September 17, 2019. For further information concerning this sale, contact Cynthia McQueer at 269-685-9074.

### 2. Bidder's Qualifications (5/16)

Purchaser shall obtain workers compensation insurance to cover claims under Michigan's Worker's Disability Compensation Act of 1969 or similar employee benefit act of any other state applicable to an employee. If all or part of a timber sale was prepared by a private contractor, the contractor and that contractor's company are not permitted to bid on the timber sale contract. Bids will not be accepted from individuals or companies appearing on the DNR/FRD No-Bid List. This list contains the names of purchasers who previously failed to execute a contract within 21-days or who have a history of poor performance.

### 3. Preparation of Sealed Bids (5/16)

Bid Forms may be completed online thru Michigan DNR Timber Sale Online Bidding (OLB) at [www.michigan.gov/timberbidding](http://www.michigan.gov/timberbidding) or by completing the hardcopy Bid Form found in the Timber Sale Prospectus. Hardcopy Bid Forms shall be manually signed in ink. Registration in OLB is considered your 'signature' for all bids submitted thru that system. Bid prices must be entered for each species and product in the Bid Price column for all material subject to bidding and all fill-in blanks must be completed. If erasures or other changes appear on the hardcopy Bid Form, each erasure or change must be initialed by the person signing the bid.

### 4. Submission of Sealed Bids (5/16)

Bid forms may be obtained from the Unit Manager or thru OLB. Bids may be submitted hardcopy or thru OLB. All hardcopy bids must be submitted on the bid form and in an envelope clearly identified as described in this section. NOTE: Only one bid form per bid envelope. Sealed bids must be submitted to the Unit office designated in the prospectus and must be submitted at or prior to the time established in the prospectus. The envelope should show on the outside (a) the sale name or number and (b) the date and time of bid opening, as shown in the prospectus. Bids received after the time specified in the sale prospectus are late bids and will be rejected.

It is possible for a bidder to submit multiple bids on a single sale. For example, a bid may be submitted hardcopy and a bid may be submitted thru OLB. Or, two bidders from the same company could both submit bids on the same sale. If this were to happen, the State would accept all bids received and award the contract accordingly. All bidding and contractual requirements would apply to all bids received.

### 5. Public Opening of Sealed Bids (7/16)

If conditions permit, the sealed bids will be publicly opened and posted at the time and place set in the prospectus.

If a bidder, present at a bid opening, has submitted bids on more than one sale, that bidder may withdraw their unopened bid envelopes or announce the withdrawal of their online bid after being declared the successful bidder on one sale.

### 6. Award of Contract (1/11)

Award of the contract will be made to the Bidder whose bid, conforming to the prospectus, is most advantageous to the State of Michigan on the basis of total value at rates bid for the estimated quantities. The State reserves the right to reject any bid or waive any minor irregularity in bids received. A written award mailed (or otherwise furnished) to the successful Bidder shall be deemed to result in a binding contract without further action by either party.

### 7. Down Payment (1/11)

The Bidder to whom award is made must make a down payment within 21 days of the sale award. The amount of the down payment will be calculated as shown in the Bond and Payment Schedule of this prospectus. Only cash may be used to meet this requirement.

### 8. Performance Security (1/11)

As guarantee of faithful performance, a cash bond, certificate of deposit, surety bond or irrevocable letter of credit (LOC) is required within 21 days of the sale award. The amount of the performance security is shown in the Bond and

Payment Schedule of this prospectus. If an LOC or surety is used, the coverage must extend for at least 6 months beyond the contract expiration.

#### 9. Timber Sale Contract (7/18)

Additional conditions and requirements common to all timber sales are listed on the timber sale contract (R4031) and are available on line at [www.michigan.gov/timber](http://www.michigan.gov/timber). Contact the Unit Manager for additional information or a sample contract. Within 21 days of the date of the award letter, the bidder must sign the contract and provide the required down payment, performance security, and verification of worker's disability compensation. The down payment and performance security shall be in accordance with the provisions of the timber sale contract, in the sums stated in this prospectus. If these actions are not taken, then the Bidder, the Bidder's corporation, and the corporation's principals may not be permitted to bid on State timber sales for a period of 3 months after the first offense, 6 months after the second offense, and 1 year after the third offense. An offense will only be counted against the Bidder for 5 years. In addition, the Bidder certifies that if awarded this contract, the Bidder will complete the timber sale contract in accordance with its terms and any modifications thereof including requirements to purchase, cut, and remove the included timber by the expiration date.

Payment Unit values in the State Forest Timber Sale Contract are calculated based on the advertised value of the Payment Unit as a percentage of the total advertised value of the contract. The advertised value of each Payment Unit is given in the Description of Timber by Payment Unit table on the Timber Sale Information page. For example, if the value of Payment Unit 1 is advertised as \$1,500 and the total Timber Sale value is advertised as \$10,000, the contract price for Payment Unit 1 will be 15% of the total bid price ( $\$1,500/\$10,000 * 100$ ).

#### 10. Disclaimer of Estimates and Bidder's Warranty of Inspection (7/16)

Before submitting this bid, the Bidder is advised and cautioned to inspect the sale area, review the requirements of the sale contract, and take other steps as may be reasonably necessary to ascertain the location, estimated volumes, construction estimates, and operating costs of the proposed sale. Failure to do so will not relieve the Bidder from responsibility for completing the contract.

The Bidder warrants that this bid is submitted solely on the basis of the Bidder's examination and inspection of the quality and quantity of the timber offered for sale and the Bidder's opinion of the value thereof and the costs of recovery. No reliance should be placed on the State of Michigan's estimates of timber quality, quantity or costs of recovery. Bidder further acknowledges that the State of Michigan: (i) expressly disclaims any warranty of fitness of timber for any purpose; (ii) offers this timber as is without any warranty of quality (merchantability) or quantity and (iii) expressly disclaims any warranty as to the quantity or quality of timber sold.

#### 11. Certification and Chain-of-Custody (10/14)

Unless otherwise indicated in the contract under section 7 – Other Conditions of the Sale Specific Conditions & Requirements, the area encompassed by this timber sale is certified to the standards of the Forest Stewardship Council (FSC) - Certificate #SCS-FM/COC-00090N and the Sustainable Forestry Initiative (SFI) - Certificate #NSF-SFIS-5Y031-SF5. Forest products from this sale may be delivered to the mill as "FSC 100% and / or SFI certified" as long as the contractor hauling the forest products is chain-of-custody (COC) certified or covered under a COC certificate from the destination mill. The purchaser is responsible for maintaining COC after leaving the sale area.

#### 12. Good Neighbor Authority (GNA) Requirements (7/16)

If the name of this timber sales contains the acronym GNA, it is authorized by the Good Neighbor Authority (GNA) and covered by various agreements between the U.S. Forest Service and the State. The timber sale occurs on federal land and the following conditions apply:

GNA contracts on US Forest Service land will not be awarded to purchasers on the Federal list of excluded parties. The System for Award Management (SAM) will be checked for active excluded parties prior to award of contract. In addition, the Bidder to whom award is made must complete an Assurance Regarding Felony Conviction or Tax Delinquent Status for Corporate Applicants (AD-3031).

#### 13. Good Neighbor Authority (GNA) Requirements, con't (9/16)

Bidder certifies, by signing this bid form, that to the best of Bidder's knowledge that the following representations are accurate and complete.

- a. That the Bidder and its principals are not presently debarred, suspended, proposed for debarment, declared ineligible, or voluntary excluded from timber sales (covered transactions) by any Federal department or agency.
- b. That the Bidder and its principals have not within a 3-year period preceding this bid been convicted of or had a civil judgment rendered against them for commission of fraud or a criminal offense in connection with obtaining, attempting to obtain, or performing a public (Federal, State, or local) transaction or contract under a public transaction; violation of Federal or State antitrust statutes or commission of embezzlement, theft, forgery, bribery, falsification or destruction of records, making false statements, or receiving stolen property.
- c. That the Bidder and its principals are not presently indicted for or otherwise criminally or civilly charged by a governmental entity (Federal, State, or local) with commission of any of the offenses enumerated in paragraph b of this certification.
- d. That the Bidder and its principals have not within a 3-year period preceding this bid had one or more public transactions (Federal, State, or local) terminated for breach or default of a timber or forest product contract.

Bidders that cannot certify this requirement, in whole or in part, shall submit an explanation with their bid.

DAN EICHINGER  
Director

**TIMBER SALE INFORMATION**

Keeler (21-001-19)

T04S, R16W, SEC. 18.

Van Buren County (Advertised Price \$10,333.60)

SALE NOTE: Access may be through other public land.

A timber sale contract for this lump sum, sealed bid timber sale will be awarded to the responsible bidder offering the highest sealed bid price. Bids must be at or above the following advertised price for each species:

| <u>PRODUCTS &amp; SPECIES</u> | <u>ESTIMATED UNITS*</u> | <u>ADVERTISED PRICE</u> |
|-------------------------------|-------------------------|-------------------------|
| Sawtimber                     |                         |                         |
| B. T. Aspen                   | 28.10 MBF               | \$ 99.00 / MBF          |
| Black Cherry                  | 0.80 MBF                | \$ 115.00 / MBF         |
| Red Oak                       | 4.60 MBF                | \$ 195.00 / MBF         |
| Pulpwood                      |                         |                         |
| B. T. Aspen                   | 288.00 Cords            | \$ 17.40 / Cord         |
| Mixed Hardwood                | 107.00 Cords            | \$ 14.50 / Cord         |

\* The total volume is statistically estimated within plus (+) or minus (-) 31.05 percent. The estimated units are final and not subject to adjustment. Prospective bidders are urged to examine this timber and to make their own estimates of quantity and quality.

**BOND AND PAYMENT SCHEDULE:**

- A bond in the amount of \$517.00 to insure faithful performance of the conditions of the contract will be deposited by the successful bidder within 21 days of the sale award.
- Cutting in any sale or unit without the required advance payment would be considered a trespass.
- Total payment must be paid in advance or according to the following schedule:
  - Ten percent (10%) of the sale value must be paid within 21 days of the sale award.
  - The remainder is due before cutting begins.
  - Payment for each of the following units must be made before cutting begins in that unit:
 

| PAYMENT UNIT NUMBER | PERCENT OF TOTAL SALE VALUE |
|---------------------|-----------------------------|
| 01                  | 100.0%                      |
- If no cutting takes place, the 10% down payment will not be refunded.
- Operations on the contract issued will terminate on 03/01/2021.

**Description of Timber by Payment Unit (PU)**

| PU     | MARKET GROUP    | PRODUCT   | QUANTITY | UNIT  | ACRES | ADVERTISE PRICE |
|--------|-----------------|-----------|----------|-------|-------|-----------------|
| 1      | B. T. Aspen     | Sawtimber | 28.1     | MBF   | 12.6  | \$10,333.60     |
|        | Black Cherry    |           | 0.8      | MBF   |       |                 |
|        | Red Oak         |           | 4.6      | MBF   |       |                 |
|        | B. T. Aspen     | Pulpwood  | 288.0    | Cords |       |                 |
|        | Mixed Hardwood  |           | 107.0    | Cords |       |                 |
|        | Misc. Species 1 | Sawtimber | 6.8      | MBF   |       |                 |
|        | Misc. Species 2 |           | 0.8      | MBF   |       |                 |
|        | Black Cherry    | Pulpwood  | 14.0     | Cords |       |                 |
|        | Misc. Species 1 |           | 29.0     | Cords |       |                 |
|        | Misc. Species 2 |           | 4.0      | Cords |       |                 |
|        | Red Maple       |           | 21.0     | Cords |       |                 |
|        | Red Oak         |           | 20.0     | Cords |       |                 |
|        | Sugar Maple     |           | 3.0      | Cords |       |                 |
|        | TOTAL:          |           |          | 33.5  |       |                 |
| TOTAL: |                 |           | 395.0    | Cords |       |                 |

## Sale Specific Conditions & Requirements

**Sale Name: Keeler**

**Sale Number: 21-001-19 Seq#: 1**

### 1 - Sale Area

#### 1.2 - Boundaries

##### 1.2.1 - Painted boundaries (1/14)

Exterior sale boundary lines against state are marked with red paint. The painted boundary line trees are not Included Timber and are to be protected unless marked with orange paint.

### 2 - Timber Specifications

#### 2.1 - Included Timber

##### 2.1.1 - Clearcut unit(s) with unmerchantable trees (6/14)

Within Payment Unit(s) 1, cut all trees that are two (2) inches or more at DBH.

##### 2.1.11 - Description of timber note (2/04)

Note that Misc. Species 1 = tulip poplar, and Misc. Species 2 = hickory.

#### 2.2 - Utilization

##### 2.2.1 - Utilization (2/04)

All listed board foot volumes of sawlog size products in this contract have been determined using a top diameter inside bark of 10 inches.

### 4 - Transportation

#### 4.1 - Construction

##### 4.1.3 - Slash and earthen piles (8/04)

Piles or windrows of earth along roads and landings that have been widened or constructed shall be leveled. Slash from road maintenance or construction, including stumps, shall be dispersed throughout the sale.

##### 4.1.12 - No new roads (1/12)

No new roads will be permitted in any Payment Unit. Skid trails only will be allowed.

#### 4.4 - Access

##### 4.4.3 - Access gate (12/08)

The access gate must be locked at the completion of each day unless otherwise approved by the Unit Manager or his/her representative.

### 5 - Operations

#### 5.1 - Notification

##### 5.1.1 - Pre-sale conference (10/16)

A pre-sale conference on site between the Purchaser and sale administrator is required prior to beginning any operations.

##### 5.1.4 - Post-sale conference (10/16)

A post-sale conference on site between the Purchaser and sale administrator is required 5 days prior to the completion of active logging operations to determine clean-up and repair of landings, road edges, and the fulfillment of other contract specifications.

#### 5.2 - Conduct of Operations

##### 5.2.1 - Slash

##### 5.2.1.10 - No slash in openings (5/10)

No brush or logging debris is to be left in the maintained wildlife opening which is indicated by G0 on the Timber Sale Map. Any damage to the opening shall be repaired according to specifications of the Unit Manager or his/her

representative.

#### 5.2.1.13 - Dispose of slash as directed (12/05)

Slash is to be disposed of as directed by the sale administrator.

### 5.2.2 - Hazard Trees/Snags

#### 5.2.2.1 - Den trees (10/16)

Obvious hollow and/or den trees shall be protected and left standing unless they are a safety hazard.

### 5.2.3 - Operating Restrictions

#### 5.2.3.1 - Operating restrictions (9/11)

Within Payment Unit(s) 1, unless changed by written agreement, cutting, skidding, and hauling are limited to the period of December 1 to March 1. This restriction is because of access through cropped fields, hunting season, and aspen regeneration.

### 5.2.4 - Dead and Down Creation

#### 5.2.4.4 - Dead and down creation, grouse (6/18)

To encourage grouse and other wildlife, in Payment Unit(s) 1, leave one, 12" diameter or larger log-length (8 foot minimum) piece on the ground for every 2 acres. These will be evenly scattered throughout the unit. This can be an unmerchantable piece or a full tree. Each log must be clearly identified by a piece of blue flagging.

#### 5.2.32 - Decking/landing restoration (9/13)

All decking and landing areas must have the surface area restored to a condition equal to or better than before. This is to ensure the proper regeneration of the stand. Wood debris, chips and "cookies" from trimmings must be removed or scattered away from landing and loading areas and may not be windrowed on the edge.

## 5.4 - Soil Protection

#### 5.4.1 - Rutting restriction, general (7/16)

Operations are to cease immediately if equipment and weather conditions result in rutting of roads and/or skid trails which is 12 inches or greater in depth and 50 feet in length. The Unit Manager or his/her representative may restrict hauling and/or skidding if ruts exceed the specified depth. With the Unit Manager or his/her representative's approval, the Purchaser may return to the area when the risk of rutting has decreased.

## 5.6 - Debris and Waste Material

#### 5.6.3 - Equipment cleaning (12/17)

For purposes of this provision, "Off-Road Equipment" includes all logging and construction machinery, except for log trucks, chip vans, service vehicles, water trucks, pickup trucks, cars, and similar vehicles. Off-Road Equipment brought on site must be clean and free from plant material and soil prior to arrival on any Payment Unit. Off-Road Equipment shall be cleaned of plant material and dirt prior to being moved to a new stand within the sale. Plant material includes leaves, stems, roots and seeds. Equipment shall be considered clean when a visual inspection does not disclose seeds, soil, vegetative matter, and other debris that could contain or hold seeds. This is to prevent the spread of invasive plant species.

## 7 - Other Conditions

### 7.10 - Certified Timber

#### 7.10.1 - Non-certified timber (2/16)

The area encompassed by this timber sale is not certified to the standards of the Forest Stewardship Council (FSC) or the Sustainable Forestry Initiative (SFI). Forest products from this sale may not be delivered to the mill as "FSC and / or SFI certified". The lands within this sale are managed as a State Game Area.



# TIMBER SALE MAP

This information provided by authority of Part 525, 1994 PA 451, as amended.

|             |      |
|-------------|------|
| Sale Number | Year |
| 21-001      | 2019 |

|  |                     |   |                   |           |         |
|--|---------------------|---|-------------------|-----------|---------|
| Forest Management Unit<br>Keeler State Game Area | County<br>Van Buren | Mapped By<br>Nate DeVries                   | Date<br>02/07/19  | Page<br>1 | of<br>2 |
| Township<br>04S                                  | Range<br>16W        | Section(s) and Subdivision(s)<br>Section 18 | Scale<br>1:62,500 |           |         |
| Cruised By<br>Jesse Bramer                       |                     |   |                   |           |         |

| Cover Type        |                      |                         |                   | Density                     |                        |
|-------------------|----------------------|-------------------------|-------------------|-----------------------------|------------------------|
| A = Aspen         | H = Hemlock          | N = Marsh               | U = Upland Brush  | 0 = Non Stocked             | 5 = Pole Timber Medium |
| B = Paper Birch   | J = Jack Pine        | O = Oak                 | UM = Upland Mixed | 1 = Seedling Sapling Poor   | 6 = Pole Timber Well   |
| C = Cedar         | L = Lowland Brush    | P = Lowland Poplar      | V = Bog or Marsh  | 2 = Seedling Sapling Medium | 7 = Saw Timber Poor    |
| D = Tread Bog     | LM = Lowland Mixed   | Q = Mixed Swamp Conifer | W = White Pine    | 3 = Seedling Sapling Well   | 8 = Saw Timber Medium  |
| E = Swamp Hdwoods | M = Mpl, Bch, Brch   | R = Red Pine            | X = Non Stocked   | 4 = Pole Timber Poor        | 9 = Saw Timber Well    |
| F = Spruce Fir    | MC = Mixed Conifer   | S = Black Spruce        | Z = Water         |                             |                        |
| G = Grass         | MD = Mixed Deciduous | T = Tamarack            |                   |                             |                        |

## Keeler 2018

### Compartment 88000101

12.6 Acres

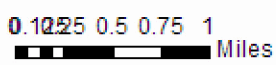
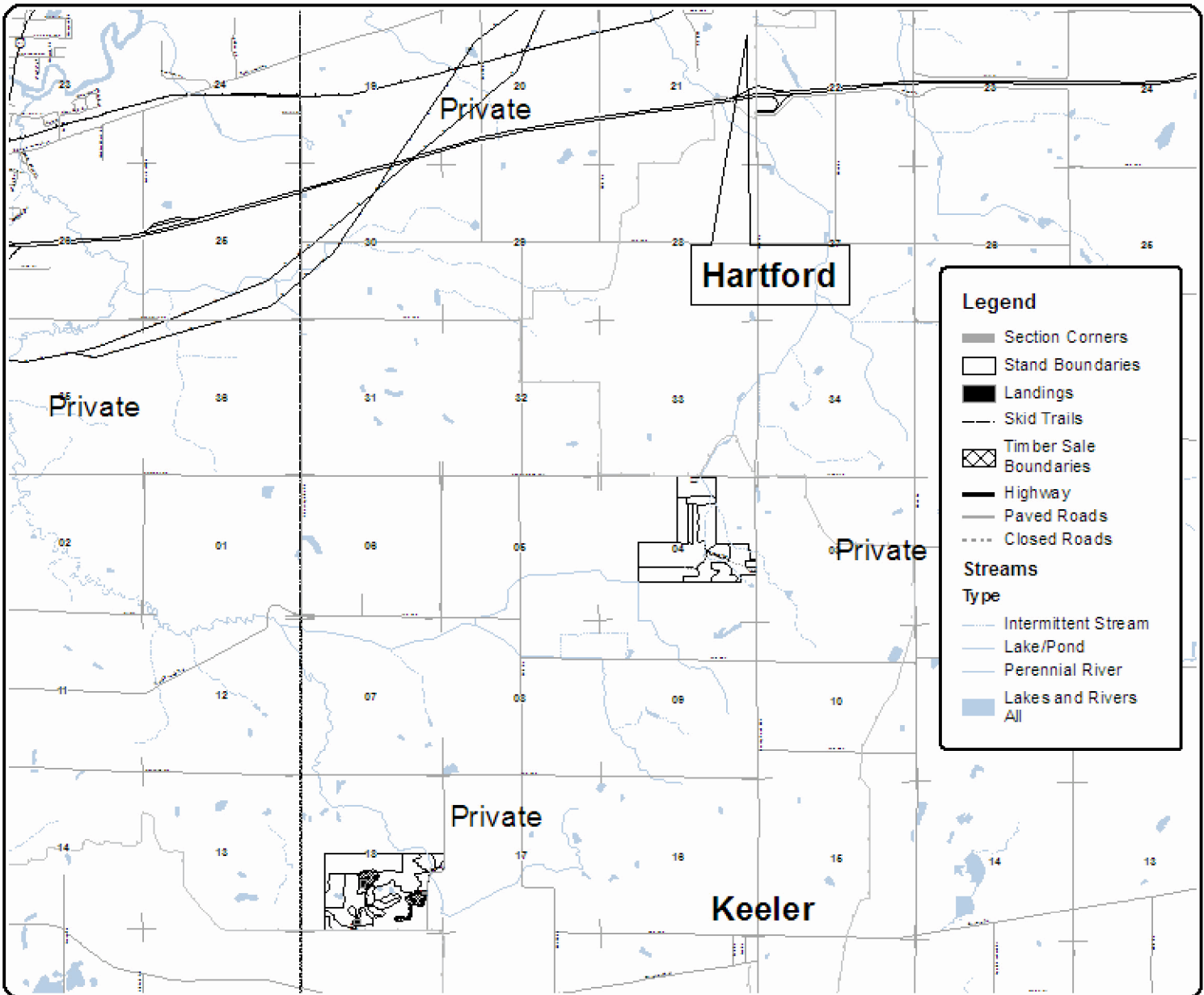
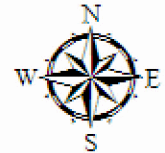





# TIMBER SALE MAP

This information provided by authority of Part 525, 1994 PA 451, as amended.

|  |              |   |                            |                   |           |         |
|--|--------------|---|----------------------------|-------------------|-----------|---------|
| Forest Management Unit<br>Keeler State Game Area |              | County<br>Van Buren                         | Mapped By<br>Nate DeVries  | Date<br>02/07/19  | Page<br>2 | of<br>2 |
| Township<br>04S                                  | Range<br>16W | Section(s) and Subdivision(s)<br>Section 18 |                            | Scale<br>1:10,000 |           |         |
|  |              |   | Cruised By<br>Jesse Bramer |                   |           |         |

| Cover Type        |                      |                         |                   | Density                     |                        |  |  |
|-------------------|----------------------|-------------------------|-------------------|-----------------------------|------------------------|--|--|
| A = Aspen         | H = Hemlock          | N = Marsh               | U = Upland Brush  | 0 = Non Stocked             | 5 = Pole Timber Medium |  |  |
| B = Paper Birch   | J = Jack Pine        | O = Oak                 | UM = Upland Mixed | 1 = Seedling Sapling Poor   | 6 = Pole Timber Well   |  |  |
| C = Cedar         | L = Lowland Brush    | P = Lowland Poplar      | V = Bog or Marsh  | 2 = Seedling Sapling Medium | 7 = Saw Timber Poor    |  |  |
| D = Treed Bog     | LM = Lowland Mixed   | Q = Mixed Swamp Conifer | W = White Pine    | 3 = Seedling Sapling Well   | 8 = Saw Timber Medium  |  |  |
| E = Swamp Hdwoods | M = Mpl, Bch, Brch   | R = Red Pine            | X = Non Stocked   | 4 = Pole Timber Poor        | 9 = Saw Timber Well    |  |  |
| F = Spruce Fir    | MC = Mixed Conifer   | S = Black Spruce        | Z = Water         |                             |                        |  |  |
| G = Grass         | MD = Mixed Deciduous | T = Tamarack            |                   |                             |                        |  |  |

## Keeler 2018

### Compartment 88000101

12.6 Acres

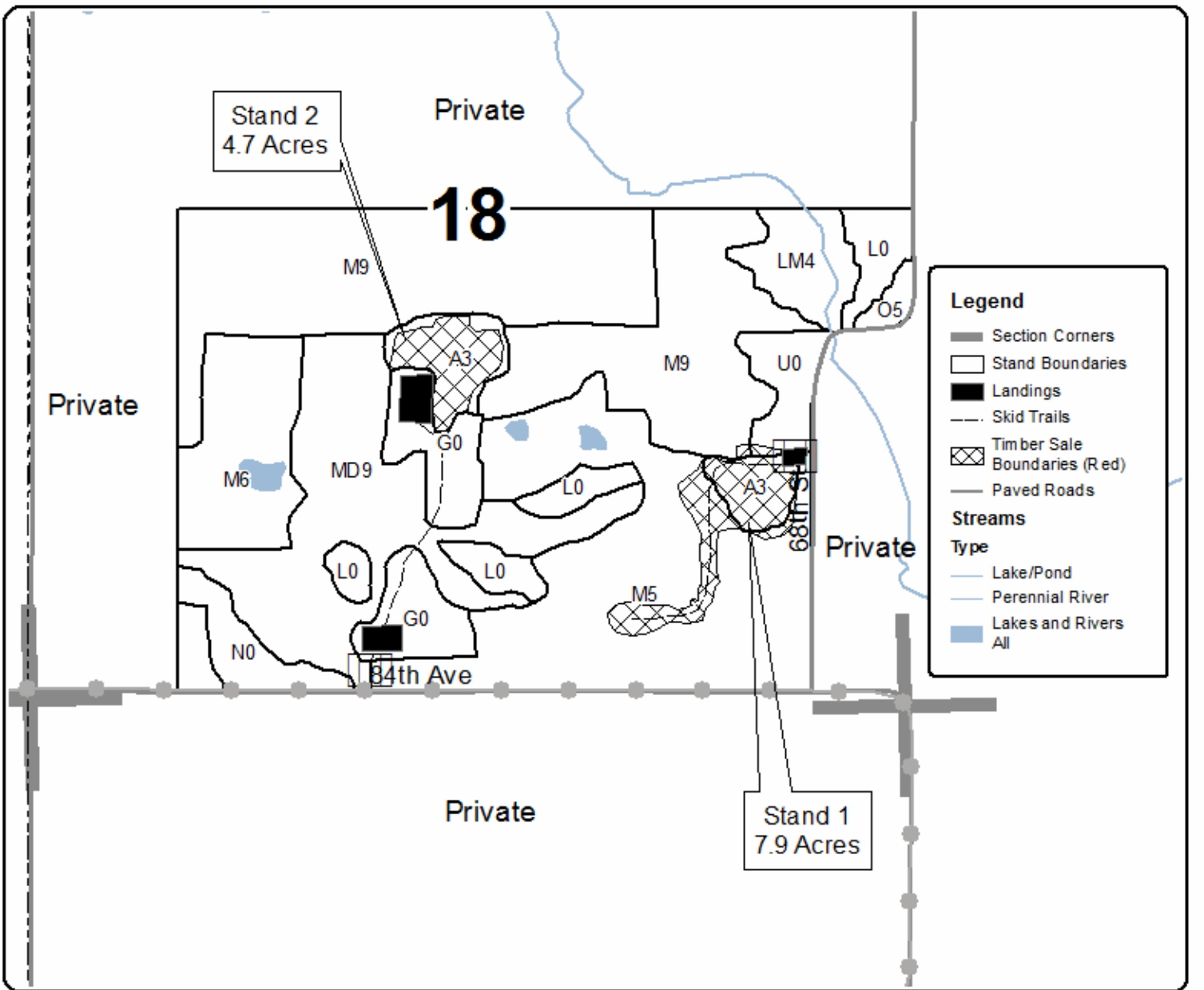

**Legend**

- Section Corners
- Stand Boundaries
- Landings
- Skid Trails
- Timber Sale Boundaries (Red)
- Paved Roads

**Streams**

Type

- Lake/Pond
- Perennial River
- Lakes and Rivers All

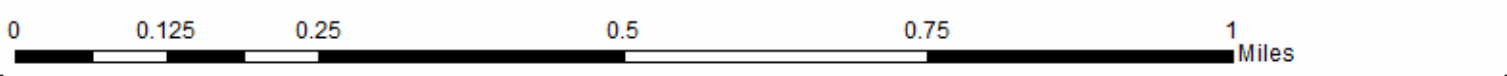



**TIMBER SALE INFORMATION**

Three Rivers 2018 (21-002-19)

T07S, R12W, SEC. 18; T07S, R12W, SEC. 19; T07S, R12W, SEC. 7.  
Saint Joseph County (Advertised Price \$17,972.00)

SALE NOTE: Access may be through other public land.

A timber sale contract for this lump sum, sealed bid timber sale will be awarded to the responsible bidder offering the highest sealed bid price. Bids must be at or above the following advertised price for each species:

| <u>PRODUCTS &amp; SPECIES</u> | <u>ESTIMATED UNITS*</u> | <u>ADVERTISED PRICE</u> |
|-------------------------------|-------------------------|-------------------------|
| <b>Sawtimber</b>              |                         |                         |
| B. T. Aspen                   | 15.80 MBF               | \$ 115.00 / MBF         |
| Black Cherry                  | 1.90 MBF                | \$ 133.00 / MBF         |
| Red Maple                     | 8.80 MBF                | \$ 118.00 / MBF         |
| Red Oak                       | 3.00 MBF                | \$ 225.00 / MBF         |
| Red Pine                      | 26.60 MBF               | \$ 125.00 / MBF         |
| Sugar Maple                   | 0.70 MBF                | \$ 315.00 / MBF         |
| White Oak                     | 0.10 MBF                | \$ 66.00 / MBF          |
| White Pine                    | 1.30 MBF                | \$ 68.00 / MBF          |
| <b>Pulpwood</b>               |                         |                         |
| B. T. Aspen                   | 46.00 Cords             | \$ 20.10 / Cord         |
| Jack Pine                     | 4.00 Cords              | \$ 15.25 / Cord         |
| Mixed Hardwood                | 70.00 Cords             | \$ 16.75 / Cord         |
| Red Pine                      | 214.00 Cords            | \$ 38.45 / Cord         |
| White Pine                    | 10.00 Cords             | \$ 16.20 / Cord         |

\* The total volume is statistically estimated within plus (+) or minus (-) 25.66 percent. The estimated units are final and not subject to adjustment. Prospective bidders are urged to examine this timber and to make their own estimates of quantity and quality.

**BOND AND PAYMENT SCHEDULE:**

1. A bond in the amount of \$899.00 to insure faithful performance of the conditions of the contract will be deposited by the successful bidder within 21 days of the sale award.
2. Cutting in any sale or unit without the required advance payment would be considered a trespass.
3. Total payment must be paid in advance or according to the following schedule:
  - (a) Ten percent (10%) of the sale value must be paid within 21 days of the sale award.
  - (b) The remainder is due before cutting begins.
  - (c) Payment for each of the following units must be made before cutting begins in that unit:
 

| <u>PAYMENT UNIT NUMBER</u> | <u>PERCENT OF TOTAL SALE VALUE</u> |
|----------------------------|------------------------------------|
| 01                         | 100.0%                             |
4. If no cutting takes place, the 10% down payment will not be refunded.
5. Operations on the contract issued will terminate on 03/01/2021.

**Description of Timber by Payment Unit (PU)**

| PU     | MARKET GROUP           | PRODUCT          | QUANTITY | UNIT        | ACRES        | ADVERTISE PRICE |       |
|--------|------------------------|------------------|----------|-------------|--------------|-----------------|-------|
| 1      | B. T. Aspen            | Sawtimber        | 15.8     | MBF         | 20.3         | \$17,972.00     |       |
|        | Black Cherry           |                  | 1.9      | MBF         |              |                 |       |
|        | Red Maple              |                  | 8.8      | MBF         |              |                 |       |
|        | Red Oak                |                  | 3.0      | MBF         |              |                 |       |
|        | Red Pine               |                  | 26.6     | MBF         |              |                 |       |
|        | Sugar Maple            |                  | 0.7      | MBF         |              |                 |       |
|        | White Oak              |                  | 0.1      | MBF         |              |                 |       |
|        | White Pine             |                  | 1.3      | MBF         |              |                 |       |
|        | B. T. Aspen            |                  | Pulpwood | 46.0        |              |                 | Cords |
|        | Jack Pine              |                  |          | 4.0         |              |                 | Cords |
|        | Mixed Hardwood         | 70.0             |          | Cords       |              |                 |       |
|        | <i>Misc. Species 1</i> | <i>Sawtimber</i> |          | <i>0.2</i>  | <i>MBF</i>   |                 |       |
|        | <i>Misc. Species 2</i> |                  |          | <i>0.3</i>  | <i>MBF</i>   |                 |       |
|        | <i>Black Cherry</i>    | <i>Pulpwood</i>  |          | <i>7.0</i>  | <i>Cords</i> |                 |       |
|        | <i>Misc. Species 1</i> |                  |          | <i>2.0</i>  | <i>Cords</i> |                 |       |
|        | <i>Misc. Species 2</i> |                  |          | <i>2.0</i>  | <i>Cords</i> |                 |       |
|        | <i>Red Maple</i>       |                  |          | <i>46.0</i> | <i>Cords</i> |                 |       |
|        | <i>Red Oak</i>         |                  |          | <i>7.0</i>  | <i>Cords</i> |                 |       |
|        | <i>Sugar Maple</i>     |                  |          | <i>3.0</i>  | <i>Cords</i> |                 |       |
|        | <i>White Oak</i>       |                  |          | <i>2.0</i>  | <i>Cords</i> |                 |       |
|        | Red Pine               |                  |          | 214.0       | Cords        |                 |       |
|        | White Pine             |                  | 10.0     | Cords       |              |                 |       |
|        | TOTAL:                 |                  |          | 58.2        | MBF          |                 |       |
| TOTAL: |                        |                  | 344.0    | Cords       |              |                 |       |

## Sale Specific Conditions & Requirements

**Sale Name: Three Rivers 2018**

**Sale Number: 21-002-19 Seq#: 1**

### 1 - Sale Area

#### 1.2 - Boundaries

##### 1.2.1 - Painted boundaries (1/14)

The sale boundary and Payment Unit boundaries are marked and identified by red paint. Exterior sale boundary lines against state are marked with red paint. The painted boundary line trees are not Included Timber and are to be protected unless marked with orange paint.

### 2 - Timber Specifications

#### 2.1 - Included Timber

##### 2.1.3 - Cut tree marked unit(s) (12/08)

Within Payment Unit(s) 1 (Stand 3, 6 and 7), all trees are designated for cutting when marked with orange paint above and below stump height, regardless of merchantability.

##### 2.1.7 - Leave tree marked unit(s) (6/14)

Within Payment Unit(s) 1 (Stands 1, 2, 4 and 5), cut all trees that are two (2) inches or more at DBH, except do not cut trees marked with green paint above and below stump height.

##### 2.1.11 - Description of timber note (2/04)

Note that Misc. Species 1 = hickory, and Misc. Species 2 = tulip poplar.

#### 2.2 - Utilization

##### 2.2.1 - Utilization (2/04)

All listed board foot volumes of sawlog size products in this contract have been determined using a top diameter inside bark of 10 inches.

#### 2.3 - Log Rule

##### 2.3.1 - Log rule (12/08)

All board foot volumes of sawlog size products in this contract have been determined by the International ¼ Inch Log Rule.

### 4 - Transportation

#### 4.1 - Construction

##### 4.1.3 - Slash and earthen piles (8/04)

Piles or windrows of earth along roads and landings that have been widened or constructed shall be leveled. Slash from road maintenance or construction, including stumps, shall be dispersed throughout the sale.

##### 4.1.12 - No new roads (1/12)

No new roads will be permitted in any Payment Unit. All operations are limited to existing roads. Skid trails only will be allowed.

#### 4.4 - Access

##### 4.4.3 - Access gate (12/08)

The access gate must be locked at the completion of each day unless otherwise approved by the Unit Manager or his/her representative.

### 5 - Operations

#### 5.1 - Notification

##### 5.1.1 - Pre-sale conference (10/16)

A pre-sale conference on site between the Purchaser and sale administrator is required prior to beginning any operations to

determine landing and road locations. The Unit Manager or his/her representative must be contacted at least 5 days in advance to schedule the conference.

#### 5.1.4 - Post-sale conference (10/16)

A post-sale conference on site between the Purchaser and sale administrator is required 5 days prior to the completion of active logging operations to determine clean-up and repair of landings, road edges, and the fulfillment of other contract specifications.

### 5.2 - Conduct of Operations

#### 5.2.2 - Hazard Trees/Snags

##### 5.2.2.1 - Den trees (10/16)

Obvious hollow and/or den trees shall be protected and left standing unless they are a safety hazard.

#### 5.2.3 - Operating Restrictions

##### 5.2.3.1 - Operating restrictions (9/11)

Within Payment Unit(s) 1 (Stands 1 - 7), unless changed by written agreement, cutting, skidding, and hauling are limited to the period of December 1 to March 1. This restriction is because of hunting seasons, aspen regeneration goals, and need to abide by eastern massasauga rattlesnake CCAA.

##### 5.2.31 - Landing locations (9/13)

Recommended landing areas are marked on the timber sale map with black shading. Landings must be confined to these designated sites unless otherwise authorized by the Unit Manager or his/her representative.

##### 5.2.32 - Decking/landing restoration (9/13)

All decking and landing areas must have the surface area restored to a condition equal to or better than before. This is to ensure the proper regeneration of the stand. Wood debris, chips and "cookies" from trimmings must be removed or scattered away from landing and loading areas and may not be windrowed on the edge.

### 5.4 - Soil Protection

#### 5.4.1 - Rutting restriction, general (7/16)

Operations are to cease immediately if equipment and weather conditions result in rutting of roads and/or skid trails which is 12 inches or greater in depth and 50 feet in length. The Unit Manager or his/her representative may restrict hauling and/or skidding if ruts exceed the specified depth. With the Unit Manager or his/her representative's approval, the Purchaser may return to the area when the risk of rutting has decreased.

#### 5.4.2 - Skid trails (2/04)

Skid trails up and down slopes should be avoided. If however this is unavoidable, these trails will be left in a non-erodible condition using water bars, logs, and slash. Placing of slash on these skid trails while logging is ongoing may alleviate need for any further action. At the direction of the sale administrator, seed, fertilizer, and mulch may also be required.

#### 5.4.4 - Slope protection (5/15)

Skid trails and roads on slopes shall be water barred with slash, stumps, and/or clean straw bales native to the area as soon as use is complete to prevent erosion.

#### 5.4.6 - Wet area protection (5/10)

No harvesting operations, including skidding and felling, are to take place within the vernal pond areas or drainages. When harvesting occurs, there should be no disturbance to the vernal pond depression. All equipment, trees and tops should be kept out of this area. Within 100 feet of the pond, equipment should only be used when the soil is in a dry or frozen condition. Care must be taken by the Purchaser to identify and avoid operating in these areas of the timber sale.

### 5.6 - Debris and Waste Material

#### 5.6.3 - Equipment cleaning (12/17)

For purposes of this provision, "Off-Road Equipment" includes all logging and construction machinery, except for log trucks, chip vans, service vehicles, water trucks, pickup trucks, cars, and similar vehicles. Off-Road Equipment brought on site must be clean and free from plant material and soil prior to arrival on any Payment Unit. Off-Road Equipment shall be cleaned of plant material and dirt prior to being moved to a new stand within the sale. Plant material includes leaves, stems, roots and

seeds. Equipment shall be considered clean when a visual inspection does not disclose seeds, soil, vegetative matter, and other debris that could contain or hold seeds. This is to prevent the spread of invasive plant species.

## **6 - Safety and Fire Prevention**

### 6.2 - Signing

#### 6.2.1 - Road posting (9/09)

The Purchaser is responsible for posting and maintaining caution signs on Purgatory Road prior to beginning operations. The road must be posted at appropriate distances from the sale area to warn of logging activity and truck traffic. Signs must be removed when harvest operations are suspended or completed. The Purchaser will provide these signs.

## **7 - Other Conditions**

### 7.5 - Loss

#### 7.5.1 - Deteriorating timber (7/09)

The sale area has received damage from prescribed fire (only Stands 4 and 5 are affected). The Purchaser should harvest the wood as soon as possible. The Department of Natural Resources is held free of responsibility of any further damage or deterioration due to delay in harvesting.

### 7.10 - Certified Timber

#### 7.10.1 - Non-certified timber (2/16)

The area encompassed by this timber sale is not certified to the standards of the Forest Stewardship Council (FSC) or the Sustainable Forestry Initiative (SFI). Forest products from this sale may not be delivered to the mill as "FSC and / or SFI certified". The lands within this sale are managed as a State Game Area.



# TIMBER SALE MAP

This information provided by authority of Part 525, 1994 PA 451, as amended.

|  |                      |  |                   |           |         |
|--|----------------------|--|-------------------|-----------|---------|
| Forest Management Unit<br>Three Rivers State Game Area | County<br>St. Joseph | Mapped By<br>Nate DeVries                      | Date<br>05/01/19  | Page<br>1 | of<br>1 |
| Township<br>07S  | Range<br>12W         | Section(s) and Subdivision(s)<br>Section 7, 18 | Scale<br>1:62,922 |           |         |

| Cover Type        |                      |                         |                   | Density                     |                        |
|-------------------|----------------------|-------------------------|-------------------|-----------------------------|------------------------|
| A = Aspen         | H = Hemlock          | N = Marsh               | U = Upland Brush  | 0 = Non Stocked             | 5 = Pole Timber Medium |
| B = Paper Birch   | J = Jack Pine        | O = Oak                 | UM = Upland Mixed | 1 = Seedling Sapling Poor   | 6 = Pole Timber Well   |
| C = Cedar         | L = Lowland Brush    | P = Lowland Poplar      | V = Bog or Marsh  | 2 = Seedling Sapling Medium | 7 = Saw Timber Poor    |
| D = Tread Bog     | LM = Lowland Mixed   | Q = Mixed Swamp Conifer | W = White Pine    | 3 = Seedling Sapling Well   | 8 = Saw Timber Medium  |
| E = Swamp Hdwoods | M = Mpl, Bch, Brch   | R = Red Pine            | X = Non Stocked   | 4 = Pole Timber Poor        | 9 = Saw Timber Well    |
| F = Spruce Fir    | MC = Mixed Conifer   | S = Black Spruce        | Z = Water         |                             |                        |
| G = Grass         | MD = Mixed Deciduous | T = Tamarack            |                   |                             |                        |

## Three Rivers 2018

### Compartment 8140101

### 20.3 Acres

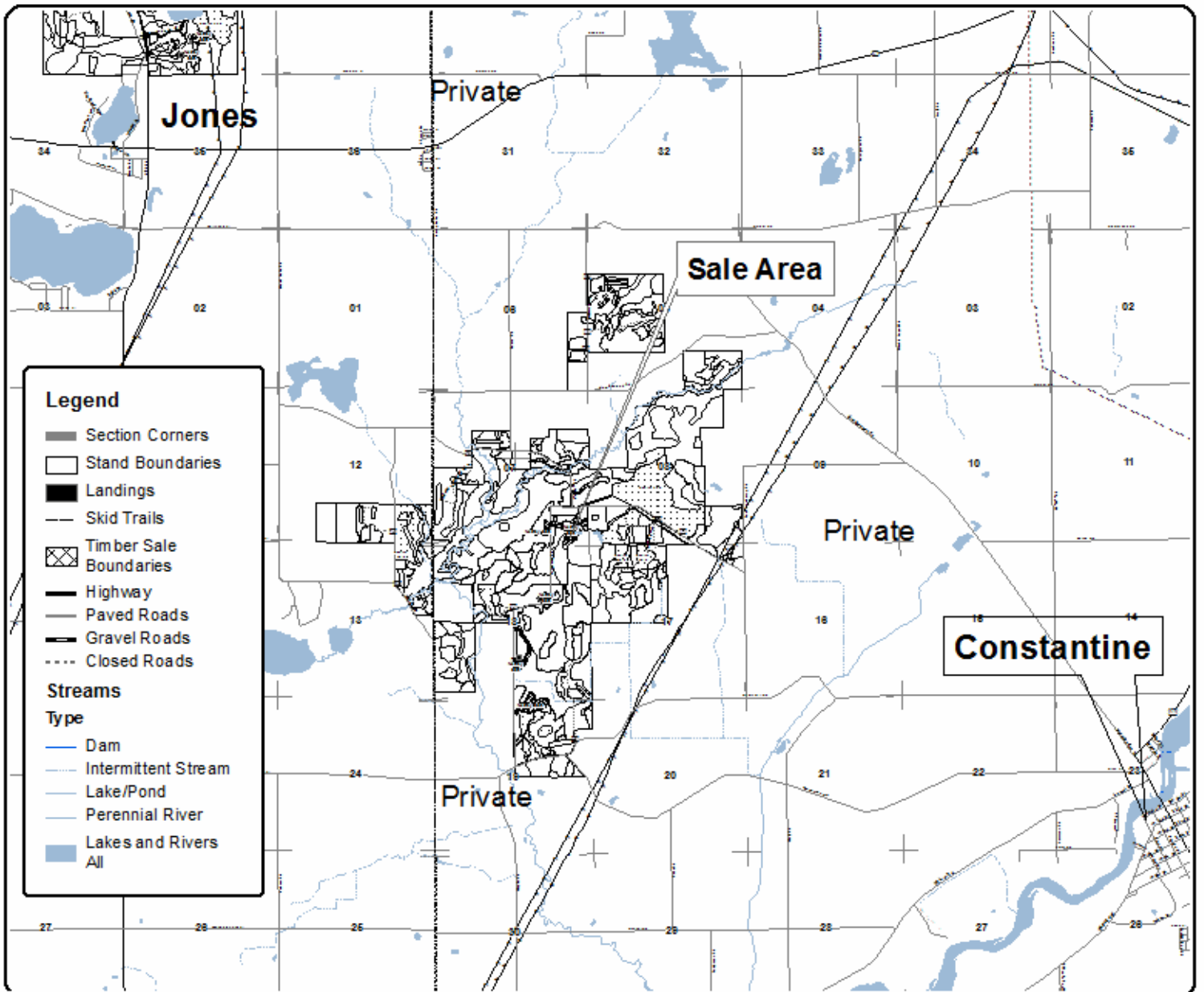

**Legend**

- Section Corners
- Stand Boundaries
- Landings
- Skid Trails
- Timber Sale Boundaries
- Highway
- Paved Roads
- Gravel Roads
- Closed Roads

**Streams**

Type

- Dam
- Intermittent Stream
- Lake/Pond
- Perennial River
- Lakes and Rivers All

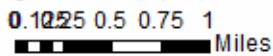





# TIMBER SALE MAP

This information provided by authority of Part 525, 1994 PA 451, as amended.

|             |      |
|-------------|------|
| Sale Number | Year |
| 21-002      | 2019 |

|  |                      |                           |                  |  |         |
|--|----------------------|---------------------------|------------------|--|---------|
| Forest Management Unit<br>Three Rivers State Game Area | County<br>St. Joseph | Mapped By<br>Nate DeVries | Date<br>05/01/19 | Page<br>2                                      | of<br>3 |
| Township<br>07S  |                      | Range<br>12W              |                  | Section(s) and Subdivision(s)<br>Section 7, 18 |         |

|       |         |
|-------|---------|
| Scale | 1:8,000 |
|-------|---------|

| Cover Type        |                      |                         |                   | Density                     |                        |  |  |
|-------------------|----------------------|-------------------------|-------------------|-----------------------------|------------------------|--|--|
| A = Aspen         | H = Hemlock          | N = Marsh               | U = Upland Brush  | 0 = Non Stocked             | 5 = Pole Timber Medium |  |  |
| B = Paper Birch   | J = Jack Pine        | O = Oak                 | UM = Upland Mixed | 1 = Seedling Sapling Poor   | 6 = Pole Timber Well   |  |  |
| C = Cedar         | L = Lowland Brush    | P = Lowland Poplar      | V = Bog or Marsh  | 2 = Seedling Sapling Medium | 7 = Saw Timber Poor    |  |  |
| D = Tread Bog     | LM = Lowland Mixed   | Q = Mixed Swamp Conifer | W = White Pine    | 3 = Seedling Sapling Well   | 8 = Saw Timber Medium  |  |  |
| E = Swamp Hdwoods | M = Mpl, Boh, Brch   | R = Red Pine            | X = Non Stocked   | 4 = Pole Timber Poor        | 9 = Saw Timber Well    |  |  |
| F = Spruce Fir    | MC = Mixed Conifer   | S = Black Spruce        | Z = Water         |                             |                        |  |  |
| G = Grass         | MD = Mixed Deciduous | T = Tamarack            |                   |                             |                        |  |  |

## Three Rivers 2018

### Compartment 8140101

20.3 Acres

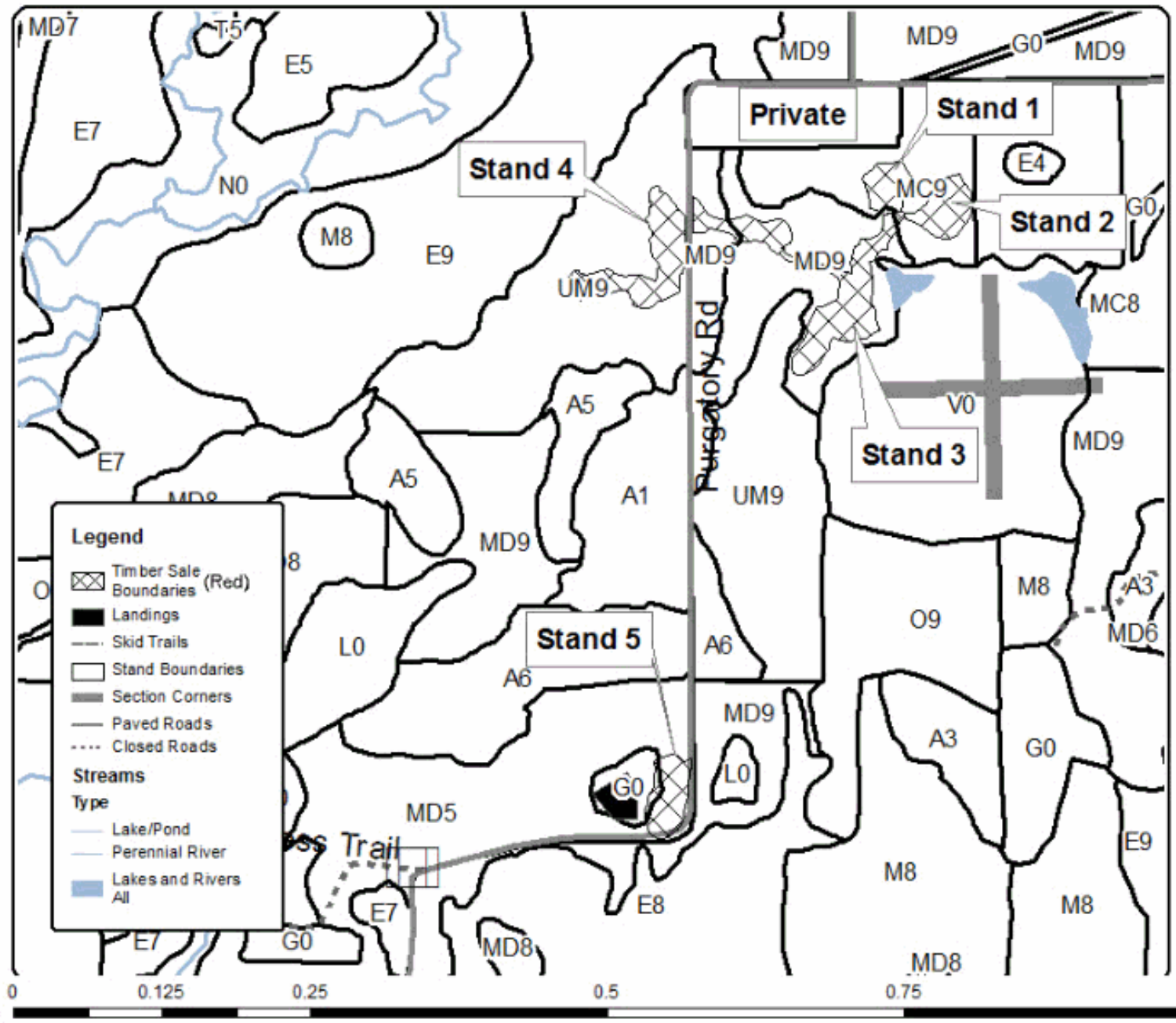



# TIMBER SALE MAP

This information provided by authority of Part 525, 1994 PA 451, as amended.

|             |      |
|-------------|------|
| Sale Number | Year |
| 21-002      | 2019 |

|                              |            |              |          |      |    |
|------------------------------|------------|--------------|----------|------|----|
| Forest Management Unit       | County     | Mapped By    | Date     | Page | of |
| Three Rivers State Game Area | St. Joseph | Nate DeVries | 05/01/19 | 3    | 3  |
|                              |            | Cruised By   |          |      |    |
|                              |            | Nate DeVries |          |      |    |

|          |       |                               |         |
|----------|-------|-------------------------------|---------|
| Township | Range | Section(s) and Subdivision(s) | Scale   |
| 07S      | 12W   | Section 18                    | 1:8,000 |

| Cover Type        |                      |                         |                   | Density                     |                        |  |  |
|-------------------|----------------------|-------------------------|-------------------|-----------------------------|------------------------|--|--|
| A = Aspen         | H = Hemlock          | N = Marsh               | U = Upland Brush  | 0 = Non Stocked             | 5 = Pole Timber Medium |  |  |
| B = Paper Birch   | J = Jack Pine        | O = Oak                 | UM = Upland Mixed | 1 = Seedling Sapling Poor   | 6 = Pole Timber Well   |  |  |
| C = Cedar         | L = Lowland Brush    | P = Lowland Poplar      | V = Bog or Marsh  | 2 = Seedling Sapling Medium | 7 = Saw Timber Poor    |  |  |
| D = Treed Bog     | LM = Lowland Mixed   | Q = Mixed Swamp Conifer | W = White Pine    | 3 = Seedling Sapling Well   | 8 = Saw Timber Medium  |  |  |
| E = Swamp Hdwoods | M = Mpl, Boh, Brch   | R = Red Pine            | X = Non Stocked   | 4 = Pole Timber Poor        | 9 = Saw Timber Well    |  |  |
| F = Spruce Fir    | MC = Mixed Conifer   | S = Black Spruce        | Z = Water         |                             |                        |  |  |
| G = Grass         | MD = Mixed Deciduous | T = Tamarack            |                   |                             |                        |  |  |

## Three Rivers 2018

### Compartment 8140101

20.3 Acres

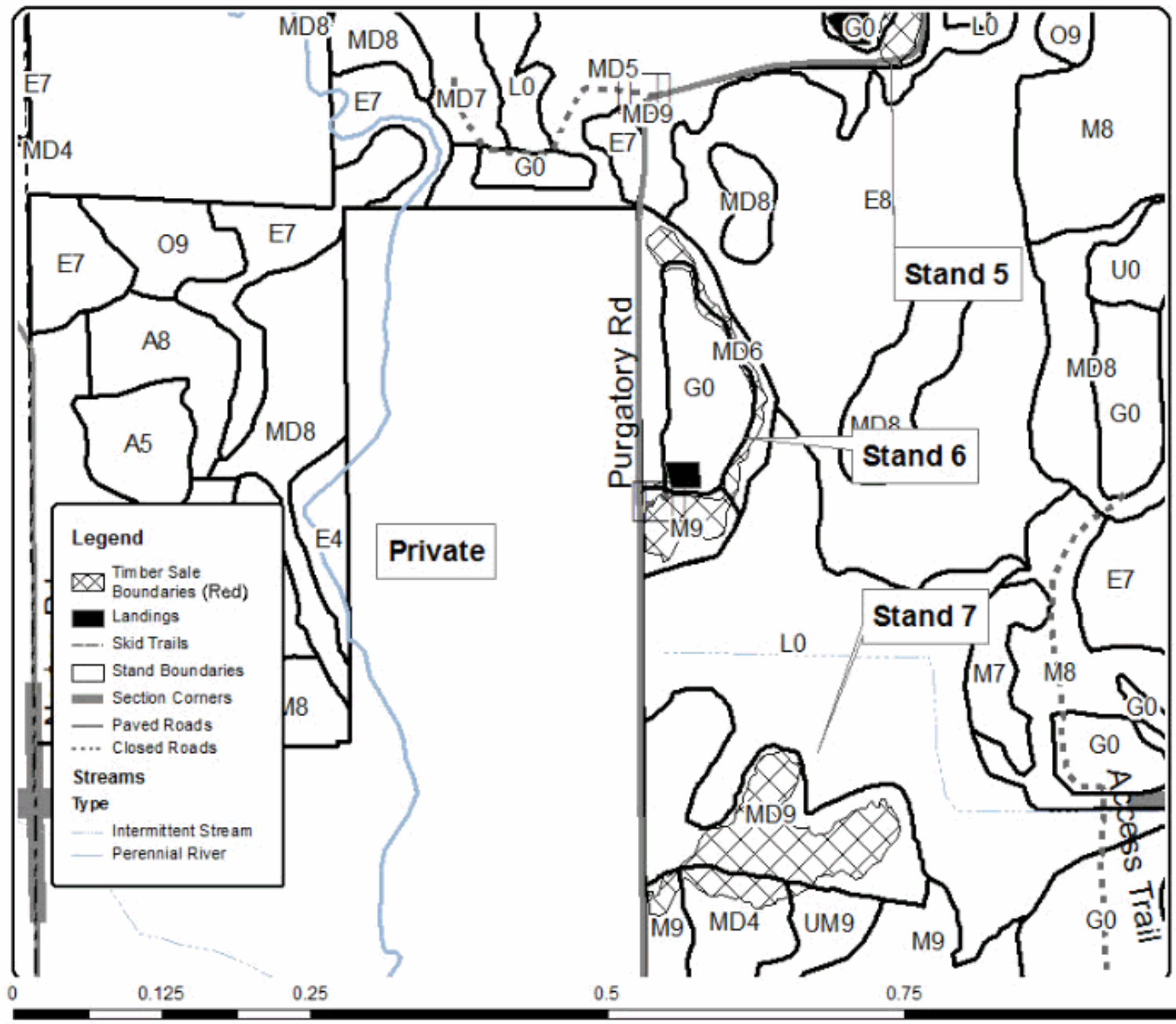

**TIMBER SALE INFORMATION**

Crane Pond 2019 (21-003-19)  
 T06S, R13W, SEC. 19; T06S, R13W, SEC. 26.  
 Cass County (Advertised Price \$9,174.65)

SALE NOTE: Access may be through other public land.

A timber sale contract for this lump sum, sealed bid timber sale will be awarded to the responsible bidder offering the highest sealed bid price. Bids must be at or above the following advertised price for each species:

| <u>PRODUCTS &amp; SPECIES</u> | <u>ESTIMATED UNITS*</u> | <u>ADVERTISED PRICE</u> |
|-------------------------------|-------------------------|-------------------------|
| <b>Sawtimber</b>              |                         |                         |
| B. T. Aspen                   | 20.60 MBF               | \$ 92.00 / MBF          |
| Black Cherry                  | 25.30 MBF               | \$ 106.00 / MBF         |
| Red Maple                     | 8.90 MBF                | \$ 95.00 / MBF          |
| Red Oak                       | 0.90 MBF                | \$ 180.00 / MBF         |
| <b>Pulpwood</b>               |                         |                         |
| B. T. Aspen                   | 35.00 Cords             | \$ 16.05 / Cord         |
| Mixed Hardwood                | 226.00 Cords            | \$ 13.40 / Cord         |

\* The total volume is statistically estimated within plus (+) or minus (-) 20.15 percent. The estimated units are final and not subject to adjustment. Prospective bidders are urged to examine this timber and to make their own estimates of quantity and quality.

**BOND AND PAYMENT SCHEDULE:**

- A bond in the amount of \$459.00 to insure faithful performance of the conditions of the contract will be deposited by the successful bidder within 21 days of the sale award.
- Cutting in any sale or unit without the required advance payment would be considered a trespass.
- Total payment must be paid in advance or according to the following schedule:
  - Ten percent (10%) of the sale value must be paid within 21 days of the sale award.
  - The remainder is due before cutting begins.
  - Payment for each of the following units must be made before cutting begins in that unit:
 

| <u>PAYMENT UNIT NUMBER</u> | <u>PERCENT OF TOTAL SALE VALUE</u> |
|----------------------------|------------------------------------|
| 01                         | 100.0%                             |
- If no cutting takes place, the 10% down payment will not be refunded.
- Operations on the contract issued will terminate on 03/01/2021.

**Description of Timber by Payment Unit (PU)**

| <u>PU</u>     | <u>MARKET GROUP</u>    | <u>PRODUCT</u>   | <u>QUANTITY</u> | <u>UNIT</u>  | <u>ACRES</u> | <u>ADVERTISE PRICE</u> |
|---------------|------------------------|------------------|-----------------|--------------|--------------|------------------------|
| 1             | B. T. Aspen            | Sawtimber        | 20.6            | MBF          | 14.2         | \$9,174.65             |
|               | Black Cherry           |                  | 25.3            | MBF          |              |                        |
|               | Red Maple              |                  | 8.9             | MBF          |              |                        |
|               | Red Oak                |                  | 0.9             | MBF          |              |                        |
|               | B. T. Aspen            | Pulpwood         | 35.0            | Cords        |              |                        |
|               | Mixed Hardwood         |                  | 226.0           | Cords        |              |                        |
|               | <i>Misc. Species 1</i> | <i>Sawtimber</i> | <i>0.1</i>      | <i>MBF</i>   |              |                        |
|               | <i>Misc. Species 2</i> |                  | <i>0.1</i>      | <i>MBF</i>   |              |                        |
|               | <i>Black Cherry</i>    | <i>Pulpwood</i>  | <i>117.0</i>    | <i>Cords</i> |              |                        |
|               | <i>Misc. Species 1</i> |                  | <i>1.0</i>      | <i>Cords</i> |              |                        |
|               | <i>Misc. Species 2</i> |                  | <i>1.0</i>      | <i>Cords</i> |              |                        |
|               | <i>Red Maple</i>       |                  | <i>100.0</i>    | <i>Cords</i> |              |                        |
|               | <i>Red Oak</i>         |                  | <i>7.0</i>      | <i>Cords</i> |              |                        |
| <b>TOTAL:</b> |                        |                  | 55.7            | MBF          |              |                        |
| <b>TOTAL:</b> |                        |                  | 261.0           | Cords        |              |                        |

## Sale Specific Conditions & Requirements

Sale Name: Crane Pond 2019

Sale Number: 21-003-19 Seq#: 1

### 1 - Sale Area

#### 1.2 - Boundaries

##### 1.2.1 - Painted boundaries (1/14)

The sale boundary and Payment Unit boundaries are marked and identified by blue and red paint. Exterior sale boundary lines against private property are marked with blue paint. Exterior sale boundary lines against state are marked with red paint. The painted boundary line trees are not Included Timber and are to be protected unless marked with orange paint.

### 2 - Timber Specifications

#### 2.1 - Included Timber

##### 2.1.1 - Clearcut unit(s) with unmerchantable trees (6/14)

Within Payment Unit(s) 1 (Stands 1 and 2), cut all trees that are two (2) inches or more at DBH.

##### 2.1.3 - Cut tree marked unit(s) (12/08)

Within Payment Unit(s) 1 (Stand 3), all trees are designated for cutting when marked with orange paint above and below stump height, regardless of merchantability.

##### 2.1.11 - Description of timber note (2/04)

Note that Misc. Species 1 = hickory, and Misc. Species 2 = tulip poplar.

#### 2.2 - Utilization

##### 2.2.1 - Utilization (2/04)

All listed board foot volumes of sawlog size products in this contract have been determined using a top diameter inside bark of 10 inches.

##### 2.2.2 - Chipping required (2/18)

Payment Unit 1 (Stand 1) must be chip harvested to facilitate subsequent planting operations. The Purchaser has the option to produce sawlogs or pulpwood bolts, but the remaining portion of the trees must be chipped and hauled. Products may be produced as roundwood and forwarded to decking areas in final product length, but the tops must be left intact and skidded to the landing for chipping in order to minimize the amount of residual slash. If market conditions limit the practicality of chipping, the producer may skid all remaining topwood out of these payment units and scatter in locations approved by the sale administrator. If the deadline is not met, damages will be collected determined by the cost to complete this work. The requirement to retain approximately 1/6 to 1/3 of tree tops and limbs less than four inches in diameter is still applicable (G. C. & R. 2.2).

##### 2.2.3 - Stump heights (4/07)

Stump heights within Payment Unit(s) 1 (Stand 1) shall not exceed 12 inches for trees greater than 10 inches DBH and 4 inches for trees smaller than 10 inches DBH. This is in order to facilitate planting operations.

#### 2.3 - Log Rule

##### 2.3.1 - Log rule (12/08)

All board foot volumes of sawlog size products in this contract have been determined by the International ¼ Inch Log Rule.

### 4 - Transportation

#### 4.1 - Construction

##### 4.1.3 - Slash and earthen piles (8/04)

Piles or windrows of earth along roads and landings that have been widened or constructed shall be leveled. Slash from road maintenance or construction, including stumps, shall be dispersed throughout the sale.

##### 4.1.12 - No new roads (1/12)

No new roads will be permitted in any Payment Unit. All operations are limited to existing roads. Skid trails only will be

allowed.

#### 4.4 - Access

##### 4.4.3 - Access gate (12/08)

The access gate must be locked at the completion of each day unless otherwise approved by the Unit Manager or his/her representative.

### 5 - Operations

#### 5.1 - Notification

##### 5.1.1 - Pre-sale conference (10/16)

A pre-sale conference on site between the Purchaser and sale administrator is required prior to beginning any operations to determine landing and road locations. The Unit Manager or his/her representative must be contacted at least 5 days in advance to schedule the conference.

##### 5.1.4 - Post-sale conference (10/16)

A post-sale conference on site between the Purchaser and sale administrator is required 5 days prior to the completion of active logging operations to determine clean-up and repair of landings, road edges, and the fulfillment of other contract specifications.

##### 5.1.6 - Utility R.O.W. (4/19)

It is the responsibility of the Purchaser to obtain permission from the utility company to utilize the power line R.O.W. for operations. American Electric Power (AEP) 1-800-311-6424.

#### 5.2 - Conduct of Operations

##### 5.2.1 - Slash

###### 5.2.1.2 - Slash Removal

###### 5.2.1.2.6 - Slash removal, general (7/05)

All slash must be removed from Payment Unit(s) 1 (Stand 1).

###### 5.2.1.8 - Slash height (12/08)

No slash or tree tops may exceed 24 inches in height. This applies to Stand 1 only. This is to facilitate future herbicide application.

##### 5.2.2 - Hazard Trees/Snags

###### 5.2.2.1 - Den trees (10/16)

Obvious hollow and/or den trees shall be protected and left standing unless they are a safety hazard.

##### 5.2.3 - Operating Restrictions

###### 5.2.3.1 - Operating restrictions (9/11)

Within Payment Unit(s) 1 (Stands 1, 2 and 3), unless changed by written agreement, cutting, skidding, and hauling are limited to the period of December 1 to March 1. This restriction is because of hunting seasons, aspen regeneration goals, and need to abide by eastern massasauga rattlesnake CCAA.

###### 5.2.31 - Landing locations (9/13)

Recommended landing areas are shown on the Timber Sale Map. Landings must be confined to these designated sites unless otherwise authorized by the Unit Manager or his/her representative.

###### 5.2.32 - Decking/landing restoration (9/13)

All decking and landing areas must have the surface area restored to a condition equal to or better than before. This is to ensure the proper regeneration of the stand. Wood debris, chips and "cookies" from trimmings must be removed or scattered away from landing and loading areas and may not be windrowed on the edge.

#### 5.4 - Soil Protection

##### 5.4.1 - Rutting restriction, general (7/16)

Operations are to cease immediately if equipment and weather conditions result in rutting of roads and/or skid trails which is 12 inches or greater in depth and 50 feet in length. The Unit Manager or his/her representative may restrict hauling and/or skidding if ruts exceed the specified depth. With the Unit Manager or his/her representative's approval, the Purchaser may return to the area when the risk of rutting has decreased.

#### 5.4.2 - Skid trails (2/04)

Skid trails up and down slopes should be avoided. If however this is unavoidable, these trails will be left in a non-erodible condition using water bars, logs, and slash. Placing of slash on these skid trails while logging is ongoing may alleviate need for any further action. At the direction of the sale administrator, seed, fertilizer, and mulch may also be required.

#### 5.4.3 - Erosion control (12/08)

Skid trails or haul roads may require erosion control structures or berms per direction of the Unit Manager or his/her representative.

#### 5.4.4 - Slope protection (5/15)

Skid trails and roads on slopes shall be water barred with slash, stumps, and/or clean straw bales native to the area as soon as use is complete to prevent erosion.

#### 5.4.6 - Wet area protection (5/10)

No harvesting operations, including skidding and felling, are to take place within the vernal pond areas or drainages. When harvesting occurs, there should be no disturbance to the vernal pond depression. All equipment, trees and tops should be kept out of this area. Within 100 feet of the pond, equipment should only be used when the soil is in a dry or frozen condition. Care must be taken by the Purchaser to identify and avoid operating in these areas of the timber sale.

### 5.6 - Debris and Waste Material

#### 5.6.3 - Equipment cleaning (12/17)

For purposes of this provision, "Off-Road Equipment" includes all logging and construction machinery, except for log trucks, chip vans, service vehicles, water trucks, pickup trucks, cars, and similar vehicles. Off-Road Equipment brought on site must be clean and free from plant material and soil prior to arrival on any Payment Unit. Off-Road Equipment shall be cleaned of plant material and dirt prior to being moved to a new stand within the sale. Plant material includes leaves, stems, roots and seeds. Equipment shall be considered clean when a visual inspection does not disclose seeds, soil, vegetative matter, and other debris that could contain or hold seeds. This is to prevent the spread of invasive plant species.

## 6 - Safety and Fire Prevention

### 6.2 - Signing

#### 6.2.1 - Road posting (9/09)

The Purchaser is responsible for posting and maintaining caution signs on Wood Lake and Pemberton roads prior to beginning operations. The road must be posted at appropriate distances from the sale area to warn of logging activity and truck traffic. Signs must be removed when harvest operations are suspended or completed. The Purchaser will provide these signs.

## 7 - Other Conditions

### 7.10 - Certified Timber

#### 7.10.1 - Non-certified timber (2/16)

The area encompassed by this timber sale is not certified to the standards of the Forest Stewardship Council (FSC) or the Sustainable Forestry Initiative (SFI). Forest products from this sale may not be delivered to the mill as "FSC and / or SFI certified". The lands within this sale are managed as a State Game Area.



# TIMBER SALE MAP

This information provided by authority of Part 525, 1994 PA 451, as amended.

|  |              |   |                           |                    |           |         |
|--|--------------|---|---------------------------|--------------------|-----------|---------|
| Forest Management Unit<br>Crane Pond State Game Area |              | County<br>Cass                                  | Mapped By<br>Nate DeVries | Date<br>05/01/2019 | Page<br>1 | of<br>3 |
| Township<br>06S                                      | Range<br>13W | Section(s) and Subdivision(s)<br>Section 19, 26 |                           | Scale<br>1:62,000  |           |         |

| Cover Type        |                      |                         |                   | Density                    |                        |
|-------------------|----------------------|-------------------------|-------------------|----------------------------|------------------------|
| A = Aspen         | H = Hemlock          | N = Marsh               | U = Upland Brush  | 0 = Non Stocked            | 5 = Pole Timber Medium |
| B = Paper Birch   | J = Jack Pine        | O = Oak                 | UM = Upland Mixed | 1 = Seeding Sapling Poor   | 6 = Pole Timber Well   |
| C = Cedar         | L = Lowland Brush    | P = Lowland Poplar      | V = Bog or Marsh  | 2 = Seeding Sapling Medium | 7 = Saw Timber Poor    |
| D = Treed Bog     | LM = Lowland Mixed   | Q = Mixed Swamp Conifer | W = White Pine    | 3 = Seeding Sapling Well   | 8 = Saw Timber Medium  |
| E = Swamp Hdwoods | M = Mpl, Bch, Brch   | R = Red Pine            | X = Non Stocked   | 4 = Pole Timber Poor       | 9 = Saw Timber Well    |
| F = Spruce Fir    | MC = Mixed Conifer   | S = Black Spruce        | Z = Water         |                            |                        |
| G = Grass         | MD = Mixed Deciduous | T = Tamarack            |                   |                            |                        |

## Crane Pond 2019

### Compartment 8140201

#### 14.2 Acres

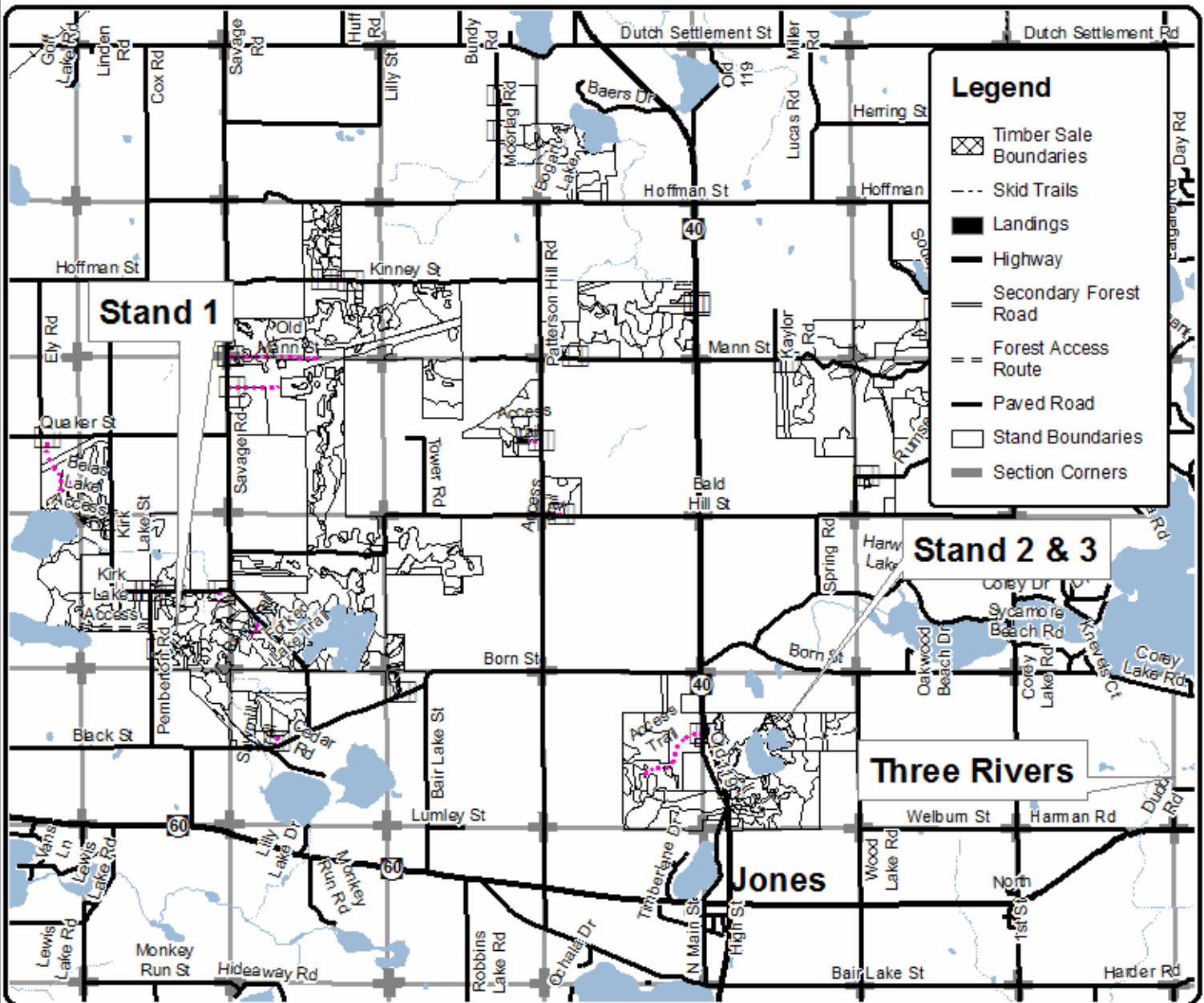



# TIMBER SALE MAP

This information provided by authority of Part 525, 1994 PA 451, as amended.

|             |      |
|-------------|------|
| Sale Number | Year |
| 21-003      | 19   |

|                            |        |              |            |          |    |
|----------------------------|--------|--------------|------------|----------|----|
| Forest Management Unit     | County | Mapped By    | Date       | Page     | of |
| Crane Pond State Game Area | Cass   | Nate DeVries | 05/01/2019 | 2        | 3  |
| Township                   |        | Cruised By   |            | Scale    |    |
| 06S                        |        | Jesse Bramer |            | 1:10,000 |    |

|       |                               |          |
|-------|-------------------------------|----------|
| Range | Section(s) and Subdivision(s) | Scale    |
| 13W   | Section 19, 26                | 1:10,000 |

| Cover Type        |                      |                         |                   | Density                    |                        |
|-------------------|----------------------|-------------------------|-------------------|----------------------------|------------------------|
| A = Aspen         | H = Hemlock          | N = Marsh               | U = Upland Brush  | 0 = Non Stocked            | 5 = Pole Timber Medium |
| B = Paper Birch   | J = Jack Pine        | O = Oak                 | UM = Upland Mixed | 1 = Seeding Sapling Poor   | 6 = Pole Timber Well   |
| C = Cedar         | L = Lowland Brush    | P = Lowland Poplar      | V = Bog or Marsh  | 2 = Seeding Sapling Medium | 7 = Saw Timber Poor    |
| D = Tread Bog     | LM = Lowland Mixed   | Q = Mixed Swamp Conifer | W = White Pine    | 3 = Seeding Sapling Well   | 8 = Saw Timber Medium  |
| E = Swamp Hdwoods | M = Mpl. Bch, Birch  | R = Red Pine            | X = Non Stocked   | 4 = Pole Timber Poor       | 9 = Saw Timber Well    |
| F = Spruce Fir    | MC = Mixed Conifer   | S = Black Spruce        | Z = Water         |                            |                        |
| G = Grass         | MD = Mixed Deciduous | T = Tamarack            |                   |                            |                        |

## Crane Pond 2019

### Compartment 8140201

#### 14.2 Acres

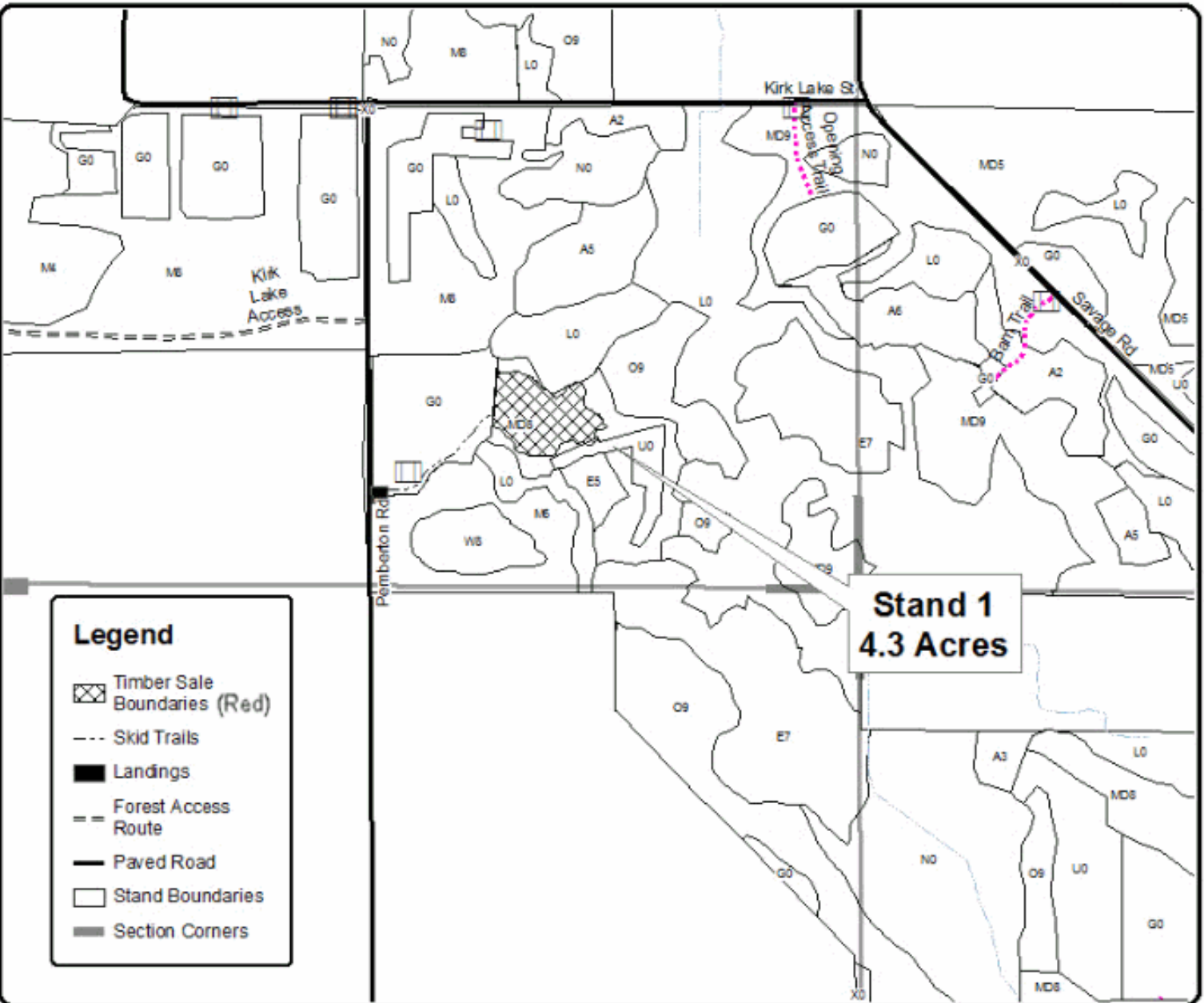





# TIMBER SALE MAP

This information provided by authority of Part 525, 1994 PA 451, as amended.

|  |              |   |                           |                    |           |         |
|--|--------------|---|---------------------------|--------------------|-----------|---------|
| Forest Management Unit<br>Crane Pond State Game Area |              | County<br>Cass                              | Mapped By<br>Nate DeVries | Date<br>05/01/2019 | Page<br>3 | of<br>3 |
| Township<br>06S                                      | Range<br>13W | Section(s) and Subdivision(s)<br>Section 26 |                           | Scale<br>1:10,000  |           |         |

| Cover Type        |                      |                         |                   | Density                    |                        |
|-------------------|----------------------|-------------------------|-------------------|----------------------------|------------------------|
| A = Aspen         | H = Hemlock          | N = Marsh               | U = Upland Brush  | 0 = Non Stocked            | 5 = Pole Timber Medium |
| B = Paper Birch   | J = Jack Pine        | O = Oak                 | UM = Upland Mixed | 1 = Seeding Sapling Poor   | 6 = Pole Timber Well   |
| C = Cedar         | L = Lowland Brush    | P = Lowland Poplar      | V = Bog or Marsh  | 2 = Seeding Sapling Medium | 7 = Saw Timber Poor    |
| D = Tread Bog     | LM = Lowland Mixed   | Q = Mixed Swamp Conifer | W = White Pine    | 3 = Seeding Sapling Well   | 8 = Saw Timber Medium  |
| E = Swamp Hdwoods | M = Mpl, Bch, Brch   | R = Red Pine            | X = Non Stocked   | 4 = Pole Timber Poor       | 9 = Saw Timber Well    |
| F = Spruce Fir    | MC = Mixed Conifer   | S = Black Spruce        | Z = Water         |                            |                        |
| G = Grass         | MD = Mixed Deciduous | T = Tamarack            |                   |                            |                        |

## Crane Pond 2019

### Compartment 8140201

#### 14.2 Acres

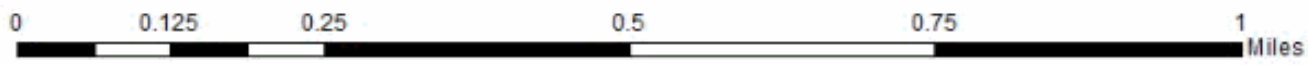
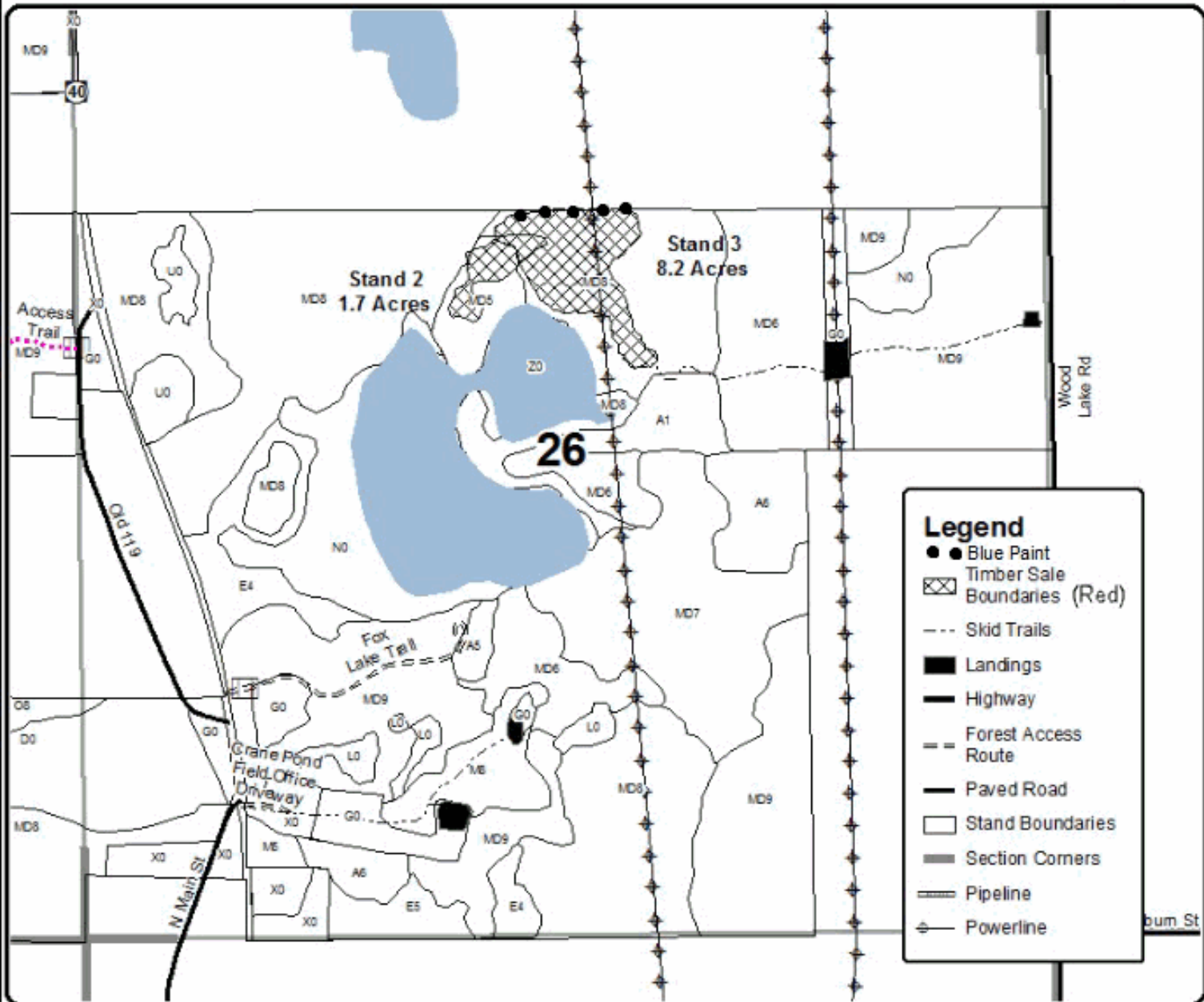



**TIMBER SALE INFORMATION**

Angling Pine (21-004-19)

T03S, R11W, SEC. 19.

Kalamazoo County (Advertised Price \$18,773.30)

SALE NOTE: Access may be through other public land.

A timber sale contract for this lump sum, sealed bid timber sale will be awarded to the responsible bidder offering the highest sealed bid price. Bids must be at or above the following advertised price for each species:

| <u>PRODUCTS &amp; SPECIES</u> | <u>ESTIMATED UNITS*</u> | <u>ADVERTISED PRICE</u> |
|-------------------------------|-------------------------|-------------------------|
| Sawtimber                     |                         |                         |
| Black Cherry                  | 2.50 MBF                | \$ 106.00 / MBF         |
| Red Pine                      | 28.40 MBF               | \$ 100.00 / MBF         |
| Pulpwood                      |                         |                         |
| B. T. Aspen                   | 14.00 Cords             | \$ 16.05 / Cord         |
| Black Cherry                  | 56.00 Cords             | \$ 14.00 / Cord         |
| Jack Pine                     | 143.00 Cords            | \$ 12.20 / Cord         |
| Red Pine                      | 420.00 Cords            | \$ 30.75 / Cord         |

\* The total volume is statistically estimated within plus (+) or minus (-) 27.63 percent. The estimated units are final and not subject to adjustment. Prospective bidders are urged to examine this timber and to make their own estimates of quantity and quality.

**BOND AND PAYMENT SCHEDULE:**

- A bond in the amount of \$939.00 to insure faithful performance of the conditions of the contract will be deposited by the successful bidder within 21 days of the sale award.
- Cutting in any sale or unit without the required advance payment would be considered a trespass.
- Total payment must be paid in advance or according to the following schedule:
  - Ten percent (10%) of the sale value must be paid within 21 days of the sale award.
  - The remainder is due before cutting begins.
  - Payment for each of the following units must be made before cutting begins in that unit:
 

| PAYMENT UNIT NUMBER | PERCENT OF TOTAL SALE VALUE |
|---------------------|-----------------------------|
| 01                  | 100.0%                      |
- If no cutting takes place, the 10% down payment will not be refunded.
- Operations on the contract issued will terminate on 03/01/2020.

**Description of Timber by Payment Unit (PU)**

| PU     | MARKET GROUP | PRODUCT   | QUANTITY | UNIT  | ACRES | ADVERTISE PRICE |
|--------|--------------|-----------|----------|-------|-------|-----------------|
| 1      | Black Cherry | Sawtimber | 2.5      | MBF   | 23.8  | \$18,773.30     |
|        | Red Pine     |           | 28.4     | MBF   |       |                 |
|        | B. T. Aspen  | Pulpwood  | 14.0     | Cords |       |                 |
|        | Black Cherry |           | 56.0     | Cords |       |                 |
|        | Jack Pine    |           | 143.0    | Cords |       |                 |
|        | Red Pine     |           | 420.0    | Cords |       |                 |
|        | TOTAL:       |           |          | 30.9  |       |                 |
| TOTAL: |              |           | 633.0    | Cords |       |                 |

## Sale Specific Conditions & Requirements

**Sale Name: Angling Pine**

**Sale Number: 21-004-19 Seq#: 1**

### 1 - Sale Area

#### 1.2 - Boundaries

##### 1.2.1 - Painted boundaries (1/14)

The sale boundary and Payment Unit boundaries are marked and identified by red paint. Exterior sale boundary lines against state are marked with red paint. The painted boundary line trees are not Included Timber and are to be protected unless marked with orange paint.

### 2 - Timber Specifications

#### 2.1 - Included Timber

##### 2.1.1 - Clearcut unit(s) with unmerchantable trees (6/14)

Within Payment Unit(s) 1, cut all trees that are two (2) inches or more at DBH, except do not cut oak and hickory.

#### 2.2 - Utilization

##### 2.2.1 - Utilization (2/04)

All listed board foot volumes of sawlog size products in this contract have been determined using a top diameter inside bark of 10 inches.

##### 2.2.3 - Stump heights (4/07)

Stump heights within the Sale Area shall not exceed 12 inches for trees greater than 10 inches DBH and 4 inches for trees smaller than 10 inches DBH.

#### 2.3 - Log Rule

##### 2.3.1 - Log rule (12/08)

All board foot volumes of sawlog size products in this contract have been determined by the International ¼ Inch Log Rule.

### 4 - Transportation

#### 4.1 - Construction

##### 4.1.3 - Slash and earthen piles (8/04)

Piles or windrows of earth along roads and landings that have been widened or constructed shall be leveled. Slash from road maintenance or construction, including stumps, shall be dispersed throughout the sale.

##### 4.1.12 - No new roads (1/12)

No new roads will be permitted in any Payment Unit. Skid trails only will be allowed.

### 5 - Operations

#### 5.1 - Notification

##### 5.1.1 - Pre-sale conference (10/16)

A pre-sale conference on site between the Purchaser and sale administrator is required prior to beginning any operations to determine landing and road locations. The Unit Manager or his/her representative must be contacted at least 10 days in advance to schedule the conference.

#### 5.2 - Conduct of Operations

##### 5.2.1 - Slash

##### 5.2.1.13 - Dispose of slash as directed (12/05)

Slash is to be disposed of as directed by the sale administrator.

##### 5.2.2 - Hazard Trees/Snags

#### 5.2.2.1 - Den trees (10/16)

Obvious hollow and/or den trees shall be protected and left standing unless they are a safety hazard.

#### 5.2.3 - Operating Restrictions

##### 5.2.3.1 - Operating restrictions (9/11)

Within Payment Unit(s) 1, unless changed by written agreement, cutting, skidding, and hauling are limited to the period of December 1 to March 1. This restriction is because of hunting seasons and endangered species protection.

##### 5.2.31 - Landing locations (9/13)

Landing areas are marked on the Timber Sale Map. Landings must be confined to these designated sites unless otherwise authorized by the Unit Manager or his/her representative.

##### 5.2.32 - Decking/landing restoration (9/13)

All decking and landing areas must have the surface area restored to a condition equal to or better than before. This is to ensure the proper regeneration of the stand. Wood debris, chips and "cookies" from trimmings must be removed or scattered away from landing and loading areas and may not be windrowed on the edge.

#### 5.4 - Soil Protection

##### 5.4.1 - Rutting restriction, general (7/16)

Operations are to cease immediately if equipment and weather conditions result in rutting on skid trails which is 12 inches or greater in depth and 50 feet in length. The Unit Manager or his/her representative may restrict hauling and/or skidding if ruts exceed the specified depth. With the Unit Manager or his/her representative's approval, the Purchaser may return to the area when the risk of rutting has decreased.

##### 5.4.2 - Skid trails (2/04)

Skid trails up and down slopes should be avoided. If however this is unavoidable, these trails will be left in a non-erodible condition using water bars, logs, and slash. Placing of slash on these skid trails while logging is ongoing may alleviate need for any further action. At the direction of the sale administrator, seed, fertilizer, and mulch may also be required.

### 7 - Other Conditions

#### 7.2 - Extensions

##### 7.2.2 - No extensions (3/09)

There will be no extensions granted on this contract. The purpose of this sale is to begin restoring oak barrens/savanna. This area is scheduled for infrastructure improvements.

#### 7.10 - Certified Timber

##### 7.10.1 - Non-certified timber (2/16)

The area encompassed by this timber sale is not certified to the standards of the Forest Stewardship Council (FSC) or the Sustainable Forestry Initiative (SFI). Forest products from this sale may not be delivered to the mill as "FSC and / or SFI certified". The lands within this sale are managed as a State Game Area.



# TIMBER SALE MAP

This information provided by authority of Part 525, 1994 PA 451, as amended.

|   |                     |   |                   |           |         |
|---|---------------------|---|-------------------|-----------|---------|
| Forest Management Unit<br>Gourdneck State Game Area | County<br>Kalamazoo | Mapped By<br>Nate DeVries                   | Date<br>05/01/19  | Page<br>1 | of<br>2 |
| Township<br>03S                                     | Range<br>11W        | Section(s) and Subdivision(s)<br>Section 19 | Scale<br>1:80,000 |           |         |

| Cover Type        |                      |                         |                   | Density                     |                        |  |  |
|-------------------|----------------------|-------------------------|-------------------|-----------------------------|------------------------|--|--|
| A = Aspen         | H = Hemlock          | N = Marsh               | U = Upland Brush  | 0 = Non Stocked             | 5 = Pole Timber Medium |  |  |
| B = Paper Birch   | J = Jack Pine        | O = Oak                 | UM = Upland Mixed | 1 = Seedling Sapling Poor   | 6 = Pole Timber Well   |  |  |
| C = Cedar         | L = Lowland Brush    | P = Lowland Poplar      | V = Bog or Marsh  | 2 = Seedling Sapling Medium | 7 = Saw Timber Poor    |  |  |
| D = Tired Bog     | LM = Lowland Mixed   | Q = Mixed Swamp Conifer | W = White Pine    | 3 = Seedling Sapling Well   | 8 = Saw Timber Medium  |  |  |
| E = Swamp Hdwoods | M = Mpl, Boh, Brch   | R = Red Pine            | X = Non Stocked   | 4 = Pole Timber Poor        | 9 = Saw Timber Well    |  |  |
| F = Spruce Fir    | MC = Mixed Conifer   | S = Black Spruce        | Z = Water         |                             |                        |  |  |
| G = Grass         | MD = Mixed Deciduous | T = Tamarack            |                   |                             |                        |  |  |

## Angling Pine Compartment 8390101 23.8 Acres

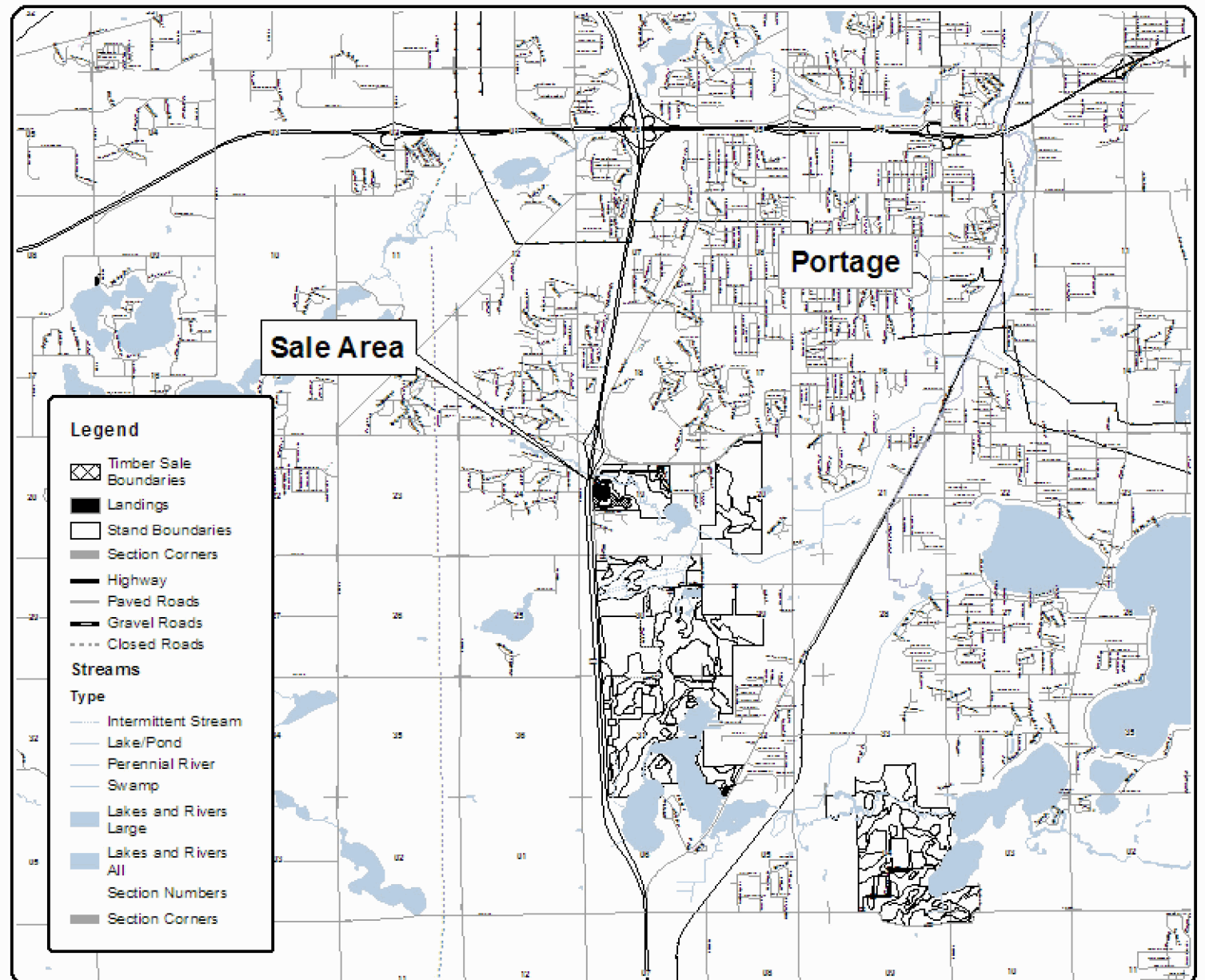
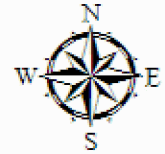

**Legend**

- Timber Sale Boundaries
- Landings
- Stand Boundaries
- Section Corners
- Highway
- Paved Roads
- Gravel Roads
- Closed Roads

**Streams**

Type

- Intermittent Stream
- Lake/Pond
- Perennial River
- Swamp
- Lakes and Rivers Large
- Lakes and Rivers All

Section Numbers

Section Corners

0 12850 50.75 1  
Miles



# TIMBER SALE MAP

This information provided by authority of Part 525, 1994 PA 451, as amended.

|   |                     |   |                  |           |         |
|---|---------------------|---|------------------|-----------|---------|
| Forest Management Unit<br>Gourdneck State Game Area | County<br>Kalamazoo | Mapped By<br>Nate DeVries                   | Date<br>05/01/19 | Page<br>2 | of<br>2 |
| Township<br>03S                                     | Range<br>11W        | Section(s) and Subdivision(s)<br>Section 19 | Scale<br>1:6,312 |           |         |
| Cruised By<br>Jesse Bramer                          |                     |   |                  |           |         |

| Cover Type        |                      |                         |                   | Density                     |                        |  |  |
|-------------------|----------------------|-------------------------|-------------------|-----------------------------|------------------------|--|--|
| A = Aspen         | H = Hemlock          | N = Marsh               | U = Upland Brush  | 0 = Non Stocked             | 5 = Pole Timber Medium |  |  |
| B = Paper Birch   | J = Jack Pine        | O = Oak                 | UM = Upland Mixed | 1 = Seedling Sapling Poor   | 6 = Pole Timber Well   |  |  |
| C = Cedar         | L = Lowland Brush    | P = Lowland Poplar      | V = Bog or Marsh  | 2 = Seedling Sapling Medium | 7 = Saw Timber Poor    |  |  |
| D = Tread Bog     | LM = Lowland Mixed   | Q = Mixed Swamp Conifer | W = White Pine    | 3 = Seedling Sapling Well   | 8 = Saw Timber Medium  |  |  |
| E = Swamp Hdwoods | M = Mpl, Bch, Brch   | R = Red Pine            | X = Non Stocked   | 4 = Pole Timber Poor        | 9 = Saw Timber Well    |  |  |
| F = Spruce Fir    | MC = Mixed Conifer   | S = Black Spruce        | Z = Water         |                             |                        |  |  |
| G = Grass         | MD = Mixed Deciduous | T = Tamarack            |                   |                             |                        |  |  |

## Angling Pine Compartment 8390101 23.8 Acres

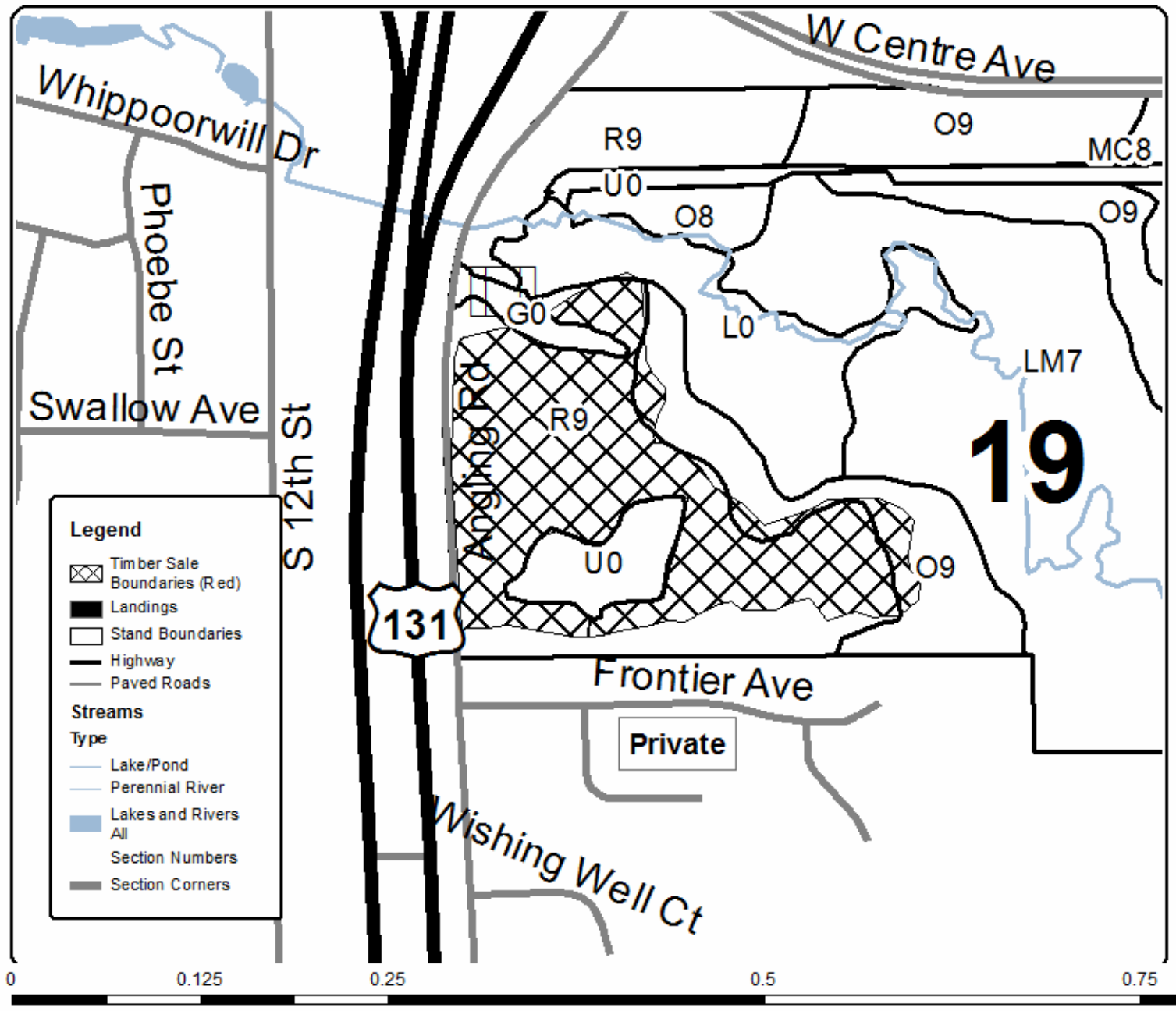





Keeler (21-001-19)

T04S, R16W, SEC. 18; Van Buren COUNTY

In response to the notice of sale to be held 11:00 a.m. (local time) on September 17, 2019, I am hereby submitting my sealed bid (firm offer) for the following forest products to be cut. Bids for individual species must be at or above the advertised price. All non-responsive bid forms may be rejected.

| <u>PRODUCTS &amp; SPECIES</u> | <u>ESTIMATED VOLUME*</u> | <u>ADVERTISED PRICE</u> | <u>BID PRICE/UNIT</u> |
|-------------------------------|--------------------------|-------------------------|-----------------------|
| <b>Sawtimber</b>              |                          |                         |                       |
| B. T. Aspen                   | 28.10 MBF                | \$ 99.00/MBF            | \$ _____              |
| Black Cherry                  | 0.80 MBF                 | \$ 115.00/MBF           | \$ _____              |
| Red Oak                       | 4.60 MBF                 | \$ 195.00/MBF           | \$ _____              |
| <b>Pulpwood</b>               |                          |                         |                       |
| B. T. Aspen                   | 288.00 Cords             | \$ 17.40/Cord           | \$ _____              |
| Mixed Hardwood                | 107.00 Cords             | \$ 14.50/Cord           | \$ _____              |

\*The volumes are statistically estimated within plus (+) or minus (-) 31.05 percent. These estimated volumes are final and not subject to adjustment. Prospective bidders are urged to examine this timber and to make their own estimates of quantity and quality.

I understand that any or all bids may be rejected. All bids must be signed and all bid items must be bid or the bid form may be rejected. I also understand that consideration and awarding a contract will be based upon my past performance and ability to complete the contract based upon equipment and staffing subject to my control.

FEDERAL ID: \_\_\_\_ - \_\_\_\_ - \_\_\_\_ or SOCIAL SECURITY NUMBER: \_\_\_\_ - \_\_\_\_ - \_\_\_\_

Company or individual bidding: \_\_\_\_\_

Company representative's name: \_\_\_\_\_

Address: \_\_\_\_\_

City: \_\_\_\_\_ State: \_\_\_\_\_ Zip: \_\_\_\_\_

IF AVAILABLE, PLEASE PLACE THE PERSONALIZED LABEL FROM YOUR PROSPECTUS IN THE ABOVE BOX.

Individual or company representative's signature: \_\_\_\_\_ Date: \_\_\_\_\_

Phone number : \_\_\_\_\_ Email (optional): \_\_\_\_\_

**THE WINNING BIDDER MUST COMPLETE THE VERIFICATION OF WORKER'S DISABILITY COMPENSATION ACT COMPLIANCE (ON REVERSE SIDE IF DOUBLE SIDED) WITHIN 21 DAYS OF SALE AWARD DATE**



|                                  |
|----------------------------------|
| <b>FOR DEPARTMENT USE ONLY</b>   |
| Sale Number (XX - XXX - XX - XX) |
| Forest Management Unit:          |

## TIMBER SALE VERIFICATION OF WORKER'S DISABILITY COMPENSATION ACT COMPLIANCE

*As required by Act 317, P.A. 1969 (Worker's Compensation) and  
Part 5 of Act 451 of 1994, as amended.*

### VERIFICATION OF WORKER'S DISABILITY COMPENSATION ACT COMPLIANCE

- This verification must be completed and submitted within 21 days of contract award and prior to the issuance of the timber sale contract.
- In addition, if boxes 2B or 2C are checked, then Notice of Exclusion or Certificate of Insurance must be submitted within twenty-one (21) days of the contract award and prior to the issuance of the timber sale contract.
- All information must be typed or printed except for written signatures.

Please Check Appropriate Categories:

1. My business is organized as (you **must** check one of the boxes below):
  - A.  Sole Proprietorship (individual)
  - B.  Partnership
  - C.  Corporation
2. You **must** check one of the boxes below:
  - A.  I certify my business is a sole proprietorship and it has no employees but the sole proprietor. I am not subject to the Worker's Compensation Laws.
  - B.  I certify my business has satisfied its obligation to the Worker's Compensation Act through the use of an approved Notice of Exclusion (BWC-337, Rev. 5/96). I will provide a copy of the Notice of Exclusion within 21 days of the contract award. (For questions or a copy of the BWC-337, please call the Worker's Compensation Bureau at 517-322-1195).
  - C.  I certify my business has a Worker's Compensation Policy. I will provide an original Certificate of Insurance within twenty-one (21) days of the contract award.
3. If you have checked item 2(A) or 2(B), you **must** indicate the number of **both** full-time and part-time employees, other than yourself, including family members and active partners (if none, you must enter "0").

\_\_\_\_\_ Full-time Employees

\_\_\_\_\_ Part-time Employees

|                  |       |                                     |  |
|------------------|-------|-------------------------------------|--|
| Name of Business |       | Federal ID (or) Social Security No. |  |
| Address          |       | Telephone<br>(       )              |  |
| City             | State | ZIP                                 |  |

*I hereby certify that the above information is true and correct. I agree to notify the Michigan DNR of any changes that occur in factors affecting my coverage during any of my present and future operations.*

\_\_\_\_\_  
Signature of Owner or Authorized Representative

\_\_\_\_\_  
Title

\_\_\_\_\_  
Date

**Please complete the "SEALED BID" information on the next page**

Three Rivers 2018 (21-002-19)

T07S, R12W, SEC. 18; T07S, R12W, SEC. 19; T07S, R12W, SEC. 7; Saint Joseph

In response to the notice of sale to be held 11:00 a.m. (local time) on September 17, 2019, I am hereby submitting my sealed bid (firm offer) for the following forest products to be cut. Bids for individual species must be at or above the advertised price. All non-responsive bid forms may be rejected.

| <u>PRODUCTS &amp; SPECIES</u> | <u>ESTIMATED VOLUME*</u> | <u>ADVERTISED PRICE</u> | <u>BID PRICE/UNIT</u> |
|-------------------------------|--------------------------|-------------------------|-----------------------|
| <b>Sawtimber</b>              |                          |                         |                       |
| B. T. Aspen                   | 15.80 MBF                | \$ 115.00/MBF           | \$ _____              |
| Black Cherry                  | 1.90 MBF                 | \$ 133.00/MBF           | \$ _____              |
| Red Maple                     | 8.80 MBF                 | \$ 118.00/MBF           | \$ _____              |
| Red Oak                       | 3.00 MBF                 | \$ 225.00/MBF           | \$ _____              |
| Red Pine                      | 26.60 MBF                | \$ 125.00/MBF           | \$ _____              |
| Sugar Maple                   | 0.70 MBF                 | \$ 315.00/MBF           | \$ _____              |
| White Oak                     | 0.10 MBF                 | \$ 66.00/MBF            | \$ _____              |
| White Pine                    | 1.30 MBF                 | \$ 68.00/MBF            | \$ _____              |
| <b>Pulpwood</b>               |                          |                         |                       |
| B. T. Aspen                   | 46.00 Cords              | \$ 20.10/Cord           | \$ _____              |
| Jack Pine                     | 4.00 Cords               | \$ 15.25/Cord           | \$ _____              |
| Mixed Hardwood                | 70.00 Cords              | \$ 16.75/Cord           | \$ _____              |
| Red Pine                      | 214.00 Cords             | \$ 38.45/Cord           | \$ _____              |
| White Pine                    | 10.00 Cords              | \$ 16.20/Cord           | \$ _____              |

\*The volumes are statistically estimated within plus (+) or minus (-) 25.66 percent. These estimated volumes are final and not subject to adjustment. Prospective bidders are urged to examine this timber and to make their own estimates of quantity and quality.

I understand that any or all bids may be rejected. All bids must be signed and all bid items must be bid or the bid form may be rejected. I also understand that consideration and awarding a contract will be based upon my past performance and ability to complete the contract based upon equipment and staffing subject to my control.

FEDERAL ID: \_\_\_\_\_ or SOCIAL SECURITY NUMBER: \_\_\_\_\_

Company or individual bidding: \_\_\_\_\_

Company representative's name: \_\_\_\_\_

Address: \_\_\_\_\_

City: \_\_\_\_\_ State: \_\_\_\_\_ Zip: \_\_\_\_\_

IF AVAILABLE, PLEASE PLACE THE PERSONALIZED LABEL FROM YOUR PROSPECTUS IN THE ABOVE BOX.

Individual or company representative's signature: \_\_\_\_\_ Date: \_\_\_\_\_

Phone number : \_\_\_\_\_ Email (optional): \_\_\_\_\_

**THE WINNING BIDDER MUST COMPLETE THE VERIFICATION OF WORKER'S DISABILITY COMPENSATION ACT COMPLIANCE (ON REVERSE SIDE IF DOUBLE SIDED) WITHIN 21 DAYS OF SALE AWARD DATE**



|                                  |
|----------------------------------|
| <b>FOR DEPARTMENT USE ONLY</b>   |
| Sale Number (XX - XXX - XX - XX) |
| Forest Management Unit:          |

## TIMBER SALE VERIFICATION OF WORKER'S DISABILITY COMPENSATION ACT COMPLIANCE

*As required by Act 317, P.A. 1969 (Worker's Compensation) and  
Part 5 of Act 451 of 1994, as amended.*

### VERIFICATION OF WORKER'S DISABILITY COMPENSATION ACT COMPLIANCE

- This verification must be completed and submitted within 21 days of contract award and prior to the issuance of the timber sale contract.
- In addition, if boxes 2B or 2C are checked, then Notice of Exclusion or Certificate of Insurance must be submitted within twenty-one (21) days of the contract award and prior to the issuance of the timber sale contract.
- All information must be typed or printed except for written signatures.

Please Check Appropriate Categories:

1. My business is organized as (you **must** check one of the boxes below):
  - A.  Sole Proprietorship (individual)
  - B.  Partnership
  - C.  Corporation
2. You **must** check one of the boxes below:
  - A.  I certify my business is a sole proprietorship and it has no employees but the sole proprietor. I am not subject to the Worker's Compensation Laws.
  - B.  I certify my business has satisfied its obligation to the Worker's Compensation Act through the use of an approved Notice of Exclusion (BWC-337, Rev. 5/96). I will provide a copy of the Notice of Exclusion within 21 days of the contract award. (For questions or a copy of the BWC-337, please call the Worker's Compensation Bureau at 517-322-1195).
  - C.  I certify my business has a Worker's Compensation Policy. I will provide an original Certificate of Insurance within twenty-one (21) days of the contract award.
3. If you have checked item 2(A) or 2(B), you **must** indicate the number of **both** full-time and part-time employees, other than yourself, including family members and active partners (if none, you must enter "0").

\_\_\_\_\_ Full-time Employees

\_\_\_\_\_ Part-time Employees

|                  |       |                                     |  |
|------------------|-------|-------------------------------------|--|
| Name of Business |       | Federal ID (or) Social Security No. |  |
| Address          |       | Telephone<br>(       )              |  |
| City             | State | ZIP                                 |  |

*I hereby certify that the above information is true and correct. I agree to notify the Michigan DNR of any changes that occur in factors affecting my coverage during any of my present and future operations.*

\_\_\_\_\_  
Signature of Owner or Authorized Representative

\_\_\_\_\_  
Title

\_\_\_\_\_  
Date

**Please complete the "SEALED BID" information on the next page**

Crane Pond 2019 (21-003-19)  
T06S, R13W, SEC. 19; T06S, R13W, SEC. 26; Cass COUNTY

In response to the notice of sale to be held 11:00 a.m. (local time) on September 17, 2019, I am hereby submitting my sealed bid (firm offer) for the following forest products to be cut. Bids for individual species must be at or above the advertised price. All non-responsive bid forms may be rejected.

| <u>PRODUCTS &amp; SPECIES</u> | <u>ESTIMATED VOLUME*</u> | <u>ADVERTISED PRICE</u> | <u>BID PRICE/UNIT</u> |
|-------------------------------|--------------------------|-------------------------|-----------------------|
| <b>Sawtimber</b>              |                          |                         |                       |
| B. T. Aspen                   | 20.60 MBF                | \$ 92.00/MBF            | \$ _____              |
| Black Cherry                  | 25.30 MBF                | \$ 106.00/MBF           | \$ _____              |
| Red Maple                     | 8.90 MBF                 | \$ 95.00/MBF            | \$ _____              |
| Red Oak                       | 0.90 MBF                 | \$ 180.00/MBF           | \$ _____              |
| <b>Pulpwood</b>               |                          |                         |                       |
| B. T. Aspen                   | 35.00 Cords              | \$ 16.05/Cord           | \$ _____              |
| Mixed Hardwood                | 226.00 Cords             | \$ 13.40/Cord           | \$ _____              |

\*The volumes are statistically estimated within plus (+) or minus (-) 20.15 percent. These estimated volumes are final and not subject to adjustment. Prospective bidders are urged to examine this timber and to make their own estimates of quantity and quality.

I understand that any or all bids may be rejected. All bids must be signed and all bid items must be bid or the bid form may be rejected. I also understand that consideration and awarding a contract will be based upon my past performance and ability to complete the contract based upon equipment and staffing subject to my control.

FEDERAL ID: \_\_\_\_\_ or SOCIAL SECURITY NUMBER: \_\_\_\_\_

Company or individual bidding: \_\_\_\_\_

Company representative's name: \_\_\_\_\_

Address: \_\_\_\_\_

City: \_\_\_\_\_ State: \_\_\_\_\_ Zip: \_\_\_\_\_

IF AVAILABLE, PLEASE PLACE THE PERSONALIZED LABEL FROM YOUR PROSPECTUS IN THE ABOVE BOX.

Individual or company representative's signature: \_\_\_\_\_ Date: \_\_\_\_\_

Phone number : \_\_\_\_\_ Email (optional): \_\_\_\_\_

**THE WINNING BIDDER MUST COMPLETE THE VERIFICATION OF WORKER'S DISABILITY COMPENSATION ACT COMPLIANCE (ON REVERSE SIDE IF DOUBLE SIDED) WITHIN 21 DAYS OF SALE AWARD DATE**



| FOR DEPARTMENT USE ONLY          |  |
|----------------------------------|--|
| Sale Number (XX - XXX - XX - XX) |  |
| Forest Management Unit:          |  |

## TIMBER SALE VERIFICATION OF WORKER'S DISABILITY COMPENSATION ACT COMPLIANCE

As required by Act 317, P.A. 1969 (Worker's Compensation) and  
Part 5 of Act 451 of 1994, as amended.

### VERIFICATION OF WORKER'S DISABILITY COMPENSATION ACT COMPLIANCE

- This verification must be completed and submitted within 21 days of contract award and prior to the issuance of the timber sale contract.
- In addition, if boxes 2B or 2C are checked, then Notice of Exclusion or Certificate of Insurance must be submitted within twenty-one (21) days of the contract award and prior to the issuance of the timber sale contract.
- All information must be typed or printed except for written signatures.

Please Check Appropriate Categories:

1. My business is organized as (you **must** check one of the boxes below):
  - A.  Sole Proprietorship (individual)
  - B.  Partnership
  - C.  Corporation
2. You **must** check one of the boxes below:
  - A.  I certify my business is a sole proprietorship and it has no employees but the sole proprietor. I am not subject to the Worker's Compensation Laws.
  - B.  I certify my business has satisfied its obligation to the Worker's Compensation Act through the use of an approved Notice of Exclusion (BWC-337, Rev. 5/96). I will provide a copy of the Notice of Exclusion within 21 days of the contract award. (For questions or a copy of the BWC-337, please call the Worker's Compensation Bureau at 517-322-1195).
  - C.  I certify my business has a Worker's Compensation Policy. I will provide an original Certificate of Insurance within twenty-one (21) days of the contract award.
3. If you have checked item 2(A) or 2(B), you **must** indicate the number of **both** full-time and part-time employees, other than yourself, including family members and active partners (if none, you must enter "0").

\_\_\_\_\_ Full-time Employees

\_\_\_\_\_ Part-time Employees

|                  |       |                                     |  |
|------------------|-------|-------------------------------------|--|
| Name of Business |       | Federal ID (or) Social Security No. |  |
| Address          |       | Telephone<br>(       )              |  |
| City             | State | ZIP                                 |  |

*I hereby certify that the above information is true and correct. I agree to notify the Michigan DNR of any changes that occur in factors affecting my coverage during any of my present and future operations.*

\_\_\_\_\_  
Signature of Owner or Authorized Representative

\_\_\_\_\_  
Title

\_\_\_\_\_  
Date

Please complete the "SEALED BID" information on the next page

Angling Pine (21-004-19)  
T03S, R11W, SEC. 19; Kalamazoo COUNTY

In response to the notice of sale to be held 11:00 a.m. (local time) on September 17, 2019, I am hereby submitting my sealed bid (firm offer) for the following forest products to be cut. Bids for individual species must be at or above the advertised price. All non-responsive bid forms may be rejected.

| <u>PRODUCTS &amp; SPECIES</u> | <u>ESTIMATED VOLUME*</u> | <u>ADVERTISED PRICE</u> | <u>BID PRICE/UNIT</u> |
|-------------------------------|--------------------------|-------------------------|-----------------------|
| <b>Sawtimber</b>              |                          |                         |                       |
| Black Cherry                  | 2.50 MBF                 | \$ 106.00/MBF           | \$ _____              |
| Red Pine                      | 28.40 MBF                | \$ 100.00/MBF           | \$ _____              |
| <b>Pulpwood</b>               |                          |                         |                       |
| B. T. Aspen                   | 14.00 Cords              | \$ 16.05/Cord           | \$ _____              |
| Black Cherry                  | 56.00 Cords              | \$ 14.00/Cord           | \$ _____              |
| Jack Pine                     | 143.00 Cords             | \$ 12.20/Cord           | \$ _____              |
| Red Pine                      | 420.00 Cords             | \$ 30.75/Cord           | \$ _____              |

\*The volumes are statistically estimated within plus (+) or minus (-) 27.63 percent. These estimated volumes are final and not subject to adjustment. Prospective bidders are urged to examine this timber and to make their own estimates of quantity and quality.

I understand that any or all bids may be rejected. All bids must be signed and all bid items must be bid or the bid form may be rejected. I also understand that consideration and awarding a contract will be based upon my past performance and ability to complete the contract based upon equipment and staffing subject to my control.

FEDERAL ID: \_\_\_\_\_ or SOCIAL SECURITY NUMBER: \_\_\_\_\_

Company or individual bidding: \_\_\_\_\_

Company representative's name: \_\_\_\_\_

Address: \_\_\_\_\_

City: \_\_\_\_\_ State: \_\_\_\_\_ Zip: \_\_\_\_\_

IF AVAILABLE, PLEASE PLACE THE PERSONALIZED LABEL FROM YOUR PROSPECTUS IN THE ABOVE BOX.

Individual or company representative's signature: \_\_\_\_\_ Date: \_\_\_\_\_

Phone number : \_\_\_\_\_ Email (optional): \_\_\_\_\_

**THE WINNING BIDDER MUST COMPLETE THE VERIFICATION OF WORKER'S DISABILITY COMPENSATION ACT COMPLIANCE (ON REVERSE SIDE IF DOUBLE SIDED) WITHIN 21 DAYS OF SALE AWARD DATE**



|                                  |  |
|----------------------------------|--|
| <b>FOR DEPARTMENT USE ONLY</b>   |  |
| Sale Number (XX - XXX - XX - XX) |  |
| Forest Management Unit:          |  |

# TIMBER SALE VERIFICATION OF WORKER'S DISABILITY COMPENSATION ACT COMPLIANCE

As required by Act 317, P.A. 1969 (Worker's Compensation) and  
Part 5 of Act 451 of 1994, as amended.

## VERIFICATION OF WORKER'S DISABILITY COMPENSATION ACT COMPLIANCE

- This verification must be completed and submitted within 21 days of contract award and prior to the issuance of the timber sale contract.
- In addition, if boxes 2B or 2C are checked, then Notice of Exclusion or Certificate of Insurance must be submitted within twenty-one (21) days of the contract award and prior to the issuance of the timber sale contract.
- All information must be typed or printed except for written signatures.

Please Check Appropriate Categories:

1. My business is organized as (you **must** check one of the boxes below):
  - A.  Sole Proprietorship (individual)
  - B.  Partnership
  - C.  Corporation
2. You **must** check one of the boxes below:
  - A.  I certify my business is a sole proprietorship and it has no employees but the sole proprietor. I am not subject to the Worker's Compensation Laws.
  - B.  I certify my business has satisfied its obligation to the Worker's Compensation Act through the use of an approved Notice of Exclusion (BWC-337, Rev. 5/96). I will provide a copy of the Notice of Exclusion within 21 days of the contract award. (For questions or a copy of the BWC-337, please call the Worker's Compensation Bureau at 517-322-1195).
  - C.  I certify my business has a Worker's Compensation Policy. I will provide an original Certificate of Insurance within twenty-one (21) days of the contract award.
3. If you have checked item 2(A) or 2(B), you **must** indicate the number of **both** full-time and part-time employees, other than yourself, including family members and active partners (if none, you must enter "0").

\_\_\_\_\_ Full-time Employees

\_\_\_\_\_ Part-time Employees

|                  |       |                                     |  |
|------------------|-------|-------------------------------------|--|
| Name of Business |       | Federal ID (or) Social Security No. |  |
| Address          |       | Telephone<br>(       )              |  |
| City             | State | ZIP                                 |  |

*I hereby certify that the above information is true and correct. I agree to notify the Michigan DNR of any changes that occur in factors affecting my coverage during any of my present and future operations.*

\_\_\_\_\_  
Signature of Owner or Authorized Representative

\_\_\_\_\_  
Title

\_\_\_\_\_  
Date

Please complete the "SEALED BID" information on the next page