



**DEPARTMENT OF NATURAL RESOURCES
STATE OF MICHIGAN**

TIMBER SALE PROSPECTUS #6236

SCHEDULED SALE DATE AND TIME: 2:00 p.m. (local time) on November 20, 2018.

LOCATION: ROSCOMMON MGMT UNIT, PO BOX 218, ROSCOMMON, MI 48653.

PROSPECTUS NOTE: The bidder is advised to inspect the sale area and review the location, estimated volumes, operating costs and contract terms of proposed sales. Please be aware that some landowners may request 60 days or more notice for access across their land.

Notice is hereby given that bids will be received by the Unit Manager, ROSCOMMON MANAGEMENT UNIT, for certain timber on the following described lands:

Canoe Camps Pine (71-003-18) / T21N, R04W, SEC. 20, E1/2NE,S1/2SW,NWSW.

T21N, R04W, SEC. 21, SWNW.

T21N, R04W, SEC. 29, NW.

Roscommon County, Advertised Price \$98,904.90, 124.0 Acres, Red Pine, White Pine.

SALE NOTE: A recreation site such as a trail, pathway, or campground is within the sale area or the vicinity. Certain restrictions/specifications may be applicable including time restrictions.

Tacoma Mix (71-018-18) / T23N, R01E, SEC. 4 , NWSW.

T23N, R01E, SEC. 5 , N1/2NW,SEnw,SWNE,N1/2SE.

T23N, R01E, SEC. 6 , N1/2SE.

T23N, R01E, SEC. 8 , E1/2SW,W1/2SE.

T24N, R01E, SEC. 31, SENW,SWNE,E1/2SW,N1/2SE,SWSE.

T24N, R01E, SEC. 32, NWSW.

Ogemaw County, Advertised Price \$94,376.20, 197.7 Acres, Jack Pine, Hardwood.

Bear Creek Harvest (71-018-17) / T21N, R04W, SEC. 4 , SWNE,NWSE.

T21N, R04W, SEC. 5 , SENW,W1/2NE,NWSE.

T21N, R04W, SEC. 6 , W1/2SW.

Roscommon County, Advertised Price \$61,924.50, 55.7 Acres, Hardwood, Red Pine.

SALE NOTE: A recreation site such as a trail, pathway, or campground is within the sale area or the vicinity. Certain restrictions/specifications may be applicable including time restrictions.

BID INSTRUCTIONS (VER. 07/02/2018):

1. Scheduled Bid Location, Date, and Time (2/11)

Bids must be received by the Unit Manager, ROSCOMMON OFFICE, PO BOX 218, ROSCOMMON, MI 48653, no later than 2:00 p.m. (local time) on November 20, 2018. For further information concerning this sale, contact Steve Anderson at 989-275-4622 extension 2740.

2. Bidder's Qualifications (5/16)

Purchaser shall obtain workers compensation insurance to cover claims under Michigan's Worker's Disability Compensation Act of 1969 or similar employee benefit act of any other state applicable to an employee. If all or part of a timber sale was prepared by a private contractor, the contractor and that contractor's company are not permitted to bid on the timber sale contract. Bids will not be accepted from individuals or companies appearing on the DNR/FRD No-Bid List. This list contains the names of purchasers who previously failed to execute a contract within 21-days or who have a history of poor performance.

3. Preparation of Sealed Bids (5/16)

Bid Forms may be completed online thru Michigan DNR Timber Sale Online Bidding (OLB) at www.michigan.gov/timberbidding or by completing the hardcopy Bid Form found in the Timber Sale Prospectus. Hardcopy Bid Forms shall be manually signed in ink. Registration in OLB is considered your 'signature' for all bids submitted thru that system. Bid prices must be entered for each species and product in the Bid Price column for all material subject to bidding and all fill-in blanks must be completed. If erasures or other changes appear on the hardcopy Bid Form, each erasure or change must be initialed by the person signing the bid.

4. Submission of Sealed Bids (5/16)

Bid forms may be obtained from the Unit Manager or thru OLB. Bids may be submitted hardcopy or thru OLB. All hardcopy bids must be submitted on the bid form and in an envelope clearly identified as described in this section. NOTE: Only one bid form per bid envelope. Sealed bids must be submitted to the Unit office designated in the prospectus and must be submitted at or prior to the time established in the prospectus. The envelope should show on the outside (a) the sale name or number and (b) the date and time of bid opening, as shown in the prospectus. Bids received after the time specified in the sale prospectus are late bids and will be rejected.

It is possible for a bidder to submit multiple bids on a single sale. For example, a bid may be submitted hardcopy and a bid may be submitted thru OLB. Or, two bidders from the same company could both submit bids on the same sale. If this were to happen, the State would accept all bids received and award the contract accordingly. All bidding and contractual requirements would apply to all bids received.

5. Public Opening of Sealed Bids (7/16)

If conditions permit, the sealed bids will be publicly opened and posted at the time and place set in the prospectus.

If a bidder, present at a bid opening, has submitted bids on more than one sale, that bidder may withdraw their unopened bid envelopes or announce the withdrawal of their online bid after being declared the successful bidder on one sale.

6. Award of Contract (1/11)

Award of the contract will be made to the Bidder whose bid, conforming to the prospectus, is most advantageous to the State of Michigan on the basis of total value at rates bid for the estimated quantities. The State reserves the right to reject any bid or waive any minor irregularity in bids received. A written award mailed (or otherwise furnished) to the successful Bidder shall be deemed to result in a binding contract without further action by either party.

7. Down Payment (1/11)

The Bidder to whom award is made must make a down payment within 21 days of the sale award. The amount of the down payment will be calculated as shown in the Bond and Payment Schedule of this prospectus. Only cash may be used to meet this requirement.

8. Performance Security (1/11)

As guarantee of faithful performance, a cash bond, certificate of deposit, surety bond or irrevocable letter of credit (LOC) is required within 21 days of the sale award. The amount of the performance security is shown in the Bond and

Payment Schedule of this prospectus. If an LOC or surety is used, the coverage must extend for at least 6 months beyond the contract expiration.

9. Timber Sale Contract (7/18)

Additional conditions and requirements common to all timber sales are listed on the timber sale contract (R4031) and are available on line at www.michigan.gov/timber. Contact the Unit Manager for additional information or a sample contract. Within 21 days of the date of the award letter, the bidder must sign the contract and provide the required down payment, performance security, and verification of worker's disability compensation. The down payment and performance security shall be in accordance with the provisions of the timber sale contract, in the sums stated in this prospectus. If these actions are not taken, then the Bidder, the Bidder's corporation, and the corporation's principals may not be permitted to bid on State timber sales for a period of 3 months after the first offense, 6 months after the second offense, and 1 year after the third offense. An offense will only be counted against the Bidder for 5 years. In addition, the Bidder certifies that if awarded this contract, the Bidder will complete the timber sale contract in accordance with its terms and any modifications thereof including requirements to purchase, cut, and remove the included timber by the expiration date.

Payment Unit values in the State Forest Timber Sale Contract are calculated based on the advertised value of the Payment Unit as a percentage of the total advertised value of the contract. The advertised value of each Payment Unit is given in the Description of Timber by Payment Unit table on the Timber Sale Information page. For example, if the value of Payment Unit 1 is advertised as \$1,500 and the total Timber Sale value is advertised as \$10,000, the contract price for Payment Unit 1 will be 15% of the total bid price ($\$1,500/\$10,000 * 100$).

10. Disclaimer of Estimates and Bidder's Warranty of Inspection (7/16)

Before submitting this bid, the Bidder is advised and cautioned to inspect the sale area, review the requirements of the sale contract, and take other steps as may be reasonably necessary to ascertain the location, estimated volumes, construction estimates, and operating costs of the proposed sale. Failure to do so will not relieve the Bidder from responsibility for completing the contract.

The Bidder warrants that this bid is submitted solely on the basis of the Bidder's examination and inspection of the quality and quantity of the timber offered for sale and the Bidder's opinion of the value thereof and the costs of recovery. No reliance should be placed on the State of Michigan's estimates of timber quality, quantity or costs of recovery. Bidder further acknowledges that the State of Michigan: (i) expressly disclaims any warranty of fitness of timber for any purpose; (ii) offers this timber as is without any warranty of quality (merchantability) or quantity and (iii) expressly disclaims any warranty as to the quantity or quality of timber sold.

11. Certification and Chain-of-Custody (10/14)

Unless otherwise indicated in the contract under section 7 – Other Conditions of the Sale Specific Conditions & Requirements, the area encompassed by this timber sale is certified to the standards of the Forest Stewardship Council (FSC) - Certificate #SCS-FM/COC-00090N and the Sustainable Forestry Initiative (SFI) - Certificate #NSF-SFIS-5Y031-SF5. Forest products from this sale may be delivered to the mill as "FSC 100% and / or SFI certified" as long as the contractor hauling the forest products is chain-of-custody (COC) certified or covered under a COC certificate from the destination mill. The purchaser is responsible for maintaining COC after leaving the sale area.

12. Good Neighbor Authority (GNA) Requirements (7/16)

If the name of this timber sales contains the acronym GNA, it is authorized by the Good Neighbor Authority (GNA) and covered by various agreements between the U.S. Forest Service and the State. The timber sale occurs on federal land and the following conditions apply:

GNA contracts on US Forest Service land will not be awarded to purchasers on the Federal list of excluded parties. The System for Award Management (SAM) will be checked for active excluded parties prior to award of contract. In addition, the Bidder to whom award is made must complete an Assurance Regarding Felony Conviction or Tax Delinquent Status for Corporate Applicants (AD-3031).

13. Good Neighbor Authority (GNA) Requirements, con't (9/16)

Bidder certifies, by signing this bid form, that to the best of Bidder's knowledge that the following representations are accurate and complete.

- a. That the Bidder and its principals are not presently debarred, suspended, proposed for debarment, declared ineligible, or voluntary excluded from timber sales (covered transactions) by any Federal department or agency.
- b. That the Bidder and its principals have not within a 3-year period preceding this bid been convicted of or had a civil judgment rendered against them for commission of fraud or a criminal offense in connection with obtaining, attempting to obtain, or performing a public (Federal, State, or local) transaction or contract under a public transaction; violation of Federal or State antitrust statutes or commission of embezzlement, theft, forgery, bribery, falsification or destruction of records, making false statements, or receiving stolen property.
- c. That the Bidder and its principals are not presently indicted for or otherwise criminally or civilly charged by a governmental entity (Federal, State, or local) with commission of any of the offenses enumerated in paragraph b of this certification.
- d. That the Bidder and its principals have not within a 3-year period preceding this bid had one or more public transactions (Federal, State, or local) terminated for breach or default of a timber or forest product contract.

Bidders that cannot certify this requirement, in whole or in part, shall submit an explanation with their bid.

KEITH CREAGH
Director

TIMBER SALE INFORMATION

Canoe Camps Pine (71-003-18)

T21N, R04W, SEC. 20; T21N, R04W, SEC. 21; T21N, R04W, SEC. 29.
Roscommon County (Advertised Price \$98,904.90)

SALE NOTE: A recreation site such as a trail, pathway, or campground is within the sale area or the vicinity. Certain restrictions/specifications may be applicable including time restrictions.

A timber sale contract for this lump sum, sealed bid timber sale will be awarded to the responsible bidder offering the highest sealed bid price. Bids must be at or above the following advertised price for each species:

<u>PRODUCTS & SPECIES</u>	<u>ESTIMATED UNITS*</u>	<u>ADVERTISED PRICE</u>
Sawtimber		
BI/R/Hybrid Oak	8.30 MBF	\$ 129.00 / MBF
Jack Pine	23.70 MBF	\$ 39.00 / MBF
Red Pine	426.60 MBF	\$ 125.00 / MBF
Scotch Pine	22.70 MBF	\$ 62.00 / MBF
White Pine	100.00 MBF	\$ 82.00 / MBF
Pulpwood		
B. T. Aspen	35.00 Cords	\$ 31.50 / Cord
BI/R/Hybrid Oak	50.00 Cords	\$ 18.60 / Cord
Jack Pine	447.00 Cords	\$ 18.65 / Cord
Red Pine	226.00 Cords	\$ 47.25 / Cord
Scotch Pine	128.00 Cords	\$ 31.40 / Cord
White Pine	327.00 Cords	\$ 27.25 / Cord

* The total volume is statistically estimated within plus (+) or minus (-) 10.88 percent. The estimated units are final and not subject to adjustment. Prospective bidders are urged to examine this timber and to make their own estimates of quantity and quality.

BOND AND PAYMENT SCHEDULE:

1. A bond in the amount of \$4,945.00 to insure faithful performance of the conditions of the contract will be deposited by the successful bidder within 21 days of the sale award.
2. Cutting in any sale or unit without the required advance payment would be considered a trespass.
3. Total payment must be paid in advance or according to the following schedule:
 - (a) Ten percent (10%) of the sale value must be paid within 21 days of the sale award.
 - (b) The 10% down payment will be credited towards the first unit cut.
 - (c) Payment for each of the following units must be made before cutting begins in that unit:

<u>PAYMENT UNIT NUMBER</u>	<u>PERCENT OF TOTAL SALE VALUE</u>
01	32.0%
02	36.7%
03	21.3%
04	10.0%
4. If no cutting takes place, the 10% down payment will not be refunded.
5. Operations on the contract issued will terminate on 09/30/2021.

Description of Timber by Payment Unit (PU)

PU	MARKET GROUP	PRODUCT	QUANTITY	UNIT	ACRES	ADVERTISE PRICE
1	Jack Pine	Sawtimber	5.6	MBF	51.1	\$31,676.55
	Red Pine		33.5	MBF		
	Scotch Pine		22.7	MBF		
	White Pine		95.9	MBF		
	BI/R/Hybrid Oak	Pulpwood	1.0	Cords		
	Jack Pine		226.0	Cords		
	Red Pine		20.0	Cords		
	Scotch Pine		128.0	Cords		
	White Pine		323.0	Cords		
	2	Red Pine	Sawtimber	242.4		
White Pine			0.8	MBF		
Jack Pine		Pulpwood	8.0	Cords		
Red Pine			120.0	Cords		
White Pine			3.0	Cords		
3		Red Pine	Sawtimber	141.4	MBF	9.3
	White Pine		3.3	MBF		
	Jack Pine	Pulpwood	2.0	Cords		
	Red Pine		65.0	Cords		
	White Pine		1.0	Cords		
	4	BI/R/Hybrid Oak	Sawtimber	8.3	MBF	
Jack Pine			18.1	MBF		
Red Pine			9.3	MBF		
B. T. Aspen		Pulpwood	35.0	Cords		
<i>B. T. Aspen</i>		<i>Sawtimber</i>	5.4	<i>MBF</i>		
<i>B. T. Aspen</i>		<i>Pulpwood</i>	24.0	<i>Cords</i>		
BI/R/Hybrid Oak			49.0	Cords		
Jack Pine			211.0	Cords		
Red Pine			21.0	Cords		
TOTAL:			581.3	MBF		
TOTAL:			1,213.0	Cords		

Sale Specific Conditions & Requirements

Sale Name: Canoe Camps Pine

Sale Number: 71-003-18 Seq#: 1

1 - Sale Area

1.2 - Boundaries

1.2.1 - Painted boundaries (1/14)

The sale boundary and Payment Unit boundaries are marked and identified by red paint. The painted boundary line trees are not Included Timber and are to be protected.

2 - Timber Specifications

2.1 - Included Timber

2.1.1 - Clearcut unit(s) with unmerchantable trees (6/14)

Within Payment Unit(s) 1, 3, and 4, cut all trees that are two (2) inches or more at DBH, except do not cut any trees marked with green paint above and below stump height within Payment Units 1 and 4. In addition, within Payment Unit 3, do not cut any oak or white pine.

2.1.2 - Clearcut unit(s) w/o unmerchantable trees (8/11)

Within Payment Unit(s) 2, cut all trees which meet minimum piece specifications in 2.2 Utilization.

2.2 - Utilization

2.2.2 - Chipping required (2/18)

Payment Units 1, 3, and 4 must be chip harvested to facilitate subsequent planting operations. Products may be produced as roundwood and forwarded to decking areas in final product length, but the tops must be left intact and skidded to the landing for chipping in order to minimize the amount of residual slash. If market conditions limit the practicality of chipping, tops and slash must be arranged in a way that will not inhibit future planting operations, as directed by the sale administrator. The requirement to retain approximately 1/6 of tree tops and limbs less than four inches in diameter is still applicable (G. C. & R. 2.2).

2.2.3 - Stump heights (4/07)

Stump heights within the Sale Area shall not exceed 12 inches for trees greater than 10 inches DBH and 4 inches for trees smaller than 10 inches DBH. This is in order to facilitate planting operations.

2.2.6 - Roundwood operation required (5/07)

The skidding of whole trees or tree segments with limbs attached is prohibited within Payment Unit 2. All products must be produced as roundwood and forwarded to existing roads or landing areas in final product length. Exception: Utility poles may be skidded to the landing after being cut to length in the woods and after all roundwood has been skidded to the landing (see Spec 3.4.1 - Damaged timber).

2.2.9 - No chipping permitted (12/08)

Within Payment Unit(s) 2, tops may not be chipped.

3 - Payments

3.3 - Pre-measured Sales

3.3.4 - Dividing payment units (7/14)

Payment Unit(s) may be divided at the request of the Purchaser and upon approval of the Unit Manager. Dividing Payment Units is a contract modification which requires a Timber Sale Contract Supplement.

3.4 - Damaged Timber

3.4.1 - Damaged timber (6/14)

General Condition and Requirement 3.4 Damaged Timber, defines liquidated damages for undesignated live merchantable trees which are cut or injured. In addition, extreme care should be taken to avoid damage to tree seedlings and saplings.

Within the Payment Unit 2, if more than 25% of the tree seedlings or saplings (1/4" to 4.5" DBH) within a specified portion of

the sale area are damaged, liquidated damages will be assessed at \$300.00 per acre for all acreage within that specified portion of the sale area that was damaged.

No damage is acceptable to merchantable trees. Within the sale area, if more than 5% of residual trees (> 4.5" DBH) within a specified area of the sale are damaged, liquidated damages will be assessed for all trees damaged. Rates will be in accordance with General Condition and Requirement 3.4 Damaged Timber.

4 - Transportation

4.1 - Construction

4.1.3 - Slash and earthen piles (8/04)

Piles or windrows of earth along roads and landings that have been widened or constructed shall be leveled. Slash from road maintenance or construction, including stumps, shall be dispersed throughout the sale or chipped, utilized or otherwise removed from the sale.

4.1.6 - Road construction (1/09)

Construction of new roads or improvements of existing roads shall be done in such a way as to minimize the environmental and visual impacts. Merchantable trees shall be cut and utilized unless otherwise directed. Non-merchantable trees shall be severed and laid flat on the ground. Slash shall be scattered, and not left in windrows and kept a minimum of 10 feet back from the road edge. Stumps shall be set upright, not left on edge, and be moved at least 10 feet away from the road edge. Disturbed soil shall be feathered into the woods and not left in berms or windrows.

4.1.7 - Road closure (10/11)

All new roads built into the sale must be blocked to vehicle traffic upon completion of the sale. Overgrown roads that are reopened shall be considered new roads. In general, this will require constructing a four (4') foot high berm of stumps and logs covered with earth. Stumps and brush must be placed along the remainder of the trail. These roads must be rendered impassable to cars and trucks. Contact the sale administrator for specific details of design and placement.

4.2 - Maintenance

4.2.1 - Hauling restriction (12/08)

Hauling may be restricted on forest roads by the Unit Manager or his/her representative. The restriction may occur during spring breakup or during wet weather conditions.

4.2.3 - Road maintenance (8/13)

The following road maintenance may be needed: Within 60 days of completion of hauling, or if no hauling occurs for 60 days, the road must be maintained and graded. This includes cleaning of drainage areas, grading, crowning and filling with gravel, if necessary. Damages will be assessed if grading/repair does not occur.

5 - Operations

5.2 - Conduct of Operations

5.2.1 - Slash

5.2.1.8 - Slash height (12/08)

No slash or tree tops may exceed 24 inches in height.

5.2.1.11 - Slash for reforestation (5/07)

To facilitate reforestation, the sale area shall be left with slash evenly distributed. Bunched tops within the cutting area shall be broken up and scattered. Stumps shall be cut low to the ground. Processing sites shall not be left with a compacted layer of slash; tops from these sites shall be hauled back into the cut area and scattered.

5.2.2 - Hazard Trees/Snags

5.2.2.1 - Den trees (10/16)

Obvious hollow and/or den trees shall be protected and left standing unless they are a safety hazard.

5.2.3 - Operating Restrictions

5.2.3.1 - Operating restrictions (9/11)

Within Payment Unit(s) 1 - 4, unless changed by written agreement, cutting, skidding, and hauling are not permitted during the period of April 1 to July 31. This restriction is because of the presence of eastern massasauga rattlesnakes and northern long-eared bats on or adjacent to the sale.

5.2.3.6 - Bark beetle restriction (12/08)

In the event drought creates a high risk of pine bark beetle infestation, pine is not to be cut during the period March 1 through July 1, unless all portions of trees greater than two inches in diameter are removed from the sale area, reduced to chips, or treated to the satisfaction of the Unit Manager or his/her representative, within fifteen days of being severed from the stump. Pine log decks, pulpwood piles and treetops that are piled for chipping in the fall or winter within a 1/4 mile of susceptible sites must be removed before March 15. Residual slash must not be placed in piles or rows and must be spread over the site for quick drying. The Department of Natural Resources will exercise this specification if the risk of damage warrants.

5.2.4 - Dead and Down Creation

5.2.4.3 - Dead and down creation, dead trees (6/07)

Except as provided for in General Condition and Requirement 5.2.2, no dead trees, standing or down, are to be cut, skidded, or processed.

5.2.38 - No decking against live trees (2/04)

Cut products may not be decked against unmarked or designated leave trees.

5.2.39 - ORV trail/route protection (4/18)

There is an ORV trail or route on this sale as shown on the Timber Sale Map. Do not damage posts with yellow ORV markers. Trees with yellow ORV markers shall be cut off above the markers and at least 5 feet above ground. All stumps within 5 feet of the trail must be cut flush with the ground. Maintain a 10 foot wide slash, debris, and rut free zone daily using the ORV trail or route as the centerline. Do not run equipment down the ORV trail or route. Skidding across the trail or route may only occur in locations approved by the sale administrator.

5.2.41 - Snowmobile trail protection (9/11)

Porky Drive is also a snowmobile trail as shown on the Timber Sale Map. Do not cut or damage posts with orange trail markers or traffic control signs. If the trail is used for hauling, it must be graded to the satisfaction of the Unit Manager or his/her representative prior to December 1st. If the trail road is to be used for hauling during the snowmobile season, then a snow covered base must be left on the trail. Maintain a 20 foot wide slash, debris, and rut free zone daily using the snowmobile trail as the centerline. No decking of forest products will be permitted along the snowmobile trail. All stumps within 20 feet of the snowmobile trail must be cut at ground level.

5.4 - Soil Protection

5.4.1 - Rutting restriction, general (7/16)

Operations are to cease immediately if equipment and weather conditions result in rutting of roads and/or skid trails which is 12 inches or greater in depth and 50 feet in length. The Unit Manager or his/her representative may restrict hauling and/or skidding if ruts exceed the specified depth. With the Unit Manager or his/her representative's approval, the Purchaser may return to the area when the risk of rutting has decreased.

5.4.3 - Erosion control (12/08)

Skid trails or haul roads may require erosion control structures or berms per direction of the Unit Manager or his/her representative.

6 - Safety and Fire Prevention

6.2 - Signing

6.2.2 - Snowmobile trail posting (8/09)

The Purchaser is responsible for posting and maintaining caution signs on the snowmobile trail (Porky Drive) prior to beginning operations during the snowmobile season (approximately December 1 to March 31). The trail must be posted at appropriate distances from the sale area to warn of logging activity and truck traffic. Signs must be removed when harvest operations are suspended or completed.

6.2.3 - Recreational trail posting (2/10)

The Purchaser is responsible for posting and maintaining caution signs on the ORV trail prior to beginning operations. The

trail must be posted at appropriate distances from the sale area to warn of logging activity and truck traffic at both ends of the trail. Signs must be removed when harvest operations are suspended or completed.



TIMBER SALE MAP

This information provided by authority of Part 525, 1994 PA 451, as amended.

Forest Management Unit Roscommon		County Roscommon	Mapped By Ekdom/Metcalf Forestry	Date 7/31/2018	Page 1	of 1
Township 21N	Range 04W	Section(s) and Subdivision(s) 20 - E1/2NE; W1/2SW; SESW 29 - NW1/4		Scale 1:15,840		

Cover Type				Density	
A = Aspen	H = Hemlock	N = Marsh	U = Upland Brush	0 = Non Stocked	5 = Pole Timber Medium
B = Paper Birch	J = Jack Pine	O = Oak	UM = Upland Mixed	1 = Seedling Sapling Poor	6 = Pole Timber Well
C = Cedar	L = Lowland Brush	P = Lowland Poplar	V = Bog or Marsh	2 = Seedling Sapling Medium	7 = Saw Timber Poor
D = Tread Bog	LM = Lowland Mixed	Q = Mixed Swamp Conifer	W = White Pine	3 = Seedling Sapling Well	8 = Saw Timber Medium
E = Swamp Hdwoods	M = Mpl, Bch, Brch	R = Red Pine	X = Non Stocked	4 = Pole Timber Poor	9 = Saw Timber Well
F = Spruce Fir	MC = Mixed Conifer	S = Black Spruce	Z = Water		
G = Grass	MD = Mixed Deciduous	T = Tamarack			

Unit	Acres	Unit	Acres
1	51.1	3	9.3
2	19.3	4	44.3

Canoe Camps Pine

Compartment 154
124.0 Acres

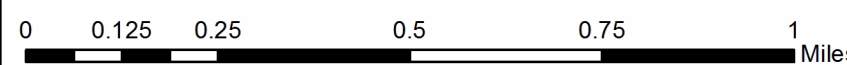
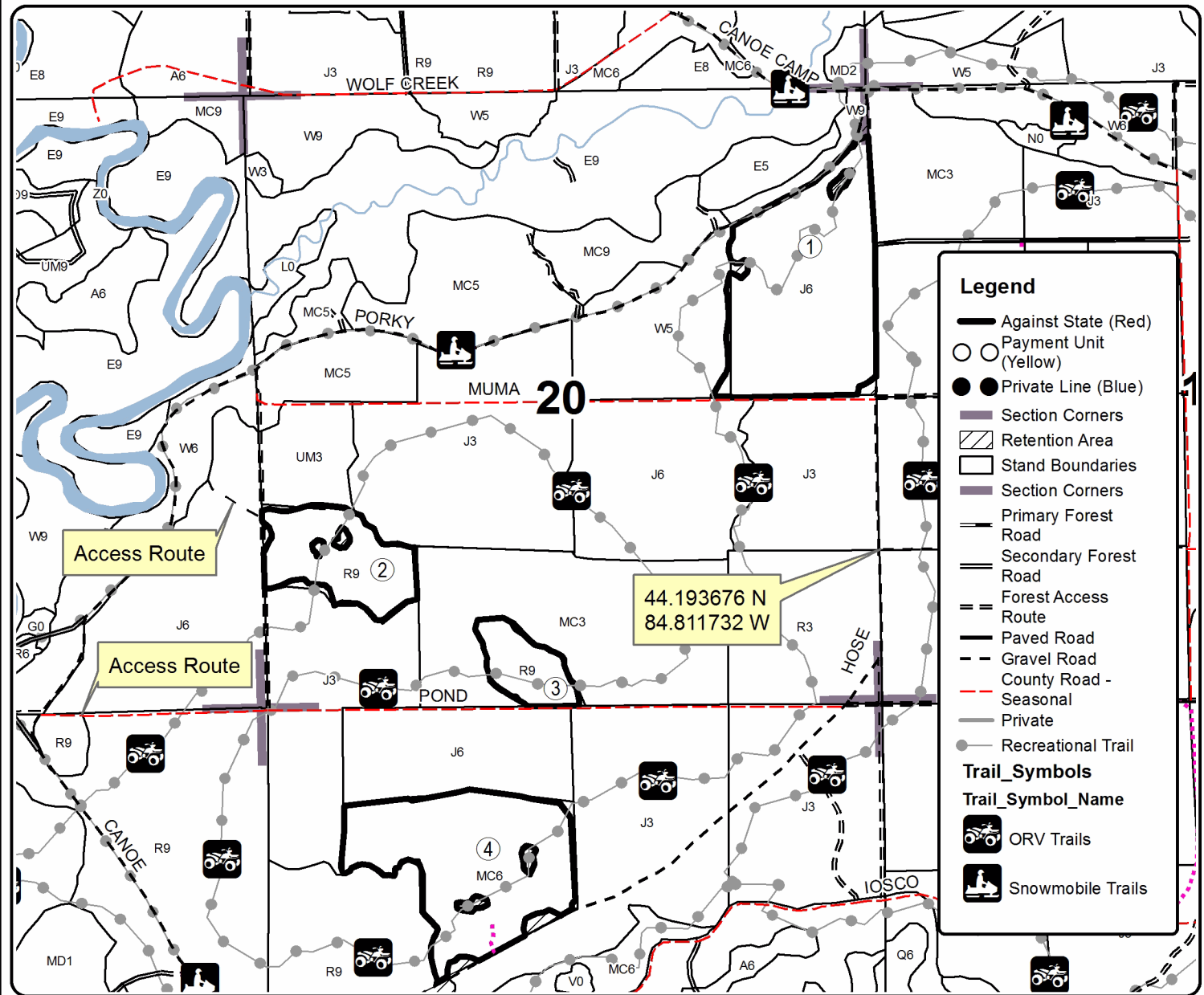

TIMBER SALE INFORMATION

Tacoma Mix (71-018-18)

T23N, R01E, SEC. 4; T23N, R01E, SEC. 5; T23N, R01E, SEC. 6; T23N, R01E, SEC. 8; T24N, R01E, SEC. 31; T24N, R01E, SEC. 32.
Ogemaw County (Advertised Price \$94,376.20)

A timber sale contract for this lump sum, sealed bid timber sale will be awarded to the responsible bidder offering the highest sealed bid price. Bids must be at or above the following advertised price for each species:

<u>PRODUCTS & SPECIES</u>	<u>ESTIMATED UNITS*</u>	<u>ADVERTISED PRICE</u>
Sawtimber		
Jack Pine	58.70 MBF	\$ 39.00 / MBF
Mixed Aspen	17.00 MBF	\$ 63.00 / MBF
Mixed Oak	33.80 MBF	\$ 129.00 / MBF
Red Maple	66.80 MBF	\$ 73.00 / MBF
Red Pine	117.90 MBF	\$ 125.00 / MBF
White Pine	91.50 MBF	\$ 82.00 / MBF
Pulpwood		
Balsam Fir	15.00 Cords	\$ 16.90 / Cord
Black Spruce	68.00 Cords	\$ 22.55 / Cord
Jack Pine	764.00 Cords	\$ 18.65 / Cord
Mixed Aspen	558.00 Cords	\$ 31.50 / Cord
Mixed Hardwood	444.00 Cords	\$ 24.40 / Cord
Mixed Oak	112.00 Cords	\$ 18.60 / Cord
Red Pine	130.00 Cords	\$ 47.25 / Cord
White Pine	252.00 Cords	\$ 27.25 / Cord

* The total volume is statistically estimated within plus (+) or minus (-) 8.31 percent. The estimated units are final and not subject to adjustment. Prospective bidders are urged to examine this timber and to make their own estimates of quantity and quality.

BOND AND PAYMENT SCHEDULE:

1. A bond in the amount of \$4,719.00 to insure faithful performance of the conditions of the contract will be deposited by the successful bidder within 21 days of the sale award.
2. Cutting in any sale or unit without the required advance payment would be considered a trespass.
3. Total payment must be paid in advance or according to the following schedule:
 - (a) Ten percent (10%) of the sale value must be paid within 21 days of the sale award.
 - (b) The 10% down payment will be credited towards the first unit cut.
 - (c) Payment for each of the following units must be made before cutting begins in that unit:

<u>PAYMENT UNIT NUMBER</u>	<u>PERCENT OF TOTAL SALE VALUE</u>
01	2.2%
02	4.1%
03	4.7%
04	26.7%
05	39.2%
06	8.1%
07	15.0%
4. If no cutting takes place, the 10% down payment will not be refunded.
5. Operations on the contract issued will terminate on 12/31/2021.

Description of Timber by Payment Unit (PU)

PU	MARKET GROUP	PRODUCT	QUANTITY	UNIT	ACRES	ADVERTISE PRICE
1	Jack Pine	Sawtimber	4.0	MBF	8.6	\$2,072.40
	Jack Pine	Pulpwood	96.0	Cords		
	Mixed Aspen		4.0	Cords		
	<i>Quaking Aspen</i>		4.0	<i>Cords</i>		
2	Jack Pine	Sawtimber	6.2	MBF	11.0	\$3,890.85
	Mixed Oak		1.0	MBF		
	<i>Northern Pin Oak</i>		1.0	<i>MBF</i>		
	Jack Pine	Pulpwood	177.0	Cords		
	Mixed Aspen		4.0	Cords		
	<i>Quaking Aspen</i>		4.0	<i>Cords</i>		
	Mixed Oak		5.0	Cords		
	<i>Northern Pin Oak</i>		5.0	<i>Cords</i>		
3	Jack Pine	Sawtimber	7.6	MBF	12.5	\$4,423.25
	Mixed Oak		6.1	MBF		
	<i>Northern Pin Oak</i>		6.1	<i>MBF</i>		
	Red Pine		0.5	MBF		
	Jack Pine	Pulpwood	122.0	Cords		
	Mixed Aspen		4.0	Cords		
	<i>Quaking Aspen</i>		4.0	<i>Cords</i>		
	Mixed Oak		9.0	Cords		
	<i>Northern Pin Oak</i>		9.0	<i>Cords</i>		
	Red Pine		15.0	Cords		
4	Jack Pine	Sawtimber	4.6	MBF	52.9	\$25,230.05
	Mixed Aspen		3.4	MBF		
	<i>B. T. Aspen</i>		1.2	<i>MBF</i>		
	<i>Quaking Aspen</i>		2.2	<i>MBF</i>		
	Mixed Oak		5.2	MBF		
	<i>Bl/R/Hybrid Oak</i>		0.7	<i>MBF</i>		
	<i>Northern Pin Oak</i>		4.5	<i>MBF</i>		
	Red Maple		18.4	MBF		
	Red Pine		44.8	MBF		
	White Pine		37.2	MBF		
	Jack Pine	Pulpwood	137.0	Cords		
	Mixed Aspen		99.0	Cords		
	<i>B. T. Aspen</i>		2.0	<i>Cords</i>		
	<i>Quaking Aspen</i>		97.0	<i>Cords</i>		
	Mixed Hardwood		105.0	Cords		
	<i>Black Cherry</i>		2.0	<i>Cords</i>		
	<i>Red Maple</i>		103.0	<i>Cords</i>		
	Mixed Oak		35.0	Cords		
	<i>Bl/R/Hybrid Oak</i>		27.0	<i>Cords</i>		
<i>Northern Pin Oak</i>		8.0	<i>Cords</i>			
Red Pine		49.0	Cords			
White Pine		109.0	Cords			
5	Jack Pine	Sawtimber	26.7	MBF	59.0	\$36,957.65
	Mixed Aspen		2.4	MBF		
	<i>B. T. Aspen</i>		0.7	<i>MBF</i>		
	<i>Quaking Aspen</i>		1.7	<i>MBF</i>		
	Mixed Oak		19.1	MBF		
	<i>Bl/R/Hybrid Oak</i>		0.5	<i>MBF</i>		
	<i>Northern Pin Oak</i>		18.6	<i>MBF</i>		
	Red Maple		46.1	MBF		
	Red Pine		65.9	MBF		
	White Pine		51.6	MBF		
	Black Spruce	Pulpwood	2.0	Cords		
	<i>Black Spruce</i>		2.0	<i>Cords</i>		

Description of Timber by Payment Unit (PU), con't

PU	MARKET GROUP	PRODUCT	QUANTITY	UNIT	ACRES	ADVERTISE PRICE
5 con't	Jack Pine	Pulpwood	107.0	Cords		
	Mixed Aspen		73.0	Cords		
	<i>B. T. Aspen</i>		2.0	<i>Cords</i>		
	<i>Quaking Aspen</i>		71.0	<i>Cords</i>		
	Mixed Hardwood		262.0	Cords		
	<i>Paper Birch</i>		1.5	<i>MBF</i>		
	<i>Black Cherry</i>		4.0	<i>Cords</i>		
	<i>Paper Birch</i>		15.0	<i>Cords</i>		
	<i>Red Maple</i>		240.0	<i>Cords</i>		
	Mixed Oak		48.0	Cords		
	<i>BI/R/Hybrid Oak</i>		17.0	<i>Cords</i>		
	<i>Northern Pin Oak</i>		31.0	<i>Cords</i>		
	Red Pine		55.0	Cords		
	White Pine		119.0	Cords		
6	Jack Pine	Sawtimber	0.8	MBF	17.4	\$7,682.45
	Mixed Aspen		7.1	MBF		
	<i>B. T. Aspen</i>		1.2	<i>MBF</i>		
	<i>Quaking Aspen</i>		5.9	<i>MBF</i>		
	Mixed Oak		2.4	MBF		
	<i>BI/R/Hybrid Oak</i>		1.0	<i>MBF</i>		
	<i>Northern Pin Oak</i>		1.4	<i>MBF</i>		
	Red Maple	1.4	MBF			
	Jack Pine	Pulpwood	13.0	Cords		
	Mixed Aspen		153.0	Cords		
	<i>B. T. Aspen</i>		13.0	<i>Cords</i>		
	<i>Quaking Aspen</i>		140.0	<i>Cords</i>		
	Mixed Hardwood		61.0	Cords		
	<i>Black Cherry</i>		3.0	<i>Cords</i>		
	<i>Red Maple</i>		58.0	<i>Cords</i>		
	Mixed Oak		13.0	Cords		
	<i>BI/R/Hybrid Oak</i>		12.0	<i>Cords</i>		
<i>Northern Pin Oak</i>	1.0		<i>Cords</i>			
7	Jack Pine	Sawtimber	8.8	MBF	36.3	\$14,119.55
	Mixed Aspen		4.1	MBF		
	<i>B. T. Aspen</i>		4.1	<i>MBF</i>		
	Red Maple		0.9	MBF		
	Red Pine		6.7	MBF		
	White Pine	2.7	MBF			
	Balsam Fir	Pulpwood	15.0	Cords		
	<i>Balsam Fir</i>		0.4	<i>MBF</i>		
	<i>Balsam Fir</i>	<i>Pulpwood</i>	14.0	<i>Cords</i>		
	Black Spruce	Sawtimber	66.0	Cords		
	<i>Black Spruce</i>		10.4	<i>MBF</i>		
	<i>Black Spruce</i>		45.0	<i>Cords</i>		
	Jack Pine	Pulpwood	112.0	Cords		
	Mixed Aspen		221.0	Cords		
	<i>B. T. Aspen</i>		190.0	<i>Cords</i>		
	<i>Quaking Aspen</i>		31.0	<i>Cords</i>		
	Mixed Hardwood		16.0	Cords		
	<i>Black Cherry</i>		9.0	<i>Cords</i>		
	<i>Red Maple</i>		7.0	<i>Cords</i>		
	Mixed Oak		2.0	Cords		
<i>BI/R/Hybrid Oak</i>	2.0		<i>Cords</i>			
Red Pine	11.0		Cords			
White Pine	24.0		Cords			

TOTAL:	385.7	MBF
--------	-------	-----

TOTAL:	2,343.0	Cords
--------	---------	-------

Sale Specific Conditions & Requirements

Sale Name: Tacoma Mix

Sale Number: 71-018-18 Seq#: 1

1 - Sale Area

1.2 - Boundaries

1.2.1 - Painted boundaries (1/14)

The sale boundary and Payment Unit boundaries are marked and identified by blue, red, and yellow paint, along with a road. Exterior sale boundary lines against private property are marked with blue paint. Exterior sale boundary lines against state are marked with red paint, with the exception of the northern boundary of Payment Unit 4, which is unpainted and identified by Berry Trail. Interior Payment Unit boundaries are marked with yellow paint. The painted boundary line trees are not Included Timber and are to be protected. Yellow painted trees designating an interior Payment Unit boundary are only to be cut when all surrounding Payment Units have been paid.

2 - Timber Specifications

2.1 - Included Timber

2.1.1 - Clearcut unit(s) with unmerchantable trees (6/14)

Within Payment Unit(s) 1-7, cut all trees that are two (2) inches or more at DBH, except do not cut oak in Payment Unit 1, red pine in Payment Unit 3, and green-marked trees in Payment Units 4, 5, and 7. In addition, within Payment Unit 1, cut oak four (4) inches and larger at DBH. Also, within Payment Unit 3, cut red pine marked with orange paint.

3 - Payments

3.3 - Pre-measured Sales

3.3.4 - Dividing payment units (7/14)

Payment Unit(s) may be divided at the request of the Purchaser and upon approval of the Unit Manager. Dividing Payment Units is a contract modification which requires a Timber Sale Contract Supplement.

4 - Transportation

4.1 - Construction

4.1.6 - Road construction (1/09)

Construction of new roads or improvements of existing roads shall be done in such a way as to minimize the environmental and visual impacts. Merchantable trees shall be cut and utilized unless otherwise directed. Non-merchantable trees shall be severed and laid flat on the ground. Slash shall be scattered, and not left in windrows and kept a minimum of 10 feet back from the road edge. Stumps shall be set upright, not left on edge, and be moved at least 10 feet away from the road edge. Disturbed soil shall be feathered into the woods and not left in berms or windrows.

4.1.7 - Road closure (10/11)

All new roads built into the sale must be blocked to vehicle traffic upon completion of the sale. Overgrown roads that are reopened shall be considered new roads. In general, this will require constructing a four (4') foot high berm of stumps and logs covered with earth. These roads must be rendered impassable to cars and trucks. Contact the sale administrator for specific details of design and placement.

5 - Operations

5.1 - Notification

5.1.6 - Utility R.O.W. (1/15)

It is the responsibility of the Purchaser to obtain permission from the utility company to utilize the power line R.O.W. for operations.

5.2 - Conduct of Operations

5.2.1 - Slash

5.2.1.8 - Slash height (12/08)

No slash or tree tops may exceed 36 inches in height.

5.2.2 - Hazard Trees/Snags

5.2.2.1 - Den trees (10/16)

Obvious hollow and/or den trees shall be protected and left standing unless they are a safety hazard.

5.2.4 - Dead and Down Creation

5.2.4.4 - Dead and down creation, grouse (8/13)

To encourage grouse and other wildlife, in Payment Unit(s) 6, leave one, 10" diameter or larger log-length (8 foot minimum) piece on the ground for every 2 acres. These will be evenly scattered throughout the unit. This can be an unmerchantable piece or a full tree.

5.2.38 - No decking against live trees (2/04)

Cut products may not be decked against unmarked or designated leave trees.

5.2.41 - Snowmobile trail protection (9/11)

There is a snowmobile trail within the sale area which is shown on the Timber Sale Map. Do not cut or damage posts with orange trail markers or traffic control signs. If the trail is used, it must be maintained and restored to a condition equal to or better than before the sale. The road maintenance/restoration must be done prior to December 1. If the trail road is to be used for hauling during the snowmobile season, then a snow covered base must be left on the trail. The snowmobile trail may not be used for any timber sale operations from December 1 to March 31, unless permission is given by the Unit Manager.

5.4 - Soil Protection

5.4.1 - Rutting restriction, general (7/16)

Operations are to cease immediately if equipment and weather conditions result in rutting of roads and/or skid trails which is 12 inches or greater in depth and 50 feet in length. The Unit Manager or his/her representative may restrict hauling and/or skidding if ruts exceed the specified depth. With the Unit Manager or his/her representative's approval, the Purchaser may return to the area when the risk of rutting has decreased.

6 - Safety and Fire Prevention

6.2 - Signing

6.2.2 - Snowmobile trail posting (8/09)

The Purchaser is responsible for posting and maintaining caution signs on the snowmobile trail prior to beginning operations during the snowmobile season (approximately December 1 to March 31). The trail must be posted at appropriate distances from the sale area to warn of logging activity and truck traffic. Signs must be removed when harvest operations are suspended or completed. The Purchaser will provide these signs.



TIMBER SALE MAP

This information provided by authority of Part 525, 1994 PA 451, as amended.

Forest Management Unit Roscommon		County Ogemaw	Mapped By Martell	Date 4/16/18	Page 1	of 2
Township 23N, 24N	Range 01E	Section(s) and Subdivision(s) Sec. 31 - SE1/4; Sec. 32 - W1/2SW; Sec. 5 - NW1/4, SWNE, N1/2SE; Sec. 6 - N1/2SE		Scale 1:15,840		

Cover Type				Density	
A = Aspen	H = Hemlock	N = Marsh	U = Upland Brush	0 = Non Stocked	5 = Pole Timber Medium
B = Paper Birch	J = Jack Pine	O = Oak	UM = Upland Mixed	1 = Seedling Sapling Poor	6 = Pole Timber Well
C = Cedar	L = Lowland Brush	P = Lowland Poplar	V = Bog or Marsh	2 = Seedling Sapling Medium	7 = Saw Timber Poor
D = Treed Bog	LM = Lowland Mixed	Q = Mixed Swamp Conifer	W = White Pine	3 = Seedling Sapling Well	8 = Saw Timber Medium
E = Swamp Hdwoods	M = Mpl, Bch, Brch	R = Red Pine	X = Non Stocked	4 = Pole Timber Poor	9 = Saw Timber Well
F = Spruce Fir	MC = Mixed Conifer	S = Black Spruce	Z = Water		
G = Grass	MD = Mixed Deciduous	T = Tamarack			

PU	Acres	PU	Acres
1	8.6	5	59.0
2	11.0	6	17.4
3	12.5	7	36.3
4	52.9		

Tacoma Mix

Compartment 074

197.7 Acres

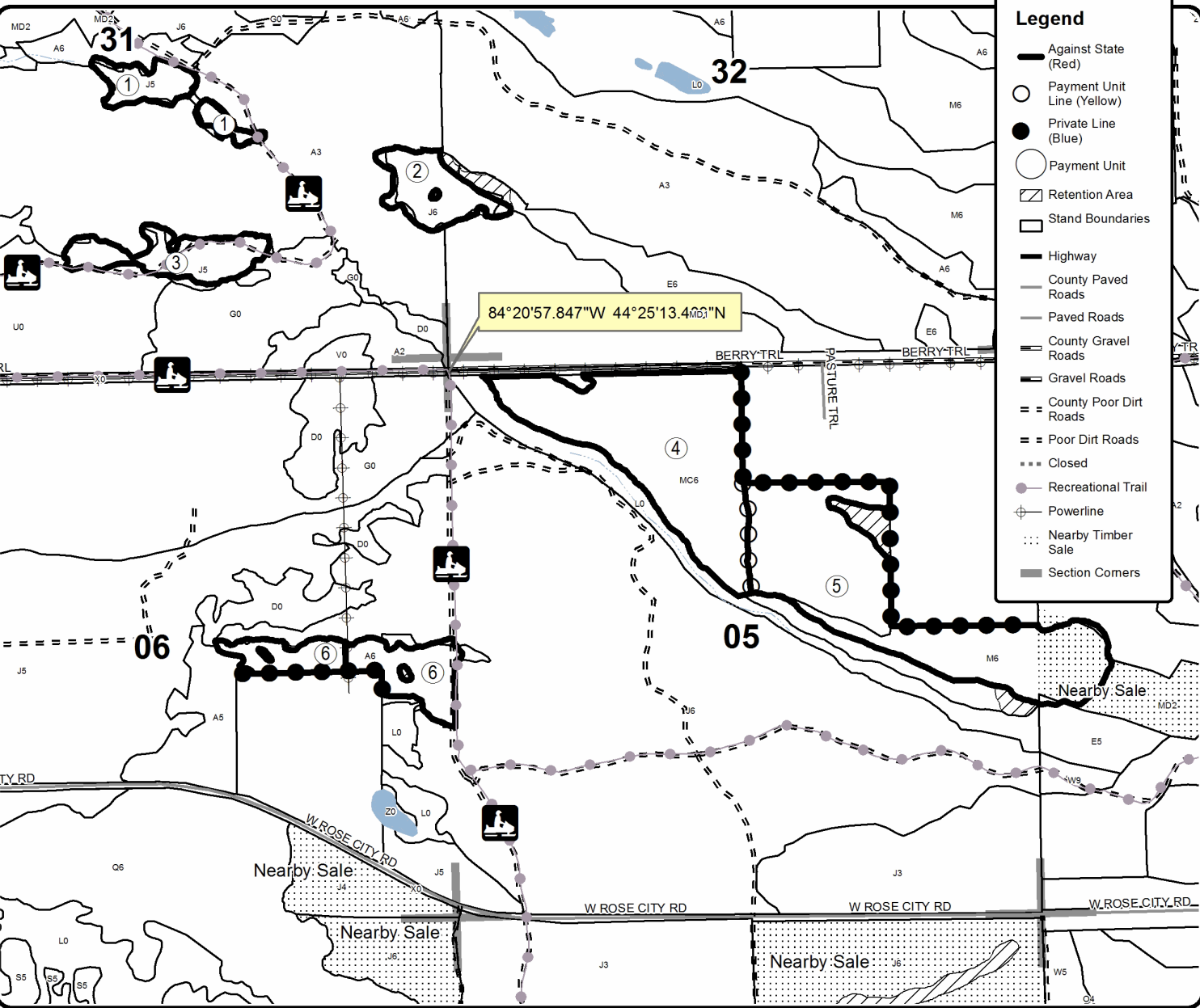
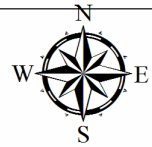

Legend

- Against State (Red)
- Payment Unit Line (Yellow)
- Private Line (Blue)
- Payment Unit
- ▨ Retention Area
- Stand Boundaries
- Highway
- County Paved Roads
- Paved Roads
- County Gravel Roads
- Gravel Roads
- County Poor Dirt Roads
- Poor Dirt Roads
- Closed
- Recreational Trail
- ⊕ Powerline
- ⋯ Nearby Timber Sale
- Section Corners

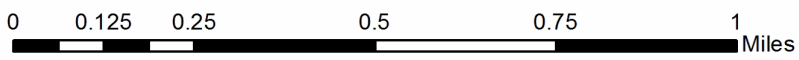



TIMBER SALE MAP

This information provided by authority of Part 525, 1994 PA 451, as amended.

Sale Number	Year
71 - 018	18

Forest Management Unit Roscommon	County Ogemaw	Mapped By Martell	Date 4/16/18	Page 2	of 2
Township 24N	Range 01E	Section(s) and Subdivision(s) Sec. 8 - W1/2SE, E1/2SW, SWSW	Scale 1:15,840		

Cover Type

A = Aspen	H = Hemlock	N = Marsh	U = Upland Brush
B = Paper Birch	J = Jack Pine	O = Oak	UM = Upland Mixed
C = Cedar	L = Lowland Brush	P = Lowland Poplar	V = Bog or Marsh
D = Treed Bog	LM = Lowland Mixed	Q = Mixed Swamp Conifer	W = White Pine
E = Swamp Hdwoods	M = Mpl, Bch, Brch	R = Red Pine	X = Non Stocked
F = Spruce Fir	MC = Mixed Conifer	S = Black Spruce	Z = Water
G = Grass	MD = Mixed Deciduous	T = Tamarack	

Density

0 = Non Stocked	5 = Pole Timber Medium
1 = Seedling Sapling Poor	6 = Pole Timber Well
2 = Seedling Sapling Medium	7 = Saw Timber Poor
3 = Seedling Sapling Well	8 = Saw Timber Medium
4 = Pole Timber Poor	9 = Saw Timber Well

PU	Acres	PU	Acres
1	8.6	5	59.0
2	11.0	6	17.4
3	12.5	7	36.3
4	52.9		

Tacoma Mix

Compartment 074

197.7 Acres

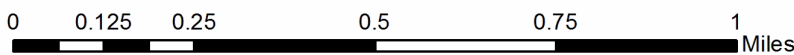
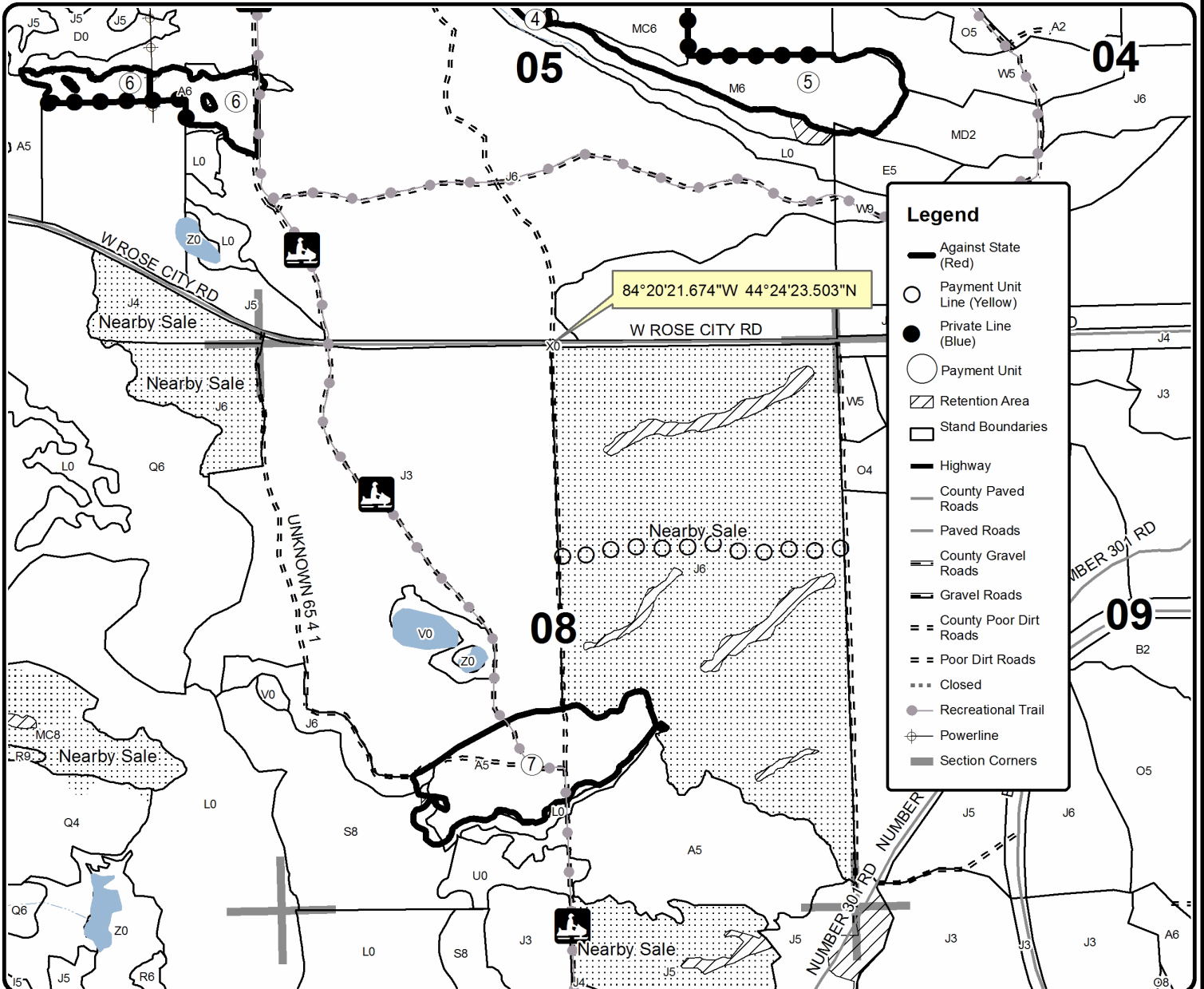
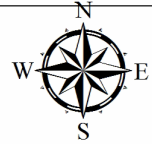

TIMBER SALE INFORMATION

Bear Creek Harvest (71-018-17)
 T21N, R04W, SEC. 4; T21N, R04W, SEC. 5; T21N, R04W, SEC. 6.
 Roscommon County (Advertised Price \$61,924.50)

SALE NOTE: A recreation site such as a trail, pathway, or campground is within the sale area or the vicinity. Certain restrictions/specifications may be applicable including time restrictions.

A timber sale contract for this lump sum, sealed bid timber sale will be awarded to the responsible bidder offering the highest sealed bid price. Bids must be at or above the following advertised price for each species:

<u>PRODUCTS & SPECIES</u>	<u>ESTIMATED UNITS*</u>	<u>ADVERTISED PRICE</u>
Sawtimber		
B. T. Aspen	24.10 MBF	\$ 63.00 / MBF
Mixed Oak	32.30 MBF	\$ 129.00 / MBF
Red Pine	125.50 MBF	\$ 125.00 / MBF
White Pine	43.50 MBF	\$ 82.00 / MBF
Pulpwood		
Balsam Fir	12.00 Cords	\$ 16.90 / Cord
Jack Pine	137.00 Cords	\$ 18.65 / Cord
Mixed Aspen	319.00 Cords	\$ 31.50 / Cord
Mixed Oak	225.00 Cords	\$ 18.60 / Cord
Red Maple	216.00 Cords	\$ 24.40 / Cord
Red Pine	168.00 Cords	\$ 47.25 / Cord
White Pine	249.00 Cords	\$ 27.25 / Cord

* The total volume is statistically estimated within plus (+) or minus (-) 13.23 percent. The estimated units are final and not subject to adjustment. Prospective bidders are urged to examine this timber and to make their own estimates of quantity and quality.

BOND AND PAYMENT SCHEDULE:

1. A bond in the amount of \$3,096.00 to insure faithful performance of the conditions of the contract will be deposited by the successful bidder within 21 days of the sale award.
2. Cutting in any sale or unit without the required advance payment would be considered a trespass.
3. Total payment must be paid in advance or according to the following schedule:
 - (a) Ten percent (10%) of the sale value must be paid within 21 days of the sale award.
 - (b) The 10% down payment will be credited towards the first unit cut.
 - (c) Payment for each of the following units must be made before cutting begins in that unit:

<u>PAYMENT UNIT NUMBER</u>	<u>PERCENT OF TOTAL SALE VALUE</u>
01	6.3%
02	54.7%
03	39.0%
4. If no cutting takes place, the 10% down payment will not be refunded.
5. Operations on the contract issued will terminate on 09/30/2020.

Description of Timber by Payment Unit (PU)

PU	MARKET GROUP	PRODUCT	QUANTITY	UNIT	ACRES	ADVERTISE PRICE
1	Mixed Oak	Sawtimber	2.9	MBF	9.2	\$3,900.55
	<i>BI/R/Hybrid Oak</i>		2.9	<i>MBF</i>		
	Red Pine		7.1	MBF		
	Balsam Fir	Pulpwood	8.0	Cords		
	Jack Pine		9.0	Cords		
	<i>Jack Pine</i>	<i>Sawtimber</i>	1.5	<i>MBF</i>		
	<i>Jack Pine</i>	<i>Pulpwood</i>	6.0	<i>Cords</i>		
	Mixed Aspen		10.0	Cords		
	<i>Quaking Aspen</i>		10.0	<i>Cords</i>		
	Mixed Oak		37.0	Cords		
	<i>BI/R/Hybrid Oak</i>		19.0	<i>Cords</i>		
	<i>Red Oak</i>		18.0	<i>Cords</i>		
	Red Maple		43.0	Cords		
	<i>Red Maple</i>	<i>Sawtimber</i>	5.9	<i>MBF</i>		
	<i>Red Maple</i>	<i>Pulpwood</i>	31.0	<i>Cords</i>		
	Red Pine		6.0	Cords		
	2	B. T. Aspen	Sawtimber	22.8		
Mixed Oak			19.6	MBF		
<i>BI/R/Hybrid Oak</i>			9.7	<i>MBF</i>		
<i>Red Oak</i>			4.7	<i>MBF</i>		
<i>White Oak</i>			5.2	<i>MBF</i>		
Red Pine			75.7	MBF		
White Pine			11.5	MBF		
Jack Pine		Pulpwood	23.0	Cords		
<i>Jack Pine</i>		<i>Sawtimber</i>	2.8	<i>MBF</i>		
<i>Jack Pine</i>		<i>Pulpwood</i>	17.0	<i>Cords</i>		
Mixed Aspen			288.0	Cords		
<i>B. T. Aspen</i>			288.0	<i>Cords</i>		
Mixed Oak			91.0	Cords		
<i>BI/R/Hybrid Oak</i>			59.0	<i>Cords</i>		
<i>Red Oak</i>			19.0	<i>Cords</i>		
<i>White Oak</i>			13.0	<i>Cords</i>		
Red Maple			71.0	Cords		
<i>Red Maple</i>		<i>Sawtimber</i>	2.2	<i>MBF</i>		
<i>Red Maple</i>		<i>Pulpwood</i>	67.0	<i>Cords</i>		
Red Pine			97.0	Cords		
White Pine			74.0	Cords		
3		B. T. Aspen	Sawtimber	1.3	MBF	22.4
	Mixed Oak		9.8	MBF		
	<i>BI/R/Hybrid Oak</i>		5.6	<i>MBF</i>		
	<i>Red Oak</i>		4.2	<i>MBF</i>		
	Red Pine		42.7	MBF		
	White Pine		32.0	MBF		
	Balsam Fir	Pulpwood	4.0	Cords		
	Jack Pine		105.0	Cords		
	<i>Jack Pine</i>	<i>Sawtimber</i>	7.3	<i>MBF</i>		
	<i>Jack Pine</i>	<i>Pulpwood</i>	90.0	<i>Cords</i>		
	Mixed Aspen		21.0	Cords		
	<i>B. T. Aspen</i>		21.0	<i>Cords</i>		
	Mixed Oak		97.0	Cords		
	<i>BI/R/Hybrid Oak</i>		41.0	<i>Cords</i>		
	<i>Red Oak</i>		56.0	<i>Cords</i>		
	Red Maple		102.0	Cords		
	<i>Red Maple</i>	<i>Sawtimber</i>	4.2	<i>MBF</i>		
	<i>Red Maple</i>	<i>Pulpwood</i>	94.0	<i>Cords</i>		
	Red Pine		65.0	Cords		

Description of Timber by Payment Unit (PU), con't

PU	MARKET GROUP	PRODUCT	QUANTITY	UNIT	ACRES	ADVERTISE PRICE
3 con't	White Pine	Pulpwood	175.0	Cords		
TOTAL:			225.4	MBF		
TOTAL:			1,326.0	Cords		

Sale Specific Conditions & Requirements

Sale Name: Bear Creek Harvest

Sale Number: 71-018-17 Seq#: 1

1 - Sale Area

1.2 - Boundaries

1.2.1 - Painted boundaries (1/14)

The sale boundary and Payment Unit boundaries are marked and identified by red paint. Exterior sale boundary lines against state are marked with red paint. The painted boundary line trees are not Included Timber and are to be protected.

2 - Timber Specifications

2.1 - Included Timber

2.1.1 - Clearcut unit(s) with unmerchantable trees (6/14)

Within Payment Unit(s) 1 - 3, cut all trees that are two (2) inches or more at DBH, except in Payment Unit 1, do not cut any white pine trees.

2.1.15 - Hazard trees near roads (7/13)

Cut and remove all dead trees within 100 feet of the cleared portion of Barney Lake Road, Reece Road, and Deadstream Road. These trees must be scattered back into the sale area.

2.2 - Utilization

2.2.2 - Chipping required (5/14)

Payment Unit 3 must be chip harvested to facilitate subsequent planting operations. Alternatively, the producer could lop the remaining portion of the tree into 3' lengths and spread them out evenly throughout the unit. The Purchaser has the option to produce sawlogs or pulpwood bolts, but the remaining portion of the trees must be chipped and hauled or lopped to 3' lengths and spread. Do not chip 1/6 of the slash from harvested trees (tree tops and limbs less than four inches in diameter).

2.2.3 - Stump heights (4/07)

Stump heights within Payment Unit 3 shall not exceed 12 inches for trees greater than 10 inches DBH and 4 inches for trees smaller than 10 inches DBH. This is in order to facilitate subsequent planting operations.

3 - Payments

3.3 - Pre-measured Sales

3.3.4 - Dividing payment units (7/14)

Payment Unit(s) may be divided at the request of the Purchaser and upon approval of the Unit Manager. Dividing Payment Units is a contract modification which requires a Timber Sale Contract Supplement.

3.6 - Payment Unit Cutting Schedule

3.6.2 - One active unit (12/08)

Each Payment Unit must be completed to the satisfaction of the Unit Manager or his/her representative before the next unit may be opened.

4 - Transportation

4.1 - Construction

4.1.6 - Road construction (1/09)

Construction of new roads or improvements of existing roads shall be done in such a way as to minimize the environmental and visual impacts. Merchantable trees shall be cut and utilized unless otherwise directed. Non-merchantable trees shall be severed and laid flat on the ground. Slash shall be scattered, and not left in windrows and kept a minimum of 10 feet back from the road edge, or be chipped, utilized or otherwise removed from the sale. Stumps shall be set upright, not left on edge, and be moved at least 10 feet away from the road edge. Disturbed soil shall be feathered into the woods and not left in berms or windrows.

4.1.7 - Road closure (10/11)

All new roads built into the sale must be blocked to vehicle traffic upon completion of the sale. Overgrown roads that are reopened shall be considered new roads. Some existing roads may also need to be closed, see the Timber Sale Map for locations. In general, this will require constructing a four (4') foot high berm of stumps and logs covered with earth. Stumps and brush must be placed along the remainder of the trail. These roads must be rendered impassable to cars and trucks. Contact the sale administrator for specific details of design and placement.

4.2 - Maintenance

4.2.1 - Hauling restriction (12/08)

Hauling may be restricted on forest roads by the Unit Manager or his/her representative. The restriction may occur during spring breakup or during wet weather conditions.

4.2.3 - Road maintenance (8/13)

The following road maintenance may be needed: Within 60 days of completion of hauling, or if no hauling occurs for 60 days, the roads must be maintained and graded. This includes cleaning of drainage areas, grading, crowning and filling with gravel, if necessary. Damages will be assessed if grading/repair does not occur.

5 - Operations

5.2 - Conduct of Operations

5.2.1 - Slash

5.2.1.8 - Slash height (12/08)

No slash or tree tops may exceed 24 inches in height.

5.2.1.10 - No slash in openings (5/10)

No brush or logging debris is to be left in the grassy opening opening which is indicated by G0 on the Timber Sale Map. Any damage to the opening shall be repaired according to specifications of the Unit Manager or his/her representative.

5.2.1.11 - Slash for reforestation (5/07)

To facilitate reforestation, Payment Unit(s) 3 shall be left with slash evenly distributed. Bunched tops within the cutting area shall be broken up and scattered. Stumps shall be cut low to the ground. Processing sites shall not be left with a compacted layer of slash; tops from these sites shall be hauled back into the cut area and scattered.

5.2.2 - Hazard Trees/Snags

5.2.2.1 - Den trees (10/16)

Obvious hollow and/or den trees shall be protected and left standing unless they are a safety hazard.

5.2.3 - Operating Restrictions

5.2.3.6 - Bark beetle restriction (12/08)

In the event drought creates a high risk of pine bark beetle infestation, pine is not to be cut during the period March 1 through July 1, unless all portions of trees greater than two inches in diameter are removed from the sale area, reduced to chips, or treated to the satisfaction of the Unit Manager or his/her representative, within fifteen days of being severed from the stump. Pine log decks, pulpwood piles and treetops that are piled for chipping in the fall or winter within a 1/4 mile of susceptible sites must be removed before March 15. Residual slash must not be placed in piles or rows and must be spread over the site for quick drying. The Department of Natural Resources will exercise this specification if the risk of damage warrants.

5.2.3.11 - Coppice regeneration protection (4/10)

Timber harvesting in any Payment Unit must be completed before significant aspen sprouting occurs in that Payment Unit so as to minimize damage to the new regeneration. Any post harvest operations, such as chipping, must be completed before sprouting of regeneration occurs. If it is anticipated that chipping will be delayed, then tops shall be carried to one central location or left unchipped. The Unit Manager or his/her representative may cease such operations if sprouting occurs before the operation is complete.

5.2.4 - Dead and Down Creation

5.2.4.2 - Dead and down creation, hare and grouse (1/14)

To improve habitat for snowshoe hare, grouse, and other species, the Purchaser is to leave two, trees or portions of trees, nine (9) inches or larger in diameter on the ground for every two acres. They should be scattered throughout the sale or positioned per the sale administrators instructions. If possible, the logs or trees should be felled so they overlap. Note these pieces should have a minimum length of five feet. They can be of any tree species and can be an un-merchantable piece of wood or a full tree.

5.2.4.3 - Dead and down creation, dead trees (6/07)

Except as provided for in General Condition and Requirement 5.2.2, no dead trees, standing or down, are to be cut, skidded, or processed. Note: The hazard trees described in spec 2.1.15 are also an exception.

5.2.29 - Shrub protection (9/07)

Do not cut or damage hawthorn, witch-hazel, dogwood or junberry. These woody-shrub plants are highly beneficial to various wildlife species.

5.2.32 - Decking/landing restoration (9/13)

All decking and landing areas must have the surface area restored to a condition equal to or better than before. This is to ensure the proper regeneration of the stand. Wood debris, chips and "cookies" from trimmings must be removed or scattered away from landing and loading areas and may not be windrowed on the edge.

5.2.38 - No decking against live trees (2/04)

Cut products may not be decked against unmarked or designated leave trees.

5.2.41 - Snowmobile trail protection (9/11)

Barney Lake Road is also a snowmobile trail as shown on the Timber Sale Map. Do not cut or damage posts with orange trail markers or traffic control signs. If the trail is used for hauling, it must be graded to the satisfaction of the Unit Manager or his/her representative prior to December 1st. If the trail road is to be used for hauling during the snowmobile season, then a snow covered base must be left on the trail. Maintain a 20 foot wide slash, debris, and rut free zone daily using the snowmobile trail as the centerline. No decking of forest products will be permitted along the snowmobile trail. All stumps within 5 feet of the snowmobile trail must be cut as close to ground level as possible.

5.4 - Soil Protection

5.4.1 - Rutting restriction, general (7/16)

Operations are to cease immediately if equipment and weather conditions result in rutting of roads and/or skid trails which is 12 inches or greater in depth and 50 feet in length. The Unit Manager or his/her representative may restrict hauling and/or skidding if ruts exceed the specified depth. With the Unit Manager or his/her representative's approval, the Purchaser may return to the area when the risk of rutting has decreased.

5.4.3 - Erosion control (12/08)

Skid trails or haul roads may require erosion control structures or berms per direction of the Unit Manager or his/her representative.

6 - Safety and Fire Prevention

6.2 - Signing

6.2.1 - Road posting (9/09)

The Purchaser is responsible for posting and maintaining caution signs on Barney Lake Road, Reece Road, and S. Deadstream Road. prior to beginning operations. The road must be posted at appropriate distances from the sale area to warn of logging activity and truck traffic. Signs must be removed when harvest operations are suspended or completed.

6.2.2 - Snowmobile trail posting (8/09)

The Purchaser is responsible for posting and maintaining caution signs on the snowmobile trail prior to beginning operations during the snowmobile season (approximately December 1 to March 31). The trail must be posted at appropriate distances from the sale area to warn of logging activity and truck traffic. Signs must be removed when harvest operations are suspended or completed.



TIMBER SALE MAP

This information provided by authority of Part 525, 1994 PA 451, as amended.

Forest Management Unit Roscommon		County Roscommon	Mapped By Hallfrisch/Ritchie	Date 09/25/2017	Page 1	of 2
Township 21N	Range 04W	Section(s) and Subdivision(s) 5 - W1/2NE;E1/2NW;NWSE 6 - W1/2SW		Scale 1:15,840		

Cover Type				Density	
A = Aspen	H = Hemlock	N = Marsh	U = Upland Brush	0 = Non Stocked	5 = Pole Timber Medium
B = Paper Birch	J = Jack Pine	O = Oak	UM = Upland Mixed	1 = Seedling Sapling Poor	6 = Pole Timber Well
C = Cedar	L = Lowland Brush	P = Lowland Poplar	V = Bog or Marsh	2 = Seedling Sapling Medium	7 = Saw Timber Poor
D = Tread Bog	LM = Lowland Mixed	Q = Mixed Swamp Conifer	W = White Pine	3 = Seedling Sapling Well	8 = Saw Timber Medium
E = Swamp Hdwoods	M = Mpl, Bch, Brch	R = Red Pine	X = Non Stocked	4 = Pole Timber Poor	9 = Saw Timber Well
F = Spruce Fir	MC = Mixed Conifer	S = Black Spruce	Z = Water		
G = Grass	MD = Mixed Deciduous	T = Tamarack			

PU	Acres
1	9.2
2	24.1
3	22.4

Bear Creek Harvest

Compartment 149

55.7 Acres

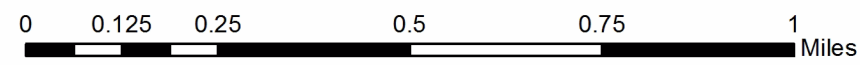
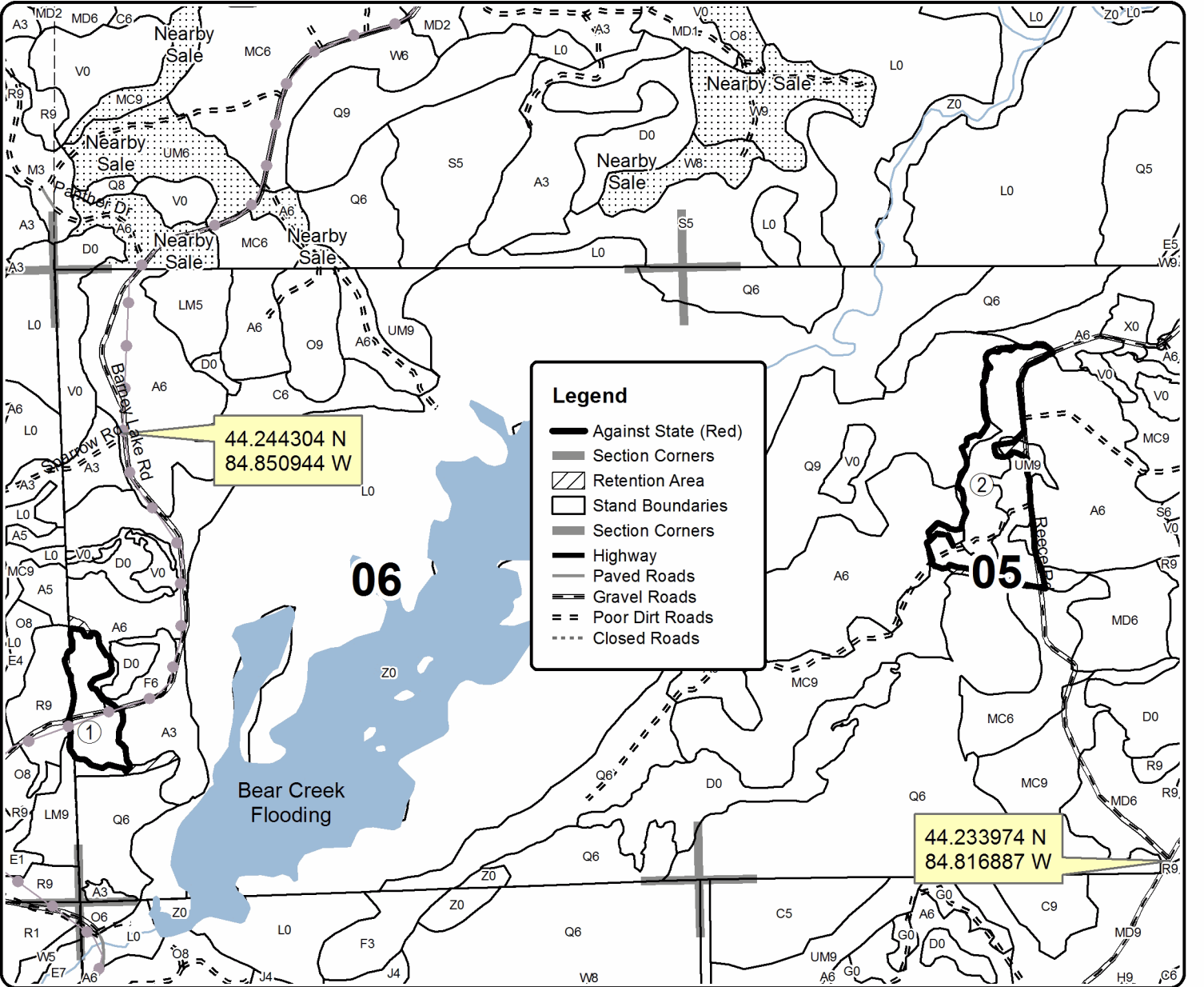



TIMBER SALE MAP

This information provided by authority of Part 525, 1994 PA 451, as amended.

Forest Management Unit Roscommon		County Roscommon	Mapped By Halfrisch/Ritchie	Date 09/25/2017	Page 2	of 2
Township 21N	Range 04W	Section(s) and Subdivision(s) 4 - SWNE; NWSE 5 - W1/2NE; E1/2NW; NWSE		Scale 1:15,840		
Cruised By Halfrisch/Ritchie						

Cover Type				Density			
A = Aspen	H = Hemlock	N = Marsh	U = Upland Brush	0 = Non Stocked	5 = Pole Timber Medium		
B = Paper Birch	J = Jack Pine	O = Oak	UM = Upland Mixed	1 = Seedling Sapling Poor	6 = Pole Timber Well		
C = Cedar	L = Lowland Brush	P = Lowland Poplar	V = Bog or Marsh	2 = Seedling Sapling Medium	7 = Saw Timber Poor		
D = Treed Bog	LM = Lowland Mixed	Q = Mixed Swamp Conifer	W = White Pine	3 = Seedling Sapling Well	8 = Saw Timber Medium		
E = Swamp Hdwoods	M = Mpl, Bch, Brch	R = Red Pine	X = Non Stocked	4 = Pole Timber Poor	9 = Saw Timber Well		
F = Spruce Fir	MC = Mixed Conifer	S = Black Spruce	Z = Water				
G = Grass	MD = Mixed Deciduous	T = Tamarack					

PU	Acres
1	9.2
2	24.1
3	22.4

Bear Creek Harvest

Compartment 149

55.7 Acres

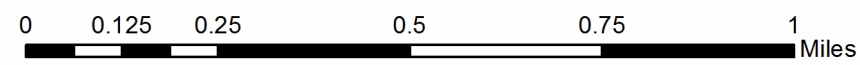
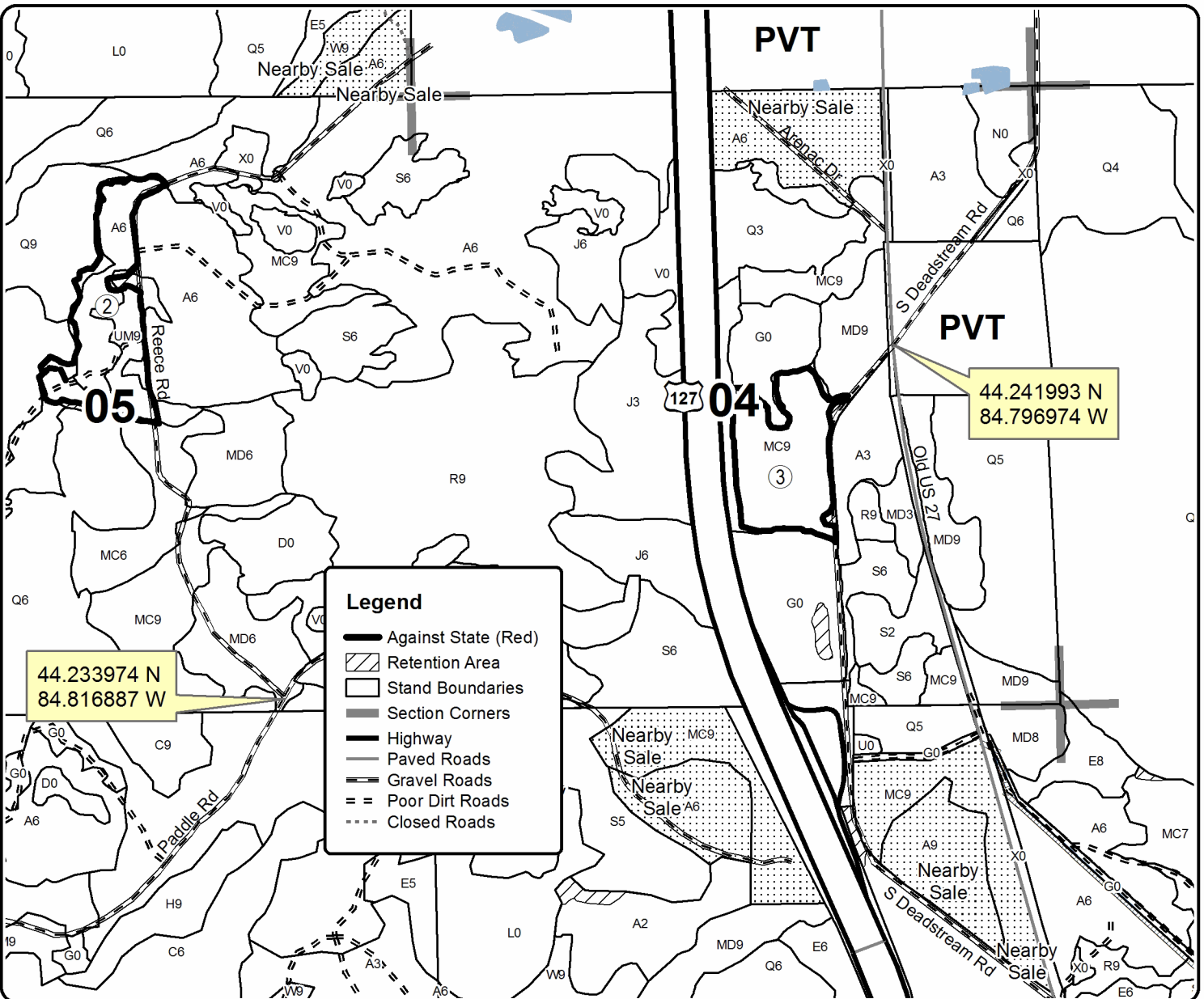

Bear Creek Harvest (71-018-17)

T21N, R04W, SEC. 4; T21N, R04W, SEC. 5; T21N, R04W, SEC. 6; Roscommon

In response to the notice of sale to be held 2:00 p.m. (local time) on November 20, 2018, I am hereby submitting my sealed bid (firm offer) for the following forest products to be cut. Bids for individual species must be at or above the advertised price. All non-responsive bid forms may be rejected.

<u>PRODUCTS & SPECIES</u>	<u>ESTIMATED VOLUME*</u>	<u>ADVERTISED PRICE</u>	<u>BID PRICE/UNIT</u>
Sawtimber			
B. T. Aspen	24.10 MBF	\$ 63.00/MBF	\$ _____
Mixed Oak	32.30 MBF	\$ 129.00/MBF	\$ _____
Red Pine	125.50 MBF	\$ 125.00/MBF	\$ _____
White Pine	43.50 MBF	\$ 82.00/MBF	\$ _____
Pulpwood			
Balsam Fir	12.00 Cords	\$ 16.90/Cord	\$ _____
Jack Pine	137.00 Cords	\$ 18.65/Cord	\$ _____
Mixed Aspen	319.00 Cords	\$ 31.50/Cord	\$ _____
Mixed Oak	225.00 Cords	\$ 18.60/Cord	\$ _____
Red Maple	216.00 Cords	\$ 24.40/Cord	\$ _____
Red Pine	168.00 Cords	\$ 47.25/Cord	\$ _____
White Pine	249.00 Cords	\$ 27.25/Cord	\$ _____

*The volumes are statistically estimated within plus (+) or minus (-) 13.23 percent. These estimated volumes are final and not subject to adjustment. Prospective bidders are urged to examine this timber and to make their own estimates of quantity and quality.

I understand that any or all bids may be rejected. All bids must be signed and all bid items must be bid or the bid form may be rejected. I also understand that consideration and awarding a contract will be based upon my past performance and ability to complete the contract based upon equipment and staffing subject to my control.

FEDERAL ID: _____ or SOCIAL SECURITY NUMBER: _____

Company or individual bidding: _____

Company representative's name: _____

Address: _____

City: _____ State: _____ Zip: _____

IF AVAILABLE, PLEASE PLACE THE PERSONALIZED LABEL FROM YOUR PROSPECTUS IN THE ABOVE BOX.

Individual or company representative's signature: _____ Date: _____

Phone number : _____ Email (optional): _____

THE WINNING BIDDER MUST COMPLETE THE VERIFICATION OF WORKER'S DISABILITY COMPENSATION ACT COMPLIANCE (ON REVERSE SIDE IF DOUBLE SIDED) WITHIN 21 DAYS OF SALE AWARD DATE



FOR DEPARTMENT USE ONLY
Sale Number (XX - XXX - XX - XX)
Forest Management Unit:

TIMBER SALE VERIFICATION OF WORKER'S DISABILITY COMPENSATION ACT COMPLIANCE

*As required by Act 317, P.A. 1969 (Worker's Compensation) and
Part 5 of Act 451 of 1994, as amended.*

VERIFICATION OF WORKER'S DISABILITY COMPENSATION ACT COMPLIANCE

- This verification must be completed and submitted within 21 days of contract award and prior to the issuance of the timber sale contract.
- In addition, if boxes 2B or 2C are checked, then Notice of Exclusion or Certificate of Insurance must be submitted within twenty-one (21) days of the contract award and prior to the issuance of the timber sale contract.
- All information must be typed or printed except for written signatures.

Please Check Appropriate Categories:

1. My business is organized as (you **must** check one of the boxes below):
 - A. Sole Proprietorship (individual)
 - B. Partnership
 - C. Corporation

2. You **must** check one of the boxes below:
 - A. I certify my business is a sole proprietorship and it has no employees but the sole proprietor. I am not subject to the Worker's Compensation Laws.
 - B. I certify my business has satisfied its obligation to the Worker's Compensation Act through the use of an approved Notice of Exclusion (BWC-337, Rev. 5/96). I will provide a copy of the Notice of Exclusion within 21 days of the contract award. (For questions or a copy of the BWC-337, please call the Worker's Compensation Bureau at 517-322-1195).
 - C. I certify my business has a Worker's Compensation Policy. I will provide an original Certificate of Insurance within twenty-one (21) days of the contract award.

3. If you have checked item 2(A) or 2(B), you **must** indicate the number of **both** full-time and part-time employees, other than yourself, including family members and active partners (if none, you must enter "0").

_____ Full-time Employees

_____ Part-time Employees

Name of Business		Federal ID (or) Social Security No.	
Address		Telephone ()	
City	State	ZIP	

I hereby certify that the above information is true and correct. I agree to notify the Michigan DNR of any changes that occur in factors affecting my coverage during any of my present and future operations.

Signature of Owner or Authorized Representative

Title

Date

Please complete the "SEALED BID" information on the next page

Tacoma Mix (71-018-18)

T23N, R01E, SEC. 4; T23N, R01E, SEC. 5; T23N, R01E, SEC. 6; T23N, R01E,

In response to the notice of sale to be held 2:00 p.m. (local time) on November 20, 2018, I am hereby submitting my sealed bid (firm offer) for the following forest products to be cut. Bids for individual species must be at or above the advertised price. All non-responsive bid forms may be rejected.

<u>PRODUCTS & SPECIES</u>	<u>ESTIMATED VOLUME*</u>	<u>ADVERTISED PRICE</u>	<u>BID PRICE/UNIT</u>
Sawtimber			
Jack Pine	58.70 MBF	\$ 39.00/MBF	\$ _____
Mixed Aspen	17.00 MBF	\$ 63.00/MBF	\$ _____
Mixed Oak	33.80 MBF	\$ 129.00/MBF	\$ _____
Red Maple	66.80 MBF	\$ 73.00/MBF	\$ _____
Red Pine	117.90 MBF	\$ 125.00/MBF	\$ _____
White Pine	91.50 MBF	\$ 82.00/MBF	\$ _____
Pulpwood			
Balsam Fir	15.00 Cords	\$ 16.90/Cord	\$ _____
Black Spruce	68.00 Cords	\$ 22.55/Cord	\$ _____
Jack Pine	764.00 Cords	\$ 18.65/Cord	\$ _____
Mixed Aspen	558.00 Cords	\$ 31.50/Cord	\$ _____
Mixed Hardwood	444.00 Cords	\$ 24.40/Cord	\$ _____
Mixed Oak	112.00 Cords	\$ 18.60/Cord	\$ _____
Red Pine	130.00 Cords	\$ 47.25/Cord	\$ _____
White Pine	252.00 Cords	\$ 27.25/Cord	\$ _____

*The volumes are statistically estimated within plus (+) or minus (-) 8.31 percent. These estimated volumes are final and not subject to adjustment. Prospective bidders are urged to examine this timber and to make their own estimates of quantity and quality.

I understand that any or all bids may be rejected. All bids must be signed and all bid items must be bid or the bid form may be rejected. I also understand that consideration and awarding a contract will be based upon my past performance and ability to complete the contract based upon equipment and staffing subject to my control.

FEDERAL ID: _____ or SOCIAL SECURITY NUMBER: _____

Company or individual bidding: _____

Company representative's name: _____

Address: _____

City: _____ State: _____ Zip: _____

IF AVAILABLE, PLEASE PLACE THE PERSONALIZED LABEL FROM YOUR PROSPECTUS IN THE ABOVE BOX.

Individual or company representative's signature: _____ Date: _____

Phone number : _____ Email (optional): _____

THE WINNING BIDDER MUST COMPLETE THE VERIFICATION OF WORKER'S DISABILITY COMPENSATION ACT COMPLIANCE (ON REVERSE SIDE IF DOUBLE SIDED) WITHIN 21 DAYS OF SALE AWARD DATE



FOR DEPARTMENT USE ONLY
Sale Number (XX - XXX - XX - XX)
Forest Management Unit:

TIMBER SALE VERIFICATION OF WORKER'S DISABILITY COMPENSATION ACT COMPLIANCE

*As required by Act 317, P.A. 1969 (Worker's Compensation) and
Part 5 of Act 451 of 1994, as amended.*

VERIFICATION OF WORKER'S DISABILITY COMPENSATION ACT COMPLIANCE

- This verification must be completed and submitted within 21 days of contract award and prior to the issuance of the timber sale contract.
- In addition, if boxes 2B or 2C are checked, then Notice of Exclusion or Certificate of Insurance must be submitted within twenty-one (21) days of the contract award and prior to the issuance of the timber sale contract.
- All information must be typed or printed except for written signatures.

Please Check Appropriate Categories:

1. My business is organized as (you **must** check one of the boxes below):
 - A. Sole Proprietorship (individual)
 - B. Partnership
 - C. Corporation
2. You **must** check one of the boxes below:
 - A. I certify my business is a sole proprietorship and it has no employees but the sole proprietor. I am not subject to the Worker's Compensation Laws.
 - B. I certify my business has satisfied its obligation to the Worker's Compensation Act through the use of an approved Notice of Exclusion (BWC-337, Rev. 5/96). I will provide a copy of the Notice of Exclusion within 21 days of the contract award. (For questions or a copy of the BWC-337, please call the Worker's Compensation Bureau at 517-322-1195).
 - C. I certify my business has a Worker's Compensation Policy. I will provide an original Certificate of Insurance within twenty-one (21) days of the contract award.
3. If you have checked item 2(A) or 2(B), you **must** indicate the number of **both** full-time and part-time employees, other than yourself, including family members and active partners (if none, you must enter "0").

_____ Full-time Employees

_____ Part-time Employees

Name of Business		Federal ID (or) Social Security No.	
Address		Telephone ()	
City	State	ZIP	

I hereby certify that the above information is true and correct. I agree to notify the Michigan DNR of any changes that occur in factors affecting my coverage during any of my present and future operations.

Signature of Owner or Authorized Representative

Title

Date

Please complete the "SEALED BID" information on the next page

Canoe Camps Pine (71-003-18)
T21N, R04W, SEC. 20; T21N, R04W, SEC. 21; T21N, R04W, SEC. 29;

In response to the notice of sale to be held 2:00 p.m. (local time) on November 20, 2018, I am hereby submitting my sealed bid (firm offer) for the following forest products to be cut. Bids for individual species must be at or above the advertised price. All non-responsive bid forms may be rejected.

<u>PRODUCTS & SPECIES</u>	<u>ESTIMATED VOLUME*</u>	<u>ADVERTISED PRICE</u>	<u>BID PRICE/UNIT</u>
Sawtimber			
Bl/R/Hybrid Oak	8.30 MBF	\$ 129.00/MBF	\$ _____
Jack Pine	23.70 MBF	\$ 39.00/MBF	\$ _____
Red Pine	426.60 MBF	\$ 125.00/MBF	\$ _____
Scotch Pine	22.70 MBF	\$ 62.00/MBF	\$ _____
White Pine	100.00 MBF	\$ 82.00/MBF	\$ _____
Pulpwood			
B. T. Aspen	35.00 Cords	\$ 31.50/Cord	\$ _____
Bl/R/Hybrid Oak	50.00 Cords	\$ 18.60/Cord	\$ _____
Jack Pine	447.00 Cords	\$ 18.65/Cord	\$ _____
Red Pine	226.00 Cords	\$ 47.25/Cord	\$ _____
Scotch Pine	128.00 Cords	\$ 31.40/Cord	\$ _____
White Pine	327.00 Cords	\$ 27.25/Cord	\$ _____

*The volumes are statistically estimated within plus (+) or minus (-) 10.88 percent. These estimated volumes are final and not subject to adjustment. Prospective bidders are urged to examine this timber and to make their own estimates of quantity and quality.

I understand that any or all bids may be rejected. All bids must be signed and all bid items must be bid or the bid form may be rejected. I also understand that consideration and awarding a contract will be based upon my past performance and ability to complete the contract based upon equipment and staffing subject to my control.

FEDERAL ID: _____ or SOCIAL SECURITY NUMBER: _____

Company or individual bidding: _____

Company representative's name: _____

Address: _____

City: _____ State: _____ Zip: _____

IF AVAILABLE, PLEASE PLACE THE PERSONALIZED LABEL FROM YOUR PROSPECTUS IN THE ABOVE BOX.

Individual or company representative's signature: _____ Date: _____

Phone number : _____ Email (optional): _____

THE WINNING BIDDER MUST COMPLETE THE VERIFICATION OF WORKER'S DISABILITY COMPENSATION ACT COMPLIANCE (ON REVERSE SIDE IF DOUBLE SIDED) WITHIN 21 DAYS OF SALE AWARD DATE

