



**DEPARTMENT OF NATURAL RESOURCES
STATE OF MICHIGAN**

TIMBER SALE PROSPECTUS #6220

SCHEDULED SALE DATE AND TIME: 9:00 a.m. (local time) on January 29, 2019.

LOCATION: GRAYLING MGMT UNIT, 1955 HARTWICK PINES ROAD, GRAYLING, MI 49738.

PROSPECTUS NOTE: The bidder is advised to inspect the sale area and review the location, estimated volumes, operating costs and contract terms of proposed sales. Please be aware that some landowners may request 60 days or more notice for access across their land.

Notice is hereby given that bids will be received by the Unit Manager, GRAYLING MANAGEMENT UNIT, for certain timber on the following described lands:

Comp 201 MtB Trail (72-625-18) / T26N, R04W, SEC. 24, S1/2SW.

T26N, R04W, SEC. 25, NW,W1/2NE,N1/2SW.

T26N, R04W, SEC. 26, SENE,NESE.

Crawford County, Advertised Price \$100,395.15, 151.5 Acres, Hardwood, Aspen.

SALE NOTE: The sale is within the Military's Land Nav orienteering course and the Hanson Hills Recreation Area lease. The Military also uses the area for bivouacking. There are pits, foxholes and concrete bunkers in and around the harvest units. The following hardware was encountered occasionally during sale prep: communications wire wrapped around the bole, and trip-wire flare brackets tacked on at the stump. Because of the Military ground training, Hanson Hills recreation trails, and oak wilt concerns, operations will not be allowed between April 15 and October 15. Because of that limited harvesting window, the contract has been given a 3-year duration. The portion of Military Road to the west and Four Mile Road to the south were Class A in 2018.

A recreation site such as a trail, pathway, or campground is within the sale area or the vicinity. Certain restrictions/specifications may be applicable including time restrictions.

Comp 201 Land Nav (72-633-18) / T26N, R04W, SEC. 23, S1/2SW,SWSE.

T26N, R04W, SEC. 26, NW,NWNE,S1/2NE,SW,W1/2SE.

Crawford County, Advertised Price \$226,748.55, 159.3 Acres, Hardwood, Aspen.

SALE NOTE: The sale is within the Military's Land Nav orienteering course and the Hanson Hills Recreation Area lease. The Military also uses the area for bivouacking. There are pits, foxholes and concrete bunkers in and around the harvest units. The following hardware was encountered occasionally during sale prep: communications wire wrapped around the bole, and trip-wire flare brackets tacked on at the stump. Because of the Military ground training, Hanson Hills recreation trails, and oak wilt concerns, operations will not be allowed between April 15 and October 15. Because of that limited harvesting window, the contract has been given a 3-year duration. The adjoining portion of Military Road was Class A in 2018.

A recreation site such as a trail, pathway, or campground is within the sale area or the vicinity. Certain restrictions/specifications may be applicable including time restrictions.

WWT Spray Fields (72-638-18) / T26N, R04W, SEC. 16, S1/2SW.

T26N, R04W, SEC. 17, S1/2SE.

T26N, R04W, SEC. 20, E1/2NE.

T26N, R04W, SEC. 21, NW.

Crawford County, Advertised Price \$131,832.50, 105.0 Acres, Hardwood, Red Oak.

SALE NOTE: Payment Unit 1 encompasses Camp Grayling's waste water treatment spray field. That spray field unit must be cut first and completed by March 31, 2019 in order to meet the Military's construction project timeframe. Payment Units 2-5 are within the fenced Small Arms Ranges and occupy rolling to steep terrain. Tracked cutting equipment is recommended for the steepest hills. Restricted on-Camp access must be coordinated through Range Control. Harvest operations will be limited primarily to winter because of the Small Arms Range activity and spray field operations. Prospective bidders will have one opportunity to look at the Timber Sale before the bid opening. Contact the DNR Grayling Field Office at 989-348-6371 ext 7443 regarding the date and time of that pre-bid meeting.

BID INSTRUCTIONS (VER. 07/02/2018):

1. Scheduled Bid Location, Date, and Time (2/11)

Bids must be received by the Unit Manager, GRAYLING OFFICE, 1955 HARTWICK PINES ROAD, GRAYLING, MI 49738, no later than 9:00 a.m. (local time) on January 29, 2019. For further information concerning this sale, contact Susan Thiel at 989-348-6371 extension 7440.

2. Bidder's Qualifications (5/16)

Purchaser shall obtain workers compensation insurance to cover claims under Michigan's Worker's Disability Compensation Act of 1969 or similar employee benefit act of any other state applicable to an employee. If all or part of a timber sale was prepared by a private contractor, the contractor and that contractor's company are not permitted to bid on the timber sale contract. Bids will not be accepted from individuals or companies appearing on the DNR/FRD No-Bid List. This list contains the names of purchasers who previously failed to execute a contract within 21-days or who have a history of poor performance.

3. Preparation of Sealed Bids (5/16)

Bid Forms may be completed online thru Michigan DNR Timber Sale Online Bidding (OLB) at www.michigan.gov/timberbidding or by completing the hardcopy Bid Form found in the Timber Sale Prospectus. Hardcopy Bid Forms shall be manually signed in ink. Registration in OLB is considered your 'signature' for all bids submitted thru that system. Bid prices must be entered for each species and product in the Bid Price column for all material subject to bidding and all fill-in blanks must be completed. If erasures or other changes appear on the hardcopy Bid Form, each erasure or change must be initialed by the person signing the bid.

4. Submission of Sealed Bids (5/16)

Bid forms may be obtained from the Unit Manager or thru OLB. Bids may be submitted hardcopy or thru OLB. All hardcopy bids must be submitted on the bid form and in an envelope clearly identified as described in this section. NOTE: Only one bid form per bid envelope. Sealed bids must be submitted to the Unit office designated in the prospectus and must be submitted at or prior to the time established in the prospectus. The envelope should show on the outside (a) the sale name or number and (b) the date and time of bid opening, as shown in the prospectus. Bids received after the time specified in the sale prospectus are late bids and will be rejected.

It is possible for a bidder to submit multiple bids on a single sale. For example, a bid may be submitted hardcopy and a bid may be submitted thru OLB. Or, two bidders from the same company could both submit bids on the same sale. If this were to happen, the State would accept all bids received and award the contract accordingly. All bidding and contractual requirements would apply to all bids received.

5. Public Opening of Sealed Bids (7/16)

If conditions permit, the sealed bids will be publicly opened and posted at the time and place set in the prospectus.

If a bidder, present at a bid opening, has submitted bids on more than one sale, that bidder may withdraw their unopened bid envelopes or announce the withdrawal of their online bid after being declared the successful bidder on one sale.

6. Award of Contract (1/11)

Award of the contract will be made to the Bidder whose bid, conforming to the prospectus, is most advantageous to the State of Michigan on the basis of total value at rates bid for the estimated quantities. The State reserves the right to reject any bid or waive any minor irregularity in bids received. A written award mailed (or otherwise furnished) to the successful Bidder shall be deemed to result in a binding contract without further action by either party.

7. Down Payment (1/11)

The Bidder to whom award is made must make a down payment within 21 days of the sale award. The amount of the down payment will be calculated as shown in the Bond and Payment Schedule of this prospectus. Only cash may be used to meet this requirement.

8. Performance Security (1/11)

As guarantee of faithful performance, a cash bond, certificate of deposit, surety bond or irrevocable letter of credit (LOC) is required within 21 days of the sale award. The amount of the performance security is shown in the Bond and

Payment Schedule of this prospectus. If an LOC or surety is used, the coverage must extend for at least 6 months beyond the contract expiration.

9. Timber Sale Contract (7/18)

Additional conditions and requirements common to all timber sales are listed on the timber sale contract (R4031) and are available on line at www.michigan.gov/timber. Contact the Unit Manager for additional information or a sample contract. Within 21 days of the date of the award letter, the bidder must sign the contract and provide the required down payment, performance security, and verification of worker's disability compensation. The down payment and performance security shall be in accordance with the provisions of the timber sale contract, in the sums stated in this prospectus. If these actions are not taken, then the Bidder, the Bidder's corporation, and the corporation's principals may not be permitted to bid on State timber sales for a period of 3 months after the first offense, 6 months after the second offense, and 1 year after the third offense. An offense will only be counted against the Bidder for 5 years. In addition, the Bidder certifies that if awarded this contract, the Bidder will complete the timber sale contract in accordance with its terms and any modifications thereof including requirements to purchase, cut, and remove the included timber by the expiration date.

Payment Unit values in the State Forest Timber Sale Contract are calculated based on the advertised value of the Payment Unit as a percentage of the total advertised value of the contract. The advertised value of each Payment Unit is given in the Description of Timber by Payment Unit table on the Timber Sale Information page. For example, if the value of Payment Unit 1 is advertised as \$1,500 and the total Timber Sale value is advertised as \$10,000, the contract price for Payment Unit 1 will be 15% of the total bid price ($\$1,500/\$10,000 * 100$).

10. Disclaimer of Estimates and Bidder's Warranty of Inspection (7/16)

Before submitting this bid, the Bidder is advised and cautioned to inspect the sale area, review the requirements of the sale contract, and take other steps as may be reasonably necessary to ascertain the location, estimated volumes, construction estimates, and operating costs of the proposed sale. Failure to do so will not relieve the Bidder from responsibility for completing the contract.

The Bidder warrants that this bid is submitted solely on the basis of the Bidder's examination and inspection of the quality and quantity of the timber offered for sale and the Bidder's opinion of the value thereof and the costs of recovery. No reliance should be placed on the State of Michigan's estimates of timber quality, quantity or costs of recovery. Bidder further acknowledges that the State of Michigan: (i) expressly disclaims any warranty of fitness of timber for any purpose; (ii) offers this timber as is without any warranty of quality (merchantability) or quantity and (iii) expressly disclaims any warranty as to the quantity or quality of timber sold.

11. Certification and Chain-of-Custody (10/14)

Unless otherwise indicated in the contract under section 7 – Other Conditions of the Sale Specific Conditions & Requirements, the area encompassed by this timber sale is certified to the standards of the Forest Stewardship Council (FSC) - Certificate #SCS-FM/COC-00090N and the Sustainable Forestry Initiative (SFI) - Certificate #NSF-SFIS-5Y031-SF5. Forest products from this sale may be delivered to the mill as "FSC 100% and / or SFI certified" as long as the contractor hauling the forest products is chain-of-custody (COC) certified or covered under a COC certificate from the destination mill. The purchaser is responsible for maintaining COC after leaving the sale area.

12. Good Neighbor Authority (GNA) Requirements (7/16)

If the name of this timber sales contains the acronym GNA, it is authorized by the Good Neighbor Authority (GNA) and covered by various agreements between the U.S. Forest Service and the State. The timber sale occurs on federal land and the following conditions apply:

GNA contracts on US Forest Service land will not be awarded to purchasers on the Federal list of excluded parties. The System for Award Management (SAM) will be checked for active excluded parties prior to award of contract. In addition, the Bidder to whom award is made must complete an Assurance Regarding Felony Conviction or Tax Delinquent Status for Corporate Applicants (AD-3031).

13. Good Neighbor Authority (GNA) Requirements, con't (9/16)

Bidder certifies, by signing this bid form, that to the best of Bidder's knowledge that the following representations are accurate and complete.

- a. That the Bidder and its principals are not presently debarred, suspended, proposed for debarment, declared ineligible, or voluntary excluded from timber sales (covered transactions) by any Federal department or agency.
- b. That the Bidder and its principals have not within a 3-year period preceding this bid been convicted of or had a civil judgment rendered against them for commission of fraud or a criminal offense in connection with obtaining, attempting to obtain, or performing a public (Federal, State, or local) transaction or contract under a public transaction; violation of Federal or State antitrust statutes or commission of embezzlement, theft, forgery, bribery, falsification or destruction of records, making false statements, or receiving stolen property.
- c. That the Bidder and its principals are not presently indicted for or otherwise criminally or civilly charged by a governmental entity (Federal, State, or local) with commission of any of the offenses enumerated in paragraph b of this certification.
- d. That the Bidder and its principals have not within a 3-year period preceding this bid had one or more public transactions (Federal, State, or local) terminated for breach or default of a timber or forest product contract.

Bidders that cannot certify this requirement, in whole or in part, shall submit an explanation with their bid.

DAN EICHINGER
Director

TIMBER SALE INFORMATION

Comp 201 MtB Trail (72-625-18)
 T26N, R04W, SEC. 24; T26N, R04W, SEC. 25; T26N, R04W, SEC. 26.
 Crawford County (Advertised Price \$100,395.15)

SALE NOTE: The sale is within the Military's Land Nav orienteering course and the Hanson Hills Recreation Area lease. The Military also uses the area for bivouacking. There are pits, foxholes and concrete bunkers in and around the harvest units. The following hardware was encountered occasionally during sale prep: communications wire wrapped around the bole, and trip-wire flare brackets tacked on at the stump. Because of the Military ground training, Hanson Hills recreation trails, and oak wilt concerns, operations will not be allowed between April 15 and October 15. Because of that limited harvesting window, the contract has been given a 3-year duration. The portion of Military Road to the west and Four Mile Road to the south were Class A in 2018.

A recreation site such as a trail, pathway, or campground is within the sale area or the vicinity. Certain restrictions/specifications may be applicable including time restrictions.

A timber sale contract for this lump sum, sealed bid timber sale will be awarded to the responsible bidder offering the highest sealed bid price. Bids must be at or above the following advertised price for each species:

<u>PRODUCTS & SPECIES</u>	<u>ESTIMATED UNITS*</u>	<u>ADVERTISED PRICE</u>
Sawtimber		
Bl/R/Hybrid Oak	223.20 MBF	\$ 205.00 / MBF
Northern Pin Oak	46.70 MBF	\$ 205.00 / MBF
White Oak	63.10 MBF	\$ 85.00 / MBF
Pulpwood		
Jack Pine	84.00 Cords	\$ 18.15 / Cord
Misc. Species 2	242.00 Cords	\$ 7.50 / Cord
Mixed Aspen	289.00 Cords	\$ 23.65 / Cord
Mixed Hardwood	251.00 Cords	\$ 32.35 / Cord
Mixed Oak	1,017.00 Cords	\$ 21.05 / Cord

* The total volume is statistically estimated within plus (+) or minus (-) 11.58 percent. The estimated units are final and not subject to adjustment. Prospective bidders are urged to examine this timber and to make their own estimates of quantity and quality.

BOND AND PAYMENT SCHEDULE:

1. A bond in the amount of \$5,020.00 to insure faithful performance of the conditions of the contract will be deposited by the successful bidder within 21 days of the sale award.
2. Cutting in any sale or unit without the required advance payment would be considered a trespass.
3. Total payment must be paid in advance or according to the following schedule:
 - (a) Ten percent (10%) of the sale value must be paid within 21 days of the sale award.
 - (b) The 10% down payment will be credited towards the first unit cut.
 - (c) Payment for each of the following units must be made before cutting begins in that unit:

PAYMENT UNIT NUMBER	PERCENT OF TOTAL SALE VALUE
01	20.3%
02	21.8%
03	25.5%
04	4.0%
05	14.9%
06	13.5%

4. If no cutting takes place, the 10% down payment will not be refunded.
5. Operations on the contract issued will terminate on 04/15/2022.

Description of Timber by Payment Unit (PU)

PU	MARKET GROUP	PRODUCT	QUANTITY	UNIT	ACRES	ADVERTISE PRICE
1	BI/R/Hybrid Oak	Sawtimber	50.5	MBF	38.8	\$20,359.55
	Northern Pin Oak		9.3	MBF		
	White Oak		15.6	MBF		
	Misc. Species 2	Pulpwood	36.0	Cords		
	Mixed Aspen		17.0	Cords		
	<i>B. T. Aspen</i>	<i>Sawtimber</i>	1.5	<i>MBF</i>		
	<i>B. T. Aspen</i>	<i>Pulpwood</i>	14.0	<i>Cords</i>		
	Mixed Hardwood		11.0	Cords		
	<i>Red Maple</i>		11.0	<i>Cords</i>		
	Mixed Oak		273.0	Cords		
	<i>BI/R/Hybrid Oak</i>		107.0	<i>Cords</i>		
	<i>Northern Pin Oak</i>		85.0	<i>Cords</i>		
	<i>White Oak</i>		81.0	<i>Cords</i>		
	2	BI/R/Hybrid Oak	Sawtimber	45.6		
Northern Pin Oak			6.6	MBF		
White Oak			18.0	MBF		
Misc. Species 2		Pulpwood	39.0	Cords		
Mixed Aspen			50.0	Cords		
<i>B. T. Aspen</i>		<i>Sawtimber</i>	7.8	<i>MBF</i>		
<i>Quaking Aspen</i>			1.6	<i>MBF</i>		
<i>B. T. Aspen</i>		<i>Pulpwood</i>	20.0	<i>Cords</i>		
<i>Quaking Aspen</i>			11.0	<i>Cords</i>		
Mixed Hardwood			106.0	Cords		
<i>Red Maple</i>		<i>Sawtimber</i>	2.4	<i>MBF</i>		
<i>Black Cherry</i>		<i>Pulpwood</i>	1.0	<i>Cords</i>		
<i>Red Maple</i>			100.0	<i>Cords</i>		
Mixed Oak			225.0	Cords		
<i>BI/R/Hybrid Oak</i>			75.0	<i>Cords</i>		
<i>Northern Pin Oak</i>			44.0	<i>Cords</i>		
<i>White Oak</i>		106.0	<i>Cords</i>			
3	BI/R/Hybrid Oak	Sawtimber	46.5	MBF	36.1	\$25,660.65
	Northern Pin Oak		18.1	MBF		
	White Oak		11.1	MBF		
	Jack Pine	Pulpwood	24.0	Cords		
	<i>Jack Pine</i>	<i>Sawtimber</i>	2.6	<i>MBF</i>		
	<i>Jack Pine</i>	<i>Pulpwood</i>	19.0	<i>Cords</i>		
	Misc. Species 2		58.0	Cords		
	Mixed Aspen		144.0	Cords		
	<i>B. T. Aspen</i>	<i>Sawtimber</i>	9.7	<i>MBF</i>		
	<i>Quaking Aspen</i>		16.1	<i>MBF</i>		
	<i>B. T. Aspen</i>	<i>Pulpwood</i>	26.0	<i>Cords</i>		
	<i>Quaking Aspen</i>		67.0	<i>Cords</i>		
	Mixed Hardwood		80.0	Cords		
	<i>Red Maple</i>	<i>Sawtimber</i>	5.8	<i>MBF</i>		
	<i>Black Cherry</i>	<i>Pulpwood</i>	3.0	<i>Cords</i>		
	<i>Red Maple</i>		65.0	<i>Cords</i>		
	Mixed Oak		219.0	Cords		
	<i>BI/R/Hybrid Oak</i>		61.0	<i>Cords</i>		
	<i>Northern Pin Oak</i>		97.0	<i>Cords</i>		
<i>White Oak</i>		61.0	<i>Cords</i>			
4	Northern Pin Oak	Sawtimber	5.0	MBF	17.4	\$4,040.55
	White Oak		0.3	MBF		
	Jack Pine	Pulpwood	59.0	Cords		
	<i>Jack Pine</i>	<i>Sawtimber</i>	6.2	<i>MBF</i>		
	<i>Jack Pine</i>	<i>Pulpwood</i>	47.0	<i>Cords</i>		
	Misc. Species 2		28.0	Cords		

Description of Timber by Payment Unit (PU), con't

PU	MARKET GROUP	PRODUCT	QUANTITY	UNIT	ACRES	ADVERTISE PRICE			
4 con't	Mixed Aspen	Pulpwood	16.0	Cords					
	<i>Quaking Aspen</i>	<i>Sawtimber</i>	1.3	<i>MBF</i>					
	<i>Quaking Aspen</i>	<i>Pulpwood</i>	13.0	<i>Cords</i>					
	Mixed Hardwood		6.0	Cords					
	<i>Red Maple</i>	<i>Sawtimber</i>	0.8	<i>MBF</i>					
	<i>Red Maple</i>	<i>Pulpwood</i>	4.0	<i>Cords</i>					
	Mixed Oak		54.0	Cords					
	<i>Northern Pin Oak</i>		50.0	<i>Cords</i>					
	<i>White Oak</i>		4.0	<i>Cords</i>					
	5	BI/R/Hybrid Oak	Sawtimber	33.2			MBF	15.2	\$14,967.70
Northern Pin Oak			5.9	MBF					
White Oak			5.6	MBF					
Misc. Species 2		Pulpwood	52.0	Cords					
Mixed Aspen			62.0	Cords					
<i>B. T. Aspen</i>		<i>Sawtimber</i>	9.5	<i>MBF</i>					
<i>Quaking Aspen</i>			0.8	<i>MBF</i>					
<i>B. T. Aspen</i>		<i>Pulpwood</i>	35.0	<i>Cords</i>					
<i>Quaking Aspen</i>			6.0	<i>Cords</i>					
Mixed Hardwood			40.0	Cords					
<i>Red Maple</i>		<i>Sawtimber</i>	2.4	<i>MBF</i>					
<i>Red Maple</i>		<i>Pulpwood</i>	35.0	<i>Cords</i>					
Mixed Oak			158.0	Cords					
<i>BI/R/Hybrid Oak</i>			72.0	<i>Cords</i>					
<i>Northern Pin Oak</i>			34.0	<i>Cords</i>					
<i>White Oak</i>			52.0	<i>Cords</i>					
6		BI/R/Hybrid Oak	Sawtimber	47.4	MBF	9.1	\$13,509.55		
		Northern Pin Oak		1.8	MBF				
	White Oak		12.5	MBF					
	Misc. Species 2	Pulpwood	29.0	Cords					
	Mixed Hardwood		9.0	Cords					
	<i>Red Maple</i>		9.0	<i>Cords</i>					
	Mixed Oak		88.0	Cords					
	<i>BI/R/Hybrid Oak</i>		40.0	<i>Cords</i>					
	<i>Northern Pin Oak</i>		10.0	<i>Cords</i>					
	<i>White Oak</i>		38.0	<i>Cords</i>					
	TOTAL:			333.0	MBF				
TOTAL:			1,883.0	Cords					

Sale Specific Conditions & Requirements

Sale Name: Comp 201 MtB Trail

Sale Number: 72-625-18 Seq#: 1

1 - Sale Area

1.2 - Boundaries

1.2.1 - Painted boundaries (1/14)

The sale boundary is marked and identified by red paint, in addition to designated unpainted Payment Unit boundaries. Exterior sale boundary lines against state and retention island boundaries are marked with red paint. Interior Payment Unit boundaries are unpainted and designated as the interior forest roads and mountain bike trails as shown on the Timber Sale Map. The red painted boundary line trees are not Included Timber and are to be protected.

2 - Timber Specifications

2.1 - Included Timber

2.1.1 - Clearcut unit(s) with unmerchantable trees (6/14)

Within Payment Unit(s) 1-6, cut all trees that are two (2) inches or more at DBH, except do not cut oak which do not meet minimum piece specifications, or any pine, white pine, and green-marked trees. Dense patches of aspen and/or red maple saplings may be left uncut if there are no merchantable Included Timber stems within them and they are left without bent/broken stems.

2.1.11 - Description of timber note (2/04)

Note that Misc. Species 2 = dead oak, which is designated for cutting when meeting any of the following conditions: Individual snags that have retained some fine branches, or dead oak of any condition that is in a multiple-stem clump with live oak or is within 100 feet of the mountain bike trail. Note that wire, nails and metal brackets may be encountered around stump height on trees within this training area.

2.2 - Utilization

2.2.2 - Chipping required (2/18)

This area must be chip harvested to meet National Guard requirements. The Purchaser has the option to produce sawlogs or pulpwood bolts, but the remaining portion of the trees must be chipped and hauled. Troops will be using the Land Nav course navigate on foot between the orienteering markers, so the chipping requirement cannot be waived. The requirement to retain approximately 1/6 to 1/3 of tree tops and limbs less than four inches in diameter does not apply (G. C. & R. 2.2) because these lands are used for Military training.

2.2.3 - Stump heights (4/07)

Stump heights within the Sale Area shall not exceed 6 inches for all trees, in order to meet Military requirements. Exceptions may be made by the sale administrator for log sized oak.

3 - Payments

3.3 - Pre-measured Sales

3.3.4 - Dividing payment units (7/14)

Payment Unit(s) may be divided at the request of the Purchaser and upon approval of the Unit Manager. Dividing Payment Units is a contract modification which requires a Timber Sale Contract Supplement.

3.4 - Damaged Timber

3.4.1 - Damaged timber (6/14)

General Condition and Requirement 3.4 Damaged Timber, defines liquidated damages for undesignated live merchantable trees which are cut or injured. In addition, reasonable care should be taken to avoid damage to the oak and pine seedlings and saplings. Within the sale area, if more than 25% of the oak or pine seedlings or saplings (1/4" to 4.5" DBH) within a specified portion of the sale area are damaged, liquidated damages will be assessed at \$300 per acre for all acreage within that specified portion of the sale area that was damaged. Limited operational paths may be cut through dense regen where needed, but must be cut cleanly, not leaving bent/broken stems.

4 - Transportation

4.1 - Construction

4.1.3 - Slash and earthen piles (8/04)

Piles or windrows of earth along roads and landings that have been widened or constructed shall be leveled. Slash from road maintenance or construction, including stumps, shall be chipped, utilized or dispersed into the sale.

4.1.6 - Road construction (1/09)

Construction of new roads or improvements of existing roads shall be done in such a way as to minimize the environmental and visual impacts. Merchantable trees shall be cut and utilized unless otherwise directed. Non-merchantable trees shall be severed and laid flat on the ground. Slash shall be chipped, utilized or moved back from the road edge. Stumps shall be set upright, not left on edge, and be moved at least 10 feet away from the road edge. Disturbed soil shall be feathered into the woods and not left in berms or windrows.

4.1.7 - Road closure (10/11)

All new roads built into the sale must be blocked to vehicle traffic upon completion of the sale. Overgrown roads that are reopened shall be considered new roads. In general, this may require constructing a four foot high berm of stumps and logs covered with earth. Stumps and brush may need to be placed along the stretch behind the berm. Contact the sale administrator for specific details of design and placement.

4.1.11 - Permits (2/12)

The Purchaser will secure any necessary permits that may be required.

5 - Operations

5.1 - Notification

5.1.1 - Pre-sale conference (10/16)

A pre-sale conference on-site between the Purchaser and sale administrator is required prior to beginning any operations to determine landing and road locations. The Unit Manager or his/her representative must be contacted at least 5 days in advance to schedule the conference.

5.1.4 - Post-sale conference (10/16)

A post-sale conference on site between the Purchaser and sale administrator is required prior to the completion of active logging operations to determine clean-up and repair of landings, road edges, and the fulfillment of other contract specifications.

5.1.5 - National Guard notification (2/15)

This sale is upon lands utilized for training by the Michigan National Guard - Camp Grayling. A minimum of five (5) business days prior to opening this sale, the producer must request that the sale administrator contact the military for information regarding training plans that may impact sale operations.

5.2 - Conduct of Operations

5.2.3 - Operating Restrictions

5.2.3.4 - Oak wilt restriction, no exceptions (1/18)

Within Payment Unit(s) 1-6, cutting, skidding and brushing of access roads to the sale are not permitted during the period of April 15 to July 15. No exceptions will be granted. This is necessary to reduce the spread of oak wilt.

5.2.3.7 - National Guard training restriction (1/09)

Operations on this contract will not be allowed during National Guard training operations. Because of the Land Nav course, Hanson Hills bike trail interface, and oak wilt concerns, operations will not be allowed between April 15 and October 15. Outside of that timeframe, the contractor must check with the sale administrator who will coordinate the cutting schedule with the Military. All harvest equipment and timber products may need to be removed from the sale area during the period of May 1 to October 15.

5.2.3.11 - Coppice regeneration protection (4/10)

Any post harvest operations, such as chipping, must be completed before sprouting of regeneration occurs. If it is anticipated that chipping will be delayed, then tops shall be pre-skidded to the landing.

5.2.29 - Shrub protection (9/07)

Do not cut or damage witch-hazel or serviceberry. These woody-shrub plants are highly beneficial to various wildlife species.

5.2.38 - No decking against live trees (2/04)

Cut products may not be decked against unmarked or designated leave trees.

5.2.40 - Pathway protection (10/10)

The Hanson Hills MtB Red and Yellow loops are mountain bike trails shown on the Timber Sale Map. Those trails are also the unpainted designated boundaries between Payment Units 1 & 2 and 5 & 6. Maintain a 20-foot wide slash, debris, and rut free zone daily, using the pathway as the centerline. Do not run equipment down the pathway. Harvesting must be completed in the Payment Unit on one side of the trail before starting on the other side. Skidding across the trail may only occur in locations approved by the sale administrator.

5.2.41 - Snowmobile trail protection (9/11)

The Hanson Hills Connector is a snowmobile trail and is shown on the Timber Sale Map. Do not cut or damage posts with orange trail markers or traffic control signs. If the trail is crossed by the haul route, that intersection must be graded to the satisfaction of the Unit Manager or his/her representative prior to December 1st. If the trail is crossed by the haul route during the snowmobile season, then a snow covered base must be left on the trail.

5.4 - Soil Protection

5.4.1 - Rutting restriction, general (7/16)

Operations are to cease immediately if equipment and weather conditions result in rutting of roads and/or skid trails which is 12 inches or greater in depth and 50 feet in length. The Unit Manager or his/her representative may restrict hauling and/or skidding if ruts exceed the specified depth. With the Unit Manager or his/her representative's approval, the Purchaser may return to the area when the risk of rutting has decreased.

5.5 - Protection of Improvements

5.5.3 - Protection of improvements detail (10/13)

The following are specific protection measures for this sale: Protect the Land Nav course markers within the sale area and along the haul route.

6 - Safety and Fire Prevention

6.2 - Signing

6.2.2 - Snowmobile trail posting (8/09)

The Purchaser is responsible for posting and maintaining caution signs on the Hanson Hills Connector snowmobile trail prior to beginning operations during the snowmobile season (approximately December 1 to March 31). The trail must be posted at appropriate distances from the haul route intersection to warn of logging activity and truck traffic. Signs must be removed when harvest operations are suspended or completed. The Purchaser will provide these signs.

6.2.3 - Recreational trail posting (2/10)

The Purchaser is responsible for posting and maintaining caution signs on the Hanson Hills MtB Trail prior to beginning operations. The trail must be posted at appropriate distances from the sale area to warn of logging activity and truck traffic at both ends of the trail. Signs must be removed when harvest operations are suspended or completed. The Purchaser will provide these signs.

7 - Other Conditions

7.5 - Loss

7.5.1 - Deteriorating timber (7/09)

The sale area has received damage from age-related decline in the oak, jack pine and aspen, and potentially oak wilt. The Purchaser should harvest the wood as soon as possible. The Department of Natural Resources is held free of responsibility of any further damage or deterioration due to delay in harvesting.

7.10 - Certified Timber

7.10.1 - Non-certified timber (2/16)

The area encompassed by this timber sale is not certified to the standards of the Forest Stewardship Council (FSC) or the Sustainable Forestry Initiative (SFI). Forest products from this sale may not be delivered to the mill as "FSC and / or SFI certified". The lands within this sale are managed for Military training.



TIMBER SALE MAP

This information provided by authority of Part 525, 1994 PA 451, as amended.

Forest Management Unit Grayling Management Unit	County Crawford	Mapped By Charlebois	Date 09/21/2018	Page 1	of 1
Township 26N	Range 04W	Section(s) and Subdivision(s) Sec 24: S1/2SW Sec 25: NW,W1/2NE, N1/2SW Sec 26: SENE, NESE	Scale 1:15,840		

Cover Type				Density	
A = Aspen	H = Hemlock	N = Marsh	U = Upland Brush	0 = Non Stocked	5 = Pole Timber Medium
B = Paper Birch	J = Jack Pine	O = Oak	UM = Upland Mixed	1 = Seedling Sapling Poor	6 = Pole Timber Well
C = Cedar	L = Lowland Brush	P = Lowland Poplar	V = Bog or Marsh	2 = Seedling Sapling Medium	7 = Saw Timber Poor
D = Treed Bog	LM = Lowland Mixed	Q = Mixed Swamp Conifer	W = White Pine	3 = Seedling Sapling Well	8 = Saw Timber Medium
E = Swamp Hdwoods	M = Mpl, Bch, Brch	R = Red Pine	X = Non Stocked	4 = Pole Timber Poor	9 = Saw Timber Well
F = Spruce Fir	MC = Mixed Conifer	S = Black Spruce	Z = Water		
G = Grass	MD = Mixed Deciduous	T = Tamarack			



QR Code opens map in PDF maps app

Comp 201 MtB Trail

Compartment 201

151.5 Acres



PU Acres	PU Acres
1 38.8	4 17.4
2 34.9	5 15.2
3 36.1	6 9.1

Legend

- Sale Boundary - Red Paint
- Payment Unit - unpainted - interior roads & rec trails
- Payment Unit #
- Retention Area
- Land Nav Marker
- Camp Grayling Fence
- Stand Boundary
- Ski Trail
- Bicycle Trail
- Snowmobile Trail
- Highway
- Poor Dirt Road
- Section Corners
- Nearby Sales

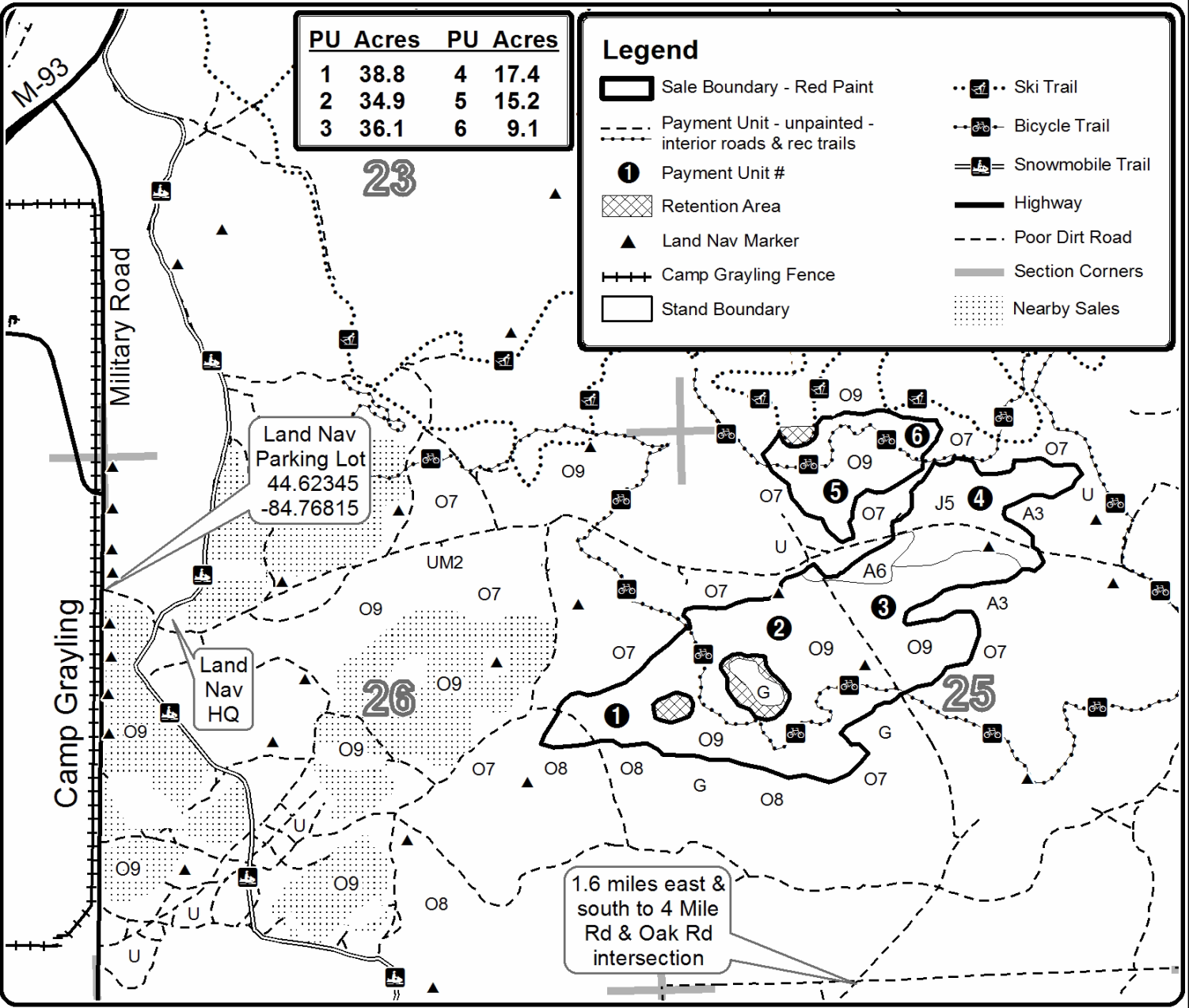

1.6 miles east & south to 4 Mile Rd & Oak Rd intersection

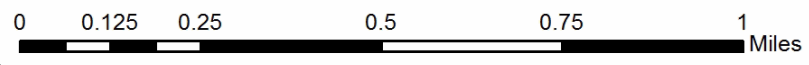

TIMBER SALE INFORMATION

Comp 201 Land Nav (72-633-18)
 T26N, R04W, SEC. 23; T26N, R04W, SEC. 26.
 Crawford County (Advertised Price \$226,748.55)

SALE NOTE: The sale is within the Military's Land Nav orienteering course and the Hanson Hills Recreation Area lease. The Military also uses the area for bivouacking. There are pits, foxholes and concrete bunkers in and around the harvest units. The following hardware was encountered occasionally during sale prep: communications wire wrapped around the bole, and trip-wire flare brackets tacked on at the stump. Because of the Military ground training, Hanson Hills recreation trails, and oak wilt concerns, operations will not be allowed between April 15 and October 15. Because of that limited harvesting window, the contract has been given a 3-year duration. The adjoining portion of Military Road was Class A in 2018.

A recreation site such as a trail, pathway, or campground is within the sale area or the vicinity. Certain restrictions/specifications may be applicable including time restrictions.

A timber sale contract for this lump sum, sealed bid timber sale will be awarded to the responsible bidder offering the highest sealed bid price. Bids must be at or above the following advertised price for each species:

<u>PRODUCTS & SPECIES</u>	<u>ESTIMATED UNITS*</u>	<u>ADVERTISED PRICE</u>
Sawtimber		
BI/R/Hybrid Oak	818.10 MBF	\$ 205.00 / MBF
White Oak	123.70 MBF	\$ 85.00 / MBF
Pulpwood		
Misc. Species 2	294.00 Cords	\$ 7.50 / Cord
Mixed Aspen	63.00 Cords	\$ 23.65 / Cord
Mixed Hardwood	275.00 Cords	\$ 32.35 / Cord
Mixed Oak	1,707.00 Cords	\$ 21.05 / Cord

* The total volume is statistically estimated within plus (+) or minus (-) 11.17 percent. The estimated units are final and not subject to adjustment. Prospective bidders are urged to examine this timber and to make their own estimates of quantity and quality.

BOND AND PAYMENT SCHEDULE:

1. A bond in the amount of \$11,337.00 to insure faithful performance of the conditions of the contract will be deposited by the successful bidder within 21 days of the sale award.
2. Cutting in any sale or unit without the required advance payment would be considered a trespass.
3. Total payment must be paid in advance or according to the following schedule:
 - (a) Ten percent (10%) of the sale value must be paid within 21 days of the sale award.
 - (b) The 10% down payment will be credited towards the first unit cut.
 - (c) Payment for each of the following units must be made before cutting begins in that unit:

<u>PAYMENT UNIT NUMBER</u>	<u>PERCENT OF TOTAL SALE VALUE</u>
01	11.6%
02	13.4%
03	7.0%
04	14.6%
05	10.2%
06	5.1%
07	6.9%
08	10.3%
09	11.4%
10	9.5%

4. If no cutting takes place, the 10% down payment will not be refunded.
5. Operations on the contract issued will terminate on 04/15/2022.

Description of Timber by Payment Unit (PU)

PU	MARKET GROUP	PRODUCT	QUANTITY	UNIT	ACRES	ADVERTISE PRICE
1	BI/R/Hybrid Oak	Sawtimber	102.6	MBF	16.1	\$26,355.40
	White Oak		1.4	MBF		
	Misc. Species 2	Pulpwood	26.0	Cords		
	Mixed Aspen		14.0	Cords		
	<i>B. T. Aspen</i>		14.0	<i>Cords</i>		
	Mixed Hardwood		19.0	Cords		
	<i>Red Maple</i>		19.0	<i>Cords</i>		
	Mixed Oak		193.0	Cords		
	<i>BI/R/Hybrid Oak</i>		177.0	<i>Cords</i>		
	<i>White Oak</i>		16.0	<i>Cords</i>		
2	BI/R/Hybrid Oak	Sawtimber	111.8	MBF	17.9	\$30,377.00
	White Oak		21.1	MBF		
	Misc. Species 2	Pulpwood	52.0	Cords		
	Mixed Aspen		37.0	Cords		
	<i>B. T. Aspen</i>	<i>Sawtimber</i>	9.9	<i>MBF</i>		
	<i>B. T. Aspen</i>	<i>Pulpwood</i>	17.0	<i>Cords</i>		
	Mixed Oak		209.0	Cords		
	<i>BI/R/Hybrid Oak</i>		133.0	<i>Cords</i>		
	<i>White Oak</i>		76.0	<i>Cords</i>		
	3	BI/R/Hybrid Oak	Sawtimber	60.2		
White Oak			7.9	MBF		
Misc. Species 2		Pulpwood	9.0	Cords		
Mixed Aspen			12.0	Cords		
<i>B. T. Aspen</i>		<i>Sawtimber</i>	2.3	<i>MBF</i>		
<i>B. T. Aspen</i>		<i>Pulpwood</i>	7.0	<i>Cords</i>		
Mixed Hardwood			13.0	Cords		
<i>Red Maple</i>		<i>Sawtimber</i>	1.6	<i>MBF</i>		
<i>Red Maple</i>		<i>Pulpwood</i>	10.0	<i>Cords</i>		
Mixed Oak			102.0	Cords		
<i>BI/R/Hybrid Oak</i>			84.0	<i>Cords</i>		
<i>White Oak</i>			18.0	<i>Cords</i>		
4	BI/R/Hybrid Oak	Sawtimber	124.6	MBF	17.2	\$32,857.55
	White Oak		11.6	MBF		
	Misc. Species 2	Pulpwood	44.0	Cords		
	Mixed Hardwood		67.0	Cords		
	<i>Red Maple</i>		67.0	<i>Cords</i>		
	Mixed Oak		182.0	Cords		
	<i>BI/R/Hybrid Oak</i>		115.0	<i>Cords</i>		
	<i>White Oak</i>		67.0	<i>Cords</i>		
5	BI/R/Hybrid Oak	Sawtimber	79.0	MBF	19.5	\$23,227.65
	White Oak		18.3	MBF		
	Misc. Species 2	Pulpwood	14.0	Cords		
	Mixed Hardwood		60.0	Cords		
	<i>Red Maple</i>		60.0	<i>Cords</i>		
	Mixed Oak		163.0	Cords		
	<i>BI/R/Hybrid Oak</i>		108.0	<i>Cords</i>		
	<i>White Oak</i>		55.0	<i>Cords</i>		
6	BI/R/Hybrid Oak	Sawtimber	43.1	MBF	10.2	\$11,674.10
	White Oak		5.4	MBF		
	Misc. Species 2	Pulpwood	31.0	Cords		
	Mixed Oak		102.0	Cords		
	<i>Northern Pin Oak</i>	<i>Sawtimber</i>	1.8	<i>MBF</i>		
	<i>BI/R/Hybrid Oak</i>	<i>Pulpwood</i>	47.0	<i>Cords</i>		
	<i>Northern Pin Oak</i>		4.0	<i>Cords</i>		
	<i>White Oak</i>		47.0	<i>Cords</i>		
7	BI/R/Hybrid Oak	Sawtimber	51.8	MBF	12.7	\$15,619.50

Description of Timber by Payment Unit (PU), con't

PU	MARKET GROUP	PRODUCT	QUANTITY	UNIT	ACRES	ADVERTISE PRICE
	White Oak		15.4	MBF		
	Mixed Hardwood	Pulpwood	10.0	Cords		
	<i>Red Maple</i>		10.0	<i>Cords</i>		
	Mixed Oak		160.0	Cords		
	<i>BI/R/Hybrid Oak</i>		61.0	<i>Cords</i>		
	<i>White Oak</i>		99.0	<i>Cords</i>		
8	BI/R/Hybrid Oak	Sawtimber	78.9	MBF	20.3	\$23,408.70
	White Oak		16.5	MBF		
	Misc. Species 2	Pulpwood	66.0	Cords		
	Mixed Hardwood		55.0	Cords		
	<i>Red Maple</i>	<i>Sawtimber</i>	5.3	<i>MBF</i>		
	<i>Red Maple</i>	<i>Pulpwood</i>	44.0	<i>Cords</i>		
	Mixed Oak		169.0	Cords		
	<i>BI/R/Hybrid Oak</i>		103.0	<i>Cords</i>		
	<i>White Oak</i>		66.0	<i>Cords</i>		
9	BI/R/Hybrid Oak	Sawtimber	92.3	MBF	21.4	\$25,830.10
	White Oak		12.9	MBF		
	Misc. Species 2	Pulpwood	30.0	Cords		
	Mixed Hardwood		25.0	Cords		
	<i>Red Maple</i>		25.0	<i>Cords</i>		
	Mixed Oak		227.0	Cords		
	<i>Northern Pin Oak</i>	<i>Sawtimber</i>	1.4	<i>MBF</i>		
	<i>BI/R/Hybrid Oak</i>	<i>Pulpwood</i>	150.0	<i>Cords</i>		
	<i>Northern Pin Oak</i>		5.0	<i>Cords</i>		
	<i>White Oak</i>		69.0	<i>Cords</i>		
10	BI/R/Hybrid Oak	Sawtimber	73.8	MBF	16.7	\$21,467.10
	White Oak		13.2	MBF		
	Misc. Species 2	Pulpwood	22.0	Cords		
	Mixed Hardwood		26.0	Cords		
	<i>Red Maple</i>	<i>Sawtimber</i>	1.3	<i>MBF</i>		
	<i>Red Maple</i>	<i>Pulpwood</i>	23.0	<i>Cords</i>		
	Mixed Oak		200.0	Cords		
	<i>BI/R/Hybrid Oak</i>		132.0	<i>Cords</i>		
	<i>White Oak</i>		68.0	<i>Cords</i>		
TOTAL:			941.8	MBF		
TOTAL:			2,339.0	Cords		

Sale Specific Conditions & Requirements

Sale Name: Comp 201 Land Nav

Sale Number: 72-633-18 Seq#: 1

1 - Sale Area

1.2 - Boundaries

1.2.1 - Painted boundaries (1/14)

The sale boundary and Payment Unit boundaries are marked and identified by red and yellow paint, in addition to designated unpainted Payment Unit boundaries. Exterior sale boundary lines against state and retention island boundaries are marked with red paint. Interior Payment Unit boundaries are marked with yellow paint, in addition to the unpainted boundaries designated as the interior forest roads and the mountain bike trail, as shown on the Timber Sale Map. The red painted boundary line trees are not Included Timber and are to be protected, with the exception of the red painted trees that are within 10 feet of the cleared snowmobile trail and Military Road corridors, which are Included Timber. Note, if a red line tree is within a clump, cut all of the stems in the clump. Yellow painted trees designating an interior Payment Unit boundary are only to be cut if they meet the 2.1.1 Included Timber definition and all surrounding Payment Units have been paid for.

2 - Timber Specifications

2.1 - Included Timber

2.1.1 - Clearcut unit(s) with unmerchantable trees (6/14)

Within Payment Unit(s) 1-10, cut all trees that are two (2) inches or more at DBH, except do not cut oak which do not meet minimum piece specifications, or any red pine, white pine, and green-marked trees. Dense patches of aspen and/or red maple saplings may be left uncut if there are no merchantable Included Timber stems within them and they are left without bent/broken stems.

2.1.11 - Description of timber note (2/04)

Note that Misc. Species 2 = dead oak, which is designated for cutting when meeting any of the following conditions: Individual snags that have retained some fine branches, dead oak of any condition that is in a multiple-stem clump with live oak, or is within 100 feet of the snowmobile or mountain bike trails. Note that wire, nails and metal brackets may be encountered around stump height on trees within this training area.

2.2 - Utilization

2.2.2 - Chipping required (2/18)

This area must be chip harvested to meet National Guard requirements. The Purchaser has the option to produce sawlogs or pulpwood bolts, but the remaining portion of the trees must be chipped and hauled. Troops will be using the Land Nav course navigate on foot between the orienteering markers, so the chipping requirement cannot be waived. The requirement to retain approximately 1/6 to 1/3 of tree tops and limbs less than four inches in diameter does not apply (G. C. & R. 2.2) because these lands are used for Military training.

2.2.3 - Stump heights (4/07)

Stump heights within the Sale Area shall not exceed 6 inches for all trees in order to meet Military requirements. Exceptions may be made by the sale administrator for log sized oak.

3 - Payments

3.3 - Pre-measured Sales

3.3.4 - Dividing payment units (7/14)

Payment Unit(s) may be divided at the request of the Purchaser and upon approval of the Unit Manager. Dividing Payment Units is a contract modification which requires a Timber Sale Contract Supplement.

3.4 - Damaged Timber

3.4.1 - Damaged timber (6/14)

General Condition and Requirement 3.4 Damaged Timber, defines liquidated damages for undesignated live merchantable trees which are cut or injured. In addition, reasonable care should be taken to avoid damage to the oak and pine seedlings and saplings. Within the sale area, if more than 25% of the oak or pine seedlings or saplings (1/4" to 4.5" DBH) within a specified

portion of the sale area are damaged, liquidated damages will be assessed at \$300 per acre for all acreage within that specified portion of the sale area that was damaged. Limited operational paths may be cut through dense regen where needed, but must be cut cleanly, not leaving bent/broken stems.

4 - Transportation

4.1 - Construction

4.1.3 - Slash and earthen piles (8/04)

Piles or windrows of earth along roads and landings that have been widened or constructed shall be leveled. Slash from road maintenance or construction, including stumps, shall be chipped, utilized or dispersed into the sale.

4.1.6 - Road construction (1/09)

Construction of new roads or improvements of existing roads shall be done in such a way as to minimize the environmental and visual impacts. Merchantable trees shall be cut and utilized unless otherwise directed. Non-merchantable trees shall be severed and laid flat on the ground. Slash shall be chipped, utilized or moved back from the road edge. Stumps shall be set upright, not left on edge, and be moved at least 10 feet away from the road edge. Disturbed soil shall be feathered into the woods and not left in berms or windrows.

4.1.7 - Road closure (10/11)

All new roads built into the sale must be blocked to vehicle traffic upon completion of the sale. Overgrown roads that are reopened shall be considered new roads. In general, this may require constructing a four foot high berm of stumps and logs covered with earth. Stumps and brush may need to be placed along the stretch behind the berm. Contact the sale administrator for specific details of design and placement.

4.1.11 - Permits (2/12)

The Purchaser will secure any necessary permits that may be required.

5 - Operations

5.1 - Notification

5.1.1 - Pre-sale conference (10/16)

A pre-sale conference on-site between the Purchaser and sale administrator is required prior to beginning any operations to determine landing and road locations. The Unit Manager or his/her representative must be contacted at least 5 days in advance to schedule the conference.

5.1.4 - Post-sale conference (10/16)

A post-sale conference on site between the Purchaser and sale administrator is required prior to the completion of active logging operations to determine clean-up and repair of landings, road edges, and the fulfillment of other contract specifications.

5.1.5 - National Guard notification (2/15)

This sale is upon lands utilized for training by the Michigan National Guard - Camp Grayling. A minimum of five (5) business days prior to opening this sale, the producer must request that the sale administrator contact the military for information regarding training plans that may impact sale operations.

5.2 - Conduct of Operations

5.2.3 - Operating Restrictions

5.2.3.4 - Oak wilt restriction, no exceptions (1/18)

Within Payment Unit(s) 1-10, cutting, skidding and brushing of access roads to the sale are not permitted during the period of April 15 to July 15. No exceptions will be granted. This is necessary to reduce the spread of oak wilt.

5.2.3.7 - National Guard training restriction (1/09)

Operations on this contract will not be allowed during National Guard training operations. Because of the Land Nav course, Hanson Hills bike trail interface, and oak wilt concerns, operations will not be allowed between April 15 and October 15. Outside of that timeframe, the contractor must check with the sale administrator who will coordinate the cutting schedule with the Military. All harvest equipment and timber products may need to be removed from the sale area during the period of May 1 to October 15.

5.2.3.11 - Coppice regeneration protection (4/10)

Any post harvest operations, such as chipping, must be completed before sprouting of regeneration occurs. If it is anticipated that chipping will be delayed, then tops shall be pre-skidded to the landing.

5.2.29 - Shrub protection (9/07)

Do not cut or damage witch-hazel. These woody-shrub plants are highly beneficial to various wildlife species.

5.2.37 - No decking areas (12/08)

No decking is allowed within the Land Nav facility parking lot without permission of the Military.

5.2.38 - No decking against live trees (2/04)

Cut products may not be decked against unmarked or designated leave trees.

5.2.40 - Pathway protection (10/10)

The Hanson Hills MtB Red loop is a mountain bike trail and is shown on the Timber Sale Map. It is also the unpainted designated boundary between Payment Units 5 & 6. Maintain a 20-foot wide slash, debris, and rut free zone daily, using the pathway as the centerline. Do not run equipment down the pathway. Harvesting must be completed in the Payment Unit on one side of the trail before starting on the other side. Skidding across the trail may only occur in locations approved by the sale administrator.

5.2.41 - Snowmobile trail protection (9/11)

The Hanson Hills Connector is a snowmobile trail and is shown on the Timber Sale Map. Do not cut or damage posts with orange trail markers or traffic control signs. If the trail is used for hauling, it must be graded to the satisfaction of the Unit Manager or his/her representative prior to December 1st. If the trail road is to be used for hauling during the snowmobile season, then a snow covered base must be left on the trail. Maintain a 20 foot wide slash, debris, and rut free zone daily using the snowmobile trail as the centerline. No decking of forest products will be permitted along the snowmobile trail. All stumps within 20 feet of the snowmobile trail centerline must be cut at ground level. In addition, any trees cut within 5 feet of the trail may need to have the stumps removed and disposed of at the direction of the sale administrator.

5.4 - Soil Protection

5.4.1 - Rutting restriction, general (7/16)

Operations are to cease immediately if equipment and weather conditions result in rutting of roads and/or skid trails which is 12 inches or greater in depth and 50 feet in length. The Unit Manager or his/her representative may restrict hauling and/or skidding if ruts exceed the specified depth. With the Unit Manager or his/her representative's approval, the Purchaser may return to the area when the risk of rutting has decreased.

5.5 - Protection of Improvements

5.5.3 - Protection of improvements detail (10/13)

The following are specific protection measures for this sale: Protect the Land Nav course markers within the sale area and along the haul route.

6 - Safety and Fire Prevention

6.2 - Signing

6.2.2 - Snowmobile trail posting (8/09)

The Purchaser is responsible for posting and maintaining caution signs on Hanson Hills Connector snowmobile trail prior to beginning operations during the snowmobile season (approximately December 1 to March 31). The trail must be posted at appropriate distances from the sale area to warn of logging activity and truck traffic. Signs must be removed when harvest operations are suspended or completed. The Purchaser will provide these signs.

6.2.3 - Recreational trail posting (2/10)

The Purchaser is responsible for posting and maintaining caution signs on the Hanson Hills MtB Red Trail prior to beginning operations. The trail must be posted at appropriate distances from the sale area to warn of logging activity and truck traffic at both ends of the trail. Signs must be removed when harvest operations are suspended or completed. The Purchaser will provide these signs.

7 - Other Conditions

7.5 - Loss

7.5.1 - Deteriorating timber (7/09)

The sale area has received damage from oak decline and potentially oak wilt. The Purchaser should harvest the wood as soon as possible. The Department of Natural Resources is held free of responsibility of any further damage or deterioration due to delay in harvesting.

7.10 - Certified Timber

7.10.1 - Non-certified timber (2/16)

The area encompassed by this timber sale is not certified to the standards of the Forest Stewardship Council (FSC) or the Sustainable Forestry Initiative (SFI). Forest products from this sale may not be delivered to the mill as "FSC and / or SFI certified". The lands within this sale are managed for Military training.



TIMBER SALE MAP

This information provided by authority of Part 525, 1994 PA 451, as amended.

Forest Management Unit Grayling Management Unit	County Crawford	Mapped By Charlebois	Date 09/20/2018	Page 1	of 1
Township 26N	Range 04W	Section(s) and Subdivision(s) Sec 23: S1/2SW, SWSE Sec 26: W1/2, W1/2E1/2, SENE	Scale 1:15,840		

Cover Type				Density	
A = Aspen	H = Hemlock	N = Marsh	U = Upland Brush	0 = Non Stocked	5 = Pole Timber Medium
B = Paper Birch	J = Jack Pine	O = Oak	UM = Upland Mixed	1 = Seedling Sapling Poor	6 = Pole Timber Well
C = Cedar	L = Lowland Brush	P = Lowland Poplar	V = Bog or Marsh	2 = Seedling Sapling Medium	7 = Saw Timber Poor
D = Treed Bog	LM = Lowland Mixed	Q = Mixed Swamp Conifer	W = White Pine	3 = Seedling Sapling Well	8 = Saw Timber Medium
E = Swamp Hdwoods	M = Mpl, Bch, Brch	R = Red Pine	X = Non Stocked	4 = Pole Timber Poor	9 = Saw Timber Well
F = Spruce Fir	MC = Mixed Conifer	S = Black Spruce	Z = Water		
G = Grass	MD = Mixed Deciduous	T = Tamarack			



QR Code opens map in PDF maps app

Comp 201 Land Nav

Compartment 201

159.3 Acres



PU	Acres	PU	Acres
1	16.1	6	10.2
2	17.9	7	12.7
3	7.3	8	20.3
4	17.2	9	21.4
5	19.5	10	16.7

Legend

- Sale Boundary - Red Paint
- Payment Unit - Yellow Paint - and mapped interior roads & rec trails
- Payment Unit #
- Retention Area
- Land Nav Marker
- Ski Trail
- Bicycle Trail
- Snowmobile Trail
- Camp Grayling Fence
- Highway
- Poor Dirt Road
- Section Corners
- Nearby Sales

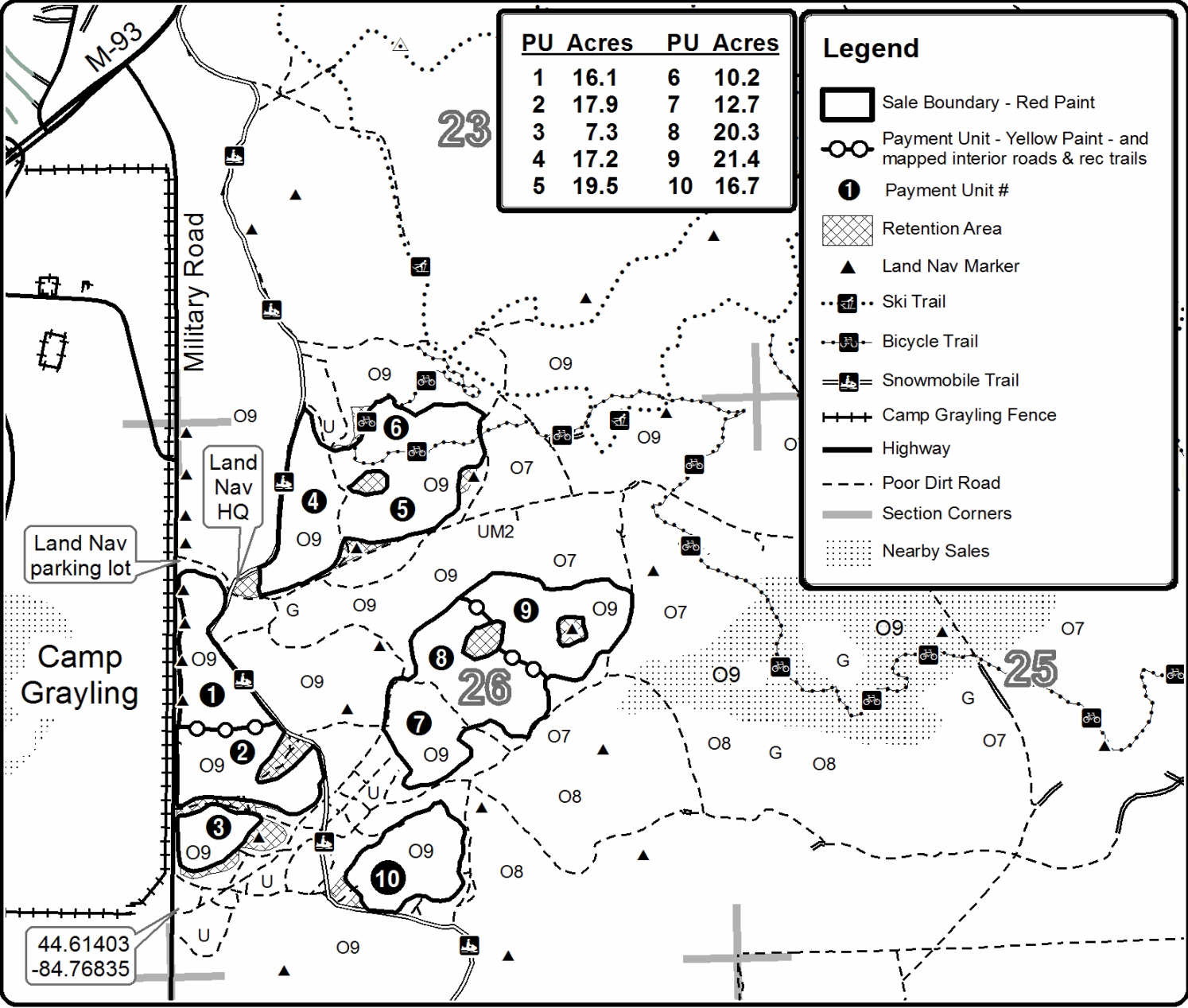

44.61403
-84.76835

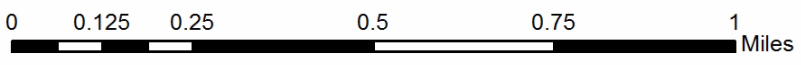

TIMBER SALE INFORMATION

WWT Spray Fields (72-638-18)

T26N, R04W, SEC. 16; T26N, R04W, SEC. 17; T26N, R04W, SEC. 20; T26N, R04W, SEC. 21.
Crawford County (Advertised Price \$131,832.50)

SALE NOTE: Payment Unit 1 encompasses Camp Grayling's waste water treatment spray field. That spray field unit must be cut first and completed by March 31, 2019 in order to meet the Military's construction project timeframe. Payment Units 2-5 are within the fenced Small Arms Ranges and occupy rolling to steep terrain. Tracked cutting equipment is recommended for the steepest hills. Restricted on-Camp access must be coordinated through Range Control. Harvest operations will be limited primarily to winter because of the Small Arms Range activity and spray field operations. Prospective bidders will have one opportunity to look at the Timber Sale before the bid opening. Contact the DNR Grayling Field Office at 989-348-6371 ext 7443 regarding the date and time of that pre-bid meeting.

A timber sale contract for this lump sum, sealed bid timber sale will be awarded to the responsible bidder offering the highest sealed bid price. Bids must be at or above the following advertised price for each species:

<u>PRODUCTS & SPECIES</u>	<u>ESTIMATED UNITS*</u>	<u>ADVERTISED PRICE</u>
Sawtimber		
B. T. Aspen	26.40 MBF	\$ 63.00 / MBF
BI/R/Hybrid Oak	37.10 MBF	\$ 164.00 / MBF
Northern Pin Oak	16.40 MBF	\$ 164.00 / MBF
Red Oak	420.70 MBF	\$ 223.00 / MBF
White Oak	41.00 MBF	\$ 68.00 / MBF
Pulpwood		
B. T. Aspen	91.00 Cords	\$ 18.90 / Cord
Jack Pine	9.00 Cords	\$ 14.50 / Cord
Misc. Species 2	213.00 Cords	\$ 6.00 / Cord
Mixed Hardwood	14.00 Cords	\$ 25.85 / Cord
Mixed Oak	1,153.00 Cords	\$ 16.85 / Cord
Red Maple	52.00 Cords	\$ 25.85 / Cord
Red Pine	3.00 Cords	\$ 31.55 / Cord
White Pine	20.00 Cords	\$ 21.70 / Cord

* The total volume is statistically estimated within plus (+) or minus (-) 10.85 percent. The estimated units are final and not subject to adjustment. Prospective bidders are urged to examine this timber and to make their own estimates of quantity and quality.

BOND AND PAYMENT SCHEDULE:

- A bond in the amount of \$6,592.00 to insure faithful performance of the conditions of the contract will be deposited by the successful bidder within 21 days of the sale award.
- Cutting in any sale or unit without the required advance payment would be considered a trespass.
- Total payment must be paid in advance or according to the following schedule:
 - Ten percent (10%) of the sale value must be paid within 21 days of the sale award.
 - The 10% down payment will be credited towards the first unit cut.
 - Payment for each of the following units must be made before cutting begins in that unit:

<u>PAYMENT UNIT NUMBER</u>	<u>PERCENT OF TOTAL SALE VALUE</u>
01	13.6%
02	17.9%
03	18.6%
04	18.9%
05	31.0%
- If no cutting takes place, the 10% down payment will not be refunded.
- Operations on the contract issued will terminate on 03/31/2022.

Description of Timber by Payment Unit (PU)

PU	MARKET GROUP	PRODUCT	QUANTITY	UNIT	ACRES	ADVERTISE PRICE			
1	BI/R/Hybrid Oak	Sawtimber	37.1	MBF	47.4	\$17,873.25			
	Northern Pin Oak		16.4	MBF					
	White Oak		12.2	MBF					
	B. T. Aspen	Pulpwood	11.0	Cords					
	Jack Pine		9.0	Cords					
	Misc. Species 2		213.0	Cords					
	Mixed Hardwood		14.0	Cords					
	Red Maple	Sawtimber	0.5	MBF					
	Black Cherry	Pulpwood	3.0	Cords					
	Red Maple		10.0	Cords					
	Mixed Oak		342.0	Cords					
	BI/R/Hybrid Oak		144.0	Cords					
	Northern Pin Oak		111.0	Cords					
	White Oak		87.0	Cords					
	Red Pine		3.0	Cords					
	White Pine		20.0	Cords					
	White Pine	Sawtimber	1.0	MBF					
	White Pine	Pulpwood	18.0	Cords					
	2	Red Oak	Sawtimber	90.3			MBF	12.5	\$23,663.90
		White Oak		3.3			MBF		
Mixed Oak		Pulpwood	196.0	Cords					
Red Oak			181.0	Cords					
White Oak			15.0	Cords					
3	Red Oak	Sawtimber	89.8	MBF	12.4	\$24,482.15			
	White Oak		8.3	MBF					
	Mixed Oak	Pulpwood	231.0	Cords					
	Red Oak		198.0	Cords					
	White Oak		33.0	Cords					
4	Red Oak	Sawtimber	96.9	MBF	10.7	\$24,937.90			
	White Oak		10.5	MBF					
	Mixed Oak	Pulpwood	146.0	Cords					
	Red Oak		104.0	Cords					
	White Oak		42.0	Cords					
	Red Maple		6.0	Cords					
	Red Maple		6.0	Cords					
5	B. T. Aspen	Sawtimber	26.4	MBF	22.0	\$40,875.30			
	Red Oak		143.7	MBF					
	White Oak		6.7	MBF					
	B. T. Aspen	Pulpwood	80.0	Cords					
	Mixed Oak		238.0	Cords					
	Red Oak		184.0	Cords					
	White Oak		54.0	Cords					
	Red Maple		46.0	Cords					
	Red Maple	Sawtimber	3.2	MBF					
	Red Maple	Pulpwood	40.0	Cords					
TOTAL:			541.6	MBF					
TOTAL:			1,555.0	Cords					

Sale Specific Conditions & Requirements

Sale Name: WWT Spray Fields

Sale Number: 72-638-18 Seq#: 2

1 - Sale Area

1.2 - Boundaries

1.2.1 - Painted boundaries (1/14)

The sale boundary is marked and identified by red and green paint, in addition to designated unpainted Payment Unit boundaries. The leave island between Payment Units 2, 3 & 5 is delineated with green paint and is not part of the harvest area. The designated unpainted boundaries between Payment Units 3, 4 & 5 are defined by the closed roads shown on the Timber Sale Map. The painted boundary line trees are not Included Timber and are to be protected, with the following exceptions: Within Payment Unit 1, cut all red painted boundary line trees that are not touching the Spray Field fence. In addition, on the southwest edge of Payment Unit 5, cut the red painted boundary line trees bordering the mapped A2 cover type. Note: If the red painted tree is part of a multiple-stem clump, cut all stems within the clump.

2 - Timber Specifications

2.1 - Included Timber

2.1.1 - Clearcut unit(s) with unmerchantable trees (6/14)

Within Payment Unit(s) 1, cut all trees that are one (1) inch or more at DBH.

Within Payment Unit(s) 2, 3, 4 & 5, cut all trees that are two (2) inches or more at DBH, except do not cut aspen and oak which do not meet minimum piece specifications in 2.2 Utilization, and do not cut any pine.

2.1.11 - Description of timber note (2/04)

Note that Misc. Species 2 = dead oak, which is designated for cutting.

2.2 - Utilization

2.2.2 - Chipping required (2/18)

This area must be chip harvested to meet National Guard requirements. The Purchaser has the option to produce sawlogs or pulpwood bolts, but the remaining portion of the trees must be chipped and hauled. The requirement to retain approximately 1/6 to 1/3 of tree tops and limbs less than four inches in diameter does not apply (G. C. & R. 2.2) because these lands are used for Military training.

2.2.3 - Stump heights (4/07)

Stump heights within the Sale Area shall not exceed 6 inches for all trees, unless exceptions are allowed by the sale administrator to protect infrastructure in the spray field or to factor in cutting on the steep slopes.

3 - Payments

3.3 - Pre-measured Sales

3.3.4 - Dividing payment units (7/14)

Payment Unit(s) 1 & 5 may be divided at the request of the Purchaser and upon approval of the Unit Manager. Dividing Payment Units is a contract modification which requires a Timber Sale Contract Supplement.

3.4 - Damaged Timber

3.4.1 - Damaged timber (6/14)

General Condition and Requirement 3.4 Damaged Timber, defines liquidated damages for undesignated live merchantable trees which are cut or injured. In addition, reasonable care should be taken to avoid damage to the oak, aspen and pine regeneration in Payment Units 2-5.

Within Payment Units 2-5, if more than 30% of the oak, aspen or pine seedlings or saplings (1/4" to 4.5" DBH) within a specified portion of the sale area are damaged, liquidated damages will be assessed at \$300 per acre for all acreage within that specified portion of the sale area that was damaged. Operational paths will have to be cut through patches of dense regen; if cut cleanly, those paths will not count as damaged areas.

3.6 - Payment Unit Cutting Schedule

3.6.1 - Order of cutting (1/09)

Payment Units shall be cut starting with Payment Unit 1.

4 - Transportation

4.1 - Construction

4.1.3 - Slash and earthen piles (8/04)

Piles or windrows of earth along roads and landings that have been widened or constructed shall be leveled. Slash from road maintenance or construction, including stumps, shall be chipped, utilized or moved to a designated location.

4.1.6 - Road construction (1/09)

Construction of new roads or improvements of existing roads shall be done in such a way as to minimize the environmental and visual impacts. Merchantable trees shall be cut and utilized unless otherwise directed. Non-merchantable trees shall be severed and laid flat on the ground. Slash shall be chipped, utilized or moved back from the road edge. Stumps shall be set upright, not left on edge, and be moved at least 10 feet away from the road edge. Disturbed soil shall be feathered into the woods and not left in berms or windrows.

4.1.7 - Road closure (10/11)

All new roads built into the sale must be blocked to vehicle traffic upon completion of the sale. Overgrown roads that are reopened shall be considered new roads. In general, this closure may involve constructing a four (4') foot high berm of stumps and logs covered with earth. Temporary breaches in the range fence must be re-closed at the direction of the Military. Contact the sale administrator for specific details of design and placement.

4.1.11 - Permits (2/12)

The Purchaser will secure any necessary permits that may be required.

4.4 - Access

4.4.3 - Access gate (12/08)

The access gate must be locked at all times unless manned by Camp Grayling security. This is to prevent someone other than the Purchaser from entering Camp Grayling's restricted access Cantonment and Range areas.

4.4.4 - Restricted access (10/05)

The sale is within the fenced Cantonment and Small Arms Range area. Daily access on-Camp must be coordinated through Range Control or their delegated contact.

5 - Operations

5.1 - Notification

5.1.1 - Pre-sale conference (10/16)

A pre-sale conference on-site between the Purchaser and sale administrator is required prior to beginning any operations to determine landing and road locations. The Unit Manager or his/her representative must be contacted at least 5 days in advance to schedule the conference.

5.1.4 - Post-sale conference (10/16)

A post-sale conference on site between the Purchaser and sale administrator is required prior to the completion of active logging operations to determine clean-up and repair of landings, road edges, and the fulfillment of other contract specifications.

5.1.5 - National Guard notification (2/15)

This sale is upon lands utilized for training by the Michigan National Guard - Camp Grayling. A minimum of five (5) business days prior to opening this sale, the producer must request that the sale administrator contact the military for information regarding training plans that may impact sale operations.

5.2 - Conduct of Operations

5.2.3 - Operating Restrictions

5.2.3.1 - Operating restrictions (9/11)

Within Payment Unit(s) 1, operations must be completed by March 31, 2019. This restriction is in order to meet the Military's construction project timeframe. The completion deadline may be postponed if the Military's construction project is delayed for other reasons.

5.2.3.7 - National Guard training restriction (1/09)

Operations on this contract will not be allowed during National Guard training operations. Because of the Small Arms Range activity, spray field operations, and oak wilt and endangered species concerns, harvest operations will not be allowed between March 31 and November 30. The Purchaser must check with the sale administrator who will coordinate the cutting schedule with the Military. All harvest equipment and timber products may need to be removed from the sale area during the period of March 31 to November 30.

5.2.16 - Equipment recommended (11/18)

Most of the hilly terrain in Payment Units 2-5 can be cut by wheeled feller-buncher, but a tracked harvester is recommended for cutting the steepest slopes.

5.2.38 - No decking against live trees (2/04)

Cut products may not be decked against unmarked or designated leave trees.

5.4 - Soil Protection

5.4.1 - Rutting restriction, general (7/16)

Operations are to cease immediately if equipment and weather conditions result in rutting of roads and/or skid trails which is 12 inches or greater in depth and 50 feet in length. The Unit Manager or his/her representative may restrict hauling and/or skidding if ruts exceed the specified depth. With the Unit Manager or his/her representative's approval, the Purchaser may return to the area when the risk of rutting has decreased.

5.4.2 - Skid trails (2/04)

Skid trails up and down slopes should be avoided. If however this is unavoidable, these trails will be left in a non-erodible condition using water bars, logs, and slash. Placing of slash on these skid trails while logging is ongoing may alleviate need for any further action. At the direction of the sale administrator, seed, fertilizer, and mulch may also be required.

5.5 - Protection of Improvements

5.5.3 - Protection of improvements detail (10/13)

The following are specific protection measures for this sale: Protect the Military fences, gates, monitor wells, and spray field infrastructure. If any damage does occur, report it immediately to the sale administrator.

6 - Safety and Fire Prevention

SKIP

6.4 - Unexploded ordinance (7/15)

Be aware that the sale area could contain UXO (unexploded ordinances). Do not touch, or drive over any metal objects. If any objects are found, please flag the area and notify the Unit Manager or his/her representative, so that they can make arrangements with the Military.

7 - Other Conditions

7.5 - Loss

7.5.1 - Deteriorating timber (7/09)

The sale area has received damage from widespread oak decline and potentially oak wilt within the spray field area. The Purchaser should harvest the wood as soon as possible. The Department of Natural Resources is held free of responsibility of any further damage or deterioration due to delay in harvesting.

7.10 - Certified Timber

7.10.1 - Non-certified timber (2/16)

The area encompassed by this timber sale is not certified to the standards of the Forest Stewardship Council (FSC) or the Sustainable Forestry Initiative (SFI). Forest products from this sale may not be delivered to the mill as "FSC and / or SFI certified". The lands within this sale are managed for Military training.



TIMBER SALE MAP

This information provided by authority of Part 525, 1994 PA 451, as amended.

Forest Management Unit Grayling Management Unit	County Crawford	Mapped By Charlebois	Date 12/4/2018	Page 1	of 1
Township 26N	Range 04W	Section(s) and Subdivision(s) Sec 16: S1/2SW Sec 20: E1/2NE Sec 17: S1/2SE Sec 21: NW	Scale 1:15,840		

Cover Type				Density			
A = Aspen	H = Hemlock	N = Marsh	U = Upland Brush	0 = Non Stocked	5 = Pole Timber Medium		
B = Paper Birch	J = Jack Pine	O = Oak	UM = Upland Mixed	1 = Seedling Sapling Poor	6 = Pole Timber Well		
C = Cedar	L = Lowland Brush	P = Lowland Poplar	V = Bog or Marsh	2 = Seedling Sapling Medium	7 = Saw Timber Poor		
D = Treed Bog	LM = Lowland Mixed	Q = Mixed Swamp Conifer	W = White Pine	3 = Seedling Sapling Well	8 = Saw Timber Medium		
E = Swamp Hdwoods	M = Mpl, Bch, Brch	R = Red Pine	X = Non Stocked	4 = Pole Timber Poor	9 = Saw Timber Well		
F = Spruce Fir	MC = Mixed Conifer	S = Black Spruce	Z = Water				
G = Grass	MD = Mixed Deciduous	T = Tamarack					

PU 1	47.4 acres
PU 2	12.5 acres
PU 3	12.4 acres
PU 4	10.7 acres
PU 5	22.0 acres



17

WWT Spray Fields Compartments 183 & 184 105 Acres

16



QR Code opens map in PDF map app

Legend

Sale Boundary

- Against State - red paint
- Leave Island - green paint
- Leave Island - no cut area

Payment Unit - unpainted, follows interior closed roads

1 Payment Unit #

Base Features

- * Monitor Wells
- X Military Gate
- Camp Grayling Fence
- Paved Road
- Gravel Road
- Poor Dirt Road
- Closed Road
- Section Corners
- Nearby Sales
- Lakes
- Stand Boundary

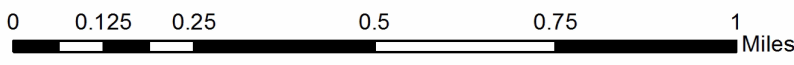
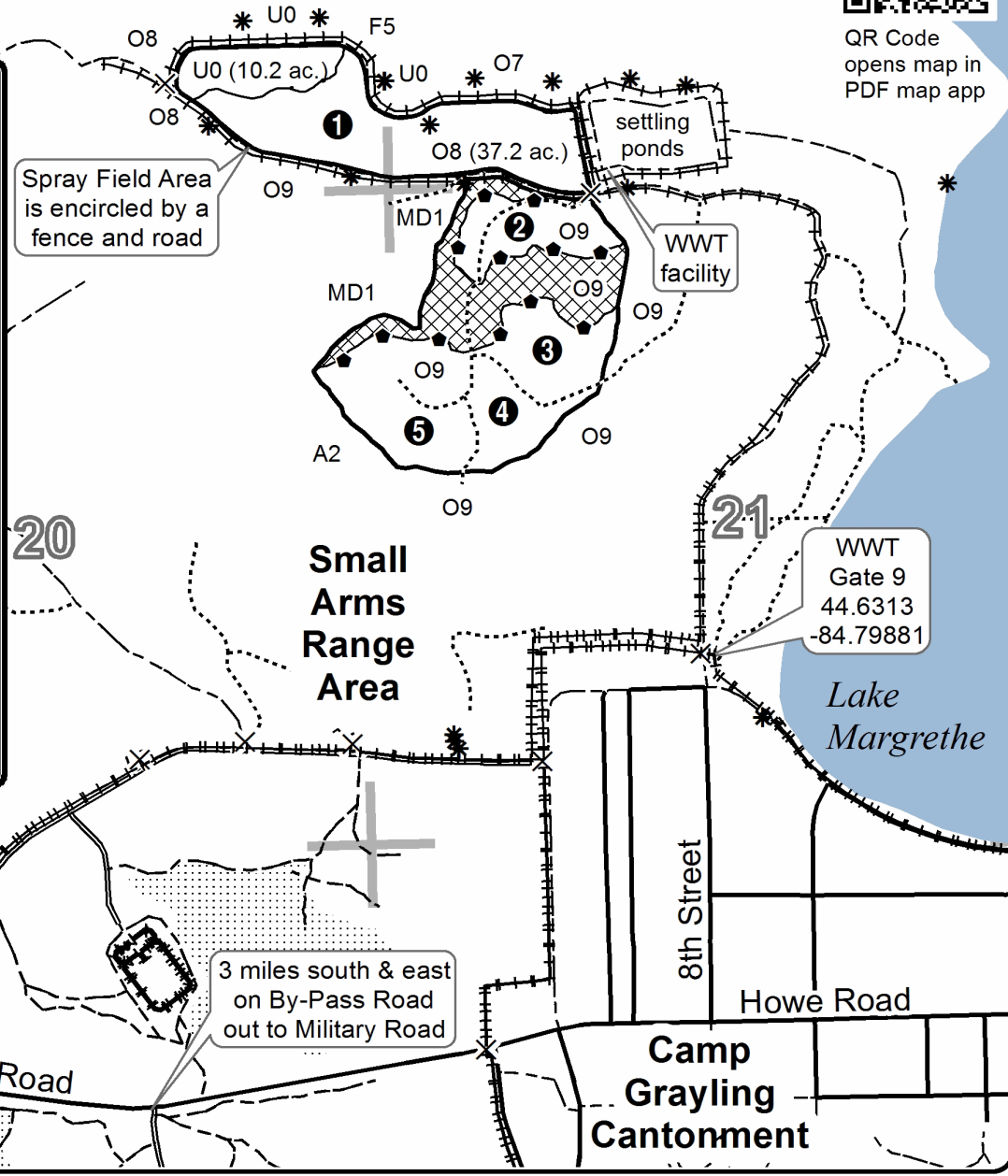

Comp 201 Land Nav (72-633-18)
T26N, R04W, SEC. 23; T26N, R04W, SEC. 26; Crawford COUNTY

In response to the notice of sale to be held 9:00 a.m. (local time) on January 29, 2019, I am hereby submitting my sealed bid (firm offer) for the following forest products to be cut. Bids for individual species must be at or above the advertised price. All non-responsive bid forms may be rejected.

<u>PRODUCTS & SPECIES</u>	<u>ESTIMATED VOLUME*</u>	<u>ADVERTISED PRICE</u>	<u>BID PRICE/UNIT</u>
Sawtimber			
BI/R/Hybrid Oak	818.10 MBF	\$ 205.00/MBF	\$ _____
White Oak	123.70 MBF	\$ 85.00/MBF	\$ _____
Pulpwood			
Misc. Species 2	294.00 Cords	\$ 7.50/Cord	\$ _____
Mixed Aspen	63.00 Cords	\$ 23.65/Cord	\$ _____
Mixed Hardwood	275.00 Cords	\$ 32.35/Cord	\$ _____
Mixed Oak	1,707.00 Cords	\$ 21.05/Cord	\$ _____

*The volumes are statistically estimated within plus (+) or minus (-) 11.17 percent. These estimated volumes are final and not subject to adjustment. Prospective bidders are urged to examine this timber and to make their own estimates of quantity and quality.

I understand that any or all bids may be rejected. All bids must be signed and all bid items must be bid or the bid form may be rejected. I also understand that consideration and awarding a contract will be based upon my past performance and ability to complete the contract based upon equipment and staffing subject to my control.

FEDERAL ID: _____ or SOCIAL SECURITY NUMBER: _____

Company or individual bidding: _____

Company representative's name: _____

Address: _____

City: _____ State: _____ Zip: _____

IF AVAILABLE, PLEASE PLACE THE PERSONALIZED LABEL FROM YOUR PROSPECTUS IN THE ABOVE BOX.

Individual or company representative's signature: _____ Date: _____

Phone number : _____ Email (optional): _____

THE WINNING BIDDER MUST COMPLETE THE VERIFICATION OF WORKER'S DISABILITY COMPENSATION ACT COMPLIANCE (ON REVERSE SIDE IF DOUBLE SIDED) WITHIN 21 DAYS OF SALE AWARD DATE



FOR DEPARTMENT USE ONLY
Sale Number (XX – XXX – XX – XX)
Forest Management Unit:

TIMBER SALE VERIFICATION OF WORKER'S DISABILITY COMPENSATION ACT COMPLIANCE

*As required by Act 317, P.A. 1969 (Worker's Compensation) and
Part 5 of Act 451 of 1994, as amended.*

VERIFICATION OF WORKER'S DISABILITY COMPENSATION ACT COMPLIANCE

- This verification must be completed and submitted within 21 days of contract award and prior to the issuance of the timber sale contract.
- In addition, if boxes 2B or 2C are checked, then Notice of Exclusion or Certificate of Insurance must be submitted within twenty-one (21) days of the contract award and prior to the issuance of the timber sale contract.
- All information must be typed or printed except for written signatures.

Please Check Appropriate Categories:

1. My business is organized as (you **must** check one of the boxes below):
 - A. Sole Proprietorship (individual)
 - B. Partnership
 - C. Corporation
2. You **must** check one of the boxes below:
 - A. I certify my business is a sole proprietorship and it has no employees but the sole proprietor. I am not subject to the Worker's Compensation Laws.
 - B. I certify my business has satisfied its obligation to the Worker's Compensation Act through the use of an approved Notice of Exclusion (BWC-337, Rev. 5/96). I will provide a copy of the Notice of Exclusion within 21 days of the contract award. (For questions or a copy of the BWC-337, please call the Worker's Compensation Bureau at 517-322-1195).
 - C. I certify my business has a Worker's Compensation Policy. I will provide an original Certificate of Insurance within twenty-one (21) days of the contract award.
3. If you have checked item 2(A) or 2(B), you **must** indicate the number of **both** full-time and part-time employees, other than yourself, including family members and active partners (if none, you must enter "0").

_____ Full-time Employees

_____ Part-time Employees

Name of Business		Federal ID (or) Social Security No.	
Address		Telephone ()	
City	State	ZIP	

I hereby certify that the above information is true and correct. I agree to notify the Michigan DNR of any changes that occur in factors affecting my coverage during any of my present and future operations.

Signature of Owner or Authorized Representative

Title

Date

Please complete the "SEALED BID" information on the next page

Comp 201 MtB Trail (72-625-18)
T26N, R04W, SEC. 24; T26N, R04W, SEC. 25; T26N, R04W, SEC. 26; Crawford

In response to the notice of sale to be held 9:00 a.m. (local time) on January 29, 2019, I am hereby submitting my sealed bid (firm offer) for the following forest products to be cut. Bids for individual species must be at or above the advertised price. All non-responsive bid forms may be rejected.

<u>PRODUCTS & SPECIES</u>	<u>ESTIMATED VOLUME*</u>	<u>ADVERTISED PRICE</u>	<u>BID PRICE/UNIT</u>
Sawtimber			
BI/R/Hybrid Oak	223.20 MBF	\$ 205.00/MBF	\$ _____
Northern Pin Oak	46.70 MBF	\$ 205.00/MBF	\$ _____
White Oak	63.10 MBF	\$ 85.00/MBF	\$ _____
Pulpwood			
Jack Pine	84.00 Cords	\$ 18.15/Cord	\$ _____
Misc. Species 2	242.00 Cords	\$ 7.50/Cord	\$ _____
Mixed Aspen	289.00 Cords	\$ 23.65/Cord	\$ _____
Mixed Hardwood	251.00 Cords	\$ 32.35/Cord	\$ _____
Mixed Oak	1,017.00 Cords	\$ 21.05/Cord	\$ _____

*The volumes are statistically estimated within plus (+) or minus (-) 11.58 percent. These estimated volumes are final and not subject to adjustment. Prospective bidders are urged to examine this timber and to make their own estimates of quantity and quality.

I understand that any or all bids may be rejected. All bids must be signed and all bid items must be bid or the bid form may be rejected. I also understand that consideration and awarding a contract will be based upon my past performance and ability to complete the contract based upon equipment and staffing subject to my control.

FEDERAL ID: _____ or SOCIAL SECURITY NUMBER: _____

Company or individual bidding: _____

Company representative's name: _____

Address: _____

City: _____ State: _____ Zip: _____

IF AVAILABLE, PLEASE PLACE THE PERSONALIZED LABEL FROM YOUR PROSPECTUS IN THE ABOVE BOX.

Individual or company representative's signature: _____ Date: _____

Phone number : _____ Email (optional): _____

THE WINNING BIDDER MUST COMPLETE THE VERIFICATION OF WORKER'S DISABILITY COMPENSATION ACT COMPLIANCE (ON REVERSE SIDE IF DOUBLE SIDED) WITHIN 21 DAYS OF SALE AWARD DATE



FOR DEPARTMENT USE ONLY
Sale Number (XX – XXX – XX – XX)
Forest Management Unit:

TIMBER SALE VERIFICATION OF WORKER'S DISABILITY COMPENSATION ACT COMPLIANCE

*As required by Act 317, P.A. 1969 (Worker's Compensation) and
Part 5 of Act 451 of 1994, as amended.*

VERIFICATION OF WORKER'S DISABILITY COMPENSATION ACT COMPLIANCE

- This verification must be completed and submitted within 21 days of contract award and prior to the issuance of the timber sale contract.
- In addition, if boxes 2B or 2C are checked, then Notice of Exclusion or Certificate of Insurance must be submitted within twenty-one (21) days of the contract award and prior to the issuance of the timber sale contract.
- All information must be typed or printed except for written signatures.

Please Check Appropriate Categories:

1. My business is organized as (you **must** check one of the boxes below):
 - A. Sole Proprietorship (individual)
 - B. Partnership
 - C. Corporation

2. You **must** check one of the boxes below:
 - A. I certify my business is a sole proprietorship and it has no employees but the sole proprietor. I am not subject to the Worker's Compensation Laws.
 - B. I certify my business has satisfied its obligation to the Worker's Compensation Act through the use of an approved Notice of Exclusion (BWC-337, Rev. 5/96). I will provide a copy of the Notice of Exclusion within 21 days of the contract award. (For questions or a copy of the BWC-337, please call the Worker's Compensation Bureau at 517-322-1195).
 - C. I certify my business has a Worker's Compensation Policy. I will provide an original Certificate of Insurance within twenty-one (21) days of the contract award.

3. If you have checked item 2(A) or 2(B), you **must** indicate the number of **both** full-time and part-time employees, other than yourself, including family members and active partners (if none, you must enter "0").

_____ Full-time Employees

_____ Part-time Employees

Name of Business		Federal ID (or) Social Security No.	
Address		Telephone ()	
City	State	ZIP	

I hereby certify that the above information is true and correct. I agree to notify the Michigan DNR of any changes that occur in factors affecting my coverage during any of my present and future operations.

Signature of Owner or Authorized Representative

Title

Date

Please complete the "SEALED BID" information on the next page

WWT Spray Fields (72-638-18)

T26N, R04W, SEC. 16; T26N, R04W, SEC. 17; T26N, R04W, SEC. 20; T26N,

In response to the notice of sale to be held 9:00 a.m. (local time) on January 29, 2019, I am hereby submitting my sealed bid (firm offer) for the following forest products to be cut. Bids for individual species must be at or above the advertised price. All non-responsive bid forms may be rejected.

<u>PRODUCTS & SPECIES</u>	<u>ESTIMATED VOLUME*</u>	<u>ADVERTISED PRICE</u>	<u>BID PRICE/UNIT</u>
Sawtimber			
B. T. Aspen	26.40 MBF	\$ 63.00/MBF	\$ _____
Bl/R/Hybrid Oak	37.10 MBF	\$ 164.00/MBF	\$ _____
Northern Pin Oak	16.40 MBF	\$ 164.00/MBF	\$ _____
Red Oak	420.70 MBF	\$ 223.00/MBF	\$ _____
White Oak	41.00 MBF	\$ 68.00/MBF	\$ _____
Pulpwood			
B. T. Aspen	91.00 Cords	\$ 18.90/Cord	\$ _____
Jack Pine	9.00 Cords	\$ 14.50/Cord	\$ _____
Misc. Species 2	213.00 Cords	\$ 6.00/Cord	\$ _____
Mixed Hardwood	14.00 Cords	\$ 25.85/Cord	\$ _____
Mixed Oak	1,153.00 Cords	\$ 16.85/Cord	\$ _____
Red Maple	52.00 Cords	\$ 25.85/Cord	\$ _____
Red Pine	3.00 Cords	\$ 31.55/Cord	\$ _____
White Pine	20.00 Cords	\$ 21.70/Cord	\$ _____

*The volumes are statistically estimated within plus (+) or minus (-) 10.85 percent. These estimated volumes are final and not subject to adjustment. Prospective bidders are urged to examine this timber and to make their own estimates of quantity and quality.

I understand that any or all bids may be rejected. All bids must be signed and all bid items must be bid or the bid form may be rejected. I also understand that consideration and awarding a contract will be based upon my past performance and ability to complete the contract based upon equipment and staffing subject to my control.

FEDERAL ID: _____ or SOCIAL SECURITY NUMBER: _____

Company or individual bidding: _____

Company representative's name: _____

Address: _____

City: _____ State: _____ Zip: _____

IF AVAILABLE, PLEASE PLACE THE PERSONALIZED LABEL FROM YOUR PROSPECTUS IN THE ABOVE BOX.

Individual or company representative's signature: _____ Date: _____

Phone number : _____ Email (optional): _____

THE WINNING BIDDER MUST COMPLETE THE VERIFICATION OF WORKER'S DISABILITY COMPENSATION ACT COMPLIANCE (ON REVERSE SIDE IF DOUBLE SIDED) WITHIN 21 DAYS OF SALE AWARD DATE



FOR DEPARTMENT USE ONLY
Sale Number (XX - XXX - XX - XX)
Forest Management Unit:

TIMBER SALE VERIFICATION OF WORKER'S DISABILITY COMPENSATION ACT COMPLIANCE

*As required by Act 317, P.A. 1969 (Worker's Compensation) and
Part 5 of Act 451 of 1994, as amended.*

VERIFICATION OF WORKER'S DISABILITY COMPENSATION ACT COMPLIANCE

- This verification must be completed and submitted within 21 days of contract award and prior to the issuance of the timber sale contract.
- In addition, if boxes 2B or 2C are checked, then Notice of Exclusion or Certificate of Insurance must be submitted within twenty-one (21) days of the contract award and prior to the issuance of the timber sale contract.
- All information must be typed or printed except for written signatures.

Please Check Appropriate Categories:

1. My business is organized as (you **must** check one of the boxes below):
 - A. Sole Proprietorship (individual)
 - B. Partnership
 - C. Corporation

2. You **must** check one of the boxes below:
 - A. I certify my business is a sole proprietorship and it has no employees but the sole proprietor. I am not subject to the Worker's Compensation Laws.
 - B. I certify my business has satisfied its obligation to the Worker's Compensation Act through the use of an approved Notice of Exclusion (BWC-337, Rev. 5/96). I will provide a copy of the Notice of Exclusion within 21 days of the contract award. (For questions or a copy of the BWC-337, please call the Worker's Compensation Bureau at 517-322-1195).
 - C. I certify my business has a Worker's Compensation Policy. I will provide an original Certificate of Insurance within twenty-one (21) days of the contract award.

3. If you have checked item 2(A) or 2(B), you **must** indicate the number of **both** full-time and part-time employees, other than yourself, including family members and active partners (if none, you must enter "0").

_____ Full-time Employees

_____ Part-time Employees

Name of Business		Federal ID (or) Social Security No.	
Address		Telephone ()	
City	State	ZIP	

I hereby certify that the above information is true and correct. I agree to notify the Michigan DNR of any changes that occur in factors affecting my coverage during any of my present and future operations.

Signature of Owner or Authorized Representative

Title

Date

Please complete the "SEALED BID" information on the next page