



**DEPARTMENT OF NATURAL RESOURCES
STATE OF MICHIGAN**

TIMBER SALE PROSPECTUS #6381

SCHEDULED SALE DATE AND TIME: 3:00 p.m. (local time) on April 25, 2019.

LOCATION: NEWBERRY MGMT UNIT, 5666 S STATE HWY M 123, NEWBERRY, MI 49868.

PROSPECTUS NOTE: The bidder is advised to inspect the sale area and review the location, estimated volumes, operating costs and contract terms of proposed sales. Please be aware that some landowners may request 60 days or more notice for access across their land.

Notice is hereby given that bids will be received by the Unit Manager, NEWBERRY MANAGEMENT UNIT, for certain timber on the following described lands:

Brown Line Pine (42-020-18) / T48N, R11W, SEC. 5 , NWNW.

T49N, R11W, SEC. 30, SW.

T49N, R11W, SEC. 31, E1/2NW,NWNE,S1/2NE,N1/2SE,SESE.

T49N, R11W, SEC. 32, SENW,SW.

Luce County, Advertised Price \$434,108.05, 232.8 Acres, Red Pine, Jack Pine.

SALE NOTE: No new roads will be permitted in any Payment Unit.

The Pine Ridge Trail is an ORV trail or route and is shown on the Timber Sale Map. See Sale Spec 5.2.39 for restrictions.

A recreation site such as a trail, pathway, or campground is within the sale area or the vicinity. Certain restrictions/specifications may be applicable including time restrictions.

Easy Does It (42-026-18) / T49N, R12W, SEC. 23, N1/2NE,SENE,NESE.

T49N, R12W, SEC. 26, S1/2NW,E1/2NE,N1/2SW,SWSW,SE.

T49N, R12W, SEC. 27, E1/2NE,NESE.

T49N, R12W, SEC. 35, N1/2NE,SENE.

Luce County, Advertised Price \$346,523.50, 230.9 Acres, Red Pine, White Pine.

SALE NOTE: The Pine Ridge Trail is an ORV trail or route and is shown on the Timber Sale Map. See Sale Spec 5.2.39 for restrictions.

A recreation site such as a trail, pathway, or campground is within the sale area or the vicinity. Certain restrictions/specifications may be applicable including time restrictions.

BID INSTRUCTIONS (VER. 07/02/2018):

1. Scheduled Bid Location, Date, and Time (2/11)

Bids must be received by the Unit Manager, NEWBERRY OFFICE, 5666 S STATE HWY M 123, NEWBERRY, MI 49868, no later than 3:00 p.m. (local time) on April 25, 2019. For further information concerning this sale, contact Keith Magnusson at 906-293-3293 extension 4740.

2. Bidder's Qualifications (5/16)

Purchaser shall obtain workers compensation insurance to cover claims under Michigan's Worker's Disability Compensation Act of 1969 or similar employee benefit act of any other state applicable to an employee. If all or part of a timber sale was prepared by a private contractor, the contractor and that contractor's company are not permitted to bid on the timber sale contract. Bids will not be accepted from individuals or companies appearing on the DNR/FRD No-Bid List. This list contains the names of purchasers who previously failed to execute a contract within 21-days or who have a history of poor performance.

3. Preparation of Sealed Bids (5/16)

Bid Forms may be completed online thru Michigan DNR Timber Sale Online Bidding (OLB) at www.michigan.gov/timberbidding or by completing the hardcopy Bid Form found in the Timber Sale Prospectus. Hardcopy Bid Forms shall be manually signed in ink. Registration in OLB is considered your 'signature' for all bids submitted thru that system. Bid prices must be entered for each species and product in the Bid Price column for all material subject to bidding and all fill-in blanks must be completed. If erasures or other changes appear on the hardcopy Bid Form, each erasure or change must be initialed by the person signing the bid.

4. Submission of Sealed Bids (5/16)

Bid forms may be obtained from the Unit Manager or thru OLB. Bids may be submitted hardcopy or thru OLB. All hardcopy bids must be submitted on the bid form and in an envelope clearly identified as described in this section. NOTE: Only one bid form per bid envelope. Sealed bids must be submitted to the Unit office designated in the prospectus and must be submitted at or prior to the time established in the prospectus. The envelope should show on the outside (a) the sale name or number and (b) the date and time of bid opening, as shown in the prospectus. Bids received after the time specified in the sale prospectus are late bids and will be rejected.

It is possible for a bidder to submit multiple bids on a single sale. For example, a bid may be submitted hardcopy and a bid may be submitted thru OLB. Or, two bidders from the same company could both submit bids on the same sale. If this were to happen, the State would accept all bids received and award the contract accordingly. All bidding and contractual requirements would apply to all bids received.

5. Public Opening of Sealed Bids (7/16)

If conditions permit, the sealed bids will be publicly opened and posted at the time and place set in the prospectus.

If a bidder, present at a bid opening, has submitted bids on more than one sale, that bidder may withdraw their unopened bid envelopes or announce the withdrawal of their online bid after being declared the successful bidder on one sale.

6. Award of Contract (1/11)

Award of the contract will be made to the Bidder whose bid, conforming to the prospectus, is most advantageous to the State of Michigan on the basis of total value at rates bid for the estimated quantities. The State reserves the right to reject any bid or waive any minor irregularity in bids received. A written award mailed (or otherwise furnished) to the successful Bidder shall be deemed to result in a binding contract without further action by either party.

7. Down Payment (1/11)

The Bidder to whom award is made must make a down payment within 21 days of the sale award. The amount of the down payment will be calculated as shown in the Bond and Payment Schedule of this prospectus. Only cash may be used to meet this requirement.

8. Performance Security (1/11)

As guarantee of faithful performance, a cash bond, certificate of deposit, surety bond or irrevocable letter of credit (LOC) is required within 21 days of the sale award. The amount of the performance security is shown in the Bond and

Payment Schedule of this prospectus. If an LOC or surety is used, the coverage must extend for at least 6 months beyond the contract expiration.

9. Timber Sale Contract (7/18)

Additional conditions and requirements common to all timber sales are listed on the timber sale contract (R4031) and are available on line at www.michigan.gov/timber. Contact the Unit Manager for additional information or a sample contract. Within 21 days of the date of the award letter, the bidder must sign the contract and provide the required down payment, performance security, and verification of worker's disability compensation. The down payment and performance security shall be in accordance with the provisions of the timber sale contract, in the sums stated in this prospectus. If these actions are not taken, then the Bidder, the Bidder's corporation, and the corporation's principals may not be permitted to bid on State timber sales for a period of 3 months after the first offense, 6 months after the second offense, and 1 year after the third offense. An offense will only be counted against the Bidder for 5 years. In addition, the Bidder certifies that if awarded this contract, the Bidder will complete the timber sale contract in accordance with its terms and any modifications thereof including requirements to purchase, cut, and remove the included timber by the expiration date.

Payment Unit values in the State Forest Timber Sale Contract are calculated based on the advertised value of the Payment Unit as a percentage of the total advertised value of the contract. The advertised value of each Payment Unit is given in the Description of Timber by Payment Unit table on the Timber Sale Information page. For example, if the value of Payment Unit 1 is advertised as \$1,500 and the total Timber Sale value is advertised as \$10,000, the contract price for Payment Unit 1 will be 15% of the total bid price ($\$1,500/\$10,000 * 100$).

10. Disclaimer of Estimates and Bidder's Warranty of Inspection (7/16)

Before submitting this bid, the Bidder is advised and cautioned to inspect the sale area, review the requirements of the sale contract, and take other steps as may be reasonably necessary to ascertain the location, estimated volumes, construction estimates, and operating costs of the proposed sale. Failure to do so will not relieve the Bidder from responsibility for completing the contract.

The Bidder warrants that this bid is submitted solely on the basis of the Bidder's examination and inspection of the quality and quantity of the timber offered for sale and the Bidder's opinion of the value thereof and the costs of recovery. No reliance should be placed on the State of Michigan's estimates of timber quality, quantity or costs of recovery. Bidder further acknowledges that the State of Michigan: (i) expressly disclaims any warranty of fitness of timber for any purpose; (ii) offers this timber as is without any warranty of quality (merchantability) or quantity and (iii) expressly disclaims any warranty as to the quantity or quality of timber sold.

11. Certification and Chain-of-Custody (10/14)

Unless otherwise indicated in the contract under section 7 – Other Conditions of the Sale Specific Conditions & Requirements, the area encompassed by this timber sale is certified to the standards of the Forest Stewardship Council (FSC) - Certificate #SCS-FM/COC-00090N and the Sustainable Forestry Initiative (SFI) - Certificate #NSF-SFIS-5Y031-SF5. Forest products from this sale may be delivered to the mill as "FSC 100% and / or SFI certified" as long as the contractor hauling the forest products is chain-of-custody (COC) certified or covered under a COC certificate from the destination mill. The purchaser is responsible for maintaining COC after leaving the sale area.

12. Good Neighbor Authority (GNA) Requirements (7/16)

If the name of this timber sales contains the acronym GNA, it is authorized by the Good Neighbor Authority (GNA) and covered by various agreements between the U.S. Forest Service and the State. The timber sale occurs on federal land and the following conditions apply:

GNA contracts on US Forest Service land will not be awarded to purchasers on the Federal list of excluded parties. The System for Award Management (SAM) will be checked for active excluded parties prior to award of contract. In addition, the Bidder to whom award is made must complete an Assurance Regarding Felony Conviction or Tax Delinquent Status for Corporate Applicants (AD-3031).

13. Good Neighbor Authority (GNA) Requirements, con't (9/16)

Bidder certifies, by signing this bid form, that to the best of Bidder's knowledge that the following representations are accurate and complete.

- a. That the Bidder and its principals are not presently debarred, suspended, proposed for debarment, declared ineligible, or voluntary excluded from timber sales (covered transactions) by any Federal department or agency.
- b. That the Bidder and its principals have not within a 3-year period preceding this bid been convicted of or had a civil judgment rendered against them for commission of fraud or a criminal offense in connection with obtaining, attempting to obtain, or performing a public (Federal, State, or local) transaction or contract under a public transaction; violation of Federal or State antitrust statutes or commission of embezzlement, theft, forgery, bribery, falsification or destruction of records, making false statements, or receiving stolen property.
- c. That the Bidder and its principals are not presently indicted for or otherwise criminally or civilly charged by a governmental entity (Federal, State, or local) with commission of any of the offenses enumerated in paragraph b of this certification.
- d. That the Bidder and its principals have not within a 3-year period preceding this bid had one or more public transactions (Federal, State, or local) terminated for breach or default of a timber or forest product contract.

Bidders that cannot certify this requirement, in whole or in part, shall submit an explanation with their bid.

DAN EICHINGER
Director

TIMBER SALE INFORMATION

Brown Line Pine (42-020-18)

T48N, R11W, SEC. 5; T49N, R11W, SEC. 30; T49N, R11W, SEC. 31; T49N, R11W, SEC. 32.
Luce County (Advertised Price \$434,108.05)

SALE NOTE: No new roads will be permitted in any Payment Unit.

The Pine Ridge Trail is an ORV trail or route and is shown on the Timber Sale Map. See Sale Spec 5.2.39 for restrictions.

A recreation site such as a trail, pathway, or campground is within the sale area or the vicinity. Certain restrictions/specifications may be applicable including time restrictions.

A timber sale contract for this lump sum, sealed bid timber sale will be awarded to the responsible bidder offering the highest sealed bid price. Bids must be at or above the following advertised price for each species:

<u>PRODUCTS & SPECIES</u>	<u>ESTIMATED UNITS*</u>	<u>ADVERTISED PRICE</u>
Pulpwood		
Balsam Fir	5.00 Cords	\$ 15.20 / Cord
Black Spruce	77.00 Cords	\$ 21.10 / Cord
Jack Pine	2,549.00 Cords	\$ 50.15 / Cord
Quaking Aspen	72.00 Cords	\$ 33.10 / Cord
Red Maple	30.00 Cords	\$ 18.25 / Cord
Red Pine	3,361.00 Cords	\$ 78.60 / Cord
White Pine	1,343.00 Cords	\$ 27.90 / Cord

* The total volume is statistically estimated within plus (+) or minus (-) 5.77 percent. The estimated units are final and not subject to adjustment. Prospective bidders are urged to examine this timber and to make their own estimates of quantity and quality.

BOND AND PAYMENT SCHEDULE:

1. A bond in the amount of \$21,705.00 to insure faithful performance of the conditions of the contract will be deposited by the successful bidder within 21 days of the sale award.
2. Cutting in any sale or unit without the required advance payment would be considered a trespass.
3. Total payment must be paid in advance or according to the following schedule:
 - (a) Ten percent (10%) of the sale value must be paid within 21 days of the sale award.
 - (b) The 10% down payment will be credited towards the first unit cut.
 - (c) Payment for each of the following units must be made before cutting begins in that unit:

<u>PAYMENT UNIT NUMBER</u>	<u>PERCENT OF TOTAL SALE VALUE</u>
01	17.9%
02	8.8%
03	11.8%
04	4.0%
05	4.5%
06	14.3%
07	7.6%
08	8.0%
09	13.0%
10	10.1%

4. If no cutting takes place, the 10% down payment will not be refunded.
5. Operations on the contract issued will terminate on 12/31/2022.

Description of Timber by Payment Unit (PU)

PU	MARKET GROUP	PRODUCT	QUANTITY	UNIT	ACRES	ADVERTISE PRICE
1	Jack Pine	Pulpwood	1,144.0	Cords	37.4	\$77,879.60
	Red Pine		224.0	Cords		
	White Pine		104.0	Cords		
	White Pine		1.7	MBF		
	White Pine		101.0	Cords		
2	Red Pine	Pulpwood	467.0	Cords	29.2	\$38,017.50
	White Pine		47.0	Cords		
	White Pine		0.6	MBF		
	White Pine		46.0	Cords		
3	Balsam Fir	Pulpwood	3.0	Cords	43.8	\$51,277.45
	Jack Pine		17.0	Cords		
	Red Pine		576.0	Cords		
	White Pine		183.0	Cords		
	White Pine		183.0	Cords		
4	Balsam Fir	Pulpwood	1.0	Cords	14.7	\$17,215.70
	Jack Pine		6.0	Cords		
	Red Pine		193.0	Cords		
	White Pine		62.0	Cords		
	White Pine		62.0	Cords		
5	Balsam Fir	Pulpwood	1.0	Cords	16.7	\$19,532.65
	Jack Pine		7.0	Cords		
	Red Pine		219.0	Cords		
	White Pine		70.0	Cords		
	White Pine		70.0	Cords		
6	Black Spruce	Pulpwood	20.0	Cords	24.5	\$61,970.50
	Jack Pine		370.0	Cords		
	Quaking Aspen		19.0	Cords		
	Red Maple		8.0	Cords		
	Red Pine		453.0	Cords		
	White Pine		237.0	Cords		
	White Pine		0.8	MBF		
	White Pine		235.0	Cords		
7	Black Spruce	Pulpwood	11.0	Cords	13.1	\$33,102.40
	Jack Pine		198.0	Cords		
	Quaking Aspen		10.0	Cords		
	Red Maple		4.0	Cords		
	Red Pine		242.0	Cords		
	White Pine		126.0	Cords		
	White Pine		0.4	MBF		
	White Pine		125.0	Cords		
8	Black Spruce	Pulpwood	12.0	Cords	13.8	\$34,943.60
	Jack Pine		209.0	Cords		
	Quaking Aspen		11.0	Cords		
	Red Maple		5.0	Cords		
	Red Pine		255.0	Cords		
	White Pine		133.0	Cords		
	White Pine		0.5	MBF		
	White Pine		132.0	Cords		
9	Black Spruce	Pulpwood	19.0	Cords	22.3	\$56,406.70
	Jack Pine		337.0	Cords		
	Quaking Aspen		18.0	Cords		
	Red Maple		7.0	Cords		
	Red Pine		412.0	Cords		
	White Pine		215.0	Cords		
	White Pine		0.8	MBF		

Description of Timber by Payment Unit (PU), con't

PU	MARKET GROUP	PRODUCT	QUANTITY	UNIT	ACRES	ADVERTISE PRICE
9 con't	<i>White Pine</i>	<i>Pulpwood</i>	213.0	<i>Cords</i>		
10	Black Spruce	Pulpwood	15.0	Cords	17.3	\$43,789.85
	Jack Pine		261.0	Cords		
	Quaking Aspen		14.0	Cords		
	Red Maple		6.0	Cords		
	Red Pine		320.0	Cords		
	White Pine		167.0	Cords		
	<i>White Pine</i>	<i>Sawtimber</i>	0.6	<i>MBF</i>		
	<i>White Pine</i>	<i>Pulpwood</i>	166.0	<i>Cords</i>		
TOTAL:			7,438.0	Cords		

Sale Specific Conditions & Requirements

Sale Name: Brown Line Pine

Sale Number: 42-020-18 Seq#: 1

1 - Sale Area

1.2 - Boundaries

1.2.1 - Painted boundaries (1/14)

The sale boundary and Payment Unit boundaries are marked and identified by blue, red and yellow paint. Exterior sale boundary lines against private are marked with blue paint. Exterior sale boundary lines against state are marked with red paint. Interior Payment Unit boundaries are marked with yellow paint. Yellow painted trees designating an interior Payment Unit boundary are only to be cut when all surrounding Payment Units have been paid.

2 - Timber Specifications

2.1 - Included Timber

2.1.2 - Clearcut unit(s) w/o unmerchantable trees (8/11)

Within Payment Unit(s) 1 - 10, cut all trees which meet minimum piece specifications in 2.2 Utilization, except do not cut oak, where present. In addition, within Payment Unit 2, leave 1-2 red or white pine greater than 12" at DBH per acre. Also, within Payment Units 6 - 10, leave any white pine greater than 24" at DBH, and leave all hemlock.

2.2 - Utilization

2.2.3 - Stump heights (4/07)

Stump heights within the Sale Area shall not exceed 12 inches for trees greater than 10 inches DBH and 6 inches for trees smaller than 10 inches DBH. This is in order to facilitate planting operations.

3 - Payments

3.3 - Pre-measured Sales

3.3.4 - Dividing payment units (7/14)

Payment Unit(s) may be divided at the request of the Purchaser and upon approval of the Unit Manager. Dividing Payment Units is a contract modification which requires a Timber Sale Contract Supplement. There will be only one division per Payment Unit.

4 - Transportation

4.1 - Construction

4.1.12 - No new roads (1/12)

No new roads will be permitted in any Payment Unit. All operations are limited to existing roads. Skid trails only will be allowed.

4.2 - Maintenance

4.2.4 - Grading (10/16)

For completion of the sale, state forest roads must be graded. In general, this will require a road grader or bull dozer to shape up the roads after forest products have been hauled off site. This includes cleaning of drainage areas, grading, crowning and filling with gravel, if necessary. The grading equipment to be used must be approved by the Unit Manager or his/her representative.

4.2.5 - Two wheel drive condition (2/04)

All existing trail roads on and adjacent to the sale area must be passable by two-wheel drive traffic for the duration of the sale.

5 - Operations

5.2 - Conduct of Operations

5.2.1 - Slash

5.2.1.8 - Slash height (12/08)

No slash or tree tops may exceed 24 inches in height.

5.2.1.11 - Slash for reforestation (5/07)

To facilitate reforestation, the sale area shall be left with slash evenly distributed. Bunched tops within the cutting area shall be broken up and scattered. Stumps shall be cut low to the ground. Processing sites shall not be left with a compacted layer of slash; tops from these sites shall be hauled back into the cut area and scattered.

5.2.2 - Hazard Trees/Snags

5.2.2.1 - Den trees (10/16)

Obvious hollow and/or den trees shall be protected and left standing unless they are a safety hazard.

5.2.3 - Operating Restrictions

5.2.3.6 - Bark beetle restriction (12/08)

In the event drought creates a high risk of pine bark beetle infestation, pine is not to be cut during the period March 1 through July 1, unless all portions of trees greater than two inches in diameter are removed from the sale area, reduced to chips, or treated to the satisfaction of the Unit Manager or his/her representative, within fifteen days of being severed from the stump. Pine log decks, pulpwood piles and treetops that are piled for chipping in the fall or winter within a 1/4 mile of susceptible sites must be removed before March 15. Residual slash must not be placed in piles or rows and must be spread over the site for quick drying. The Department of Natural Resources will exercise this specification if the risk of damage warrants.

5.2.38 - No decking against live trees (2/04)

Cut products may not be decked against unmarked or designated leave trees.

5.2.39 - ORV trail/route protection (4/18)

The Pine Ridge Trail is an ORV trail or route and is shown on the Timber Sale Map. Do not cut trees or damage posts with yellow ORV markers. All stumps within 5 feet of the trail must be cut flush with the ground. Maintain a 20 foot wide slash, debris, and rut free zone daily using the ORV trail or route as the centerline. Do not run equipment down the ORV trail or route. Skidding across the trail or route may only occur in locations approved by the sale administrator.

5.4 - Soil Protection

5.4.1 - Rutting restriction, general (7/16)

Operations are to cease immediately if equipment and weather conditions result in rutting of roads and/or skid trails which is 12 inches or greater in depth and 50 feet in length. The Unit Manager or his/her representative may restrict hauling and/or skidding if ruts exceed the specified depth. With the Unit Manager or his/her representative's approval, the Purchaser may return to the area when the risk of rutting has decreased.

5.8 - Protection of Endangered Species

5.8.5 - Protection of raptor nests (3/13)

All trees with raptor nests will be protected if found during harvesting operations. Notification will be made to the Unit Manager or his/her representative who will notify the Wildlife Biologist so an on-site evaluation and recommendation can be made, if necessary.

6 - Safety and Fire Prevention

6.2 - Signing

6.2.3 - Recreational trail posting (2/10)

The Purchaser is responsible for posting and maintaining caution signs on Pine Ridge Trail prior to beginning operations. The trail must be posted at appropriate distances from the sale area to warn of logging activity and truck traffic at both ends of the trail. Signs must be removed when harvest operations are suspended or completed.

7 - Other Conditions

7.3 - Contract Modifications

7.3.3 - Modification for reforestation (8/05)

When contractual work of Purchaser has been accepted for any Payment Unit identified on Sale Area Map, Payment Unit will be eliminated from the Sale Area on written notice so that reforestation operations can begin.



TIMBER SALE MAP

This information provided by authority of Part 525, 1994 PA 451, as amended.

Sale Number	Year
42 - 020	18

Forest Management Unit Newberry Management Unit	County Luce	Mapped By Douglass	Date 10/08/2018	Page 1	of 1
Township 49N	Range 11W	Sec 30 - S1/2NW; Sec 31 - W1/2NE, E1/2NW, N1/2SE, SESE; Sec 32 - SENW, SW1/4; T48N R11W Sec 5 - NWNW	Scale 1:15,840		

Cover Type				Density	
A = Aspen	H = Hemlock	N = Marsh	U = Upland Brush	0 = Non Stocked	5 = Pole Timber Medium
B = Paper Birch	J = Jack Pine	O = Oak	UM = Upland Mixed	1 = Seedling Sapling Poor	6 = Pole Timber Well
C = Cedar	L = Lowland Brush	P = Lowland Poplar	V = Bog or Marsh	2 = Seedling Sapling Medium	7 = Saw Timber Poor
D = Treed Bog	LM = Lowland Mixed	Q = Mixed Swamp Conifer	W = White Pine	3 = Seedling Sapling Well	8 = Saw Timber Medium
E = Swamp Hdwoods	M = Mpl, Bch, Brch	R = Red Pine	X = Non Stocked	4 = Pole Timber Poor	9 = Saw Timber Well
F = Spruce Fir	MC = Mixed Conifer	S = Black Spruce	Z = Water		
G = Grass	MD = Mixed Deciduous	T = Tamarack			

PU	Acres	PU	Acres	PU	Acres
1	37.4	5	16.7	9	22.3
2	29.2	6	24.5	10	17.3
3	43.8	7	13.1		
4	14.7	8	13.8		

Brown Line Pine

Compartment 15

232.8 Acres

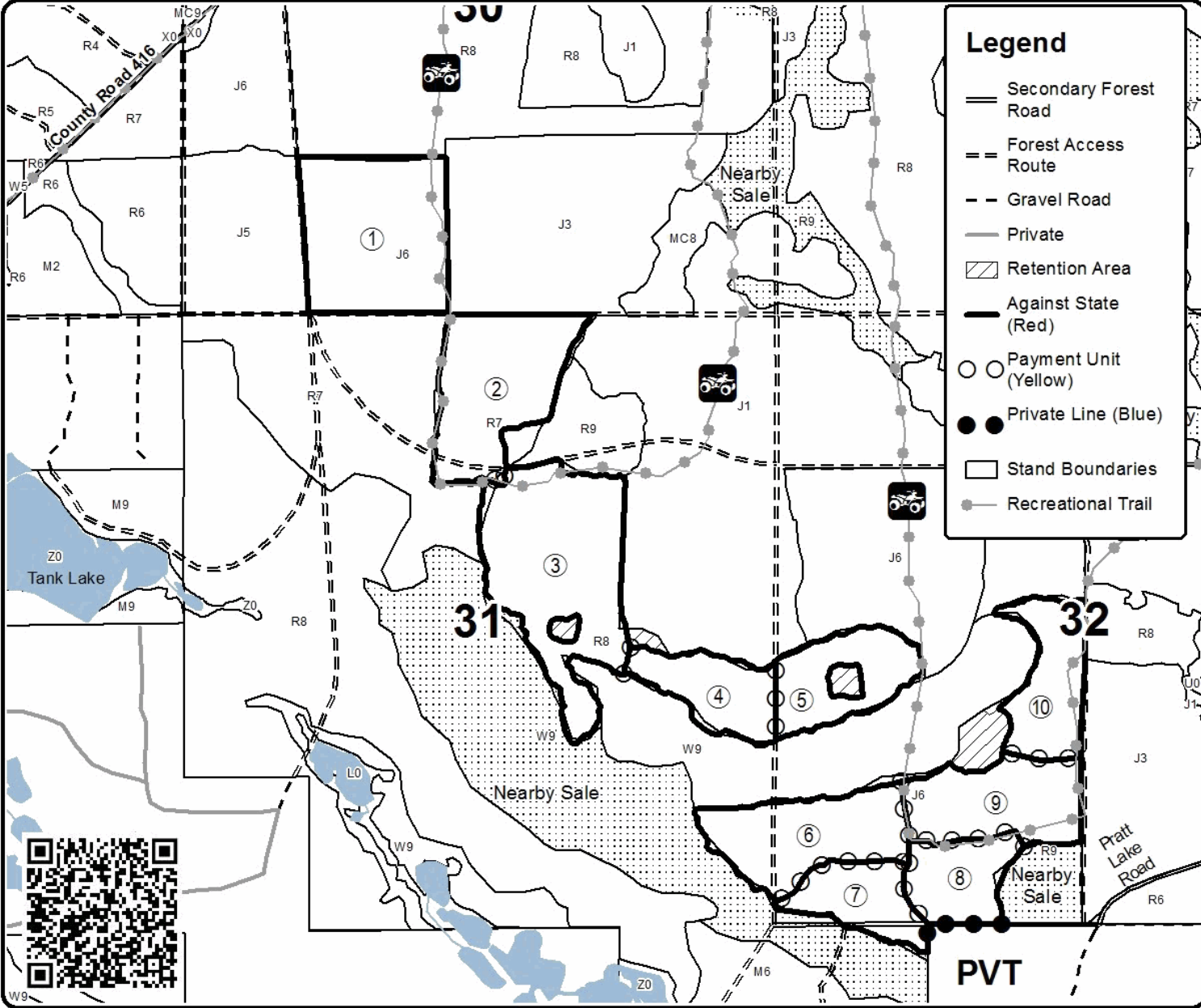

TIMBER SALE INFORMATION

Easy Does It (42-026-18)

T49N, R12W, SEC. 23; T49N, R12W, SEC. 26; T49N, R12W, SEC. 27; T49N, R12W, SEC. 35.
Luce County (Advertised Price \$346,523.50)

SALE NOTE: The Pine Ridge Trail is an ORV trail or route and is shown on the Timber Sale Map. See Sale Spec 5.2.39 for restrictions.

A recreation site such as a trail, pathway, or campground is within the sale area or the vicinity. Certain restrictions/specifications may be applicable including time restrictions.

A timber sale contract for this lump sum, sealed bid timber sale will be awarded to the responsible bidder offering the highest sealed bid price. Bids must be at or above the following advertised price for each species:

<u>PRODUCTS & SPECIES</u>	<u>ESTIMATED UNITS*</u>		<u>ADVERTISED PRICE</u>
Sawtimber			
Red Maple	6.30	MBF	\$ 142.00 / MBF
Pulpwood			
Balsam Fir	242.00	Cords	\$ 15.20 / Cord
Hemlock	79.00	Cords	\$ 17.00 / Cord
Jack Pine	1,825.00	Cords	\$ 50.15 / Cord
Mixed Aspen	86.00	Cords	\$ 33.10 / Cord
Mixed Hardwood	403.00	Cords	\$ 18.25 / Cord
Mixed Spruce	150.00	Cords	\$ 21.10 / Cord
Paper Birch	38.00	Cords	\$ 20.05 / Cord
Red Pine	2,252.00	Cords	\$ 78.60 / Cord
White Pine	2,077.00	Cords	\$ 27.90 / Cord

* The total volume is statistically estimated within plus (+) or minus (-) 4.75 percent. The estimated units are final and not subject to adjustment. Prospective bidders are urged to examine this timber and to make their own estimates of quantity and quality.

BOND AND PAYMENT SCHEDULE:

1. A bond in the amount of \$17,326.00 to insure faithful performance of the conditions of the contract will be deposited by the successful bidder within 21 days of the sale award.
2. Cutting in any sale or unit without the required advance payment would be considered a trespass.
3. Total payment must be paid in advance or according to the following schedule:
 - (a) Ten percent (10%) of the sale value must be paid within 21 days of the sale award.
 - (b) The 10% down payment will be credited towards the first unit cut.
 - (c) Payment for each of the following units must be made before cutting begins in that unit:

PAYMENT UNIT NUMBER	PERCENT OF TOTAL SALE VALUE
01	2.5%
02	5.7%
03	3.0%
04	10.0%
05	29.2%
06	33.7%
07	12.8%
08	3.1%
4. If no cutting takes place, the 10% down payment will not be refunded.
5. Operations on the contract issued will terminate on 12/31/2022.

Description of Timber by Payment Unit (PU)

PU	MARKET GROUP	PRODUCT	QUANTITY	UNIT	ACRES	ADVERTISE PRICE
1	Balsam Fir	Pulpwood	76.0	Cords	12.1	\$8,683.85
	Hemlock		79.0	Cords		
	Jack Pine		12.0	Cords		
	Mixed Hardwood		141.0	Cords		
	<i>Red Maple</i>		128.0	Cords		
	<i>Yellow Birch</i>		13.0	Cords		
	Mixed Spruce		19.0	Cords		
	<i>White Spruce</i>		19.0	Cords		
	Red Pine		8.0	Cords		
	White Pine		71.0	Cords		
2	Jack Pine	Pulpwood	143.0	Cords	8.1	\$19,655.80
	Mixed Hardwood		3.0	Cords		
	<i>Red Maple</i>		3.0	Cords		
	Red Pine		134.0	Cords		
	White Pine		68.0	Cords		
3	Red Maple	Sawtimber	0.5	MBF	18.2	\$10,535.70
	Balsam Fir	Pulpwood	32.0	Cords		
	Jack Pine		64.0	Cords		
	Mixed Hardwood		30.0	Cords		
	<i>Red Maple</i>		30.0	Cords		
	Mixed Spruce		37.0	Cords		
	<i>White Spruce</i>		37.0	Cords		
	White Pine		195.0	Cords		
4	Jack Pine	Pulpwood	306.0	Cords	15.3	\$34,684.50
	Mixed Aspen		12.0	Cords		
	<i>Quaking Aspen</i>		12.0	Cords		
	Red Pine		192.0	Cords		
	White Pine		138.0	Cords		
5	Balsam Fir	Pulpwood	6.0	Cords	35.2	\$101,016.05
	Jack Pine		599.0	Cords		
	Mixed Aspen		23.0	Cords		
	<i>B. T. Aspen</i>		23.0	Cords		
	Mixed Hardwood		5.0	Cords		
	<i>Red Maple</i>		5.0	Cords		
	Mixed Spruce		2.0	Cords		
	<i>Black Spruce</i>		2.0	Cords		
	Paper Birch		13.0	Cords		
	Red Pine		748.0	Cords		
White Pine	392.0	Cords				
6	Balsam Fir	Pulpwood	8.0	Cords	40.7	\$116,748.55
	Jack Pine		692.0	Cords		
	Mixed Aspen		27.0	Cords		
	<i>B. T. Aspen</i>		27.0	Cords		
	Mixed Hardwood		6.0	Cords		
	<i>Red Maple</i>		6.0	Cords		
	Mixed Spruce		2.0	Cords		
	<i>Black Spruce</i>		2.0	Cords		
	Paper Birch		15.0	Cords		
	Red Pine		864.0	Cords		
White Pine	454.0	Cords				
7	Balsam Fir	Pulpwood	3.0	Cords	78.5	\$44,457.95
	Jack Pine		9.0	Cords		
	Mixed Spruce		41.0	Cords		
	<i>White Spruce</i>		41.0	Cords		
	Paper Birch		6.0	Cords		
Red Pine	299.0	Cords				

Description of Timber by Payment Unit (PU), con't

PU	MARKET GROUP	PRODUCT	QUANTITY	UNIT	ACRES	ADVERTISE PRICE
	White Pine		698.0	Cords		
8	Red Maple	Sawtimber	5.8	MBF	22.8	\$10,741.10
	Balsam Fir	Pulpwood	117.0	Cords		
	Mixed Aspen		24.0	Cords		
	<i>Quaking Aspen</i>		24.0	<i>Cords</i>		
	Mixed Hardwood		218.0	Cords		
	<i>Beech</i>		5.0	<i>Cords</i>		
	<i>Red Maple</i>		213.0	<i>Cords</i>		
	Mixed Spruce		49.0	Cords		
	<i>White Spruce</i>		49.0	<i>Cords</i>		
	Paper Birch		4.0	Cords		
	Red Pine		7.0	Cords		
	White Pine		61.0	Cords		
TOTAL:			6.3	MBF		
TOTAL:			7,152.0	Cords		

Sale Specific Conditions & Requirements

Sale Name: Easy Does It

Sale Number: 42-026-18 Seq#: 1

1 - Sale Area

1.2 - Boundaries

1.2.1 - Painted boundaries (1/14)

The sale boundary and Payment Unit boundaries are marked and identified by red and yellow paint. Exterior sale boundary lines against state are marked with red paint. Interior Payment Unit boundaries are marked with yellow paint. Yellow painted trees designating an interior Payment Unit boundary are only to be cut when all surrounding Payment Units have been paid.

2 - Timber Specifications

2.1 - Included Timber

2.1.2 - Clearcut unit(s) w/o unmerchantable trees (8/11)

Within Payment Unit(s) 1 - 8, cut all trees which meet minimum piece specifications in 2.2 Utilization, except do not cut oak, where present. The following exceptions apply:

- Within Payment Unit 1, leave one (1) white pine or hemlock per acre.
- Within Payment Unit 3, leave all hemlock, and twelve (12) scattered larger white pine.
- Within Payment Unit 8, leave all hemlock and yellow birch. Also, leave one (1) white pine per acre.

2.2 - Utilization

2.2.3 - Stump heights (4/07)

Stump heights within Payment Unit(s) 2 - 7 shall not exceed 12 inches for trees greater than 10 inches DBH and 6 inches for trees smaller than 10 inches DBH. This is in order to facilitate reforestation operations.

3 - Payments

3.3 - Pre-measured Sales

3.3.4 - Dividing payment units (7/14)

Payment Unit(s) 2, 4, 5, 6 & 7 may be divided at the request of the Purchaser and upon approval of the Unit Manager. Dividing Payment Units is a contract modification which requires a Timber Sale Contract Supplement.

3.4 - Damaged Timber

3.4.1 - Damaged timber (6/14)

General Condition and Requirement 3.4 Damaged Timber, defines liquidated damages for undesignated live merchantable trees which are cut or injured. In addition, extreme care should be taken to avoid damage to tree seedlings and saplings.

4 - Transportation

4.1 - Construction

4.1.6 - Road construction (1/09)

Construction of new roads or improvements of existing roads shall be done in such a way as to minimize the environmental and visual impacts. Merchantable trees shall be cut and utilized unless otherwise directed. Non-merchantable trees shall be severed and laid flat on the ground. Slash shall be scattered, and not left in windrows and kept a minimum of 10 feet back from the road edge. Stumps shall be set upright, not left on edge, and be moved at least 10 feet away from the road edge. Disturbed soil shall be feathered into the woods and not left in berms or windrows.

4.1.7 - Road closure (10/11)

All new roads built into the sale must be blocked to vehicle traffic upon completion of the sale. In general, this will require constructing double earthen berms at strategic locations. Stumps and brush must be placed along the remainder of the trail.

These roads must be rendered impassable to cars and trucks. Contact the sale administrator for specific details of design and placement.

4.2 - Maintenance

4.2.4 - Grading (10/16)

For completion of the sale, state forest roads must be graded. In general, this will require a road grader or bull dozer to shape up the roads after forest products have been hauled off site. The grading equipment to be used must be approved by the Unit Manager or his/her representative.

4.2.5 - Two wheel drive condition (2/04)

All existing trail roads on and adjacent to the sale area must be passable by two-wheel drive traffic for the duration of the sale.

5 - Operations

5.2 - Conduct of Operations

5.2.1 - Slash

5.2.1.8 - Slash height (12/08)

No slash or tree tops may exceed 24 inches in height.

5.2.1.11 - Slash for reforestation (5/07)

To facilitate reforestation, the sale area shall be left with slash evenly distributed. Bunched tops within the cutting area shall be broken up and scattered. Stumps shall be cut low to the ground. Processing sites shall not be left with a compacted layer of slash; tops from these sites shall be hauled back into the cut area and scattered.

5.2.2 - Hazard Trees/Snags

5.2.2.1 - Den trees (10/16)

Obvious hollow and/or den trees shall be protected and left standing unless they are a safety hazard.

5.2.3 - Operating Restrictions

5.2.3.6 - Bark beetle restriction (12/08)

In the event drought creates a high risk of pine bark beetle infestation, pine is not to be cut during the period March 1 through July 1, unless all portions of trees greater than two inches in diameter are removed from the sale area, reduced to chips, or treated to the satisfaction of the Unit Manager or his/her representative, within fifteen days of being severed from the stump. Pine log decks, pulpwood piles and treetops that are piled for chipping in the fall or winter within a 1/4 mile of susceptible sites must be removed before March 15. Residual slash must not be placed in piles or rows and must be spread over the site for quick drying. The Department of Natural Resources will exercise this specification if the risk of damage warrants.

5.2.38 - No decking against live trees (2/04)

Cut products may not be decked against unmarked or designated leave trees.

5.2.39 - ORV trail/route protection (4/18)

The Pine Ridge Trail is an ORV trail or route and is shown on the Timber Sale Map. Do not cut trees or damage posts with yellow ORV markers. All stumps within 5 feet of the trail must be cut flush with the ground. Maintain a 20 foot wide slash, debris, and rut free zone daily using the ORV trail or route as the centerline. Do not run equipment down the ORV trail or route. Skidding across the trail or route may only occur in locations approved by the sale administrator.

5.4 - Soil Protection

5.4.1 - Rutting restriction, general (7/16)

Operations are to cease immediately if equipment and weather conditions result in rutting of roads and/or skid trails which is 12 inches or greater in depth and 50 feet in length. The Unit Manager or his/her representative may restrict hauling and/or skidding if ruts exceed the specified depth. With the Unit Manager or his/her representative's approval, the Purchaser may return to the area when the risk of rutting has decreased.

5.8 - Protection of Endangered Species

5.8.5 - Protection of raptor nests (3/13)

All trees with raptor nests will be protected if found during harvesting operations. Notification will be made to the Unit Manager or his/her representative who will notify the Wildlife Biologist so an on-site evaluation and recommendation can be made, if necessary.

6 - Safety and Fire Prevention

6.2 - Signing

6.2.1 - Road posting (9/09)

The Purchaser is responsible for posting and maintaining caution signs on County Road 416 prior to beginning operations. The road must be posted at appropriate distances from the sale areato warn of logging activity and truck traffic. Signs must be removed when harvest operations are suspended or completed. The Purchaser will provide these signs.

7 - Other Conditions

7.3 - Contract Modifications

7.3.3 - Modification for reforestation (8/05)

When contractual work of Purchaser has been accepted for any Payment Unit identified on Sale Area Map, Payment Unit will be eliminated from the Sale Area on written notice so that reforestation operations can begin.



TIMBER SALE MAP

This information provided by authority of Part 525, 1994 PA 451, as amended.

Sale Number	Year
42 - 026	18

Forest Management Unit	County	Mapped By	Date	Page	of
Newberry Management Unit	County Name	Douglass	10/05/2018	1	2
Township	Range	23 - N1/2NE, SENE, NESE; 26 - E/12NE, SENE, N1/2SW, SWSW, SE1/4; 27 - E1/2NE; 35 - N1/2NE, SENE		Scale	
49N	12W			1:15,840	

Cover Type				Density	
A = Aspen	H = Hemlock	N = Marsh	U = Upland Brush	0 = Non Stocked	5 = Pole Timber Medium
B = Paper Birch	J = Jack Pine	O = Oak	UM = Upland Mixed	1 = Seedling Sapling Poor	6 = Pole Timber Well
C = Cedar	L = Lowland Brush	P = Lowland Poplar	V = Bog or Marsh	2 = Seedling Sapling Medium	7 = Saw Timber Poor
D = Treed Bog	LM = Lowland Mixed	Q = Mixed Swamp Conifer	W = White Pine	3 = Seedling Sapling Well	8 = Saw Timber Medium
E = Swamp Hdwoods	M = Mpl, Bch, Brch	R = Red Pine	X = Non Stocked	4 = Pole Timber Poor	9 = Saw Timber Well
F = Spruce Fir	MC = Mixed Conifer	S = Black Spruce	Z = Water		
G = Grass	MD = Mixed Deciduous	T = Tamarack			

PU	Acres	PU	Acres	PU	Acres
1	12.1	4	15.3	7	78.5
2	8.1	5	35.2	8	22.8
3	18.2	6	40.7		

Easy Does It
Compartment 007
230.9 Acres

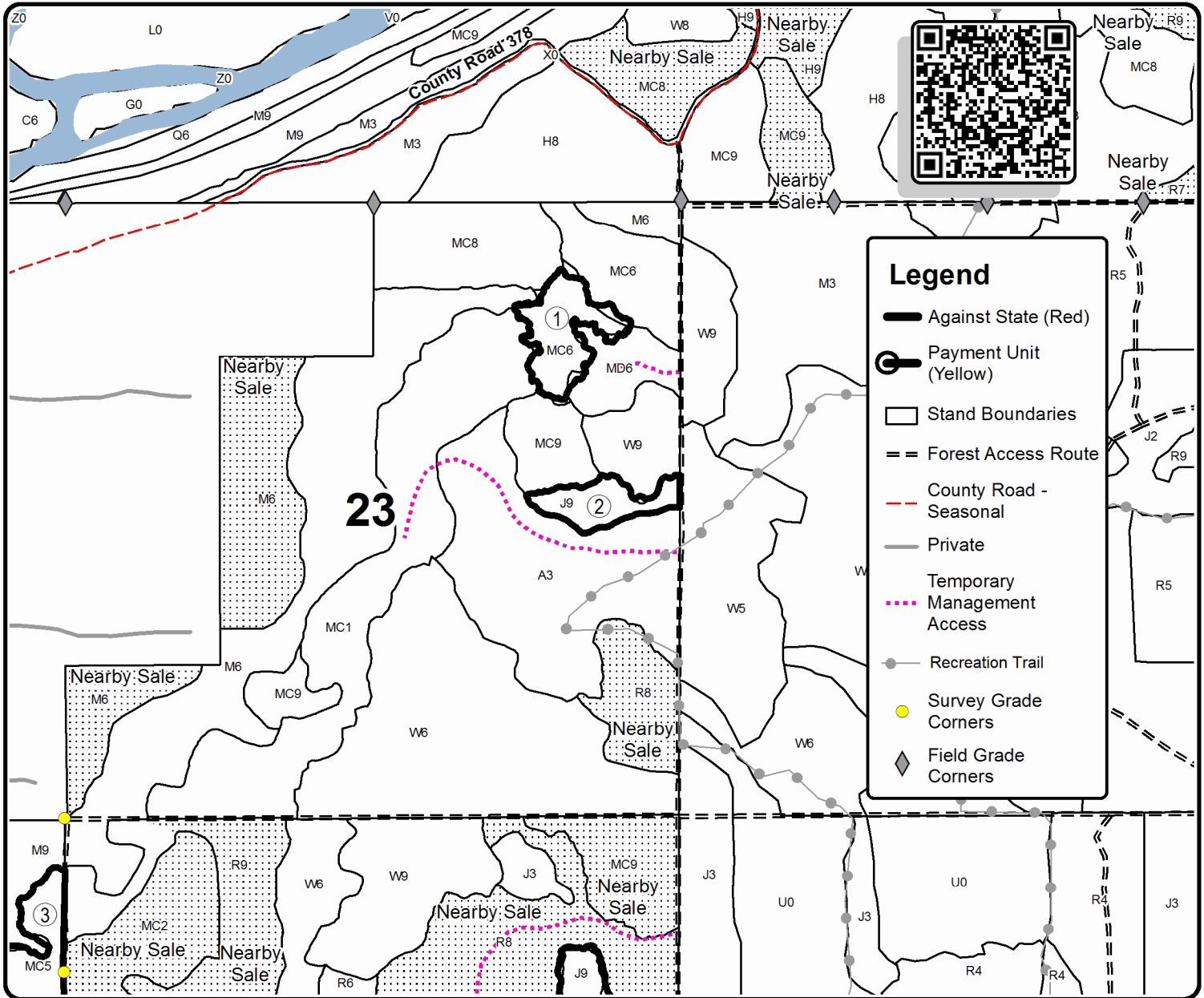



Sale Number	Year
42 - 026	18

TIMBER SALE MAP

This information provided by authority of Part 525, 1994 PA 451, as amended.

Forest Management Unit	County	Mapped By	Date	Page	of
Newberry Management Unit	County Name	Douglass	10/05/2018	2	2
Township	Range	Cruised By		Scale	
49N	12W	Newberry/Naubinway Staff		1:15,840	
23 - N1/2NE, SENE, NESE; 26 - E/12NE, SENE, N1/2SW, SWSW, SE1/4; 27 - E1/2NE; 35 - N1/2NE, SENE					

Cover Type

A = Aspen	H = Hemlock	N = Marsh	U = Upland Brush
B = Paper Birch	J = Jack Pine	O = Oak	UM = Upland Mixed
C = Cedar	L = Lowland Brush	P = Lowland Poplar	V = Bog or Marsh
D = Treed Bog	LM = Lowland Mixed	Q = Mixed Swamp Conifer	W = White Pine
E = Swamp Hdwoods	M = Mpl, Bch, Brch	R = Red Pine	X = Non Stocked
F = Spruce Fir	MC = Mixed Conifer	S = Black Spruce	Z = Water
G = Grass	MD = Mixed Deciduous	T = Tamarack	

Density

0 = Non Stocked	5 = Pole Timber Medium
1 = Seedling Sapling Poor	6 = Pole Timber Well
2 = Seedling Sapling Medium	7 = Saw Timber Poor
3 = Seedling Sapling Well	8 = Saw Timber Medium
4 = Pole Timber Poor	9 = Saw Timber Well

PU	Acres	PU	Acres	PU	Acres
1	12.1	4	15.3	7	78.5
2	8.1	5	35.2	8	22.8
3	18.2	6	40.7		

Easy Does It

Compartment 007

230.9 Acres

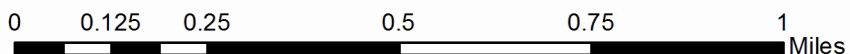
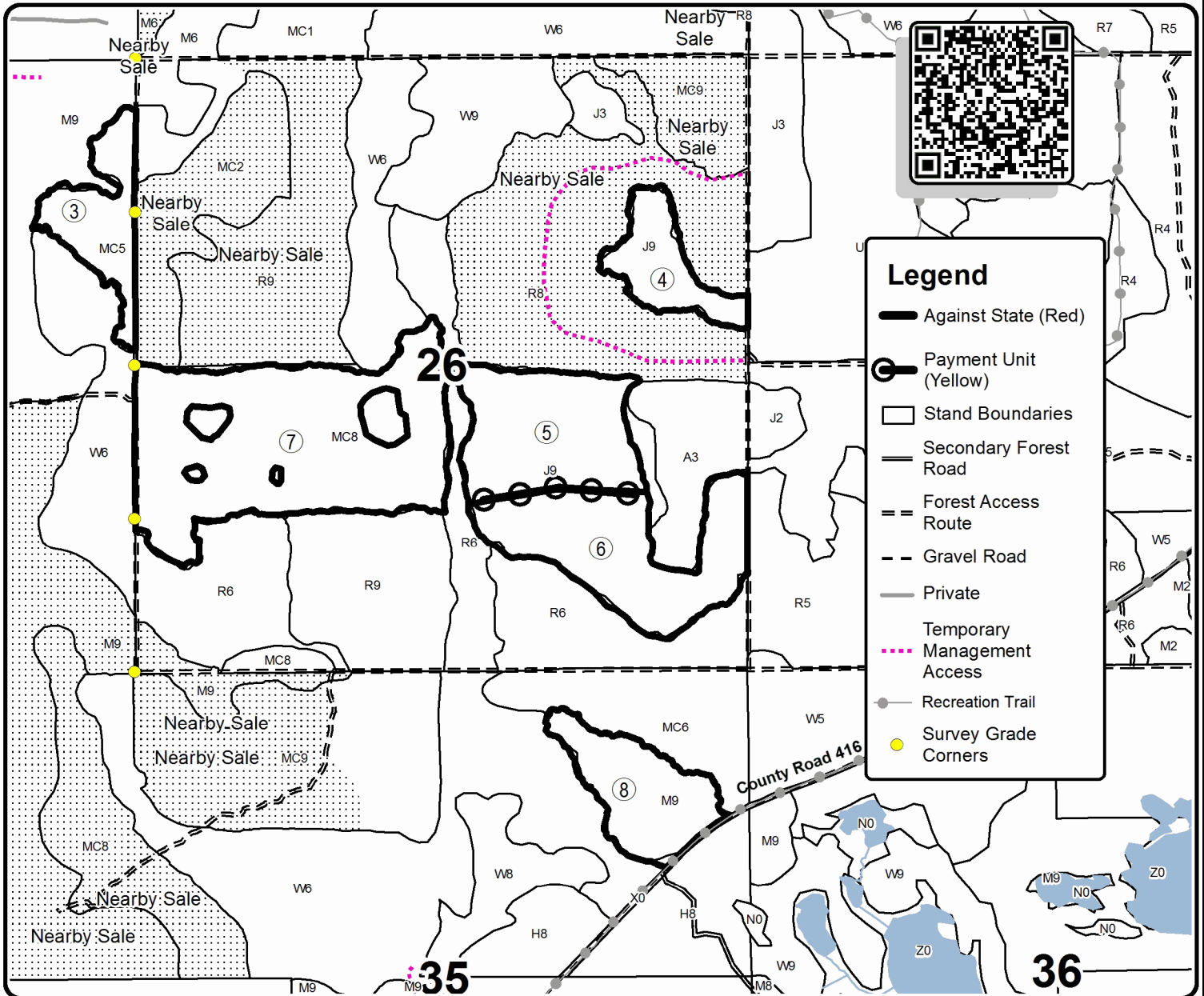

Brown Line Pine (42-020-18)

T48N, R11W, SEC. 5; T49N, R11W, SEC. 30; T49N, R11W, SEC. 31; T49N, R11W,

In response to the notice of sale to be held 3:00 p.m. (local time) on April 25, 2019, I am hereby submitting my sealed bid (firm offer) for the following forest products to be cut. Bids for individual species must be at or above the advertised price. All non-responsive bid forms may be rejected.

<u>PRODUCTS & SPECIES</u>	<u>ESTIMATED VOLUME*</u>	<u>ADVERTISED PRICE</u>	<u>BID PRICE/UNIT</u>
Pulpwood			
Balsam Fir	5.00 Cords	\$ 15.20/Cord	\$ _____
Black Spruce	77.00 Cords	\$ 21.10/Cord	\$ _____
Jack Pine	2,549.00 Cords	\$ 50.15/Cord	\$ _____
Quaking Aspen	72.00 Cords	\$ 33.10/Cord	\$ _____
Red Maple	30.00 Cords	\$ 18.25/Cord	\$ _____
Red Pine	3,361.00 Cords	\$ 78.60/Cord	\$ _____
White Pine	1,343.00 Cords	\$ 27.90/Cord	\$ _____

*The volumes are statistically estimated within plus (+) or minus (-) 5.77 percent. These estimated volumes are final and not subject to adjustment. Prospective bidders are urged to examine this timber and to make their own estimates of quantity and quality.

I understand that any or all bids may be rejected. All bids must be signed and all bid items must be bid or the bid form may be rejected. I also understand that consideration and awarding a contract will be based upon my past performance and ability to complete the contract based upon equipment and staffing subject to my control.

FEDERAL ID: ____ - ____ - ____ or SOCIAL SECURITY NUMBER: ____ - ____ - ____

Company or individual bidding: _____

Company representative's name: _____

Address: _____

City: _____ State: _____ Zip: _____

IF AVAILABLE, PLEASE PLACE THE PERSONALIZED LABEL FROM YOUR PROSPECTUS IN THE ABOVE BOX.

Individual or company representative's signature: _____ Date: _____

Phone number : _____ Email (optional): _____

THE WINNING BIDDER MUST COMPLETE THE VERIFICATION OF WORKER'S DISABILITY COMPENSATION ACT COMPLIANCE (ON REVERSE SIDE IF DOUBLE SIDED) WITHIN 21 DAYS OF SALE AWARD DATE



FOR DEPARTMENT USE ONLY
Sale Number (XX - XXX - XX - XX)
Forest Management Unit:

TIMBER SALE VERIFICATION OF WORKER'S DISABILITY COMPENSATION ACT COMPLIANCE

*As required by Act 317, P.A. 1969 (Worker's Compensation) and
Part 5 of Act 451 of 1994, as amended.*

VERIFICATION OF WORKER'S DISABILITY COMPENSATION ACT COMPLIANCE

- This verification must be completed and submitted within 21 days of contract award and prior to the issuance of the timber sale contract.
- In addition, if boxes 2B or 2C are checked, then Notice of Exclusion or Certificate of Insurance must be submitted within twenty-one (21) days of the contract award and prior to the issuance of the timber sale contract.
- All information must be typed or printed except for written signatures.

Please Check Appropriate Categories:

1. My business is organized as (you **must** check one of the boxes below):
 - A. Sole Proprietorship (individual)
 - B. Partnership
 - C. Corporation

2. You **must** check one of the boxes below:
 - A. I certify my business is a sole proprietorship and it has no employees but the sole proprietor. I am not subject to the Worker's Compensation Laws.
 - B. I certify my business has satisfied its obligation to the Worker's Compensation Act through the use of an approved Notice of Exclusion (BWC-337, Rev. 5/96). I will provide a copy of the Notice of Exclusion within 21 days of the contract award. (For questions or a copy of the BWC-337, please call the Worker's Compensation Bureau at 517-322-1195).
 - C. I certify my business has a Worker's Compensation Policy. I will provide an original Certificate of Insurance within twenty-one (21) days of the contract award.

3. If you have checked item 2(A) or 2(B), you **must** indicate the number of **both** full-time and part-time employees, other than yourself, including family members and active partners (if none, you must enter "0").

_____ Full-time Employees

_____ Part-time Employees

Name of Business		Federal ID (or) Social Security No.	
Address		Telephone ()	
City	State	ZIP	

I hereby certify that the above information is true and correct. I agree to notify the Michigan DNR of any changes that occur in factors affecting my coverage during any of my present and future operations.

Signature of Owner or Authorized Representative

Title

Date

Please complete the "SEALED BID" information on the next page

Easy Does It (42-026-18)

T49N, R12W, SEC. 23; T49N, R12W, SEC. 26; T49N, R12W, SEC. 27; T49N,

In response to the notice of sale to be held 3:00 p.m. (local time) on April 25, 2019, I am hereby submitting my sealed bid (firm offer) for the following forest products to be cut. Bids for individual species must be at or above the advertised price. All non-responsive bid forms may be rejected.

<u>PRODUCTS & SPECIES</u>	<u>ESTIMATED VOLUME*</u>	<u>ADVERTISED PRICE</u>	<u>BID PRICE/UNIT</u>
Sawtimber			
Red Maple	6.30 MBF	\$ 142.00/MBF	\$ _____
Pulpwood			
Balsam Fir	242.00 Cords	\$ 15.20/Cord	\$ _____
Hemlock	79.00 Cords	\$ 17.00/Cord	\$ _____
Jack Pine	1,825.00 Cords	\$ 50.15/Cord	\$ _____
Mixed Aspen	86.00 Cords	\$ 33.10/Cord	\$ _____
Mixed Hardwood	403.00 Cords	\$ 18.25/Cord	\$ _____
Mixed Spruce	150.00 Cords	\$ 21.10/Cord	\$ _____
Paper Birch	38.00 Cords	\$ 20.05/Cord	\$ _____
Red Pine	2,252.00 Cords	\$ 78.60/Cord	\$ _____
White Pine	2,077.00 Cords	\$ 27.90/Cord	\$ _____

*The volumes are statistically estimated within plus (+) or minus (-) 4.75 percent. These estimated volumes are final and not subject to adjustment. Prospective bidders are urged to examine this timber and to make their own estimates of quantity and quality.

I understand that any or all bids may be rejected. All bids must be signed and all bid items must be bid or the bid form may be rejected. I also understand that consideration and awarding a contract will be based upon my past performance and ability to complete the contract based upon equipment and staffing subject to my control.

FEDERAL ID: _____ or SOCIAL SECURITY NUMBER: _____

Company or individual bidding: _____

Company representative's name: _____

Address: _____

City: _____ State: _____ Zip: _____

IF AVAILABLE, PLEASE PLACE THE PERSONALIZED LABEL FROM YOUR PROSPECTUS IN THE ABOVE BOX.

Individual or company representative's signature: _____ Date: _____

Phone number : _____ Email (optional): _____

THE WINNING BIDDER MUST COMPLETE THE VERIFICATION OF WORKER'S DISABILITY COMPENSATION ACT COMPLIANCE (ON REVERSE SIDE IF DOUBLE SIDED) WITHIN 21 DAYS OF SALE AWARD DATE



FOR DEPARTMENT USE ONLY
Sale Number (XX - XXX - XX - XX)
Forest Management Unit:

TIMBER SALE VERIFICATION OF WORKER'S DISABILITY COMPENSATION ACT COMPLIANCE

*As required by Act 317, P.A. 1969 (Worker's Compensation) and
Part 5 of Act 451 of 1994, as amended.*

VERIFICATION OF WORKER'S DISABILITY COMPENSATION ACT COMPLIANCE

- This verification must be completed and submitted within 21 days of contract award and prior to the issuance of the timber sale contract.
- In addition, if boxes 2B or 2C are checked, then Notice of Exclusion or Certificate of Insurance must be submitted within twenty-one (21) days of the contract award and prior to the issuance of the timber sale contract.
- All information must be typed or printed except for written signatures.

Please Check Appropriate Categories:

1. My business is organized as (you **must** check one of the boxes below):
 - A. Sole Proprietorship (individual)
 - B. Partnership
 - C. Corporation
2. You **must** check one of the boxes below:
 - A. I certify my business is a sole proprietorship and it has no employees but the sole proprietor. I am not subject to the Worker's Compensation Laws.
 - B. I certify my business has satisfied its obligation to the Worker's Compensation Act through the use of an approved Notice of Exclusion (BWC-337, Rev. 5/96). I will provide a copy of the Notice of Exclusion within 21 days of the contract award. (For questions or a copy of the BWC-337, please call the Worker's Compensation Bureau at 517-322-1195).
 - C. I certify my business has a Worker's Compensation Policy. I will provide an original Certificate of Insurance within twenty-one (21) days of the contract award.
3. If you have checked item 2(A) or 2(B), you **must** indicate the number of **both** full-time and part-time employees, other than yourself, including family members and active partners (if none, you must enter "0").

_____ Full-time Employees

_____ Part-time Employees

Name of Business		Federal ID (or) Social Security No.	
Address		Telephone ()	
City	State	ZIP	

I hereby certify that the above information is true and correct. I agree to notify the Michigan DNR of any changes that occur in factors affecting my coverage during any of my present and future operations.

Signature of Owner or Authorized Representative

Title

Date

Please complete the "SEALED BID" information on the next page