



**DEPARTMENT OF NATURAL RESOURCES  
STATE OF MICHIGAN**

**TIMBER SALE PROSPECTUS #6410**

SCHEDULED SALE DATE AND TIME: 9:00 a.m. (local time) on May 7, 2019.

LOCATION: GRAYLING MGMT UNIT, 1955 HARTWICK PINES ROAD, GRAYLING, MI 49738.

PROSPECTUS NOTE: The bidder is advised to inspect the sale area and review the location, estimated volumes, operating costs and contract terms of proposed sales. Please be aware that some landowners may request 60 days or more notice for access across their land.

Notice is hereby given that bids will be received by the Unit Manager, GRAYLING MANAGEMENT UNIT, for certain timber on the following described lands:

Comp 171 Selection (72-003-18) / T28N, R04W, SEC. 16, NW,NE,N1/2SW.

Crawford County, Advertised Price \$162,651.50, 213.5 Acres, Hardwood, Aspen.

SALE NOTE: This sale contains 149 acres of marked thinning and 63.8 acres of clearcut. In Payment Units 1-4, pockets delineated by a green painted boundary are to be clearcut. Snowmobile Trail 679 runs through Payment Units 4 and 6; it may be crossed at right angles, but is not to be used for other harvest activities during the snowmobile season.

A recreation site such as a trail, pathway, or campground is within the sale area or the vicinity. Certain restrictions/specifications may be applicable including time restrictions.

Goshawk Mix (72-007-18) / T28N, R01W, SEC. 15, NESW,S1/2SW,NWSE.

T28N, R01W, SEC. 22, NWNW.

Crawford County, Advertised Price \$15,703.90, 41.1 Acres, Jack Pine, Red Pine.

SALE NOTE: Sale is only accessible via the snowmobile trail. There is a Goshawk nest within the sale area: If the nest is active, Payment Unit 3 could be removed and Payment Unit 2 would have operational restrictions.

A recreation site such as a trail, pathway, or campground is within the sale area or the vicinity. Certain restrictions/specifications may be applicable including time restrictions.

Lovells Hideaway (72-008-18) / T28N, R01W, SEC. 17, SWSW,SESE.

T28N, R01W, SEC. 19, NENE.

T28N, R01W, SEC. 20, W1/2NW.

Crawford County, Advertised Price \$6,259.05, 30.1 Acres, Jack Pine, Aspen.

SALE NOTE: Sale is located off Lovells Rd.

A recreation site such as a trail, pathway, or campground is within the sale area or the vicinity. Certain restrictions/specifications may be applicable including time restrictions.

Lost Can Aspen (72-009-18) / T28N, R01W, SEC. 11, S1/2SE,NESE.

T28N, R01W, SEC. 12, SWNW,W1/2SW.

T28N, R01W, SEC. 13, NWNW.

T28N, R01W, SEC. 14, NENE.

Crawford County, Advertised Price \$44,387.25, 122.7 Acres, Aspen, Jack Pine.

SALE NOTE: This sale can be accessed off of Walsh Road. Walsh Road also is used as a horse, ORV and snowmobile trail. A temporary bridge will be used to access the sale and provided by the DNR.

A recreation site such as a trail, pathway, or campground is within the sale area or the vicinity. Certain restrictions/specifications may be applicable including time restrictions.

Remote Float Aspen (72-010-18) / T28N, R01W, SEC. 12, SESE.

T28N, R01W, SEC. 13, NENE,SE.

Crawford County, Advertised Price \$26,227.90, 57.6 Acres, Aspen, Hardwood.

SALE NOTE: The sale can be access a couple of ways off Pickeral Lake Rd. Pickeral Lake Rd is also use by both motorized and non-motorized recreationalist. Access to Payment Units 2 and 3 is through a locked gate. There is a timing restriction for an eagles nest in the southwest corner of Payment Unit 2; harvesting is limited to September 1 through December 31 in this area.

A recreation site such as a trail, pathway, or campground is within the sale area or the vicinity. Certain restrictions/specifications may be applicable including time restrictions.

SW Comp 281 (72-024-18) / T26N, R01W, SEC. 4 , SENW,SWNE,N1/2SW.

Crawford County, Advertised Price \$24,608.90, 54.1 Acres, Jack Pine, Hardwood.

SALE NOTE: Overmature oak and jack pine continue to lose volume to age-related decline and mortality.

## BID INSTRUCTIONS (VER. 07/02/2018):

### 1. Scheduled Bid Location, Date, and Time (2/11)

Bids must be received by the Unit Manager, GRAYLING OFFICE, 1955 HARTWICK PINES ROAD, GRAYLING, MI 49738, no later than 9:00 a.m. (local time) on May 7, 2019. For further information concerning this sale, contact Susan Thiel at 989-348-6371 extension 7440.

### 2. Bidder's Qualifications (5/16)

Purchaser shall obtain workers compensation insurance to cover claims under Michigan's Worker's Disability Compensation Act of 1969 or similar employee benefit act of any other state applicable to an employee. If all or part of a timber sale was prepared by a private contractor, the contractor and that contractor's company are not permitted to bid on the timber sale contract. Bids will not be accepted from individuals or companies appearing on the DNR/FRD No-Bid List. This list contains the names of purchasers who previously failed to execute a contract within 21-days or who have a history of poor performance.

### 3. Preparation of Sealed Bids (5/16)

Bid Forms may be completed online thru Michigan DNR Timber Sale Online Bidding (OLB) at [www.michigan.gov/timberbidding](http://www.michigan.gov/timberbidding) or by completing the hardcopy Bid Form found in the Timber Sale Prospectus. Hardcopy Bid Forms shall be manually signed in ink. Registration in OLB is considered your 'signature' for all bids submitted thru that system. Bid prices must be entered for each species and product in the Bid Price column for all material subject to bidding and all fill-in blanks must be completed. If erasures or other changes appear on the hardcopy Bid Form, each erasure or change must be initialed by the person signing the bid.

### 4. Submission of Sealed Bids (5/16)

Bid forms may be obtained from the Unit Manager or thru OLB. Bids may be submitted hardcopy or thru OLB. All hardcopy bids must be submitted on the bid form and in an envelope clearly identified as described in this section. NOTE: Only one bid form per bid envelope. Sealed bids must be submitted to the Unit office designated in the prospectus and must be submitted at or prior to the time established in the prospectus. The envelope should show on the outside (a) the sale name or number and (b) the date and time of bid opening, as shown in the prospectus. Bids received after the time specified in the sale prospectus are late bids and will be rejected.

It is possible for a bidder to submit multiple bids on a single sale. For example, a bid may be submitted hardcopy and a bid may be submitted thru OLB. Or, two bidders from the same company could both submit bids on the same sale. If this were to happen, the State would accept all bids received and award the contract accordingly. All bidding and contractual requirements would apply to all bids received.

### 5. Public Opening of Sealed Bids (7/16)

If conditions permit, the sealed bids will be publicly opened and posted at the time and place set in the prospectus.

If a bidder, present at a bid opening, has submitted bids on more than one sale, that bidder may withdraw their unopened bid envelopes or announce the withdrawal of their online bid after being declared the successful bidder on one sale.

### 6. Award of Contract (1/11)

Award of the contract will be made to the Bidder whose bid, conforming to the prospectus, is most advantageous to the State of Michigan on the basis of total value at rates bid for the estimated quantities. The State reserves the right to reject any bid or waive any minor irregularity in bids received. A written award mailed (or otherwise furnished) to the successful Bidder shall be deemed to result in a binding contract without further action by either party.

### 7. Down Payment (1/11)

The Bidder to whom award is made must make a down payment within 21 days of the sale award. The amount of the down payment will be calculated as shown in the Bond and Payment Schedule of this prospectus. Only cash may be used to meet this requirement.

### 8. Performance Security (1/11)

As guarantee of faithful performance, a cash bond, certificate of deposit, surety bond or irrevocable letter of credit (LOC) is required within 21 days of the sale award. The amount of the performance security is shown in the Bond and

Payment Schedule of this prospectus. If an LOC or surety is used, the coverage must extend for at least 6 months beyond the contract expiration.

#### 9. Timber Sale Contract (7/18)

Additional conditions and requirements common to all timber sales are listed on the timber sale contract (R4031) and are available on line at [www.michigan.gov/timber](http://www.michigan.gov/timber). Contact the Unit Manager for additional information or a sample contract. Within 21 days of the date of the award letter, the bidder must sign the contract and provide the required down payment, performance security, and verification of worker's disability compensation. The down payment and performance security shall be in accordance with the provisions of the timber sale contract, in the sums stated in this prospectus. If these actions are not taken, then the Bidder, the Bidder's corporation, and the corporation's principals may not be permitted to bid on State timber sales for a period of 3 months after the first offense, 6 months after the second offense, and 1 year after the third offense. An offense will only be counted against the Bidder for 5 years. In addition, the Bidder certifies that if awarded this contract, the Bidder will complete the timber sale contract in accordance with its terms and any modifications thereof including requirements to purchase, cut, and remove the included timber by the expiration date.

Payment Unit values in the State Forest Timber Sale Contract are calculated based on the advertised value of the Payment Unit as a percentage of the total advertised value of the contract. The advertised value of each Payment Unit is given in the Description of Timber by Payment Unit table on the Timber Sale Information page. For example, if the value of Payment Unit 1 is advertised as \$1,500 and the total Timber Sale value is advertised as \$10,000, the contract price for Payment Unit 1 will be 15% of the total bid price ( $\$1,500/\$10,000 * 100$ ).

#### 10. Disclaimer of Estimates and Bidder's Warranty of Inspection (7/16)

Before submitting this bid, the Bidder is advised and cautioned to inspect the sale area, review the requirements of the sale contract, and take other steps as may be reasonably necessary to ascertain the location, estimated volumes, construction estimates, and operating costs of the proposed sale. Failure to do so will not relieve the Bidder from responsibility for completing the contract.

The Bidder warrants that this bid is submitted solely on the basis of the Bidder's examination and inspection of the quality and quantity of the timber offered for sale and the Bidder's opinion of the value thereof and the costs of recovery. No reliance should be placed on the State of Michigan's estimates of timber quality, quantity or costs of recovery. Bidder further acknowledges that the State of Michigan: (i) expressly disclaims any warranty of fitness of timber for any purpose; (ii) offers this timber as is without any warranty of quality (merchantability) or quantity and (iii) expressly disclaims any warranty as to the quantity or quality of timber sold.

#### 11. Certification and Chain-of-Custody (10/14)

Unless otherwise indicated in the contract under section 7 – Other Conditions of the Sale Specific Conditions & Requirements, the area encompassed by this timber sale is certified to the standards of the Forest Stewardship Council (FSC) - Certificate #SCS-FM/COC-00090N and the Sustainable Forestry Initiative (SFI) - Certificate #NSF-SFIS-5Y031-SF5. Forest products from this sale may be delivered to the mill as "FSC 100% and / or SFI certified" as long as the contractor hauling the forest products is chain-of-custody (COC) certified or covered under a COC certificate from the destination mill. The purchaser is responsible for maintaining COC after leaving the sale area.

#### 12. Good Neighbor Authority (GNA) Requirements (7/16)

If the name of this timber sales contains the acronym GNA, it is authorized by the Good Neighbor Authority (GNA) and covered by various agreements between the U.S. Forest Service and the State. The timber sale occurs on federal land and the following conditions apply:

GNA contracts on US Forest Service land will not be awarded to purchasers on the Federal list of excluded parties. The System for Award Management (SAM) will be checked for active excluded parties prior to award of contract. In addition, the Bidder to whom award is made must complete an Assurance Regarding Felony Conviction or Tax Delinquent Status for Corporate Applicants (AD-3031).

#### 13. Good Neighbor Authority (GNA) Requirements, con't (9/16)

Bidder certifies, by signing this bid form, that to the best of Bidder's knowledge that the following representations are accurate and complete.

- a. That the Bidder and its principals are not presently debarred, suspended, proposed for debarment, declared ineligible, or voluntary excluded from timber sales (covered transactions) by any Federal department or agency.
- b. That the Bidder and its principals have not within a 3-year period preceding this bid been convicted of or had a civil judgment rendered against them for commission of fraud or a criminal offense in connection with obtaining, attempting to obtain, or performing a public (Federal, State, or local) transaction or contract under a public transaction; violation of Federal or State antitrust statutes or commission of embezzlement, theft, forgery, bribery, falsification or destruction of records, making false statements, or receiving stolen property.
- c. That the Bidder and its principals are not presently indicted for or otherwise criminally or civilly charged by a governmental entity (Federal, State, or local) with commission of any of the offenses enumerated in paragraph b of this certification.
- d. That the Bidder and its principals have not within a 3-year period preceding this bid had one or more public transactions (Federal, State, or local) terminated for breach or default of a timber or forest product contract.

Bidders that cannot certify this requirement, in whole or in part, shall submit an explanation with their bid.

DAN EICHINGER  
Director



# TIMBER SALE INFORMATION

Comp 171 Selection (72-003-18)  
 T28N, R04W, SEC. 16.  
 Crawford County (Advertised Price \$162,651.50)

SALE NOTE: This sale contains 149 acres of marked thinning and 63.8 acres of clearcut. In Payment Units 1-4, pockets delineated by a green painted boundary are to be clearcut. Snowmobile Trail 679 runs through Payment Units 4 and 6; it may be crossed at right angles, but is not to be used for other harvest activities during the snowmobile season.

A recreation site such as a trail, pathway, or campground is within the sale area or the vicinity. Certain restrictions/specifications may be applicable including time restrictions.

A timber sale contract for this lump sum, sealed bid timber sale will be awarded to the responsible bidder offering the highest sealed bid price. Bids must be at or above the following advertised price for each species:

<u>PRODUCTS &amp; SPECIES</u>	<u>ESTIMATED UNITS*</u>	<u>ADVERTISED PRICE</u>
<b>Sawtimber</b>		
Basswood	157.80 MBF	\$ 114.00 / MBF
Beech	24.80 MBF	\$ 113.00 / MBF
Mixed Aspen	233.50 MBF	\$ 79.00 / MBF
Sugar Maple	101.10 MBF	\$ 278.00 / MBF
White Spruce	134.90 MBF	\$ 64.00 / MBF
<b>Pulpwood</b>		
Basswood	373.00 Cords	\$ 20.35 / Cord
Mixed Aspen	980.00 Cords	\$ 24.00 / Cord
Mixed Hardwood	1,185.00 Cords	\$ 33.60 / Cord
Red Oak	3.00 Cords	\$ 21.75 / Cord
White Spruce	886.00 Cords	\$ 17.70 / Cord

\* The total volume is statistically estimated within plus (+) or minus (-) 11.42 percent. The estimated units are final and not subject to adjustment. Prospective bidders are urged to examine this timber and to make their own estimates of quantity and quality.

**BOND AND PAYMENT SCHEDULE:**

1. A bond in the amount of \$8,133.00 to insure faithful performance of the conditions of the contract will be deposited by the successful bidder within 21 days of the sale award.
2. Cutting in any sale or unit without the required advance payment would be considered a trespass.
3. Total payment must be paid in advance or according to the following schedule:
  - (a) Ten percent (10%) of the sale value must be paid within 21 days of the sale award.
  - (b) The 10% down payment will be credited towards the first unit cut.
  - (c) Payment for each of the following units must be made before cutting begins in that unit:

PAYMENT UNIT NUMBER	PERCENT OF TOTAL SALE VALUE
01	13.6%
02	17.0%
03	21.6%
04	15.6%
05	20.6%
06	11.6%

4. If no cutting takes place, the 10% down payment will not be refunded.
5. Operations on the contract issued will terminate on 03/31/2022.

**Description of Timber by Payment Unit (PU)**

PU	MARKET GROUP	PRODUCT	QUANTITY	UNIT	ACRES	ADVERTISE PRICE	
1	Basswood	Sawtimber	32.2	MBF	38.0	\$22,143.50	
	Beech		5.7	MBF			
	Mixed Aspen		24.0	MBF			
	<i>B. T. Aspen</i>		22.5	<i>MBF</i>			
	<i>Quaking Aspen</i>		1.5	<i>MBF</i>			
	Sugar Maple		18.7	MBF			
	Basswood		Pulpwood	72.0			Cords
	Mixed Aspen			39.0			Cords
	<i>B. T. Aspen</i>			38.0			<i>Cords</i>
	<i>Quaking Aspen</i>			1.0			<i>Cords</i>
	Mixed Hardwood			248.0			Cords
	<i>Beech</i>			22.0			<i>Cords</i>
	<i>Ironwood</i>			2.0			<i>Cords</i>
	<i>Sugar Maple</i>			224.0			<i>Cords</i>
2	Basswood	Sawtimber	35.1	MBF	42.6	\$27,695.55	
	Beech		6.0	MBF			
	Mixed Aspen		42.0	MBF			
	<i>B. T. Aspen</i>		39.4	<i>MBF</i>			
	<i>Quaking Aspen</i>		2.6	<i>MBF</i>			
	Sugar Maple		24.3	MBF			
	Basswood		Pulpwood	81.0			Cords
	Mixed Aspen			66.0			Cords
	<i>B. T. Aspen</i>			63.0			<i>Cords</i>
	<i>Quaking Aspen</i>			3.0			<i>Cords</i>
	Mixed Hardwood			289.0			Cords
	<i>Beech</i>			23.0			<i>Cords</i>
	<i>Ironwood</i>			2.0			<i>Cords</i>
	<i>Sugar Maple</i>			264.0			<i>Cords</i>
3	Basswood	Sawtimber	25.3	MBF	35.7	\$35,189.75	
	Beech		3.4	MBF			
	Mixed Aspen		98.3	MBF			
	<i>B. T. Aspen</i>		92.2	<i>MBF</i>			
	<i>Quaking Aspen</i>		6.1	<i>MBF</i>			
	Sugar Maple		33.9	MBF			
	Basswood		Pulpwood	67.0			Cords
	Mixed Aspen			151.0			Cords
	<i>B. T. Aspen</i>			137.0			<i>Cords</i>
	<i>Quaking Aspen</i>			14.0			<i>Cords</i>
	Mixed Hardwood			290.0			Cords
	<i>Beech</i>			13.0			<i>Cords</i>
	<i>Ironwood</i>			1.0			<i>Cords</i>
	<i>Sugar Maple</i>			276.0			<i>Cords</i>
4	Basswood	Sawtimber	61.9	MBF	33.4	\$25,321.30	
	Beech		9.7	MBF			
	Mixed Aspen		7.1	MBF			
	<i>B. T. Aspen</i>		5.7	<i>MBF</i>			
	<i>Quaking Aspen</i>		1.4	<i>MBF</i>			
	Sugar Maple		20.3	MBF			
	Basswood		Pulpwood	122.0			Cords
	Mixed Aspen			9.0			Cords
	<i>B. T. Aspen</i>			8.0			<i>Cords</i>
	<i>Quaking Aspen</i>			1.0			<i>Cords</i>
	Mixed Hardwood			246.0			Cords
	<i>Beech</i>			54.0			<i>Cords</i>
	<i>Paper Birch</i>			2.0			<i>Cords</i>
	<i>Sugar Maple</i>			190.0			<i>Cords</i>



**Description of Timber by Payment Unit (PU), con't**

PU	MARKET GROUP	PRODUCT	QUANTITY	UNIT	ACRES	ADVERTISE PRICE
5	Mixed Aspen	Sawtimber	32.4	MBF	28.8	\$33,507.40
	<i>Quaking Aspen</i>		32.4	<i>MBF</i>		
	Sugar Maple		3.5	MBF		
	White Spruce		134.9	MBF		
	Basswood	Pulpwood	4.0	Cords		
	Mixed Aspen		147.0	Cords		
	<i>Quaking Aspen</i>		147.0	<i>Cords</i>		
	Mixed Hardwood		61.0	Cords		
	<i>American Elm</i>	<i>Sawtimber</i>	1.6	<i>MBF</i>		
	<i>American Elm</i>	<i>Pulpwood</i>	4.0	<i>Cords</i>		
	<i>Sugar Maple</i>		54.0	<i>Cords</i>		
	White Spruce		886.0	Cords		
	6	Basswood	Sawtimber	3.3		
Mixed Aspen			29.7	MBF		
<i>B. T. Aspen</i>			29.7	<i>MBF</i>		
Sugar Maple			0.4	MBF		
Basswood		Pulpwood	27.0	Cords		
Mixed Aspen			568.0	Cords		
<i>B. T. Aspen</i>			541.0	<i>Cords</i>		
<i>Quaking Aspen</i>			27.0	<i>Cords</i>		
Mixed Hardwood			51.0	Cords		
<i>Black Cherry</i>			13.0	<i>Cords</i>		
<i>Ironwood</i>			11.0	<i>Cords</i>		
<i>Red Maple</i>			23.0	<i>Cords</i>		
<i>Sugar Maple</i>			4.0	<i>Cords</i>		
Red Oak			3.0	Cords		
TOTAL:			652.1	MBF		
TOTAL:			3,427.0	Cords		

## Sale Specific Conditions & Requirements

**Sale Name: Comp 171 Selection**

**Sale Number: 72-003-18 Seq#: 1**

### 1 - Sale Area

#### 1.2 - Boundaries

##### 1.2.1 - Painted boundaries (1/14)

The sale boundary and Payment Unit boundaries are marked and identified by red and yellow paint, along with timber type changes. Exterior sale boundary lines against state are marked with red paint. The sale boundary lies inside the pipeline corridor along Post Road and Deward Road. Boundaries around gas well sites are unpainted. Interior Payment Unit boundaries are marked with yellow paint, with the exception of those adjacent to Payment Unit 5, which are unpainted and identified by the hardwoods to spruce type change. The painted boundary line trees are not Included Timber and are to be protected unless marked with orange paint. Within Payment Units 1-4, green paint has been used to mark the boundary of regen gaps and 15.6 acres of aspen pockets which are to be final harvested.

### 2 - Timber Specifications

#### 2.1 - Included Timber

##### 2.1.1 - Clearcut unit(s) with unmerchantable trees (6/14)

Within Payment Unit(s) 5 and 6, cut all trees that are two (2) inches or more at DBH, except within Payment Unit 6, do not cut apple trees.

##### 2.1.3 - Cut tree marked unit(s) (12/08)

Within Payment Unit(s) 1-4, all trees are designated for cutting when marked with orange paint above and below stump height, regardless of merchantability. In addition, cut all trees within the green painted patch cut areas.

#### 2.2 - Utilization

##### 2.2.3 - Stump heights (4/07)

Stump heights within the Sale Area shall not exceed 12 inches for trees greater than 10 inches DBH and 6 inches for trees smaller than 10 inches DBH. A written waiver of this requirement may be obtained if wet summer weather makes winter logging necessary.

##### 2.2.6 - Roundwood operation required (5/07)

The skidding of whole trees or tree segments with limbs attached is prohibited within Payment Unit(s) 1-4. All products must be produced as roundwood and forwarded to existing roads or landing areas in final product length.

##### 2.2.7 - Uncut designated trees (2/04)

Liquidated damages of \$5.00 per tree will be assessed for every marked tree not cut.

### 3 - Payments

#### 3.3 - Pre-measured Sales

##### 3.3.4 - Dividing payment units (7/14)

Payment Unit(s) may be divided at the request of the Purchaser and upon approval of the Unit Manager. Dividing Payment Units is a contract modification which requires a Timber Sale Contract Supplement.

### 4 - Transportation

#### 4.1 - Construction

##### 4.1.3 - Slash and earthen piles (8/04)

Piles or windrows of earth along roads and landings that have been widened or constructed shall be leveled. Slash from road maintenance or construction, including stumps, shall be disbursed evenly throughout the sale, chipped, utilized or otherwise removed from the sale.

##### 4.1.4 - Timber removed for construction (12/09)

Trees cut or damaged in the process of pre-approved road, landing or skid trail construction will be decked in an area separate

from other Designated Timber and not removed until measured by the sale administrator. Payment will be made at the specified Purchase Unit Price.

#### 4.1.6 - Road construction (1/09)

Construction of new roads or improvements of existing roads shall be done in such a way as to minimize the environmental and visual impacts. Merchantable trees shall be cut and utilized unless otherwise directed. Non-merchantable trees shall be severed and laid flat on the ground. Slash shall be scattered, and not left in windrows and kept a minimum of 10 feet back from the road edge. Stumps shall be set upright, not left on edge, and be moved at least 10 feet away from the road edge. Disturbed soil shall be feathered into the woods and not left in berms or windrows.

#### 4.1.7 - Road closure (10/11)

All new roads built into the sale must be blocked to vehicle traffic upon completion of the sale. Overgrown roads that are reopened shall be considered new roads. In general, this will require constructing a four (4') foot high berm of stumps and logs covered with earth. All stumps from road building and landing construction must be reserved to block any newly constructed roads upon completion of the sale. These stumps must be scattered along the road system to prohibit vehicular movement. Contact the sale administrator for specific details of design and placement.

## 5 - Operations

### 5.1 - Notification

#### 5.1.1 - Pre-sale conference (10/16)

A pre-sale conference on site between the Purchaser and sale administrator is required prior to beginning any operations to determine landing and road locations. The Unit Manager or his/her representative must be contacted at least 5 days in advance to schedule the conference.

#### 5.1.3 - Well heads and natural gas pipelines (11/15)

The Purchaser is responsible for contacting the gas or pipeline company prior to operating equipment in the vicinity of well heads or natural gas pipelines. Contact Linn Operating at 231-922-7302.

### 5.2 - Conduct of Operations

#### 5.2.1 - Slash

##### 5.2.1.13 - Dispose of slash as directed (12/05)

Slash is to be disposed of as directed by the sale administrator (i.e. flattening taller slash piles within the visual depth zone of roads, trails and private property).

#### 5.2.2 - Hazard Trees/Snags

##### 5.2.2.1 - Den trees (10/16)

Obvious hollow and/or den trees shall be protected and left standing unless they are a safety hazard.

#### 5.2.3 - Operating Restrictions

##### 5.2.3.3 - Bark slippage restriction (3/09)

Within Payment Unit(s) 1-4, unless changed by written agreement, cutting and skidding are not permitted during the period of April 15 to July 15. This restriction is because of bark slippage.

#### 5.2.4 - Dead and Down Creation

##### 5.2.4.4 - Dead and down creation, grouse (6/18)

To encourage grouse and other wildlife, in Payment Unit(s) 6, leave one, 12" or larger diameter (or largest diameter trees within stand) whole tree on the ground for every 2 acres, preferably a hardwood species such as oak or maple or if no hardwoods are present, a pine species (white or red). These trees will be evenly scattered throughout the unit, preferably at least two chains from any roads, two-tracks, or trails open to vehicles.

##### 5.2.32 - Decking/landing restoration (9/13)

All decking and landing areas must have the surface area restored to a condition equal to or better than before. This is to ensure the proper regeneration of the stand. Wood debris, chips and "cookies" from trimmings must be removed or scattered away from landing and loading areas and may not be windrowed on the edge.

#### 5.2.38 - No decking against live trees (2/04)

Cut products may not be decked against unmarked or designated leave trees.

#### 5.2.41 - Snowmobile trail protection (9/11)

Trail 679 is a snowmobile trail and is shown on the Timber Sale Map. Do not cut or damage posts with orange trail markers or traffic control signs. If the trail is used, it must be maintained and restored to a condition equal to or better than before the sale. The road maintenance/restoration must be done prior to December 1. The snowmobile trail may not be used for any timber sale operations from December 1 to March 31 without written permission. The snowmobile trail may only be crossed at right angles. Maintain a 20 foot wide slash, debris, and rut free zone daily using the snowmobile trail as the centerline. No decking of forest products will be permitted along the snowmobile trail. All stumps within 20 feet of the snowmobile trail must be cut at ground level.

#### 5.2.43 - Opening protection (12/08)

No activities are permitted in openings marked on the Timber Sale Map with the letter "G". Any damage to the openings shall be repaired according to specifications of the Unit Manager or his/her representative.

### 5.4 - Soil Protection

#### 5.4.1 - Rutting restriction, general (7/16)

Operations are to cease immediately if equipment and weather conditions result in rutting of roads and/or skid trails which is 12 inches or greater in depth and 50 feet in length. The Unit Manager or his/her representative may restrict hauling and/or skidding if ruts exceed the specified depth. With the Unit Manager or his/her representative's approval, the Purchaser may return to the area when the risk of rutting has decreased.

### 5.8 - Protection of Endangered Species

#### 5.8.5 - Protection of raptor nests (3/13)

All trees with raptor nests will be protected if found during harvesting operations. Notification will be made to the Unit Manager or his/her representative who will notify the Wildlife Biologist so an on-site evaluation and recommendation can be made, if necessary.

## 6 - Safety and Fire Prevention

### 6.2 - Signing

#### 6.2.1 - Road posting (9/09)

The Purchaser is responsible for posting and maintaining caution signs on Deward and Post Roads prior to beginning operations. The road must be posted at appropriate distances from the sale area to warn of logging activity and truck traffic. Signs must be removed when harvest operations are suspended or completed. The Purchaser will provide these signs.

#### 6.2.2 - Snowmobile trail posting (8/09)

The Purchaser is responsible for posting and maintaining caution signs on Trail 679 prior to beginning operations during the snowmobile season (approximately December 1 to March 31). The trail must be posted at appropriate distances from the sale area to warn of logging activity and truck traffic. Signs must be removed when harvest operations are suspended or completed. The Purchaser will provide these signs.



# TIMBER SALE MAP

This information provided by authority of Part 525, 1994 PA 451, as amended.

Sale Number	Year
72 - 003	18

Forest Management Unit Grayling	County Crawford	Mapped By Metcalfe	Date 09/12/2018	Page 1	of 1
Township 28N	Range 04W	Section(s) and Subdivision(s) Sec 16: NW, NE, N1/2 SW	Scale 1:15,840		

Cover Type				Density	
A = Aspen	H = Hemlock	N = Marsh	U = Upland Brush	0 = Non Stocked	5 = Pole Timber Medium
B = Paper Birch	J = Jack Pine	O = Oak	UM = Upland Mixed	1 = Seedling Sapling Poor	6 = Pole Timber Well
C = Cedar	L = Lowland Brush	P = Lowland Poplar	V = Bog or Marsh	2 = Seedling Sapling Medium	7 = Saw Timber Poor
D = Tread Bog	LM = Lowland Mixed	Q = Mixed Swamp Conifer	W = White Pine	3 = Seedling Sapling Well	8 = Saw Timber Medium
E = Swamp Hdwoods	M = Mpl. Bch, Brch	R = Red Pine	X = Non Stocked	4 = Pole Timber Poor	9 = Saw Timber Well
F = Spruce Fir	MC = Mixed Conifer	S = Black Spruce	Z = Water		
G = Grass	MD = Mixed Deciduous	T = Tamarack			

PU	Acres	PU	Acres
1	38	4	33.4
2	42.6	5	28.8
3	35.7	6	35

## Comp 171 Selection

Compartment 171  
213.5 Acres

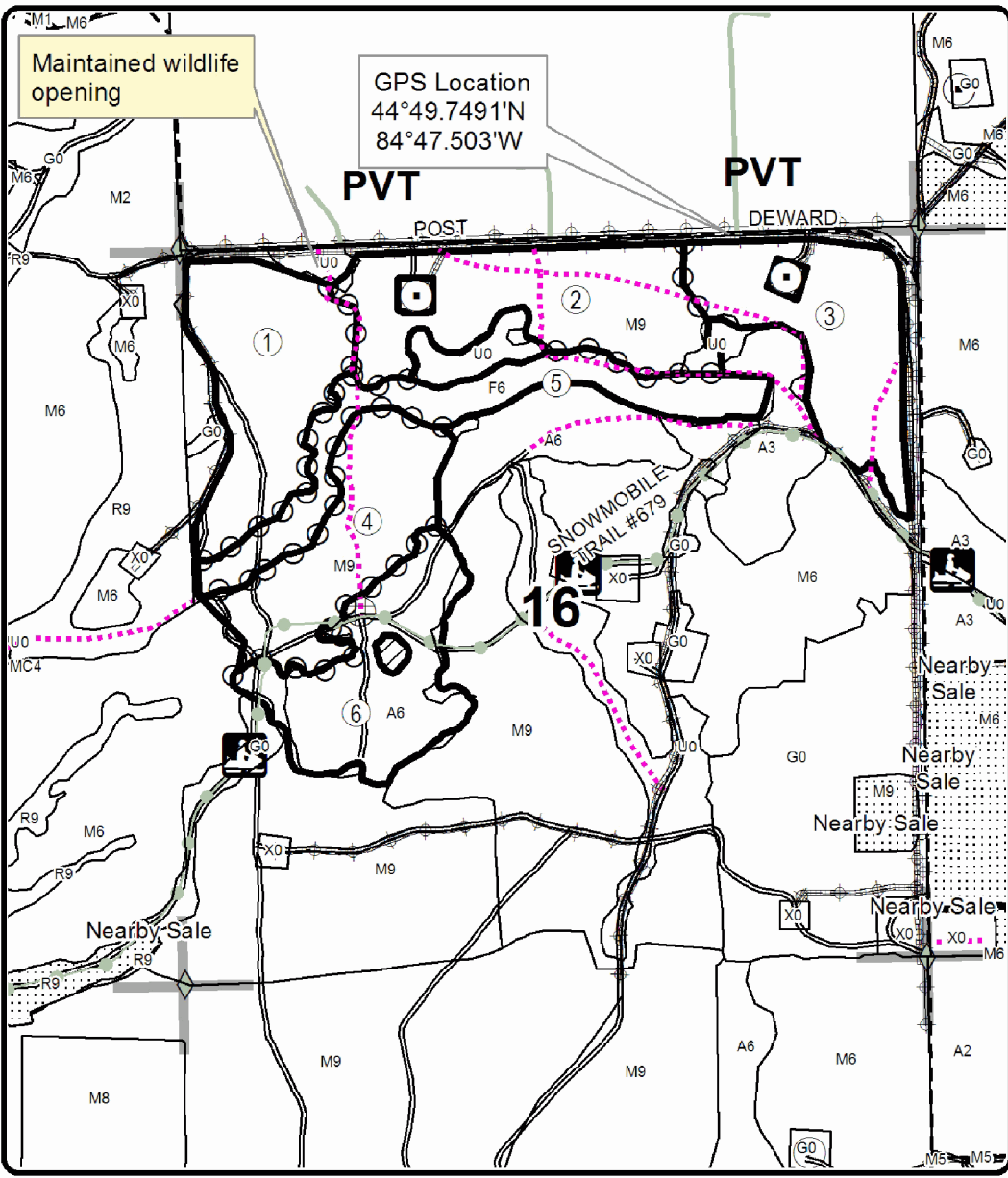

### Legend

- Against State (Red)
- Payment Unit (Yellow or Hardwood / Softwood Type Change)
- ▨ Retention Area
- Stand Boundaries
- ▤ Nearby Timber Sales
- Section Corners
- == Secondary Forest Road
- - Gravel Road
- Private
- ⋯ Temporary Management Access
- ◆ Field Grade Corners
- Oil & Gas Well Surface Locations
- Snowmobile Trail
- Pipeline
- ⚡ Powerline
- PU Label

Locator Map  
1:200,000

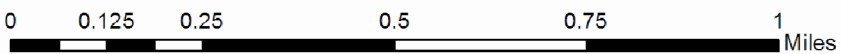
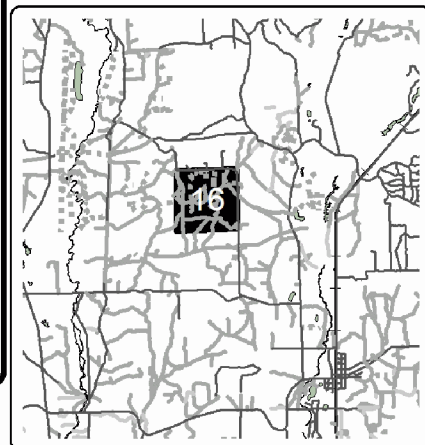



**TIMBER SALE INFORMATION**

Goshawk Mix (72-007-18)

T28N, R01W, SEC. 15; T28N, R01W, SEC. 22.  
Crawford County (Advertised Price \$15,703.90)

SALE NOTE: Sale is only accessible via the snowmobile trail. There is a Goshawk nest within the sale area: If the nest is active, Payment Unit 3 could be removed and Payment Unit 2 would have operational restrictions.

A recreation site such as a trail, pathway, or campground is within the sale area or the vicinity. Certain restrictions/specifications may be applicable including time restrictions.

A timber sale contract for this lump sum, sealed bid timber sale will be awarded to the responsible bidder offering the highest sealed bid price. Bids must be at or above the following advertised price for each species:

<u>PRODUCTS &amp; SPECIES</u>	<u>ESTIMATED UNITS*</u>	<u>ADVERTISED PRICE</u>
Sawtimber		
Red Pine	44.30 MBF	\$ 104.00 / MBF
Pulpwood		
Balsam Fir	3.00 Cords	\$ 14.45 / Cord
Black Spruce	24.00 Cords	\$ 16.50 / Cord
Jack Pine	214.00 Cords	\$ 18.05 / Cord
Mixed Oak	54.00 Cords	\$ 20.30 / Cord
Quaking Aspen	40.00 Cords	\$ 22.40 / Cord
Red Maple	25.00 Cords	\$ 31.35 / Cord
Red Pine	74.00 Cords	\$ 36.90 / Cord
Scotch Pine	41.00 Cords	\$ 23.65 / Cord
Tamarack	11.00 Cords	\$ 28.95 / Cord

\* The total volume is statistically estimated within plus (+) or minus (-) 17.76 percent. The estimated units are final and not subject to adjustment. Prospective bidders are urged to examine this timber and to make their own estimates of quantity and quality.

**BOND AND PAYMENT SCHEDULE:**

1. A bond in the amount of \$1,000.00 to insure faithful performance of the conditions of the contract will be deposited by the successful bidder within 21 days of the sale award.
2. Cutting in any sale or unit without the required advance payment would be considered a trespass.
3. Total payment must be paid in advance or according to the following schedule:
  - (a) Ten percent (10%) of the sale value must be paid within 21 days of the sale award.
  - (b) The 10% down payment will be credited towards the first unit cut.
  - (c) Payment for each of the following units must be made before cutting begins in that unit:

<u>PAYMENT UNIT NUMBER</u>	<u>PERCENT OF TOTAL SALE VALUE</u>
01	28.1%
02	23.2%
03	17.6%
04	31.1%

4. If no cutting takes place, the 10% down payment will not be refunded.
5. Operations on the contract issued will terminate on 12/31/2021.

**Description of Timber by Payment Unit (PU)**

PU	MARKET GROUP	PRODUCT	QUANTITY	UNIT	ACRES	ADVERTISE PRICE
1	Red Pine	Sawtimber	13.2	MBF	11.0	\$4,419.00
	Black Spruce	Pulpwood	4.0	Cords		
	Jack Pine		58.0	Cords		
	Mixed Oak		16.0	Cords		
	<i>Bl/R/Hybrid Oak</i>		14.0	<i>Cords</i>		
	<i>White Oak</i>		2.0	<i>Cords</i>		
	Quaking Aspen		11.0	Cords		
	Red Maple		8.0	Cords		
	Red Pine		21.0	Cords		
	Scotch Pine		13.0	Cords		
	Tamarack		1.0	Cords		
2	Red Pine	Sawtimber	9.3	MBF	10.1	\$3,647.75
	Balsam Fir	Pulpwood	1.0	Cords		
	Black Spruce		9.0	Cords		
	Jack Pine		54.0	Cords		
	Mixed Oak		11.0	Cords		
	<i>Bl/R/Hybrid Oak</i>		10.0	<i>Cords</i>		
	<i>White Oak</i>		1.0	<i>Cords</i>		
	Quaking Aspen		9.0	Cords		
	Red Maple		5.0	Cords		
	Red Pine		17.0	Cords		
	Scotch Pine		8.0	Cords		
Tamarack		5.0	Cords			
3	Red Pine	Sawtimber	8.6	MBF	6.8	\$2,762.85
	Balsam Fir	Pulpwood	1.0	Cords		
	Black Spruce		1.0	Cords		
	Jack Pine		35.0	Cords		
	Mixed Oak		11.0	Cords		
	<i>Bl/R/Hybrid Oak</i>		10.0	<i>Cords</i>		
	<i>White Oak</i>		1.0	<i>Cords</i>		
	Quaking Aspen		7.0	Cords		
	Red Maple		5.0	Cords		
	Red Pine		13.0	Cords		
	Scotch Pine		8.0	Cords		
4	Red Pine	Sawtimber	13.2	MBF	13.2	\$4,874.30
	Balsam Fir	Pulpwood	1.0	Cords		
	Black Spruce		10.0	Cords		
	Jack Pine		67.0	Cords		
	Mixed Oak		16.0	Cords		
	<i>Bl/R/Hybrid Oak</i>		15.0	<i>Cords</i>		
	<i>White Oak</i>		1.0	<i>Cords</i>		
	Quaking Aspen		13.0	Cords		
	Red Maple		7.0	Cords		
	Red Pine		23.0	Cords		
	Scotch Pine		12.0	Cords		
Tamarack		5.0	Cords			
TOTAL:			44.3	MBF		
TOTAL:			486.0	Cords		



## Sale Specific Conditions & Requirements

**Sale Name: Goshawk Mix**

**Sale Number: 72-007-18 Seq#: 1**

### 1 - Sale Area

#### 1.2 - Boundaries

##### 1.2.1 - Painted boundaries (1/14)

The sale boundary and Payment Unit boundaries are marked and identified by red and yellow paint. Exterior sale boundary lines against state are marked with red paint. The retention island within Payment Unit 3 is marked with red and green paint. Interior Payment Unit boundaries are marked with yellow and red paint (see Timber Sale Map). The painted boundary line trees are not Included Timber and are to be protected. Red painted trees along the snowmobile trail can be cut. Yellow and red painted trees designating an interior Payment Unit boundary are only to be cut when all surrounding Payment Units have been paid.

### 2 - Timber Specifications

#### 2.1 - Included Timber

##### 2.1.1 - Clearcut unit(s) with unmerchantable trees (6/14)

Within Payment Unit(s) 1 - 4, cut all trees that are two (2) inches or more at DBH.

#### 2.2 - Utilization

##### 2.2.2 - Chipping required (2/18)

This sale must be chip harvested to facilitate subsequent planting operations. The Purchaser has the option to produce sawlogs or pulpwood bolts, but the remaining portion of the trees must be chipped and hauled. If market conditions limit the practicality of chipping, tops and slash must be arranged in a way that will not inhibit future planting operations, as directed by the sale administrator. A chipping exemption can be obtained if proposed operations are determined to be suitable for planting by reforestation staff. This exemption must be granted in writing. The requirement to retain approximately 1/6 of tree tops and limbs less than four inches in diameter is still applicable (G. C. & R. 2.2).

##### 2.2.3 - Stump heights (4/07)

Stump heights within the Sale Area shall not exceed 6 inches for all trees. This is in order to facilitate planting operations. A written waiver of this requirement may be obtained if wet summer weather makes winter logging necessary.

### 3 - Payments

#### 3.3 - Pre-measured Sales

##### 3.3.4 - Dividing payment units (7/14)

Payment Unit(s) may be divided at the request of the Purchaser and upon approval of the Unit Manager. Dividing Payment Units is a contract modification which requires a Timber Sale Contract Supplement.

### 4 - Transportation

#### 4.1 - Construction

##### 4.1.3 - Slash and earthen piles (8/04)

Piles or windrows of earth along roads and landings that have been widened or constructed shall be leveled. Slash from road maintenance or construction, including stumps, shall be chipped, utilized or dispersed throughout the sale so that it doesn't hinder trenching and planting operations.

##### 4.1.6 - Road construction (1/09)

Construction of new roads or improvements of existing roads shall be done in such a way as to minimize the environmental and visual impacts. Merchantable trees shall be cut and utilized unless otherwise directed. Non-merchantable trees shall be severed and laid flat on the ground. Slash shall be chipped, utilized or dispersed throughout the sale so that it does not hinder trenching and planting operations. Stumps shall be set upright, not left on edge, and be moved at least 10 feet away from the road edge. Disturbed soil shall be feathered into the woods and not left in berms or windrows.

#### 4.1.7 - Road closure (10/11)

All new roads built into the sale must be blocked to vehicle traffic upon completion of the sale. Overgrown roads that are reopened shall be considered new roads. In general, this will require constructing a four (4') foot high berm of stumps and logs covered with earth. Stumps and brush must be placed along the remainder of the trail. These roads must be rendered impassable to cars and trucks. All stumps from road building and landing construction must be reserved to block any newly constructed roads upon completion of the sale. These stumps must be scattered along the road system to prohibit vehicular movement. Contact the sale administrator for specific details of design and placement.

#### 4.1.11 - Permits (2/12)

The Purchaser will secure any necessary permits that may be required.

### 4.2 - Maintenance

#### 4.2.5 - Two wheel drive condition (2/04)

All existing trail roads on and adjacent to the sale area must be passable by two-wheel drive traffic for the duration of the sale.

## 5 - Operations

### 5.2 - Conduct of Operations

#### 5.2.1 - Slash

##### 5.2.1.8 - Slash height (12/08)

No slash may exceed 24 inches in height.

#### 5.2.2 - Hazard Trees/Snags

##### 5.2.2.1 - Den trees (10/16)

Obvious hollow and/or den trees shall be protected and left standing unless they are a safety hazard.

#### 5.2.3 - Operating Restrictions

##### 5.2.3.6 - Bark beetle restriction (12/08)

In the event drought creates a high risk of pine bark beetle infestation, pine is not to be cut during the period March 1 through July 1, unless all portions of trees greater than two inches in diameter are removed from the sale area, reduced to chips, or treated to the satisfaction of the Unit Manager or his/her representative, within fifteen days of being severed from the stump. Pine log decks, pulpwood piles and treetops that are piled for chipping in the fall or winter within a 1/4 mile of susceptible sites must be removed before March 15. Residual slash must not be placed in piles or rows and must be spread over the site for quick drying. The Department of Natural Resources will exercise this specification if the risk of damage warrants.

#### 5.2.4 - Dead and Down Creation

##### 5.2.4.1 - Dead and down creation, marked trees (10/13)

Red painted spruce and balsam fir boundary line trees along the swamp edge in Payment Units 1 - 4 must be left until the adjacent Included Timber has been cut and taken to the landing. After that, those line trees are to be felled into the adjacent swamp for snowshoe hare habitat. If more than one tree is marked next to another, fall them so their tops or trunks overlap.

#### 5.2.31 - Landing locations (9/13)

Trees, slash, and tops from Payment Unit 2 and west part of Payment Unit 3 must be processed at a landing within or immediately adjacent to that unit. This is necessary to limit the spread of scotch pine seed into adjacent units.

#### 5.2.38 - No decking against live trees (2/04)

Cut products may not be decked against unmarked or designated leave trees.

#### 5.2.39 - ORV trail/route protection (4/18)

An ORV trail or route and is shown on the Timber Sale Map. Do not cut trees or damage posts with yellow ORV markers. All stumps within 5 feet of the trail must be cut flush with the ground. Maintain a 20 foot wide slash, debris, and rut free zone daily using the ORV trail or route as the centerline.

#### 5.2.40 - Pathway protection (10/10)

The Midland to Mackinaw Pathway is a hiking trail and is shown on the Timber Sale Map (it runs down the Snowmobile Trail). Do not cut trees or damage posts with blue pathway markers. Maintain a 20-foot wide slash, debris, and rut free zone daily, using the pathway as the centerline.

#### 5.2.41 - Snowmobile trail protection (9/11)

Trail 409 is a snowmobile trail and is shown on the Timber Sale Map. The Midland to Mackinaw Pathway also runs down this segment of the snowmobile trail. This trail is also used by ORV's and horseback riders. Do not cut or damage posts with orange trail markers or traffic control signs. Do not cut or damage posts with orange trail markers or traffic control signs. The snowmobile trail may not be used for any timber sale operations from December 1 to March 31 without Unit Manager permission. If the trail is used for hauling, it must be graded to the satisfaction of the Unit Manager or his/her representative prior to December 1st. If permission is granted to use the trail for hauling during the snowmobile season, then a snow covered base must be left on the trail. Maintain a 20 foot wide slash, debris, and rut free zone daily using the snowmobile trail as the centerline. In addition, any trees cut within 5 feet of the trail may need to have the stumps removed and disposed of according to the direction of the Unit Manager or his/her representative. Decking of forest products will not be permitted along the snowmobile trail without Unit Manager permission.

### 5.4 - Soil Protection

#### 5.4.1 - Rutting restriction, general (7/16)

Operations are to cease immediately if equipment and weather conditions result in rutting of roads and/or skid trails which is 12 inches or greater in depth and 50 feet in length. The Unit Manager or his/her representative may restrict hauling and/or skidding if ruts exceed the specified depth. With the Unit Manager or his/her representative's approval, the Purchaser may return to the area when the risk of rutting has decreased.

#### 5.4.7 - Rutting restriction, Riparian Management Zone (RMZ) (1/09)

Within the low lying areas, operations are to cease immediately if equipment and weather conditions result in rutting of skid trails which is 6 inches or greater in depth and 25 feet in length. The Unit Manager or his/her representative may restrict hauling and/or skidding if ruts exceed the specified depth. With the Unit Manager or his/her representative's approval, the Purchaser may return to the area when the risk of rutting has decreased.

### 5.8 - Protection of Endangered Species

#### 5.8.1 - Kirtland's warbler (1) (10/12)

This sale is adjacent to a young jack pine stand which may be used by the endangered Kirtland's Warbler. The Department reserves the right to temporarily restrict all harvesting operations in a buffer zone of up to 500 feet if it is determined that Warbler territory has been established in the adjacent stand. The restricted period, if put into effect, would apply from May 1st to August 15th.

#### 5.8.3 - Red shoulder hawk or goshawk (2/16)

In the event that an active red shoulder hawk or goshawk nest is found, the contract may be amended to protect the nest site until the nest is determined to be inactive. The value of the trees in this excluded area will be refunded or credited to the Purchaser. The nest will be buffered with a five-chain radius (eight acre) protection area, centered on the nest tree, in which there will be no cutting or new roads constructed. Avoid human disturbance, including loading and skidding, in the protection area.

An additional zone of five chains (ten chains centered on the active nest tree) will be established in which there is no management activity from March 15 to July 15 (NLP). Limit biomass harvesting and chipping operations within this ten-chain zone, retain the maximum one-third of residues per the Woody Biomass Harvesting Guidelines (Michigan DNR 2010). Nests determined to be inactive will be protected with a one-chain no-harvest buffer.

## 6 - Safety and Fire Prevention

### 6.2 - Signing

#### 6.2.1 - Road posting (9/09)

The Purchaser is responsible for posting and maintaining caution signs on County Road 612 prior to beginning operations. The road must be posted at appropriate distances from the sale area to warn of logging activity and truck traffic. Signs must be removed when harvest operations are suspended or completed.

#### 6.2.2 - Snowmobile trail posting (8/09)

The Purchaser is responsible for posting and maintaining caution signs on Snowmobile Trail 409 prior to beginning operations during the snowmobile season (approximately December 1 to March 31). The trail must be posted at appropriate distances from the sale area to warn of logging activity and truck traffic. Signs must be removed when harvest operations are suspended or completed.

#### 6.2.3 - Recreational trail posting (2/10)

The Purchaser is responsible for posting and maintaining caution signs on Snowmobile Trail 409 prior to beginning operations. The trail must be posted at appropriate distances from the sale area to warn of logging activity and truck traffic at both ends of the trail. Signs must be removed when harvest operations are suspended or completed.



# TIMBER SALE MAP

This information provided by authority of Part 525, 1994 PA 451, as amended.

Forest Management Unit Grayling		County Crawford	Mapped By Barnes	Date 02/20/2018	Page 1	of 1
Township 28N	Range 01W	Section(s) and Subdivision(s) Sec 15 - S1/2SW, NESW, NWSE; Sec 22 - NWNW		Scale 1:15,840		

Cover Type				Density	
A = Aspen	H = Hemlock	N = Marsh	U = Upland Brush	0 = Non Stocked	5 = Pole Timber Medium
B = Paper Birch	J = Jack Pine	O = Oak	UM = Upland Mixed	1 = Seedling Sapling Poor	6 = Pole Timber Well
C = Cedar	L = Lowland Brush	P = Lowland Poplar	V = Bog or Marsh	2 = Seedling Sapling Medium	7 = Saw Timber Poor
D = Treed Bog	LM = Lowland Mixed	Q = Mixed Swamp Conifer	W = White Pine	3 = Seedling Sapling Well	8 = Saw Timber Medium
E = Swamp Hdwoods	M = Mpl, Bch, Brch	R = Red Pine	X = Non Stocked	4 = Pole Timber Poor	9 = Saw Timber Well
F = Spruce Fir	MC = Mixed Conifer	S = Black Spruce	Z = Water		
G = Grass	MD = Mixed Deciduous	T = Tamarack			

PU	Acres	MBF	Cords
1	11.0	13.2	132
2	10.1	9.3	119
3	6.8	8.6	81
4	13.2	13.2	154

**Goshawk Mix**  
**Compartment 272**  
**41.1 Acres**  
**44.3 MBF & 486 Cords**

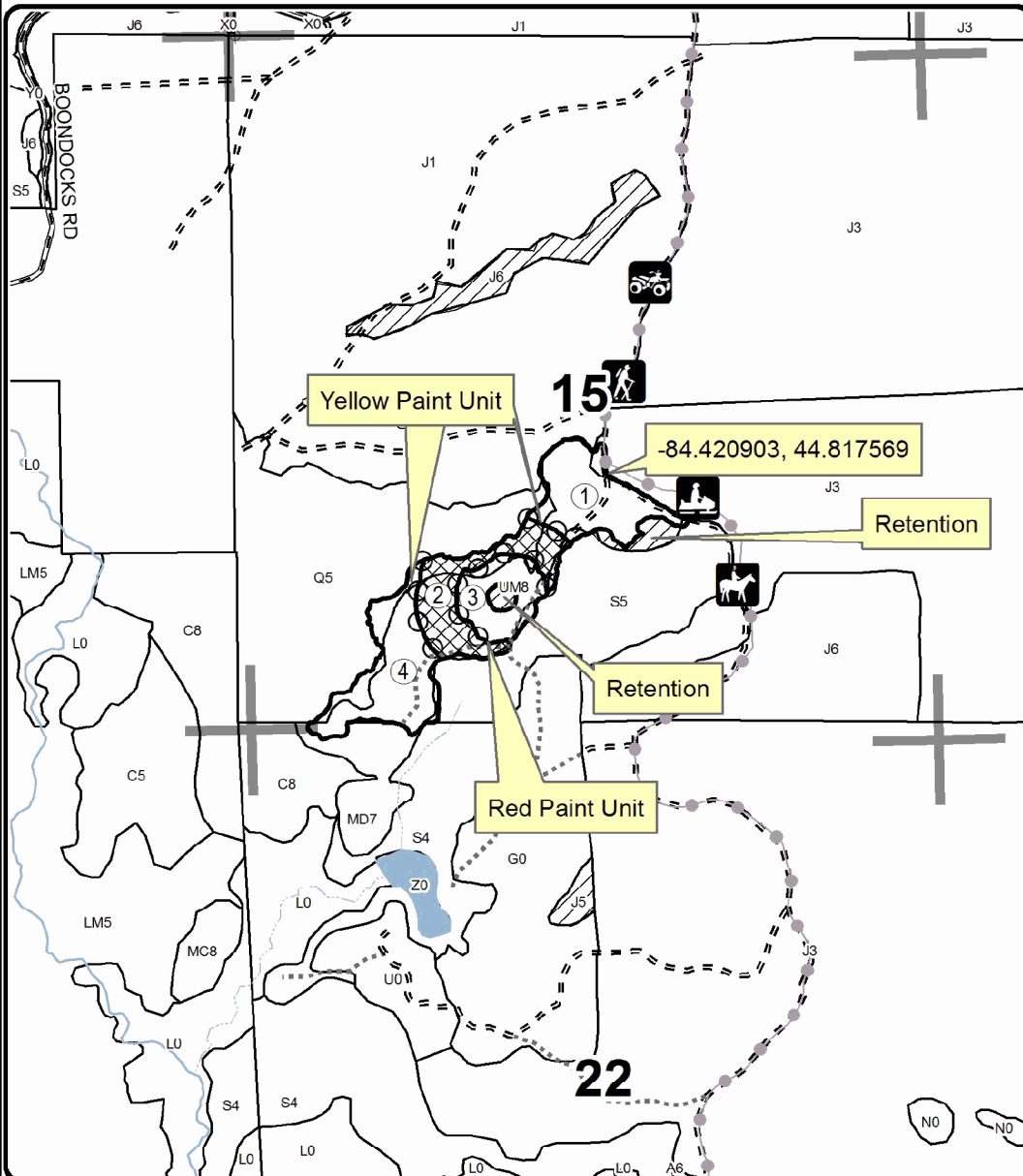
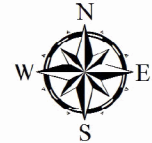

**Legend**

- Against State (Red)
- Payment Unit (Yellow & Red)
- ▨ Retention Area (Red and Green Paint)
- ⊠ Goshawk Harvesting Restriction (Potential)
- PU\_Label
- Stand Boundaries
- Section Corners
- Highway
- Paved Roads
- Gravel Roads
- == Poor Dirt Roads
- ... Closed
- Lakes and Rivers All
- Recreational Trail

**Locator Map**  
1:200,000

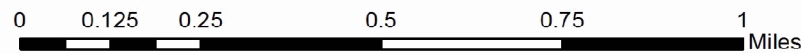
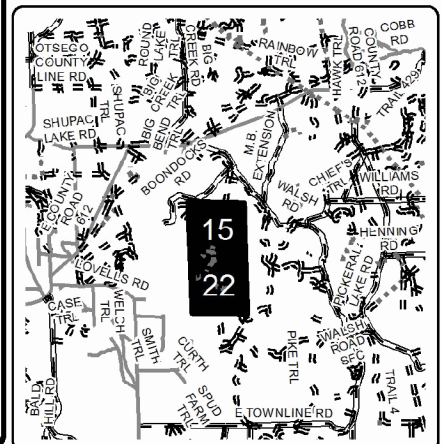



**TIMBER SALE INFORMATION**

Lovells Hideaway (72-008-18)  
 T28N, R01W, SEC. 17; T28N, R01W, SEC. 19; T28N, R01W, SEC. 20.  
 Crawford County (Advertised Price \$6,259.05)

SALE NOTE: Sale is located off Lovells Rd.

A recreation site such as a trail, pathway, or campground is within the sale area or the vicinity. Certain restrictions/specifications may be applicable including time restrictions.

A timber sale contract for this lump sum, sealed bid timber sale will be awarded to the responsible bidder offering the highest sealed bid price. Bids must be at or above the following advertised price for each species:

<u>PRODUCTS &amp; SPECIES</u>	<u>ESTIMATED UNITS*</u>	<u>ADVERTISED PRICE</u>
Pulpwood		
BI/R/Hybrid Oak	12.00 Cords	\$ 21.75 / Cord
Jack Pine	247.00 Cords	\$ 19.35 / Cord
Quaking Aspen	31.00 Cords	\$ 24.00 / Cord
Red Pine	12.00 Cords	\$ 39.55 / Cord

\* The total volume is statistically estimated within plus (+) or minus (-) 18.42 percent. The estimated units are final and not subject to adjustment. Prospective bidders are urged to examine this timber and to make their own estimates of quantity and quality.

**BOND AND PAYMENT SCHEDULE:**

- A bond in the amount of \$1,000.00 to insure faithful performance of the conditions of the contract will be deposited by the successful bidder within 21 days of the sale award.
- Cutting in any sale or unit without the required advance payment would be considered a trespass.
- Total payment must be paid in advance or according to the following schedule:
  - Ten percent (10%) of the sale value must be paid within 21 days of the sale award.
  - The 10% down payment will be credited towards the first unit cut.
  - Payment for each of the following units must be made before cutting begins in that unit:
 

PAYMENT UNIT NUMBER	PERCENT OF TOTAL SALE VALUE
01	79.9%
02	20.1%
- If no cutting takes place, the 10% down payment will not be refunded.
- Operations on the contract issued will terminate on 06/30/2021.

**Description of Timber by Payment Unit (PU)**

PU	MARKET GROUP	PRODUCT	QUANTITY	UNIT	ACRES	ADVERTISE PRICE
1	BI/R/Hybrid Oak	Pulpwood	3.0	Cords	24.3	\$4,999.65
	Jack Pine		228.0	Cords		
	Quaking Aspen		2.0	Cords		
	Red Pine		12.0	Cords		
2	BI/R/Hybrid Oak	Pulpwood	9.0	Cords	5.8	\$1,259.40
	Jack Pine		19.0	Cords		
	Quaking Aspen		29.0	Cords		
<b>TOTAL:</b>			302.0	Cords		

## Sale Specific Conditions & Requirements

**Sale Name: Lovells Hideaway**

**Sale Number: 72-008-18 Seq#: 1**

### 1 - Sale Area

#### 1.2 - Boundaries

##### 1.2.1 - Painted boundaries (1/14)

The sale boundary and Payment Unit boundaries are marked and identified by blue and red paint. Exterior sale boundary lines against private property are marked with blue paint. Exterior sale boundary lines against state are marked with red paint. The painted boundary line trees are not Included Timber and are to be protected.

### 2 - Timber Specifications

#### 2.1 - Included Timber

##### 2.1.1 - Clearcut unit(s) with unmerchantable trees (6/14)

Within Payment Unit(s) 1, cut all trees that are two (2) inches or more at DBH.

##### 2.1.2 - Clearcut unit(s) w/o unmerchantable trees (8/11)

Within Payment Unit(s) 2, cut all trees which meet minimum piece specifications in 2.2 Utilization (100" piece to a top diameter inside bark 4 of inches).

#### 2.2 - Utilization

##### 2.2.2 - Chipping required (2/18)

Payment Unit 1 must be chip harvested to facilitate subsequent planting operations and also to meet Kirtland's warbler habitat requirements. The Purchaser has the option to produce sawlogs or pulpwood bolts, but the remaining portion of the trees must be chipped and hauled. If market conditions limit the practicality of chipping, the producer may skid all remaining topwood out of these payment units and scatter in locations approved by the sale administrator. A chipping exemption can be obtained if proposed operations are determined to be suitable for planting by reforestation staff. This exemption must be granted in writing. If the deadline is not met, damages will be collected determined by the cost to complete this work. The requirement to retain approximately 1/6 to 1/3 of tree tops and limbs less than four inches in diameter does not apply (G. C. & R. 2.2). This is because this is a jack pine stand.

##### 2.2.3 - Stump heights (4/07)

Stump heights within the Sale Area shall not exceed 6 inches for all trees. This is in order to facilitate planting operations. A written waiver of this requirement may be obtained if wet summer weather makes winter logging necessary.

### 4 - Transportation

#### 4.1 - Construction

##### 4.1.3 - Slash and earthen piles (8/04)

Piles or windrows of earth along roads and landings that have been widened or constructed shall be leveled. Slash from road maintenance or construction, including stumps, shall be chipped, utilized or dispersed throughout the sale.

##### 4.1.6 - Road construction (1/09)

Construction of new roads or improvements of existing roads shall be done in such a way as to minimize the environmental and visual impacts. Merchantable trees shall be cut and utilized unless otherwise directed. Non-merchantable trees shall be severed and laid flat on the ground. Slash shall be chipped, utilized or dispersed throughout the sale. Stumps shall be set upright, not left on edge, and be moved at least 10 feet away from the road edge. Disturbed soil shall be feathered into the woods and not left in berms or windrows.

##### 4.1.7 - Road closure (10/11)

All new roads built into the sale must be blocked to vehicle traffic upon completion of the sale. Overgrown roads that are reopened shall be considered new roads. In general, this will require constructing a four (4') foot high berm of stumps and logs and may be covered with earth. Stumps and brush must be placed along the remainder of the trail. These roads must be rendered impassable to cars and trucks. All stumps from road building and landing construction must be reserved to block any newly constructed roads upon completion of the sale. These stumps must be scattered along the road system to prohibit



vehicular movement. Contact the sale administrator for specific details of design and placement.

#### 4.1.11 - Permits (2/12)

The Purchaser will secure any necessary permits that may be required.

### 4.2 - Maintenance

#### 4.2.5 - Two wheel drive condition (2/04)

All existing trail roads on and adjacent to the sale area must be passable by two-wheel drive traffic for the duration of the sale.

## 5 - Operations

### 5.2 - Conduct of Operations

#### 5.2.1 - Slash

##### 5.2.1.8 - Slash height (12/08)

No slash or tree tops may exceed 24 inches in height.

#### 5.2.2 - Hazard Trees/Snags

##### 5.2.2.1 - Den trees (10/16)

Obvious hollow and/or den trees shall be protected and left standing unless they are a safety hazard.

#### 5.2.4 - Dead and Down Creation

##### 5.2.4.4 - Dead and down creation, grouse (6/18)

To encourage grouse and other wildlife, in Payment Unit(s) 2, leave one, 8" diameter or larger log-length (8 foot minimum) piece on the ground for every 2 acres or one 8" or larger diameter (or largest diameter trees within stand) whole tree on the ground for every 2 acres, preferably a hardwood species such as oak or maple or if no hardwoods are present, a pine species (white or red). These trees will be evenly scattered throughout the unit, preferably at least two chains from any roads, two-tracks, or trails open to vehicles.

#### 5.2.39 - ORV trail/route protection (4/18)

The LP 47 is an ORV trail or route and is shown on the Timber Sale Map. Do not cut trees or damage posts with yellow ORV markers. All stumps within 5 feet of the trail must be cut flush with the ground. Maintain a 20 foot wide slash, debris, and rut free zone daily using the ORV trail or route as the centerline. Do not run equipment down the ORV trail or route. Skidding across the trail or route may only occur in locations approved by the sale administrator.

#### 5.2.41 - Snowmobile trail protection (9/11)

The LP 47 is a snowmobile trail and is also used as an ORV Trail and is shown on the Timber Sale Map. Do not cut or damage posts with orange trail markers or traffic control signs. Do not cut or damage posts with orange trail markers or traffic control signs. If the trail is used, it must be maintained and restored to a condition equal to or better than before the sale. The road maintenance/restoration must be done prior to December 1. If the trail is used for hauling, it must be graded to the satisfaction of the Unit Manager or his/her representative prior to December 1st. The snowmobile trail may not be used for any timber sale operations from December 1 to March 31 without written approval of Unit Manager. If the trail road is to be used for hauling during the snowmobile season, then a snow covered base must be left on the trail. The snowmobile trail may only be crossed at right angles. Maintain a 20 foot wide slash, debris, and rut free zone daily using the snowmobile trail as the centerline. No decking of forest products will be permitted along the snowmobile trail. All stumps within 20 feet of the snowmobile trail must be cut at ground level.

### 5.4 - Soil Protection

#### 5.4.1 - Rutting restriction, general (7/16)

Operations are to cease immediately if equipment and weather conditions result in rutting of roads and/or skid trails which is 12 inches or greater in depth and 50 feet in length. The Unit Manager or his/her representative may restrict hauling and/or skidding if ruts exceed the specified depth. With the Unit Manager or his/her representative's approval, the Purchaser may return to the area when the risk of rutting has decreased.

### 5.8 - Protection of Endangered Species

#### 5.8.1 - Kirtland's warbler (1) (10/12)

This sale is adjacent to a young jack pine stand which may be used by the endangered Kirtland's Warbler. The Department reserves the right to temporarily restrict all harvesting operations in a buffer zone of up to 500 feet if it is determined that Warbler territory has been established in the adjacent stand. The restricted period, if put into effect, would apply from May 1st to August 15th.

### **6 - Safety and Fire Prevention**

#### 6.2 - Signing

##### 6.2.1 - Road posting (9/09)

The Purchaser is responsible for posting and maintaining caution signs on Kengel Trail and County Rd 612 prior to beginning operations. The road must be posted at appropriate distances from the sale area to warn of logging activity and truck traffic. Signs must be removed when harvest operations are suspended or completed. The Purchaser will provide these signs.

##### 6.2.3 - Recreational trail posting (2/10)

The Purchaser is responsible for posting and maintaining caution signs on LP 47 (trail is used by both ORV's and snowmobiles) prior to beginning operations. The trail must be posted at appropriate distances from the sale area to warn of logging activity and truck traffic at both ends of the trail. Signs must be removed when harvest operations are suspended or completed. The Purchaser will provide these signs.



# TIMBER SALE MAP

This information provided by authority of Part 525, 1994 PA 451, as amended.

Forest Management Unit Grayling		County Crawford	Mapped By Barnes	Date 9/24/2018	Page 1	of 1
Township 28N	Range 01W	Section(s) and Subdivision(s) Sec 17 - SWSW, SESE; Sec 19 - NENE; Sec 20 - W1/2NW		Scale 1:15,840		

Cover Type				Density			
A = Aspen	H = Hemlock	N = Marsh	U = Upland Brush	0 = Non Stocked	5 = Pole Timber Medium		
B = Paper Birch	J = Jack Pine	O = Oak	UM = Upland Mixed	1 = Seedling Sapling Poor	6 = Pole Timber Well		
C = Cedar	L = Lowland Brush	P = Lowland Poplar	V = Bog or Marsh	2 = Seedling Sapling Medium	7 = Saw Timber Poor		
D = Treed Bog	LM = Lowland Mixed	Q = Mixed Swamp Conifer	W = White Pine	3 = Seedling Sapling Well	8 = Saw Timber Medium		
E = Swamp Hdwoods	M = Mpl, Bch, Brch	R = Red Pine	X = Non Stocked	4 = Pole Timber Poor	9 = Saw Timber Well		
F = Spruce Fir	MC = Mixed Conifer	S = Black Spruce	Z = Water				
G = Grass	MD = Mixed Deciduous	T = Tamarack					

PU	Acres	MBF	Cords
1	24.3	000	245
2	5.8	000	57

**Lovells Hideaway**  
 Compartment 272  
 30.1 Acres  
 302 Cords

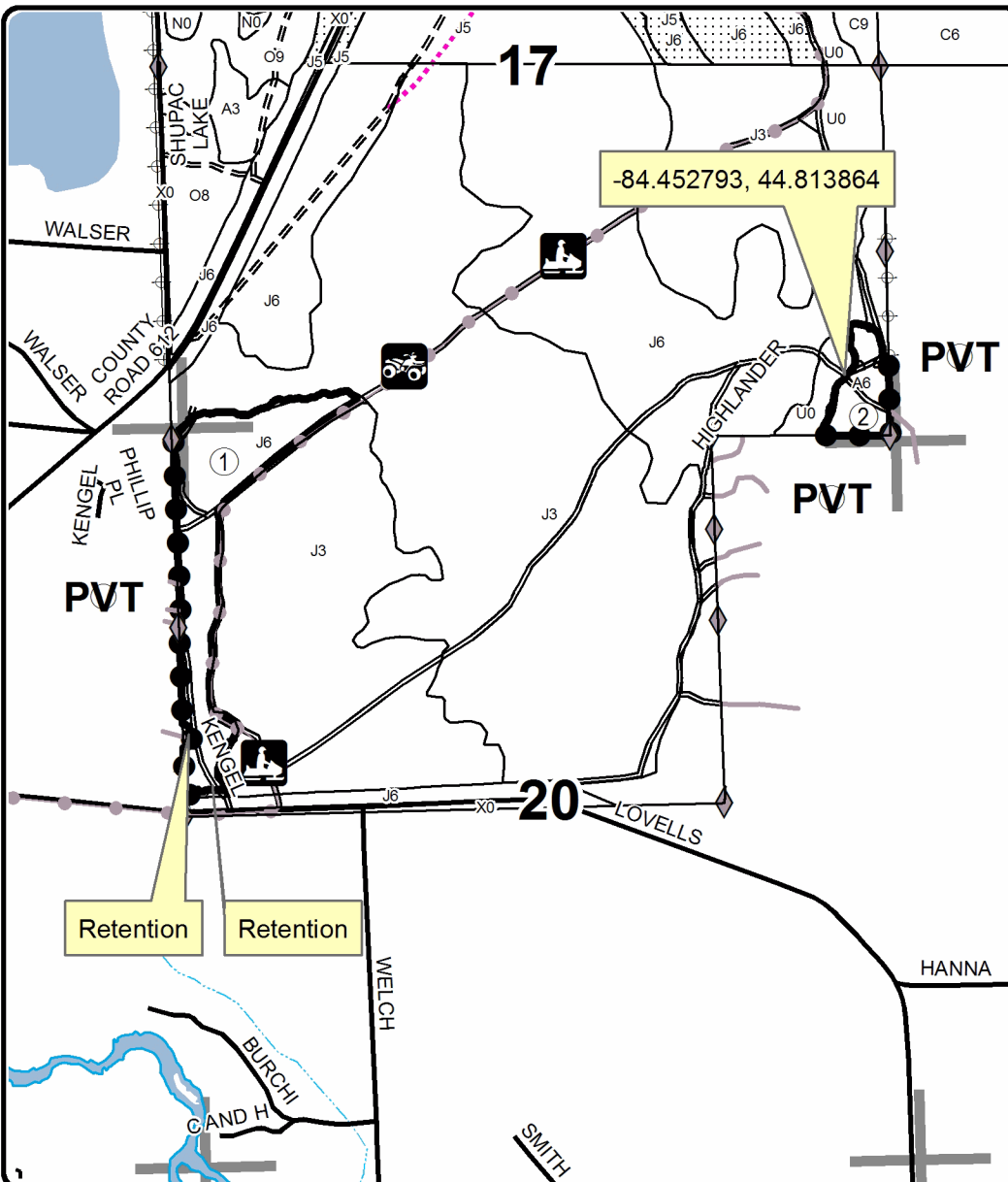
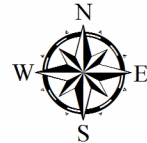

### Legend

- Against State (Red)
- Private Line (Blue)
- Stand Boundaries
- Field Grade Corners
- Secondary Forest Road
- Forest Access Route
- Paved Road
- Gravel Road
- Private
- Retention Area
- Nearby Timber Sales
- Section Corners
- PU\_Label
- Powerline

Locator Map  
1:200,000

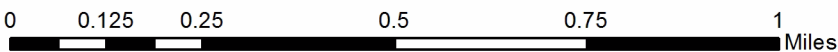
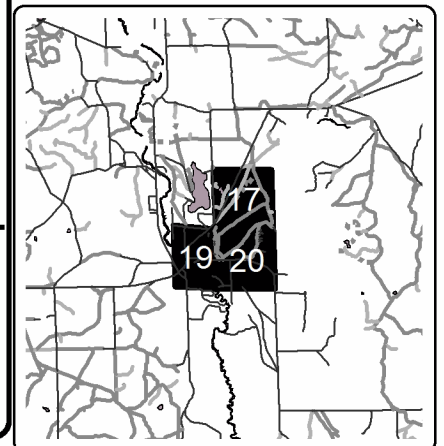



**TIMBER SALE INFORMATION**

Lost Can Aspen (72-009-18)

T28N, R01W, SEC. 11; T28N, R01W, SEC. 12; T28N, R01W, SEC. 13; T28N, R01W, SEC. 14.  
Crawford County (Advertised Price \$44,387.25)

SALE NOTE: This sale can be accessed off of Walsh Road. Walsh Road also is used as a horse, ORV and snowmobile trail. A temporary bridge will be used to access the sale and provided by the DNR.

A recreation site such as a trail, pathway, or campground is within the sale area or the vicinity. Certain restrictions/specifications may be applicable including time restrictions.

A timber sale contract for this lump sum, sealed bid timber sale will be awarded to the responsible bidder offering the highest sealed bid price. Bids must be at or above the following advertised price for each species:

<u>PRODUCTS &amp; SPECIES</u>	<u>ESTIMATED UNITS*</u>	<u>ADVERTISED PRICE</u>
Pulpwood		
BI/R/Hybrid Oak	10.00 Cords	\$ 20.30 / Cord
Jack Pine	450.00 Cords	\$ 18.05 / Cord
Mixed Aspen	978.00 Cords	\$ 22.40 / Cord
Red Maple	26.00 Cords	\$ 31.35 / Cord
Red Pine	298.00 Cords	\$ 36.90 / Cord
White Pine	91.00 Cords	\$ 25.75 / Cord

\* The total volume is statistically estimated within plus (+) or minus (-) 11.45 percent. The estimated units are final and not subject to adjustment. Prospective bidders are urged to examine this timber and to make their own estimates of quantity and quality.

**BOND AND PAYMENT SCHEDULE:**

1. A bond in the amount of \$2,219.00 to insure faithful performance of the conditions of the contract will be deposited by the successful bidder within 21 days of the sale award.
2. Cutting in any sale or unit without the required advance payment would be considered a trespass.
3. Total payment must be paid in advance or according to the following schedule:
  - (a) Ten percent (10%) of the sale value must be paid within 21 days of the sale award.
  - (b) The 10% down payment will be credited towards the first unit cut.
  - (c) Payment for each of the following units must be made before cutting begins in that unit:
 

<u>PAYMENT UNIT NUMBER</u>	<u>PERCENT OF TOTAL SALE VALUE</u>
01	47.9%
02	33.9%
03	18.2%
4. If no cutting takes place, the 10% down payment will not be refunded.
5. Operations on the contract issued will terminate on 12/31/2021.

**Description of Timber by Payment Unit (PU)**

PU	MARKET GROUP	PRODUCT	QUANTITY	UNIT	ACRES	ADVERTISE PRICE
1	BI/R/Hybrid Oak	Pulpwood	2.0	Cords	51.0	\$21,263.65
	Jack Pine		130.0	Cords		
	Mixed Aspen		502.0	Cords		
	<i>B. T. Aspen</i>		15.0	<i>Cords</i>		
	<i>Quaking Aspen</i>		487.0	<i>Cords</i>		
	Red Maple		15.0	Cords		
	Red Pine		155.0	Cords		
	White Pine		56.0	Cords		
	2		BI/R/Hybrid Oak	Pulpwood		
Jack Pine		173.0	Cords			
Mixed Aspen		341.0	Cords			
<i>B. T. Aspen</i>		13.0	<i>Cords</i>			
<i>Quaking Aspen</i>		328.0	<i>Cords</i>			
Red Maple		8.0	Cords			
Red Pine		89.0	Cords			
White Pine		26.0	Cords			
3		BI/R/Hybrid Oak	Pulpwood		4.0	Cords
	Jack Pine	147.0		Cords		
	Mixed Aspen	135.0		Cords		
	<i>Quaking Aspen</i>	135.0		<i>Cords</i>		
	Red Maple	3.0		Cords		
	Red Pine	54.0		Cords		
	White Pine	9.0		Cords		
	TOTAL:			1,853.0	Cords	

## Sale Specific Conditions & Requirements

**Sale Name: Lost Can Aspen**

**Sale Number: 72-009-18 Seq#: 1**

### 1 - Sale Area

#### 1.2 - Boundaries

##### 1.2.1 - Painted boundaries (1/14)

The sale boundary and Payment Unit boundaries are marked and identified by red and yellow paint. Exterior sale boundary lines against state are marked with red paint. Interior Payment Unit boundaries are marked with yellow paint. The painted boundary line trees are not Included Timber and are to be protected. Yellow painted trees designating an interior Payment Unit boundary are only to be cut when all surrounding Payment Units have been paid.

### 2 - Timber Specifications

#### 2.1 - Included Timber

##### 2.1.1 - Clearcut unit(s) with unmerchantable trees (6/14)

Within Payment Unit(s) 1 - 3, cut all trees that are two (2) inches or more at DBH, except do not cut any spruce or fir.

### 3 - Payments

#### 3.3 - Pre-measured Sales

##### 3.3.4 - Dividing payment units (7/14)

Payment Unit(s) may be divided at the request of the Purchaser and upon approval of the Unit Manager. Dividing Payment Units is a contract modification which requires a Timber Sale Contract Supplement.

### 4 - Transportation

#### 4.1 - Construction

##### 4.1.2 - Stream crossings, specific (3/11)

The creek/river crossing will require the installation of a portable bridge which may be borrowed from the DNR. This installation will be performed in accordance with the specifications on the appropriate permits which shall be provided by the DNR.

##### 4.1.3 - Slash and earthen piles (8/04)

Piles or windrows of earth along roads and landings that have been widened or constructed shall be leveled. Slash from road maintenance or construction, including stumps, shall be chipped, utilized or dispersed throughout the sale.

##### 4.1.6 - Road construction (1/09)

Construction of new roads or improvements of existing roads shall be done in such a way as to minimize the environmental and visual impacts. Merchantable trees shall be cut and utilized unless otherwise directed. Non-merchantable trees shall be severed and laid flat on the ground. Slash shall be chipped, utilized or dispersed throughout the sale. Stumps shall be set upright, not left on edge, and be moved at least 10 feet away from the road edge. Disturbed soil shall be feathered into the woods and not left in berms or windrows.

##### 4.1.7 - Road closure (10/11)

All new roads built into the sale must be blocked to vehicle traffic upon completion of the sale. Overgrown roads that are reopened shall be considered new roads. In general, this will require constructing a four (4') foot high berm of stumps and logs covered with earth. Stumps and brush must be placed along the remainder of the trail. These roads must be rendered impassable to cars and trucks. All stumps from road building and landing construction must be reserved to block any newly constructed roads upon completion of the sale. These stumps must be scattered along the road system to prohibit vehicular movement. Contact the sale administrator for specific details of design and placement.

##### 4.1.11 - Permits (2/12)

The Purchaser will secure any necessary road permits that may be required.

#### 4.2 - Maintenance

#### 4.2.5 - Two wheel drive condition (2/04)

All existing trail roads on and adjacent to the sale area must be passable by two-wheel drive traffic for the duration of the sale.

### 5 - Operations

#### 5.2 - Conduct of Operations

##### 5.2.1 - Slash

###### 5.2.1.8 - Slash height (12/08)

No slash or tree tops may exceed 24 inches in height.

##### 5.2.2 - Hazard Trees/Snags

###### 5.2.2.1 - Den trees (10/16)

Obvious hollow and/or den trees shall be protected and left standing unless they are a safety hazard.

##### 5.2.4 - Dead and Down Creation

###### 5.2.4.4 - Dead and down creation, grouse (4/18)

To encourage grouse and other wildlife, in Payment Unit(s) 1 - 3, leave one, 10" or larger diameter (or largest diameter trees within stand) whole tree on the ground for every 2 acres, preferably a hardwood species such as oak or maple or if no hardwoods are present, a pine species (white or red). These will be evenly scattered throughout the unit.

##### 5.2.29 - Shrub protection (9/07)

Do not cut or damage hawthorn, witch-hazel, dogwood or junberry. These woody-shrub plants are highly beneficial to various wildlife species.

##### 5.2.32 - Decking/landing restoration (9/13)

All decking and landing areas must have the surface area restored to a condition equal to or better than before. This is to ensure the proper regeneration of the stand. Wood debris, chips and "cookies" from trimmings must be removed or scattered away from landing and loading areas and may not be windrowed on the edge.

##### 5.2.40 - Pathway protection (10/10)

The LP 4 is a bike, hiking, horse, ski, orv and snowmobile trail and is shown on the Timber Sale Map. This trail is also part of Walsh Road which is a seasonal county road. Walsh Road will be utilized for hauling wood produces. This trail does not run through any of the sale area.

#### 5.3 - Stream Protection

##### 5.3.1 - Operating near stream (7/04)

No tracked or wheeled vehicles shall be operated within 30 feet of the creek/river, except at an approved crossing.

#### 5.4 - Soil Protection

##### 5.4.1 - Rutting restriction, general (7/16)

Operations are to cease immediately if equipment and weather conditions result in rutting of roads and/or skid trails which is 12 inches or greater in depth and 50 feet in length. The Unit Manager or his/her representative may restrict hauling and/or skidding if ruts exceed the specified depth. With the Unit Manager or his/her representative's approval, the Purchaser may return to the area when the risk of rutting has decreased.

##### 5.4.7 - Rutting restriction, Riparian Management Zone (RMZ) (1/09)

Within the low lying areas along the sale boundary, operations are to cease immediately if equipment and weather conditions result in rutting of roads and skid trails which is 6 inches or greater in depth and 25 feet in length. The Unit Manager or his/her representative may restrict hauling and/or skidding if ruts exceed the specified depth. With the Unit Manager or his/her representative's approval, the Purchaser may return to the area when the risk of rutting has decreased.

#### 5.8 - Protection of Endangered Species

##### 5.8.1 - Kirtland's warbler (1) (10/12)

This sale is adjacent to a young jack pine stand which may be used by the endangered Kirtland's Warbler. The Department



reserves the right to temporarily restrict all harvesting operations in a buffer zone of up to 500 feet if it is determined that Warbler territory has been established in the adjacent stand. The restricted period, if put into effect, would apply from May 1st to August 15th.

## **6 - Safety and Fire Prevention**

### **6.2 - Signing**

#### **6.2.1 - Road posting (9/09)**

The Purchaser is responsible for posting and maintaining caution signs on Walsh Road and the un-named two track prior to beginning operations. The road must be posted at appropriate distances from the sale area to warn of logging activity and truck traffic. Signs must be removed when harvest operations are suspended or completed. The Purchaser will provide these signs.

#### **6.2.3 - Recreational trail posting (2/10)**

The Purchaser is responsible for posting and maintaining caution signs on LP 4/Walsh Road prior to beginning operations. The trail must be posted at appropriate distances from the sale area to warn of logging activity and truck traffic at both ends of the trail. Signs must be removed when harvest operations are suspended or completed. The Purchaser will provide these signs.



# TIMBER SALE MAP

This information provided by authority of Part 525, 1994 PA 451, as amended.

Sale Number	Year
72-009	18

Forest Management Unit Grayling		County Crawford	Mapped By Barnes	Date 04/18/2018	Page 1	of 1
Township 28N	Range 01W	Section(s) and Subdivision(s) Sec 11 - SENE, E1/2SE, SWSE; Sec 12 - W1/2SW, SWNW; Sec 13 - NWNW; Sec 14 - N1/2NE		Scale 1:15,840		

Cover Type				Density			
A = Aspen	H = Hemlock	N = Marsh	U = Upland Brush	0 = Non Stocked	5 = Pole Timber Medium		
B = Paper Birch	J = Jack Pine	O = Oak	UM = Upland Mixed	1 = Seedling Sapling Poor	6 = Pole Timber Well		
C = Cedar	L = Lowland Brush	P = Lowland Poplar	V = Bog or Marsh	2 = Seedling Sapling Medium	7 = Saw Timber Poor		
D = Tread Bog	LM = Lowland Mixed	Q = Mixed Swamp Conifer	W = White Pine	3 = Seedling Sapling Well	8 = Saw Timber Medium		
E = Swamp Hdwoods	M = Mpl. Bch. Brch	R = Red Pine	X = Non Stocked	4 = Pole Timber Poor	9 = Saw Timber Well		
F = Spruce Fir	MC = Mixed Conifer	S = Black Spruce	Z = Water				
G = Grass	MD = Mixed Deciduous	T = Tamarack					

PU	Acres	PU	Acres
1	51.0		
2	42.4		
3	29.3		

**Lost Can Aspen**  
 Compartment(s) 272, 291, 292  
 122.7 Acres

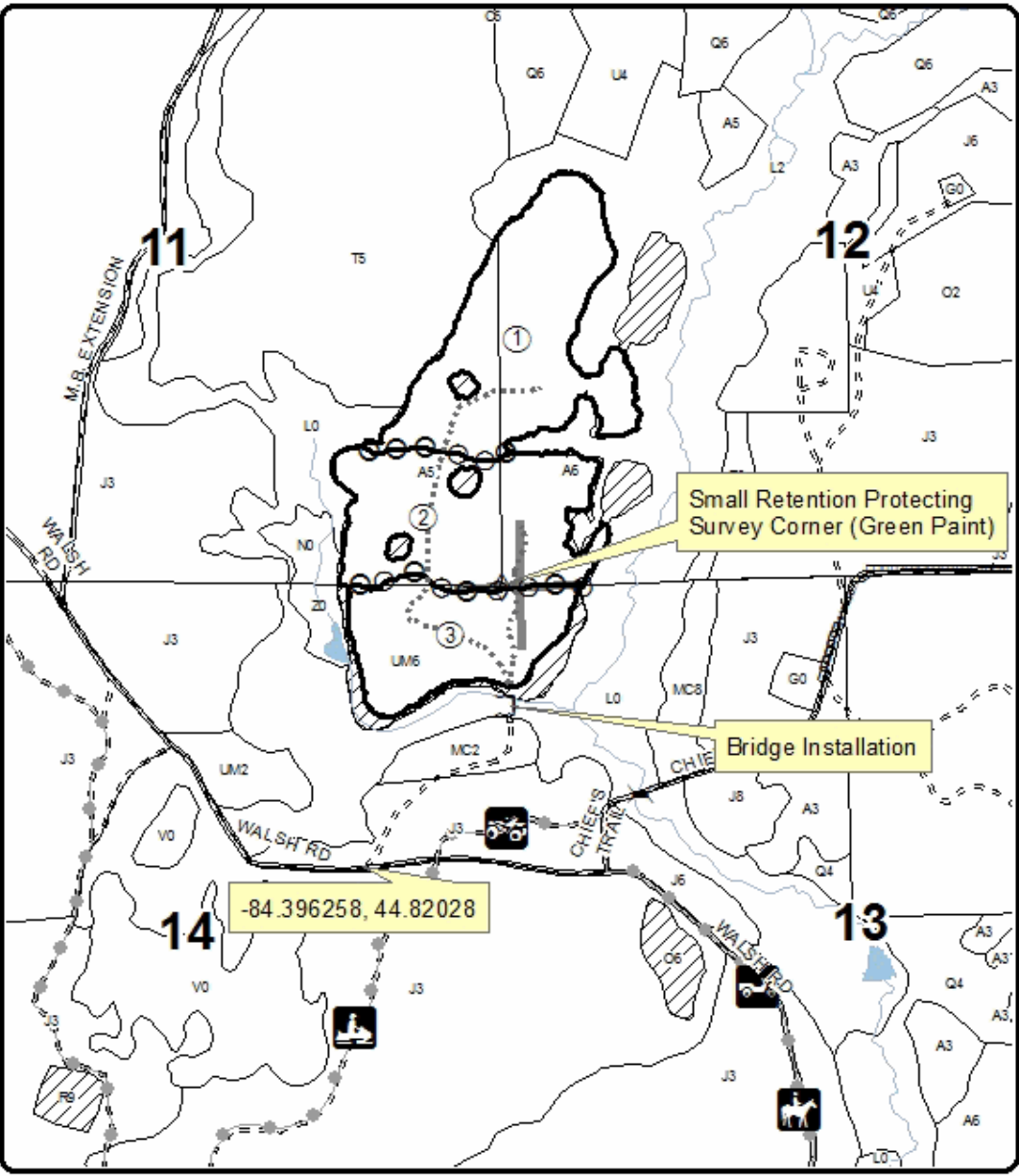

**Legend**

- ◇ Survey Corner
- ▨ Retention Area
- Against State (Red)
- Payment Unit (Yellow)
- Stand Boundaries
- ≡ Bridge
- ≡ Culvert
- County Gravel Roads
- = = County Poor Dirt Roads
- = = Poor Dirt Roads
- .... Closed
- Pipeline
- Powerline
- Recreational Trail
- Lakes and Rivers All

**Locator Map**  
1:200,000

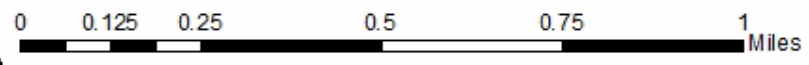
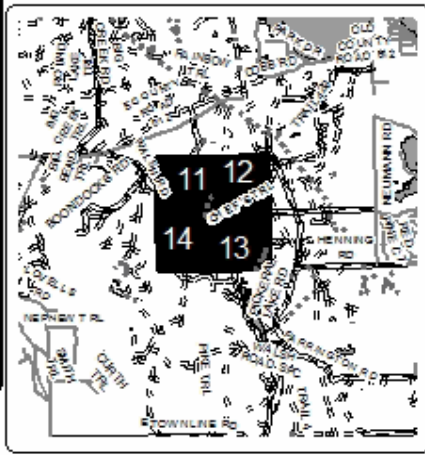

## TIMBER SALE INFORMATION

Remote Float Aspen (72-010-18)  
 T28N, R01W, SEC. 12; T28N, R01W, SEC. 13.  
 Crawford County (Advertised Price \$26,227.90)

SALE NOTE: The sale can be access a couple of ways off Pickeral Lake Rd. Pickeral Lake Rd is also use by both motorized and non-motorized recreationalist. Access to Payment Units 2 and 3 is through a locked gate. There is a timing restriction for an eagles nest in the southwest corner of Payment Unit 2; harvesting is limited to September 1 through December 31 in this area.

A recreation site such as a trail, pathway, or campground is within the sale area or the vicinity. Certain restrictions/specifications may be applicable including time restrictions.

A timber sale contract for this lump sum, sealed bid timber sale will be awarded to the responsible bidder offering the highest sealed bid price. Bids must be at or above the following advertised price for each species:

<u>PRODUCTS &amp; SPECIES</u>	<u>ESTIMATED UNITS*</u>	<u>ADVERTISED PRICE</u>
Pulpwood		
Balsam Fir	47.00 Cords	\$ 15.50 / Cord
Black Spruce	32.00 Cords	\$ 17.70 / Cord
Jack Pine	93.00 Cords	\$ 19.35 / Cord
Mixed Hardwood	178.00 Cords	\$ 33.60 / Cord
Mixed Oak	10.00 Cords	\$ 21.75 / Cord
Quaking Aspen	453.00 Cords	\$ 24.00 / Cord
Red Pine	57.00 Cords	\$ 39.55 / Cord
White Pine	138.00 Cords	\$ 27.60 / Cord

\* The total volume is statistically estimated within plus (+) or minus (-) 11.92 percent. The estimated units are final and not subject to adjustment. Prospective bidders are urged to examine this timber and to make their own estimates of quantity and quality.

**BOND AND PAYMENT SCHEDULE:**

1. A bond in the amount of \$1,311.00 to insure faithful performance of the conditions of the contract will be deposited by the successful bidder within 21 days of the sale award.
2. Cutting in any sale or unit without the required advance payment would be considered a trespass.
3. Total payment must be paid in advance or according to the following schedule:
  - (a) Ten percent (10%) of the sale value must be paid within 21 days of the sale award.
  - (b) The 10% down payment will be credited towards the first unit cut.
  - (c) Payment for each of the following units must be made before cutting begins in that unit:

PAYMENT UNIT NUMBER	PERCENT OF TOTAL SALE VALUE
01	11.5%
02	54.4%
03	34.1%

4. If no cutting takes place, the 10% down payment will not be refunded.
5. Operations on the contract issued will terminate on 09/30/2021.

**Description of Timber by Payment Unit (PU)**

PU	MARKET GROUP	PRODUCT	QUANTITY	UNIT	ACRES	ADVERTISE PRICE
1	Balsam Fir	Pulpwood	9.0	Cords	11.4	\$3,020.60
	Jack Pine		61.0	Cords		
	Mixed Hardwood		6.0	Cords		
	<i>Red Maple</i>		6.0	<i>Cords</i>		
	Quaking Aspen		31.0	Cords		
	Red Pine		17.0	Cords		
	White Pine		3.0	Cords		
2	Balsam Fir	Pulpwood	29.0	Cords	27.7	\$14,270.15
	Black Spruce		1.0	Cords		
	Jack Pine		3.0	Cords		
	Mixed Hardwood		117.0	Cords		
	<i>Black Cherry</i>		5.0	<i>Cords</i>		
	<i>Paper Birch</i>		1.0	<i>Cords</i>		
	<i>Red Maple</i>		111.0	<i>Cords</i>		
	Mixed Oak		6.0	Cords		
	<i>Bl/R/Hybrid Oak</i>		3.0	<i>Cords</i>		
	<i>White Oak</i>		3.0	<i>Cords</i>		
	Quaking Aspen		292.0	Cords		
	Red Pine		16.0	Cords		
	White Pine		74.0	Cords		
	3		Balsam Fir	Pulpwood		
Black Spruce		31.0	Cords			
Jack Pine		29.0	Cords			
Mixed Hardwood		55.0	Cords			
<i>Black Cherry</i>		2.0	<i>Cords</i>			
<i>Paper Birch</i>		1.0	<i>Cords</i>			
<i>Red Maple</i>		52.0	<i>Cords</i>			
Mixed Oak		4.0	Cords			
<i>Bl/R/Hybrid Oak</i>		2.0	<i>Cords</i>			
<i>White Oak</i>		2.0	<i>Cords</i>			
Quaking Aspen		130.0	Cords			
Red Pine		24.0	Cords			
White Pine		61.0	Cords			
TOTAL:			1,008.0	Cords		

# Sale Specific Conditions & Requirements

**Sale Name: Remote Float Aspen**

**Sale Number: 72-010-18 Seq#: 1**

## 1 - Sale Area

### 1.2 - Boundaries

#### 1.2.1 - Painted boundaries (1/14)

The sale boundary and Payment Unit boundaries are marked and identified by red and blue paint, along with a 2 track. Exterior sale boundary lines against state are marked with red paint. Exterior sale boundary lines against private land are marked with blue paint. The interior Payment Unit boundary between Payment Units 2 & 3 is unpainted and identified by the 2 track. The painted boundary line trees are not Included Timber and are to be protected.

## 2 - Timber Specifications

### 2.1 - Included Timber

#### 2.1.1 - Clearcut unit(s) with unmerchantable trees (6/14)

Within Payment Unit(s) 1 - 3, cut all trees that are two (2) inches or more at DBH, except within Payment Units 2 & 3, do not cut any red pine or white pine trees greater than 16 inches at DBH.

### 2.2 - Utilization

#### 2.2.3 - Stump heights (4/07)

Stump heights within the Sale Area shall not exceed 6 inches for all trees. This is in order to facilitate chipping operations, if chipped. A written waiver of this requirement may be obtained if wet summer weather makes winter logging necessary.

## 3 - Payments

### 3.3 - Pre-measured Sales

#### 3.3.4 - Dividing payment units (7/14)

Payment Unit(s) may be divided at the request of the Purchaser and upon approval of the Unit Manager. Dividing Payment Units is a contract modification which requires a Timber Sale Contract Supplement.

## 4 - Transportation

### 4.1 - Construction

#### 4.1.3 - Slash and earthen piles (8/04)

Piles or windrows of earth along roads and landings that have been widened or constructed shall be leveled. Slash from road maintenance or construction, including stumps, shall be chipped, utilized or dispersed throughout the sale.

#### 4.1.6 - Road construction (1/09)

Construction of new roads or improvements of existing roads shall be done in such a way as to minimize the environmental and visual impacts. Merchantable trees shall be cut and utilized unless otherwise directed. Non-merchantable trees shall be severed and laid flat on the ground. Slash shall be chipped, utilized or dispersed throughout the sale. Stumps shall be set upright, not left on edge, and be moved at least 10 feet away from the road edge. Disturbed soil shall be feathered into the woods and not left in berms or windrows.

#### 4.1.7 - Road closure (10/11)

All new roads built into the sale must be blocked to vehicle traffic upon completion of the sale. Overgrown roads that are reopened shall be considered new roads. In general, this will require constructing a four (4') foot high berm of stumps and logs covered with earth. Stumps and brush must be placed along the remainder of the trail. These roads must be rendered impassable to cars and trucks. All stumps from road building and landing construction must be reserved to block any newly constructed roads upon completion of the sale. These stumps must be scattered along the road system to prohibit vehicular movement. Contact the sale administrator for specific details of design and placement.

#### 4.1.11 - Permits (2/12)

The Purchaser will secure any necessary road permits that may be required.

## 4.2 - Maintenance

### 4.2.5 - Two wheel drive condition (2/04)

All existing trail roads on and adjacent to the sale area must be passable by two-wheel drive traffic for the duration of the sale.

## 5 - Operations

### 5.1 - Notification

#### 5.1.3 - Well heads and natural gas pipelines (11/15)

The Purchaser is responsible for contacting the gas or pipeline company 30 days prior to operating equipment in the vicinity of well heads or natural gas pipelines. Contact Enbridge at 800-858-5253 and Linn Energy at 231-922-7302. Written permission may be required before harvest operations begin and must be submitted to the Unit Manager.

### 5.2 - Conduct of Operations

#### 5.2.1 - Slash

##### 5.2.1.8 - Slash height (12/08)

No slash or tree tops may exceed 24 inches in height.

#### 5.2.2 - Hazard Trees/Snags

##### 5.2.2.1 - Den trees (10/16)

Obvious hollow and/or den trees shall be protected and left standing unless they are a safety hazard.

#### 5.2.4 - Dead and Down Creation

##### 5.2.4.4 - Dead and down creation, grouse (6/18)

To encourage grouse and other wildlife, in Payment Unit(s) 2 & 3, leave one, 8" diameter or larger log-length (8 foot minimum) piece on the ground for every 2 acres, or one, 10" or larger diameter (or largest diameter trees within stand) whole tree on the ground for every 2 acres, preferably a hardwood species such as oak or maple or if no hardwoods are present, a pine species (white or red). These trees will be evenly scattered throughout the unit, preferably at least two chains from any roads, two-tracks, or trails open to vehicles.

##### 5.2.29 - Shrub protection (9/07)

Do not cut or damage hawthorn, witch-hazel, dogwood or juneberry. These woody-shrub plants are highly beneficial to various wildlife species.

##### 5.2.32 - Decking/landing restoration (9/13)

All decking and landing areas must have the surface area restored to a condition equal to or better than before. This is to ensure the proper regeneration of the stand. Wood debris, chips and "cookies" from trimmings must be removed or scattered away from landing and loading areas and may not be windrowed on the edge.

##### 5.2.40 - Pathway protection (10/10)

Pickeral Lake Road is a seasonal county road that is also used as a bike, hiking, horse, ski, orv and snowmobile trail, and is shown on the Timber Sale Map. Pickeral Lake Road will be utilized for hauling wood produces. This trail does not run through any of the sale area.

### 5.4 - Soil Protection

#### 5.4.1 - Rutting restriction, general (7/16)

Operations are to cease immediately if equipment and weather conditions result in rutting of roads and/or skid trails which is 12 inches or greater in depth and 50 feet in length. The Unit Manager or his/her representative may restrict hauling and/or skidding if ruts exceed the specified depth. With the Unit Manager or his/her representative's approval, the Purchaser may return to the area when the risk of rutting has decreased.

#### 5.4.7 - Rutting restriction, Riparian Management Zone (RMZ) (1/09)

Within the low laying areas along the sale boundary or the wet area within Payment Unit 2, operations are to cease immediately if equipment and weather conditions result in rutting of roads and skid trails which is 6 inches or greater in depth

and 25 feet in length. The Unit Manager or his/her representative may restrict hauling and/or skidding if ruts exceed the specified depth. With the Unit Manager or his/her representative's approval, the Purchaser may return to the area when the risk of rutting has decreased.

#### 5.8 - Protection of Endangered Species

##### 5.8.6 - Protection of eagle nests (5/12)

To protect an active eagle's nest, all harvesting operations within Southwest Corner Payment Unit 2 (see Timber Sale Map) are limited to the period of September 1 through December 31.

### 6 - Safety and Fire Prevention

#### 6.2 - Signing

##### 6.2.1 - Road posting (9/09)

The Purchaser is responsible for posting and maintaining caution signs on Pickeral Lake Road and the un-named two track prior to beginning operations. The road must be posted at appropriate distances from the sale area to warn of logging activity and truck traffic. Signs must be removed when harvest operations are suspended or completed. The Purchaser will provide these signs.

##### 6.2.3 - Recreational trail posting (2/10)

The Purchaser is responsible for posting and maintaining caution signs on Pickeral Lake Road prior to beginning operations. The trail must be posted at appropriate distances from the sale area to warn of logging activity and truck traffic at both ends of the trail. Signs must be removed when harvest operations are suspended or completed. The Purchaser will provide these signs.



# TIMBER SALE MAP

This information provided by authority of Part 525, 1994 PA 451, as amended.

Sale Number	Year
72-010	18

Forest Management Unit Grayling	County Crawford	Mapped By Barnes	Date 07/17/18	Page 1	of 1
Township 28N	Range 01W & 01E	Section(s) and Subdivision(s) Sec 12- SESE; Sec 13- SE; Sec 24 - NENE; 28N 01E Sec 18 - NWSW	Scale 1:15,840		

Cover Type				Density	
A = Aspen	H = Hemlock	N = Marsh	U = Upland Brush	0 = Non Stocked	5 = Pole Timber Medium
B = Paper Birch	J = Jack Pine	O = Oak	UM = Upland Mixed	1 = Seedling Sapling Poor	6 = Pole Timber Well
C = Cedar	L = Lowland Brush	P = Lowland Poplar	V = Bog or Marsh	2 = Seedling Sapling Medium	7 = Saw Timber Poor
D = Treed Bog	LM = Lowland Mixed	Q = Mixed Swamp Conifer	W = White Pine	3 = Seedling Sapling Well	8 = Saw Timber Medium
E = Swamp Hdwoods	M = Mpl, Bch, Brch	R = Red Pine	X = Non Stocked	4 = Pole Timber Poor	9 = Saw Timber Well
F = Spruce Fir	MC = Mixed Conifer	S = Black Spruce	Z = Water		
G = Grass	MD = Mixed Deciduous	T = Tamarack			

PU	Acres	PU	Acres
1	11.4		
2	27.7		
3	18.5		

## Remote Float Aspen

Compartment(s) 272  
57.6 Acres

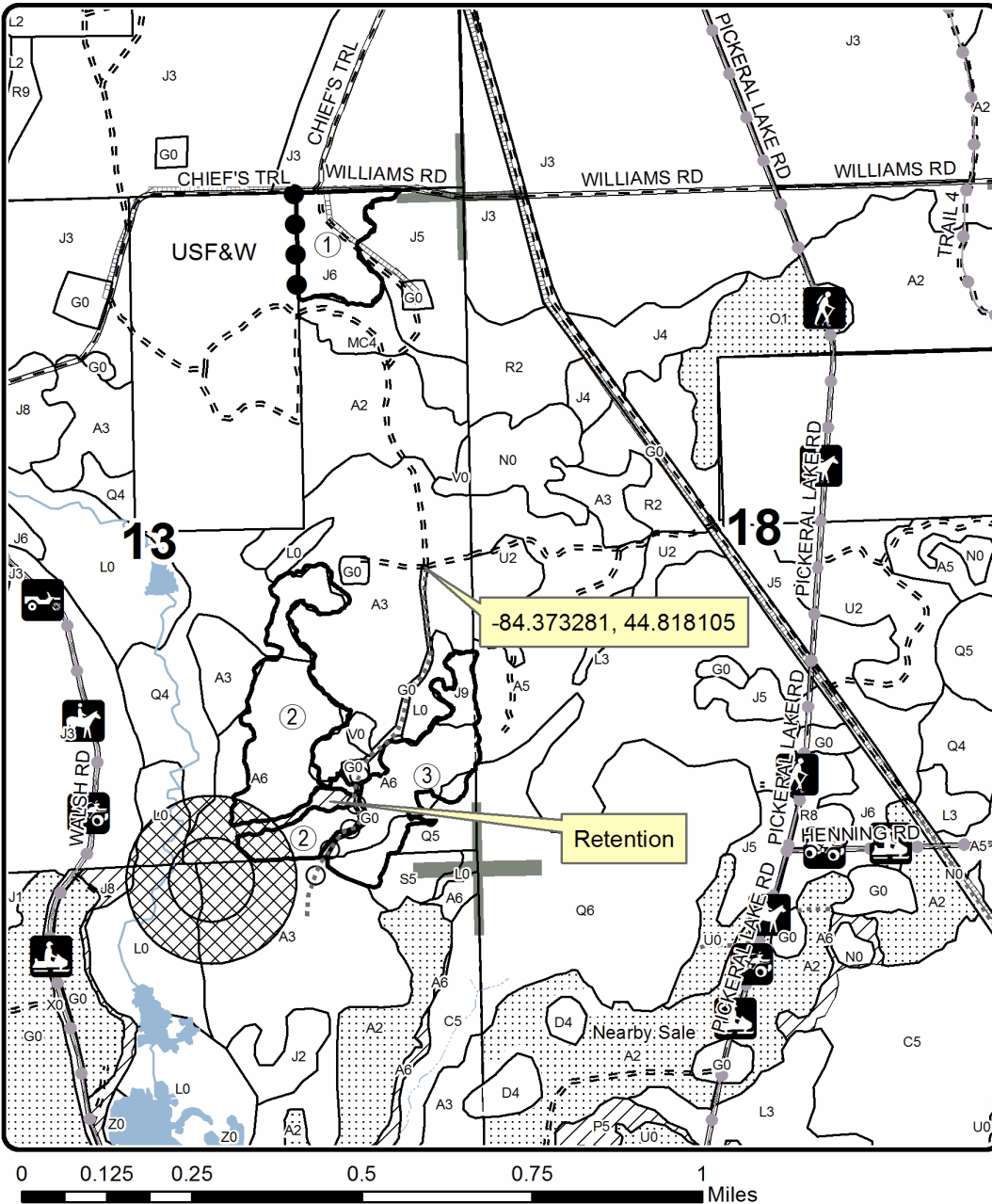
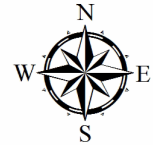

### Legend

- Eagle Nest Harvesting Restriction Area
- Retention Area
- Against State (Red)
- Payment Unit (Non Painted 2 track)
- Private Line (Blue)
- PU\_Label
- County Gravel Roads
- Gravel Roads
- County Poor Dirt Roads
- Poor Dirt Roads
- Closed
- Stand Boundaries
- Nearby Timber Sale
- Section Corners
- Pipeline
- Powerline
- Lakes and Rivers All
- Recreational Trail

Locator Map  
1:200,000

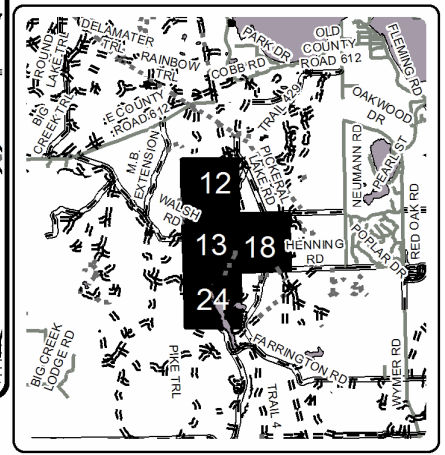



**TIMBER SALE INFORMATION**

SW Comp 281 (72-024-18)

T26N, R01W, SEC. 4.

Crawford County (Advertised Price \$24,608.90)

SALE NOTE: Overmature oak and jack pine continue to lose volume to age-related decline and mortality.

A timber sale contract for this lump sum, sealed bid timber sale will be awarded to the responsible bidder offering the highest sealed bid price. Bids must be at or above the following advertised price for each species:

<u>PRODUCTS &amp; SPECIES</u>	<u>ESTIMATED UNITS*</u>	<u>ADVERTISED PRICE</u>
<b>Sawtimber</b>		
Northern Pin Oak	35.20 MBF	\$ 203.00 / MBF
Red Pine	21.40 MBF	\$ 112.00 / MBF
White Pine	1.50 MBF	\$ 67.00 / MBF
<b>Pulpwood</b>		
Balsam Fir	18.00 Cords	\$ 15.50 / Cord
Black Spruce	8.00 Cords	\$ 17.70 / Cord
Jack Pine	268.00 Cords	\$ 19.35 / Cord
Misc. Species 1	5.00 Cords	\$ 7.50 / Cord
Misc. Species 2	14.00 Cords	\$ 3.75 / Cord
Mixed Aspen	34.00 Cords	\$ 24.00 / Cord
Mixed Hardwood	23.00 Cords	\$ 33.60 / Cord
Mixed Oak	198.00 Cords	\$ 21.75 / Cord
Red Pine	26.00 Cords	\$ 39.55 / Cord
White Pine	85.00 Cords	\$ 27.60 / Cord

\* The total volume is statistically estimated within plus (+) or minus (-) 11.58 percent. The estimated units are final and not subject to adjustment. Prospective bidders are urged to examine this timber and to make their own estimates of quantity and quality.

**BOND AND PAYMENT SCHEDULE:**

1. A bond in the amount of \$1,230.00 to insure faithful performance of the conditions of the contract will be deposited by the successful bidder within 21 days of the sale award.
2. Cutting in any sale or unit without the required advance payment would be considered a trespass.
3. Total payment must be paid in advance or according to the following schedule:
  - (a) Ten percent (10%) of the sale value must be paid within 21 days of the sale award.
  - (b) The 10% down payment will be credited towards the first unit cut.
  - (c) Payment for each of the following units must be made before cutting begins in that unit:
 

<u>PAYMENT UNIT NUMBER</u>	<u>PERCENT OF TOTAL SALE VALUE</u>
01	49.6%
02	50.4%

4. If no cutting takes place, the 10% down payment will not be refunded.
5. Operations on the contract issued will terminate on 12/31/2021.

**Description of Timber by Payment Unit (PU)**

PU	MARKET GROUP	PRODUCT	QUANTITY	UNIT	ACRES	ADVERTISE PRICE
1	Northern Pin Oak	Sawtimber	19.6	MBF	21.5	\$12,212.15
	Red Pine		5.2	MBF		
	White Pine		1.1	MBF		
	Balsam Fir	Pulpwood	11.0	Cords		
	Black Spruce		8.0	Cords		
	Jack Pine		56.0	Cords		
	<i>Jack Pine</i>	<i>Sawtimber</i>	2.9	<i>MBF</i>		
	<i>Jack Pine</i>	<i>Pulpwood</i>	50.0	<i>Cords</i>		
	Misc. Species 1		3.0	Cords		
	Misc. Species 2		5.0	Cords		
	Mixed Aspen		34.0	Cords		
	<i>B. T. Aspen</i>	<i>Sawtimber</i>	4.5	<i>MBF</i>		
	<i>B. T. Aspen</i>	<i>Pulpwood</i>	25.0	<i>Cords</i>		
	Mixed Hardwood		23.0	Cords		
	<i>Red Maple</i>	<i>Sawtimber</i>	0.4	<i>MBF</i>		
	<i>Red Maple</i>	<i>Pulpwood</i>	22.0	<i>Cords</i>		
	Mixed Oak		105.0	Cords		
	<i>White Oak</i>	<i>Sawtimber</i>	2.8	<i>MBF</i>		
	<i>Northern Pin Oak</i>	<i>Pulpwood</i>	89.0	<i>Cords</i>		
	<i>White Oak</i>		10.0	<i>Cords</i>		
	Red Pine		5.0	Cords		
White Pine		75.0	Cords			
2	Northern Pin Oak	Sawtimber	15.6	MBF	32.6	\$12,416.10
	Red Pine		16.2	MBF		
	White Pine		0.4	MBF		
	Balsam Fir	Pulpwood	7.0	Cords		
	Jack Pine		213.0	Cords		
	<i>Jack Pine</i>	<i>Sawtimber</i>	11.8	<i>MBF</i>		
	<i>Jack Pine</i>	<i>Pulpwood</i>	189.0	<i>Cords</i>		
	Misc. Species 1		2.0	Cords		
	Misc. Species 2		9.0	Cords		
	Mixed Oak		93.0	Cords		
	<i>Northern Pin Oak</i>		93.0	<i>Cords</i>		
	Red Pine		21.0	Cords		
	White Pine		10.0	Cords		
	TOTAL:			58.1		
TOTAL:			680.0	Cords		

## Sale Specific Conditions & Requirements

**Sale Name: SW Comp 281**

**Sale Number: 72-024-18 Seq#: 2**

### 1 - Sale Area

#### 1.2 - Boundaries

##### 1.2.1 - Painted boundaries (1/14)

The sale boundary and Payment Unit boundaries are marked and identified by red and blue paint, along with a road. Exterior sale boundary lines against private property are marked with blue paint. Exterior sale boundary lines against state are marked with red paint. The interior Payment Unit boundary is unpainted and designated as Conners Flat Road. Blue painted boundary line trees are not Included Timber and are to be protected. Red painted boundary line trees along Conners Flat Road may be cut and utilized, unless they are also marked with blue paint (transition tree from blue line to red line). If the red painted tree is part of a multiple-stem clump, cut all trees within the clump.

### 2 - Timber Specifications

#### 2.1 - Included Timber

##### 2.1.1 - Clearcut unit(s) with unmerchantable trees (6/14)

Within Payment Unit(s) 1 & 2, cut all trees that are 2" or more at DBH, except do not cut trees marked with green paint.

##### 2.1.11 - Description of timber note (2/04)

Note that Misc. Species 1 is recently-dead oak, and Misc. Species 2 is recently-dead jack pine. Recently-dead was defined during cruising as stems that retained some fine branches.

#### 2.2 - Utilization

##### 2.2.2 - Chipping required (2/18)

This area must be chip harvested to facilitate subsequent planting operations. The Purchaser has the option to produce sawlogs or pulpwood bolts, but the remaining portion of the trees must be chipped and hauled. A chipping exemption can be obtained if proposed operations are determined to be suitable for planting by reforestation staff. This exemption must be granted in writing. The requirement to retain approximately 1/6 to 1/3 of tree tops and limbs less than four inches in diameter is still applicable (G. C. & R. 2.2), but may be lower in areas with heavier pre-existing downed woody debris.

##### 2.2.3 - Stump heights (4/07)

Stump heights within Payment Units 1 & 2 shall not exceed 6 inches for all trees. Exceptions may be made by the sale administrator for large oak in multiple stem clumps. This is in order to facilitate planting operations.

### 3 - Payments

#### 3.3 - Pre-measured Sales

##### 3.3.4 - Dividing payment units (7/14)

Payment Unit(s) may be divided at the request of the Purchaser and upon approval of the Unit Manager. Dividing Payment Units is a contract modification which requires a Timber Sale Contract Supplement.

#### 3.4 - Damaged Timber

##### 3.4.2 - Special Protection Trees (4/14)

The Purchaser shall not cut live or dead special protection trees within cutting units or clearings. Special protection trees are the red pine and white pine marked with green paint. If the Purchaser's operations have cut or damaged special protection trees through carelessness, the Purchaser shall pay \$300 as fixed, agreed and liquidated damages for each special protection tree cut or damaged. Such payment does not constitute ownership of the undesignated timber.

### 4 - Transportation

#### 4.1 - Construction

##### 4.1.3 - Slash and earthen piles (8/04)

Piles or windrows of earth along roads and landings that have been widened or constructed shall be leveled. Slash from road

maintenance or construction, including stumps, shall be chipped, utilized or otherwise dispersed into the sale.

#### 4.1.6 - Road construction (1/09)

Construction of new roads or improvements of existing roads shall be done in such a way as to minimize the environmental and visual impacts. Merchantable trees shall be cut and utilized unless otherwise directed. Non-merchantable trees shall be severed and laid flat on the ground. Slash shall be chipped, utilized or dispersed away from the road edge. Stumps shall be set upright, not left on edge, and be moved at least 10 feet away from the road edge. Disturbed soil shall be feathered into the woods and not left in berms or windrows.

#### 4.1.7 - Road closure (10/11)

All new roads built into the sale must be blocked to vehicle traffic upon completion of the sale. Overgrown roads that are reopened shall be considered new roads. In general, closure may require constructing a four (4') foot high berm of stumps and logs covered with earth. Stumps and brush may also need to be placed along portions of the trail. Contact the sale administrator for specific details of design and placement.

#### 4.1.11 - Permits (2/12)

The Purchaser will secure any necessary permits that may be required.

## 5 - Operations

### 5.1 - Notification

#### 5.1.1 - Pre-sale conference (10/16)

A pre-sale conference between the Purchaser and sale administrator is required prior to beginning any operations to determine landing and road locations. The Unit Manager or his/her representative must be contacted at least 5 days in advance to schedule the conference.

#### 5.1.4 - Post-sale conference (10/16)

A post-sale conference on site between the Purchaser and sale administrator is required prior to the completion of active logging operations to determine clean-up and repair of landings, road edges, and the fulfillment of other contract specifications.

### 5.2 - Conduct of Operations

#### 5.2.3 - Operating Restrictions

##### 5.2.3.1 - Operating restrictions (9/11)

Within Payment Unit(s) 2, unless changed by written agreement, skidding will not be permitted when the ground is snow-covered. This restriction is needed in order to maximize ground scarification for natural pine regeneration.

#### 5.2.38 - No decking against live trees (2/04)

Cut products may not be decked against unmarked or designated leave trees.

#### 5.2.43 - Opening protection (12/08)

No activities are permitted in openings marked on the Timber Sale Map with the letter "G". Any damage to the openings shall be repaired according to specifications of the Unit Manager or his/her representative.

### 5.4 - Soil Protection

#### 5.4.1 - Rutting restriction, general (7/16)

Operations are to cease immediately if equipment and weather conditions result in rutting of roads and/or skid trails which is 12 inches or greater in depth and 50 feet in length. The Unit Manager or his/her representative may restrict hauling and/or skidding if ruts exceed the specified depth. With the Unit Manager or his/her representative's approval, the Purchaser may return to the area when the risk of rutting has decreased.

## 6 - Safety and Fire Prevention

### 6.2 - Signing

#### 6.2.1 - Road posting (9/09)

The Purchaser is responsible for posting and maintaining caution signs on Connors Flat Road prior to beginning operations. The road must be posted at appropriate distances from the sale area to warn of logging activity and truck traffic. Signs must be removed when harvest operations are suspended or completed. The Purchaser will provide these signs.

## **7 - Other Conditions**

### **7.5 - Loss**

#### **7.5.1 - Deteriorating timber (7/09)**

The sale area has received damage from age-related decline in the mature jack pine and oak, and branch flagging in the white pine. The Purchaser should harvest the wood as soon as possible. The Department of Natural Resources is held free of responsibility of any further damage or deterioration due to delay in harvesting.



# TIMBER SALE MAP

This information provided by authority of Part 525, 1994 PA 451, as amended.

Forest Management Unit Grayling	County Crawford	Mapped By Charlebois	Date 09/23/2018	Page 1	of 1
Township 26N	Range 01W	Section(s) and Subdivision(s) Sec 4: SWNE, SENW, N1/2SW	Scale 1:7,920		

Cover Type				Density	
A = Aspen	H = Hemlock	N = Marsh	U = Upland Brush	0 = Non Stocked	5 = Pole Timber Medium
B = Paper Birch	J = Jack Pine	O = Oak	UM = Upland Mixed	1 = Seedling Sapling Poor	6 = Pole Timber Well
C = Cedar	L = Lowland Brush	P = Lowland Poplar	V = Bog or Marsh	2 = Seedling Sapling Medium	7 = Saw Timber Poor
D = Treed Bog	LM = Lowland Mixed	Q = Mixed Swamp Conifer	W = White Pine	3 = Seedling Sapling Well	8 = Saw Timber Medium
E = Swamp Hdwoods	M = Mpl, Bch, Brch	R = Red Pine	X = Non Stocked	4 = Pole Timber Poor	9 = Saw Timber Well
F = Spruce Fir	MC = Mixed Conifer	S = Black Spruce	Z = Water		
G = Grass	MD = Mixed Deciduous	T = Tamarack			



QR Code opens map in PDF maps app

PU	Acres
1	21.5
2	32.6

## SW Comp 281

Compartment 281  
54.1 Acres

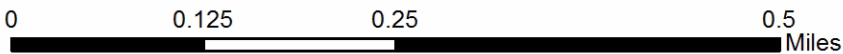
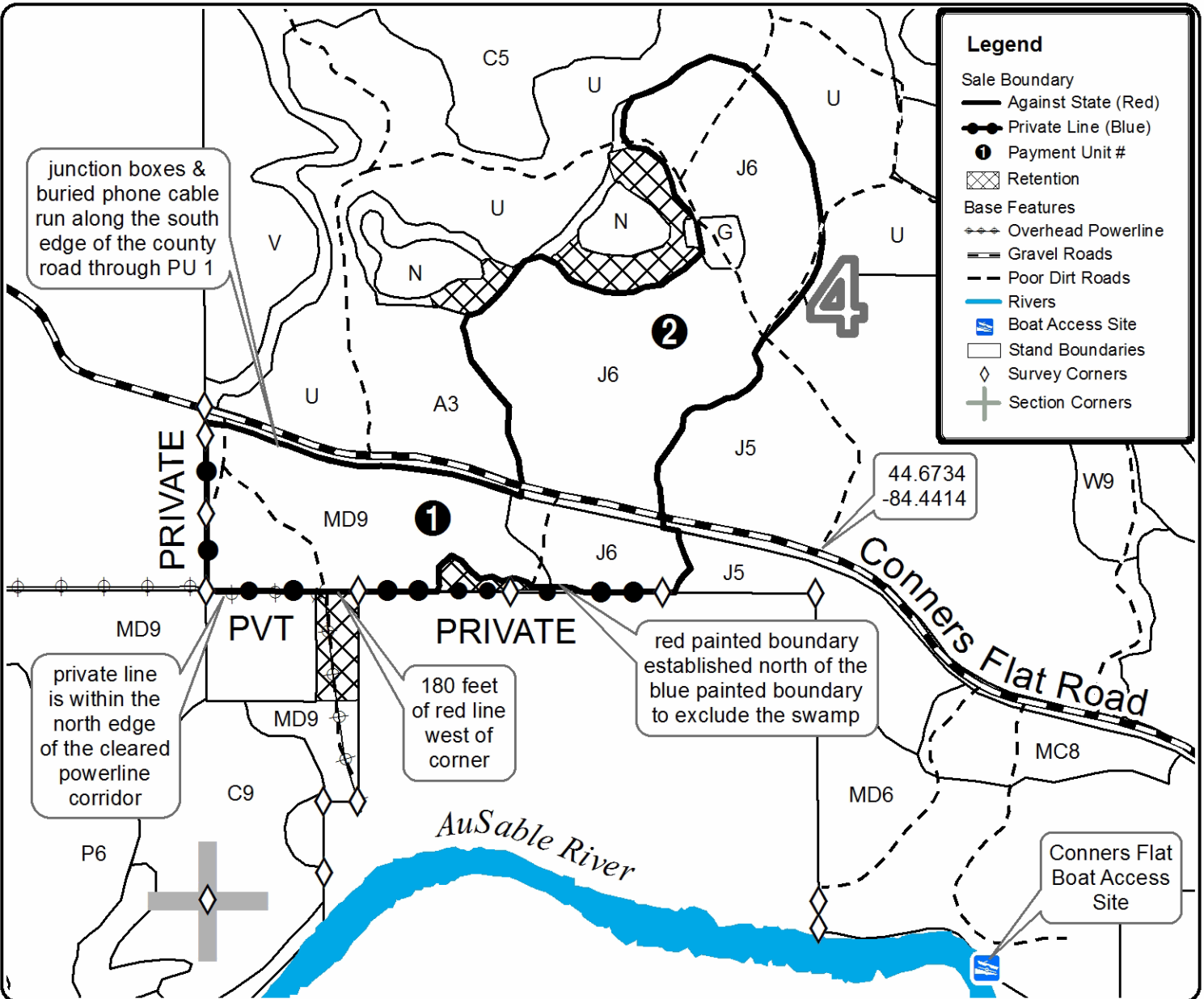

Goshawk Mix (72-007-18)  
T28N, R01W, SEC. 15; T28N, R01W, SEC. 22; Crawford COUNTY

In response to the notice of sale to be held 9:00 a.m. (local time) on May 7, 2019, I am hereby submitting my sealed bid (firm offer) for the following forest products to be cut. Bids for individual species must be at or above the advertised price. All non-responsive bid forms may be rejected.

<u>PRODUCTS &amp; SPECIES</u>	<u>ESTIMATED VOLUME*</u>	<u>ADVERTISED PRICE</u>	<u>BID PRICE/UNIT</u>
Sawtimber			
Red Pine	44.30 MBF	\$ 104.00/MBF	\$ _____
Pulpwood			
Balsam Fir	3.00 Cords	\$ 14.45/Cord	\$ _____
Black Spruce	24.00 Cords	\$ 16.50/Cord	\$ _____
Jack Pine	214.00 Cords	\$ 18.05/Cord	\$ _____
Mixed Oak	54.00 Cords	\$ 20.30/Cord	\$ _____
Quaking Aspen	40.00 Cords	\$ 22.40/Cord	\$ _____
Red Maple	25.00 Cords	\$ 31.35/Cord	\$ _____
Red Pine	74.00 Cords	\$ 36.90/Cord	\$ _____
Scotch Pine	41.00 Cords	\$ 23.65/Cord	\$ _____
Tamarack	11.00 Cords	\$ 28.95/Cord	\$ _____

\*The volumes are statistically estimated within plus (+) or minus (-) 17.76 percent. These estimated volumes are final and not subject to adjustment. Prospective bidders are urged to examine this timber and to make their own estimates of quantity and quality.

I understand that any or all bids may be rejected. All bids must be signed and all bid items must be bid or the bid form may be rejected. I also understand that consideration and awarding a contract will be based upon my past performance and ability to complete the contract based upon equipment and staffing subject to my control.

FEDERAL ID: \_\_\_\_\_ or SOCIAL SECURITY NUMBER: \_\_\_\_\_

Company or individual bidding: \_\_\_\_\_

Company representative's name: \_\_\_\_\_

Address: \_\_\_\_\_

City: \_\_\_\_\_ State: \_\_\_\_\_ Zip: \_\_\_\_\_

IF AVAILABLE, PLEASE PLACE THE PERSONALIZED LABEL FROM YOUR PROSPECTUS IN THE ABOVE BOX.

Individual or company representative's signature: \_\_\_\_\_ Date: \_\_\_\_\_

Phone number : \_\_\_\_\_ Email (optional): \_\_\_\_\_

**THE WINNING BIDDER MUST COMPLETE THE VERIFICATION OF WORKER'S DISABILITY COMPENSATION ACT COMPLIANCE (ON REVERSE SIDE IF DOUBLE SIDED) WITHIN 21 DAYS OF SALE AWARD DATE**



<b>FOR DEPARTMENT USE ONLY</b>
Sale Number (XX - XXX - XX - XX)
Forest Management Unit:

## TIMBER SALE VERIFICATION OF WORKER'S DISABILITY COMPENSATION ACT COMPLIANCE

*As required by Act 317, P.A. 1969 (Worker's Compensation) and  
Part 5 of Act 451 of 1994, as amended.*

### VERIFICATION OF WORKER'S DISABILITY COMPENSATION ACT COMPLIANCE

- This verification must be completed and submitted within 21 days of contract award and prior to the issuance of the timber sale contract.
- In addition, if boxes 2B or 2C are checked, then Notice of Exclusion or Certificate of Insurance must be submitted within twenty-one (21) days of the contract award and prior to the issuance of the timber sale contract.
- All information must be typed or printed except for written signatures.

Please Check Appropriate Categories:

1. My business is organized as (you **must** check one of the boxes below):
  - A.  Sole Proprietorship (individual)
  - B.  Partnership
  - C.  Corporation
2. You **must** check one of the boxes below:
  - A.  I certify my business is a sole proprietorship and it has no employees but the sole proprietor. I am not subject to the Worker's Compensation Laws.
  - B.  I certify my business has satisfied its obligation to the Worker's Compensation Act through the use of an approved Notice of Exclusion (BWC-337, Rev. 5/96). I will provide a copy of the Notice of Exclusion within 21 days of the contract award. (For questions or a copy of the BWC-337, please call the Worker's Compensation Bureau at 517-322-1195).
  - C.  I certify my business has a Worker's Compensation Policy. I will provide an original Certificate of Insurance within twenty-one (21) days of the contract award.
3. If you have checked item 2(A) or 2(B), you **must** indicate the number of **both** full-time and part-time employees, other than yourself, including family members and active partners (if none, you must enter "0").

\_\_\_\_\_ Full-time Employees

\_\_\_\_\_ Part-time Employees

Name of Business		Federal ID (or) Social Security No.	
Address		Telephone (       )	
City	State	ZIP	

*I hereby certify that the above information is true and correct. I agree to notify the Michigan DNR of any changes that occur in factors affecting my coverage during any of my present and future operations.*

\_\_\_\_\_  
Signature of Owner or Authorized Representative

\_\_\_\_\_  
Title

\_\_\_\_\_  
Date

**Please complete the "SEALED BID" information on the next page**



Lost Can Aspen (72-009-18)  
T28N, R01W, SEC. 11; T28N, R01W, SEC. 12; T28N, R01W, SEC. 13; T28N,

In response to the notice of sale to be held 9:00 a.m. (local time) on May 7, 2019, I am hereby submitting my sealed bid (firm offer) for the following forest products to be cut. Bids for individual species must be at or above the advertised price. All non-responsive bid forms may be rejected.

<u>PRODUCTS &amp; SPECIES</u>	<u>ESTIMATED VOLUME*</u>	<u>ADVERTISED PRICE</u>	<u>BID PRICE/UNIT</u>
Pulpwood			
BI/R/Hybrid Oak	10.00 Cords	\$ 20.30/Cord	\$ _____
Jack Pine	450.00 Cords	\$ 18.05/Cord	\$ _____
Mixed Aspen	978.00 Cords	\$ 22.40/Cord	\$ _____
Red Maple	26.00 Cords	\$ 31.35/Cord	\$ _____
Red Pine	298.00 Cords	\$ 36.90/Cord	\$ _____
White Pine	91.00 Cords	\$ 25.75/Cord	\$ _____

\*The volumes are statistically estimated within plus (+) or minus (-) 11.45 percent. These estimated volumes are final and not subject to adjustment. Prospective bidders are urged to examine this timber and to make their own estimates of quantity and quality.

I understand that any or all bids may be rejected. All bids must be signed and all bid items must be bid or the bid form may be rejected. I also understand that consideration and awarding a contract will be based upon my past performance and ability to complete the contract based upon equipment and staffing subject to my control.

FEDERAL ID: \_\_\_\_ - \_\_\_\_ - \_\_\_\_ or SOCIAL SECURITY NUMBER: \_\_\_\_ - \_\_\_\_ - \_\_\_\_

Company or individual bidding: \_\_\_\_\_

Company representative's name: \_\_\_\_\_

Address: \_\_\_\_\_

City: \_\_\_\_\_ State: \_\_\_\_\_ Zip: \_\_\_\_\_

IF AVAILABLE, PLEASE PLACE THE PERSONALIZED LABEL FROM YOUR PROSPECTUS IN THE ABOVE BOX.

Individual or company representative's signature: \_\_\_\_\_ Date: \_\_\_\_\_

Phone number : \_\_\_\_\_ Email (optional): \_\_\_\_\_

**THE WINNING BIDDER MUST COMPLETE THE VERIFICATION OF WORKER'S DISABILITY COMPENSATION ACT COMPLIANCE (ON REVERSE SIDE IF DOUBLE SIDED) WITHIN 21 DAYS OF SALE AWARD DATE**



FOR DEPARTMENT USE ONLY	
Sale Number (XX - XXX - XX - XX)	
Forest Management Unit:	

# TIMBER SALE VERIFICATION OF WORKER'S DISABILITY COMPENSATION ACT COMPLIANCE

As required by Act 317, P.A. 1969 (Worker's Compensation) and  
Part 5 of Act 451 of 1994, as amended.

## VERIFICATION OF WORKER'S DISABILITY COMPENSATION ACT COMPLIANCE

- This verification must be completed and submitted within 21 days of contract award and prior to the issuance of the timber sale contract.
- In addition, if boxes 2B or 2C are checked, then Notice of Exclusion or Certificate of Insurance must be submitted within twenty-one (21) days of the contract award and prior to the issuance of the timber sale contract.
- All information must be typed or printed except for written signatures.

Please Check Appropriate Categories:

1. My business is organized as (you **must** check one of the boxes below):
  - A.  Sole Proprietorship (individual)
  - B.  Partnership
  - C.  Corporation
2. You **must** check one of the boxes below:
  - A.  I certify my business is a sole proprietorship and it has no employees but the sole proprietor. I am not subject to the Worker's Compensation Laws.
  - B.  I certify my business has satisfied its obligation to the Worker's Compensation Act through the use of an approved Notice of Exclusion (BWC-337, Rev. 5/96). I will provide a copy of the Notice of Exclusion within 21 days of the contract award. (For questions or a copy of the BWC-337, please call the Worker's Compensation Bureau at 517-322-1195).
  - C.  I certify my business has a Worker's Compensation Policy. I will provide an original Certificate of Insurance within twenty-one (21) days of the contract award.
3. If you have checked item 2(A) or 2(B), you **must** indicate the number of **both** full-time and part-time employees, other than yourself, including family members and active partners (if none, you must enter "0").

\_\_\_\_\_ Full-time Employees

\_\_\_\_\_ Part-time Employees

Name of Business		Federal ID (or) Social Security No.	
Address		Telephone (       )	
City	State	ZIP	

*I hereby certify that the above information is true and correct. I agree to notify the Michigan DNR of any changes that occur in factors affecting my coverage during any of my present and future operations.*

\_\_\_\_\_  
Signature of Owner or Authorized Representative

\_\_\_\_\_  
Title

\_\_\_\_\_  
Date

Please complete the "SEALED BID" information on the next page

Remote Float Aspen (72-010-18)  
T28N, R01W, SEC. 12; T28N, R01W, SEC. 13; Crawford COUNTY

In response to the notice of sale to be held 9:00 a.m. (local time) on May 7, 2019, I am hereby submitting my sealed bid (firm offer) for the following forest products to be cut. Bids for individual species must be at or above the advertised price. All non-responsive bid forms may be rejected.

<u>PRODUCTS &amp; SPECIES</u>	<u>ESTIMATED VOLUME*</u>	<u>ADVERTISED PRICE</u>	<u>BID PRICE/UNIT</u>
<u>Pulpwood</u>			
Balsam Fir	47.00 Cords	\$ 15.50/Cord	\$ _____
Black Spruce	32.00 Cords	\$ 17.70/Cord	\$ _____
Jack Pine	93.00 Cords	\$ 19.35/Cord	\$ _____
Mixed Hardwood	178.00 Cords	\$ 33.60/Cord	\$ _____
Mixed Oak	10.00 Cords	\$ 21.75/Cord	\$ _____
Quaking Aspen	453.00 Cords	\$ 24.00/Cord	\$ _____
Red Pine	57.00 Cords	\$ 39.55/Cord	\$ _____
White Pine	138.00 Cords	\$ 27.60/Cord	\$ _____

\*The volumes are statistically estimated within plus (+) or minus (-) 11.92 percent. These estimated volumes are final and not subject to adjustment. Prospective bidders are urged to examine this timber and to make their own estimates of quantity and quality.

I understand that any or all bids may be rejected. All bids must be signed and all bid items must be bid or the bid form may be rejected. I also understand that consideration and awarding a contract will be based upon my past performance and ability to complete the contract based upon equipment and staffing subject to my control.

FEDERAL ID: \_\_\_\_\_ - \_\_\_\_\_ or SOCIAL SECURITY NUMBER: \_\_\_\_\_ - \_\_\_\_\_ - \_\_\_\_\_

Company or individual bidding: \_\_\_\_\_

Company representative's name: \_\_\_\_\_

Address: \_\_\_\_\_

City: \_\_\_\_\_ State: \_\_\_\_\_ Zip: \_\_\_\_\_

IF AVAILABLE, PLEASE PLACE THE PERSONALIZED LABEL FROM YOUR PROSPECTUS IN THE ABOVE BOX.

Individual or company representative's signature: \_\_\_\_\_ Date: \_\_\_\_\_

Phone number : \_\_\_\_\_ Email (optional): \_\_\_\_\_

**THE WINNING BIDDER MUST COMPLETE THE VERIFICATION OF WORKER'S DISABILITY COMPENSATION ACT COMPLIANCE (ON REVERSE SIDE IF DOUBLE SIDED) WITHIN 21 DAYS OF SALE AWARD DATE**



<b>FOR DEPARTMENT USE ONLY</b>
Sale Number (XX - XXX - XX - XX)
Forest Management Unit:

## TIMBER SALE VERIFICATION OF WORKER'S DISABILITY COMPENSATION ACT COMPLIANCE

*As required by Act 317, P.A. 1969 (Worker's Compensation) and  
Part 5 of Act 451 of 1994, as amended.*

### VERIFICATION OF WORKER'S DISABILITY COMPENSATION ACT COMPLIANCE

- This verification must be completed and submitted within 21 days of contract award and prior to the issuance of the timber sale contract.
- In addition, if boxes 2B or 2C are checked, then Notice of Exclusion or Certificate of Insurance must be submitted within twenty-one (21) days of the contract award and prior to the issuance of the timber sale contract.
- All information must be typed or printed except for written signatures.

Please Check Appropriate Categories:

1. My business is organized as (you **must** check one of the boxes below):
  - A.  Sole Proprietorship (individual)
  - B.  Partnership
  - C.  Corporation
  
2. You **must** check one of the boxes below:
  - A.  I certify my business is a sole proprietorship and it has no employees but the sole proprietor. I am not subject to the Worker's Compensation Laws.
  - B.  I certify my business has satisfied its obligation to the Worker's Compensation Act through the use of an approved Notice of Exclusion (BWC-337, Rev. 5/96). I will provide a copy of the Notice of Exclusion within 21 days of the contract award. (For questions or a copy of the BWC-337, please call the Worker's Compensation Bureau at 517-322-1195).
  - C.  I certify my business has a Worker's Compensation Policy. I will provide an original Certificate of Insurance within twenty-one (21) days of the contract award.
  
3. If you have checked item 2(A) or 2(B), you **must** indicate the number of **both** full-time and part-time employees, other than yourself, including family members and active partners (if none, you must enter "0").

\_\_\_\_\_ Full-time Employees

\_\_\_\_\_ Part-time Employees

Name of Business		Federal ID (or) Social Security No.	
Address		Telephone (       )	
City	State	ZIP	

*I hereby certify that the above information is true and correct. I agree to notify the Michigan DNR of any changes that occur in factors affecting my coverage during any of my present and future operations.*

\_\_\_\_\_  
Signature of Owner or Authorized Representative

\_\_\_\_\_  
Title

\_\_\_\_\_  
Date

**Please complete the "SEALED BID" information on the next page**

Lovells Hideaway (72-008-18)

T28N, R01W, SEC. 17; T28N, R01W, SEC. 19; T28N, R01W, SEC. 20; Crawford

In response to the notice of sale to be held 9:00 a.m. (local time) on May 7, 2019, I am hereby submitting my sealed bid (firm offer) for the following forest products to be cut. Bids for individual species must be at or above the advertised price. All non-responsive bid forms may be rejected.

<u>PRODUCTS &amp; SPECIES</u>	<u>ESTIMATED VOLUME*</u>	<u>ADVERTISED PRICE</u>	<u>BID PRICE/UNIT</u>
Pulpwood			
BI/R/Hybrid Oak	12.00 Cords	\$ 21.75/Cord	\$ _____
Jack Pine	247.00 Cords	\$ 19.35/Cord	\$ _____
Quaking Aspen	31.00 Cords	\$ 24.00/Cord	\$ _____
Red Pine	12.00 Cords	\$ 39.55/Cord	\$ _____

\*The volumes are statistically estimated within plus (+) or minus (-) 18.42 percent. These estimated volumes are final and not subject to adjustment. Prospective bidders are urged to examine this timber and to make their own estimates of quantity and quality.

I understand that any or all bids may be rejected. All bids must be signed and all bid items must be bid or the bid form may be rejected. I also understand that consideration and awarding a contract will be based upon my past performance and ability to complete the contract based upon equipment and staffing subject to my control.

FEDERAL ID: \_\_\_\_ - \_\_\_\_ - \_\_\_\_ or SOCIAL SECURITY NUMBER: \_\_\_\_ - \_\_\_\_ - \_\_\_\_

Company or individual bidding: \_\_\_\_\_

Company representative's name: \_\_\_\_\_

Address: \_\_\_\_\_

City: \_\_\_\_\_ State: \_\_\_\_\_ Zip: \_\_\_\_\_

IF AVAILABLE, PLEASE PLACE THE PERSONALIZED LABEL FROM YOUR PROSPECTUS IN THE ABOVE BOX.

Individual or company representative's signature: \_\_\_\_\_ Date: \_\_\_\_\_

Phone number : \_\_\_\_\_ Email (optional): \_\_\_\_\_

**THE WINNING BIDDER MUST COMPLETE THE VERIFICATION OF WORKER'S DISABILITY COMPENSATION ACT COMPLIANCE (ON REVERSE SIDE IF DOUBLE SIDED) WITHIN 21 DAYS OF SALE AWARD DATE**



FOR DEPARTMENT USE ONLY	
Sale Number (XX - XXX - XX - XX)	
Forest Management Unit:	

## TIMBER SALE VERIFICATION OF WORKER'S DISABILITY COMPENSATION ACT COMPLIANCE

As required by Act 317, P.A. 1969 (Worker's Compensation) and  
Part 5 of Act 451 of 1994, as amended.

### VERIFICATION OF WORKER'S DISABILITY COMPENSATION ACT COMPLIANCE

- This verification must be completed and submitted within 21 days of contract award and prior to the issuance of the timber sale contract.
- In addition, if boxes 2B or 2C are checked, then Notice of Exclusion or Certificate of Insurance must be submitted within twenty-one (21) days of the contract award and prior to the issuance of the timber sale contract.
- All information must be typed or printed except for written signatures.

Please Check Appropriate Categories:

1. My business is organized as (you **must** check one of the boxes below):
  - A.  Sole Proprietorship (individual)
  - B.  Partnership
  - C.  Corporation
2. You **must** check one of the boxes below:
  - A.  I certify my business is a sole proprietorship and it has no employees but the sole proprietor. I am not subject to the Worker's Compensation Laws.
  - B.  I certify my business has satisfied its obligation to the Worker's Compensation Act through the use of an approved Notice of Exclusion (BWC-337, Rev. 5/96). I will provide a copy of the Notice of Exclusion within 21 days of the contract award. (For questions or a copy of the BWC-337, please call the Worker's Compensation Bureau at 517-322-1195).
  - C.  I certify my business has a Worker's Compensation Policy. I will provide an original Certificate of Insurance within twenty-one (21) days of the contract award.
3. If you have checked item 2(A) or 2(B), you **must** indicate the number of **both** full-time and part-time employees, other than yourself, including family members and active partners (if none, you must enter "0").

\_\_\_\_\_ Full-time Employees

\_\_\_\_\_ Part-time Employees

Name of Business		Federal ID (or) Social Security No.	
Address		Telephone (       )	
City	State	ZIP	

*I hereby certify that the above information is true and correct. I agree to notify the Michigan DNR of any changes that occur in factors affecting my coverage during any of my present and future operations.*

\_\_\_\_\_  
Signature of Owner or Authorized Representative

\_\_\_\_\_  
Title

\_\_\_\_\_  
Date

Please complete the "SEALED BID" information on the next page

Comp 171 Selection (72-003-18)  
T28N, R04W, SEC. 16; Crawford COUNTY

In response to the notice of sale to be held 9:00 a.m. (local time) on May 7, 2019, I am hereby submitting my sealed bid (firm offer) for the following forest products to be cut. Bids for individual species must be at or above the advertised price. All non-responsive bid forms may be rejected.

<u>PRODUCTS &amp; SPECIES</u>	<u>ESTIMATED VOLUME*</u>	<u>ADVERTISED PRICE</u>	<u>BID PRICE/UNIT</u>
<b>Sawtimber</b>			
Basswood	157.80 MBF	\$ 114.00/MBF	\$ _____
Beech	24.80 MBF	\$ 113.00/MBF	\$ _____
Mixed Aspen	233.50 MBF	\$ 79.00/MBF	\$ _____
Sugar Maple	101.10 MBF	\$ 278.00/MBF	\$ _____
White Spruce	134.90 MBF	\$ 64.00/MBF	\$ _____
<b>Pulpwood</b>			
Basswood	373.00 Cords	\$ 20.35/Cord	\$ _____
Mixed Aspen	980.00 Cords	\$ 24.00/Cord	\$ _____
Mixed Hardwood	1,185.00 Cords	\$ 33.60/Cord	\$ _____
Red Oak	3.00 Cords	\$ 21.75/Cord	\$ _____
White Spruce	886.00 Cords	\$ 17.70/Cord	\$ _____

\*The volumes are statistically estimated within plus (+) or minus (-) 11.42 percent. These estimated volumes are final and not subject to adjustment. Prospective bidders are urged to examine this timber and to make their own estimates of quantity and quality.

I understand that any or all bids may be rejected. All bids must be signed and all bid items must be bid or the bid form may be rejected. I also understand that consideration and awarding a contract will be based upon my past performance and ability to complete the contract based upon equipment and staffing subject to my control.

FEDERAL ID: \_\_\_\_\_ or SOCIAL SECURITY NUMBER: \_\_\_\_\_

Company or individual bidding: \_\_\_\_\_

Company representative's name: \_\_\_\_\_

Address: \_\_\_\_\_

City: \_\_\_\_\_ State: \_\_\_\_\_ Zip: \_\_\_\_\_

IF AVAILABLE, PLEASE PLACE THE PERSONALIZED LABEL FROM YOUR PROSPECTUS IN THE ABOVE BOX.

Individual or company representative's signature: \_\_\_\_\_ Date: \_\_\_\_\_

Phone number : \_\_\_\_\_ Email (optional): \_\_\_\_\_

**THE WINNING BIDDER MUST COMPLETE THE VERIFICATION OF WORKER'S DISABILITY COMPENSATION ACT COMPLIANCE (ON REVERSE SIDE IF DOUBLE SIDED) WITHIN 21 DAYS OF SALE AWARD DATE**



<b>FOR DEPARTMENT USE ONLY</b>
Sale Number (XX - XXX - XX - XX)
Forest Management Unit:

## TIMBER SALE VERIFICATION OF WORKER'S DISABILITY COMPENSATION ACT COMPLIANCE

*As required by Act 317, P.A. 1969 (Worker's Compensation) and  
Part 5 of Act 451 of 1994, as amended.*

### VERIFICATION OF WORKER'S DISABILITY COMPENSATION ACT COMPLIANCE

- This verification must be completed and submitted within 21 days of contract award and prior to the issuance of the timber sale contract.
- In addition, if boxes 2B or 2C are checked, then Notice of Exclusion or Certificate of Insurance must be submitted within twenty-one (21) days of the contract award and prior to the issuance of the timber sale contract.
- All information must be typed or printed except for written signatures.

Please Check Appropriate Categories:

1. My business is organized as (you **must** check one of the boxes below):
  - A.  Sole Proprietorship (individual)
  - B.  Partnership
  - C.  Corporation
  
2. You **must** check one of the boxes below:
  - A.  I certify my business is a sole proprietorship and it has no employees but the sole proprietor. I am not subject to the Worker's Compensation Laws.
  - B.  I certify my business has satisfied its obligation to the Worker's Compensation Act through the use of an approved Notice of Exclusion (BWC-337, Rev. 5/96). I will provide a copy of the Notice of Exclusion within 21 days of the contract award. (For questions or a copy of the BWC-337, please call the Worker's Compensation Bureau at 517-322-1195).
  - C.  I certify my business has a Worker's Compensation Policy. I will provide an original Certificate of Insurance within twenty-one (21) days of the contract award.
  
3. If you have checked item 2(A) or 2(B), you **must** indicate the number of **both** full-time and part-time employees, other than yourself, including family members and active partners (if none, you must enter "0").

\_\_\_\_\_ Full-time Employees

\_\_\_\_\_ Part-time Employees

Name of Business		Federal ID (or) Social Security No.	
Address		Telephone (       )	
City	State	ZIP	

*I hereby certify that the above information is true and correct. I agree to notify the Michigan DNR of any changes that occur in factors affecting my coverage during any of my present and future operations.*

\_\_\_\_\_  
Signature of Owner or Authorized Representative

\_\_\_\_\_  
Title

\_\_\_\_\_  
Date

**Please complete the "SEALED BID" information on the next page**



SW Comp 281 (72-024-18)  
T26N, R01W, SEC. 4; Crawford COUNTY

In response to the notice of sale to be held 9:00 a.m. (local time) on May 7, 2019, I am hereby submitting my sealed bid (firm offer) for the following forest products to be cut. Bids for individual species must be at or above the advertised price. All non-responsive bid forms may be rejected.

<u>PRODUCTS &amp; SPECIES</u>	<u>ESTIMATED VOLUME*</u>	<u>ADVERTISED PRICE</u>	<u>BID PRICE/UNIT</u>
<b>Sawtimber</b>			
Northern Pin Oak	35.20 MBF	\$ 203.00/MBF	\$ _____
Red Pine	21.40 MBF	\$ 112.00/MBF	\$ _____
White Pine	1.50 MBF	\$ 67.00/MBF	\$ _____
<b>Pulpwood</b>			
Balsam Fir	18.00 Cords	\$ 15.50/Cord	\$ _____
Black Spruce	8.00 Cords	\$ 17.70/Cord	\$ _____
Jack Pine	268.00 Cords	\$ 19.35/Cord	\$ _____
Misc. Species 1	5.00 Cords	\$ 7.50/Cord	\$ _____
Misc. Species 2	14.00 Cords	\$ 3.75/Cord	\$ _____
Mixed Aspen	34.00 Cords	\$ 24.00/Cord	\$ _____
Mixed Hardwood	23.00 Cords	\$ 33.60/Cord	\$ _____
Mixed Oak	198.00 Cords	\$ 21.75/Cord	\$ _____
Red Pine	26.00 Cords	\$ 39.55/Cord	\$ _____
White Pine	85.00 Cords	\$ 27.60/Cord	\$ _____

\*The volumes are statistically estimated within plus (+) or minus (-) 11.58 percent. These estimated volumes are final and not subject to adjustment. Prospective bidders are urged to examine this timber and to make their own estimates of quantity and quality.

I understand that any or all bids may be rejected. All bids must be signed and all bid items must be bid or the bid form may be rejected. I also understand that consideration and awarding a contract will be based upon my past performance and ability to complete the contract based upon equipment and staffing subject to my control.

FEDERAL ID: \_\_\_\_ - \_\_\_\_ - \_\_\_\_ or SOCIAL SECURITY NUMBER: \_\_\_\_ - \_\_\_\_ - \_\_\_\_

Company or individual bidding: \_\_\_\_\_

Company representative's name: \_\_\_\_\_

Address: \_\_\_\_\_

City: \_\_\_\_\_ State: \_\_\_\_\_ Zip: \_\_\_\_\_

IF AVAILABLE, PLEASE PLACE THE PERSONALIZED LABEL FROM YOUR PROSPECTUS IN THE ABOVE BOX.

Individual or company representative's signature: \_\_\_\_\_ Date: \_\_\_\_\_

Phone number : \_\_\_\_\_ Email (optional): \_\_\_\_\_

**THE WINNING BIDDER MUST COMPLETE THE VERIFICATION OF WORKER'S DISABILITY COMPENSATION ACT COMPLIANCE (ON REVERSE SIDE IF DOUBLE SIDED) WITHIN 21 DAYS OF SALE AWARD DATE**



<b>FOR DEPARTMENT USE ONLY</b>
Sale Number (XX - XXX - XX - XX)
Forest Management Unit:

## TIMBER SALE VERIFICATION OF WORKER'S DISABILITY COMPENSATION ACT COMPLIANCE

*As required by Act 317, P.A. 1969 (Worker's Compensation) and  
Part 5 of Act 451 of 1994, as amended.*

### VERIFICATION OF WORKER'S DISABILITY COMPENSATION ACT COMPLIANCE

- This verification must be completed and submitted within 21 days of contract award and prior to the issuance of the timber sale contract.
- In addition, if boxes 2B or 2C are checked, then Notice of Exclusion or Certificate of Insurance must be submitted within twenty-one (21) days of the contract award and prior to the issuance of the timber sale contract.
- All information must be typed or printed except for written signatures.

Please Check Appropriate Categories:

1. My business is organized as (you **must** check one of the boxes below):
  - A.  Sole Proprietorship (individual)
  - B.  Partnership
  - C.  Corporation
  
2. You **must** check one of the boxes below:
  - A.  I certify my business is a sole proprietorship and it has no employees but the sole proprietor. I am not subject to the Worker's Compensation Laws.
  - B.  I certify my business has satisfied its obligation to the Worker's Compensation Act through the use of an approved Notice of Exclusion (BWC-337, Rev. 5/96). I will provide a copy of the Notice of Exclusion within 21 days of the contract award. (For questions or a copy of the BWC-337, please call the Worker's Compensation Bureau at 517-322-1195).
  - C.  I certify my business has a Worker's Compensation Policy. I will provide an original Certificate of Insurance within twenty-one (21) days of the contract award.
  
3. If you have checked item 2(A) or 2(B), you **must** indicate the number of **both** full-time and part-time employees, other than yourself, including family members and active partners (if none, you must enter "0").

\_\_\_\_\_ Full-time Employees

\_\_\_\_\_ Part-time Employees

Name of Business		Federal ID (or) Social Security No.	
Address		Telephone (       )	
City	State	ZIP	

*I hereby certify that the above information is true and correct. I agree to notify the Michigan DNR of any changes that occur in factors affecting my coverage during any of my present and future operations.*

\_\_\_\_\_  
Signature of Owner or Authorized Representative

\_\_\_\_\_  
Title

\_\_\_\_\_  
Date

**Please complete the "SEALED BID" information on the next page**