



**DEPARTMENT OF NATURAL RESOURCES
STATE OF MICHIGAN**

TIMBER SALE PROSPECTUS #6746

SCHEDULED SALE DATE AND TIME: 3:00 p.m. (local time) on October 28, 2020.

LOCATION: **BALDWIN FIELD OFFICE, 2468 W 24TH STREET, BALDWIN, MI 49304.**

PROSPECTUS NOTE: The bidder is advised to inspect the sale area and review the location, estimated volumes, operating costs and contract terms of proposed sales. Please be aware that some landowners may request 60 days or more notice for access across their land.

Notice is hereby given that bids will be received by the Unit Manager, CADILLAC MANAGEMENT UNIT, for certain timber on the following described lands:

Manton Classic Aspen (63-008-20) / T24N, R10W, SEC. 13, W1/2NW,NWSW,SESW,S1/2SE.

T24N, R10W, SEC. 14, S1/2NE,NESE.

Wexford County, Advertised Price \$66,880.05, 112.6 Acres, Aspen, Hardwood.

Baxter Road Aspen (63-009-20) / T24N, R10W, SEC. 15, SESW.

T24N, R10W, SEC. 22, NW,SW.

Wexford County, Advertised Price \$77,634.30, 95.8 Acres, Aspen, Hardwood.

Face Paint Oak (63-028-19) / T19N, R12W, SEC. 25, SENW,SWNE,NESW,NWSE.

T19N, R12W, SEC. 26, NWSW,SESW,SWSE.

T19N, R12W, SEC. 35, NENW,NWNE.

Lake County, Advertised Price \$20,442.20, 75.1 Acres, Hardwood, Aspen.

BID INSTRUCTIONS (VER. 07/02/2018):

1. Scheduled Bid Location, Date, and Time (2/11)

Bids must be received by the Unit Manager, BALDWIN FIELD OFFICE, 2468 W 24th Street, Baldwin, MI 49304, no later than 3:00 p.m. (local time) on October 28, 2020. For further information concerning this sale, contact Joe Ventimglia at 231-878-0047 extension .

2. Bidder's Qualifications (5/16)

Purchaser shall obtain workers compensation insurance to cover claims under Michigan's Worker's Disability Compensation Act of 1969 or similar employee benefit act of any other state applicable to an employee. If all or part of a timber sale was prepared by a private contractor, the contractor and that contractor's company are not permitted to bid on the timber sale contract. Bids will not be accepted from individuals or companies appearing on the DNR/FRD No-Bid List. This list contains the names of purchasers who previously failed to execute a contract within 21-days or who have a history of poor performance.

3. Preparation of Sealed Bids (5/16)

Bid Forms may be completed online thru Michigan DNR Timber Sale Online Bidding (OLB) at www.michigan.gov/timberbidding or by completing the hardcopy Bid Form found in the Timber Sale Prospectus . Hardcopy Bid Forms shall be manually signed in ink. Registration in OLB is considered your 'signature' for all bids submitted thru that system. Bid prices must be entered for each species and product in the Bid Price column for all material subject to bidding and all fill-in blanks must be completed. If erasures or other changes appear on the hardcopy Bid Form, each erasure or change must be initialed by the person signing the bid.

4. Submission of Sealed Bids (5/16)

Bid forms may be obtained from the Unit Manager or thru OLB. Bids may be submitted hardcopy or thru OLB. All hardcopy bids must be submitted on the bid form and in an envelope clearly identified as described in this section. NOTE: Only one bid form per bid envelope. Sealed bids must be submitted to the Unit office designated in the prospectus and must be submitted at or prior to the time established in the prospectus. The envelope should show on the outside (a) the sale name or number and (b) the date and time of bid opening, as shown in the prospectus. Bids received after the time specified in the sale prospectus are late bids and will be rejected.

It is possible for a bidder to submit multiple bids on a single sale. For example, a bid may be submitted hardcopy and a bid may be submitted thru OLB. Or, two bidders from the same company could both submit bids on the same sale. If this were to happen, the State would accept all bids received and award the contract accordingly. All bidding and contractual requirements would apply to all bids received.

5. Public Opening of Sealed Bids (7/16)

If conditions permit, the sealed bids will be publicly opened and posted at the time and place set in the prospectus.

If a bidder, present at a bid opening, has submitted bids on more than one sale, that bidder may withdraw their unopened bid envelopes or announce the withdrawal of their online bid after being declared the successful bidder on one sale.

6. Award of Contract (1/11)

Award of the contract will be made to the Bidder whose bid, conforming to the prospectus, is most advantageous to the State of Michigan on the basis of total value at rates bid for the estimated quantities. The State reserves the right to reject any bid or waive any minor irregularity in bids received. A written award mailed (or otherwise furnished) to the successful Bidder shall be deemed to result in a binding contract without further action by either party.

7. Down Payment (1/11)

The Bidder to whom award is made must make a down payment within 21 days of the sale award. The amount of the down payment will be calculated as shown in the Bond and Payment Schedule of this prospectus. Only cash may be used to meet this requirement.

8. Performance Security (1/11)

As guarantee of faithful performance, a cash bond, certificate of deposit, surety bond or irrevocable letter of credit (LOC) is required within 21 days of the sale award. The amount of the performance security is shown in the Bond and

Payment Schedule of this prospectus. If an LOC or surety is used, the coverage must extend for at least 6 months beyond the contract expiration.

9. Timber Sale Contract (7/18)

Additional conditions and requirements common to all timber sales are listed on the timber sale contract (R4031) and are available on line at www.michigan.gov/timber. Contact the Unit Manager for additional information or a sample contract. Within 21 days of the date of the award letter, the bidder must sign the contract and provide the required down payment, performance security, and verification of worker's disability compensation. The down payment and performance security shall be in accordance with the provisions of the timber sale contract, in the sums stated in this prospectus. If these actions are not taken, then the Bidder, the Bidder's corporation, and the corporation's principals may not be permitted to bid on State timber sales for a period of 3 months after the first offense, 6 months after the second offense, and 1 year after the third offense. An offense will only be counted against the Bidder for 5 years. In addition, the Bidder certifies that if awarded this contract, the Bidder will complete the timber sale contract in accordance with its terms and any modifications thereof including requirements to purchase, cut, and remove the included timber by the expiration date.

Payment Unit values in the State Forest Timber Sale Contract are calculated based on the advertised value of the Payment Unit as a percentage of the total advertised value of the contract. The advertised value of each Payment Unit is given in the Description of Timber by Payment Unit table on the Timber Sale Information page. For example, if the value of Payment Unit 1 is advertised as \$1,500 and the total Timber Sale value is advertised as \$10,000, the contract price for Payment Unit 1 will be 15% of the total bid price ($\$1,500/\$10,000 * 100$).

10. Disclaimer of Estimates and Bidder's Warranty of Inspection (7/16)

Before submitting this bid, the Bidder is advised and cautioned to inspect the sale area, review the requirements of the sale contract, and take other steps as may be reasonably necessary to ascertain the location, estimated volumes, construction estimates, and operating costs of the proposed sale. Failure to do so will not relieve the Bidder from responsibility for completing the contract.

The Bidder warrants that this bid is submitted solely on the basis of the Bidder's examination and inspection of the quality and quantity of the timber offered for sale and the Bidder's opinion of the value thereof and the costs of recovery. No reliance should be placed on the State of Michigan's estimates of timber quality, quantity or costs of recovery. Bidder further acknowledges that the State of Michigan: (i) expressly disclaims any warranty of fitness of timber for any purpose; (ii) offers this timber as is without any warranty of quality (merchantability) or quantity and (iii) expressly disclaims any warranty as to the quantity or quality of timber sold.

11. Certification and Chain-of-Custody (10/14)

Unless otherwise indicated in the contract under section 7 – Other Conditions of the Sale Specific Conditions & Requirements, the area encompassed by this timber sale is certified to the standards of the Forest Stewardship Council (FSC) - Certificate #SCS-FM/COC-00090N and the Sustainable Forestry Initiative (SFI) - Certificate #NSF-SFIS-5Y031-SF5. Forest products from this sale may be delivered to the mill as "FSC 100% and / or SFI certified" as long as the contractor hauling the forest products is chain-of-custody (COC) certified or covered under a COC certificate from the destination mill. The purchaser is responsible for maintaining COC after leaving the sale area.

12. Good Neighbor Authority (GNA) Requirements (7/16)

If the name of this timber sales contains the acronym GNA, it is authorized by the Good Neighbor Authority (GNA) and covered by various agreements between the U.S. Forest Service and the State. The timber sale occurs on federal land and the following conditions apply:

GNA contracts on US Forest Service land will not be awarded to purchasers on the Federal list of excluded parties. The System for Award Management (SAM) will be checked for active excluded parties prior to award of contract. In addition, the Bidder to whom award is made must complete an Assurance Regarding Felony Conviction or Tax Delinquent Status for Corporate Applicants (AD-3031).

13. Good Neighbor Authority (GNA) Requirements, con't (9/16)

Bidder certifies, by signing this bid form, that to the best of Bidder's knowledge that the following representations are accurate and complete.

- a. That the Bidder and its principals are not presently debarred, suspended, proposed for debarment, declared ineligible, or voluntary excluded from timber sales (covered transactions) by any Federal department or agency.
- b. That the Bidder and its principals have not within a 3-year period preceding this bid been convicted of or had a civil judgment rendered against them for commission of fraud or a criminal offense in connection with obtaining , attempting to obtain, or performing a public (Federal, State, or local) transaction or contract under a public transaction; violation of Federal or State antitrust statutes or commission of embezzlement, theft, forgery, bribery, falsification or destruction of records, making false statements, or receiving stolen property.
- c. That the Bidder and its principals are not presently indicted for or otherwise criminally or civilly charged by a governmental entity (Federal, State, or local) with commission of any of the offenses enumerated in paragraph b of this certification.
- d. That the Bidder and its principals have not within a 3-year period preceding this bid had one or more public transactions (Federal, State, or local) terminated for breach or default of a timber or forest product contract.

Bidders that cannot certify this requirement, in whole or in part, shall submit an explanation with their bid.

DAN EICHINGER
Director

TIMBER SALE INFORMATION

Manton Classic Aspen (63-008-20)
T24N, R10W, SEC. 13; T24N, R10W, SEC. 14.
Wexford County (Advertised Price \$66,880.05)

A timber sale contract for this lump sum, sealed bid timber sale will be awarded to the responsible bidder offering the highest sealed bid price. All units of volume listed below were estimated using the T-Sale computer program and our traditional volume equations. Bids must be at or above the following advertised price for each product and species:

<u>PRODUCTS & SPECIES</u>	<u>ESTIMATED UNITS*</u>	<u>ADVERTISED PRICE</u>
Sawtimber		
Mixed Aspen	152.2 MBF	\$ 92.00 / MBF
Red Maple	28.1 MBF	\$ 87.00 / MBF
Red Pine	70.9 MBF	\$ 101.00 / MBF
White Pine	31.6 MBF	\$ 72.00 / MBF
Pulpwood		
Balsam Fir	68 Cords	\$ 10.05 / Cord
Mixed Aspen	1,418 Cords	\$ 13.85 / Cord
Mixed Hardwood	26 Cords	\$ 11.95 / Cord
Red Maple	438 Cords	\$ 11.95 / Cord
Red Oak	32 Cords	\$ 15.40 / Cord
Red Pine	285 Cords	\$ 41.80 / Cord
White Pine	201 Cords	\$ 13.55 / Cord

* The total volume is statistically estimated within plus (+) or minus (-) 10.63 percent. There are an estimated 3,032 cords on this timber sale, plus or minus 322 cords at the 95% confidence level. The estimated units are final and not subject to adjustment. Prospective bidders are urged to examine this timber and to make their own estimates of quantity and quality.

BOND AND PAYMENT SCHEDULE:

1. A bond in the amount of \$3,344.00 to insure faithful performance of the conditions of the contract will be deposited by the successful bidder within 21 days of the sale award.
2. Cutting in any sale or unit without the required advance payment would be considered a trespass.
3. Total payment must be paid in advance or according to the following schedule :
 - (a) Ten percent (10%) of the sale value must be paid within 21 days of the sale award.
 - (b) The 10% down payment will be credited towards the first unit cut.
 - (c) Payment for each of the following units must be made before cutting begins in that unit:

PAYMENT UNIT NUMBER	PERCENT OF TOTAL SALE VALUE
01	23.0%
02	9.1%
03	39.1%
04	20.9%
05	7.9%
4. If no cutting takes place, the 10% down payment will not be refunded.
5. Operations on the contract issued will terminate on 12/31/2022.

SALE STATISTICS

SALE VOLUMES

VOLUME		STATISTICAL RANGE IN CORDS		
TOTAL CUBIC FEET	TOTAL CORDS	PERCENT ERROR	MINIMUM	MAXIMUM
239,526	3,032	10.63%	2,710	3,354

VDU VOLUMES

A VDU is a Volume Determination Unit. Volumes and their associated statistics are calculated at the VDU level and summarized to the sale level. There is often a one to one relationship between a VDU and a Payment Unit, but not always, depending on the cruise design. Refer to the VDU TO PAYMENT UNIT table.

VDU	VOLUME		PERCENT ERROR	RANGE IN CORDS	
	TOTAL CUBIC FEET	TOTAL CORDS		MINIMUM	MAXIMUM
48	137,002	1,734	13.88%	1,493	1,975
68	57,623	729	15.72%	615	844
85	25,059	317	16.01%	266	368
93	19,821	251	35.71%	161	340
TOTAL:	239,504	3,032		2,536	3,527

VDU TO PAYMENT UNIT

When a VDU is associated with more than one Payment Unit (PU), the VDU volumes are assigned to the PU based on acres of the VDU within the PU.

VDU	VDU ACRES	PU	PU ACRES
48	62.4	2	11.8
		3	50.6
68	19.1	1	19.1
85	17.5	4	17.5
93	13.6	5	13.6
TOTAL:	112.6		112.6

DESCRIPTION OF TIMBER BY PAYMENT UNIT (PU)

PU	MARKET GROUP	PRODUCT	QUANTITY	UNIT	ACRES	ADVERTISE PRICE	
1	Mixed Aspen	Sawtimber	53.9	MBF	19.1	\$15,408.45	
	<i>B. T. Aspen</i>		23.8	<i>MBF</i>			
	<i>Quaking Aspen</i>		30.1	<i>MBF</i>			
	Red Maple		11.8	MBF			
	Red Pine		7.5	MBF			
	White Pine		10.5	MBF			
	Balsam Fir		Pulpwood	37			Cords
	Mixed Aspen			233			Cords
	<i>B. T. Aspen</i>			97			<i>Cords</i>
	<i>Quaking Aspen</i>			136			<i>Cords</i>
	Red Maple			194			Cords
	Red Pine			24			Cords
	White Pine			73			Cords
	2			Mixed Aspen			Sawtimber
<i>B. T. Aspen</i>		4.2	<i>MBF</i>				
<i>Quaking Aspen</i>		9.6	<i>MBF</i>				
Red Maple		3.1	MBF				
Red Pine		3.7	MBF				
White Pine		4.0	MBF				
Balsam Fir		Pulpwood	6	Cords			
Mixed Aspen			188	Cords			
<i>B. T. Aspen</i>			68	<i>Cords</i>			
<i>Quaking Aspen</i>			120	<i>Cords</i>			
Mixed Hardwood			5	Cords			
<i>American Elm</i>			2	<i>Cords</i>			
<i>Black Cherry</i>			1	<i>Cords</i>			
<i>Paper Birch</i>			2	<i>Cords</i>			
Red Maple			45	Cords			
Red Oak			6	Cords			
<i>Red Oak</i>		Sawtimber	0.4	<i>MBF</i>			
<i>Red Oak</i>			Pulpwood	5	<i>Cords</i>		
Red Pine	5			Cords			
White Pine	24			Cords			
3	Mixed Aspen	Sawtimber		59.4	MBF	50.6	\$26,121.35
	<i>B. T. Aspen</i>		18.1	<i>MBF</i>			
	<i>Quaking Aspen</i>		41.3	<i>MBF</i>			
	Red Maple		13.2	MBF			
	Red Pine		16.0	MBF			
	White Pine		17.1	MBF			
	Balsam Fir		Pulpwood	25	Cords		
	Mixed Aspen			807	Cords		
	<i>B. T. Aspen</i>			293	<i>Cords</i>		
	<i>Quaking Aspen</i>			514	<i>Cords</i>		
	Mixed Hardwood			21	Cords		
	<i>American Elm</i>			9	<i>Cords</i>		
	<i>Black Cherry</i>			4	<i>Cords</i>		
	<i>Paper Birch</i>			8	<i>Cords</i>		
	Red Maple			192	Cords		
	Red Oak			26	Cords		
	<i>Red Oak</i>		Sawtimber	1.7	<i>MBF</i>		
	<i>Red Oak</i>			Pulpwood	23		
Red Pine	21	Cords					
White Pine	104	Cords					
4	Red Pine	Sawtimber	43.0		MBF	17.5	\$13,998.80
	Red Pine	Pulpwood	231	Cords			
5	Mixed Aspen	Sawtimber	25.1	MBF	13.6	\$5,262.25	

DESCRIPTION OF TIMBER BY PAYMENT UNIT (PU), CON'T

PU	MARKET GROUP	PRODUCT	QUANTITY	UNIT	ACRES	ADVERTISE PRICE
5 con't	<i>B. T. Aspen</i>	<i>Sawtimber</i>	3.0	<i>MBF</i>		
	<i>Quaking Aspen</i>		22.1	<i>MBF</i>		
	Red Pine		0.7	MBF		
	Mixed Aspen		190	Cords		
	<i>B. T. Aspen</i>		55	<i>Cords</i>		
	<i>Quaking Aspen</i>		135	<i>Cords</i>		
	Red Maple		7	Cords		
	Red Pine		4	Cords		
TOTAL:			282.8	MBF		
TOTAL:			2,468	Cords		

Sale Specific Conditions & Requirements

Sale Name: Manton Classic Aspen

Sale Number: 63-008-20 Seq#: 1

1 - Sale Area

1.2 - Boundaries

1.2.1 - Painted boundaries (9/19)

The sale boundary is marked in red and blue paint. Exterior sale boundary lines against private property are marked with blue paint. Exterior sale boundary lines against state are marked with red paint. Retention patches are marked with red paint; no harvesting activities may occur within these areas. The painted boundary line trees are not Included Timber and are to be protected.

2 - Timber Specifications

2.1 - Included Timber

2.1.1 - Clearcut unit(s) with unmerchantable trees (6/14)

Within Payment Unit(s) 1, 2, 3 and 5, cut all trees that are two (2) inches or more at DBH, except do not cut cedar and hemlock. In addition, the following exceptions apply:

- Within Payment Unit 1, do not cut any white pine 25 inches or greater at DBH.
- Within Payment Units 2 and 5, do not cut any white pine 30 inches or greater at DBH, or white pine and red pine under 4 inches at DBH. In addition, do not cut any trees marked with green paint.
- Within Payment Units 5, do not cut any pine under 8 inches at DBH.

2.1.3 - Cut tree marked unit(s) (12/08)

Within Payment Unit(s) 4, all trees are designated for cutting when marked with orange paint above and below stump height, regardless of merchantability.

2.2 - Utilization

2.2.6 - Roundwood operation required (5/07)

The skidding of whole trees or tree segments with limbs attached is prohibited within Payment Unit 4. All products must be produced as roundwood and forwarded to existing roads or landing areas in final product length.

3 - Payments

3.3 - Pre-measured Sales

3.3.4 - Dividing payment units (7/14)

Payment Unit(s) 3 may be divided at the request of the Purchaser and upon approval of the Unit Manager. Dividing Payment Units is a contract modification which requires a Timber Sale Contract Supplement. There will be only one division per Payment Unit.

4 - Transportation

4.1 - Construction

4.1.12 - No new roads (1/12)

No new roads will be permitted. All operations are limited to existing roads. Skid trails only will be allowed.

4.2 - Maintenance

4.2.5 - Two wheel drive condition (2/04)

All existing trail roads on and adjacent to the sale area must be passable by two-wheel drive traffic for the duration of the sale.

5 - Operations

5.1 - Notification

5.1.1 - Pre-sale conference (10/16)

A pre-sale conference on site between the Purchaser and sale administrator is required prior to beginning any operations in a Payment Unit to determine landing and road locations. The Unit Manager or his/her representative must be contacted at least 3 days in advance to schedule the conference.

5.2 - Conduct of Operations

5.2.3 - Operating Restrictions

5.2.3.1 - Operating restrictions (9/11)

Within Payment Unit(s) 1, 2, 3, and 5, unless changed by written agreement, cutting, skidding, limited to dry or frozen conditions. This restriction is the result of seasonally wet conditions of most or portions of these units.

5.2.3.11 - Coppice regeneration protection (4/10)

Timber harvesting in Payment Units 1, 2, 3, and 5 must be completed before significant aspen sprouting occurs in that Payment Unit so as to minimize damage to the new regeneration. Any post harvest operations, such as chipping, must be completed before sprouting of regeneration occurs. If it is anticipated that chipping will be delayed, then tops shall be carried to one central location or left unchipped. The Unit Manager or his/her representative may cease such operations if sprouting occurs before the operation is complete.

5.2.4 - Dead and Down Creation

5.2.4.4 - Dead and down creation, grouse (6/18)

To encourage grouse and other wildlife, in Payment Unit(s) 1, 2, 3 and 5, leave one, 12" diameter or larger log-length (8 foot minimum) piece on the ground for every 4 acres. These trees will be evenly scattered throughout the unit, preferably at least two chains from any roads, two-tracks, or trails open to vehicles.

5.4 - Soil Protection

5.4.1 - Rutting restriction, general (7/16)

Operations are to cease immediately if equipment and weather conditions result in rutting of roads and/or skid trails which is 12 inches or greater in depth and 50 feet in length. The Unit Manager or his/her representative may restrict hauling and/or skidding if ruts exceed the specified depth. With the Unit Manager or his/her representative's approval, the Purchaser may return to the area when the risk of rutting has decreased.

6 - Safety and Fire Prevention

6.2 - Signing

6.2.1 - Road posting (9/09)

The Purchaser is responsible for posting and maintaining caution signs on 35 road prior to beginning operations. The road must be posted at appropriate distances from the sale area to warn of logging activity and truck traffic. Signs must be removed when harvest operations are suspended or completed. The Purchaser will provide these signs.



TIMBER SALE MAP

This information provided by authority of Part 525, 1994 PA 451, as amended.

Forest Management Unit Cadillac		County Wexford	Mapped By Ventimiglia	Date 08/07/20	Page 1	of 1
Township 24N	Range 10W	Section(s) and Subdivision(s) Section 13 and 14 Various		Scale 1:15,840		

Cover Type				Density	
A = Aspen	H = Hemlock	N = Marsh	U = Upland Brush	0 = Non Stocked	5 = Pole Timber Medium
B = Paper Birch	J = Jack Pine	O = Oak	UM = Upland Mixed	1 = Seedling Sapling Poor	6 = Pole Timber Well
C = Cedar	L = Lowland Brush	P = Lowland Poplar	V = Bog or Marsh	2 = Seedling Sapling Medium	7 = Saw Timber Poor
D = Treed Bog	LM = Lowland Mixed	Q = Mixed Swamp Conifer	W = White Pine	3 = Seedling Sapling Well	8 = Saw Timber Medium
E = Swamp Hdwoods	M = Mpl, Bch, Brch	R = Red Pine	X = Non Stocked	4 = Pole Timber Poor	9 = Saw Timber Well
F = Spruce Fir	MC = Mixed Conifer	S = Black Spruce	Z = Water		
G = Grass	MD = Mixed Deciduous	T = Tamarack			

PU	Acres	PU	Acres
1	19.1	4	17.5
2	11.8	5	13.6
3	50.6		

Manton Classic Aspen

Compartment 136

112.6 Acres

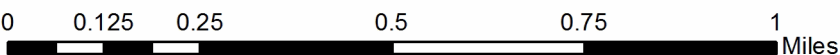
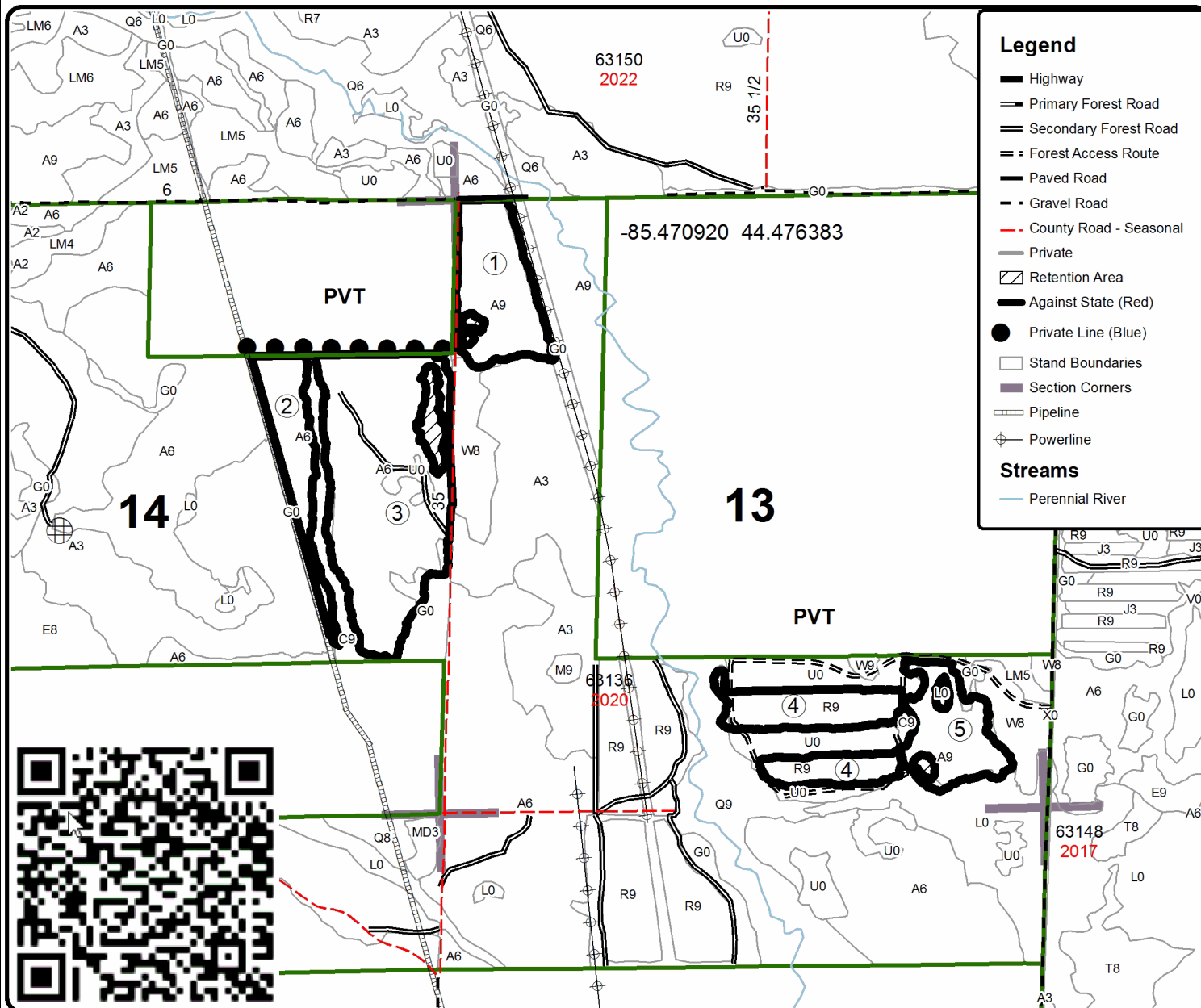
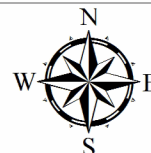

TIMBER SALE INFORMATION

Baxter Road Aspen (63-009-20)
T24N, R10W, SEC. 15; T24N, R10W, SEC. 22.
Wexford County (Advertised Price \$77,634.30)

A timber sale contract for this lump sum, sealed bid timber sale will be awarded to the responsible bidder offering the highest sealed bid price. All units of volume listed below were estimated using the T-Sale computer program and our traditional volume equations. Bids must be at or above the following advertised price for each product and species:

<u>PRODUCTS & SPECIES</u>	<u>ESTIMATED UNITS*</u>	<u>ADVERTISED PRICE</u>
Sawtimber		
Mixed Aspen	307.8 MBF	\$ 92.00 / MBF
Red Maple	50.2 MBF	\$ 87.00 / MBF
Red Oak	12.8 MBF	\$ 198.00 / MBF
White Pine	95.5 MBF	\$ 72.00 / MBF
Pulpwood		
Balsam Fir	66 Cords	\$ 10.05 / Cord
Black Cherry	45 Cords	\$ 11.95 / Cord
Mixed Aspen	1,815 Cords	\$ 13.85 / Cord
Mixed Hardwood	469 Cords	\$ 11.95 / Cord
Mixed Spruce	15 Cords	\$ 12.80 / Cord
Red Oak	46 Cords	\$ 15.40 / Cord
Tamarack	9 Cords	\$ 11.90 / Cord
White Pine	191 Cords	\$ 13.55 / Cord

* The total volume is statistically estimated within plus (+) or minus (-) 13.45 percent. There are an estimated 3,542 cords on this timber sale, plus or minus 476 cords at the 95% confidence level. The estimated units are final and not subject to adjustment. Prospective bidders are urged to examine this timber and to make their own estimates of quantity and quality.

BOND AND PAYMENT SCHEDULE:

1. A bond in the amount of \$3,882.00 to insure faithful performance of the conditions of the contract will be deposited by the successful bidder within 21 days of the sale award.
2. Cutting in any sale or unit without the required advance payment would be considered a trespass.
3. Total payment must be paid in advance or according to the following schedule :
 - (a) Ten percent (10%) of the sale value must be paid within 21 days of the sale award.
 - (b) The 10% down payment will be credited towards the first unit cut.
 - (c) Payment for each of the following units must be made before cutting begins in that unit:

PAYMENT UNIT NUMBER	PERCENT OF TOTAL SALE VALUE
01	16.1%
02	21.0%
03	10.3%
04	29.9%
05	22.7%
4. If no cutting takes place, the 10% down payment will not be refunded.
5. Operations on the contract issued will terminate on 12/31/2022.

SALE STATISTICS

SALE VOLUMES

VOLUME		STATISTICAL RANGE IN CORDS		
TOTAL CUBIC FEET	TOTAL CORDS	PERCENT ERROR	MINIMUM	MAXIMUM
279,804	3,542	13.45%	3,065	4,018

VDU VOLUMES

A VDU is a Volume Determination Unit. Volumes and their associated statistics are calculated at the VDU level and summarized to the sale level. There is often a one to one relationship between a VDU and a Payment Unit, but not always, depending on the cruise design. Refer to the VDU TO PAYMENT UNIT table.

VDU	VOLUME		PERCENT ERROR	RANGE IN CORDS	
	TOTAL CUBIC FEET	TOTAL CORDS		MINIMUM	MAXIMUM
36	27,808	352	49.13%	179	525
54	153,710	1,946	13.00%	1,693	2,199
109	98,308	1,244	30.76%	862	1,627
TOTAL:	279,826	3,542		2,733	4,351

VDU TO PAYMENT UNIT

When a VDU is associated with more than one Payment Unit (PU), the VDU volumes are assigned to the PU based on acres of the VDU within the PU.

VDU	VDU ACRES	PU	PU ACRES
36	9.9	3	9.9
54	48.8	4	27.4
		5	21.4
109	37.1	1	16.1
		2	21.0
TOTAL:	95.8		95.8

DESCRIPTION OF TIMBER BY PAYMENT UNIT (PU)

PU	MARKET GROUP	PRODUCT	QUANTITY	UNIT	ACRES	ADVERTISE PRICE
1	Mixed Aspen	Sawtimber	38.6	MBF	16.1	\$12,523.35
	<i>B. T. Aspen</i>		9.5	<i>MBF</i>		
	<i>Quaking Aspen</i>		29.1	<i>MBF</i>		
	Red Maple		8.3	MBF		
	Red Oak		2.9	MBF		
	White Pine		41.0	MBF		
	Balsam Fir	Pulpwood	16	Cords		
	Mixed Aspen		163	Cords		
	<i>B. T. Aspen</i>		71	<i>Cords</i>		
	<i>Quaking Aspen</i>		92	<i>Cords</i>		
	Mixed Hardwood		81	Cords		
	<i>Black Cherry</i>	<i>Sawtimber</i>	0.7	<i>MBF</i>		
	<i>Black Cherry</i>	<i>Pulpwood</i>	7	<i>Cords</i>		
	<i>Red Maple</i>		73	<i>Cords</i>		
	Mixed Spruce		3	Cords		
	<i>Black Spruce</i>		3	<i>Cords</i>		
	Red Oak		10	Cords		
	Tamarack		4	Cords		
	<i>Tamarack</i>	<i>Sawtimber</i>	1.0	<i>MBF</i>		
	<i>Tamarack</i>	<i>Pulpwood</i>	2	<i>Cords</i>		
White Pine		81	Cords			
2	Mixed Aspen	Sawtimber	50.4	MBF	21.0	\$16,334.40
	<i>B. T. Aspen</i>		12.5	<i>MBF</i>		
	<i>Quaking Aspen</i>		37.9	<i>MBF</i>		
	Red Maple		10.9	MBF		
	Red Oak		3.7	MBF		
	White Pine		53.4	MBF		
	Balsam Fir	Pulpwood	22	Cords		
	Mixed Aspen		211	Cords		
	<i>B. T. Aspen</i>		92	<i>Cords</i>		
	<i>Quaking Aspen</i>		119	<i>Cords</i>		
	Mixed Hardwood		107	Cords		
	<i>Black Cherry</i>	<i>Sawtimber</i>	1.0	<i>MBF</i>		
	<i>Black Cherry</i>	<i>Pulpwood</i>	10	<i>Cords</i>		
	<i>Red Maple</i>		95	<i>Cords</i>		
	Mixed Spruce		3	Cords		
	<i>Black Spruce</i>		3	<i>Cords</i>		
	Red Oak		14	Cords		
	Tamarack		5	Cords		
	<i>Tamarack</i>	<i>Sawtimber</i>	1.4	<i>MBF</i>		
	<i>Tamarack</i>	<i>Pulpwood</i>	2	<i>Cords</i>		
White Pine		106	Cords			
3	Mixed Aspen	Sawtimber	45.9	MBF	9.9	\$7,968.80
	<i>B. T. Aspen</i>		36.5	<i>MBF</i>		
	<i>Quaking Aspen</i>		9.4	<i>MBF</i>		
	Red Maple		4.3	MBF		
	Balsam Fir	Pulpwood	2	Cords		
	Mixed Aspen		194	Cords		
	<i>B. T. Aspen</i>		106	<i>Cords</i>		
	<i>Quaking Aspen</i>		88	<i>Cords</i>		
	Mixed Hardwood		46	Cords		
	<i>Black Cherry</i>		12	<i>Cords</i>		
	<i>Red Maple</i>		34	<i>Cords</i>		
	Mixed Spruce		9	Cords		
	<i>White Spruce</i>		9	<i>Cords</i>		
4	Mixed Aspen	Sawtimber	97.1	MBF	27.4	\$22,609.45

DESCRIPTION OF TIMBER BY PAYMENT UNIT (PU), CON'T

PU	MARKET GROUP	PRODUCT	QUANTITY	UNIT	ACRES	ADVERTISE PRICE
4 con't	<i>B. T. Aspen</i>	<i>Sawtimber</i>	92.5	<i>MBF</i>		
	<i>Quaking Aspen</i>		4.6	<i>MBF</i>		
	Red Maple		15.0	MBF		
	Red Oak		3.5	MBF		
	White Pine		0.6	MBF		
	Balsam Fir	Pulpwood	15	Cords		
	Mixed Aspen		700	Cords		
	<i>B. T. Aspen</i>		533	<i>Cords</i>		
	<i>Quaking Aspen</i>		167	<i>Cords</i>		
	Mixed Hardwood		132	Cords		
	<i>Black Cherry</i>	<i>Sawtimber</i>	0.5	<i>MBF</i>		
	<i>Black Cherry</i>	<i>Pulpwood</i>	6	<i>Cords</i>		
	<i>Red Maple</i>		125	<i>Cords</i>		
	Red Oak		12	Cords		
	White Pine		2	Cords		
	5	Mixed Aspen	Sawtimber	75.8	MBF	21.4
<i>B. T. Aspen</i>			72.2	<i>MBF</i>		
<i>Quaking Aspen</i>			3.6	<i>MBF</i>		
Red Maple			11.7	MBF		
Red Oak			2.7	MBF		
White Pine			0.5	MBF		
Balsam Fir		Pulpwood	11	Cords		
Mixed Aspen			547	Cords		
<i>B. T. Aspen</i>			417	<i>Cords</i>		
<i>Quaking Aspen</i>			130	<i>Cords</i>		
Mixed Hardwood			103	Cords		
<i>Black Cherry</i>		<i>Sawtimber</i>	0.4	<i>MBF</i>		
<i>Black Cherry</i>		<i>Pulpwood</i>	5	<i>Cords</i>		
<i>Red Maple</i>			97	<i>Cords</i>		
Red Oak			10	Cords		
White Pine			2	Cords		
TOTAL:			466.3	MBF		
TOTAL:			2,611	Cords		

Sale Specific Conditions & Requirements

Sale Name: Baxter Road Aspen

Sale Number: 63-009-20 Seq#: 1

1 - Sale Area

1.2 - Boundaries

1.2.1 - Painted boundaries (9/19)

The sale boundary is marked in red paint. The interior Payment Unit boundaries are unpainted and identified by the north/south two track, as shown on the Timber Sale Map. Retention patches are marked with red paint; no harvesting activities may occur within these areas. The painted boundary line trees are not Included Timber and are to be protected.

2 - Timber Specifications

2.1 - Included Timber

2.1.1 - Clearcut unit(s) with unmerchantable trees (6/14)

Within Payment Unit(s) 1, 2, 4 and 5, cut all trees that are two (2) inches or more at DBH, except do not cut cedar and any trees marked with green paint. In addition, within Payment Unit 1 and 2, do not cut any pine under 4 inches at DBH. Also, within Payment Unit 4 and 5, do not cut any pine under 8 inches at DBH.

2.1.2 - Clearcut unit(s) w/o unmerchantable trees (8/11)

Within Payment Unit(s) 3, cut all trees which meet minimum piece specifications in 2.2 Utilization.

4 - Transportation

4.1 - Construction

4.1.12 - No new roads (1/12)

No new roads will be permitted in any Payment Unit. All operations are limited to existing roads. Skid trails only will be allowed.

4.2 - Maintenance

4.2.5 - Two wheel drive condition (2/04)

All existing trail roads on and adjacent to the sale area must be passable by two-wheel drive traffic for the duration of the sale.

5 - Operations

5.1 - Notification

5.1.1 - Pre-sale conference (10/16)

A pre-sale conference on site between the Purchaser and sale administrator is required prior to beginning any operations in a Payment Unit to determine landing and road locations. The Unit Manager or his/her representative must be contacted at least 3 days in advance to schedule the conference.

5.2 - Conduct of Operations

5.2.3 - Operating Restrictions

5.2.3.11 - Coppice regeneration protection (4/10)

Timber harvesting in any Payment Unit must be completed before significant aspen sprouting occurs in that Payment Unit so as to minimize damage to the new regeneration. Any post harvest operations, such as chipping, must be completed before sprouting of regeneration occurs. If it is anticipated that chipping will be delayed, then tops shall be carried to one central location or left unchipped. The Unit Manager or his/her representative may cease such operations if sprouting occurs before the operation is complete.

5.2.4 - Dead and Down Creation

5.2.4.4 - Dead and down creation, grouse (6/18)

To encourage grouse and other wildlife, in Payment Unit(s) 1-5, leave one, 10" diameter or larger log-length (8 foot

minimum) piece on the ground for every 4 acres. These will be evenly scattered throughout the unit. These trees will be evenly scattered throughout the unit, preferably at least two chains from any roads, two-tracks, or trails open to vehicles.

5.4 - Soil Protection

5.4.1 - Rutting restriction, general (7/16)

Operations are to cease immediately if equipment and weather conditions result in rutting of roads and/or skid trails which is 12 inches or greater in depth and 50 feet in length. The Unit Manager or his/her representative may restrict hauling and/or skidding if ruts exceed the specified depth. With the Unit Manager or his/her representative's approval, the Purchaser may return to the area when the risk of rutting has decreased.

6 - Safety and Fire Prevention

6.2 - Signing

6.2.1 - Road posting (9/09)

The Purchaser is responsible for posting and maintaining caution signs on roads near the landing prior to beginning operations. The road must be posted at appropriate distances from the sale area to warn of logging activity and truck traffic. Signs must be removed when harvest operations are suspended or completed. The Purchaser will provide these signs.



TIMBER SALE MAP

This information provided by authority of Part 525, 1994 PA 451, as amended.

Forest Management Unit Cadillac		County Wexford	Mapped By Ventimiglia	Date 07/31/20	Page 1	of 1
Township 24N	Range 10W	Section(s) and Subdivision(s) Section 22 W1/2		Scale 1:15,840		

Cover Type				Density	
A = Aspen	H = Hemlock	N = Marsh	U = Upland Brush	0 = Non Stocked	5 = Pole Timber Medium
B = Paper Birch	J = Jack Pine	O = Oak	UM = Upland Mixed	1 = Seedling Sapling Poor	6 = Pole Timber Well
C = Cedar	L = Lowland Brush	P = Lowland Poplar	V = Bog or Marsh	2 = Seedling Sapling Medium	7 = Saw Timber Poor
D = Treed Bog	LM = Lowland Mixed	Q = Mixed Swamp Conifer	W = White Pine	3 = Seedling Sapling Well	8 = Saw Timber Medium
E = Swamp Hdwoods	M = Mpl, Bch, Brch	R = Red Pine	X = Non Stocked	4 = Pole Timber Poor	9 = Saw Timber Well
F = Spruce Fir	MC = Mixed Conifer	S = Black Spruce	Z = Water		
G = Grass	MD = Mixed Deciduous	T = Tamarack			

PU	Acres	PU	Acres
1	16.1	4	27.4
2	21	5	21.4
3	9.9		

Baxter Road Aspen

Compartment 136

95.8 Acres

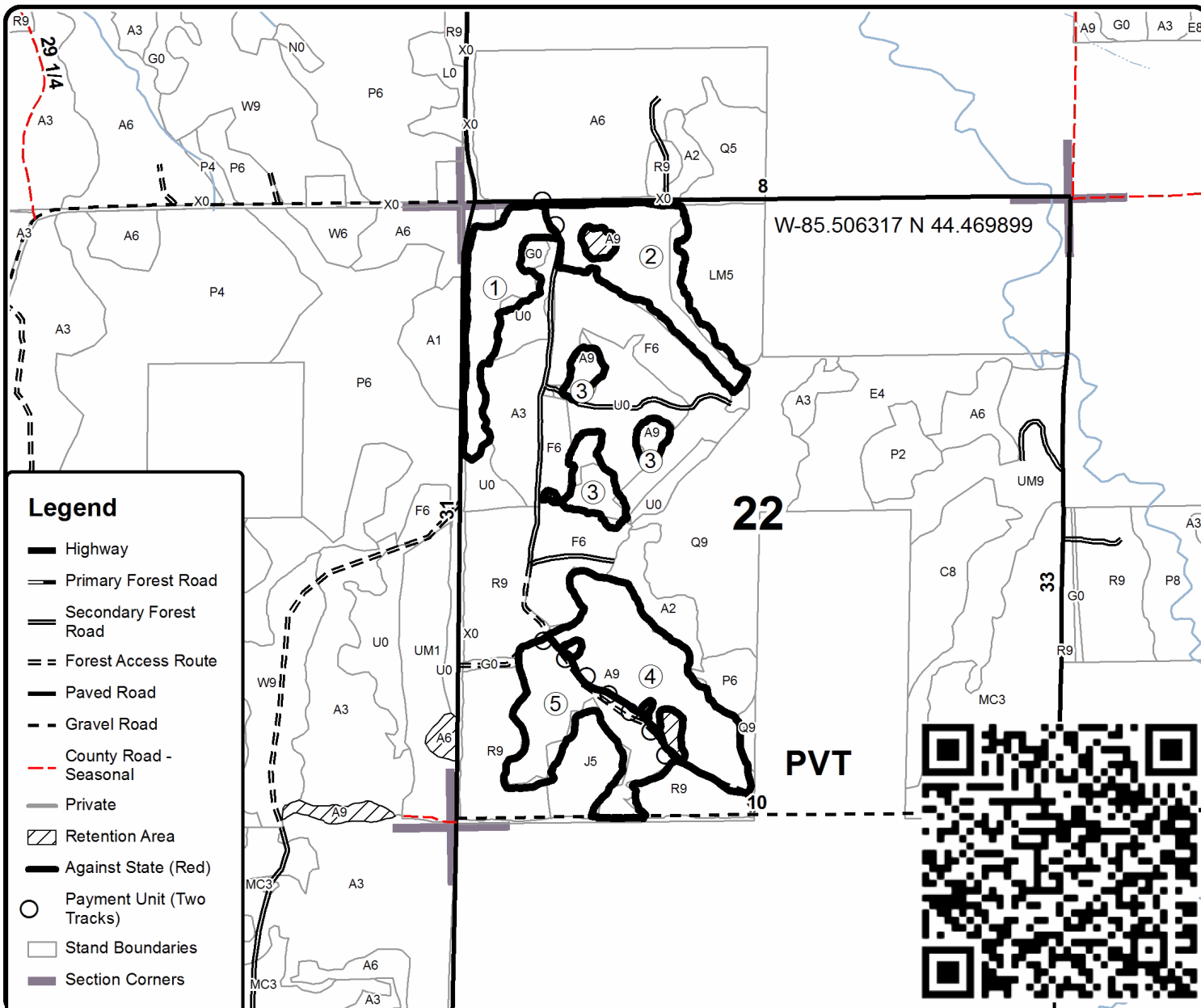
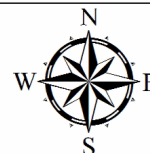

TIMBER SALE INFORMATION

Face Paint Oak (63-028-19)

T19N, R12W, SEC. 25; T19N, R12W, SEC. 26; T19N, R12W, SEC. 35.
Lake County (Advertised Price \$20,442.20)

A timber sale contract for this lump sum, sealed bid timber sale will be awarded to the responsible bidder offering the highest sealed bid price. All units of volume listed below were estimated using the T-Sale computer program and our traditional volume equations. Bids must be at or above the following advertised price for each product and species:

<u>PRODUCTS & SPECIES</u>	<u>ESTIMATED UNITS*</u>	<u>ADVERTISED PRICE</u>
Sawtimber		
B. T. Aspen	16.6 MBF	\$ 43.00 / MBF
Bl/R/Hybrid Oak	178.4 MBF	\$ 44.00 / MBF
Red Maple	12.8 MBF	\$ 40.00 / MBF
Red Oak	18.8 MBF	\$ 91.00 / MBF
Sugar Maple	23.3 MBF	\$ 106.00 / MBF
White Oak	12.9 MBF	\$ 35.00 / MBF
Pulpwood		
B. T. Aspen	39 Cords	\$ 6.40 / Cord
Basswood	21 Cords	\$ 4.75 / Cord
Mixed Hardwood	299 Cords	\$ 5.50 / Cord
Mixed Oak	651 Cords	\$ 7.10 / Cord
White Pine	19 Cords	\$ 6.25 / Cord

* The total volume is statistically estimated within plus (+) or minus (-) 13.78 percent. There are an estimated 1,557 cords on this timber sale, plus or minus 215 cords at the 95% confidence level. The estimated units are final and not subject to adjustment. Prospective bidders are urged to examine this timber and to make their own estimates of quantity and quality.

BOND AND PAYMENT SCHEDULE:

- A bond in the amount of \$1,022.00 to insure faithful performance of the conditions of the contract will be deposited by the successful bidder within 21 days of the sale award.
- Cutting in any sale or unit without the required advance payment would be considered a trespass.
- Total payment must be paid in advance or according to the following schedule :
 - Ten percent (10%) of the sale value must be paid within 21 days of the sale award.
 - The 10% down payment will be credited towards the first unit cut.
 - Payment for each of the following units must be made before cutting begins in that unit:

PAYMENT UNIT NUMBER	PERCENT OF TOTAL SALE VALUE
01	15.8%
02	53.9%
03	25.6%
04	4.7%
- If no cutting takes place, the 10% down payment will not be refunded.
- Operations on the contract issued will terminate on 12/31/2022.

SALE STATISTICS

SALE VOLUMES

VOLUME		STATISTICAL RANGE IN CORDS		
TOTAL CUBIC FEET	TOTAL CORDS	PERCENT ERROR	MINIMUM	MAXIMUM
122,980	1,557	13.78%	1,342	1,771

VDU VOLUMES

A VDU is a Volume Determination Unit. Volumes and their associated statistics are calculated at the VDU level and summarized to the sale level. There is often a one to one relationship between a VDU and a Payment Unit, but not always, depending on the cruise design. Refer to the VDU TO PAYMENT UNIT table.

VDU	VOLUME		PERCENT ERROR	RANGE IN CORDS	
	TOTAL CUBIC FEET	TOTAL CORDS		MINIMUM	MAXIMUM
13	14,860	188	16.45%	157	219
44	29,759	377	16.86%	313	440
61	5,799	73	63.17%	27	120
83	72,569	919	14.02%	790	1,047
TOTAL:	122,987	1,557		1,287	1,826

VDU TO PAYMENT UNIT

When a VDU is associated with more than one Payment Unit (PU), the VDU volumes are assigned to the PU based on acres of the VDU within the PU.

VDU	VDU ACRES	PU	PU ACRES
13	19.9	1	19.9
44	20.4	3	20.4
61	1.6	4	1.6
83	33.2	2	33.2
TOTAL:	75.1		75.1

DESCRIPTION OF TIMBER BY PAYMENT UNIT (PU)

PU	MARKET GROUP	PRODUCT	QUANTITY	UNIT	ACRES	ADVERTISE PRICE
1	Sugar Maple	Sawtimber	23.3	MBF	19.9	\$3,232.05
	Basswood	Pulpwood	21	Cords		
	<i>Basswood</i>	<i>Sawtimber</i>	5.8	<i>MBF</i>		
	<i>Basswood</i>	<i>Pulpwood</i>	9	<i>Cords</i>		
	Mixed Hardwood		114	Cords		
	<i>Beech</i>	<i>Sawtimber</i>	9.1	<i>MBF</i>		
	<i>Black Cherry</i>		3.8	<i>MBF</i>		
	<i>Red Maple</i>		1.7	<i>MBF</i>		
	<i>Beech</i>	<i>Pulpwood</i>	19	<i>Cords</i>		
	<i>Black Cherry</i>		4	<i>Cords</i>		
	<i>Ironwood</i>		7	<i>Cords</i>		
	<i>Red Maple</i>		5	<i>Cords</i>		
	<i>Sugar Maple</i>		50	<i>Cords</i>		
	Mixed Oak		5	Cords		
	<i>Red Oak</i>	<i>Sawtimber</i>	1.3	<i>MBF</i>		
	<i>Red Oak</i>	<i>Pulpwood</i>	2	<i>Cords</i>		
2	BI/R/Hybrid Oak	Sawtimber	146.6	MBF	33.2	\$11,020.80
	White Oak		12.9	MBF		
	B. T. Aspen	Pulpwood	20	Cords		
	<i>B. T. Aspen</i>	<i>Sawtimber</i>	6.2	<i>MBF</i>		
	<i>B. T. Aspen</i>	<i>Pulpwood</i>	8	<i>Cords</i>		
	Mixed Hardwood		75	Cords		
	<i>Red Maple</i>	<i>Sawtimber</i>	5.5	<i>MBF</i>		
	<i>Red Maple</i>	<i>Pulpwood</i>	64	<i>Cords</i>		
	Mixed Oak		504	Cords		
	<i>Red Oak</i>	<i>Sawtimber</i>	4.8	<i>MBF</i>		
	<i>BI/R/Hybrid Oak</i>	<i>Pulpwood</i>	398	<i>Cords</i>		
	<i>Red Oak</i>		10	<i>Cords</i>		
	<i>White Oak</i>		86	<i>Cords</i>		
	3	BI/R/Hybrid Oak	Sawtimber	31.8		
Red Maple			12.8	MBF		
Red Oak			18.8	MBF		
Mixed Hardwood		Pulpwood	91	Cords		
<i>Red Maple</i>			91	<i>Cords</i>		
Mixed Oak			142	Cords		
<i>White Oak</i>		<i>Sawtimber</i>	5.0	<i>MBF</i>		
<i>BI/R/Hybrid Oak</i>		<i>Pulpwood</i>	87	<i>Cords</i>		
<i>Red Oak</i>			22	<i>Cords</i>		
<i>White Oak</i>			23	<i>Cords</i>		
White Pine			17	Cords		
<i>White Pine</i>		<i>Sawtimber</i>	3.6	<i>MBF</i>		
<i>White Pine</i>		<i>Pulpwood</i>	10	<i>Cords</i>		
4	B. T. Aspen	Sawtimber	16.6	MBF	1.6	\$952.40
	B. T. Aspen	Pulpwood	19	Cords		
	<i>B. T. Aspen</i>		19	<i>Cords</i>		
	Mixed Hardwood		19	Cords		
	<i>Red Maple</i>	<i>Sawtimber</i>	4.4	<i>MBF</i>		
	<i>Red Maple</i>	<i>Pulpwood</i>	10	<i>Cords</i>		
	White Pine		2	Cords		
	<i>White Pine</i>	<i>Sawtimber</i>	0.6	<i>MBF</i>		
	<i>White Pine</i>	<i>Pulpwood</i>	1	<i>Cords</i>		
TOTAL:			262.8	MBF		
TOTAL:			1,029	Cords		

Sale Specific Conditions & Requirements

Sale Name: Face Paint Oak

Sale Number: 63-028-19 Seq#: 3

1 - Sale Area

1.2 - Boundaries

1.2.1 - Painted boundaries (9/19)

The sale boundary and Payment Unit boundaries are marked and identified by blue, red, and yellow paint. Exterior sale boundary lines against private property are marked with blue paint. Exterior sale boundary lines against state are marked with red paint. Interior Payment Unit boundaries are marked with yellow paint. The painted boundary line trees are not Included Timber and are to be protected. Yellow painted trees designating an interior Payment Unit boundary are only to be cut when all surrounding Payment Units have been paid.

2 - Timber Specifications

2.1 - Included Timber

2.1.1 - Clearcut unit(s) with unmerchantable trees (6/14)

Within Payment Unit(s) 4, cut all trees that are two (2) inches or more at DBH, except do not cut red oak and white oak.

2.1.3 - Cut tree marked unit(s) (12/08)

Within Payment Unit(s) 1 and 3, all trees are designated for cutting when marked with orange paint above and below stump height, regardless of merchantability. In addition, within Payment Unit 1, cut all ironwood and dead ash. Dead ash will be scaled at \$15.00 per cord.

2.1.7 - Leave tree marked unit(s) (6/14)

Within Payment Unit(s) 2, all trees which meet minimum piece specifications in 2.2 Utilization are designated for cutting, except do not cut red pine, white pine, and trees marked with green paint above and below stump height.

2.2 - Utilization

2.2.3 - Stump heights (4/07)

Stump heights within the Sale Area shall not exceed 12 inches for trees greater than 10 inches DBH and 4 inches for trees smaller than 10 inches DBH. A written waiver of this requirement may be obtained if wet summer weather makes winter logging necessary.

3 - Payments

3.4 - Damaged Timber

3.4.1 - Damaged timber (7/16)

General Condition and Requirement 3.4 Damaged Timber, defines liquidated damages for undesignated live merchantable trees which are cut or injured. In addition, extreme care should be taken to avoid damage to tree seedlings and saplings. Within the sale area, if more than 5% of trees (> 4.5" DBH) within a specified area of the sale are damaged, liquidated damages will be assessed for all trees damaged. Rates will be in accordance with General Condition and Requirement 3.4 Damaged Timber.

3.6 - Payment Unit Cutting Schedule

3.6.2 - One active unit (12/08)

Each Payment Unit must be completed to the satisfaction of the Unit Manager or his/her representative before the next unit may be opened. The Purchaser must give a one week notice before finishing a unit to allow for inspection.

4 - Transportation

4.1 - Construction

4.1.1 - Stream crossings, general (3/11)

All stream crossing structures will be temporary and therefore, shall be provided by the Purchaser, and must be removed upon completion of the sale. All permits for stream crossings will be provided by the DNR.

4.1.3 - Slash and earthen piles (8/04)

Piles or windrows of earth along roads and landings that have been widened or constructed shall be leveled. Slash from road maintenance or construction, including stumps, shall be dispersed throughout the sale.

4.1.6 - Road construction (1/09)

Construction of new roads or improvements of existing roads shall be done in such a way as to minimize the environmental and visual impacts. Merchantable trees shall be cut and utilized unless otherwise directed. Non-merchantable trees shall be severed and laid flat on the ground. Slash shall be scattered, and not left in windrows and kept a minimum of 10 feet back from the road edge. Stumps shall be set upright, not left on edge, and be moved at least 10 feet away from the road edge. Disturbed soil shall be feathered into the woods and not left in berms or windrows.

4.1.7 - Road closure (10/11)

All new roads built into the sale must be blocked to vehicle traffic upon completion of the sale. Overgrown roads that are reopened shall be considered new roads. In general, this will require constructing a four (4') foot high berm of stumps and logs covered with earth. Stumps and brush must be placed along the remainder of the trail. These roads must be rendered impassable to cars and trucks. Contact the sale administrator for specific details of design and placement.

4.2 - Maintenance

4.2.1 - Hauling restriction (12/08)

Hauling may be restricted on forest roads by the Unit Manager or his/her representative. The restriction may occur during spring breakup or may occur during wet weather conditions.

4.2.4 - Grading (10/16)

For completion of the sale, state forest roads must be graded. In general, this will require a road grader or bull dozer to shape up the roads after forest products have been hauled off site. This includes cleaning of drainage areas, grading, crowning and filling with gravel, if necessary. The grading equipment to be used must be approved by the Unit Manager or his/her representative.

4.2.5 - Two wheel drive condition (2/04)

All existing trail roads on and adjacent to the sale area must be passable by two-wheel drive traffic for the duration of the sale.

5 - Operations

5.1 - Notification

5.1.1 - Pre-sale conference (10/16)

A pre-sale conference on site between the Purchaser and sale administrator is required prior to beginning a Payment Unit to determine landing and road locations. The Unit Manager or his/her representative must be contacted at least 5 days in advance to schedule the conference.

5.2 - Conduct of Operations

5.2.1 - Slash

5.2.1.8 - Slash height (12/08)

No slash or tree tops may exceed 24 inches in height.

5.2.2 - Hazard Trees/Snags

5.2.2.1 - Den trees (10/16)

Obvious hollow and/or den trees shall be protected and left standing unless they are a safety hazard.

5.2.3 - Operating Restrictions

5.2.3.1 - Operating restrictions (9/11)

Within Payment Unit(s) 1, unless changed by written agreement, cutting, skidding, and hauling are only permitted during frozen winter conditions. This restriction is to minimize soil disturbance within and nearby the payment unit area.

5.2.3.4 - Oak wilt restriction, no exceptions (1/18)

Within Payment Units 1-4, cutting, skidding, hauling within the sale and brushing of access roads to the sale are not

permitted during the period of April 15 to July 15. No exceptions will be granted. This is necessary to reduce the spread of oak wilt.

5.2.29 - Shrub protection (9/07)

Do not cut or damage hawthorn, witch-hazel, dogwood or juneberry. These woody-shrub plants are highly beneficial to various wildlife species.

5.2.32 - Decking/landing restoration (9/13)

All decking and landing areas must have the surface area restored to a condition equal to or better than before. This is to ensure the proper regeneration of the stand. Wood debris, chips and "cookies" from trimmings must be removed or scattered away from landing and loading areas and may not be windrowed on the edge.

5.2.38 - No decking against live trees (2/04)

Cut products may not be decked against unmarked or designated leave trees.

5.4 - Soil Protection

5.4.1 - Rutting restriction, general (7/16)

Operations are to cease immediately if equipment and weather conditions result in rutting of roads and/or skid trails which is 12 inches or greater in depth and 50 feet in length. The Unit Manager or his/her representative may restrict hauling and/or skidding if ruts exceed the specified depth. With the Unit Manager or his/her representative's approval, the Purchaser may return to the area when the risk of rutting has decreased.

5.4.6 - Wet area protection (5/10)

No harvesting operations, including skidding and felling, are to take place within the vernal pond areas or drainages. When harvesting occurs, there should be no disturbance to the vernal pond depression. All equipment, trees and tops should be kept out of this area. Within 100 feet of the pond, equipment should only be used when the soil is in a dry or frozen condition. Care must be taken by the Purchaser to identify and avoid operating in these areas of the timber sale.

6 - Safety and Fire Prevention

6.2 - Signing

6.2.1 - Road posting (9/09)

The Purchaser is responsible for posting and maintaining caution signs on state forest roads prior to beginning operations. The road must be posted at appropriate distances from the sale area to warn of logging activity and truck traffic. Signs must be removed when harvest operations are suspended or completed. The Purchaser will provide these signs.

6.2.3 - Recreational trail posting (2/10)

The Purchaser is responsible for posting and maintaining caution signs on Tin Cup Trail prior to beginning operations. The trail must be posted at appropriate distances from the sale area to warn of logging activity and truck traffic at both ends of the trail. Signs must be removed when harvest operations are suspended or completed. The Purchaser will provide these signs.

7 - Other Conditions

7.2 - Extensions

7.2.1 - One year extension (2/04)

Given justification, only one, 1 year extension may be granted if the contract has been paid for in full.



TIMBER SALE MAP

This information provided by authority of Part 525, 1994 PA 451, as amended.

Forest Management Unit Cadillac	County Lake County	Mapped By R. Adamczyk	Date 09/24/2019	Page 1	of 2
Cruised By R. Adamczyk & J. Park					

Township 19N	Range 12W	Section(s) and Subdivision(s) Section 26: NW1/4SW, SW1/4SE Section 25: NE1/4SW	Scale 1:15,840
-----------------	--------------	-----------------------------------------------------------------------------------	-------------------

Cover Type				Density			
A = Aspen	H = Hemlock	N = Marsh	U = Upland Brush	0 = Non Stocked	5 = Pole Timber Medium		
B = Paper Birch	J = Jack Pine	O = Oak	UM = Upland Mixed	1 = Seedling Sapling Poor	6 = Pole Timber Well		
C = Cedar	L = Lowland Brush	P = Lowland Poplar	V = Bog or Marsh	2 = Seedling Sapling Medium	7 = Saw Timber Poor		
D = Tread Bog	LM = Lowland Mixed	Q = Mixed Swamp Conifer	W = White Pine	3 = Seedling Sapling Well	8 = Saw Timber Medium		
E = Swamp Hdwoods	M = Mpl, Bch, Brch	R = Red Pine	X = Non Stocked	4 = Pole Timber Poor	9 = Saw Timber Well		
F = Spruce Fir	MC = Mixed Conifer	S = Black Spruce	Z = Water				
G = Grass	MD = Mixed Deciduous	T = Tamarack					

PU	Acres
1	19.9
2	33.2

Face Paint Oak

Compartment 63015

75.1 Acres

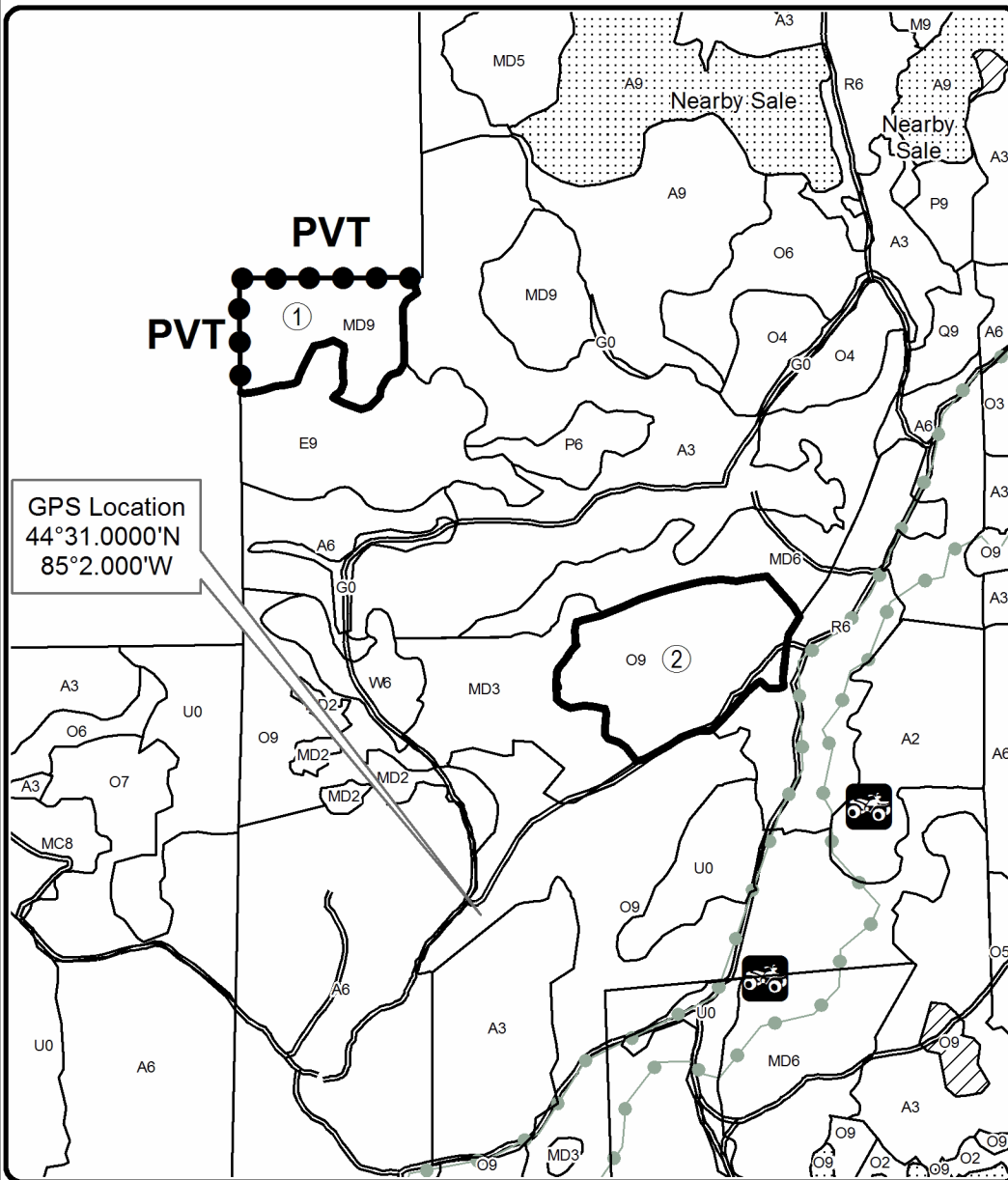
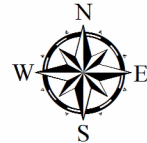

GPS Location
44°31.0000'N
85°2.000'W

Legend

- Stand Boundaries
- Secondary Forest Road
- Retention Area
- Against State (Red)
- Private Line (Blue)
- Nearby Timber Sales
- Recreational Trail

Locator Map
1:200,000

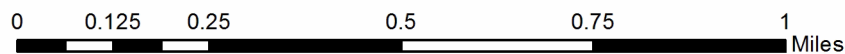
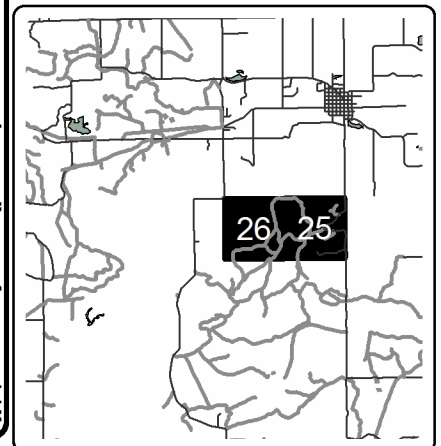



TIMBER SALE MAP

This information provided by authority of Part 525, 1994 PA 451, as amended.

Sale Number	Year
63-028	2019

Forest Management Unit Cadillac	County Lake County	Mapped By R. Adamczyk	Date 09/24/2019	Page 2	of 2
Cruised By R. Adamczyk & J. Park					

Township 19N	Range 12W	Section(s) and Subdivision(s) Section 26: NW1/4SW, SW1/4SE Section 25: NE1/4SW	Scale 1:15,840
-----------------	--------------	-----------------------------------------------------------------------------------	-------------------

Cover Type				Density	
A = Aspen	H = Hemlock	N = Marsh	U = Upland Brush	0 = Non Stocked	5 = Pole Timber Medium
B = Paper Birch	J = Jack Pine	O = Oak	UM = Upland Mixed	1 = Seedling Sapling Poor	6 = Pole Timber Well
C = Cedar	L = Lowland Brush	P = Lowland Poplar	V = Bog or Marsh	2 = Seedling Sapling Medium	7 = Saw Timber Poor
D = Treed Bog	LM = Lowland Mixed	Q = Mixed Swamp Conifer	W = White Pine	3 = Seedling Sapling Well	8 = Saw Timber Medium
E = Swamp Hdwoods	M = Mpl, Bch, Brch	R = Red Pine	X = Non Stocked	4 = Pole Timber Poor	9 = Saw Timber Well
F = Spruce Fir	MC = Mixed Conifer	S = Black Spruce	Z = Water		
G = Grass	MD = Mixed Deciduous	T = Tamarack			

PU	Acres
2	33.2
3	20.4
4	1.6

Face Paint Oak

Compartment 63015

75.1 Acres

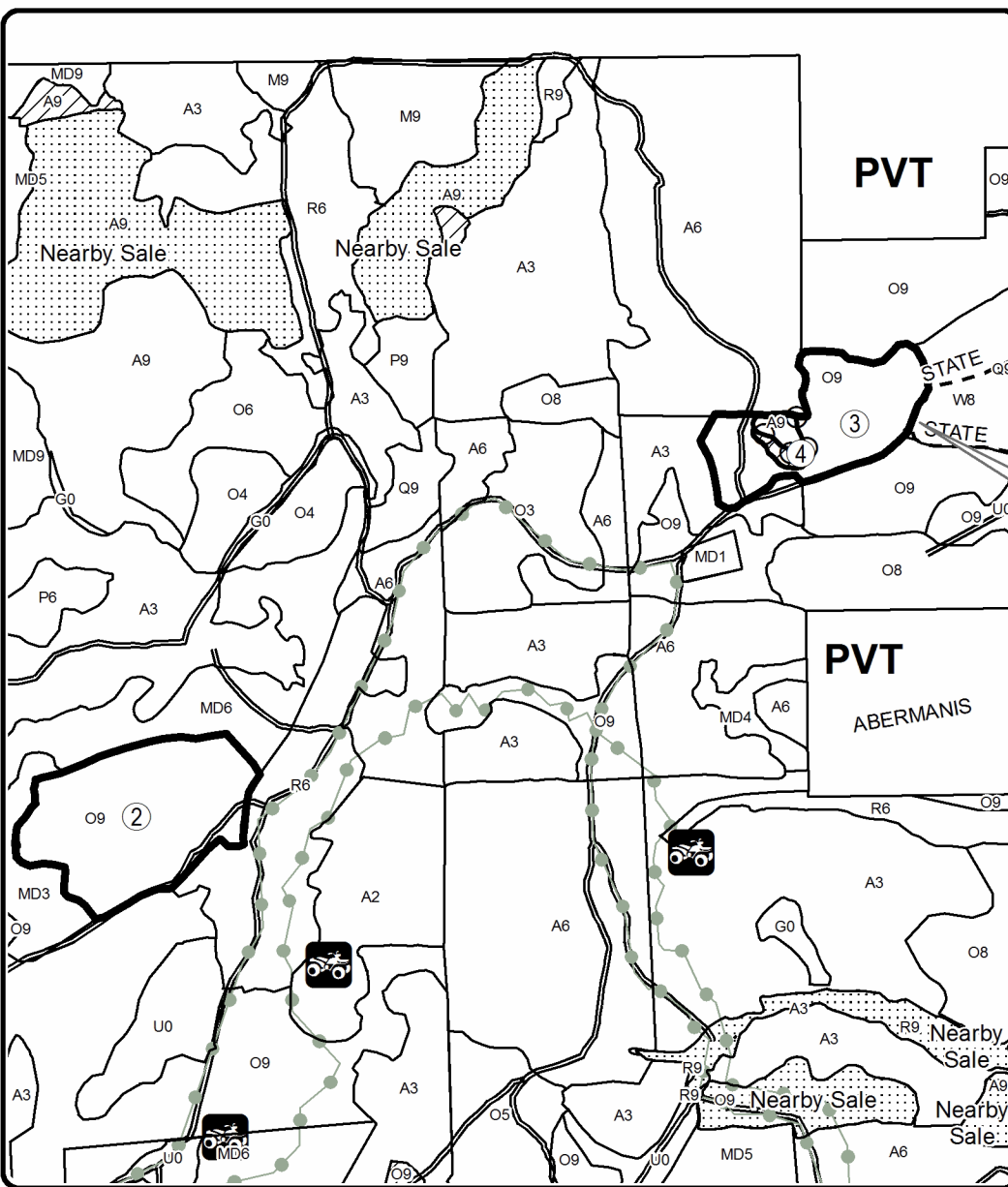
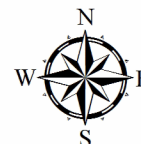

Legend

- Stand Boundaries
- Secondary Forest Road
- Gravel Road
- Retention Area
- Against State (Red)
- Payment Unit (Yellow)
- Nearby Timber Sales
- Recreational Trail

GPS Location
44°31.0000'N
85°2.000'W

Locator Map
1:200,000

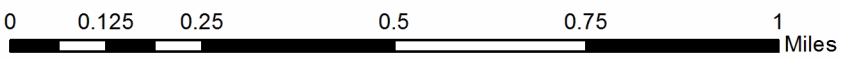
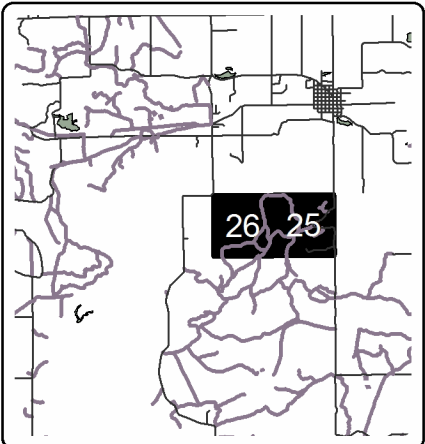

Baxter Road Aspen (63-009-20)
T24N, R10W, SEC. 15; T24N, R10W, SEC. 22; Wexford COUNTY

In response to the notice of sale to be held 3:00 p.m. (local time) on October 28, 2020, I am hereby submitting my sealed bid (firm offer) for the following forest products to be cut. Bids for individual species must be at or above the advertised price. All non-responsive bid forms may be rejected.

<u>PRODUCTS & SPECIES</u>	<u>ESTIMATED VOLUME*</u>	<u>ADVERTISED PRICE</u>	<u>BID PRICE/UNIT</u>
Sawtimber			
Mixed Aspen	307.8 MBF	\$ 92.00/MBF	\$ _____
Red Maple	50.2 MBF	\$ 87.00/MBF	\$ _____
Red Oak	12.8 MBF	\$ 198.00/MBF	\$ _____
White Pine	95.5 MBF	\$ 72.00/MBF	\$ _____
Pulpwood			
Balsam Fir	66 Cords	\$ 10.05/Cord	\$ _____
Black Cherry	45 Cords	\$ 11.95/Cord	\$ _____
Mixed Aspen	1,815 Cords	\$ 13.85/Cord	\$ _____
Mixed Hardwood	469 Cords	\$ 11.95/Cord	\$ _____
Mixed Spruce	15 Cords	\$ 12.80/Cord	\$ _____
Red Oak	46 Cords	\$ 15.40/Cord	\$ _____
Tamarack	9 Cords	\$ 11.90/Cord	\$ _____
White Pine	191 Cords	\$ 13.55/Cord	\$ _____

*The volumes are statistically estimated within plus (+) or minus (-) 13.45 percent at 95% confidence level. These estimated volumes are final and not subject to adjustment. Prospective bidders are urged to examine this timber and to make their own estimates of quantity and quality.

I understand that any or all bids may be rejected. All bids must be signed and all bid items must be bid or the bid form may be rejected. I also understand that consideration and awarding a contract will be based upon my past performance and ability to complete the contract based upon equipment and staffing subject to my control.

FEDERAL ID: ____ - ____ - ____ or SOCIAL SECURITY NUMBER: ____ - ____ - ____

Company or individual bidding: _____

Company representative's name: _____

Address: _____

City: _____ State: _____ Zip: _____

IF AVAILABLE, PLEASE PLACE THE PERSONALIZED LABEL FROM YOUR PROSPECTUS IN THE ABOVE BOX.

Individual or company representative's signature: _____ Date: _____

Phone number : _____ Email (optional): _____

THE WINNING BIDDER MUST COMPLETE THE VERIFICATION OF WORKER'S DISABILITY COMPENSATION ACT COMPLIANCE (ON REVERSE SIDE IF DOUBLE SIDED) WITHIN 21 DAYS OF SALE AWARD DATE



FOR DEPARTMENT USE ONLY	
Sale Number (XX – XXX – XX – XX)	
Forest Management Unit:	

TIMBER SALE VERIFICATION OF WORKER'S DISABILITY COMPENSATION ACT COMPLIANCE

*As required by Act 317, P.A. 1969 (Worker's Compensation) and
Part 5 of Act 451 of 1994, as amended.*

VERIFICATION OF WORKER'S DISABILITY COMPENSATION ACT COMPLIANCE

- This verification must be completed and submitted within 21 days of contract award and prior to the issuance of the timber sale contract.
- In addition, if boxes 2B or 2C are checked, then Notice of Exclusion or Certificate of Insurance must be submitted within twenty-one (21) days of the contract award and prior to the issuance of the timber sale contract.
- All information must be typed or printed except for written signatures.

Please Check Appropriate Categories:

- My business is organized as (you **must** check one of the boxes below):
 - Sole Proprietorship (individual)
 - Partnership
 - Corporation
- You **must** check one of the boxes below:
 - I certify my business is a sole proprietorship and it has no employees but the sole proprietor. I am not subject to the Worker's Compensation Laws.
 - I certify my business has satisfied its obligation to the Worker's Compensation Act through the use of an approved Notice of Exclusion (BWC-337, Rev. 5/96). I will provide a copy of the Notice of Exclusion within 21 days of the contract award. (For questions or a copy of the BWC-337, please call the Worker's Compensation Bureau at 517-322-1195).
 - I certify my business has a Worker's Compensation Policy. I will provide an original Certificate of Insurance within twenty-one (21) days of the contract award.
- If you have checked item 2(A) or 2(B), you **must** indicate the number of **both** full-time and part-time employees, other than yourself, including family members and active partners (if none, you must enter "0").

_____ Full-time Employees

_____ Part-time Employees

Name of Business		Federal ID (or) Social Security No.	
Address		Telephone ()	
City	State	ZIP	

I hereby certify that the above information is true and correct. I agree to notify the Michigan DNR of any changes that occur in factors affecting my coverage during any of my present and future operations.

Signature of Owner or Authorized Representative

Title

Date

Please complete the "SEALED BID" information on the next page

Manton Classic Aspen (63-008-20)
T24N, R10W, SEC. 13; T24N, R10W, SEC. 14; Wexford COUNTY

In response to the notice of sale to be held 3:00 p.m. (local time) on October 28, 2020, I am hereby submitting my sealed bid (firm offer) for the following forest products to be cut. Bids for individual species must be at or above the advertised price. All non-responsive bid forms may be rejected.

<u>PRODUCTS & SPECIES</u>	<u>ESTIMATED VOLUME*</u>	<u>ADVERTISED PRICE</u>	<u>BID PRICE/UNIT</u>
Sawtimber			
Mixed Aspen	152.2 MBF	\$ 92.00/MBF	\$ _____
Red Maple	28.1 MBF	\$ 87.00/MBF	\$ _____
Red Pine	70.9 MBF	\$ 101.00/MBF	\$ _____
White Pine	31.6 MBF	\$ 72.00/MBF	\$ _____
Pulpwood			
Balsam Fir	68 Cords	\$ 10.05/Cord	\$ _____
Mixed Aspen	1,418 Cords	\$ 13.85/Cord	\$ _____
Mixed Hardwood	26 Cords	\$ 11.95/Cord	\$ _____
Red Maple	438 Cords	\$ 11.95/Cord	\$ _____
Red Oak	32 Cords	\$ 15.40/Cord	\$ _____
Red Pine	285 Cords	\$ 41.80/Cord	\$ _____
White Pine	201 Cords	\$ 13.55/Cord	\$ _____

*The volumes are statistically estimated within plus (+) or minus (-) 10.63 percent at 95% confidence level. These estimated volumes are final and not subject to adjustment. Prospective bidders are urged to examine this timber and to make their own estimates of quantity and quality.

I understand that any or all bids may be rejected. All bids must be signed and all bid items must be bid or the bid form may be rejected. I also understand that consideration and awarding a contract will be based upon my past performance and ability to complete the contract based upon equipment and staffing subject to my control.

FEDERAL ID: _____ or SOCIAL SECURITY NUMBER: _____

Company or individual bidding: _____

Company representative's name: _____

Address: _____

City: _____ State: _____ Zip: _____

IF AVAILABLE, PLEASE PLACE THE PERSONALIZED LABEL FROM YOUR PROSPECTUS IN THE ABOVE BOX.

Individual or company representative's signature: _____ Date: _____

Phone number : _____ Email (optional): _____

THE WINNING BIDDER MUST COMPLETE THE VERIFICATION OF WORKER'S DISABILITY COMPENSATION ACT COMPLIANCE (ON REVERSE SIDE IF DOUBLE SIDED) WITHIN 21 DAYS OF SALE AWARD DATE



FOR DEPARTMENT USE ONLY	
Sale Number (XX - XXX - XX - XX)	
Forest Management Unit:	

TIMBER SALE VERIFICATION OF WORKER'S DISABILITY COMPENSATION ACT COMPLIANCE

As required by Act 317, P.A. 1969 (Worker's Compensation) and
Part 5 of Act 451 of 1994, as amended.

VERIFICATION OF WORKER'S DISABILITY COMPENSATION ACT COMPLIANCE

- This verification must be completed and submitted within 21 days of contract award and prior to the issuance of the timber sale contract.
- In addition, if boxes 2B or 2C are checked, then Notice of Exclusion or Certificate of Insurance must be submitted within twenty-one (21) days of the contract award and prior to the issuance of the timber sale contract.
- All information must be typed or printed except for written signatures.

Please Check Appropriate Categories:

1. My business is organized as (you **must** check one of the boxes below):
 - A. Sole Proprietorship (individual)
 - B. Partnership
 - C. Corporation
2. You **must** check one of the boxes below:
 - A. I certify my business is a sole proprietorship and it has no employees but the sole proprietor. I am not subject to the Worker's Compensation Laws.
 - B. I certify my business has satisfied its obligation to the Worker's Compensation Act through the use of an approved Notice of Exclusion (BWC-337, Rev. 5/96). I will provide a copy of the Notice of Exclusion within 21 days of the contract award. (For questions or a copy of the BWC-337, please call the Worker's Compensation Bureau at 517-322-1195).
 - C. I certify my business has a Worker's Compensation Policy. I will provide an original Certificate of Insurance within twenty-one (21) days of the contract award.
3. If you have checked item 2(A) or 2(B), you **must** indicate the number of **both** full-time and part-time employees, other than yourself, including family members and active partners (if none, you must enter "0").

_____ Full-time Employees

_____ Part-time Employees

Name of Business		Federal ID (or) Social Security No.	
Address		Telephone ()	
City	State	ZIP	

I hereby certify that the above information is true and correct. I agree to notify the Michigan DNR of any changes that occur in factors affecting my coverage during any of my present and future operations.

Signature of Owner or Authorized Representative

Title

Date

Please complete the "SEALED BID" information on the next page

Face Paint Oak (63-028-19)

T19N, R12W, SEC. 25; T19N, R12W, SEC. 26; T19N, R12W, SEC. 35; Lake

In response to the notice of sale to be held 3:00 p.m. (local time) on October 28, 2020, I am hereby submitting my sealed bid (firm offer) for the following forest products to be cut. Bids for individual species must be at or above the advertised price. All non-responsive bid forms may be rejected.

<u>PRODUCTS & SPECIES</u>	<u>ESTIMATED VOLUME*</u>	<u>ADVERTISED PRICE</u>	<u>BID PRICE/UNIT</u>
Sawtimber			
B. T. Aspen	16.6 MBF	\$ 43.00/MBF	\$ _____
Bl/R/Hybrid Oak	178.4 MBF	\$ 44.00/MBF	\$ _____
Red Maple	12.8 MBF	\$ 40.00/MBF	\$ _____
Red Oak	18.8 MBF	\$ 91.00/MBF	\$ _____
Sugar Maple	23.3 MBF	\$ 106.00/MBF	\$ _____
White Oak	12.9 MBF	\$ 35.00/MBF	\$ _____
Pulpwood			
B. T. Aspen	39 Cords	\$ 6.40/Cord	\$ _____
Basswood	21 Cords	\$ 4.75/Cord	\$ _____
Mixed Hardwood	299 Cords	\$ 5.50/Cord	\$ _____
Mixed Oak	651 Cords	\$ 7.10/Cord	\$ _____
White Pine	19 Cords	\$ 6.25/Cord	\$ _____

*The volumes are statistically estimated within plus (+) or minus (-) 13.78 percent at 95% confidence level. These estimated volumes are final and not subject to adjustment. Prospective bidders are urged to examine this timber and to make their own estimates of quantity and quality.

I understand that any or all bids may be rejected. All bids must be signed and all bid items must be bid or the bid form may be rejected. I also understand that consideration and awarding a contract will be based upon my past performance and ability to complete the contract based upon equipment and staffing subject to my control.

FEDERAL ID: _____ or SOCIAL SECURITY NUMBER: _____

Company or individual bidding: _____

Company representative's name: _____

Address: _____

City: _____ State: _____ Zip: _____

IF AVAILABLE, PLEASE PLACE THE PERSONALIZED LABEL FROM YOUR PROSPECTUS IN THE ABOVE BOX.

Individual or company representative's signature: _____ Date: _____

Phone number : _____ Email (optional): _____

THE WINNING BIDDER MUST COMPLETE THE VERIFICATION OF WORKER'S DISABILITY COMPENSATION ACT COMPLIANCE (ON REVERSE SIDE IF DOUBLE SIDED) WITHIN 21 DAYS OF SALE AWARD DATE



FOR DEPARTMENT USE ONLY	
Sale Number (XX - XXX - XX - XX)	
Forest Management Unit:	

TIMBER SALE VERIFICATION OF WORKER'S DISABILITY COMPENSATION ACT COMPLIANCE

As required by Act 317, P.A. 1969 (Worker's Compensation) and
Part 5 of Act 451 of 1994, as amended.

- VERIFICATION OF WORKER'S DISABILITY COMPENSATION ACT COMPLIANCE**
- This verification must be completed and submitted within 21 days of contract award and prior to the issuance of the timber sale contract.
 - In addition, if boxes 2B or 2C are checked, then Notice of Exclusion or Certificate of Insurance must be submitted within twenty-one (21) days of the contract award and prior to the issuance of the timber sale contract.
 - All information must be typed or printed except for written signatures.

Please Check Appropriate Categories:

1. My business is organized as (you **must** check one of the boxes below):
 - A. Sole Proprietorship (individual)
 - B. Partnership
 - C. Corporation
2. You **must** check one of the boxes below:
 - A. I certify my business is a sole proprietorship and it has no employees but the sole proprietor. I am not subject to the Worker's Compensation Laws.
 - B. I certify my business has satisfied its obligation to the Worker's Compensation Act through the use of an approved Notice of Exclusion (BWC-337, Rev. 5/96). I will provide a copy of the Notice of Exclusion within 21 days of the contract award. (For questions or a copy of the BWC-337, please call the Worker's Compensation Bureau at 517-322-1195).
 - C. I certify my business has a Worker's Compensation Policy. I will provide an original Certificate of Insurance within twenty-one (21) days of the contract award.
3. If you have checked item 2(A) or 2(B), you **must** indicate the number of **both** full-time and part-time employees, other than yourself, including family members and active partners (if none, you must enter "0").

_____ Full-time Employees

_____ Part-time Employees

Name of Business		Federal ID (or) Social Security No.	
Address		Telephone ()	
City	State	ZIP	

I hereby certify that the above information is true and correct. I agree to notify the Michigan DNR of any changes that occur in factors affecting my coverage during any of my present and future operations.

Signature of Owner or Authorized Representative

Title

Date

Please complete the "SEALED BID" information on the next page