



**DEPARTMENT OF NATURAL RESOURCES
STATE OF MICHIGAN**

TIMBER SALE PROSPECTUS #6765

SCHEDULED SALE DATE AND TIME: 3:00 p.m. (local time) on December 16, 2020.

LOCATION: ESCANABA MGMT UNIT, 6833 HWY'S 2, 41 & M-35, GLADSTONE, MI 49837.

PROSPECTUS NOTE: The bidder is advised to inspect the sale area and review the location, estimated volumes, operating costs and contract terms of proposed sales. Please be aware that some landowners may request 60 days or more notice for access across their land.

Notice is hereby given that bids will be received by the Unit Manager, ESCANABA MANAGEMENT UNIT, for certain timber on the following described lands:

LONE WOLF GRAVEL (33-005-20) / T43N, R22W, SEC. 4 , E1/2NW,E1/2SW,SE.
T43N, R22W, SEC. 9 , NENW,NWNE.
Delta County, Advertised Price \$55,982.08, 77.9 Acres, Hardwood, Aspen.

South Deadhorse Split (33-006-20) / T43N, R22W, SEC. 17, NENW,NE.
T43N, R22W, SEC. 5 , SWSE.
T43N, R22W, SEC. 6 , S1/2NW,N1/2SW,SESW,W1/2SE.
T43N, R22W, SEC. 7 , NWNW,NE,N1/2SE.
T43N, R22W, SEC. 8 , NW,NE,SW,N1/2SE,SWSE.
Delta County, Advertised Price \$148,860.80, 327.4 Acres, Hardwood, Aspen.

Behind the Gate (33-007-20) / T43N, R22W, SEC. 18, S1/2NW,N1/2NE.
T43N, R22W, SEC. 7 , S1/2SE.
Delta County, Advertised Price \$14,136.95, 40.4 Acres, Hardwood, Aspen.

SALE NOTE: Access may be through private land.

South of Days (33-008-20) / T41N, R22W, SEC. 22, S1/2SW,SWSE.
T41N, R22W, SEC. 26, W1/2NW,W1/2SW.
T41N, R22W, SEC. 27, NE,S1/2SW,SE.
T41N, R22W, SEC. 34, NWNW.
Delta County, Advertised Price \$105,507.20, 281.5 Acres, Red Pine, Spruce/Fir/Tamarack.

SALE NOTE: Several Payment Units require a two week notice to the sale administrator before beginning operations, due to impacts on recreational trails. See sale spec 5.2.3.1 for more information.

A recreation site such as a trail, pathway, or campground is within the sale area or the vicinity. Certain restrictions/specifications may be applicable including time restrictions.

BID INSTRUCTIONS (VER. 07/02/2018):

1. Scheduled Bid Location, Date, and Time (2/11)

Bids must be received by the Unit Manager, ESCANABA OFFICE, 6833 Hwy's 2, 41 & M-35, Gladstone, MI 49837, no later than 3:00 p.m. (local time) on December 16, 2020. For further information concerning this sale, contact Eric Thompson at 906-789-8231.

2. Bidder's Qualifications (5/16)

Purchaser shall obtain workers compensation insurance to cover claims under Michigan's Worker's Disability Compensation Act of 1969 or similar employee benefit act of any other state applicable to an employee. If all or part of a timber sale was prepared by a private contractor, the contractor and that contractor's company are not permitted to bid on the timber sale contract. Bids will not be accepted from individuals or companies appearing on the DNR/FRD No-Bid List. This list contains the names of purchasers who previously failed to execute a contract within 21-days or who have a history of poor performance.

3. Preparation of Sealed Bids (5/16)

Bid Forms may be completed online thru Michigan DNR Timber Sale Online Bidding (OLB) at www.michigan.gov/timberbidding or by completing the hardcopy Bid Form found in the Timber Sale Prospectus. Hardcopy Bid Forms shall be manually signed in ink. Registration in OLB is considered your 'signature' for all bids submitted thru that system. Bid prices must be entered for each species and product in the Bid Price column for all material subject to bidding and all fill-in blanks must be completed. If erasures or other changes appear on the hardcopy Bid Form, each erasure or change must be initialed by the person signing the bid.

4. Submission of Sealed Bids (5/16)

Bid forms may be obtained from the Unit Manager or thru OLB. Bids may be submitted hardcopy or thru OLB. All hardcopy bids must be submitted on the bid form and in an envelope clearly identified as described in this section. NOTE: Only one bid form per bid envelope. Sealed bids must be submitted to the Unit office designated in the prospectus and must be submitted at or prior to the time established in the prospectus. The envelope should show on the outside (a) the sale name or number and (b) the date and time of bid opening, as shown in the prospectus. Bids received after the time specified in the sale prospectus are late bids and will be rejected.

It is possible for a bidder to submit multiple bids on a single sale. For example, a bid may be submitted hardcopy and a bid may be submitted thru OLB. Or, two bidders from the same company could both submit bids on the same sale. If this were to happen, the State would accept all bids received and award the contract accordingly. All bidding and contractual requirements would apply to all bids received.

5. Public Opening of Sealed Bids (7/16)

If conditions permit, the sealed bids will be publicly opened and posted at the time and place set in the prospectus.

If a bidder, present at a bid opening, has submitted bids on more than one sale, that bidder may withdraw their unopened bid envelopes or announce the withdrawal of their online bid after being declared the successful bidder on one sale.

6. Award of Contract (1/11)

Award of the contract will be made to the Bidder whose bid, conforming to the prospectus, is most advantageous to the State of Michigan on the basis of total value at rates bid for the estimated quantities. The State reserves the right to reject any bid or waive any minor irregularity in bids received. A written award mailed (or otherwise furnished) to the successful Bidder shall be deemed to result in a binding contract without further action by either party.

7. Down Payment (1/11)

The Bidder to whom award is made must make a down payment within 21 days of the sale award. The amount of the down payment will be calculated as shown in the Bond and Payment Schedule of this prospectus. Only cash may be used to meet this requirement.

8. Performance Security (1/11)

As guarantee of faithful performance, a cash bond, certificate of deposit, surety bond or irrevocable letter of credit (LOC) is required within 21 days of the sale award. The amount of the performance security is shown in the Bond and

Payment Schedule of this prospectus. If an LOC or surety is used, the coverage must extend for at least 6 months beyond the contract expiration.

9. Timber Sale Contract (7/18)

Additional conditions and requirements common to all timber sales are listed on the timber sale contract (R4031) and are available on line at www.michigan.gov/timber. Contact the Unit Manager for additional information or a sample contract. Within 21 days of the date of the award letter, the bidder must sign the contract and provide the required down payment, performance security, and verification of worker's disability compensation. The down payment and performance security shall be in accordance with the provisions of the timber sale contract, in the sums stated in this prospectus. If these actions are not taken, then the Bidder, the Bidder's corporation, and the corporation's principals may not be permitted to bid on State timber sales for a period of 3 months after the first offense, 6 months after the second offense, and 1 year after the third offense. An offense will only be counted against the Bidder for 5 years. In addition, the Bidder certifies that if awarded this contract, the Bidder will complete the timber sale contract in accordance with its terms and any modifications thereof including requirements to purchase, cut, and remove the included timber by the expiration date.

Payment Unit values in the State Forest Timber Sale Contract are calculated based on the advertised value of the Payment Unit as a percentage of the total advertised value of the contract. The advertised value of each Payment Unit is given in the Description of Timber by Payment Unit table on the Timber Sale Information page. For example, if the value of Payment Unit 1 is advertised as \$1,500 and the total Timber Sale value is advertised as \$10,000, the contract price for Payment Unit 1 will be 15% of the total bid price ($\$1,500/\$10,000 * 100$).

10. Disclaimer of Estimates and Bidder's Warranty of Inspection (7/16)

Before submitting this bid, the Bidder is advised and cautioned to inspect the sale area, review the requirements of the sale contract, and take other steps as may be reasonably necessary to ascertain the location, estimated volumes, construction estimates, and operating costs of the proposed sale. Failure to do so will not relieve the Bidder from responsibility for completing the contract.

The Bidder warrants that this bid is submitted solely on the basis of the Bidder's examination and inspection of the quality and quantity of the timber offered for sale and the Bidder's opinion of the value thereof and the costs of recovery. No reliance should be placed on the State of Michigan's estimates of timber quality, quantity or costs of recovery. Bidder further acknowledges that the State of Michigan: (i) expressly disclaims any warranty of fitness of timber for any purpose; (ii) offers this timber as is without any warranty of quality (merchantability) or quantity and (iii) expressly disclaims any warranty as to the quantity or quality of timber sold.

11. Certification and Chain-of-Custody (10/14)

Unless otherwise indicated in the contract under section 7 – Other Conditions of the Sale Specific Conditions & Requirements, the area encompassed by this timber sale is certified to the standards of the Forest Stewardship Council (FSC) - Certificate #SCS-FM/COC-00090N and the Sustainable Forestry Initiative (SFI) - Certificate #NSF-SFIS-5Y031-SF5. Forest products from this sale may be delivered to the mill as "FSC 100% and / or SFI certified" as long as the contractor hauling the forest products is chain-of-custody (COC) certified or covered under a COC certificate from the destination mill. The purchaser is responsible for maintaining COC after leaving the sale area.

12. Good Neighbor Authority (GNA) Requirements (7/16)

If the name of this timber sales contains the acronym GNA, it is authorized by the Good Neighbor Authority (GNA) and covered by various agreements between the U.S. Forest Service and the State. The timber sale occurs on federal land and the following conditions apply:

GNA contracts on US Forest Service land will not be awarded to purchasers on the Federal list of excluded parties. The System for Award Management (SAM) will be checked for active excluded parties prior to award of contract. In addition, the Bidder to whom award is made must complete an Assurance Regarding Felony Conviction or Tax Delinquent Status for Corporate Applicants (AD-3031).

13. Good Neighbor Authority (GNA) Requirements, con't (9/16)

Bidder certifies, by signing this bid form, that to the best of Bidder's knowledge that the following representations are accurate and complete.

- a. That the Bidder and its principals are not presently debarred, suspended, proposed for debarment, declared ineligible, or voluntary excluded from timber sales (covered transactions) by any Federal department or agency.
- b. That the Bidder and its principals have not within a 3-year period preceding this bid been convicted of or had a civil judgment rendered against them for commission of fraud or a criminal offense in connection with obtaining , attempting to obtain, or performing a public (Federal, State, or local) transaction or contract under a public transaction; violation of Federal or State antitrust statutes or commission of embezzlement, theft, forgery, bribery, falsification or destruction of records, making false statements, or receiving stolen property.
- c. That the Bidder and its principals are not presently indicted for or otherwise criminally or civilly charged by a governmental entity (Federal, State, or local) with commission of any of the offenses enumerated in paragraph b of this certification.
- d. That the Bidder and its principals have not within a 3-year period preceding this bid had one or more public transactions (Federal, State, or local) terminated for breach or default of a timber or forest product contract.

Bidders that cannot certify this requirement, in whole or in part, shall submit an explanation with their bid.

DAN EICHINGER
Director

TIMBER SALE INFORMATION

South Deadhorse Split (33-006-20)

T43N, R22W, SEC. 17; T43N, R22W, SEC. 5; T43N, R22W, SEC. 6; T43N, R22W, SEC. 7; T43N, R22W, SEC. 8.
Delta County (Advertised Price \$148,860.80)

A timber sale contract for this lump sum, sealed bid timber sale will be awarded to the responsible bidder offering the highest sealed bid price. All units of volume listed below were estimated using the T-Sale computer program and our traditional volume equations. Bids must be at or above the following advertised price for each product and species:

<u>PRODUCTS & SPECIES</u>	<u>ESTIMATED UNITS*</u>	<u>ADVERTISED PRICE</u>
Sawtimber		
Basswood	7.3 MBF	\$ 72.00 / MBF
Black Ash	6.3 MBF	\$ 41.00 / MBF
Paper Birch	2.3 MBF	\$ 60.00 / MBF
Red Maple	215.3 MBF	\$ 96.00 / MBF
Sugar Maple	98.6 MBF	\$ 163.00 / MBF
Yellow Birch	15.8 MBF	\$ 59.00 / MBF
Pulpwood		
Balsam Fir	587 Cords	\$ 13.10 / Cord
Mixed Aspen	1,494 Cords	\$ 17.15 / Cord
Mixed Hardwood	3,693 Cords	\$ 20.15 / Cord
Mixed Spruce	159 Cords	\$ 15.55 / Cord
Tamarack	7 Cords	\$ 9.70 / Cord

* The estimated units are final and not subject to adjustment. Prospective bidders are urged to examine this timber and to make their own estimates of quantity and quality.

BOND AND PAYMENT SCHEDULE:

1. A bond in the amount of \$7,443.00 to insure faithful performance of the conditions of the contract will be deposited by the successful bidder within 21 days of the sale award.
2. Cutting in any sale or unit without the required advance payment would be considered a trespass.
3. Total payment must be paid in advance or according to the following schedule :
 - (a) Ten percent (10%) of the sale value must be paid within 21 days of the sale award.
 - (b) The 10% down payment will be credited towards the first unit cut.
 - (c) Payment for each of the following units must be made before cutting begins in that unit:

PAYMENT UNIT NUMBER	PERCENT OF TOTAL SALE VALUE
01	1.8%
02	14.1%
03	2.1%
04	2.3%
05	2.8%
06	10.9%
07	3.3%
08	1.9%
09	1.1%
10	1.7%
11	1.1%
12	4.2%
13	4.7%
14	1.1%
15	0.6%
16	6.4%
17	5.8%
18	5.5%
19	2.7%
20	7.2%
21	5.5%
22	11.8%
23	1.4%

4. If no cutting takes place, the 10% down payment will not be refunded.
5. Operations on the contract issued will terminate on 09/30/2024.

SALE STATISTICS

SALE VOLUMES

VOLUME			STATISTICAL RANGE IN CORDS	
TOTAL CUBIC FEET	TOTAL CORDS	PERCENT ERROR	MINIMUM	MAXIMUM
523,886	6,631	7.39%	6,141	7,122

VDU VOLUMES

A VDU is a Volume Determination Unit. Volumes and their associated statistics are calculated at the VDU level and summarized to the sale level. There is often a one to one relationship between a VDU and a Payment Unit, but not always, depending on the cruise design. Refer to the VDU TO PAYMENT UNIT table.

	VOLUME			RANGE IN CORDS	
VDU	TOTAL CUBIC FEET	TOTAL CORDS	PERCENT ERROR	MINIMUM	MAXIMUM
11	8,358	106	53.50%	49	162
20	77,420	980	18.32%	800	1,160
33	65,965	835	21.14%	658	1,012
34	18,107	229	28.21%	165	294
43	36,830	466	36.89%	294	638
54	12,838	163	45.17%	89	236
56	7,300	92	17.97%	76	109
57	43,774	554	19.23%	448	661
61	44,619	565	22.78%	436	693
67	7,924	100	35.57%	65	136
68	9,109	115	41.45%	68	163
69	5,309	67	58.67%	28	107
98	4,337	55	46.07%	30	80
101	47,060	596	20.15%	476	716
102	119,811	1,517	16.21%	1,271	1,762
104	15,200	192	39.43%	117	268
TOTAL:	523,960	6,632		5,068	8,197

VDU TO PAYMENT UNIT

When a VDU is associated with more than one Payment Unit (PU), the VDU volumes are assigned to the PU based on acres of the VDU within the PU.

VDU	VDU ACRES	PU	PU ACRES
11	11.1	1	11.1
20	51.1	2	44.5
		3	6.6
33	37.0	5	8.1
		7	9.4
		11	3.0
		13	13.5
		14	3.0
34	14.3	12	14.3
43	15.8	17	15.8
54	7.3	4	7.3
56	3.5	23	3.5
57	32.5	22	32.5
61	35.5	6	35.5
67	3.1	10	3.1
68	8.2	8	8.2
69	4.8	9	4.8
98	6.4	15	6.4
101	19.6	16	19.6
102	67.6	18	20.4
		20	26.6
		21	20.6
104	9.6	19	9.6
TOTAL:	327.4		327.4

DESCRIPTION OF TIMBER BY PAYMENT UNIT (PU), CON'T

PU	MARKET GROUP	PRODUCT	QUANTITY	UNIT	ACRES	ADVERTISE PRICE
5 con't	<i>Red Maple</i> <i>Sugar Maple</i> <i>Yellow Birch</i> Mixed Spruce <i>White Spruce</i>	<i>Pulpwood</i>	91 16 9 11 11	<i>Cords</i> <i>Cords</i> <i>Cords</i> Cords <i>Cords</i>		
6	Red Maple Sugar Maple Balsam Fir Mixed Hardwood <i>Balsam Poplar</i> <i>Red Maple</i> <i>Sugar Maple</i>	Sawtimber Pulpwood	28.6 28.0 17 435 5 163 267	MBF MBF Cords Cords <i>Cords</i> <i>Cords</i> <i>Cords</i>	35.5	\$16,297.55
7	Black Ash Red Maple Sugar Maple Yellow Birch Balsam Fir Mixed Hardwood <i>Balsam Poplar</i> <i>Black Ash</i> <i>Red Maple</i> <i>Sugar Maple</i> <i>Yellow Birch</i> Mixed Spruce <i>White Spruce</i>	Sawtimber Pulpwood	0.6 11.3 0.5 2.9 8 161 10 17 105 19 10 12 12	MBF MBF MBF MBF Cords Cords <i>Cords</i> <i>Cords</i> <i>Cords</i> <i>Cords</i> <i>Cords</i> Cords <i>Cords</i>	9.4	\$4,897.55
8	Red Maple Sugar Maple Mixed Hardwood <i>Black Cherry</i> <i>Red Maple</i> <i>Sugar Maple</i>	Sawtimber Pulpwood	5.7 1.7 101 9 60 32	MBF MBF Cords <i>Cords</i> <i>Cords</i> <i>Cords</i>	8.2	\$2,859.45
9	Red Maple Sugar Maple Balsam Fir Mixed Hardwood <i>Balsam Poplar</i> <i>Black Ash</i> <i>Paper Birch</i> <i>Red Maple</i> <i>Sugar Maple</i>	Sawtimber Pulpwood	1.2 2.0 8 52 11 4 2 26 9	MBF MBF Cords Cords <i>Cords</i> <i>Cords</i> <i>Cords</i> <i>Cords</i> <i>Cords</i>	4.8	\$1,593.80
10	Basswood Red Maple Sugar Maple Balsam Fir Mixed Hardwood <i>Basswood</i> <i>Black Cherry</i> <i>Red Maple</i> <i>Sugar Maple</i>	Sawtimber Pulpwood	1.2 0.7 4.1 12 77 5 4 32 36	MBF MBF MBF Cords Cords <i>Cords</i> <i>Cords</i> <i>Cords</i> <i>Cords</i>	3.1	\$2,530.65
11	Black Ash Red Maple Sugar Maple Yellow Birch Balsam Fir Mixed Hardwood	Sawtimber Pulpwood	0.2 3.6 0.2 0.9 3 51	MBF MBF MBF MBF Cords Cords	3.0	\$1,568.65

DESCRIPTION OF TIMBER BY PAYMENT UNIT (PU), CON'T

PU	MARKET GROUP	PRODUCT	QUANTITY	UNIT	ACRES	ADVERTISE PRICE				
11 con't	<i>Balsam Poplar</i>	<i>Pulpwood</i>	3	<i>Cords</i>						
	<i>Black Ash</i>		5	<i>Cords</i>						
	<i>Red Maple</i>		34	<i>Cords</i>						
	<i>Sugar Maple</i>		6	<i>Cords</i>						
	<i>Yellow Birch</i>		3	<i>Cords</i>						
	Mixed Spruce		4	Cords						
	<i>White Spruce</i>		4	<i>Cords</i>						
12	Red Maple	Sawtimber	17.3	MBF	14.3	\$6,322.40				
	Sugar Maple		6.1	MBF						
	Mixed Hardwood	<i>Pulpwood</i>	182	Cords						
	<i>Red Maple</i>		119	<i>Cords</i>						
	<i>Sugar Maple</i>		63	<i>Cords</i>						
13	Black Ash	Sawtimber	0.8	MBF	13.5	\$7,057.15				
	Red Maple		16.3	MBF						
	Sugar Maple		0.7	MBF						
	Yellow Birch		4.3	MBF						
	Balsam Fir		<i>Pulpwood</i>	12			Cords			
	Mixed Hardwood	231		Cords						
	<i>Balsam Poplar</i>	14		<i>Cords</i>						
	<i>Black Ash</i>	24		<i>Cords</i>						
	<i>Red Maple</i>	151		<i>Cords</i>						
	<i>Sugar Maple</i>	27		<i>Cords</i>						
	<i>Yellow Birch</i>	15		<i>Cords</i>						
	Mixed Spruce	18		Cords						
	<i>White Spruce</i>	18		<i>Cords</i>						
	14	Black Ash		Sawtimber			0.2	MBF	3.0	\$1,568.65
		Red Maple					3.6	MBF		
		Sugar Maple	0.2				MBF			
Yellow Birch		0.9	MBF							
Balsam Fir		<i>Pulpwood</i>	3		Cords					
Mixed Hardwood			51	Cords						
<i>Balsam Poplar</i>			3	<i>Cords</i>						
<i>Black Ash</i>			5	<i>Cords</i>						
<i>Red Maple</i>			34	<i>Cords</i>						
<i>Sugar Maple</i>			6	<i>Cords</i>						
<i>Yellow Birch</i>			3	<i>Cords</i>						
Mixed Spruce			4	Cords						
<i>White Spruce</i>			4	<i>Cords</i>						
15		Paper Birch	Sawtimber	0.9	MBF	6.4	\$847.00			
	Balsam Fir	<i>Pulpwood</i>	39	Cords						
	Mixed Hardwood		14	Cords						
	<i>Balsam Poplar</i>		5	<i>Cords</i>						
	<i>Paper Birch</i>		5	<i>Cords</i>						
	<i>Red Maple</i>		4	<i>Cords</i>						
16	Balsam Fir	<i>Pulpwood</i>	149	Cords	19.6	\$9,574.00				
	Mixed Aspen		379	Cords						
	<i>Quaking Aspen</i>		379	<i>Cords</i>						
	Mixed Hardwood		23	Cords						
	<i>Balsam Poplar</i>		12	<i>Cords</i>						
	<i>Paper Birch</i>		5	<i>Cords</i>						
	<i>Red Maple</i>		6	<i>Cords</i>						
	Mixed Spruce		38	Cords						
	<i>Black Spruce</i>		12	<i>Cords</i>						
	<i>White Spruce</i>		26	<i>Cords</i>						
	Tamarack		7	Cords						

DESCRIPTION OF TIMBER BY PAYMENT UNIT (PU), CON'T

PU	MARKET GROUP	PRODUCT	QUANTITY	UNIT	ACRES	ADVERTISE PRICE
17	Sugar Maple	Sawtimber	1.3	MBF	15.8	\$8,639.75
	Yellow Birch		2.0	MBF		
	Balsam Fir	Pulpwood	11	Cords		
	Mixed Aspen		277	Cords		
	<i>Quaking Aspen</i>		277	<i>Cords</i>		
	Mixed Hardwood		161	Cords		
	<i>Balsam Poplar</i>		78	<i>Cords</i>		
	<i>Paper Birch</i>		8	<i>Cords</i>		
	<i>Red Maple</i>		42	<i>Cords</i>		
	<i>Sugar Maple</i>		26	<i>Cords</i>		
	<i>Yellow Birch</i>		7	<i>Cords</i>		
	Mixed Spruce		11	Cords		
	<i>White Spruce</i>		11	<i>Cords</i>		
18	Basswood	Sawtimber	0.4	MBF	20.4	\$8,189.75
	Red Maple		1.3	MBF		
	Balsam Fir	Pulpwood	54	Cords		
	Mixed Aspen		229	Cords		
	<i>Quaking Aspen</i>		229	<i>Cords</i>		
	Mixed Hardwood		158	Cords		
	<i>Balsam Poplar</i>		17	<i>Cords</i>		
	<i>Basswood</i>		2	<i>Cords</i>		
	<i>Black Ash</i>		43	<i>Cords</i>		
	<i>Red Maple</i>		61	<i>Cords</i>		
	<i>Sugar Maple</i>		5	<i>Cords</i>		
	<i>Yellow Birch</i>		30	<i>Cords</i>		
	Mixed Spruce		14	Cords		
	<i>Black Spruce</i>		2	<i>Cords</i>		
<i>White Spruce</i>		12	<i>Cords</i>			
19	Red Maple	Sawtimber	4.5	MBF	9.6	\$4,006.65
	Yellow Birch		1.5	MBF		
	Balsam Fir	Pulpwood	17	Cords		
	Mixed Aspen		7	Cords		
	<i>Quaking Aspen</i>		7	<i>Cords</i>		
	Mixed Hardwood		156	Cords		
	<i>Balsam Poplar</i>		7	<i>Cords</i>		
	<i>Black Ash</i>		19	<i>Cords</i>		
	<i>Paper Birch</i>		14	<i>Cords</i>		
	<i>Red Maple</i>		108	<i>Cords</i>		
	<i>Yellow Birch</i>		8	<i>Cords</i>		
20	Basswood	Sawtimber	0.5	MBF	26.6	\$10,674.85
	Red Maple		1.7	MBF		
	Balsam Fir	Pulpwood	70	Cords		
	Mixed Aspen		299	Cords		
	<i>Quaking Aspen</i>		299	<i>Cords</i>		
	Mixed Hardwood		206	Cords		
	<i>Balsam Poplar</i>		22	<i>Cords</i>		
	<i>Basswood</i>		3	<i>Cords</i>		
	<i>Black Ash</i>		56	<i>Cords</i>		
	<i>Red Maple</i>		80	<i>Cords</i>		
	<i>Sugar Maple</i>		6	<i>Cords</i>		
	<i>Yellow Birch</i>		39	<i>Cords</i>		
	Mixed Spruce		18	Cords		
	<i>Black Spruce</i>		2	<i>Cords</i>		
<i>White Spruce</i>		16	<i>Cords</i>			
21	Basswood	Sawtimber	0.4	MBF	20.6	\$8,257.30
	Red Maple		1.3	MBF		

DESCRIPTION OF TIMBER BY PAYMENT UNIT (PU), CON'T

PU	MARKET GROUP	PRODUCT	QUANTITY	UNIT	ACRES	ADVERTISE PRICE
21 con't	Balsam Fir	Pulpwood	55	Cords		
	Mixed Aspen		231	Cords		
	<i>Quaking Aspen</i>		231	<i>Cords</i>		
	Mixed Hardwood		159	Cords		
	<i>Balsam Poplar</i>		17	<i>Cords</i>		
	<i>Basswood</i>		2	<i>Cords</i>		
	<i>Black Ash</i>		43	<i>Cords</i>		
	<i>Red Maple</i>		62	<i>Cords</i>		
	<i>Sugar Maple</i>		5	<i>Cords</i>		
	<i>Yellow Birch</i>		30	<i>Cords</i>		
	Mixed Spruce		14	Cords		
	<i>Black Spruce</i>		2	<i>Cords</i>		
	<i>White Spruce</i>		12	<i>Cords</i>		
22	Basswood	Sawtimber	4.8	MBF	32.5	\$17,563.45
	Red Maple		23.9	MBF		
	Sugar Maple		40.5	MBF		
	Mixed Hardwood	Pulpwood	413	Cords		
	<i>Basswood</i>		11	<i>Cords</i>		
	<i>Red Maple</i>		105	<i>Cords</i>		
	<i>Sugar Maple</i>		297	<i>Cords</i>		
23	Paper Birch	Sawtimber	1.4	MBF	3.5	\$2,035.25
	Red Maple		4.1	MBF		
	Balsam Fir	Pulpwood	6	Cords		
	Mixed Hardwood		68	Cords		
	<i>Black Ash</i>		4	<i>Cords</i>		
	<i>Paper Birch</i>		20	<i>Cords</i>		
	<i>Red Maple</i>		36	<i>Cords</i>		
	<i>Yellow Birch</i>		8	<i>Cords</i>		
	Mixed Spruce		7	Cords		
	<i>White Spruce</i>		7	<i>Cords</i>		
TOTAL:			345.6	MBF		
TOTAL:			5,940	Cords		

Sale Specific Conditions & Requirements

Sale Name: South Deadhorse Split

Sale Number: 33-006-20 Seq#: 1

1 - Sale Area

1.2 - Boundaries

1.2.1 - Painted boundaries (9/19)

The sale boundary and Payment Unit boundaries are marked and identified by blue, red and yellow paint. Exterior sale boundary lines against private property are marked with blue paint. Exterior sale boundary lines against state are marked with red paint. Interior Payment Unit boundaries are marked with yellow paint. Retention patches are marked with red paint; no harvesting activities may occur within these areas. The painted boundary line trees are not Included Timber and are to be protected unless marked with orange paint. Yellow painted trees designating an interior Payment Unit boundary are only to be cut when all surrounding Payment Units have been paid.

2 - Timber Specifications

2.1 - Included Timber

2.1.1 - Clearcut unit(s) with unmerchantable trees (6/14)

Within Payment Unit(s) 4, 5, 7, 11, 13-21, and 23, cut all trees that are three (3) inches or more at DBH, with the following exceptions:

- Within Payment Units 4 and 23, do not cut any cedar and hemlock.
- Within Payment Units 5, 7, 11, 13 and 14, do not cut any cedar, hemlock, and trees marked with green paint.
- Within Payment Units 15-21, do not cut any cedar.

2.1.2 - Clearcut unit(s) w/o unmerchantable trees (8/11)

Within Payment Unit(s) 9 and 10, cut all trees which meet minimum piece specifications in 2.2 Utilization, except within Payment Unit 10, do not cut any green marked trees.

2.1.3 - Cut tree marked unit(s) (12/08)

Within Payment Unit(s) 1, 6, 8, 12 and 22, all trees are designated for cutting when marked with orange paint above and below stump height, regardless of merchantability.

2.1.7 - Leave tree marked unit(s) (6/14)

Within Payment Unit(s) 2 and 3, all trees which meet minimum piece specifications in 2.2 Utilization are designated for cutting, except do not cut hemlock, cedar, and trees marked with green paint above and below stump height.

3 - Payments

3.3 - Pre-measured Sales

3.3.4 - Dividing payment units (7/14)

Payment Unit(s) with a contract bid value of \$18,000 or greater may be divided at the request of the Purchaser and upon approval of the Unit Manager. Dividing Payment Units is a contract modification which requires a Timber Sale Contract Amendment.

3.4 - Damaged Timber

3.4.1 - Damaged timber (7/16)

General Condition and Requirement 3.4 Damaged Timber, defines liquidated damages for undesignated live merchantable trees which are cut or injured. In addition, extreme care should be taken to avoid damage to tree seedlings and saplings within Payment Unit 1.

Within Payment Unit 1, if more than 25% of the tree seedlings or saplings (1/4" to 4.5" DBH) within a specified portion of the unit area are damaged, liquidated damages will be assessed at \$100 dollars per acre for all acreage within that specified portion of the unit area that was damaged.

4 - Transportation

4.1 - Construction

4.1.6 - Road construction (1/09)

Construction of new roads or improvements of existing roads shall be done in such a way as to minimize the environmental and visual impacts. Merchantable trees shall be cut and utilized unless otherwise directed. Non-merchantable trees shall be severed and laid flat on the ground. Slash shall be scattered, and not left in windrows and kept a minimum of 10 feet back from the road edge. Stumps shall be set upright, not left on edge, and be moved at least 10 feet away from the road edge. Disturbed soil shall be feathered into the woods and not left in berms or windrows.

4.1.7 - Road closure (10/11)

All new roads built into the sale must be blocked to vehicle traffic upon completion of the sale. Overgrown roads that are reopened shall be considered new roads. In general, this will require constructing a four (4') foot high berm of stumps and logs covered with earth. These roads must be rendered impassable to cars and trucks. Contact the sale administrator for specific details of design and placement.

4.2 - Maintenance

4.2.1 - Hauling restriction (12/08)

Hauling may be restricted on forest roads by the Unit Manager or his/her representative. The restriction may occur during spring breakup and/or during wet weather conditions.

4.2.2 - Fill material (4/07)

To maintain roads, fill material may be needed in areas where "holes" exist or may be expected to develop. This fill material should be placed before trucking begins. Contact the sale administrator regarding the availability of onsite sand or gravel from adjacent State-owned lands.

4.2.4 - Grading (10/16)

For completion of the sale, state forest roads must be graded. In general, this will require a road grader or bull dozer to shape up the roads after forest products have been hauled off site. This includes cleaning of drainage areas, grading, crowning and filling with gravel, if necessary. The grading equipment to be used must be approved by the Unit Manager or his/her representative.

5 - Operations

5.2 - Conduct of Operations

5.2.2 - Hazard Trees/Snags

5.2.2.1 - Den trees (10/16)

Obvious hollow and/or den trees shall be protected and left standing unless they are a safety hazard.

5.2.3 - Operating Restrictions

5.2.3.1 - Operating restrictions (9/11)

Within Payment Unit(s) 13, 15, 18, 20 and 21, unless changed by written agreement, cutting, skidding, and hauling are limited to the period of December 1 to March 31. This restriction is because the ground within these units are low and wet.

5.2.3.3 - Bark slippage restriction (3/09)

Within Payment Unit(s) 1, 6, 8, 12 and 22, unless changed by written agreement, cutting and skidding are not permitted during the period of April 15 to July 15. This restriction is because of bark slippage.

5.2.22 - Operating Caution

5.2.22.1 - Operating caution (6/11)

It is recommended, but not required, that within Payment Unit(s) 23, cutting, skidding, and hauling occur during dry summer or frozen winter conditions. The reason for the recommendation is because this unit has low ground.

5.2.43 - Opening protection (12/08)

No activities are permitted in openings marked on the Timber Sale Map with the letter "G". Any damage to the openings shall be repaired according to specifications of the Unit Manager or his/her representative.

5.4 - Soil Protection

5.4.1 - Rutting restriction, general (7/16)

Operations are to cease immediately if equipment and weather conditions result in rutting of roads and/or skid trails which is 12 inches or greater in depth and 50 feet in length. The Unit Manager or his/her representative may restrict hauling and/or skidding if ruts exceed the specified depth. With the Unit Manager or his/her representative's approval, the Purchaser may return to the area when the risk of rutting has decreased.

6 - Safety and Fire Prevention

6.2 - Signing

6.2.1 - Road posting (9/09)

The Purchaser is responsible for posting and maintaining caution signs on the North and South Deadhorse roads prior to beginning operations. The road must be posted at appropriate distances from the sale area to warn of logging activity and truck traffic. Signs must be removed when harvest operations are suspended or completed. The Purchaser will provide these signs.



TIMBER SALE MAP

This information provided by authority of Part 525, 1994 PA 451, as amended.

Sale Number	Year
33 - 006	20

Forest Management Unit Escanaba		County Delta	Mapped By Urlich	Date 09/03/2020	Page 1	of 1
Township 43N	Range 22W	Section(s) and Subdivision(s) S1/2NW1/4,N1/2SW1/4,SE1/4SW1/4,W1/2SE1/4 Sec 6 W1/2NW1/4,NE1/4,N1/2SE1/4 Sec 7 SE1/4SE1/4 Sec 5 Sec 8 N1/2NW1/4,NE1/4 Sec 17		Scale 1:31,680		

Cover Type				Density			
A = Aspen	H = Hemlock	N = Marsh	U = Upland Brush	0 = Non Stocked	5 = Pole Timber Medium		
B = Paper Birch	J = Jack Pine	O = Oak	UM = Upland Mixed	1 = Seedling Sapling Poor	6 = Pole Timber Well		
C = Cedar	L = Lowland Brush	P = Lowland Poplar	V = Bog or Marsh	2 = Seedling Sapling Medium	7 = Saw Timber Poor		
D = Treed Bog	LM = Lowland Mixed	Q = Mixed Swamp Conifer	W = White Pine	3 = Seedling Sapling Well	8 = Saw Timber Medium		
E = Swamp Hdwoods	M = Mpl, Bch, Brch	R = Red Pine	X = Non Stocked	4 = Pole Timber Poor	9 = Saw Timber Well		
F = Spruce Fir	MC = Mixed Conifer	S = Black Spruce	Z = Water				
G = Grass	MD = Mixed Deciduous	T = Tamarack					

South Deadhorse Split Compartment 90 and 91 327.4 Acres

PU	Acres	PU	Acres	PU	Acres	PU	Acres	PU	Acres
1	11.1	6	35.5	11	3	16	19.6	21	20.6
2	44.5	7	9.4	12	14.3	17	15.8	22	32.5
3	6.6	8	8.2	13	13.5	18	20.4	23	3.5
4	7.3	9	4.8	14	3	19	9.6		
5	8.1	10	3.1	15	6.4	20	26.6		

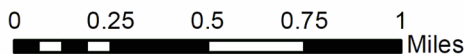
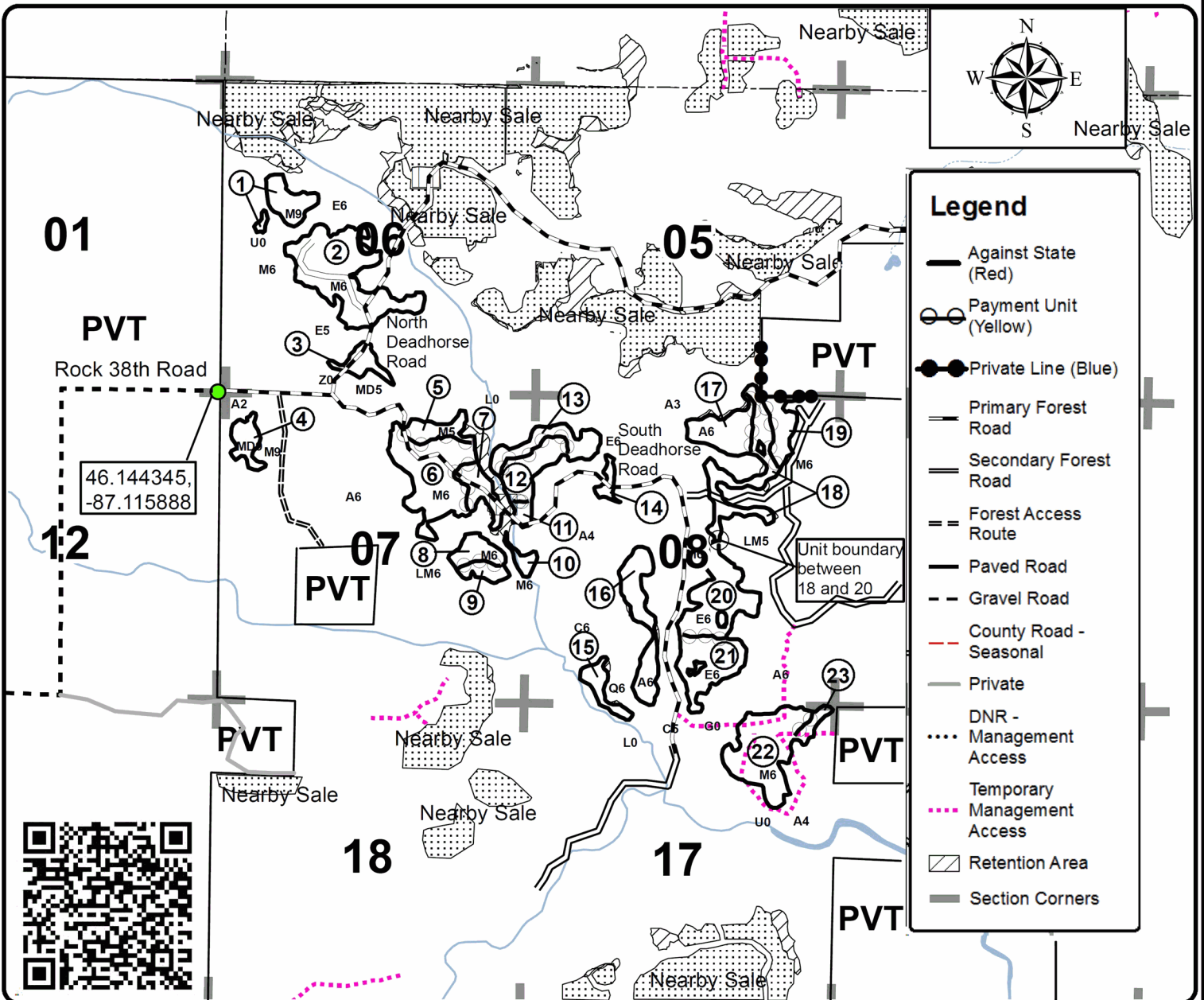

TIMBER SALE INFORMATION

Behind the Gate (33-007-20)
 T43N, R22W, SEC. 18; T43N, R22W, SEC. 7.
 Delta County (Advertised Price \$14,136.95)

SALE NOTE: Access may be through private land.

A timber sale contract for this lump sum, sealed bid timber sale will be awarded to the responsible bidder offering the highest sealed bid price. All units of volume listed below were estimated using the T-Sale computer program and our traditional volume equations. Bids must be at or above the following advertised price for each product and species:

<u>PRODUCTS & SPECIES</u>	<u>ESTIMATED UNITS*</u>	<u>ADVERTISED PRICE</u>
Sawtimber		
Basswood	2.5 MBF	\$ 59.00 / MBF
Black Ash	0.9 MBF	\$ 33.00 / MBF
Red Maple	50.0 MBF	\$ 78.00 / MBF
Sugar Maple	11.4 MBF	\$ 133.00 / MBF
Yellow Birch	0.9 MBF	\$ 48.00 / MBF
Pulpwood		
Balsam Fir	57 Cords	\$ 10.70 / Cord
Mixed Hardwood	325 Cords	\$ 16.50 / Cord
Quaking Aspen	151 Cords	\$ 14.05 / Cord
White Spruce	32 Cords	\$ 12.70 / Cord

* The estimated units are final and not subject to adjustment. Prospective bidders are urged to examine this timber and to make their own estimates of quantity and quality.

BOND AND PAYMENT SCHEDULE:

1. A bond in the amount of \$707.00 to insure faithful performance of the conditions of the contract will be deposited by the successful bidder within 21 days of the sale award.
2. Cutting in any sale or unit without the required advance payment would be considered a trespass.
3. Total payment must be paid in advance or according to the following schedule :
 - (a) Ten percent (10%) of the sale value must be paid within 21 days of the sale award.
 - (b) The 10% down payment will be credited towards the first unit cut.
 - (c) Payment for each of the following units must be made before cutting begins in that unit:

PAYMENT UNIT NUMBER	PERCENT OF TOTAL SALE VALUE
01	23.2%
02	68.4%
03	8.4%
4. If no cutting takes place, the 10% down payment will not be refunded.
5. Operations on the contract issued will terminate on 09/30/2024.

SALE STATISTICS

SALE VOLUMES

VOLUME		STATISTICAL RANGE IN CORDS		
TOTAL CUBIC FEET	TOTAL CORDS	PERCENT ERROR	MINIMUM	MAXIMUM
54,866	695	21.14%	548	841

VDU VOLUMES

A VDU is a Volume Determination Unit. Volumes and their associated statistics are calculated at the VDU level and summarized to the sale level. There is often a one to one relationship between a VDU and a Payment Unit, but not always, depending on the cruise design. Refer to the VDU TO PAYMENT UNIT table.

VDU	VOLUME		PERCENT ERROR	RANGE IN CORDS	
	TOTAL CUBIC FEET	TOTAL CORDS		MINIMUM	MAXIMUM
90	7,355	93	49.14%	47	139
94	29,838	378	23.32%	290	466
98	17,688	224	47.60%	117	330
TOTAL:	54,881	695		454	935

VDU TO PAYMENT UNIT

When a VDU is associated with more than one Payment Unit (PU), the VDU volumes are assigned to the PU based on acres of the VDU within the PU.

VDU	VDU ACRES	PU	PU ACRES
90	7.5	3	7.5
94	24.0	2	24.0
98	8.9	1	8.9
TOTAL:	40.4		40.4

DESCRIPTION OF TIMBER BY PAYMENT UNIT (PU)

PU	MARKET GROUP	PRODUCT	QUANTITY	UNIT	ACRES	ADVERTISE PRICE
1	Balsam Fir	Pulpwood	9	Cords	8.9	\$3,283.65
	Mixed Hardwood		68	Cords		
	<i>Balsam Poplar</i>		52	<i>Cords</i>		
	<i>Black Ash</i>		4	<i>Cords</i>		
	<i>Black Cherry</i>		12	<i>Cords</i>		
	Quaking Aspen		147	Cords		
2	Basswood	Sawtimber	2.5	MBF	24.0	\$9,671.00
	Black Ash		0.9	MBF		
	Red Maple		50.0	MBF		
	Sugar Maple		11.4	MBF		
	Yellow Birch		0.9	MBF		
	Balsam Fir	Pulpwood	6	Cords		
	Mixed Hardwood		236	Cords		
	<i>Basswood</i>		5	<i>Cords</i>		
	<i>Black Ash</i>		6	<i>Cords</i>		
	<i>Red Maple</i>		127	<i>Cords</i>		
	<i>Sugar Maple</i>		94	<i>Cords</i>		
	<i>Yellow Birch</i>		4	<i>Cords</i>		
	White Spruce		6	Cords		
3	Balsam Fir	Pulpwood	42	Cords	7.5	\$1,182.30
	Mixed Hardwood		21	Cords		
	<i>Balsam Poplar</i>		8	<i>Cords</i>		
	<i>Black Cherry</i>		13	<i>Cords</i>		
	Quaking Aspen		4	Cords		
	White Spruce		26	Cords		
	TOTAL:			65.7		
TOTAL:			565	Cords		

Sale Specific Conditions & Requirements

Sale Name: Behind the Gate

Sale Number: 33-007-20 Seq#: 1

1 - Sale Area

1.2 - Boundaries

1.2.1 - Painted boundaries (9/19)

The sale boundary and Payment Unit boundaries are marked and identified by blue and red paint. Exterior sale boundary lines against private property are marked with blue paint. Exterior sale boundary lines against state are marked with red paint. Retention patches are marked with red paint; no harvesting activities may occur within these areas. The painted boundary line trees are not Included Timber and are to be protected unless marked with orange paint.

2 - Timber Specifications

2.1 - Included Timber

2.1.1 - Clearcut unit(s) with unmerchantable trees (6/14)

Within Payment Unit(s) 1, cut all trees that are three (3) inches or more at DBH.

2.1.2 - Clearcut unit(s) w/o unmerchantable trees (8/11)

Within Payment Unit(s) 3, cut all trees which meet minimum piece specifications in 2.2 Utilization.

2.1.3 - Cut tree marked unit(s) (12/08)

Within Payment Unit(s) 2, all trees are designated for cutting when marked with orange paint above and below stump height, regardless of merchantability.

3 - Payments

3.3 - Pre-measured Sales

3.3.4 - Dividing payment units (7/14)

Payment Unit(s) with a contract bid value of \$18,000 or greater may be divided at the request of the Purchaser and upon approval of the Unit Manager. Dividing Payment Units is a contract modification which requires a Timber Sale Contract Amendment.

4 - Transportation

4.1 - Construction

4.1.5 - Culverts (5/14)

Roads may require the installation of culverts for cross drainage or at natural drainage-ways. If culverts are needed in these locations, their placement will be specified by the sale administrator and they shall be installed prior to hauling. The culverts shall be new, corrugated metal or plastic gauge. Culverts will be a minimum of 18 inches in diameter and 24 feet in length. If culverts are removed, fill shall be removed from wetland soils as specified. Soils shall be maintained and left in a non-erodible condition, with water bars, seed, fertilizer, mulch, and slash installed as directed by the sale administrator and as specified in the BMP manual. Stream crossing permits, if needed, will be obtained by the DNR.

4.1.6 - Road construction (1/09)

Construction of new roads or improvements of existing roads shall be done in such a way as to minimize the environmental and visual impacts. Merchantable trees shall be cut and utilized unless otherwise directed. Non-merchantable trees shall be severed and laid flat on the ground. Slash shall be scattered, and not left in windrows and kept a minimum of 10 feet back from the road edge. Stumps shall be set upright, not left on edge, and be moved at least 10 feet away from the road edge. Disturbed soil shall be feathered into the woods and not left in berms or windrows.

4.1.7 - Road closure (10/11)

All new roads built into the sale must be blocked to vehicle traffic upon completion of the sale. In general, this will require constructing a four (4') foot high berm of stumps and logs covered with earth. These roads must be rendered impassable to cars and trucks. Contact the sale administrator for specific details of design and placement.

4.2 - Maintenance

4.2.2 - Fill material (4/07)

To maintain roads, fill material may be needed in areas where "holes" exist or may be expected to develop. This fill material should be placed before trucking begins. Contact the sale administrator regarding the availability of onsite sand or gravel from adjacent State-owned lands.

4.4 - Access

4.4.1 - Private property access (3/11)

Permission for access across private land is the responsibility of the Purchaser. Should the Purchaser desire to cross private land, a copy of the written permission from the private land-owner shall be required by the DNR. Contact the Escanaba Forest Resources Unit office for landowner contact information.

5 - Operations

5.2 - Conduct of Operations

5.2.2 - Hazard Trees/Snags

5.2.2.1 - Den trees (10/16)

Obvious hollow and/or den trees shall be protected and left standing unless they are a safety hazard.

5.2.3 - Operating Restrictions

5.2.3.1 - Operating restrictions (9/11)

Within Payment Unit(s) 1, 2 and 3, unless changed by written agreement, cutting, skidding, and hauling are limited to the period of December 1 to March 31. This restriction is due to the private landowners request and the access to Payment Units 2 and 3 are low and wet.

5.4 - Soil Protection

5.4.1 - Rutting restriction, general (7/16)

Operations are to cease immediately if equipment and weather conditions result in rutting of roads and/or skid trails which is 12 inches or greater in depth and 50 feet in length. The Unit Manager or his/her representative may restrict hauling and/or skidding if ruts exceed the specified depth. With the Unit Manager or his/her representative's approval, the Purchaser may return to the area when the risk of rutting has decreased.

6 - Safety and Fire Prevention

6.2 - Signing

6.2.1 - Road posting (9/09)

The Purchaser is responsible for posting and maintaining caution signs on the North Deadhorse access road prior to beginning operations. The road must be posted at appropriate distances from the sale area to warn of logging activity and truck traffic. Signs must be removed when harvest operations are suspended or completed. The Purchaser will provide these signs.



TIMBER SALE MAP

This information provided by authority of Part 525, 1994 PA 451, as amended.

Forest Management Unit Escanaba	County Delta	Mapped By Urlich	Date 08/26/2020	Page 1	of 1
Township 43N	Range 22W	Section(s) and Subdivision(s) S1/2SW1/4 Sec. 7 S1/2NW 1/4, N1/2NE 1/4 Sec. 18	Scale 1:15,840		

Cover Type				Density			
A = Aspen	H = Hemlock	N = Marsh	U = Upland Brush	0 = Non Stocked	5 = Pole Timber Medium		
D = Paper Birch	J = Jack Pine	O = Oak	UM = Upland Mixed	1 = Seedling Sapling Poor	6 = Pole Timber Well		
C = Cedar	L = Lowland Brush	P = Lowland Poplar	V = Bog or Marsh	2 = Seedling Sapling Medium	7 = Saw Timber Poor		
D = Treed Bog	LM = Lowland Mixed	Q = Mixed Swamo Conifer	W = White Pine	3 = Seedling Sapling Well	8 = Saw Timber Medium		
E = Swamp Hdwoods	M = Mpl. Och, Dorch	R = Red Pine	X = Non Stocked	4 = Pole Timber Poor	9 = Saw Timber Well		
F = Spruce Fir	MC = Mixed Conifer	S = Black Spruce	Z = Water				
G = Grass	MD = Mixed Deciduous	T = Tamarack					

PU	Acres
1	8.9
2	24
3	7.5

Behind the Gate
Compartment 090
40.4 Acres

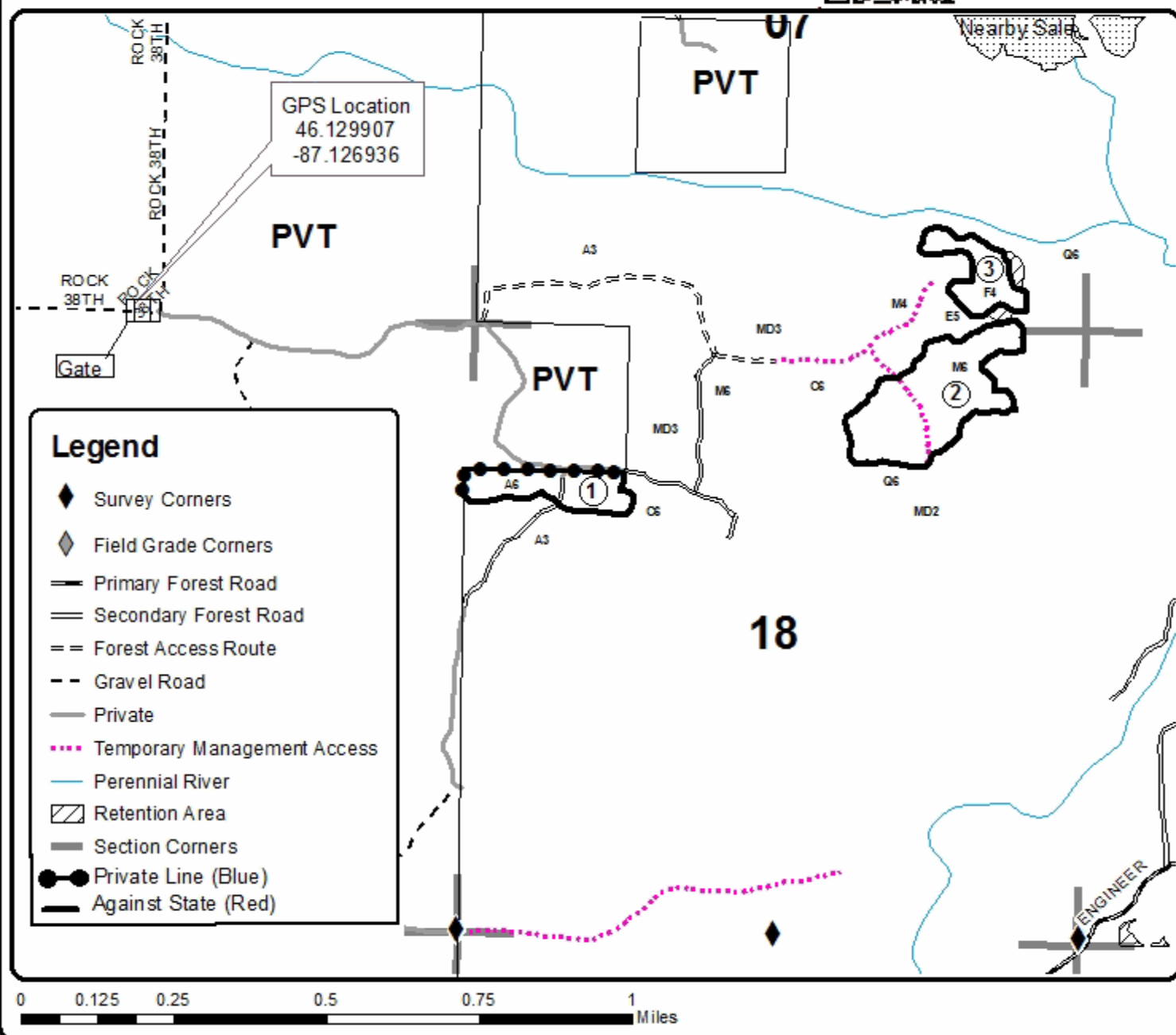

TIMBER SALE INFORMATION

South of Days (33-008-20)

T41N, R22W, SEC. 22; T41N, R22W, SEC. 26; T41N, R22W, SEC. 27; T41N, R22W, SEC. 34.
Delta County (Advertised Price \$105,507.20)

SALE NOTE: Several Payment Units require a two week notice to the sale administrator before beginning operations, due to impacts on recreational trails. See sale spec 5.2.3.1 for more information.

A recreation site such as a trail, pathway, or campground is within the sale area or the vicinity. Certain restrictions/specifications may be applicable including time restrictions.

A timber sale contract for this lump sum, sealed bid timber sale will be awarded to the responsible bidder offering the highest sealed bid price. All units of volume listed below were estimated using the T-Sale computer program and our traditional volume equations. Bids must be at or above the following advertised price for each product and species:

<u>PRODUCTS & SPECIES</u>	<u>ESTIMATED UNITS*</u>	<u>ADVERTISED PRICE</u>
Sawtimber		
Paper Birch	3.5 MBF	\$ 60.00 / MBF
Red Maple	2.8 MBF	\$ 96.00 / MBF
Sugar Maple	12.9 MBF	\$ 163.00 / MBF
Yellow Birch	3.4 MBF	\$ 59.00 / MBF
Pulpwood		
Balsam Fir	114 Cords	\$ 13.10 / Cord
Jack Pine	2 Cords	\$ 31.65 / Cord
Mixed Aspen	301 Cords	\$ 17.15 / Cord
Mixed Hardwood	446 Cords	\$ 20.15 / Cord
Mixed Spruce	247 Cords	\$ 15.55 / Cord
N. White Cedar	74 Cords	\$ 10.95 / Cord
Paper Birch	71 Cords	\$ 13.90 / Cord
Red Pine	1,663 Cords	\$ 43.55 / Cord
Tamarack	157 Cords	\$ 9.70 / Cord
White Pine	431 Cords	\$ 17.25 / Cord

* The estimated units are final and not subject to adjustment. Prospective bidders are urged to examine this timber and to make their own estimates of quantity and quality.

BOND AND PAYMENT SCHEDULE:

1. A bond in the amount of \$5,275.00 to insure faithful performance of the conditions of the contract will be deposited by the successful bidder within 21 days of the sale award.
2. Cutting in any sale or unit without the required advance payment would be considered a trespass.
3. Total payment must be paid in advance or according to the following schedule :
 - (a) Ten percent (10%) of the sale value must be paid within 21 days of the sale award.
 - (b) The 10% down payment will be credited towards the first unit cut.

(c) Payment for each of the following units must be made before cutting begins in that unit:

PAYMENT UNIT NUMBER	PERCENT OF TOTAL SALE VALUE
01	4.7%
02	1.9%
03	5.3%
04	15.8%
05	4.1%
06	14.0%
07	3.2%
08	1.1%
09	8.6%
10	4.0%
11	6.3%
12	7.9%
13	6.1%
14	7.2%
15	1.2%
16	2.3%
17	3.2%
18	3.1%

4. If no cutting takes place, the 10% down payment will not be refunded.

5. Operations on the contract issued will terminate on 12/31/2023.

SALE STATISTICS

SALE VOLUMES

VOLUME		STATISTICAL RANGE IN CORDS		
TOTAL CUBIC FEET	TOTAL CORDS	PERCENT ERROR	MINIMUM	MAXIMUM
280,081	3,545	0.00%	3,545	3,545

VDU VOLUMES

A VDU is a Volume Determination Unit. Volumes and their associated statistics are calculated at the VDU level and summarized to the sale level. There is often a one to one relationship between a VDU and a Payment Unit, but not always, depending on the cruise design. Refer to the VDU TO PAYMENT UNIT table.

VDU	VOLUME		PERCENT ERROR	RANGE IN CORDS	
	TOTAL CUBIC FEET	TOTAL CORDS		MINIMUM	MAXIMUM
11	22,191	281	27.04%	205	357
18	38,860	492	25.15%	368	616
30	13,043	165	21.27%	130	200
32	4,282	54	28.98%	38	70
33	8,951	113	11.85%	100	127
42	12,000	152	27.49%	110	194
63	37,809	479	13.40%	414	543
76	20,256	256	23.43%	196	316
81	8,485	107	27.72%	78	137
83	12,419	157	20.97%	124	190
92	32,303	409	19.62%	329	489
94	6,518	83	8.32%	76	89
109	2,481	31	77.09%	7	56
120	6,383	81	18.45%	66	96
123	5,309	67	63.45%	25	110
127	7,639	97	42.64%	55	138
135	32,216	408	18.73%	331	484
137	8,959	113	33.98%	75	152
TOTAL:	280,102	3,546		2,728	4,363

VDU TO PAYMENT UNIT

When a VDU is associated with more than one Payment Unit (PU), the VDU volumes are assigned to the PU based on acres of the VDU within the PU.

VDU	VDU ACRES	PU	PU ACRES
11	8.4	3	8.4
18	14.7	14	14.7
30	14.0	1	14.0
32	2.6	2	2.6
33	2.2	18	2.2
42	25.2	13	25.2
63	26.8	4	26.8
76	41.5	9	41.5
81	12.7	5	12.7
83	15.4	11	15.4
92	38.1	12	38.1
94	4.2	16	4.2
109	3.7	8	3.7
120	3.2	17	3.2
123	2.9	15	2.9
127	13.5	7	13.5
135	38.8	6	38.8
137	13.6	10	13.6
TOTAL:	281.5		281.5

DESCRIPTION OF TIMBER BY PAYMENT UNIT (PU)

PU	MARKET GROUP	PRODUCT	QUANTITY	UNIT	ACRES	ADVERTISE PRICE
1	Sugar Maple	Sawtimber	12.9	MBF	14.0	\$4,927.75
	Yellow Birch		3.4	MBF		
	Balsam Fir	Pulpwood	7	Cords		
	Mixed Hardwood		122	Cords		
	<i>Beech</i>		21	<i>Cords</i>		
	<i>Black Cherry</i>		2	<i>Cords</i>		
	<i>Sugar Maple</i>		87	<i>Cords</i>		
	<i>Yellow Birch</i>		12	<i>Cords</i>		
	Mixed Spruce		3	Cords		
	<i>White Spruce</i>		3	<i>Cords</i>		
	Paper Birch		2	Cords		
2	Balsam Fir	Pulpwood	2	Cords	2.6	\$2,050.85
	Mixed Hardwood		2	Cords		
	<i>Red Maple</i>		2	<i>Cords</i>		
	Red Pine		42	Cords		
	White Pine		9	Cords		
3	Balsam Fir	Pulpwood	65	Cords	8.4	\$5,576.90
	Mixed Hardwood		35	Cords		
	<i>Black Cherry</i>		3	<i>Cords</i>		
	<i>Red Maple</i>		32	<i>Cords</i>		
	Mixed Spruce		13	Cords		
	<i>Black Spruce</i>		13	<i>Cords</i>		
	Paper Birch		21	Cords		
	Red Pine		37	Cords		
	White Pine		111	Cords		
4	Red Maple	Sawtimber	0.5	MBF	26.8	\$16,616.30
	Balsam Fir	Pulpwood	4	Cords		
	Mixed Aspen		39	Cords		
	<i>B. T. Aspen</i>		31	<i>Cords</i>		
	<i>Quaking Aspen</i>		8	<i>Cords</i>		
	Mixed Hardwood		39	Cords		
	<i>Red Maple</i>		39	<i>Cords</i>		
	Mixed Spruce		1	Cords		
	<i>White Spruce</i>		1	<i>Cords</i>		
	Red Pine		313	Cords		
	White Pine		82	Cords		
5	Balsam Fir	Pulpwood	2	Cords	12.7	\$4,353.20
	Red Pine		95	Cords		
	White Pine		11	Cords		
6	Balsam Fir	Pulpwood	7	Cords	38.8	\$14,810.45
	Jack Pine		2	Cords		
	Mixed Aspen		5	Cords		
	<i>B. T. Aspen</i>		5	<i>Cords</i>		
	Mixed Hardwood		36	Cords		
	<i>Red Maple</i>		36	<i>Cords</i>		
	Mixed Spruce		10	Cords		
	<i>Black Spruce</i>		9	<i>Cords</i>		
	<i>White Spruce</i>		1	<i>Cords</i>		
	Paper Birch		6	Cords		
	Red Pine		293	Cords		
White Pine		49	Cords			
7	Mixed Spruce	Pulpwood	11	Cords	13.5	\$3,364.05
	<i>White Spruce</i>		11	<i>Cords</i>		
	Red Pine		65	Cords		
	White Pine		21	Cords		

DESCRIPTION OF TIMBER BY PAYMENT UNIT (PU), CON'T

PU	MARKET GROUP	PRODUCT	QUANTITY	UNIT	ACRES	ADVERTISE PRICE
8	Mixed Hardwood	Pulpwood	1	Cords	3.7	\$1,195.15
	<i>Red Maple</i>		1	<i>Cords</i>		
	Red Pine		25	Cords		
	White Pine		5	Cords		
9	Balsam Fir	Pulpwood	14	Cords	41.5	\$9,105.10
	Mixed Hardwood		11	Cords		
	<i>Red Maple</i>		11	<i>Cords</i>		
	Mixed Spruce		11	Cords		
	<i>Black Spruce</i>		2	<i>Cords</i>		
	<i>White Spruce</i>		9	<i>Cords</i>		
	Red Pine		180	Cords		
	White Pine		40	Cords		
10	Mixed Hardwood	Pulpwood	6	Cords	13.6	\$4,202.15
	<i>Red Maple</i>		6	<i>Cords</i>		
	Red Pine		85	Cords		
	White Pine		22	Cords		
11	Mixed Aspen	Pulpwood	3	Cords	15.4	\$6,617.75
	<i>B. T. Aspen</i>		3	<i>Cords</i>		
	Mixed Hardwood		6	Cords		
	<i>Red Maple</i>		6	<i>Cords</i>		
12	Paper Birch	Sawtimber	3.5	MBF	38.1	\$8,326.05
	Red Maple		2.3	MBF		
	Balsam Fir	Pulpwood	13	Cords		
	Mixed Aspen		134	Cords		
	<i>B. T. Aspen</i>		134	<i>Cords</i>		
	Mixed Hardwood		165	Cords		
	<i>Black Cherry</i>		2	<i>Cords</i>		
	<i>Red Maple</i>		163	<i>Cords</i>		
	Mixed Spruce		2	Cords		
	<i>White Spruce</i>		2	<i>Cords</i>		
	Paper Birch		42	Cords		
	Red Pine		29	Cords		
White Pine	13	Cords				
13	Mixed Hardwood	Pulpwood	3	Cords	25.2	\$6,487.75
	<i>Red Maple</i>		3	<i>Cords</i>		
	Red Pine		146	Cords		
	White Pine		4	Cords		
14	Mixed Spruce	Pulpwood	191	Cords	14.7	\$7,589.05
	<i>Black Spruce</i>		191	<i>Cords</i>		
	N. White Cedar		74	Cords		
	Red Pine		41	Cords		
	Tamarack		157	Cords		
	White Pine		29	Cords		
15	Mixed Aspen	Pulpwood	35	Cords	2.9	\$1,242.95
	<i>B. T. Aspen</i>		27	<i>Cords</i>		
	<i>Quaking Aspen</i>		8	<i>Cords</i>		
	Mixed Hardwood		7	Cords		
	<i>Red Maple</i>		7	<i>Cords</i>		
	Mixed Spruce		5	Cords		
	<i>Black Spruce</i>		5	<i>Cords</i>		
	Red Pine		3	Cords		
White Pine	17	Cords				
16	Mixed Aspen	Pulpwood	38	Cords	4.2	\$2,418.80
	<i>B. T. Aspen</i>		38	<i>Cords</i>		

DESCRIPTION OF TIMBER BY PAYMENT UNIT (PU), CON'T

PU	MARKET GROUP	PRODUCT	QUANTITY	UNIT	ACRES	ADVERTISE PRICE
16 con't	Mixed Hardwood	Pulpwood	3	Cords		
	<i>Red Maple</i>		3	<i>Cords</i>		
	Red Pine		38	Cords		
	White Pine		3	Cords		
17	Red Pine	Pulpwood	75	Cords	3.2	\$3,369.75
	White Pine		6	Cords		
18	Mixed Aspen	Pulpwood	47	Cords	2.2	\$3,253.20
	<i>B. T. Aspen</i>		47	<i>Cords</i>		
	Mixed Hardwood		10	Cords		
	<i>Red Maple</i>		10	<i>Cords</i>		
	Red Pine		48	Cords		
	White Pine		9	Cords		
TOTAL:			22.6	MBF		
TOTAL:			3,506	Cords		

Sale Specific Conditions & Requirements

Sale Name: South of Days

Sale Number: 33-008-20 Seq#: 1

1 - Sale Area

1.2 - Boundaries

1.2.1 - Painted boundaries (9/19)

The sale boundary and Payment Unit boundaries are marked and identified by blue, red and yellow paint. Exterior sale boundary lines against private property are marked with blue paint. Exterior sale boundary lines against state are marked with red paint. Interior Payment Unit boundaries are marked with yellow paint. Retention patches are marked with red paint; no harvesting activities may occur within these areas. The painted boundary line trees are not Included Timber and are to be protected unless marked with orange paint. Yellow painted trees designating an interior Payment Unit boundary are only to be cut when all surrounding Payment Units have been paid.

2 - Timber Specifications

2.1 - Included Timber

2.1.1 - Clearcut unit(s) with unmerchantable trees (6/14)

Within Payment Unit(s) 15, 16 and 18, cut all trees that are two (2) inches or more at DBH.

Within Payment Unit(s) 12, all pine trees are designated for cutting when marked with orange paint. In addition, cut all trees that are two (2) inches or more at DBH, except do not cut unmarked pine.

Within Payment Unit(s) 14, cut all trees that are two (2) inches or more at DBH, except do not cut the small groups of retention marked with red paint.

2.1.3 - Cut tree marked unit(s) (12/08)

Within Payment Unit(s) 1, 2, 6, 7, 9, 10, 11 and 13, all trees are designated for cutting when marked with orange paint above and below stump height, regardless of merchantability.

2.1.7 - Leave tree marked unit(s) (6/14)

Within Payment Unit(s) 3, 4 and 17, all trees which meet minimum piece specifications in 2.2 Utilization are designated for cutting, except do not cut trees marked with green paint above and below stump height.

2.1.8 - Designated plantation row unit(s) (12/08)

Within Payment Unit(s) 5 and 8, all trees which meet minimum piece specifications in 2.2 Utilization, within designated plantation rows are designated for cutting. Designated plantation rows are identified by orange paint. Contact the sale administrator with any questions regarding the marking of plantation rows.

2.2 - Utilization

2.2.3 - Stump heights (4/07)

Stump heights within Payment Unit 4 shall not exceed 6 inches for all trees. In addition, Payment Units 6, 11 and 13 have scattered areas (.25 to .5 acres in size) which are marked to be canopy gaps in the stand. Stump heights shall not exceed 6 inches for all trees within these openings. Contact the sale administrator for direction on the locations of the openings. This is in order to facilitate scarification operations. A written waiver of this requirement may be obtained if wet summer weather makes winter logging necessary.

3 - Payments

3.3 - Pre-measured Sales

3.3.4 - Dividing payment units (7/14)

Payment Unit(s) with a purchase value of \$18,000 or more may be divided at the request of the Purchaser and upon approval of the Unit Manager. Dividing Payment Units is a contract modification which requires a Timber Sale Contract Amendment. There will be only one division per Payment Unit.

3.4 - Damaged Timber

3.4.1 - Damaged timber (7/16)

General Condition and Requirement 3.4 Damaged Timber, defines liquidated damages for undesignated live merchantable trees which are cut or injured. In addition, extreme care should be taken to avoid damage to tree seedlings and saplings.

Within the sale area, if more than 40% of the tree seedlings or saplings (1/4" to 4.5" DBH) within a specified portion of the sale area are damaged, liquidated damages will be assessed at \$100 per acre for all acreage within that specified portion of the sale area that was damaged.

4 - Transportation

4.1 - Construction

4.1.6 - Road construction (1/09)

Construction of new roads or improvements of existing roads shall be done in such a way as to minimize the environmental and visual impacts. Merchantable trees shall be cut and utilized unless otherwise directed. Non-merchantable trees shall be severed and laid flat on the ground. Slash shall be scattered, and not left in windrows and kept a minimum of 10 feet back from the road edge. Stumps shall be set upright, not left on edge, and be moved at least 10 feet away from the road edge. Disturbed soil shall be feathered into the woods and not left in berms or windrows.

4.1.7 - Road closure (10/11)

All new roads built into the sale must be blocked to vehicle traffic upon completion of the sale. In general, this will require constructing a four (4') foot high berm of stumps and logs covered with earth. These roads must be rendered impassible to cars and trucks. Temporary berms may be required if no sale activity occurs for 30 or more consecutive days. Contact the sale administrator for specific details of design and placement.

5 - Operations

5.2 - Conduct of Operations

5.2.1 - Slash

5.2.1.2 - Slash Removal

5.2.1.2.6 - Slash removal, general (7/05)

All slash must be removed from Payment Unit 4. This is required because of a post harvest scarification treatment.

5.2.1.8 - Slash height (12/08)

No slash or tree tops may exceed 24 inches in height.

5.2.2 - Hazard Trees/Snags

5.2.2.1 - Den trees (10/16)

Obvious hollow and/or den trees shall be protected and left standing unless they are a safety hazard.

5.2.3 - Operating Restrictions

5.2.3.1 - Operating restrictions (9/11)

Within Payment Unit(s) 14, 15 and 16, unless changed by written agreement, cutting, skidding, and hauling are limited to the period of December 1 to March 31, or during frozen ground conditions. This restriction is due to low wet ground within the unit.

The Purchaser is required to inform the sale administrator of their intent to open Payment Units 14, 15 and 16 at least two weeks prior to operations. This is because the surrounding ski trail (Days River Pathway loops 4 and 5) must be closed during harvesting operations.

5.2.3.3 - Bark slippage restriction (3/09)

Within Payment Unit(s) 1, 2, 5-13, and 17, unless changed by written agreement, cutting and skidding are not permitted during the period of April 15 to July 15. This restriction is because of bark slippage.

5.2.3.6 - Bark beetle restriction (12/08)

In the event drought creates a high risk of pine bark beetle infestation, pine is not to be cut during the period March 1

through July 1, unless all portions of trees greater than two inches in diameter are removed from the sale area, reduced to chips, or treated to the satisfaction of the Unit Manager or his/her representative, within fifteen days of being severed from the stump. Pine log decks, pulpwood piles and treetops that are piled for chipping in the fall or winter within a 1/4 mile of susceptible sites must be removed before March 15. Residual slash must not be placed in piles or rows and must be spread over the site for quick drying. The Department of Natural Resources will exercise this specification if the risk of damage warrants.

5.2.38 - No decking against live trees (2/04)

Cut products may not be decked against unmarked or designated leave trees.

5.2.39 - ORV trail/route protection (4/18)

An ORV trail runs through the sale and is shown on the Timber Sale Map. Do not cut trees or damage posts with yellow ORV markers. Maintain a 20 foot wide slash, debris, and rut free zone daily using the ORV trail or route as the centerline.

5.2.40 - Pathway protection (10/10)

The Days River Pathway is a bike, hiking, ski trail and is shown on the Timber Sale Map, and is buffered on either side where the sale boundaries occur. Do not run equipment down the pathway. Skidding or hauling across the trail may only occur in locations approved by the sale administrator.

5.4 - Soil Protection

5.4.1 - Rutting restriction, general (7/16)

Operations are to cease immediately if equipment and weather conditions result in rutting of roads and/or skid trails which is 12 inches or greater in depth and 50 feet in length. The Unit Manager or his/her representative may restrict hauling and/or skidding if ruts exceed the specified depth. With the Unit Manager or his/her representative's approval, the Purchaser may return to the area when the risk of rutting has decreased.

6 - Safety and Fire Prevention

6.2 - Signing

6.2.3 - Recreational trail posting (2/10)

The Purchaser is responsible for posting and maintaining caution signs on the recreational trails prior to beginning operations. The trail must be posted at appropriate distances from the sale area to warn of logging activity and truck traffic at both ends of the trail. Signs must be removed when harvest operations are suspended or completed. The Purchaser will provide these signs.



TIMBER SALE MAP

This information provided by authority of Part 525, 1994 PA 451, as amended.

Sale Number	Year
33 - 008	20

Forest Management Unit Escanaba	County Delta	Mapped By Urlich	Date 09/03/2020	Page 1	of 1
Township 41N	Range 22W	Section(s) and Subdivision(s) S1/2SW,SW,SE Sec22 W1/2NW,W1/2SW Sec26 NE,S1/2SW,SE Sec27 NWNW Sec34	Scale 1:15,840		

Cover Type				Density	
A = Aspen	H = Hemlock	N = Marsh	U = Upland Brush	0 = Non Stocked	5 = Pole Timber Medium
B = Paper Birch	J = Jack Pine	O = Oak	UM = Upland Mixed	1 = Seedling Sapling Poor	6 = Pole Timber Well
C = Cedar	L = Lowland Brush	P = Lowland Poplar	V = Bog or Marsh	2 = Seedling Sapling Medium	7 = Saw Timber Poor
D = Tread Bog	LM = Lowland Mixed	Q = Mixed Swamp Conifer	W = White Pine	3 = Seedling Sapling Well	8 = Saw Timber Medium
E = Swamp Hardwoods	M = Mpl. Ech. Birch	R = Red Pine	X = Non Stocked	4 = Pole Timber Poor	9 = Saw Timber Well
F = Spruce Fir	MC = Mixed Conifer	S = Black Spruce	Z = Water		
G = Creas	MD = Mixed Deciduous	T = Tamarack			

South of Days Compartment 106 281.5 Acres

PU	Acres	PU	Acres	PU	Acres	PU	Acres
1	14	6	38.8	11	15.4	16	4.2
2	2.6	7	13.5	12	38.1	17	3.2
3	8.4	8	3.7	13	25.2	18	2.2
4	26.8	9	41.5	14	14.7		
5	12.7	10	13.6	15	2.9		

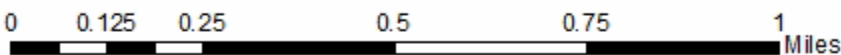
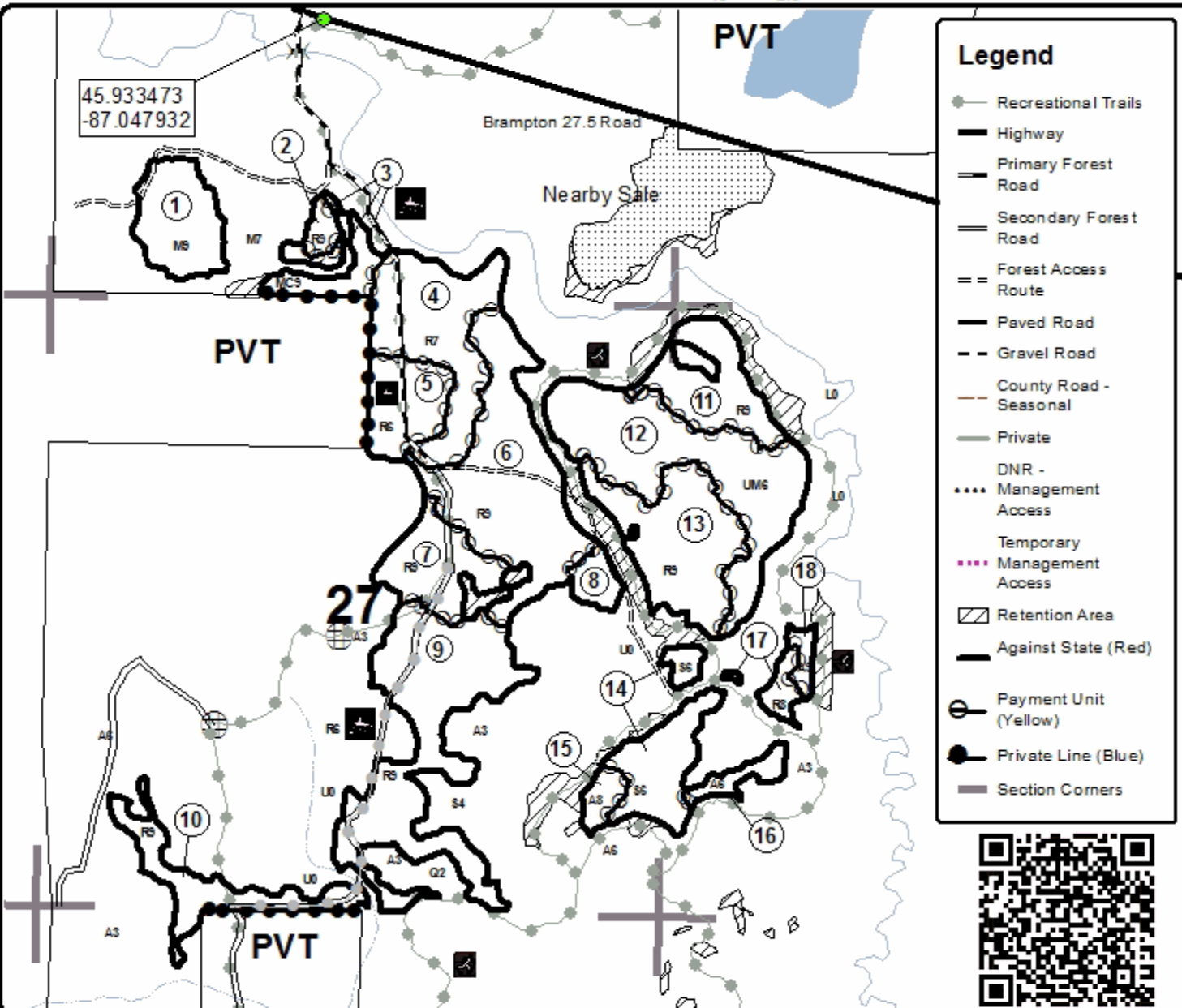

South Deadhorse Split (33-006-20)

T43N, R22W, SEC. 17; T43N, R22W, SEC. 5; T43N, R22W, SEC. 6; T43N, R22W,

In response to the notice of sale to be held 3:00 p.m. (local time) on December 16, 2020, I am hereby submitting my sealed bid (firm offer) for the following forest products to be cut. Bids for individual species must be at or above the advertised price. All non-responsive bid forms may be rejected.

<u>PRODUCTS & SPECIES</u>	<u>ESTIMATED VOLUME*</u>	<u>ADVERTISED PRICE</u>	<u>BID PRICE/UNIT</u>
Sawtimber			
Basswood	7.3 MBF	\$ 72.00/MBF	\$ _____
Black Ash	6.3 MBF	\$ 41.00/MBF	\$ _____
Paper Birch	2.3 MBF	\$ 60.00/MBF	\$ _____
Red Maple	215.3 MBF	\$ 96.00/MBF	\$ _____
Sugar Maple	98.6 MBF	\$ 163.00/MBF	\$ _____
Yellow Birch	15.8 MBF	\$ 59.00/MBF	\$ _____
Pulpwood			
Balsam Fir	587 Cords	\$ 13.10/Cord	\$ _____
Mixed Aspen	1,494 Cords	\$ 17.15/Cord	\$ _____
Mixed Hardwood	3,693 Cords	\$ 20.15/Cord	\$ _____
Mixed Spruce	159 Cords	\$ 15.55/Cord	\$ _____
Tamarack	7 Cords	\$ 9.70/Cord	\$ _____

*These estimated volumes are final and not subject to adjustment. Prospective bidders are urged to examine this timber and to make their own estimates of quantity and quality.

I understand that any or all bids may be rejected. All bids must be signed and all bid items must be bid or the bid form may be rejected. I also understand that consideration and awarding a contract will be based upon my past performance and ability to complete the contract based upon equipment and staffing subject to my control.

FEDERAL ID: _____ or SOCIAL SECURITY NUMBER: _____

Company or individual bidding: _____

Company representative's name: _____

Address: _____

City: _____ State: _____ Zip: _____

IF AVAILABLE, PLEASE PLACE THE PERSONALIZED LABEL FROM YOUR PROSPECTUS IN THE ABOVE BOX.

Individual or company representative's signature: _____ Date: _____

Phone number : _____ Email (optional): _____

THE WINNING BIDDER MUST COMPLETE THE VERIFICATION OF WORKER'S DISABILITY COMPENSATION ACT COMPLIANCE (ON REVERSE SIDE IF DOUBLE SIDED) WITHIN 21 DAYS OF SALE AWARD DATE



FOR DEPARTMENT USE ONLY	
Sale Number (XX - XXX - XX - XX)	
Forest Management Unit:	

TIMBER SALE VERIFICATION OF WORKER'S DISABILITY COMPENSATION ACT COMPLIANCE

As required by Act 317, P.A. 1969 (Worker's Compensation) and
Part 5 of Act 451 of 1994, as amended.

VERIFICATION OF WORKER'S DISABILITY COMPENSATION ACT COMPLIANCE

- This verification must be completed and submitted within 21 days of contract award and prior to the issuance of the timber sale contract.
- In addition, if boxes 2B or 2C are checked, then Notice of Exclusion or Certificate of Insurance must be submitted within twenty-one (21) days of the contract award and prior to the issuance of the timber sale contract.
- All information must be typed or printed except for written signatures.

Please Check Appropriate Categories:

1. My business is organized as (you **must** check one of the boxes below):
 - A. Sole Proprietorship (individual)
 - B. Partnership
 - C. Corporation
2. You **must** check one of the boxes below:
 - A. I certify my business is a sole proprietorship and it has no employees but the sole proprietor. I am not subject to the Worker's Compensation Laws.
 - B. I certify my business has satisfied its obligation to the Worker's Compensation Act through the use of an approved Notice of Exclusion (BWC-337, Rev. 5/96). I will provide a copy of the Notice of Exclusion within 21 days of the contract award. (For questions or a copy of the BWC-337, please call the Worker's Compensation Bureau at 517-322-1195).
 - C. I certify my business has a Worker's Compensation Policy. I will provide an original Certificate of Insurance within twenty-one (21) days of the contract award.
3. If you have checked item 2(A) or 2(B), you **must** indicate the number of **both** full-time and part-time employees, other than yourself, including family members and active partners (if none, you must enter "0").

_____ Full-time Employees

_____ Part-time Employees

Name of Business		Federal ID (or) Social Security No.	
Address		Telephone ()	
City	State	ZIP	

I hereby certify that the above information is true and correct. I agree to notify the Michigan DNR of any changes that occur in factors affecting my coverage during any of my present and future operations.

Signature of Owner or Authorized Representative

Title

Date

Please complete the "SEALED BID" information on the next page

Behind the Gate (33-007-20)
T43N, R22W, SEC. 18; T43N, R22W, SEC. 7; Delta COUNTY

In response to the notice of sale to be held 3:00 p.m. (local time) on December 16, 2020, I am hereby submitting my sealed bid (firm offer) for the following forest products to be cut. Bids for individual species must be at or above the advertised price. All non-responsive bid forms may be rejected.

<u>PRODUCTS & SPECIES</u>	<u>ESTIMATED VOLUME*</u>	<u>ADVERTISED PRICE</u>	<u>BID PRICE/UNIT</u>
Sawtimber			
Basswood	2.5 MBF	\$ 59.00/MBF	\$ _____
Black Ash	0.9 MBF	\$ 33.00/MBF	\$ _____
Red Maple	50.0 MBF	\$ 78.00/MBF	\$ _____
Sugar Maple	11.4 MBF	\$ 133.00/MBF	\$ _____
Yellow Birch	0.9 MBF	\$ 48.00/MBF	\$ _____
Pulpwood			
Balsam Fir	57 Cords	\$ 10.70/Cord	\$ _____
Mixed Hardwood	325 Cords	\$ 16.50/Cord	\$ _____
Quaking Aspen	151 Cords	\$ 14.05/Cord	\$ _____
White Spruce	32 Cords	\$ 12.70/Cord	\$ _____

*These estimated volumes are final and not subject to adjustment. Prospective bidders are urged to examine this timber and to make their own estimates of quantity and quality.

I understand that any or all bids may be rejected. All bids must be signed and all bid items must be bid or the bid form may be rejected. I also understand that consideration and awarding a contract will be based upon my past performance and ability to complete the contract based upon equipment and staffing subject to my control.

FEDERAL ID: ____ - ____ - ____ or SOCIAL SECURITY NUMBER: ____ - ____ - ____

Company or individual bidding: _____

Company representative's name: _____

Address: _____

City: _____ State: _____ Zip: _____

IF AVAILABLE, PLEASE PLACE THE PERSONALIZED LABEL FROM YOUR PROSPECTUS IN THE ABOVE BOX.

Individual or company representative's signature: _____ Date: _____

Phone number : _____ Email (optional): _____

THE WINNING BIDDER MUST COMPLETE THE VERIFICATION OF WORKER'S DISABILITY COMPENSATION ACT COMPLIANCE (ON REVERSE SIDE IF DOUBLE SIDED) WITHIN 21 DAYS OF SALE AWARD DATE

South of Days (33-008-20)
T41N, R22W, SEC. 22; T41N, R22W, SEC. 26; T41N, R22W, SEC. 27; T41N,

In response to the notice of sale to be held 3:00 p.m. (local time) on December 16, 2020, I am hereby submitting my sealed bid (firm offer) for the following forest products to be cut. Bids for individual species must be at or above the advertised price. All non-responsive bid forms may be rejected.

<u>PRODUCTS & SPECIES</u>	<u>ESTIMATED VOLUME*</u>	<u>ADVERTISED PRICE</u>	<u>BID PRICE/UNIT</u>
Sawtimber			
Paper Birch	3.5 MBF	\$ 60.00/MBF	\$ _____
Red Maple	2.8 MBF	\$ 96.00/MBF	\$ _____
Sugar Maple	12.9 MBF	\$ 163.00/MBF	\$ _____
Yellow Birch	3.4 MBF	\$ 59.00/MBF	\$ _____
Pulpwood			
Balsam Fir	114 Cords	\$ 13.10/Cord	\$ _____
Jack Pine	2 Cords	\$ 31.65/Cord	\$ _____
Mixed Aspen	301 Cords	\$ 17.15/Cord	\$ _____
Mixed Hardwood	446 Cords	\$ 20.15/Cord	\$ _____
Mixed Spruce	247 Cords	\$ 15.55/Cord	\$ _____
N. White Cedar	74 Cords	\$ 10.95/Cord	\$ _____
Paper Birch	71 Cords	\$ 13.90/Cord	\$ _____
Red Pine	1,663 Cords	\$ 43.55/Cord	\$ _____
Tamarack	157 Cords	\$ 9.70/Cord	\$ _____
White Pine	431 Cords	\$ 17.25/Cord	\$ _____

*These estimated volumes are final and not subject to adjustment. Prospective bidders are urged to examine this timber and to make their own estimates of quantity and quality.

I understand that any or all bids may be rejected. All bids must be signed and all bid items must be bid or the bid form may be rejected. I also understand that consideration and awarding a contract will be based upon my past performance and ability to complete the contract based upon equipment and staffing subject to my control.

FEDERAL ID: ____ - ____ - ____ or SOCIAL SECURITY NUMBER: ____ - ____ - ____

Company or individual bidding: _____

Company representative's name: _____

Address: _____

City: _____ State: _____ Zip: _____

IF AVAILABLE, PLEASE PLACE THE PERSONALIZED LABEL FROM YOUR PROSPECTUS IN THE ABOVE BOX.

Individual or company representative's signature: _____ Date: _____

Phone number : _____ Email (optional): _____

THE WINNING BIDDER MUST COMPLETE THE VERIFICATION OF WORKER'S DISABILITY COMPENSATION ACT COMPLIANCE (ON REVERSE SIDE IF DOUBLE SIDED) WITHIN 21 DAYS OF SALE AWARD DATE

