



**DEPARTMENT OF NATURAL RESOURCES  
STATE OF MICHIGAN**

**TIMBER SALE PROSPECTUS #6773**

SCHEDULED SALE DATE AND TIME: 4:00 p.m. (local time) on July 15, 2021.

LOCATION: TRAVERSE CITY MGMT UNIT, 2122 M 37 SOUTH, TRAVERSE CITY, MI 49685.

PROSPECTUS NOTE: The bidder is advised to inspect the sale area and review the location, estimated volumes, operating costs and contract terms of proposed sales. Please be aware that some landowners may request 60 days or more notice for access across their land.

Notice is hereby given that bids will be received by the Unit Manager, TRAVERSE CITY MANAGEMENT UNIT, for certain timber on the following described lands:

Old Supply Pine (61-040-20) / T26N, R09W, SEC. 3, NESE,S1/2SE.

Grand Traverse County, Advertised Price \$30,276.75, 29.4 Acres, White Pine, Red Pine.

SALE NOTE: Final harvest of mature mixed pine. Chipping of tops required.

Jack Pine Jag (61-050-20) / T26N, R09W, SEC. 10, SWSW.

T26N, R09W, SEC. 9, NESW,S1/2SW,NESE,S1/2SE.

Grand Traverse County, Advertised Price \$34,673.85, 48.2 Acres, Hardwood, Red Oak.

SALE NOTE: A recreation site such as a trail, pathway, or campground is within the sale area or the vicinity. Certain restrictions/specifications may be applicable including time restrictions.

Bracken Bad Aspen (61-059-20) / T27N, R14W, SEC. 22, SESE.

T27N, R14W, SEC. 23, SW,SWSE.

T27N, R14W, SEC. 26, NW,W1/2NE,N1/2SW.

T27N, R14W, SEC. 27, NESE.

Benzie County, Advertised Price \$31,075.00, 190.6 Acres, Hardwood, Aspen.

SALE NOTE: A recreation site such as a trail, pathway, or campground is within the sale area or the vicinity. Certain restrictions/specifications may be applicable including time restrictions.

Many Hands Hardwood (61-060-20) / T27N, R14W, SEC. 22, NENW,NE,NESW,SE.

T27N, R14W, SEC. 23, W1/2NW.

Benzie County, Advertised Price \$73,169.00, 142.6 Acres, Hardwood, White Pine.

SALE NOTE: A recreation site such as a trail, pathway, or campground is within the sale area or the vicinity. Certain restrictions/specifications may be applicable including time restrictions.

Farmer's Wife Mix (61-061-20) / T27N, R14W, SEC. 34, N1/2NE,SENE,W1/2SW.

Benzie County, Advertised Price \$31,025.25, 68.8 Acres, Hardwood, Red Pine.

## BID INSTRUCTIONS (VER. 07/02/2018):

### 1. Scheduled Bid Location, Date, and Time (2/11)

Bids must be received by the Unit Manager, TRAVERSE CITY OFFICE, 2122 M 37 South, Traverse City, MI 49685, no later than 4:00 p.m. (local time) on July 15, 2021. For further information concerning this sale, contact David Lemmien at 231-922-6040.

### 2. Bidder's Qualifications (5/16)

Purchaser shall obtain workers compensation insurance to cover claims under Michigan's Worker's Disability Compensation Act of 1969 or similar employee benefit act of any other state applicable to an employee. If all or part of a timber sale was prepared by a private contractor, the contractor and that contractor's company are not permitted to bid on the timber sale contract. Bids will not be accepted from individuals or companies appearing on the DNR/FRD No-Bid List. This list contains the names of purchasers who previously failed to execute a contract within 21-days or who have a history of poor performance.

### 3. Preparation of Sealed Bids (5/16)

Bid Forms may be completed online thru Michigan DNR Timber Sale Online Bidding (OLB) at [www.michigan.gov/timberbidding](http://www.michigan.gov/timberbidding) or by completing the hardcopy Bid Form found in the Timber Sale Prospectus. Hardcopy Bid Forms shall be manually signed in ink. Registration in OLB is considered your 'signature' for all bids submitted thru that system. Bid prices must be entered for each species and product in the Bid Price column for all material subject to bidding and all fill-in blanks must be completed. If erasures or other changes appear on the hardcopy Bid Form, each erasure or change must be initialed by the person signing the bid.

### 4. Submission of Sealed Bids (5/16)

Bid forms may be obtained from the Unit Manager or thru OLB. Bids may be submitted hardcopy or thru OLB. All hardcopy bids must be submitted on the bid form and in an envelope clearly identified as described in this section. NOTE: Only one bid form per bid envelope. Sealed bids must be submitted to the Unit office designated in the prospectus and must be submitted at or prior to the time established in the prospectus. The envelope should show on the outside (a) the sale name or number and (b) the date and time of bid opening, as shown in the prospectus. Bids received after the time specified in the sale prospectus are late bids and will be rejected.

It is possible for a bidder to submit multiple bids on a single sale. For example, a bid may be submitted hardcopy and a bid may be submitted thru OLB. Or, two bidders from the same company could both submit bids on the same sale. If this were to happen, the State would accept all bids received and award the contract accordingly. All bidding and contractual requirements would apply to all bids received.

### 5. Public Opening of Sealed Bids (7/16)

If conditions permit, the sealed bids will be publicly opened and posted at the time and place set in the prospectus.

If a bidder, present at a bid opening, has submitted bids on more than one sale, that bidder may withdraw their unopened bid envelopes or announce the withdrawal of their online bid after being declared the successful bidder on one sale.

### 6. Award of Contract (1/11)

Award of the contract will be made to the Bidder whose bid, conforming to the prospectus, is most advantageous to the State of Michigan on the basis of total value at rates bid for the estimated quantities. The State reserves the right to reject any bid or waive any minor irregularity in bids received. A written award mailed (or otherwise furnished) to the successful Bidder shall be deemed to result in a binding contract without further action by either party.

### 7. Down Payment (1/11)

The Bidder to whom award is made must make a down payment within 21 days of the sale award. The amount of the down payment will be calculated as shown in the Bond and Payment Schedule of this prospectus. Only cash may be used to meet this requirement.

### 8. Performance Security (1/11)

As guarantee of faithful performance, a cash bond, certificate of deposit, surety bond or irrevocable letter of credit (LOC) is required within 21 days of the sale award. The amount of the performance security is shown in the Bond and

Payment Schedule of this prospectus. If an LOC or surety is used, the coverage must extend for at least 6 months beyond the contract expiration.

#### 9. Timber Sale Contract (7/18)

Additional conditions and requirements common to all timber sales are listed on the timber sale contract (R4031) and are available on line at [www.michigan.gov/timber](http://www.michigan.gov/timber). Contact the Unit Manager for additional information or a sample contract. Within 21 days of the date of the award letter, the bidder must sign the contract and provide the required down payment, performance security, and verification of worker's disability compensation. The down payment and performance security shall be in accordance with the provisions of the timber sale contract, in the sums stated in this prospectus. If these actions are not taken, then the Bidder, the Bidder's corporation, and the corporation's principals may not be permitted to bid on State timber sales for a period of 3 months after the first offense, 6 months after the second offense, and 1 year after the third offense. An offense will only be counted against the Bidder for 5 years. In addition, the Bidder certifies that if awarded this contract, the Bidder will complete the timber sale contract in accordance with its terms and any modifications thereof including requirements to purchase, cut, and remove the included timber by the expiration date.

Payment Unit values in the State Forest Timber Sale Contract are calculated based on the advertised value of the Payment Unit as a percentage of the total advertised value of the contract. The advertised value of each Payment Unit is given in the Description of Timber by Payment Unit table on the Timber Sale Information page. For example, if the value of Payment Unit 1 is advertised as \$1,500 and the total Timber Sale value is advertised as \$10,000, the contract price for Payment Unit 1 will be 15% of the total bid price ( $\$1,500/\$10,000 * 100$ ).

#### 10. Disclaimer of Estimates and Bidder's Warranty of Inspection (7/16)

Before submitting this bid, the Bidder is advised and cautioned to inspect the sale area, review the requirements of the sale contract, and take other steps as may be reasonably necessary to ascertain the location, estimated volumes, construction estimates, and operating costs of the proposed sale. Failure to do so will not relieve the Bidder from responsibility for completing the contract.

The Bidder warrants that this bid is submitted solely on the basis of the Bidder's examination and inspection of the quality and quantity of the timber offered for sale and the Bidder's opinion of the value thereof and the costs of recovery. No reliance should be placed on the State of Michigan's estimates of timber quality, quantity or costs of recovery. Bidder further acknowledges that the State of Michigan: (i) expressly disclaims any warranty of fitness of timber for any purpose; (ii) offers this timber as is without any warranty of quality (merchantability) or quantity and (iii) expressly disclaims any warranty as to the quantity or quality of timber sold.

#### 11. Certification and Chain-of-Custody (10/14)

Unless otherwise indicated in the contract under section 7 – Other Conditions of the Sale Specific Conditions & Requirements, the area encompassed by this timber sale is certified to the standards of the Forest Stewardship Council (FSC) - Certificate #SCS-FM/COC-00090N and the Sustainable Forestry Initiative (SFI) - Certificate # NSF-SFIS-5Y031-SF5. Forest products from this sale may be delivered to the mill as "FSC 100% and / or SFI certified" as long as the contractor hauling the forest products is chain-of-custody (COC) certified or covered under a COC certificate from the destination mill. The purchaser is responsible for maintaining COC after leaving the sale area.

#### 12. Good Neighbor Authority (GNA) Requirements (7/16)

If the name of this timber sales contains the acronym GNA, it is authorized by the Good Neighbor Authority (GNA) and covered by various agreements between the U.S. Forest Service and the State. The timber sale occurs on federal land and the following conditions apply:

GNA contracts on US Forest Service land will not be awarded to purchasers on the Federal list of excluded parties. The System for Award Management (SAM) will be checked for active excluded parties prior to award of contract. In addition, the Bidder to whom award is made must complete an Assurance Regarding Felony Conviction or Tax Delinquent Status for Corporate Applicants (AD-3031).

#### 13. Good Neighbor Authority (GNA) Requirements, con't (9/16)

Bidder certifies, by signing this bid form, that to the best of Bidder's knowledge that the following representations are accurate and complete.

- a. That the Bidder and its principals are not presently debarred, suspended, proposed for debarment, declared ineligible, or voluntary excluded from timber sales (covered transactions) by any Federal department or agency.
- b. That the Bidder and its principals have not within a 3-year period preceding this bid been convicted of or had a civil judgment rendered against them for commission of fraud or a criminal offense in connection with obtaining , attempting to obtain, or performing a public (Federal, State, or local) transaction or contract under a public transaction; violation of Federal or State antitrust statutes or commission of embezzlement, theft, forgery, bribery, falsification or destruction of records, making false statements, or receiving stolen property.
- c. That the Bidder and its principals are not presently indicted for or otherwise criminally or civilly charged by a governmental entity (Federal, State, or local) with commission of any of the offenses enumerated in paragraph b of this certification.
- d. That the Bidder and its principals have not within a 3-year period preceding this bid had one or more public transactions (Federal, State, or local) terminated for breach or default of a timber or forest product contract.

Bidders that cannot certify this requirement, in whole or in part, shall submit an explanation with their bid.

DAN EICHINGER  
Director

**TIMBER SALE INFORMATION**

Old Supply Pine (61-040-20)

T26N, R09W, SEC. 3.

Grand Traverse County (Advertised Price \$30,276.75)

SALE NOTE: Final harvest of mature mixed pine. Chipping of tops required.

A timber sale contract for this lump sum, sealed bid timber sale will be awarded to the responsible bidder offering the highest sealed bid price. All units of volume listed below were estimated using the T-Sale computer program and our traditional volume equations. Bids must be at or above the following advertised price for each product and species:

<u>PRODUCTS &amp; SPECIES</u>	<u>ESTIMATED UNITS*</u>	<u>ADVERTISED PRICE</u>
Sawtimber		
B. T. Aspen	5.1 MBF	\$ 87.00 / MBF
Red Oak	28.7 MBF	\$ 118.00 / MBF
Red Pine	134.5 MBF	\$ 79.00 / MBF
White Oak	9.9 MBF	\$ 74.00 / MBF
White Pine	115.8 MBF	\$ 35.00 / MBF
Pulpwood		
B. T. Aspen	65 Cords	\$ 12.55 / Cord
Jack Pine	31 Cords	\$ 8.15 / Cord
Mixed Oak	149 Cords	\$ 11.20 / Cord
Red Maple	78 Cords	\$ 12.05 / Cord
Red Pine	175 Cords	\$ 27.45 / Cord
White Pine	195 Cords	\$ 13.10 / Cord

\* The total volume is statistically estimated within plus (+) or minus (-) 9.72 percent. There are an estimated 1,279 cords on this timber sale, plus or minus 124 cords at the 95% confidence level. The estimated units are final and not subject to adjustment. Prospective bidders are urged to examine this timber and to make their own estimates of quantity and quality.

**BOND AND PAYMENT SCHEDULE:**

- A bond in the amount of \$3,028.00 to insure faithful performance of the conditions of the contract will be deposited by the successful bidder within 21 days of the sale award.
- Cutting in any sale or unit without the required advance payment would be considered a trespass.
- Total payment must be paid in advance or according to the following schedule :
  - Ten percent (10%) of the sale value must be paid within 21 days of the sale award.
  - The 10% down payment will be credited towards the first unit cut.
  - Payment for each of the following units must be made before cutting begins in that unit:
 

PAYMENT UNIT NUMBER	PERCENT OF TOTAL SALE VALUE
01	35.4%
02	64.6%
- If no cutting takes place, the 10% down payment will not be refunded.
- Operations on the contract issued will terminate on 09/30/2023.

**SALE STATISTICS**

**SALE VOLUMES**

VOLUME		STATISTICAL RANGE IN CORDS		
TOTAL CUBIC FEET	TOTAL CORDS	PERCENT ERROR	MINIMUM	MAXIMUM
101,057	1,279	9.72%	1,155	1,404

**VDU VOLUMES**

A VDU is a Volume Determination Unit. Volumes and their associated statistics are calculated at the VDU level and summarized to the sale level. There is often a one to one relationship between a VDU and a Payment Unit, but not always, depending on the cruise design. Refer to the VDU TO PAYMENT UNIT table.

VDU	VOLUME		PERCENT ERROR	RANGE IN CORDS	
	TOTAL CUBIC FEET	TOTAL CORDS		MINIMUM	MAXIMUM
155	65,538	830	13.31%	719	940
176	35,518	450	12.86%	392	507
<b>TOTAL:</b>	<b>101,057</b>	<b>1,279</b>		<b>1,111</b>	<b>1,447</b>

**VDU TO PAYMENT UNIT**

When a VDU is associated with more than one Payment Unit (PU), the VDU volumes are assigned to the PU based on acres of the VDU within the PU.

VDU	VDU ACRES	PU	PU ACRES
155	18.5	2	18.5
176	10.9	1	10.9
<b>TOTAL:</b>	<b>29.4</b>		<b>29.4</b>

**DESCRIPTION OF TIMBER BY PAYMENT UNIT (PU)**

PU	MARKET GROUP	PRODUCT	QUANTITY	UNIT	ACRES	ADVERTISE PRICE	
1	Red Oak	Sawtimber	6.0	MBF	10.9	\$10,708.75	
	Red Pine		56.5	MBF			
	White Oak		3.0	MBF			
	White Pine		25.2	MBF			
	B. T. Aspen		Pulpwood	31			Cords
	Jack Pine			23			Cords
	<i>Jack Pine</i>		<i>Sawtimber</i>	1.3			<i>MBF</i>
	<i>Jack Pine</i>			20			<i>Cords</i>
	Mixed Oak		<i>Pulpwood</i>	37			Cords
	<i>Red Oak</i>			16			<i>Cords</i>
	<i>White Oak</i>			21			<i>Cords</i>
	Red Maple			22			Cords
	Red Pine			79			Cords
	White Pine		77	Cords			
	2		B. T. Aspen	Sawtimber			5.1
Red Oak		22.7	MBF				
Red Pine		78.0	MBF				
White Oak		6.9	MBF				
White Pine		90.6	MBF				
B. T. Aspen		Pulpwood	34		Cords		
Jack Pine			8		Cords		
<i>Jack Pine</i>		8	<i>Cords</i>				
Mixed Oak		<i>Pulpwood</i>	112		Cords		
<i>Red Oak</i>			66		<i>Cords</i>		
<i>White Oak</i>			46		<i>Cords</i>		
Red Maple			56		Cords		
Red Pine			96		Cords		
White Pine		118	Cords				
<b>TOTAL:</b>			294.0		MBF		
<b>TOTAL:</b>			693	Cords			

# Sale Specific Conditions & Requirements

**Sale Name: Old Supply Pine**

**Sale Number: 61-040-20 Seq#: 1**

## 1 - Sale Area

### 1.2 - Boundaries

#### 1.2.1 - Painted boundaries (9/19)

The sale boundary and Payment Unit boundaries are marked and identified by blue, red, and yellow paint. Exterior sale boundary lines against private property are marked with blue paint. Exterior sale boundary lines against state are marked with red paint. Interior Payment Unit boundaries are marked with yellow paint. The painted boundary line trees are not Included Timber and are to be protected. Yellow painted trees designating an interior Payment Unit boundary are only to be cut when all surrounding Payment Units have been paid.

## 2 - Timber Specifications

### 2.1 - Included Timber

#### 2.1.1 - Clearcut unit(s) with unmerchantable trees (6/14)

Within Payment Unit(s) 1 and 2 , cut all trees that are one (1) inch or more at DBH.

### 2.2 - Utilization

#### 2.2.2 - Chipping required (2/18)

This area must be chip harvested to facilitate subsequent planting operations. The Purchaser has the option to produce sawlogs or pulpwood bolts, but the remaining portion of the trees must be chipped and hauled. Products may be produced as roundwood and forwarded to decking areas in final product length, but the tops must be left intact and skidded to the landing for chipping to minimize the amount of residual slash. The requirement to retain approximately 1/6 to 1/3 of tree tops and limbs less than four inches in diameter does not apply (G. C. & R. 2.2). This is because slash would interfere with planting operations.

#### 2.2.3 - Stump heights (4/07)

Stump heights within the Sale Area shall not exceed 6 inches for all trees. This is to facilitate planting operations.

## 4 - Transportation

### 4.1 - Construction

#### 4.1.12 - No new roads (1/12)

No new roads will be permitted in any Payment Unit. All operations are limited to existing roads. Skid trails only will be allowed.

### 4.2 - Maintenance

#### 4.2.4 - Grading (10/16)

For completion of the sale, state forest roads must be graded. In general, this will require a road grader or bulldozer to shape up the roads after forest products have been hauled off site. This includes cleaning of drainage areas, grading, crowning, and filling with gravel, if necessary. The grading equipment to be used must be approved by the Unit Manager or his/her representative.

## 5 - Operations

### 5.1 - Notification

#### 5.1.1 - Pre-sale conference (10/16)

A pre-sale conference on site between the Purchaser and sale administrator is required prior to beginning any operations to determine landing and road locations. The Unit Manager or his/her representative must be contacted at least 3 days in advance to schedule the conference.

#### 5.1.4 - Post-sale conference (10/16)

A post-sale conference on site between the Purchaser and sale administrator is required 5 days prior to the completion of

active logging operations to determine clean-up and repair of landings, road edges, and the fulfillment of other contract specifications.

## 5.2 - Conduct of Operations

### 5.2.3 - Operating Restrictions

#### 5.2.3.5 - Oak wilt restriction (1/18)

Within Payment Unit(s) 1 and 2, unless changed by written agreement, cutting, skidding, hauling within the sale and brushing of access roads to the sale are not permitted during the period of April 15 to July 15. Operations may be allowed if specific steps are taken to prevent damaging uncut oak during the high risk period. Those steps may include completing all road brushing before April 15th and clearing a tree-length buffer along uncut oak cover before April 15th. This is necessary to reduce the spread of oak wilt. For more information, contact the Unit Manager or his/her representative.

#### 5.2.38 - No decking against live trees (2/04)

Cut products may not be decked against unmarked or designated leave trees.

## 5.4 - Soil Protection

### 5.4.1 - Rutting restriction, general (7/16)

Operations are to cease immediately if equipment and weather conditions result in rutting of roads and/or skid trails which is 12 inches or greater in depth and 50 feet in length. The Unit Manager or his/her representative may restrict hauling and/or skidding if ruts exceed the specified depth. With the Unit Manager or his/her representative's approval, the Purchaser may return to the area when the risk of rutting has decreased.

## 6 - Safety and Fire Prevention

### 6.2 - Signing

#### 6.2.1 - Road posting (9/09)

The Purchaser is responsible for posting and maintaining caution signs on Supply Road prior to beginning operations. The road must be posted at appropriate distances from the Sale Area to warn of logging activity and truck traffic. Signs must be removed when harvest operations are suspended or completed. The Purchaser will provide these signs.





Sale Number	Year
61-040	20

# TIMBER SALE MAP

This information provided by authority of Part 525, 1994 PA 451, as amended.

Forest Management Unit Traverse City	County Grand Traverse	Mapped By Ruppen	Date 09/30/2020	Page 1	of 1
Township 26N	Range 9W	Section(s) and Subdivision(s) Sec 3 NESE, S1/2SE	Scale 1:15,840		

Cover Type				Density	
A = Aspen	H = Hemlock	N = Marsh	U = Upland Brush	0 = Non Stocked	5 = Pole Timber Medium
B = Paper Birch	J = Jack Pine	O = Oak	UM = Upland Mixed	1 = Seeding Sapling Poor	6 = Pole Timber Well
C = Cedar	L = Lowland Brush	P = Lowland Poplar	V = Bog or Marsh	2 = Seeding Sapling Medium	7 = Saw Timber Poor
D = Tread Bog	LM = Lowland Mixed	Q = Mixed Swamp Conifer	W = White Pine	3 = Seeding Sapling Well	8 = Saw Timber Medium
E = Swamp Hardwoods	M = Mpl. Ech. Birch	R = Red Pine	X = Non Stocked	4 = Pole Timber Poor	9 = Saw Timber Well
F = Spruce Fir	MC = Mixed Conifer	S = Black Spruce	Z = Water		
G = Creas	MD = Mixed Deciduous	T = Tamarack			

PU	Acres
1	10.9
2	18.5

## Old Supply Pine

### Compartment 47

29.4 Acres

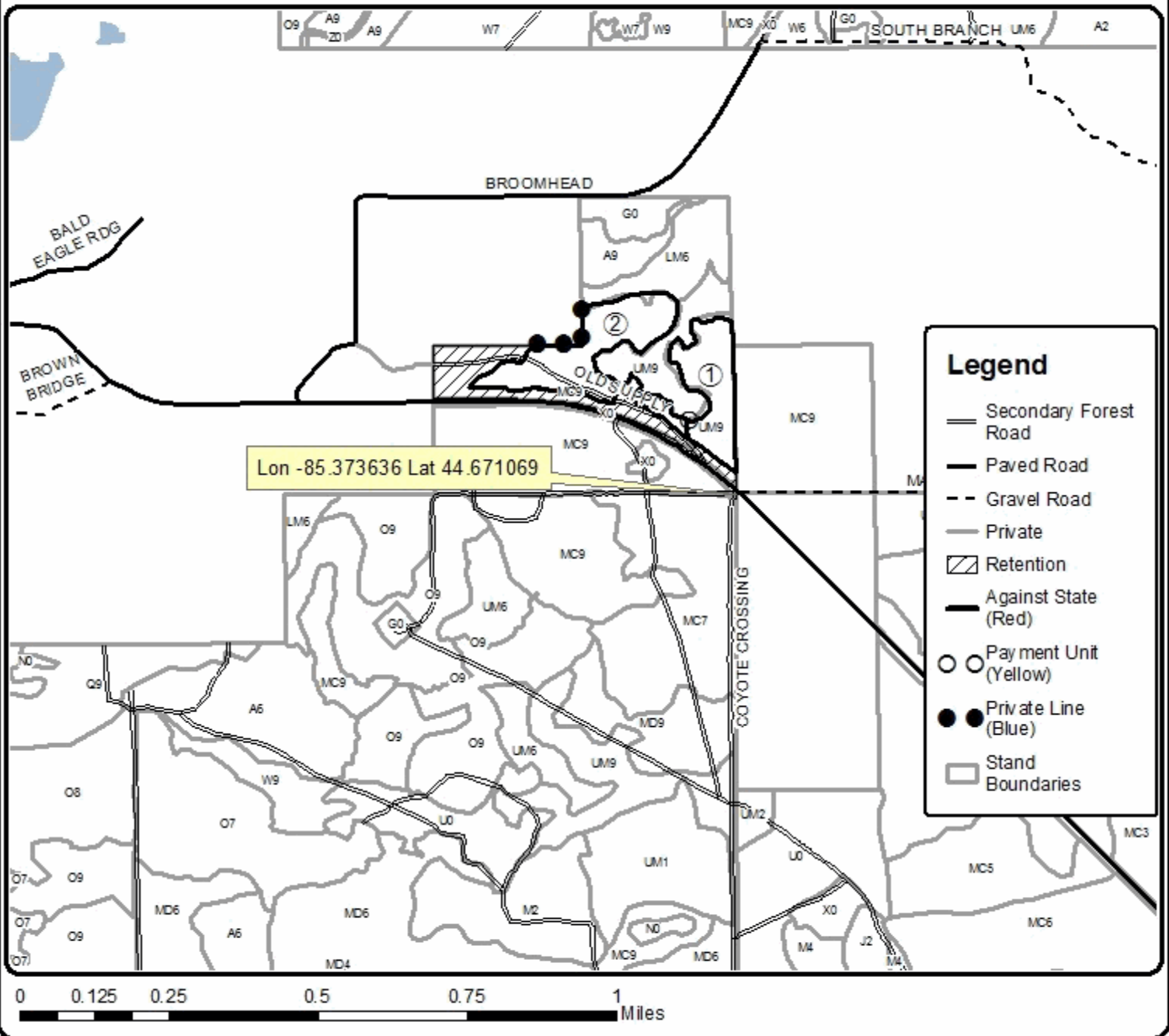



## TIMBER SALE INFORMATION

Jack Pine Jag (61-050-20)  
 T26N, R09W, SEC. 10; T26N, R09W, SEC. 9.  
 Grand Traverse County (Advertised Price \$34,673.85)

SALE NOTE: A recreation site such as a trail, pathway, or campground is within the sale area or the vicinity. Certain restrictions/specifications may be applicable including time restrictions.

A timber sale contract for this lump sum, sealed bid timber sale will be awarded to the responsible bidder offering the highest sealed bid price. All units of volume listed below were estimated using the T-Sale computer program and our traditional volume equations. Bids must be at or above the following advertised price for each product and species:

<u>PRODUCTS &amp; SPECIES</u>	<u>ESTIMATED UNITS*</u>	<u>ADVERTISED PRICE</u>
Sawtimber		
B. T. Aspen	7.1 MBF	\$ 87.00 / MBF
Red Oak	140.4 MBF	\$ 118.00 / MBF
Red Pine	18.2 MBF	\$ 79.00 / MBF
White Oak	65.0 MBF	\$ 74.00 / MBF
White Pine	36.2 MBF	\$ 35.00 / MBF
Pulpwood		
B. T. Aspen	53 Cords	\$ 12.55 / Cord
Jack Pine	7 Cords	\$ 8.15 / Cord
Mixed Oak	541 Cords	\$ 11.20 / Cord
Red Maple	117 Cords	\$ 12.05 / Cord
Red Pine	22 Cords	\$ 27.45 / Cord
White Pine	90 Cords	\$ 13.10 / Cord

\* The total volume is statistically estimated within plus (+) or minus (-) 9.95 percent. There are an estimated 1,362 cords on this timber sale, plus or minus 135 cords at the 95% confidence level. The estimated units are final and not subject to adjustment. Prospective bidders are urged to examine this timber and to make their own estimates of quantity and quality.

### **BOND AND PAYMENT SCHEDULE:**

1. A bond in the amount of \$3,467.00 to insure faithful performance of the conditions of the contract will be deposited by the successful bidder within 21 days of the sale award.
2. Cutting in any sale or unit without the required advance payment would be considered a trespass.
3. Total payment must be paid in advance or according to the following schedule :
  - (a) Ten percent (10%) of the sale value must be paid within 21 days of the sale award.
  - (b) The 10% down payment will be credited towards the first unit cut.
  - (c) Payment for each of the following units must be made before cutting begins in that unit:
 

PAYMENT UNIT NUMBER	PERCENT OF TOTAL SALE VALUE
01	46.5%
02	53.5%
4. If no cutting takes place, the 10% down payment will not be refunded.
5. Operations on the contract issued will terminate on 09/30/2023.

### **SALE STATISTICS**

#### **SALE VOLUMES**

VOLUME		STATISTICAL RANGE IN CORDS		
TOTAL CUBIC FEET	TOTAL CORDS	PERCENT ERROR	MINIMUM	MAXIMUM
107,571	1,362	9.95%	1,226	1,497

## VDU VOLUMES

A VDU is a Volume Determination Unit. Volumes and their associated statistics are calculated at the VDU level and summarized to the sale level. There is often a one to one relationship between a VDU and a Payment Unit, but not always, depending on the cruise design. Refer to the VDU TO PAYMENT UNIT table.

VDU	VOLUME		PERCENT ERROR	RANGE IN CORDS	
	TOTAL CUBIC FEET	TOTAL CORDS		MINIMUM	MAXIMUM
124	23,179	293	16.85%	244	343
128	18,407	233	28.96%	166	300
139	54,131	685	12.64%	599	772
199	11,858	150	41.30%	88	212
<b>TOTAL:</b>	<b>107,574</b>	<b>1,362</b>		<b>1,096</b>	<b>1,627</b>

## VDU TO PAYMENT UNIT

When a VDU is associated with more than one Payment Unit (PU), the VDU volumes are assigned to the PU based on acres of the VDU within the PU.

VDU	VDU ACRES	PU	PU ACRES
124	11.8	1	11.8
128	7.0	1	7.0
139	23.3	2	23.3
199	6.1	1	6.1
<b>TOTAL:</b>	<b>48.2</b>		<b>48.2</b>

## DESCRIPTION OF TIMBER BY PAYMENT UNIT (PU)

PU	MARKET GROUP	PRODUCT	QUANTITY	UNIT	ACRES	ADVERTISE PRICE				
1	B. T. Aspen	Sawtimber	3.3	MBF	24.9	\$16,110.30				
	Red Oak		53.7	MBF						
	Red Pine		13.9	MBF						
	White Oak		28.9	MBF						
	White Pine		31.7	MBF						
	B. T. Aspen	Pulpwood	24	Cords						
	Jack Pine		7	Cords						
	Mixed Oak		226	Cords						
	<i>Red Oak</i>		117	Cords						
	<i>White Oak</i>		109	Cords						
	Red Maple		61	Cords						
	Red Pine		18	Cords						
	White Pine		78	Cords						
	2		B. T. Aspen	Sawtimber			3.8	MBF	23.3	\$18,563.55
Red Oak		86.7	MBF							
Red Pine		4.3	MBF							
White Oak		36.1	MBF							
White Pine		4.5	MBF							
B. T. Aspen		Pulpwood	29	Cords						
Mixed Oak			315	Cords						
<i>Red Oak</i>			191	Cords						
<i>White Oak</i>			124	Cords						
Red Maple			56	Cords						
Red Pine			4	Cords						
White Pine			12	Cords						
TOTAL:			266.9	MBF						
TOTAL:			830	Cords						

## Sale Specific Conditions & Requirements

**Sale Name: Jack Pine Jag**

**Sale Number: 61-050-20 Seq#: 1**

### 1 - Sale Area

#### 1.2 - Boundaries

##### 1.2.1 - Painted boundaries (9/19)

The sale boundary and Payment Unit boundaries are marked and identified by blue and red paint. Exterior sale boundary lines against private property are marked with blue paint. Exterior sale boundary lines against state are marked with red paint. The painted boundary line trees are not Included Timber and are to be protected.

### 2 - Timber Specifications

#### 2.1 - Included Timber

##### 2.1.1 - Clearcut unit(s) with unmerchantable trees (6/14)

Within Payment Unit(s) 1 and 2, cut all trees that are one (1) inches or more at DBH.

#### 2.2 - Utilization

##### 2.2.2 - Chipping required (2/18)

This area must be chip harvested to facilitate subsequent planting operations. The Purchaser has the option to produce sawlogs or pulpwood bolts, but the remaining portion of the trees must be chipped and hauled. Products may be produced as roundwood and forwarded to decking areas in final product length, but the tops must be left intact and skidded to the landing for chipping to minimize the amount of residual slash. The requirement to retain approximately 1/6 to 1/3 of tree tops and limbs less than four inches in diameter does not apply (G. C. & R. 2.2). This is because slash would interfere with planting operations.

##### 2.2.3 - Stump heights (4/07)

Stump heights within the Sale Area shall not exceed 6 inches for all trees. This is to facilitate planting operations.

### 4 - Transportation

#### 4.1 - Construction

##### 4.1.12 - No new roads (1/12)

No new roads will be permitted in any Payment Unit. All operations are limited to existing roads. Skid trails only will be allowed.

#### 4.2 - Maintenance

##### 4.2.4 - Grading (10/16)

For completion of the sale, state forest roads must be graded. In general, this will require a road grader or bulldozer to shape up the roads after forest products have been hauled off site. This includes cleaning of drainage areas, grading, crowning, and filling with gravel, if necessary. The grading equipment to be used must be approved by the Unit Manager or his/her representative.

##### 4.2.5 - Two wheel drive condition (2/04)

All existing trail roads on and adjacent to the sale area must be passable by two-wheel drive traffic for the duration of the sale.

### 5 - Operations

#### 5.1 - Notification

##### 5.1.1 - Pre-sale conference (10/16)

A pre-sale conference on site between the Purchaser and sale administrator is required prior to beginning any operations to determine landing and road locations. The Unit Manager or his/her representative must be contacted at least 3 days in advance to schedule the conference.

#### 5.1.4 - Post-sale conference (10/16)

A post-sale conference on site between the Purchaser and sale administrator is required 3 days prior to the completion of active logging operations to determine clean-up and repair of landings, road edges, and the fulfillment of other contract specifications.

### 5.2 - Conduct of Operations

#### 5.2.3 - Operating Restrictions

##### 5.2.3.5 - Oak wilt restriction (1/18)

Within Payment Unit(s) 1 and 2 unless changed by written agreement, cutting, skidding, hauling within the sale and brushing of access roads to the sale are not permitted during the period of April 15 to July 15. Operations may be allowed if specific steps are taken to prevent damaging uncut oak during the high risk period. Those steps may include completing all road brushing before April 15th and clearing a tree-length buffer along uncut oak cover before April 15th. This is necessary to reduce the spread of oak wilt. For more information, contact the Unit Manager or his/her representative.

##### 5.2.38 - No decking against live trees (2/04)

Cut products may not be decked against unmarked or designated leave trees.

##### 5.2.40 - Pathway protection (10/10)

The ORV trail and is shown on the Timber Sale Map. The trail is within the retention area and should not affect sale. Do not run equipment down the pathway. Skidding across the trail may only occur at the existing road crossing.

### 5.4 - Soil Protection

#### 5.4.1 - Rutting restriction, general (7/16)

Operations are to cease immediately if equipment and weather conditions result in rutting of roads and/or skid trails which is 12 inches or greater in depth and 50 feet in length. The Unit Manager or his/her representative may restrict hauling and/or skidding if ruts exceed the specified depth. With the Unit Manager or his/her representative's approval, the Purchaser may return to the area when the risk of rutting has decreased.

## 6 - Safety and Fire Prevention

### 6.2 - Signing

#### 6.2.1 - Road posting (9/09)

The Purchaser is responsible for posting and maintaining caution signs on the access road and Jack Pine Road prior to beginning operations. The road must be posted at appropriate distances from the Sale Area to warn of logging activity and truck traffic. Signs must be removed when harvest operations are suspended or completed. The Purchaser will provide these signs.

#### 6.2.3 - Recreational trail posting (2/10)

The Purchaser is responsible for posting and maintaining caution signs on the ORV trail prior to beginning operations. The trail must be posted at appropriate distances from the Sale Area to warn of logging activity and truck traffic at both ends of the trail. Signs must be removed when harvest operations are suspended or completed. The Purchaser will provide these signs.



Sale Number	Year
61-050	20

# TIMBER SALE MAP

This information provided by authority of Part 525, 1994 PA 451 as amended.

Forest Management Unit Traverse City	County Grand Traverse	Mapped By Ruppen	Date 09/30/2020	Page 1	of 1
Township 26N	Range 9W	Section(s) and Subdivision(s) Sec 9 NESW,S1/2SW,NESE,S1/2SE Sec 10 SWSW	Scale 1:15,840		

Cover Type				Density	
A = Aspen	H = Hemlock	N = Marsh	U = Upland Brush	0 = Non Stocked	5 = Pole Timber Medium
B = Paper Birch	J = Jack Pine	O = Oak	UM = Upland Mixed	1 = Seeding Sapling Poor	6 = Pole Timber Well
C = Cedar	L = Lowland Brush	P = Lowland Poplar	V = Bog or Marsh	2 = Seeding Sapling Medium	7 = Saw Timber Poor
D = Tread Bog	LM = Lowland Mixed	Q = Mixed Swamp Conifer	W = White Pine	3 = Seeding Sapling Well	8 = Saw Timber Medium
E = Swamp Hardwoods	M = Mpl. Ech. Birch	R = Red Pine	X = Non Stocked	4 = Pole Timber Poor	9 = Saw Timber Well
F = Spruce Fir	MC = Mixed Conifer	S = Black Spruce	Z = Water		
G = Creas	MD = Mixed Deciduous	T = Tamarack			

## PU Acres

1	24.9
2	23.3

## Jack Pine Jag

Compartment 47  
48.2 Acres

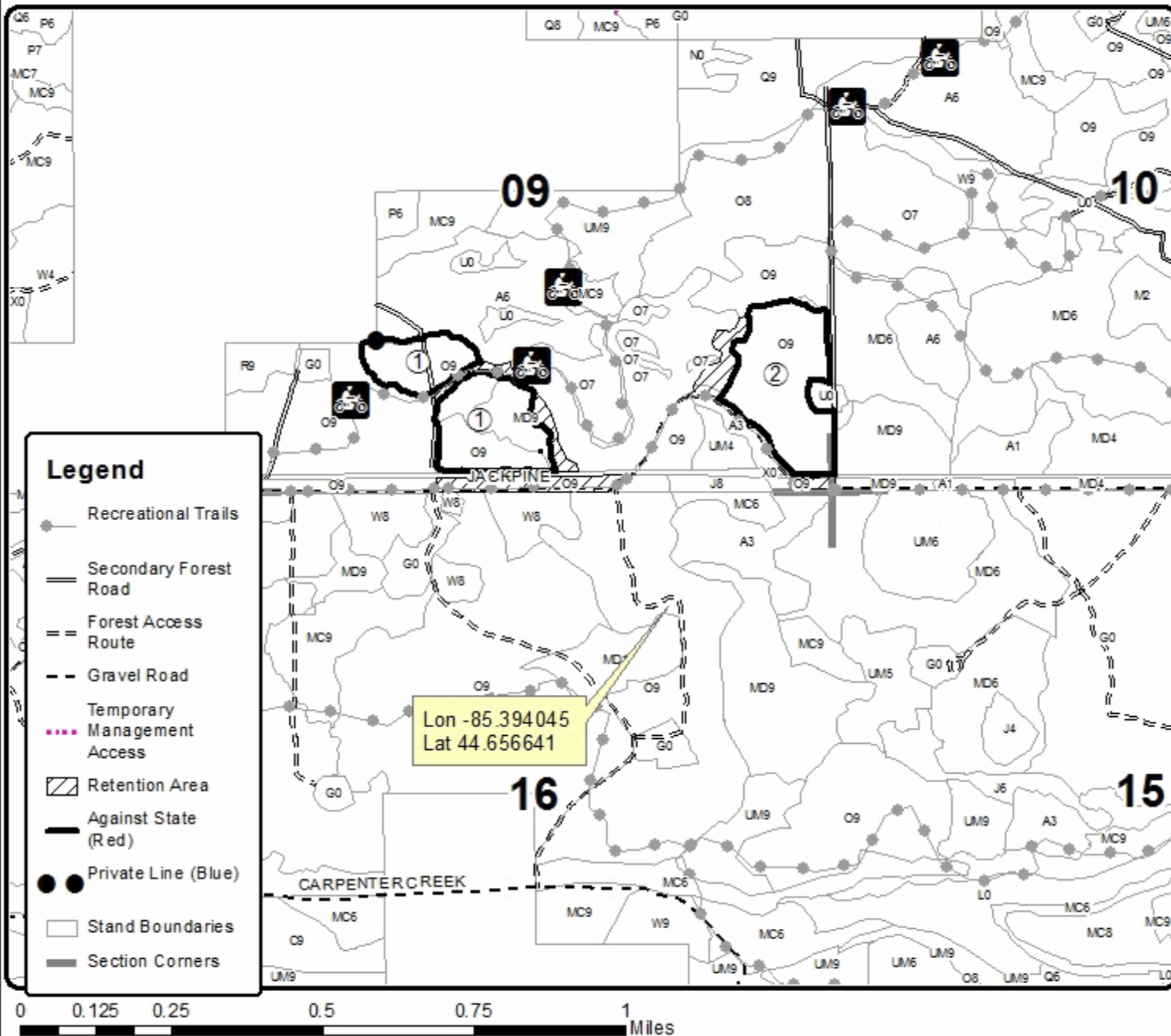





## TIMBER SALE INFORMATION

### Bracken Bad Aspen (61-059-20)

T27N, R14W, SEC. 22; T27N, R14W, SEC. 23; T27N, R14W, SEC. 26; T27N, R14W, SEC. 27.  
Benzie County (Advertised Price \$31,075.00)

SALE NOTE: A recreation site such as a trail, pathway, or campground is within the sale area or the vicinity. Certain restrictions/specifications may be applicable including time restrictions.

A timber sale contract for this lump sum, sealed bid timber sale will be awarded to the responsible bidder offering the highest sealed bid price. All units of volume listed below were estimated using the T-Sale computer program and our traditional volume equations. Bids must be at or above the following advertised price for each product and species:

<u>PRODUCTS &amp; SPECIES</u>	<u>ESTIMATED UNITS*</u>	<u>ADVERTISED PRICE</u>
Sawtimber		
Black Cherry	41.9 MBF	\$ 147.00 / MBF
Mixed Aspen	47.0 MBF	\$ 87.00 / MBF
Red Maple	18.6 MBF	\$ 118.00 / MBF
Sugar Maple	1.7 MBF	\$ 171.00 / MBF
White Pine	4.2 MBF	\$ 35.00 / MBF
Pulpwood		
Mixed Aspen	653 Cords	\$ 12.55 / Cord
Mixed Hardwood	745 Cords	\$ 12.05 / Cord
White Pine	78 Cords	\$ 13.10 / Cord

\* The total volume is statistically estimated within plus (+) or minus (-) 13.02 percent. There are an estimated 1,704 cords on this timber sale, plus or minus 222 cords at the 95% confidence level. The estimated units are final and not subject to adjustment. Prospective bidders are urged to examine this timber and to make their own estimates of quantity and quality.

### **BOND AND PAYMENT SCHEDULE:**

1. A bond in the amount of \$1,554.00 to insure faithful performance of the conditions of the contract will be deposited by the successful bidder within 21 days of the sale award.
2. Cutting in any sale or unit without the required advance payment would be considered a trespass.
3. Total payment must be paid in advance or according to the following schedule :
  - (a) Ten percent (10%) of the sale value must be paid within 21 days of the sale award.
  - (b) The 10% down payment will be credited towards the first unit cut.
  - (c) Payment for each of the following units must be made before cutting begins in that unit:
 

PAYMENT UNIT NUMBER	PERCENT OF TOTAL SALE VALUE
01	26.6%
02	15.4%
03	27.0%
04	22.3%
05	8.7%
4. If no cutting takes place, the 10% down payment will not be refunded.
5. Operations on the contract issued will terminate on 09/30/2023.

### **SALE STATISTICS**

#### **SALE VOLUMES**

VOLUME		STATISTICAL RANGE IN CORDS		
TOTAL CUBIC FEET	TOTAL CORDS	PERCENT ERROR	MINIMUM	MAXIMUM
134,640	1,704	13.02%	1,482	1,926

## VDU VOLUMES

A VDU is a Volume Determination Unit. Volumes and their associated statistics are calculated at the VDU level and summarized to the sale level. There is often a one to one relationship between a VDU and a Payment Unit, but not always, depending on the cruise design. Refer to the VDU TO PAYMENT UNIT table.

VDU	VOLUME		PERCENT ERROR	RANGE IN CORDS	
	TOTAL CUBIC FEET	TOTAL CORDS		MINIMUM	MAXIMUM
23	40,014	507	27.30%	368	645
39	26,678	338	25.58%	251	424
51	26,481	335	21.69%	262	408
60	82,934	1,050	25.18%	785	1,314
<b>TOTAL:</b>	<b>176,107</b>	<b>2,229</b>		<b>1,667</b>	<b>2,791</b>

## VDU TO PAYMENT UNIT

When a VDU is associated with more than one Payment Unit (PU), the VDU volumes are assigned to the PU based on acres of the VDU within the PU.

VDU	VDU ACRES	PU	PU ACRES
23	26.1	1	26.1
39	87.0	2	87.0
51	24.5	3	24.5
60	53.0	4	38.2
		5	14.8
<b>TOTAL:</b>	<b>190.6</b>		<b>190.6</b>

**DESCRIPTION OF TIMBER BY PAYMENT UNIT (PU)**

PU	MARKET GROUP	PRODUCT	QUANTITY	UNIT	ACRES	ADVERTISE PRICE	
1	Black Cherry	Sawtimber	3.1	MBF	26.1	\$8,258.40	
	Mixed Aspen		13.9	MBF			
	<i>B. T. Aspen</i>		12.3	<i>MBF</i>			
	<i>Quaking Aspen</i>		1.6	<i>MBF</i>			
	Red Maple		4.8	MBF			
	Sugar Maple		1.7	MBF			
	White Pine		1.2	MBF			
	Mixed Aspen		Pulpwood	313			Cords
	<i>B. T. Aspen</i>	264		<i>Cords</i>			
	<i>Quaking Aspen</i>	49		<i>Cords</i>			
	Mixed Hardwood	127		Cords			
	<i>Black Cherry</i>	50		<i>Cords</i>			
	<i>Ironwood</i>	6		<i>Cords</i>			
	<i>Red Maple</i>	51		<i>Cords</i>			
	<i>Sugar Maple</i>	20	<i>Cords</i>				
White Pine	18	Cords					
2	Black Cherry	Sawtimber	1.3	MBF	87.0	\$4,800.30	
	Mixed Aspen		1.0	MBF			
	<i>B. T. Aspen</i>		1.0	<i>MBF</i>			
	Red Maple		4.9	MBF			
	Mixed Aspen		Pulpwood	48			Cords
	<i>B. T. Aspen</i>			22			<i>Cords</i>
	<i>Quaking Aspen</i>			26			<i>Cords</i>
	Mixed Hardwood			236			Cords
	<i>Black Cherry</i>			198			<i>Cords</i>
	<i>Ironwood</i>			1			<i>Cords</i>
	<i>Red Maple</i>			36			<i>Cords</i>
	<i>Sugar Maple</i>		1	<i>Cords</i>			
	White Pine		38	Cords			
3	Black Cherry	Sawtimber	18.9	MBF	24.5	\$8,401.55	
	Mixed Aspen		17.9	MBF			
	<i>B. T. Aspen</i>		12.0	<i>MBF</i>			
	<i>Quaking Aspen</i>		5.9	<i>MBF</i>			
	Red Maple		8.9	MBF			
	White Pine		3.0	MBF			
	Mixed Aspen		Pulpwood	93			Cords
	<i>B. T. Aspen</i>			18			<i>Cords</i>
	<i>Quaking Aspen</i>			75			<i>Cords</i>
	Mixed Hardwood			136			Cords
	<i>Black Cherry</i>			85			<i>Cords</i>
	<i>Red Maple</i>			51			<i>Cords</i>
	White Pine			8			Cords
4	Black Cherry	Sawtimber	13.4	MBF	38.2	\$6,915.70	
	Mixed Aspen		10.2	MBF			
	<i>B. T. Aspen</i>		4.0	<i>MBF</i>			
	<i>Quaking Aspen</i>		6.2	<i>MBF</i>			
	Mixed Aspen		Pulpwood	143			Cords
	<i>B. T. Aspen</i>			31			<i>Cords</i>
	<i>Quaking Aspen</i>			112			<i>Cords</i>
	Mixed Hardwood			177			Cords
	<i>Black Cherry</i>			145			<i>Cords</i>
	<i>Red Maple</i>			32			<i>Cords</i>
	White Pine			10			Cords
5	Black Cherry	Sawtimber	5.2	MBF	14.8	\$2,699.05	
	Mixed Aspen		4.0	MBF			
	<i>B. T. Aspen</i>		1.6	<i>MBF</i>			

**DESCRIPTION OF TIMBER BY PAYMENT UNIT (PU), CON'T**

PU	MARKET GROUP	PRODUCT	QUANTITY	UNIT	ACRES	ADVERTISE PRICE
5 con't	<i>Quaking Aspen</i>	<i>Sawtimber</i>	2.4	<i>MBF</i>		
	Mixed Aspen	Pulpwood	56	Cords		
	<i>B. T. Aspen</i>		12	<i>Cords</i>		
	<i>Quaking Aspen</i>		44	<i>Cords</i>		
	Mixed Hardwood		69	Cords		
	<i>Black Cherry</i>		56	<i>Cords</i>		
	<i>Red Maple</i>		13	<i>Cords</i>		
	White Pine		4	Cords		
TOTAL:			113.4	MBF		
TOTAL:			1,476	Cords		

# Sale Specific Conditions & Requirements

**Sale Name: Bracken Bad Aspen**

**Sale Number: 61-059-20 Seq#: 1**

## 1 - Sale Area

### 1.2 - Boundaries

#### 1.2.1 - Painted boundaries (9/19)

The sale boundary and Payment Unit boundaries are marked and identified by red and yellow paint. Exterior sale boundary lines against state land are marked with red paint. Interior Payment Unit boundaries are marked with yellow paint. Retention patches are marked with double red paint marks; no harvesting activities may occur within these areas. The painted boundary line trees are not Included Timber and are to be protected.

## 2 - Timber Specifications

### 2.1 - Included Timber

#### 2.1.1 - Clearcut unit(s) with unmerchantable trees (6/14)

Within Payment Unit(s) 1 - 5, cut all trees that are two (2) inches or more at DBH, except elm or any trees marked with green paint. In addition, within Payment Unit 2, do not cut any red pine, and leave at least one mature clump of juneberry (> 10' tall) standing per acre. Within Payment Unit 3, do not cut patches of maple saplings (<5" DBH) unless necessary to facilitate harvest of designated timber.

### 2.2 - Utilization

#### 2.2.2 - Chipping required (2/18)

Payment Unit 2 must be chip harvested to facilitate subsequent prescribed burning operations. The Purchaser has the option to produce sawlogs or pulpwood bolts, but the remaining portion of the trees must be chipped and hauled. The requirement to retain approximately 1/6 to 1/3 of tree tops and limbs less than four inches in diameter does not apply for this Payment Unit (G. C. & R. 2.2).

## 4 - Transportation

### 4.1 - Construction

#### 4.1.6 - Road construction (1/09)

Construction of new roads or improvements of existing roads shall be done in such a way as to minimize the environmental and visual impacts. Merchantable trees shall be cut and utilized unless otherwise directed. Non-merchantable trees shall be severed and laid flat on the ground. Slash shall be scattered, and not left in windrows and kept a minimum of 10 feet back from the road edge. Stumps shall be set upright, not left on edge, and be moved at least 20 feet away from the road edge. Disturbed soil shall be feathered into the woods and not left in berms or windrows.

#### 4.1.7 - Road closure (10/11)

All new roads built into the sale must be blocked to vehicle traffic upon completion of the sale. In general, this will require constructing a four (4') foot high berm of stumps and logs covered with earth. Stumps and brush must be placed along the remainder of the trail. Contact the sale administrator for specific details of design and placement.

## 5 - Operations

### 5.2 - Conduct of Operations

#### 5.2.1 - Slash

##### 5.2.1.8 - Slash height (12/08)

No slash or tree tops may exceed 24 inches in height.

##### 5.2.1.12 - Slash for prescribed burning (1/05)

To facilitate prescribed burning, slash shall be moved at least 10 feet inside the sale boundary in Payment Unit 2. Slash cannot be piled or placed near residual trees.

#### 5.2.3 - Operating Restrictions

#### 5.2.3.1 - Operating restrictions (9/11)

Within Payment Unit(s) no vehicle traffic or sale operations may take place in areas labeled as "rye" on the Timber Sale Map. This restriction is to prevent damage to these wildlife food plots.

#### 5.2.4 - Dead and Down Creation

##### 5.2.4.1 - Dead and down creation, marked trees (10/13)

All trees marked with an "X" must be felled and left on site for wildlife. Either cut these trees at 4 feet above ground level and place the cut trunk against the resulting high stump or cut at ground level and place the cut trunk against a small nearby tree retained for this purpose.

##### 5.2.38 - No decking against live trees (2/04)

Cut products may not be decked against unmarked or designated leave trees.

##### 5.2.41 - Snowmobile trail protection (9/11)

The Platte River snowmobile trail is shown on the Timber Sale Map. Do not cut or damage posts with orange trail markers or traffic control signs. The snowmobile trail may not be used for any timber sale operations from December 1 to March 31. The snowmobile trail may only be crossed at right angles. Maintain a 20-foot-wide slash, debris, and rut free zone daily using the snowmobile trail as the centerline. No decking of forest products will be permitted along the snowmobile trail. All stumps within 20 feet of the snowmobile trail must be cut at ground level. In addition, any trees cut within 5 feet of the trail must have the stumps removed and be disposed of according to the direction of the Unit Manager or his/her representative.

#### 5.4 - Soil Protection

##### 5.4.3 - Erosion control (12/08)

Skid trails or haul roads may require erosion control structures or berms per direction of the Unit Manager or his/her representative.

### 6 - Safety and Fire Prevention

#### 6.2 - Signing

##### 6.2.1 - Road posting (10/20)

The Purchaser is responsible for posting and maintaining caution signs on Fortine Road prior to beginning operations. The road must be posted at appropriate distances from the Sale Area to warn of logging activity and truck traffic. Signs must be removed when harvest operations are suspended or completed. The Purchaser will provide these signs.

##### 6.2.2 - Snowmobile trail posting (10/20)

The Purchaser is responsible for posting and maintaining caution signs on the Platte River snowmobile trail prior to beginning operations during the snowmobile season (approximately December 1 to March 31). The trail must be posted approximately 350 feet from the Sale Area to warn of logging activity and truck traffic. Signs must be removed when harvest operations are suspended or completed. The Purchaser will provide these signs.



# TIMBER SALE MAP

This information provided by authority of Part 525, 1994 PA 451, as amended.

Forest Management Unit  
Traverse City

County  
Benzie

Mapped By Tim Webb  
Cruised By Webb, Cotant, Roell

Date  
9/30/2020

Page 1 of 1

Township  
27N

Range  
14W

Section(s) and Subdivision(s)  
Sec 22: SESE; Sec. 23: SW, SWSE;  
Sec. 26: NW, W1/2NE, N1/2SW; Sec. 27: NESE

Scale

1:15,840

### Cover Type

A = Aspen	H = Hemlock	N = Marsh	U = Upland Brush
B = Paper Birch	J = Jack Pine	O = Oak	UM = Upland Mixed
C = Cedar	L = Lowland Brush	P = Lowland Poplar	V = Bog or Marsh
D = Tread Bog	LM = Lowland Mixed	Q = Mixed Swamp Conifer	W = White Pine
E = Swamp Hdwoods	M = Mpl, Bch, Brch	R = Red Pine	X = Non Stocked
F = Spruce Fir	MC = Mixed Conifer	S = Black Spruce	Z = Water
G = Grass	MD = Mixed Deciduous	T = Tamarack	

### Density

0 = Non Stocked	5 = Pole Timber Medium
1 = Seedling Sapling Poor	6 = Pole Timber Well
2 = Seedling Sapling Medium	7 = Saw Timber Poor
3 = Seedling Sapling Well	8 = Saw Timber Medium
4 = Pole Timber Poor	9 = Saw Timber Well

PU	Acres	PU	Acres
1	26.1	4	38.2
2	87.0	5	14.8
3	24.5		

## Bracken Bad Aspen

### Compartment 8

190.6 acres

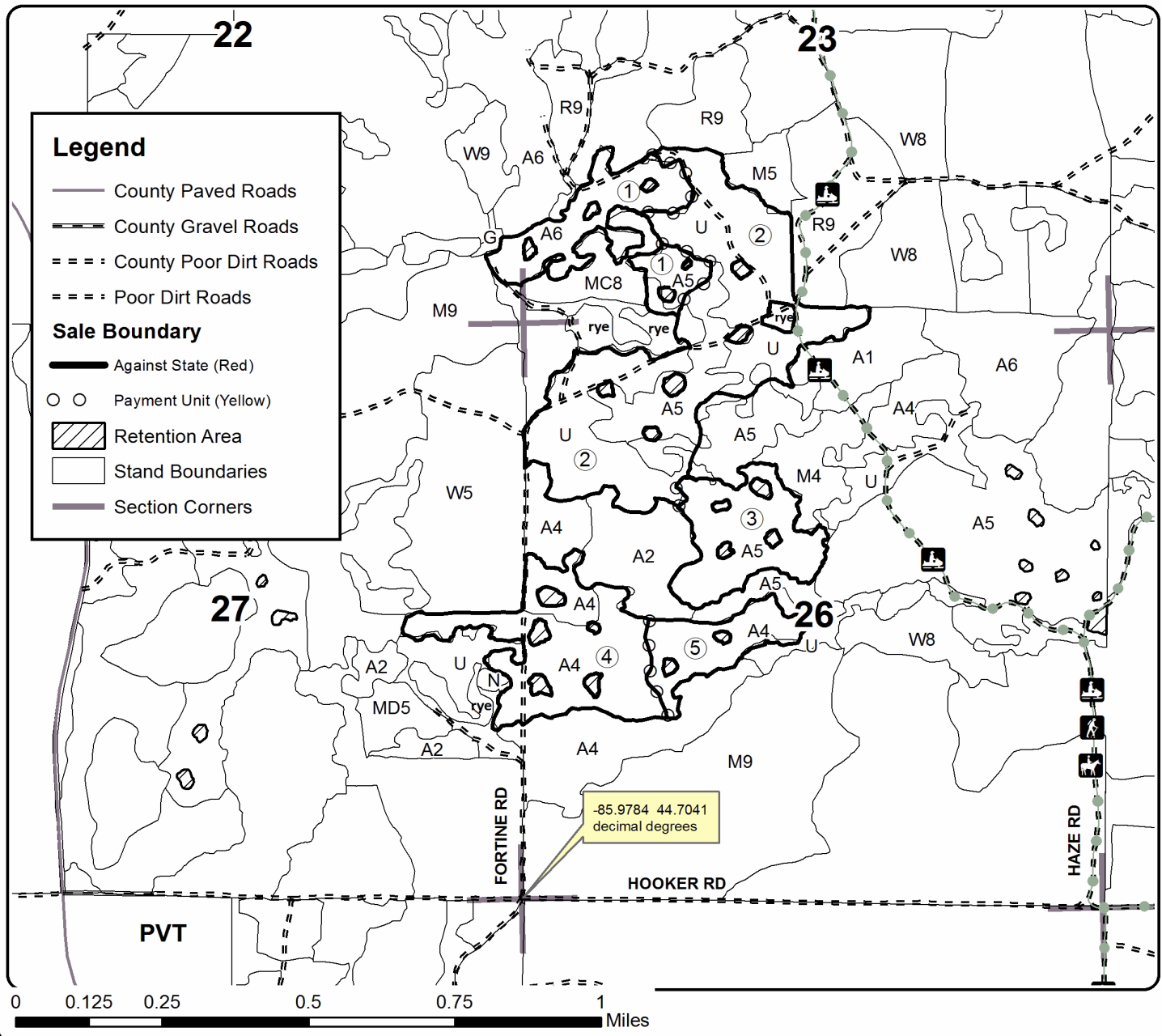





## TIMBER SALE INFORMATION

Many Hands Hardwood (61-060-20)  
T27N, R14W, SEC. 22; T27N, R14W, SEC. 23.  
Benzie County (Advertised Price \$73,169.00)

SALE NOTE: A recreation site such as a trail, pathway, or campground is within the sale area or the vicinity. Certain restrictions/specifications may be applicable including time restrictions.

A timber sale contract for this lump sum, sealed bid timber sale will be awarded to the responsible bidder offering the highest sealed bid price. All units of volume listed below were estimated using the T-Sale computer program and our traditional volume equations. Bids must be at or above the following advertised price for each product and species:

<u>PRODUCTS &amp; SPECIES</u>	<u>ESTIMATED UNITS*</u>	<u>ADVERTISED PRICE</u>
<b>Sawtimber</b>		
Basswood	70.8 MBF	\$ 75.00 / MBF
Beech	124.1 MBF	\$ 53.00 / MBF
Black Cherry	46.2 MBF	\$ 147.00 / MBF
Mixed Aspen	48.2 MBF	\$ 87.00 / MBF
Red Maple	90.8 MBF	\$ 118.00 / MBF
Red Pine	11.4 MBF	\$ 79.00 / MBF
Sugar Maple	81.3 MBF	\$ 171.00 / MBF
White Pine	103.6 MBF	\$ 35.00 / MBF
<b>Pulpwood</b>		
Basswood	60 Cords	\$ 10.95 / Cord
Mixed Aspen	70 Cords	\$ 12.55 / Cord
Mixed Hardwood	930 Cords	\$ 12.05 / Cord
Red Pine	64 Cords	\$ 27.45 / Cord
White Pine	508 Cords	\$ 13.10 / Cord

\* The estimated units are final and not subject to adjustment. Prospective bidders are urged to examine this timber and to make their own estimates of quantity and quality.

### **BOND AND PAYMENT SCHEDULE:**

1. A bond in the amount of \$3,658.00 to insure faithful performance of the conditions of the contract will be deposited by the successful bidder within 21 days of the sale award.
2. Cutting in any sale or unit without the required advance payment would be considered a trespass.
3. Total payment must be paid in advance or according to the following schedule :
  - (a) Ten percent (10%) of the sale value must be paid within 21 days of the sale award.
  - (b) The 10% down payment will be credited towards the first unit cut.
  - (c) Payment for each of the following units must be made before cutting begins in that unit:
 

PAYMENT UNIT NUMBER	PERCENT OF TOTAL SALE VALUE
01	14.4%
02	3.8%
03	2.3%
04	21.6%
05	2.7%
06	41.8%
07	13.4%
4. If no cutting takes place, the 10% down payment will not be refunded.
5. Operations on the contract issued will terminate on 09/30/2023.

### **SALE STATISTICS**

#### **SALE VOLUMES**

VOLUME		STATISTICAL RANGE IN CORDS		
TOTAL CUBIC FEET	TOTAL CORDS	PERCENT ERROR	MINIMUM	MAXIMUM
219,766	2,782	11.61%	2,459	3,105

## VDU VOLUMES

A VDU is a Volume Determination Unit. Volumes and their associated statistics are calculated at the VDU level and summarized to the sale level. There is often a one to one relationship between a VDU and a Payment Unit, but not always, depending on the cruise design. Refer to the VDU TO PAYMENT UNIT table.

VDU	VOLUME		PERCENT ERROR	RANGE IN CORDS	
	TOTAL CUBIC FEET	TOTAL CORDS		MINIMUM	MAXIMUM
2	28,077	355	34.42%	233	478
9	78,850	998	17.28%	826	1,171
10	7,244	92	37.03%	58	126
13	9,764	124	48.10%	64	183
16	50,284	637	32.88%	427	846
209	91,198	1,154	14.27%	990	1,319
<b>TOTAL:</b>	<b>265,416</b>	<b>3,360</b>		<b>2,597</b>	<b>4,122</b>

## VDU TO PAYMENT UNIT

When a VDU is associated with more than one Payment Unit (PU), the VDU volumes are assigned to the PU based on acres of the VDU within the PU.

VDU	VDU ACRES	PU	PU ACRES
2	20.2	1	20.2
9	71.5	6	71.5
10	12.2	2	12.2
13	7.0	5	7.0
16	11.7	7	11.7
209	20.0	3	1.9
		4	18.1
<b>TOTAL:</b>	<b>142.6</b>		<b>142.6</b>

**DESCRIPTION OF TIMBER BY PAYMENT UNIT (PU)**

PU	MARKET GROUP	PRODUCT	QUANTITY	UNIT	ACRES	ADVERTISE PRICE	
1	Basswood	Sawtimber	24.1	MBF	20.2	\$10,500.30	
	Beech		27.5	MBF			
	Black Cherry		1.4	MBF			
	Mixed Aspen		24.1	MBF			
	<i>B. T. Aspen</i>		24.1	<i>MBF</i>			
	Red Maple		5.8	MBF			
	Sugar Maple		13.4	MBF			
	Basswood		Pulpwood	22			Cords
	Mixed Aspen			10			Cords
	<i>B. T. Aspen</i>			10			<i>Cords</i>
	Mixed Hardwood	132		Cords			
	<i>Beech</i>	85		<i>Cords</i>			
	<i>Black Cherry</i>	3	<i>Cords</i>				
	<i>Ironwood</i>	2	<i>Cords</i>				
	<i>Red Maple</i>	7	<i>Cords</i>				
<i>Sugar Maple</i>	35	<i>Cords</i>					
2	Black Cherry	Sawtimber	0.5	MBF	12.2	\$2,772.20	
	Red Pine		11.4	MBF			
	Sugar Maple		0.5	MBF			
	Mixed Hardwood		Pulpwood	10			Cords
	<i>Black Cherry</i>			5			<i>Cords</i>
	<i>Sugar Maple</i>			5			<i>Cords</i>
	Red Pine			58			Cords
3	Beech	Sawtimber	0.6	MBF	1.9	\$1,671.90	
	Black Cherry		1.6	MBF			
	Mixed Aspen		1.5	MBF			
	<i>B. T. Aspen</i>		1.4	<i>MBF</i>			
	<i>Quaking Aspen</i>		0.1	<i>MBF</i>			
	Red Maple		4.9	MBF			
	Sugar Maple		1.5	MBF			
	Mixed Aspen		Pulpwood	3			Cords
	<i>B. T. Aspen</i>			3			<i>Cords</i>
	Mixed Hardwood			30			Cords
	<i>Beech</i>			4			<i>Cords</i>
	<i>Black Cherry</i>			6			<i>Cords</i>
	<i>Red Maple</i>			14			<i>Cords</i>
	<i>Sugar Maple</i>			6			<i>Cords</i>
	Red Pine			1			Cords
White Pine	1	Cords					
4	Beech	Sawtimber	5.8	MBF	18.1	\$15,796.80	
	Black Cherry		15.2	MBF			
	Mixed Aspen		14.8	MBF			
	<i>B. T. Aspen</i>		13.8	<i>MBF</i>			
	<i>Quaking Aspen</i>		1.0	<i>MBF</i>			
	Red Maple		46.3	MBF			
	Sugar Maple		14.2	MBF			
	Mixed Aspen		Pulpwood	32			Cords
	<i>B. T. Aspen</i>			29			<i>Cords</i>
	<i>Quaking Aspen</i>			3			<i>Cords</i>
	Mixed Hardwood			287			Cords
	<i>Beech</i>			41			<i>Cords</i>
	<i>Black Cherry</i>			56			<i>Cords</i>
	<i>Red Maple</i>			137			<i>Cords</i>
	<i>Sugar Maple</i>			53			<i>Cords</i>
	Red Pine			5			Cords
	White Pine		6	Cords			

**DESCRIPTION OF TIMBER BY PAYMENT UNIT (PU), CON'T**

PU	MARKET GROUP	PRODUCT	QUANTITY	UNIT	ACRES	ADVERTISE PRICE	
5	Black Cherry	Sawtimber	1.6	MBF	7.0	\$1,939.40	
	Mixed Aspen		0.8	MBF			
	<i>B. T. Aspen</i>		0.4	<i>MBF</i>			
	<i>Quaking Aspen</i>		0.4	<i>MBF</i>			
	White Pine		9.7	MBF			
	Mixed Aspen	Pulpwood	8	Cords			
	<i>B. T. Aspen</i>		2	<i>Cords</i>			
	<i>Quaking Aspen</i>		6	<i>Cords</i>			
	Mixed Hardwood		10	Cords			
	<i>Black Cherry</i>		10	<i>Cords</i>			
	White Pine		82	Cords			
6	Basswood	Sawtimber	46.7	MBF	71.5	\$30,654.45	
	Beech		90.2	MBF			
	Black Cherry		23.1	MBF			
	Mixed Aspen		7.0	MBF			
	<i>B. T. Aspen</i>		7.0	<i>MBF</i>			
	Red Maple		32.3	MBF			
	Sugar Maple		49.8	MBF			
	White Pine		3.2	MBF			
	Basswood		Pulpwood	38			Cords
	Mixed Aspen			11			Cords
	<i>B. T. Aspen</i>			11			<i>Cords</i>
	Mixed Hardwood			422			Cords
	<i>Beech</i>			172			<i>Cords</i>
	<i>Black Cherry</i>			35			<i>Cords</i>
	<i>Ironwood</i>			11			<i>Cords</i>
	<i>Red Maple</i>			40			<i>Cords</i>
	<i>Sugar Maple</i>			164			<i>Cords</i>
White Pine	22	Cords					
7	Black Cherry	Sawtimber	2.8	MBF	11.7	\$9,833.95	
	Red Maple		1.5	MBF			
	Sugar Maple		1.9	MBF			
	White Pine		90.7	MBF			
	Mixed Aspen		Pulpwood	6			Cords
	<i>Quaking Aspen</i>			6			<i>Cords</i>
	Mixed Hardwood			39			Cords
	<i>Black Cherry</i>			15			<i>Cords</i>
	<i>Red Maple</i>			3			<i>Cords</i>
	<i>Sugar Maple</i>			17			<i>Cords</i>
	<i>White Ash</i>			4			<i>Cords</i>
	White Pine			397			Cords
	TOTAL:			576.4			MBF
TOTAL:				1,632	Cords		

# Sale Specific Conditions & Requirements

**Sale Name: Many Hands Hardwood**

**Sale Number: 61-060-20 Seq#: 2**

## 1 - Sale Area

### 1.2 - Boundaries

#### 1.2.1 - Painted boundaries (9/19)

The sale boundary and Payment Unit boundaries are marked and identified by blue, red, and yellow paint. Exterior sale boundary lines against private property are marked with blue paint. Exterior sale boundary lines against state land are marked with red paint. Interior Payment Unit boundaries are marked with yellow paint. Retention patches are marked with red paint; no harvesting activities may occur within these areas. The painted boundary line trees are not Included Timber and are to be protected unless marked with orange paint.

## 2 - Timber Specifications

### 2.1 - Included Timber

#### 2.1.1 - Clearcut unit(s) with unmerchantable trees (6/14)

Within Payment Unit(s) 3 and 7, cut all trees that are two (2) inches or more at DBH except for trees marked with green paint.

#### 2.1.3 - Cut tree marked unit(s) (12/08)

Within Payment Unit(s) 1, 2, and 6, all trees are designated for cutting when marked with orange paint above and below stump height, regardless of merchantability. In addition, within Payment Units 1 and 6, cut all aspen and beech trees greater than 3" at DBH unless marked with green paint.

#### 2.1.7 - Leave tree marked unit(s) (6/14)

Within Payment Unit(s) 4 and 5, cut all trees that are three (3) inches or more at DBH, except trees marked with green paint above and below stump height or any elm trees. In addition, within Payment Unit 5 only, do not cut any maple trees, and within Payment Unit 4, do not cut any maple saplings (less than 5" at DBH).

### 2.2 - Utilization

#### 2.2.3 - Stump heights (4/07)

Stump heights within Payment Unit 7 shall not exceed 4 inches for all trees. This is to facilitate planting operations.

#### 2.2.4 - Skidding length (2/14)

Skidding of unlimbed tops or lengths over 17 feet is not permissible within Payment Units 1, 2, 5, and 6 unless approved by the Unit Manager or his/her representative.

## 3 - Payments

### 3.3 - Pre-measured Sales

#### 3.3.4 - Dividing payment units (7/14)

Payment Unit(s) 6 may be divided at the request of the Purchaser and upon approval of the Unit Manager. Dividing Payment Units is a contract modification which requires a Timber Sale Contract Amendment. There will be only one division allowed.

## 4 - Transportation

### 4.1 - Construction

#### 4.1.3 - Slash and earthen piles (8/04)

Piles or windrows of earth along roads and landings that have been widened or constructed shall be leveled. Slash from road maintenance or construction, including stumps, shall be dispersed throughout the Sale Area.

#### 4.1.7 - Road closure (10/11)

All new roads built into the sale must be blocked to vehicle traffic upon completion of the sale. Overgrown roads that are reopened shall be considered new roads. In general, this will require constructing a four (4') foot high berm of stumps and logs covered with earth. Contact the sale administrator for specific details of design and placement.

## 5 - Operations

### 5.2 - Conduct of Operations

#### 5.2.1 - Slash

##### 5.2.1.8 - Slash height (12/08)

No slash or tree tops may exceed 36 inches in height.

#### 5.2.3 - Operating Restrictions

##### 5.2.3.3 - Bark slippage restriction (3/09)

Within Payment Unit(s) 1, 2, and 4 - 6, unless changed by written agreement, cutting and skidding are not permitted during the period of April 15 to July 15. This restriction is because of bark slippage.

##### 5.2.3.6 - Bark beetle restriction (12/08)

In the event drought creates a high risk of pine bark beetle infestation, pine is not to be cut during the period March 1 through July 1, unless all portions of trees greater than two inches in diameter are removed from the sale area, reduced to chips, or treated to the satisfaction of the Unit Manager or his/her representative, within fifteen days of being severed from the stump. Pine log decks, pulpwood piles and treetops that are piled for chipping in the fall or winter within a 1/4 mile of susceptible sites must be removed before March 15. Residual slash must not be placed in piles or rows and must be spread over the site for quick drying. The Department of Natural Resources will exercise this specification if the risk of damage warrants.

#### 5.2.4 - Dead and Down Creation

##### 5.2.4.1 - Dead and down creation, marked trees (10/13)

All trees marked with an "X" must be felled and left on site for wildlife.

##### 5.2.38 - No decking against live trees (2/04)

Cut products may not be decked against unmarked or designated leave trees.

##### 5.2.41 - Snowmobile trail protection (9/11)

The Platte River Snowmobile Trail is shown on the Timber Sale Map. Do not cut or damage posts with orange trail markers or traffic control signs. If the trail is used, it must be maintained and restored to a condition equal to or better than before the sale. The road maintenance/restoration must be done prior to December 1. The snowmobile trail may not be used for any timber sale operations from December 1 to March 31 unless approved in writing by the sale administrator. Maintain a 20-foot-wide slash, debris, and rut free zone daily using the snowmobile trail as the centerline. All stumps within 20 feet of the snowmobile trail must be cut at ground level. In addition, any trees cut within 5 feet of the trail must have the stumps removed and be disposed of according to the direction of the Unit Manager or his/her representative.

### 5.4 - Soil Protection

#### 5.4.3 - Erosion control (12/08)

Skid trails or haul roads may require erosion control structures or berms per direction of the Unit Manager or his/her representative.

### 5.8 - Protection of Endangered Species

#### 5.8.3 - Red shoulder hawk or goshawk (2/16)

In the event that an active red shoulder hawk or goshawk nest is found, the contract may be amended to protect the nest site until the nest is determined to be inactive. The value of the trees in this excluded area will be refunded or credited to the Purchaser. The nest will be buffered with a five-chain radius (eight acre) protection area, centered on the nest tree, in which there will be no cutting or new roads constructed. Avoid human disturbance, including loading and skidding, in the protection area.

An additional zone of five chains (ten chains centered on the active nest tree) will be established in which there is no management activity from March 15 to July 15. Limit biomass harvesting and chipping operations within this ten-chain zone, retain the maximum one-third of residues per the Woody Biomass Harvesting Guidelines (Michigan DNR 2010). Nests determined to be inactive will be protected with a one-chain no-harvest buffer.

## **6 - Safety and Fire Prevention**

### **6.2 - Signing**

#### **6.2.1 - Road posting (10/20)**

The Purchaser is responsible for posting and maintaining caution signs on Fortine Road prior to beginning operations. The road must be posted approximately 350 feet from the Sale Area to warn of logging activity and truck traffic. Signs must be removed when harvest operations are suspended or completed. The Purchaser will provide these signs.



# TIMBER SALE MAP

This information provided by authority of Part 525, 1994 PA 451, as amended.

Forest Management Unit Traverse City		County Benzie	Mapped By Tim Webb	Date 9/30/2020	Page 1	of 1
Township 27N	Range 14W	Section(s) and Subdivision(s) Sec. 22: NENW,NE,NESW,SE; Sec. 23: W1/2NW		Scale 1:15,840		

Cover Type				Density	
A = Aspen	H = Hemlock	N = Marsh	U = Upland Brush	0 = Non Stocked	5 = Pole Timber Medium
B = Paper Birch	J = Jack Pine	O = Oak	UM = Upland Mixed	1 = Seedling Sapling Poor	6 = Pole Timber Well
C = Cedar	L = Lowland Brush	P = Lowland Poplar	V = Bog or Marsh	2 = Seedling Sapling Medium	7 = Saw Timber Poor
D = Treed Bog	LM = Lowland Mixed	Q = Mixed Swamp Conifer	W = White Pine	3 = Seedling Sapling Well	8 = Saw Timber Medium
E = Swamp Hdwoods	M = Mpl, Bch, Brch	R = Red Pine	X = Non Stocked	4 = Pole Timber Poor	9 = Saw Timber Well
F = Spruce Fir	MC = Mixed Conifer	S = Black Spruce	Z = Water		
G = Grass	MD = Mixed Deciduous	T = Tamarack			

PU	Acres	PU	Acres	PU	Acres
1	20.2	4	18.1	7	11.7
2	12.2	5	7.0		
3	1.9	6	71.5		

## Many Hands Hardwood Compartment 8 142.6 acres

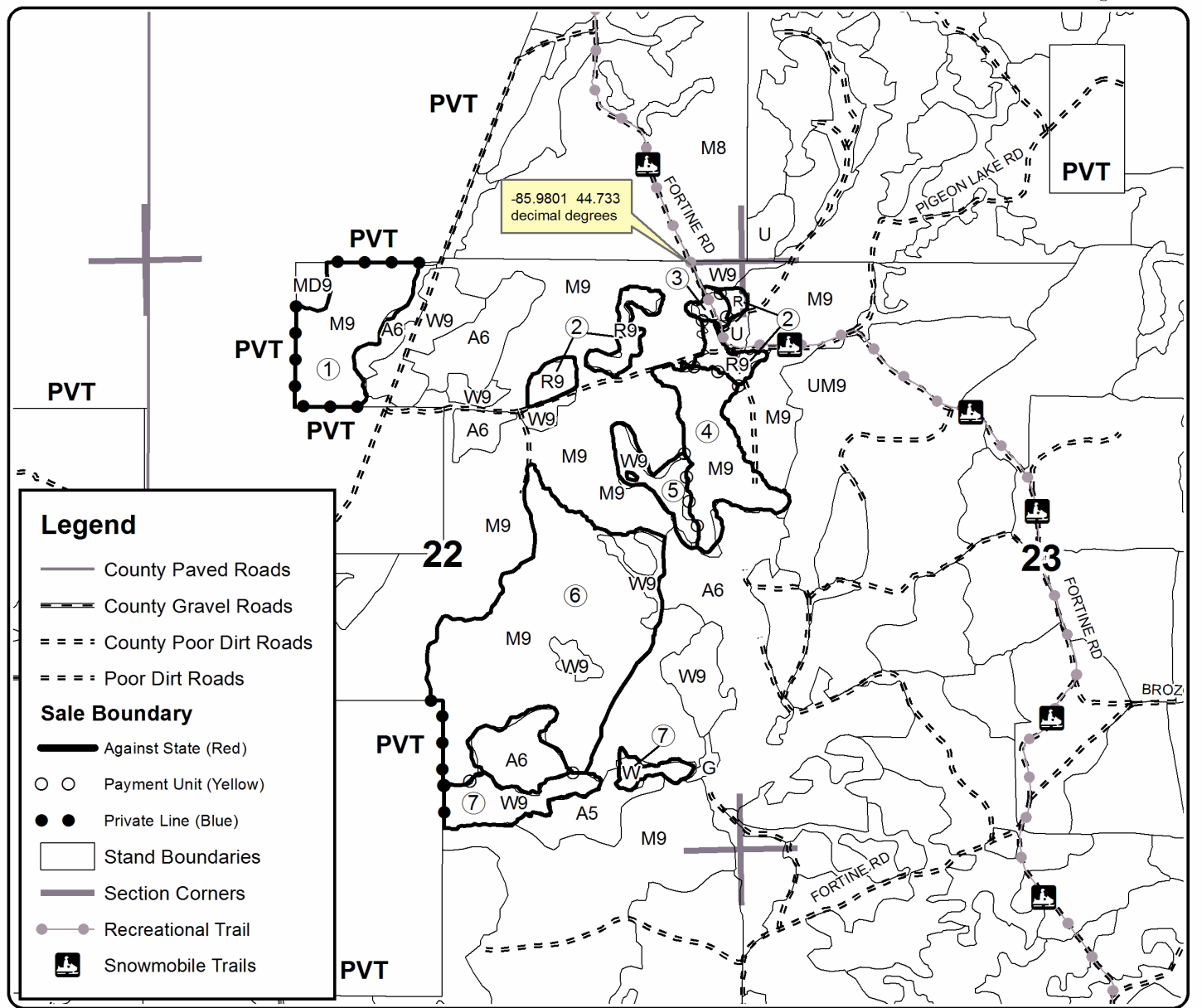

**Legend**

- County Paved Roads
- County Gravel Roads
- County Poor Dirt Roads
- Poor Dirt Roads

**Sale Boundary**

- Against State (Red)
- Payment Unit (Yellow)
- Private Line (Blue)
- Stand Boundaries
- Section Corners
- Recreational Trail
- Snowmobile Trails

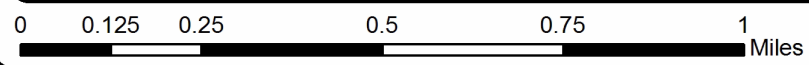



## TIMBER SALE INFORMATION

Farmer's Wife Mix (61-061-20)  
 T27N, R14W, SEC. 34.  
 Benzie County (Advertised Price \$31,025.25)

A timber sale contract for this lump sum, sealed bid timber sale will be awarded to the responsible bidder offering the highest sealed bid price. All units of volume listed below were estimated using the T-Sale computer program and our traditional volume equations. Bids must be at or above the following advertised price for each product and species:

<u>PRODUCTS &amp; SPECIES</u>	<u>ESTIMATED UNITS*</u>	<u>ADVERTISED PRICE</u>
<b>Sawtimber</b>		
Basswood	28.4 MBF	\$ 75.00 / MBF
Beech	8.1 MBF	\$ 53.00 / MBF
Black Cherry	17.5 MBF	\$ 147.00 / MBF
Mixed Aspen	12.1 MBF	\$ 87.00 / MBF
Red Maple	31.3 MBF	\$ 118.00 / MBF
Red Pine	34.5 MBF	\$ 79.00 / MBF
Sugar Maple	30.5 MBF	\$ 171.00 / MBF
White Pine	3.1 MBF	\$ 35.00 / MBF
<b>Pulpwood</b>		
Basswood	65 Cords	\$ 10.95 / Cord
Mixed Aspen	54 Cords	\$ 12.55 / Cord
Mixed Hardwood	532 Cords	\$ 12.05 / Cord
Red Pine	172 Cords	\$ 27.45 / Cord
White Pine	44 Cords	\$ 13.10 / Cord

\* The total volume is statistically estimated within plus (+) or minus (-) 14.27 percent. There are an estimated 1,199 cords on this timber sale, plus or minus 171 cords at the 95% confidence level. The estimated units are final and not subject to adjustment. Prospective bidders are urged to examine this timber and to make their own estimates of quantity and quality.

### BOND AND PAYMENT SCHEDULE:

1. A bond in the amount of \$1,551.00 to insure faithful performance of the conditions of the contract will be deposited by the successful bidder within 21 days of the sale award.
2. Cutting in any sale or unit without the required advance payment would be considered a trespass.
3. Total payment must be paid in advance or according to the following schedule :
  - (a) Ten percent (10%) of the sale value must be paid within 21 days of the sale award.
  - (b) The 10% down payment will be credited towards the first unit cut.
  - (c) Payment for each of the following units must be made before cutting begins in that unit:
 

PAYMENT UNIT NUMBER	PERCENT OF TOTAL SALE VALUE
01	31.5%
02	11.5%
03	24.0%
04	33.0%
4. If no cutting takes place, the 10% down payment will not be refunded.
5. Operations on the contract issued will terminate on 09/30/2023.

### SALE STATISTICS

#### **SALE VOLUMES**

VOLUME		STATISTICAL RANGE IN CORDS		
TOTAL CUBIC FEET	TOTAL CORDS	PERCENT ERROR	MINIMUM	MAXIMUM
94,704	1,199	14.27%	1,028	1,370

## VDU VOLUMES

A VDU is a Volume Determination Unit. Volumes and their associated statistics are calculated at the VDU level and summarized to the sale level. There is often a one to one relationship between a VDU and a Payment Unit, but not always, depending on the cruise design. Refer to the VDU TO PAYMENT UNIT table.

VDU	VOLUME		PERCENT ERROR	RANGE IN CORDS	
	TOTAL CUBIC FEET	TOTAL CORDS		MINIMUM	MAXIMUM
68	19,039	241	25.72%	179	303
85	33,291	421	24.59%	318	525
92	32,272	409	26.20%	301	516
292	10,144	128	44.55%	71	186
<b>TOTAL:</b>	<b>94,745</b>	<b>1,199</b>		<b>869</b>	<b>1,529</b>

## VDU TO PAYMENT UNIT

When a VDU is associated with more than one Payment Unit (PU), the VDU volumes are assigned to the PU based on acres of the VDU within the PU.

VDU	VDU ACRES	PU	PU ACRES
68	13.5	3	13.5
85	20.8	4	20.8
92	29.1	1	29.1
292	5.4	2	5.4
<b>TOTAL:</b>	<b>68.8</b>		<b>68.8</b>

**DESCRIPTION OF TIMBER BY PAYMENT UNIT (PU)**

PU	MARKET GROUP	PRODUCT	QUANTITY	UNIT	ACRES	ADVERTISE PRICE	
1	Basswood	Sawtimber	28.4	MBF	29.1	\$9,766.40	
	Beech		6.4	MBF			
	Black Cherry		2.1	MBF			
	Mixed Aspen		1.7	MBF			
	<i>Quaking Aspen</i>		1.7	<i>MBF</i>			
	Sugar Maple		19.8	MBF			
	Basswood		Pulpwood	65			Cords
	Mixed Aspen			29			Cords
	<i>B. T. Aspen</i>			3			<i>Cords</i>
	<i>Quaking Aspen</i>			26			<i>Cords</i>
	Mixed Hardwood			192			Cords
	<i>Beech</i>			43			<i>Cords</i>
	<i>Black Cherry</i>			22			<i>Cords</i>
	<i>Ironwood</i>			19			<i>Cords</i>
	<i>Sugar Maple</i>			108			<i>Cords</i>
	White Pine	5		Cords			
2	Beech	Sawtimber	0.8	MBF	5.4	\$3,581.45	
	Mixed Aspen		10.4	MBF			
	<i>B. T. Aspen</i>		7.8	<i>MBF</i>			
	<i>Quaking Aspen</i>		2.6	<i>MBF</i>			
	Sugar Maple		9.1	MBF			
	Mixed Aspen		Pulpwood	25			Cords
	<i>B. T. Aspen</i>			16			<i>Cords</i>
	<i>Quaking Aspen</i>			9			<i>Cords</i>
	Mixed Hardwood			58			Cords
	<i>Beech</i>			18			<i>Cords</i>
	<i>Ironwood</i>			6			<i>Cords</i>
	<i>Sugar Maple</i>			34			<i>Cords</i>
	White Pine			5			Cords
3	Red Pine	Sawtimber		34.5	MBF	13.5	\$7,446.90
	Red Pine	Pulpwood	172	Cords			
4	Beech	Sawtimber	0.9	MBF	20.8	\$10,230.50	
	Black Cherry		15.4	MBF			
	Red Maple		31.3	MBF			
	Sugar Maple		1.6	MBF			
	White Pine		3.1	MBF			
	Mixed Hardwood		Pulpwood	282			Cords
	<i>Beech</i>			21			<i>Cords</i>
	<i>Black Cherry</i>			64			<i>Cords</i>
	<i>Red Maple</i>			164			<i>Cords</i>
	<i>Sugar Maple</i>			33			<i>Cords</i>
White Pine	34	Cords					
TOTAL:			165.5	MBF			
TOTAL:			867	Cords			

## Sale Specific Conditions & Requirements

**Sale Name: Farmer's Wife Mix**

**Sale Number: 61-061-20 Seq#: 2**

### 1 - Sale Area

#### 1.2 - Boundaries

##### 1.2.1 - Painted boundaries (9/19)

The sale boundary and Payment Unit boundaries are marked and identified by blue, red, and yellow paint. Exterior sale boundary lines against private property are marked with blue paint. Exterior sale boundary lines against state land are marked with red paint. Interior Payment Unit boundaries are marked with yellow paint. The painted boundary line trees are not Included Timber and are to be protected unless marked with orange paint.

### 2 - Timber Specifications

#### 2.1 - Included Timber

##### 2.1.1 - Clearcut unit(s) with unmerchantable trees (6/14)

Within Payment Unit(s) 2, cut all trees that are two (2) inches or more at DBH unless marked with green paint.

##### 2.1.3 - Cut tree marked unit(s) (12/08)

Within Payment Unit(s) 1, 3, and 4, all trees are designated for cutting when marked with orange paint above and below stump height, regardless of merchantability. In addition, cut all beech, ironwood, and aspen trees greater than 3" at DBH unless marked with green paint.

#### 2.2 - Utilization

##### 2.2.4 - Skidding length (2/14)

Skidding of unlimbed tops or lengths over 17 feet is not permissible unless approved by the Unit Manager or his/her representative.

### 4 - Transportation

#### 4.1 - Construction

##### 4.1.3 - Slash and earthen piles (8/04)

Piles or windrows of earth along roads and landings that have been widened or constructed shall be leveled. Slash from road maintenance or construction, including stumps, shall be dispersed throughout the sale.

##### 4.1.7 - Road closure (10/11)

All new roads built into the sale must be blocked to vehicle traffic upon completion of the sale. In general, this will require constructing a four (4') foot high berm of stumps and logs covered with earth. Contact the sale administrator for specific details of design and placement.

### 5 - Operations

#### 5.2 - Conduct of Operations

##### 5.2.1 - Slash

###### 5.2.1.8 - Slash height (12/08)

No slash or tree tops may exceed 36 inches in height.

##### 5.2.3 - Operating Restrictions

###### 5.2.3.3 - Bark slippage restriction (3/09)

Within Payment Unit(s) 1, 3, and 4, unless changed by written agreement, cutting and skidding are not permitted during the period of April 15 to July 15. This restriction is because of bark slippage.

###### 5.2.3.6 - Bark beetle restriction (12/08)

In the event drought creates a high risk of pine bark beetle infestation, pine is not to be cut during the period March 1 through July 1, unless all portions of trees greater than two inches in diameter are removed from the sale area, reduced to

chips, or treated to the satisfaction of the Unit Manager or his/her representative, within fifteen days of being severed from the stump. Pine log decks, pulpwood piles and treetops that are piled for chipping in the fall or winter within a 1/4 mile of susceptible sites must be removed before March 15. Residual slash must not be placed in piles or rows and must be spread over the site for quick drying. The Department of Natural Resources will exercise this specification if the risk of damage warrants.

#### 5.2.4 - Dead and Down Creation

##### 5.2.4.1 - Dead and down creation, marked trees (10/13)

All trees marked with an orange "X" must be felled and left on site for wildlife. These trees have been taken off the timber tally.

##### 5.2.38 - No decking against live trees (2/04)

Cut products may not be decked against unmarked or designated leave trees.

#### 5.4 - Soil Protection

##### 5.4.3 - Erosion control (12/08)

Skid trails or haul roads may require erosion control structures or berms per direction of the Unit Manager or his/her representative.

##### 5.4.6 - Wet area protection (5/10)

No harvesting operations, including skidding and felling, are to take place within the wetland abutting the north edge of Payment Unit 4 ("E7" type on the Timber Sale Map). Care must be taken by the Purchaser to identify and avoid operating in these areas of the timber sale.

### 6 - Safety and Fire Prevention

#### 6.2 - Signing

##### 6.2.1 - Road posting (10/20)

The Purchaser is responsible for posting and maintaining caution signs on Fortine and Hooker roads prior to beginning operations. The road must be posted at appropriate distances from the Sale Area to warn of logging activity and truck traffic. Signs must be removed when harvest operations are suspended or completed. The Purchaser will provide these signs.



# TIMBER SALE MAP

This information provided by authority of Part 525, 1994 PA 451, as amended.

Forest Management Unit Traverse City		County Benzie	Mapped By Tim Webb	Date 9/30/2020	Page 1	of 1
Township 27N	Range 14W	Section(s) and Subdivision(s) Sec. 34: N1/2NE, SENE, W1/2SW		Scale 1:15,840		

Cover Type				Density	
A = Aspen	H = Hemlock	N = Marsh	U = Upland Brush	0 = Non Stocked	5 = Pole Timber Medium
B = Paper Birch	J = Jack Pine	O = Oak	UM = Upland Mixed	1 = Seedling Sapling Poor	6 = Pole Timber Well
C = Cedar	L = Lowland Brush	P = Lowland Poplar	V = Bog or Marsh	2 = Seedling Sapling Medium	7 = Saw Timber Poor
D = Tread Bog	LM = Lowland Mixed	Q = Mixed Swamp Conifer	W = White Pine	3 = Seedling Sapling Well	8 = Saw Timber Medium
E = Swamp Hdwoods	M = Mpl, Bch, Brch	R = Red Pine	X = Non Stocked	4 = Pole Timber Poor	9 = Saw Timber Well
F = Spruce Fir	MC = Mixed Conifer	S = Black Spruce	Z = Water		
G = Grass	MD = Mixed Deciduous	T = Tamarack			

PU	Acres	PU	Acres
1	29.1	4	20.8
2	5.4		
3	13.5		

## Farmer's Wife Mix

### Compartment 8

68.8 acres

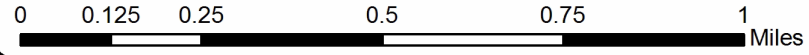
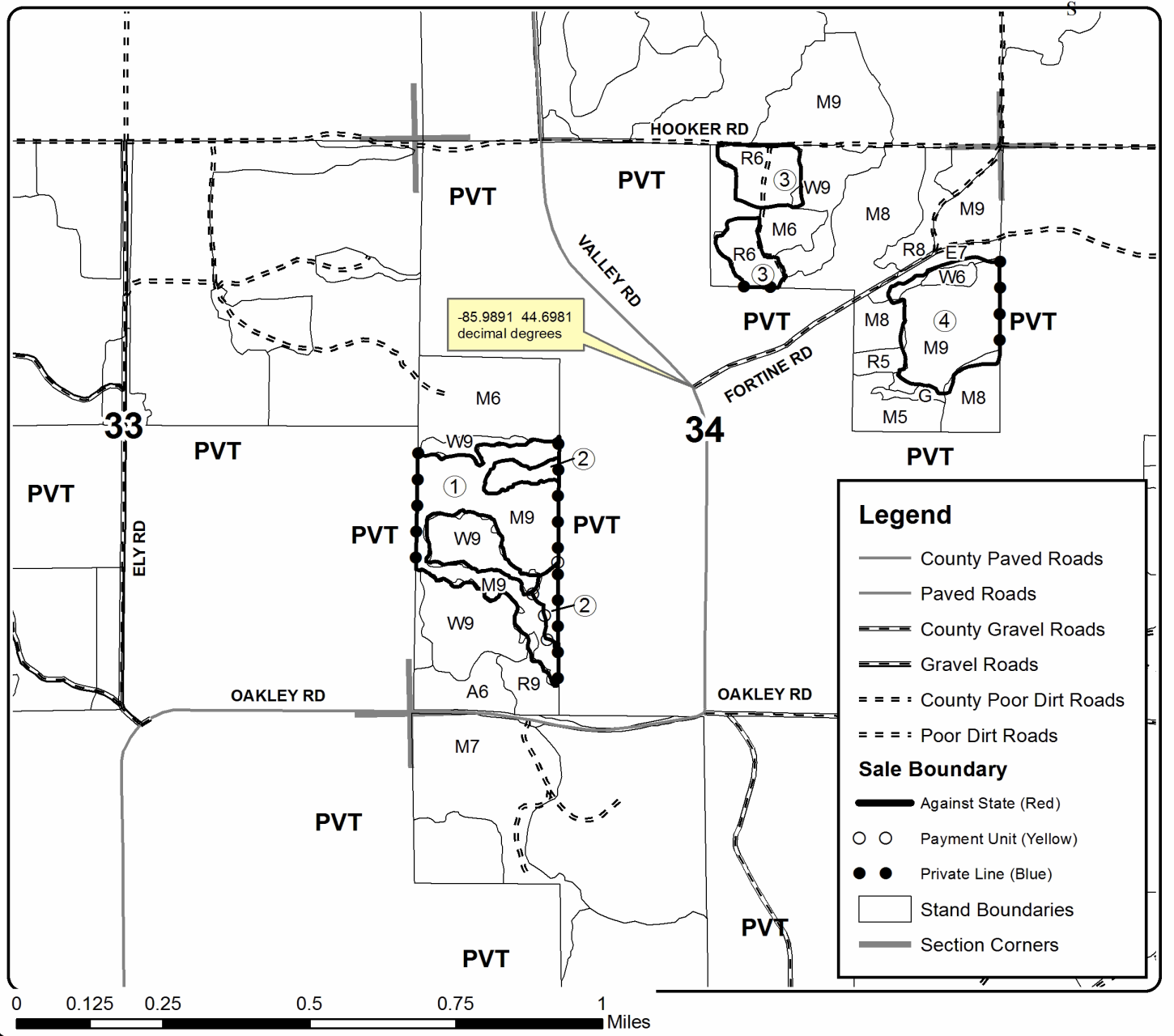

Old Supply Pine (61-040-20)  
T26N, R09W, SEC. 3; Grand Traverse COUNTY

In response to the notice of sale to be held 4:00 p.m. (local time) on July 15, 2021, I am hereby submitting my sealed bid ( firm offer) for the following forest products to be cut. Bids for individual species must be at or above the advertised price. All non-responsive bid forms may be rejected.

<u>PRODUCTS &amp; SPECIES</u>	<u>ESTIMATED VOLUME*</u>	<u>ADVERTISED PRICE</u>	<u>BID PRICE/UNIT</u>
<b>Sawtimber</b>			
B. T. Aspen	5.1 MBF	\$ 87.00/MBF	\$ _____
Red Oak	28.7 MBF	\$ 118.00/MBF	\$ _____
Red Pine	134.5 MBF	\$ 79.00/MBF	\$ _____
White Oak	9.9 MBF	\$ 74.00/MBF	\$ _____
White Pine	115.8 MBF	\$ 35.00/MBF	\$ _____
<b>Pulpwood</b>			
B. T. Aspen	65 Cords	\$ 12.55/Cord	\$ _____
Jack Pine	31 Cords	\$ 8.15/Cord	\$ _____
Mixed Oak	149 Cords	\$ 11.20/Cord	\$ _____
Red Maple	78 Cords	\$ 12.05/Cord	\$ _____
Red Pine	175 Cords	\$ 27.45/Cord	\$ _____
White Pine	195 Cords	\$ 13.10/Cord	\$ _____

\*The volumes are statistically estimated within plus (+) or minus (-) 9.72 percent at 95% confidence level. These estimated volumes are final and not subject to adjustment. Prospective bidders are urged to examine this timber and to make their own estimates of quantity and quality.

I understand that any or all bids may be rejected. All bids must be signed and all bid items must be bid or the bid form may be rejected. I also understand that consideration and awarding a contract will be based upon my past performance and ability to complete the contract based upon equipment and staffing subject to my control .

FEDERAL ID: \_\_\_\_\_ or SOCIAL SECURITY NUMBER: \_\_\_\_\_

Company or individual bidding: \_\_\_\_\_

Company representative's name: \_\_\_\_\_

Address: \_\_\_\_\_

City: \_\_\_\_\_ State: \_\_\_\_\_ Zip: \_\_\_\_\_

IF AVAILABLE, PLEASE PLACE THE PERSONALIZED LABEL FROM YOUR PROSPECTUS IN THE ABOVE BOX.

Individual or company representative's signature: \_\_\_\_\_ Date: \_\_\_\_\_

Phone number : \_\_\_\_\_ Email (optional): \_\_\_\_\_

**THE WINNING BIDDER MUST COMPLETE THE VERIFICATION OF WORKER'S DISABILITY COMPENSATION ACT COMPLIANCE (ON REVERSE SIDE IF DOUBLE SIDED) WITHIN 21 DAYS OF SALE AWARD DATE**



# TIMBER SALE VERIFICATION OF WORKER'S DISABILITY COMPENSATION ACT COMPLIANCE

As required by Act 317, P.A. 1969 (Worker's Compensation) and  
Part 5 of Act 451 of 1994, as amended.

FOR DEPARTMENT USE ONLY	
Sale Number (XX - XXX - XX - XX)	
Forest Management Unit:	

## VERIFICATION OF WORKER'S DISABILITY COMPENSATION ACT COMPLIANCE

- This verification must be completed and submitted within 21 days of contract award and prior to the issuance of the timber sale contract.
- In addition, if boxes 2B or 2C are checked, then Notice of Exclusion or Certificate of Insurance must be submitted within twenty-one (21) days of the contract award and prior to the issuance of the timber sale contract.
- All information must be typed or printed except for written signatures.

Please Check Appropriate Categories:

1. My business is organized as (you **must** check one of the boxes below):
  - A.  Sole Proprietorship (individual)
  - B.  Partnership
  - C.  Corporation
2. You **must** check one of the boxes below:
  - A.  I certify my business is a sole proprietorship and it has no employees but the sole proprietor. I am not subject to the Worker's Compensation Laws.
  - B.  I certify my business has satisfied its obligation to the Worker's Compensation Act through the use of an approved Notice of Exclusion (BWC-337, Rev. 5/96). I will provide a copy of the Notice of Exclusion within 21 days of the contract award. (For questions or a copy of the BWC-337, please call the Worker's Compensation Bureau at 517-322-1195).
  - C.  I certify my business has a Worker's Compensation Policy. I will provide an original Certificate of Insurance within twenty-one (21) days of the contract award.
3. If you have checked item 2(A) or 2(B), you **must** indicate the number of **both** full-time and part-time employees, other than yourself, including family members and active partners (if none, you must enter "0").

\_\_\_\_\_ Full-time Employees

\_\_\_\_\_ Part-time Employees

Name of Business		Federal ID (or) Social Security No.	
Address		Telephone (       )	
City	State	ZIP	

*I hereby certify that the above information is true and correct. I agree to notify the Michigan DNR of any changes that occur in factors affecting my coverage during any of my present and future operations.*

\_\_\_\_\_  
Signature of Owner or Authorized Representative

\_\_\_\_\_  
Title

\_\_\_\_\_  
Date

Please complete the "SEALED BID" information on the next page



Jack Pine Jag (61-050-20)  
T26N, R09W, SEC. 10; T26N, R09W, SEC. 9; Grand Traverse COUNTY

In response to the notice of sale to be held 4:00 p.m. (local time) on July 15, 2021, I am hereby submitting my sealed bid ( firm offer) for the following forest products to be cut. Bids for individual species must be at or above the advertised price. All non-responsive bid forms may be rejected.

<u>PRODUCTS &amp; SPECIES</u>	<u>ESTIMATED VOLUME*</u>	<u>ADVERTISED PRICE</u>	<u>BID PRICE/UNIT</u>
<b>Sawtimber</b>			
B. T. Aspen	7.1 MBF	\$ 87.00/MBF	\$ _____
Red Oak	140.4 MBF	\$ 118.00/MBF	\$ _____
Red Pine	18.2 MBF	\$ 79.00/MBF	\$ _____
White Oak	65.0 MBF	\$ 74.00/MBF	\$ _____
White Pine	36.2 MBF	\$ 35.00/MBF	\$ _____
<b>Pulpwood</b>			
B. T. Aspen	53 Cords	\$ 12.55/Cord	\$ _____
Jack Pine	7 Cords	\$ 8.15/Cord	\$ _____
Mixed Oak	541 Cords	\$ 11.20/Cord	\$ _____
Red Maple	117 Cords	\$ 12.05/Cord	\$ _____
Red Pine	22 Cords	\$ 27.45/Cord	\$ _____
White Pine	90 Cords	\$ 13.10/Cord	\$ _____

\*The volumes are statistically estimated within plus (+) or minus (-) 9.95 percent at 95% confidence level. These estimated volumes are final and not subject to adjustment. Prospective bidders are urged to examine this timber and to make their own estimates of quantity and quality.

I understand that any or all bids may be rejected. All bids must be signed and all bid items must be bid or the bid form may be rejected. I also understand that consideration and awarding a contract will be based upon my past performance and ability to complete the contract based upon equipment and staffing subject to my control .

FEDERAL ID: \_\_\_\_\_ or SOCIAL SECURITY NUMBER: \_\_\_\_\_

Company or individual bidding: \_\_\_\_\_

Company representative's name: \_\_\_\_\_

Address: \_\_\_\_\_

City: \_\_\_\_\_ State: \_\_\_\_\_ Zip: \_\_\_\_\_

IF AVAILABLE, PLEASE PLACE THE PERSONALIZED LABEL FROM YOUR PROSPECTUS IN THE ABOVE BOX.

Individual or company representative's signature: \_\_\_\_\_ Date: \_\_\_\_\_

Phone number : \_\_\_\_\_ Email (optional): \_\_\_\_\_

**THE WINNING BIDDER MUST COMPLETE THE VERIFICATION OF WORKER'S DISABILITY COMPENSATION ACT COMPLIANCE (ON REVERSE SIDE IF DOUBLE SIDED) WITHIN 21 DAYS OF SALE AWARD DATE**



Bracken Bad Aspen (61-059-20)  
T27N, R14W, SEC. 22; T27N, R14W, SEC. 23; T27N, R14W, SEC. 26; T27N,

In response to the notice of sale to be held 4:00 p.m. (local time) on July 15, 2021, I am hereby submitting my sealed bid ( firm offer) for the following forest products to be cut. Bids for individual species must be at or above the advertised price. All non-responsive bid forms may be rejected.

<u>PRODUCTS &amp; SPECIES</u>	<u>ESTIMATED VOLUME*</u>	<u>ADVERTISED PRICE</u>	<u>BID PRICE/UNIT</u>
<b>Sawtimber</b>			
Black Cherry	41.9 MBF	\$ 147.00/MBF	\$ _____
Mixed Aspen	47.0 MBF	\$ 87.00/MBF	\$ _____
Red Maple	18.6 MBF	\$ 118.00/MBF	\$ _____
Sugar Maple	1.7 MBF	\$ 171.00/MBF	\$ _____
White Pine	4.2 MBF	\$ 35.00/MBF	\$ _____
<b>Pulpwood</b>			
Mixed Aspen	653 Cords	\$ 12.55/Cord	\$ _____
Mixed Hardwood	745 Cords	\$ 12.05/Cord	\$ _____
White Pine	78 Cords	\$ 13.10/Cord	\$ _____

\*The volumes are statistically estimated within plus (+) or minus (-) 13.02 percent at 95% confidence level. These estimated volumes are final and not subject to adjustment. Prospective bidders are urged to examine this timber and to make their own estimates of quantity and quality.

I understand that any or all bids may be rejected. All bids must be signed and all bid items must be bid or the bid form may be rejected. I also understand that consideration and awarding a contract will be based upon my past performance and ability to complete the contract based upon equipment and staffing subject to my control .

FEDERAL ID: \_\_\_\_ - \_\_\_\_ - \_\_\_\_ or SOCIAL SECURITY NUMBER: \_\_\_\_ - \_\_\_\_ - \_\_\_\_

Company or individual bidding: \_\_\_\_\_

Company representative's name: \_\_\_\_\_

Address: \_\_\_\_\_

City: \_\_\_\_\_ State: \_\_\_\_\_ Zip: \_\_\_\_\_

IF AVAILABLE, PLEASE PLACE THE PERSONALIZED LABEL FROM YOUR PROSPECTUS IN THE ABOVE BOX.

Individual or company representative's signature: \_\_\_\_\_ Date: \_\_\_\_\_

Phone number : \_\_\_\_\_ Email (optional): \_\_\_\_\_

**THE WINNING BIDDER MUST COMPLETE THE VERIFICATION OF WORKER'S DISABILITY COMPENSATION ACT COMPLIANCE (ON REVERSE SIDE IF DOUBLE SIDED) WITHIN 21 DAYS OF SALE AWARD DATE**



<b>FOR DEPARTMENT USE ONLY</b>
Sale Number (XX - XXX - XX - XX)
Forest Management Unit:

## TIMBER SALE VERIFICATION OF WORKER'S DISABILITY COMPENSATION ACT COMPLIANCE

*As required by Act 317, P.A. 1969 (Worker's Compensation) and  
Part 5 of Act 451 of 1994, as amended.*

### VERIFICATION OF WORKER'S DISABILITY COMPENSATION ACT COMPLIANCE

- This verification must be completed and submitted within 21 days of contract award and prior to the issuance of the timber sale contract.
- In addition, if boxes 2B or 2C are checked, then Notice of Exclusion or Certificate of Insurance must be submitted within twenty-one (21) days of the contract award and prior to the issuance of the timber sale contract.
- All information must be typed or printed except for written signatures.

Please Check Appropriate Categories:

1. My business is organized as (you **must** check one of the boxes below):
  - A.  Sole Proprietorship (individual)
  - B.  Partnership
  - C.  Corporation
  
2. You **must** check one of the boxes below:
  - A.  I certify my business is a sole proprietorship and it has no employees but the sole proprietor. I am not subject to the Worker's Compensation Laws.
  - B.  I certify my business has satisfied its obligation to the Worker's Compensation Act through the use of an approved Notice of Exclusion (BWC-337, Rev. 5/96). I will provide a copy of the Notice of Exclusion within 21 days of the contract award. (For questions or a copy of the BWC-337, please call the Worker's Compensation Bureau at 517-322-1195).
  - C.  I certify my business has a Worker's Compensation Policy. I will provide an original Certificate of Insurance within twenty-one (21) days of the contract award.
  
3. If you have checked item 2(A) or 2(B), you **must** indicate the number of **both** full-time and part-time employees, other than yourself, including family members and active partners (if none, you must enter "0").

\_\_\_\_\_ Full-time Employees

\_\_\_\_\_ Part-time Employees

Name of Business		Federal ID (or) Social Security No.	
Address		Telephone (       )	
City	State	ZIP	

*I hereby certify that the above information is true and correct. I agree to notify the Michigan DNR of any changes that occur in factors affecting my coverage during any of my present and future operations.*

\_\_\_\_\_  
Signature of Owner or Authorized Representative

\_\_\_\_\_  
Title

\_\_\_\_\_  
Date

**Please complete the "SEALED BID" information on the next page**

Farmer's Wife Mix (61-061-20)  
T27N, R14W, SEC. 34; Benzie COUNTY

In response to the notice of sale to be held 4:00 p.m. (local time) on July 15, 2021, I am hereby submitting my sealed bid ( firm offer) for the following forest products to be cut. Bids for individual species must be at or above the advertised price. All non-responsive bid forms may be rejected.

<u>PRODUCTS &amp; SPECIES</u>	<u>ESTIMATED VOLUME*</u>	<u>ADVERTISED PRICE</u>	<u>BID PRICE/UNIT</u>
<b>Sawtimber</b>			
Basswood	28.4 MBF	\$ 75.00/MBF	\$ _____
Beech	8.1 MBF	\$ 53.00/MBF	\$ _____
Black Cherry	17.5 MBF	\$ 147.00/MBF	\$ _____
Mixed Aspen	12.1 MBF	\$ 87.00/MBF	\$ _____
Red Maple	31.3 MBF	\$ 118.00/MBF	\$ _____
Red Pine	34.5 MBF	\$ 79.00/MBF	\$ _____
Sugar Maple	30.5 MBF	\$ 171.00/MBF	\$ _____
White Pine	3.1 MBF	\$ 35.00/MBF	\$ _____
<b>Pulpwood</b>			
Basswood	65 Cords	\$ 10.95/Cord	\$ _____
Mixed Aspen	54 Cords	\$ 12.55/Cord	\$ _____
Mixed Hardwood	532 Cords	\$ 12.05/Cord	\$ _____
Red Pine	172 Cords	\$ 27.45/Cord	\$ _____
White Pine	44 Cords	\$ 13.10/Cord	\$ _____

\*The volumes are statistically estimated within plus (+) or minus (-) 14.27 percent at 95% confidence level. These estimated volumes are final and not subject to adjustment. Prospective bidders are urged to examine this timber and to make their own estimates of quantity and quality.

I understand that any or all bids may be rejected. All bids must be signed and all bid items must be bid or the bid form may be rejected. I also understand that consideration and awarding a contract will be based upon my past performance and ability to complete the contract based upon equipment and staffing subject to my control.

FEDERAL ID: \_\_\_\_\_ or SOCIAL SECURITY NUMBER: \_\_\_\_\_

Company or individual bidding: \_\_\_\_\_

Company representative's name: \_\_\_\_\_

Address: \_\_\_\_\_

City: \_\_\_\_\_ State: \_\_\_\_\_ Zip: \_\_\_\_\_

IF AVAILABLE, PLEASE PLACE THE PERSONALIZED LABEL FROM YOUR PROSPECTUS IN THE ABOVE BOX.

Individual or company representative's signature: \_\_\_\_\_ Date: \_\_\_\_\_

Phone number : \_\_\_\_\_ Email (optional): \_\_\_\_\_

**THE WINNING BIDDER MUST COMPLETE THE VERIFICATION OF WORKER'S DISABILITY COMPENSATION ACT COMPLIANCE (ON REVERSE SIDE IF DOUBLE SIDED) WITHIN 21 DAYS OF SALE AWARD DATE**



FOR DEPARTMENT USE ONLY	
Sale Number (XX - XXX - XX - XX)	
Forest Management Unit:	

## TIMBER SALE VERIFICATION OF WORKER'S DISABILITY COMPENSATION ACT COMPLIANCE

As required by Act 317, P.A. 1969 (Worker's Compensation) and  
Part 5 of Act 451 of 1994, as amended.

### VERIFICATION OF WORKER'S DISABILITY COMPENSATION ACT COMPLIANCE

- This verification must be completed and submitted within 21 days of contract award and prior to the issuance of the timber sale contract.
- In addition, if boxes 2B or 2C are checked, then Notice of Exclusion or Certificate of Insurance must be submitted within twenty-one (21) days of the contract award and prior to the issuance of the timber sale contract.
- All information must be typed or printed except for written signatures.

Please Check Appropriate Categories:

1. My business is organized as (you **must** check one of the boxes below):
  - A.  Sole Proprietorship (individual)
  - B.  Partnership
  - C.  Corporation
2. You **must** check one of the boxes below:
  - A.  I certify my business is a sole proprietorship and it has no employees but the sole proprietor. I am not subject to the Worker's Compensation Laws.
  - B.  I certify my business has satisfied its obligation to the Worker's Compensation Act through the use of an approved Notice of Exclusion (BWC-337, Rev. 5/96). I will provide a copy of the Notice of Exclusion within 21 days of the contract award. (For questions or a copy of the BWC-337, please call the Worker's Compensation Bureau at 517-322-1195).
  - C.  I certify my business has a Worker's Compensation Policy. I will provide an original Certificate of Insurance within twenty-one (21) days of the contract award.
3. If you have checked item 2(A) or 2(B), you **must** indicate the number of **both** full-time and part-time employees, other than yourself, including family members and active partners (if none, you must enter "0").

\_\_\_\_\_ Full-time Employees

\_\_\_\_\_ Part-time Employees

Name of Business		Federal ID (or) Social Security No.	
Address		Telephone (       )	
City	State	ZIP	

*I hereby certify that the above information is true and correct. I agree to notify the Michigan DNR of any changes that occur in factors affecting my coverage during any of my present and future operations.*

\_\_\_\_\_  
Signature of Owner or Authorized Representative

\_\_\_\_\_  
Title

\_\_\_\_\_  
Date

Please complete the "SEALED BID" information on the next page

Many Hands Hardwood (61-060-20)  
T27N, R14W, SEC. 22; T27N, R14W, SEC. 23; Benzie COUNTY

In response to the notice of sale to be held 4:00 p.m. (local time) on July 15, 2021, I am hereby submitting my sealed bid ( firm offer) for the following forest products to be cut. Bids for individual species must be at or above the advertised price. All non-responsive bid forms may be rejected.

<u>PRODUCTS &amp; SPECIES</u>	<u>ESTIMATED VOLUME*</u>	<u>ADVERTISED PRICE</u>	<u>BID PRICE/UNIT</u>
<b>Sawtimber</b>			
Basswood	70.8 MBF	\$ 75.00/MBF	\$ _____
Beech	124.1 MBF	\$ 53.00/MBF	\$ _____
Black Cherry	46.2 MBF	\$ 147.00/MBF	\$ _____
Mixed Aspen	48.2 MBF	\$ 87.00/MBF	\$ _____
Red Maple	90.8 MBF	\$ 118.00/MBF	\$ _____
Red Pine	11.4 MBF	\$ 79.00/MBF	\$ _____
Sugar Maple	81.3 MBF	\$ 171.00/MBF	\$ _____
White Pine	103.6 MBF	\$ 35.00/MBF	\$ _____
<b>Pulpwood</b>			
Basswood	60 Cords	\$ 10.95/Cord	\$ _____
Mixed Aspen	70 Cords	\$ 12.55/Cord	\$ _____
Mixed Hardwood	930 Cords	\$ 12.05/Cord	\$ _____
Red Pine	64 Cords	\$ 27.45/Cord	\$ _____
White Pine	508 Cords	\$ 13.10/Cord	\$ _____

\*These estimated volumes are final and not subject to adjustment. Prospective bidders are urged to examine this timber and to make their own estimates of quantity and quality.

I understand that any or all bids may be rejected. All bids must be signed and all bid items must be bid or the bid form may be rejected. I also understand that consideration and awarding a contract will be based upon my past performance and ability to complete the contract based upon equipment and staffing subject to my control.

FEDERAL ID: \_\_\_\_\_ or SOCIAL SECURITY NUMBER: \_\_\_\_\_

Company or individual bidding: \_\_\_\_\_

Company representative's name: \_\_\_\_\_

Address: \_\_\_\_\_

City: \_\_\_\_\_ State: \_\_\_\_\_ Zip: \_\_\_\_\_

IF AVAILABLE, PLEASE PLACE THE PERSONALIZED LABEL FROM YOUR PROSPECTUS IN THE ABOVE BOX.

Individual or company representative's signature: \_\_\_\_\_ Date: \_\_\_\_\_

Phone number : \_\_\_\_\_ Email (optional): \_\_\_\_\_

**THE WINNING BIDDER MUST COMPLETE THE VERIFICATION OF WORKER'S DISABILITY COMPENSATION ACT COMPLIANCE (ON REVERSE SIDE IF DOUBLE SIDED) WITHIN 21 DAYS OF SALE AWARD DATE**



<b>FOR DEPARTMENT USE ONLY</b>	
Sale Number (XX - XXX - XX - XX)	
Forest Management Unit:	

## TIMBER SALE VERIFICATION OF WORKER'S DISABILITY COMPENSATION ACT COMPLIANCE

As required by Act 317, P.A. 1969 (Worker's Compensation) and  
Part 5 of Act 451 of 1994, as amended.

### VERIFICATION OF WORKER'S DISABILITY COMPENSATION ACT COMPLIANCE

- This verification must be completed and submitted within 21 days of contract award and prior to the issuance of the timber sale contract.
- In addition, if boxes 2B or 2C are checked, then Notice of Exclusion or Certificate of Insurance must be submitted within twenty-one (21) days of the contract award and prior to the issuance of the timber sale contract.
- All information must be typed or printed except for written signatures.

Please Check Appropriate Categories:

1. My business is organized as (you **must** check one of the boxes below):
  - A.  Sole Proprietorship (individual)
  - B.  Partnership
  - C.  Corporation
2. You **must** check one of the boxes below:
  - A.  I certify my business is a sole proprietorship and it has no employees but the sole proprietor. I am not subject to the Worker's Compensation Laws.
  - B.  I certify my business has satisfied its obligation to the Worker's Compensation Act through the use of an approved Notice of Exclusion (BWC-337, Rev. 5/96). I will provide a copy of the Notice of Exclusion within 21 days of the contract award. (For questions or a copy of the BWC-337, please call the Worker's Compensation Bureau at 517-322-1195).
  - C.  I certify my business has a Worker's Compensation Policy. I will provide an original Certificate of Insurance within twenty-one (21) days of the contract award.
3. If you have checked item 2(A) or 2(B), you **must** indicate the number of **both** full-time and part-time employees, other than yourself, including family members and active partners (if none, you must enter "0").

\_\_\_\_\_ Full-time Employees

\_\_\_\_\_ Part-time Employees

Name of Business		Federal ID (or) Social Security No.	
Address		Telephone (       )	
City	State	ZIP	

*I hereby certify that the above information is true and correct. I agree to notify the Michigan DNR of any changes that occur in factors affecting my coverage during any of my present and future operations.*

\_\_\_\_\_  
Signature of Owner or Authorized Representative

\_\_\_\_\_  
Title

\_\_\_\_\_  
Date

Please complete the "SEALED BID" information on the next page