



**DEPARTMENT OF NATURAL RESOURCES  
STATE OF MICHIGAN**

**TIMBER SALE PROSPECTUS #6805**

SCHEDULED SALE DATE AND TIME: 3:00 p.m. (local time) on April 1, 2021.

LOCATION: NEWBERRY MGMT UNIT, 5666 S STATE HWY M 123, NEWBERRY, MI 49868.

PROSPECTUS NOTE: The bidder is advised to inspect the sale area and review the location, estimated volumes, operating costs and contract terms of proposed sales. Please be aware that some landowners may request 60 days or more notice for access across their land.

Notice is hereby given that bids will be received by the Unit Manager, NEWBERRY MANAGEMENT UNIT, for certain timber on the following described lands:

Sixteen Split Spruce Mix (42-010-20) / T46N, R09W, SEC. 15, W1/2NW,NWSW.

T46N, R09W, SEC. 16, N1/2NW,SENE,NE,E1/2SW,SE.

T46N, R09W, SEC. 9 , E1/2SW,SWSE.

Luce County, Advertised Price \$77,824.75, 275.0 Acres, Spruce/Fir/Tamarack, Hardwood.

SALE NOTE: Road maintenance may be needed. See Sale Spec 4.2.3 for additional information.

Harvesting is limited to the period of December 1 to April 1 due to wet soils.

The Charcoal Grade is a snowmobile trail and is shown on the Timber Sale Map. See Spec 5.2.41 for additional information.

A recreation site such as a trail, pathway, or campground is within the sale area or the vicinity. Certain restrictions/specifications may be applicable including time restrictions.

Wheel Hub Lowlands (42-011-20) / T46N, R09W, SEC. 18, NWNW,S1/2NW,N1/2SW.

T46N, R10W, SEC. 13, E1/2NE.

Luce County, Advertised Price \$19,167.00, 74.5 Acres, N White Cedar, Hardwood.

SALE NOTE: No new roads will be permitted in any Payment Unit. All operations are limited to existing roads. Skid trails and stub roads off main roads will only be allowed.

Harvesting is limited to the period of December 1 to April 1 due to wet soil types that occur throughout the Sale Area.

The Charcoal Grade is a snowmobile trail and is shown on the Timber Sale Map. See Sale Spec 5.2.41 for additional information.

A recreation site such as a trail, pathway, or campground is within the sale area or the vicinity. Certain restrictions/specifications may be applicable including time restrictions.

## BID INSTRUCTIONS (VER. 07/02/2018):

### 1. Scheduled Bid Location, Date, and Time (2/11)

Bids must be received by the Unit Manager, NEWBERRY OFFICE, 5666 S STATE HWY M 123, NEWBERRY, MI 49868, no later than 3:00 p.m. (local time) on April 1, 2021. For further information concerning this sale, contact Keith Magnusson at 906-293-3293 extension 4740.

### 2. Bidder's Qualifications (5/16)

Purchaser shall obtain workers compensation insurance to cover claims under Michigan's Worker's Disability Compensation Act of 1969 or similar employee benefit act of any other state applicable to an employee. If all or part of a timber sale was prepared by a private contractor, the contractor and that contractor's company are not permitted to bid on the timber sale contract. Bids will not be accepted from individuals or companies appearing on the DNR/FRD No-Bid List. This list contains the names of purchasers who previously failed to execute a contract within 21-days or who have a history of poor performance.

### 3. Preparation of Sealed Bids (5/16)

Bid Forms may be completed online thru Michigan DNR Timber Sale Online Bidding (OLB) at [www.michigan.gov/timberbidding](http://www.michigan.gov/timberbidding) or by completing the hardcopy Bid Form found in the Timber Sale Prospectus. Hardcopy Bid Forms shall be manually signed in ink. Registration in OLB is considered your 'signature' for all bids submitted thru that system. Bid prices must be entered for each species and product in the Bid Price column for all material subject to bidding and all fill-in blanks must be completed. If erasures or other changes appear on the hardcopy Bid Form, each erasure or change must be initialed by the person signing the bid.

### 4. Submission of Sealed Bids (5/16)

Bid forms may be obtained from the Unit Manager or thru OLB. Bids may be submitted hardcopy or thru OLB. All hardcopy bids must be submitted on the bid form and in an envelope clearly identified as described in this section. NOTE: Only one bid form per bid envelope. Sealed bids must be submitted to the Unit office designated in the prospectus and must be submitted at or prior to the time established in the prospectus. The envelope should show on the outside (a) the sale name or number and (b) the date and time of bid opening, as shown in the prospectus. Bids received after the time specified in the sale prospectus are late bids and will be rejected.

It is possible for a bidder to submit multiple bids on a single sale. For example, a bid may be submitted hardcopy and a bid may be submitted thru OLB. Or, two bidders from the same company could both submit bids on the same sale. If this were to happen, the State would accept all bids received and award the contract accordingly. All bidding and contractual requirements would apply to all bids received.

### 5. Public Opening of Sealed Bids (7/16)

If conditions permit, the sealed bids will be publicly opened and posted at the time and place set in the prospectus.

If a bidder, present at a bid opening, has submitted bids on more than one sale, that bidder may withdraw their unopened bid envelopes or announce the withdrawal of their online bid after being declared the successful bidder on one sale.

### 6. Award of Contract (1/11)

Award of the contract will be made to the Bidder whose bid, conforming to the prospectus, is most advantageous to the State of Michigan on the basis of total value at rates bid for the estimated quantities. The State reserves the right to reject any bid or waive any minor irregularity in bids received. A written award mailed (or otherwise furnished) to the successful Bidder shall be deemed to result in a binding contract without further action by either party.

### 7. Down Payment (1/11)

The Bidder to whom award is made must make a down payment within 21 days of the sale award. The amount of the down payment will be calculated as shown in the Bond and Payment Schedule of this prospectus. Only cash may be used to meet this requirement.

### 8. Performance Security (1/11)

As guarantee of faithful performance, a cash bond, certificate of deposit, surety bond or irrevocable letter of credit (LOC) is required within 21 days of the sale award. The amount of the performance security is shown in the Bond and

Payment Schedule of this prospectus. If an LOC or surety is used, the coverage must extend for at least 6 months beyond the contract expiration.

#### 9. Timber Sale Contract (7/18)

Additional conditions and requirements common to all timber sales are listed on the timber sale contract (R4031) and are available on line at [www.michigan.gov/timber](http://www.michigan.gov/timber). Contact the Unit Manager for additional information or a sample contract. Within 21 days of the date of the award letter, the bidder must sign the contract and provide the required down payment, performance security, and verification of worker's disability compensation. The down payment and performance security shall be in accordance with the provisions of the timber sale contract, in the sums stated in this prospectus. If these actions are not taken, then the Bidder, the Bidder's corporation, and the corporation's principals may not be permitted to bid on State timber sales for a period of 3 months after the first offense, 6 months after the second offense, and 1 year after the third offense. An offense will only be counted against the Bidder for 5 years. In addition, the Bidder certifies that if awarded this contract, the Bidder will complete the timber sale contract in accordance with its terms and any modifications thereof including requirements to purchase, cut, and remove the included timber by the expiration date.

Payment Unit values in the State Forest Timber Sale Contract are calculated based on the advertised value of the Payment Unit as a percentage of the total advertised value of the contract. The advertised value of each Payment Unit is given in the Description of Timber by Payment Unit table on the Timber Sale Information page. For example, if the value of Payment Unit 1 is advertised as \$1,500 and the total Timber Sale value is advertised as \$10,000, the contract price for Payment Unit 1 will be 15% of the total bid price ( $\$1,500/\$10,000 * 100$ ).

#### 10. Disclaimer of Estimates and Bidder's Warranty of Inspection (7/16)

Before submitting this bid, the Bidder is advised and cautioned to inspect the sale area, review the requirements of the sale contract, and take other steps as may be reasonably necessary to ascertain the location, estimated volumes, construction estimates, and operating costs of the proposed sale. Failure to do so will not relieve the Bidder from responsibility for completing the contract.

The Bidder warrants that this bid is submitted solely on the basis of the Bidder's examination and inspection of the quality and quantity of the timber offered for sale and the Bidder's opinion of the value thereof and the costs of recovery. No reliance should be placed on the State of Michigan's estimates of timber quality, quantity or costs of recovery. Bidder further acknowledges that the State of Michigan: (i) expressly disclaims any warranty of fitness of timber for any purpose; (ii) offers this timber as is without any warranty of quality (merchantability) or quantity and (iii) expressly disclaims any warranty as to the quantity or quality of timber sold.

#### 11. Certification and Chain-of-Custody (10/14)

Unless otherwise indicated in the contract under section 7 – Other Conditions of the Sale Specific Conditions & Requirements, the area encompassed by this timber sale is certified to the standards of the Forest Stewardship Council (FSC) - Certificate #SCS-FM/COC-00090N and the Sustainable Forestry Initiative (SFI) - Certificate #NSF-SFIS-5Y031-SF5. Forest products from this sale may be delivered to the mill as "FSC 100% and / or SFI certified" as long as the contractor hauling the forest products is chain-of-custody (COC) certified or covered under a COC certificate from the destination mill. The purchaser is responsible for maintaining COC after leaving the sale area.

#### 12. Good Neighbor Authority (GNA) Requirements (7/16)

If the name of this timber sales contains the acronym GNA, it is authorized by the Good Neighbor Authority (GNA) and covered by various agreements between the U.S. Forest Service and the State. The timber sale occurs on federal land and the following conditions apply:

GNA contracts on US Forest Service land will not be awarded to purchasers on the Federal list of excluded parties. The System for Award Management (SAM) will be checked for active excluded parties prior to award of contract. In addition, the Bidder to whom award is made must complete an Assurance Regarding Felony Conviction or Tax Delinquent Status for Corporate Applicants (AD-3031).

#### 13. Good Neighbor Authority (GNA) Requirements, con't (9/16)

Bidder certifies, by signing this bid form, that to the best of Bidder's knowledge that the following representations are accurate and complete.

- a. That the Bidder and its principals are not presently debarred, suspended, proposed for debarment, declared ineligible, or voluntary excluded from timber sales (covered transactions) by any Federal department or agency.
- b. That the Bidder and its principals have not within a 3-year period preceding this bid been convicted of or had a civil judgment rendered against them for commission of fraud or a criminal offense in connection with obtaining , attempting to obtain, or performing a public (Federal, State, or local) transaction or contract under a public transaction; violation of Federal or State antitrust statutes or commission of embezzlement, theft, forgery, bribery, falsification or destruction of records, making false statements, or receiving stolen property.
- c. That the Bidder and its principals are not presently indicted for or otherwise criminally or civilly charged by a governmental entity (Federal, State, or local) with commission of any of the offenses enumerated in paragraph b of this certification.
- d. That the Bidder and its principals have not within a 3-year period preceding this bid had one or more public transactions (Federal, State, or local) terminated for breach or default of a timber or forest product contract.

Bidders that cannot certify this requirement, in whole or in part, shall submit an explanation with their bid.

DAN EICHINGER  
Director

## TIMBER SALE INFORMATION

Sixteen Split Spruce Mix (42-010-20)  
 T46N, R09W, SEC. 15; T46N, R09W, SEC. 16; T46N, R09W, SEC. 9.  
 Luce County (Advertised Price \$77,824.75)

SALE NOTE: Road maintenance may be needed. See Sale Spec 4.2.3 for additional information.

Harvesting is limited to the period of December 1 to April 1 due to wet soils.

The Charcoal Grade is a snowmobile trail and is shown on the Timber Sale Map. See Spec 5.2.41 for additional information.

A recreation site such as a trail, pathway, or campground is within the sale area or the vicinity. Certain restrictions/specifications may be applicable including time restrictions.

A timber sale contract for this lump sum, sealed bid timber sale will be awarded to the responsible bidder offering the highest sealed bid price. All units of volume listed below were estimated using the T-Sale computer program and our traditional volume equations. Bids must be at or above the following advertised price for each product and species:

<u>PRODUCTS &amp; SPECIES</u>	<u>ESTIMATED UNITS*</u>	<u>ADVERTISED PRICE</u>
Sawtimber		
Paper Birch	6.6 MBF	\$ 25.00 / MBF
Red Maple	31.1 MBF	\$ 71.00 / MBF
Pulpwood		
Balsam Fir	356 Cords	\$ 9.00 / Cord
Mixed Aspen	805 Cords	\$ 13.80 / Cord
Mixed Hardwood	1,398 Cords	\$ 11.65 / Cord
Mixed Spruce	3,059 Cords	\$ 11.75 / Cord
N. White Cedar	1,144 Cords	\$ 4.15 / Cord
Red Pine	33 Cords	\$ 49.80 / Cord
Tamarack	62 Cords	\$ 5.05 / Cord
White Pine	146 Cords	\$ 15.10 / Cord

\* The total volume is statistically estimated within plus (+) or minus (-) 9.83 percent. There are an estimated 7,129 cords on this timber sale, plus or minus 701 cords at the 95% confidence level. The estimated units are final and not subject to adjustment. Prospective bidders are urged to examine this timber and to make their own estimates of quantity and quality.

### **BOND AND PAYMENT SCHEDULE:**

1. A bond in the amount of \$3,891.00 to insure faithful performance of the conditions of the contract will be deposited by the successful bidder within 21 days of the sale award.
2. Cutting in any sale or unit without the required advance payment would be considered a trespass.
3. Total payment must be paid in advance or according to the following schedule :
  - (a) Ten percent (10%) of the sale value must be paid within 21 days of the sale award.
  - (b) The 10% down payment will be credited towards the first unit cut.

(c) Payment for each of the following units must be made before cutting begins in that unit:

PAYMENT UNIT NUMBER	PERCENT OF TOTAL SALE VALUE
01	5.2%
02	4.0%
03	7.7%
04	2.2%
05	5.5%
06	6.7%
07	11.6%
08	6.9%
09	16.0%
10	12.0%
11	11.5%
12	10.7%

4. If no cutting takes place, the 10% down payment will not be refunded.
5. Operations on the contract issued will terminate on 06/30/2025.

### **SALE STATISTICS**

**SALE VOLUMES**

VOLUME			STATISTICAL RANGE IN CORDS	
TOTAL CUBIC FEET	TOTAL CORDS	PERCENT ERROR	MINIMUM	MAXIMUM
563,174	7,129	9.83%	6,428	7,830

**VDU VOLUMES**

A VDU is a Volume Determination Unit. Volumes and their associated statistics are calculated at the VDU level and summarized to the sale level. There is often a one to one relationship between a VDU and a Payment Unit, but not always, depending on the cruise design. Refer to the VDU TO PAYMENT UNIT table.

VDU	VOLUME			RANGE IN CORDS	
	TOTAL CUBIC FEET	TOTAL CORDS	PERCENT ERROR	MINIMUM	MAXIMUM
2	204,610	2,590	28.45%	1,853	3,327
3	84,372	1,068	21.54%	838	1,298
4	34,420	436	27.93%	314	557
34	18,526	235	0.32%	234	235
36	945,662	11,970	15.21%	10,150	13,791
37	80,493	1,019	21.90%	796	1,242
42	48,822	618	27.31%	449	787
<b>TOTAL:</b>	<b>1,416,905</b>	<b>17,936</b>		<b>14,634</b>	<b>21,237</b>

**VDU TO PAYMENT UNIT**

When a VDU is associated with more than one Payment Unit (PU), the VDU volumes are assigned to the PU based on acres of the VDU within the PU.

VDU	VDU ACRES	PU	PU ACRES
2	56.1	6	20.2
		10	35.9
3	21.9	4	6.2
		5	15.7
		1	11.7
34	5.1	2	5.1
36	122.5	7	34.9
		8	20.7
		11	34.8
		12	32.1
37	29.0	9	29.0
42	28.7	3	28.7
<b>TOTAL:</b>	<b>275.0</b>		<b>275.0</b>

**DESCRIPTION OF TIMBER BY PAYMENT UNIT (PU)**

PU	MARKET GROUP	PRODUCT	QUANTITY	UNIT	ACRES	ADVERTISE PRICE
1	Balsam Fir	Pulpwood	41	Cords	11.7	\$4,071.65
	Mixed Hardwood		38	Cords		
	<i>Red Maple</i>		38	Cords		
	Mixed Spruce		234	Cords		
	<i>Black Spruce</i>		216	Cords		
	<i>White Spruce</i>		18	Cords		
	N. White Cedar		123	Cords		
2	Red Maple	Sawtimber	17.5	MBF	5.1	\$3,110.30
	Mixed Aspen	Pulpwood	13	Cords		
	<i>Quaking Aspen</i>		13	Cords		
	Mixed Hardwood		107	Cords		
	<i>Red Maple</i>		107	Cords		
	Mixed Spruce		15	Cords		
	<i>Black Spruce</i>		15	Cords		
N. White Cedar	64		Cords			
3	Red Maple	Sawtimber	2.1	MBF	28.7	\$5,993.70
	Balsam Fir	Pulpwood	15	Cords		
	Mixed Hardwood		24	Cords		
	<i>Red Maple</i>		24	Cords		
	Mixed Spruce		395	Cords		
	<i>Black Spruce</i>		395	Cords		
	N. White Cedar		128	Cords		
Tamarack	51		Cords			
4	Paper Birch	Sawtimber	0.6	MBF	6.2	\$1,702.15
	Balsam Fir	Pulpwood	20	Cords		
	Mixed Aspen		4	Cords		
	<i>Quaking Aspen</i>		4	Cords		
	Mixed Hardwood		23	Cords		
	<i>Paper Birch</i>		7	Cords		
	<i>Red Maple</i>		16	Cords		
	Mixed Spruce		99	Cords		
	<i>Black Spruce</i>		96	Cords		
	<i>White Spruce</i>		3	Cords		
N. White Cedar	5		Cords			
5	Paper Birch	Sawtimber	1.4	MBF	15.7	\$4,272.40
	Balsam Fir	Pulpwood	50	Cords		
	Mixed Aspen		9	Cords		
	<i>Quaking Aspen</i>		9	Cords		
	Mixed Hardwood		56	Cords		
	<i>Paper Birch</i>		17	Cords		
	<i>Red Maple</i>		39	Cords		
	Mixed Spruce		252	Cords		
	<i>Black Spruce</i>		244	Cords		
	<i>White Spruce</i>		8	Cords		
N. White Cedar	12		Cords			
6	Balsam Fir	Pulpwood	12	Cords	20.2	\$5,245.45
	Mixed Aspen		21	Cords		
	<i>Quaking Aspen</i>		21	Cords		
	Mixed Hardwood		5	Cords		
	<i>Red Maple</i>		5	Cords		
	Mixed Spruce		396	Cords		
	<i>Black Spruce</i>		384	Cords		
	<i>White Spruce</i>		12	Cords		
	N. White Cedar		28	Cords		
	Tamarack		4	Cords		

**DESCRIPTION OF TIMBER BY PAYMENT UNIT (PU), CON'T**

PU	MARKET GROUP	PRODUCT	QUANTITY	UNIT	ACRES	ADVERTISE PRICE
7	Paper Birch	Sawtimber	1.3	MBF	34.9	\$9,005.45
	Red Maple		1.3	MBF		
	Balsam Fir	Pulpwood	44	Cords		
	Mixed Aspen		74	Cords		
	<i>B. T. Aspen</i>		6	<i>Cords</i>		
	<i>Quaking Aspen</i>		68	<i>Cords</i>		
	Mixed Hardwood		240	Cords		
	<i>Paper Birch</i>		51	<i>Cords</i>		
	<i>Red Maple</i>		189	<i>Cords</i>		
	Mixed Spruce		232	Cords		
	<i>Black Spruce</i>		210	<i>Cords</i>		
	<i>White Spruce</i>		22	<i>Cords</i>		
	N. White Cedar		207	Cords		
	Red Pine		9	Cords		
	White Pine		42	Cords		
8	Paper Birch	Sawtimber	0.8	MBF	20.7	\$5,366.75
	Red Maple		0.8	MBF		
	Balsam Fir	Pulpwood	26	Cords		
	Mixed Aspen		43	Cords		
	<i>B. T. Aspen</i>		3	<i>Cords</i>		
	<i>Quaking Aspen</i>		40	<i>Cords</i>		
	Mixed Hardwood		142	Cords		
	<i>Paper Birch</i>		30	<i>Cords</i>		
	<i>Red Maple</i>		112	<i>Cords</i>		
	Mixed Spruce		138	Cords		
	<i>Black Spruce</i>		125	<i>Cords</i>		
	<i>White Spruce</i>		13	<i>Cords</i>		
	N. White Cedar		123	Cords		
	Red Pine		6	Cords		
	White Pine		25	Cords		
9	Red Maple	Sawtimber	6.9	MBF	29.0	\$12,462.80
	Balsam Fir	Pulpwood	41	Cords		
	Mixed Aspen		462	Cords		
	<i>Quaking Aspen</i>		462	<i>Cords</i>		
	Mixed Hardwood		295	Cords		
	<i>Paper Birch</i>		17	<i>Cords</i>		
	<i>Red Maple</i>		278	<i>Cords</i>		
	Mixed Spruce		150	Cords		
	<i>Black Spruce</i>		60	<i>Cords</i>		
	<i>White Spruce</i>		90	<i>Cords</i>		
	N. White Cedar		7	Cords		
	10	Balsam Fir	Pulpwood	22		
Mixed Aspen			37	Cords		
<i>Quaking Aspen</i>			37	<i>Cords</i>		
Mixed Hardwood			9	Cords		
<i>Red Maple</i>			9	<i>Cords</i>		
Mixed Spruce			704	Cords		
<i>Black Spruce</i>			682	<i>Cords</i>		
<i>White Spruce</i>			22	<i>Cords</i>		
N. White Cedar			51	Cords		
Tamarack			7	Cords		
11	Paper Birch	Sawtimber	1.3	MBF	34.8	\$8,962.80
	Red Maple		1.3	MBF		
	Balsam Fir	Pulpwood	44	Cords		
	Mixed Aspen		74	Cords		
	<i>B. T. Aspen</i>		6	<i>Cords</i>		



**DESCRIPTION OF TIMBER BY PAYMENT UNIT (PU), CON'T**

PU	MARKET GROUP	PRODUCT	QUANTITY	UNIT	ACRES	ADVERTISE PRICE
11 con't	<i>Quaking Aspen</i>	<i>Pulpwood</i>	68	<i>Cords</i>		
	Mixed Hardwood		239	Cords		
	<i>Paper Birch</i>		50	<i>Cords</i>		
	<i>Red Maple</i>		189	<i>Cords</i>		
	Mixed Spruce		231	Cords		
	<i>Black Spruce</i>		209	<i>Cords</i>		
	<i>White Spruce</i>		22	<i>Cords</i>		
	N. White Cedar		206	Cords		
	Red Pine		9	Cords		
	White Pine		41	Cords		
12	Paper Birch	Sawtimber	1.2	MBF	32.1	\$8,298.85
	Red Maple		1.2	MBF		
	Balsam Fir	Pulpwood	41	Cords		
	Mixed Aspen		68	Cords		
	<i>B. T. Aspen</i>		5	<i>Cords</i>		
	<i>Quaking Aspen</i>		63	<i>Cords</i>		
	Mixed Hardwood		220	Cords		
	<i>Paper Birch</i>		46	<i>Cords</i>		
	<i>Red Maple</i>		174	<i>Cords</i>		
	Mixed Spruce		213	Cords		
	<i>Black Spruce</i>		193	<i>Cords</i>		
	<i>White Spruce</i>		20	<i>Cords</i>		
	N. White Cedar		190	Cords		
	Red Pine		9	Cords		
	White Pine		38	Cords		
	TOTAL:			37.7		
TOTAL:			7,003	Cords		

## Sale Specific Conditions & Requirements

**Sale Name: Sixteen Split Spruce Mix**

**Sale Number: 42-010-20 Seq#: 2**

### 1 - Sale Area

#### 1.2 - Boundaries

##### 1.2.1 - Painted boundaries (9/19)

The sale boundary and Payment Unit boundaries are marked and identified by red, blue, and yellow paint. Exterior sale boundary lines against private land are marked with blue paint. Exterior sale boundary lines against state are marked with red paint. Interior Payment Unit boundaries are marked with yellow paint. Yellow painted trees designating an interior Payment Unit boundary are only to be cut when all surrounding Payment Units have been paid.

### 2 - Timber Specifications

#### 2.1 - Included Timber

##### 2.1.2 - Clearcut unit(s) w/o unmerchantable trees (8/11)

Within Payment Unit(s) 1-12, cut all trees which meet minimum piece specifications in 2.2 Utilization, except do not cut hemlock. In addition, the following exceptions apply:

- Within Payment Units 1-7, 9, and 10, leave all white pine.
- Within Payment Units 3, 7, 8, 11, and 12, leave all yellow birch.
- Within Payment Units 8, 11, and 12, leave any red pine over 16 inches at DBH and any white pine over 18 inches at DBH.

### 3 - Payments

#### 3.3 - Pre-measured Sales

##### 3.3.4 - Dividing payment units (7/14)

Payment Unit(s) 7, 9, 10, 11, and 12 may be divided at the request of the Purchaser and upon approval of the Unit Manager. Dividing Payment Units is a contract modification which requires a Timber Sale Contract Amendment. There will be only one division per Payment Unit.

### 4 - Transportation

#### 4.1 - Construction

##### 4.1.3 - Slash and earthen piles (8/04)

Piles or windrows of earth along roads and landings that have been widened or constructed shall be leveled. Slash from road maintenance or construction, including stumps, shall be dispersed throughout the sale.

##### 4.1.4 - Timber removed for construction (12/09)

Trees cut or damaged in the process of pre-approved road, landing or skid trail construction will be decked in an area separate from other Designated Timber and not removed until measured by the sale administrator. Payment will be made at the specified Purchase Unit Price.

##### 4.1.6 - Road construction (1/09)

Construction of new roads or improvements of existing roads shall be done in such a way as to minimize the environmental and visual impacts. Merchantable trees shall be cut and utilized unless otherwise directed. Non-merchantable trees shall be severed and laid flat on the ground. Slash shall be scattered, and not left in windrows and kept a minimum of 10 feet back from the road edge. Stumps shall be set upright, not left on edge, and be moved at least 10 feet away from the road edge. Disturbed soil shall be feathered into the woods and not left in berms or windrows.

##### 4.1.7 - Road closure (10/11)

All new roads built into the sale must be blocked to vehicle traffic upon completion of the sale. Overgrown roads that are reopened shall be considered new roads. In general, this will require constructing a four (4') foot high berm of stumps and logs covered with earth. These roads must be rendered impassable to cars and trucks. Contact the sale administrator for specific details of design and placement.

#### 4.2 - Maintenance

#### 4.2.1 - Hauling restriction (12/08)

Hauling may be restricted on forest roads by the Unit Manager or his/her representative. The restriction may occur during spring breakup or during wet weather conditions.

#### 4.2.3 - Road maintenance (8/13)

The following road maintenance may be needed: cleaning of drainage areas, grading, crowning, and filling with gravel, if necessary. Damages will be assessed if grading/repair does not occur.

#### 4.2.5 - Two wheel drive condition (2/04)

All existing trail roads on and adjacent to the sale area must be passable by two-wheel drive traffic for the duration of the sale.

### 5 - Operations

#### 5.2 - Conduct of Operations

##### 5.2.1 - Slash

###### 5.2.1.8 - Slash height (12/08)

No slash or tree tops may exceed 24 inches in height.

##### 5.2.2 - Hazard Trees/Snags

###### 5.2.2.1 - Den trees (10/16)

Obvious hollow and/or den trees shall be protected and left standing unless they are a safety hazard.

##### 5.2.3 - Operating Restrictions

###### 5.2.3.1 - Operating restrictions (9/11)

Within Payment Unit(s) 1-12, unless changed by written agreement, cutting, skidding, and hauling are limited to the period of December 1 to April 1. This restriction is because of wet soils.

##### 5.2.17 - Timber Mats and Interlocking Composite Mats (3/18)

Some roads or skid trails may require extra protection such as that afforded by timber mats, interlocking composite mats, or another approved system. If available, mats may be borrowed from the DNR. A Timber Sale Contract Supplement will be used to document the Purchaser's use of the DNR's mats. Contact the sale administrator regarding availability and pick-up. Timber mats are available from various field offices. Composite mats are only available from the Grayling field office. The Purchaser is responsible for picking up and hauling the mats to and from the site. The composite mats will require DNR staff onsite for installation and removal. Contact the sale administrator to schedule at least 30 days before desired install/removal date. All mats must be cleaned prior to drop off. This may include, but is not limited to, power washing and brushing to remove mud and debris. A charge of \$400.00 per timber mat and \$2,000.00 per composite mat will be assessed for all damaged or non-returned mats. Damage for the crane/timber mats is defined as three or more broken cants. Damage for the composite mats is defined as cracked or broken mats.

##### 5.2.32 - Decking/landing restoration (9/13)

All decking and landing areas must have the surface area restored to a condition equal to or better than before. This is to ensure the proper regeneration of the stand. Wood debris, chips and "cookies" from trimmings must be removed or scattered away from landing and loading areas and may not be windrowed on the edge.

##### 5.2.38 - No decking against live trees (2/04)

Cut products may not be decked against unmarked or designated leave trees.

##### 5.2.41 - Snowmobile trail protection (9/11)

The Charcoal Grade is a snowmobile trail and is shown on the Timber Sale Map. Do not cut or damage posts with orange trail markers or traffic control signs. When the trail is used, it must be maintained and restored to a condition equal to or better than before the sale. The road maintenance/restoration must be done prior to December 1. When the trail is used for hauling, it must be graded to the satisfaction of the Unit Manager or his/her representative prior to December 1. When the trail road is to be used for hauling during the snowmobile season, then a snow covered base must be left on the trail. Maintain a 20 foot wide slash, debris, and rut free zone daily using the snowmobile trail as the centerline. No decking of forest products on the trail. All stumps within 20 feet of the snowmobile trail must be cut at ground level.

## 5.4 - Soil Protection

### 5.4.1 - Rutting restriction, general (7/16)

Operations are to cease immediately if equipment and weather conditions result in rutting of roads and/or skid trails which is 12 inches or greater in depth and 50 feet in length. The Unit Manager or his/her representative may restrict hauling and/or skidding if ruts exceed the specified depth. With the Unit Manager or his/her representative's approval, the Purchaser may return to the area when the risk of rutting has decreased.

## 5.8 - Protection of Endangered Species

### 5.8.5 - Protection of raptor nests (3/13)

All trees with raptor nests will be protected if found during harvesting operations. Notification will be made to the Unit Manager or his/her representative who will notify the Wildlife Biologist so an on-site evaluation and recommendation can be made, if necessary.

## 6 - Safety and Fire Prevention

### 6.2 - Signing

#### 6.2.1 - Road posting (9/09)

The Purchaser is responsible for posting and maintaining caution signs on Charcoal Grade prior to beginning operations. The road must be posted 500 feet from the Sale Area to warn of logging activity and truck traffic. Signs must be removed when harvest operations are suspended or completed. The Purchaser will provide these signs.



Sale Number	Year
42-010-20	20

# TIMBER SALE MAP

This information provided by authority of Part 525, 1994 PA 451, as amended.

Forest Management Unit Newberry	County Luce	Mapped By Livermore	Date 9/26/2020	Page 1	of 1
Cruised By Grossman Forestry					

Township 46N	Range 09W	Section(s) and Subdivision(s) Section 16: N $\frac{1}{2}$ NW, SENW, NE $\frac{1}{4}$ , E $\frac{1}{2}$ SW, SE $\frac{1}{4}$ Section 9: E $\frac{1}{2}$ SW, SWSE Section 15: W $\frac{1}{2}$ NW, NWSW	Scale 1:15,840
-----------------	--------------	--	-------------------

Cover Type				Density			
A = Aspen	H = Hemlock	N = Marsh	U = Upland Brush	0 = Non Stocked	5 = Pole Timber Medium		
B = Paper Birch	J = Jack Pine	O = Oak	UM = Upland Mixed	1 = Seedling Sapling Poor	6 = Pole Timber Well		
C = Cedar	L = Lowland Brush	P = Lowland Poplar	V = Bog or Marsh	2 = Seedling Sapling Medium	7 = Saw Timber Poor		
D = Treed Bog	LM = Lowland Mixed	Q = Mixed Swamp Conifer	W = White Pine	3 = Seedling Sapling Well	8 = Saw Timber Medium		
E = Swamp Hdwoods	M = Mpl, Bch, Brch	R = Red Pine	X = Non Stocked	4 = Pole Timber Poor	9 = Saw Timber Well		
F = Spruce Fir	MC = Mixed Conifer	S = Black Spruce	Z = Water				
G = Grass	MD = Mixed Deciduous	T = Tamarack					

**Sixteen Split  
Spruce Mix  
Compartment 115  
275.0 Acres**

	PU Acres	PU Acres
1	11.7	7 34.9
2	5.1	8 20.7
3	28.7	9 29.0
4	6.2	10 35.9
5	15.7	11 34.8
6	20.2	12 32.1

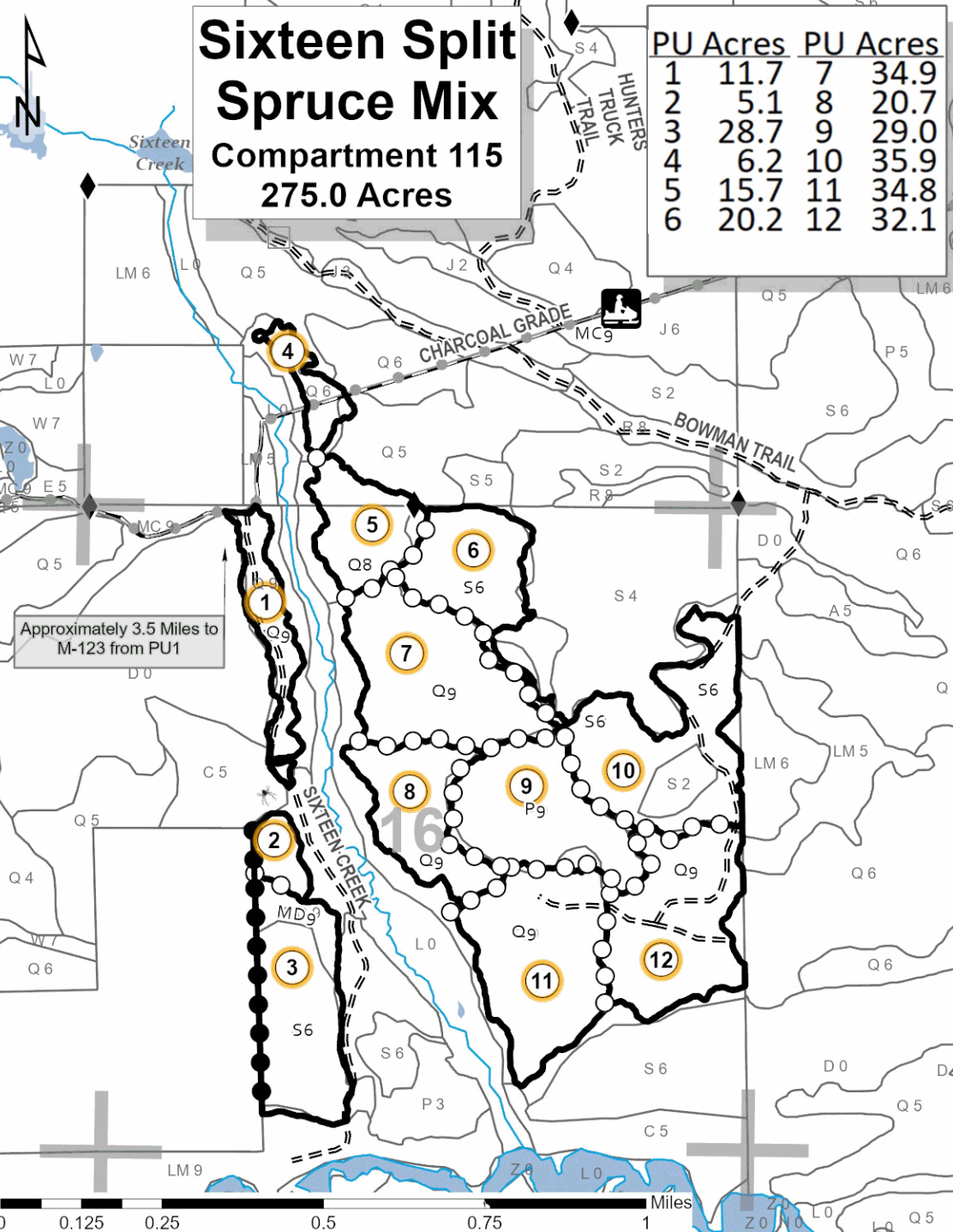

- Against State (Red)
- Payment Unit (Yellow)
- Private Line (Blue)
- Payment Unit Label
- Snowmobile Trails
- Recreational Trail
- Section Numbers
- Section Corners
- Survey Corners
- Gate
- Primary Forest Road
- Secondary Forest Road
- Forest Access Route
- Paved Road
- Gravel Road
- County Road - Seasonal
- Private
- DNR - Management Access
- Temporary Management Access
- Perennial River
- Lakes and Rivers

Locator Map: 1:200,000  
- Main Map Extent

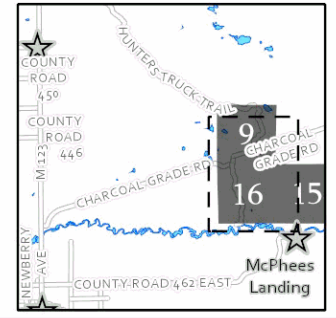



## TIMBER SALE INFORMATION

Wheel Hub Lowlands (42-011-20)  
 T46N, R09W, SEC. 18; T46N, R10W, SEC. 13.  
 Luce County (Advertised Price \$19,167.00)

SALE NOTE: No new roads will be permitted in any Payment Unit. All operations are limited to existing roads. Skid trails and stub roads off main roads will only be allowed.

Harvesting is limited to the period of December 1 to April 1 due to wet soil types that occur throughout the Sale Area.

The Charcoal Grade is a snowmobile trail and is shown on the Timber Sale Map. See Sale Spec 5.2.41 for additional information.

A recreation site such as a trail, pathway, or campground is within the sale area or the vicinity. Certain restrictions/specifications may be applicable including time restrictions.

A timber sale contract for this lump sum, sealed bid timber sale will be awarded to the responsible bidder offering the highest sealed bid price. All units of volume listed below were estimated using the T-Sale computer program and our traditional volume equations. Bids must be at or above the following advertised price for each product and species:

<u>PRODUCTS &amp; SPECIES</u>	<u>ESTIMATED UNITS*</u>	<u>ADVERTISED PRICE</u>
Sawtimber		
Paper Birch	9.8 MBF	\$ 25.00 / MBF
Red Maple	14.8 MBF	\$ 71.00 / MBF
Pulpwood		
Balsam Fir	98 Cords	\$ 9.00 / Cord
Mixed Aspen	128 Cords	\$ 13.80 / Cord
Mixed Hardwood	388 Cords	\$ 11.65 / Cord
Mixed Spruce	140 Cords	\$ 11.75 / Cord
N. White Cedar	1,224 Cords	\$ 4.15 / Cord
Paper Birch	390 Cords	\$ 10.20 / Cord

\* The total volume is statistically estimated within plus (+) or minus (-) 10.87 percent. There are an estimated 2,417 cords on this timber sale, plus or minus 263 cords at the 95% confidence level. The estimated units are final and not subject to adjustment. Prospective bidders are urged to examine this timber and to make their own estimates of quantity and quality.

### **BOND AND PAYMENT SCHEDULE:**

1. A bond in the amount of \$958.00 to insure faithful performance of the conditions of the contract will be deposited by the successful bidder within 21 days of the sale award.
2. Cutting in any sale or unit without the required advance payment would be considered a trespass.
3. Total payment must be paid in advance or according to the following schedule :
  - (a) Ten percent (10%) of the sale value must be paid within 21 days of the sale award.
  - (b) The 10% down payment will be credited towards the first unit cut.
  - (c) Payment for each of the following units must be made before cutting begins in that unit:

PAYMENT UNIT NUMBER	PERCENT OF TOTAL SALE VALUE
01	27.2%
02	26.4%
03	18.7%
04	27.7%

4. If no cutting takes place, the 10% down payment will not be refunded.
5. Operations on the contract issued will terminate on 06/30/2025.

### **SALE STATISTICS**

#### **SALE VOLUMES**

VOLUME		STATISTICAL RANGE IN CORDS		
TOTAL CUBIC FEET	TOTAL CORDS	PERCENT ERROR	MINIMUM	MAXIMUM
190,917	2,417	10.87%	2,154	2,679

**VDU VOLUMES**

A VDU is a Volume Determination Unit. Volumes and their associated statistics are calculated at the VDU level and summarized to the sale level. There is often a one to one relationship between a VDU and a Payment Unit, but not always, depending on the cruise design. Refer to the VDU TO PAYMENT UNIT table.

VDU	VOLUME		PERCENT ERROR	RANGE IN CORDS	
	TOTAL CUBIC FEET	TOTAL CORDS		MINIMUM	MAXIMUM
17	36,269	459	25.80%	341	578
161	188,747	2,389	12.83%	2,083	2,696
162	60,261	763	19.77%	612	914
<b>TOTAL:</b>	<b>285,277</b>	<b>3,611</b>		<b>3,035</b>	<b>4,187</b>

**VDU TO PAYMENT UNIT**

When a VDU is associated with more than one Payment Unit (PU), the VDU volumes are assigned to the PU based on acres of the VDU within the PU.

VDU	VDU ACRES	PU	PU ACRES
17	17.0	3	17.0
161	34.5	1	17.5
		2	17.0
162	23.0	4	23.0
<b>TOTAL:</b>	<b>74.5</b>		<b>74.5</b>



**DESCRIPTION OF TIMBER BY PAYMENT UNIT (PU)**

PU	MARKET GROUP	PRODUCT	QUANTITY	UNIT	ACRES	ADVERTISE PRICE
1	Paper Birch	Sawtimber	0.8	MBF	17.5	\$5,203.95
	Red Maple		5.0	MBF		
	Balsam Fir	Pulpwood	22	Cords		
	Mixed Aspen		29	Cords		
	<i>Quaking Aspen</i>		29	Cords		
	Mixed Hardwood		123	Cords		
	<i>Red Maple</i>		123	Cords		
	Mixed Spruce		26	Cords		
	<i>Black Spruce</i>		18	Cords		
	<i>White Spruce</i>		8	Cords		
	N. White Cedar		254	Cords		
	Paper Birch		141	Cords		
2	Paper Birch	Sawtimber	0.8	MBF	17.0	\$5,052.55
	Red Maple		4.8	MBF		
	Balsam Fir	Pulpwood	21	Cords		
	Mixed Aspen		29	Cords		
	<i>Quaking Aspen</i>		29	Cords		
	Mixed Hardwood		119	Cords		
	<i>Red Maple</i>		119	Cords		
	Mixed Spruce		25	Cords		
	<i>Black Spruce</i>		17	Cords		
	<i>White Spruce</i>		8	Cords		
	N. White Cedar		247	Cords		
	Paper Birch		137	Cords		
3	Paper Birch	Sawtimber	4.1	MBF	17.0	\$3,577.95
	Red Maple		5.0	MBF		
	Balsam Fir	Pulpwood	15	Cords		
	Mixed Aspen		5	Cords		
	<i>B. T. Aspen</i>		5	Cords		
	Mixed Hardwood		61	Cords		
	<i>Black Ash</i>		11	Cords		
	<i>Red Maple</i>		33	Cords		
	<i>Sugar Maple</i>		17	Cords		
	Mixed Spruce		65	Cords		
	<i>Black Spruce</i>		51	Cords		
	<i>White Spruce</i>		14	Cords		
	N. White Cedar		259	Cords		
	Paper Birch		36	Cords		
4	Paper Birch	Sawtimber	4.1	MBF	23.0	\$5,332.55
	Balsam Fir	Pulpwood	40	Cords		
	Mixed Aspen		65	Cords		
	<i>Balsam Poplar</i>		10	Cords		
	<i>Quaking Aspen</i>		55	Cords		
	Mixed Hardwood		85	Cords		
	<i>Red Maple</i>		85	Cords		
	Mixed Spruce		24	Cords		
	<i>Black Spruce</i>		24	Cords		
	N. White Cedar		464	Cords		
	Paper Birch		76	Cords		
	TOTAL:			24.6		
TOTAL:			2,368	Cords		

## Sale Specific Conditions & Requirements

**Sale Name: Wheel Hub Lowlands**

**Sale Number: 42-011-20 Seq#: 1**

### 1 - Sale Area

#### 1.2 - Boundaries

##### 1.2.1 - Painted boundaries (9/19)

The sale boundary and Payment Unit boundaries are marked and identified by red, blue, and yellow paint. Exterior sale boundary lines against state are marked with red paint. Exterior sale boundary lines against private are marked with blue paint. Interior Payment Unit boundaries are marked with yellow paint. Yellow painted trees designating an interior Payment Unit boundary are only to be cut when all surrounding Payment Units have been paid.

### 2 - Timber Specifications

#### 2.1 - Included Timber

##### 2.1.2 - Clearcut unit(s) w/o unmerchantable trees (8/11)

Within Payment Unit(s) 1 - 4, cut all trees which meet minimum piece specifications in 2.2 Utilization, except do not cut hemlock, white pine, and yellow birch.

### 4 - Transportation

#### 4.1 - Construction

##### 4.1.5 - Culverts (5/14)

Skid Trails may require the installation of culverts for cross drainage or at natural drainage-ways. The culverts shall be new, corrugated metal or plastic gauge. Culverts will be a minimum of 12 inches in diameter and 24 feet in length. Brush debris and snow can be used to cover the culvert while in use. Culverts must be removed before sale is complete.

##### 4.1.12 - No new roads (1/12)

No new roads will be permitted in any Payment Unit. All operations are limited to existing roads. Skid trails and stub roads off main roads only will be allowed.

#### 4.2 - Maintenance

##### 4.2.1 - Hauling restriction (12/08)

Hauling may be restricted on forest roads by the Unit Manager or his/her representative. The restriction may occur during spring breakup or during wet weather conditions.

##### 4.2.3 - Road maintenance (8/13)

The following road maintenance may be needed: cleaning of drainage areas, grading, crowning, and filling with gravel, if necessary. Damages will be assessed if grading/repair does not occur. The road should be in as good or better condition than it was before harvesting operations.

##### 4.2.5 - Two wheel drive condition (2/04)

All existing trail roads on and adjacent to the sale area must be passable by two-wheel drive traffic for the duration of the sale.

### 5 - Operations

#### 5.2 - Conduct of Operations

##### 5.2.1 - Slash

##### 5.2.1.2 - Slash Removal

##### 5.2.1.2.1 - Slash removal, right-of-way (9/16)

All slash must be removed at least 10 feet from the cleared right-of-way of existing forest roads and Charcoal Grade.

##### 5.2.1.8 - Slash height (12/08)

No slash or tree tops may exceed 24 inches in height.

## 5.2.2 - Hazard Trees/Snags

### 5.2.2.1 - Den trees (10/16)

Obvious hollow and/or den trees shall be protected and left standing unless they are a safety hazard.

## 5.2.3 - Operating Restrictions

### 5.2.3.1 - Operating restrictions (9/11)

Within Payment Unit(s) 1 - 4, unless changed by written agreement, cutting, skidding, and hauling are limited to the period of December 1 to April 1. This restriction is because of wet soil types that occur throughout the Sale Area. Winter conditions will be necessary for harvesting operations to occur.

### 5.2.16 - Equipment recommended (11/18)

Tracked harvesting equipment is recommended due to the low ground nature of the Sale Area.

### 5.2.32 - Decking/landing restoration (9/13)

All decking and landing areas must have the surface area restored to a condition equal to or better than before. This is to ensure the proper regeneration of the stand. Wood debris, chips and "cookies" from trimmings must be removed or scattered away from landing and loading areas and may not be windrowed on the edge.

### 5.2.38 - No decking against live trees (2/04)

Cut products may not be decked against unmarked or designated leave trees.

### 5.2.41 - Snowmobile trail protection (9/11)

The Charcoal Grade is a snowmobile trail and is shown on the Timber Sale Map. Do not cut or damage posts with orange trail markers or traffic control signs. If the trail is used, it must be maintained and restored to a condition equal to or better than before the sale. The road maintenance/restoration must be done prior to December 1. No decking of forest products along the snowmobile trail during the snowmobile season. If the trail road is to be used for hauling during the snowmobile season, then a snow covered base must be left on the trail. Maintain a 20 foot wide slash, debris, and rut free zone daily using the snowmobile trail as the centerline. All stumps within 20 feet of the snowmobile trail must be cut at ground level.

## 5.4 - Soil Protection

### 5.4.1 - Rutting restriction, general (7/16)

Operations are to cease immediately if equipment and weather conditions result in rutting of roads and/or skid trails which is 12 inches or greater in depth and 50 feet in length. The Unit Manager or his/her representative may restrict hauling and/or skidding if ruts exceed the specified depth. With the Unit Manager or his/her representative's approval, the Purchaser may return to the area when the risk of rutting has decreased.

### 5.4.5 - Soil caution (11/04)

Care must be taken to minimize soil damage due to the low/wet nature of the site.

## 5.8 - Protection of Endangered Species

### 5.8.5 - Protection of raptor nests (3/13)

All trees with raptor nests will be protected if found during harvesting operations. Notification will be made to the Unit Manager or his/her representative who will notify the Wildlife Biologist so an on-site evaluation and recommendation can be made, if necessary.

## 6 - Safety and Fire Prevention

### 6.2 - Signing

#### 6.2.2 - Snowmobile trail posting (8/09)

The Purchaser is responsible for posting and maintaining caution signs on the snowmobile trail prior to beginning operations during the snowmobile season (approximately December 1 to March 31). The trail must be posted at appropriate distances from the Sale Area to warn of logging activity and truck traffic. Signs must be removed when harvest operations are suspended or completed. The DNR will provide these signs.



# TIMBER SALE MAP

This information provided by authority of Part 525, 1994 PA 451, as amended.

Forest Management Unit Newberry	County Luce	Crused By Grossman Forestry	Date 7/13/2020	Page 1	Sale Number 42-011-20	Year 2020
Range 9W / 10W	Section(s) and Subdivision(s) <b>Section 18: NWNW, S<sup>1</sup>/<sub>2</sub>NW, N<sup>1</sup>/<sub>2</sub>SW Section 13: E<sup>1</sup>/<sub>2</sub>NE</b>		Scale 1:15,840			

Cover Type		Density
A = Aspen	H = Hemlock	0 = Non Stocked
B = Paper Birch	J = Jack Pine	1 = Seeding Sapling Poor
C = Cedar	L = Lowland Brush	2 = Seeding Sapling Medium
D = Tread Bog	LM = Lowland Mixed	3 = Seeding Sapling Well
E = Swamp Hdwoods	M = Mpl, Bch, Birch	4 = Pole Timber Poor
F = Spruce Fir	MC = Mixed Conifer	5 = Pole Timber Medium
G = Grass	MD = Mixed Deciduous	6 = Pole Timber Well
	N = Marsh	7 = Saw Timber Poor
	O = Oak	8 = Saw Timber Medium
	P = Lowland Poplar	9 = Saw Timber Well
	Q = Mixed Swamp Conifer	
	R = Red Pine	
	X = Non Stocked	
	S = Black Spruce	
	Z = Water	
	T = Tamarack	
	U = Upland Brush	
	UM = Upland Mixed	
	V = Bog or Marsh	
	W = White Pine	

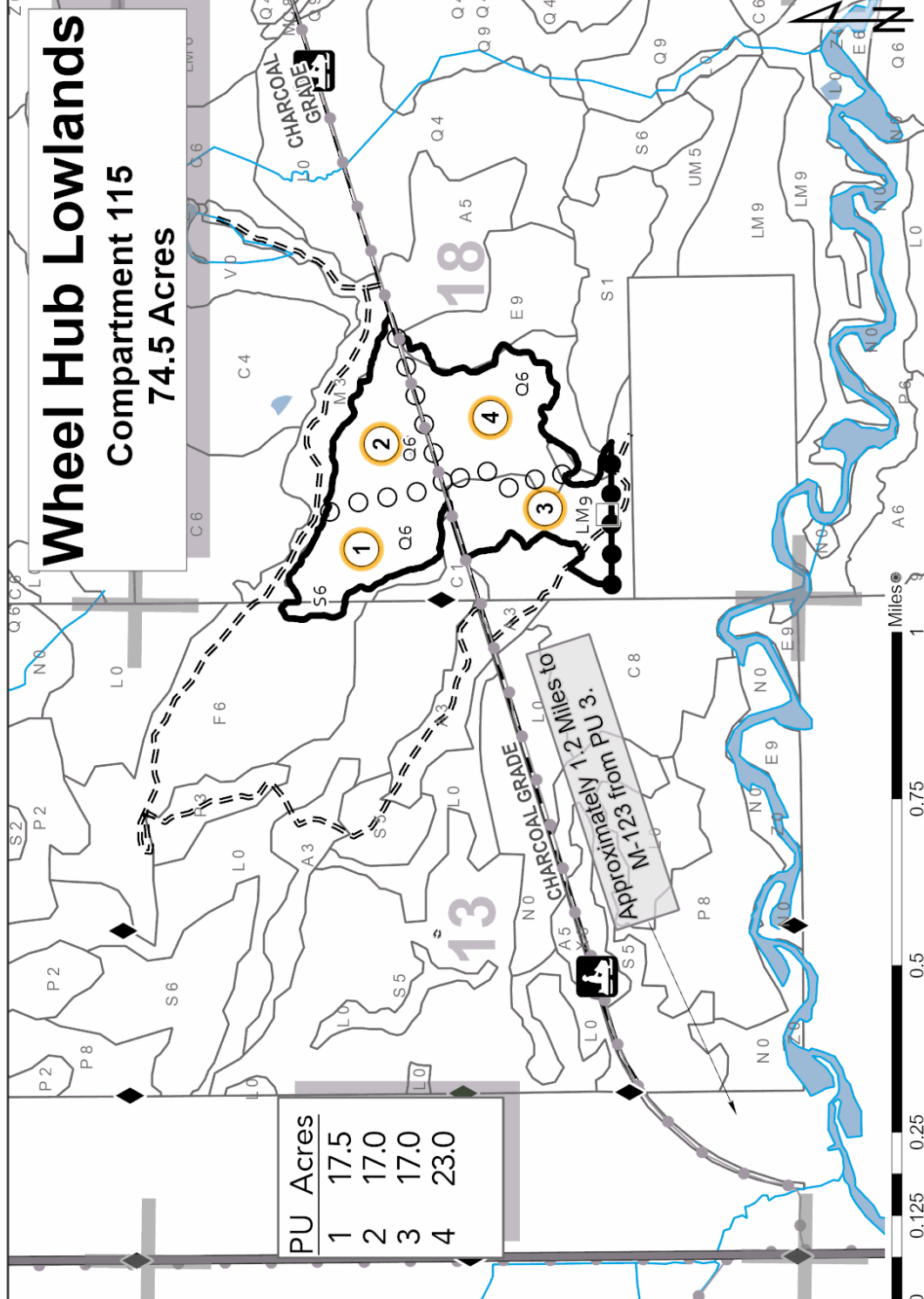

- Against State (Red)
- Payment Unit (Yellow)
- Private Line (Blue)
- Payment Unit Label
- Snowmobile Trails
- Recreational Trail
- Section Numbers
- Section Corners
- Survey Corners
- Gate
- Highways
- Primary Forest Road
- Secondary Forest Road
- Forest Access Route
- Paved Road
- Gravel Road
- County Road - Seasonal
- Private
- Drain
- Perennial River
- Lakes and Rivers
- DNR - Management Access
- Temporary Management Access
- Retention Area
- Nearby Timber Sale

Locator Map: 1:200,000  
- Main Map Extent

Wheel Hub Lowlands (42-011-20)  
T46N, R09W, SEC. 18; T46N, R10W, SEC. 13; Luce COUNTY

In response to the notice of sale to be held 3:00 p.m. (local time) on April 1, 2021, I am hereby submitting my sealed bid (firm offer) for the following forest products to be cut. Bids for individual species must be at or above the advertised price. All non-responsive bid forms may be rejected.

<u>PRODUCTS &amp; SPECIES</u>	<u>ESTIMATED VOLUME*</u>	<u>ADVERTISED PRICE</u>	<u>BID PRICE/UNIT</u>
<b>Sawtimber</b>			
Paper Birch	9.8 MBF	\$ 25.00/MBF	\$ _____
Red Maple	14.8 MBF	\$ 71.00/MBF	\$ _____
<b>Pulpwood</b>			
Balsam Fir	98 Cords	\$ 9.00/Cord	\$ _____
Mixed Aspen	128 Cords	\$ 13.80/Cord	\$ _____
Mixed Hardwood	388 Cords	\$ 11.65/Cord	\$ _____
Mixed Spruce	140 Cords	\$ 11.75/Cord	\$ _____
N. White Cedar	1,224 Cords	\$ 4.15/Cord	\$ _____
Paper Birch	390 Cords	\$ 10.20/Cord	\$ _____

\*The volumes are statistically estimated within plus (+) or minus (-) 10.87 percent at 95% confidence level. These estimated volumes are final and not subject to adjustment. Prospective bidders are urged to examine this timber and to make their own estimates of quantity and quality.

I understand that any or all bids may be rejected. All bids must be signed and all bid items must be bid or the bid form may be rejected. I also understand that consideration and awarding a contract will be based upon my past performance and ability to complete the contract based upon equipment and staffing subject to my control.

FEDERAL ID: \_\_\_\_ - \_\_\_\_ - \_\_\_\_ or SOCIAL SECURITY NUMBER: \_\_\_\_ - \_\_\_\_ - \_\_\_\_

Company or individual bidding: \_\_\_\_\_

Company representative's name: \_\_\_\_\_

Address: \_\_\_\_\_

City: \_\_\_\_\_ State: \_\_\_\_\_ Zip: \_\_\_\_\_

IF AVAILABLE, PLEASE PLACE THE PERSONALIZED LABEL FROM YOUR PROSPECTUS IN THE ABOVE BOX.

Individual or company representative's signature: \_\_\_\_\_ Date: \_\_\_\_\_

Phone number : \_\_\_\_\_ Email (optional): \_\_\_\_\_

**THE WINNING BIDDER MUST COMPLETE THE VERIFICATION OF WORKER'S DISABILITY COMPENSATION ACT COMPLIANCE (ON REVERSE SIDE IF DOUBLE SIDED) WITHIN 21 DAYS OF SALE AWARD DATE**



# TIMBER SALE VERIFICATION OF WORKER'S DISABILITY COMPENSATION ACT COMPLIANCE

As required by Act 317, P.A. 1969 (Worker's Compensation) and  
Part 5 of Act 451 of 1994, as amended.

FOR DEPARTMENT USE ONLY	
Sale Number (XX - XXX - XX - XX)	
Forest Management Unit:	

## VERIFICATION OF WORKER'S DISABILITY COMPENSATION ACT COMPLIANCE

- This verification must be completed and submitted within 21 days of contract award and prior to the issuance of the timber sale contract.
- In addition, if boxes 2B or 2C are checked, then Notice of Exclusion or Certificate of Insurance must be submitted within twenty-one (21) days of the contract award and prior to the issuance of the timber sale contract.
- All information must be typed or printed except for written signatures.

Please Check Appropriate Categories:

1. My business is organized as (you **must** check one of the boxes below):
  - A.  Sole Proprietorship (individual)
  - B.  Partnership
  - C.  Corporation
2. You **must** check one of the boxes below:
  - A.  I certify my business is a sole proprietorship and it has no employees but the sole proprietor. I am not subject to the Worker's Compensation Laws.
  - B.  I certify my business has satisfied its obligation to the Worker's Compensation Act through the use of an approved Notice of Exclusion (BWC-337, Rev. 5/96). I will provide a copy of the Notice of Exclusion within 21 days of the contract award. (For questions or a copy of the BWC-337, please call the Worker's Compensation Bureau at 517-322-1195).
  - C.  I certify my business has a Worker's Compensation Policy. I will provide an original Certificate of Insurance within twenty-one (21) days of the contract award.
3. If you have checked item 2(A) or 2(B), you **must** indicate the number of **both** full-time and part-time employees, other than yourself, including family members and active partners (if none, you must enter "0").

\_\_\_\_\_ Full-time Employees

\_\_\_\_\_ Part-time Employees

Name of Business		Federal ID (or) Social Security No.	
Address		Telephone (       )	
City	State	ZIP	

*I hereby certify that the above information is true and correct. I agree to notify the Michigan DNR of any changes that occur in factors affecting my coverage during any of my present and future operations.*

\_\_\_\_\_  
Signature of Owner or Authorized Representative

\_\_\_\_\_  
Title

\_\_\_\_\_  
Date

Please complete the "SEALED BID" information on the next page

Sixteen Split Spruce Mix (42-010-20)  
T46N, R09W, SEC. 15; T46N, R09W, SEC. 16; T46N, R09W, SEC. 9; Luce

In response to the notice of sale to be held 3:00 p.m. (local time) on April 1, 2021, I am hereby submitting my sealed bid (firm offer) for the following forest products to be cut. Bids for individual species must be at or above the advertised price. All non-responsive bid forms may be rejected.

<u>PRODUCTS &amp; SPECIES</u>	<u>ESTIMATED VOLUME*</u>	<u>ADVERTISED PRICE</u>	<u>BID PRICE/UNIT</u>
<b>Sawtimber</b>			
Paper Birch	6.6 MBF	\$ 25.00/MBF	\$ _____
Red Maple	31.1 MBF	\$ 71.00/MBF	\$ _____
<b>Pulpwood</b>			
Balsam Fir	356 Cords	\$ 9.00/Cord	\$ _____
Mixed Aspen	805 Cords	\$ 13.80/Cord	\$ _____
Mixed Hardwood	1,398 Cords	\$ 11.65/Cord	\$ _____
Mixed Spruce	3,059 Cords	\$ 11.75/Cord	\$ _____
N. White Cedar	1,144 Cords	\$ 4.15/Cord	\$ _____
Red Pine	33 Cords	\$ 49.80/Cord	\$ _____
Tamarack	62 Cords	\$ 5.05/Cord	\$ _____
White Pine	146 Cords	\$ 15.10/Cord	\$ _____

\*The volumes are statistically estimated within plus (+) or minus (-) 9.83 percent at 95% confidence level. These estimated volumes are final and not subject to adjustment. Prospective bidders are urged to examine this timber and to make their own estimates of quantity and quality.

I understand that any or all bids may be rejected. All bids must be signed and all bid items must be bid or the bid form may be rejected. I also understand that consideration and awarding a contract will be based upon my past performance and ability to complete the contract based upon equipment and staffing subject to my control.

FEDERAL ID: \_\_\_\_\_ - \_\_\_\_\_ or SOCIAL SECURITY NUMBER: \_\_\_\_\_ - \_\_\_\_\_ - \_\_\_\_\_

Company or individual bidding: \_\_\_\_\_

Company representative's name: \_\_\_\_\_

Address: \_\_\_\_\_

City: \_\_\_\_\_ State: \_\_\_\_\_ Zip: \_\_\_\_\_

IF AVAILABLE, PLEASE PLACE THE PERSONALIZED LABEL FROM YOUR PROSPECTUS IN THE ABOVE BOX.

Individual or company representative's signature: \_\_\_\_\_ Date: \_\_\_\_\_

Phone number : \_\_\_\_\_ Email (optional): \_\_\_\_\_

**THE WINNING BIDDER MUST COMPLETE THE VERIFICATION OF WORKER'S DISABILITY COMPENSATION ACT COMPLIANCE (ON REVERSE SIDE IF DOUBLE SIDED) WITHIN 21 DAYS OF SALE AWARD DATE**



<b>FOR DEPARTMENT USE ONLY</b>	
Sale Number (XX - XXX - XX - XX)	
Forest Management Unit:	

# TIMBER SALE VERIFICATION OF WORKER'S DISABILITY COMPENSATION ACT COMPLIANCE

As required by Act 317, P.A. 1969 (Worker's Compensation) and  
Part 5 of Act 451 of 1994, as amended.

## VERIFICATION OF WORKER'S DISABILITY COMPENSATION ACT COMPLIANCE

- This verification must be completed and submitted within 21 days of contract award and prior to the issuance of the timber sale contract.
- In addition, if boxes 2B or 2C are checked, then Notice of Exclusion or Certificate of Insurance must be submitted within twenty-one (21) days of the contract award and prior to the issuance of the timber sale contract.
- All information must be typed or printed except for written signatures.

Please Check Appropriate Categories:

1. My business is organized as (you **must** check one of the boxes below):
  - A.  Sole Proprietorship (individual)
  - B.  Partnership
  - C.  Corporation
2. You **must** check one of the boxes below:
  - A.  I certify my business is a sole proprietorship and it has no employees but the sole proprietor. I am not subject to the Worker's Compensation Laws.
  - B.  I certify my business has satisfied its obligation to the Worker's Compensation Act through the use of an approved Notice of Exclusion (BWC-337, Rev. 5/96). I will provide a copy of the Notice of Exclusion within 21 days of the contract award. (For questions or a copy of the BWC-337, please call the Worker's Compensation Bureau at 517-322-1195).
  - C.  I certify my business has a Worker's Compensation Policy. I will provide an original Certificate of Insurance within twenty-one (21) days of the contract award.
3. If you have checked item 2(A) or 2(B), you **must** indicate the number of **both** full-time and part-time employees, other than yourself, including family members and active partners (if none, you must enter "0").

\_\_\_\_\_ Full-time Employees

\_\_\_\_\_ Part-time Employees

Name of Business		Federal ID (or) Social Security No.	
Address		Telephone (       )	
City	State	ZIP	

*I hereby certify that the above information is true and correct. I agree to notify the Michigan DNR of any changes that occur in factors affecting my coverage during any of my present and future operations.*

\_\_\_\_\_  
Signature of Owner or Authorized Representative

\_\_\_\_\_  
Title

\_\_\_\_\_  
Date

Please complete the "SEALED BID" information on the next page