



**DEPARTMENT OF NATURAL RESOURCES
STATE OF MICHIGAN**

TIMBER SALE PROSPECTUS #6858

SCHEDULED SALE DATE AND TIME: 9:00 a.m. (local time) on April 9, 2021.

LOCATION: GRAYLING MGMT UNIT, 1955 HARTWICK PINES ROAD, GRAYLING, MI 49738.

PROSPECTUS NOTE: The bidder is advised to inspect the sale area and review the location, estimated volumes, operating costs and contract terms of proposed sales. Please be aware that some landowners may request 60 days or more notice for access across their land.

Notice is hereby given that bids will be received by the Unit Manager, GRAYLING MANAGEMENT UNIT, for certain timber on the following described lands:

Plowtruck I'm Stuck Mix (72-003-20) / T27N, R02E, SEC. 6 , S1/2NW,SWNE,SW,W1/2SE.

Oscoda County, Advertised Price \$94,802.40, 168.5 Acres, Red Pine, Jack Pine.

SALE NOTE: A recreation site such as a trail, pathway, or campground is within the sale area or the vicinity. Certain restrictions/specifications may be applicable including time restrictions.

Penn Pine and Oak (72-021-20) / T28N, R02E, SEC. 17, SW.

T28N, R02E, SEC. 18, SESE.

Oscoda County, Advertised Price \$48,935.15, 46.6 Acres, Red Pine, Hardwood.

SALE NOTE: Sale contains 46.6 acres of final harvest. Payment Unit 1 has two retention islands in the East end. Payment Unit(s) 2 and 4 each contain a retention pocket that has been boundary excluded and shown on the Timber Sale Map.

MPRC Fuelbreak (72-624-20) / T27N, R03W, SEC. 13, NENE,S1/2NE,SESW,W1/2SE.

T27N, R03W, SEC. 23, SENE,SESW,W1/2SE.

T27N, R03W, SEC. 24, N1/2NW,SWNW.

Crawford County, Advertised Price \$23,363.85, 52.3 Acres, Hardwood, Red Oak.

SALE NOTE: The purpose of this harvest is to facilitate fuelbreak construction within Range 30. Access will be limited and there is the potential to encounter unexploded ordinance.

Dollar Lk Rd Oak (72-626-20) / T26N, R04W, SEC. 4 , NW,N1/2NE,SWNE,N1/2SW.

T27N, R04W, SEC. 33, SWSE.

Crawford County, Advertised Price \$58,172.90, 149.6 Acres, Hardwood, Red Oak.

SALE NOTE: The harvest is on lands used for Military training and the terrain is rolling to steep. This is the second cut in the shelterwood system. There is dense 15-year old regen from the first harvest that has to be worked around. Because there is oak regen throughout the harvest, there will be no exceptions to the oak wilt seasonal operating restriction.

Arrowhead JP & Spruce (72-627-20) / T26N, R04W, SEC. 5 , SWNW,N1/2SW,SWSW.

T26N, R04W, SEC. 6 , NENE,S1/2NE,N1/2SE,SESE.

Crawford County, Advertised Price \$19,334.90, 100.9 Acres, Jack Pine, Spruce/Fir/Tamarack.

SALE NOTE: The sale is on low ground that cannot be cut during spring breakup. The jack pine is overmature and losing volume to age-related decline and mortality. The sale is on Military Board lands.

Mossy Runway Pine (72-012-19) / T28N, R04E, SEC. 12, SENW,E1/2NE,E1/2SW,W1/2SE.

T28N, R04E, SEC. 13, NENW.

T28N, R05E, SEC. 6 , SWSW.

Oscoda County, Advertised Price \$46,036.70, 126.5 Acres, Jack Pine, Red Pine.

SALE NOTE: Payment Units 4, 5 and 6 were contractor prepared by VanOss Forestry Services.

BID INSTRUCTIONS (VER. 07/02/2018):

1. Scheduled Bid Location, Date, and Time (2/11)

Bids must be received by the Unit Manager, GRAYLING OFFICE, 1955 HARTWICK PINES ROAD, GRAYLING, MI 49738, no later than 9:00 a.m. (local time) on April 9, 2021. For further information concerning this sale, contact Thomas Barnes at 989-348-6371 extension 7440.

2. Bidder's Qualifications (5/16)

Purchaser shall obtain workers compensation insurance to cover claims under Michigan's Worker's Disability Compensation Act of 1969 or similar employee benefit act of any other state applicable to an employee. If all or part of a timber sale was prepared by a private contractor, the contractor and that contractor's company are not permitted to bid on the timber sale contract. Bids will not be accepted from individuals or companies appearing on the DNR/FRD No-Bid List. This list contains the names of purchasers who previously failed to execute a contract within 21-days or who have a history of poor performance.

3. Preparation of Sealed Bids (5/16)

Bid Forms may be completed online thru Michigan DNR Timber Sale Online Bidding (OLB) at www.michigan.gov/timberbidding or by completing the hardcopy Bid Form found in the Timber Sale Prospectus. Hardcopy Bid Forms shall be manually signed in ink. Registration in OLB is considered your 'signature' for all bids submitted thru that system. Bid prices must be entered for each species and product in the Bid Price column for all material subject to bidding and all fill-in blanks must be completed. If erasures or other changes appear on the hardcopy Bid Form, each erasure or change must be initialed by the person signing the bid.

4. Submission of Sealed Bids (5/16)

Bid forms may be obtained from the Unit Manager or thru OLB. Bids may be submitted hardcopy or thru OLB. All hardcopy bids must be submitted on the bid form and in an envelope clearly identified as described in this section. NOTE: Only one bid form per bid envelope. Sealed bids must be submitted to the Unit office designated in the prospectus and must be submitted at or prior to the time established in the prospectus. The envelope should show on the outside (a) the sale name or number and (b) the date and time of bid opening, as shown in the prospectus. Bids received after the time specified in the sale prospectus are late bids and will be rejected.

It is possible for a bidder to submit multiple bids on a single sale. For example, a bid may be submitted hardcopy and a bid may be submitted thru OLB. Or, two bidders from the same company could both submit bids on the same sale. If this were to happen, the State would accept all bids received and award the contract accordingly. All bidding and contractual requirements would apply to all bids received.

5. Public Opening of Sealed Bids (7/16)

If conditions permit, the sealed bids will be publicly opened and posted at the time and place set in the prospectus.

If a bidder, present at a bid opening, has submitted bids on more than one sale, that bidder may withdraw their unopened bid envelopes or announce the withdrawal of their online bid after being declared the successful bidder on one sale.

6. Award of Contract (1/11)

Award of the contract will be made to the Bidder whose bid, conforming to the prospectus, is most advantageous to the State of Michigan on the basis of total value at rates bid for the estimated quantities. The State reserves the right to reject any bid or waive any minor irregularity in bids received. A written award mailed (or otherwise furnished) to the successful Bidder shall be deemed to result in a binding contract without further action by either party.

7. Down Payment (1/11)

The Bidder to whom award is made must make a down payment within 21 days of the sale award. The amount of the down payment will be calculated as shown in the Bond and Payment Schedule of this prospectus. Only cash may be used to meet this requirement.

8. Performance Security (1/11)

As guarantee of faithful performance, a cash bond, certificate of deposit, surety bond or irrevocable letter of credit (LOC) is required within 21 days of the sale award. The amount of the performance security is shown in the Bond and

Payment Schedule of this prospectus. If an LOC or surety is used, the coverage must extend for at least 6 months beyond the contract expiration.

9. Timber Sale Contract (7/18)

Additional conditions and requirements common to all timber sales are listed on the timber sale contract (R4031) and are available on line at www.michigan.gov/timber. Contact the Unit Manager for additional information or a sample contract. Within 21 days of the date of the award letter, the bidder must sign the contract and provide the required down payment, performance security, and verification of worker's disability compensation. The down payment and performance security shall be in accordance with the provisions of the timber sale contract, in the sums stated in this prospectus. If these actions are not taken, then the Bidder, the Bidder's corporation, and the corporation's principals may not be permitted to bid on State timber sales for a period of 3 months after the first offense, 6 months after the second offense, and 1 year after the third offense. An offense will only be counted against the Bidder for 5 years. In addition, the Bidder certifies that if awarded this contract, the Bidder will complete the timber sale contract in accordance with its terms and any modifications thereof including requirements to purchase, cut, and remove the included timber by the expiration date.

Payment Unit values in the State Forest Timber Sale Contract are calculated based on the advertised value of the Payment Unit as a percentage of the total advertised value of the contract. The advertised value of each Payment Unit is given in the Description of Timber by Payment Unit table on the Timber Sale Information page. For example, if the value of Payment Unit 1 is advertised as \$1,500 and the total Timber Sale value is advertised as \$10,000, the contract price for Payment Unit 1 will be 15% of the total bid price ($\$1,500/\$10,000 * 100$).

10. Disclaimer of Estimates and Bidder's Warranty of Inspection (7/16)

Before submitting this bid, the Bidder is advised and cautioned to inspect the sale area, review the requirements of the sale contract, and take other steps as may be reasonably necessary to ascertain the location, estimated volumes, construction estimates, and operating costs of the proposed sale. Failure to do so will not relieve the Bidder from responsibility for completing the contract.

The Bidder warrants that this bid is submitted solely on the basis of the Bidder's examination and inspection of the quality and quantity of the timber offered for sale and the Bidder's opinion of the value thereof and the costs of recovery. No reliance should be placed on the State of Michigan's estimates of timber quality, quantity or costs of recovery. Bidder further acknowledges that the State of Michigan: (i) expressly disclaims any warranty of fitness of timber for any purpose; (ii) offers this timber as is without any warranty of quality (merchantability) or quantity and (iii) expressly disclaims any warranty as to the quantity or quality of timber sold.

11. Certification and Chain-of-Custody (10/14)

Unless otherwise indicated in the contract under section 7 – Other Conditions of the Sale Specific Conditions & Requirements, the area encompassed by this timber sale is certified to the standards of the Forest Stewardship Council (FSC) - Certificate #SCS-FM/COC-00090N and the Sustainable Forestry Initiative (SFI) - Certificate #NSF-SFIS-5Y031-SF5. Forest products from this sale may be delivered to the mill as "FSC 100% and / or SFI certified" as long as the contractor hauling the forest products is chain-of-custody (COC) certified or covered under a COC certificate from the destination mill. The purchaser is responsible for maintaining COC after leaving the sale area.

12. Good Neighbor Authority (GNA) Requirements (7/16)

If the name of this timber sales contains the acronym GNA, it is authorized by the Good Neighbor Authority (GNA) and covered by various agreements between the U.S. Forest Service and the State. The timber sale occurs on federal land and the following conditions apply:

GNA contracts on US Forest Service land will not be awarded to purchasers on the Federal list of excluded parties. The System for Award Management (SAM) will be checked for active excluded parties prior to award of contract. In addition, the Bidder to whom award is made must complete an Assurance Regarding Felony Conviction or Tax Delinquent Status for Corporate Applicants (AD-3031).

13. Good Neighbor Authority (GNA) Requirements, con't (9/16)

Bidder certifies, by signing this bid form, that to the best of Bidder's knowledge that the following representations are accurate and complete.

- a. That the Bidder and its principals are not presently debarred, suspended, proposed for debarment, declared ineligible, or voluntary excluded from timber sales (covered transactions) by any Federal department or agency.
- b. That the Bidder and its principals have not within a 3-year period preceding this bid been convicted of or had a civil judgment rendered against them for commission of fraud or a criminal offense in connection with obtaining , attempting to obtain, or performing a public (Federal, State, or local) transaction or contract under a public transaction; violation of Federal or State antitrust statutes or commission of embezzlement, theft, forgery, bribery, falsification or destruction of records, making false statements, or receiving stolen property.
- c. That the Bidder and its principals are not presently indicted for or otherwise criminally or civilly charged by a governmental entity (Federal, State, or local) with commission of any of the offenses enumerated in paragraph b of this certification.
- d. That the Bidder and its principals have not within a 3-year period preceding this bid had one or more public transactions (Federal, State, or local) terminated for breach or default of a timber or forest product contract.

Bidders that cannot certify this requirement, in whole or in part, shall submit an explanation with their bid.

DAN EICHINGER
Director

TIMBER SALE INFORMATION

Plowtruck l'm Stuck Mix (72-003-20)
T27N, R02E, SEC. 6.
Oscoda County (Advertised Price \$94,802.40)

SALE NOTE: A recreation site such as a trail, pathway, or campground is within the sale area or the vicinity. Certain restrictions/specifications may be applicable including time restrictions.

A timber sale contract for this lump sum, sealed bid timber sale will be awarded to the responsible bidder offering the highest sealed bid price. All units of volume listed below were estimated using the T-Sale computer program and our traditional volume equations. Bids must be at or above the following advertised price for each product and species:

<u>PRODUCTS & SPECIES</u>	<u>ESTIMATED UNITS*</u>	<u>ADVERTISED PRICE</u>
Sawtimber		
BI/R/Hybrid Oak	11.5 MBF	\$ 136.00 / MBF
Red Pine	542.0 MBF	\$ 91.00 / MBF
Pulpwood		
BI/R/Hybrid Oak	193 Cords	\$ 20.50 / Cord
Jack Pine	802 Cords	\$ 15.30 / Cord
Red Pine	818 Cords	\$ 33.85 / Cord

* The total volume is statistically estimated within plus (+) or minus (-) 13.05 percent. There are an estimated 2,920 cords on this timber sale, plus or minus 381 cords at the 95% confidence level. The estimated units are final and not subject to adjustment. Prospective bidders are urged to examine this timber and to make their own estimates of quantity and quality.

BOND AND PAYMENT SCHEDULE:

1. A bond in the amount of \$4,740.00 to insure faithful performance of the conditions of the contract will be deposited by the successful bidder within 21 days of the sale award.
 2. Cutting in any sale or unit without the required advance payment would be considered a trespass.
 3. Total payment must be paid in advance or according to the following schedule :
 - (a) Ten percent (10%) of the sale value must be paid within 21 days of the sale award.
 - (b) The 10% down payment will be credited towards the first unit cut.
 - (c) Payment for each of the following units must be made before cutting begins in that unit:
- | PAYMENT UNIT NUMBER | PERCENT OF TOTAL SALE VALUE |
|---------------------|-----------------------------|
| 01 | 25.9% |
| 02 | 58.0% |
| 03 | 10.6% |
| 04 | 5.5% |
4. If no cutting takes place, the 10% down payment will not be refunded.
 5. Operations on the contract issued will terminate on 06/30/2023.

SALE STATISTICS

SALE VOLUMES

VOLUME			STATISTICAL RANGE IN CORDS	
TOTAL CUBIC FEET	TOTAL CORDS	PERCENT ERROR	MINIMUM	MAXIMUM
230,653	2,920	13.05%	2,539	3,301

VDU VOLUMES

A VDU is a Volume Determination Unit. Volumes and their associated statistics are calculated at the VDU level and summarized to the sale level. There is often a one to one relationship between a VDU and a Payment Unit, but not always, depending on the cruise design. Refer to the VDU TO PAYMENT UNIT table.

VDU	VOLUME			RANGE IN CORDS	
	TOTAL CUBIC FEET	TOTAL CORDS	PERCENT ERROR	MINIMUM	MAXIMUM
17	402,284	5,092	13.98%	4,380	5,804
41	59,045	747	36.31%	476	1,019
TOTAL:	461,328	5,840		4,856	6,823

VDU TO PAYMENT UNIT

When a VDU is associated with more than one Payment Unit (PU), the VDU volumes are assigned to the PU based on acres of the VDU within the PU.

VDU	VDU ACRES	PU	PU ACRES
17	101.5	1	31.3
		2	70.2
41	67.0	3	44.0
		4	23.0
TOTAL:	168.5		168.5

DESCRIPTION OF TIMBER BY PAYMENT UNIT (PU)

PU	MARKET GROUP	PRODUCT	QUANTITY	UNIT	ACRES	ADVERTISE PRICE
1	BI/R/Hybrid Oak Red Pine	Sawtimber	3.5	MBF	31.3	\$24,540.45
			132.4	MBF		
	BI/R/Hybrid Oak Jack Pine Red Pine	Pulpwood	60	Cords		
			247	Cords		
			207	Cords		
2	BI/R/Hybrid Oak Red Pine	Sawtimber	8.0	MBF	70.2	\$54,996.45
			296.9	MBF		
	BI/R/Hybrid Oak Jack Pine Red Pine	Pulpwood	133	Cords		
			555	Cords		
			463	Cords		
3	Red Pine	Sawtimber	74.0	MBF	44.0	\$10,017.45
		Pulpwood	97	Cords		
4	Red Pine	Sawtimber	38.7	MBF	23.0	\$5,248.05
		Pulpwood	51	Cords		
TOTAL:			553.5	MBF		
TOTAL:			1,813	Cords		

Sale Specific Conditions & Requirements

Sale Name: Plowtruck I'm Stuck Mix

Sale Number: 72-003-20 Seq#: 2

1 - Sale Area

1.2 - Boundaries

1.2.1 - Painted boundaries (9/19)

The sale boundary and Payment Unit boundaries are marked and identified by red, yellow, and blue paint, as well as Town Line, Penn, and Muskrat Lake Roads. Exterior sale boundary lines against state are marked with red paint, Towline Road and Muskrat Lake Road. The sale boundary along Town Line and Muskrat is not painted. Interior Payment Unit boundaries are marked with yellow paint or are unmarked and designated by Penn Road. Exterior sale boundaries against private are marked with blue paint. The painted boundary line trees are not Included Timber and are to be protected. Yellow painted trees designating an interior Payment Unit boundary are only to be cut when all surrounding Payment Units have been paid.

2 - Timber Specifications

2.1 - Included Timber

2.1.1 - Clearcut unit(s) with unmerchantable trees (6/14)

Within Payment Unit(s) 1 and 2, cut all trees that are two (2) inches or more at DBH.

2.1.3 - Cut tree marked unit(s) (12/08)

Within Payment Unit(s) 3 and 4, all trees are designated for cutting when marked with orange paint above and below stump height, regardless of merchantability.

2.2 - Utilization

2.2.2 - Chipping required (2/18)

Payment Units 1 and 2 must be chip harvested to facilitate subsequent planting operations. The Purchaser has the option to produce sawlogs or pulpwood bolts, but the remaining portion of the trees must be chipped and hauled. If market conditions limit the practicality of chipping, tops and slash must be arranged in a way that will not inhibit future planting operations, as directed by the sale administrator. The requirement to retain approximately 1/6 to 1/3 of tree tops and limbs less than four inches in diameter is still applicable (G. C. & R. 2.2).

2.2.3 - Stump heights (4/07)

Stump heights within Payment Units 1-4 shall not exceed 6 inches for all trees. This is to facilitate planting operations.

3 - Payments

3.3 - Pre-measured Sales

3.3.4 - Dividing payment units (7/14)

Payment Unit(s) may be divided at the request of the Purchaser and upon approval of the Unit Manager. Dividing Payment Units is a contract modification which requires a Timber Sale Contract Amendment. There will be only one division per Payment Unit.

4 - Transportation

4.1 - Construction

4.1.6 - Road construction (1/09)

Construction of new roads shall be done in such a way as to minimize the environmental and visual impacts. Merchantable trees shall be cut and utilized unless otherwise directed. Non-merchantable trees shall be severed and laid flat on the ground. Slash shall be chipped, utilized, or otherwise removed from the sale. Stumps shall be set upright, not left on edge, and be moved at least 10 feet away from the road edge. Disturbed soil shall be feathered into the woods and not left in berms or windrows.

4.1.7 - Road closure (10/11)

All new roads built into the sale must be blocked to vehicle traffic upon completion of the sale. In general, this will require constructing a four (4') foot high berm of stumps and logs covered with earth. Stumps and brush must be placed along the

remainder of the trail. These roads must be rendered impassable to cars and trucks. All stumps from road building and landing construction must be reserved to block any newly constructed roads upon completion of the sale. These stumps must be scattered along the road system to prohibit vehicular movement. Contact the sale administrator for specific details of design and placement.

4.1.11 - Permits (2/12)

The Purchaser will secure any necessary permits that may be required.

5 - Operations

5.1 - Notification

5.1.1 - Pre-sale conference (10/16)

A pre-sale conference on site between the Purchaser and sale administrator is required prior to beginning any operations to determine landing and road locations. The Unit Manager or his/her representative must be contacted at least three days in advance to schedule the conference.

5.1.3 - Well heads and natural gas pipelines (11/15)

The Purchaser is responsible for contacting the pipeline company, DCP Midstream, prior to operating equipment in the vicinity of well heads or natural gas pipelines.

5.2 - Conduct of Operations

5.2.2 - Hazard Trees/Snags

5.2.2.1 - Den trees (10/16)

Obvious hollow and/or den trees shall be protected and left standing unless they are a safety hazard.

5.2.3 - Operating Restrictions

5.2.3.3 - Bark slippage restriction (3/09)

Within Payment Unit(s) 3 and 4, unless changed by written agreement, cutting and skidding are not permitted during the period of April 15 to July 15. This restriction is because of bark slippage.

5.2.3.6 - Bark beetle restriction (12/08)

In the event drought creates a high risk of pine bark beetle infestation, pine is not to be cut during the period March 1 through July 1, unless all portions of trees greater than two inches in diameter are removed from the sale area, reduced to chips, or treated to the satisfaction of the Unit Manager or his/her representative, within fifteen days of being severed from the stump. Pine log decks, pulpwood piles and treetops that are piled for chipping in the fall or winter within a 1/4 mile of susceptible sites must be removed before March 15. Residual slash must not be placed in piles or rows and must be spread over the site for quick drying. The Department of Natural Resources will exercise this specification if the risk of damage warrants.

5.2.32 - Decking/landing restoration (9/13)

All decking and landing areas must have the surface area restored to a condition equal to or better than before. This is to ensure the proper regeneration of the stand. Wood debris, chips, and "cookies" from trimmings must be removed or scattered away from landing and loading areas and may not be windrowed on the edge.

5.2.38 - No decking against live trees (2/04)

Cut products may not be decked against unmarked or designated leave trees.

5.2.41 - Snowmobile trail protection (9/11)

The snowmobile trail is shown on the Timber Sale Map. Do not cut or damage posts with orange trail markers or traffic control signs. If the trail is used, it must be maintained and restored to a condition equal to or better than before the sale. The road maintenance/restoration must be done prior to December 1. If the trail is used for hauling, it must be graded to the satisfaction of the Unit Manager or his/her representative prior to December 1. The snowmobile trail may not be used for any timber sale operations from December 1 to March 31 without written approval from the Unit Manager. If the trail road is to be used for hauling during the snowmobile season, then a snow-covered base must be left on the trail. The snowmobile trail may only be crossed at right angles. Maintain a 20-foot-wide slash, debris, and rut free zone daily using the snowmobile trail as the centerline. No decking of forest products will be permitted along the snowmobile trail. In addition, any trees cut within 5 feet of the trail must be cut at ground level.

5.4 - Soil Protection

5.4.1 - Rutting restriction, general (7/16)

Operations are to cease immediately if equipment and weather conditions result in rutting of roads and/or skid trails which is 12 inches or greater in depth and 50 feet in length. The Unit Manager or his/her representative may restrict hauling and/or skidding if ruts exceed the specified depth. With the Unit Manager or his/her representative's approval, the Purchaser may return to the area when the risk of rutting has decreased.

5.8 - Protection of Endangered Species

5.8.1 - Kirtland's warbler (1) (10/12)

This sale is adjacent to a young jack pine stand which may be used by the endangered Kirtland's Warbler. The Department reserves the right to temporarily restrict all harvesting operations in a buffer zone of up to 500 feet if it is determined that Warbler territory has been established in the adjacent stand. The restricted period, if put into effect, would apply from May 1 to August 15.

6 - Safety and Fire Prevention

6.2 - Signing

6.2.1 - Road posting (9/09)

The Purchaser is responsible for posting and maintaining caution signs on Muskrat Lake Road, Penn Road, and Townline Road prior to beginning operations. The road must be posted at appropriate distances from the Sale Area to warn of logging activity and truck traffic. Signs must be removed when harvest operations are suspended or completed. The Purchaser will provide these signs.

6.2.2 - Snowmobile trail posting (8/09)

The Purchaser is responsible for posting and maintaining caution signs on the snowmobile trail prior to beginning operations during the snowmobile season (approximately December 1 to March 31). The trail must be posted at appropriate distances from the Sale Area to warn of logging activity and truck traffic. Signs must be removed when harvest operations are suspended or completed. The Purchaser will provide these signs.



TIMBER SALE MAP

This information provided by authority of Part 525, 1994 PA 451, as amended.

Forest Management Unit Grayling		County Oscoda	Mapped By Mittig		Date 09/08/2020	Page 1 of 1	
		Cruised By Mittig and Ehlert					
Township 27N	Range 02E	Section(s) and Subdivision(s) SW1/4 Sec 6			Scale 1:15,840		

Cover Type				Density			
A = Aspen	H = Hemlock	N = Marsh	U = Upland Brush	0 = Non Stocked	5 = Pole Timber Medium		
B = Paper Birch	J = Jack Pine	O = Oak	UM = Upland Mixed	1 = Seedling Sapling Poor	6 = Pole Timber Well		
C = Cedar	L = Lowland Brush	P = Lowland Poplar	V = Bog or Marsh	2 = Seedling Sapling Medium	7 = Saw Timber Poor		
D = Treed Bog	LM = Lowland Mixed	Q = Mixed Swamp Conifer	W = White Pine	3 = Seedling Sapling Well	8 = Saw Timber Medium		
E = Swamp Hdwoods	M = Mpl, Bch, Brch	R = Red Pine	X = Non Stocked	4 = Pole Timber Poor	9 = Saw Timber Well		
F = Spruce Fir	MC = Mixed Conifer	S = Black Spruce	Z = Water				
G = Grass	MD = Mixed Deciduous	T = Tamarack					

PU	Acres	PU	Acres
1	31.3	4	23
2	70.2		
3	44		

Plowtruck I'm Stuck Mix

Compartment 9
168.5 Acres

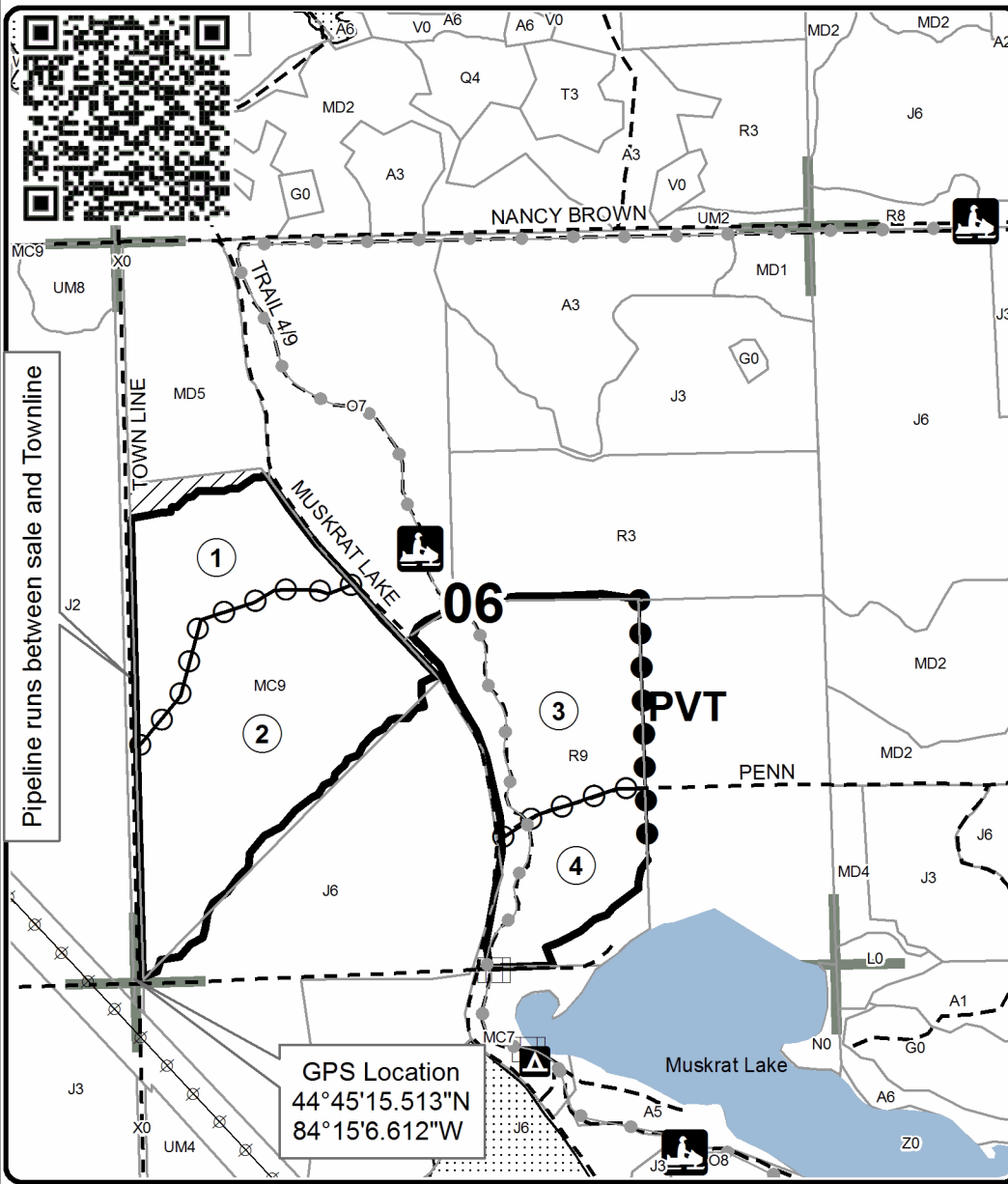
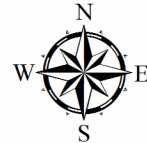

Pipeline runs between sale and Townline

GPS Location
44°45'15.513"N
84°15'6.612"W

Legend

- Against State (Red)
- Payment Unit (Yellow)
- Private Line (Blue)
- Payment Unit
- ▨ Nearby Timber Sales
- ▨ Retention Area
- ▭ Stand Boundaries
- Recreational Trail
- - - Road
- ▭ Gate
- ▭ Pipeline
- ⊕ Powerline
- Lakes and Rivers
- Section Corners

Locator Map 1:100,000

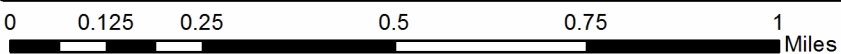
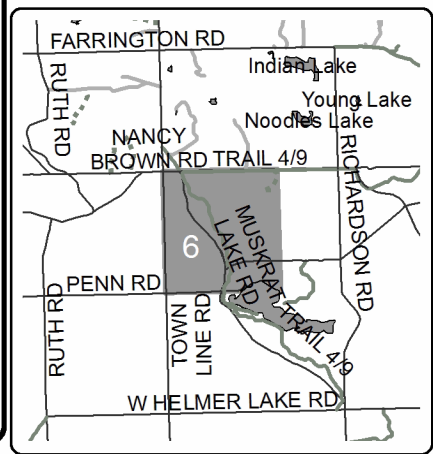

TIMBER SALE INFORMATION

Penn Pine and Oak (72-021-20)
T28N, R02E, SEC. 17; T28N, R02E, SEC. 18.
Oscoda County (Advertised Price \$48,935.15)

SALE NOTE: Sale contains 46.6 acres of final harvest. Payment Unit 1 has two retention islands in the East end. Payment Unit(s) 2 and 4 each contain a retention pocket that has been boundary excluded and shown on the Timber Sale Map .

A timber sale contract for this lump sum, sealed bid timber sale will be awarded to the responsible bidder offering the highest sealed bid price. All units of volume listed below were estimated using the T-Sale computer program and our traditional volume equations. Bids must be at or above the following advertised price for each product and species:

<u>PRODUCTS & SPECIES</u>	<u>ESTIMATED UNITS*</u>	<u>ADVERTISED PRICE</u>
Sawtimber		
Mixed Oak	54.3 MBF	\$ 136.00 / MBF
Red Pine	244.8 MBF	\$ 91.00 / MBF
Pulpwood		
Jack Pine	10 Cords	\$ 15.30 / Cord
Mixed Aspen	35 Cords	\$ 14.05 / Cord
Mixed Oak	128 Cords	\$ 20.50 / Cord
Red Maple	81 Cords	\$ 20.40 / Cord
Red Pine	424 Cords	\$ 33.85 / Cord

* The total volume is statistically estimated within plus (+) or minus (-) 16.53 percent. There are an estimated 1,275 cords on this timber sale, plus or minus 211 cords at the 95% confidence level. The estimated units are final and not subject to adjustment. Prospective bidders are urged to examine this timber and to make their own estimates of quantity and quality.

BOND AND PAYMENT SCHEDULE:

1. A bond in the amount of \$2,447.00 to insure faithful performance of the conditions of the contract will be deposited by the successful bidder within 21 days of the sale award.
2. Cutting in any sale or unit without the required advance payment would be considered a trespass.
3. Total payment must be paid in advance or according to the following schedule :
 - (a) Ten percent (10%) of the sale value must be paid within 21 days of the sale award.
 - (b) The 10% down payment will be credited towards the first unit cut.
 - (c) Payment for each of the following units must be made before cutting begins in that unit:

PAYMENT UNIT NUMBER	PERCENT OF TOTAL SALE VALUE
01	16.6%
02	25.6%
03	20.5%
04	37.3%
4. If no cutting takes place, the 10% down payment will not be refunded.
5. Operations on the contract issued will terminate on 06/30/2023.

SALE STATISTICS

SALE VOLUMES

VOLUME		STATISTICAL RANGE IN CORDS		
TOTAL CUBIC FEET	TOTAL CORDS	PERCENT ERROR	MINIMUM	MAXIMUM
100,727	1,275	16.53%	1,064	1,486

VDU VOLUMES

A VDU is a Volume Determination Unit. Volumes and their associated statistics are calculated at the VDU level and summarized to the sale level. There is often a one to one relationship between a VDU and a Payment Unit, but not always, depending on the cruise design. Refer to the VDU TO PAYMENT UNIT table.

VDU	VOLUME		PERCENT ERROR	RANGE IN CORDS	
	TOTAL CUBIC FEET	TOTAL CORDS		MINIMUM	MAXIMUM
5	18,415	233	28.12%	168	299
15	30,115	381	28.55%	272	490
17	53,941	683	35.24%	442	923
89	24,861	315	46.25%	169	460
115	16,961	215	18.00%	176	253
TOTAL:	144,294	1,827		1,227	2,426

VDU TO PAYMENT UNIT

When a VDU is associated with more than one Payment Unit (PU), the VDU volumes are assigned to the PU based on acres of the VDU within the PU.

VDU	VDU ACRES	PU	PU ACRES
5	11.0	1	11.0
15	10.7	4	10.7
17	11.7	2	9.7
		4	2.0
89	7.4	2	2.2
		3	2.9
		4	2.3
115	5.8	3	5.8
TOTAL:	46.6		46.6

DESCRIPTION OF TIMBER BY PAYMENT UNIT (PU)

PU	MARKET GROUP	PRODUCT	QUANTITY	UNIT	ACRES	ADVERTISE PRICE
1	Mixed Oak	Sawtimber	37.7	MBF	11.0	\$8,145.30
	<i>B/I/R/Hybrid Oak</i>		18.5	<i>MBF</i>		
	<i>Northern Pin Oak</i>		13.4	<i>MBF</i>		
	<i>Red Oak</i>		5.8	<i>MBF</i>		
	Jack Pine	Pulpwood	10	Cords		
	<i>Jack Pine</i>	<i>Sawtimber</i>	1.1	<i>MBF</i>		
	<i>Jack Pine</i>	<i>Pulpwood</i>	8	<i>Cords</i>		
	Mixed Aspen		22	Cords		
	<i>B. T. Aspen</i>	<i>Sawtimber</i>	3.8	<i>MBF</i>		
	<i>B. T. Aspen</i>	<i>Pulpwood</i>	14	<i>Cords</i>		
	Mixed Oak		60	Cords		
	<i>B/I/R/Hybrid Oak</i>		30	<i>Cords</i>		
	<i>Northern Pin Oak</i>		25	<i>Cords</i>		
	<i>Red Oak</i>		5	<i>Cords</i>		
	Red Maple		65	Cords		
	<i>Red Maple</i>	<i>Sawtimber</i>	5.6	<i>MBF</i>		
	<i>Red Maple</i>	<i>Pulpwood</i>	54	<i>Cords</i>		
2	Mixed Oak	Sawtimber	6.7	MBF	11.9	\$12,530.40
	<i>B/I/R/Hybrid Oak</i>		0.5	<i>MBF</i>		
	<i>Northern Pin Oak</i>		6.2	<i>MBF</i>		
	Red Pine		80.8	MBF		
	Mixed Aspen	Pulpwood	6	Cords		
	<i>Quaking Aspen</i>	<i>Sawtimber</i>	0.9	<i>MBF</i>		
	<i>Quaking Aspen</i>	<i>Pulpwood</i>	4	<i>Cords</i>		
	Mixed Oak		24	Cords		
	<i>B/I/R/Hybrid Oak</i>		3	<i>Cords</i>		
	<i>Northern Pin Oak</i>		21	<i>Cords</i>		
	Red Maple		5	Cords		
	<i>Red Maple</i>	<i>Sawtimber</i>	0.9	<i>MBF</i>		
	<i>Red Maple</i>	<i>Pulpwood</i>	3	<i>Cords</i>		
	Red Pine		106	Cords		
3	Mixed Oak	Sawtimber	5.2	MBF	8.7	\$10,018.65
	<i>B/I/R/Hybrid Oak</i>		0.7	<i>MBF</i>		
	<i>Northern Pin Oak</i>		4.5	<i>MBF</i>		
	Red Pine		60.3	MBF		
	Mixed Aspen	Pulpwood	3	Cords		
	<i>Quaking Aspen</i>	<i>Sawtimber</i>	1.2	<i>MBF</i>		
	<i>Quaking Aspen</i>	<i>Pulpwood</i>	1	<i>Cords</i>		
	Mixed Oak		20	Cords		
	<i>B/I/R/Hybrid Oak</i>		4	<i>Cords</i>		
	<i>Northern Pin Oak</i>		16	<i>Cords</i>		
	Red Maple		6	Cords		
	<i>Red Maple</i>	<i>Sawtimber</i>	1.1	<i>MBF</i>		
	<i>Red Maple</i>	<i>Pulpwood</i>	4	<i>Cords</i>		
	Red Pine		96	Cords		
4	Mixed Oak	Sawtimber	4.7	MBF	15.0	\$18,240.80
	<i>B/I/R/Hybrid Oak</i>		0.5	<i>MBF</i>		
	<i>Northern Pin Oak</i>		4.2	<i>MBF</i>		
	Red Pine		103.7	MBF		
	Mixed Aspen	Pulpwood	4	Cords		
	<i>Quaking Aspen</i>	<i>Sawtimber</i>	1.0	<i>MBF</i>		
	<i>Quaking Aspen</i>	<i>Pulpwood</i>	2	<i>Cords</i>		
	Mixed Oak		24	Cords		
	<i>B/I/R/Hybrid Oak</i>		10	<i>Cords</i>		
	<i>Northern Pin Oak</i>		14	<i>Cords</i>		
	Red Maple		5	Cords		

DESCRIPTION OF TIMBER BY PAYMENT UNIT (PU), CON'T

PU	MARKET GROUP	PRODUCT	QUANTITY	UNIT	ACRES	ADVERTISE PRICE
4 con't	<i>Red Maple</i>	<i>Sawtimber</i>	0.9	<i>MBF</i>		
	<i>Red Maple</i>	<i>Pulpwood</i>	3	<i>Cords</i>		
	Red Pine		222	Cords		
TOTAL:			299.1	MBF		
TOTAL:			678	Cords		

Sale Specific Conditions & Requirements

Sale Name: Penn Pine and Oak

Sale Number: 72-021-20 Seq#: 2

1 - Sale Area

1.2 - Boundaries

1.2.1 - Painted boundaries (9/19)

The sale boundary and Payment Unit boundaries are marked and identified by blue and red paint as well as the surrounding roads. Exterior sale boundary lines against private property are marked with blue paint. Exterior sale boundary lines against state are marked with red paint. Payment Unit boundaries are designated by Pennsylvania Crossing Road and Oak Lake Road are unmarked. Retention patches are marked with red paint; no harvesting activities may occur within these areas. The painted boundary line trees in Payment Unit 1 are not Included Timber and are to be protected. In Payment Units 2-4, cut all red pine boundary trees.

2 - Timber Specifications

2.1 - Included Timber

2.1.1 - Clearcut unit(s) with unmerchantable trees (6/14)

Within Payment Unit(s) 1-4, cut all trees that are two (2) inches or more at DBH.

2.2 - Utilization

2.2.2 - Chipping required (2/18)

Payment Units 2-4 must be chip harvested to facilitate subsequent planting operations. The Purchaser has the option to produce sawlogs or pulpwood bolts, but the remaining portion of the trees must be chipped and hauled. If market conditions limit the practicality of chipping, tops and slash must be arranged in a way that will not inhibit future planting operations, as directed by the sale administrator. The requirement to retain approximately 1/6 to 1/3 of tree tops and limbs less than four inches in diameter is still applicable (G. C. & R. 2.2).

2.2.3 - Stump heights (4/07)

Stump heights within the Sale Area shall not exceed 6 inches for all trees. This is to facilitate planting operations. A written waiver of this requirement may be obtained if wet summer weather makes winter logging necessary.

3 - Payments

3.3 - Pre-measured Sales

3.3.4 - Dividing payment units (7/14)

Payment Unit(s) may be divided at the request of the Purchaser and upon approval of the Unit Manager. Dividing Payment Units is a contract modification which requires a Timber Sale Contract Amendment. There will be only one division per Payment Unit.

4 - Transportation

4.1 - Construction

4.1.3 - Slash and earthen piles (8/04)

Piles or windrows of earth along roads and landings that have been widened or constructed shall be leveled. Slash from road maintenance or construction, including stumps, shall be dispersed throughout the sale.

4.1.6 - Road construction (1/09)

Construction of new roads or improvements of existing roads shall be done in such a way as to minimize the environmental and visual impacts. Merchantable trees shall be cut and utilized unless otherwise directed. Non-merchantable trees shall be severed and laid flat on the ground. Slash shall be scattered, and not left in windrows and kept a minimum of 10 feet back from the road edge. Stumps shall be set upright, not left on edge, and be moved at least 10 feet away from the road edge. Disturbed soil shall be feathered into the woods and not left in berms or windrows.

4.1.7 - Road closure (10/11)

All new roads built into the sale must be blocked to vehicle traffic upon completion of the sale. Overgrown roads that are

reopened shall be considered new roads. In general, this will require constructing a four (4') foot high berm of stumps and logs covered with earth. Stumps and brush must be placed along the remainder of the trail. Contact the sale administrator for specific details of design and placement.

4.1.11 - Permits (2/12)

The Purchaser will secure any necessary permits that may be required.

5 - Operations

5.1 - Notification

5.1.1 - Pre-sale conference (10/16)

A pre-sale conference between the Purchaser and sale administrator is required prior to beginning any operations to determine landing and road locations. The Unit Manager or his/her representative must be contacted at least 5 days in advance to schedule the conference.

5.1.4 - Post-sale conference (10/16)

A post-sale conference on site between the Purchaser and sale administrator is required 5 days prior to the completion of active logging operations to determine clean-up and repair of landings, road edges, and the fulfillment of other contract specifications.

5.2 - Conduct of Operations

5.2.1 - Slash

5.2.1.8 - Slash height (12/08)

No slash or tree tops may exceed 24 inches in height.

5.2.2 - Hazard Trees/Snags

5.2.2.1 - Den trees (10/16)

Obvious hollow and/or den trees shall be protected and left standing unless they are a safety hazard.

5.2.3 - Operating Restrictions

5.2.3.4 - Oak wilt restriction, no exceptions (1/18)

Within Payment Unit(s) 1, cutting, skidding, hauling within the sale and brushing of access roads to the sale are not permitted during the period of April 15 to July 15. No exceptions will be granted. This is necessary to reduce the spread of oak wilt.

5.2.32 - Decking/landing restoration (9/13)

All decking and landing areas must have the surface area restored to a condition equal to or better than before. This is to ensure the proper regeneration of the stand. Wood debris, chips, and "cookies" from trimmings must be removed or scattered away from landing and loading areas and may not be windrowed on the edge.

5.4 - Soil Protection

5.4.1 - Rutting restriction, general (7/16)

Operations are to cease immediately if equipment and weather conditions result in rutting of roads and/or skid trails which is 12 inches or greater in depth and 50 feet in length. The Unit Manager or his/her representative may restrict hauling and/or skidding if ruts exceed the specified depth. With the Unit Manager or his/her representative's approval, the Purchaser may return to the area when the risk of rutting has decreased.

6 - Safety and Fire Prevention

6.2 - Signing

6.2.1 - Road posting (9/09)

The Purchaser is responsible for posting and maintaining caution signs on Oak Lake Road and Pennsylvania Crossing Road prior to beginning operations. The road must be posted at appropriate distances from the Sale Area to warn of logging activity and truck traffic. Signs must be removed when harvest operations are suspended or completed. The Purchaser will provide these signs.



TIMBER SALE MAP

This information provided by authority of Part 525, 1994 PA 451, as amended.

Forest Management Unit Grayling	County Oscoda	Mapped By Ehlert	Date 09/08/2020	Page 1	of 1
Cruised By Ehlert					

Township 28N	Range 02E	Section(s) and Subdivision(s) Sec 17- SW; Sec 18- SESE	Scale 1:7,920
-----------------	--------------	---	------------------

Cover Type				Density			
A = Aspen	H = Hemlock	N = Marsh	U = Upland Brush	0 = Non Stocked	5 = Pole Timber Medium		
B = Paper Birch	J = Jack Pine	O = Oak	UM = Upland Mixed	1 = Seedling Sapling Poor	6 = Pole Timber Well		
C = Cedar	L = Lowland Brush	P = Lowland Poplar	V = Bog or Marsh	2 = Seedling Sapling Medium	7 = Saw Timber Poor		
D = Treed Bog	LM = Lowland Mixed	Q = Mixed Swamp Conifer	W = White Pine	3 = Seedling Sapling Well	8 = Saw Timber Medium		
E = Swamp Hdwoods	M = Mpl, Bch, Brch	R = Red Pine	X = Non Stocked	4 = Pole Timber Poor	9 = Saw Timber Well		
F = Spruce Fir	MC = Mixed Conifer	S = Black Spruce	Z = Water				
G = Grass	MD = Mixed Deciduous	T = Tamarack					

PU	Acres	PU	Acres
1	11	4	15
2	11.9		
3	8.7		

Penn Pine and Oak

Compartment 018
46.6 Acres

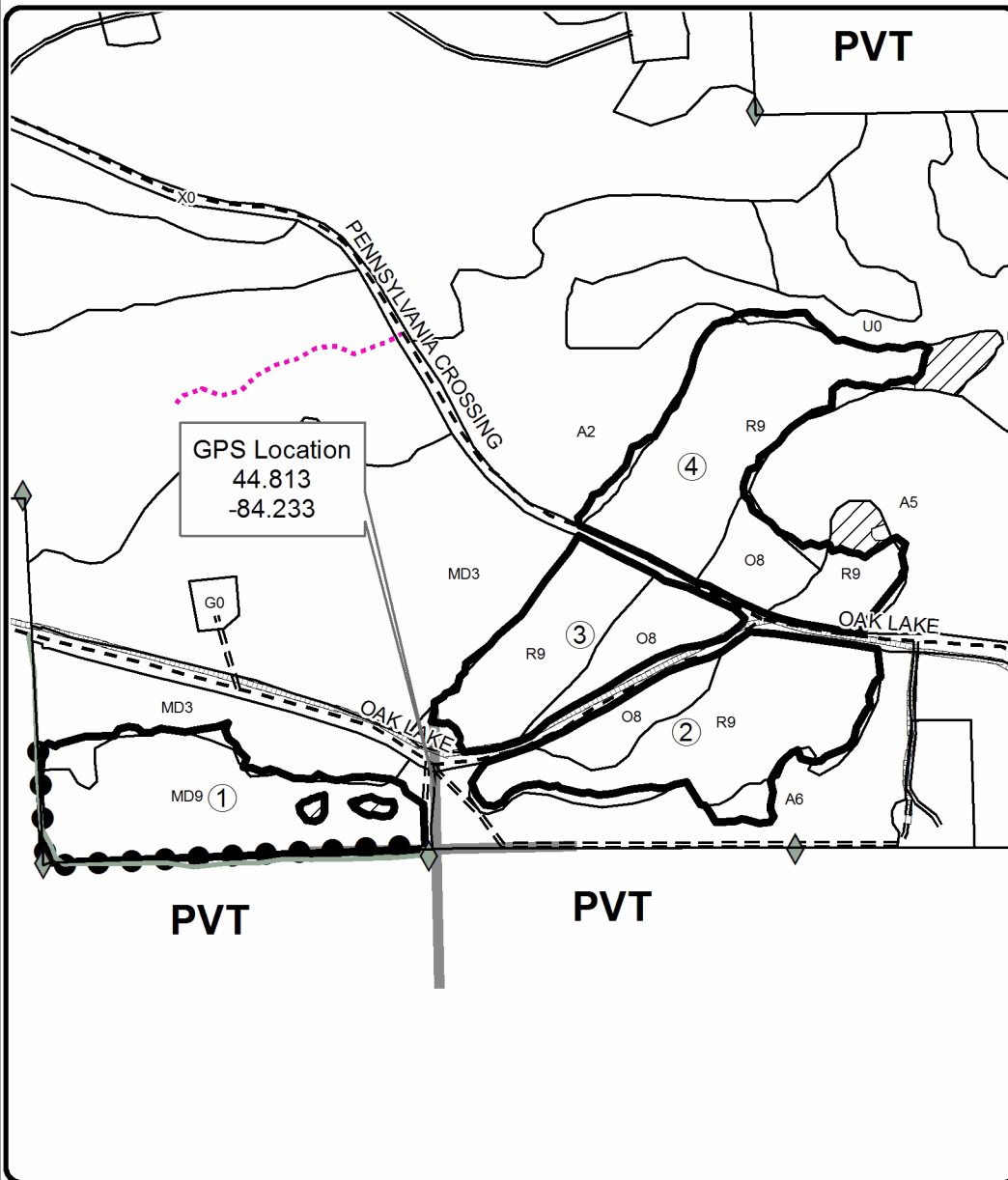
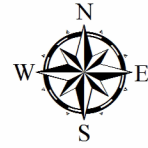

GPS Location
44.813
-84.233

Legend

- Stand Boundaries
- Field Grade Corners
- Secondary Forest Road
- Forest Access Route
- Gravel Road
- Private
- Temporary Management Access
- Retention Area
- Against State (Red)
- Private Line (Blue)
- Section Corners

Locator Map
1:200,000

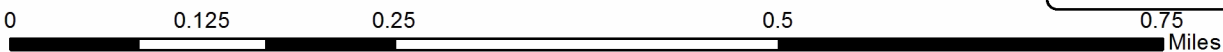
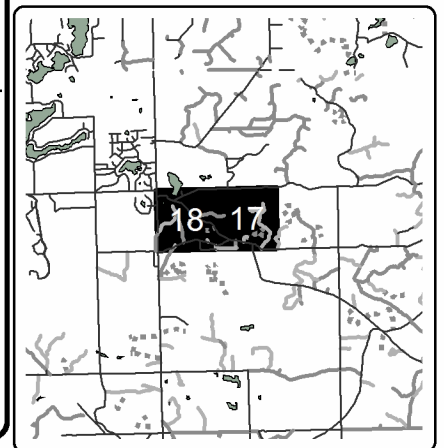

TIMBER SALE INFORMATION

MPRC Fuelbreak (72-624-20)

T27N, R03W, SEC. 13; T27N, R03W, SEC. 23; T27N, R03W, SEC. 24.
Crawford County (Advertised Price \$23,363.85)

SALE NOTE: The purpose of this harvest is to facilitate fuelbreak construction within Range 30. Access will be limited and there is the potential to encounter unexploded ordinance.

A timber sale contract for this lump sum, sealed bid timber sale will be awarded to the responsible bidder offering the highest sealed bid price. All units of volume listed below were estimated using the T-Sale computer program and our traditional volume equations. Bids must be at or above the following advertised price for each product and species:

<u>PRODUCTS & SPECIES</u>	<u>ESTIMATED UNITS*</u>	<u>ADVERTISED PRICE</u>
Sawtimber		
Northern Pin Oak	11.6 MBF	\$ 63.00 / MBF
Red Oak	143.6 MBF	\$ 80.00 / MBF
White Oak	19.4 MBF	\$ 46.00 / MBF
Pulpwood		
Jack Pine	41 Cords	\$ 11.15 / Cord
Misc. Species 1	136 Cords	\$ 4.00 / Cord
Misc. Species 2	12 Cords	\$ 2.00 / Cord
Mixed Aspen	105 Cords	\$ 10.20 / Cord
Mixed Hardwood	162 Cords	\$ 14.85 / Cord
Mixed Oak	378 Cords	\$ 14.90 / Cord
Red Pine	3 Cords	\$ 24.60 / Cord
White Pine	4 Cords	\$ 11.20 / Cord

* The total volume is statistically estimated within plus (+) or minus (-) 16.69 percent. There are an estimated 1,187 cords on this timber sale, plus or minus 198 cords at the 95% confidence level. The estimated units are final and not subject to adjustment. Prospective bidders are urged to examine this timber and to make their own estimates of quantity and quality.

BOND AND PAYMENT SCHEDULE:

1. A bond in the amount of \$1,168.00 to insure faithful performance of the conditions of the contract will be deposited by the successful bidder within 21 days of the sale award.
2. Cutting in any sale or unit without the required advance payment would be considered a trespass.
3. Total payment must be paid in advance or according to the following schedule :
 - (a) Ten percent (10%) of the sale value must be paid within 21 days of the sale award.
 - (b) The 10% down payment will be credited towards the first unit cut.
 - (c) Payment for each of the following units must be made before cutting begins in that unit:

PAYMENT UNIT NUMBER	PERCENT OF TOTAL SALE VALUE
01	28.7%
02	71.3%
4. If no cutting takes place, the 10% down payment will not be refunded.
5. Operations on the contract issued will terminate on 06/30/2023.

SALE STATISTICS

SALE VOLUMES

VOLUME		STATISTICAL RANGE IN CORDS		
TOTAL CUBIC FEET	TOTAL CORDS	PERCENT ERROR	MINIMUM	MAXIMUM
93,751	1,187	16.69%	989	1,385

VDU VOLUMES

A VDU is a Volume Determination Unit. Volumes and their associated statistics are calculated at the VDU level and summarized to the sale level. There is often a one to one relationship between a VDU and a Payment Unit, but not always, depending on the cruise design. Refer to the VDU TO PAYMENT UNIT table.

VDU	VOLUME		PERCENT ERROR	RANGE IN CORDS	
	TOTAL CUBIC FEET	TOTAL CORDS		MINIMUM	MAXIMUM
3	8,840	112	35.99%	72	152
4	3,073	39	83.40%	6	71
18	6,794	86	49.12%	44	128
19	2,125	27	89.45%	3	51
20	11,194	142	39.46%	86	198
48	4,195	53	63.34%	19	87
53	20,817	264	38.04%	163	364
153	36,703	465	24.09%	353	577
TOTAL:	93,741	1,187		746	1,627

VDU TO PAYMENT UNIT

When a VDU is associated with more than one Payment Unit (PU), the VDU volumes are assigned to the PU based on acres of the VDU within the PU.

VDU	VDU ACRES	PU	PU ACRES
3	8.2	1	8.2
4	3.6	1	3.6
18	6.0	1	6.0
19	3.1	1	3.1
20	7.9	1	7.9
48	3.2	2	3.2
53	10.5	2	10.5
153	9.8	2	9.8
TOTAL:	52.3		52.3

DESCRIPTION OF TIMBER BY PAYMENT UNIT (PU)

PU	MARKET GROUP	PRODUCT	QUANTITY	UNIT	ACRES	ADVERTISE PRICE			
1	Northern Pin Oak	Sawtimber	8.0	MBF	28.8	\$6,711.30			
	Red Oak		20.5	MBF					
	White Oak		6.9	MBF					
	Jack Pine	Pulpwood	33	Cords					
	<i>Jack Pine</i>	<i>Sawtimber</i>	3.4	<i>MBF</i>					
	<i>Jack Pine</i>	<i>Pulpwood</i>	26	<i>Cords</i>					
	Misc. Species 1		20	Cords					
	Misc. Species 2		8	Cords					
	Mixed Aspen		69	Cords					
	<i>B. T. Aspen</i>	<i>Sawtimber</i>	3.1	<i>MBF</i>					
	<i>B. T. Aspen</i>	<i>Pulpwood</i>	63	<i>Cords</i>					
	Mixed Hardwood		31	Cords					
	<i>Red Maple</i>	<i>Sawtimber</i>	0.4	<i>MBF</i>					
	<i>Red Maple</i>	<i>Pulpwood</i>	30	<i>Cords</i>					
	Mixed Oak		168	Cords					
	<i>Northern Pin Oak</i>		76	<i>Cords</i>					
	<i>Red Oak</i>		42	<i>Cords</i>					
	<i>White Oak</i>		50	<i>Cords</i>					
	Red Pine		3	Cords					
	<i>Red Pine</i>	<i>Sawtimber</i>	1.0	<i>MBF</i>					
	<i>Red Pine</i>	<i>Pulpwood</i>	1	<i>Cords</i>					
	White Pine		4	Cords					
	2	Northern Pin Oak	Sawtimber	3.6			MBF	23.5	\$16,637.70
Red Oak			123.1	MBF					
White Oak			12.5	MBF					
Jack Pine		Pulpwood	8	Cords					
<i>Jack Pine</i>		<i>Sawtimber</i>	1.5	<i>MBF</i>					
<i>Jack Pine</i>		<i>Pulpwood</i>	5	<i>Cords</i>					
Misc. Species 1			116	Cords					
Misc. Species 2			4	Cords					
Mixed Aspen			36	Cords					
<i>B. T. Aspen</i>		<i>Sawtimber</i>	3.3	<i>MBF</i>					
<i>B. T. Aspen</i>		<i>Pulpwood</i>	29	<i>Cords</i>					
Mixed Hardwood			130	Cords					
<i>Red Maple</i>		<i>Sawtimber</i>	1.6	<i>MBF</i>					
<i>Red Maple</i>		<i>Pulpwood</i>	127	<i>Cords</i>					
Mixed Oak			210	Cords					
<i>Northern Pin Oak</i>			14	<i>Cords</i>					
<i>Red Oak</i>			155	<i>Cords</i>					
<i>White Oak</i>			41	<i>Cords</i>					
TOTAL:			174.6	MBF					
TOTAL:			840	Cords					

Sale Specific Conditions & Requirements

Sale Name: MPRC Fuelbreak

Sale Number: 72-624-20 Seq#: 2

1 - Sale Area

1.2 - Boundaries

1.2.1 - Painted boundaries (9/19)

The sale boundary and Payment Unit boundaries are marked and identified by red paint in addition to unpainted boundaries. Exterior sale boundary lines against state are marked with red paint in addition to an unpainted boundary designated as the Range fence. The interior Payment Unit boundary is unpainted and designated as the mapped road shown on the Timber Sale Map. The painted boundary line trees are not Included Timber and are to be protected.

2 - Timber Specifications

2.1 - Included Timber

2.1.1 - Clearcut unit(s) with unmerchantable trees (6/14)

Within Payment Unit(s) 1 & 2, cut all trees that are one (1) inch or more at DBH.

2.1.11 - Description of timber note (2/04)

Note that Misc Species 1 is dead oak & red maple. Misc Species 2 is dead pine

2.2 - Utilization

2.2.2 - Chipping required (2/18)

This area must be chip harvested to meet National Guard requirements. The Purchaser has the option to produce sawlogs or pulpwood bolts, but the remaining portion of the trees must be chipped and hauled. The requirement to retain approximately 1/6 to 1/3 of tree tops and limbs less than four inches in diameter does not apply (G. C. & R. 2.2) because the sale is on lands used for Military training.

2.2.3 - Stump heights (4/07)

Stump heights within the Sale Area shall not exceed 6 inches for all trees. This is to facilitate military requirements.

3 - Payments

3.3 - Pre-measured Sales

3.3.4 - Dividing payment units (7/14)

Payment Unit(s) may be divided at the request of the Purchaser and upon approval of the Unit Manager. Dividing Payment Units is a contract modification which requires a Timber Sale Contract Amendment.

4 - Transportation

4.1 - Construction

4.1.3 - Slash and earthen piles (8/04)

Piles or windrows of earth along roads and landings that have been widened or constructed shall be leveled. Slash from road maintenance or construction, including stumps, shall be chipped or used to close temporary roads.

4.1.6 - Road construction (1/09)

Construction of new roads or improvements of existing roads shall be done in such a way as to minimize the environmental and visual impacts. Merchantable trees shall be cut and utilized unless otherwise directed. Non-merchantable trees shall be severed and laid flat on the ground. Slash shall be chipped or utilized. Stumps shall be set upright, not left on edge, and be moved at least 10 feet away from the road edge. Disturbed soil shall be feathered into the woods and not left in berms or windrows.

4.1.7 - Road closure (10/11)

All new roads built into the sale must be blocked to vehicle traffic upon completion of the sale, unless otherwise directed by the Military. Overgrown roads that are reopened shall be considered new roads. In general, this closure will require constructing a four (4') foot high berm of stumps and logs covered with earth.

4.1.11 - Permits (2/12)

The Purchaser will secure any necessary highway and county road permits that may be required.

4.4 - Access

4.4.3 - Access gate (12/08)

The Range access gate must be locked at all times unless otherwise directed by the Military.

5 - Operations

5.1 - Notification

5.1.1 - Pre-sale conference (10/16)

A pre-sale conference on site between the Purchaser and sale administrator is required prior to beginning any operations to determine landing and road locations. The Unit Manager or his/her representative must be contacted at least 5 days in advance to schedule the conference.

5.1.4 - Post-sale conference (10/16)

A post-sale conference on site between the Purchaser and sale administrator is required 5 days prior to the completion of active logging operations to determine clean-up and repair of landings, road edges, and the fulfillment of other contract specifications.

5.1.5 - National Guard notification (2/15)

This sale is upon lands utilized for training by the Michigan National Guard - Camp Grayling. A minimum of five (5) business days prior to opening this sale, the producer must request that the sale administrator contact the military for information regarding training plans that may impact sale operations.

5.2 - Conduct of Operations

5.2.3 - Operating Restrictions

5.2.3.5 - Oak wilt restriction (1/18)

Within Payment Units 1 & 2, unless changed by written agreement, cutting, skidding, hauling within the sale and brushing of access roads to the sale are not permitted during the period of April 15 to July 15. Operations may be allowed if specific steps are taken to prevent damaging uncut oak during the high risk period. Those steps may include completing all road brushing before April 15th and clearing a tree-length buffer along uncut oak cover before April 15th. This is necessary to reduce the spread of oak wilt. For more information, contact the Unit Manager or his/her representative.

5.2.3.7 - National Guard training restriction (1/09)

Operations on this contract will not be allowed during National Guard training operations. Typically, the restricted period is from May 1 to October 31. The contractor must check with the Unit Manager who will coordinate the cutting schedule with the Military. All harvest equipment and timber products must be removed from the Sale Area during the period of May 1 to October 31.

5.2.38 - No decking against live trees (2/04)

Cut products may not be decked against unmarked or designated leave trees.

5.4 - Soil Protection

5.4.1 - Rutting restriction, general (7/16)

Operations are to cease immediately if equipment and weather conditions result in rutting of roads and/or skid trails which is 12 inches or greater in depth and 50 feet in length. The Unit Manager or his/her representative may restrict hauling and/or skidding if ruts exceed the specified depth. With the Unit Manager or his/her representative's approval, the Purchaser may return to the area when the risk of rutting has decreased.

6 - Safety and Fire Prevention

6.2 - Signing

6.2.1 - Road posting (10/20)

The Purchaser is responsible for posting and maintaining caution signs on Aragon Trail prior to beginning operations. The road

must be posted at both ends -- only if it will be used for hauling -- to warn of logging activity and truck traffic. Signs must be removed when harvest operations are suspended or completed. The Purchaser will provide these signs.

SKIP

6.4 - Unexploded ordinance (7/15)

Be aware that the sale area could contain UXO (unexploded ordinances). Do not touch, or drive over any metal objects. If any objects are found, please flag the area and notify the Unit Manager or his/her representative, so that they can make arrangements with the Military.

7 - Other Conditions

7.10 - Certified Timber

7.10.1 - Non-certified timber (2/16)

The area encompassed by this timber sale is not certified to the standards of the Forest Stewardship Council (FSC) or the Sustainable Forestry Initiative (SFI). Forest products from this sale may not be delivered to the mill as "FSC and / or SFI certified". The lands within this sale are managed for military training.



TIMBER SALE MAP

This information provided by authority of Part 525, 1994 PA 451, as amended.

Forest Management Unit Grayling	County Crawford	Mapped By Charlebois & Mittig	Date 09/30/2020	Page 1	of 1
Township 27N	Range 3W	Section(s) and Subdivision(s) Sec 13: E1/2NE, SWNE, E1/2SE, SESW Sec 23: SENE, N1/2SE, SWSE, SESW; Sec 24: N1/2NW, SWNW	Scale 1:15,840		

Cover Type

A = Aspen	H = Hemlock	N = Marsh	U = Upland Brush
B = Paper Birch	J = Jack Pine	O = Oak	UM = Upland Mixed
C = Cedar	L = Lowland Brush	P = Lowland Poplar	V = Bog or Marsh
D = Treed Bog	LM = Lowland Mixed	Q = Mixed Swamp Conifer	W = White Pine
E = Swamp Hdwoods	M = Mpl, Bch, Brch	R = Red Pine	X = Non Stocked
F = Spruce Fir	MC = Mixed Conifer	S = Black Spruce	Z = Water
	MD = Mixed Deciduous		

Density

0 = Non Stocked	5 = Pole Timber Medium
1 = Seedling Sapling Poor	6 = Pole Timber Well
2 = Seedling Sapling Medium	7 = Saw Timber Poor
3 = Seedling Sapling Well	8 = Saw Timber Medium
4 = Pole Timber Poor	9 = Saw Timber Well

MPRC Fuelbreak
Compartments 238, 239, 240
52.3 Acres

PU	Acres
1	28.8
2	23.5

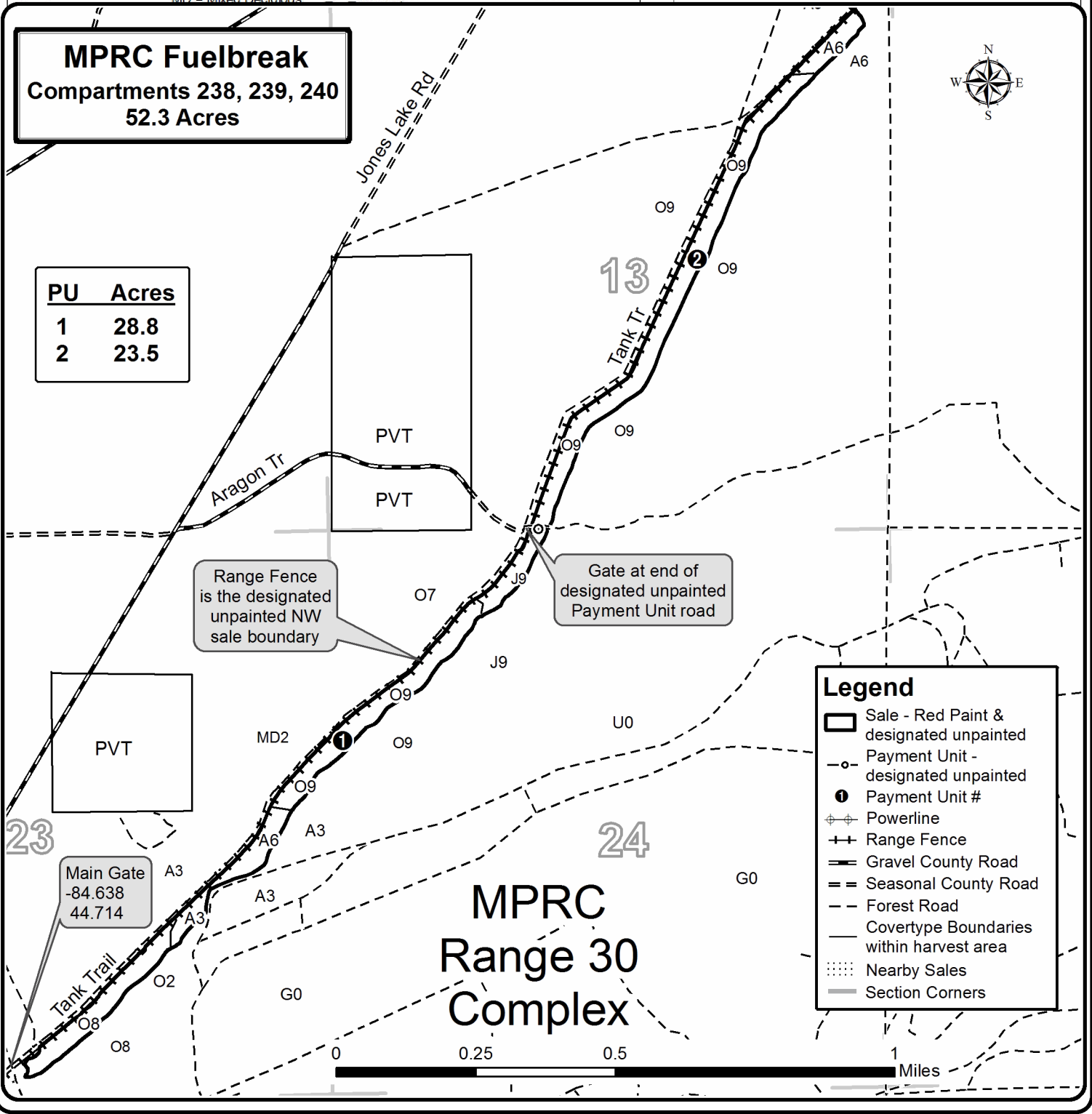

Legend

- Sale - Red Paint & designated unpainted
- Payment Unit - designated unpainted
- Payment Unit #
- Powerline
- Range Fence
- Gravel County Road
- Seasonal County Road
- Forest Road
- Covertype Boundaries within harvest area
- Nearby Sales
- Section Corners



Sale Number	Year
72 - 624	20

TIMBER SALE MAP

This information provided by authority of Part 525, 1994 PA 451, as amended.

Forest Management Unit Grayling		County Crawford	Mapped By Charlebois & Mittig	Date 09/30/2020	Supplemental Map
			Cruised By Charlebois & Mittig		
Township 27N	Range 3W	Section(s) and Subdivision(s) Sec 13: E1/2NE, SWNE, E1/2SE, SESW Sec 23: SENE, N1/2SE, SWSE, SESW; Sec 24: N1/2NW, SWNW		Scale 1:20,000	

Cover Type

A = Aspen	H = Hemlock	N = Marsh	U = Upland Brush
B = Paper Birch	J = Jack Pine	O = Oak	UM = Upland Mixed
C = Cedar	L = Lowland Brush	P = Lowland Poplar	V = Bog or Marsh
D = Treed Bog	LM = Lowland Mixed	Q = Mixed Swamp Conifer	W = White Pine
E = Swamp Hdwoods	M = Mpl. Bch, Brch	R = Red Pine	X = Non Stocked
F = Spruce Fir	MC = Mixed Conifer	S = Black Spruce	Z = Water
G = Grass	MD = Mixed Deciduous	T = Tamarack	

Density

0 = Non Stocked	5 = Pole Timber Medium
1 = Seedling Sapling Poor	6 = Pole Timber Well
2 = Seedling Sapling Medium	7 = Saw Timber Poor
3 = Seedling Sapling Well	8 = Saw Timber Medium
4 = Pole Timber Poor	9 = Saw Timber Well

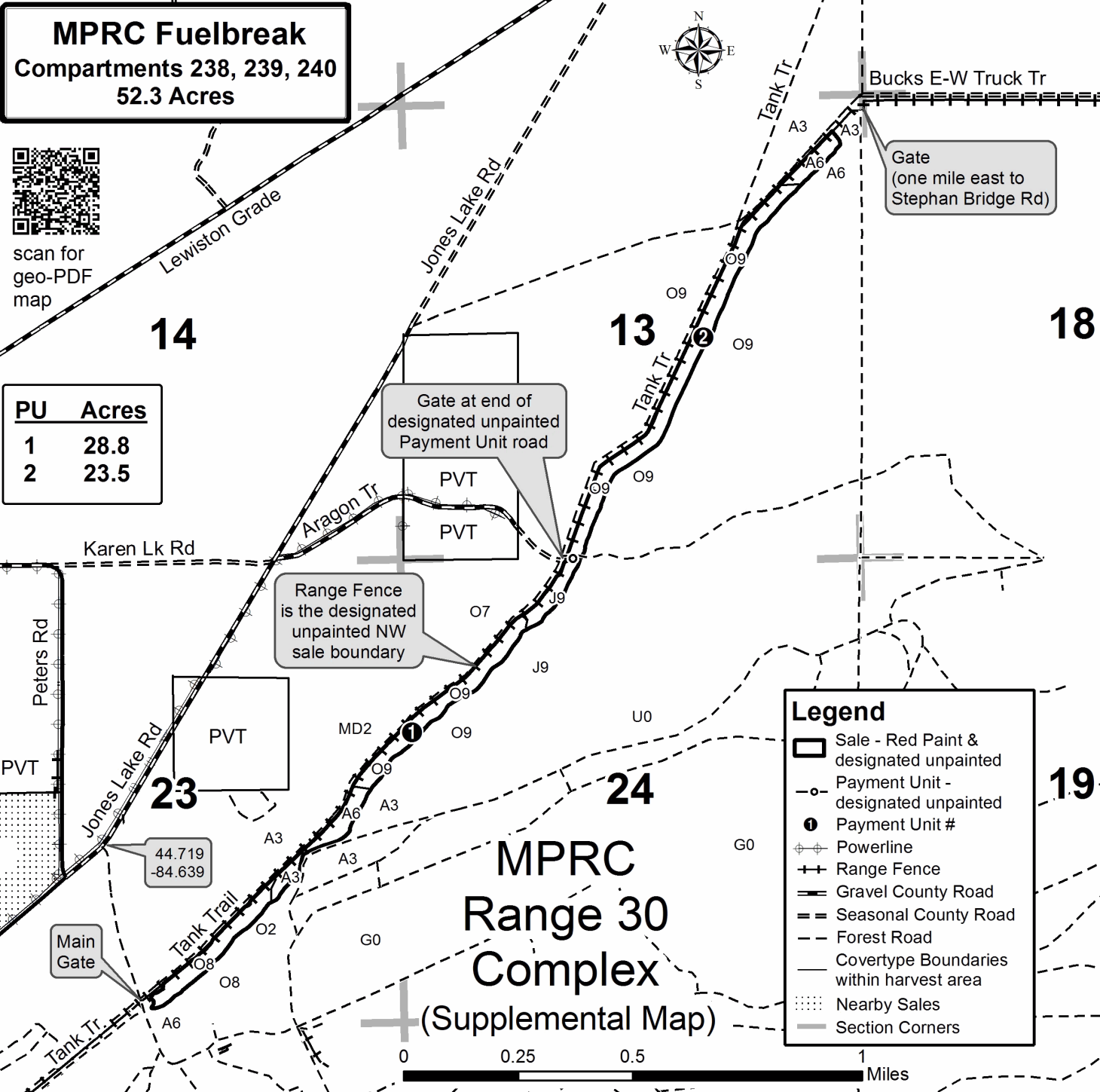

TIMBER SALE INFORMATION

Dollar Lk Rd Oak (72-626-20)
T26N, R04W, SEC. 4; T27N, R04W, SEC. 33.
Crawford County (Advertised Price \$58,172.90)

SALE NOTE: The harvest is on lands used for Military training and the terrain is rolling to steep. This is the second cut in the shelterwood system. There is dense 15-year old regen from the first harvest that has to be worked around. Because there is oak regen throughout the harvest, there will be no exceptions to the oak wilt seasonal operating restriction.

A timber sale contract for this lump sum, sealed bid timber sale will be awarded to the responsible bidder offering the highest sealed bid price. All units of volume listed below were estimated using the T-Sale computer program and our traditional volume equations. Bids must be at or above the following advertised price for each product and species:

<u>PRODUCTS & SPECIES</u>	<u>ESTIMATED UNITS*</u>	<u>ADVERTISED PRICE</u>
Sawtimber		
Northern Pin Oak	12.4 MBF	\$ 71.00 / MBF
Red Oak	466.5 MBF	\$ 90.00 / MBF
White Oak	55.6 MBF	\$ 51.00 / MBF
Pulpwood		
Jack Pine	2 Cords	\$ 12.50 / Cord
Misc. Species 1	105 Cords	\$ 4.50 / Cord
Mixed Oak	673 Cords	\$ 16.80 / Cord
Red Maple	40 Cords	\$ 16.70 / Cord

* The total volume is statistically estimated within plus (+) or minus (-) 14.67 percent. There are an estimated 1,890 cords on this timber sale, plus or minus 277 cords at the 95% confidence level. The estimated units are final and not subject to adjustment. Prospective bidders are urged to examine this timber and to make their own estimates of quantity and quality.

BOND AND PAYMENT SCHEDULE:

1. A bond in the amount of \$2,909.00 to insure faithful performance of the conditions of the contract will be deposited by the successful bidder within 21 days of the sale award.
2. Cutting in any sale or unit without the required advance payment would be considered a trespass.
3. Total payment must be paid in advance or according to the following schedule :
 - (a) Ten percent (10%) of the sale value must be paid within 21 days of the sale award.
 - (b) The 10% down payment will be credited towards the first unit cut.
 - (c) Payment for each of the following units must be made before cutting begins in that unit:

PAYMENT UNIT NUMBER	PERCENT OF TOTAL SALE VALUE
01	23.8%
02	41.3%
03	18.7%
04	16.2%
4. If no cutting takes place, the 10% down payment will not be refunded.
5. Operations on the contract issued will terminate on 03/31/2024.

SALE STATISTICS

SALE VOLUMES

VOLUME		STATISTICAL RANGE IN CORDS		
TOTAL CUBIC FEET	TOTAL CORDS	PERCENT ERROR	MINIMUM	MAXIMUM
149,272	1,890	14.67%	1,612	2,167

VDU VOLUMES

A VDU is a Volume Determination Unit. Volumes and their associated statistics are calculated at the VDU level and summarized to the sale level. There is often a one to one relationship between a VDU and a Payment Unit, but not always, depending on the cruise design. Refer to the VDU TO PAYMENT UNIT table.

VDU	VOLUME		PERCENT ERROR	RANGE IN CORDS	
	TOTAL CUBIC FEET	TOTAL CORDS		MINIMUM	MAXIMUM
23	22,199	281	26.82%	206	356
123	27,089	343	29.99%	240	446
223	61,035	773	24.64%	582	963
323	38,955	493	26.48%	363	624
TOTAL:	149,278	1,890		1,390	2,389

VDU TO PAYMENT UNIT

When a VDU is associated with more than one Payment Unit (PU), the VDU volumes are assigned to the PU based on acres of the VDU within the PU.

VDU	VDU ACRES	PU	PU ACRES
23	27.1	4	27.1
123	33.6	3	33.6
223	45.9	2	45.9
323	43.0	1	43.0
TOTAL:	149.6		149.6

DESCRIPTION OF TIMBER BY PAYMENT UNIT (PU)

PU	MARKET GROUP	PRODUCT	QUANTITY	UNIT	ACRES	ADVERTISE PRICE			
1	Northern Pin Oak	Sawtimber	4.5	MBF	43.0	\$13,831.80			
	Red Oak		97.2	MBF					
	White Oak		23.7	MBF					
	Jack Pine	Pulpwood	2	Cords					
	Misc. Species 1		42	Cords					
	Mixed Oak		183	Cords					
	<i>Northern Pin Oak</i>		11	<i>Cords</i>					
	<i>Red Oak</i>		125	<i>Cords</i>					
	<i>White Oak</i>		47	<i>Cords</i>					
	Red Maple		16	Cords					
	<i>Red Maple</i>	<i>Sawtimber</i>	0.9	<i>MBF</i>					
	<i>Red Maple</i>	<i>Pulpwood</i>	14	<i>Cords</i>					
	2	Northern Pin Oak	Sawtimber	3.6			MBF	45.9	\$24,001.20
		Red Oak		198.9			MBF		
White Oak			12.6	MBF					
Misc. Species 1		Pulpwood	44	Cords					
Mixed Oak			274	Cords					
<i>Northern Pin Oak</i>			20	<i>Cords</i>					
<i>Red Oak</i>			221	<i>Cords</i>					
<i>White Oak</i>			33	<i>Cords</i>					
Red Maple			24	Cords					
<i>Red Maple</i>			24	<i>Cords</i>					
3		Northern Pin Oak	Sawtimber	4.3	MBF	33.6	\$10,893.80		
	Red Oak		88.8	MBF					
	White Oak		9.4	MBF					
	Misc. Species 1	Pulpwood	15	Cords					
	Mixed Oak		122	Cords					
	<i>Northern Pin Oak</i>		4	<i>Cords</i>					
	<i>Red Oak</i>		95	<i>Cords</i>					
	<i>White Oak</i>		23	<i>Cords</i>					
4	Red Oak	Sawtimber	81.6	MBF	27.1	\$9,446.10			
	White Oak		9.9	MBF					
	Misc. Species 1	Pulpwood	4	Cords					
	Mixed Oak		94	Cords					
	<i>Red Oak</i>		73	<i>Cords</i>					
	<i>White Oak</i>		21	<i>Cords</i>					
TOTAL:			534.5	MBF					
TOTAL:			820	Cords					

Sale Specific Conditions & Requirements

Sale Name: Dollar Lk Rd Oak

Sale Number: 72-626-20 Seq#: 2

1 - Sale Area

1.2 - Boundaries

1.2.1 - Painted boundaries (9/19)

The sale boundary and Payment Unit boundaries are marked and identified by red and yellow paint in addition to an unpainted payment unit boundary. Exterior sale boundary lines against state are marked with red paint. Interior Payment Unit boundaries are marked with yellow paint, in addition to an unpainted payment unit boundary designated as the closed road between Payment Unit 3 & 4 shown on the Timber Sale Map. Interior retention islands are marked with red paint; no harvesting activities may occur within these areas. The painted boundary line trees are not Included Timber and are to be protected except cut all red painted trees on the north edge of Payment Unit 4 and cut the red painted northern pin oak (including dead standing) bordering Dollar Lake Road. If the red painted tree is within a multiple-stem clump, cut all stems within that clump. Yellow painted trees designating an interior Payment Unit boundary are only to be cut when all surrounding Payment Units have been paid.

2 - Timber Specifications

2.1 - Included Timber

2.1.5 - Overstory removal unit(s) (8/11)

Within Payment Unit(s) 1-4, all trees which meet minimum piece specifications in 2.2 Utilization, are designated for cutting except white pine, red pine and the one green-painted oak along the north edge road. Dead standing oak is designated for cutting. Note that there are remnants of faded green paint throughout the Sale Area from the previous harvest.

2.1.11 - Description of timber note (2/04)

Note that Misc Species 1 is dead oak.

2.2 - Utilization

2.2.3 - Stump heights (4/07)

Stump heights within the Sale Area shall not exceed 12 inches except for on the steeper slopes where stumps up to 24 inches will be allowed. This is to facilitate military requirements while taking into consideration the larger diameter oak and equipment limitations on the hilly terrain.

2.2.6 - Roundwood operation required (5/07)

The skidding of whole trees or tree segments with limbs attached is prohibited. All products must be produced as roundwood and forwarded to existing roads or landing areas in final product length.

2.2.9 - No chipping permitted (12/08)

Within Payment Unit(s) 1-4, no chipping is permitted.

3 - Payments

3.3 - Pre-measured Sales

3.3.4 - Dividing payment units (7/14)

Payment Unit(s) may be divided at the request of the Purchaser and upon approval of the Unit Manager. Dividing Payment Units is a contract modification which requires a Timber Sale Contract Amendment.

3.4 - Damaged Timber

3.4.1 - Damaged timber (7/16)

General Condition and Requirement 3.4 Damaged Timber, defines liquidated damages for undesignated live merchantable trees which are cut or injured. In addition, reasonable care should be taken to avoid damage to tree seedlings and saplings.

Within the Sale Area, if more than 50% of the tree seedlings or saplings (1/4" to 4.5" DBH) within a specified portion of the Sale Area are damaged, liquidated damages will be assessed at \$500 per acre for all acreage within that specified portion of

the Sale Area that was damaged. Operational paths will have to be cut through the dense sapling cover to not leave bent/broken stems during felling and forwarding. Damages will not be assessed for those areas provided that the regen is cut cleanly.

No damage is acceptable to undesignated live merchantable trees. Within the Sale Area, if more than 10% of trees (> 4.5" DBH) within a specified area of the sale are damaged, liquidated damages will be assessed for all trees damaged. Rates will be in accordance with General Condition and Requirement 3.4 Damaged Timber.

4 - Transportation

4.1 - Construction

4.1.3 - Slash and earthen piles (8/04)

Piles or windrows of earth along roads and landings that have been widened or constructed shall be leveled. Slash from road maintenance or construction, including stumps, shall be used for re-closing temporary roads, or be dispersed into the sale.

4.1.6 - Road construction (1/09)

Construction of new roads or improvements of existing roads shall be done in such a way as to minimize the environmental and visual impacts. Merchantable trees shall be cut and utilized unless otherwise directed. Non-merchantable trees shall be severed and laid flat on the ground. Slash shall be scattered, and not left in windrows and kept a minimum of 10 feet back from the road edge. Stumps shall be set upright, not left on edge, and be moved at least 10 feet away from the road edge. Disturbed soil shall be feathered into the woods and not left in berms or windrows.

4.1.7 - Road closure (10/11)

All new roads built into the sale must be blocked to vehicle traffic upon completion of the sale. Overgrown roads that are reopened shall be considered new roads. Illegal ORV trails within the Sale Area also need to be closed; see the Timber Sale Map for locations. In general, this road and trail closure will require broadcast spreading stumps and slash across the first 100 feet into the sale boundary. Additional slash may be needed further into the Sale Area for erosion control on the hills. Contact the sale administrator for specific details of design and placement.

4.1.11 - Permits (2/12)

The Purchaser will secure any necessary highway and county road permits that may be required.

5 - Operations

5.1 - Notification

5.1.1 - Pre-sale conference (10/16)

A pre-sale conference on site between the Purchaser and sale administrator is required prior to beginning any operations to determine landing and road locations. The Unit Manager or his/her representative must be contacted at least 5 days in advance to schedule the conference.

5.1.4 - Post-sale conference (10/16)

A post-sale conference on site between the Purchaser and sale administrator is required 5 days prior to the completion of active logging operations to determine clean-up and repair of landings, road edges, and the fulfillment of other contract specifications.

5.1.5 - National Guard notification (2/15)

This sale is upon lands utilized for training by the Michigan National Guard - Camp Grayling. A minimum of five (5) business days prior to opening this sale, the producer must request that the sale administrator contact the military for information regarding training plans that may impact sale operations.

5.2 - Conduct of Operations

5.2.3 - Operating Restrictions

5.2.3.4 - Oak wilt restriction, no exceptions (1/18)

Within Payment Unit(s) 1-4, cutting, skidding, and brushing of access roads are not permitted during the period of April 15 to July 15. No exceptions will be granted. This is necessary to reduce the spread of oak wilt.

5.2.3.7 - National Guard training restriction (1/09)

Operations on this contract may not be allowed during National Guard training operations. Typically, the restricted period is from May 1 to October 31. The contractor must check with the Unit Manager who will coordinate the cutting schedule with the Military. All harvest equipment and timber products may need to be removed from the Sale Area during the period of May 1 to October 31.

5.2.38 - No decking against live trees (2/04)

Cut products may not be decked against unmarked or designated leave trees.

5.4 - Soil Protection

5.4.3 - Erosion control (12/08)

Skid trails or haul roads may require erosion control structures or berms per direction of the Unit Manager or his/her representative.

6 - Safety and Fire Prevention

6.2 - Signing

6.2.1 - Road posting (9/09)

The Purchaser is responsible for posting and maintaining caution signs on Dollar Lake Road prior to beginning operations. The road must be posted at appropriate distances from the Sale Area to warn of logging activity and truck traffic. Signs must be removed when harvest operations are suspended or completed. In addition, post caution signs on the north edge road during active felling operations along it. The Purchaser will provide these signs.

7 - Other Conditions

7.10 - Certified Timber

7.10.1 - Non-certified timber (2/16)

The area encompassed by this timber sale is not certified to the standards of the Forest Stewardship Council (FSC) or the Sustainable Forestry Initiative (SFI). Forest products from this sale may not be delivered to the mill as "FSC and / or SFI certified". The lands within this sale are managed for Military training.



TIMBER SALE MAP

This information provided by authority of Part 525, 1994 PA 451, as amended.

Forest Management Unit Grayling	County Crawford	Mapped By Charlebois	Date 09/30/2020	Page 1	of 1
Township 26N	Range 4W	Section(s) and Subdivision(s) Section 4: NW, W1/2NE, N1/2SW, NENE	Scale 1:15,840		

Cover Type				Density	
A = Aspen	H = Hemlock	N = Marsh	U = Upland Brush	0 = Non Stocked	5 = Pole Timber Medium
B = Paper Birch	J = Jack Pine	O = Oak	UM = Upland Mixed	1 = Seedling Sapling Poor	6 = Pole Timber Well
C = Cedar	L = Lowland Brush	P = Lowland Poplar	V = Bog or Marsh	2 = Seedling Sapling Medium	7 = Saw Timber Poor
D = Treed Bog	LM = Lowland Mixed	Q = Mixed Swamp Conifer	W = White Pine	3 = Seedling Sapling Well	8 = Saw Timber Medium
E = Swamp Hdwoods	M = Mpl, Bch, Brch	R = Red Pine	X = Non Stocked	4 = Pole Timber Poor	9 = Saw Timber Well
F = Spruce Fir	MC = Mixed Conifer	S = Black Spruce	Z = Water		
G = Grass	MD = Mixed Deciduous	T = Tamarack			

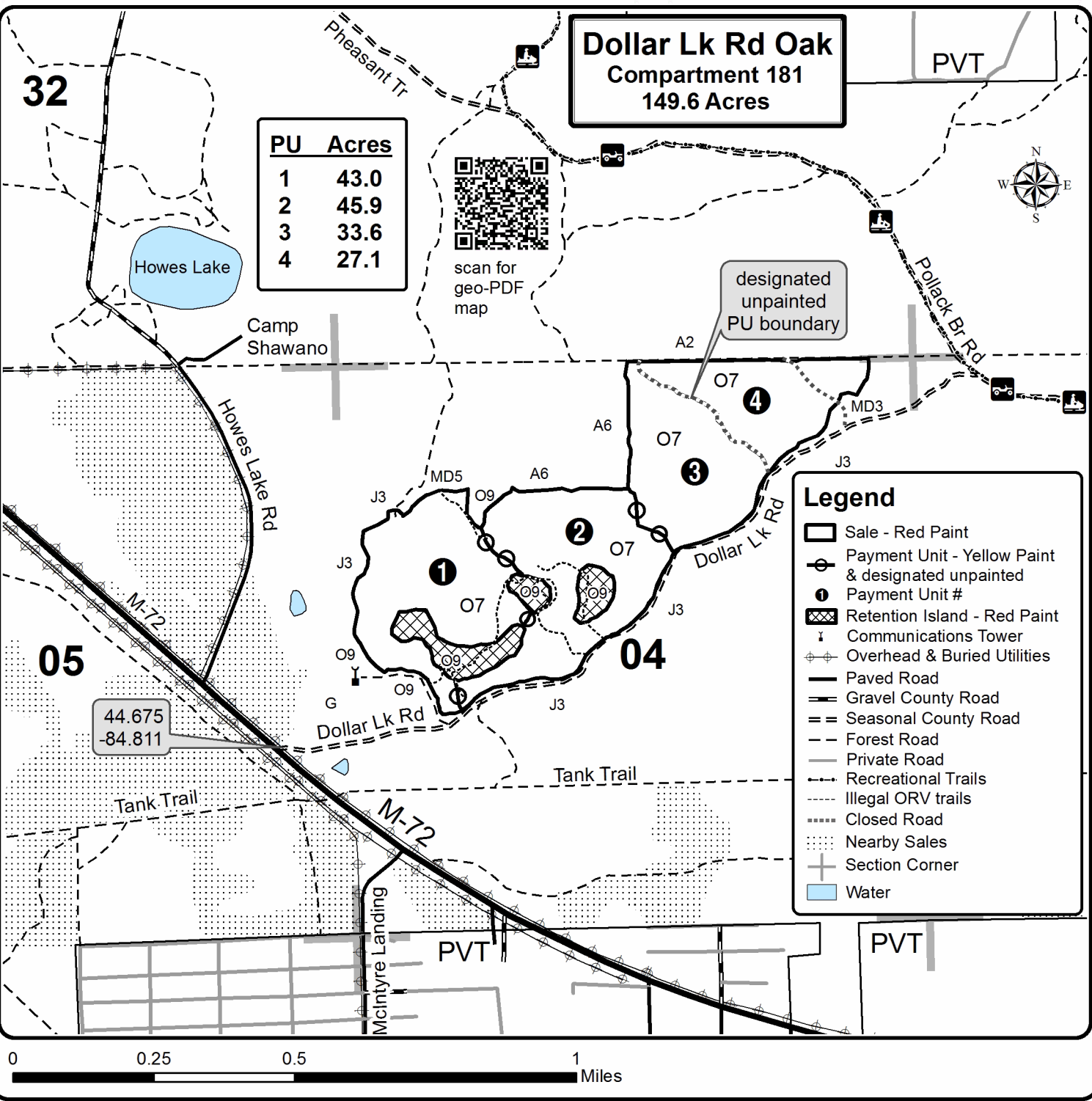

Legend

- Sale - Red Paint
- Payment Unit - Yellow Paint & designated unpainted
- ① Payment Unit #
- ▨ Retention Island - Red Paint
- 📡 Communications Tower
- ⊕ Overhead & Buried Utilities
- Paved Road
- Gravel County Road
- == Seasonal County Road
- - Forest Road
- - Private Road
- ⋯ Recreational Trails
- ⋯ Illegal ORV trails
- ⋯ Closed Road
- ⋯ Nearby Sales
- ⊕ Section Corner
- 🟦 Water



Sale Number	Year
72 - 626	20

TIMBER SALE MAP

This information provided by authority of Part 525, 1994 PA 451, as amended.

Forest Management Unit	County	Mapped By	Date	Page	of
Grayling	Crawford	Charlebois	09/30/2020	1	1
Township	Range	Section(s) and Subdivision(s)	Scale		
26N	4W	Section 4: NW, W1/2NE, N1/2SW, NENE	1:15,840		

Cover Type

A = Aspen	H = Hemlock	N = Marsh	U = Upland Brush
B = Paper Birch	J = Jack Pine	O = Oak	UM = Upland Mixed
C = Cedar	L = Lowland Brush	P = Lowland Poplar	V = Bog or Marsh
D = Treed Bog	LM = Lowland Mixed	Q = Mixed Swamp Conifer	W = White Pine
E = Swamp Hdwoods	M = Mpl. Bch. Brch	R = Red Pine	X = Non Stocked
F = Spruce Fir	MC = Mixed Conifer	S = Black Spruce	Z = Water
G = Grass	MD = Mixed Deciduous	T = Tamarack	

Density

0 = Non Stocked	5 = Pole Timber Medium
1 = Seedling Sapling Poor	6 = Pole Timber Well
2 = Seedling Sapling Medium	7 = Saw Timber Poor
3 = Seedling Sapling Well	8 = Saw Timber Medium
4 = Pole Timber Poor	9 = Saw Timber Well

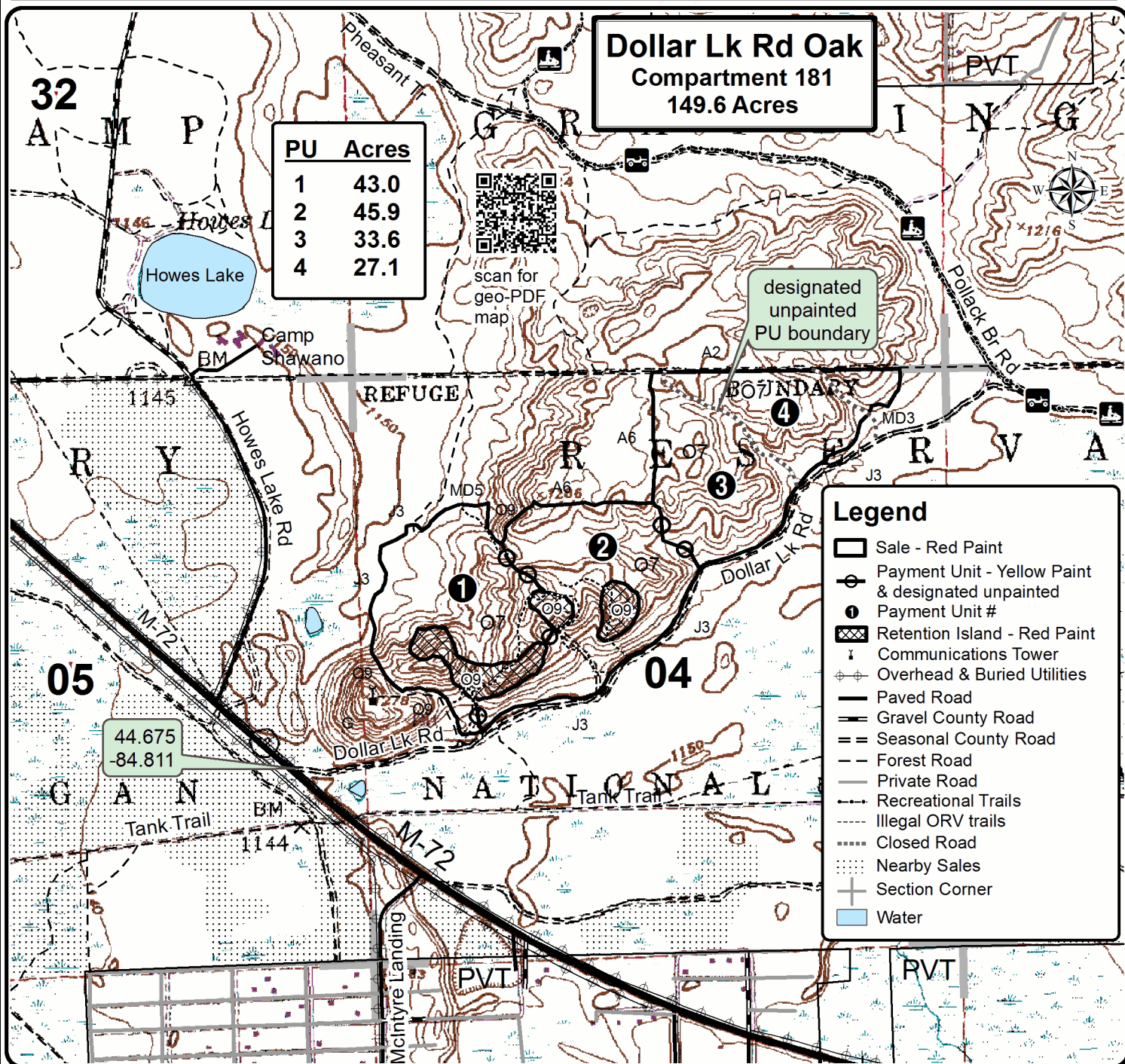

PU	Acres
1	43.0
2	45.9
3	33.6
4	27.1

Dollar Lk Rd Oak
Compartment 181
149.6 Acres

Legend

- Sale - Red Paint
- Payment Unit - Yellow Paint & designated unpainted
- Payment Unit #
- Retention Island - Red Paint
- Communications Tower
- Overhead & Buried Utilities
- Paved Road
- Gravel County Road
- Seasonal County Road
- Forest Road
- Private Road
- Recreational Trails
- Illegal ORV trails
- Closed Road
- Nearby Sales
- Section Corner
- Water

TIMBER SALE INFORMATION

Arrowhead JP & Spruce (72-627-20)
 T26N, R04W, SEC. 5; T26N, R04W, SEC. 6.
 Crawford County (Advertised Price \$19,334.90)

SALE NOTE: The sale is on low ground that cannot be cut during spring breakup. The jack pine is overmature and losing volume to age-related decline and mortality. The sale is on Military Board lands.

A timber sale contract for this lump sum, sealed bid timber sale will be awarded to the responsible bidder offering the highest sealed bid price. All units of volume listed below were estimated using the T-Sale computer program and our traditional volume equations. Bids must be at or above the following advertised price for each product and species:

<u>PRODUCTS & SPECIES</u>	<u>ESTIMATED UNITS*</u>	<u>ADVERTISED PRICE</u>
Pulpwood		
Black Spruce	564 Cords	\$ 10.90 / Cord
Jack Pine	1,029 Cords	\$ 12.50 / Cord
Misc. Species 1	6 Cords	\$ 4.50 / Cord
Mixed Oak	8 Cords	\$ 16.80 / Cord
Red Pine	2 Cords	\$ 27.70 / Cord
Tamarack	12 Cords	\$ 9.00 / Cord

* The total volume is statistically estimated within plus (+) or minus (-) 13.85 percent. There are an estimated 1,620 cords on this timber sale, plus or minus 224 cords at the 95% confidence level. The estimated units are final and not subject to adjustment. Prospective bidders are urged to examine this timber and to make their own estimates of quantity and quality.

BOND AND PAYMENT SCHEDULE:

1. A bond in the amount of \$967.00 to insure faithful performance of the conditions of the contract will be deposited by the successful bidder within 21 days of the sale award.
2. Cutting in any sale or unit without the required advance payment would be considered a trespass.
3. Total payment must be paid in advance or according to the following schedule :
 - (a) Ten percent (10%) of the sale value must be paid within 21 days of the sale award.
 - (b) The 10% down payment will be credited towards the first unit cut.
 - (c) Payment for each of the following units must be made before cutting begins in that unit:

PAYMENT UNIT NUMBER	PERCENT OF TOTAL SALE VALUE
01	7.4%
02	30.5%
03	46.9%
04	15.2%
4. If no cutting takes place, the 10% down payment will not be refunded.
5. Operations on the contract issued will terminate on 03/31/2024.

SALE STATISTICS

SALE VOLUMES

VOLUME		STATISTICAL RANGE IN CORDS		
TOTAL CUBIC FEET	TOTAL CORDS	PERCENT ERROR	MINIMUM	MAXIMUM
128,017	1,620	13.85%	1,396	1,845

VDU VOLUMES

A VDU is a Volume Determination Unit. Volumes and their associated statistics are calculated at the VDU level and summarized to the sale level. There is often a one to one relationship between a VDU and a Payment Unit, but not always, depending on the cruise design. Refer to the VDU TO PAYMENT UNIT table.

VDU	VOLUME		PERCENT ERROR	RANGE IN CORDS	
	TOTAL CUBIC FEET	TOTAL CORDS		MINIMUM	MAXIMUM
9	33,630	426	26.87%	311	540
10	20,343	258	37.71%	160	355
109	38,015	481	27.84%	347	615
110	27,065	343	19.68%	275	410
209	8,982	114	36.18%	73	155
TOTAL:	128,035	1,621		1,167	2,075

VDU TO PAYMENT UNIT

When a VDU is associated with more than one Payment Unit (PU), the VDU volumes are assigned to the PU based on acres of the VDU within the PU.

VDU	VDU ACRES	PU	PU ACRES
9	25.9	3	25.9
10	16.3	4	16.3
109	38.1	2	38.1
110	14.5	3	14.5
209	6.1	1	6.1
TOTAL:	100.9		100.9

DESCRIPTION OF TIMBER BY PAYMENT UNIT (PU)

PU	MARKET GROUP	PRODUCT	QUANTITY	UNIT	ACRES	ADVERTISE PRICE
1	Jack Pine	Pulpwood	114	Cords	6.1	\$1,425.00
	<i>Jack Pine</i>	<i>Sawtimber</i>	27.5	<i>MBF</i>		
	<i>Jack Pine</i>	<i>Pulpwood</i>	59	<i>Cords</i>		
2	Black Spruce	Pulpwood	60	Cords	38.1	\$5,899.00
	<i>Black Spruce</i>	<i>Sawtimber</i>	5.1	<i>MBF</i>		
	<i>Black Spruce</i>	<i>Pulpwood</i>	50	<i>Cords</i>		
	Jack Pine		416	Cords		
	<i>Jack Pine</i>	<i>Sawtimber</i>	75.4	<i>MBF</i>		
	<i>Jack Pine</i>	<i>Pulpwood</i>	265	<i>Cords</i>		
	Tamarack		5	Cords		
3	Black Spruce	Pulpwood	317	Cords	40.4	\$9,084.70
	<i>Black Spruce</i>	<i>Sawtimber</i>	25.9	<i>MBF</i>		
	<i>Black Spruce</i>	<i>Pulpwood</i>	265	<i>Cords</i>		
	Jack Pine		436	Cords		
	<i>Jack Pine</i>	<i>Sawtimber</i>	91.6	<i>MBF</i>		
	<i>Jack Pine</i>	<i>Pulpwood</i>	253	<i>Cords</i>		
	Misc. Species 1		6	Cords		
	Mixed Oak		8	Cords		
	<i>Northern Pin Oak</i>	<i>Sawtimber</i>	1.5	<i>MBF</i>		
	<i>Northern Pin Oak</i>	<i>Pulpwood</i>	5	<i>Cords</i>		
	Tamarack		2	Cords		
	4	Black Spruce	Pulpwood	188		
<i>Black Spruce</i>		<i>Sawtimber</i>	12.4	<i>MBF</i>		
<i>Black Spruce</i>		<i>Pulpwood</i>	163	<i>Cords</i>		
Jack Pine			63	Cords		
<i>Jack Pine</i>		<i>Sawtimber</i>	7.9	<i>MBF</i>		
<i>Jack Pine</i>		<i>Pulpwood</i>	47	<i>Cords</i>		
Red Pine			2	Cords		
Tamarack			5	Cords		
TOTAL:			1,622	Cords		

Sale Specific Conditions & Requirements

Sale Name: Arrowhead JP & Spruce

Sale Number: 72-627-20 Seq#: 2

1 - Sale Area

1.2 - Boundaries

1.2.1 - Painted boundaries (9/19)

The sale boundary and Payment Unit boundaries are marked and identified by red and yellow paint, in addition to an unpainted Payment Unit boundary. Exterior sale boundary lines against state are marked with red paint. Interior Payment Unit boundaries are marked with yellow paint, in addition to an unpainted Payment Unit boundary designated as the former railroad grade shown on the Timber Sale Map. The painted boundary line trees are not Included Timber and are to be protected. Yellow painted trees designating an interior Payment Unit boundary are only to be cut when all surrounding Payment Units have been paid.

2 - Timber Specifications

2.1 - Included Timber

2.1.2 - Clearcut unit(s) w/o unmerchantable trees (8/11)

Within Payment Unit(s) 1-4, cut all trees which meet minimum piece specifications in 2.2 Utilization except white pine and cedar. Standing dead oak is designated for cutting. In addition, cut all live oak 2" or greater at DBH.

2.1.11 - Description of timber note (2/04)

Note that Misc Species 1 is dead oak.

2.2 - Utilization

2.2.3 - Stump heights (4/07)

Stump heights within the Sale Area shall not exceed 12 inches for all trees. This is to facilitate military requirements while also taking into consideration the pit-and-mound ground form.

2.2.6 - Roundwood operation required (5/07)

The skidding of whole trees or tree segments with limbs attached is prohibited within the Sale Area. All products must be produced as roundwood and forwarded to existing roads or landing areas in final product length.

2.2.9 - No chipping permitted (12/08)

Within Payment Unit(s) 1-4, no chipping is permitted.

3 - Payments

3.3 - Pre-measured Sales

3.3.4 - Dividing payment units (7/14)

Payment Unit(s) 2 & 3 may be divided at the request of the Purchaser and upon approval of the Unit Manager. Dividing Payment Units is a contract modification which requires a Timber Sale Contract Amendment. There will be only one division per Payment Unit.

3.4 - Damaged Timber

3.4.1 - Damaged timber (7/16)

General Condition and Requirement 3.4 Damaged Timber, defines liquidated damages for undesignated live merchantable trees which are cut or injured. In addition, reasonable care should be taken to avoid damage to tree seedlings and saplings.

Within the Sale Area, if more than 30% of the tree seedlings or saplings (1/4" to 4.5" DBH) within a specified portion of the Sale Area are damaged, liquidated damages will be assessed at \$500 per acre for all acreage within that specified portion of the Sale Area that was damaged.

No damage is acceptable to undesignated live merchantable trees. Within the Sale Area, if more than 10% of trees (> 4.5" DBH) within a specified area of the sale are damaged, liquidated damages will be assessed for all trees damaged. Rates will

be in accordance with General Condition and Requirement 3.4 Damaged Timber.

4 - Transportation

4.1 - Construction

4.1.3 - Slash and earthen piles (8/04)

Piles or windrows of earth along roads and landings that have been widened or constructed shall be leveled. Slash from road maintenance or construction, including stumps, shall be dispersed into the sale if not needed for road closures.

4.1.6 - Road construction (1/09)

Construction of new roads or improvements of existing roads shall be done in such a way as to minimize the environmental and visual impacts. Merchantable trees shall be cut and utilized unless otherwise directed. Non-merchantable trees shall be severed and laid flat on the ground. Slash shall be scattered, and not left in windrows and kept a minimum of 10 feet back from the road edge. Stumps shall be set upright, not left on edge, and be moved at least 10 feet away from the road edge. Disturbed soil shall be feathered into the woods and not left in berms or windrows.

4.1.7 - Road closure (10/11)

All new roads built into the sale must be blocked to vehicle traffic upon completion of the sale. Overgrown roads that are reopened shall be considered new roads. In general, this will require broadcast-spreading slash across the first 100 feet of the road to be closed. Contact the sale administrator for specific details of design and placement.

4.1.11 - Permits (2/12)

The Purchaser will secure any necessary highway and county road permits that may be required.

5 - Operations

5.1 - Notification

5.1.1 - Pre-sale conference (10/16)

A pre-sale conference on site between the Purchaser and sale administrator is required prior to beginning any operations to determine landing and road locations. The Unit Manager or his/her representative must be contacted at least 5 days in advance to schedule the conference.

5.1.4 - Post-sale conference (10/16)

A post-sale conference on site between the Purchaser and sale administrator is required 5 days prior to the completion of active logging operations to determine clean-up and repair of landings, road edges, and the fulfillment of other contract specifications.

5.1.5 - National Guard notification (2/15)

This sale is upon lands utilized for training by the Michigan National Guard - Camp Grayling. A minimum of five (5) business days prior to opening this sale, the producer must request that the sale administrator contact the military for information regarding training plans that may impact sale operations.

5.2 - Conduct of Operations

5.2.1 - Slash

5.2.1.11 - Slash for reforestation (5/07)

To facilitate reforestation, the Sale Area shall be left with slash evenly distributed. Bunched tops within the cutting area shall be broken up and scattered. Stumps shall be cut low to the ground. Processing sites shall not be left with a compacted layer of slash; tops from these sites shall be hauled back into the cut area and scattered.

5.2.3 - Operating Restrictions

5.2.3.1 - Operating restrictions (9/11)

Within Payment Unit(s) 1-4, unless changed by written agreement, cutting and skidding are limited to dry summer or frozen winter conditions. This restriction is needed because the sale is on organic soil with a seasonal high water table.

5.2.3.7 - National Guard training restriction (1/09)

Operations on this contract may not be allowed during National Guard training operations. Typically, the restricted period is from May 1 to October 31. The contractor must check with the Unit Manager who will coordinate the cutting schedule

with the Military. Harvest equipment and timber products may need to be removed from the Sale Area during the period of May 1 to October 31.

5.2.38 - No decking against live trees (2/04)

Cut products may not be decked against unmarked or designated leave trees.

5.4 - Soil Protection

5.4.1 - Rutting restriction, general (7/16)

Operations are to cease immediately if equipment and weather conditions result in rutting of roads and/or skid trails which is 12 inches or greater in depth and 50 feet in length. The Unit Manager or his/her representative may restrict hauling and/or skidding if ruts exceed the specified depth. With the Unit Manager or his/her representative's approval, the Purchaser may return to the area when the risk of rutting has decreased.

7 - Other Conditions

7.5 - Loss

7.5.1 - Deteriorating timber (7/09)

The sale area has received damage from age-related decline and dieback in the jack pine. The Purchaser should harvest the wood as soon as possible. The Department of Natural Resources is held free of responsibility of any further damage or deterioration due to delay in harvesting.

7.10 - Certified Timber

7.10.1 - Non-certified timber (2/16)

The area encompassed by this timber sale is not certified to the standards of the Forest Stewardship Council (FSC) or the Sustainable Forestry Initiative (SFI). Forest products from this sale may not be delivered to the mill as "FSC and / or SFI certified". The lands within this sale are managed for military training.



TIMBER SALE MAP

This information provided by authority of Part 525, 1994 PA 451, as amended.

Forest Management Unit Grayling	County Crawford	Mapped By Charlebois	Date 09/30/2020	Page 1	of 1
Township 26N	Range 4W	Section(s) and Subdivision(s) Sec 5: SWNW, N1/2SW, SWSW Sec 6: NENE, S1/2NE, N1/2SE, SESE	Scale 1:15,840		

Cover Type				Density	
A = Aspen	H = Hemlock	N = Marsh	U = Upland Brush	0 = Non Stocked	5 = Pole Timber Medium
B = Paper Birch	J = Jack Pine	O = Oak	UM = Upland Mixed	1 = Seedling Sapling Poor	6 = Pole Timber Well
C = Cedar	L = Lowland Brush	P = Lowland Poplar	V = Bog or Marsh	2 = Seedling Sapling Medium	7 = Saw Timber Poor
D = Treed Bog	LM = Lowland Mixed	Q = Mixed Swamp Conifer	W = White Pine	3 = Seedling Sapling Well	8 = Saw Timber Medium
E = Swamp Hdwoods	M = Mpl, Bch, Brch	R = Red Pine	X = Non Stocked	4 = Pole Timber Poor	9 = Saw Timber Well
F = Spruce Fir	MC = Mixed Conifer	S = Black Spruce	Z = Water		
G = Grass	MD = Mixed Deciduous	T = Tamarack			

Legend

Sale Boundary

- Against State - Red Paint
- Payment Unit - Yellow Paint
- Payment Unit - unpainted along former railroad grade
- Payment Unit #
- Communications Tower
- Overhead & Buried Utilities
- Paved Road
- Gravel County Road
- Seasonal County Road
- Forest Road
- Private Road
- Closed Road
- Cover Type Boundary
- Nearby Sales
- Survey Corner
- Section Corner
- Water

Arrowhead JP & Spruce
Compartment 181
100.9 Acres



PU	Acres
1	6.1
2	38.1
3	40.4
4	16.3



scan for geo-PDF map

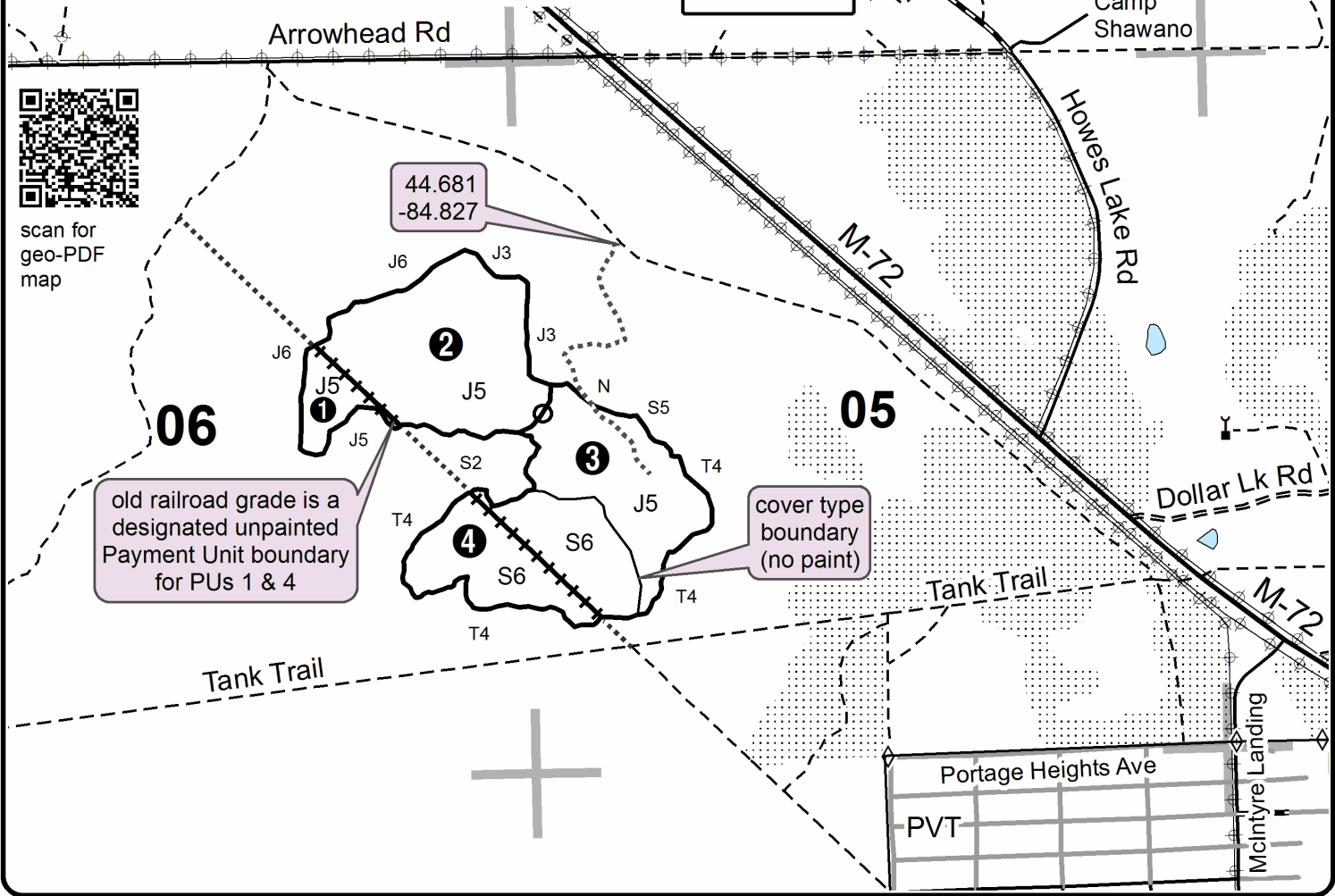

TIMBER SALE INFORMATION

Mossy Runway Pine (72-012-19)
 T28N, R04E, SEC. 12; T28N, R04E, SEC. 13; T28N, R05E, SEC. 6.
 Oscoda County (Advertised Price \$46,036.70)

SALE NOTE: Payment Units 4, 5 and 6 were contractor prepared by VanOss Forestry Services.

A timber sale contract for this lump sum, sealed bid timber sale will be awarded to the responsible bidder offering the highest sealed bid price. All units of volume listed below were estimated using the T-Sale computer program and our traditional volume equations. Bids must be at or above the following advertised price for each product and species:

<u>PRODUCTS & SPECIES</u>	<u>ESTIMATED UNITS*</u>	<u>ADVERTISED PRICE</u>
Sawtimber		
Red Pine	104.6 MBF	\$ 91.00 / MBF
Pulpwood		
Black Cherry	3 Cords	\$ 20.40 / Cord
Jack Pine	1,693 Cords	\$ 15.30 / Cord
Mixed Aspen	134 Cords	\$ 14.05 / Cord
Mixed Oak	30 Cords	\$ 20.50 / Cord
Red Pine	238 Cords	\$ 33.85 / Cord

* The total volume is statistically estimated within plus (+) or minus (-) 11.05 percent. There are an estimated 2,309 cords on this timber sale, plus or minus 255 cords at the 95% confidence level. The estimated units are final and not subject to adjustment. Prospective bidders are urged to examine this timber and to make their own estimates of quantity and quality.

BOND AND PAYMENT SCHEDULE:

- A bond in the amount of \$2,302.00 to insure faithful performance of the conditions of the contract will be deposited by the successful bidder within 21 days of the sale award.
- Cutting in any sale or unit without the required advance payment would be considered a trespass.
- Total payment must be paid in advance or according to the following schedule :
 - Ten percent (10%) of the sale value must be paid within 21 days of the sale award.
 - The 10% down payment will be credited towards the first unit cut.
 - Payment for each of the following units must be made before cutting begins in that unit:

PAYMENT UNIT NUMBER	PERCENT OF TOTAL SALE VALUE
01	48.7%
02	5.4%
03	7.9%
04	9.6%
05	23.2%
06	5.2%
- If no cutting takes place, the 10% down payment will not be refunded.
- Operations on the contract issued will terminate on 06/30/2023.

SALE STATISTICS

SALE VOLUMES

VOLUME		STATISTICAL RANGE IN CORDS		
TOTAL CUBIC FEET	TOTAL CORDS	PERCENT ERROR	MINIMUM	MAXIMUM
182,381	2,309	11.05%	2,054	2,564

VDU VOLUMES

A VDU is a Volume Determination Unit. Volumes and their associated statistics are calculated at the VDU level and summarized to the sale level. There is often a one to one relationship between a VDU and a Payment Unit, but not always, depending on the cruise design. Refer to the VDU TO PAYMENT UNIT table.

VDU	VOLUME		PERCENT ERROR	RANGE IN CORDS	
	TOTAL CUBIC FEET	TOTAL CORDS		MINIMUM	MAXIMUM
3	4,985	63	49.73%	32	94
9	22,863	289	26.98%	211	367
10	114,795	1,453	12.45%	1,272	1,634
13	8,406	106	62.73%	40	173
16	12,909	163	41.95%	95	232
17	18,423	233	30.27%	163	304
TOTAL:	182,379	2,309		1,812	2,805

VDU TO PAYMENT UNIT

When a VDU is associated with more than one Payment Unit (PU), the VDU volumes are assigned to the PU based on acres of the VDU within the PU.

VDU	VDU ACRES	PU	PU ACRES
3	3.6	6	3.6
9	18.7	5	18.7
10	64.7	1	64.7
13	7.7	4	7.7
16	16.1	2	16.1
17	15.7	3	15.7
TOTAL:	126.5		126.5

DESCRIPTION OF TIMBER BY PAYMENT UNIT (PU)

PU	MARKET GROUP	PRODUCT	QUANTITY	UNIT	ACRES	ADVERTISE PRICE
1	Red Pine	Sawtimber	1.3	MBF	64.7	\$22,384.95
	Jack Pine	Pulpwood	1,442	Cords		
	<i>Jack Pine</i>	<i>Sawtimber</i>	10.0	<i>MBF</i>		
	<i>Jack Pine</i>	<i>Pulpwood</i>	1,422	<i>Cords</i>		
	Mixed Oak		5	Cords		
	<i>White Oak</i>		5	<i>Cords</i>		
	Red Pine		3	Cords		
2	Jack Pine	Pulpwood	19	Cords	16.1	\$2,489.20
	<i>Jack Pine</i>	<i>Sawtimber</i>	0.4	<i>MBF</i>		
	<i>Jack Pine</i>	<i>Pulpwood</i>	18	<i>Cords</i>		
	Mixed Aspen		120	Cords		
	<i>B. T. Aspen</i>	<i>Sawtimber</i>	0.4	<i>MBF</i>		
	<i>Quaking Aspen</i>		1.2	<i>MBF</i>		
	<i>B. T. Aspen</i>	<i>Pulpwood</i>	25	<i>Cords</i>		
	<i>Quaking Aspen</i>		92	<i>Cords</i>		
	Mixed Oak		25	Cords		
	<i>White Oak</i>	<i>Sawtimber</i>	0.9	<i>MBF</i>		
	<i>Red Oak</i>	<i>Pulpwood</i>	9	<i>Cords</i>		
	<i>White Oak</i>		14	<i>Cords</i>		
3	Red Pine	Sawtimber	1.2	MBF	15.7	\$3,644.55
	Black Cherry	Pulpwood	3	Cords		
	Jack Pine		212	Cords		
	<i>Jack Pine</i>		212	<i>Cords</i>		
	Mixed Aspen		14	Cords		
	<i>Quaking Aspen</i>		14	<i>Cords</i>		
	Red Pine		1	Cords		
4	Red Pine	Sawtimber	36.1	MBF	7.7	\$4,436.00
	Red Pine	Pulpwood	34	Cords		
5	Red Pine	Sawtimber	55.1	MBF	18.7	\$10,702.25
	Jack Pine	Pulpwood	20	Cords		
	<i>Jack Pine</i>		20	<i>Cords</i>		
	Red Pine		159	Cords		
6	Red Pine	Sawtimber	10.9	MBF	3.6	\$2,379.75
	Red Pine	Pulpwood	41	Cords		
TOTAL:			104.6	MBF		
TOTAL:			2,098	Cords		

Sale Specific Conditions & Requirements

Sale Name: Mossy Runway Pine

Sale Number: 72-012-19 Seq#: 2

1 - Sale Area

1.2 - Boundaries

1.2.1 - Painted boundaries (1/14)

The sale boundary and Payment Unit boundaries are marked and identified by blue, red, and yellow paint. Exterior sale boundary lines against private property are marked with blue paint. Exterior sale boundary lines against state are marked with red paint. Interior Payment Unit boundaries are marked with yellow paint. The painted boundary line trees are not Included Timber and are to be protected. Yellow painted trees designating an interior Payment Unit boundary are only to be cut when all surrounding Payment Units have been paid.

2 - Timber Specifications

2.1 - Included Timber

2.1.1 - Clearcut unit(s) with unmerchantable trees (6/14)

Within Payment Unit(s) 1 and 3, cut all trees that are two (2) inches or more at DBH.

Within Payment Unit(s) 2, cut all trees that are four (4) inches or more at DBH.

2.1.3 - Cut tree marked unit(s) (12/08)

Within Payment Unit(s) 4-6, all trees are designated for cutting when marked with orange paint above and below stump height, regardless of merchantability. In addition, in Payment Units 4 and 5, cut all jack pine.

2.2 - Utilization

2.2.2 - Chipping required (2/18)

Payment Units 1 and 3 must be chip harvested to facilitate future silvicultural activities. If market conditions limit the practicality of chipping, tops and slash must be arranged in a way that will not inhibit future planting operations, as directed by the sale administrator. The requirement to retain approximately 1/6 to 1/3 of tree tops and limbs less than four inches in diameter is still applicable (G. C. & R. 2.2).

2.2.3 - Stump heights (4/07)

Stump heights within the Sale Area shall not exceed 6 inches for all trees. This is to facilitate planting operations.

2.2.4 - Skidding length (2/14)

Tree length skidding is required in Payment Units 1 and 3. This is to promote soil scarification.

3 - Payments

3.3 - Pre-measured Sales

3.3.4 - Dividing payment units (7/14)

Payment Unit(s) may be divided at the request of the Purchaser and upon approval of the Unit Manager. Dividing Payment Units is a contract modification which requires a Timber Sale Contract Amendment. There will be only one division per Payment Unit.

3.4 - Damaged Timber

3.4.1 - Damaged timber (7/16)

General Condition and Requirement 3.4 Damaged Timber, defines liquidated damages for undesignated live merchantable trees which are cut or injured. No damage is acceptable to undesignated live merchantable trees. Within the Sale Area, if more than 5% of trees (> 4.5" DBH) within a specified area of the sale are damaged, liquidated damages will be assessed for all trees damaged. Rates will be in accordance with General Condition and Requirement 3.4 Damaged Timber.

4 - Transportation

4.1 - Construction

4.1.3 - Slash and earthen piles (8/04)

Piles or windrows of earth along roads and landings that have been widened or constructed shall be leveled. Slash from road maintenance or construction, including stumps, shall be chipped, utilized or otherwise removed from the sale.

4.1.6 - Road construction (1/09)

Construction of new roads or improvements of existing roads shall be done in such a way as to minimize the environmental and visual impacts. Merchantable trees shall be cut and utilized unless otherwise directed. Non-merchantable trees shall be severed and laid flat on the ground. Slash shall be scattered, and not left in windrows and kept a minimum of 10 feet back from the road edge or utilized. Stumps shall be set upright, not left on edge, and be moved at least 10 feet away from the road edge. Disturbed soil shall be feathered into the woods and not left in berms or windrows.

4.1.7 - Road closure (10/11)

All new roads built into the sale must be blocked to vehicle traffic upon completion of the sale. Overgrown roads that are reopened shall be considered new roads. In general, this will require constructing a four (4') foot high berm of stumps and logs covered with earth. All stumps from road building and landing construction must be reserved to block any newly constructed roads upon completion of the sale. These stumps must be scattered along the road system to prohibit vehicular movement. Contact the sale administrator for specific details of design and placement.

5 - Operations

5.1 - Notification

5.1.1 - Pre-sale conference (10/16)

A pre-sale conference on site between the Purchaser and sale administrator is required prior to beginning any operations to determine landing and road locations. The Unit Manager or his/her representative must be contacted at least 5 days in advance to schedule the conference.

5.1.3 - Well heads and natural gas pipelines (11/15)

The Purchaser is responsible for contacting the gas or pipeline company prior to operating equipment in the vicinity of well heads or natural gas pipelines. Contact Paxton Resources at 517-732-9400.

5.1.4 - Post-sale conference (10/16)

A post-sale conference on site between the Purchaser and sale administrator is required 5 days prior to the completion of active logging operations to determine clean-up and repair of landings, road edges, and the fulfillment of other contract specifications.

5.2 - Conduct of Operations

5.2.2 - Hazard Trees/Snags

5.2.2.1 - Den trees (10/16)

Obvious hollow and/or den trees shall be protected and left standing unless they are a safety hazard.

5.2.3 - Operating Restrictions

5.2.3.3 - Bark slippage restriction (3/09)

Within Payment Unit(s) 4-6, unless changed by written agreement, cutting and skidding are not permitted during the period of April 15 to July 15. This restriction is because of bark slippage.

5.2.32 - Decking/landing restoration (9/13)

All decking and landing areas must have the surface area restored to a condition equal to or better than before. This is to ensure the proper regeneration of the stand. Wood debris, chips, and "cookies" from trimmings must be removed or scattered away from landing and loading areas and may not be windrowed on the edge.

5.2.38 - No decking against live trees (2/04)

Cut products may not be decked against unmarked or designated leave trees.

5.4 - Soil Protection

5.4.1 - Rutting restriction, general (7/16)

Operations are to cease immediately if equipment and weather conditions result in rutting of roads and/or skid trails which is 12 inches or greater in depth and 50 feet in length. The Unit Manager or his/her representative may restrict hauling and/or

skidding if ruts exceed the specified depth. With the Unit Manager or his/her representative's approval, the Purchaser may return to the area when the risk of rutting has decreased.

6 - Safety and Fire Prevention

6.2 - Signing

6.2.1 - Road posting (9/09)

The Purchaser is responsible for posting and maintaining caution signs on Flynn Valley Road prior to beginning operations. The road must be posted at appropriate distances from the Sale Area to warn of logging activity and truck traffic. Signs must be removed when harvest operations are suspended or completed. The Purchaser will provide these signs.



TIMBER SALE MAP

This information provided by authority of Part 525, 1994 PA 451, as amended.

Forest Management Unit Grayling	County Oscoda	Mapped By Zaremba, VanOss	Date 09/21/2020	Page 1	of 1
Township 28N	Range 04E; 05E	Section(s) and Subdivision(s) Sec 12-SENW, E1/2NE, E1/2SW, W1/2SE, Sec 13-NENW; Sec 6- SWSW	Scale 1:15,840		

Cover Type				Density			
A = Aspen	H = Hemlock	N = Marsh	U = Upland Brush	0 = Non Stocked	5 = Pole Timber Medium		
B = Paper Birch	J = Jack Pine	O = Oak	UM = Upland Mixed	1 = Seedling Sapling Poor	6 = Pole Timber Well		
C = Cedar	L = Lowland Brush	P = Lowland Poplar	V = Bog or Marsh	2 = Seedling Sapling Medium	7 = Saw Timber Poor		
D = Treed Bog	LM = Lowland Mixed	Q = Mixed Swamp Conifer	W = White Pine	3 = Seedling Sapling Well	8 = Saw Timber Medium		
E = Swamp Hdwoods	M = Mpl, Bch, Brch	R = Red Pine	X = Non Stocked	4 = Pole Timber Poor	9 = Saw Timber Well		
F = Spruce Fir	MC = Mixed Conifer	S = Black Spruce	Z = Water				
G = Grass	MD = Mixed Deciduous	T = Tamarack					

PU	Acres	PU	Acres
1	64.7	4	7.7
2	16.1	5	18.7
3	15.7	6	3.6

Mossy Runway Pine

Compartment 028

126.5 Acres

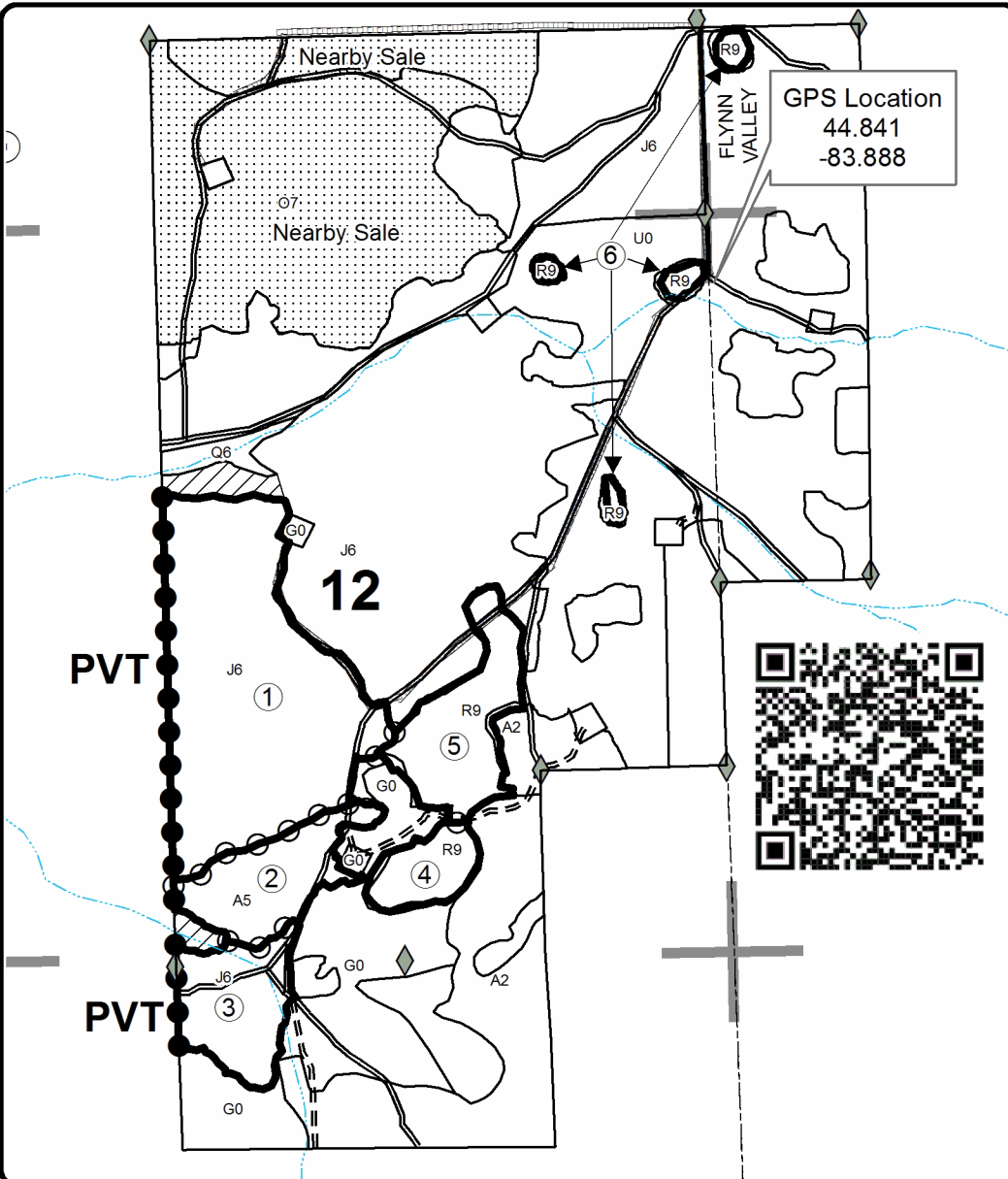
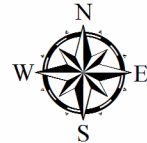

Legend

- Stand Boundaries
- Field Grade Corners
- Oil & Gas Well Surface Locations
- Secondary Forest Road
- Forest Access Route
- Paved Road
- Intermittent Stream
- Retention Area
- Against State (Red)
- Payment Unit (Yellow)
- Private Line (Blue)
- Nearby Timber Sales
- Section Corners
- Pipeline

Locator Map

1:200,000

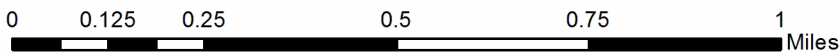
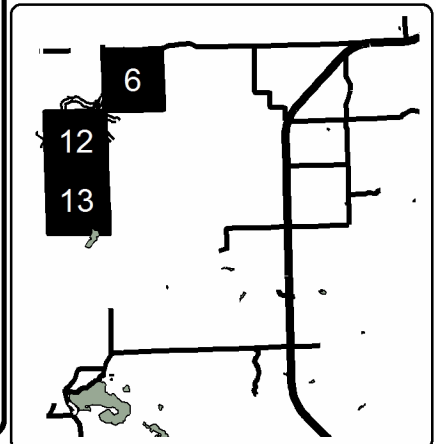

Mossy Runway Pine (72-012-19)
T28N, R04E, SEC. 12; T28N, R04E, SEC. 13; T28N, R05E, SEC. 6; Oscoda

In response to the notice of sale to be held 9:00 a.m. (local time) on April 9, 2021, I am hereby submitting my sealed bid (firm offer) for the following forest products to be cut. Bids for individual species must be at or above the advertised price. All non-responsive bid forms may be rejected.

<u>PRODUCTS & SPECIES</u>	<u>ESTIMATED VOLUME*</u>	<u>ADVERTISED PRICE</u>	<u>BID PRICE/UNIT</u>
Sawtimber			
Red Pine	104.6 MBF	\$ 91.00/MBF	\$ _____
Pulpwood			
Black Cherry	3 Cords	\$ 20.40/Cord	\$ _____
Jack Pine	1,693 Cords	\$ 15.30/Cord	\$ _____
Mixed Aspen	134 Cords	\$ 14.05/Cord	\$ _____
Mixed Oak	30 Cords	\$ 20.50/Cord	\$ _____
Red Pine	238 Cords	\$ 33.85/Cord	\$ _____

*The volumes are statistically estimated within plus (+) or minus (-) 11.05 percent at 95% confidence level. These estimated volumes are final and not subject to adjustment. Prospective bidders are urged to examine this timber and to make their own estimates of quantity and quality.

I understand that any or all bids may be rejected. All bids must be signed and all bid items must be bid or the bid form may be rejected. I also understand that consideration and awarding a contract will be based upon my past performance and ability to complete the contract based upon equipment and staffing subject to my control.

FEDERAL ID: _____ - _____ or SOCIAL SECURITY NUMBER: _____ - _____ - _____

Company or individual bidding: _____

Company representative's name: _____

Address: _____

City: _____ State: _____ Zip: _____

IF AVAILABLE, PLEASE PLACE THE PERSONALIZED LABEL FROM YOUR PROSPECTUS IN THE ABOVE BOX.

Individual or company representative's signature: _____ Date: _____

Phone number : _____ Email (optional): _____

THE WINNING BIDDER MUST COMPLETE THE VERIFICATION OF WORKER'S DISABILITY COMPENSATION ACT COMPLIANCE (ON REVERSE SIDE IF DOUBLE SIDED) WITHIN 21 DAYS OF SALE AWARD DATE



FOR DEPARTMENT USE ONLY	
Sale Number (XX – XXX – XX – XX)	
Forest Management Unit:	

TIMBER SALE VERIFICATION OF WORKER'S DISABILITY COMPENSATION ACT COMPLIANCE

*As required by Act 317, P.A. 1969 (Worker's Compensation) and
Part 5 of Act 451 of 1994, as amended.*

VERIFICATION OF WORKER'S DISABILITY COMPENSATION ACT COMPLIANCE

- This verification must be completed and submitted within 21 days of contract award and prior to the issuance of the timber sale contract.
- In addition, if boxes 2B or 2C are checked, then Notice of Exclusion or Certificate of Insurance must be submitted within twenty-one (21) days of the contract award and prior to the issuance of the timber sale contract.
- All information must be typed or printed except for written signatures.

Please Check Appropriate Categories:

1. My business is organized as (you **must** check one of the boxes below):
 - A. Sole Proprietorship (individual)
 - B. Partnership
 - C. Corporation
2. You **must** check one of the boxes below:
 - A. I certify my business is a sole proprietorship and it has no employees but the sole proprietor. I am not subject to the Worker's Compensation Laws.
 - B. I certify my business has satisfied its obligation to the Worker's Compensation Act through the use of an approved Notice of Exclusion (BWC-337, Rev. 5/96). I will provide a copy of the Notice of Exclusion within 21 days of the contract award. (For questions or a copy of the BWC-337, please call the Worker's Compensation Bureau at 517-322-1195).
 - C. I certify my business has a Worker's Compensation Policy. I will provide an original Certificate of Insurance within twenty-one (21) days of the contract award.
3. If you have checked item 2(A) or 2(B), you **must** indicate the number of **both** full-time and part-time employees, other than yourself, including family members and active partners (if none, you must enter "0").

_____ Full-time Employees

_____ Part-time Employees

Name of Business		Federal ID (or) Social Security No.	
Address		Telephone ()	
City	State	ZIP	

I hereby certify that the above information is true and correct. I agree to notify the Michigan DNR of any changes that occur in factors affecting my coverage during any of my present and future operations.

Signature of Owner or Authorized Representative

Title

Date

Please complete the "SEALED BID" information on the next page

Plowtruck I'm Stuck Mix (72-003-20)
T27N, R02E, SEC. 6; Oscoda COUNTY

In response to the notice of sale to be held 9:00 a.m. (local time) on April 9, 2021, I am hereby submitting my sealed bid (firm offer) for the following forest products to be cut. Bids for individual species must be at or above the advertised price. All non-responsive bid forms may be rejected.

<u>PRODUCTS & SPECIES</u>	<u>ESTIMATED VOLUME*</u>	<u>ADVERTISED PRICE</u>	<u>BID PRICE/UNIT</u>
Sawtimber			
BI/R/Hybrid Oak	11.5 MBF	\$ 136.00/MBF	\$ _____
Red Pine	542.0 MBF	\$ 91.00/MBF	\$ _____
Pulpwood			
BI/R/Hybrid Oak	193 Cords	\$ 20.50/Cord	\$ _____
Jack Pine	802 Cords	\$ 15.30/Cord	\$ _____
Red Pine	818 Cords	\$ 33.85/Cord	\$ _____

*The volumes are statistically estimated within plus (+) or minus (-) 13.05 percent at 95% confidence level. These estimated volumes are final and not subject to adjustment. Prospective bidders are urged to examine this timber and to make their own estimates of quantity and quality.

I understand that any or all bids may be rejected. All bids must be signed and all bid items must be bid or the bid form may be rejected. I also understand that consideration and awarding a contract will be based upon my past performance and ability to complete the contract based upon equipment and staffing subject to my control.

FEDERAL ID: _____ - _____ or SOCIAL SECURITY NUMBER: _____ - _____ - _____

Company or individual bidding: _____

Company representative's name: _____

Address: _____

City: _____ State: _____ Zip: _____

IF AVAILABLE, PLEASE PLACE THE PERSONALIZED LABEL FROM YOUR PROSPECTUS IN THE ABOVE BOX.

Individual or company representative's signature: _____ Date: _____

Phone number : _____ Email (optional): _____

THE WINNING BIDDER MUST COMPLETE THE VERIFICATION OF WORKER'S DISABILITY COMPENSATION ACT COMPLIANCE (ON REVERSE SIDE IF DOUBLE SIDED) WITHIN 21 DAYS OF SALE AWARD DATE



FOR DEPARTMENT USE ONLY	
Sale Number (XX - XXX - XX - XX)	
Forest Management Unit:	

TIMBER SALE VERIFICATION OF WORKER'S DISABILITY COMPENSATION ACT COMPLIANCE

As required by Act 317, P.A. 1969 (Worker's Compensation) and
Part 5 of Act 451 of 1994, as amended.

VERIFICATION OF WORKER'S DISABILITY COMPENSATION ACT COMPLIANCE

- This verification must be completed and submitted within 21 days of contract award and prior to the issuance of the timber sale contract.
- In addition, if boxes 2B or 2C are checked, then Notice of Exclusion or Certificate of Insurance must be submitted within twenty-one (21) days of the contract award and prior to the issuance of the timber sale contract.
- All information must be typed or printed except for written signatures.

Please Check Appropriate Categories:

1. My business is organized as (you **must** check one of the boxes below):
 - A. Sole Proprietorship (individual)
 - B. Partnership
 - C. Corporation
2. You **must** check one of the boxes below:
 - A. I certify my business is a sole proprietorship and it has no employees but the sole proprietor. I am not subject to the Worker's Compensation Laws.
 - B. I certify my business has satisfied its obligation to the Worker's Compensation Act through the use of an approved Notice of Exclusion (BWC-337, Rev. 5/96). I will provide a copy of the Notice of Exclusion within 21 days of the contract award. (For questions or a copy of the BWC-337, please call the Worker's Compensation Bureau at 517-322-1195).
 - C. I certify my business has a Worker's Compensation Policy. I will provide an original Certificate of Insurance within twenty-one (21) days of the contract award.
3. If you have checked item 2(A) or 2(B), you **must** indicate the number of **both** full-time and part-time employees, other than yourself, including family members and active partners (if none, you must enter "0").

_____ Full-time Employees

_____ Part-time Employees

Name of Business		Federal ID (or) Social Security No.	
Address		Telephone ()	
City	State	ZIP	

I hereby certify that the above information is true and correct. I agree to notify the Michigan DNR of any changes that occur in factors affecting my coverage during any of my present and future operations.

Signature of Owner or Authorized Representative

Title

Date

Please complete the "SEALED BID" information on the next page

Penn Pine and Oak (72-021-20)
T28N, R02E, SEC. 17; T28N, R02E, SEC. 18; Oscoda COUNTY

In response to the notice of sale to be held 9:00 a.m. (local time) on April 9, 2021, I am hereby submitting my sealed bid (firm offer) for the following forest products to be cut. Bids for individual species must be at or above the advertised price. All non-responsive bid forms may be rejected.

<u>PRODUCTS & SPECIES</u>	<u>ESTIMATED VOLUME*</u>	<u>ADVERTISED PRICE</u>	<u>BID PRICE/UNIT</u>
Sawtimber			
Mixed Oak	54.3 MBF	\$ 136.00/MBF	\$ _____
Red Pine	244.8 MBF	\$ 91.00/MBF	\$ _____
Pulpwood			
Jack Pine	10 Cords	\$ 15.30/Cord	\$ _____
Mixed Aspen	35 Cords	\$ 14.05/Cord	\$ _____
Mixed Oak	128 Cords	\$ 20.50/Cord	\$ _____
Red Maple	81 Cords	\$ 20.40/Cord	\$ _____
Red Pine	424 Cords	\$ 33.85/Cord	\$ _____

*The volumes are statistically estimated within plus (+) or minus (-) 16.53 percent at 95% confidence level. These estimated volumes are final and not subject to adjustment. Prospective bidders are urged to examine this timber and to make their own estimates of quantity and quality.

I understand that any or all bids may be rejected. All bids must be signed and all bid items must be bid or the bid form may be rejected. I also understand that consideration and awarding a contract will be based upon my past performance and ability to complete the contract based upon equipment and staffing subject to my control.

FEDERAL ID: _____ or SOCIAL SECURITY NUMBER: _____
 Company or individual bidding: _____
 Company representative's name: _____
 Address: _____
 City: _____ State: _____ Zip: _____

IF AVAILABLE, PLEASE PLACE THE PERSONALIZED LABEL FROM YOUR PROSPECTUS IN THE ABOVE BOX.

Individual or company representative's signature: _____ Date: _____
Phone number : _____ Email (optional): _____

THE WINNING BIDDER MUST COMPLETE THE VERIFICATION OF WORKER'S DISABILITY COMPENSATION ACT COMPLIANCE (ON REVERSE SIDE IF DOUBLE SIDED) WITHIN 21 DAYS OF SALE AWARD DATE



FOR DEPARTMENT USE ONLY	
Sale Number (XX - XXX - XX - XX)	
Forest Management Unit:	

TIMBER SALE VERIFICATION OF WORKER'S DISABILITY COMPENSATION ACT COMPLIANCE

As required by Act 317, P.A. 1969 (Worker's Compensation) and
Part 5 of Act 451 of 1994, as amended.

VERIFICATION OF WORKER'S DISABILITY COMPENSATION ACT COMPLIANCE

- This verification must be completed and submitted within 21 days of contract award and prior to the issuance of the timber sale contract.
- In addition, if boxes 2B or 2C are checked, then Notice of Exclusion or Certificate of Insurance must be submitted within twenty-one (21) days of the contract award and prior to the issuance of the timber sale contract.
- All information must be typed or printed except for written signatures.

Please Check Appropriate Categories:

1. My business is organized as (you **must** check one of the boxes below):
 - A. Sole Proprietorship (individual)
 - B. Partnership
 - C. Corporation
2. You **must** check one of the boxes below:
 - A. I certify my business is a sole proprietorship and it has no employees but the sole proprietor. I am not subject to the Worker's Compensation Laws.
 - B. I certify my business has satisfied its obligation to the Worker's Compensation Act through the use of an approved Notice of Exclusion (BWC-337, Rev. 5/96). I will provide a copy of the Notice of Exclusion within 21 days of the contract award. (For questions or a copy of the BWC-337, please call the Worker's Compensation Bureau at 517-322-1195).
 - C. I certify my business has a Worker's Compensation Policy. I will provide an original Certificate of Insurance within twenty-one (21) days of the contract award.
3. If you have checked item 2(A) or 2(B), you **must** indicate the number of **both** full-time and part-time employees, other than yourself, including family members and active partners (if none, you must enter "0").

_____ Full-time Employees

_____ Part-time Employees

Name of Business		Federal ID (or) Social Security No.	
Address		Telephone ()	
City	State	ZIP	

I hereby certify that the above information is true and correct. I agree to notify the Michigan DNR of any changes that occur in factors affecting my coverage during any of my present and future operations.

Signature of Owner or Authorized Representative

Title

Date

Please complete the "SEALED BID" information on the next page

Dollar Lk Rd Oak (72-626-20)
T26N, R04W, SEC. 4; T27N, R04W, SEC. 33; Crawford COUNTY

In response to the notice of sale to be held 9:00 a.m. (local time) on April 9, 2021, I am hereby submitting my sealed bid (firm offer) for the following forest products to be cut. Bids for individual species must be at or above the advertised price. All non-responsive bid forms may be rejected.

<u>PRODUCTS & SPECIES</u>	<u>ESTIMATED VOLUME*</u>	<u>ADVERTISED PRICE</u>	<u>BID PRICE/UNIT</u>
Sawtimber			
Northern Pin Oak	12.4 MBF	\$ 71.00/MBF	\$ _____
Red Oak	466.5 MBF	\$ 90.00/MBF	\$ _____
White Oak	55.6 MBF	\$ 51.00/MBF	\$ _____
Pulpwood			
Jack Pine	2 Cords	\$ 12.50/Cord	\$ _____
Misc. Species 1	105 Cords	\$ 4.50/Cord	\$ _____
Mixed Oak	673 Cords	\$ 16.80/Cord	\$ _____
Red Maple	40 Cords	\$ 16.70/Cord	\$ _____

*The volumes are statistically estimated within plus (+) or minus (-) 14.67 percent at 95% confidence level. These estimated volumes are final and not subject to adjustment. Prospective bidders are urged to examine this timber and to make their own estimates of quantity and quality.

I understand that any or all bids may be rejected. All bids must be signed and all bid items must be bid or the bid form may be rejected. I also understand that consideration and awarding a contract will be based upon my past performance and ability to complete the contract based upon equipment and staffing subject to my control.

FEDERAL ID: _____ or SOCIAL SECURITY NUMBER: _____

Company or individual bidding: _____

Company representative's name: _____

Address: _____

City: _____ State: _____ Zip: _____

IF AVAILABLE, PLEASE PLACE THE PERSONALIZED LABEL FROM YOUR PROSPECTUS IN THE ABOVE BOX.

Individual or company representative's signature: _____ Date: _____
Phone number : _____ Email (optional): _____

THE WINNING BIDDER MUST COMPLETE THE VERIFICATION OF WORKER'S DISABILITY COMPENSATION ACT COMPLIANCE (ON REVERSE SIDE IF DOUBLE SIDED) WITHIN 21 DAYS OF SALE AWARD DATE



FOR DEPARTMENT USE ONLY	
Sale Number (XX - XXX - XX - XX)	
Forest Management Unit:	

TIMBER SALE VERIFICATION OF WORKER'S DISABILITY COMPENSATION ACT COMPLIANCE

As required by Act 317, P.A. 1969 (Worker's Compensation) and
Part 5 of Act 451 of 1994, as amended.

VERIFICATION OF WORKER'S DISABILITY COMPENSATION ACT COMPLIANCE

- This verification must be completed and submitted within 21 days of contract award and prior to the issuance of the timber sale contract.
- In addition, if boxes 2B or 2C are checked, then Notice of Exclusion or Certificate of Insurance must be submitted within twenty-one (21) days of the contract award and prior to the issuance of the timber sale contract.
- All information must be typed or printed except for written signatures.

Please Check Appropriate Categories:

1. My business is organized as (you **must** check one of the boxes below):
 - A. Sole Proprietorship (individual)
 - B. Partnership
 - C. Corporation
2. You **must** check one of the boxes below:
 - A. I certify my business is a sole proprietorship and it has no employees but the sole proprietor. I am not subject to the Worker's Compensation Laws.
 - B. I certify my business has satisfied its obligation to the Worker's Compensation Act through the use of an approved Notice of Exclusion (BWC-337, Rev. 5/96). I will provide a copy of the Notice of Exclusion within 21 days of the contract award. (For questions or a copy of the BWC-337, please call the Worker's Compensation Bureau at 517-322-1195).
 - C. I certify my business has a Worker's Compensation Policy. I will provide an original Certificate of Insurance within twenty-one (21) days of the contract award.
3. If you have checked item 2(A) or 2(B), you **must** indicate the number of **both** full-time and part-time employees, other than yourself, including family members and active partners (if none, you must enter "0").

_____ Full-time Employees

_____ Part-time Employees

Name of Business		Federal ID (or) Social Security No.	
Address		Telephone ()	
City	State	ZIP	

I hereby certify that the above information is true and correct. I agree to notify the Michigan DNR of any changes that occur in factors affecting my coverage during any of my present and future operations.

Signature of Owner or Authorized Representative

Title

Date

Please complete the "SEALED BID" information on the next page

MPRC Fuelbreak (72-624-20)

T27N, R03W, SEC. 13; T27N, R03W, SEC. 23; T27N, R03W, SEC. 24; Crawford

In response to the notice of sale to be held 9:00 a.m. (local time) on April 9, 2021, I am hereby submitting my sealed bid (firm offer) for the following forest products to be cut. Bids for individual species must be at or above the advertised price. All non-responsive bid forms may be rejected.

<u>PRODUCTS & SPECIES</u>	<u>ESTIMATED VOLUME*</u>	<u>ADVERTISED PRICE</u>	<u>BID PRICE/UNIT</u>
Sawtimber			
Northern Pin Oak	11.6 MBF	\$ 63.00/MBF	\$ _____
Red Oak	143.6 MBF	\$ 80.00/MBF	\$ _____
White Oak	19.4 MBF	\$ 46.00/MBF	\$ _____
Pulpwood			
Jack Pine	41 Cords	\$ 11.15/Cord	\$ _____
Misc. Species 1	136 Cords	\$ 4.00/Cord	\$ _____
Misc. Species 2	12 Cords	\$ 2.00/Cord	\$ _____
Mixed Aspen	105 Cords	\$ 10.20/Cord	\$ _____
Mixed Hardwood	162 Cords	\$ 14.85/Cord	\$ _____
Mixed Oak	378 Cords	\$ 14.90/Cord	\$ _____
Red Pine	3 Cords	\$ 24.60/Cord	\$ _____
White Pine	4 Cords	\$ 11.20/Cord	\$ _____

*The volumes are statistically estimated within plus (+) or minus (-) 16.69 percent at 95% confidence level. These estimated volumes are final and not subject to adjustment. Prospective bidders are urged to examine this timber and to make their own estimates of quantity and quality.

I understand that any or all bids may be rejected. All bids must be signed and all bid items must be bid or the bid form may be rejected. I also understand that consideration and awarding a contract will be based upon my past performance and ability to complete the contract based upon equipment and staffing subject to my control.

FEDERAL ID: _____ or SOCIAL SECURITY NUMBER: _____

Company or individual bidding: _____

Company representative's name: _____

Address: _____

City: _____ State: _____ Zip: _____

IF AVAILABLE, PLEASE PLACE THE PERSONALIZED LABEL FROM YOUR PROSPECTUS IN THE ABOVE BOX.

Individual or company representative's signature: _____ Date: _____

Phone number : _____ Email (optional): _____

THE WINNING BIDDER MUST COMPLETE THE VERIFICATION OF WORKER'S DISABILITY COMPENSATION ACT COMPLIANCE (ON REVERSE SIDE IF DOUBLE SIDED) WITHIN 21 DAYS OF SALE AWARD DATE



FOR DEPARTMENT USE ONLY	
Sale Number (XX - XXX - XX - XX)	
Forest Management Unit:	

TIMBER SALE VERIFICATION OF WORKER'S DISABILITY COMPENSATION ACT COMPLIANCE

As required by Act 317, P.A. 1969 (Worker's Compensation) and
Part 5 of Act 451 of 1994, as amended.

VERIFICATION OF WORKER'S DISABILITY COMPENSATION ACT COMPLIANCE

- This verification must be completed and submitted within 21 days of contract award and prior to the issuance of the timber sale contract.
- In addition, if boxes 2B or 2C are checked, then Notice of Exclusion or Certificate of Insurance must be submitted within twenty-one (21) days of the contract award and prior to the issuance of the timber sale contract.
- All information must be typed or printed except for written signatures.

Please Check Appropriate Categories:

1. My business is organized as (you **must** check one of the boxes below):
 - A. Sole Proprietorship (individual)
 - B. Partnership
 - C. Corporation
2. You **must** check one of the boxes below:
 - A. I certify my business is a sole proprietorship and it has no employees but the sole proprietor. I am not subject to the Worker's Compensation Laws.
 - B. I certify my business has satisfied its obligation to the Worker's Compensation Act through the use of an approved Notice of Exclusion (BWC-337, Rev. 5/96). I will provide a copy of the Notice of Exclusion within 21 days of the contract award. (For questions or a copy of the BWC-337, please call the Worker's Compensation Bureau at 517-322-1195).
 - C. I certify my business has a Worker's Compensation Policy. I will provide an original Certificate of Insurance within twenty-one (21) days of the contract award.
3. If you have checked item 2(A) or 2(B), you **must** indicate the number of **both** full-time and part-time employees, other than yourself, including family members and active partners (if none, you must enter "0").

_____ Full-time Employees

_____ Part-time Employees

Name of Business		Federal ID (or) Social Security No.	
Address		Telephone ()	
City	State	ZIP	

I hereby certify that the above information is true and correct. I agree to notify the Michigan DNR of any changes that occur in factors affecting my coverage during any of my present and future operations.

Signature of Owner or Authorized Representative

Title

Date

Please complete the "SEALED BID" information on the next page

Arrowhead JP & Spruce (72-627-20)
T26N, R04W, SEC. 5; T26N, R04W, SEC. 6; Crawford COUNTY

In response to the notice of sale to be held 9:00 a.m. (local time) on April 9, 2021, I am hereby submitting my sealed bid (firm offer) for the following forest products to be cut. Bids for individual species must be at or above the advertised price. All non-responsive bid forms may be rejected.

<u>PRODUCTS & SPECIES</u>	<u>ESTIMATED VOLUME*</u>	<u>ADVERTISED PRICE</u>	<u>BID PRICE/UNIT</u>
Pulpwood			
Black Spruce	564 Cords	\$ 10.90/Cord	\$ _____
Jack Pine	1,029 Cords	\$ 12.50/Cord	\$ _____
Misc. Species 1	6 Cords	\$ 4.50/Cord	\$ _____
Mixed Oak	8 Cords	\$ 16.80/Cord	\$ _____
Red Pine	2 Cords	\$ 27.70/Cord	\$ _____
Tamarack	12 Cords	\$ 9.00/Cord	\$ _____

*The volumes are statistically estimated within plus (+) or minus (-) 13.85 percent at 95% confidence level. These estimated volumes are final and not subject to adjustment. Prospective bidders are urged to examine this timber and to make their own estimates of quantity and quality.

I understand that any or all bids may be rejected. All bids must be signed and all bid items must be bid or the bid form may be rejected. I also understand that consideration and awarding a contract will be based upon my past performance and ability to complete the contract based upon equipment and staffing subject to my control.

FEDERAL ID: ____ - ____ - ____ or SOCIAL SECURITY NUMBER: ____ - ____ - ____

Company or individual bidding: _____

Company representative's name: _____

Address: _____

City: _____ State: _____ Zip: _____

IF AVAILABLE, PLEASE PLACE THE PERSONALIZED LABEL FROM YOUR PROSPECTUS IN THE ABOVE BOX.

Individual or company representative's signature: _____ Date: _____

Phone number : _____ Email (optional): _____

THE WINNING BIDDER MUST COMPLETE THE VERIFICATION OF WORKER'S DISABILITY COMPENSATION ACT COMPLIANCE (ON REVERSE SIDE IF DOUBLE SIDED) WITHIN 21 DAYS OF SALE AWARD DATE



FOR DEPARTMENT USE ONLY	
Sale Number (XX - XXX - XX - XX)	
Forest Management Unit:	

TIMBER SALE VERIFICATION OF WORKER'S DISABILITY COMPENSATION ACT COMPLIANCE

As required by Act 317, P.A. 1969 (Worker's Compensation) and
Part 5 of Act 451 of 1994, as amended.

VERIFICATION OF WORKER'S DISABILITY COMPENSATION ACT COMPLIANCE

- This verification must be completed and submitted within 21 days of contract award and prior to the issuance of the timber sale contract.
- In addition, if boxes 2B or 2C are checked, then Notice of Exclusion or Certificate of Insurance must be submitted within twenty-one (21) days of the contract award and prior to the issuance of the timber sale contract.
- All information must be typed or printed except for written signatures.

Please Check Appropriate Categories:

1. My business is organized as (you **must** check one of the boxes below):
 - A. Sole Proprietorship (individual)
 - B. Partnership
 - C. Corporation
2. You **must** check one of the boxes below:
 - A. I certify my business is a sole proprietorship and it has no employees but the sole proprietor. I am not subject to the Worker's Compensation Laws.
 - B. I certify my business has satisfied its obligation to the Worker's Compensation Act through the use of an approved Notice of Exclusion (BWC-337, Rev. 5/96). I will provide a copy of the Notice of Exclusion within 21 days of the contract award. (For questions or a copy of the BWC-337, please call the Worker's Compensation Bureau at 517-322-1195).
 - C. I certify my business has a Worker's Compensation Policy. I will provide an original Certificate of Insurance within twenty-one (21) days of the contract award.
3. If you have checked item 2(A) or 2(B), you **must** indicate the number of **both** full-time and part-time employees, other than yourself, including family members and active partners (if none, you must enter "0").

_____ Full-time Employees

_____ Part-time Employees

Name of Business		Federal ID (or) Social Security No.	
Address		Telephone ()	
City	State	ZIP	

I hereby certify that the above information is true and correct. I agree to notify the Michigan DNR of any changes that occur in factors affecting my coverage during any of my present and future operations.

Signature of Owner or Authorized Representative

Title

Date

Please complete the "SEALED BID" information on the next page