



**DEPARTMENT OF NATURAL RESOURCES
STATE OF MICHIGAN**

TIMBER SALE PROSPECTUS #7017

SCHEDULED SALE DATE AND TIME: 10:00 a.m. (local time) on March 22, 2022.

LOCATION: ATLANTA MGMT UNIT, 13501 M 33, ATLANTA, MI 49709.

PROSPECTUS NOTE: The bidder is advised to inspect the sale area and review the location, estimated volumes, operating costs and contract terms of proposed sales. Please be aware that some landowners may request 60 days or more notice for access across their land.

Notice is hereby given that bids will be received by the Unit Manager, ATLANTA MANAGEMENT UNIT, for certain timber on the following described lands:

Mucho Michabo Mix (54-006-21) / T32N, R03E, SEC. 29, S1/2NW,SW.

T32N, R03E, SEC. 30, S1/2SE.

Montmorency County, Advertised Price \$74,808.35, 79.0 Acres, Aspen, Hardwood.

SALE NOTE: All units of volume listed for this sale were estimated using the Inventory Manager computer program and the new Michigan taper model.

This sale includes multiple timing restrictions.

Long Haul Mix (54-007-21) / T32N, R03E, SEC. 19, SESW,SWSE.

T32N, R03E, SEC. 30, E1/2NW,NWNE,S1/2NE,N1/2SW.

T32N, R03E, SEC. 30, N1/2SE.

Montmorency County, Advertised Price \$81,521.05, 93.0 Acres, Hardwood, Aspen.

SALE NOTE: All units of volume listed for this sale were estimated using the Inventory Manager computer program and the new Michigan taper model.

This sale requires a long haul road and has a multiple timing restrictions.

Finger Point Hardwood (54-030-21) / T29N, R03E, SEC. 20, SENW,SWNE,SW,W1/2SE.

T29N, R03E, SEC. 29, E1/2NE.

Montmorency County, Advertised Price \$44,694.20, 94.9 Acres, Hardwood, Red Oak.

SALE NOTE: All units of volume listed for this sale were estimated using the Inventory Manager computer program and the new Michigan taper model.

BID INSTRUCTIONS (VER. 07/02/2018):

1. Scheduled Bid Location, Date, and Time (2/11)

Bids must be received by the Unit Manager, ATLANTA OFFICE, 13501 M 33, ATLANTA, MI 49709, no later than 10:00 a.m. (local time) on March 22, 2022. For further information concerning this sale, contact Cody Stevens at 989-785-4251 extension 5240.

2. Bidder's Qualifications (5/16)

Purchaser shall obtain workers compensation insurance to cover claims under Michigan's Worker's Disability Compensation Act of 1969 or similar employee benefit act of any other state applicable to an employee. If all or part of a timber sale was prepared by a private contractor, the contractor and that contractor's company are not permitted to bid on the timber sale contract. Bids will not be accepted from individuals or companies appearing on the DNR/FRD No-Bid List. This list contains the names of purchasers who previously failed to execute a contract within 21-days or who have a history of poor performance.

3. Preparation of Sealed Bids (5/16)

Bid Forms may be completed online thru Michigan DNR Timber Sale Online Bidding (OLB) at www.michigan.gov/timberbidding or by completing the hardcopy Bid Form found in the Timber Sale Prospectus. Hardcopy Bid Forms shall be manually signed in ink. Registration in OLB is considered your 'signature' for all bids submitted thru that system. Bid prices must be entered for each species and product in the Bid Price column for all material subject to bidding and all fill-in blanks must be completed. If erasures or other changes appear on the hardcopy Bid Form, each erasure or change must be initialed by the person signing the bid.

4. Submission of Sealed Bids (5/16)

Bid forms may be obtained from the Unit Manager or thru OLB. Bids may be submitted hardcopy or thru OLB. All hardcopy bids must be submitted on the bid form and in an envelope clearly identified as described in this section. NOTE: Only one bid form per bid envelope. Sealed bids must be submitted to the Unit office designated in the prospectus and must be submitted at or prior to the time established in the prospectus. The envelope should show on the outside (a) the sale name or number and (b) the date and time of bid opening, as shown in the prospectus. Bids received after the time specified in the sale prospectus are late bids and will be rejected.

It is possible for a bidder to submit multiple bids on a single sale. For example, a bid may be submitted hardcopy and a bid may be submitted thru OLB. Or, two bidders from the same company could both submit bids on the same sale. If this were to happen, the State would accept all bids received and award the contract accordingly. All bidding and contractual requirements would apply to all bids received.

5. Public Opening of Sealed Bids (7/16)

If conditions permit, the sealed bids will be publicly opened and posted at the time and place set in the prospectus.

If a bidder, present at a bid opening, has submitted bids on more than one sale, that bidder may withdraw their unopened bid envelopes or announce the withdrawal of their online bid after being declared the successful bidder on one sale.

6. Award of Contract (1/11)

Award of the contract will be made to the Bidder whose bid, conforming to the prospectus, is most advantageous to the State of Michigan on the basis of total value at rates bid for the estimated quantities. The State reserves the right to reject any bid or waive any minor irregularity in bids received. A written award mailed (or otherwise furnished) to the successful Bidder shall be deemed to result in a binding contract without further action by either party.

7. Down Payment (1/11)

The Bidder to whom award is made must make a down payment within 21 days of the sale award. The amount of the down payment will be calculated as shown in the Bond and Payment Schedule of this prospectus. Only cash may be used to meet this requirement.

8. Performance Security (1/11)

As guarantee of faithful performance, a cash bond, certificate of deposit, surety bond or irrevocable letter of credit (LOC) is required within 21 days of the sale award. The amount of the performance security is shown in the Bond and

Payment Schedule of this prospectus. If an LOC or surety is used, the coverage must extend for at least 6 months beyond the contract expiration.

9. Timber Sale Contract (7/18)

Additional conditions and requirements common to all timber sales are listed on the timber sale contract (R4031) and are available on line at www.michigan.gov/timber. Contact the Unit Manager for additional information or a sample contract. Within 21 days of the date of the award letter, the bidder must sign the contract and provide the required down payment, performance security, and verification of worker's disability compensation. The down payment and performance security shall be in accordance with the provisions of the timber sale contract, in the sums stated in this prospectus. If these actions are not taken, then the Bidder, the Bidder's corporation, and the corporation's principals may not be permitted to bid on State timber sales for a period of 3 months after the first offense, 6 months after the second offense, and 1 year after the third offense. An offense will only be counted against the Bidder for 5 years. In addition, the Bidder certifies that if awarded this contract, the Bidder will complete the timber sale contract in accordance with its terms and any modifications thereof including requirements to purchase, cut, and remove the included timber by the expiration date.

Payment Unit values in the State Forest Timber Sale Contract are calculated based on the advertised value of the Payment Unit as a percentage of the total advertised value of the contract. The advertised value of each Payment Unit is given in the Description of Timber by Payment Unit table on the Timber Sale Information page. For example, if the value of Payment Unit 1 is advertised as \$1,500 and the total Timber Sale value is advertised as \$10,000, the contract price for Payment Unit 1 will be 15% of the total bid price ($\$1,500/\$10,000 * 100$).

10. Disclaimer of Estimates and Bidder's Warranty of Inspection (7/16)

Before submitting this bid, the Bidder is advised and cautioned to inspect the sale area, review the requirements of the sale contract, and take other steps as may be reasonably necessary to ascertain the location, estimated volumes, construction estimates, and operating costs of the proposed sale. Failure to do so will not relieve the Bidder from responsibility for completing the contract.

The Bidder warrants that this bid is submitted solely on the basis of the Bidder's examination and inspection of the quality and quantity of the timber offered for sale and the Bidder's opinion of the value thereof and the costs of recovery. No reliance should be placed on the State of Michigan's estimates of timber quality, quantity or costs of recovery. Bidder further acknowledges that the State of Michigan: (i) expressly disclaims any warranty of fitness of timber for any purpose; (ii) offers this timber as is without any warranty of quality (merchantability) or quantity and (iii) expressly disclaims any warranty as to the quantity or quality of timber sold.

11. Certification and Chain-of-Custody (10/14)

Unless otherwise indicated in the contract under section 7 – Other Conditions of the Sale Specific Conditions & Requirements, the area encompassed by this timber sale is certified to the standards of the Forest Stewardship Council (FSC) - Certificate #SCS-FM/COC-00090N and the Sustainable Forestry Initiative (SFI) - Certificate #NSF-SFIS-5Y031-SF5. Forest products from this sale may be delivered to the mill as "FSC 100% and / or SFI certified" as long as the contractor hauling the forest products is chain-of-custody (COC) certified or covered under a COC certificate from the destination mill. The purchaser is responsible for maintaining COC after leaving the sale area.

12. Good Neighbor Authority (GNA) Requirements (7/16)

If the name of this timber sales contains the acronym GNA, it is authorized by the Good Neighbor Authority (GNA) and covered by various agreements between the U.S. Forest Service and the State. The timber sale occurs on federal land and the following conditions apply:

GNA contracts on US Forest Service land will not be awarded to purchasers on the Federal list of excluded parties. The System for Award Management (SAM) will be checked for active excluded parties prior to award of contract. In addition, the Bidder to whom award is made must complete an Assurance Regarding Felony Conviction or Tax Delinquent Status for Corporate Applicants (AD-3031).

13. Good Neighbor Authority (GNA) Requirements, con't (9/16)

Bidder certifies, by signing this bid form, that to the best of Bidder's knowledge that the following representations are accurate and complete.

- a. That the Bidder and its principals are not presently debarred, suspended, proposed for debarment, declared ineligible, or voluntary excluded from timber sales (covered transactions) by any Federal department or agency.
- b. That the Bidder and its principals have not within a 3-year period preceding this bid been convicted of or had a civil judgment rendered against them for commission of fraud or a criminal offense in connection with obtaining , attempting to obtain, or performing a public (Federal, State, or local) transaction or contract under a public transaction; violation of Federal or State antitrust statutes or commission of embezzlement, theft, forgery, bribery, falsification or destruction of records, making false statements, or receiving stolen property.
- c. That the Bidder and its principals are not presently indicted for or otherwise criminally or civilly charged by a governmental entity (Federal, State, or local) with commission of any of the offenses enumerated in paragraph b of this certification.
- d. That the Bidder and its principals have not within a 3-year period preceding this bid had one or more public transactions (Federal, State, or local) terminated for breach or default of a timber or forest product contract.

Bidders that cannot certify this requirement, in whole or in part, shall submit an explanation with their bid.

DAN EICHINGER
Director

TIMBER SALE INFORMATION

Mucho Michabo Mix (54-006-21)
T32N, R03E, SEC. 29; T32N, R03E, SEC. 30.
Montmorency County (Advertised Price \$74,808.35)

SALE NOTE: All units of volume listed for this sale were estimated using the Inventory Manager computer program and the new Michigan taper model.

This sale includes multiple timing restrictions.

A timber sale contract for this lump sum, sealed bid timber sale will be awarded to the responsible bidder offering the highest sealed bid price. All units of volume listed below were estimated using the Inventory Manager computer program and the new Michigan taper model. Bids must be at or above the following advertised price for each product and species:

<u>PRODUCTS & SPECIES</u>	<u>ESTIMATED UNITS*</u>	<u>ADVERTISED PRICE</u>
Sawtimber		
Red Maple	8.5 MBF	\$ 48.00 / MBF
Red Oak	28.4 MBF	\$ 168.00 / MBF
Red Pine	43.2 MBF	\$ 106.00 / MBF
White Pine	27.8 MBF	\$ 37.00 / MBF
Pulpwood		
Balsam Fir	118 Cords	\$ 16.60 / Cord
Jack Pine	5 Cords	\$ 11.00 / Cord
Mixed Aspen	1,890 Cords	\$ 25.60 / Cord
Mixed Hardwood	298 Cords	\$ 21.55 / Cord
Mixed Oak	114 Cords	\$ 36.40 / Cord
Mixed Spruce	17 Cords	\$ 7.75 / Cord
Red Pine	46 Cords	\$ 28.30 / Cord
White Pine	130 Cords	\$ 12.45 / Cord

* The total volume is statistically estimated within plus (+) or minus (-) 5.05 percent. There are an estimated 2,999 cords on this timber sale, plus or minus 152 cords at the 95% confidence level. The estimated units are final and not subject to adjustment. Prospective bidders are urged to examine this timber and to make their own estimates of quantity and quality.

BOND AND PAYMENT SCHEDULE:

1. A bond in the amount of \$3,740.00 to insure faithful performance of the conditions of the contract will be deposited by the successful bidder within 21 days of the sale award.
2. Cutting in any sale or unit without the required advance payment would be considered a trespass.
3. Total payment must be paid in advance or according to the following schedule :
 - (a) Ten percent (10%) of the sale value must be paid within 21 days of the sale award.
 - (b) The 10% down payment will be credited towards the first unit cut.
 - (c) Payment for each of the following units must be made before cutting begins in that unit:

PAYMENT UNIT NUMBER	PERCENT OF TOTAL SALE VALUE
01	15.9%
02	34.9%
03	49.2%

4. If no cutting takes place, the 10% down payment will not be refunded.
5. Operations on the contract issued will terminate on 06/30/2026.

SALE STATISTICS

Volumes were calculated in cubic feet using the Michigan taper model. Cubic foot volume includes all wood inside bark for the product indicated. For display purposes, cubic feet were converted to cords and MBF using a simple conversion factor, e.g. 79 cubic feet per cord and 185 cubic feet per MBF. The cubic foot volumes are precise; the cords and MBF volumes are not. Cubic foot volume cannot be directly converted to cords or boards with precision.

SALE VOLUMES

The total estimated sale volume may not equal the sum of the species/products due to the nature of statistical calculations associated with double sampling methodology.

VOLUME			STATISTICAL RANGE IN CORDS	
TOTAL CUBIC FEET	TOTAL CORDS	PERCENT ERROR	MINIMUM	MAXIMUM
236,915	2,999	5.05%	2,847	3,151

VDU VOLUMES

A VDU is a Volume Determination Unit. Volumes and their associated statistics are calculated at the VDU level and summarized to the sale level. There is often a one to one relationship between a VDU and a Payment Unit, but not always, depending on the cruise design. Refer to the VDU TO PAYMENT UNIT table.

	VOLUME			RANGE IN CORDS	
VDU	TOTAL CUBIC FEET	TOTAL CORDS	PERCENT ERROR	MINIMUM	MAXIMUM
39	34,601	438	11.97%	386	490
51	189,305	2,396	5.57%	2,263	2,530
TOTAL:	223,907	2,834		2,648	3,020

VDU TO PAYMENT UNIT

When a VDU is associated with more than one Payment Unit (PU), the VDU volumes are assigned to the PU based on acres of the VDU within the PU.

VDU	VDU ACRES	PU	PU ACRES
39	14.1	1	14.1
51	64.9	2	27.0
		3	37.9
TOTAL:	79.0		79.0

DESCRIPTION OF TIMBER BY PAYMENT UNIT (PU)

PU	MARKET GROUP	PRODUCT	QUANTITY	UNIT	ACRES	ADVERTISE PRICE
1	Red Maple	Sawtimber	5.7	MBF	14.1	\$11,911.80
	Red Oak		8.2	MBF		
	Red Pine		22.7	MBF		
	White Pine		20.3	MBF		
	Balsam Fir	Pulpwood	6	Cords		
	Jack Pine		5	Cords		
	<i>Jack Pine</i>	<i>Sawtimber</i>	1.2	<i>MBF</i>		
	<i>Jack Pine</i>	<i>Pulpwood</i>	3	<i>Cords</i>		
	Mixed Aspen		81	Cords		
	<i>B. T. Aspen</i>	<i>Sawtimber</i>	8.6	<i>MBF</i>		
	<i>B. T. Aspen</i>	<i>Pulpwood</i>	35	<i>Cords</i>		
	<i>Quaking Aspen</i>		29	<i>Cords</i>		
	Mixed Hardwood		137	Cords		
	<i>Paper Birch</i>	<i>Sawtimber</i>	1.1	<i>MBF</i>		
	<i>Sugar Maple</i>		1.4	<i>MBF</i>		
	<i>Paper Birch</i>	<i>Pulpwood</i>	17	<i>Cords</i>		
	<i>Red Maple</i>		104	<i>Cords</i>		
	<i>Sugar Maple</i>		11	<i>Cords</i>		
	Mixed Oak		17	Cords		
	<i>White Oak</i>	<i>Sawtimber</i>	1.0	<i>MBF</i>		
	<i>Red Oak</i>	<i>Pulpwood</i>	12	<i>Cords</i>		
	<i>White Oak</i>		3	<i>Cords</i>		
	Red Pine		21	Cords		
White Pine		57	Cords			
2	Red Maple	Sawtimber	1.2	MBF	27.0	\$26,104.95
	Red Oak		8.4	MBF		
	Red Pine		8.5	MBF		
	White Pine		3.1	MBF		
	Balsam Fir	Pulpwood	47	Cords		
	Mixed Aspen		752	Cords		
	<i>B. T. Aspen</i>	<i>Sawtimber</i>	23.9	<i>MBF</i>		
	<i>Quaking Aspen</i>		18.9	<i>MBF</i>		
	<i>B. T. Aspen</i>	<i>Pulpwood</i>	171	<i>Cords</i>		
	<i>Balsam Poplar</i>		7	<i>Cords</i>		
	<i>Quaking Aspen</i>		488	<i>Cords</i>		
	Mixed Hardwood		66	Cords		
	<i>Sugar Maple</i>	<i>Sawtimber</i>	0.4	<i>MBF</i>		
	<i>White Ash</i>		0.8	<i>MBF</i>		
	<i>American Elm</i>	<i>Pulpwood</i>	3	<i>Cords</i>		
	<i>Paper Birch</i>		2	<i>Cords</i>		
	<i>Red Maple</i>		37	<i>Cords</i>		
	<i>Sugar Maple</i>		17	<i>Cords</i>		
	<i>White Ash</i>		4	<i>Cords</i>		
	Mixed Oak		40	Cords		
	<i>Red Oak</i>		40	<i>Cords</i>		
	Mixed Spruce		7	Cords		
	<i>Black Spruce</i>		2	<i>Cords</i>		
<i>White Spruce</i>		5	<i>Cords</i>			
Red Pine		10	Cords			
White Pine		30	Cords			
3	Red Maple	Sawtimber	1.6	MBF	37.9	\$36,791.60
	Red Oak		11.8	MBF		
	Red Pine		12.0	MBF		
	White Pine		4.4	MBF		
	Balsam Fir	Pulpwood	65	Cords		
	Mixed Aspen		1,057	Cords		

DESCRIPTION OF TIMBER BY PAYMENT UNIT (PU), CON'T

PU	MARKET GROUP	PRODUCT	QUANTITY	UNIT	ACRES	ADVERTISE PRICE
3 con't	<i>B. T. Aspen</i>	<i>Sawtimber</i>	33.6	<i>MBF</i>		
	<i>Quaking Aspen</i>		26.6	<i>MBF</i>		
	<i>B. T. Aspen</i>	<i>Pulpwood</i>	241	<i>Cords</i>		
	<i>Balsam Poplar</i>		11	<i>Cords</i>		
	<i>Quaking Aspen</i>		685	<i>Cords</i>		
	Mixed Hardwood		95	<i>Cords</i>		
	<i>Sugar Maple</i>	<i>Sawtimber</i>	0.6	<i>MBF</i>		
	<i>White Ash</i>		1.1	<i>MBF</i>		
	<i>American Elm</i>	<i>Pulpwood</i>	5	<i>Cords</i>		
	<i>Paper Birch</i>		4	<i>Cords</i>		
	<i>Red Maple</i>		52	<i>Cords</i>		
	<i>Sugar Maple</i>		25	<i>Cords</i>		
	<i>White Ash</i>		6	<i>Cords</i>		
	Mixed Oak		57	<i>Cords</i>		
	<i>Red Oak</i>		57	<i>Cords</i>		
	Mixed Spruce		10	<i>Cords</i>		
	<i>Black Spruce</i>		3	<i>Cords</i>		
	<i>White Spruce</i>		7	<i>Cords</i>		
	Red Pine		15	<i>Cords</i>		
	White Pine		43	<i>Cords</i>		
TOTAL:			107.9	MBF		
TOTAL:			2,618	Cords		

Sale Specific Conditions & Requirements

Sale Name: Mucho Michabo Mix

Sale Number: 54-006-21 Seq#: 1

1 - Sale Area

1.2 - Boundaries

1.2.1 - Painted boundaries (9/19)

The sale boundary and Payment Unit boundaries are marked and identified by blue, red, and yellow paint. Exterior sale boundary lines against private property are marked with blue paint. Exterior sale boundary lines against state are marked with red paint or are represented by Michabo Trail. Interior Payment Unit boundaries are marked with yellow paint. Retention patches are marked with red paint; no harvesting activities may occur within these areas. The painted boundary line trees are not Included Timber and are to be protected unless marked with orange paint. Yellow painted trees designating an interior Payment Unit boundary are only to be cut when all surrounding Payment Units have been paid.

2 - Timber Specifications

2.1 - Included Timber

2.1.1 - Clearcut unit(s) with unmerchantable trees (6/14)

Within Payment Unit(s) 1-3, cut all trees that are two (2) inches or more at DBH.

2.1.7 - Leave tree marked unit(s) (6/14)

Within Payment Unit(s) 1-3, cut all trees that are two (2) inches or more at DBH, except trees marked with green paint above and below stump height. Special protection trees identified in accordance with condition 3.4.2, within clearcutting unit boundaries, are not Included Timber and are to be protected.

2.1.15 - Hazard trees near roads (11/20)

Cut and remove all standing dead trees within 100 feet of the cleared portion of Michabo Trail. These trees must be scattered back into the Sale Area.

3 - Payments

3.3 - Pre-measured Sales

3.3.4 - Dividing payment units (7/14)

Payment Unit(s) exceeding \$25,000 in value may be divided at the request of the Purchaser and upon approval of the Unit Manager. Dividing Payment Units is a contract modification which requires a Timber Sale Contract Amendment. There will be only one division per Payment Unit.

3.4 - Damaged Timber

3.4.2 - Special Protection Trees (4/14)

The Purchaser shall not cut live or dead special protection trees within cutting units or clearings. Special protection trees are marked with green paint above and below stump height. If the Purchaser's operations have cut or damaged special protection trees through carelessness, the Purchaser shall pay \$200 as fixed, agreed and liquidated damages for each special protection tree cut or damaged. Such payment does not constitute ownership of the undesignated timber.

4 - Transportation

4.1 - Construction

4.1.6 - Road construction (1/09)

Improvements of existing roads shall be done in such a way as to minimize the environmental and visual impacts. Merchantable trees shall be cut and utilized unless otherwise directed. Non-merchantable trees shall be severed and laid flat on the ground. Slash shall be scattered, and not left in windrows and kept a minimum of 10 feet back from the road edge. Stumps shall be set upright, not left on edge, and be moved at least 10 feet away from the road edge. Disturbed soil shall be feathered into the woods and not left in berms or windrows.

4.1.12 - No new roads (1/12)

No new roads will be permitted. All operations are limited to existing roads. Skid trails only will be allowed.

4.2 - Maintenance

4.2.2 - Fill material (4/07)

To maintain roads, fill material may be needed in areas where "holes" exist or may be expected to develop. This fill material should be placed before trucking begins. This fill material must not contain clay, as found in pit run gravel, or organic material.

4.2.3 - Road maintenance (8/13)

The following road maintenance is required: Within 60 days of completion of hauling, or if no hauling occurs for 60 days, the Michabo Trail must be maintained and graded. This includes cleaning of drainage areas, grading, crowning, and filling with gravel, if necessary. Damages will be assessed if grading/repair does not occur.

4.2.4 - Grading (10/16)

For completion of the sale, Michabo Trail must be graded. In general, this will require a road grader or bulldozer to shape up the roads after forest products have been hauled off site. This includes cleaning of drainage areas, grading, crowning, and filling with gravel, if necessary. The grading equipment to be used must be approved by the Unit Manager or his/her representative.

4.2.5 - Two wheel drive condition (2/04)

All existing trail roads on and adjacent to the sale area must be passable by two-wheel drive traffic for the duration of the sale.

5 - Operations

5.1 - Notification

5.1.1 - Pre-sale conference (10/16)

A pre-sale conference between the Purchaser and sale administrator is required prior to beginning any operations in a Payment Unit to determine landing and road locations. The Unit Manager or his/her representative must be contacted in advance to schedule the conference.

5.1.4 - Post-sale conference (10/16)

A post-sale conference on site between the Purchaser and sale administrator is required prior to the completion of active logging operations to determine clean-up and repair of landings, road edges, and the fulfillment of other contract specifications.

5.2 - Conduct of Operations

5.2.1 - Slash

5.2.1.10 - No slash in openings (5/10)

No brush or logging debris is to be left in the maintained wildlife opening which is indicated by G0 on the Timber Sale Map. Any damage to the opening shall be repaired according to specifications of the Unit Manager or his/her representative.

5.2.2 - Hazard Trees/Snags

5.2.2.1 - Den trees (10/16)

Obvious hollow and/or den trees shall be protected and left standing unless they are a safety hazard.

5.2.3 - Operating Restrictions

5.2.3.2 - Operating restrictions (9/11)

Within Payment Unit(s) 1, unless changed by written agreement, slash must be treated for visual concerns. This may include operating over slash to reduce its height or pulling slash 100' back from Michabo Trail. Accumulations of slash may be piled on top of oak stumps to protect regeneration from browse or concentrated for wildlife habitat. This restriction is necessary to meet the aesthetic concerns along Michabo Trail.

5.2.3.5 - Oak wilt restriction (1/18)

Within Payment Unit(s) 1-3, unless changed by written agreement, cutting, skidding, hauling within the sale and brushing of access roads to the sale are not permitted during the period of April 15 to July 15. Operations may be allowed if specific steps are taken to prevent damaging uncut oak during the high risk period. Those steps may include completing all road brushing before April 15th and clearing a tree-length buffer along uncut oak cover before April 15th. This is

necessary to reduce the spread of oak wilt. For more information, contact the Unit Manager or his/her representative.

5.2.3.11 - Coppice regeneration protection (4/10)

All timber harvesting operations in any Payment Unit must be completed before significant deciduous sprouting occurs to minimize damage to the new regeneration. Remove all severed merchantable timber products to the landing within 30 calendar days of severing or cutting stems. If the Purchaser damages sprouting regeneration due to slow operations, liquidated damages will be assessed at \$200 per acre for all acreage within the specified portion of the Sale Area that was damaged.

Once harvest operations are complete within the Payment Unit, the Purchaser shall haul, or chip all decked timber products within 60 calendar days and the landing restored immediately thereafter.

5.2.3.12 - Hunting operating restriction (1/18)

No Payment Unit may be started during the period of September 29 through December 31 without permission of the Unit Manager or his/her representative.

5.2.4 - Dead and Down Creation

5.2.4.6 - Dead and down creation, other (9/09)

In Payment Unit 2, to improve habitat for hare, rabbits and other species, the Purchaser shall leave slash piles every 3 chains along the wetland edge. Use the tops or slash from several trees to create a pile with a cavity for wildlife cover.

5.2.4.7 - Dead and down creation: hare, grouse, deer and other species (5/15)

To improve horizontal cover habitat for snowshoe hare, grouse, deer, and other species, the Purchaser is to push over trees marked in orange paint in Payment Units 2 and 3. These trees should be tipped over with the root ball still attached so the base of the tree is suspended off the ground. The crown of the fallen tree should be at or near ground level after it is pushed over. If it is impossible or impractical to push these trees over, they may be severed or partially severed at the stump. Whenever possible the stem of the tree should rest above ground level. For practicality, these trees may form part of the wildlife brush piles for hare and other species along wetland edges.

5.2.22 - Operating Caution

5.2.22.1 - Operating caution (6/11)

It is recommended, but not required, that within Payment Unit(s) 1-3, cutting, skidding, and hauling occur during dry summer or frozen winter conditions. The reason for the recommendation is because of seasonally wet and fragile soils in Payment Units 2 and 3, and to minimize damage to Michabo Trail. The Purchaser must use the utmost caution to avoid rutting these soils.

5.2.32 - Decking/landing restoration (9/13)

All decking and landing areas must have the surface area restored to a condition equal to or better than before. This is to ensure the proper regeneration of the stand. Wood debris, chips, and "cookies" from trimmings must be removed or scattered away from landing and loading areas and may not be windrowed on the edge.

5.2.38 - No decking against live trees (2/04)

Cut products may not be decked against unmarked or designated leave trees.

5.4 - Soil Protection

5.4.1 - Rutting restriction, general (7/16)

Operations are to cease immediately if equipment and weather conditions result in rutting of roads and/or skid trails which is 12 inches or greater in depth and 50 feet in length. The Unit Manager or his/her representative may restrict hauling and/or skidding if ruts exceed the specified depth. With the Unit Manager or his/her representative's approval, the Purchaser may return to the area when the risk of rutting has decreased.

5.8 - Protection of Endangered Species

5.8.5 - Protection of raptor nests (3/13)

All trees with raptor nests will be protected if found during harvesting operations. Notification will be made to the Unit Manager or his/her representative who will notify the Wildlife Biologist so an on-site evaluation and recommendation can be made, if necessary.

6 - Safety and Fire Prevention

6.2 - Signing

6.2.1 - Road posting (10/20)

The Purchaser is responsible for posting and maintaining caution signs on Michabo Trail prior to beginning operations. The road must be posted at appropriate distances from the Sale Area to warn of logging activity and truck traffic. Signs must be removed when harvest operations are suspended or completed. The Purchaser will provide and maintain these signs.



Sale Number	Year
54 - 006	21

TIMBER SALE MAP

This information provided by authority of Part 525, 1994 PA 451, as amended.

Forest Management Unit Atlanta Management Unit	County Montmorency	Mapped By Natzke	Date 04/11/2021	Page 1	of 1
		Cruised By Natzke			

Township 32N	Range 03E	Section(s) and Subdivision(s) Sec. 29 S2NW, SW; Sec. 30 S2SE	Scale 1:15,840
-----------------	--------------	---	-------------------

Cover Type				Density			
A = Aspen	H = Hemlock	N = Marsh	U = Upland Brush	0 = Non Stocked	5 = Pole Timber Medium		
B = Paper Birch	J = Jack Pine	O = Oak	UM = Upland Mixed	1 = Seedling Sapling Poor	6 = Pole Timber Well		
C = Cedar	L = Lowland Brush	P = Lowland Poplar	V = Bog or Marsh	2 = Seedling Sapling Medium	7 = Saw Timber Poor		
D = Treed Bog	LM = Lowland Mixed	Q = Mixed Swamp Conifer	W = White Pine	3 = Seedling Sapling Well	8 = Saw Timber Medium		
E = Swamp Hdwoods	M = Mpl, Bch, Brch	R = Red Pine	X = Non Stocked	4 = Pole Timber Poor	9 = Saw Timber Well		
F = Spruce Fir	MC = Mixed Conifer	S = Black Spruce	Z = Water				
G = Grass	MD = Mixed Deciduous	T = Tamarack					

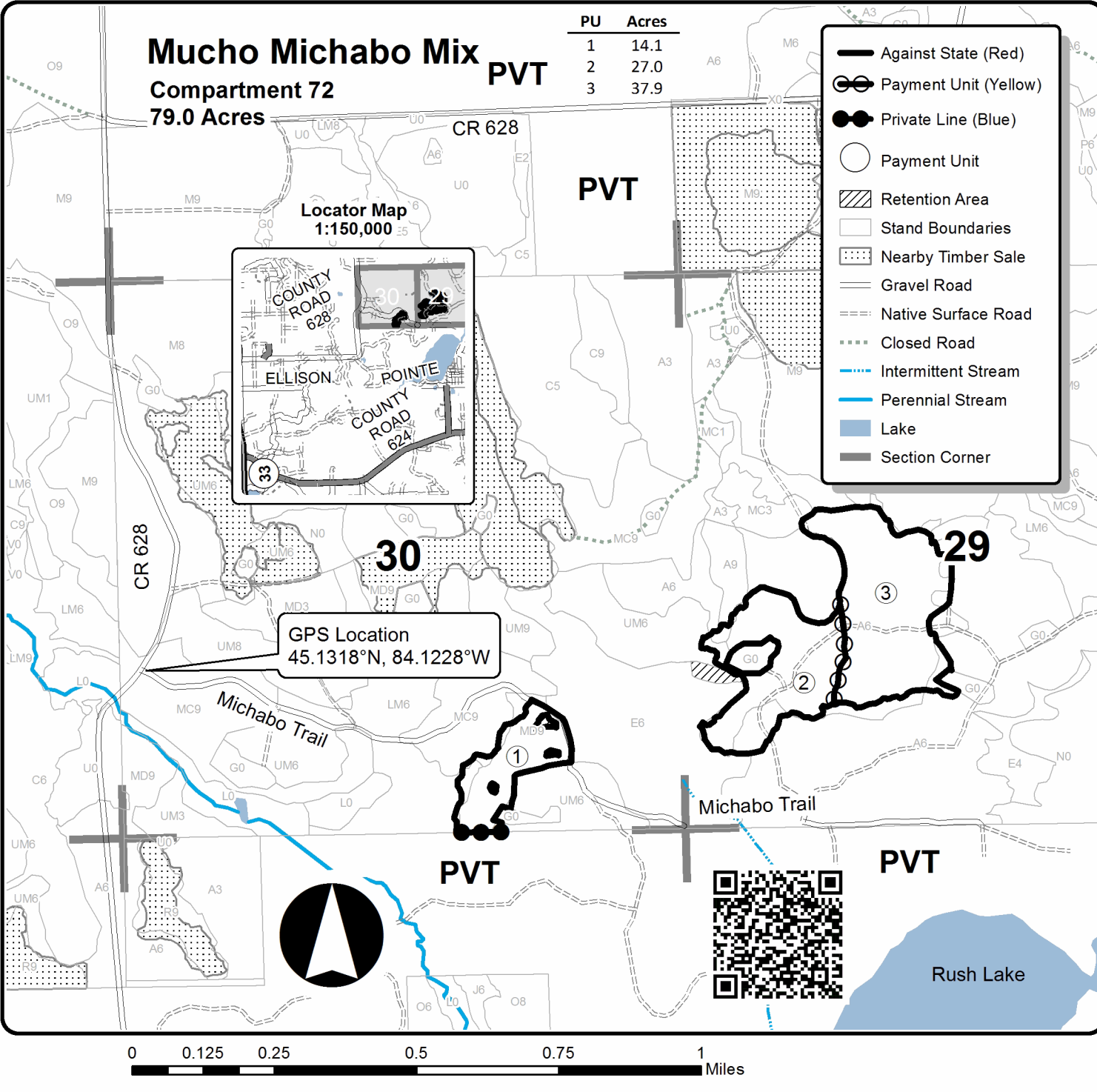

TIMBER SALE INFORMATION

Long Haul Mix (54-007-21)

T32N, R03E, SEC. 19; T32N, R03E, SEC. 30.
Montmorency County (Advertised Price \$81,521.05)

SALE NOTE: All units of volume listed for this sale were estimated using the Inventory Manager computer program and the new Michigan taper model.

This sale requires a long haul road and has a multiple timing restrictions.

A timber sale contract for this lump sum, sealed bid timber sale will be awarded to the responsible bidder offering the highest sealed bid price. All units of volume listed below were estimated using the Inventory Manager computer program and the new Michigan taper model. Bids must be at or above the following advertised price for each product and species:

<u>PRODUCTS & SPECIES</u>	<u>ESTIMATED UNITS*</u>	<u>ADVERTISED PRICE</u>
Sawtimber		
Basswood	74.3 MBF	\$ 44.00 / MBF
Beech	28.4 MBF	\$ 37.00 / MBF
Paper Birch	18.4 MBF	\$ 35.00 / MBF
Red Maple	76.9 MBF	\$ 39.00 / MBF
Red Oak	15.8 MBF	\$ 137.00 / MBF
Sugar Maple	97.0 MBF	\$ 324.00 / MBF
Pulpwood		
Balsam Fir	280 Cords	\$ 13.60 / Cord
Mixed Aspen	583 Cords	\$ 20.95 / Cord
Mixed Hardwood	1,305 Cords	\$ 17.60 / Cord
Mixed Spruce	8 Cords	\$ 6.35 / Cord
N. White Cedar	3 Cords	\$ 11.25 / Cord
Red Oak	24 Cords	\$ 29.75 / Cord
Red Pine	5 Cords	\$ 23.15 / Cord
White Pine	6 Cords	\$ 10.20 / Cord

* The total volume is statistically estimated within plus (+) or minus (-) 4.72 percent. There are an estimated 3,092 cords on this timber sale, plus or minus 146 cords at the 95% confidence level. The estimated units are final and not subject to adjustment. Prospective bidders are urged to examine this timber and to make their own estimates of quantity and quality.

BOND AND PAYMENT SCHEDULE:

1. A bond in the amount of \$4,076.00 to insure faithful performance of the conditions of the contract will be deposited by the successful bidder within 21 days of the sale award.
2. Cutting in any sale or unit without the required advance payment would be considered a trespass.
3. Total payment must be paid in advance or according to the following schedule:
 - (a) Ten percent (10%) of the sale value must be paid within 21 days of the sale award.
 - (b) The 10% down payment will be credited towards the first unit cut.
 - (c) Payment for each of the following units must be made before cutting begins in that unit:

PAYMENT UNIT NUMBER	PERCENT OF TOTAL SALE VALUE
01	2.1%
02	10.4%
03	8.7%
04	23.0%
05	20.6%
06	22.0%
07	10.0%
08	3.2%

4. If no cutting takes place, the 10% down payment will not be refunded.
5. Operations on the contract issued will terminate on 12/31/2025.

SALE STATISTICS

Volumes were calculated in cubic feet using the Michigan taper model. Cubic foot volume includes all wood inside bark for the product indicated. For display purposes, cubic feet were converted to cords and MBF using a simple conversion factor, e.g. 79 cubic feet per cord and 185 cubic feet per MBF. The cubic foot volumes are precise; the cords and MBF volumes are not. Cubic foot volume cannot be directly converted to cords or boards with precision.

SALE VOLUMES

The total estimated sale volume may not equal the sum of the species/products due to the nature of statistical calculations associated with double sampling methodology.

VOLUME			STATISTICAL RANGE IN CORDS	
TOTAL CUBIC FEET	TOTAL CORDS	PERCENT ERROR	MINIMUM	MAXIMUM
244,294	3,092	4.72%	2,946	3,238

VDU VOLUMES

A VDU is a Volume Determination Unit. Volumes and their associated statistics are calculated at the VDU level and summarized to the sale level. There is often a one to one relationship between a VDU and a Payment Unit, but not always, depending on the cruise design. Refer to the VDU TO PAYMENT UNIT table.

VDU	VOLUME			RANGE IN CORDS	
	TOTAL CUBIC FEET	TOTAL CORDS	PERCENT ERROR	MINIMUM	MAXIMUM
7	10,920	138	16.91%	115	162
9	5,902	75	19.34%	60	89
11	143,703	1,819	5.91%	1,712	1,926
14	34,634	438	10.98%	390	487
15	29,753	377	16.45%	315	439
TOTAL:	224,913	2,847		2,592	3,102

VDU TO PAYMENT UNIT

When a VDU is associated with more than one Payment Unit (PU), the VDU volumes are assigned to the PU based on acres of the VDU within the PU.

VDU	VDU ACRES	PU	PU ACRES
7	5.1	7	5.1
9	4.4	1	4.4
11	58.6	3	6.6
		4	17.9
		5	16.1
		6	17.2
		7	0.8
14	12.3	2	11.9
		3	0.4
15	12.6	7	8.0
		8	4.6
TOTAL:	93.0		93.0

DESCRIPTION OF TIMBER BY PAYMENT UNIT (PU)

PU	MARKET GROUP	PRODUCT	QUANTITY	UNIT	ACRES	ADVERTISE PRICE
1	Red Oak	Sawtimber	3.4	MBF	4.4	\$1,689.25
	Balsam Fir	Pulpwood	26	Cords		
	Mixed Aspen		34	Cords		
	<i>B. T. Aspen</i>		3	<i>Cords</i>		
	<i>Quaking Aspen</i>		31	<i>Cords</i>		
	Mixed Hardwood		2	Cords		
	<i>Red Maple</i>		2	<i>Cords</i>		
	Mixed Spruce		2	Cords		
	<i>White Spruce</i>	<i>Sawtimber</i>	0.6	<i>MBF</i>		
	<i>White Spruce</i>	<i>Pulpwood</i>	1	<i>Cords</i>		
	Red Oak		3	Cords		
	White Pine		2	Cords		
2	Paper Birch	Sawtimber	8.4	MBF	11.9	\$8,457.80
	Red Maple		6.2	MBF		
	Red Oak		1.8	MBF		
	Sugar Maple		2.6	MBF		
	Balsam Fir	Pulpwood	149	Cords		
	Mixed Aspen		183	Cords		
	<i>B. T. Aspen</i>	<i>Sawtimber</i>	3.6	<i>MBF</i>		
	<i>Quaking Aspen</i>		10.2	<i>MBF</i>		
	<i>B. T. Aspen</i>	<i>Pulpwood</i>	4	<i>Cords</i>		
	<i>Quaking Aspen</i>		152	<i>Cords</i>		
	Mixed Hardwood		46	Cords		
	<i>Paper Birch</i>		29	<i>Cords</i>		
	<i>Red Maple</i>		12	<i>Cords</i>		
	<i>Sugar Maple</i>		5	<i>Cords</i>		
	Red Oak		1	Cords		
	Red Pine		4	Cords		
	<i>Red Pine</i>	<i>Sawtimber</i>	1.7	<i>MBF</i>		
	<i>Red Pine</i>	<i>Pulpwood</i>	1	<i>Cords</i>		
White Pine		4	Cords			
3	Basswood	Sawtimber	8.4	MBF	7.0	\$7,124.60
	Beech		3.2	MBF		
	Paper Birch		1.4	MBF		
	Red Maple		7.1	MBF		
	Red Oak		1.0	MBF		
	Sugar Maple		10.7	MBF		
	Balsam Fir	Pulpwood	6	Cords		
	Mixed Aspen		13	Cords		
	<i>B. T. Aspen</i>	<i>Sawtimber</i>	0.4	<i>MBF</i>		
	<i>Quaking Aspen</i>		0.8	<i>MBF</i>		
	<i>B. T. Aspen</i>	<i>Pulpwood</i>	1	<i>Cords</i>		
	<i>Quaking Aspen</i>		9	<i>Cords</i>		
	Mixed Hardwood		132	Cords		
	<i>Basswood</i>		13	<i>Cords</i>		
	<i>Beech</i>		8	<i>Cords</i>		
	<i>Ironwood</i>		1	<i>Cords</i>		
	<i>Paper Birch</i>		3	<i>Cords</i>		
	<i>Red Maple</i>		33	<i>Cords</i>		
	<i>Sugar Maple</i>		74	<i>Cords</i>		
Red Oak		1	Cords			
4	Basswood	Sawtimber	22.7	MBF	17.9	\$18,649.70
	Beech		8.7	MBF		
	Paper Birch		3.0	MBF		
	Red Maple		18.8	MBF		
	Red Oak		2.6	MBF		

DESCRIPTION OF TIMBER BY PAYMENT UNIT (PU), CON'T

PU	MARKET GROUP	PRODUCT	QUANTITY	UNIT	ACRES	ADVERTISE PRICE
4 con't	Sugar Maple	Sawtimber	28.8	MBF		
	Balsam Fir	Pulpwood	4	Cords		
	Mixed Aspen		18	Cords		
	<i>B. T. Aspen</i>	<i>Sawtimber</i>	0.7	<i>MBF</i>		
	<i>Quaking Aspen</i>		1.2	<i>MBF</i>		
	<i>B. T. Aspen</i>	<i>Pulpwood</i>	3	<i>Cords</i>		
	<i>Quaking Aspen</i>		12	<i>Cords</i>		
	Mixed Hardwood		354	Cords		
	<i>Basswood</i>		36	<i>Cords</i>		
	<i>Beech</i>		21	<i>Cords</i>		
	<i>Ironwood</i>		3	<i>Cords</i>		
	<i>Paper Birch</i>		7	<i>Cords</i>		
	<i>Red Maple</i>		88	<i>Cords</i>		
	<i>Sugar Maple</i>		199	<i>Cords</i>		
	N. White Cedar		2	Cords		
	<i>N. White Cedar</i>	<i>Sawtimber</i>	0.4	<i>MBF</i>		
	<i>N. White Cedar</i>	<i>Pulpwood</i>	1	<i>Cords</i>		
	Red Oak		4	Cords		
5	Basswood	Sawtimber	20.4	MBF	16.1	\$16,805.70
	Beech		7.8	MBF		
	Paper Birch		2.7	MBF		
	Red Maple		16.9	MBF		
	Red Oak		2.3	MBF		
	Sugar Maple		25.9	MBF		
	Balsam Fir	Pulpwood	3	Cords		
	Mixed Aspen		17	Cords		
	<i>B. T. Aspen</i>	<i>Sawtimber</i>	0.6	<i>MBF</i>		
	<i>Quaking Aspen</i>		1.1	<i>MBF</i>		
	<i>B. T. Aspen</i>	<i>Pulpwood</i>	3	<i>Cords</i>		
	<i>Quaking Aspen</i>		11	<i>Cords</i>		
	Mixed Hardwood		320	Cords		
	<i>Basswood</i>		33	<i>Cords</i>		
	<i>Beech</i>		19	<i>Cords</i>		
	<i>Ironwood</i>		2	<i>Cords</i>		
	<i>Paper Birch</i>		6	<i>Cords</i>		
	<i>Red Maple</i>		80	<i>Cords</i>		
	<i>Sugar Maple</i>		180	<i>Cords</i>		
	N. White Cedar		1	Cords		
	<i>N. White Cedar</i>	<i>Sawtimber</i>	0.3	<i>MBF</i>		
Red Oak	Pulpwood	4	Cords			
6	Basswood	Sawtimber	21.8	MBF	17.2	\$17,943.60
	Beech		8.3	MBF		
	Paper Birch		2.8	MBF		
	Red Maple		18.0	MBF		
	Red Oak		2.5	MBF		
	Sugar Maple		27.7	MBF		
	Balsam Fir	Pulpwood	4	Cords		
	Mixed Aspen		17	Cords		
	<i>B. T. Aspen</i>	<i>Sawtimber</i>	0.6	<i>MBF</i>		
	<i>Quaking Aspen</i>		1.2	<i>MBF</i>		
	<i>B. T. Aspen</i>	<i>Pulpwood</i>	3	<i>Cords</i>		
	<i>Quaking Aspen</i>		11	<i>Cords</i>		
	Mixed Hardwood		342	Cords		
	<i>Basswood</i>		35	<i>Cords</i>		
	<i>Beech</i>		21	<i>Cords</i>		
	<i>Ironwood</i>		3	<i>Cords</i>		

DESCRIPTION OF TIMBER BY PAYMENT UNIT (PU), CON'T

PU	MARKET GROUP	PRODUCT	QUANTITY	UNIT	ACRES	ADVERTISE PRICE			
6 con't	<i>Paper Birch</i>	<i>Pulpwood</i>	6	<i>Cords</i>					
	<i>Red Maple</i>		85	<i>Cords</i>					
	<i>Sugar Maple</i>		192	<i>Cords</i>					
	N. White Cedar		1	<i>Cords</i>					
	<i>N. White Cedar</i>	<i>Sawtimber</i>	0.4	<i>MBF</i>					
	Red Oak	<i>Pulpwood</i>	4	<i>Cords</i>					
7	Basswood	<i>Sawtimber</i>	1.0	<i>MBF</i>	13.9	\$8,175.25			
	Beech		0.4	<i>MBF</i>					
	<i>Paper Birch</i>		0.1	<i>MBF</i>					
	<i>Red Maple</i>		9.9	<i>MBF</i>					
	<i>Red Oak</i>		2.2	<i>MBF</i>					
	<i>Sugar Maple</i>		1.3	<i>MBF</i>					
	Balsam Fir	<i>Pulpwood</i>	71	<i>Cords</i>					
	Mixed Aspen		204	<i>Cords</i>					
	<i>Quaking Aspen</i>	<i>Sawtimber</i>	8.9	<i>MBF</i>					
	<i>Balsam Poplar</i>	<i>Pulpwood</i>	6	<i>Cords</i>					
	<i>Quaking Aspen</i>		180	<i>Cords</i>					
	Mixed Hardwood		87	<i>Cords</i>					
	<i>American Elm</i>		1	<i>Cords</i>					
	<i>Basswood</i>		2	<i>Cords</i>					
	<i>Beech</i>		1	<i>Cords</i>					
	<i>Paper Birch</i>		5	<i>Cords</i>					
	<i>Red Maple</i>		55	<i>Cords</i>					
	<i>Sugar Maple</i>		20	<i>Cords</i>					
	<i>White Ash</i>		3	<i>Cords</i>					
	Mixed Spruce		4	<i>Cords</i>					
	<i>White Spruce</i>	<i>Sawtimber</i>	0.6	<i>MBF</i>					
	<i>White Spruce</i>	<i>Pulpwood</i>	3	<i>Cords</i>					
	Red Oak		7	<i>Cords</i>					
	8	Balsam Fir	<i>Pulpwood</i>	17			<i>Cords</i>	4.6	\$2,642.30
		Mixed Aspen		96			<i>Cords</i>		
		<i>Quaking Aspen</i>	<i>Sawtimber</i>	3.2			<i>MBF</i>		
<i>Balsam Poplar</i>		<i>Pulpwood</i>	3	<i>Cords</i>					
<i>Quaking Aspen</i>			87	<i>Cords</i>					
Mixed Hardwood			22	<i>Cords</i>					
<i>American Elm</i>			1	<i>Cords</i>					
<i>Red Maple</i>			15	<i>Cords</i>					
<i>Sugar Maple</i>			6	<i>Cords</i>					
Mixed Spruce			2	<i>Cords</i>					
<i>White Spruce</i>		<i>Sawtimber</i>	0.4	<i>MBF</i>					
<i>White Spruce</i>		<i>Pulpwood</i>	1	<i>Cords</i>					
TOTAL:			310.8	<i>MBF</i>					
TOTAL:			2,213	<i>Cords</i>					

Sale Specific Conditions & Requirements

Sale Name: Long Haul Mix

Sale Number: 54-007-21 Seq#: 2

1 - Sale Area

1.2 - Boundaries

1.2.1 - Painted boundaries (9/19)

The sale boundary and Payment Unit boundaries are marked and identified by red and yellow paint. Exterior sale boundary lines against state are marked with red paint. Interior Payment Unit boundaries are marked with yellow paint. Retention patches are marked with red paint; no harvesting activities may occur within these areas. The painted boundary line trees are not Included Timber and are to be protected unless marked with orange paint. Yellow painted trees designating an interior Payment Unit boundary are only to be cut when all surrounding Payment Units have been paid.

2 - Timber Specifications

2.1 - Included Timber

2.1.1 - Clearcut unit(s) with unmerchantable trees (6/14)

Within Payment Unit(s) 1-5 and 8, cut all trees that are two (2) inches or more at DBH with the following exceptions:

- Within Payment Units 1, 2, and 8 do not cut trees marked with green paint about and below stump height,
- Do not cut any hemlock.

These are special protection trees identified in accordance with condition 3.4.2, within clearcutting unit boundaries, are not Included Timber and are to be protected.

2.1.2 - Clearcut unit(s) w/o unmerchantable trees (8/11)

Within Payment Unit(s) 6 and 7, cut all trees which meet minimum piece specifications in 2.2 Utilization with the following exceptions:

- Do not cut any hemlock,
- Do not cut any trees marked with green paint above and below stump height,
- Within Payment Unit 6 do not cut red and white pine with a DBH greater than 18”.

2.2 - Utilization

2.2.2 - Chipping required (2/18)

Payment Units 3-5 must be chip harvested to facilitate subsequent planting operations. The Purchaser has the option to produce sawlogs or pulpwood bolts, but the remaining portion of the trees must be chipped and hauled. Products may be produced as roundwood and forwarded to decking areas in final product length, but the tops must be left intact and skidded to the landing for chipping to minimize the amount of residual slash. If market conditions limit the practicality of chipping, a written chipping exemption is possible only in the case the sale administrator determines that operational modifications will not inhibit future planting operations. Conditions that satisfy this modification require:

- trees greater than 4" DBH must be cut to a 2" top or smaller;
- sub-merchantable trees and hardwood limbs 4" or greater where they attach to the stem, must be cut/reduced to 4-foot lengths or smaller;
- slash must be evenly dispersed throughout the Payment Unit and not be more than 2-feet high.

The requirement to retain approximately 1/6 to 1/3 of tree tops and limbs less than four inches in diameter is still applicable (G. C. & R. 2.2).

2.2.3 - Stump heights (4/07)

Stump heights within Payment Units 3-5 shall not exceed 6 inches for all trees. This is to facilitate planting operations.

3 - Payments

3.4 - Damaged Timber

3.4.2 - Special Protection Trees (4/14)

The Purchaser shall not cut live or dead special protection trees within cutting units or clearings. Special protection trees are marked with green paint above and below stump height in Payment Units 1, 2, and 6-8, red and white pine 18" or larger in diameter in Payment Unit 6, and hemlock in all Payment Units. If the Purchaser's operations have cut or damaged special

protection trees through carelessness, the Purchaser shall pay \$200 as fixed, agreed and liquidated damages for each special protection tree cut or damaged. Such payment does not constitute ownership of the undesignated timber.

4 - Transportation

4.1 - Construction

4.1.3 - Slash and earthen piles (8/04)

Piles or windrows of earth along roads and landings that have been widened or constructed shall be leveled. Slash from road maintenance or construction, including stumps, shall be chipped, utilized, or otherwise removed from the sale.

4.1.4 - Timber removed for construction (12/09)

Trees cut or damaged in the process of pre-approved road, landing or skid trail construction will be decked in an area separate from other Designated Timber and not removed until measured by the sale administrator. Payment will be made at the specified Purchase Unit Price. If not included in the contract, the Purchaser will pay for the species or product at the average sold price for Michigan's northern lower peninsula.

4.1.6 - Road construction (1/09)

Construction of new roads or improvements of existing roads shall be done in such a way as to minimize the environmental and visual impacts. Merchantable trees shall be cut and utilized unless otherwise directed. Non-merchantable trees shall be severed and laid flat on the ground. Slash shall be chipped, utilized, or otherwise removed from the sale. Stumps shall be set upright, not left on edge, and be moved at least 10 feet away from the road edge. Disturbed soil shall be feathered into the woods and not left in berms or windrows.

4.1.7 - Road closure (10/11)

All new roads built into the sale must be blocked to vehicle traffic upon completion of the sale. Overgrown roads that are reopened shall be considered new roads. In general, this will require constructing a four (4') foot high berm of stumps and logs covered with earth. These roads must be rendered impassable to cars and trucks. Stumps from road building and landing construction may be reserved to block any newly constructed roads upon completion of the sale. Contact the sale administrator for specific details of design and placement.

4.2 - Maintenance

4.2.2 - Fill material (4/07)

To maintain roads, fill material may be needed in areas where "holes" exist or may be expected to develop. This fill material should be placed before trucking begins. The fill material must be inorganic material such as cobbles or crushed rock and must not contain clay.

4.2.5 - Two wheel drive condition (2/04)

All existing trail roads on and adjacent to the sale area must be passable by two-wheel drive traffic for the duration of the sale.

5 - Operations

5.1 - Notification

5.1.1 - Pre-sale conference (10/16)

A pre-sale conference between the Purchaser and sale administrator is required prior to beginning any operations to determine landing and road locations. The Unit Manager or his/her representative must be contacted in advance to schedule the conference.

5.1.4 - Post-sale conference (10/16)

A post-sale conference on site between the Purchaser and sale administrator is required prior to the completion of active logging operations to determine clean-up and repair of landings, road edges, and the fulfillment of other contract specifications.

5.2 - Conduct of Operations

5.2.1 - Slash

5.2.1.10 - No slash in openings (5/10)

No brush or logging debris is to be left in the maintained wildlife opening which is indicated by G0 on the Timber Sale Map. Any damage to the opening shall be repaired according to specifications of the Unit Manager or his/her

representative.

5.2.1.11 - Slash for reforestation (3/21)

To facilitate reforestation, the Sale Area or Payment Units 3-5 shall be left with slash evenly distributed and stumps cut low to the ground. These Payment Units must either be chipped or have slash treated in a manner consistent with this contract. Areas which the Unit Manager or his or her representative deem unsatisfactory will be assessed liquidated damages at the rate of \$250 an acre to offset the remediation of these areas.

5.2.2 - Hazard Trees/Snags

5.2.2.1 - Den trees (10/16)

Obvious hollow and/or den trees shall be protected and left standing unless they are a safety hazard.

5.2.3 - Operating Restrictions

5.2.3.1 - Operating restrictions (9/11)

Within Payment Unit(s) 2-8 cutting, skidding, and hauling are not permitted during spring. This restriction is because access crosses wet swales.

5.2.3.5 - Oak wilt restriction (1/18)

Within the Sale Area, unless changed by written agreement, cutting, skidding, hauling within the sale and brushing of access roads to the sale are not permitted during the period of April 15 to July 15. Operations may be allowed if specific steps are taken to prevent damaging uncut oak during the high risk period. Those steps may include completing all road brushing before April 15th and clearing a tree-length buffer along uncut oak cover before April 15th. This is necessary to reduce the spread of oak wilt. For more information, contact the Unit Manager or his/her representative.

5.2.3.11 - Coppice regeneration protection (4/10)

Timber harvesting in Payment Units 1, 2, and 6-8 must be completed before significant deciduous sprouting occurs in those Payment Units to minimize damage to the new regeneration. Any post-harvest operations, such as chipping, must be completed before sprouting of regeneration occurs. If it is anticipated that chipping will be delayed, then tops shall be carried to one central location or left unchipped. Remove all severed timber products to the landing within 30 calendar days of severing or cutting stems. The Unit Manager or his/her representative may cease such operations if sprouting occurs before the operation is complete. If the Purchaser damages sprouting regeneration due to slow operations, liquidated damages will be assessed at \$200 per acre for all acreage within the specified portion of the Sale Area that was damaged.

5.2.4 - Dead and Down Creation

5.2.4.7 - Dead and down creation: hare, grouse, deer and other species (5/15)

To improve horizontal cover habitat for snowshoe hare, grouse, deer, and other species, the Purchaser is to push over trees marked in orange paint. These trees should be tipped over with the root ball still attached so the base of the tree is suspended off the ground. The crown of the fallen tree should be at or near ground level after it is pushed over. If it is impossible or impractical to push these trees over, they may be severed or partially severed at the stump.

Whenever possible the stem of the tree should rest above ground level. Within Payment Units 1, 2, 6, and 7 the Purchaser shall push over trees designated with orange painted "R"s in the same fashion as orange marked trees above. The Purchaser shall pile the tops of several surrounding trees over orange marked "R" trees to create cover for rabbits and other species.

5.2.17 - Timber Mats and Interlocking Composite Mats (10/20)

Some roads or skid trails may require extra protection such as that afforded by timber mats, interlocking composite mats, or another approved system. Approximately 270 feet of road or trail will need extra protection at locations shown on the Timber Sale Map. If available, mats may be borrowed from the DNR. A Timber Sale Contract Supplement will be used to document the Purchaser's use of the DNR's mats. Contact the sale administrator regarding availability and pick-up. Timber mats are available from various field offices. Composite mats are only available from the Grayling field office and the Marquette ICC. The Purchaser is responsible for picking up and hauling the mats to and from the site. The composite mats will require DNR staff onsite for installation and removal. Contact the sale administrator to schedule at least 30 days before desired install/removal date. All mats must be cleaned prior to drop off. This may include, but is not limited to, power washing and brushing to remove mud and debris. A charge of \$700.00 per timber mat and \$2,000.00 per composite mat will be assessed for all damaged or non-returned mats. Damage for the crane/timber mats is defined as three or more broken cants. Damage

for the composite mats is defined as cracked or broken mats.

5.2.22 - Operating Caution

5.2.22.1 - Operating caution (6/11)

It is recommended, but not required, that within Payment Unit(s) 2-7, cutting, skidding, and hauling occur during dry or frozen conditions. The reason for the recommendation is because areas of wet or fragile soils within these Payment Units.

5.2.32 - Decking/landing restoration (9/13)

All decking and landing areas must have the surface area restored to a condition equal to or better than before. This is to ensure the proper regeneration of the stand. Wood debris, chips, and "cookies" from trimmings must be removed or scattered away from landing and loading areas and may not be windrowed on the edge.

5.2.38 - No decking against live trees (2/04)

Cut products may not be decked against unmarked or designated leave trees.

5.4 - Soil Protection

5.4.1 - Rutting restriction, general (7/16)

Operations are to cease immediately if equipment and weather conditions result in rutting of roads and/or skid trails which is 12 inches or greater in depth and 50 feet in length. The Unit Manager or his/her representative may restrict hauling and/or skidding if ruts exceed the specified depth. With the Unit Manager or his/her representative's approval, the Purchaser may return to the area when the risk of rutting has decreased.

5.8 - Protection of Endangered Species

5.8.5 - Protection of raptor nests (3/13)

All trees with raptor nests will be protected if found during harvesting operations. Notification will be made to the Unit Manager or his/her representative who will notify the Wildlife Biologist so an on-site evaluation and recommendation can be made, if necessary.



Sale Number	Year
54 - 006	21

TIMBER SALE MAP

This information provided by authority of Part 525, 1994 PA 451, as amended.

Forest Management Unit Atlanta Management Unit		County Montmorency	Mapped By Natzke	Date 04/11/2021	Page 1	of 1
Township 32N	Range 03E	Section(s) and Subdivision(s) Sec. 19 SESW, SWSE; Sec. 30 E2NW, NWNE, S2NE, N2SW, N2SE		Scale 1:15,840		

Cover Type				Density			
A = Aspen	H = Hemlock	N = Marsh	U = Upland Brush	0 = Non Stocked	5 = Pole Timber Medium		
B = Paper Birch	J = Jack Pine	O = Oak	UM = Upland Mixed	1 = Seedling Sapling Poor	6 = Pole Timber Well		
C = Cedar	L = Lowland Brush	P = Lowland Poplar	V = Bog or Marsh	2 = Seedling Sapling Medium	7 = Saw Timber Poor		
D = Treed Bog	LM = Lowland Mixed	Q = Mixed Swamp Conifer	W = White Pine	3 = Seedling Sapling Well	8 = Saw Timber Medium		
E = Swamp Hdwoods	M = Mpl, Bch, Brch	R = Red Pine	X = Non Stocked	4 = Pole Timber Poor	9 = Saw Timber Well		
F = Spruce Fir	MC = Mixed Conifer	S = Black Spruce	Z = Water				
G = Grass	MD = Mixed Deciduous	T = Tamarack					

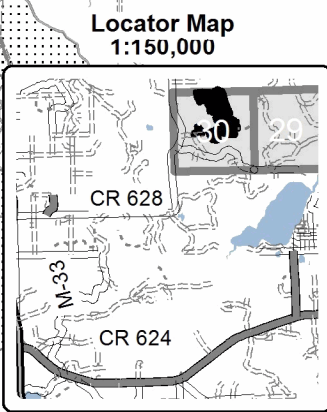
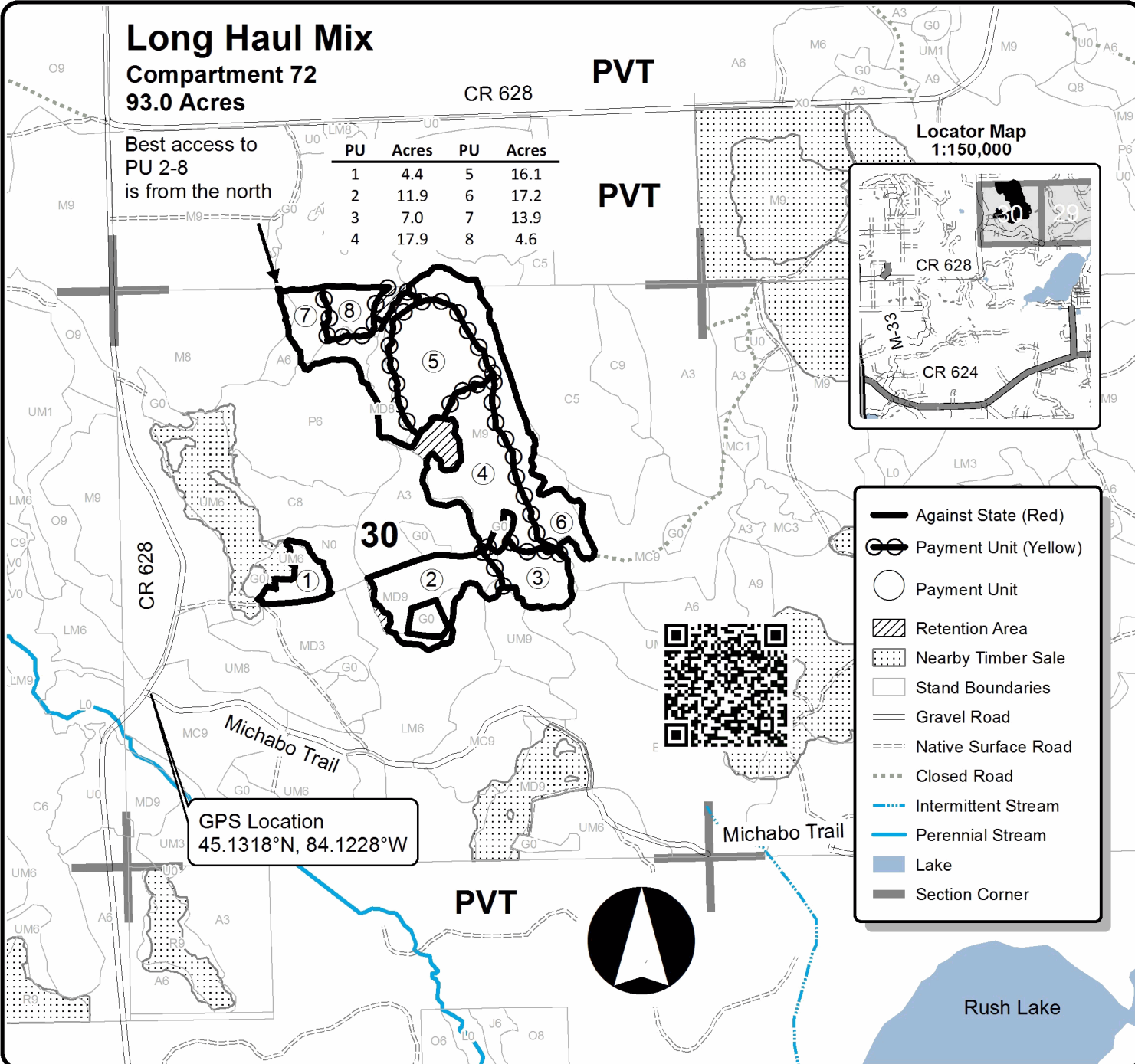

- Against State (Red)
- Payment Unit (Yellow)
- Payment Unit
- Retention Area
- Nearby Timber Sale
- Stand Boundaries
- Gravel Road
- Native Surface Road
- Closed Road
- Intermittent Stream
- Perennial Stream
- Lake
- Section Corner

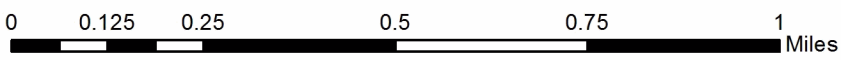

TIMBER SALE INFORMATION

Finger Point Hardwood (54-030-21)
T29N, R03E, SEC. 20; T29N, R03E, SEC. 29.
Montmorency County (Advertised Price \$44,694.20)

SALE NOTE: All units of volume listed for this sale were estimated using the Inventory Manager computer program and the new Michigan taper model.

A timber sale contract for this lump sum, sealed bid timber sale will be awarded to the responsible bidder offering the highest sealed bid price. All units of volume listed below were estimated using the Inventory Manager computer program and the new Michigan taper model. Bids must be at or above the following advertised price for each product and species:

<u>PRODUCTS & SPECIES</u>	<u>ESTIMATED UNITS*</u>	<u>ADVERTISED PRICE</u>
Sawtimber		
B. T. Aspen	23.2 MBF	\$ 101.00 / MBF
Basswood	78.5 MBF	\$ 53.00 / MBF
Beech	36.9 MBF	\$ 45.00 / MBF
Red Oak	40.2 MBF	\$ 168.00 / MBF
Sugar Maple	31.0 MBF	\$ 396.00 / MBF
Pulpwood		
B. T. Aspen	27 Cords	\$ 25.60 / Cord
Mixed Hardwood	704 Cords	\$ 21.55 / Cord
Red Oak	45 Cords	\$ 36.40 / Cord

* The total volume is statistically estimated within plus (+) or minus (-) 6.03 percent. There are an estimated 1,328 cords on this timber sale, plus or minus 80 cords at the 95% confidence level. The estimated units are final and not subject to adjustment. Prospective bidders are urged to examine this timber and to make their own estimates of quantity and quality.

BOND AND PAYMENT SCHEDULE:

1. A bond in the amount of \$2,235.00 to insure faithful performance of the conditions of the contract will be deposited by the successful bidder within 21 days of the sale award.
2. Cutting in any sale or unit without the required advance payment would be considered a trespass.
3. Total payment must be paid in advance or according to the following schedule :
 - (a) Ten percent (10%) of the sale value must be paid within 21 days of the sale award.
 - (b) The 10% down payment will be credited towards the first unit cut.
 - (c) Payment for each of the following units must be made before cutting begins in that unit:

PAYMENT UNIT NUMBER	PERCENT OF TOTAL SALE VALUE
01	23.2%
02	19.2%
03	24.6%
04	33.0%
4. If no cutting takes place, the 10% down payment will not be refunded.
5. Operations on the contract issued will terminate on 12/31/2024.

SALE STATISTICS

Volumes were calculated in cubic feet using the Michigan taper model. Cubic foot volume includes all wood inside bark for the product indicated. For display purposes, cubic feet were converted to cords and MBF using a simple conversion factor, e.g. 79 cubic feet per cord and 185 cubic feet per MBF. The cubic foot volumes are precise; the cords and MBF volumes are not. Cubic foot volume cannot be directly converted to cords or boards with precision.

SALE VOLUMES

The total estimated sale volume may not equal the sum of the species/products due to the nature of statistical calculations associated with double sampling methodology.

VOLUME		STATISTICAL RANGE IN CORDS		
TOTAL CUBIC FEET	TOTAL CORDS	PERCENT ERROR	MINIMUM	MAXIMUM
104,924	1,328	6.03%	1,248	1,408

VDU VOLUMES

A VDU is a Volume Determination Unit. Volumes and their associated statistics are calculated at the VDU level and summarized to the sale level. There is often a one to one relationship between a VDU and a Payment Unit, but not always, depending on the cruise design. Refer to the VDU TO PAYMENT UNIT table.

VDU	VOLUME		PERCENT ERROR	RANGE IN CORDS	
	TOTAL CUBIC FEET	TOTAL CORDS		MINIMUM	MAXIMUM
28	64,684	819	7.84%	755	883
65	29,616	375	8.62%	343	407
TOTAL:	94,300	1,194		1,097	1,290

VDU TO PAYMENT UNIT

When a VDU is associated with more than one Payment Unit (PU), the VDU volumes are assigned to the PU based on acres of the VDU within the PU.

VDU	VDU ACRES	PU	PU ACRES
28	71.6	1	24.8
		2	20.5
		3	26.3
65	23.3	4	23.3
TOTAL:	94.9		94.9

DESCRIPTION OF TIMBER BY PAYMENT UNIT (PU)

PU	MARKET GROUP	PRODUCT	QUANTITY	UNIT	ACRES	ADVERTISE PRICE				
1	Basswood	Sawtimber	22.4	MBF	24.8	\$10,357.40				
	Beech		6.8	MBF						
	Red Oak		3.4	MBF						
	Sugar Maple		10.0	MBF						
	Mixed Hardwood		Pulpwood	196			Cords			
	<i>Basswood</i>			61			<i>Cords</i>			
	<i>Beech</i>			59			<i>Cords</i>			
	<i>Ironwood</i>			6			<i>Cords</i>			
	<i>Sugar Maple</i>			70			<i>Cords</i>			
	Red Oak			3			Cords			
2	Basswood	Sawtimber	18.6	MBF	20.5	\$8,580.45				
	Beech		5.6	MBF						
	Red Oak		2.8	MBF						
	Sugar Maple		8.3	MBF						
	Mixed Hardwood		Pulpwood	163			Cords			
	<i>Basswood</i>			51			<i>Cords</i>			
	<i>Beech</i>			49			<i>Cords</i>			
	<i>Ironwood</i>			5			<i>Cords</i>			
	<i>Sugar Maple</i>			58			<i>Cords</i>			
	Red Oak			2			Cords			
3	Basswood	Sawtimber	23.8	MBF	26.3	\$10,979.40				
	Beech		7.2	MBF						
	Red Oak		3.6	MBF						
	Sugar Maple		10.6	MBF						
	Mixed Hardwood		Pulpwood	208			Cords			
	<i>Basswood</i>			65			<i>Cords</i>			
	<i>Beech</i>			62			<i>Cords</i>			
	<i>Ironwood</i>			6			<i>Cords</i>			
	<i>Sugar Maple</i>			75			<i>Cords</i>			
	Red Oak			3			Cords			
4	B. T. Aspen	Sawtimber	23.2	MBF	23.3	\$14,776.95				
	Basswood		13.7	MBF						
	Beech		17.3	MBF						
	Red Oak		30.4	MBF						
	Sugar Maple		2.1	MBF						
	B. T. Aspen		Pulpwood	27			Cords			
	Mixed Hardwood			137			Cords			
	<i>Basswood</i>			35			<i>Cords</i>			
	<i>Beech</i>			83			<i>Cords</i>			
	<i>Ironwood</i>			7			<i>Cords</i>			
	<i>Sugar Maple</i>			12			<i>Cords</i>			
	Red Oak			37			Cords			
	TOTAL:			209.8			MBF			
	TOTAL:			776			Cords			

Sale Specific Conditions & Requirements

Sale Name: Finger Point Hardwood

Sale Number: 54-030-21 Seq#: 2

1 - Sale Area

1.2 - Boundaries

1.2.1 - Painted boundaries (9/19)

The sale boundary and Payment Unit boundaries are marked and identified by red and yellow paint. Exterior sale boundary lines against state are marked with red paint. Interior Payment Unit boundaries are marked with yellow paint as shown on the Timber Sale Map. The painted boundary line trees are not Included Timber and are to be protected. Do not cut trees marked with only yellow paint. Yellow and orange painted trees designating an interior Payment Unit boundary are only to be cut when all surrounding Payment Units have been paid.

2 - Timber Specifications

2.1 - Included Timber

2.1.3 - Cut tree marked unit(s) (12/08)

Within Payment Unit(s) 1-4, all trees are designated for cutting when marked with orange paint above and below stump height, regardless of merchantability. In addition, cut all ash and beech, except for those marked with green paint.

2.2 - Utilization

2.2.6 - Roundwood operation required (3/21)

The skidding of whole trees or tree segments with limbs attached is prohibited within all Payment Units. All products must be produced as roundwood and forwarded to existing roads or landing areas in final product length.

3 - Payments

3.4 - Damaged Timber

3.4.1 - Damaged timber (7/16)

General Condition and Requirement 3.4 Damaged Timber, defines liquidated damages for undesignated live merchantable trees which are cut or injured.

No damage is acceptable to undesignated live merchantable trees. Within the Sale Area, if more than 5% of trees (> 4.5" DBH) within a specified area of the sale are damaged, liquidated damages will be assessed for all trees damaged. Rates will be in accordance with General Condition and Requirement 3.4 Damaged Timber.

4 - Transportation

4.1 - Construction

4.1.3 - Slash and earthen piles (8/04)

Piles or windrows of earth along roads and landings that have been widened or constructed shall be leveled. Slash from road maintenance or construction, including stumps, shall be chipped, utilized, or otherwise removed from the sale.

4.1.6 - Road construction (1/09)

Construction or improvements of existing roads shall be done in such a way as to minimize the environmental and visual impacts. Merchantable trees shall be cut and utilized unless otherwise directed. Non-merchantable trees shall be severed and laid flat on the ground. Slash shall be scattered, and not left in windrows and kept a minimum of 10 feet back from the road edge. Stumps shall be set upright, not left on edge, and be moved at least 10 feet away from the road edge. Disturbed soil shall be feathered into the woods and not left in berms or windrows.

4.1.7 - Road closure (10/11)

All new roads built into the sale must be blocked to vehicle traffic upon completion of the sale. Overgrown roads that are reopened shall be considered new roads. In general, this will require constructing a four (4') foot high berm of stumps and logs covered with earth. Stumps and brush must be placed along the remainder of the trail. These roads must be rendered impassable to cars and trucks. Contact the sale administrator for specific details of design and placement.

4.2 - Maintenance

4.2.5 - Two wheel drive condition (2/04)

All existing trail roads on and adjacent to the sale area must be passable by two-wheel drive traffic for the duration of the sale.

4.4 - Access

4.4.3 - Access gate (12/08)

The access gate to Payment Units 1-3 is shown on the Timber Sale Map. It must be locked at the completion of each day unless otherwise approved by the Unit Manager or his/her representative. Contact the well operating company or the Atlanta office within 7 days of beginning operations to obtain a key.

5 - Operations

5.1 - Notification

5.1.1 - Pre-sale conference (10/16)

A pre-sale conference between the Purchaser and sale administrator is required prior to beginning any operations to determine landing and road locations. The Unit Manager or his/her representative must be contacted at least 5 days in advance to schedule the conference.

5.1.3 - Well heads and natural gas pipelines (11/15)

The Purchaser is responsible for contacting the following party 30 days prior to operating equipment in the vicinity of well heads or natural gas pipelines.

Merit Energy Company
13727 Noel Road, Suite 1200, Tower 2
Dallas, Texas 75240

Phone: 972-701-8377

Fax: 972-960-1252

5.1.4 - Post-sale conference (10/16)

A post-sale conference on site between the Purchaser and sale administrator is required 5 days prior to the completion of active logging operations to determine clean-up and repair of landings, road edges, and the fulfillment of other contract specifications.

5.2 - Conduct of Operations

5.2.2 - Hazard Trees/Snags

5.2.2.1 - Den trees (10/16)

Obvious hollow and/or den trees shall be protected and left standing unless they are a safety hazard.

5.2.3 - Operating Restrictions

5.2.3.3 - Bark slippage restriction (3/09)

Within Payment Unit(s) 1-4, unless changed by written agreement, cutting and skidding are not permitted during the period of April 15 to July 15. This restriction is because of bark slippage.

5.2.3.4 - Oak wilt restriction, no exceptions (1/18)

Within Payment Unit(s) 1-4 cutting, skidding, hauling within the sale and brushing of access roads to the sale are not permitted during the period of April 15 to July 15. No exceptions will be granted. This is necessary to reduce the spread of oak wilt.

5.2.32 - Decking/landing restoration (9/13)

All decking and landing areas must have the surface area restored to a condition equal to or better than before. This is to ensure the proper regeneration of the stand. Wood debris, chips, and "cookies" from trimmings must be removed or scattered away from landing and loading areas and may not be windrowed on the edge.

5.2.38 - No decking against live trees (2/04)

Cut products may not be decked against unmarked or designated leave trees.

5.4 - Soil Protection

5.4.1 - Rutting restriction, general (7/16)

Operations are to cease immediately if equipment and weather conditions result in rutting of roads and/or skid trails which is 12 inches or greater in depth and 50 feet in length. The Unit Manager or his/her representative may restrict hauling and/or skidding if ruts exceed the specified depth. With the Unit Manager or his/her representative's approval, the Purchaser may return to the area when the risk of rutting has decreased.

5.4.2 - Skid trails (2/04)

Skid trails up and down slopes should be avoided. If however this is unavoidable, these trails will be left in a non-erodible condition using water bars, logs, and slash. Placing of slash on these skid trails while logging is ongoing may alleviate need for any further action. At the direction of the sale administrator, seed, fertilizer, and mulch may also be required.

5.8 - Protection of Endangered Species

5.8.5 - Protection of raptor nests (3/13)

All trees with raptor nests will be protected if found during harvesting operations. Notification will be made to the Unit Manager or his/her representative who will notify the Wildlife Biologist so an on-site evaluation and recommendation can be made, if necessary.

7 - Other Conditions

7.5 - Loss

7.5.1 - Deteriorating timber (7/09)

The sale area has received damage from beech bark disease and the emerald ash borer. The Purchaser should harvest the wood as soon as possible. The Department of Natural Resources is held free of responsibility of any further damage or deterioration due to delay in harvesting.



Sale Number	Year
54 - 030	21

TIMBER SALE MAP

This information provided by authority of Part 525, 1994 PA 451, as amended.

Forest Management Unit Atlanta Management Unit	County Montmorency	Mapped By Coy	Date 09/14/2021	Page 1	of 1
Cruised By UMLMWS					

Township 29N	Range 03E	Section(s) and Subdivision(s) 20-SENW,SWNE,SW,W1/2SE 29-E1/2NE	Scale 1:15,840
-----------------	--------------	---	-------------------

Cover Type

A = Aspen	H = Hemlock	N = Marsh	U = Upland Brush
B = Paper Birch	J = Jack Pine	O = Oak	UM = Upland Mixed
C = Cedar	L = Lowland Brush	P = Lowland Poplar	V = Bog or Marsh
D = Treed Bog	LM = Lowland Mixed	Q = Mixed Swamp Conifer	W = White Pine
E = Swamp Hdwoods	M = Mpl, Bch, Brch	R = Red Pine	X = Non Stocked
F = Spruce Fir	MC = Mixed Conifer	S = Black Spruce	Z = Water
G = Grass	MD = Mixed Deciduous	T = Tamarack	

Density

0 = Non Stocked	5 = Pole Timber Medium
1 = Seedling Sapling Poor	6 = Pole Timber Well
2 = Seedling Sapling Medium	7 = Saw Timber Poor
3 = Seedling Sapling Well	8 = Saw Timber Medium
4 = Pole Timber Poor	9 = Saw Timber Well

PU Acres

1	24.8
2	20.5
3	26.3
4	23.3

Finger Point Hardwood

Compartment 16

94.9 Acres

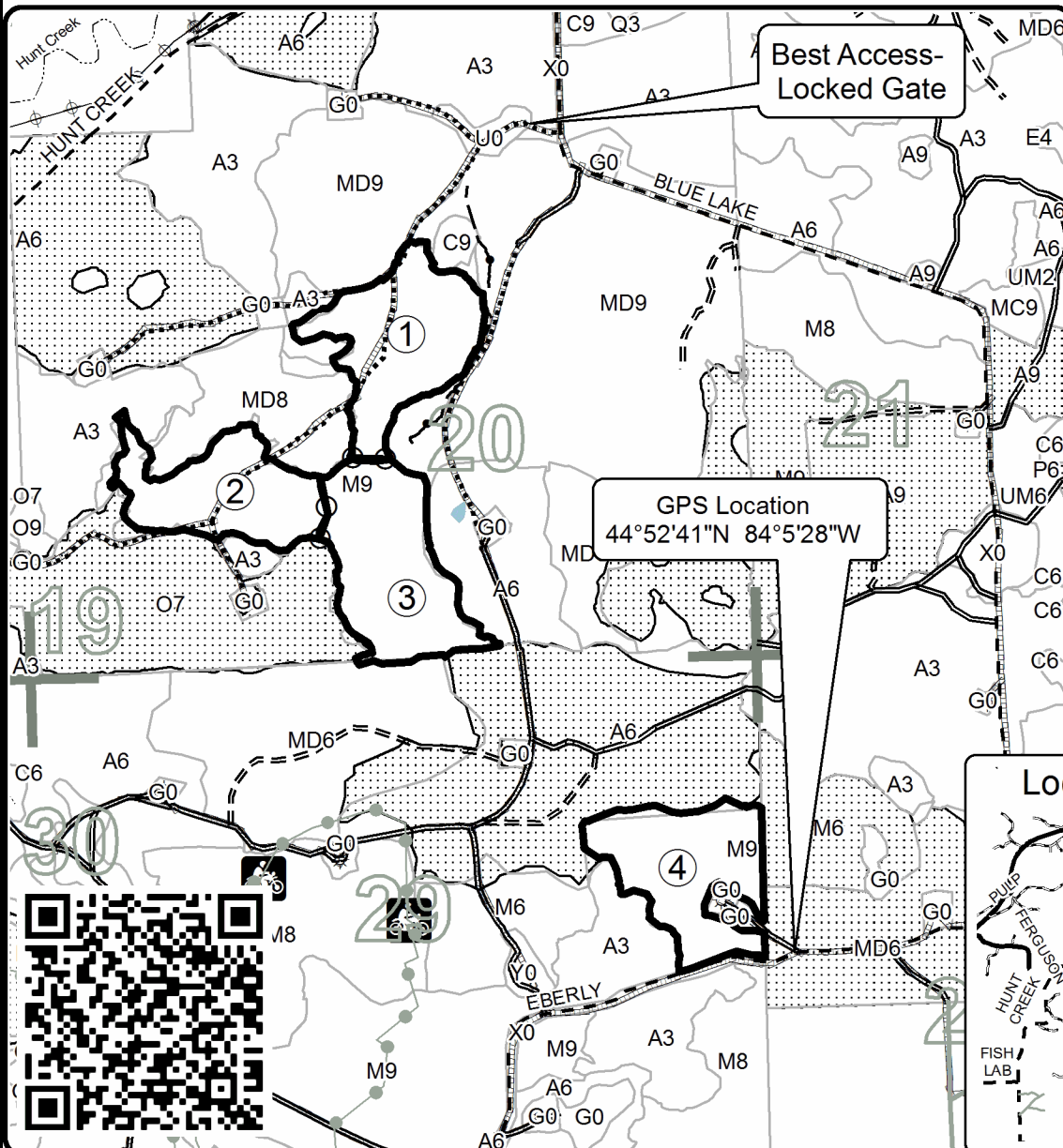
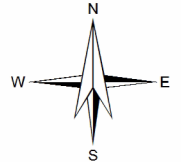

Legend

- Against State (Red)
- Payment Unit (Yellow)
- Payment Unit
- Nearby Timber Sales
- Stand Boundaries
- Lakes
- Gas Well
- Recreational Trail
- Secondary Road
- Forest Access Route
- Gravel Road
- Private Road
- Pipeline
- Powerline
- Temporary Access
- Drain
- Perennial River
- Section Corner

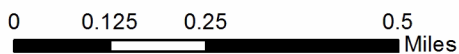
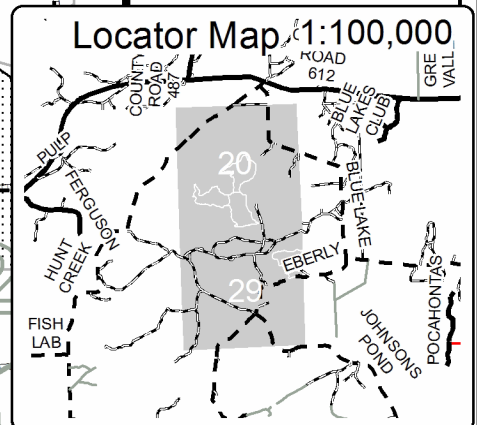

Mucho Michabo Mix (54-006-21)
T32N, R03E, SEC. 29; T32N, R03E, SEC. 30; Montmorency COUNTY

In response to the notice of sale to be held 10:00 a.m. (local time) on March 22, 2022, I am hereby submitting my sealed bid (firm offer) for the following forest products to be cut. Bids for individual species must be at or above the advertised price. All non-responsive bid forms may be rejected.

<u>PRODUCTS & SPECIES</u>	<u>ESTIMATED VOLUME*</u>	<u>ADVERTISED PRICE</u>	<u>BID PRICE/UNIT</u>
Sawtimber			
Red Maple	8.5 MBF	\$ 48.00/MBF	\$ _____
Red Oak	28.4 MBF	\$ 168.00/MBF	\$ _____
Red Pine	43.2 MBF	\$ 106.00/MBF	\$ _____
White Pine	27.8 MBF	\$ 37.00/MBF	\$ _____
Pulpwood			
Balsam Fir	118 Cords	\$ 16.60/Cord	\$ _____
Jack Pine	5 Cords	\$ 11.00/Cord	\$ _____
Mixed Aspen	1,890 Cords	\$ 25.60/Cord	\$ _____
Mixed Hardwood	298 Cords	\$ 21.55/Cord	\$ _____
Mixed Oak	114 Cords	\$ 36.40/Cord	\$ _____
Mixed Spruce	17 Cords	\$ 7.75/Cord	\$ _____
Red Pine	46 Cords	\$ 28.30/Cord	\$ _____
White Pine	130 Cords	\$ 12.45/Cord	\$ _____

*The volumes are statistically estimated within plus (+) or minus (-) 5.05 percent at 95% confidence level. These estimated volumes are final and not subject to adjustment. Prospective bidders are urged to examine this timber and to make their own estimates of quantity and quality.

I understand that any or all bids may be rejected. All bids must be signed and all bid items must be bid or the bid form may be rejected. I also understand that consideration and awarding a contract will be based upon my past performance and ability to complete the contract based upon equipment and staffing subject to my control.

FEDERAL ID: ____ - ____ - ____ or SOCIAL SECURITY NUMBER: ____ - ____ - ____

Company or individual bidding: _____

Company representative's name: _____

Address: _____

City: _____ State: _____ Zip: _____

IF AVAILABLE, PLEASE PLACE THE PERSONALIZED LABEL FROM YOUR PROSPECTUS IN THE ABOVE BOX.

Individual or company representative's signature: _____ Date: _____

Phone number : _____ Email (optional): _____

THE WINNING BIDDER MUST COMPLETE THE VERIFICATION OF WORKER'S DISABILITY COMPENSATION ACT COMPLIANCE (ON REVERSE SIDE IF DOUBLE SIDED) WITHIN 21 DAYS OF SALE AWARD DATE



FOR DEPARTMENT USE ONLY
Sale Number (XX - XXX - XX - XX)
Forest Management Unit:

TIMBER SALE VERIFICATION OF WORKER'S DISABILITY COMPENSATION ACT COMPLIANCE

*As required by Act 317, P.A. 1969 (Worker's Compensation) and
Part 5 of Act 451 of 1994, as amended.*

VERIFICATION OF WORKER'S DISABILITY COMPENSATION ACT COMPLIANCE

- This verification must be completed and submitted within 21 days of contract award and prior to the issuance of the timber sale contract.
- In addition, if boxes 2B or 2C are checked, then Notice of Exclusion or Certificate of Insurance must be submitted within twenty-one (21) days of the contract award and prior to the issuance of the timber sale contract.
- All information must be typed or printed except for written signatures.

Please Check Appropriate Categories:

1. My business is organized as (you **must** check one of the boxes below):
 - A. Sole Proprietorship (individual)
 - B. Partnership
 - C. Corporation

2. You **must** check one of the boxes below:
 - A. I certify my business is a sole proprietorship and it has no employees but the sole proprietor. I am not subject to the Worker's Compensation Laws.
 - B. I certify my business has satisfied its obligation to the Worker's Compensation Act through the use of an approved Notice of Exclusion (BWC-337, Rev. 5/96). I will provide a copy of the Notice of Exclusion within 21 days of the contract award. (For questions or a copy of the BWC-337, please call the Worker's Compensation Bureau at 517-322-1195).
 - C. I certify my business has a Worker's Compensation Policy. I will provide an original Certificate of Insurance within twenty-one (21) days of the contract award.

3. If you have checked item 2(A) or 2(B), you **must** indicate the number of **both** full-time and part-time employees, other than yourself, including family members and active partners (if none, you must enter "0").

_____ Full-time Employees

_____ Part-time Employees

Name of Business		Federal ID (or) Social Security No.	
Address		Telephone ()	
City	State	ZIP	

I hereby certify that the above information is true and correct. I agree to notify the Michigan DNR of any changes that occur in factors affecting my coverage during any of my present and future operations.

Signature of Owner or Authorized Representative

Title

Date

Please complete the "SEALED BID" information on the next page

Finger Point Hardwood (54-030-21)
T29N, R03E, SEC. 20; T29N, R03E, SEC. 29; Montmorency COUNTY

In response to the notice of sale to be held 10:00 a.m. (local time) on March 22, 2022, I am hereby submitting my sealed bid (firm offer) for the following forest products to be cut. Bids for individual species must be at or above the advertised price. All non-responsive bid forms may be rejected.

<u>PRODUCTS & SPECIES</u>	<u>ESTIMATED VOLUME*</u>	<u>ADVERTISED PRICE</u>	<u>BID PRICE/UNIT</u>
Sawtimber			
B. T. Aspen	23.2 MBF	\$ 101.00/MBF	\$ _____
Basswood	78.5 MBF	\$ 53.00/MBF	\$ _____
Beech	36.9 MBF	\$ 45.00/MBF	\$ _____
Red Oak	40.2 MBF	\$ 168.00/MBF	\$ _____
Sugar Maple	31.0 MBF	\$ 396.00/MBF	\$ _____
Pulpwood			
B. T. Aspen	27 Cords	\$ 25.60/Cord	\$ _____
Mixed Hardwood	704 Cords	\$ 21.55/Cord	\$ _____
Red Oak	45 Cords	\$ 36.40/Cord	\$ _____

*The volumes are statistically estimated within plus (+) or minus (-) 6.03 percent at 95% confidence level. These estimated volumes are final and not subject to adjustment. Prospective bidders are urged to examine this timber and to make their own estimates of quantity and quality.

I understand that any or all bids may be rejected. All bids must be signed and all bid items must be bid or the bid form may be rejected. I also understand that consideration and awarding a contract will be based upon my past performance and ability to complete the contract based upon equipment and staffing subject to my control.

FEDERAL ID: ____ - ____ - ____ or SOCIAL SECURITY NUMBER: ____ - ____ - ____
 Company or individual bidding: _____
 Company representative's name: _____
 Address: _____
 City: _____ State: _____ Zip: _____

IF AVAILABLE, PLEASE PLACE THE PERSONALIZED LABEL FROM YOUR PROSPECTUS IN THE ABOVE BOX.

Individual or company representative's signature: _____ Date: _____

Phone number : _____ Email (optional): _____

THE WINNING BIDDER MUST COMPLETE THE VERIFICATION OF WORKER'S DISABILITY COMPENSATION ACT COMPLIANCE (ON REVERSE SIDE IF DOUBLE SIDED) WITHIN 21 DAYS OF SALE AWARD DATE



FOR DEPARTMENT USE ONLY	
Sale Number (XX - XXX - XX - XX)	
Forest Management Unit:	

TIMBER SALE VERIFICATION OF WORKER'S DISABILITY COMPENSATION ACT COMPLIANCE

As required by Act 317, P.A. 1969 (Worker's Compensation) and
Part 5 of Act 451 of 1994, as amended.

VERIFICATION OF WORKER'S DISABILITY COMPENSATION ACT COMPLIANCE

- This verification must be completed and submitted within 21 days of contract award and prior to the issuance of the timber sale contract.
- In addition, if boxes 2B or 2C are checked, then Notice of Exclusion or Certificate of Insurance must be submitted within twenty-one (21) days of the contract award and prior to the issuance of the timber sale contract.
- All information must be typed or printed except for written signatures.

Please Check Appropriate Categories:

1. My business is organized as (you **must** check one of the boxes below):
 - A. Sole Proprietorship (individual)
 - B. Partnership
 - C. Corporation
2. You **must** check one of the boxes below:
 - A. I certify my business is a sole proprietorship and it has no employees but the sole proprietor. I am not subject to the Worker's Compensation Laws.
 - B. I certify my business has satisfied its obligation to the Worker's Compensation Act through the use of an approved Notice of Exclusion (BWC-337, Rev. 5/96). I will provide a copy of the Notice of Exclusion within 21 days of the contract award. (For questions or a copy of the BWC-337, please call the Worker's Compensation Bureau at 517-322-1195).
 - C. I certify my business has a Worker's Compensation Policy. I will provide an original Certificate of Insurance within twenty-one (21) days of the contract award.
3. If you have checked item 2(A) or 2(B), you **must** indicate the number of **both** full-time and part-time employees, other than yourself, including family members and active partners (if none, you must enter "0").

_____ Full-time Employees

_____ Part-time Employees

Name of Business		Federal ID (or) Social Security No.	
Address		Telephone ()	
City	State	ZIP	

I hereby certify that the above information is true and correct. I agree to notify the Michigan DNR of any changes that occur in factors affecting my coverage during any of my present and future operations.

Signature of Owner or Authorized Representative

Title

Date

Please complete the "SEALED BID" information on the next page

Long Haul Mix (54-007-21)
T32N, R03E, SEC. 19; T32N, R03E, SEC. 30; Montmorency COUNTY

In response to the notice of sale to be held 10:00 a.m. (local time) on March 22, 2022, I am hereby submitting my sealed bid (firm offer) for the following forest products to be cut. Bids for individual species must be at or above the advertised price. All non-responsive bid forms may be rejected.

<u>PRODUCTS & SPECIES</u>	<u>ESTIMATED VOLUME*</u>	<u>ADVERTISED PRICE</u>	<u>BID PRICE/UNIT</u>
Sawtimber			
Basswood	74.3 MBF	\$ 44.00/MBF	\$ _____
Beech	28.4 MBF	\$ 37.00/MBF	\$ _____
Paper Birch	18.4 MBF	\$ 35.00/MBF	\$ _____
Red Maple	76.9 MBF	\$ 39.00/MBF	\$ _____
Red Oak	15.8 MBF	\$ 137.00/MBF	\$ _____
Sugar Maple	97.0 MBF	\$ 324.00/MBF	\$ _____
Pulpwood			
Balsam Fir	280 Cords	\$ 13.60/Cord	\$ _____
Mixed Aspen	583 Cords	\$ 20.95/Cord	\$ _____
Mixed Hardwood	1,305 Cords	\$ 17.60/Cord	\$ _____
Mixed Spruce	8 Cords	\$ 6.35/Cord	\$ _____
N. White Cedar	3 Cords	\$ 11.25/Cord	\$ _____
Red Oak	24 Cords	\$ 29.75/Cord	\$ _____
Red Pine	5 Cords	\$ 23.15/Cord	\$ _____
White Pine	6 Cords	\$ 10.20/Cord	\$ _____

*The volumes are statistically estimated within plus (+) or minus (-) 4.72 percent at 95% confidence level. These estimated volumes are final and not subject to adjustment. Prospective bidders are urged to examine this timber and to make their own estimates of quantity and quality.

I understand that any or all bids may be rejected. All bids must be signed and all bid items must be bid or the bid form may be rejected. I also understand that consideration and awarding a contract will be based upon my past performance and ability to complete the contract based upon equipment and staffing subject to my control.

FEDERAL ID: _____ - _____ or SOCIAL SECURITY NUMBER: _____ - _____ - _____

Company or individual bidding: _____

Company representative's name: _____

Address: _____

City: _____ State: _____ Zip: _____

IF AVAILABLE, PLEASE PLACE THE PERSONALIZED LABEL FROM YOUR PROSPECTUS IN THE ABOVE BOX.

Individual or company representative's signature: _____ Date: _____

Phone number : _____ Email (optional): _____

THE WINNING BIDDER MUST COMPLETE THE VERIFICATION OF WORKER'S DISABILITY COMPENSATION ACT COMPLIANCE (ON REVERSE SIDE IF DOUBLE SIDED) WITHIN 21 DAYS OF SALE AWARD DATE



FOR DEPARTMENT USE ONLY	
Sale Number (XX - XXX - XX - XX)	
Forest Management Unit:	

TIMBER SALE VERIFICATION OF WORKER'S DISABILITY COMPENSATION ACT COMPLIANCE

As required by Act 317, P.A. 1969 (Worker's Compensation) and
Part 5 of Act 451 of 1994, as amended.

VERIFICATION OF WORKER'S DISABILITY COMPENSATION ACT COMPLIANCE

- This verification must be completed and submitted within 21 days of contract award and prior to the issuance of the timber sale contract.
- In addition, if boxes 2B or 2C are checked, then Notice of Exclusion or Certificate of Insurance must be submitted within twenty-one (21) days of the contract award and prior to the issuance of the timber sale contract.
- All information must be typed or printed except for written signatures.

Please Check Appropriate Categories:

1. My business is organized as (you **must** check one of the boxes below):
 - A. Sole Proprietorship (individual)
 - B. Partnership
 - C. Corporation
2. You **must** check one of the boxes below:
 - A. I certify my business is a sole proprietorship and it has no employees but the sole proprietor. I am not subject to the Worker's Compensation Laws.
 - B. I certify my business has satisfied its obligation to the Worker's Compensation Act through the use of an approved Notice of Exclusion (BWC-337, Rev. 5/96). I will provide a copy of the Notice of Exclusion within 21 days of the contract award. (For questions or a copy of the BWC-337, please call the Worker's Compensation Bureau at 517-322-1195).
 - C. I certify my business has a Worker's Compensation Policy. I will provide an original Certificate of Insurance within twenty-one (21) days of the contract award.
3. If you have checked item 2(A) or 2(B), you **must** indicate the number of **both** full-time and part-time employees, other than yourself, including family members and active partners (if none, you must enter "0").

_____ Full-time Employees

_____ Part-time Employees

Name of Business		Federal ID (or) Social Security No.	
Address		Telephone ()	
City	State	ZIP	

I hereby certify that the above information is true and correct. I agree to notify the Michigan DNR of any changes that occur in factors affecting my coverage during any of my present and future operations.

Signature of Owner or Authorized Representative

Title

Date

Please complete the "SEALED BID" information on the next page