



**DEPARTMENT OF NATURAL RESOURCES
STATE OF MICHIGAN**

TIMBER SALE PROSPECTUS #7041

SCHEDULED SALE DATE AND TIME: 10:00 a.m. (local time) on April 19, 2022.

LOCATION: ATLANTA MGMT UNIT, 13501 M 33, ATLANTA, MI 49709.

PROSPECTUS NOTE: The bidder is advised to inspect the sale area and review the location, estimated volumes, operating costs and contract terms of proposed sales. Please be aware that some landowners may request 60 days or more notice for access across their land.

Notice is hereby given that bids will be received by the Unit Manager, ATLANTA MANAGEMENT UNIT, for certain timber on the following described lands:

Hossler Hussle Mix (54-001-21) / T30N, R02E, SEC. 20, NESE.

T30N, R02E, SEC. 29, SENW,SENE,SW,N1/2SE,SESE.

T30N, R02E, SEC. 30, E1/2SE.

Montmorency County, Advertised Price \$164,262.05, 182.0 Acres, Aspen, Hardwood.

SALE NOTE: All units of volume listed for this sale were estimated using the Inventory Manager computer program and the new Michigan taper model.

A recreation site such as a trail, pathway, or campground is within the sale area or the vicinity. Certain restrictions/specifications may be applicable including time restrictions.

McCormick and Shoreline Mix (54-002-21) / T29N, R02E, SEC. 6 , N1/2NW.

T30N, R01E, SEC. 25, SESE.

T30N, R01E, SEC. 36, NENE.

T30N, R02E, SEC. 28, W1/2SE.

T30N, R02E, SEC. 31, NESW,S1/2SW,SE.

T30N, R02E, SEC. 33, S1/2NE.

Montmorency County, Advertised Price \$214,860.55, 218.6 Acres, Hardwood, Aspen.

SALE NOTE: All units of volume listed for this sale were estimated using the Inventory Manager computer program and the new Michigan taper model.

A recreation site such as a trail, pathway, or campground is within the sale area or the vicinity. Certain restrictions/specifications may be applicable including time restrictions.

489 and Scenic Route 3 RP (54-003-21) / T30N, R02E, SEC. 28, SWSE.

T30N, R02E, SEC. 31, N1/2SE.

Montmorency County, Advertised Price \$67,940.20, 24.3 Acres, Red Pine, Aspen.

SALE NOTE: All units of volume listed for this sale were estimated using the Inventory Manager computer program and the new Michigan taper model.

A recreation site such as a trail, pathway, or campground is within the sale area or the vicinity. Certain restrictions/specifications may be applicable including time restrictions.

Crunchy Country Mix (54-009-21) / T29N, R01E, SEC. 6 , NENW,W1/2NE.

T30N, R01E, SEC. 31, SESW,SWSE.

Montmorency County, Advertised Price \$41,936.85, 49.8 Acres, Hardwood, Red Oak.

SALE NOTE: All units of volume listed for this sale were estimated using the Inventory Manager computer program and the new Michigan taper model.

A recreation site such as a trail, pathway, or campground is within the sale area or the vicinity. Certain restrictions/specifications may be applicable including time restrictions.

BID INSTRUCTIONS (VER. 07/02/2018):

1. Scheduled Bid Location, Date, and Time (2/11)

Bids must be received by the Unit Manager, ATLANTA OFFICE, 13501 M 33, ATLANTA, MI 49709, no later than 10:00 a.m. (local time) on April 19, 2022. For further information concerning this sale, contact Cody Stevens at 989-785-4251 extension 5240.

2. Bidder's Qualifications (5/16)

Purchaser shall obtain workers compensation insurance to cover claims under Michigan's Worker's Disability Compensation Act of 1969 or similar employee benefit act of any other state applicable to an employee. If all or part of a timber sale was prepared by a private contractor, the contractor and that contractor's company are not permitted to bid on the timber sale contract. Bids will not be accepted from individuals or companies appearing on the DNR/FRD No-Bid List. This list contains the names of purchasers who previously failed to execute a contract within 21-days or who have a history of poor performance.

3. Preparation of Sealed Bids (5/16)

Bid Forms may be completed online thru Michigan DNR Timber Sale Online Bidding (OLB) at www.michigan.gov/timberbidding or by completing the hardcopy Bid Form found in the Timber Sale Prospectus. Hardcopy Bid Forms shall be manually signed in ink. Registration in OLB is considered your 'signature' for all bids submitted thru that system. Bid prices must be entered for each species and product in the Bid Price column for all material subject to bidding and all fill-in blanks must be completed. If erasures or other changes appear on the hardcopy Bid Form, each erasure or change must be initialed by the person signing the bid.

4. Submission of Sealed Bids (5/16)

Bid forms may be obtained from the Unit Manager or thru OLB. Bids may be submitted hardcopy or thru OLB. All hardcopy bids must be submitted on the bid form and in an envelope clearly identified as described in this section. NOTE: Only one bid form per bid envelope. Sealed bids must be submitted to the Unit office designated in the prospectus and must be submitted at or prior to the time established in the prospectus. The envelope should show on the outside (a) the sale name or number and (b) the date and time of bid opening, as shown in the prospectus. Bids received after the time specified in the sale prospectus are late bids and will be rejected.

It is possible for a bidder to submit multiple bids on a single sale. For example, a bid may be submitted hardcopy and a bid may be submitted thru OLB. Or, two bidders from the same company could both submit bids on the same sale. If this were to happen, the State would accept all bids received and award the contract accordingly. All bidding and contractual requirements would apply to all bids received.

5. Public Opening of Sealed Bids (7/16)

If conditions permit, the sealed bids will be publicly opened and posted at the time and place set in the prospectus.

If a bidder, present at a bid opening, has submitted bids on more than one sale, that bidder may withdraw their unopened bid envelopes or announce the withdrawal of their online bid after being declared the successful bidder on one sale.

6. Award of Contract (1/11)

Award of the contract will be made to the Bidder whose bid, conforming to the prospectus, is most advantageous to the State of Michigan on the basis of total value at rates bid for the estimated quantities. The State reserves the right to reject any bid or waive any minor irregularity in bids received. A written award mailed (or otherwise furnished) to the successful Bidder shall be deemed to result in a binding contract without further action by either party.

7. Down Payment (1/11)

The Bidder to whom award is made must make a down payment within 21 days of the sale award. The amount of the down payment will be calculated as shown in the Bond and Payment Schedule of this prospectus. Only cash may be used to meet this requirement.

8. Performance Security (1/11)

As guarantee of faithful performance, a cash bond, certificate of deposit, surety bond or irrevocable letter of credit (LOC) is required within 21 days of the sale award. The amount of the performance security is shown in the Bond and

Payment Schedule of this prospectus. If an LOC or surety is used, the coverage must extend for at least 6 months beyond the contract expiration.

9. Timber Sale Contract (7/18)

Additional conditions and requirements common to all timber sales are listed on the timber sale contract (R4031) and are available on line at www.michigan.gov/timber. Contact the Unit Manager for additional information or a sample contract. Within 21 days of the date of the award letter, the bidder must sign the contract and provide the required down payment, performance security, and verification of worker's disability compensation. The down payment and performance security shall be in accordance with the provisions of the timber sale contract, in the sums stated in this prospectus. If these actions are not taken, then the Bidder, the Bidder's corporation, and the corporation's principals may not be permitted to bid on State timber sales for a period of 3 months after the first offense, 6 months after the second offense, and 1 year after the third offense. An offense will only be counted against the Bidder for 5 years. In addition, the Bidder certifies that if awarded this contract, the Bidder will complete the timber sale contract in accordance with its terms and any modifications thereof including requirements to purchase, cut, and remove the included timber by the expiration date.

Payment Unit values in the State Forest Timber Sale Contract are calculated based on the advertised value of the Payment Unit as a percentage of the total advertised value of the contract. The advertised value of each Payment Unit is given in the Description of Timber by Payment Unit table on the Timber Sale Information page. For example, if the value of Payment Unit 1 is advertised as \$1,500 and the total Timber Sale value is advertised as \$10,000, the contract price for Payment Unit 1 will be 15% of the total bid price ($\$1,500/\$10,000 * 100$).

10. Disclaimer of Estimates and Bidder's Warranty of Inspection (7/16)

Before submitting this bid, the Bidder is advised and cautioned to inspect the sale area, review the requirements of the sale contract, and take other steps as may be reasonably necessary to ascertain the location, estimated volumes, construction estimates, and operating costs of the proposed sale. Failure to do so will not relieve the Bidder from responsibility for completing the contract.

The Bidder warrants that this bid is submitted solely on the basis of the Bidder's examination and inspection of the quality and quantity of the timber offered for sale and the Bidder's opinion of the value thereof and the costs of recovery. No reliance should be placed on the State of Michigan's estimates of timber quality, quantity or costs of recovery. Bidder further acknowledges that the State of Michigan: (i) expressly disclaims any warranty of fitness of timber for any purpose; (ii) offers this timber as is without any warranty of quality (merchantability) or quantity and (iii) expressly disclaims any warranty as to the quantity or quality of timber sold.

11. Certification and Chain-of-Custody (10/14)

Unless otherwise indicated in the contract under section 7 – Other Conditions of the Sale Specific Conditions & Requirements, the area encompassed by this timber sale is certified to the standards of the Forest Stewardship Council (FSC) - Certificate #SCS-FM/COC-00090N and the Sustainable Forestry Initiative (SFI) - Certificate #NSF-SFIS-5Y031-SF5. Forest products from this sale may be delivered to the mill as "FSC 100% and / or SFI certified" as long as the contractor hauling the forest products is chain-of-custody (COC) certified or covered under a COC certificate from the destination mill. The purchaser is responsible for maintaining COC after leaving the sale area.

12. Good Neighbor Authority (GNA) Requirements (7/16)

If the name of this timber sales contains the acronym GNA, it is authorized by the Good Neighbor Authority (GNA) and covered by various agreements between the U.S. Forest Service and the State. The timber sale occurs on federal land and the following conditions apply:

GNA contracts on US Forest Service land will not be awarded to purchasers on the Federal list of excluded parties. The System for Award Management (SAM) will be checked for active excluded parties prior to award of contract. In addition, the Bidder to whom award is made must complete an Assurance Regarding Felony Conviction or Tax Delinquent Status for Corporate Applicants (AD-3031).

13. Good Neighbor Authority (GNA) Requirements, con't (9/16)

Bidder certifies, by signing this bid form, that to the best of Bidder's knowledge that the following representations are accurate and complete.

- a. That the Bidder and its principals are not presently debarred, suspended, proposed for debarment, declared ineligible, or voluntary excluded from timber sales (covered transactions) by any Federal department or agency.
- b. That the Bidder and its principals have not within a 3-year period preceding this bid been convicted of or had a civil judgment rendered against them for commission of fraud or a criminal offense in connection with obtaining , attempting to obtain, or performing a public (Federal, State, or local) transaction or contract under a public transaction; violation of Federal or State antitrust statutes or commission of embezzlement, theft, forgery, bribery, falsification or destruction of records, making false statements, or receiving stolen property.
- c. That the Bidder and its principals are not presently indicted for or otherwise criminally or civilly charged by a governmental entity (Federal, State, or local) with commission of any of the offenses enumerated in paragraph b of this certification.
- d. That the Bidder and its principals have not within a 3-year period preceding this bid had one or more public transactions (Federal, State, or local) terminated for breach or default of a timber or forest product contract.

Bidders that cannot certify this requirement, in whole or in part, shall submit an explanation with their bid.

DAN EICHINGER
Director

TIMBER SALE INFORMATION

Hossler Hussle Mix (54-001-21)

T30N, R02E, SEC. 20; T30N, R02E, SEC. 29; T30N, R02E, SEC. 30.

Montmorency County (Advertised Price \$164,262.05)

SALE NOTE: All units of volume listed for this sale were estimated using the Inventory Manager computer program and the new Michigan taper model.

A recreation site such as a trail, pathway, or campground is within the sale area or the vicinity. Certain restrictions/specifications may be applicable including time restrictions.

A timber sale contract for this lump sum, sealed bid timber sale will be awarded to the responsible bidder offering the highest sealed bid price. All units of volume listed below were estimated using the Inventory Manager computer program and the new Michigan taper model. Bids must be at or above the following advertised price for each product and species:

<u>PRODUCTS & SPECIES</u>	<u>ESTIMATED UNITS*</u>	<u>ADVERTISED PRICE</u>
Sawtimber		
Mixed Aspen	85.5 MBF	\$ 106.00 / MBF
Paper Birch	4.5 MBF	\$ 29.00 / MBF
Red Maple	25.8 MBF	\$ 47.00 / MBF
Red Oak	263.5 MBF	\$ 176.00 / MBF
Red Pine	133.0 MBF	\$ 109.00 / MBF
Sugar Maple	1.9 MBF	\$ 396.00 / MBF
White Oak	74.6 MBF	\$ 64.00 / MBF
White Pine	8.0 MBF	\$ 34.00 / MBF
Pulpwood		
Balsam Fir	396 Cords	\$ 16.65 / Cord
Jack Pine	168 Cords	\$ 11.00 / Cord
Mixed Aspen	1,467 Cords	\$ 25.70 / Cord
Mixed Hardwood	606 Cords	\$ 21.75 / Cord
Mixed Oak	644 Cords	\$ 38.75 / Cord
Mixed Spruce	17 Cords	\$ 7.75 / Cord
Red Pine	76 Cords	\$ 28.85 / Cord
Tamarack	6 Cords	\$ 5.90 / Cord
White Pine	44 Cords	\$ 12.40 / Cord

* The total volume is statistically estimated within plus (+) or minus (-) 4.26 percent. There are an estimated 5,012 cords on this timber sale, plus or minus 214 cords at the 95% confidence level. The estimated units are final and not subject to adjustment. Prospective bidders are urged to examine this timber and to make their own estimates of quantity and quality.

BOND AND PAYMENT SCHEDULE:

1. A bond in the amount of \$8,213.00 to insure faithful performance of the conditions of the contract will be deposited by the successful bidder within 21 days of the sale award.
2. Cutting in any sale or unit without the required advance payment would be considered a trespass.
3. Total payment must be paid in advance or according to the following schedule :
 - (a) Ten percent (10%) of the sale value must be paid within 21 days of the sale award.
 - (b) The 10% down payment will be credited towards the first unit cut.
 - (c) Payment for each of the following units must be made before cutting begins in that unit:

PAYMENT UNIT NUMBER	PERCENT OF TOTAL SALE VALUE
01	3.0%
02	8.9%
03	9.4%
04	7.0%
05	11.9%
06	12.5%
07	8.4%
08	7.8%
09	15.7%
10	15.4%

4. If no cutting takes place, the 10% down payment will not be refunded.
5. Operations on the contract issued will terminate on 12/31/2024.

SALE STATISTICS

Volumes were calculated in cubic feet using the Michigan taper model. Cubic foot volume includes all wood inside bark for the product indicated. For display purposes, cubic feet were converted to cords and MBF using a simple conversion factor, e.g. 79 cubic feet per cord and 185 cubic feet per MBF. The cubic foot volumes are precise; the cords and MBF volumes are not. Cubic foot volume cannot be directly converted to cords or boards with precision.

SALE VOLUMES

The total estimated sale volume may not equal the sum of the species/products due to the nature of statistical calculations associated with double sampling methodology.

VOLUME			STATISTICAL RANGE IN CORDS	
TOTAL CUBIC FEET	TOTAL CORDS	PERCENT ERROR	MINIMUM	MAXIMUM
395,924	5,012	4.26%	4,798	5,225

VDU VOLUMES

A VDU is a Volume Determination Unit. Volumes and their associated statistics are calculated at the VDU level and summarized to the sale level. There is often a one to one relationship between a VDU and a Payment Unit, but not always, depending on the cruise design. Refer to the VDU TO PAYMENT UNIT table.

	VOLUME			RANGE IN CORDS	
VDU	TOTAL CUBIC FEET	TOTAL CORDS	PERCENT ERROR	MINIMUM	MAXIMUM
23	4,972	63	32.99%	42	84
30	14,906	189	17.98%	155	223
33	35,906	455	17.77%	374	535
39	74,823	947	7.47%	876	1,018
44	80,686	1,021	9.96%	920	1,123
49	130,978	1,658	7.09%	1,540	1,775
59	22,378	283	14.12%	243	323
TOTAL:	364,650	4,616		4,150	5,081

VDU TO PAYMENT UNIT

When a VDU is associated with more than one Payment Unit (PU), the VDU volumes are assigned to the PU based on acres of the VDU within the PU.

VDU	VDU ACRES	PU	PU ACRES
23	3.8	1	3.8
30	9.5	1	9.5
33	16.9	6	2.4
		8	14.5
39	28.9	9	14.6
		10	14.3
44	51.9	5	26.6
		6	25.3
49	62.2	2	21.9
		3	23.2
		4	17.1
59	8.8	7	8.8
TOTAL:	182.0		182.0

DESCRIPTION OF TIMBER BY PAYMENT UNIT (PU)

PU	MARKET GROUP	PRODUCT	QUANTITY	UNIT	ACRES	ADVERTISE PRICE	
1	Red Pine	Sawtimber	7.5	MBF	13.3	\$4,882.50	
	White Pine		8.0	MBF			
	Balsam Fir		Pulpwood	9			Cords
	Jack Pine			80			Cords
	Mixed Aspen			53			Cords
	<i>B. T. Aspen</i>			28			<i>Cords</i>
	<i>Quaking Aspen</i>			25			<i>Cords</i>
	Mixed Hardwood			13			Cords
	<i>Paper Birch</i>			1			<i>Cords</i>
	<i>Red Maple</i>			12			<i>Cords</i>
	Mixed Spruce			5			Cords
	<i>Black Spruce</i>			5			<i>Cords</i>
	Red Pine			19			Cords
	Tamarack			6			Cords
White Pine	40	Cords					
2	Mixed Aspen	Sawtimber	7.1	MBF	21.9	\$14,628.70	
	<i>B. T. Aspen</i>		1.4	<i>MBF</i>			
	<i>Quaking Aspen</i>		5.7	<i>MBF</i>			
	Paper Birch		1.6	MBF			
	Red Maple		4.1	MBF			
	Red Oak		6.2	MBF			
	Red Pine		2.4	MBF			
	White Oak		5.1	MBF			
	Balsam Fir		Pulpwood	133			Cords
	Jack Pine			21			Cords
	Mixed Aspen			253			Cords
	<i>B. T. Aspen</i>			74			<i>Cords</i>
	<i>Quaking Aspen</i>			179			<i>Cords</i>
	Mixed Hardwood			96			Cords
	<i>Paper Birch</i>			2			<i>Cords</i>
	<i>Red Maple</i>			94			<i>Cords</i>
	Mixed Oak			23			Cords
	<i>Red Oak</i>			12			<i>Cords</i>
	<i>White Oak</i>			11			<i>Cords</i>
	Mixed Spruce			4			Cords
<i>Black Spruce</i>	3	<i>Cords</i>					
<i>White Spruce</i>	1	<i>Cords</i>					
3	Mixed Aspen	Sawtimber	7.5	MBF	23.2	\$15,458.55	
	<i>B. T. Aspen</i>		1.5	<i>MBF</i>			
	<i>Quaking Aspen</i>		6.0	<i>MBF</i>			
	Paper Birch		1.7	MBF			
	Red Maple		4.3	MBF			
	Red Oak		6.5	MBF			
	Red Pine		2.6	MBF			
	White Oak		5.4	MBF			
	Balsam Fir		Pulpwood	140			Cords
	Jack Pine			22			Cords
	Mixed Aspen			267			Cords
	<i>B. T. Aspen</i>			78			<i>Cords</i>
	<i>Quaking Aspen</i>			189			<i>Cords</i>
	Mixed Hardwood			101			Cords
	<i>Paper Birch</i>			2			<i>Cords</i>
	<i>Red Maple</i>			99			<i>Cords</i>
	Mixed Oak			25			Cords
<i>Red Oak</i>	13	<i>Cords</i>					
<i>White Oak</i>	12	<i>Cords</i>					

DESCRIPTION OF TIMBER BY PAYMENT UNIT (PU), CON'T

PU	MARKET GROUP	PRODUCT	QUANTITY	UNIT	ACRES	ADVERTISE PRICE	
3 con't	Mixed Spruce	Pulpwood	5	Cords			
	<i>Black Spruce</i>		3	<i>Cords</i>			
	<i>White Spruce</i>		2	<i>Cords</i>			
4	Mixed Aspen	Sawtimber	5.5	MBF	17.1	\$11,463.05	
	<i>B. T. Aspen</i>		1.1	<i>MBF</i>			
	<i>Quaking Aspen</i>		4.4	<i>MBF</i>			
	Paper Birch		1.2	MBF			
	Red Maple		3.2	MBF			
	Red Oak		4.8	MBF			
	Red Pine		1.9	MBF			
	White Oak		4.0	MBF			
	Balsam Fir		Pulpwood	104			Cords
	Jack Pine			16			Cords
	Mixed Aspen	198		Cords			
	<i>B. T. Aspen</i>	58		<i>Cords</i>			
	<i>Quaking Aspen</i>	140		<i>Cords</i>			
	Mixed Hardwood	75		Cords			
	<i>Paper Birch</i>	2		<i>Cords</i>			
	<i>Red Maple</i>	73		<i>Cords</i>			
	Mixed Oak	19		Cords			
	<i>Red Oak</i>	10		<i>Cords</i>			
	<i>White Oak</i>	9		<i>Cords</i>			
	Mixed Spruce	3		Cords			
	<i>Black Spruce</i>	2		<i>Cords</i>			
	<i>White Spruce</i>	1	<i>Cords</i>				
	5	Mixed Aspen	Sawtimber	8.0			MBF
<i>B. T. Aspen</i>		1.0		<i>MBF</i>			
<i>Quaking Aspen</i>		7.0		<i>MBF</i>			
Red Maple		5.2		MBF			
Red Oak		19.8		MBF			
Red Pine		38.3		MBF			
Sugar Maple		1.0		MBF			
White Oak		12.2		MBF			
Balsam Fir		Pulpwood		5	Cords		
Jack Pine				15	Cords		
Mixed Aspen			156	Cords			
<i>B. T. Aspen</i>			21	<i>Cords</i>			
<i>Quaking Aspen</i>			135	<i>Cords</i>			
Mixed Hardwood			87	Cords			
<i>Red Maple</i>			85	<i>Cords</i>			
<i>Sugar Maple</i>			2	<i>Cords</i>			
Mixed Oak			77	Cords			
<i>Red Oak</i>		32	<i>Cords</i>				
<i>White Oak</i>		45	<i>Cords</i>				
Red Pine	16	Cords					
6	Mixed Aspen	Sawtimber	10.8	MBF	27.7	\$20,589.05	
	<i>B. T. Aspen</i>		3.8	<i>MBF</i>			
	<i>Quaking Aspen</i>		7.0	<i>MBF</i>			
	Red Maple		5.2	MBF			
	Red Oak		20.5	MBF			
	Red Pine		37.7	MBF			
	Sugar Maple		0.9	MBF			
	White Oak	11.9	MBF				
	Balsam Fir	Pulpwood	5	Cords			
	Jack Pine		14	Cords			
	Mixed Aspen		186	Cords			

DESCRIPTION OF TIMBER BY PAYMENT UNIT (PU), CON'T

PU	MARKET GROUP	PRODUCT	QUANTITY	UNIT	ACRES	ADVERTISE PRICE
6 con't	<i>B. T. Aspen</i>	<i>Pulpwood</i>	50	<i>Cords</i>		
	<i>Quaking Aspen</i>		136	<i>Cords</i>		
	Mixed Hardwood		91	<i>Cords</i>		
	<i>Red Maple</i>		90	<i>Cords</i>		
	<i>Sugar Maple</i>		1	<i>Cords</i>		
	Mixed Oak		75	<i>Cords</i>		
	<i>Red Oak</i>		32	<i>Cords</i>		
	<i>White Oak</i>		43	<i>Cords</i>		
	Red Pine		16	<i>Cords</i>		
7	Mixed Aspen	Sawtimber	5.5	MBF	8.8	\$13,803.45
	<i>B. T. Aspen</i>		5.5	<i>MBF</i>		
	Red Maple		0.8	MBF		
	Red Oak		34.0	MBF		
	Red Pine		20.8	MBF		
	White Oak		7.4	MBF		
	Mixed Aspen	Pulpwood	26	<i>Cords</i>		
	<i>B. T. Aspen</i>		2	<i>Cords</i>		
	<i>Quaking Aspen</i>		24	<i>Cords</i>		
	Mixed Hardwood		39	<i>Cords</i>		
	<i>Red Maple</i>		39	<i>Cords</i>		
	Mixed Oak		64	<i>Cords</i>		
	<i>Red Oak</i>		49	<i>Cords</i>		
	<i>White Oak</i>		15	<i>Cords</i>		
	Red Pine		16	<i>Cords</i>		
8	Mixed Aspen	Sawtimber	19.7	MBF	14.5	\$12,801.20
	<i>B. T. Aspen</i>		17.3	<i>MBF</i>		
	<i>Quaking Aspen</i>		2.4	<i>MBF</i>		
	Red Maple		0.9	MBF		
	Red Oak		9.6	MBF		
	Red Pine		8.0	MBF		
	White Oak	1.5	MBF			
	Mixed Aspen	Pulpwood	229	<i>Cords</i>		
	<i>B. T. Aspen</i>		184	<i>Cords</i>		
	<i>Quaking Aspen</i>		45	<i>Cords</i>		
	Mixed Hardwood		60	<i>Cords</i>		
	<i>Red Maple</i>		60	<i>Cords</i>		
	Mixed Oak		19	<i>Cords</i>		
	<i>Red Oak</i>		13	<i>Cords</i>		
	<i>White Oak</i>		6	<i>Cords</i>		
Red Pine	3		<i>Cords</i>			
9	Mixed Aspen	Sawtimber	10.8	MBF	14.6	\$25,829.30
	<i>B. T. Aspen</i>		10.8	<i>MBF</i>		
	Red Maple		1.1	MBF		
	Red Oak		81.9	MBF		
	Red Pine		7.0	MBF		
	White Oak		13.7	MBF		
	Mixed Aspen	Pulpwood	50	<i>Cords</i>		
	<i>B. T. Aspen</i>		50	<i>Cords</i>		
	Mixed Hardwood		22	<i>Cords</i>		
	<i>Red Maple</i>		22	<i>Cords</i>		
	Mixed Oak		173	<i>Cords</i>		
	<i>Red Oak</i>		130	<i>Cords</i>		
	<i>White Oak</i>		43	<i>Cords</i>		
	Red Pine		3	<i>Cords</i>		
	White Pine		2	<i>Cords</i>		
10	Mixed Aspen	Sawtimber	10.6	MBF	14.3	\$25,282.50

DESCRIPTION OF TIMBER BY PAYMENT UNIT (PU), CON'T

PU	MARKET GROUP	PRODUCT	QUANTITY	UNIT	ACRES	ADVERTISE PRICE
10 con't	<i>B. T. Aspen</i>	<i>Sawtimber</i>	10.6	<i>MBF</i>		
	Red Maple		1.0	MBF		
	Red Oak		80.2	MBF		
	Red Pine		6.8	MBF		
	White Oak		13.4	MBF		
	Mixed Aspen	Pulpwood	49	Cords		
	<i>B. T. Aspen</i>		49	<i>Cords</i>		
	Mixed Hardwood		22	Cords		
	<i>Red Maple</i>		22	<i>Cords</i>		
	Mixed Oak		169	Cords		
	<i>Red Oak</i>		127	<i>Cords</i>		
	<i>White Oak</i>		42	<i>Cords</i>		
	Red Pine		3	Cords		
	White Pine		2	Cords		
TOTAL:			596.8	MBF		
TOTAL:			3,424	Cords		

Sale Specific Conditions & Requirements

Sale Name: Hossler Hussle Mix

Sale Number: 54-001-21 Seq#: 2

1 - Sale Area

1.2 - Boundaries

1.2.1 - Painted boundaries (9/19)

The sale boundary and Payment Unit boundaries are marked and identified by blue, red, and yellow paint. Exterior sale boundary lines against private are marked with blue paint. Exterior sale boundary lines against state are marked with red paint. Interior retention boundaries are marked with red paint; no harvesting activities may occur within these areas. Interior Payment Unit boundaries are marked with yellow paint, except for the north lines of Payment Units 6 and 9 which use Lutz Road as shown on the Timber Sale Map. The painted boundary line trees are not Included Timber and are to be protected. Yellow painted trees designating an interior Payment Unit boundary are only to be cut when all surrounding Payment Units have been paid.

2 - Timber Specifications

2.1 - Included Timber

2.1.1 - Clearcut unit(s) with unmerchantable trees (6/14)

Within Payment Unit(s) 1-10, cut all trees that are two (2) inches or more at DBH, with the following exceptions:

- Within Payment Units 2-8, do not cut any white pine and purple or green painted trees;
- Within Payment Unit 1 do not cut any purple painted trees;
- Within Payment Units 8-10 do not cut any oak less than 4 inches in diameter.

Note: See spec 5.2.4.4 - 'Dead and down creation, grouse' for instructions on orange marked trees.

2.2 - Utilization

2.2.2 - Chipping required (2/18)

Payment Units 9 and 10 must be chip harvested to facilitate future silvicultural activities. The Purchaser has the option to produce sawlogs or pulpwood bolts, but the remaining portion of the trees must be chipped and hauled. Products may be produced as roundwood and forwarded to decking areas in final product length, but the tops must be left intact and skidded to the landing for chipping to minimize the amount of residual slash. If market conditions limit the practicality of chipping the following is required: Tops must be cut into lengths 4 feet or less and trees greater than 4 inches at DBH must be cut to a 2-inch top or smaller. Sub-merchantable trees, and hardwood limbs 4 inches or greater where they attach to the stem, are to be cut/reduced to 4-foot lengths. Tops and slash must also be spread evenly across the sale. This is to speed the breakdown of tops and slash. The requirement to retain approximately 1/6 to 1/3 of tree tops and limbs less than four inches in diameter is still applicable (G. C. & R. 2.2).

2.2.3 - Stump heights (4/07)

Stump heights within Payment Units 9 and 10 shall not exceed 6 inches for all trees. This is to facilitate future silvicultural activities. A written waiver of this requirement may be obtained if wet summer weather makes winter logging necessary.

3 - Payments

3.3 - Pre-measured Sales

3.3.4 - Dividing payment units (7/14)

Payment Unit(s) may be divided at the request of the Purchaser and upon approval of the Unit Manager. Dividing Payment Units is a contract modification which requires a Timber Sale Contract Amendment. Payment Units valued over \$25,000 may be divided. There will be only one division per Payment Unit.

3.4 - Damaged Timber

3.4.1 - Damaged timber (7/16)

General Condition and Requirement 3.4 Damaged Timber, defines liquidated damages for undesignated live merchantable trees which are cut or injured.

Within Payment Units 8-10, operations must avoid damaging oak seedlings and saplings (1/4" to 4" DBH) where it is possible.

No damage is acceptable to undesignated live merchantable trees. Within the Sale Area, if more than 5% of trees (> 4.5" DBH) within a specified area of the sale are damaged, liquidated damages will be assessed for all trees damaged. Rates will be in accordance with General Condition and Requirement 3.4 Damaged Timber.

4 - Transportation

4.1 - Construction

4.1.3 - Slash and earthen piles (8/04)

Piles or windrows of earth along roads and landings that have been widened or constructed shall be leveled. Slash from road maintenance or construction, including stumps, shall be chipped, utilized, or otherwise removed from the sale.

4.1.6 - Road construction (1/09)

Construction or improvements of existing roads shall be done in such a way as to minimize the environmental and visual impacts. Merchantable trees shall be cut and utilized unless otherwise directed. Non-merchantable trees shall be severed and laid flat on the ground. Slash shall be scattered, and not left in windrows and kept a minimum of 10 feet back from the road edge. Stumps shall be set upright, not left on edge, and be moved at least 10 feet away from the road edge. Disturbed soil shall be feathered into the woods and not left in berms or windrows.

4.1.7 - Road closure (10/11)

All new roads built into the sale must be blocked to vehicle traffic upon completion of the sale. Overgrown roads that are reopened shall be considered new roads. In general, this will require constructing a four (4') foot high berm of stumps and logs covered with earth. Stumps and brush must be placed along the remainder of the trail. These roads must be rendered impassable to cars and trucks. Contact the sale administrator for specific details of design and placement.

4.2 - Maintenance

4.2.5 - Two wheel drive condition (2/04)

All existing trail roads on and adjacent to the sale area must be passable by two-wheel drive traffic for the duration of the sale.

5 - Operations

5.1 - Notification

5.1.1 - Pre-sale conference (10/16)

A pre-sale conference between the Purchaser and sale administrator is required prior to beginning any operations to determine landing and road locations. The Unit Manager or his/her representative must be contacted at least 5 days in advance to schedule the conference.

5.1.3 - Well heads and natural gas pipelines (11/15)

The Purchaser is responsible for contacting the following party 30 days prior to operating equipment in the vicinity of well heads or natural gas pipelines.

(All Payment Units)

Riverside Energy Michigan

10691 E Carter Rd, Suite 201

Traverse City, MI 49684

Phone: (231) 995-4000 (M-F, 8am-5pm)

5.1.4 - Post-sale conference (10/16)

A post-sale conference on site between the Purchaser and sale administrator is required 5 days prior to the completion of active logging operations to determine clean-up and repair of landings, road edges, and the fulfillment of other contract specifications.

5.2 - Conduct of Operations

5.2.2 - Hazard Trees/Snags

5.2.2.1 - Den trees (10/16)

Obvious hollow and/or den trees shall be protected and left standing unless they are a safety hazard.

5.2.3 - Operating Restrictions

5.2.3.5 - Oak wilt restriction (1/18)

Within Payment Unit(s) 5-10, unless changed by written agreement, cutting, skidding, hauling within the sale and brushing of access roads to the sale are not permitted during the period of April 15 to July 15. Operations may be allowed if specific steps are taken to prevent damaging uncut oak during the high risk period. Those steps may include completing all road brushing before April 15th and clearing a tree-length buffer along uncut oak cover before April 15th. This is necessary to reduce the spread of oak wilt. For more information, contact the Unit Manager or his/her representative.

5.2.3.11 - Coppice regeneration protection (4/10)

Timber harvesting in Payment Units 1-10 must be completed within 60 days of severing/cutting stem(s) to minimize damage to deciduous regeneration. Any post-harvest operations, such as chipping, must be completed before sprouting of regeneration occurs. If it is anticipated that chipping will be delayed, then tops shall be carried to one central location or left unchipped. The Unit Manager or his/her representative may cease such operations if sprouting occurs before the operation is complete.

5.2.4 - Dead and Down Creation

5.2.4.4 - Dead and down creation, grouse (6/18)

To encourage grouse and other wildlife, in Payment Unit(s) 2-8, leave on-site all orange painted trees. Orange painted trees are to be cut and pushed over with the root ball attached. If it is impractical to push the trees over, they may be cut or partially cut and pushed over. Whenever possible, the tree stem should remain suspended off the ground.

5.2.31 - Landing locations (9/13)

Landing locations are shown on the Timber Sale Map. Landings must be confined to these designated sites unless otherwise authorized by the Unit Manager or his/her representative.

5.2.32 - Decking/landing restoration (9/13)

All decking and landing areas must have the surface area restored to a condition equal to or better than before. This is to ensure the proper regeneration of the stand. Wood debris, chips, and "cookies" from trimmings must be removed or scattered away from landing and loading areas and may not be windrowed on the edge.

5.2.38 - No decking against live trees (2/04)

Cut products may not be decked against unmarked or designated leave trees.

5.2.39 - ORV trail/route protection (4/18)

The Atlanta to Hunt Creek Motorcycle MCCCT is shown on the Timber Sale Map. Do not cut trees or damage posts with yellow ORV markers. All stumps within 5 feet of the trail must be cut flush with the ground. Maintain a 20-foot-wide slash, debris, and rut free zone daily using the ORV trail or route as the centerline.

5.4 - Soil Protection

5.4.1 - Rutting restriction, general (7/16)

Operations are to cease immediately if equipment and weather conditions result in rutting of roads and/or skid trails which is 12 inches or greater in depth and 50 feet in length. The Unit Manager or his/her representative may restrict hauling and/or skidding if ruts exceed the specified depth. With the Unit Manager or his/her representative's approval, the Purchaser may return to the area when the risk of rutting has decreased.

5.4.2 - Skid trails (2/04)

Skid trails up and down slopes should be avoided. If however this is unavoidable, these trails will be left in a non-erodible condition using water bars, logs, and slash. Placing of slash on these skid trails while logging is ongoing may alleviate need for any further action. At the direction of the sale administrator, seed, fertilizer, and mulch may also be required.

5.8 - Protection of Endangered Species

5.8.5 - Protection of raptor nests (3/13)

All trees with raptor nests will be protected if found during harvesting operations. Notification will be made to the Unit Manager or his/her representative who will notify the Wildlife Biologist so an on-site evaluation and recommendation can be made, if necessary.

6 - Safety and Fire Prevention

6.2 - Signing

6.2.3 - Recreational trail posting (10/20)

The Purchaser is responsible for posting and maintaining caution signs on the Atlanta to Hunt Creek Motorcycle MCCCT prior to beginning operations. The trail must be posted at appropriate distances from the Sale Area to warn of logging activity and truck traffic at both ends of the trail. Signs must be removed when harvest operations are suspended or completed. The Purchaser will provide these signs.



TIMBER SALE MAP

This information provided by authority of Part 525, 1994 PA 451, as amended.

Sale Number	Year
54 - 001	21

Forest Management Unit Atlanta Management Unit	County Montmorency	Mapped By Coy	Date 04/26/2021	Page 1	of 1
Township 30N		Range 02E		Section(s) and Subdivision(s) 20-NESE 29-SENW,SENE,SW,N2SE,SESE 30-E2SE	
Cruised By Coy				Scale 1:15,840	

Cover Type				Density			
A = Aspen	H = Hemlock	N = Marsh	U = Upland Brush	0 = Non Stocked	5 = Pole Timber Medium		
B = Paper Birch	J = Jack Pine	O = Oak	UM = Upland Mixed	1 = Seedling Sapling Poor	6 = Pole Timber Well		
C = Cedar	L = Lowland Brush	P = Lowland Poplar	V = Bog or Marsh	2 = Seedling Sapling Medium	7 = Saw Timber Poor		
D = Treed Bog	LM = Lowland Mixed	Q = Mixed Swamp Conifer	W = White Pine	3 = Seedling Sapling Well	8 = Saw Timber Medium		
E = Swamp Hdwoods	M = Mpl, Bch, Brch	R = Red Pine	X = Non Stocked	4 = Pole Timber Poor	9 = Saw Timber Well		
F = Spruce Fir	MC = Mixed Conifer	S = Black Spruce	Z = Water				
G = Grass	MD = Mixed Deciduous	T = Tamarack					

PU	Acres	PU	Acres
1	13.3	6	27.7
2	21.9	7	8.8
3	23.2	8	14.5
4	17.1	9	14.6
5	26.6	10	14.3

Hossler Hussle Mix

Compartment 23

182.0 Acres

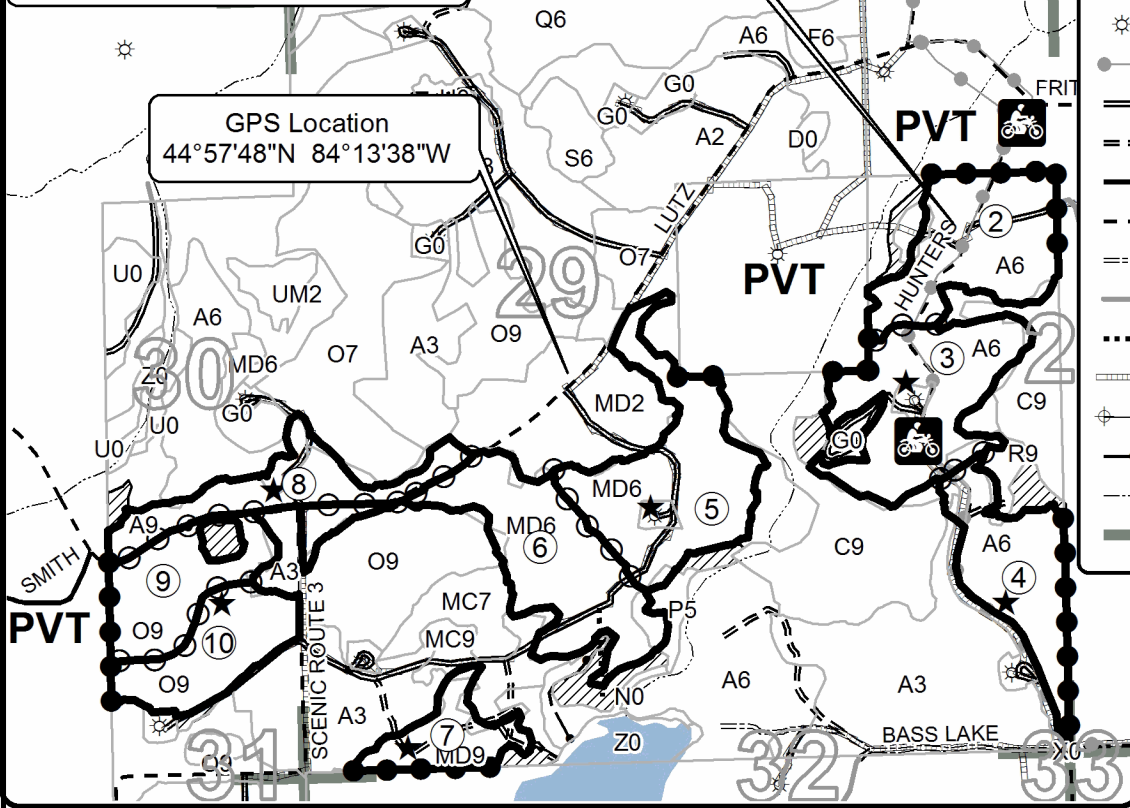
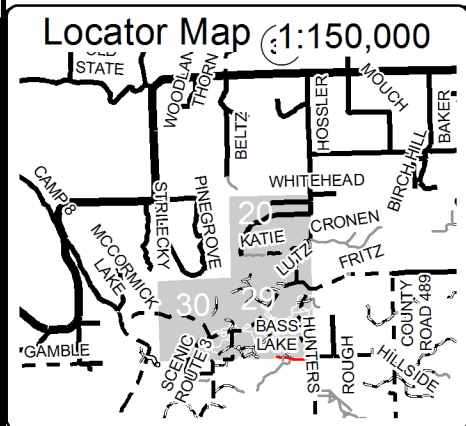
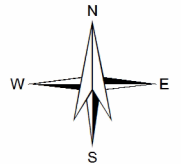

Legend

- Against State (Red)
- Private Line (Blue)
- Payment Unit (Yellow or Road)
- ▨ Retention Area (Red)
- Stand Boundaries
- Lakes
- Payment Unit
- ★ Landing
- ⊛ Gas Well
- Recreational Trail
- == Secondary Road
- == Forest Access Route
- Paved Road
- - Gravel Road
- County Road - Seasonal
- Private Road
- Temporary Access
- Pipeline
- ⚡ Powerline
- Drain
- Perennial River
- Section Corner

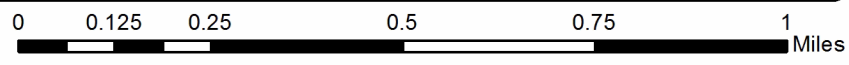

TIMBER SALE INFORMATION

McCormick and Shoreline Mix (54-002-21)

T29N, R02E, SEC. 6; T30N, R01E, SEC. 25; T30N, R01E, SEC. 36; T30N, R02E, SEC. 28; T30N, R02E, SEC. 31; T30N, R02E, SEC. 33.

SALE NOTE: All units of volume listed for this sale were estimated using the Inventory Manager computer program and the new Michigan taper model.

A recreation site such as a trail, pathway, or campground is within the sale area or the vicinity. Certain restrictions/specifications may be applicable including time restrictions.

A timber sale contract for this lump sum, sealed bid timber sale will be awarded to the responsible bidder offering the highest sealed bid price. All units of volume listed below were estimated using the Inventory Manager computer program and the new Michigan taper model. Bids must be at or above the following advertised price for each product and species:

<u>PRODUCTS & SPECIES</u>	<u>ESTIMATED UNITS*</u>	<u>ADVERTISED PRICE</u>
Sawtimber		
Basswood	4.9 MBF	\$ 53.00 / MBF
Mixed Aspen	89.9 MBF	\$ 106.00 / MBF
Red Maple	37.8 MBF	\$ 47.00 / MBF
Red Oak	521.3 MBF	\$ 176.00 / MBF
Red Pine	60.7 MBF	\$ 109.00 / MBF
Sugar Maple	12.1 MBF	\$ 396.00 / MBF
White Oak	63.5 MBF	\$ 64.00 / MBF
White Pine	2.0 MBF	\$ 34.00 / MBF
Pulpwood		
Balsam Fir	3 Cords	\$ 16.65 / Cord
Jack Pine	2 Cords	\$ 11.00 / Cord
Mixed Aspen	1,140 Cords	\$ 25.70 / Cord
Mixed Hardwood	1,140 Cords	\$ 21.75 / Cord
Mixed Oak	1,049 Cords	\$ 38.75 / Cord
Red Pine	25 Cords	\$ 28.85 / Cord
White Pine	38 Cords	\$ 12.40 / Cord

* The total volume is statistically estimated within plus (+) or minus (-) 3.63 percent. There are an estimated 5,359 cords on this timber sale, plus or minus 195 cords at the 95% confidence level. The estimated units are final and not subject to adjustment. Prospective bidders are urged to examine this timber and to make their own estimates of quantity and quality.

BOND AND PAYMENT SCHEDULE:

1. A bond in the amount of \$10,743.00 to insure faithful performance of the conditions of the contract will be deposited by the successful bidder within 21 days of the sale award.
2. Cutting in any sale or unit without the required advance payment would be considered a trespass.
3. Total payment must be paid in advance or according to the following schedule :
 - (a) Ten percent (10%) of the sale value must be paid within 21 days of the sale award.
 - (b) The 10% down payment will be credited towards the first unit cut.
 - (c) Payment for each of the following units must be made before cutting begins in that unit:

PAYMENT UNIT NUMBER	PERCENT OF TOTAL SALE VALUE
01	5.1%
02	3.0%
03	10.1%
04	14.2%
05	13.5%
06	9.0%
07	16.7%
08	20.5%
09	4.1%
10	3.8%

4. If no cutting takes place, the 10% down payment will not be refunded.
5. Operations on the contract issued will terminate on 12/31/2024.

SALE STATISTICS

Volumes were calculated in cubic feet using the Michigan taper model. Cubic foot volume includes all wood inside bark for the product indicated. For display purposes, cubic feet were converted to cords and MBF using a simple conversion factor, e.g. 79 cubic feet per cord and 185 cubic feet per MBF. The cubic foot volumes are precise; the cords and MBF volumes are not. Cubic foot volume cannot be directly converted to cords or boards with precision.

SALE VOLUMES

The total estimated sale volume may not equal the sum of the species/products due to the nature of statistical calculations associated with double sampling methodology.

VOLUME			STATISTICAL RANGE IN CORDS	
TOTAL CUBIC FEET	TOTAL CORDS	PERCENT ERROR	MINIMUM	MAXIMUM
423,325	5,359	3.63%	5,164	5,553

VDU VOLUMES

A VDU is a Volume Determination Unit. Volumes and their associated statistics are calculated at the VDU level and summarized to the sale level. There is often a one to one relationship between a VDU and a Payment Unit, but not always, depending on the cruise design. Refer to the VDU TO PAYMENT UNIT table.

VDU	VOLUME		PERCENT ERROR	RANGE IN CORDS	
	TOTAL CUBIC FEET	TOTAL CORDS		MINIMUM	MAXIMUM
8	36,683	464	10.47%	416	513
41	42,833	542	13.92%	467	618
84	127,522	1,614	5.22%	1,530	1,699
85	85,628	1,084	9.13%	985	1,183
88	27,129	343	13.11%	298	388
90	23,405	296	20.23%	236	356
91	5,376	68	35.94%	44	93
96	4,707	60	34.97%	39	80
97	29,366	372	8.88%	339	405
98	4,602	58	47.34%	31	86
103	6,405	81	15.79%	68	94
TOTAL:	393,655	4,983		4,452	5,514

VDU TO PAYMENT UNIT

When a VDU is associated with more than one Payment Unit (PU), the VDU volumes are assigned to the PU based on acres of the VDU within the PU.

VDU	VDU ACRES	PU	PU ACRES
8	18.8	6	18.8
41	27.9	9	14.3
		10	13.6
84	51.2	7	27.4
		8	23.8
85	57.9	4	29.6
		5	28.3
88	7.7	8	7.7
90	8.9	1	8.9
91	5.7	1	5.7
96	6.3	2	6.3
97	18.4	3	18.4
98	5.4	3	5.4
103	10.4	2	10.4
TOTAL:	218.6		218.6

DESCRIPTION OF TIMBER BY PAYMENT UNIT (PU)

PU	MARKET GROUP	PRODUCT	QUANTITY	UNIT	ACRES	ADVERTISE PRICE	
1	Mixed Aspen	Sawtimber	10.1	MBF	14.6	\$11,016.25	
	<i>Quaking Aspen</i>		10.1	<i>MBF</i>			
	Red Maple		1.4	MBF			
	Red Oak		7.0	MBF			
	Red Pine		3.9	MBF			
	White Oak		9.5	MBF			
	Jack Pine		Pulpwood	2			Cords
	Mixed Aspen			239			Cords
	<i>B. T. Aspen</i>			4			<i>Cords</i>
	<i>Quaking Aspen</i>			235			<i>Cords</i>
	Mixed Hardwood			48			Cords
	<i>Black Cherry</i>			19			<i>Cords</i>
	<i>Red Maple</i>			29			<i>Cords</i>
	Mixed Oak			9			Cords
	<i>Red Oak</i>			3			<i>Cords</i>
	<i>White Oak</i>			6			<i>Cords</i>
	Red Pine		2	Cords			
2	Mixed Aspen	Sawtimber	1.6	MBF	16.7	\$6,343.60	
	<i>Quaking Aspen</i>		1.6	<i>MBF</i>			
	Red Oak		11.5	MBF			
	Mixed Aspen		Pulpwood	2			Cords
	<i>Quaking Aspen</i>			2			<i>Cords</i>
	Mixed Hardwood			8			Cords
	<i>Red Maple</i>			8			<i>Cords</i>
	Mixed Oak			100			Cords
	<i>Red Oak</i>			92			<i>Cords</i>
	<i>White Oak</i>			8			<i>Cords</i>
White Pine	4	Cords					
3	Mixed Aspen	Sawtimber	5.0	MBF	23.8	\$21,703.15	
	<i>B. T. Aspen</i>		5.0	<i>MBF</i>			
	Red Oak		70.1	MBF			
	White Oak		9.2	MBF			
	White Pine		0.8	MBF			
	Mixed Aspen		Pulpwood	45			Cords
	<i>B. T. Aspen</i>			45			<i>Cords</i>
	Mixed Hardwood			25			Cords
	<i>Red Maple</i>			25			<i>Cords</i>
	Mixed Oak			158			Cords
	<i>Red Oak</i>			137			<i>Cords</i>
	<i>White Oak</i>			21			<i>Cords</i>
White Pine	32	Cords					
4	Mixed Aspen	Sawtimber	5.9	MBF	29.6	\$30,470.45	
	<i>B. T. Aspen</i>		5.9	<i>MBF</i>			
	Red Maple		4.7	MBF			
	Red Oak		107.8	MBF			
	Red Pine		9.8	MBF			
	White Oak		15.9	MBF			
	White Pine		0.6	MBF			
	Mixed Aspen		Pulpwood	92			Cords
	<i>B. T. Aspen</i>			38			<i>Cords</i>
	<i>Quaking Aspen</i>			54			<i>Cords</i>
	Mixed Hardwood			28			Cords
	<i>Black Cherry</i>			5			<i>Cords</i>
	<i>Red Maple</i>			23			<i>Cords</i>
	Mixed Oak			139			Cords

DESCRIPTION OF TIMBER BY PAYMENT UNIT (PU), CON'T

PU	MARKET GROUP	PRODUCT	QUANTITY	UNIT	ACRES	ADVERTISE PRICE	
4 con't	<i>Red Oak</i>	<i>Pulpwood</i>	112	<i>Cords</i>			
	<i>White Oak</i>		27	<i>Cords</i>			
	Red Pine		6	Cords			
	White Pine		1	Cords			
5	Mixed Aspen	Sawtimber	5.7	MBF	28.3	\$29,047.65	
	<i>B. T. Aspen</i>		5.7	<i>MBF</i>			
	Red Maple		4.5	MBF			
	Red Oak		103.1	MBF			
	Red Pine		9.3	MBF			
	White Oak		15.3	MBF			
	White Pine		0.6	MBF			
	Mixed Aspen		Pulpwood	87			Cords
	<i>B. T. Aspen</i>			36			<i>Cords</i>
	<i>Quaking Aspen</i>			51			<i>Cords</i>
	Mixed Hardwood	26		Cords			
	<i>Black Cherry</i>	4		<i>Cords</i>			
	<i>Red Maple</i>	22		<i>Cords</i>			
	Mixed Oak	132		Cords			
	<i>Red Oak</i>	107		<i>Cords</i>			
	<i>White Oak</i>	25		<i>Cords</i>			
	Red Pine	5	Cords				
	White Pine	1	Cords				
	6	Mixed Aspen	Sawtimber	4.7			MBF
<i>B. T. Aspen</i>		4.7		<i>MBF</i>			
Red Maple		6.9		MBF			
Red Oak		35.8		MBF			
Red Pine		37.7		MBF			
White Oak		13.6	MBF				
Mixed Aspen		Pulpwood	80	Cords			
<i>B. T. Aspen</i>			74	<i>Cords</i>			
<i>Quaking Aspen</i>			6	<i>Cords</i>			
Mixed Hardwood			113	Cords			
<i>Red Maple</i>			113	<i>Cords</i>			
Mixed Oak			62	Cords			
<i>Red Oak</i>			33	<i>Cords</i>			
<i>White Oak</i>			29	<i>Cords</i>			
Red Pine	12		Cords				
7	Mixed Aspen	Sawtimber	16.2	MBF	27.4	\$35,963.90	
	<i>B. T. Aspen</i>		15.2	<i>MBF</i>			
	<i>Quaking Aspen</i>		1.0	<i>MBF</i>			
	Red Maple	6.0	MBF				
	Red Oak	90.1	MBF				
	Mixed Aspen	Pulpwood	123	Cords			
	<i>B. T. Aspen</i>		121	<i>Cords</i>			
	<i>Quaking Aspen</i>		2	<i>Cords</i>			
	Mixed Hardwood		297	Cords			
	<i>Red Maple</i>		285	<i>Cords</i>			
	<i>æberry (Juneberry)</i>		12	<i>Cords</i>			
	Mixed Oak		219	Cords			
	<i>Red Oak</i>		217	<i>Cords</i>			
<i>White Oak</i>	2		<i>Cords</i>				
8	Mixed Aspen		Sawtimber	40.7	MBF	31.5	\$43,992.85
	<i>B. T. Aspen</i>	39.9		<i>MBF</i>			
	<i>Quaking Aspen</i>	0.8		<i>MBF</i>			
	Red Maple	7.5		MBF			
	Red Oak	95.9		MBF			

DESCRIPTION OF TIMBER BY PAYMENT UNIT (PU), CON'T

PU	MARKET GROUP	PRODUCT	QUANTITY	UNIT	ACRES	ADVERTISE PRICE
8 con't	Mixed Aspen	Pulpwood	255	Cords		
	<i>B. T. Aspen</i>		253	<i>Cords</i>		
	<i>Quaking Aspen</i>		2	<i>Cords</i>		
	Mixed Hardwood		321	Cords		
	<i>Red Maple</i>		310	<i>Cords</i>		
	<i>æberry (Juneberry)</i>		11	<i>Cords</i>		
	Mixed Oak		230	Cords		
	<i>Red Oak</i>		228	<i>Cords</i>		
	<i>White Oak</i>		2	<i>Cords</i>		
9	Basswood	Sawtimber	2.5	MBF	14.3	\$8,704.95
	Red Maple	Pulpwood	3.5	MBF		
	Sugar Maple		6.2	MBF		
	Balsam Fir		2	Cords		
	Mixed Aspen		111	Cords		
	<i>Quaking Aspen</i>		111	<i>Cords</i>		
	Mixed Hardwood		141	Cords		
	<i>Basswood</i>		15	<i>Cords</i>		
	<i>Beech</i>		5	<i>Cords</i>		
	<i>Red Maple</i>		22	<i>Cords</i>		
	<i>Sugar Maple</i>		99	<i>Cords</i>		
10	Basswood		Sawtimber	2.4	MBF	13.6
	Red Maple	Pulpwood	3.3	MBF		
	Sugar Maple		5.9	MBF		
	Balsam Fir		1	Cords		
	Mixed Aspen		106	Cords		
	<i>Quaking Aspen</i>		106	<i>Cords</i>		
	Mixed Hardwood		133	Cords		
	<i>Basswood</i>		14	<i>Cords</i>		
	<i>Beech</i>		5	<i>Cords</i>		
	<i>Red Maple</i>		20	<i>Cords</i>		
	<i>Sugar Maple</i>		94	<i>Cords</i>		
TOTAL:			792.2	MBF		
TOTAL:			3,397	Cords		

Sale Specific Conditions & Requirements

Sale Name: McCormick and Shoreline Mix

Sale Number: 54-002-21 Seq#: 2

1 - Sale Area

1.2 - Boundaries

1.2.1 - Painted boundaries (9/19)

The sale boundary and Payment Unit boundaries are marked and identified by blue, red, and yellow paint. Exterior sale boundary lines against private are marked with blue paint. Exterior sale boundary lines against state are marked with red paint. Interior retention boundaries are marked with red paint; no harvesting activities may occur within these areas. Interior Payment Unit boundaries are marked with yellow paint, except for Scenic Route 3 Road which is a Payment Unit line for Payment Units 5, 7, and 8 as shown on the Timber Sale Map. The painted boundary line trees are not Included Timber and are to be protected. Yellow painted trees designating an interior Payment Unit boundary are only to be cut when all surrounding Payment Units have been paid.

2 - Timber Specifications

2.1 - Included Timber

2.1.1 - Clearcut unit(s) with unmerchantable trees (6/14)

Within Payment Unit(s) 1 and 3-10, cut all trees that are two (2) inches or more at DBH, except:

- Within Payment Units 4-5 do not cut oak less than 4 inches;
- Within Payment Unit 6 do not cut purple painted pine trees;
- Within Payment Units 7-8 do not cut white or red pine;
- Within Payment Units 9-10 do not cut white pine.

Note: See spec 5.2.4.4 - 'Dead and down creation, grouse' for instructions on orange marked trees.

2.1.3 - Cut tree marked unit(s) (12/08)

Within Payment Unit(s) 2, all trees are designated for cutting when marked with orange paint above and below stump height, regardless of merchantability.

2.2 - Utilization

2.2.2 - Chipping required (2/18)

Payment Units 4 and 5 must be chip harvested to facilitate future silvicultural activities. The Purchaser has the option to produce sawlogs or pulpwood bolts, but the remaining portion of the trees must be chipped and hauled. Products may be produced as roundwood and forwarded to decking areas in final product length, but the tops must be left intact and skidded to the landing for chipping to minimize the amount of residual slash. If market conditions limit the practicality of chipping the following is required: Tops must be cut into lengths 4 feet or less and trees greater than 4 inches at DBH must be cut to a 2-inch top or smaller. Sub-merchantable trees, and hardwood limbs 4 inches or greater where they attach to the stem, are to be cut/reduced to 4-foot lengths. Tops and slash must also be spread evenly across the sale. This is to speed the breakdown of tops and slash. The requirement to retain approximately 1/6 to 1/3 of tree tops and limbs less than four inches in diameter is still applicable (G. C. & R. 2.2).

2.2.3 - Stump heights (4/07)

Stump heights within Payment Units 4 and 5 shall not exceed 6 inches for all trees. This is to facilitate future silvicultural activities. A written waiver of this requirement may be obtained if wet summer weather makes winter logging necessary.

2.2.5 - Limbed tree skidding (1/09)

The skidding of whole trees or tree segments with limbs attached is prohibited within Payment Unit 2 unless approved by the Unit Manager or his/her representative.

3 - Payments

3.3 - Pre-measured Sales

3.3.4 - Dividing payment units (7/14)

Payment Unit(s) may be divided at the request of the Purchaser and upon approval of the Unit Manager. Dividing Payment Units is a contract modification which requires a Timber Sale Contract Amendment. Payment Units valued over \$25,000 may

be divided. There will be only one division per Payment Unit.

3.4 - Damaged Timber

3.4.1 - Damaged timber (7/16)

General Condition and Requirement 3.4 Damaged Timber, defines liquidated damages for undesignated live merchantable trees which are cut or injured.

Within Payment Units 4-5, operations must avoid damaging oak seedlings and saplings (1/4" to 4" DBH) where it is possible. No damage is acceptable to undesignated live merchantable trees. Within the Sale Area, if more than 5% of trees (> 4.5" DBH) within a specified area of the sale are damaged, liquidated damages will be assessed for all trees damaged. Rates will be in accordance with General Condition and Requirement 3.4 Damaged Timber.

4 - Transportation

4.1 - Construction

4.1.3 - Slash and earthen piles (8/04)

Piles or windrows of earth along roads and landings that have been widened or constructed shall be leveled. Slash from road maintenance or construction, including stumps, shall be chipped, utilized, or otherwise removed from the sale.

4.1.6 - Road construction (1/09)

Construction or improvements of existing roads shall be done in such a way as to minimize the environmental and visual impacts. Merchantable trees shall be cut and utilized unless otherwise directed. Non-merchantable trees shall be severed and laid flat on the ground. Slash shall be scattered, and not left in windrows and kept a minimum of 10 feet back from the road edge. Stumps shall be set upright, not left on edge, and be moved at least 10 feet away from the road edge. Disturbed soil shall be feathered into the woods and not left in berms or windrows.

4.1.7 - Road closure (10/11)

All new roads built into the sale must be blocked to vehicle traffic upon completion of the sale. Overgrown roads that are reopened shall be considered new roads. In general, this will require constructing a four (4') foot high berm of stumps and logs covered with earth. Stumps and brush must be placed along the remainder of the trail. These roads must be rendered impassable to cars and trucks. Contact the sale administrator for specific details of design and placement.

4.2 - Maintenance

4.2.5 - Two wheel drive condition (2/04)

All existing trail roads on and adjacent to the sale area must be passable by two-wheel drive traffic for the duration of the sale.

5 - Operations

5.1 - Notification

5.1.1 - Pre-sale conference (10/16)

A pre-sale conference between the Purchaser and sale administrator is required prior to beginning any operations to determine landing and road locations. The Unit Manager or his/her representative must be contacted at least 5 days in advance to schedule the conference.

5.1.3 - Well heads and natural gas pipelines (11/15)

The Purchaser is responsible for contacting the following party 30 days prior to operating equipment in the vicinity of well heads or natural gas pipelines.

(All Payment Units)

Riverside Energy Michigan

10691 E Carter Rd, Suite 201

Traverse City, MI 49684

Phone: (231) 995-4000 (M-F, 8am-5pm)

5.1.4 - Post-sale conference (10/16)

A post-sale conference on site between the Purchaser and sale administrator is required 5 days prior to the completion of active logging operations to determine clean-up and repair of landings, road edges, and the fulfillment of other contract specifications.

5.2 - Conduct of Operations

5.2.2 - Hazard Trees/Snags

5.2.2.1 - Den trees (10/16)

Obvious hollow and/or den trees shall be protected and left standing unless they are a safety hazard.

5.2.3 - Operating Restrictions

5.2.3.3 - Bark slippage restriction (3/09)

Within Payment Unit(s) 2, unless changed by written agreement, cutting and skidding are not permitted during the period of April 15 to July 15. This restriction is because of bark slippage.

5.2.3.5 - Oak wilt restriction (1/18)

Within Payment Unit(s) 1-8, unless changed by written agreement, cutting, skidding, hauling within the sale and brushing of access roads to the sale are not permitted during the period of April 15 to July 15. Operations may be allowed if specific steps are taken to prevent damaging uncut oak during the high risk period. Those steps may include completing all road brushing before April 15th and clearing a tree-length buffer along uncut oak cover before April 15th. This is necessary to reduce the spread of oak wilt. For more information, contact the Unit Manager or his/her representative.

5.2.3.11 - Coppice regeneration protection (4/10)

Timber harvesting in Payment Units 1 and 3-10 must be completed within 60 days of severing/cutting stem(s) to minimize damage to deciduous regeneration. Any post-harvest operations, such as chipping, must be completed before sprouting of regeneration occurs. If it is anticipated that chipping will be delayed, then tops shall be carried to one central location or left unchipped. The Unit Manager or his/her representative may cease such operations if sprouting occurs before the operation is complete.

5.2.4 - Dead and Down Creation

5.2.4.4 - Dead and down creation, grouse (6/18)

To encourage grouse and other wildlife, in Payment Unit(s) 1, 3, and 6-10, leave on-site all orange painted trees. These trees should be tipped over with the root ball still attached so the base of the tree is suspended off the ground. The crown of the fallen tree should be at or near ground level after it is pushed over. If it is impractical to push the trees over, they may be cut or partially cut and pushed over. Whenever possible, the tree stem should remain suspended off the ground.

5.2.31 - Landing locations (9/13)

Landing locations are shown on the Timber Sale Map. Landings must be confined to these designated sites unless otherwise authorized by the Unit Manager or his/her representative.

5.2.32 - Decking/landing restoration (9/13)

All decking and landing areas must have the surface area restored to a condition equal to or better than before. This is to ensure the proper regeneration of the stand. Wood debris, chips, and "cookies" from trimmings must be removed or scattered away from landing and loading areas and may not be windrowed on the edge.

5.2.38 - No decking against live trees (2/04)

Cut products may not be decked against unmarked or designated leave trees.

5.2.39 - ORV trail/route protection (4/18)

The Atlanta to Hunt Creek Motorcycle MCCCT is shown on the Timber Sale Map. Do not cut trees or damage posts with yellow ORV markers. All stumps within 5 feet of the trail must be cut flush with the ground. Maintain a 20-foot-wide slash, debris, and rut free zone daily using the ORV trail or route as the centerline.

5.4 - Soil Protection

5.4.1 - Rutting restriction, general (7/16)

Operations are to cease immediately if equipment and weather conditions result in rutting of roads and/or skid trails which is 12 inches or greater in depth and 50 feet in length. The Unit Manager or his/her representative may restrict hauling and/or skidding if ruts exceed the specified depth. With the Unit Manager or his/her representative's approval, the Purchaser may return to the area when the risk of rutting has decreased.

5.4.2 - Skid trails (2/04)

Skid trails up and down slopes should be avoided. If however this is unavoidable, these trails will be left in a non-erodible condition using water bars, logs, and slash. Placing of slash on these skid trails while logging is ongoing may alleviate need for any further action. At the direction of the sale administrator, seed, fertilizer, and mulch may also be required.

5.8 - Protection of Endangered Species

5.8.5 - Protection of raptor nests (3/13)

All trees with raptor nests will be protected if found during harvesting operations. Notification will be made to the Unit Manager or his/her representative who will notify the Wildlife Biologist so an on-site evaluation and recommendation can be made, if necessary.

6 - Safety and Fire Prevention

6.2 - Signing

6.2.3 - Recreational trail posting (10/20)

The Purchaser is responsible for posting and maintaining caution signs on the Atlanta to Hunt Creek Motorcycle MCCCT prior to beginning operations. The trail must be posted at appropriate distances from the Sale Area to warn of logging activity and truck traffic at both ends of the trail. Signs must be removed when harvest operations are suspended or completed. The Purchaser will provide these signs.



TIMBER SALE MAP

This information provided by authority of Part 525, 1994 PA 451, as amended.

Forest Management Unit Atlanta Management Unit	County Montmorency	Mapped By Coy	Date 04/14/2021	Page 1	of 2
Cruised By Coy					

Township 29N & 30N	Range 01E & 02E	Section(s) and Subdivision(s) 25-SESE 36-NENE 28-W2SE 31-NESW,S2SW,SE 33-S2NE	6-N2NW	Scale 1:15,840
-----------------------	--------------------	--	--------	-------------------

Cover Type				Density			
A = Aspen	H = Hemlock	N = Marsh	U = Upland Brush	0 = Non Stocked	5 = Pole Timber Medium		
B = Paper Birch	J = Jack Pine	O = Oak	UM = Upland Mixed	1 = Seedling Sapling Poor	6 = Pole Timber Well		
C = Cedar	L = Lowland Brush	P = Lowland Poplar	V = Bog or Marsh	2 = Seedling Sapling Medium	7 = Saw Timber Poor		
D = Treed Bog	LM = Lowland Mixed	Q = Mixed Swamp Conifer	W = White Pine	3 = Seedling Sapling Well	8 = Saw Timber Medium		
E = Swamp Hdwoods	M = Mpl, Bch, Brch	R = Red Pine	X = Non Stocked	4 = Pole Timber Poor	9 = Saw Timber Well		
F = Spruce Fir	MC = Mixed Conifer	S = Black Spruce	Z = Water				
G = Grass	MD = Mixed Deciduous	T = Tamarack					

PU	Acres	PU	Acres
1	14.6	6	18.8
2	16.7	7	27.4
3	23.8	8	31.5
4	29.6	9	14.3
5	28.3	10	13.6

McCormick and Shoreline Mix

Compartment 23

218.6 Acres

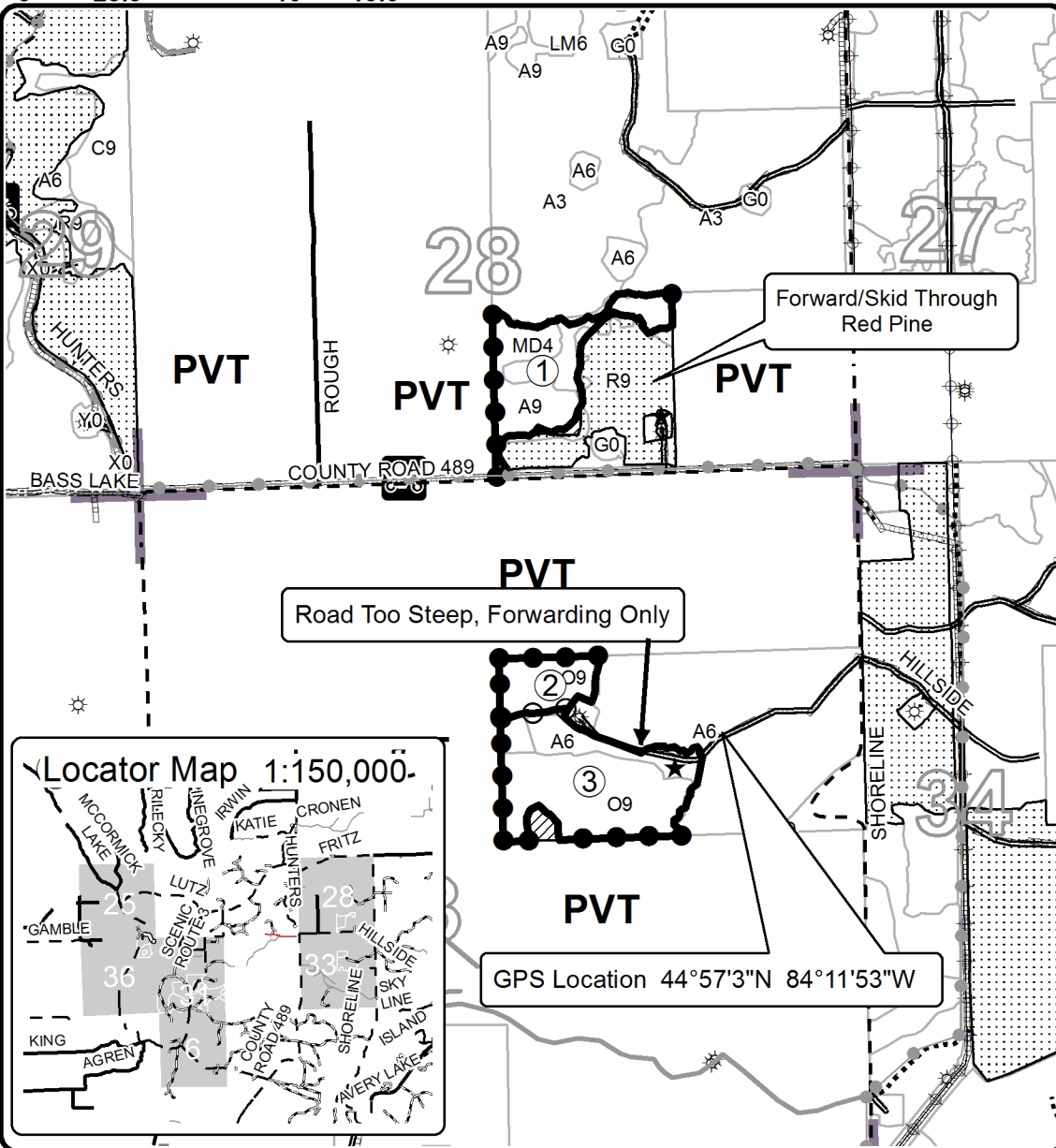
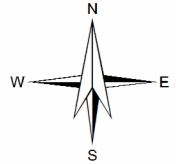

Legend

- Against State (Red)
- Private Line (Blue)
- Payment Unit (Yellow)
- Retention Area (Red)
- Nearby Timber Sales
- Stand Boundaries
- Payment Unit
- Landing
- Gas Well
- Section Corner
- Recreational Trail
- Secondary Forest Road
- Forest Access Route
- Paved Road
- Gravel Road
- County Road - Seasonal
- Private Road
- Temporary Access
- Pipeline
- Powerline

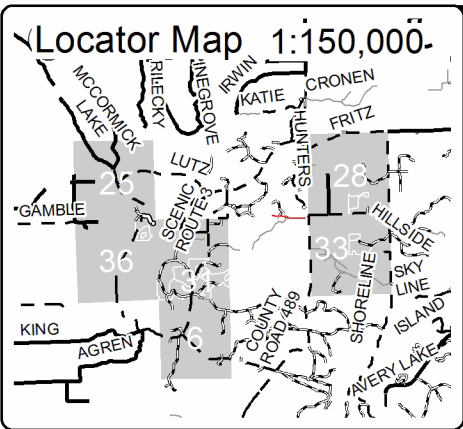

GPS Location 44°57'3"N 84°11'53"W

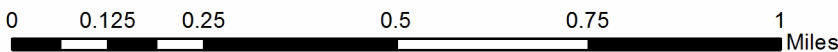



TIMBER SALE MAP

This information provided by authority of Part 525, 1994 PA 451, as amended.

Sale Number	Year
54 - 002	21

Forest Management Unit Atlanta Management Unit	County Montmorency	Mapped By Coy	Date 04/14/2021	Page 2	of 2
Township 29N & 30N	Range 01E & 02E	Section(s) and Subdivision(s) 25-SESE 36-NENE 28-W2SE 31-NESW,S2SW,SE 33-S2NE	Scale 1:15,840		

Cover Type

A = Aspen	H = Hemlock	N = Marsh	U = Upland Brush
B = Paper Birch	J = Jack Pine	O = Oak	UM = Upland Mixed
C = Cedar	L = Lowland Brush	P = Lowland Poplar	V = Bog or Marsh
D = Treed Bog	LM = Lowland Mixed	Q = Mixed Swamp Conifer	W = White Pine
E = Swamp Hdwoods	M = Mpl, Bch, Brch	R = Red Pine	X = Non Stocked
F = Spruce Fir	MC = Mixed Conifer	S = Black Spruce	Z = Water
G = Grass	MD = Mixed Deciduous	T = Tamarack	

Density

0 = Non Stocked	5 = Pole Timber Medium
1 = Seedling Sapling Poor	6 = Pole Timber Well
2 = Seedling Sapling Medium	7 = Saw Timber Poor
3 = Seedling Sapling Well	8 = Saw Timber Medium
4 = Pole Timber Poor	9 = Saw Timber Well

PU	Acres	PU	Acres
1	14.6	6	18.8
2	16.7	7	27.4
3	23.8	8	31.5
4	29.6	9	14.3
5	28.3	10	13.6

McCormick and Shoreline Mix

Compartment 23

218.6 Acres

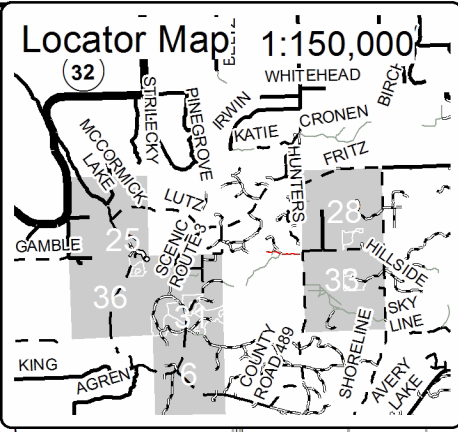
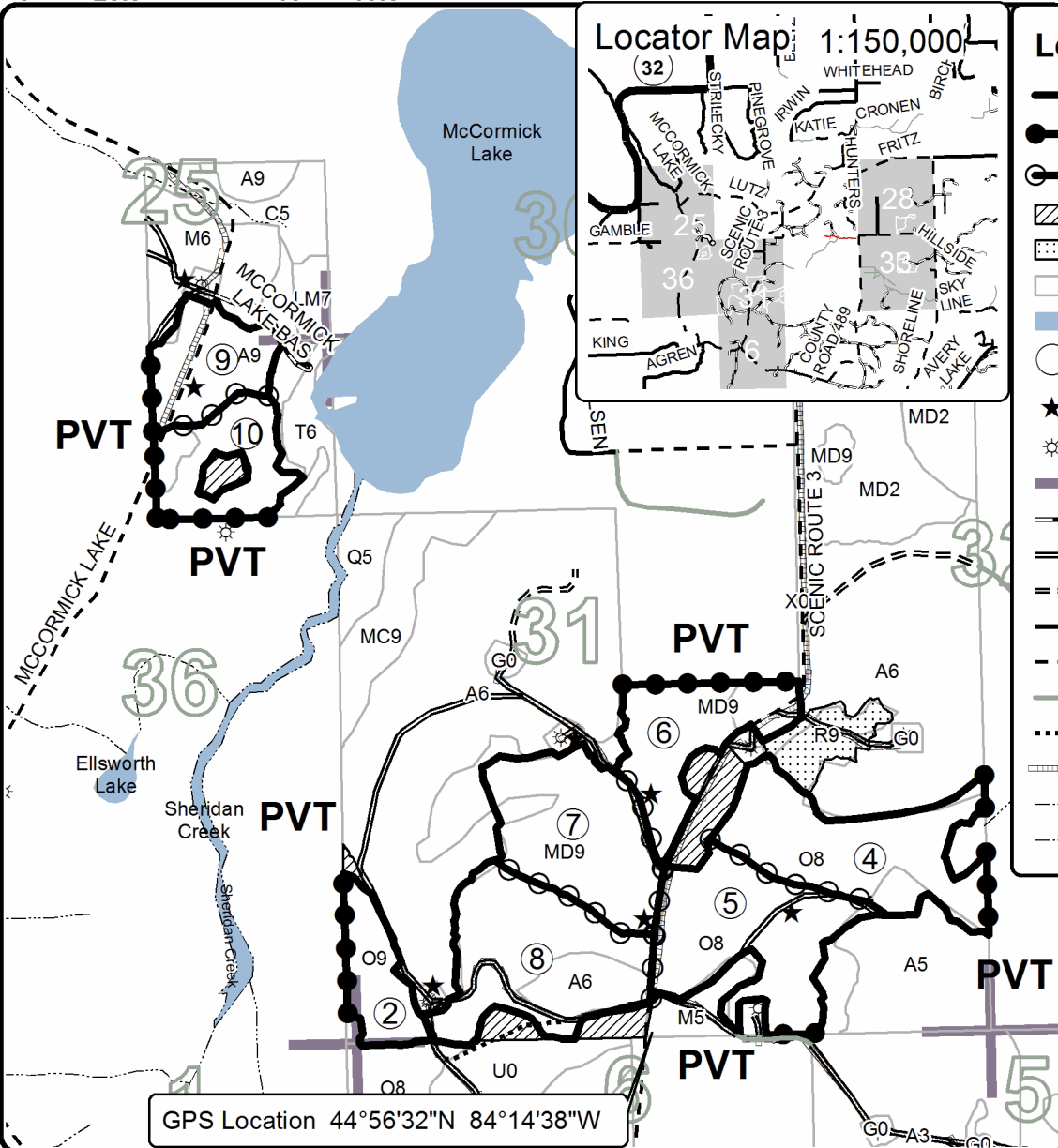
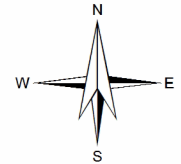

Legend

- Against State (Red)
- Private Line (Blue)
- Payment Unit (Yellow or Road)
- Retention Area (Red)
- Nearby Timber Sales
- Stand Boundaries
- Lakes
- Payment Unit
- Landing
- Gas Well
- Section Corner
- Primary Forest Road
- Secondary Forest Road
- Forest Access Route
- Paved Road
- Gravel Road
- Private Road
- Temporary Access
- Pipeline
- Intermittent Stream
- Perennial River

GPS Location 44°56'32"N 84°14'38"W

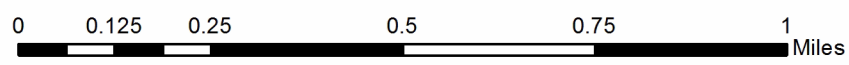

TIMBER SALE INFORMATION

489 and Scenic Route 3 RP (54-003-21)
 T30N, R02E, SEC. 28; T30N, R02E, SEC. 31.
 Montmorency County (Advertised Price \$67,940.20)

SALE NOTE: All units of volume listed for this sale were estimated using the Inventory Manager computer program and the new Michigan taper model.

A recreation site such as a trail, pathway, or campground is within the sale area or the vicinity. Certain restrictions/specifications may be applicable including time restrictions.

A timber sale contract for this lump sum, sealed bid timber sale will be awarded to the responsible bidder offering the highest sealed bid price. All units of volume listed below were estimated using the Inventory Manager computer program and the new Michigan taper model. Bids must be at or above the following advertised price for each product and species:

<u>PRODUCTS & SPECIES</u>	<u>ESTIMATED UNITS*</u>	<u>ADVERTISED PRICE</u>
Sawtimber		
B. T. Aspen	1.8 MBF	\$ 126.00 / MBF
Black Cherry	1.3 MBF	\$ 128.00 / MBF
Red Maple	1.9 MBF	\$ 56.00 / MBF
Red Pine	385.4 MBF	\$ 129.00 / MBF
Pulpwood		
B. T. Aspen	85 Cords	\$ 30.35 / Cord
Black Cherry	45 Cords	\$ 25.70 / Cord
Northern Pin Oak	3 Cords	\$ 45.80 / Cord
Quaking Aspen	3 Cords	\$ 30.35 / Cord
Red Maple	9 Cords	\$ 25.70 / Cord
Red Pine	390 Cords	\$ 34.10 / Cord
White Oak	5 Cords	\$ 45.80 / Cord

* The total volume is statistically estimated within plus (+) or minus (-) 11.51 percent. There are an estimated 1,408 cords on this timber sale, plus or minus 162 cords at the 95% confidence level. The estimated units are final and not subject to adjustment. Prospective bidders are urged to examine this timber and to make their own estimates of quantity and quality.

BOND AND PAYMENT SCHEDULE:

1. A bond in the amount of \$3,397.00 to insure faithful performance of the conditions of the contract will be deposited by the successful bidder within 21 days of the sale award.
2. Cutting in any sale or unit without the required advance payment would be considered a trespass.
3. Total payment must be paid in advance or according to the following schedule :
 - (a) Ten percent (10%) of the sale value must be paid within 21 days of the sale award.
 - (b) The 10% down payment will be credited towards the first unit cut.
 - (c) Payment for each of the following units must be made before cutting begins in that unit:

PAYMENT UNIT NUMBER	PERCENT OF TOTAL SALE VALUE
01	73.5%
02	26.5%

4. If no cutting takes place, the 10% down payment will not be refunded.
5. Operations on the contract issued will terminate on 12/31/2024.

SALE STATISTICS

Volumes were calculated in cubic feet using the Michigan taper model. Cubic foot volume includes all wood inside bark for the product indicated. For display purposes, cubic feet were converted to cords and MBF using a simple conversion factor, e.g. 79 cubic feet per cord and 185 cubic feet per MBF. The cubic foot volumes are precise; the cords and MBF volumes are not. Cubic foot volume cannot be directly converted to cords or boards with precision.

SALE VOLUMES

The total estimated sale volume may not equal the sum of the species/products due to the nature of statistical calculations associated with double sampling methodology.

VOLUME			STATISTICAL RANGE IN CORDS	
TOTAL CUBIC FEET	TOTAL CORDS	PERCENT ERROR	MINIMUM	MAXIMUM
111,271	1,408	11.51%	1,246	1,571

VDU VOLUMES

A VDU is a Volume Determination Unit. Volumes and their associated statistics are calculated at the VDU level and summarized to the sale level. There is often a one to one relationship between a VDU and a Payment Unit, but not always, depending on the cruise design. Refer to the VDU TO PAYMENT UNIT table.

	VOLUME			RANGE IN CORDS	
VDU	TOTAL CUBIC FEET	TOTAL CORDS	PERCENT ERROR	MINIMUM	MAXIMUM
83	29,195	370	15.07%	314	425
94	75,172	952	14.56%	813	1,090
TOTAL:	104,367	1,321		1,127	1,515

VDU TO PAYMENT UNIT

When a VDU is associated with more than one Payment Unit (PU), the VDU volumes are assigned to the PU based on acres of the VDU within the PU.

VDU	VDU ACRES	PU	PU ACRES
83	7.3	2	7.3
94	17.0	1	17.0
TOTAL:	24.3		24.3

DESCRIPTION OF TIMBER BY PAYMENT UNIT (PU)

PU	MARKET GROUP	PRODUCT	QUANTITY	UNIT	ACRES	ADVERTISE PRICE
1	Black Cherry	Sawtimber	1.3	MBF	17.0	\$49,946.20
	Red Pine		292.6	MBF		
	Black Cherry	Pulpwood	45	Cords		
	Red Pine		319	Cords		
2	B. T. Aspen	Sawtimber	1.8	MBF	7.3	\$17,994.00
	Red Maple		1.9	MBF		
	Red Pine		92.8	MBF		
	B. T. Aspen	Pulpwood	85	Cords		
	Northern Pin Oak		3	Cords		
	Quaking Aspen		3	Cords		
	Red Maple		9	Cords		
	Red Pine		71	Cords		
	White Oak		5	Cords		
	TOTAL:			390.4		
TOTAL:			540	Cords		

Sale Specific Conditions & Requirements

Sale Name: 489 and Scenic Route 3 RP

Sale Number: 54-003-21 Seq#: 1

1 - Sale Area

1.2 - Boundaries

1.2.1 - Painted boundaries (9/19)

The sale boundaries are marked and identified by blue and/or red paint. Exterior sale boundary lines against private are marked with blue paint. Exterior sale boundary lines against state are marked with red paint. Interior retention boundaries are marked with red paint; no harvesting activities may occur within these areas. The painted boundary line trees are not Included Timber and are to be protected.

2 - Timber Specifications

2.1 - Included Timber

2.1.1 - Clearcut unit(s) with unmerchantable trees (6/14)

Within Payment Unit(s) 1 and 2, cut all trees that are two (2) inches or more at DBH.

2.2 - Utilization

2.2.2 - Chipping required (2/18)

Payment Units 1 and 2 must be chip harvested to facilitate future silvicultural activities. The Purchaser has the option to produce sawlogs or pulpwood bolts, but the remaining portion of the trees must be chipped and hauled. Products may be produced as roundwood and forwarded to decking areas in final product length, but the tops must be left intact and skidded to the landing for chipping to minimize the amount of residual slash. If market conditions limit the practicality of chipping the following is required: Tops must be cut into lengths 4 feet or less and trees greater than 4 inches at DBH must be cut to a 2-inch top or smaller. Sub-merchantable trees, and hardwood limbs 4 inches or greater where they attach to the stem, are to be cut/reduced to 4-foot lengths. Tops and slash must also be spread evenly across the sale. This is to speed the breakdown of tops and slash. The requirement to retain approximately 1/6 to 1/3 of tree tops and limbs less than four inches in diameter is still applicable (G. C. & R. 2.2).

2.2.3 - Stump heights (4/07)

Stump heights within Payment Units 1 and 2 shall not exceed 6 inches for all trees. This is to facilitate future silvicultural activities. A written waiver of this requirement may be obtained if wet summer weather makes winter logging necessary.

4 - Transportation

4.1 - Construction

4.1.3 - Slash and earthen piles (8/04)

Piles or windrows of earth along roads and landings that have been widened or constructed shall be leveled. Slash from road maintenance or construction, including stumps, shall be chipped, utilized, or otherwise removed from the sale.

4.1.12 - No new roads (1/12)

No new roads will be permitted in any Payment Unit. All operations are limited to existing roads. Skid trails only will be allowed.

4.2 - Maintenance

4.2.5 - Two wheel drive condition (2/04)

All existing trail roads on and adjacent to the sale area must be passable by two-wheel drive traffic for the duration of the sale.

5 - Operations

5.1 - Notification

5.1.1 - Pre-sale conference (10/16)

A pre-sale conference between the Purchaser and sale administrator is required prior to beginning any operations to determine

landing and road locations. The Unit Manager or his/her representative must be contacted at least 5 days in advance to schedule the conference.

5.1.3 - Well heads and natural gas pipelines (11/15)

The Purchaser is responsible for contacting the following parties 30 days prior to operating equipment in the vicinity of well heads or natural gas pipelines.

(All Payment Units)

Riverside Energy Michigan

10691 E Carter Rd, Suite 201

Traverse City, MI 49684

Phone: (231) 995-4000 (M-F, 8am-5pm)

5.1.4 - Post-sale conference (10/16)

A post-sale conference on site between the Purchaser and sale administrator is required 5 days prior to the completion of active logging operations to determine clean-up and repair of landings, road edges, and the fulfillment of other contract specifications.

5.1.6 - Utility R.O.W. (4/19)

It is the responsibility of the Purchaser to obtain permission from the utility company to utilize the power line R.O.W. for operations. Contact:

Presque Isle Electric and Gas Cooperative

19831 M-68 Highway

PO Box 308

Onaway, MI 49765-0308

Phone: 1-800-423-6634 (Hours of Operation: Monday-Friday 8:00am-4:30pm)

5.2 - Conduct of Operations

5.2.3 - Operating Restrictions

5.2.3.6 - Bark beetle restriction (12/08)

In the event drought creates a high risk of pine bark beetle infestation, pine is not to be cut during the period March 1 through July 1, unless all portions of trees greater than two inches in diameter are removed from the sale area, reduced to chips, or treated to the satisfaction of the Unit Manager or his/her representative, within fifteen days of being severed from the stump. Pine log decks, pulpwood piles and treetops that are piled for chipping in the fall or winter within a 1/4 mile of susceptible sites must be removed before March 15. Residual slash must not be placed in piles or rows and must be spread over the site for quick drying. The Department of Natural Resources will exercise this specification if the risk of damage warrants.

5.2.31 - Landing locations (9/13)

Landing locations are shown on the Timber Sale Map. Landings must be confined to these designated sites unless otherwise authorized by the Unit Manager or his/her representative.

5.2.32 - Decking/landing restoration (9/13)

All decking and landing areas must have the surface area restored to a condition equal to or better than before. This is to ensure the proper regeneration of the stand. Wood debris, chips, and "cookies" from trimmings must be removed or scattered away from landing and loading areas and may not be windrowed on the edge.

5.2.38 - No decking against live trees (2/04)

Cut products may not be decked against unmarked or designated leave trees.

5.2.39 - ORV trail/route protection (4/18)

The Atlanta to Hunt Creek Motorcycle MCCCT is shown on the Timber Sale Map. Do not cut trees or damage posts with yellow ORV markers. Maintain a 20-foot-wide slash, debris, and rut free zone daily using the ORV trail or route as the centerline.

5.4 - Soil Protection

5.4.1 - Rutting restriction, general (7/16)

Operations are to cease immediately if equipment and weather conditions result in rutting of roads and/or skid trails which is 12 inches or greater in depth and 50 feet in length. The Unit Manager or his/her representative may restrict hauling and/or skidding if ruts exceed the specified depth. With the Unit Manager or his/her representative's approval, the Purchaser may return to the area when the risk of rutting has decreased.

5.8 - Protection of Endangered Species

5.8.5 - Protection of raptor nests (3/13)

All trees with raptor nests will be protected if found during harvesting operations. Notification will be made to the Unit Manager or his/her representative who will notify the Wildlife Biologist so an on-site evaluation and recommendation can be made, if necessary.

6 - Safety and Fire Prevention

6.2 - Signing

6.2.3 - Recreational trail posting (10/20)

The Purchaser is responsible for posting and maintaining caution signs on the Atlanta to Hunt Creek Motorcycle MCCCT prior to beginning operations. The trail must be posted at appropriate distances from the Sale Area to warn of logging activity and truck traffic at both ends of the trail. Signs must be removed when harvest operations are suspended or completed. The Purchaser will provide these signs.



TIMBER SALE MAP

This information provided by authority of Part 525, 1994 PA 451, as amended.

Forest Management Unit Atlanta Management Unit	County Montmorency	Mapped By Coy	Date 4/26/2021	Page 1	of 2
Cruised By Coy					

Township 30N	Range 02E	Section(s) and Subdivision(s) 28-SWSE 31-N1/2SE	Scale 1:7,920
-----------------	--------------	--	------------------

Cover Type				Density			
A = Aspen	H = Hemlock	N = Marsh	U = Upland Brush	0 = Non Stocked	5 = Pole Timber Medium		
B = Paper Birch	J = Jack Pine	O = Oak	UM = Upland Mixed	1 = Seedling Sapling Poor	6 = Pole Timber Well		
C = Cedar	L = Lowland Brush	P = Lowland Poplar	V = Bog or Marsh	2 = Seedling Sapling Medium	7 = Saw Timber Poor		
D = Treed Bog	LM = Lowland Mixed	Q = Mixed Swamp Conifer	W = White Pine	3 = Seedling Sapling Well	8 = Saw Timber Medium		
E = Swamp Hdwoods	M = Mpl, Bch, Brch	R = Red Pine	X = Non Stocked	4 = Pole Timber Poor	9 = Saw Timber Well		
F = Spruce Fir	MC = Mixed Conifer	S = Black Spruce	Z = Water				
G = Grass	MD = Mixed Deciduous	T = Tamarack					

PU	Acres
1	17.0
2	7.3

489 and Scenic Route 3 RP

Compartment 23

24.3 Acres

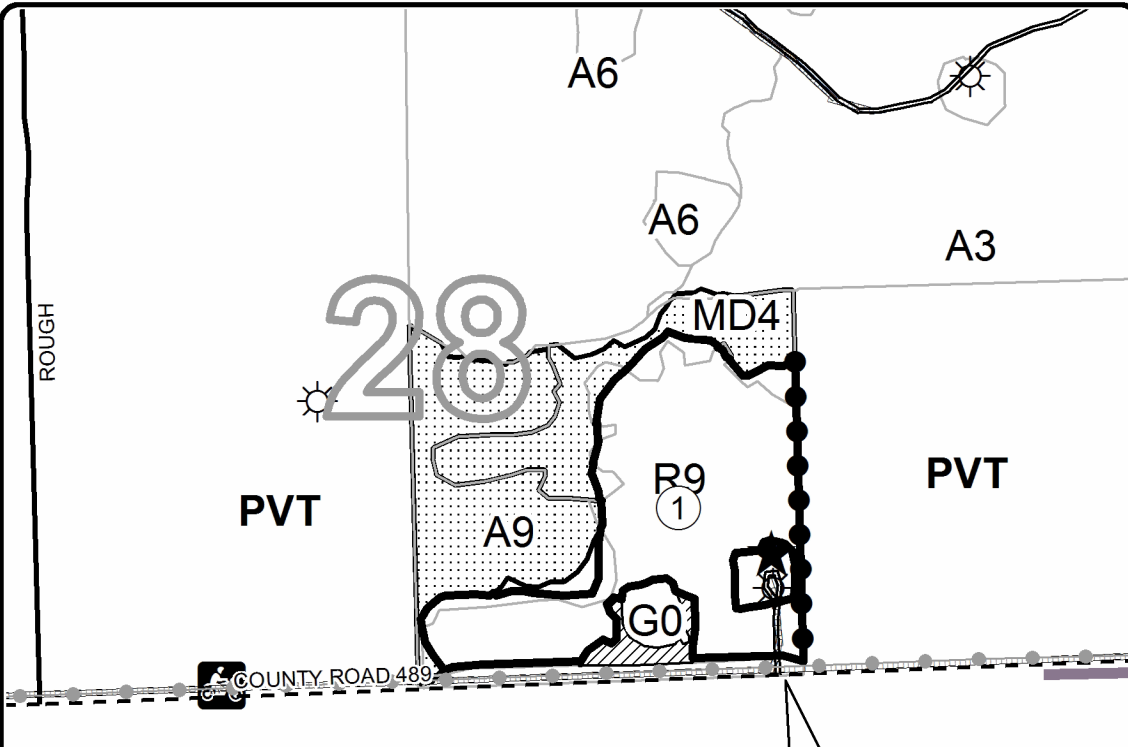
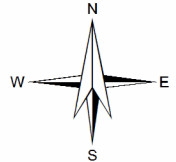

Legend

- Against State (Red)
- Private Line (Blue)
- Retention Area (Red)
- Stand Boundaries
- Nearby Timber Sales
- Landing
- Payment Unit
- Gas Well
- Section Corner
- Recreational Trail
- Secondary Forest Road
- Paved Road
- Gravel Road
- Pipeline

GPS Location 44°57'23"N 84°11'55"W

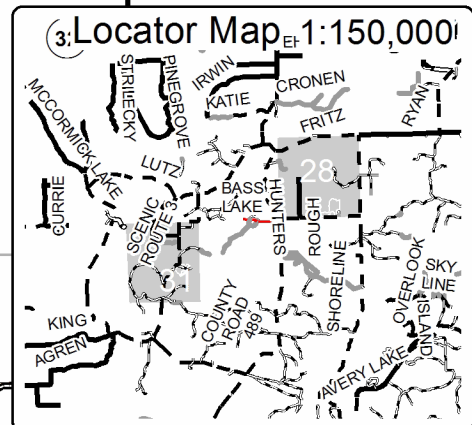



TIMBER SALE MAP

This information provided by authority of Part 525, 1994 PA 451, as amended.

Forest Management Unit Atlanta Management Unit	County Montmorency	Mapped By Coy	Date 04/19/2021	Page 2	of 2
Township 30N	Range 02E	Section(s) and Subdivision(s) 28-SWSE 31-N1/2SE	Scale 1:7,920		

Cover Type				Density	
A = Aspen	H = Hemlock	N = Marsh	U = Upland Brush	0 = Non Stocked	5 = Pole Timber Medium
B = Paper Birch	J = Jack Pine	O = Oak	UM = Upland Mixed	1 = Seedling Sapling Poor	6 = Pole Timber Well
C = Cedar	L = Lowland Brush	P = Lowland Poplar	V = Bog or Marsh	2 = Seedling Sapling Medium	7 = Saw Timber Poor
D = Treed Bog	LM = Lowland Mixed	Q = Mixed Swamp Conifer	W = White Pine	3 = Seedling Sapling Well	8 = Saw Timber Medium
E = Swamp Hdwoods	M = Mpl, Bch, Brch	R = Red Pine	X = Non Stocked	4 = Pole Timber Poor	9 = Saw Timber Well
F = Spruce Fir	MC = Mixed Conifer	S = Black Spruce	Z = Water		
G = Grass	MD = Mixed Deciduous	T = Tamarack			

PU Acres

1	17.0
2	7.3

489 and Scenic Route 3 RP

Compartment 23

24.3 Acres

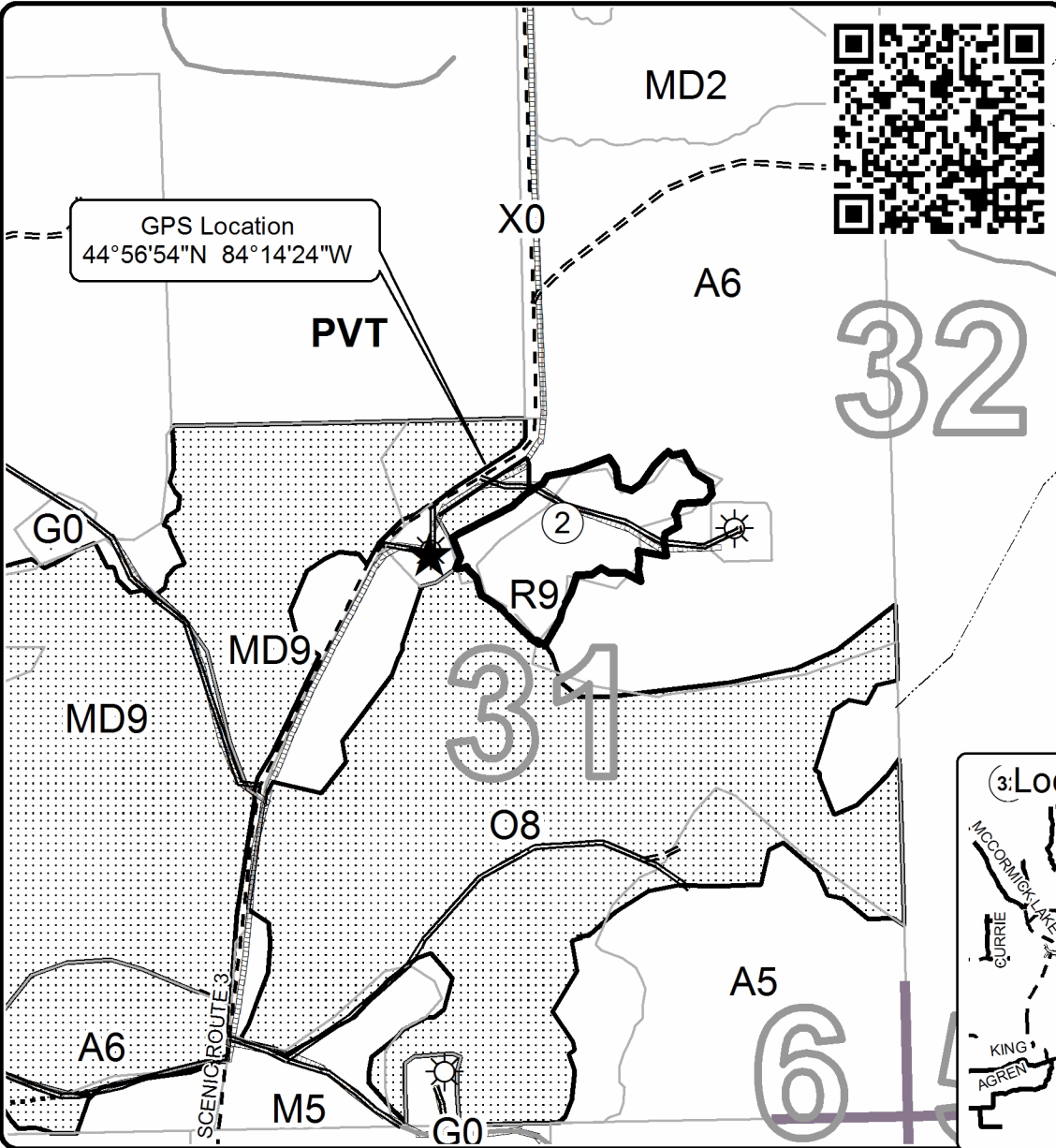
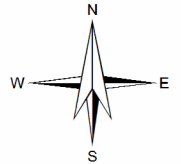

Legend

- Against State (Red)
- Stand Boundaries
- Nearby Timber Sales
- Landing
- Payment Unit
- Gas Well
- Section Corner
- Secondary Forest Road
- Forest Access Route
- Gravel Road
- Private Road
- Temporary Access
- Pipeline
- Perennial River

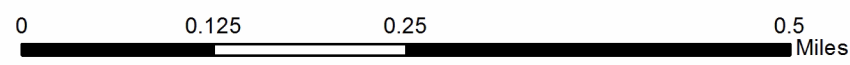
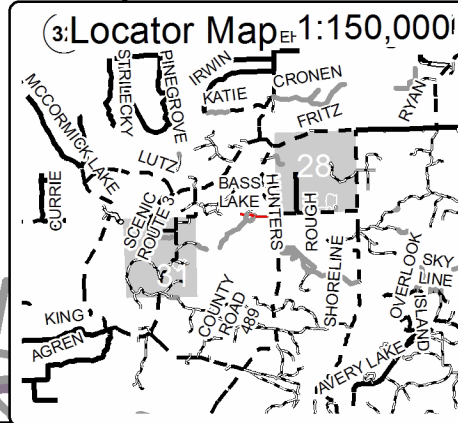

TIMBER SALE INFORMATION

Crunchy Country Mix (54-009-21)
 T29N, R01E, SEC. 6; T30N, R01E, SEC. 31.
 Montmorency County (Advertised Price \$41,936.85)

SALE NOTE: All units of volume listed for this sale were estimated using the Inventory Manager computer program and the new Michigan taper model.

A recreation site such as a trail, pathway, or campground is within the sale area or the vicinity. Certain restrictions/specifications may be applicable including time restrictions.

A timber sale contract for this lump sum, sealed bid timber sale will be awarded to the responsible bidder offering the highest sealed bid price. All units of volume listed below were estimated using the Inventory Manager computer program and the new Michigan taper model. Bids must be at or above the following advertised price for each product and species:

<u>PRODUCTS & SPECIES</u>	<u>ESTIMATED UNITS*</u>	<u>ADVERTISED PRICE</u>
Sawtimber		
Northern Pin Oak	19.8 MBF	\$ 58.00 / MBF
Red Oak	88.4 MBF	\$ 176.00 / MBF
Red Pine	8.0 MBF	\$ 109.00 / MBF
White Oak	8.1 MBF	\$ 64.00 / MBF
Pulpwood		
Jack Pine	60 Cords	\$ 11.00 / Cord
Mixed Aspen	115 Cords	\$ 25.70 / Cord
Mixed Oak	434 Cords	\$ 38.75 / Cord
Red Maple	139 Cords	\$ 21.75 / Cord
Red Pine	12 Cords	\$ 28.85 / Cord
White Pine	3 Cords	\$ 12.40 / Cord

* The total volume is statistically estimated within plus (+) or minus (-) 7.87 percent. There are an estimated 1,075 cords on this timber sale, plus or minus 85 cords at the 95% confidence level. The estimated units are final and not subject to adjustment. Prospective bidders are urged to examine this timber and to make their own estimates of quantity and quality.

BOND AND PAYMENT SCHEDULE:

1. A bond in the amount of \$2,097.00 to insure faithful performance of the conditions of the contract will be deposited by the successful bidder within 21 days of the sale award.
2. Cutting in any sale or unit without the required advance payment would be considered a trespass.
3. Total payment must be paid in advance or according to the following schedule :
 - (a) Ten percent (10%) of the sale value must be paid within 21 days of the sale award.
 - (b) The 10% down payment will be credited towards the first unit cut.
 - (c) Payment for each of the following units must be made before cutting begins in that unit:

PAYMENT UNIT NUMBER	PERCENT OF TOTAL SALE VALUE
01	23.4%
02	25.9%
03	50.7%

4. If no cutting takes place, the 10% down payment will not be refunded.
5. Operations on the contract issued will terminate on 12/31/2025.

SALE STATISTICS

Volumes were calculated in cubic feet using the Michigan taper model. Cubic foot volume includes all wood inside bark for the product indicated. For display purposes, cubic feet were converted to cords and MBF using a simple conversion factor, e.g. 79 cubic feet per cord and 185 cubic feet per MBF. The cubic foot volumes are precise; the cords and MBF volumes are not. Cubic foot volume cannot be directly converted to cords or boards with precision.

SALE VOLUMES

The total estimated sale volume may not equal the sum of the species/products due to the nature of statistical calculations associated with double sampling methodology.

VOLUME			STATISTICAL RANGE IN CORDS	
TOTAL CUBIC FEET	TOTAL CORDS	PERCENT ERROR	MINIMUM	MAXIMUM
84,911	1,075	7.87%	990	1,159

VDU VOLUMES

A VDU is a Volume Determination Unit. Volumes and their associated statistics are calculated at the VDU level and summarized to the sale level. There is often a one to one relationship between a VDU and a Payment Unit, but not always, depending on the cruise design. Refer to the VDU TO PAYMENT UNIT table.

	VOLUME			RANGE IN CORDS	
VDU	TOTAL CUBIC FEET	TOTAL CORDS	PERCENT ERROR	MINIMUM	MAXIMUM
8	28,002	354	10.89%	316	393
16	4,215	53	8.12%	49	58
19	42,787	542	12.57%	474	610
32	4,772	60	18.26%	49	71
TOTAL:	79,777	1,010		888	1,132

VDU TO PAYMENT UNIT

When a VDU is associated with more than one Payment Unit (PU), the VDU volumes are assigned to the PU based on acres of the VDU within the PU.

VDU	VDU ACRES	PU	PU ACRES
8	21.6	1	13.9
		2	7.7
16	3.4	2	3.4
		2	3.2
19	20.1	3	16.9
		1	4.5
32	4.7	2	0.2
TOTAL:	49.8		49.8

DESCRIPTION OF TIMBER BY PAYMENT UNIT (PU)

PU	MARKET GROUP	PRODUCT	QUANTITY	UNIT	ACRES	ADVERTISE PRICE
1	Northern Pin Oak	Sawtimber	5.7	MBF	18.4	\$9,817.00
	Red Oak		7.5	MBF		
	Red Pine		5.1	MBF		
	White Oak		1.2	MBF		
	Jack Pine	Pulpwood	3	Cords		
	<i>Jack Pine</i>	<i>Sawtimber</i>	0.5	<i>MBF</i>		
	<i>Jack Pine</i>	<i>Pulpwood</i>	2	<i>Cords</i>		
	Mixed Aspen		68	Cords		
	<i>B. T. Aspen</i>	<i>Sawtimber</i>	2.7	<i>MBF</i>		
	<i>Quaking Aspen</i>		0.5	<i>MBF</i>		
	<i>B. T. Aspen</i>	<i>Pulpwood</i>	21	<i>Cords</i>		
	<i>Quaking Aspen</i>		41	<i>Cords</i>		
	Mixed Oak		111	Cords		
	<i>Northern Pin Oak</i>		61	<i>Cords</i>		
	<i>Red Oak</i>		44	<i>Cords</i>		
	<i>White Oak</i>		6	<i>Cords</i>		
	Red Maple		55	Cords		
	<i>Red Maple</i>	<i>Sawtimber</i>	0.6	<i>MBF</i>		
	<i>Red Maple</i>	<i>Pulpwood</i>	54	<i>Cords</i>		
	Red Pine		8	Cords		
White Pine		2	Cords			
2	Northern Pin Oak	Sawtimber	5.7	MBF	14.5	\$10,872.95
	Red Oak		19.5	MBF		
	Red Pine		2.9	MBF		
	White Oak		2.9	MBF		
	Jack Pine	Pulpwood	10	Cords		
	<i>Jack Pine</i>	<i>Sawtimber</i>	1.6	<i>MBF</i>		
	<i>Jack Pine</i>	<i>Pulpwood</i>	7	<i>Cords</i>		
	Mixed Aspen		38	Cords		
	<i>B. T. Aspen</i>	<i>Sawtimber</i>	1.5	<i>MBF</i>		
	<i>Quaking Aspen</i>		0.3	<i>MBF</i>		
	<i>B. T. Aspen</i>	<i>Pulpwood</i>	11	<i>Cords</i>		
	<i>Quaking Aspen</i>		23	<i>Cords</i>		
	Mixed Oak		119	Cords		
	<i>Northern Pin Oak</i>		41	<i>Cords</i>		
	<i>Red Oak</i>		62	<i>Cords</i>		
	<i>White Oak</i>		16	<i>Cords</i>		
	Red Maple		36	Cords		
	<i>Red Maple</i>	<i>Sawtimber</i>	0.3	<i>MBF</i>		
	<i>Red Maple</i>	<i>Pulpwood</i>	35	<i>Cords</i>		
	Red Pine		4	Cords		
White Pine		1	Cords			
3	Northern Pin Oak	Sawtimber	8.4	MBF	16.9	\$21,246.90
	Red Oak		61.4	MBF		
	White Oak		4.0	MBF		
	Jack Pine	Pulpwood	47	Cords		
	<i>Jack Pine</i>	<i>Sawtimber</i>	6.9	<i>MBF</i>		
	<i>Jack Pine</i>	<i>Pulpwood</i>	33	<i>Cords</i>		
	Mixed Aspen		9	Cords		
	<i>B. T. Aspen</i>		9	<i>Cords</i>		
	Mixed Oak		204	Cords		
	<i>Northern Pin Oak</i>		13	<i>Cords</i>		
	<i>Red Oak</i>		159	<i>Cords</i>		
	<i>White Oak</i>		32	<i>Cords</i>		
	Red Maple		48	Cords		
	<i>Red Maple</i>	<i>Sawtimber</i>	0.6	<i>MBF</i>		

DESCRIPTION OF TIMBER BY PAYMENT UNIT (PU), CON'T

PU	MARKET GROUP	PRODUCT	QUANTITY	UNIT	ACRES	ADVERTISE PRICE
3 con't	<i>Red Maple</i>	<i>Pulpwood</i>	47	<i>Cords</i>		
TOTAL:			124.3	MBF		
TOTAL:			763	Cords		

Sale Specific Conditions & Requirements

Sale Name: Crunchy Country Mix

Sale Number: 54-009-21 Seq#: 2

1 - Sale Area

1.2 - Boundaries

1.2.1 - Painted boundaries (9/19)

The sale boundary and Payment Unit boundaries are marked and identified by blue, red, and yellow paint. Exterior sale boundary lines against private property are marked with blue paint. Exterior sale boundary lines against state are marked with red paint and unmarked portions follow Winding Road as shown in the Timber Sale Map. Interior Payment Unit boundaries are marked with yellow paint and an unmarked portion follows a pipeline road southward from Winding Road. Retention patches are marked with red paint; no harvesting activities may occur within these areas. The painted boundary line trees are not Included Timber and are to be protected unless marked with two red rings. Trees marked with two red rings are Included Timber. Yellow painted trees designating an interior Payment Unit boundary are only to be cut when all surrounding Payment Units have been paid.

2 - Timber Specifications

2.1 - Included Timber

2.1.7 - Leave tree marked unit(s) (6/14)

Within Payment Unit(s) 1-3, cut all trees that are two (2) inches or more at DBH, except trees marked with green paint above and below stump height. Green marked trees are special protection trees identified in accordance with condition 3.4.2, within clearcutting unit boundaries, are not Included Timber and are to be protected.

2.1.15 - Hazard trees near roads (11/20)

Cut and remove all standing dead trees within 100 feet of the cleared portion of designated county roads. These trees may be utilized or must be scattered back into the Sale Area. If utilized, these trees must be skidded and piled separately on the landing. The sale administrator will measure the dead trees, and the wood cannot be hauled prior to scaling. The Purchaser will be invoiced at \$15.00 per cord and will have 30 days to pay from the date of the invoice.

3 - Payments

3.4 - Damaged Timber

3.4.2 - Special Protection Trees (4/14)

The Purchaser shall not cut live or dead special protection trees within cutting units or clearings. Special protection trees are marked with green paint. If the Purchaser's operations have cut or damaged special protection trees through carelessness, the Purchaser shall pay \$200 as fixed, agreed and liquidated damages for each special protection tree cut or damaged. Such payment does not constitute ownership of the undesignated timber.

4 - Transportation

4.1 - Construction

4.1.3 - Slash and earthen piles (8/04)

Piles or windrows of earth along roads and landings that have been widened or constructed shall be leveled. Slash from road maintenance or construction, including stumps, shall be dispersed throughout the sale.

4.1.6 - Road construction (1/09)

Improvements of existing roads shall be done in such a way as to minimize the environmental and visual impacts. Merchantable trees shall be cut and utilized unless otherwise directed. Non-merchantable trees shall be severed and laid flat on the ground. Slash shall not be left in windrows and kept a minimum of 10 feet back from the road edge. Stumps shall be set upright, not left on edge, and be moved at least 10 feet away from the road edge. Disturbed soil shall be feathered into the woods and not left in berms or windrows.

4.1.7 - Road closure (10/11)

All new roads built into the sale must be blocked to vehicle traffic upon completion of the sale. Overgrown roads that are reopened shall be considered new roads. In general, this will require constructing a four (4') foot high berm of stumps and

logs covered with earth. These roads must be rendered impassable to cars and trucks. All stumps from road building and landing construction must be reserved to block any newly constructed roads upon completion of the sale. These stumps may be scattered along the road system to prohibit vehicular movement. Contact the sale administrator for specific details of design and placement.

4.2 - Maintenance

4.2.5 - Two wheel drive condition (2/04)

All existing trail roads on and adjacent to the sale area must be passable by two-wheel drive traffic for the duration of the sale.

5 - Operations

5.1 - Notification

5.1.1 - Pre-sale conference (10/16)

A pre-sale conference between the Purchaser and sale administrator is required prior to beginning any operations to determine landing and road locations. The Unit Manager or his/her representative must be contacted in advance to schedule the conference.

5.1.3 - Well heads and natural gas pipelines (11/15)

The Purchaser is responsible for contacting the gas or pipeline company 30 days prior to operating equipment in the vicinity of well heads or natural gas pipelines. Contact Trendwell Energy Corporation at (616) 866-5024.

5.1.4 - Post-sale conference (10/16)

A post-sale conference on site between the Purchaser and sale administrator is required prior to the completion of active logging operations to determine clean-up and repair of landings, road edges, and the fulfillment of other contract specifications.

5.2 - Conduct of Operations

5.2.1 - Slash

5.2.1.10 - No slash in openings (5/10)

No brush or logging debris is to be left in the maintained wildlife opening which is indicated by G0 on the Timber Sale Map. Any damage to the opening shall be repaired according to specifications of the Unit Manager or his/her representative.

5.2.2 - Hazard Trees/Snags

5.2.2.1 - Den trees (10/16)

Obvious hollow and/or den trees shall be protected and left standing unless they are a safety hazard.

5.2.3 - Operating Restrictions

5.2.3.5 - Oak wilt restriction (1/18)

Within the Sale Area, unless changed by written agreement, cutting, skidding, hauling within the sale and brushing of access roads to the sale are not permitted during the period of April 15 to July 15. Operations may be allowed if specific steps are taken to prevent damaging uncut oak during the high risk period. Those steps may include completing all road brushing before April 15th and clearing a tree-length buffer along uncut oak cover before April 15th. This is necessary to reduce the spread of oak wilt. For more information, contact the Unit Manager or his/her representative.

5.2.3.11 - Coppice regeneration protection (4/10)

Timber harvesting in any Payment Unit must be completed before significant deciduous sprouting occurs in that Payment Unit to minimize damage to the new regeneration. Any post-harvest operations, such as chipping, must be completed before sprouting of regeneration occurs. If it is anticipated that these operations will be delayed, then all merchantable material shall be carried to one central location. The Unit Manager or his/her representative may cease such operations if sprouting occurs before the operation is complete.

5.2.4 - Dead and Down Creation

5.2.4.7 - Dead and down creation: hare, grouse, deer and other species (5/15)

To improve horizontal cover habitat for snowshoe hare, grouse, deer, and other species, the Purchaser is to push over

trees marked with orange paint. These trees should be tipped over with the root ball still attached so the base of the tree is suspended off the ground. The crown of the fallen tree should be at or near ground level after it is pushed over. If it is impossible or impractical to push these trees over, they may be severed or partially severed at the stump. Whenever possible the stem of the tree should rest above ground level.

5.2.32 - Decking/landing restoration (9/13)

All decking and landing areas must have the surface area restored to a condition equal to or better than before. This is to ensure the proper regeneration of the stand. Wood debris, chips, and "cookies" from trimmings must be removed or scattered away from landing and loading areas and may not be windrowed on the edge.

5.2.38 - No decking against live trees (2/04)

Cut products may not be decked against unmarked or designated leave trees.

5.2.39 - ORV trail/route protection (4/18)

The Big Bear ORV Trail is an ORV trail or route and is shown on the Timber Sale Map. Do not cut trees or damage posts with yellow ORV markers. All stumps within 5 feet of the trail must be cut flush with the ground. Maintain a 20-foot-wide slash, debris, and rut free zone daily using the ORV trail or route as the centerline. Do not run equipment down the ORV trail or route. Skidding across the trail or route may only occur in locations approved by the sale administrator.

5.2.41 - Snowmobile trail protection (9/11)

Trail #448 is a snowmobile trail and is shown on the Timber Sale Map. Do not cut or damage posts with orange trail markers or traffic control signs. If the trail is used, it must be maintained and restored to a condition equal to or better than before the sale. The road maintenance/restoration must be done prior to December 1. The snowmobile trail may only be crossed at right angles. Maintain a 20-foot-wide slash, debris, and rut free zone daily using the snowmobile trail as the centerline. No decking of forest products will be permitted along the snowmobile trail. All stumps within 20 feet of the snowmobile trail must be cut at ground level.

5.2.43 - Opening protection (2/21)

No activities are permitted in openings marked G0 on the Timber Sale Map. Any damage to the openings shall be repaired according to specifications of the Unit Manager or his/her representative.

5.4 - Soil Protection

5.4.1 - Rutting restriction, general (7/16)

Operations are to cease immediately if equipment and weather conditions result in rutting of roads and/or skid trails which is 12 inches or greater in depth and 50 feet in length. The Unit Manager or his/her representative may restrict hauling and/or skidding if ruts exceed the specified depth. With the Unit Manager or his/her representative's approval, the Purchaser may return to the area when the risk of rutting has decreased.

5.8 - Protection of Endangered Species

5.8.5 - Protection of raptor nests (3/13)

All trees with raptor nests will be protected if found during harvesting operations. Notification will be made to the Unit Manager or his/her representative who will notify the Wildlife Biologist so an on-site evaluation and recommendation can be made, if necessary.

6 - Safety and Fire Prevention

6.2 - Signing

6.2.2 - Snowmobile trail posting (10/20)

The Purchaser is responsible for posting and maintaining caution signs on snowmobile trail # 448 prior to beginning operations during the snowmobile season (approximately December 1 to March 31). The trail must be posted at appropriate distances from the Sale Area to warn of logging activity and truck traffic. Signs must be removed when harvest operations are suspended or completed. The Purchaser will provide these signs.

6.2.3 - Recreational trail posting (10/20)

The Purchaser is responsible for posting and maintaining caution signs on the Big Bear ORV trail prior to beginning operations. The trail must be posted at appropriate distances from the Sale Area to warn of logging activity and truck traffic at both ends of the trail. Signs must be removed when harvest operations are suspended or completed. The Purchaser will provide these signs.



TIMBER SALE MAP

This information provided by authority of Part 525, 1994 PA 451, as amended.

Forest Management Unit Atlanta Management Unit	County Montmorency	Mapped By Natzke	Date 07/08/2021	Page 1	of 1
Township 29N	Range 01E	Section(s) and Subdivision(s) Sec. 6 NENW, NWNE, S2NE, T30N R01E Sec. 31 S2SW, SWSE	Scale 1:15,840		

Cover Type				Density	
A = Aspen	H = Hemlock	N = Marsh	U = Upland Brush	0 = Non Stocked	5 = Pole Timber Medium
B = Paper Birch	J = Jack Pine	O = Oak	UM = Upland Mixed	1 = Seedling Sapling Poor	6 = Pole Timber Well
C = Cedar	L = Lowland Brush	P = Lowland Poplar	V = Bog or Marsh	2 = Seedling Sapling Medium	7 = Saw Timber Poor
D = Treed Bog	LM = Lowland Mixed	Q = Mixed Swamp Conifer	W = White Pine	3 = Seedling Sapling Well	8 = Saw Timber Medium
E = Swamp Hdwoods	M = Mpl, Bch, Brch	R = Red Pine	X = Non Stocked	4 = Pole Timber Poor	9 = Saw Timber Well
F = Spruce Fir	MC = Mixed Conifer	S = Black Spruce	Z = Water		
G = Grass	MD = Mixed Deciduous	T = Tamarack			

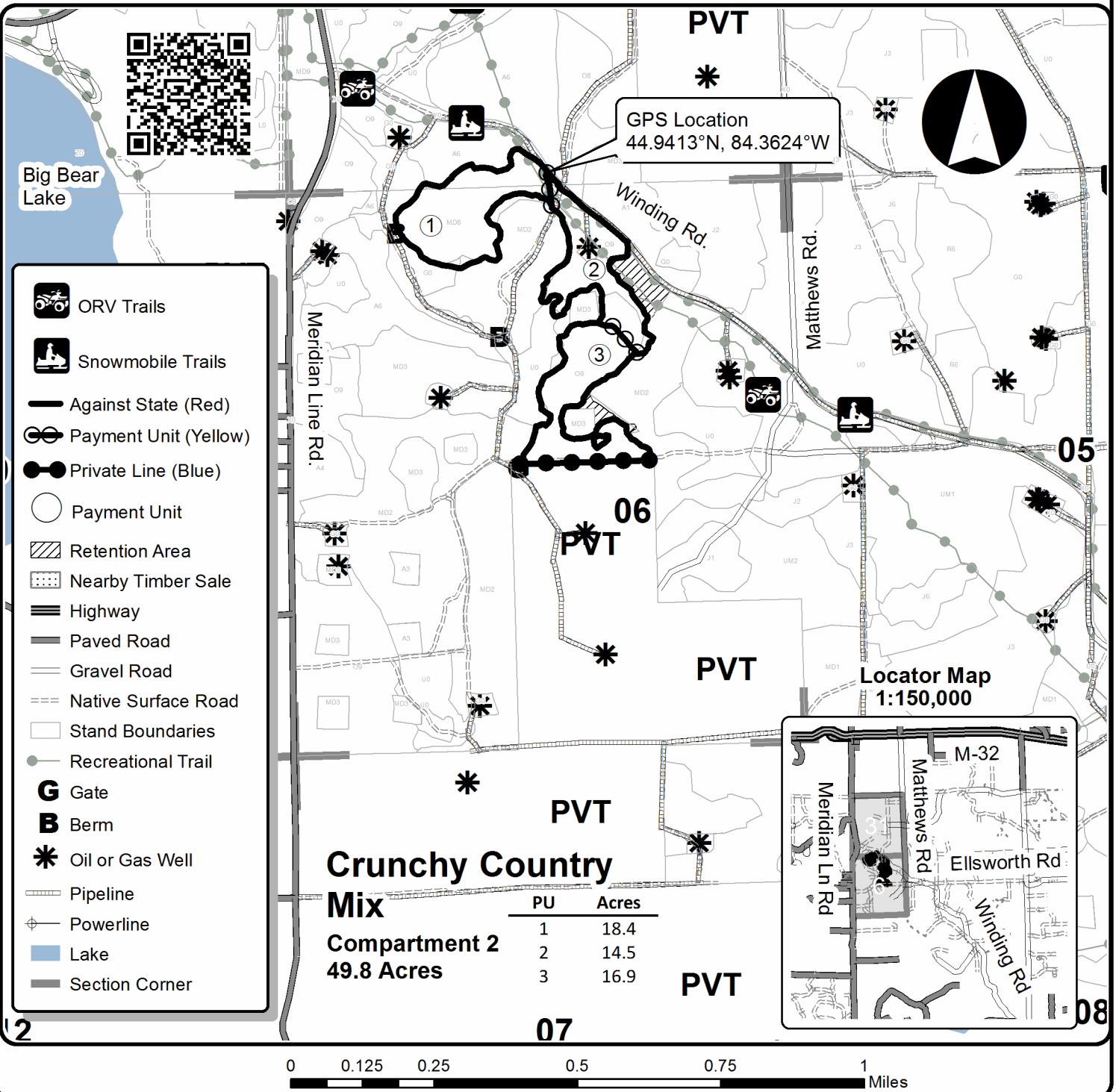

- ORV Trails
- Snowmobile Trails
- Against State (Red)
- Payment Unit (Yellow)
- Private Line (Blue)
- Payment Unit
- Retention Area
- Nearby Timber Sale
- Highway
- Paved Road
- Gravel Road
- Native Surface Road
- Stand Boundaries
- Recreational Trail
- G** Gate
- B** Berm
- Oil or Gas Well
- Pipeline
- Powerline
- Lake
- Section Corner

489 and Scenic Route 3 RP (54-003-21)
T30N, R02E, SEC. 28; T30N, R02E, SEC. 31; Montmorency COUNTY

In response to the notice of sale to be held 10:00 a.m. (local time) on April 19, 2022, I am hereby submitting my sealed bid (firm offer) for the following forest products to be cut. Bids for individual species must be at or above the advertised price. All non-responsive bid forms may be rejected.

<u>PRODUCTS & SPECIES</u>	<u>ESTIMATED VOLUME*</u>	<u>ADVERTISED PRICE</u>	<u>BID PRICE/UNIT</u>
Sawtimber			
B. T. Aspen	1.8 MBF	\$ 126.00/MBF	\$ _____
Black Cherry	1.3 MBF	\$ 128.00/MBF	\$ _____
Red Maple	1.9 MBF	\$ 56.00/MBF	\$ _____
Red Pine	385.4 MBF	\$ 129.00/MBF	\$ _____
Pulpwood			
B. T. Aspen	85 Cords	\$ 30.35/Cord	\$ _____
Black Cherry	45 Cords	\$ 25.70/Cord	\$ _____
Northern Pin Oak	3 Cords	\$ 45.80/Cord	\$ _____
Quaking Aspen	3 Cords	\$ 30.35/Cord	\$ _____
Red Maple	9 Cords	\$ 25.70/Cord	\$ _____
Red Pine	390 Cords	\$ 34.10/Cord	\$ _____
White Oak	5 Cords	\$ 45.80/Cord	\$ _____

*The volumes are statistically estimated within plus (+) or minus (-) 11.51 percent at 95% confidence level. These estimated volumes are final and not subject to adjustment. Prospective bidders are urged to examine this timber and to make their own estimates of quantity and quality.

I understand that any or all bids may be rejected. All bids must be signed and all bid items must be bid or the bid form may be rejected. I also understand that consideration and awarding a contract will be based upon my past performance and ability to complete the contract based upon equipment and staffing subject to my control.

FEDERAL ID: _____ or SOCIAL SECURITY NUMBER: _____

Company or individual bidding: _____

Company representative's name: _____

Address: _____

City: _____ State: _____ Zip: _____

IF AVAILABLE, PLEASE PLACE THE PERSONALIZED LABEL FROM YOUR PROSPECTUS IN THE ABOVE BOX.

Individual or company representative's signature: _____ Date: _____

Phone number : _____ Email (optional): _____

THE WINNING BIDDER MUST COMPLETE THE VERIFICATION OF WORKER'S DISABILITY COMPENSATION ACT COMPLIANCE (ON REVERSE SIDE IF DOUBLE SIDED) WITHIN 21 DAYS OF SALE AWARD DATE



FOR DEPARTMENT USE ONLY	
Sale Number (XX - XXX - XX - XX)	
Forest Management Unit:	

TIMBER SALE VERIFICATION OF WORKER'S DISABILITY COMPENSATION ACT COMPLIANCE

As required by Act 317, P.A. 1969 (Worker's Compensation) and
Part 5 of Act 451 of 1994, as amended.

VERIFICATION OF WORKER'S DISABILITY COMPENSATION ACT COMPLIANCE

- This verification must be completed and submitted within 21 days of contract award and prior to the issuance of the timber sale contract.
- In addition, if boxes 2B or 2C are checked, then Notice of Exclusion or Certificate of Insurance must be submitted within twenty-one (21) days of the contract award and prior to the issuance of the timber sale contract.
- All information must be typed or printed except for written signatures.

Please Check Appropriate Categories:

1. My business is organized as (you **must** check one of the boxes below):
 - A. Sole Proprietorship (individual)
 - B. Partnership
 - C. Corporation
2. You **must** check one of the boxes below:
 - A. I certify my business is a sole proprietorship and it has no employees but the sole proprietor. I am not subject to the Worker's Compensation Laws.
 - B. I certify my business has satisfied its obligation to the Worker's Compensation Act through the use of an approved Notice of Exclusion (BWC-337, Rev. 5/96). I will provide a copy of the Notice of Exclusion within 21 days of the contract award. (For questions or a copy of the BWC-337, please call the Worker's Compensation Bureau at 517-322-1195).
 - C. I certify my business has a Worker's Compensation Policy. I will provide an original Certificate of Insurance within twenty-one (21) days of the contract award.
3. If you have checked item 2(A) or 2(B), you **must** indicate the number of **both** full-time and part-time employees, other than yourself, including family members and active partners (if none, you must enter "0").

_____ Full-time Employees

_____ Part-time Employees

Name of Business		Federal ID (or) Social Security No.	
Address		Telephone ()	
City	State	ZIP	

I hereby certify that the above information is true and correct. I agree to notify the Michigan DNR of any changes that occur in factors affecting my coverage during any of my present and future operations.

Signature of Owner or Authorized Representative

Title

Date

Please complete the "SEALED BID" information on the next page

Crunchy Country Mix (54-009-21)
T29N, R01E, SEC. 6; T30N, R01E, SEC. 31; Montmorency COUNTY

In response to the notice of sale to be held 10:00 a.m. (local time) on April 19, 2022, I am hereby submitting my sealed bid (firm offer) for the following forest products to be cut. Bids for individual species must be at or above the advertised price. All non-responsive bid forms may be rejected.

<u>PRODUCTS & SPECIES</u>	<u>ESTIMATED VOLUME*</u>	<u>ADVERTISED PRICE</u>	<u>BID PRICE/UNIT</u>
Sawtimber			
Northern Pin Oak	19.8 MBF	\$ 58.00/MBF	\$ _____
Red Oak	88.4 MBF	\$ 176.00/MBF	\$ _____
Red Pine	8.0 MBF	\$ 109.00/MBF	\$ _____
White Oak	8.1 MBF	\$ 64.00/MBF	\$ _____
Pulpwood			
Jack Pine	60 Cords	\$ 11.00/Cord	\$ _____
Mixed Aspen	115 Cords	\$ 25.70/Cord	\$ _____
Mixed Oak	434 Cords	\$ 38.75/Cord	\$ _____
Red Maple	139 Cords	\$ 21.75/Cord	\$ _____
Red Pine	12 Cords	\$ 28.85/Cord	\$ _____
White Pine	3 Cords	\$ 12.40/Cord	\$ _____

*The volumes are statistically estimated within plus (+) or minus (-) 7.87 percent at 95% confidence level. These estimated volumes are final and not subject to adjustment. Prospective bidders are urged to examine this timber and to make their own estimates of quantity and quality.

I understand that any or all bids may be rejected. All bids must be signed and all bid items must be bid or the bid form may be rejected. I also understand that consideration and awarding a contract will be based upon my past performance and ability to complete the contract based upon equipment and staffing subject to my control.

FEDERAL ID: _____ - _____ or SOCIAL SECURITY NUMBER: _____ - _____ - _____

Company or individual bidding: _____

Company representative's name: _____

Address: _____

City: _____ State: _____ Zip: _____

IF AVAILABLE, PLEASE PLACE THE PERSONALIZED LABEL FROM YOUR PROSPECTUS IN THE ABOVE BOX.

Individual or company representative's signature: _____ Date: _____

Phone number : _____ Email (optional): _____

THE WINNING BIDDER MUST COMPLETE THE VERIFICATION OF WORKER'S DISABILITY COMPENSATION ACT COMPLIANCE (ON REVERSE SIDE IF DOUBLE SIDED) WITHIN 21 DAYS OF SALE AWARD DATE



FOR DEPARTMENT USE ONLY
Sale Number (XX – XXX – XX – XX)
Forest Management Unit:

TIMBER SALE VERIFICATION OF WORKER'S DISABILITY COMPENSATION ACT COMPLIANCE

*As required by Act 317, P.A. 1969 (Worker's Compensation) and
Part 5 of Act 451 of 1994, as amended.*

VERIFICATION OF WORKER'S DISABILITY COMPENSATION ACT COMPLIANCE

- This verification must be completed and submitted within 21 days of contract award and prior to the issuance of the timber sale contract.
- In addition, if boxes 2B or 2C are checked, then Notice of Exclusion or Certificate of Insurance must be submitted within twenty-one (21) days of the contract award and prior to the issuance of the timber sale contract.
- All information must be typed or printed except for written signatures.

Please Check Appropriate Categories:

1. My business is organized as (you **must** check one of the boxes below):
 - A. Sole Proprietorship (individual)
 - B. Partnership
 - C. Corporation
2. You **must** check one of the boxes below:
 - A. I certify my business is a sole proprietorship and it has no employees but the sole proprietor. I am not subject to the Worker's Compensation Laws.
 - B. I certify my business has satisfied its obligation to the Worker's Compensation Act through the use of an approved Notice of Exclusion (BWC-337, Rev. 5/96). I will provide a copy of the Notice of Exclusion within 21 days of the contract award. (For questions or a copy of the BWC-337, please call the Worker's Compensation Bureau at 517-322-1195).
 - C. I certify my business has a Worker's Compensation Policy. I will provide an original Certificate of Insurance within twenty-one (21) days of the contract award.
3. If you have checked item 2(A) or 2(B), you **must** indicate the number of **both** full-time and part-time employees, other than yourself, including family members and active partners (if none, you must enter "0").

_____ Full-time Employees

_____ Part-time Employees

Name of Business		Federal ID (or) Social Security No.	
Address		Telephone ()	
City	State	ZIP	

I hereby certify that the above information is true and correct. I agree to notify the Michigan DNR of any changes that occur in factors affecting my coverage during any of my present and future operations.

Signature of Owner or Authorized Representative

Title

Date

Please complete the "SEALED BID" information on the next page

Hossler Hussle Mix (54-001-21)

T30N, R02E, SEC. 20; T30N, R02E, SEC. 29; T30N, R02E, SEC. 30; Montmorency

In response to the notice of sale to be held 10:00 a.m. (local time) on April 19, 2022, I am hereby submitting my sealed bid (firm offer) for the following forest products to be cut. Bids for individual species must be at or above the advertised price. All non-responsive bid forms may be rejected.

<u>PRODUCTS & SPECIES</u>	<u>ESTIMATED VOLUME*</u>	<u>ADVERTISED PRICE</u>	<u>BID PRICE/UNIT</u>
Sawtimber			
Mixed Aspen	85.5 MBF	\$ 106.00/MBF	\$ _____
Paper Birch	4.5 MBF	\$ 29.00/MBF	\$ _____
Red Maple	25.8 MBF	\$ 47.00/MBF	\$ _____
Red Oak	263.5 MBF	\$ 176.00/MBF	\$ _____
Red Pine	133.0 MBF	\$ 109.00/MBF	\$ _____
Sugar Maple	1.9 MBF	\$ 396.00/MBF	\$ _____
White Oak	74.6 MBF	\$ 64.00/MBF	\$ _____
White Pine	8.0 MBF	\$ 34.00/MBF	\$ _____
Pulpwood			
Balsam Fir	396 Cords	\$ 16.65/Cord	\$ _____
Jack Pine	168 Cords	\$ 11.00/Cord	\$ _____
Mixed Aspen	1,467 Cords	\$ 25.70/Cord	\$ _____
Mixed Hardwood	606 Cords	\$ 21.75/Cord	\$ _____
Mixed Oak	644 Cords	\$ 38.75/Cord	\$ _____
Mixed Spruce	17 Cords	\$ 7.75/Cord	\$ _____
Red Pine	76 Cords	\$ 28.85/Cord	\$ _____
Tamarack	6 Cords	\$ 5.90/Cord	\$ _____
White Pine	44 Cords	\$ 12.40/Cord	\$ _____

*The volumes are statistically estimated within plus (+) or minus (-) 4.26 percent at 95% confidence level. These estimated volumes are final and not subject to adjustment. Prospective bidders are urged to examine this timber and to make their own estimates of quantity and quality.

I understand that any or all bids may be rejected. All bids must be signed and all bid items must be bid or the bid form may be rejected. I also understand that consideration and awarding a contract will be based upon my past performance and ability to complete the contract based upon equipment and staffing subject to my control.

FEDERAL ID: _____ or SOCIAL SECURITY NUMBER: _____

Company or individual bidding: _____

Company representative's name: _____

Address: _____

City: _____ State: _____ Zip: _____

IF AVAILABLE, PLEASE PLACE THE PERSONALIZED LABEL FROM YOUR PROSPECTUS IN THE ABOVE BOX.

Individual or company representative's signature: _____ Date: _____

Phone number : _____ Email (optional): _____

THE WINNING BIDDER MUST COMPLETE THE VERIFICATION OF WORKER'S DISABILITY COMPENSATION ACT COMPLIANCE (ON REVERSE SIDE IF DOUBLE SIDED) WITHIN 21 DAYS OF SALE AWARD DATE



FOR DEPARTMENT USE ONLY
Sale Number (XX - XXX - XX - XX)
Forest Management Unit:

TIMBER SALE VERIFICATION OF WORKER'S DISABILITY COMPENSATION ACT COMPLIANCE

*As required by Act 317, P.A. 1969 (Worker's Compensation) and
Part 5 of Act 451 of 1994, as amended.*

VERIFICATION OF WORKER'S DISABILITY COMPENSATION ACT COMPLIANCE

- This verification must be completed and submitted within 21 days of contract award and prior to the issuance of the timber sale contract.
- In addition, if boxes 2B or 2C are checked, then Notice of Exclusion or Certificate of Insurance must be submitted within twenty-one (21) days of the contract award and prior to the issuance of the timber sale contract.
- All information must be typed or printed except for written signatures.

Please Check Appropriate Categories:

1. My business is organized as (you **must** check one of the boxes below):
 - A. Sole Proprietorship (individual)
 - B. Partnership
 - C. Corporation
2. You **must** check one of the boxes below:
 - A. I certify my business is a sole proprietorship and it has no employees but the sole proprietor. I am not subject to the Worker's Compensation Laws.
 - B. I certify my business has satisfied its obligation to the Worker's Compensation Act through the use of an approved Notice of Exclusion (BWC-337, Rev. 5/96). I will provide a copy of the Notice of Exclusion within 21 days of the contract award. (For questions or a copy of the BWC-337, please call the Worker's Compensation Bureau at 517-322-1195).
 - C. I certify my business has a Worker's Compensation Policy. I will provide an original Certificate of Insurance within twenty-one (21) days of the contract award.
3. If you have checked item 2(A) or 2(B), you **must** indicate the number of **both** full-time and part-time employees, other than yourself, including family members and active partners (if none, you must enter "0").

_____ Full-time Employees

_____ Part-time Employees

Name of Business		Federal ID (or) Social Security No.	
Address		Telephone ()	
City	State	ZIP	

I hereby certify that the above information is true and correct. I agree to notify the Michigan DNR of any changes that occur in factors affecting my coverage during any of my present and future operations.

Signature of Owner or Authorized Representative

Title

Date

Please complete the "SEALED BID" information on the next page

McCormick and Shoreline Mix (54-002-21)
T29N, R02E, SEC. 6; T30N, R01E, SEC. 25; T30N, R01E, SEC. 36; T30N, R02E,

In response to the notice of sale to be held 10:00 a.m. (local time) on April 19, 2022, I am hereby submitting my sealed bid (firm offer) for the following forest products to be cut. Bids for individual species must be at or above the advertised price. All non-responsive bid forms may be rejected.

<u>PRODUCTS & SPECIES</u>	<u>ESTIMATED VOLUME*</u>	<u>ADVERTISED PRICE</u>	<u>BID PRICE/UNIT</u>
Sawtimber			
Basswood	4.9 MBF	\$ 53.00/MBF	\$ _____
Mixed Aspen	89.9 MBF	\$ 106.00/MBF	\$ _____
Red Maple	37.8 MBF	\$ 47.00/MBF	\$ _____
Red Oak	521.3 MBF	\$ 176.00/MBF	\$ _____
Red Pine	60.7 MBF	\$ 109.00/MBF	\$ _____
Sugar Maple	12.1 MBF	\$ 396.00/MBF	\$ _____
White Oak	63.5 MBF	\$ 64.00/MBF	\$ _____
White Pine	2.0 MBF	\$ 34.00/MBF	\$ _____
Pulpwood			
Balsam Fir	3 Cords	\$ 16.65/Cord	\$ _____
Jack Pine	2 Cords	\$ 11.00/Cord	\$ _____
Mixed Aspen	1,140 Cords	\$ 25.70/Cord	\$ _____
Mixed Hardwood	1,140 Cords	\$ 21.75/Cord	\$ _____
Mixed Oak	1,049 Cords	\$ 38.75/Cord	\$ _____
Red Pine	25 Cords	\$ 28.85/Cord	\$ _____
White Pine	38 Cords	\$ 12.40/Cord	\$ _____

*The volumes are statistically estimated within plus (+) or minus (-) 3.63 percent at 95% confidence level. These estimated volumes are final and not subject to adjustment. Prospective bidders are urged to examine this timber and to make their own estimates of quantity and quality.

I understand that any or all bids may be rejected. All bids must be signed and all bid items must be bid or the bid form may be rejected. I also understand that consideration and awarding a contract will be based upon my past performance and ability to complete the contract based upon equipment and staffing subject to my control.

FEDERAL ID: ____ - ____ - ____ or SOCIAL SECURITY NUMBER: ____ - ____ - ____

Company or individual bidding: _____

Company representative's name: _____

Address: _____

City: _____ State: _____ Zip: _____

IF AVAILABLE, PLEASE PLACE THE PERSONALIZED LABEL FROM YOUR PROSPECTUS IN THE ABOVE BOX.

Individual or company representative's signature: _____ Date: _____

Phone number : _____ Email (optional): _____

THE WINNING BIDDER MUST COMPLETE THE VERIFICATION OF WORKER'S DISABILITY COMPENSATION ACT COMPLIANCE (ON REVERSE SIDE IF DOUBLE SIDED) WITHIN 21 DAYS OF SALE AWARD DATE



FOR DEPARTMENT USE ONLY	
Sale Number (XX - XXX - XX - XX)	
Forest Management Unit:	

TIMBER SALE VERIFICATION OF WORKER'S DISABILITY COMPENSATION ACT COMPLIANCE

As required by Act 317, P.A. 1969 (Worker's Compensation) and
Part 5 of Act 451 of 1994, as amended.

VERIFICATION OF WORKER'S DISABILITY COMPENSATION ACT COMPLIANCE

- This verification must be completed and submitted within 21 days of contract award and prior to the issuance of the timber sale contract.
- In addition, if boxes 2B or 2C are checked, then Notice of Exclusion or Certificate of Insurance must be submitted within twenty-one (21) days of the contract award and prior to the issuance of the timber sale contract.
- All information must be typed or printed except for written signatures.

Please Check Appropriate Categories:

1. My business is organized as (you **must** check one of the boxes below):
 - A. Sole Proprietorship (individual)
 - B. Partnership
 - C. Corporation
2. You **must** check one of the boxes below:
 - A. I certify my business is a sole proprietorship and it has no employees but the sole proprietor. I am not subject to the Worker's Compensation Laws.
 - B. I certify my business has satisfied its obligation to the Worker's Compensation Act through the use of an approved Notice of Exclusion (BWC-337, Rev. 5/96). I will provide a copy of the Notice of Exclusion within 21 days of the contract award. (For questions or a copy of the BWC-337, please call the Worker's Compensation Bureau at 517-322-1195).
 - C. I certify my business has a Worker's Compensation Policy. I will provide an original Certificate of Insurance within twenty-one (21) days of the contract award.
3. If you have checked item 2(A) or 2(B), you **must** indicate the number of **both** full-time and part-time employees, other than yourself, including family members and active partners (if none, you must enter "0").

_____ Full-time Employees

_____ Part-time Employees

Name of Business		Federal ID (or) Social Security No.	
Address		Telephone ()	
City	State	ZIP	

I hereby certify that the above information is true and correct. I agree to notify the Michigan DNR of any changes that occur in factors affecting my coverage during any of my present and future operations.

Signature of Owner or Authorized Representative

Title

Date

Please complete the "SEALED BID" information on the next page