



**DEPARTMENT OF NATURAL RESOURCES  
STATE OF MICHIGAN  
TIMBER SALE PROSPECTUS #7067**

**SCHEDULED SALE DATE AND TIME: 9:00 a.m. (local time) on July 11, 2022.**

**LOCATION: GRAYLING MGMT UNIT, 1955 HARTWICK PINES ROAD, GRAYLING, MI 49738.**

**PROSPECTUS NOTE:** The bidder is advised to inspect the sale area and review the location, estimated volumes, operating costs and contract terms of proposed sales. Please be aware that some landowners may request 60 days or more notice for access across their land.

Notice is hereby given that bids will be received by the Unit Manager, GRAYLING MANAGEMENT UNIT, for certain timber on the following described lands:

Townline Jack (72-033-21) / T27N, R01W, SEC. 1 , NWNW.

T27N, R01W, SEC. 2 , NENW,N1/2NE.

T28N, R01W, SEC. 34, SESE.

T28N, R01W, SEC. 35, SESW,S1/2SE.

T28N, R01W, SEC. 36, NWSW,S1/2SW.

Crawford County, Advertised Price \$34,232.25, 99.9 Acres, Jack Pine, Hardwood.

SALE NOTE: All units of volume listed for this sale were estimated using the Inventory Manager computer program and the new Michigan taper model.

See sale spec 2.2.10 for information on chipping restrictions.

A recreation site such as a trail, pathway, or campground is within the sale area or the vicinity. Certain restrictions/specifications may be applicable including time restrictions.

Technician Party KW (72-038-21) / T28N, R01W, SEC. 17, N1/2NW,SWNW.

T28N, R01W, SEC. 6 , SESW.

T28N, R01W, SEC. 7 , E1/2NW,SWNE,E1/2SW,SE.

T28N, R01W, SEC. 8 , SENW,SW,W1/2SE.

T28N, R02W, SEC. 1 , SESE.

T28N, R02W, SEC. 12, NE,N1/2SE,SESE.

Crawford County, Advertised Price \$84,813.30, 498.8 Acres, Jack Pine, Aspen.

SALE NOTE: All units of volume listed for this sale were estimated using the Inventory Manager computer program and the new Michigan taper model.

See sale spec 5.1.3 for information on nearby pipelines.

See sale spec 2.2.3 for information on stump heights.

See sale spec 5.2.41 for information on snowmobile trail protection.

See sale spec 5.8.1 for information on Kirtland Warbler restrictions.

A recreation site such as a trail, pathway, or campground is within the sale area or the vicinity. Certain restrictions/specifications may be applicable including time restrictions.

Well Daisy If You Do Pine (72-046-21) / T28N, R01W, SEC. 25, S1/2SE.

T28N, R01W, SEC. 36, SENW,NENE,S1/2NE,E1/2SW,NWSE.

Crawford County, Advertised Price \$9,723.00, 76.4 Acres, Jack Pine, Red Pine.

SALE NOTE: All units of volume listed for this sale were estimated using the Inventory Manager computer program and the new Michigan taper model.

See sale spec 5.2.40 for information on pathway protection requirements.

See sale spec 5.4.1 for information on rutting restrictions.

See sale spec 2.2.2 and 2.2.3 for information on stump heights and chipping.

Payment Unit 1 has high variability in cruise data due to large portions of the unit being open or sub-merchantable. Purchaser is strongly encouraged to make their own estimates of volume and feasibility.

Due to the sub-merchantable and open areas, in addition to the variability of the volume estimates for Payment Unit 1, an additional 5% reduction of the advertised price has been applied to this sale.

A recreation site such as a trail, pathway, or campground is within the sale area or the vicinity. Certain restrictions/specifications may be applicable including time restrictions.

You're No Daisy At All Oak (72-047-21) / T28N, R01W, SEC. 35, NE,SE.

T28N, R01W, SEC. 36, W1/2NW,W1/2SW.

Crawford County, Advertised Price \$38,703.35, 127.7 Acres, Hardwood, Red Pine.

SALE NOTE: All units of volume listed for this sale were estimated using the Inventory Manager computer program and the new Michigan taper model.

Access is a sandy forest access road shown on the map north off of Townline Road .

See sale spec 2.1.11 for information Misc. Species 1.

See sale spec 5.2.3.4 and 5.2.3.5 for information on oak wilt restrictions.

Fell Through the Crack Jack (72-048-21) / T28N, R01E, SEC. 6 , SWSW.

T28N, R01W, SEC. 1 , W1/2NW,N1/2NE,E1/2SE.

T28N, R01W, SEC. 2 , E1/2NE.

T29N, R01W, SEC. 35, SESE.

T29N, R01W, SEC. 36, SWSW,S1/2SE.

Crawford County, Advertised Price \$26,330.95, 52.9 Acres, Jack Pine, Hardwood.

SALE NOTE: All units of volume listed for this sale were estimated using the Inventory Manager computer program and the new Michigan taper model.

See sale spec 5.2.3.4 for information on oak wilt restrictions.

A recreation site such as a trail, pathway, or campground is within the sale area or the vicinity. Certain restrictions/specifications may be applicable including time restrictions.

## BID INSTRUCTIONS (VER. 07/02/2018):

### 1. Scheduled Bid Location, Date, and Time (2/11)

Bids must be received by the Unit Manager, GRAYLING OFFICE, 1955 HARTWICK PINES ROAD, GRAYLING, MI 49738, no later than 9:00 a.m. (local time) on July 11, 2022. For further information concerning this sale, contact Thomas Barnes at 989-348-6371 extension 7440.

### 2. Bidder's Qualifications (5/16)

Purchaser shall obtain workers compensation insurance to cover claims under Michigan's Worker's Disability Compensation Act of 1969 or similar employee benefit act of any other state applicable to an employee. If all or part of a timber sale was prepared by a private contractor, the contractor and that contractor's company are not permitted to bid on the timber sale contract. Bids will not be accepted from individuals or companies appearing on the DNR/FRD No-Bid List. This list contains the names of purchasers who previously failed to execute a contract within 21-days or who have a history of poor performance.

### 3. Preparation of Sealed Bids (5/16)

Bid Forms may be completed online thru Michigan DNR Timber Sale Online Bidding (OLB) at [www.michigan.gov/timberbidding](http://www.michigan.gov/timberbidding) or by completing the hardcopy Bid Form found in the Timber Sale Prospectus. Hardcopy Bid Forms shall be manually signed in ink. Registration in OLB is considered your 'signature' for all bids submitted thru that system. Bid prices must be entered for each species and product in the Bid Price column for all material subject to bidding and all fill-in blanks must be completed. If erasures or other changes appear on the hardcopy Bid Form, each erasure or change must be initialed by the person signing the bid.

### 4. Submission of Sealed Bids (5/16)

Bid forms may be obtained from the Unit Manager or thru OLB. Bids may be submitted hardcopy or thru OLB. All hardcopy bids must be submitted on the bid form and in an envelope clearly identified as described in this section. NOTE: Only one bid form per bid envelope. Sealed bids must be submitted to the Unit office designated in the prospectus and must be submitted at or prior to the time established in the prospectus. The envelope should show on the outside (a) the sale name or number and (b) the date and time of bid opening, as shown in the prospectus. Bids received after the time specified in the sale prospectus are late bids and will be rejected.

It is possible for a bidder to submit multiple bids on a single sale. For example, a bid may be submitted hardcopy and a bid may be submitted thru OLB. Or, two bidders from the same company could both submit bids on the same sale. If this were to happen, the State would accept all bids received and award the contract accordingly. All bidding and contractual requirements would apply to all bids received.

### 5. Public Opening of Sealed Bids (7/16)

If conditions permit, the sealed bids will be publicly opened and posted at the time and place set in the prospectus.

If a bidder, present at a bid opening, has submitted bids on more than one sale, that bidder may withdraw their unopened bid envelopes or announce the withdrawal of their online bid after being declared the successful bidder on one sale.

### 6. Award of Contract (1/11)

Award of the contract will be made to the Bidder whose bid, conforming to the prospectus, is most advantageous to the State of Michigan on the basis of total value at rates bid for the estimated quantities. The State reserves the right to reject any bid or waive any minor irregularity in bids received. A written award mailed (or otherwise furnished) to the successful Bidder shall be deemed to result in a binding contract without further action by either party.

### 7. Down Payment (1/11)

The Bidder to whom award is made must make a down payment within 21 days of the sale award. The amount of the down payment will be calculated as shown in the Bond and Payment Schedule of this prospectus. Only cash may be used to meet this requirement.

### 8. Performance Security (1/11)

As guarantee of faithful performance, a cash bond, certificate of deposit, surety bond or irrevocable letter of credit (LOC) is required within 21 days of the sale award. The amount of the performance security is shown in the Bond and

Payment Schedule of this prospectus. If an LOC or surety is used, the coverage must extend for at least 6 months beyond the contract expiration.

#### 9. Timber Sale Contract (7/18)

Additional conditions and requirements common to all timber sales are listed on the timber sale contract (R4031) and are available on line at [www.michigan.gov/timber](http://www.michigan.gov/timber). Contact the Unit Manager for additional information or a sample contract. Within 21 days of the date of the award letter, the bidder must sign the contract and provide the required down payment, performance security, and verification of worker's disability compensation. The down payment and performance security shall be in accordance with the provisions of the timber sale contract, in the sums stated in this prospectus. If these actions are not taken, then the Bidder, the Bidder's corporation, and the corporation's principals may not be permitted to bid on State timber sales for a period of 3 months after the first offense, 6 months after the second offense, and 1 year after the third offense. An offense will only be counted against the Bidder for 5 years. In addition, the Bidder certifies that if awarded this contract, the Bidder will complete the timber sale contract in accordance with its terms and any modifications thereof including requirements to purchase, cut, and remove the included timber by the expiration date.

Payment Unit values in the State Forest Timber Sale Contract are calculated based on the advertised value of the Payment Unit as a percentage of the total advertised value of the contract. The advertised value of each Payment Unit is given in the Description of Timber by Payment Unit table on the Timber Sale Information page. For example, if the value of Payment Unit 1 is advertised as \$1,500 and the total Timber Sale value is advertised as \$10,000, the contract price for Payment Unit 1 will be 15% of the total bid price ( $\$1,500/\$10,000 * 100$ ).

#### 10. Disclaimer of Estimates and Bidder's Warranty of Inspection (7/16)

Before submitting this bid, the Bidder is advised and cautioned to inspect the sale area, review the requirements of the sale contract, and take other steps as may be reasonably necessary to ascertain the location, estimated volumes, construction estimates, and operating costs of the proposed sale. Failure to do so will not relieve the Bidder from responsibility for completing the contract.

The Bidder warrants that this bid is submitted solely on the basis of the Bidder's examination and inspection of the quality and quantity of the timber offered for sale and the Bidder's opinion of the value thereof and the costs of recovery. No reliance should be placed on the State of Michigan's estimates of timber quality, quantity or costs of recovery. Bidder further acknowledges that the State of Michigan: (i) expressly disclaims any warranty of fitness of timber for any purpose; (ii) offers this timber as is without any warranty of quality (merchantability) or quantity and (iii) expressly disclaims any warranty as to the quantity or quality of timber sold.

#### 11. Certification and Chain-of-Custody (10/14)

Unless otherwise indicated in the contract under section 7 – Other Conditions of the Sale Specific Conditions & Requirements, the area encompassed by this timber sale is certified to the standards of the Forest Stewardship Council (FSC) - Certificate #SCS-FM/COC-00090N and the Sustainable Forestry Initiative (SFI) - Certificate #NSF-SFIS-5Y031-SF5. Forest products from this sale may be delivered to the mill as "FSC 100% and / or SFI certified" as long as the contractor hauling the forest products is chain-of-custody (COC) certified or covered under a COC certificate from the destination mill. The purchaser is responsible for maintaining COC after leaving the sale area.

#### 12. Good Neighbor Authority (GNA) Requirements (7/16)

If the name of this timber sales contains the acronym GNA, it is authorized by the Good Neighbor Authority (GNA) and covered by various agreements between the U.S. Forest Service and the State. The timber sale occurs on federal land and the following conditions apply:

GNA contracts on US Forest Service land will not be awarded to purchasers on the Federal list of excluded parties. The System for Award Management (SAM) will be checked for active excluded parties prior to award of contract. In addition, the Bidder to whom award is made must complete an Assurance Regarding Felony Conviction or Tax Delinquent Status for Corporate Applicants (AD-3031).

#### 13. Good Neighbor Authority (GNA) Requirements, con't (9/16)

Bidder certifies, by signing this bid form, that to the best of Bidder's knowledge that the following representations are accurate and complete.

- a. That the Bidder and its principals are not presently debarred, suspended, proposed for debarment, declared ineligible, or voluntary excluded from timber sales (covered transactions) by any Federal department or agency.
- b. That the Bidder and its principals have not within a 3-year period preceding this bid been convicted of or had a civil judgment rendered against them for commission of fraud or a criminal offense in connection with obtaining , attempting to obtain, or performing a public (Federal, State, or local) transaction or contract under a public transaction; violation of Federal or State antitrust statutes or commission of embezzlement, theft, forgery, bribery, falsification or destruction of records, making false statements, or receiving stolen property.
- c. That the Bidder and its principals are not presently indicted for or otherwise criminally or civilly charged by a governmental entity (Federal, State, or local) with commission of any of the offenses enumerated in paragraph b of this certification.
- d. That the Bidder and its principals have not within a 3-year period preceding this bid had one or more public transactions (Federal, State, or local) terminated for breach or default of a timber or forest product contract.

Bidders that cannot certify this requirement, in whole or in part, shall submit an explanation with their bid.

DAN EICHINGER  
Director



# TIMBER SALE INFORMATION

Townline Jack (72-033-21)

T27N, R01W, SEC. 1; T27N, R01W, SEC. 2; T28N, R01W, SEC. 34; T28N, R01W, SEC. 35; T28N, R01W, SEC. 36.  
Crawford County (Advertised Price \$34,232.25)

SALE NOTE: All units of volume listed for this sale were estimated using the Inventory Manager computer program and the new Michigan taper model.

See sale spec 2.2.10 for information on chipping restrictions.

A recreation site such as a trail, pathway, or campground is within the sale area or the vicinity. Certain restrictions/specifications may be applicable including time restrictions.

A timber sale contract for this lump sum, sealed bid timber sale will be awarded to the responsible bidder offering the highest sealed bid price. All units of volume listed below were estimated using the Inventory Manager computer program and the new Michigan taper model. Bids must be at or above the following advertised price for each product and species:

<u>PRODUCTS &amp; SPECIES</u>	<u>ESTIMATED UNITS*</u>	<u>ADVERTISED PRICE</u>
<b>Sawtimber</b>		
Jack Pine	88.4 MBF	\$ 32.00 / MBF
Northern Pin Oak	28.8 MBF	\$ 103.00 / MBF
Red Pine	35.3 MBF	\$ 89.00 / MBF
<b>Pulpwood</b>		
Jack Pine	1,293 Cords	\$ 16.15 / Cord
Mixed Hardwood	12 Cords	\$ 26.90 / Cord
Mixed Oak	116 Cords	\$ 24.65 / Cord
Red Pine	38 Cords	\$ 32.40 / Cord

\* The total volume is statistically estimated within plus (+) or minus (-) 6.83 percent. There are an estimated 1,844 cords on this timber sale, plus or minus 126 cords at the 95% confidence level. The estimated units are final and not subject to adjustment. Prospective bidders are urged to examine this timber and to make their own estimates of quantity and quality.

**BOND AND PAYMENT SCHEDULE:**

1. A bond in the amount of \$1,712.00 to insure faithful performance of the conditions of the contract will be deposited by the successful bidder within 21 days of the sale award.
2. Cutting in any sale or unit without the required advance payment would be considered a trespass.
3. Total payment must be paid in advance or according to the following schedule :
  - (a) Ten percent (10%) of the sale value must be paid within 21 days of the sale award.
  - (b) The 10% down payment will be credited towards the first unit cut.
  - (c) Payment for each of the following units must be made before cutting begins in that unit:
 

PAYMENT UNIT NUMBER	PERCENT OF TOTAL SALE VALUE
01	11.6%
02	31.2%
03	57.2%
4. If no cutting takes place, the 10% down payment will not be refunded.
5. Operations on the contract issued will terminate on 09/30/2024.

**SALE STATISTICS**

Volumes were calculated in cubic feet using the Michigan taper model. Cubic foot volume includes all wood inside bark for the product indicated. For display purposes, cubic feet were converted to cords and MBF using a simple conversion factor, e.g. 79 cubic feet per cord and 185 cubic feet per MBF. The cubic foot volumes are precise; the cords and MBF volumes are not. Cubic foot volume cannot be directly converted to cords or boards with precision.

**SALE VOLUMES**

The total estimated sale volume may not equal the sum of the species/products due to the nature of statistical calculations associated with double sampling methodology.

VOLUME		STATISTICAL RANGE IN CORDS		
TOTAL CUBIC FEET	TOTAL CORDS	PERCENT ERROR	MINIMUM	MAXIMUM
145,666	1,844	6.83%	1,718	1,970

**VDU VOLUMES**

A VDU is a Volume Determination Unit. Volumes and their associated statistics are calculated at the VDU level and summarized to the sale level. There is often a one to one relationship between a VDU and a Payment Unit, but not always, depending on the cruise design. Refer to the VDU TO PAYMENT UNIT table.

VDU	VOLUME		PERCENT ERROR	RANGE IN CORDS	
	TOTAL CUBIC FEET	TOTAL CORDS		MINIMUM	MAXIMUM
10	19,678	249	21.40%	196	302
30	125,989	1,595	7.17%	1,481	1,709
<b>TOTAL:</b>	<b>145,666</b>	<b>1,844</b>		<b>1,676</b>	<b>2,011</b>

**VDU TO PAYMENT UNIT**

When a VDU is associated with more than one Payment Unit (PU), the VDU volumes are assigned to the PU based on acres of the VDU within the PU.

VDU	VDU ACRES	PU	PU ACRES
10	11.1	1	11.1
30	88.8	2	31.3
		3	57.5
<b>TOTAL:</b>	<b>99.9</b>		<b>99.9</b>



**DESCRIPTION OF TIMBER BY PAYMENT UNIT (PU)**

PU	MARKET GROUP	PRODUCT	QUANTITY	UNIT	ACRES	ADVERTISE PRICE
1	Jack Pine	Sawtimber	20.3	MBF	11.1	\$3,975.70
	Red Pine		1.8	MBF		
	Jack Pine	Pulpwood	186	Cords		
	Red Pine		5	Cords		
2	Jack Pine	Sawtimber	24.0	MBF	31.3	\$10,674.35
	Northern Pin Oak		10.2	MBF		
	Red Pine		11.8	MBF		
	Jack Pine	Pulpwood	390	Cords		
	Mixed Hardwood		4	Cords		
	<i>Black Cherry</i>		2	<i>Cords</i>		
	<i>Red Maple</i>		2	<i>Cords</i>		
	Mixed Oak		41	Cords		
	<i>White Oak</i>		0.5	<i>MBF</i>		
	<i>Northern Pin Oak</i>	<i>Pulpwood</i>	39	<i>Cords</i>		
	<i>White Oak</i>		1	<i>Cords</i>		
	Red Pine		12	Cords		
3	Jack Pine	Sawtimber	44.1	MBF	57.5	\$19,582.20
	Northern Pin Oak		18.6	MBF		
	Red Pine		21.7	MBF		
	Jack Pine	Pulpwood	717	Cords		
	Mixed Hardwood		8	Cords		
	<i>Black Cherry</i>		3	<i>Cords</i>		
	<i>Red Maple</i>		5	<i>Cords</i>		
	Mixed Oak		75	Cords		
	<i>White Oak</i>		0.8	<i>MBF</i>		
	<i>Northern Pin Oak</i>	<i>Pulpwood</i>	72	<i>Cords</i>		
	<i>White Oak</i>		1	<i>Cords</i>		
	Red Pine		21	Cords		
TOTAL:			152.5	MBF		
TOTAL:			1,459	Cords		

## Sale Specific Conditions & Requirements

**Sale Name: Townline Jack**

**Sale Number: 72-033-21 Seq#: 2**

### 1 - Sale Area

#### 1.2 - Boundaries

##### 1.2.1 - Painted boundaries (9/19)

The sale boundary and Payment Unit boundaries are marked and identified by blue, red, and yellow paint. Exterior sale boundary lines against private property are marked with blue paint. Exterior sale boundary lines against state are marked with red paint and the southern boundary of Payment Units 1-3 are unmarked and identified by Townline Road. Interior Payment Unit boundaries are marked with yellow paint. Retention patches are marked with red paint; no harvesting activities may occur within these areas. The painted boundary line trees are not Included Timber and are to be protected. Yellow painted trees designating an interior Payment Unit boundary are only to be cut when all surrounding Payment Units have been paid.

### 2 - Timber Specifications

#### 2.1 - Included Timber

##### 2.1.1 - Clearcut unit(s) with unmerchantable trees (6/14)

Within Payment Unit(s) 1-3, cut all trees that are two (2) inches or more at DBH, except do not cut red pine greater than 22-inch DBH.

#### 2.2 - Utilization

##### 2.2.10 - No chipping tops and limbs (8/16)

Within Payment Unit(s) 1-3, chipping of limbs or tops is not permitted. Limbs and the remaining top must be left on site and scattered.

### 3 - Payments

#### 3.3 - Pre-measured Sales

##### 3.3.4 - Dividing payment units (7/14)

Payment Unit(s) 2 and 3 may be divided at the request of the Purchaser and upon approval of the Unit Manager. Dividing Payment Units is a contract modification which requires a Timber Sale Contract Amendment. There will be only one division per Payment Unit.

### 4 - Transportation

#### 4.1 - Construction

##### 4.1.3 - Slash and earthen piles (8/04)

Piles or windrows of earth along roads and landings that have been widened or constructed shall be leveled. Slash from road maintenance or construction, including stumps, shall be dispersed throughout the sale.

##### 4.1.6 - Road construction (1/09)

Construction of new roads or improvements of existing roads shall be done in such a way as to minimize the environmental and visual impacts. Merchantable trees shall be cut and utilized unless otherwise directed. Non-merchantable trees shall be severed and laid flat on the ground. Slash shall be scattered, and not left in windrows and kept a minimum of 10 feet back from the road edge. Stumps shall be set upright, not left on edge, and be moved at least 10 feet away from the road edge. Disturbed soil shall be feathered into the woods and not left in berms or windrows.

##### 4.1.7 - Road closure (10/11)

All new roads built into the sale must be blocked to vehicle traffic within 30 days of completion of hauling. Overgrown roads that are reopened shall be considered new roads. In general, this will require constructing a four (4') foot high berm of stumps and logs covered with earth. These roads must be rendered impassable to cars and trucks. Temporary berms may be required if no sale activity occurs for 30 or more consecutive days. Contact the sale administrator for specific details of design and placement.

#### 4.1.11 - Permits (2/12)

The Purchaser will secure any necessary permits that may be required.

### 5 - Operations

#### 5.1 - Notification

##### 5.1.6 - Utility R.O.W. (4/19)

It is the responsibility of the Purchaser to obtain permission from the utility company to utilize the power line R.O.W. for operations.

#### 5.2 - Conduct of Operations

##### 5.2.2 - Hazard Trees/Snags

###### 5.2.2.1 - Den trees (10/16)

Obvious hollow and/or den trees shall be protected and left standing unless they are a safety hazard.

##### 5.2.32 - Decking/landing restoration (9/13)

All decking and landing areas must have the surface area restored to a condition equal to or better than before. This is to ensure the proper regeneration of the stand. Wood debris, chips, and "cookies" from trimmings must be removed or scattered away from landing and loading areas and may not be windrowed on the edge.

##### 5.2.37 - No decking areas (12/08)

No decking is allowed within 50 feet of Townline Road without permission of the Unit Manager or his/her representative.

##### 5.2.38 - No decking against live trees (2/04)

Cut products may not be decked against unmarked or designated leave trees.

##### 5.2.41 - Snowmobile trail protection (9/11)

The LP 409 is a snowmobile trail and is shown on the Timber Sale Map. Do not cut or damage posts with orange trail markers or traffic control signs. If the trail is used for hauling, it must be graded to the satisfaction of the Unit Manager or his/her representative prior to December 1. If the trail road is to be used for hauling during the snowmobile season, then a snow-covered base must be left on the trail. Maintain a 20-foot-wide slash, debris, and rut free zone daily using the snowmobile trail as the centerline. All stumps within 20 feet of the snowmobile trail must be cut at ground level.

#### 5.4 - Soil Protection

##### 5.4.1 - Rutting restriction, general (7/16)

The Unit Manager or his/her representative may restrict hauling and/or skidding if ruts exceed the specified depth. With the Unit Manager or his/her representative's approval, the Purchaser may return to the area when the risk of rutting has decreased.

### 6 - Safety and Fire Prevention

#### 6.2 - Signing

##### 6.2.1 - Road posting (10/20)

The Purchaser is responsible for posting and maintaining caution signs on Townline Road prior to beginning operations. The road must be posted at appropriate distances from the Sale Area to warn of logging activity and truck traffic. Signs must be removed when harvest operations are suspended or completed. The Purchaser will provide these signs.

##### 6.2.2 - Snowmobile trail posting (10/20)

The Purchaser is responsible for posting and maintaining caution signs on LP 409 prior to beginning operations during the snowmobile season (approximately December 1 to March 31). The trail must be posted at appropriate distances from the Sale Area to warn of logging activity and truck traffic. Signs must be removed when harvest operations are suspended or completed. The Purchaser will provide these signs.



# TIMBER SALE MAP

This information provided by authority of Part 525, 1994 PA 451, as amended.

Sale Number	Year
72-033	21

Forest Management Unit	County	Mapped By	Date	Page	of
Grayling	Crawford	Derek Nellis	9/30/2021	1	1
Township	Range	Section(s) and Subdivision(s)	Scale		
28N	01W	Sec 34 SESE, 35 SESW,S1/2SE, 36 NWSW,S1/2SW	1:15,840		

Cover Type				Density	
A = Aspen	H = Hemlock	N = Marsh	U = Upland Brush	0 = Non Stocked	5 = Pole Timber Medium
B = Paper Birch	J = Jack Pine	O = Oak	UM = Upland Mixed	1 = Seedling Sapling Poor	6 = Pole Timber Well
C = Cedar	L = Lowland Brush	P = Lowland Poplar	V = Bog or Marsh	2 = Seedling Sapling Medium	7 = Saw Timber Poor
D = Treed Bog	LM = Lowland Mixed	Q = Mixed Swamp Conifer	W = White Pine	3 = Seedling Sapling Well	8 = Saw Timber Medium
E = Swamp Hdwoods	M = Mpl, Bch, Brch	R = Red Pine	X = Non Stocked	4 = Pole Timber Poor	9 = Saw Timber Well
F = Spruce Fir	MC = Mixed Conifer	S = Black Spruce	Z = Water		
G = Grass	MD = Mixed Deciduous	T = Tamarack			

PU	Acres
1	11.1
2	31.3
3	57.5

## Townline Jack

### Compartment 288

### 99.9 Acres

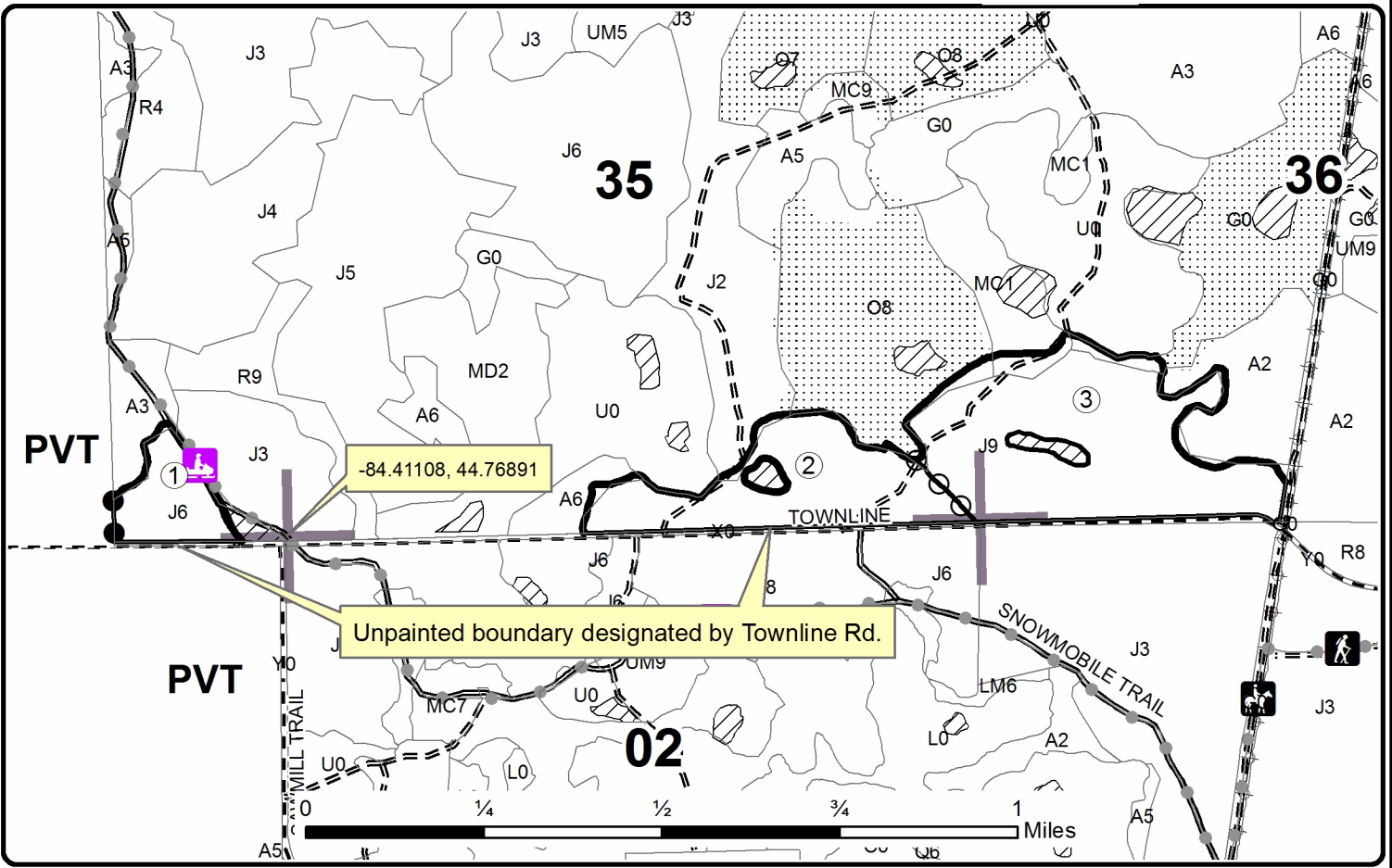
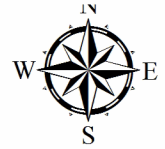

### Legend

- Hiking Trails
- Horse Trails
- Snowmobile Trails
- Recreational Trails
- Payment Unit Label
- Primary Forest Road
- Secondary Forest Road
- Forest Access Route
- Gravel Road
- Powerline
- Against State (Red)
- Payment Unit (Yellow)
- Private Line (Blue)
- Nearby Timber Sale
- Section Corners

## TIMBER SALE INFORMATION

### Technician Party KW (72-038-21)

T28N, R01W, SEC. 17; T28N, R01W, SEC. 6; T28N, R01W, SEC. 7; T28N, R01W, SEC. 8; T28N, R02W, SEC. 1; T28N, R02W, SEC. 12.

SALE NOTE: All units of volume listed for this sale were estimated using the Inventory Manager computer program and the new Michigan taper model.

See sale spec 5.1.3 for information on nearby pipelines.

See sale spec 2.2.3 for information on stump heights.

See sale spec 5.2.41 for information on snowmobile trail protection.

See sale spec 5.8.1 for information on Kirtland Warbler restrictions.

A recreation site such as a trail, pathway, or campground is within the sale area or the vicinity. Certain restrictions/specifications may be applicable including time restrictions.

A timber sale contract for this lump sum, sealed bid timber sale will be awarded to the responsible bidder offering the highest sealed bid price. All units of volume listed below were estimated using the Inventory Manager computer program and the new Michigan taper model. Bids must be at or above the following advertised price for each product and species:

<u>PRODUCTS &amp; SPECIES</u>	<u>ESTIMATED UNITS*</u>	<u>ADVERTISED PRICE</u>
Sawtimber		
Red Pine	29.9 MBF	\$ 89.00 / MBF
Pulpwood		
Black Cherry	6 Cords	\$ 26.90 / Cord
Jack Pine	4,875 Cords	\$ 16.15 / Cord
Quaking Aspen	100 Cords	\$ 25.70 / Cord
Red Oak	3 Cords	\$ 24.65 / Cord
Red Pine	19 Cords	\$ 32.40 / Cord

\* The total volume is statistically estimated within plus (+) or minus (-) 4.78 percent. There are an estimated 5,069 cords on this timber sale, plus or minus 243 cords at the 95% confidence level. The estimated units are final and not subject to adjustment. Prospective bidders are urged to examine this timber and to make their own estimates of quantity and quality.

### **BOND AND PAYMENT SCHEDULE:**

1. A bond in the amount of \$4,241.00 to insure faithful performance of the conditions of the contract will be deposited by the successful bidder within 21 days of the sale award.
2. Cutting in any sale or unit without the required advance payment would be considered a trespass.
3. Total payment must be paid in advance or according to the following schedule :
  - (a) Ten percent (10%) of the sale value must be paid within 21 days of the sale award.
  - (b) The 10% down payment will be credited towards the first unit cut.
  - (c) Payment for each of the following units must be made before cutting begins in that unit:

PAYMENT UNIT NUMBER	PERCENT OF TOTAL SALE VALUE
01	3.8%
02	21.3%
03	4.1%
04	10.7%
05	16.7%
06	12.2%
07	15.1%
08	10.1%
09	6.0%

4. If no cutting takes place, the 10% down payment will not be refunded.
5. Operations on the contract issued will terminate on 09/30/2025.

### **SALE STATISTICS**

Volumes were calculated in cubic feet using the Michigan taper model. Cubic foot volume includes all wood inside bark for the product indicated. For display purposes, cubic feet were converted to cords and MBF using a simple conversion factor, e.g. 79 cubic feet per cord and 185 cubic feet per MBF. The cubic foot volumes are precise; the cords and MBF volumes are not. Cubic foot volume cannot be directly converted to cords or boards with precision.

### SALE VOLUMES

The total estimated sale volume may not equal the sum of the species/products due to the nature of statistical calculations associated with double sampling methodology.

VOLUME			STATISTICAL RANGE IN CORDS	
TOTAL CUBIC FEET	TOTAL CORDS	PERCENT ERROR	MINIMUM	MAXIMUM
400,459	5,069	4.78%	4,826	5,312

### VDU VOLUMES

A VDU is a Volume Determination Unit. Volumes and their associated statistics are calculated at the VDU level and summarized to the sale level. There is often a one to one relationship between a VDU and a Payment Unit, but not always, depending on the cruise design. Refer to the VDU TO PAYMENT UNIT table.

VDU	VOLUME		PERCENT ERROR	RANGE IN CORDS	
	TOTAL CUBIC FEET	TOTAL CORDS		MINIMUM	MAXIMUM
1	85,399	1,081	7.12%	1,004	1,158
2	99,936	1,265	9.00%	1,151	1,379
5	82,985	1,050	15.66%	886	1,215
7	8,136	103	32.77%	69	137
8	12,822	162	12.09%	143	182
14	14,403	182	24.58%	138	227
16	96,777	1,225	7.91%	1,128	1,322
<b>TOTAL:</b>	<b>400,459</b>	<b>5,069</b>		<b>4,519</b>	<b>5,619</b>

**VDU TO PAYMENT UNIT**

When a VDU is associated with more than one Payment Unit (PU), the VDU volumes are assigned to the PU based on acres of the VDU within the PU.

VDU	VDU ACRES	PU	PU ACRES
1	109.5	1	20.1
		2	89.4
2	152.1	2	27.2
		3	26.1
		4	67.7
		5	31.1
		5	31.7
5	78.4	6	41.8
		7	3.0
		8	0.1
		9	1.8
		5	11.8
		6	22.5
		8	0.4
		9	2.6
		5	14.7
8	14.7		
14	6.3	6	0.2
16	100.5	9	6.1
		6	1.6
		7	58.2
		8	40.7
<b>TOTAL:</b>	<b>498.8</b>		<b>498.8</b>

**DESCRIPTION OF TIMBER BY PAYMENT UNIT (PU)**

PU	MARKET GROUP	PRODUCT	QUANTITY	UNIT	ACRES	ADVERTISE PRICE
1	Black Cherry	Pulpwood	1	Cords	20.1	\$3,224.60
	Jack Pine		198	Cords		
	<i>Jack Pine</i>		198	<i>Cords</i>		
2	Black Cherry	Pulpwood	5	Cords	116.6	\$17,980.25
	Jack Pine		1,105	Cords		
	<i>Jack Pine</i>		<i>1,105</i>	<i>Cords</i>		
3	Jack Pine	Pulpwood	217	Cords	26.1	\$3,504.55
	<i>Jack Pine</i>		<i>217</i>	<i>Cords</i>		
4	Jack Pine	Pulpwood	563	Cords	67.7	\$9,092.45
	<i>Jack Pine</i>		<i>563</i>	<i>Cords</i>		
5	Jack Pine	Pulpwood	878	Cords	89.3	\$14,204.35
	<i>Jack Pine</i>	<i>Sawtimber</i>	5.8	<i>MBF</i>		
	<i>Jack Pine</i>	<i>Pulpwood</i>	866	<i>Cords</i>		
	Red Oak		1	Cords		
6	Red Pine	Sawtimber	0.9	MBF	66.1	\$10,354.55
	Jack Pine	Pulpwood	631	Cords		
	<i>Jack Pine</i>	<i>Sawtimber</i>	8.3	<i>MBF</i>		
	<i>Jack Pine</i>	<i>Pulpwood</i>	614	<i>Cords</i>		
	Quaking Aspen		2	Cords		
	Red Pine		1	Cords		
7	Jack Pine	Pulpwood	700	Cords	61.2	\$12,820.25
	<i>Jack Pine</i>	<i>Sawtimber</i>	0.4	<i>MBF</i>		
	<i>Jack Pine</i>	<i>Pulpwood</i>	699	<i>Cords</i>		
	Quaking Aspen		58	Cords		
	Red Oak		1	Cords		
8	Jack Pine	Pulpwood	464	Cords	41.2	\$8,546.25
	<i>Jack Pine</i>	<i>Sawtimber</i>	0.1	<i>MBF</i>		
	<i>Jack Pine</i>	<i>Pulpwood</i>	464	<i>Cords</i>		
	Quaking Aspen		40	Cords		
	Red Oak		1	Cords		
9	Red Pine	Sawtimber	29.0	MBF	10.5	\$5,086.05
	Jack Pine	Pulpwood	119	Cords		
	<i>Jack Pine</i>	<i>Sawtimber</i>	0.5	<i>MBF</i>		
	<i>Jack Pine</i>	<i>Pulpwood</i>	118	<i>Cords</i>		
	Red Pine		18	Cords		
TOTAL:			29.9	MBF		
TOTAL:			5,003	Cords		



## Sale Specific Conditions & Requirements

**Sale Name: Technician Party KW**

**Sale Number: 72-038-21 Seq#: 2**

### 1 - Sale Area

#### 1.2 - Boundaries

##### 1.2.1 - Painted boundaries (9/19)

The sale boundary and Payment Unit boundaries are primarily marked and identified by blue, red, and yellow paint, but also include unpainted designated boundaries. Exterior sale boundary lines against private property are marked with blue paint, with an exception for boundaries along Shupac Lake Road and a small section along Twin Bridge Road. These boundaries are unpainted and identified by the roads. Exterior sale boundary lines against state are marked with red paint, with an exception for boundaries along Jack Pine Plains Road, Twin Bridge Road, and Campground Road. These boundaries are unpainted and identified by the roads. There are also boundaries along unnamed forest roads that are unpainted and identified by the forest roads. These boundaries exist along the East edge of Payment Unit 3 and along the North edge of Payment Units 5, 6, and 8. Additionally, the Northeast boundary of Payment Unit 8 is unpainted and identified by the snowmobile trail. There are also several unpainted boundaries that are identified by a cover type change. These boundaries are located along the East edge of Payment Units 1 and 2, and along the South edge of Payment Unit 7. Interior Payment Unit boundaries are marked with yellow paint. Retention patches are marked with red paint; no harvesting activities may occur within these areas. The painted boundary line trees are not Included Timber and are to be protected. Yellow painted trees designating an interior Payment Unit boundary are only to be cut when all surrounding Payment Units have been paid.

### 2 - Timber Specifications

#### 2.1 - Included Timber

##### 2.1.1 - Clearcut unit(s) with unmerchantable trees (6/14)

Within Payment Unit(s) 1-9, cut all trees that are two (2) inches or more at DBH. Leave red pine in Payment Units 1-5 and leave red pine and white pine in Payment Units 7 and 8.

#### 2.2 - Utilization

##### 2.2.2 - Chipping required (2/18)

Payment Units 1-9 must be chip harvested to meet Kirtland's warbler habitat requirements. The requirement to retain approximately 1/6 to 1/3 of tree tops and limbs less than four inches in diameter does not apply (G. C. & R. 2.2).

##### 2.2.3 - Stump heights (4/07)

Stump heights within the Sale Area shall not exceed 6 inches for all trees, this is to facilitate planting operations.

### 3 - Payments

#### 3.3 - Pre-measured Sales

##### 3.3.4 - Dividing payment units (7/14)

Payment Unit(s) may be divided at the request of the Purchaser and upon approval of the Unit Manager. Dividing Payment Units is a contract modification which requires a Timber Sale Contract Amendment.

#### 3.4 - Damaged Timber

##### 3.4.2 - Special Protection Trees (4/14)

The Purchaser shall not cut live or dead special protection trees within cutting units or clearings. Special protection trees are red pine within Payment Units 1-5, red and white pine in Payment Units 7 and 8, green painted trees, witness trees (which are painted red), and any Legacy trees. If the Purchaser's operations have cut or damaged special protection trees through carelessness, the Purchaser shall pay \$100 as fixed, agreed and liquidated damages for each special protection tree cut or damaged. Such payment does not constitute ownership of the undesignated timber.

### 4 - Transportation

#### 4.1 - Construction

#### 4.1.3 - Slash and earthen piles (8/04)

Piles or windrows of earth along roads and landings that have been widened or constructed shall be leveled. Slash from road maintenance or construction, including stumps, shall be chipped, utilized, or otherwise removed from the sale.

#### 4.1.6 - Road construction (1/09)

Construction of new roads or improvements of existing roads shall be done in such a way as to minimize the environmental and visual impacts. Merchantable trees shall be cut and utilized unless otherwise directed. Non-merchantable trees shall be severed and laid flat on the ground. Slash shall be chipped, utilized, or otherwise removed from the sale. Stumps shall be set upright, not left on edge, and be moved at least 10 feet away from the road edge. Disturbed soil shall be feathered into the woods and not left in berms or windrows.

#### 4.1.7 - Road closure (10/11)

All new roads built into the sale and existing temporary access roads (shown on the Timber Sale Map) must be blocked to vehicle traffic upon completion of the sale. Overgrown roads that are reopened shall be considered new roads. In general, this will require constructing a four (4') foot high berm of stumps and logs covered with earth. Stumps and brush must be placed along the remainder of the trail. These roads must be rendered impassable to cars and trucks. Contact the sale administrator for specific details of design and placement.

#### 4.1.11 - Permits (2/12)

The Purchaser will secure any necessary permits that may be required.

## 5 - Operations

### 5.1 - Notification

#### 5.1.1 - Pre-sale conference (10/16)

A pre-sale conference on site between the Purchaser and sale administrator is required prior to beginning any operations to determine landing and road locations. The Unit Manager or his/her representative must be contacted at least 5 days in advance to schedule the conference.

#### 5.1.3 - Well heads and natural gas pipelines (11/15)

The Purchaser is responsible for contacting the gas or pipeline company and obtaining any necessary permits prior to operating equipment in the vicinity of well heads or natural gas pipelines.

#### 5.1.6 - Utility R.O.W. (4/19)

It is the responsibility of the Purchaser to obtain permission from the utility company to utilize the power line R.O.W. for operations.

### 5.2 - Conduct of Operations

#### 5.2.31 - Landing locations (9/13)

Landing areas are marked on the Timber Sale Map as the letter "L" with a circle surrounding it. Landings must be confined to these designated sites or other identified areas that are approved by the Unit Manager or his/her representative.

#### 5.2.32 - Decking/landing restoration (9/13)

All decking and landing areas must have the surface area restored to a condition equal to or better than before. This is to ensure the proper regeneration of the stand. Wood debris, chips, and "cookies" from trimmings must be removed or scattered away from landing and loading areas and may not be windrowed on the edge.

#### 5.2.38 - No decking against live trees (2/04)

Cut products may not be decked against unmarked or designated leave trees.

#### 5.2.41 - Snowmobile trail protection (9/11)

The Shupac Trail is a snowmobile trail and is shown on the Timber Sale Map. Do not cut or damage posts with orange trail markers or traffic control signs. If the trail is used, it must be maintained and restored to a condition equal to or better than before the sale. The road maintenance/restoration must be done prior to December 1. If the trail is used for hauling, it must be graded to the satisfaction of the Unit Manager or his/her representative prior to December 1. If the trail road is to be used for hauling during the snowmobile season, then a snow-covered base must be left on the trail. The snowmobile may not be used for any timber sale operations from December 1 through March 31 without written approval from the Unit Manager. The snowmobile trail may only be crossed at right angles. Maintain a 20-foot-wide slash, debris, and rut free zone daily using the snowmobile trail as the centerline. No decking of forest products will be permitted along the snowmobile trail. In addition,

any trees cut within 5 feet of the trail must be cut at ground level or have the stumps removed and disposed of according to the direction of the Unit Manager or his/her representative.

#### 5.2.43 - Opening protection (2/21)

No activities are permitted in the cover type "U0" openings (shown on map) to the East of Payment Units 1 and 2, and to the North of Payment Unit 3. Any damage to the openings shall be repaired according to specifications of the Unit Manager or his/her representative.

### 5.4 - Soil Protection

#### 5.4.1 - Rutting restriction, general (7/16)

Operations are to cease immediately if equipment and weather conditions result in rutting of roads and/or skid trails which is 12 inches or greater in depth and 50 feet in length. The Unit Manager or his/her representative may restrict hauling and/or skidding if ruts exceed the specified depth. With the Unit Manager or his/her representative's approval, the Purchaser may return to the area when the risk of rutting has decreased.

### 5.8 - Protection of Endangered Species

#### 5.8.1 - Kirtland's warbler (1) (10/12)

This sale is adjacent to a young jack pine stand which may be used by the endangered Kirtland's Warbler. The Department reserves the right to temporarily restrict all harvesting operations in a buffer zone of up to 500 feet if it is determined that Warbler territory has been established in the adjacent stand. The restricted period, if put into effect, would apply from May 1 to August 15.

## 6 - Safety and Fire Prevention

### 6.2 - Signing

#### 6.2.1 - Road posting (10/20)

The Purchaser is responsible for posting and maintaining caution signs on County Road 612, Twin Bridge Road, Shupac Lake Road, Jack Pine Plains Road, and Campground Road prior to beginning operations. The road must be posted at appropriate distances from the Sale Area to warn of logging activity and truck traffic. Signs must be removed when harvest operations are suspended or completed. The Purchaser will provide these signs.

#### 6.2.2 - Snowmobile trail posting (10/20)

The Purchaser is responsible for posting and maintaining caution signs on Shupac Trail prior to beginning operations during the snowmobile season (approximately December 1 to March 31). The trail must be posted at appropriate distances from the Sale Area to warn of logging activity and truck traffic. Signs must be removed when harvest operations are suspended or completed. The Purchaser will provide these signs.



# TIMBER SALE MAP

This information provided by authority of Part 525, 1994 PA 451, as amended.

Forest Management Unit Grayling	County Crawford	Mapped By Dakota Ewald	Date 10/07/2021	Page 1	of 2
Township 28N	Range 01&02 W	Section(s) and Subdivision(s) R01W, Sec 6- SWSW, Sec 7- W1/2NW, SENW, SE, SW, Sec 8- W1/2SE, SW Sec 17- N1/2NW Sec 18- NENER02W, Sec 1- SESE, Sec 12- E1/2NE, E1/2SE	Scale 1:15,840		

### Cover Type

A = Aspen	H = Hemlock	N = Marsh	U = Upland Brush
B = Paper Birch	J = Jack Pine	O = Oak	UM = Upland Mixed
C = Cedar	L = Lowland Brush	P = Lowland Poplar	V = Bog or Marsh
D = Treed Bog	LM = Lowland Mixed	Q = Mixed Swamp Conifer	W = White Pine
E = Swamp Hdwoods	M = Mpl, Bch, Brch	R = Red Pine	X = Non Stocked
F = Spruce Fir	MC = Mixed Conifer	S = Black Spruce	Z = Water
G = Grass	MD = Mixed Deciduous	T = Tamarack	

### Density

0 = Non Stocked	5 = Pole Timber Medium
1 = Seedling Sapling Poor	6 = Pole Timber Well
2 = Seedling Sapling Medium	7 = Saw Timber Poor
3 = Seedling Sapling Well	8 = Saw Timber Medium
4 = Pole Timber Poor	9 = Saw Timber Well

PU	Acres	PU	Acres
1	20.1	6	66.1
2	116.6	7	61.2
3	26.1	8	41.2
4	67.7	9	10.5
5	89.3		

## Technician Party KW

### Compartment 271

#### 498.8 Acres

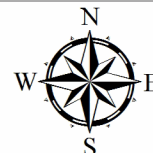

QR code opens map in PDF map apps

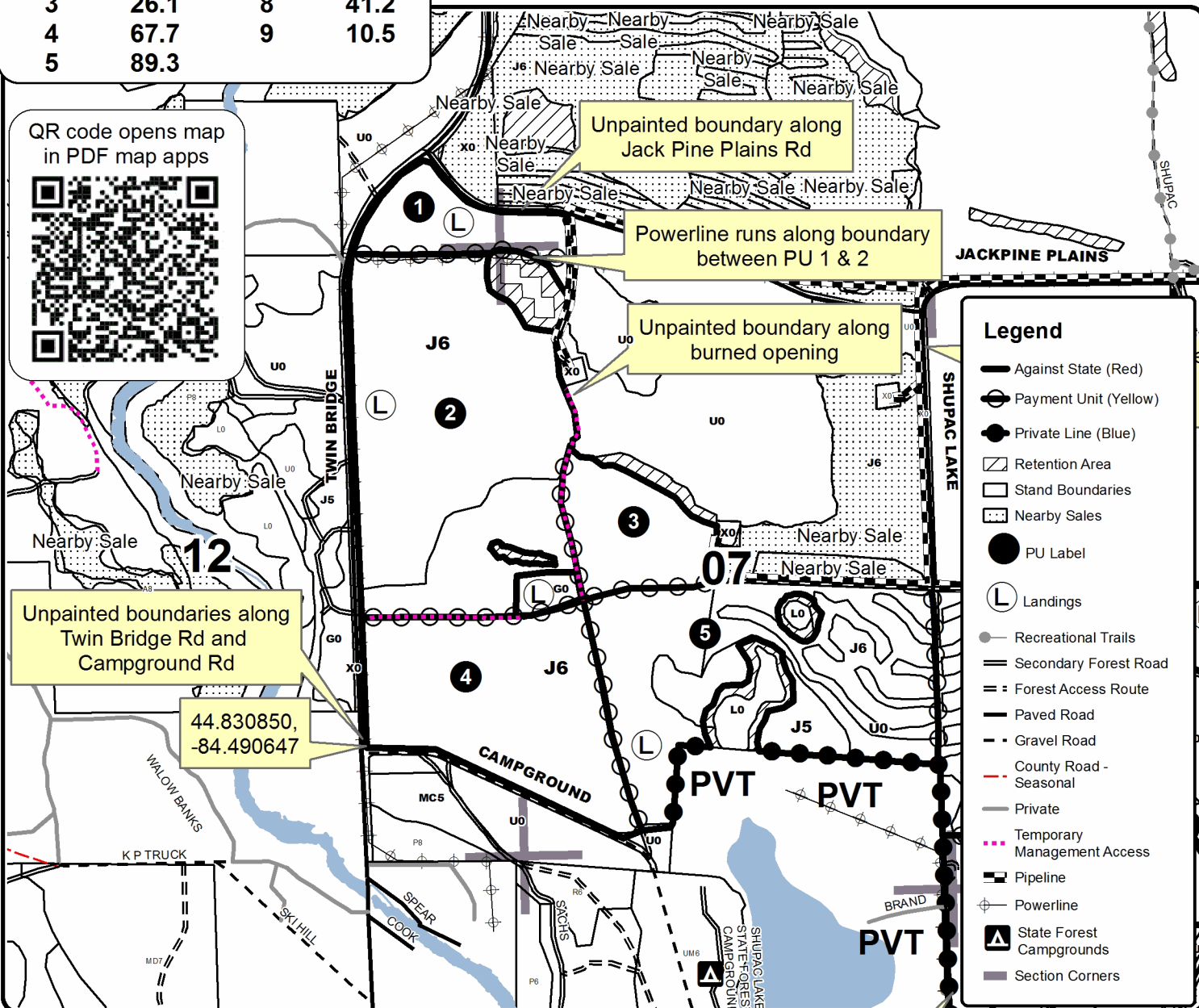

### Legend

- Against State (Red)
- Payment Unit (Yellow)
- Private Line (Blue)
- Retention Area
- Stand Boundaries
- Nearby Sales
- PU Label
- Landings
- Recreational Trails
- Secondary Forest Road
- Forest Access Route
- Paved Road
- Gravel Road
- County Road - Seasonal
- Private
- Temporary Management Access
- Pipeline
- Powerline
- State Forest Campgrounds
- Section Corners

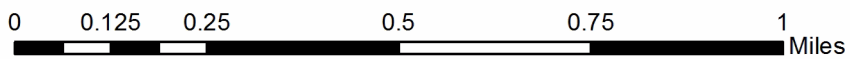



Sale Number	Year
72-038	21

# TIMBER SALE MAP

This information provided by authority of Part 525, 1994 PA 451, as amended.

Forest Management Unit	County	Mapped By	Date	Page	of
Grayling	Crawford	Dakota Ewald	10/07/2021	2	2
Township	Range	Section(s) and Subdivision(s)	Scale		
28N	01&02 W	R01W, Sec 6- SWSW, Sec 7- W1/2NW, SENW, SE, SW, Sec 8- W1/2SE, SW Sec 17- N1/2NW Sec 18- NENER02W, Sec 1- SESE, Sec 12- E1/2NE, E1/2SE	1:15,840		

### Cover Type

A = Aspen	H = Hemlock	N = Marsh	U = Upland Brush
B = Paper Birch	J = Jack Pine	O = Oak	UM = Upland Mixed
C = Cedar	L = Lowland Brush	P = Lowland Poplar	V = Bog or Marsh
D = Treed Bog	LM = Lowland Mixed	Q = Mixed Swamp Conifer	W = White Pine
E = Swamp Hdwoods	M = Mpl. Bch, Brch	R = Red Pine	X = Non Stocked
F = Spruce Fir	MC = Mixed Conifer	S = Black Spruce	Z = Water
G = Grass	MD = Mixed Deciduous	T = Tamarack	

### Density

0 = Non Stocked	5 = Pole Timber Medium
1 = Seedling Sapling Poor	6 = Pole Timber Well
2 = Seedling Sapling Medium	7 = Saw Timber Poor
3 = Seedling Sapling Well	8 = Saw Timber Medium
4 = Pole Timber Poor	9 = Saw Timber Well

PU	Acres	PU	Acres
1	20.1	6	66.1
2	116.6	7	61.2
3	26.1	8	41.2
4	67.7	9	10.5
5	89.3		

## Technician Party KW

### Compartment 271

#### 498.8 Acres

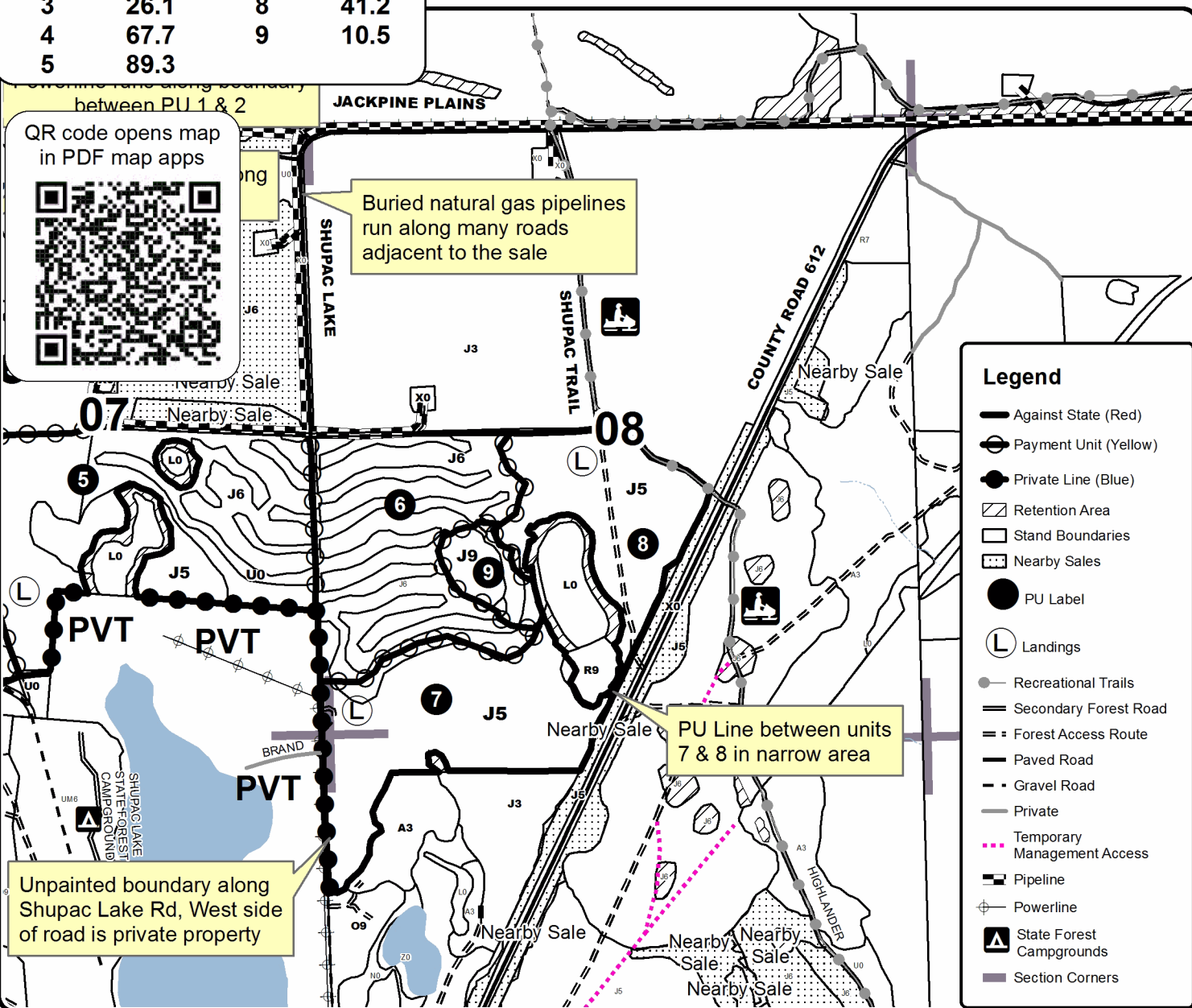
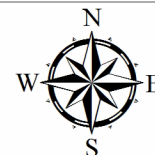

QR code opens map in PDF map apps



Buried natural gas pipelines run along many roads adjacent to the sale

PU Line between units 7 & 8 in narrow area

Unpainted boundary along Shupac Lake Rd, West side of road is private property



# TIMBER SALE INFORMATION

Well Daisy If You Do Pine (72-046-21)  
T28N, R01W, SEC. 25; T28N, R01W, SEC. 36.  
Crawford County (Advertised Price \$9,723.00)

SALE NOTE: All units of volume listed for this sale were estimated using the Inventory Manager computer program and the new Michigan taper model.

See sale spec 5.2.40 for information on pathway protection requirements.

See sale spec 5.4.1 for information on rutting restrictions.

See sale spec 2.2.2 and 2.2.3 for information on stump heights and chipping.

Payment Unit 1 has high variability in cruise data due to large portions of the unit being open or sub-merchantable. Purchaser is strongly encouraged to make their own estimates of volume and feasibility.

Due to the sub-merchantable and open areas, in addition to the variability of the volume estimates for Payment Unit 1, an additional 5% reduction of the advertised price has been applied to this sale.

A recreation site such as a trail, pathway, or campground is within the sale area or the vicinity. Certain restrictions/specifications may be applicable including time restrictions.

A timber sale contract for this lump sum, sealed bid timber sale will be awarded to the responsible bidder offering the highest sealed bid price. All units of volume listed below were estimated using the Inventory Manager computer program and the new Michigan taper model. Bids must be at or above the following advertised price for each product and species:

<u>PRODUCTS &amp; SPECIES</u>	<u>ESTIMATED UNITS*</u>	<u>ADVERTISED PRICE</u>
Sawtimber		
Red Pine	39.9 MBF	\$ 81.00 / MBF
Pulpwood		
Jack Pine	340 Cords	\$ 14.65 / Cord
Red Pine	50 Cords	\$ 29.45 / Cord
White Pine	2 Cords	\$ 18.80 / Cord

\* The total volume is statistically estimated within plus (+) or minus (-) 10.70 percent. There are an estimated 507 cords on this timber sale, plus or minus 54 cords at the 95% confidence level. The estimated units are final and not subject to adjustment. Prospective bidders are urged to examine this timber and to make their own estimates of quantity and quality.

## **BOND AND PAYMENT SCHEDULE:**

1. A bond in the amount of \$486.00 to insure faithful performance of the conditions of the contract will be deposited by the successful bidder within 21 days of the sale award.
2. Cutting in any sale or unit without the required advance payment would be considered a trespass.
3. Total payment must be paid in advance or according to the following schedule:
  - (a) Ten percent (10%) of the sale value must be paid within 21 days of the sale award.
  - (b) The 10% down payment will be credited towards the first unit cut.

(c) Payment for each of the following units must be made before cutting begins in that unit:

<u>PAYMENT UNIT NUMBER</u>	<u>PERCENT OF TOTAL SALE VALUE</u>
01	49.1%
02	31.0%
03	19.9%

4. If no cutting takes place, the 10% down payment will not be refunded.
5. Operations on the contract issued will terminate on 03/31/2025.

## **SALE STATISTICS**

Volumes were calculated in cubic feet using the Michigan taper model. Cubic foot volume includes all wood inside bark for the product indicated. For display purposes, cubic feet were converted to cords and MBF using a simple conversion factor, e.g. 79 cubic feet per cord and 185 cubic feet per MBF. The cubic foot volumes are precise; the cords and MBF volumes are not. Cubic foot volume cannot be directly converted to cords or boards with precision.

## SALE VOLUMES

The total estimated sale volume may not equal the sum of the species/products due to the nature of statistical calculations associated with double sampling methodology.

VOLUME			STATISTICAL RANGE IN CORDS	
TOTAL CUBIC FEET	TOTAL CORDS	PERCENT ERROR	MINIMUM	MAXIMUM
40,020	507	10.70%	452	561

## VDU VOLUMES

A VDU is a Volume Determination Unit. Volumes and their associated statistics are calculated at the VDU level and summarized to the sale level. There is often a one to one relationship between a VDU and a Payment Unit, but not always, depending on the cruise design. Refer to the VDU TO PAYMENT UNIT table.

	VOLUME			RANGE IN CORDS	
VDU	TOTAL CUBIC FEET	TOTAL CORDS	PERCENT ERROR	MINIMUM	MAXIMUM
6	17,805	225	12.85%	196	254
28	11,222	142	23.45%	109	175
48	10,994	139	22.67%	108	171
<b>TOTAL:</b>	<b>40,020</b>	<b>507</b>		<b>413</b>	<b>600</b>

## VDU TO PAYMENT UNIT

When a VDU is associated with more than one Payment Unit (PU), the VDU volumes are assigned to the PU based on acres of the VDU within the PU.

VDU	VDU ACRES	PU	PU ACRES
6	22.1	2	22.1
28	18.9	3	18.9
48	35.4	1	35.4
<b>TOTAL:</b>	<b>76.4</b>		<b>76.4</b>

## DESCRIPTION OF TIMBER BY PAYMENT UNIT (PU)

PU	MARKET GROUP	PRODUCT	QUANTITY	UNIT	ACRES	ADVERTISE PRICE
1	Red Pine	Sawtimber	39.9	MBF	35.4	\$4,771.30
	Jack Pine	Pulpwood	2	Cords		
	<i>Jack Pine</i>		2	<i>Cords</i>		
	Red Pine		50	Cords		
	White Pine		2	Cords		
2	Jack Pine	Pulpwood	206	Cords	22.1	\$3,017.90
	<i>Jack Pine</i>	<i>Sawtimber</i>	9.8	<i>MBF</i>		
	<i>Jack Pine</i>	<i>Pulpwood</i>	186	<i>Cords</i>		
3	Jack Pine	Pulpwood	132	Cords	18.9	\$1,933.80
	<i>Jack Pine</i>	<i>Sawtimber</i>	12.0	<i>MBF</i>		
	<i>Jack Pine</i>	<i>Pulpwood</i>	108	<i>Cords</i>		
TOTAL:			39.9	MBF		
TOTAL:			392	Cords		



## Sale Specific Conditions & Requirements

**Sale Name: Well Daisy If You Do Pine**

**Sale Number: 72-046-21 Seq#: 2**

### 1 - Sale Area

#### 1.2 - Boundaries

##### 1.2.1 - Painted boundaries (9/19)

The sale boundary and Payment Unit boundaries are marked and identified by red and yellow paint. Exterior sale boundary lines against state are marked with red paint. Interior Payment Unit boundaries are marked with yellow paint. Retention patches are marked with red paint; no harvesting activities may occur within these areas. The painted boundary line trees are not Included Timber and are to be protected. Yellow painted trees designating an interior Payment Unit boundary are only to be cut when all surrounding Payment Units have been paid.

### 2 - Timber Specifications

#### 2.1 - Included Timber

##### 2.1.1 - Clearcut unit(s) with unmerchantable trees (6/14)

Within Payment Unit(s) 1, cut all trees that are two (2) inches or more at DBH, except do not cut any pine that are greater than 26 inches at DBH.

##### 2.1.4 - Designated timber unit(s) (6/17)

Within Payment Unit(s) 2 and 3, all jack pine that are six (6) inches or more at DBH are designated for cutting, except those witness trees identified by a blaze and red paint ring. In addition, all aspen and dead trees are to be cut and removed from the sale regardless of merchantability.

#### 2.2 - Utilization

##### 2.2.2 - Chipping required (2/18)

Payment Units 1-3 must be chip harvested to facilitate future silvicultural activities in Payment Unit 1, and to reduce the visual and functional impacts of logging around the Walsh Road Trail Camp in Payment Units 2 and 3. In Payment Units 2 and 3, the Purchaser has the option to produce sawlogs or pulpwood bolts, but the remaining portion of the trees must be chipped and hauled. Products may be produced as roundwood and forwarded to decking areas in final product length, but the tops must be left intact and skidded to the landing for chipping to minimize the amount of residual slash. In Payment Unit 1 a chipping exemption can be obtained if proposed operations are determined to be suitable for planting by reforestation staff. This exemption must be granted in writing. If market conditions limit the practicality of chipping, the Purchaser may skid all remaining topwood out of these Payment Units and pile in locations approved by the sale administrator. If the deadline is not met, damages will be applied commensurate with the cost to complete this work. In Payment Unit 1 the requirement to retain approximately 1/6 to 1/3 of tree tops and limbs less than four inches in diameter is still applicable (G. C. & R. 2.2). In Payment Units 2 and 3 the requirement to retain approximately 1/6 to 1/3 of tree tops and limbs less than four inches in diameter does not apply (G. C. & R. 2.2). This is because the Sale Area is around the Walsh Road Trail Camp and removal of all logging slash possible is important for maintaining the aesthetics and function of the recreational site.

##### 2.2.3 - Stump heights (4/07)

Stump heights within Payment Unit 1 shall not exceed 6 inches for all trees. This is to facilitate planting operations. Stumps within Payment Units 2 and 3 must be cut flush with ground level within 50 feet of campground improvements, and no more than 6 inches within the remaining area of the Payment Units. This is to maintain the integrity and function of the Walsh Road Trail Camp.

##### 2.2.4 - Skidding length (2/14)

Within Payment Units 2 and 3 skidding of lengths over 17 feet is permissible if the timber sale administrator approves the method and machinery used. If at any point damage exceeds specification 3.4.1, all the remaining wood must be skid in lengths less than 17 feet.

### 3 - Payments

#### 3.3 - Pre-measured Sales

##### 3.3.4 - Dividing payment units (7/14)

Payment Unit(s) may be divided at the request of the Purchaser and upon approval of the Unit Manager. Dividing Payment Units is a contract modification which requires a Timber Sale Contract Amendment. There will be only one division per Payment Unit.

### 3.4 - Damaged Timber

#### 3.4.1 - Damaged timber (7/16)

General Condition and Requirement 3.4 Damaged Timber, defines liquidated damages for undesignated live merchantable trees which are cut or injured. In addition, extreme care should be taken to avoid damage to tree seedlings and saplings. Within Payment Units 2 and 3, if more than 30% of the tree seedlings or saplings (1/4" to 4.5" DBH) within a specified portion of the Sale Area are damaged, liquidated damages will be assessed at \$300.00 per acre for all acreage within that specified portion of the Sale Area that was damaged.

Within the Sale Area, if more than 5% of trees (> 4.5" DBH) within a specified area of the sale are damaged, liquidated damages will be assessed for all trees damaged. Rates will be in accordance with General Condition and Requirement 3.4 Damaged Timber, or at a rate of \$100.00 per sawtimber tree and \$30.00 per pole sized tree, whichever is greater.

#### 3.4.2 - Special Protection Trees (4/14)

The Purchaser shall not cut live or dead special protection trees within cutting units or clearings. Special protection trees are witness trees marked with red rings. If the Purchaser's operations have cut or damaged special protection trees through carelessness, the Purchaser shall pay \$300.00 as fixed, agreed and liquidated damages for each special protection tree cut or damaged. Such payment does not constitute ownership of the undesignated timber.

## 4 - Transportation

### 4.1 - Construction

#### 4.1.6 - Road construction (1/09)

Within Payment Unit 1 construction of new roads or improvements of existing roads shall be done in such a way as to minimize the environmental and visual impacts. Merchantable trees shall be cut and utilized unless otherwise directed. Non-merchantable trees shall be severed and laid flat on the ground. Slash shall be chipped, utilized, or otherwise removed from the sale. Stumps shall be set upright, not left on edge, and be moved at least 100 feet from the Sale Area or chipped. Disturbed soil shall be feathered into the woods and not left in berms or windrows.

#### 4.1.7 - Road closure (10/11)

In Payment Unit 1, all new roads built into the sale must be blocked to vehicle traffic upon completion of the sale. All new roads built into the sale must be blocked to vehicle traffic within 30 days of completion of hauling. Overgrown roads that are reopened shall be considered new roads. In general, this will require constructing double earthen berms at strategic locations. These roads must be rendered impassable to cars and trucks. All stumps from road building and landing construction must be reserved to block any newly constructed roads upon completion of the sale. These stumps must be scattered along the road system to prohibit vehicular movement. Contact the sale administrator for specific details of design and placement.

#### 4.1.11 - Permits (2/12)

The Purchaser will secure any necessary permits that may be required.

#### 4.1.12 - No new roads (1/12)

No new roads will be permitted in Payment Units 2 and 3. All operations are limited to existing roads. Skid trails only will be allowed.

### 4.2 - Maintenance

#### 4.2.3 - Road maintenance (8/13)

The following road maintenance may be needed in the event of unseasonably warm weather:

If weather causes any roads or improvements in the Walsh Road Trail Camp Area to degrade due to logging operations it is required within 60 days of completion of hauling, or if no hauling occurs for 60 days, the road or improvements must be maintained and graded. This includes cleaning of drainage areas, grading, crowning, and filling with gravel, if necessary. Damages will be assessed if grading/repair does not occur.

#### 4.2.4 - Grading (10/16)

For completion of the sale, any disturbed improvements within the area of the Walsh Road Trail Camp must be graded. In general, this will require a road grader or bulldozer to shape up the roads after forest products have been hauled off site. This

includes cleaning of drainage areas, grading, crowning, and filling with gravel, if necessary. The grading equipment to be used must be approved by the Unit Manager or his/her representative.

#### 4.2.5 - Two wheel drive condition (2/04)

All existing trail roads on and adjacent to the sale area must be passable by two-wheel drive traffic for the duration of the sale.

## 5 - Operations

### 5.1 - Notification

#### 5.1.1 - Pre-sale conference (10/16)

A pre-sale conference on site between the Purchaser and sale administrator is required prior to beginning any operations in Payment Unit 2 and 3, to determine landing and road locations. The Unit Manager or his/her representative must be contacted at least 5 days in advance to schedule the conference.

#### 5.1.4 - Post-sale conference (10/16)

A post-sale conference on site between the Purchaser and sale administrator is required 5 days prior to the completion of active logging operations to determine clean-up and repair of landings, road edges, and the fulfillment of other contract specifications.

#### 5.1.6 - Utility R.O.W. (4/19)

It is the responsibility of the Purchaser to obtain permission from the utility company to utilize the power line R.O.W. for operations.

### 5.2 - Conduct of Operations

#### 5.2.3 - Operating Restrictions

##### 5.2.3.1 - Operating restrictions (9/11)

Within Payment Unit(s) 2 and 3, unless approved in writing by the Unit Manager, cutting, skidding, and hauling are limited to the period of 12/01 through 03/31. Cutting, skidding, and hauling must be completed by 03/31. This restriction is to minimize the impact of logging operations to the Walsh Road Trail Camp.

#### 5.2.18 - Equipment requirements (1/09)

In Payment Units 2 and 3, the Purchaser is required to use low ground pressure equipment to reduce the impact of logging equipment in the Sale Area around Walsh Road Trail Camp. A written waiver of this requirement may be obtained from the Unit Manager if ground conditions are frozen or dry, or if Purchaser can harvest and remove timber with minimal rutting.

#### 5.2.31 - Landing locations (9/13)

Landings in Payment Units 2 and 3 must be authorized by the Unit Manager or his/her representative. The Purchaser and Sale Administrator shall agree on landing locations which best facilitate cleanup of slash and debris, as well as minimize the impact on the Walsh Road Trail Camp area.

#### 5.2.32 - Decking/landing restoration (9/13)

All decking and landing areas must have the surface area restored to a condition equal to or better than before. This is to ensure the proper regeneration of the stand. Wood debris, chips, and "cookies" from trimmings must be removed or scattered away from landing and loading areas and may not be windrowed on the edge.

#### 5.2.38 - No decking against live trees (2/04)

Cut products may not be decked against unmarked or designated leave trees.

#### 5.2.40 - Pathway protection (10/10)

The Shore To Shore Trail is a horse trail adjacent to Payment Units 2 and 3 on Walsh Road and is shown on the Timber Sale Map. Do not cut trees or damage posts with blue pathway markers. Do not haul wood along the trail route during scheduled trail rides. The sale administrator will provide a minimum of two week's notice when scheduled trail rides are to occur.

### 5.4 - Soil Protection

#### 5.4.1 - Rutting restriction, general (7/16)

Operations are to cease immediately if equipment and weather conditions result in rutting of roads and/or skid trails which is 12 inches or greater in depth and 50 feet in length. The Unit Manager or his/her representative may restrict hauling and/or

skidding if ruts exceed the specified depth. With the Unit Manager or his/her representative's approval, the Purchaser may return to the area when the risk of rutting has decreased.

## **6 - Safety and Fire Prevention**

### 6.2 - Signing

#### 6.2.1 - Road posting (10/20)

The Purchaser is responsible for posting and maintaining caution signs on Walsh Road prior to beginning operations. The road must be posted at appropriate distances from the Sale Area to warn of logging activity and truck traffic. Signs must be removed when harvest operations are suspended or completed. The Purchaser will provide these signs.



# TIMBER SALE MAP

This information provided by authority of Part 525, 1994 PA 451, as amended.

Sale Number	Year
72 - 046	21

Forest Management Unit	County	Mapped By	Price	Date	Page	of
Grayling	Crawford	Cruised By	Price	10/06/2021	2	2
Township	Range	Section(s) and Subdivision(s)		Scale		
28N	01W	SEC 25 S1/2E and SEC 36 SENW,NENE,S1/2NE,E1/2SW,NWSE		1:7,920		

Cover Type				Density	
A = Aspen	H = Hemlock	N = Marsh	U = Upland Brush	0 = Non Stocked	5 = Pole Timber Medium
B = Paper Birch	J = Jack Pine	O = Oak	UM = Upland Mixed	1 = Seedling Sapling Poor	6 = Pole Timber Well
C = Cedar	L = Lowland Brush	P = Lowland Poplar	V = Bog or Marsh	2 = Seedling Sapling Medium	7 = Saw Timber Poor
D = Treed Bog	LM = Lowland Mixed	Q = Mixed Swamp Conifer	W = White Pine	3 = Seedling Sapling Well	8 = Saw Timber Medium
E = Swamp Hdwoods	M = Mpl, Bch, Brch	R = Red Pine	X = Non Stocked	4 = Pole Timber Poor	9 = Saw Timber Well
F = Spruce Fir	MC = Mixed Conifer	S = Black Spruce	Z = Water		
G = Grass	MD = Mixed Deciduous	T = Tamarack			

PU	Acres	PU	Acres
1	35.4		
2	22.1		
3	18.9		

## Well Daisy If You Do Pine

### Compartment 288 & 289

76.4 Acres

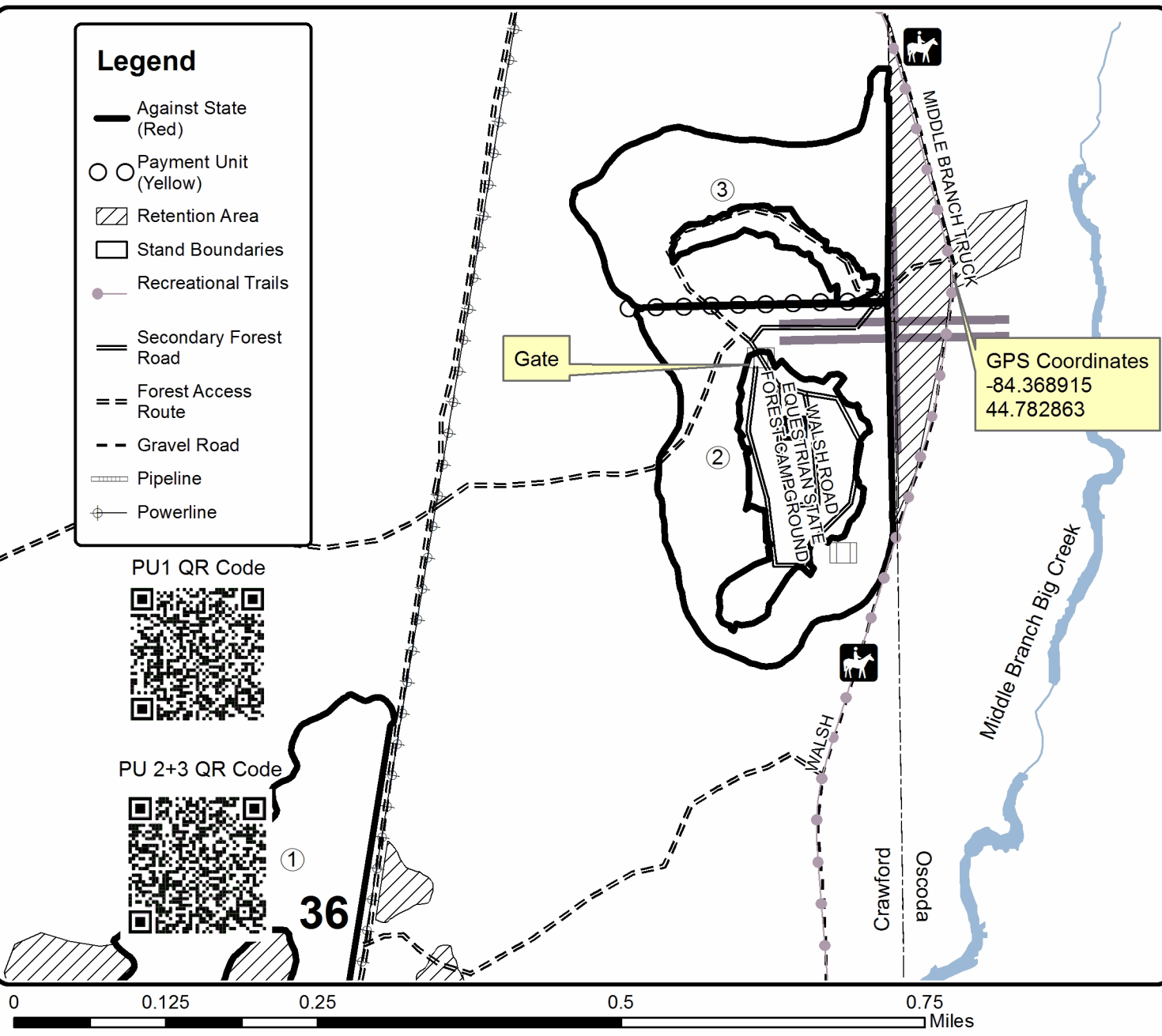
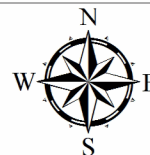



Sale Number	Year
72 - 046	21

# TIMBER SALE MAP

This information provided by authority of Part 525, 1994 PA 451, as amended.

Forest Management Unit	County	Mapped By	Price	Date	Page	of
Grayling	Crawford	Cruised By	Price	10/06/2021	1	2
Township	Range	Section(s) and Subdivision(s)		Scale		
28N	01W	SEC 25 S1/2E and SEC 36 SENW,NENE,S1/2NE,E1/2SW,NWSE		1:7,920		

Cover Type				Density	
A = Aspen	H = Hemlock	N = Marsh	U = Upland Brush	0 = Non Stocked	5 = Pole Timber Medium
B = Paper Birch	J = Jack Pine	O = Oak	UM = Upland Mixed	1 = Seedling Sapling Poor	6 = Pole Timber Well
C = Cedar	L = Lowland Brush	P = Lowland Poplar	V = Bog or Marsh	2 = Seedling Sapling Medium	7 = Saw Timber Poor
D = Treed Bog	LM = Lowland Mixed	Q = Mixed Swamp Conifer	W = White Pine	3 = Seedling Sapling Well	8 = Saw Timber Medium
E = Swamp Hdwoods	M = Mpl. Bch, Brch	R = Red Pine	X = Non Stocked	4 = Pole Timber Poor	9 = Saw Timber Well
F = Spruce Fir	MC = Mixed Conifer	S = Black Spruce	Z = Water		
G = Grass	MD = Mixed Deciduous	T = Tamarack			

PU	Acres	PU	Acres
1	35.4		
2	22.1		
3	18.9		

## Well Daisy If You Do Pine

### Compartment 288

### 76.4 Acres

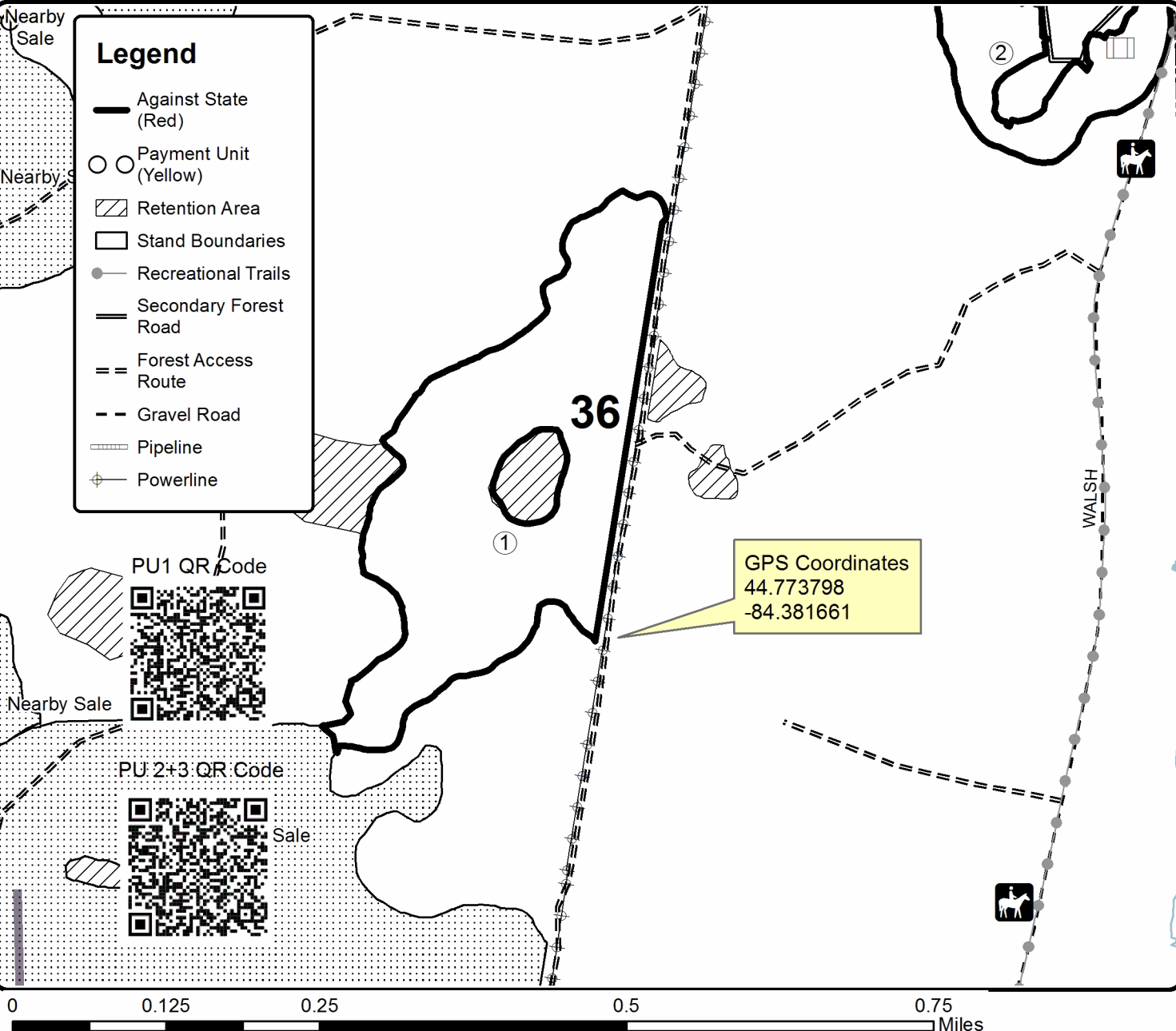

## TIMBER SALE INFORMATION

You're No Daisy At All Oak (72-047-21)  
 T28N, R01W, SEC. 35; T28N, R01W, SEC. 36.  
 Crawford County (Advertised Price \$38,703.35)

SALE NOTE: All units of volume listed for this sale were estimated using the Inventory Manager computer program and the new Michigan taper model.

Access is a sandy forest access road shown on the map north off of Townline Road .

See sale spec 2.1.11 for information Misc. Species 1.

See sale spec 5.2.3.4 and 5.2.3.5 for information on oak wilt restrictions.

A timber sale contract for this lump sum, sealed bid timber sale will be awarded to the responsible bidder offering the highest sealed bid price. All units of volume listed below were estimated using the Inventory Manager computer program and the new Michigan taper model. Bids must be at or above the following advertised price for each product and species:

<u>PRODUCTS &amp; SPECIES</u>	<u>ESTIMATED UNITS*</u>	<u>ADVERTISED PRICE</u>
Sawtimber		
BI/R/Hybrid Oak	205.5 MBF	\$ 103.00 / MBF
White Oak	61.3 MBF	\$ 64.00 / MBF
Pulpwood		
B. T. Aspen	3 Cords	\$ 25.70 / Cord
Misc. Species 1	43 Cords	\$ 5.00 / Cord
Mixed Oak	519 Cords	\$ 24.65 / Cord
Red Maple	10 Cords	\$ 26.90 / Cord
Red Pine	8 Cords	\$ 32.40 / Cord

\* The total volume is statistically estimated within plus (+) or minus (-) 5.15 percent. There are an estimated 1,277 cords on this timber sale, plus or minus 66 cords at the 95% confidence level. The estimated units are final and not subject to adjustment. Prospective bidders are urged to examine this timber and to make their own estimates of quantity and quality.

**BOND AND PAYMENT SCHEDULE:**

1. A bond in the amount of \$1,935.00 to insure faithful performance of the conditions of the contract will be deposited by the successful bidder within 21 days of the sale award.
2. Cutting in any sale or unit without the required advance payment would be considered a trespass.
3. Total payment must be paid in advance or according to the following schedule :
  - (a) Ten percent (10%) of the sale value must be paid within 21 days of the sale award.
  - (b) The 10% down payment will be credited towards the first unit cut.
  - (c) Payment for each of the following units must be made before cutting begins in that unit:

PAYMENT UNIT NUMBER	PERCENT OF TOTAL SALE VALUE
01	18.4%
02	25.6%
03	25.8%
04	30.2%

4. If no cutting takes place, the 10% down payment will not be refunded.
5. Operations on the contract issued will terminate on 09/30/2024.

**SALE STATISTICS**

Volumes were calculated in cubic feet using the Michigan taper model. Cubic foot volume includes all wood inside bark for the product indicated. For display purposes, cubic feet were converted to cords and MBF using a simple conversion factor, e.g. 79 cubic feet per cord and 185 cubic feet per MBF. The cubic foot volumes are precise; the cords and MBF volumes are not. Cubic foot volume cannot be directly converted to cords or boards with precision.

## SALE VOLUMES

The total estimated sale volume may not equal the sum of the species/products due to the nature of statistical calculations associated with double sampling methodology.

VOLUME			STATISTICAL RANGE IN CORDS	
TOTAL CUBIC FEET	TOTAL CORDS	PERCENT ERROR	MINIMUM	MAXIMUM
100,917	1,277	5.15%	1,212	1,343

## VDU VOLUMES

A VDU is a Volume Determination Unit. Volumes and their associated statistics are calculated at the VDU level and summarized to the sale level. There is often a one to one relationship between a VDU and a Payment Unit, but not always, depending on the cruise design. Refer to the VDU TO PAYMENT UNIT table.

	VOLUME			RANGE IN CORDS	
VDU	TOTAL CUBIC FEET	TOTAL CORDS	PERCENT ERROR	MINIMUM	MAXIMUM
14	27,101	343	10.11%	308	378
22	24,042	304	10.95%	271	338
31	20,253	256	13.69%	221	291
50	29,520	374	7.52%	346	402
<b>TOTAL:</b>	<b>100,917</b>	<b>1,277</b>		<b>1,146</b>	<b>1,409</b>

## VDU TO PAYMENT UNIT

When a VDU is associated with more than one Payment Unit (PU), the VDU volumes are assigned to the PU based on acres of the VDU within the PU.

VDU	VDU ACRES	PU	PU ACRES
14	27.8	2	27.8
22	27.5	3	27.5
31	46.5	1	46.5
50	25.9	4	25.9
<b>TOTAL:</b>	<b>127.7</b>		<b>127.7</b>



**DESCRIPTION OF TIMBER BY PAYMENT UNIT (PU)**

PU	MARKET GROUP	PRODUCT	QUANTITY	UNIT	ACRES	ADVERTISE PRICE
1	BI/R/Hybrid Oak	Sawtimber	16.1	MBF	46.5	\$7,122.45
	White Oak		30.3	MBF		
	Mixed Oak	Pulpwood	143	Cords		
	<i>BI/R/Hybrid Oak</i>		76	<i>Cords</i>		
	<i>White Oak</i>		67	<i>Cords</i>		
2	BI/R/Hybrid Oak	Sawtimber	54.2	MBF	27.8	\$9,902.40
	White Oak		13.7	MBF		
	B. T. Aspen	Pulpwood	3	Cords		
	Mixed Oak		130	Cords		
	<i>BI/R/Hybrid Oak</i>		94	<i>Cords</i>		
	<i>White Oak</i>		36	<i>Cords</i>		
	Red Maple		6	Cords		
	<i>Red Maple</i>		6	<i>Cords</i>		
3	BI/R/Hybrid Oak	Sawtimber	61.2	MBF	27.5	\$9,983.60
	White Oak		8.1	MBF		
	Misc. Species 1	Pulpwood	21	Cords		
	Mixed Oak		124	Cords		
	<i>BI/R/Hybrid Oak</i>		105	<i>Cords</i>		
<i>White Oak</i>		19	<i>Cords</i>			
4	BI/R/Hybrid Oak	Sawtimber	74.0	MBF	25.9	\$11,694.90
	White Oak		9.2	MBF		
	Misc. Species 1	Pulpwood	22	Cords		
	Mixed Oak		122	Cords		
	<i>BI/R/Hybrid Oak</i>		90	<i>Cords</i>		
	<i>White Oak</i>		32	<i>Cords</i>		
	Red Maple		4	Cords		
	<i>Red Maple</i>	<i>Sawtimber</i>	1.0	<i>MBF</i>		
	<i>Red Maple</i>	<i>Pulpwood</i>	2	<i>Cords</i>		
	Red Pine		8	Cords		
	<i>Red Pine</i>	<i>Sawtimber</i>	1.9	<i>MBF</i>		
	<i>Red Pine</i>	<i>Pulpwood</i>	4	<i>Cords</i>		
TOTAL:			266.8	MBF		
TOTAL:			583	Cords		

## Sale Specific Conditions & Requirements

**Sale Name: You're No Daisy At All Oak**

**Sale Number: 72-047-21 Seq#: 2**

### 1 - Sale Area

#### 1.2 - Boundaries

##### 1.2.1 - Painted boundaries (9/19)

The sale boundary and Payment Unit boundaries are marked and identified by blue, red, and yellow paint. Exterior sale boundary lines against private property are marked with blue paint. Exterior sale boundary lines against state are marked with red paint. Interior Payment Unit boundaries are marked with yellow paint. Retention patches are marked with red paint; no harvesting activities may occur within these areas. The painted boundary line trees are not Included Timber and are to be protected. Yellow painted trees designating an interior Payment Unit boundary are only to be cut when all surrounding Payment Units have been paid.

### 2 - Timber Specifications

#### 2.1 - Included Timber

##### 2.1.1 - Clearcut unit(s) with unmerchantable trees (6/14)

Within Payment Unit(s) 4, cut all trees that are two (2) inches or more at DBH, except do not cut any trees 26 inches or more at DBH. Special protection trees identified in accordance with condition 3.4.2, within clearcutting unit boundaries, are not Included Timber and are to be protected.

##### 2.1.5 - Overstory removal unit(s) (8/11)

Within Payment Unit(s) 1-3, all trees with DBH equal to or greater than 5 inches which meet minimum piece specifications in 2.2 Utilization, are designated for cutting, except do not cut any red pine, white pine, and jack pine. In addition, do not cut any trees 26 inches or more at DBH. Special protection trees identified in accordance with condition 3.4.2, within clearcutting unit boundaries, are not Included Timber and are to be protected.

##### 2.1.11 - Description of timber note (2/04)

Note that "Misc. Species 1" in the volumes is for the standing dead hardwood in the Sale Area. This volume is almost entirely black/red hybrid oak.

#### 2.2 - Utilization

##### 2.2.2 - Chipping required (2/18)

Payment Unit 4 must be chip harvested to facilitate subsequent planting operations. The Purchaser has the option to produce sawlogs or pulpwood bolts, but the remaining portion of the trees must be chipped and hauled. If market conditions limit the practicality of chipping, tops and slash must be arranged in a way that will not inhibit future planting operations, as directed by the sale administrator. A chipping exemption can be obtained if proposed operations are determined to be suitable for planting by reforestation staff. This exemption must be granted in writing. The requirement to retain approximately 1/6 to 1/3 of tree tops and limbs less than four inches in diameter is still applicable (G. C. & R. 2.2).

##### 2.2.3 - Stump heights (4/07)

Stump heights within Payment Unit(s) 4 shall not exceed 6 inches for all trees. This is to facilitate planting operations.

##### 2.2.4 - Skidding length (2/14)

In Payment Units 1-3, skidding of unlimbed tops or lengths over 17 feet is not permissible. Tree length skidding is not permissible, unless approved by the Unit Manager or his/her representative.

### 3 - Payments

#### 3.3 - Pre-measured Sales

##### 3.3.4 - Dividing payment units (7/14)

Payment Unit(s) may be divided at the request of the Purchaser and upon approval of the Unit Manager. Dividing Payment Units is a contract modification which requires a Timber Sale Contract Amendment. There will be only one division per Payment Unit.

### 3.4 - Damaged Timber

#### 3.4.1 - Damaged timber (7/16)

General Condition and Requirement 3.4 Damaged Timber, defines liquidated damages for undesignated live merchantable trees which are cut or injured. In addition, extreme care should be taken to avoid damage to tree seedlings and saplings. Seedlings and saplings that must be cut for access to Designated Timber are to be cut cleanly within 12 inches of ground level. Within the Sale Area, if more than 50% of the tree seedlings or saplings (1/4" to 4.5" DBH) within a specified portion of the Sale Area are damaged, liquidated damages will be assessed at \$300.00 per acre for all acreage within the specified portion of the Sale Area that was damaged.

Damage is not acceptable to undesignated live merchantable trees. Within the Sale Area, if more than 5% of undesignated live merchantable trees (> 4.5" DBH) within a specified area of the sale are damaged, liquidated damages will be assessed for all trees damaged. Rates will be in accordance with General Condition and Requirement 3.4 Damaged Timber.

#### 3.4.2 - Special Protection Trees (4/14)

The Purchaser shall not cut live or dead special protection trees within cutting units or clearings. Special protection trees are marked with green paint or designated by diameter (26 inches or more at DBH). If the Purchaser's operations have cut or damaged special protection trees through carelessness, the Purchaser shall pay \$300.00 as fixed, agreed and liquidated damages for each special protection tree cut or damaged. Such payment does not constitute ownership of the undesignated timber.

## 4 - Transportation

### 4.1 - Construction

#### 4.1.3 - Slash and earthen piles (8/04)

Piles or windrows of earth along roads and landings that have been widened or constructed shall be leveled. Slash from road maintenance or construction, including stumps, shall be utilized to close any new roads and landings into the Sale Area.

#### 4.1.6 - Road construction (1/09)

Construction of new roads or improvements of existing roads shall be done in such a way as to minimize the environmental and visual impacts. Merchantable trees shall be cut and utilized unless otherwise directed. Non-merchantable trees shall be severed and laid flat on the ground. Slash shall be scattered, and not left in windrows and kept a minimum of 10 feet back from the road edge, or be chipped, utilized, or otherwise removed from the sale. Stumps shall be set upright, not left on edge, and be moved at least 10 feet away from the road edge. Disturbed soil shall be feathered into the woods and not left in berms or windrows.

#### 4.1.7 - Road closure (10/11)

All new roads built into the sale must be blocked to vehicle traffic upon completion of the sale. In general, this will require constructing a four (4') foot high berm of stumps and logs covered with earth. Stumps and brush must be placed along the remainder of the trail. These roads must be rendered impassable to cars and trucks. All stumps from road building and landing construction must be reserved to block any newly constructed roads upon completion of the sale. These stumps must be scattered along the road system to prohibit vehicular movement. Contact the sale administrator for specific details of design and placement.

### 4.2 - Maintenance

#### 4.2.5 - Two wheel drive condition (2/04)

All existing trail roads on and adjacent to the sale area must be passable by two-wheel drive traffic for the duration of the sale.

## 5 - Operations

### 5.2 - Conduct of Operations

#### 5.2.3 - Operating Restrictions

##### 5.2.3.4 - Oak wilt restriction, no exceptions (1/18)

Within Payment Units 1-3, cutting, skidding, and hauling within the sale and brushing of access roads to the sale are not permitted during the period of April 15 to July 15. No exceptions will be granted. This is necessary to reduce the spread of oak wilt.

#### 5.2.3.5 - Oak wilt restriction (1/18)

Within Payment Unit 4, unless changed by written agreement, cutting, skidding, hauling within the sale and brushing of access roads to the sale are not permitted during the period of April 15 to July 15. Operations may be allowed if specific steps are taken to prevent damaging uncut oak during the high risk period. Those steps may include completing all road brushing before April 15th and clearing a tree-length buffer along uncut oak cover before April 15th. This is necessary to reduce the spread of oak wilt. For more information, contact the Unit Manager or his/her representative.

#### 5.2.29 - Shrub protection (1/20)

Reasonable care should be taken to avoid cutting or damaging hawthorn or juneberry. These woody-shrub plants are highly beneficial to various wildlife species.

#### 5.2.32 - Decking/landing restoration (9/13)

All decking and landing areas must have the surface area restored to a condition equal to or better than before. This is to ensure the proper regeneration of the stand. Wood debris, chips, and "cookies" from trimmings must be removed or scattered away from landing and loading areas and may not be windrowed on the edge.

### **6 - Safety and Fire Prevention**

#### 6.2 - Signing

##### 6.2.1 - Road posting (10/20)

The Purchaser is responsible for posting and maintaining caution signs on Townline Road prior to beginning operations. The road must be posted at appropriate distances from the Sale Area to warn of logging activity and truck traffic. Signs must be removed when harvest operations are suspended or completed. The Purchaser will provide these signs.



# TIMBER SALE MAP

This information provided by authority of Part 525, 1994 PA 451, as amended.

Forest Management Unit Grayling		County Crawford	Mapped By Price	Date 10/06/2021	Page 1	of 1
Township 28N	Range 01W	Section(s) and Subdivision(s) SEC 35 NE, SE & SEC 36 W1/2NW, W1/2SW		Scale 1:15,840		

Cover Type				Density			
A = Aspen	H = Hemlock	N = Marsh	U = Upland Brush	0 = Non Stocked	5 = Pole Timber Medium		
B = Paper Birch	J = Jack Pine	O = Oak	UM = Upland Mixed	1 = Seedling Sapling Poor	6 = Pole Timber Well		
C = Cedar	L = Lowland Brush	P = Lowland Poplar	V = Bog or Marsh	2 = Seedling Sapling Medium	7 = Saw Timber Poor		
D = Treed Bog	LM = Lowland Mixed	Q = Mixed Swamp Conifer	W = White Pine	3 = Seedling Sapling Well	8 = Saw Timber Medium		
E = Swamp Hdwoods	M = Mpl, Bch, Brch	R = Red Pine	X = Non Stocked	4 = Pole Timber Poor	9 = Saw Timber Well		
F = Spruce Fir	MC = Mixed Conifer	S = Black Spruce	Z = Water				
G = Grass	MD = Mixed Deciduous	T = Tamarack					

PU	Acres	PU	Acres
1	46.5	4	25.9
2	27.8		
3	27.5		

**You're No Daisy At All**  
 Compartment 288  
 127.7 Acres

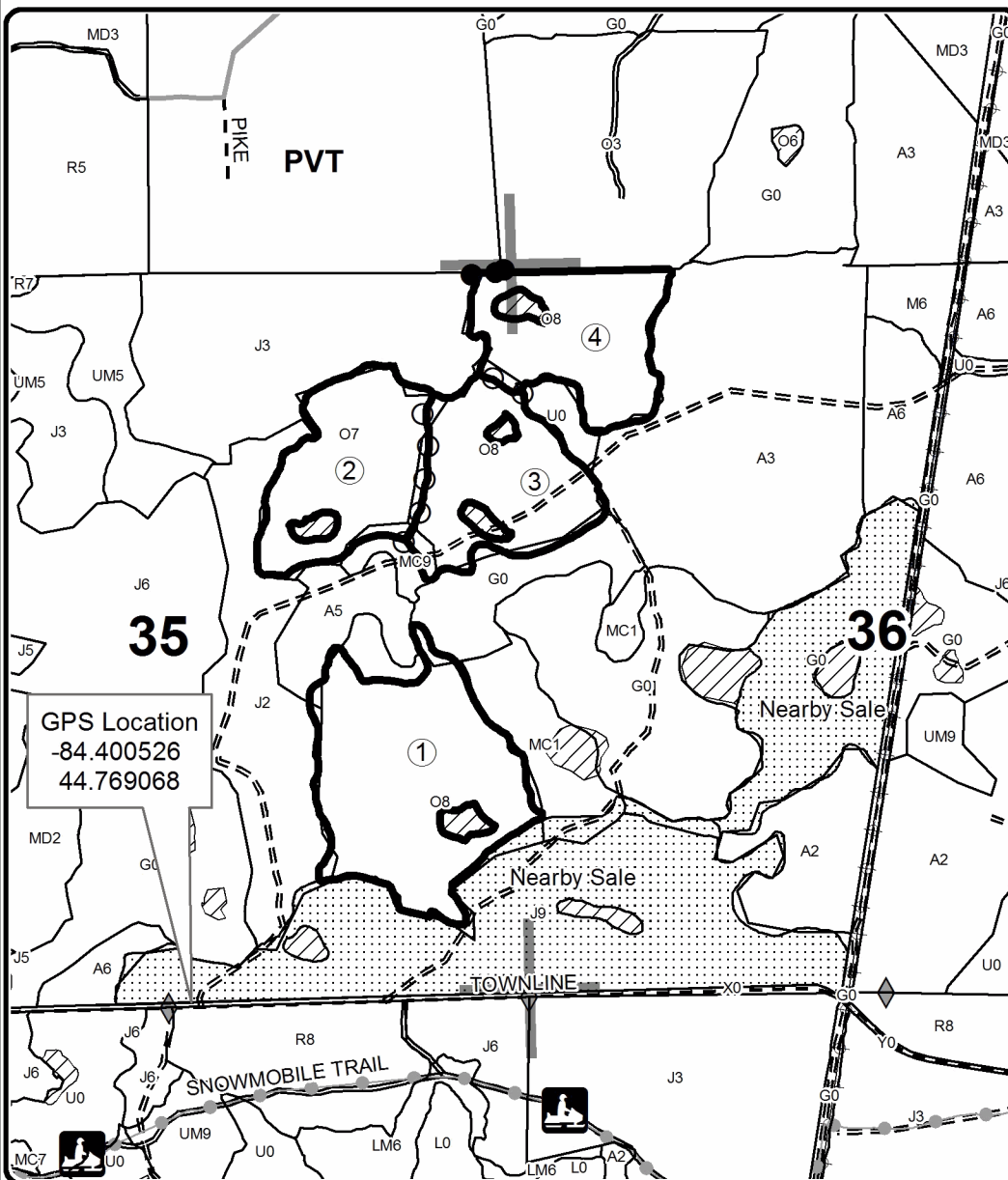

## Legend

- Against State (Red)
- Payment Pole Unit (Yellow)
- Private Line (Blue)
- Retention Area
- Nearby Timber Sales
- Powerline
- Stand Boundaries
- Secondary Forest Road
- Forest Access Route
- Gravel Road
- Private
- Recreational Trail

## QR Code

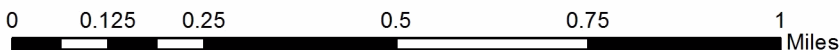



## TIMBER SALE INFORMATION

### Fell Through the Crack Jack (72-048-21)

T28N, R01E, SEC. 6; T28N, R01W, SEC. 1; T28N, R01W, SEC. 2; T29N, R01W, SEC. 35; T29N, R01W, SEC. 36.  
Crawford County (Advertised Price \$26,330.95)

SALE NOTE: All units of volume listed for this sale were estimated using the Inventory Manager computer program and the new Michigan taper model.

See sale spec 5.2.3.4 for information on oak wilt restrictions.

A recreation site such as a trail, pathway, or campground is within the sale area or the vicinity. Certain restrictions/specifications may be applicable including time restrictions.

A timber sale contract for this lump sum, sealed bid timber sale will be awarded to the responsible bidder offering the highest sealed bid price. All units of volume listed below were estimated using the Inventory Manager computer program and the new Michigan taper model. Bids must be at or above the following advertised price for each product and species:

<u>PRODUCTS &amp; SPECIES</u>	<u>ESTIMATED UNITS*</u>	<u>ADVERTISED PRICE</u>
<b>Sawtimber</b>		
Jack Pine	41.5 MBF	\$ 32.00 / MBF
Northern Pin Oak	30.4 MBF	\$ 103.00 / MBF
Quaking Aspen	9.8 MBF	\$ 50.00 / MBF
Red Oak	11.4 MBF	\$ 141.00 / MBF
Red Pine	38.8 MBF	\$ 89.00 / MBF
White Oak	4.5 MBF	\$ 64.00 / MBF
White Pine	12.1 MBF	\$ 63.00 / MBF
<b>Pulpwood</b>		
Jack Pine	419 Cords	\$ 16.15 / Cord
Mixed Oak	86 Cords	\$ 24.65 / Cord
Quaking Aspen	98 Cords	\$ 25.70 / Cord
Red Maple	27 Cords	\$ 26.90 / Cord
Red Pine	51 Cords	\$ 32.40 / Cord
White Pine	72 Cords	\$ 20.65 / Cord

\* The total volume is statistically estimated within plus (+) or minus (-) 7.16 percent. There are an estimated 1,098 cords on this timber sale, plus or minus 79 cords at the 95% confidence level. The estimated units are final and not subject to adjustment. Prospective bidders are urged to examine this timber and to make their own estimates of quantity and quality.

### **BOND AND PAYMENT SCHEDULE:**

1. A bond in the amount of \$1,317.00 to insure faithful performance of the conditions of the contract will be deposited by the successful bidder within 21 days of the sale award.
2. Cutting in any sale or unit without the required advance payment would be considered a trespass.
3. Total payment must be paid in advance or according to the following schedule:
  - (a) Ten percent (10%) of the sale value must be paid within 21 days of the sale award.
  - (b) The 10% down payment will be credited towards the first unit cut.
  - (c) Payment for each of the following units must be made before cutting begins in that unit:
 

PAYMENT UNIT NUMBER	PERCENT OF TOTAL SALE VALUE
01	7.3%
02	28.2%
03	18.0%
04	46.5%
4. If no cutting takes place, the 10% down payment will not be refunded.
5. Operations on the contract issued will terminate on 09/30/2024.

### **SALE STATISTICS**

Volumes were calculated in cubic feet using the Michigan taper model. Cubic foot volume includes all wood inside bark for the product indicated. For display purposes, cubic feet were converted to cords and MBF using a simple conversion factor, e.g. 79 cubic feet per cord and 185 cubic feet per MBF. The cubic foot volumes are precise; the cords and MBF volumes are not. Cubic foot volume cannot be directly converted to cords or boards with precision.

## SALE VOLUMES

The total estimated sale volume may not equal the sum of the species/products due to the nature of statistical calculations associated with double sampling methodology.

VOLUME			STATISTICAL RANGE IN CORDS	
TOTAL CUBIC FEET	TOTAL CORDS	PERCENT ERROR	MINIMUM	MAXIMUM
86,762	1,098	7.16%	1,020	1,177

## VDU VOLUMES

A VDU is a Volume Determination Unit. Volumes and their associated statistics are calculated at the VDU level and summarized to the sale level. There is often a one to one relationship between a VDU and a Payment Unit, but not always, depending on the cruise design. Refer to the VDU TO PAYMENT UNIT table.

	VOLUME			RANGE IN CORDS	
VDU	TOTAL CUBIC FEET	TOTAL CORDS	PERCENT ERROR	MINIMUM	MAXIMUM
1	18,024	228	10.60%	204	252
6	32,356	410	14.97%	348	471
7	5,595	71	25.82%	53	89
16	30,787	390	10.00%	351	429
<b>TOTAL:</b>	<b>86,762</b>	<b>1,098</b>		<b>955</b>	<b>1,241</b>

## VDU TO PAYMENT UNIT

When a VDU is associated with more than one Payment Unit (PU), the VDU volumes are assigned to the PU based on acres of the VDU within the PU.

VDU	VDU ACRES	PU	PU ACRES
1	7.2	3	7.2
6	25.9	2	25.9
7	6.0	1	6.0
16	13.8	4	13.8
<b>TOTAL:</b>	<b>52.9</b>		<b>52.9</b>



**DESCRIPTION OF TIMBER BY PAYMENT UNIT (PU)**

PU	MARKET GROUP	PRODUCT	QUANTITY	UNIT	ACRES	ADVERTISE PRICE
1	Northern Pin Oak	Sawtimber	8.8	MBF	6.0	\$1,931.65
	Red Pine		2.1	MBF		
	Jack Pine	Pulpwood	13	Cords		
	Mixed Oak		17	Cords		
	<i>Northern Pin Oak</i>		17	<i>Cords</i>		
	Red Pine		2	Cords		
	White Pine		7	Cords		
	<i>Scotch Pine</i>		2.5	<i>MBF</i>		
	<i>Scotch Pine</i>		2	<i>Cords</i>		
2	Jack Pine	Sawtimber	24.5	MBF	25.9	\$7,433.75
	Northern Pin Oak		11.4	MBF		
	White Oak		4.5	MBF		
	Jack Pine	Pulpwood	251	Cords		
	Mixed Oak		46	Cords		
	<i>Northern Pin Oak</i>		42	<i>Cords</i>		
	<i>White Oak</i>		4	<i>Cords</i>		
3	Jack Pine	Sawtimber	17.0	MBF	7.2	\$4,741.10
	Red Pine		8.5	MBF		
	Jack Pine	Pulpwood	143	Cords		
	Red Pine		33	Cords		
	White Pine		3	Cords		
	<i>White Pine</i>		3	<i>Cords</i>		
4	Northern Pin Oak	Sawtimber	10.2	MBF	13.8	\$12,224.45
	Quaking Aspen		9.8	MBF		
	Red Oak		11.4	MBF		
	Red Pine	Pulpwood	28.2	MBF		
	White Pine		12.1	MBF		
	Jack Pine		12	Cords		
	Mixed Oak		23	Cords		
	<i>Northern Pin Oak</i>		17	<i>Cords</i>		
	<i>Red Oak</i>		6	<i>Cords</i>		
	Quaking Aspen		98	Cords		
	Red Maple		27	Cords		
	Red Pine		16	Cords		
	White Pine		62	Cords		
	<i>White Pine</i>		62	<i>Cords</i>		
	TOTAL:			148.5		
TOTAL:			753	Cords		

# Sale Specific Conditions & Requirements

**Sale Name: Fell Through the Crack Jack**

**Sale Number: 72-048-21 Seq#: 2**

## 1 - Sale Area

### 1.2 - Boundaries

#### 1.2.1 - Painted boundaries (9/19)

The sale boundary is marked by red paint or is unmarked and identified by existing roads or utility right-of-way. Exterior sale boundary lines against state are marked with red paint, except the following: the boundaries of Payment Units 1 and 2 along County Road 612 are unmarked, the east boundaries of Payment Unit's 1 and 2 along the utility ROW is unmarked, the west boundary of Payment Unit 3 is unmarked and identified by utility ROW. The painted boundary line trees are not Included Timber and are to be protected.

## 2 - Timber Specifications

### 2.1 - Included Timber

#### 2.1.1 - Clearcut unit(s) with unmerchantable trees (6/14)

Within Payment Unit(s) 2 and 4, cut all trees that are two (2) inches or more at DBH, except do not cut red and white pine over 20" at DBH in Payment Unit 4.

#### 2.1.2 - Clearcut unit(s) w/o unmerchantable trees (8/11)

Within Payment Unit(s) 1 and 3, cut all trees which meet minimum piece specifications in 2.2 Utilization.

### 2.2 - Utilization

#### 2.2.2 - Chipping required (2/18)

Payment Unit 2 must be chip harvested to facilitate subsequent planting operations. If market conditions limit the practicality of chipping, tops and slash must be arranged in a way that will not inhibit future planting operations, as directed by the sale administrator. A chipping exemption can be obtained if proposed operations are determined to be suitable for planting by reforestation staff. This exemption must be granted in writing. The requirement to retain approximately 1/6 to 1/3 of tree tops and limbs less than four inches in diameter is still applicable (G. C. & R. 2.2).

#### 2.2.3 - Stump heights (4/07)

Stump heights within Payment Unit(s) 1-3 shall not exceed 6 inches for all trees. This is to facilitate planting operations.

#### 2.2.6 - Roundwood operation required (3/21)

The skidding of whole trees or tree segments with limbs attached is prohibited within Payment Unit(s) 1 and 3. All products must be produced as roundwood and forwarded to existing roads or landing areas in final product length. This is to retain existing understory.

#### 2.2.10 - No chipping tops and limbs (8/16)

Within Payment Unit(s) 1 and 3, chipping of limbs or tops is not permitted. Limbs and the remaining top must be left on site and scattered.

## 3 - Payments

### 3.4 - Damaged Timber

#### 3.4.1 - Damaged timber (7/16)

General Condition and Requirement 3.4 Damaged Timber, defines liquidated damages for undesignated live merchantable trees which are cut or injured. In addition, extreme care should be taken to avoid damage to tree seedlings and saplings. Within Payment Unit(s) 1 and 3, if more than 25% of the tree seedlings or saplings (1/4" to 4.5" DBH) within a specified portion of the Sale Area are damaged, liquidated damages will be assessed at \$500 per acre for all acreage within that specified portion of the Sale Area that was damaged.

## 4 - Transportation

### 4.1 - Construction

#### 4.1.3 - Slash and earthen piles (8/04)

Piles or windrows of earth along roads and landings that have been widened or constructed shall be leveled. Slash from road maintenance or construction, including stumps, shall be dispersed throughout the sale.

#### 4.1.6 - Road construction (1/09)

Construction of new roads or improvements of existing roads shall be done in such a way as to minimize the environmental and visual impacts. Merchantable trees shall be cut and utilized unless otherwise directed. Non-merchantable trees shall be severed and laid flat on the ground. Slash shall be scattered, and not left in windrows and kept a minimum of 10 feet back from the road edge. Stumps shall be set upright, not left on edge, and be moved at least 10 feet away from the road edge. Disturbed soil shall be feathered into the woods and not left in berms or windrows. All trees cut outside of the harvest boundary require the pre-approval of the sale administrator.

#### 4.1.7 - Road closure (10/11)

All new roads built into the sale must be blocked to vehicle traffic upon completion of the sale. Overgrown roads that are reopened shall be considered new roads. In general, this will require constructing a four (4') foot high berm of stumps and logs covered with earth. Temporary berms may be required if no sale activity occurs for 30 or more consecutive days. Contact the sale administrator for specific details of design and placement.

#### 4.1.11 - Permits (2/12)

The Purchaser will secure any necessary highway permits that may be required.

## 5 - Operations

### 5.1 - Notification

#### 5.1.3 - Well heads and natural gas pipelines (11/15)

The Purchaser is responsible for contacting the gas or pipeline company prior to operating equipment in the vicinity of well heads or natural gas pipelines.

#### 5.1.6 - Utility R.O.W. (4/19)

It is the responsibility of the Purchaser to obtain permission from the utility company to utilize the power line R.O.W. for operations.

### 5.2 - Conduct of Operations

#### 5.2.2 - Hazard Trees/Snags

##### 5.2.2.1 - Den trees (10/16)

Obvious hollow and/or den trees shall be protected and left standing unless they are a safety hazard.

#### 5.2.3 - Operating Restrictions

##### 5.2.3.4 - Oak wilt restriction, no exceptions (1/18)

Within Payment Unit(s) 1, 3, and 4, cutting, skidding, hauling within the sale and brushing of access roads to the sale are not permitted during the period of April 15 to July 15. No exceptions will be granted. This is necessary to reduce the spread of oak wilt.

#### 5.2.32 - Decking/landing restoration (9/13)

All decking and landing areas must have the surface area restored to a condition equal to or better than before. This is to ensure the proper regeneration of the stand. Wood debris, chips, and "cookies" from trimmings must be removed or scattered away from landing and loading areas and may not be windrowed on the edge.

#### 5.2.37 - No decking areas (12/08)

No decking is allowed within 50 feet of County Road 612. No decking is allowed within 50 feet of injection sites without permission of the pipeline company.

#### 5.2.38 - No decking against live trees (2/04)

Cut products may not be decked against unmarked or designated leave trees.

#### 5.2.40 - Pathway protection (10/10)

The Shore to Shore trail is a hiking and horse trail and is shown on the Timber Sale Map. Do not cut trees or damage posts with blue pathway markers or green paint. Maintain a rut and slash free zone within 10 feet of the trail. Do not deck wood

along the trail. Do not run equipment down the pathway. Do not operate equipment along the trail during scheduled trail rides. The administrator will provide a minimum of two week's notice of when scheduled trail rides are to occur.

#### 5.4 - Soil Protection

##### 5.4.1 - Rutting restriction, general (7/16)

Operations are to cease immediately if equipment and weather conditions result in rutting of roads and/or skid trails which is 12 inches or greater in depth and 50 feet in length. The Unit Manager or his/her representative may restrict hauling and/or skidding if ruts exceed the specified depth. With the Unit Manager or his/her representative's approval, the Purchaser may return to the area when the risk of rutting has decreased.

### 6 - Safety and Fire Prevention

#### 6.2 - Signing

##### 6.2.1 - Road posting (10/20)

The Purchaser is responsible for posting and maintaining caution signs on County Road 612 prior to beginning operations. The road must be posted at appropriate distances from the Sale Area to warn of logging activity and truck traffic. Signs must be removed when harvest operations are suspended or completed. The Purchaser will provide these signs.

##### 6.2.3 - Recreational trail posting (10/20)

The Purchaser is responsible for posting and maintaining caution signs on the Shore-to-Shore trail prior to beginning operations. The trail must be posted at appropriate distances from the Sale Area to warn of logging activity and truck traffic at both ends of the trail. Signs must be removed when harvest operations are suspended or completed. The Purchaser will provide these signs.



# TIMBER SALE MAP

This information provided by authority of Part 525, 1994 PA 451, as amended.

Forest Management Unit Grayling	County Crawford	Mapped By Derek Nellis	Date 9/30/2021	Page 1	of 1
Township 28N	Range 01W	Section(s) and Subdivision(s) Sec 1, W1/2NW,N1/2NE,E1/2SE	Scale 1:15,840		

Cover Type				Density	
A = Aspen	H = Hemlock	N = Marsh	U = Upland Brush	0 = Non Stocked	5 = Pole Timber Medium
B = Paper Birch	J = Jack Pine	O = Oak	UM = Upland Mixed	1 = Seedling Sapling Poor	6 = Pole Timber Well
C = Cedar	L = Lowland Brush	P = Lowland Poplar	V = Bog or Marsh	2 = Seedling Sapling Medium	7 = Saw Timber Poor
D = Treed Bog	LM = Lowland Mixed	Q = Mixed Swamp Conifer	W = White Pine	3 = Seedling Sapling Well	8 = Saw Timber Medium
E = Swamp Hdwoods	M = Mpl, Bch, Brch	R = Red Pine	X = Non Stocked	4 = Pole Timber Poor	9 = Saw Timber Well
F = Spruce Fir	MC = Mixed Conifer	S = Black Spruce	Z = Water		
G = Grass	MD = Mixed Deciduous	T = Tamarack			

PU	Acres
1	6.0
2	25.9
3	7.2
4	13.8

## Fell Through the Crack Jack

### Compartment 292

### 52.9 Acres

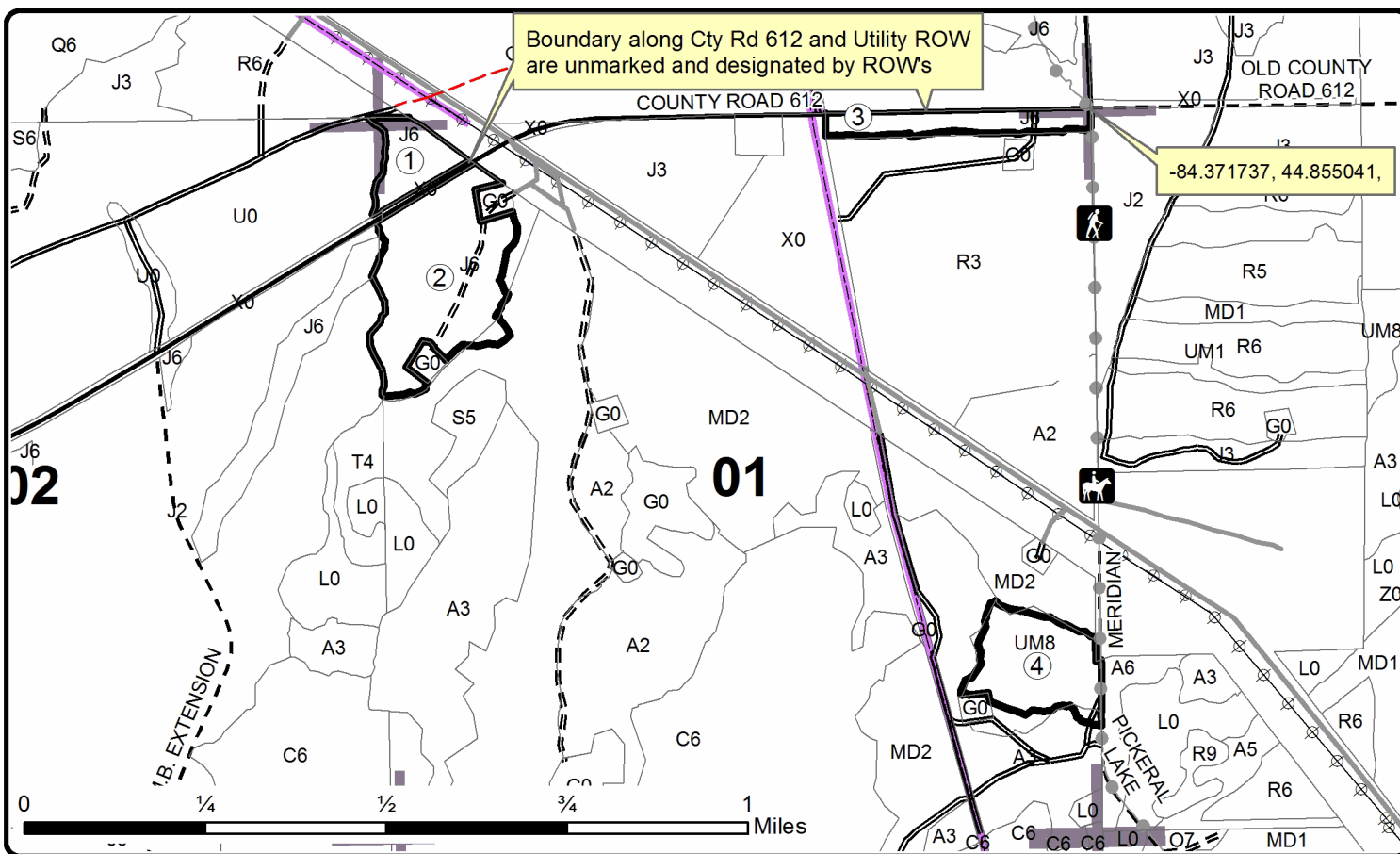
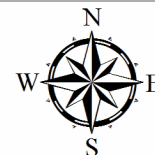

### Legend

- Hiking Trails
- Horse Trails
- Snowmobile Trails
- Recreational Trails
- Payment Unit Label
- Primary Forest Road
- Secondary Forest Road
- Forest Access Route
- Gravel Road
- Powerline
- Pipeline
- Paved Road
- Private
- County Road - Seasonal
- Against State (Red)
- Section Corners



Technician Party KW (72-038-21)  
T28N, R01W, SEC. 17; T28N, R01W, SEC. 6; T28N, R01W, SEC. 7; T28N, R01W,

In response to the notice of sale to be held 9:00 a.m. (local time) on July 11, 2022, I am hereby submitting my sealed bid (firm offer) for the following forest products to be cut. Bids for individual species must be at or above the advertised price. All non-responsive bid forms may be rejected.

<u>PRODUCTS &amp; SPECIES</u>	<u>ESTIMATED VOLUME*</u>	<u>ADVERTISED PRICE</u>	<u>BID PRICE/UNIT</u>
Sawtimber			
Red Pine	29.9 MBF	\$ 89.00/MBF	\$ _____
Pulpwood			
Black Cherry	6 Cords	\$ 26.90/Cord	\$ _____
Jack Pine	4,875 Cords	\$ 16.15/Cord	\$ _____
Quaking Aspen	100 Cords	\$ 25.70/Cord	\$ _____
Red Oak	3 Cords	\$ 24.65/Cord	\$ _____
Red Pine	19 Cords	\$ 32.40/Cord	\$ _____

\*The volumes are statistically estimated within plus (+) or minus (-) 4.78 percent at 95% confidence level. These estimated volumes are final and not subject to adjustment. Prospective bidders are urged to examine this timber and to make their own estimates of quantity and quality.

I understand that any or all bids may be rejected. All bids must be signed and all bid items must be bid or the bid form may be rejected. I also understand that consideration and awarding a contract will be based upon my past performance and ability to complete the contract based upon equipment and staffing subject to my control.

FEDERAL ID: \_\_\_\_\_ - \_\_\_\_\_ or SOCIAL SECURITY NUMBER: \_\_\_\_\_ - \_\_\_\_\_ - \_\_\_\_\_

Company or individual bidding: \_\_\_\_\_

Company representative's name: \_\_\_\_\_

Address: \_\_\_\_\_

City: \_\_\_\_\_ State: \_\_\_\_\_ Zip: \_\_\_\_\_

IF AVAILABLE, PLEASE PLACE THE PERSONALIZED LABEL FROM YOUR PROSPECTUS IN THE ABOVE BOX.

Individual or company representative's signature: \_\_\_\_\_ Date: \_\_\_\_\_

Phone number : \_\_\_\_\_ Email (optional): \_\_\_\_\_

**THE WINNING BIDDER MUST COMPLETE THE VERIFICATION OF WORKER'S DISABILITY COMPENSATION ACT COMPLIANCE (ON REVERSE SIDE IF DOUBLE SIDED) WITHIN 21 DAYS OF SALE AWARD DATE**



FOR DEPARTMENT USE ONLY	
Sale Number (XX - XXX - XX - XX)	
Forest Management Unit:	

## TIMBER SALE VERIFICATION OF WORKER'S DISABILITY COMPENSATION ACT COMPLIANCE

As required by Act 317, P.A. 1969 (Worker's Compensation) and  
Part 5 of Act 451 of 1994, as amended.

### VERIFICATION OF WORKER'S DISABILITY COMPENSATION ACT COMPLIANCE

- This verification must be completed and submitted within 21 days of contract award and prior to the issuance of the timber sale contract.
- In addition, if boxes 2B or 2C are checked, then Notice of Exclusion or Certificate of Insurance must be submitted within twenty-one (21) days of the contract award and prior to the issuance of the timber sale contract.
- All information must be typed or printed except for written signatures.

Please Check Appropriate Categories:

1. My business is organized as (you **must** check one of the boxes below):
  - A.  Sole Proprietorship (individual)
  - B.  Partnership
  - C.  Corporation
2. You **must** check one of the boxes below:
  - A.  I certify my business is a sole proprietorship and it has no employees but the sole proprietor. I am not subject to the Worker's Compensation Laws.
  - B.  I certify my business has satisfied its obligation to the Worker's Compensation Act through the use of an approved Notice of Exclusion (BWC-337, Rev. 5/96). I will provide a copy of the Notice of Exclusion within 21 days of the contract award. (For questions or a copy of the BWC-337, please call the Worker's Compensation Bureau at 517-322-1195).
  - C.  I certify my business has a Worker's Compensation Policy. I will provide an original Certificate of Insurance within twenty-one (21) days of the contract award.
3. If you have checked item 2(A) or 2(B), you **must** indicate the number of **both** full-time and part-time employees, other than yourself, including family members and active partners (if none, you must enter "0").

\_\_\_\_\_ Full-time Employees

\_\_\_\_\_ Part-time Employees

Name of Business		Federal ID (or) Social Security No.	
Address		Telephone (       )	
City	State	ZIP	

*I hereby certify that the above information is true and correct. I agree to notify the Michigan DNR of any changes that occur in factors affecting my coverage during any of my present and future operations.*

\_\_\_\_\_  
Signature of Owner or Authorized Representative

\_\_\_\_\_  
Title

\_\_\_\_\_  
Date

Please complete the "SEALED BID" information on the next page



Townline Jack (72-033-21)

T27N, R01W, SEC. 1; T27N, R01W, SEC. 2; T28N, R01W, SEC. 34; T28N, R01W,

In response to the notice of sale to be held 9:00 a.m. (local time) on July 11, 2022, I am hereby submitting my sealed bid (firm offer) for the following forest products to be cut. Bids for individual species must be at or above the advertised price. All non-responsive bid forms may be rejected.

<u>PRODUCTS &amp; SPECIES</u>	<u>ESTIMATED VOLUME*</u>	<u>ADVERTISED PRICE</u>	<u>BID PRICE/UNIT</u>
<b>Sawtimber</b>			
Jack Pine	88.4 MBF	\$ 32.00/MBF	\$ _____
Northern Pin Oak	28.8 MBF	\$ 103.00/MBF	\$ _____
Red Pine	35.3 MBF	\$ 89.00/MBF	\$ _____
<b>Pulpwood</b>			
Jack Pine	1,293 Cords	\$ 16.15/Cord	\$ _____
Mixed Hardwood	12 Cords	\$ 26.90/Cord	\$ _____
Mixed Oak	116 Cords	\$ 24.65/Cord	\$ _____
Red Pine	38 Cords	\$ 32.40/Cord	\$ _____

\*The volumes are statistically estimated within plus (+) or minus (-) 6.83 percent at 95% confidence level. These estimated volumes are final and not subject to adjustment. Prospective bidders are urged to examine this timber and to make their own estimates of quantity and quality.

I understand that any or all bids may be rejected. All bids must be signed and all bid items must be bid or the bid form may be rejected. I also understand that consideration and awarding a contract will be based upon my past performance and ability to complete the contract based upon equipment and staffing subject to my control.

FEDERAL ID: \_\_\_\_\_ or SOCIAL SECURITY NUMBER: \_\_\_\_\_

Company or individual bidding: \_\_\_\_\_

Company representative's name: \_\_\_\_\_

Address: \_\_\_\_\_

City: \_\_\_\_\_ State: \_\_\_\_\_ Zip: \_\_\_\_\_

IF AVAILABLE, PLEASE PLACE THE PERSONALIZED LABEL FROM YOUR PROSPECTUS IN THE ABOVE BOX.

Individual or company representative's signature: \_\_\_\_\_ Date: \_\_\_\_\_

Phone number : \_\_\_\_\_ Email (optional): \_\_\_\_\_

**THE WINNING BIDDER MUST COMPLETE THE VERIFICATION OF WORKER'S DISABILITY COMPENSATION ACT COMPLIANCE (ON REVERSE SIDE IF DOUBLE SIDED) WITHIN 21 DAYS OF SALE AWARD DATE**



<b>FOR DEPARTMENT USE ONLY</b>	
Sale Number (XX - XXX - XX - XX)	
Forest Management Unit:	

# TIMBER SALE VERIFICATION OF WORKER'S DISABILITY COMPENSATION ACT COMPLIANCE

As required by Act 317, P.A. 1969 (Worker's Compensation) and  
Part 5 of Act 451 of 1994, as amended.

## VERIFICATION OF WORKER'S DISABILITY COMPENSATION ACT COMPLIANCE

- This verification must be completed and submitted within 21 days of contract award and prior to the issuance of the timber sale contract.
- In addition, if boxes 2B or 2C are checked, then Notice of Exclusion or Certificate of Insurance must be submitted within twenty-one (21) days of the contract award and prior to the issuance of the timber sale contract.
- All information must be typed or printed except for written signatures.

Please Check Appropriate Categories:

1. My business is organized as (you **must** check one of the boxes below):
  - A.  Sole Proprietorship (individual)
  - B.  Partnership
  - C.  Corporation
2. You **must** check one of the boxes below:
  - A.  I certify my business is a sole proprietorship and it has no employees but the sole proprietor. I am not subject to the Worker's Compensation Laws.
  - B.  I certify my business has satisfied its obligation to the Worker's Compensation Act through the use of an approved Notice of Exclusion (BWC-337, Rev. 5/96). I will provide a copy of the Notice of Exclusion within 21 days of the contract award. (For questions or a copy of the BWC-337, please call the Worker's Compensation Bureau at 517-322-1195).
  - C.  I certify my business has a Worker's Compensation Policy. I will provide an original Certificate of Insurance within twenty-one (21) days of the contract award.
3. If you have checked item 2(A) or 2(B), you **must** indicate the number of **both** full-time and part-time employees, other than yourself, including family members and active partners (if none, you must enter "0").

\_\_\_\_\_ Full-time Employees

\_\_\_\_\_ Part-time Employees

Name of Business		Federal ID (or) Social Security No.	
Address		Telephone (       )	
City	State	ZIP	

*I hereby certify that the above information is true and correct. I agree to notify the Michigan DNR of any changes that occur in factors affecting my coverage during any of my present and future operations.*

\_\_\_\_\_  
Signature of Owner or Authorized Representative

\_\_\_\_\_  
Title

\_\_\_\_\_  
Date

Please complete the "SEALED BID" information on the next page

Well Daisy If You Do Pine (72-046-21)  
T28N, R01W, SEC. 25; T28N, R01W, SEC. 36; Crawford COUNTY

In response to the notice of sale to be held 9:00 a.m. (local time) on July 11, 2022, I am hereby submitting my sealed bid (firm offer) for the following forest products to be cut. Bids for individual species must be at or above the advertised price. All non-responsive bid forms may be rejected.

<u>PRODUCTS &amp; SPECIES</u>	<u>ESTIMATED VOLUME*</u>	<u>ADVERTISED PRICE</u>	<u>BID PRICE/UNIT</u>
Sawtimber			
Red Pine	39.9 MBF	\$ 81.00/MBF	\$ _____
Pulpwood			
Jack Pine	340 Cords	\$ 14.65/Cord	\$ _____
Red Pine	50 Cords	\$ 29.45/Cord	\$ _____
White Pine	2 Cords	\$ 18.80/Cord	\$ _____

\*The volumes are statistically estimated within plus (+) or minus (-) 10.70 percent at 95% confidence level. These estimated volumes are final and not subject to adjustment. Prospective bidders are urged to examine this timber and to make their own estimates of quantity and quality.

I understand that any or all bids may be rejected. All bids must be signed and all bid items must be bid or the bid form may be rejected. I also understand that consideration and awarding a contract will be based upon my past performance and ability to complete the contract based upon equipment and staffing subject to my control.

FEDERAL ID: \_\_\_\_\_ or SOCIAL SECURITY NUMBER: \_\_\_\_\_

Company or individual bidding: \_\_\_\_\_

Company representative's name: \_\_\_\_\_

Address: \_\_\_\_\_

City: \_\_\_\_\_ State: \_\_\_\_\_ Zip: \_\_\_\_\_

IF AVAILABLE, PLEASE PLACE THE PERSONALIZED LABEL FROM YOUR PROSPECTUS IN THE ABOVE BOX.

Individual or company representative's signature: \_\_\_\_\_ Date: \_\_\_\_\_

Phone number : \_\_\_\_\_ Email (optional): \_\_\_\_\_

**THE WINNING BIDDER MUST COMPLETE THE VERIFICATION OF WORKER'S DISABILITY COMPENSATION ACT COMPLIANCE (ON REVERSE SIDE IF DOUBLE SIDED) WITHIN 21 DAYS OF SALE AWARD DATE**



<b>FOR DEPARTMENT USE ONLY</b>	
Sale Number (XX - XXX - XX - XX)	
Forest Management Unit:	

## TIMBER SALE VERIFICATION OF WORKER'S DISABILITY COMPENSATION ACT COMPLIANCE

As required by Act 317, P.A. 1969 (Worker's Compensation) and  
Part 5 of Act 451 of 1994, as amended.

### VERIFICATION OF WORKER'S DISABILITY COMPENSATION ACT COMPLIANCE

- This verification must be completed and submitted within 21 days of contract award and prior to the issuance of the timber sale contract.
- In addition, if boxes 2B or 2C are checked, then Notice of Exclusion or Certificate of Insurance must be submitted within twenty-one (21) days of the contract award and prior to the issuance of the timber sale contract.
- All information must be typed or printed except for written signatures.

Please Check Appropriate Categories:

1. My business is organized as (you **must** check one of the boxes below):
  - A.  Sole Proprietorship (individual)
  - B.  Partnership
  - C.  Corporation
2. You **must** check one of the boxes below:
  - A.  I certify my business is a sole proprietorship and it has no employees but the sole proprietor. I am not subject to the Worker's Compensation Laws.
  - B.  I certify my business has satisfied its obligation to the Worker's Compensation Act through the use of an approved Notice of Exclusion (BWC-337, Rev. 5/96). I will provide a copy of the Notice of Exclusion within 21 days of the contract award. (For questions or a copy of the BWC-337, please call the Worker's Compensation Bureau at 517-322-1195).
  - C.  I certify my business has a Worker's Compensation Policy. I will provide an original Certificate of Insurance within twenty-one (21) days of the contract award.
3. If you have checked item 2(A) or 2(B), you **must** indicate the number of **both** full-time and part-time employees, other than yourself, including family members and active partners (if none, you must enter "0").

\_\_\_\_\_ Full-time Employees

\_\_\_\_\_ Part-time Employees

Name of Business		Federal ID (or) Social Security No.	
Address		Telephone (       )	
City	State	ZIP	

*I hereby certify that the above information is true and correct. I agree to notify the Michigan DNR of any changes that occur in factors affecting my coverage during any of my present and future operations.*

\_\_\_\_\_  
Signature of Owner or Authorized Representative

\_\_\_\_\_  
Title

\_\_\_\_\_  
Date

Please complete the "SEALED BID" information on the next page

You're No Daisy At All Oak (72-047-21)  
T28N, R01W, SEC. 35; T28N, R01W, SEC. 36; Crawford COUNTY

In response to the notice of sale to be held 9:00 a.m. (local time) on July 11, 2022, I am hereby submitting my sealed bid (firm offer) for the following forest products to be cut. Bids for individual species must be at or above the advertised price. All non-responsive bid forms may be rejected.

<u>PRODUCTS &amp; SPECIES</u>	<u>ESTIMATED VOLUME*</u>	<u>ADVERTISED PRICE</u>	<u>BID PRICE/UNIT</u>
<b>Sawtimber</b>			
BI/R/Hybrid Oak	205.5 MBF	\$ 103.00/MBF	\$ _____
White Oak	61.3 MBF	\$ 64.00/MBF	\$ _____
<b>Pulpwood</b>			
B. T. Aspen	3 Cords	\$ 25.70/Cord	\$ _____
Misc. Species 1	43 Cords	\$ 5.00/Cord	\$ _____
Mixed Oak	519 Cords	\$ 24.65/Cord	\$ _____
Red Maple	10 Cords	\$ 26.90/Cord	\$ _____
Red Pine	8 Cords	\$ 32.40/Cord	\$ _____

\*The volumes are statistically estimated within plus (+) or minus (-) 5.15 percent at 95% confidence level. These estimated volumes are final and not subject to adjustment. Prospective bidders are urged to examine this timber and to make their own estimates of quantity and quality.

I understand that any or all bids may be rejected. All bids must be signed and all bid items must be bid or the bid form may be rejected. I also understand that consideration and awarding a contract will be based upon my past performance and ability to complete the contract based upon equipment and staffing subject to my control.

FEDERAL ID: \_\_\_\_\_ or SOCIAL SECURITY NUMBER: \_\_\_\_\_

Company or individual bidding: \_\_\_\_\_

Company representative's name: \_\_\_\_\_

Address: \_\_\_\_\_

City: \_\_\_\_\_ State: \_\_\_\_\_ Zip: \_\_\_\_\_

IF AVAILABLE, PLEASE PLACE THE PERSONALIZED LABEL FROM YOUR PROSPECTUS IN THE ABOVE BOX.

Individual or company representative's signature: \_\_\_\_\_ Date: \_\_\_\_\_

Phone number : \_\_\_\_\_ Email (optional): \_\_\_\_\_

**THE WINNING BIDDER MUST COMPLETE THE VERIFICATION OF WORKER'S DISABILITY COMPENSATION ACT COMPLIANCE (ON REVERSE SIDE IF DOUBLE SIDED) WITHIN 21 DAYS OF SALE AWARD DATE**



Fell Through the Crack Jack (72-048-21)  
T28N, R01E, SEC. 6; T28N, R01W, SEC. 1; T28N, R01W, SEC. 2; T29N, R01W,

In response to the notice of sale to be held 9:00 a.m. (local time) on July 11, 2022, I am hereby submitting my sealed bid (firm offer) for the following forest products to be cut. Bids for individual species must be at or above the advertised price. All non-responsive bid forms may be rejected.

<u>PRODUCTS &amp; SPECIES</u>	<u>ESTIMATED VOLUME*</u>	<u>ADVERTISED PRICE</u>	<u>BID PRICE/UNIT</u>
<b>Sawtimber</b>			
Jack Pine	41.5 MBF	\$ 32.00/MBF	\$ _____
Northern Pin Oak	30.4 MBF	\$ 103.00/MBF	\$ _____
Quaking Aspen	9.8 MBF	\$ 50.00/MBF	\$ _____
Red Oak	11.4 MBF	\$ 141.00/MBF	\$ _____
Red Pine	38.8 MBF	\$ 89.00/MBF	\$ _____
White Oak	4.5 MBF	\$ 64.00/MBF	\$ _____
White Pine	12.1 MBF	\$ 63.00/MBF	\$ _____
<b>Pulpwood</b>			
Jack Pine	419 Cords	\$ 16.15/Cord	\$ _____
Mixed Oak	86 Cords	\$ 24.65/Cord	\$ _____
Quaking Aspen	98 Cords	\$ 25.70/Cord	\$ _____
Red Maple	27 Cords	\$ 26.90/Cord	\$ _____
Red Pine	51 Cords	\$ 32.40/Cord	\$ _____
White Pine	72 Cords	\$ 20.65/Cord	\$ _____

\*The volumes are statistically estimated within plus (+) or minus (-) 7.16 percent at 95% confidence level. These estimated volumes are final and not subject to adjustment. Prospective bidders are urged to examine this timber and to make their own estimates of quantity and quality.

I understand that any or all bids may be rejected. All bids must be signed and all bid items must be bid or the bid form may be rejected. I also understand that consideration and awarding a contract will be based upon my past performance and ability to complete the contract based upon equipment and staffing subject to my control.

FEDERAL ID: \_\_\_\_\_ or SOCIAL SECURITY NUMBER: \_\_\_\_\_

Company or individual bidding: \_\_\_\_\_

Company representative's name: \_\_\_\_\_

Address: \_\_\_\_\_

City: \_\_\_\_\_ State: \_\_\_\_\_ Zip: \_\_\_\_\_

IF AVAILABLE, PLEASE PLACE THE PERSONALIZED LABEL FROM YOUR PROSPECTUS IN THE ABOVE BOX.

Individual or company representative's signature: \_\_\_\_\_ Date: \_\_\_\_\_

Phone number : \_\_\_\_\_ Email (optional): \_\_\_\_\_

**THE WINNING BIDDER MUST COMPLETE THE VERIFICATION OF WORKER'S DISABILITY COMPENSATION ACT COMPLIANCE (ON REVERSE SIDE IF DOUBLE SIDED) WITHIN 21 DAYS OF SALE AWARD DATE**



<b>FOR DEPARTMENT USE ONLY</b>	
Sale Number (XX - XXX - XX - XX)	
Forest Management Unit:	

# TIMBER SALE VERIFICATION OF WORKER'S DISABILITY COMPENSATION ACT COMPLIANCE

As required by Act 317, P.A. 1969 (Worker's Compensation) and  
Part 5 of Act 451 of 1994, as amended.

## VERIFICATION OF WORKER'S DISABILITY COMPENSATION ACT COMPLIANCE

- This verification must be completed and submitted within 21 days of contract award and prior to the issuance of the timber sale contract.
- In addition, if boxes 2B or 2C are checked, then Notice of Exclusion or Certificate of Insurance must be submitted within twenty-one (21) days of the contract award and prior to the issuance of the timber sale contract.
- All information must be typed or printed except for written signatures.

Please Check Appropriate Categories:

1. My business is organized as (you **must** check one of the boxes below):
  - A.  Sole Proprietorship (individual)
  - B.  Partnership
  - C.  Corporation
2. You **must** check one of the boxes below:
  - A.  I certify my business is a sole proprietorship and it has no employees but the sole proprietor. I am not subject to the Worker's Compensation Laws.
  - B.  I certify my business has satisfied its obligation to the Worker's Compensation Act through the use of an approved Notice of Exclusion (BWC-337, Rev. 5/96). I will provide a copy of the Notice of Exclusion within 21 days of the contract award. (For questions or a copy of the BWC-337, please call the Worker's Compensation Bureau at 517-322-1195).
  - C.  I certify my business has a Worker's Compensation Policy. I will provide an original Certificate of Insurance within twenty-one (21) days of the contract award.
3. If you have checked item 2(A) or 2(B), you **must** indicate the number of **both** full-time and part-time employees, other than yourself, including family members and active partners (if none, you must enter "0").

\_\_\_\_\_ Full-time Employees

\_\_\_\_\_ Part-time Employees

Name of Business		Federal ID (or) Social Security No.	
Address		Telephone (       )	
City	State	ZIP	

*I hereby certify that the above information is true and correct. I agree to notify the Michigan DNR of any changes that occur in factors affecting my coverage during any of my present and future operations.*

\_\_\_\_\_  
Signature of Owner or Authorized Representative

\_\_\_\_\_  
Title

\_\_\_\_\_  
Date

Please complete the "SEALED BID" information on the next page