



**DEPARTMENT OF NATURAL RESOURCES
STATE OF MICHIGAN
TIMBER SALE PROSPECTUS #7072**

SCHEDULED SALE DATE AND TIME: 10:00 a.m. (local time) on July 19, 2022.

LOCATION: ATLANTA MGMT UNIT, 13501 M 33, ATLANTA, MI 49709.

PROSPECTUS NOTE: The bidder is advised to inspect the sale area and review the location, estimated volumes, operating costs and contract terms of proposed sales. Please be aware that some landowners may request 60 days or more notice for access across their land.

Notice is hereby given that bids will be received by the Unit Manager, ATLANTA MANAGEMENT UNIT, for certain timber on the following described lands:

Helicopter Seed Pine (54-013-21) / T32N, R01E, SEC. 21, NESE.

T32N, R01E, SEC. 22, SW,SE.

T32N, R01E, SEC. 27, E1/2NW,N1/2NE,SWNE.

Montmorency County, Advertised Price \$39,304.70, 121.2 Acres, Jack Pine, Red Pine.

SALE NOTE: All units of volume listed for this sale were estimated using the Inventory Manager computer program and the new Michigan taper model.

See sale spec 2.2.4 for skidding requirements.

The Big Little Mix (54-014-21) / T31N, R03E, SEC. 10, SW,W1/2SE.

T31N, R03E, SEC. 15, NENW,NWNE,SWSE.

T31N, R03E, SEC. 3, SENW,S1/2NE,NESW.

T32N, R03E, SEC. 34, SWSE.

Montmorency County, Advertised Price \$125,910.70, 115.1 Acres, Aspen, Red Pine.

SALE NOTE: All units of volume listed for this sale were estimated using the Inventory Manager computer program and the new Michigan taper model.

A recreation site such as a trail, pathway, or campground is within the sale area or the vicinity. Certain restrictions/specifications may be applicable including time restrictions.

Lonely Little Aspen (54-016-21) / T31N, R03E, SEC. 10, SENE.

T31N, R03E, SEC. 11, SWNW,NWSW.

Montmorency County, Advertised Price \$14,016.95, 21.4 Acres, Aspen, Spruce/Fir/Tamarack.

SALE NOTE: All units of volume listed for this sale were estimated using the Inventory Manager computer program and the new Michigan taper model.

A recreation site such as a trail, pathway, or campground is within the sale area or the vicinity. Certain restrictions/specifications may be applicable including time restrictions.

Aspen Kerr-fuffle (54-017-21) / T31N, R02E, SEC. 25, SENW,SWNE,NESW,S1/2SW,SE.

T31N, R02E, SEC. 26, SESW,SESE.

T31N, R02E, SEC. 35, E1/2NW,NE,NESW,N1/2SE.

T31N, R02E, SEC. 36, N1/2NW,SEW,NWNE.

T31N, R03E, SEC. 30, SWSW.

Montmorency County, Advertised Price \$271,979.95, 295.4 Acres, Aspen, Hardwood.

SALE NOTE: All units of volume listed for this sale were estimated using the Inventory Manager computer program and the new Michigan taper model.

See sale spec 5.2.3.1 for information on operating restrictions.

A recreation site such as a trail, pathway, or campground is within the sale area or the vicinity. Certain restrictions/specifications may be applicable including time restrictions.

Scarface Mix (54-035-21) / T32N, R02E, SEC. 26, SWNE,N1/2SW,NWSE.

T32N, R04E, SEC. 4 , E1/2SW.

Montmorency County, Advertised Price \$18,059.35, 68.2 Acres, Hardwood, Aspen.

SALE NOTE: All units of volume listed for this sale were estimated using the Inventory Manager computer program and the new Michigan taper model.

Note that Payment Unit 3 is approximately 28 miles from Payment Units 1 and 2.

A recreation site such as a trail, pathway, or campground is within the sale area or the vicinity. Certain restrictions/specifications may be applicable including time restrictions.

BID INSTRUCTIONS (VER. 07/02/2018):

1. Scheduled Bid Location, Date, and Time (2/11)

Bids must be received by the Unit Manager, ATLANTA OFFICE, 13501 M 33, ATLANTA, MI 49709, no later than 10:00 a.m. (local time) on July 19, 2022. For further information concerning this sale, contact Cody Stevens at 989-785-4251 extension 5240.

2. Bidder's Qualifications (5/16)

Purchaser shall obtain workers compensation insurance to cover claims under Michigan's Worker's Disability Compensation Act of 1969 or similar employee benefit act of any other state applicable to an employee. If all or part of a timber sale was prepared by a private contractor, the contractor and that contractor's company are not permitted to bid on the timber sale contract. Bids will not be accepted from individuals or companies appearing on the DNR/FRD No-Bid List. This list contains the names of purchasers who previously failed to execute a contract within 21-days or who have a history of poor performance.

3. Preparation of Sealed Bids (5/16)

Bid Forms may be completed online thru Michigan DNR Timber Sale Online Bidding (OLB) at www.michigan.gov/timberbidding or by completing the hardcopy Bid Form found in the Timber Sale Prospectus. Hardcopy Bid Forms shall be manually signed in ink. Registration in OLB is considered your 'signature' for all bids submitted thru that system. Bid prices must be entered for each species and product in the Bid Price column for all material subject to bidding and all fill-in blanks must be completed. If erasures or other changes appear on the hardcopy Bid Form, each erasure or change must be initialed by the person signing the bid.

4. Submission of Sealed Bids (5/16)

Bid forms may be obtained from the Unit Manager or thru OLB. Bids may be submitted hardcopy or thru OLB. All hardcopy bids must be submitted on the bid form and in an envelope clearly identified as described in this section. NOTE: Only one bid form per bid envelope. Sealed bids must be submitted to the Unit office designated in the prospectus and must be submitted at or prior to the time established in the prospectus. The envelope should show on the outside (a) the sale name or number and (b) the date and time of bid opening, as shown in the prospectus. Bids received after the time specified in the sale prospectus are late bids and will be rejected.

It is possible for a bidder to submit multiple bids on a single sale. For example, a bid may be submitted hardcopy and a bid may be submitted thru OLB. Or, two bidders from the same company could both submit bids on the same sale. If this were to happen, the State would accept all bids received and award the contract accordingly. All bidding and contractual requirements would apply to all bids received.

5. Public Opening of Sealed Bids (7/16)

If conditions permit, the sealed bids will be publicly opened and posted at the time and place set in the prospectus.

If a bidder, present at a bid opening, has submitted bids on more than one sale, that bidder may withdraw their unopened bid envelopes or announce the withdrawal of their online bid after being declared the successful bidder on one sale.

6. Award of Contract (1/11)

Award of the contract will be made to the Bidder whose bid, conforming to the prospectus, is most advantageous to the State of Michigan on the basis of total value at rates bid for the estimated quantities. The State reserves the right to reject any bid or waive any minor irregularity in bids received. A written award mailed (or otherwise furnished) to the successful Bidder shall be deemed to result in a binding contract without further action by either party.

7. Down Payment (1/11)

The Bidder to whom award is made must make a down payment within 21 days of the sale award. The amount of the down payment will be calculated as shown in the Bond and Payment Schedule of this prospectus. Only cash may be used to meet this requirement.

8. Performance Security (1/11)

As guarantee of faithful performance, a cash bond, certificate of deposit, surety bond or irrevocable letter of credit (LOC) is required within 21 days of the sale award. The amount of the performance security is shown in the Bond and

Payment Schedule of this prospectus. If an LOC or surety is used, the coverage must extend for at least 6 months beyond the contract expiration.

9. Timber Sale Contract (7/18)

Additional conditions and requirements common to all timber sales are listed on the timber sale contract (R4031) and are available on line at www.michigan.gov/timber. Contact the Unit Manager for additional information or a sample contract. Within 21 days of the date of the award letter, the bidder must sign the contract and provide the required down payment, performance security, and verification of worker's disability compensation. The down payment and performance security shall be in accordance with the provisions of the timber sale contract, in the sums stated in this prospectus. If these actions are not taken, then the Bidder, the Bidder's corporation, and the corporation's principals may not be permitted to bid on State timber sales for a period of 3 months after the first offense, 6 months after the second offense, and 1 year after the third offense. An offense will only be counted against the Bidder for 5 years. In addition, the Bidder certifies that if awarded this contract, the Bidder will complete the timber sale contract in accordance with its terms and any modifications thereof including requirements to purchase, cut, and remove the included timber by the expiration date.

Payment Unit values in the State Forest Timber Sale Contract are calculated based on the advertised value of the Payment Unit as a percentage of the total advertised value of the contract. The advertised value of each Payment Unit is given in the Description of Timber by Payment Unit table on the Timber Sale Information page. For example, if the value of Payment Unit 1 is advertised as \$1,500 and the total Timber Sale value is advertised as \$10,000, the contract price for Payment Unit 1 will be 15% of the total bid price ($\$1,500/\$10,000 * 100$).

10. Disclaimer of Estimates and Bidder's Warranty of Inspection (7/16)

Before submitting this bid, the Bidder is advised and cautioned to inspect the sale area, review the requirements of the sale contract, and take other steps as may be reasonably necessary to ascertain the location, estimated volumes, construction estimates, and operating costs of the proposed sale. Failure to do so will not relieve the Bidder from responsibility for completing the contract.

The Bidder warrants that this bid is submitted solely on the basis of the Bidder's examination and inspection of the quality and quantity of the timber offered for sale and the Bidder's opinion of the value thereof and the costs of recovery. No reliance should be placed on the State of Michigan's estimates of timber quality, quantity or costs of recovery. Bidder further acknowledges that the State of Michigan: (i) expressly disclaims any warranty of fitness of timber for any purpose; (ii) offers this timber as is without any warranty of quality (merchantability) or quantity and (iii) expressly disclaims any warranty as to the quantity or quality of timber sold.

11. Certification and Chain-of-Custody (10/14)

Unless otherwise indicated in the contract under section 7 – Other Conditions of the Sale Specific Conditions & Requirements, the area encompassed by this timber sale is certified to the standards of the Forest Stewardship Council (FSC) - Certificate #SCS-FM/COC-00090N and the Sustainable Forestry Initiative (SFI) - Certificate #NSF-SFIS-5Y031-SF5. Forest products from this sale may be delivered to the mill as "FSC 100% and / or SFI certified" as long as the contractor hauling the forest products is chain-of-custody (COC) certified or covered under a COC certificate from the destination mill. The purchaser is responsible for maintaining COC after leaving the sale area.

12. Good Neighbor Authority (GNA) Requirements (7/16)

If the name of this timber sales contains the acronym GNA, it is authorized by the Good Neighbor Authority (GNA) and covered by various agreements between the U.S. Forest Service and the State. The timber sale occurs on federal land and the following conditions apply:

GNA contracts on US Forest Service land will not be awarded to purchasers on the Federal list of excluded parties. The System for Award Management (SAM) will be checked for active excluded parties prior to award of contract. In addition, the Bidder to whom award is made must complete an Assurance Regarding Felony Conviction or Tax Delinquent Status for Corporate Applicants (AD-3031).

13. Good Neighbor Authority (GNA) Requirements, con't (9/16)

Bidder certifies, by signing this bid form, that to the best of Bidder's knowledge that the following representations are accurate and complete.

- a. That the Bidder and its principals are not presently debarred, suspended, proposed for debarment, declared ineligible, or voluntary excluded from timber sales (covered transactions) by any Federal department or agency.
- b. That the Bidder and its principals have not within a 3-year period preceding this bid been convicted of or had a civil judgment rendered against them for commission of fraud or a criminal offense in connection with obtaining , attempting to obtain, or performing a public (Federal, State, or local) transaction or contract under a public transaction; violation of Federal or State antitrust statutes or commission of embezzlement, theft, forgery, bribery, falsification or destruction of records, making false statements, or receiving stolen property.
- c. That the Bidder and its principals are not presently indicted for or otherwise criminally or civilly charged by a governmental entity (Federal, State, or local) with commission of any of the offenses enumerated in paragraph b of this certification.
- d. That the Bidder and its principals have not within a 3-year period preceding this bid had one or more public transactions (Federal, State, or local) terminated for breach or default of a timber or forest product contract.

Bidders that cannot certify this requirement, in whole or in part, shall submit an explanation with their bid.

DAN EICHINGER
Director

TIMBER SALE INFORMATION

Helicopter Seed Pine (54-013-21)
 T32N, R01E, SEC. 21; T32N, R01E, SEC. 22; T32N, R01E, SEC. 27.
 Montmorency County (Advertised Price \$39,304.70)

SALE NOTE: All units of volume listed for this sale were estimated using the Inventory Manager computer program and the new Michigan taper model.

See sale spec 2.2.4 for skidding requirements.

A timber sale contract for this lump sum, sealed bid timber sale will be awarded to the responsible bidder offering the highest sealed bid price. All units of volume listed below were estimated using the Inventory Manager computer program and the new Michigan taper model. Bids must be at or above the following advertised price for each product and species:

<u>PRODUCTS & SPECIES</u>	<u>ESTIMATED UNITS*</u>	<u>ADVERTISED PRICE</u>
Sawtimber		
Red Pine	147.9 MBF	\$ 122.00 / MBF
Pulpwood		
Black Spruce	3 Cords	\$ 7.55 / Cord
Jack Pine	1,209 Cords	\$ 9.25 / Cord
Mixed Aspen	8 Cords	\$ 24.60 / Cord
Red Oak	7 Cords	\$ 36.25 / Cord
Red Pine	223 Cords	\$ 42.90 / Cord
White Spruce	5 Cords	\$ 7.55 / Cord

* The total volume is statistically estimated within plus (+) or minus (-) 5.87 percent. There are an estimated 1,964 cords on this timber sale, plus or minus 115 cords at the 95% confidence level. The estimated units are final and not subject to adjustment. Prospective bidders are urged to examine this timber and to make their own estimates of quantity and quality.

BOND AND PAYMENT SCHEDULE:

1. A bond in the amount of \$1,965.00 to insure faithful performance of the conditions of the contract will be deposited by the successful bidder within 21 days of the sale award.
2. Cutting in any sale or unit without the required advance payment would be considered a trespass.
3. Total payment must be paid in advance or according to the following schedule :
 - (a) Ten percent (10%) of the sale value must be paid within 21 days of the sale award.
 - (b) The 10% down payment will be credited towards the first unit cut.
 - (c) Payment for each of the following units must be made before cutting begins in that unit:

PAYMENT UNIT NUMBER	PERCENT OF TOTAL SALE VALUE
01	76.4%
02	15.8%
03	6.7%
04	1.1%
4. If no cutting takes place, the 10% down payment will not be refunded.
5. Operations on the contract issued will terminate on 12/31/2024.

SALE STATISTICS

Volumes were calculated in cubic feet using the Michigan taper model. Cubic foot volume includes all wood inside bark for the product indicated. For display purposes, cubic feet were converted to cords and MBF using a simple conversion factor, e.g. 79 cubic feet per cord and 185 cubic feet per MBF. The cubic foot volumes are precise; the cords and MBF volumes are not. Cubic foot volume cannot be directly converted to cords or boards with precision.

SALE VOLUMES

The total estimated sale volume may not equal the sum of the species/products due to the nature of statistical calculations associated with double sampling methodology.

VOLUME		STATISTICAL RANGE IN CORDS		
TOTAL CUBIC FEET	TOTAL CORDS	PERCENT ERROR	MINIMUM	MAXIMUM
155,121	1,964	5.87%	1,848	2,079

VDU VOLUMES

A VDU is a Volume Determination Unit. Volumes and their associated statistics are calculated at the VDU level and summarized to the sale level. There is often a one to one relationship between a VDU and a Payment Unit, but not always, depending on the cruise design. Refer to the VDU TO PAYMENT UNIT table.

VDU	VOLUME		PERCENT ERROR	RANGE IN CORDS	
	TOTAL CUBIC FEET	TOTAL CORDS		MINIMUM	MAXIMUM
4	28,057	355	16.71%	296	414
6	127,065	1,608	6.15%	1,510	1,707
TOTAL:	155,121	1,964		1,805	2,122

VDU TO PAYMENT UNIT

When a VDU is associated with more than one Payment Unit (PU), the VDU volumes are assigned to the PU based on acres of the VDU within the PU.

VDU	VDU ACRES	PU	PU ACRES
4	34.0	3	28.9
		4	5.1
6	87.2	1	72.2
		2	15.0
TOTAL:	121.2		121.2

DESCRIPTION OF TIMBER BY PAYMENT UNIT (PU)

PU	MARKET GROUP	PRODUCT	QUANTITY	UNIT	ACRES	ADVERTISE PRICE
1	Red Pine	Sawtimber	122.5	MBF	72.2	\$30,050.25
	Jack Pine	Pulpwood	775	Cords		
	<i>Jack Pine</i>	<i>Sawtimber</i>	43.1	<i>MBF</i>		
	<i>Jack Pine</i>	<i>Pulpwood</i>	689	<i>Cords</i>		
	Red Pine		185	Cords		
2	Red Pine	Sawtimber	25.4	MBF	15.0	\$6,218.25
	Jack Pine	Pulpwood	161	Cords		
	<i>Jack Pine</i>	<i>Sawtimber</i>	8.9	<i>MBF</i>		
	<i>Jack Pine</i>	<i>Pulpwood</i>	143	<i>Cords</i>		
	Red Pine		38	Cords		
3	Black Spruce	Pulpwood	3	Cords	28.9	\$2,624.80
	Jack Pine		232	Cords		
	<i>Jack Pine</i>	<i>Sawtimber</i>	24.6	<i>MBF</i>		
	<i>Jack Pine</i>	<i>Pulpwood</i>	183	<i>Cords</i>		
	Mixed Aspen		7	Cords		
	<i>Quaking Aspen</i>	<i>Sawtimber</i>	2.6	<i>MBF</i>		
	<i>Quaking Aspen</i>	<i>Pulpwood</i>	2	<i>Cords</i>		
	Red Oak		7	Cords		
	<i>Red Oak</i>	<i>Sawtimber</i>	2.3	<i>MBF</i>		
	<i>Red Oak</i>	<i>Pulpwood</i>	2	<i>Cords</i>		
	White Spruce		4	Cords		
4	Jack Pine	Pulpwood	41	Cords	5.1	\$447.65
	<i>Jack Pine</i>	<i>Sawtimber</i>	4.3	<i>MBF</i>		
	<i>Jack Pine</i>	<i>Pulpwood</i>	32	<i>Cords</i>		
	Mixed Aspen		1	Cords		
	<i>Quaking Aspen</i>	<i>Sawtimber</i>	0.5	<i>MBF</i>		
	Red Oak	Pulpwood	1	Cords		
	<i>Red Oak</i>	<i>Sawtimber</i>	0.4	<i>MBF</i>		
	White Spruce	Pulpwood	1	Cords		
TOTAL:			147.9	MBF		
TOTAL:			1,456	Cords		

Sale Specific Conditions & Requirements

Sale Name: Helicopter Seed Pine

Sale Number: 54-013-21 Seq#: 2

1 - Sale Area

1.2 - Boundaries

1.2.1 - Painted boundaries (9/19)

The sale boundaries are marked and identified by red and blue paint. Exterior sale boundary lines against state are marked with red paint. Exterior sale boundary lines against private property are marked with blue paint. The painted boundary line trees are not Included Timber and are to be protected unless marked with orange paint.

2 - Timber Specifications

2.1 - Included Timber

2.1.1 - Clearcut unit(s) with unmerchantable trees (6/14)

Within Payment Unit(s) 1-4, cut all trees that are two (2) inches or more at DBH, except within Payment Unit(s) 3 and 4, do not cut any red pine, white pine, or white oak.

2.2 - Utilization

2.2.2 - Chipping required (2/18)

All Payment Units must be chip harvested to facilitate subsequent planting operations. The Purchaser has the option to produce sawlogs or pulpwood bolts, but the remaining portion of the trees must be chipped and hauled. If market conditions limit the practicality of chipping, chipping is not required if the following conditions are met:

- Trees greater than 4 inches at DBH must be cut to a 2-inch top or smaller,
- Sub-merchantable trees, and hardwood limbs 4-inches or greater where they attach to the stem, are to be cut/reduced to 4-foot lengths,
- Slash must be evenly dispersed throughout the Sale Area, and not be more than 2-feet high.

In all cases harvesting operations must allow for subsequent planting operations, as determined by the sale administrator. The requirement to retain approximately 1/6 to 1/3 of tree tops and limbs less than four inches in diameter is still applicable.

2.2.3 - Stump heights (4/07)

Stump heights within the Sale Area shall not exceed 6 inches for all trees. This is to facilitate planting operations.

2.2.4 - Skidding length (2/14)

Tree length skidding is required within all Payment Units and must occur during snow off conditions. See specification 5.2.3.1 for more information.

4 - Transportation

4.1 - Construction

4.1.6 - Road construction (1/09)

Improvements of existing roads shall be done in such a way as to minimize the environmental and visual impacts. Merchantable trees shall be cut and utilized unless otherwise directed. Non-merchantable trees shall be severed and laid flat on the ground. Slash shall be scattered, and not left in windrows and kept a minimum of 10 feet back from the road edge. Stumps shall be set upright, not left on edge, and be moved at least 10 feet away from the road edge. Disturbed soil shall be feathered into the woods and not left in berms or windrows.

4.1.7 - Road closure (10/11)

Overgrown roads that are reopened must be blocked to vehicle traffic upon completion of the sale. In general, this will require constructing a four (4') foot high berm of stumps and logs covered with earth. These roads must be rendered impassable to cars and trucks. Contact the sale administrator for specific details of design and placement.

4.1.12 - No new roads (1/12)

No new roads will be permitted in any Payment Unit. All operations are limited to existing roads. Skid trails only will be allowed.

4.2 - Maintenance

4.2.5 - Two wheel drive condition (2/04)

All existing trail roads on and adjacent to the sale area must be passable by two-wheel drive traffic for the duration of the sale.

5 - Operations

5.1 - Notification

5.1.1 - Pre-sale conference (10/16)

A pre-sale conference on site between the Purchaser and sale administrator is required prior to beginning any operations to determine landing and road locations. The Unit Manager or his/her representative must be contacted at least 5 days in advance to schedule the conference.

5.1.4 - Post-sale conference (10/16)

A post-sale conference on site between the Purchaser and sale administrator is required 5 days prior to the completion of active logging operations to determine clean-up and repair of landings, road edges, and the fulfillment of other contract specifications.

5.2 - Conduct of Operations

5.2.3 - Operating Restrictions

5.2.3.1 - Operating restrictions (9/11)

Within Payment Unit(s) 1-4, unless changed by written agreement, cutting, skidding, and hauling are not permitted during snow on conditions. This restriction is to scarify the soil for natural regeneration.

5.2.3.5 - Oak wilt restriction (1/18)

Within Payment Unit(s) 2, unless changed by written agreement, cutting, skidding, hauling within the sale and brushing of access roads to the sale are not permitted during the period of April 15 to July 15. Operations may be allowed if specific steps are taken to prevent damaging uncut oak during the high risk period. Those steps may include completing all road brushing before April 15th and clearing a tree-length buffer along uncut oak cover before April 15th. This is necessary to reduce the spread of oak wilt. For more information, contact the Unit Manager or his/her representative.

5.2.3.6 - Bark beetle restriction (12/08)

In the event drought creates a high risk of pine bark beetle infestation, pine is not to be cut during the period March 1 through July 1, unless all portions of trees greater than two inches in diameter are removed from the sale area, reduced to chips, or treated to the satisfaction of the Unit Manager or his/her representative, within fifteen days of being severed from the stump. Pine log decks, pulpwood piles and treetops that are piled for chipping in the fall or winter within a 1/4 mile of susceptible sites must be removed before March 15. Residual slash must not be placed in piles or rows and must be spread over the site for quick drying. The Department of Natural Resources will exercise this specification if the risk of damage warrants.

5.2.3.11 - Coppice regeneration protection (4/10)

Timber harvesting in any Payment Unit must be completed before significant tree sprouting occurs in that Payment Unit to minimize damage to the new regeneration. Any post-harvest operations, such as chipping, must be completed before sprouting of regeneration occurs. If it is anticipated that chipping will be delayed, then tops shall be carried to one central location or left unchipped. The Unit Manager or his/her representative may cease such operations if sprouting occurs before the operation is complete.

5.2.32 - Decking/landing restoration (9/13)

All decking and landing areas must have the surface area restored to a condition equal to or better than before. This is to ensure the proper regeneration of the stand. Wood debris, chips, and "cookies" from trimmings must be removed or scattered away from landing and loading areas and may not be windrowed on the edge.

5.2.38 - No decking against live trees (2/04)

Cut products may not be decked against unmarked or designated leave trees.

5.4 - Soil Protection

5.4.1 - Rutting restriction, general (7/16)

Operations are to cease immediately if equipment and weather conditions result in rutting of roads and/or skid trails which is 12 inches or greater in depth and 50 feet in length. The Unit Manager or his/her representative may restrict hauling and/or skidding if ruts exceed the specified depth. With the Unit Manager or his/her representative's approval, the Purchaser may return to the area when the risk of rutting has decreased.

5.8 - Protection of Endangered Species

5.8.5 - Protection of raptor nests (3/13)

All trees with raptor nests will be protected if found during harvesting operations. Notification will be made to the Unit Manager or his/her representative who will notify the Wildlife Biologist so an on-site evaluation and recommendation can be made, if necessary.

6 - Safety and Fire Prevention

6.2 - Signing

6.2.1 - Road posting (10/20)

The Purchaser is responsible for posting and maintaining caution signs on state forest roads prior to beginning operations. The road must be posted at appropriate distances from the Sale Area to warn of logging activity and truck traffic. Signs must be removed when harvest operations are suspended or completed. The Purchaser will provide these signs.



TIMBER SALE MAP

This information provided by authority of Part 525, 1994 PA 451, as amended.

Sale Number	Year
54-013	21

Forest Management Unit Atlanta	County Montmorency	Mapped By Doug Tyrn	Date 08/27/2021	Page 1	of 1
Township 32N	Range 01E	Section(s) and Subdivision(s) 21: NESE 22: SW, SE 27: E1/2NW, N1/2NE, SWNE	Scale 1:15,840		

Cover Type				Density			
A = Aspen	H = Hemlock	N = Marsh	U = Upland Brush	0 = Non Stocked	5 = Pole Timber Medium		
D = Paper Birch	J = Jack Pine	O = Oak	UM = Upland Mixed	1 = Seedling Sapling Poor	6 = Pole Timber Well		
C = Cedar	L = Lowland Brush	P = Lowland Poplar	V = Bog or Marsh	2 = Seedling Sapling Medium	7 = Saw Timber Poor		
D = Tread Bog	LM = Lowland Mixed	Q = Mixed Swam Conifer	W = White Pine	3 = Seedling Sapling Well	8 = Saw Timber Medium		
E = Swamp Hdwoods	M = Mpl. Dec. Dec.	R = Red Pine	X = Non Stocked	4 = Pole Timber Poor	9 = Saw Timber Well		
F = Spruce Fir	MC = Mixed Conifer	S = Black Spruce	Z = Water				
G = Grass	MD = Mixed Deciduous	T = Tamarack					

PU	Acres	PU	Acres
1	72.2	4	5.1
2	15.0		
3	28.9		

Helicopter Seed Pine

Compartment 060
121.2 Acres

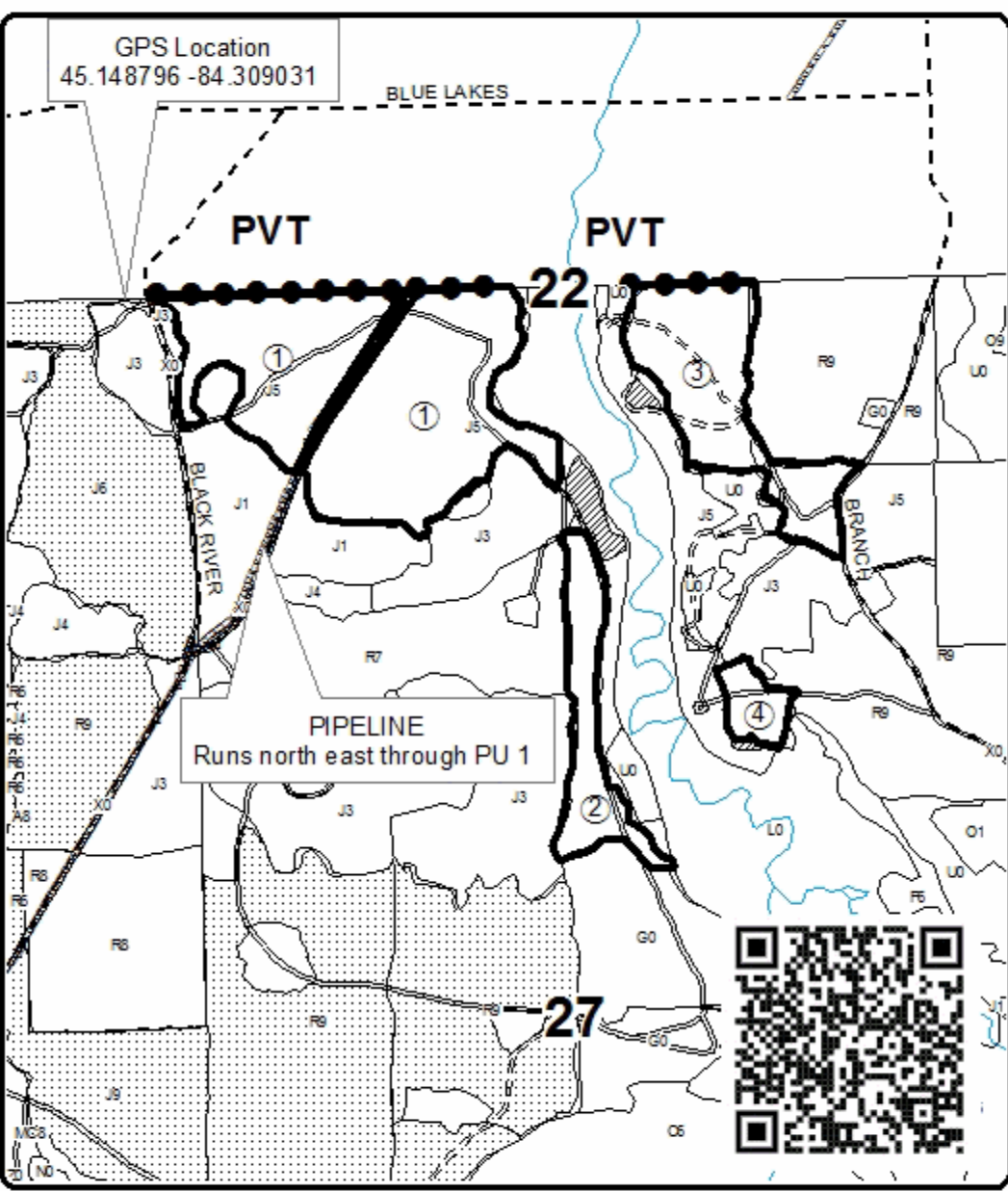

Legend

- Against State (Red)
- Private Line (Blue)
- Retention Area
- Nearby Timber Sales
- Stand Boundaries
- Lakes and Rivers
- Payment Unit Label
- Primary Forest Road
- Secondary Forest Road
- Forest Access Route
- Paved Road
- Gravel Road
- Pipeline

Locator Map
1:200,000

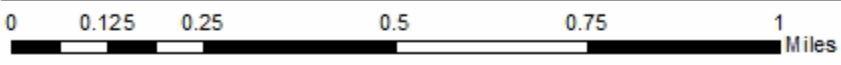
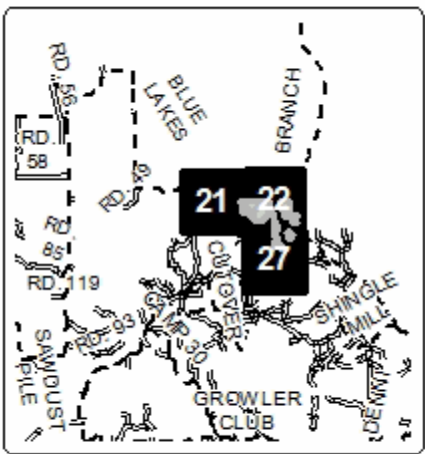

TIMBER SALE INFORMATION

The Big Little Mix (54-014-21)

T31N, R03E, SEC. 10; T31N, R03E, SEC. 15; T31N, R03E, SEC. 3; T32N, R03E, SEC. 34.
Montmorency County (Advertised Price \$125,910.70)

SALE NOTE: All units of volume listed for this sale were estimated using the Inventory Manager computer program and the new Michigan taper model.

A recreation site such as a trail, pathway, or campground is within the sale area or the vicinity. Certain restrictions/specifications may be applicable including time restrictions.

A timber sale contract for this lump sum, sealed bid timber sale will be awarded to the responsible bidder offering the highest sealed bid price. All units of volume listed below were estimated using the Inventory Manager computer program and the new Michigan taper model. Bids must be at or above the following advertised price for each product and species:

<u>PRODUCTS & SPECIES</u>	<u>ESTIMATED UNITS*</u>		<u>ADVERTISED PRICE</u>
Sawtimber			
Jack Pine	17.1	MBF	\$ 25.00 / MBF
Quaking Aspen	45.6	MBF	\$ 91.00 / MBF
Red Maple	69.5	MBF	\$ 46.00 / MBF
Red Oak	228.2	MBF	\$ 153.00 / MBF
Red Pine	317.3	MBF	\$ 122.00 / MBF
White Pine	48.6	MBF	\$ 64.00 / MBF
Pulpwood			
Balsam Fir	47	Cords	\$ 16.00 / Cord
Black Spruce	2	Cords	\$ 7.55 / Cord
Jack Pine	189	Cords	\$ 9.25 / Cord
Mixed Aspen	608	Cords	\$ 24.60 / Cord
Mixed Hardwood	11	Cords	\$ 19.15 / Cord
Northern Pin Oak	4	Cords	\$ 36.25 / Cord
Red Maple	464	Cords	\$ 19.15 / Cord
Red Oak	184	Cords	\$ 36.25 / Cord
Red Pine	169	Cords	\$ 42.90 / Cord
White Pine	50	Cords	\$ 15.35 / Cord

* The total volume is statistically estimated within plus (+) or minus (-) 4.25 percent. There are an estimated 3,388 cords on this timber sale, plus or minus 144 cords at the 95% confidence level. The estimated units are final and not subject to adjustment. Prospective bidders are urged to examine this timber and to make their own estimates of quantity and quality.

BOND AND PAYMENT SCHEDULE:

1. A bond in the amount of \$6,296.00 to insure faithful performance of the conditions of the contract will be deposited by the successful bidder within 21 days of the sale award.
2. Cutting in any sale or unit without the required advance payment would be considered a trespass.
3. Total payment must be paid in advance or according to the following schedule :
 - (a) Ten percent (10%) of the sale value must be paid within 21 days of the sale award.
 - (b) The 10% down payment will be credited towards the first unit cut.
 - (c) Payment for each of the following units must be made before cutting begins in that unit:

PAYMENT UNIT NUMBER	PERCENT OF TOTAL SALE VALUE
01	7.7%
02	5.5%
03	36.9%
04	33.8%
05	0.7%
06	1.8%
07	13.6%

4. If no cutting takes place, the 10% down payment will not be refunded.
5. Operations on the contract issued will terminate on 06/30/2025.

SALE STATISTICS

Volumes were calculated in cubic feet using the Michigan taper model. Cubic foot volume includes all wood inside bark for the product indicated. For display purposes, cubic feet were converted to cords and MBF using a simple conversion factor, e.g. 79 cubic feet per cord and 185 cubic feet per MBF. The cubic foot volumes are precise; the cords and MBF volumes are not. Cubic foot volume cannot be directly converted to cords or boards with precision.

SALE VOLUMES

The total estimated sale volume may not equal the sum of the species/products due to the nature of statistical calculations associated with double sampling methodology.

VOLUME			STATISTICAL RANGE IN CORDS	
TOTAL CUBIC FEET	TOTAL CORDS	PERCENT ERROR	MINIMUM	MAXIMUM
267,658	3,388	4.25%	3,244	3,532

VDU VOLUMES

A VDU is a Volume Determination Unit. Volumes and their associated statistics are calculated at the VDU level and summarized to the sale level. There is often a one to one relationship between a VDU and a Payment Unit, but not always, depending on the cruise design. Refer to the VDU TO PAYMENT UNIT table.

VDU	VOLUME			RANGE IN CORDS	
	TOTAL CUBIC FEET	TOTAL CORDS	PERCENT ERROR	MINIMUM	MAXIMUM
2	4,362	55	21.03%	44	67
3	15,056	191	19.58%	153	228
10	19,917	252	12.41%	221	283
34	28,445	360	10.04%	324	396
40	7,636	97	15.83%	81	112
41	1,608	20	11.11%	18	23
43	81,183	1,028	6.80%	958	1,098
44	6,914	88	16.74%	73	102
68	38,090	482	7.43%	446	518
97	7,107	90	38.19%	56	124
98	57,341	726	13.18%	630	822
TOTAL:	267,658	3,388		3,004	3,772

VDU TO PAYMENT UNIT

When a VDU is associated with more than one Payment Unit (PU), the VDU volumes are assigned to the PU based on acres of the VDU within the PU.

VDU	VDU ACRES	PU	PU ACRES
2	3.7	1	3.7
3	9.6	1	9.6
10	10.0	2	10.0
34	10.7	3	10.7
40	5.2	6	5.2
41	1.9	6	1.9
43	21.2	4	21.2
44	6.0	5	6.0
68	23.5	7	23.5
97	2.6	3	2.6
98	20.7	3	20.7
TOTAL:	115.1		115.1

DESCRIPTION OF TIMBER BY PAYMENT UNIT (PU)

PU	MARKET GROUP	PRODUCT	QUANTITY	UNIT	ACRES	ADVERTISE PRICE
1	Jack Pine	Sawtimber	1.1	MBF	13.3	\$9,753.95
	Red Maple		9.2	MBF		
	Red Oak		1.1	MBF		
	Red Pine		48.4	MBF		
	Balsam Fir	Pulpwood	10	Cords		
	<i>Balsam Fir</i>	<i>Sawtimber</i>	0.6	<i>MBF</i>		
	<i>Balsam Fir</i>	<i>Pulpwood</i>	9	<i>Cords</i>		
	Black Spruce		2	Cords		
	Jack Pine		36	Cords		
	Mixed Aspen		15	Cords		
	<i>Quaking Aspen</i>		15	<i>Cords</i>		
	Red Maple		25	Cords		
	Red Oak		2	Cords		
	Red Pine		42	Cords		
2	Quaking Aspen	Sawtimber	6.3	MBF	10.0	\$6,892.70
	Red Maple		9.3	MBF		
	Red Pine		17.5	MBF		
	White Pine		2.4	MBF		
	Mixed Aspen	Pulpwood	81	Cords		
	<i>Balsam Poplar</i>		3	<i>Cords</i>		
	<i>Quaking Aspen</i>		78	<i>Cords</i>		
	Northern Pin Oak		4	Cords		
	<i>Northern Pin Oak</i>	<i>Sawtimber</i>	0.9	<i>MBF</i>		
	<i>Northern Pin Oak</i>	<i>Pulpwood</i>	2	<i>Cords</i>		
	Red Maple		69	Cords		
	Red Pine		3	Cords		
	White Pine		1	Cords		
	3	Quaking Aspen	Sawtimber	6.5		
Red Maple			26.6	MBF		
Red Oak			63.5	MBF		
Red Pine			145.0	MBF		
White Pine			46.2	MBF		
Balsam Fir		Pulpwood	21	Cords		
<i>Balsam Fir</i>		<i>Sawtimber</i>	1.0	<i>MBF</i>		
<i>Balsam Fir</i>		<i>Pulpwood</i>	19	<i>Cords</i>		
Mixed Aspen			188	Cords		
<i>B. T. Aspen</i>		<i>Sawtimber</i>	2.7	<i>MBF</i>		
<i>B. T. Aspen</i>		<i>Pulpwood</i>	51	<i>Cords</i>		
<i>Quaking Aspen</i>			132	<i>Cords</i>		
Red Maple			126	Cords		
Red Oak			56	Cords		
Red Pine			95	Cords		
White Pine			49	Cords		
4		Quaking Aspen	Sawtimber	32.8	MBF	21.2
	Red Maple		17.0	MBF		
	Red Oak		158.9	MBF		
	Balsam Fir	Pulpwood	5	Cords		
	<i>Balsam Fir</i>		5	<i>Cords</i>		
	Mixed Aspen		249	Cords		
	<i>Quaking Aspen</i>		249	<i>Cords</i>		
	Mixed Hardwood		9	Cords		
	<i>Paper Birch</i>		5	<i>Cords</i>		
	<i>Sugar Maple</i>		4	<i>Cords</i>		
	Red Maple		182	Cords		
	Red Oak		120	Cords		
	Red Pine		6	Cords		

DESCRIPTION OF TIMBER BY PAYMENT UNIT (PU), CON'T

PU	MARKET GROUP	PRODUCT	QUANTITY	UNIT	ACRES	ADVERTISE PRICE
5	Jack Pine	Sawtimber	9.4	MBF	6.0	\$921.50
	Jack Pine	Pulpwood	57	Cords		
	Mixed Aspen		5	Cords		
	<i>B. T. Aspen</i>	<i>Sawtimber</i>	1.1	<i>MBF</i>		
	<i>B. T. Aspen</i>	<i>Pulpwood</i>	3	<i>Cords</i>		
	Red Oak		1	Cords		
6	Jack Pine	Sawtimber	0.7	MBF	7.1	\$2,318.50
	Red Maple		3.5	MBF		
	Balsam Fir	Pulpwood	11	Cords		
	<i>Balsam Fir</i>		11	<i>Cords</i>		
	Jack Pine		7	Cords		
	Mixed Aspen		33	Cords		
	<i>Quaking Aspen</i>		33	<i>Cords</i>		
	Mixed Hardwood		2	Cords		
	<i>Black Cherry</i>		2	<i>Cords</i>		
	Red Maple		51	Cords		
	Red Oak		2	Cords		
7	Jack Pine	Sawtimber	5.9	MBF	23.5	\$17,066.35
	Red Maple		3.9	MBF		
	Red Oak		4.7	MBF		
	Red Pine		106.4	MBF		
	Jack Pine	Pulpwood	89	Cords		
	Mixed Aspen		37	Cords		
	<i>Quaking Aspen</i>		37	<i>Cords</i>		
	Red Maple		11	Cords		
	Red Oak		3	Cords		
	Red Pine		23	Cords		
TOTAL:			726.3	MBF		
TOTAL:			1,728	Cords		

Sale Specific Conditions & Requirements

Sale Name: The Big Little Mix

Sale Number: 54-014-21 Seq#: 2

1 - Sale Area

1.2 - Boundaries

1.2.1 - Painted boundaries (9/19)

The sale boundaries are marked and identified by red, blue, and green paint. Exterior sale boundary lines against state are marked with red paint. Exterior sale boundary lines against private property are marked with blue paint. Retention patches are marked with green paint; no harvesting activities may occur within these areas. The painted boundary line trees are not Included Timber.

2 - Timber Specifications

2.1 - Included Timber

2.1.1 - Clearcut unit(s) with unmerchantable trees (6/14)

Within Payment Unit(s) 1-7, cut all trees that are two (2) inches or more at DBH, except within Payment Unit(s) 1-3 and 6, do not cut trees marked with orange paint and within Payment Unit(s) 4 and 6, do not cut trees marked with green paint. See specifications 5.2.4.7 and 3.4.2 respectively for more information.

2.2 - Utilization

2.2.2 - Chipping required (2/18)

Payment Unit 7 must be chip harvested to facilitate subsequent planting operations. The Purchaser has the option to produce sawlogs or pulpwood bolts, but the remaining portion of the trees must be chipped and hauled. If market conditions limit the practicality of chipping, chipping is not required if the following conditions are met:

- Trees greater than 4 inches at DBH must be cut to a 2-inch top or smaller,
- Sub-merchantable trees, and hardwood limbs 4-inches or greater where they attach to the stem, are to be cut/reduced to 4-foot lengths,
- Slash must be evenly dispersed throughout the Sale Area, and not be more than 2-feet high.

In all cases harvesting operations must allow for subsequent planting operations, as determined by the sale administrator. The requirement to retain approximately 1/6 to 1/3 of tree tops and limbs less than four inches in diameter is still applicable.

2.2.3 - Stump heights (4/07)

Stump heights within Payment Unit 7 shall not exceed 6 inches for all trees. This is to facilitate planting operations.

3 - Payments

3.4 - Damaged Timber

3.4.2 - Special Protection Trees (4/14)

The Purchaser shall not cut live or dead special protection trees within cutting units or clearings. Special protection trees are marked with green paint. If the Purchaser's operations have cut or damaged special protection trees through carelessness, the Purchaser shall pay \$150.00 as fixed, agreed and liquidated damages for each special protection tree cut or damaged. Such payment does not constitute ownership of the undesignated timber.

4 - Transportation

4.1 - Construction

4.1.6 - Road construction (1/09)

Improvements of existing roads shall be done in such a way as to minimize the environmental and visual impacts.

Merchantable trees shall be cut and utilized unless otherwise directed. Non-merchantable trees shall be severed and laid flat on the ground. Slash shall be scattered, and not left in windrows and kept a minimum of 10 feet back from the road edge.

Stumps shall be set upright, not left on edge, and be moved at least 10 feet away from the road edge. Disturbed soil shall be feathered into the woods and not left in berms or windrows.

4.1.7 - Road closure (10/11)

Overgrown roads that are reopened must be blocked to vehicle traffic upon completion of the sale. In general, this will require constructing a four (4') foot high berm of stumps and logs covered with earth. Contact the sale administrator for specific details of design and placement.

4.1.12 - No new roads (1/12)

No new roads will be permitted in any Payment Unit. All operations are limited to existing roads. Skid trails only will be allowed.

4.2 - Maintenance

4.2.5 - Two wheel drive condition (2/04)

All existing trail roads on and adjacent to the sale area must be passable by two-wheel drive traffic for the duration of the sale.

5 - Operations

5.1 - Notification

5.1.1 - Pre-sale conference (10/16)

A pre-sale conference on site between the Purchaser and sale administrator is required prior to beginning any operations to determine landing and road locations. The Unit Manager or his/her representative must be contacted at least 5 days in advance to schedule the conference.

5.1.4 - Post-sale conference (10/16)

A post-sale conference on site between the Purchaser and sale administrator is required 5 days prior to the completion of active logging operations to determine clean-up and repair of landings, road edges, and the fulfillment of other contract specifications.

5.2 - Conduct of Operations

5.2.2 - Hazard Trees/Snags

5.2.2.1 - Den trees (10/16)

Obvious hollow and/or den trees shall be protected and left standing unless they are a safety hazard.

5.2.3 - Operating Restrictions

5.2.3.5 - Oak wilt restriction (1/18)

Within Payment Unit(s) 1, 3-5, and 7 unless changed by written agreement, cutting, skidding, hauling within the sale and brushing of access roads to the sale are not permitted during the period of April 15 to July 15. Operations may be allowed if specific steps are taken to prevent damaging uncut oak during the high risk period. Those steps may include completing all road brushing before April 15th and clearing a tree-length buffer along uncut oak cover before April 15th. This is necessary to reduce the spread of oak wilt. For more information, contact the Unit Manager or his/her representative. Payment Unit 4 has scattered oak marked to leave and will not be approved for operation during this period.

5.2.3.6 - Bark beetle restriction (12/08)

In the event drought creates a high risk of pine bark beetle infestation, pine is not to be cut during the period March 1 through July 1, unless all portions of trees greater than two inches in diameter are removed from the sale area, reduced to chips, or treated to the satisfaction of the Unit Manager or his/her representative, within fifteen days of being severed from the stump. Pine log decks, pulpwood piles and treetops that are piled for chipping in the fall or winter within a 1/4 mile of susceptible sites must be removed before March 15. Residual slash must not be placed in piles or rows and must be spread over the site for quick drying. The Department of Natural Resources will exercise this specification if the risk of damage warrants.

5.2.4 - Dead and Down Creation

5.2.4.7 - Dead and down creation: hare, grouse, deer and other species (5/15)

To improve horizontal cover habitat for snowshoe hare, grouse, deer, and other species, the Purchaser is to push over orange painted trees in Payment Unit(s) 1-3 and 6. These trees should be tipped over with the root ball still attached so the base of the tree is suspended off the ground. The crown of the fallen tree should be at or near ground level after it is pushed over.

5.2.32 - Decking/landing restoration (9/13)

All decking and landing areas must have the surface area restored to a condition equal to or better than before. This is to ensure the proper regeneration of the stand. Wood debris, chips, and "cookies" from trimmings must be removed or scattered away from landing and loading areas and may not be windrowed on the edge.

5.2.38 - No decking against live trees (2/04)

Cut products may not be decked against unmarked or designated leave trees.

5.2.39 - ORV trail/route protection (4/18)

The ORV trail is shown on the Timber Sale Map, located in Payment Unit(s) 2 and 7. Do not cut trees or damage posts with yellow ORV markers. If the trail is used, it must be maintained and restored to a condition equal to or better than before the sale. Maintain a 50-foot-wide slash, debris and rut free zone daily using the ORV trail as the centerline. No decking of forest products will be permitted along the ORV trail. All stumps within 10 feet of the snowmobile trail must be cut at ground level.

5.2.41 - Snowmobile trail protection (9/11)

The snowmobile trail is shown on the Timber Sale Map, located in Payment Unit 7. Do not cut or damage posts with orange trail markers or traffic control signs. If the trail is used, it must be maintained and restored to a condition equal to or better than before the sale. If the trail road is to be used for hauling during the snowmobile season, then a snow-covered base must be left on the trail. Maintain a 50-foot-wide slash, debris, and rut free zone daily using the snowmobile trail as the centerline. No decking of forest products will be permitted along the snowmobile trail. All stumps within 20 feet of the snowmobile trail must be cut at ground level.

5.4 - Soil Protection

5.4.1 - Rutting restriction, general (7/16)

Operations are to cease immediately if equipment and weather conditions result in rutting of roads and/or skid trails which is 12 inches or greater in depth and 50 feet in length. The Unit Manager or his/her representative may restrict hauling and/or skidding if ruts exceed the specified depth. With the Unit Manager or his/her representative's approval, the Purchaser may return to the area when the risk of rutting has decreased.

5.8 - Protection of Endangered Species

5.8.5 - Protection of raptor nests (3/13)

All trees with raptor nests will be protected if found during harvesting operations. Notification will be made to the Unit Manager or his/her representative who will notify the Wildlife Biologist so an on-site evaluation and recommendation can be made, if necessary.

6 - Safety and Fire Prevention

6.2 - Signing

6.2.1 - Road posting (10/20)

The Purchaser is responsible for posting and maintaining caution signs on state forest roads prior to beginning operations. The road must be posted at appropriate distances from the Sale Area to warn of logging activity and truck traffic. Signs must be removed when harvest operations are suspended or completed. The Purchaser will provide these signs.

6.2.3 - Recreational trail posting (10/20)

The Purchaser is responsible for posting and maintaining caution signs on recreation trails prior to beginning operations. The trail must be posted at appropriate distances from the Sale Area to warn of logging activity and truck traffic at both ends of the trail. Signs must be removed when harvest operations are suspended or completed. The Purchaser will provide these signs.



TIMBER SALE MAP

This information provided by authority of Part 525, 1994 PA 451, as amended.

Sale Number	Year
54-014	21

Forest Management Unit Atlanta	County Montmorency	Mapped By Doug Tyran	Date 09/07/2021	Page 1	of 2
Township 31N/32N	Range 03E	Section(s) and Subdivision(s) 3: SENW, S1/2NE, NESW, 34: SWSE	Scale 1:15,840		

Cover Type				Density			
A = Aspen	H = Hemlock	N = Marsh	U = Upland Brush	0 = Non Stocked	5 = Pole Timber Medium		
D = Paper Birch	J = Jack Pine	O = Oak	UM = Upland Mixed	1 = Seedling Sapling Poor	6 = Pole Timber Well		
C = Cedar	L = Lowland Brush	P = Lowland Poplar	V = Bog or Marsh	2 = Seedling Sapling Medium	7 = Saw Timber Poor		
D = Tread Bog	LM = Lowland Mixed	Q = Mixed Swamo Conifer	W = White Pine	3 = Seedling Sapling Well	8 = Saw Timber Medium		
E = Swamp Hdwoods	M = Mpl. Dec. Dec.	R = Red Pine	X = Non Stocked	4 = Pole Timber Poor	9 = Saw Timber Well		
F = Spruce Fir	MC = Mixed Conifer	S = Black Spruce	Z = Water				
G = Grass	MD = Mixed Deciduous	T = Tamarack					

PU	Acres	PU	Acres
1	13.3	5	6.0
2	10.0	6	7.1
3	34.0	7	23.5
4	21.2		

The Big Little Mix

Compartment 050

115.1 Acres



Legend

- Against State (Red)
- Retention Area (Green)
- Nearby Timber Sales
- Stand Boundaries
- Lakes and Rivers
- Primary Forest Road
- Secondary Forest Road
- Forest Access Route
- Paved Road
- Gravel Road
- County Road - Seasonal
- Private
- Recreational Trail
- Payment Unit Label

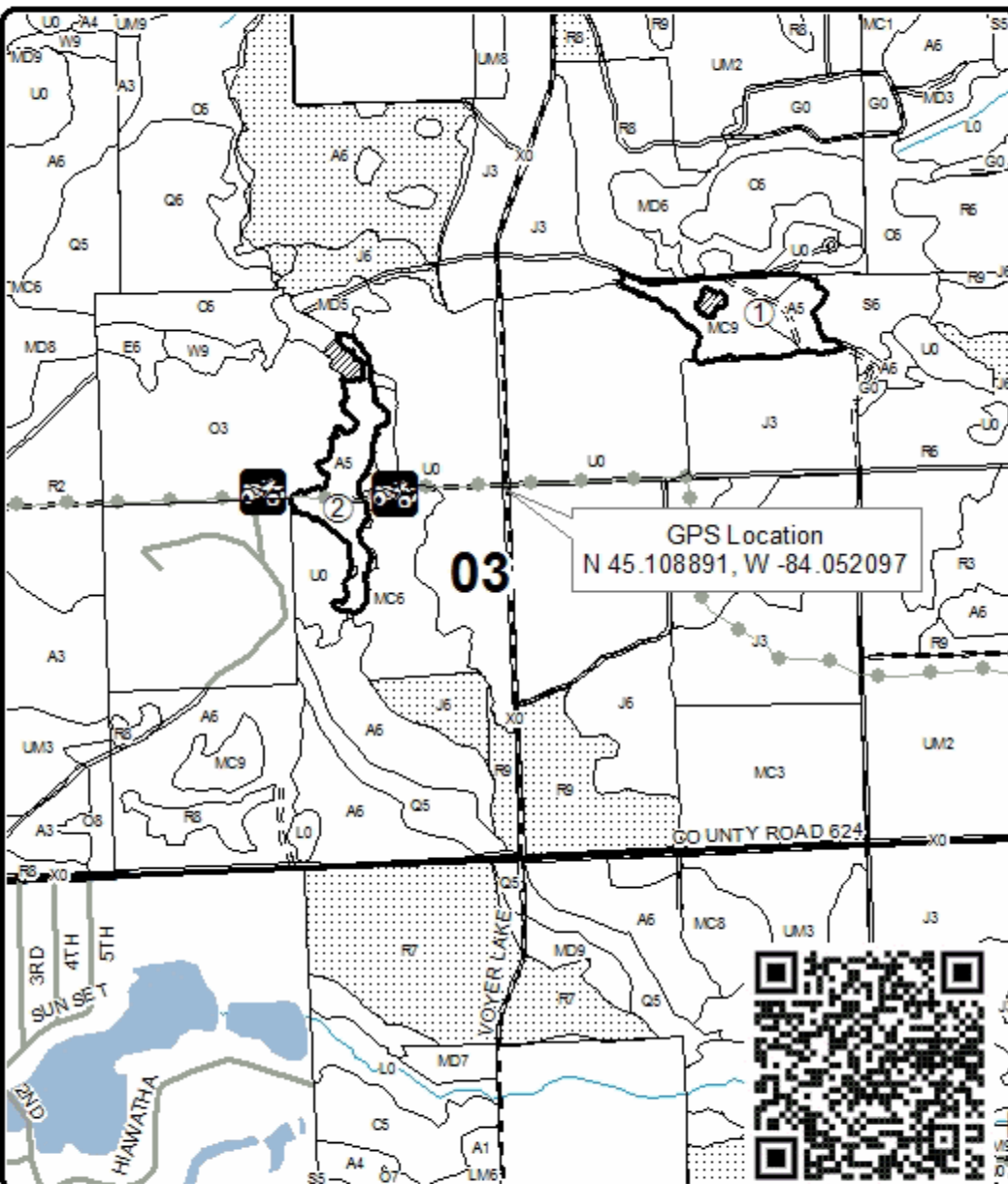

Locator Map
1:200,000

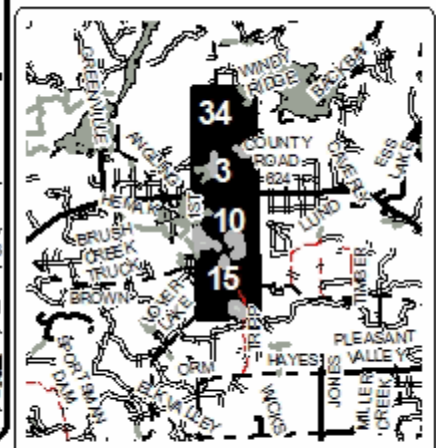



TIMBER SALE MAP

This information provided by authority of Part 525, 1994 PA 451, as amended.

Sale Number	Year
54-014	21

Forest Management Unit Atlanta	County Montmorency	Mapped By Doug Tyran	Date 09/14/2021	Page 2	of 2
Township 31N		Range 03E		Section(s) and Subdivision(s) 10: SW, W1/2SE, 15: NENW, NWNE, SWSE	

Scale	1:15,840
-------	----------

Cover Type				Density	
A = Aspen	H = Hemlock	N = Marsh	U = Upland Brush	0 = Non Stocked	5 = Pole Timber Medium
D = Paper Birch	J = Jack Pine	O = Oak	UM = Upland Mixed	1 = Seedling Sapling Poor	6 = Pole Timber Well
C = Cedar	L = Lowland Brush	P = Lowland Poplar	V = Bog or Marsh	2 = Seedling Sapling Medium	7 = Saw Timber Poor
D = Tread Bog	LM = Lowland Mixed	Q = Mixed Swamp Conifer	W = White Pine	3 = Seedling Sapling Well	8 = Saw Timber Medium
E = Swamp Hdwoods	M = Mpl. Dec. Birch	R = Red Pine	X = Non Stocked	4 = Pole Timber Poor	9 = Saw Timber Well
F = Spruce Fir	MC = Mixed Conifer	S = Black Spruce	Z = Water		
G = Grass	MD = Mixed Deciduous	T = Tamarack			

PU	Acres	PU	Acres
1	13.3	5	6.0
2	10.0	6	7.1
3	34.0	7	23.5
4	21.2		

The Big Little Mix

Compartment 050

115.1 Acres



Legend

- Against State (Red)
- Private Line (Blue)
- Retention Area (Green)
- Nearby Timber Sales
- Stand Boundaries
- Lakes and Rivers
- Primary Forest Road
- Secondary Forest Road
- Forest Access Route
- Gravel Road
- County Road - Seasonal
- Private
- Recreational Trail
- Payment Unit Label

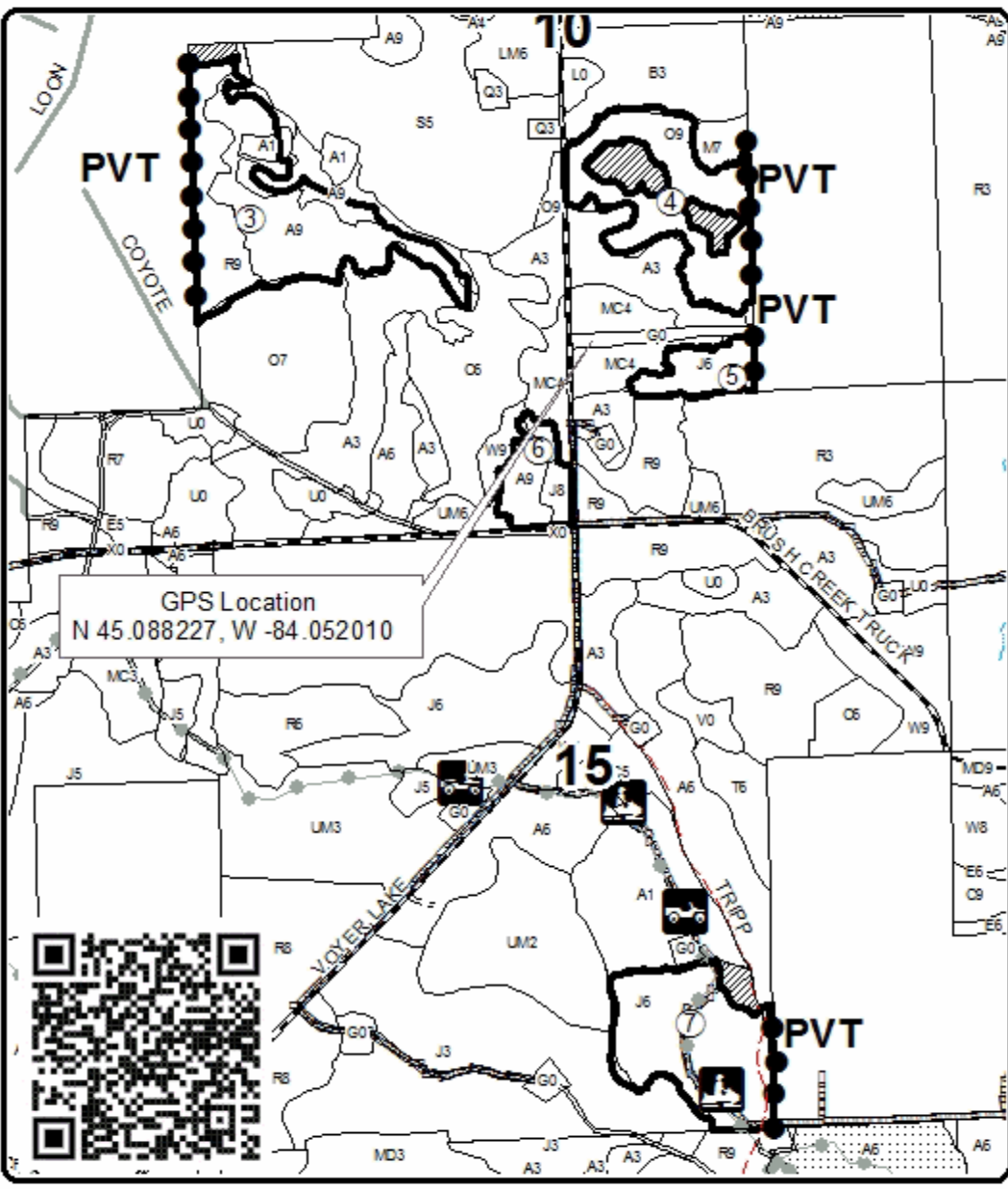

Locator Map

1:200,000

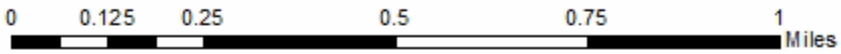
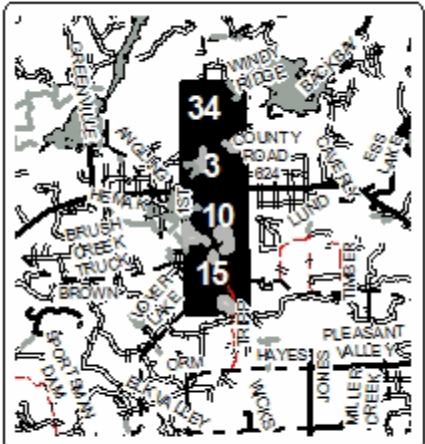

TIMBER SALE INFORMATION

Lonely Little Aspen (54-016-21)
 T31N, R03E, SEC. 10; T31N, R03E, SEC. 11.
 Montmorency County (Advertised Price \$14,016.95)

SALE NOTE: All units of volume listed for this sale were estimated using the Inventory Manager computer program and the new Michigan taper model.

A recreation site such as a trail, pathway, or campground is within the sale area or the vicinity. Certain restrictions/specifications may be applicable including time restrictions.

A timber sale contract for this lump sum, sealed bid timber sale will be awarded to the responsible bidder offering the highest sealed bid price. All units of volume listed below were estimated using the Inventory Manager computer program and the new Michigan taper model. Bids must be at or above the following advertised price for each product and species:

<u>PRODUCTS & SPECIES</u>	<u>ESTIMATED UNITS*</u>	<u>ADVERTISED PRICE</u>
Pulpwood		
Balsam Fir	65 Cords	\$ 16.00 / Cord
Quaking Aspen	415 Cords	\$ 24.60 / Cord
Red Maple	48 Cords	\$ 19.15 / Cord
Red Oak	28 Cords	\$ 36.25 / Cord
Red Pine	13 Cords	\$ 42.90 / Cord
White Pine	17 Cords	\$ 15.35 / Cord
White Spruce	2 Cords	\$ 7.55 / Cord

* The total volume is statistically estimated within plus (+) or minus (-) 14.51 percent. There are an estimated 532 cords on this timber sale, plus or minus 77 cords at the 95% confidence level. The estimated units are final and not subject to adjustment. Prospective bidders are urged to examine this timber and to make their own estimates of quantity and quality.

BOND AND PAYMENT SCHEDULE:

- A bond in the amount of \$701.00 to insure faithful performance of the conditions of the contract will be deposited by the successful bidder within 21 days of the sale award.
- Cutting in any sale or unit without the required advance payment would be considered a trespass.
- Total payment must be paid in advance or according to the following schedule :
 - Ten percent (10%) of the sale value must be paid within 21 days of the sale award.
 - The remainder is due before cutting begins.
 - Payment for each of the following units must be made before cutting begins in that unit:

PAYMENT UNIT NUMBER	PERCENT OF TOTAL SALE VALUE
01	100.0%
- If no cutting takes place, the 10% down payment will not be refunded.
- Operations on the contract issued will terminate on 12/31/2024.

SALE STATISTICS

Volumes were calculated in cubic feet using the Michigan taper model. Cubic foot volume includes all wood inside bark for the product indicated. For display purposes, cubic feet were converted to cords and MBF using a simple conversion factor, e.g. 79 cubic feet per cord and 185 cubic feet per MBF. The cubic foot volumes are precise; the cords and MBF volumes are not. Cubic foot volume cannot be directly converted to cords or boards with precision.

SALE VOLUMES

The total estimated sale volume may not equal the sum of the species/products due to the nature of statistical calculations associated with double sampling methodology.

VOLUME		STATISTICAL RANGE IN CORDS		
TOTAL CUBIC FEET	TOTAL CORDS	PERCENT ERROR	MINIMUM	MAXIMUM
42,001	532	14.51%	455	609

VDU VOLUMES

A VDU is a Volume Determination Unit. Volumes and their associated statistics are calculated at the VDU level and summarized to the sale level. There is often a one to one relationship between a VDU and a Payment Unit, but not always, depending on the cruise design. Refer to the VDU TO PAYMENT UNIT table.

VDU	VOLUME		PERCENT ERROR	RANGE IN CORDS	
	TOTAL CUBIC FEET	TOTAL CORDS		MINIMUM	MAXIMUM
24	28,397	359	15.65%	303	416
36	13,604	172	30.65%	119	225
TOTAL:	42,001	532		423	641

VDU TO PAYMENT UNIT

When a VDU is associated with more than one Payment Unit (PU), the VDU volumes are assigned to the PU based on acres of the VDU within the PU.

VDU	VDU ACRES	PU	PU ACRES
24	14.4	1	14.4
36	7.0	1	7.0
TOTAL:	21.4		21.4

DESCRIPTION OF TIMBER BY PAYMENT UNIT (PU)

PU	MARKET GROUP	PRODUCT	QUANTITY	UNIT	ACRES	ADVERTISE PRICE
1	Balsam Fir	Pulpwood	65	Cords	21.4	\$14,016.95
	Quaking Aspen		415	Cords		
	Red Maple		48	Cords		
	<i>Red Maple</i>	<i>Sawtimber</i>	6.1	<i>MBF</i>		
	<i>Red Maple</i>	<i>Pulpwood</i>	36	<i>Cords</i>		
	Red Oak		28	Cords		
	<i>Red Oak</i>	<i>Sawtimber</i>	9.8	<i>MBF</i>		
	<i>Red Oak</i>	<i>Pulpwood</i>	8	<i>Cords</i>		
	Red Pine		13	Cords		
	<i>Red Pine</i>	<i>Sawtimber</i>	3.9	<i>MBF</i>		
	<i>Red Pine</i>	<i>Pulpwood</i>	5	<i>Cords</i>		
	White Pine		17	Cords		
	White Spruce		2	Cords		
TOTAL:			588	Cords		

Sale Specific Conditions & Requirements

Sale Name: Lonely Little Aspen

Sale Number: 54-016-21 Seq#: 2

1 - Sale Area

1.2 - Boundaries

1.2.1 - Painted boundaries (9/19)

The sale boundaries are marked and identified by red and blue paint. Exterior sale boundary lines against state are marked with red paint. Exterior sale boundary lines against private property are marked with blue paint. The painted boundary line trees are not Included Timber.

2 - Timber Specifications

2.1 - Included Timber

2.1.1 - Clearcut unit(s) with unmerchantable trees (6/14)

Within Payment Unit(s) 1, cut all trees that are two (2) inches or more at DBH, except do not cut trees marked with orange paint. See specification 5.2.4.7 for more information.

4 - Transportation

4.1 - Construction

4.1.6 - Road construction (1/09)

Construction of new roads or improvements of existing roads shall be done in such a way as to minimize the environmental and visual impacts. Merchantable trees shall be cut and utilized unless otherwise directed. Non-merchantable trees shall be severed and laid flat on the ground. Slash shall be scattered, and not left in windrows and kept a minimum of 10 feet back from the road edge. Stumps shall be set upright, not left on edge, and be moved at least 10 feet away from the road edge. Disturbed soil shall be feathered into the woods and not left in berms or windrows.

4.1.7 - Road closure (10/11)

All new roads built into the sale must be blocked to vehicle traffic upon completion of the sale. Overgrown roads that are reopened shall be considered new roads. In general, this will require constructing a four (4') foot high berm of stumps and logs covered with earth. These roads must be rendered impassable to cars and trucks. Contact the sale administrator for specific details of design and placement.

4.2 - Maintenance

4.2.5 - Two wheel drive condition (2/04)

All existing trail roads on and adjacent to the sale area must be passable by two-wheel drive traffic for the duration of the sale.

5 - Operations

5.1 - Notification

5.1.1 - Pre-sale conference (10/16)

A pre-sale conference on site between the Purchaser and sale administrator is required prior to beginning to determine landing and road locations. The Unit Manager or his/her representative must be contacted at least 5 days in advance to schedule the conference.

5.1.4 - Post-sale conference (10/16)

A post-sale conference on site between the Purchaser and sale administrator is required 5 days prior to the completion of active logging operations to determine clean-up and repair of landings, road edges, and the fulfillment of other contract specifications.

5.2 - Conduct of Operations

5.2.1 - Slash

5.2.1.8 - Slash height (12/08)

No slash or tree tops may exceed 24 inches in height.

5.2.2 - Hazard Trees/Snags

5.2.2.1 - Den trees (10/16)

Obvious hollow and/or den trees shall be protected and left standing unless they are a safety hazard.

5.2.3 - Operating Restrictions

5.2.3.5 - Oak wilt restriction (1/18)

Within Payment Unit 1 unless changed by written agreement, cutting, skidding, hauling within the sale and brushing of access roads to the sale are not permitted during the period of April 15 to July 15. Operations may be allowed if specific steps are taken to prevent damaging uncut oak during the high risk period. Those steps may include completing all road brushing before April 15th and clearing a tree-length buffer along uncut oak cover before April 15th. This is necessary to reduce the spread of oak wilt. For more information, contact the Unit Manager or his/her representative.

5.2.3.11 - Coppice regeneration protection (4/10)

Timber harvesting must be completed before significant aspen sprouting occurs to minimize damage to the new regeneration. The Unit Manager or his/her representative may cease such operations if sprouting occurs before the operation is complete.

5.2.4 - Dead and Down Creation

5.2.4.7 - Dead and down creation: hare, grouse, deer and other species (5/15)

To improve horizontal cover habitat for snowshoe hare, grouse, deer, and other species, the Purchaser is to push over orange painted trees. These trees should be tipped over with the root ball still attached so the base of the tree is suspended off the ground. The crown of the fallen tree should be at or near ground level after it is pushed over.

5.2.32 - Decking/landing restoration (9/13)

All decking and landing areas must have the surface area restored to a condition equal to or better than before. This is to ensure the proper regeneration of the stand. Wood debris, chips, and "cookies" from trimmings must be removed or scattered away from landing and loading areas and may not be windrowed on the edge.

5.2.38 - No decking against live trees (2/04)

Cut products may not be decked against unmarked or designated leave trees.

5.2.39 - ORV trail/route protection (4/18)

The ORV trail is shown on the Timber Sale Map. Do not cut trees or damage posts with ORV markers. If the trail is used, it must be maintained and restored to a condition equal to or better than before the sale. Maintain a 50-foot-wide slash, debris and rut free zone daily using the ORV trail as the centerline. No decking of forest products will be permitted along the ORV trail. All stumps within 10 feet of the trail must be cut at ground level.

5.4 - Soil Protection

5.4.1 - Rutting restriction, general (7/16)

Operations are to cease immediately if equipment and weather conditions result in rutting of roads and/or skid trails which is 12 inches or greater in depth and 50 feet in length. The Unit Manager or his/her representative may restrict hauling and/or skidding if ruts exceed the specified depth. With the Unit Manager or his/her representative's approval, the Purchaser may return to the area when the risk of rutting has decreased.

6 - Safety and Fire Prevention

6.2 - Signing

6.2.3 - Recreational trail posting (10/20)

The Purchaser is responsible for posting and maintaining caution signs on recreation trails prior to beginning operations. The trail must be posted at appropriate distances from the Sale Area to warn of logging activity and truck traffic at both ends of the trail. Signs must be removed when harvest operations are suspended or completed. The Purchaser will provide these signs.



TIMBER SALE MAP

This information provided by authority of Part 525, 1994 PA 451, as amended.

Sale Number	Year
54-016	21

Forest Management Unit Atlanta	County Montmorency	Mapped By Doug Tyran	Date 09/24/2021	Page 1	of 1
Township 31N	Range 03E	Section(s) and Subdivision(s) 10: SENE, 11: SWNW, NWSW	Scale 1:15,840		

Cover Type				Density	
A = Aspen	H = Hemlock	N = Marsh	U = Upland Brush	0 = Non Stocked	5 = Pole Timber Medium
D = Paper Birch	J = Jack Pine	O = Oak	UM = Upland Mixed	1 = Seedling Sapling Poor	6 = Pole Timber Well
C = Cedar	L = Lowland Brush	P = Lowland Poplar	V = Bog or Marsh	2 = Seedling Sapling Medium	7 = Saw Timber Poor
D = Tread Bog	LM = Lowland Mixed	Q = Mixed Swam Conifer	W = White Pine	3 = Seedling Sapling Well	8 = Saw Timber Medium
E = Swamp Hdwoods	M = Mpl. Dec. Decid	R = Red Pine	X = Non Stocked	4 = Pole Timber Poor	9 = Saw Timber Well
F = Spruce Fir	MC = Mixed Conifer	S = Black Spruce	Z = Water		
G = Grass	MD = Mixed Deciduous	T = Tamarack			

PU Acres

1 21.4

Lonely Little Aspen Compartments 049 & 050 21.4 Acres

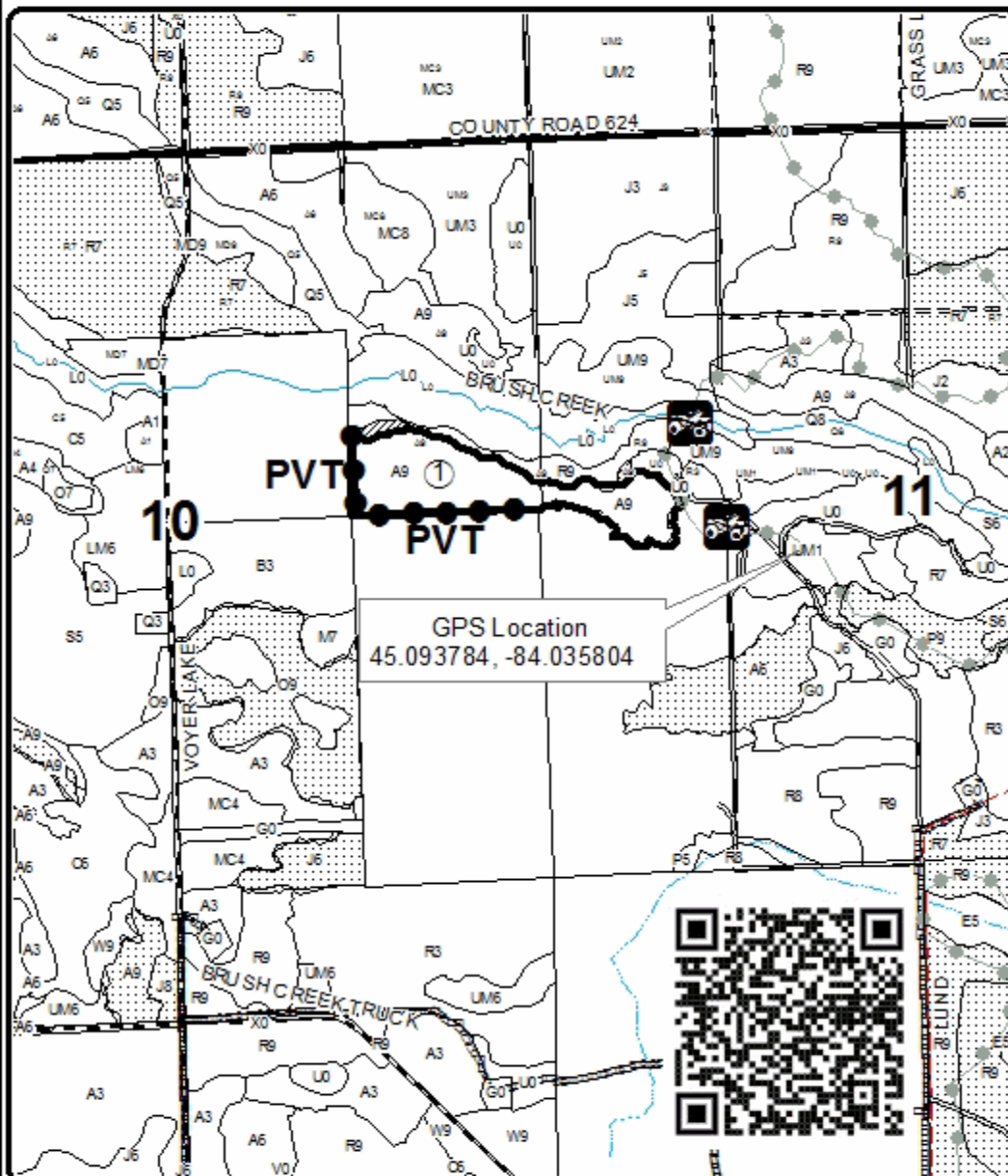

Legend

- Against State Red
- Private Line (Blue)
- Retention Area
- Nearby Timber Sales
- Stand Boundaries
- Lakes and Rivers
- ORV Trail
- Primary Forest Road
- Secondary Forest Road
- Forest Access Route
- Paved Road
- Gravel Road
- County Road - Seasonal

Locator Map
1:200,000

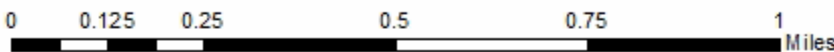
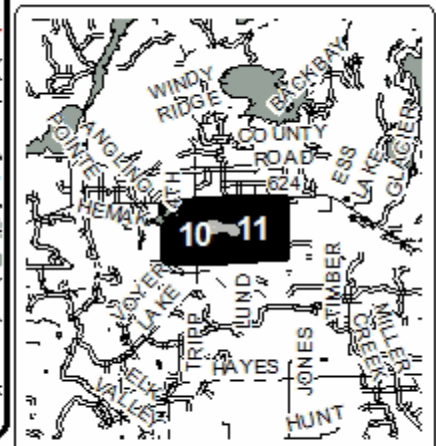

TIMBER SALE INFORMATION

Aspen Kerr-fuffle (54-017-21)

T31N, R02E, SEC. 25; T31N, R02E, SEC. 26; T31N, R02E, SEC. 35; T31N, R02E, SEC. 36; T31N, R03E, SEC. 30.
Montmorency County (Advertised Price \$271,979.95)

SALE NOTE: All units of volume listed for this sale were estimated using the Inventory Manager computer program and the new Michigan taper model.

See sale spec 5.2.3.1 for information on operating restrictions.

A recreation site such as a trail, pathway, or campground is within the sale area or the vicinity. Certain restrictions/specifications may be applicable including time restrictions.

A timber sale contract for this lump sum, sealed bid timber sale will be awarded to the responsible bidder offering the highest sealed bid price. All units of volume listed below were estimated using the Inventory Manager computer program and the new Michigan taper model. Bids must be at or above the following advertised price for each product and species:

<u>PRODUCTS & SPECIES</u>	<u>ESTIMATED UNITS*</u>		<u>ADVERTISED PRICE</u>
Sawtimber			
BI/R/Hybrid Oak	294.3	MBF	\$ 102.00 / MBF
Mixed Aspen	312.1	MBF	\$ 91.00 / MBF
Red Maple	13.7	MBF	\$ 46.00 / MBF
Red Oak	111.1	MBF	\$ 153.00 / MBF
Red Pine	165.9	MBF	\$ 122.00 / MBF
White Pine	24.4	MBF	\$ 64.00 / MBF
Pulpwood			
Balsam Fir	75	Cords	\$ 16.00 / Cord
Jack Pine	64	Cords	\$ 9.25 / Cord
Mixed Aspen	3,960	Cords	\$ 24.60 / Cord
Mixed Hardwood	593	Cords	\$ 19.15 / Cord
Mixed Oak	1,599	Cords	\$ 36.25 / Cord
Red Pine	78	Cords	\$ 42.90 / Cord
White Pine	147	Cords	\$ 15.35 / Cord

* The total volume is statistically estimated within plus (+) or minus (-) 11.09 percent. There are an estimated 8,455 cords on this timber sale, plus or minus 938 cords at the 95% confidence level. The estimated units are final and not subject to adjustment. Prospective bidders are urged to examine this timber and to make their own estimates of quantity and quality.

BOND AND PAYMENT SCHEDULE:

1. A bond in the amount of \$13,599.00 to insure faithful performance of the conditions of the contract will be deposited by the successful bidder within 21 days of the sale award.
2. Cutting in any sale or unit without the required advance payment would be considered a trespass.
3. Total payment must be paid in advance or according to the following schedule:
 - (a) Ten percent (10%) of the sale value must be paid within 21 days of the sale award.
 - (b) The 10% down payment will be credited towards the first unit cut.

(c) Payment for each of the following units must be made before cutting begins in that unit:

PAYMENT UNIT NUMBER	PERCENT OF TOTAL SALE VALUE
01	6.3%
02	8.2%
03	1.8%
04	5.9%
05	9.6%
06	4.8%
07	13.2%
08	11.5%
09	2.5%
10	9.1%
11	5.5%
12	2.3%
13	8.1%
14	1.6%
15	7.2%
16	2.4%

4. If no cutting takes place, the 10% down payment will not be refunded.

5. Operations on the contract issued will terminate on 10/31/2024.

SALE STATISTICS

Volumes were calculated in cubic feet using the Michigan taper model. Cubic foot volume includes all wood inside bark for the product indicated. For display purposes, cubic feet were converted to cords and MBF using a simple conversion factor, e.g. 79 cubic feet per cord and 185 cubic feet per MBF. The cubic foot volumes are precise; the cords and MBF volumes are not. Cubic foot volume cannot be directly converted to cords or boards with precision.

SALE VOLUMES

The total estimated sale volume may not equal the sum of the species/products due to the nature of statistical calculations associated with double sampling methodology.

VOLUME		STATISTICAL RANGE IN CORDS		
TOTAL CUBIC FEET	TOTAL CORDS	PERCENT ERROR	MINIMUM	MAXIMUM
667,940	8,455	11.09%	7,517	9,393

VDU VOLUMES

A VDU is a Volume Determination Unit. Volumes and their associated statistics are calculated at the VDU level and summarized to the sale level. There is often a one to one relationship between a VDU and a Payment Unit, but not always, depending on the cruise design. Refer to the VDU TO PAYMENT UNIT table.

VDU	VOLUME			RANGE IN CORDS	
	TOTAL CUBIC FEET	TOTAL CORDS	PERCENT ERROR	MINIMUM	MAXIMUM
19	37,642	476	45.01%	262	691
35	19,095	242	29.15%	171	312
37	252,569	3,197	19.29%	2,580	3,814
40	72,258	915	35.24%	592	1,237
56	125,095	1,583	25.05%	1,187	1,980
62	95,167	1,205	21.51%	946	1,464
80	66,114	837	33.49%	557	1,117
TOTAL:	667,940	8,455		6,295	10,615

VDU TO PAYMENT UNIT

When a VDU is associated with more than one Payment Unit (PU), the VDU volumes are assigned to the PU based on acres of the VDU within the PU.

VDU	VDU ACRES	PU	PU ACRES
19	13.8	1	13.8
35	21.3	3	21.3
37	116.0	9	7.6
		10	27.3
		11	16.3
		12	7.0
		13	24.2
		14	4.8
		15	21.6
		16	7.2
40	19.6	8	19.6
56	49.4	4	18.8
		5	30.6
62	52.3	6	14.0
		7	38.3
80	23.0	2	23.0
TOTAL:	295.4		295.4

DESCRIPTION OF TIMBER BY PAYMENT UNIT (PU)

PU	MARKET GROUP	PRODUCT	QUANTITY	UNIT	ACRES	ADVERTISE PRICE
1	Mixed Aspen	Sawtimber	47.9	MBF	13.8	\$17,174.10
	<i>Quaking Aspen</i>		47.9	<i>MBF</i>		
	Red Oak	Pulpwood	36.4	MBF		
	Mixed Aspen		236	Cords		
	<i>B. T. Aspen</i>		104	<i>Cords</i>		
	<i>Quaking Aspen</i>		132	<i>Cords</i>		
	Mixed Hardwood		26	Cords		
	<i>Red Maple</i>		26	<i>Cords</i>		
	Mixed Oak		26	Cords		
	<i>Red Oak</i>		26	<i>Cords</i>		
2	Red Maple	Sawtimber	8.3	MBF	23.0	\$22,168.15
	Red Pine		38.2	MBF		
	White Pine	3.5	MBF			
	Jack Pine	Pulpwood	8	Cords		
	Mixed Aspen		472	Cords		
	<i>Quaking Aspen</i>		472	<i>Cords</i>		
	Mixed Hardwood		223	Cords		
	<i>Red Maple</i>		223	<i>Cords</i>		
	Mixed Oak		13	Cords		
	<i>Red Oak</i>		13	<i>Cords</i>		
	Red Pine		10	Cords		
	White Pine		3	Cords		
3	Mixed Aspen		Sawtimber	1.5	MBF	21.3
	<i>B. T. Aspen</i>	1.5		<i>MBF</i>		
	Red Maple	2.1	MBF			
	Red Pine	2.2	MBF			
	Balsam Fir	Pulpwood	15	Cords		
	Jack Pine		47	Cords		
	Mixed Aspen		117	Cords		
	<i>B. T. Aspen</i>		15	<i>Cords</i>		
	<i>Quaking Aspen</i>		102	<i>Cords</i>		
	Mixed Hardwood		35	Cords		
	<i>Black Cherry</i>		9	<i>Cords</i>		
	<i>Red Maple</i>		26	<i>Cords</i>		
	Mixed Oak		7	Cords		
	<i>Red Oak</i>		7	<i>Cords</i>		
Red Pine	1		Cords			
4	Mixed Aspen		Sawtimber	9.4	MBF	18.8
	<i>Quaking Aspen</i>	9.4		<i>MBF</i>		
	Red Maple	1.3	MBF			
	Red Pine	7.9	MBF			
	Balsam Fir	Pulpwood	23	Cords		
	Jack Pine		3	Cords		
	Mixed Aspen		521	Cords		
	<i>B. T. Aspen</i>		65	<i>Cords</i>		
	<i>Quaking Aspen</i>		456	<i>Cords</i>		
	Mixed Hardwood		36	Cords		
	<i>Black Cherry</i>		6	<i>Cords</i>		
	<i>Red Maple</i>		30	<i>Cords</i>		
	Mixed Oak		1	Cords		
	<i>Red Oak</i>		1	<i>Cords</i>		
Red Pine	1		Cords			
White Pine	12		Cords			
5	Mixed Aspen	Sawtimber	15.3	MBF	30.6	\$26,066.50
	<i>Quaking Aspen</i>		15.3	<i>MBF</i>		
	Red Maple		2.0	MBF		

DESCRIPTION OF TIMBER BY PAYMENT UNIT (PU), CON'T

PU	MARKET GROUP	PRODUCT	QUANTITY	UNIT	ACRES	ADVERTISE PRICE
5 con't	Red Pine	Sawtimber	12.8	MBF		
	Balsam Fir	Pulpwood	37	Cords		
	Jack Pine		6	Cords		
	Mixed Aspen		847	Cords		
	<i>B. T. Aspen</i>		106	Cords		
	<i>Quaking Aspen</i>		741	Cords		
	Mixed Hardwood		59	Cords		
	<i>Black Cherry</i>		10	Cords		
	<i>Red Maple</i>		49	Cords		
	Mixed Oak		2	Cords		
	<i>Red Oak</i>		2	Cords		
	Red Pine		1	Cords		
	White Pine		19	Cords		
6	BI/R/Hybrid Oak	Sawtimber	58.2	MBF	14.0	\$12,973.85
	Red Oak		2.5	MBF		
	Red Pine		6.1	MBF		
	Mixed Hardwood	Pulpwood	11	Cords		
	<i>Red Maple</i>		11	Cords		
	Mixed Oak		152	Cords		
	<i>BI/R/Hybrid Oak</i>		146	Cords		
	<i>Red Oak</i>		6	Cords		
	Red Pine		3	Cords		
	White Pine		4	Cords		
7	BI/R/Hybrid Oak	Sawtimber	159.3	MBF	38.3	\$35,507.55
	Red Oak		7.0	MBF		
	Red Pine		16.6	MBF		
	Mixed Hardwood	Pulpwood	29	Cords		
	<i>Red Maple</i>		29	Cords		
	Mixed Oak		416	Cords		
	<i>BI/R/Hybrid Oak</i>		401	Cords		
	<i>Red Oak</i>		15	Cords		
	Red Pine		8	Cords		
	White Pine		12	Cords		
8	Mixed Aspen	Sawtimber	34.4	MBF	19.6	\$31,398.80
	<i>B. T. Aspen</i>		34.4	MBF		
	Red Oak		19.6	MBF		
	Red Pine		55.0	MBF		
	White Pine		20.9	MBF		
	Mixed Aspen	Pulpwood	421	Cords		
	<i>B. T. Aspen</i>		421	Cords		
	Mixed Hardwood		18	Cords		
	<i>Red Maple</i>		18	Cords		
	Mixed Oak		132	Cords		
	<i>Red Oak</i>		132	Cords		
	Red Pine		24	Cords		
	White Pine		46	Cords		
9	BI/R/Hybrid Oak	Sawtimber	5.0	MBF	7.6	\$6,917.05
	Mixed Aspen		13.3	MBF		
	<i>B. T. Aspen</i>		13.1	MBF		
	<i>Quaking Aspen</i>		0.2	MBF		
	Red Oak		3.0	MBF		
	Red Pine		1.8	MBF		
	Mixed Aspen	Pulpwood	88	Cords		
	<i>B. T. Aspen</i>		87	Cords		
	<i>Quaking Aspen</i>		1	Cords		
	Mixed Hardwood		10	Cords		

DESCRIPTION OF TIMBER BY PAYMENT UNIT (PU), CON'T

PU	MARKET GROUP	PRODUCT	QUANTITY	UNIT	ACRES	ADVERTISE PRICE
9 con't	<i>Red Maple</i>	<i>Pulpwood</i>	10	<i>Cords</i>		
	Mixed Oak		56	Cords		
	<i>Bl/R/Hybrid Oak</i>		13	<i>Cords</i>		
	<i>Red Oak</i>		43	<i>Cords</i>		
	Red Pine		2	Cords		
	White Pine		3	Cords		
10	Bl/R/Hybrid Oak	Sawtimber	18.1	MBF	27.3	\$24,837.10
	Mixed Aspen		48.0	MBF		
	<i>B. T. Aspen</i>		47.2	<i>MBF</i>		
	<i>Quaking Aspen</i>		0.8	<i>MBF</i>		
	Red Oak		10.7	MBF		
	Red Pine		6.4	MBF		
	Mixed Aspen	Pulpwood	317	Cords		
	<i>B. T. Aspen</i>		313	<i>Cords</i>		
	<i>Quaking Aspen</i>		4	<i>Cords</i>		
	Mixed Hardwood		37	Cords		
	<i>Red Maple</i>		37	<i>Cords</i>		
	Mixed Oak		199	Cords		
	<i>Bl/R/Hybrid Oak</i>		46	<i>Cords</i>		
	<i>Red Oak</i>		153	<i>Cords</i>		
	Red Pine		7	Cords		
White Pine	12	Cords				
11	Bl/R/Hybrid Oak	Sawtimber	10.8	MBF	16.3	\$14,871.35
	Mixed Aspen		28.6	MBF		
	<i>B. T. Aspen</i>		28.1	<i>MBF</i>		
	<i>Quaking Aspen</i>		0.5	<i>MBF</i>		
	Red Oak		6.4	MBF		
	Red Pine		3.8	MBF		
	Mixed Aspen	Pulpwood	190	Cords		
	<i>B. T. Aspen</i>		187	<i>Cords</i>		
	<i>Quaking Aspen</i>		3	<i>Cords</i>		
	Mixed Hardwood		22	Cords		
	<i>Red Maple</i>		22	<i>Cords</i>		
	Mixed Oak		120	Cords		
	<i>Bl/R/Hybrid Oak</i>		28	<i>Cords</i>		
	<i>Red Oak</i>		92	<i>Cords</i>		
	Red Pine		4	Cords		
White Pine	7	Cords				
12	Bl/R/Hybrid Oak	Sawtimber	4.6	MBF	7.0	\$6,357.65
	Mixed Aspen		12.3	MBF		
	<i>B. T. Aspen</i>		12.1	<i>MBF</i>		
	<i>Quaking Aspen</i>		0.2	<i>MBF</i>		
	Red Oak		2.8	MBF		
	Red Pine		1.6	MBF		
	Mixed Aspen	Pulpwood	81	Cords		
	<i>B. T. Aspen</i>		80	<i>Cords</i>		
	<i>Quaking Aspen</i>		1	<i>Cords</i>		
	Mixed Hardwood		9	Cords		
	<i>Red Maple</i>		9	<i>Cords</i>		
	Mixed Oak		51	Cords		
	<i>Bl/R/Hybrid Oak</i>		12	<i>Cords</i>		
	<i>Red Oak</i>		39	<i>Cords</i>		
	Red Pine		2	Cords		
White Pine	3	Cords				
13	Bl/R/Hybrid Oak	Sawtimber	16.0	MBF	24.2	\$22,035.45
	Mixed Aspen		42.5	MBF		

DESCRIPTION OF TIMBER BY PAYMENT UNIT (PU), CON'T

PU	MARKET GROUP	PRODUCT	QUANTITY	UNIT	ACRES	ADVERTISE PRICE	
13 con't	<i>B. T. Aspen</i>	<i>Sawtimber</i>	41.8	<i>MBF</i>			
	<i>Quaking Aspen</i>		0.7	<i>MBF</i>			
	Red Oak		9.5	MBF			
	Red Pine		5.7	MBF			
	Mixed Aspen		Pulpwood	281			Cords
	<i>B. T. Aspen</i>			277			<i>Cords</i>
	<i>Quaking Aspen</i>			4			<i>Cords</i>
	Mixed Hardwood			33			Cords
	<i>Red Maple</i>			33			<i>Cords</i>
	Mixed Oak			177			Cords
	<i>BI/R/Hybrid Oak</i>			41			<i>Cords</i>
	<i>Red Oak</i>			136			<i>Cords</i>
	Red Pine			6			Cords
	White Pine			11			Cords
14	<i>BI/R/Hybrid Oak</i>	<i>Sawtimber</i>	3.2	MBF	4.8	\$4,350.55	
	Mixed Aspen		8.4	MBF			
	<i>B. T. Aspen</i>		8.3	<i>MBF</i>			
	<i>Quaking Aspen</i>		0.1	<i>MBF</i>			
	Red Oak		1.9	MBF			
	Red Pine		1.1	MBF			
	Mixed Aspen		Pulpwood	56			Cords
	<i>B. T. Aspen</i>			55			<i>Cords</i>
	<i>Quaking Aspen</i>			1			<i>Cords</i>
	Mixed Hardwood			6			Cords
	<i>Red Maple</i>			6			<i>Cords</i>
	Mixed Oak			35			Cords
	<i>BI/R/Hybrid Oak</i>			8			<i>Cords</i>
	<i>Red Oak</i>			27			<i>Cords</i>
Red Pine	1	Cords					
White Pine	2	Cords					
15	<i>BI/R/Hybrid Oak</i>	<i>Sawtimber</i>	14.3	MBF	21.6	\$19,698.00	
	Mixed Aspen		37.9	MBF			
	<i>B. T. Aspen</i>		37.3	<i>MBF</i>			
	<i>Quaking Aspen</i>		0.6	<i>MBF</i>			
	Red Oak		8.5	MBF			
	Red Pine		5.0	MBF			
	Mixed Aspen		Pulpwood	250			Cords
	<i>B. T. Aspen</i>			247			<i>Cords</i>
	<i>Quaking Aspen</i>			3			<i>Cords</i>
	Mixed Hardwood			29			Cords
	<i>Red Maple</i>			29			<i>Cords</i>
	Mixed Oak			159			Cords
	<i>BI/R/Hybrid Oak</i>			37			<i>Cords</i>
	<i>Red Oak</i>			122			<i>Cords</i>
Red Pine	6	Cords					
White Pine	10	Cords					
16	<i>BI/R/Hybrid Oak</i>	<i>Sawtimber</i>	4.8	MBF	7.2	\$6,558.40	
	Mixed Aspen		12.6	MBF			
	<i>B. T. Aspen</i>		12.4	<i>MBF</i>			
	<i>Quaking Aspen</i>		0.2	<i>MBF</i>			
	Red Oak		2.8	MBF			
	Red Pine		1.7	MBF			
	Mixed Aspen		Pulpwood	83			Cords
	<i>B. T. Aspen</i>			82			<i>Cords</i>
	<i>Quaking Aspen</i>			1			<i>Cords</i>
	Mixed Hardwood			10			Cords

DESCRIPTION OF TIMBER BY PAYMENT UNIT (PU), CON'T

PU	MARKET GROUP	PRODUCT	QUANTITY	UNIT	ACRES	ADVERTISE PRICE
16 con't	<i>Red Maple</i>	<i>Pulpwood</i>	10	<i>Cords</i>		
	Mixed Oak		53	Cords		
	<i>B/R/Hybrid Oak</i>		12	<i>Cords</i>		
	<i>Red Oak</i>		41	<i>Cords</i>		
	Red Pine		2	Cords		
	White Pine		3	Cords		
TOTAL:			921.5	MBF		
TOTAL:			6,516	Cords		

Sale Specific Conditions & Requirements

Sale Name: Aspen Kerr-fuffle

Sale Number: 54-017-21 Seq#: 2

1 - Sale Area

1.2 - Boundaries

1.2.1 - Painted boundaries (9/19)

The sale boundary and Payment Unit boundaries are marked and identified by blue, red, and yellow paint. Also, county roads and recreation trails serve as sale boundaries and Payment Unit boundaries, as shown on Timber Sale Map. Exterior sale boundary lines against private property are marked with blue paint. Exterior sale boundary lines against state are marked with red paint. Interior Payment Unit boundaries are marked with yellow paint except along the snowmobile trail, Voyer Lake Road, Nickerson Valley Road and Stevens Spring Road. Retention patches are marked with red paint; no harvesting activities may occur within these areas. The painted boundary line trees are not Included Timber and are to be protected. Yellow painted trees designating an interior Payment Unit boundary are only to be cut when all surrounding Payment Units have been paid.

2 - Timber Specifications

2.1 - Included Timber

2.1.1 - Clearcut unit(s) with unmerchantable trees (6/14)

Within Payment Unit(s) 1-16, cut all trees that are two (2) inches or more at DBH, except do not cut white oak in Payment Units 6 and 7. Special protection trees identified in accordance with condition 3.4.2, within clearcutting unit boundaries, are not Included Timber and are to be protected.

3 - Payments

3.3 - Pre-measured Sales

3.3.4 - Dividing payment units (7/14)

Payment Unit(s) over \$50,000 may be divided at the request of the Purchaser and upon approval of the Unit Manager.

Dividing Payment Units is a contract modification which requires a Timber Sale Contract Amendment. Payment Unit 11 may not be divided and all others may only have one division per Payment Unit.

3.4 - Damaged Timber

3.4.2 - Special Protection Trees (4/14)

The Purchaser shall not cut live or dead special protection trees within cutting units or clearings. Special protection trees are red pine and white pine marked with green paint. If the Purchaser's operations have cut or damaged special protection trees through carelessness, the Purchaser shall pay \$300.00 as fixed, agreed and liquidated damages for each special protection tree cut or damaged. Such payment does not constitute ownership of the undesignated timber.

3.6 - Payment Unit Cutting Schedule

3.6.3 - Operating schedule (12/08)

Unless changed by written agreement, only 2 Payment Unit(s) may be operated at any one time. All contractual requirements on a Payment Unit shall be completed and accepted by the Unit Manager or his/her representative prior to the opening of an additional Payment Unit.

4 - Transportation

4.1 - Construction

4.1.3 - Slash and earthen piles (8/04)

Piles or windrows of earth along roads and landings that have been widened or constructed shall be leveled. Slash from road maintenance or construction, including stumps, shall be dispersed throughout the sale, chipped, utilized, or reserved for closing the landings.

4.1.6 - Road construction (1/09)

Improvements of existing roads shall be done in such a way as to minimize the environmental and visual impacts. Merchantable trees shall be cut and utilized unless otherwise directed. Non-merchantable trees shall be severed and laid flat on the ground. Slash shall be scattered, and not left in windrows and kept a minimum of 10 feet back from the road edge. Stumps shall be set upright, not left on edge, and be moved at least 10 feet away from the road edge. Disturbed soil shall be feathered into the woods and not left in berms or windrows.

4.1.7 - Road closure (10/11)

Overgrown roads that are reopened must be blocked to vehicle traffic upon completion of the sale. In general, this will require constructing double earthen berms four (4') foot high berm of stumps and logs covered with earth. Stumps and brush must be placed along the remainder of the trail. These roads must be rendered impassable to cars and trucks. All stumps from road building and landing construction must be reserved to block any newly constructed roads upon completion of the sale. These stumps must be scattered along the road system to prohibit vehicular movement. Temporary berms may be required if no sale activity occurs for 30 or more consecutive days. Contact the sale administrator for specific details of design and placement.

4.1.12 - No new roads (1/12)

No new roads will be permitted in any Payment Unit. All operations are limited to existing roads. Skid trails only will be allowed.

4.2 - Maintenance

4.2.5 - Two wheel drive condition (2/04)

All existing trail roads on and adjacent to the sale area must be passable by two-wheel drive traffic for the duration of the sale.

4.3 - Public Right-of-Way

4.3.1 - MDOT R-O-W (11/14)

The Michigan Department of Transportation (MDOT) must be contacted prior to harvesting timber within the MDOT right-of-way.

5 - Operations

5.1 - Notification

5.1.1 - Pre-sale conference (10/16)

A pre-sale conference on site between the Purchaser and sale administrator is required prior to beginning any operations. The Unit Manager or his/her representative must be contacted at least 10 days in advance to schedule the conference.

5.1.4 - Post-sale conference (10/16)

A post-sale conference on site between the Purchaser and sale administrator is required 5 days prior to the completion of active logging operations to determine clean-up and repair of landings, road edges, and the fulfillment of other contract specifications.

5.2 - Conduct of Operations

5.2.2 - Hazard Trees/Snags

5.2.2.1 - Den trees (10/16)

Obvious hollow and/or den trees shall be protected and left standing unless they are a safety hazard.

5.2.3 - Operating Restrictions

5.2.3.1 - Operating restrictions (9/11)

Within Payment Unit(s) 11, unless changed by written agreement, cutting, skidding, and hauling are limited to the period of January 15 through March 15. All operations including hauling and closing landings must be completed in one season.

This restriction is due to the necessity of closing an adjacent gun range. The Unit Manager or his/her representative must be given 15 days' notice before entering.

5.2.3.5 - Oak wilt restriction (1/18)

Within Payment Unit(s) 1-16, unless changed by written agreement, cutting, skidding, hauling within the sale and brushing of access roads to the sale are not permitted during the period of April 15 to July 15. Operations may be allowed if

specific steps are taken to prevent damaging uncut oak during the high risk period. Those steps may include completing all road brushing before April 15th and clearing a tree-length buffer along uncut oak cover before April 15th. This is necessary to reduce the spread of oak wilt. For more information, contact the Unit Manager or his/her representative.

5.2.3.11 - Coppice regeneration protection (4/10)

Timber harvesting in any Payment Unit must be completed before significant aspen sprouting occurs in that Payment Unit to minimize damage to the new regeneration. Any post-harvest operations, such as chipping, must be completed before sprouting of regeneration occurs. If it is anticipated that chipping will be delayed, then tops shall be carried to one central location or left unchipped. The Unit Manager or his/her representative may cease such operations if sprouting occurs before the operation is complete.

5.2.4 - Dead and Down Creation

5.2.4.7 - Dead and down creation: hare, grouse, deer and other species (5/15)

To improve horizontal cover habitat for snowshoe hare, grouse, deer, and other species, the Purchaser is to push over one 12" or larger diameter (or largest diameter trees within stand) whole tree on the ground for every 2 acres, a hardwood species such as oak or maple or if no hardwoods are present, a pine species (white or red). These will be fully merchantable, healthy trees. These trees should be tipped over with the root ball still attached so the base of the tree is suspended off the ground. The crown of the fallen tree should be at or near ground level after it is pushed over.

5.2.29 - Shrub protection (1/20)

Do not cut or damage hawthorn, witch-hazel, dogwood, or junberry. These woody-shrub plants are highly beneficial to various wildlife species.

5.2.31 - Landing locations (9/13)

Landing areas are marked on the Timber Sale Map with a black square. Landings must be confined to these designated sites unless otherwise authorized by the Unit Manager or his/her representative. In general, landings are limited to a "T" turnaround which will accommodate a truck with a 50-foot trailer.

5.2.32 - Decking/landing restoration (9/13)

All decking and landing areas must have the surface area restored to a condition equal to or better than before. This is to ensure the proper regeneration of the stand. Wood debris, chips, and "cookies" from trimmings must be removed or scattered away from landing and loading areas and may not be windrowed on the edge.

5.2.38 - No decking against live trees (2/04)

Cut products may not be decked against unmarked or designated leave trees.

5.2.39 - ORV trail/route protection (4/18)

An ORV route and is shown on the Timber Sale Map. Do not cut trees or damage posts with yellow ORV markers. Trees with yellow ORV markers shall be cut off above the markers and at least 5 feet above ground. All stumps within 5 feet of the trail must be cut flush with the ground. All stumps within 5 feet of the trail must be cut off at least 5 feet above ground level. Maintain a 20-foot-wide slash, debris, and rut free zone daily using the ORV route as the centerline. Do not run harvesting equipment down the ORV route. Skidding across the trail or route may only occur in locations approved by the sale administrator.

5.2.41 - Snowmobile trail protection (9/11)

A snowmobile trail is shown on the Timber Sale Map. Do not cut or damage posts with orange trail markers or traffic control signs. If the trail is used, it must be maintained and restored to a condition equal to or better than before the sale. The road maintenance/restoration must be done prior to December 1. If the trail is used for hauling, it must be graded to the satisfaction of the Unit Manager or his/her representative prior to December 1. If the trail is to be used for hauling during the snowmobile season, then a snow-covered base must be left on the trail. The snowmobile trail is not recommended for any timber sale operations from December 1 to March 31. The snowmobile trail may only be crossed at right angles. Maintain a 20-foot-wide slash, debris, and rut free zone daily using the snowmobile trail as the centerline. No decking of forest products will be permitted along the snowmobile trail from December 1 to March 31. All stumps within 20 feet of the snowmobile trail must be cut at ground level. In addition, any trees cut within 5 feet of the trail must have the stumps removed and be disposed of according to the direction of the Unit Manager or his/her representative.

5.4 - Soil Protection

5.4.1 - Rutting restriction, general (7/16)

Operations are to cease immediately if equipment and weather conditions result in rutting of roads and/or skid trails which is 12 inches or greater in depth and 50 feet in length. The Unit Manager or his/her representative may restrict hauling and/or skidding if ruts exceed the specified depth. With the Unit Manager or his/her representative's approval, the Purchaser may return to the area when the risk of rutting has decreased.

5.4.2 - Skid trails (2/04)

Skid trails up and down slopes should be avoided. If however this is unavoidable, these trails will be left in a non-erodible condition using water bars, logs, and slash. Placing of slash on these skid trails while logging is ongoing may alleviate need for any further action. At the direction of the sale administrator, seed, fertilizer, and mulch may also be required.

5.4.3 - Erosion control (12/08)

Skid trails or haul roads may require erosion control structures or berms per direction of the Unit Manager or his/her representative.

5.5 - Protection of Improvements

5.5.3 - Protection of improvements detail (10/13)

Do not enter or damage the shooting range in Payment Unit 11.

6 - Safety and Fire Prevention

6.2 - Signing

6.2.1 - Road posting (10/20)

The Purchaser is responsible for posting and maintaining caution signs on forest roads prior to beginning operations. The road must be posted at appropriate distances from the Sale Area to warn of logging activity and truck traffic. Signs must be removed when harvest operations are suspended or completed. The Purchaser will provide these signs.

6.2.2 - Snowmobile trail posting (10/20)

The Purchaser is responsible for posting and maintaining caution signs on the snowmobile trail prior to beginning operations during the snowmobile season (approximately December 1 to March 31). The trail must be posted approximately 350 feet from the Sale Area to warn of logging activity and truck traffic. Signs must be removed when harvest operations are suspended or completed. The Purchaser will provide these signs.

6.2.3 - Recreational trail posting (10/20)

The Purchaser is responsible for posting and maintaining caution signs on the ORV Route prior to beginning operations. The trail must be posted approximately 350 feet from the Sale Area to warn of logging activity and truck traffic at both ends of the trail. Signs must be removed when harvest operations are suspended or completed. The Purchaser will provide these signs.

7 - Other Conditions

7.3 - Contract Modifications

7.3.2 - Modification for oak wilt (2/05)

Within the sale area, there may be patches of oak wilt. If oak wilt is identified within the sale area, this contract may be modified. The following modifications could occur: time of cutting, species to cut, volume to harvest, or various others dealing with the treatment of oak wilt. If a species is not specified in this contract, it shall be paid for at the average price received for that species and product.

8 - Performance and Settlement

8.3 - Uncompleted or Terminated Contracts

8.3.1 - Completion of contract, chipping (1/16)

In addition to cutting, all chipping must be completed by the contract expiration date. If chipping has not been completed, an extension fee or damages may be charged per General Condition & Requirement 7.2 and 8.3.

8.3.2 - Completion of contract, other (11/16)

Areas of this sale may be difficult to log. Per General Condition & Requirement 3.5 - Adjustment of Quantity, there will be no adjustment to contract volume, but unharvested timber may not be considered a violation of General Condition & Requirement 8.3 - Uncompleted or Terminated Contract.



TIMBER SALE MAP

This information provided by authority of Part 525, 1994 PA 451, as amended.

Forest Management Unit Atlanta FMU	County Montmorency	Mapped By Barber	Date 06/10/2022	Page 1	of 1
Township 31N	Range 02E/03E	Section(s) and Subdivision(s) Various in Sections 25, 26, 35, 36/30	Scale 1:15,840		

Cover Type				Density	
A = Aspen	H = Hemlock	N = Marsh	U = Upland Brush	0 = Non Stocked	5 = Pole Timber Medium
B = Paper Birch	J = Jack Pine	O = Oak	UM = Upland Mixed	1 = Seedling Sapling Poor	6 = Pole Timber Well
C = Cedar	L = Lowland Brush	P = Lowland Poplar	V = Bog or Marsh	2 = Seedling Sapling Medium	7 = Saw Timber Poor
D = Treed Bog	LM = Lowland Mixed	Q = Mixed Swamp Conifer	W = White Pine	3 = Seedling Sapling Well	8 = Saw Timber Medium
E = Swamp Hdwoods	M = Mpl, Bch, Brch	R = Red Pine	X = Non Stocked	4 = Pole Timber Poor	9 = Saw Timber Well
F = Spruce Fir	MC = Mixed Conifer	S = Black Spruce	Z = Water		
G = Grass	MD = Mixed Deciduous	T = Tamarack			

PU	Acres	PU	Acres	PU	Acres	PU	Acres
1	13.8	5	30.6	9	7.6	13	24.2
2	23.0	6	14.0	10	27.3	14	4.8
3	21.3	7	38.3	11	16.3	15	21.6
4	18.6	8	19.6	12	7.0	16	7.2

Aspen Kerr-fuffle

Compartment 47

Acres 295.4

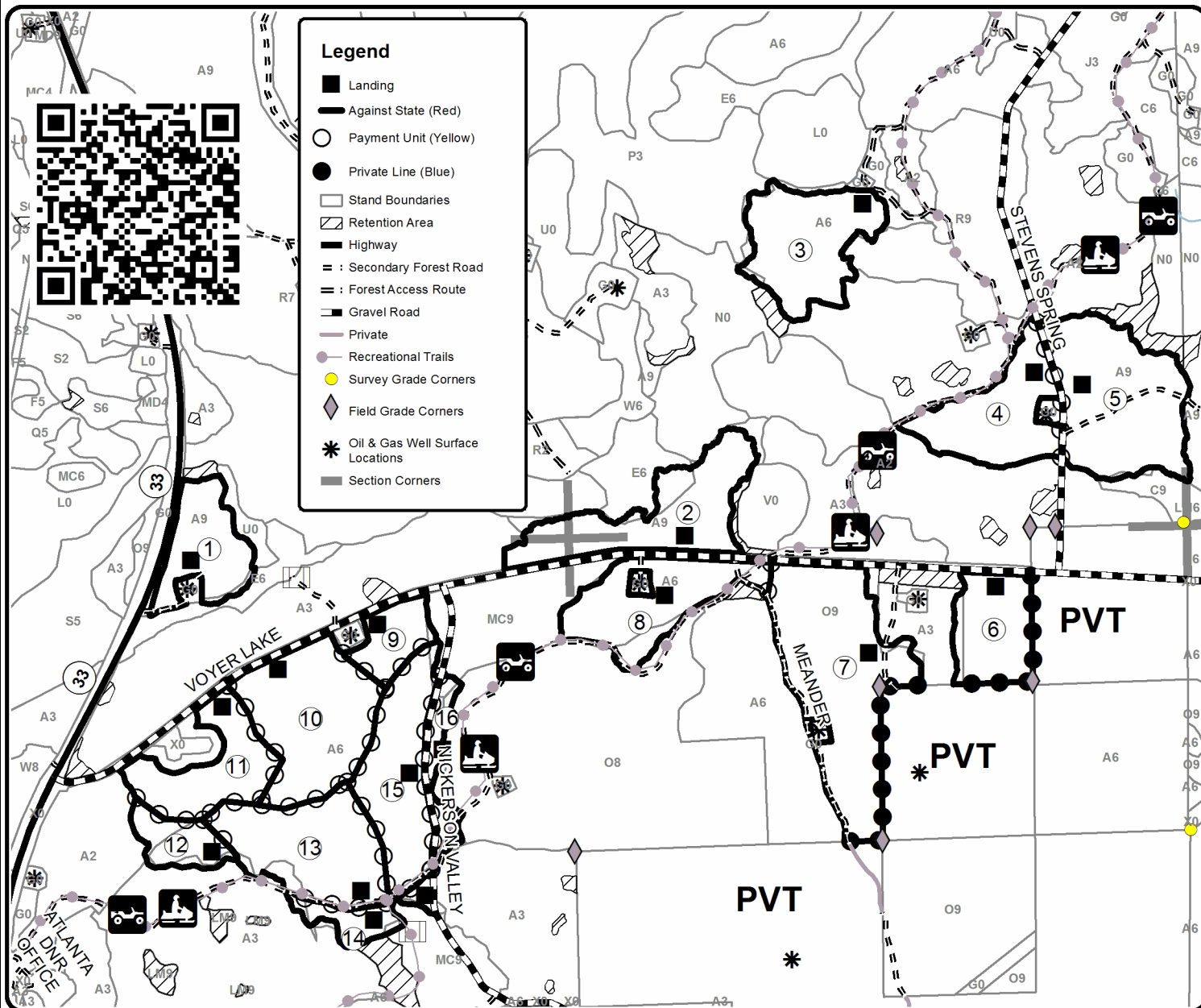
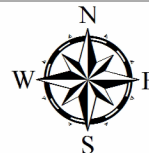

TIMBER SALE INFORMATION

Scarface Mix (54-035-21)

T32N, R02E, SEC. 26; T32N, R04E, SEC. 4.
Montmorency County (Advertised Price \$18,059.35)

SALE NOTE: All units of volume listed for this sale were estimated using the Inventory Manager computer program and the new Michigan taper model.

Note that Payment Unit 3 is approximately 28 miles from Payment Units 1 and 2.

A recreation site such as a trail, pathway, or campground is within the sale area or the vicinity. Certain restrictions/specifications may be applicable including time restrictions.

A timber sale contract for this lump sum, sealed bid timber sale will be awarded to the responsible bidder offering the highest sealed bid price. All units of volume listed below were estimated using the Inventory Manager computer program and the new Michigan taper model. Bids must be at or above the following advertised price for each product and species:

<u>PRODUCTS & SPECIES</u>	<u>ESTIMATED UNITS*</u>	<u>ADVERTISED PRICE</u>
Sawtimber		
N. White Cedar	2.9 MBF	\$ 25.00 / MBF
Red Maple	14.2 MBF	\$ 43.00 / MBF
Red Pine	11.7 MBF	\$ 113.00 / MBF
Sugar Maple	8.0 MBF	\$ 216.00 / MBF
White Oak	14.0 MBF	\$ 83.00 / MBF
White Pine	2.0 MBF	\$ 59.00 / MBF
Yellow Birch	4.7 MBF	\$ 39.00 / MBF
Pulpwood		
B. T. Aspen	199 Cords	\$ 22.80 / Cord
Balsam Fir	172 Cords	\$ 14.85 / Cord
Mixed Hardwood	294 Cords	\$ 17.75 / Cord
N. White Cedar	19 Cords	\$ 15.30 / Cord
Red Pine	5 Cords	\$ 39.80 / Cord
White Pine	1 Cords	\$ 14.25 / Cord
White Spruce	7 Cords	\$ 7.00 / Cord

* The total volume is statistically estimated within plus (+) or minus (-) 10.66 percent. There are an estimated 828 cords on this timber sale, plus or minus 88 cords at the 95% confidence level. The estimated units are final and not subject to adjustment. Prospective bidders are urged to examine this timber and to make their own estimates of quantity and quality.

BOND AND PAYMENT SCHEDULE:

1. A bond in the amount of \$903.00 to insure faithful performance of the conditions of the contract will be deposited by the successful bidder within 21 days of the sale award.
2. Cutting in any sale or unit without the required advance payment would be considered a trespass.
3. Total payment must be paid in advance or according to the following schedule :
 - (a) Ten percent (10%) of the sale value must be paid within 21 days of the sale award.
 - (b) The 10% down payment will be credited towards the first unit cut.
 - (c) Payment for each of the following units must be made before cutting begins in that unit:

PAYMENT UNIT NUMBER	PERCENT OF TOTAL SALE VALUE
01	38.9%
02	44.3%
03	16.8%
4. If no cutting takes place, the 10% down payment will not be refunded.
5. Operations on the contract issued will terminate on 06/30/2025.

SALE STATISTICS

Volumes were calculated in cubic feet using the Michigan taper model. Cubic foot volume includes all wood inside bark for the product indicated. For display purposes, cubic feet were converted to cords and MBF using a simple conversion factor, e.g. 79 cubic feet per cord and 185 cubic feet per MBF. The cubic foot volumes are precise; the cords and MBF volumes are not. Cubic foot volume cannot be directly converted to cords or boards with precision.

SALE VOLUMES

The total estimated sale volume may not equal the sum of the species/products due to the nature of statistical calculations associated with double sampling methodology.

VOLUME			STATISTICAL RANGE IN CORDS	
TOTAL CUBIC FEET	TOTAL CORDS	PERCENT ERROR	MINIMUM	MAXIMUM
65,436	828	10.66%	740	917

VDU VOLUMES

A VDU is a Volume Determination Unit. Volumes and their associated statistics are calculated at the VDU level and summarized to the sale level. There is often a one to one relationship between a VDU and a Payment Unit, but not always, depending on the cruise design. Refer to the VDU TO PAYMENT UNIT table.

	VOLUME			RANGE IN CORDS	
VDU	TOTAL CUBIC FEET	TOTAL CORDS	PERCENT ERROR	MINIMUM	MAXIMUM
34	6,332	80	32.87%	54	107
72	26,815	339	10.41%	304	375
98	32,289	409	18.73%	332	485
TOTAL:	65,436	828		690	967

VDU TO PAYMENT UNIT

When a VDU is associated with more than one Payment Unit (PU), the VDU volumes are assigned to the PU based on acres of the VDU within the PU.

VDU	VDU ACRES	PU	PU ACRES
34	44.3	3	44.3
72	8.2	1	8.1
		2	0.1
98	15.7	2	15.7
TOTAL:	68.2		68.2

DESCRIPTION OF TIMBER BY PAYMENT UNIT (PU)

PU	MARKET GROUP	PRODUCT	QUANTITY	UNIT	ACRES	ADVERTISE PRICE	
1	Red Maple	Sawtimber	10.6	MBF	8.1	\$7,024.20	
	Sugar Maple		7.9	MBF			
	Yellow Birch		4.6	MBF			
	B. T. Aspen		Pulpwood	36			Cords
	Balsam Fir			120			Cords
	Mixed Hardwood			112			Cords
	<i>Paper Birch</i>			20			<i>Cords</i>
	<i>Red Maple</i>			50			<i>Cords</i>
	<i>Sugar Maple</i>			9			<i>Cords</i>
	<i>Yellow Birch</i>			33			<i>Cords</i>
	N. White Cedar			6			Cords
2	N. White Cedar	Sawtimber		2.9	MBF	15.8	\$8,006.80
	Red Maple			3.6	MBF		
	Sugar Maple		0.1	MBF			
	Yellow Birch		0.1	MBF			
	B. T. Aspen		Pulpwood	163	Cords		
	Balsam Fir			52	Cords		
	Mixed Hardwood			170	Cords		
	<i>Paper Birch</i>			8	<i>Cords</i>		
	<i>Red Maple</i>			125	<i>Cords</i>		
	<i>Red Oak</i>			8	<i>Cords</i>		
	<i>Sugar Maple</i>			29	<i>Cords</i>		
	N. White Cedar			13	Cords		
	White Spruce			7	Cords		
	3			Red Pine	Sawtimber		
White Oak		14.0	MBF				
White Pine		2.0	MBF				
Mixed Hardwood		Pulpwood	12	Cords			
<i>White Oak</i>			12	<i>Cords</i>			
Red Pine			5	Cords			
White Pine			1	Cords			
TOTAL:			57.5	MBF			
TOTAL:			697	Cords			

Sale Specific Conditions & Requirements

Sale Name: Scarface Mix

Sale Number: 54-035-21 Seq#: 2

1 - Sale Area

1.2 - Boundaries

1.2.1 - Painted boundaries (9/19)

The sale boundary and Payment Unit boundaries are marked and identified by blue, red, and yellow paint. Exterior sale boundary lines against private are marked with blue paint. Exterior sale boundary lines against state are marked with red paint, except for the southern edge Payment Unit 2, which is unpainted and follows Hubert Road as shown on the Timber Sale Map. Interior Payment Unit boundaries are marked with yellow paint. The painted boundary line trees are not Included Timber and are to be protected. Yellow painted trees designating an interior Payment Unit boundary are only to be cut when all surrounding Payment Units have been paid.

2 - Timber Specifications

2.1 - Included Timber

2.1.1 - Clearcut unit(s) with unmerchantable trees (6/14)

Within Payment Unit(s) 1-3, cut all trees that are two (2) inches or more at DBH.

Note: See spec 5.2.4.7 - 'Dead and down creation' for instructions on orange marked trees.

2.2 - Utilization

2.2.2 - Chipping required (2/18)

Payment Unit 3 must be chip harvested to facilitate future silvicultural activities. The Purchaser has the option to produce sawlogs or pulpwood bolts, but the remaining portion of the trees must be chipped and hauled. Products may be produced as roundwood and forwarded to decking areas in final product length, but the tops must be left intact and skidded to the landing for chipping to minimize the amount of residual slash. If market conditions limit the practicality of chipping the following is required: Tops must be cut into lengths 4 feet or less and trees greater than 4 inches at DBH must be cut to a 2-inch top or smaller. Sub-merchantable trees, and hardwood limbs 4 inches or greater where they attach to the stem, are to be cut/reduced to 4-foot lengths. Tops and slash must also be spread evenly across the sale. This is to speed the breakdown of tops and slash. The requirement to retain approximately 1/6 to 1/3 of tree tops and limbs less than four inches in diameter is still applicable (G. C. & R. 2.2).

2.2.3 - Stump heights (4/07)

Stump heights within Payment Unit 3 shall not exceed 6 inches for all trees. This is to facilitate future silvicultural activities. A written waiver of this requirement may be obtained if wet summer weather makes winter logging necessary.

3 - Payments

3.4 - Damaged Timber

3.4.1 - Damaged timber (7/16)

General Condition and Requirement 3.4 Damaged Timber, defines liquidated damages for undesignated live merchantable trees which are cut or injured. No damage is acceptable to undesignated live merchantable trees. Within the Sale Area, if more than 5% of trees (> 4.5" DBH) within a specified area of the sale are damaged, liquidated damages will be assessed for all trees damaged. Rates will be in accordance with General Condition and Requirement 3.4 Damaged Timber.

4 - Transportation

4.1 - Construction

4.1.3 - Slash and earthen piles (8/04)

Piles or windrows of earth along roads and landings that have been widened or constructed shall be leveled. Slash from road maintenance or construction, including stumps, shall be chipped, utilized, or otherwise removed from the sale.

4.1.6 - Road construction (1/09)

Construction or improvements of existing roads shall be done in such a way as to minimize the environmental and visual

impacts. Merchantable trees shall be cut and utilized unless otherwise directed. Non-merchantable trees shall be severed and laid flat on the ground. Slash shall be scattered, and not left in windrows and kept a minimum of 10 feet back from the road edge. Stumps shall be set upright, not left on edge, and be moved at least 10 feet away from the road edge. Disturbed soil shall be feathered into the woods and not left in berms or windrows.

4.1.7 - Road closure (10/11)

All new roads built into the sale must be blocked to vehicle traffic upon completion of the sale. Overgrown roads that are reopened shall be considered new roads. In general, this will require constructing a four (4') foot high berm of stumps and logs covered with earth. Stumps and brush must be placed along the remainder of the trail. These roads must be rendered impassable to cars and trucks. Contact the sale administrator for specific details of design and placement.

4.2 - Maintenance

4.2.5 - Two wheel drive condition (2/04)

All existing trail roads on and adjacent to the sale area must be passable by two-wheel drive traffic for the duration of the sale.

5 - Operations

5.1 - Notification

5.1.1 - Pre-sale conference (10/16)

A pre-sale conference between the Purchaser and sale administrator is required prior to beginning any operations to determine landing and road locations. The Unit Manager or his/her representative must be contacted at least 5 days in advance to schedule the conference.

5.1.4 - Post-sale conference (10/16)

A post-sale conference on site between the Purchaser and sale administrator is required 5 days prior to the completion of active logging operations to determine clean-up and repair of landings, road edges, and the fulfillment of other contract specifications.

5.2 - Conduct of Operations

5.2.2 - Hazard Trees/Snags

5.2.2.1 - Den trees (10/16)

Obvious hollow and/or den trees shall be protected and left standing unless they are a safety hazard.

5.2.3 - Operating Restrictions

5.2.3.2 - Operating restrictions (9/11)

Within Payment Unit(s) 1 and 2, unless changed by written agreement, cutting, skidding, and hauling are limited to the period of July 15 to March 15. This restriction is to protect the wet and sensitive areas within the sale.

5.2.3.5 - Oak wilt restriction (1/18)

Within Payment Unit 3 unless changed by written agreement, cutting, skidding, hauling within the sale and brushing of access roads to the sale are not permitted during the period of April 15 to July 15. Operations may be allowed if specific steps are taken to prevent damaging uncut oak during the high risk period. Those steps may include completing all road brushing before April 15th and clearing a tree-length buffer along uncut oak cover before April 15th. This is necessary to reduce the spread of oak wilt. For more information, contact the Unit Manager or his/her representative.

5.2.3.11 - Coppice regeneration protection (4/10)

Timber harvesting in Payment Units 1 and 2 must be completed within 60 days of severing/cutting stem(s) to minimize damage to deciduous regeneration. Any post-harvest operations, such as chipping, must be completed before sprouting of regeneration occurs. If it is anticipated that chipping will be delayed, then tops shall be carried to one central location or left unchipped. The Unit Manager or his/her representative may cease such operations if sprouting occurs before the operation is complete.

5.2.4 - Dead and Down Creation

5.2.4.7 - Dead and down creation: hare, grouse, deer and other species (5/15)

To improve horizontal cover habitat for snowshoe hare, grouse, deer, and other species, the Purchaser is to push over

trees marked with orange paint once the Payment Unit is cut. These trees should be tipped over with the root ball still attached so the base of the tree is suspended off the ground. The crown of the fallen tree should be at or near ground level after it is pushed over. If the tree is too large to be pushed over, the tree may be partially severed or hinged to allow for the tree to be pushed over.

5.2.17 - Timber Mats and Interlocking Composite Mats (10/20)

Some roads or skid trails may require extra protection such as that afforded by timber mats, interlocking composite mats, or another approved system. Approximately 80 feet of road or trail will need extra protection at locations shown on the Timber Sale Map. If available, mats may be borrowed from the DNR. A Timber Sale Contract Supplement will be used to document the Purchaser's use of the DNR's mats. Contact the sale administrator regarding availability and pick-up. Timber mats are available from various field offices. Composite mats are only available from the Grayling field office and the Marquette ICC. The Purchaser is responsible for picking up and hauling the mats to and from the site. The composite mats will require DNR staff onsite for installation and removal. Contact the sale administrator to schedule at least 30 days before desired install/removal date. All mats must be cleaned prior to drop off. This may include, but is not limited to, power washing and brushing to remove mud and debris. A charge of \$700.00 per timber mat and \$2,000.00 per composite mat will be assessed for all damaged or non-returned mats. Damage for the crane/timber mats is defined as three or more broken cants. Damage for the composite mats is defined as cracked or broken mats.

5.2.32 - Decking/landing restoration (9/13)

All decking and landing areas must have the surface area restored to a condition equal to or better than before. This is to ensure the proper regeneration of the stand. Wood debris, chips, and "cookies" from trimmings must be removed or scattered away from landing and loading areas and may not be windrowed on the edge.

5.2.38 - No decking against live trees (2/04)

Cut products may not be decked against unmarked or designated leave trees.

5.2.41 - Snowmobile trail protection (9/11)

The LP 9 trail is a snowmobile trail and is shown on the Timber Sale Map. Do not cut or damage posts with orange trail markers or traffic control signs. If the trail is used, it must be maintained and restored to a condition equal to or better than before the sale. The road maintenance/restoration must be done prior to December 1. If the trail is used for hauling, it must be graded to the satisfaction of the Unit Manager or his/her representative prior to December 1. If the trail road is to be used for hauling during the snowmobile season, then a snow-covered base must be left on the trail. The snowmobile trail may not be used for any timber sale operations from December 1 to March 31. The snowmobile trail may only be crossed at right angles. Maintain a 20-foot-wide slash, debris, and rut free zone daily using the snowmobile trail as the centerline. No decking of forest products will be permitted along the snowmobile trail. All stumps within 20 feet of the snowmobile trail must be cut at ground level.

5.4 - Soil Protection

5.4.1 - Rutting restriction, general (7/16)

Operations are to cease immediately if equipment and weather conditions result in rutting of roads and/or skid trails which is 12 inches or greater in depth and 50 feet in length. The Unit Manager or his/her representative may restrict hauling and/or skidding if ruts exceed the specified depth. With the Unit Manager or his/her representative's approval, the Purchaser may return to the area when the risk of rutting has decreased.

5.4.2 - Skid trails (2/04)

Skid trails up and down slopes should be avoided. If however this is unavoidable, these trails will be left in a non-erodible condition using water bars, logs, and slash. Placing of slash on these skid trails while logging is ongoing may alleviate need for any further action. At the direction of the sale administrator, seed, fertilizer, and mulch may also be required.

5.4.4 - Slope protection (9/19)

Skid trails and roads on slopes shall be water barred with slash and stumps as soon as use is complete to prevent erosion.

5.8 - Protection of Endangered Species

5.8.5 - Protection of raptor nests (3/13)

All trees with raptor nests will be protected if found during harvesting operations. Notification will be made to the Unit Manager or his/her representative who will notify the Wildlife Biologist so an on-site evaluation and recommendation can be made, if necessary.

6 - Safety and Fire Prevention

6.2 - Signing

6.2.3 - Recreational trail posting (10/20)

The Purchaser is responsible for posting and maintaining caution signs on the LP 9 trail prior to beginning operations. The trail must be posted at appropriate distances from the Sale Area to warn of logging activity and truck traffic at both ends of the trail. Signs must be removed when harvest operations are suspended or completed. The Purchaser will provide these signs.



TIMBER SALE MAP

This information provided by authority of Part 525, 1994 PA 451, as amended.

Forest Management Unit Atlanta Management Unit	County Montmorency	Mapped By Fenton	Date 09/28/2021	Page 1	of 2
Township 32N	Range 02E/04E	Section(s) and Subdivision(s) 4-E1/2SW, 26-SWNE, N1/2SW, NWSE	Scale 1:15,840		

Cover Type				Density			
A = Aspen	H = Hemlock	N = Marsh	U = Upland Brush	0 = Non Stocked	5 = Pole Timber Medium		
B = Paper Birch	J = Jack Pine	O = Oak	UM = Upland Mixed	1 = Seedling Sapling Poor	6 = Pole Timber Well		
C = Cedar	L = Lowland Brush	P = Lowland Poplar	V = Bog or Marsh	2 = Seedling Sapling Medium	7 = Saw Timber Poor		
D = Treed Bog	LM = Lowland Mixed	Q = Mixed Swamp Conifer	W = White Pine	3 = Seedling Sapling Well	8 = Saw Timber Medium		
E = Swamp Hdwoods	M = Mpl, Bch, Brch	R = Red Pine	X = Non Stocked	4 = Pole Timber Poor	9 = Saw Timber Well		
F = Spruce Fir	MC = Mixed Conifer	S = Black Spruce	Z = Water				
G = Grass	MD = Mixed Deciduous	T = Tamarack					

PU Acres

1	8.1
2	15.8
3	44.3

Scarface Mix

Compartment 76 & 65

68.2 Acres

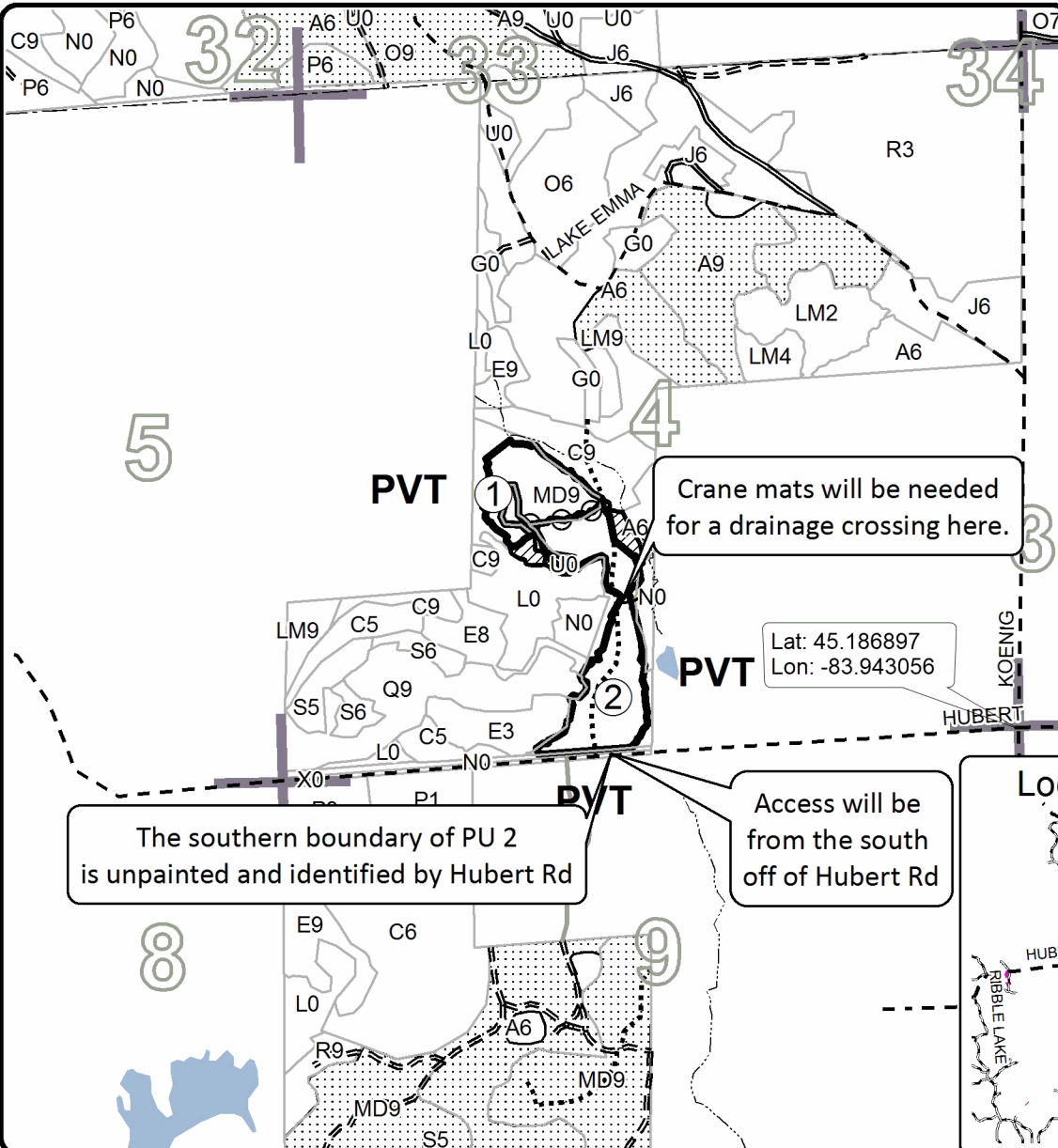
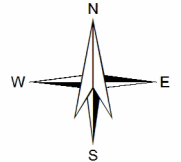

Legend

- Secondary Road
- Forest Access Route
- Gravel Road
- Private Road
- Temporary Access
- Drain
- Intermittent Stream
- Perennial River
- Lakes
- Retention Area (Red)
- Section Corner
- Stand Boundaries
- Against State (Red)
- Payment Unit (Yellow)
- Nearby Timber Sales

Lat: 45.186897
Lon: -83.943056

Locator Map 1:100,000

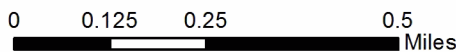
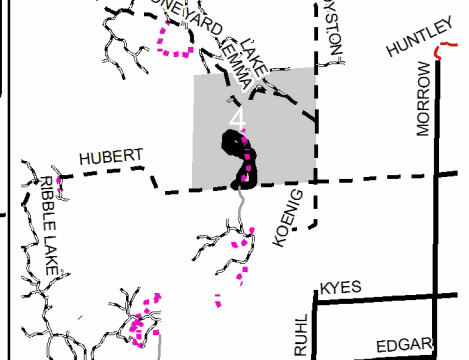



TIMBER SALE MAP

This information provided by authority of Part 525, 1994 PA 451, as amended.

Forest Management Unit Atlanta Management Unit	County Montmorency	Mapped By Fenton	Date 11/12/2021	Page 2	of 2
Township 32N	Range 02E/04E	Section(s) and Subdivision(s) 4-E1/2SW, 26- SWNE,N1/2SW,NWSE	Scale 1:15,840		

Cover Type				Density			
A = Aspen	H = Hemlock	N = Marsh	U = Upland Brush	0 = Non Stocked	5 = Pole Timber Medium		
B = Paper Birch	J = Jack Pine	O = Oak	UM = Upland Mixed	1 = Seedling Sapling Poor	6 = Pole Timber Well		
C = Cedar	L = Lowland Brush	P = Lowland Poplar	V = Bog or Marsh	2 = Seedling Sapling Medium	7 = Saw Timber Poor		
D = Treed Bog	LM = Lowland Mixed	Q = Mixed Swamp Conifer	W = White Pine	3 = Seedling Sapling Well	8 = Saw Timber Medium		
E = Swamp Hdwoods	M = Mpl, Bch, Brch	R = Red Pine	X = Non Stocked	4 = Pole Timber Poor	9 = Saw Timber Well		
F = Spruce Fir	MC = Mixed Conifer	S = Black Spruce	Z = Water				
G = Grass	MD = Mixed Deciduous	T = Tamarack					

PU Acres
3 44.3

Scarface Mix

Compartment 76 & 65

68.2 Acres

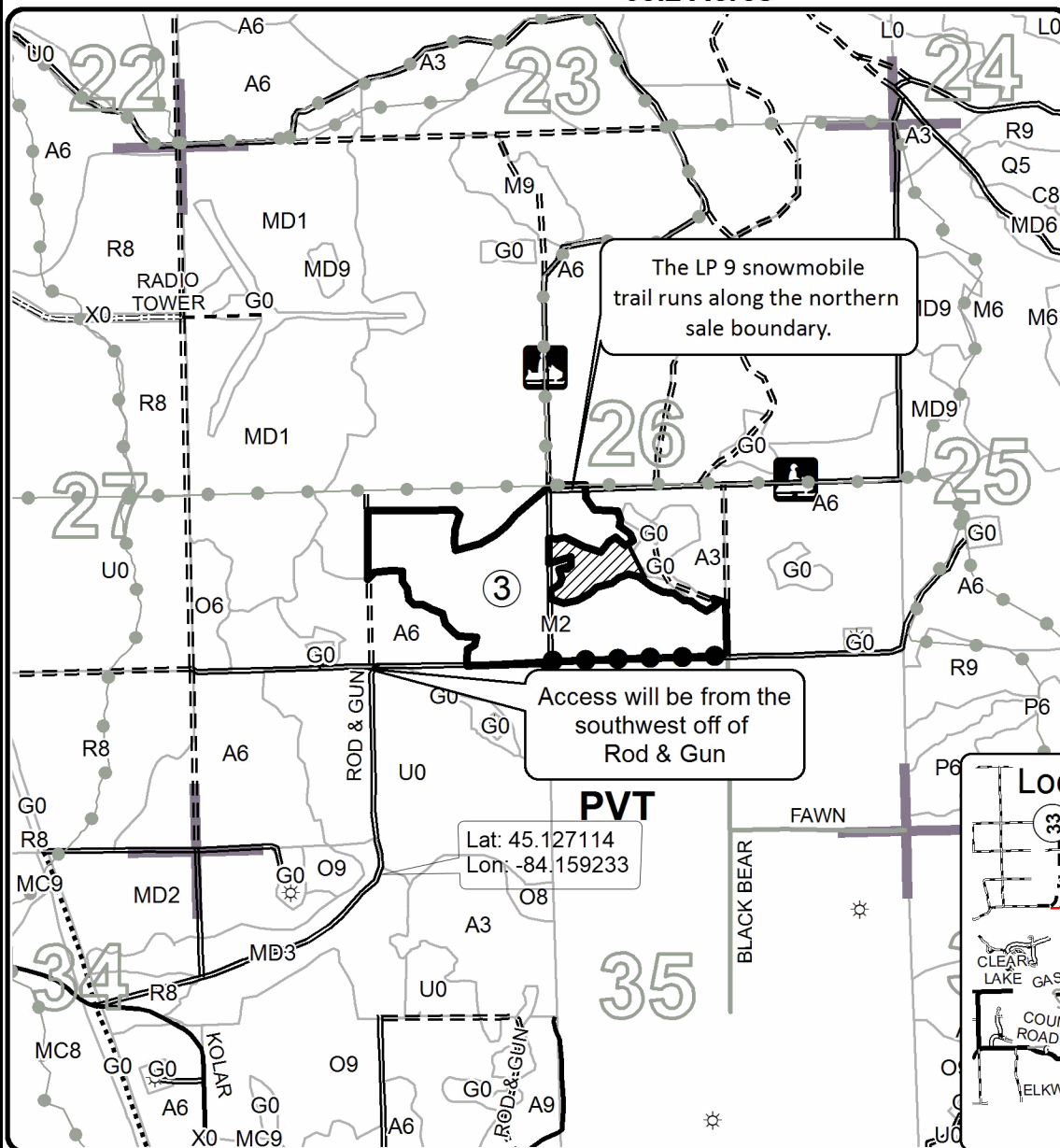
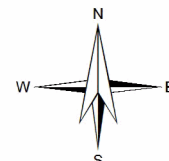

Legend

- Against State (Red)
- Private Line (Blue)
- Retention Area (Red)
- Payment Unit
- Recreational Trail
- Secondary Road
- Forest Access Route
- Paved Road
- Gravel Road
- County Road - Seasonal
- Private Road
- Temporary Access
- Gas Well
- Section Corner
- Stand Boundaries

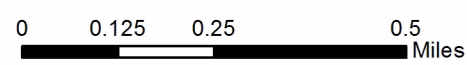
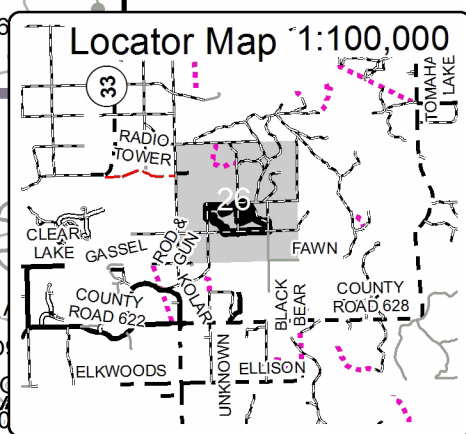

Helicopter Seed Pine (54-013-21)
T32N, R01E, SEC. 21; T32N, R01E, SEC. 22; T32N, R01E, SEC. 27; Montmorency

In response to the notice of sale to be held 10:00 a.m. (local time) on July 19, 2022, I am hereby submitting my sealed bid (firm offer) for the following forest products to be cut. Bids for individual species must be at or above the advertised price. All non-responsive bid forms may be rejected.

<u>PRODUCTS & SPECIES</u>	<u>ESTIMATED VOLUME*</u>	<u>ADVERTISED PRICE</u>	<u>BID PRICE/UNIT</u>
Sawtimber			
Red Pine	147.9 MBF	\$ 122.00/MBF	\$ _____
Pulpwood			
Black Spruce	3 Cords	\$ 7.55/Cord	\$ _____
Jack Pine	1,209 Cords	\$ 9.25/Cord	\$ _____
Mixed Aspen	8 Cords	\$ 24.60/Cord	\$ _____
Red Oak	7 Cords	\$ 36.25/Cord	\$ _____
Red Pine	223 Cords	\$ 42.90/Cord	\$ _____
White Spruce	5 Cords	\$ 7.55/Cord	\$ _____

*The volumes are statistically estimated within plus (+) or minus (-) 5.87 percent at 95% confidence level. These estimated volumes are final and not subject to adjustment. Prospective bidders are urged to examine this timber and to make their own estimates of quantity and quality.

I understand that any or all bids may be rejected. All bids must be signed and all bid items must be bid or the bid form may be rejected. I also understand that consideration and awarding a contract will be based upon my past performance and ability to complete the contract based upon equipment and staffing subject to my control.

FEDERAL ID: _____ or SOCIAL SECURITY NUMBER: _____

Company or individual bidding: _____

Company representative's name: _____

Address: _____

City: _____ State: _____ Zip: _____

IF AVAILABLE, PLEASE PLACE THE PERSONALIZED LABEL FROM YOUR PROSPECTUS IN THE ABOVE BOX.

Individual or company representative's signature: _____ Date: _____

Phone number : _____ Email (optional): _____

THE WINNING BIDDER MUST COMPLETE THE VERIFICATION OF WORKER'S DISABILITY COMPENSATION ACT COMPLIANCE (ON REVERSE SIDE IF DOUBLE SIDED) WITHIN 21 DAYS OF SALE AWARD DATE



FOR DEPARTMENT USE ONLY	
Sale Number (XX - XXX - XX - XX)	
Forest Management Unit:	

TIMBER SALE VERIFICATION OF WORKER'S DISABILITY COMPENSATION ACT COMPLIANCE

As required by Act 317, P.A. 1969 (Worker's Compensation) and
Part 5 of Act 451 of 1994, as amended.

VERIFICATION OF WORKER'S DISABILITY COMPENSATION ACT COMPLIANCE

- This verification must be completed and submitted within 21 days of contract award and prior to the issuance of the timber sale contract.
- In addition, if boxes 2B or 2C are checked, then Notice of Exclusion or Certificate of Insurance must be submitted within twenty-one (21) days of the contract award and prior to the issuance of the timber sale contract.
- All information must be typed or printed except for written signatures.

Please Check Appropriate Categories:

1. My business is organized as (you **must** check one of the boxes below):
 - A. Sole Proprietorship (individual)
 - B. Partnership
 - C. Corporation
2. You **must** check one of the boxes below:
 - A. I certify my business is a sole proprietorship and it has no employees but the sole proprietor. I am not subject to the Worker's Compensation Laws.
 - B. I certify my business has satisfied its obligation to the Worker's Compensation Act through the use of an approved Notice of Exclusion (BWC-337, Rev. 5/96). I will provide a copy of the Notice of Exclusion within 21 days of the contract award. (For questions or a copy of the BWC-337, please call the Worker's Compensation Bureau at 517-322-1195).
 - C. I certify my business has a Worker's Compensation Policy. I will provide an original Certificate of Insurance within twenty-one (21) days of the contract award.
3. If you have checked item 2(A) or 2(B), you **must** indicate the number of **both** full-time and part-time employees, other than yourself, including family members and active partners (if none, you must enter "0").

_____ Full-time Employees

_____ Part-time Employees

Name of Business		Federal ID (or) Social Security No.	
Address		Telephone ()	
City	State	ZIP	

I hereby certify that the above information is true and correct. I agree to notify the Michigan DNR of any changes that occur in factors affecting my coverage during any of my present and future operations.

Signature of Owner or Authorized Representative

Title

Date

Please complete the "SEALED BID" information on the next page

Lonely Little Aspen (54-016-21)
T31N, R03E, SEC. 10; T31N, R03E, SEC. 11; Montmorency COUNTY

In response to the notice of sale to be held 10:00 a.m. (local time) on July 19, 2022, I am hereby submitting my sealed bid (firm offer) for the following forest products to be cut. Bids for individual species must be at or above the advertised price. All non-responsive bid forms may be rejected.

<u>PRODUCTS & SPECIES</u>	<u>ESTIMATED VOLUME*</u>	<u>ADVERTISED PRICE</u>	<u>BID PRICE/UNIT</u>
Pulpwood			
Balsam Fir	65 Cords	\$ 16.00/Cord	\$ _____
Quaking Aspen	415 Cords	\$ 24.60/Cord	\$ _____
Red Maple	48 Cords	\$ 19.15/Cord	\$ _____
Red Oak	28 Cords	\$ 36.25/Cord	\$ _____
Red Pine	13 Cords	\$ 42.90/Cord	\$ _____
White Pine	17 Cords	\$ 15.35/Cord	\$ _____
White Spruce	2 Cords	\$ 7.55/Cord	\$ _____

*The volumes are statistically estimated within plus (+) or minus (-) 14.51 percent at 95% confidence level. These estimated volumes are final and not subject to adjustment. Prospective bidders are urged to examine this timber and to make their own estimates of quantity and quality.

I understand that any or all bids may be rejected. All bids must be signed and all bid items must be bid or the bid form may be rejected. I also understand that consideration and awarding a contract will be based upon my past performance and ability to complete the contract based upon equipment and staffing subject to my control.

FEDERAL ID: ___ - ___ - _____ or SOCIAL SECURITY NUMBER: ___ - ___ - _____

Company or individual bidding: _____

Company representative's name: _____

Address: _____

City: _____ State: _____ Zip: _____

IF AVAILABLE, PLEASE PLACE THE PERSONALIZED LABEL FROM YOUR PROSPECTUS IN THE ABOVE BOX.

Individual or company representative's signature: _____ Date: _____

Phone number : _____ Email (optional): _____

THE WINNING BIDDER MUST COMPLETE THE VERIFICATION OF WORKER'S DISABILITY COMPENSATION ACT COMPLIANCE (ON REVERSE SIDE IF DOUBLE SIDED) WITHIN 21 DAYS OF SALE AWARD DATE



FOR DEPARTMENT USE ONLY	
Sale Number (XX - XXX - XX - XX)	
Forest Management Unit:	

TIMBER SALE VERIFICATION OF WORKER'S DISABILITY COMPENSATION ACT COMPLIANCE

As required by Act 317, P.A. 1969 (Worker's Compensation) and
Part 5 of Act 451 of 1994, as amended.

VERIFICATION OF WORKER'S DISABILITY COMPENSATION ACT COMPLIANCE

- This verification must be completed and submitted within 21 days of contract award and prior to the issuance of the timber sale contract.
- In addition, if boxes 2B or 2C are checked, then Notice of Exclusion or Certificate of Insurance must be submitted within twenty-one (21) days of the contract award and prior to the issuance of the timber sale contract.
- All information must be typed or printed except for written signatures.

Please Check Appropriate Categories:

1. My business is organized as (you **must** check one of the boxes below):
 - A. Sole Proprietorship (individual)
 - B. Partnership
 - C. Corporation
2. You **must** check one of the boxes below:
 - A. I certify my business is a sole proprietorship and it has no employees but the sole proprietor. I am not subject to the Worker's Compensation Laws.
 - B. I certify my business has satisfied its obligation to the Worker's Compensation Act through the use of an approved Notice of Exclusion (BWC-337, Rev. 5/96). I will provide a copy of the Notice of Exclusion within 21 days of the contract award. (For questions or a copy of the BWC-337, please call the Worker's Compensation Bureau at 517-322-1195).
 - C. I certify my business has a Worker's Compensation Policy. I will provide an original Certificate of Insurance within twenty-one (21) days of the contract award.
3. If you have checked item 2(A) or 2(B), you **must** indicate the number of **both** full-time and part-time employees, other than yourself, including family members and active partners (if none, you must enter "0").

_____ Full-time Employees

_____ Part-time Employees

Name of Business		Federal ID (or) Social Security No.	
Address		Telephone ()	
City	State	ZIP	

I hereby certify that the above information is true and correct. I agree to notify the Michigan DNR of any changes that occur in factors affecting my coverage during any of my present and future operations.

Signature of Owner or Authorized Representative

Title

Date

Please complete the "SEALED BID" information on the next page

The Big Little Mix (54-014-21)
T31N, R03E, SEC. 10; T31N, R03E, SEC. 15; T31N, R03E, SEC. 3; T32N, R03E,

In response to the notice of sale to be held 10:00 a.m. (local time) on July 19, 2022, I am hereby submitting my sealed bid (firm offer) for the following forest products to be cut. Bids for individual species must be at or above the advertised price. All non-responsive bid forms may be rejected.

<u>PRODUCTS & SPECIES</u>	<u>ESTIMATED VOLUME*</u>	<u>ADVERTISED PRICE</u>	<u>BID PRICE/UNIT</u>
Sawtimber			
Jack Pine	17.1 MBF	\$ 25.00/MBF	\$ _____
Quaking Aspen	45.6 MBF	\$ 91.00/MBF	\$ _____
Red Maple	69.5 MBF	\$ 46.00/MBF	\$ _____
Red Oak	228.2 MBF	\$ 153.00/MBF	\$ _____
Red Pine	317.3 MBF	\$ 122.00/MBF	\$ _____
White Pine	48.6 MBF	\$ 64.00/MBF	\$ _____
Pulpwood			
Balsam Fir	47 Cords	\$ 16.00/Cord	\$ _____
Black Spruce	2 Cords	\$ 7.55/Cord	\$ _____
Jack Pine	189 Cords	\$ 9.25/Cord	\$ _____
Mixed Aspen	608 Cords	\$ 24.60/Cord	\$ _____
Mixed Hardwood	11 Cords	\$ 19.15/Cord	\$ _____
Northern Pin Oak	4 Cords	\$ 36.25/Cord	\$ _____
Red Maple	464 Cords	\$ 19.15/Cord	\$ _____
Red Oak	184 Cords	\$ 36.25/Cord	\$ _____
Red Pine	169 Cords	\$ 42.90/Cord	\$ _____
White Pine	50 Cords	\$ 15.35/Cord	\$ _____

*The volumes are statistically estimated within plus (+) or minus (-) 4.25 percent at 95% confidence level. These estimated volumes are final and not subject to adjustment. Prospective bidders are urged to examine this timber and to make their own estimates of quantity and quality.

I understand that any or all bids may be rejected. All bids must be signed and all bid items must be bid or the bid form may be rejected. I also understand that consideration and awarding a contract will be based upon my past performance and ability to complete the contract based upon equipment and staffing subject to my control.

FEDERAL ID: ___ - ___ - ___ or SOCIAL SECURITY NUMBER: ___ - ___ - ___

Company or individual bidding: _____

Company representative's name: _____

Address: _____

City: _____ State: _____ Zip: _____

IF AVAILABLE, PLEASE PLACE THE PERSONALIZED LABEL FROM YOUR PROSPECTUS IN THE ABOVE BOX.

Individual or company representative's signature: _____ Date: _____

Phone number : _____ Email (optional): _____

THE WINNING BIDDER MUST COMPLETE THE VERIFICATION OF WORKER'S DISABILITY COMPENSATION ACT COMPLIANCE (ON REVERSE SIDE IF DOUBLE SIDED) WITHIN 21 DAYS OF SALE AWARD DATE



FOR DEPARTMENT USE ONLY
Sale Number (XX - XXX - XX - XX)
Forest Management Unit:

TIMBER SALE VERIFICATION OF WORKER'S DISABILITY COMPENSATION ACT COMPLIANCE

*As required by Act 317, P.A. 1969 (Worker's Compensation) and
Part 5 of Act 451 of 1994, as amended.*

VERIFICATION OF WORKER'S DISABILITY COMPENSATION ACT COMPLIANCE

- This verification must be completed and submitted within 21 days of contract award and prior to the issuance of the timber sale contract.
- In addition, if boxes 2B or 2C are checked, then Notice of Exclusion or Certificate of Insurance must be submitted within twenty-one (21) days of the contract award and prior to the issuance of the timber sale contract.
- All information must be typed or printed except for written signatures.

Please Check Appropriate Categories:

1. My business is organized as (you **must** check one of the boxes below):
 - A. Sole Proprietorship (individual)
 - B. Partnership
 - C. Corporation

2. You **must** check one of the boxes below:
 - A. I certify my business is a sole proprietorship and it has no employees but the sole proprietor. I am not subject to the Worker's Compensation Laws.
 - B. I certify my business has satisfied its obligation to the Worker's Compensation Act through the use of an approved Notice of Exclusion (BWC-337, Rev. 5/96). I will provide a copy of the Notice of Exclusion within 21 days of the contract award. (For questions or a copy of the BWC-337, please call the Worker's Compensation Bureau at 517-322-1195).
 - C. I certify my business has a Worker's Compensation Policy. I will provide an original Certificate of Insurance within twenty-one (21) days of the contract award.

3. If you have checked item 2(A) or 2(B), you **must** indicate the number of **both** full-time and part-time employees, other than yourself, including family members and active partners (if none, you must enter "0").

_____ Full-time Employees

_____ Part-time Employees

Name of Business		Federal ID (or) Social Security No.	
Address		Telephone ()	
City	State	ZIP	

I hereby certify that the above information is true and correct. I agree to notify the Michigan DNR of any changes that occur in factors affecting my coverage during any of my present and future operations.

Signature of Owner or Authorized Representative

Title

Date

Please complete the "SEALED BID" information on the next page

Scarface Mix (54-035-21)
T32N, R02E, SEC. 26; T32N, R04E, SEC. 4; Montmorency COUNTY

In response to the notice of sale to be held 10:00 a.m. (local time) on July 19, 2022, I am hereby submitting my sealed bid (firm offer) for the following forest products to be cut. Bids for individual species must be at or above the advertised price. All non-responsive bid forms may be rejected.

<u>PRODUCTS & SPECIES</u>	<u>ESTIMATED VOLUME*</u>	<u>ADVERTISED PRICE</u>	<u>BID PRICE/UNIT</u>
Sawtimber			
N. White Cedar	2.9 MBF	\$ 25.00/MBF	\$ _____
Red Maple	14.2 MBF	\$ 43.00/MBF	\$ _____
Red Pine	11.7 MBF	\$ 113.00/MBF	\$ _____
Sugar Maple	8.0 MBF	\$ 216.00/MBF	\$ _____
White Oak	14.0 MBF	\$ 83.00/MBF	\$ _____
White Pine	2.0 MBF	\$ 59.00/MBF	\$ _____
Yellow Birch	4.7 MBF	\$ 39.00/MBF	\$ _____
Pulpwood			
B. T. Aspen	199 Cords	\$ 22.80/Cord	\$ _____
Balsam Fir	172 Cords	\$ 14.85/Cord	\$ _____
Mixed Hardwood	294 Cords	\$ 17.75/Cord	\$ _____
N. White Cedar	19 Cords	\$ 15.30/Cord	\$ _____
Red Pine	5 Cords	\$ 39.80/Cord	\$ _____
White Pine	1 Cords	\$ 14.25/Cord	\$ _____
White Spruce	7 Cords	\$ 7.00/Cord	\$ _____

*The volumes are statistically estimated within plus (+) or minus (-) 10.66 percent at 95% confidence level. These estimated volumes are final and not subject to adjustment. Prospective bidders are urged to examine this timber and to make their own estimates of quantity and quality.

I understand that any or all bids may be rejected. All bids must be signed and all bid items must be bid or the bid form may be rejected. I also understand that consideration and awarding a contract will be based upon my past performance and ability to complete the contract based upon equipment and staffing subject to my control.

FEDERAL ID: _____ - _____ or SOCIAL SECURITY NUMBER: _____ - _____ - _____

Company or individual bidding: _____

Company representative's name: _____

Address: _____

City: _____ State: _____ Zip: _____

IF AVAILABLE, PLEASE PLACE THE PERSONALIZED LABEL FROM YOUR PROSPECTUS IN THE ABOVE BOX.

Individual or company representative's signature: _____ Date: _____

Phone number : _____ Email (optional): _____

THE WINNING BIDDER MUST COMPLETE THE VERIFICATION OF WORKER'S DISABILITY COMPENSATION ACT COMPLIANCE (ON REVERSE SIDE IF DOUBLE SIDED) WITHIN 21 DAYS OF SALE AWARD DATE



FOR DEPARTMENT USE ONLY	
Sale Number (XX - XXX - XX - XX)	
Forest Management Unit:	

TIMBER SALE VERIFICATION OF WORKER'S DISABILITY COMPENSATION ACT COMPLIANCE

As required by Act 317, P.A. 1969 (Worker's Compensation) and
Part 5 of Act 451 of 1994, as amended.

VERIFICATION OF WORKER'S DISABILITY COMPENSATION ACT COMPLIANCE

- This verification must be completed and submitted within 21 days of contract award and prior to the issuance of the timber sale contract.
- In addition, if boxes 2B or 2C are checked, then Notice of Exclusion or Certificate of Insurance must be submitted within twenty-one (21) days of the contract award and prior to the issuance of the timber sale contract.
- All information must be typed or printed except for written signatures.

Please Check Appropriate Categories:

1. My business is organized as (you **must** check one of the boxes below):
 - A. Sole Proprietorship (individual)
 - B. Partnership
 - C. Corporation
2. You **must** check one of the boxes below:
 - A. I certify my business is a sole proprietorship and it has no employees but the sole proprietor. I am not subject to the Worker's Compensation Laws.
 - B. I certify my business has satisfied its obligation to the Worker's Compensation Act through the use of an approved Notice of Exclusion (BWC-337, Rev. 5/96). I will provide a copy of the Notice of Exclusion within 21 days of the contract award. (For questions or a copy of the BWC-337, please call the Worker's Compensation Bureau at 517-322-1195).
 - C. I certify my business has a Worker's Compensation Policy. I will provide an original Certificate of Insurance within twenty-one (21) days of the contract award.
3. If you have checked item 2(A) or 2(B), you **must** indicate the number of **both** full-time and part-time employees, other than yourself, including family members and active partners (if none, you must enter "0").

_____ Full-time Employees

_____ Part-time Employees

Name of Business		Federal ID (or) Social Security No.	
Address		Telephone ()	
City	State	ZIP	

I hereby certify that the above information is true and correct. I agree to notify the Michigan DNR of any changes that occur in factors affecting my coverage during any of my present and future operations.

Signature of Owner or Authorized Representative

Title

Date

Please complete the "SEALED BID" information on the next page

Aspen Kerr-fuffle (54-017-21)

T31N, R02E, SEC. 25; T31N, R02E, SEC. 26; T31N, R02E, SEC. 35; T31N, R02E,

In response to the notice of sale to be held 10:00 a.m. (local time) on July 19, 2022, I am hereby submitting my sealed bid (firm offer) for the following forest products to be cut. Bids for individual species must be at or above the advertised price. All non-responsive bid forms may be rejected.

<u>PRODUCTS & SPECIES</u>	<u>ESTIMATED VOLUME*</u>	<u>ADVERTISED PRICE</u>	<u>BID PRICE/UNIT</u>
Sawtimber			
Bl/R/Hybrid Oak	294.3 MBF	\$ 102.00/MBF	\$ _____
Mixed Aspen	312.1 MBF	\$ 91.00/MBF	\$ _____
Red Maple	13.7 MBF	\$ 46.00/MBF	\$ _____
Red Oak	111.1 MBF	\$ 153.00/MBF	\$ _____
Red Pine	165.9 MBF	\$ 122.00/MBF	\$ _____
White Pine	24.4 MBF	\$ 64.00/MBF	\$ _____
Pulpwood			
Balsam Fir	75 Cords	\$ 16.00/Cord	\$ _____
Jack Pine	64 Cords	\$ 9.25/Cord	\$ _____
Mixed Aspen	3,960 Cords	\$ 24.60/Cord	\$ _____
Mixed Hardwood	593 Cords	\$ 19.15/Cord	\$ _____
Mixed Oak	1,599 Cords	\$ 36.25/Cord	\$ _____
Red Pine	78 Cords	\$ 42.90/Cord	\$ _____
White Pine	147 Cords	\$ 15.35/Cord	\$ _____

*The volumes are statistically estimated within plus (+) or minus (-) 11.09 percent at 95% confidence level. These estimated volumes are final and not subject to adjustment. Prospective bidders are urged to examine this timber and to make their own estimates of quantity and quality.

I understand that any or all bids may be rejected. All bids must be signed and all bid items must be bid or the bid form may be rejected. I also understand that consideration and awarding a contract will be based upon my past performance and ability to complete the contract based upon equipment and staffing subject to my control.

FEDERAL ID: _____ or SOCIAL SECURITY NUMBER: _____

Company or individual bidding: _____

Company representative's name: _____

Address: _____

City: _____ State: _____ Zip: _____

IF AVAILABLE, PLEASE PLACE THE PERSONALIZED LABEL FROM YOUR PROSPECTUS IN THE ABOVE BOX.

Individual or company representative's signature: _____ Date: _____

Phone number : _____ Email (optional): _____

THE WINNING BIDDER MUST COMPLETE THE VERIFICATION OF WORKER'S DISABILITY COMPENSATION ACT COMPLIANCE (ON REVERSE SIDE IF DOUBLE SIDED) WITHIN 21 DAYS OF SALE AWARD DATE



FOR DEPARTMENT USE ONLY	
Sale Number (XX - XXX - XX - XX)	
Forest Management Unit:	

TIMBER SALE VERIFICATION OF WORKER'S DISABILITY COMPENSATION ACT COMPLIANCE

As required by Act 317, P.A. 1969 (Worker's Compensation) and
Part 5 of Act 451 of 1994, as amended.

VERIFICATION OF WORKER'S DISABILITY COMPENSATION ACT COMPLIANCE

- This verification must be completed and submitted within 21 days of contract award and prior to the issuance of the timber sale contract.
- In addition, if boxes 2B or 2C are checked, then Notice of Exclusion or Certificate of Insurance must be submitted within twenty-one (21) days of the contract award and prior to the issuance of the timber sale contract.
- All information must be typed or printed except for written signatures.

Please Check Appropriate Categories:

1. My business is organized as (you **must** check one of the boxes below):
 - A. Sole Proprietorship (individual)
 - B. Partnership
 - C. Corporation
2. You **must** check one of the boxes below:
 - A. I certify my business is a sole proprietorship and it has no employees but the sole proprietor. I am not subject to the Worker's Compensation Laws.
 - B. I certify my business has satisfied its obligation to the Worker's Compensation Act through the use of an approved Notice of Exclusion (BWC-337, Rev. 5/96). I will provide a copy of the Notice of Exclusion within 21 days of the contract award. (For questions or a copy of the BWC-337, please call the Worker's Compensation Bureau at 517-322-1195).
 - C. I certify my business has a Worker's Compensation Policy. I will provide an original Certificate of Insurance within twenty-one (21) days of the contract award.
3. If you have checked item 2(A) or 2(B), you **must** indicate the number of **both** full-time and part-time employees, other than yourself, including family members and active partners (if none, you must enter "0").

_____ Full-time Employees

_____ Part-time Employees

Name of Business		Federal ID (or) Social Security No.	
Address		Telephone ()	
City	State	ZIP	

I hereby certify that the above information is true and correct. I agree to notify the Michigan DNR of any changes that occur in factors affecting my coverage during any of my present and future operations.

Signature of Owner or Authorized Representative

Title

Date

Please complete the "SEALED BID" information on the next page