



**DEPARTMENT OF NATURAL RESOURCES
STATE OF MICHIGAN
TIMBER SALE PROSPECTUS #7231**

SCHEDULED SALE DATE AND TIME: 10:00 a.m. (local time) on July 25, 2023.

LOCATION: ATLANTA MGMT UNIT, 13501 M 33, ATLANTA, MI 49709.

PROSPECTUS NOTE: The bidder is advised to inspect the sale area and review the location, estimated volumes, operating costs and contract terms of proposed sales. Please be aware that some landowners may request 60 days or more notice for access across their land.

Notice is hereby given that bids will be received by the Unit Manager, ATLANTA MANAGEMENT UNIT, for certain timber on the following described lands:

Second Try Koenig Rd RP (54-008-22) / T33N, R04E, SEC. 28, SWSW.

T33N, R04E, SEC. 32, SENE.

T33N, R04E, SEC. 33, NWNW,S1/2NW,NE,N1/2SW.

Presque Isle County, Advertised Price \$76,155.90, 120.1 Acres, Red Pine, Aspen.

Press Eject RP (54-013-22) / T30N, R01E, SEC. 28, SWSW.

T30N, R01E, SEC. 29, NESE,S1/2SE.

T30N, R01E, SEC. 32, N1/2NE.

T30N, R01E, SEC. 33, NWNW.

T30N, R01E, SEC. 34, W1/2NW.

Montmorency County, Advertised Price \$42,093.30, 100.9 Acres, Red Pine, Jack Pine.

SALE NOTE: A recreation site such as a trail, pathway, or campground is within the sale area or the vicinity. Certain restrictions/specifications may be applicable including time restrictions.

Remote Call Aspen (54-017-22) / T31N, R02E, SEC. 19, SENE,SE.

T31N, R02E, SEC. 29, W1/2NW.

T31N, R02E, SEC. 30, NW,NE,NESW,S1/2SW,W1/2SE.

Montmorency County, Advertised Price \$228,886.25, 243.5 Acres, Aspen, Hardwood.

SALE NOTE: Payment Units 1-4 (spec. 5.8.8): Operations only from October 16 through March 31.

Payment Units 5, 7-10 (spec. 5.2.3.4): Operations only from July 16 through April 14.

Payment Unit 6 (spec. 5.2.3.5): Operations only from July 16 through April 14, unless other arrangements are made.

Radio Tower Aspen Oak (54-024-22) / T32N, R02E, SEC. 23, NWSW,S1/2SW,NESE,S1/2SE.

T32N, R02E, SEC. 26, NW,N1/2NE,SENE,N1/2SW,NESE.

T32N, R02E, SEC. 34, N1/2SW,SESW.

T32N, R02E, SEC. 35, SENW.

Montmorency County, Advertised Price \$401,493.25, 248.6 Acres, Aspen, Hardwood.

SALE NOTE: The sale has fair to good quality timber within, as well as good access to the timber.

A recreation site such as a trail, pathway, or campground is within the sale area or the vicinity. Certain restrictions/specifications may be applicable including time restrictions. Access may be through other public land.

BID INSTRUCTIONS (VER. 10/10/2022):

1. Scheduled Bid Location, Date, and Time (2/11)

Bids must be received by the Unit Manager, ATLANTA OFFICE, 13501 M 33, ATLANTA, MI 49709, no later than 10:00 a.m. (local time) on July 25, 2023. For further information concerning this sale, contact Matt Foster at 989-619-5921 extension .

2. Bidder's Qualifications (10/22)

If all or part of a timber sale was prepared by a private contractor, the contractor and that contractor's company are not permitted to bid on the timber sale. A person must be 18 years of age or older to purchase timber. Permanent employees of the Department of Natural Resources or members of their immediate household may not bid. Former employees, in the permanent or seasonal class, may not bid until 3 months after the last day of active duty. Bids will not be accepted from individuals or companies appearing on the DNR/FRD No-Bid List. This list contains the names of purchasers who previously failed to execute a contract within 21-days or who have a history of poor performance.

3. Preparation of Sealed Bids (5/16)

Bid Forms may be completed online thru Michigan DNR Timber Sale Online Bidding (OLB) at www.michigan.gov/timberbidding or by completing the hardcopy Bid Form found in the Timber Sale Prospectus . Hardcopy Bid Forms shall be manually signed in ink. Registration in OLB is considered your 'signature' for all bids submitted thru that system. Bid prices must be entered for each species and product in the Bid Price column for all material subject to bidding and all fill-in blanks must be completed. If erasures or other changes appear on the hardcopy Bid Form, each erasure or change must be initialed by the person signing the bid.

4. Submission of Sealed Bids (5/16)

Bid forms may be obtained from the Unit Manager or thru OLB. Bids may be submitted hardcopy or thru OLB. All hardcopy bids must be submitted on the bid form and in an envelope clearly identified as described in this section. NOTE: Only one bid form per bid envelope. Sealed bids must be submitted to the Unit office designated in the prospectus and must be submitted at or prior to the time established in the prospectus. The envelope should show on the outside (a) the sale name or number and (b) the date and time of bid opening, as shown in the prospectus. Bids received after the time specified in the sale prospectus are late bids and will be rejected.

It is possible for a bidder to submit multiple bids on a single sale. For example, a bid may be submitted hardcopy and a bid may be submitted thru OLB. Or, two bidders from the same company could both submit bids on the same sale. If this were to happen, the State would accept all bids received and award the contract accordingly. All bidding and contractual requirements would apply to all bids received.

5. Public Opening of Sealed Bids (7/16)

If conditions permit, the sealed bids will be publicly opened and posted at the time and place set in the prospectus.

If a bidder, present at a bid opening, has submitted bids on more than one sale, that bidder may withdraw their unopened bid envelopes or announce the withdrawal of their online bid after being declared the successful bidder on one sale.

6. Award of Contract (1/11)

Award of the contract will be made to the Bidder whose bid, conforming to the prospectus, is most advantageous to the State of Michigan on the basis of total value at rates bid for the estimated quantities. The State reserves the right to reject any bid or waive any minor irregularity in bids received. A written award mailed (or otherwise furnished) to the successful Bidder shall be deemed to result in a binding contract without further action by either party.

7. Down Payment (1/11)

The Bidder to whom award is made must make a down payment within 21 days of the sale award. The amount of the down payment will be calculated as shown in the Bond and Payment Schedule of this prospectus. Only cash may be used to meet this requirement.

8. Performance Security (1/11)

As guarantee of faithful performance, a cash bond, certificate of deposit, surety bond or irrevocable letter of credit (LOC) is required within 21 days of the sale award. The amount of the performance security is shown in the Bond and

Payment Schedule of this prospectus. If an LOC or surety is used, the coverage must extend for at least 6 months beyond the contract expiration.

9. Worker's Compensation (10/22)

Purchaser shall obtain worker's compensation insurance to cover claims under Michigan's Worker's Disability Compensation Act of 1969 or similar employee benefit act of any other state applicable to an employee. Verification of Worker's Disability Compensation Act Compliance must be completed and submitted within 21 days of contract award and prior to the issuance of the timber sale contract. In addition, if applicable, Notice of Exclusion or Certificate of Insurance must also be submitted.

10. Timber Sale Contract (10/22)

Additional conditions and requirements common to all timber sales are listed on the timber sale contract (R4031) and are available on line at www.michigan.gov/timber. Contact the Unit Manager for additional information or a sample contract. Within 21 days of the date of the award letter, the bidder must sign the contract and provide the required down payment, performance security, and verification of worker's disability compensation. The down payment and performance security shall be in accordance with the provisions of the timber sale contract, in the sums stated in this prospectus. If these actions are not taken, then the Bidder, the Bidder's corporation, and the corporation's principals may not be permitted to bid on State timber sales for a period of 3 months after the first offense, 6 months after the second offense, and 1 year after the third offense. An offense will only be counted against the Bidder for 5 years. In addition, the Bidder certifies that if awarded this contract, the Bidder will complete the timber sale contract in accordance with its terms and any modifications thereof including requirements to purchase, cut, and remove the included timber by the expiration date.

Payment Unit values in the State Forest Timber Sale Contract are calculated based on the advertised value of the Payment Unit as a percentage of the total advertised value of the contract. The advertised value of each Payment Unit is given in the Description of Timber by Payment Unit table on the Timber Sale Information page. For example, if the value of Payment Unit 1 is advertised as \$1,500 and the total Timber Sale value is advertised as \$10,000, the contract price for Payment Unit 1 will be 15% of the total bid price ($\$1,500/\$10,000 * 100$).

11. Disclaimer of Estimates and Bidder's Warranty of Inspection (10/22)

Before submitting this bid, the Bidder is advised and cautioned to inspect the sale area, review the requirements of the sale contract, and take other steps as may be reasonably necessary to ascertain the location, estimated volumes, construction estimates, and operating costs of the proposed sale. Failure to do so will not relieve the Bidder from responsibility for completing the contract.

The Bidder warrants that this bid is submitted solely on the basis of the Bidder's examination and inspection of the quality and quantity of the timber offered for sale and the Bidder's opinion of the value thereof and the costs of recovery. No reliance should be placed on the State of Michigan's estimates of timber quality, quantity or costs of recovery. Bidder further acknowledges that the State of Michigan: (i) expressly disclaims any warranty of fitness of timber for any purpose; (ii) offers this timber as is without any warranty of quality (merchantability) or quantity and (iii) expressly disclaims any warranty as to the quantity or quality of timber sold.

12. Certification and Chain-of-Custody (10/22)

Unless otherwise indicated in the contract under section 7 – Other Conditions of the Sale Specific Conditions & Requirements, the area encompassed by this timber sale is certified to the standards of the Forest Stewardship Council (FSC) - Certificate #SCS-FM/COC-00090N and the Sustainable Forestry Initiative (SFI) - Certificate #NSF-SFIS-5Y031-SF5. Forest products from this sale may be delivered to the mill as "FSC 100% and / or SFI certified" as long as the contractor hauling the forest products is chain-of-custody (COC) certified or covered under a COC certificate from the destination mill. The purchaser is responsible for maintaining COC after leaving the sale area.

13. Good Neighbor Authority (GNA) Requirements (10/22)

If the name of this timber sales contains the acronym GNA, it is authorized by the Good Neighbor Authority (GNA) and covered by various agreements between the U.S. Forest Service and the State. The timber sale occurs on federal land and the following conditions apply:

GNA contracts on US Forest Service land will not be awarded to purchasers on the Federal list of excluded parties. The System for Award Management (SAM) will be checked for active excluded parties prior to award of contract. In

addition, the Bidder to whom award is made must complete an Assurance Regarding Felony Conviction or Tax Delinquent Status for Corporate Applicants (AD-3031).

14. Good Neighbor Authority (GNA) Requirements, con't (10/22)

Bidder certifies, by signing this bid form, that to the best of Bidder's knowledge that the following representations are accurate and complete.

- a. That the Bidder and its principals are not presently debarred, suspended, proposed for debarment, declared ineligible, or voluntary excluded from timber sales (covered transactions) by any Federal department or agency.
- b. That the Bidder and its principals have not within a 3-year period preceding this bid been convicted of or had a civil judgment rendered against them for commission of fraud or a criminal offense in connection with obtaining , attempting to obtain, or performing a public (Federal, State, or local) transaction or contract under a public transaction; violation of Federal or State antitrust statutes or commission of embezzlement, theft, forgery, bribery, falsification or destruction of records, making false statements, or receiving stolen property.
- c. That the Bidder and its principals are not presently indicted for or otherwise criminally or civilly charged by a governmental entity (Federal, State, or local) with commission of any of the offenses enumerated in paragraph b of this certification.
- d. That the Bidder and its principals have not within a 3-year period preceding this bid had one or more public transactions (Federal, State, or local) terminated for breach or default of a timber or forest product contract.

Bidders that cannot certify this requirement, in whole or in part, shall submit an explanation with their bid.

SHANNON LOTT, Acting
Director

TIMBER SALE INFORMATION

Second Try Koenig Rd RP (54-008-22)
 T33N, R04E, SEC. 28; T33N, R04E, SEC. 32; T33N, R04E, SEC. 33.
 Presque Isle County (Advertised Price \$76,155.90)

A timber sale contract for this lump sum, sealed bid timber sale will be awarded to the responsible bidder offering the highest sealed bid price. All units of volume listed below were estimated using the Inventory Manager computer program and the new Michigan taper model. Bids must be at or above the following advertised price for each product and species:

<u>PRODUCTS & SPECIES</u>	<u>ESTIMATED UNITS*</u>	<u>ADVERTISED PRICE</u>
Sawtimber		
B. T. Aspen	3.6 MBF	\$ 88.00 / MBF
Black/Red (Hybrid) Oak	22.1 MBF	\$ 123.00 / MBF
Red Pine	38.3 MBF	\$ 133.00 / MBF
Pulpwood		
B. T. Aspen	119 Cords	\$ 24.55 / Cord
Jack Pine	22 Cords	\$ 13.50 / Cord
Mixed Hardwood	8 Cords	\$ 28.15 / Cord
Mixed Oak	59 Cords	\$ 29.25 / Cord
Red Pine	1,479 Cords	\$ 42.50 / Cord

* The total volume is statistically estimated within plus (+) or minus (-) 11.84 percent. There are an estimated 1,835 cords on this timber sale, plus or minus 217 cords at the 95% confidence level. The estimated units are final and not subject to adjustment. Prospective bidders are urged to examine this timber and to make their own estimates of quantity and quality.

BOND AND PAYMENT SCHEDULE:

1. A bond in the amount of \$3,808.00 to insure faithful performance of the conditions of the contract will be deposited by the successful bidder within 21 days of the sale award.
 2. Cutting in any sale or unit without the required advance payment would be considered a trespass.
 3. Total payment must be paid in advance or according to the following schedule :
 - (a) Ten percent (10%) of the sale value must be paid within 21 days of the sale award.
 - (b) The 10% down payment will be credited towards the first unit cut.
 - (c) Payment for each of the following units must be made before cutting begins in that unit:
- | PAYMENT UNIT NUMBER | PERCENT OF TOTAL SALE VALUE |
|---------------------|-----------------------------|
| 01 | 10.2% |
| 02 | 29.7% |
| 03 | 1.7% |
| 04 | 15.1% |
| 05 | 16.5% |
| 06 | 21.1% |
| 07 | 5.7% |
4. If no cutting takes place, the 10% down payment will not be refunded.
 5. Operations on the contract issued will terminate on 12/31/2025.

SALE STATISTICS

Volumes were calculated in cubic feet using the Michigan taper model. Cubic foot volume includes all wood inside bark for the product indicated. For display purposes, cubic feet were converted to cords and MBF using a simple conversion factor, e.g. 79 cubic feet per cord and 185 cubic feet per MBF. The cubic foot volumes are precise; the cords and MBF volumes are not. Cubic foot volume cannot be directly converted to cords or boards with precision.

SALE VOLUMES

The total estimated sale volume may not equal the sum of the species/products due to the nature of statistical calculations associated with double sampling methodology.

VOLUME		STATISTICAL RANGE IN CORDS		
TOTAL CUBIC FEET	TOTAL CORDS	PERCENT ERROR	MINIMUM	MAXIMUM
144,954	1,835	11.84%	1,617	2,052

VDU VOLUMES

A VDU is a Volume Determination Unit. Volumes and their associated statistics are calculated at the VDU level and summarized to the sale level. There is often a one to one relationship between a VDU and a Payment Unit, but not always, depending on the cruise design. Refer to the VDU TO PAYMENT UNIT table.

VDU	VOLUME		PERCENT ERROR	RANGE IN CORDS	
	TOTAL CUBIC FEET	TOTAL CORDS		MINIMUM	MAXIMUM
29	75,592	957	19.00%	775	1,139
37	14,269	181	27.32%	131	230
57	11,139	141	47.76%	74	208
64	2,592	33	879.68%	256	321
67	41,363	524	21.91%	409	638
TOTAL:	144,954	1,835		1,133	2,537

VDU TO PAYMENT UNIT

When a VDU is associated with more than one Payment Unit (PU), the VDU volumes are assigned to the PU based on acres of the VDU within the PU.

VDU	VDU ACRES	PU	PU ACRES
29	70.0	4	20.0
		5	21.9
		6	28.1
37	11.5	1	11.5
57	8.6	7	8.6
64	2.0	3	2.0
67	28.0	2	28.0
TOTAL:	120.1		120.1

DESCRIPTION OF TIMBER BY PAYMENT UNIT (PU)

PU	MARKET GROUP	PRODUCT	QUANTITY	UNIT	ACRES	ADVERTISE PRICE
1	Red Pine	Sawtimber	6.3	MBF	11.5	\$7,781.40
	Mixed Oak	Pulpwood	2	Cords		
	<i>Red Oak</i>		2	<i>Cords</i>		
	Red Pine		162	Cords		
2	Black/Red (Hybrid)	Sawtimber	9.2	MBF	28.0	\$22,562.10
	Red Pine		6.2	MBF		
	Jack Pine	Pulpwood	22	Cords		
	Mixed Hardwood		6	Cords		
	<i>Red Maple</i>		6	<i>Cords</i>		
	Mixed Oak		10	Cords		
	<i>/Red (Hybrid) Oak</i>		10	<i>Cords</i>		
	Red Pine		467	Cords		
3	B. T. Aspen	Sawtimber	0.5	MBF	2.0	\$1,313.75
	Black/Red (Hybrid)		6.9	MBF		
	B. T. Aspen	Pulpwood	6	Cords		
	Mixed Oak		5	Cords		
	<i>/Red (Hybrid) Oak</i>		5	<i>Cords</i>		
	Red Pine		3	Cords		
4	Red Pine	Sawtimber	7.4	MBF	20.0	\$11,489.10
	B. T. Aspen	Pulpwood	3	Cords		
	Mixed Oak		5	Cords		
	<i>/Red (Hybrid) Oak</i>		5	<i>Cords</i>		
	Red Pine		242	Cords		
5	Red Pine	Sawtimber	8.1	MBF	21.9	\$12,559.70
	B. T. Aspen	Pulpwood	3	Cords		
	Mixed Oak		5	Cords		
	<i>/Red (Hybrid) Oak</i>		5	<i>Cords</i>		
	Red Pine		265	Cords		
6	Red Pine	Sawtimber	10.3	MBF	28.1	\$16,093.60
	B. T. Aspen	Pulpwood	4	Cords		
	Mixed Oak		6	Cords		
	<i>/Red (Hybrid) Oak</i>		6	<i>Cords</i>		
	Red Pine		340	Cords		
	7	B. T. Aspen	Sawtimber	3.1		
Black/Red (Hybrid)			6.0	MBF		
B. T. Aspen		Pulpwood	103	Cords		
Mixed Hardwood			2	Cords		
<i>Black Cherry</i>			1	<i>Cords</i>		
<i>Red Maple</i>			1	<i>Cords</i>		
Mixed Oak			26	Cords		
<i>White Oak</i>		<i>Sawtimber</i>	0.6	<i>MBF</i>		
<i>/Red (Hybrid) Oak</i>		<i>Pulpwood</i>	22	<i>Cords</i>		
<i>White Oak</i>			3	<i>Cords</i>		
TOTAL:			64.0	MBF		
TOTAL:			1,687	Cords		

Sale Specific Conditions & Requirements

Sale Name: Second Try Koenig Rd RP

Sale Number: 54-008-22 Seq#: 3

1 - Sale Area

1.2 - Boundaries

1.2.1 - Painted boundaries (9/19)

The sale boundary and Payment Unit boundaries are marked and identified by red, blue, and yellow paint. Exterior sale boundary lines against state are marked with red paint, with the exception of the Payment Unit 2 east sale boundary adjacent to Royston Road, which is unpainted and identified by the road edge. Exterior sale boundary lines against private are marked with blue paint. Interior Payment Unit boundaries are marked with yellow paint. The painted boundary line trees are not Included Timber and are to be protected. Yellow painted trees designate an interior Payment Unit boundary can be cut once all surrounding Payment Units have been paid.

2 - Timber Specifications

2.1 - Included Timber

2.1.1 - Clearcut unit(s) with unmerchantable trees (6/14)

Within Payment Unit(s) 3 and 7, cut all trees that are two (2) inches or more at DBH.

Note: See spec 5.2.4.7 - 'Dead and down creation' for instructions on orange marked trees.

2.1.3 - Cut tree marked unit(s) (12/08)

Within Payment Unit(s) 4-6, all trees are designated for cutting when marked with orange paint above and below stump height, regardless of merchantability. Trees with orange dots or slashes represent cut trees. Note that orange dots on cut trees indicate direction of travel within rows for harvest equipment. Dots are being used to assist operations and minimize damage to residual trees. In addition to orange painted trees, cut all jack pine.

2.1.8 - Designated plantation row unit(s) (12/08)

Within Payment Unit(s) 1 and 2, all jack pine which meet minimum piece specifications are designated for cutting. In addition, all trees which meet minimum piece specifications in 2.2 Utilization, within designated plantation rows are designated for cutting. Designated plantation rows begin with the third row in from the outside of the plantation, then continue every third row. Because of the variability of row direction, it shall be the responsibility of the producer to maintain the third-row sequence.

2.2 - Utilization

2.2.5 - Limbed tree skidding (1/09)

The skidding of whole trees or tree segments with limbs attached is prohibited within Payment Units 1, 2, and 4-6.

3 - Payments

3.3 - Pre-measured Sales

3.3.4 - Dividing payment units (7/14)

Payment Unit(s) may be divided at the request of the Purchaser and upon approval of the Unit Manager. Dividing Payment Units is a contract modification which requires a Timber Sale Contract Amendment. Payment Units valued over \$25,000 may be divided. There will be only one division per Payment Unit.

3.4 - Damaged Timber

3.4.1 - Damaged timber (7/16)

General Condition and Requirement 3.4 Damaged Timber, defines liquidated damages for undesignated live merchantable trees which are cut or injured.

No damage is acceptable to undesignated live merchantable trees. Within the sale area, if more than 5% of trees (> 4.5" DBH) within a specified area of the sale are damaged, liquidated damages will be assessed for all trees damaged. Rates will be in accordance with General Condition and Requirement 3.4 Damaged Timber.

4 - Transportation

4.1 - Construction

4.1.3 - Slash and earthen piles (8/04)

Piles or windrows of earth along roads and landings that have been widened or constructed shall be leveled. Slash from road maintenance or construction, including stumps, shall be chipped, utilized or otherwise removed from the sale.

4.1.6 - Road construction (1/09)

Construction or improvements of existing roads shall be done in such a way as to minimize the environmental and visual impacts. Merchantable trees shall be cut and utilized unless otherwise directed. Non-merchantable trees shall be severed and laid flat on the ground. Slash shall be scattered, and not left in windrows and kept a minimum of 10 feet back from the road edge. Stumps shall be set upright, not left on edge, and be moved at least 10 feet away from the road edge. Disturbed soil shall be feathered into the woods and not left in berms or windrows. A new temporary access road through the south end of Payment Unit 6 and into Payment Unit 7 may need to be established to shorten forwarding and trucking distances. At the south line of Payment Unit 6, orange arrows pointing up on cut trees designate the new road route into Payment Unit 7.

4.1.7 - Road closure (10/11)

All new roads built into the sale must be blocked to vehicle traffic upon completion of the sale. Overgrown roads that are reopened shall be considered new roads. In general, this will require constructing a four (4') foot high berm of stumps and logs covered with earth. Stumps and brush must be placed along the remainder of the trail. These roads must be rendered impassable to cars and trucks. Contact the sale administrator for specific details of design and placement.

4.2 - Maintenance

4.2.5 - Two wheel drive condition (2/04)

All existing trail roads on and adjacent to the sale area must be passable by two-wheel drive traffic for the duration of the sale.

5 - Operations

5.1 - Notification

5.1.1 - Pre-sale conference (10/16)

A pre-sale conference between the Purchaser and sale administrator is required prior to beginning any operations to determine landing and road locations. The Unit Manager or his/her representative must be contacted at least 5 days in advance to schedule the conference.

5.1.4 - Post-sale conference (10/16)

A post-sale conference on site between the Purchaser and sale administrator is required 5 days prior to the completion of active logging operations to determine clean-up and repair of landings, road edges, and the fulfillment of other contract specifications.

5.2 - Conduct of Operations

5.2.1 - Slash

5.2.1.10 - No slash in openings (5/10)

No brush or logging debris is to be left in the maintained wildlife openings which are indicated by U0 on the Timber Sale Map. Any damage to the opening shall be repaired according to specifications of the Unit Manager or his/her representative.

5.2.2 - Hazard Trees/Snags

5.2.2.1 - Den trees (10/16)

Obvious hollow and/or den trees shall be protected and left standing unless they are a safety hazard.

5.2.3 - Operating Restrictions

5.2.3.3 - Bark slippage restriction (3/09)

Within Payment Unit(s) 1-2 and 4-6, unless changed by written agreement, cutting and skidding are not permitted during

the period of April 15 to July 15. This restriction is because of bark slippage.

5.2.3.4 - Oak wilt restriction, no exceptions (1/18)

Within Payment Unit(s) 1-7 cutting, skidding, hauling within the sale and brushing of access roads to the sale are not permitted during the period of April 15 to July 15. No exceptions will be granted. This is necessary to reduce the spread of oak wilt.

5.2.3.6 - Bark beetle restriction (12/08)

In the event drought creates a high risk of pine bark beetle infestation, pine is not to be cut during the period March 1 through July 1, unless all portions of trees greater than two inches in diameter are removed from the sale area, reduced to chips, or treated to the satisfaction of the Unit Manager or his/her representative, within fifteen days of being severed from the stump. Pine log decks, pulpwood piles and treetops that are piled for chipping in the fall or winter within a 1/4 mile of susceptible sites must be removed before March 15. Residual slash must not be placed in piles or rows and must be spread over the site for quick drying. The Department of Natural Resources will exercise this specification if the risk of damage warrants.

5.2.3.11 - Coppice regeneration protection (4/10)

Timber harvesting in Payment Units 3 and 7 must be completed within 60 days of severing/cutting stem(s) to minimize damage to deciduous regeneration. Some regeneration damage will be allowed for trucking and forwarding if landings are located in these Payment Units. Forwarding and trucking routes must be kept to a minimum and not go beyond a reasonable width of 15 feet. Landings must not be excessively large (over 1/2 acre) within these units.

5.2.4 - Dead and Down Creation

5.2.4.7 - Dead and down creation: hare, grouse, deer and other species (5/15)

To improve horizontal cover habitat for snowshoe hare, grouse, deer, and other species, the Purchaser is to push over all orange painted trees in Payment Unit 7. These trees should be tipped over with the root ball still attached so the base of the tree is suspended off the ground. The crown of the fallen tree should be at or near ground level after it is pushed over. If it is impractical to push the trees over, they may be cut or partially cut and pushed over.

5.2.31 - Landing locations (9/13)

Landing locations are shown on the Timber Sale Map. Landings must be confined to these designated sites unless otherwise authorized by the Unit Manager or his/her representative. For landings established within Payment Units 3 or 7, forwarding and trucking routes must be kept to a minimum and not go beyond a reasonable width (15ft). Landings must not be excessively large (over 1/2 acre) within these units to maximize natural regeneration.

5.2.32 - Decking/landing restoration (9/13)

All decking and landing areas must have the surface area restored to a condition equal to or better than before. This is to ensure the proper regeneration of the stand.

5.2.38 - No decking against live trees (2/04)

Cut products may not be decked against unmarked or designated leave trees.

5.4 - Soil Protection

5.4.1 - Rutting restriction, general (7/16)

Operations are to cease immediately if equipment and weather conditions result in rutting of roads and/or skid trails which is 12 inches or greater in depth and 50 feet in length. The Unit Manager or his/her representative may restrict hauling and/or skidding if ruts exceed the specified depth. With the Unit Manager or his/her representative's approval, the Purchaser may return to the area when the risk of rutting has decreased.

5.8 - Protection of Endangered Species

5.8.5 - Protection of raptor nests (3/13)

All trees with raptor nests will be protected if found during harvesting operations. Notification will be made to the Unit Manager or his/her representative who will notify the Wildlife Biologist so an on-site evaluation and recommendation can be made, if necessary.



TIMBER SALE MAP

This information provided by authority of Part 525, 1994 PA 451, as amended.

Forest Management Unit
Atlanta Management Unit

County
Presque Isle

Mapped By
Coy
Cruised By
Coy

Date
08/03/2022

Page
1 of
1

Township
33N

Range
04E

Section(s) and Subdivision(s)
28- SWSW 32- SENE 33- NWNW,S1/2NW,NE,N1/2SW

1:15,840

Cover Type

A = Aspen	J = Jack Pine	O = Oak	U = Upland Brush
B = Paper Birch	K = Rock	P = Lowland Poplar	UM = Upland Mix Forest
C = Cedar	L = Lowland Brush	Q = Mixed Swamp Conifer	V = Bog or Marsh
D = Treed Bog	LM = Lowland Mix Forest	R = Red Pine	W = White Pine
E = Swamp Hardwoods	M = Maple, Beech, Birch	S = Black Spruce	X = Non Stocked
F = Spruce/Fir	MC = Mixed Conifer	T = Tamarack	Y = Sand
G = Grass	MD = Mixed Deciduous		Z = Water
H = Hemlock	N = Marsh		

Density

0 = Non Stocked	5 = Pole Timber Medium
1 = Seedling Sapling Poor	6 = Pole Timber Well
2 = Seedling Sapling Medium	7 = Saw Timber Poor
3 = Seedling Sapling Well	8 = Saw Timber Medium
4 = Pole Timber Poor	9 = Saw Timber Well

PU	Acres	PU	Acres
1	11.5	7	8.6
2	28.0		
3	2.0		
4	20.0		
5	21.9		
6	28.1		

Second Try Koenig Rd RP

Compartment 128

120.1 Acres

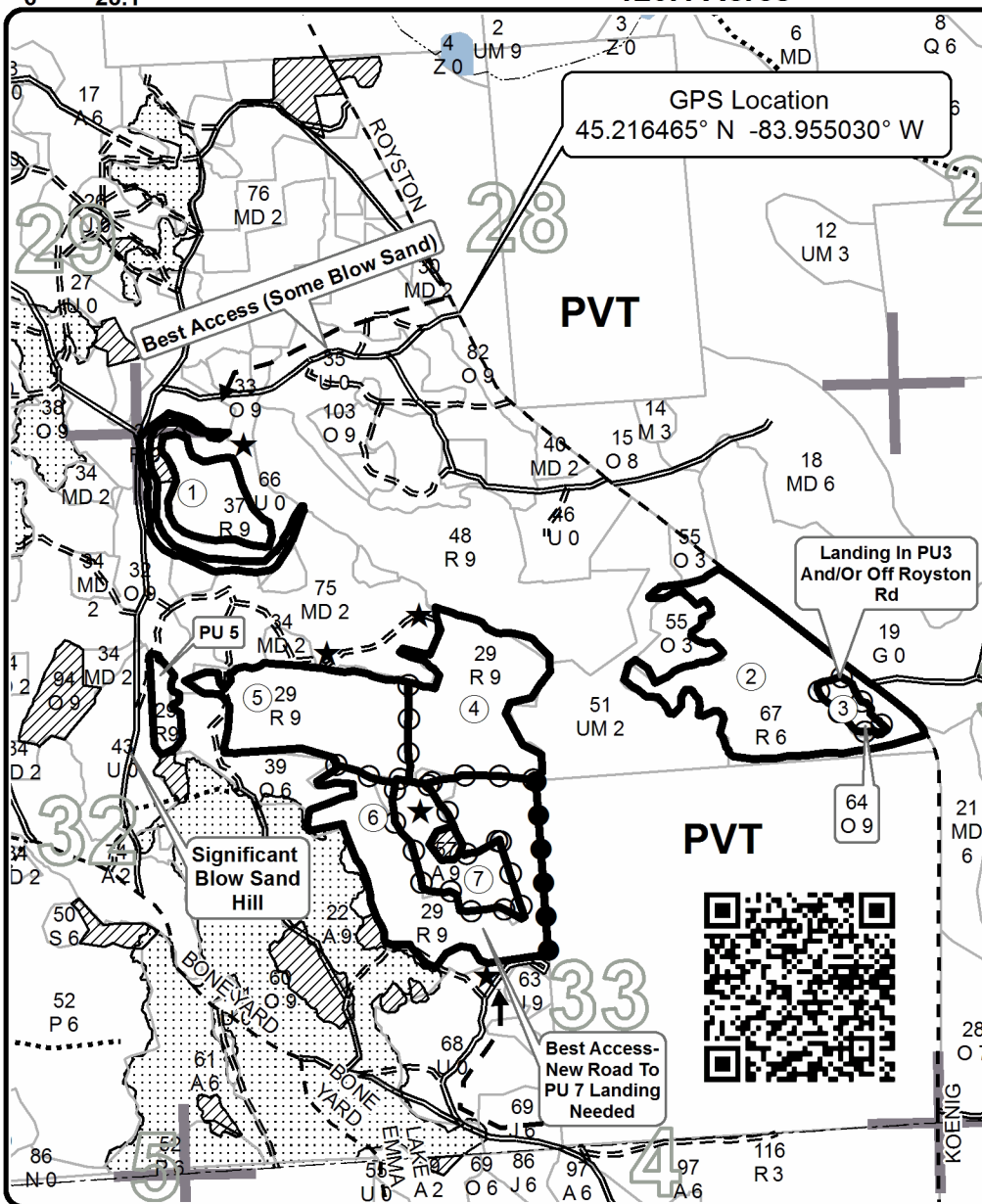
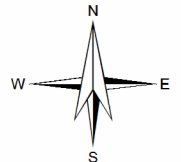

Legend

- Against State (Red)
- Private Line (Blue)
- Payment Unit Line (Yellow)
- Retention Area (Red)
- Nearby Timber Sales
- Stand Boundaries
- Payment Unit
- Landing
- Secondary Road
- Forest Access Route
- Gravel Road
- Temporary Access
- Perennial River
- Lakes
- Section Corner

Locator Map 1:150,000

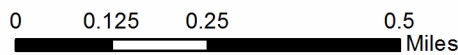
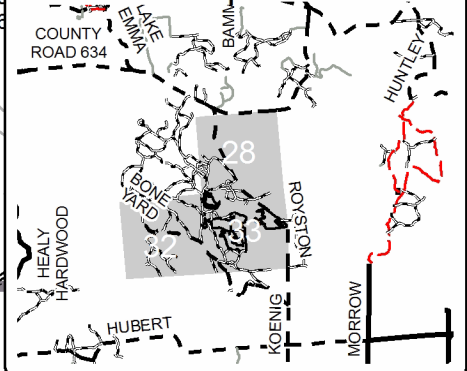

TIMBER SALE INFORMATION

Press Eject RP (54-013-22)

T30N, R01E, SEC. 28; T30N, R01E, SEC. 29; T30N, R01E, SEC. 32; T30N, R01E, SEC. 33; T30N, R01E, SEC. 34.
Montmorency County (Advertised Price \$42,093.30)

SALE NOTE: A recreation site such as a trail, pathway, or campground is within the sale area or the vicinity. Certain restrictions/specifications may be applicable including time restrictions.

A timber sale contract for this lump sum, sealed bid timber sale will be awarded to the responsible bidder offering the highest sealed bid price. All units of volume listed below were estimated using the Inventory Manager computer program and the new Michigan taper model. Bids must be at or above the following advertised price for each product and species:

<u>PRODUCTS & SPECIES</u>	<u>ESTIMATED UNITS*</u>	<u>ADVERTISED PRICE</u>
Sawtimber		
Red Pine	34.6 MBF	\$ 154.00 / MBF
Pulpwood		
Jack Pine	101 Cords	\$ 15.60 / Cord
Northern Pin Oak	27 Cords	\$ 45.00 / Cord
Quaking Aspen	11 Cords	\$ 28.30 / Cord
Red Pine	687 Cords	\$ 49.00 / Cord

* The total volume is statistically estimated within plus (+) or minus (-) 21.12 percent. There are an estimated 906 cords on this timber sale, plus or minus 191 cords at the 95% confidence level. The estimated units are final and not subject to adjustment. Prospective bidders are urged to examine this timber and to make their own estimates of quantity and quality.

BOND AND PAYMENT SCHEDULE:

1. A bond in the amount of \$2,105.00 to insure faithful performance of the conditions of the contract will be deposited by the successful bidder within 21 days of the sale award.
2. Cutting in any sale or unit without the required advance payment would be considered a trespass.
3. Total payment must be paid in advance or according to the following schedule :
 - (a) Ten percent (10%) of the sale value must be paid within 21 days of the sale award.
 - (b) The 10% down payment will be credited towards the first unit cut.
 - (c) Payment for each of the following units must be made before cutting begins in that unit:

PAYMENT UNIT NUMBER	PERCENT OF TOTAL SALE VALUE
01	53.0%
02	16.8%
03	16.0%
04	14.2%

4. If no cutting takes place, the 10% down payment will not be refunded.
5. Operations on the contract issued will terminate on 12/31/2025.

SALE STATISTICS

Volumes were calculated in cubic feet using the Michigan taper model. Cubic foot volume includes all wood inside bark for the product indicated. For display purposes, cubic feet were converted to cords and MBF using a simple conversion factor, e.g. 79 cubic feet per cord and 185 cubic feet per MBF. The cubic foot volumes are precise; the cords and MBF volumes are not. Cubic foot volume cannot be directly converted to cords or boards with precision.

SALE VOLUMES

The total estimated sale volume may not equal the sum of the species/products due to the nature of statistical calculations associated with double sampling methodology.

VOLUME		STATISTICAL RANGE IN CORDS		
TOTAL CUBIC FEET	TOTAL CORDS	PERCENT ERROR	MINIMUM	MAXIMUM
71,559	906	21.12%	714	1,097

VDU VOLUMES

A VDU is a Volume Determination Unit. Volumes and their associated statistics are calculated at the VDU level and summarized to the sale level. There is often a one to one relationship between a VDU and a Payment Unit, but not always, depending on the cruise design. Refer to the VDU TO PAYMENT UNIT table.

VDU	VOLUME		PERCENT ERROR	RANGE IN CORDS	
	TOTAL CUBIC FEET	TOTAL CORDS		MINIMUM	MAXIMUM
43	41,448	525	35.40%	339	710
74	10,678	135	32.17%	92	179
76	10,015	127	48.57%	65	188
80	9,418	119	37.11%	75	163
TOTAL:	71,559	906		571	1,241

VDU TO PAYMENT UNIT

When a VDU is associated with more than one Payment Unit (PU), the VDU volumes are assigned to the PU based on acres of the VDU within the PU.

VDU	VDU ACRES	PU	PU ACRES
43	73.7	1	73.7
74	7.0	2	7.0
76	14.0	3	14.0
80	6.2	4	6.2
TOTAL:	100.9		100.9

DESCRIPTION OF TIMBER BY PAYMENT UNIT (PU)

PU	MARKET GROUP	PRODUCT	QUANTITY	UNIT	ACRES	ADVERTISE PRICE
1	Red Pine	Sawtimber	6.1	MBF	73.7	\$22,318.30
	Jack Pine	Pulpwood	101	Cords		
	Northern Pin Oak		27	Cords		
	Quaking Aspen		11	Cords		
	Red Pine		373	Cords		
2	Red Pine	Sawtimber	8.9	MBF	7.0	\$7,054.60
	Red Pine	Pulpwood	116	Cords		
3	Red Pine	Sawtimber	16.1	MBF	14.0	\$6,742.40
	Red Pine	Pulpwood	87	Cords		
4	Red Pine	Sawtimber	3.5	MBF	6.2	\$5,978.00
	Red Pine	Pulpwood	111	Cords		
TOTAL:			34.6	MBF		
TOTAL:			826	Cords		

Sale Specific Conditions & Requirements

Sale Name: Press Eject RP

Sale Number: 54-013-22 Seq#: 2

1 - Sale Area

1.2 - Boundaries

1.2.1 - Painted boundaries (9/19)

The sale boundary and Payment Unit boundaries are marked and identified by blue, red and yellow paint. Exterior sale boundary lines against private property are marked with blue paint. Exterior sale boundary lines against state are marked with red paint. Interior Payment Unit boundaries are marked with yellow paint. The painted boundary line trees are not Included Timber and are to be protected. Yellow painted trees designating an interior Payment Unit boundary are only to be cut when all surrounding Payment Units have been paid.

2 - Timber Specifications

2.1 - Included Timber

2.1.3 - Cut tree marked unit(s) (12/08)

Within Payment Unit(s) 1-4, all trees are designated for cutting when marked with orange paint above and below stump height, regardless of merchantability. In addition, cut all jack pine.

2.2 - Utilization

2.2.6 - Roundwood operation required (3/21)

The skidding of whole trees or tree segments with limbs attached is prohibited. All products must be produced as roundwood and forwarded to existing roads or landing areas in final product length.

3 - Payments

3.3 - Pre-measured Sales

3.3.4 - Dividing payment units (7/14)

Payment Unit(s) exceeding \$25,000 in value may be divided at the request of the Purchaser and upon approval of the Unit Manager. Dividing Payment Units is a contract modification which requires a Timber Sale Contract Amendment. There will be only one division per Payment Unit.

3.4 - Damaged Timber

3.4.1 - Damaged timber (7/16)

General Condition and Requirement 3.4 Damaged Timber, defines liquidated damages for undesignated live merchantable trees which are cut or injured. No damage is acceptable to undesignated live merchantable trees. Within the Sale Area, if more than 5% of trees (> 4.5" DBH) within a specified area of the sale are damaged, liquidated damages will be assessed for all trees damaged. Rates will be in accordance with General Condition and Requirement 3.4 Damaged Timber.

4 - Transportation

4.1 - Construction

4.1.3 - Slash and earthen piles (8/04)

Piles or windrows of earth along roads and landings that have been widened or constructed shall be leveled. Slash from road maintenance or construction, including stumps, shall be dispersed throughout the sale.

4.1.6 - Road construction (1/09)

Improvements of existing roads shall be done in such a way as to minimize the environmental and visual impacts. Merchantable trees shall be cut and utilized unless otherwise directed. Non-merchantable trees shall be severed and laid flat on the ground. Slash shall be scattered, and not left in windrows and kept a minimum of 10 feet back from the road edge. Stumps shall be set upright, not left on edge, and be moved at least 10 feet away from the road edge. Disturbed soil shall be feathered into the woods and not left in berms or windrows.

4.1.12 - No new roads (1/12)

No new roads will be permitted. All operations are limited to existing roads. Skid trails will only be allowed.

4.2 - Maintenance

4.2.2 - Fill material (4/07)

To maintain roads, fill material may be needed in areas where "holes" exist or may be expected to develop. This fill material should be placed before trucking begins. Fill material shall be cobbles or crushed stone and must not contain clay or organic matter.

4.2.5 - Two wheel drive condition (2/04)

All existing trail roads on and adjacent to the sale area must be passable by two-wheel drive traffic for the duration of the sale.

5 - Operations

5.1 - Notification

5.1.1 - Pre-sale conference (10/16)

A pre-sale conference between the Purchaser and sale administrator is required prior to beginning any operations to determine landing and road locations. The Unit Manager or his/her representative must be contacted in advance to schedule the conference.

5.1.3 - Well heads and natural gas pipelines (11/15)

The Purchaser is responsible for contacting the gas or pipeline company 30 days prior to operating equipment in the vicinity of well heads or natural gas pipelines.

5.1.4 - Post-sale conference (10/16)

A post-sale conference on site between the Purchaser and sale administrator is required prior to the completion of active logging operations to determine clean-up and repair of landings, road edges, and the fulfillment of other contract specifications.

5.1.6 - Utility R.O.W. (4/19)

It is the responsibility of the Purchaser to obtain permission from the utility company to utilize the power line R.O.W. for operations.

5.2 - Conduct of Operations

5.2.2 - Hazard Trees/Snags

5.2.2.1 - Den trees (10/16)

Obvious hollow and/or den trees shall be protected and left standing unless they are a safety hazard.

5.2.3 - Operating Restrictions

5.2.3.3 - Bark slippage restriction (3/09)

Within Payment Unit(s) 1-4, unless changed by written agreement, cutting and skidding are not permitted during the period of April 15 to July 15. This restriction is because of bark slippage.

5.2.3.6 - Bark beetle restriction (12/08)

In the event drought creates a high risk of pine bark beetle infestation, pine is not to be cut during the period March 1 through July 1, unless all portions of trees greater than two inches in diameter are removed from the sale area, reduced to chips, or treated to the satisfaction of the Unit Manager or his/her representative, within fifteen days of being severed from the stump. Pine log decks, pulpwood piles and treetops that are piled for chipping in the fall or winter within a 1/4 mile of susceptible sites must be removed before March 15. Residual slash must not be placed in piles or rows and must be spread over the site for quick drying. The Department of Natural Resources will exercise this specification if the risk of damage warrants.

5.2.32 - Decking/landing restoration (9/13)

All decking and landing areas must have the surface area restored to a condition equal to or better than before. This is to ensure the proper regeneration of the stand. Wood debris, chips and "cookies" from trimmings must be removed or scattered away from landing and loading areas and may not be windrowed on the edge.

5.2.38 - No decking against live trees (2/04)

Cut products may not be decked against unmarked or designated leave trees.

5.2.39 - ORV trail/route protection (4/18)

The Big Bear ORV trail is shown on the Timber Sale Map. Do not cut trees or damage posts with yellow ORV markers. All stumps within 5 feet of the trail must be cut flush with the ground. Maintain a 20-foot-wide slash, debris, and rut free zone daily using the ORV trail or route as the centerline. Do not run equipment down the ORV trail or route. Skidding across the trail or route may only occur in locations approved by the Sale Administrator.

5.4 - Soil Protection

5.4.1 - Rutting restriction, general (7/16)

Operations are to cease immediately if equipment and weather conditions result in rutting of roads and/or skid trails which are 12 inches or greater in depth and 50 feet in length. The Unit Manager or his/her representative may restrict hauling and/or skidding if ruts exceed the specified depth. With the Unit Manager or his/her representative's approval, the Purchaser may return to the area when the risk of rutting has decreased.

5.8 - Protection of Endangered Species

5.8.5 - Protection of raptor nests (3/13)

All trees with raptor nests will be protected if found during harvesting operations. Notification will be made to the Unit Manager or his/her representative who will notify the Wildlife Biologist so an on-site evaluation and recommendation can be made, if necessary.

6 - Safety and Fire Prevention

6.2 - Signing

6.2.3 - Recreational trail posting (10/20)

The Purchaser is responsible for posting and maintaining caution signs on the Big Bear ORV trail prior to beginning operations. The trail must be posted at appropriate distances from the Sale Area to warn of logging activity and truck traffic at both ends of the trail. Signs must be removed when harvest operations are suspended or completed. The Purchaser will provide these signs.



Sale Number	Year
54 - 003	22

TIMBER SALE MAP

This information provided by authority of Part 525, 1994 PA 451, as amended.

Forest Management Unit Atlanta		County Montmorency	Mapped By Natzke	Date 09/19/2022	Page 1	of 1
Township 30N	Range 01E	Section(s) and Subdivision(s) Sec. 28, 29, 32, 33, 34 various		Scale 1:15,840		

Cover Type				Density			
A = Aspen	H = Hemlock	N = Marsh	U = Upland Brush	0 = Non Stocked	5 = Pole Timber Medium		
B = Paper Birch	J = Jack Pine	O = Oak	UM = Upland Mixed	1 = Seedling Sapling Poor	6 = Pole Timber Well		
C = Cedar	L = Lowland Brush	P = Lowland Poplar	V = Bog or Marsh	2 = Seedling Sapling Medium	7 = Saw Timber Poor		
D = Treed Bog	LM = Lowland Mixed	Q = Mixed Swamp Conifer	W = White Pine	3 = Seedling Sapling Well	8 = Saw Timber Medium		
E = Swamp Hdwoods	M = Mpl. Bch, Brch	R = Red Pine	X = Non Stocked	4 = Pole Timber Poor	9 = Saw Timber Well		
F = Spruce Fir	MC = Mixed Conifer	S = Black Spruce	Z = Water				
G = Grass	MD = Mixed Deciduous	T = Tamarack					

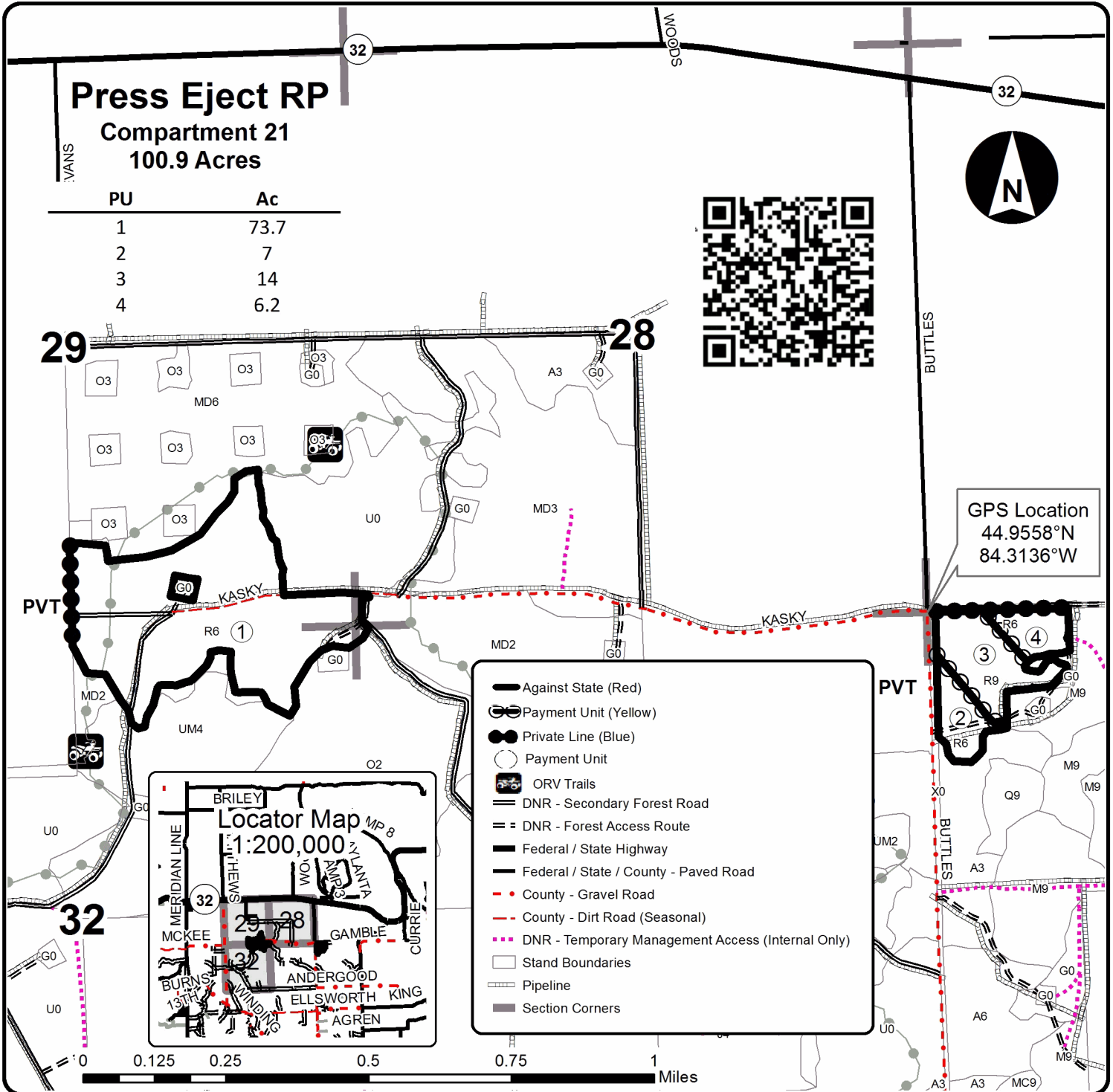

TIMBER SALE INFORMATION

Remote Call Aspen (54-017-22)

T31N, R02E, SEC. 19; T31N, R02E, SEC. 29; T31N, R02E, SEC. 30.
Montmorency County (Advertised Price \$228,886.25)

SALE NOTE: Payment Units 1-4 (spec. 5.8.8): Operations only from October 16 through March 31.

Payment Units 5, 7-10 (spec. 5.2.3.4): Operations only from July 16 through April 14.

Payment Unit 6 (spec. 5.2.3.5): Operations only from July 16 through April 14, unless other arrangements are made.

A timber sale contract for this lump sum, sealed bid timber sale will be awarded to the responsible bidder offering the highest sealed bid price. All units of volume listed below were estimated using the Inventory Manager computer program and the new Michigan taper model. Bids must be at or above the following advertised price for each product and species:

<u>PRODUCTS & SPECIES</u>	<u>ESTIMATED UNITS*</u>	<u>ADVERTISED PRICE</u>
Sawtimber		
Basswood	80.7 MBF	\$ 80.00 / MBF
Beech	6.5 MBF	\$ 65.00 / MBF
Mixed Aspen	418.0 MBF	\$ 101.00 / MBF
Red Oak	33.8 MBF	\$ 196.00 / MBF
Sugar Maple	41.4 MBF	\$ 331.00 / MBF
Pulpwood		
Balsam Fir	130 Cords	\$ 37.35 / Cord
Basswood	149 Cords	\$ 15.65 / Cord
Mixed Aspen	4,092 Cords	\$ 28.30 / Cord
Mixed Hardwood	824 Cords	\$ 32.45 / Cord
Paper Birch	136 Cords	\$ 16.30 / Cord
Red Oak	167 Cords	\$ 45.00 / Cord

* The total volume is statistically estimated within plus (+) or minus (-) 18.47 percent. There are an estimated 6,209 cords on this timber sale, plus or minus 1,147 cords at the 95% confidence level. The estimated units are final and not subject to adjustment. Prospective bidders are urged to examine this timber and to make their own estimates of quantity and quality.

BOND AND PAYMENT SCHEDULE:

1. A bond in the amount of \$22,889.00 to insure faithful performance of the conditions of the contract will be deposited by the successful bidder within 21 days of the sale award.
2. Cutting in any sale or unit without the required advance payment would be considered a trespass.
3. Total payment must be paid in advance or according to the following schedule :
 - (a) Ten percent (10%) of the sale value must be paid within 21 days of the sale award.
 - (b) The 10% down payment will be credited towards the first unit cut.
 - (c) Payment for each of the following units must be made before cutting begins in that unit:

PAYMENT UNIT NUMBER	PERCENT OF TOTAL SALE VALUE
01	13.5%
02	8.9%
03	7.1%
04	1.9%
05	13.2%
06	13.4%
07	13.7%
08	9.1%
09	13.6%
10	5.6%

4. If no cutting takes place, the 10% down payment will not be refunded.
5. Operations on the contract issued will terminate on 12/31/2025.

SALE STATISTICS

Volumes were calculated in cubic feet using the Michigan taper model. Cubic foot volume includes all wood inside bark for the product indicated. For display purposes, cubic feet were converted to cords and MBF using a simple conversion factor, e.g. 79 cubic feet per cord and 185 cubic feet per MBF. The cubic foot volumes are precise; the cords and MBF volumes are not. Cubic foot volume cannot be directly converted to cords or boards with precision.

SALE VOLUMES

The total estimated sale volume may not equal the sum of the species/products due to the nature of statistical calculations associated with double sampling methodology.

VOLUME			STATISTICAL RANGE IN CORDS	
TOTAL CUBIC FEET	TOTAL CORDS	PERCENT ERROR	MINIMUM	MAXIMUM
490,523	6,209	18.47%	5,062	7,356

VDU VOLUMES

A VDU is a Volume Determination Unit. Volumes and their associated statistics are calculated at the VDU level and summarized to the sale level. There is often a one to one relationship between a VDU and a Payment Unit, but not always, depending on the cruise design. Refer to the VDU TO PAYMENT UNIT table.

VDU	VOLUME		PERCENT ERROR	RANGE IN CORDS	
	TOTAL CUBIC FEET	TOTAL CORDS		MINIMUM	MAXIMUM
21	159,806	2,023	37.74%	1,259	2,786
42	330,717	4,186	22.56%	3,242	5,131
TOTAL:	490,523	6,209		4,501	7,917

VDU TO PAYMENT UNIT

When a VDU is associated with more than one Payment Unit (PU), the VDU volumes are assigned to the PU based on acres of the VDU within the PU.

VDU	VDU ACRES	PU	PU ACRES
21	81.3	1	35.1
		2	23.0
		3	18.3
42	162.2	4	4.9
		5	31.2
		6	31.7
		7	32.6
		8	21.4
		9	32.2
		10	13.1
TOTAL:	243.5		243.5

DESCRIPTION OF TIMBER BY PAYMENT UNIT (PU)

PU	MARKET GROUP	PRODUCT	QUANTITY	UNIT	ACRES	ADVERTISE PRICE	
1	Basswood	Sawtimber	34.8	MBF	35.1	\$30,893.90	
	Beech		2.8	MBF			
	Mixed Aspen		44.8	MBF			
	<i>B. T. Aspen</i>		34.3	<i>MBF</i>			
	<i>Quaking Aspen</i>		10.5	<i>MBF</i>			
	Red Oak		3.2	MBF			
	Sugar Maple		10.4	MBF			
	Balsam Fir		Pulpwood	20			Cords
	Basswood			59			Cords
	Mixed Aspen			421			Cords
	<i>B. T. Aspen</i>			190			<i>Cords</i>
	<i>Quaking Aspen</i>			231			<i>Cords</i>
	Mixed Hardwood			173			Cords
	<i>Beech</i>			3			<i>Cords</i>
	<i>Misc. Species 1</i>			4			<i>Cords</i>
	<i>Red Maple</i>			40			<i>Cords</i>
	<i>Sugar Maple</i>			126			<i>Cords</i>
	Red Oak		3	Cords			
2	Basswood	Sawtimber	22.8	MBF	23.0	\$20,321.80	
	Beech		1.8	MBF			
	Mixed Aspen		29.4	MBF			
	<i>B. T. Aspen</i>		22.5	<i>MBF</i>			
	<i>Quaking Aspen</i>		6.9	<i>MBF</i>			
	Red Oak		2.1	MBF			
	Sugar Maple		6.8	MBF			
	Balsam Fir		Pulpwood	14			Cords
	Basswood			40			Cords
	Mixed Aspen			276			Cords
	<i>B. T. Aspen</i>			124			<i>Cords</i>
	<i>Quaking Aspen</i>			152			<i>Cords</i>
	Mixed Hardwood			114			Cords
	<i>Beech</i>			3			<i>Cords</i>
	<i>Misc. Species 1</i>			2			<i>Cords</i>
	<i>Red Maple</i>			26			<i>Cords</i>
	<i>Sugar Maple</i>			83			<i>Cords</i>
	Red Oak		2	Cords			
3	Basswood	Sawtimber	18.2	MBF	18.3	\$16,185.65	
	Beech		1.5	MBF			
	Mixed Aspen		23.4	MBF			
	<i>B. T. Aspen</i>		17.9	<i>MBF</i>			
	<i>Quaking Aspen</i>		5.5	<i>MBF</i>			
	Red Oak		1.7	MBF			
	Sugar Maple		5.4	MBF			
	Balsam Fir		Pulpwood	11			Cords
	Basswood			32			Cords
	Mixed Aspen			220			Cords
	<i>B. T. Aspen</i>			99			<i>Cords</i>
	<i>Quaking Aspen</i>			121			<i>Cords</i>
	Mixed Hardwood			90			Cords
	<i>Beech</i>			2			<i>Cords</i>
	<i>Misc. Species 1</i>			2			<i>Cords</i>
	<i>Red Maple</i>			20			<i>Cords</i>
	<i>Sugar Maple</i>			66			<i>Cords</i>
	Red Oak		2	Cords			
4	Basswood	Sawtimber	4.9	MBF	4.9	\$4,314.95	
	Beech		0.4	MBF			

DESCRIPTION OF TIMBER BY PAYMENT UNIT (PU), CON'T

PU	MARKET GROUP	PRODUCT	QUANTITY	UNIT	ACRES	ADVERTISE PRICE	
4 con't	Mixed Aspen	Sawtimber	6.3	MBF			
	<i>B. T. Aspen</i>		4.8	<i>MBF</i>			
	<i>Quaking Aspen</i>		1.5	<i>MBF</i>			
	Red Oak		0.4	MBF			
	Sugar Maple		1.5	MBF			
	Balsam Fir		Pulpwood	3			Cords
	Basswood			8			Cords
	Mixed Aspen			59			Cords
	<i>B. T. Aspen</i>			27			<i>Cords</i>
	<i>Quaking Aspen</i>			32			<i>Cords</i>
	Mixed Hardwood			24			Cords
	<i>Beech</i>			1			<i>Cords</i>
	<i>Red Maple</i>			5			<i>Cords</i>
	<i>Sugar Maple</i>		18	<i>Cords</i>			
5	Mixed Aspen	Sawtimber	60.5	MBF	31.2	\$30,262.70	
	<i>B. T. Aspen</i>		51.9	<i>MBF</i>			
	<i>Quaking Aspen</i>		8.6	<i>MBF</i>			
	Red Oak		5.1	MBF			
	Sugar Maple		3.3	MBF			
	Balsam Fir		Pulpwood	16			Cords
	Basswood			2			Cords
	Mixed Aspen			599			Cords
	<i>B. T. Aspen</i>			466			<i>Cords</i>
	<i>Quaking Aspen</i>			133			<i>Cords</i>
	Mixed Hardwood			82			Cords
	<i>Beech</i>			3			<i>Cords</i>
	<i>Ironwood</i>			4			<i>Cords</i>
	<i>Red Maple</i>			4			<i>Cords</i>
	<i>Sugar Maple</i>			69			<i>Cords</i>
	<i>White Ash</i>		2	<i>Cords</i>			
	Paper Birch		26	Cords			
Red Oak	31	Cords					
6	Mixed Aspen	Sawtimber	61.4	MBF	31.7	\$30,738.05	
	<i>B. T. Aspen</i>		52.7	<i>MBF</i>			
	<i>Quaking Aspen</i>		8.7	<i>MBF</i>			
	Red Oak		5.2	MBF			
	Sugar Maple		3.4	MBF			
	Balsam Fir		Pulpwood	16			Cords
	Basswood			2			Cords
	Mixed Aspen			609			Cords
	<i>B. T. Aspen</i>			473			<i>Cords</i>
	<i>Quaking Aspen</i>			136			<i>Cords</i>
	Mixed Hardwood			83			Cords
	<i>Beech</i>			3			<i>Cords</i>
	<i>Ironwood</i>			4			<i>Cords</i>
	<i>Red Maple</i>			4			<i>Cords</i>
	<i>Sugar Maple</i>			70			<i>Cords</i>
	<i>White Ash</i>		2	<i>Cords</i>			
	Paper Birch		27	Cords			
Red Oak	31	Cords					
7	Mixed Aspen	Sawtimber	63.0	MBF	32.6	\$31,450.15	
	<i>B. T. Aspen</i>		54.1	<i>MBF</i>			
	<i>Quaking Aspen</i>		8.9	<i>MBF</i>			
	Red Oak		5.3	MBF			
	Sugar Maple		3.5	MBF			
	Balsam Fir		Pulpwood	16			Cords

DESCRIPTION OF TIMBER BY PAYMENT UNIT (PU), CON'T

PU	MARKET GROUP	PRODUCT	QUANTITY	UNIT	ACRES	ADVERTISE PRICE	
7 con't	Basswood	Pulpwood	2	Cords			
	Mixed Aspen		625	Cords			
	<i>B. T. Aspen</i>		486	<i>Cords</i>			
	<i>Quaking Aspen</i>		139	<i>Cords</i>			
	Mixed Hardwood		83	Cords			
	<i>Beech</i>		3	<i>Cords</i>			
	<i>Ironwood</i>		3	<i>Cords</i>			
	<i>Red Maple</i>		4	<i>Cords</i>			
	<i>Sugar Maple</i>		72	<i>Cords</i>			
	<i>White Ash</i>		1	<i>Cords</i>			
	Paper Birch		27	Cords			
Red Oak	32	Cords					
8	Mixed Aspen	Sawtimber	41.5	MBF	21.4	\$20,780.50	
	<i>B. T. Aspen</i>		35.6	<i>MBF</i>			
	<i>Quaking Aspen</i>		5.9	<i>MBF</i>			
	Red Oak	3.5	MBF				
	Sugar Maple	2.3	MBF				
	Balsam Fir	Pulpwood	11	Cords			
	Basswood		1	Cords			
	Mixed Aspen		412	Cords			
	<i>B. T. Aspen</i>		320	<i>Cords</i>			
	<i>Quaking Aspen</i>		92	<i>Cords</i>			
	Mixed Hardwood		56	Cords			
	<i>Beech</i>		2	<i>Cords</i>			
	<i>Ironwood</i>		3	<i>Cords</i>			
	<i>Red Maple</i>		3	<i>Cords</i>			
	<i>Sugar Maple</i>		47	<i>Cords</i>			
	<i>White Ash</i>		1	<i>Cords</i>			
	Paper Birch		18	Cords			
	Red Oak		21	Cords			
9	Mixed Aspen		Sawtimber	62.3	MBF	32.2	\$31,189.40
	<i>B. T. Aspen</i>			53.5	<i>MBF</i>		
	<i>Quaking Aspen</i>	8.8		<i>MBF</i>			
	Red Oak	5.2	MBF				
	Sugar Maple	3.4	MBF				
	Balsam Fir	Pulpwood	16	Cords			
	Basswood		2	Cords			
	Mixed Aspen		619	Cords			
	<i>B. T. Aspen</i>		481	<i>Cords</i>			
	<i>Quaking Aspen</i>		138	<i>Cords</i>			
	Mixed Hardwood		84	Cords			
	<i>Beech</i>		3	<i>Cords</i>			
	<i>Ironwood</i>		4	<i>Cords</i>			
	<i>Red Maple</i>		4	<i>Cords</i>			
	<i>Sugar Maple</i>		71	<i>Cords</i>			
	<i>White Ash</i>		2	<i>Cords</i>			
	Paper Birch		27	Cords			
	Red Oak		32	Cords			
10	Mixed Aspen		Sawtimber	25.4	MBF	13.1	\$12,749.15
	<i>B. T. Aspen</i>			21.8	<i>MBF</i>		
	<i>Quaking Aspen</i>	3.6		<i>MBF</i>			
	Red Oak	2.1	MBF				
	Sugar Maple	1.4	MBF				
	Balsam Fir	Pulpwood	7	Cords			
	Basswood		1	Cords			
	Mixed Aspen		252	Cords			

DESCRIPTION OF TIMBER BY PAYMENT UNIT (PU), CON'T

PU	MARKET GROUP	PRODUCT	QUANTITY	UNIT	ACRES	ADVERTISE PRICE
10 con't	<i>B. T. Aspen</i>	<i>Pulpwood</i>	196	<i>Cords</i>		
	<i>Quaking Aspen</i>		56	<i>Cords</i>		
	Mixed Hardwood		35	Cords		
	<i>Beech</i>		1	<i>Cords</i>		
	<i>Ironwood</i>		2	<i>Cords</i>		
	<i>Red Maple</i>		2	<i>Cords</i>		
	<i>Sugar Maple</i>		29	<i>Cords</i>		
	<i>White Ash</i>		1	<i>Cords</i>		
	Paper Birch		11	Cords		
	Red Oak		13	Cords		
TOTAL:			580.4	MBF		
TOTAL:			5,498	Cords		

Sale Specific Conditions & Requirements

Sale Name: Remote Call Aspen

Sale Number: 54-017-22 Seq#: 2

1 - Sale Area

1.2 - Boundaries

1.2.1 - Painted boundaries (9/19)

The sale boundary and Payment Unit boundaries are marked and identified by red and yellow paint, and roads. Exterior sale boundary lines against state are marked with red paint, with the exception of the north boundary of Payment Unit 5, which is unpainted and identified by Meaford Road. Interior Payment Unit boundaries are marked with yellow paint, with the exception of the boundaries between Payment Units 1 & 2, 2 & 3, 6 & 7, 8 & 9, and 8 & 10, which are unpainted and identified by the roads shown on the Timber Sale Map. Retention patches are marked with red paint; no harvesting activities may occur within these areas. The painted boundary line trees are not Included Timber and are to be protected. Yellow painted trees designating an interior Payment Unit boundary are only to be cut when all surrounding Payment Units have been paid.

2 - Timber Specifications

2.1 - Included Timber

2.1.1 - Clearcut unit(s) with unmerchantable trees (6/14)

Within Payment Unit(s) 1-10, cut all trees that are two (2) inches or more at DBH, except cedar and hemlock, if present, and apple.

2.1.11 - Description of timber note (2/04)

Note that Misc. Species 1 = Yellow birch.

2.2 - Utilization

2.2.6 - Roundwood operation required (3/21)

The skidding of whole trees or tree segments with limbs attached is prohibited. All products must be produced as roundwood and forwarded to existing roads or landing areas in final product length.

2.2.10 - No chipping tops and limbs (8/16)

Within Payment Unit(s) 1-10, chipping of limbs or tops is not permitted. Limbs and the remaining top must be left on site and scattered. Slash near oak stumps shall be processed as described in General Condition 5.2.1.11.

3 - Payments

3.3 - Pre-measured Sales

3.3.4 - Dividing payment units (7/14)

Payment Unit(s) exceeding \$50,000 in value, may be divided at the request of the Purchaser and upon approval of the Unit Manager. Dividing Payment Units is a contract modification which requires a Timber Sale Contract Amendment. There will be only one division per Payment Unit.

3.4 - Damaged Timber

3.4.3 - Special Protection Areas (8/11)

The Purchaser shall protect special protection areas from damage by the Purchaser's operations. Special protection areas are exclusions within Payment Units 1 & 2 marked by red painted trees.

3.6 - Payment Unit Cutting Schedule

3.6.3 - Operating schedule (12/08)

Unless changed by written agreement, only two Payment Unit(s) may be operated at any one time. All contractual requirements on a Payment Unit shall be completed and accepted by the Unit Manager or his/her representative prior to the opening of an additional Payment Unit.

4 - Transportation

4.1 - Construction

4.1.3 - Slash and earthen piles (8/04)

Piles or windrows of earth along roads and landings that have been widened or constructed shall be leveled. Slash from road maintenance or construction, including stumps, shall be dispersed throughout the sale.

4.1.6 - Road construction (1/09)

Improvements of existing roads shall be done in such a way as to minimize the environmental and visual impacts. Merchantable trees shall be cut and utilized unless otherwise directed. Non-merchantable trees shall be severed and laid flat on the ground. Slash shall be scattered, and not left in windrows and kept a minimum of 10 feet back from the road edge. Stumps shall be set upright, not left on edge, and be moved at least 10 feet away from the road edge. Disturbed soil shall be feathered into the woods and not left in berms or windrows.

4.1.7 - Road closure (10/11)

All new roads built into the sale must be blocked to vehicle traffic within 30 days of completion of hauling. Overgrown roads that are reopened shall be considered new roads. In general, this will require constructing a four (4') foot high berm of stumps and logs covered with earth. All stumps from road building and landing construction must be reserved to block any newly constructed roads upon completion of the sale. These stumps must be scattered along the road system to prohibit vehicular movement. Temporary berms may be required if no sale activity occurs for 30 or more consecutive days.

4.1.12 - No new roads (1/12)

No new roads will be permitted in any Payment Unit. All operations are limited to existing roads. Skid trails will only be allowed.

4.2 - Maintenance

4.2.5 - Two wheel drive condition (2/04)

All existing trail roads on and adjacent to the sale area must be passable by two-wheel drive traffic for the duration of the sale.

5 - Operations

5.1 - Notification

5.1.1 - Pre-sale conference (10/16)

A pre-sale conference on site between the Purchaser and sale administrator is required prior to beginning any operations. The Unit Manager or his/her representative must be contacted at least 10 days in advance to schedule the conference.

5.1.3 - Well heads and natural gas pipelines (11/15)

The Purchaser is responsible for contacting the gas or pipeline company 30 days prior to operating equipment in the vicinity of well heads or natural gas pipelines.

5.1.4 - Post-sale conference (10/16)

A post-sale conference on site between the Purchaser and sale administrator is required 5 days prior to the completion of active logging operations to determine clean-up and repair of landings, road edges, and the fulfillment of other contract specifications.

5.2 - Conduct of Operations

5.2.1 - Slash

5.2.1.10 - No slash in openings (5/10)

No brush or logging debris is to be left in the maintained wildlife opening which is indicated by "G0" and/or "X0" on the Timber Sale Map. Any damage to the opening shall be repaired according to specifications of the Unit Manager or his/her representative.

5.2.1.11 - Slash for reforestation (3/21)

To protect oak stump sprout regeneration in Payment Units 5-10, sub-merchantable oak tops/slash are to be placed high and wide centered over harvested oak stumps with the goal of making the slash impenetrable by deer.

Note: Do not doom future oak sprouts by smothering them with compacted mats of windrowed slash that have been

driven over by equipment. Instead, construct open, airy piles which more closely resemble naturally fallen treetops.

5.2.2 - Hazard Trees/Snags

5.2.2.1 - Den trees (10/16)

Obvious hollow and/or den trees shall be protected and left standing unless they are a safety hazard.

5.2.3 - Operating Restrictions

5.2.3.1 - Operating restrictions (9/11)

Within Payment Unit(s) 1-4, cutting, skidding, and hauling are not permitted during the period of April 1 to October 15. In addition, the ground must be frozen or dry and firm. Furthermore, wood cut during the operational period must be hauled prior to April 1. This restriction is to protect the eastern massasauga rattlesnake and its habitat.

5.2.3.4 - Oak wilt restriction, no exceptions (1/18)

Within Payment Unit(s) 5 & 7-10, cutting, skidding, and hauling within the sale, and brushing of access roads to the sale, are not permitted during the period of April 15 to July 15. No exceptions will be granted. This is necessary to reduce the spread of oak wilt.

5.2.3.5 - Oak wilt restriction (1/18)

Within Payment Unit(s) 6, unless changed by written agreement, cutting, skidding, hauling within the sale and brushing of access roads to the sale are not permitted during the period of April 15 to July 15. Operations may be allowed if specific steps are taken to prevent damaging uncut oak during the high risk period. Those steps may include completing all road brushing before April 15th and clearing a tree-length buffer along uncut oak cover before April 15th. This is necessary to reduce the spread of oak wilt. For more information, contact the Unit Manager or his/her representative.

5.2.3.11 - Coppice regeneration protection (4/10)

Timber harvesting in any Payment Unit must be completed before significant deciduous tree sprouting occurs in that Payment Unit so as to minimize damage to the new regeneration.

5.2.4 - Dead and Down Creation

5.2.4.3 - Dead and down creation, dead trees (6/07)

Except as provided for in General Condition and Requirement 5.2.2, no dead trees, standing or down, are to be cut, skidded, or processed.

5.2.4.6 - Dead and down creation, other (9/09)

To encourage reptiles and amphibians, within Payment Unit(s) 1-4, create one brush pile for every 2 acres. Brush piles must be at least 6 feet by 6 feet, with a thickness of 4 feet, and dense enough to substantially shade the ground. These brush piles will preferably be placed near lowland edges and at least 2 chains away from any roads, two-tracks, or trails open to vehicles.

5.2.4.7 - Dead and down creation: hare, grouse, deer and other species (5/15)

To improve horizontal cover habitat for snowshoe hare, grouse, deer, and other species, the Purchaser is to push over one 12" or larger diameter (or largest diameter trees within stand) whole tree for every 2 acres. Push over trees are preferably a hardwood species such as oak or maple or if no hardwoods are present, a pine species (white or red). These will be fully merchantable, healthy trees. These trees should be tipped over with the root ball still attached so the base of the tree is suspended off the ground. The crown of the fallen tree should be at or near ground level after it is pushed over.

5.2.31 - Landing locations (9/13)

Landing areas are marked on the Timber Sale Map with a black square. Landings must be confined to these designated sites unless otherwise authorized by the Unit Manager or his/her representative. In general, landings are limited to a "T" turnaround which will accommodate a truck with a 50 foot trailer. Landings may not exceed 1/2-acre in size.

5.2.32 - Decking/landing restoration (9/13)

All decking and landing areas must have the surface area restored to a condition equal to or better than before. This is to ensure the proper regeneration of the stand. Wood debris, chips and "cookies" from trimmings must be removed or scattered away from landing and loading areas and may not be windrowed on the edge.

5.2.38 - No decking against live trees (2/04)

Cut products may not be decked against unmarked or designated leave trees.

5.4 - Soil Protection

5.4.2 - Skid trails (2/04)

Skid trails up and down slopes should be avoided. If however this is unavoidable, these trails will be left in a non-erodible condition using water bars, logs, and slash. Placing of slash on these skid trails while logging is ongoing may alleviate need for any further action. At the direction of the sale administrator, seed, fertilizer, and mulch may also be required.

7 - Other Conditions

7.3 - Contract Modifications

7.3.2 - Modification for oak wilt (2/05)

Within the sale area, there may be patches of oak wilt. If oak wilt is identified within the sale area, this contract may be modified. The following modifications could occur: time of cutting, species to cut, volume to harvest, or various others dealing with the treatment of oak wilt. If a species is not specified in this contract, it shall be paid for at the average price received for that species and product.



TIMBER SALE MAP

This information provided by authority of Part 525, 1994 PA 451, as amended.

Forest Management Unit Atlanta Management Unit	County Montmorency	Mapped By Barber	Date 09-26-2022	Page 1	of 1
Township 31N	Range 02E	Section(s) and Subdivision(s) 19: SENE,SE; 29: W1/2NW; 30: NW,NE,NESW,S1/2SW,W1/2SE	Scale 1:15,840		

Cover Type				Density	
A = Aspen	H = Hemlock	N = Marsh	U = Upland Brush	0 = Non Stocked	5 = Pole Timber Medium
B = Paper Birch	J = Jack Pine	O = Oak	UM = Upland Mixed	1 = Seedling Sapling Poor	6 = Pole Timber Well
C = Cedar	L = Lowland Brush	P = Lowland Poplar	V = Bog or Marsh	2 = Seedling Sapling Medium	7 = Saw Timber Poor
D = Treed Bog	LM = Lowland Mixed	Q = Mixed Swamp Conifer	W = White Pine	3 = Seedling Sapling Well	8 = Saw Timber Medium
E = Swamp Hdwoods	M = Mpl. Bch, Brch	R = Red Pine	X = Non Stocked	4 = Pole Timber Poor	9 = Saw Timber Well
F = Spruce Fir	MC = Mixed Conifer	S = Black Spruce	Z = Water		
G = Grass	MD = Mixed Deciduous	T = Tamarack			

PU	Acres	PU	Acres	PU	Acres
1	35.1	5	31.2	9	32.2
2	23.0	6	31.7	10	13.1
3	18.3	7	32.6		
4	4.9	8	21.4		

Remote Call Aspen

Compartment 042

243.5 Acres

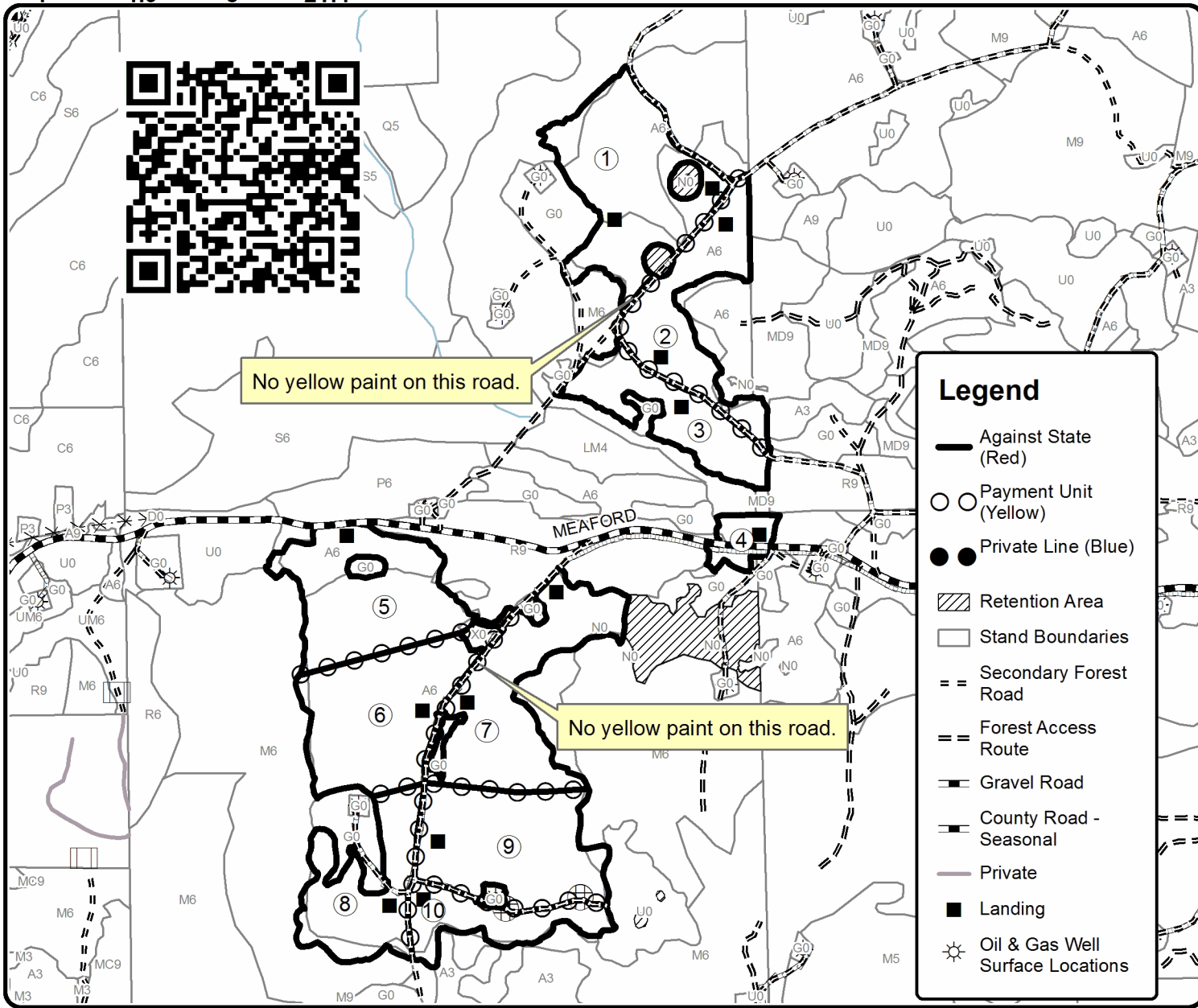
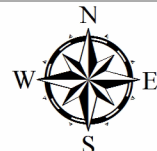

Legend

- Against State (Red)
- Payment Unit (Yellow)
- Private Line (Blue)
- Retention Area
- Stand Boundaries
- Secondary Forest Road
- Forest Access Route
- Gravel Road
- County Road - Seasonal
- Private
- Landing
- Oil & Gas Well Surface Locations

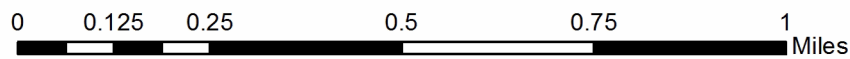

TIMBER SALE INFORMATION

Radio Tower Aspen Oak (54-024-22)

T32N, R02E, SEC. 23; T32N, R02E, SEC. 26; T32N, R02E, SEC. 34; T32N, R02E, SEC. 35.
Montmorency County (Advertised Price \$401,493.25)

SALE NOTE: The sale has fair to good quality timber within, as well as good access to the timber.

A recreation site such as a trail, pathway, or campground is within the sale area or the vicinity. Certain restrictions/specifications may be applicable including time restrictions. Access may be through other public land.

A timber sale contract for this lump sum, sealed bid timber sale will be awarded to the responsible bidder offering the highest sealed bid price. All units of volume listed below were estimated using the Inventory Manager computer program and the new Michigan taper model. Bids must be at or above the following advertised price for each product and species:

<u>PRODUCTS & SPECIES</u>	<u>ESTIMATED UNITS*</u>	<u>ADVERTISED PRICE</u>
Sawtimber		
B. T. Aspen	607.6 MBF	\$ 108.00 / MBF
Mixed Oak	399.5 MBF	\$ 152.00 / MBF
Red Maple	53.9 MBF	\$ 104.00 / MBF
Red Pine	52.9 MBF	\$ 164.00 / MBF
White Pine	78.0 MBF	\$ 169.00 / MBF
Pulpwood		
B. T. Aspen	4,258 Cords	\$ 30.20 / Cord
Jack Pine	18 Cords	\$ 16.65 / Cord
Mixed Oak	1,711 Cords	\$ 36.00 / Cord
Paper Birch	49 Cords	\$ 17.40 / Cord
Red Maple	1,019 Cords	\$ 34.65 / Cord
Red Pine	172 Cords	\$ 52.30 / Cord
White Pine	564 Cords	\$ 21.35 / Cord

* The total volume is statistically estimated within plus (+) or minus (-) 11.03 percent. There are an estimated 10,256 cords on this timber sale, plus or minus 1,132 cords at the 95% confidence level. The estimated units are final and not subject to adjustment. Prospective bidders are urged to examine this timber and to make their own estimates of quantity and quality.

BOND AND PAYMENT SCHEDULE:

1. A bond in the amount of \$20,075.00 to insure faithful performance of the conditions of the contract will be deposited by the successful bidder within 21 days of the sale award.
2. Cutting in any sale or unit without the required advance payment would be considered a trespass.
3. Total payment must be paid in advance or according to the following schedule :
 - (a) Ten percent (10%) of the sale value must be paid within 21 days of the sale award.
 - (b) The 10% down payment will be credited towards the first unit cut.
 - (c) Payment for each of the following units must be made before cutting begins in that unit:

<u>PAYMENT UNIT NUMBER</u>	<u>PERCENT OF TOTAL SALE VALUE</u>
01	3.9%
02	3.0%
03	7.7%
04	9.9%
05	10.2%
06	15.1%
07	10.6%
08	9.1%
09	10.2%
10	9.3%
11	3.0%
12	4.0%
13	4.0%

4. If no cutting takes place, the 10% down payment will not be refunded.
5. Operations on the contract issued will terminate on 12/31/2026.

SALE STATISTICS

Volumes were calculated in cubic feet using the Michigan taper model. Cubic foot volume includes all wood inside bark for the product indicated. For display purposes, cubic feet were converted to cords and MBF using a simple conversion factor, e.g. 79 cubic feet per cord and 185 cubic feet per MBF. The cubic foot volumes are precise; the cords and MBF volumes are not. Cubic foot volume cannot be directly converted to cords or boards with precision.

SALE VOLUMES

The total estimated sale volume may not equal the sum of the species/products due to the nature of statistical calculations associated with double sampling methodology.

VOLUME			STATISTICAL RANGE IN CORDS	
TOTAL CUBIC FEET	TOTAL CORDS	PERCENT ERROR	MINIMUM	MAXIMUM
810,258	10,256	11.03%	9,124	11,389

VDU VOLUMES

A VDU is a Volume Determination Unit. Volumes and their associated statistics are calculated at the VDU level and summarized to the sale level. There is often a one to one relationship between a VDU and a Payment Unit, but not always, depending on the cruise design. Refer to the VDU TO PAYMENT UNIT table.

VDU	VOLUME		PERCENT ERROR	RANGE IN CORDS	
	TOTAL CUBIC FEET	TOTAL CORDS		MINIMUM	MAXIMUM
5	34,582	438	53.30%	204	671
7	28,995	367	40.11%	220	514
51	63,165	800	26.02%	591	1,008
86	513,053	6,494	11.16%	5,770	7,219
120	25,360	321	55.31%	143	499
123	145,103	1,837	23.57%	1,404	2,270
TOTAL:	810,258	10,256		8,333	12,180

VDU TO PAYMENT UNIT

When a VDU is associated with more than one Payment Unit (PU), the VDU volumes are assigned to the PU based on acres of the VDU within the PU.

VDU	VDU ACRES	PU	PU ACRES
5	10.3	1	10.3
7	20.6	2	20.6
51	36.2	12	17.9
		13	18.3
86	137.9	3	17.0
		4	21.8
		5	22.4
		6	33.3
		7	23.4
		8	20.0
120	9.0	11	9.0
123	34.6	9	18.1
		10	16.5
TOTAL:	248.6		248.6

DESCRIPTION OF TIMBER BY PAYMENT UNIT (PU)

PU	MARKET GROUP	PRODUCT	QUANTITY	UNIT	ACRES	ADVERTISE PRICE	
1	B. T. Aspen	Sawtimber	11.0	MBF	10.3	\$15,464.40	
	Mixed Oak		6.0	MBF			
	<i>White Oak</i>		6.0	<i>MBF</i>			
	B. T. Aspen	Pulpwood	330	Cords			
	Mixed Oak		79	Cords			
	<i>Red Oak</i>		64	<i>Cords</i>			
	<i>White Oak</i>		15	<i>Cords</i>			
	Red Maple		16	Cords			
2	B. T. Aspen	Pulpwood	186	Cords	20.6	\$12,072.10	
	Mixed Oak		171	Cords			
	<i>Red (Hybrid) Oak</i>		99	<i>Cords</i>			
	<i>Red Oak</i>		72	<i>Cords</i>			
	White Pine		14	Cords			
	3		B. T. Aspen	Sawtimber			40.7
Mixed Oak		34.7	MBF				
<i>Red Oak</i>		27.3	<i>MBF</i>				
<i>White Oak</i>		7.4	<i>MBF</i>				
Red Maple		3.4	MBF				
Red Pine		2.8	MBF				
White Pine		5.8	MBF				
B. T. Aspen		Pulpwood	319	Cords			
Mixed Oak			141	Cords			
<i>Red Oak</i>			104	<i>Cords</i>			
<i>White Oak</i>			37	<i>Cords</i>			
Paper Birch			6	Cords			
Red Maple			90	Cords			
Red Pine			15	Cords			
White Pine			38	Cords			
4			B. T. Aspen	Sawtimber	52.2	MBF	21.8
	Mixed Oak		44.5		MBF		
	<i>Red Oak</i>		35.0		<i>MBF</i>		
	<i>White Oak</i>	9.5	<i>MBF</i>				
	Red Maple	4.3	MBF				
	Red Pine	3.6	MBF				
	White Pine	7.4	MBF				
	B. T. Aspen	Pulpwood	409		Cords		
	Mixed Oak		181		Cords		
	<i>Red Oak</i>		133		<i>Cords</i>		
	<i>White Oak</i>		48		<i>Cords</i>		
	Paper Birch		8		Cords		
	Red Maple		116		Cords		
	Red Pine		19		Cords		
	White Pine		49		Cords		
5	B. T. Aspen	Sawtimber	53.7	MBF	22.4	\$40,861.25	
	Mixed Oak		45.7	MBF			
	<i>Red Oak</i>		35.9	<i>MBF</i>			
	<i>White Oak</i>		9.8	<i>MBF</i>			
	Red Maple		4.5	MBF			
	Red Pine		3.7	MBF			
	White Pine		7.6	MBF			
	B. T. Aspen		Pulpwood	420			Cords
	Mixed Oak			186			Cords
	<i>Red Oak</i>			137			<i>Cords</i>
	<i>White Oak</i>			49			<i>Cords</i>
	Paper Birch			8			Cords
	Red Maple			119			Cords

DESCRIPTION OF TIMBER BY PAYMENT UNIT (PU), CON'T

PU	MARKET GROUP	PRODUCT	QUANTITY	UNIT	ACRES	ADVERTISE PRICE
5 con't	Red Pine	Pulpwood	20	Cords		
	White Pine		50	Cords		
6	B. T. Aspen	Sawtimber	79.8	MBF	33.3	\$60,707.65
	Mixed Oak		67.8	MBF		
	<i>Red Oak</i>		53.3	<i>MBF</i>		
	<i>White Oak</i>		14.5	<i>MBF</i>		
	Red Maple		6.6	MBF		
	Red Pine	5.6	MBF			
	White Pine	11.3	MBF			
	B. T. Aspen	Pulpwood	625	Cords		
	Mixed Oak		278	Cords		
	<i>Red Oak</i>		204	<i>Cords</i>		
	<i>White Oak</i>		74	<i>Cords</i>		
	Paper Birch		12	Cords		
	Red Maple		177	Cords		
	Red Pine		28	Cords		
White Pine	74		Cords			
7	B. T. Aspen	Sawtimber	56.0	MBF	23.4	\$42,682.65
	Mixed Oak		47.7	MBF		
	<i>Red Oak</i>		37.5	<i>MBF</i>		
	<i>White Oak</i>		10.2	<i>MBF</i>		
	Red Maple		4.7	MBF		
	Red Pine	3.9	MBF			
	White Pine	7.9	MBF			
	B. T. Aspen	Pulpwood	439	Cords		
	Mixed Oak		194	Cords		
	<i>Red Oak</i>		143	<i>Cords</i>		
	<i>White Oak</i>		51	<i>Cords</i>		
	Paper Birch		8	Cords		
	Red Maple		125	Cords		
	Red Pine		21	Cords		
White Pine	52		Cords			
8	B. T. Aspen	Sawtimber	47.9	MBF	20.0	\$36,479.05
	Mixed Oak		40.8	MBF		
	<i>Red Oak</i>		32.1	<i>MBF</i>		
	<i>White Oak</i>		8.7	<i>MBF</i>		
	Red Maple		4.0	MBF		
	Red Pine	3.3	MBF			
	White Pine	6.8	MBF			
	B. T. Aspen	Pulpwood	375	Cords		
	Mixed Oak		166	Cords		
	<i>Red Oak</i>		122	<i>Cords</i>		
	<i>White Oak</i>		44	<i>Cords</i>		
	Paper Birch		7	Cords		
	Red Maple		106	Cords		
	Red Pine		18	Cords		
White Pine	45		Cords			
9	B. T. Aspen	Sawtimber	139.3	MBF	18.1	\$41,123.55
	Mixed Oak		23.1	MBF		
	<i>/Red (Hybrid) Oak</i>		2.2	<i>MBF</i>		
	<i>Red Oak</i>		20.9	<i>MBF</i>		
	Red Maple		9.4	MBF		
	Red Pine	6.9	MBF			
	B. T. Aspen	Pulpwood	535	Cords		
	Mixed Oak		29	Cords		
	<i>/Red (Hybrid) Oak</i>		10	<i>Cords</i>		

DESCRIPTION OF TIMBER BY PAYMENT UNIT (PU), CON'T

PU	MARKET GROUP	PRODUCT	QUANTITY	UNIT	ACRES	ADVERTISE PRICE
9 con't	<i>Red Oak</i>	<i>Pulpwood</i>	14	<i>Cords</i>		
	<i>White Oak</i>		5	<i>Cords</i>		
	Red Maple		91	Cords		
	Red Pine		2	Cords		
10	B. T. Aspen	Sawtimber	127.0	MBF	16.5	\$37,396.85
	Mixed Oak		21.0	MBF		
	<i>/Red (Hybrid) Oak</i>		2.0	<i>MBF</i>		
	<i>Red Oak</i>		19.0	<i>MBF</i>		
	Red Maple	8.5	MBF			
	Red Pine	6.3	MBF			
	B. T. Aspen	Pulpwood	487	Cords		
	Mixed Oak		26	Cords		
	<i>/Red (Hybrid) Oak</i>		9	<i>Cords</i>		
	<i>Red Oak</i>		13	<i>Cords</i>		
	<i>White Oak</i>		4	<i>Cords</i>		
	Red Maple		83	Cords		
	Red Pine		1	Cords		
11	Mixed Oak	Sawtimber	16.8	MBF	9.0	\$11,962.60
	<i>Red Oak</i>		5.3	<i>MBF</i>		
	<i>White Oak</i>		11.5	<i>MBF</i>		
	Red Maple	8.5	MBF			
	B. T. Aspen	Pulpwood	103	Cords		
	Mixed Oak		58	Cords		
	<i>Red Oak</i>		18	<i>Cords</i>		
	<i>White Oak</i>		40	<i>Cords</i>		
	Red Maple		96	Cords		
12	Mixed Oak	Sawtimber	25.5	MBF	17.9	\$15,876.75
	<i>Red Oak</i>		13.1	<i>MBF</i>		
	<i>White Oak</i>		12.4	<i>MBF</i>		
	Red Pine	8.3	MBF			
	White Pine	15.5	MBF			
	B. T. Aspen	Pulpwood	15	Cords		
	Jack Pine		9	Cords		
	Mixed Oak		100	Cords		
	<i>Red Oak</i>		77	<i>Cords</i>		
	<i>White Oak</i>		23	<i>Cords</i>		
	Red Pine		24	Cords		
White Pine	120		Cords			
13	Mixed Oak	Sawtimber	25.9	MBF	18.3	\$16,118.85
	<i>Red Oak</i>		13.3	<i>MBF</i>		
	<i>White Oak</i>		12.6	<i>MBF</i>		
	Red Pine	8.5	MBF			
	White Pine	15.7	MBF			
	B. T. Aspen	Pulpwood	15	Cords		
	Jack Pine		9	Cords		
	Mixed Oak		102	Cords		
	<i>Red Oak</i>		78	<i>Cords</i>		
	<i>White Oak</i>		24	<i>Cords</i>		
	Red Pine		24	Cords		
White Pine	122		Cords			
TOTAL:			1,191.9	MBF		
TOTAL:			7,791	Cords		

Sale Specific Conditions & Requirements

Sale Name: Radio Tower Aspen Oak

Sale Number: 54-024-22 Seq#: 1

1 - Sale Area

1.2 - Boundaries

1.2.1 - Painted boundaries (9/19)

The sale boundary and Payment Unit boundaries are marked and identified by blue, red, and yellow paint. Exterior sale boundary lines against private are marked with blue paint. Exterior sale boundary lines against state are marked with red paint. The west boundary of Payment Units 6 & 7 is designated by the young saplings from a previous harvest in the adjacent stand, as shown on the Timber Sale Map. Interior Payment Unit boundaries are marked with yellow paint. Retention patches are marked with red paint; no harvesting activities may occur within these areas. The painted boundary line trees are not Included Timber and are to be protected. Yellow painted trees designating an interior Payment Unit boundary are only to be cut when all surrounding Payment Units have been paid.

2 - Timber Specifications

2.1 - Included Timber

2.1.1 - Clearcut unit(s) with unmerchantable trees (6/14)

Within Payment Unit(s) 1-13, cut all trees that are two (2) inches or more at DBH. In addition, see spec 5.2.4.7 - 'Dead and down creation' for instructions on orange marked trees.

2.1.5 - Overstory removal unit(s) (8/11)

Within Payment Unit(s) 12 & 13, all trees, which meet minimum piece specifications in 2.2 Utilization, are designated for cutting.

3 - Payments

3.4 - Damaged Timber

3.4.1 - Damaged timber (7/16)

General Condition and Requirement 3.4 Damaged Timber, defines liquidated damages for undesignated live merchantable trees which are cut or injured. In addition, within Payment Units 12 & 13, extreme care should be taken to avoid damage to tree seedlings and saplings.

Within Payment Units 12 & 13, if more than 50% of the tree seedlings or saplings (1/4" to 4.5" DBH) within a specified portion of the Sale Area are damaged, liquidated damages will be assessed at \$200 per acre for all acreage within that specified portion of the Sale Area that was damaged.

No damage is acceptable to undesignated live merchantable trees. Within the Sale Area, if more than 5% of trees (> 4.5" DBH) within a specified area of the sale are damaged, liquidated damages will be assessed for all trees damaged. Rates will be in accordance with General Condition and Requirement 3.4 Damaged Timber.

4 - Transportation

4.1 - Construction

4.1.3 - Slash and earthen piles (8/04)

Piles or windrows of earth along roads and landings that have been widened or constructed shall be leveled. Slash from road maintenance or construction, including stumps, shall be dispersed throughout the sale or be chipped, utilized or otherwise removed from the sale.

4.1.6 - Road construction (1/09)

Construction of new roads or improvements of existing roads shall be done in such a way as to minimize the environmental and visual impacts. Merchantable trees shall be cut and utilized unless otherwise directed. Non-merchantable trees shall be severed and laid flat on the ground. Slash shall be scattered, and not left in windrows and kept a minimum of 10 feet back from the road edge. Stumps shall be set upright, not left on edge, and be moved at least 10 feet away from the road edge.

Disturbed soil shall be feathered into the woods and not left in berms or windrows.

4.1.7 - Road closure (10/11)

All new roads built into the sale must be blocked to vehicle traffic upon completion of the sale. Overgrown roads that are reopened shall be considered new roads. In general, this will require constructing a four (4') foot high berm of stumps and logs covered with earth. Stumps and brush must be placed along the remainder of the trail. These roads must be rendered impassable to cars and trucks. Contact the Sale Administrator for specific details of design and placement.

4.2 - Maintenance

4.2.5 - Two wheel drive condition (2/04)

All existing trail roads on and adjacent to the sale area must be passable by two-wheel drive traffic for the duration of the sale.

5 - Operations

5.1 - Notification

5.1.1 - Pre-sale conference (10/16)

A pre-sale conference between the Purchaser and sale administrator is required prior to beginning any operations, to determine landing and road locations. The Unit Manager or his/her representative must be contacted at least 5 days in advance to schedule the conference.

5.1.3 - Well heads and natural gas pipelines (11/15)

The Purchaser is responsible for contacting the gas or pipeline company 14 days prior to operating equipment in the vicinity of well heads or natural gas pipelines. Contact RIVERSIDE ENERGY MICHIGAN LLC at 231-995-4001.

5.1.4 - Post-sale conference (10/16)

A post-sale conference on site between the Purchaser and sale administrator is required 5 days prior to the completion of active logging operations to determine clean-up and repair of landings, road edges, and the fulfillment of other contract specifications.

5.2 - Conduct of Operations

5.2.2 - Hazard Trees/Snags

5.2.2.1 - Den trees (10/16)

Obvious hollow and/or den trees shall be protected and left standing unless they are a safety hazard.

5.2.3 - Operating Restrictions

5.2.3.5 - Oak wilt restriction (1/18)

Within Payment Unit(s) 1-13, unless changed by written agreement, cutting, skidding, hauling within the sale and brushing of access roads to the sale are not permitted during the period of April 15 to July 15. Operations may be allowed if specific steps are taken to prevent damaging uncut oak during the high risk period. Those steps may include completing all road brushing before April 15th and clearing a tree-length buffer along uncut oak cover before April 15th. This is necessary to reduce the spread of oak wilt. For more information, contact the Unit Manager or his/her representative.

5.2.3.11 - Coppice regeneration protection (4/10)

Timber harvesting in any Payment Unit must be completed before significant aspen sprouting occurs in that Payment Unit so as to minimize damage to the new regeneration. Any post harvest operations, such as chipping, must be completed before sprouting of regeneration occurs. If it is anticipated that chipping will be delayed, then tops shall be carried to one central location or left unchipped. The Unit Manager or his/her representative may cease such operations if sprouting occurs before the operation is complete.

5.2.4 - Dead and Down Creation

5.2.4.7 - Dead and down creation: hare, grouse, deer and other species (5/15)

To improve horizontal cover habitat for snowshoe hare, grouse, deer, and other species, the Purchaser is to push over trees marked with an orange slash. These trees should be tipped over with the root ball still attached so the base of the tree is suspended off the ground. The crown of the fallen tree should be at or near ground level after it is pushed over.

5.2.32 - Decking/landing restoration (9/13)

All decking and landing areas must have the surface area restored to a condition equal to or better than before. This is to ensure the proper regeneration of the stand. Wood debris, chips and "cookies" from trimmings must be removed or scattered away from landing and loading areas and may not be windrowed on the edge.

5.2.37 - No decking areas (12/08)

No decking is allowed within 50 feet of roads or recreation trails within or adjacent to sale boundaries.

5.2.40 - Pathway protection (10/10)

Within Payment Units 12 & 13, is a hiking trail and is shown on the Timber Sale Map. Do not cut trees or damage posts with blue pathway markers, blue paint, or pink ribbon. Maintain a 20-foot-wide slash, debris, and rut free zone daily, using the pathway as the centerline. Do not run equipment down the pathway. Skidding across the trail may only occur in locations approved by the Sale Administrator.

5.2.41 - Snowmobile trail protection (9/11)

The trail #9 is a snowmobile trail and is shown on the Timber Sale Map. Do not cut or damage posts with orange trail markers or traffic control signs. If the trail is used, it must be maintained and restored to a condition equal to or better than before the sale. The road maintenance/restoration must be done prior to December 1. If the trail road is to be used for hauling during the snowmobile season, then a snow covered base must be left on the trail. Maintain a 20-foot-wide slash, debris, and rut free zone daily using the snowmobile trail as the centerline. No decking of forest products will be permitted along the snowmobile trail. All stumps within 20 feet of the snowmobile trail must be cut at ground level. In addition, any trees cut within 5 feet of the trail must have the stumps removed and be disposed of according to the direction of the Unit Manager or his/her representative.

5.4 - Soil Protection

5.4.1 - Rutting restriction, general (7/16)

Operations are to cease immediately if equipment and weather conditions result in rutting of roads and/or skid trails which are 12 inches or greater in depth and 50 feet in length. The Unit Manager or his/her representative may restrict hauling and/or skidding if ruts exceed the specified depth. With the Unit Manager or his/her representative's approval, the Purchaser may return to the area when the risk of rutting has decreased.

5.4.2 - Skid trails (2/04)

Skid trails up and down slopes should be avoided. If however this is unavoidable, these trails will be left in a non-erodible condition using water bars, logs, and slash. Placing of slash on these skid trails while logging is ongoing may alleviate need for any further action. At the direction of the sale administrator, seed, fertilizer, and mulch may also be required.

5.8 - Protection of Endangered Species

5.8.5 - Protection of raptor nests (3/13)

All trees with raptor nests will be protected if found during harvesting operations. Notification will be made to the Unit Manager or his/her representative who will notify the Wildlife Biologist so an on-site evaluation and recommendation can be made, if necessary.

6 - Safety and Fire Prevention

6.2 - Signing

6.2.1 - Road posting (10/20)

The Purchaser is responsible for posting and maintaining caution signs on roads and trails within and adjacent to sale boundaries prior to beginning operations. The road must be posted at appropriate distances from the Sale Area to warn of logging activity and truck traffic. Signs must be removed when harvest operations are suspended or completed. The Purchaser will provide these signs.

6.2.2 - Snowmobile trail posting (10/20)

The Purchaser is responsible for posting and maintaining caution signs on snowmobile trail 9 prior to beginning operations during the snowmobile season (approximately December 1 to March 31). The trail must be posted at appropriate distances from the Sale Area to warn of logging activity and truck traffic. Signs must be removed when harvest operations are suspended or completed. The Purchaser will provide these signs.

6.2.3 - Recreational trail posting (10/20)

The Purchaser is responsible for posting and maintaining caution signs on the hiking trail within Payment Units 12 & 13, prior to beginning operations. The trail must be posted at appropriate distances from the Sale Area to warn of logging activity and truck traffic at both ends of the trail. Signs must be removed when harvest operations are suspended or completed. The Purchaser will provide these signs.



TIMBER SALE MAP

This information provided by authority of Part 525, 1994 PA 451, as amended.

Sale Number	Year
54-024	22

Forest Management Unit Atlanta Management Unit	County Montmerency	Mapped By Michaud	Date 09/29/22	Page 1	of 3
Township 32N	Range 02E	Section(s) and Subdivision(s) Sections 23 NWSW,S1/2SW,NESE,S1/2SE 26 NW,N1/2NE,SENE,N1/2SW,NESE	Scale 1:15,840		

Cover Type				Density			
A = Aspen	H = Hemlock	N = Marsh	U = Upland Brush	0 = Non Stocked	5 = Pole Timber Medium		
B = Paper Birch	J = Jack Pine	O = Oak	UM = Upland Mixed	1 = Seedling Sapling Poor	6 = Pole Timber Well		
C = Cedar	L = Lowland Brush	P = Lowland Poplar	V = Bog or Marsh	2 = Seedling Sapling Medium	7 = Saw Timber Poor		
D = Treed Bog	LM = Lowland Mixed	Q = Mixed Swamp Conifer	W = White Pine	3 = Seedling Sapling Well	8 = Saw Timber Medium		
E = Swamp Hdwoods	M = Mpl, Bch, Brch	R = Red Pine	X = Non Stocked	4 = Pole Timber Poor	9 = Saw Timber Well		
F = Spruce Fir	MC = Mixed Conifer	S = Black Spruce	Z = Water				
G = Grass	MD = Mixed Deciduous	T = Tamarack					

PU	Acres	PU	Acres
1	10.3	6	33.3
2	20.6	7	23.4
3	17.0	8	20
4	21.8	9	18.1
5	22.4	10	16.5

Radio Tower Aspen Oak

Compartment 065

248.6 Acres

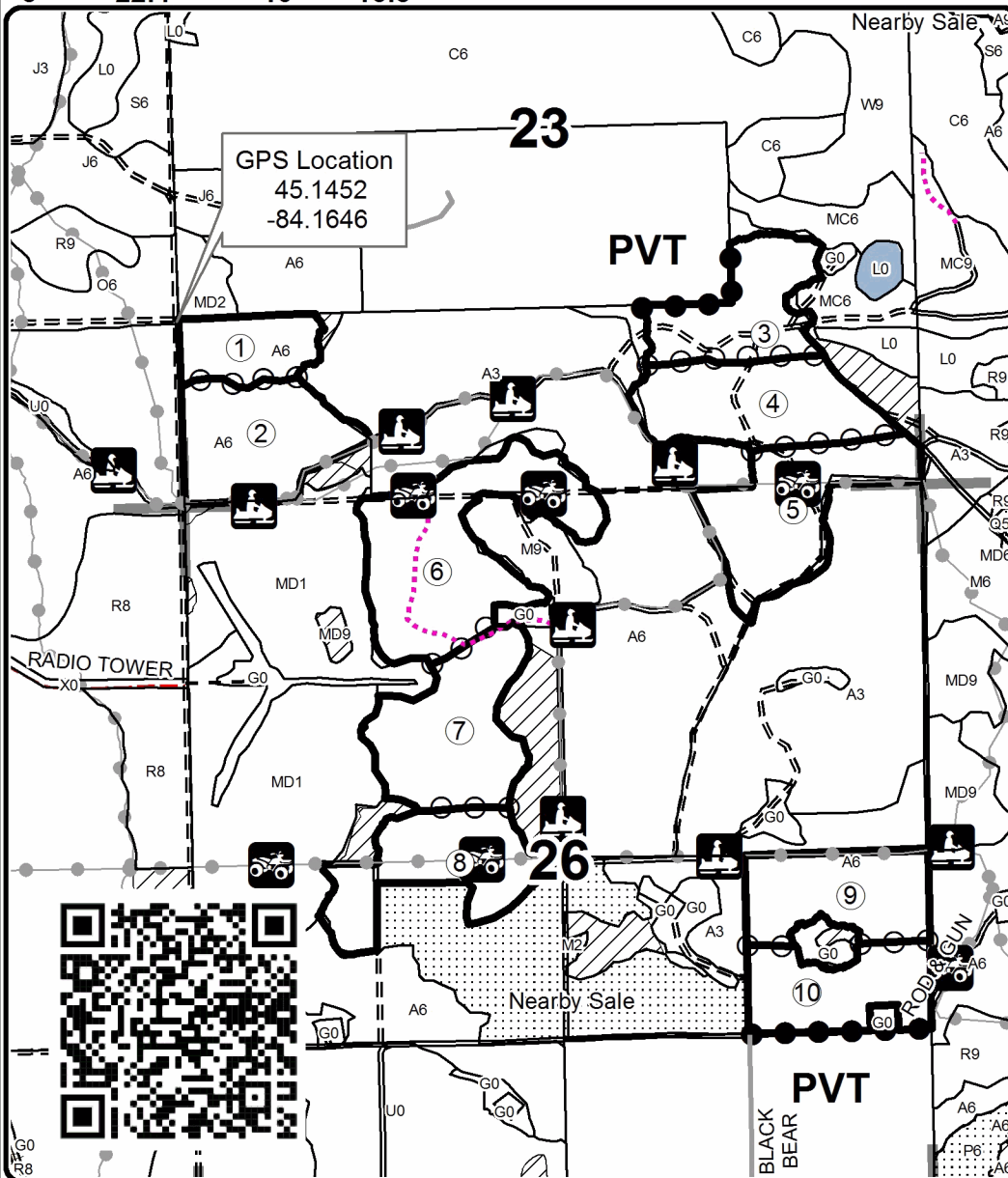

Legend

- ○ Payment Unit (Yellow)
- ● Private Line (Blue)
- State Line (Red)
- ⋯ Nearby Timber Sales
- Stand Boundaries
- ▨ Retention Area
- Recreational Trail
- Secondary Forest Road
- == Forest Access Route
- - Gravel Road
- - County Road - Seasonal
- Private
- ⋯ Temporary Management Access
- Lakes and Rivers

Locator Map
1:150,000

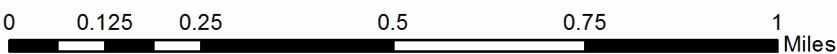
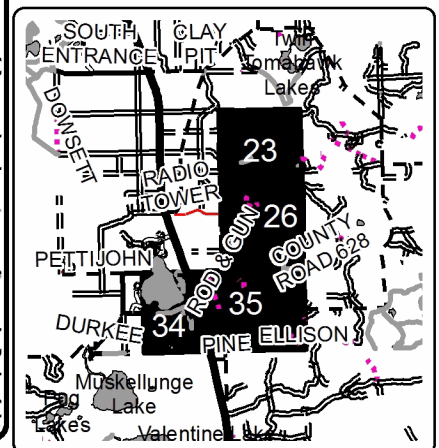



TIMBER SALE MAP

This information provided by authority of Part 525, 1994 PA 451, as amended.

Forest Management Unit Atlanta Management Unit	County Montmerency	Mapped By Michaud	Date 9/29/22	Page 2	of 3
Cruised By Michaud					

Township 32N	Range 02E	Section(s) and Subdivision(s) Section 34 N1/2SW,SESW	Scale 1:7,920
-----------------	--------------	---	------------------

Cover Type				Density	
A = Aspen	H = Hemlock	N = Marsh	U = Upland Brush	0 = Non Stocked	5 = Pole Timber Medium
B = Paper Birch	J = Jack Pine	O = Oak	UM = Upland Mixed	1 = Seedling Sapling Poor	6 = Pole Timber Well
C = Cedar	L = Lowland Brush	P = Lowland Poplar	V = Bog or Marsh	2 = Seedling Sapling Medium	7 = Saw Timber Poor
D = Treed Bog	LM = Lowland Mixed	Q = Mixed Swamp Conifer	W = White Pine	3 = Seedling Sapling Well	8 = Saw Timber Medium
E = Swamp Hdwoods	M = Mpl, Bch, Brch	R = Red Pine	X = Non Stocked	4 = Pole Timber Poor	9 = Saw Timber Well
F = Spruce Fir	MC = Mixed Conifer	S = Black Spruce	Z = Water		
G = Grass	MD = Mixed Deciduous	T = Tamarack			

PU Acres
11 9

Radio Tower Aspen Oak

Compartment 065
248.6 Acres

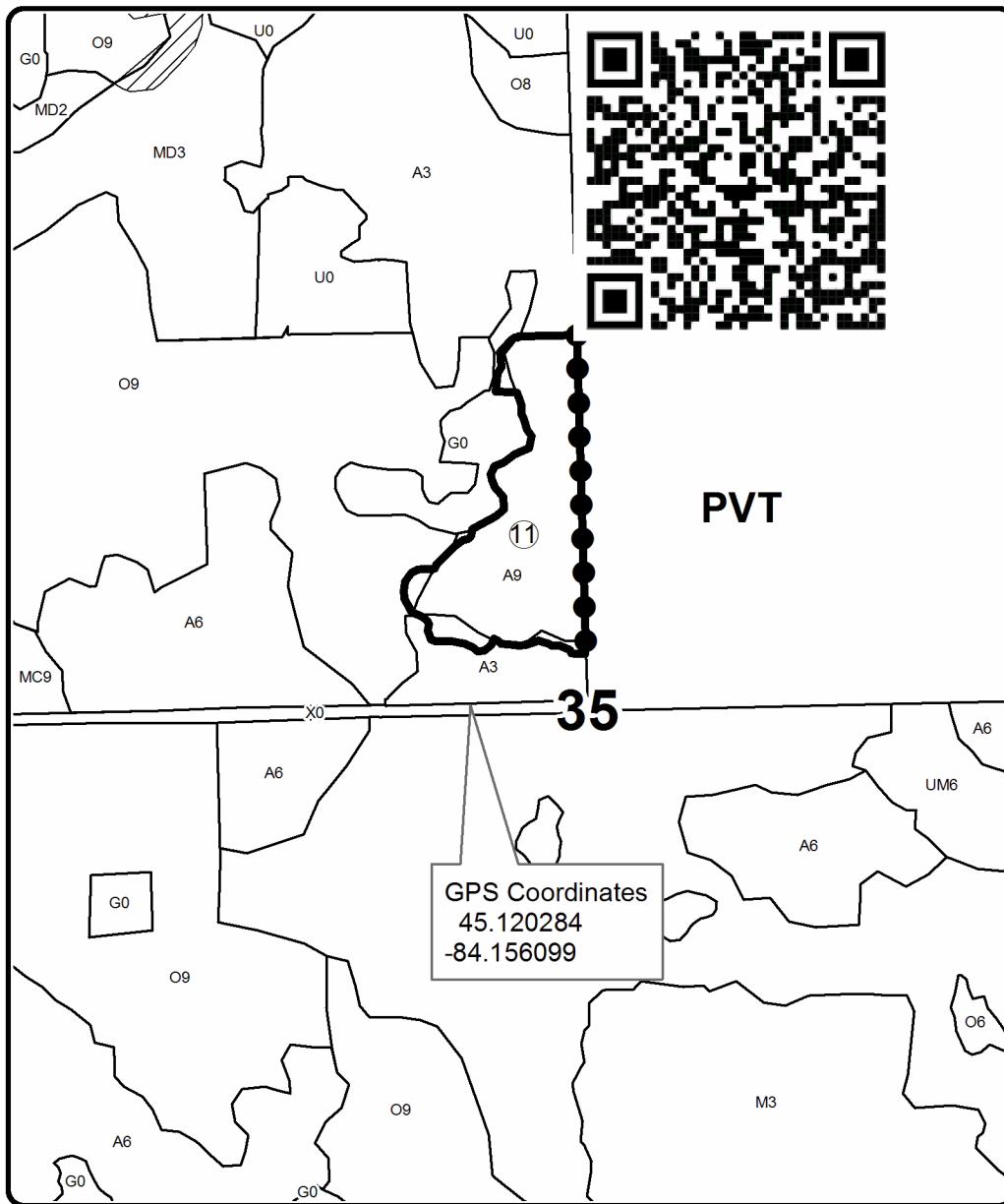
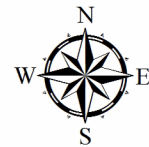

PVT

35

GPS Coordinates
45.120284
-84.156099

Legend

- Sale Boundary (Red)
- Private Line (Blue)
- Retention Area
- Stand Boundaries

Locator Map
1:150,000

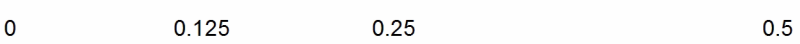
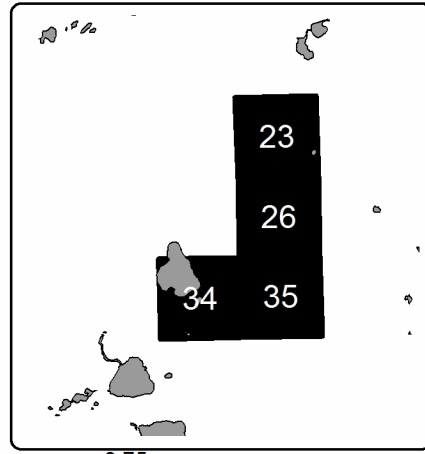



TIMBER SALE MAP

This information provided by authority of Part 525, 1994 PA 451, as amended.

Forest Management Unit Atlanta Management Unit	County Montmerency	Mapped By Michaud	Date 9/29/22	Page 3	of 3
Township 32N	Range 02E	Section(s) and Subdivision(s) Section 35 SENW	Scale 1:7,920		

Cover Type				Density	
A = Aspen	H = Hemlock	N = Marsh	U = Upland Brush	0 = Non Stocked	5 = Pole Timber Medium
B = Paper Birch	J = Jack Pine	O = Oak	UM = Upland Mixed	1 = Seedling Sapling Poor	6 = Pole Timber Well
C = Cedar	L = Lowland Brush	P = Lowland Poplar	V = Bog or Marsh	2 = Seedling Sapling Medium	7 = Saw Timber Poor
D = Treed Bog	LM = Lowland Mixed	Q = Mixed Swamp Conifer	W = White Pine	3 = Seedling Sapling Well	8 = Saw Timber Medium
E = Swamp Hdwoods	M = Mpl, Bch, Brch	R = Red Pine	X = Non Stocked	4 = Pole Timber Poor	9 = Saw Timber Well
F = Spruce Fir	MC = Mixed Conifer	S = Black Spruce	Z = Water		
G = Grass	MD = Mixed Deciduous	T = Tamarack			

PU	Acres
12	17.9
13	18.3

Radio Tower Aspen Oak

Compartment 065
248.6 Acres

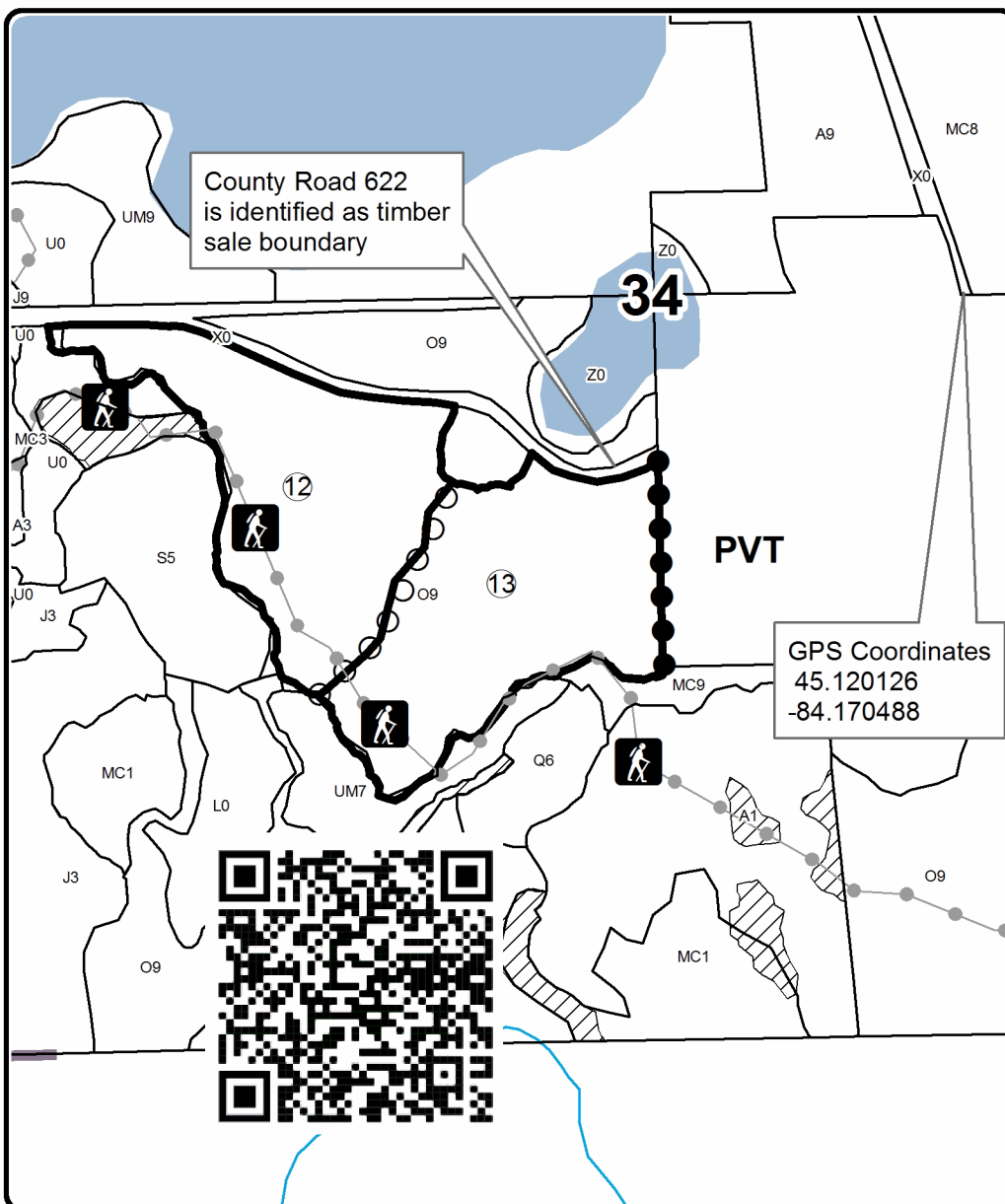
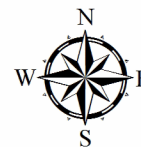

Legend

- Sale Boundary (Red)
- Payment Unit (Yellow)
- Private Line (Blue)
- Retention Area
- Stand Boundaries
- Recreational Trail
- Perennial River
- Lakes and Rivers

Locator Map
1:150,000

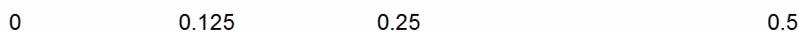
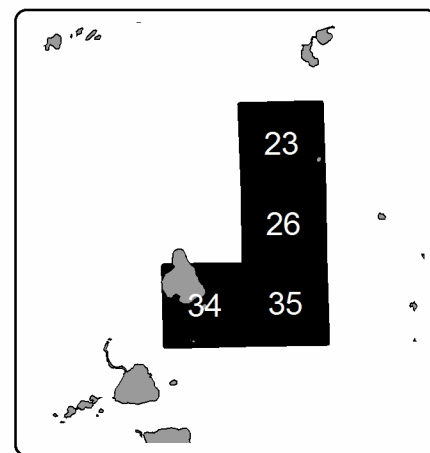

Radio Tower Aspen Oak (54-024-22)

T32N, R02E, SEC. 23; T32N, R02E, SEC. 26; T32N, R02E, SEC. 34; T32N, R02E,

In response to the notice of sale to be held 10:00 a.m. (local time) on July 25, 2023, I am hereby submitting my sealed bid (firm offer) for the following forest products to be cut. Bids for individual species must be at or above the advertised price. All non-responsive bid forms may be rejected.

<u>PRODUCTS & SPECIES</u>	<u>ESTIMATED VOLUME*</u>	<u>ADVERTISED PRICE</u>	<u>BID PRICE/UNIT</u>
Sawtimber			
B. T. Aspen	607.6 MBF	\$ 108.00/MBF	\$ _____
Mixed Oak	399.5 MBF	\$ 152.00/MBF	\$ _____
Red Maple	53.9 MBF	\$ 104.00/MBF	\$ _____
Red Pine	52.9 MBF	\$ 164.00/MBF	\$ _____
White Pine	78.0 MBF	\$ 169.00/MBF	\$ _____
Pulpwood			
B. T. Aspen	4,258 Cords	\$ 30.20/Cord	\$ _____
Jack Pine	18 Cords	\$ 16.65/Cord	\$ _____
Mixed Oak	1,711 Cords	\$ 36.00/Cord	\$ _____
Paper Birch	49 Cords	\$ 17.40/Cord	\$ _____
Red Maple	1,019 Cords	\$ 34.65/Cord	\$ _____
Red Pine	172 Cords	\$ 52.30/Cord	\$ _____
White Pine	564 Cords	\$ 21.35/Cord	\$ _____

*The volumes are statistically estimated within plus (+) or minus (-) 11.03 percent at 95% confidence level. These estimated volumes are final and not subject to adjustment. Prospective bidders are urged to examine this timber and to make their own estimates of quantity and quality.

I understand that any or all bids may be rejected. All bids must be signed and all bid items must be bid or the bid form may be rejected. I also understand that consideration and awarding a contract will be based upon my past performance and ability to complete the contract based upon equipment and staffing subject to my control.

FEDERAL ID: ____ - ____ - ____ or SOCIAL SECURITY NUMBER: ____ - ____ - ____

Company or individual bidding: _____

Company representative's name: _____

Address: _____

City: _____ State: _____ Zip: _____

IF AVAILABLE, PLEASE PLACE THE PERSONALIZED LABEL FROM YOUR PROSPECTUS IN THE ABOVE BOX.

Individual or company representative's signature: _____ Date: _____

Phone number : _____ Email (optional): _____

THE WINNING BIDDER MUST COMPLETE THE VERIFICATION OF WORKER'S DISABILITY COMPENSATION ACT COMPLIANCE (ON REVERSE SIDE IF DOUBLE SIDED) WITHIN 21 DAYS OF SALE AWARD DATE



FOR DEPARTMENT USE ONLY	
Sale Number (XX - XXX - XX - XX)	
Forest Management Unit:	

TIMBER SALE VERIFICATION OF WORKER'S DISABILITY COMPENSATION ACT COMPLIANCE

As required by Act 317, P.A. 1969 (Worker's Compensation) and
Part 5 of Act 451 of 1994, as amended.

VERIFICATION OF WORKER'S DISABILITY COMPENSATION ACT COMPLIANCE

- This verification must be completed and submitted within 21 days of contract award and prior to the issuance of the timber sale contract.
- In addition, if boxes 2B or 2C are checked, then Notice of Exclusion or Certificate of Insurance must be submitted within twenty-one (21) days of the contract award and prior to the issuance of the timber sale contract.
- All information must be typed or printed except for written signatures.

Please Check Appropriate Categories:

1. My business is organized as (you **must** check one of the boxes below):
 - A. Sole Proprietorship (individual)
 - B. Partnership
 - C. Corporation
2. You **must** check one of the boxes below:
 - A. I certify my business is a sole proprietorship and it has no employees but the sole proprietor. I am not subject to the Worker's Compensation Laws.
 - B. I certify my business has satisfied its obligation to the Worker's Compensation Act through the use of an approved Notice of Exclusion (BWC-337, Rev. 5/96). I will provide a copy of the Notice of Exclusion within 21 days of the contract award. (For questions or a copy of the BWC-337, please call the Worker's Compensation Bureau at 517-322-1195).
 - C. I certify my business has a Worker's Compensation Policy. I will provide an original Certificate of Insurance within twenty-one (21) days of the contract award.
3. If you have checked item 2(A) or 2(B), you **must** indicate the number of **both** full-time and part-time employees, other than yourself, including family members and active partners (if none, you must enter "0").

_____ Full-time Employees

_____ Part-time Employees

Name of Business		Federal ID (or) Social Security No.	
Address		Telephone ()	
City	State	ZIP	

I hereby certify that the above information is true and correct. I agree to notify the Michigan DNR of any changes that occur in factors affecting my coverage during any of my present and future operations.

Signature of Owner or Authorized Representative

Title

Date

Please complete the "SEALED BID" information on the next page

Remote Call Aspen (54-017-22)

T31N, R02E, SEC. 19; T31N, R02E, SEC. 29; T31N, R02E, SEC. 30; Montmorency

In response to the notice of sale to be held 10:00 a.m. (local time) on July 25, 2023, I am hereby submitting my sealed bid (firm offer) for the following forest products to be cut. Bids for individual species must be at or above the advertised price. All non-responsive bid forms may be rejected.

<u>PRODUCTS & SPECIES</u>	<u>ESTIMATED VOLUME*</u>	<u>ADVERTISED PRICE</u>	<u>BID PRICE/UNIT</u>
Sawtimber			
Basswood	80.7 MBF	\$ 80.00/MBF	\$ _____
Beech	6.5 MBF	\$ 65.00/MBF	\$ _____
Mixed Aspen	418.0 MBF	\$ 101.00/MBF	\$ _____
Red Oak	33.8 MBF	\$ 196.00/MBF	\$ _____
Sugar Maple	41.4 MBF	\$ 331.00/MBF	\$ _____
Pulpwood			
Balsam Fir	130 Cords	\$ 37.35/Cord	\$ _____
Basswood	149 Cords	\$ 15.65/Cord	\$ _____
Mixed Aspen	4,092 Cords	\$ 28.30/Cord	\$ _____
Mixed Hardwood	824 Cords	\$ 32.45/Cord	\$ _____
Paper Birch	136 Cords	\$ 16.30/Cord	\$ _____
Red Oak	167 Cords	\$ 45.00/Cord	\$ _____

*The volumes are statistically estimated within plus (+) or minus (-) 18.47 percent at 95% confidence level. These estimated volumes are final and not subject to adjustment. Prospective bidders are urged to examine this timber and to make their own estimates of quantity and quality.

I understand that any or all bids may be rejected. All bids must be signed and all bid items must be bid or the bid form may be rejected. I also understand that consideration and awarding a contract will be based upon my past performance and ability to complete the contract based upon equipment and staffing subject to my control.

FEDERAL ID: _____ or SOCIAL SECURITY NUMBER: _____

Company or individual bidding: _____

Company representative's name: _____

Address: _____

City: _____ State: _____ Zip: _____

IF AVAILABLE, PLEASE PLACE THE PERSONALIZED LABEL FROM YOUR PROSPECTUS IN THE ABOVE BOX.

Individual or company representative's signature: _____ Date: _____

Phone number : _____ Email (optional): _____

THE WINNING BIDDER MUST COMPLETE THE VERIFICATION OF WORKER'S DISABILITY COMPENSATION ACT COMPLIANCE (ON REVERSE SIDE IF DOUBLE SIDED) WITHIN 21 DAYS OF SALE AWARD DATE



FOR DEPARTMENT USE ONLY	
Sale Number (XX - XXX - XX - XX)	
Forest Management Unit:	

TIMBER SALE VERIFICATION OF WORKER'S DISABILITY COMPENSATION ACT COMPLIANCE

As required by Act 317, P.A. 1969 (Worker's Compensation) and
Part 5 of Act 451 of 1994, as amended.

VERIFICATION OF WORKER'S DISABILITY COMPENSATION ACT COMPLIANCE

- This verification must be completed and submitted within 21 days of contract award and prior to the issuance of the timber sale contract.
- In addition, if boxes 2B or 2C are checked, then Notice of Exclusion or Certificate of Insurance must be submitted within twenty-one (21) days of the contract award and prior to the issuance of the timber sale contract.
- All information must be typed or printed except for written signatures.

Please Check Appropriate Categories:

1. My business is organized as (you **must** check one of the boxes below):
 - A. Sole Proprietorship (individual)
 - B. Partnership
 - C. Corporation
2. You **must** check one of the boxes below:
 - A. I certify my business is a sole proprietorship and it has no employees but the sole proprietor. I am not subject to the Worker's Compensation Laws.
 - B. I certify my business has satisfied its obligation to the Worker's Compensation Act through the use of an approved Notice of Exclusion (BWC-337, Rev. 5/96). I will provide a copy of the Notice of Exclusion within 21 days of the contract award. (For questions or a copy of the BWC-337, please call the Worker's Compensation Bureau at 517-322-1195).
 - C. I certify my business has a Worker's Compensation Policy. I will provide an original Certificate of Insurance within twenty-one (21) days of the contract award.
3. If you have checked item 2(A) or 2(B), you **must** indicate the number of **both** full-time and part-time employees, other than yourself, including family members and active partners (if none, you must enter "0").

_____ Full-time Employees

_____ Part-time Employees

Name of Business		Federal ID (or) Social Security No.	
Address		Telephone ()	
City	State	ZIP	

I hereby certify that the above information is true and correct. I agree to notify the Michigan DNR of any changes that occur in factors affecting my coverage during any of my present and future operations.

Signature of Owner or Authorized Representative

Title

Date

Please complete the "SEALED BID" information on the next page

Press Eject RP (54-013-22)

T30N, R01E, SEC. 28; T30N, R01E, SEC. 29; T30N, R01E, SEC. 32; T30N, R01E,

In response to the notice of sale to be held 10:00 a.m. (local time) on July 25, 2023, I am hereby submitting my sealed bid (firm offer) for the following forest products to be cut. Bids for individual species must be at or above the advertised price. All non-responsive bid forms may be rejected.

<u>PRODUCTS & SPECIES</u>	<u>ESTIMATED VOLUME*</u>	<u>ADVERTISED PRICE</u>	<u>BID PRICE/UNIT</u>
Sawtimber			
Red Pine	34.6 MBF	\$ 154.00/MBF	\$ _____
Pulpwood			
Jack Pine	101 Cords	\$ 15.60/Cord	\$ _____
Northern Pin Oak	27 Cords	\$ 45.00/Cord	\$ _____
Quaking Aspen	11 Cords	\$ 28.30/Cord	\$ _____
Red Pine	687 Cords	\$ 49.00/Cord	\$ _____

*The volumes are statistically estimated within plus (+) or minus (-) 21.12 percent at 95% confidence level. These estimated volumes are final and not subject to adjustment. Prospective bidders are urged to examine this timber and to make their own estimates of quantity and quality.

I understand that any or all bids may be rejected. All bids must be signed and all bid items must be bid or the bid form may be rejected. I also understand that consideration and awarding a contract will be based upon my past performance and ability to complete the contract based upon equipment and staffing subject to my control .

FEDERAL ID: ____ - ____ or SOCIAL SECURITY NUMBER: ____ - ____ - ____

Company or individual bidding: _____

Company representative's name: _____

Address: _____

City: _____ State: _____ Zip: _____

IF AVAILABLE, PLEASE PLACE THE PERSONALIZED LABEL FROM YOUR PROSPECTUS IN THE ABOVE BOX.

Individual or company representative's signature: _____ Date: _____

Phone number : _____ Email (optional): _____

THE WINNING BIDDER MUST COMPLETE THE VERIFICATION OF WORKER'S DISABILITY COMPENSATION ACT COMPLIANCE (ON REVERSE SIDE IF DOUBLE SIDED) WITHIN 21 DAYS OF SALE AWARD DATE



FOR DEPARTMENT USE ONLY	
Sale Number (XX - XXX - XX - XX)	
Forest Management Unit:	

TIMBER SALE VERIFICATION OF WORKER'S DISABILITY COMPENSATION ACT COMPLIANCE

As required by Act 317, P.A. 1969 (Worker's Compensation) and
Part 5 of Act 451 of 1994, as amended.

VERIFICATION OF WORKER'S DISABILITY COMPENSATION ACT COMPLIANCE

- This verification must be completed and submitted within 21 days of contract award and prior to the issuance of the timber sale contract.
- In addition, if boxes 2B or 2C are checked, then Notice of Exclusion or Certificate of Insurance must be submitted within twenty-one (21) days of the contract award and prior to the issuance of the timber sale contract.
- All information must be typed or printed except for written signatures.

Please Check Appropriate Categories:

1. My business is organized as (you **must** check one of the boxes below):
 - A. Sole Proprietorship (individual)
 - B. Partnership
 - C. Corporation
2. You **must** check one of the boxes below:
 - A. I certify my business is a sole proprietorship and it has no employees but the sole proprietor. I am not subject to the Worker's Compensation Laws.
 - B. I certify my business has satisfied its obligation to the Worker's Compensation Act through the use of an approved Notice of Exclusion (BWC-337, Rev. 5/96). I will provide a copy of the Notice of Exclusion within 21 days of the contract award. (For questions or a copy of the BWC-337, please call the Worker's Compensation Bureau at 517-322-1195).
 - C. I certify my business has a Worker's Compensation Policy. I will provide an original Certificate of Insurance within twenty-one (21) days of the contract award.
3. If you have checked item 2(A) or 2(B), you **must** indicate the number of **both** full-time and part-time employees, other than yourself, including family members and active partners (if none, you must enter "0").

_____ Full-time Employees

_____ Part-time Employees

Name of Business		Federal ID (or) Social Security No.	
Address		Telephone ()	
City	State	ZIP	

I hereby certify that the above information is true and correct. I agree to notify the Michigan DNR of any changes that occur in factors affecting my coverage during any of my present and future operations.

Signature of Owner or Authorized Representative

Title

Date

Please complete the "SEALED BID" information on the next page

Second Try Koenig Rd RP (54-008-22)
T33N, R04E, SEC. 28; T33N, R04E, SEC. 32; T33N, R04E, SEC. 33; Presque Isle

In response to the notice of sale to be held 10:00 a.m. (local time) on July 25, 2023, I am hereby submitting my sealed bid (firm offer) for the following forest products to be cut. Bids for individual species must be at or above the advertised price. All non-responsive bid forms may be rejected.

<u>PRODUCTS & SPECIES</u>	<u>ESTIMATED VOLUME*</u>	<u>ADVERTISED PRICE</u>	<u>BID PRICE/UNIT</u>
Sawtimber			
B. T. Aspen	3.6 MBF	\$ 88.00/MBF	\$ _____
Black/Red (Hybrid) Oak	22.1 MBF	\$ 123.00/MBF	\$ _____
Red Pine	38.3 MBF	\$ 133.00/MBF	\$ _____
Pulpwood			
B. T. Aspen	119 Cords	\$ 24.55/Cord	\$ _____
Jack Pine	22 Cords	\$ 13.50/Cord	\$ _____
Mixed Hardwood	8 Cords	\$ 28.15/Cord	\$ _____
Mixed Oak	59 Cords	\$ 29.25/Cord	\$ _____
Red Pine	1,479 Cords	\$ 42.50/Cord	\$ _____

*The volumes are statistically estimated within plus (+) or minus (-) 11.84 percent at 95% confidence level. These estimated volumes are final and not subject to adjustment. Prospective bidders are urged to examine this timber and to make their own estimates of quantity and quality.

I understand that any or all bids may be rejected. All bids must be signed and all bid items must be bid or the bid form may be rejected. I also understand that consideration and awarding a contract will be based upon my past performance and ability to complete the contract based upon equipment and staffing subject to my control .

FEDERAL ID: ____ - ____ - ____ or SOCIAL SECURITY NUMBER: ____ - ____ - ____

Company or individual bidding: _____

Company representative's name: _____

Address: _____

City: _____ State: _____ Zip: _____

IF AVAILABLE, PLEASE PLACE THE PERSONALIZED LABEL FROM YOUR PROSPECTUS IN THE ABOVE BOX.

Individual or company representative's signature : _____ Date: _____

Phone number : _____ Email (optional): _____

THE WINNING BIDDER MUST COMPLETE THE VERIFICATION OF WORKER'S DISABILITY COMPENSATION ACT COMPLIANCE (ON REVERSE SIDE IF DOUBLE SIDED) WITHIN 21 DAYS OF SALE AWARD DATE



FOR DEPARTMENT USE ONLY	
Sale Number (XX - XXX - XX - XX)	
Forest Management Unit:	

TIMBER SALE VERIFICATION OF WORKER'S DISABILITY COMPENSATION ACT COMPLIANCE

As required by Act 317, P.A. 1969 (Worker's Compensation) and
Part 5 of Act 451 of 1994, as amended.

VERIFICATION OF WORKER'S DISABILITY COMPENSATION ACT COMPLIANCE

- This verification must be completed and submitted within 21 days of contract award and prior to the issuance of the timber sale contract.
- In addition, if boxes 2B or 2C are checked, then Notice of Exclusion or Certificate of Insurance must be submitted within twenty-one (21) days of the contract award and prior to the issuance of the timber sale contract.
- All information must be typed or printed except for written signatures.

Please Check Appropriate Categories:

1. My business is organized as (you **must** check one of the boxes below):
 - A. Sole Proprietorship (individual)
 - B. Partnership
 - C. Corporation
2. You **must** check one of the boxes below:
 - A. I certify my business is a sole proprietorship and it has no employees but the sole proprietor. I am not subject to the Worker's Compensation Laws.
 - B. I certify my business has satisfied its obligation to the Worker's Compensation Act through the use of an approved Notice of Exclusion (BWC-337, Rev. 5/96). I will provide a copy of the Notice of Exclusion within 21 days of the contract award. (For questions or a copy of the BWC-337, please call the Worker's Compensation Bureau at 517-322-1195).
 - C. I certify my business has a Worker's Compensation Policy. I will provide an original Certificate of Insurance within twenty-one (21) days of the contract award.
3. If you have checked item 2(A) or 2(B), you **must** indicate the number of **both** full-time and part-time employees, other than yourself, including family members and active partners (if none, you must enter "0").

_____ Full-time Employees

_____ Part-time Employees

Name of Business		Federal ID (or) Social Security No.	
Address		Telephone ()	
City	State	ZIP	

I hereby certify that the above information is true and correct. I agree to notify the Michigan DNR of any changes that occur in factors affecting my coverage during any of my present and future operations.

Signature of Owner or Authorized Representative

Title

Date

Please complete the "SEALED BID" information on the next page