



**DEPARTMENT OF NATURAL RESOURCES  
STATE OF MICHIGAN  
TIMBER SALE PROSPECTUS #7346**

SCHEDULED SALE DATE AND TIME: 10:00 a.m. (local time) on November 28, 2023.

LOCATION: GLADWIN MGMT UNIT, 801 NORTH SILVERLEAF, GLADWIN, MI 48624.

PROSPECTUS NOTE: The bidder is advised to inspect the sale area and review the location, estimated volumes, operating costs and contract terms of proposed sales. Please be aware that some landowners may request 60 days or more notice for access across their land.

Notice is hereby given that bids will be received by the Unit Manager, GLADWIN MANAGEMENT UNIT, for certain timber on the following described lands:

Eymer Oasis Mix (73-001-23) / T19N, R03E, SEC. 1 , N1/2NW,N1/2NE,S1/2SW.

T19N, R03E, SEC. 11, NENE.

T19N, R03E, SEC. 12, NWNW.

T19N, R03E, SEC. 2 , NW,NENE,NWSE,S1/2SE.

T20N, R03E, SEC. 26, SESW.

T20N, R03E, SEC. 34, E1/2NE,NESE.

T20N, R03E, SEC. 35, NW,NENE,S1/2NE,SW.

T20N, R03E, SEC. 36, W1/2NW.

Arenac County, Advertised Price \$443,408.10, 387.0 Acres, Red Pine, Hardwood.

SALE NOTE: Some Payment Units are wet, and caution will be needed to avoid rutting. The access into Payment Units 16, 20 & 21 will need to be discussed on site. The Payment Units have steep slopes and/or wet drainages that will need to be addressed. The cut areas along Black Creek Road will need to be cut clean from the yellow line to the road. In addition, Black Creek Road acts as a Payment Unit line for Payment Units 4 & 5; 6 & 7; 8 & 9. Lastly, some road work will be needed on the trail that crosses through Payment Unit 17 to make it useable.

Access may be through other public land.

Bone Yard Jack (73-002-23) / T20N, R03E, SEC. 22, SWNE,S1/2SW,W1/2SE.

T20N, R03E, SEC. 27, NW,NE,SW,W1/2SE.

T20N, R03E, SEC. 28, SESE.

Arenac County, Advertised Price \$175,336.95, 216.2 Acres, Hardwood, Red Pine.

SALE NOTE: Payment Unit 1 will need an access road built into the unit. Payment Unit 2 access is the open forest road that follows the northern boundary of Payment Unit 3. Payment Units 7 & 8 access is from the closed road to the north. No access on the west side of M-76 due to railroad tracks.

## BID INSTRUCTIONS (VER. 10/10/2022):

### 1. Scheduled Bid Location, Date, and Time (2/11)

Bids must be received by the Unit Manager, GLADWIN OFFICE, 801 NORTH SILVERLEAF, GLADWIN, MI 48624, no later than 10:00 a.m. (local time) on November 28, 2023. For further information concerning this sale, contact Blair Tweedale at 989-426-9205 extension 7640.

### 2. Bidder's Qualifications (10/22)

If all or part of a timber sale was prepared by a private contractor, the contractor and that contractor's company are not permitted to bid on the timber sale. A person must be 18 years of age or older to purchase timber. Permanent employees of the Department of Natural Resources or members of their immediate household may not bid. Former employees, in the permanent or seasonal class, may not bid until 3 months after the last day of active duty. Bids will not be accepted from individuals or companies appearing on the DNR/FRD No-Bid List. This list contains the names of purchasers who previously failed to execute a contract within 21-days or who have a history of poor performance.

### 3. Preparation of Sealed Bids (5/16)

Bid Forms may be completed online thru Michigan DNR Timber Sale Online Bidding (OLB) at [www.michigan.gov/timberbidding](http://www.michigan.gov/timberbidding) or by completing the hardcopy Bid Form found in the Timber Sale Prospectus. Hardcopy Bid Forms shall be manually signed in ink. Registration in OLB is considered your 'signature' for all bids submitted thru that system. Bid prices must be entered for each species and product in the Bid Price column for all material subject to bidding and all fill-in blanks must be completed. If erasures or other changes appear on the hardcopy Bid Form, each erasure or change must be initialed by the person signing the bid.

### 4. Submission of Sealed Bids (5/16)

Bid forms may be obtained from the Unit Manager or thru OLB. Bids may be submitted hardcopy or thru OLB. All hardcopy bids must be submitted on the bid form and in an envelope clearly identified as described in this section. NOTE: Only one bid form per bid envelope. Sealed bids must be submitted to the Unit office designated in the prospectus and must be submitted at or prior to the time established in the prospectus. The envelope should show on the outside (a) the sale name or number and (b) the date and time of bid opening, as shown in the prospectus. Bids received after the time specified in the sale prospectus are late bids and will be rejected.

It is possible for a bidder to submit multiple bids on a single sale. For example, a bid may be submitted hardcopy and a bid may be submitted thru OLB. Or, two bidders from the same company could both submit bids on the same sale. If this were to happen, the State would accept all bids received and award the contract accordingly. All bidding and contractual requirements would apply to all bids received.

### 5. Public Opening of Sealed Bids (7/16)

If conditions permit, the sealed bids will be publicly opened and posted at the time and place set in the prospectus.

If a bidder, present at a bid opening, has submitted bids on more than one sale, that bidder may withdraw their unopened bid envelopes or announce the withdrawal of their online bid after being declared the successful bidder on one sale.

### 6. Award of Contract (1/11)

Award of the contract will be made to the Bidder whose bid, conforming to the prospectus, is most advantageous to the State of Michigan on the basis of total value at rates bid for the estimated quantities. The State reserves the right to reject any bid or waive any minor irregularity in bids received. A written award mailed (or otherwise furnished) to the successful Bidder shall be deemed to result in a binding contract without further action by either party.

### 7. Down Payment (1/11)

The Bidder to whom award is made must make a down payment within 21 days of the sale award. The amount of the down payment will be calculated as shown in the Bond and Payment Schedule of this prospectus. Only cash may be used to meet this requirement.

### 8. Performance Security (1/11)

As guarantee of faithful performance, a cash bond, certificate of deposit, surety bond or irrevocable letter of credit (LOC) is required within 21 days of the sale award. The amount of the performance security is shown in the Bond and

Payment Schedule of this prospectus. If an LOC or surety is used, the coverage must extend for at least 6 months beyond the contract expiration.

#### 9. Worker's Compensation (10/22)

Purchaser shall obtain worker's compensation insurance to cover claims under Michigan's Worker's Disability Compensation Act of 1969 or similar employee benefit act of any other state applicable to an employee. Verification of Worker's Disability Compensation Act Compliance must be completed and submitted within 21 days of contract award and prior to the issuance of the timber sale contract. In addition, if applicable, Notice of Exclusion or Certificate of Insurance must also be submitted.

#### 10. Timber Sale Contract (10/22)

Additional conditions and requirements common to all timber sales are listed on the timber sale contract (R4031) and are available on line at [www.michigan.gov/timber](http://www.michigan.gov/timber). Contact the Unit Manager for additional information or a sample contract. Within 21 days of the date of the award letter, the bidder must sign the contract and provide the required down payment, performance security, and verification of worker's disability compensation. The down payment and performance security shall be in accordance with the provisions of the timber sale contract, in the sums stated in this prospectus. If these actions are not taken, then the Bidder, the Bidder's corporation, and the corporation's principals may not be permitted to bid on State timber sales for a period of 3 months after the first offense, 6 months after the second offense, and 1 year after the third offense. An offense will only be counted against the Bidder for 5 years. In addition, the Bidder certifies that if awarded this contract, the Bidder will complete the timber sale contract in accordance with its terms and any modifications thereof including requirements to purchase, cut, and remove the included timber by the expiration date.

Payment Unit values in the State Forest Timber Sale Contract are calculated based on the advertised value of the Payment Unit as a percentage of the total advertised value of the contract. The advertised value of each Payment Unit is given in the Description of Timber by Payment Unit table on the Timber Sale Information page. For example, if the value of Payment Unit 1 is advertised as \$1,500 and the total Timber Sale value is advertised as \$10,000, the contract price for Payment Unit 1 will be 15% of the total bid price ( $\$1,500/\$10,000 * 100$ ).

#### 11. Disclaimer of Estimates and Bidder's Warranty of Inspection (10/22)

Before submitting this bid, the Bidder is advised and cautioned to inspect the sale area, review the requirements of the sale contract, and take other steps as may be reasonably necessary to ascertain the location, estimated volumes, construction estimates, and operating costs of the proposed sale. Failure to do so will not relieve the Bidder from responsibility for completing the contract.

The Bidder warrants that this bid is submitted solely on the basis of the Bidder's examination and inspection of the quality and quantity of the timber offered for sale and the Bidder's opinion of the value thereof and the costs of recovery. No reliance should be placed on the State of Michigan's estimates of timber quality, quantity or costs of recovery. Bidder further acknowledges that the State of Michigan: (i) expressly disclaims any warranty of fitness of timber for any purpose; (ii) offers this timber as is without any warranty of quality (merchantability) or quantity and (iii) expressly disclaims any warranty as to the quantity or quality of timber sold.

#### 12. Certification and Chain-of-Custody (10/22)

Unless otherwise indicated in the contract under section 7 – Other Conditions of the Sale Specific Conditions & Requirements, the area encompassed by this timber sale is certified to the standards of the Forest Stewardship Council (FSC) - Certificate #SCS-FM/COC-00090N and the Sustainable Forestry Initiative (SFI) - Certificate #NSF-SFIS-5Y031-SF5. Forest products from this sale may be delivered to the mill as "FSC 100% and / or SFI certified" as long as the contractor hauling the forest products is chain-of-custody (COC) certified or covered under a COC certificate from the destination mill. The purchaser is responsible for maintaining COC after leaving the sale area.

#### 13. Good Neighbor Authority (GNA) Requirements (10/22)

If the name of this timber sales contains the acronym GNA, it is authorized by the Good Neighbor Authority (GNA) and covered by various agreements between the U.S. Forest Service and the State. The timber sale occurs on federal land and the following conditions apply:

GNA contracts on US Forest Service land will not be awarded to purchasers on the Federal list of excluded parties. The System for Award Management (SAM) will be checked for active excluded parties prior to award of contract. In

addition, the Bidder to whom award is made must complete an Assurance Regarding Felony Conviction or Tax Delinquent Status for Corporate Applicants (AD-3031).

14. Good Neighbor Authority (GNA) Requirements, con't (10/22)

Bidder certifies, by signing this bid form, that to the best of Bidder's knowledge that the following representations are accurate and complete.

- a. That the Bidder and its principals are not presently debarred, suspended, proposed for debarment, declared ineligible, or voluntary excluded from timber sales (covered transactions) by any Federal department or agency.
- b. That the Bidder and its principals have not within a 3-year period preceding this bid been convicted of or had a civil judgment rendered against them for commission of fraud or a criminal offense in connection with obtaining , attempting to obtain, or performing a public (Federal, State, or local) transaction or contract under a public transaction; violation of Federal or State antitrust statutes or commission of embezzlement, theft, forgery, bribery, falsification or destruction of records, making false statements, or receiving stolen property.
- c. That the Bidder and its principals are not presently indicted for or otherwise criminally or civilly charged by a governmental entity (Federal, State, or local) with commission of any of the offenses enumerated in paragraph b of this certification.
- d. That the Bidder and its principals have not within a 3-year period preceding this bid had one or more public transactions (Federal, State, or local) terminated for breach or default of a timber or forest product contract.

Bidders that cannot certify this requirement, in whole or in part, shall submit an explanation with their bid.

Scott Bowen  
Director

## TIMBER SALE INFORMATION

### Eymer Oasis Mix (73-001-23)

T19N, R03E, SEC. 1; T19N, R03E, SEC. 11; T19N, R03E, SEC. 12; T19N, R03E, SEC. 2; T20N, R03E, SEC. 26; T20N, R03E, SEC. 34; T20N, R03E, SEC. 35; T20N, R03E, SEC. 36.

SALE NOTE: Some Payment Units are wet, and caution will be needed to avoid rutting. The access into Payment Units 16, 20 & 21 will need to be discussed on site. The Payment Units have steep slopes and/or wet drainages that will need to be addressed. The cut areas along Black Creek Road will need to be cut clean from the yellow line to the road. In addition, Black Creek Road acts as a Payment Unit line for Payment Units 4 & 5; 6 & 7; 8 & 9. Lastly, some road work will be needed on the trail that crosses through Payment Unit 17 to make it useable.

Access may be through other public land.

A timber sale contract for this lump sum, sealed bid timber sale will be awarded to the responsible bidder offering the highest sealed bid price. All units of volume listed below were estimated using the Inventory Manager computer program and the new Michigan taper model. Bids must be at or above the following advertised price for each product and species:

<u>PRODUCTS &amp; SPECIES</u>	<u>ESTIMATED UNITS*</u>		<u>ADVERTISED PRICE</u>
<b>Sawtimber</b>			
Black/Red (Hybrid) Oak	242.0	MBF	\$ 120.00 / MBF
Jack Pine	27.8	MBF	\$ 49.00 / MBF
Mixed Aspen	739.8	MBF	\$ 67.00 / MBF
Red Maple	239.0	MBF	\$ 65.00 / MBF
Red Oak	36.9	MBF	\$ 150.00 / MBF
Red Pine	641.5	MBF	\$ 129.00 / MBF
White Oak	37.4	MBF	\$ 90.00 / MBF
White Pine	483.7	MBF	\$ 67.00 / MBF
<b>Pulpwood</b>			
Black Cherry	29	Cords	\$ 20.00 / Cord
Jack Pine	289	Cords	\$ 24.15 / Cord
Mixed Aspen	1,165	Cords	\$ 28.80 / Cord
Mixed Oak	516	Cords	\$ 16.40 / Cord
Paper Birch	67	Cords	\$ 21.45 / Cord
Red Maple	1,200	Cords	\$ 20.00 / Cord
Red Oak	50	Cords	\$ 16.40 / Cord
Red Pine	2,110	Cords	\$ 54.10 / Cord
Sugar Maple	13	Cords	\$ 20.00 / Cord
White Pine	1,120	Cords	\$ 30.00 / Cord

\* The total volume is statistically estimated within plus (+) or minus (-) 6.37 percent. There are an estimated 11,987 cords on this timber sale, plus or minus 764 cords at the 95% confidence level. The estimated units are final and not subject to adjustment. Prospective bidders are urged to examine this timber and to make their own estimates of quantity and quality.

### **BOND AND PAYMENT SCHEDULE:**

1. A bond in the amount of \$44,341.00 to insure faithful performance of the conditions of the contract will be deposited by the successful bidder within 21 days of the sale award.
2. Cutting in any sale or unit without the required advance payment would be considered a trespass.
3. Total payment must be paid in advance or according to the following schedule :
  - (a) Ten percent (10%) of the sale value must be paid within 21 days of the sale award.
  - (b) The 10% down payment will be credited towards the first unit cut.

(c) Payment for each of the following units must be made before cutting begins in that unit:

PAYMENT UNIT NUMBER	PERCENT OF TOTAL SALE VALUE
01	3.0%
02	4.4%
03	8.8%
04	5.3%
05	3.6%
06	7.5%
07	6.2%
08	4.1%
09	5.4%
10	5.9%
11	5.4%
12	2.2%
13	2.3%
14	3.0%
15	5.0%
16	4.4%
17	5.0%
18	6.2%
19	5.8%
20	1.8%
21	4.7%

4. If no cutting takes place, the 10% down payment will not be refunded.

5. Operations on the contract issued will terminate on 03/31/2026.

**SALE STATISTICS**

Volumes were calculated in cubic feet using the Michigan taper model. Cubic foot volume includes all wood inside bark for the product indicated. For display purposes, cubic feet were converted to cords and MBF using a simple conversion factor, e.g. 79 cubic feet per cord and 185 cubic feet per MBF. The cubic foot volumes are precise; the cords and MBF volumes are not. Cubic foot volume cannot be directly converted to cords or boards with precision.

**SALE VOLUMES**

The total estimated sale volume may not equal the sum of the species/products due to the nature of statistical calculations associated with double sampling methodology.

VOLUME		PERCENT ERROR	STATISTICAL RANGE IN CORDS	
TOTAL CUBIC FEET	TOTAL CORDS		MINIMUM	MAXIMUM
946,976	11,987	6.37%	11,223	12,751

**VDU VOLUMES**

A VDU is a Volume Determination Unit. Volumes and their associated statistics are calculated at the VDU level and summarized to the sale level. There is often a one to one relationship between a VDU and a Payment Unit, but not always, depending on the cruise design. Refer to the VDU TO PAYMENT UNIT table.

VDU	VOLUME		PERCENT ERROR	RANGE IN CORDS	
	TOTAL CUBIC FEET	TOTAL CORDS		MINIMUM	MAXIMUM
55	106,177	1,344	15.32%	1,138	1,550
145	25,544	323	47.55%	170	477
171	24,995	316	32.05%	215	418
174	66,625	843	22.66%	652	1,034
187	55,946	708	22.27%	550	866
189	62,508	791	30.68%	548	1,034
209	64,468	816	26.27%	602	1,030
224	84,956	1,075	17.76%	884	1,266
225	33,373	422	18.82%	343	502
230	92,938	1,176	19.83%	943	1,410
231	82,482	1,044	28.57%	746	1,342
241	54,311	687	21.58%	539	836
244	31,563	400	34.41%	262	537
265	71,923	910	20.34%	725	1,096
309	41,464	525	24.14%	398	652
312	27,110	343	25.25%	257	430
313	20,594	261	30.99%	180	341
<b>TOTAL:</b>	<b>946,976</b>	<b>11,987</b>		<b>9,153</b>	<b>14,821</b>

**VDU TO PAYMENT UNIT**

When a VDU is associated with more than one Payment Unit (PU), the VDU volumes are assigned to the PU based on acres of the VDU within the PU.

VDU	VDU ACRES	PU	PU ACRES
55	44.6	8	19.1
		9	25.5
145	8.3	20	8.3
171	10.4	14	10.4
174	15.6	18	15.6
187	14.5	16	14.5
189	38.0	17	38.0
209	31.3	21	31.3
224	39.5	6	21.7
		7	17.8
225	15.7	1	15.7
230	35.6	4	21.0
		5	14.6
231	27.6	10	14.4
		11	13.2
241	35.5	3	35.5
244	8.0	2	8.0
265	17.3	19	17.3
309	19.9	15	19.9
312	13.4	12	13.4
313	11.8	13	11.8
<b>TOTAL:</b>	<b>387.0</b>		<b>387.0</b>



**DESCRIPTION OF TIMBER BY PAYMENT UNIT (PU)**

PU	MARKET GROUP	PRODUCT	QUANTITY	UNIT	ACRES	ADVERTISE PRICE
1	Black/Red (Hybrid)	Sawtimber	31.8	MBF	15.7	\$13,178.20
	Jack Pine		1.6	MBF		
	Red Pine		1.9	MBF		
	White Oak		2.8	MBF		
	White Pine		40.3	MBF		
	Jack Pine	Pulpwood	22	Cords		
	Mixed Aspen		82	Cords		
	<i>B. T. Aspen</i>		33	Cords		
	<i>Quaking Aspen</i>		49	Cords		
	Mixed Oak		86	Cords		
	<i>/Red (Hybrid) Oak</i>		74	Cords		
	<i>White Oak</i>		12	Cords		
	Red Pine		13	Cords		
	White Pine		36	Cords		
2	Mixed Aspen	Sawtimber	3.6	MBF	8.0	\$19,309.20
	<i>Quaking Aspen</i>		3.6	MBF		
	Red Oak		15.8	MBF		
	Red Pine		93.1	MBF		
	White Pine		14.7	MBF		
	Mixed Aspen	Pulpwood	39	Cords		
	<i>Quaking Aspen</i>		39	Cords		
	Red Maple		15	Cords		
	Red Oak		17	Cords		
	Red Pine		32	Cords		
	White Pine		9	Cords		
3	Red Pine	Sawtimber	58.3	MBF	35.5	\$38,478.80
	Black Cherry	Pulpwood	3	Cords		
	<i>Black Cherry</i>	Sawtimber	0.5	MBF		
	<i>Black Cherry</i>	Pulpwood	2	Cords		
	Mixed Aspen		4	Cords		
	<i>B. T. Aspen</i>		4	Cords		
	Red Pine		569	Cords		
4	Black/Red (Hybrid)	Sawtimber	35.2	MBF	21.0	\$23,291.25
	Jack Pine		1.8	MBF		
	Mixed Aspen		6.9	MBF		
	<i>B. T. Aspen</i>		6.9	MBF		
	Red Maple		1.1	MBF		
	Red Pine		42.2	MBF		
	White Oak		2.9	MBF		
	White Pine		51.4	MBF		
	Black Cherry	Pulpwood	13	Cords		
	<i>Black Cherry</i>		13	Cords		
	Jack Pine		5	Cords		
	Mixed Aspen		63	Cords		
	<i>B. T. Aspen</i>		50	Cords		
	<i>Quaking Aspen</i>		13	Cords		
	Mixed Oak		99	Cords		
	<i>/Red (Hybrid) Oak</i>		93	Cords		
	<i>White Oak</i>		6	Cords		
	Red Maple		59	Cords		
	Red Pine		19	Cords		
White Pine		109	Cords			
5	Black/Red (Hybrid)	Sawtimber	24.5	MBF	14.6	\$16,136.70
	Jack Pine		1.2	MBF		
	Mixed Aspen		4.8	MBF		
	<i>B. T. Aspen</i>		4.8	MBF		

**DESCRIPTION OF TIMBER BY PAYMENT UNIT (PU), CON'T**

PU	MARKET GROUP	PRODUCT	QUANTITY	UNIT	ACRES	ADVERTISE PRICE	
5 con't	Red Maple	Sawtimber	0.7	MBF			
	Red Pine		29.3	MBF			
	White Oak		2.1	MBF			
	White Pine		35.8	MBF			
	Black Cherry		Pulpwood	9			Cords
	<i>Black Cherry</i>			9			<i>Cords</i>
	Jack Pine			4			Cords
	Mixed Aspen			43			Cords
	<i>B. T. Aspen</i>			34			<i>Cords</i>
	<i>Quaking Aspen</i>			9			<i>Cords</i>
	Mixed Oak			68			Cords
	<i>/Red (Hybrid) Oak</i>			64			<i>Cords</i>
	<i>White Oak</i>			4			<i>Cords</i>
	Red Maple			41			Cords
	Red Pine			13			Cords
White Pine	75	Cords					
6	Black/Red (Hybrid)	Sawtimber		3.0	MBF	21.7	\$33,297.20
	Red Pine			54.2	MBF		
	Mixed Oak			Pulpwood	4		
	<i>/Red (Hybrid) Oak</i>		4		<i>Cords</i>		
	Red Maple		1		Cords		
	Red Pine		478		Cords		
7	Black/Red (Hybrid)	Sawtimber	2.4		MBF	17.8	\$27,342.50
	Red Pine		44.4		MBF		
	Mixed Oak		Pulpwood	4	Cords		
	<i>/Red (Hybrid) Oak</i>			4	<i>Cords</i>		
	Red Pine			393	Cords		
8	Black/Red (Hybrid)	Sawtimber		26.3	MBF	19.1	\$18,159.45
	Jack Pine			3.4	MBF		
	Red Maple		12.2	MBF			
	Red Pine		16.2	MBF			
	White Oak		1.9	MBF			
	White Pine		45.9	MBF			
	Black Cherry		Pulpwood	2	Cords		
	<i>Black Cherry</i>			2	<i>Cords</i>		
	Jack Pine			12	Cords		
	Mixed Aspen			35	Cords		
	<i>B. T. Aspen</i>			17	<i>Cords</i>		
	<i>Quaking Aspen</i>			18	<i>Cords</i>		
	Mixed Oak			49	Cords		
	<i>/Red (Hybrid) Oak</i>			47	<i>Cords</i>		
	<i>White Oak</i>			2	<i>Cords</i>		
	Paper Birch			3	Cords		
	<i>Paper Birch</i>			3	<i>Cords</i>		
	Red Maple			34	Cords		
	Red Pine			20	Cords		
	White Pine			158	Cords		
9	Black/Red (Hybrid)	Sawtimber		35.0	MBF	25.5	\$24,160.35
	Jack Pine			4.5	MBF		
	Red Maple			16.2	MBF		
	Red Pine			21.7	MBF		
	White Oak			2.6	MBF		
	White Pine			61.2	MBF		
	Black Cherry		Pulpwood	2	Cords		
	<i>Black Cherry</i>			2	<i>Cords</i>		
	Jack Pine			15	Cords		

**DESCRIPTION OF TIMBER BY PAYMENT UNIT (PU), CON'T**

PU	MARKET GROUP	PRODUCT	QUANTITY	UNIT	ACRES	ADVERTISE PRICE
9 con't	Mixed Aspen	Pulpwood	46	Cords		
	<i>B. T. Aspen</i>		23	<i>Cords</i>		
	<i>Quaking Aspen</i>		23	<i>Cords</i>		
	Mixed Oak		64	Cords		
	<i>/Red (Hybrid) Oak</i>		62	<i>Cords</i>		
	<i>White Oak</i>		2	<i>Cords</i>		
	Paper Birch		4	Cords		
	<i>Paper Birch</i>		4	<i>Cords</i>		
	Red Maple		45	Cords		
	Red Pine		27	Cords		
White Pine	211	Cords				
10	Black/Red (Hybrid)	Sawtimber	11.7	MBF	14.4	\$26,283.00
	Red Pine		71.6	MBF		
	White Pine		39.1	MBF		
	Mixed Oak	Pulpwood	15	Cords		
	<i>/Red (Hybrid) Oak</i>		15	<i>Cords</i>		
	Red Pine		209	Cords		
	White Pine		49	Cords		
11	Black/Red (Hybrid)	Sawtimber	10.7	MBF	13.2	\$24,024.20
	Red Pine		65.7	MBF		
	White Pine		35.8	MBF		
	Mixed Oak	Pulpwood	13	Cords		
	<i>/Red (Hybrid) Oak</i>		13	<i>Cords</i>		
	Red Pine		191	Cords		
	White Pine		44	Cords		
12	Jack Pine	Sawtimber	10.4	MBF	13.4	\$9,884.75
	Red Pine		5.6	MBF		
	White Pine		21.3	MBF		
	Jack Pine	Pulpwood	185	Cords		
	Mixed Oak		2	Cords		
	<i>/Red (Hybrid) Oak</i>		2	<i>Cords</i>		
	Red Pine		11	Cords		
White Pine	71	Cords				
13	Black/Red (Hybrid)	Sawtimber	12.3	MBF	11.8	\$10,072.90
	Jack Pine		4.9	MBF		
	Red Pine		14.6	MBF		
	White Pine	14.8	MBF			
	Jack Pine	Pulpwood	46	Cords		
	Mixed Aspen		27	Cords		
	<i>Quaking Aspen</i>		27	<i>Cords</i>		
	Mixed Oak		18	Cords		
	<i>/Red (Hybrid) Oak</i>		16	<i>Cords</i>		
	<i>White Oak</i>		2	<i>Cords</i>		
	Red Pine		41	Cords		
White Pine	36		Cords			
14	Black/Red (Hybrid)	Sawtimber	9.0	MBF	10.4	\$13,363.60
	Mixed Aspen		20.1	MBF		
	<i>Quaking Aspen</i>		20.1	<i>MBF</i>		
	Red Pine	36.4	MBF			
	White Oak	4.8	MBF			
	White Pine	24.8	MBF			
	Mixed Aspen	Pulpwood	17	Cords		
	<i>Quaking Aspen</i>		17	<i>Cords</i>		
	Mixed Oak		28	Cords		
	<i>/Red (Hybrid) Oak</i>		18	<i>Cords</i>		
	<i>White Oak</i>		10	<i>Cords</i>		

**DESCRIPTION OF TIMBER BY PAYMENT UNIT (PU), CON'T**

PU	MARKET GROUP	PRODUCT	QUANTITY	UNIT	ACRES	ADVERTISE PRICE	
14 con't	Red Maple	Pulpwood	2	Cords			
	Red Pine		29	Cords			
	White Pine		53	Cords			
15	Black/Red (Hybrid)	Sawtimber	14.4	MBF	19.9	\$22,304.00	
	Red Pine		76.5	MBF			
	White Oak		0.1	MBF			
	White Pine	41.1	MBF				
	Mixed Aspen	Pulpwood	22	Cords			
	<i>B. T. Aspen</i>		22	Cords			
	Mixed Oak		20	Cords			
	<i>/Red (Hybrid) Oak</i>		14	Cords			
	<i>White Oak</i>		6	Cords			
	Red Maple		3	Cords			
	Red Pine		52	Cords			
	White Pine	137	Cords				
16	Black/Red (Hybrid)	Sawtimber	19.0	MBF	14.5	\$19,517.15	
	Mixed Aspen		100.4	MBF			
	<i>B. T. Aspen</i>		75.0	MBF			
	<i>Quaking Aspen</i>		25.4	MBF			
	Red Maple		20.1	MBF			
	White Pine	8.7	MBF				
	Mixed Aspen	Pulpwood	108	Cords			
	<i>B. T. Aspen</i>		69	Cords			
	<i>Quaking Aspen</i>		39	Cords			
	Mixed Oak		17	Cords			
	<i>/Red (Hybrid) Oak</i>		17	Cords			
	Paper Birch		15	Cords			
	<i>Paper Birch</i>		1.3	MBF			
	<i>Paper Birch</i>		12	Cords			
	Red Maple	214	Cords				
White Pine	21	Cords					
17	Black/Red (Hybrid)	Sawtimber	6.7	MBF	38.0	\$22,341.50	
	Mixed Aspen		129.5	MBF			
	<i>B. T. Aspen</i>		129.5	MBF			
	Red Maple		55.8	MBF			
	Red Oak		4.0	MBF			
	White Pine		4.2	MBF			
	Mixed Aspen		Pulpwood	159			Cords
	<i>B. T. Aspen</i>			102			Cords
	<i>Quaking Aspen</i>			57			Cords
	Mixed Oak			6			Cords
	<i>/Red (Hybrid) Oak</i>	6		Cords			
	Paper Birch	36		Cords			
	<i>Paper Birch</i>	Sawtimber	4.2	MBF			
	<i>Paper Birch</i>		Pulpwood	28			Cords
	Red Maple			142			Cords
	Red Oak			2			Cords
White Pine	1	Cords					
18	Mixed Aspen	Sawtimber	247.8	MBF	15.6	\$27,622.40	
	<i>B. T. Aspen</i>		247.8	MBF			
	Red Maple		8.3	MBF			
	Red Oak	10.4	MBF				
	White Oak	5.9	MBF				
	White Pine	4.7	MBF				
	Mixed Aspen	Pulpwood	193	Cords			
	<i>B. T. Aspen</i>		193	Cords			

**DESCRIPTION OF TIMBER BY PAYMENT UNIT (PU), CON'T**

PU	MARKET GROUP	PRODUCT	QUANTITY	UNIT	ACRES	ADVERTISE PRICE
18 con't	Mixed Oak	Pulpwood	3	Cords		
	<i>White Oak</i>		3	<i>Cords</i>		
	Red Maple		32	Cords		
	Red Oak		10	Cords		
	Red Pine		8	Cords		
	White Pine		41	Cords		
19	Mixed Aspen	Sawtimber	111.2	MBF	17.3	\$25,896.10
	<i>B. T. Aspen</i>		76.0	<i>MBF</i>		
	<i>Quaking Aspen</i>		35.2	<i>MBF</i>		
	Red Maple		43.6	MBF		
	Red Oak		6.7	MBF		
	Red Pine		4.3	MBF		
	White Oak		11.5	MBF		
	White Pine		33.5	MBF		
	Mixed Aspen		Pulpwood	165		
	<i>B. T. Aspen</i>	139		<i>Cords</i>		
	<i>Quaking Aspen</i>	26		<i>Cords</i>		
	Mixed Oak	17		Cords		
	<i>White Oak</i>	17		<i>Cords</i>		
	Red Maple	204		Cords		
	Red Oak	9		Cords		
	Red Pine	1		Cords		
	Sugar Maple	13		Cords		
	White Pine	40	Cords			
20	Mixed Aspen	Sawtimber	4.6	MBF	8.3	\$7,794.00
	<i>Quaking Aspen</i>		4.6	<i>MBF</i>		
	Red Maple		8.3	MBF		
	Red Pine		5.5	MBF		
	White Oak		2.8	MBF		
	White Pine	6.4	MBF			
	Mixed Aspen	Pulpwood	72	Cords		
	<i>Quaking Aspen</i>		72	<i>Cords</i>		
	Mixed Oak		3	Cords		
	<i>White Oak</i>		3	<i>Cords</i>		
	Red Maple		121	Cords		
	Red Oak		12	Cords		
	Red Pine		4	Cords		
White Pine	20		Cords			
21	Mixed Aspen	Sawtimber	110.9	MBF	31.3	\$20,950.85
	<i>B. T. Aspen</i>		110.9	<i>MBF</i>		
	Red Maple	72.7	MBF			
	Mixed Aspen	Pulpwood	90	Cords		
	<i>B. T. Aspen</i>		90	<i>Cords</i>		
	Paper Birch		9	Cords		
	<i>Paper Birch</i>		9	<i>Cords</i>		
	Red Maple		287	Cords		
White Pine	9		Cords			
TOTAL:			2,448.1	MBF		
TOTAL:			6,559	Cords		

## Sale Specific Conditions & Requirements

Sale Name: Eymer Oasis Mix

Sale Number: 73-001-23 Seq#: 1

### 1 - Sale Area

#### 1.2 - Boundaries

##### 1.2.1 - Painted boundaries (9/19)

The sale boundary and Payment Unit boundaries are marked and identified by blue, red and yellow paint along with a road. Exterior sale boundary lines against private property are marked with blue paint. Exterior sale boundary lines against state are marked with red paint. Interior Payment Unit boundaries are marked with yellow paint. In addition, the yellow paint that parallels Black Creek Road delineate the clearcut portions of payment units 4, 5, 6, 7, 8, 9 & 15 adjacent to the road. Retention patches are marked with red paint; no harvesting activities may occur within these areas. The painted boundary line trees are not Included Timber and are to be protected unless marked with orange paint.

### 2 - Timber Specifications

#### 2.1 - Included Timber

##### 2.1.1 - Clearcut unit(s) with unmerchantable trees (6/14)

Within Payment Unit(s) 1, 2, 12, 13, 16, 18, 19, & 20, cut all trees that are two (2) inches or more at DBH, except do not cut trees marked with green paint above and below stump height.

##### 2.1.3 - Cut tree marked unit(s) (12/08)

Within Payment Unit(s) 3, 6, 7, 17, & 21, all trees are designated for cutting when marked with orange paint above and below stump height, regardless of merchantability. Additionally, within Payment Units 17 & 21 cut all aspen and birch that are two (2) inches or more at DBH.

##### 2.1.7 - Leave tree marked unit(s) (6/14)

Within Payment Unit(s) 4, 5, 8, 9, 10, 11, 14, & 15, all trees, which meet minimum piece specifications in 2.2 Utilization, are designated for cutting, except trees marked with green paint above and below stump height.

### 3 - Payments

#### 3.3 - Pre-measured Sales

##### 3.3.4 - Dividing payment units (7/14)

Payment Unit(s) 3, 6, 18, & 19 may be divided at the request of the Purchaser and upon approval of the Unit Manager. Dividing Payment Units is a contract modification which requires a Timber Sale Contract Amendment. There will be only one division per Payment Unit.

#### 3.4 - Damaged Timber

##### 3.4.1 - Damaged timber (7/16)

General Condition and Requirement 3.4 Damaged Timber, defines liquidated damages for undesignated live merchantable trees which are cut or injured. In addition, extreme care should be taken to avoid damage to tree seedlings and saplings.

Within Payment Units 4, 5, 8, 9, 10, 11, 14, 15, 17, 20, & 21, if more than 25% of the tree seedlings or saplings (1/4" to 4.5" DBH) within a specified portion of the Sale Area are damaged, liquidated damages will be assessed at \$300 per acre for all acreage within that specified portion of the sale area that was damaged.

No damage is acceptable to undesignated live merchantable trees. Within the Sale Area, if more than 5% of trees (> 4.5" DBH) within a specified area of the sale are damaged, liquidated damages will be assessed for all trees damaged. Rates will be in accordance with General Condition and Requirement 3.4 Damaged Timber.

### 4 - Transportation

#### 4.1 - Construction

##### 4.1.12 - No new roads (1/12)

No new roads will be permitted in any Payment Unit. All operations are limited to existing roads. Skid trails only will be allowed.

#### 4.2 - Maintenance

##### 4.2.5 - Two wheel drive condition (2/04)

All existing trail roads on and adjacent to the sale area must be passable by two-wheel drive traffic for the duration of the sale.

### 5 - Operations

#### 5.2 - Conduct of Operations

##### 5.2.2 - Hazard Trees/Snags

###### 5.2.2.1 - Den trees (10/16)

Obvious hollow and/or den trees shall be protected and left standing unless they are a safety hazard.

##### 5.2.3 - Operating Restrictions

###### 5.2.3.3 - Bark slippage restriction (3/09)

Within Payment Unit(s) 3, 6, & 7, unless changed by written agreement, cutting and skidding are not permitted during the period of April 15 to July 15. This restriction is because of bark slippage.

###### 5.2.3.4 - Oak wilt restriction, no exceptions (1/18)

Within Payment Unit(s) 4, 5, 8, 9, 15, 17, & 21, cutting, skidding, hauling within the sale and brushing of access roads to the sale are not permitted during the period of April 15 to July 15. No exceptions will be granted. This is necessary to reduce the spread of oak wilt.

###### 5.2.3.6 - Bark beetle restriction (12/08)

In the event drought creates a high risk of pine bark beetle infestation, pine is not to be cut during the period March 1 through July 1, unless all portions of trees greater than two inches in diameter are removed from the sale area, reduced to chips, or treated to the satisfaction of the Unit Manager or his/her representative, within fifteen days of being severed from the stump. Pine log decks, pulpwood piles and treetops that are piled for chipping in the fall or winter within a 1/4 mile of susceptible sites must be removed before March 15. Residual slash must not be placed in piles or rows and must be spread over the site for quick drying. The Department of Natural Resources will exercise this specification if the risk of damage warrants.

##### 5.2.4 - Dead and Down Creation

###### 5.2.4.4 - Dead and down creation, grouse (6/18)

To encourage grouse and other wildlife, in Payment Unit(s) 1, 16, 18, & 19, leave one 12" or larger diameter whole tree on the ground for every 3 acres. Trees should scattered throughout the Sale Area and at least two chains from any roads, two-tracks, or trails open to vehicles, or positioned per the Sale Administrator's instructions. Stumps must be at least 3 feet tall.

##### 5.2.17 - Timber Mats and Interlocking Composite Mats (5/23)

Some roads or skid trails may require extra protection such as that afforded by timber mats, interlocking composite mats, or another approved system. If available, mats may be borrowed from the DNR. A Timber Sale Contract Amendment will be used to document the Purchaser's use of the DNR's mats. Contact the Sale Administrator regarding availability and pick-up. Timber mats are available from various field offices. Composite mats are only available from the Grayling field office and the Marquette ICC. The Purchaser is responsible for picking up and hauling the mats to and from the site. The composite mats will require DNR staff onsite for installation and removal. Contact the Sale Administrator to schedule at least 30 days before desired install/removal date. All mats must be cleaned prior to drop off. This may include, but is not limited to, power washing and brushing to remove mud and debris. A charge of \$700.00 per timber mat and \$2,000.00 per composite mat will be assessed for all damaged or non-returned mats. Damage for the crane/timber mats is defined as three or more broken cants. Damage for the composite mats is defined as cracked or broken mats.

##### 5.2.22 - Operating Caution

###### 5.2.22.1 - Operating caution (6/11)

It is recommended, but not required, that within Payment Unit(s) 1, 4, 5, 8, 9, 12, 13, 14, 16, 17, 19, 20, & 21, cutting, skidding, and hauling occur during dry summer or frozen winter conditions. The reason for the recommendation is because of wet areas present within and along the edges of the Payment Units.

#### 5.4 - Soil Protection

##### 5.4.1 - Rutting restriction, general (7/16)

Operations are to cease immediately if equipment and weather conditions result in rutting of roads and/or skid trails which is 12 inches or greater in depth and 50 feet in length. The Unit Manager or his/her representative may restrict hauling and/or skidding if ruts exceed the specified depth. With the Unit Manager or his/her representative's approval, the Purchaser may return to the area when the risk of rutting has decreased.





# TIMBER SALE MAP

This information provided by authority of Part 525, 1994 PA 451, as amended.

Forest Management Unit Gladwin Management Unit	County Arenac	Mapped By Steven Nyhoff	Date 06/20/2023	Page 1	of 2
Township 19 & 20N	Range 03E	Section(s) and Subdivision(s) Various	Scale 1:15,840		

Cover Type				Density			
A = Aspen	H = Hemlock	N = Marsh	U = Upland Brush	0 = Non Stocked	5 = Pole Timber Medium		
B = Paper Birch	J = Jack Pine	O = Oak	UM = Upland Mixed	1 = Seedling Sapling Poor	6 = Pole Timber Well		
C = Cedar	L = Lowland Brush	P = Lowland Poplar	V = Bog or Marsh	2 = Seedling Sapling Medium	7 = Saw Timber Poor		
D = Treed Bog	LM = Lowland Mixed	Q = Mixed Swamp Conifer	W = White Pine	3 = Seedling Sapling Well	8 = Saw Timber Medium		
E = Swamp Hdwoods	M = Mpl, Bch, Brch	R = Red Pine	X = Non Stocked	4 = Pole Timber Poor	9 = Saw Timber Well		
F = Spruce Fir	MC = Mixed Conifer	S = Black Spruce	Z = Water				
G = Grass	MD = Mixed Deciduous	T = Tamarack					

PU	Acres	PU	Acres	PU	Acres	PU	Acres
1	15.7	7	38.0	13	11.8	19	17.3
2	8.0	8	19.1	14	10.4	20	8.3
3	35.5	9	25.5	15	19.9	21	31.3
4	21.0	10	14.4	16	14.5		
5	14.6	11	13.2	17	38.0		
6	21.7	12	13.4	18	15.6		

## Eymer Oasis Mix

### Compartment 124

#### 387.0 Acres

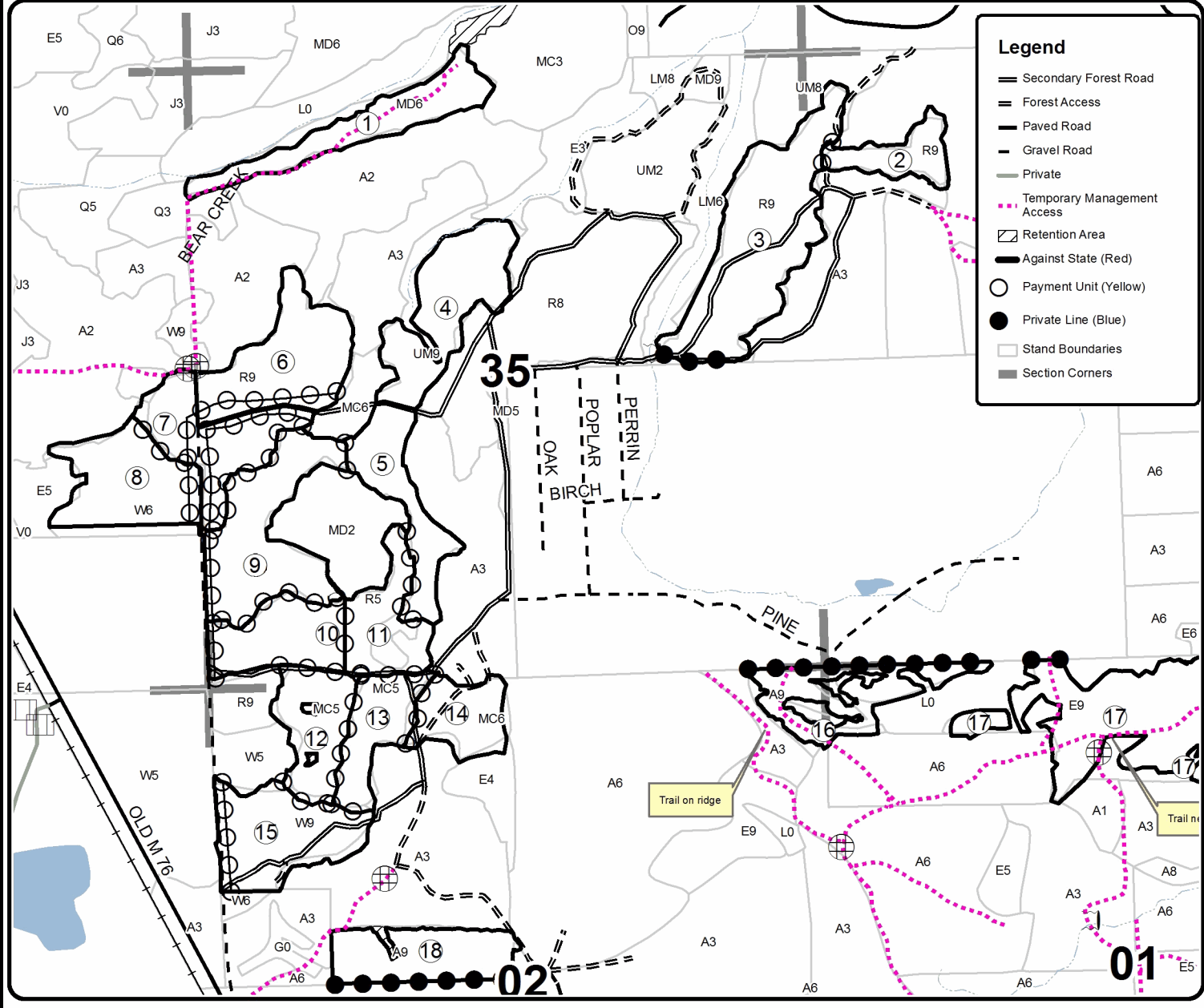

### Legend

- Secondary Forest Road (dashed line)
- Forest Access (dotted line)
- Paved Road (solid line)
- Gravel Road (dashed line)
- Private (solid line)
- Temporary Management Access (dotted line)
- Retention Area (shaded area)
- Against State (Red) (thick black line)
- Payment Unit (Yellow) (circle with number)
- Private Line (Blue) (solid black line)
- Stand Boundaries (dashed line)
- Section Corners (square with cross)

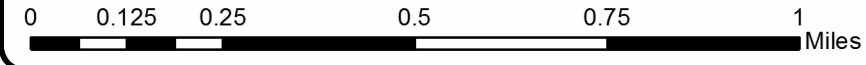



Sale Number	Year
73 - 001	23

# TIMBER SALE MAP

This information provided by authority of Part 525, 1994 PA 451, as amended.

Forest Management Unit	County	Mapped By	Date	Page	of
Gladwin Management Unit	Arenac	Steven Nyhoff	06/20/2023	2	2
Township	Range	Section(s) and Subdivision(s)	Scale		
19 & 20N	03E	Various	1:15,840		

### Cover Type

A = Aspen	H = Hemlock	N = Marsh	U = Upland Brush
B = Paper Birch	J = Jack Pine	O = Oak	UM = Upland Mixed
C = Cedar	L = Lowland Brush	P = Lowland Poplar	V = Bog or Marsh
D = Treed Bog	LM = Lowland Mixed	Q = Mixed Swamp Conifer	W = White Pine
E = Swamp Hdwoods	M = Mpl. Bch. Brch	R = Red Pine	X = Non Stocked
F = Spruce Fir	MC = Mixed Conifer	S = Black Spruce	Z = Water
G = Grass	MD = Mixed Deciduous	T = Tamarack	

### Density

0 = Non Stocked	5 = Pole Timber Medium
1 = Seedling Sapling Poor	6 = Pole Timber Well
2 = Seedling Sapling Medium	7 = Saw Timber Poor
3 = Seedling Sapling Well	8 = Saw Timber Medium
4 = Pole Timber Poor	9 = Saw Timber Well

PU	Acres	PU	Acres	PU	Acres	PU	Acres
1	15.7	7	38.0	13	11.8	19	17.3
2	8.0	8	19.1	14	10.4	20	8.3
3	35.5	9	25.5	15	19.9	21	31.3
4	21.0	10	14.4	16	14.5		
5	14.6	11	13.2	17	38.0		
6	21.7	12	13.4	18	15.6		

## Eymer Oasis Mix

### Compartment 124

387.0 Acres

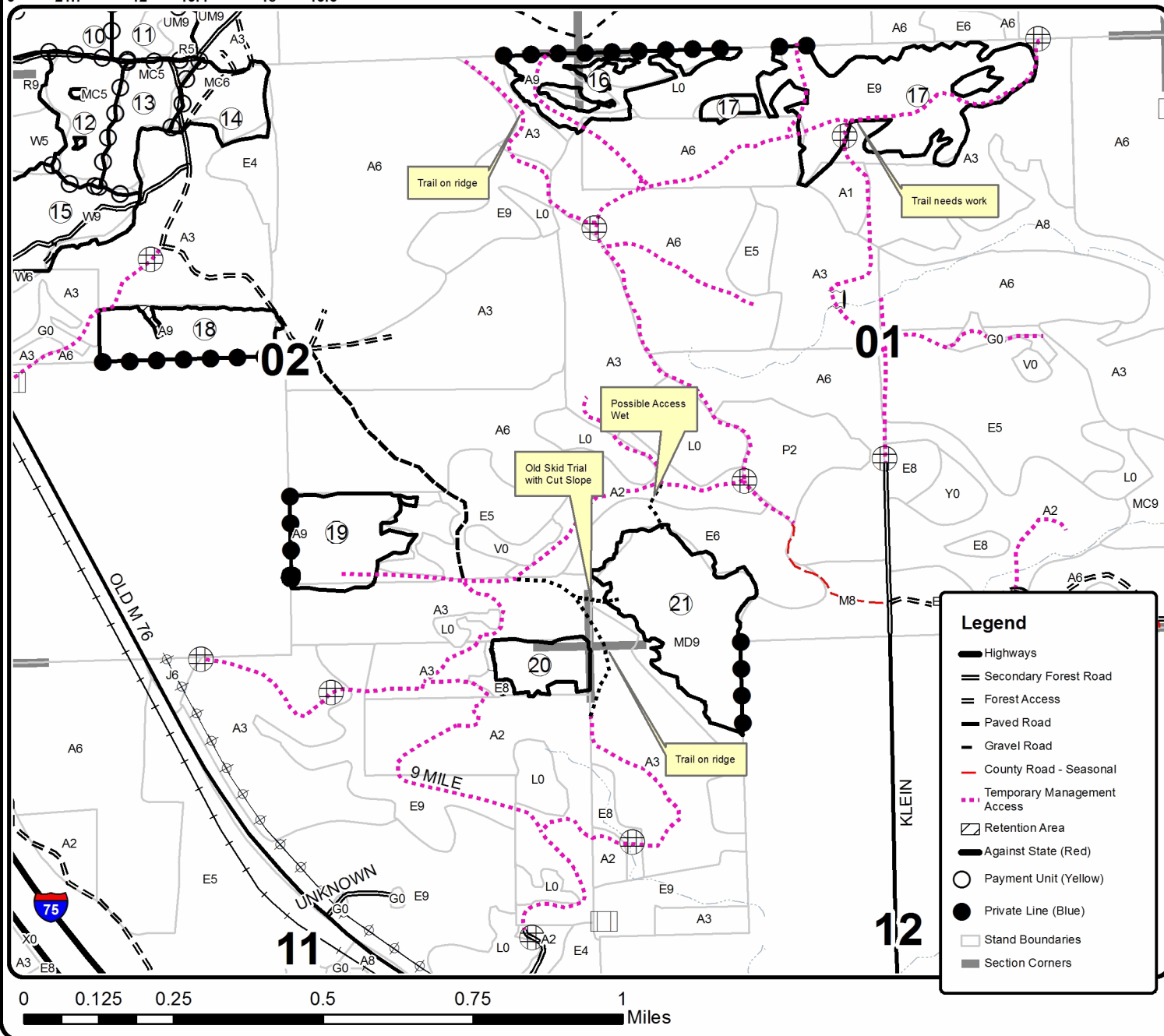
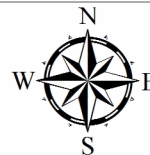

### Legend

- Highways
- Secondary Forest Road
- Forest Access
- Paved Road
- Gravel Road
- County Road - Seasonal
- Temporary Management Access
- Retention Area
- Against State (Red)
- Payment Unit (Yellow)
- Private Line (Blue)
- Stand Boundaries
- Section Corners

## TIMBER SALE INFORMATION

### Bone Yard Jack (73-002-23)

T20N, R03E, SEC. 22; T20N, R03E, SEC. 27; T20N, R03E, SEC. 28.  
Arenac County (Advertised Price \$175,336.95)

SALE NOTE: Payment Unit 1 will need an access road built into the unit. Payment Unit 2 access is the open forest road that follows the northern boundary of Payment Unit 3. Payment Units 7 & 8 access is from the closed road to the north. No access on the west side of M-76 due to railroad tracks.

A timber sale contract for this lump sum, sealed bid timber sale will be awarded to the responsible bidder offering the highest sealed bid price. All units of volume listed below were estimated using the Inventory Manager computer program and the new Michigan taper model. Bids must be at or above the following advertised price for each product and species:

<u>PRODUCTS &amp; SPECIES</u>	<u>ESTIMATED UNITS*</u>		<u>ADVERTISED PRICE</u>
<b>Sawtimber</b>			
Black/Red (Hybrid) Oak	125.9	MBF	\$ 120.00 / MBF
Jack Pine	90.5	MBF	\$ 49.00 / MBF
Quaking Aspen	48.5	MBF	\$ 67.00 / MBF
Red Maple	76.5	MBF	\$ 65.00 / MBF
Red Oak	4.0	MBF	\$ 150.00 / MBF
Red Pine	277.4	MBF	\$ 129.00 / MBF
White Pine	114.7	MBF	\$ 67.00 / MBF
<b>Pulpwood</b>			
Jack Pine	924	Cords	\$ 24.15 / Cord
Mixed Aspen	289	Cords	\$ 28.80 / Cord
Mixed Hardwood	895	Cords	\$ 20.00 / Cord
Mixed Oak	328	Cords	\$ 16.40 / Cord
Paper Birch	7	Cords	\$ 21.45 / Cord
Red Pine	851	Cords	\$ 54.10 / Cord
Tamarack	19	Cords	\$ 19.30 / Cord
White Pine	101	Cords	\$ 30.00 / Cord

\* The total volume is statistically estimated within plus (+) or minus (-) 14.19 percent. There are an estimated 5,147 cords on this timber sale, plus or minus 731 cords at the 95% confidence level. The estimated units are final and not subject to adjustment. Prospective bidders are urged to examine this timber and to make their own estimates of quantity and quality.

### **BOND AND PAYMENT SCHEDULE:**

1. A bond in the amount of \$8,767.00 to insure faithful performance of the conditions of the contract will be deposited by the successful bidder within 21 days of the sale award.
2. Cutting in any sale or unit without the required advance payment would be considered a trespass.
3. Total payment must be paid in advance or according to the following schedule :
  - (a) Ten percent (10%) of the sale value must be paid within 21 days of the sale award.
  - (b) The 10% down payment will be credited towards the first unit cut.
  - (c) Payment for each of the following units must be made before cutting begins in that unit:
 

PAYMENT UNIT NUMBER	PERCENT OF TOTAL SALE VALUE
01	9.4%
02	15.5%
03	9.2%
04	4.8%
05	42.4%
06	14.8%
07	2.9%
08	1.0%
4. If no cutting takes place, the 10% down payment will not be refunded.
5. Operations on the contract issued will terminate on 12/31/2025.

### **SALE STATISTICS**

Volumes were calculated in cubic feet using the Michigan taper model. Cubic foot volume includes all wood inside bark for the product indicated. For display purposes, cubic feet were converted to cords and MBF using a simple conversion factor, e.g. 79 cubic feet per cord and 185 cubic feet per MBF. The cubic foot volumes are precise; the cords and MBF volumes are not. Cubic foot volume cannot be directly converted to cords or boards with precision.

### SALE VOLUMES

The total estimated sale volume may not equal the sum of the species/products due to the nature of statistical calculations associated with double sampling methodology.

VOLUME			STATISTICAL RANGE IN CORDS	
TOTAL CUBIC FEET	TOTAL CORDS	PERCENT ERROR	MINIMUM	MAXIMUM
406,649	5,147	14.19%	4,417	5,878

### VDU VOLUMES

A VDU is a Volume Determination Unit. Volumes and their associated statistics are calculated at the VDU level and summarized to the sale level. There is often a one to one relationship between a VDU and a Payment Unit, but not always, depending on the cruise design. Refer to the VDU TO PAYMENT UNIT table.

VDU	VOLUME		PERCENT ERROR	RANGE IN CORDS	
	TOTAL CUBIC FEET	TOTAL CORDS		MINIMUM	MAXIMUM
1	45,285	573	27.63%	415	732
7	108,872	1,378	19.91%	1,104	1,652
8	7,890	100	65.30%	35	165
14	5,065	64	59.97%	26	103
15	53,369	676	19.48%	544	807
17	11,824	150	42.67%	86	214
20	79,915	1,012	21.79%	791	1,232
22	27,916	353	26.11%	261	446
109	24,524	310	27.16%	226	395
165	24,178	306	63.30%	112	500
166	17,812	225	34.53%	148	303
<b>TOTAL:</b>	<b>406,649</b>	<b>5,147</b>		<b>3,747</b>	<b>6,548</b>

### VDU TO PAYMENT UNIT

When a VDU is associated with more than one Payment Unit (PU), the VDU volumes are assigned to the PU based on acres of the VDU within the PU.

VDU	VDU ACRES	PU	PU ACRES
1	25.5	2	25.5
7	46.7	5	46.7
8	4.7	2	4.7
14	6.2	8	6.2
15	20.5	3	20.5
17	10.9	7	10.9
20	56.6	6	56.6
22	14.7	4	14.7
109	12.3	2	12.3
165	9.1	1	9.1
166	9.0	1	9.0
<b>TOTAL:</b>	<b>216.2</b>		<b>216.2</b>

**DESCRIPTION OF TIMBER BY PAYMENT UNIT (PU)**

PU	MARKET GROUP	PRODUCT	QUANTITY	UNIT	ACRES	ADVERTISE PRICE
1	Black/Red (Hybrid)	Sawtimber	16.3	MBF	18.1	\$16,502.75
	Jack Pine		10.9	MBF		
	Red Maple		8.5	MBF		
	Red Pine		29.3	MBF		
	White Pine		55.5	MBF		
	Jack Pine	Pulpwood	30	Cords		
	Mixed Aspen		7	Cords		
	<i>Quaking Aspen</i>		7	Cords		
	Mixed Hardwood		115	Cords		
	<i>Black Cherry</i>		3	Cords		
	<i>Red Maple</i>		112	Cords		
	Mixed Oak		49	Cords		
	/Red (Hybrid) Oak		47	Cords		
	<i>White Oak</i>		2	Cords		
	Paper Birch		3	Cords		
	<i>Paper Birch</i>		3	Cords		
	Red Pine		19	Cords		
	White Pine		28	Cords		
2	Black/Red (Hybrid)	Sawtimber	36.9	MBF	42.5	\$27,212.85
	Quaking Aspen		30.7	MBF		
	Red Maple		46.4	MBF		
	Red Pine		20.5	MBF		
	White Pine		12.8	MBF		
	Jack Pine	Pulpwood	13	Cords		
	Mixed Aspen		163	Cords		
	<i>Quaking Aspen</i>		163	Cords		
	Mixed Hardwood		364	Cords		
	<i>Black Cherry</i>	Sawtimber	4.8	MBF		
	<i>Black Cherry</i>	Pulpwood	34	Cords		
	<i>Red Maple</i>		320	Cords		
	Mixed Oak		78	Cords		
	/Red (Hybrid) Oak		78	Cords		
	Red Pine		3	Cords		
	White Pine		16	Cords		
3	Black/Red (Hybrid)	Sawtimber	6.1	MBF	20.5	\$16,159.95
	Jack Pine		49.8	MBF		
	Red Maple		1.2	MBF		
	White Pine		2.0	MBF		
	Jack Pine	Pulpwood	465	Cords		
	Mixed Aspen		15	Cords		
	<i>Quaking Aspen</i>		15	Cords		
	Mixed Hardwood		46	Cords		
	<i>Red Maple</i>		46	Cords		
	Mixed Oak		10	Cords		
	/Red (Hybrid) Oak		10	Cords		
	White Pine		1	Cords		
4	Black/Red (Hybrid)	Sawtimber	1.2	MBF	14.7	\$8,355.50
	Jack Pine		3.8	MBF		
	Red Maple		0.9	MBF		
	Jack Pine	Pulpwood	280	Cords		
	Mixed Aspen		10	Cords		
	<i>Quaking Aspen</i>		10	Cords		
	Mixed Hardwood		30	Cords		
	<i>Black Cherry</i>		15	Cords		
	<i>Red Maple</i>		15	Cords		
	Mixed Oak		12	Cords		

**DESCRIPTION OF TIMBER BY PAYMENT UNIT (PU), CON'T**

PU	MARKET GROUP	PRODUCT	QUANTITY	UNIT	ACRES	ADVERTISE PRICE
4 con't	<i>/Red (Hybrid) Oak</i> White Pine	<i>Pulpwood</i>	12	<i>Cords</i>		
			4	<i>Cords</i>		
5	Red Pine	Sawtimber	225.5	MBF	46.7	\$74,368.60
	Mixed Aspen	Pulpwood	12	<i>Cords</i>		
	<i>B. T. Aspen</i>		12	<i>Cords</i>		
	Mixed Hardwood		8	<i>Cords</i>		
	<i>Red Maple</i>		8	<i>Cords</i>		
	Mixed Oak		2	<i>Cords</i>		
	<i>/Red (Hybrid) Oak</i>		2	<i>Cords</i>		
	Red Pine		827	<i>Cords</i>		
6	Black/Red (Hybrid)	Sawtimber	35.1	MBF	56.6	\$25,908.75
	Jack Pine		24.9	MBF		
	Quaking Aspen		15.6	MBF		
	Red Maple		17.9	MBF		
	Red Oak		4.0	MBF		
	Red Pine		2.1	MBF		
	White Pine		39.8	MBF		
	Jack Pine	Pulpwood	113	<i>Cords</i>		
	Mixed Aspen		56	<i>Cords</i>		
	<i>Quaking Aspen</i>		56	<i>Cords</i>		
	Mixed Hardwood		321	<i>Cords</i>		
	<i>Black Cherry</i>		4	<i>Cords</i>		
	<i>Red Maple</i>		317	<i>Cords</i>		
	Mixed Oak		120	<i>Cords</i>		
	<i>White Oak</i>	<i>Sawtimber</i>	2.4	<i>MBF</i>		
	<i>/Red (Hybrid) Oak</i>	<i>Pulpwood</i>	66	<i>Cords</i>		
	<i>Red Oak</i>		48	<i>Cords</i>		
	<i>White Oak</i>		1	<i>Cords</i>		
	Paper Birch		4	<i>Cords</i>		
	<i>Paper Birch</i>	<i>Sawtimber</i>	1.7	<i>MBF</i>		
	<i>Paper Birch</i>	<i>Pulpwood</i>	1	<i>Cords</i>		
	Red Pine		2	<i>Cords</i>		
Tamarack		19	<i>Cords</i>			
White Pine		48	<i>Cords</i>			
7	Black/Red (Hybrid)	Sawtimber	27.6	MBF	10.9	\$5,088.50
	Quaking Aspen		2.2	MBF		
	Red Maple		1.6	MBF		
	White Pine		1.3	MBF		
	Mixed Aspen	Pulpwood	16	<i>Cords</i>		
	<i>Quaking Aspen</i>		16	<i>Cords</i>		
	Mixed Hardwood		8	<i>Cords</i>		
	<i>Black Cherry</i>		1	<i>Cords</i>		
	<i>Red Maple</i>		7	<i>Cords</i>		
	Mixed Oak		48	<i>Cords</i>		
	<i>/Red (Hybrid) Oak</i>		48	<i>Cords</i>		
White Pine		1	<i>Cords</i>			
8	Black/Red (Hybrid)	Sawtimber	2.7	MBF	6.2	\$1,740.05
	Jack Pine		1.1	MBF		
	White Pine		3.3	MBF		
	Jack Pine	Pulpwood	23	<i>Cords</i>		
	Mixed Aspen		10	<i>Cords</i>		
	<i>Quaking Aspen</i>		10	<i>Cords</i>		
	Mixed Hardwood		3	<i>Cords</i>		
	<i>Black Cherry</i>		2	<i>Cords</i>		
	<i>Red Maple</i>		1	<i>Cords</i>		
	Mixed Oak		9	<i>Cords</i>		

**DESCRIPTION OF TIMBER BY PAYMENT UNIT (PU), CON'T**

PU	MARKET GROUP	PRODUCT	QUANTITY	UNIT	ACRES	ADVERTISE PRICE
8 con't	<i>/Red (Hybrid) Oak</i>	<i>Pulpwood</i>	9	<i>Cords</i>		
	White Pine		3	Cords		
TOTAL:			737.5	MBF		
TOTAL:			3,414	Cords		

## Sale Specific Conditions & Requirements

**Sale Name: Bone Yard Jack**

**Sale Number: 73-002-23 Seq#: 1**

### 1 - Sale Area

#### 1.2 - Boundaries

##### 1.2.1 - Painted boundaries (9/19)

The sale boundary and Payment Unit boundaries are marked and identified by blue, red, yellow paint along with a road. Exterior sale boundary lines against private property are marked with blue paint. Exterior sale boundary lines against state are marked with red paint. Interior Payment Unit boundaries are marked with yellow paint, with the exception of the south boundary of Payment Unit 3 and the north boundary of Payment Unit 4. Retention patches are marked with red paint; no harvesting activities may occur within these areas. The painted boundary line trees are not Included Timber and are to be protected unless marked with orange paint. Yellow painted trees designating an interior Payment Unit boundary are only to be cut when all surrounding Payment Units have been paid.

### 2 - Timber Specifications

#### 2.1 - Included Timber

##### 2.1.1 - Clearcut unit(s) with unmerchantable trees (6/14)

Within Payment Unit(s) 1, 2, & 5-9, cut all trees that are two (2) inches or more at DBH, except trees marked with green paint above and below stump height.

##### 2.1.3 - Cut tree marked unit(s) (12/08)

Within Payment Unit(s) 4, all trees are designated for cutting when marked with orange paint above and below stump height, regardless of merchantability.

##### 2.1.7 - Leave tree marked unit(s) (6/14)

Within Payment Unit(s) 3, all oak and white pine which meet minimum piece specifications in 2.2 Utilization are designated for cutting. Cut all other species that are two (2) inches or more at DBH, except trees marked with green paint above and below stump height.

#### 2.2 - Utilization

##### 2.2.3 - Stump heights (4/07)

Stump heights within Payment Unit 4 shall not exceed 6 inches for all trees. This is in order to facilitate planting operations.

### 3 - Payments

#### 3.3 - Pre-measured Sales

##### 3.3.4 - Dividing payment units (7/14)

Payment Unit(s) may be divided at the request of the Purchaser and upon approval of the Unit Manager. Dividing Payment Units is a contract modification which requires a Timber Sale Contract Amendment. There will be only one division per Payment Unit.

#### 3.4 - Damaged Timber

##### 3.4.1 - Damaged timber (7/16)

General Condition and Requirement 3.4 Damaged Timber, defines liquidated damages for undesignated live merchantable trees which are cut or injured. In addition, extreme care should be taken to avoid damage to tree seedlings and saplings.

Within Payment Unit 3, if more than 25% of oak and white pine seedlings or saplings (1/4" to 4.5" DBH) within a specified portion of the Sale Area are damaged, liquidated damages will be assessed at \$500 per acre for all acreage within that specified portion of the Sale Area that was damaged.

No damage is acceptable to undesignated live merchantable trees. Within the Sale Area, if more than 20% of trees (> 4.5" DBH) within a specified area of the sale are damaged, liquidated damages will be assessed for all trees damaged. Rates will be in accordance with General Condition and Requirement 3.4 Damaged Timber.



## **4 - Transportation**

### 4.1 - Construction

#### 4.1.6 - Road construction (1/09)

Construction of new roads or improvements of existing roads shall be done in such a way as to minimize the environmental and visual impacts. Merchantable trees shall be cut and utilized unless otherwise directed. Non-merchantable trees shall be severed and laid flat on the ground. Slash shall be scattered and not left in windrows. Stumps shall be set upright, not left on edge, and be moved at least 10 feet away from the road edge. Disturbed soil shall be feathered into the woods and not left in berms or windrows.

#### 4.1.7 - Road closure (10/11)

All new roads built into the sale must be blocked to vehicle traffic upon completion of the sale. Overgrown roads that are reopened shall be considered new roads. In general, this will require constructing a four (4') foot high berm of stumps and logs covered with earth. Stumps and brush must be placed along the remainder of the trail. These roads must be rendered impassable to cars and trucks. Contact the Sale Administrator for specific details of design and placement.

## **5 - Operations**

### 5.1 - Notification

#### 5.1.1 - Pre-sale conference (10/16)

A pre-sale conference on site between the Purchaser and sale administrator is required prior to beginning any operations to determine landing and road locations. The Unit Manager or his/her representative must be contacted at least 3 business days in advance to schedule the conference.

### 5.2 - Conduct of Operations

#### 5.2.1 - Slash

##### 5.2.1.11 - Slash for reforestation (3/21)

To facilitate reforestation, Payment Units 5, 6, & 8 shall be left with slash evenly distributed. Bunched tops within the cutting area shall be broken up and scattered. Stumps shall be cut low to the ground. Processing sites shall not be left with a compacted layer of slash; tops from these sites shall be hauled back into the cut area and scattered.

#### 5.2.3 - Operating Restrictions

##### 5.2.3.4 - Oak wilt restriction, no exceptions (1/18)

Within Payment Units 1-3 & 7-9, cutting, skidding, hauling within the sale and brushing of access roads to the sale are not permitted during the period of April 15 to July 15. No exceptions will be granted. This is necessary to reduce the spread of oak wilt.

#### 5.2.22 - Operating Caution

##### 5.2.22.1 - Operating caution (6/11)

It is recommended, but not required, that within Payment Unit(s) 2, 6, & 7, cutting, skidding, and hauling occur during dry summer or frozen winter conditions. The reason for the recommendation is because of potential wet soils.

#### 5.2.32 - Decking/landing restoration (9/13)

All decking and landing areas must have the surface area restored to a condition equal to or better than before. This is to ensure the proper regeneration of the stand. Wood debris, chips and "cookies" from trimmings must be removed or scattered away from landing and loading areas and may not be windrowed on the edge.

#### 5.2.38 - No decking against live trees (2/04)

Cut products may not be decked against unmarked or designated leave trees.

## **6 - Safety and Fire Prevention**

### 6.2 - Signing

#### 6.2.1 - Road posting (10/20)

The Purchaser is responsible for posting and maintaining caution signs on Jack Pine Trail, M-76 & Yarish road prior to beginning operations. The road must be posted at appropriate distances from the Sale Area to warn of logging activity and truck traffic. Signs must be removed when harvest operations are suspended or completed. The Purchaser will provide these signs.



# TIMBER SALE MAP

This information provided by authority of Part 525, 1994 PA 451, as amended.

Sale Number	Year
73-002	23

Forest Management Unit	County	Mapped By	Date	Page	of
Gladwin Management Unit	Arenac	Behrmann	7/14/2023	1	2
Township	Range	Section(s) and Subdivision(s)	Scale		
20N	03W	Sec 27 SW, SWSE, N1/2, Sec 22 SWSW, SWNE, NWSE	1:15,840		

Cover Type				Density	
A = Aspen	H = Hemlock	N = Marsh	U = Upland Brush	0 = Non Stocked	5 = Pole Timber Medium
B = Paper Birch	J = Jack Pine	O = Oak	UM = Upland Mixed	1 = Seedling Sapling Poor	6 = Pole Timber Well
C = Cedar	L = Lowland Brush	P = Lowland Poplar	V = Bog or Marsh	2 = Seedling Sapling Medium	7 = Saw Timber Poor
D = Tied Bog	LM = Lowland Mixed	Q = Mixed Swamp Conifer	W = White Pine	3 = Seedling Sapling Well	8 = Saw Timber Medium
E = Swamp Hardwoods	M = Mpl, Boh, Brch	R = Red Pine	X = Non Stocked	4 = Pole Timber Poor	9 = Saw Timber Well
F = Spruce Fir	MC = Mixed Conifer	S = Black Spruce	Z = Water		
G = Grass	MD = Mixed Deciduous	T = Tamarack			

PU	Acres	PU	Acres	PU	Acres
1	18.1	4	14.7	7	10.9
2	42.5	5	46.7	8	6.2
3	20.5	6	56.6		

**Bone Yard Jack**  
 Compartment 124  
 Acres 216.2

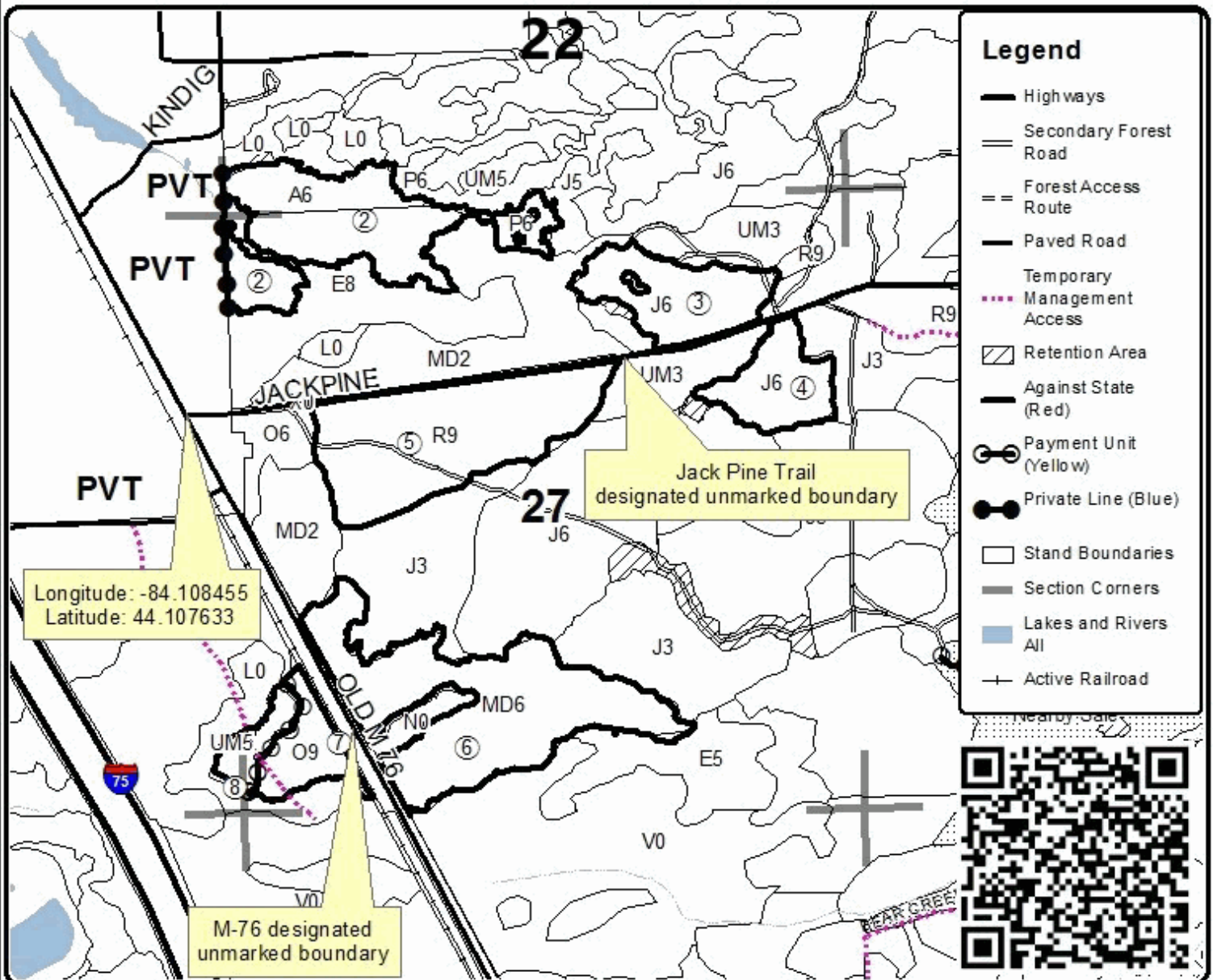

Longitude: -84.108455  
 Latitude: 44.107633

M-76 designated unmarked boundary

Jack Pine Trail designated unmarked boundary

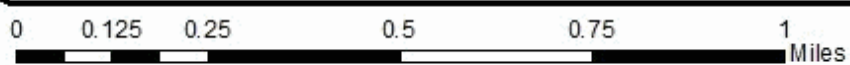



# TIMBER SALE MAP

This information provided by authority of Part 525, 1994 PA 451, as amended.

Sale Number	Year
73-002	23

Forest Management Unit	County	Mapped By	Date	Page	of
Gladwin Management Unit	Arenac	Behrmann	7/14/2023	2	2
Township	Range	Section(s) and Subdivision(s)	Scale		
20N	03W	Sec 27 SW, SWSE, N1/2, Sec 22 SWSW, SWNE, NWSE	1:7,920		

Cover Type				Density	
A = Aspen	H = Hemlock	N = Marsh	U = Upland Brush	0 = Non Stocked	5 = Pole Timber Medium
B = Paper Birch	J = Jack Pine	O = Oak	UM = Upland Mixed	1 = Seedling Sapling Poor	6 = Pole Timber Well
C = Cedar	L = Lowland Brush	P = Lowland Poplar	V = Bog or Marsh	2 = Seedling Sapling Medium	7 = Saw Timber Poor
D = Tied Bog	LM = Lowland Mixed	Q = Mixed Swamp Conifer	W = White Pine	3 = Seedling Sapling Well	8 = Saw Timber Medium
E = Swamp Hardwoods	M = Mpl, Bch, Brch	R = Red Pine	X = Non Stocked	4 = Pole Timber Poor	9 = Saw Timber Well
F = Spruce Fir	MC = Mixed Conifer	S = Black Spruce	Z = Water		
G = Grass	MD = Mixed Deciduous	T = Tamarack			

PU	Acres	PU	Acres	PU	Acres
1	18.1	4	14.7	7	10.9
2	42.5	5	46.7	8	6.2
3	20.5	6	56.6		

**Bone Yard Jack**  
 Compartment 124  
 Acres 216.2

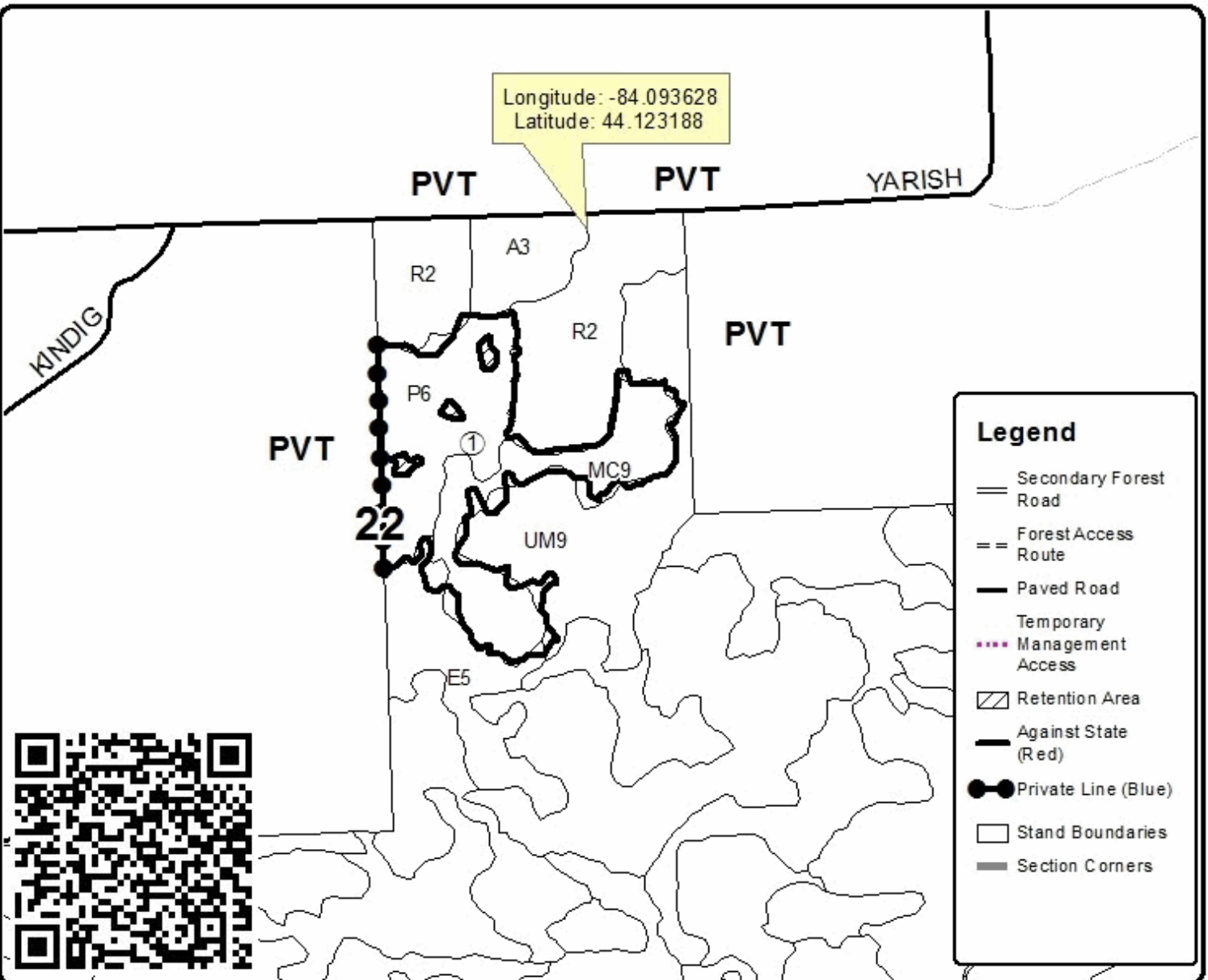

Legend	
	Secondary Forest Road
	Forest Access Route
	Paved Road
	Temporary Management Access
	Retention Area
	Against State (Red)
	Private Line (Blue)
	Stand Boundaries
	Section Corners

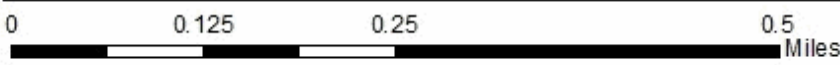

Eymer Oasis Mix (73-001-23)

T19N, R03E, SEC. 1; T19N, R03E, SEC. 11; T19N, R03E, SEC. 12; T19N, R03E,

In response to the notice of sale to be held 10:00 a.m. (local time) on November 28, 2023, I am hereby submitting my sealed bid (firm offer) for the following forest products to be cut. Bids for individual species must be at or above the advertised price. All non-responsive bid forms may be rejected.

<u>PRODUCTS &amp; SPECIES</u>	<u>ESTIMATED VOLUME*</u>	<u>ADVERTISED PRICE</u>	<u>BID PRICE/UNIT</u>
<b>Sawtimber</b>			
Black/Red (Hybrid) Oak	242.0 MBF	\$ 120.00/MBF	\$ _____
Jack Pine	27.8 MBF	\$ 49.00/MBF	\$ _____
Mixed Aspen	739.8 MBF	\$ 67.00/MBF	\$ _____
Red Maple	239.0 MBF	\$ 65.00/MBF	\$ _____
Red Oak	36.9 MBF	\$ 150.00/MBF	\$ _____
Red Pine	641.5 MBF	\$ 129.00/MBF	\$ _____
White Oak	37.4 MBF	\$ 90.00/MBF	\$ _____
White Pine	483.7 MBF	\$ 67.00/MBF	\$ _____
<b>Pulpwood</b>			
Black Cherry	29 Cords	\$ 20.00/Cord	\$ _____
Jack Pine	289 Cords	\$ 24.15/Cord	\$ _____
Mixed Aspen	1,165 Cords	\$ 28.80/Cord	\$ _____
Mixed Oak	516 Cords	\$ 16.40/Cord	\$ _____
Paper Birch	67 Cords	\$ 21.45/Cord	\$ _____
Red Maple	1,200 Cords	\$ 20.00/Cord	\$ _____
Red Oak	50 Cords	\$ 16.40/Cord	\$ _____
Red Pine	2,110 Cords	\$ 54.10/Cord	\$ _____
Sugar Maple	13 Cords	\$ 20.00/Cord	\$ _____
White Pine	1,120 Cords	\$ 30.00/Cord	\$ _____

\*The volumes are statistically estimated within plus (+) or minus (-) 6.37 percent at 95% confidence level. These estimated volumes are final and not subject to adjustment. Prospective bidders are urged to examine this timber and to make their own estimates of quantity and quality.

I understand that any or all bids may be rejected. All bids must be signed and all bid items must be bid or the bid form may be rejected. I also understand that consideration and awarding a contract will be based upon my past performance and ability to complete the contract based upon equipment and staffing subject to my control.

FEDERAL ID: \_\_\_\_ - \_\_\_\_ - \_\_\_\_ or SOCIAL SECURITY NUMBER: \_\_\_\_ - \_\_\_\_ - \_\_\_\_

Company or individual bidding: \_\_\_\_\_

Company representative's name: \_\_\_\_\_

Address: \_\_\_\_\_

City: \_\_\_\_\_ State: \_\_\_\_\_ Zip: \_\_\_\_\_

IF AVAILABLE, PLEASE PLACE THE PERSONALIZED LABEL FROM YOUR PROSPECTUS IN THE ABOVE BOX.

Individual or company representative's signature: \_\_\_\_\_ Date: \_\_\_\_\_

Phone number : \_\_\_\_\_ Email (optional): \_\_\_\_\_

**THE WINNING BIDDER MUST COMPLETE THE VERIFICATION OF WORKER'S DISABILITY COMPENSATION ACT COMPLIANCE (ON REVERSE SIDE IF DOUBLE SIDED) WITHIN 21 DAYS OF SALE AWARD DATE**



# TIMBER SALE VERIFICATION OF WORKER'S DISABILITY COMPENSATION ACT COMPLIANCE

As required by Act 317, P.A. 1969 (Worker's Compensation) and  
Part 5 of Act 451 of 1994, as amended.

<b>FOR DEPARTMENT USE ONLY</b>	
Sale Number (XX - XXX - XX - XX)	
Forest Management Unit:	

- VERIFICATION OF WORKER'S DISABILITY COMPENSATION ACT COMPLIANCE**
- This verification must be completed and submitted within 21 days of contract award and prior to the issuance of the timber sale contract.
  - In addition, if boxes 2B or 2C are checked, then Notice of Exclusion or Certificate of Insurance must be submitted within twenty-one (21) days of the contract award and prior to the issuance of the timber sale contract.
  - All information must be typed or printed except for written signatures.

Please Check Appropriate Categories:

- My business is organized as (you **must** check one of the boxes below):
  - Sole Proprietorship (individual)
  - Partnership
  - Corporation
- You **must** check one of the boxes below:
  - I certify my business is a sole proprietorship and it has no employees but the sole proprietor. I am not subject to the Worker's Compensation Laws.
  - I certify my business has satisfied its obligation to the Worker's Compensation Act through the use of an approved Notice of Exclusion (BWC-337, Rev. 5/96). I will provide a copy of the Notice of Exclusion within 21 days of the contract award. (For questions or a copy of the BWC-337, please call the Worker's Compensation Bureau at 517-322-1195).
  - I certify my business has a Worker's Compensation Policy. I will provide an original Certificate of Insurance within twenty-one (21) days of the contract award.
- If you have checked item 2(A) or 2(B), you **must** indicate the number of **both** full-time and part-time employees, other than yourself, including family members and active partners (if none, you must enter "0").

\_\_\_\_\_ Full-time Employees

\_\_\_\_\_ Part-time Employees

Name of Business		Federal ID (or) Social Security No.	
Address		Telephone (       )	
City	State	ZIP	

*I hereby certify that the above information is true and correct. I agree to notify the Michigan DNR of any changes that occur in factors affecting my coverage during any of my present and future operations.*

\_\_\_\_\_  
Signature of Owner or Authorized Representative

\_\_\_\_\_  
Title

\_\_\_\_\_  
Date

**Please complete the "SEALED BID" information on the next page**

Bone Yard Jack (73-002-23)

T20N, R03E, SEC. 22; T20N, R03E, SEC. 27; T20N, R03E, SEC. 28; Arenac

In response to the notice of sale to be held 10:00 a.m. (local time) on November 28, 2023, I am hereby submitting my sealed bid (firm offer) for the following forest products to be cut. Bids for individual species must be at or above the advertised price. All non-responsive bid forms may be rejected.

<u>PRODUCTS &amp; SPECIES</u>	<u>ESTIMATED VOLUME*</u>	<u>ADVERTISED PRICE</u>	<u>BID PRICE/UNIT</u>
<b>Sawtimber</b>			
Black/Red (Hybrid) Oak	125.9 MBF	\$ 120.00/MBF	\$ _____
Jack Pine	90.5 MBF	\$ 49.00/MBF	\$ _____
Quaking Aspen	48.5 MBF	\$ 67.00/MBF	\$ _____
Red Maple	76.5 MBF	\$ 65.00/MBF	\$ _____
Red Oak	4.0 MBF	\$ 150.00/MBF	\$ _____
Red Pine	277.4 MBF	\$ 129.00/MBF	\$ _____
White Pine	114.7 MBF	\$ 67.00/MBF	\$ _____
<b>Pulpwood</b>			
Jack Pine	924 Cords	\$ 24.15/Cord	\$ _____
Mixed Aspen	289 Cords	\$ 28.80/Cord	\$ _____
Mixed Hardwood	895 Cords	\$ 20.00/Cord	\$ _____
Mixed Oak	328 Cords	\$ 16.40/Cord	\$ _____
Paper Birch	7 Cords	\$ 21.45/Cord	\$ _____
Red Pine	851 Cords	\$ 54.10/Cord	\$ _____
Tamarack	19 Cords	\$ 19.30/Cord	\$ _____
White Pine	101 Cords	\$ 30.00/Cord	\$ _____

\*The volumes are statistically estimated within plus (+) or minus (-) 14.19 percent at 95% confidence level. These estimated volumes are final and not subject to adjustment. Prospective bidders are urged to examine this timber and to make their own estimates of quantity and quality.

I understand that any or all bids may be rejected. All bids must be signed and all bid items must be bid or the bid form may be rejected. I also understand that consideration and awarding a contract will be based upon my past performance and ability to complete the contract based upon equipment and staffing subject to my control.

FEDERAL ID: \_\_\_\_ - \_\_\_\_ - \_\_\_\_ or SOCIAL SECURITY NUMBER: \_\_\_\_ - \_\_\_\_ - \_\_\_\_

Company or individual bidding: \_\_\_\_\_

Company representative's name: \_\_\_\_\_

Address: \_\_\_\_\_

City: \_\_\_\_\_ State: \_\_\_\_\_ Zip: \_\_\_\_\_

IF AVAILABLE, PLEASE PLACE THE PERSONALIZED LABEL FROM YOUR PROSPECTUS IN THE ABOVE BOX.

Individual or company representative's signature: \_\_\_\_\_ Date: \_\_\_\_\_

Phone number : \_\_\_\_\_ Email (optional): \_\_\_\_\_

**THE WINNING BIDDER MUST COMPLETE THE VERIFICATION OF WORKER'S DISABILITY COMPENSATION ACT COMPLIANCE (ON REVERSE SIDE IF DOUBLE SIDED) WITHIN 21 DAYS OF SALE AWARD DATE**



**TIMBER SALE**  
**VERIFICATION OF WORKER'S DISABILITY**  
**COMPENSATION ACT COMPLIANCE**

*As required by Act 317, P.A. 1969 (Worker's Compensation) and  
Part 5 of Act 451 of 1994, as amended.*

<b>FOR DEPARTMENT USE ONLY</b>	
Sale Number (XX - XXX - XX - XX)	
Forest Management Unit:	

**VERIFICATION OF WORKER'S DISABILITY COMPENSATION ACT COMPLIANCE**

- This verification must be completed and submitted within 21 days of contract award and prior to the issuance of the timber sale contract.
- In addition, if boxes 2B or 2C are checked, then Notice of Exclusion or Certificate of Insurance must be submitted within twenty-one (21) days of the contract award and prior to the issuance of the timber sale contract.
- All information must be typed or printed except for written signatures.

Please Check Appropriate Categories:

1. My business is organized as (you **must** check one of the boxes below):
  - A.  Sole Proprietorship (individual)
  - B.  Partnership
  - C.  Corporation
2. You **must** check one of the boxes below:
  - A.  I certify my business is a sole proprietorship and it has no employees but the sole proprietor. I am not subject to the Worker's Compensation Laws.
  - B.  I certify my business has satisfied its obligation to the Worker's Compensation Act through the use of an approved Notice of Exclusion (BWC-337, Rev. 5/96). I will provide a copy of the Notice of Exclusion within 21 days of the contract award. (For questions or a copy of the BWC-337, please call the Worker's Compensation Bureau at 517-322-1195).
  - C.  I certify my business has a Worker's Compensation Policy. I will provide an original Certificate of Insurance within twenty-one (21) days of the contract award.
3. If you have checked item 2(A) or 2(B), you **must** indicate the number of **both** full-time and part-time employees, other than yourself, including family members and active partners (if none, you must enter "0").

\_\_\_\_\_ Full-time Employees                      \_\_\_\_\_ Part-time Employees

Name of Business		Federal ID (or) Social Security No.	
Address		Telephone (        )	
City	State	ZIP	

*I hereby certify that the above information is true and correct. I agree to notify the Michigan DNR of any changes that occur in factors affecting my coverage during any of my present and future operations.*

\_\_\_\_\_  
Signature of Owner or Authorized Representative

\_\_\_\_\_  
Title

\_\_\_\_\_  
Date

**Please complete the "SEALED BID" information on the next page**