



**DEPARTMENT OF NATURAL RESOURCES
STATE OF MICHIGAN
TIMBER SALE PROSPECTUS #7416**

SCHEDULED SALE DATE AND TIME: 9:00 a.m. (local time) on April 15, 2024.

LOCATION: GRAYLING MGMT UNIT, 1955 HARTWICK PINES ROAD, GRAYLING, MI 49738.

PROSPECTUS NOTE: The bidder is advised to inspect the sale area and review the location, estimated volumes, operating costs and contract terms of proposed sales. Please be aware that some landowners may request 60 days or more notice for access across their land.

Notice is hereby given that bids will be received by the Unit Manager, GRAYLING MANAGEMENT UNIT, for certain timber on the following described lands:

C 65 Lowlands (72-036-23) / T25N, R08E, SEC. 20, SESW.

T25N, R08E, SEC. 29, NENW,S1/2NW,NWSW.

T25N, R08E, SEC. 30, SENE.

T25N, R08E, SEC. 32, SENW,E1/2SW.

Alcona County, Advertised Price \$54,166.50, 107.9 Acres, Aspen, Hardwood.

SALE NOTE: The sale is on majority low ground and is within a large block of Eastern Massasauga Rattlesnake Managed Lands where minimizing rutting is a priority. Access to the south half of the sale involves over six miles of seasonal county and state forest roads. Part of the south access route coincides with a designated snowmobile trail.

A recreation site such as a trail, pathway, or campground is within the sale area or the vicinity. Certain restrictions/specifications may be applicable including time restrictions. Access may be through private or other public land.

Buteo Buffer Mix (72-616-23) / T28N, R03W, SEC. 11, SWSE.

T28N, R03W, SEC. 14, N1/2NW,SEW,NENE,SWNE,W1/2SW.

Crawford County, Advertised Price \$84,337.05, 105.2 Acres, Hardwood, Aspen.

SALE NOTE: Sale is non-certified on military lands.

Butterfly Lane Jack Pine (72-621-23) / T27N, R01W, SEC. 6 , E1/2SE.

T27N, R01W, SEC. 8 , NWNW,S1/2NW,SW,SWSE.

Crawford County, Advertised Price \$40,839.65, 79.6 Acres, Jack Pine, Red Pine.

SALE NOTE: This is a military sale on non-certified land, low stump and chipping required for military and planting requirements. Soft oak wilt restrictions and KW timing restrictions. Sale was cruised by summer student and dropped additional 20% to account for possible unforeseen error.

Let's See Your ID Hardwood (72-625-23) / T28N, R03W, SEC. 13, SWNW,W1/2SW.

T28N, R03W, SEC. 14, SENW,S1/2NE,NESW,N1/2SE,SWSE.

T28N, R03W, SEC. 24, NWNW.

Crawford County, Advertised Price \$92,974.75, 106.7 Acres, Hardwood, Aspen.

SALE NOTE: This sale is on non-certified military lands.

Unplugged Oak (72-626-23) / T26N, R04W, SEC. 34, SENE,SW,N1/2SE.

Crawford County, Advertised Price \$85,833.30, 72.1 Acres, Hardwood, Red Oak.

SALE NOTE: Sale is on non-certified military lands. Portions of this sale have an operating restriction for oak wilt. This sale has class A road access.

BID INSTRUCTIONS (VER. 10/10/2022):

1. Scheduled Bid Location, Date, and Time (2/11)

Bids must be received by the Unit Manager, GRAYLING OFFICE, 1955 HARTWICK PINES ROAD, GRAYLING, MI 49738, no later than 9:00 a.m. (local time) on April 15, 2024. For further information concerning this sale, contact Thomas Barnes at 989-348-6371 extension 7440.

2. Bidder's Qualifications (10/22)

If all or part of a timber sale was prepared by a private contractor, the contractor and that contractor's company are not permitted to bid on the timber sale. A person must be 18 years of age or older to purchase timber. Permanent employees of the Department of Natural Resources or members of their immediate household may not bid. Former employees, in the permanent or seasonal class, may not bid until 3 months after the last day of active duty. Bids will not be accepted from individuals or companies appearing on the DNR/FRD No-Bid List. This list contains the names of purchasers who previously failed to execute a contract within 21-days or who have a history of poor performance.

3. Preparation of Sealed Bids (5/16)

Bid Forms may be completed online thru Michigan DNR Timber Sale Online Bidding (OLB) at www.michigan.gov/timberbidding or by completing the hardcopy Bid Form found in the Timber Sale Prospectus. Hardcopy Bid Forms shall be manually signed in ink. Registration in OLB is considered your 'signature' for all bids submitted thru that system. Bid prices must be entered for each species and product in the Bid Price column for all material subject to bidding and all fill-in blanks must be completed. If erasures or other changes appear on the hardcopy Bid Form, each erasure or change must be initialed by the person signing the bid.

4. Submission of Sealed Bids (5/16)

Bid forms may be obtained from the Unit Manager or thru OLB. Bids may be submitted hardcopy or thru OLB. All hardcopy bids must be submitted on the bid form and in an envelope clearly identified as described in this section. NOTE: Only one bid form per bid envelope. Sealed bids must be submitted to the Unit office designated in the prospectus and must be submitted at or prior to the time established in the prospectus. The envelope should show on the outside (a) the sale name or number and (b) the date and time of bid opening, as shown in the prospectus. Bids received after the time specified in the sale prospectus are late bids and will be rejected.

It is possible for a bidder to submit multiple bids on a single sale. For example, a bid may be submitted hardcopy and a bid may be submitted thru OLB. Or, two bidders from the same company could both submit bids on the same sale. If this were to happen, the State would accept all bids received and award the contract accordingly. All bidding and contractual requirements would apply to all bids received.

5. Public Opening of Sealed Bids (7/16)

If conditions permit, the sealed bids will be publicly opened and posted at the time and place set in the prospectus.

If a bidder, present at a bid opening, has submitted bids on more than one sale, that bidder may withdraw their unopened bid envelopes or announce the withdrawal of their online bid after being declared the successful bidder on one sale.

6. Award of Contract (1/11)

Award of the contract will be made to the Bidder whose bid, conforming to the prospectus, is most advantageous to the State of Michigan on the basis of total value at rates bid for the estimated quantities. The State reserves the right to reject any bid or waive any minor irregularity in bids received. A written award mailed (or otherwise furnished) to the successful Bidder shall be deemed to result in a binding contract without further action by either party.

7. Down Payment (1/11)

The Bidder to whom award is made must make a down payment within 21 days of the sale award. The amount of the down payment will be calculated as shown in the Bond and Payment Schedule of this prospectus. Only cash may be used to meet this requirement.

8. Performance Security (1/11)

As guarantee of faithful performance, a cash bond, certificate of deposit, surety bond or irrevocable letter of credit (LOC) is required within 21 days of the sale award. The amount of the performance security is shown in the Bond and

Payment Schedule of this prospectus. If an LOC or surety is used, the coverage must extend for at least 6 months beyond the contract expiration.

9. Worker's Compensation (10/22)

Purchaser shall obtain worker's compensation insurance to cover claims under Michigan's Worker's Disability Compensation Act of 1969 or similar employee benefit act of any other state applicable to an employee. Verification of Worker's Disability Compensation Act Compliance must be completed and submitted within 21 days of contract award and prior to the issuance of the timber sale contract. In addition, if applicable, Notice of Exclusion or Certificate of Insurance must also be submitted.

10. Timber Sale Contract (10/22)

Additional conditions and requirements common to all timber sales are listed on the timber sale contract (R4031) and are available on line at www.michigan.gov/timber. Contact the Unit Manager for additional information or a sample contract. Within 21 days of the date of the award letter, the bidder must sign the contract and provide the required down payment, performance security, and verification of worker's disability compensation. The down payment and performance security shall be in accordance with the provisions of the timber sale contract, in the sums stated in this prospectus. If these actions are not taken, then the Bidder, the Bidder's corporation, and the corporation's principals may not be permitted to bid on State timber sales for a period of 3 months after the first offense, 6 months after the second offense, and 1 year after the third offense. An offense will only be counted against the Bidder for 5 years. In addition, the Bidder certifies that if awarded this contract, the Bidder will complete the timber sale contract in accordance with its terms and any modifications thereof including requirements to purchase, cut, and remove the included timber by the expiration date.

Payment Unit values in the State Forest Timber Sale Contract are calculated based on the advertised value of the Payment Unit as a percentage of the total advertised value of the contract. The advertised value of each Payment Unit is given in the Description of Timber by Payment Unit table on the Timber Sale Information page. For example, if the value of Payment Unit 1 is advertised as \$1,500 and the total Timber Sale value is advertised as \$10,000, the contract price for Payment Unit 1 will be 15% of the total bid price ($\$1,500/\$10,000 * 100$).

11. Disclaimer of Estimates and Bidder's Warranty of Inspection (10/22)

Before submitting this bid, the Bidder is advised and cautioned to inspect the sale area, review the requirements of the sale contract, and take other steps as may be reasonably necessary to ascertain the location, estimated volumes, construction estimates, and operating costs of the proposed sale. Failure to do so will not relieve the Bidder from responsibility for completing the contract.

The Bidder warrants that this bid is submitted solely on the basis of the Bidder's examination and inspection of the quality and quantity of the timber offered for sale and the Bidder's opinion of the value thereof and the costs of recovery. No reliance should be placed on the State of Michigan's estimates of timber quality, quantity or costs of recovery. Bidder further acknowledges that the State of Michigan: (i) expressly disclaims any warranty of fitness of timber for any purpose; (ii) offers this timber as is without any warranty of quality (merchantability) or quantity and (iii) expressly disclaims any warranty as to the quantity or quality of timber sold.

12. Certification and Chain-of-Custody (10/22)

Unless otherwise indicated in the contract under section 7 – Other Conditions of the Sale Specific Conditions & Requirements, the area encompassed by this timber sale is certified to the standards of the Forest Stewardship Council (FSC) - Certificate #SCS-FM/COC-00090N and the Sustainable Forestry Initiative (SFI) - Certificate #NSF-SFIS-5Y031-SF5. Forest products from this sale may be delivered to the mill as "FSC 100% and / or SFI certified" as long as the contractor hauling the forest products is chain-of-custody (COC) certified or covered under a COC certificate from the destination mill. The purchaser is responsible for maintaining COC after leaving the sale area.

13. Good Neighbor Authority (GNA) Requirements (10/22)

If the name of this timber sales contains the acronym GNA, it is authorized by the Good Neighbor Authority (GNA) and covered by various agreements between the U.S. Forest Service and the State. The timber sale occurs on federal land and the following conditions apply:

GNA contracts on US Forest Service land will not be awarded to purchasers on the Federal list of excluded parties. The System for Award Management (SAM) will be checked for active excluded parties prior to award of contract. In

addition, the Bidder to whom award is made must complete an Assurance Regarding Felony Conviction or Tax Delinquent Status for Corporate Applicants (AD-3031).

14. Good Neighbor Authority (GNA) Requirements, con't (10/22)

Bidder certifies, by signing this bid form, that to the best of Bidder's knowledge that the following representations are accurate and complete.

- a. That the Bidder and its principals are not presently debarred, suspended, proposed for debarment, declared ineligible, or voluntary excluded from timber sales (covered transactions) by any Federal department or agency.
- b. That the Bidder and its principals have not within a 3-year period preceding this bid been convicted of or had a civil judgment rendered against them for commission of fraud or a criminal offense in connection with obtaining , attempting to obtain, or performing a public (Federal, State, or local) transaction or contract under a public transaction; violation of Federal or State antitrust statutes or commission of embezzlement, theft, forgery, bribery, falsification or destruction of records, making false statements, or receiving stolen property.
- c. That the Bidder and its principals are not presently indicted for or otherwise criminally or civilly charged by a governmental entity (Federal, State, or local) with commission of any of the offenses enumerated in paragraph b of this certification.
- d. That the Bidder and its principals have not within a 3-year period preceding this bid had one or more public transactions (Federal, State, or local) terminated for breach or default of a timber or forest product contract.

Bidders that cannot certify this requirement, in whole or in part, shall submit an explanation with their bid.

Scott Bowen
Director

TIMBER SALE INFORMATION

C 65 Lowlands (72-036-23)

T25N, R08E, SEC. 20; T25N, R08E, SEC. 29; T25N, R08E, SEC. 30; T25N, R08E, SEC. 32.

Alcona County (Advertised Price \$54,166.50)

SALE NOTE: The sale is on majority low ground and is within a large block of Eastern Massasauga Rattlesnake Managed Lands where minimizing rutting is a priority. Access to the south half of the sale involves over six miles of seasonal county and state forest roads. Part of the south access route coincides with a designated snowmobile trail.

A recreation site such as a trail, pathway, or campground is within the sale area or the vicinity. Certain restrictions/specifications may be applicable including time restrictions. Access may be through private or other public land.

A timber sale contract for this lump sum, sealed bid timber sale will be awarded to the responsible bidder offering the highest sealed bid price. All units of volume listed below were estimated using the Inventory Manager computer program and the new Michigan taper model. Bids must be at or above the following advertised price for each product and species:

<u>PRODUCTS & SPECIES</u>	<u>ESTIMATED UNITS*</u>	<u>ADVERTISED PRICE</u>
Pulpwood		
Balsam Fir	230 Cords	\$ 25.95 / Cord
Jack Pine	31 Cords	\$ 15.40 / Cord
Mixed Aspen	1,373 Cords	\$ 20.40 / Cord
Mixed Hardwood	708 Cords	\$ 21.20 / Cord
Northern Pin Oak	9 Cords	\$ 17.70 / Cord
Red Pine	33 Cords	\$ 37.50 / Cord
Tamarack	29 Cords	\$ 15.00 / Cord
White Pine	175 Cords	\$ 16.40 / Cord

* The total volume is statistically estimated within plus (+) or minus (-) 31.20 percent. There are an estimated 2,588 cords on this timber sale, plus or minus 808 cords at the 95% confidence level. The estimated units are final and not subject to adjustment. Prospective bidders are urged to examine this timber and to make their own estimates of quantity and quality.

BOND AND PAYMENT SCHEDULE:

1. A bond in the amount of \$2,708.00 to insure faithful performance of the conditions of the contract will be deposited by the successful bidder within 21 days of the sale award.
2. Cutting in any sale or unit without the required advance payment would be considered a trespass.
3. Total payment must be paid in advance or according to the following schedule :
 - (a) Ten percent (10%) of the sale value must be paid within 21 days of the sale award.
 - (b) The 10% down payment will be credited towards the first unit cut.
 - (c) Payment for each of the following units must be made before cutting begins in that unit:

PAYMENT UNIT NUMBER	PERCENT OF TOTAL SALE VALUE
01	24.9%
02	32.1%
03	24.9%
04	8.9%
05	9.2%
4. If no cutting takes place, the 10% down payment will not be refunded.
5. Operations on the contract issued will terminate on 06/30/2027.

SALE STATISTICS

Volumes were calculated in cubic feet using the Michigan taper model. Cubic foot volume includes all wood inside bark for the product indicated. For display purposes, cubic feet were converted to cords and MBF using a simple conversion factor, e.g. 79 cubic feet per cord and 185 cubic feet per MBF. The cubic foot volumes are precise; the cords and MBF volumes are not. Cubic foot volume cannot be directly converted to cords or boards with precision.

SALE VOLUMES

The total estimated sale volume may not equal the sum of the species/products due to the nature of statistical calculations associated with double sampling methodology.

VOLUME		STATISTICAL RANGE IN CORDS		
TOTAL CUBIC FEET	TOTAL CORDS	PERCENT ERROR	MINIMUM	MAXIMUM
204,490	2,588	31.20%	1,781	3,396

VDU VOLUMES

A VDU is a Volume Determination Unit. Volumes and their associated statistics are calculated at the VDU level and summarized to the sale level. There is often a one to one relationship between a VDU and a Payment Unit, but not always, depending on the cruise design. Refer to the VDU TO PAYMENT UNIT table.

VDU	VOLUME		PERCENT ERROR	RANGE IN CORDS	
	TOTAL CUBIC FEET	TOTAL CORDS		MINIMUM	MAXIMUM
53	116,757	1,478	28.35%	1,059	1,897
84	50,826	643	44.72%	356	931
89	36,907	467	30.15%	326	608
TOTAL:	204,490	2,588		1,741	3,436

VDU TO PAYMENT UNIT

When a VDU is associated with more than one Payment Unit (PU), the VDU volumes are assigned to the PU based on acres of the VDU within the PU.

VDU	VDU ACRES	PU	PU ACRES
53	70.6	1	30.8
		2	39.8
84	16.5	3	16.5
89	20.8	4	10.2
		5	10.6
TOTAL:	107.9		107.9

DESCRIPTION OF TIMBER BY PAYMENT UNIT (PU)

PU	MARKET GROUP	PRODUCT	QUANTITY	UNIT	ACRES	ADVERTISE PRICE
1	Balsam Fir	Pulpwood	71	Cords	30.8	\$13,471.15
	Jack Pine		14	Cords		
	Mixed Aspen		376	Cords		
	<i>B. T. Aspen</i>		83	<i>Cords</i>		
	<i>Quaking Aspen</i>		293	<i>Cords</i>		
	Mixed Hardwood		123	Cords		
	<i>Black Cherry</i>		6	<i>Cords</i>		
	<i>Paper Birch</i>		7	<i>Cords</i>		
	<i>Red Maple</i>		110	<i>Cords</i>		
	Northern Pin Oak		4	Cords		
	Red Pine		7	Cords		
	Tamarack		13	Cords		
	White Pine		37	Cords		
	2		Balsam Fir	Pulpwood		
Jack Pine		17	Cords			
Mixed Aspen		486	Cords			
<i>B. T. Aspen</i>		107	<i>Cords</i>			
<i>Quaking Aspen</i>		379	<i>Cords</i>			
Mixed Hardwood		159	Cords			
<i>Black Cherry</i>		8	<i>Cords</i>			
<i>Paper Birch</i>		10	<i>Cords</i>			
<i>Red Maple</i>		141	<i>Cords</i>			
Northern Pin Oak		5	Cords			
Red Pine		10	Cords			
Tamarack		16	Cords			
White Pine		47	Cords			
3		Balsam Fir	Pulpwood		50	Cords
	Mixed Aspen	497		Cords		
	<i>B. T. Aspen</i>	172		<i>Cords</i>		
	<i>Quaking Aspen</i>	325		<i>Cords</i>		
	Mixed Hardwood	97		Cords		
	<i>Red Maple</i>	97		<i>Cords</i>		
4	Balsam Fir	Pulpwood	8	Cords	10.2	\$4,801.60
	Mixed Aspen		7	Cords		
	<i>B. T. Aspen</i>		4	<i>Cords</i>		
	<i>Quaking Aspen</i>		3	<i>Cords</i>		
	Mixed Hardwood		161	Cords		
	<i>Paper Birch</i>		4	<i>Cords</i>		
	<i>Red Maple</i>		157	<i>Cords</i>		
	Red Pine		8	Cords		
White Pine	45	Cords				
5	Balsam Fir	Pulpwood	9	Cords	10.6	\$4,992.35
	Mixed Aspen		7	Cords		
	<i>B. T. Aspen</i>		4	<i>Cords</i>		
	<i>Quaking Aspen</i>		3	<i>Cords</i>		
	Mixed Hardwood		168	Cords		
	<i>Paper Birch</i>		5	<i>Cords</i>		
	<i>Red Maple</i>		163	<i>Cords</i>		
	Red Pine		8	Cords		
	White Pine		46	Cords		
TOTAL:			2,588	Cords		

Sale Specific Conditions & Requirements

Sale Name: C 65 Lowlands

Sale Number: 72-036-23 Seq#: 2

1 - Sale Area

1.2 - Boundaries

1.2.1 - Painted boundaries (9/19)

The sale boundary and Payment Unit boundaries are marked and identified by blue, red and yellow paint, along with unpainted boundaries. Exterior sale boundary lines against private property are marked with blue paint. Exterior sale boundary lines against state are marked with red paint, in addition to unpainted boundaries along wetlands, lowland shrub covers, or lowland shrub swales (see Timber Sale Map). Interior Payment Unit boundaries are marked with yellow paint, with the exception of the boundary between Payment Units 1 & 2, which is unpainted and designated as Schrade Road. Retention patches are marked with red paint; no harvesting activities may occur within these areas. The red and blue painted boundary line trees are not Included Timber and are to be protected. Yellow painted trees designating an interior Payment Unit boundary are only to be cut when all surrounding Payment Units have been paid.

2 - Timber Specifications

2.1 - Included Timber

2.1.1 - Clearcut unit(s) with unmerchantable trees (6/14)

Within Payment Unit(s) 1 & 2, cut all trees that are two (2) inches or more at DBH, except do not cut cedar, hemlock, or any trees marked with green paint.

Within Payment Units 3-5, cut all trees that are two (2) inches or more at DBH, except do not cut red pine and white pine that are greater than 20 inches at DBH, or any hemlock, cedar, oak, or trees marked with green paint.

Across the Sale Area, patches of saplings greater than 2 inches at DBH may be left uncut if they are intact (not bent/broken) and located away from aspen. Special protection trees identified in accordance with condition 3.4.2, within clearcutting unit boundaries, are not Included Timber and are to be protected.

2.1.11 - Description of timber note (2/04)

Note that all species were cruised as pulp. Note also that there are remnants of an old fence in the east end of Payment Units 3 & 5. Some of the fence wire was attached directly to trees.

2.2 - Utilization

2.2.6 - Roundwood operation required (3/21)

The skidding of whole trees or tree segments with limbs attached is prohibited. All products must be produced as roundwood and forwarded to existing roads or landing areas in final product length.

2.2.9 - No chipping permitted (12/08)

Within Payment Unit(s) 1-5, No chipping is permitted.

3 - Payments

3.3 - Pre-measured Sales

3.3.4 - Dividing payment units (7/14)

Payment Unit(s) 1, 2 & 3, may be divided at the request of the Purchaser and upon approval of the Unit Manager. Dividing Payment Units is a contract modification which requires a Timber Sale Contract Amendment. There will be only one division per Payment Unit.

3.4 - Damaged Timber

3.4.1 - Damaged timber (7/16)

General Condition and Requirement 3.4 Damaged Timber, defines liquidated damages for undesignated live merchantable trees which are cut or injured. In addition, reasonable care should be taken to avoid damage to tree seedlings and saplings less than 2 inches at DBH.

Within the Sale Area, if more than 30% of the tree seedlings or saplings less than 2 inches at DBH within a specified portion of the Sale Area are damaged, liquidated damages will be assessed at \$300 per acre for all acreage within that specified portion of the Sale Area that was damaged. Operable paths will need to be cut through dense regen; if those paths are cut cleanly, they will not be considered damaged areas.

3.4.2 - Special Protection Trees (4/14)

The Purchaser shall not cut live or dead special protection trees within cutting units or clearings. Special protection trees are cedar, hemlock and red pine & white pine greater than 20 inches at DBH. If the Purchaser's operations have cut or damaged special protection trees through carelessness, the Purchaser shall pay \$200 as fixed, agreed and liquidated damages for each special protection tree cut or damaged. Such payment does not constitute ownership of the undesignated timber.

4 - Transportation

4.1 - Construction

4.1.6 - Road construction (1/09)

Construction of new roads and landings, or improvement of existing roads shall be done in such a way as to minimize the environmental and visual impacts. Merchantable trees shall be cut and utilized unless otherwise directed. Non-merchantable trees shall be severed and laid flat on the ground. Slash shall be scattered, and not left in windrows and kept a minimum of 10 feet back from the road edge. Stumps shall be set upright, not left on edge, and be moved at least 10 feet away from the road edge. Disturbed soil shall be feathered into the woods and not left in berms or windrows.

4.1.7 - Road closure (10/11)

All new roads built into the sale must be blocked to vehicle traffic upon completion of the sale. Overgrown roads that are reopened shall be considered new roads. In general, closure will require constructing a four (4') foot high berm of stumps and logs covered with earth. Stumps and brush may also need to be placed along portions of the trail. Contact the Sale Administrator for specific details of design and placement.

4.1.11 - Permits (2/12)

The Purchaser will secure any necessary permits that may be required.

5 - Operations

5.1 - Notification

5.1.1 - Pre-sale conference (10/16)

A pre-sale conference on site between the Purchaser and sale administrator is required prior to beginning any operations, to determine landing and road locations. The Unit Manager or his/her representative must be contacted at least 5 days in advance to schedule the conference.

5.1.4 - Post-sale conference (10/16)

A post-sale conference on site between the Purchaser and sale administrator is required prior to the completion of active logging operations to determine clean-up and repair of landings, road edges, and the fulfillment of other contract specifications.

5.2 - Conduct of Operations

5.2.3 - Operating Restrictions

5.2.3.1 - Operating restrictions (9/11)

Within Payment Unit(s) 1-5, unless changed by written agreement, cutting, skidding, and hauling can only occur during dry summer or frozen winter conditions. This restriction is necessary to protect the overwintering habitat of the state threatened Eastern Massasauga Rattlesnake.

5.2.4 - Dead and Down Creation

5.2.4.4 - Dead and down creation, grouse (6/18)

To encourage grouse and other wildlife, in Payment Unit(s) 1-5 leave one, 12" diameter or larger log-length (8 foot minimum) piece on the ground for every 2 acres, or one 12" or larger diameter (or largest diameter trees within stand) whole tree on the ground for every 4 acres, preferably a hardwood species such as maple or if no hardwoods are present, a pine species (white or red). These trees will be evenly scattered throughout the unit, preferably at least 200 feet from

any roads open to vehicles.

5.2.29 - Shrub protection (1/20)

Reasonable care should be taken to avoid cutting or damaging juneberry. These woody-shrub plants are highly beneficial to various wildlife species.

5.2.38 - No decking against live trees (2/04)

Cut products may not be decked against unmarked or designated leave trees.

5.2.41 - Snowmobile trail protection (9/11)

LP_96/963 is a snowmobile trail and is shown on the Timber Sale Map. Do not cut or damage posts with orange trail markers or traffic control signs. If the trail is used, it must be maintained and restored to a condition equal to or better than before the sale. The road maintenance/restoration must be done prior to December 1. If the trail is used for hauling, it must be graded to the satisfaction of the Unit Manager or his/her representative prior to December 1. The snowmobile trail may not be used for any timber sale operations from December 1 to March 31 without written permission from the Unit Manager.

5.4 - Soil Protection

5.4.1 - Rutting restriction, general (7/16)

Operations are to cease immediately if equipment and weather conditions result in rutting of skid trails which is 6 inches or greater in depth and 25 feet in length. The Unit Manager or his/her representative may restrict hauling and/or skidding if ruts exceed the specified depth. With the Unit Manager or his/her representative's approval, the Purchaser may return to the area when the risk of rutting has decreased.

5.4.6 - Wet area protection (5/10)

No harvesting operations, including skidding and felling, are to take place within dense patches of lowland shrub cover. This tag alder and winterberry cover occupies the timber sale's most saturated ground where the risk of rutting is the greatest. The lowland shrub swale shown on the Timber Sale Map in the south end of Payment Units 1 & 2 may only be crossed on Schrade Road or at locations identified by the Sale Administrator and protected with matting. Care must be taken by the Purchaser to identify and avoid operating in these areas of the timber sale.

6 - Safety and Fire Prevention

6.2 - Signing

6.2.1 - Road posting (10/20)

The Purchaser is responsible for posting and maintaining caution signs on the forest road haul route prior to beginning operations. The road must be posted at appropriate distances from the Sale Area to warn of logging activity and truck traffic. Signs must be removed when harvest operations are suspended or completed. The Purchaser will provide these signs.

6.2.2 - Snowmobile trail posting (10/20)

The Purchaser is responsible for posting and maintaining caution signs on the snowmobile trail prior to beginning operations during the snowmobile season (approximately December 1 to March 31). The trail must be posted at appropriate distances from the Sale Area to warn of logging activity and truck traffic. Signs must be removed when harvest operations are suspended or completed. The Purchaser will provide these signs.

7 - Other Conditions

7.2 - Extensions

7.2.5 - Weather related extension (1/13)

If weather conditions during the operating period of this contract prevent harvesting, this sale may qualify for a weather related extension. If approved, the normal extension fee would be waived. To qualify, there must be a documented attempt each year to harvest in the difficult portion of the sale.

7.5 - Loss

7.5.1 - Deteriorating timber (7/09)

The sale area has received damage from spruce budworm in the balsam fir and heart rot in the aspen. The Purchaser should harvest the wood as soon as possible. The Department of Natural Resources is held free of responsibility of any further damage or deterioration due to delay in harvesting.



TIMBER SALE MAP

This information provided by authority of Part 525, 1994 PA 451, as amended.

Forest Management Unit Grayling	County Alcona	Mapped By Charlebois, Lovelace	Date 10/08/2023	Page 1	of 3
Township 25N	Range 8E	Section(s) and Subdivision(s) Sec 29: NENW, S1/2NW, NWSW Sec 30: SENE; Sec 32: SENW, E1/2SW	Scale 1:52,000		

Cover Type				Density	
A = Aspen	H = Hemlock	N = Marsh	U = Upland Brush	0 = Non Stocked	5 = Pole Timber Medium
B = Paper Birch	J = Jack Pine	O = Oak	UM = Upland Mixed	1 = Seedling Sapling Poor	6 = Pole Timber Well
C = Cedar	L = Lowland Brush	P = Lowland Poplar	V = Bog or Marsh	2 = Seedling Sapling Medium	7 = Saw Timber Poor
D = Treed Bog	LM = Lowland Mixed	Q = Mixed Swamp Conifer	W = White Pine	3 = Seedling Sapling Well	8 = Saw Timber Medium
E = Swamp Hdwoods	M = Mpl, Bch, Brch	R = Red Pine	X = Non Stocked	4 = Pole Timber Poor	9 = Saw Timber Well
F = Spruce Fir	MC = Mixed Conifer	S = Black Spruce	Z = Water		
G = Grass	MD = Mixed Deciduous	T = Tamarack			

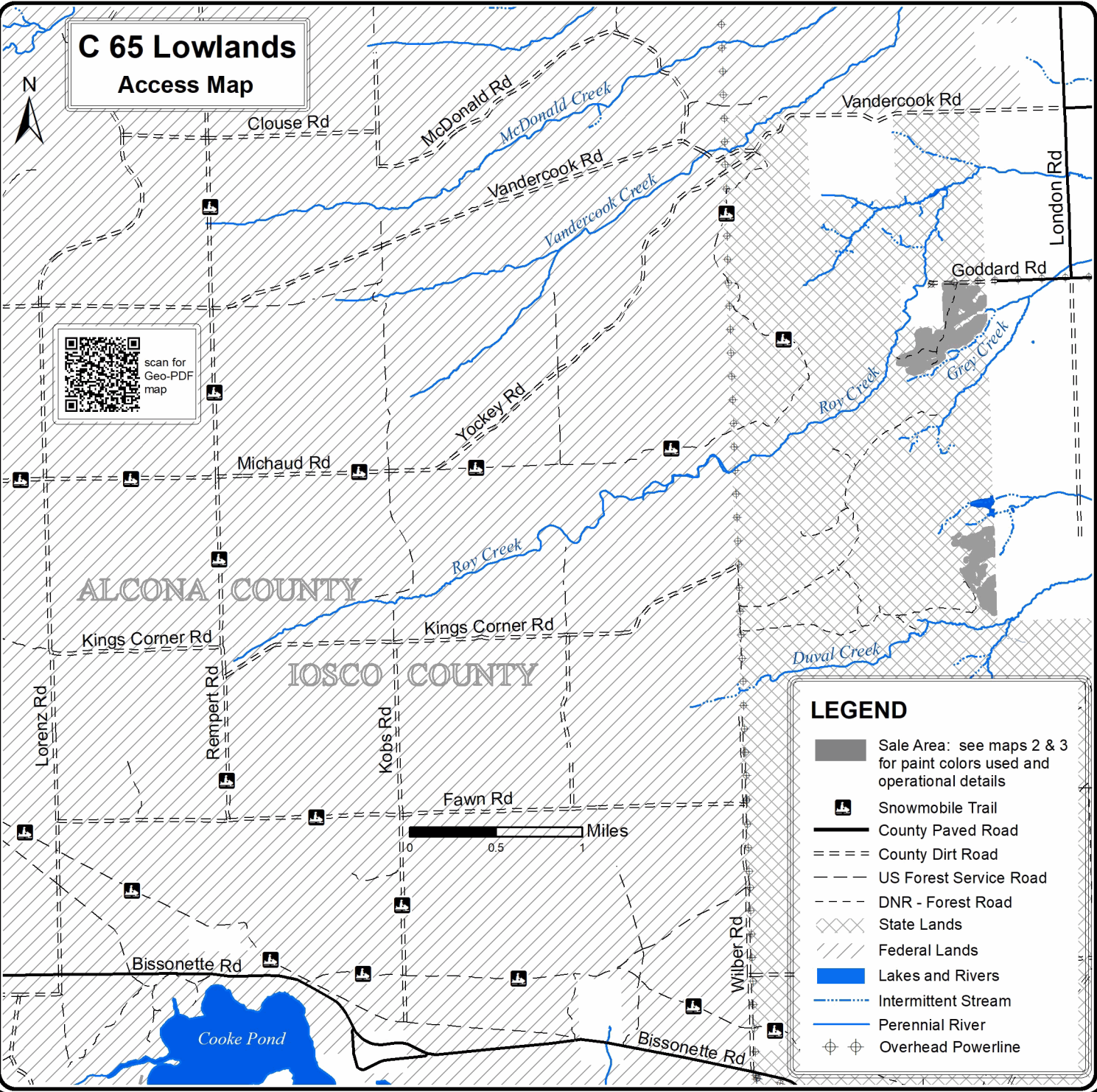



Sale Number	Year
72 - 036	23

TIMBER SALE MAP

This information provided by authority of Part 525, 1994 PA 451, as amended.

Forest Management Unit	County	Mapped By	Date	Page	of
Grayling	Alcona	Charlebois, Lovelace	10/08/2023	2	3
Township	Range	Section(s) and Subdivision(s)	Scale		
25N	8E	Sec 29: NENW, S1/2NW, NWSW Sec 30: SENE; Sec 32: SENW, E1/2SW	1:7,920		

Cover Type

A = Aspen	H = Hemlock	N = Marsh	U = Upland Brush
B = Paper Birch	J = Jack Pine	O = Oak	UM = Upland Mixed
C = Cedar	L = Lowland Brush	P = Lowland Poplar	V = Bog or Marsh
D = Treed Bog	LM = Lowland Mixed	Q = Mixed Swamp Conifer	W = White Pine
E = Swamp Hdwoods	M = Mpl. Bch, Brch	R = Red Pine	X = Non Stocked
F = Spruce Fir	MC = Mixed Conifer	S = Black Spruce	Z = Water
G = Grass	MD = Mixed Deciduous	T = Tamarack	

Density

0 = Non Stocked	5 = Pole Timber Medium
1 = Seedling Sapling Poor	6 = Pole Timber Well
2 = Seedling Sapling Medium	7 = Saw Timber Poor
3 = Seedling Sapling Well	8 = Saw Timber Medium
4 = Pole Timber Poor	9 = Saw Timber Well

Legend

Sale Boundary

- Against Private - Blue paint
- Against State - Red paint
- Payment Unit - Yellow paint & designated unpainted
- Retention Area - Red paint
- Payment Unit Number
- Field Grade Corners
- Snowmobile Trail
- DNR - Forest Road
- DNR - Temp Access Road
- County Paved Road
- County Gravel Road
- US Forest Service Road
- Ownership Boundary
- Lakes and Rivers
- Intermittent Stream
- Perennial River
- Overhead Powerline

PU	Acres
1	30.8
2	39.8
3	16.5
4	10.2
5	10.6



scan for Geo-PDF map

C 65 Lowlands
Compartment 65
107.9 Acres

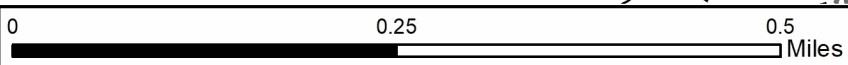
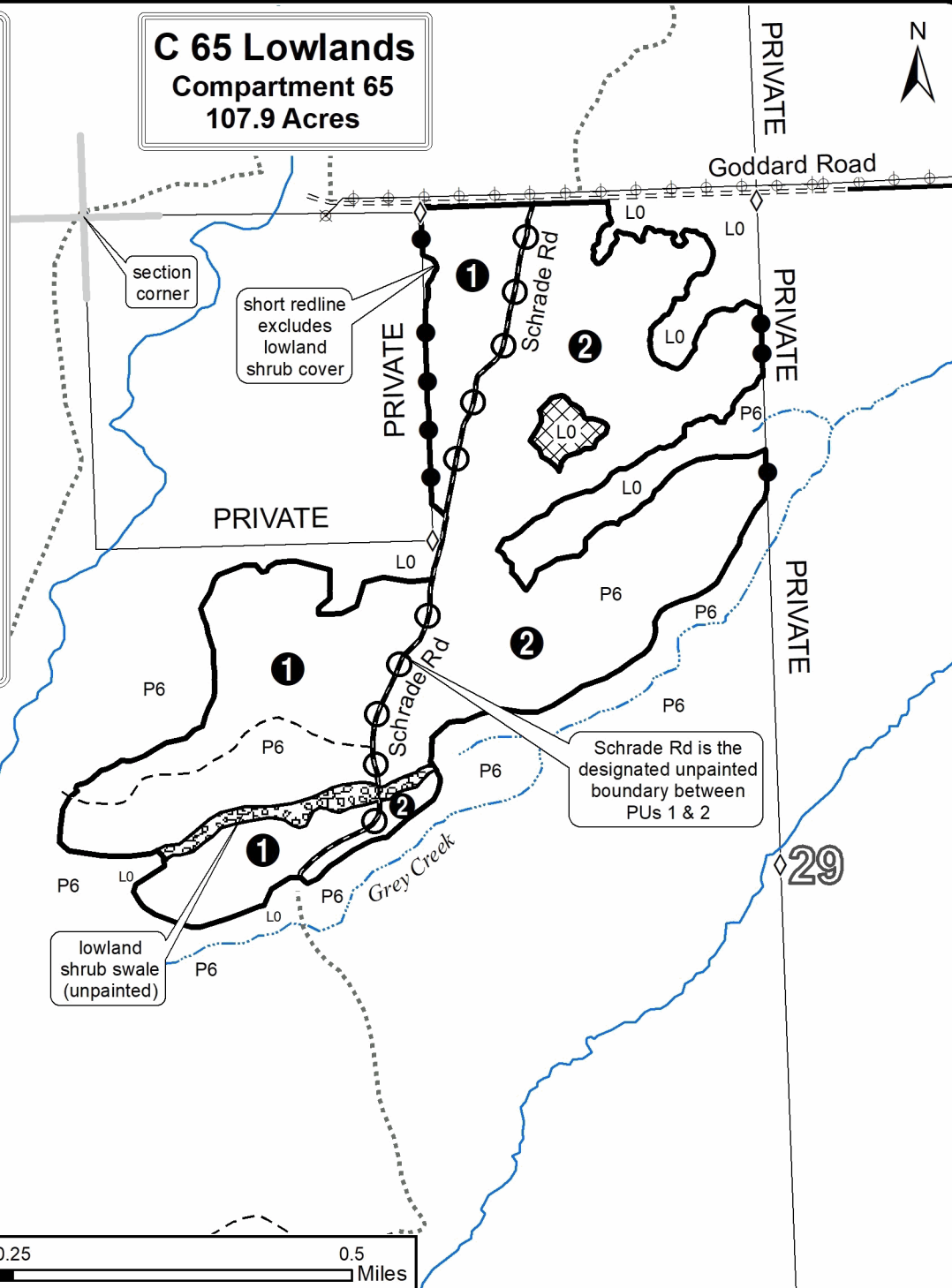



TIMBER SALE MAP

This information provided by authority of Part 525, 1994 PA 451, as amended.

Sale Number	Year
72 - 036	23

Forest Management Unit	County	Mapped By	Date	Page	of
Grayling	Alcona	Charlebois, Lovelace	10/08/2023	3	3
Township	Range	Section(s) and Subdivision(s)	Scale		
25N	8E	Sec 29: NENW, S1/2NW, NWSW Sec 30: SENE; Sec 32: SENW, E1/2SW	1:5,000		

Cover Type

A = Aspen	H = Hemlock	N = Marsh
B = Paper Birch	J = Jack Pine	O = Oak
C = Cedar	L = Lowland Brush	P = Lowland Poplar
D = Treed Bog	LM = Lowland Mixed	Q = Mixed Swamp Conifer
E = Swamp Hdwoods	M = Mpl, Bch, Brch	R = Red Pine
F = Spruce Fir	MC = Mixed Conifer	S = Black Spruce
G = Grass	MD = Mixed Deciduous	T = Tamarack

Density

0 = Non Stocked	5 = Pole Timber Medium
1 = Seedling Sapling Poor	6 = Pole Timber Well
2 = Seedling Sapling Medium	7 = Saw Timber Poor
3 = Seedling Sapling Well	8 = Saw Timber Medium
4 = Pole Timber Poor	9 = Saw Timber Well

Legend

Sale Boundary

- Against Private - Blue paint
- Against State - Red paint
- Payment Unit - Yellow paint & designated unpainted
- Retention Area - Red paint
- Payment Unit Number
- Field Grade Corners
- Snowmobile Trail
- DNR - Forest Road
- DNR - Temp Access Road
- County Paved Road
- County Gravel Road
- US Forest Service Road
- Ownership Boundary
- Cover Type Line
- Lakes and Rivers
- Intermittent Stream
- Perennial River
- Overhead Powerline

C 65 Lowlands

Compartment 65

107.9 Acres

PU	Acres
1	30.8
2	39.8
3	16.5
4	10.2
5	10.6



scan for Geo-PDF map

section corner

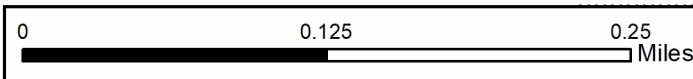

Nearby Sale

low swale will need matting

short redline excludes wetland

Duval Creek

PRIVATE

TIMBER SALE INFORMATION

Buteo Buffer Mix (72-616-23)
T28N, R03W, SEC. 11; T28N, R03W, SEC. 14.
Crawford County (Advertised Price \$84,337.05)

SALE NOTE: Sale is non-certified on military lands.

A timber sale contract for this lump sum, sealed bid timber sale will be awarded to the responsible bidder offering the highest sealed bid price. All units of volume listed below were estimated using the Inventory Manager computer program and the new Michigan taper model. Bids must be at or above the following advertised price for each product and species:

<u>PRODUCTS & SPECIES</u>	<u>ESTIMATED UNITS*</u>	<u>ADVERTISED PRICE</u>
Sawtimber		
Basswood	52.6 MBF	\$ 74.00 / MBF
Beech	16.2 MBF	\$ 130.00 / MBF
Red Maple	68.4 MBF	\$ 90.00 / MBF
Sugar Maple	44.6 MBF	\$ 279.00 / MBF
White Pine	53.4 MBF	\$ 77.00 / MBF
Pulpwood		
Basswood	54 Cords	\$ 14.55 / Cord
Jack Pine	2 Cords	\$ 23.10 / Cord
Mixed Aspen	549 Cords	\$ 30.65 / Cord
Mixed Hardwood	1,037 Cords	\$ 31.75 / Cord
Mixed Oak	19 Cords	\$ 26.55 / Cord
Paper Birch	4 Cords	\$ 22.55 / Cord
Red Pine	10 Cords	\$ 56.25 / Cord
White Pine	158 Cords	\$ 24.60 / Cord

* The total volume is statistically estimated within plus (+) or minus (-) 15.48 percent. There are an estimated 2,394 cords on this timber sale, plus or minus 371 cords at the 95% confidence level. The estimated units are final and not subject to adjustment. Prospective bidders are urged to examine this timber and to make their own estimates of quantity and quality.

BOND AND PAYMENT SCHEDULE:

1. A bond in the amount of \$4,217.00 to insure faithful performance of the conditions of the contract will be deposited by the successful bidder within 21 days of the sale award.
2. Cutting in any sale or unit without the required advance payment would be considered a trespass.
3. Total payment must be paid in advance or according to the following schedule :
 - (a) Ten percent (10%) of the sale value must be paid within 21 days of the sale award.
 - (b) The 10% down payment will be credited towards the first unit cut.
 - (c) Payment for each of the following units must be made before cutting begins in that unit:

PAYMENT UNIT NUMBER	PERCENT OF TOTAL SALE VALUE
01	32.3%
02	17.8%
03	35.1%
04	14.8%

4. If no cutting takes place, the 10% down payment will not be refunded.
5. Operations on the contract issued will terminate on 06/30/2026.

SALE STATISTICS

Volumes were calculated in cubic feet using the Michigan taper model. Cubic foot volume includes all wood inside bark for the product indicated. For display purposes, cubic feet were converted to cords and MBF using a simple conversion factor, e.g. 79 cubic feet per cord and 185 cubic feet per MBF. The cubic foot volumes are precise; the cords and MBF volumes are not. Cubic foot volume cannot be directly converted to cords or boards with precision.

SALE VOLUMES

The total estimated sale volume may not equal the sum of the species/products due to the nature of statistical calculations associated with double sampling methodology.

VOLUME			STATISTICAL RANGE IN CORDS	
TOTAL CUBIC FEET	TOTAL CORDS	PERCENT ERROR	MINIMUM	MAXIMUM
189,088	2,394	15.48%	2,023	2,764

VDU VOLUMES

A VDU is a Volume Determination Unit. Volumes and their associated statistics are calculated at the VDU level and summarized to the sale level. There is often a one to one relationship between a VDU and a Payment Unit, but not always, depending on the cruise design. Refer to the VDU TO PAYMENT UNIT table.

	VOLUME			RANGE IN CORDS	
VDU	TOTAL CUBIC FEET	TOTAL CORDS	PERCENT ERROR	MINIMUM	MAXIMUM
1	30,494	386	40.03%	231	541
2	2,517	32	60.97%	12	51
4	85,290	1,080	21.17%	851	1,308
6	33,052	418	25.77%	311	526
7	37,734	478	32.78%	321	634
TOTAL:	189,088	2,394		1,727	3,060

VDU TO PAYMENT UNIT

When a VDU is associated with more than one Payment Unit (PU), the VDU volumes are assigned to the PU based on acres of the VDU within the PU.

VDU	VDU ACRES	PU	PU ACRES
1	11.2	2	0.1
		3	11.1
		3	2.5
4	35.7	1	23.6
		2	8.4
		3	3.5
		4	0.2
6	41.2	2	4.3
		4	36.9
7	14.0	2	3.2
		3	10.8
TOTAL:	105.2		105.2

DESCRIPTION OF TIMBER BY PAYMENT UNIT (PU)

PU	MARKET GROUP	PRODUCT	QUANTITY	UNIT	ACRES	ADVERTISE PRICE
1	Basswood	Sawtimber	8.2	MBF	23.6	\$27,249.30
	Beech		9.5	MBF		
	Red Maple		33.0	MBF		
	Sugar Maple		18.6	MBF		
	White Pine		3.7	MBF		
	Basswood	Pulpwood	7	Cords		
	Mixed Aspen		101	Cords		
	<i>B. T. Aspen</i>		88	Cords		
	<i>Quaking Aspen</i>		13	Cords		
	Mixed Hardwood		419	Cords		
	<i>Beech</i>		71	Cords		
	<i>Black Cherry</i>		1	Cords		
	<i>Ironwood</i>		5	Cords		
	<i>Red Maple</i>		175	Cords		
	<i>Sugar Maple</i>		167	Cords		
	Mixed Oak		6	Cords		
	<i>Red Oak</i>		6	Cords		
	Paper Birch		3	Cords		
	<i>Paper Birch</i>	Sawtimber	0.4	MBF		
	<i>Paper Birch</i>	Pulpwood	2	Cords		
	Red Pine		2	Cords		
	<i>Red Pine</i>	Sawtimber	0.7	MBF		
	<i>Red Pine</i>	Pulpwood	1	Cords		
White Pine		5	Cords			
2	Basswood	Sawtimber	5.0	MBF	16.6	\$15,010.60
	Beech		3.4	MBF		
	Red Maple		15.0	MBF		
	Sugar Maple		9.0	MBF		
	White Pine		11.6	MBF		
	Basswood	Pulpwood	4	Cords		
	Mixed Aspen		78	Cords		
	<i>B. T. Aspen</i>		52	Cords		
	<i>Quaking Aspen</i>		26	Cords		
	Mixed Hardwood		188	Cords		
	<i>Black Cherry</i>	Sawtimber	0.6	MBF		
	<i>Beech</i>	Pulpwood	26	Cords		
	<i>Black Cherry</i>		7	Cords		
	<i>Ironwood</i>		4	Cords		
	<i>Pin Cherry</i>		1	Cords		
	<i>Red Maple</i>		80	Cords		
	<i>Sugar Maple</i>		69	Cords		
	Mixed Oak		3	Cords		
	<i>/Red (Hybrid) Oak</i>		1	Cords		
	<i>Red Oak</i>		2	Cords		
	Paper Birch		1	Cords		
	<i>Paper Birch</i>	Sawtimber	0.2	MBF		
	<i>Paper Birch</i>	Pulpwood	1	Cords		
Red Pine		2	Cords			
<i>Red Pine</i>	Sawtimber	0.6	MBF			
<i>Red Pine</i>	Pulpwood	1	Cords			
White Pine		33	Cords			
3	Basswood	Sawtimber	38.3	MBF	27.9	\$29,622.30
	Beech		3.2	MBF		
	Red Maple		14.2	MBF		
	Sugar Maple		12.1	MBF		
	White Pine		37.5	MBF		

DESCRIPTION OF TIMBER BY PAYMENT UNIT (PU), CON'T

PU	MARKET GROUP	PRODUCT	QUANTITY	UNIT	ACRES	ADVERTISE PRICE
3 con't	Basswood	Pulpwood	40	Cords		
	Jack Pine		2	Cords		
	Mixed Aspen		136	Cords		
	<i>B. T. Aspen</i>		130	<i>Cords</i>		
	<i>Quaking Aspen</i>		6	<i>Cords</i>		
	Mixed Hardwood		343	Cords		
	<i>Black Cherry</i>		1.4	<i>MBF</i>		
	<i>Beech</i>		13	<i>Cords</i>		
	<i>Black Cherry</i>		29	<i>Cords</i>		
	<i>Ironwood</i>		17	<i>Cords</i>		
	<i>Red Maple</i>		109	<i>Cords</i>		
	<i>Sugar Maple</i>		172	<i>Cords</i>		
	Mixed Oak		1	Cords		
	<i>Red Oak</i>		1	<i>Cords</i>		
	Red Pine		6	Cords		
	<i>Red Pine</i>		1.3	<i>MBF</i>		
	<i>Red Pine</i>		3	<i>Cords</i>		
	White Pine		113	Cords		
4	Basswood	Sawtimber	1.1	MBF	37.1	\$12,454.85
	Beech		0.1	MBF		
	Red Maple		6.2	MBF		
	Sugar Maple		4.9	MBF		
	White Pine		0.6	MBF		
	Basswood	Pulpwood	3	Cords		
	Mixed Aspen		234	Cords		
	<i>B. T. Aspen</i>		55	<i>Cords</i>		
	<i>Quaking Aspen</i>		179	<i>Cords</i>		
	Mixed Hardwood		87	Cords		
	<i>Black Cherry</i>		1.4	<i>MBF</i>		
	<i>Beech</i>		1	<i>Cords</i>		
	<i>Black Cherry</i>		6	<i>Cords</i>		
	<i>Ironwood</i>		3	<i>Cords</i>		
	<i>Pin Cherry</i>		6	<i>Cords</i>		
	<i>Red Maple</i>		54	<i>Cords</i>		
	<i>Sugar Maple</i>		14	<i>Cords</i>		
	Mixed Oak		9	Cords		
	<i>/Red (Hybrid) Oak</i>		7	<i>Cords</i>		
	<i>Red Oak</i>		2	<i>Cords</i>		
	White Pine		7	Cords		
	TOTAL:			235.2		
TOTAL:			1,833	Cords		

Sale Specific Conditions & Requirements

Sale Name: Buteo Buffer Mix

Sale Number: 72-616-23 Seq#: 2

1 - Sale Area

1.2 - Boundaries

1.2.1 - Painted boundaries (9/19)

The sale boundary and Payment Unit boundaries are marked and identified by blue, red and yellow paint. Exterior sale boundary lines against private property are marked with blue paint. Exterior sale boundary lines against state are marked with red paint. Interior Payment Unit boundaries are marked with yellow paint. Retention patches are marked with red paint; no harvesting activities may occur within these areas. The painted boundary line trees are not Included Timber and are to be protected. Yellow painted trees designating an interior Payment Unit boundary are only to be cut when all surrounding Payment Units have been paid.

2 - Timber Specifications

2.1 - Included Timber

2.1.1 - Clearcut unit(s) with unmerchantable trees (6/14)

Within Payment Unit(s) 1-4, cut all trees that are two (2) inches or more at DBH.

2.2 - Utilization

2.2.2 - Chipping required (2/18)

This area must be chip harvested to meet National Guard requirements. However, the chipping requirement could be waived with military approval, if chip markets are depressed. If market conditions limit the practicality of chipping, tops and slash must be arranged in a way that will not inhibit future planting operations, as directed by the Sale Administrator. The requirement to retain approximately 1/6 to 1/3 of tree tops and limbs less than four inches in diameter does not apply (G. C. & R. 2.2). This is because the sale is on non-certified military lands.

2.2.3 - Stump heights (4/07)

Stump heights within all Payment Units shall not exceed 6 inches to meet National Guard requirements.

3 - Payments

3.3 - Pre-measured Sales

3.3.4 - Dividing payment units (7/14)

Payment Unit(s) may be divided at the request of the Purchaser and upon approval of the Unit Manager. Dividing Payment Units is a contract modification which requires a Timber Sale Contract Amendment. There will be only one division per Payment Unit.

3.4 - Damaged Timber

3.4.3 - Special Protection Areas (8/11)

The Purchaser shall protect special protection areas from damage by the Purchaser's operations. Special protection areas are within the retention area adjacent to Payment Unit 2. The Purchaser shall not cut live or dead trees within special protection areas. If the Purchaser's operations have cut or damaged special protection areas through carelessness, the Purchaser shall pay \$500 as fixed, agreed and liquidated damages for each acre or part thereof cut or damaged. Such payment does not constitute ownership of the undesignated timber.

4 - Transportation

4.1 - Construction

4.1.3 - Slash and earthen piles (8/04)

Piles or windrows of earth along roads and landings that have been widened or constructed shall be leveled. Slash from road maintenance or construction, including stumps, shall be dispersed throughout the sale.

4.1.6 - Road construction (1/09)

shall be done in such a way as to minimize the environmental and visual impacts. Merchantable trees shall be cut and utilized unless otherwise directed. Non-merchantable trees shall be severed and laid flat on the ground. Slash shall Stumps shall be set upright, not left on edge, and be moved at least Disturbed soil shall be feathered into the woods and not left in berms or windrows.

4.1.7 - Road closure (10/11)

All new roads built into the sale must be blocked to vehicle traffic upon completion of the sale. Overgrown roads that are reopened shall be considered new roads. In general, this will require constructing double earthen berms at strategic locations. In general, this will require constructing a four (4') foot high berm of stumps and logs covered with earth. Temporary berms may be required if no sale activity occurs for 30 or more consecutive days. Contact the Sale Administrator for specific details of design and placement.

4.1.11 - Permits (2/12)

The Purchaser will secure any necessary permits that may be required.

5 - Operations

5.1 - Notification

5.1.3 - Well heads and natural gas pipelines (11/15)

The Purchaser is responsible for contacting the gas or pipeline company prior to operating equipment in the vicinity of well heads or natural gas pipelines.

5.1.5 - National Guard notification (2/15)

This sale is upon lands utilized for training by the Michigan National Guard - Camp Grayling. A minimum of five (5) business days prior to opening this sale, the producer must request that the sale administrator contact the military for information regarding training plans that may impact sale operations.

5.2 - Conduct of Operations

5.2.1 - Slash

5.2.1.14 - Chipping of slash (10/08)

If tops are chipped, they must be skidded to the landing separately from the bole section of the tree. Skidding of tops must be done in such a way as to minimize damage to the residual trees. See related specs 2.2.4 - Skidding Length and 3.4.1 - Damaged Timber.

5.2.2 - Hazard Trees/Snags

5.2.2.1 - Den trees (10/16)

Obvious hollow and/or den trees shall be protected and left standing unless they are a safety hazard.

5.2.3 - Operating Restrictions

5.2.3.7 - National Guard training restriction (1/09)

Operations on this contract may not be allowed during National Guard training operations. Typically, the restricted period is from May 1 to October 31. The contractor must check with the Unit Manager who will coordinate the cutting schedule with the Military.

5.2.4 - Dead and Down Creation

5.2.4.4 - Dead and down creation, grouse (6/18)

To encourage grouse and other wildlife, in Payment Unit(s) 4, leave one 12" or larger diameter (or largest diameter trees within stand) whole tree on the ground for every 2 acres, preferably a hardwood species such as oak or maple or if no hardwoods are present, a pine species (white or red). These trees will be evenly scattered throughout the unit, preferably at least two chains from any roads, two-tracks, or trails open to vehicles.

5.2.29 - Shrub protection (1/20)

Reasonable care should be taken to avoid cutting or damaging hawthorn or juneberry. These woody-shrub plants are highly beneficial to various wildlife species.

5.2.32 - Decking/landing restoration (9/13)

All decking and landing areas must have the surface area restored to a condition equal to or better than before. This is to ensure the proper regeneration of the stand.

5.2.43 - Opening protection (2/21)

No activities are permitted in openings marked on the Timber Sale Map with a red asterisk. Any damage to the openings shall be repaired according to specifications of the Unit Manager or his/her representative.

5.4 - Soil Protection

5.4.1 - Rutting restriction, general (7/16)

Operations are to cease immediately if equipment and weather conditions result in rutting of roads and/or skid trails which are 12 inches or greater in depth and 50 feet in length. The Unit Manager or his/her representative may restrict hauling and/or skidding if ruts exceed the specified depth. With the Unit Manager or his/her representative's approval, the Purchaser may return to the area when the risk of rutting has decreased.

5.8 - Protection of Endangered Species

5.8.3 - Red shoulder hawk or goshawk (1) (2/16)

In the event that an active red shoulder hawk or goshawk nest is found, the contract may be amended to protect the nest site until the nest is determined to be inactive. The value of the trees in this excluded area will be refunded or credited to the Purchaser. The nest will be buffered with a five-chain radius (eight acre) protection area, centered on the nest tree, in which there will be no cutting or new roads constructed. Avoid human disturbance, including loading and skidding, in the protection area.

An additional zone of five chains (ten chains centered on the active nest tree) will be established in which there is no management activity from March 15 to July 15. Limit biomass harvesting and chipping operations within this ten-chain zone, retain the maximum one-third of residues per the Woody Biomass Harvesting Guidelines (Michigan DNR 2010). Nests determined to be inactive will be protected with a one-chain no-harvest buffer.

6 - Safety and Fire Prevention

6.2 - Signing

6.2.1 - Road posting (10/20)

The Purchaser is responsible for posting and maintaining caution signs on roads used for hauling prior to beginning operations. The road must be posted at appropriate distances from the Sale Area to warn of logging activity and truck traffic. Signs must be removed when harvest operations are suspended or completed. The Purchaser will provide these signs.

SKIP

6.4 - Unexploded ordinance (7/15)

Be aware that the sale area could contain UXO (unexploded ordinances). Do not touch, or drive over any metal objects. If any objects are found, please flag the area and notify the Unit Manager or his/her representative, so that they can make arrangements with the Military.

7 - Other Conditions

7.10 - Certified Timber

7.10.1 - Non-certified timber (2/16)

The area encompassed by this timber sale is not certified to the standards of the Forest Stewardship Council (FSC) or the Sustainable Forestry Initiative (SFI). Forest products from this sale may not be delivered to the mill as "FSC and / or SFI certified".



TIMBER SALE MAP

This information provided by authority of Part 525, 1994 PA 451, as amended.

Sale Number

72-616-23

Date

03/08/2024

Forest Management Unit

Grayling

County

Crawford

Mapped By: Derek Nellis

Cruised By: Chas Osborn

Scale

1:10,000

Page

1

Of

1

Township
28N

Range
03W

Section(s) and
Subdivision(s)

Sec: 11, SWSE Sec: 14, N1/2NW, SENW, NENE, SWNE, W1/2SW

Cover Type

A = Aspen	J = Jack Pine	O = Oak	U = Upland Brush
B = Paper Birch	K = Rock	P = Lowland Poplar	UM = Upland Mix Forest
C = Cedar	L = Lowland Brush	Q = Mixed Swamp Conifer	V = Bog or Marsh
D = Treed Bog	LM = Lowland Mix Forest	R = Red Pine	W = White Pine
E = Swamp Hardwoods	M = Maple, Beech, Birch	S = Black Spruce	X = Non Stocked
F = Spruce/Fir	MC = Mixed Conifer	T = Tamarack	Y = Sand
G = Grass	MD = Mixed Deciduous	Z = Water	
H = Hemlock	N = Marsh		

Density

0 = Non Stocked	5 = Pole Timber Medium
1 = Seedling Sapling Poor	6 = Pole Timber Well
2 = Seedling Sapling Medium	7 = Saw Timber Poor
3 = Seedling Sapling Well	8 = Saw Timber Medium
4 = Pole Timber Poor	9 = Saw Timber Well

Locator Map (1:200,000)

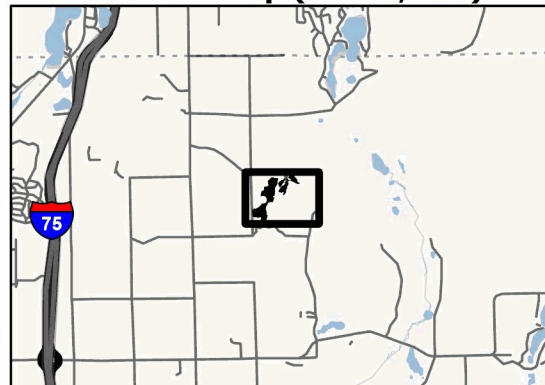

Buteo Buffer Mix

105.2 Acres

PU	Acres
1	23.6
2	16.6
3	27.9
4	37.1

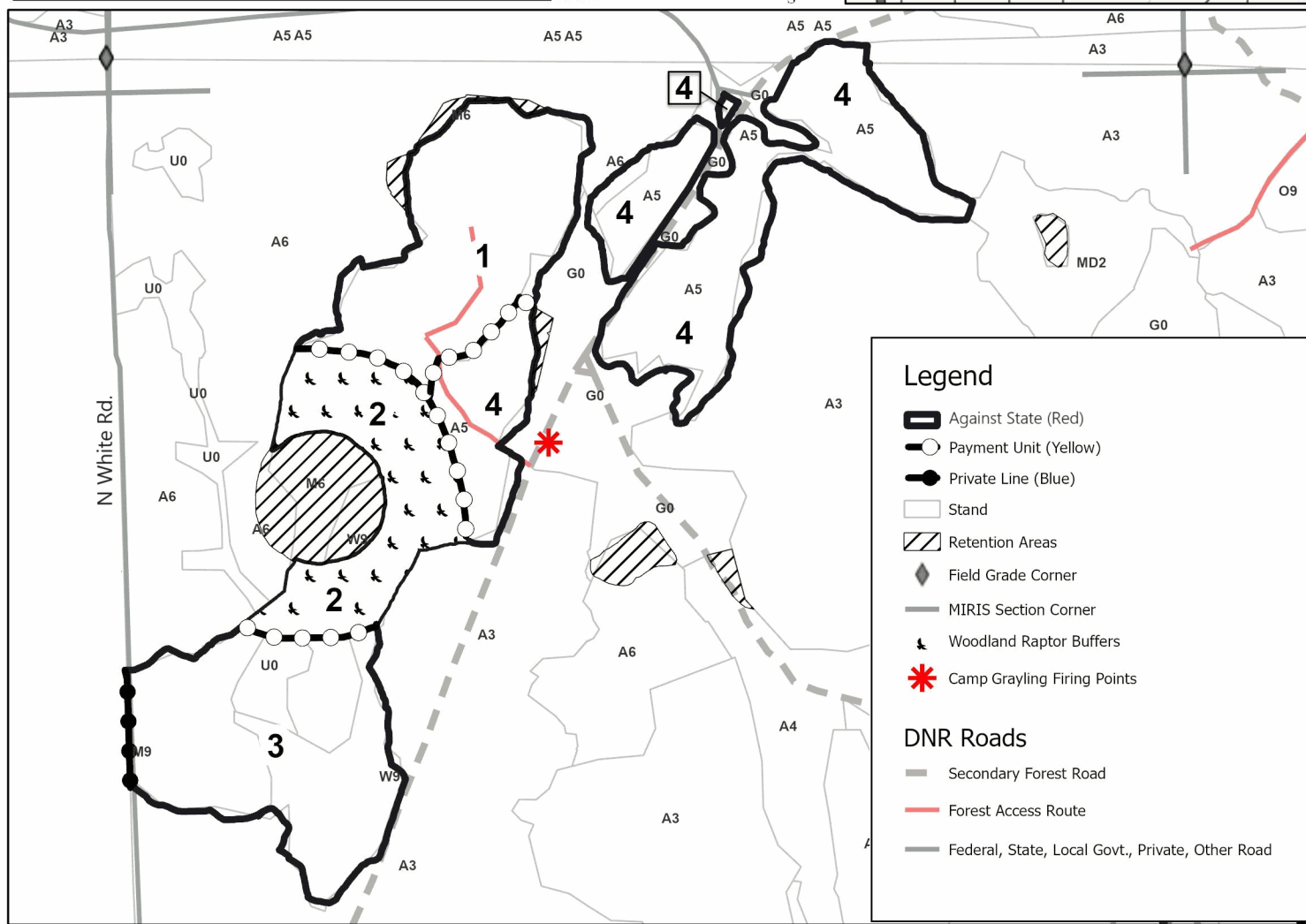
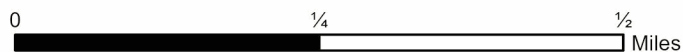

Legend

- Against State (Red)
- Payment Unit (Yellow)
- Private Line (Blue)
- Stand
- Retention Areas
- Field Grade Corner
- MIRIS Section Corner
- Woodland Raptor Buffers
- Camp Grayling Firing Points

DNR Roads

- Secondary Forest Road
- Forest Access Route
- Federal, State, Local Govt., Private, Other Road

TIMBER SALE INFORMATION

Butterfly Lane Jack Pine (72-621-23)

T27N, R01W, SEC. 6; T27N, R01W, SEC. 8.
Crawford County (Advertised Price \$40,839.65)

SALE NOTE: This is a military sale on non-certified land, low stump and chipping required for military and planting requirements. Soft oak wilt restrictions and KW timing restrictions. Sale was cruised by summer student and dropped additional 20% to account for possible unforeseen error.

A timber sale contract for this lump sum, sealed bid timber sale will be awarded to the responsible bidder offering the highest sealed bid price. All units of volume listed below were estimated using the Inventory Manager computer program and the new Michigan taper model. Bids must be at or above the following advertised price for each product and species:

<u>PRODUCTS & SPECIES</u>	<u>ESTIMATED UNITS*</u>		<u>ADVERTISED PRICE</u>
Sawtimber			
Black/Red (Hybrid) Oak	35.9	MBF	\$ 116.00 / MBF
Jack Pine	16.4	MBF	\$ 34.00 / MBF
Pulpwood			
B. T. Aspen	64	Cords	\$ 22.45 / Cord
Jack Pine	882	Cords	\$ 16.95 / Cord
Mixed Hardwood	4	Cords	\$ 23.30 / Cord
Mixed Oak	181	Cords	\$ 19.50 / Cord
Red Pine	373	Cords	\$ 41.25 / Cord
White Pine	40	Cords	\$ 18.05 / Cord

* The total volume is statistically estimated within plus (+) or minus (-) 12.32 percent. There are an estimated 1,644 cords on this timber sale, plus or minus 203 cords at the 95% confidence level. The estimated units are final and not subject to adjustment. Prospective bidders are urged to examine this timber and to make their own estimates of quantity and quality.

BOND AND PAYMENT SCHEDULE:

1. A bond in the amount of \$2,042.00 to insure faithful performance of the conditions of the contract will be deposited by the successful bidder within 21 days of the sale award.
2. Cutting in any sale or unit without the required advance payment would be considered a trespass.
3. Total payment must be paid in advance or according to the following schedule :
 - (a) Ten percent (10%) of the sale value must be paid within 21 days of the sale award.
 - (b) The 10% down payment will be credited towards the first unit cut.
 - (c) Payment for each of the following units must be made before cutting begins in that unit:

PAYMENT UNIT NUMBER	PERCENT OF TOTAL SALE VALUE
01	34.3%
02	33.8%
03	31.9%

4. If no cutting takes place, the 10% down payment will not be refunded.
5. Operations on the contract issued will terminate on 06/30/2026.

SALE STATISTICS

Volumes were calculated in cubic feet using the Michigan taper model. Cubic foot volume includes all wood inside bark for the product indicated. For display purposes, cubic feet were converted to cords and MBF using a simple conversion factor, e.g. 79 cubic feet per cord and 185 cubic feet per MBF. The cubic foot volumes are precise; the cords and MBF volumes are not. Cubic foot volume cannot be directly converted to cords or boards with precision.

SALE VOLUMES

The total estimated sale volume may not equal the sum of the species/products due to the nature of statistical calculations associated with double sampling methodology.

VOLUME		STATISTICAL RANGE IN CORDS		
TOTAL CUBIC FEET	TOTAL CORDS	PERCENT ERROR	MINIMUM	MAXIMUM
129,855	1,644	12.32%	1,441	1,846

VDU VOLUMES

A VDU is a Volume Determination Unit. Volumes and their associated statistics are calculated at the VDU level and summarized to the sale level. There is often a one to one relationship between a VDU and a Payment Unit, but not always, depending on the cruise design. Refer to the VDU TO PAYMENT UNIT table.

VDU	VOLUME		PERCENT ERROR	RANGE IN CORDS	
	TOTAL CUBIC FEET	TOTAL CORDS		MINIMUM	MAXIMUM
12	48,356	612	26.34%	451	773
28	41,152	521	15.47%	440	602
35	40,347	511	19.89%	409	612
TOTAL:	129,855	1,644		1,300	1,987

VDU TO PAYMENT UNIT

When a VDU is associated with more than one Payment Unit (PU), the VDU volumes are assigned to the PU based on acres of the VDU within the PU.

VDU	VDU ACRES	PU	PU ACRES
12	31.5	1	31.5
28	20.4	2	20.4
35	27.7	3	27.7
TOTAL:	79.6		79.6

DESCRIPTION OF TIMBER BY PAYMENT UNIT (PU)

PU	MARKET GROUP	PRODUCT	QUANTITY	UNIT	ACRES	ADVERTISE PRICE
1	Black/Red (Hybrid)	Sawtimber	23.0	MBF	31.5	\$13,990.10
	Jack Pine		16.4	MBF		
	B. T. Aspen	Pulpwood	49	Cords		
	<i>B. T. Aspen</i>		49	<i>Cords</i>		
	Jack Pine		220	Cords		
	Mixed Hardwood		4	Cords		
	<i>Black Cherry</i>		2	<i>Cords</i>		
	<i>Red Maple</i>		2	<i>Cords</i>		
	Mixed Oak		142	Cords		
	<i>White Oak</i>	<i>Sawtimber</i>	5.8	<i>MBF</i>		
	<i>/Red (Hybrid) Oak</i>	<i>Pulpwood</i>	109	<i>Cords</i>		
	<i>White Oak</i>		21	<i>Cords</i>		
	Red Pine		57	Cords		
	<i>Red Pine</i>	<i>Sawtimber</i>	9.1	<i>MBF</i>		
	<i>Red Pine</i>	<i>Pulpwood</i>	39	<i>Cords</i>		
	White Pine		40	Cords		
	<i>White Pine</i>	<i>Sawtimber</i>	1.7	<i>MBF</i>		
<i>White Pine</i>	<i>Pulpwood</i>	37	<i>Cords</i>			
2	Black/Red (Hybrid)	Sawtimber	4.3	MBF	20.4	\$13,803.05
	Jack Pine	Pulpwood	325	Cords		
	Mixed Oak		19	Cords		
	<i>/Red (Hybrid) Oak</i>		19	<i>Cords</i>		
	Red Pine		180	Cords		
	<i>Red Pine</i>		180	<i>Cords</i>		
3	Black/Red (Hybrid)	Sawtimber	8.6	MBF	27.7	\$13,046.50
	B. T. Aspen	Pulpwood	15	Cords		
	<i>B. T. Aspen</i>	<i>Sawtimber</i>	0.7	<i>MBF</i>		
	<i>B. T. Aspen</i>	<i>Pulpwood</i>	14	<i>Cords</i>		
	Jack Pine		337	Cords		
	Mixed Oak		20	Cords		
	<i>White Oak</i>	<i>Sawtimber</i>	0.9	<i>MBF</i>		
	<i>/Red (Hybrid) Oak</i>	<i>Pulpwood</i>	14	<i>Cords</i>		
	<i>White Oak</i>		4	<i>Cords</i>		
	Red Pine		136	Cords		
	<i>Red Pine</i>		136	<i>Cords</i>		
TOTAL:			52.3	MBF		
TOTAL:			1,544	Cords		

Sale Specific Conditions & Requirements

Sale Name: Butterfly Lane Jack Pine

Sale Number: 72-621-23 Seq#: 2

1 - Sale Area

1.2 - Boundaries

1.2.1 - Painted boundaries (9/19)

The sale boundary and Payment Unit boundaries are marked and identified by blue and red paint, along with a road. Exterior sale boundary lines against private property are marked with blue paint. Exterior sale boundary lines against state are marked with red paint, with the exception of the partial western boundary of Payment Unit 2 and the partial eastern boundary of Payment Unit 3, both of which are unpainted and represented by Hi Banks Road (see Timber Sale Map). Retention patches are marked with green paint; no harvesting activities may occur within these areas. The painted boundary line trees are not Included Timber and are to be protected, except for blue marked trees along Hi Banks Road.

2 - Timber Specifications

2.1 - Included Timber

2.1.1 - Clearcut unit(s) with unmerchantable trees (6/14)

Within Payment Unit(s) 1-3, cut all trees that are two (2) inches or more at DBH, except do not cut any pine that are twenty-six inches (26) or more at DBH. Special protection trees identified in accordance with condition 3.4.2, within clearcutting unit boundaries, are not Included Timber and are to be protected.

2.1.16 - Timber along county or forest roads (6/14)

Cut and remove all blue marked trees along Hi Banks Road.

2.2 - Utilization

2.2.2 - Chipping required (2/18)

Payment Units 1-3 must be chip harvested to facilitate subsequent planting operations and to meet National Guard requirements. However, the chipping requirement could be waived with military approval, if chip markets are depressed. The Purchaser has the option to produce sawlogs or pulpwood bolts, but the remaining portion of the trees must be chipped and hauled. If market conditions limit the practicality of chipping, tops and slash must be arranged in a way that will not inhibit future planting operations, as directed by the Sale Administrator. The requirement to retain approximately 1/6 to 1/3 of treetops and limbs less than four inches in diameter does not apply (G. C. & R. 2.2). This is because this is non-certified military land.

2.2.3 - Stump heights (4/07)

Stump heights within Payment Unit(s) 1-3 shall not exceed 6 inches for all trees. This is in order to facilitate military requirements and planting operations.

3 - Payments

3.3 - Pre-measured Sales

3.3.4 - Dividing payment units (7/14)

Payment Unit(s) may be divided at the request of the Purchaser and upon approval of the Unit Manager. Dividing Payment Units is a contract modification which requires a Timber Sale Contract Amendment. There will be only one division per Payment Unit.

3.4 - Damaged Timber

3.4.2 - Special Protection Trees (4/14)

The Purchaser shall not cut live or dead special protection trees within cutting units or clearings. Special protection trees are pine that are over twenty-six inches (26) at DBH. If the Purchaser's operations have cut or damaged special protection trees through carelessness, the Purchaser shall pay \$500 per tree as fixed, agreed and liquidated damages for each special protection tree cut or damaged. Such payment does not constitute ownership of the undesignated timber.

4 - Transportation

4.1 - Construction

4.1.6 - Road construction (1/09)

Construction of new roads or improvements of existing roads shall be done in such a way as to minimize the environmental and visual impacts. Merchantable trees shall be cut and utilized unless otherwise directed. Non-merchantable trees shall be severed and laid flat on the ground. Slash shall be chipped, utilized or otherwise removed from the sale. Stumps shall be set upright, not left on edge, and be moved at least 10 feet away from the road edge. Disturbed soil shall be feathered into the woods and not left in berms or windrows.

4.1.7 - Road closure (10/11)

All new roads built into the sale must be blocked to vehicle traffic upon completion of the sale. Overgrown roads that are reopened shall be considered new roads. In general, this will require constructing a four (4') foot high berm of stumps and logs covered with earth. Stumps and brush must be placed along the remainder of the trail. These roads must be rendered impassable to cars and trucks. All stumps from road building and landing construction must be reserved to block any newly constructed roads upon completion of the sale. These stumps must be scattered along the road system to prohibit vehicular movement. Contact the Sale Administrator for specific details of design and placement.

4.1.11 - Permits (2/12)

The Purchaser will secure any necessary permits that may be required.

5 - Operations

5.1 - Notification

5.1.5 - National Guard notification (2/15)

This sale is upon lands utilized for training by the Michigan National Guard - Camp Grayling. A minimum of five (5) business days prior to opening this sale, the producer must request that the sale administrator contact the military for information regarding training plans that may impact sale operations.

5.2 - Conduct of Operations

5.2.2 - Hazard Trees/Snags

5.2.2.1 - Den trees (10/16)

Obvious hollow and/or den trees shall be protected and left standing unless they are a safety hazard.

5.2.3 - Operating Restrictions

5.2.3.5 - Oak wilt restriction (1/18)

Within Payment Units 1-3, unless changed by written agreement, cutting, skidding, hauling within the sale and brushing of access roads to the sale are not permitted during the period of April 15 to July 15. Operations may be allowed if specific steps are taken to prevent damaging uncut oak during the high risk period. Those steps may include completing all road brushing before April 15th and clearing a tree-length buffer along uncut oak cover before April 15th. This is necessary to reduce the spread of oak wilt. For more information, contact the Unit Manager or his/her representative.

5.2.3.7 - National Guard training restriction (1/09)

Operations on this contract may not be allowed during National Guard training operations. Typically, the restricted period is from May 1 to October 31. The contractor must check with the Unit Manager who will coordinate the cutting schedule with the Military.

5.2.32 - Decking/landing restoration (9/13)

All decking and landing areas must have the surface area restored to a condition equal to or better than before. This is to ensure the proper regeneration of the stand. Wood debris, chips and "cookies" from trimmings must be removed or scattered away from landing and loading areas and may not be windrowed on the edge.

5.8 - Protection of Endangered Species

5.8.1 - Kirtland's warbler (1) (10/12)

This sale is adjacent to a young jack pine stand which may be used by the endangered Kirtland's Warbler. The Department reserves the right to temporarily restrict all harvesting operations in a buffer zone of up to 500 feet if it is determined that Warbler territory has been established in the adjacent stand. The restricted period, if put into effect, would apply from May 1

to August 15.

6 - Safety and Fire Prevention

6.2 - Signing

6.2.1 - Road posting (10/20)

The Purchaser is responsible for posting and maintaining caution signs on Hi Banks Road prior to beginning operations. The road must be posted at appropriate distances from the Sale Area to warn of logging activity and truck traffic. Signs must be removed when harvest operations are suspended or completed. The Purchaser will provide these signs.

7 - Other Conditions

7.10 - Certified Timber

7.10.1 - Non-certified timber (2/16)

The area encompassed by this timber sale is not certified to the standards of the Forest Stewardship Council (FSC) or the Sustainable Forestry Initiative (SFI). Forest products from this sale may not be delivered to the mill as "FSC and / or SFI certified". The lands within this sale are managed for military training.



TIMBER SALE MAP

This information provided by authority of Part 525, 1994 PA 451, as amended.

Sale Number 72-621-23	Date 08/25/2023
---------------------------------	---------------------------

Forest Management Unit Grayling Mgt Unit	County Crawford	Mapped By: McClarren & Hoffman Cruised By: Daisy Hoffman	Scale 1:24,000	Page 1	Of 1
---	--------------------	---	-------------------	-----------	---------

Township 27N	Range 01W	Section(s) and Subdivision(s) Sec. 6 E1/2SE; Sec. 8 NWNW,S1/2NW,SW,SWSE;
-----------------	--------------	--

Cover Type			
A = Aspen	J = Jack Pine	O = Oak	U = Upland Brush
B = Paper Birch	K = Rock	P = Lowland Poplar	UM = Upland Mix Forest
C = Cedar	L = Lowland Brush	Q = Mixed Swamp Conifer	V = Bog or Marsh
D = Tread Bog	LM = Lowland Mix Forest	R = Red Pine	W = White Pine
E = Swamp Hardwoods	M = Maple, Beech, Birch	S = Black Spruce	X = Non Stocked
F = Spruce/Fir	MC = Mixed Conifer	T = Tamarack	Y = Sand
G = Grass	MD = Mixed Deciduous	Z = Water	
H = Hemlock	N = Marsh		

Density	
0 = Non Stocked	5 = Pole Timber Medium
1 = Seedling Sapling Poor	6 = Pole Timber Well
2 = Seedling Sapling Medium	7 = Saw Timber Poor
3 = Seedling Sapling Well	8 = Saw Timber Medium
4 = Pole Timber Poor	9 = Saw Timber Well

PU #	Acres
1	31.5
2	20.4
3	27.7

Butterfly Lane Jack Pine
79.6 Acres

Locator Map (1:200,000)

35	36	31	32	33	34
2	1	6	5	4	3
11	12	7	8	9	10
14	13	18	17	16	15

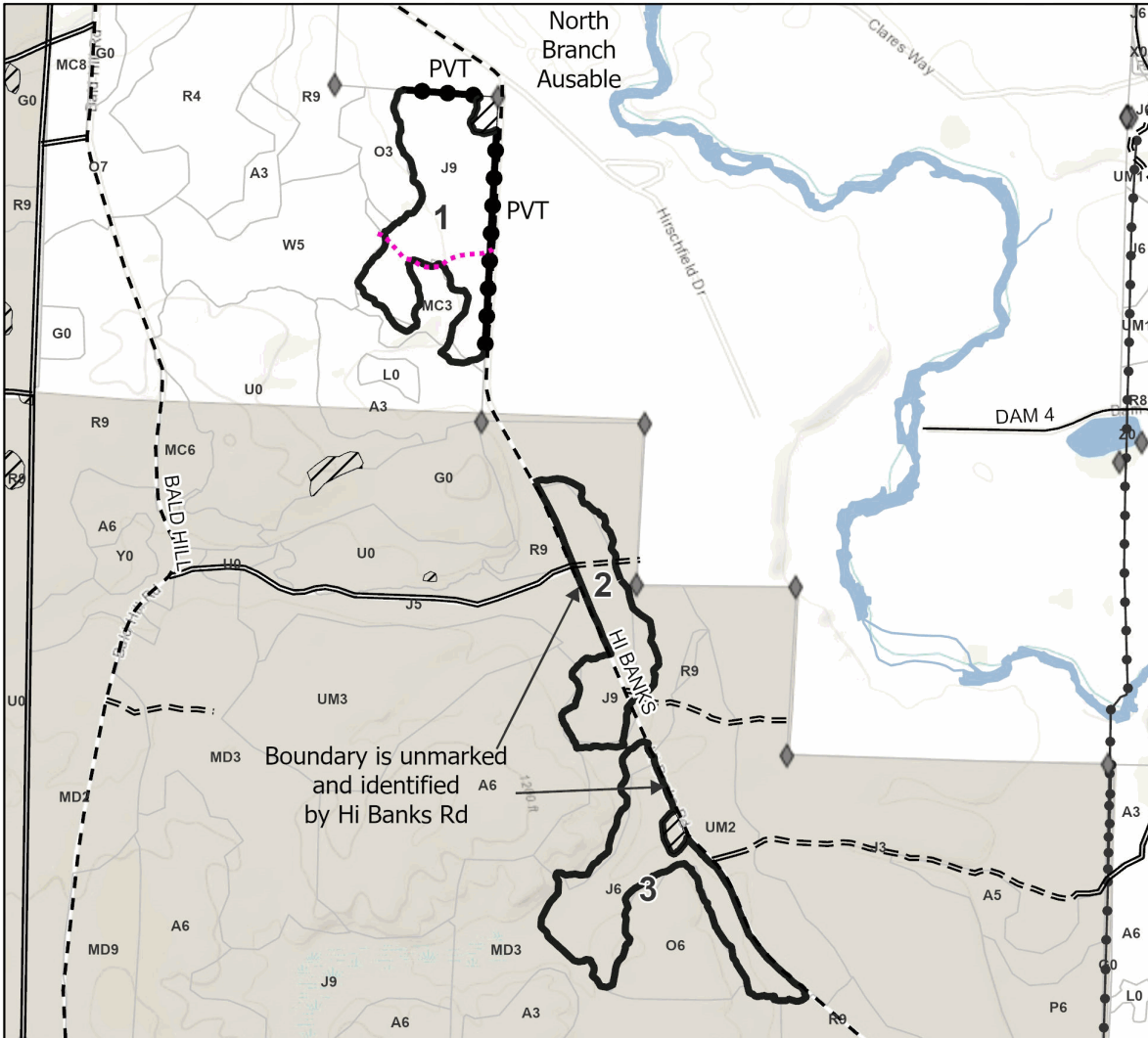
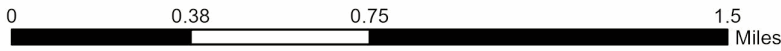

Legend

- Against State (red) or unpainted border along Hi Banks Road (see below)
- Private Line (Blue)
- Primary Forest Road
- Secondary Forest Road
- Forest Access Route
- Paved Road
- Gravel Road
- County Road - Seasonal
- Private Road
- Temporary Management Access
- Field Grade Corner
- Powerline
- Perennial River
- Lakes and Rivers
- Retention Areas
- Stand

Use QR Code to open Map in App



TIMBER SALE INFORMATION

Let's See Your ID Hardwood (72-625-23)

T28N, R03W, SEC. 13; T28N, R03W, SEC. 14; T28N, R03W, SEC. 24.
Crawford County (Advertised Price \$92,974.75)

SALE NOTE: This sale is on non-certified military lands.

A timber sale contract for this lump sum, sealed bid timber sale will be awarded to the responsible bidder offering the highest sealed bid price. All units of volume listed below were estimated using the Inventory Manager computer program and the new Michigan taper model. Bids must be at or above the following advertised price for each product and species:

<u>PRODUCTS & SPECIES</u>	<u>ESTIMATED UNITS*</u>	<u>ADVERTISED PRICE</u>
Sawtimber		
B. T. Aspen	16.7 MBF	\$ 102.00 / MBF
Basswood	11.1 MBF	\$ 74.00 / MBF
Beech	53.1 MBF	\$ 130.00 / MBF
Red Maple	60.3 MBF	\$ 90.00 / MBF
Sugar Maple	109.9 MBF	\$ 279.00 / MBF
Pulpwood		
Basswood	22 Cords	\$ 14.55 / Cord
Mixed Aspen	329 Cords	\$ 30.65 / Cord
Mixed Hardwood	1,152 Cords	\$ 31.75 / Cord
Mixed Oak	18 Cords	\$ 26.55 / Cord

* The total volume is statistically estimated within plus (+) or minus (-) 15.58 percent. There are an estimated 2,263 cords on this timber sale, plus or minus 353 cords at the 95% confidence level. The estimated units are final and not subject to adjustment. Prospective bidders are urged to examine this timber and to make their own estimates of quantity and quality.

BOND AND PAYMENT SCHEDULE:

1. A bond in the amount of \$4,649.00 to insure faithful performance of the conditions of the contract will be deposited by the successful bidder within 21 days of the sale award.
2. Cutting in any sale or unit without the required advance payment would be considered a trespass.
3. Total payment must be paid in advance or according to the following schedule :
 - (a) Ten percent (10%) of the sale value must be paid within 21 days of the sale award.
 - (b) The 10% down payment will be credited towards the first unit cut.
 - (c) Payment for each of the following units must be made before cutting begins in that unit:

PAYMENT UNIT NUMBER	PERCENT OF TOTAL SALE VALUE
01	5.4%
02	4.2%
03	45.2%
04	16.4%
05	27.8%
06	1.0%
4. If no cutting takes place, the 10% down payment will not be refunded.
5. Operations on the contract issued will terminate on 06/30/2026.

SALE STATISTICS

Volumes were calculated in cubic feet using the Michigan taper model. Cubic foot volume includes all wood inside bark for the product indicated. For display purposes, cubic feet were converted to cords and MBF using a simple conversion factor, e.g. 79 cubic feet per cord and 185 cubic feet per MBF. The cubic foot volumes are precise; the cords and MBF volumes are not. Cubic foot volume cannot be directly converted to cords or boards with precision.

SALE VOLUMES

The total estimated sale volume may not equal the sum of the species/products due to the nature of statistical calculations associated with double sampling methodology.

VOLUME		STATISTICAL RANGE IN CORDS		
TOTAL CUBIC FEET	TOTAL CORDS	PERCENT ERROR	MINIMUM	MAXIMUM
178,802	2,263	15.58%	1,911	2,616

VDU VOLUMES

A VDU is a Volume Determination Unit. Volumes and their associated statistics are calculated at the VDU level and summarized to the sale level. There is often a one to one relationship between a VDU and a Payment Unit, but not always, depending on the cruise design. Refer to the VDU TO PAYMENT UNIT table.

VDU	VOLUME		PERCENT ERROR	RANGE IN CORDS	
	TOTAL CUBIC FEET	TOTAL CORDS		MINIMUM	MAXIMUM
8	12,474	158	38.23%	98	218
15	79,951	1,012	20.96%	800	1,224
22	10,261	130	43.26%	74	186
27	42,013	532	22.29%	413	650
30	3,576	45	84.24%	7	83
43	30,526	386	40.01%	232	541
TOTAL:	178,802	2,263		1,623	2,903

VDU TO PAYMENT UNIT

When a VDU is associated with more than one Payment Unit (PU), the VDU volumes are assigned to the PU based on acres of the VDU within the PU.

VDU	VDU ACRES	PU	PU ACRES
8	12.1	1	12.1
15	31.8	3	31.8
22	20.8	2	20.8
27	20.5	5	20.5
30	9.2	6	9.2
43	12.3	4	12.3
TOTAL:	106.7		106.7

DESCRIPTION OF TIMBER BY PAYMENT UNIT (PU)

PU	MARKET GROUP	PRODUCT	QUANTITY	UNIT	ACRES	ADVERTISE PRICE
1	Red Maple	Sawtimber	5.9	MBF	12.1	\$5,053.20
	Mixed Aspen	Pulpwood	103	Cords		
	<i>B. T. Aspen</i>		62	<i>Cords</i>		
	<i>Quaking Aspen</i>		41	<i>Cords</i>		
	Mixed Hardwood		43	Cords		
	<i>Yellow Birch</i>	<i>Sawtimber</i>	0.4	<i>MBF</i>		
	<i>Black Cherry</i>	<i>Pulpwood</i>	4	<i>Cords</i>		
	<i>Red Maple</i>		29	<i>Cords</i>		
	<i>Sugar Maple</i>		8	<i>Cords</i>		
	<i>Yellow Birch</i>		1	<i>Cords</i>		
	2	Red Maple	Sawtimber	2.6		
Sugar Maple			0.2	MBF		
Mixed Aspen		Pulpwood	49	Cords		
<i>B. T. Aspen</i>			2	<i>Cords</i>		
<i>Quaking Aspen</i>			47	<i>Cords</i>		
Mixed Hardwood			59	Cords		
<i>Black Cherry</i>		<i>Sawtimber</i>	0.3	<i>MBF</i>		
<i>Black Cherry</i>		<i>Pulpwood</i>	10	<i>Cords</i>		
<i>Red Maple</i>			44	<i>Cords</i>		
<i>Sugar Maple</i>			4	<i>Cords</i>		
Mixed Oak			8	Cords		
<i>Northern Pin Oak</i>			8	<i>Cords</i>		
3		Beech	Sawtimber	34.0	MBF	31.8
	Red Maple		40.8	MBF		
	Sugar Maple		43.8	MBF		
	Mixed Aspen	Pulpwood	92	Cords		
	<i>Quaking Aspen</i>	<i>Sawtimber</i>	2.9	<i>MBF</i>		
	<i>B. T. Aspen</i>	<i>Pulpwood</i>	60	<i>Cords</i>		
	<i>Quaking Aspen</i>		26	<i>Cords</i>		
	Mixed Hardwood		593	Cords		
	<i>Beech</i>		233	<i>Cords</i>		
	<i>Red Maple</i>		129	<i>Cords</i>		
	<i>Sugar Maple</i>		231	<i>Cords</i>		
	4	B. T. Aspen	Sawtimber	2.0	MBF	
Beech			7.2	MBF		
Red Maple			6.4	MBF		
Sugar Maple			20.0	MBF		
Mixed Aspen		Pulpwood	24	Cords		
<i>B. T. Aspen</i>			24	<i>Cords</i>		
Mixed Hardwood			228	Cords		
<i>Beech</i>			70	<i>Cords</i>		
<i>Red Maple</i>			15	<i>Cords</i>		
<i>Sugar Maple</i>			143	<i>Cords</i>		
5		B. T. Aspen	Sawtimber	14.7	MBF	20.5
	Basswood		9.1	MBF		
	Beech		11.9	MBF		
	Red Maple		4.6	MBF		
	Sugar Maple		45.9	MBF		
	Basswood	Pulpwood	11	Cords		
	Mixed Aspen		53	Cords		
	<i>Quaking Aspen</i>	<i>Sawtimber</i>	5.8	<i>MBF</i>		
	<i>B. T. Aspen</i>	<i>Pulpwood</i>	35	<i>Cords</i>		
	<i>Quaking Aspen</i>		6	<i>Cords</i>		
	Mixed Hardwood		220	Cords		
	<i>Beech</i>		58	<i>Cords</i>		
	<i>Ironwood</i>		6	<i>Cords</i>		

DESCRIPTION OF TIMBER BY PAYMENT UNIT (PU), CON'T

PU	MARKET GROUP	PRODUCT	QUANTITY	UNIT	ACRES	ADVERTISE PRICE			
5 con't	<i>Red Maple</i>	<i>Pulpwood</i>	10	<i>Cords</i>					
	<i>Sugar Maple</i>		146	<i>Cords</i>					
	Mixed Oak		5	<i>Cords</i>					
	<i>Northern Pin Oak</i>	<i>Sawtimber</i>	1.0	<i>MBF</i>					
	<i>Northern Pin Oak</i>	<i>Pulpwood</i>	3	<i>Cords</i>					
6	Basswood	Sawtimber	2.0	MBF	9.2	\$971.75			
	Basswood	Pulpwood	11	Cords					
	Mixed Aspen		8	Cords					
	<i>Quaking Aspen</i>		8	<i>Cords</i>					
	Mixed Hardwood		9	Cords					
	<i>Red Maple</i>		2	<i>Cords</i>					
	<i>Sugar Maple</i>		5	<i>Cords</i>					
	<i>White Ash</i>		2	<i>Cords</i>					
	Mixed Oak		5	Cords					
	<i>Red Oak</i>	<i>Sawtimber</i>	1.2	<i>MBF</i>					
	<i>Red Oak</i>	<i>Pulpwood</i>	3	<i>Cords</i>					
	TOTAL:			251.1			MBF		
	TOTAL:			1,521			Cords		

Sale Specific Conditions & Requirements

Sale Name: Let's See Your ID Hardwood

Sale Number: 72-625-23 Seq#: 2

1 - Sale Area

1.2 - Boundaries

1.2.1 - Painted boundaries (9/19)

The sale boundary and Payment Unit boundaries are marked and identified by red and yellow paint. Exterior sale boundary lines against state are marked with red paint. Interior Payment Unit boundaries are marked with yellow paint. Retention patches are marked with red paint; no harvesting activities may occur within these areas. The painted boundary line trees are not Included Timber. Yellow painted trees designating an interior Payment Unit boundary are only to be cut when all surrounding Payment Units have been paid.

2 - Timber Specifications

2.1 - Included Timber

2.1.1 - Clearcut unit(s) with unmerchantable trees (6/14)

Within Payment Unit(s) 1-6, cut all trees that are two (2) inches or more at DBH, with the following exceptions:

- Within Payment Unit 3, do not cut oak that are eighteen (18) inches or more at DBH.
- Within Payment Unit 5, do not cut any white pine.

2.2 - Utilization

2.2.2 - Chipping required (2/18)

This area must be chip harvested to meet National Guard requirements. However, the chipping requirement could be waived with military approval, if chip markets are depressed. The Purchaser has the option to produce sawlogs or pulpwood bolts, but the remaining portion of the trees must be chipped and hauled. The requirement to retain approximately 1/6 to 1/3 of treetops and limbs less than four inches in diameter does not apply (G. C. & R. 2.2). This is because the sale is on non-certified military lands.

2.2.3 - Stump heights (4/07)

Stump heights within the Sale Area shall not exceed 6 inches for all trees. This is in order to facilitate military requirements. A written waiver of this requirement may be obtained if wet summer weather makes winter logging necessary.

3 - Payments

3.3 - Pre-measured Sales

3.3.4 - Dividing payment units (7/14)

Payment Unit(s) may be divided at the request of the Purchaser and upon approval of the Unit Manager. Dividing Payment Units is a contract modification which requires a Timber Sale Contract Amendment. There will be only one division per Payment Unit.

4 - Transportation

4.1 - Construction

4.1.3 - Slash and earthen piles (8/04)

Piles or windrows of earth along roads and landings that have been widened or constructed shall be leveled. Slash from road maintenance or construction, including stumps, shall be dispersed throughout the sale.

4.1.6 - Road construction (1/09)

Construction of new roads or improvements of existing roads shall be done in such a way as to minimize the environmental and visual impacts. Merchantable trees shall be cut and utilized unless otherwise directed. Non-merchantable trees shall be severed and laid flat on the ground. Slash shall be scattered, and not left in windrows and kept a minimum of 10 feet back from the road edge. Stumps shall be set upright, not left on edge, and be moved at least 10 feet away from the road edge. Disturbed soil shall be feathered into the woods and not left in berms or windrows.

4.1.7 - Road closure (10/11)

All new roads built into the sale must be blocked to vehicle traffic upon completion of the sale. Overgrown roads that are reopened shall be considered new roads. In general, this will require constructing a four (4') foot high berm of stumps and logs covered with earth. Stumps and brush must be placed along the remainder of the trail. These roads must be rendered impassable to cars and trucks. Temporary berms may be required if no sale activity occurs for 30 or more consecutive days. Contact the Sale Administrator for specific details of design and placement.

4.1.11 - Permits (2/12)

The Purchaser will secure any necessary permits that may be required.

5 - Operations

5.1 - Notification

5.1.5 - National Guard notification (2/15)

This sale is upon lands utilized for training by the Michigan National Guard - Camp Grayling. A minimum of five (5) business days prior to opening this sale, the producer must request that the sale administrator contact the military for information regarding training plans that may impact sale operations.

5.2 - Conduct of Operations

5.2.2 - Hazard Trees/Snags

5.2.2.1 - Den trees (10/16)

Obvious hollow and/or den trees shall be protected and left standing unless they are a safety hazard.

5.2.3 - Operating Restrictions

5.2.3.7 - National Guard training restriction (1/09)

Operations on this contract may not be allowed during National Guard training operations. Typically, the restricted period is from May 1 to October 31. The contractor must check with the Unit Manager who will coordinate the cutting schedule with the Military.

5.2.4 - Dead and Down Creation

5.2.4.4 - Dead and down creation, grouse (6/18)

To encourage grouse and other wildlife, in Payment Unit(s) 1, 2, & 6 leave one 12" or larger diameter (or largest diameter trees within stand) whole tree on the ground for every 2 acres, preferably a hardwood species such as oak or maple or if no hardwoods are present, a pine species (white or red). These trees will be evenly scattered throughout the Payment Unit, preferably at least two chains from any roads, two-tracks, or trails open to vehicles.

5.2.29 - Shrub protection (1/20)

Reasonable care should be taken to avoid cutting or damaging hawthorn, witch-hazel, dogwood or juneberry. These woody-shrub plants are highly beneficial to various wildlife species.

5.2.32 - Decking/landing restoration (9/13)

All decking and landing areas must have the surface area restored to a condition equal to or better than before. This is to ensure the proper regeneration of the stand. Wood debris, chips and "cookies" from trimmings must be removed or scattered away from landing and loading areas and may not be windrowed on the edge.

5.4 - Soil Protection

5.4.1 - Rutting restriction, general (7/16)

Operations are to cease immediately if equipment and weather conditions result in rutting of roads and/or skid trails which is 12 inches or greater in depth and 50 feet in length. The Unit Manager or his/her representative may restrict hauling and/or skidding if ruts exceed the specified depth. With the Unit Manager or his/her representative's approval, the Purchaser may return to the area when the risk of rutting has decreased.

6 - Safety and Fire Prevention

6.2 - Signing

6.2.1 - Road posting (10/20)

The Purchaser is responsible for posting and maintaining caution signs on Bear Lake Road prior to beginning operations. The road must be posted at appropriate distances from the Sale Area to warn of logging activity and truck traffic. Signs must be removed when harvest operations are suspended or completed. The Purchaser will provide these signs.

SKIP

6.4 - Unexploded ordinance (7/15)

Be aware that the sale area could contain UXO (unexploded ordinances). Do not touch, or drive over any metal objects. If any objects are found, please flag the area and notify the Unit Manager or his/her representative, so that they can make arrangements with the Military.

7 - Other Conditions

7.10 - Certified Timber

7.10.1 - Non-certified timber (2/16)

The area encompassed by this timber sale is not certified to the standards of the Forest Stewardship Council (FSC) or the Sustainable Forestry Initiative (SFI). Forest products from this sale may not be delivered to the mill as "FSC and / or SFI certified".



TIMBER SALE MAP

This information provided by authority of Part 525, 1994 PA 451, as amended.

Sale Number 72-625-23	Date 01/12/2024
Scale 1:10,000	Page 1
	Of 1

Forest Management Unit Grayling Mgt Unit	County Crawford	Mapped By: Derek Nellis
		Cruised By: Nellis/Osborn

Township 28N	Range 03W	Section(s) and Subdivision(s) Sec. 13 SWNW,W1/2SW; Sec. 14 SENW,S1/2NE,NESW,N1/2SE,SWSE; Sec. 24 NWNW;
-----------------	--------------	--

Cover Type			
A = Aspen	J = Jack Pine	O = Oak	U = Upland Brush
B = Paper Birch	K = Rock	P = Lowland Poplar	UM = Upland Mix Forest
C = Cedar	L = Lowland Brush	Q = Mixed Swamp Conifer	V = Bog or Marsh
D = Treed Bog	LM = Lowland Mix Forest	R = Red Pine	W = White Pine
E = Swamp Hardwoods	M = Maple, Beech, Birch	S = Black Spruce	X = Non Stocked
F = Spruce/Fir	MC = Mixed Conifer	T = Tamarack	Y = Sand
G = Grass	MD = Mixed Deciduous	Z = Water	
H = Hemlock	N = Marsh		

Density	
0 = Non Stocked	5 = Pole Timber Medium
1 = Seedling Sapling Poor	6 = Pole Timber Well
2 = Seedling Sapling Medium	7 = Saw Timber Poor
3 = Seedling Sapling Well	8 = Saw Timber Medium
4 = Pole Timber Poor	9 = Saw Timber Well

PU #	Acres	PU #	Acres
1	12.1	4	12.3
2	20.8	5	20.5
3	31.8	6	9.2



**Let's See
Your ID
Hardwood**
106.7 Acres

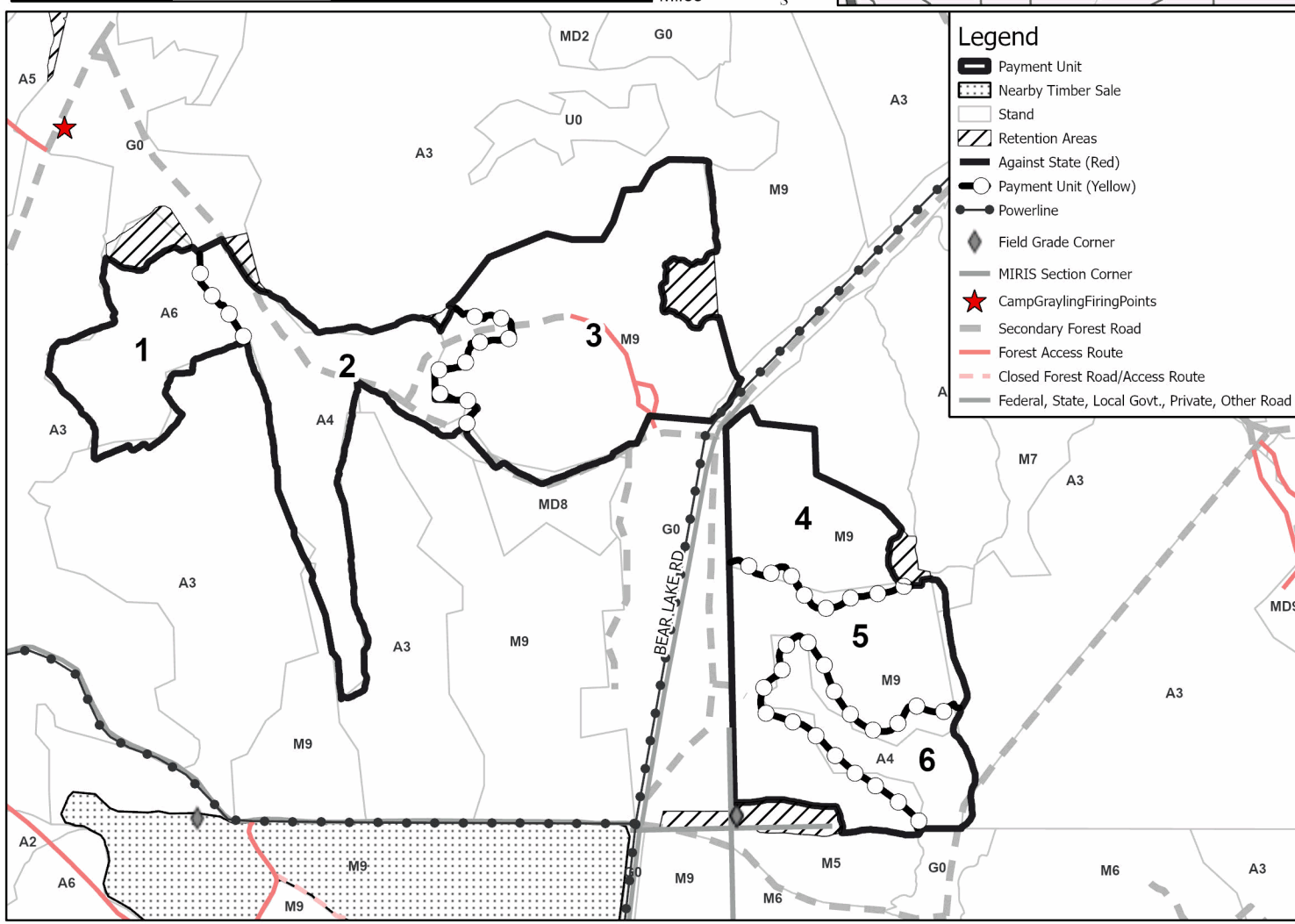
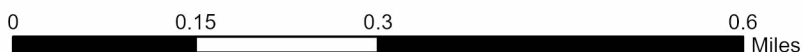
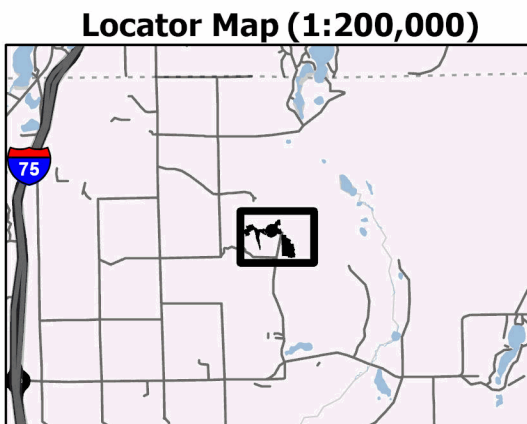

TIMBER SALE INFORMATION

Unplugged Oak (72-626-23)

T26N, R04W, SEC. 34.

Crawford County (Advertised Price \$85,833.30)

SALE NOTE: Sale is on non-certified military lands. Portions of this sale have an operating restriction for oak wilt. This sale has class A road access.

A timber sale contract for this lump sum, sealed bid timber sale will be awarded to the responsible bidder offering the highest sealed bid price. All units of volume listed below were estimated using the Inventory Manager computer program and the new Michigan taper model. Bids must be at or above the following advertised price for each product and species:

<u>PRODUCTS & SPECIES</u>	<u>ESTIMATED UNITS*</u>	<u>ADVERTISED PRICE</u>
Sawtimber		
Black/Red (Hybrid) Oak	188.2 MBF	\$ 158.00 / MBF
Red Maple	41.0 MBF	\$ 90.00 / MBF
Red Oak	159.4 MBF	\$ 145.00 / MBF
White Oak	7.8 MBF	\$ 126.00 / MBF
Pulpwood		
Mixed Aspen	33 Cords	\$ 30.65 / Cord
Mixed Hardwood	418 Cords	\$ 31.75 / Cord
Mixed Oak	388 Cords	\$ 26.55 / Cord
Paper Birch	4 Cords	\$ 22.55 / Cord
Red Oak	137 Cords	\$ 26.55 / Cord

* The total volume is statistically estimated within plus (+) or minus (-) 12.60 percent. There are an estimated 1,843 cords on this timber sale, plus or minus 232 cords at the 95% confidence level. The estimated units are final and not subject to adjustment. Prospective bidders are urged to examine this timber and to make their own estimates of quantity and quality.

BOND AND PAYMENT SCHEDULE:

- A bond in the amount of \$4,292.00 to insure faithful performance of the conditions of the contract will be deposited by the successful bidder within 21 days of the sale award.
- Cutting in any sale or unit without the required advance payment would be considered a trespass.
- Total payment must be paid in advance or according to the following schedule :
 - Ten percent (10%) of the sale value must be paid within 21 days of the sale award.
 - The 10% down payment will be credited towards the first unit cut.
 - Payment for each of the following units must be made before cutting begins in that unit:

PAYMENT UNIT NUMBER	PERCENT OF TOTAL SALE VALUE
01	23.9%
02	27.0%
03	29.8%
04	19.3%
- If no cutting takes place, the 10% down payment will not be refunded.
- Operations on the contract issued will terminate on 06/30/2026.

SALE STATISTICS

Volumes were calculated in cubic feet using the Michigan taper model. Cubic foot volume includes all wood inside bark for the product indicated. For display purposes, cubic feet were converted to cords and MBF using a simple conversion factor, e.g. 79 cubic feet per cord and 185 cubic feet per MBF. The cubic foot volumes are precise; the cords and MBF volumes are not. Cubic foot volume cannot be directly converted to cords or boards with precision.

SALE VOLUMES

The total estimated sale volume may not equal the sum of the species/products due to the nature of statistical calculations associated with double sampling methodology.

VOLUME		STATISTICAL RANGE IN CORDS		
TOTAL CUBIC FEET	TOTAL CORDS	PERCENT ERROR	MINIMUM	MAXIMUM
145,602	1,843	12.60%	1,611	2,075

VDU VOLUMES

A VDU is a Volume Determination Unit. Volumes and their associated statistics are calculated at the VDU level and summarized to the sale level. There is often a one to one relationship between a VDU and a Payment Unit, but not always, depending on the cruise design. Refer to the VDU TO PAYMENT UNIT table.

VDU	VOLUME		PERCENT ERROR	RANGE IN CORDS	
	TOTAL CUBIC FEET	TOTAL CORDS		MINIMUM	MAXIMUM
20	47,959	607	26.09%	449	765
22	30,004	380	30.13%	265	494
23	40,409	512	24.30%	387	636
30	27,230	345	25.93%	255	434
TOTAL:	145,602	1,843		1,357	2,330

VDU TO PAYMENT UNIT

When a VDU is associated with more than one Payment Unit (PU), the VDU volumes are assigned to the PU based on acres of the VDU within the PU.

VDU	VDU ACRES	PU	PU ACRES
20	21.9	2	21.9
22	15.2	1	15.2
23	22.3	3	22.3
30	12.7	4	12.7
TOTAL:	72.1		72.1

DESCRIPTION OF TIMBER BY PAYMENT UNIT (PU)

PU	MARKET GROUP	PRODUCT	QUANTITY	UNIT	ACRES	ADVERTISE PRICE			
1	Red Maple	Sawtimber	1.1	MBF	15.2	\$20,530.15			
	Red Oak		114.6	MBF					
	Mixed Hardwood	Pulpwood	34	Cords					
	<i>Beech</i>		17	<i>Cords</i>					
	<i>Red Maple</i>		13	<i>Cords</i>					
	<i>Sugar Maple</i>		4	<i>Cords</i>					
	Red Oak		103	Cords					
	2	Red Maple	Sawtimber	39.9			MBF	21.9	\$23,180.90
Red Oak			44.8	MBF					
Mixed Aspen		Pulpwood	25	Cords					
<i>Quaking Aspen</i>		<i>Sawtimber</i>	1.8	<i>MBF</i>					
<i>Quaking Aspen</i>		<i>Pulpwood</i>	21	<i>Cords</i>					
Mixed Hardwood			357	Cords					
<i>Sugar Maple</i>		<i>Sawtimber</i>	1.5	<i>MBF</i>					
<i>Beech</i>		<i>Pulpwood</i>	29	<i>Cords</i>					
<i>Red Maple</i>			317	<i>Cords</i>					
<i>Sugar Maple</i>			8	<i>Cords</i>					
Paper Birch			4	Cords					
Red Oak			34	Cords					
3		Black/Red (Hybrid)	Sawtimber	114.0	MBF	22.3	\$25,520.40		
		White Oak		5.5	MBF				
	Mixed Hardwood	Pulpwood	24	Cords					
	<i>Beech</i>		4	<i>Cords</i>					
	<i>Red Maple</i>		20	<i>Cords</i>					
	Mixed Oak		228	Cords					
	<i>/Red (Hybrid) Oak</i>		221	<i>Cords</i>					
	<i>White Oak</i>		7	<i>Cords</i>					
4	Black/Red (Hybrid)	Sawtimber	74.2	MBF	12.7	\$16,601.85			
	White Oak		2.3	MBF					
	Mixed Aspen	Pulpwood	8	Cords					
	<i>B. T. Aspen</i>		8	<i>Cords</i>					
	Mixed Hardwood		3	Cords					
	<i>Red Maple</i>		3	<i>Cords</i>					
	Mixed Oak		160	Cords					
	<i>/Red (Hybrid) Oak</i>		130	<i>Cords</i>					
	<i>White Oak</i>		30	<i>Cords</i>					
	TOTAL:			396.4			MBF		
TOTAL:			980	Cords					

Sale Specific Conditions & Requirements

Sale Name: Unplugged Oak

Sale Number: 72-626-23 Seq#: 2

1 - Sale Area

1.2 - Boundaries

1.2.1 - Painted boundaries (9/19)

The sale boundary and Payment Unit boundaries are marked and identified by red and yellow paint. Exterior sale boundary lines against state are marked with red paint. Interior Payment Unit boundaries are marked with yellow paint. Retention patches are marked with red paint; no harvesting activities may occur within these areas. The painted boundary line trees are not Included Timber and are to be protected, except for those along Military Road. Yellow painted trees designating an interior Payment Unit boundary are only to be cut when all surrounding Payment Units have been paid.

2 - Timber Specifications

2.1 - Included Timber

2.1.1 - Clearcut unit(s) with unmerchantable trees (6/14)

Within Payment Unit(s) 1, 3, & 4, cut all trees that are one (1) inch or more at DBH, except in Payment Units 1 & 4, do not cut any pine or trees marked with green paint.

Within Payment Unit 2, cut all trees that are two (2) inches or more at DBH, except do not cut pine, white oak, or trees marked with green paint.

2.2 - Utilization

2.2.2 - Chipping required (2/18)

This area must be chip harvested to meet National Guard requirements. However, the chipping requirement could be waived with military approval, if chip markets are depressed. The Purchaser has the option to produce sawlogs or pulpwood bolts, but the remaining portion of the trees must be chipped and hauled. The requirement to retain approximately 1/6 to 1/3 of treetops and limbs less than four inches in diameter does not apply (G. C. & R. 2.2). This is because this sale is on non-certified military lands.

2.2.3 - Stump heights (4/07)

Stump heights within the Sale Area shall not exceed 6 inches for all trees. This is in order to facilitate military requirements. A written waiver of this requirement may be obtained if wet summer weather makes winter logging necessary.

3 - Payments

3.3 - Pre-measured Sales

3.3.4 - Dividing payment units (7/14)

Payment Unit(s) may be divided at the request of the Purchaser and upon approval of the Unit Manager. Dividing Payment Units is a contract modification which requires a Timber Sale Contract Amendment. There will be only one division per Payment Unit.

3.4 - Damaged Timber

3.4.1 - Damaged timber (7/16)

General Condition and Requirement 3.4 Damaged Timber, defines liquidated damages for undesignated live merchantable trees which are cut or injured. In addition, extreme care should be taken to avoid damage to tree seedlings and saplings.

Within Payment Units 1, 2, & 4, if more than 20% of the tree seedlings or saplings (1/4" to 4.5" DBH) within a specified portion of the Sale Area are damaged, liquidated damages will be assessed at \$500 per acre for all acreage within that specified portion of the Sale Area that was damaged.

No damage is acceptable to undesignated live merchantable trees. Within the Sale Area, if more than 10% of trees (> 4.5" DBH) within a specified area of the sale are damaged, liquidated damages will be assessed for all trees damaged. Rates will

be in accordance with General Condition and Requirement 3.4 Damaged Timber, or at a rate of \$300 per sawtimber tree and \$50 per pole sized tree, whichever is greater.

4 - Transportation

4.1 - Construction

4.1.3 - Slash and earthen piles (8/04)

Piles or windrows of earth along roads and landings that have been widened or constructed shall be leveled. Slash from road maintenance or construction, including stumps, shall be

4.1.6 - Road construction (1/09)

Construction of new roads or improvements of existing roads shall be done in such a way as to minimize the environmental and visual impacts. Merchantable trees shall be cut and utilized unless otherwise directed. Non-merchantable trees shall be severed and laid flat on the ground. Slash shall be scattered, and not left in windrows and kept a minimum of 10 feet back from the road edge. Stumps shall be set upright, not left on edge, and be moved at least 10 feet away from the road edge. Disturbed soil shall be feathered into the woods and not left in berms or windrows.

4.1.7 - Road closure (10/11)

All new roads built into the sale must be blocked to vehicle traffic upon completion of the sale. Overgrown roads that are reopened shall be considered new roads. In general, this will require constructing a four (4') foot high berm of stumps and logs covered with earth. Stumps and brush must be placed along the remainder of the trail. These roads must be rendered impassable to cars and trucks. Temporary berms may be required if no sale activity occurs for 30 or more consecutive days. Contact the Sale Administrator for specific details of design and placement.

4.1.11 - Permits (2/12)

The Purchaser will secure any necessary permits that may be required.

5 - Operations

5.1 - Notification

5.1.5 - National Guard notification (2/15)

This sale is upon lands utilized for training by the Michigan National Guard - Camp Grayling. A minimum of five (5) business days prior to opening this sale, the producer must request that the sale administrator contact the military for information regarding training plans that may impact sale operations.

5.2 - Conduct of Operations

5.2.2 - Hazard Trees/Snags

5.2.2.1 - Den trees (10/16)

Obvious hollow and/or den trees shall be protected and left standing unless they are a safety hazard.

5.2.3 - Operating Restrictions

5.2.3.4 - Oak wilt restriction, no exceptions (1/18)

Within Payment Units 1, 2, & 4, cutting, skidding, hauling within the sale and brushing of access roads to the sale are not permitted during the period of April 15 to July 15. No exceptions will be granted. This is necessary to reduce the spread of oak wilt.

5.2.3.7 - National Guard training restriction (1/09)

Operations on this contract may not be allowed during National Guard training operations. Typically, the restricted period is from May 1 to October 31. The contractor must check with the Unit Manager who will coordinate the cutting schedule with the Military.

5.2.32 - Decking/landing restoration (9/13)

All decking and landing areas must have the surface area restored to a condition equal to or better than before. This is to ensure the proper regeneration of the stand. Wood debris, chips and "cookies" from trimmings must be removed or scattered away from landing and loading areas and may not be windrowed on the edge.

5.2.38 - No decking against live trees (2/04)

Cut products may not be decked against unmarked or designated leave trees.

5.4 - Soil Protection

5.4.1 - Rutting restriction, general (7/16)

Operations are to cease immediately if equipment and weather conditions result in rutting of roads and/or skid trails which is 12 inches or greater in depth and 50 feet in length. The Unit Manager or his/her representative may restrict hauling and/or skidding if ruts exceed the specified depth. With the Unit Manager or his/her representative's approval, the Purchaser may return to the area when the risk of rutting has decreased.

6 - Safety and Fire Prevention

6.2 - Signing

6.2.1 - Road posting (10/20)

The Purchaser is responsible for posting and maintaining caution signs on roads used for hauling adjacent to the Sale Area prior to beginning operations. The road must be posted at appropriate distances from the Sale Area to warn of logging activity and truck traffic. Signs must be removed when harvest operations are suspended or completed. The Purchaser will provide these signs.

SKIP

6.4 - Unexploded ordinance (7/15)

Be aware that the sale area could contain UXO (unexploded ordinances). Do not touch, or drive over any metal objects. If any objects are found, please flag the area and notify the Unit Manager or his/her representative, so that they can make arrangements with the Military.

7 - Other Conditions

7.10 - Certified Timber

7.10.1 - Non-certified timber (2/16)

The area encompassed by this timber sale is not certified to the standards of the Forest Stewardship Council (FSC) or the Sustainable Forestry Initiative (SFI). Forest products from this sale may not be delivered to the mill as "FSC and / or SFI certified".



TIMBER SALE MAP

This information provided by authority of Part 525, 1994 PA 451, as amended.

Sale Number

72-626-23

Date

10/13/2023

Forest Management Unit

Grayling Mgt Unit

County

Crawford

Mapped By: Derek Nellis

Cruised By: Derek Nellis

Scale

1:15,840

Page

1

Of

1

Township
26N

Range
04W

Section(s) and
Subdivision(s) Sec. 34 SENE,SW,N1/2SE;

Cover Type

A = Aspen	J = Jack Pine	O = Oak	U = Upland Brush
B = Paper Birch	K = Rock	P = Lowland Poplar	UM = Upland Mix Forest
C = Cedar	L = Lowland Brush	Q = Mixed Swamp Conifer	V = Bog or Marsh
D = Treed Bog	LM = Lowland Mix Forest	R = Red Pine	W = White Pine
E = Swamp Hardwoods	M = Maple, Beech, Birch	S = Black Spruce	X = Non Stocked
F = Spruce/Fir	MC = Mixed Conifer	T = Tamarack	Y = Sand
G = Grass	MD = Mixed Deciduous	Z = Water	
H = Hemlock	N = Marsh		

Density

0 = Non Stocked	5 = Pole Timber Medium
1 = Seedling Sapling Poor	6 = Pole Timber Well
2 = Seedling Sapling Medium	7 = Saw Timber Poor
3 = Seedling Sapling Well	8 = Saw Timber Medium
4 = Pole Timber Poor	9 = Saw Timber Well

Locator Map (1:200,000)

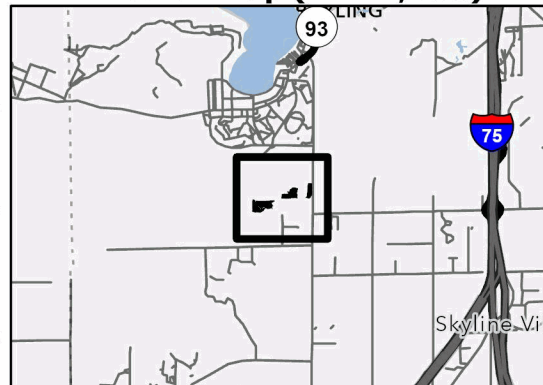

PU # Acres

1	15.2
2	21.9
3	22.3
4	12.7

Unplugged Oak

72.1 Acres

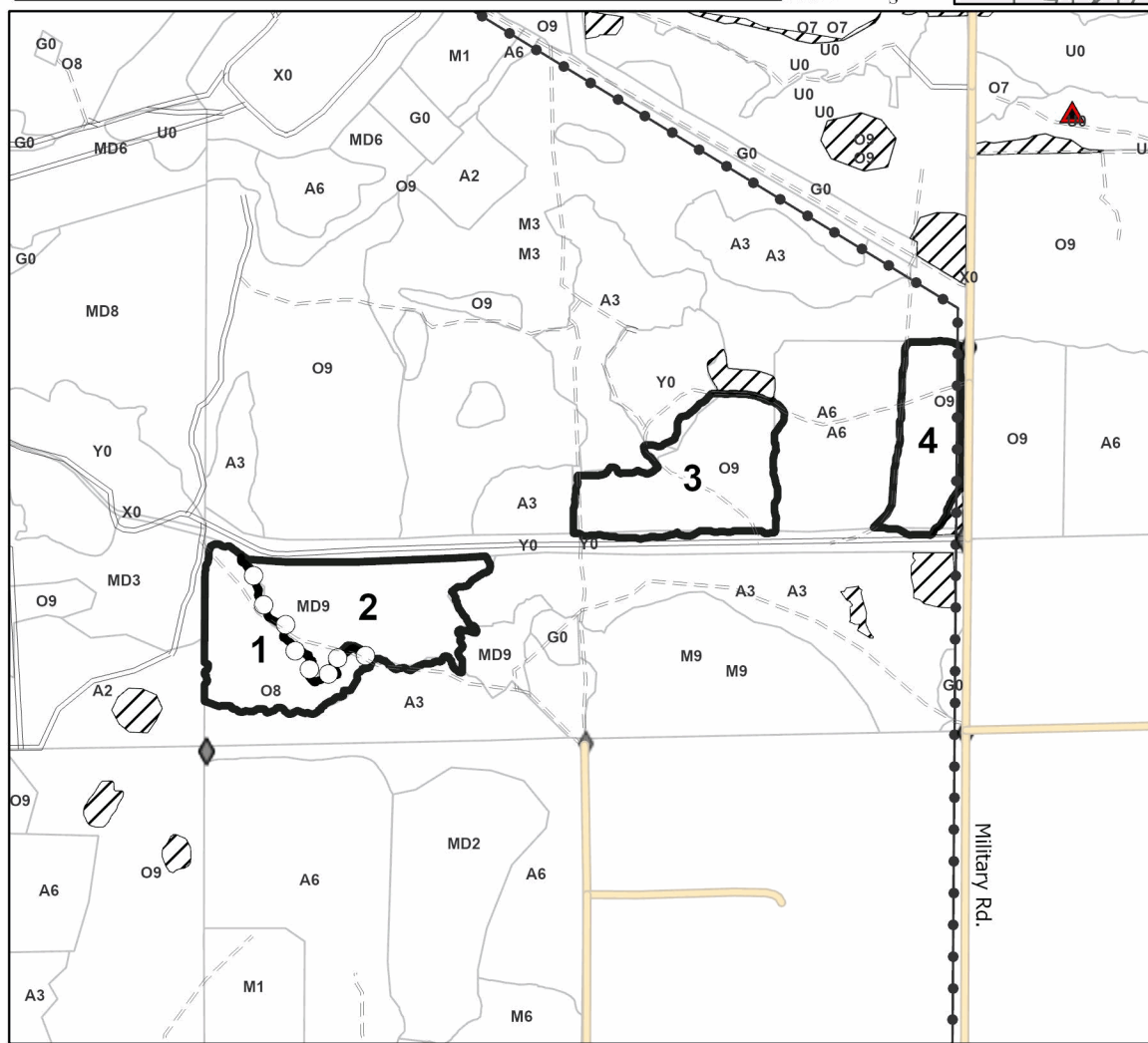
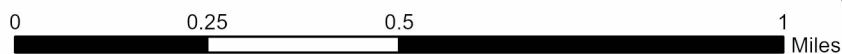

Legend

- Payment Unit (Red)
- Stand
- Retention Areas
- Payment Unit (Yellow)
- Powerline
- Primary Forest Road
- Secondary Forest Road
- Forest Access Route
- Administrative Access Only
- Non-DNR Road
- Field Grade Corner
- CampGraylingLandNavMarkers



Buteo Buffer Mix (72-616-23)
T28N, R03W, SEC. 11; T28N, R03W, SEC. 14; Crawford COUNTY

In response to the notice of sale to be held 9:00 a.m. (local time) on April 15, 2024, I am hereby submitting my sealed bid (firm offer) for the following forest products to be cut. Bids for individual species must be at or above the advertised price. All non-responsive bid forms may be rejected.

<u>PRODUCTS & SPECIES</u>	<u>ESTIMATED VOLUME*</u>	<u>ADVERTISED PRICE</u>	<u>BID PRICE/UNIT</u>
Sawtimber			
Basswood	52.6 MBF	\$ 74.00/MBF	\$ _____
Beech	16.2 MBF	\$ 130.00/MBF	\$ _____
Red Maple	68.4 MBF	\$ 90.00/MBF	\$ _____
Sugar Maple	44.6 MBF	\$ 279.00/MBF	\$ _____
White Pine	53.4 MBF	\$ 77.00/MBF	\$ _____
Pulpwood			
Basswood	54 Cords	\$ 14.55/Cord	\$ _____
Jack Pine	2 Cords	\$ 23.10/Cord	\$ _____
Mixed Aspen	549 Cords	\$ 30.65/Cord	\$ _____
Mixed Hardwood	1,037 Cords	\$ 31.75/Cord	\$ _____
Mixed Oak	19 Cords	\$ 26.55/Cord	\$ _____
Paper Birch	4 Cords	\$ 22.55/Cord	\$ _____
Red Pine	10 Cords	\$ 56.25/Cord	\$ _____
White Pine	158 Cords	\$ 24.60/Cord	\$ _____

*The volumes are statistically estimated within plus (+) or minus (-) 15.48 percent at 95% confidence level. These estimated volumes are final and not subject to adjustment. Prospective bidders are urged to examine this timber and to make their own estimates of quantity and quality.

I understand that any or all bids may be rejected. All bids must be signed and all bid items must be bid or the bid form may be rejected. I also understand that consideration and awarding a contract will be based upon my past performance and ability to complete the contract based upon equipment and staffing subject to my control.

FEDERAL ID: _____ or SOCIAL SECURITY NUMBER: _____

Company or individual bidding: _____

Company representative's name: _____

Address: _____

City: _____ State: _____ Zip: _____

IF AVAILABLE, PLEASE PLACE THE PERSONALIZED LABEL FROM YOUR PROSPECTUS IN THE ABOVE BOX.

Individual or company representative's signature: _____ Date: _____

Phone number : _____ Email (optional): _____

THE WINNING BIDDER MUST COMPLETE THE VERIFICATION OF WORKER'S DISABILITY COMPENSATION ACT COMPLIANCE (ON REVERSE SIDE IF DOUBLE SIDED) WITHIN 21 DAYS OF SALE AWARD DATE



FOR DEPARTMENT USE ONLY	
Sale Number (XX - XXX - XX - XX)	
Forest Management Unit:	

TIMBER SALE VERIFICATION OF WORKER'S DISABILITY COMPENSATION ACT COMPLIANCE

As required by Act 317, P.A. 1969 (Worker's Compensation) and
Part 5 of Act 451 of 1994, as amended.

VERIFICATION OF WORKER'S DISABILITY COMPENSATION ACT COMPLIANCE

- This verification must be completed and submitted within 21 days of contract award and prior to the issuance of the timber sale contract.
- In addition, if boxes 2B or 2C are checked, then Notice of Exclusion or Certificate of Insurance must be submitted within twenty-one (21) days of the contract award and prior to the issuance of the timber sale contract.
- All information must be typed or printed except for written signatures.

Please Check Appropriate Categories:

1. My business is organized as (you **must** check one of the boxes below):
 - A. Sole Proprietorship (individual)
 - B. Partnership
 - C. Corporation
2. You **must** check one of the boxes below:
 - A. I certify my business is a sole proprietorship and it has no employees but the sole proprietor. I am not subject to the Worker's Compensation Laws.
 - B. I certify my business has satisfied its obligation to the Worker's Compensation Act through the use of an approved Notice of Exclusion (BWC-337, Rev. 5/96). I will provide a copy of the Notice of Exclusion within 21 days of the contract award. (For questions or a copy of the BWC-337, please call the Worker's Compensation Bureau at 517-322-1195).
 - C. I certify my business has a Worker's Compensation Policy. I will provide an original Certificate of Insurance within twenty-one (21) days of the contract award.
3. If you have checked item 2(A) or 2(B), you **must** indicate the number of **both** full-time and part-time employees, other than yourself, including family members and active partners (if none, you must enter "0").

_____ Full-time Employees

_____ Part-time Employees

Name of Business		Federal ID (or) Social Security No.	
Address		Telephone ()	
City	State	ZIP	

I hereby certify that the above information is true and correct. I agree to notify the Michigan DNR of any changes that occur in factors affecting my coverage during any of my present and future operations.

Signature of Owner or Authorized Representative

Title

Date

Please complete the "SEALED BID" information on the next page

Let's See Your ID Hardwood (72-625-23)

T28N, R03W, SEC. 13; T28N, R03W, SEC. 14; T28N, R03W, SEC. 24; Crawford

In response to the notice of sale to be held 9:00 a.m. (local time) on April 15, 2024, I am hereby submitting my sealed bid (firm offer) for the following forest products to be cut. Bids for individual species must be at or above the advertised price. All non-responsive bid forms may be rejected.

<u>PRODUCTS & SPECIES</u>	<u>ESTIMATED VOLUME*</u>	<u>ADVERTISED PRICE</u>	<u>BID PRICE/UNIT</u>
Sawtimber			
B. T. Aspen	16.7 MBF	\$ 102.00/MBF	\$ _____
Basswood	11.1 MBF	\$ 74.00/MBF	\$ _____
Beech	53.1 MBF	\$ 130.00/MBF	\$ _____
Red Maple	60.3 MBF	\$ 90.00/MBF	\$ _____
Sugar Maple	109.9 MBF	\$ 279.00/MBF	\$ _____
Pulpwood			
Basswood	22 Cords	\$ 14.55/Cord	\$ _____
Mixed Aspen	329 Cords	\$ 30.65/Cord	\$ _____
Mixed Hardwood	1,152 Cords	\$ 31.75/Cord	\$ _____
Mixed Oak	18 Cords	\$ 26.55/Cord	\$ _____

*The volumes are statistically estimated within plus (+) or minus (-) 15.58 percent at 95% confidence level. These estimated volumes are final and not subject to adjustment. Prospective bidders are urged to examine this timber and to make their own estimates of quantity and quality.

I understand that any or all bids may be rejected. All bids must be signed and all bid items must be bid or the bid form may be rejected. I also understand that consideration and awarding a contract will be based upon my past performance and ability to complete the contract based upon equipment and staffing subject to my control.

FEDERAL ID: ____ - ____ - ____ or SOCIAL SECURITY NUMBER: ____ - ____ - ____

Company or individual bidding: _____

Company representative's name: _____

Address: _____

City: _____ State: _____ Zip: _____

IF AVAILABLE, PLEASE PLACE THE PERSONALIZED LABEL FROM YOUR PROSPECTUS IN THE ABOVE BOX.

Individual or company representative's signature: _____ Date: _____

Phone number : _____ Email (optional): _____

THE WINNING BIDDER MUST COMPLETE THE VERIFICATION OF WORKER'S DISABILITY COMPENSATION ACT COMPLIANCE (ON REVERSE SIDE IF DOUBLE SIDED) WITHIN 21 DAYS OF SALE AWARD DATE



FOR DEPARTMENT USE ONLY	
Sale Number (XX - XXX - XX - XX)	
Forest Management Unit:	

TIMBER SALE VERIFICATION OF WORKER'S DISABILITY COMPENSATION ACT COMPLIANCE

As required by Act 317, P.A. 1969 (Worker's Compensation) and
Part 5 of Act 451 of 1994, as amended.

VERIFICATION OF WORKER'S DISABILITY COMPENSATION ACT COMPLIANCE

- This verification must be completed and submitted within 21 days of contract award and prior to the issuance of the timber sale contract.
- In addition, if boxes 2B or 2C are checked, then Notice of Exclusion or Certificate of Insurance must be submitted within twenty-one (21) days of the contract award and prior to the issuance of the timber sale contract.
- All information must be typed or printed except for written signatures.

Please Check Appropriate Categories:

1. My business is organized as (you **must** check one of the boxes below):
 - A. Sole Proprietorship (individual)
 - B. Partnership
 - C. Corporation
2. You **must** check one of the boxes below:
 - A. I certify my business is a sole proprietorship and it has no employees but the sole proprietor. I am not subject to the Worker's Compensation Laws.
 - B. I certify my business has satisfied its obligation to the Worker's Compensation Act through the use of an approved Notice of Exclusion (BWC-337, Rev. 5/96). I will provide a copy of the Notice of Exclusion within 21 days of the contract award. (For questions or a copy of the BWC-337, please call the Worker's Compensation Bureau at 517-322-1195).
 - C. I certify my business has a Worker's Compensation Policy. I will provide an original Certificate of Insurance within twenty-one (21) days of the contract award.
3. If you have checked item 2(A) or 2(B), you **must** indicate the number of **both** full-time and part-time employees, other than yourself, including family members and active partners (if none, you must enter "0").

_____ Full-time Employees

_____ Part-time Employees

Name of Business		Federal ID (or) Social Security No.	
Address		Telephone ()	
City	State	ZIP	

I hereby certify that the above information is true and correct. I agree to notify the Michigan DNR of any changes that occur in factors affecting my coverage during any of my present and future operations.

Signature of Owner or Authorized Representative

Title

Date

Please complete the "SEALED BID" information on the next page

Butterfly Lane Jack Pine (72-621-23)
T27N, R01W, SEC. 6; T27N, R01W, SEC. 8; Crawford COUNTY

In response to the notice of sale to be held 9:00 a.m. (local time) on April 15, 2024, I am hereby submitting my sealed bid (firm offer) for the following forest products to be cut. Bids for individual species must be at or above the advertised price. All non-responsive bid forms may be rejected.

<u>PRODUCTS & SPECIES</u>	<u>ESTIMATED VOLUME*</u>	<u>ADVERTISED PRICE</u>	<u>BID PRICE/UNIT</u>
Sawtimber			
Black/Red (Hybrid) Oak	35.9 MBF	\$ 116.00/MBF	\$ _____
Jack Pine	16.4 MBF	\$ 34.00/MBF	\$ _____
Pulpwood			
B. T. Aspen	64 Cords	\$ 22.45/Cord	\$ _____
Jack Pine	882 Cords	\$ 16.95/Cord	\$ _____
Mixed Hardwood	4 Cords	\$ 23.30/Cord	\$ _____
Mixed Oak	181 Cords	\$ 19.50/Cord	\$ _____
Red Pine	373 Cords	\$ 41.25/Cord	\$ _____
White Pine	40 Cords	\$ 18.05/Cord	\$ _____

*The volumes are statistically estimated within plus (+) or minus (-) 12.32 percent at 95% confidence level. These estimated volumes are final and not subject to adjustment. Prospective bidders are urged to examine this timber and to make their own estimates of quantity and quality.

I understand that any or all bids may be rejected. All bids must be signed and all bid items must be bid or the bid form may be rejected. I also understand that consideration and awarding a contract will be based upon my past performance and ability to complete the contract based upon equipment and staffing subject to my control.

FEDERAL ID: ____ - ____ - ____ or SOCIAL SECURITY NUMBER: ____ - ____ - ____

Company or individual bidding: _____

Company representative's name: _____

Address: _____

City: _____ State: _____ Zip: _____

IF AVAILABLE, PLEASE PLACE THE PERSONALIZED LABEL FROM YOUR PROSPECTUS IN THE ABOVE BOX.

Individual or company representative's signature: _____ Date: _____

Phone number : _____ Email (optional): _____

THE WINNING BIDDER MUST COMPLETE THE VERIFICATION OF WORKER'S DISABILITY COMPENSATION ACT COMPLIANCE (ON REVERSE SIDE IF DOUBLE SIDED) WITHIN 21 DAYS OF SALE AWARD DATE



FOR DEPARTMENT USE ONLY
Sale Number (XX - XXX - XX - XX)
Forest Management Unit:

TIMBER SALE VERIFICATION OF WORKER'S DISABILITY COMPENSATION ACT COMPLIANCE

*As required by Act 317, P.A. 1969 (Worker's Compensation) and
Part 5 of Act 451 of 1994, as amended.*

VERIFICATION OF WORKER'S DISABILITY COMPENSATION ACT COMPLIANCE

- This verification must be completed and submitted within 21 days of contract award and prior to the issuance of the timber sale contract.
- In addition, if boxes 2B or 2C are checked, then Notice of Exclusion or Certificate of Insurance must be submitted within twenty-one (21) days of the contract award and prior to the issuance of the timber sale contract.
- All information must be typed or printed except for written signatures.

Please Check Appropriate Categories:

1. My business is organized as (you **must** check one of the boxes below):
 - A. Sole Proprietorship (individual)
 - B. Partnership
 - C. Corporation

2. You **must** check one of the boxes below:
 - A. I certify my business is a sole proprietorship and it has no employees but the sole proprietor. I am not subject to the Worker's Compensation Laws.
 - B. I certify my business has satisfied its obligation to the Worker's Compensation Act through the use of an approved Notice of Exclusion (BWC-337, Rev. 5/96). I will provide a copy of the Notice of Exclusion within 21 days of the contract award. (For questions or a copy of the BWC-337, please call the Worker's Compensation Bureau at 517-322-1195).
 - C. I certify my business has a Worker's Compensation Policy. I will provide an original Certificate of Insurance within twenty-one (21) days of the contract award.

3. If you have checked item 2(A) or 2(B), you **must** indicate the number of **both** full-time and part-time employees, other than yourself, including family members and active partners (if none, you must enter "0").

_____ Full-time Employees _____ Part-time Employees

Name of Business		Federal ID (or) Social Security No.	
Address		Telephone ()	
City	State	ZIP	

I hereby certify that the above information is true and correct. I agree to notify the Michigan DNR of any changes that occur in factors affecting my coverage during any of my present and future operations.

Signature of Owner or Authorized Representative

Title

Date

Please complete the "SEALED BID" information on the next page

C 65 Lowlands (72-036-23)

T25N, R08E, SEC. 20; T25N, R08E, SEC. 29; T25N, R08E, SEC. 30; T25N, R08E,

In response to the notice of sale to be held 9:00 a.m. (local time) on April 15, 2024, I am hereby submitting my sealed bid (firm offer) for the following forest products to be cut. Bids for individual species must be at or above the advertised price. All non-responsive bid forms may be rejected.

<u>PRODUCTS & SPECIES</u>	<u>ESTIMATED VOLUME*</u>	<u>ADVERTISED PRICE</u>	<u>BID PRICE/UNIT</u>
Pulpwood			
Balsam Fir	230 Cords	\$ 25.95/Cord	\$ _____
Jack Pine	31 Cords	\$ 15.40/Cord	\$ _____
Mixed Aspen	1,373 Cords	\$ 20.40/Cord	\$ _____
Mixed Hardwood	708 Cords	\$ 21.20/Cord	\$ _____
Northern Pin Oak	9 Cords	\$ 17.70/Cord	\$ _____
Red Pine	33 Cords	\$ 37.50/Cord	\$ _____
Tamarack	29 Cords	\$ 15.00/Cord	\$ _____
White Pine	175 Cords	\$ 16.40/Cord	\$ _____

*The volumes are statistically estimated within plus (+) or minus (-) 31.20 percent at 95% confidence level. These estimated volumes are final and not subject to adjustment. Prospective bidders are urged to examine this timber and to make their own estimates of quantity and quality.

I understand that any or all bids may be rejected. All bids must be signed and all bid items must be bid or the bid form may be rejected. I also understand that consideration and awarding a contract will be based upon my past performance and ability to complete the contract based upon equipment and staffing subject to my control.

FEDERAL ID: ____ - ____ - ____ or SOCIAL SECURITY NUMBER: ____ - ____ - ____

Company or individual bidding: _____

Company representative's name: _____

Address: _____

City: _____ State: _____ Zip: _____

IF AVAILABLE, PLEASE PLACE THE PERSONALIZED LABEL FROM YOUR PROSPECTUS IN THE ABOVE BOX.

Individual or company representative's signature: _____ Date: _____

Phone number : _____ Email (optional): _____

THE WINNING BIDDER MUST COMPLETE THE VERIFICATION OF WORKER'S DISABILITY COMPENSATION ACT COMPLIANCE (ON REVERSE SIDE IF DOUBLE SIDED) WITHIN 21 DAYS OF SALE AWARD DATE



FOR DEPARTMENT USE ONLY	
Sale Number (XX - XXX - XX - XX)	
Forest Management Unit:	

TIMBER SALE VERIFICATION OF WORKER'S DISABILITY COMPENSATION ACT COMPLIANCE

As required by Act 317, P.A. 1969 (Worker's Compensation) and
Part 5 of Act 451 of 1994, as amended.

VERIFICATION OF WORKER'S DISABILITY COMPENSATION ACT COMPLIANCE

- This verification must be completed and submitted within 21 days of contract award and prior to the issuance of the timber sale contract.
- In addition, if boxes 2B or 2C are checked, then Notice of Exclusion or Certificate of Insurance must be submitted within twenty-one (21) days of the contract award and prior to the issuance of the timber sale contract.
- All information must be typed or printed except for written signatures.

Please Check Appropriate Categories:

1. My business is organized as (you **must** check one of the boxes below):
 - A. Sole Proprietorship (individual)
 - B. Partnership
 - C. Corporation
2. You **must** check one of the boxes below:
 - A. I certify my business is a sole proprietorship and it has no employees but the sole proprietor. I am not subject to the Worker's Compensation Laws.
 - B. I certify my business has satisfied its obligation to the Worker's Compensation Act through the use of an approved Notice of Exclusion (BWC-337, Rev. 5/96). I will provide a copy of the Notice of Exclusion within 21 days of the contract award. (For questions or a copy of the BWC-337, please call the Worker's Compensation Bureau at 517-322-1195).
 - C. I certify my business has a Worker's Compensation Policy. I will provide an original Certificate of Insurance within twenty-one (21) days of the contract award.
3. If you have checked item 2(A) or 2(B), you **must** indicate the number of **both** full-time and part-time employees, other than yourself, including family members and active partners (if none, you must enter "0").

_____ Full-time Employees

_____ Part-time Employees

Name of Business		Federal ID (or) Social Security No.	
Address		Telephone ()	
City	State	ZIP	

I hereby certify that the above information is true and correct. I agree to notify the Michigan DNR of any changes that occur in factors affecting my coverage during any of my present and future operations.

Signature of Owner or Authorized Representative

Title

Date

Please complete the "SEALED BID" information on the next page

Unplugged Oak (72-626-23)
T26N, R04W, SEC. 34; Crawford COUNTY

In response to the notice of sale to be held 9:00 a.m. (local time) on April 15, 2024, I am hereby submitting my sealed bid (firm offer) for the following forest products to be cut. Bids for individual species must be at or above the advertised price. All non-responsive bid forms may be rejected.

<u>PRODUCTS & SPECIES</u>	<u>ESTIMATED VOLUME*</u>	<u>ADVERTISED PRICE</u>	<u>BID PRICE/UNIT</u>
Sawtimber			
Black/Red (Hybrid) Oak	188.2 MBF	\$ 158.00/MBF	\$ _____
Red Maple	41.0 MBF	\$ 90.00/MBF	\$ _____
Red Oak	159.4 MBF	\$ 145.00/MBF	\$ _____
White Oak	7.8 MBF	\$ 126.00/MBF	\$ _____
Pulpwood			
Mixed Aspen	33 Cords	\$ 30.65/Cord	\$ _____
Mixed Hardwood	418 Cords	\$ 31.75/Cord	\$ _____
Mixed Oak	388 Cords	\$ 26.55/Cord	\$ _____
Paper Birch	4 Cords	\$ 22.55/Cord	\$ _____
Red Oak	137 Cords	\$ 26.55/Cord	\$ _____

*The volumes are statistically estimated within plus (+) or minus (-) 12.60 percent at 95% confidence level. These estimated volumes are final and not subject to adjustment. Prospective bidders are urged to examine this timber and to make their own estimates of quantity and quality.

I understand that any or all bids may be rejected. All bids must be signed and all bid items must be bid or the bid form may be rejected. I also understand that consideration and awarding a contract will be based upon my past performance and ability to complete the contract based upon equipment and staffing subject to my control.

FEDERAL ID: ____ - ____ - ____ or SOCIAL SECURITY NUMBER: ____ - ____ - ____

Company or individual bidding: _____

Company representative's name: _____

Address: _____

City: _____ State: _____ Zip: _____

IF AVAILABLE, PLEASE PLACE THE PERSONALIZED LABEL FROM YOUR PROSPECTUS IN THE ABOVE BOX.

Individual or company representative's signature: _____ Date: _____

Phone number : _____ Email (optional): _____

THE WINNING BIDDER MUST COMPLETE THE VERIFICATION OF WORKER'S DISABILITY COMPENSATION ACT COMPLIANCE (ON REVERSE SIDE IF DOUBLE SIDED) WITHIN 21 DAYS OF SALE AWARD DATE



FOR DEPARTMENT USE ONLY	
Sale Number (XX - XXX - XX - XX)	
Forest Management Unit:	

TIMBER SALE VERIFICATION OF WORKER'S DISABILITY COMPENSATION ACT COMPLIANCE

As required by Act 317, P.A. 1969 (Worker's Compensation) and
Part 5 of Act 451 of 1994, as amended.

VERIFICATION OF WORKER'S DISABILITY COMPENSATION ACT COMPLIANCE

- This verification must be completed and submitted within 21 days of contract award and prior to the issuance of the timber sale contract.
- In addition, if boxes 2B or 2C are checked, then Notice of Exclusion or Certificate of Insurance must be submitted within twenty-one (21) days of the contract award and prior to the issuance of the timber sale contract.
- All information must be typed or printed except for written signatures.

Please Check Appropriate Categories:

1. My business is organized as (you **must** check one of the boxes below):
 - A. Sole Proprietorship (individual)
 - B. Partnership
 - C. Corporation
2. You **must** check one of the boxes below:
 - A. I certify my business is a sole proprietorship and it has no employees but the sole proprietor. I am not subject to the Worker's Compensation Laws.
 - B. I certify my business has satisfied its obligation to the Worker's Compensation Act through the use of an approved Notice of Exclusion (BWC-337, Rev. 5/96). I will provide a copy of the Notice of Exclusion within 21 days of the contract award. (For questions or a copy of the BWC-337, please call the Worker's Compensation Bureau at 517-322-1195).
 - C. I certify my business has a Worker's Compensation Policy. I will provide an original Certificate of Insurance within twenty-one (21) days of the contract award.
3. If you have checked item 2(A) or 2(B), you **must** indicate the number of **both** full-time and part-time employees, other than yourself, including family members and active partners (if none, you must enter "0").

_____ Full-time Employees

_____ Part-time Employees

Name of Business		Federal ID (or) Social Security No.	
Address		Telephone ()	
City	State	ZIP	

I hereby certify that the above information is true and correct. I agree to notify the Michigan DNR of any changes that occur in factors affecting my coverage during any of my present and future operations.

Signature of Owner or Authorized Representative

Title

Date

Please complete the "SEALED BID" information on the next page