



**DEPARTMENT OF NATURAL RESOURCES
STATE OF MICHIGAN
TIMBER SALE PROSPECTUS #7412**

SCHEDULED SALE DATE AND TIME: **3:00 p.m. (local time) on April 17, 2024.**

LOCATION: **BALDWIN OFFICE, 2468 W 24TH STREET, BALDWIN, MI 49304.**

PROSPECTUS NOTE: The bidder is advised to inspect the sale area and review the location, estimated volumes, operating costs and contract terms of proposed sales. Please be aware that some landowners may request 60 days or more notice for access across their land.

Notice is hereby given that bids will be received by the Unit Manager, CADILLAC MANAGEMENT UNIT, for certain timber on the following described lands:

Manton Mix Remastered (63-001-24) / T24N, R09W, SEC. 21, S1/2NE.

T24N, R09W, SEC. 22, SWNW,NWSW.

Wexford County, Advertised Price \$28,411.75, 27.4 Acres, Red Pine, Hardwood.

SALE NOTE: A recreation site such as a trail, pathway, or campground is within the sale area or the vicinity. Certain restrictions/specifications may be applicable including time restrictions.

103 RP Transition (63-002-23) / T21N, R05W, SEC. 34, NESE.

T21N, R05W, SEC. 36, NENW,S1/2NW,N1/2SW.

Missaukee County, Advertised Price \$72,962.50, 116.1 Acres, Red Pine, Hardwood.

SALE NOTE: A recreation site such as a trail, pathway, or campground is within the sale area or the vicinity. Certain restrictions/specifications may be applicable including time restrictions.

Seeley Aspen (63-011-23) / T24N, R09W, SEC. 1 , SESW,SWSE.

T24N, R09W, SEC. 10, SENW,NE,NESW,NWSE.

T24N, R09W, SEC. 11, N1/2NW.

T24N, R09W, SEC. 12, NENW,S1/2NW,N1/2NE,SWNE.

T24N, R09W, SEC. 2 , NESW,S1/2SW.

T24N, R09W, SEC. 3 , SESE.

Wexford County, Advertised Price \$282,927.95, 202.0 Acres, Aspen, Hardwood.

SALE NOTE: Access may be through private or other public land.

Norton My Friend Mix (63-027-23) / T24N, R05W, SEC. 29, SENW,N1/2SW,SESW,NWSE,S1/2SE.

T24N, R05W, SEC. 30, SENE,NESE.

T24N, R05W, SEC. 31, NESE.

T24N, R05W, SEC. 32, NENW,N1/2NE,SWNE,NWSW.

Missaukee County, Advertised Price \$130,364.65, 129.2 Acres, Aspen, Hardwood.

SALE NOTE: Sale contains areas of variable volume.

BID INSTRUCTIONS (VER. 10/10/2022):

1. Scheduled Bid Location, Date, and Time (2/11)

Bids must be received by the Unit Manager, BALDWIN OFFICE, 2468 W 24th Street, Baldwin, MI 49304, no later than 3:00 p.m. (local time) on April 17, 2024. For further information concerning this sale, contact David Flsher at 231-745-4651 extension 9064.

2. Bidder's Qualifications (10/22)

If all or part of a timber sale was prepared by a private contractor, the contractor and that contractor's company are not permitted to bid on the timber sale. A person must be 18 years of age or older to purchase timber. Permanent employees of the Department of Natural Resources or members of their immediate household may not bid. Former employees, in the permanent or seasonal class, may not bid until 3 months after the last day of active duty. Bids will not be accepted from individuals or companies appearing on the DNR/FRD No-Bid List. This list contains the names of purchasers who previously failed to execute a contract within 21-days or who have a history of poor performance.

3. Preparation of Sealed Bids (5/16)

Bid Forms may be completed online thru Michigan DNR Timber Sale Online Bidding (OLB) at www.michigan.gov/timberbidding or by completing the hardcopy Bid Form found in the Timber Sale Prospectus. Hardcopy Bid Forms shall be manually signed in ink. Registration in OLB is considered your 'signature' for all bids submitted thru that system. Bid prices must be entered for each species and product in the Bid Price column for all material subject to bidding and all fill-in blanks must be completed. If erasures or other changes appear on the hardcopy Bid Form, each erasure or change must be initialed by the person signing the bid.

4. Submission of Sealed Bids (5/16)

Bid forms may be obtained from the Unit Manager or thru OLB. Bids may be submitted hardcopy or thru OLB. All hardcopy bids must be submitted on the bid form and in an envelope clearly identified as described in this section. NOTE: Only one bid form per bid envelope. Sealed bids must be submitted to the Unit office designated in the prospectus and must be submitted at or prior to the time established in the prospectus. The envelope should show on the outside (a) the sale name or number and (b) the date and time of bid opening, as shown in the prospectus. Bids received after the time specified in the sale prospectus are late bids and will be rejected.

It is possible for a bidder to submit multiple bids on a single sale. For example, a bid may be submitted hardcopy and a bid may be submitted thru OLB. Or, two bidders from the same company could both submit bids on the same sale. If this were to happen, the State would accept all bids received and award the contract accordingly. All bidding and contractual requirements would apply to all bids received.

5. Public Opening of Sealed Bids (7/16)

If conditions permit, the sealed bids will be publicly opened and posted at the time and place set in the prospectus.

If a bidder, present at a bid opening, has submitted bids on more than one sale, that bidder may withdraw their unopened bid envelopes or announce the withdrawal of their online bid after being declared the successful bidder on one sale.

6. Award of Contract (1/11)

Award of the contract will be made to the Bidder whose bid, conforming to the prospectus, is most advantageous to the State of Michigan on the basis of total value at rates bid for the estimated quantities. The State reserves the right to reject any bid or waive any minor irregularity in bids received. A written award mailed (or otherwise furnished) to the successful Bidder shall be deemed to result in a binding contract without further action by either party.

7. Down Payment (1/11)

The Bidder to whom award is made must make a down payment within 21 days of the sale award. The amount of the down payment will be calculated as shown in the Bond and Payment Schedule of this prospectus. Only cash may be used to meet this requirement.

8. Performance Security (1/11)

As guarantee of faithful performance, a cash bond, certificate of deposit, surety bond or irrevocable letter of credit (LOC) is required within 21 days of the sale award. The amount of the performance security is shown in the Bond and

Payment Schedule of this prospectus. If an LOC or surety is used, the coverage must extend for at least 6 months beyond the contract expiration.

9. Worker's Compensation (10/22)

Purchaser shall obtain worker's compensation insurance to cover claims under Michigan's Worker's Disability Compensation Act of 1969 or similar employee benefit act of any other state applicable to an employee. Verification of Worker's Disability Compensation Act Compliance must be completed and submitted within 21 days of contract award and prior to the issuance of the timber sale contract. In addition, if applicable, Notice of Exclusion or Certificate of Insurance must also be submitted.

10. Timber Sale Contract (10/22)

Additional conditions and requirements common to all timber sales are listed on the timber sale contract (R4031) and are available on line at www.michigan.gov/timber. Contact the Unit Manager for additional information or a sample contract. Within 21 days of the date of the award letter, the bidder must sign the contract and provide the required down payment, performance security, and verification of worker's disability compensation. The down payment and performance security shall be in accordance with the provisions of the timber sale contract, in the sums stated in this prospectus. If these actions are not taken, then the Bidder, the Bidder's corporation, and the corporation's principals may not be permitted to bid on State timber sales for a period of 3 months after the first offense, 6 months after the second offense, and 1 year after the third offense. An offense will only be counted against the Bidder for 5 years. In addition, the Bidder certifies that if awarded this contract, the Bidder will complete the timber sale contract in accordance with its terms and any modifications thereof including requirements to purchase, cut, and remove the included timber by the expiration date.

Payment Unit values in the State Forest Timber Sale Contract are calculated based on the advertised value of the Payment Unit as a percentage of the total advertised value of the contract. The advertised value of each Payment Unit is given in the Description of Timber by Payment Unit table on the Timber Sale Information page. For example, if the value of Payment Unit 1 is advertised as \$1,500 and the total Timber Sale value is advertised as \$10,000, the contract price for Payment Unit 1 will be 15% of the total bid price ($\$1,500/\$10,000 * 100$).

11. Disclaimer of Estimates and Bidder's Warranty of Inspection (10/22)

Before submitting this bid, the Bidder is advised and cautioned to inspect the sale area, review the requirements of the sale contract, and take other steps as may be reasonably necessary to ascertain the location, estimated volumes, construction estimates, and operating costs of the proposed sale. Failure to do so will not relieve the Bidder from responsibility for completing the contract.

The Bidder warrants that this bid is submitted solely on the basis of the Bidder's examination and inspection of the quality and quantity of the timber offered for sale and the Bidder's opinion of the value thereof and the costs of recovery. No reliance should be placed on the State of Michigan's estimates of timber quality, quantity or costs of recovery. Bidder further acknowledges that the State of Michigan: (i) expressly disclaims any warranty of fitness of timber for any purpose; (ii) offers this timber as is without any warranty of quality (merchantability) or quantity and (iii) expressly disclaims any warranty as to the quantity or quality of timber sold.

12. Certification and Chain-of-Custody (10/22)

Unless otherwise indicated in the contract under section 7 – Other Conditions of the Sale Specific Conditions & Requirements, the area encompassed by this timber sale is certified to the standards of the Forest Stewardship Council (FSC) - Certificate #SCS-FM/COC-00090N and the Sustainable Forestry Initiative (SFI) - Certificate #NSF-SFIS-5Y031-SF5. Forest products from this sale may be delivered to the mill as "FSC 100% and / or SFI certified" as long as the contractor hauling the forest products is chain-of-custody (COC) certified or covered under a COC certificate from the destination mill. The purchaser is responsible for maintaining COC after leaving the sale area.

13. Good Neighbor Authority (GNA) Requirements (10/22)

If the name of this timber sales contains the acronym GNA, it is authorized by the Good Neighbor Authority (GNA) and covered by various agreements between the U.S. Forest Service and the State. The timber sale occurs on federal land and the following conditions apply:

GNA contracts on US Forest Service land will not be awarded to purchasers on the Federal list of excluded parties. The System for Award Management (SAM) will be checked for active excluded parties prior to award of contract. In

addition, the Bidder to whom award is made must complete an Assurance Regarding Felony Conviction or Tax Delinquent Status for Corporate Applicants (AD-3031).

14. Good Neighbor Authority (GNA) Requirements, con't (10/22)

Bidder certifies, by signing this bid form, that to the best of Bidder's knowledge that the following representations are accurate and complete.

- a. That the Bidder and its principals are not presently debarred, suspended, proposed for debarment, declared ineligible, or voluntary excluded from timber sales (covered transactions) by any Federal department or agency.
- b. That the Bidder and its principals have not within a 3-year period preceding this bid been convicted of or had a civil judgment rendered against them for commission of fraud or a criminal offense in connection with obtaining , attempting to obtain, or performing a public (Federal, State, or local) transaction or contract under a public transaction; violation of Federal or State antitrust statutes or commission of embezzlement, theft, forgery, bribery, falsification or destruction of records, making false statements, or receiving stolen property.
- c. That the Bidder and its principals are not presently indicted for or otherwise criminally or civilly charged by a governmental entity (Federal, State, or local) with commission of any of the offenses enumerated in paragraph b of this certification.
- d. That the Bidder and its principals have not within a 3-year period preceding this bid had one or more public transactions (Federal, State, or local) terminated for breach or default of a timber or forest product contract.

Bidders that cannot certify this requirement, in whole or in part, shall submit an explanation with their bid.

Scott Bowen
Director

TIMBER SALE INFORMATION

Manton Mix Remastered (63-001-24)
T24N, R09W, SEC. 21; T24N, R09W, SEC. 22.
Wexford County (Advertised Price \$28,411.75)

SALE NOTE: A recreation site such as a trail, pathway, or campground is within the sale area or the vicinity. Certain restrictions/specifications may be applicable including time restrictions.

A timber sale contract for this lump sum, sealed bid timber sale will be awarded to the responsible bidder offering the highest sealed bid price. All units of volume listed below were estimated using the Inventory Manager computer program and the new Michigan taper model. Bids must be at or above the following advertised price for each product and species:

<u>PRODUCTS & SPECIES</u>	<u>ESTIMATED UNITS*</u>	<u>ADVERTISED PRICE</u>
Sawtimber		
Jack Pine	6.6 MBF	\$ 33.00 / MBF
Red Maple	21.8 MBF	\$ 106.00 / MBF
Red Oak	16.0 MBF	\$ 168.00 / MBF
Red Pine	132.7 MBF	\$ 99.00 / MBF
Pulpwood		
Jack Pine	69 Cords	\$ 19.90 / Cord
Mixed Oak	128 Cords	\$ 31.20 / Cord
Quaking Aspen	16 Cords	\$ 27.50 / Cord
Red Maple	27 Cords	\$ 23.20 / Cord
Red Pine	81 Cords	\$ 44.75 / Cord

* The total volume is statistically estimated within plus (+) or minus (-) 38.04 percent. There are an estimated 739 cords on this timber sale, plus or minus 281 cords at the 95% confidence level. The estimated units are final and not subject to adjustment. Prospective bidders are urged to examine this timber and to make their own estimates of quantity and quality.

BOND AND PAYMENT SCHEDULE:

1. A bond in the amount of \$2,841.00 to insure faithful performance of the conditions of the contract will be deposited by the successful bidder within 21 days of the sale award.
2. Cutting in any sale or unit without the required advance payment would be considered a trespass.
3. Total payment must be paid in advance or according to the following schedule :
 - (a) Ten percent (10%) of the sale value must be paid within 21 days of the sale award.
 - (b) The 10% down payment will be credited towards the first unit cut.
 - (c) Payment for each of the following units must be made before cutting begins in that unit:

PAYMENT UNIT NUMBER	PERCENT OF TOTAL SALE VALUE
01	66.3%
02	33.7%
4. If no cutting takes place, the 10% down payment will not be refunded.
5. Operations on the contract issued will terminate on 06/30/2026.

SALE STATISTICS

Volumes were calculated in cubic feet using the Michigan taper model. Cubic foot volume includes all wood inside bark for the product indicated. For display purposes, cubic feet were converted to cords and MBF using a simple conversion factor, e.g. 79 cubic feet per cord and 185 cubic feet per MBF. The cubic foot volumes are precise; the cords and MBF volumes are not. Cubic foot volume cannot be directly converted to cords or boards with precision.

SALE VOLUMES

The total estimated sale volume may not equal the sum of the species/products due to the nature of statistical calculations associated with double sampling methodology.

VOLUME		STATISTICAL RANGE IN CORDS		
TOTAL CUBIC FEET	TOTAL CORDS	PERCENT ERROR	MINIMUM	MAXIMUM
58,382	739	38.04%	458	1,020

VDU VOLUMES

A VDU is a Volume Determination Unit. Volumes and their associated statistics are calculated at the VDU level and summarized to the sale level. There is often a one to one relationship between a VDU and a Payment Unit, but not always, depending on the cruise design. Refer to the VDU TO PAYMENT UNIT table.

VDU	VOLUME		PERCENT ERROR	RANGE IN CORDS	
	TOTAL CUBIC FEET	TOTAL CORDS		MINIMUM	MAXIMUM
4	40,153	508	34.00%	335	681
7	18,229	231	57.22%	99	363
TOTAL:	58,382	739		434	1,044

VDU TO PAYMENT UNIT

When a VDU is associated with more than one Payment Unit (PU), the VDU volumes are assigned to the PU based on acres of the VDU within the PU.

VDU	VDU ACRES	PU	PU ACRES
4	22.6	1	22.6
7	4.8	2	4.8
TOTAL:	27.4		27.4

DESCRIPTION OF TIMBER BY PAYMENT UNIT (PU)

PU	MARKET GROUP	PRODUCT	QUANTITY	UNIT	ACRES	ADVERTISE PRICE
1	Jack Pine	Sawtimber	4.0	MBF	22.6	\$18,850.05
	Red Maple		21.8	MBF		
	Red Oak		16.0	MBF		
	Red Pine		66.8	MBF		
	Jack Pine	Pulpwood	65	Cords		
	Mixed Oak		122	Cords		
	White Oak	Sawtimber	5.2	MBF		
	Red Oak	Pulpwood	84	Cords		
	White Oak		28	Cords		
	Quaking Aspen		16	Cords		
	Red Maple		27	Cords		
	Red Pine		21	Cords		
	2	Jack Pine	Sawtimber	2.6		
Red Pine			65.9	MBF		
Jack Pine		Pulpwood	4	Cords		
Mixed Oak			6	Cords		
/Red (Hybrid) Oak		Sawtimber	2.4	MBF		
/Red (Hybrid) Oak		Pulpwood	1	Cords		
Red Pine			60	Cords		
TOTAL:			177.1	MBF		
TOTAL:			321	Cords		

Sale Specific Conditions & Requirements

Sale Name: Manton Mix Remastered

Sale Number: 63-001-24 Seq#: 1

1 - Sale Area

1.2 - Boundaries

1.2.1 - Painted boundaries (9/19)

The sale boundary and Payment Unit boundaries are marked and identified by red paint. Exterior sale boundary lines against state are marked with red paint. The painted boundary line trees are not Included Timber and are to be protected.

2 - Timber Specifications

2.1 - Included Timber

2.1.1 - Clearcut unit(s) with unmerchantable trees (6/14)

Within Payment Unit(s) 2, cut all trees that are three (3) inches or more at DBH, except do not cut trees marked in green paint.

2.1.5 - Overstory removal unit(s) (8/11)

Within Payment Unit(s) 1, all trees with DBH greater than or equal to four (4) inches which meet minimum piece specifications in 2.2 Utilization, are designated for cutting.

4 - Transportation

4.1 - Construction

4.1.12 - No new roads (1/12)

No new roads will be permitted. All operations are limited to existing roads. Skid trails will only be allowed.

4.2 - Maintenance

4.2.5 - Two wheel drive condition (2/04)

All existing trail roads on and adjacent to the sale area must be passable by two-wheel drive traffic for the duration of the sale.

5 - Operations

5.2 - Conduct of Operations

5.2.3 - Operating Restrictions

5.2.3.5 - Oak wilt restriction (1/18)

Within Payment Unit(s) 1 and 2, unless changed by written agreement, cutting, skidding, hauling within the sale and brushing of access roads to the sale are not permitted during the period of April 15 to July 15. Operations may be allowed if specific steps are taken to prevent damaging uncut oak during the high risk period. Those steps may include completing all road brushing before April 15th and clearing a tree-length buffer along uncut oak cover before April 15th. This is necessary to reduce the spread of oak wilt. For more information, contact the Unit Manager or his/her representative.

5.2.41 - Snowmobile trail protection (9/11)

The snowmobile trail runs through Payment Unit 1 and 2. Do not cut or damage posts with orange trail markers or traffic control signs. The snowmobile trail may only be crossed at right angles. Maintain a 20-foot-wide slash, debris, and rut free zone daily using the snowmobile trail as the centerline. No decking of forest products will be permitted along the snowmobile trail. All stumps within 20 feet of the snowmobile trail must be cut at ground level. In addition, any trees cut within 5 feet of the trail must have the stumps removed and be disposed of according to the direction of the Unit Manager or his/her representative.

5.4 - Soil Protection

5.4.1 - Rutting restriction, general (7/16)

Operations are to cease immediately if equipment and weather conditions result in rutting of roads and/or skid trails which are

12 inches or greater in depth and 50 feet in length. The Unit Manager or his/her representative may restrict hauling and/or skidding if ruts exceed the specified depth. With the Unit Manager or his/her representative's approval, the Purchaser may return to the area when the risk of rutting has decreased.

6 - Safety and Fire Prevention

6.2 - Signing

6.2.1 - Road posting (10/20)

The Purchaser is responsible for posting and maintaining caution signs on timber access roads near landing prior to beginning operations. The road must be posted at appropriate distances from the Sale Area to warn of logging activity and truck traffic. Signs must be removed when harvest operations are suspended or completed. The Purchaser will provide these signs.

6.2.2 - Snowmobile trail posting (10/20)

The Purchaser is responsible for posting and maintaining caution signs on snowmobile trail prior to beginning operations during the snowmobile season (approximately December 1 to March 31). The trail must be posted at appropriate distances from the Sale Area to warn of logging activity and truck traffic. Signs must be removed when harvest operations are suspended or completed. The Purchaser will provide these signs.



TIMBER SALE MAP

This information provided by authority of Part 525, 1994 PA 451, as amended.

Sale Number
63-001-24

Date
01/05/2024

Forest Management Unit	County	Mapped By: Krugh	Scale	Page	Of
Cadillac Mgt Unit	Wexford	Cruised By: Ventimiglia	1:15,840	1	1

Township	Range	Section(s) and Subdivision(s)
24N	09W	Sec. 21 S1/2NE; Sec. 22 SWNW,NWSW;

Cover Type			
A = Aspen	J = Jack Pine	O = Oak	U = Upland Brush
B = Paper Birch	K = Rock	P = Lowland Poplar	UM = Upland Mix Forest
C = Cedar	L = Lowland Brush	Q = Mixed Swamp Conifer	V = Bog or Marsh
D = Treed Bog	LM = Lowland Mix Forest	R = Red Pine	W = White Pine
E = Swamp Hardwoods	M = Maple, Beech, Birch	S = Black Spruce	X = Non Stocked
F = Spruce/Fir	MC = Mixed Conifer	T = Tamarack	Y = Sand
G = Grass	MD = Mixed Deciduous	Z = Water	
H = Hemlock	N = Marsh		

Density	
0 = Non Stocked	5 = Pole Timber Medium
1 = Seedling Sapling Poor	6 = Pole Timber Well
2 = Seedling Sapling Medium	7 = Saw Timber Poor
3 = Seedling Sapling Well	8 = Saw Timber Medium
4 = Pole Timber Poor	9 = Saw Timber Well

PU	Acres
1	22.6
2	4.8

Manton Mix Remastered

27.4 Acres

Locator Map (1:200,000)

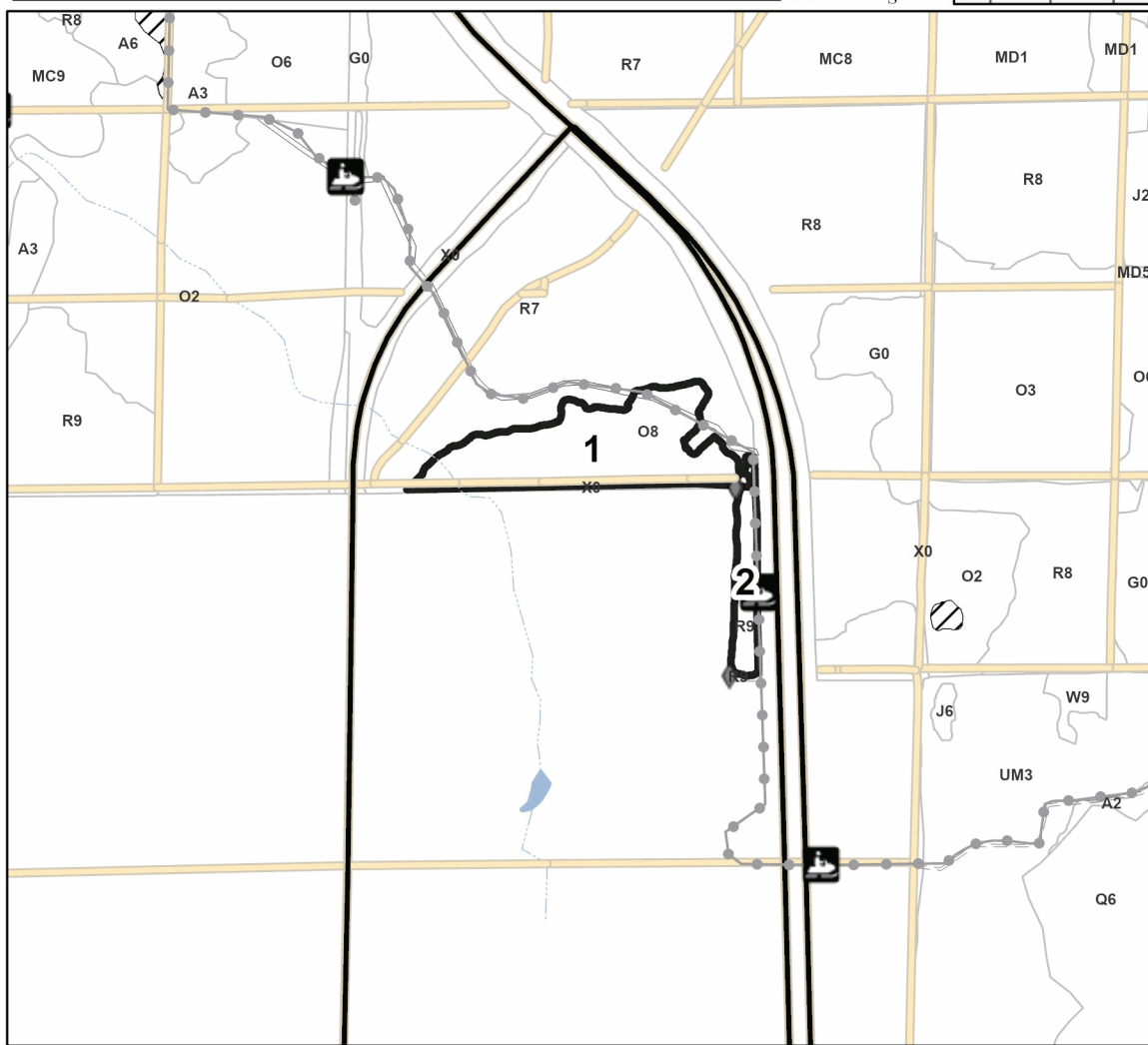
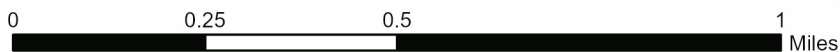
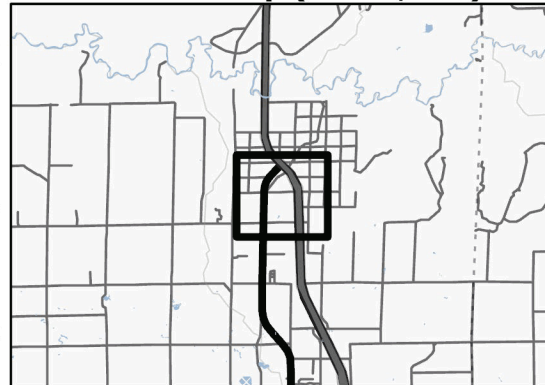

Legend

- Against State (Red)
- Stand
- Retention Areas
- Recreational Trail
- Secondary Forest Road
- Forest Access Route
- Non-DNR Road
- Highway
- Field Grade Corner

Use QR Code to open Map in App



TIMBER SALE INFORMATION

103 RP Transition (63-002-23)
 T21N, R05W, SEC. 34; T21N, R05W, SEC. 36.
 Missaukee County (Advertised Price \$72,962.50)

SALE NOTE: A recreation site such as a trail, pathway, or campground is within the sale area or the vicinity. Certain restrictions/specifications may be applicable including time restrictions.

A timber sale contract for this lump sum, sealed bid timber sale will be awarded to the responsible bidder offering the highest sealed bid price. All units of volume listed below were estimated using the Inventory Manager computer program and the new Michigan taper model. Bids must be at or above the following advertised price for each product and species:

<u>PRODUCTS & SPECIES</u>	<u>ESTIMATED UNITS*</u>	<u>ADVERTISED PRICE</u>
Sawtimber		
Red Oak	13.7 MBF	\$ 168.00 / MBF
Red Pine	169.1 MBF	\$ 99.00 / MBF
Pulpwood		
Mixed Oak	30 Cords	\$ 31.20 / Cord
Red Pine	1,184 Cords	\$ 44.75 / Cord

* The total volume is statistically estimated within plus (+) or minus (-) 15.16 percent. There are an estimated 1,579 cords on this timber sale, plus or minus 239 cords at the 95% confidence level. The estimated units are final and not subject to adjustment. Prospective bidders are urged to examine this timber and to make their own estimates of quantity and quality.

BOND AND PAYMENT SCHEDULE:

1. A bond in the amount of \$7,296.00 to insure faithful performance of the conditions of the contract will be deposited by the successful bidder within 21 days of the sale award.
2. Cutting in any sale or unit without the required advance payment would be considered a trespass.
3. Total payment must be paid in advance or according to the following schedule :
 - (a) Ten percent (10%) of the sale value must be paid within 21 days of the sale award.
 - (b) The 10% down payment will be credited towards the first unit cut.
 - (c) Payment for each of the following units must be made before cutting begins in that unit:

PAYMENT UNIT NUMBER	PERCENT OF TOTAL SALE VALUE
01	13.0%
02	49.9%
03	37.1%

4. If no cutting takes place, the 10% down payment will not be refunded.
5. Operations on the contract issued will terminate on 06/30/2026.

SALE STATISTICS

Volumes were calculated in cubic feet using the Michigan taper model. Cubic foot volume includes all wood inside bark for the product indicated. For display purposes, cubic feet were converted to cords and MBF using a simple conversion factor, e.g. 79 cubic feet per cord and 185 cubic feet per MBF. The cubic foot volumes are precise; the cords and MBF volumes are not. Cubic foot volume cannot be directly converted to cords or boards with precision.

SALE VOLUMES

The total estimated sale volume may not equal the sum of the species/products due to the nature of statistical calculations associated with double sampling methodology.

VOLUME		STATISTICAL RANGE IN CORDS		
TOTAL CUBIC FEET	TOTAL CORDS	PERCENT ERROR	MINIMUM	MAXIMUM
124,748	1,579	15.16%	1,340	1,819

VDU VOLUMES

A VDU is a Volume Determination Unit. Volumes and their associated statistics are calculated at the VDU level and summarized to the sale level. There is often a one to one relationship between a VDU and a Payment Unit, but not always, depending on the cruise design. Refer to the VDU TO PAYMENT UNIT table.

VDU	VOLUME		PERCENT ERROR	RANGE IN CORDS	
	TOTAL CUBIC FEET	TOTAL CORDS		MINIMUM	MAXIMUM
75	16,812	213	39.74%	128	297
98	107,936	1,366	16.11%	1,146	1,586
TOTAL:	124,748	1,579		1,274	1,884

VDU TO PAYMENT UNIT

When a VDU is associated with more than one Payment Unit (PU), the VDU volumes are assigned to the PU based on acres of the VDU within the PU.

VDU	VDU ACRES	PU	PU ACRES
75	9.9	1	9.9
98	106.2	2	60.9
		3	45.3
TOTAL:	116.1		116.1

DESCRIPTION OF TIMBER BY PAYMENT UNIT (PU)

PU	MARKET GROUP	PRODUCT	QUANTITY	UNIT	ACRES	ADVERTISE PRICE
1	Red Pine	Sawtimber	5.3	MBF	9.9	\$9,474.70
	Red Pine	Pulpwood	200	Cords		
2	Red Oak	Sawtimber	7.9	MBF	60.9	\$36,392.70
	Red Pine		93.9	MBF		
	Mixed Oak	Pulpwood	17	Cords		
	/Red (Hybrid) Oak	Sawtimber	2.1	MBF		
	/Red (Hybrid) Oak	Pulpwood	5	Cords		
	Red Oak		8	Cords		
	Red Pine		564	Cords		
3	Red Oak	Sawtimber	5.8	MBF	45.3	\$27,095.10
	Red Pine		69.9	MBF		
	Mixed Oak	Pulpwood	13	Cords		
	/Red (Hybrid) Oak	Sawtimber	1.5	MBF		
	/Red (Hybrid) Oak	Pulpwood	4	Cords		
	Red Oak		6	Cords		
	Red Pine		420	Cords		
TOTAL:			182.8	MBF		
TOTAL:			1,214	Cords		

Sale Specific Conditions & Requirements

Sale Name: 103 RP Transition

Sale Number: 63-002-23 Seq#: 2

1 - Sale Area

1.2 - Boundaries

1.2.1 - Painted boundaries (9/19)

The sale boundary and Payment Unit boundaries are marked and identified by red and yellow paint. Exterior sale boundary lines against state are marked with red paint. Interior Payment Unit boundaries are marked with yellow paint. The painted boundary line trees are not Included Timber and are to be protected unless marked with orange paint. Yellow painted trees designating an interior Payment Unit boundary are only to be cut when all surrounding Payment Units have been paid.

2 - Timber Specifications

2.1 - Included Timber

2.1.3 - Cut tree marked unit(s) (12/08)

Within Payment Unit(s) 1-3, all trees are designated for cutting when marked with orange paint above and below stump height, regardless of merchantability.

3 - Payments

3.3 - Pre-measured Sales

3.3.4 - Dividing payment units (7/14)

Payment Unit(s) 1-3, may be divided at the request of the Purchaser and upon approval of the Unit Manager. Dividing Payment Units is a contract modification which requires a Timber Sale Contract Amendment.

4 - Transportation

4.1 - Construction

4.1.7 - Road closure (10/11)

All new roads built into the sale must be blocked to vehicle traffic within 30 days of completion of hauling. Overgrown roads that are reopened shall be considered new roads. In general, this will require constructing a four (4') foot high berm of stumps and logs covered with earth. Stumps and brush must be placed along the remainder of the trail. These roads must be rendered impassable to cars and trucks. All stumps from road building and landing construction must be reserved to block any newly constructed roads upon completion of the sale. These stumps must be scattered along the road system to prohibit vehicular movement. Contact the Sale Administrator for specific details of design and placement.

4.2 - Maintenance

4.2.5 - Two wheel drive condition (2/04)

All existing trail roads on and adjacent to the sale area must be passable by two-wheel drive traffic for the duration of the sale.

5 - Operations

5.2 - Conduct of Operations

5.2.1 - Slash

5.2.1.8 - Slash height (12/08)

No slash or tree tops may exceed 24 inches in height.

5.2.2 - Hazard Trees/Snags

5.2.2.1 - Den trees (10/16)

Obvious hollow and/or den trees shall be protected and left standing unless they are a safety hazard.

5.2.3 - Operating Restrictions

5.2.3.3 - Bark slippage restriction (3/09)

Within Payment Unit(s) 1, unless changed by written agreement, cutting and skidding are not permitted during the period of April 15 to July 15. This restriction is because of bark slippage.

5.2.3.5 - Oak wilt restriction (1/18)

Within Payment Unit(s) 1-3, unless changed by written agreement, cutting, skidding, hauling within the sale and brushing of access roads to the sale are not permitted during the period of April 15 to July 15. Operations may be allowed if specific steps are taken to prevent damaging uncut oak during the high risk period. Those steps may include completing all road brushing before April 15th and clearing a tree-length buffer along uncut oak cover before April 15th. This is necessary to reduce the spread of oak wilt. For more information, contact the Unit Manager or his/her representative.

5.2.32 - Decking/landing restoration (9/13)

All decking and landing areas must have the surface area restored to a condition equal to or better than before. This is to ensure the proper regeneration of the stand. Wood debris, chips and "cookies" from trimmings must be removed or scattered away from landing and loading areas and may not be windrowed on the edge.

5.2.38 - No decking against live trees (2/04)

Cut products may not be decked against unmarked or designated leave trees.

5.2.40 - Pathway protection (10/10)

A motorcycle trail is shown on the Timber Sale Map. Do not cut trees or damage posts with blue pathway markers. Maintain a 20-foot-wide slash, debris, and rut free zone daily, using the pathway as the centerline. Do not run equipment down the pathway. Skidding across the trail may only occur in locations approved by the Sale Administrator.

5.4 - Soil Protection

5.4.1 - Rutting restriction, general (7/16)

Operations are to cease immediately if equipment and weather conditions result in rutting of roads and/or skid trails which are 12 inches or greater in depth and 50 feet in length. The Unit Manager or his/her representative may restrict hauling and/or skidding if ruts exceed the specified depth. With the Unit Manager or his/her representative's approval, the Purchaser may return to the area when the risk of rutting has decreased.

6 - Safety and Fire Prevention

6.2 - Signing

6.2.3 - Recreational trail posting (10/20)

The Purchaser is responsible for posting and maintaining caution signs on prior to beginning operations. The trail must be posted at appropriate distances from the Sale Area to warn of logging activity and truck traffic at both ends of the trail. Signs must be removed when harvest operations are suspended or completed.



TIMBER SALE MAP

This information provided by authority of Part 525, 1994 PA 451, as amended.

Forest Management Unit Cadillac Management Unit	County Missaukee	Mapped By Krugh	Date 08/18/2023	Page 1	of 1
Township 21N	Range 05W	Section(s) and Subdivision(s) Sec 34: NESE Sec 36 NENW,S1/2NW,N1/2SW	Scale 1:15,840		

Cover Type				Density	
A = Aspen	H = Hemlock	N = Marsh	U = Upland Brush	0 = Non Stocked	5 = Pole Timber Medium
B = Paper Birch	J = Jack Pine	O = Oak	UM = Upland Mixed	1 = Seedling Sapling Poor	6 = Pole Timber Well
C = Cedar	L = Lowland Brush	P = Lowland Poplar	V = Bog or Marsh	2 = Seedling Sapling Medium	7 = Saw Timber Poor
D = Treed Bog	LM = Lowland Mixed	Q = Mixed Swamp Conifer	W = White Pine	3 = Seedling Sapling Well	8 = Saw Timber Medium
E = Swamp Hdwoods	M = Mpl, Bch, Brch	R = Red Pine	X = Non Stocked	4 = Pole Timber Poor	9 = Saw Timber Well
F = Spruce Fir	MC = Mixed Conifer	S = Black Spruce	Z = Water		
G = Grass	MD = Mixed Deciduous	T = Tamarack			

PU	Acres
1	9.9
2	60.9
3	45.3

103 RP Transition

Compartment 103

116.1 Acres

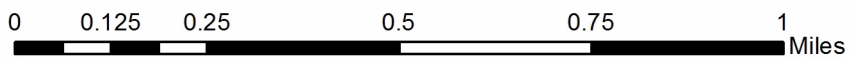
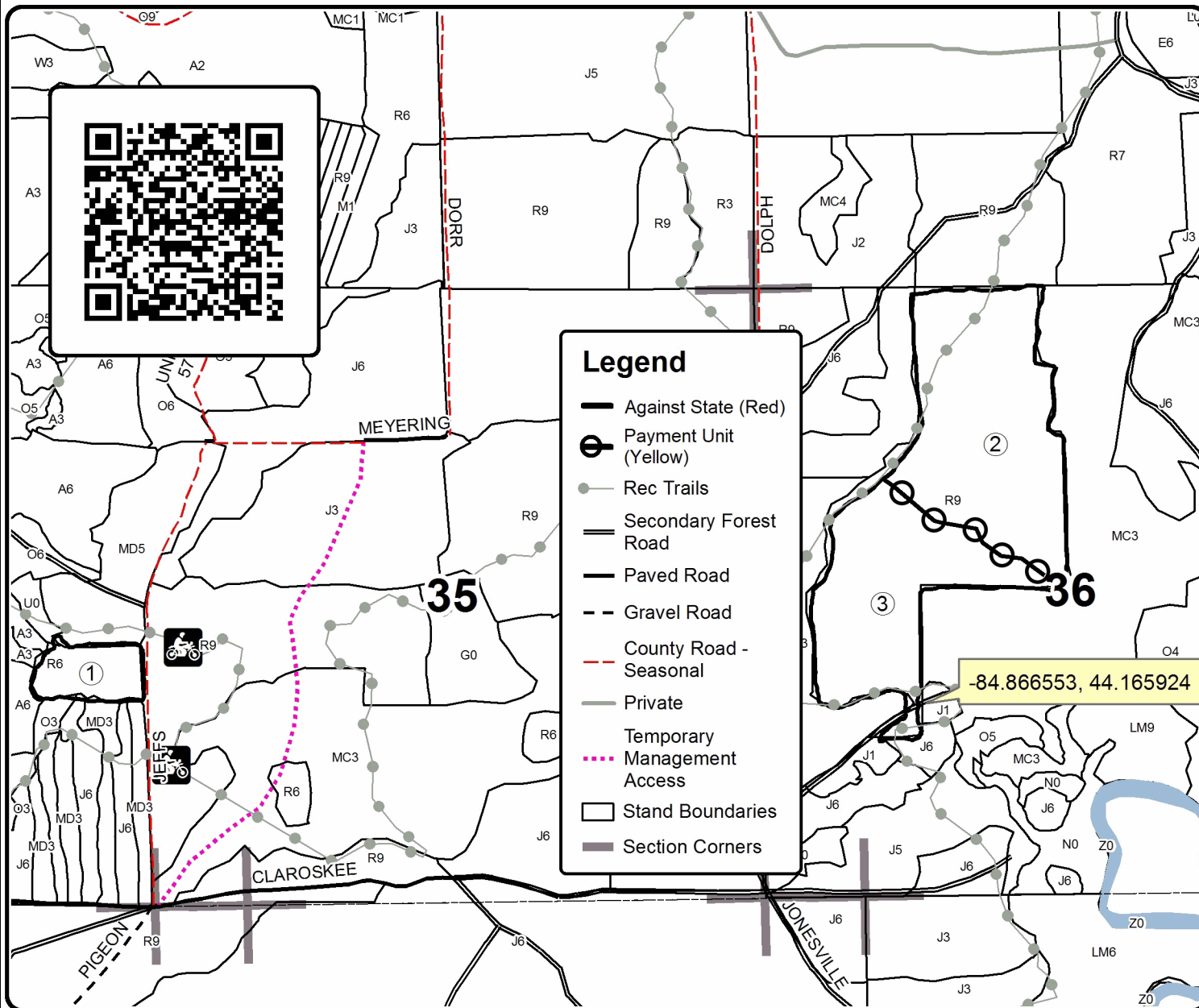
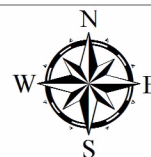

TIMBER SALE INFORMATION

Seeley Aspen (63-011-23)

T24N, R09W, SEC. 1; T24N, R09W, SEC. 10; T24N, R09W, SEC. 11; T24N, R09W, SEC. 12; T24N, R09W, SEC. 2; T24N, R09W, SEC. 3.

SALE NOTE: Access may be through private or other public land.

A timber sale contract for this lump sum, sealed bid timber sale will be awarded to the responsible bidder offering the highest sealed bid price. All units of volume listed below were estimated using the Inventory Manager computer program and the new Michigan taper model. Bids must be at or above the following advertised price for each product and species:

<u>PRODUCTS & SPECIES</u>	<u>ESTIMATED UNITS*</u>		<u>ADVERTISED PRICE</u>
Sawtimber			
Black/Red (Hybrid) Oak	35.2	MBF	\$ 99.00 / MBF
Mixed Aspen	876.6	MBF	\$ 92.00 / MBF
Red Maple	128.1	MBF	\$ 106.00 / MBF
Red Oak	74.3	MBF	\$ 168.00 / MBF
Red Pine	35.1	MBF	\$ 99.00 / MBF
Sugar Maple	59.6	MBF	\$ 299.00 / MBF
White Oak	45.5	MBF	\$ 107.00 / MBF
White Pine	131.2	MBF	\$ 73.00 / MBF
Pulpwood			
Balsam Fir	220	Cords	\$ 31.30 / Cord
Mixed Aspen	2,874	Cords	\$ 27.50 / Cord
Mixed Hardwood	902	Cords	\$ 23.20 / Cord
Mixed Oak	297	Cords	\$ 31.20 / Cord
Red Pine	41	Cords	\$ 44.75 / Cord
White Pine	650	Cords	\$ 29.30 / Cord

* The total volume is statistically estimated within plus (+) or minus (-) 17.79 percent. There are an estimated 8,546 cords on this timber sale, plus or minus 1,521 cords at the 95% confidence level. The estimated units are final and not subject to adjustment. Prospective bidders are urged to examine this timber and to make their own estimates of quantity and quality.

BOND AND PAYMENT SCHEDULE:

1. A bond in the amount of \$28,293.00 to insure faithful performance of the conditions of the contract will be deposited by the successful bidder within 21 days of the sale award.
2. Cutting in any sale or unit without the required advance payment would be considered a trespass.
3. Total payment must be paid in advance or according to the following schedule :
 - (a) Ten percent (10%) of the sale value must be paid within 21 days of the sale award.
 - (b) The 10% down payment will be credited towards the first unit cut.
 - (c) Payment for each of the following units must be made before cutting begins in that unit:

PAYMENT UNIT NUMBER	PERCENT OF TOTAL SALE VALUE
01	17.6%
02	12.8%
03	3.3%
04	10.2%
05	13.2%
06	4.8%
07	38.1%
4. If no cutting takes place, the 10% down payment will not be refunded.
5. Operations on the contract issued will terminate on 06/30/2026.

SALE STATISTICS

Volumes were calculated in cubic feet using the Michigan taper model. Cubic foot volume includes all wood inside bark for the product indicated. For display purposes, cubic feet were converted to cords and MBF using a simple conversion factor, e.g. 79 cubic feet per cord and 185 cubic feet per MBF. The cubic foot volumes are precise; the cords and MBF volumes are not. Cubic foot volume cannot be directly converted to cords or boards with precision.

SALE VOLUMES

The total estimated sale volume may not equal the sum of the species/products due to the nature of statistical calculations associated with double sampling methodology.

VOLUME			STATISTICAL RANGE IN CORDS	
TOTAL CUBIC FEET	TOTAL CORDS	PERCENT ERROR	MINIMUM	MAXIMUM
675,134	8,546	17.79%	7,025	10,067

VDU VOLUMES

A VDU is a Volume Determination Unit. Volumes and their associated statistics are calculated at the VDU level and summarized to the sale level. There is often a one to one relationship between a VDU and a Payment Unit, but not always, depending on the cruise design. Refer to the VDU TO PAYMENT UNIT table.

	VOLUME			RANGE IN CORDS	
VDU	TOTAL CUBIC FEET	TOTAL CORDS	PERCENT ERROR	MINIMUM	MAXIMUM
58	258,254	3,269	18.63%	2,660	3,878
62	104,556	1,323	29.69%	931	1,716
73	118,341	1,498	23.69%	1,143	1,853
103	52,002	658	63.14%	243	1,074
123	21,221	269	50.98%	132	406
125	120,760	1,529	29.00%	1,085	1,972
TOTAL:	675,134	8,546		6,194	10,898

VDU TO PAYMENT UNIT

When a VDU is associated with more than one Payment Unit (PU), the VDU volumes are assigned to the PU based on acres of the VDU within the PU.

VDU	VDU ACRES	PU	PU ACRES
58	77.1	7	77.1
62	28.8	2	28.8
73	37.7	1	37.7
103	13.1	4	13.1
123	5.7	3	5.7
125	39.6	5	29.0
		6	10.6
TOTAL:	202.0		202.0

DESCRIPTION OF TIMBER BY PAYMENT UNIT (PU)

PU	MARKET GROUP	PRODUCT	QUANTITY	UNIT	ACRES	ADVERTISE PRICE	
1	Black/Red (Hybrid)	Sawtimber	16.1	MBF	37.7	\$49,764.95	
	Mixed Aspen		44.9	MBF			
	<i>B. T. Aspen</i>		15.8	<i>MBF</i>			
	<i>Quaking Aspen</i>		29.1	<i>MBF</i>			
	Red Maple		30.4	MBF			
	Red Oak		32.3	MBF			
	Red Pine		3.2	MBF			
	White Oak		23.0	MBF			
	White Pine		97.2	MBF			
	Balsam Fir		Pulpwood	5			Cords
	<i>Balsam Fir</i>	5		<i>Cords</i>			
	Mixed Aspen	215		Cords			
	<i>B. T. Aspen</i>	74		<i>Cords</i>			
	<i>Quaking Aspen</i>	141		<i>Cords</i>			
	Mixed Hardwood	223		Cords			
	<i>Red Maple</i>	223		<i>Cords</i>			
	Mixed Oak	134		Cords			
	<i>/Red (Hybrid) Oak</i>	20		<i>Cords</i>			
	<i>Red Oak</i>	61		<i>Cords</i>			
	<i>White Oak</i>	53		<i>Cords</i>			
	Red Pine	1	Cords				
White Pine	343	Cords					
2	Mixed Aspen	Sawtimber	227.7	MBF	28.8	\$36,186.10	
	<i>B. T. Aspen</i>		134.8	<i>MBF</i>			
	<i>Quaking Aspen</i>		92.9	<i>MBF</i>			
	Red Maple		12.4	MBF			
	Sugar Maple		2.9	MBF			
	White Oak		7.5	MBF			
	Balsam Fir	Pulpwood	20	Cords			
	<i>Balsam Fir</i>		<i>Sawtimber</i>	1.9			<i>MBF</i>
	<i>Balsam Fir</i>		<i>Pulpwood</i>	16			<i>Cords</i>
	Mixed Aspen		319	Cords			
	<i>B. T. Aspen</i>		284	<i>Cords</i>			
	<i>Quaking Aspen</i>		35	<i>Cords</i>			
	Mixed Hardwood		115	Cords			
	<i>Ironwood</i>		<i>Sawtimber</i>	0.6			<i>MBF</i>
	<i>Ironwood</i>		<i>Pulpwood</i>	6			<i>Cords</i>
	<i>Red Maple</i>		105	<i>Cords</i>			
	<i>Sugar Maple</i>		3	<i>Cords</i>			
	Mixed Oak		6	Cords			
	<i>White Oak</i>		6	<i>Cords</i>			
3	Mixed Aspen	Sawtimber	63.9	MBF	5.7	\$9,343.70	
	<i>Quaking Aspen</i>		63.9	<i>MBF</i>			
	Red Maple		3.0	MBF			
	Balsam Fir	Pulpwood	21	Cords			
	<i>Balsam Fir</i>		21	<i>Cords</i>			
	Mixed Aspen		88	Cords			
	<i>Quaking Aspen</i>		88	<i>Cords</i>			
	Mixed Hardwood		3	Cords			
<i>Red Maple</i>	3	<i>Cords</i>					
4	Mixed Aspen	Sawtimber	32.4	MBF	13.1	\$28,738.50	
	<i>B. T. Aspen</i>		17.1	<i>MBF</i>			
	<i>Quaking Aspen</i>		15.3	<i>MBF</i>			
	Red Maple	18.7	MBF				
	Sugar Maple	40.5	MBF				
	Balsam Fir	Pulpwood	110	Cords			

DESCRIPTION OF TIMBER BY PAYMENT UNIT (PU), CON'T

PU	MARKET GROUP	PRODUCT	QUANTITY	UNIT	ACRES	ADVERTISE PRICE			
4 con't	<i>Balsam Fir</i>	<i>Pulpwood</i>	110	<i>Cords</i>					
	Mixed Aspen		202	Cords					
	<i>B. T. Aspen</i>		140	<i>Cords</i>					
	<i>Quaking Aspen</i>		62	<i>Cords</i>					
	Mixed Hardwood		115	Cords					
	<i>Red Maple</i>		98	<i>Cords</i>					
	<i>Sugar Maple</i>		9	<i>Cords</i>					
	<i>White Ash</i>		8	<i>Cords</i>					
5	Mixed Aspen	Sawtimber	138.8	MBF	29.0	\$37,253.70			
	<i>B. T. Aspen</i>		129.7	<i>MBF</i>					
	<i>Quaking Aspen</i>		9.1	<i>MBF</i>					
	Red Maple		7.3	MBF					
	Sugar Maple		11.9	MBF					
	Balsam Fir	Pulpwood	37	Cords					
	<i>Balsam Fir</i>	<i>Sawtimber</i>	4.5	<i>MBF</i>					
	<i>Balsam Fir</i>	<i>Pulpwood</i>	28	<i>Cords</i>					
	Mixed Aspen		599	Cords					
	<i>B. T. Aspen</i>		372	<i>Cords</i>					
	<i>Quaking Aspen</i>		227	<i>Cords</i>					
	Mixed Hardwood		106	Cords					
	<i>Black Cherry</i>		7	<i>Cords</i>					
	<i>Ironwood</i>		1	<i>Cords</i>					
	<i>Red Maple</i>		49	<i>Cords</i>					
	<i>Sugar Maple</i>		49	<i>Cords</i>					
	Mixed Oak		2	Cords					
	<i>Red Oak</i>		2	<i>Cords</i>					
	6	Mixed Aspen	Sawtimber	50.7			MBF	10.6	\$13,601.70
		<i>B. T. Aspen</i>		47.4			<i>MBF</i>		
<i>Quaking Aspen</i>			3.3	<i>MBF</i>					
Red Maple			2.7	MBF					
Sugar Maple			4.3	MBF					
Balsam Fir		Pulpwood	13	Cords					
<i>Balsam Fir</i>		<i>Sawtimber</i>	1.6	<i>MBF</i>					
<i>Balsam Fir</i>		<i>Pulpwood</i>	10	<i>Cords</i>					
Mixed Aspen			219	Cords					
<i>B. T. Aspen</i>			136	<i>Cords</i>					
<i>Quaking Aspen</i>			83	<i>Cords</i>					
Mixed Hardwood			39	Cords					
<i>Black Cherry</i>			2	<i>Cords</i>					
<i>Ironwood</i>			1	<i>Cords</i>					
<i>Red Maple</i>			18	<i>Cords</i>					
<i>Sugar Maple</i>			18	<i>Cords</i>					
Mixed Oak			1	Cords					
<i>Red Oak</i>			1	<i>Cords</i>					
7		Black/Red (Hybrid)	Sawtimber	19.1	MBF	77.1	\$108,039.30		
		Mixed Aspen		318.2	MBF				
	<i>B. T. Aspen</i>		244.2	<i>MBF</i>					
	<i>Quaking Aspen</i>		74.0	<i>MBF</i>					
	Red Maple		53.6	MBF					
	Red Oak		42.0	MBF					
	Red Pine		31.9	MBF					
	White Oak		15.0	MBF					
	White Pine		34.0	MBF					
	Balsam Fir	Pulpwood	14	Cords					
	<i>Balsam Fir</i>		14	<i>Cords</i>					
	Mixed Aspen		1,232	Cords					

DESCRIPTION OF TIMBER BY PAYMENT UNIT (PU), CON'T

PU	MARKET GROUP	PRODUCT	QUANTITY	UNIT	ACRES	ADVERTISE PRICE
7 con't	<i>B. T. Aspen</i>	<i>Pulpwood</i>	1,018	<i>Cords</i>		
	<i>Quaking Aspen</i>		214	<i>Cords</i>		
	Mixed Hardwood		301	<i>Cords</i>		
	<i>Red Maple</i>		301	<i>Cords</i>		
	Mixed Oak		154	<i>Cords</i>		
	<i>/Red (Hybrid) Oak</i>		9	<i>Cords</i>		
	<i>Red Oak</i>		25	<i>Cords</i>		
	<i>White Oak</i>		120	<i>Cords</i>		
	Red Pine		40	<i>Cords</i>		
	White Pine		307	<i>Cords</i>		
TOTAL:			1,385.6	MBF		
TOTAL:			4,984	Cords		

Sale Specific Conditions & Requirements

Sale Name: Seeley Aspen

Sale Number: 63-011-23 Seq#: 1

1 - Sale Area

1.2 - Boundaries

1.2.1 - Painted boundaries (9/19)

The sale boundary and Payment Unit boundaries are marked and identified by blue, red and yellow paint, or are unpainted and designated by a cover type change. Exterior sale boundary lines against private property are marked with blue paint. Exterior sale boundary lines against state are marked with red paint, with the exception of the Payment Unit 5 boundaries adjacent to red pine stands, which are unmarked and identified by the A9/R9 cover type change (see Timber Sale Map). Interior Payment Unit boundaries are marked with yellow paint. Retention patches are marked with red paint; no harvesting activities may occur within these areas. The painted boundary line trees are not Included Timber and are to be protected. Yellow painted trees designating an interior Payment Unit boundary are only to be cut when all surrounding Payment Units have been paid.

2 - Timber Specifications

2.1 - Included Timber

2.1.1 - Clearcut unit(s) with unmerchantable trees (6/14)

Within Payment Unit(s) 1-7, cut all trees that are two (2) inches or more at DBH. In addition, the following exceptions apply:

- Within Payment Units 2-6, do not cut red pine, white pine, cedar, paper birch, or hemlock.
- Within Payment Units 1 & 7, do not cut oak 22 inches or more at DBH, or any red or white pine.

3 - Payments

3.3 - Pre-measured Sales

3.3.4 - Dividing payment units (7/14)

Payment Unit(s) may be divided at the request of the Purchaser and upon approval of the Unit Manager. Dividing Payment Units is a contract modification which requires a Timber Sale Contract Amendment.

4 - Transportation

4.1 - Construction

4.1.6 - Road construction (1/09)

Construction of new roads or improvements of existing roads shall be done in such a way as to minimize the environmental and visual impacts. Merchantable trees shall be cut and utilized unless otherwise directed. Non-merchantable trees shall be severed and laid flat on the ground. Slash shall be scattered, and not left in windrows and kept a minimum of 10 feet back from the road edge. Stumps shall be set upright, not left on edge, and be moved at least 10 feet away from the road edge. Disturbed soil shall be feathered into the woods and not left in berms or windrows.

4.1.7 - Road closure (10/11)

All new roads built into the sale must be blocked to vehicle traffic within 30 days of completion of hauling. Overgrown roads that are reopened shall be considered new roads. In general, this will require constructing a four (4') foot high berm of stumps and logs covered with earth. These roads must be rendered impassable to cars and trucks. All stumps from road building and landing construction must be reserved to block any newly constructed roads upon completion of the sale. These stumps must be scattered along the road system to prohibit vehicular movement. Temporary berms may be required if no sale activity occurs for 30 or more consecutive days. Contact the Sale Administrator for specific details of design and placement.

4.2 - Maintenance

4.2.4 - Grading (10/16)

For completion of the sale, state forest roads must be graded. In general, this will require a road grader or bulldozer to shape up the roads after forest products have been hauled off site. This includes cleaning of drainage areas, grading, crowning and filling with gravel, if necessary. The grading equipment to be used must be approved by the Unit Manager or his/her representative.

4.2.5 - Two wheel drive condition (2/04)

All existing trail roads on and adjacent to the sale area must be passable by two-wheel drive traffic for the duration of the sale.

4.4 - Access

4.4.1 - Private property access (3/11)

Permission for access across private land is the responsibility of the Purchaser. Should the Purchaser desire to cross private land, a copy of the written permission from the private land-owner may be required by the DNR.

4.4.2 - Alternate route on private property (2/04)

It is the Purchaser's responsibility to obtain access across private land for any routes other than the route shown on the Timber Sale Map.

5 - Operations

5.2 - Conduct of Operations

5.2.1 - Slash

5.2.1.8 - Slash height (12/08)

No slash or tree tops may exceed 24 inches in height.

5.2.2 - Hazard Trees/Snags

5.2.2.1 - Den trees (10/16)

Obvious hollow and/or den trees shall be protected and left standing unless they are a safety hazard.

5.2.3 - Operating Restrictions

5.2.3.5 - Oak wilt restriction (1/18)

Within Payment Unit(s) 1-6, unless changed by written agreement, cutting, skidding, hauling within the sale and brushing of access roads to the sale are not permitted during the period of April 15 to July 15. Operations may be allowed if specific steps are taken to prevent damaging uncut oak during the high risk period. Those steps may include completing all road brushing before April 15th and clearing a tree-length buffer along uncut oak cover before April 15th. This is necessary to reduce the spread of oak wilt. For more information, contact the Unit Manager or his/her representative.

5.2.3.2 - Decking/landing restoration (9/13)

All decking and landing areas must have the surface area restored to a condition equal to or better than before. This is to ensure the proper regeneration of the stand. Wood debris, chips and "cookies" from trimmings must be removed or scattered away from landing and loading areas and may not be windrowed on the edge.

5.4 - Soil Protection

5.4.1 - Rutting restriction, general (7/16)

Operations are to cease immediately if equipment and weather conditions result in rutting of roads and/or skid trails which are 12 inches or greater in depth and 50 feet in length. The Unit Manager or his/her representative may restrict hauling and/or skidding if ruts exceed the specified depth. With the Unit Manager or his/her representative's approval, the Purchaser may return to the area when the risk of rutting has decreased.

5.8 - Protection of Endangered Species

5.8.5 - Protection of raptor nests (3/13)

All trees with raptor nests will be protected if found during harvesting operations. Notification will be made to the Unit Manager or his/her representative who will notify the Wildlife Biologist so an on-site evaluation and recommendation can be made, if necessary.



TIMBER SALE MAP

This information provided by authority of Part 525, 1994 PA 451, as amended.

Sale Number	Year
63-011	23

Forest Management Unit	County	Mapped By	Date	Page	of
Cadillac Management Unit	Wexford	Krugh	08/19/2023	2	2
Township	Range	Section(s) and Subdivision	Scale		
24N	09W	Sec 1:SESW,SWSE Sec2:NEV, S1/2SW Sec 3:SESE Sec 10:SEV,NE,NEV,NVSE Sec 11:N1/2NW Sec12:NEV,S1/2NW,N1/2NE,SWNE	1:15,840		

Cover Type

A = Aspen	H = Hemlock	N = Marsh	U = Upland Brush
B = Paper Birch	J = Jack Pine	O = Oak	UM = Upland Mixed
C = Cedar	L = Lowland Brush	P = Lowland Poplar	V = Bog or Marsh
D = Treed Bog	LM = Lowland Mixed	Q = Mixed Swamp Conifer	W = White Pine
E = Swamp Hdwoods	M = Mpl. Bch, Brch	R = Red Pine	X = Non Stocked
F = Spruce Fir	MC = Mixed Conifer	S = Black Spruce	Z = Water
G = Grass	MD = Mixed Deciduous	T = Tamarack	

Density

0 = Non Stocked	5 = Pole Timber Medium
1 = Seedling Sapling Poor	6 = Pole Timber Well
2 = Seedling Sapling Medium	7 = Saw Timber Poor
3 = Seedling Sapling Well	8 = Saw Timber Medium
4 = Pole Timber Poor	9 = Saw Timber Well

PU	Acres	PU	Acres
1	37.7	5	29
2	28.8	6	10.6
3	5.7	7	77.1
4	13.1		

Seeley Aspen

Compartment 126

202 Acres

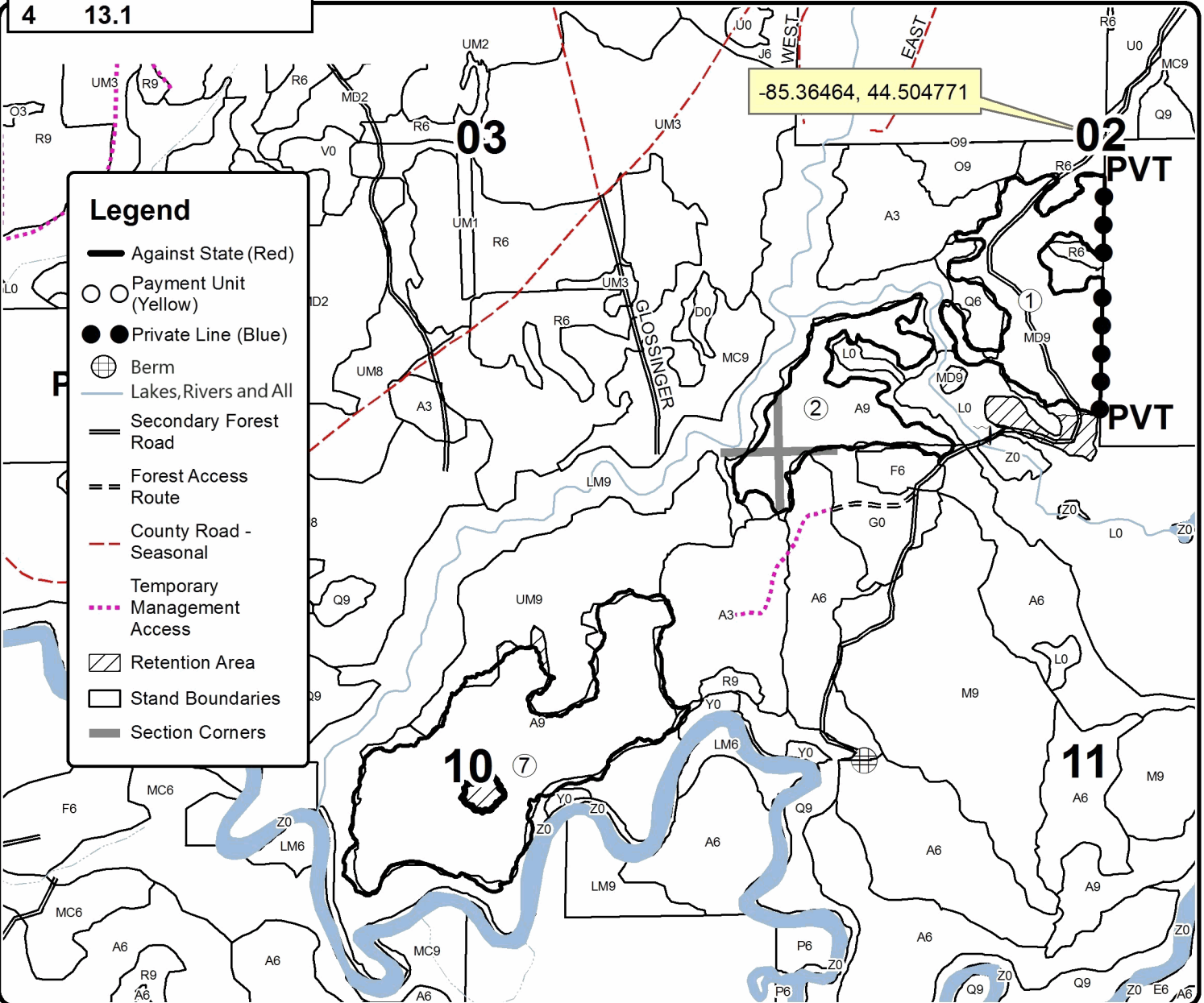

Legend

- Against State (Red)
- Payment Unit (Yellow)
- Private Line (Blue)
- Berm
- Lakes, Rivers and All
- Secondary Forest Road
- Forest Access Route
- County Road - Seasonal
- Temporary Management Access
- Retention Area
- Stand Boundaries
- Section Corners

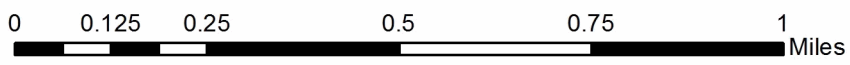

TIMBER SALE INFORMATION

Norton My Friend Mix (63-027-23)

T24N, R05W, SEC. 29; T24N, R05W, SEC. 30; T24N, R05W, SEC. 31; T24N, R05W, SEC. 32.
Missaukee County (Advertised Price \$130,364.65)

SALE NOTE: Sale contains areas of variable volume.

A timber sale contract for this lump sum, sealed bid timber sale will be awarded to the responsible bidder offering the highest sealed bid price. All units of volume listed below were estimated using the Inventory Manager computer program and the new Michigan taper model. Bids must be at or above the following advertised price for each product and species:

<u>PRODUCTS & SPECIES</u>	<u>ESTIMATED UNITS*</u>		<u>ADVERTISED PRICE</u>
Sawtimber			
Balsam Fir	20.5	MBF	\$ 49.00 / MBF
Black Cherry	27.8	MBF	\$ 237.00 / MBF
Mixed Aspen	325.5	MBF	\$ 73.00 / MBF
Red Maple	153.3	MBF	\$ 84.00 / MBF
Red Pine	110.6	MBF	\$ 80.00 / MBF
White Pine	133.6	MBF	\$ 58.00 / MBF
Pulpwood			
Balsam Fir	120	Cords	\$ 25.05 / Cord
Mixed Aspen	1,741	Cords	\$ 22.00 / Cord
Mixed Hardwood	993	Cords	\$ 18.55 / Cord
Mixed Oak	71	Cords	\$ 24.95 / Cord
Red Pine	64	Cords	\$ 35.80 / Cord
White Pine	245	Cords	\$ 23.45 / Cord

* The total volume is statistically estimated within plus (+) or minus (-) 26.75 percent. There are an estimated 5,040 cords on this timber sale, plus or minus 1,348 cords at the 95% confidence level. The estimated units are final and not subject to adjustment. Prospective bidders are urged to examine this timber and to make their own estimates of quantity and quality.

BOND AND PAYMENT SCHEDULE:

1. A bond in the amount of \$13,036.00 to insure faithful performance of the conditions of the contract will be deposited by the successful bidder within 21 days of the sale award.
2. Cutting in any sale or unit without the required advance payment would be considered a trespass.
3. Total payment must be paid in advance or according to the following schedule :
 - (a) Ten percent (10%) of the sale value must be paid within 21 days of the sale award.
 - (b) The 10% down payment will be credited towards the first unit cut.
 - (c) Payment for each of the following units must be made before cutting begins in that unit:

PAYMENT UNIT NUMBER	PERCENT OF TOTAL SALE VALUE
01	34.9%
02	25.9%
03	32.8%
04	6.4%

4. If no cutting takes place, the 10% down payment will not be refunded.
5. Operations on the contract issued will terminate on 06/30/2027.

SALE STATISTICS

Volumes were calculated in cubic feet using the Michigan taper model. Cubic foot volume includes all wood inside bark for the product indicated. For display purposes, cubic feet were converted to cords and MBF using a simple conversion factor, e.g. 79 cubic feet per cord and 185 cubic feet per MBF. The cubic foot volumes are precise; the cords and MBF volumes are not. Cubic foot volume cannot be directly converted to cords or boards with precision.

SALE VOLUMES

The total estimated sale volume may not equal the sum of the species/products due to the nature of statistical calculations associated with double sampling methodology.

VOLUME		STATISTICAL RANGE IN CORDS		
TOTAL CUBIC FEET	TOTAL CORDS	PERCENT ERROR	MINIMUM	MAXIMUM
398,130	5,040	26.75%	3,691	6,388

VDU VOLUMES

A VDU is a Volume Determination Unit. Volumes and their associated statistics are calculated at the VDU level and summarized to the sale level. There is often a one to one relationship between a VDU and a Payment Unit, but not always, depending on the cruise design. Refer to the VDU TO PAYMENT UNIT table.

VDU	VOLUME		PERCENT ERROR	RANGE IN CORDS	
	TOTAL CUBIC FEET	TOTAL CORDS		MINIMUM	MAXIMUM
18	38,856	492	66.72%	164	820
46	174,094	2,204	26.79%	1,613	2,794
50	28,377	359	62.00%	136	582
57	23,191	294	81.11%	55	532
73	133,613	1,691	36.37%	1,076	2,307
TOTAL:	398,130	5,040		3,045	7,034

VDU TO PAYMENT UNIT

When a VDU is associated with more than one Payment Unit (PU), the VDU volumes are assigned to the PU based on acres of the VDU within the PU.

VDU	VDU ACRES	PU	PU ACRES
18	20.7	2	7.7
		3	13.0
46	54.0	2	25.4
		3	28.6
50	15.4	2	5.9
		3	9.5
57	5.1	4	5.1
73	34.0	1	34.0
TOTAL:	129.2		129.2

DESCRIPTION OF TIMBER BY PAYMENT UNIT (PU)

PU	MARKET GROUP	PRODUCT	QUANTITY	UNIT	ACRES	ADVERTISE PRICE
1	Black Cherry	Sawtimber	8.4	MBF	34.0	\$45,497.15
	Mixed Aspen		198.2	MBF		
	<i>B. T. Aspen</i>		81.1	<i>MBF</i>		
	<i>Quaking Aspen</i>		117.1	<i>MBF</i>		
	Red Maple		91.5	MBF		
	Balsam Fir	Pulpwood	14	Cords		
	Mixed Aspen		805	Cords		
	<i>B. T. Aspen</i>		267	<i>Cords</i>		
	<i>Quaking Aspen</i>		538	<i>Cords</i>		
	Mixed Hardwood		168	Cords		
	<i>Sugar Maple</i>	<i>Sawtimber</i>	1.8	<i>MBF</i>		
	<i>Black Cherry</i>	<i>Pulpwood</i>	13	<i>Cords</i>		
	<i>Red Maple</i>		146	<i>Cords</i>		
	<i>Sugar Maple</i>		5	<i>Cords</i>		
	Mixed Oak		7	Cords		
	<i>/Red (Hybrid) Oak</i>	<i>Sawtimber</i>	1.3	<i>MBF</i>		
	<i>/Red (Hybrid) Oak</i>	<i>Pulpwood</i>	4	<i>Cords</i>		
2	Balsam Fir	Sawtimber	9.6	MBF	39.0	\$33,825.40
	Black Cherry		9.1	MBF		
	Mixed Aspen		35.3	MBF		
	<i>B. T. Aspen</i>		20.2	<i>MBF</i>		
	<i>Quaking Aspen</i>		15.1	<i>MBF</i>		
	Red Maple		21.0	MBF		
	Red Pine		42.6	MBF		
	White Pine		52.8	MBF		
	Balsam Fir	Pulpwood	50	Cords		
	Mixed Aspen		417	Cords		
	<i>B. T. Aspen</i>		101	<i>Cords</i>		
	<i>Quaking Aspen</i>		316	<i>Cords</i>		
	Mixed Hardwood		375	Cords		
	<i>Black Cherry</i>		33	<i>Cords</i>		
	<i>Red Maple</i>		342	<i>Cords</i>		
	Red Pine		23	Cords		
	White Pine		93	Cords		
3	Balsam Fir	Sawtimber	10.9	MBF	51.1	\$42,737.50
	Black Cherry		10.3	MBF		
	Mixed Aspen		39.7	MBF		
	<i>B. T. Aspen</i>		22.7	<i>MBF</i>		
	<i>Quaking Aspen</i>		17.0	<i>MBF</i>		
	Red Maple		24.5	MBF		
	Red Pine		68.0	MBF		
	White Pine		80.8	MBF		
	Balsam Fir	Pulpwood	56	Cords		
	Mixed Aspen		492	Cords		
	<i>B. T. Aspen</i>		118	<i>Cords</i>		
	<i>Quaking Aspen</i>		374	<i>Cords</i>		
	Mixed Hardwood		423	Cords		
	<i>Black Cherry</i>		38	<i>Cords</i>		
	<i>Red Maple</i>		385	<i>Cords</i>		
	Red Pine		35	Cords		
	White Pine		143	Cords		
4	Mixed Aspen	Sawtimber	52.3	MBF	5.1	\$8,304.60
	<i>Quaking Aspen</i>		52.3	<i>MBF</i>		
	Red Maple		16.3	MBF		
	Mixed Aspen	Pulpwood	27	Cords		
	<i>Quaking Aspen</i>		27	<i>Cords</i>		

DESCRIPTION OF TIMBER BY PAYMENT UNIT (PU), CON'T

PU	MARKET GROUP	PRODUCT	QUANTITY	UNIT	ACRES	ADVERTISE PRICE
4 con't	Mixed Hardwood	Pulpwood	27	Cords		
	<i>Red Maple</i>		27	<i>Cords</i>		
	Mixed Oak		64	Cords		
	<i>Red Oak</i>		64	<i>Cords</i>		
	Red Pine		6	Cords		
	White Pine		9	Cords		
TOTAL:			771.3	MBF		
TOTAL:			3,234	Cords		

Sale Specific Conditions & Requirements

Sale Name: Norton My Friend Mix

Sale Number: 63-027-23 Seq#: 1

1 - Sale Area

1.2 - Boundaries

1.2.1 - Painted boundaries (9/19)

The sale boundary and Payment Unit boundaries are marked and identified by red and yellow paint. Exterior sale boundary lines against state are marked with red paint. Interior Payment Unit boundaries are marked with yellow paint. The painted boundary line trees are not Included Timber and are to be protected unless marked with orange paint. Yellow painted trees designating an interior Payment Unit boundary are only to be cut when all surrounding Payment Units have been paid.

2 - Timber Specifications

2.1 - Included Timber

2.1.1 - Clearcut unit(s) with unmerchantable trees (6/14)

Within Payment Unit(s) 1-4, cut all trees that are two (2) inches or more at DBH, except do not cut paper birch, hemlock, and any trees of any species over 22 inches in diameter at DBH.

3 - Payments

3.3 - Pre-measured Sales

3.3.4 - Dividing payment units (7/14)

Payment Unit(s) may be divided at the request of the Purchaser and upon approval of the Unit Manager. Dividing Payment Units is a contract modification which requires a Timber Sale Contract Amendment.

4 - Transportation

4.1 - Construction

4.1.12 - No new roads (1/12)

No new roads will be permitted in any Payment Unit. All operations are limited to existing roads. Skid trails will only be allowed.

4.2 - Maintenance

4.2.5 - Two wheel drive condition (2/04)

All existing trail roads on and adjacent to the sale area must be passable by two-wheel drive traffic for the duration of the sale.

4.4 - Access

4.4.1 - Private property access (3/11)

Permission for access across private land has been obtained by the DNR. A copy of the written permission from the private landowner must be given to the Unit Manager within 30 days of the bid opening and prior to the beginning of operations.

5 - Operations

5.1 - Notification

5.1.1 - Pre-sale conference (10/16)

A pre-sale conference on site between the Purchaser and sale administrator is required prior to beginning any operations, to determine landing and road locations. The Unit Manager or his/her representative must be contacted at least 3 days in advance to schedule the conference.

5.2 - Conduct of Operations

5.2.2 - Hazard Trees/Snags

5.2.2.1 - Den trees (10/16)

Obvious hollow and/or den trees shall be protected and left standing unless they are a safety hazard.

5.2.22 - Operating Caution

5.2.22.1 - Operating caution (6/11)

It is recommended, but not required, that within Payment Unit(s) , cutting, skidding, and hauling occur during dry summer or frozen winter conditions. The reason for the recommendation is to protect against damage to areas of seasonally wet soil and roads.

5.2.38 - No decking against live trees (2/04)

Cut products may not be decked against unmarked or designated leave trees.

5.4 - Soil Protection

5.4.1 - Rutting restriction, general (7/16)

Operations are to cease immediately if equipment and weather conditions result in rutting of roads and/or skid trails which are 12 inches or greater in depth and 50 feet in length. The Unit Manager or his/her representative may restrict hauling and/or skidding if ruts exceed the specified depth. With the Unit Manager or his/her representative's approval, the Purchaser may return to the area when the risk of rutting has decreased.

5.4.6 - Wet area protection (5/10)

No harvesting operations, including skidding and felling, are to take place within any wet areas or seasonal vernal ponds. Care must be taken by the Purchaser to identify and avoid operating in these areas of the timber sale.

5.8 - Protection of Endangered Species

5.8.5 - Protection of raptor nests (3/13)

All trees with raptor nests will be protected if found during harvesting operations. Notification will be made to the Unit Manager or his/her representative who will notify the Wildlife Biologist so an on-site evaluation and recommendation can be made, if necessary.



TIMBER SALE MAP

This information provided by authority of Part 525, 1994 PA 451, as amended.

Sale Number	Year
63-011	23

Forest Management Unit Cadillac Management Unit	County Wexford	Mapped By Krugh	Date 08/19/2023	Page 1	of 1
Township 24N	Range 05W	Section(s) and Subdivision(s) Sec5:SENW,N1/2SW,SESW,NWSE,S1/2SE Sec30: SENE,NESE Sec 31: NESE Sec 32: NENW,N1/2NE,SWNE,NWSW	Scale 1:15,840		

Cover Type				Density	
A = Aspen	H = Hemlock	N = Marsh	U = Upland Brush	0 = Non Stocked	5 = Pole Timber Medium
B = Paper Birch	J = Jack Pine	O = Oak	UM = Upland Mixed	1 = Seedling Sapling Poor	6 = Pole Timber Well
C = Cedar	L = Lowland Brush	P = Lowland Poplar	V = Bog or Marsh	2 = Seedling Sapling Medium	7 = Saw Timber Poor
D = Treed Bog	LM = Lowland Mixed	Q = Mixed Swamp Conifer	W = White Pine	3 = Seedling Sapling Well	8 = Saw Timber Medium
E = Swamp Hdwoods	M = Mpl, Bch, Brch	R = Red Pine	X = Non Stocked	4 = Pole Timber Poor	9 = Saw Timber Well
F = Spruce Fir	MC = Mixed Conifer	S = Black Spruce	Z = Water		
G = Grass	MD = Mixed Deciduous	T = Tamarack			

PU	Acres	PU	Acres
1	34	3	51.1
2	39	4	5.1

Norton My Friend Mix

Compartment 82

129.2 Acres

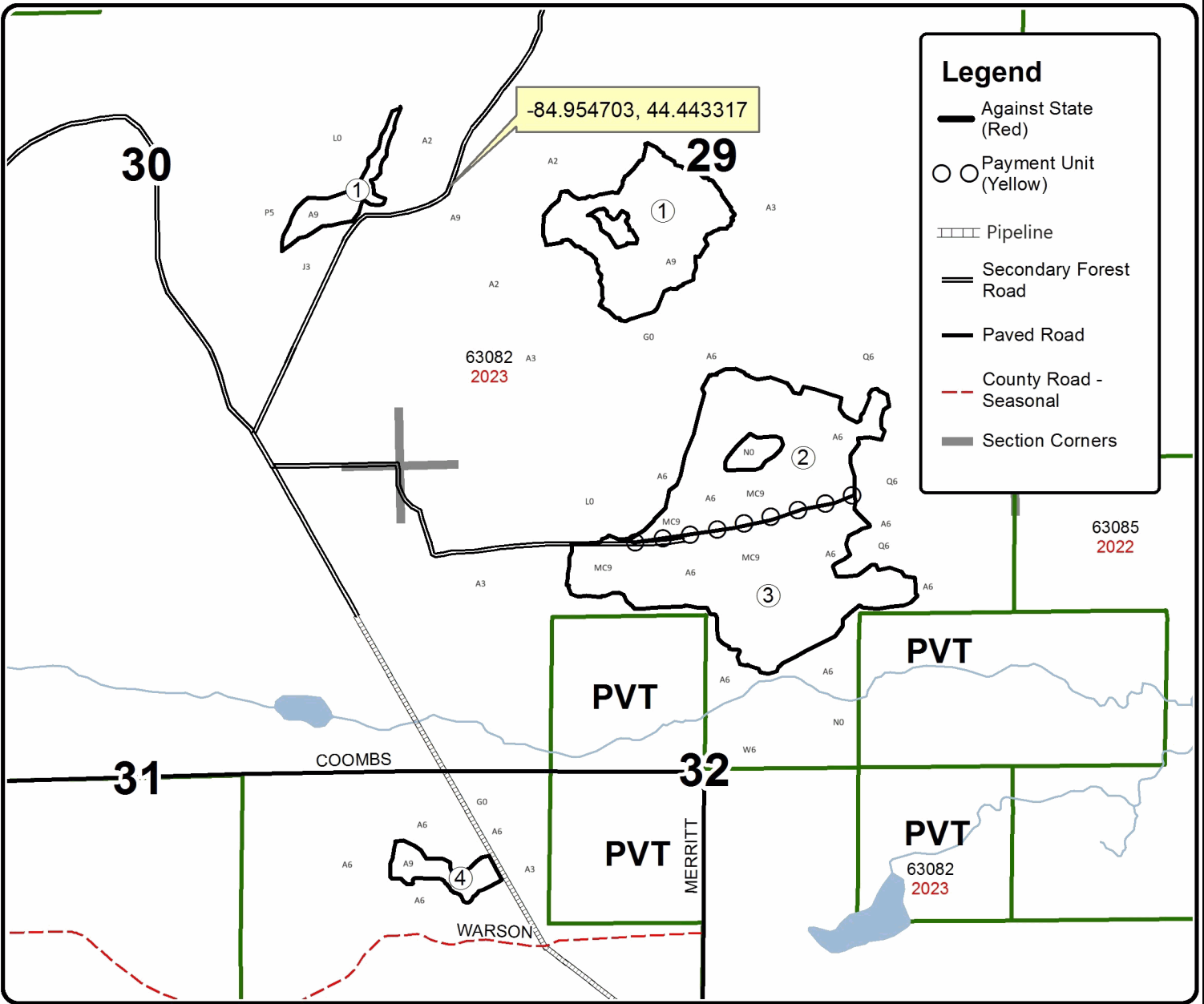

Legend

- Against State (Red)
- Payment Unit (Yellow)
- ▤ Pipeline
- ▬ Secondary Forest Road
- ▬ Paved Road
- - - County Road - Seasonal
- Section Corners

Seeley Aspen (63-011-23)

T24N, R09W, SEC. 1; T24N, R09W, SEC. 10; T24N, R09W, SEC. 11; T24N, R09W,

In response to the notice of sale to be held 3:00 p.m. (local time) on April 17, 2024, I am hereby submitting my sealed bid (firm offer) for the following forest products to be cut. Bids for individual species must be at or above the advertised price. All non-responsive bid forms may be rejected.

<u>PRODUCTS & SPECIES</u>	<u>ESTIMATED VOLUME*</u>	<u>ADVERTISED PRICE</u>	<u>BID PRICE/UNIT</u>
Sawtimber			
Black/Red (Hybrid) Oak	35.2 MBF	\$ 99.00/MBF	\$ _____
Mixed Aspen	876.6 MBF	\$ 92.00/MBF	\$ _____
Red Maple	128.1 MBF	\$ 106.00/MBF	\$ _____
Red Oak	74.3 MBF	\$ 168.00/MBF	\$ _____
Red Pine	35.1 MBF	\$ 99.00/MBF	\$ _____
Sugar Maple	59.6 MBF	\$ 299.00/MBF	\$ _____
White Oak	45.5 MBF	\$ 107.00/MBF	\$ _____
White Pine	131.2 MBF	\$ 73.00/MBF	\$ _____
Pulpwood			
Balsam Fir	220 Cords	\$ 31.30/Cord	\$ _____
Mixed Aspen	2,874 Cords	\$ 27.50/Cord	\$ _____
Mixed Hardwood	902 Cords	\$ 23.20/Cord	\$ _____
Mixed Oak	297 Cords	\$ 31.20/Cord	\$ _____
Red Pine	41 Cords	\$ 44.75/Cord	\$ _____
White Pine	650 Cords	\$ 29.30/Cord	\$ _____

*The volumes are statistically estimated within plus (+) or minus (-) 17.79 percent at 95% confidence level. These estimated volumes are final and not subject to adjustment. Prospective bidders are urged to examine this timber and to make their own estimates of quantity and quality.

I understand that any or all bids may be rejected. All bids must be signed and all bid items must be bid or the bid form may be rejected. I also understand that consideration and awarding a contract will be based upon my past performance and ability to complete the contract based upon equipment and staffing subject to my control.

FEDERAL ID: _____ - _____ or SOCIAL SECURITY NUMBER: _____ - _____ - _____

Company or individual bidding: _____

Company representative's name: _____

Address: _____

City: _____ State: _____ Zip: _____

IF AVAILABLE, PLEASE PLACE THE PERSONALIZED LABEL FROM YOUR PROSPECTUS IN THE ABOVE BOX.

Individual or company representative's signature: _____ Date: _____

Phone number : _____ Email (optional): _____

THE WINNING BIDDER MUST COMPLETE THE VERIFICATION OF WORKER'S DISABILITY COMPENSATION ACT COMPLIANCE (ON REVERSE SIDE IF DOUBLE SIDED) WITHIN 21 DAYS OF SALE AWARD DATE



FOR DEPARTMENT USE ONLY	
Sale Number (XX - XXX - XX - XX)	
Forest Management Unit:	

TIMBER SALE VERIFICATION OF WORKER'S DISABILITY COMPENSATION ACT COMPLIANCE

As required by Act 317, P.A. 1969 (Worker's Compensation) and
Part 5 of Act 451 of 1994, as amended.

VERIFICATION OF WORKER'S DISABILITY COMPENSATION ACT COMPLIANCE

- This verification must be completed and submitted within 21 days of contract award and prior to the issuance of the timber sale contract.
- In addition, if boxes 2B or 2C are checked, then Notice of Exclusion or Certificate of Insurance must be submitted within twenty-one (21) days of the contract award and prior to the issuance of the timber sale contract.
- All information must be typed or printed except for written signatures.

Please Check Appropriate Categories:

1. My business is organized as (you **must** check one of the boxes below):
 - A. Sole Proprietorship (individual)
 - B. Partnership
 - C. Corporation
2. You **must** check one of the boxes below:
 - A. I certify my business is a sole proprietorship and it has no employees but the sole proprietor. I am not subject to the Worker's Compensation Laws.
 - B. I certify my business has satisfied its obligation to the Worker's Compensation Act through the use of an approved Notice of Exclusion (BWC-337, Rev. 5/96). I will provide a copy of the Notice of Exclusion within 21 days of the contract award. (For questions or a copy of the BWC-337, please call the Worker's Compensation Bureau at 517-322-1195).
 - C. I certify my business has a Worker's Compensation Policy. I will provide an original Certificate of Insurance within twenty-one (21) days of the contract award.
3. If you have checked item 2(A) or 2(B), you **must** indicate the number of **both** full-time and part-time employees, other than yourself, including family members and active partners (if none, you must enter "0").

_____ Full-time Employees

_____ Part-time Employees

Name of Business		Federal ID (or) Social Security No.	
Address		Telephone ()	
City	State	ZIP	

I hereby certify that the above information is true and correct. I agree to notify the Michigan DNR of any changes that occur in factors affecting my coverage during any of my present and future operations.

Signature of Owner or Authorized Representative

Title

Date

Please complete the "SEALED BID" information on the next page

Norton My Friend Mix (63-027-23)
T24N, R05W, SEC. 29; T24N, R05W, SEC. 30; T24N, R05W, SEC. 31; T24N,

In response to the notice of sale to be held 3:00 p.m. (local time) on April 17, 2024, I am hereby submitting my sealed bid (firm offer) for the following forest products to be cut. Bids for individual species must be at or above the advertised price. All non-responsive bid forms may be rejected.

<u>PRODUCTS & SPECIES</u>	<u>ESTIMATED VOLUME*</u>	<u>ADVERTISED PRICE</u>	<u>BID PRICE/UNIT</u>
Sawtimber			
Balsam Fir	20.5 MBF	\$ 49.00/MBF	\$ _____
Black Cherry	27.8 MBF	\$ 237.00/MBF	\$ _____
Mixed Aspen	325.5 MBF	\$ 73.00/MBF	\$ _____
Red Maple	153.3 MBF	\$ 84.00/MBF	\$ _____
Red Pine	110.6 MBF	\$ 80.00/MBF	\$ _____
White Pine	133.6 MBF	\$ 58.00/MBF	\$ _____
Pulpwood			
Balsam Fir	120 Cords	\$ 25.05/Cord	\$ _____
Mixed Aspen	1,741 Cords	\$ 22.00/Cord	\$ _____
Mixed Hardwood	993 Cords	\$ 18.55/Cord	\$ _____
Mixed Oak	71 Cords	\$ 24.95/Cord	\$ _____
Red Pine	64 Cords	\$ 35.80/Cord	\$ _____
White Pine	245 Cords	\$ 23.45/Cord	\$ _____

*The volumes are statistically estimated within plus (+) or minus (-) 26.75 percent at 95% confidence level. These estimated volumes are final and not subject to adjustment. Prospective bidders are urged to examine this timber and to make their own estimates of quantity and quality.

I understand that any or all bids may be rejected. All bids must be signed and all bid items must be bid or the bid form may be rejected. I also understand that consideration and awarding a contract will be based upon my past performance and ability to complete the contract based upon equipment and staffing subject to my control.

FEDERAL ID: ____ - ____ - ____ or SOCIAL SECURITY NUMBER: ____ - ____ - ____

Company or individual bidding: _____

Company representative's name: _____

Address: _____

City: _____ State: _____ Zip: _____

IF AVAILABLE, PLEASE PLACE THE PERSONALIZED LABEL FROM YOUR PROSPECTUS IN THE ABOVE BOX.

Individual or company representative's signature: _____ Date: _____

Phone number : _____ Email (optional): _____

THE WINNING BIDDER MUST COMPLETE THE VERIFICATION OF WORKER'S DISABILITY COMPENSATION ACT COMPLIANCE (ON REVERSE SIDE IF DOUBLE SIDED) WITHIN 21 DAYS OF SALE AWARD DATE

Manton Mix Remastered (63-001-24)
T24N, R09W, SEC. 21; T24N, R09W, SEC. 22; Wexford COUNTY

In response to the notice of sale to be held 3:00 p.m. (local time) on April 17, 2024, I am hereby submitting my sealed bid (firm offer) for the following forest products to be cut. Bids for individual species must be at or above the advertised price. All non-responsive bid forms may be rejected.

<u>PRODUCTS & SPECIES</u>	<u>ESTIMATED VOLUME*</u>	<u>ADVERTISED PRICE</u>	<u>BID PRICE/UNIT</u>
Sawtimber			
Jack Pine	6.6 MBF	\$ 33.00/MBF	\$ _____
Red Maple	21.8 MBF	\$ 106.00/MBF	\$ _____
Red Oak	16.0 MBF	\$ 168.00/MBF	\$ _____
Red Pine	132.7 MBF	\$ 99.00/MBF	\$ _____
Pulpwood			
Jack Pine	69 Cords	\$ 19.90/Cord	\$ _____
Mixed Oak	128 Cords	\$ 31.20/Cord	\$ _____
Quaking Aspen	16 Cords	\$ 27.50/Cord	\$ _____
Red Maple	27 Cords	\$ 23.20/Cord	\$ _____
Red Pine	81 Cords	\$ 44.75/Cord	\$ _____

*The volumes are statistically estimated within plus (+) or minus (-) 38.04 percent at 95% confidence level. These estimated volumes are final and not subject to adjustment. Prospective bidders are urged to examine this timber and to make their own estimates of quantity and quality.

I understand that any or all bids may be rejected. All bids must be signed and all bid items must be bid or the bid form may be rejected. I also understand that consideration and awarding a contract will be based upon my past performance and ability to complete the contract based upon equipment and staffing subject to my control.

FEDERAL ID: ____ - ____ - ____ or SOCIAL SECURITY NUMBER: ____ - ____ - ____

Company or individual bidding: _____

Company representative's name: _____

Address: _____

City: _____ State: _____ Zip: _____

IF AVAILABLE, PLEASE PLACE THE PERSONALIZED LABEL FROM YOUR PROSPECTUS IN THE ABOVE BOX.

Individual or company representative's signature: _____ Date: _____

Phone number : _____ Email (optional): _____

THE WINNING BIDDER MUST COMPLETE THE VERIFICATION OF WORKER'S DISABILITY COMPENSATION ACT COMPLIANCE (ON REVERSE SIDE IF DOUBLE SIDED) WITHIN 21 DAYS OF SALE AWARD DATE



FOR DEPARTMENT USE ONLY	
Sale Number (XX - XXX - XX - XX)	
Forest Management Unit:	

TIMBER SALE VERIFICATION OF WORKER'S DISABILITY COMPENSATION ACT COMPLIANCE

As required by Act 317, P.A. 1969 (Worker's Compensation) and
Part 5 of Act 451 of 1994, as amended.

VERIFICATION OF WORKER'S DISABILITY COMPENSATION ACT COMPLIANCE

- This verification must be completed and submitted within 21 days of contract award and prior to the issuance of the timber sale contract.
- In addition, if boxes 2B or 2C are checked, then Notice of Exclusion or Certificate of Insurance must be submitted within twenty-one (21) days of the contract award and prior to the issuance of the timber sale contract.
- All information must be typed or printed except for written signatures.

Please Check Appropriate Categories:

1. My business is organized as (you **must** check one of the boxes below):
 - A. Sole Proprietorship (individual)
 - B. Partnership
 - C. Corporation
2. You **must** check one of the boxes below:
 - A. I certify my business is a sole proprietorship and it has no employees but the sole proprietor. I am not subject to the Worker's Compensation Laws.
 - B. I certify my business has satisfied its obligation to the Worker's Compensation Act through the use of an approved Notice of Exclusion (BWC-337, Rev. 5/96). I will provide a copy of the Notice of Exclusion within 21 days of the contract award. (For questions or a copy of the BWC-337, please call the Worker's Compensation Bureau at 517-322-1195).
 - C. I certify my business has a Worker's Compensation Policy. I will provide an original Certificate of Insurance within twenty-one (21) days of the contract award.
3. If you have checked item 2(A) or 2(B), you **must** indicate the number of **both** full-time and part-time employees, other than yourself, including family members and active partners (if none, you must enter "0").

_____ Full-time Employees

_____ Part-time Employees

Name of Business		Federal ID (or) Social Security No.	
Address		Telephone ()	
City	State	ZIP	

I hereby certify that the above information is true and correct. I agree to notify the Michigan DNR of any changes that occur in factors affecting my coverage during any of my present and future operations.

Signature of Owner or Authorized Representative

Title

Date

Please complete the "SEALED BID" information on the next page

103 RP Transition (63-002-23)
T21N, R05W, SEC. 34; T21N, R05W, SEC. 36; Missaukee COUNTY

In response to the notice of sale to be held 3:00 p.m. (local time) on April 17, 2024, I am hereby submitting my sealed bid (firm offer) for the following forest products to be cut. Bids for individual species must be at or above the advertised price. All non-responsive bid forms may be rejected.

<u>PRODUCTS & SPECIES</u>	<u>ESTIMATED VOLUME*</u>	<u>ADVERTISED PRICE</u>	<u>BID PRICE/UNIT</u>
Sawtimber			
Red Oak	13.7 MBF	\$ 168.00/MBF	\$ _____
Red Pine	169.1 MBF	\$ 99.00/MBF	\$ _____
Pulpwood			
Mixed Oak	30 Cords	\$ 31.20/Cord	\$ _____
Red Pine	1,184 Cords	\$ 44.75/Cord	\$ _____

*The volumes are statistically estimated within plus (+) or minus (-) 15.16 percent at 95% confidence level. These estimated volumes are final and not subject to adjustment. Prospective bidders are urged to examine this timber and to make their own estimates of quantity and quality.

I understand that any or all bids may be rejected. All bids must be signed and all bid items must be bid or the bid form may be rejected. I also understand that consideration and awarding a contract will be based upon my past performance and ability to complete the contract based upon equipment and staffing subject to my control.

FEDERAL ID: _____ - _____ or SOCIAL SECURITY NUMBER: _____ - _____ - _____

Company or individual bidding: _____

Company representative's name: _____

Address: _____

City: _____ State: _____ Zip: _____

IF AVAILABLE, PLEASE PLACE THE PERSONALIZED LABEL FROM YOUR PROSPECTUS IN THE ABOVE BOX.

Individual or company representative's signature: _____ Date: _____

Phone number : _____ Email (optional): _____

THE WINNING BIDDER MUST COMPLETE THE VERIFICATION OF WORKER'S DISABILITY COMPENSATION ACT COMPLIANCE (ON REVERSE SIDE IF DOUBLE SIDED) WITHIN 21 DAYS OF SALE AWARD DATE



FOR DEPARTMENT USE ONLY	
Sale Number (XX - XXX - XX - XX)	
Forest Management Unit:	

TIMBER SALE VERIFICATION OF WORKER'S DISABILITY COMPENSATION ACT COMPLIANCE

As required by Act 317, P.A. 1969 (Worker's Compensation) and
Part 5 of Act 451 of 1994, as amended.

VERIFICATION OF WORKER'S DISABILITY COMPENSATION ACT COMPLIANCE

- This verification must be completed and submitted within 21 days of contract award and prior to the issuance of the timber sale contract.
- In addition, if boxes 2B or 2C are checked, then Notice of Exclusion or Certificate of Insurance must be submitted within twenty-one (21) days of the contract award and prior to the issuance of the timber sale contract.
- All information must be typed or printed except for written signatures.

Please Check Appropriate Categories:

1. My business is organized as (you **must** check one of the boxes below):
 - A. Sole Proprietorship (individual)
 - B. Partnership
 - C. Corporation
2. You **must** check one of the boxes below:
 - A. I certify my business is a sole proprietorship and it has no employees but the sole proprietor. I am not subject to the Worker's Compensation Laws.
 - B. I certify my business has satisfied its obligation to the Worker's Compensation Act through the use of an approved Notice of Exclusion (BWC-337, Rev. 5/96). I will provide a copy of the Notice of Exclusion within 21 days of the contract award. (For questions or a copy of the BWC-337, please call the Worker's Compensation Bureau at 517-322-1195).
 - C. I certify my business has a Worker's Compensation Policy. I will provide an original Certificate of Insurance within twenty-one (21) days of the contract award.
3. If you have checked item 2(A) or 2(B), you **must** indicate the number of **both** full-time and part-time employees, other than yourself, including family members and active partners (if none, you must enter "0").

_____ Full-time Employees

_____ Part-time Employees

Name of Business		Federal ID (or) Social Security No.	
Address		Telephone ()	
City	State	ZIP	

I hereby certify that the above information is true and correct. I agree to notify the Michigan DNR of any changes that occur in factors affecting my coverage during any of my present and future operations.

Signature of Owner or Authorized Representative

Title

Date

Please complete the "SEALED BID" information on the next page